

J. R. DUNHAM
COMPILER & DRAFTSMAN
Clinton, Iowa.

OUTLINE MAP
OF
ALLEN COUNTY
KANSAS

1906
Scale 1/4 of an Inch to the Mile.

- EXPLANATION**
- Section Line
 - Farm or Lot Line
 - Wagon Road
 - Railroad
 - Creeks & Springs
 - Rivers
 - Churches
 - School Houses
 - Adjacent Lands owned by same party connected by a hook, thus
 - Post Office
 - Coal, Lead or Zinc Mine
 - County Bridge
 - Border Page Numbers
 - Oil Well
 - Gas Well

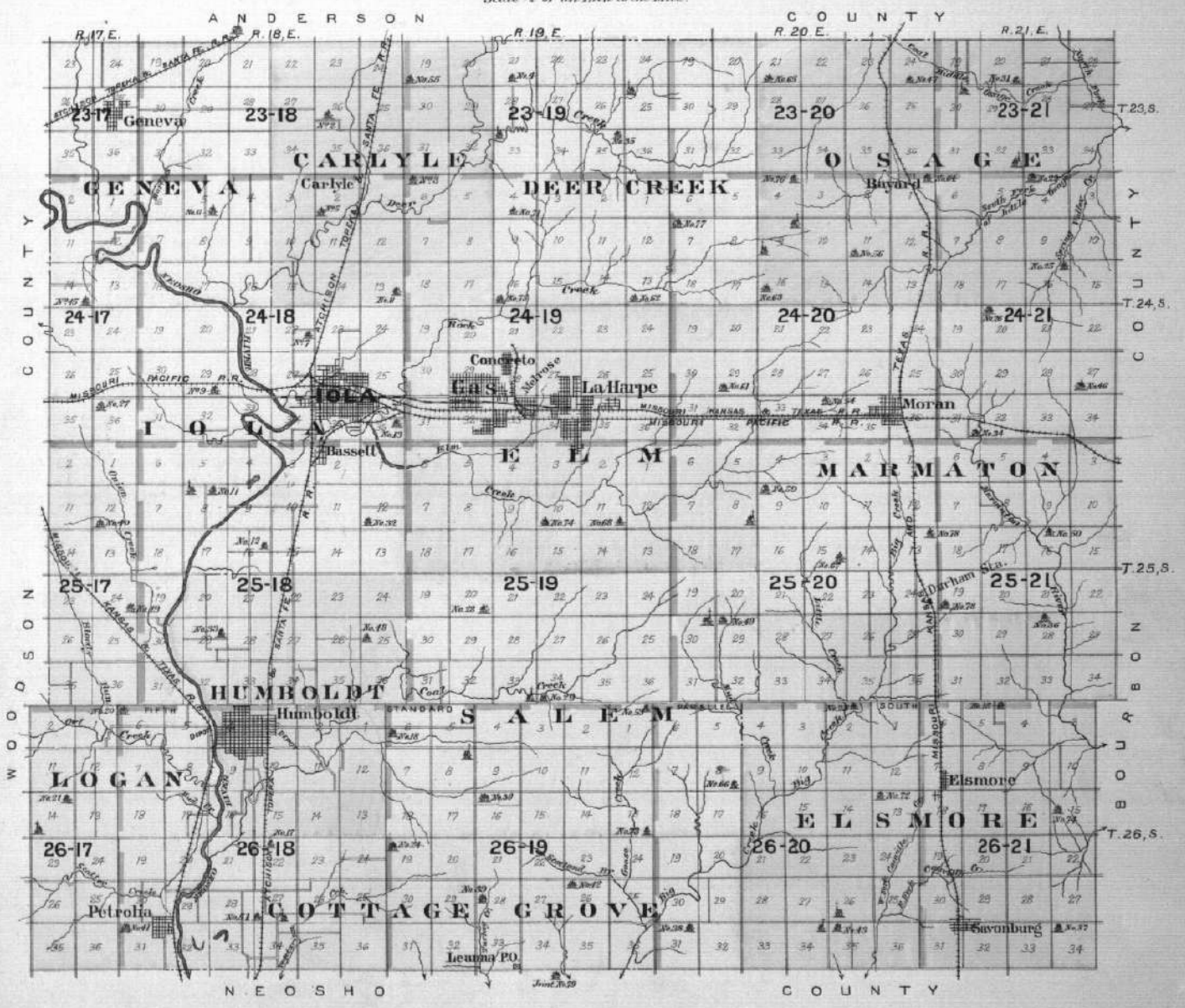



TOWNSHIP 23 SOUTH RANGES 17 & 18 EAST

Scale 2 inches to the Mile

of the 6th Principal Meridian.



9

5

TOWNSHIP 23 SOUTH RANGE 19 EAST.

Scale 2 Inches to the Mile.

of the 6th Principal Meridian.

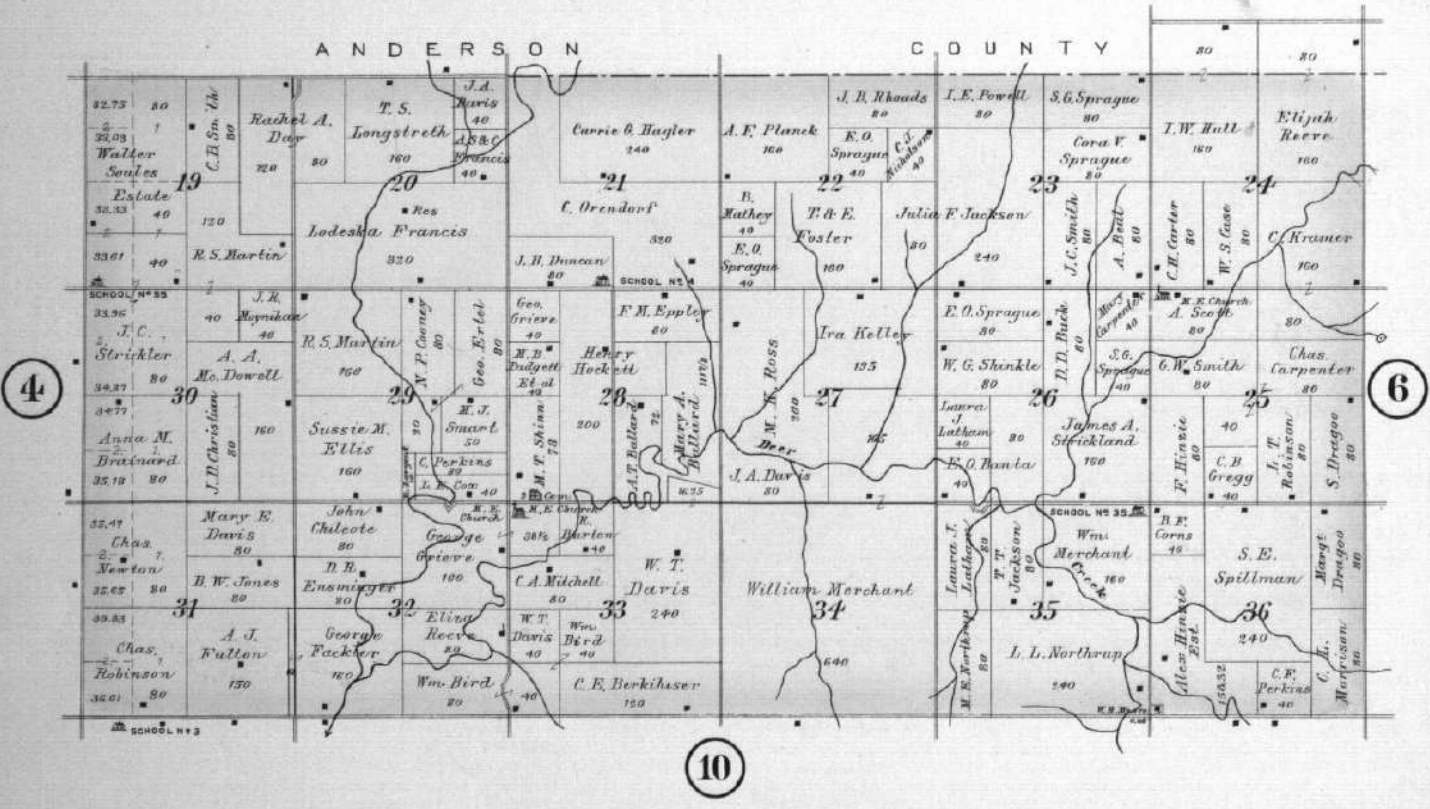

4

6

10

TOWNSHIP 23 SOUTH RANGE 20 EAST

Scale 2 Inches to the Mile.

of the 6th Principal Meridian.

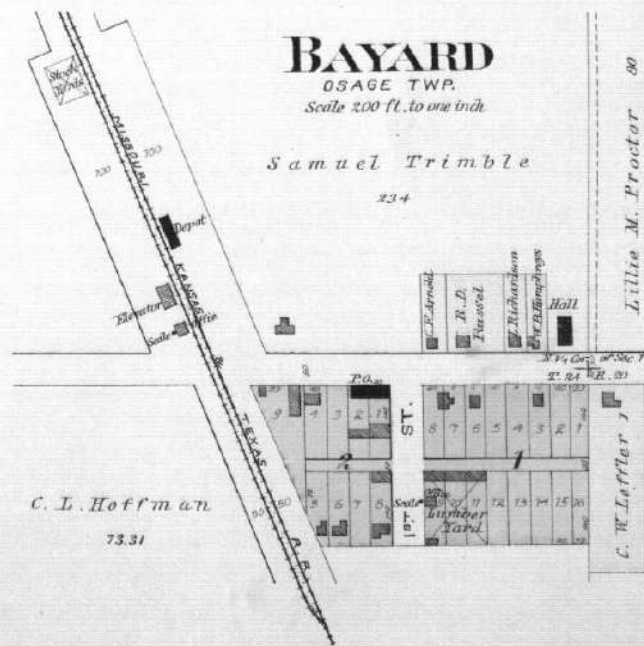
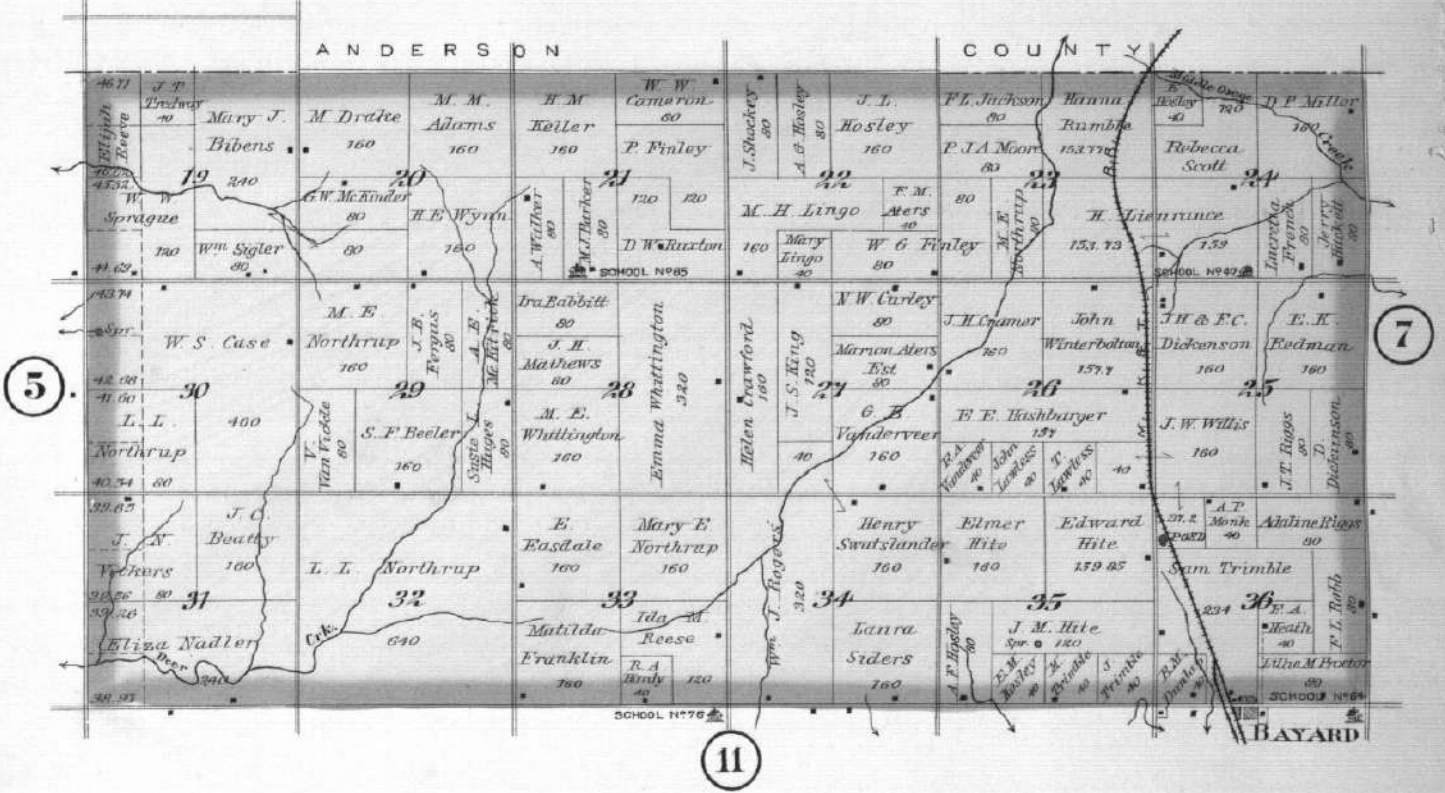

CARLYLE

CARLYLE TWP.

Scale 250 ft. to one inch

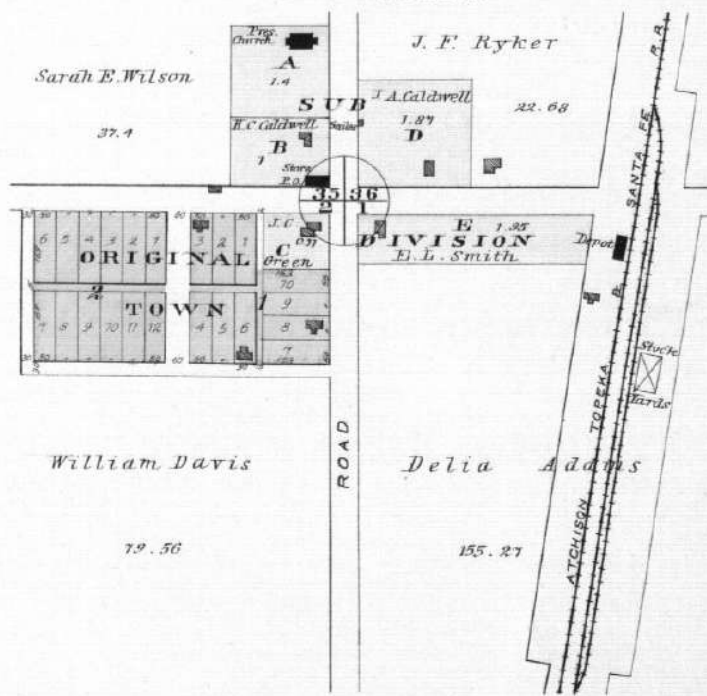

TOWNSHIP 23 SOUTH RANGE 21 EAST.

Scale 2 Inches to the Mile.

of the 6th Principal Meridian.

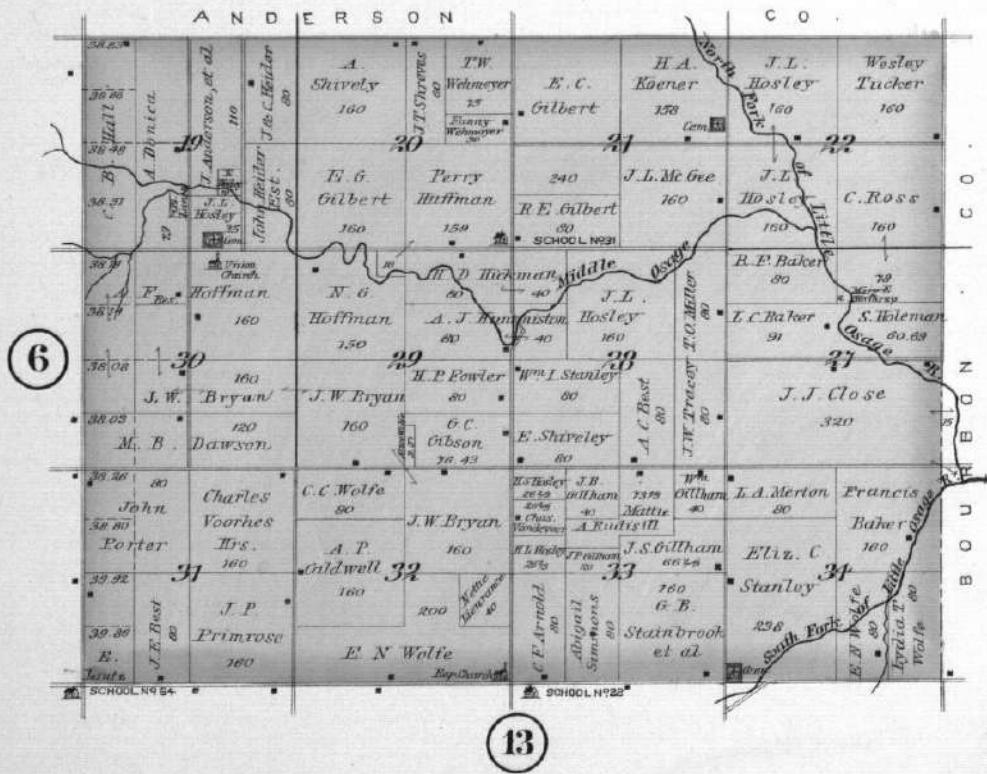

TOWNSHIP 24 SOUTH RANGES 17&18 EAST.

Scale 2 inches to the Mile.

of the 6th Principal Meridian.

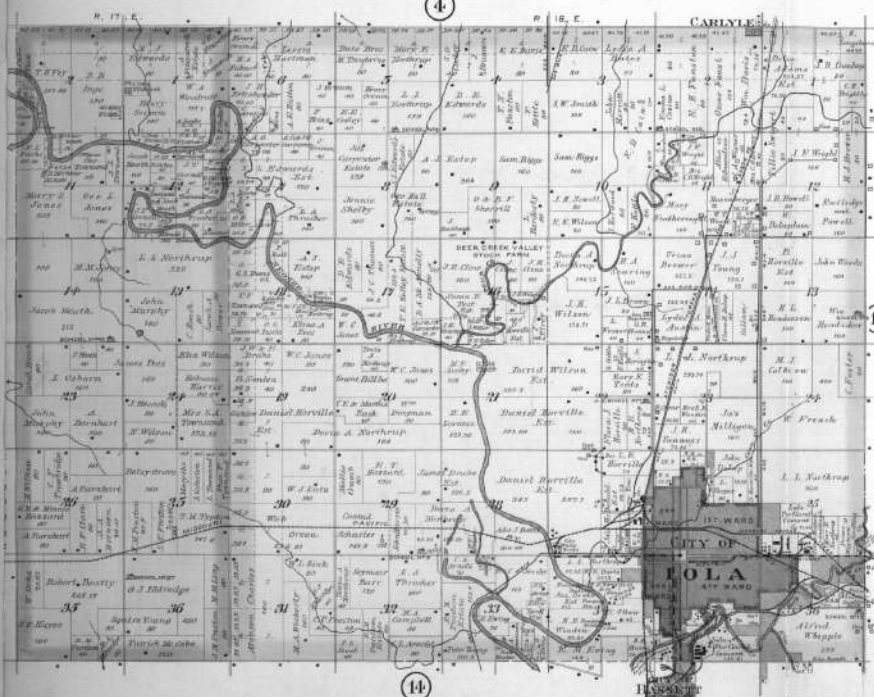

TOWNSHIP 24 SOUTH RANGE 19 EAST.

Scale 2 inches to the Mile.

of the 6th Principal Meridian.

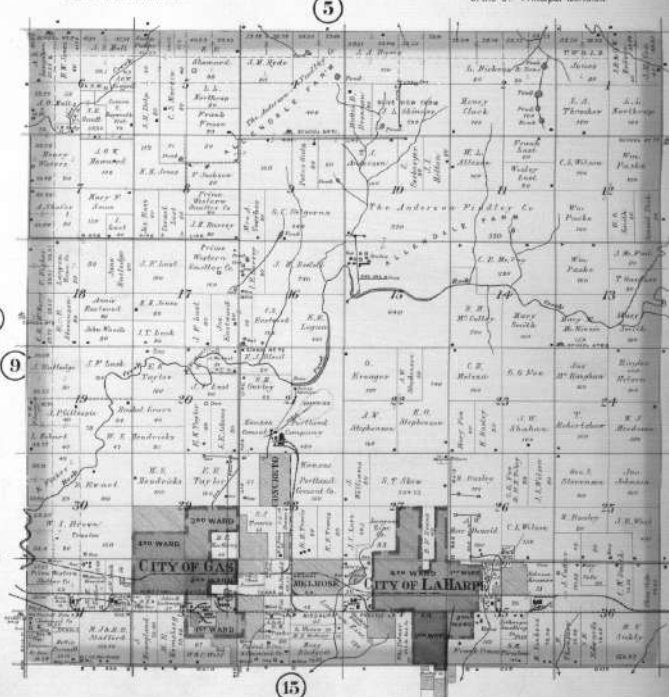

TOWNSHIP 24 SOUTH RANGE 20 EAST.

Scale 2 Inches to the Mile.

of the 6th Principal Meridian.

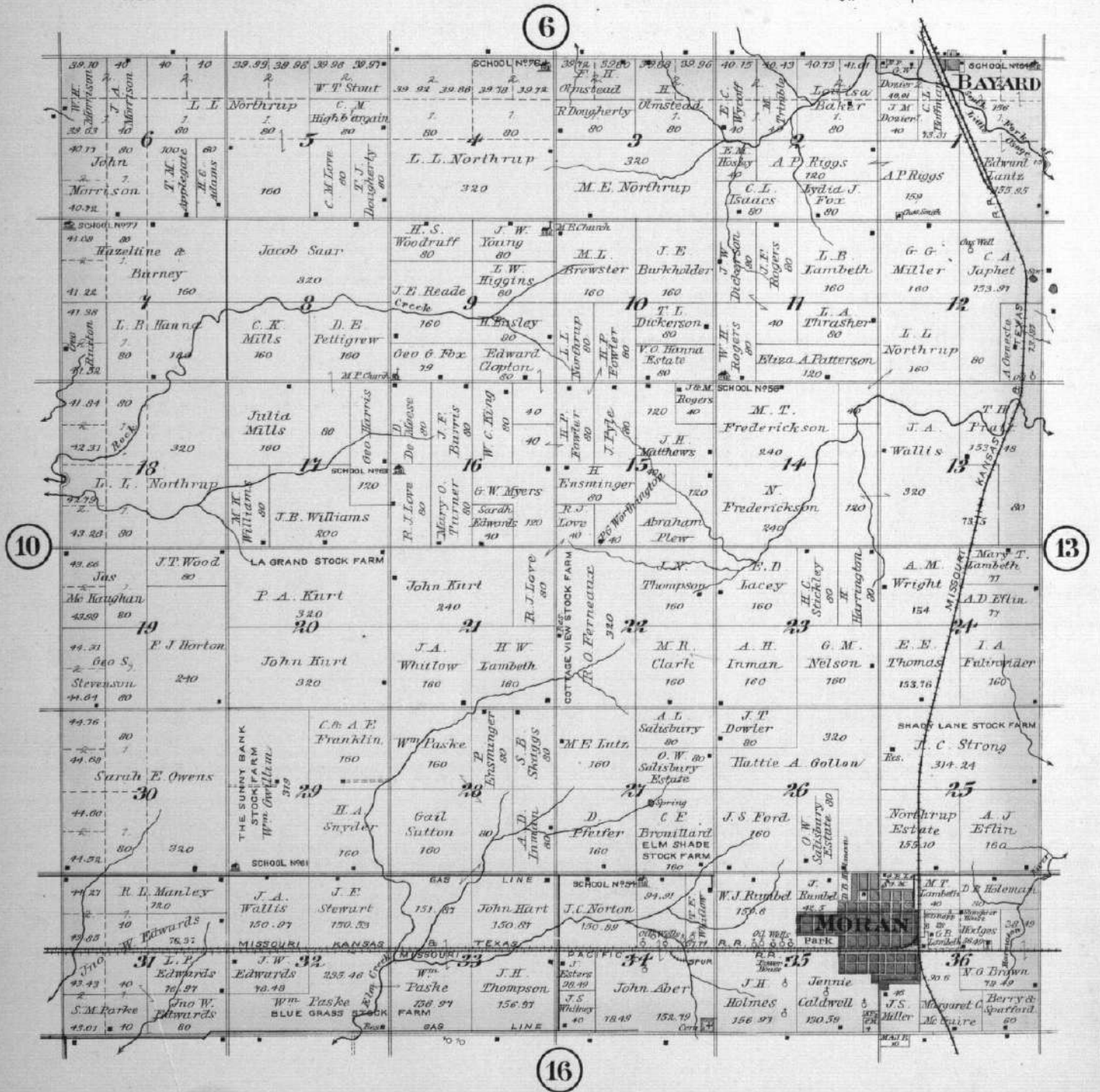

J. Rumbel
42.8

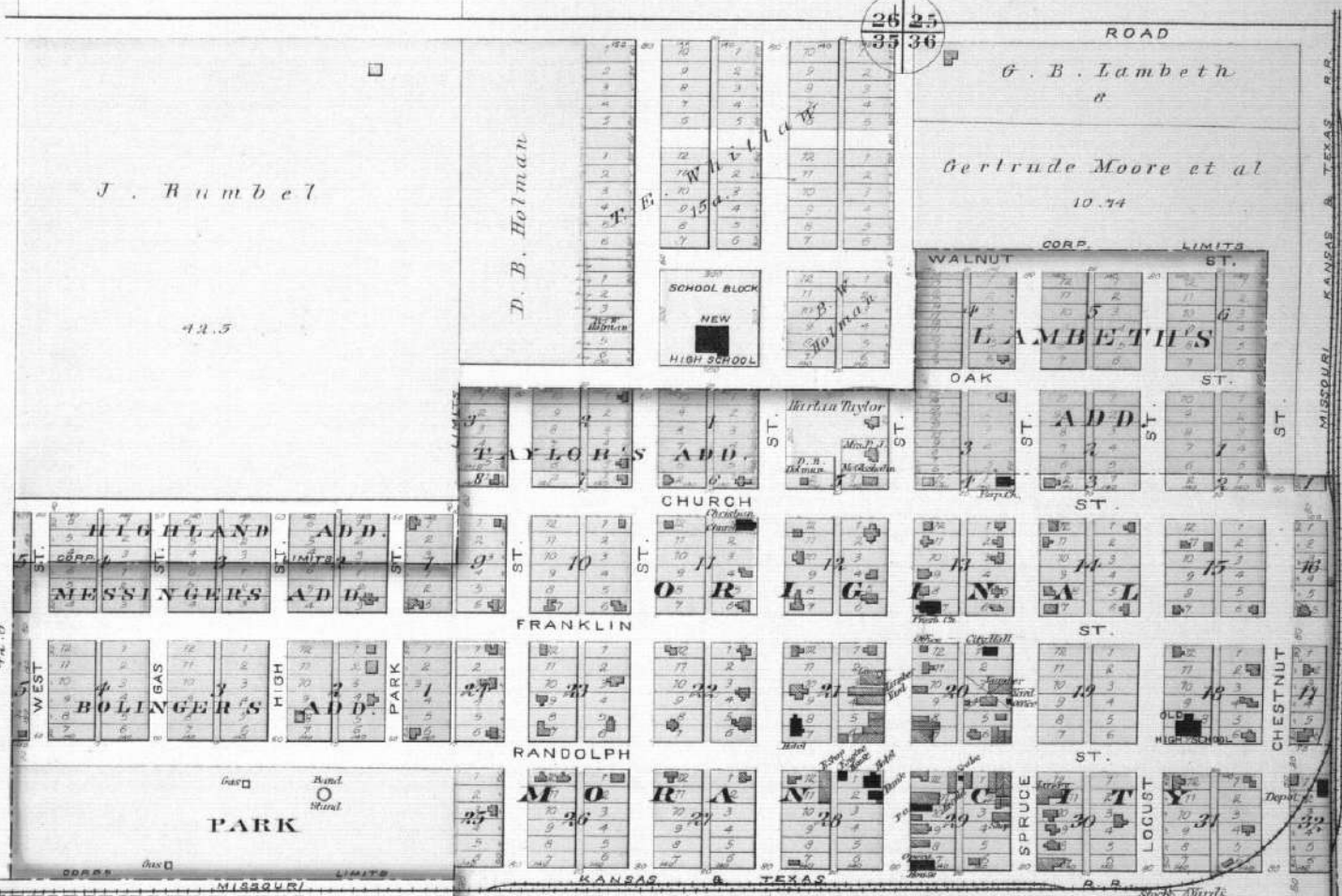

MORAN
MARMATON TWP.
Scale 300 ft. to 1 inch.

Jennie Caldwell

130.59

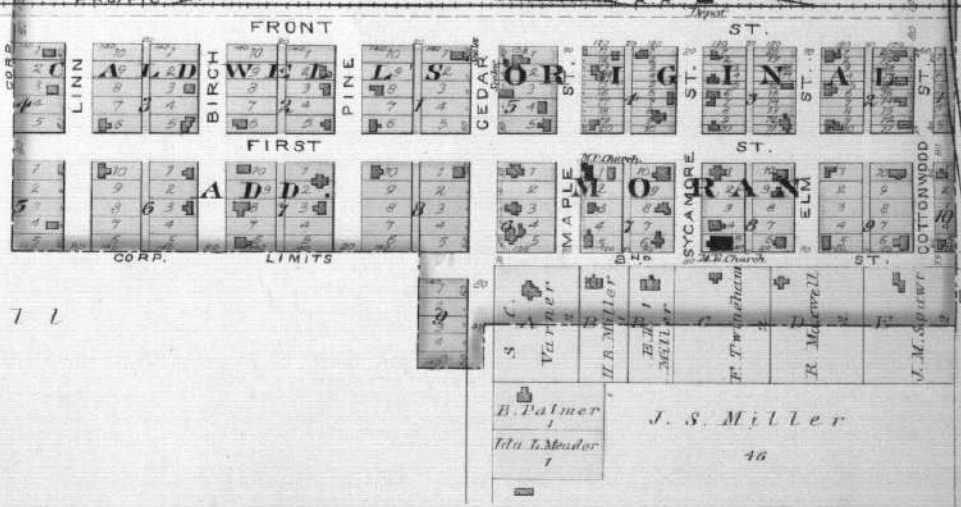

Mary T. Lambeth
E.D. Rapp
Morrison
Margaret C. Me. Gill

TOWNSHIP 25 SOUTH, RANGE 20 EAST.

Scale 2 Inches to the Mile.

of the 6th Principal Meridian.

11

19

15

26

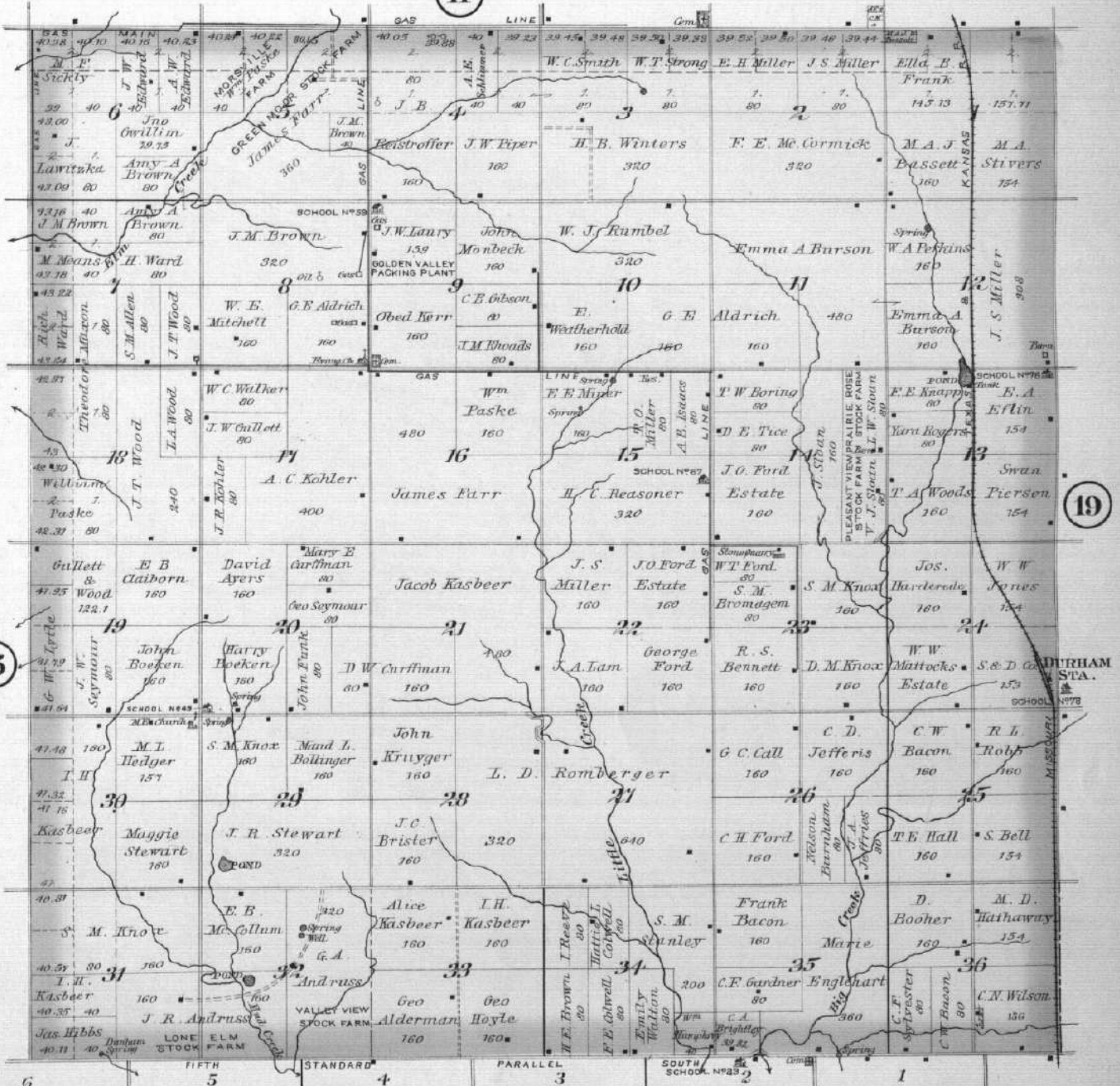

CITY OF HUMBOLDT
 IN HUMBOLDT TWP.
 Scale 400 feet to one inch.

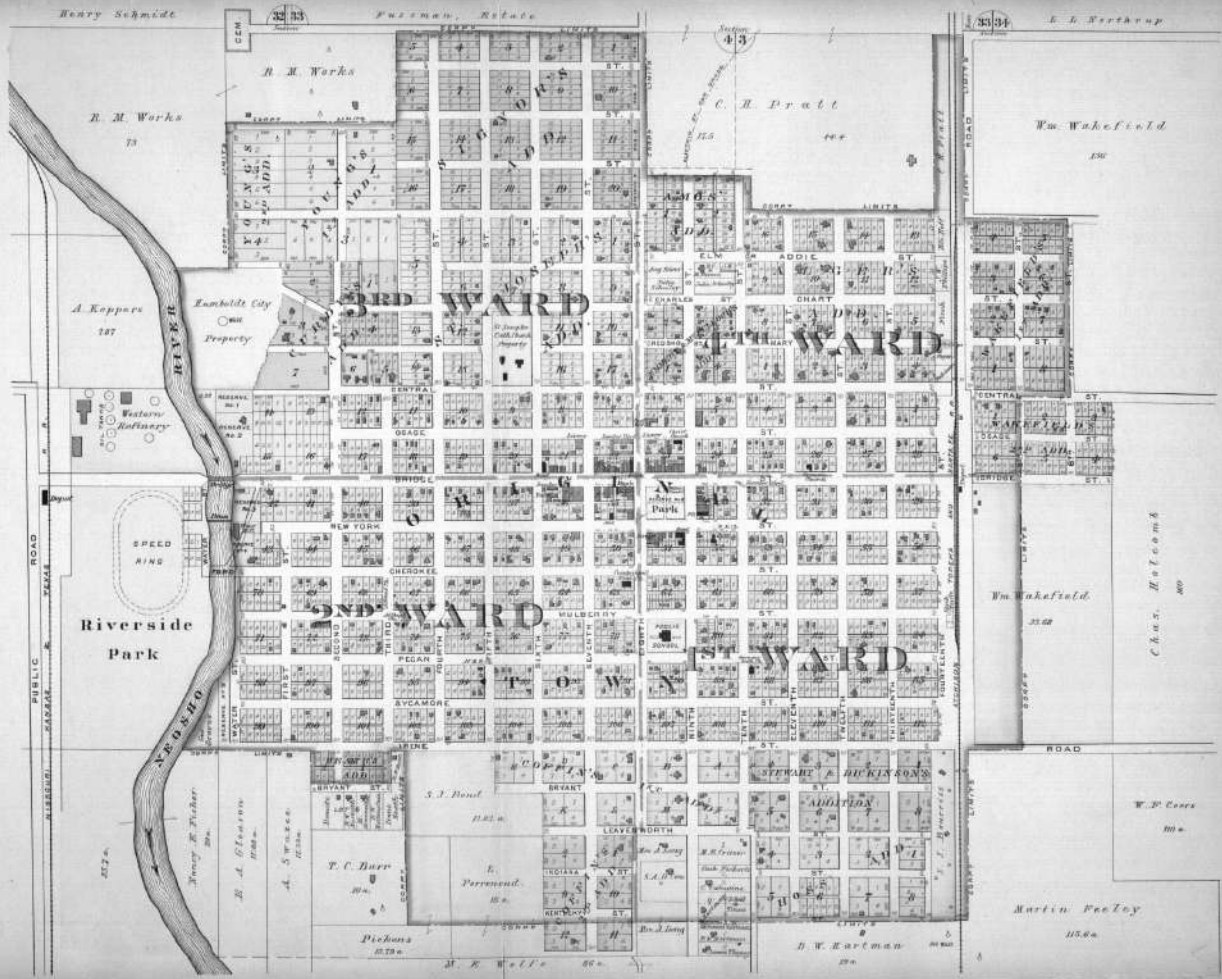

Henry Schmidt

Fuzzman, Kitaco

E. L. Northrup

R. M. Works

R. M. Works

C. R. Pratt

Wm. Wakefield

A. Koppers

Humboldt City Property

Riverside Park

Henry E. Fisher

T. C. Burr

S. J. Bond

STEWART & HURKINSONS

Martin Kelley

PUBLIC ROAD

SAGAZA

WATER ST

WALTON ST

WATER ST

WATER ST

WATER ST

WATER ST

WATER ST

WATER ST

WATER ST

WATER ST

WATER ST

WATER ST

WATER ST

WATER ST

WATER ST

WATER ST

WATER ST

WATER ST

WATER ST

WATER ST

WATER ST

WATER ST

WATER ST

WATER ST

WATER ST

WATER ST

WATER ST

WATER ST

WATER ST

WATER ST

WATER ST

WATER ST

WATER ST

WATER ST

WATER ST

WATER ST

WATER ST

WATER ST

WATER ST

WATER ST

WATER ST

WATER ST

WATER ST

WATER ST

WATER ST

WATER ST

WATER ST

WATER ST

WATER ST

WATER ST

WATER ST

WATER ST

TOWNSHIP 25 SOUTH RANGE 21 EAST.

Scale 2 Inches to the Mile.

13

of the 6th Principal Meridian.

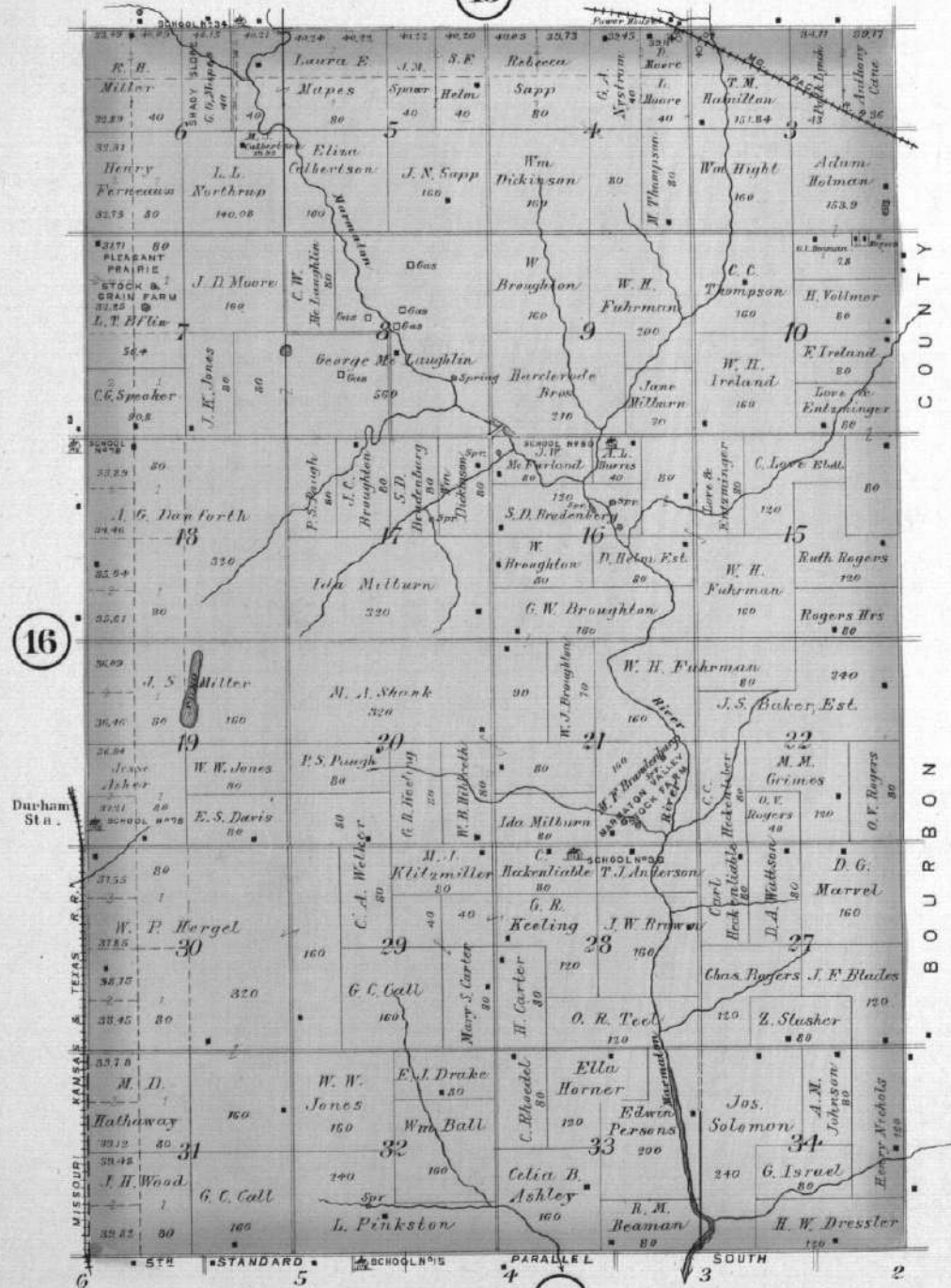

16

27

COUNTY BOURBON

Durham Sta.

6 5 4 3 2
STANDARD PARALLEL SOUTH

CONCRETO

ELM TOWNSHIP
Scale 300-ft.-1 inch

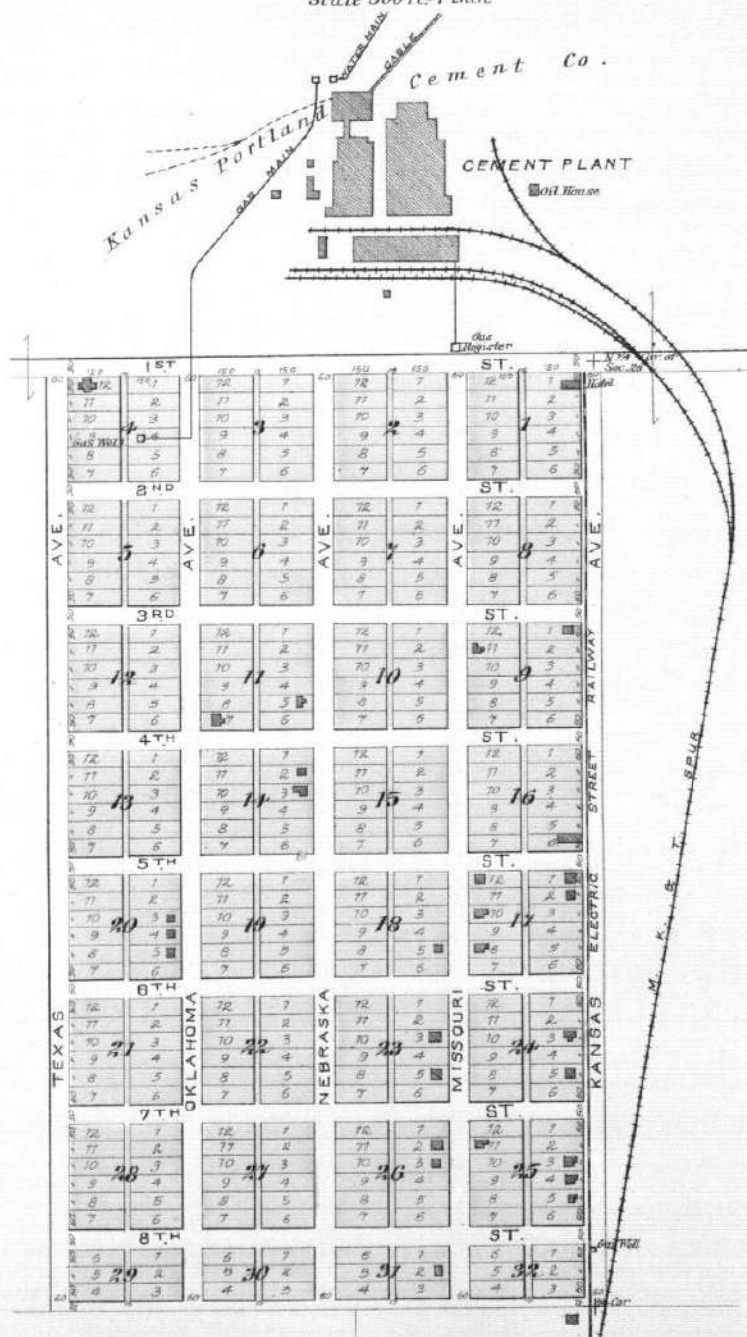

TOWNSHIP 26 SOUTH RANGES 17 & 18 EAST

Scale 2 Inches to the Mile.

of the 8th Principal Meridian.

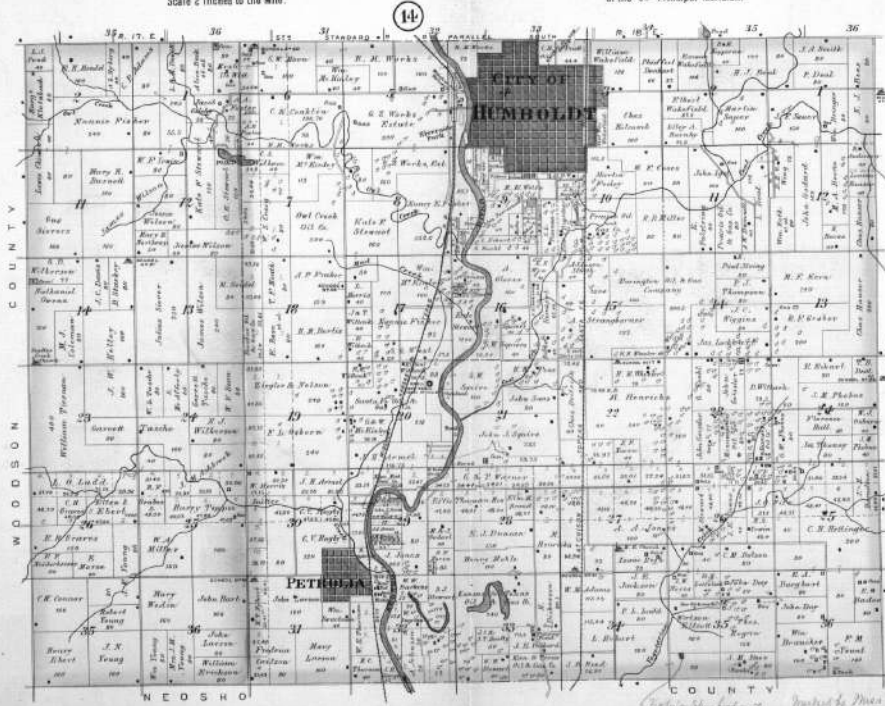

Checked by Miss Francis

PETROLIA

LOGAN TWP.

Scale 200 ft. to 1 inch.

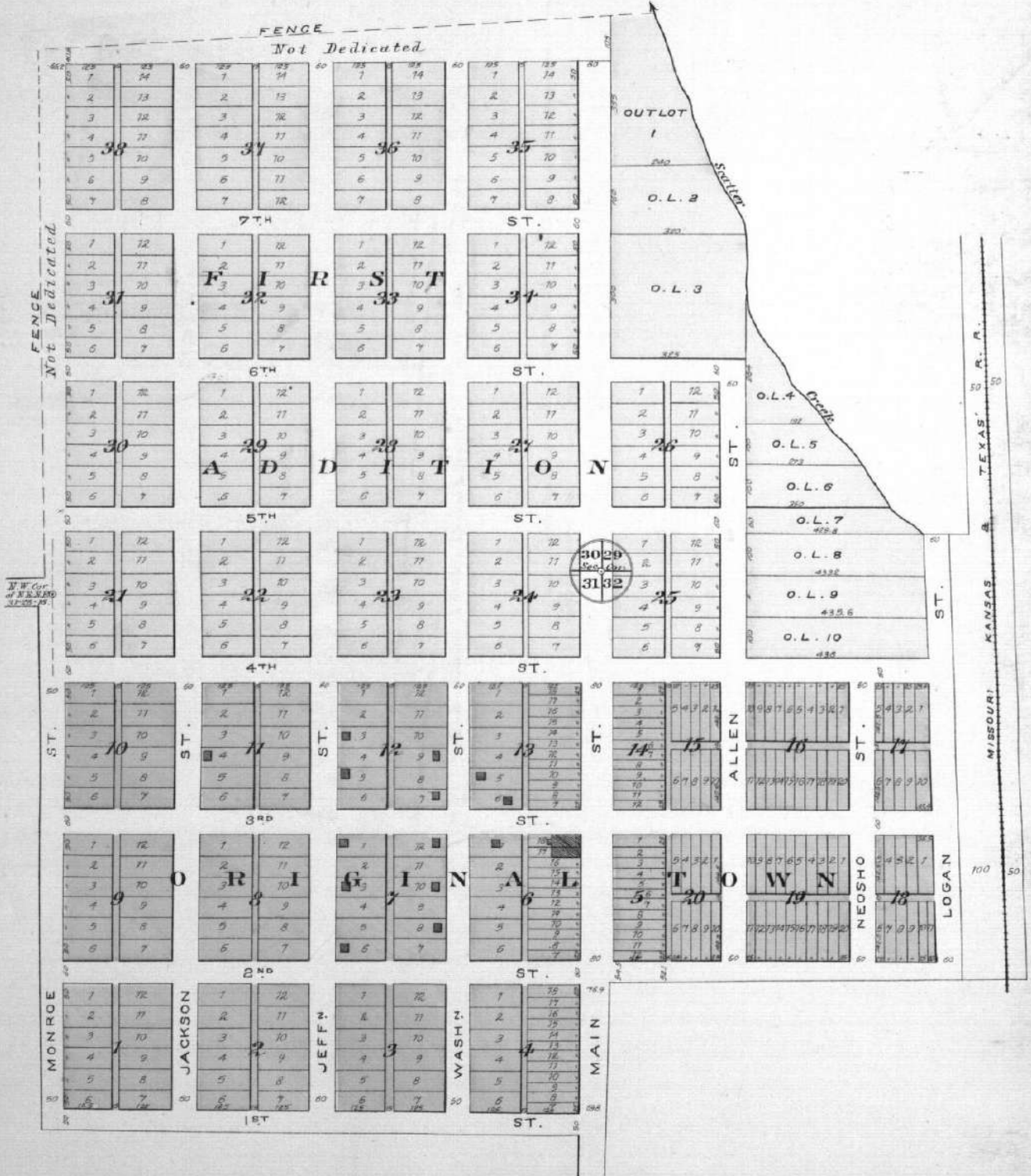

MELROSE

ELM TWP.
Scale 300 ft. = 1 inch.

R. H. Travis

H. F. Travis

J. C. Love

Lanyon Zinc Co.

80

80

645



2827
3334

Lanyon Zinc Co.

48

MISSOURI

PACIFIC

RY.

TOWNSHIP 26 SOUTH RANGE 19 EAST.

Scale 2 Inches to the Mile.

15

of the 6th Principal Meridian.

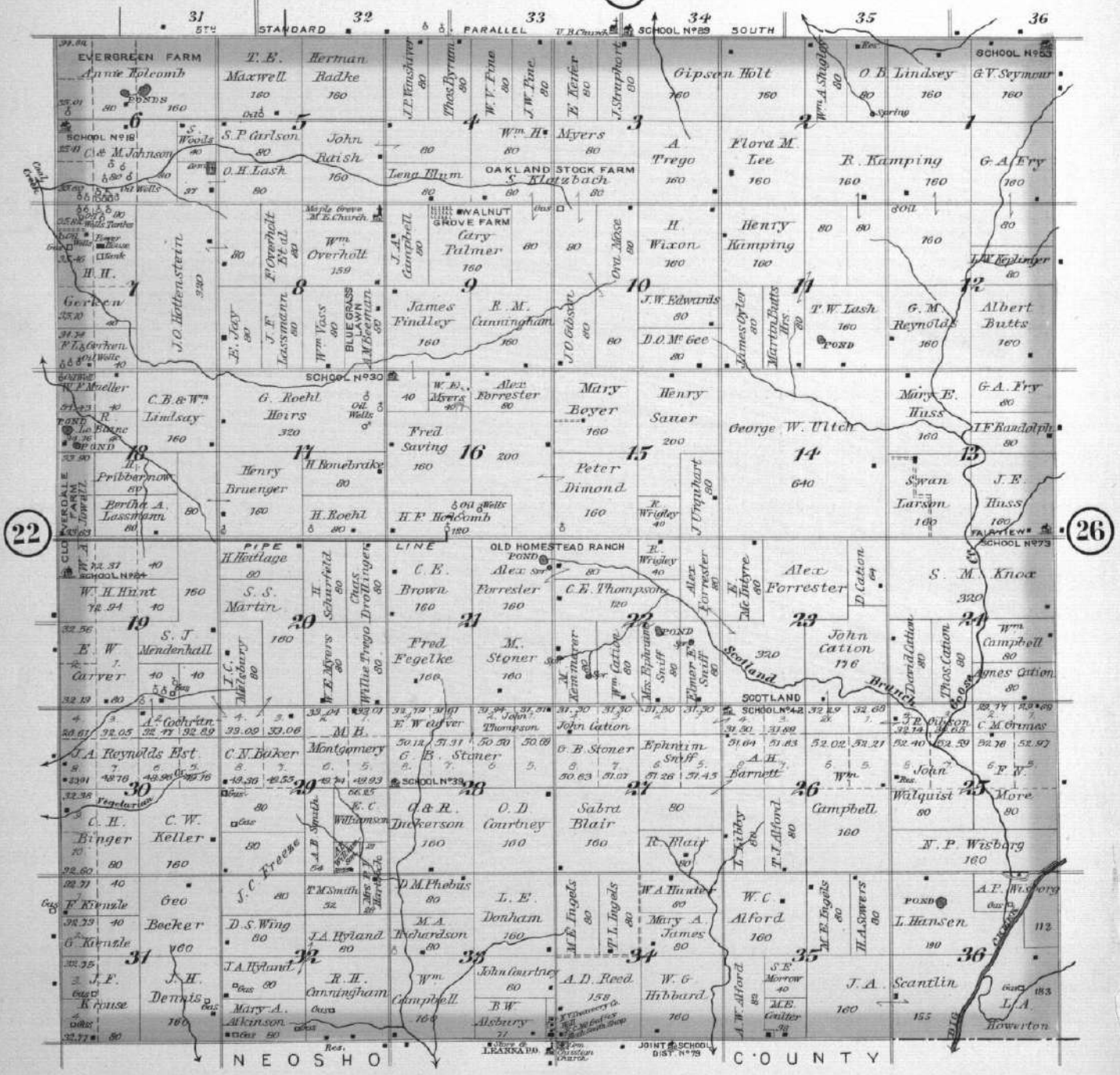

22

26

NE OSHO COUNTY

TOWNSHIP 26 SOUTH RANGE 20 EAST

Scale 2 Inches to the Mile.

16

of the 6th Principal Meridian.

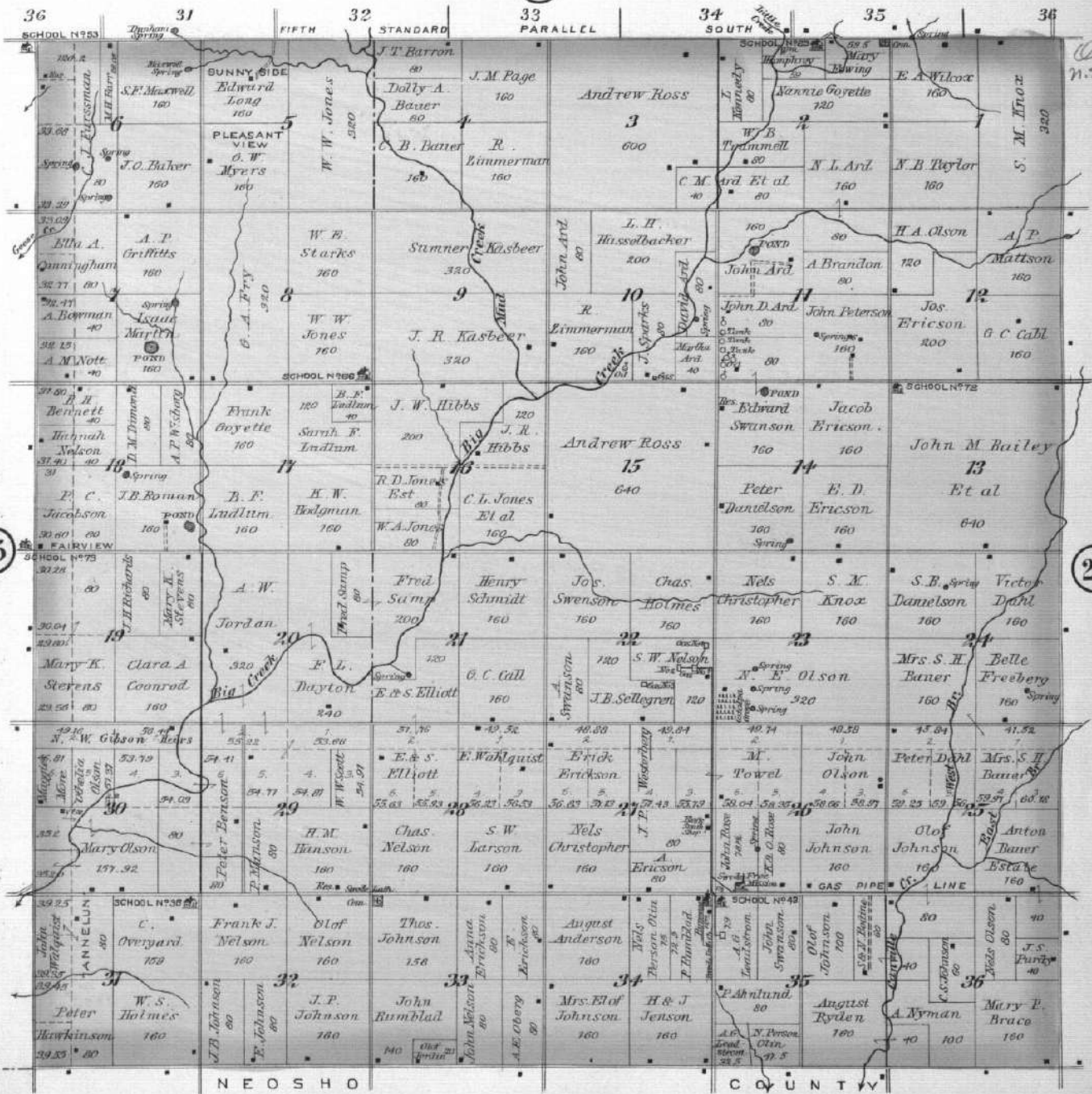

25

27

NEOSHO

COUNTY

TOWNSHIP 26 SOUTH RANGE 21 EAST.

Scale 2 Inches to the Mile.

19

of the 6th Principal Meridian.

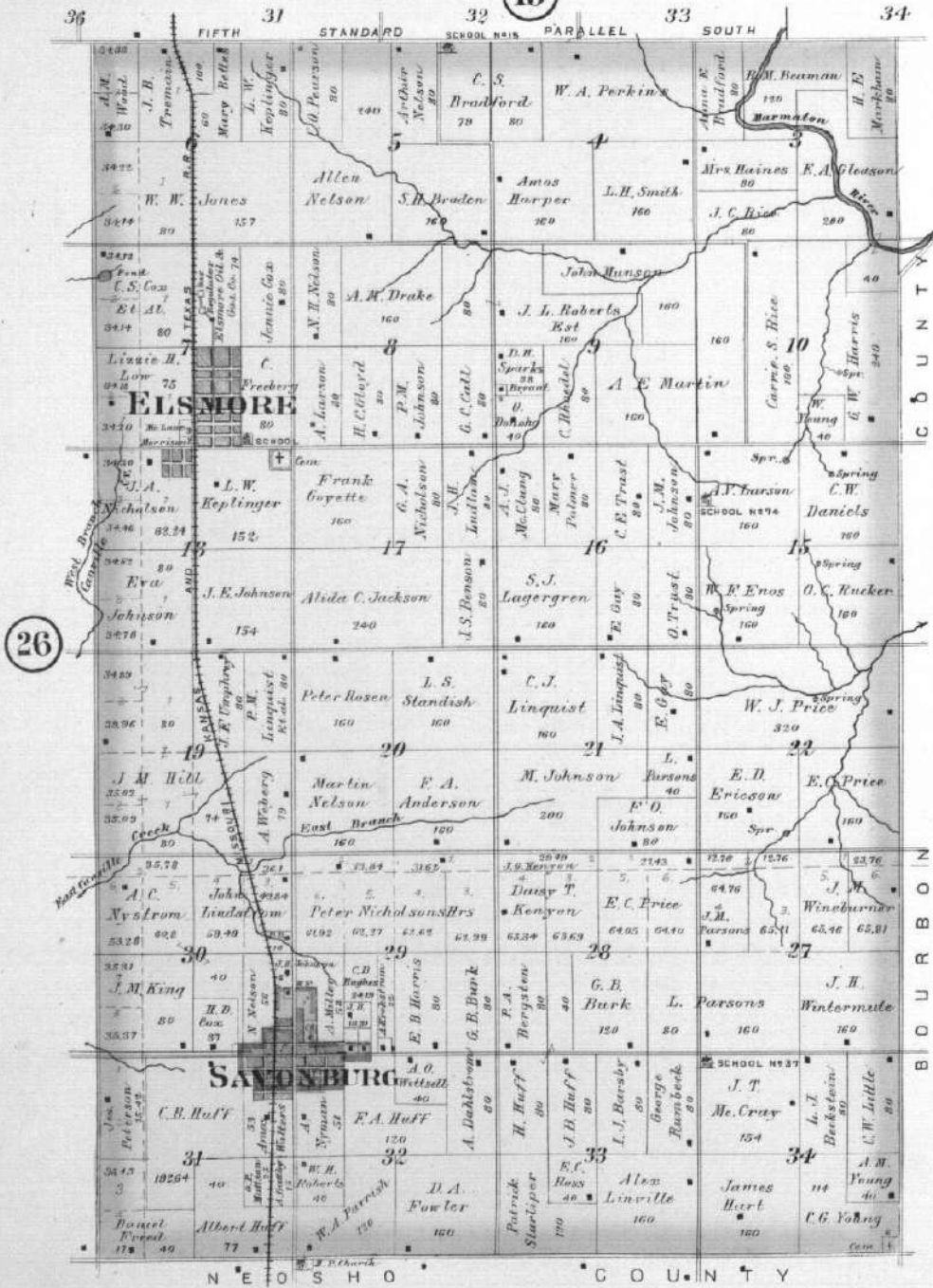

ELSMORE

ELSMORE TWP.

Scale 300 Feet to one inch

Lizzie H. Low

143.38

A. H.
McLane
3
DEPOT
L.
Morrison
2



C. Freeberg

Original name was Elsinore

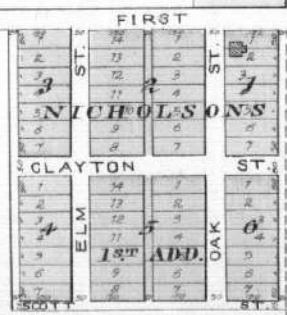

L. W. Keplinger

TOWNSHIP 25 SOUTH RANGE 19 EAST.

Scale 2 Inches to the Mile.

of the 6th Principal Meridian.

