

Map of **BOURBON CO.** KANSAS.

Scale 1/2 in. to one mile

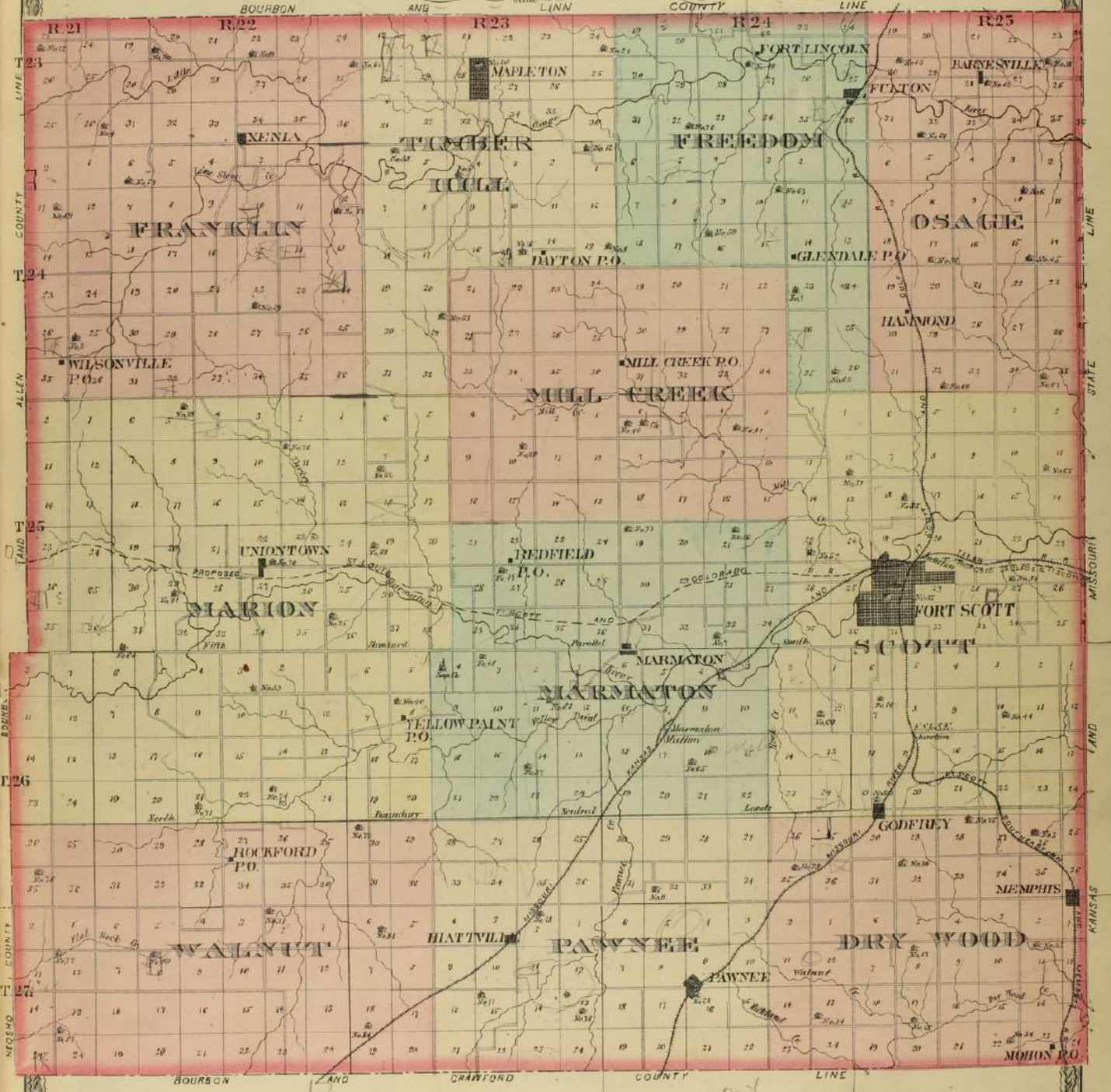

LINE
T 23
T 24
T 25
T 26
T 27
BOURBON COUNTY
ALLEN COUNTY
BOWEN COUNTY
NEOSHO COUNTY

LINE
R 21
R 22
R 23
R 24
R 25
BOURBON COUNTY
CRAWFORD COUNTY
DREY KANSAS

TOWNSHIP 27 SOUTH RANGE 25 EAST

OF THE 6TH PRINCIPAL MERIDIAN.

Scale: 2 inches to the mile.

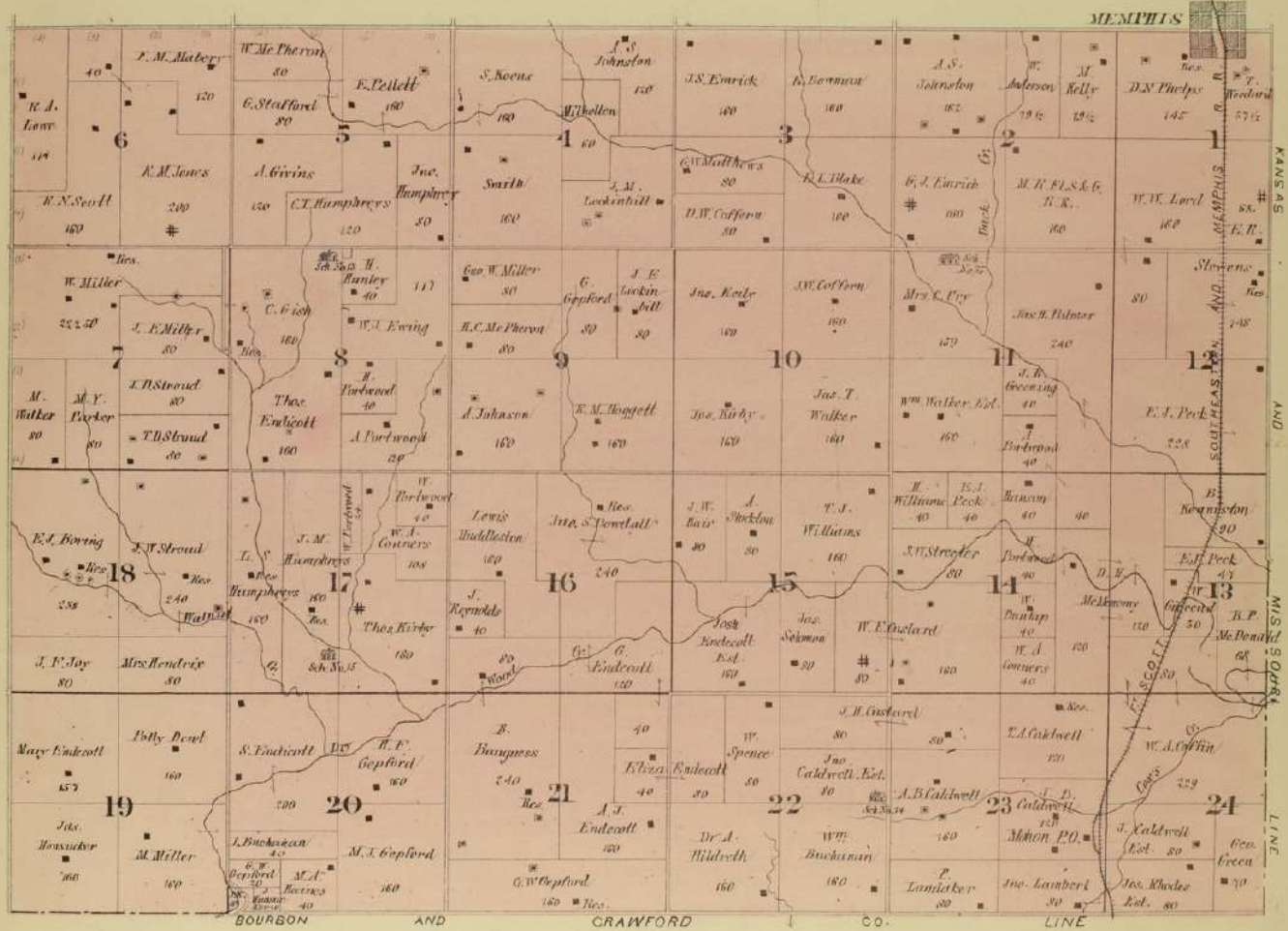

TOWNSHIP 25 SOUTH RANGE 25 EAST

OF THE 6TH PRINCIPAL MERIDIAN.

Scale 2 inches to the mile.

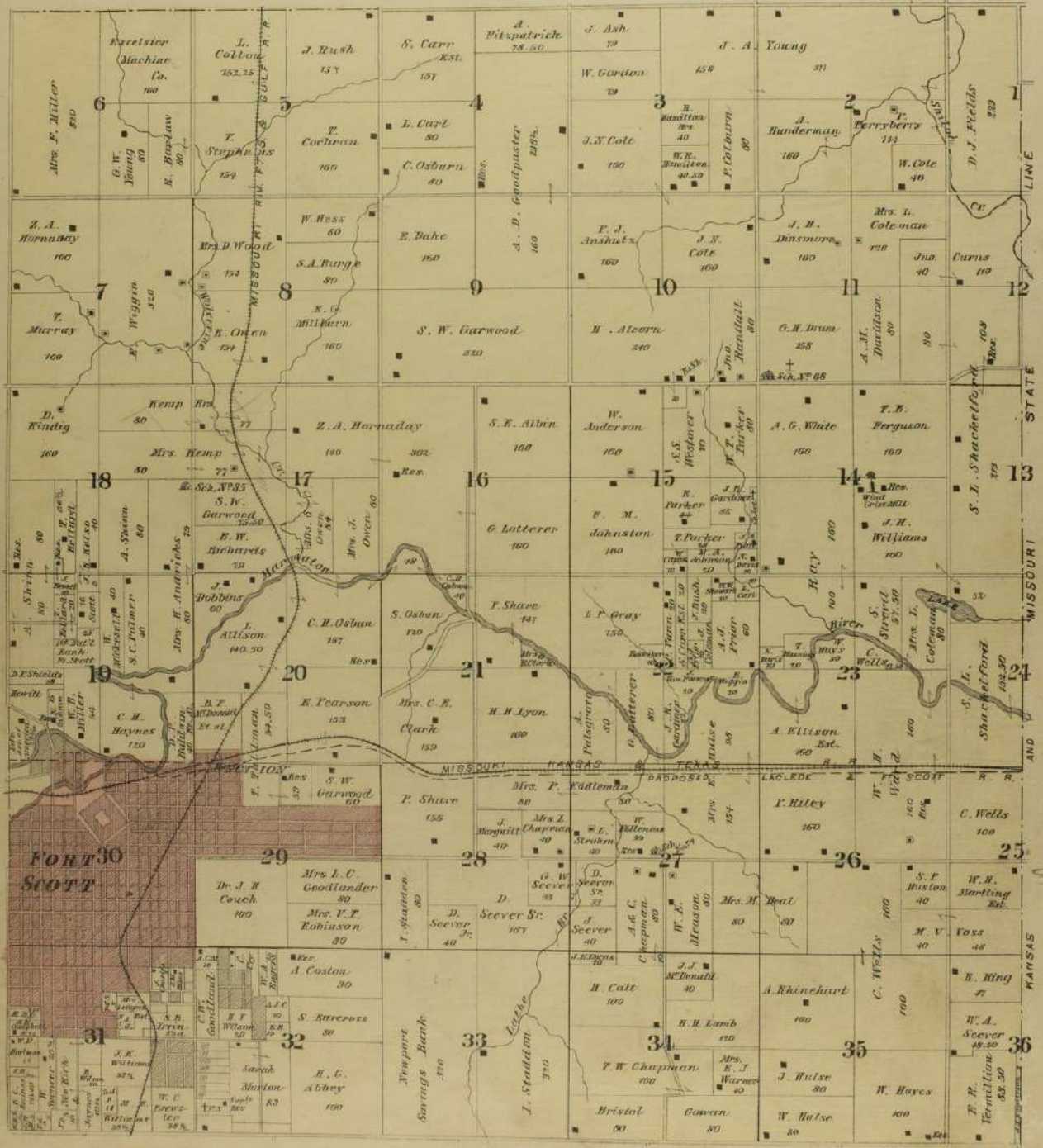

CITY OF FORT SCOTT

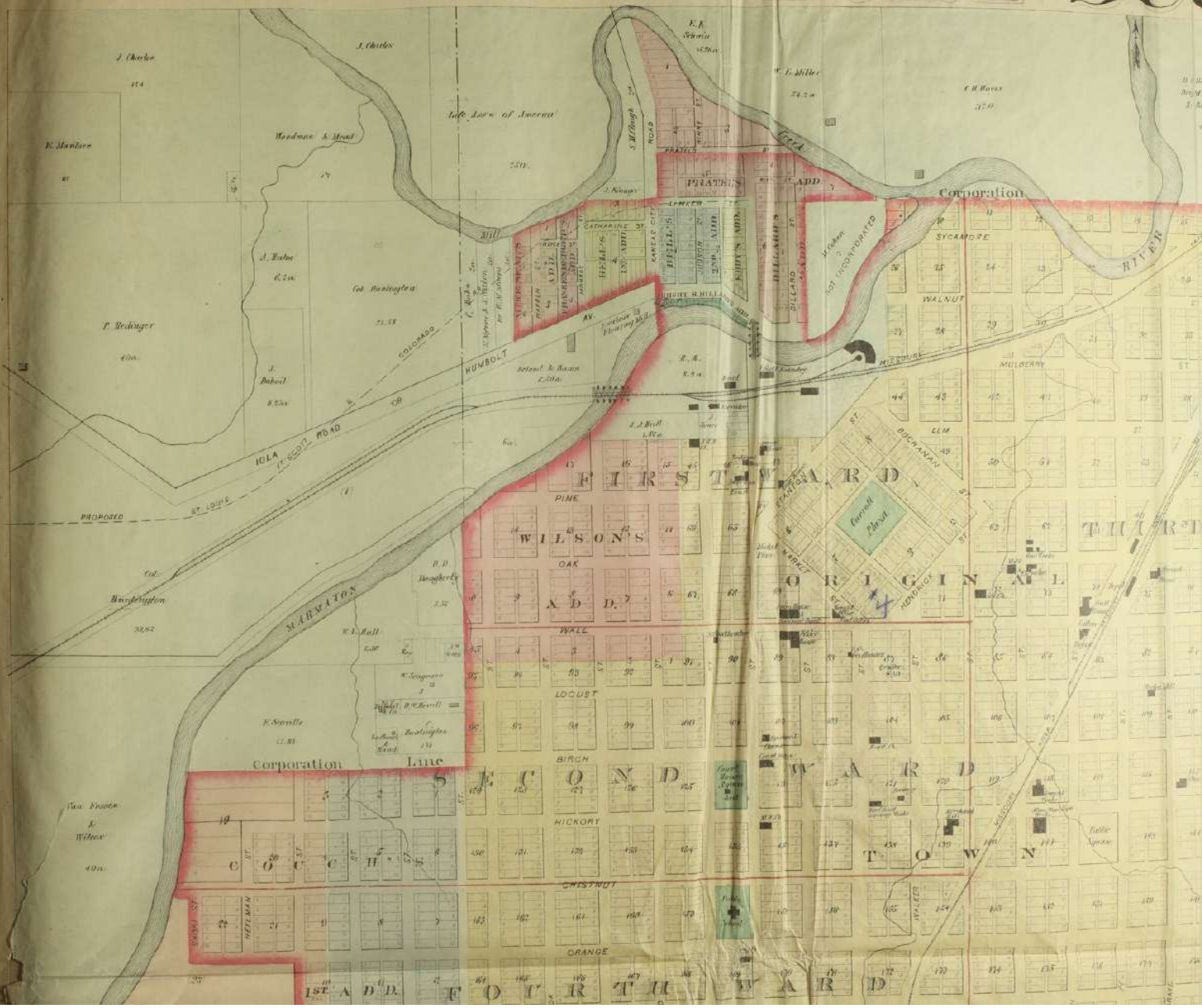

CITY OF FORT SCOTT



SCOTT

Scale of feet to one inch

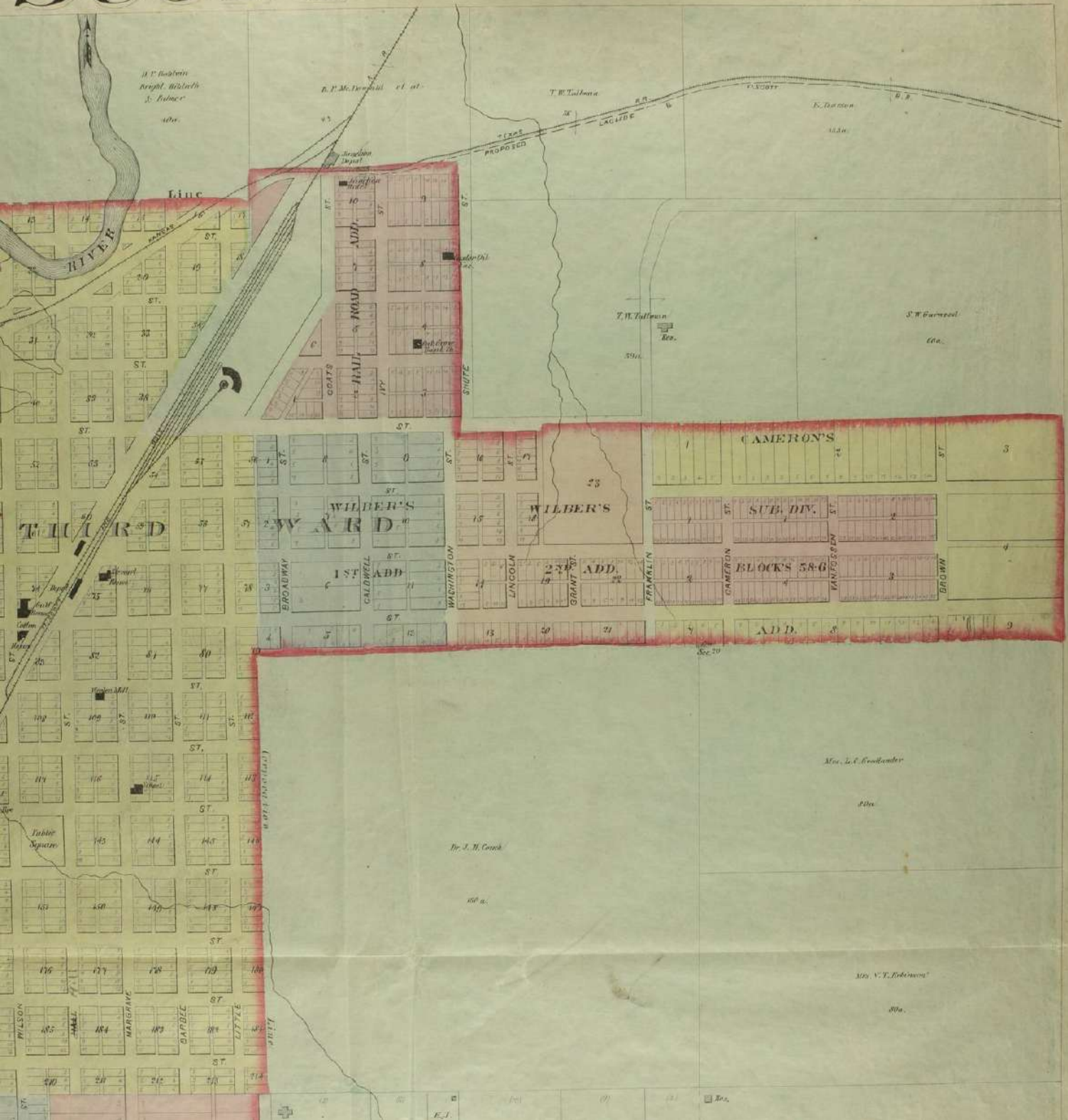

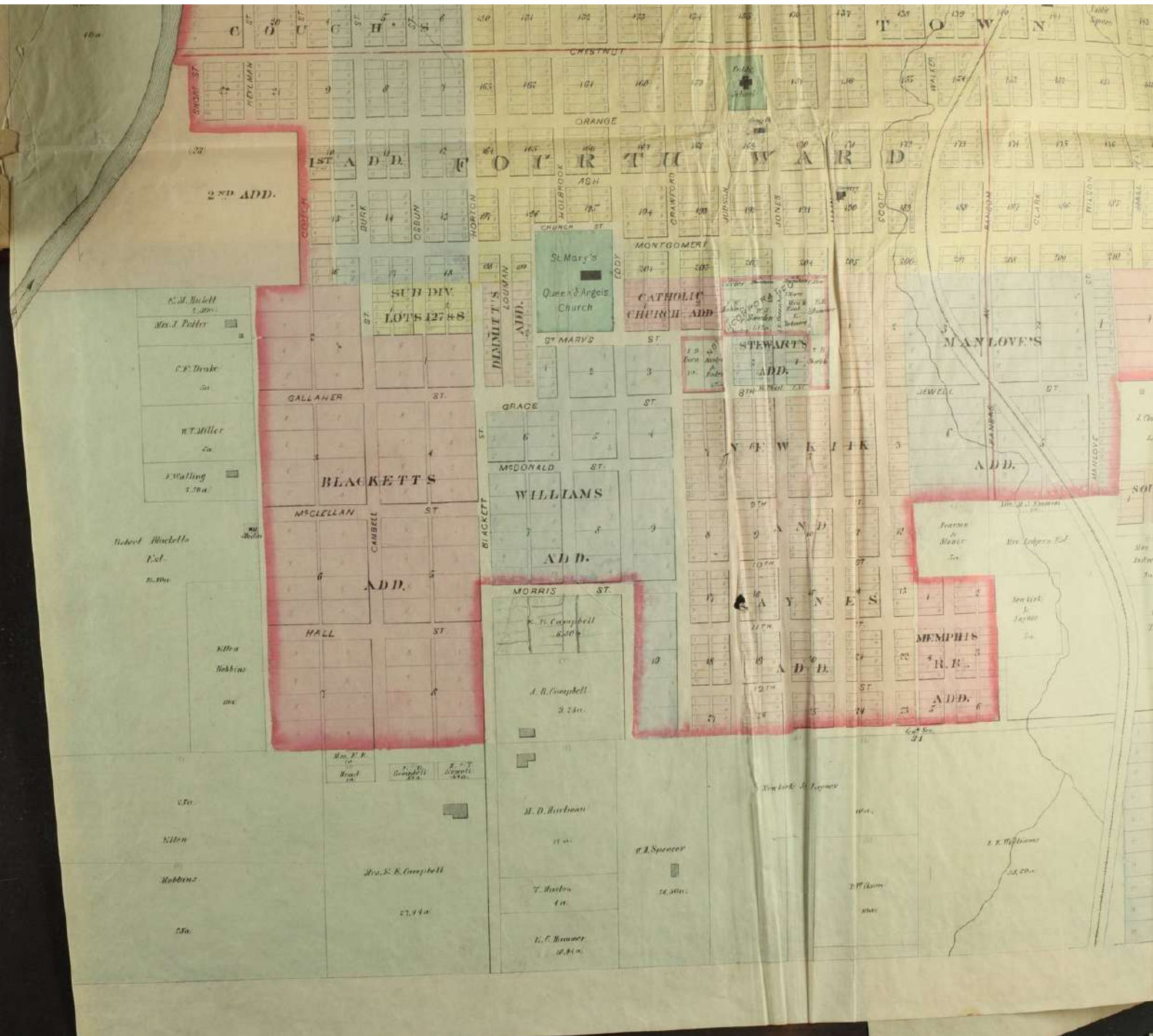

C O U G H L I N S T

CHRISTIE

ORANGE

1ST ADD. F O U R T W A R D

ASH

CHURCH ST

MONTGOMERY

STEWARTS ADD.

MANLOVE'S

ADD.

WILLIAMS

ADD.

MORRIS ST.

ADD.

MEMPHIS

ADD.

ADD.

ADD.

ADD.

ADD.

ADD.

ADD.

ADD.

ADD.

ADD.

ADD.

ADD.

ADD.

TOWNSHIP 25 SOUTH RANGE 24 EAST

OF THE 6TH PRINCIPAL MERIDIAN.

Scale: 2 inches to the mile.

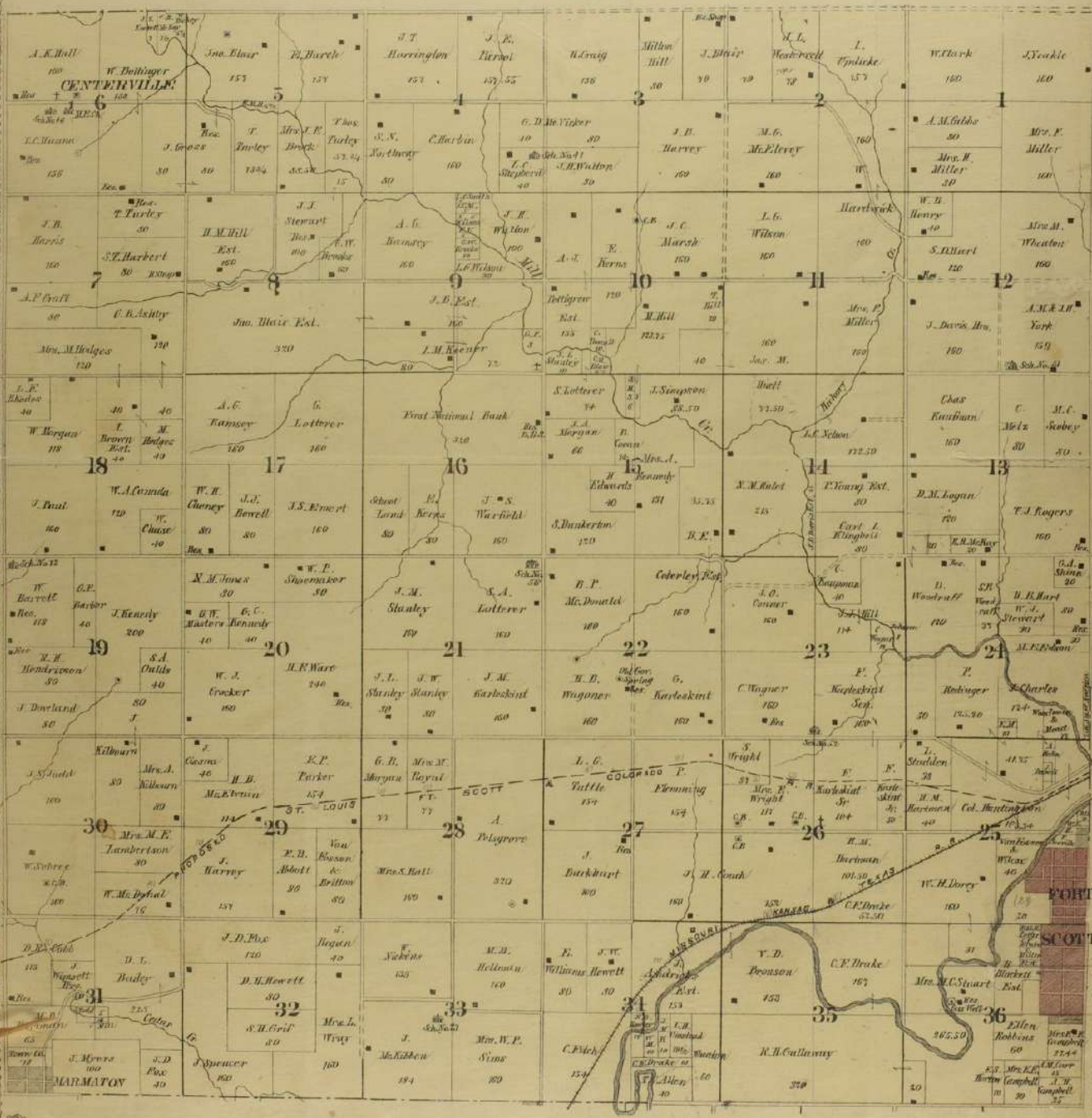

TOWNSHIP 24 SOUTH RANGE 25 EAST

OF THE 6TH PRINCIPAL MERIDIAN.

Scale: 2 inches to the mile.

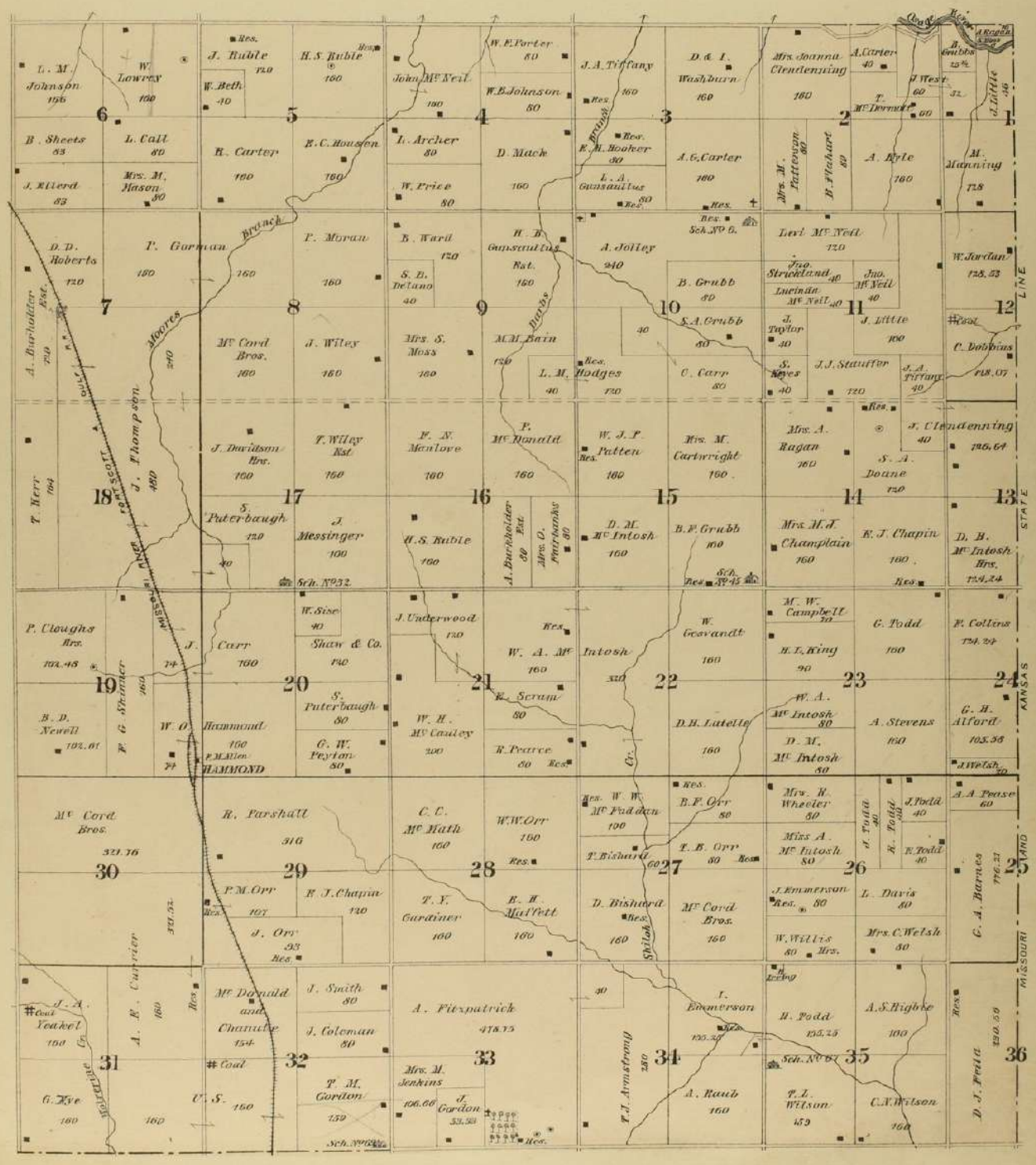

TOWNSHIP 23 SOUTH RANGE 25 EAST

OF THE 6TH PRINCIPAL MERIDIAN.

Scale: 2 inches to the mile.

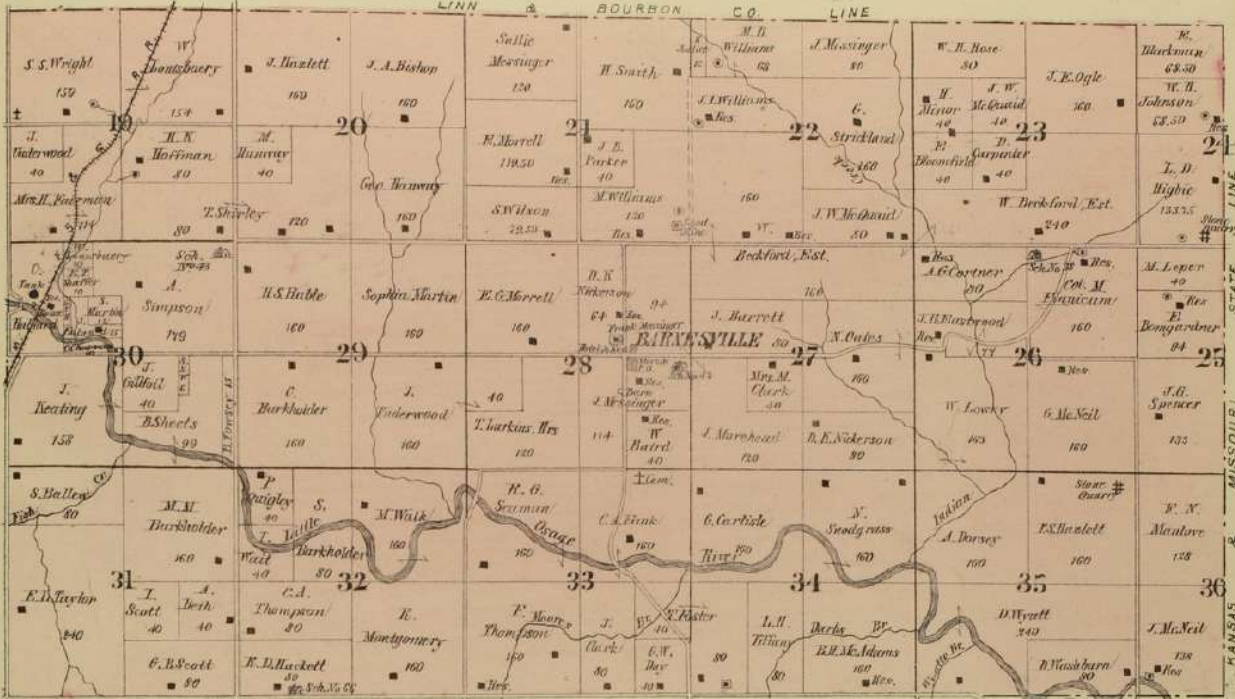

TOWNSHIP 23 SOUTH RANGE 24 EAST

OF THE 6TH PRINCIPAL MERIDIAN.

Scale: 2 inches to the mile.

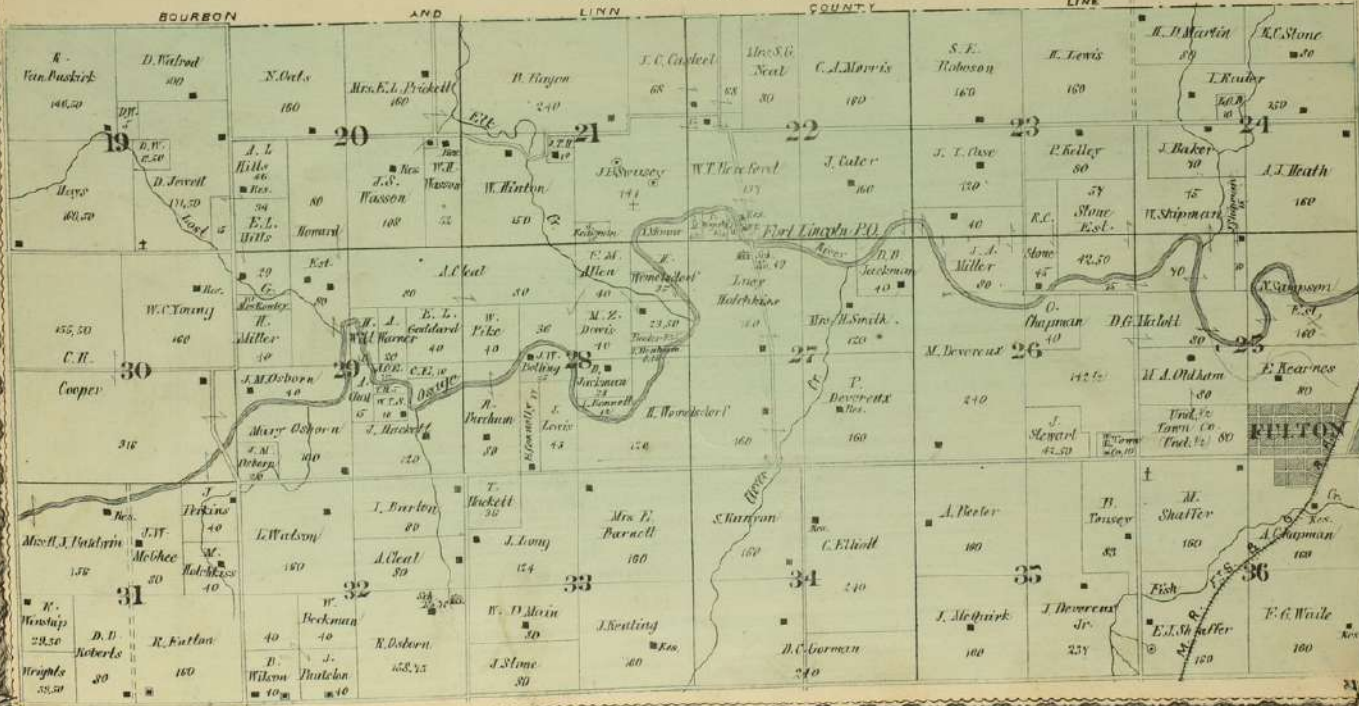

TOWNSHIP 24 SOUTH RANGE 24 EAST

OF THE 6TH PRINCIPAL MERIDIAN.

Scale: 2 inches to the mile.

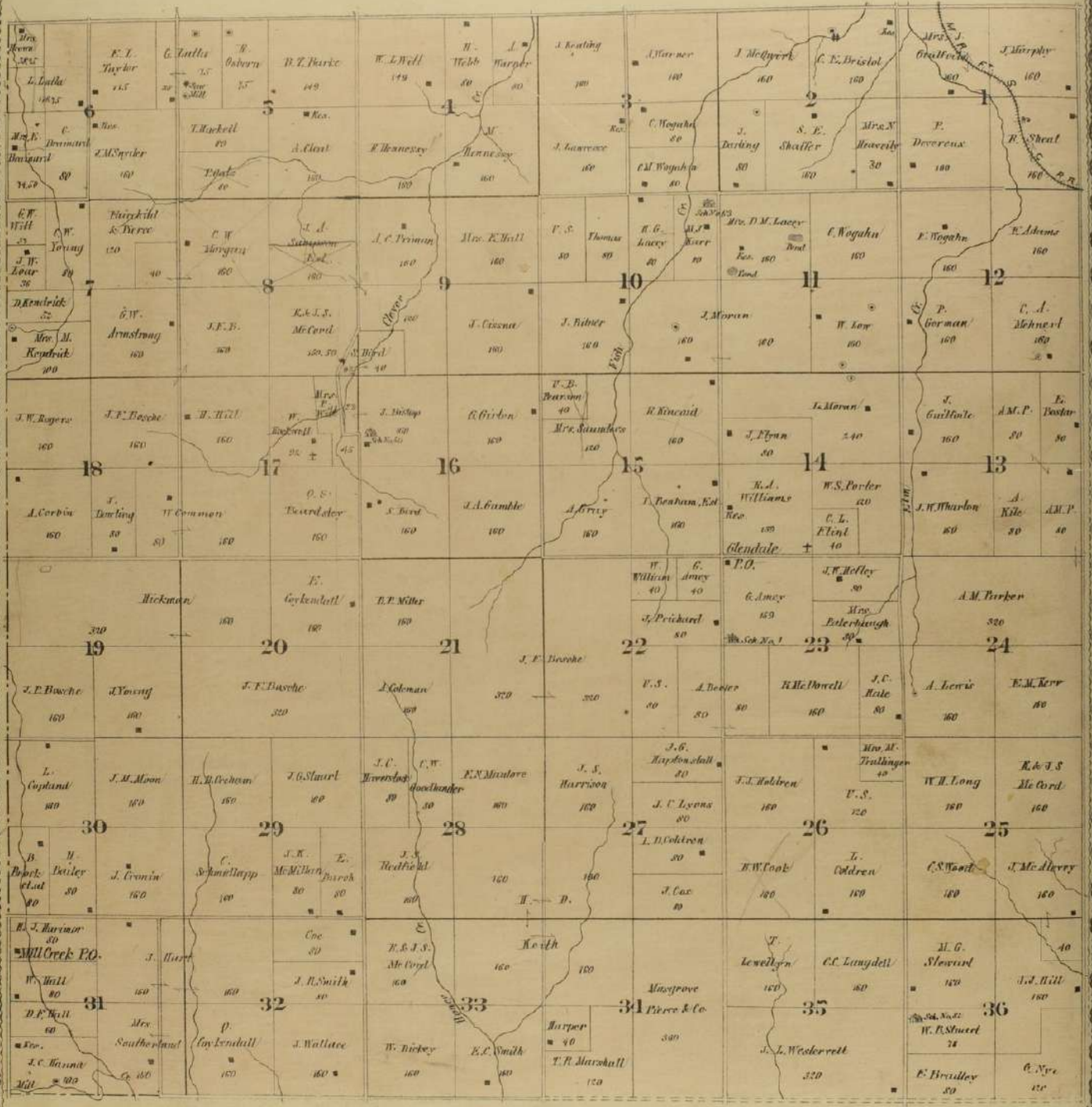

TOWNSHIP 26 SOUTH RANGE 24 EAST

OF THE 6TH PRINCIPAL MERIDIAN.

Scale: 2 inches to the mile.

MARMATON

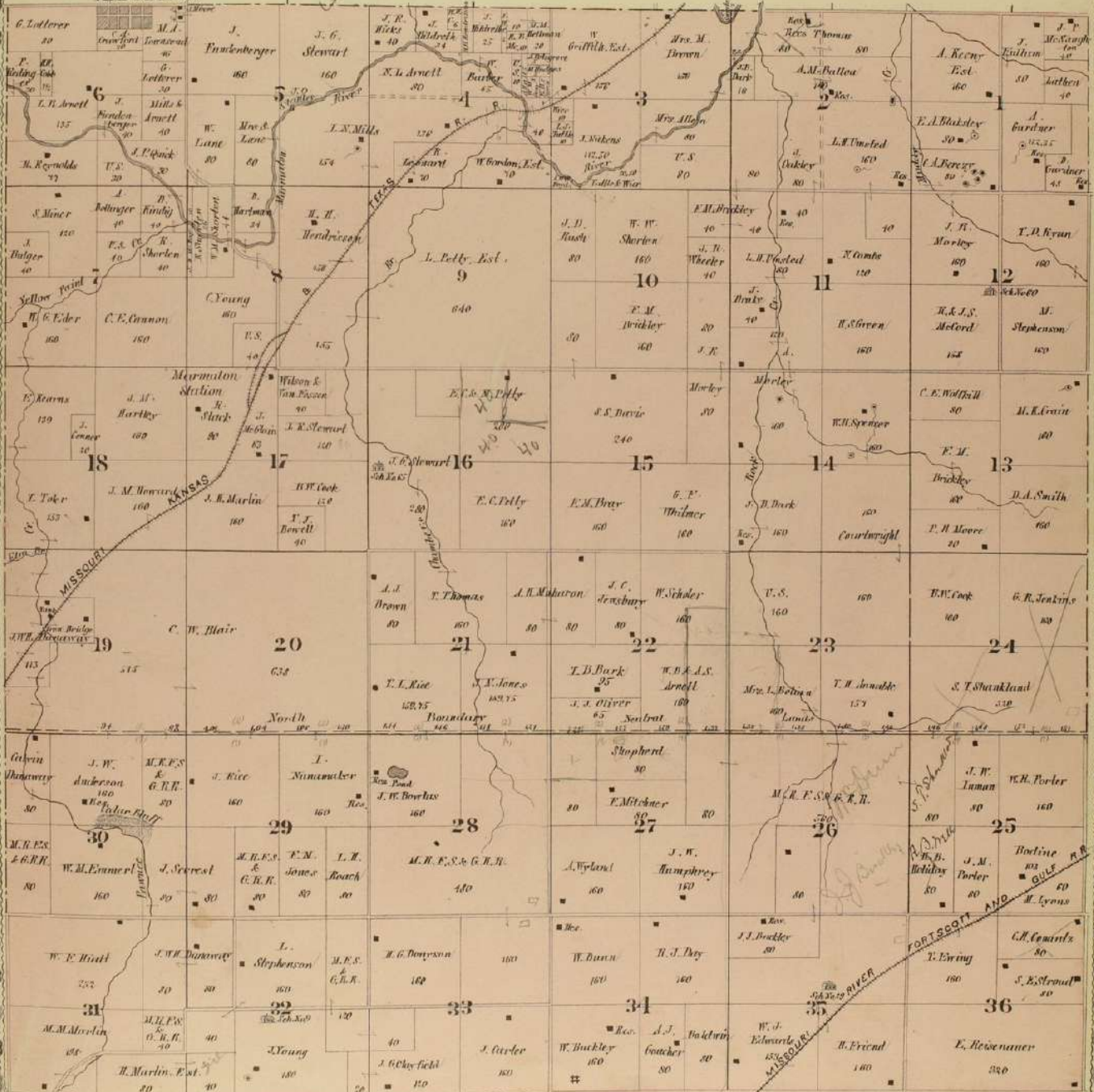

TOWNSHIP 27 SOUTH RANGE 24 EAST

OF THE 6TH PRINCIPAL MERIDIAN.

Scale, 2 inches to the mile.

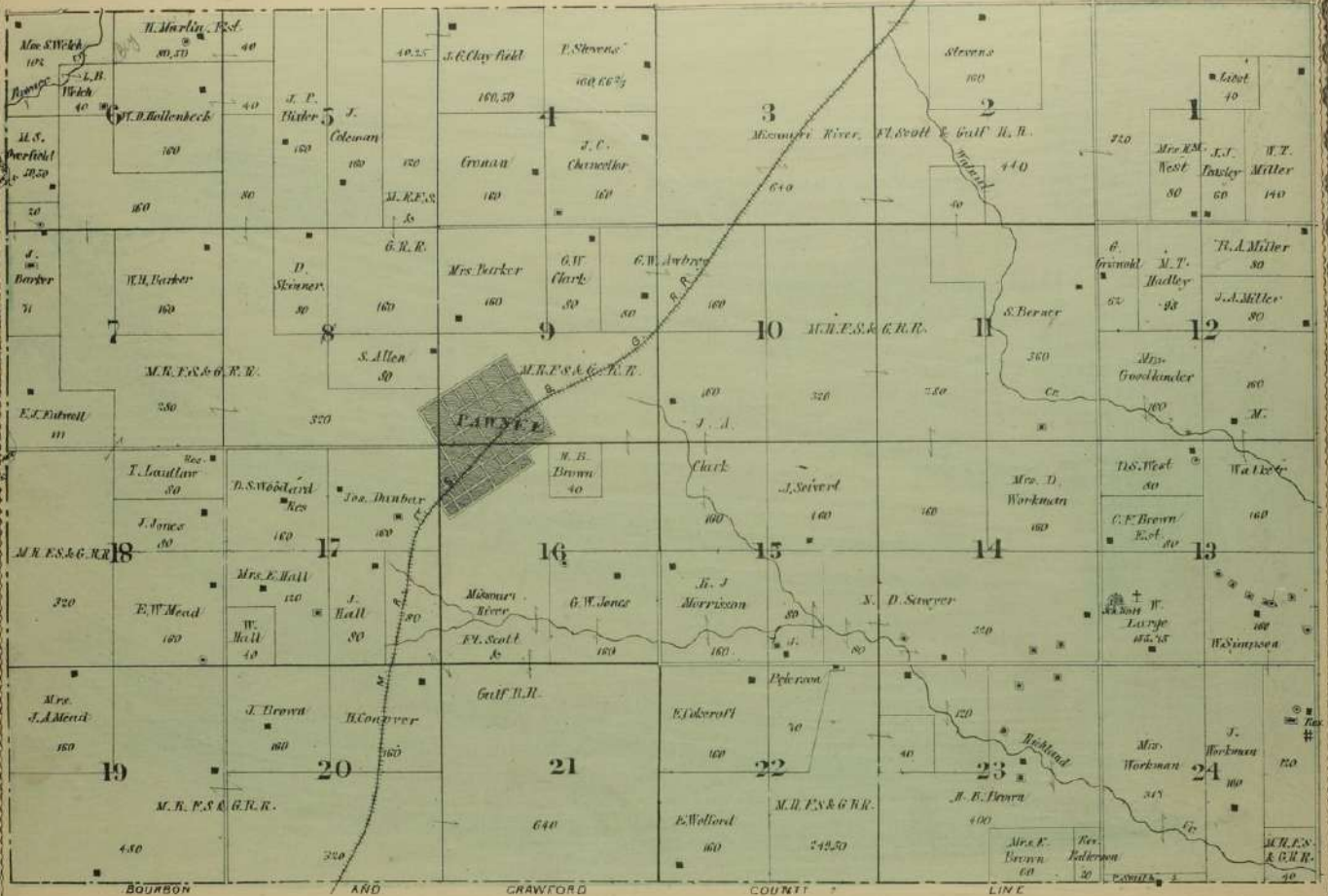

Xenia

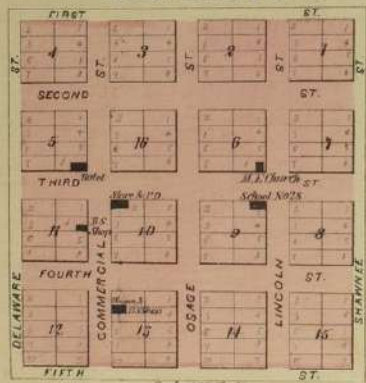

GODFREY

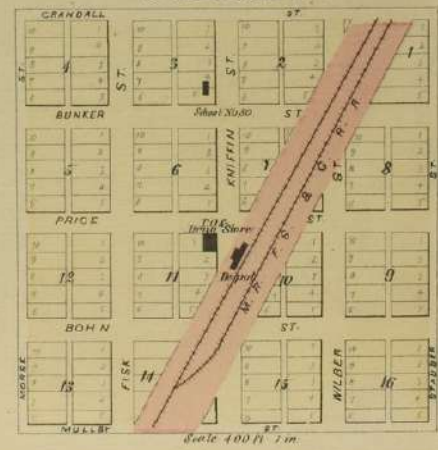

TOWNSHIP 27 SOUTH RANGE 23 EAST

OF THE 6TH PRINCIPAL MERIDIAN.

Scale: 2 inches to the mile.

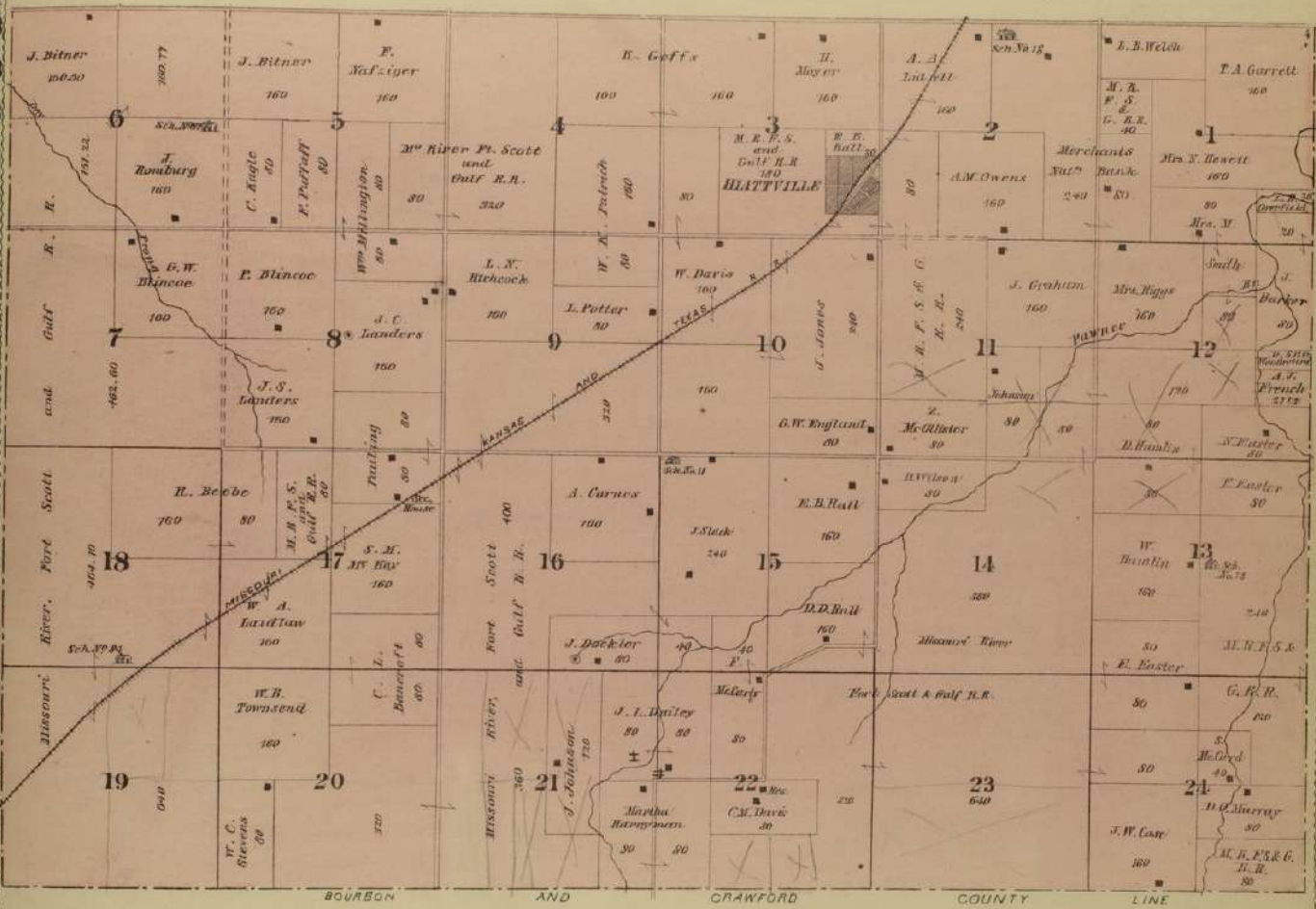

Hiattville

Scale 400 ft. = 1 in.

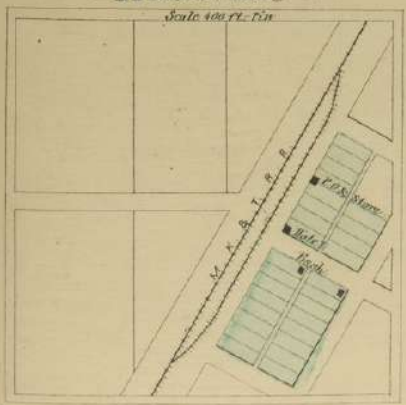

MEMPHIS

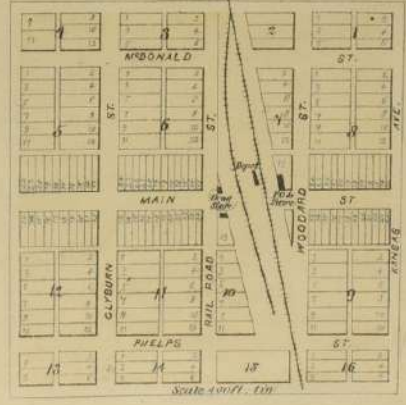

MARMATON

Scale 400 ft. = 1 in.

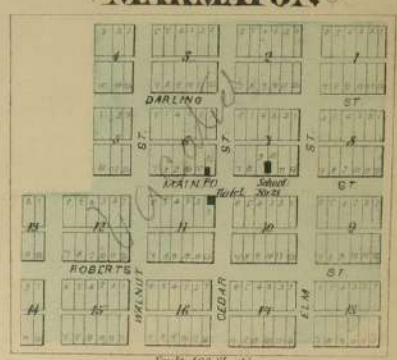

TOWNSHIP 26 SOUTH RANGE 23 EAST

OF THE 6TH PRINCIPAL MERIDIAN.

Scale, 2 inches to the mile.

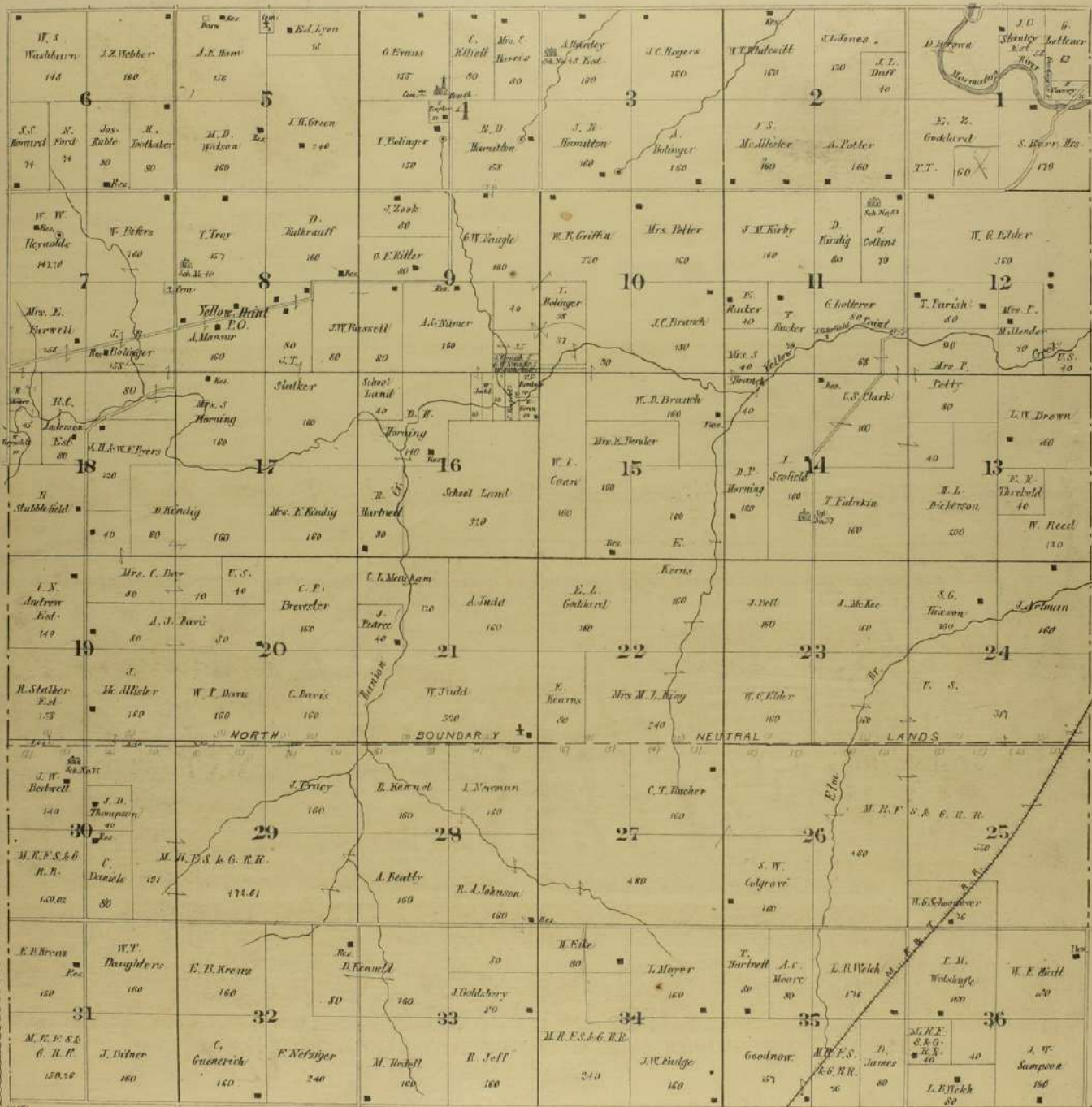

TOWNSHIP 25 SOUTH RANGE 23 EAST

OF THE 6TH PRINCIPAL MERIDIAN.

Scale. Scale 2 inches to the mile.

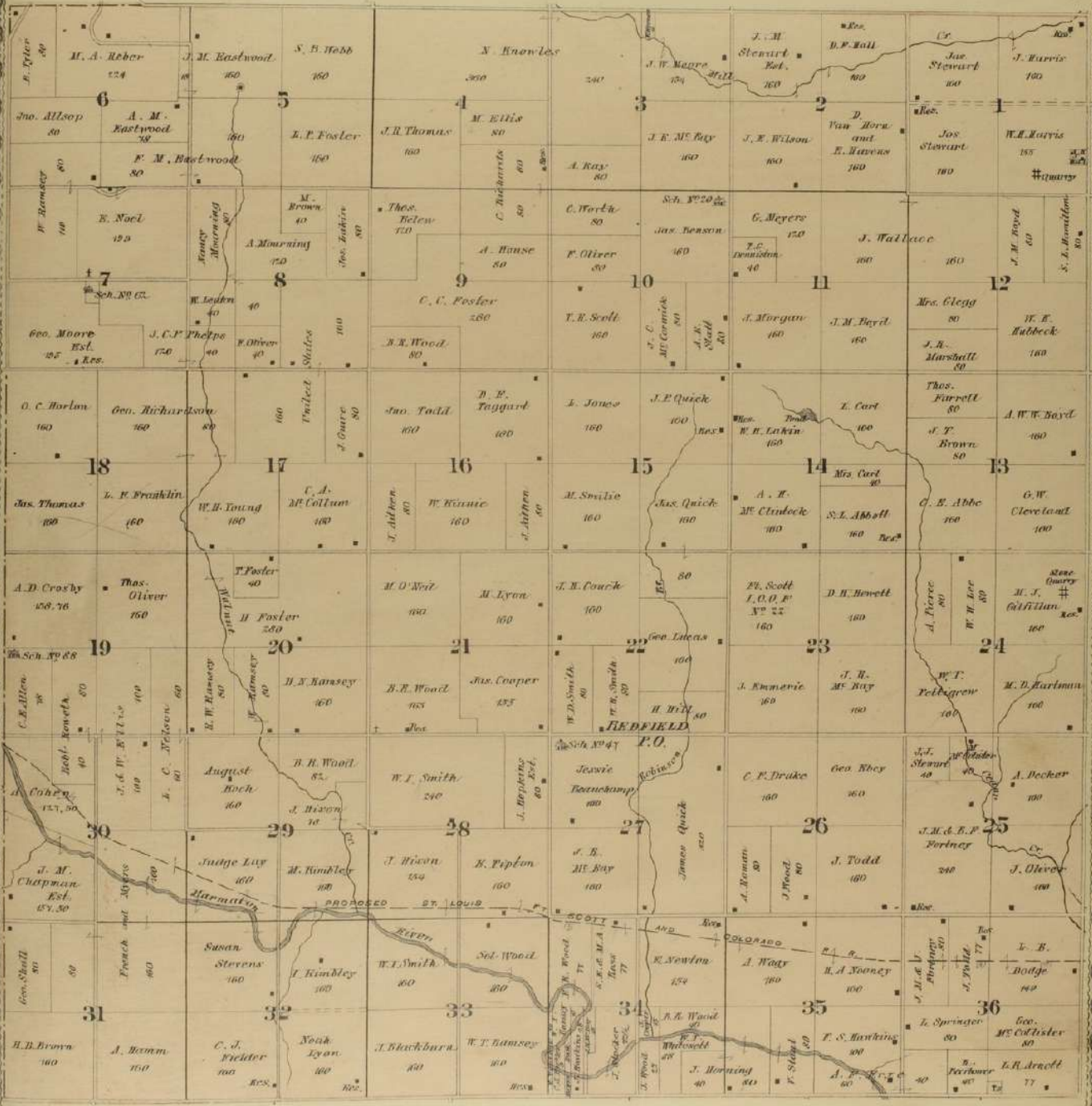

TOWNSHIP 24 SOUTH RANGE 23 EAST

OF THE 6TH PRINCIPAL MERIDIAN.

Scale: 2 inches to the mile.

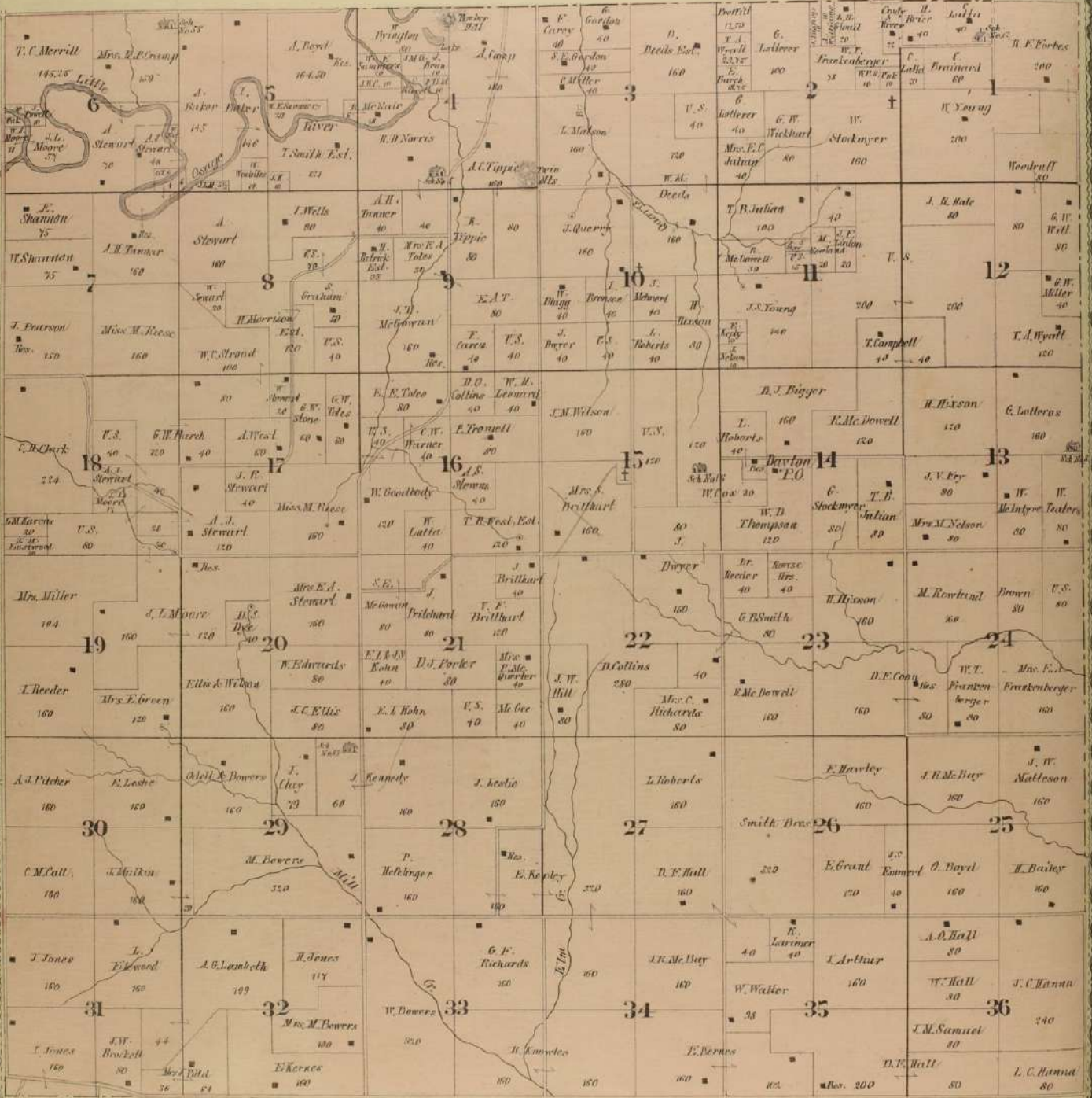

TOWNSHIP 23 SOUTH RANGE 23 EAST

OF THE 6TH PRINCIPAL MERIDIAN.

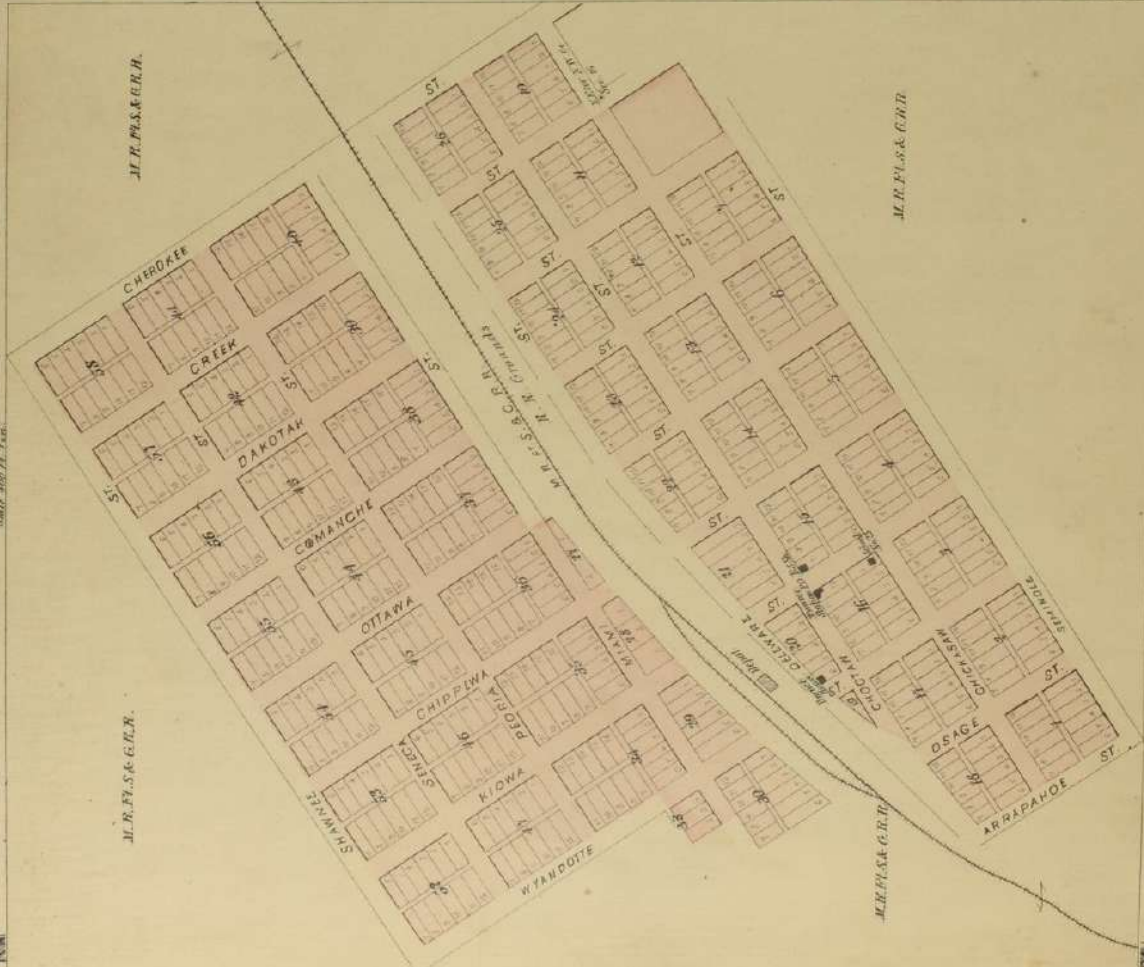
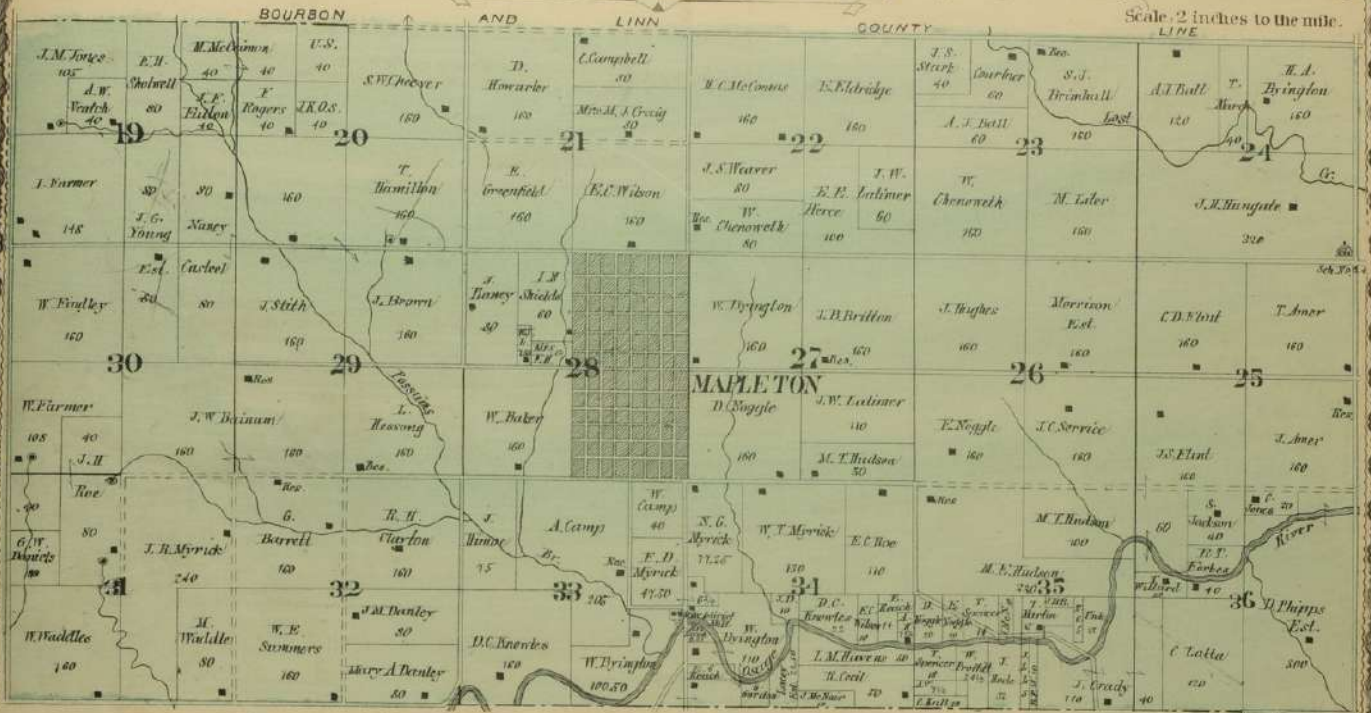

TOWNSHIP 23 SOUTH RANGES 21 & 22 EAST

OF THE 6TH PRINCIPAL MERIDIAN.

Scale: 2 inches to the mile.

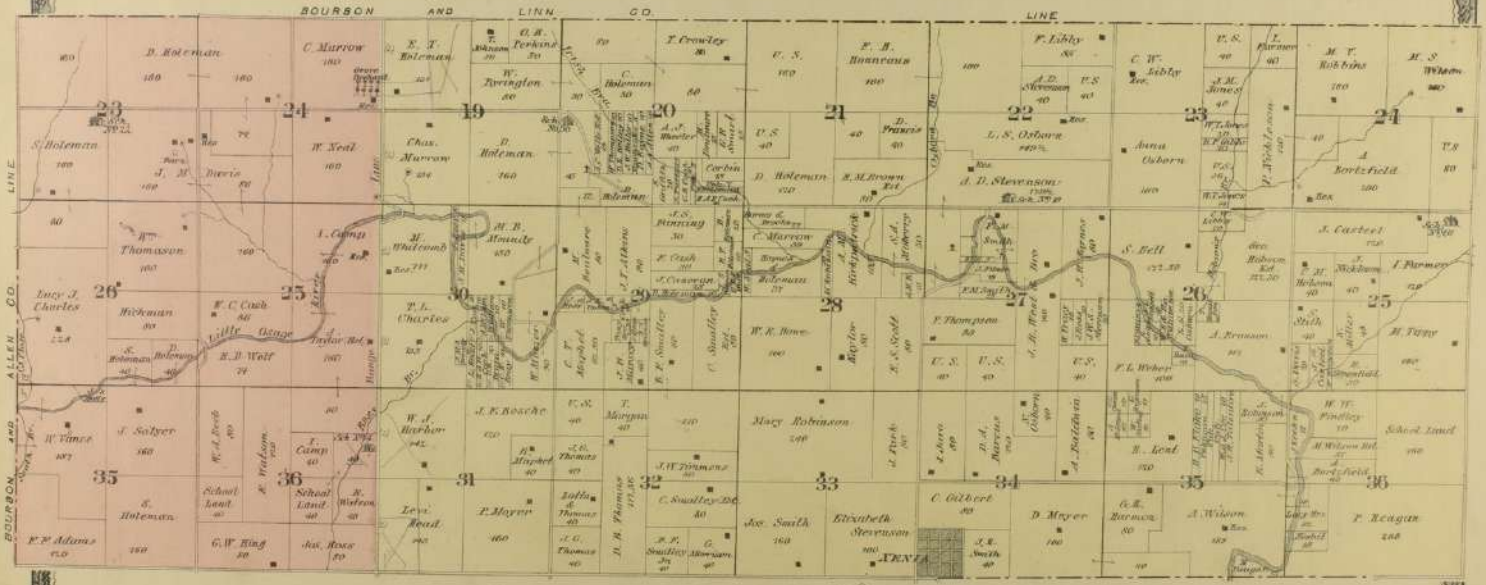

142
143
144
145
146
147
148
149
150
151
152
153
154
155
156
157
158
159
160

TOWNSHIP 25 SOUTH RANGES 21 & 22 EAST
OF THE 6TH PRINCIPAL MERIDIAN

Scale 2 inches to the mile

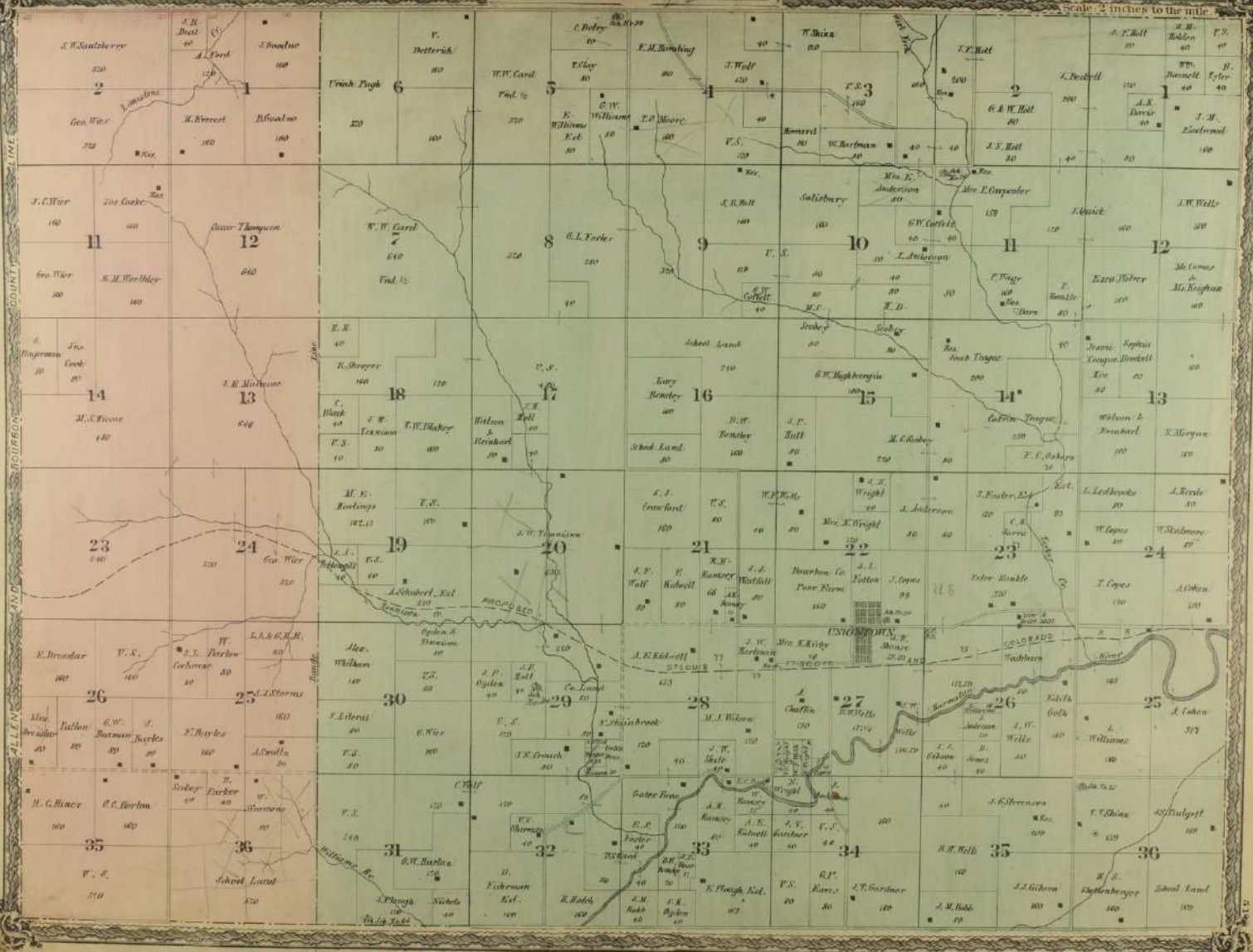

TOWNSHIP 26 SOUTH RANGES 21 & 22 EAST
OF THE 6th PRINCIPAL MERIDIAN

Scale 2 inches to the mile



MAPLETON

Scale 400 Ft. = 1 in.

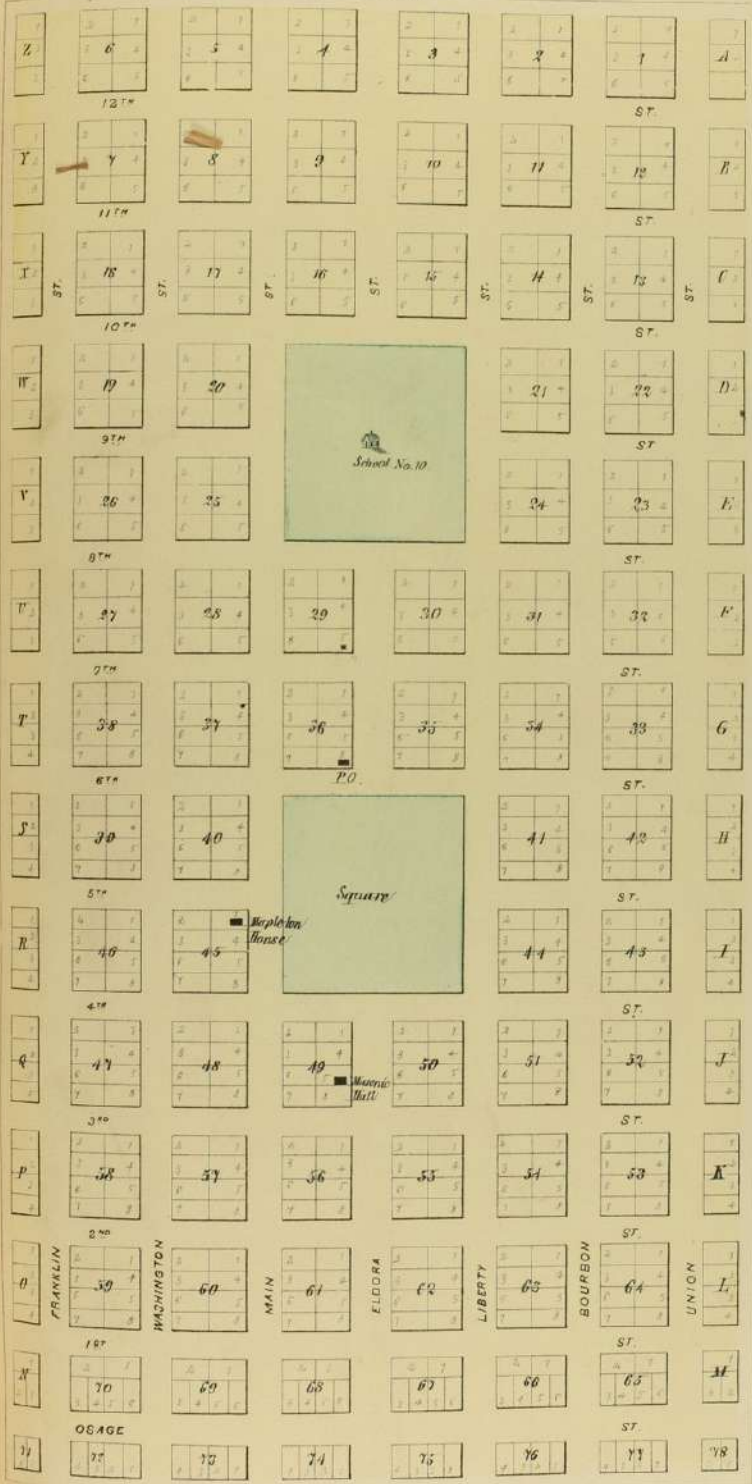

FULTON

Scale 400 Feet to the Inch



UNIONTOWN

Scale 400 Ft. = 1 in.



TOWNSHIP 27 SOUTH RANGES 21 & 22 EAST

OF THE 6TH PRINCIPAL MERIDIAN.

Scale 2 inches to the mile.

22

