

OUTLINE MAP OF BOURBON COUNTY KANSAS

Copyright 1920 by Geo. A. Doyle & Co.

Scale 2 1/2 inches to 1 mile

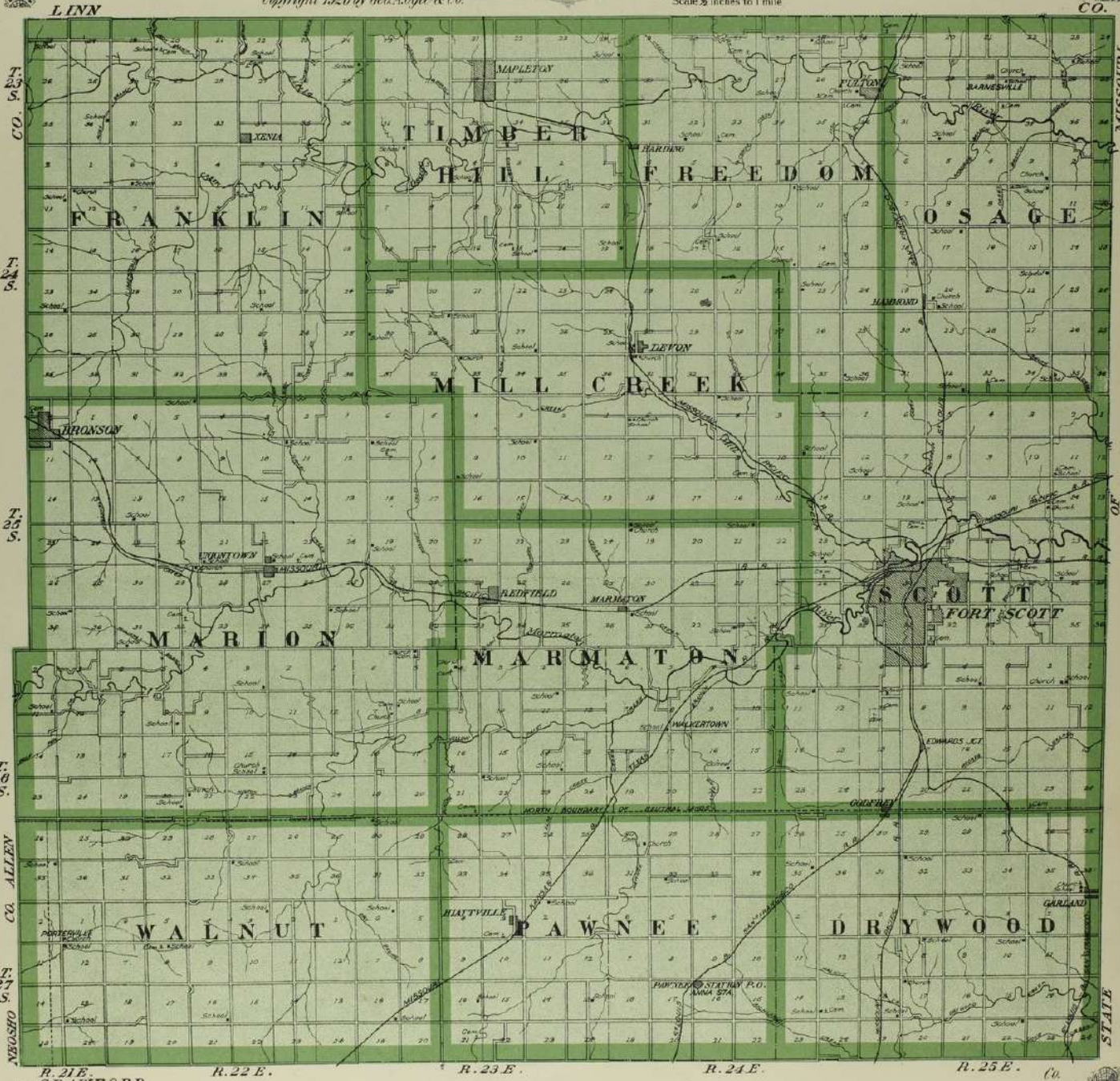

T. 23 S.
CO.

T. 24 S.

T. 25 S.

T. 26 S.

CO. ALLEN

T. 27 S.

NEOSHO

R. 21 E.
CRAWFORD

R. 22 E.

R. 23 E.

R. 24 E.

R. 25 E.

CO.

CO.

MISSOURI

OF

STATE

NORTH PART THE CITY FORT S COUNTY SEAT OF B KANSAS

Scale 500 feet to 1

Copyright 1910 by Geo. A. Ogle

Note: Large shaded figures denote

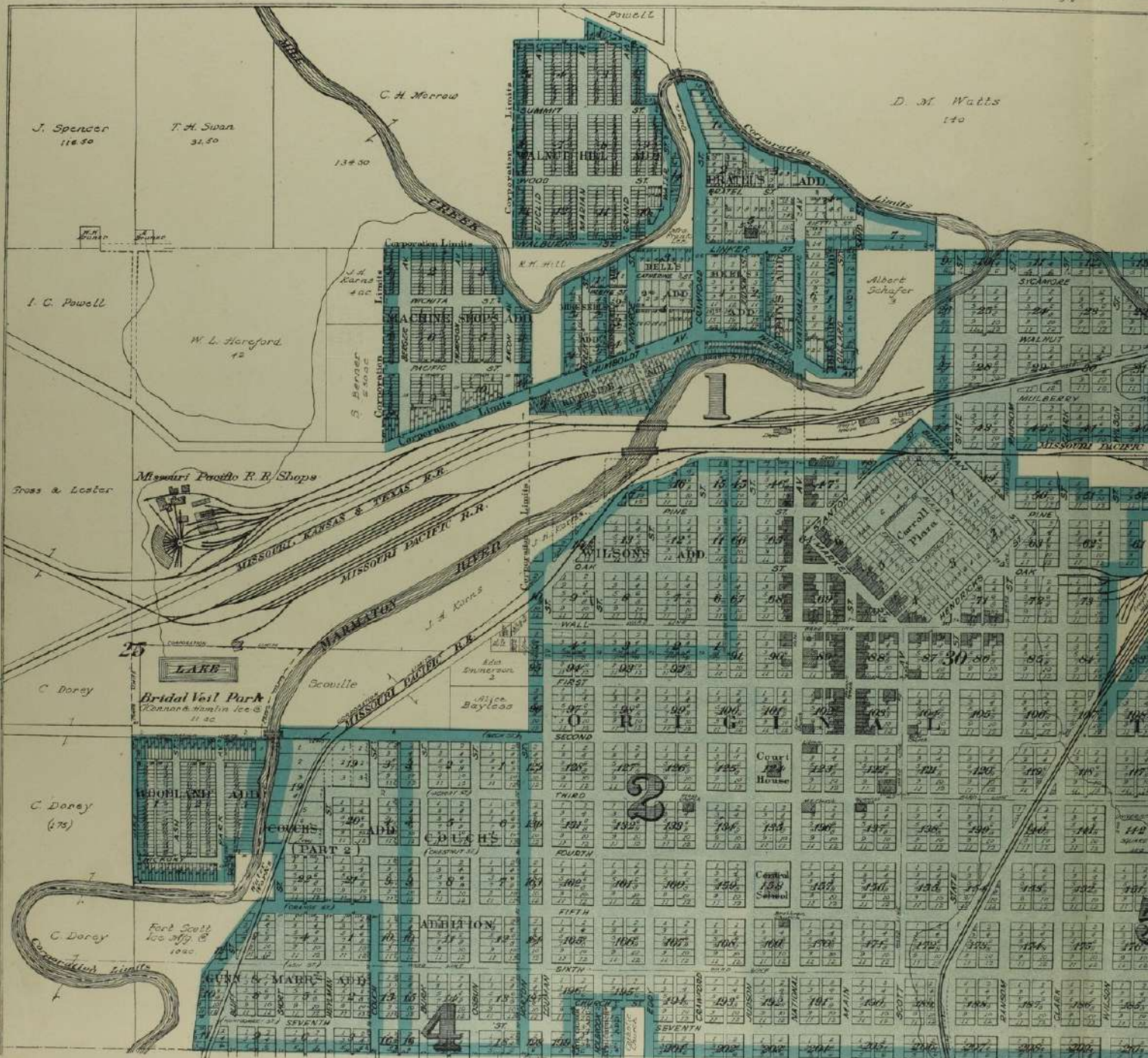

FOR SOUTH PART SEE PAGES 12

ORTH PART OF
CITY OF
T SCOTT

AT OF BOURBON CO.,
KANSAS

Scale 500 feet to inch
Copyright 1930 by Geo. A. Coy & Co.
Figures denote Ward Numbers

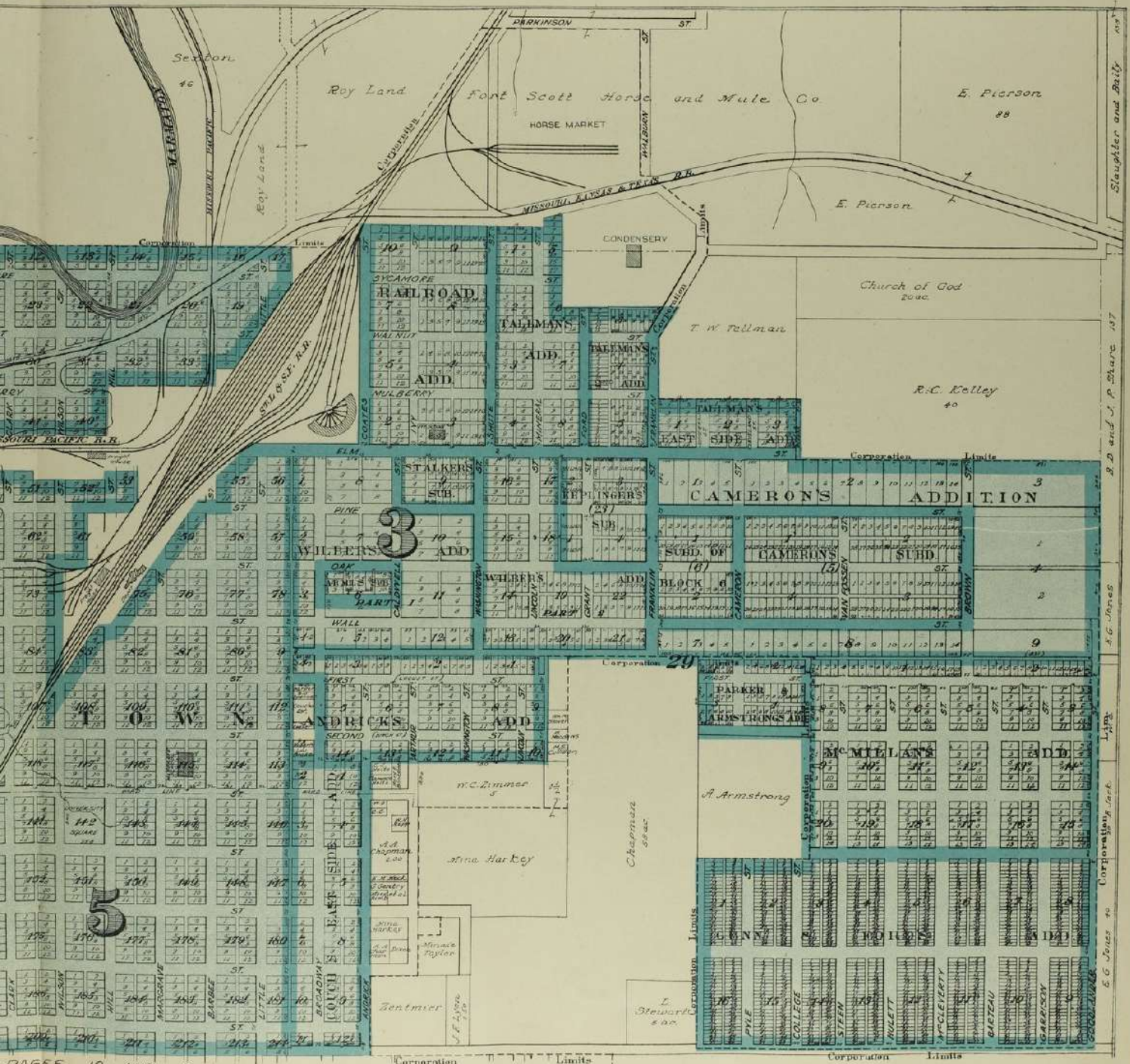

Slaughter and Daily
R. D. and J. P. Shaw
A. G. Jones
L. J. ...
C. G. Jones to Corporation, Park

BRONSON

T. 25S., R. 21E.

Scale 1/4" = 100 feet

Copyright 1904 by Geo. F. Johnson

E. T. Hodge

CEMETERY

E. Zimmerman

S. Stewart

Wm. Bohlers

W. D. Freeman

MRS. E. WEIHS

ADD. ORIGINAL TOWN

ADD. ORIGINAL TOWN

ADD. ORIGINAL TOWN

ADD. ORIGINAL TOWN

ADD. ORIGINAL TOWN

ADD. ORIGINAL TOWN

ADD. ORIGINAL TOWN

ADD. ORIGINAL TOWN

ADD. ORIGINAL TOWN

ADD. ORIGINAL TOWN

ADD. ORIGINAL TOWN

ADD. ORIGINAL TOWN

ADD. ORIGINAL TOWN

ADD. ORIGINAL TOWN

ADD. ORIGINAL TOWN

ADD. ORIGINAL TOWN

ADD. ORIGINAL TOWN

ADD. ORIGINAL TOWN

ADD. ORIGINAL TOWN

ADD. ORIGINAL TOWN

ADD. ORIGINAL TOWN

ADD. ORIGINAL TOWN

ADD. ORIGINAL TOWN

ADD. ORIGINAL TOWN

ADD. ORIGINAL TOWN

ADD. ORIGINAL TOWN

ADD. ORIGINAL TOWN

ADD. ORIGINAL TOWN

ADD. ORIGINAL TOWN

ADD. ORIGINAL TOWN

ADD. ORIGINAL TOWN

ADD. ORIGINAL TOWN

ADD. ORIGINAL TOWN

ADD. ORIGINAL TOWN

ADD. ORIGINAL TOWN

ADD. ORIGINAL TOWN

ADD. ORIGINAL TOWN

ADD. ORIGINAL TOWN

ADD. ORIGINAL TOWN

ADD. ORIGINAL TOWN

ADD. ORIGINAL TOWN

ADD. ORIGINAL TOWN

ADD. ORIGINAL TOWN

MARMATON

T. 25S., R. 23E.

Scale 1/4" = 100 feet



MAPLETON

PLATTED AS ELDORA

T. 25S., R. 23E.

Scale 1/4" = 100 feet

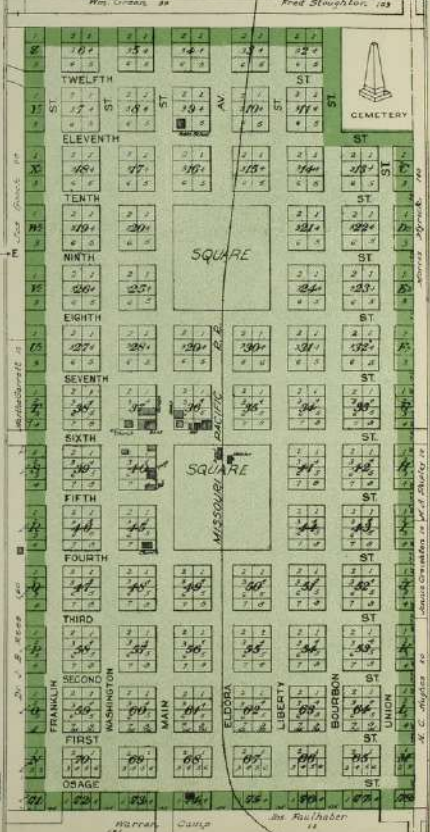

N

E

S

W

MISSOURI PACIFIC R.R.

MISSOURI PACIFIC R.R.

MISSOURI PACIFIC R.R.

MISSOURI PACIFIC R.R.

MISSOURI PACIFIC R.R.

MISSOURI PACIFIC R.R.

MISSOURI PACIFIC R.R.

MISSOURI PACIFIC R.R.

MISSOURI PACIFIC R.R.

MISSOURI PACIFIC R.R.



Part of Township 27 S., Ranges 21 and 22 E.

OF THE 6th P. M.

Scale 2 inches to 1 mile

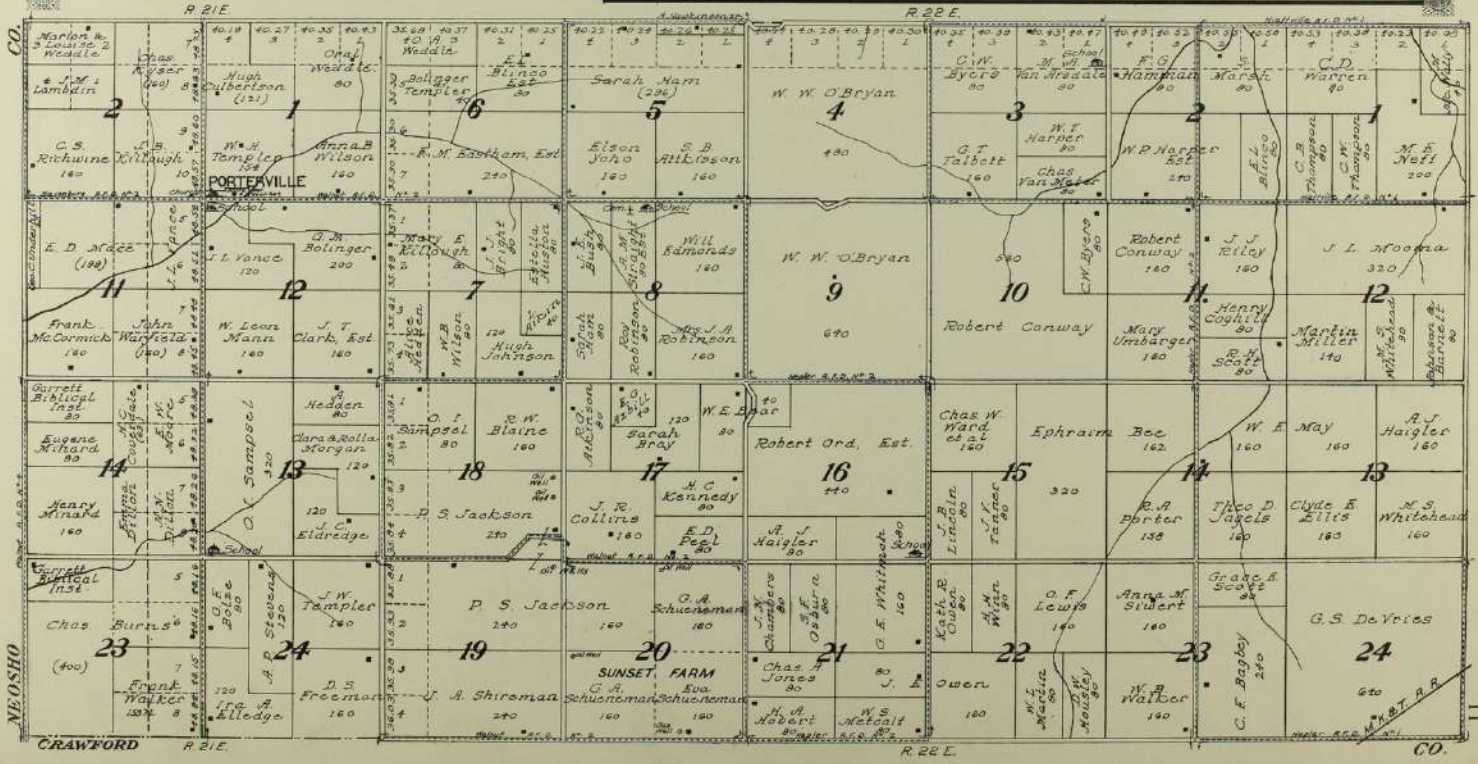

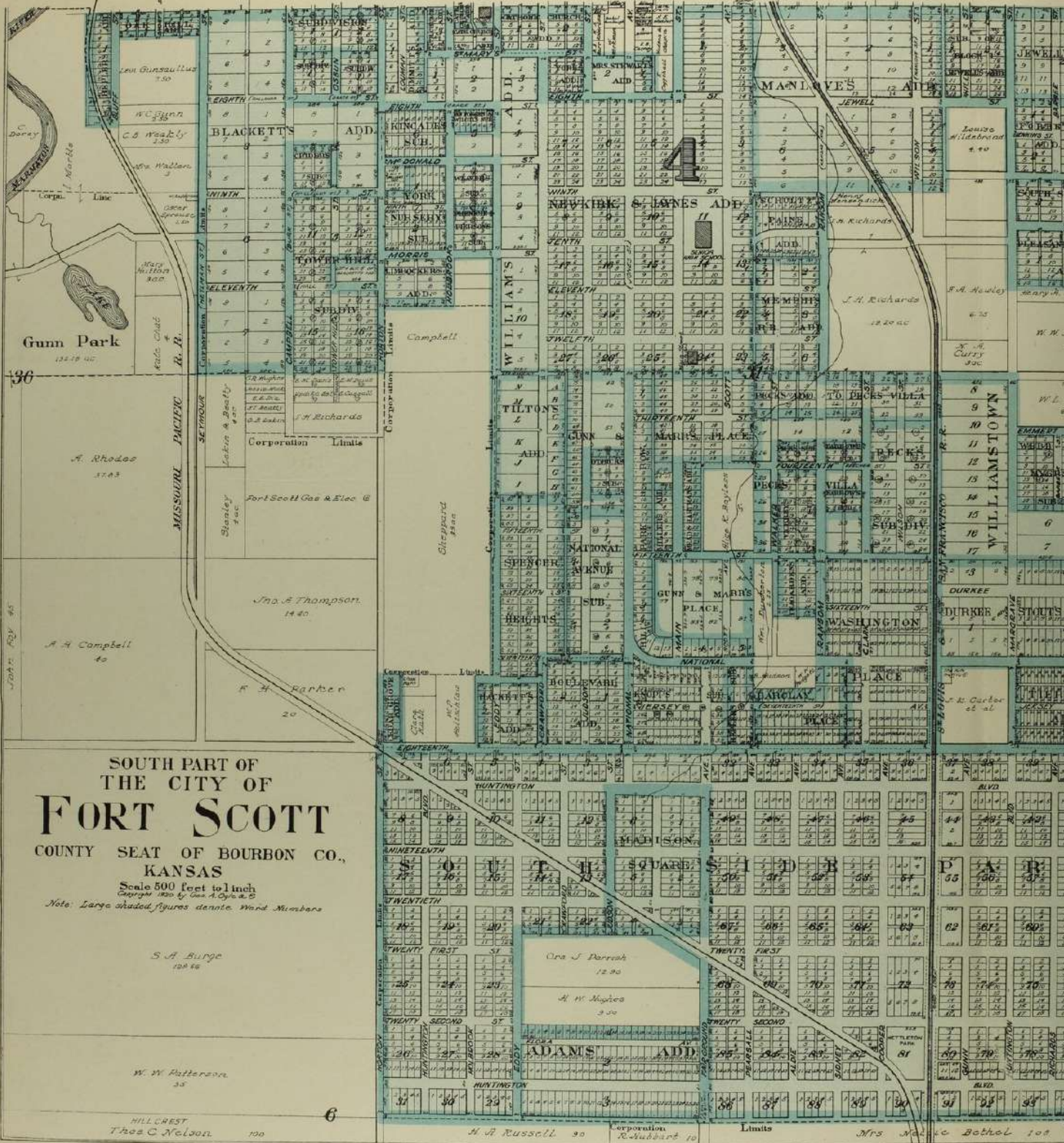

SOUTH PART OF
THE CITY OF
FORT SCOTT
COUNTY SEAT OF BOURBON CO.,
KANSAS

Scale 500 feet to inch
Copyright 1900 by Geo. A. Doyle & Co.
Note: Large shaded figures denote Ward Members

S. A. Burge
120 45

W. W. Patterson
33

HILLCREST
The C. Nelson 100

6

H. A. Russell 90 Corporation Kludwart 10 Limits Mrs. N. C. Bethel 100

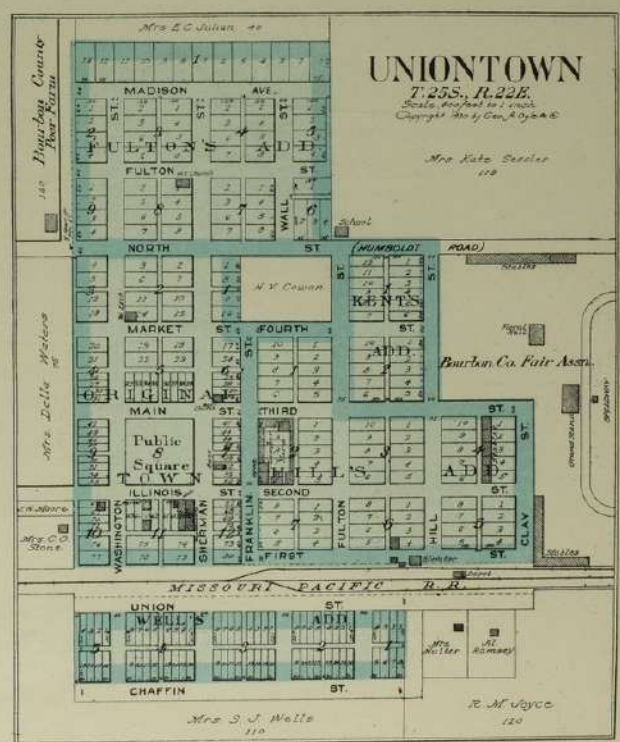
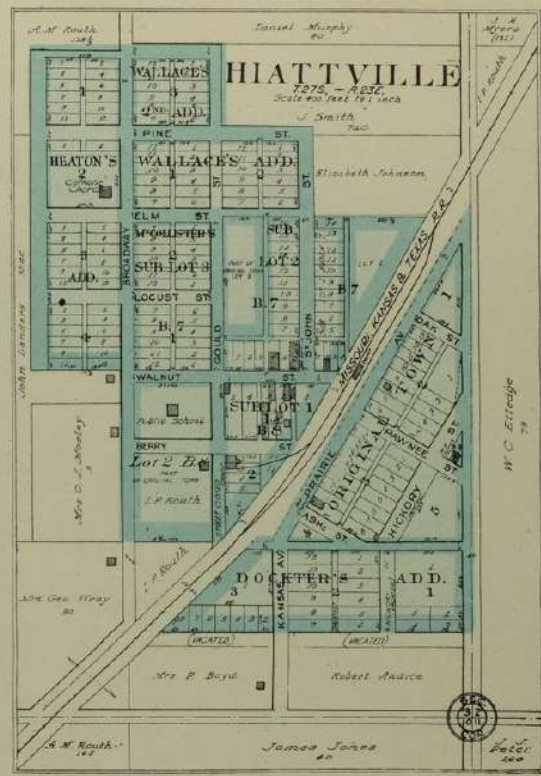
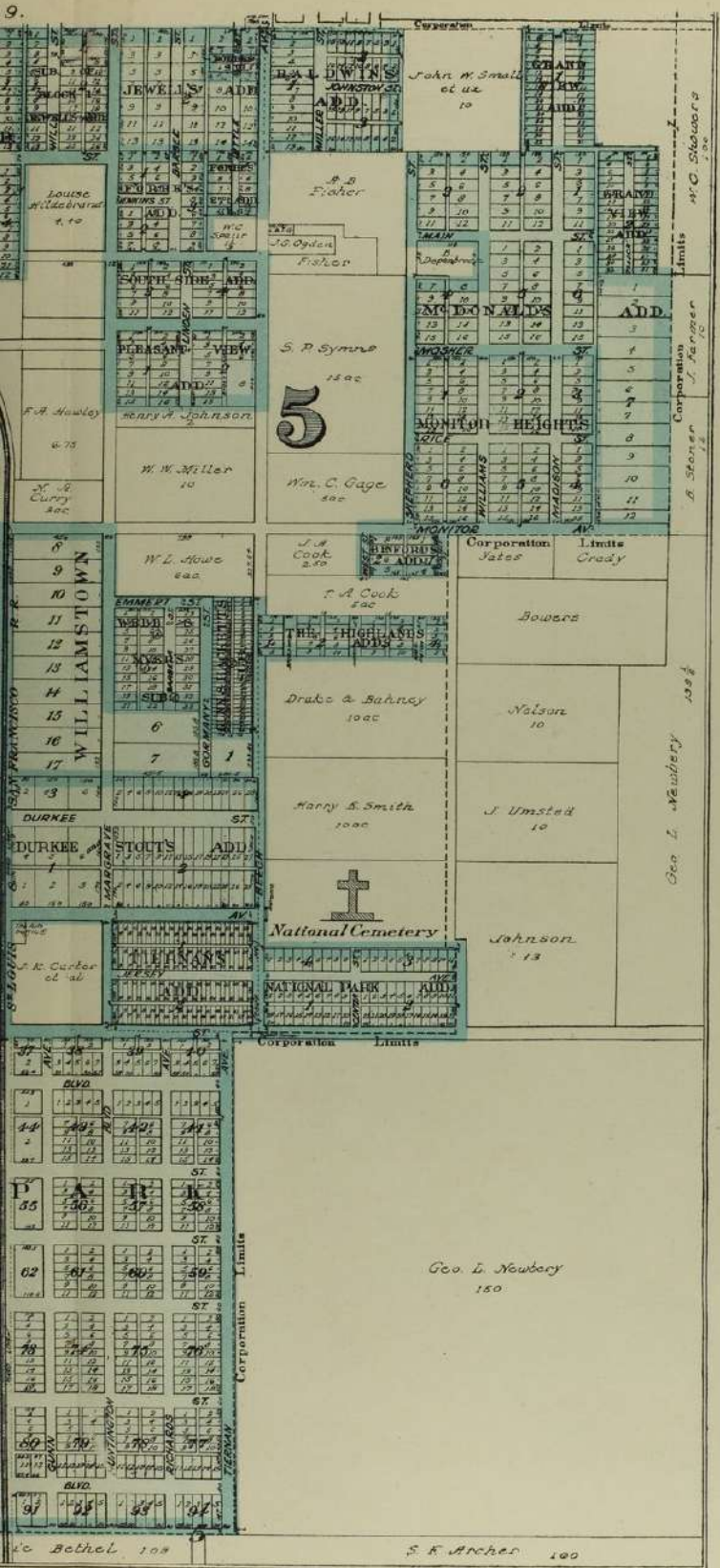

MAP OF
Part of Township 27 S., Range 24 E.
 OF THE 6th P. M.
 Scale 2 inches to 1 mile

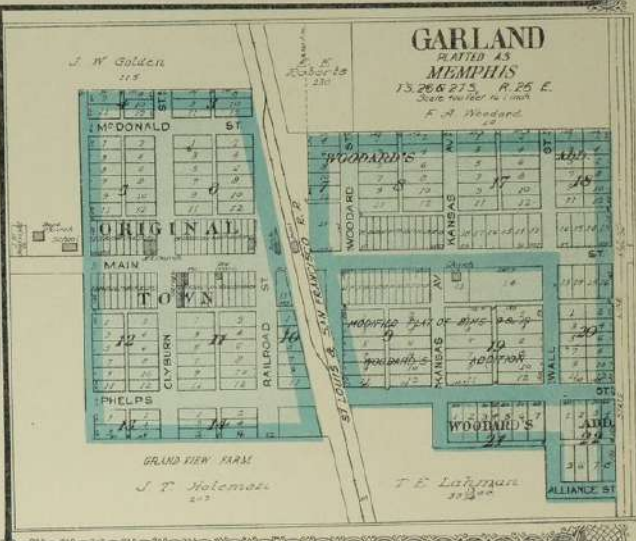
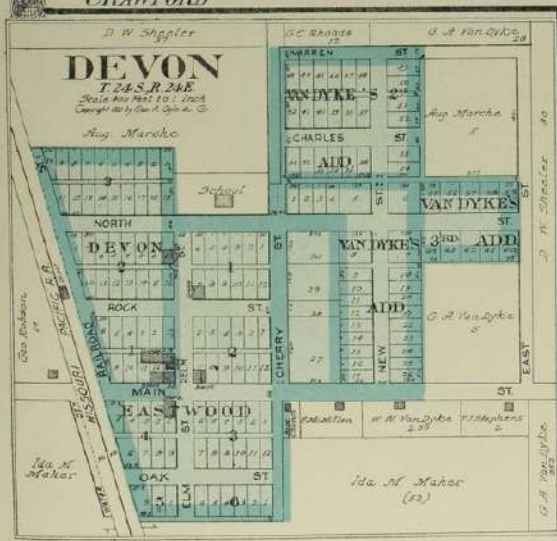
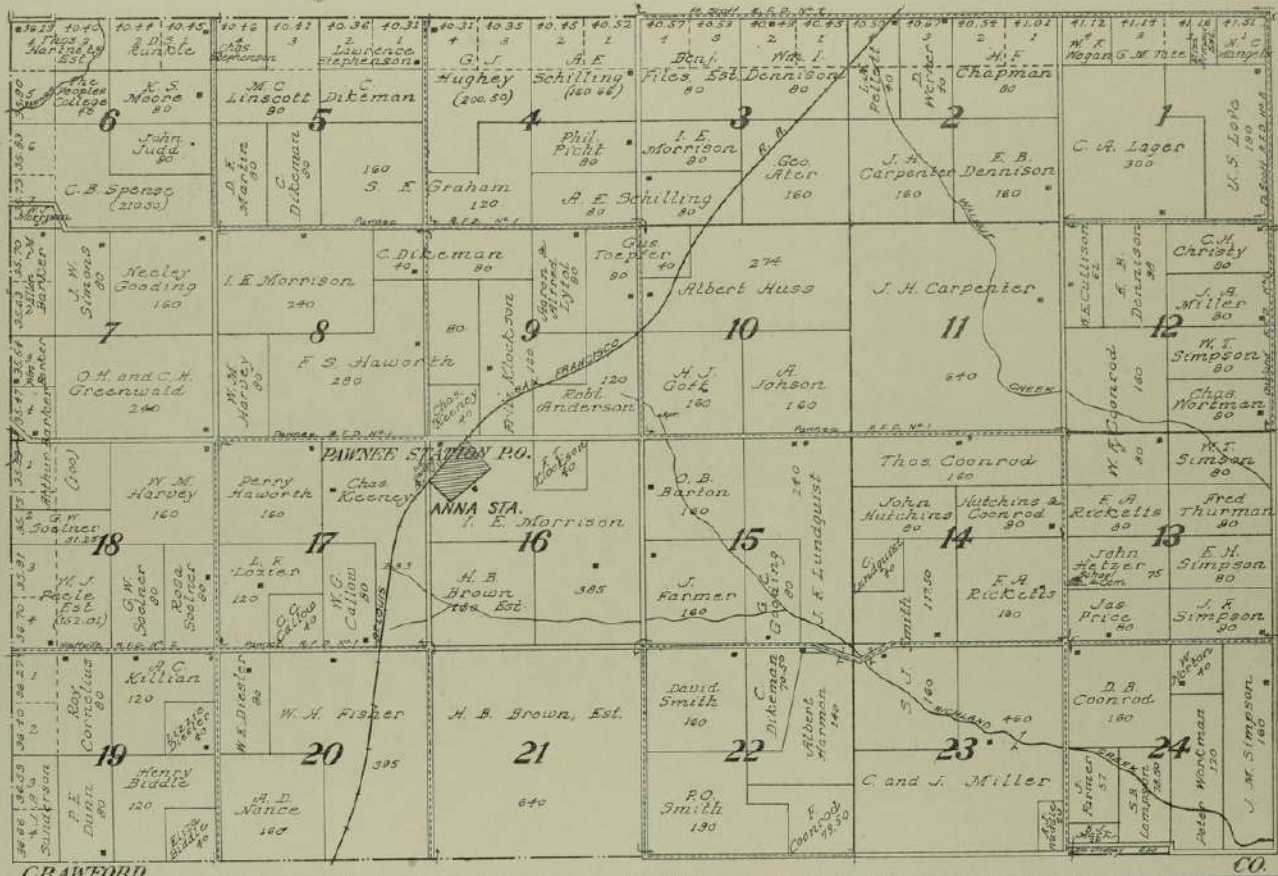

MAP OF
TOWNSHIP 26 S., RANGE 22 E. and
PART of TOWNSHIP 26 S., RANGE 21 E.
 OF THE 6th P. M.

Scale 2 inches to 1 mile



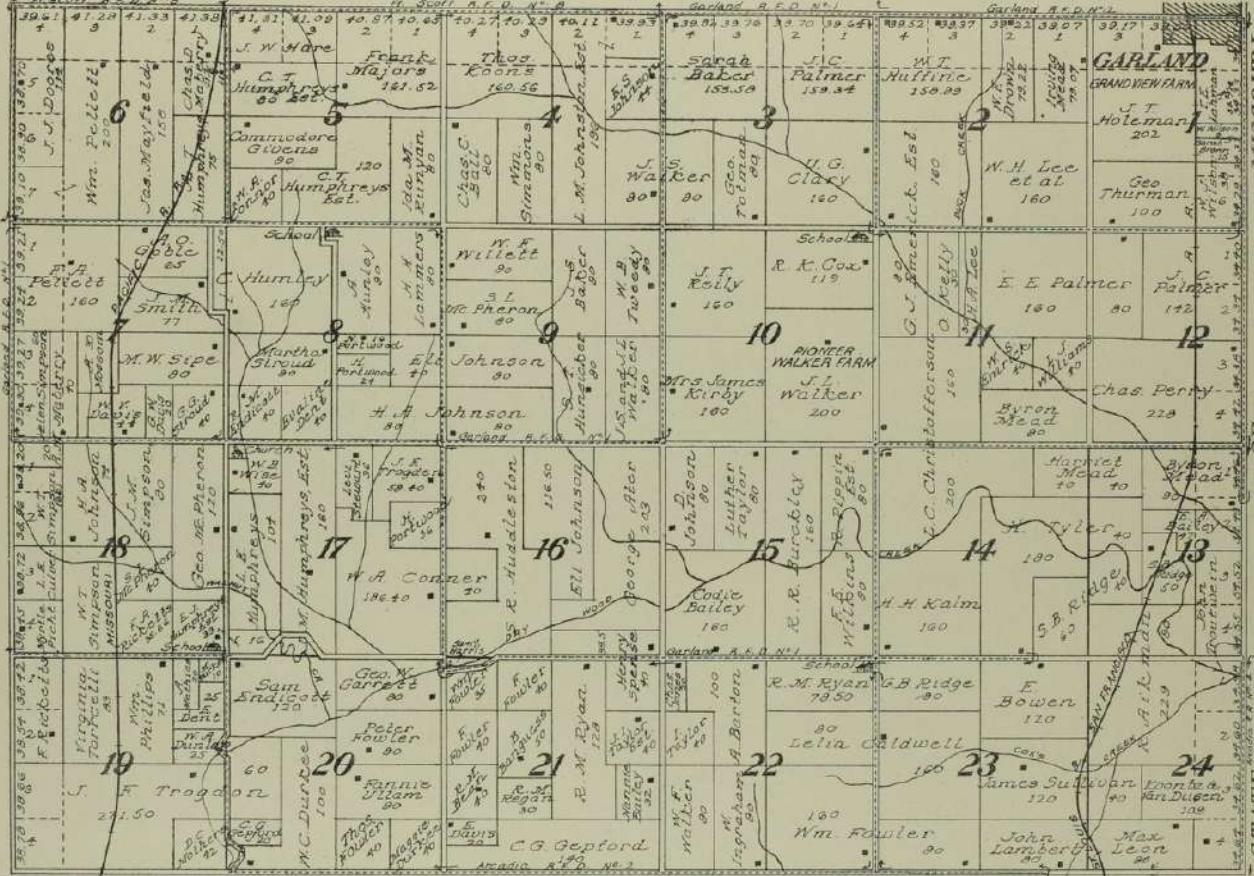

MAP OF
 Part of Township 27 S., Range 25 E.
 OF THE 6th P. M.

Scale 2 inches to 1 mile

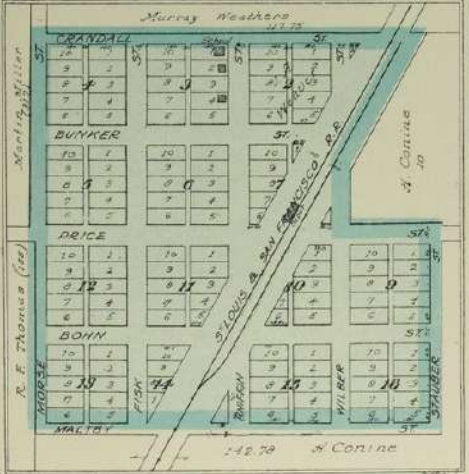

MISSOURI OF STATE

GODFREY
T. 26 S., R. 25 E.



XENIA
SW 1/4 of SW 1/4 SECTION 34
T. 25 S., R. 22 E.

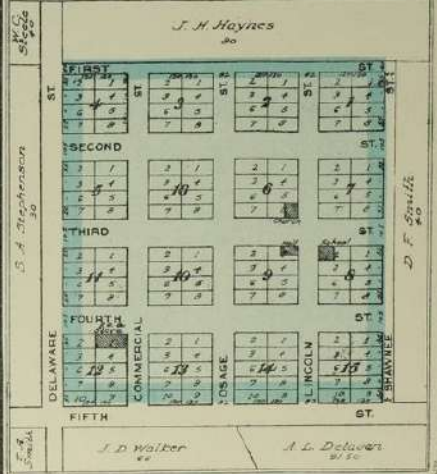

HAMMOND
T. 24 S., R. 25 E.

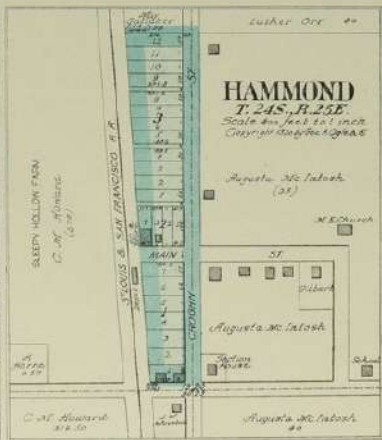



MAP OF
TOWNSHIP 26 S., RANGE 23 E.
OF THE 6th P. M.
 Scale 2 inches to 1 mile

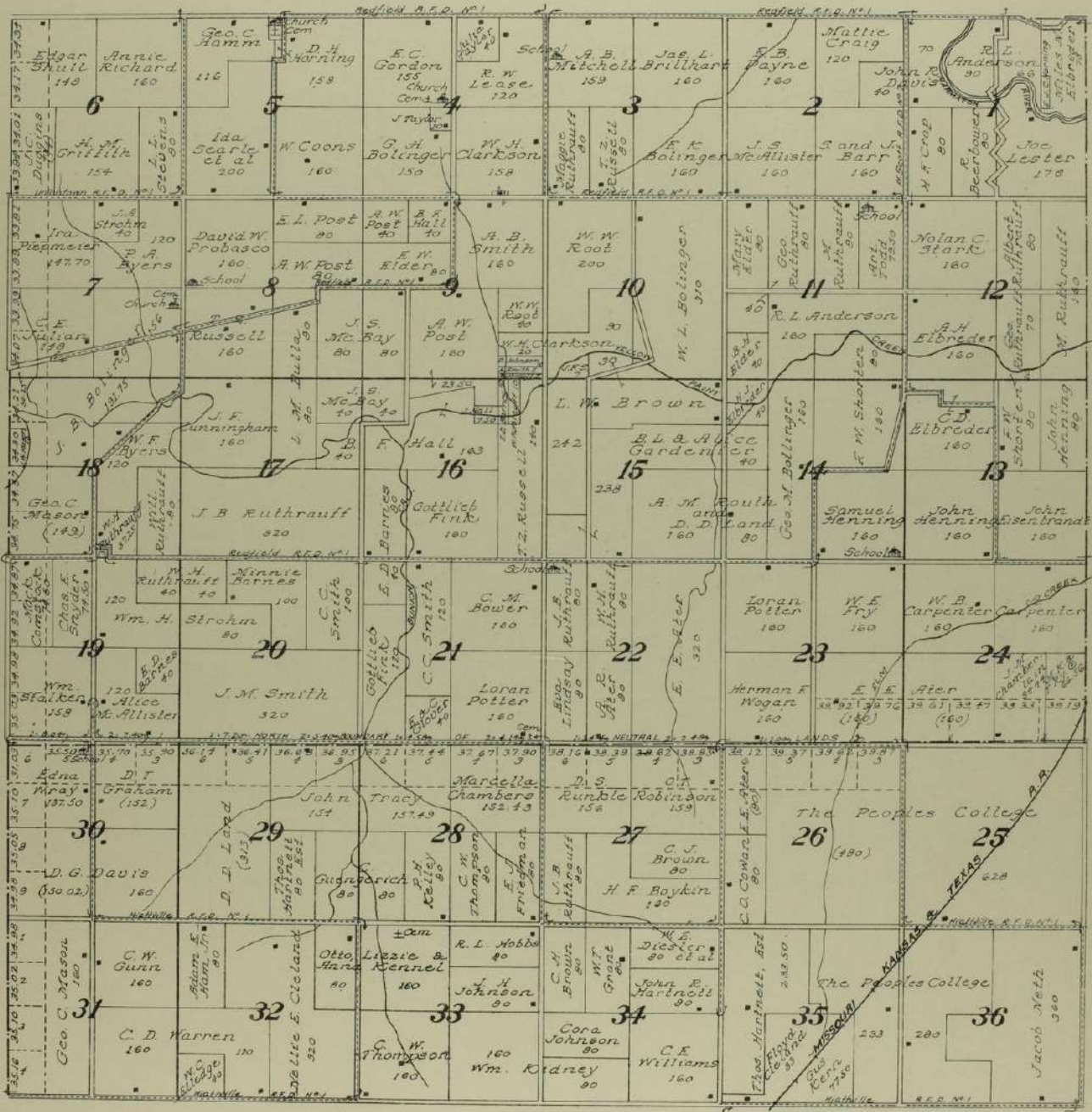

MAP OF
 TOWNSHIP 25 S., RANGE 22 E. and
 PART of TOWNSHIP 25 S., RANGE 21 E.
 OF THE 6th P. M.

Scale 2 inches to 1 mile

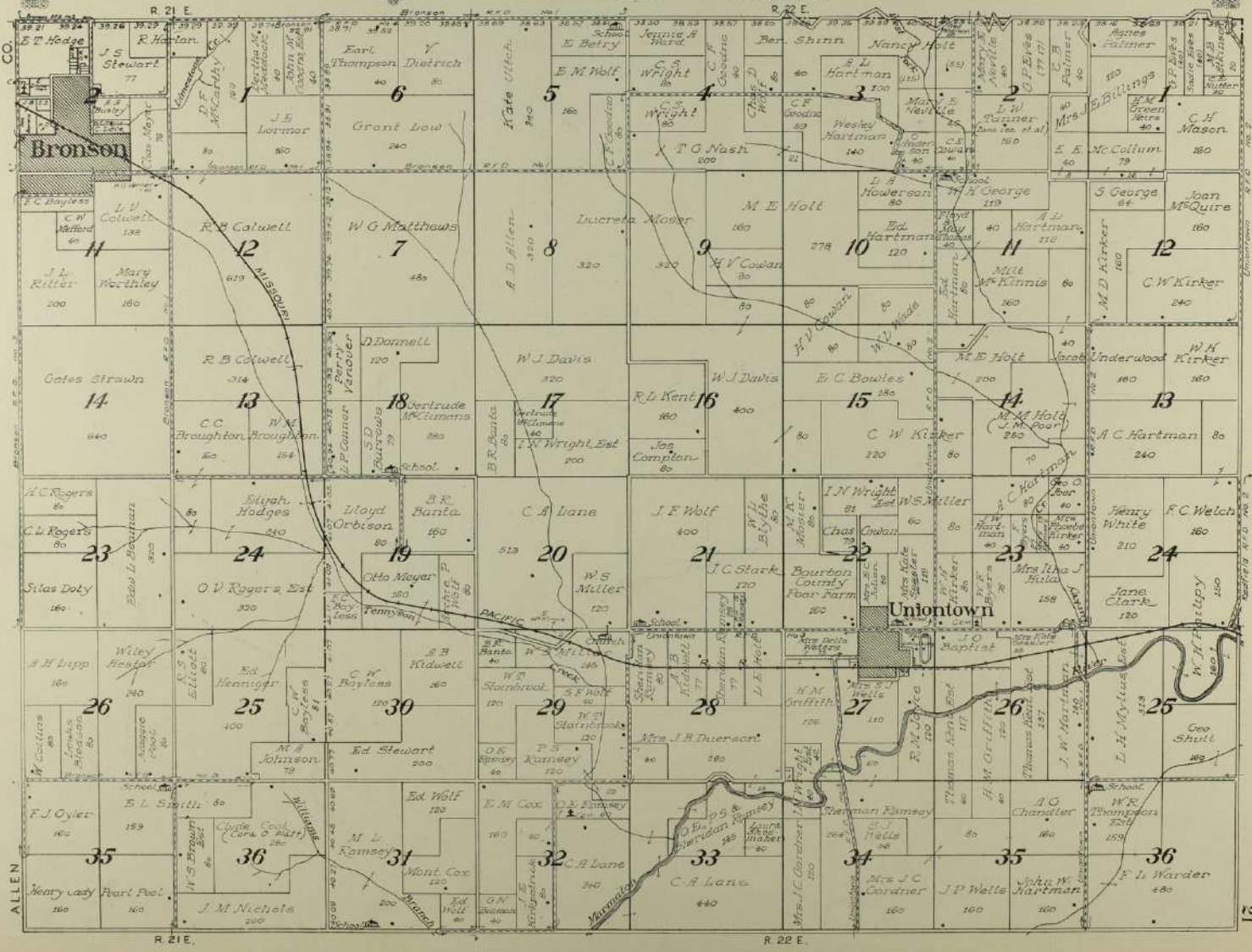

R. 21 E.

R. 22 E.

MAP OF
TOWNSHIP 25 S., RANGE 23 E.
OF THE 6th P. M.
 Scale 2 inches to 1 mile

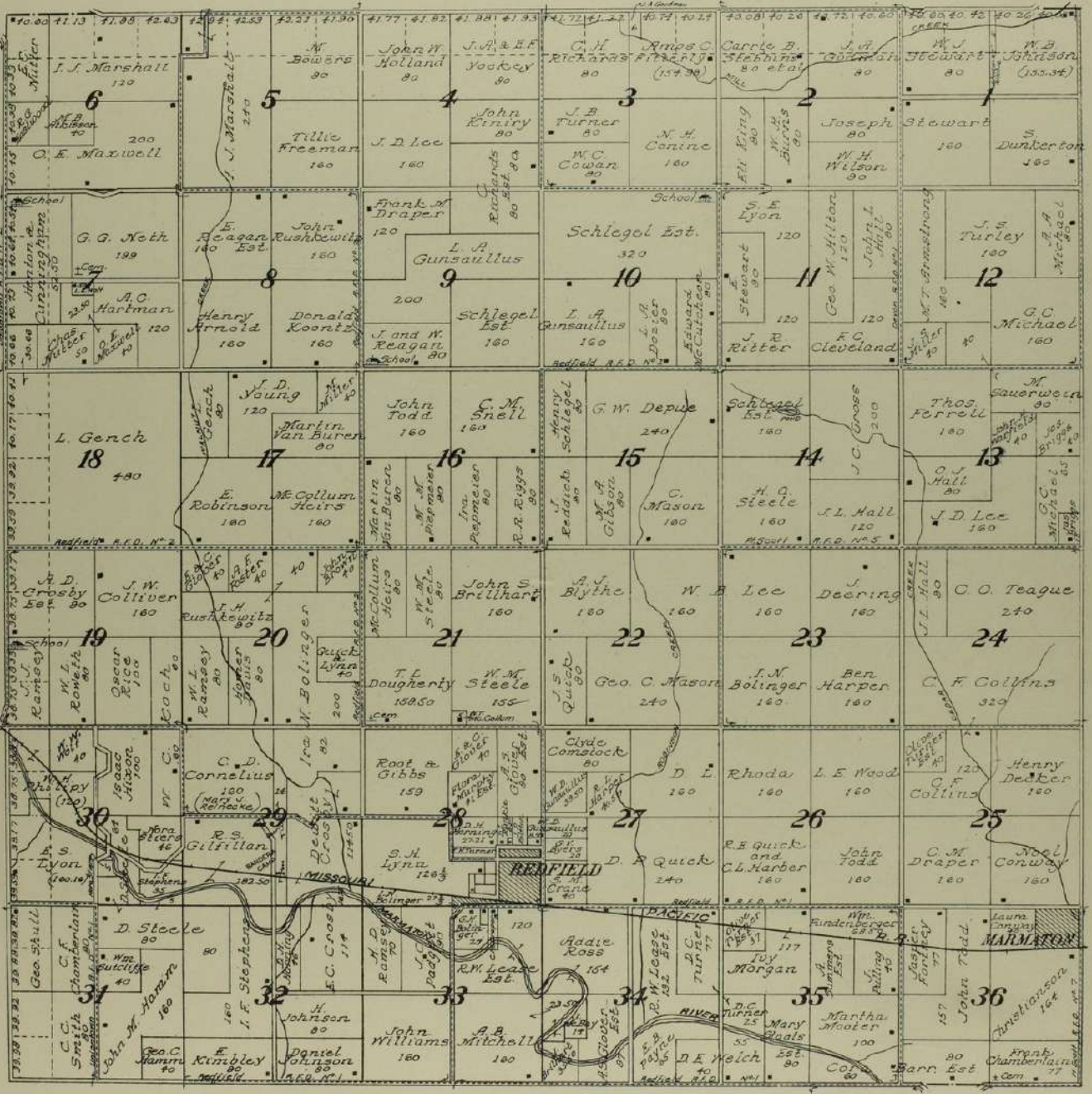



MAP OF
TOWNSHIP 25 S., RANGE 25 E.
OF THE 6th P. M.
 Scale 2 inches to 1 mile

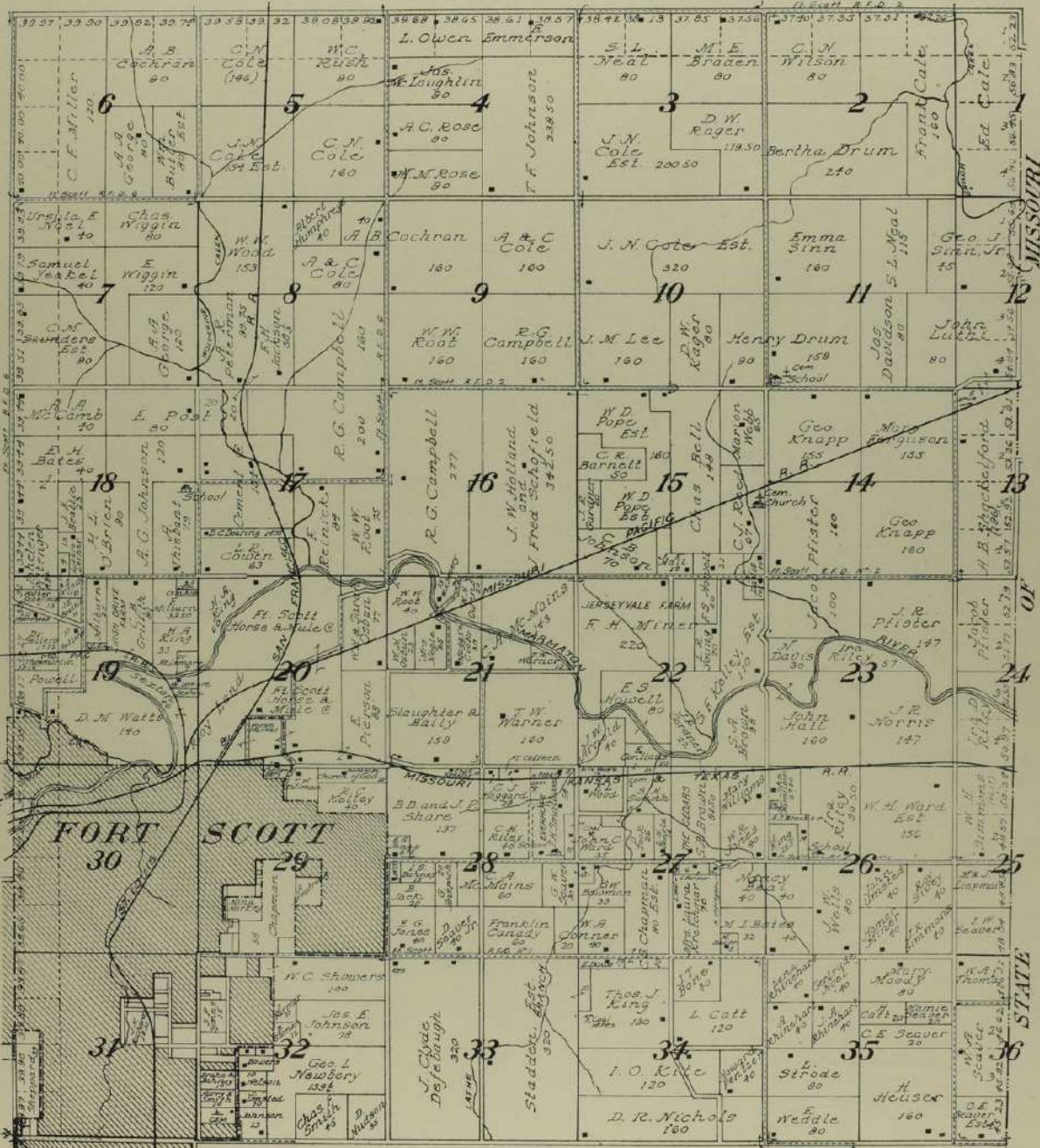



MAP OF

TOWNSHIP 24 S., RANGE 23 E.

 OF THE 6th P. M.

Scale 2 inches to 1 mile

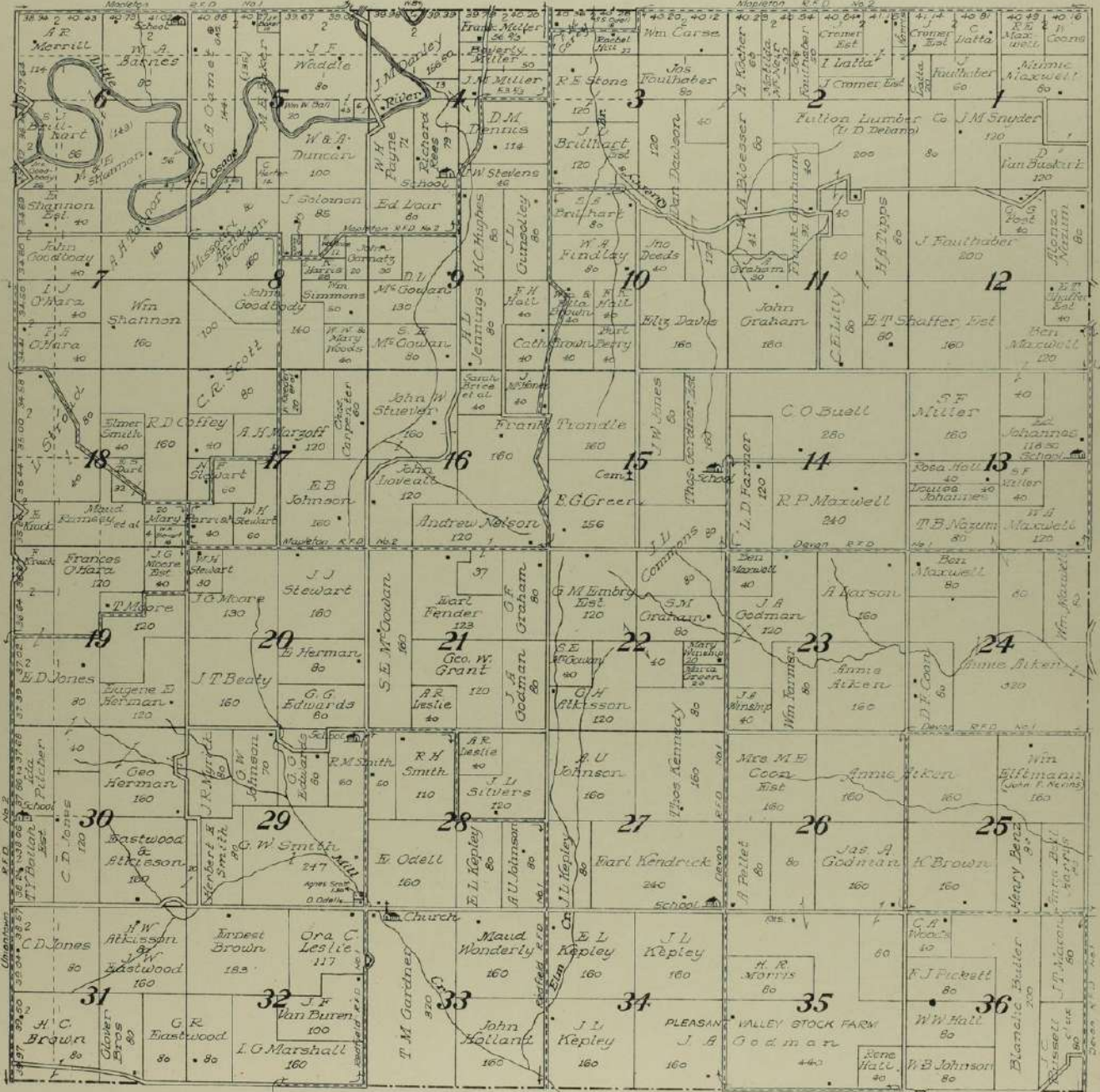



MAP OF
TOWNSHIP 24 S., RANGE 24 E.
 OF THE 6th P. M.
 Scale 2 inches to 1 mile

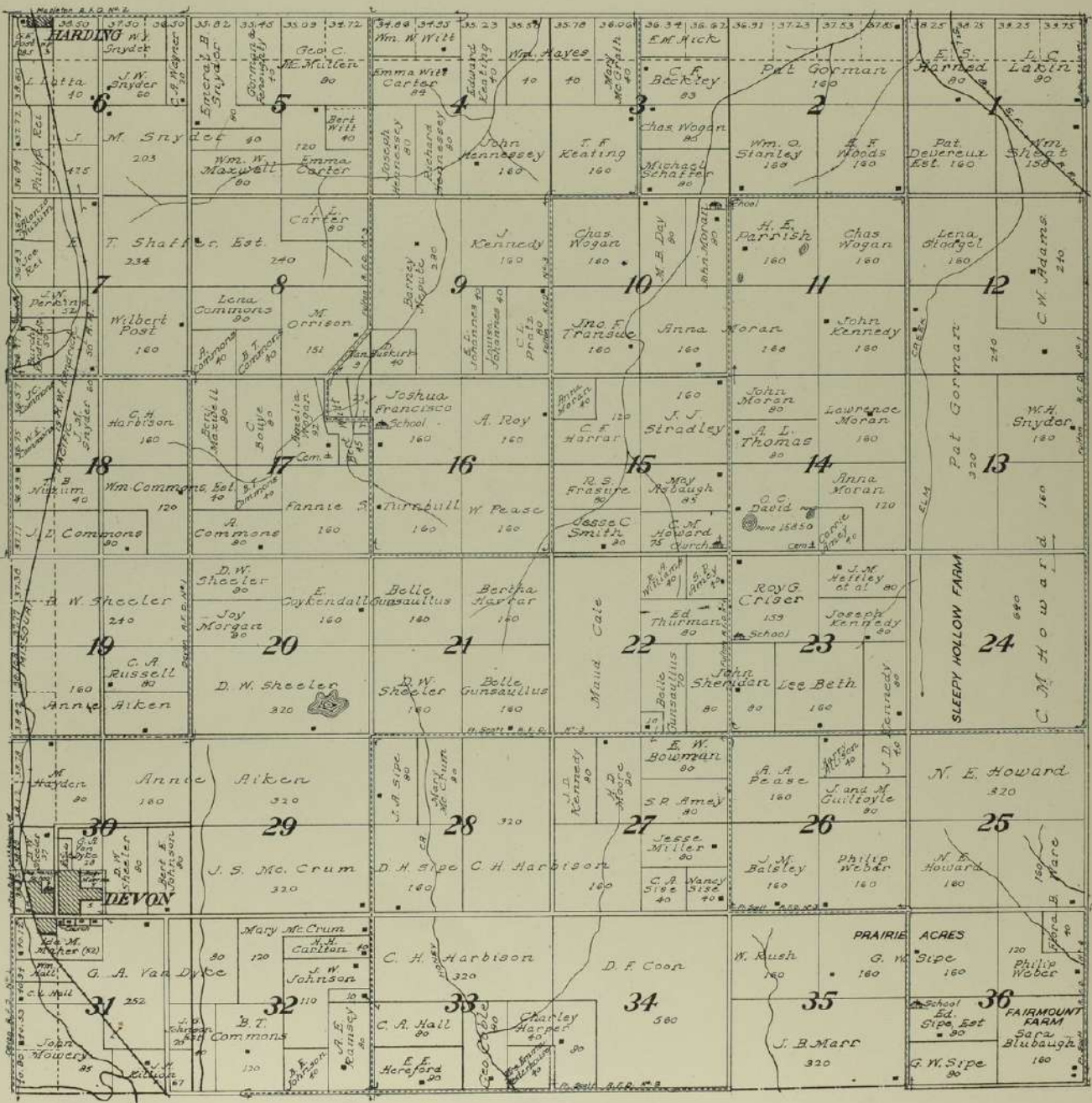

MAP OF
Part of Township 23 S., Ranges 21 and 22 E.
OF THE 6th P. M.

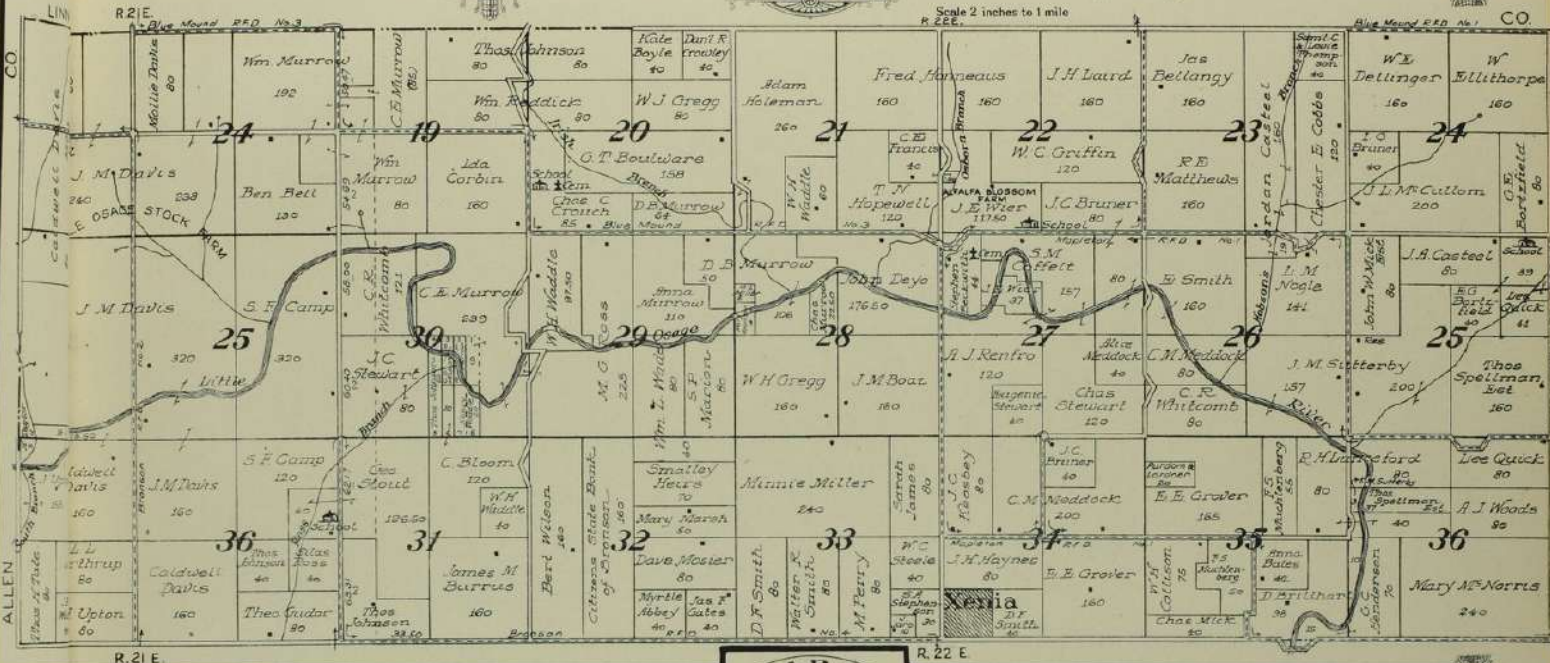

MAP OF
Part of Township 23 S., Range 23 E.
OF THE 6th P. M.

