

OUTLINE MAP OF
CHEYENNE COUNTY
KANSAS

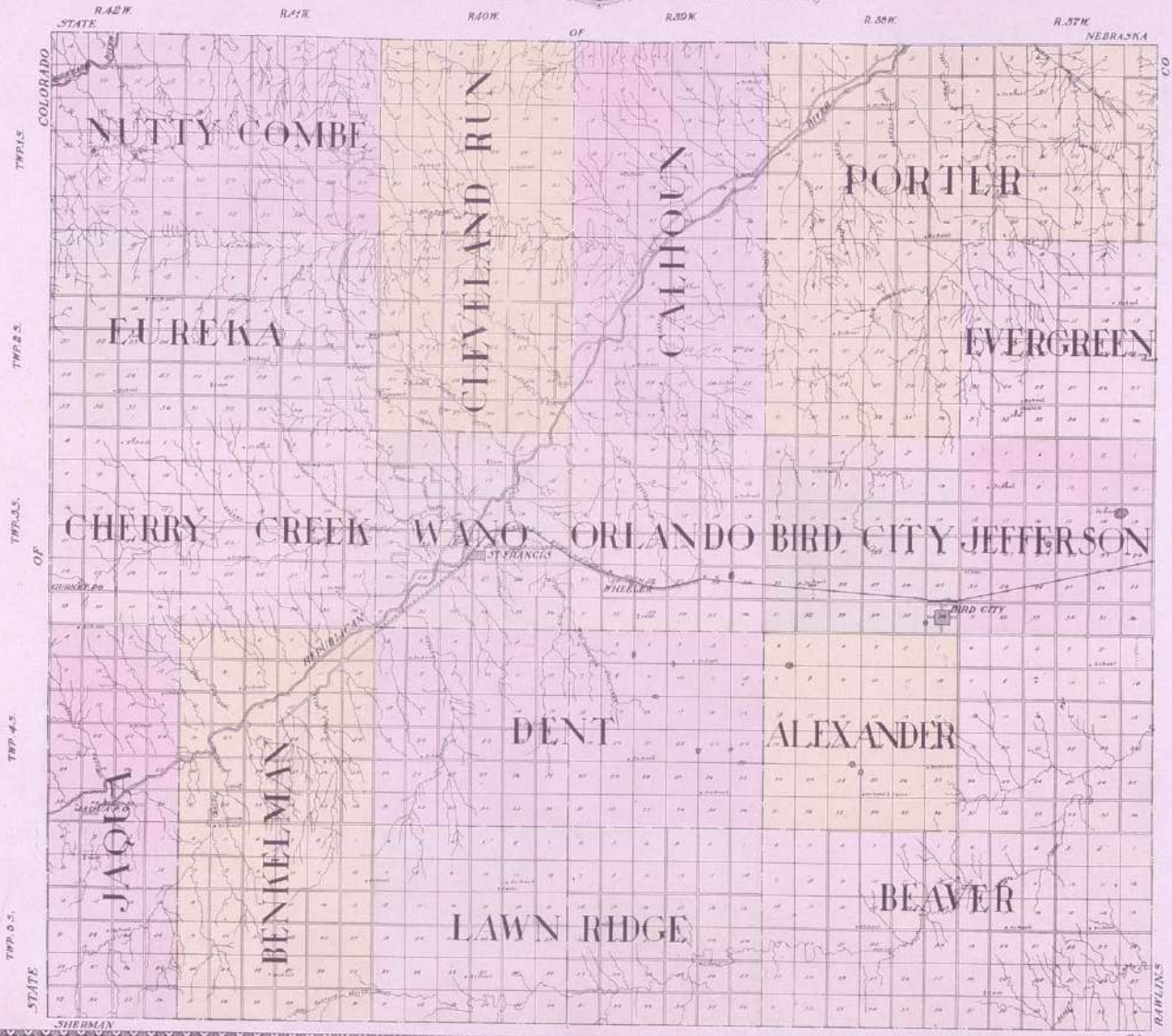

SAINT FRANCIS

COUNTY SEAT OF CHYBENNE CO. KAN.
TWP 3 S. R. 40 W.

Scale 50 ft. to one inch

Abraham Biddell
120 a

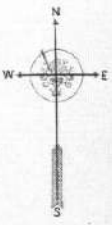
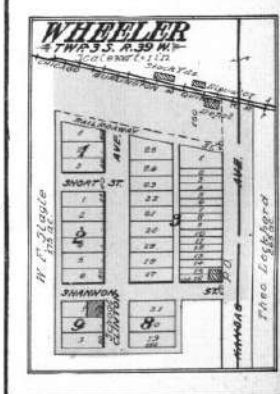
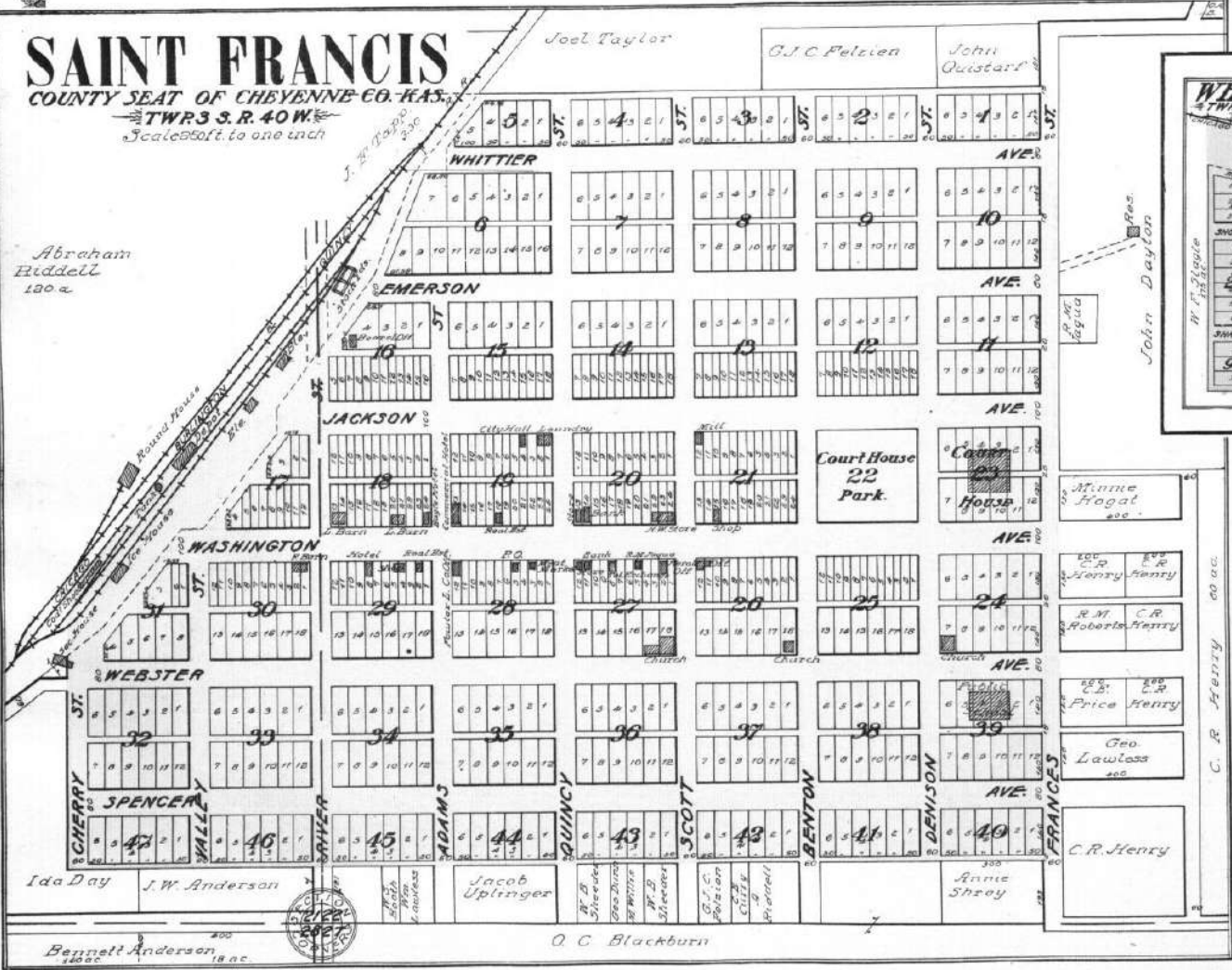

BIRD CITY

S. 36. T. 3 S., R. 38 W.

Scale 900 ft to 1 inch.



Located in N.W. Corner, S.W. Quarter of MAP OF
S. 36. T. 3 S., R. 38 W.



MAP OF Fractional Township 5 S Range 42 West

Scale 1/4 inch to 1 mile.

of the 6th P.M.

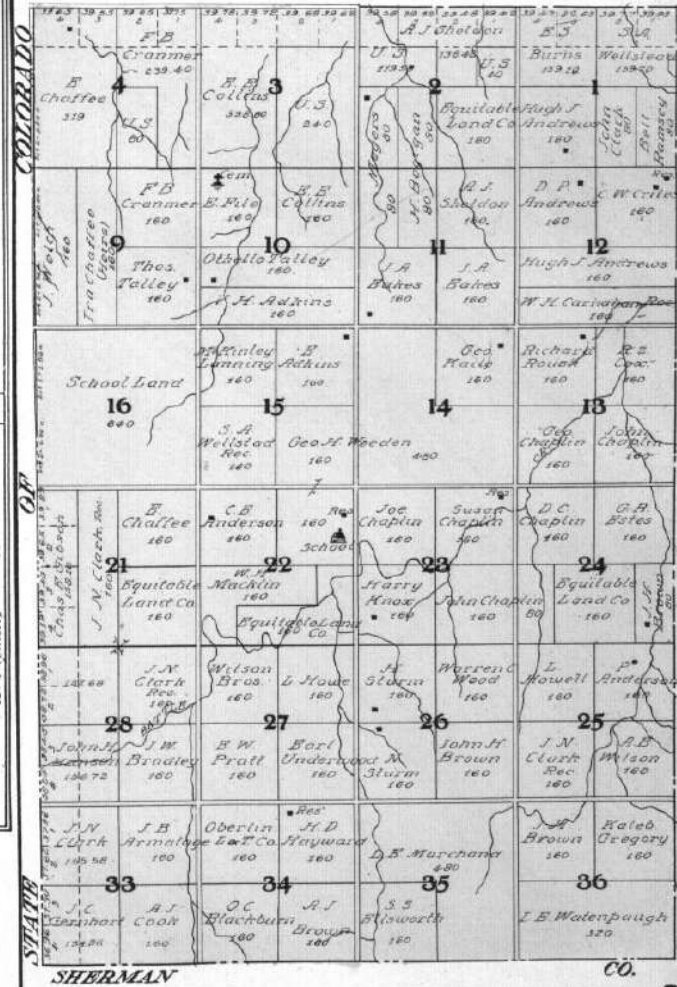

MAP OF
Fractional Township 4 S Range 42 West
Scale 1/4" = 1000 Feet

40. 6th P.M.

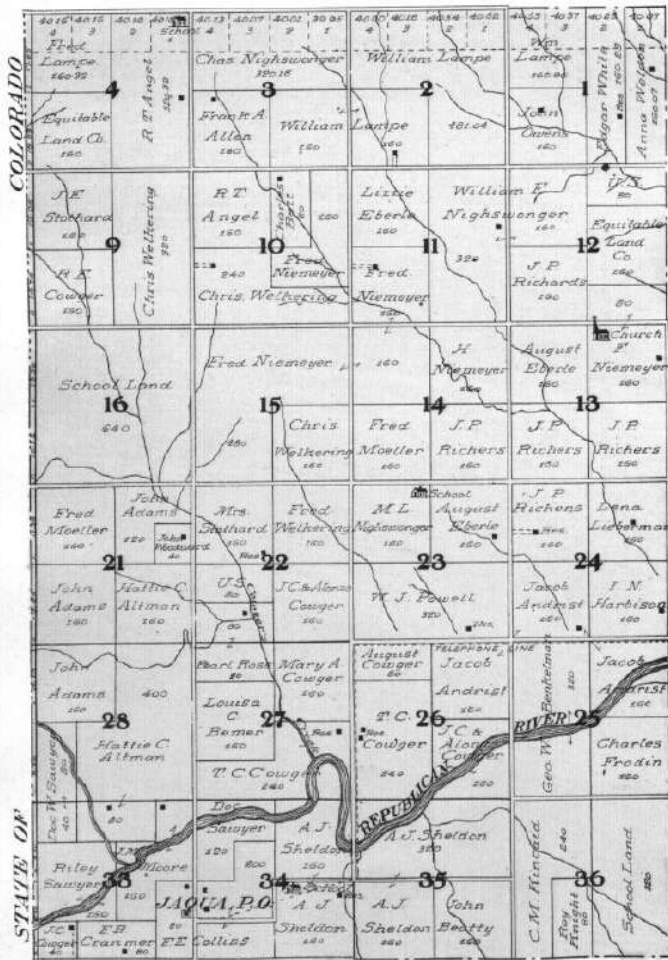

MAP OF
Fractional Township 3 S Range 42 West
Scale 1/4" = 1000 Feet

40. 6th P.M.

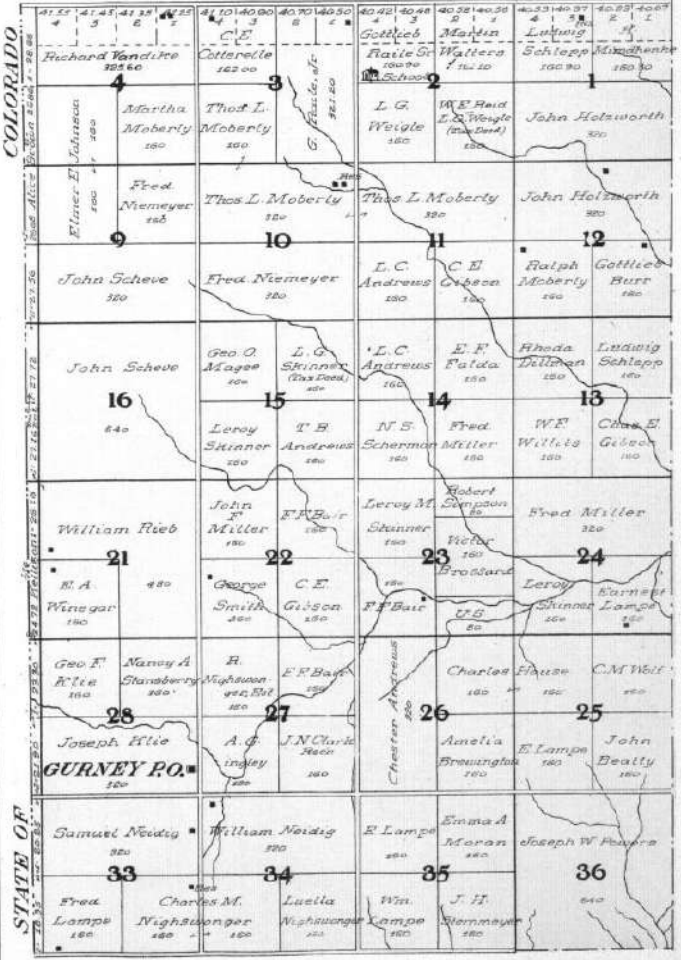

MAP OF
Fractional Township 2 S Range 42 West

Scale 1/4" = 1 mile to 1/2" = 1 mile.

of the 6th P.M.

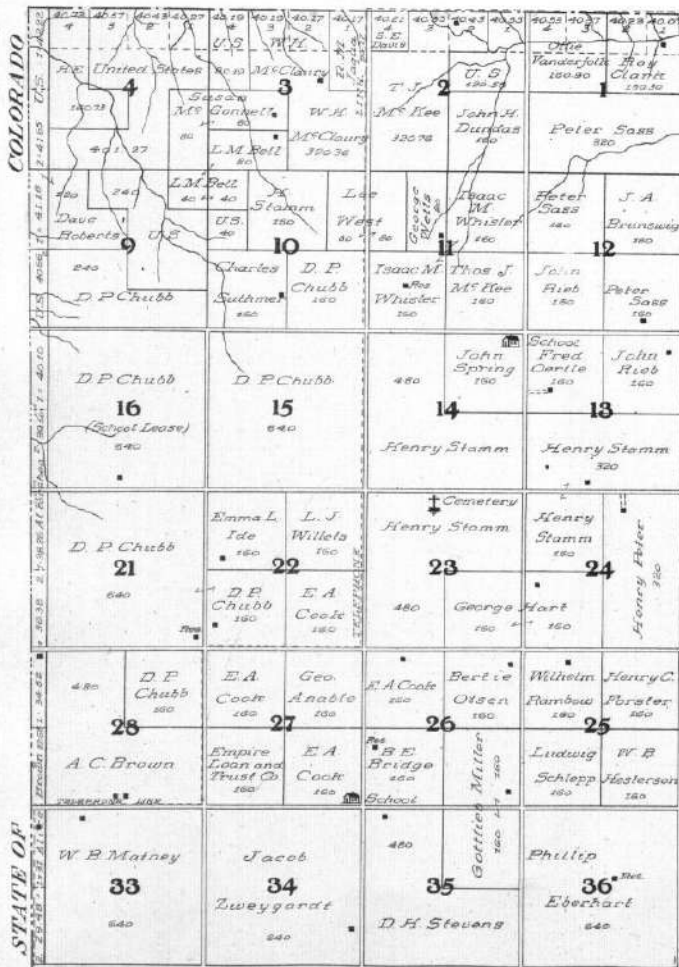

MAP OF
Fractional Township 1 S Range 42 West

Scale 1/4" = 1 mile to 1/2" = 1 mile.

of the 6th P.M.

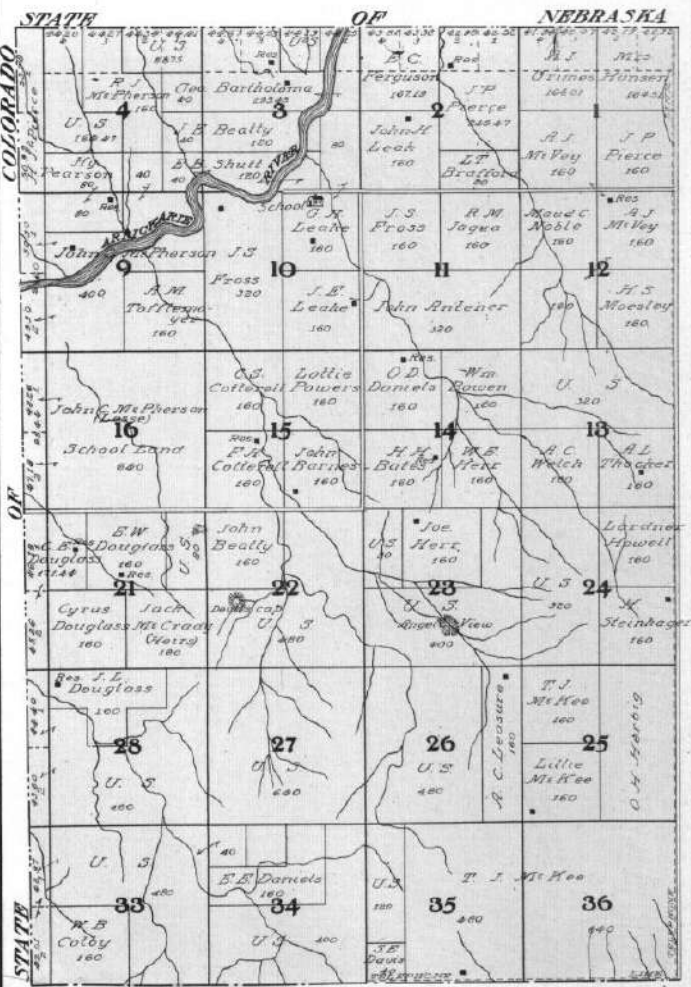



MAP OF
TOWNSHIP 1 S RANGE 37 W.
Scale 1/4 inch to 1 Mile.

OF THE 6TH P. M.

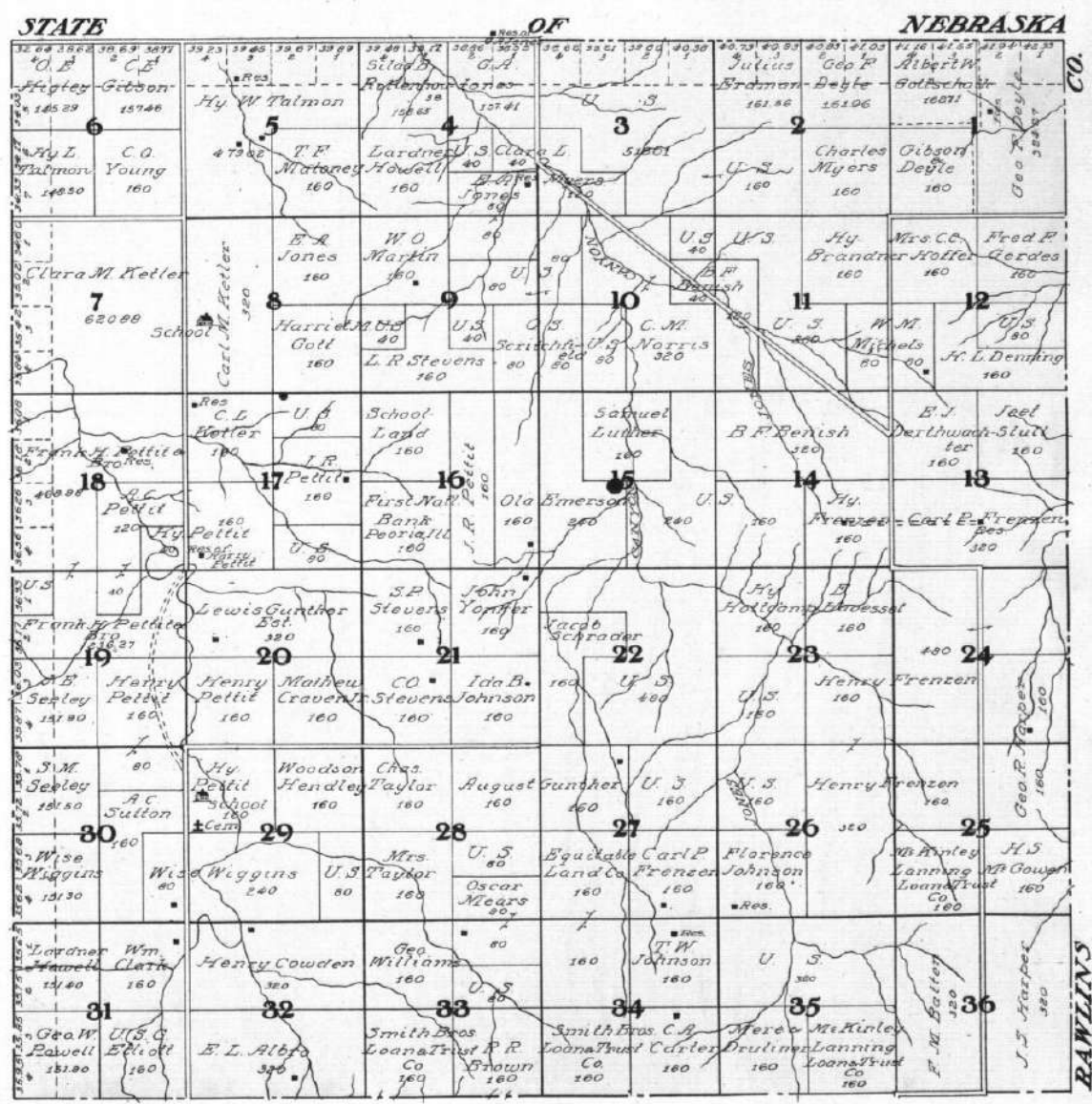



MAP OF

TOWNSHIP 1 S RANGE 38 W.

 Scale 1/4 inch to 1 Mile.

OF THE 6TH P. M.

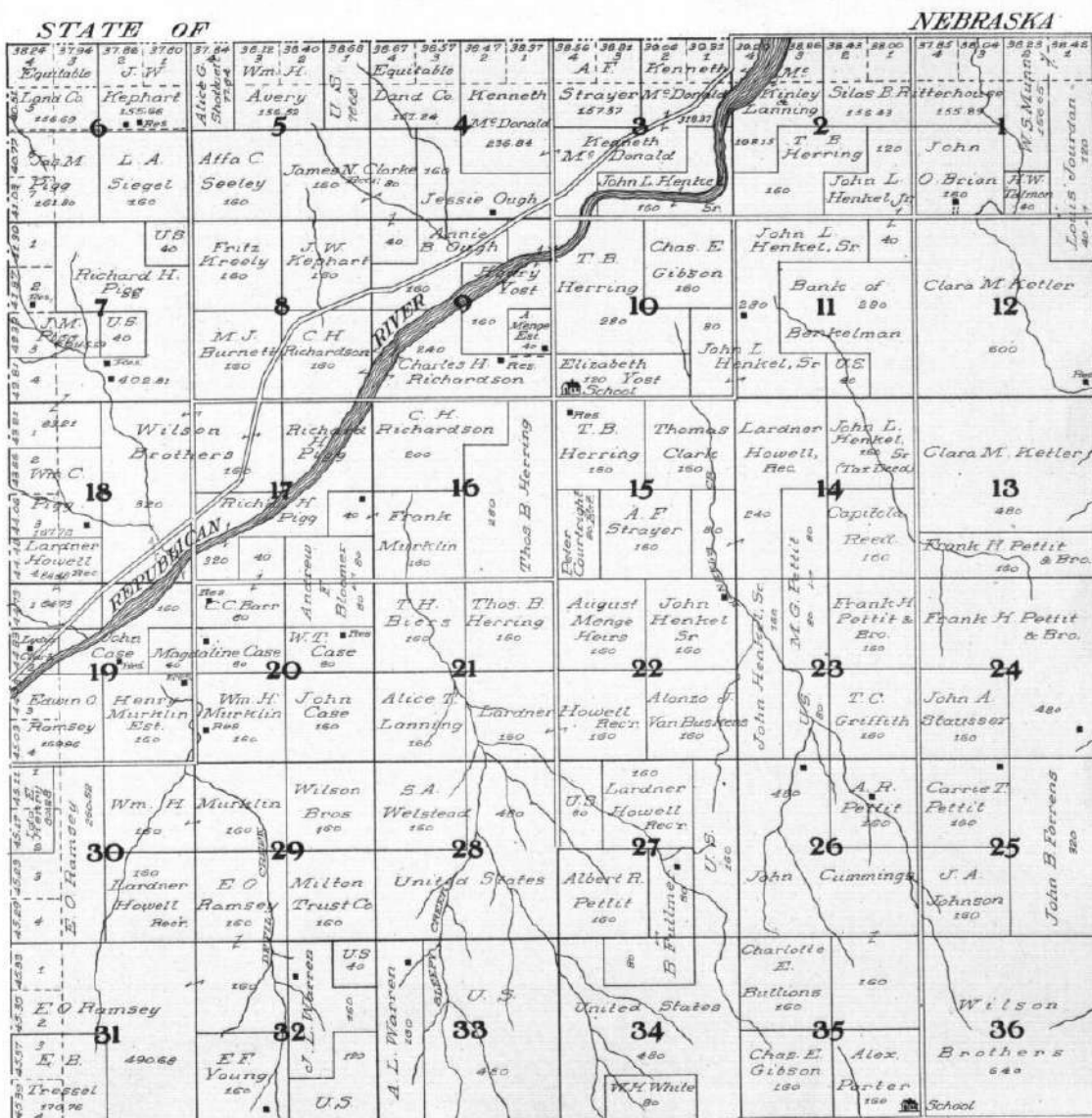

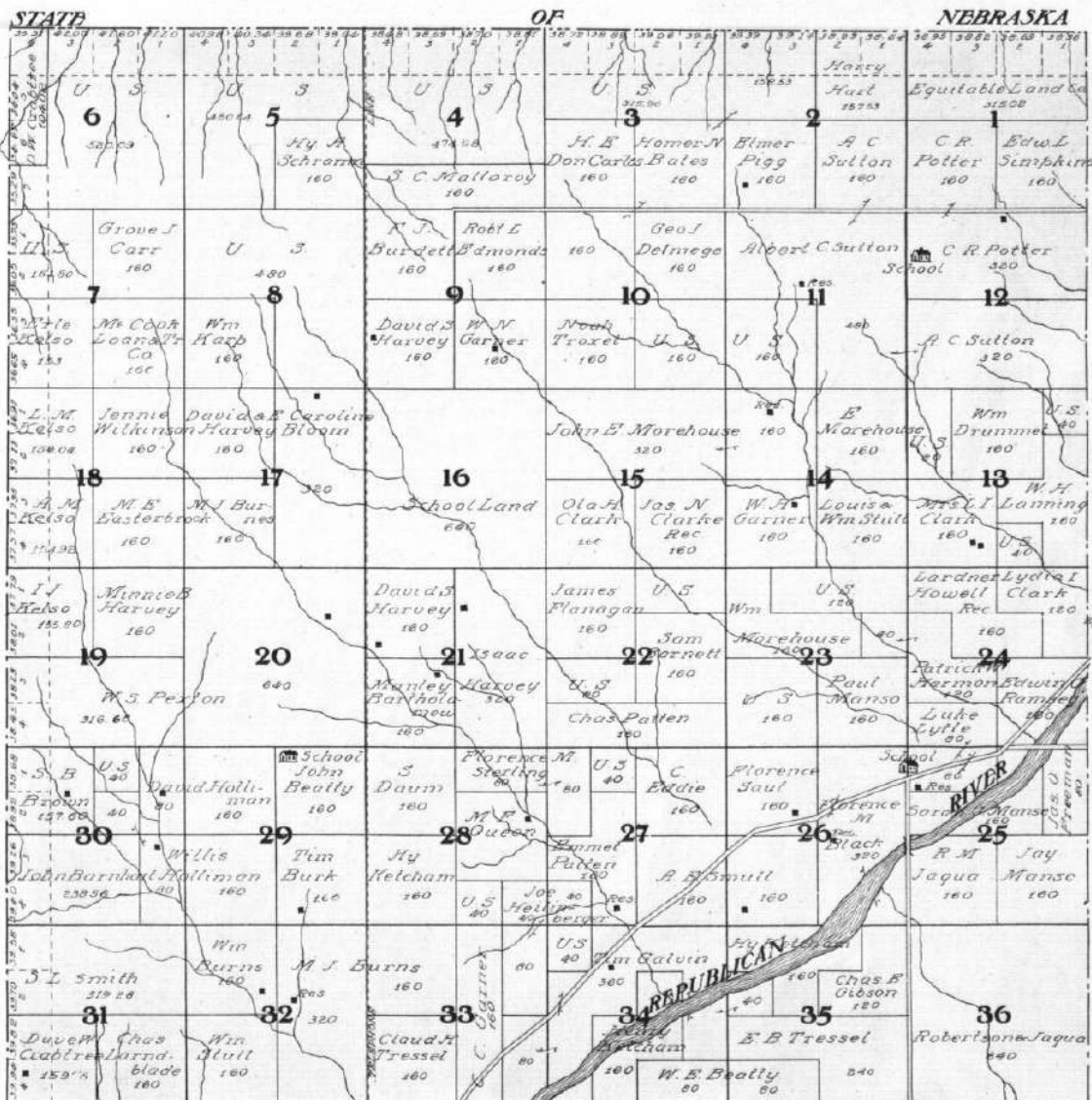

MAP OF
TOWNSHIP 1 S RANGE 40 W.
 Scale 1/4 inch to 1 mile.
OF THE 6TH P. M.

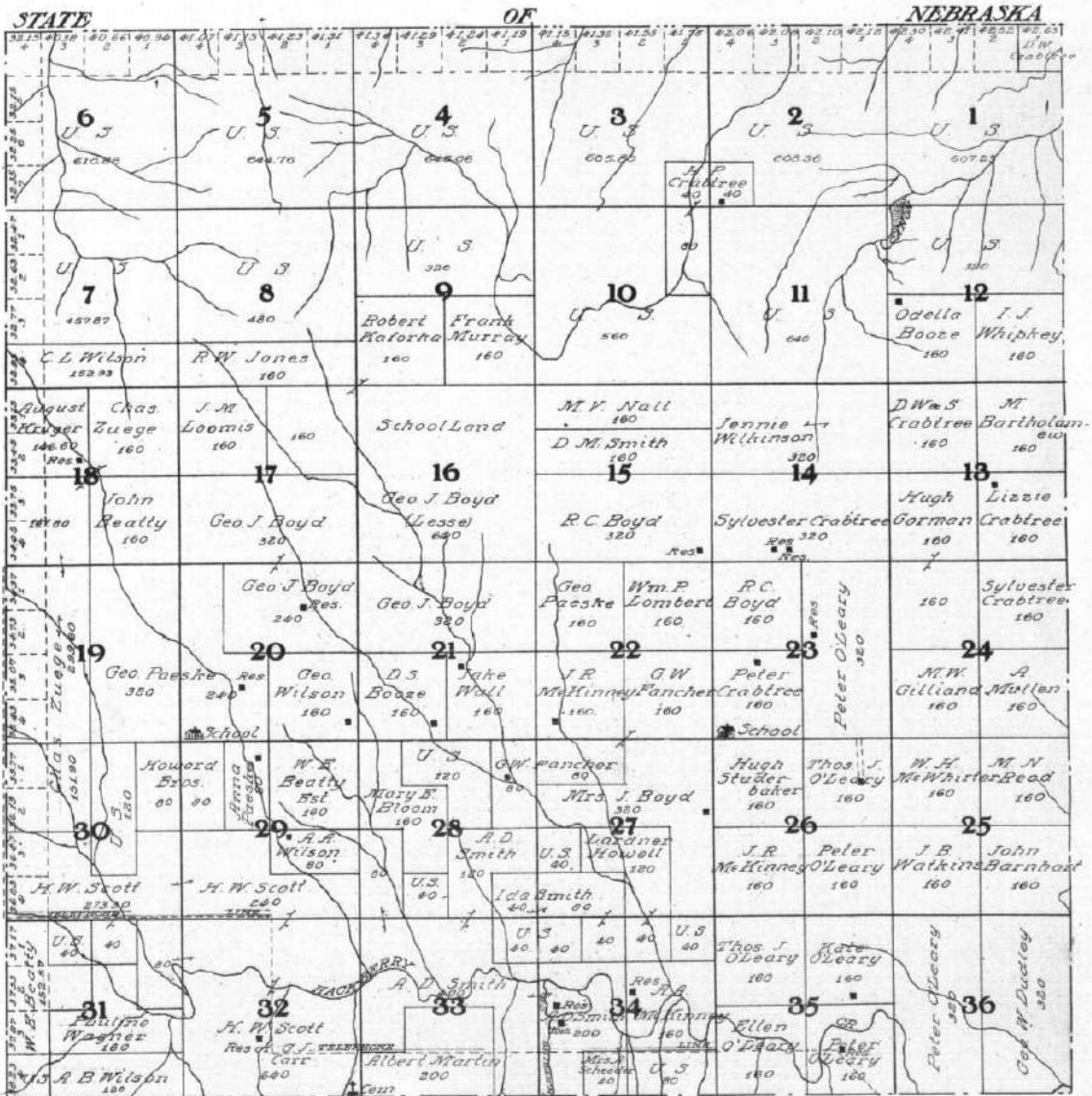



MAP OF

TOWNSHIP 1 S RANGE 41 W.

Scale 1/4" = 1 Mile.

OF THE 6TH P. M.

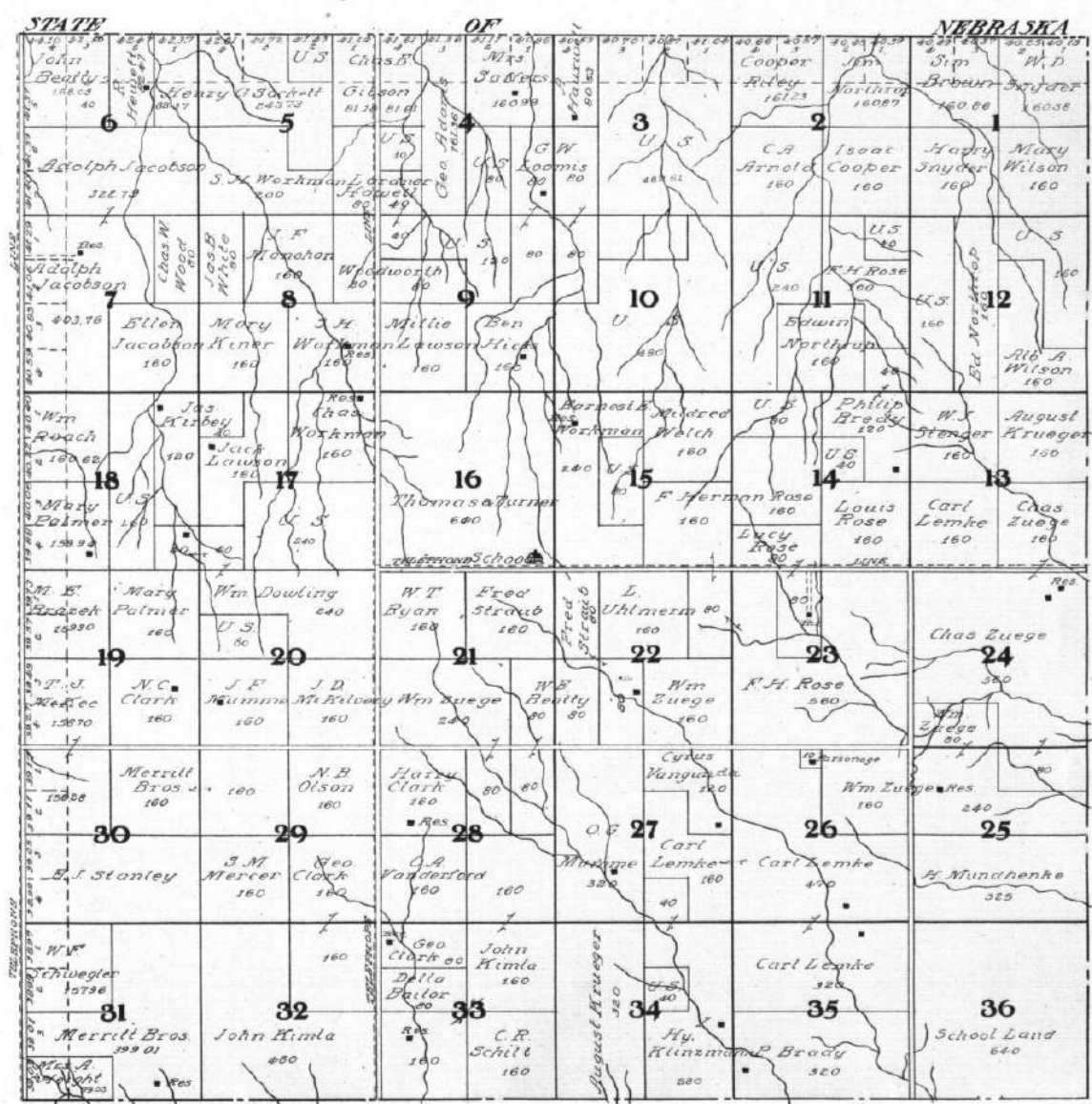



MAP OF
TOWNSHIP 2 S RANGE 41 W.
 Scale 1/4 inch to 1 Mile.

OF THE 6TH P. M.

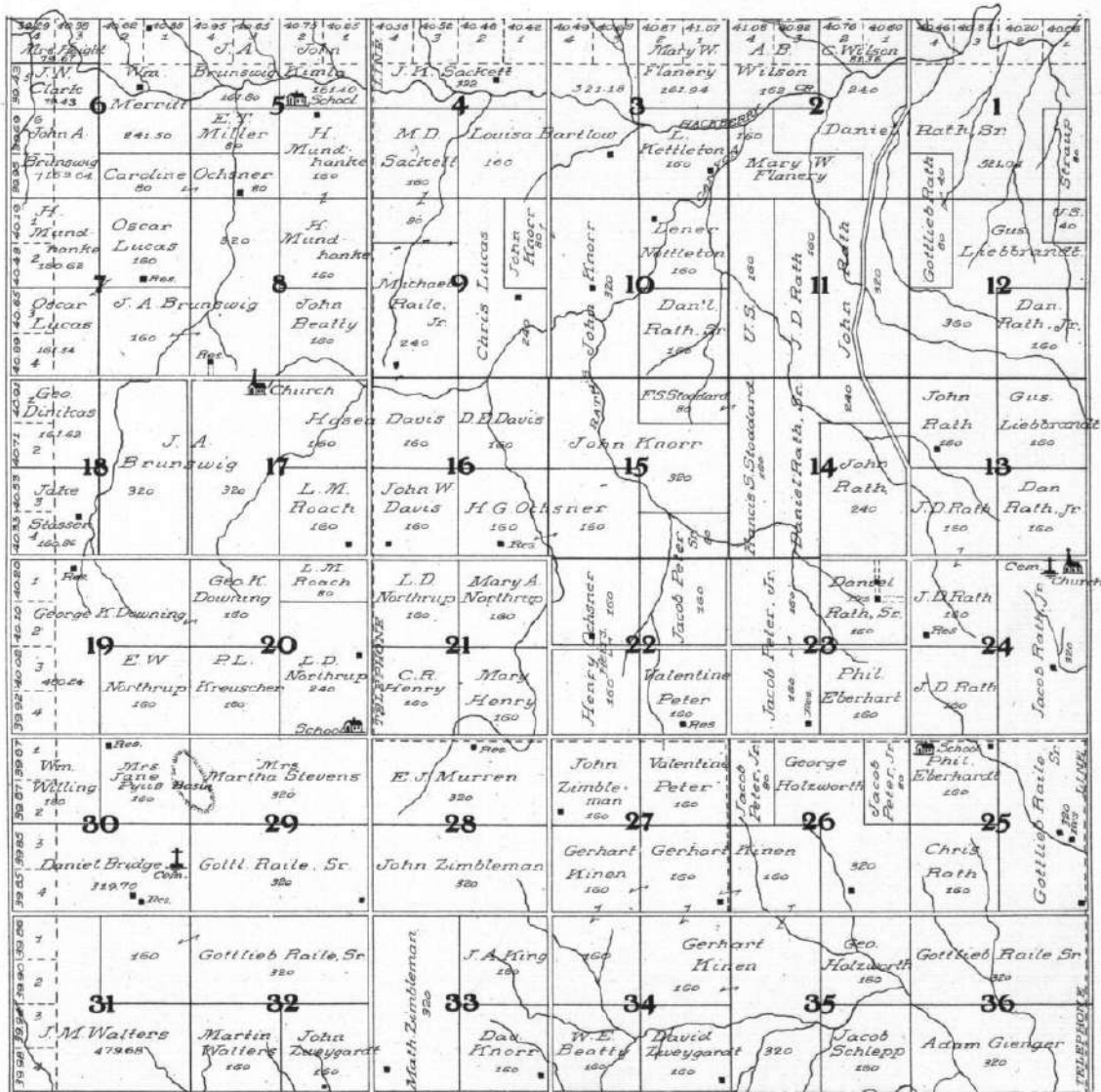



MAP OF
TOWNSHIP 2 S RANGE 40 W.
 Scale 1/4 inch to 1 Mile.
OF THE 6TH P. M.

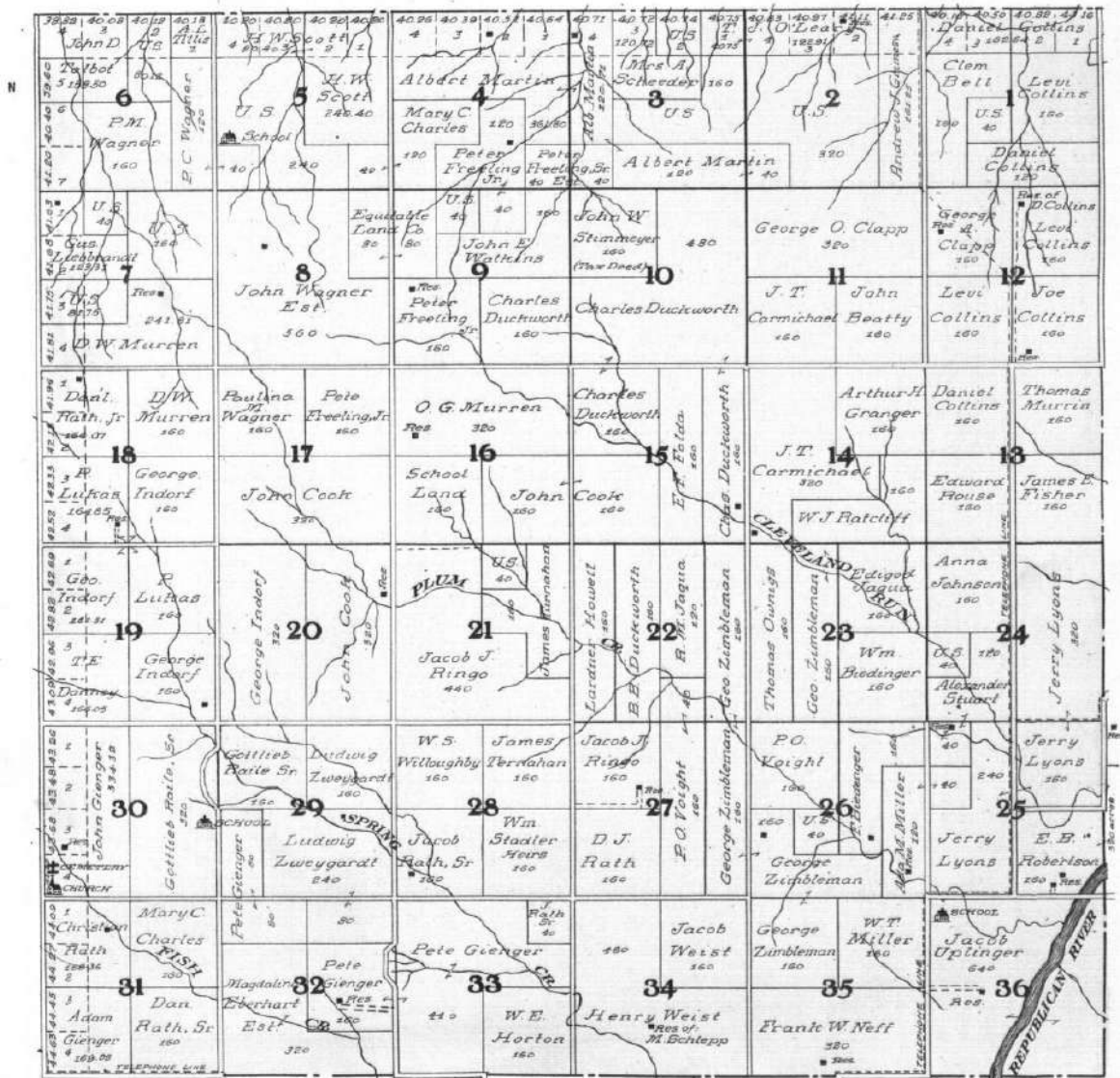

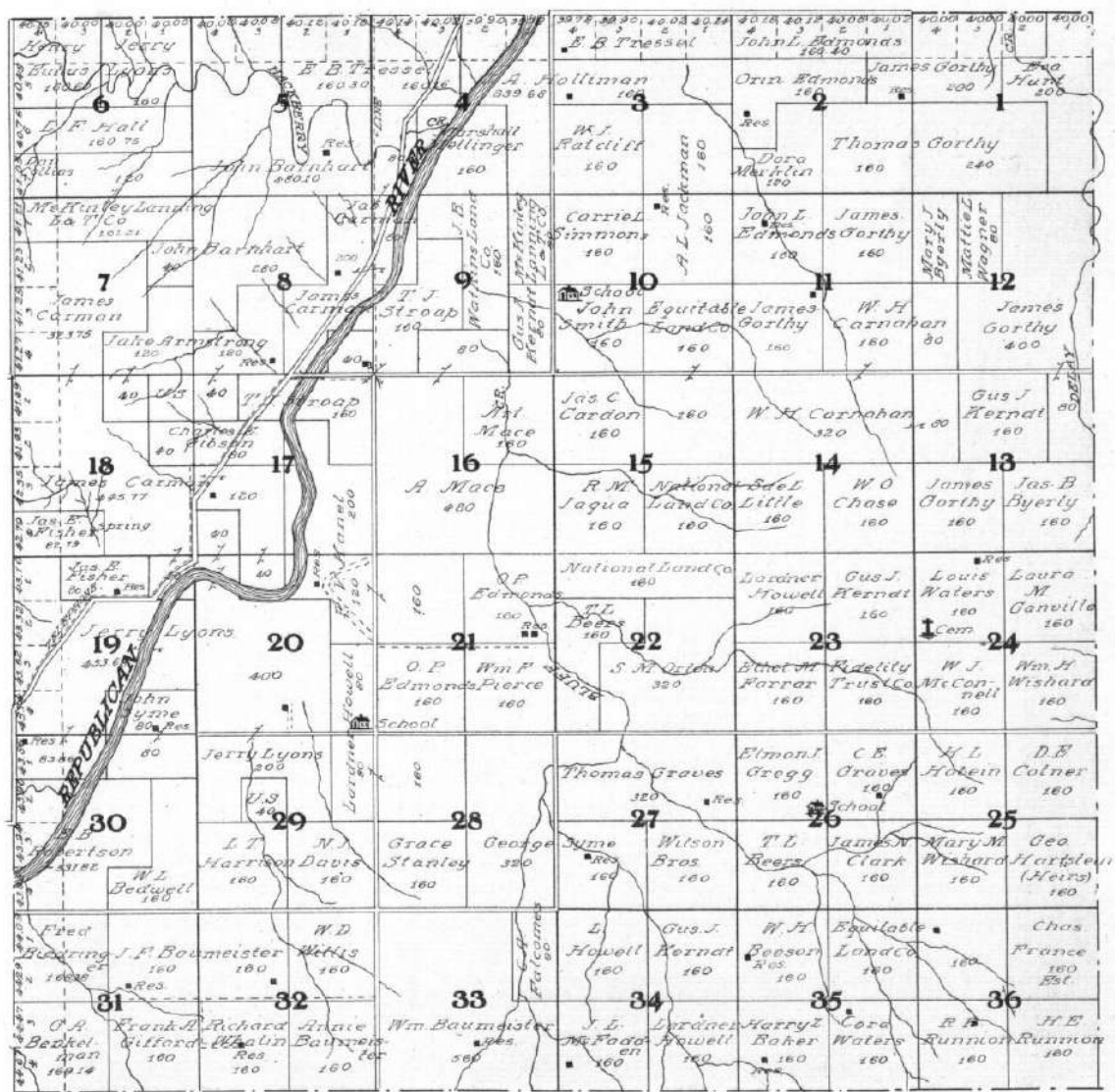

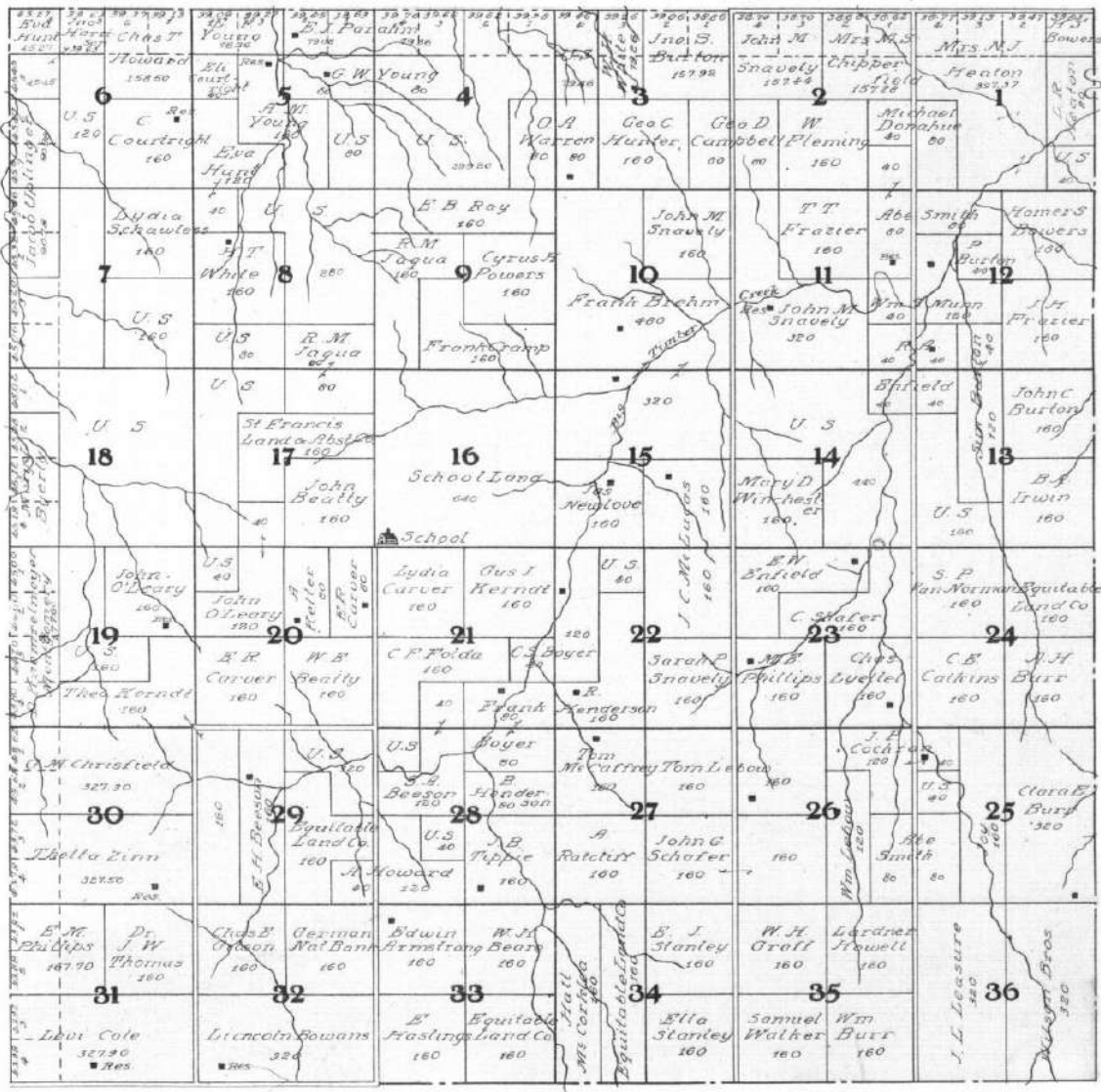

TOWNSHIP 25 RANGE 37 W.

 OF THE 6TH P. M.

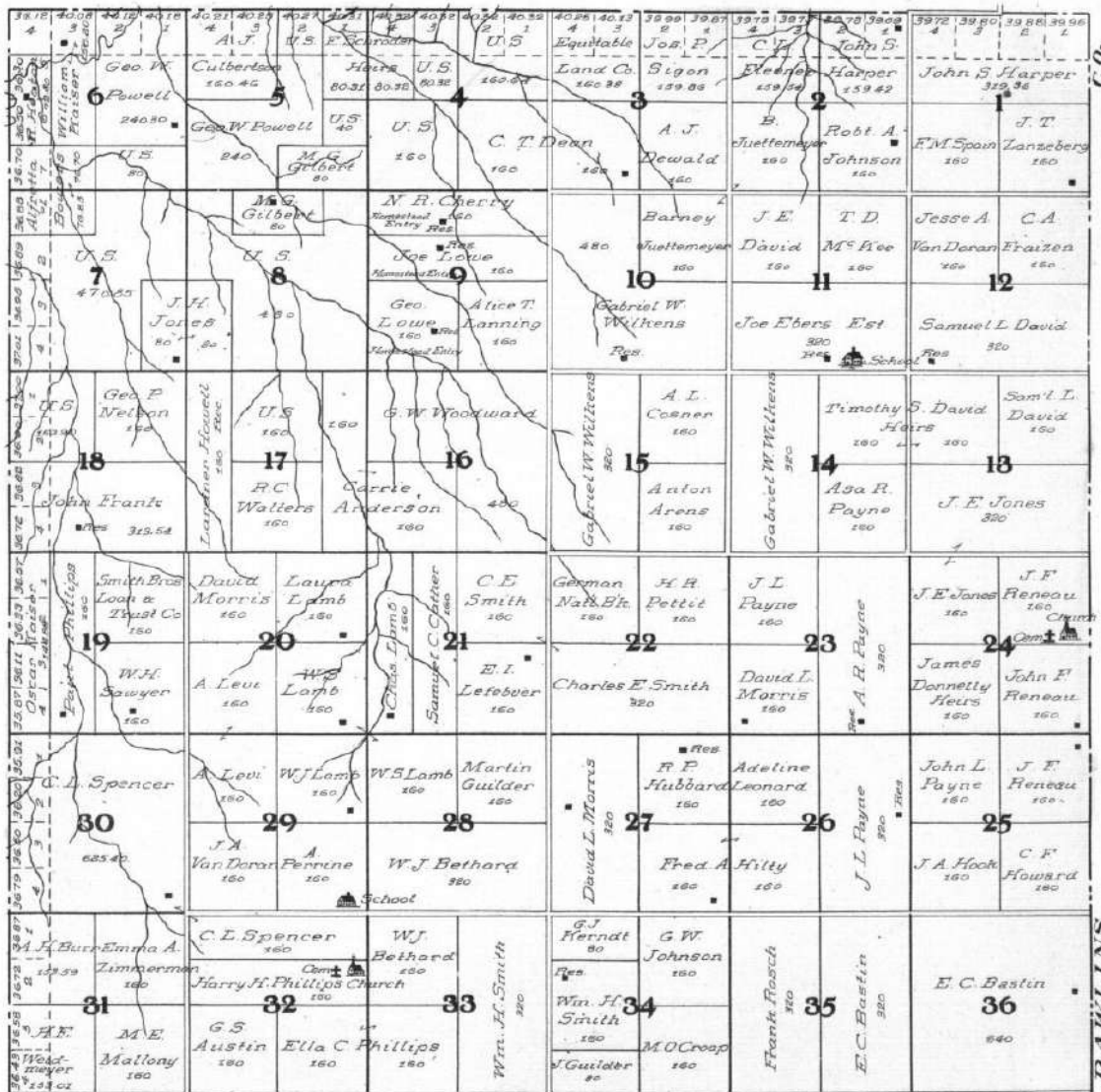



TOWNSHIP 3 S RANGE 37 W.

Scale 1/4 of inch to 1 Mile.

OF THE 6TH P. M.

31 David Morris 152 00	32 James M Diver 100	33 Dr G R Pegg 160	34 Jasa Dora Lane 160	35 J H Dorsch 632 68	36 Ana J Res Johnson 160	37 Henry Focht 160	38 E C Bustin 320	39 Henry Ahrens 160
40 L Rutherford 314 66	41 Dora A Lane 160	42 John Pochow 160	43 J H 160	44 J A Dorsch 320	45 FW 160	46 J Fleming 160	47 W B Garsuch 160	48 Martin Maley 160
49 A T Branning 160	50 School T W Jones 160	51 Dr Geo R Pegg 400	52 J A Dorsch 160	53 Van Doran 160	54 Baumana Wm Tjaden 320	55 Wm Tjaden 160	56 Wm Elleger 160	57 Ed Lyman 320
58 H T Branning 160	59 E J Byers 160	60 Wm Gebers 160	61 E G Owens 160	62 J W Jones 160	63 Wm Tjaden 160	64 S Denning 160	65 School Wm Ellinger 160	66 H C 160
67 Kouber Byers 160	68 Coxa Downer 160	69 Wiemann 320	70 Hy Kite Est 160	71 Thos Blake 160	72 Ed Wagner 160	73 Thomas Cole 400	74 Hattie M Cole 160	75 Robert A Voorhies 160
76 E J Byers 157 66	77 Geo O Byers 160	78 Henry Kite Est 400	79 Hy Kite Est 160	80 Thos Blake 160	81 Pearl Weinstine 160	82 J L Cooper 160	83 Fred Robertson 160	84 J F Fisher 160
85 P D Carell 150 96	86 D C Pelhoue 160	87 E J Miller 160	88 E J Miller 320	89 L H Ellenger 160	90 Gus J Herndt 160	91 E E Duncan 160	92 Phippa 320	93 Henry Zimmer 160
94 J M Batcher 152 96	95 C S Fuller 160	96 Cleo Bettner 160	97 Jas H Hummery 160	98 J H Downer 160	99 M L Kennedy 160	100 Nellie Kekerbock 160	101 J P Garrison 320	102 Christian Ruch 160
103 Jas Hermon 160 90	104 M F Hutchins 160	105 T O Weesner 160	106 Chas Songwine 160	107 J Bertrand 160	108 J Fleming 160	109 E M Slerims 160	110 J A Van Doren 160	111 Deruy Wicker 160
112 Sam T Doyle 321 90	113 Chas Bertrand 160	114 J B McCall 160	115 C F Drahe 160	116 W H Erret 160	117 Chas M Slerims 160	118 W A Compton 160	119 J B Jones 160	120 Edmund C Bustin 160
121 J A Kluehild 160 96	122 Chas Harry 160	123 R A Van Doran 160	124 J B Walker 160	125 H B Peterson 160	126 H B Curtis 160	127 Abger Smutz 160	128 Mrs B Allen 160	129 Albert Drennan 160
130 School Land 320	131 School Land 320	132 School Land 320	133 School Land 320	134 School Land 320	135 School Land 320	136 School Land 320	137 School Land 320	138 School Land 320

KANSAS STATE HISTORICAL SOCIETY

CO.

RAWLINS



MAP OF

TOWNSHIP 3 S RANGE 38 W.

 State 1/4 of inch to 1 mile.

OF THE 6TH P. M.

23 74 30 82 30 87 30 83 4 3 2 1 5 6 7 8 9 10 11 12 13 14 15 16 17 18 19 20 21 22 23 24 25 26 27 28 29 30 31 32 33 34 35 36	30 74 30 82 4 Ed. 3 5 6 7 8 9 10 11 12 13 14 15 16 17 18 19 20 21 22 23 24 25 26 27 28 29 30 31 32 33 34 35 36	30 50 30 58 4 H. 3 5 6 7 8 9 10 11 12 13 14 15 16 17 18 19 20 21 22 23 24 25 26 27 28 29 30 31 32 33 34 35 36	30 30 30 26 4 Wm 3 5 6 7 8 9 10 11 12 13 14 15 16 17 18 19 20 21 22 23 24 25 26 27 28 29 30 31 32 33 34 35 36	30 22 30 16 2 Martin 1 3 4 5 6 7 8 9 10 11 12 13 14 15 16 17 18 19 20 21 22 23 24 25 26 27 28 29 30 31 32 33 34 35 36	30 05 30 00 4 W.P. 3 5 6 7 8 9 10 11 12 13 14 15 16 17 18 19 20 21 22 23 24 25 26 27 28 29 30 31 32 33 34 35 36	30 74 30 51 4 3 5 6 7 8 9 10 11 12 13 14 15 16 17 18 19 20 21 22 23 24 25 26 27 28 29 30 31 32 33 34 35 36	30 51 30 50 4 3 5 6 7 8 9 10 11 12 13 14 15 16 17 18 19 20 21 22 23 24 25 26 27 28 29 30 31 32 33 34 35 36	30 65 30 72 2 1 3 4 5 6 7 8 9 10 11 12 13 14 15 16 17 18 19 20 21 22 23 24 25 26 27 28 29 30 31 32 33 34 35 36	30 01 30 23 4 3 5 6 7 8 9 10 11 12 13 14 15 16 17 18 19 20 21 22 23 24 25 26 27 28 29 30 31 32 33 34 35 36	30 53 30 25 4 3 5 6 7 8 9 10 11 12 13 14 15 16 17 18 19 20 21 22 23 24 25 26 27 28 29 30 31 32 33 34 35 36		
Levi Cole 306.23	Ed. Bowers 150.36	H. Follett 150.88	Lincoln Bowers 150	Geo A. Pope 150	W.T. Ratcliff 150	FD. Cary 150	German National Bank 150	Conrad Hall 150	Lycia A. Clark 312.37	Walker Van Doren 150.16	John Van Doren 150.33	William Burr 150
Gus J. Kerndt 716.22	H.W. Thomas 150	H. Follett 150	Lincoln Bowers 150	Geo A. Pope 150	W.T. Ratcliff 150	FD. Cary 150	German National Bank 150	Conrad Hall 150	Lycia A. Clark 312.37	Walker Van Doren 150.16	John Van Doren 150.33	William Burr 150
E.A. McPherson 104.08	Henry Clark 150	Florence Hurley 150	School Lincoln Bowers 150	Geo A. Pope 150	W.T. Ratcliff 150	FD. Cary 150	German National Bank 150	Conrad Hall 150	Lycia A. Clark 312.37	Walker Van Doren 150.16	John Van Doren 150.33	William Burr 150
Eleanor Gilling 104.10	Gus J. Kerndt 150	A. Weaver 150	School Lincoln Bowers 150	Geo A. Pope 150	W.T. Ratcliff 150	FD. Cary 150	German National Bank 150	Conrad Hall 150	Lycia A. Clark 312.37	Walker Van Doren 150.16	John Van Doren 150.33	William Burr 150
Harvey E. Rose 150	Bernard Hickert 320	Orsie Chitwood 150	School Lincoln Bowers 150	Geo A. Pope 150	W.T. Ratcliff 150	FD. Cary 150	German National Bank 150	Conrad Hall 150	Lycia A. Clark 312.37	Walker Van Doren 150.16	John Van Doren 150.33	William Burr 150
W.T. Rattford 150	William H. Nell 320	Bernard Hickert 320	School Lincoln Bowers 150	Geo A. Pope 150	W.T. Ratcliff 150	FD. Cary 150	German National Bank 150	Conrad Hall 150	Lycia A. Clark 312.37	Walker Van Doren 150.16	John Van Doren 150.33	William Burr 150
Thos. L. Ray 163.36	W.A. Cross 150	Wesley Trickett 150	School Lincoln Bowers 150	Geo A. Pope 150	W.T. Ratcliff 150	FD. Cary 150	German National Bank 150	Conrad Hall 150	Lycia A. Clark 312.37	Walker Van Doren 150.16	John Van Doren 150.33	William Burr 150
W.H. Caplan 161.48	Smith Bros Loan & Trust Co. 150	Howard Eros 150	William Haterer 150	John R. Steen 150	Nancy J. Heaton 150	Howard Bees 150	H.G. Bruning 150	Wm. Stockton 150	John Linholm 150	Cox & Downer 150	J.H. Hermon 150	Joseph Greaser 150
A.E. Edwards 101.22	Nancy F. Edwards 150	C. Cannon 150	John R. Steen 150	St Francis Land & Abstract Co. 150	Geo. M. Stout 150	R.A. Frater 150	J.N. Conger 150	W.W. Eberhart 150	Irene L. Smith 150	E.B. Turner 150	J.A. Van Doren 150	Joseph Greaser 150
Allen Fleming 101.22	Charles E. Hickman 150	Chicago, Bailey Palmer 150	John R. Steen 150	St Francis Land & Abstract Co. 150	Geo. M. Stout 150	R.A. Frater 150	J.N. Conger 150	W.W. Eberhart 150	Irene L. Smith 150	E.B. Turner 150	J.A. Van Doren 150	Joseph Greaser 150
R.H.G. Cooper 101.50	Thomas Stanley 150	Chicago, Bailey Palmer 150	John R. Steen 150	St Francis Land & Abstract Co. 150	Geo. M. Stout 150	R.A. Frater 150	J.N. Conger 150	W.W. Eberhart 150	Irene L. Smith 150	E.B. Turner 150	J.A. Van Doren 150	Joseph Greaser 150
Chris. Nelson 102.50	Hiram Vansyckle 150	Chicago, Bailey Palmer 150	John R. Steen 150	St Francis Land & Abstract Co. 150	Geo. M. Stout 150	R.A. Frater 150	J.N. Conger 150	W.W. Eberhart 150	Irene L. Smith 150	E.B. Turner 150	J.A. Van Doren 150	Joseph Greaser 150

BIRD
CITY

MAP OF
TOWNSHIP 3 S RANGE 39 W
OF THE 6TH P. M.

Scale 1/8" = 1 Mile.

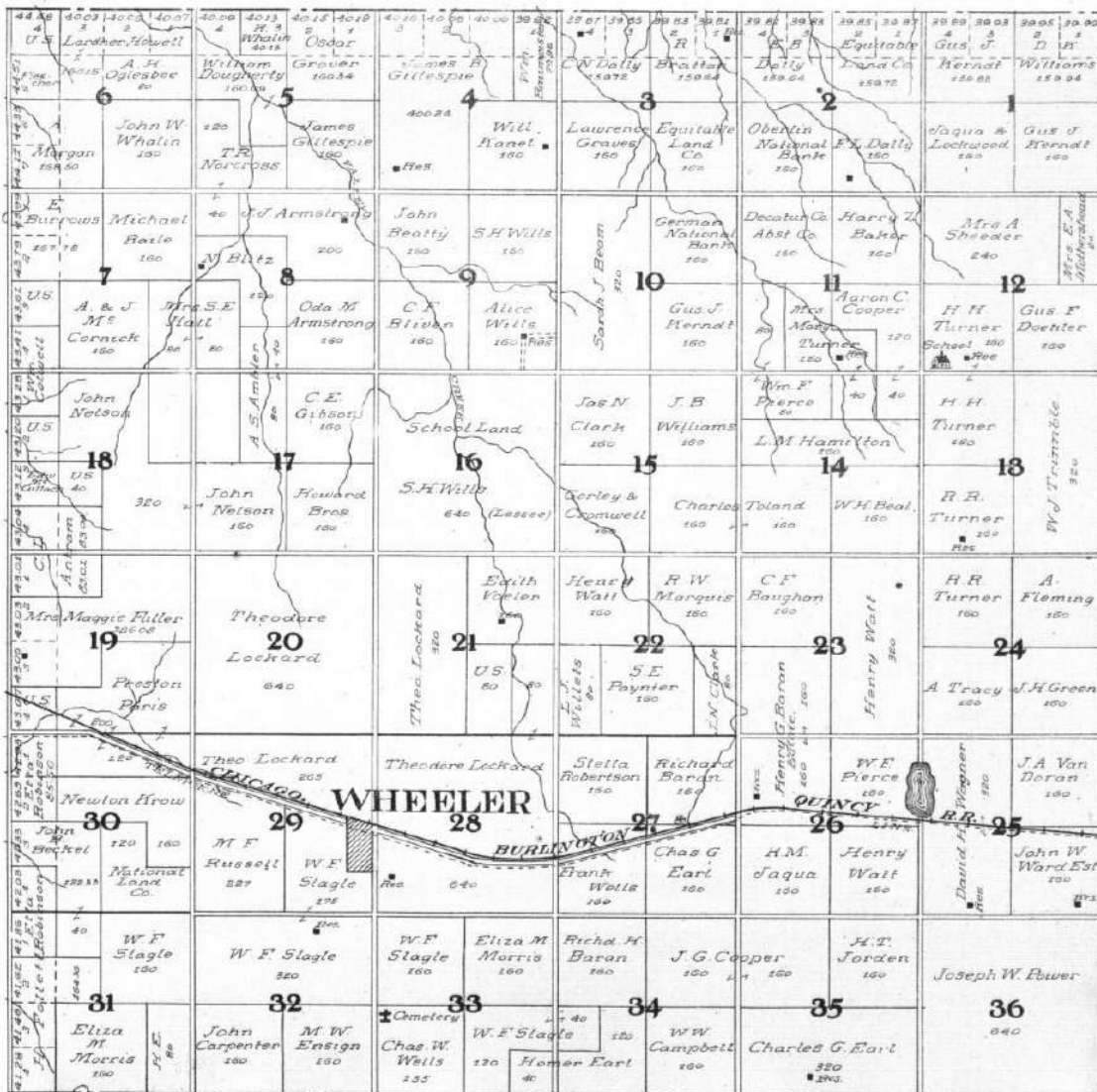



MAP OF

TOWNSHIP 3 S RANGE 40 W.

Scale 1/4 of inch to 1 Mile.

OF THE 6TH P. M.

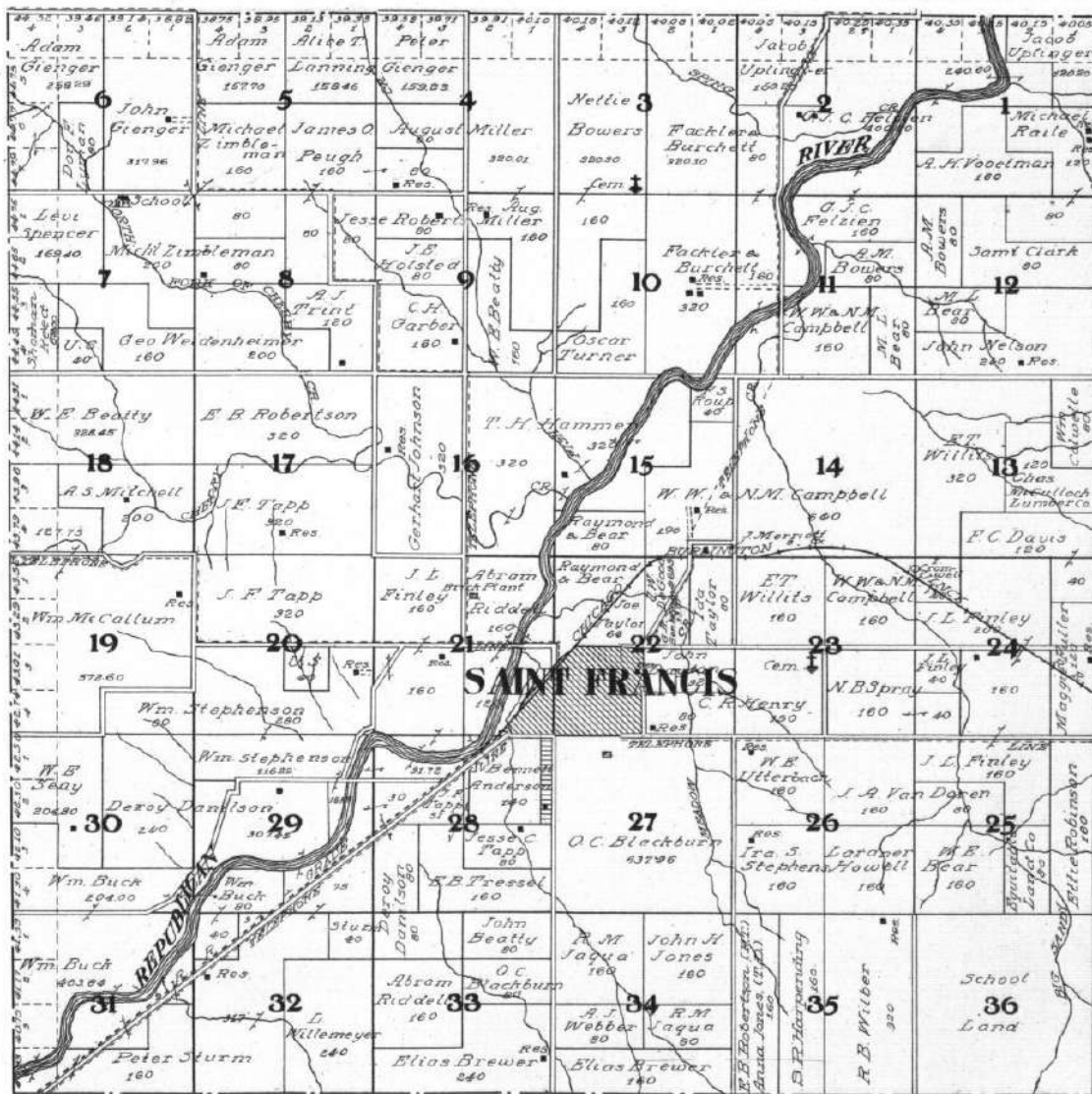



MAP OF
TOWNSHIP 3 S RANGE 41 W.
Scale 1/4 inch to 1 mile.

OF THE 6TH P. M.

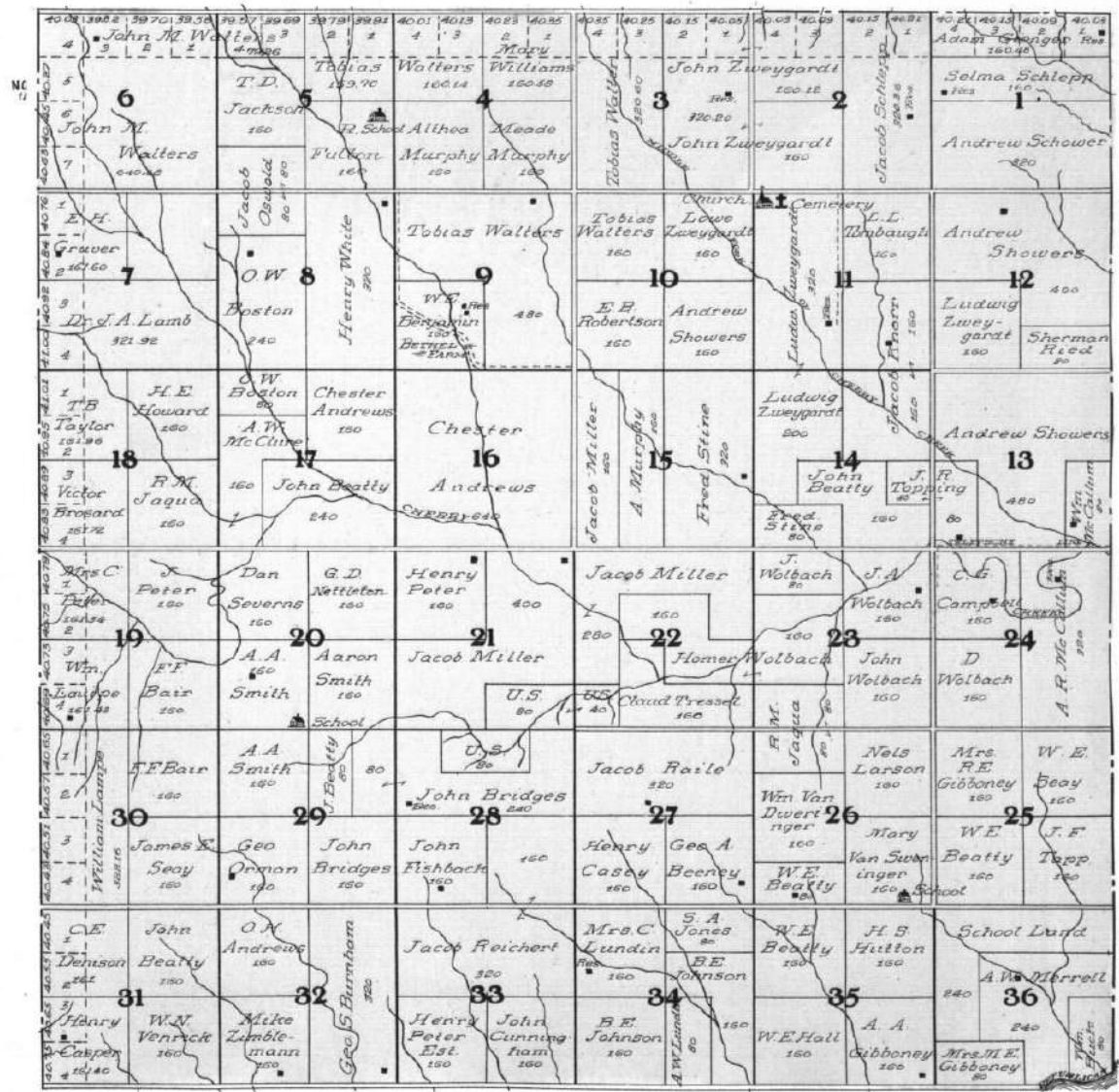

MAP OF
TOWNSHIP 4 S RANGE 41 W.

Scale 1/8 of inch to 1 Mile.

OF THE 6TH P. M.

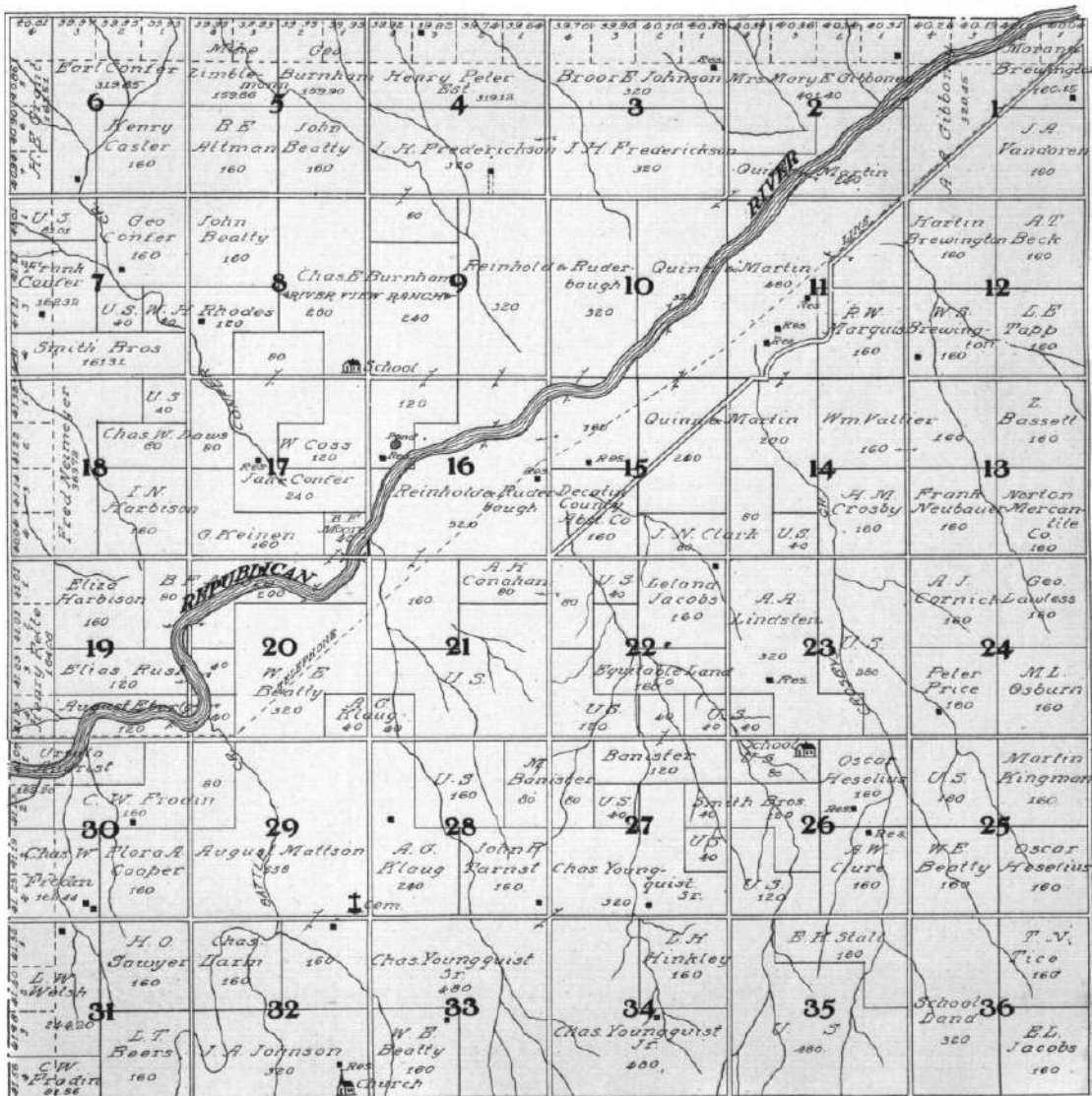

TOWNSHIP 4 S RANGE 40 W.

 Scale 1/4" of Inch to 1 Mile.

OF THE 6TH P. M.

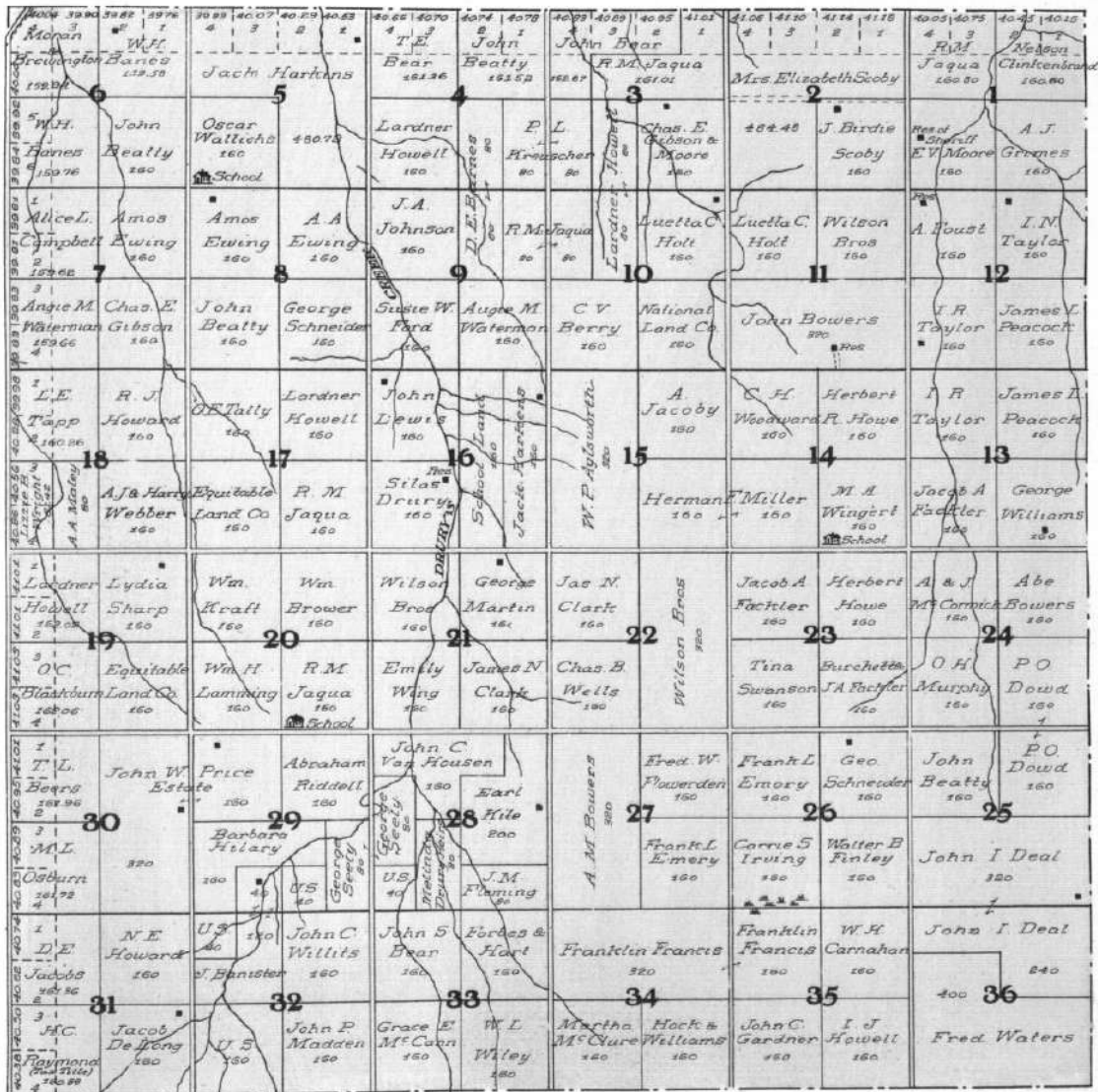

MAP OF
TOWNSHIP 4 S RANGE 39 W.

Scale 1/4 inch to 1 Mile.

OF THE 6TH P. M.

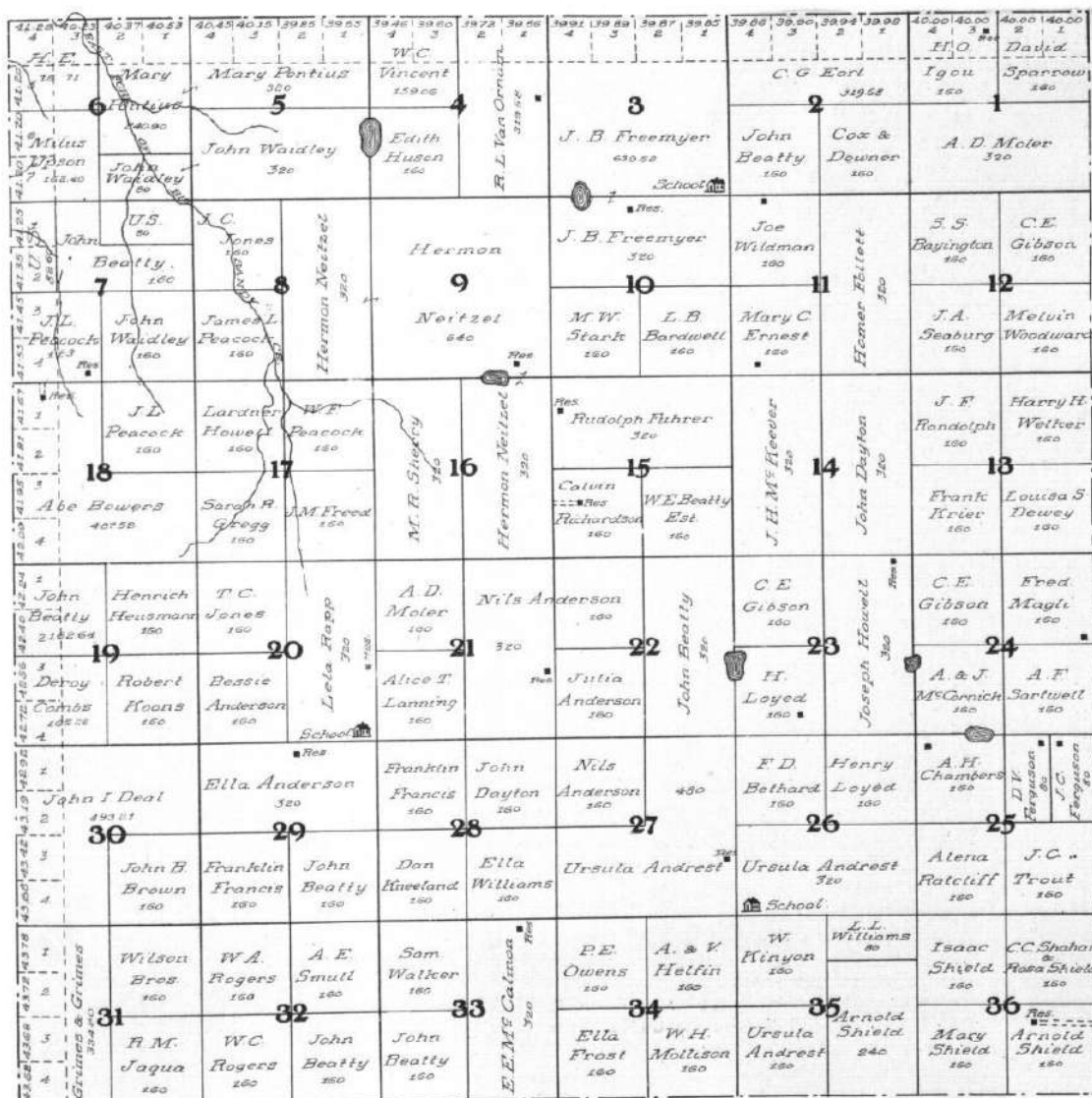

MAP OF
TOWNSHIP 4 S RANGE 37 W.
 Scale 1/4" of inch to 1 Mile.

OF THE 6TH P. M.

6 J. L. Overlurf 320 162.60	5 Jennie Mrs. C. 160 160	4 Katie Rand 160 160	3 L. H. Benton 160 160	2 Overlurf 160 160	1 J. W. White 160 160	1 W. H. Rogers 160 160	1 Marion Hawk 320 160			
7 Robt. H. Elvaston 160 160	8 J. N. Conger 160 160	9 A. Fleming 160 160	10 H. T. Bruning 160 160	11 William Anderson 160 160	12 Mabel Hull 160 160	12 G. H. Hancock 160 160	12 E. B. Davis 160 160	12 Wilber M. Martin 160 160		
18 Wm. W. Shahan 160 160	17 Edw. J. Nolsche 160 160	16 H. Naup 160 160	15 Aug. Nu 160 160	14 J. A. James Wm. Anderson 160 160	13 Jun Frayes 160 160	13 James Johnson 320 160	13 James Johnson 320 160			
19 C. Peters 160 160	20 Roscoe O. Wilcox 160 160	21 A. Weaver 160 160	22 J. R. Jackson 160 160	23 E. O. Casford 160 160	24 Lizzie Clark 160 160	25 U. T. Baughan 160 160	26 B. Rotcliff 160 160	27 W. B. Beatty 160 160		
30 Thos. N. Shanan 160 160	29 John D. Bonelson 160 160	28 J. A. Downer Cox 160 160	27 N. N. Boyson 160 160	26 G. J. Kernat 160 160	25 E. E. Smith 160 160	24 C. F. Baughan 160 160	23 H. S. Foster 160 160	22 Samuel Luther 160 160	21 M. Doran 160 160	
31 Wm. H. Switzer 160 160	30 Wm. Farr 160 160	29 Frank Gochen 160 160	28 Wm. Temple 160 160	27 Melissa Smith 160 160	26 St. Fran. Land 160 160	25 Viola Berry 160 160	24 Geo. Shaffer 160 160	23 C. G. Roop 160 160	22 Chas. H. Hillen 160 160	
32 James N. Clark 160 160	31 Chas. Kendall 160 160	30 T. E. Dooty 160 160	29 Chas. Kern 160 160	28 A. O. Sanders 110 160	27 Gustave Kernat 160 160	26 J. L. & F. Norfolk 80 160	25 Porter Shaffer 160 160	24 St. Francis Co. 160 160	23 Wm. Abt. Burk 160 160	
33 C. W. Miner 160 160	32 Adolph Howard 160 160	31 John Ross 160 160	30 Wm. Wildaman 160 160	29 John L. Norfolk 160 160	28 John L. Norfolk 160 160	27 Geo. N. Brandt 160 160	26 Geo. N. Brandt 160 160	25 Brandt 320 160		
34 J. Miller 160 160	33 M. R. Shahan 160 160	32 R. H. Fritts 160 160	31 M. R. Shahan 160 160	30 John A. Anderson 160 160	29 Minnie Pasick 320 160	28 Homer Child 160 160	27 L. N. Brandt 160 160	26 Jas. N. Clark 160 160	25 Geo. Shaffer 160 160	24 Allen Shaffer 160 160
35 J. Miller 160 160	34 M. R. Shahan 160 160	33 R. H. Fritts 160 160	32 M. R. Shahan 160 160	31 John A. Anderson 160 160	30 John A. Anderson 160 160	29 John A. Anderson 160 160	28 John A. Anderson 160 160	27 John A. Anderson 160 160	26 John A. Anderson 160 160	25 John A. Anderson 160 160

RAWLINS



OF THE 6TH P. M.

3330 Wm H 4	4010 Sotana 2	4014 M. Crackan 2	4016 M. Crackan 2	4017 Sora A. Jones 2	4019 E. Egan 2	4020 E. Egan 2	4028 J. C. Sanderson 2	4009 Easter 2	4001 F. H. 2	3994 W. H. Martin 2	3990 Anzeletta 2	3995 Newton 2	3981 Brown 2	3976 Jova Deisher 2	3973 4	3925 4	3921 2	3907 2		
6 Lutesa 24	J. T. Justice 25	C. Swisher 100	BT Futter 160	Wm. C. Restine 150	O. D. Scott 320	J. D. Clausen 320	47952 John Forrest 160													
M Goodenberger 12430	Joseph Baker 160	Grace E. Shahan 160	J. H. Hoffe 160	S. M. Warford 160	M. H. Phillips 150	Frank A. Baizer 100	Harry N. Timms 150	C. E. Hoyt 160											W. N. Brown 150	Milton Trust Co. 160
Chas. W. Barber 18480	St. Francis Land & Abst. Co. 150	Chas. T. Killen 160	St. Francis Land & Abst. Co. 160	J. C. Trout 160	Chas. M. Baizer 160	F. A. Wandersee 150	J. W. Springer 160	J. T. Baughan 220											Theodore Berndt 160	Chas. E. Gibson 160
Chas. E. Gibson 15476	J. C. Thompson 160	Geo. W. Wessling 160	B. S. Chapman 360		J. L. Seaney 620	Ada A. Wilcox 160	Jacob Eggers 260	Wm. Lamont 160	J. T. Baughan 160											Jas. N. Clark 160
J. A. Fauchild 15178	J. B. Shepard 150	Chas. A. Seaberg 160														J. A. Van Dusen 160	W. H. Lanning 160	Chas. T. Killen 160		
Geo. H. Sphar 14281	J. B. Shepard 160	A. A. Nowers 160	H. E. Hoyt 160	Samuel Fishback 160	320	O. H. Phillips Esq. 160	J. C. Trout 160	F. G. Bursch 160	G. L. Smith 160	Frank Murray 160								Equitable Land Co. 160		
C. E. Ayers 15189	Geo. H. Sphar 150	J. A. Wacker 160	Mrs. H. M. Hoyt 160	Wm. E. Deeds 160	A. J. Phillips 160	Oliver Fleet 160	120 Chas. T. Killen 160	120 Chas. T. Callahan 160	120 St. Francis Land & Abst. Co. 220	160 James W. Gehz 160									James W. Gehz 160	
Geo. L. Smith 16173	John Forrest 160	Vernor Heirs 160	Hency Goodale 160	G. J. Kernat 160	100 W. L. Stemmens 160	Chas. T. Killen 160	James W. Gehz 160	James W. Gehz 400											Charles T. Killen 320	
J. T. Baughan 16207	A. Ratcliff 150	Alice T. Lanning 160	Equitable Land Co. 160	1st Natl. Bank 160	W. L. Stemmens 160	Chas. T. Killen 160	James W. Gehz 160	James W. Gehz 400											Charles T. Killen 320	
L. A. Haffon 20409	H. R. Pettit 160	John Forrest 160	James E. Hartley 160	W. M. Stults 160	C. T. Killen 150	Anna J. Phillips 200	J. W. Gehz 160	Chas. T. Killen 160	Chas. T. Killen 160	Fill Fishback 160	George Thompson 160							D. Bryant 160		
G. H. Hawkins 20456	Peter Arens 160	Murphy & Scott 160	George W. Hartley 160	Lardner Howell 150	Joseph C. Jones 160	Anna J. Phillips 200	J. W. Gehz 160	Chas. T. Killen 160	Lardner Howell 160	Chas. T. Killen 160	Chas. T. Blair 160								J. H. Souder 160	

SHERMAN

CO.

RAWLINS

TOWNSHIP 5 S RANGE 38 W.

 Scale 1/4 of inch to 1 Mile.

OF THE 6TH P. M.

41 46, 39 75 4 1 3 Louis S Dewey 158 74	38 62, 39 48 2 1 3 Wills C Davis 159 10	39 30, 39 35 Lardner	39 35, 39 35 Fielding 158 63	39 25, 39 17 P Page 158 42	39 22, 39 03 D. J Hedge 158 14	39 02, 39 18 A J Rogers 158 16 1	38 50, 38 28 2 1 3 George B 158 48	39 30, 39 28 4 1 3 Bowers 158 24	39 40, 39 25 2 1 3 Lizette Setola 15 14	39 01, 39 02 4 1 3 J. H. Spaulding 159 21	39 07, 39 00 E 1 4 Ella 159 90
6 L.L. M ^{rs} Finch 7 14 22	Wm D Kile 160	Hayworth 160	David W Hine 160	Equitable Land Co 160	J. H. Meyer 160	H. E Rogers 160	Fred W Pollitz 160	W. J Bethora 160	Frank Milner 160	J. W Cox 160	W A Wolf 160
1 Wills C Davis 158 62	Edwin O Curry 160	Chas E Curry 160	M W Gilliland 160	WE Ireland 160	Grenville Hubble 160	EJ Waddle & JD Ferguson 160	WJ Bethora 160	G.L Finn 160	Susan Sawyer 160	Nels Thompson 160	Sarah Hastin 160
5 A O Wiser 158 28	Carrie B Willcom 160	Wm Lutzshorn 160	Harry O Harris 160	Otis Crouch 160	U A Whitless 160	Henry Weaver 160	W A Young 160	J T Baughan 160	T E Donley 160	Wm Lebow 160	Louis DeWey 160
1 A W Benton 161 85	Minnie Ashby 160	Wills C Davis 160	John J Woods 160	John Meyer 160	George Capsitch 160	John P Foot 160	Chas Mooberry 160	Albert 160	Charles F Ayers 160		
3 Don M Gray 160 22	James M 160	Clark 160	W H Carnahan 160	640 School	Ralph W Weaver 160	Henry Weaver 160	J N Clark 160	F N Baker 160	M L Boyart 160	W H Bliss 160	
1 W A Cress 390 54	Dora Hemp 160	Equitable Land Company 320	Equitable Land Co 160	F C Davis 160	F W Smith 160	J W Caster 160	Wm E Weaver 160	W A Wolf 160			
2 C E Gibson 160 88	C Marie Bennett 160	Wm H Thurston 160	W H Carnahan Recr. 160	A L Hulmes 160	W H Carnahan Recr. 160	J A Peterson 160	W A Wolf 160	W H Carnahan 160	Chas F Ayers 160		
1 Albert Weaver 160	Wm H Thurston 160	Lardner Howell Rec. 160	G W Boyd 160	Henry Goodhile 160	Frank J Bennett 160	Chas M Harris 160	Chas W Anton 160	W E Weaver 160	George Trout 160		
3 R D Hawley 160	E L Angel 160	Geo Henry 160	Dora Balcer 160	Mrs M Waick 160	J H Lane 160	Dan Hramer 160	Jas N Clarke Recr. 160	J K Lane 160	Don't K Conard 160		
1 Equitable Land Co 160 84	E L Angel 160	W H Carnahan Rec. 160	Equitable Land Co 160	R H Hotchkiss 160	James W Clarke 160	T S Crane 160	Geo Wagner 160	John O Magruda 160	J F Stunkel 160		
1 Chas T Kitten 160 22	Emma Ketchman 160	Jacob Webster Jr 160	B F Thompson 160	Jno L Pirka 160	(Reco...) 320	Martin Traber 160	Chas C May 160	C E Gurs 160	J D Walters 160	B M Walters 160	

SHERMAN

CO.

TOWNSHIP 5 S RANGE 39 W.

 Scale 1/4 of Inch to 1 Mile.

OF THE 6TH P. M.

32 30 33 60 E. A. Folida Rec 166 61	33 31 33 30 J. W. Clarke Rec 150 60	33 31 33 30 W. H. Carnahan 152 50	33 31 33 30 Phogres Minich 159 18	33 31 33 30 M. F. Kopp 150 02	33 31 33 30 Clifford Beeler 160 42	33 31 33 30 Harry B. Garey 160 60	33 31 33 30 Carl	33 31 33 30 Mingrove Bischoff 160 32	33 31 33 30 Arnold Schild 160 48	33 31 33 30 Elizabeth	33 31 33 30 J. A. Overteer 160 16
6 W. A. Foyers 166 30	5 G. S. C. Felzien 160	5 S. C. Lang 160	5 Geo C. Walker 160	4 M. H. Blume 160	4 John W. Palmer 160	3 J. A. Lomb 160	3 Carl 320 36	2 Chas T. Killen 160	2 Frank Owen 160	2 Schram 320 46	2 My A. Schram 160
7 Newton How 166 44	7 160	8 O. C. Blackburn 160	8 Chas Blackburn 160	9 O. H. C. Feltzen 160	9 Aug Palmer 160	10 Carl Neitzel 640	11 J. A. Lane 160	11 Vego Miller 160	11 F. D. Belhard 160	12 Joseph	12 Chas. B. Gibson 160
18 John H. Adler 324 32 Rec	17 W. B. Shoemaker 160	17 W. And R. Pelzen 160	17 German Nulbark 160	16 J. K. Lane 640	15 Jagua 320	15 Peter M. Feltzen 160	14 H. S. Ruppert 480	13 D. M. Cress 160	13 Alice T. Lanning 160		
19 Chas B. Gibson 163 82	20 Geo P. Geklinger 320	20 Wm Kiser 480	21 John Beatty 160	21 And R. Feltzen 160	21 Howard Bros 160	22 Solah R. Carwin 160	22 A. D. Archer 160	23 H. D. Hurdles 160	23 Geo A. Gearhart 160	24 Gus J. Kerndt 160	24 Chas T. Kellen 160
30 Cotrie Auchley 163 38	29 Geo P. Geklinger 160	29 Wm Kiser 160	28 J. G. Forton 160	28 I. G. Forton 160	27 160	27 C. D. Archer 160	26 School Chas W. Sanburn 160	26 John 160	25 John Beatty 160	25 J. N. Clark Rec.	
31 Blmer Chaffin 160	32 Lardner Howell 160	32 Louisa S. Dewey 160	33 J. A. Seaywick 160	33 Frank Mimet 160	34 F. W. Wimer 160	34 G. L. Rock 160	35 Res Chas H. Five 160	35 John M. Sanburn 160	36 Ellie Sanburn 160		
81 J. J. Wick 160	82 W. F. Gays 160	82 J. S. Moore 160	83 John Hartzler 160	83 E. L. Cary 160	84 I. R. Proft 160	84 Anthony Martin 160	85 W. H. Lanning 160	85 M. A. Taylor 400	86 R. L. Rust 200		
81 Jardner Koswell 160 36	82 J. W. Pibbels 160	82 S. A. Jones 160	83 J. F. Sorewell 160	83 A. A. Gearhart 160	84 Wm. F. Reese 160	84 James Spyer 160	85 W. J. Oltham 160	85 W. Wolf 160			

SHERMAN

CO.

MAP OF
TOWNSHIP 5 S RANGE 40 W.
Scale 1/4 of inch to a Mile.

OF THE 6TH P. M.

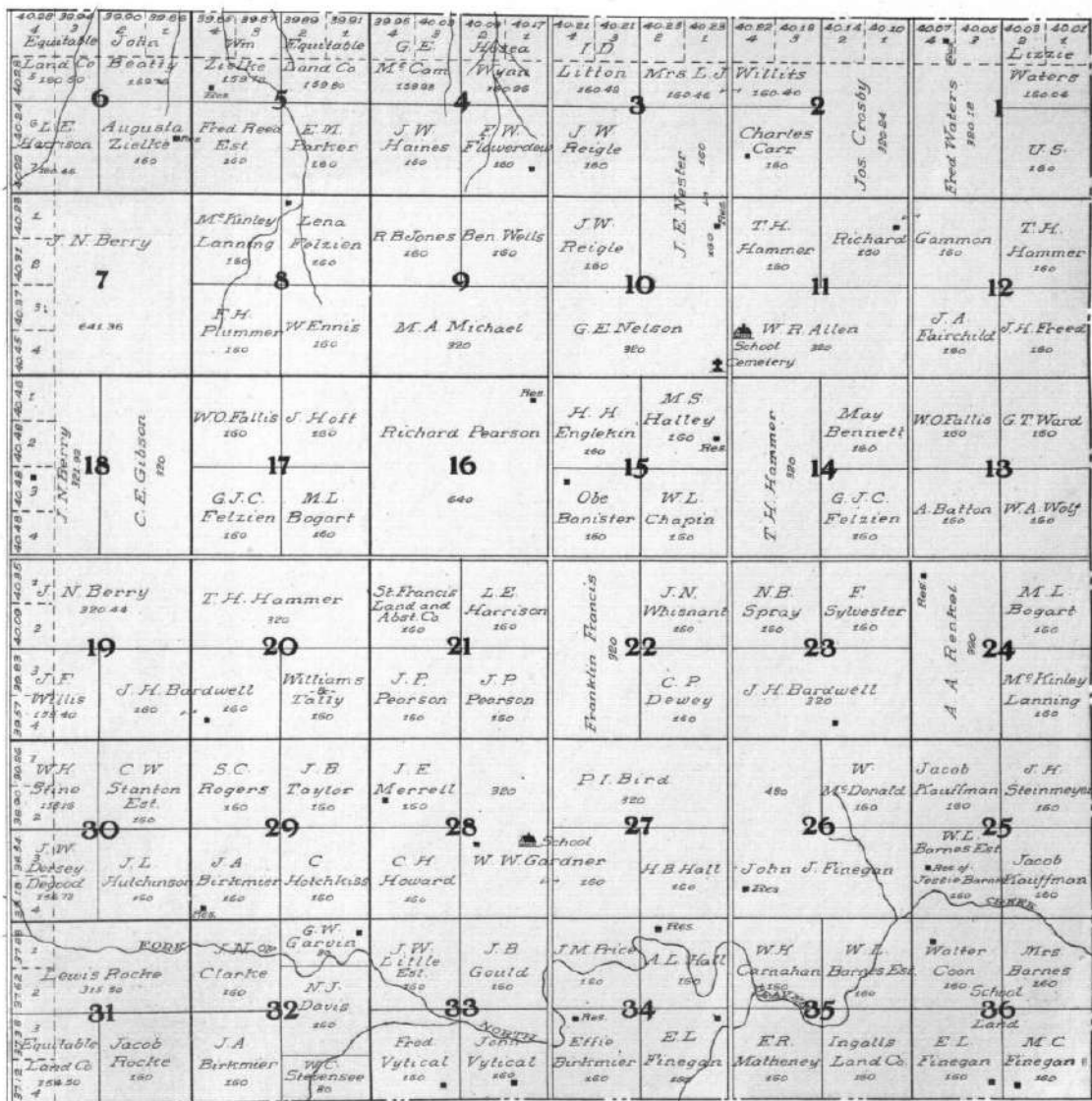

SHERMAN

CO.



MAP OF

TOWNSHIP 5 S RANGE 41 W.

 Scale 1/4 of inch to a Mile.

OF THE 6TH P. M.



SHERMAN

CO.