

CLAY COUNTY

KANSAS

Scale 200 of Inch to Mile

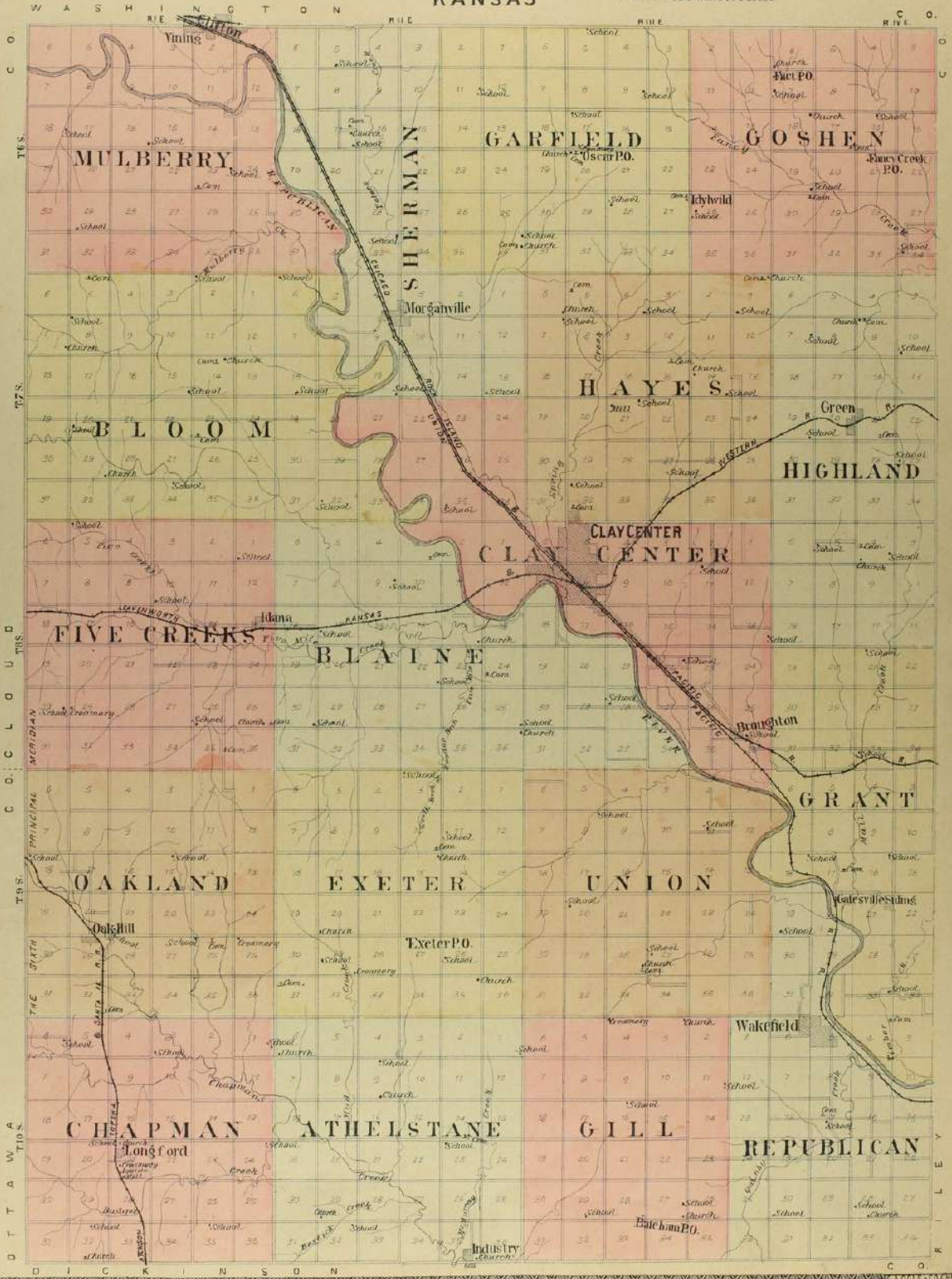



TOWNSHIP 6 S. RANGE 1 E.

 OF THE 6th P. M.

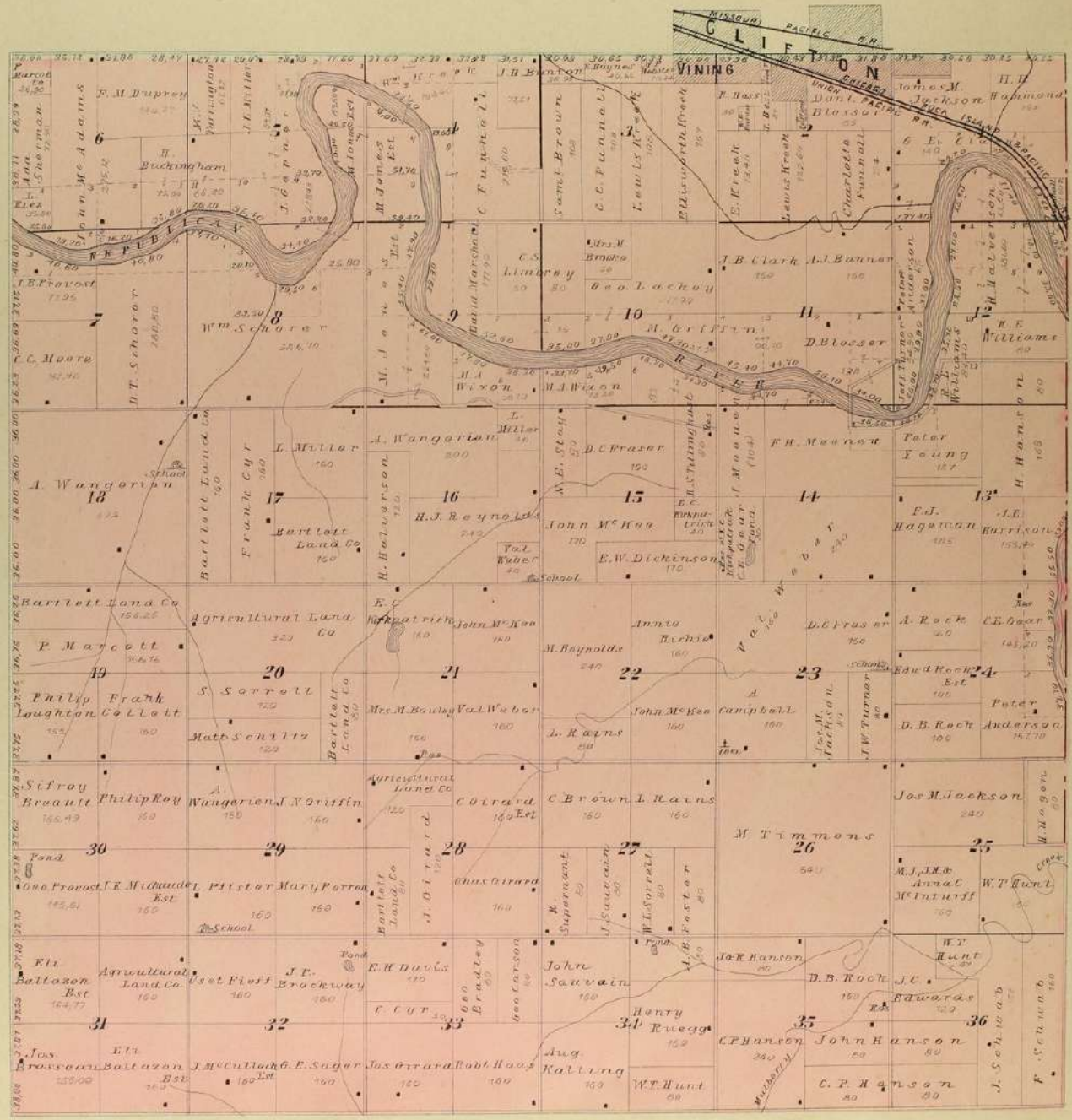

TOWNSHIP 6 S. RANGE II E.

 OF THE 6th P. M.

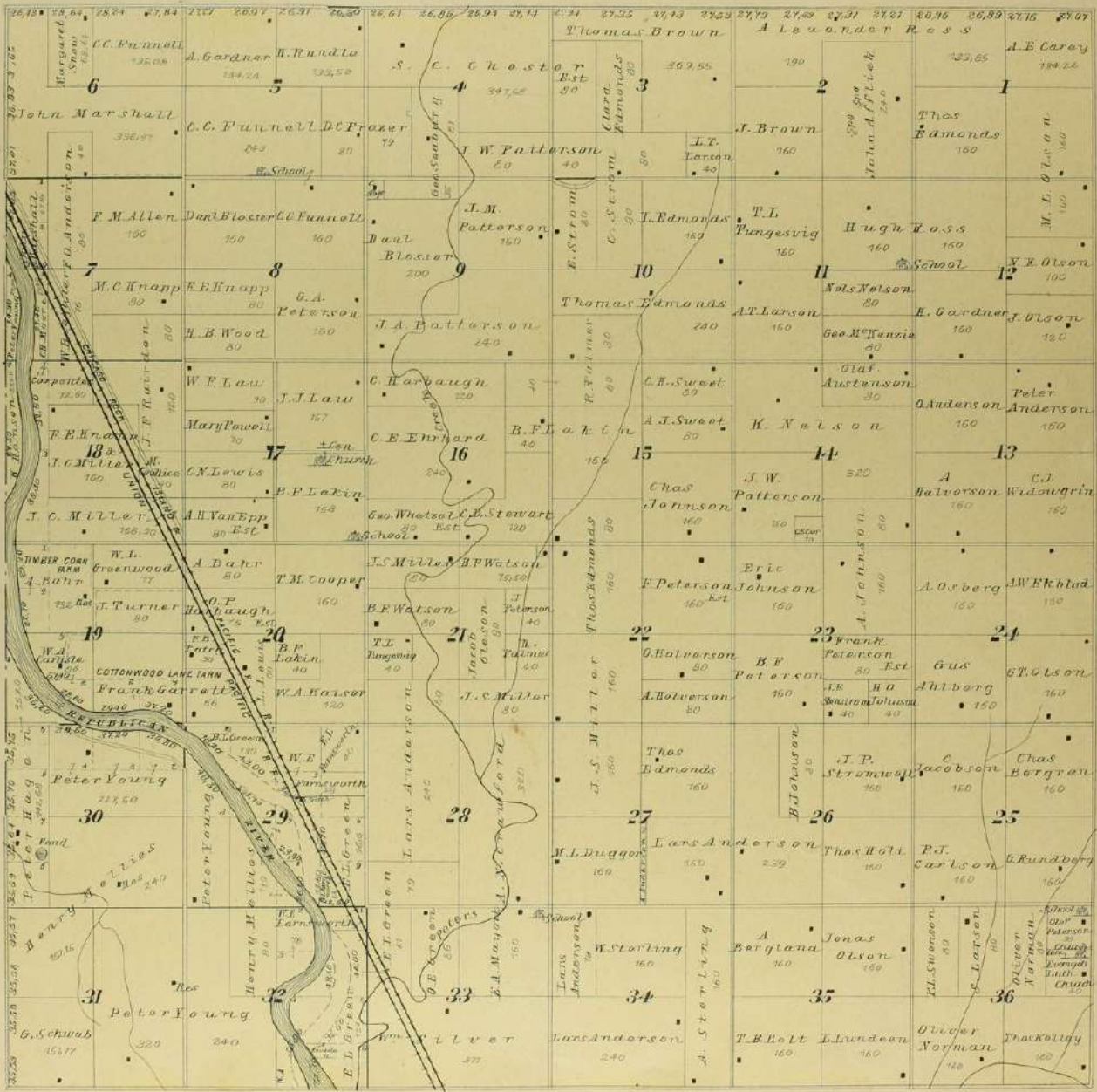



TOWNSHIP 6 S. RANGE IV E.

OF THE 6th P. M.



GREEN

T. 7 S. R. 1 E.
Some 300 ft to 1 inch.

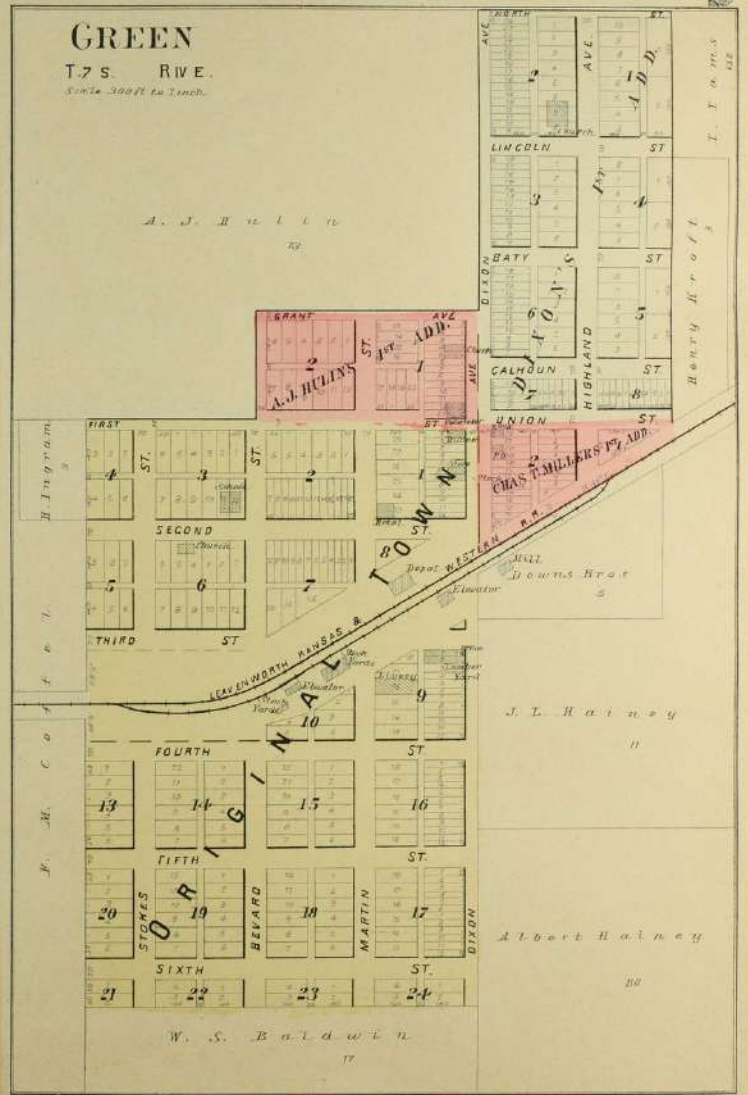

TOWNSHIP 7 S. RANGE IV E.

OF THE 6th P. M.

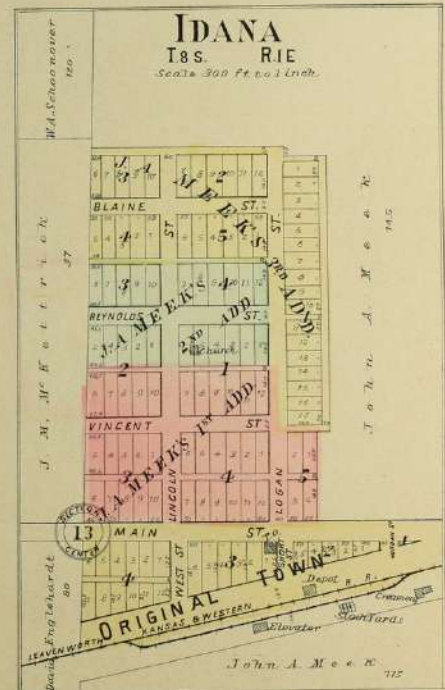
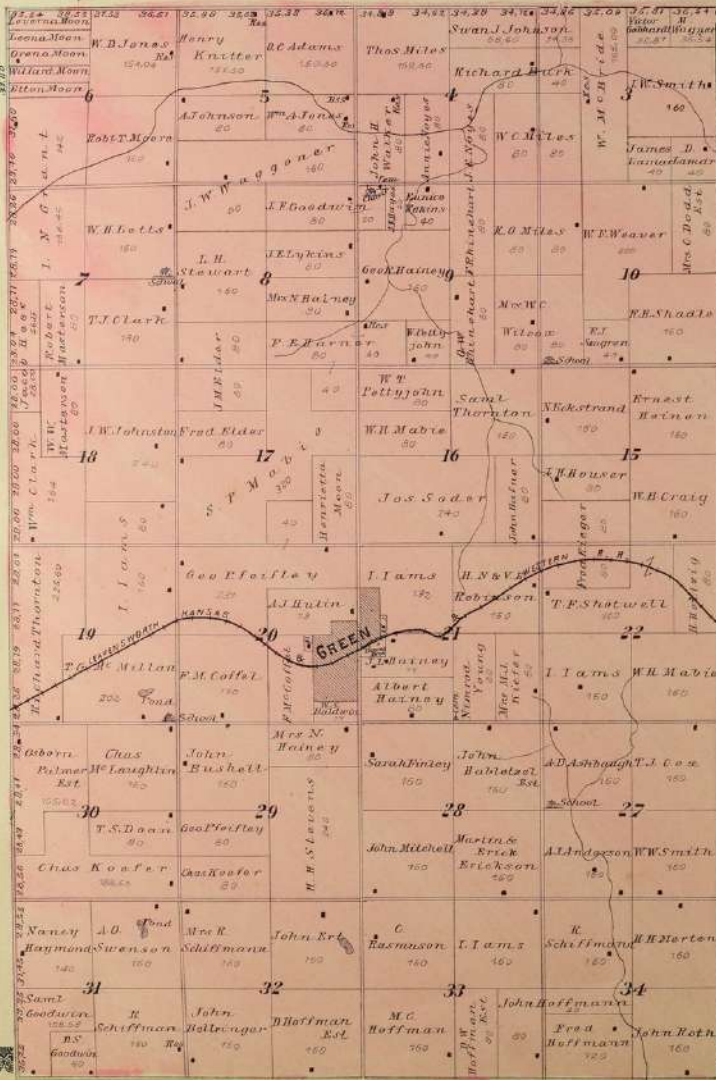

MAP OF
TOWNSHIP 7 S. RANGE III E.
OF THE 6th P. M.

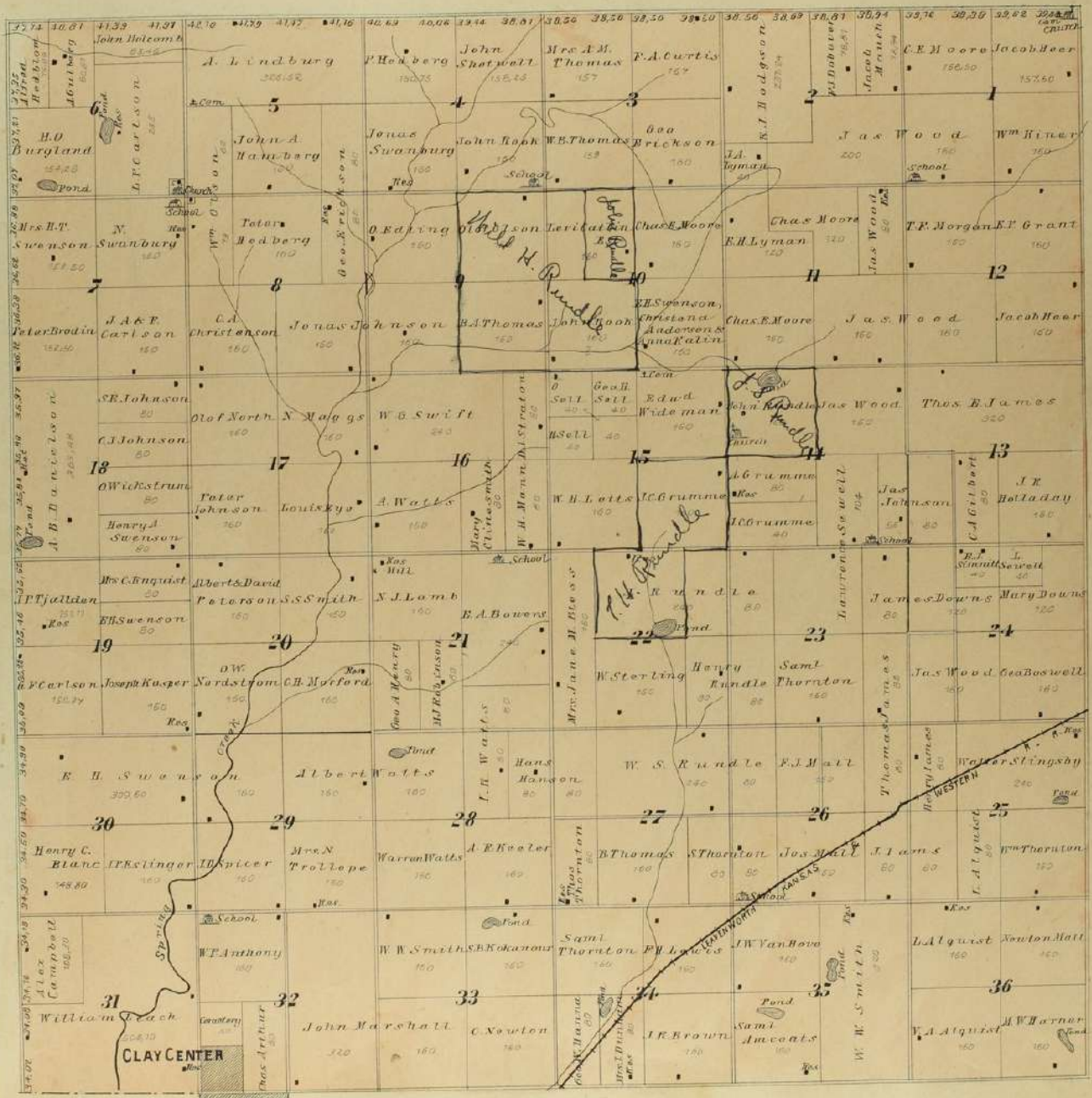



TOWNSHIP 7 S. RANGE II E.

 OF THE 6th P. M.

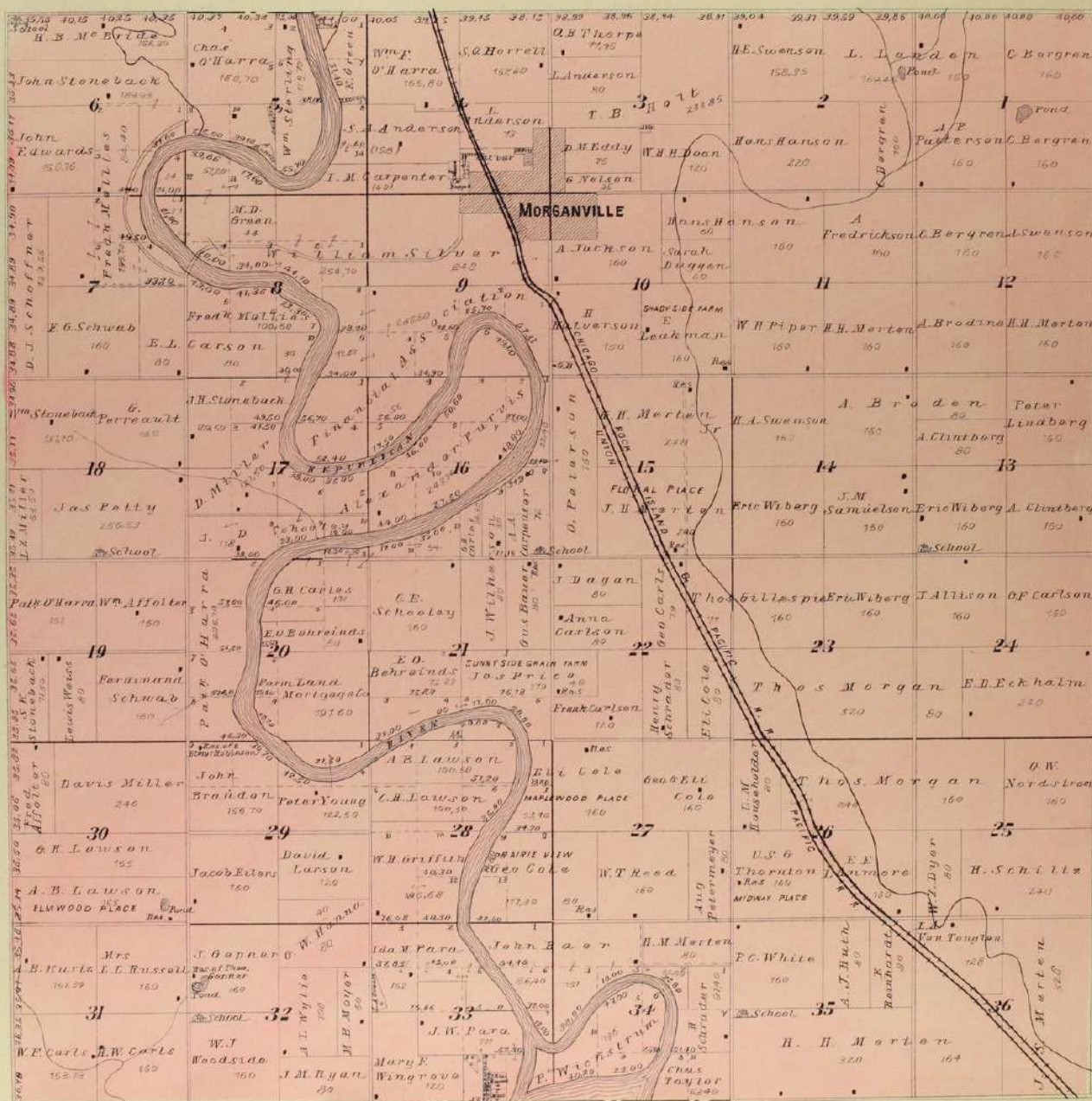



TOWNSHIP 7 S. RANGE 1 E.

 OF THE 6th P. M.

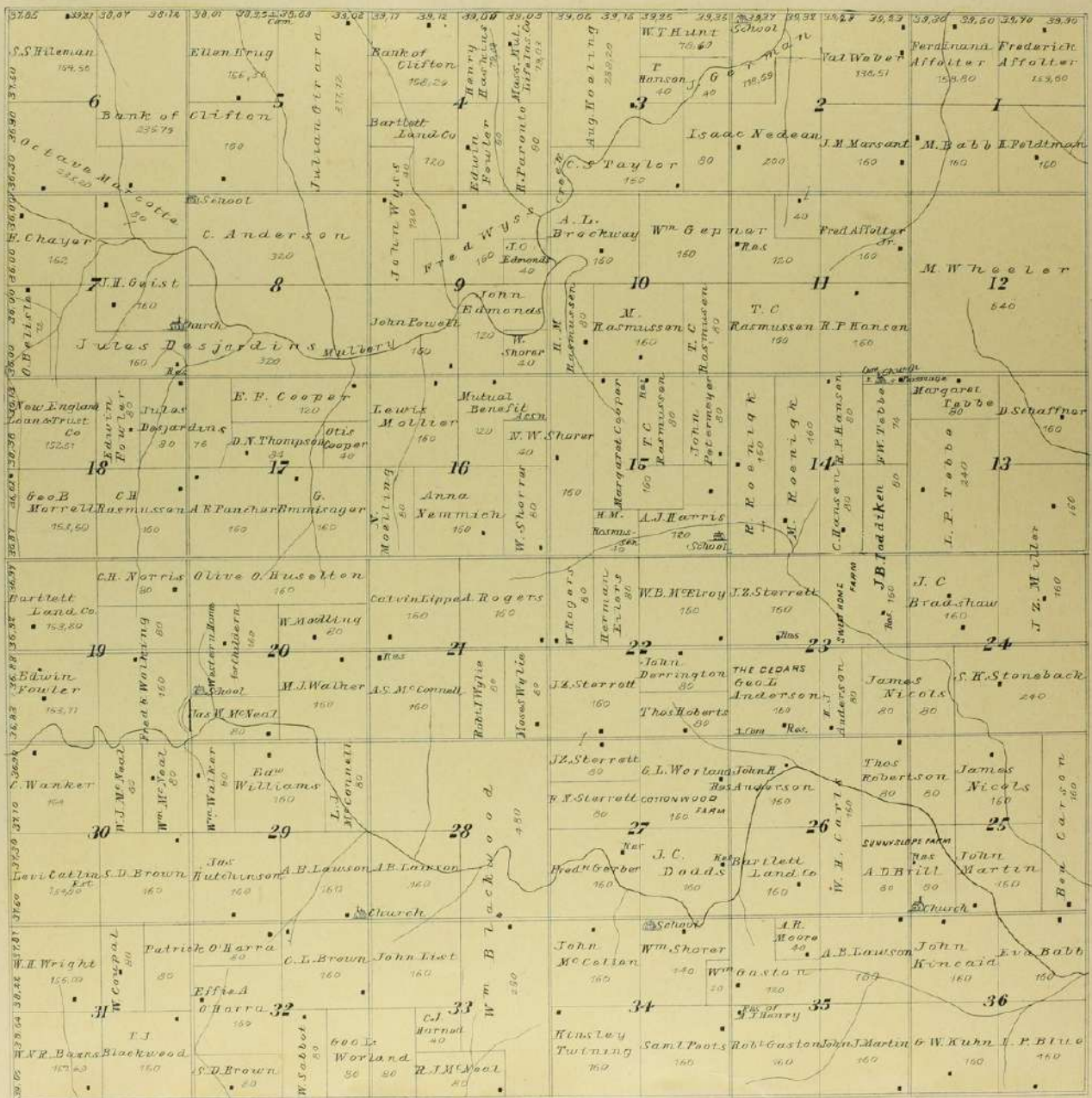



 MAP OF
TOWNSHIP 8 S. RANGE 1 E.
 OF THE 6TH P. M.

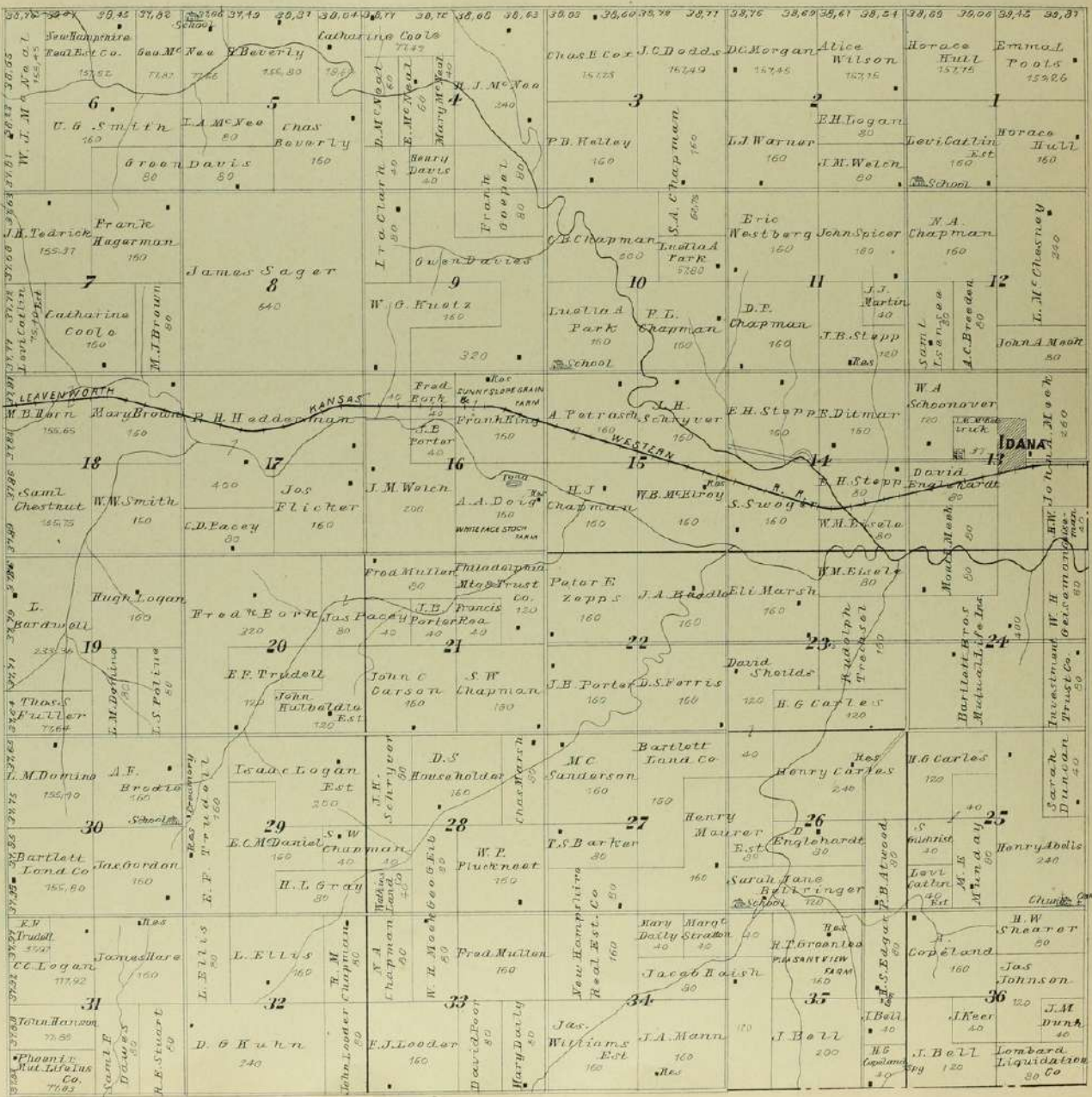



MAP OF
TOWNSHIP 8 S. RANGE 11 E.
 OF THE 6th P. M.

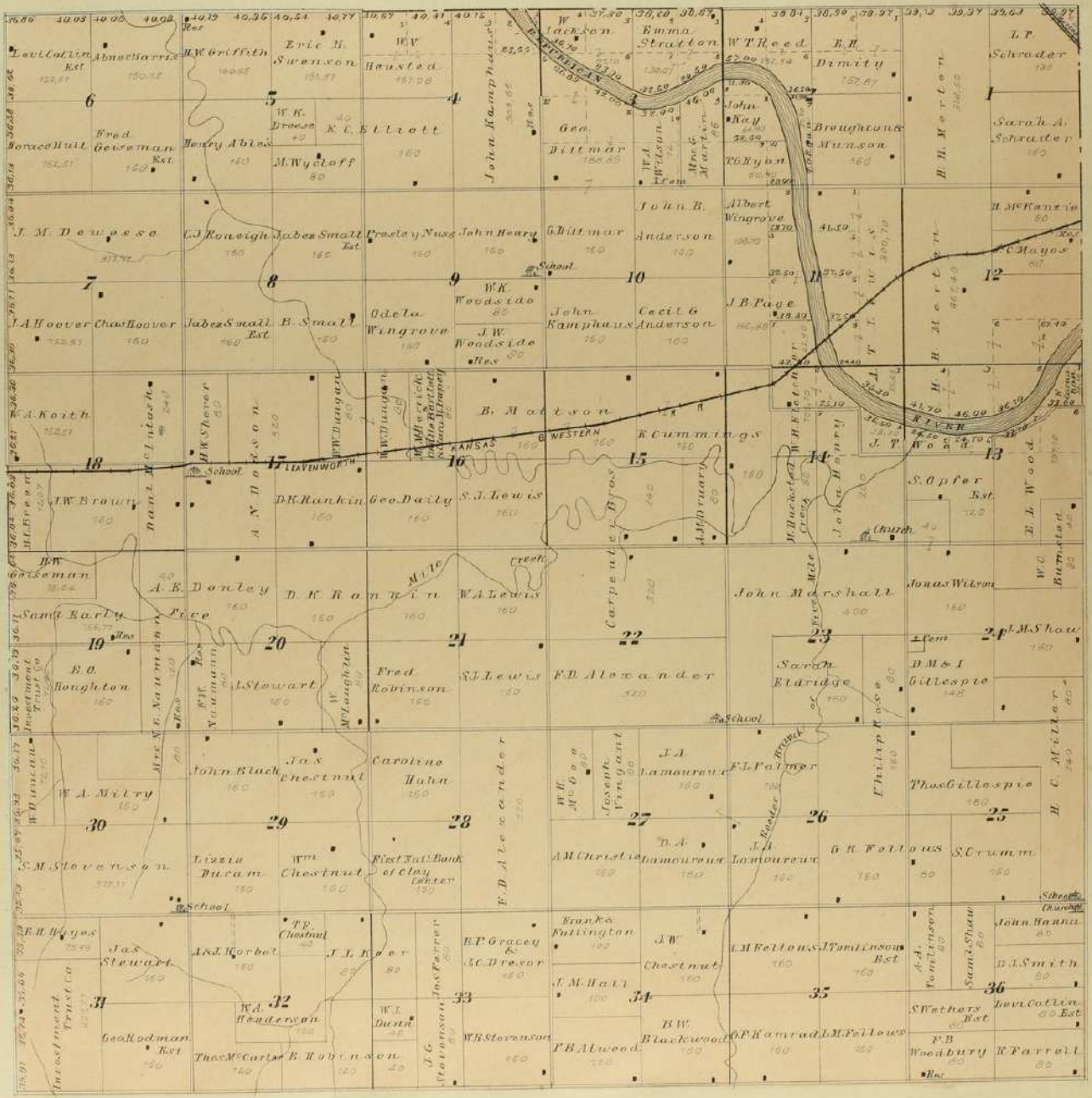



TOWNSHIP 8 S. RANGE III E.

 OF THE 6th P. M.

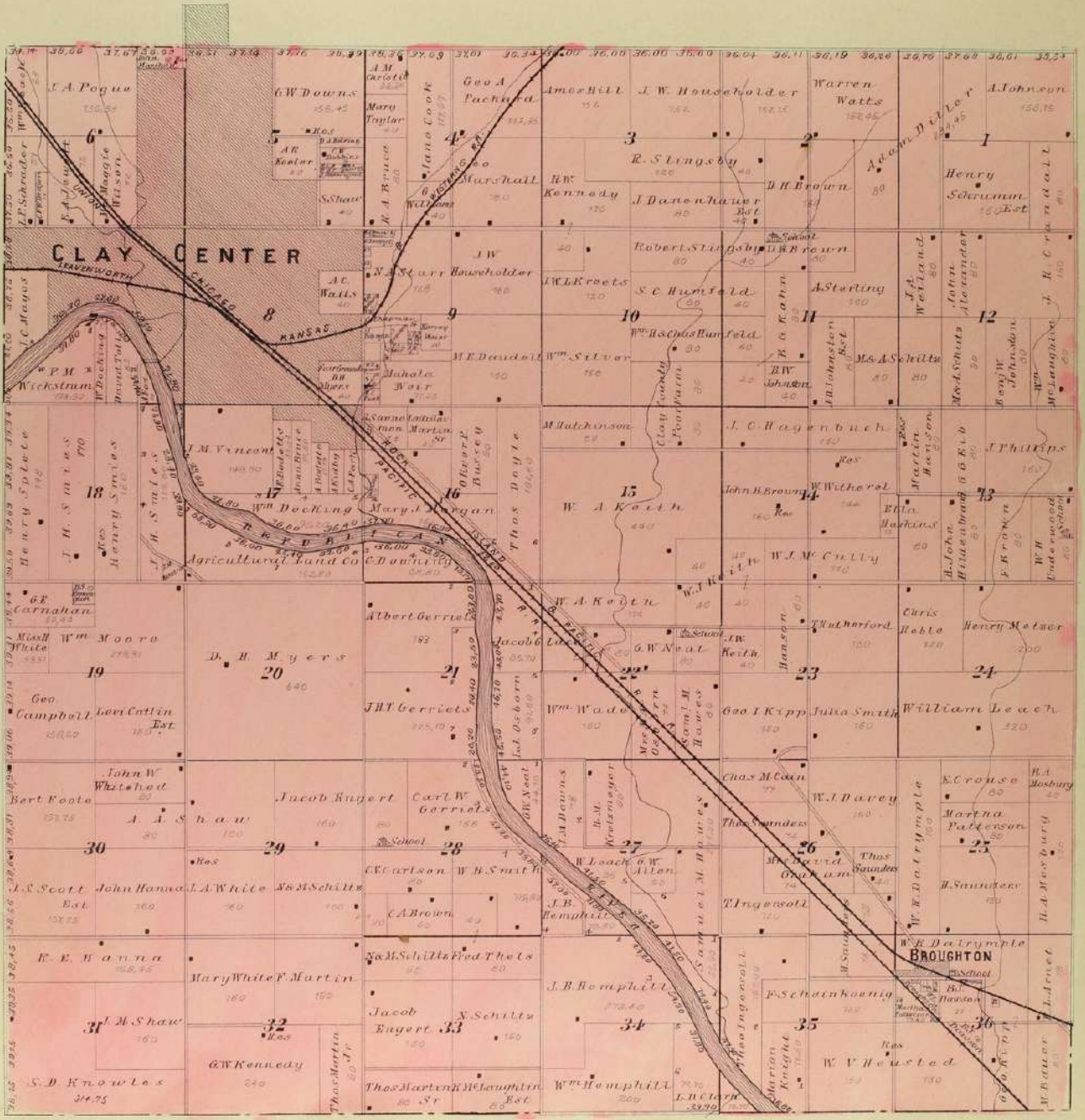

MAP OF TOWNSHIP 8 S. RANGE IV E.

OF THE 6th P. M.

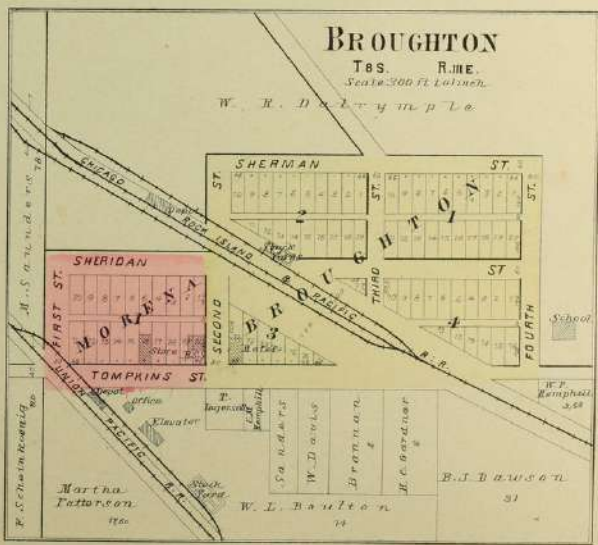
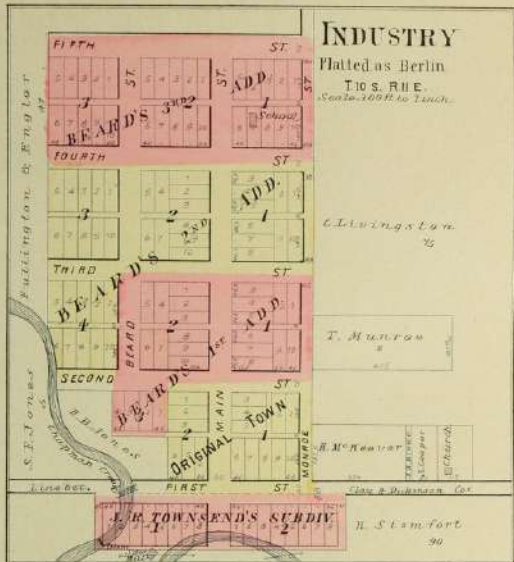
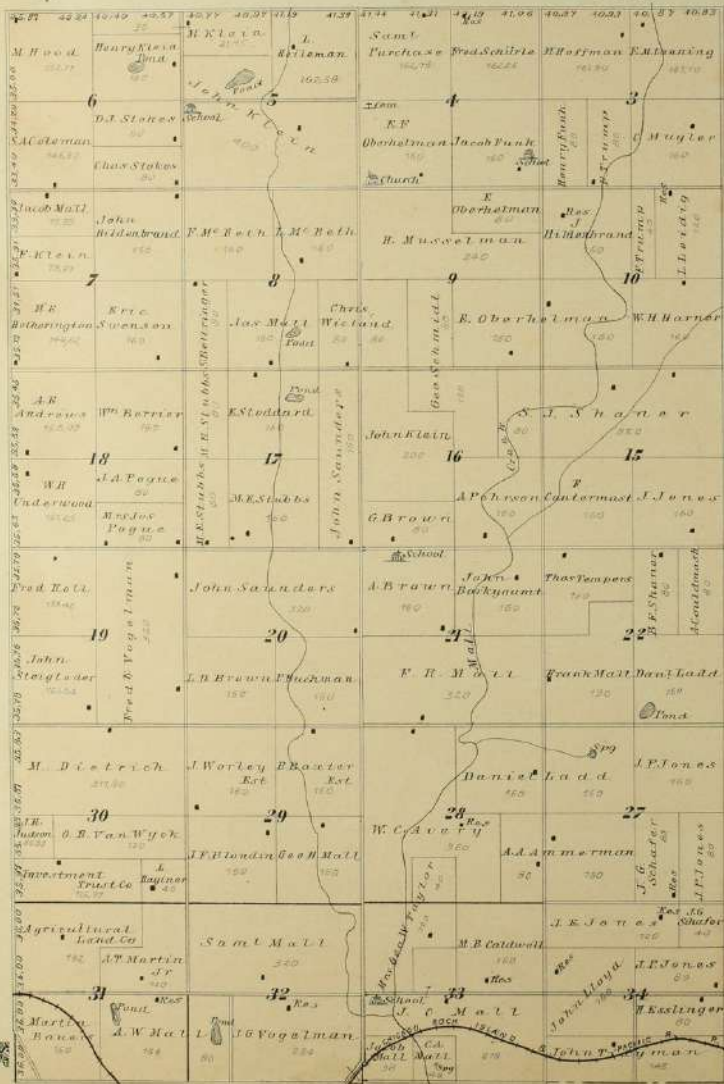

KANSAS STATE GEOLOGICAL SURVEY
PLATE NUMBER 1030

TOWNSHIP 9 S. RANGE IV E.

OF THE 6th P.M.

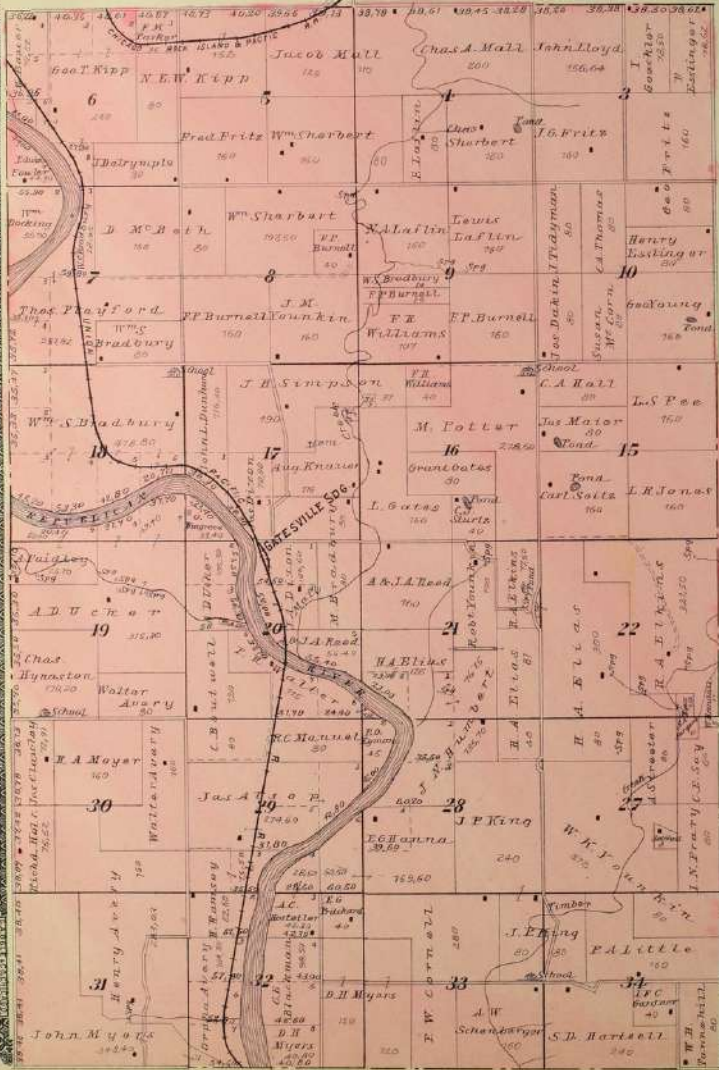

LONGFORD

T9S. R1E.

Scale 200 ft. to 1 inch

School

Union Pacific R. Co.

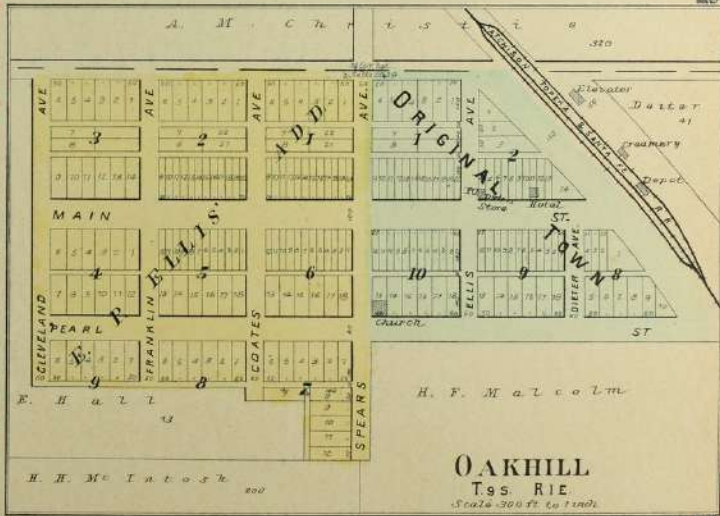
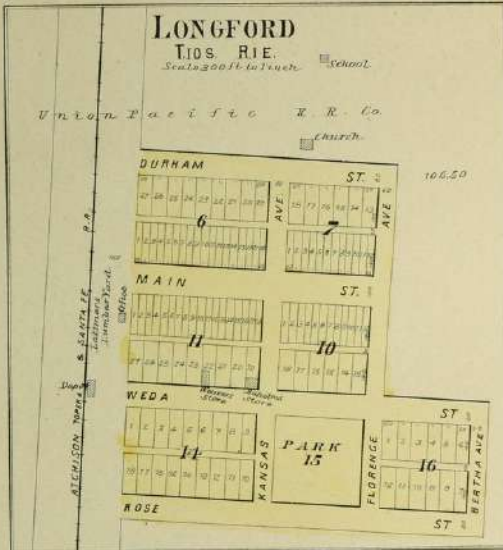

OAKHILL

T9S. R1E.

Scale 200 ft. to 1 inch



TOWNSHIP 9 S. RANGE III E.

 OF THE 6th P. M.

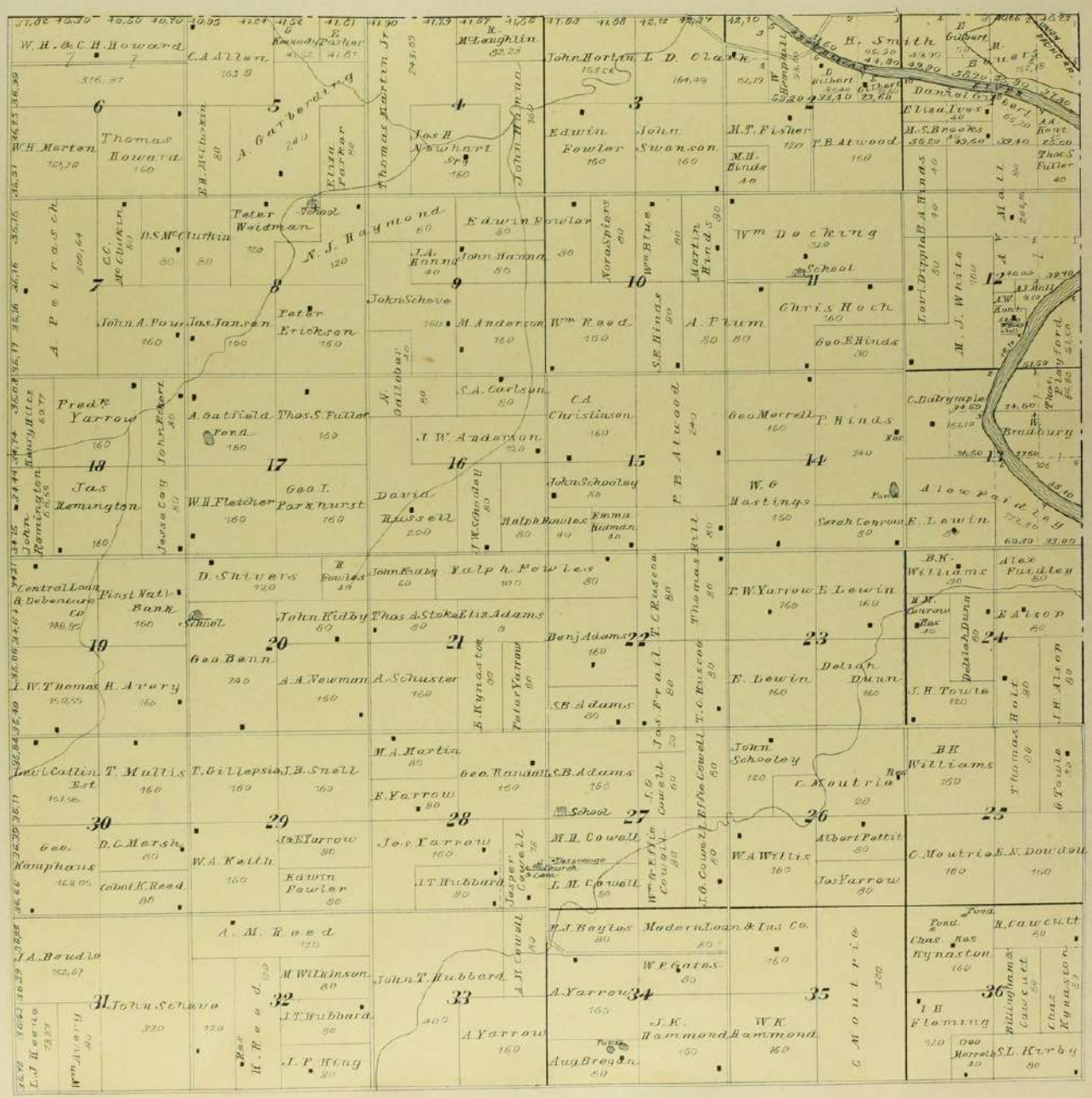



MAP OF
TOWNSHIP 9 S. RANGE 11 E.
 OF THE 6th P. M.

30.55	28.95	28.80	29.56	29.88	30.24	30.54	30.74	31.76	31.86	31.96	30.07	30.43	30.76	30.77	30.77	30.26	30.39	30.31	30.64	30.66	30.74	30.31	30.94	30.94	
Investment Trust Co John Head C Schooley John Chestnut Robert Craig Wood & Wade F. A. Butler F. A. Butler L. H. Conrow J. H. Hibler F. D. Balliett	Investment Trust Co John Head C Schooley John Chestnut John Chestnut John Chestnut C. S. Small Howard Hill Jas Woodham F. A. Butler F. A. Butler L. H. Conrow John & James Tond Jasso Wilson	Est. Alice A. Hall Samt Loehart J. F. Hine J. A. Huston M. J. Campbell L. Davis Dolita Davis J. Erick Woodham Erickson Jas. Erick Jas. Erick Richard L. Lloyd John Emerson Wm Emerson Jas Emerson	Est. Alice A. Hall J. Schryver Franklin W. S. Sturgeon M. Cook M. L. Chapin G. A. Spence J. M. Spence J. H. Hoath A. C. Hill A. C. Hill W. Sturgeon E. M. Davis John Olinstead Eric David Fulton	Est. Alice A. Hall J. Schryver Franklin W. S. Sturgeon M. Cook M. L. Chapin G. A. Spence J. M. Spence J. H. Hoath A. C. Hill A. C. Hill W. Sturgeon E. M. Davis John Olinstead Eric David Fulton	Est. Alice A. Hall J. Schryver Franklin W. S. Sturgeon M. Cook M. L. Chapin G. A. Spence J. M. Spence J. H. Hoath A. C. Hill A. C. Hill W. Sturgeon E. M. Davis John Olinstead Eric David Fulton	Est. Alice A. Hall J. Schryver Franklin W. S. Sturgeon M. Cook M. L. Chapin G. A. Spence J. M. Spence J. H. Hoath A. C. Hill A. C. Hill W. Sturgeon E. M. Davis John Olinstead Eric David Fulton	Est. Alice A. Hill J. Schryver Franklin W. S. Sturgeon M. Cook M. L. Chapin G. A. Spence J. M. Spence J. H. Hoath A. C. Hill A. C. Hill W. Sturgeon E. M. Davis John Olinstead Eric David Fulton	Est. Alice A. Hill J. Schryver Franklin W. S. Sturgeon M. Cook M. L. Chapin G. A. Spence J. M. Spence J. H. Hoath A. C. Hill A. C. Hill W. Sturgeon E. M. Davis John Olinstead Eric David Fulton	Est. Alice A. Hill J. Schryver Franklin W. S. Sturgeon M. Cook M. L. Chapin G. A. Spence J. M. Spence J. H. Hoath A. C. Hill A. C. Hill W. Sturgeon E. M. Davis John Olinstead Eric David Fulton	Est. Alice A. Hill J. Schryver Franklin W. S. Sturgeon M. Cook M. L. Chapin G. A. Spence J. M. Spence J. H. Hoath A. C. Hill A. C. Hill W. Sturgeon E. M. Davis John Olinstead Eric David Fulton	Est. Alice A. Hill J. Schryver Franklin W. S. Sturgeon M. Cook M. L. Chapin G. A. Spence J. M. Spence J. H. Hoath A. C. Hill A. C. Hill W. Sturgeon E. M. Davis John Olinstead Eric David Fulton	Est. Alice A. Hill J. Schryver Franklin W. S. Sturgeon M. Cook M. L. Chapin G. A. Spence J. M. Spence J. H. Hoath A. C. Hill A. C. Hill W. Sturgeon E. M. Davis John Olinstead Eric David Fulton	Est. Alice A. Hill J. Schryver Franklin W. S. Sturgeon M. Cook M. L. Chapin G. A. Spence J. M. Spence J. H. Hoath A. C. Hill A. C. Hill W. Sturgeon E. M. Davis John Olinstead Eric David Fulton	Est. Alice A. Hill J. Schryver Franklin W. S. Sturgeon M. Cook M. L. Chapin G. A. Spence J. M. Spence J. H. Hoath A. C. Hill A. C. Hill W. Sturgeon E. M. Davis John Olinstead Eric David Fulton	Est. Alice A. Hill J. Schryver Franklin W. S. Sturgeon M. Cook M. L. Chapin G. A. Spence J. M. Spence J. H. Hoath A. C. Hill A. C. Hill W. Sturgeon E. M. Davis John Olinstead Eric David Fulton	Est. Alice A. Hill J. Schryver Franklin W. S. Sturgeon M. Cook M. L. Chapin G. A. Spence J. M. Spence J. H. Hoath A. C. Hill A. C. Hill W. Sturgeon E. M. Davis John Olinstead Eric David Fulton	Est. Alice A. Hill J. Schryver Franklin W. S. Sturgeon M. Cook M. L. Chapin G. A. Spence J. M. Spence J. H. Hoath A. C. Hill A. C. Hill W. Sturgeon E. M. Davis John Olinstead Eric David Fulton	Est. Alice A. Hill J. Schryver Franklin W. S. Sturgeon M. Cook M. L. Chapin G. A. Spence J. M. Spence J. H. Hoath A. C. Hill A. C. Hill W. Sturgeon E. M. Davis John Olinstead Eric David Fulton	Est. Alice A. Hill J. Schryver Franklin W. S. Sturgeon M. Cook M. L. Chapin G. A. Spence J. M. Spence J. H. Hoath A. C. Hill A. C. Hill W. Sturgeon E. M. Davis John Olinstead Eric David Fulton	Est. Alice A. Hill J. Schryver Franklin W. S. Sturgeon M. Cook M. L. Chapin G. A. Spence J. M. Spence J. H. Hoath A. C. Hill A. C. Hill W. Sturgeon E. M. Davis John Olinstead Eric David Fulton	Est. Alice A. Hill J. Schryver Franklin W. S. Sturgeon M. Cook M. L. Chapin G. A. Spence J. M. Spence J. H. Hoath A. C. Hill A. C. Hill W. Sturgeon E. M. Davis John Olinstead Eric David Fulton	Est. Alice A. Hill J. Schryver Franklin W. S. Sturgeon M. Cook M. L. Chapin G. A. Spence J. M. Spence J. H. Hoath A. C. Hill A. C. Hill W. Sturgeon E. M. Davis John Olinstead Eric David Fulton	Est. Alice A. Hill J. Schryver Franklin W. S. Sturgeon M. Cook M. L. Chapin G. A. Spence J. M. Spence J. H. Hoath A. C. Hill A. C. Hill W. Sturgeon E. M. Davis John Olinstead Eric David Fulton	Est. Alice A. Hill J. Schryver Franklin W. S. Sturgeon M. Cook M. L. Chapin G. A. Spence J. M. Spence J. H. Hoath A. C. Hill A. C. Hill W. Sturgeon E. M. Davis John Olinstead Eric David Fulton	Est. Alice A. Hill J. Schryver Franklin W. S. Sturgeon M. Cook M. L. Chapin G. A. Spence J. M. Spence J. H. Hoath A. C. Hill A. C. Hill W. Sturgeon E. M. Davis John Olinstead Eric David Fulton

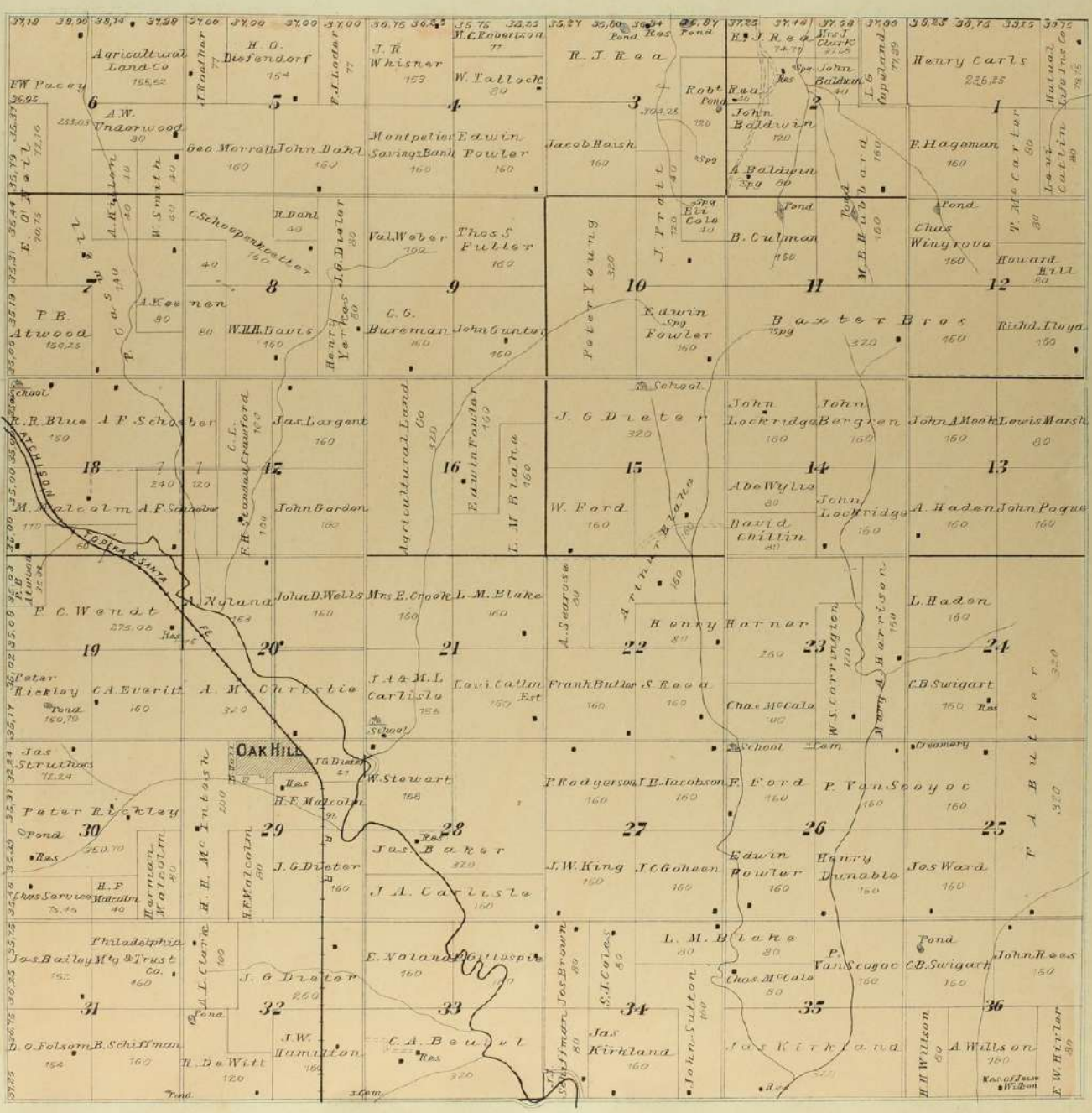

TOWNSHIP 9 S. RANGE 1 E.

 OF THE 6th P. M.



MAP OF
TOWNSHIP 10 S. RANGE 1 E.
 OF THE 6th P. M.

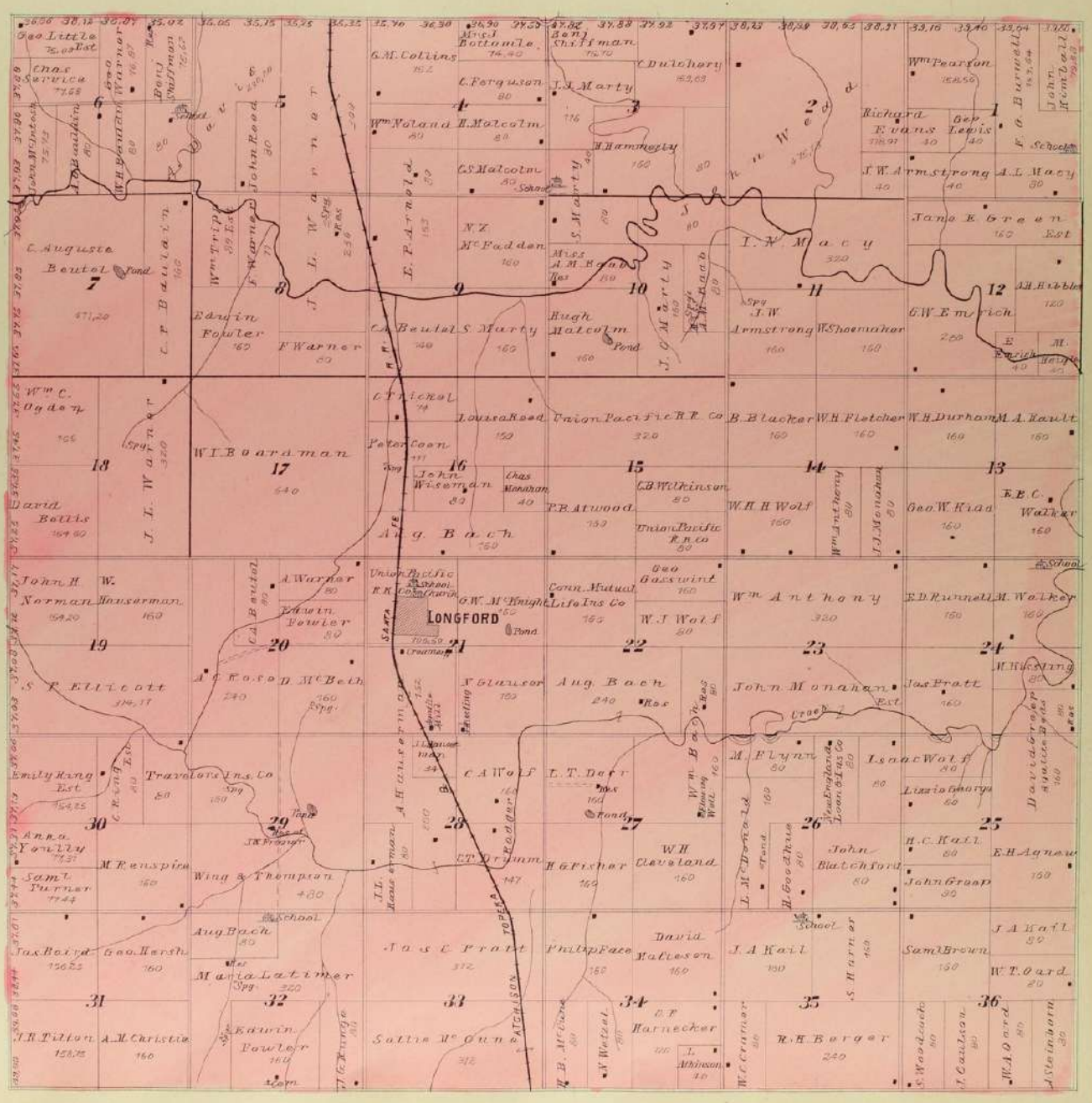

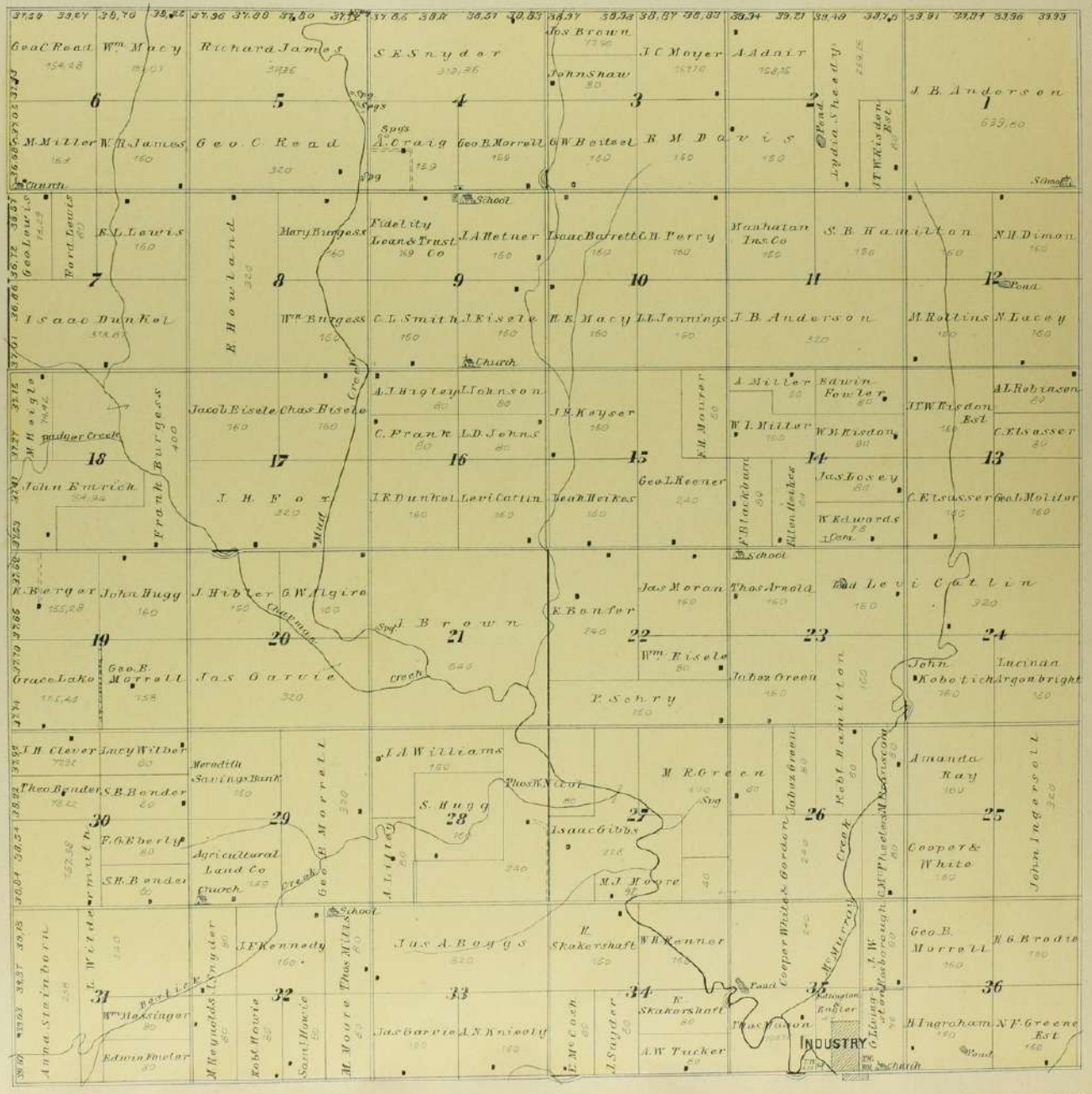



 MAP OF
TOWNSHIP 10 S. RANGE 4 E.
 OF THE 6th P. M.

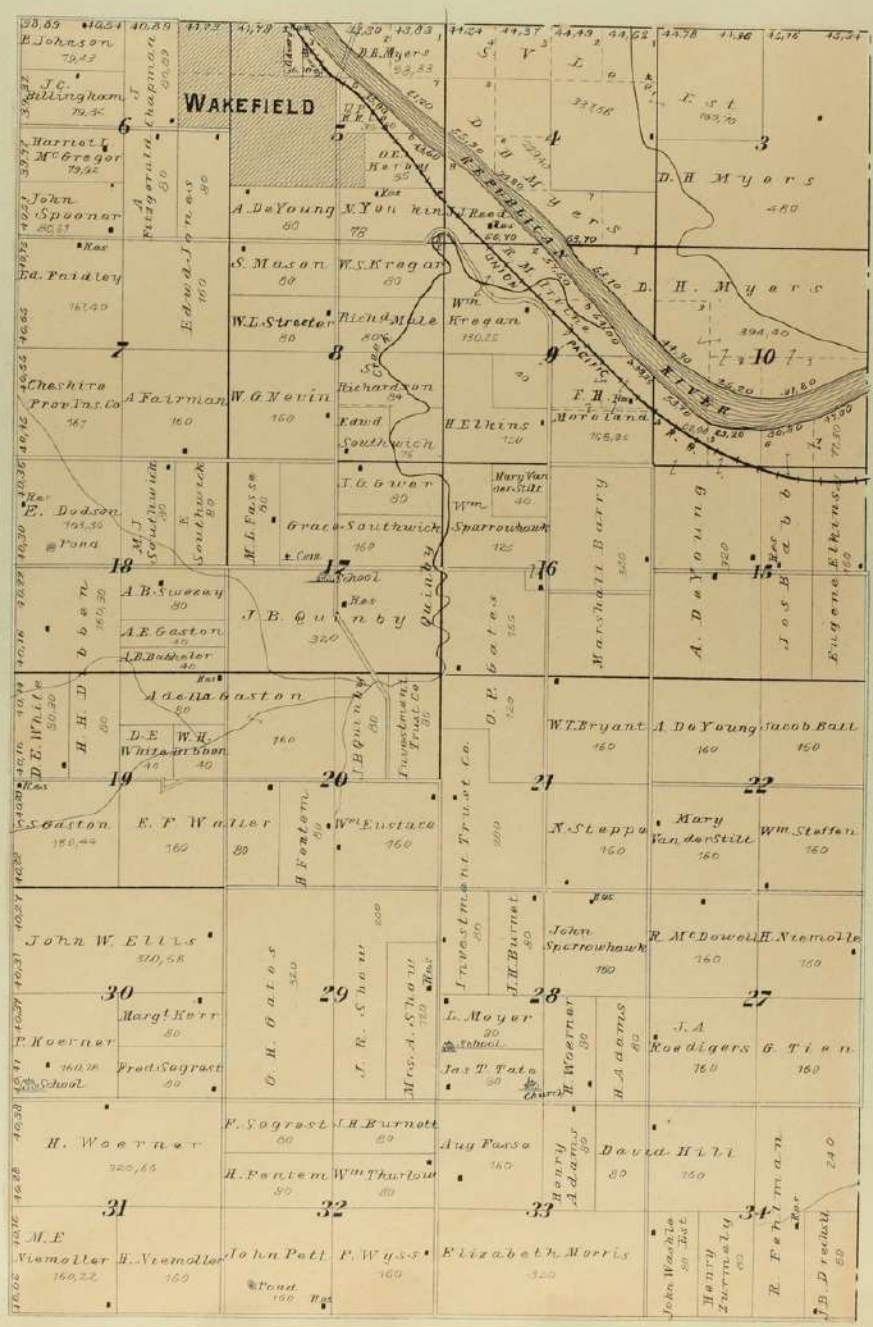

William Jackson

500.70

J. A. F. O. 500

156.33

Wm. O. A. C. 70
6.8

I. H. S. C. H. A. D. O. R.
ST

C. W. D. O. S. T. J. O. H. N.
R

R. A.

Mrs. Magale Wilson
78

COUNTY ROAD

CLARKE ST

John Marshall
19

LIBERTY ST

ANTHONY ST

ST. MICHAEL'S

2ND ST

3RD ST

4TH ST

5TH ST

6TH ST

7TH ST

8TH ST

9TH ST

10TH ST

11TH ST

12TH ST

13TH ST

14TH ST

15TH ST

16TH ST

17TH ST

18TH ST

19TH ST

20TH ST

21ST

22ND ST

23RD ST

24TH ST

25TH ST

26TH ST

27TH ST

28TH ST

29TH ST

30TH ST

HIGHLAND

FLORENCE

HIGHLAND

LOCAN

LAFAYETTE

LIBERTY

ANTHONY

ARTHUR

C. M. ANTHONY'S

PROSPECT

WASHINGTON

ADD.

WEBSTER

FREDERICK

HUNTRESS

LANE

BLUNT

CRAWFORD

CLARKE

DIY

ORIGINAL

10

4

9

10

4

5

12

3

4

2

3

6

3

4

5

8

3

4

5

8

14

12

11

12

13

14

15

16

17

18

19

20

21

22

23

24

25

26

27

28

29

30

31

32

33

34

35

36

37

38

39

40

41

42

43

44

45

46

47

48

49

50

51

52

53

54

55

56

57

58

59

60

61

62

63

64

65

66

67

68

69

70

71

72

73

74

75

76

77

78

79

80

81

82

83

84

85

86

87

88

89

90

91

92

93

94

95

96

97

98

99

100

NORTH PART OF CLAY CENTER

County Seat of Clay Co. Kansas

Scale 400 ft. to inch

G. W. Downs

126

M. T. A. B. T. U. C. O. 80

D. Holmes 8

C. W. Dobbins 15

M. I. Bonham W. Underwood
W. H. Fletcher 4

J. Underwood 8

S. S. Snow 10

J. Wallace W. F. Roserman 33

Frank Morrow

Geo J August 5

A. R. Kessler 40

W. H. Fletcher
W. D. Sturgeon St. Smith
J. J. Roth
Miller
W. H. Fletcher
W. H. Saldon
W. E. Roserman

W. H. Fletcher
W. H. Saldon
W. E. Roserman

J. J. Roth
Miller
W. H. Fletcher
W. H. Saldon
W. E. Roserman

J. J. Roth
Miller
W. H. Fletcher
W. H. Saldon
W. E. Roserman

J. J. Roth
Miller
W. H. Fletcher
W. H. Saldon
W. E. Roserman

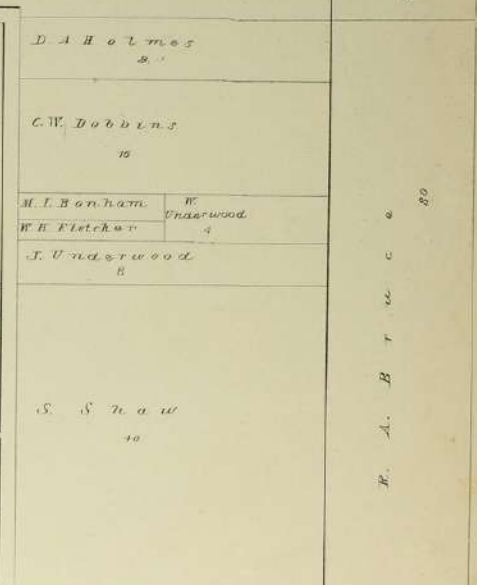
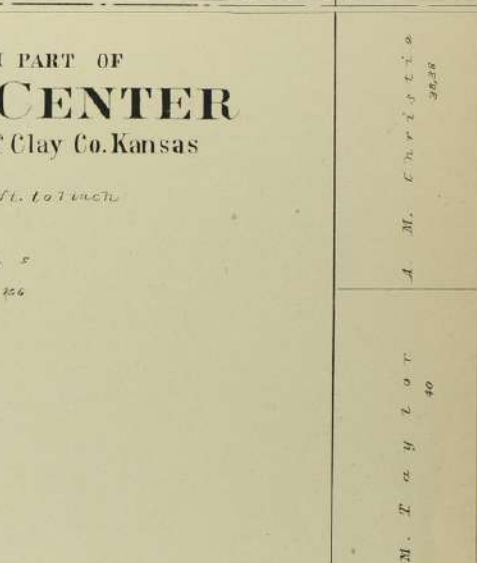
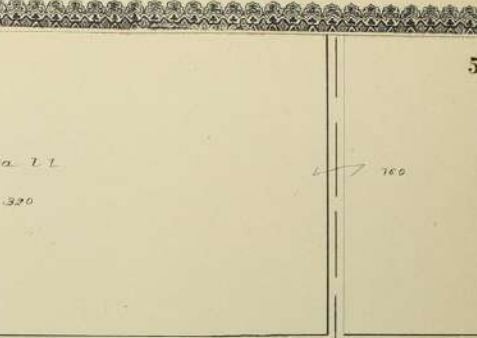
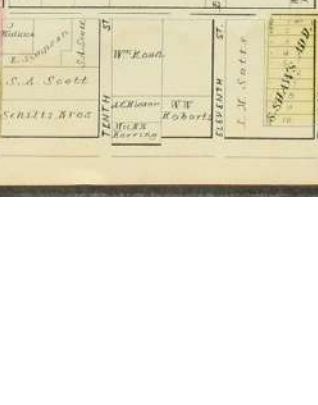
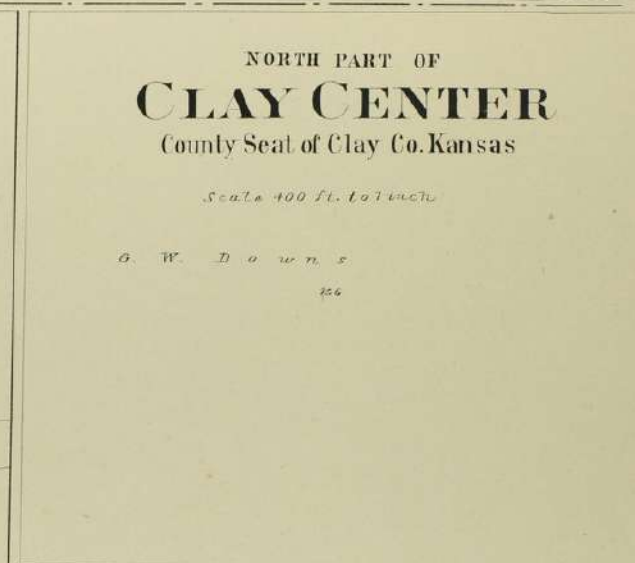

ORIGINAL

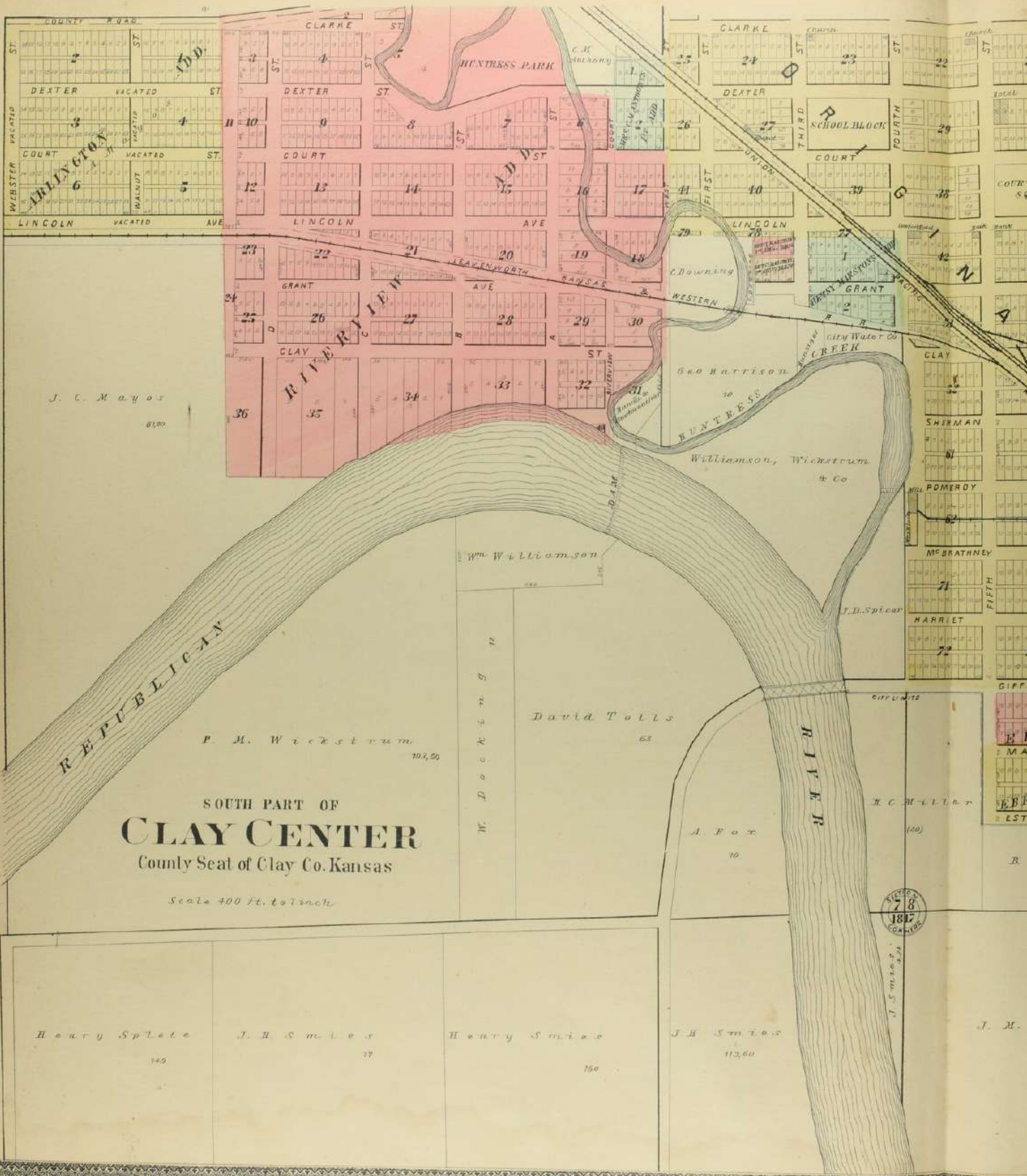

J. C. Mays
81.00

REPUBLICAN RIVER

P. M. Wickstrom
102.50

SOUTH PART OF
CLAY CENTER
County Seat of Clay Co. Kansas

Scale 400 Ft. to inch

Wm Williamson
12
David Tolls
63
W. Dockering

A. Fox
10

PLAT 78
1887
COM. 1887

Henry Spate
149

J. H. Smies
17

Henry Smies
150

J. H. Smies
112.50

J. M.

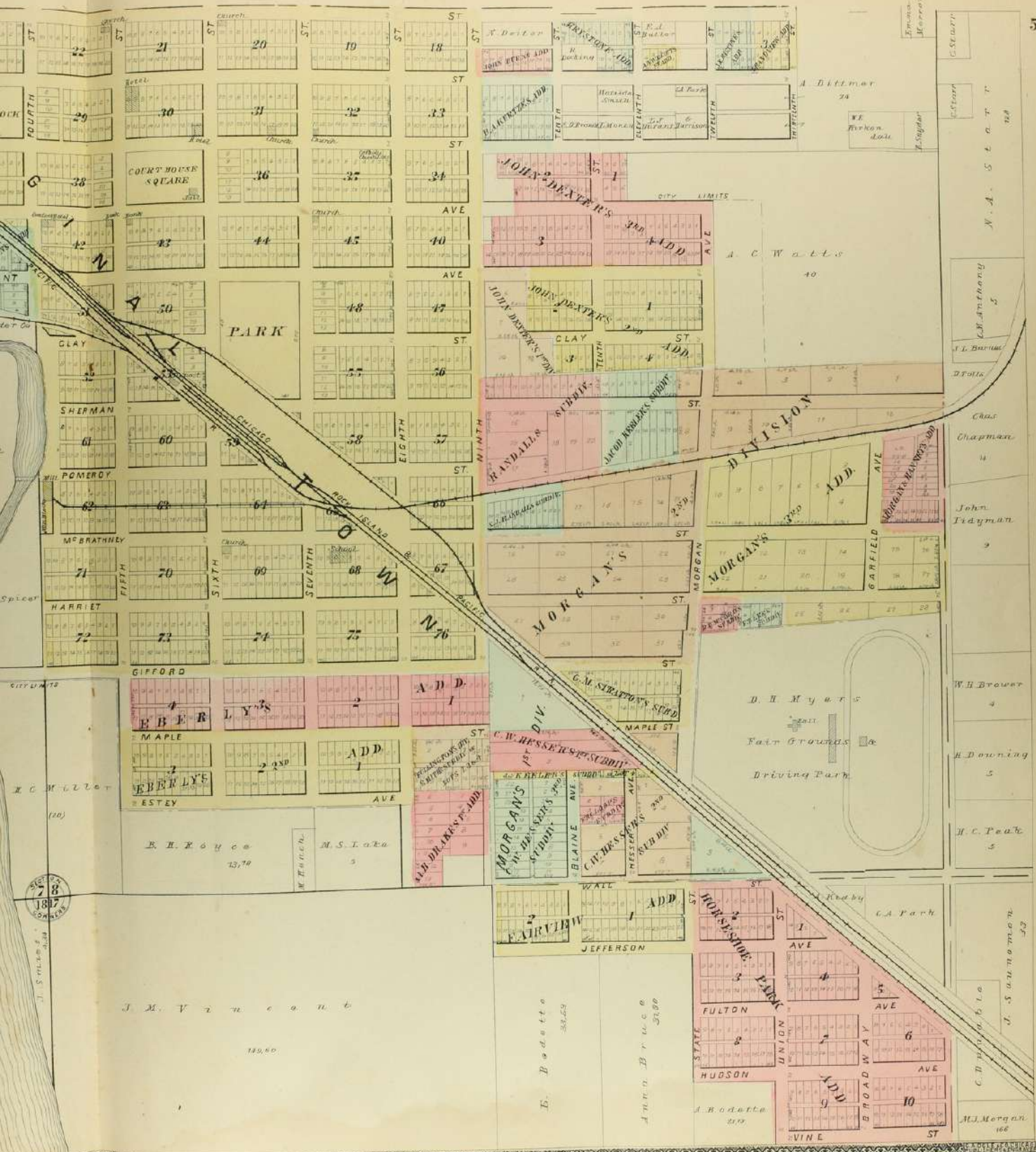

J. M. V. z. n. e. a. n. b.
189.00

E. B. Odette 34.64
Ann. B. r. u. c. e 31.00

A. B. Odette 21.00

M. J. Morgan 166
C. D. Morgan 160
H. S. S. u. a. n. m. o. n. 33
J. C. Peab 5
H. D. o. n. n. i. n. g 5
W. H. B. r. o. w. e. r 5
Chas. Chapman 4
John Trayman 2
I. L. Barthelemy 5
A. C. W. a. l. l. e. s 40
A. D. i. t. t. m. e. r 24
W. E. F. i. r. k. o. n. d. a. l. e
T. S. a. y. l. a. r

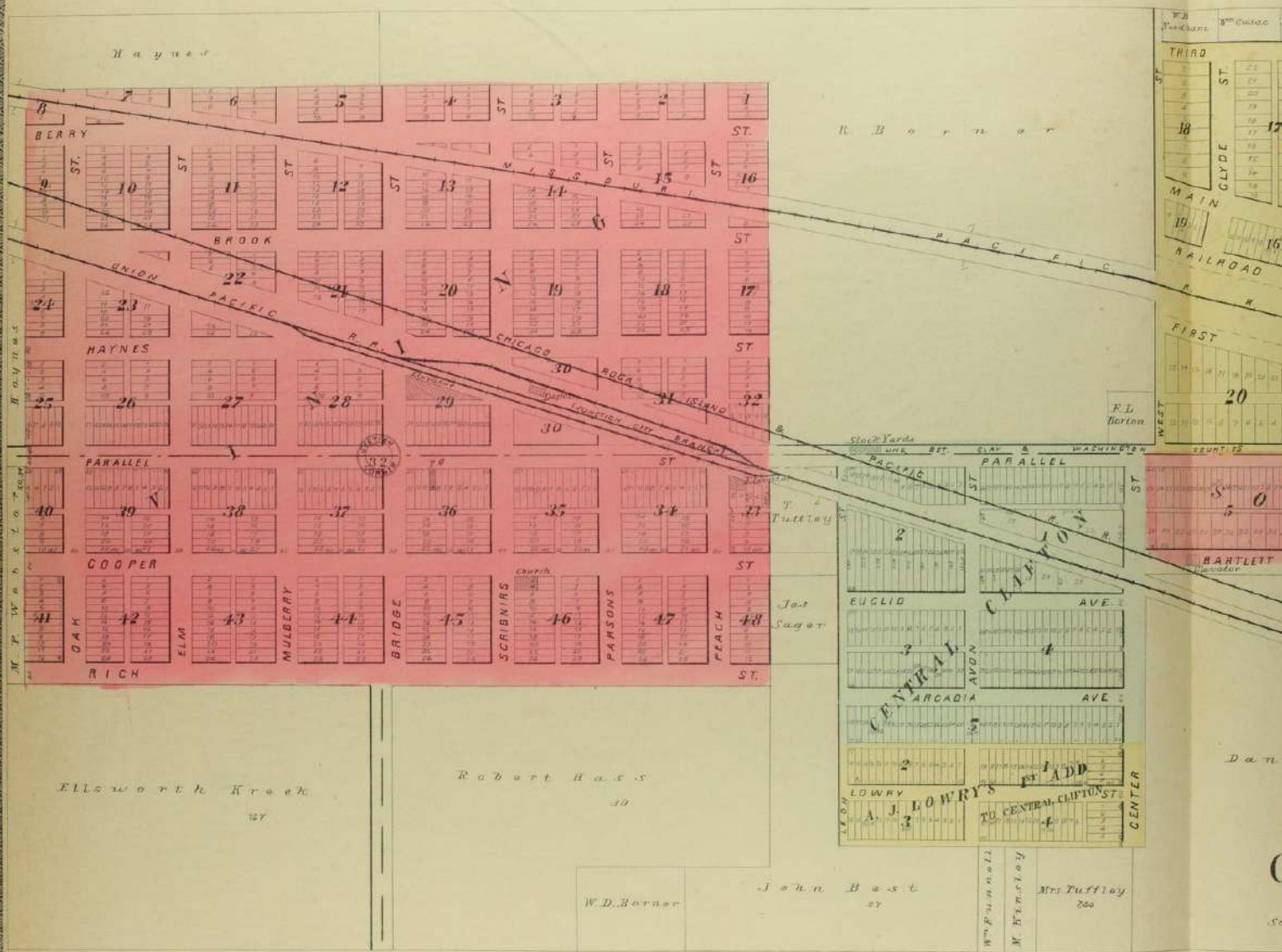

Haynes

Robert

Haynes

Ellsworth Creek

Robert H. S.

W.D. Barner

John. Best

Mrs. Tuffley

200

10

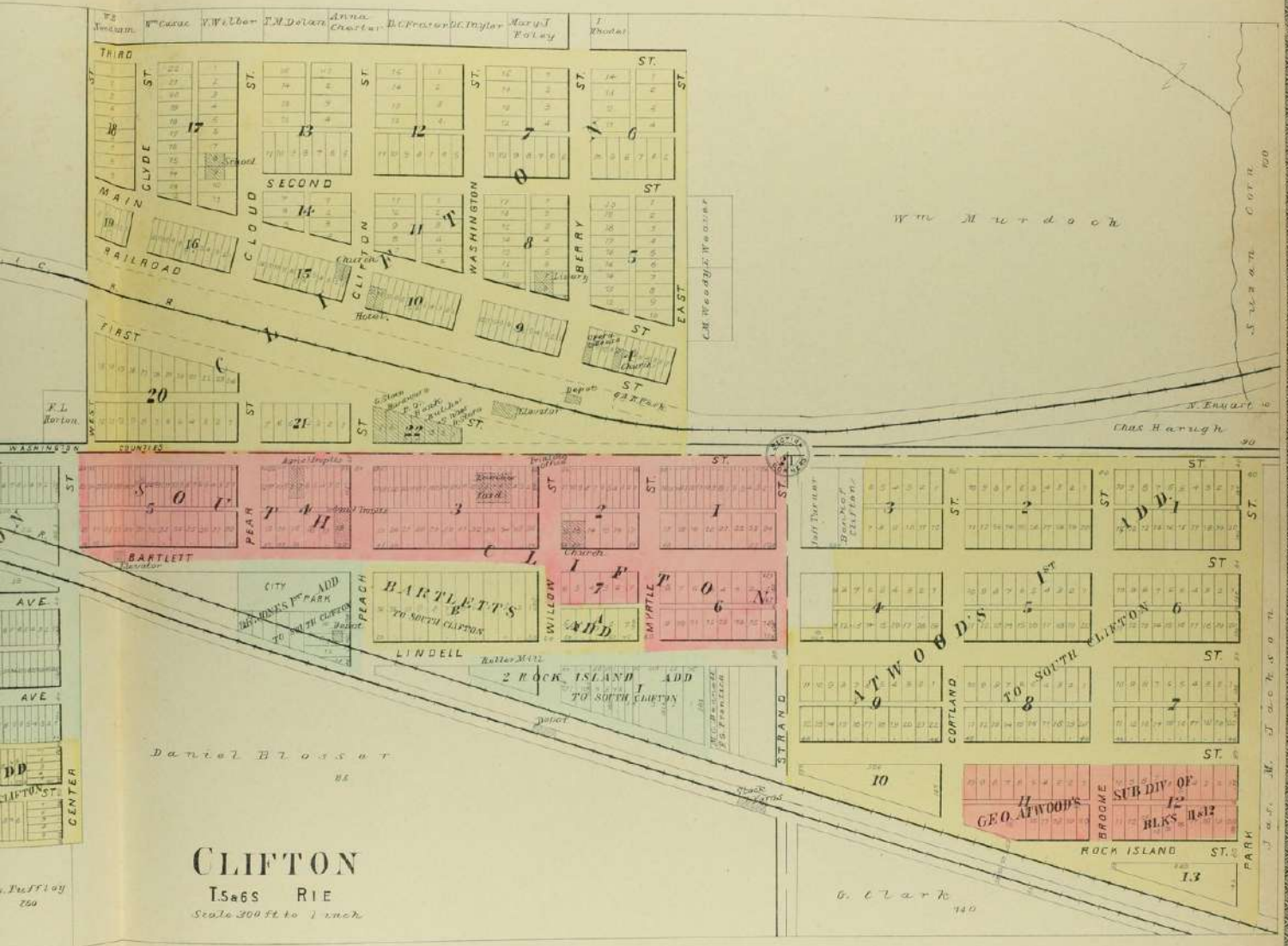

CLIFTON
 15a6s R1E
 Scale 300 ft. to 1 inch

G. Clark 140

STANDARD MAP CO.

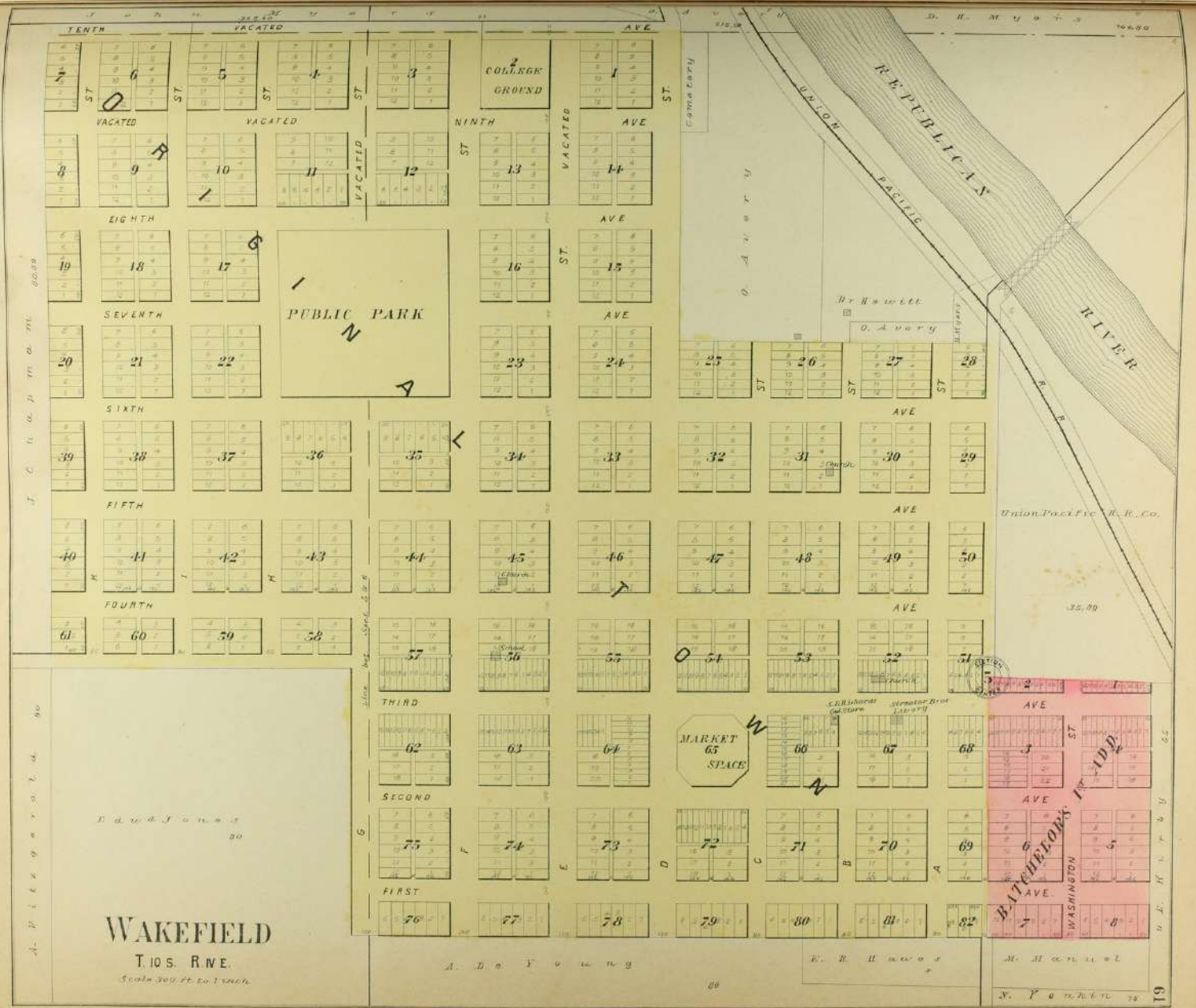

WAKEFIELD

T10S. R1E.

Scale 300 Ft. to 1 inch.

J. C. H. & D. M. & M. 0088

A. D. Y. & S. L. & C. 000

W. H. & S. P. & C. 000

A. D. Y. & S. L. & C. 000

E. H. & S. L. & C. 000

M. H. & S. L. & C. 000

N. P. & S. L. & C. 000

MORGANVILLE

Platted as Morgan City & Silver

T. 75. R. 11 E

Scale 300 ft. to 1 inch

L. Anderson

72

