

EDWARDS'
TOWNSHIP MAP OF
COWLEY COUNTY,

KANSAS.

Scale 3 Miles to the inch.

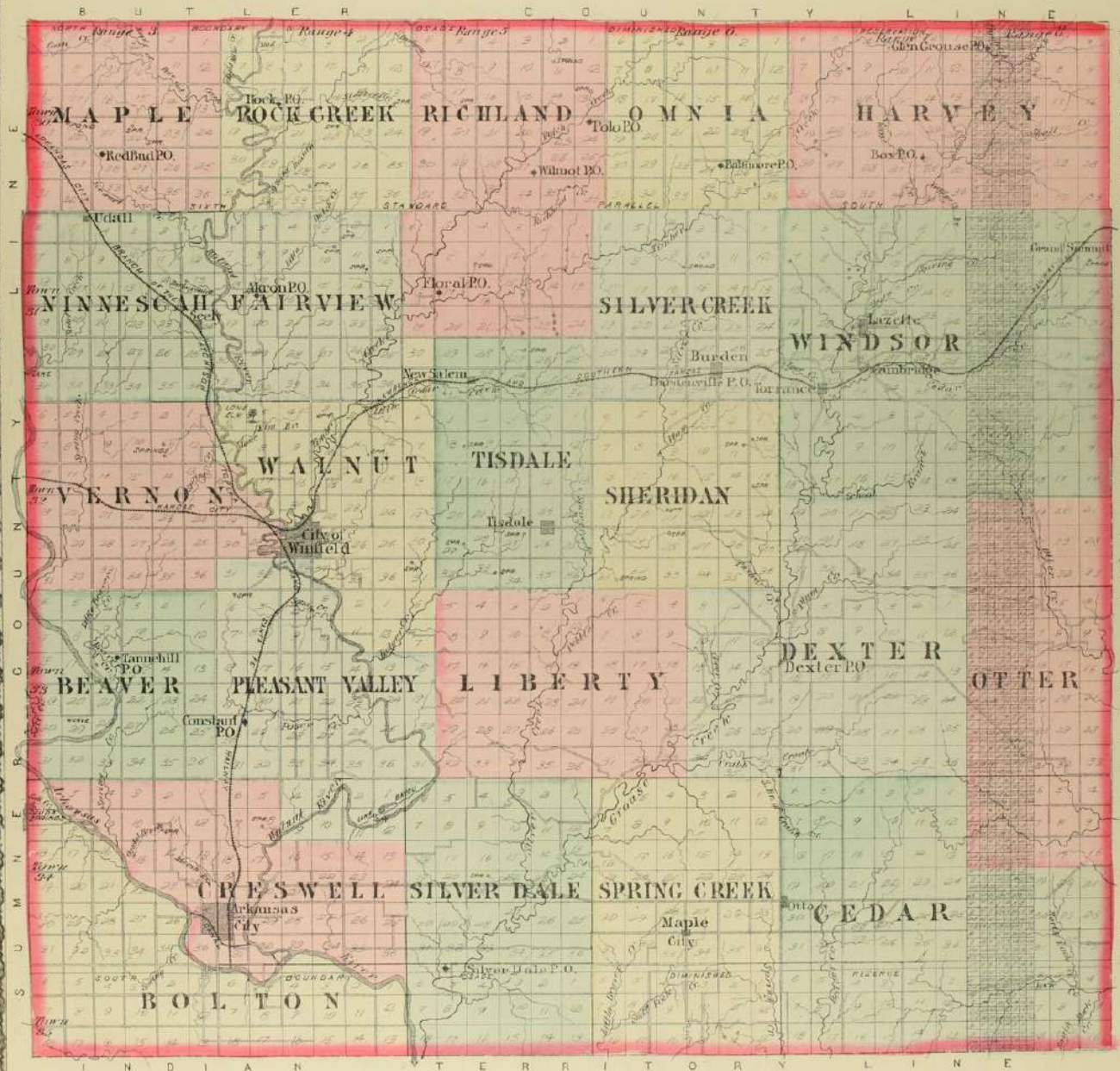

TOWNSHIP 30 SOUTH RANGE 3 EAST.

OF THE 6TH PRINCIPAL MERIDIAN
SCALE: 2 INCHES TO 1 MILE.

BUTLER COUNTY LINE

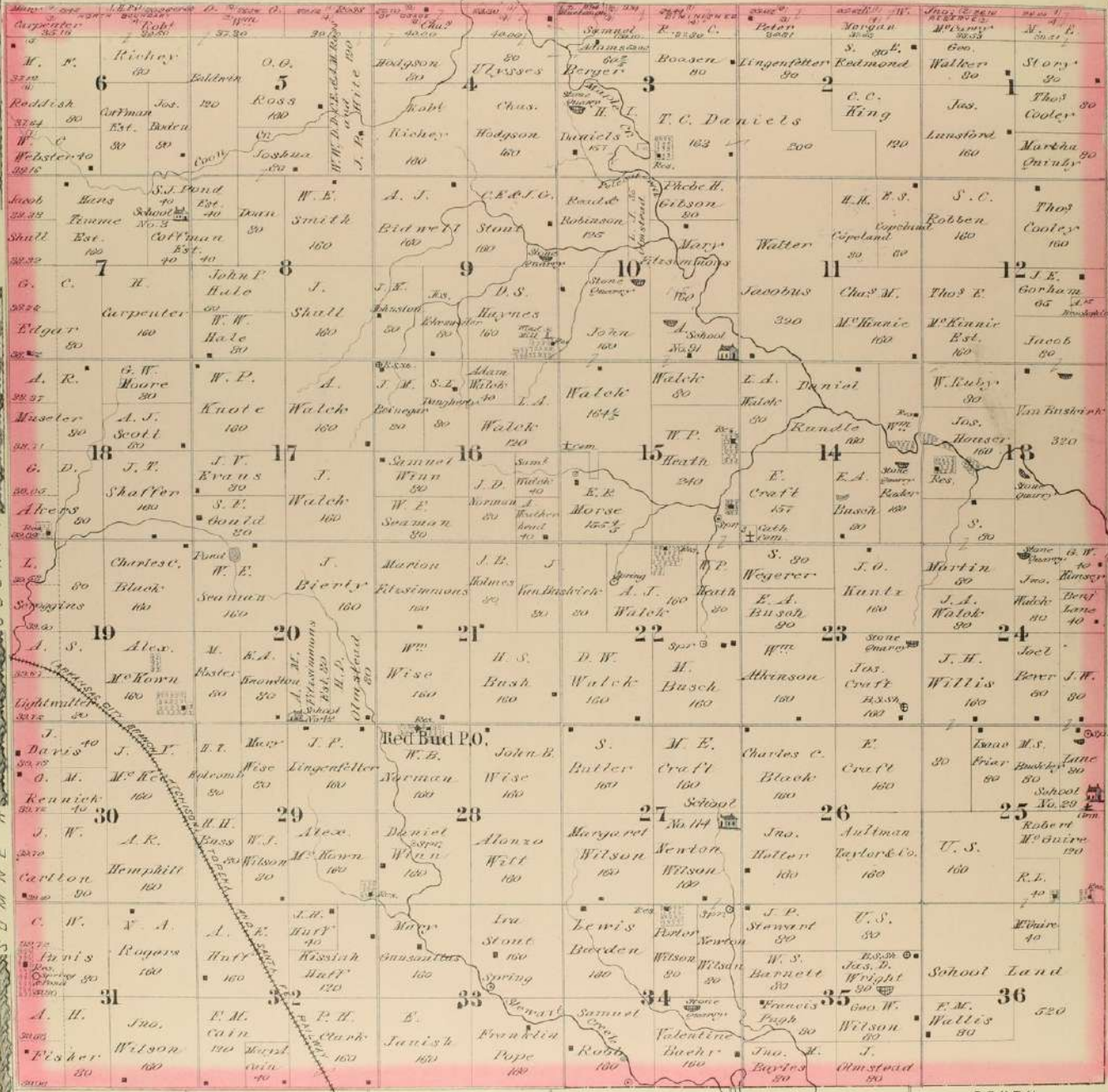

SIXTH STANDARD PARALLEL SOUTH

TOWNSHIP 31 SOUTH RANGE 3 EAST.

OF THE 6TH PRINCIPAL MERIDIAN
SCALE 2 INCHES TO A MILE

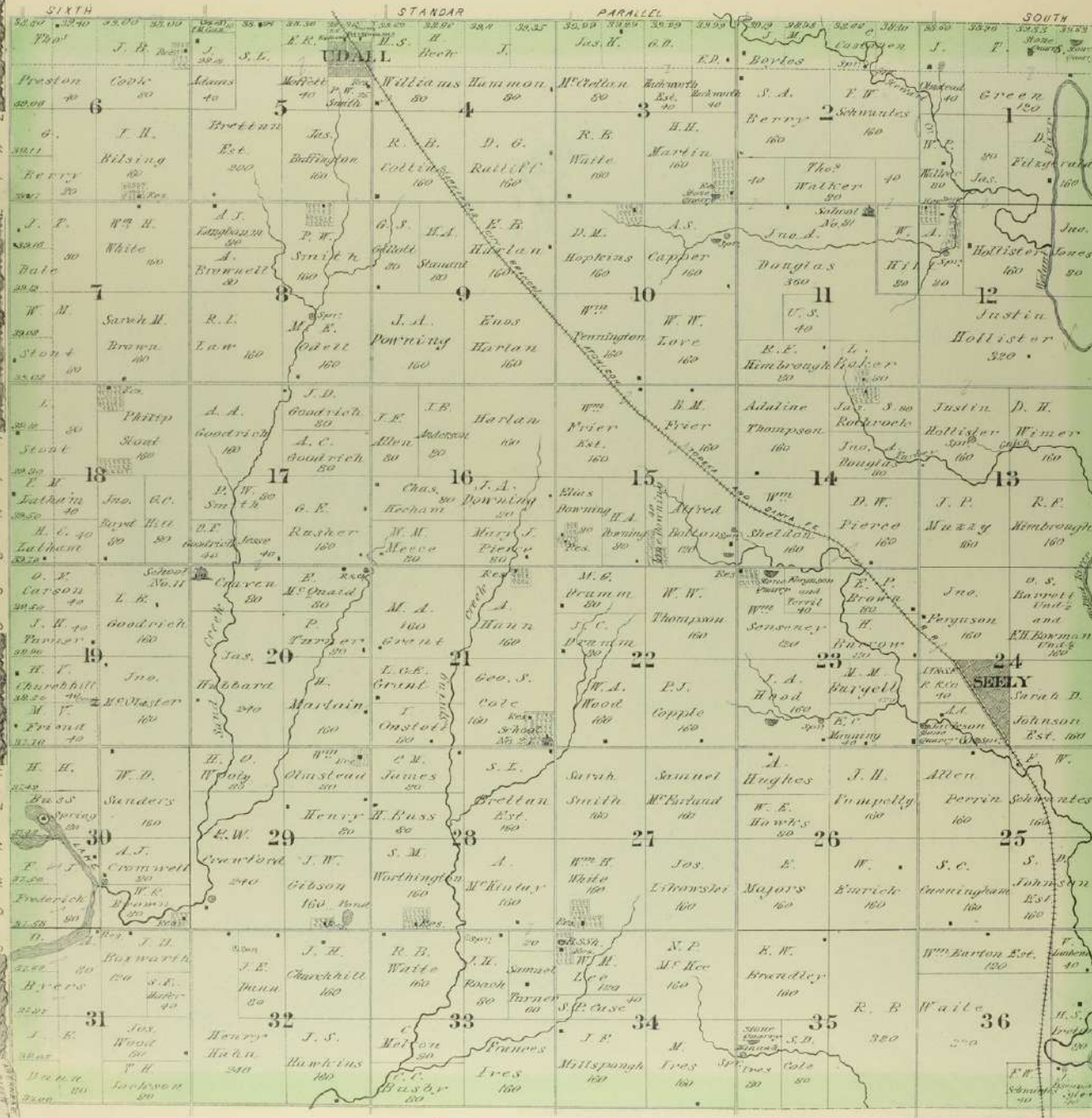

TOWNSHIP 33 SOUTH RANGE 3 EAST.

OF THE 6TH PRINCIPAL MERIDIAN
SCALE: 6 INCHES TO 1 MILE

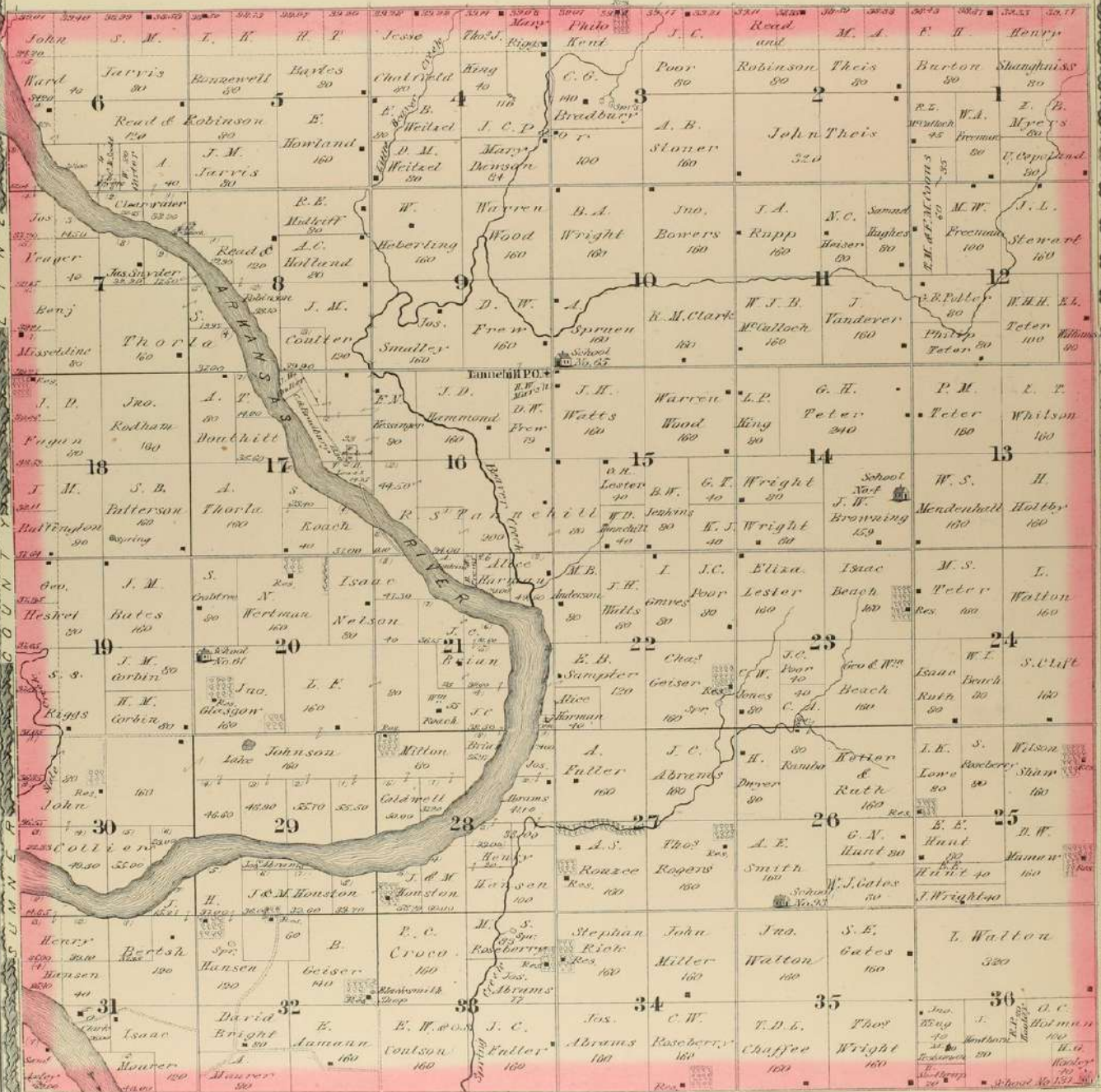

TOWNSHIP 34 SOUTH RANGE 3 EAST

OF THE 6th PRINCIPAL MERIDIAN
SCALE: 2 INCHES TO 1 MILE.

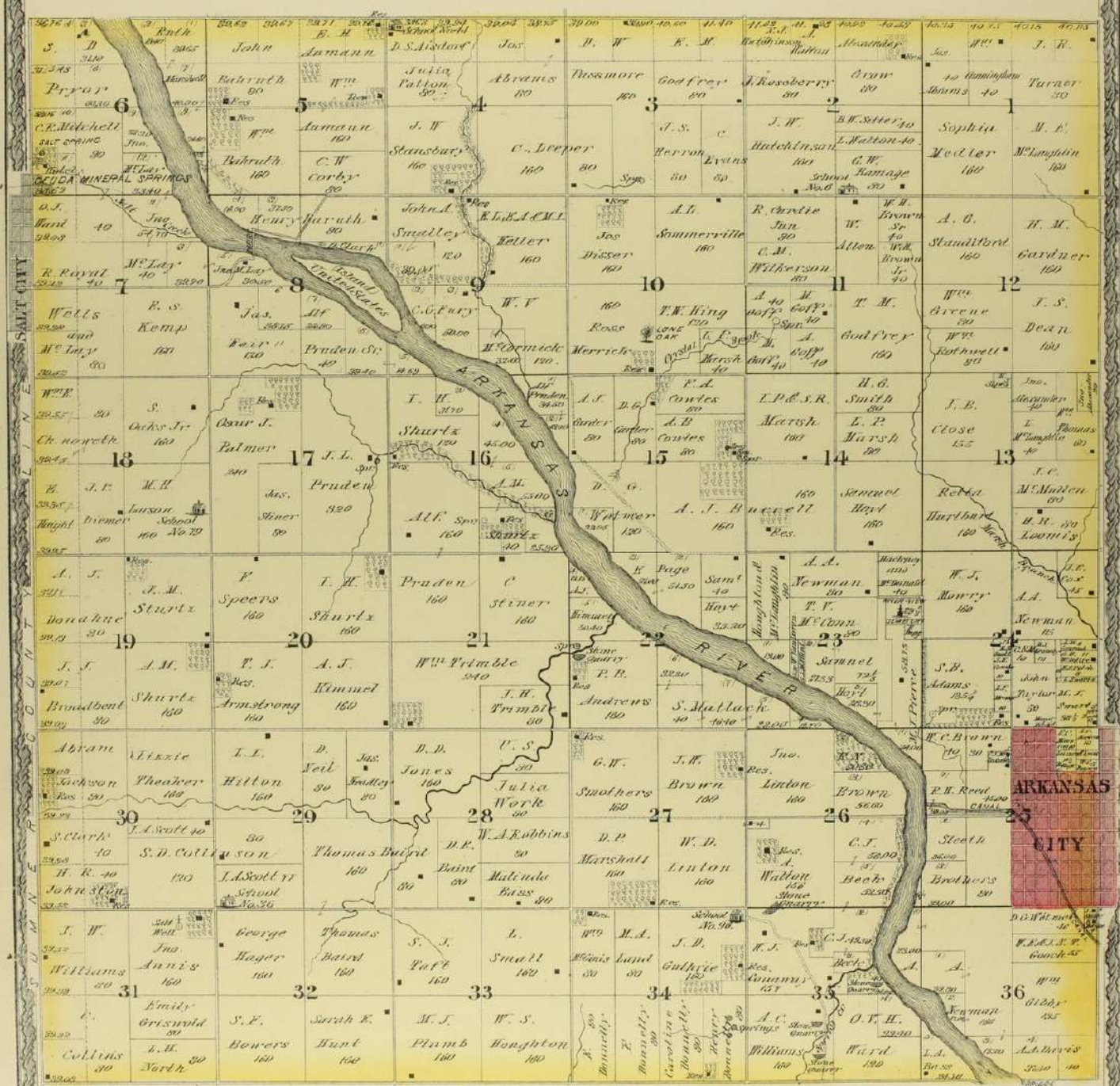

ARKANSAS CITY

TOWNSHIP 30 SOUTH RANGE 4 EAST.

OF THE 6TH PRINCIPAL MERIDIAN.
SCALE: 2 INCHES TO 1 MILE

BUTLER COUNTY LINE

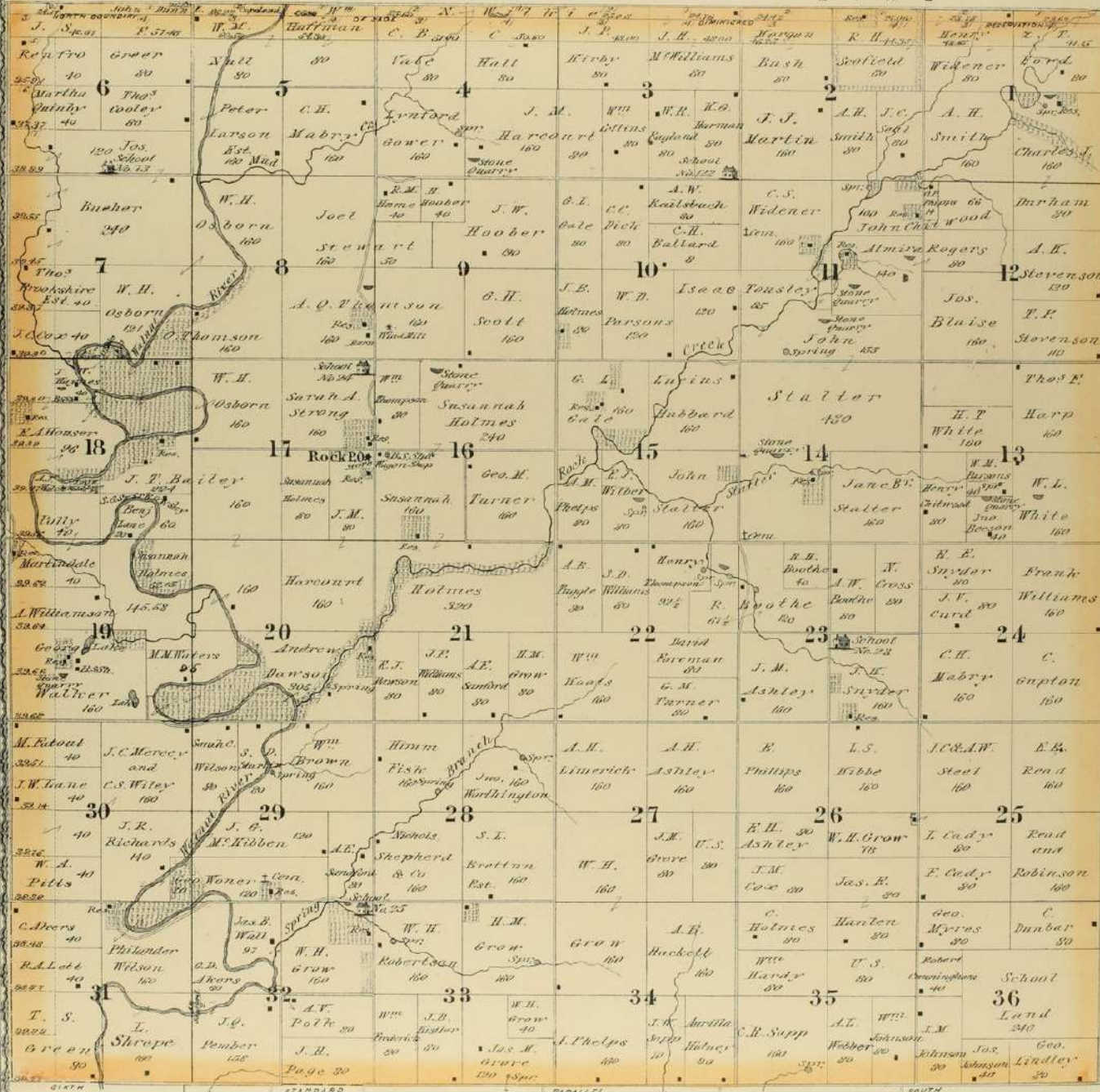

TOWNSHIP 31 SOUTH RANGE 4 EAST.

OF THE 6TH PRINCIPAL MERIDIAN
SCALE 2 INCHES TO 1 MILE

MISSOURI HISTORICAL SOCIETY

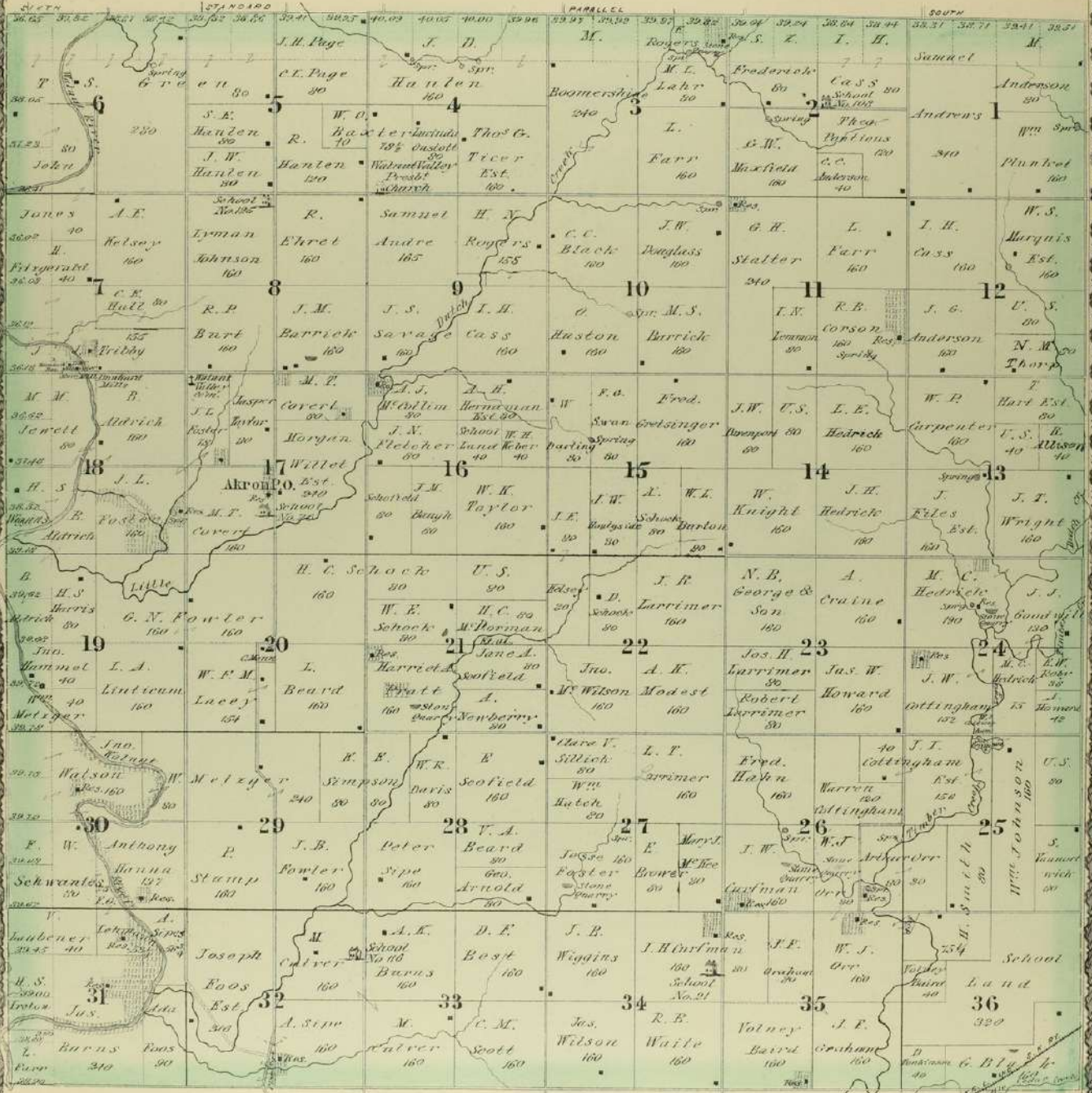

TOWNSHIP 34 SOUTH RANGE 1 EAST.
 OF THE 6th PRINCIPAL MERIDIAN
 SCALE: 1 INCH TO 1 MILE

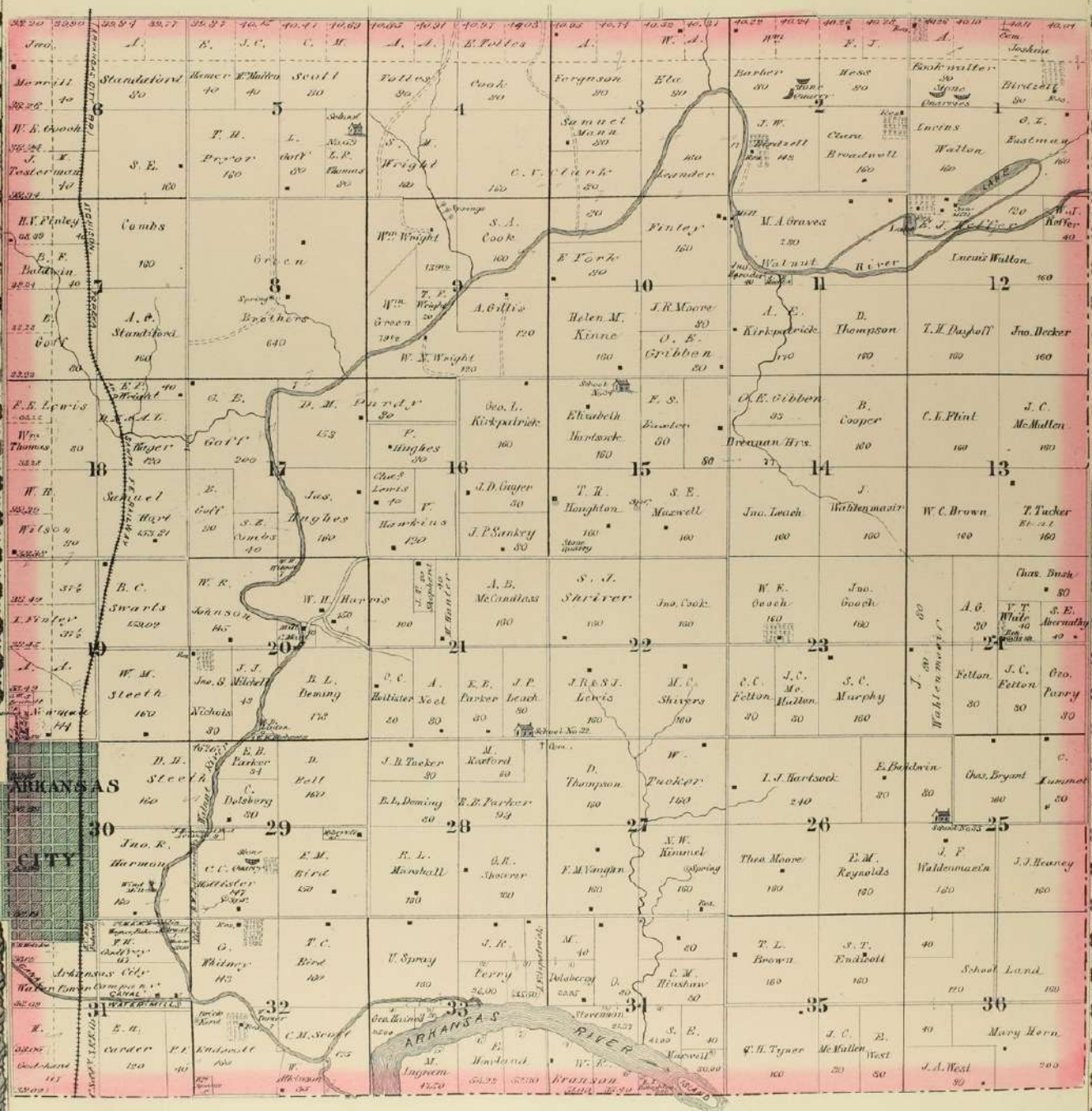

EDWARDS MAP OF ARKANSAS CITY KANSAS.

Scale 400 feet to the inch.

Leisure & Lyons
Ave.

W. C.
Brown
500.
CORPORATION

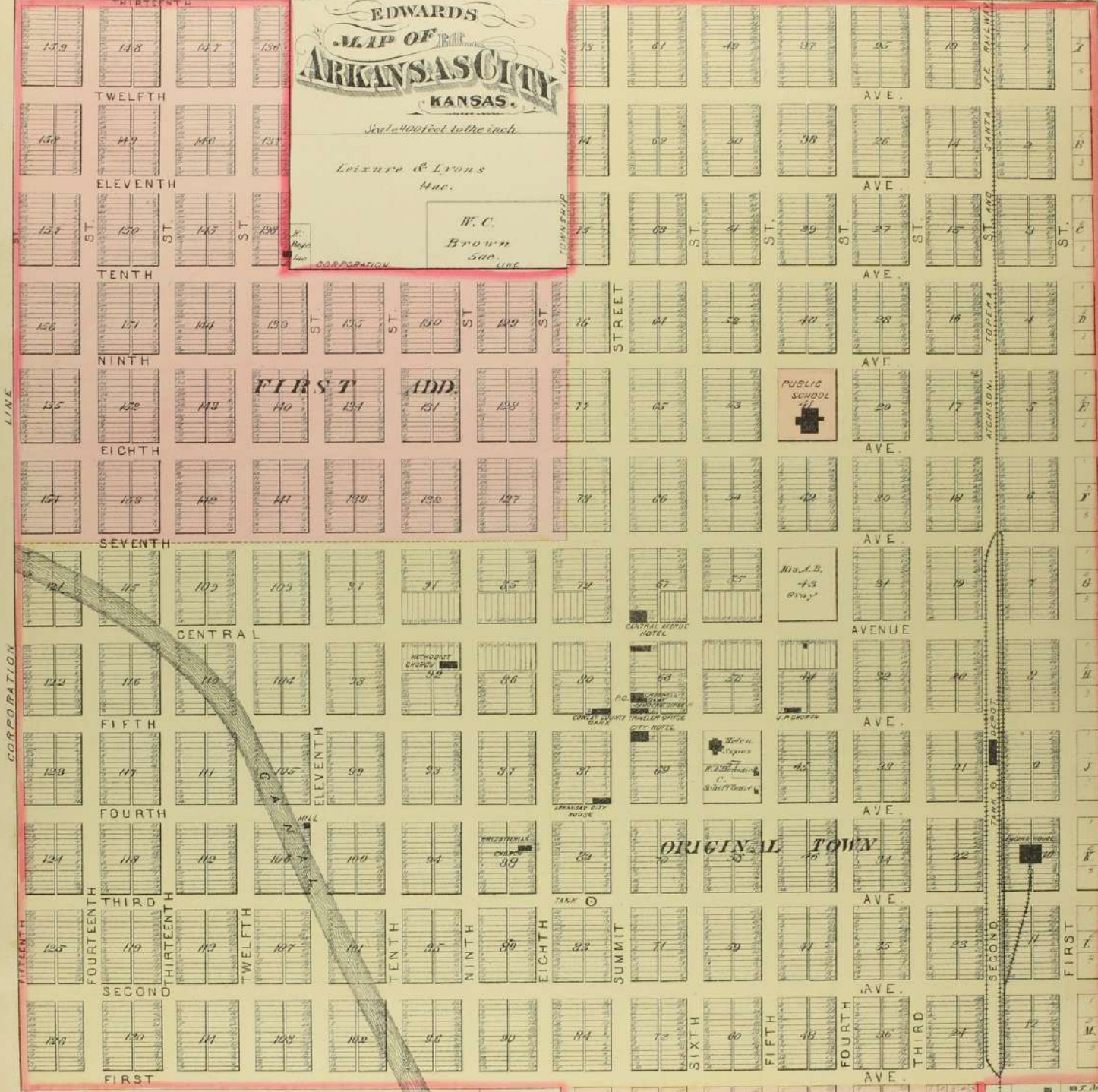

D. C. Wetmer
46 ac.

J. Shibley
44.
B. M. & Co
4 ac.

160 165 160 171 172 177
LEONARD'S ADD
LEONARD ST

101 104 107 170 173 176

CORPORATION LINE
Arkansas City Water Power Company

H. C.
Lutscott
112 ac.

TOWNSHIP 31 SOUTH RANGE 5 EAST.

OF THE 6TH PRINCIPAL MERIDIAN

SCALE: 1 INCHES TO A MILE

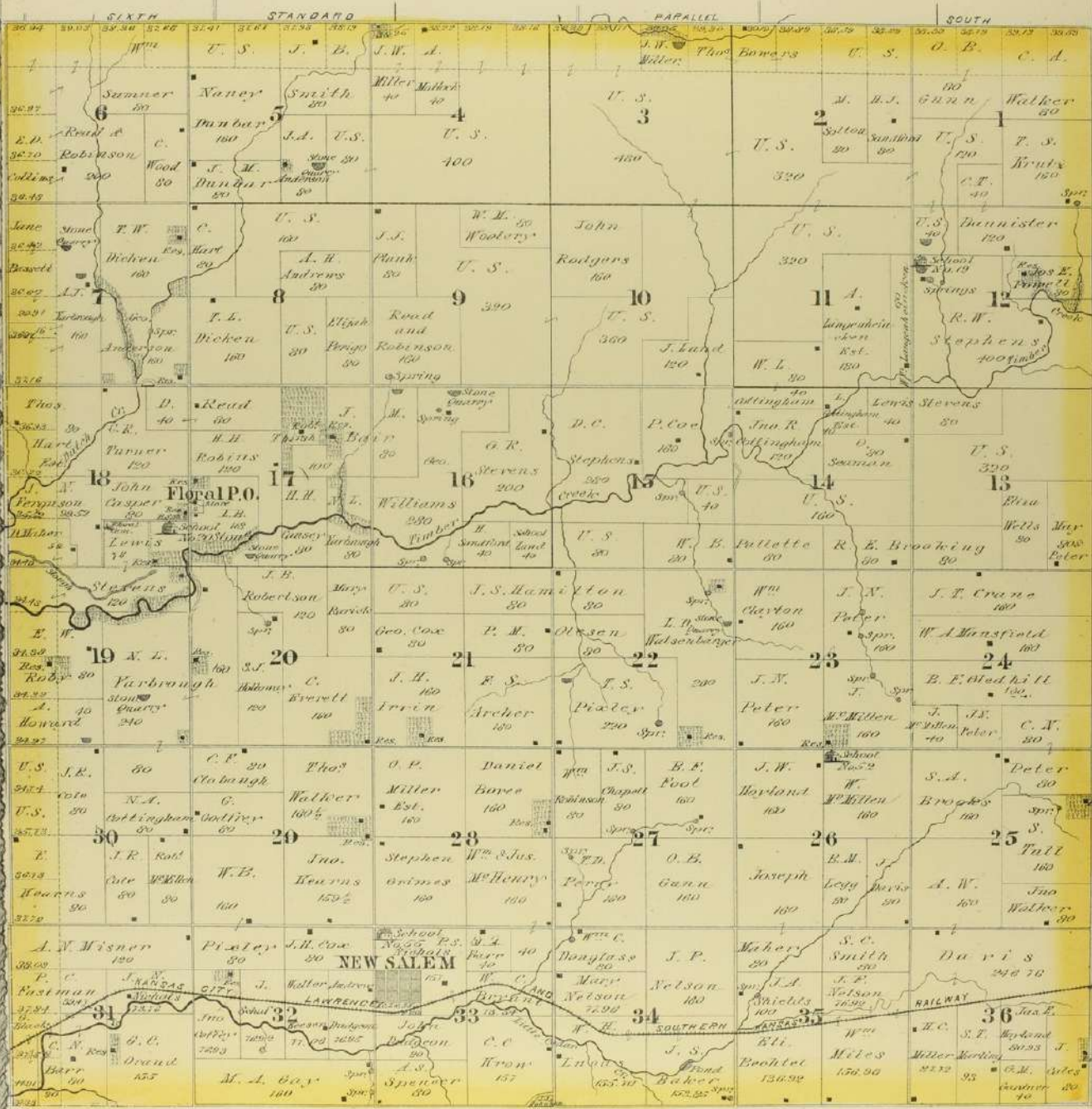

TOWNSHIP 32 SOUTH RANGE 5 EAST.

OF THE 6TH PRINCIPAL MERIDIAN

SCALE: 2 INCHES TO 1 MILE.

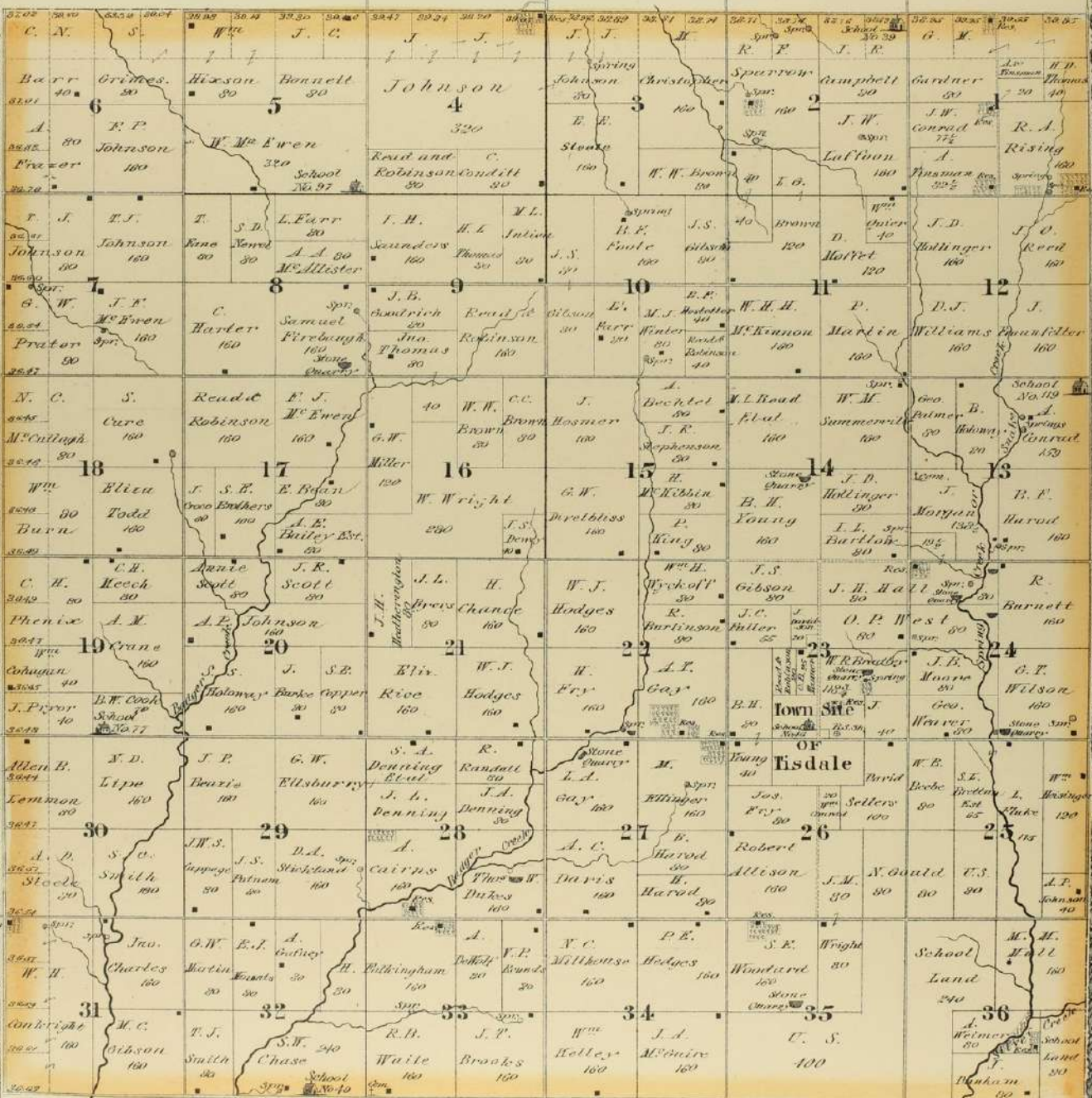

TOWNSHIP 33 SOUTH RANGE 5 EAST.

OF THE 6TH PRINCIPAL MERIDIAN
SCALE: 2 INCHES TO A MILE.

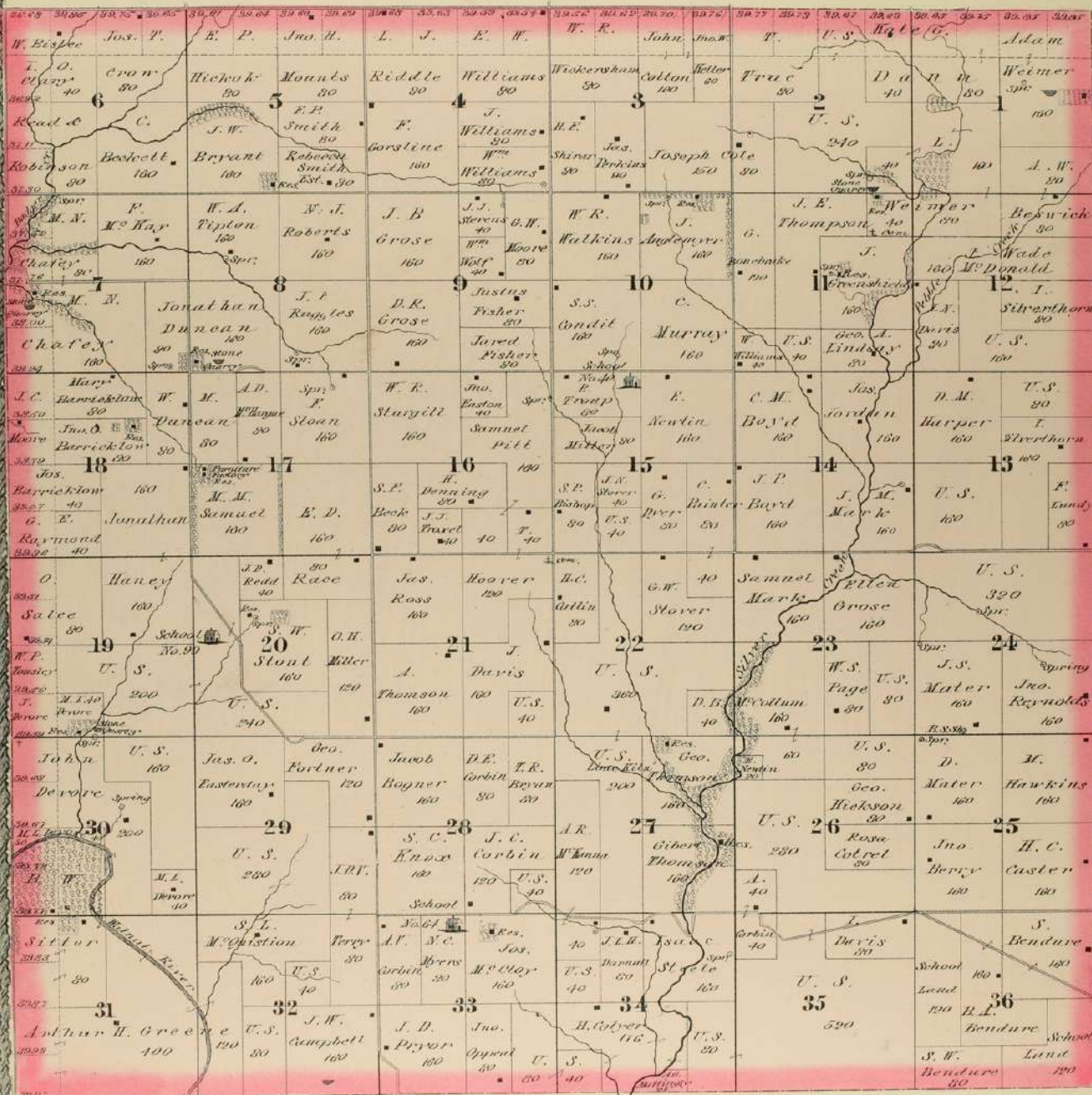

TOWNSHIP 34 SOUTH RANGE 5 EAST.

OF THE 6TH PRINCIPAL MERIDIAN

SCALE: 2 INCHES TO 1 MILE

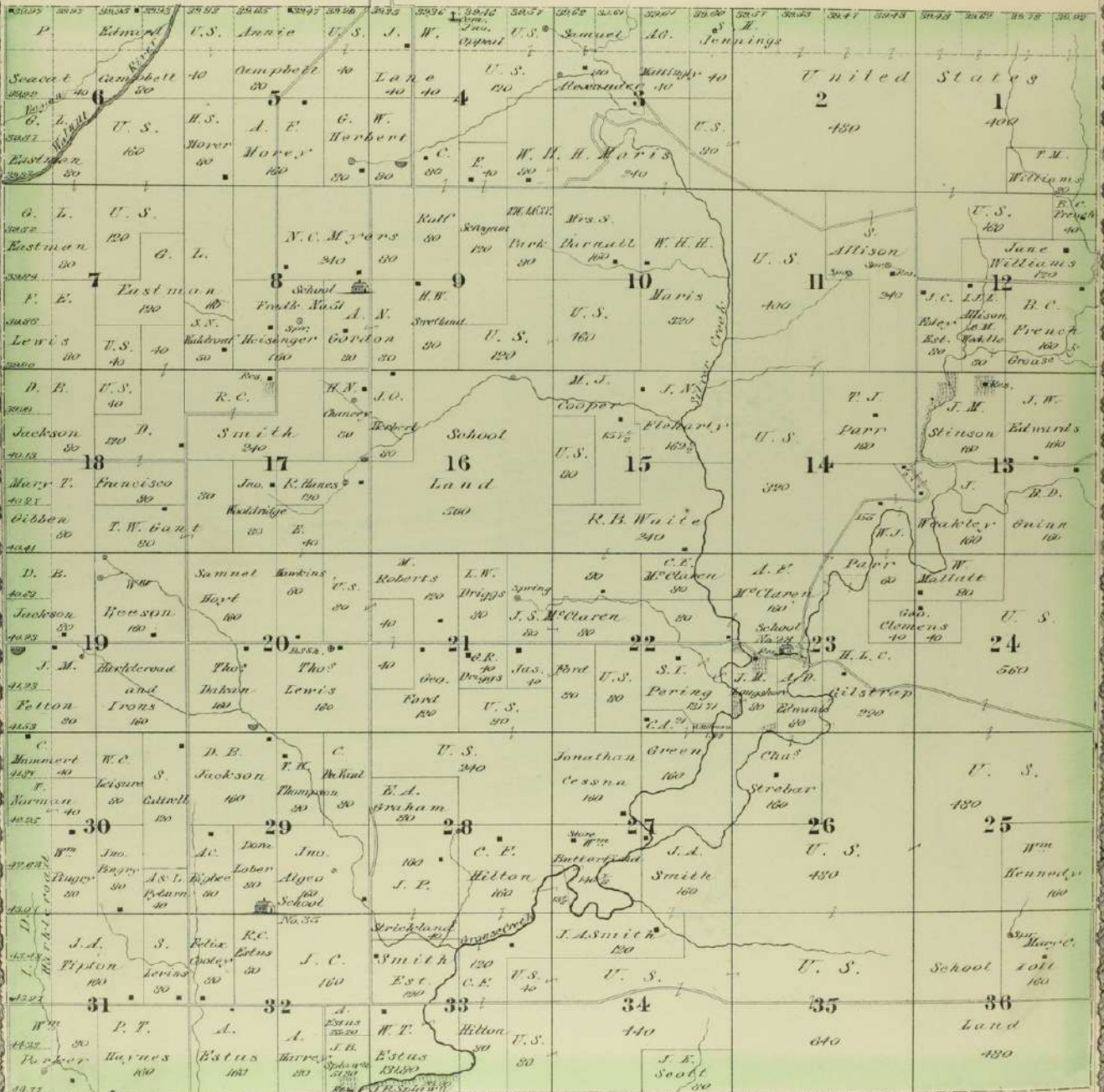

BURIDEN

BURDENVILLE, P.O.

Scale 400 ft. to the inch.

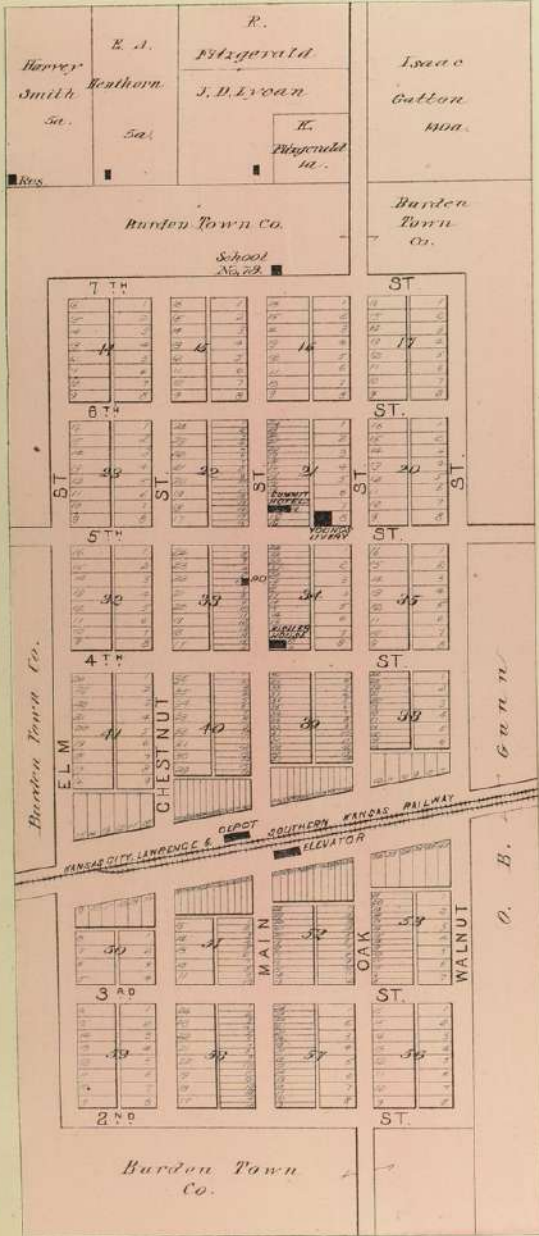

GAMBRIDGE

Scale 400 ft. to the inch.

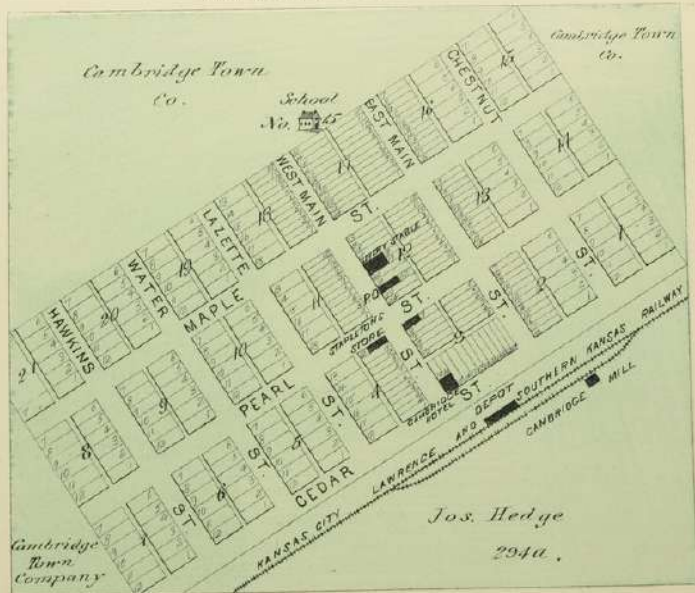

TOWNSHIP 30 SOUTH RANGE 6 EAST.

OF THE 10th PRINCIPAL MERIDIAN
SCALE: 1 INCH TO 1 MILE

BUTLER COUNTY LINE

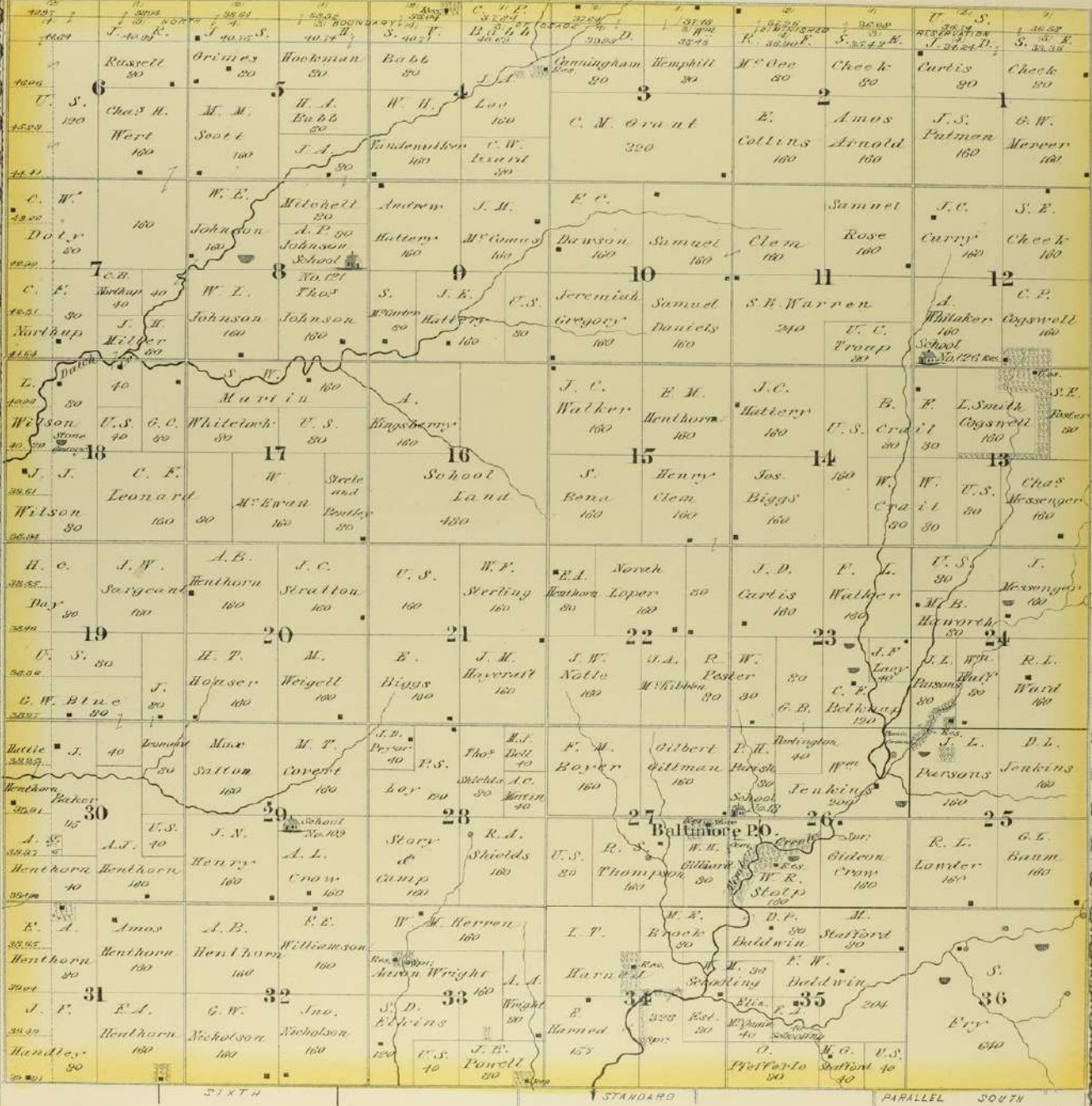

SIXTH STANDARD PARALLEL SOUTH

TOWNSHIP 32 SOUTH RANGE 6 EAST.

OF THE 6TH PRINCIPAL MERIDIAN
SCALE: 1 INCH TO 1 MILE

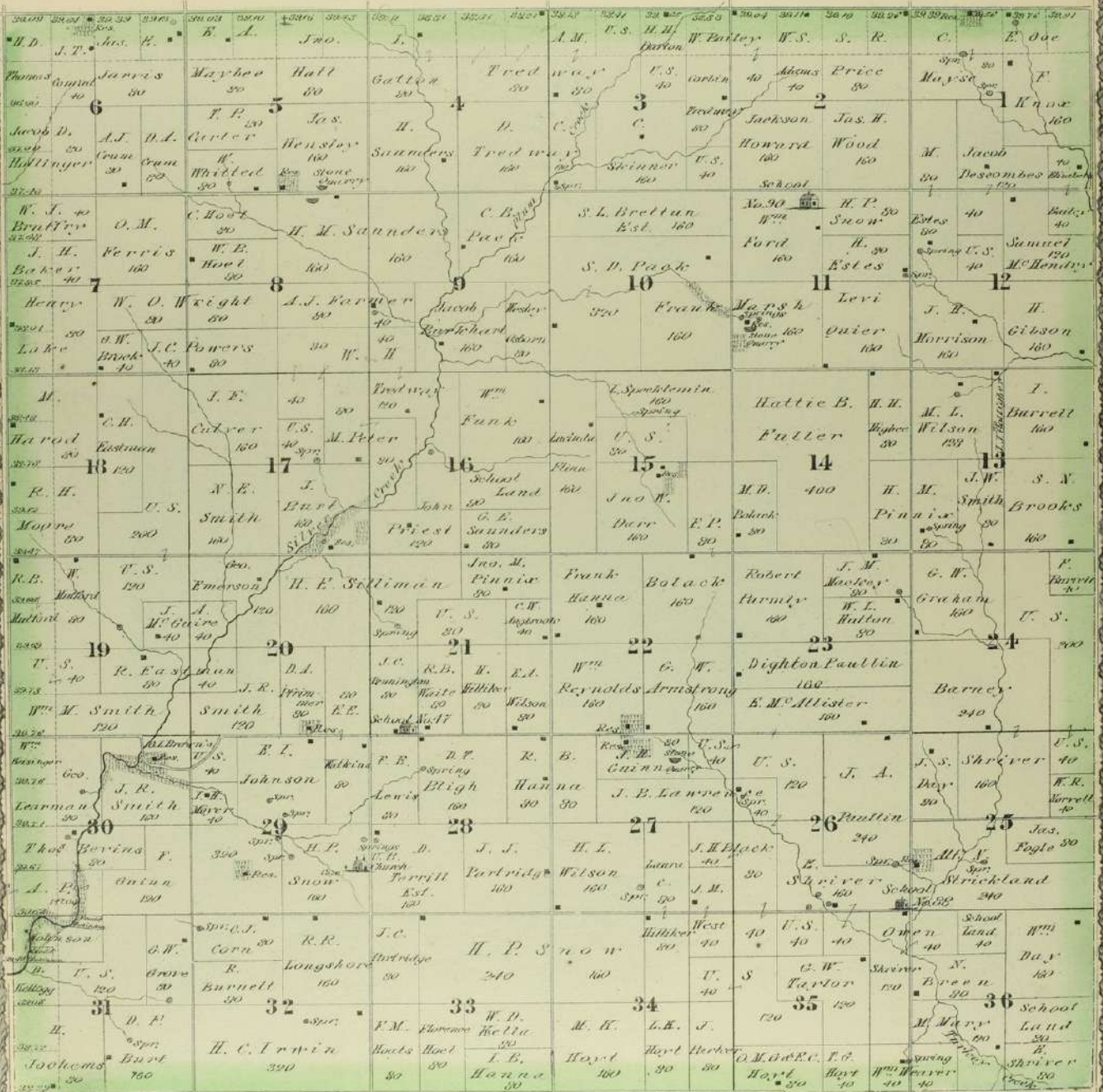

TOWNSHIP 33 SOUTH RANGE 6 EAST.

OF THE 6TH PRINCIPAL MERIDIAN
SCALE 2 INCHES TO 1 MILE.

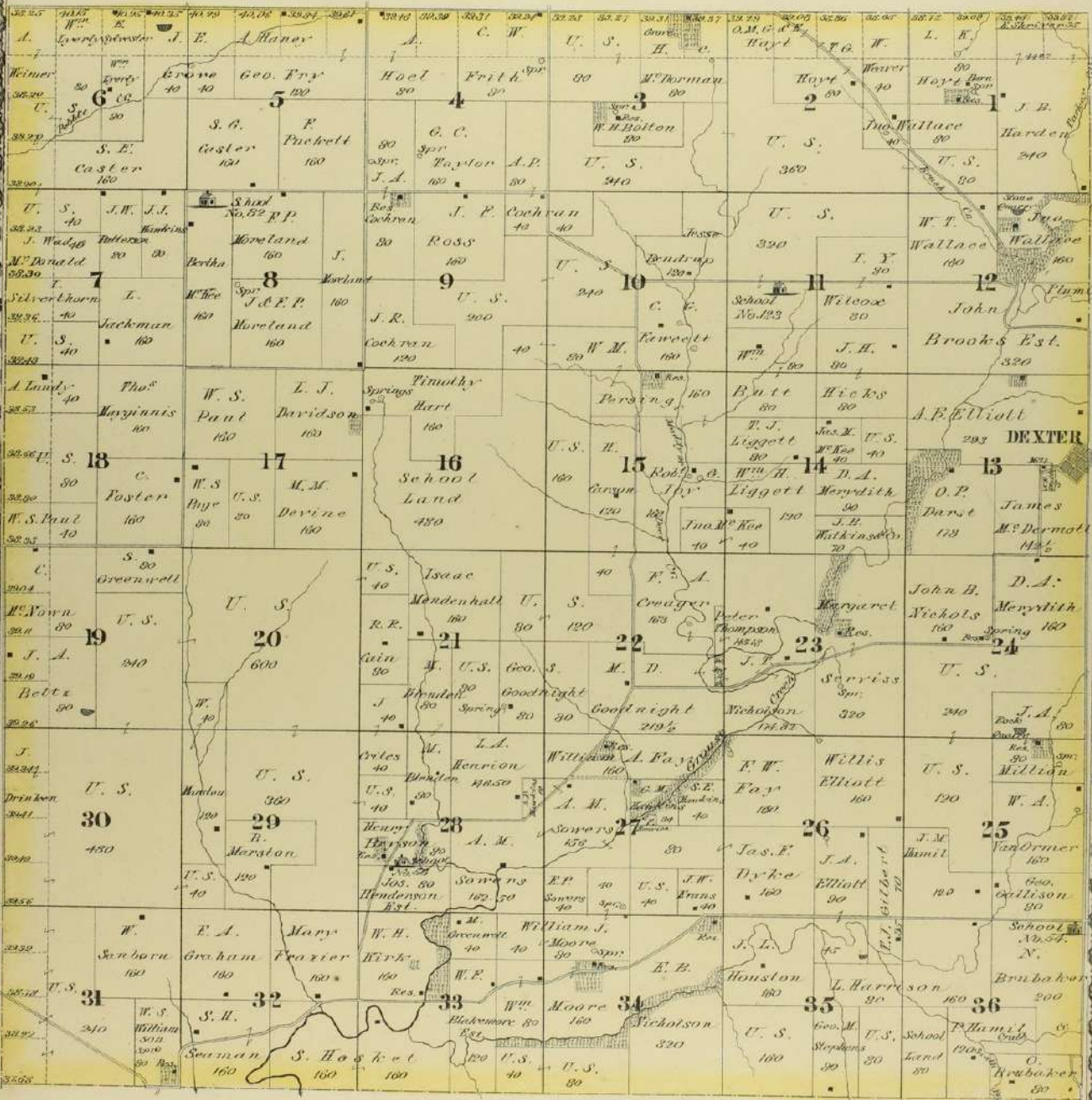

TOWNSHIP 34 SOUTH RANGE 6 EAST.

OF THE 4TH PRINCIPAL MERIDIAN
SCALE: 2 INCHES TO A MILE

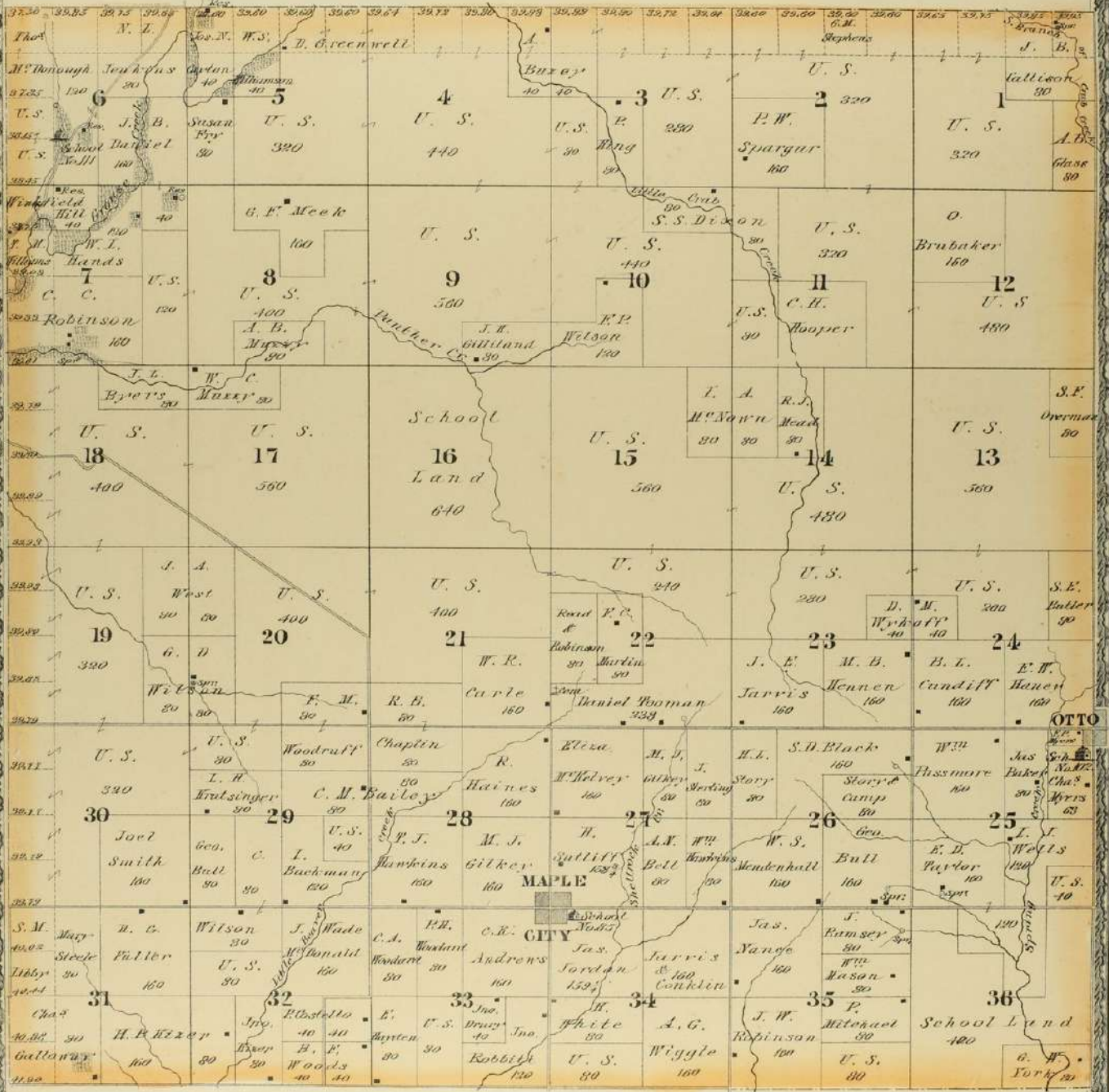

TOWNSHIP 30 SOUTH RANGE 7 EAST.

OF THE 6th PRINCIPAL MERIDIAN
SCALE: 2 INCHES TO 1 MILE

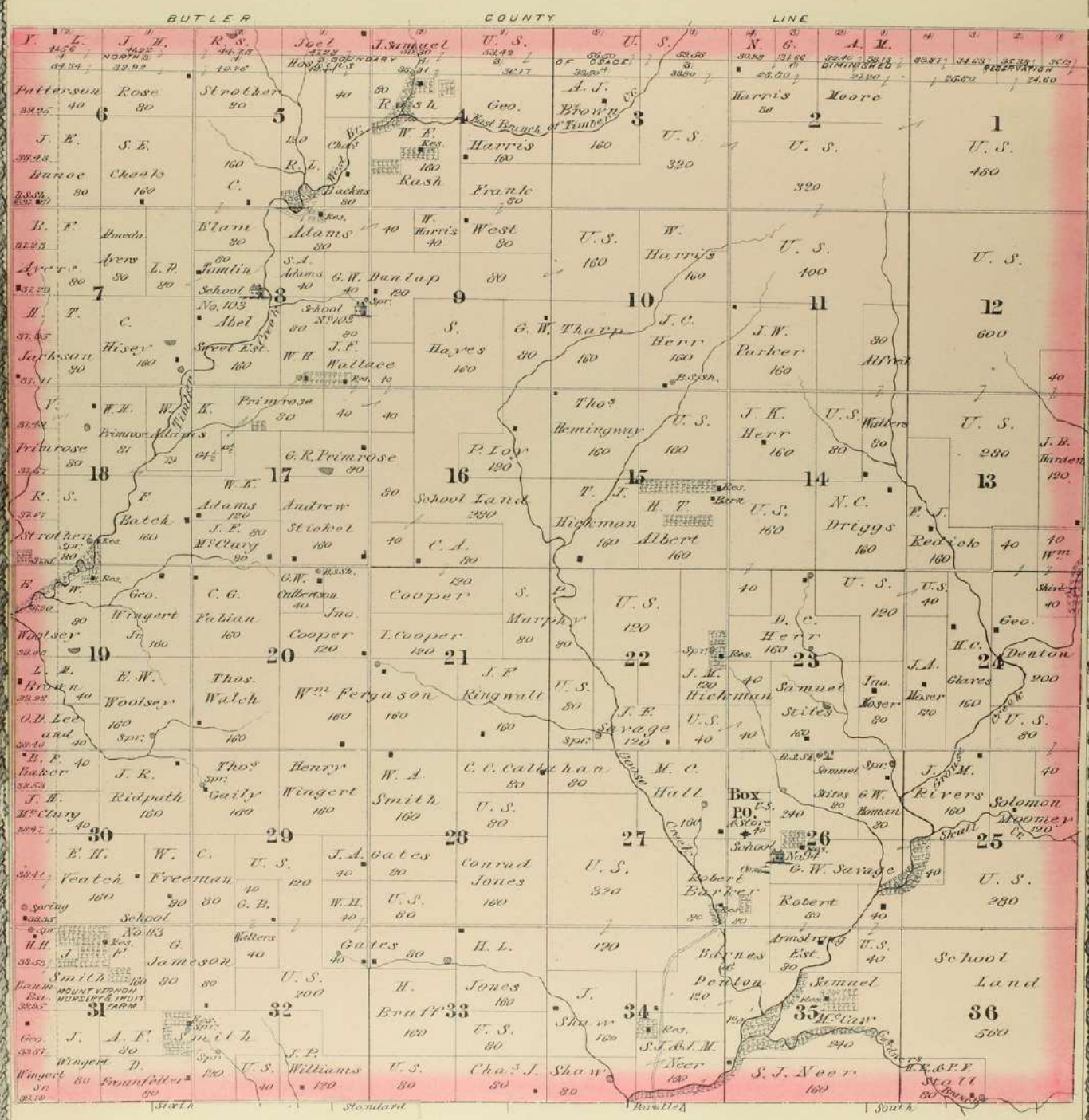

TOWNSHIP 33 SOUTH RANGE 7 EAST.

OF THE 6th PRINCIPAL MERIDIAN

SCALE: 2 INCHES TO 1 MILE



TOWNSHIP 34 SOUTH RANGE 7 EAST

OF THE 10TH PRINCIPAL MERIDIAN
SCALE 2 INCHES TO 1 MILE

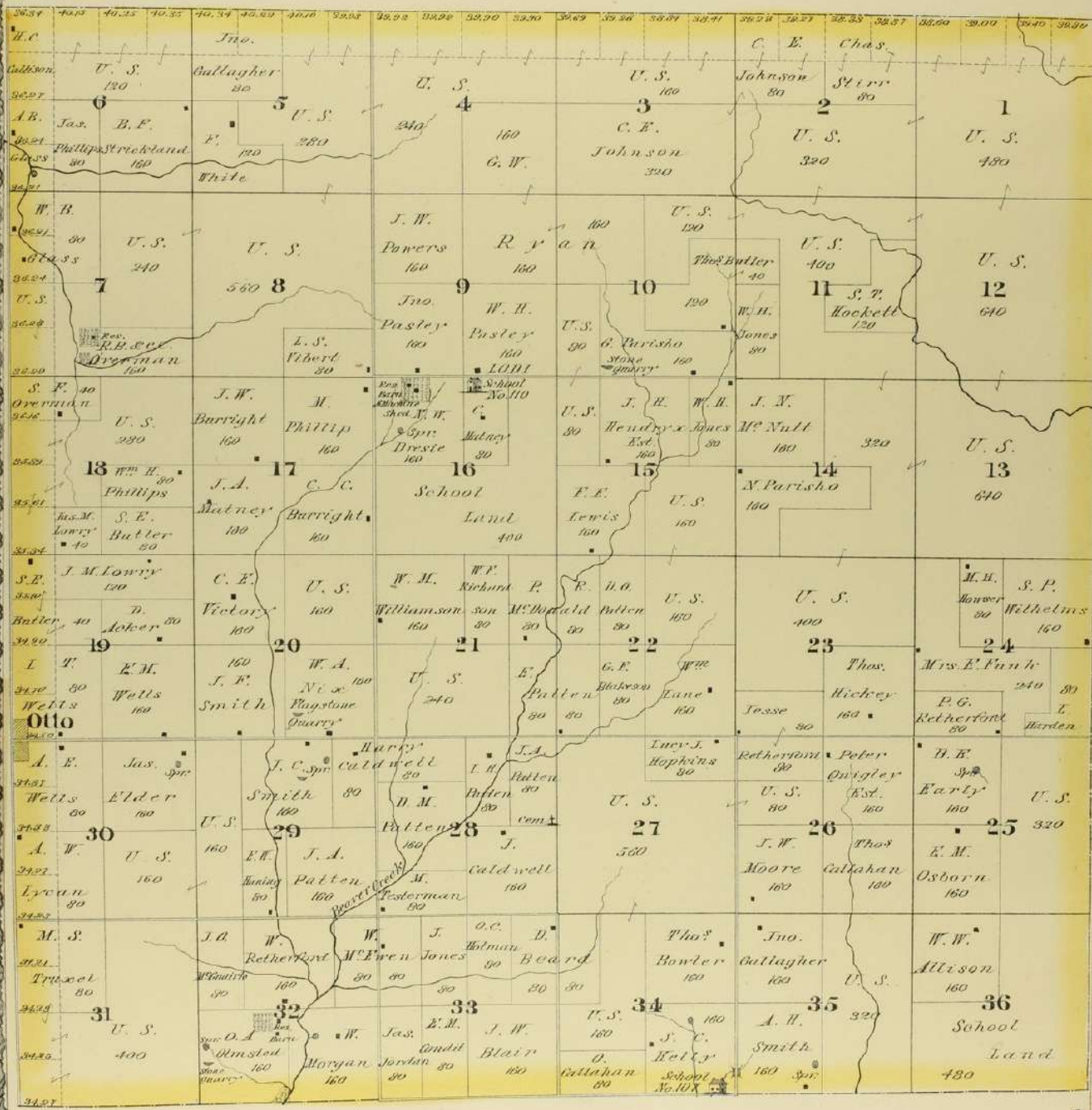

TOWNSHIP 30 SOUTH RANGE 8 EAST.

OF THE 6TH PRINCIPAL MERIDIAN
SCALE: 1 INCHES TO 1 MILE

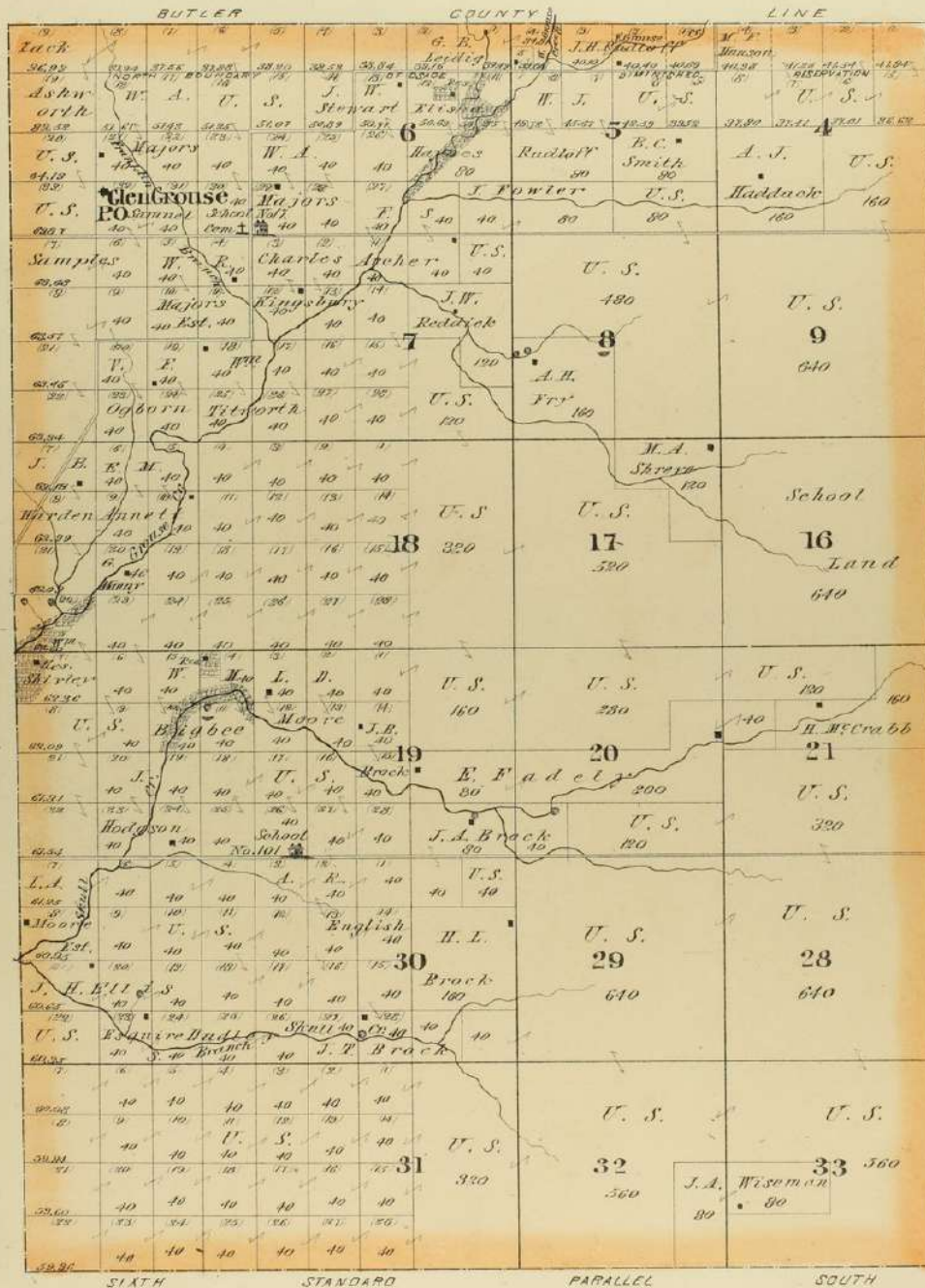

E. L. R. COUNTY LINE

SIXTH STANDARD PARALLEL SOUTH

TOWNSHIP 31 SOUTH RANGE 8 EAST.

OF THE 6TH PRINCIPAL MERIDIAN
SCALE: 2 INCHES TO 1 MILE

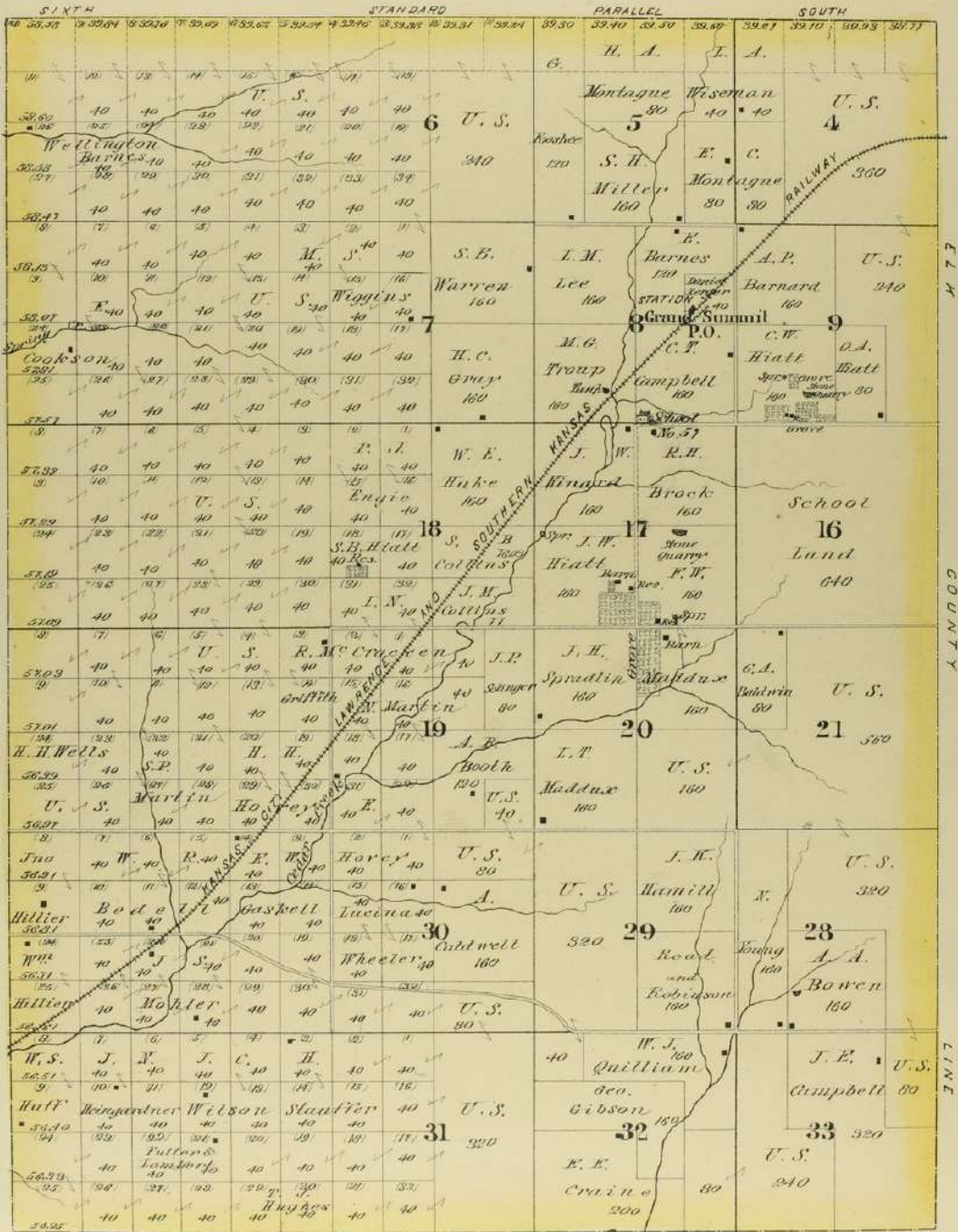

E. T. H. COUNTY LINE

TOWNSHIP 32 SOUTH RANGE 8 EAST.

OF THE 6TH PRINCIPAL MERIDIAN
SCALE 2 INCHES TO 1 MILE.

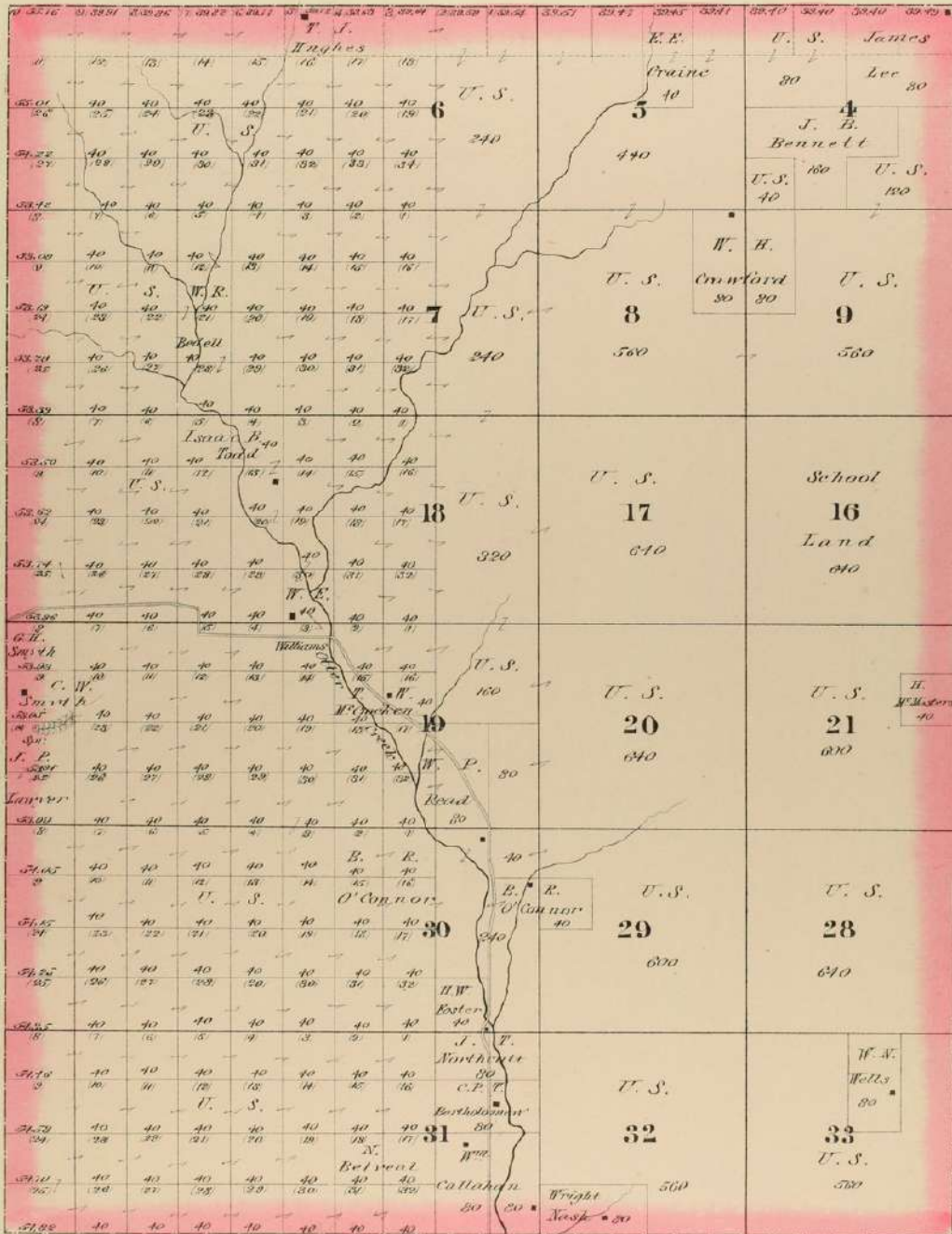

CHAUTAUQUA

COUNTY

LINE

TOWNSHIP 34 SOUTH RANGE 8 EAST.

OF THE 6TH PRINCIPAL MERIDIAN
SCALE 1 INCH TO 1 MILE

