

Outline Map of COWLEY COUNTY Kansas

Scale 4 inch to one Mile.

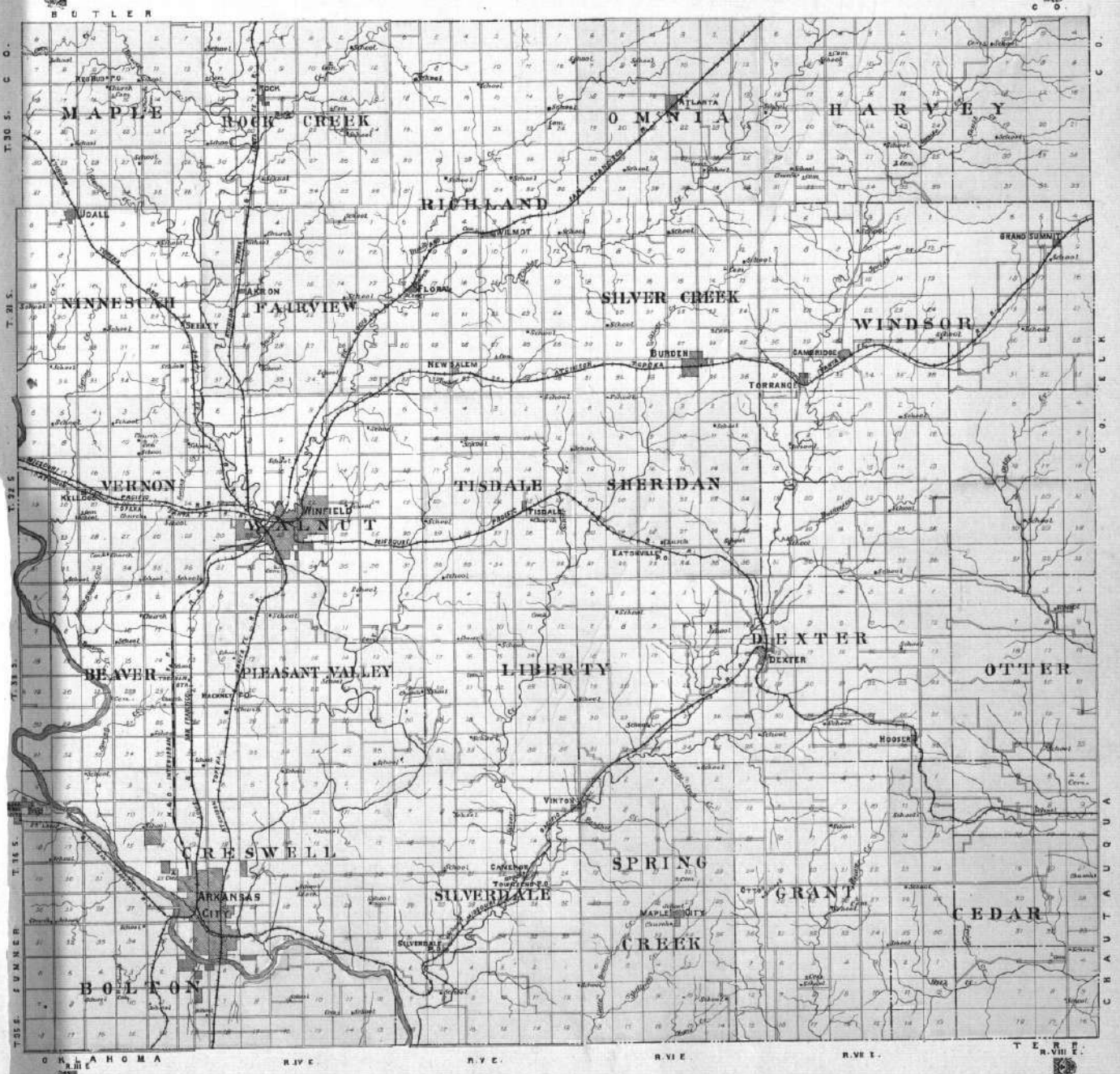

T. 30 S.
T. 31 S.
T. 32 S.
T. 33 S.
T. 34 S.
T. 35 S.

BUTLER OKLAHOMA R. 1 E. R. 2 E. R. 3 E. R. 4 E. R. 5 E. R. 6 E. R. 7 E. TURNER



MAP OF
OTTER
TOWNSHIP

Parts of Townships 32, 33 and 34 South Range VIII East of the 6th P.M.

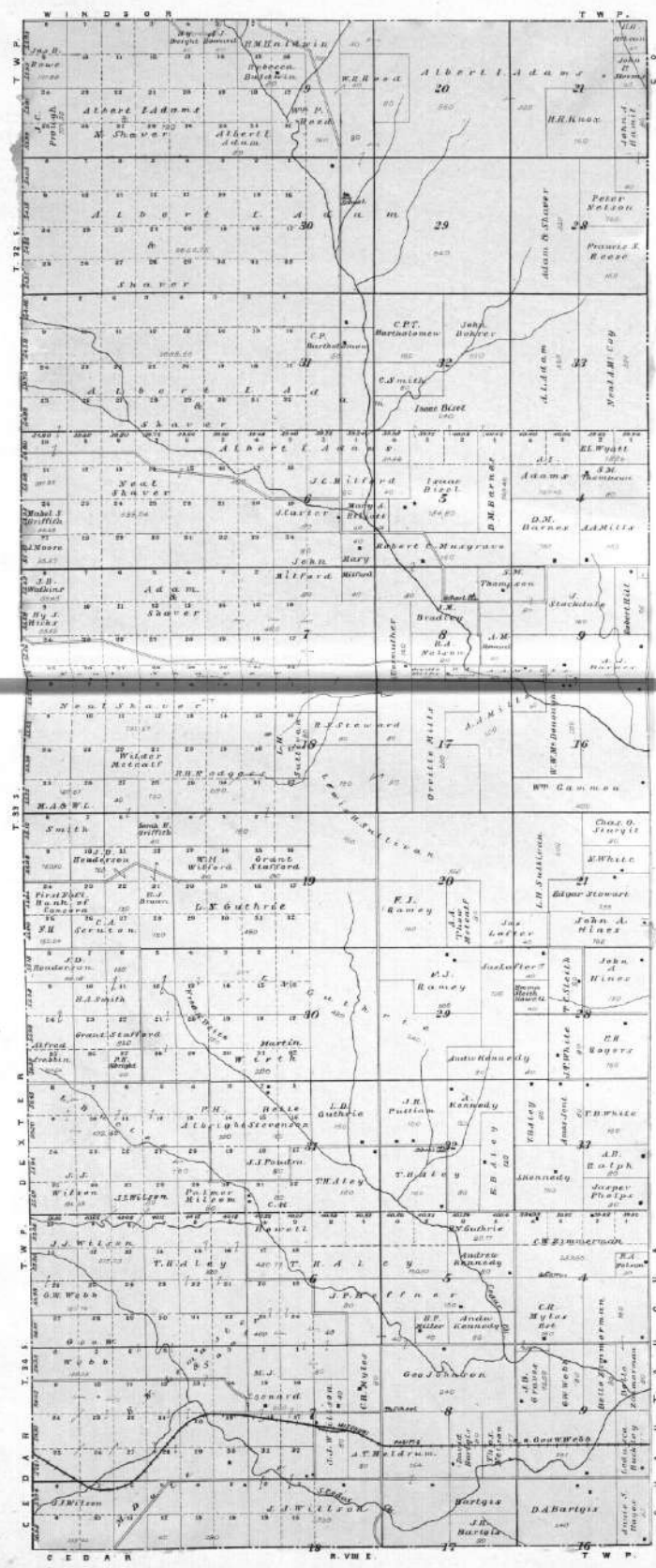



MAP OF
CEDAR
TOWNSHIP

Part of Township 34 South Ranges VII and VIII East
and Part of Fract' Township 35 South, Ranges VII and VIII East of the 6th P.M.

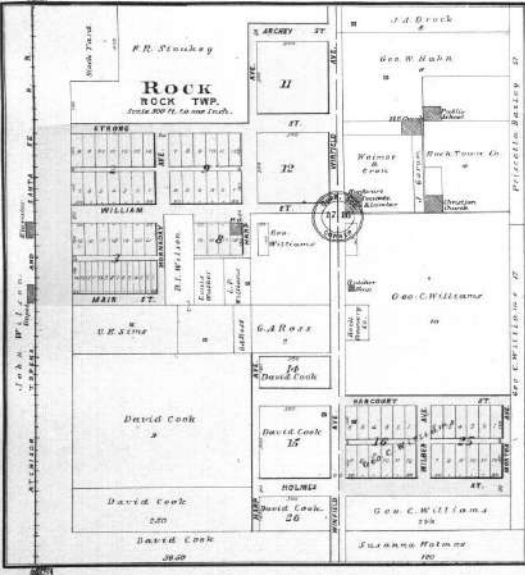
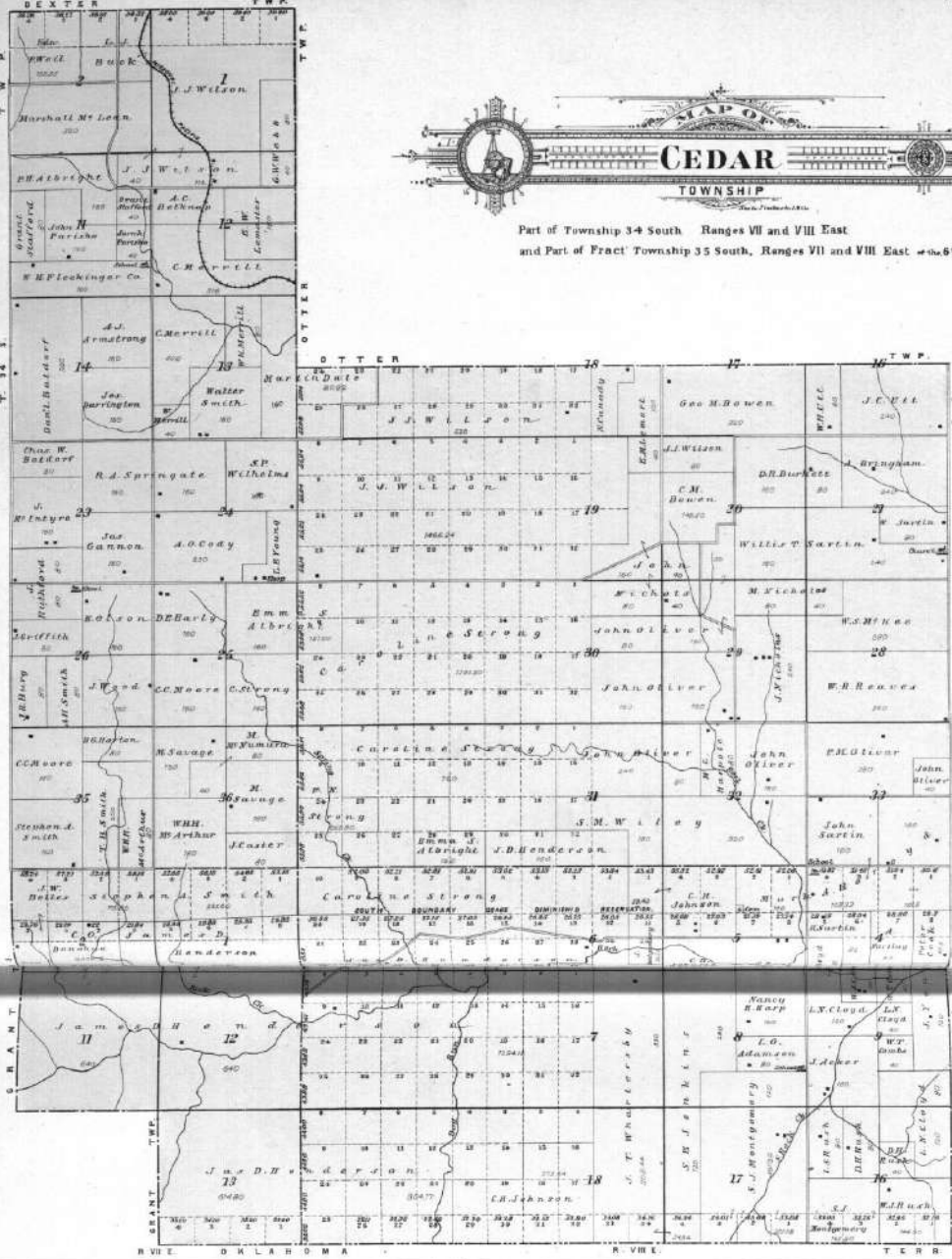

MAP OF GRANT TOWNSHIP

Part of Township 34 South, Ranges 1 and 7 East and Part of Fract' Township 35 South Ranges 1 and 7 East at the 6th P.M.

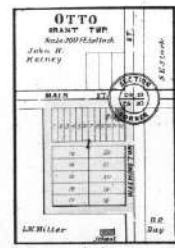
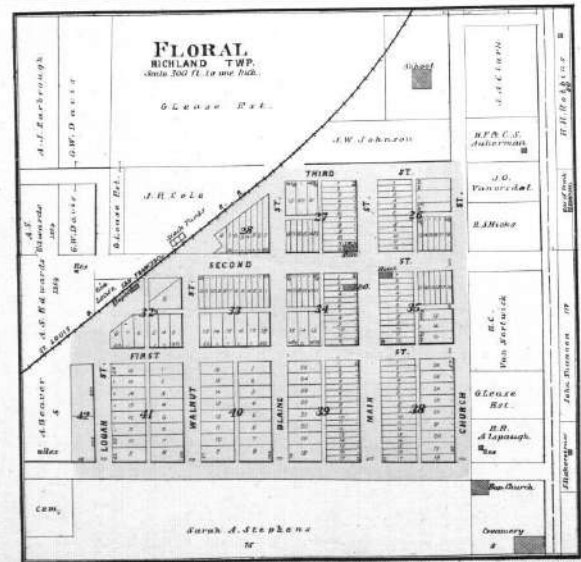
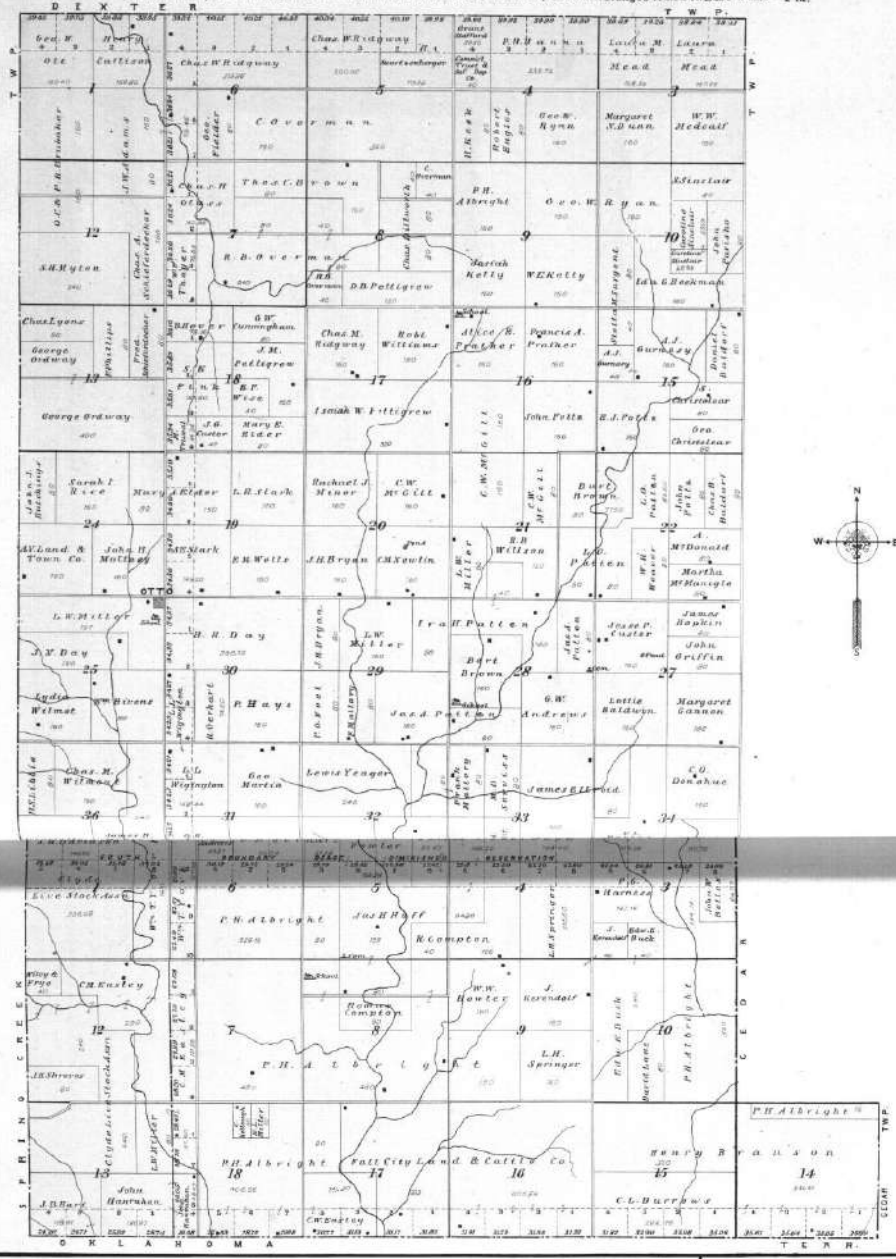

MAP OF SPRING CREEK TOWNSHIP

Part of Township 34 South Range VI East and Part of Fract. Township 35 South Range VI East of the 6th P.M.

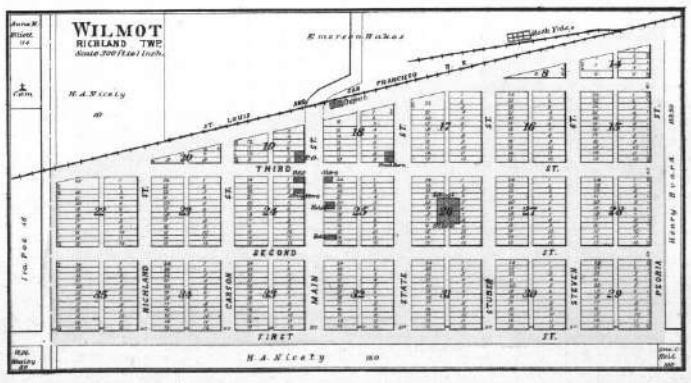
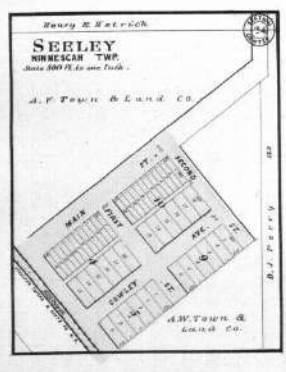
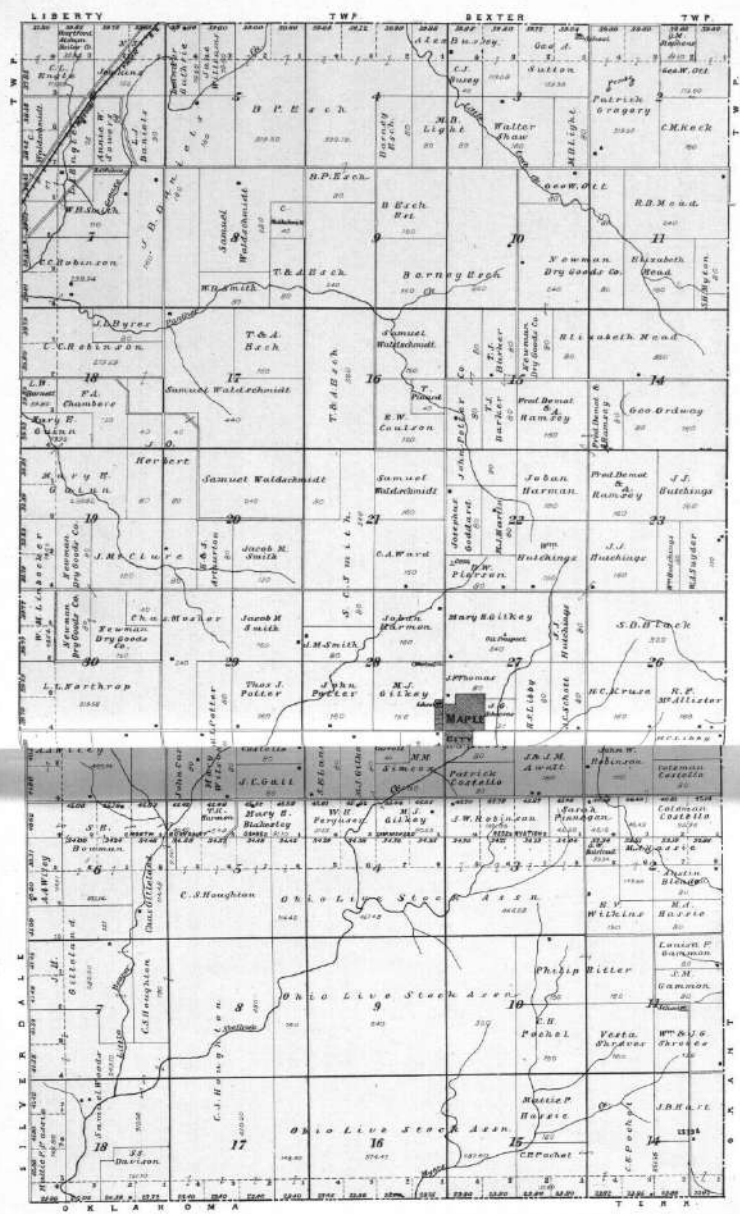

MAP OF SILVERDALE TOWNSHIP

Township 34 South Range V East and Fract Township 35 South Range V East - 6th 6th P.M.

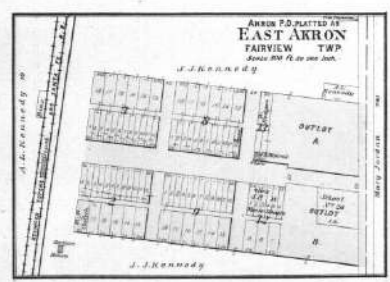
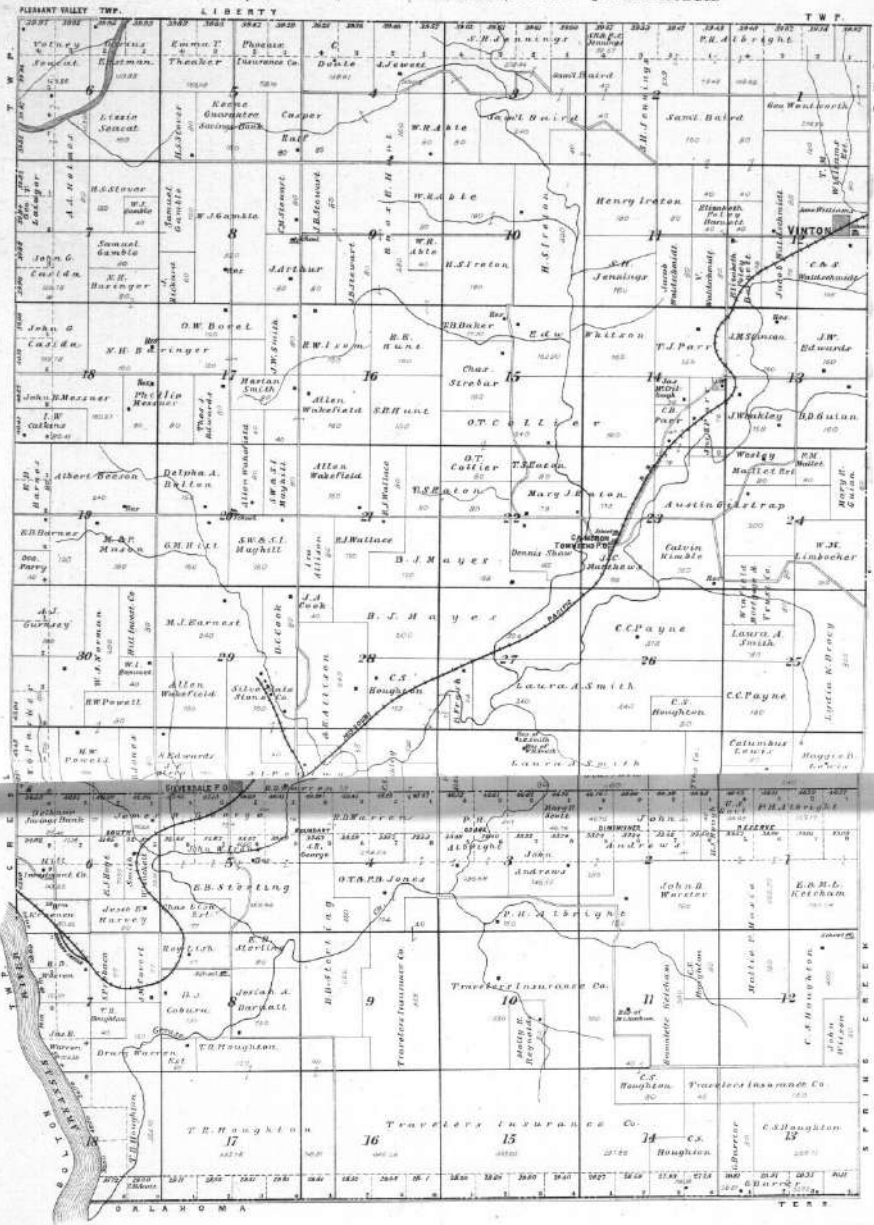

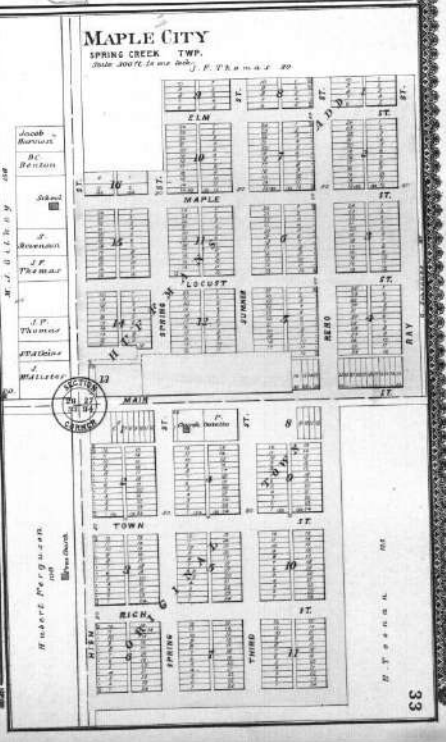
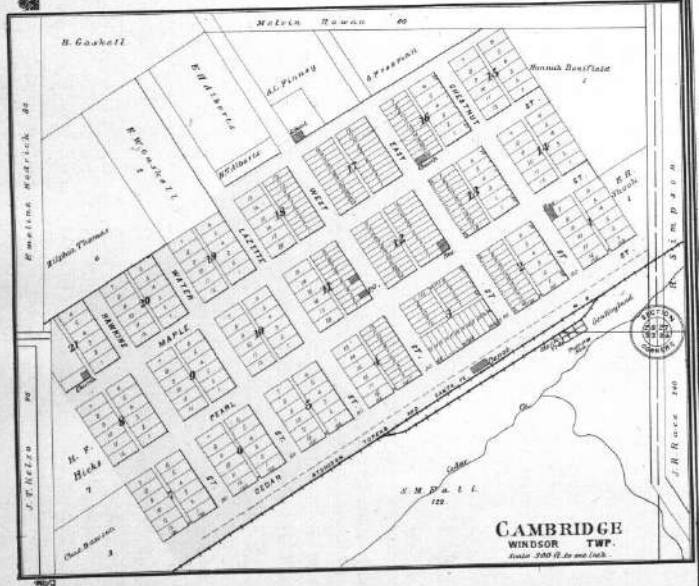

VERNON

TOWNSHIP

Part of Township 32 South, Range III and IV East of the 6th P.M.

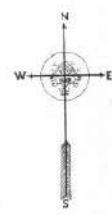
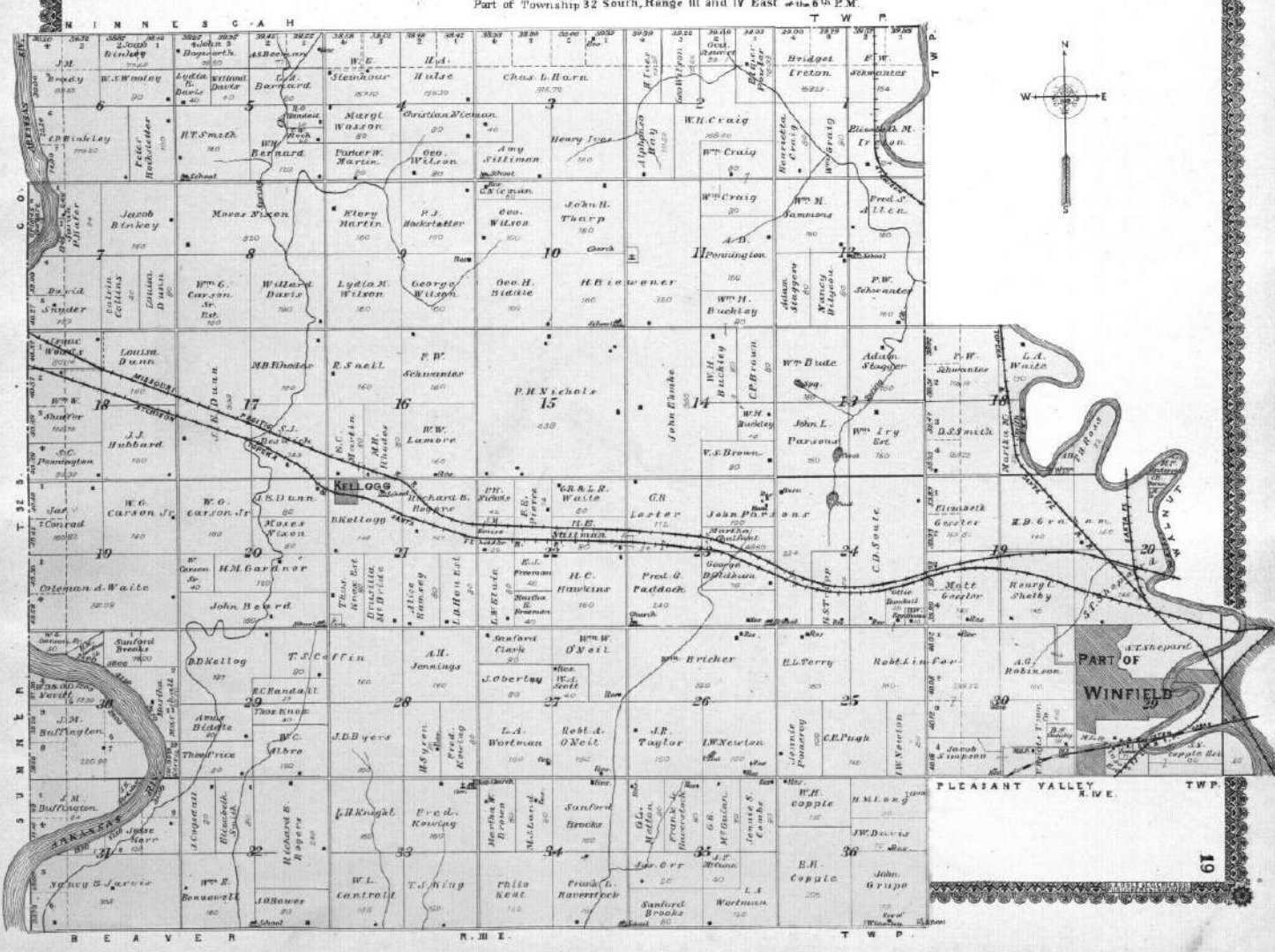



Part of Township 34 South East and Part of Fraction Township 35 South
Range 11 West and 1 East

MILTON		ATLANTA	
1st	2nd	1st	2nd
1	2	1	2
3	4	3	4
5	6	5	6
7	8	7	8
9	10	9	10
11	12	11	12
13	14	13	14
15	16	15	16
17	18	17	18
19	20	19	20
21	22	21	22
23	24	23	24
25	26	25	26
27	28	27	28
29	30	29	30
31	32	31	32
33	34	33	34
35	36	35	36
37	38	37	38
39	40	39	40
41	42	41	42
43	44	43	44
45	46	45	46
47	48	47	48
49	50	49	50
51	52	51	52
53	54	53	54
55	56	55	56
57	58	57	58
59	60	59	60
61	62	61	62
63	64	63	64
65	66	65	66
67	68	67	68
69	70	69	70
71	72	71	72
73	74	73	74
75	76	75	76
77	78	77	78
79	80	79	80
81	82	81	82
83	84	83	84
85	86	85	86
87	88	87	88
89	90	89	90
91	92	91	92
93	94	93	94
95	96	95	96
97	98	97	98
99	100	99	100

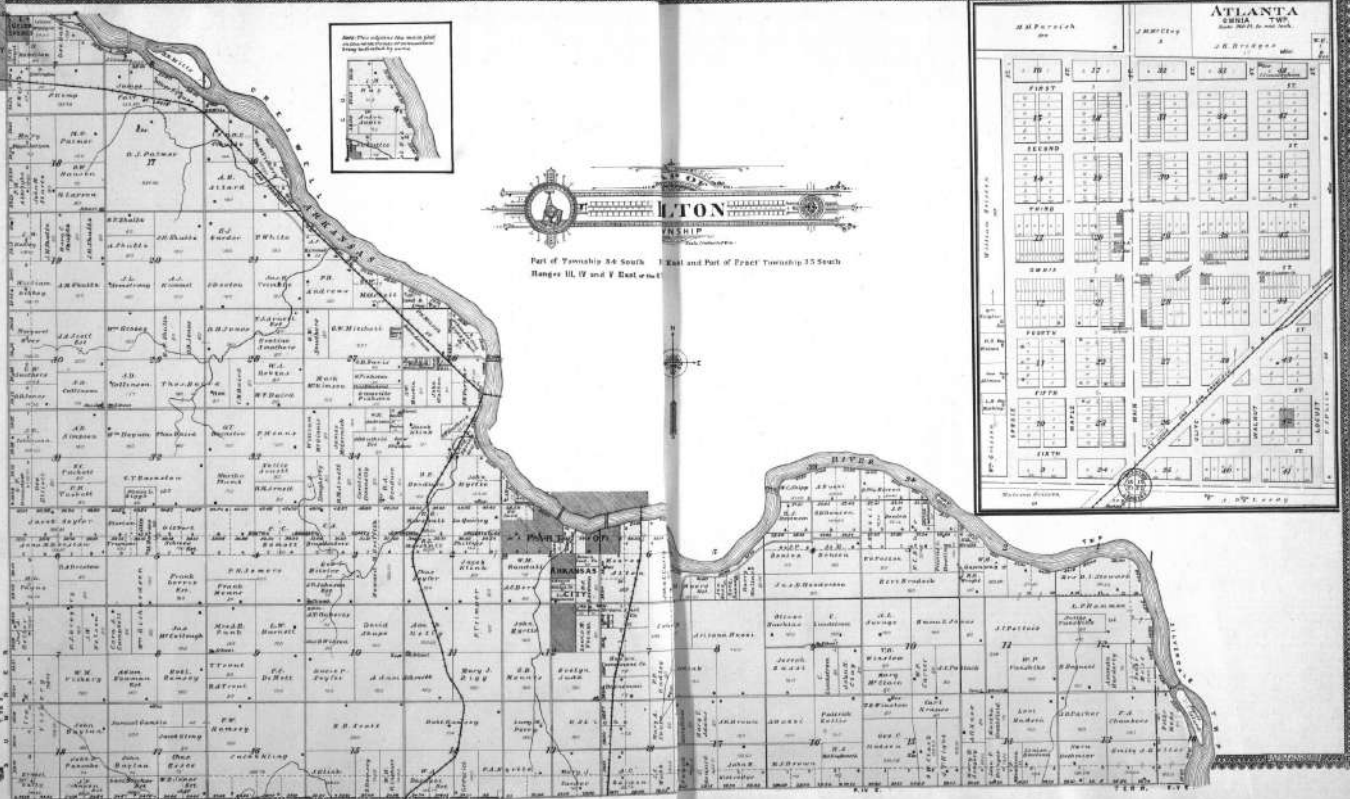

CRESWELL
TOWNSHIP

Parts of Townships 24 and 25 South, Ranges 11 and 12 East - 5th P.M.

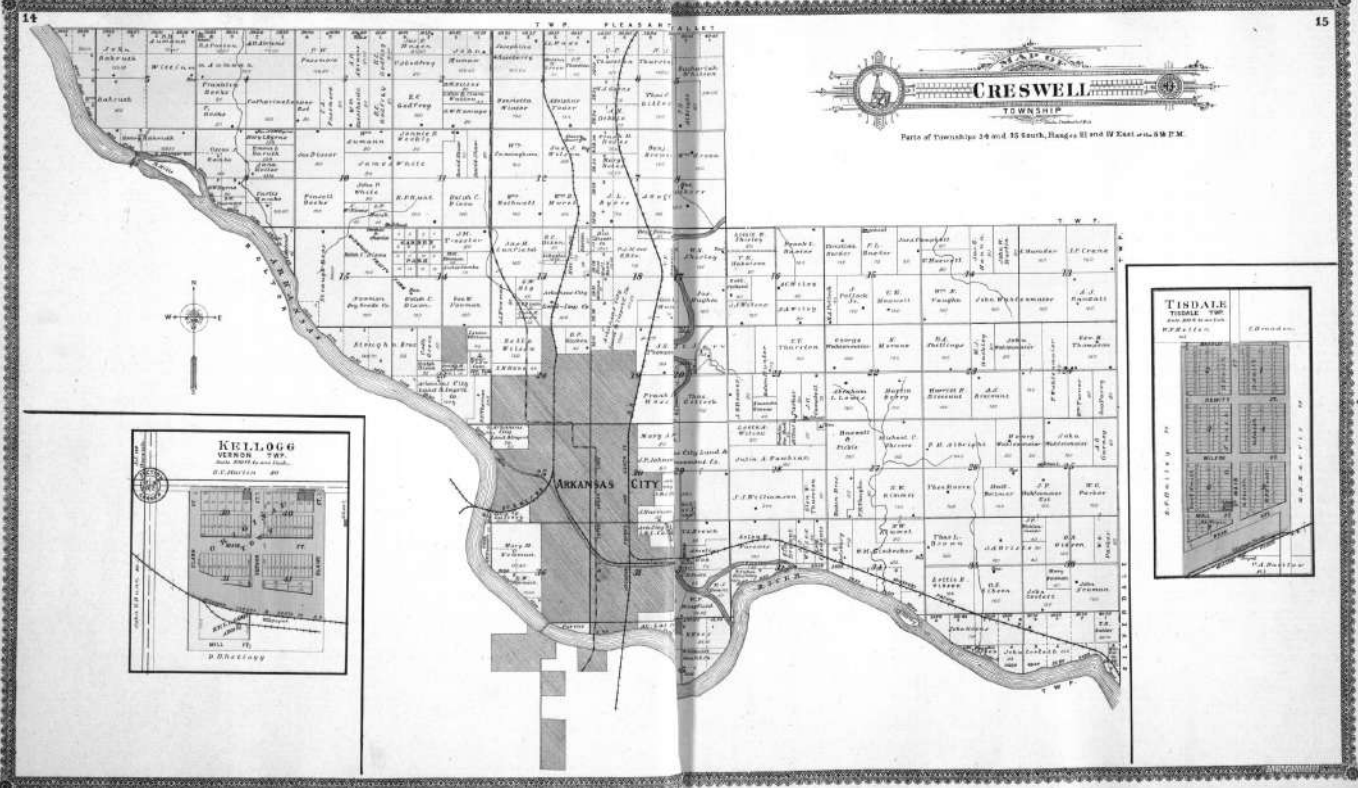



MAP OF
BEAVER
 TOWNSHIP
 Township 33 South Range III East of the 6th P.M.



BOLTON TWP. C H E S W E L L T W P.

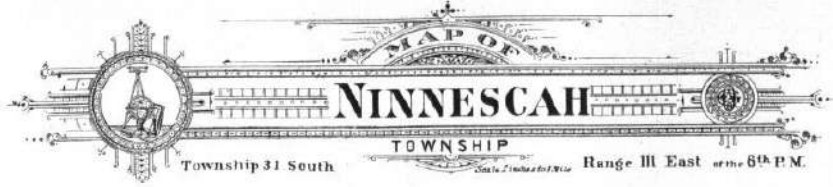

 MAP OF
NINNESCAH
 TOWNSHIP
 Township 31 South Range III East of the 6th P.M.

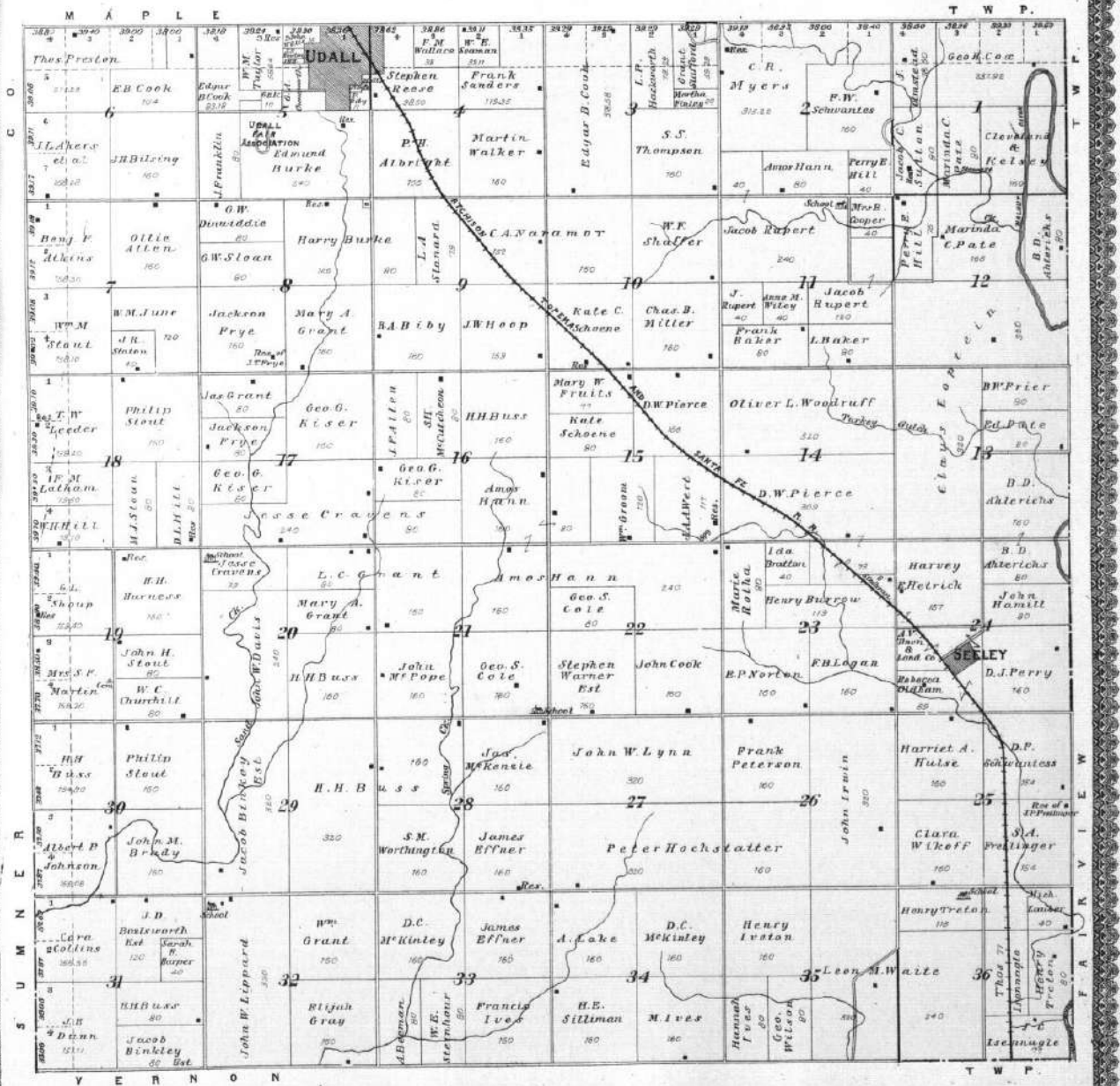



MAP OF
MAPLE
TOWNSHIP
 Township 30 South Range III East of the 6th P.M.

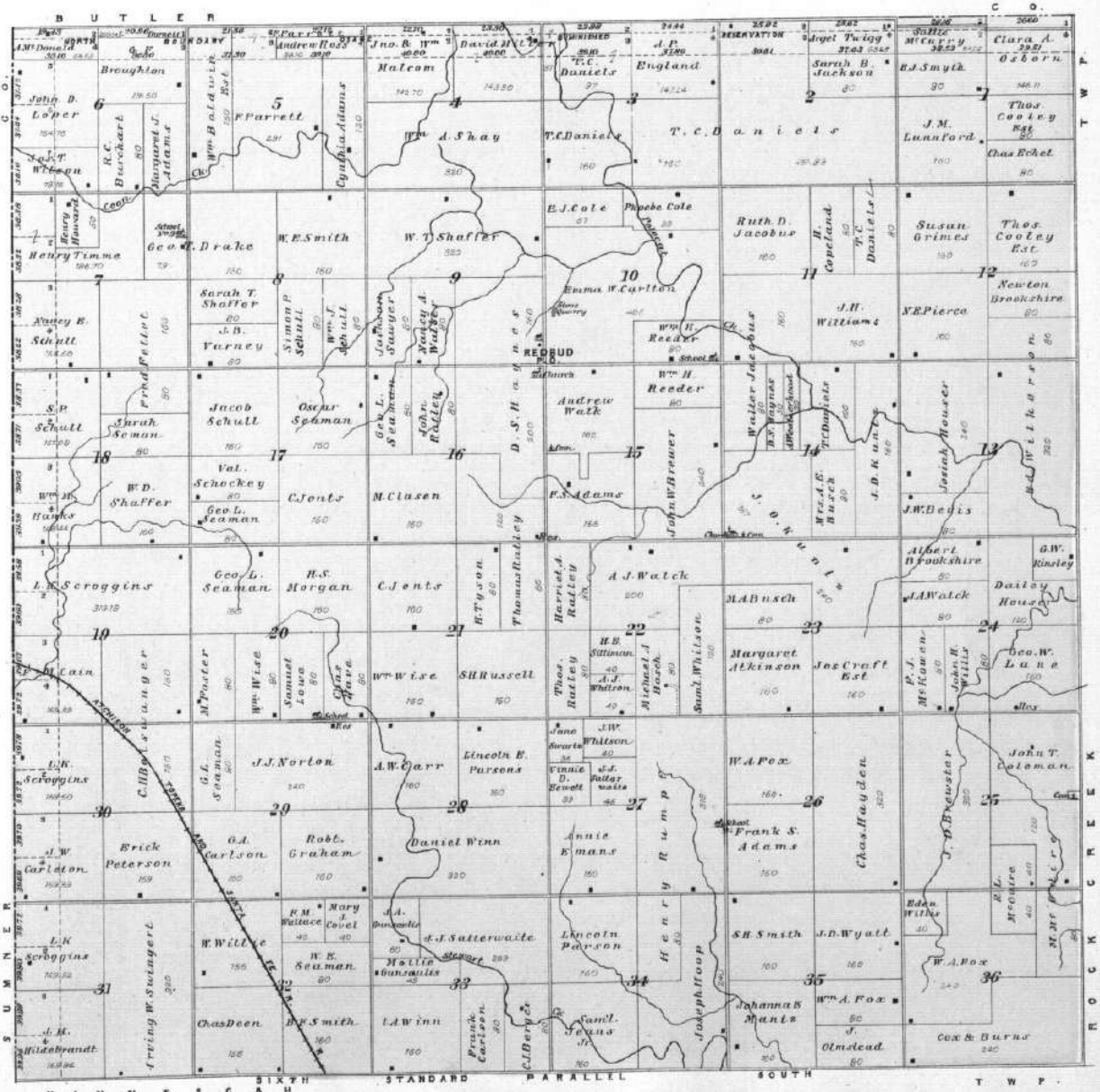

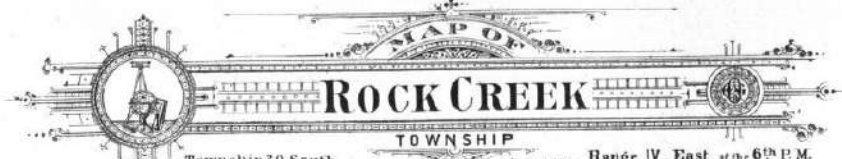

MAP OF
Rock Creek
TOWNSHIP
 Township 20 South Range IV East of the 6th P.M.

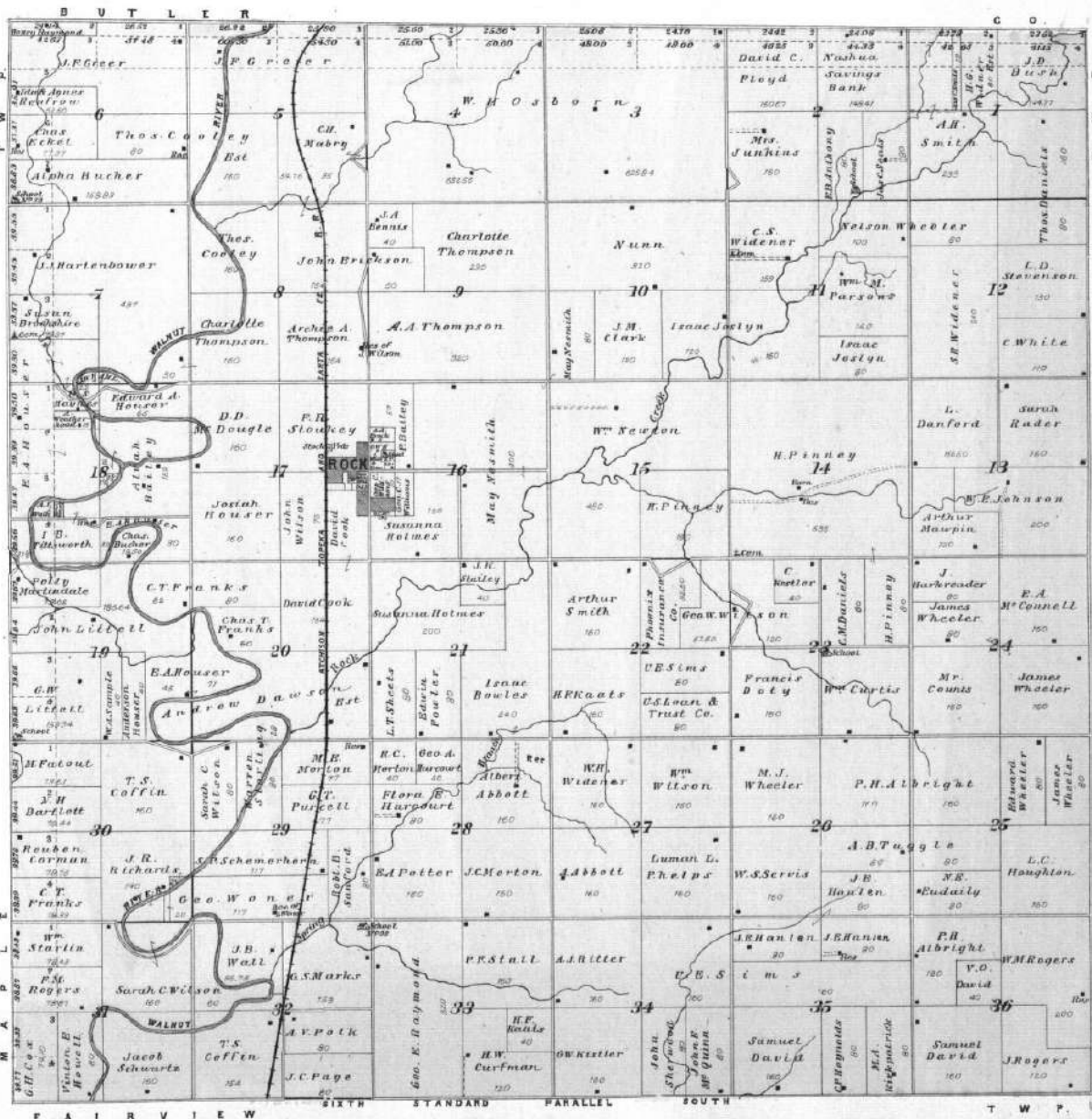



MAP OF FAIRVIEW TOWNSHIP

 Township 31 South Range IV East of the 6th P.M.

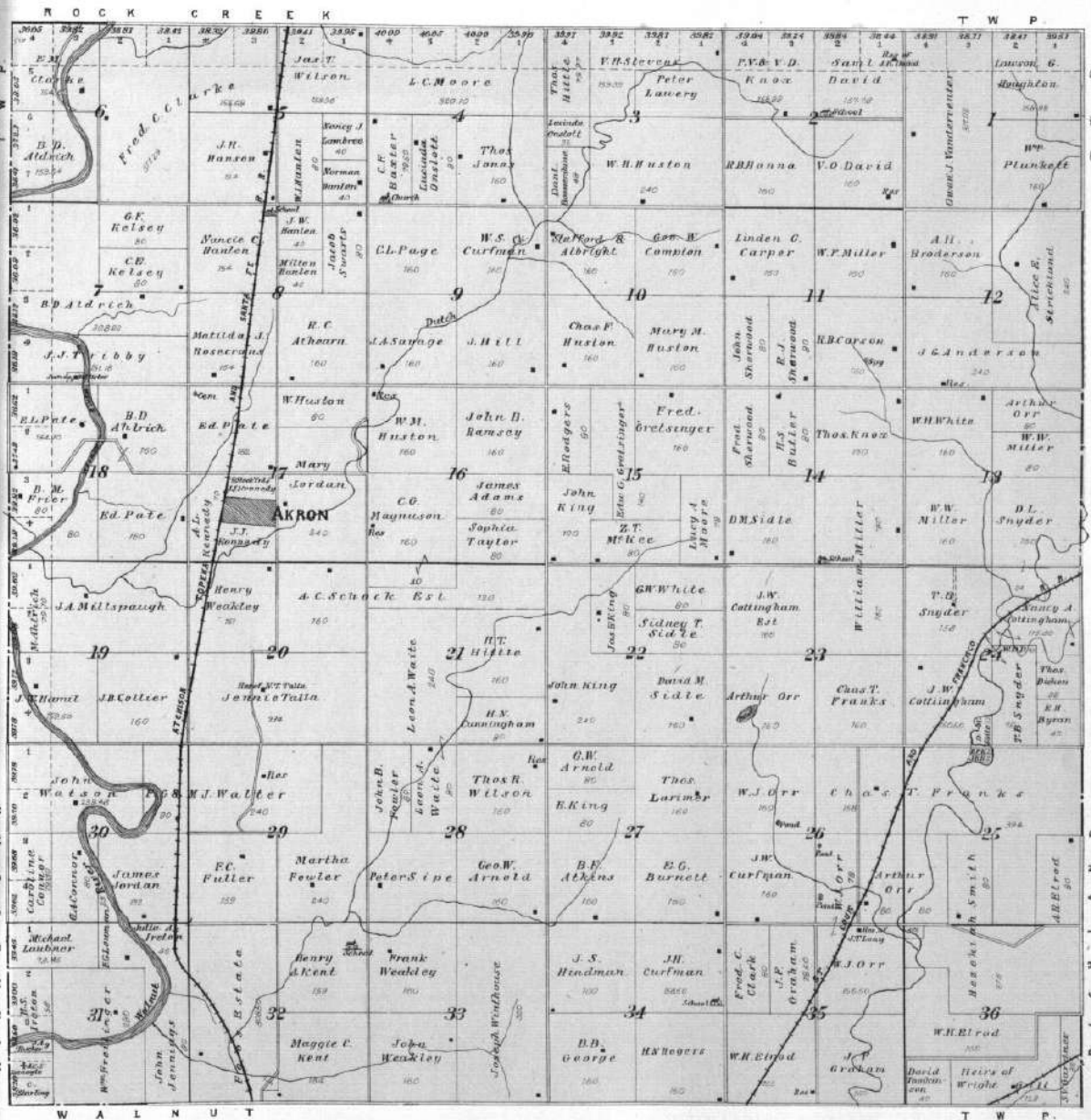

FAIRVIEW

T W P.

RICHLAND

TWP.

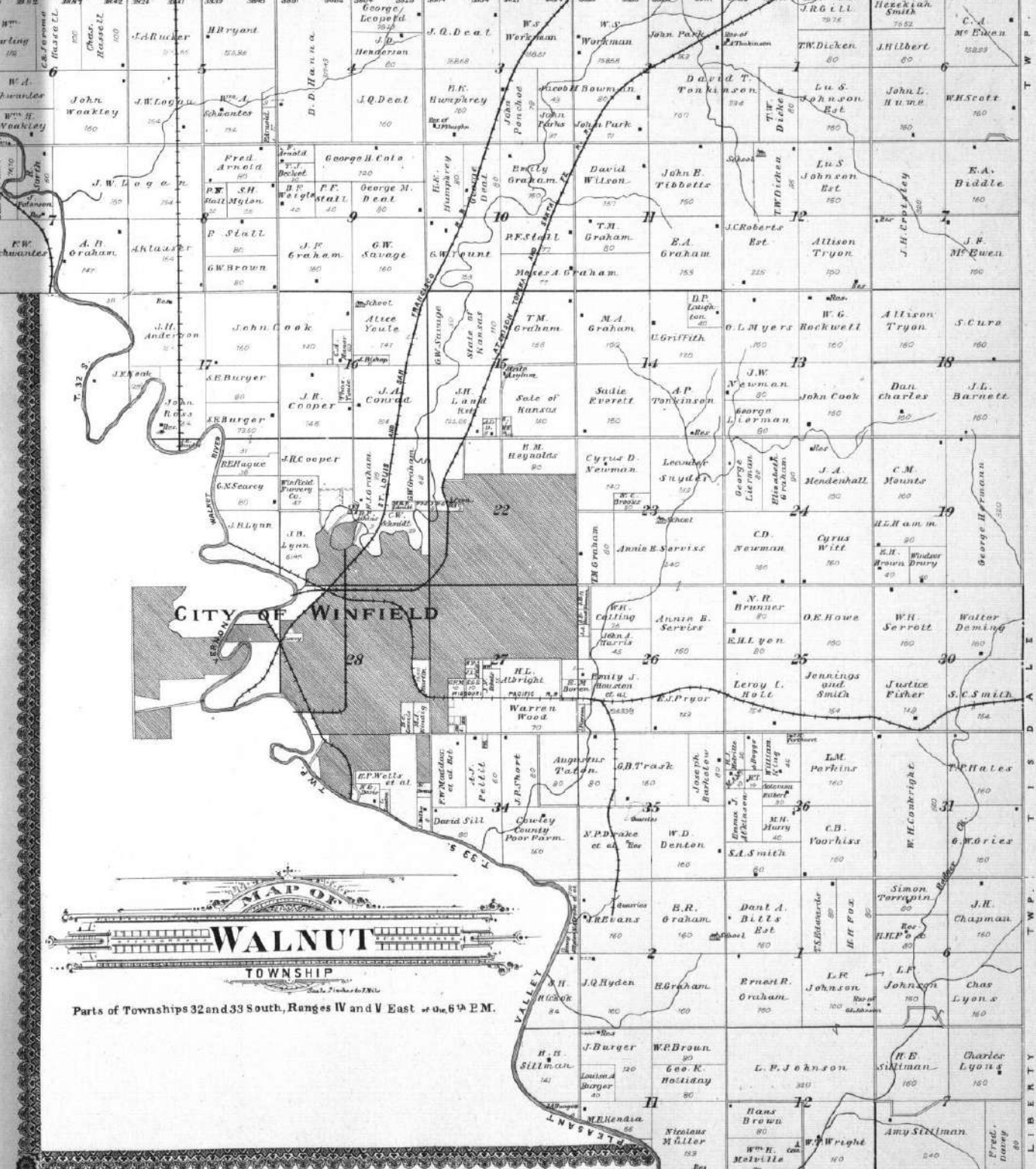

CITY OF WINFIELD

WALNUT TOWNSHIP

Parts of Townships 32 and 33 South, Ranges IV and V East of the 6th P.M.

PLEASANT VALLEY R. IV E. TWP. R. V E. TWP.

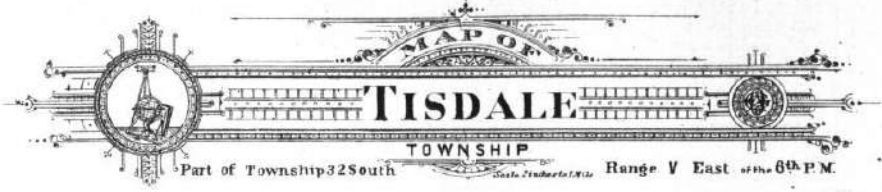

TISDALE

 TOWNSHIP

Part of Township 32 South Range V East of the 6th P.M.

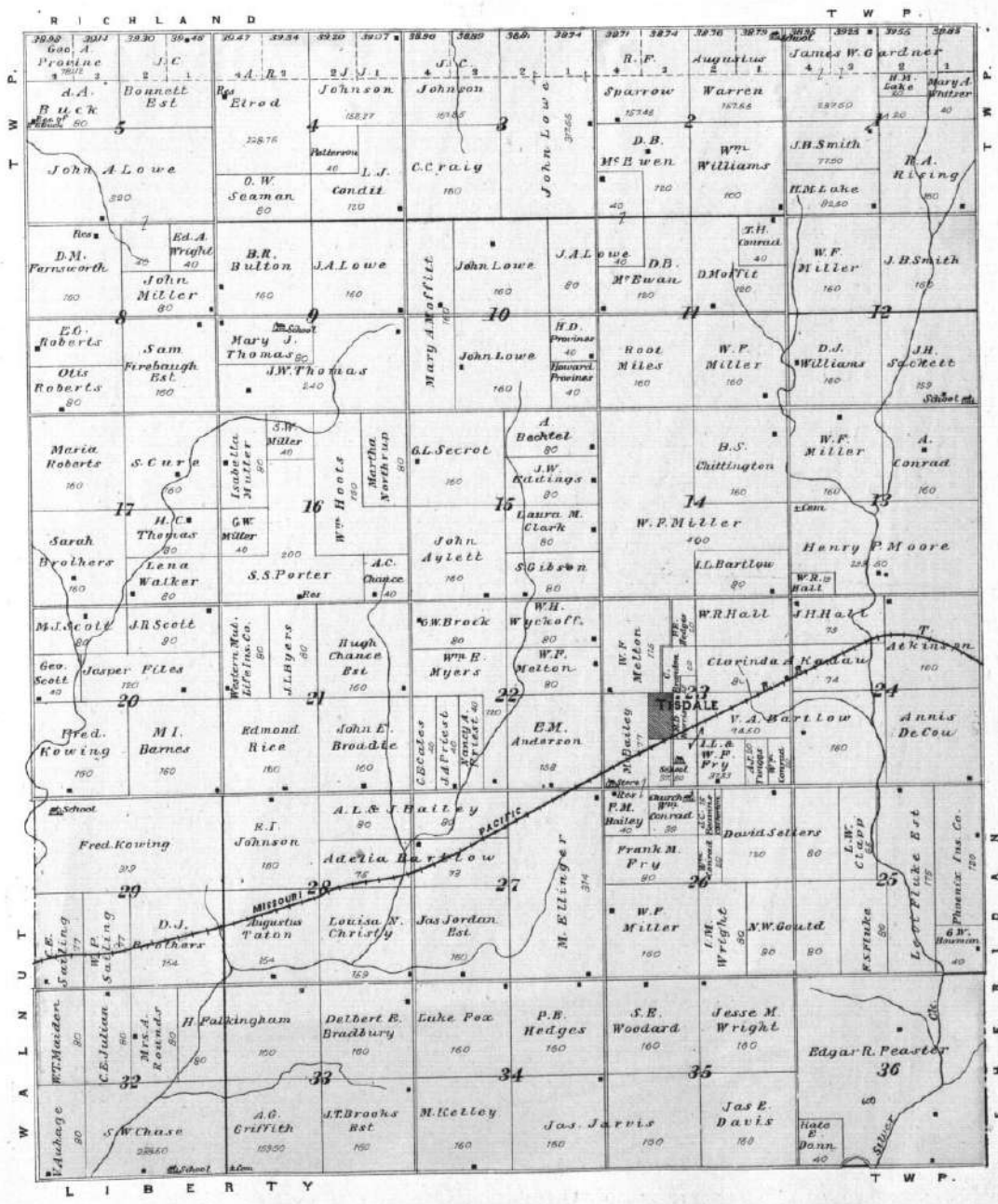



MAP OF
OMNIA
TOWNSHIP
 Township 30 South Range VI East of the 6th P.M.

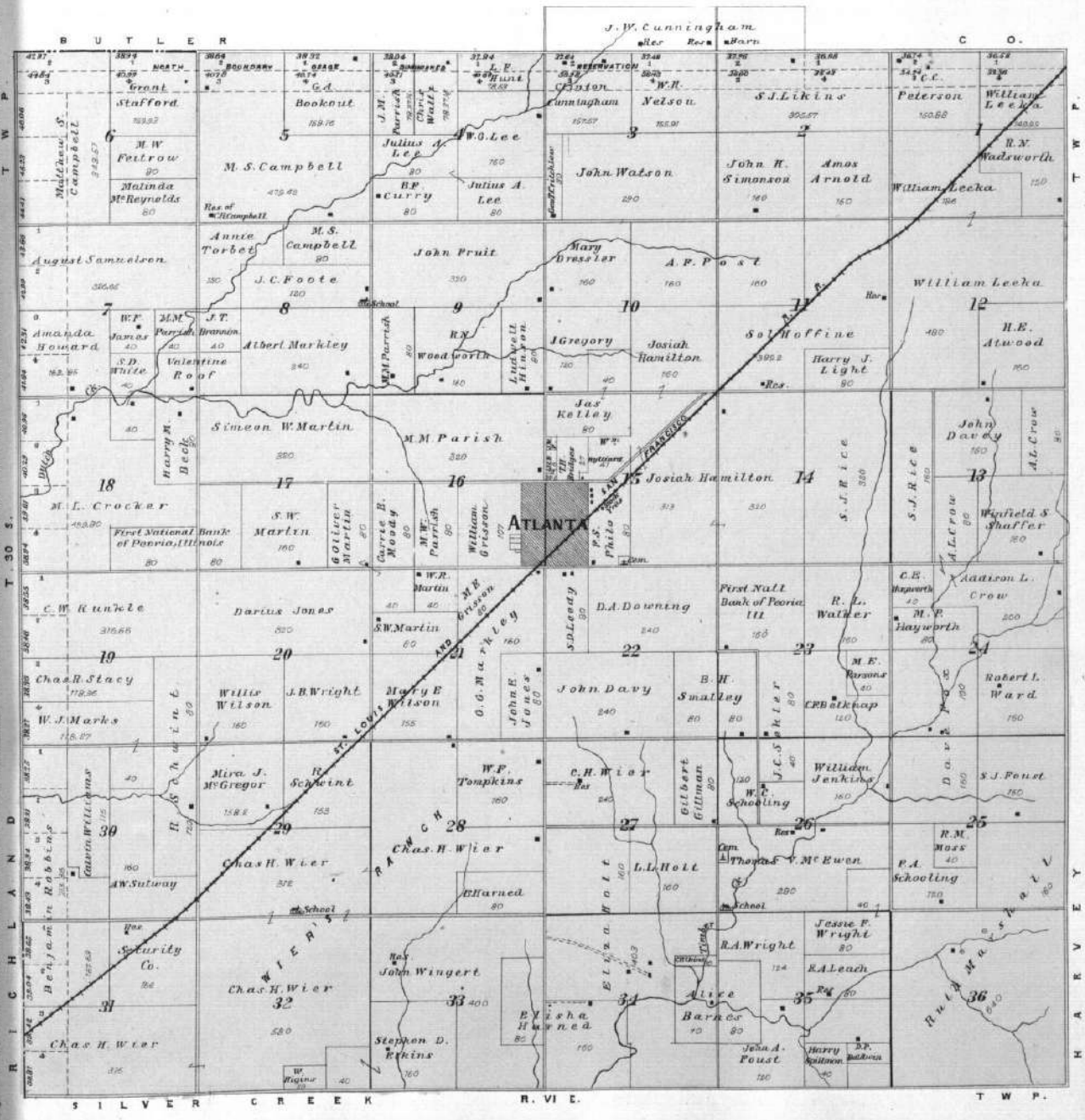

MAP OF
SILVER CREEK
 TOWNSHIP
 Township 31 South Range VI East of the 6th P.M.

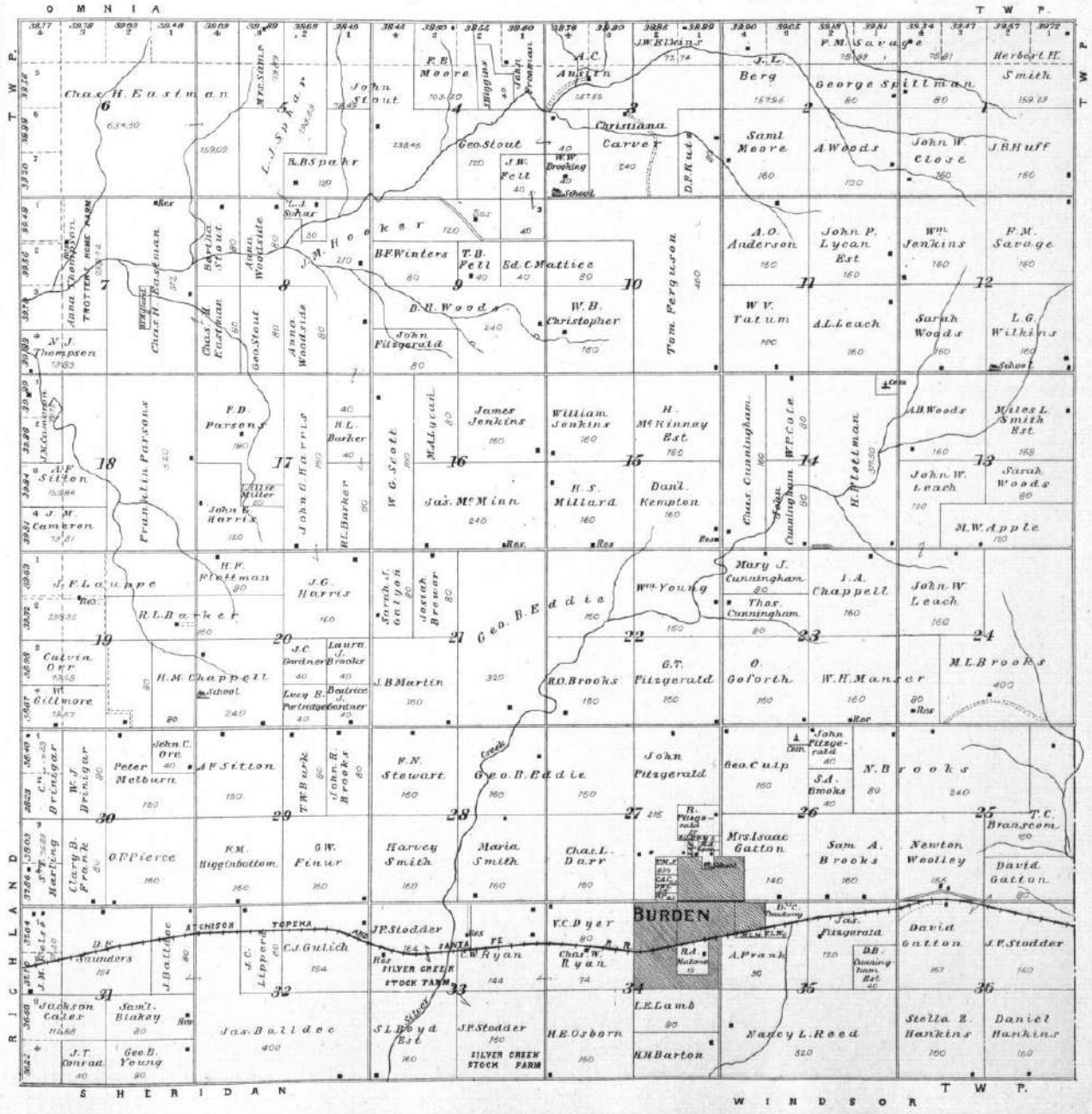



SHERIDAN

 TOWNSHIP

Township 32 South Range VI East of the 6th P.M.

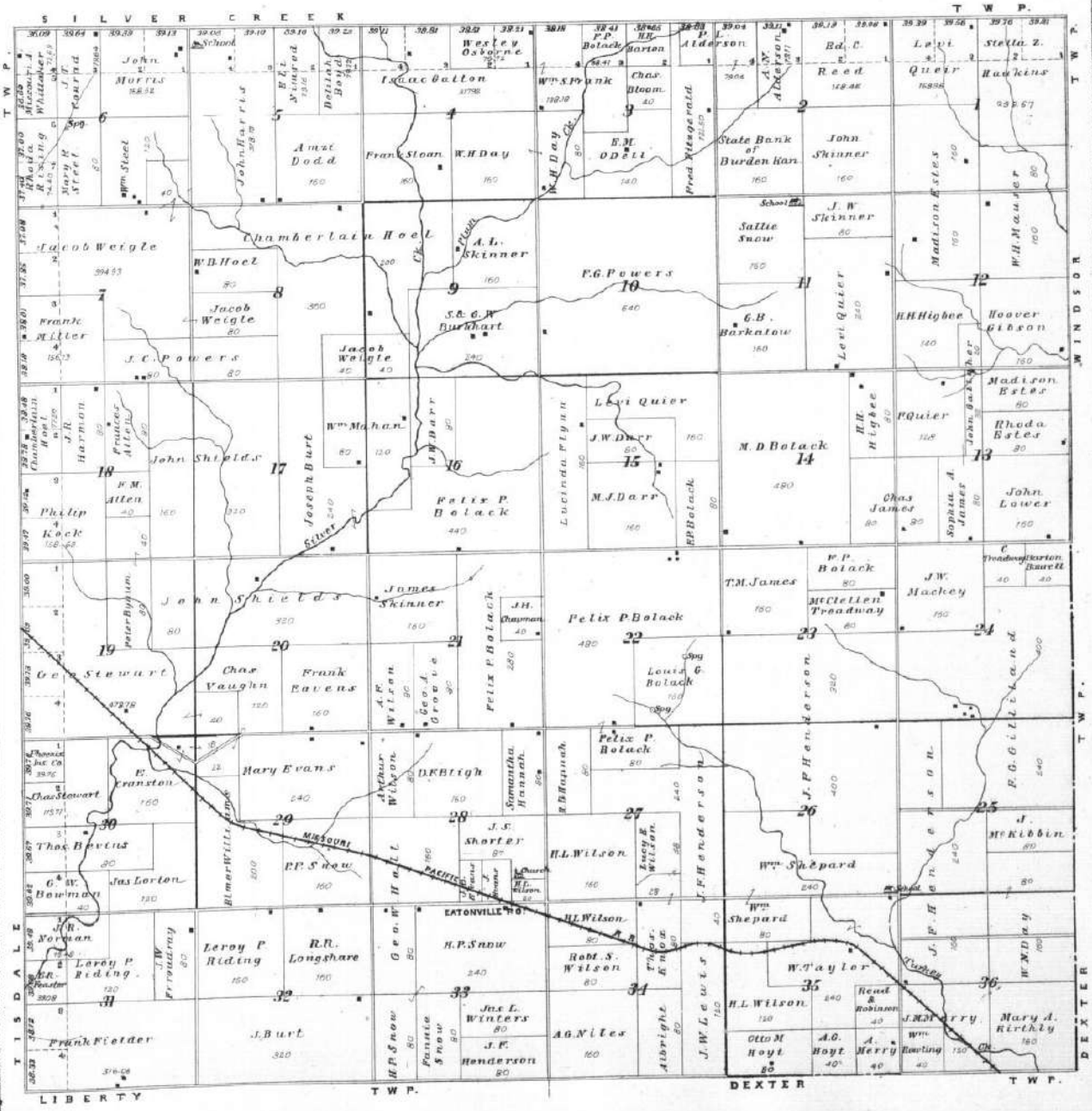

FOR TOP TIER OF SECTIONS IN WINDSOR TWP SEE PAGES 76-78 Connecting points indicated by ...

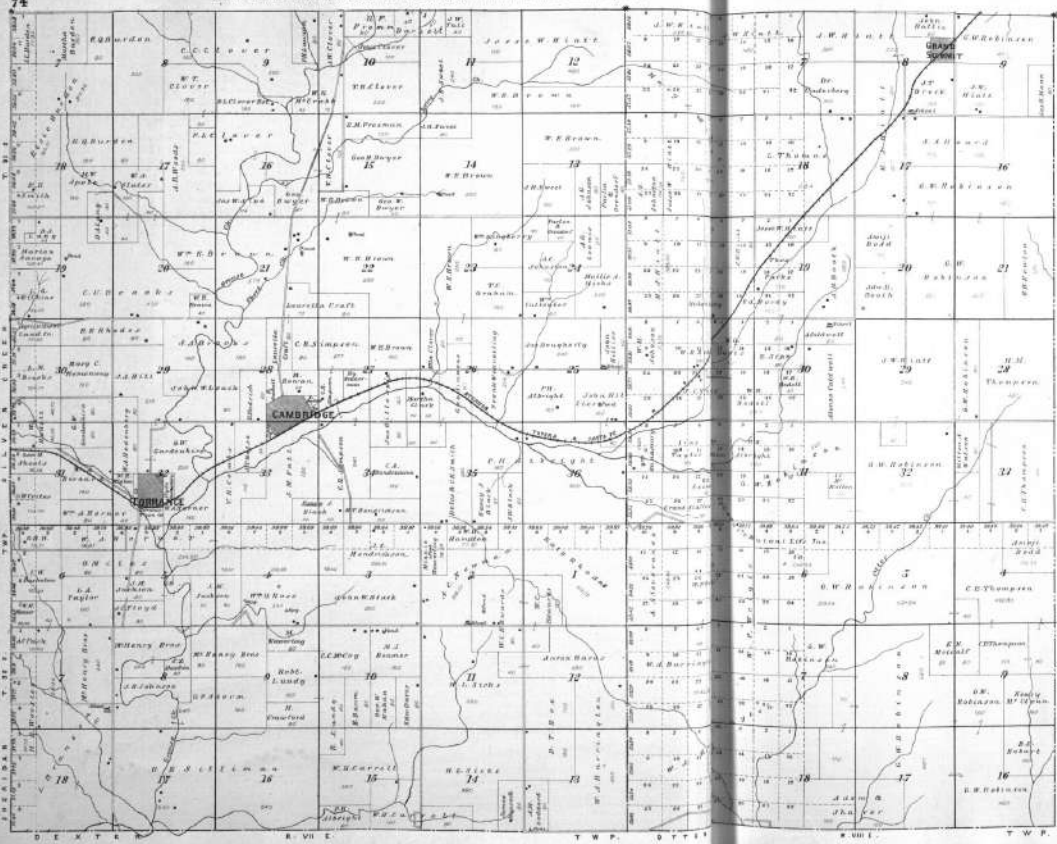

WINDSOR
 TOWNSHIP
 Township 31 South Range VI East and Part of Townships 31-32 South,
 Ranges VI and VII East of the 9th P.M.

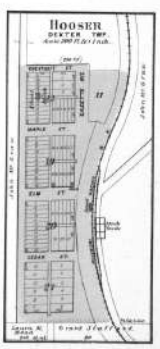

NORTH PART OF
CITY OF WINFIELD
and Environs
COUNTY SEAT OF COWLEY COUNTY,
KAS. *Scale: Not to Scale*

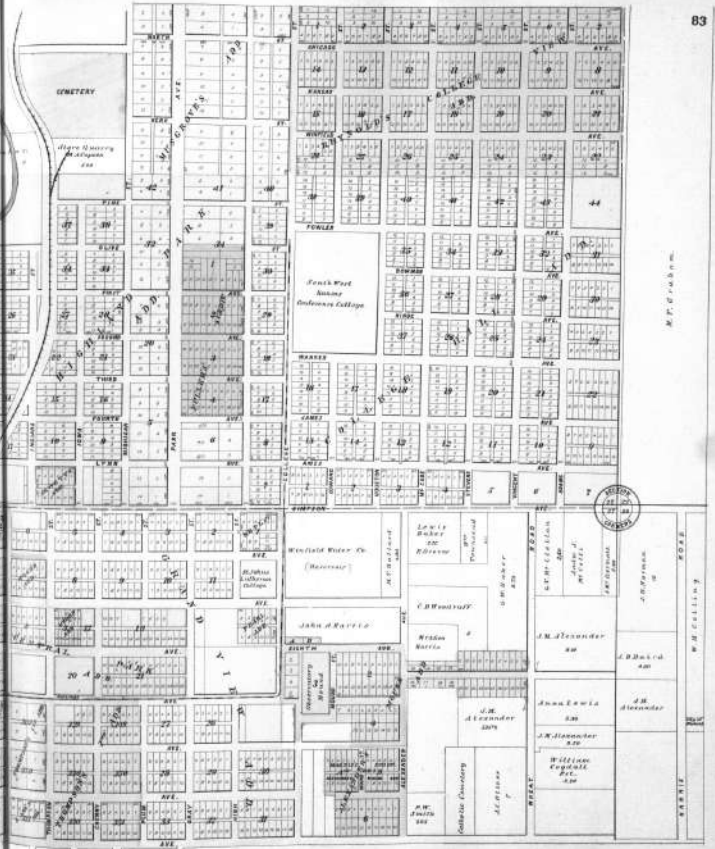
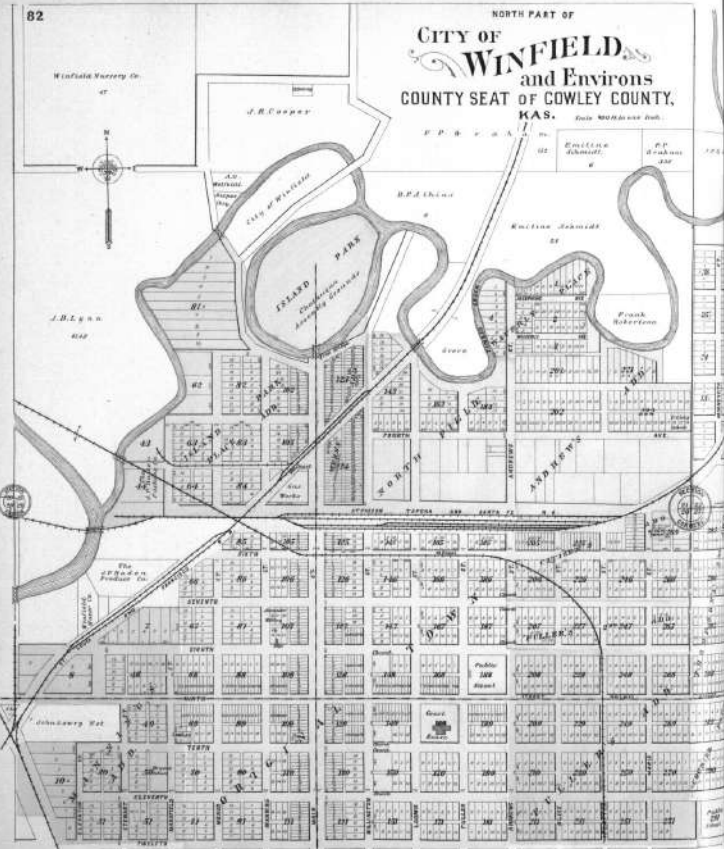

W. P. Crabb

W. H. Collins

W. H. Collins

SOUTH
CITY OF WINFIELD
 and Environs
 COUNTY SEAT OF WINN COUNTY,
 KANSAS



WEST PART OF
CITY OF WINFIELD
and Environs
COUNTY SEAT OF COWLEY COUNTY,
KAS. Scale 400 Ft. to one Inch.

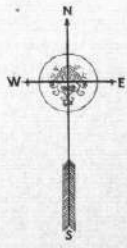
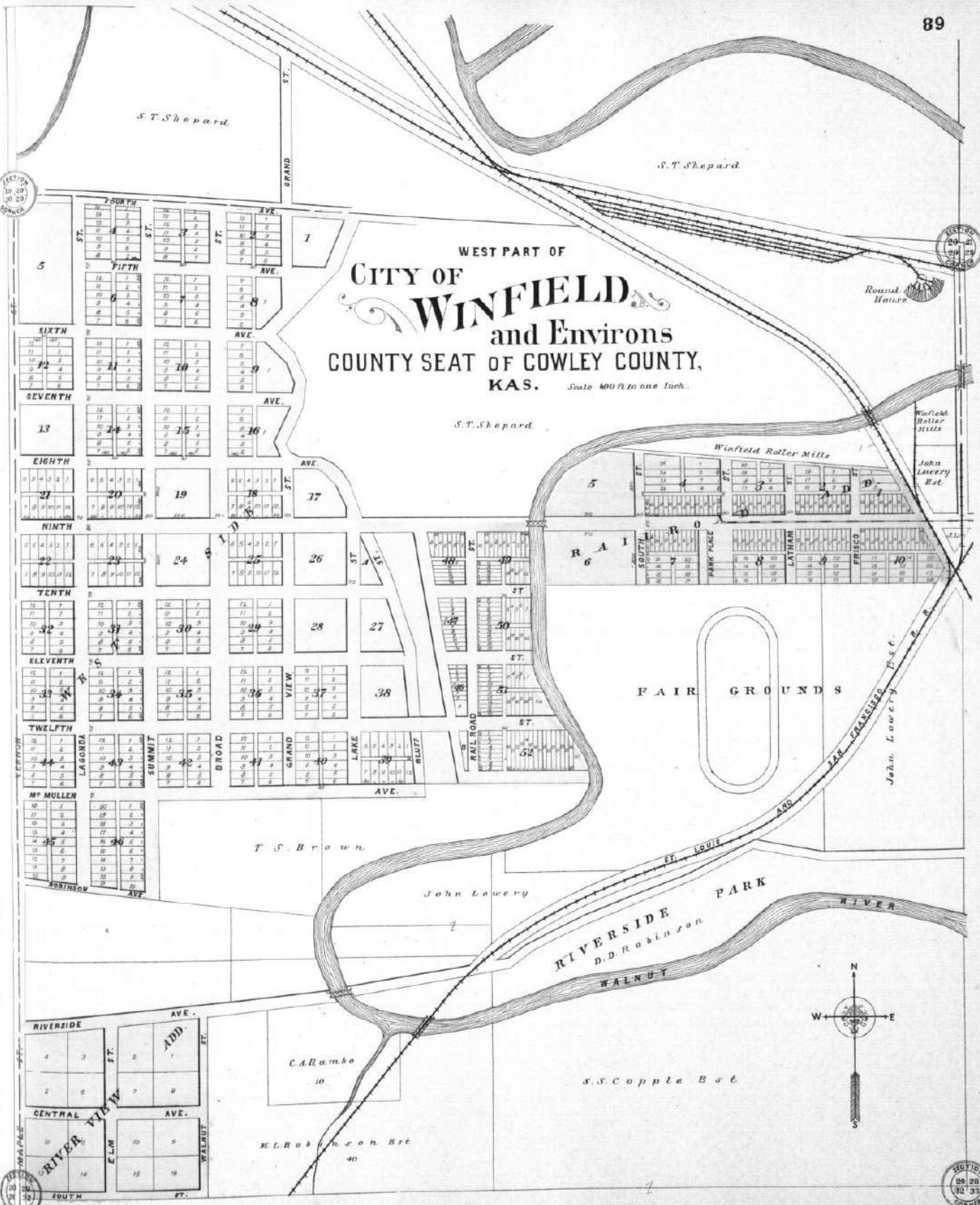

**SOUTH PART OF
ARKANSAS CITY**
WESTWELL & BOLTON TWP
COWLEY CO. KAS.

Scale 400 FT. to one Inch.

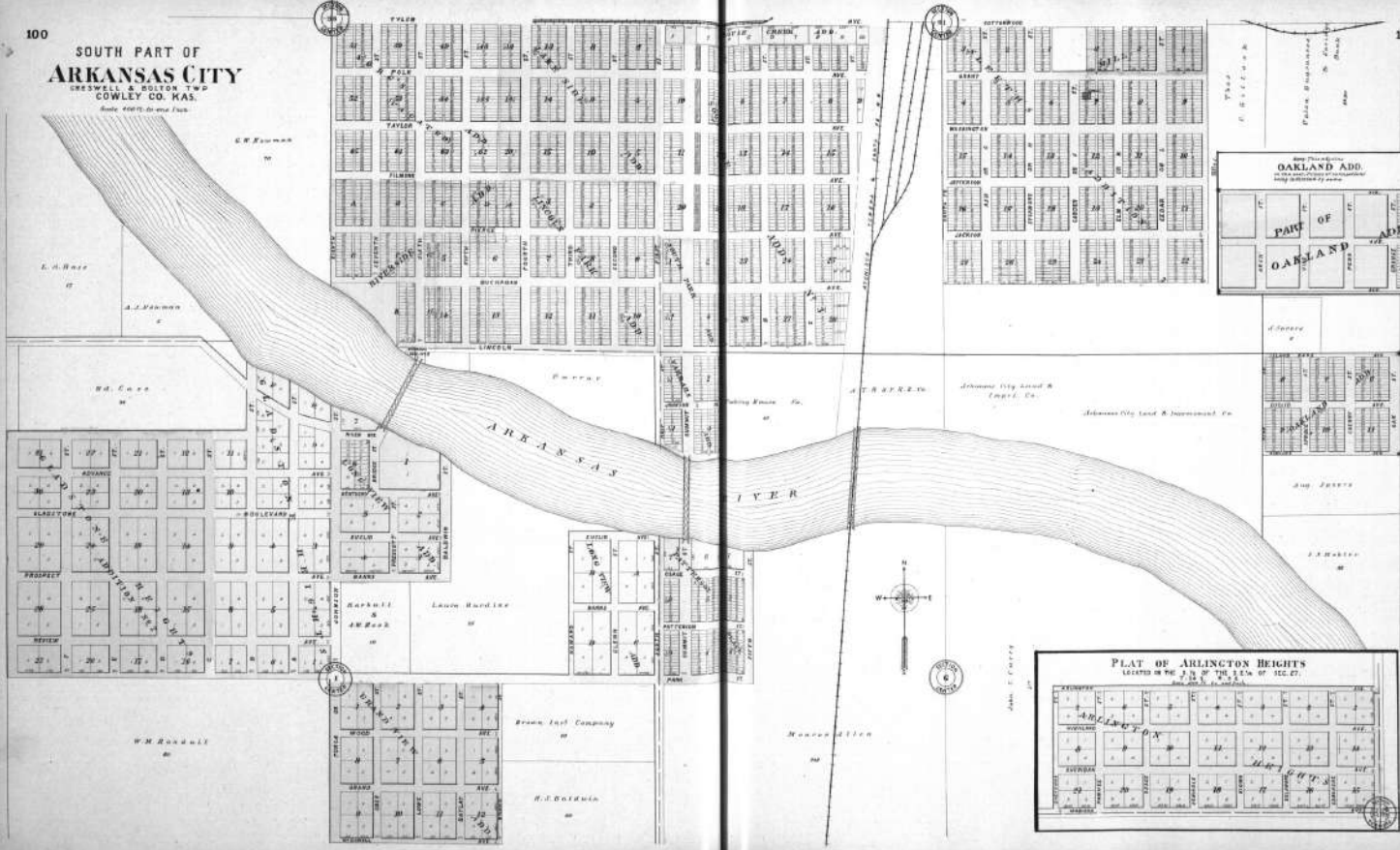

OAKLAND ADD.
PART OF
OAKLAND ADD.

PLAT OF ARLINGTON HEIGHTS
LOCATED IN THE S. 1/4 OF THE S. 1/4 OF SEC. 17.

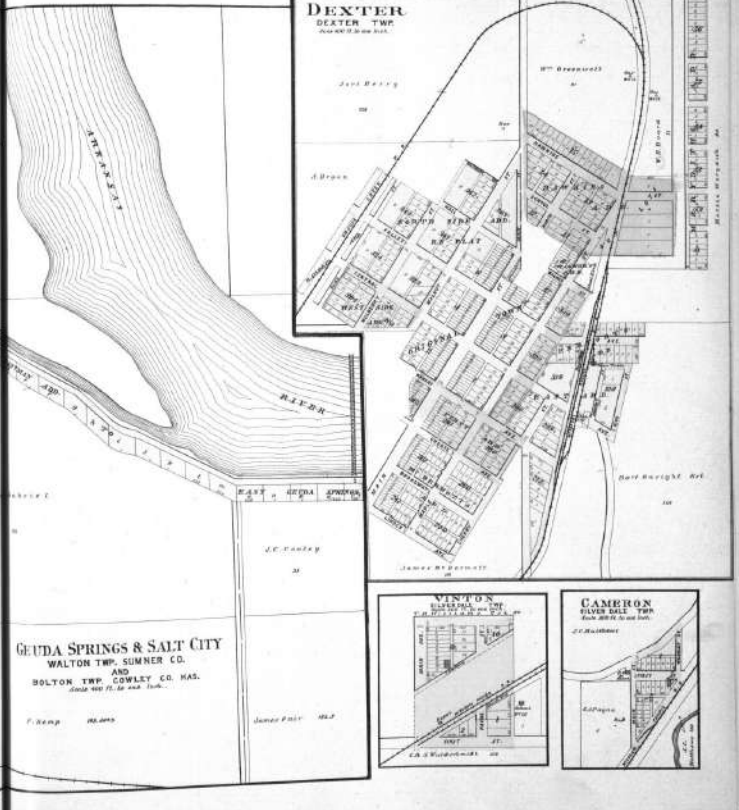
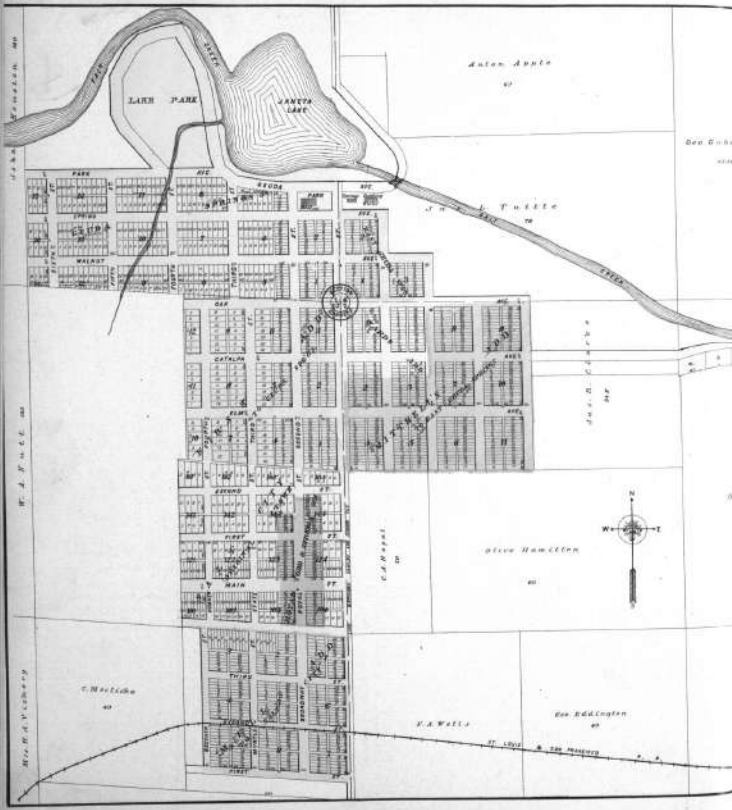

Chas. L. Dorr 1860

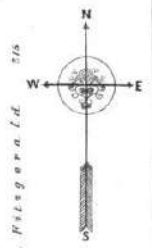

John Fitzgerald 215

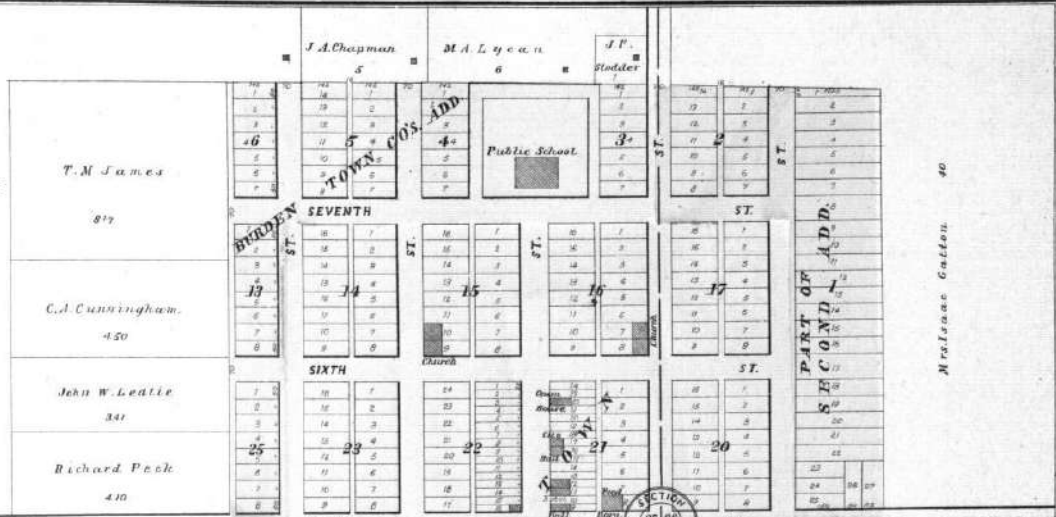

W.C. Dyer 80

CITY PARK ADD.



Chas. W. Ryan 14

Robert Parmlay ADD.

W.E.S.T. S. O.U.T.H. J. S. K. H. R. I. N. G. T. O. N

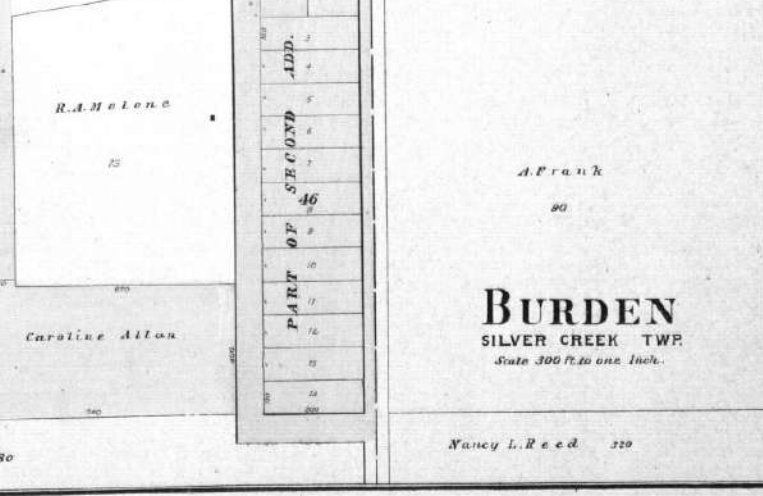

L. E. L. a. m. b 80