

J.R. DUNHAM
 Compiler & Draftsman
 CLINTON, IOWA.

OUTLINE MAP OF
CRAWFORD CO.

KANSAS

1906

Scale 1/2 Inch to the Mile

- EXPLANATION**
- Section line
 - Farm or lot line
 - Wagon Road
 - Railroad
 - Creeks & Springs
 - Houses
 - Churches
 - School Houses
 - Adjacent lands owned by same party connected by a link, thus
 - Post Office
 - Coal, lead or Zinc Mine
 - County Bridge
 - Border Page Numbers

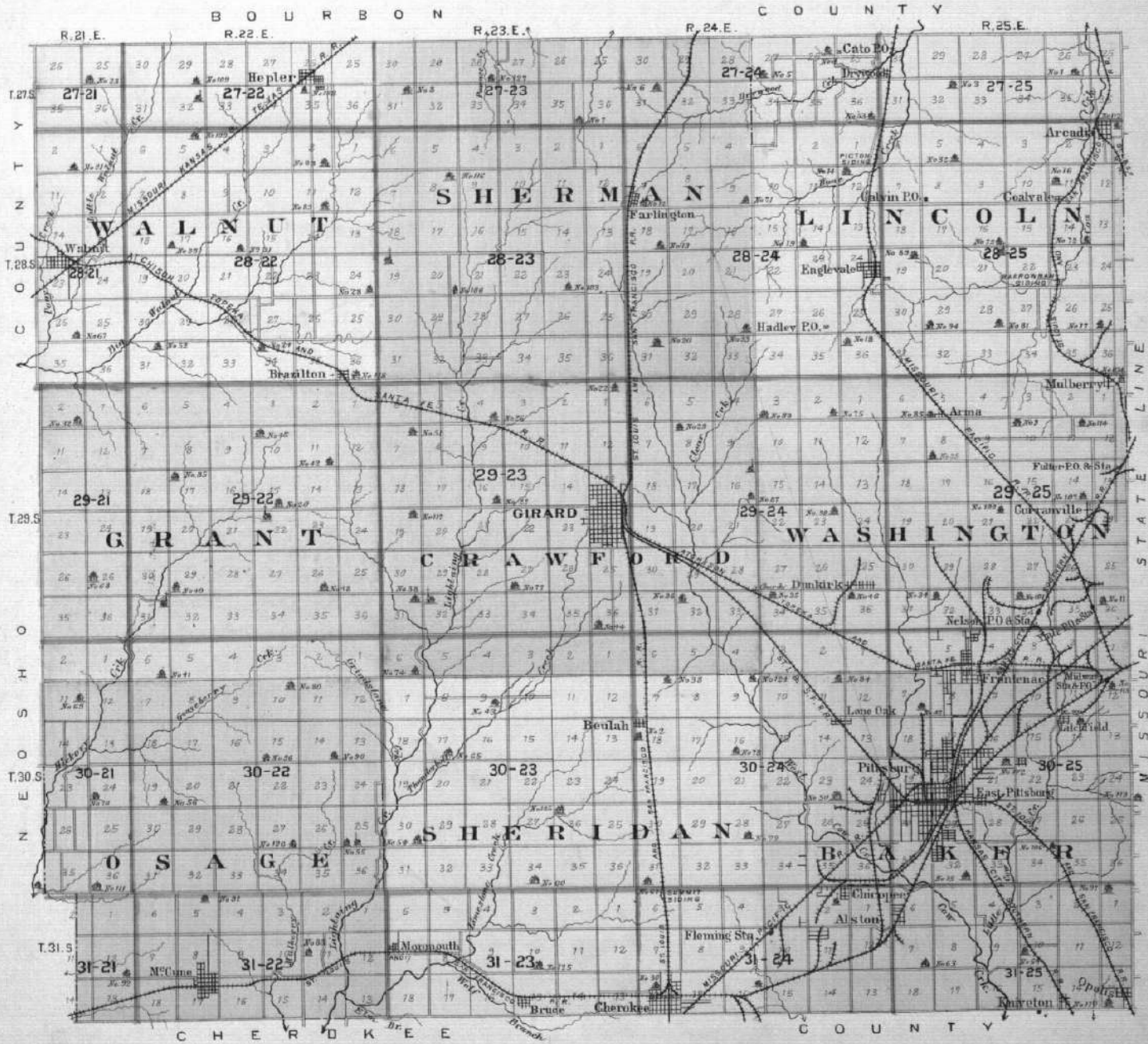

TOWNSHIPS 27 & 28 SOUTH RANGES 21 & 22 EAST

Scale 2 Inches to the Mile.

of the 6th Principal Meridian.

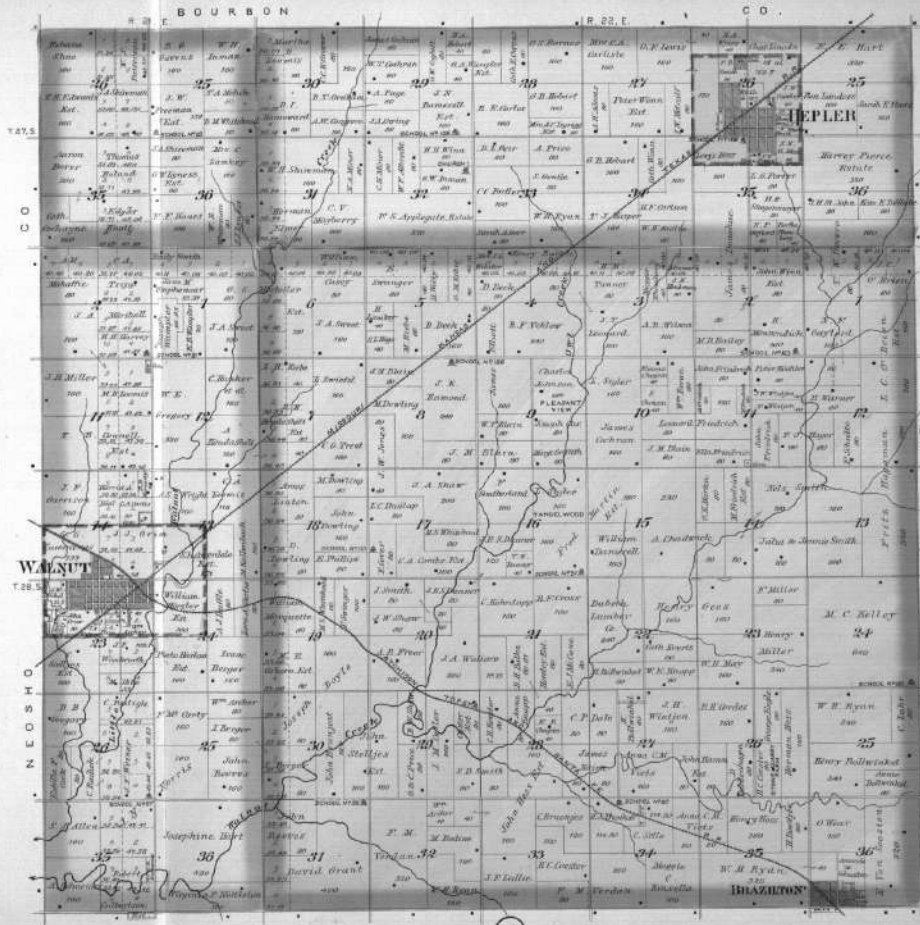

WALNUT
 WALNUT TWP.
 Scale 300 Feet to 1 inch

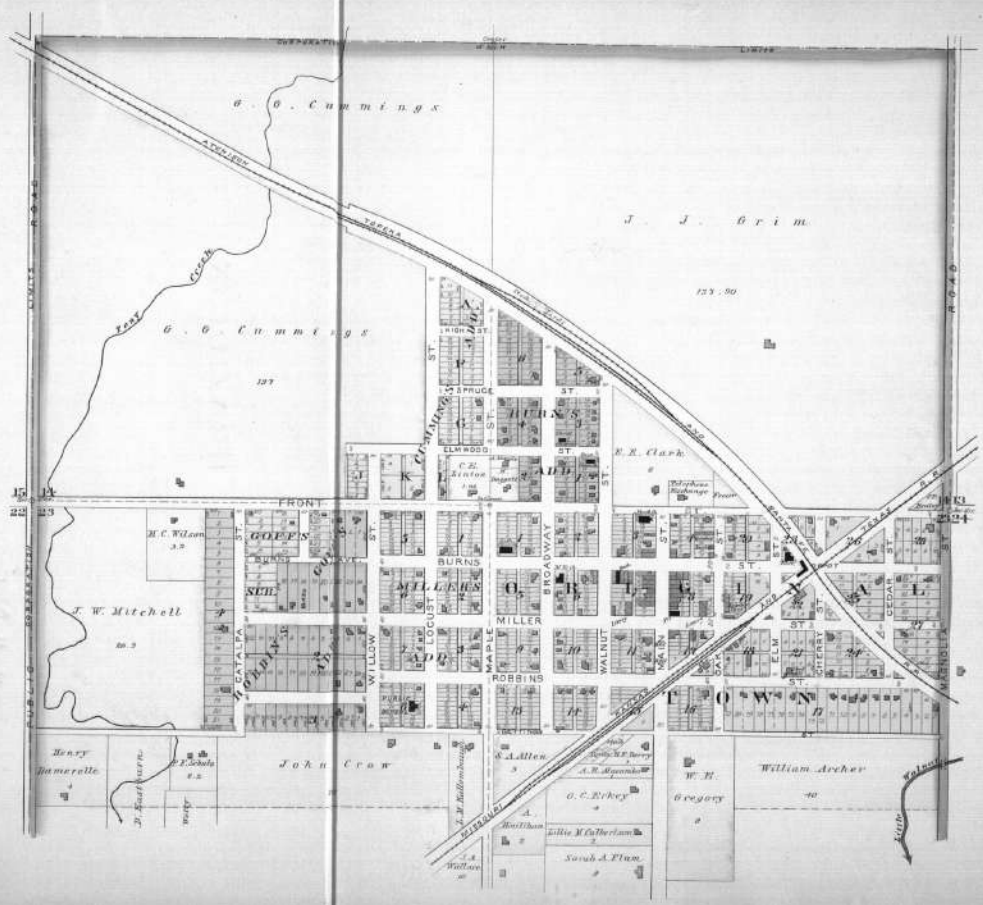

FARLINGTON

SHERMAN TOWNSHIP

Scale 300 ft. to one inch

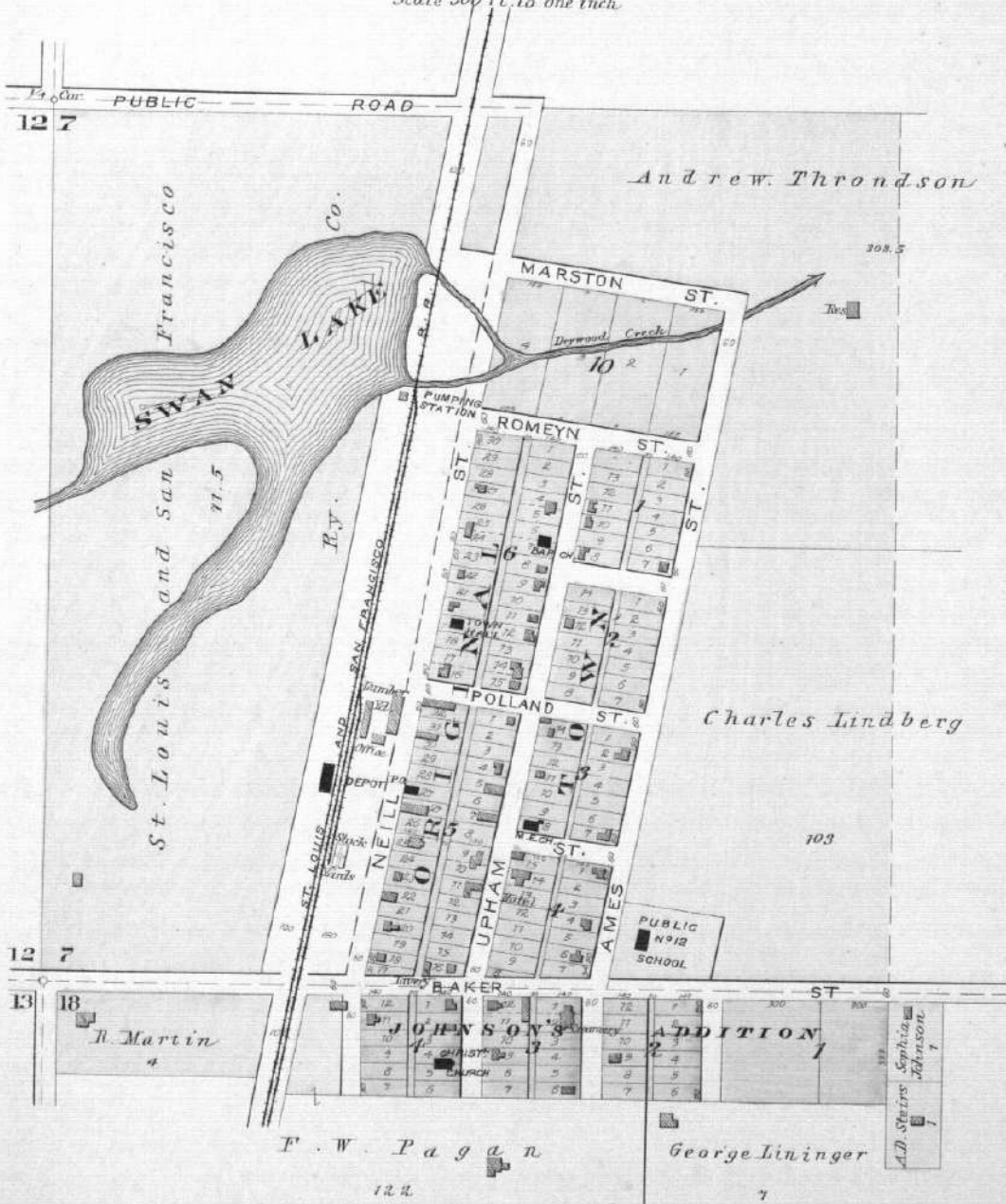

TOWNSHIPS 27 & 28 SOUTH RANGE 23 EAST

Scale 2 Inches to the Mile.

of the 6th Principal Meridian.

B O U R B O N C O U N T Y

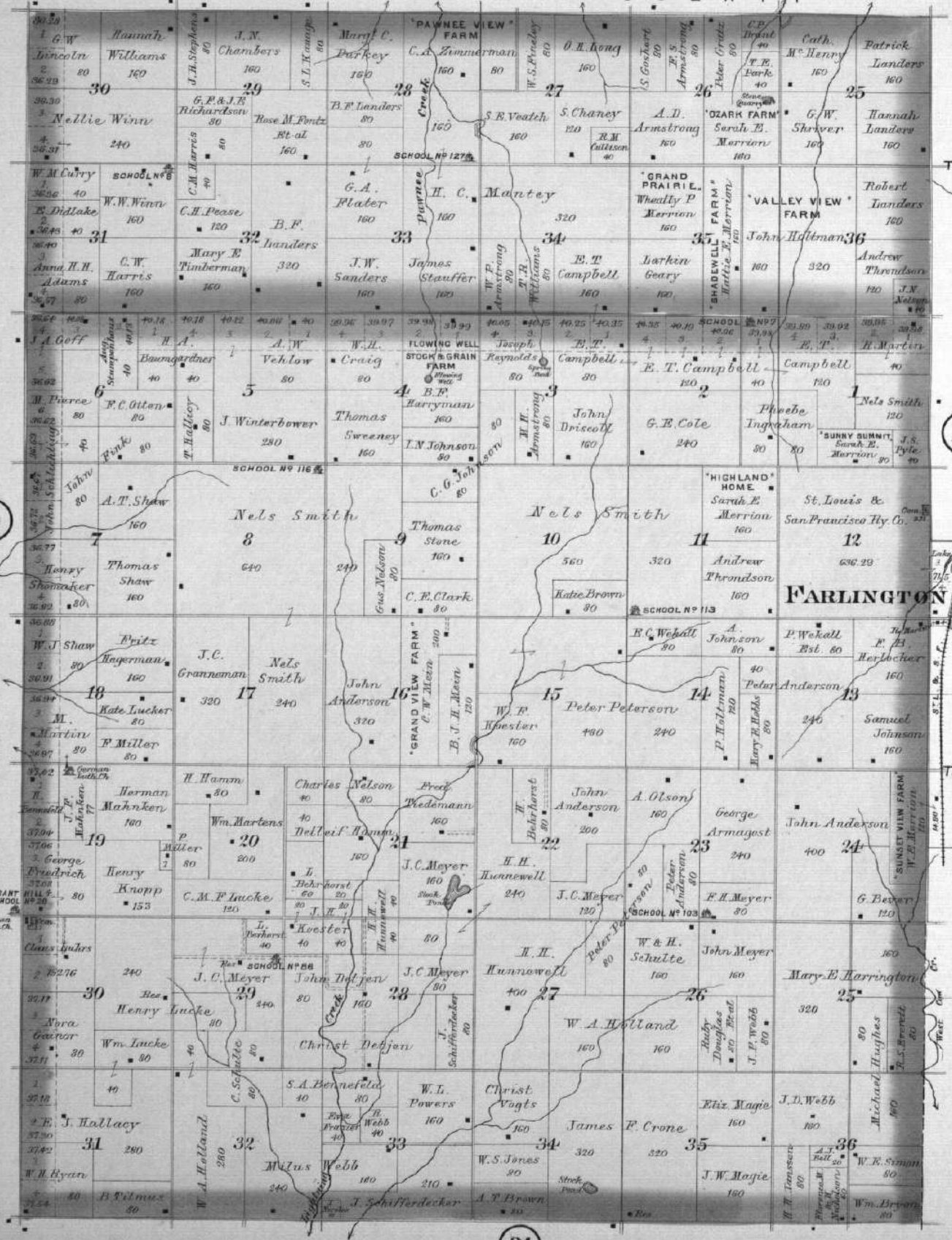

T. 27, S.

T. 28, S.

4

11

21

PLEASANT SCHOOL

SCHOOL NO. 116

SCHOOL NO. 117

SCHOOL NO. 118

SCHOOL NO. 119

SCHOOL NO. 120

SCHOOL NO. 121

SCHOOL NO. 122

SCHOOL NO. 123

SCHOOL NO. 124

SCHOOL NO. 125

St. Louis & San Francisco Ry. Co.

SUNSET VIEW FARM

HIGHLAND HOME

PAWNEE VIEW FARM

GRAND PRAIRIE FARM

VALLEY VIEW FARM

SHADEWELL FARM

SUNNY SUMMIT

TOWNSHIPS 27 & 28 SOUTH RANGE 24 EAST

Scale 2 Inches to the Mile.

of the 6th Principal Meridian.

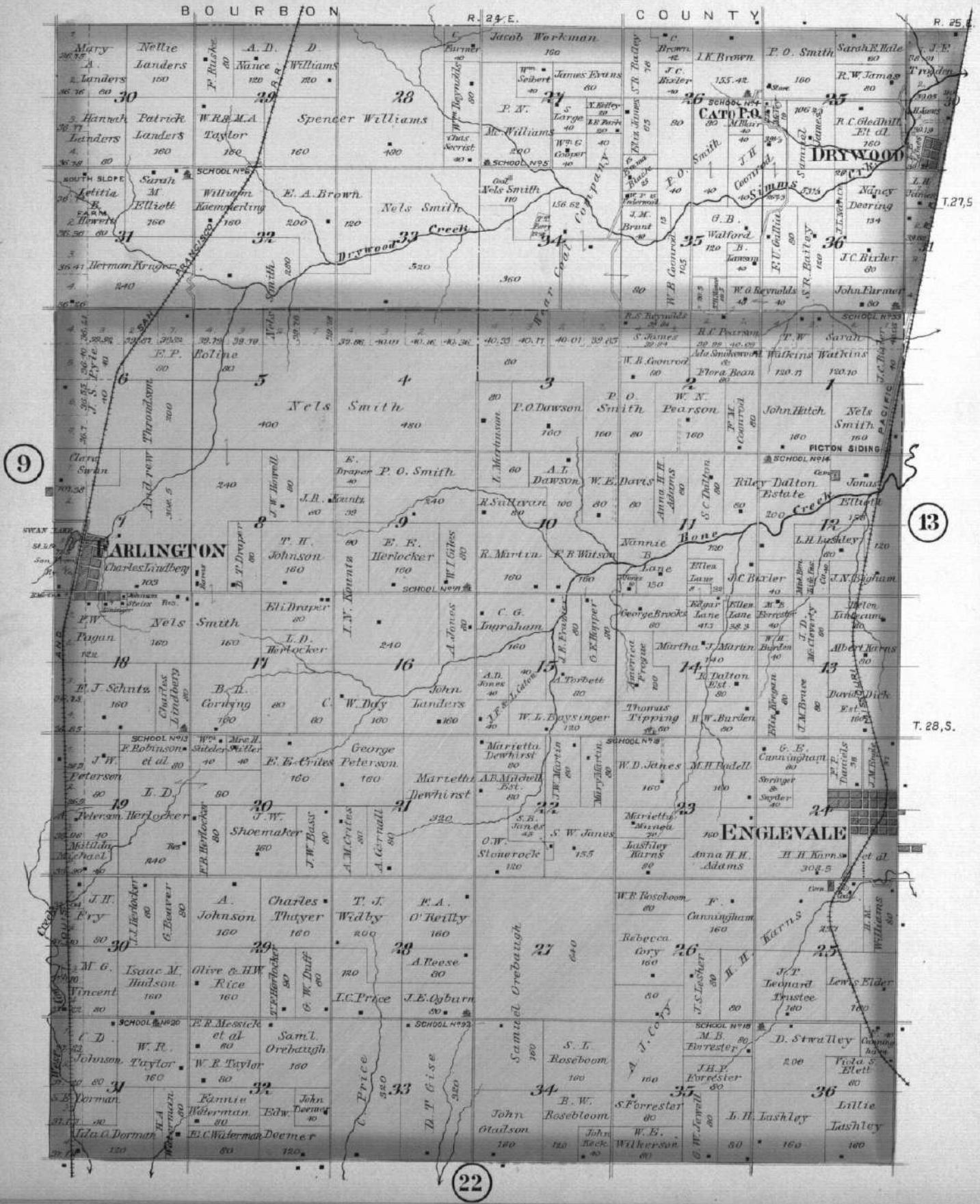

CATO

LINCOLN TWP.
Scale 200 ft. to 1 Inch

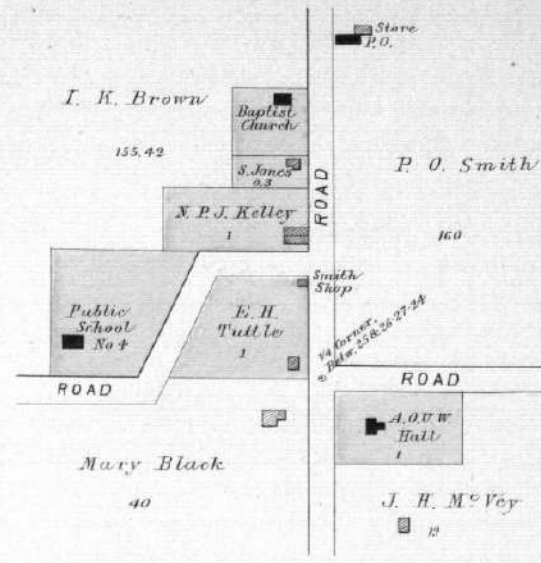

ENGLEVALE

LINCOLN TWP.
Scale 300 ft. to one inch

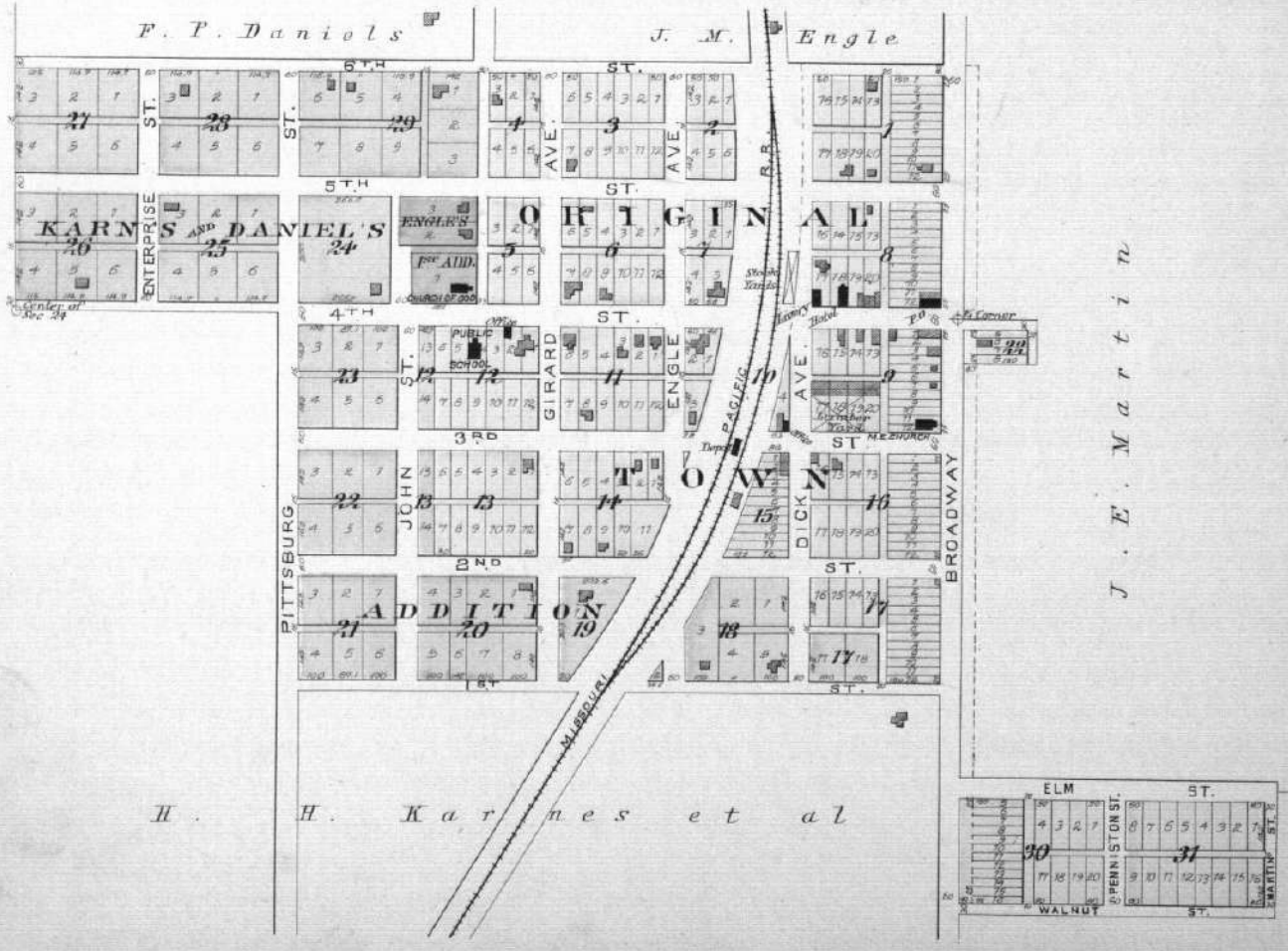

TOWNSHIPS 27 & 28 SOUTH RANGE 25 EAST

Scale 2 Inches to the Mile.

BOURBON

CO of the 6th Principal Meridian.

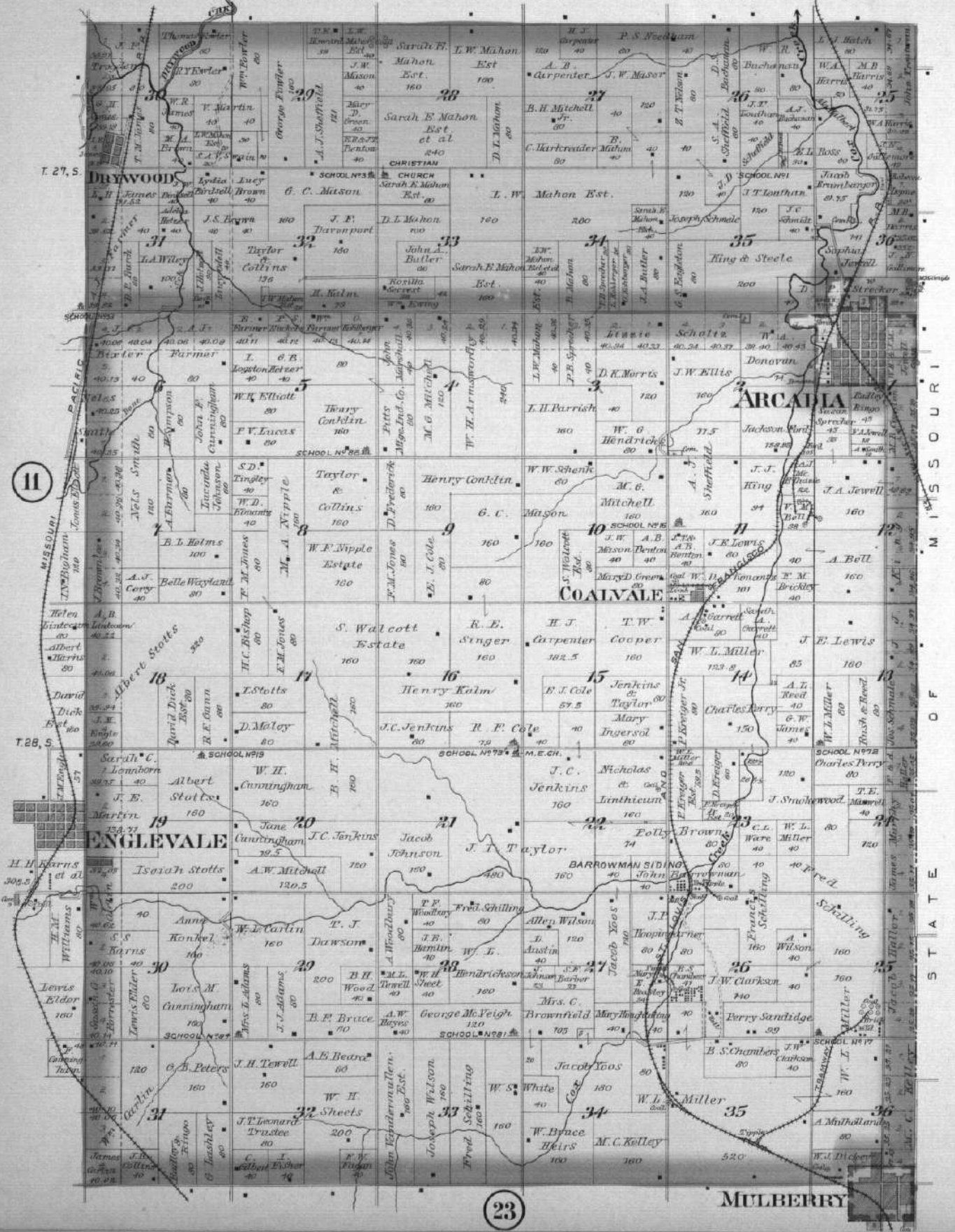

COALVALE

LINCOLN TWP.

Scale 300 ft. to 1 Inch.

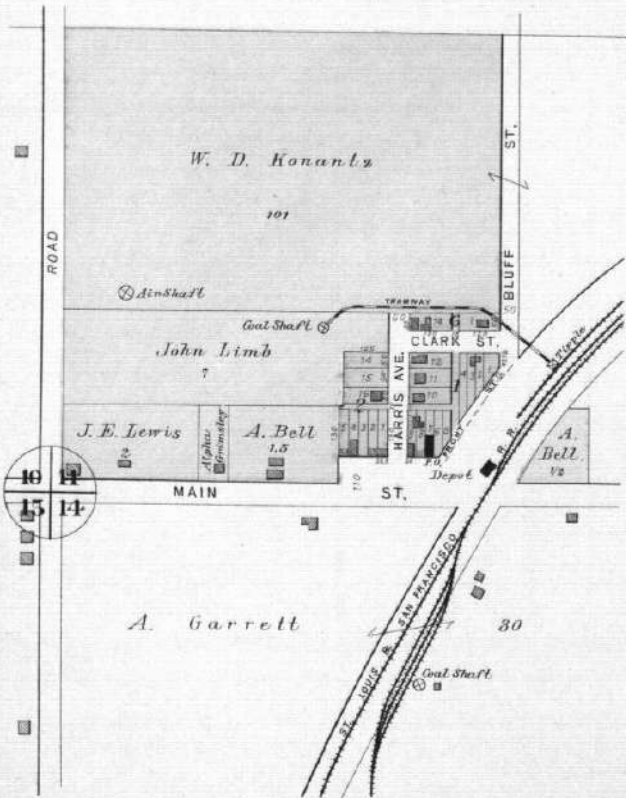

DRYWOOD

IN SECTION 30-27-25

LINCOLN TWP.

Scale 300 feet to one inch.

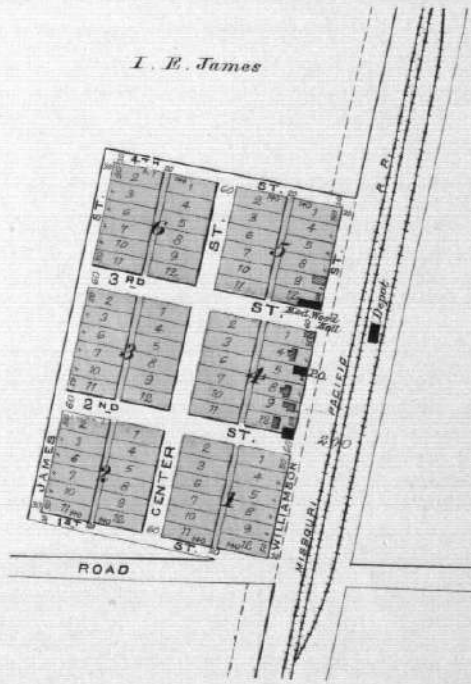

ARCADIA

LINCOLN TWP.
Scale 1/32" = 1 Inch.

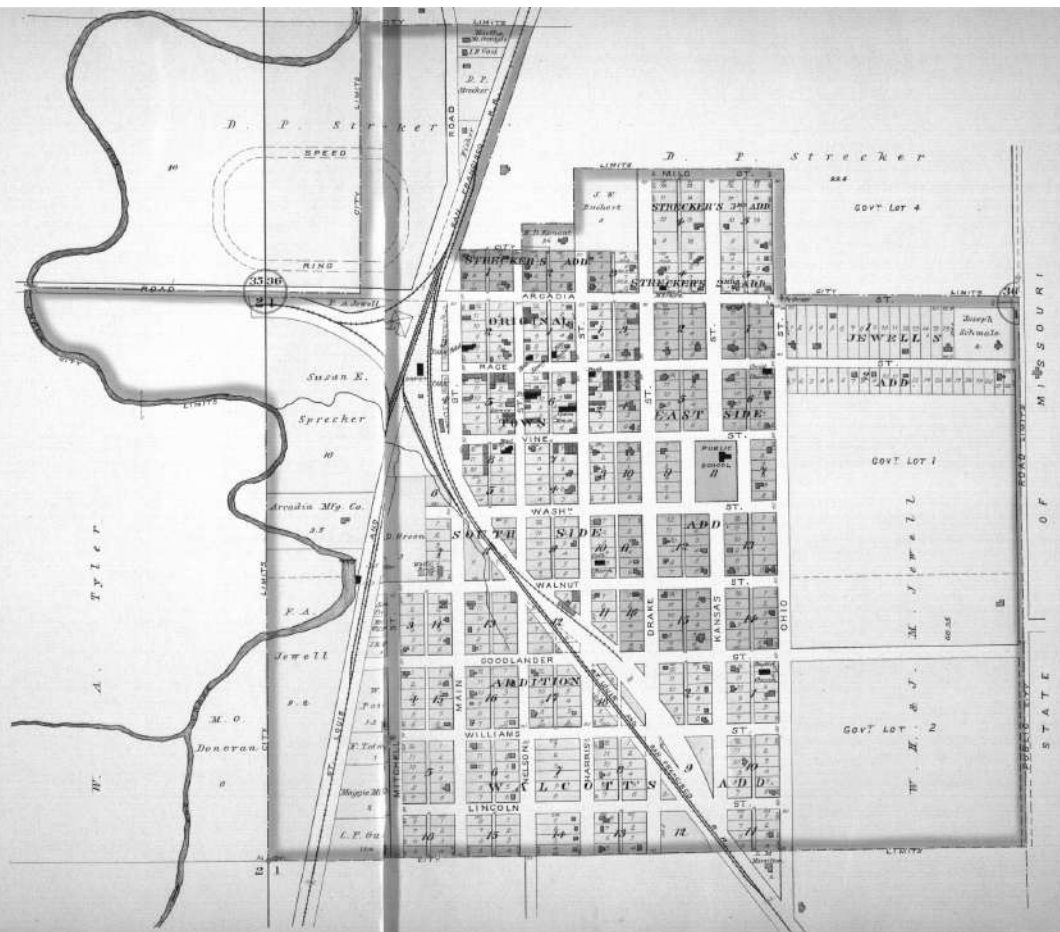

DUNKIRK

WASHINGTON TWP.

Scale 300 feet to one inch

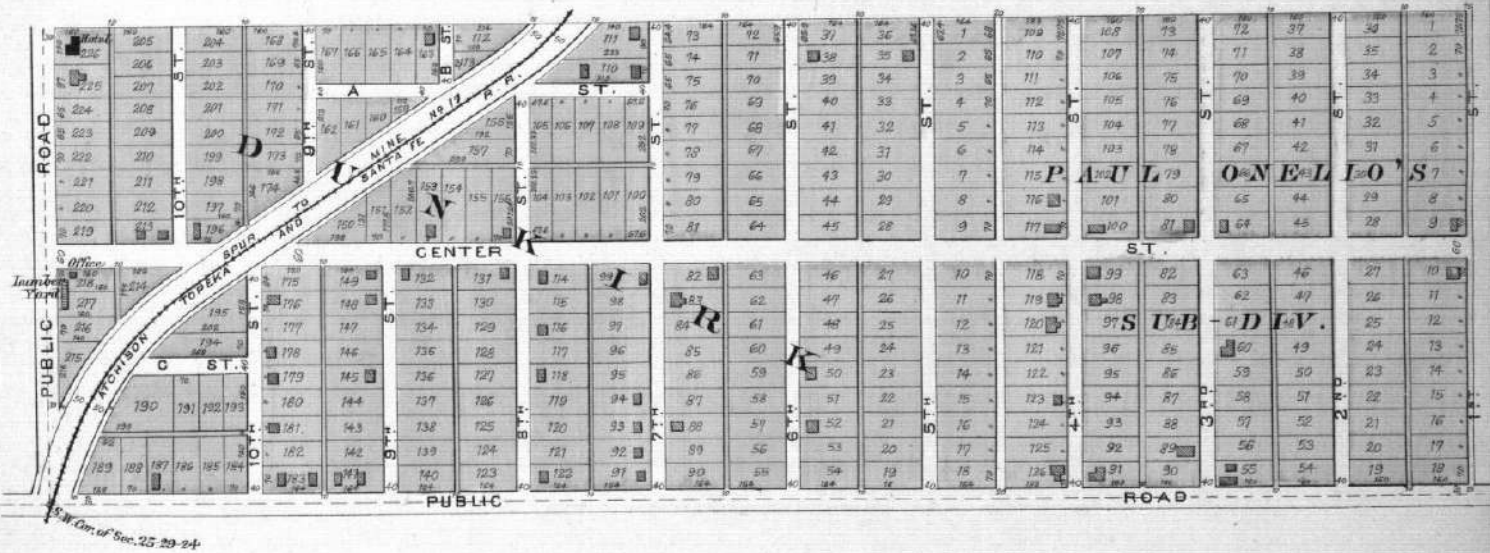

TOWNSHIP 29 SOUTH RANGE 23 EAST.

Scale 2 Inches to the Mile.

of the 6th Principal Meridian.

9

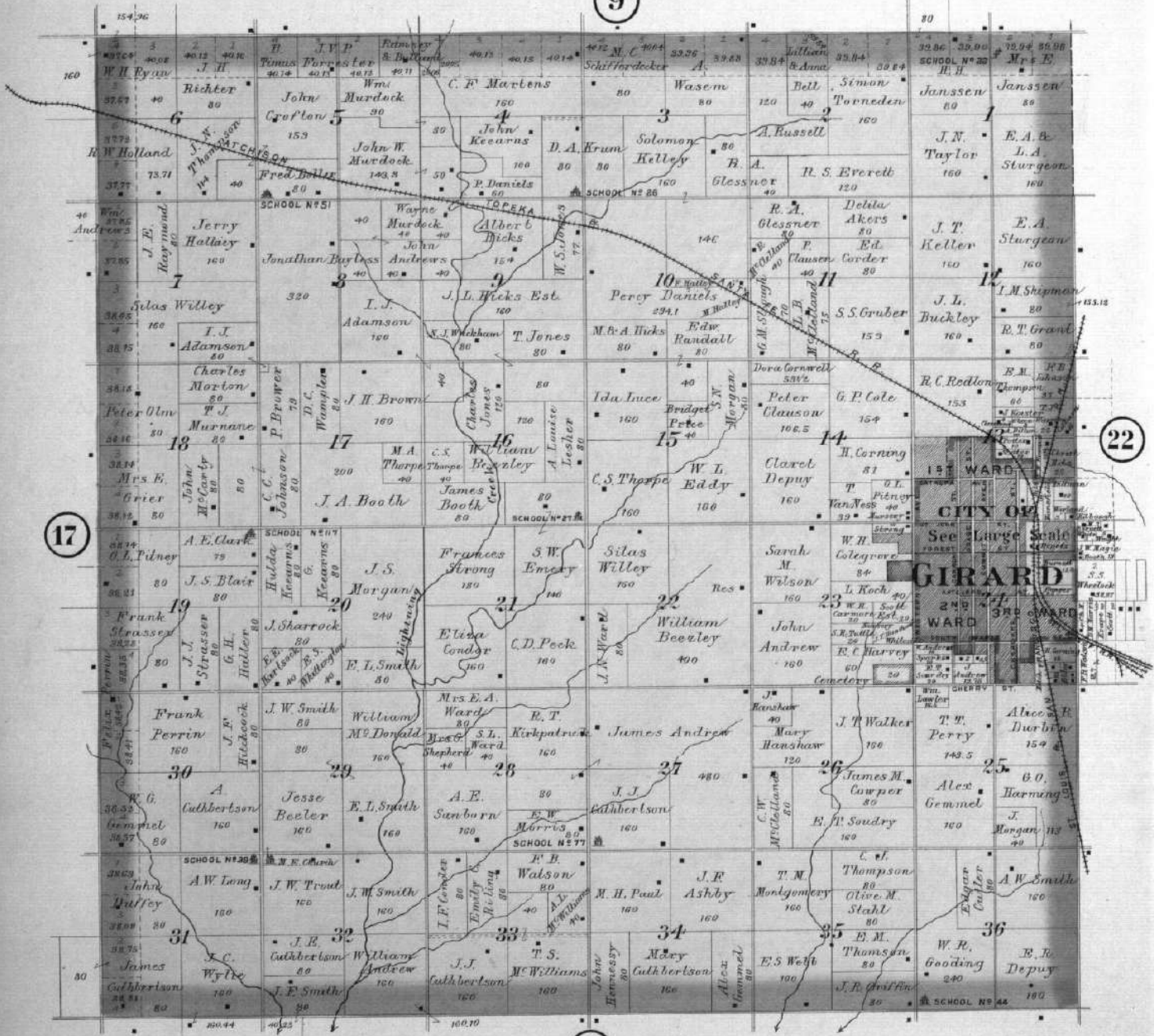

22

17

27

GIRARD

See Large Scale

WARD 245 WARD 342 WARD 343

WARD 246 WARD 344 WARD 345

WARD 247 WARD 346 WARD 347

WARD 248 WARD 348 WARD 349

WARD 249 WARD 350 WARD 351

WARD 250 WARD 352 WARD 353

WARD 251 WARD 354 WARD 355

WARD 252 WARD 356 WARD 357

WARD 253 WARD 358 WARD 359

WARD 254 WARD 360 WARD 361

WARD 255 WARD 362 WARD 363

WARD 256 WARD 364 WARD 365

TOWNSHIP 29 SOUTH RANGE 24 EAST.

Scale 2 Inches to the Mile.

11

of the 6th Principal Meridian.

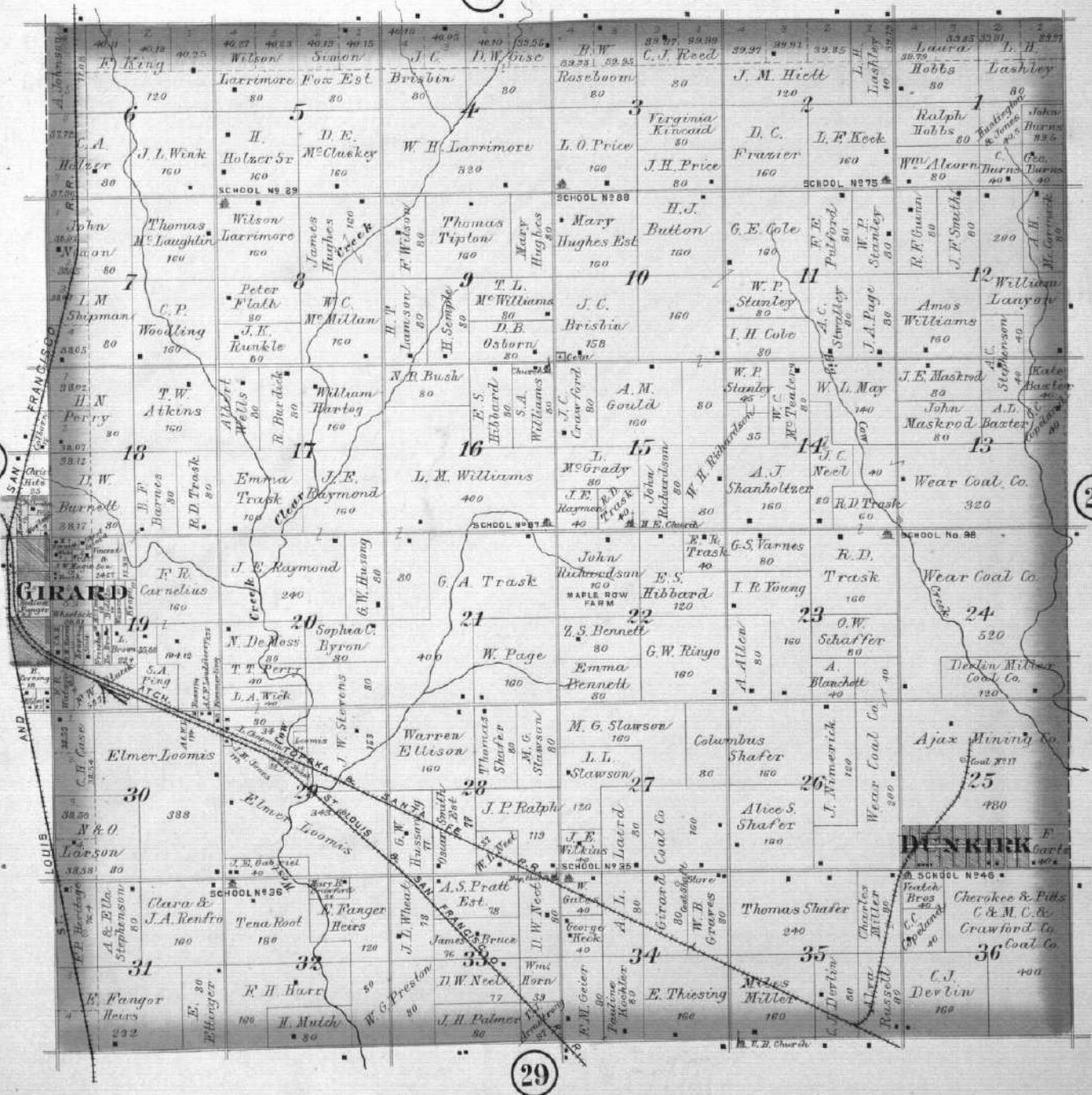

TOWNSHIP 29 SOUTH RANGE 25 EAST

Scale 2 Inches to the Mile.

of the 6th Principal Meridian.

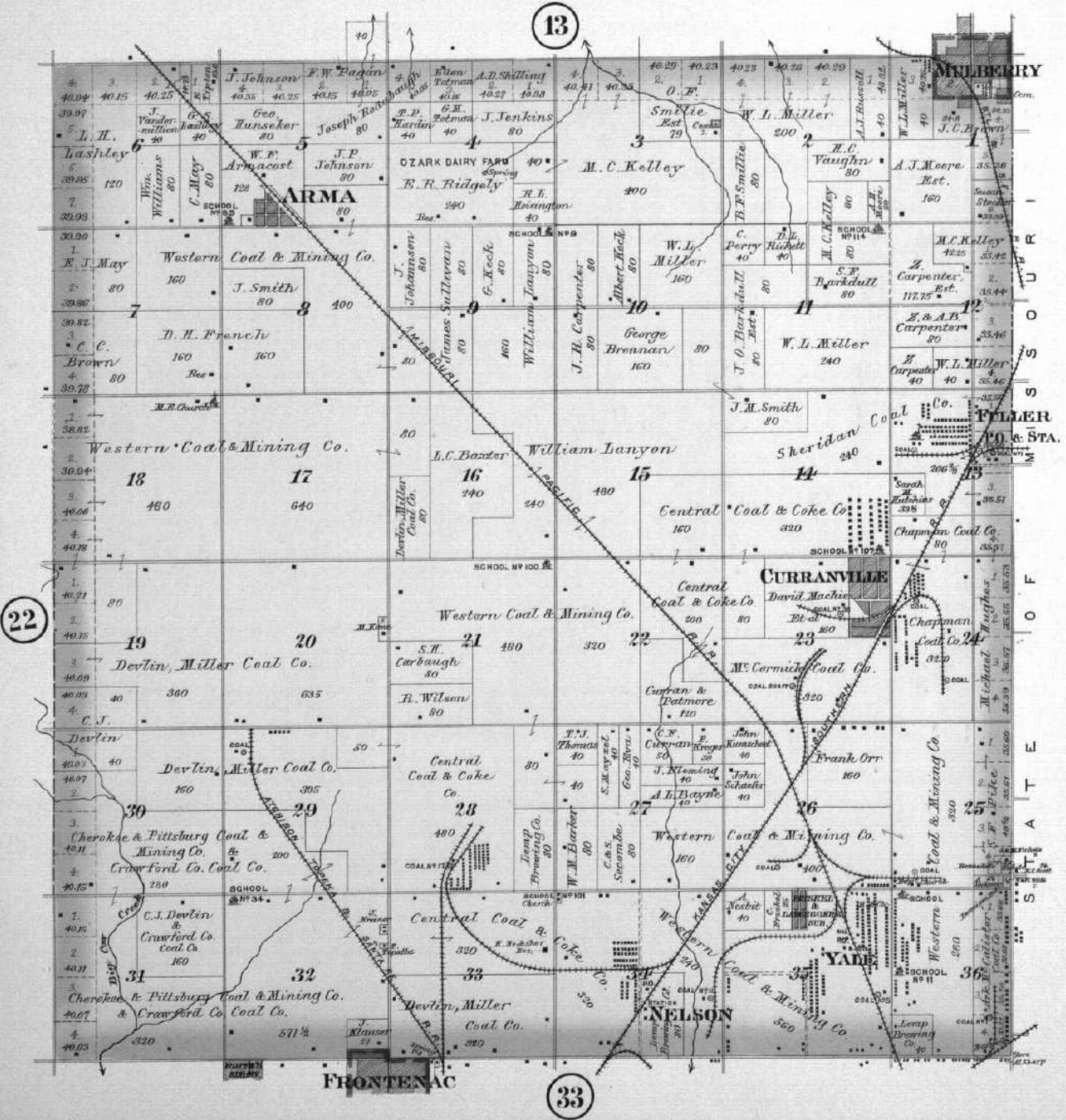

MULBERRY

WASHINGTON AND LINCOLN TPS.

Scale 300 ft. to one inch

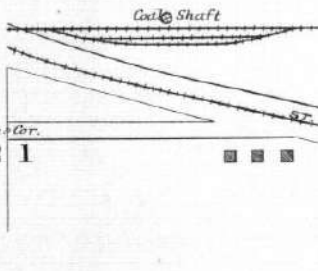
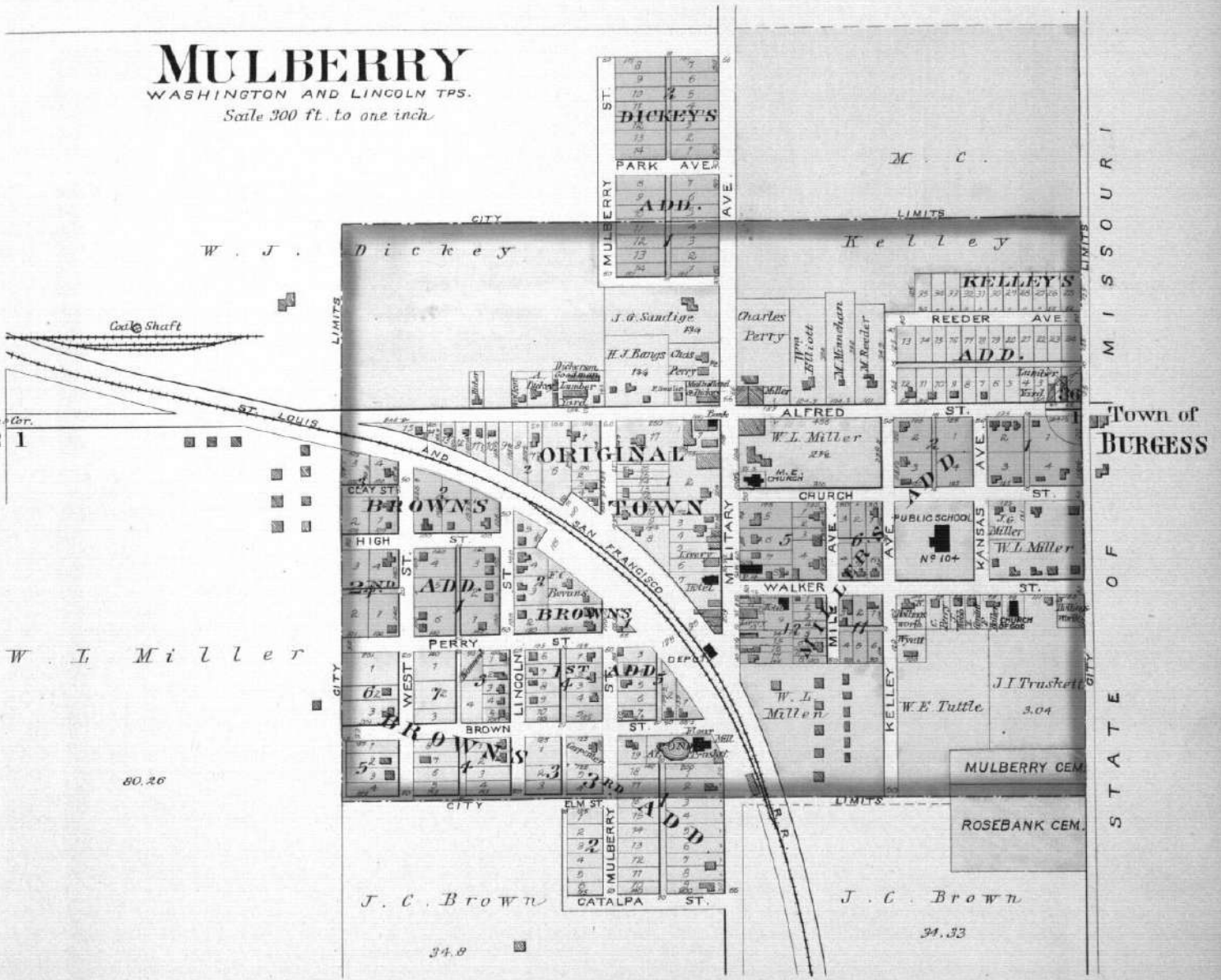

W. I. Miller

80.26

J. C. Brown

34.8

J. C. Brown

34.33

MISSOURI STATE

Town of BURGESS

CURRANVILLE

PLATTED AS CURRAN

WASHINGTON TWP.

Scale 300 Ft. to 1 Inch.

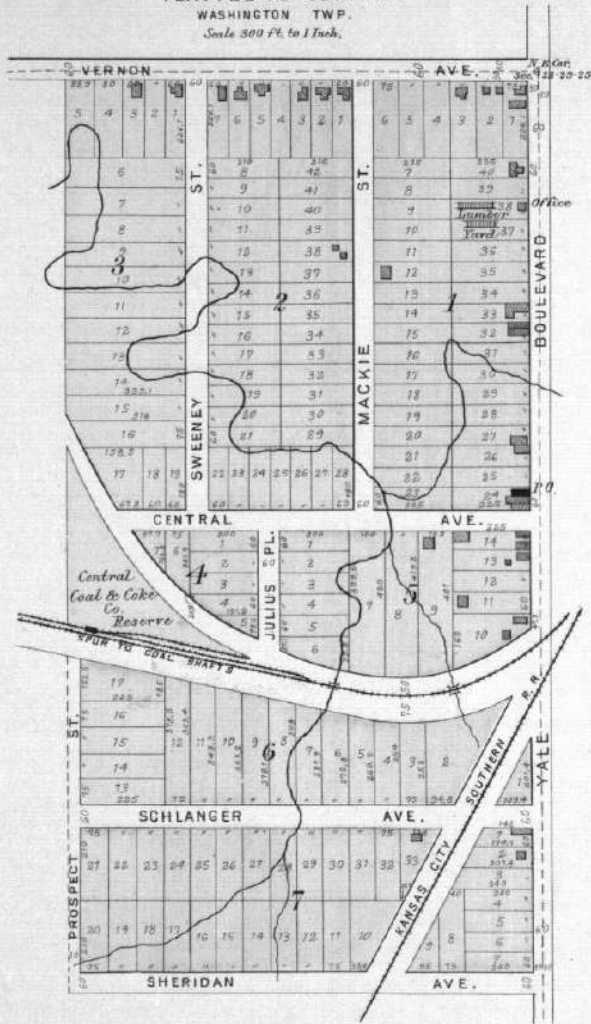

ARMA

WASHINGTON TWP.

Scale 250 Ft. to 1 Inch.

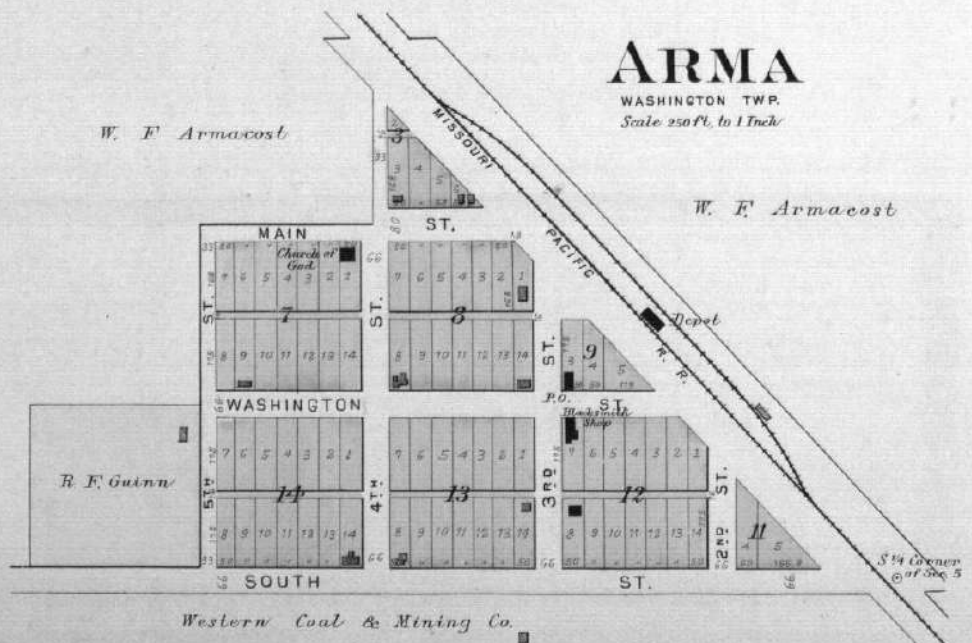

TOWNSHIP 30 SOUTH RANGE 23 EAST

Scale 2 Inches to the Mile.

of the 6th Principal Meridian.

21

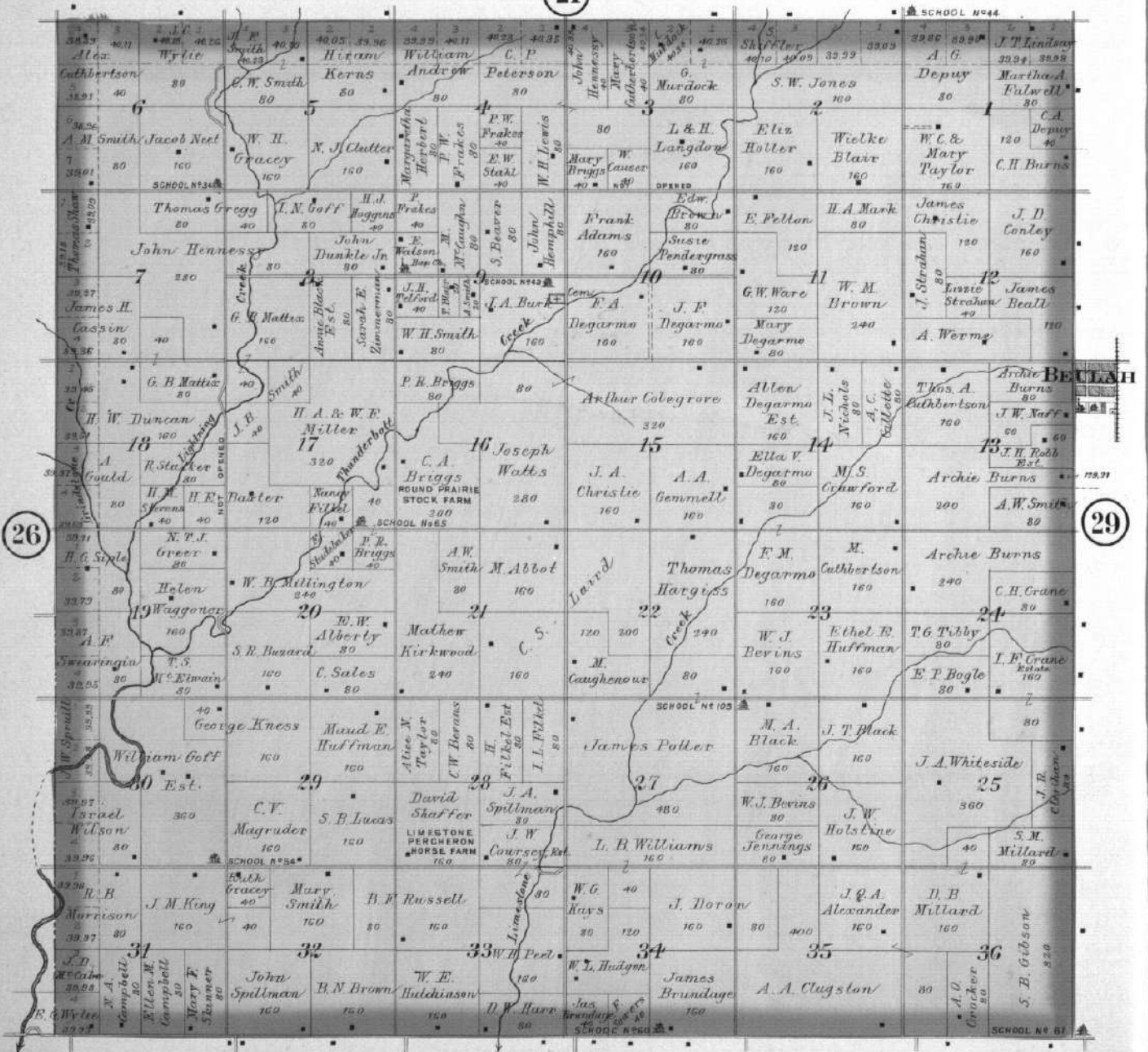

39

VAN FRANK PLACE

BAKER TWP.
Scale 400ft. to one inch.

C. J. Devlin

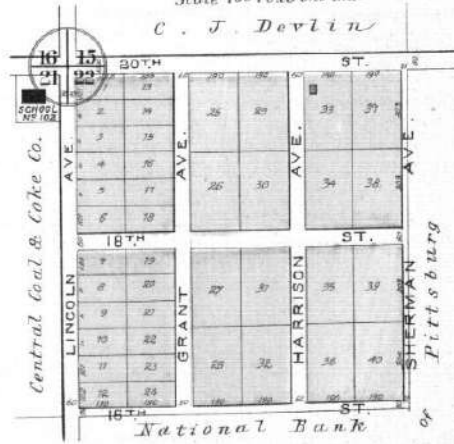

TOWNSHIP 30 SOUTH RANGE 24 EAST

Scale 2 Inches to the Mile.

22

of the 6th Principal Meridian.

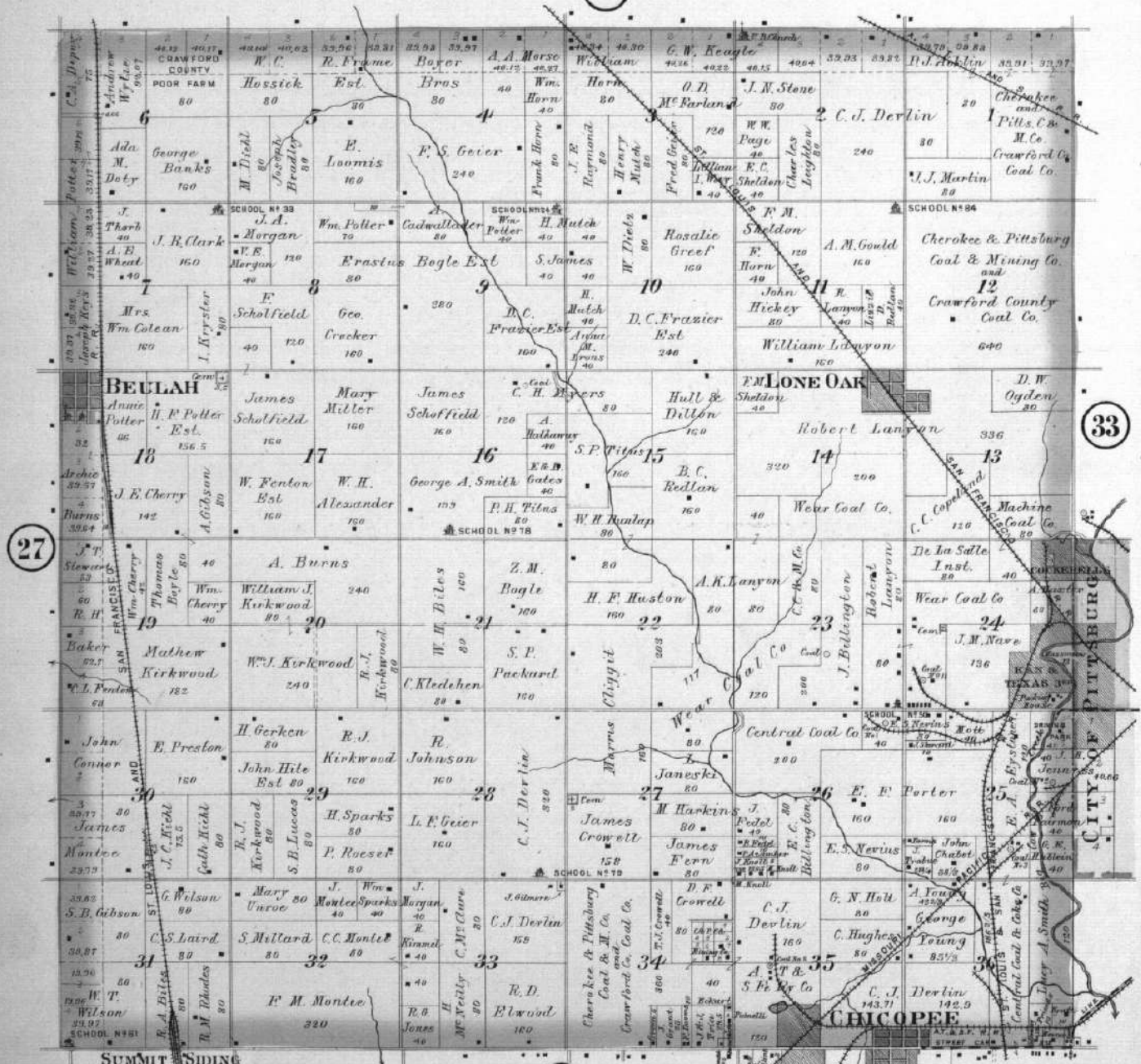

33

27

43

SUMMIT SIDING

CHICOPEE

CHEROKEE AND PITTSBURG
 COAL & MINING CO'S SUB.
 OF S.E.N.E. OF 34-30-34
 BAKER TWP.
 Scale 400 ft. to one inch
 D. F. Crowell

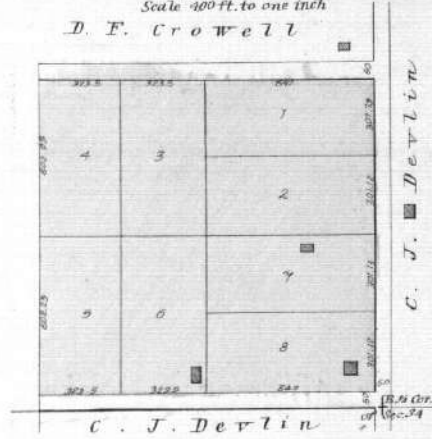

BEULAH

SHERIDAN TWP.
 Scale 300 ft. to one Inch.

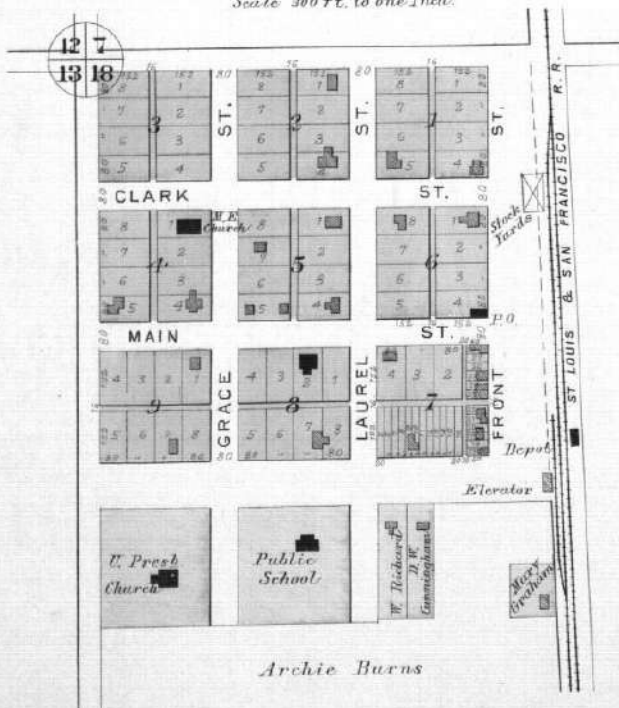

LONE OAK

BAKER TWP.
 Scale 400 ft. to 1 Inch.

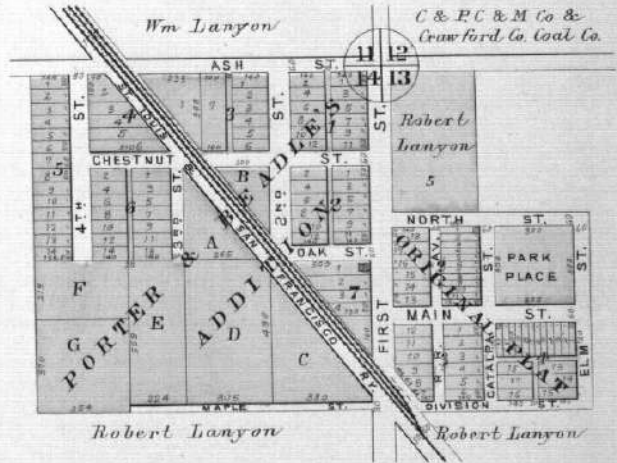

TOWNSHIP 30 SOUTH RANGE 25 EAST.

Scale 2 Inches to the Mile.

of the 6th Principal Meridian.

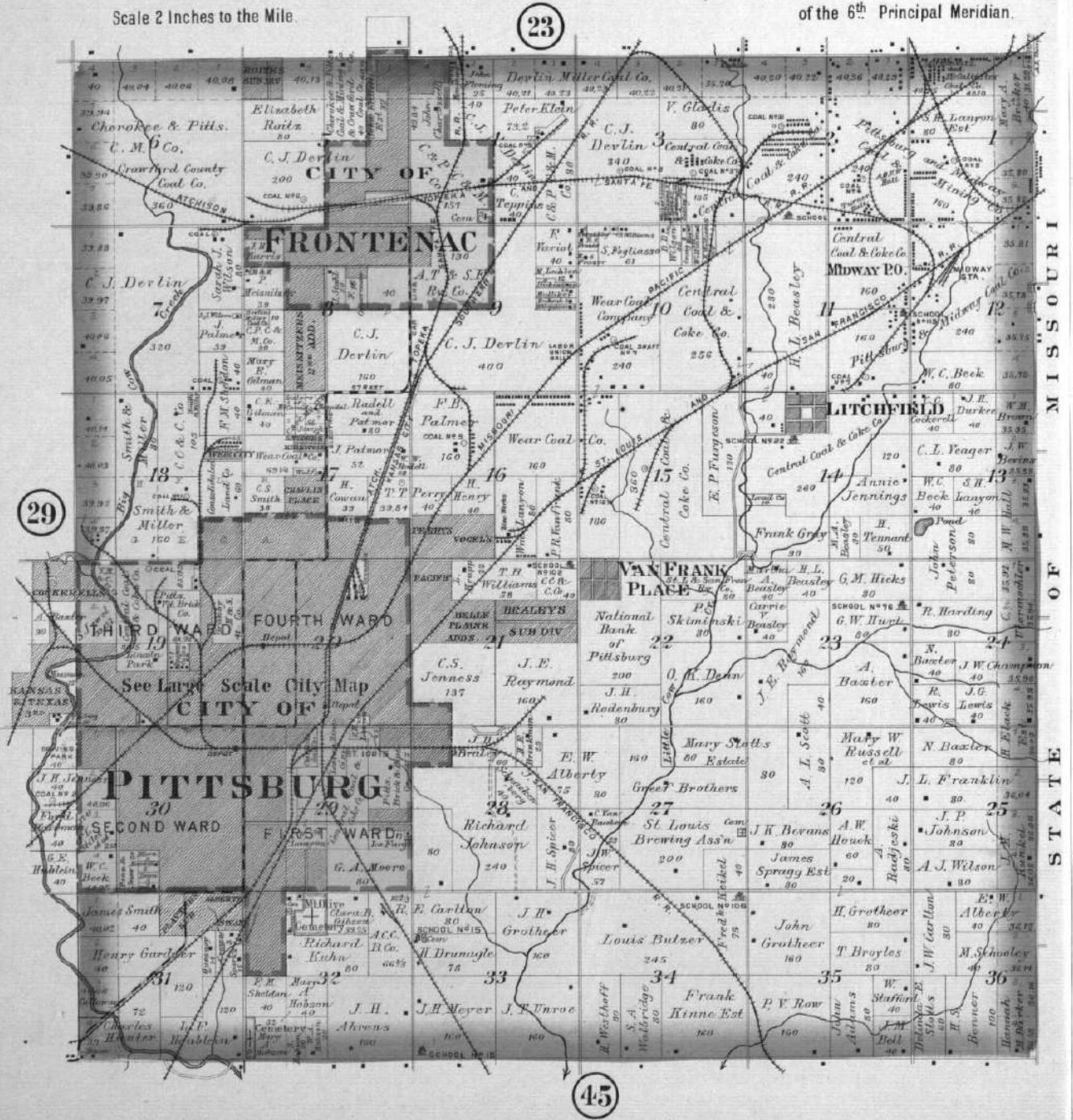

LITCHFIELD

BAKER TWP.

Scale 300 Ft. to one inch.

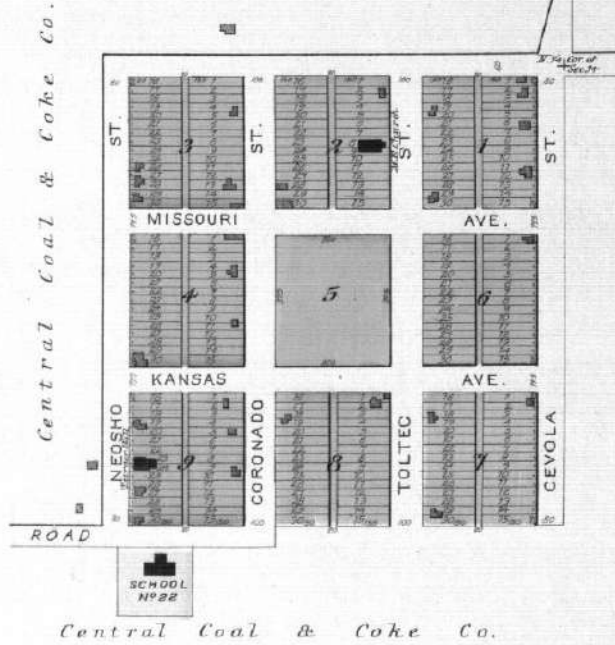

BRALEYS SUB.

IN S 1/2 N.E. OF 21-30 25
BAKER TWP.

Scale 400 Feet to one inch.

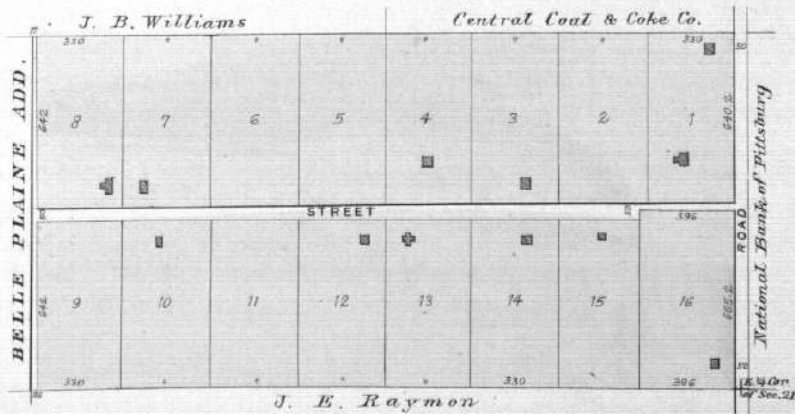

M^c CUNE

OSAGE TWP.
Scale 300 Ft. = 1 Inch

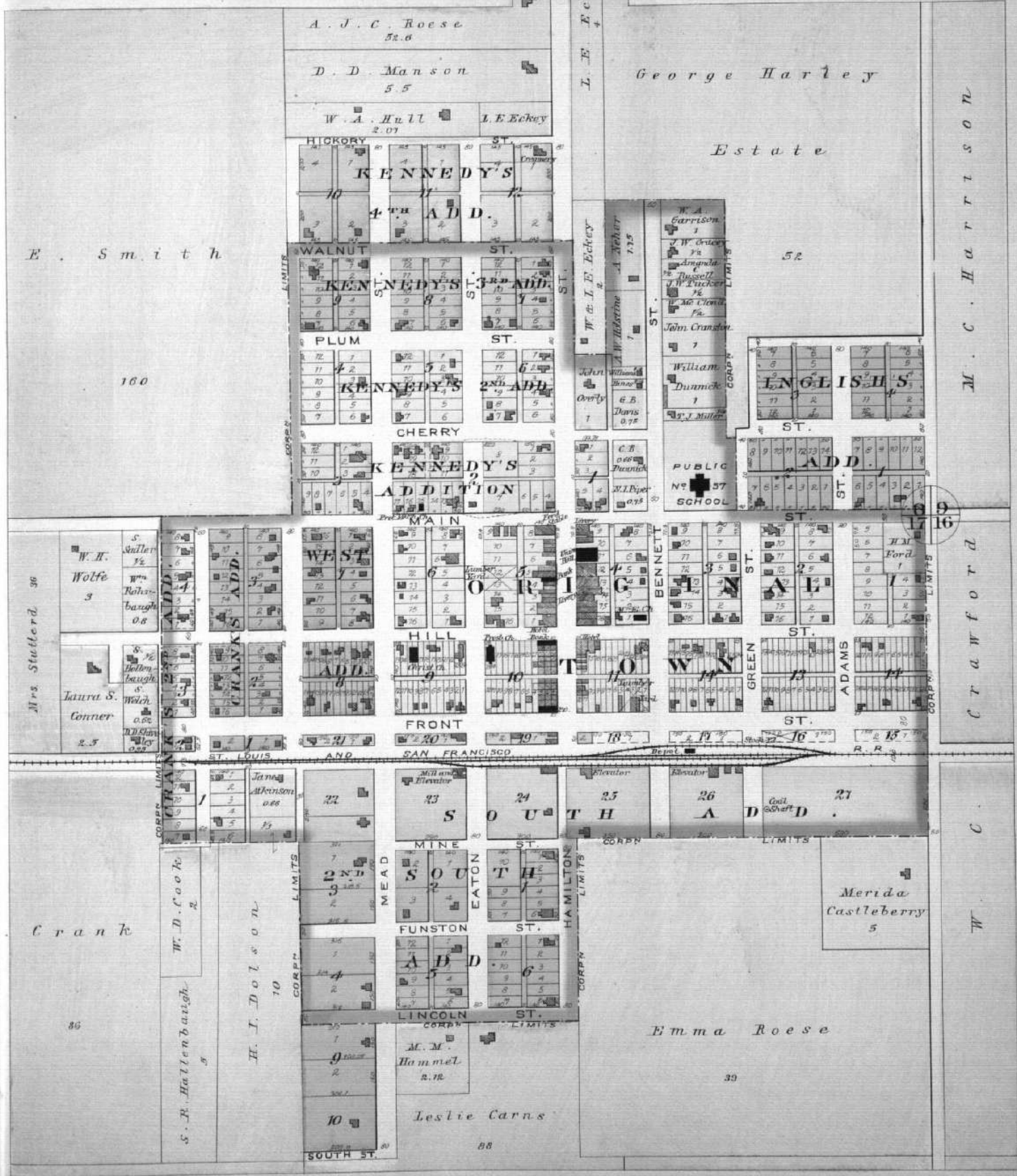

E. Smith

160

Mrs. Stutterd

Crank

W.D. Cook
S.W. Hallenbargh

H.I. Dolson

Leslie Carns

Emma Roese

Merida Castleberry

George Harley

Estate

ENGLISH'S

PUBLIC SCHOOL No. 57

L. E. Eckey

W. & I. D. Eckey

M. C. HARRISON

CRAWFORD

C

W

MONMOUTH

SHERIDAN TWP.

Scale 250 Ft. to 1 Inch.

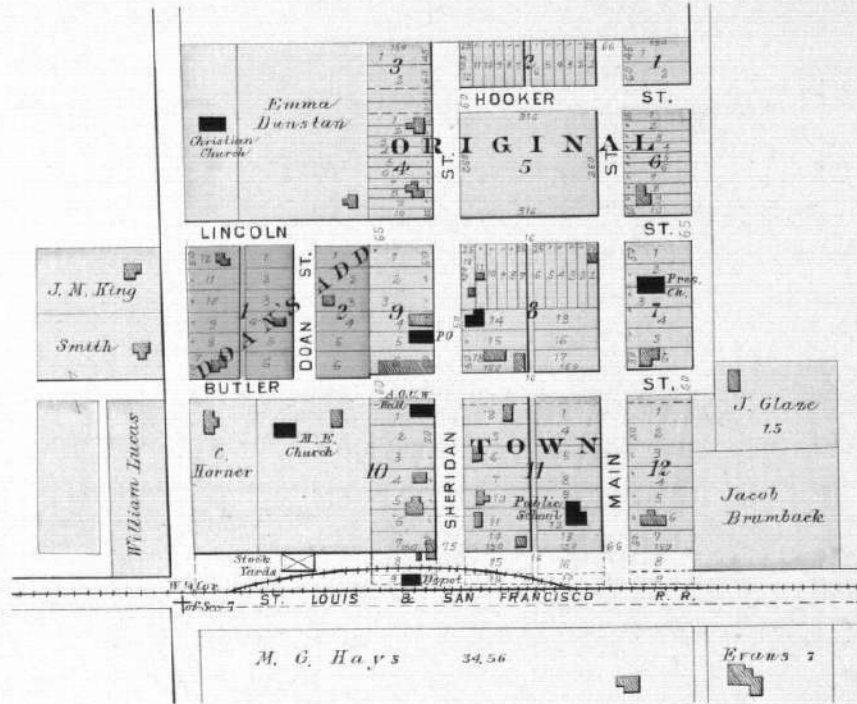

BRUCE

Platted as Midland

SHERIDAN TWP.

Scale 300 Ft. to one inch.

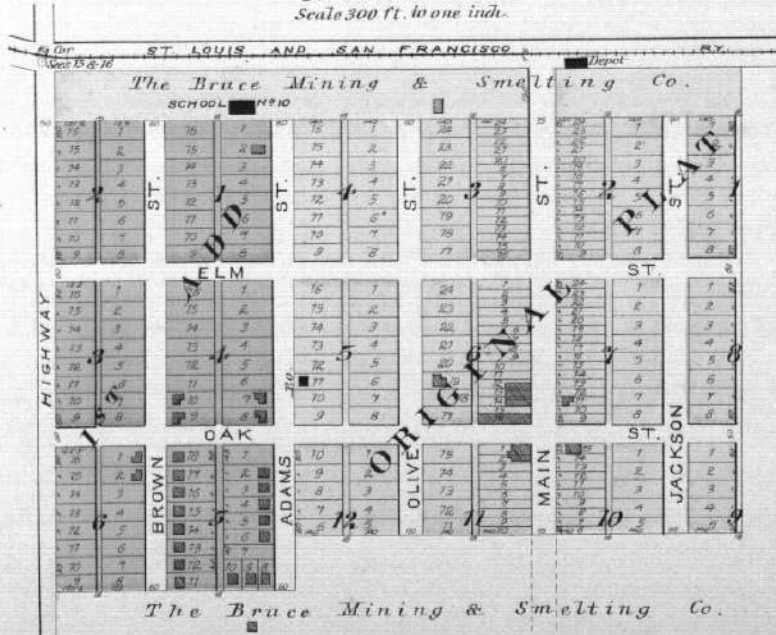

TOWNSHIP 31 SOUTH RANGE 23 EAST.

Scale 2 Inches to the Mile.

27

of the 6th Principal Meridian.

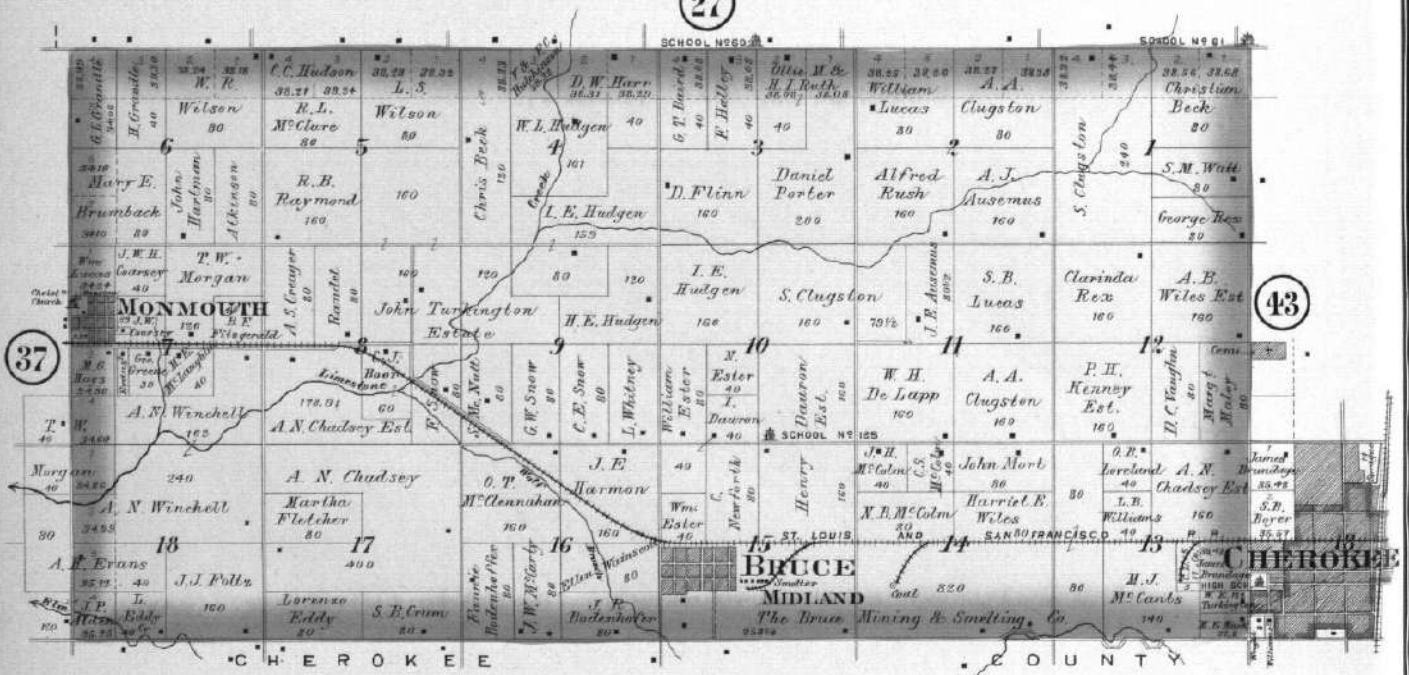

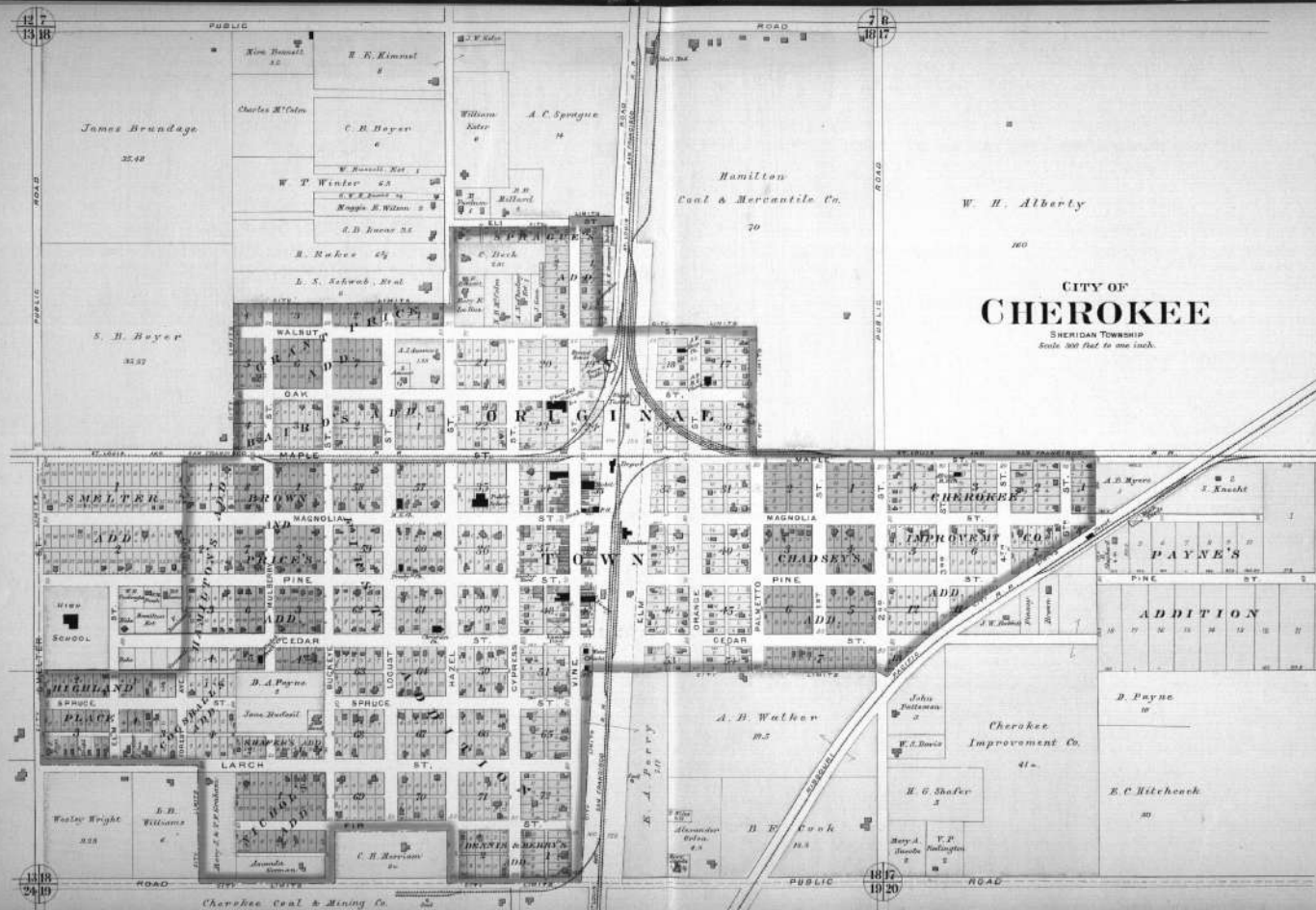

CITY OF
CHEROKEE

SHERIDAN TOWNSHIP
Scale one inch to one foot.

137
1318

78
1617

1318
2410

1617
1620

TOWNSHIP 31 SOUTH RANGE 24 EAST

Scale 2 Inches to the Mile.

of the 6th Principal Meridian.

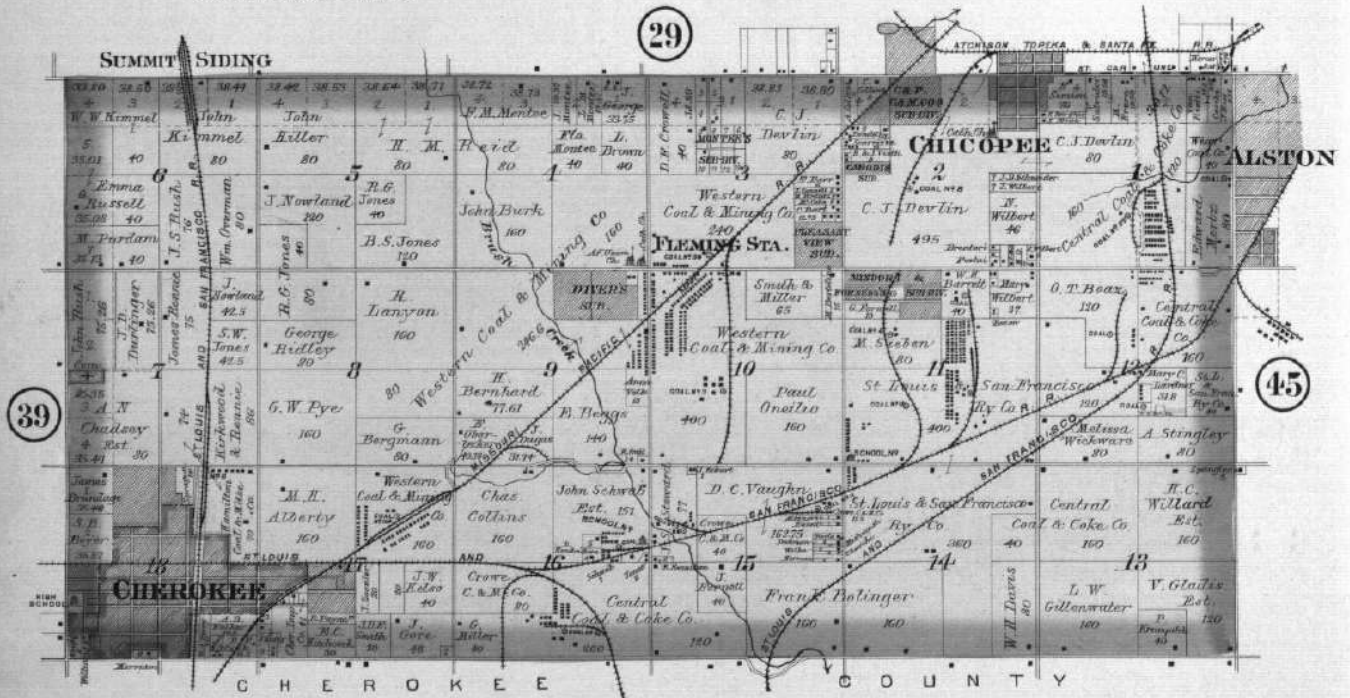

MONTEE'S SUB.

OF E 1/2 N.E. 3-31-24

BAKER TWP.

Scale 400 feet to one inch.

Cherokee & Pittsburg Coal & Mining Co.
& Crawford Co. Coal Co.

Wm. Green

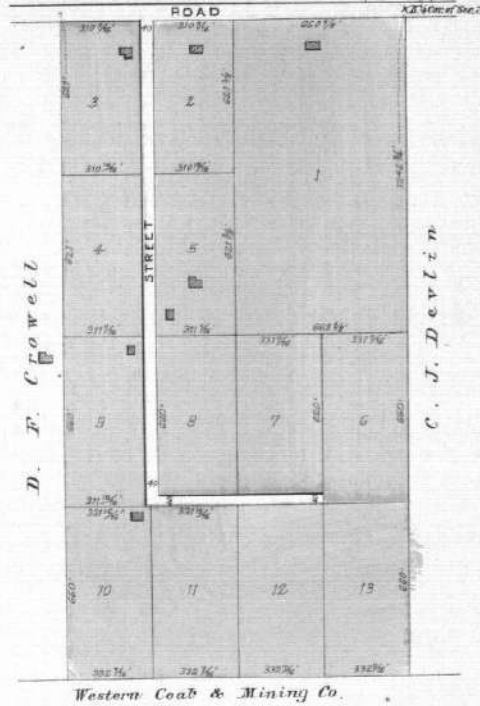

DIVER'S SUB OF N 1/2 N.E. OF 9, 31, 24

SHERIDAN TWP.

Scale 400 ft. to one Inch

Western Coal & Mining Co

A. E. Union Co.

Cath. Ch.

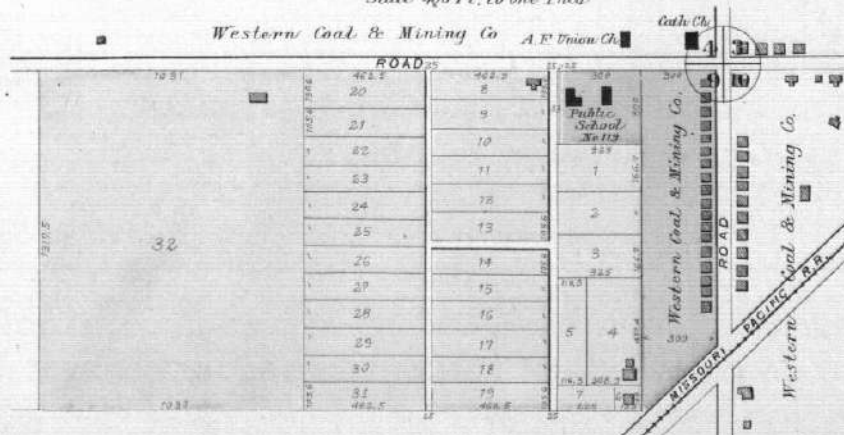

TOWNSHIP 31 SOUTH RANGE 25 EAST

Scale 2 Inches to the Mile.

of the 6th Principal Meridian.

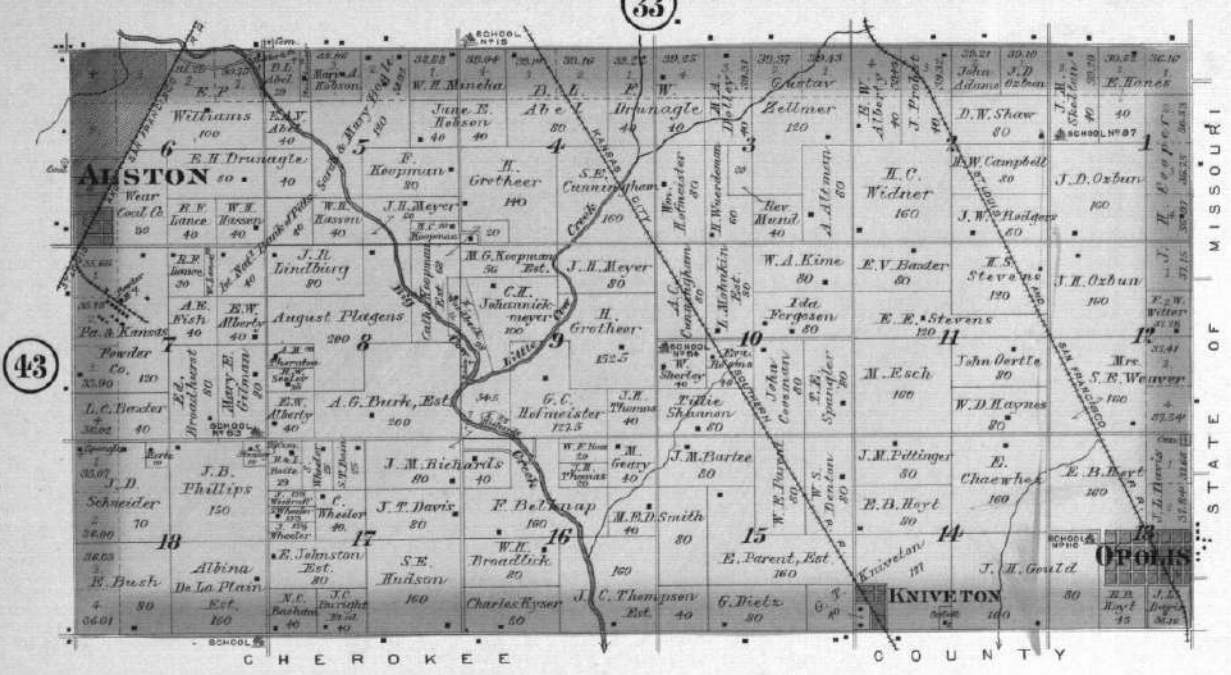

OPOLIS

BAKER TWP.
Scale 300 ft. to one inch.

KNIVETON

BAKER TWP.
Scale 300 ft. to one inch.
G. T. Kniveton

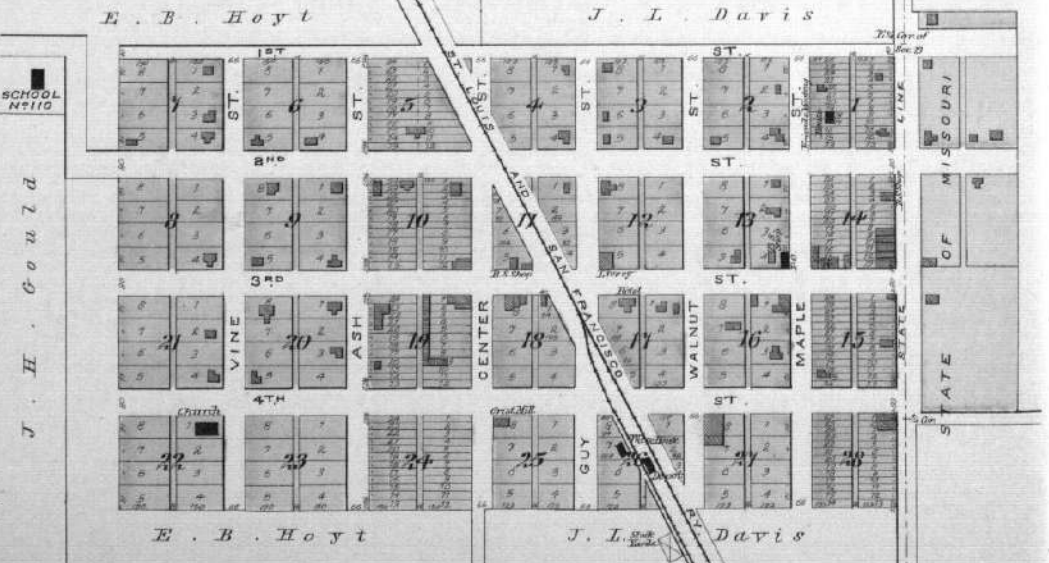
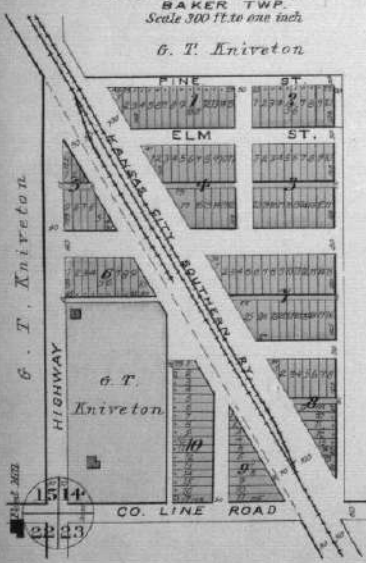

ALSTON

BAKER TWP.
Scale 100 ft. to one inch

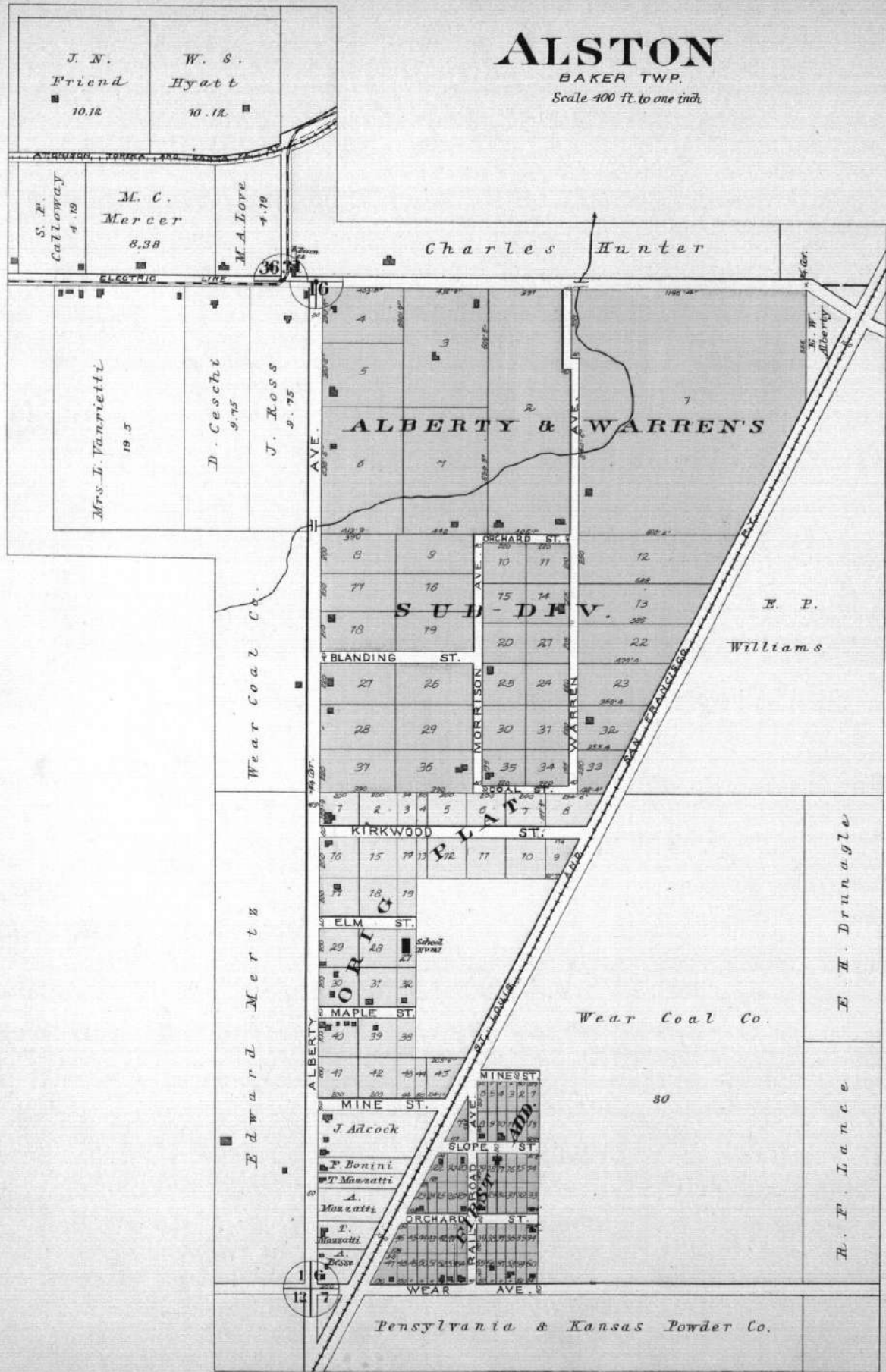

BRAZILTON

WALNUT TOWNSHIP
Scale 200 ft. to one inch.



HEPLER

WALNUT TWP.
Scale 300 ft. to one inch.

SANDERSON'S

ADD.

Missouri Kansas & Texas Ry. Co. A. Lincoln, et al 188.5



J. W. Cawley

Harry Hess

O. F. Lewis

J. A. Wheeler

Mrs. J. Rhomberg

C. Harris

PUBLIC No 108 SCHOOL

MS CULLOUGH'S
ADDITION

J. H. St. John

Lewis Hess

C. L. Linton T. W. Devero

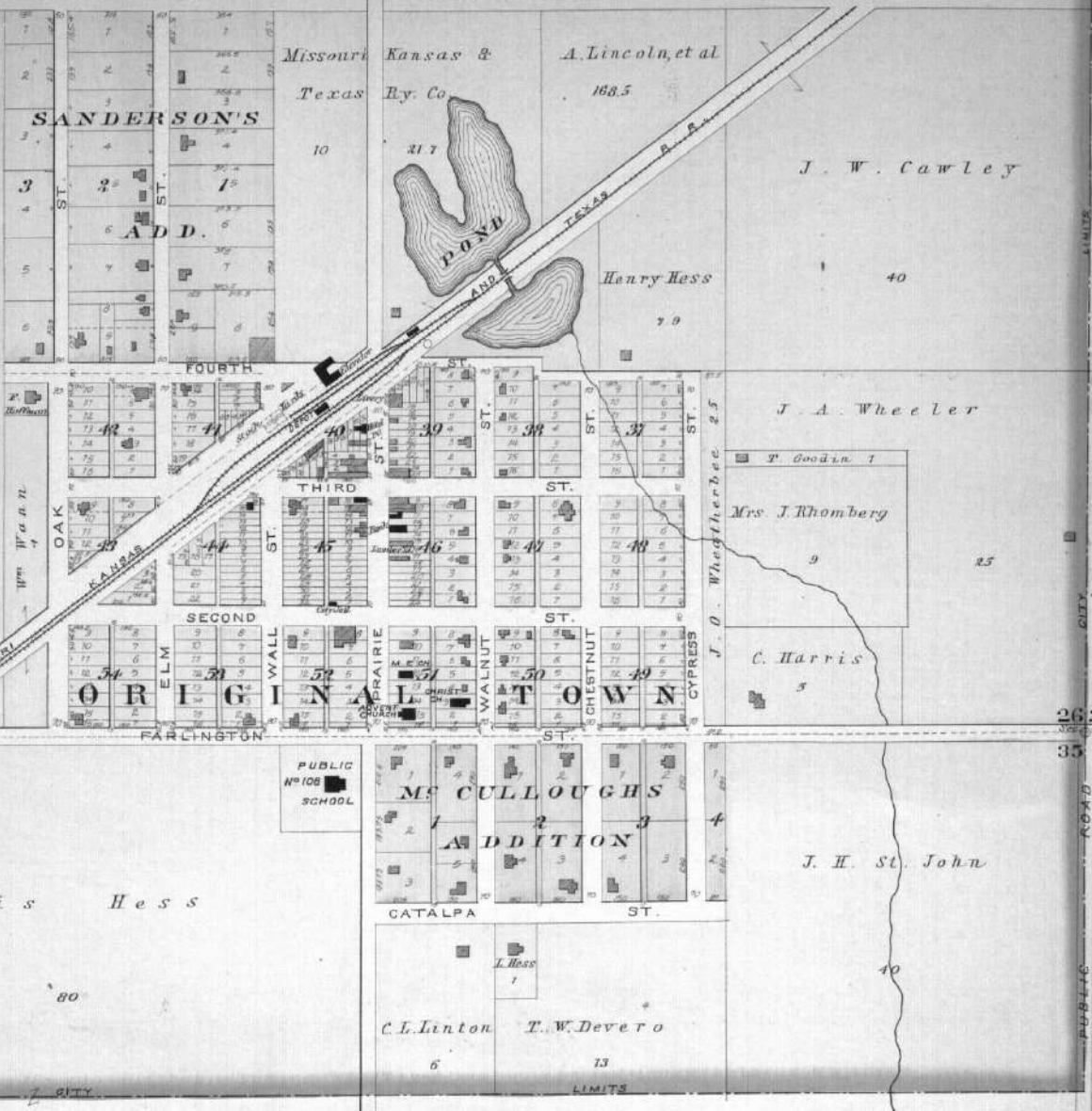

31

26 25
35 36

PUBLIC ROAD

80

TOWNSHIP 29 SOUTH RANGES 21 & 22 EAST

Scale 2 Inches to the Mile

of the 6th Principal Meridian.

3

4

BRAZILTON

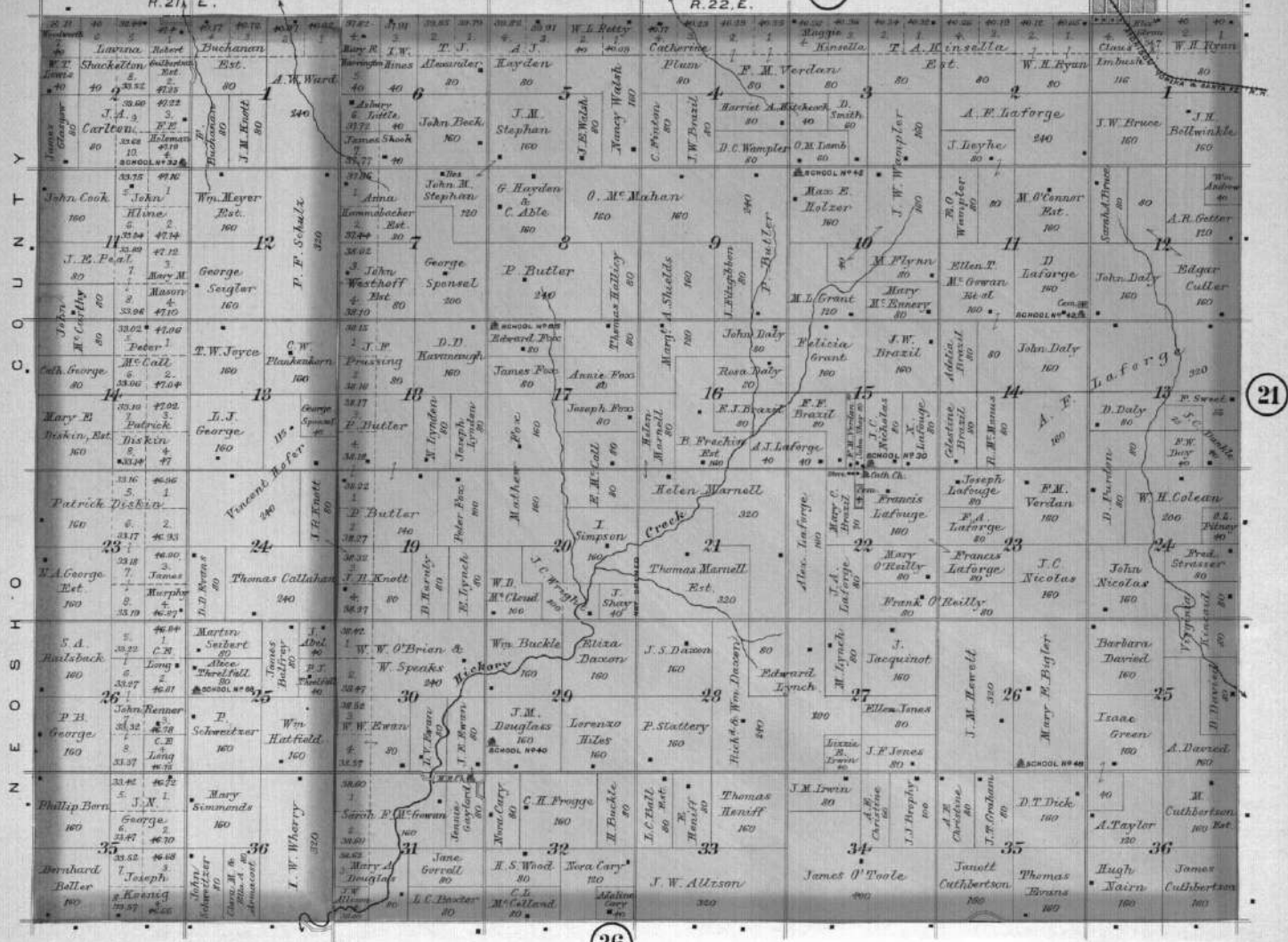

26

21

CHICOPEE

AND SUBURBAN PLATS
BAKER TWP.
Scale, 400 feet to 1 inch.

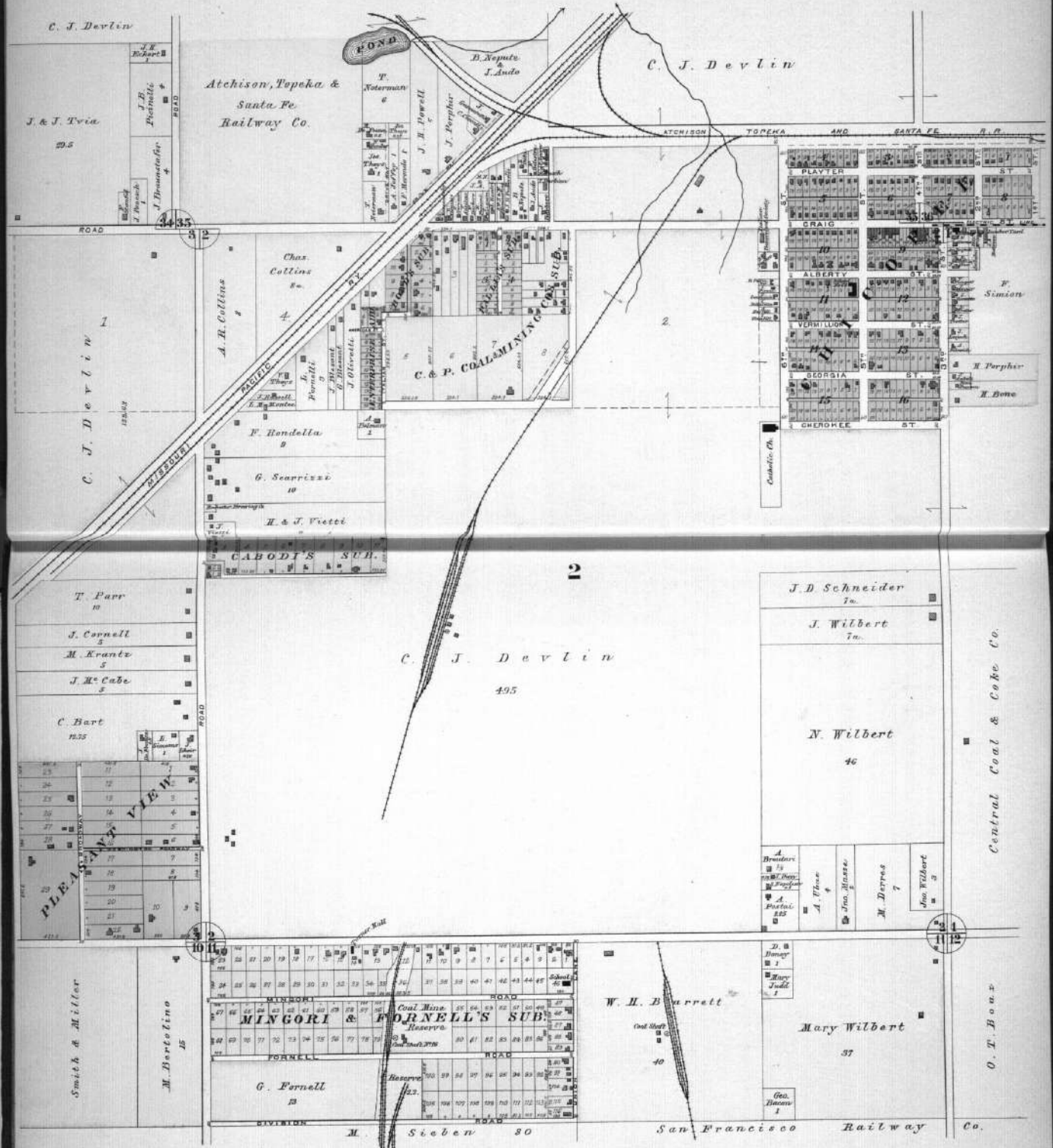

Central Coal & Coke Co.

O. T. Board

TOWNSHIP 30 SOUTH RANGES 21 & 22 EAST

Scale 2 Inches to the Mile

17

of the 6th Principal Meridian.

R. 21, E.

R. 22, E.

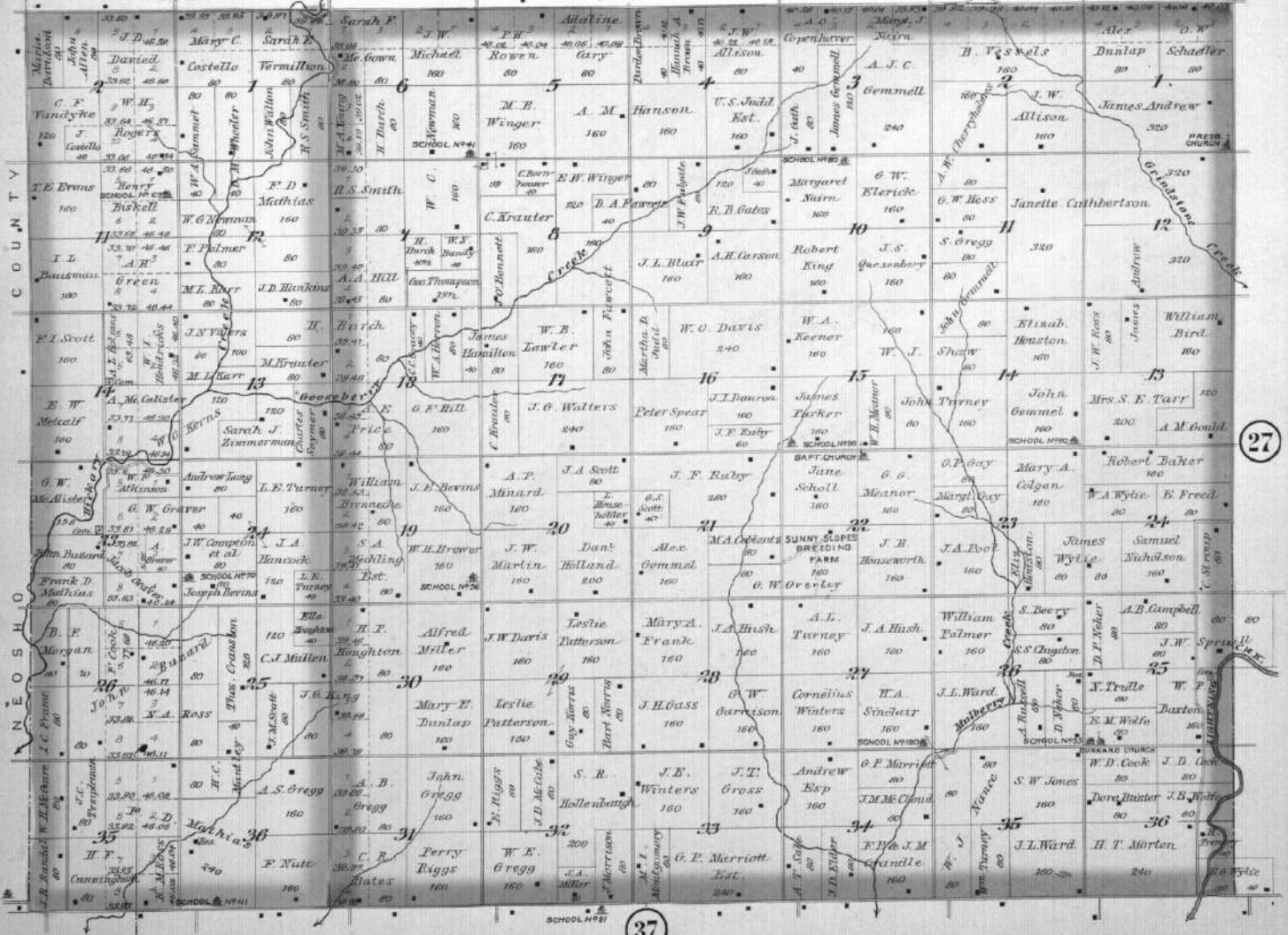

37

TOWNSHIP 31 SOUTH RANGES 21&22 EAST

Scale 2 Inches to the Mile

of the 6th Principal Meridian.

26

39

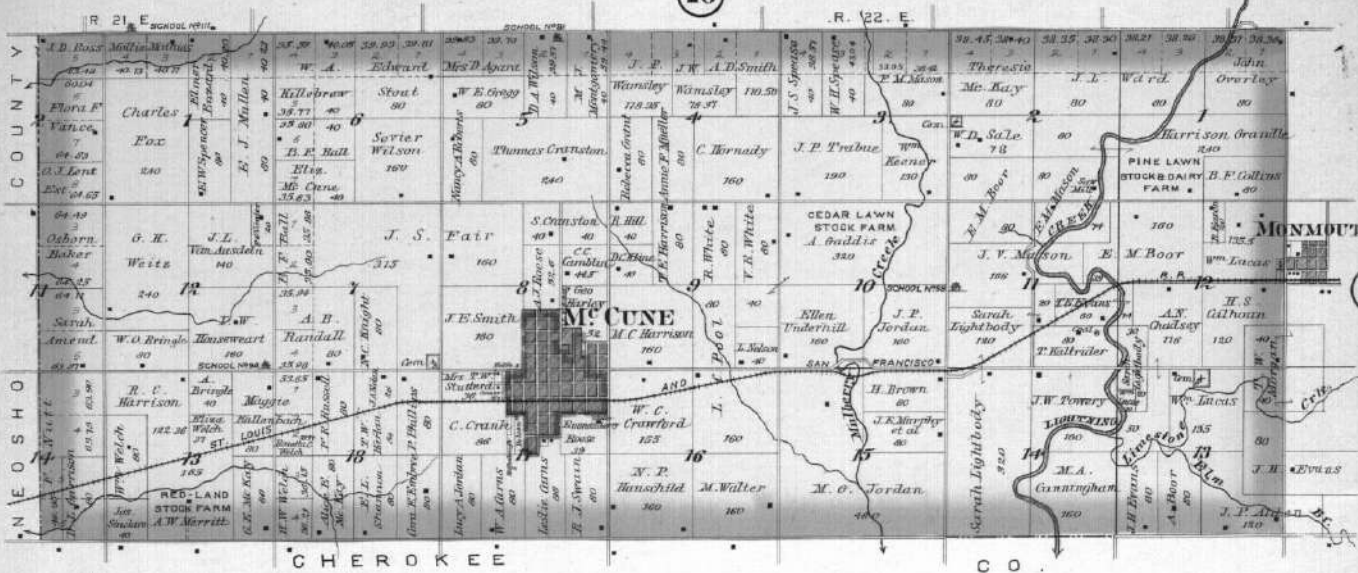

CITY OF
GIRARD
 County Seat of Crawford County
 CRAWFORD TWP.
 Scale 400 feet to one Inch.

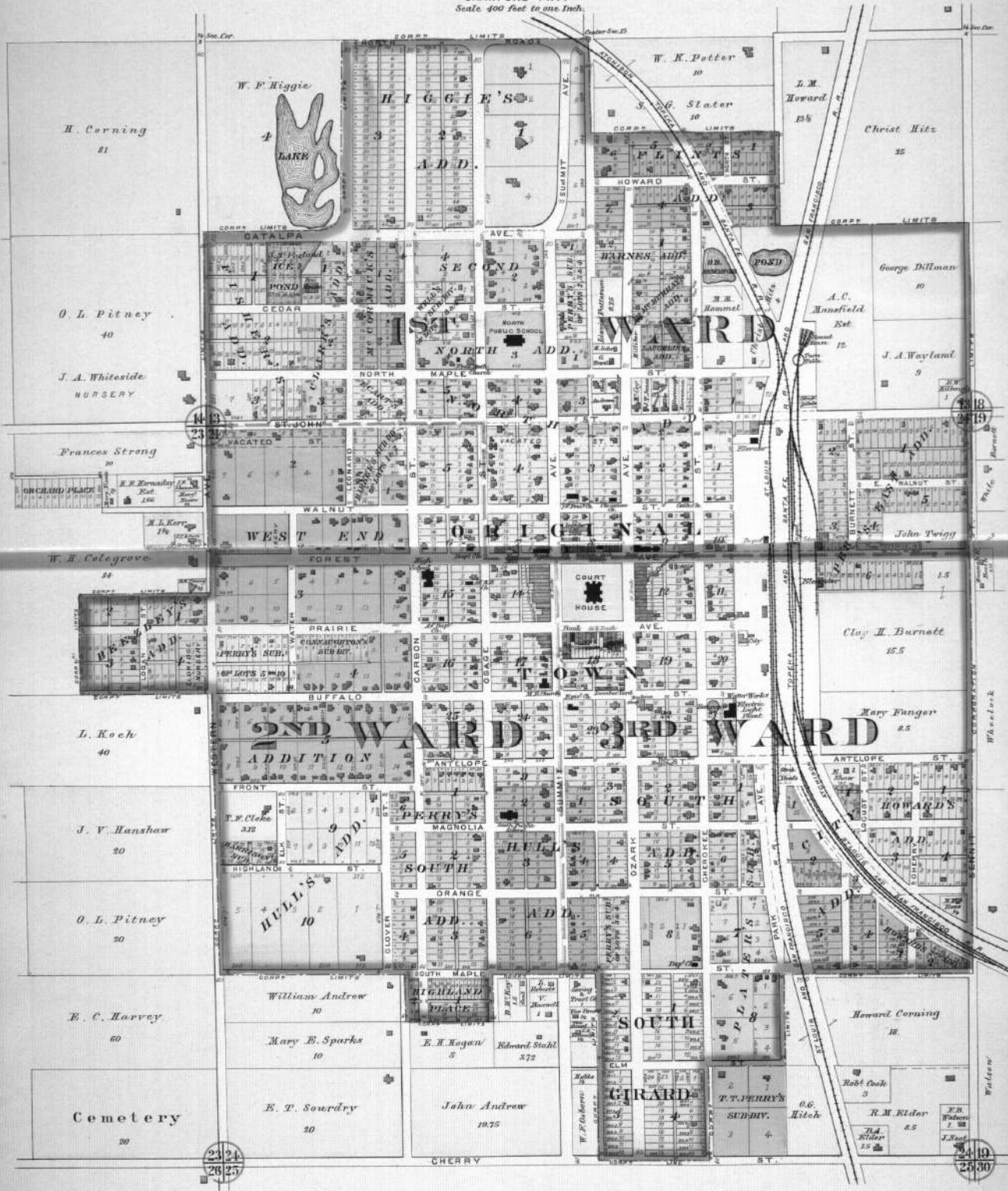

23
24
25
26
27

24
25
26
27