

K-19

# LECOMPTON

Scale 2 Inches to the Mile

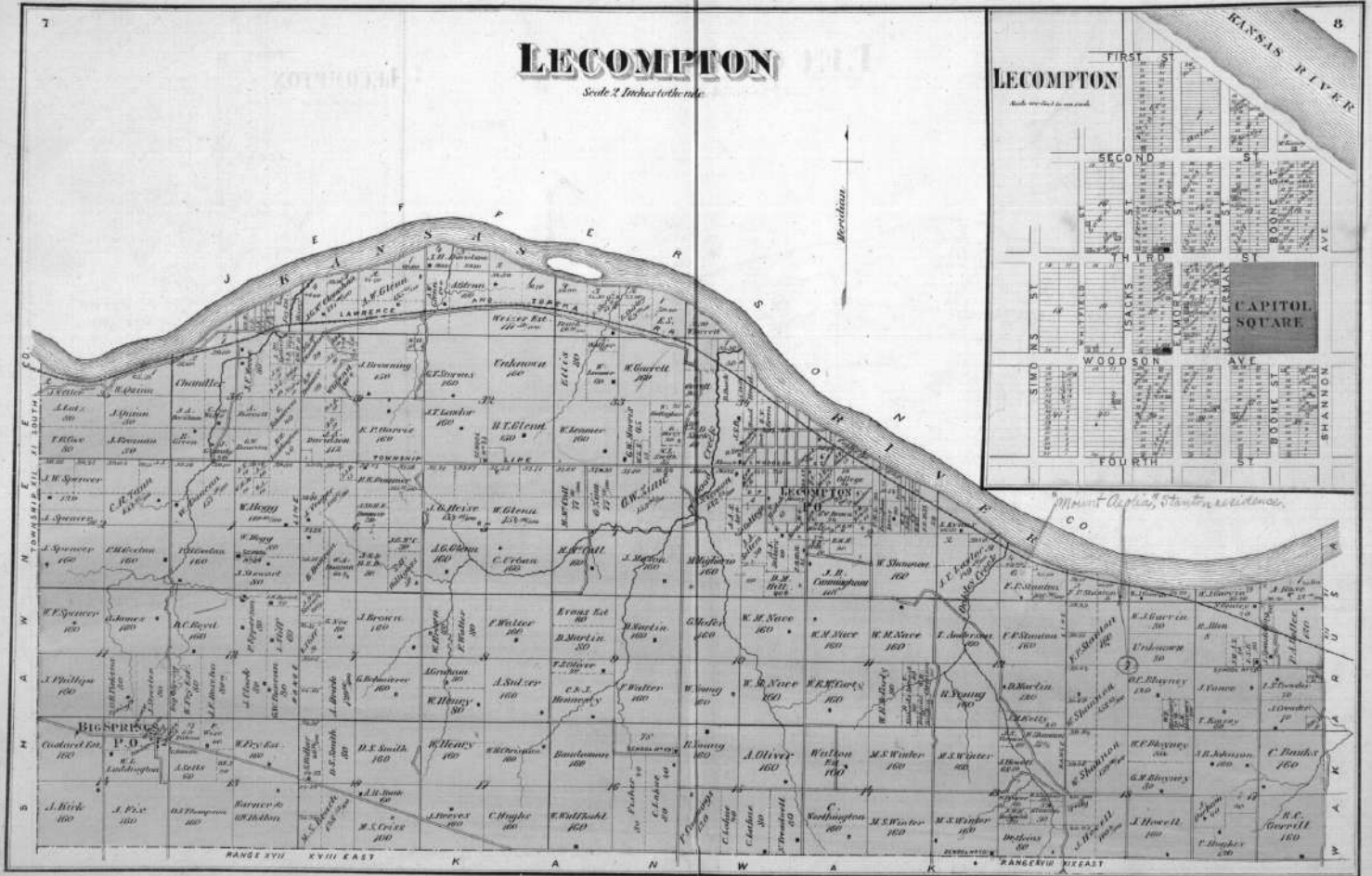

RANGE XVII XVIII EAST

RANGEXVII EAST

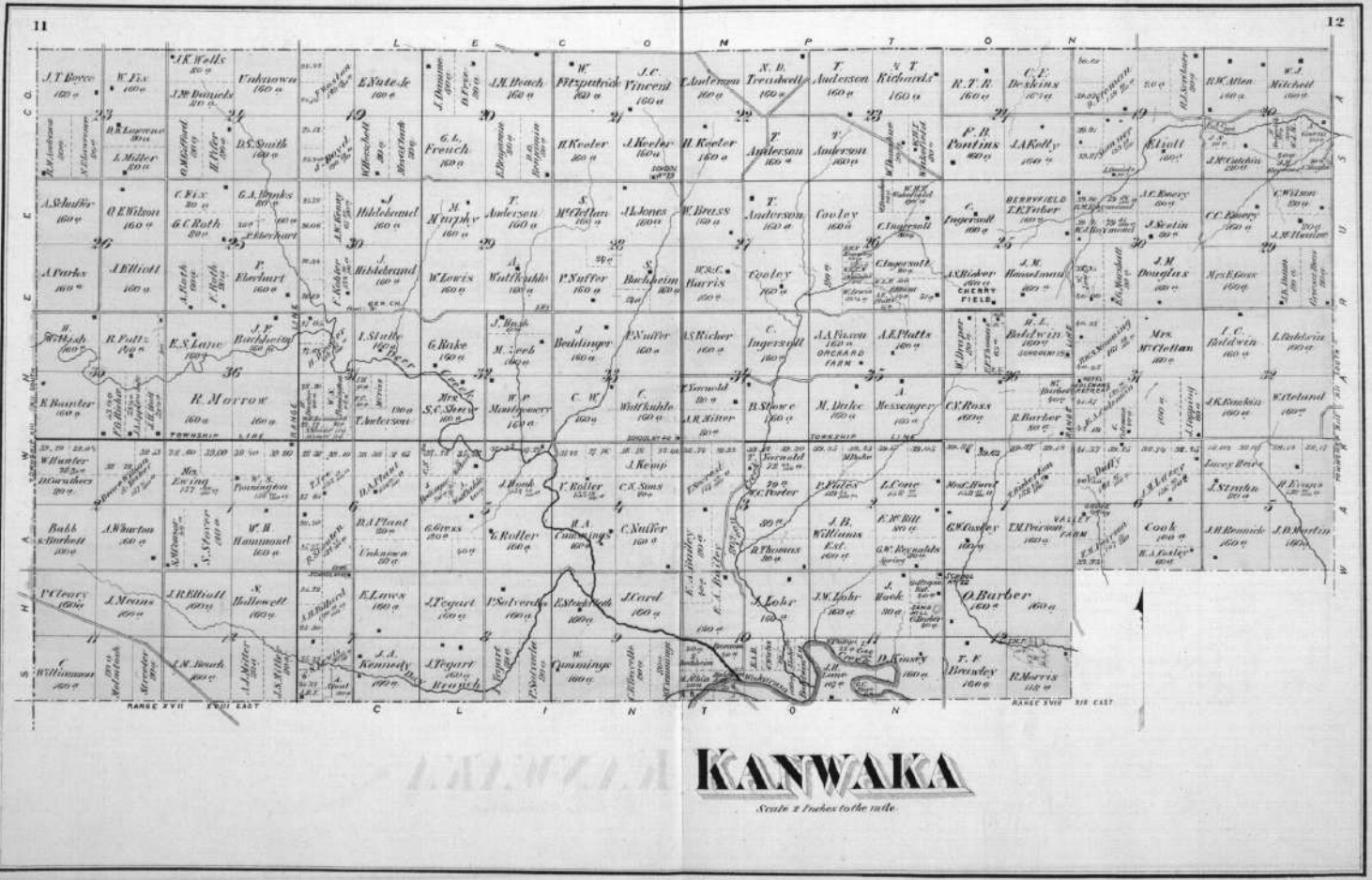

# KANWAKA

Scale 2 inches to the mile.

# GRANT & WAKARUSA

Scale 2 inches to the mile

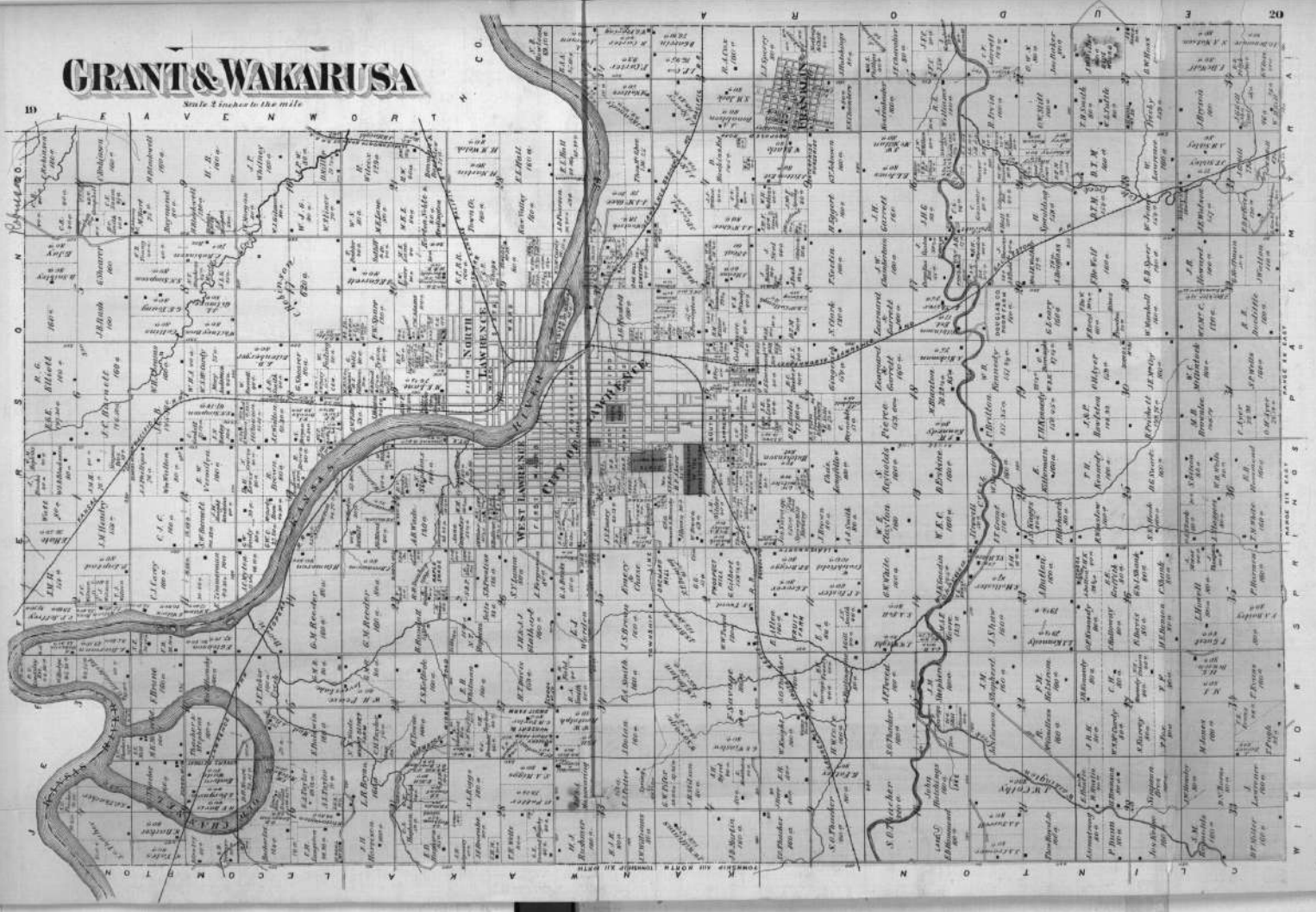

A. M. Wilder	A. M. Wilder	M. S. Beach	A. M. Wilder
E. Rollens		M. C. Leach	M. S. Beach
Corporation Line			

ARKANSAS ST	MISSOURI ST	MAINE ST	ALABAMA ST	ILLINOIS ST	MISSISSIPPI ST	INDIANA ST	DELAWARE ST
1-10	1-10	1-10	1-10	1-10	1-10	1-10	1-10

Parts of  
**CITY OF LAWRENCE**  
 GRANT & WAKARUSA TOWNSHIPS  
 Part of 1st 5th & 6th Wards  
 Scale 300 Feet to the inch

This is a detailed street grid map of Lawrence, Kansas. It shows a network of streets including RIVER ST, VERMONT ST, WYOMING ST, NEBRASKA ST, IOWA ST, ARKANSAS ST, MISSOURI ST, MAINE ST, ALABAMA ST, ILLINOIS ST, MISSISSIPPI ST, INDIANA ST, DELAWARE ST, LYON ST, and MAPLE ST. The map is divided into numerous lots, many of which are labeled with names such as 'Addition', 'Six', 'Seven', 'Eight', 'Nine', and 'Ten'. A 'Corporation Line' is indicated near the top. The map also shows various streets like 'DANE ST', 'REED ST', 'HICKORY ST', 'WYOMING ST', 'LYON ST', and 'MAPLE ST' running horizontally and vertically. A large river is shown on the left side of the map.

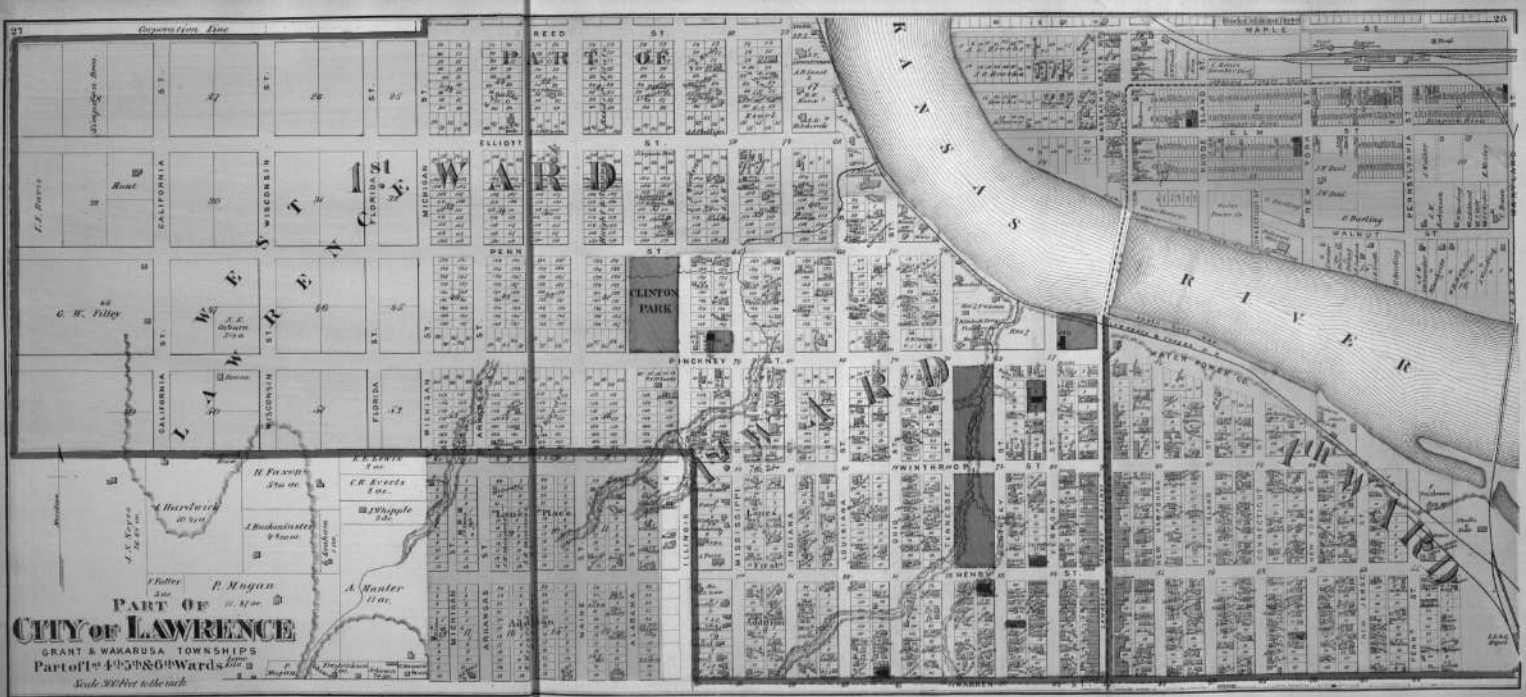

Open from 1890

**PART OF**  
**CITY OF LAWRENCE**  
GRANT & WAKARUSA TOWNSHIPS  
Part of 45th & 60th Wards

Scale 300 Feet to the inch



PART OF  
**CITY OF LAWRENCE**  
 GRANT & WAKARUSA TOWNSHIPS  
 Part of 6th Ward  
 Scale 300 Feet to the inch

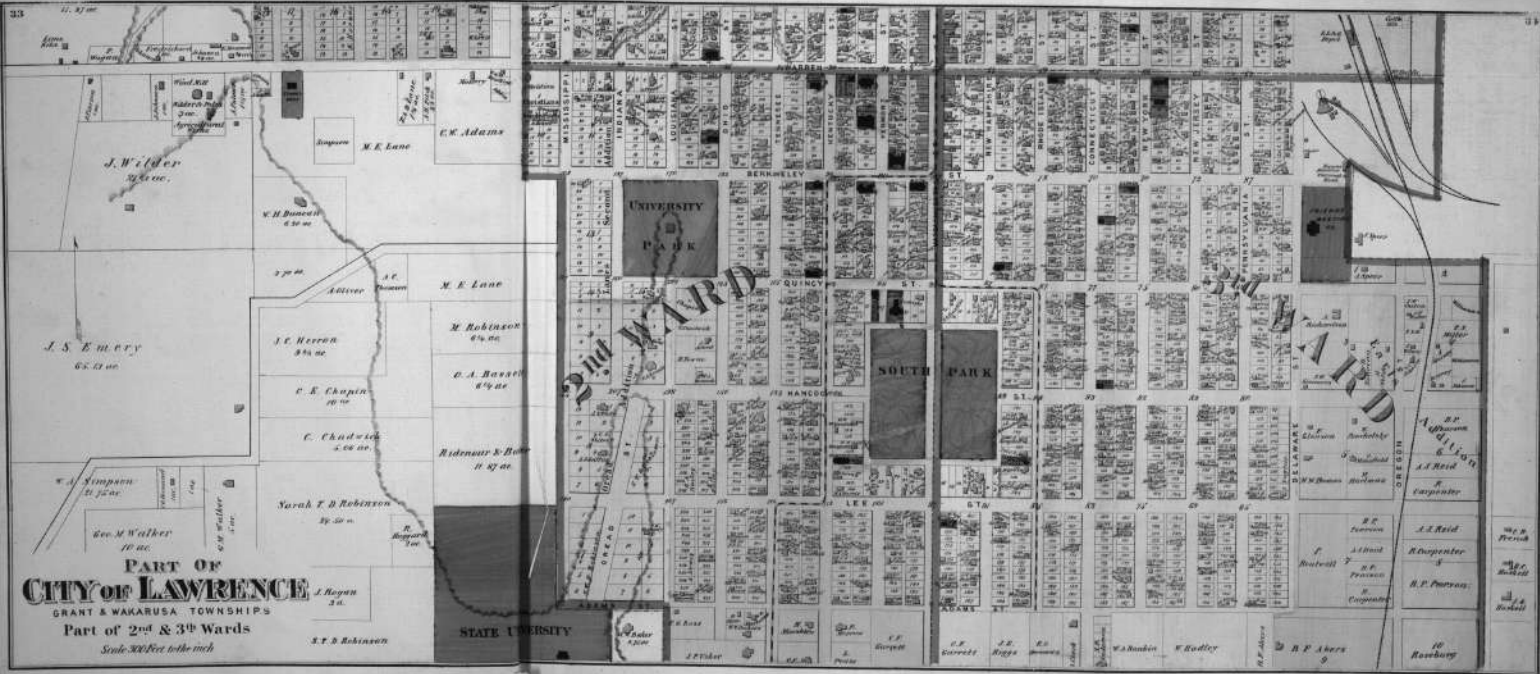

**PART OF**  
**CITY OF LAWRENCE**  
GRANT & WAKARUSA TOWNSHIPS  
Part of 2<sup>nd</sup> & 3<sup>rd</sup> Wards  
Scale 300 Feet to the inch

STATE UNIVERSITY

UNIVERSITY PARK

SOUTH PARK

2<sup>nd</sup> WARD



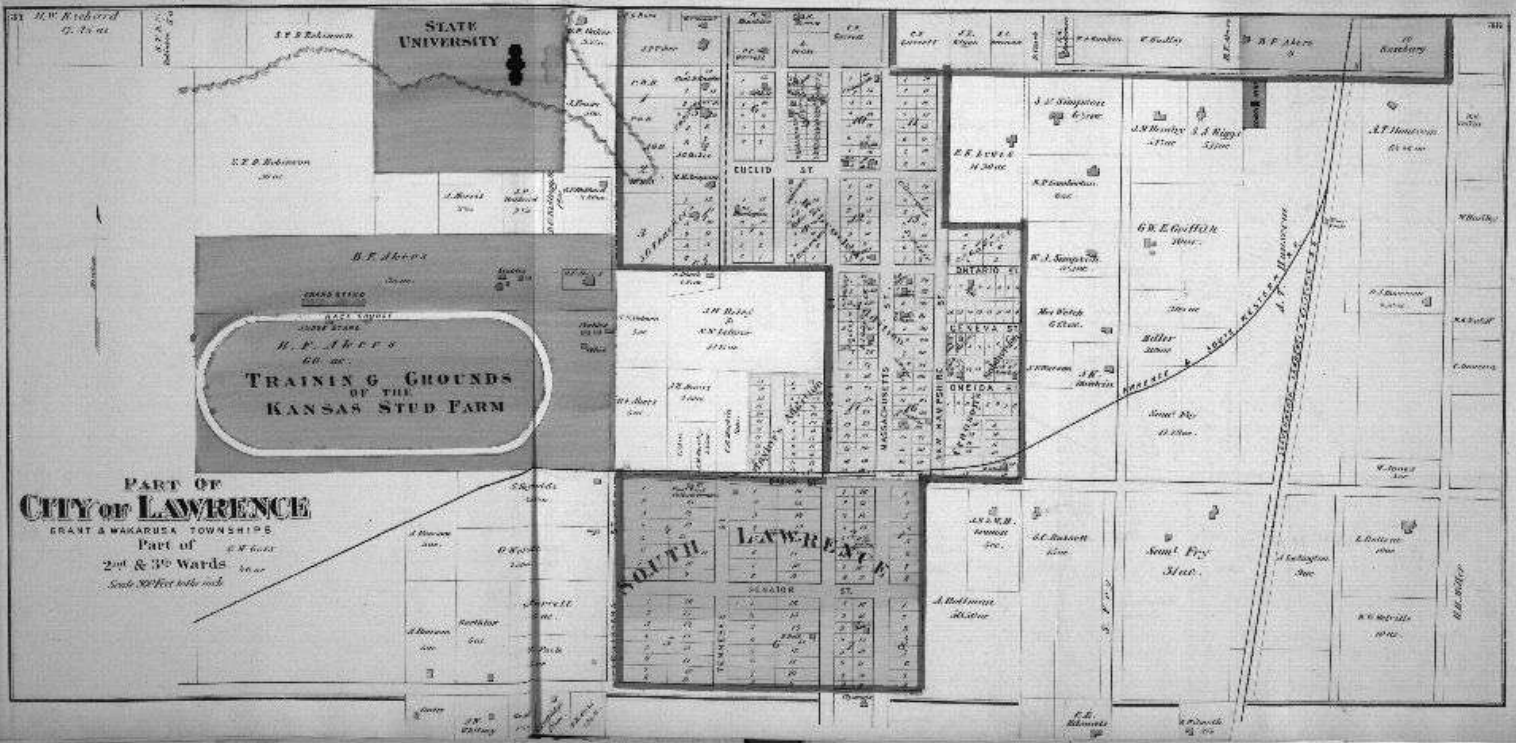

# EUDORA

Scale 2 inches to the mile

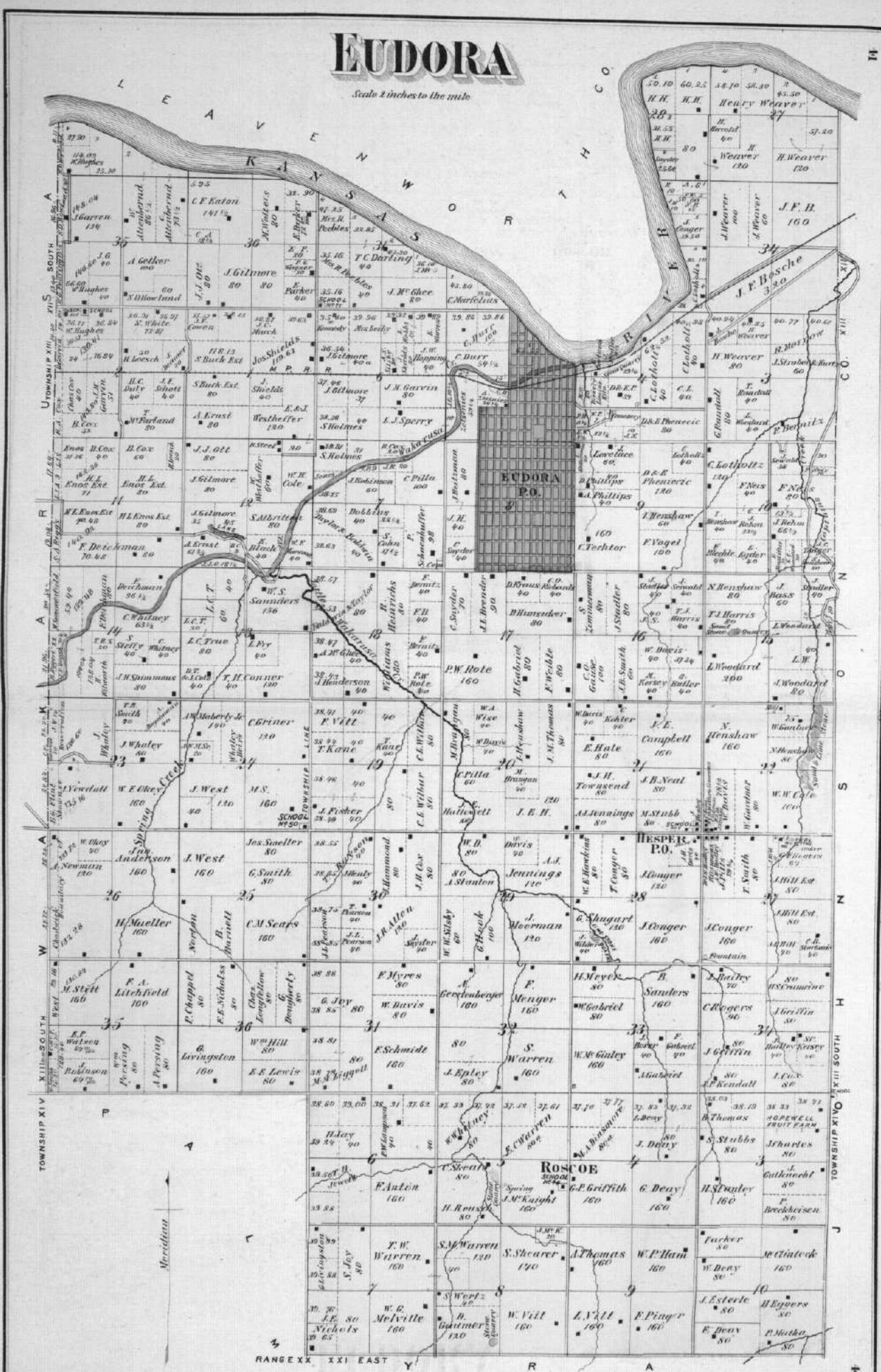

TOWNSHIP XIV SOUTH  
XIII SOUTH  
XII SOUTH  
XI SOUTH  
X SOUTH  
IX SOUTH  
VIII SOUTH  
VII SOUTH  
VI SOUTH  
V SOUTH  
IV SOUTH  
III SOUTH  
II SOUTH  
I SOUTH

RANGE XX EAST  
XXI EAST  
XXII EAST  
XXIII EAST  
XXIV EAST  
XXV EAST  
XXVI EAST  
XXVII EAST  
XXVIII EAST  
XXIX EAST  
XXX EAST  
XXXI EAST  
XXXII EAST  
XXXIII EAST  
XXXIV EAST  
XXXV EAST  
XXXVI EAST  
XXXVII EAST  
XXXVIII EAST  
XXXIX EAST  
XL EAST

Meridian

Section numbers 1 through 36 are indicated along the right edge of the map grid.

**EUDORA P.O.**

**HESPER P.O.**

**ROSCOE**

RANGE XX XXI EAST

# EUDORA

EUDORA TP  
Scale 300 Feet to the inch

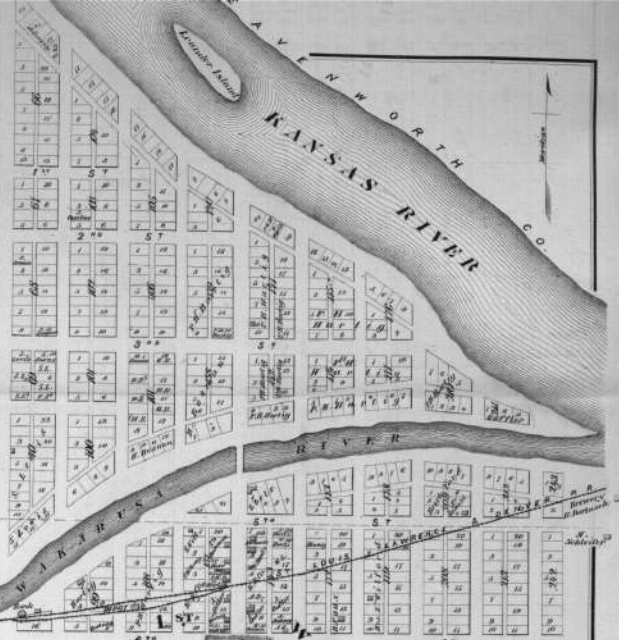
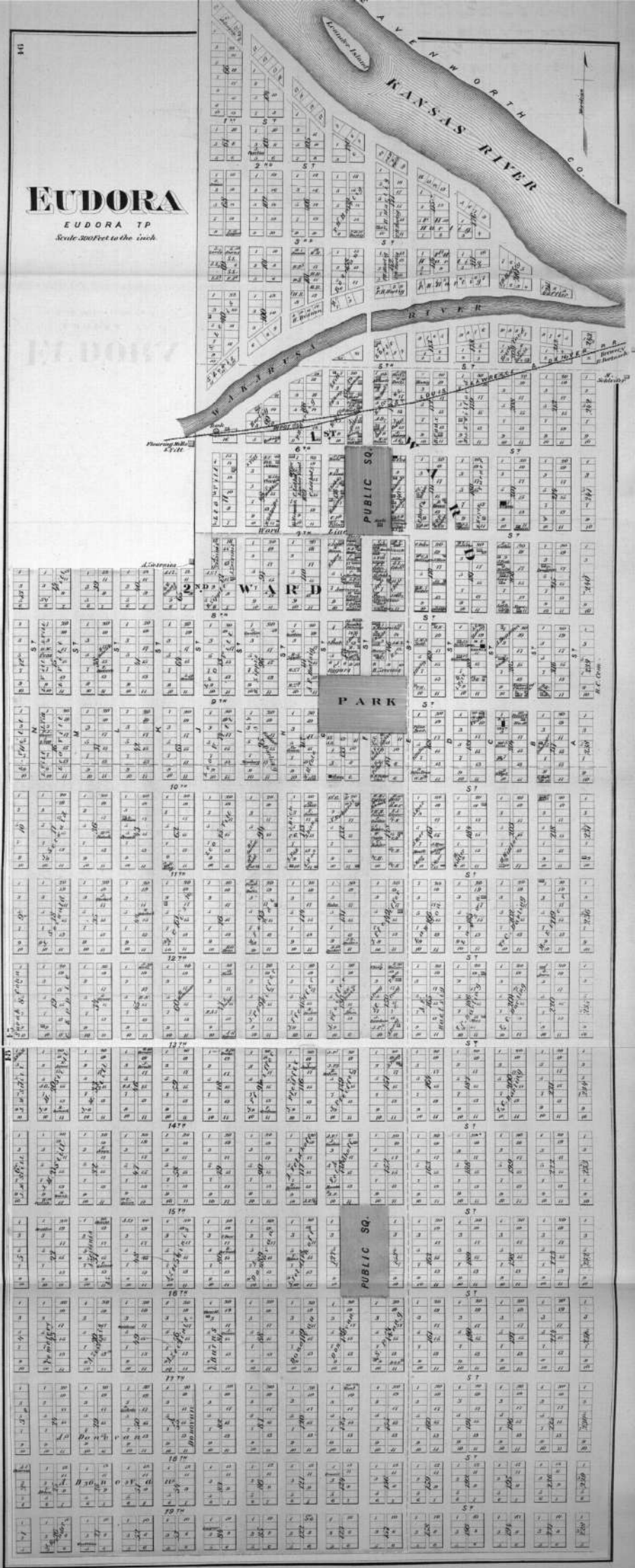

# BLOOMINGTON

CLINTON TP  
Scale 400 Feet to the inch.

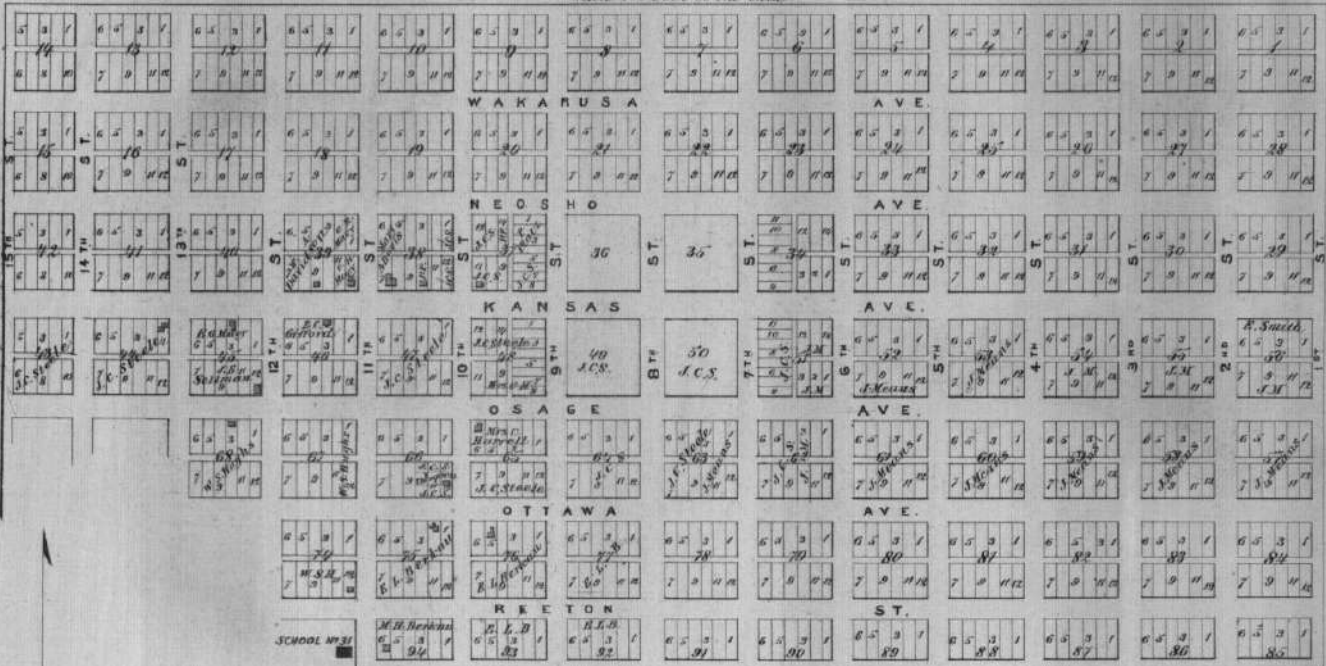

# PART OF MARION

Scale 2 Inches to the mile

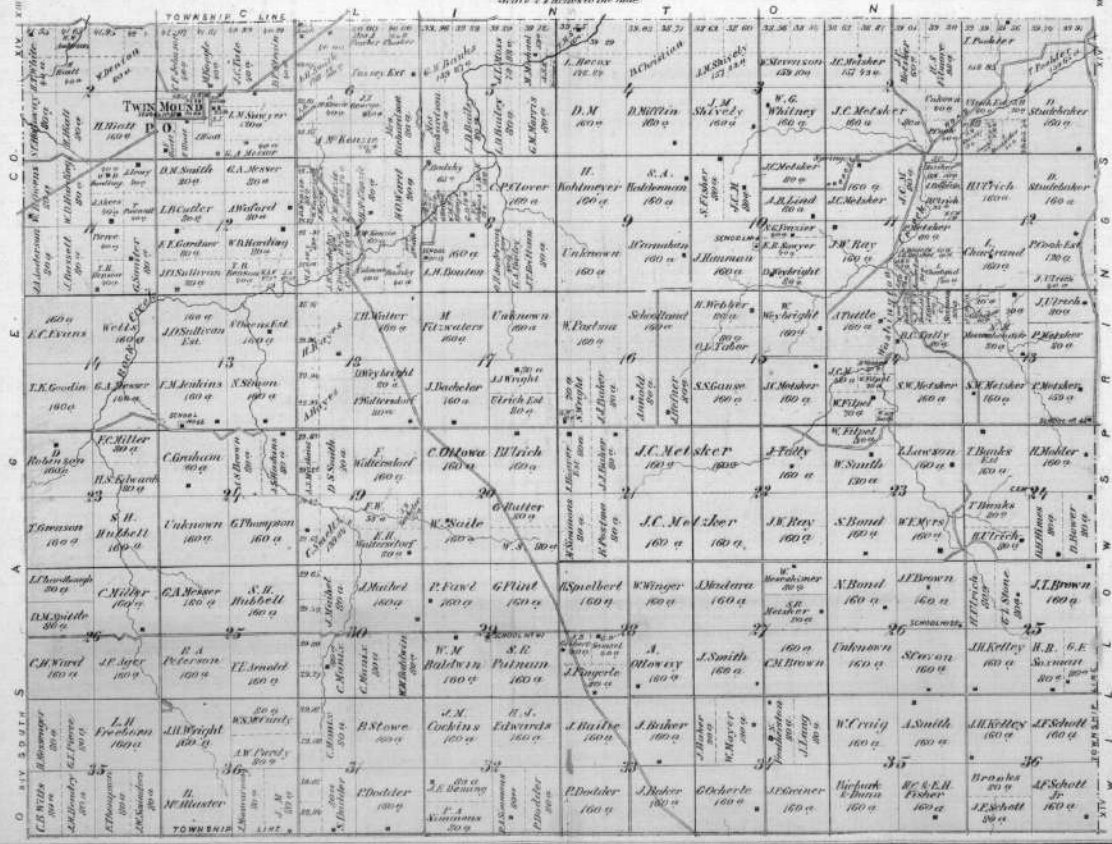

# CLINTON

CLINTON T.P.

Scale 400 Feet to the inch.

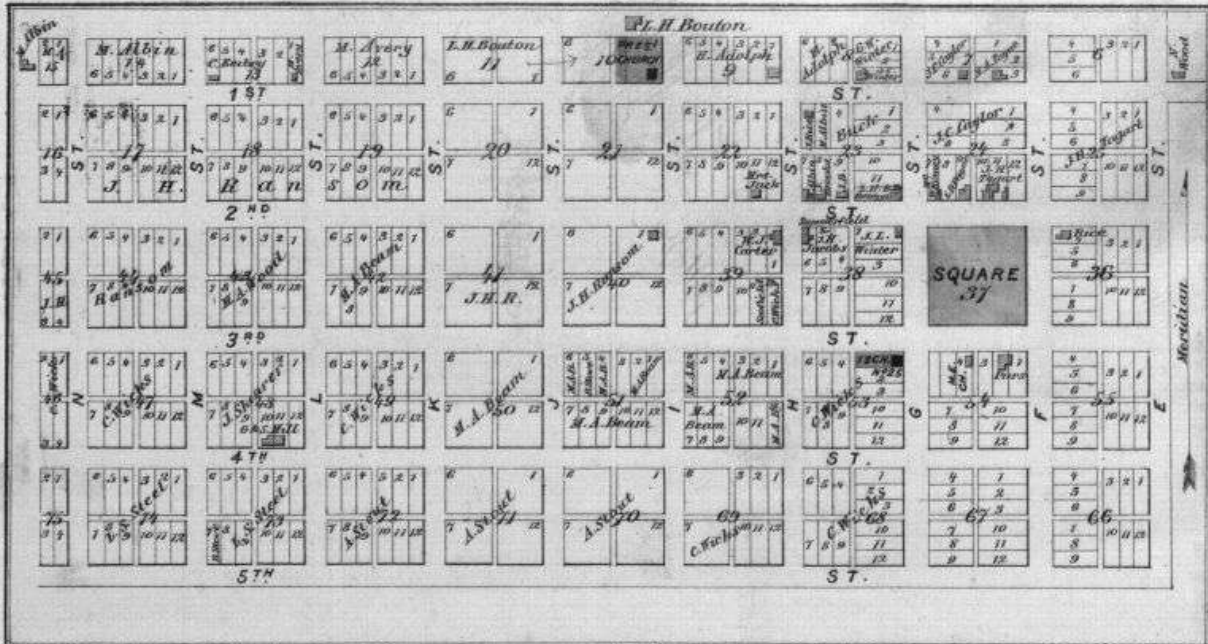

# PRAIRIE CITY

PALMYRA TP.

Scale 400 Feet to the inch.

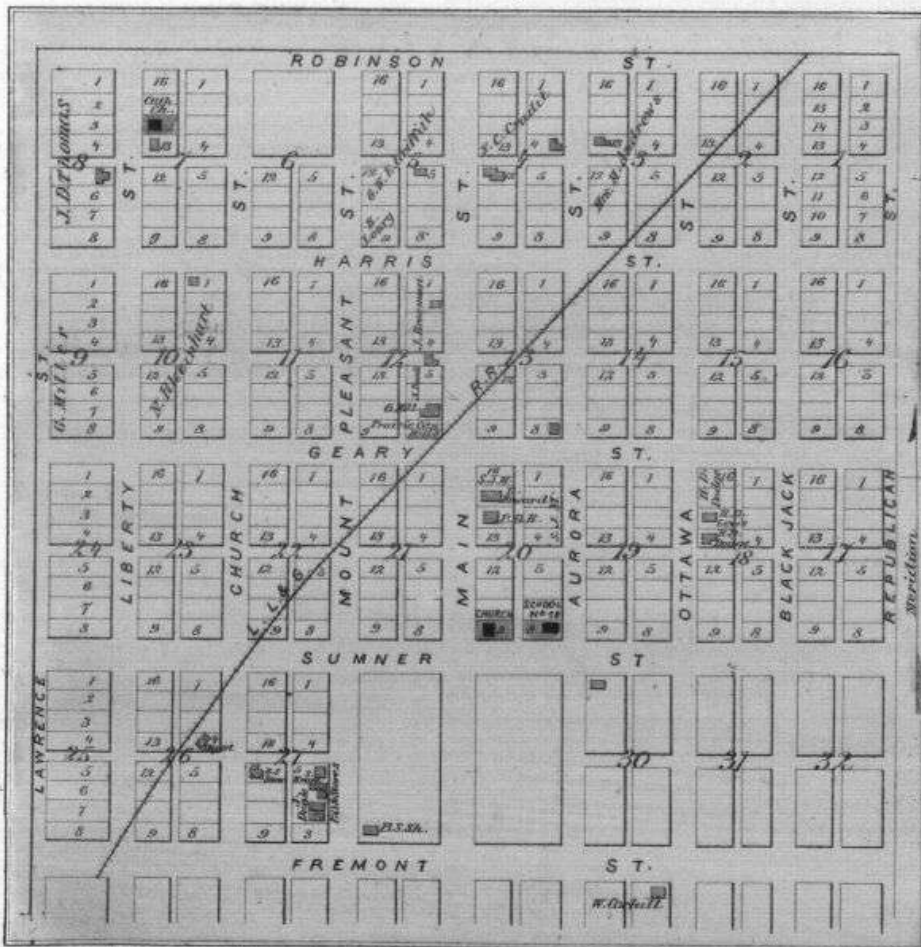

# PART OF MARION

Scale 1/4 inch to the mile

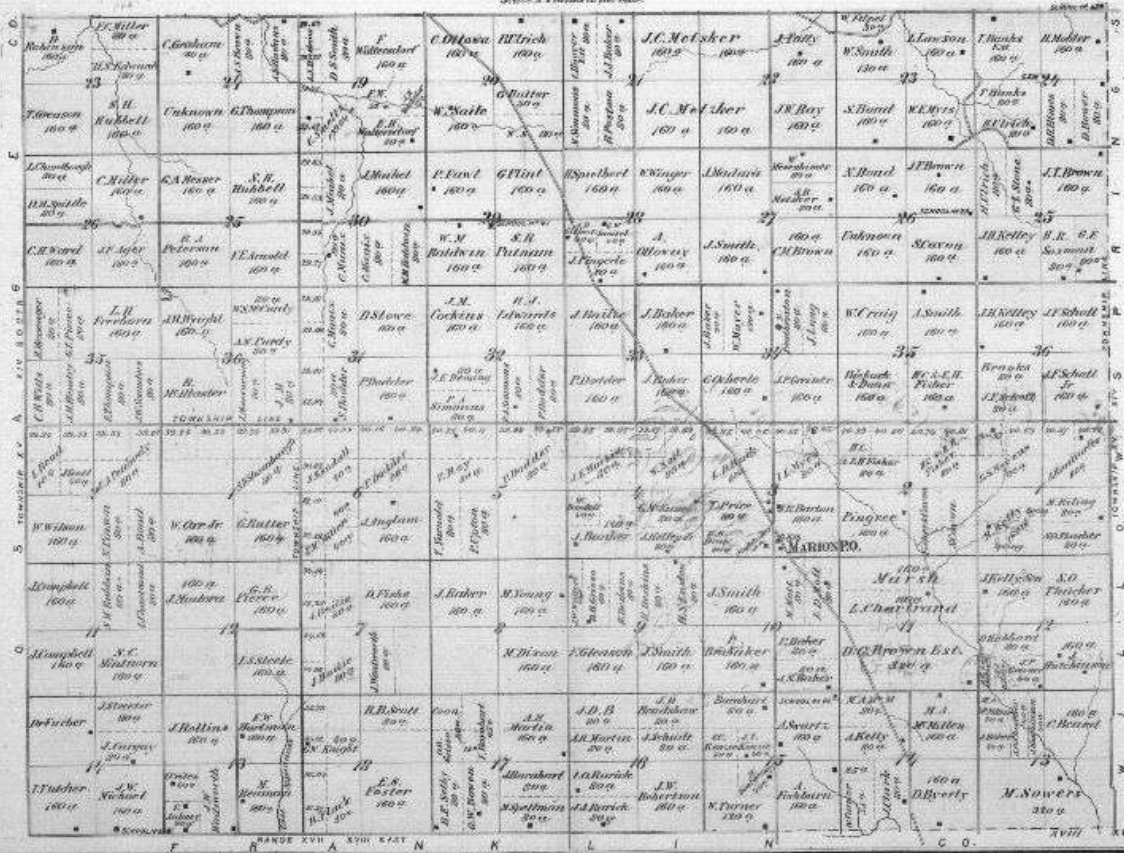



# BALDWIN CITY

PALMYRA TP.  
Scale 500 Feet to the inch

Meridian

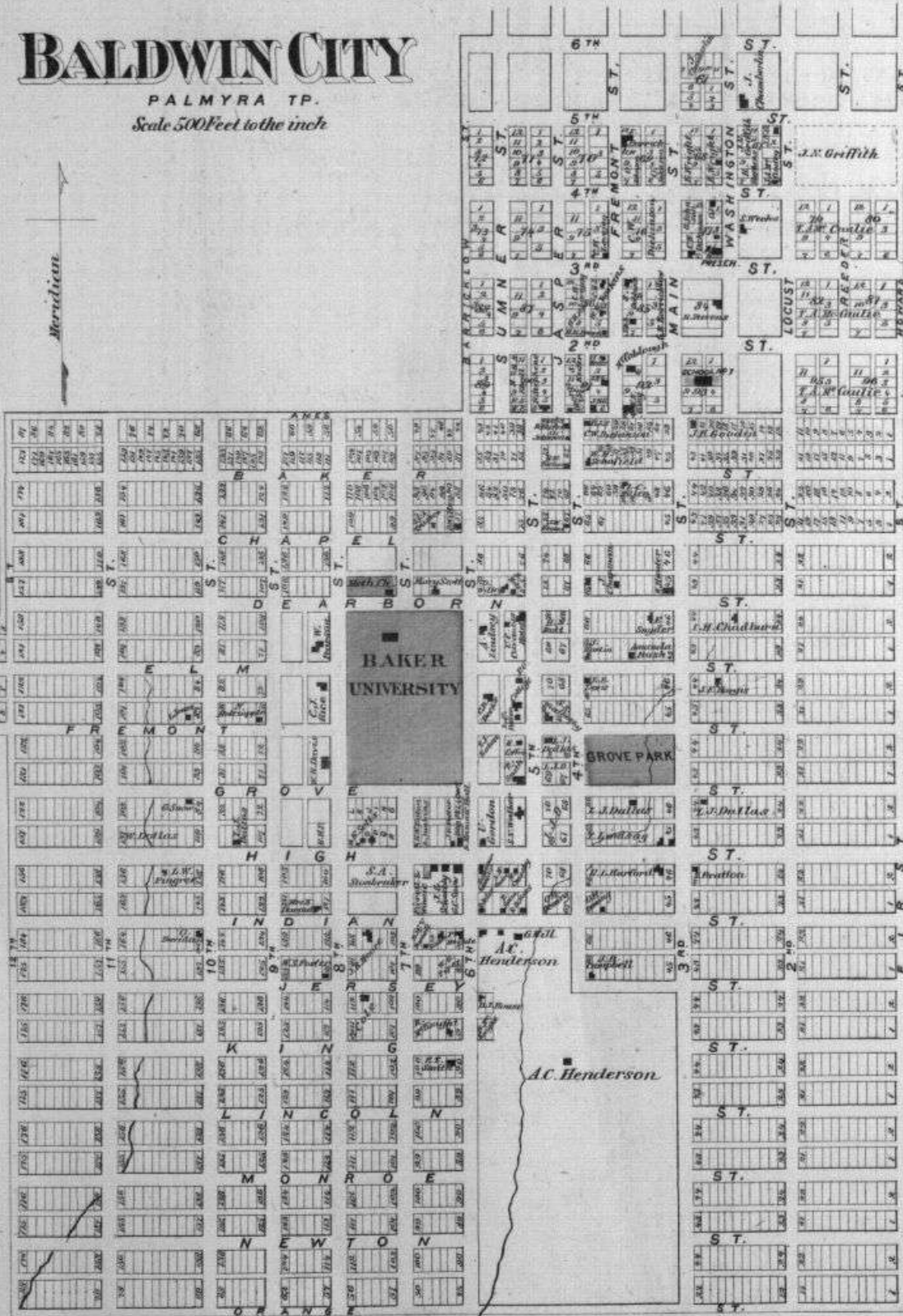

# WILLOW SPRINGS

Scale 2 Inches to the mile

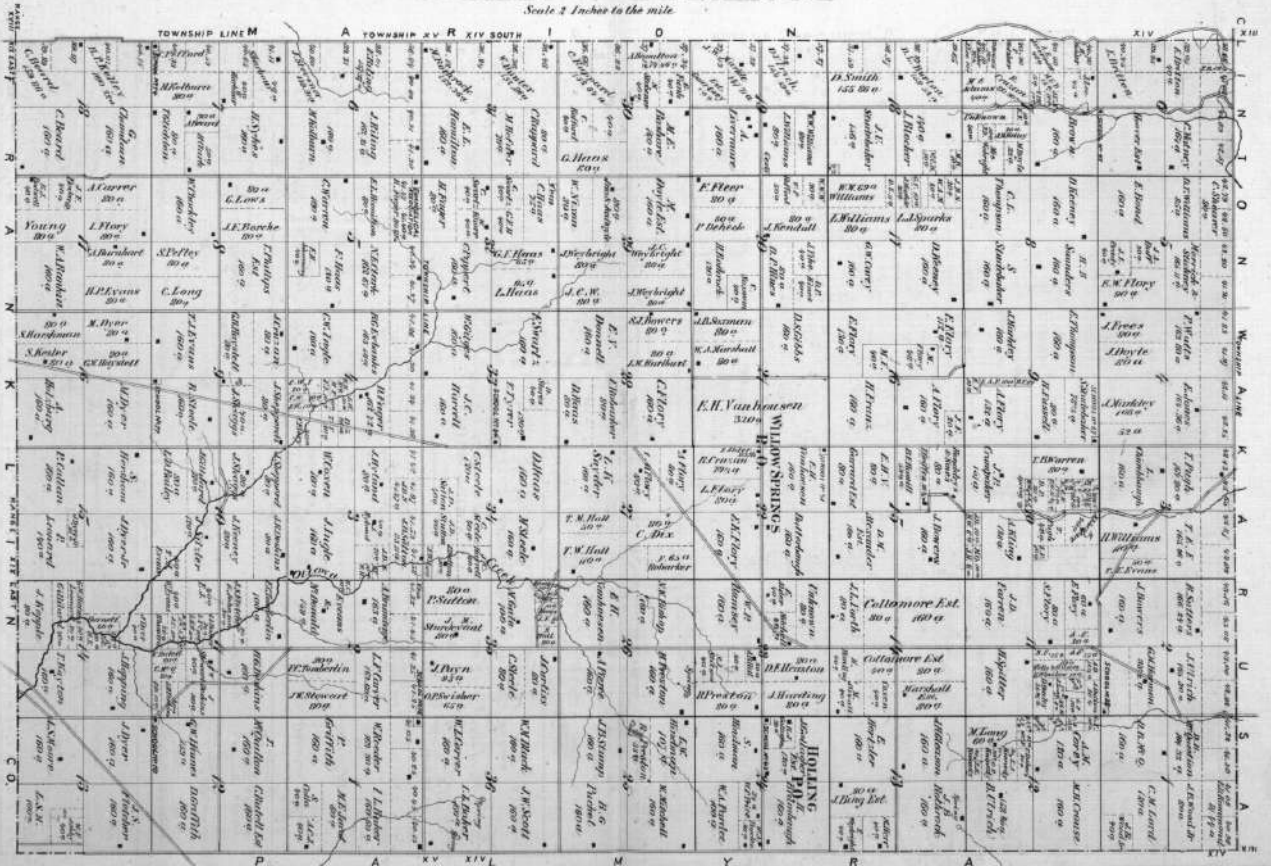

TOWNSHIP LINE M  
 A TOWNSHIP XV R XIV SOUTH  
 I D N  
 XIV  
 N  
 O  
 N  
 N  
 K  
 A  
 R  
 U  
 S  
 A  
 P  
 A  
 Y  
 R  
 A

XIV  
 N  
 O  
 N  
 N  
 K  
 A  
 R  
 U  
 S  
 A  
 P  
 A  
 Y  
 R  
 A

Palmyra Township Business Notices

Carson House, Palmyra City, W. G. Carson, Prop.
Harris W. H. Prop. of United Nursery, 2nd Street, Palmyra, Pa. P. O.
Bohl J. J. Farmer, Maple, Orchard and Stock Farm in Palmyra.

Flasker W. Prop. of Union Nursery and Fruit Farm, One mile North-west of P. O. and U. S. Depot, on the L. & O. R.R.
Finger S. W. Carpenter and Builder, Palmyra City
Fottigall H. D. Farmer, Rock Jack P. O.

PART OF PALMYRA

Scale 2 Inches to the mile.

Marion Township Business Notices

Baker J. J. Farmer, Clinton P. O.
Boyd W. H. Farmer and Stock Dealer, Willow Springs P. O.
Carmichael J. P. Farmer, Clinton P. O.
Dunning J. E. Physician and Farmer, Marion P. O.

Eudora Business Notices

ATTOENEY
Richardson A. G. Attorney, Real Estate and Insurance Agent
MERCHANTS AND DEALERS
Coles H. Dealer in General Merchandise

Clinton Township Business Notices

Barber G. Farmer, Kemora P. O.
Berkman C. P. Farmer, Hamilton P. O.
Boventon L. M. Blacksmith, Clinton P. O.
Boyd E. A. Farmer, Clinton P. O.

Willow Springs Township Business Notices

Edward Cyrus, Farmer, Catawissa P. O.
Henry Isaker E. Farmer and Stock Dealer, Clinton City P. O.
Gale M. Farmer and Stock Dealer, Willow Springs P. O.

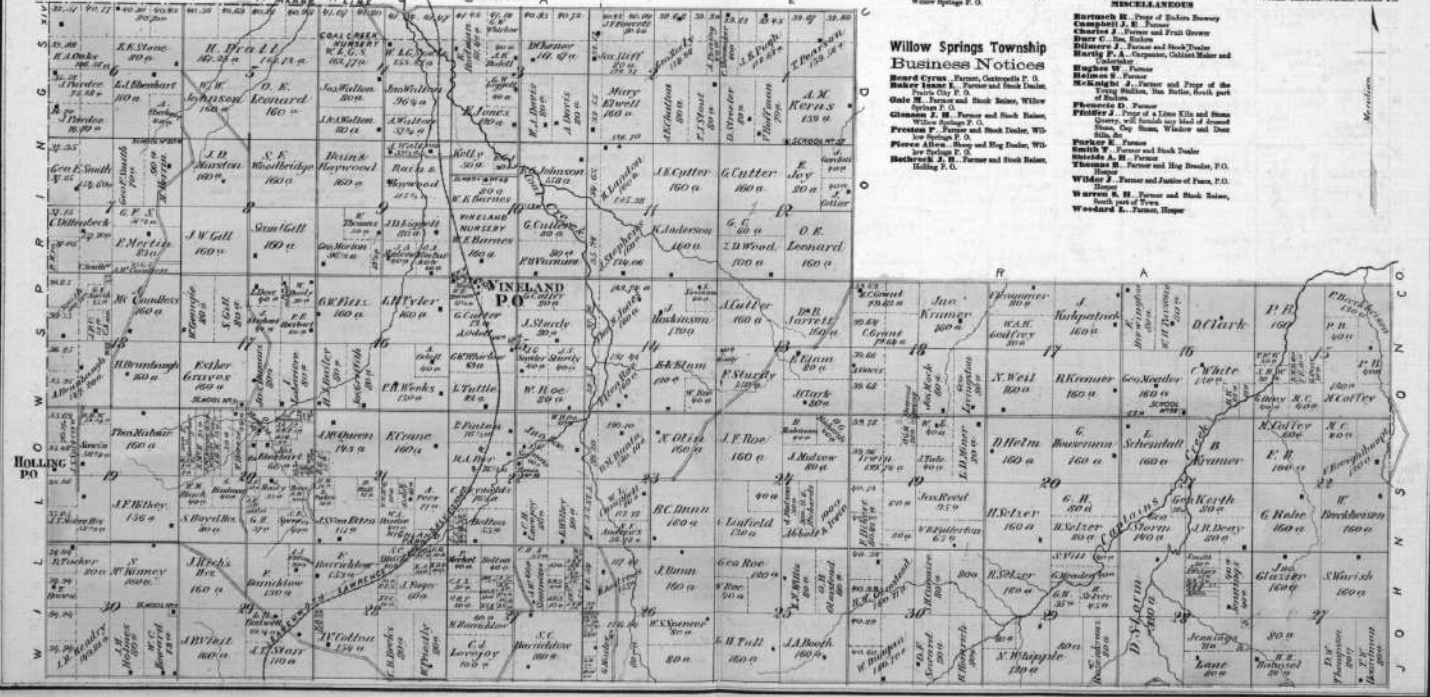

# PART OF PALMYRA

Scale 2 inches to the mile

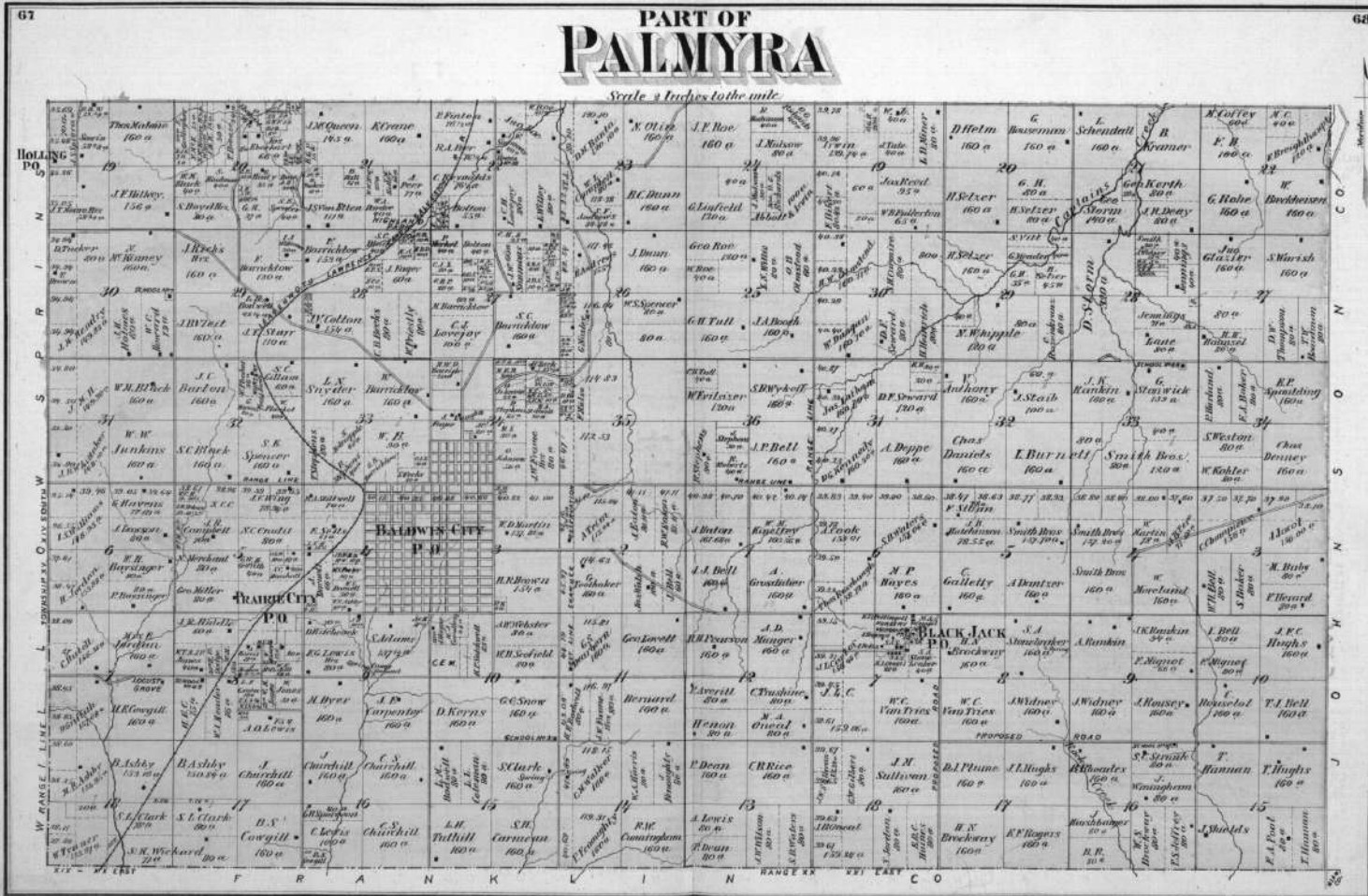

# CLINTON

Scale 2 inches to the mile

