

First Settlement Ellis Co 1845-1848

Sec 20 T11 R19

Second Settlement Ellis Co 1842-1845

Sec 16 T15 R19

Benson Trappers

# OUTLINE MAP OF ELLIS COUNTY KANSAS

Copyright 1924 by Geo. A. Ogle & Co.

Scale 2 1/2 in. to 1 mile

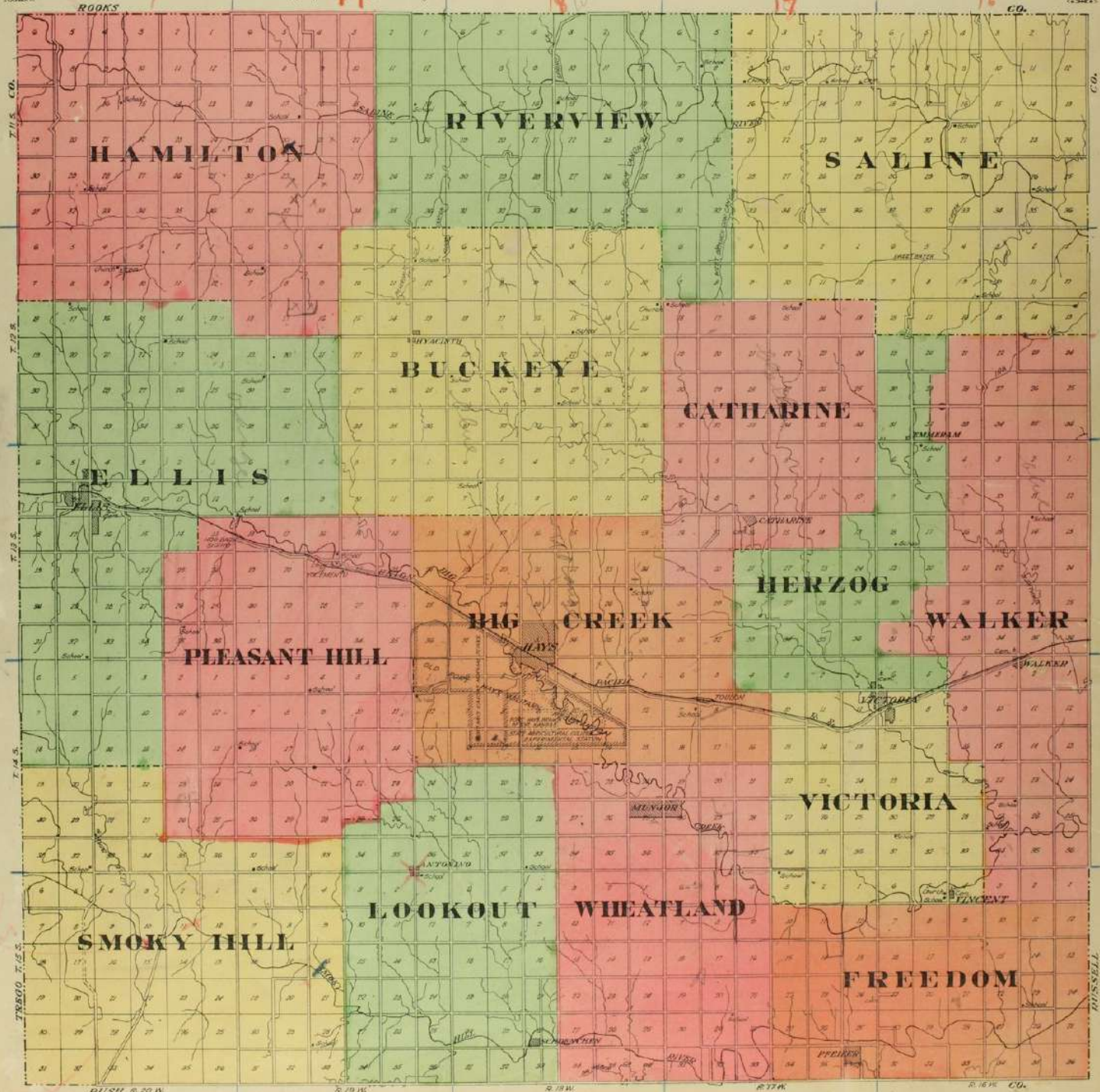

RUSH R. 20 W.

R. 11 W.

R. 12 W.

R. 13 W.

R. 14 W. CO.

RUSSELL



# HAYS

PLATTED AS HAYS CITY  
County Seat of Ellis Co.  
Kansas  
Twp 13 & 14 S. R. 18 West  
Scale 400 ft. to Inch  
Copyright 1925 by Geo. A. Goyne

Etta Ward  
75

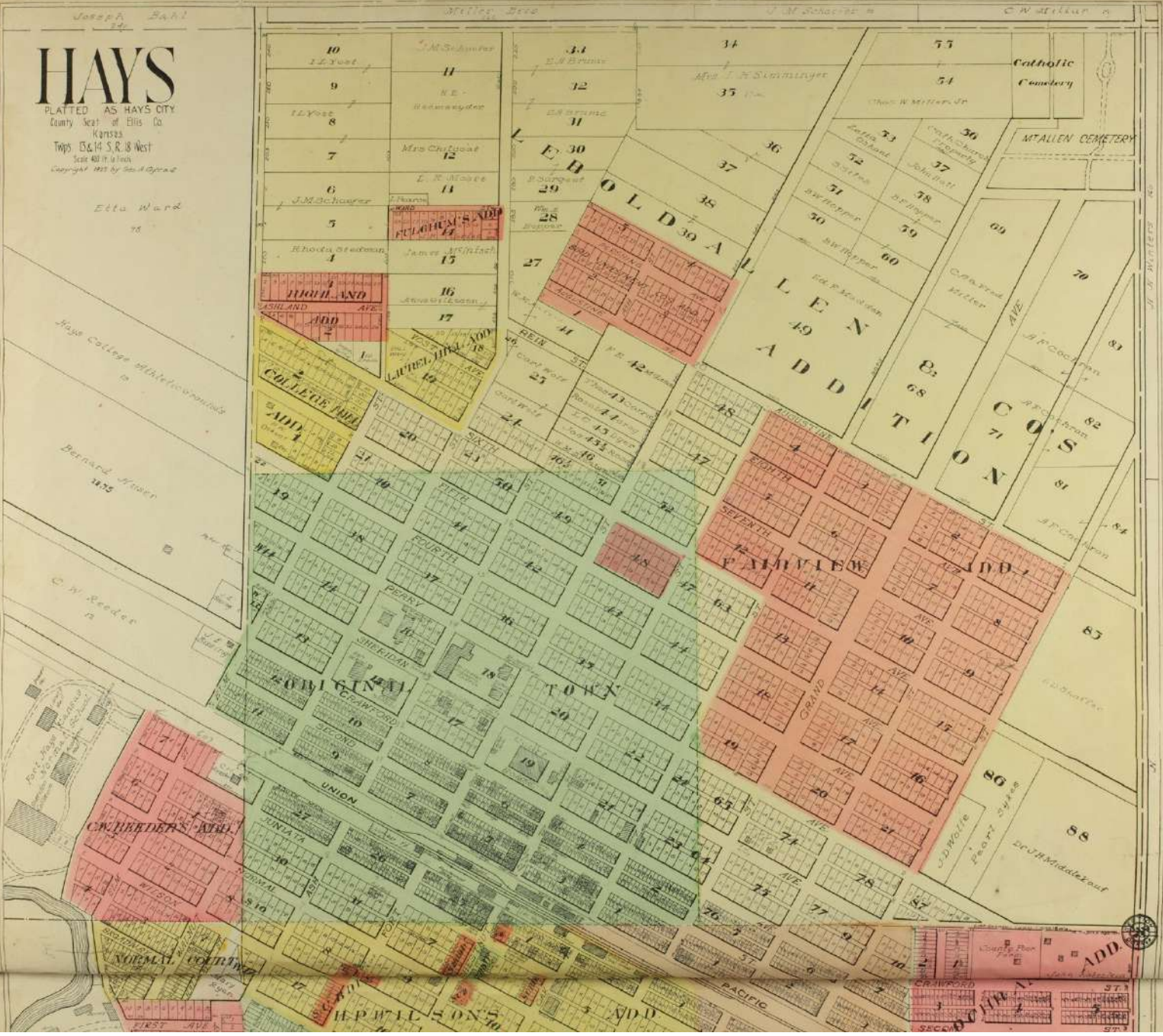

U.S. DISTRICT COURT





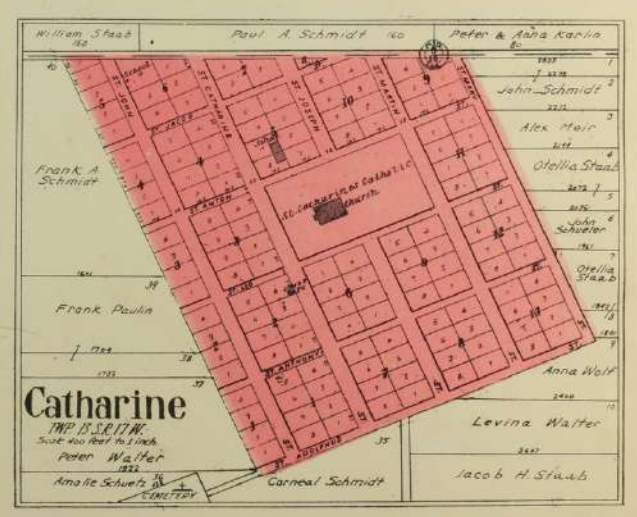
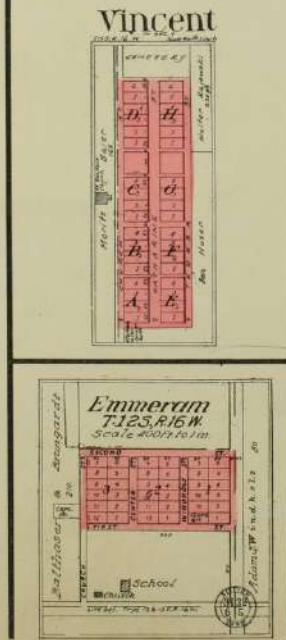
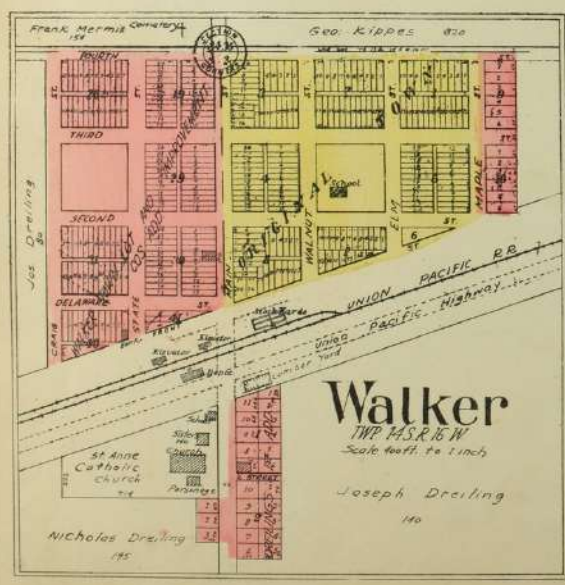
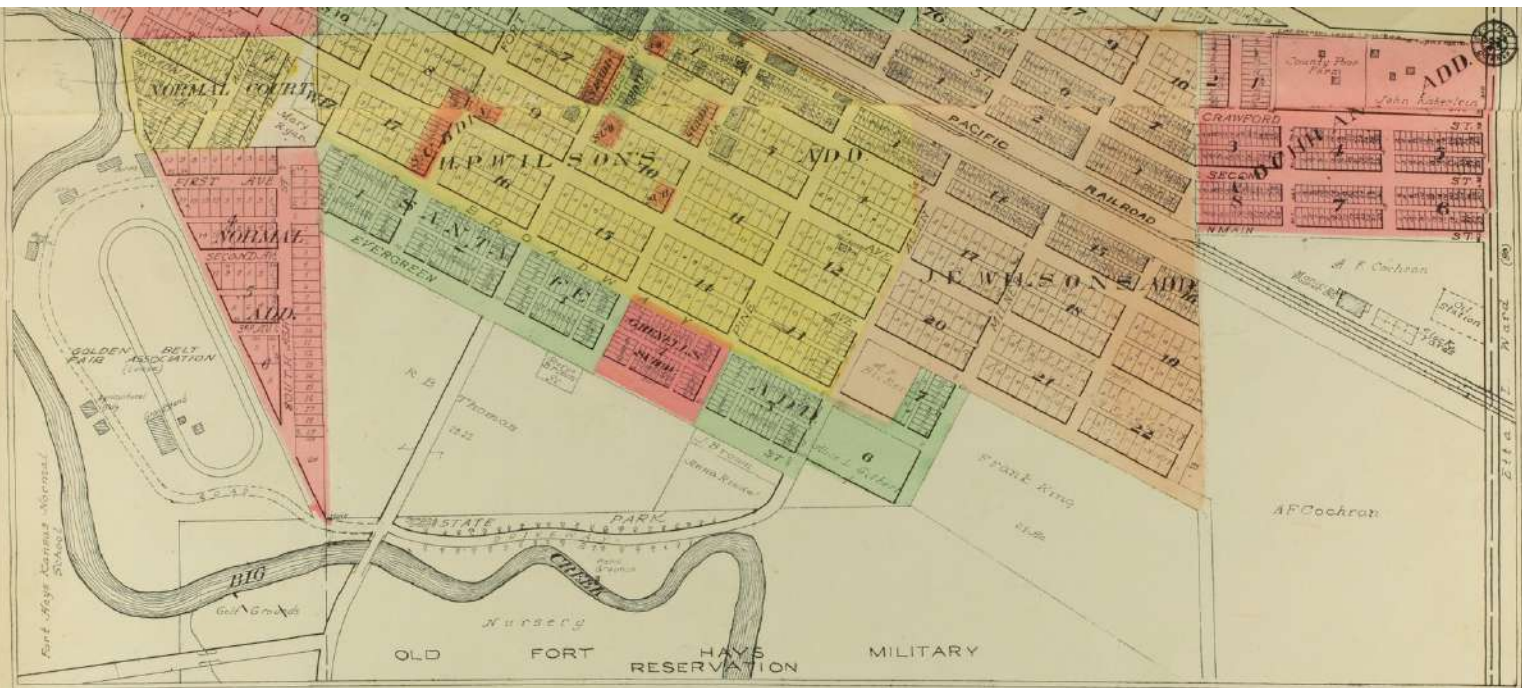



# VICTORIA (HERZOG)

T. 14 S. R. 65. 16 & 17 W.  
Scale 400 ft. to 1 inch

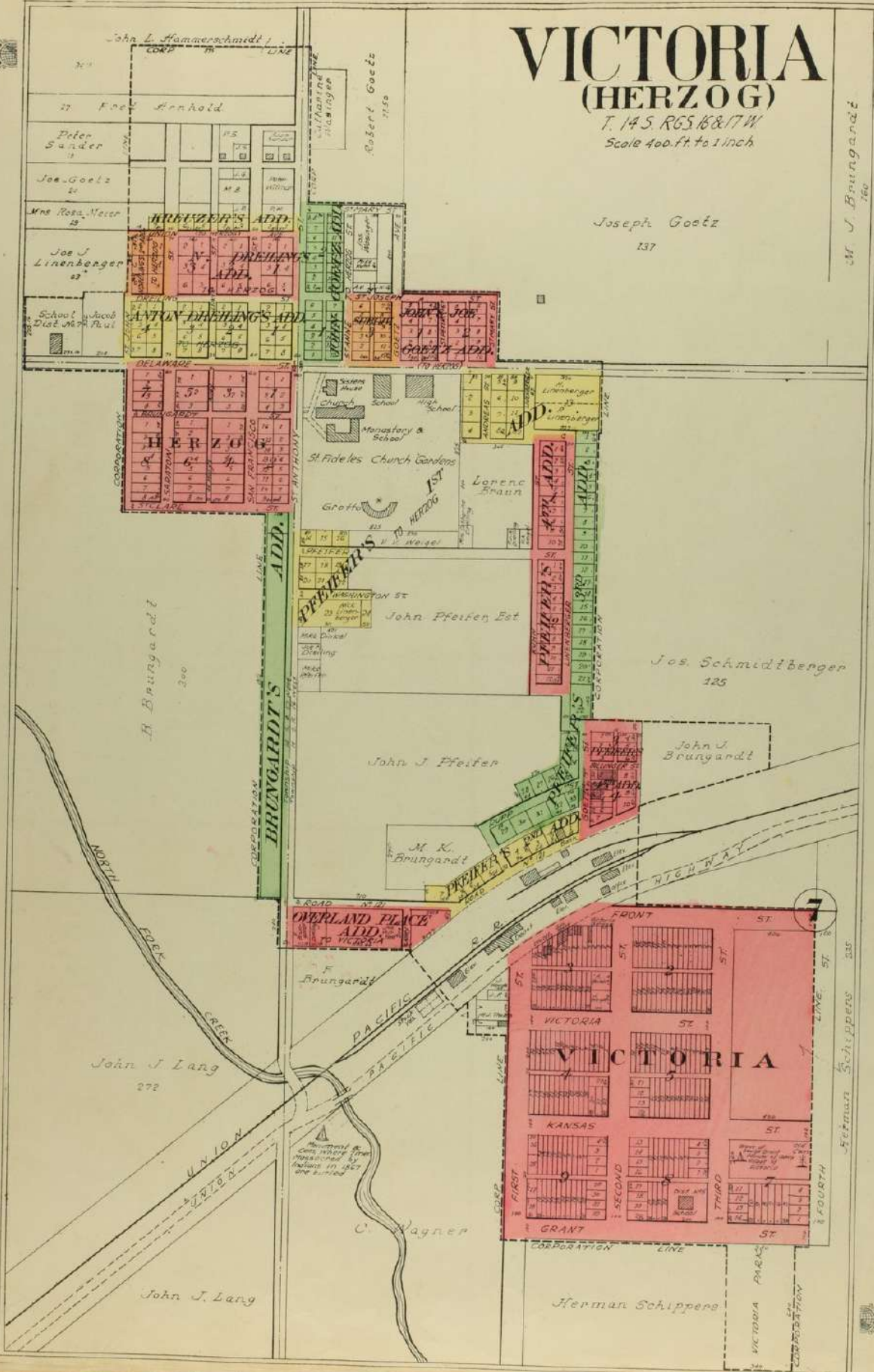

Mr. J. Brungardt  
760

Joseph Goetz  
137

A. Brungardt  
200

BRUNGARDT'S  
ADD.

Jos. Schmidtberger  
125

John J. Pfeifer

John J. Brungardt

John J. Lang  
272

C. Wagner

Herman Schippers  
235

Herman Schippers

7



T.14S., Rgs. 17 & 18 W.

# MUNJOR

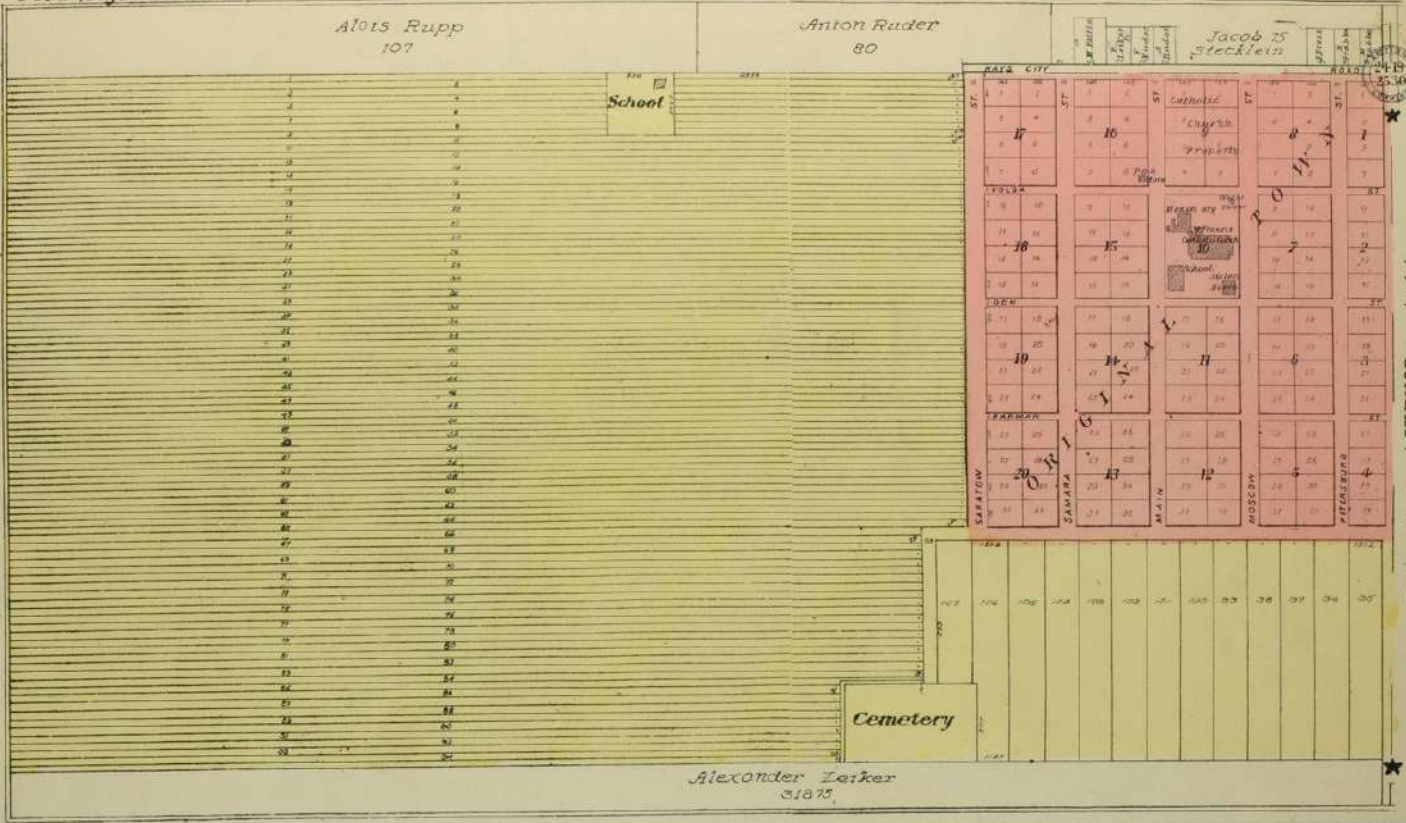

For East Portion of MUNJOR see plat below

## PFEIFER

T.15S. R.17W.  
Scale 400 ft to 1 in

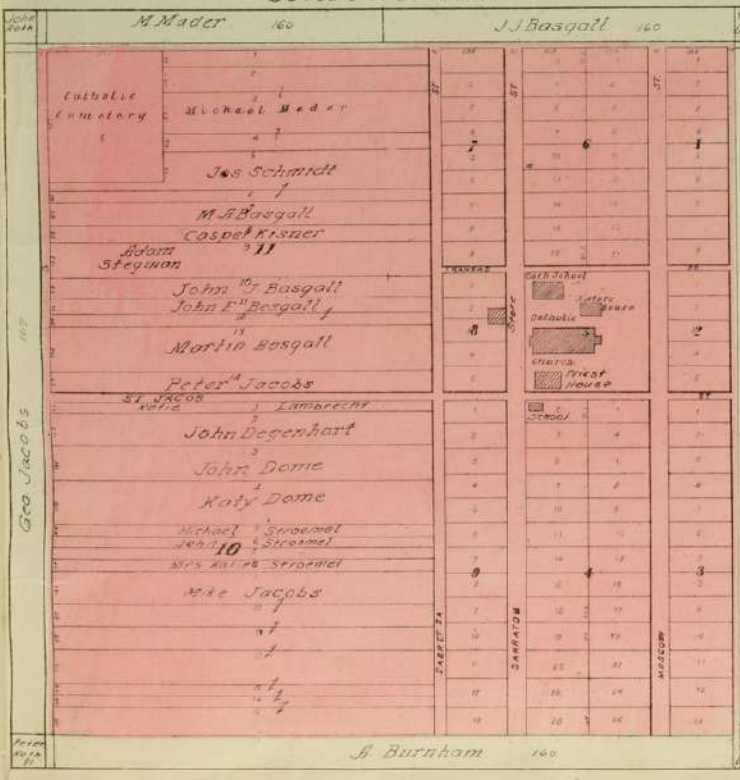

## PART OF MUNJOR

This plat adjoins MunJOR on the East  
at points indicated thus \* \* \*

Scale 400ft to an inch

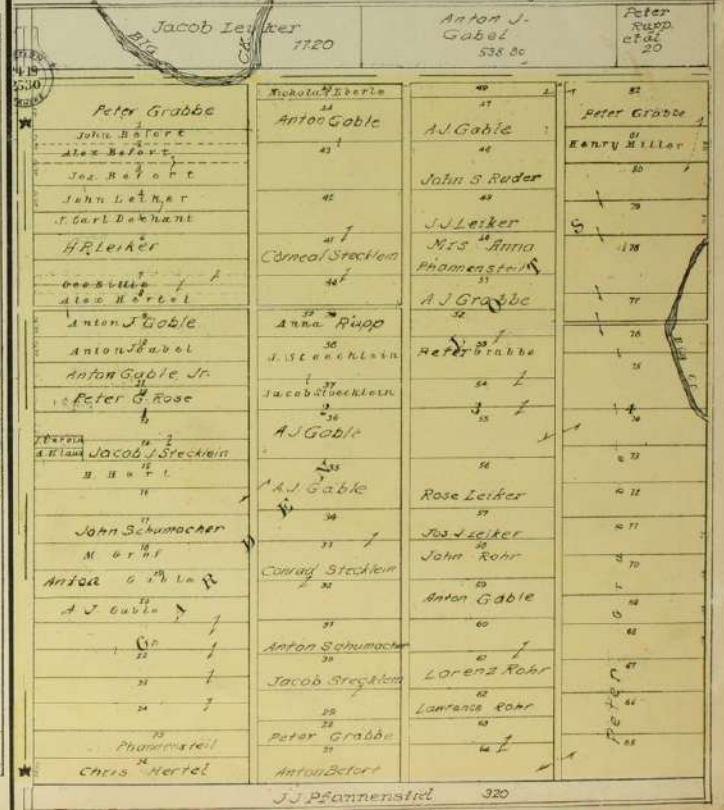



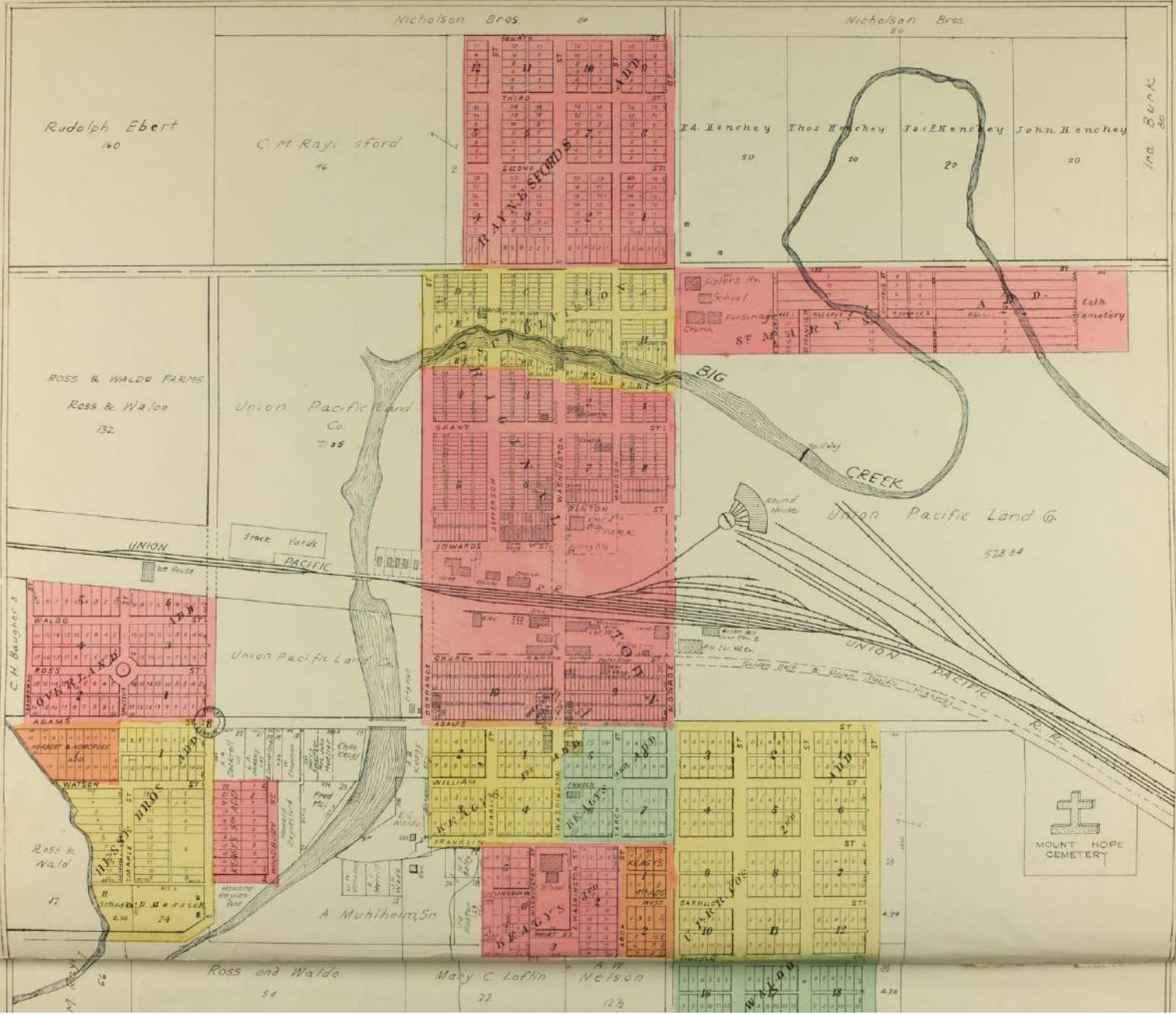

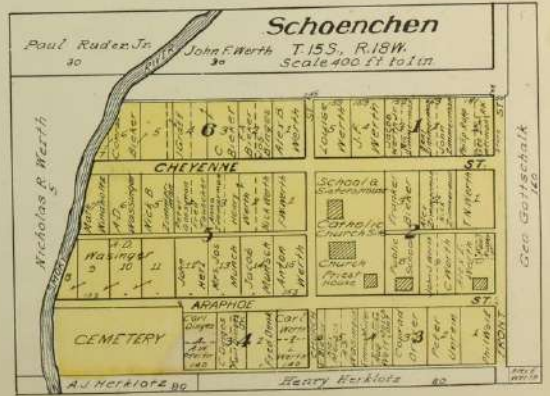
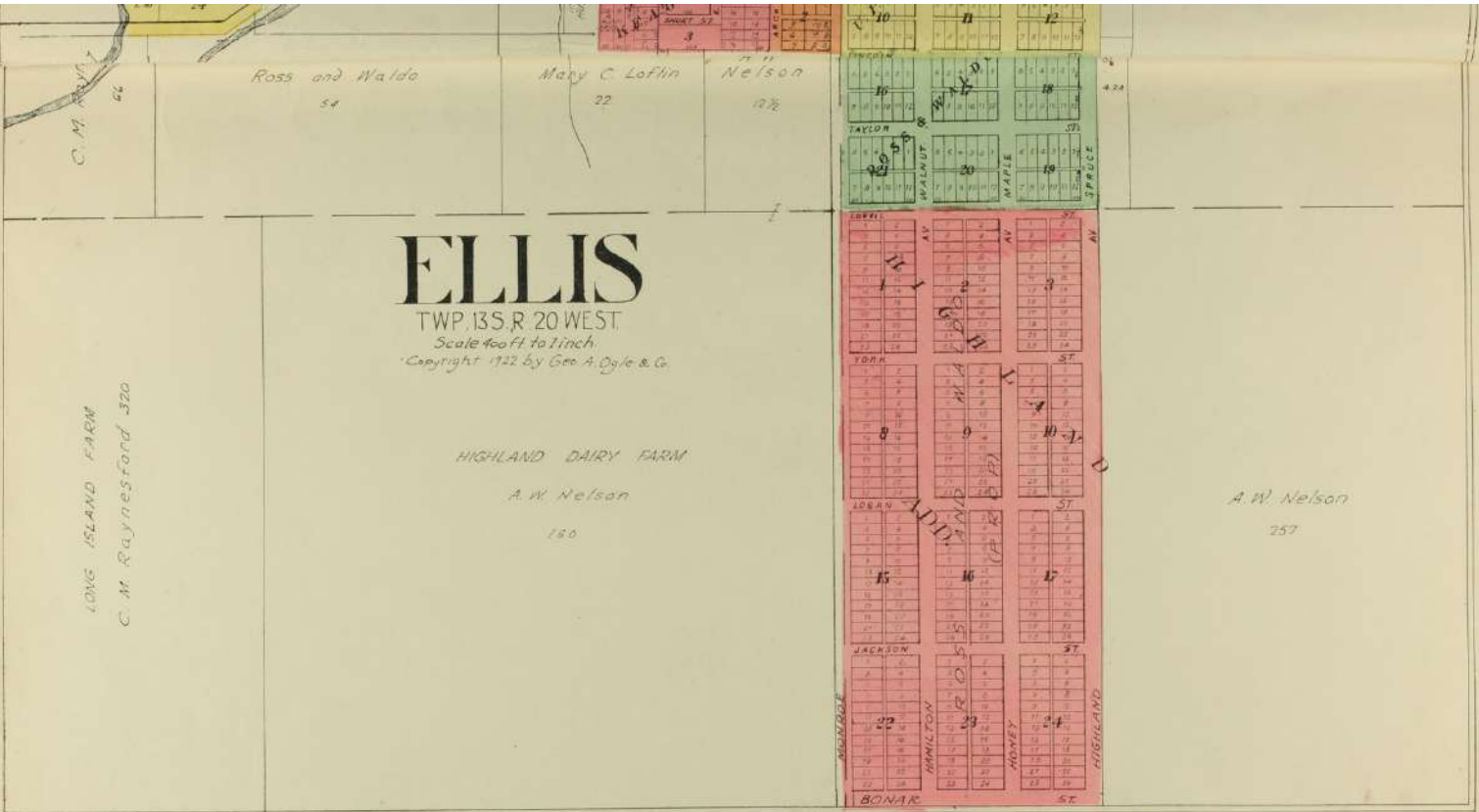



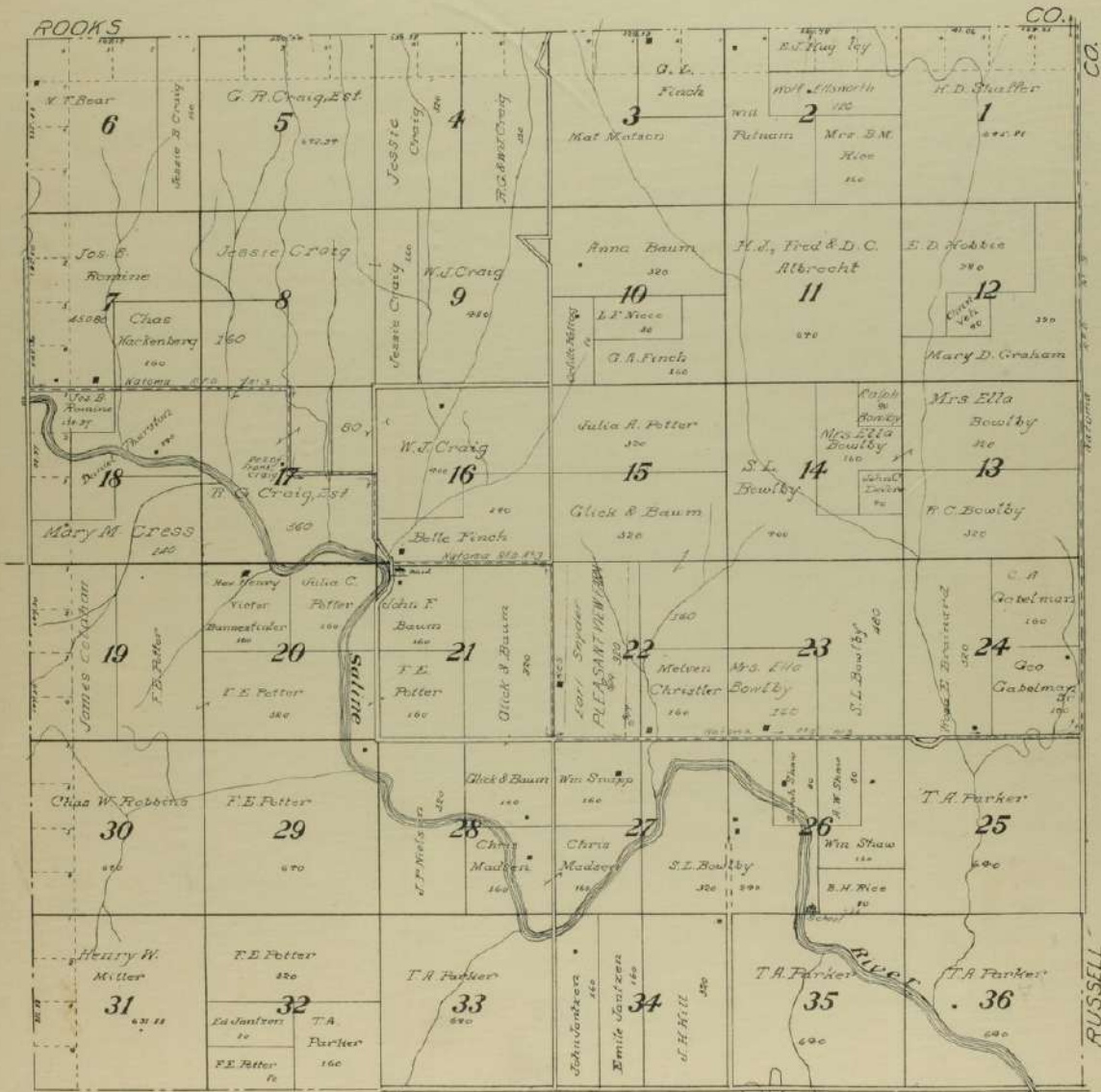

  
**MAP OF**  
**TOWNSHIP 11 S., RANGE 16 W.**  
 OF THE 6th P. M.

Scale 1 3/4 inches to 1 mile



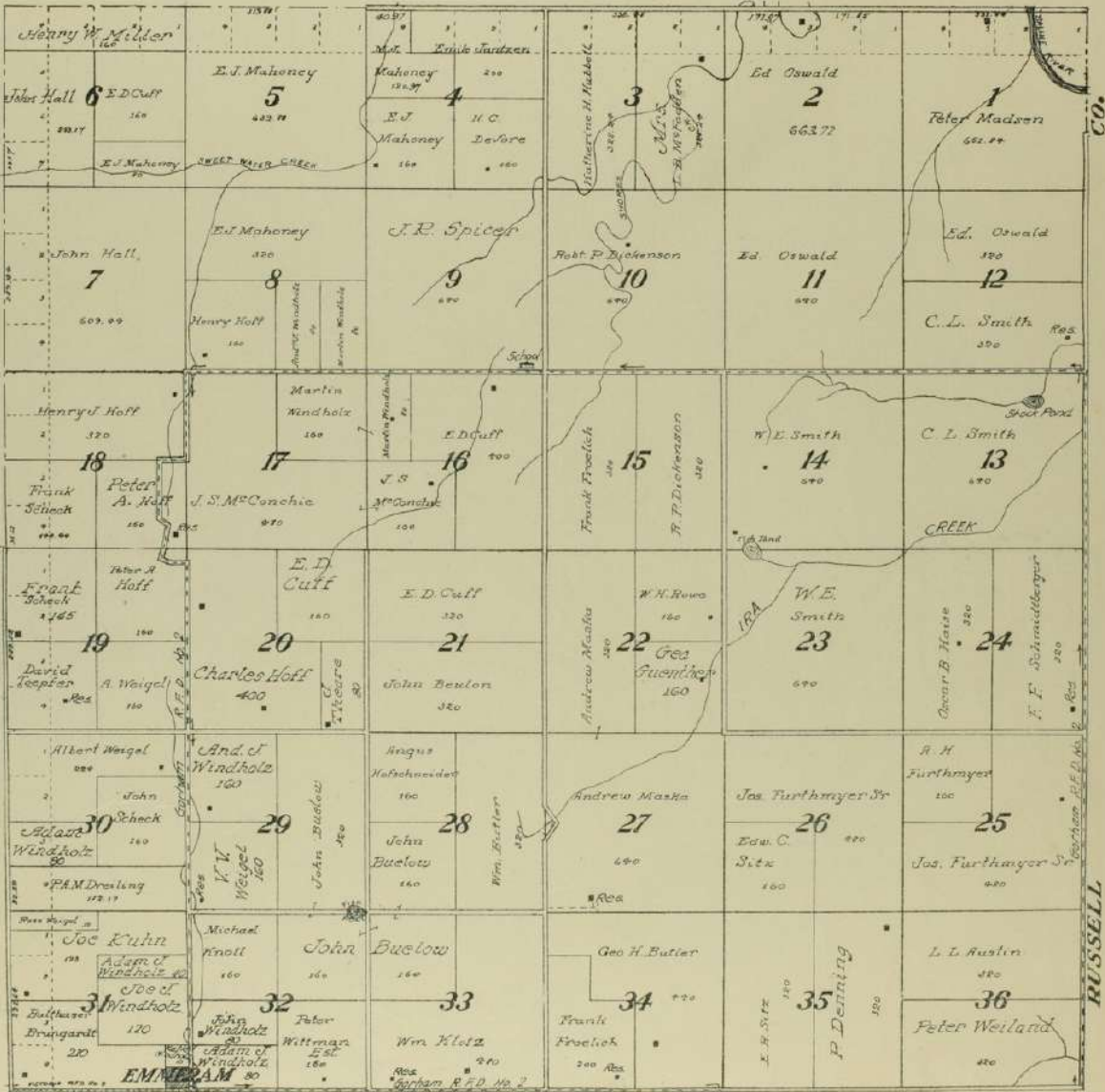





**MAP OF**  
**TOWNSHIP 13 S., RANGE 16 W.**  
 OF THE 6th P. M.  
 Scale 1 1/4 inches to 1 mile

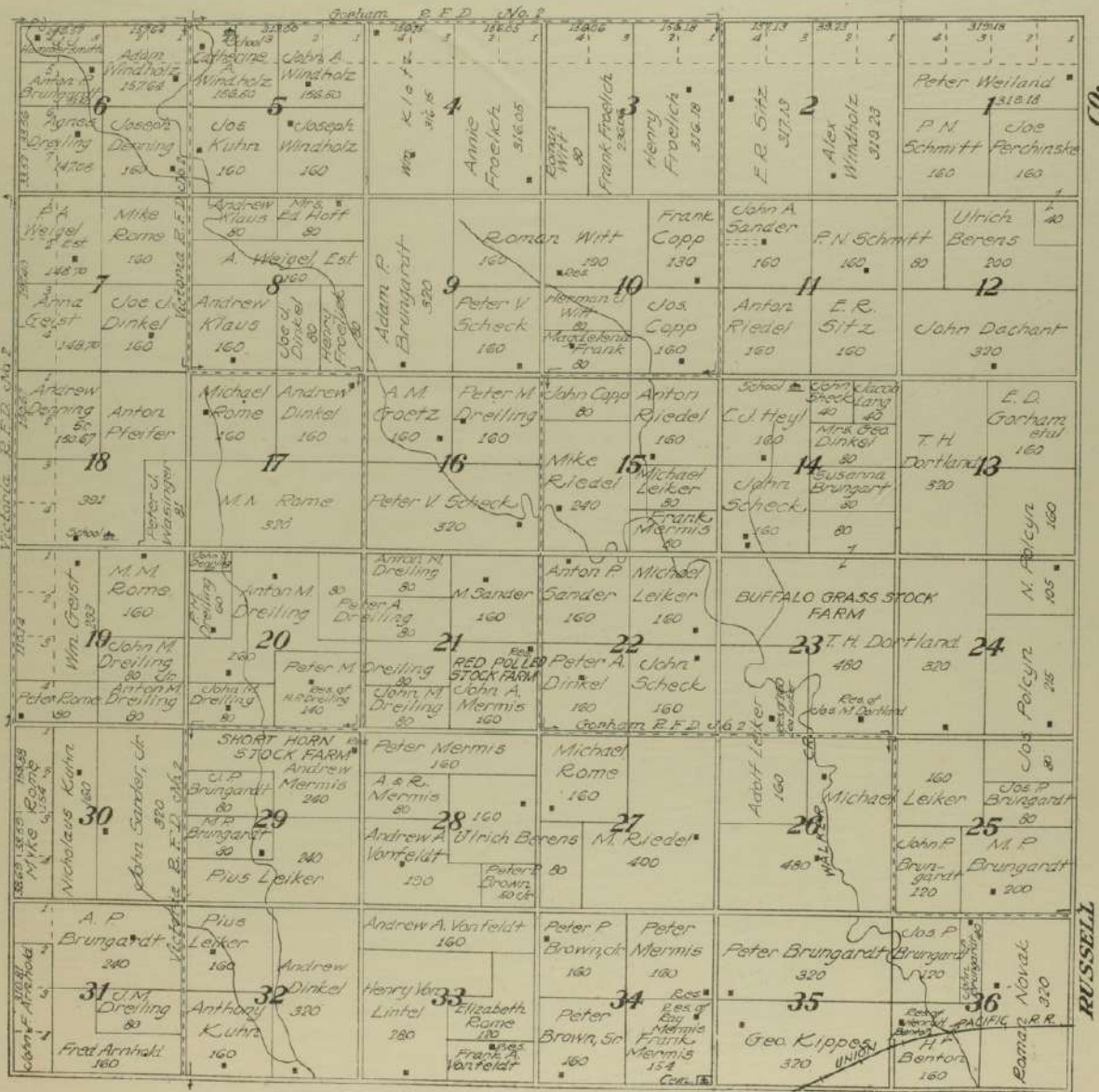



  
**MAP OF**  
**TOWNSHIP 14 S., RANGE 16 W.**  
 OF THE 6th P. M.  
 Scale 1 1/2 inches to 1 mile

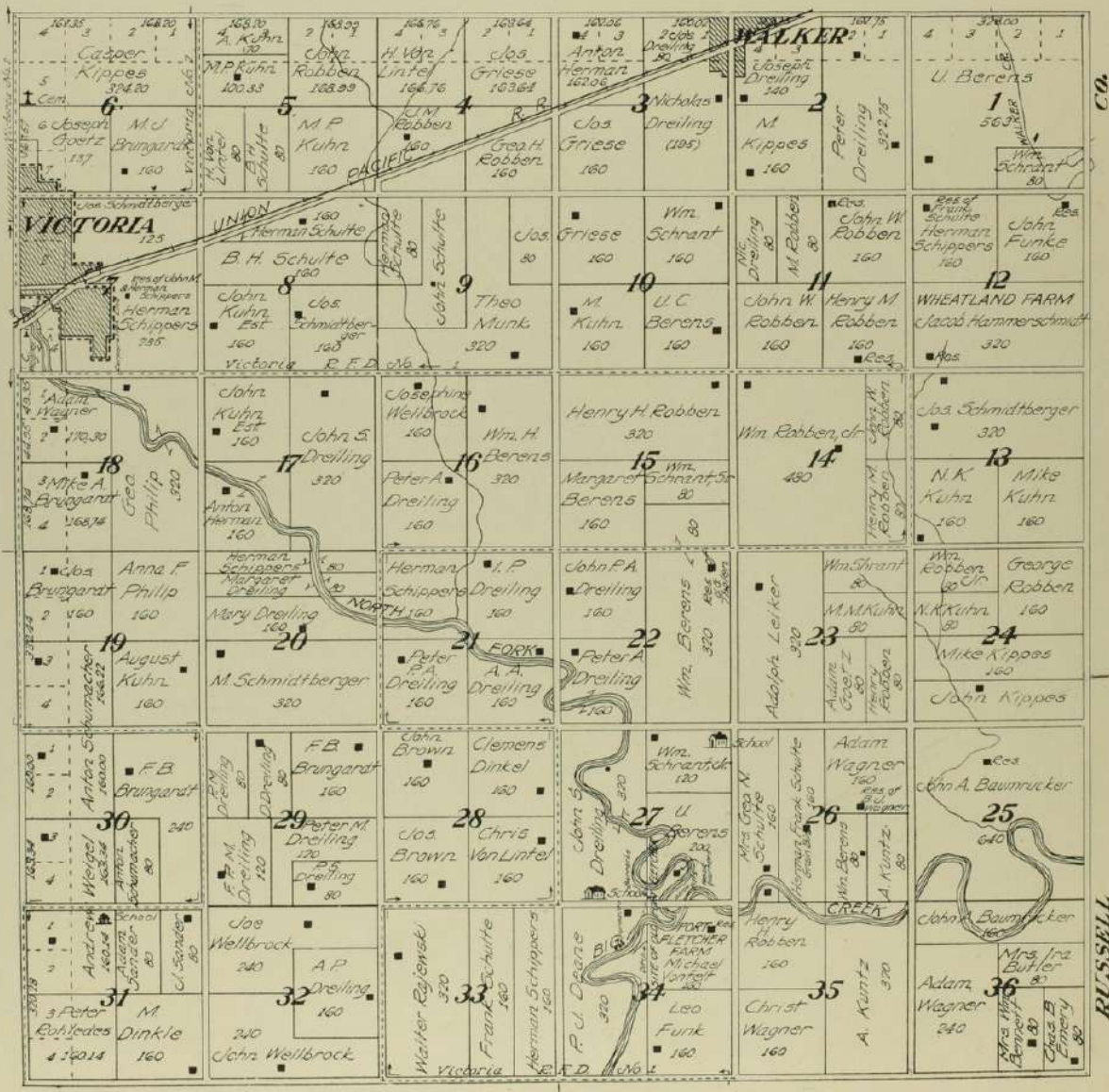

CO.

RUSSELL



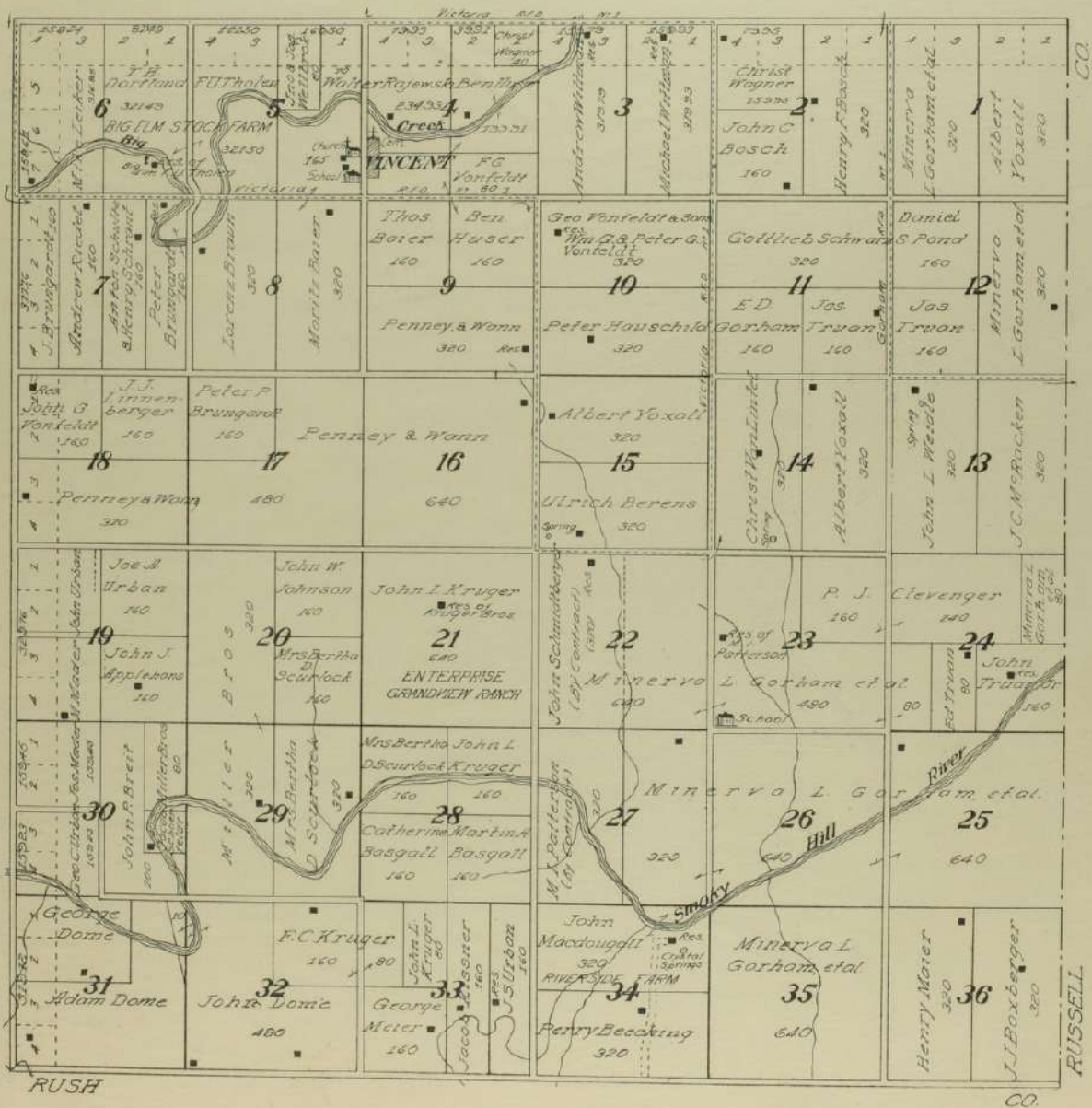

  
**MAP OF**
  
**TOWNSHIP 15 S., RANGE 16 W.**
  
 OF THE 6th P. M.

Scale 1 1/4 inches to 1 mile





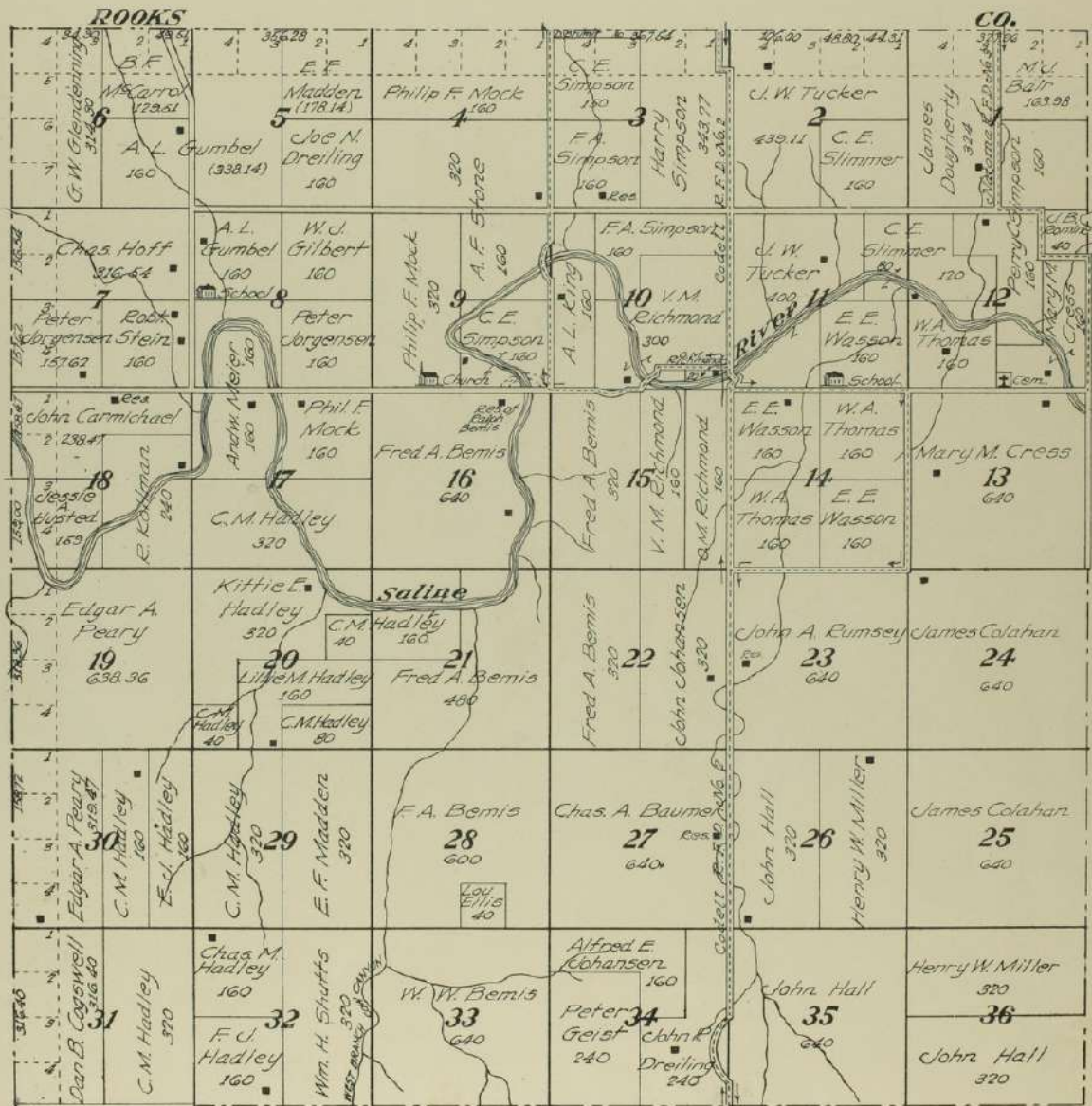

  
**MAP OF**  
**TOWNSHIP 11 S., RANGE 17 W.**  
**OF THE 6th P. M.**  
 Scale 1 1/4 inches to 1 mile



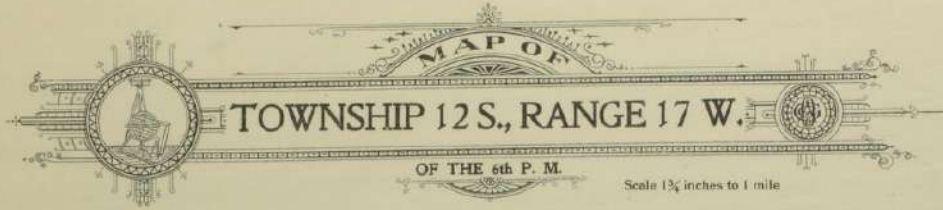

  
**MAP OF**
  
**TOWNSHIP 12 S., RANGE 17 W.**
  
 OF THE 6th P. M.

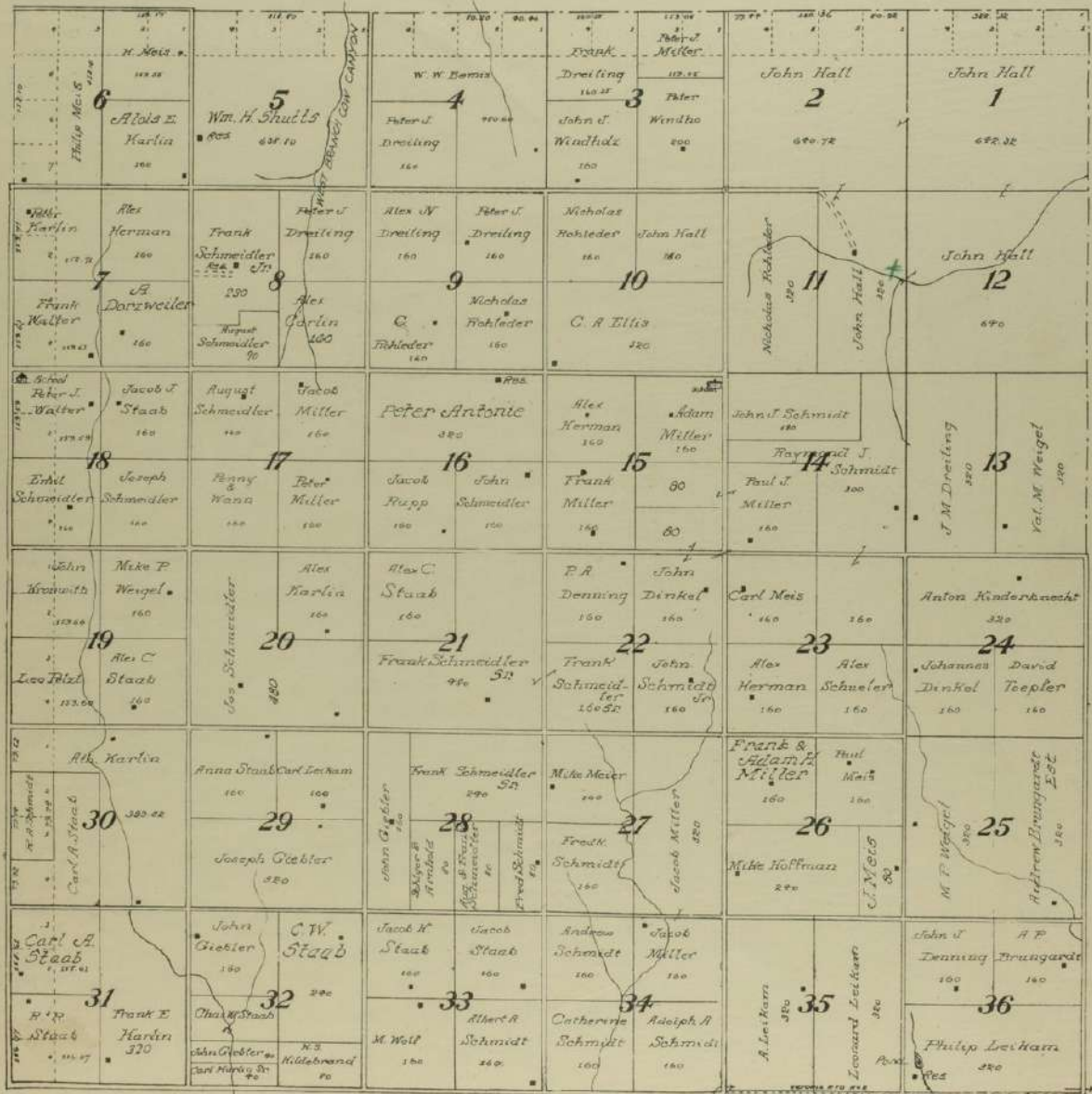
Scale 1 1/4 inches to 1 mile





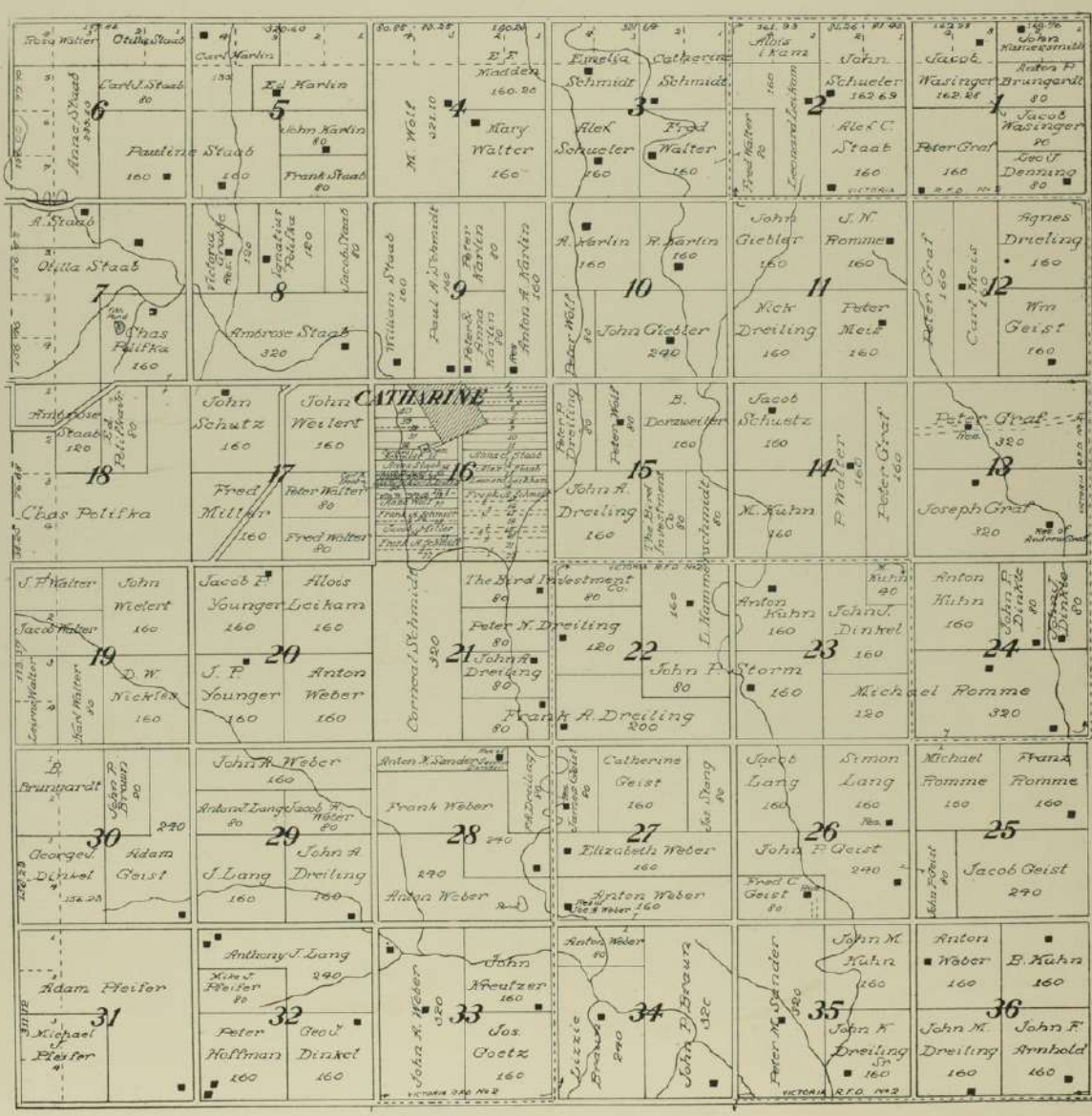

  
**MAP OF**  
**TOWNSHIP 13 S., RANGE 17 W.**  
 OF THE 6th P. M.

Scale 1 3/4 inches to 1 mile



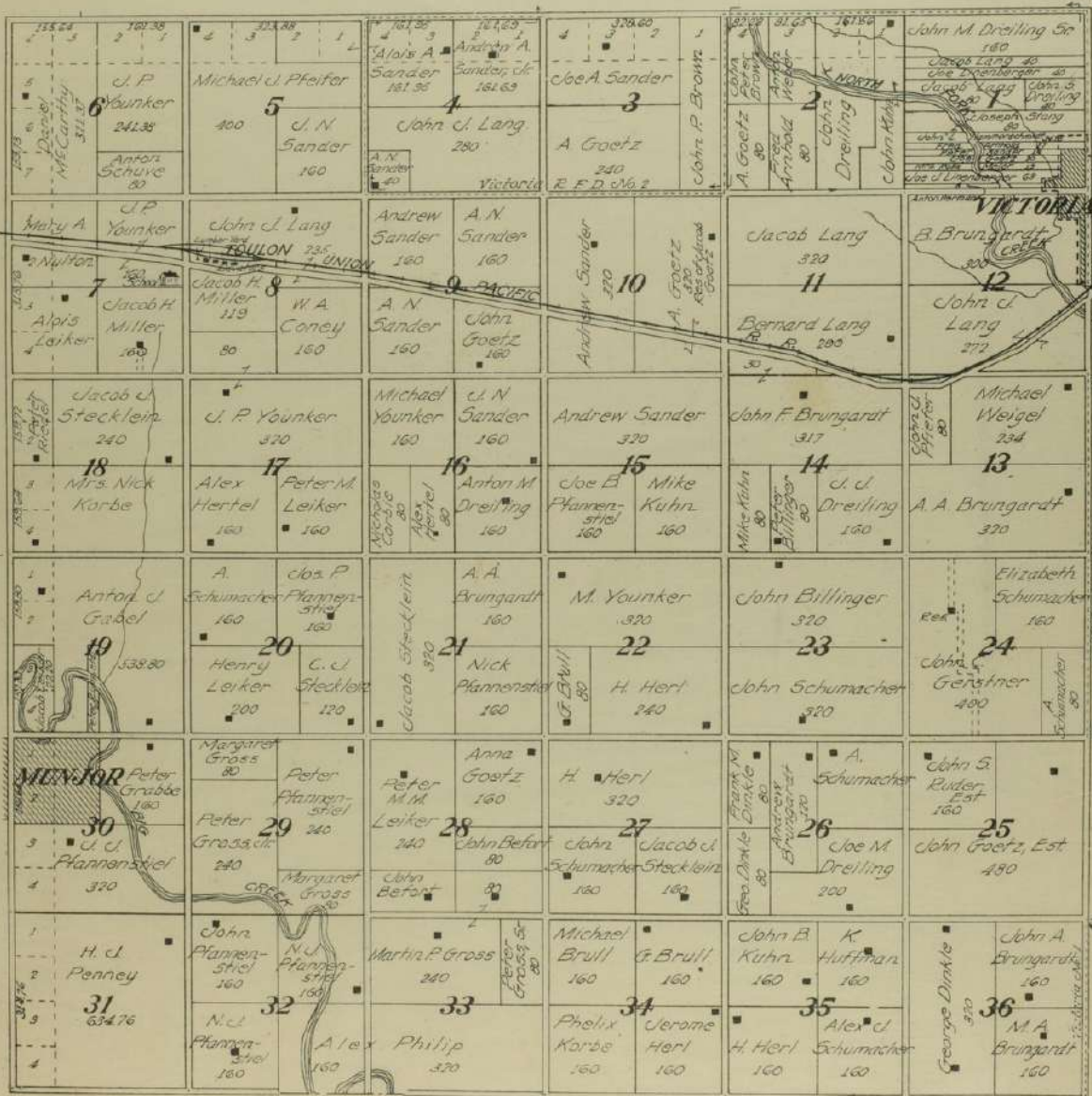

MAP OF  
**TOWNSHIP 14 S., RANGE 17 W.**  
 OF THE 6th P. M.  
 Scale 1 1/4 inches to 1 mile





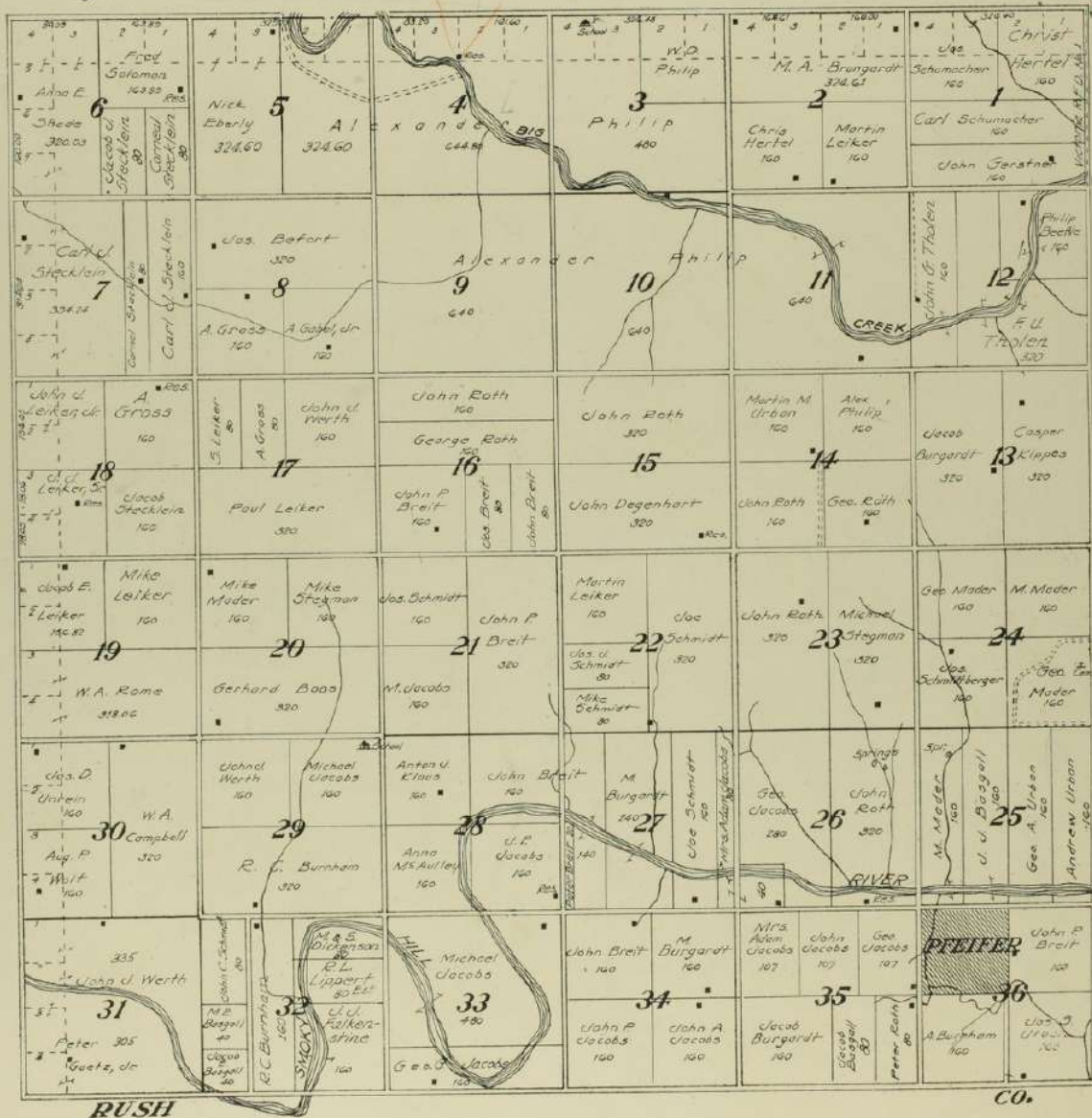

  
**MAP OF**  
**TOWNSHIP 15 S., RANGE 17 W.**  
 OF THE 6th P. M.  
 Scale 1 1/4 inches to 1 mile





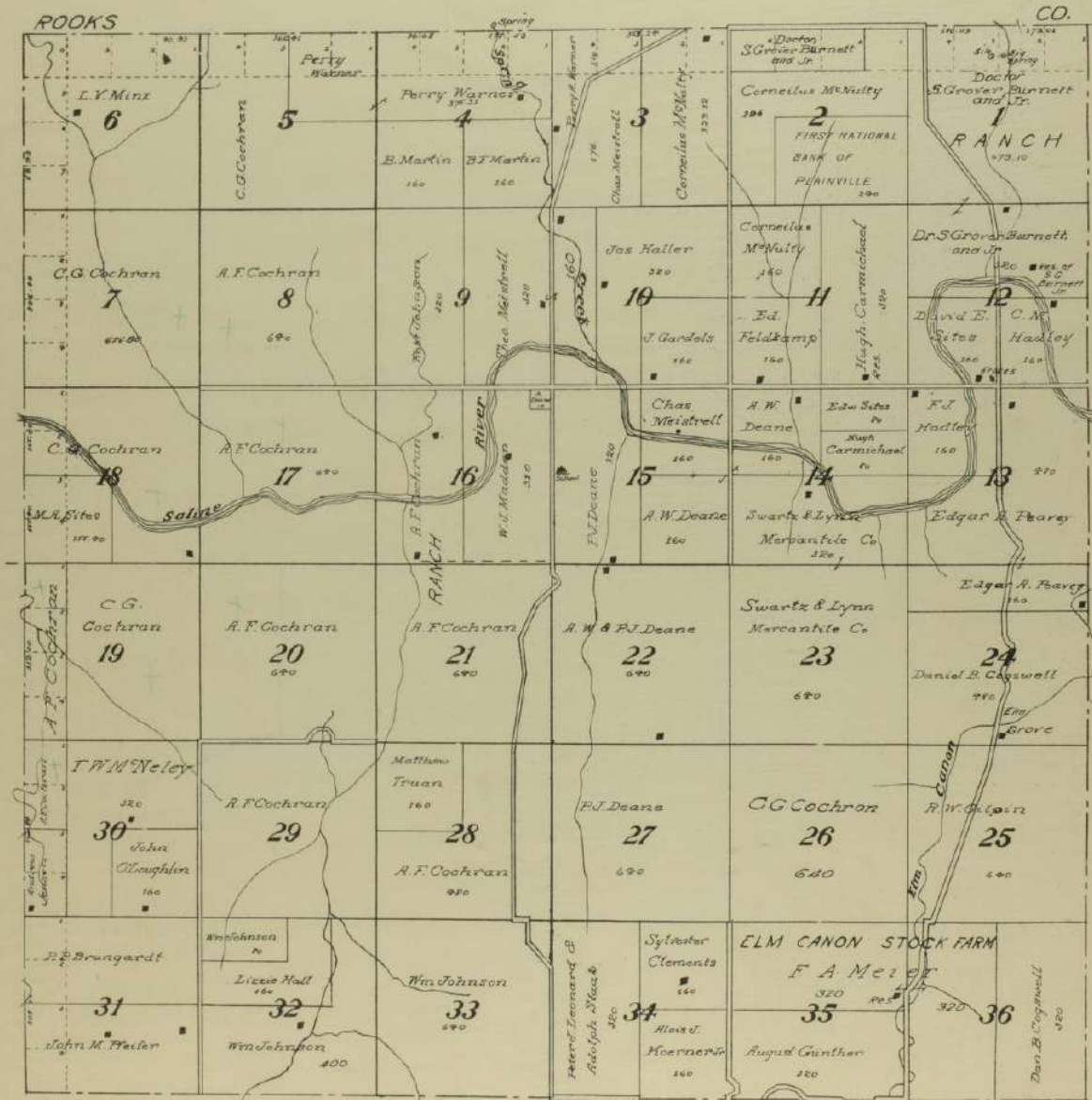

  
**MAP OF**  
**TOWNSHIP 11 S., RANGE 18 W.**  
 OF THE 6th P. M.

Scale 1 1/4 inches to 1 mile



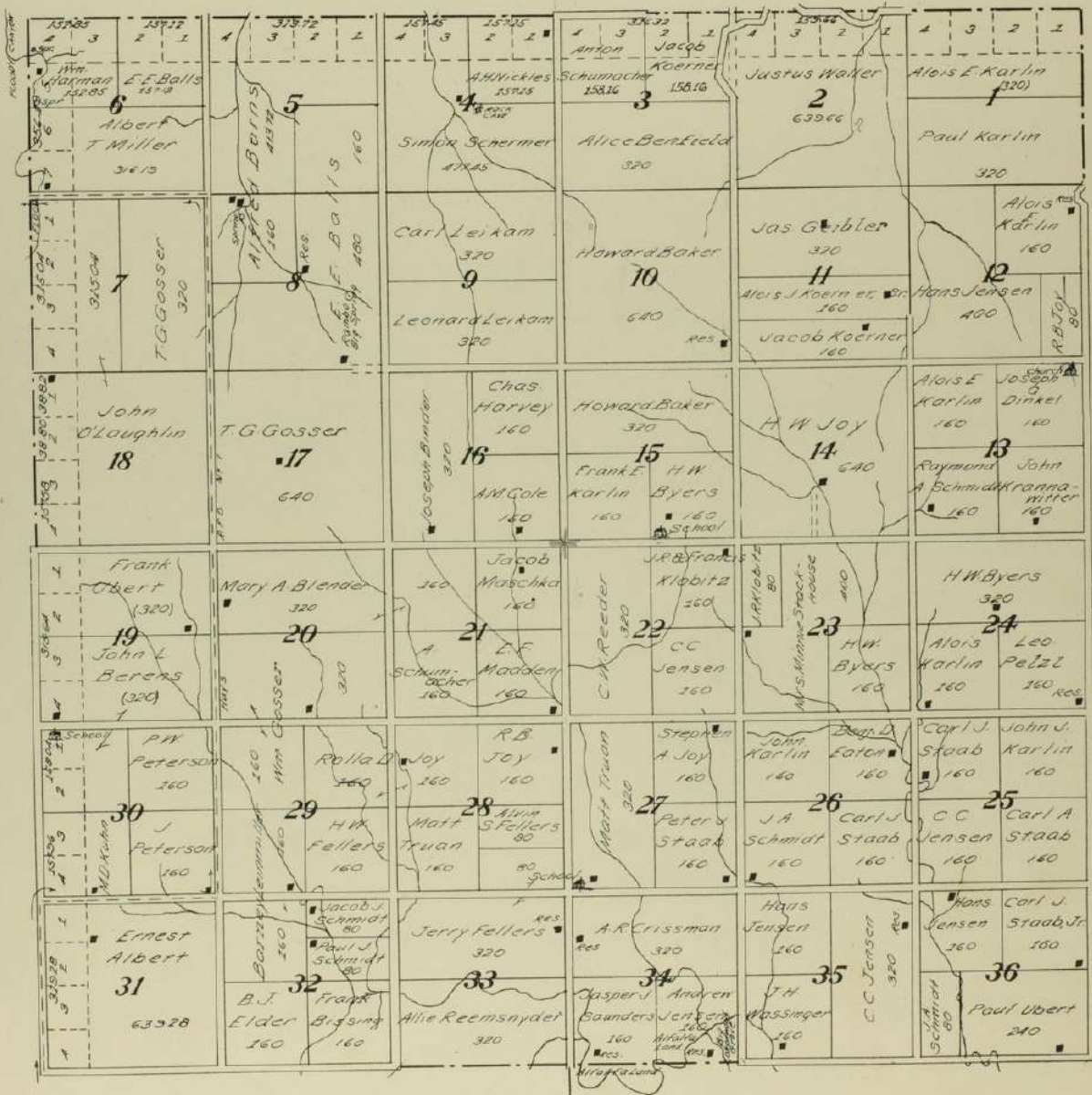

Scale 1 3/4 inches to 1 mile





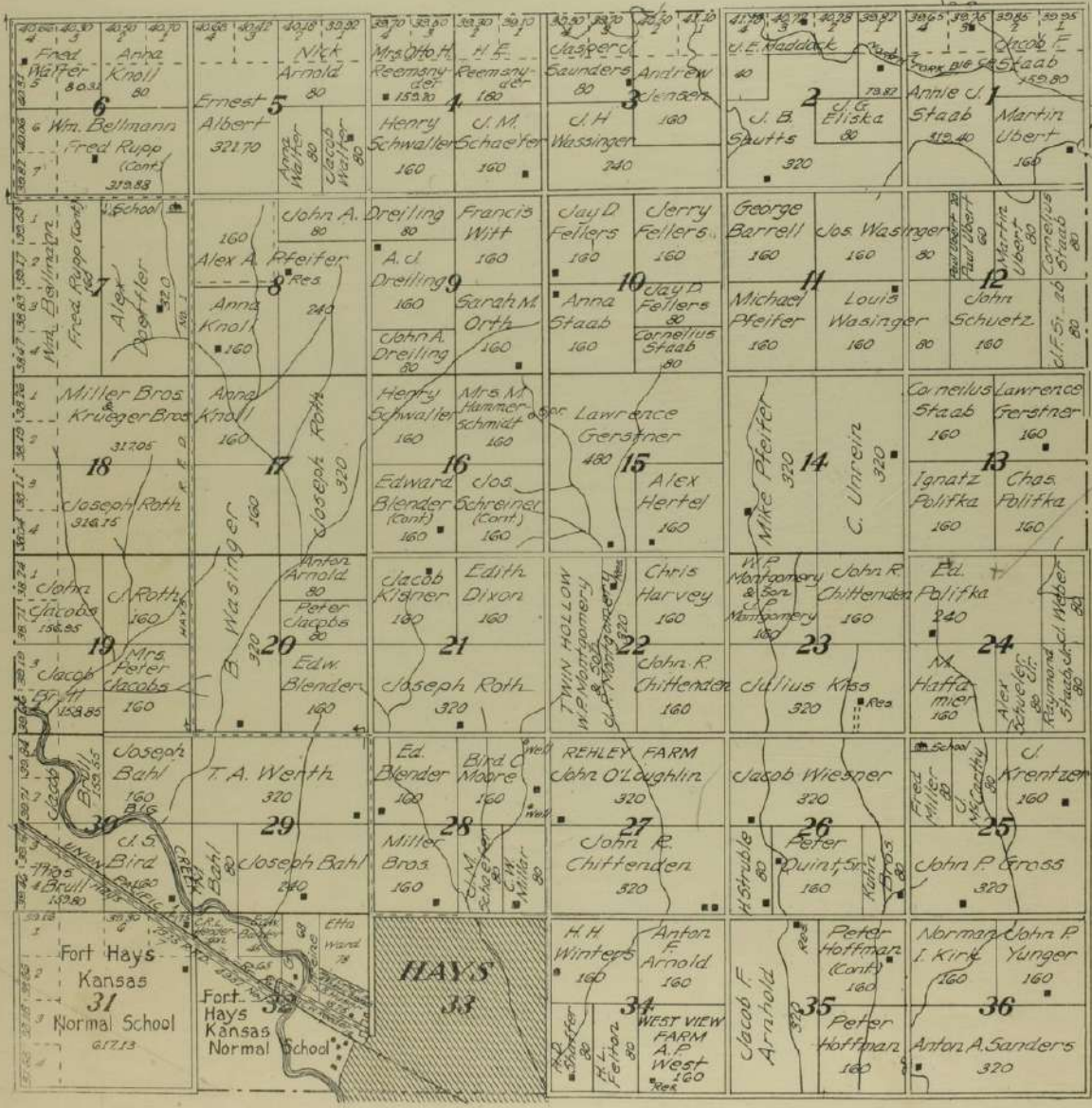

**MAP OF**  
**TOWNSHIP 13 S., RANGE 18 W.**  
 OF THE 6th P. M. Scale 1 1/4 inches to 1 mile



*WS  
Muster*

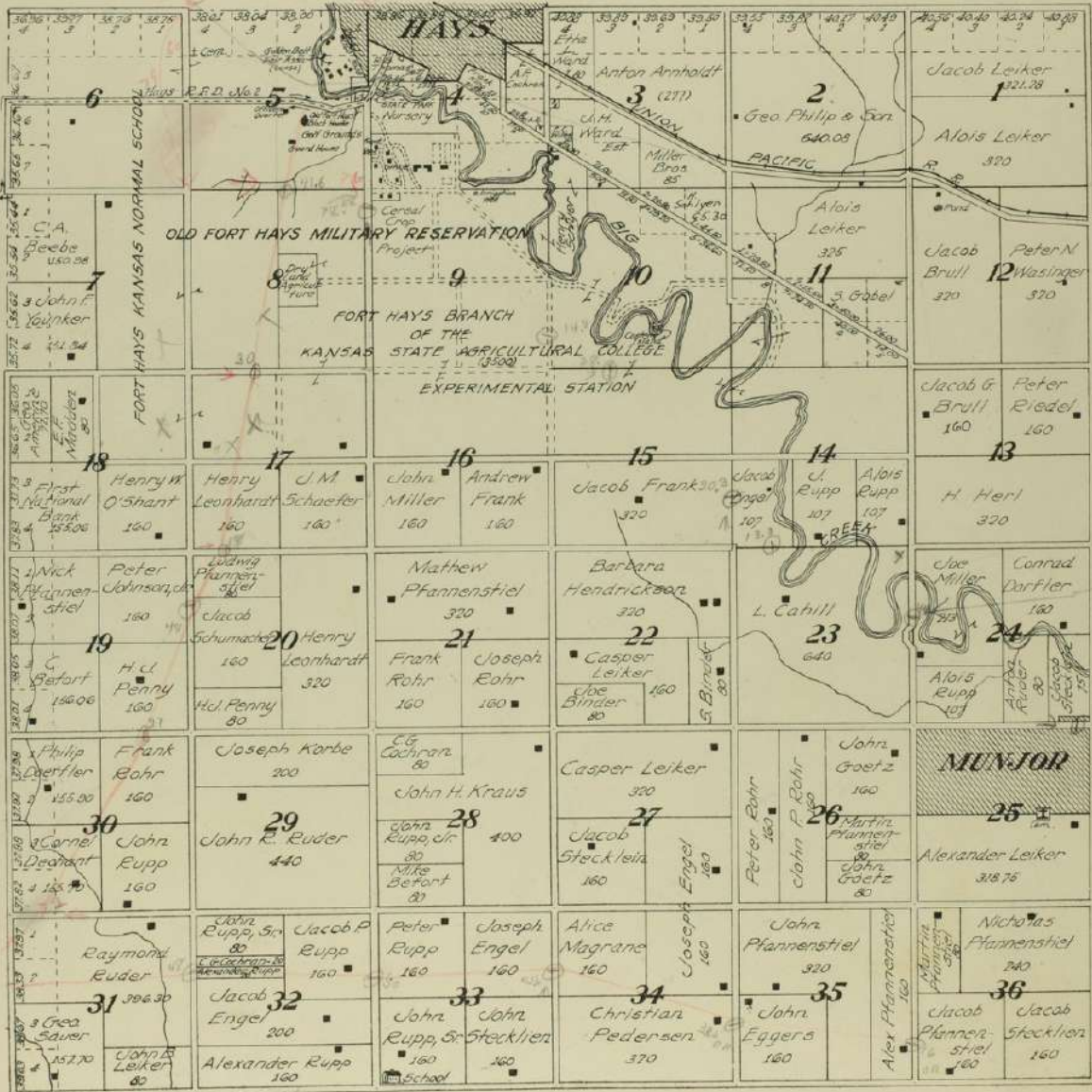

MAP OF  
**TOWNSHIP 14 S., RANGE 18 W.**  
 OF THE 6th P. M.  
 Scale 1 1/4 inches to 1 mile





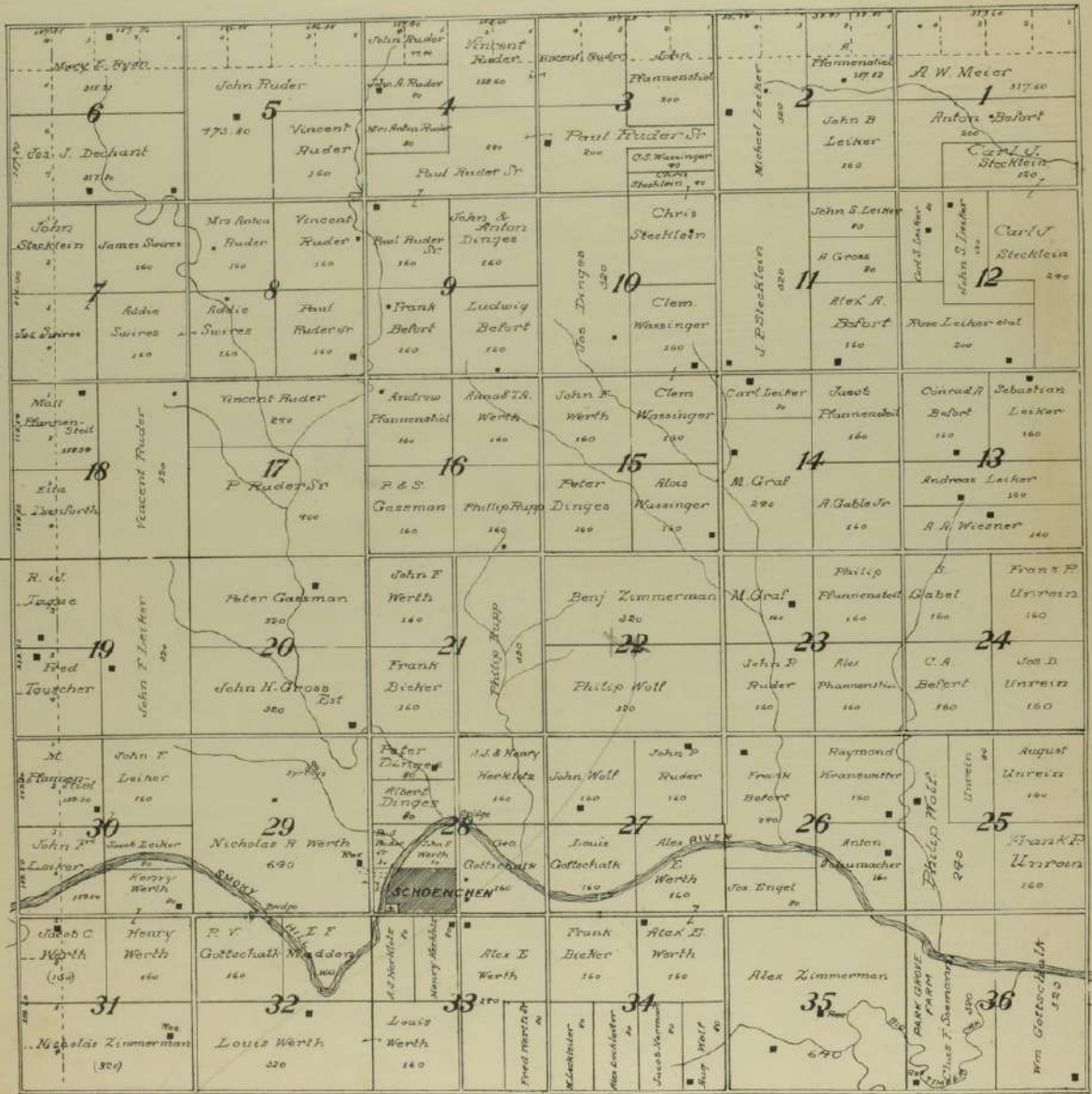

*RUSH*  
 High Point Summit towers can be seen from near the center of  
 Sec 22 T 15 R 18



  
**MAP OF**  
**TOWNSHIP 11 S., RANGE 19 W.**  
 OF THE 6th P. M.

Scale 1 1/4 inches to 1 mile

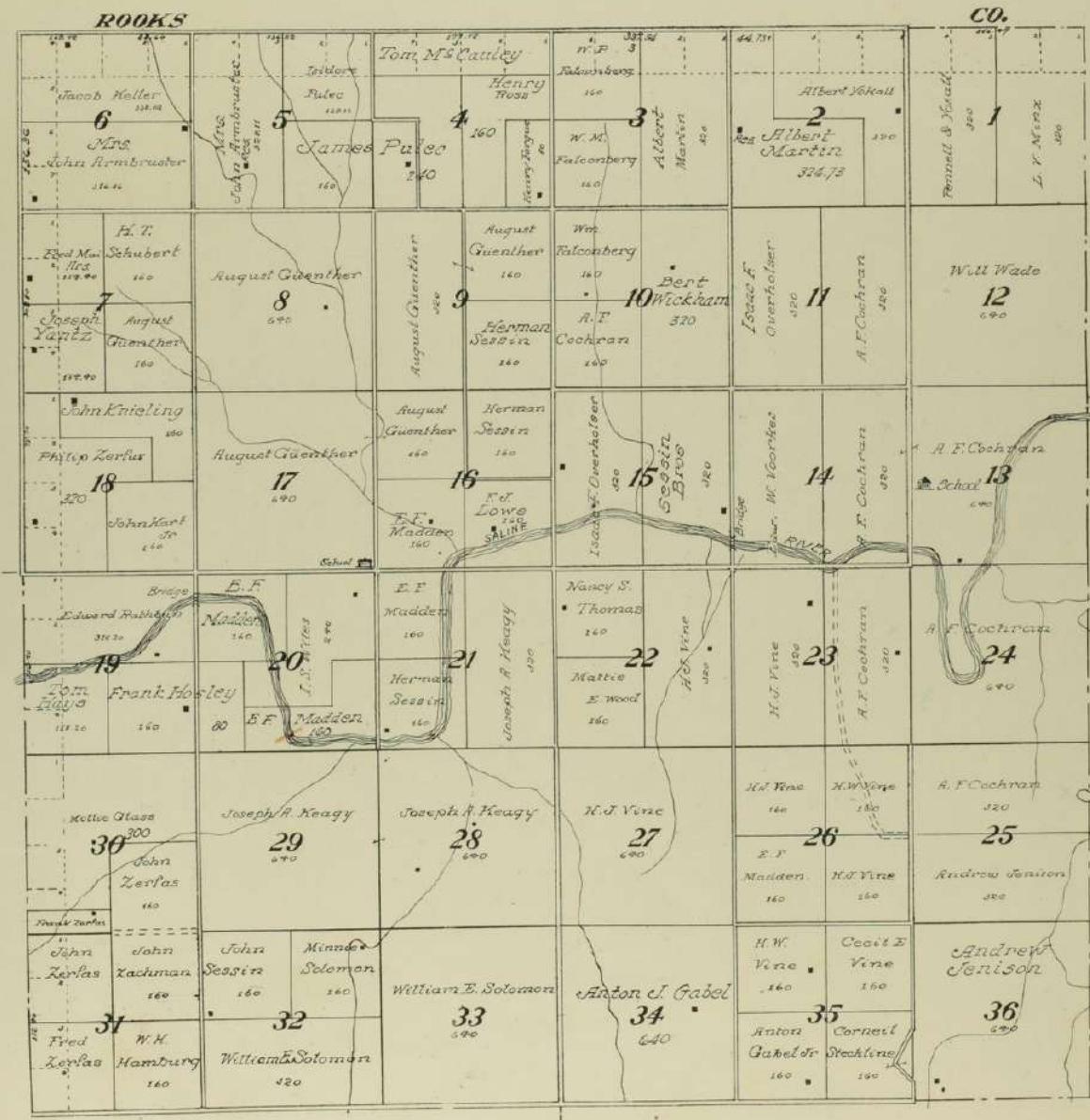

First Settlement in this Co. 1810-1840  
 Sec 20 T11 R19  
 Bureau Trappers



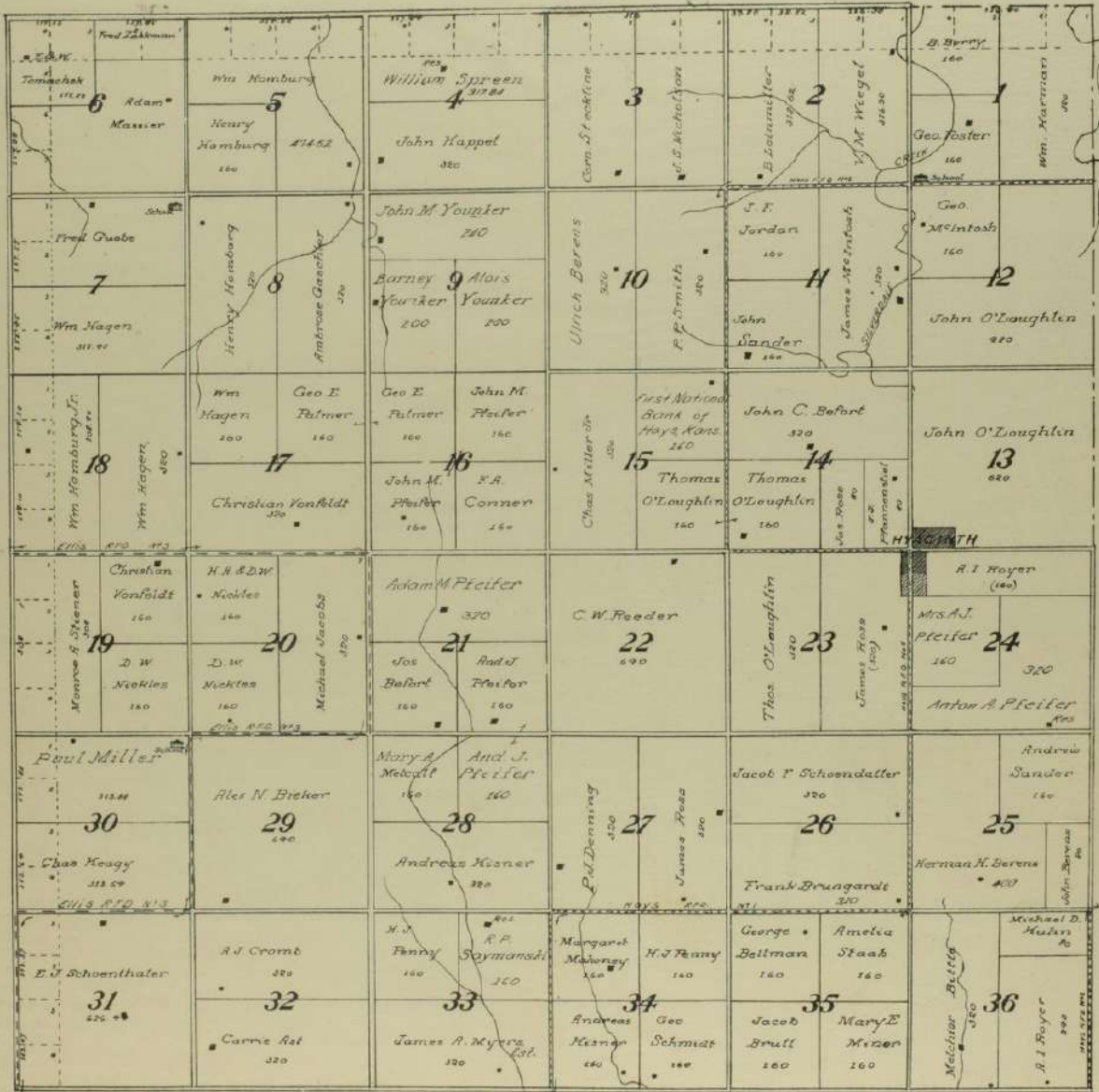

  
**MAP OF**
  
**TOWNSHIP 12 S., RANGE 19 W.**
  
 OF THE 6th P. M.

Scale 1 1/4 inches to 1 mile



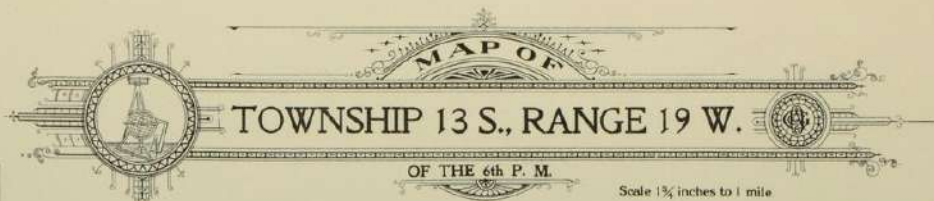



  
**MAP OF**
  
**TOWNSHIP 13 S., RANGE 19 W.**
  
**OF THE 6th P. M.**

Scale 1 1/4 inches to 1 mile

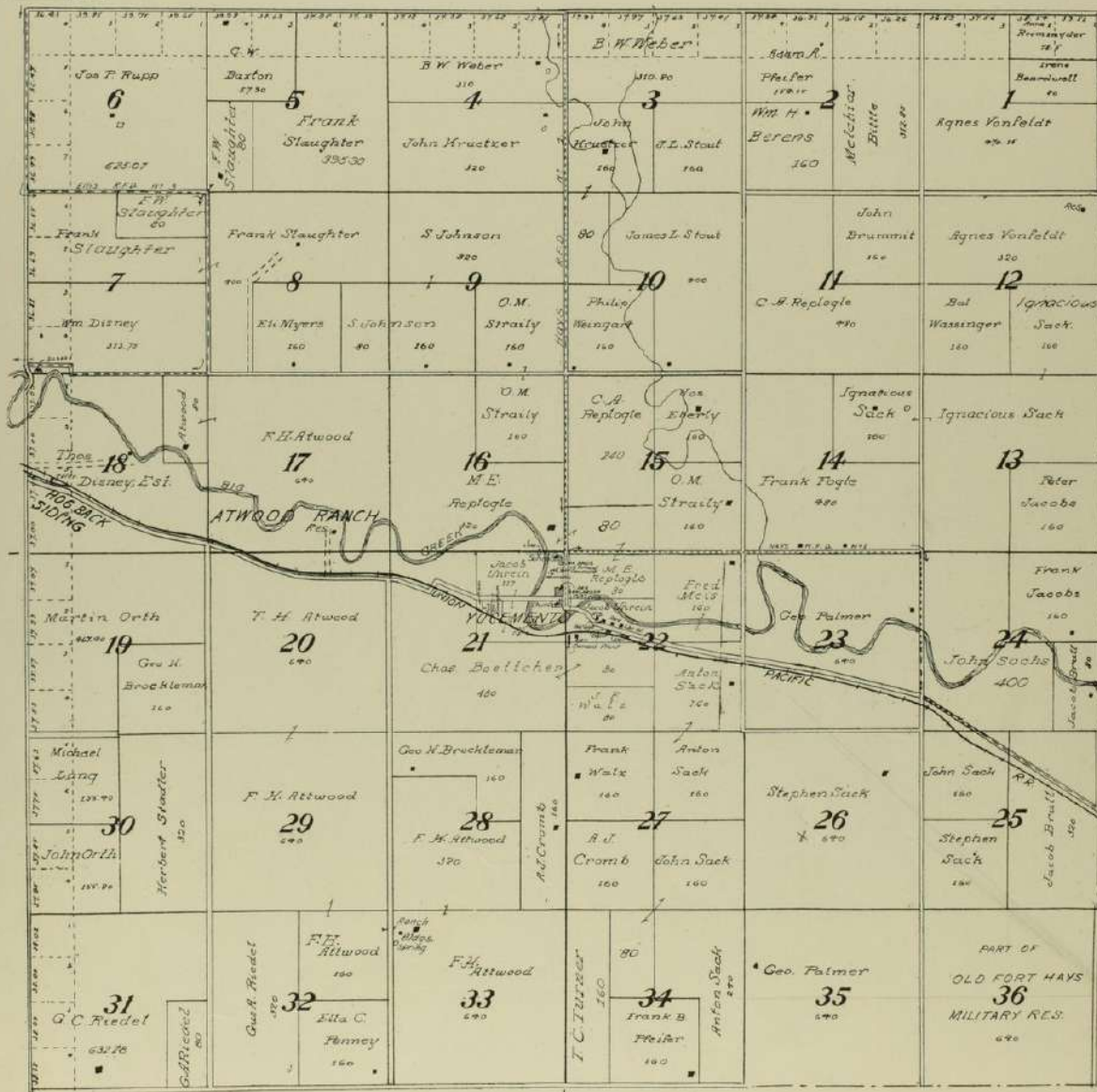
Section	Area
1	3600
2	3600
3	3600
4	3600
5	3600
6	3600
7	3600
8	3600
9	3600
10	3600
11	3600
12	3600
13	3600
14	3600
15	3600
16	3600
17	3600
18	3600
19	3600
20	3600
21	3600
22	3600
23	3600
24	3600
25	3600
26	3600
27	3600
28	3600
29	3600
30	3600
31	3600
32	3600
33	3600
34	3600
35	3600
36	3600





Scale 1 1/4 inches to 1 mile

36



T13S. R19W

1135  
 1136  
 1137  
 1138  
 1139  
 1140  
 1141  
 1142  
 1143  
 1144  
 1145  
 1146  
 1147  
 1148  
 1149  
 1150  
 1151  
 1152  
 1153  
 1154  
 1155  
 1156  
 1157  
 1158  
 1159  
 1160  
 1161  
 1162  
 1163  
 1164  
 1165  
 1166  
 1167  
 1168  
 1169  
 1170  
 1171  
 1172  
 1173  
 1174  
 1175  
 1176  
 1177  
 1178  
 1179  
 1180  
 1181  
 1182  
 1183  
 1184  
 1185  
 1186  
 1187  
 1188  
 1189  
 1190  
 1191  
 1192  
 1193  
 1194  
 1195  
 1196  
 1197  
 1198  
 1199  
 1200



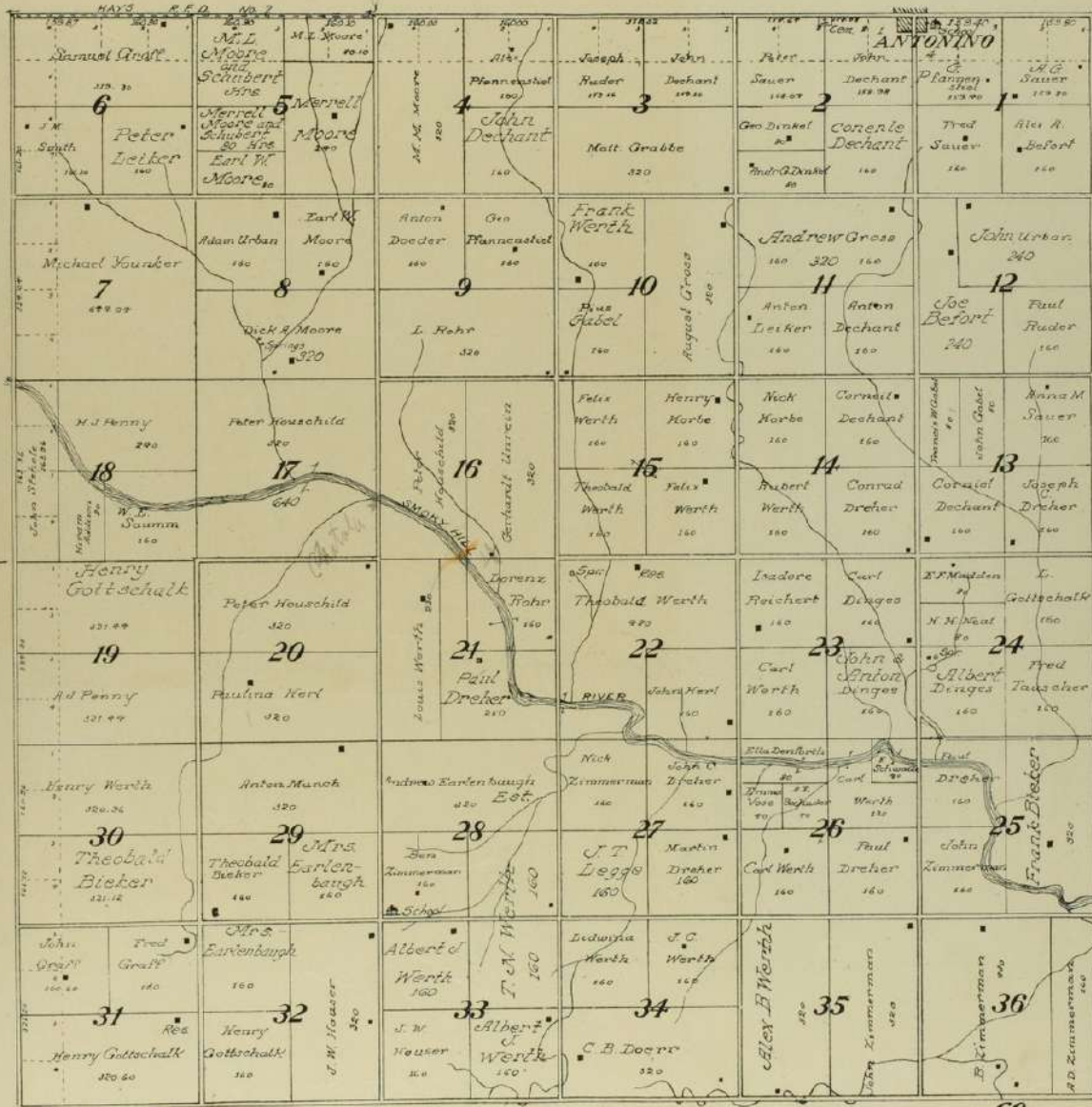

Second Settlement in E. 1/2 Sec 6 1815-1840  
 Sec 16 T15 R19  
 Deann Pieggen

+ Chetols  
 17-15-19



  
**MAP OF**
  
**TOWNSHIP 11 S., RANGE 20 W.**
  
 OF THE 6th P. M.

Scale 1 1/4 inches to 1 mile

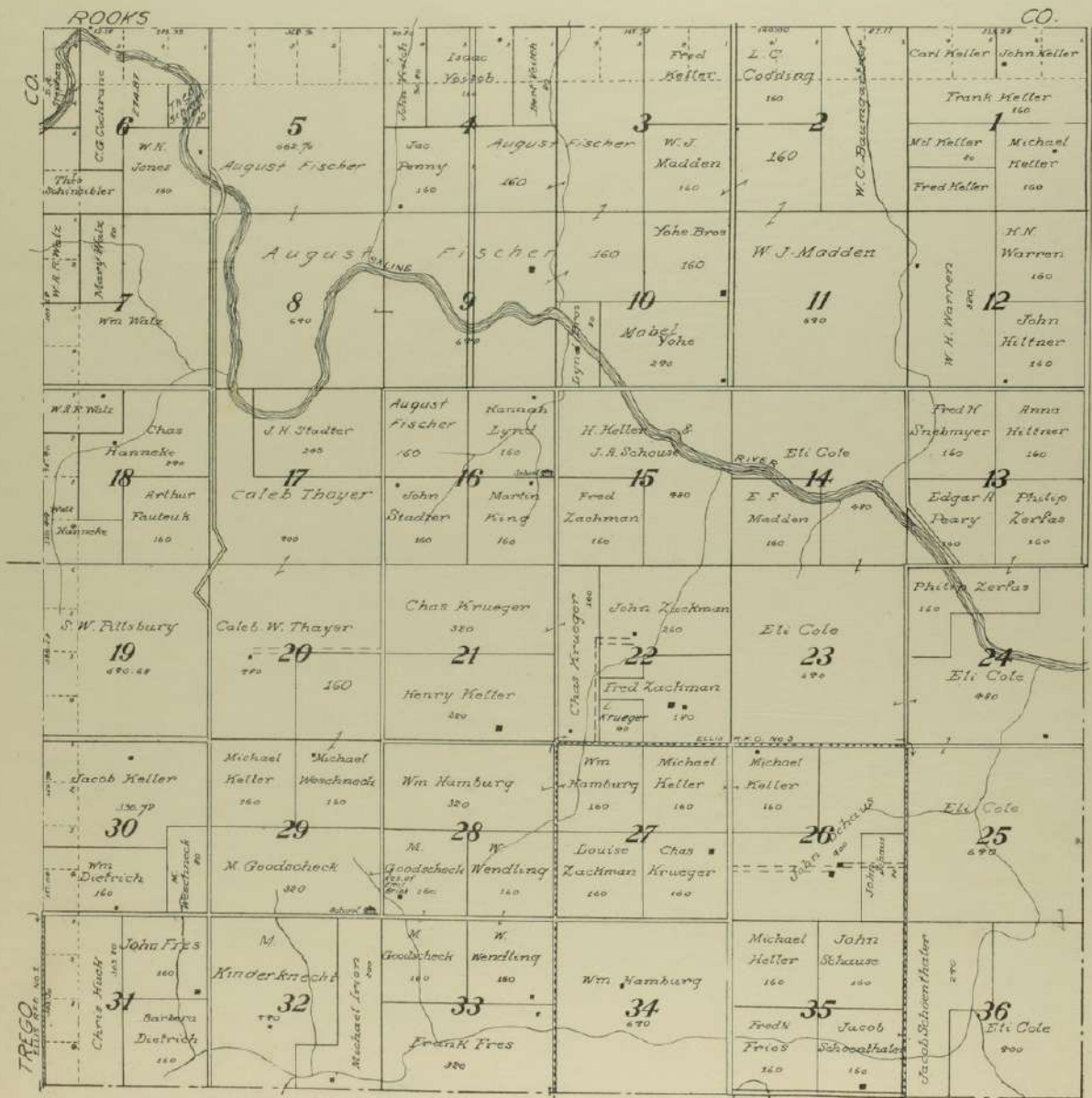



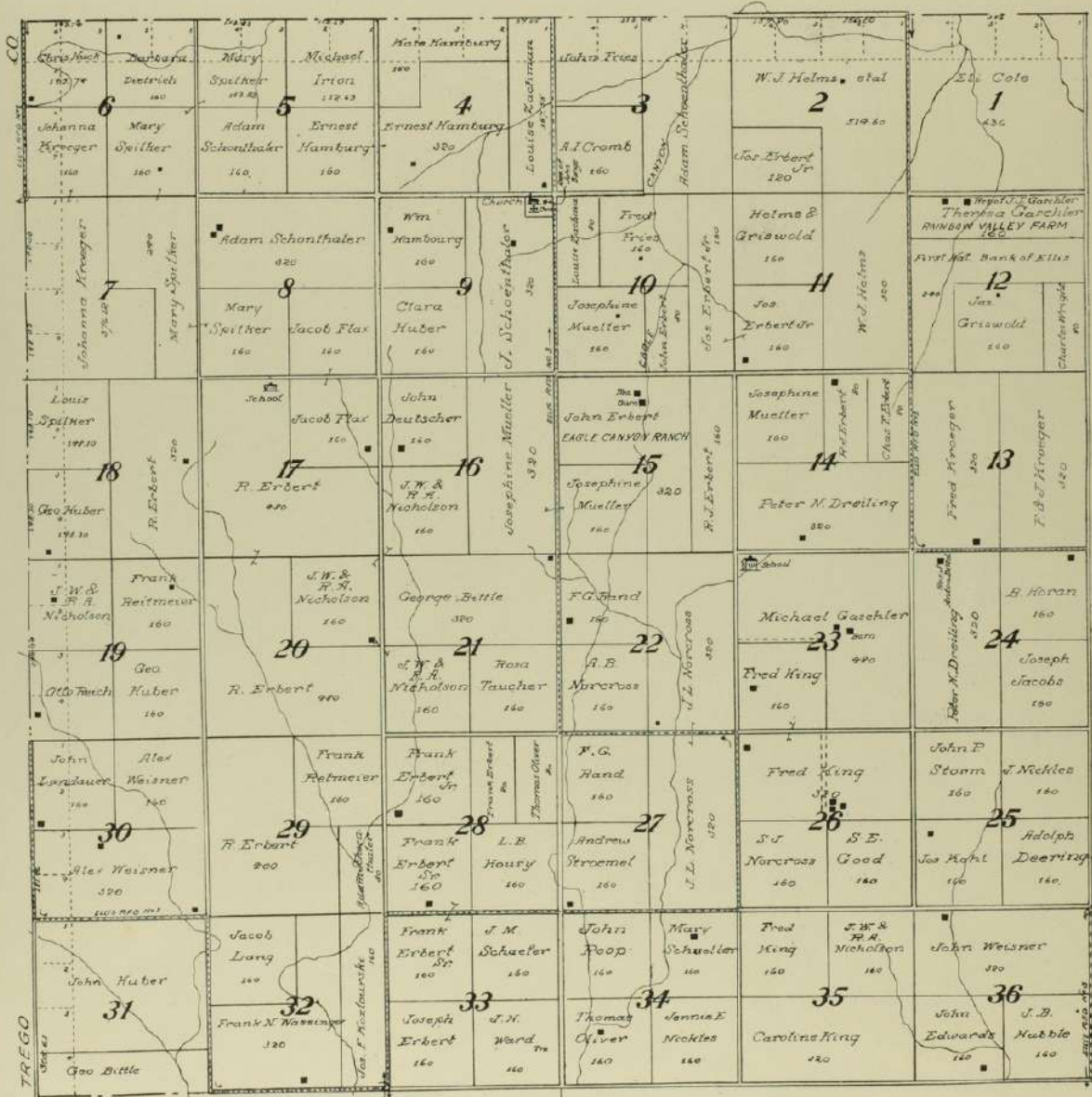

  
**MAP OF**
  
**TOWNSHIP 12 S., RANGE 20 W.**
  
 OF THE 6th P. M.

Scale 1 1/4 inches to 1 mile



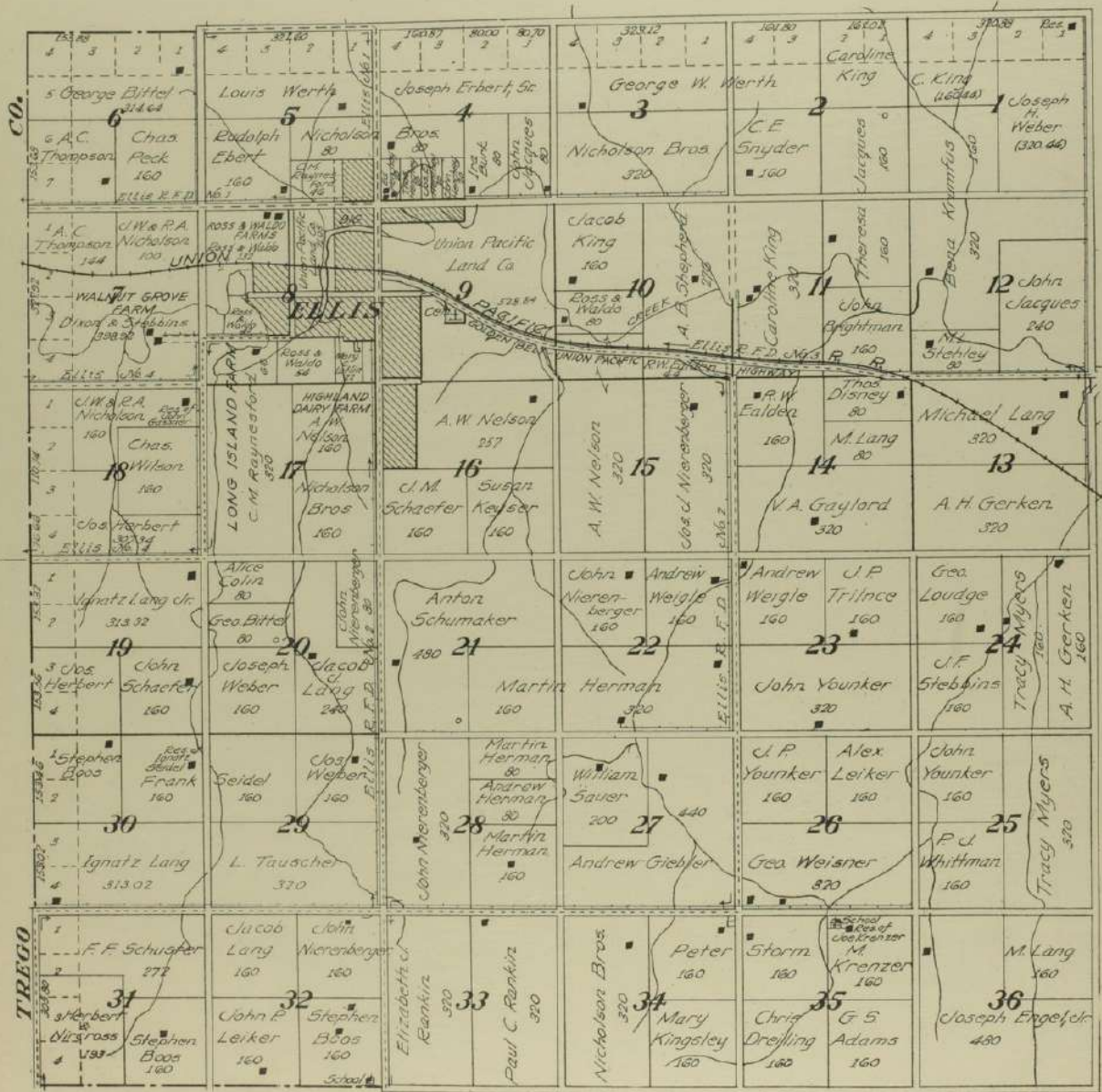

**MAP OF**  
**TOWNSHIP 13 S., RANGE 20 W.**  
 OF THE 6th P. M. Scale 1 1/4 inches to 1 mile





**MAP OF**  
**TOWNSHIP 14 S., RANGE 20 W.**  
**OF THE 6th P. M.**  
 Scale 1 1/4 inches to 1 mile

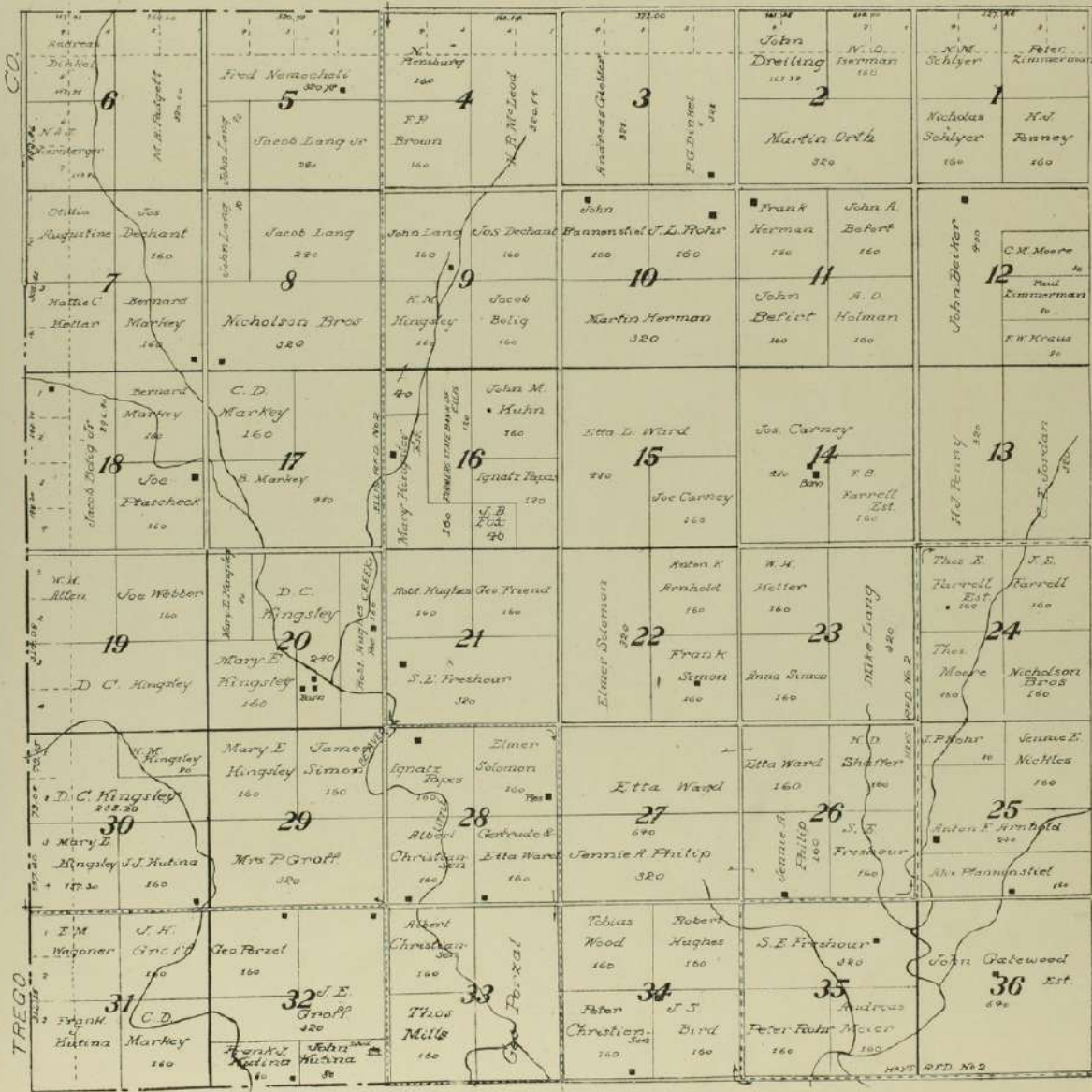



  
**MAP OF**  
**TOWNSHIP 15 S., RANGE 20 W.**  
**OF THE 6th P. M.**

Scale 1 1/4 inches to 1 mile

