

MAP OF JACKSON CO. KAN.

LEGEND

Black	Section Lines
Blue	Water
Green	Timber
Yellow	Grass
Pink	Woods
Light Blue	Swamp
Dark Blue	Highway
Red	County Line
Black	Section Number
Black	Section Letter
Black	Section Area
Black	Section Perimeter
Black	Section Center
Black	Section Corner
Black	Section Boundary
Black	Section Mark
Black	Section Note
Black	Section Title
Black	Section Subtitle
Black	Section Description
Black	Section Reference
Black	Section Citation
Black	Section Footnote
Black	Section Appendix
Black	Section Index
Black	Section Glossary
Black	Section Bibliography
Black	Section Bibliography
Black	Section Bibliography

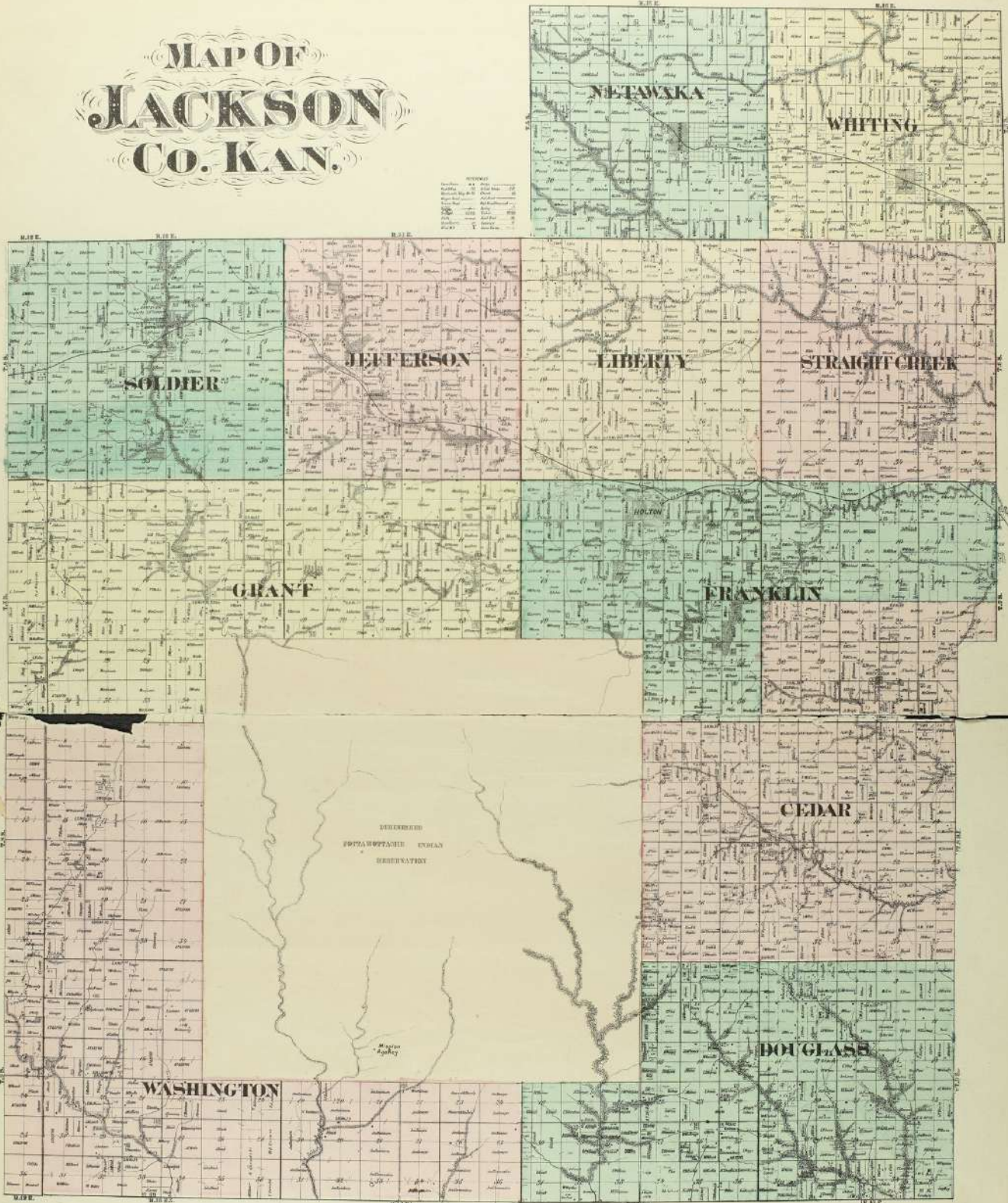

T. 6 S.

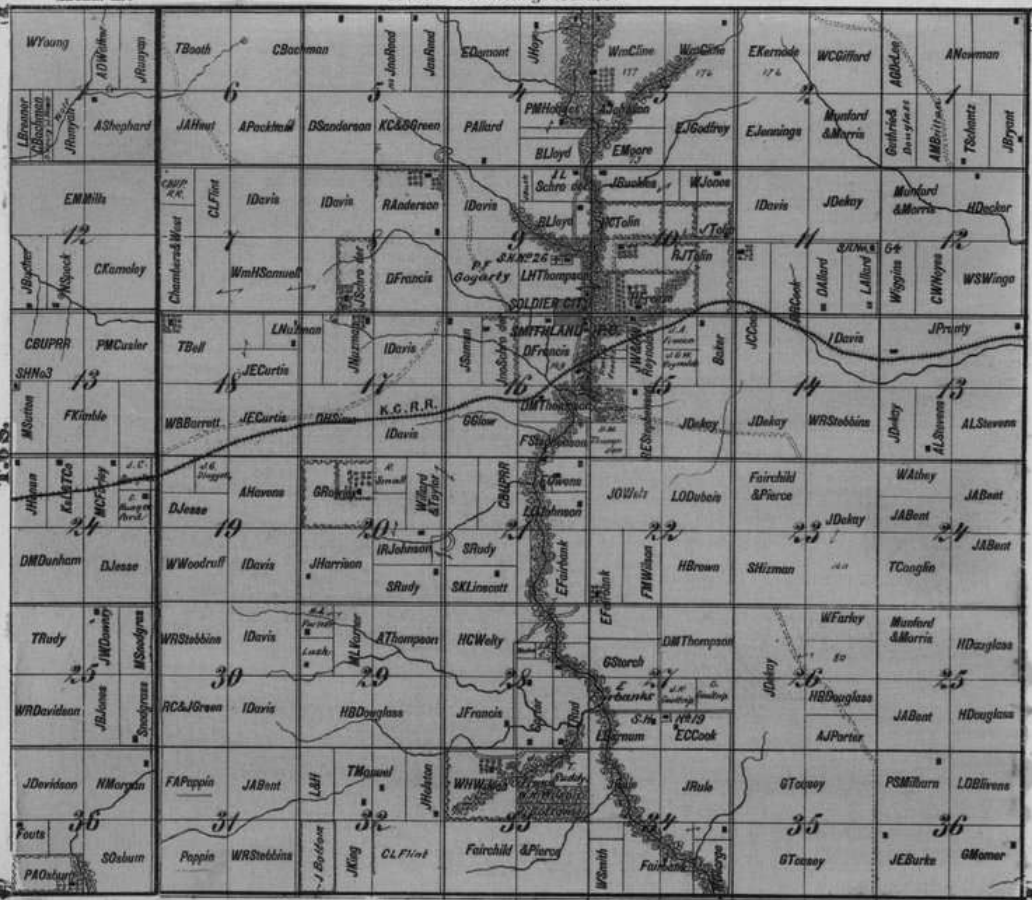

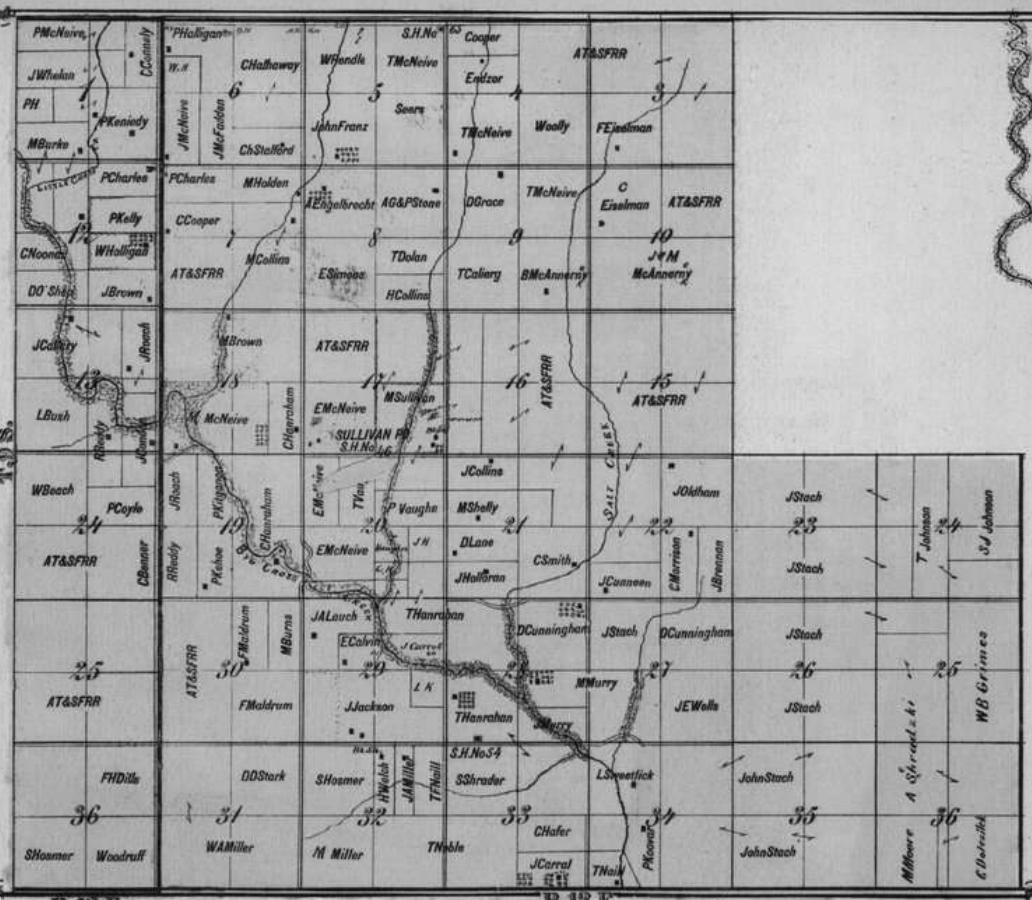

Town 8 South Range 13 East.

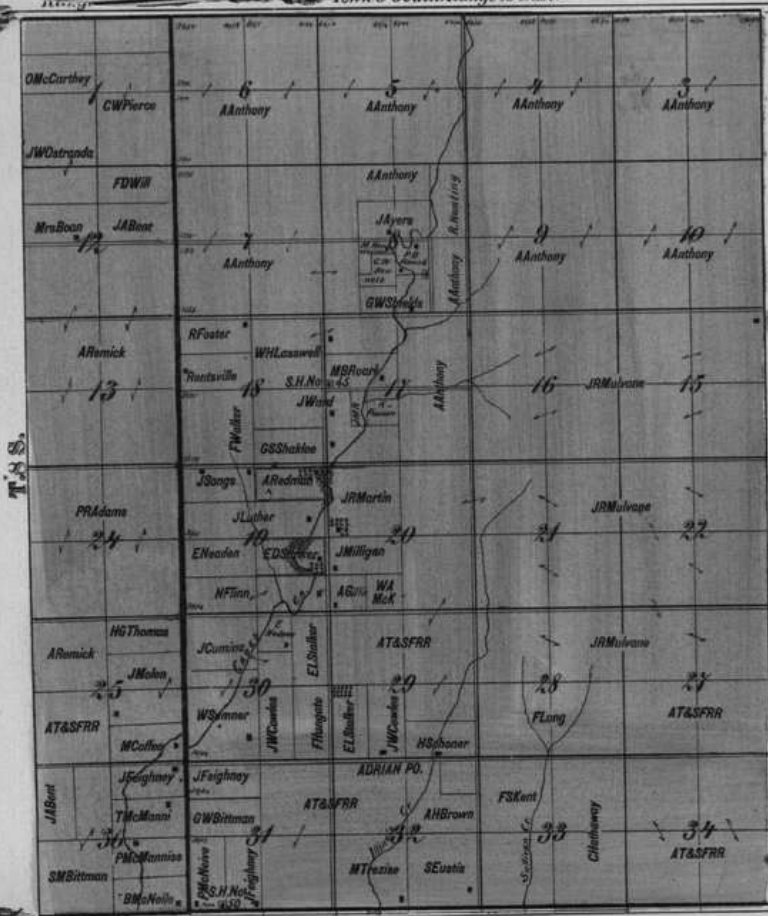

T. 8 S.



PLAT
TOWN 6 SOUTH
RANGE 14 EAST
BY BIRD & MIDDLE
CHICAGO

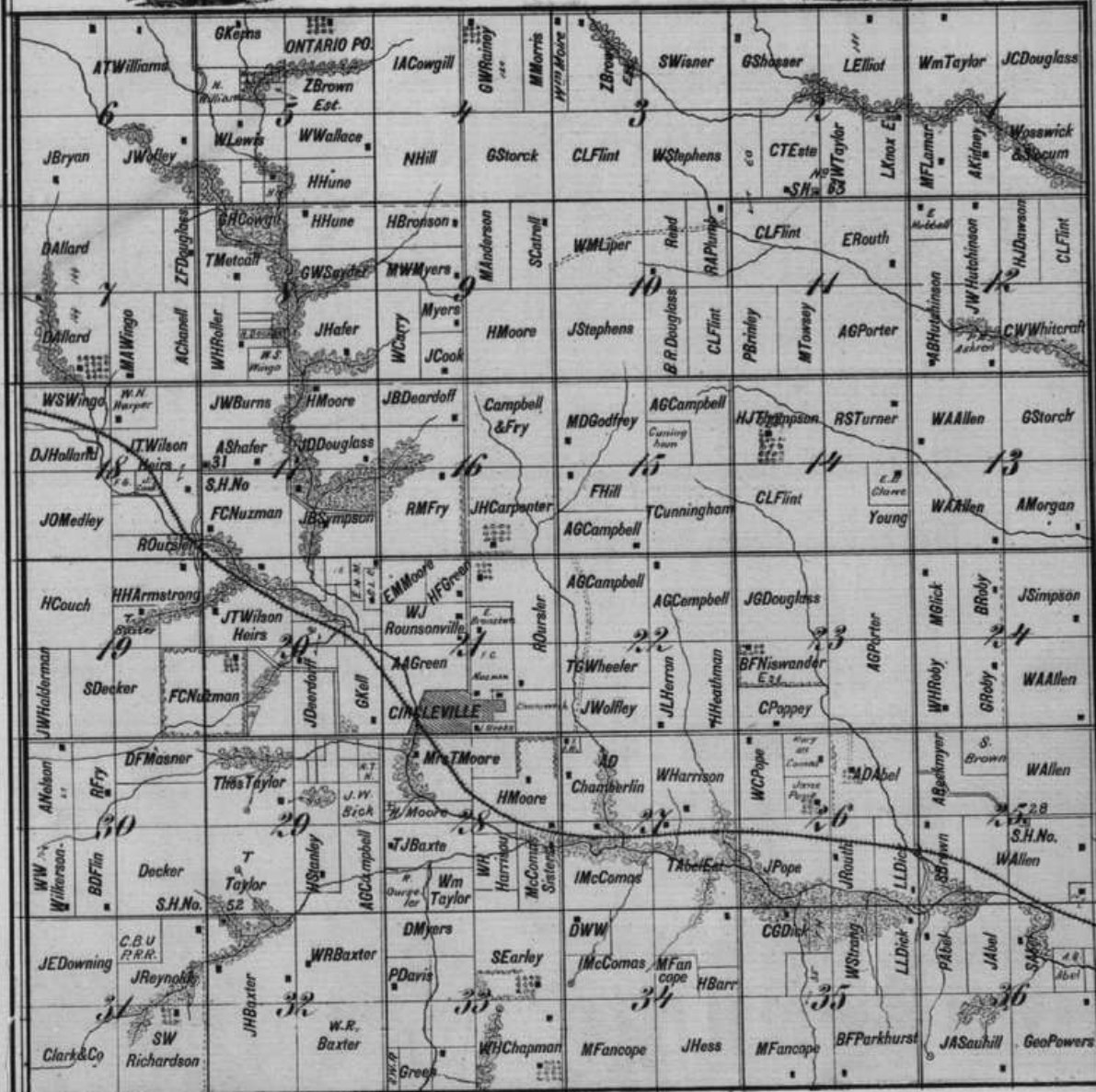

REFERENCES

- | | | | |
|-----------------|--------------------|--------------|------------|
| Farm House | Hedge | Bridge | Spring |
| Post Office | School House | Orchard | Timber |
| Blacksmith Shop | Ch. | Bluffs | Sand Bank |
| Wagon Road | Rail Road | Stone Quarry | Cometary |
| Private Road | Rail Road Proposed | Wind Mill | Same Owner |





PLAT
TOWN OF SOUTH
RANGE 14 EAST
3RD & 4TH
CHICAGO



REFERENCES

- | | | | |
|-----------------|-------|--------------------|-------|
| Farm House | | Hedge | |
| Post Office | | School House | |
| Blacksmith Shop | | Church | |
| Wagon Road | | Rail Road | |
| Private Road | | Rail Road Proposed | |

- | | | | |
|--------------|-------|------------|-------|
| Bridge | | Spring | |
| Orchard | | Timber | |
| Bluffs | | Sand Bank | |
| Stone Quarry | | Cemetery | |
| Wind Mill | | Same Owner | |



PLAT
TOWN 8 SOUTH
RANGE 14 EAST
BY
BIRD & MIDDLE
CHICAGO.



DIMINISHED
POTTAWOTTAMIE INDIAN
RESERVATION

REFERENCES

Farm House	H. H.	Hedge	
Post Office	P.O.	School House	S.H.
Blacksmith Shop	Bl. Sh.	Church	Ch.
Wagon Road		Rail Road	
Private Road		Rail Road Proposed	



Bridge		Spring	
Orchard	455111	Timber	
Bluffs		Sand Bank	
Stone Quarry		Cemetery	+
Wind Mill	I	Same Owner	



PLATE
TOWN 9 SOUTH
RANGE 14 EAST
BY
BIRD & MIDDLE
CHICAGO.

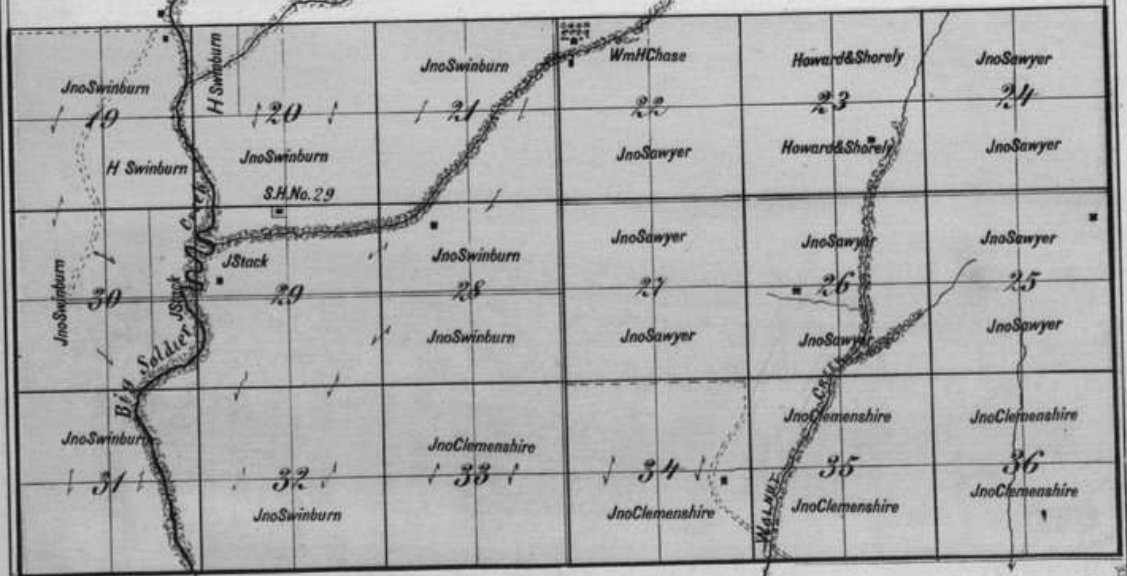

REFERENCES

- Farm House H. H.
- Post Office P.O.
- Blacksmith Shop Bk. Sh.
- Wagon Road W.R.
- Private Road P.R.
- Hedge H.
- School House S.H.
- Church Ch.
- Rail Road R.R.
- Rail Road Proposed R.R.P.



- Bridge B.
- Orchard O.
- Bluffs Bl.
- Stone Quarry S.Q.
- Wind Mill W.M.
- Spring S.
- Timber T.
- Sand Bank S.B.
- Cemetery C.
- Same Owner S.O.



PLAT
TOWN 5 SOUTH
RANGE 15 EAST
 BY
BIRD & MICKLE
CHICAGO



T.S.S.

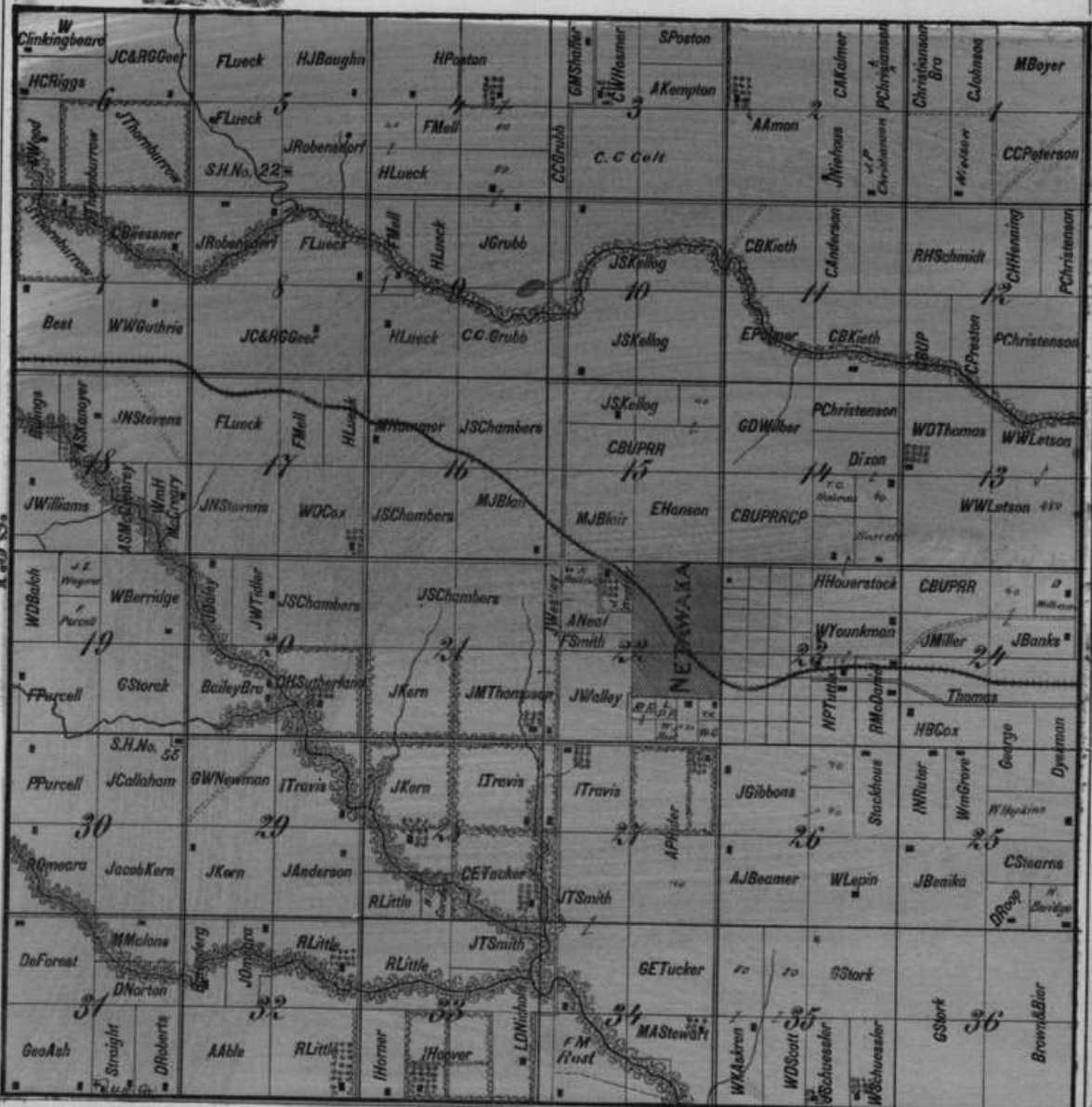

REFERENCES

- Farm House . . . ■
- Post Office . . . PO.
- Blacksmith Shop . . . Bk. Sh.
- Wagon Road . . . ———
- Private Road . . . - - - -
- Hedge . . . ———
- School House . . . S.H.
- Church . . . Ch.
- Rail Road . . . ———
- Rail Road Proposed . . . - - - -



- Bridge . . . ———
- Orchard . . . ———
- Bluffs . . . ———
- Stone Quarry . . . ———
- Wind Mill . . . ———
- Spring . . . ———
- Timber . . . ———
- Sand Bank . . . ———
- Cemetery . . . ———
- Same Owner . . . ———



PLAT
TOWN 6 SOUTH
RANGE 15 EAST
BY
BIRD & MICKLETH
CHICAGO

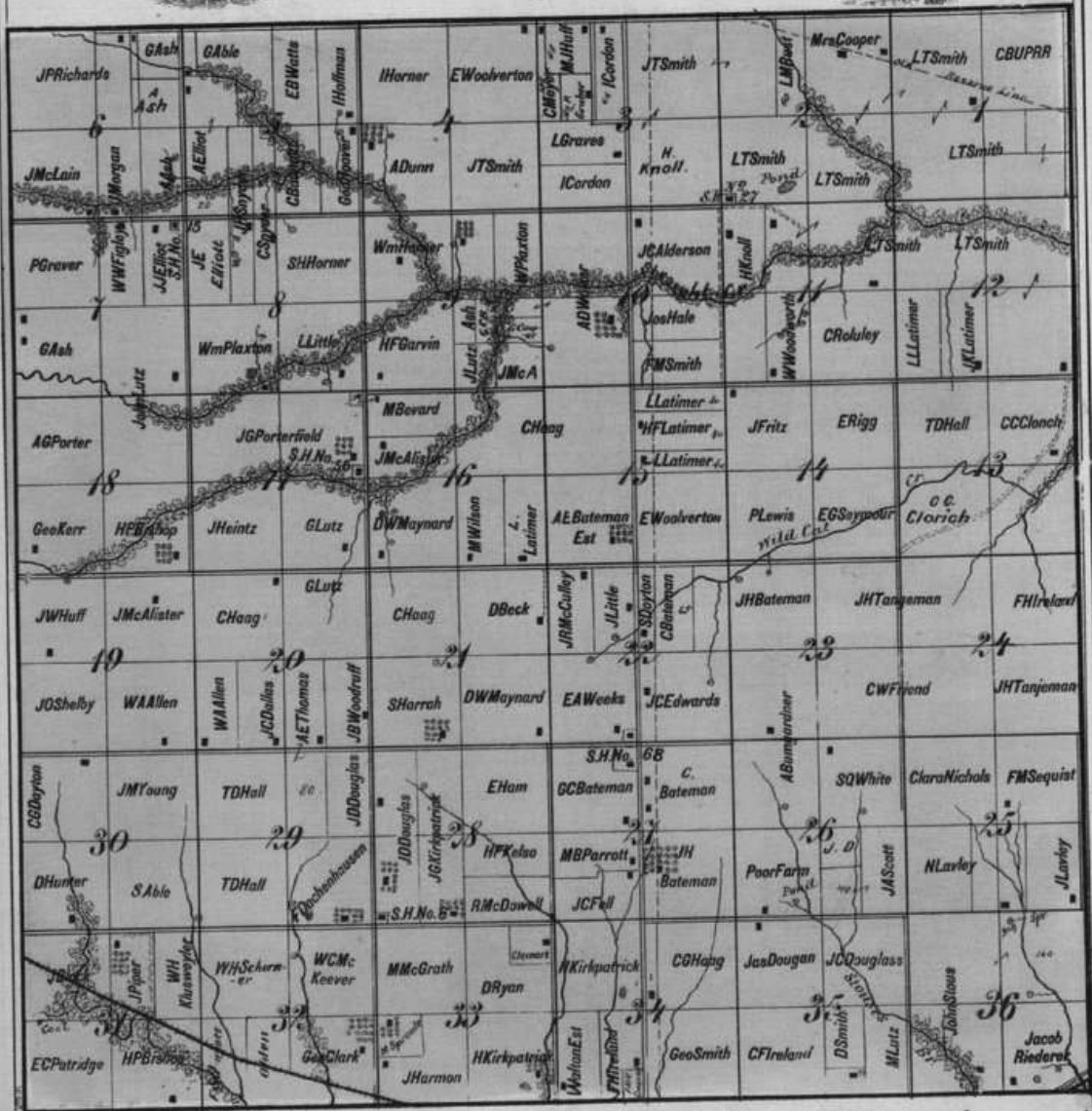

REFERENCES

Farm House	Hedge
Post Office	School House
Blacksmith Shop	Cherch
Wagon Road	Rail Road
Private Road	Rail Road Proposed



Bridge	Spring
Orchard	Timber
Bluffs	Sand Bank
Stone Quarry	Cemetery
Wind Mill	Same Owner

PLAT
TOWN SOUTH
RANGE 15 EAST
BIRD & NICHOLS
CHICAGO.

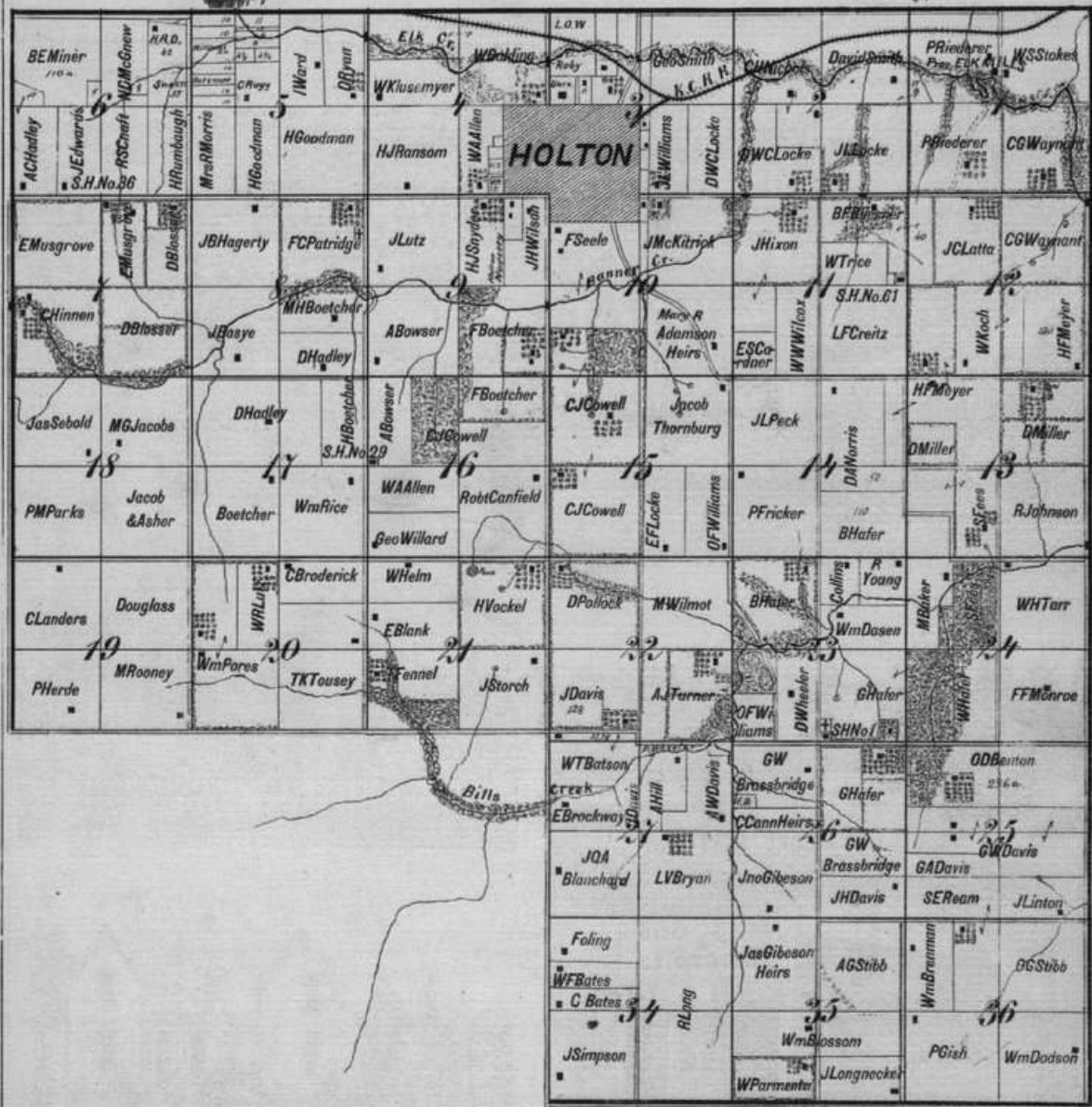

REFERENCES

- Farm House
- Post Office
- Blacksmith Shop
- Wagon Road
- Private Road
- Hedge
- School House
- Church
- Rail Road
- Rail Road Proposed



- Bridge
- Orchard
- Bluffs
- Stone Quarry
- Wind Mill
- Spring
- Timber
- Sand Bank
- Cemetery
- Same Owner



PLAT TOWN 8 SOUTH RANGE 15 EAST BY BIRD & MICKLE CHICAGO.

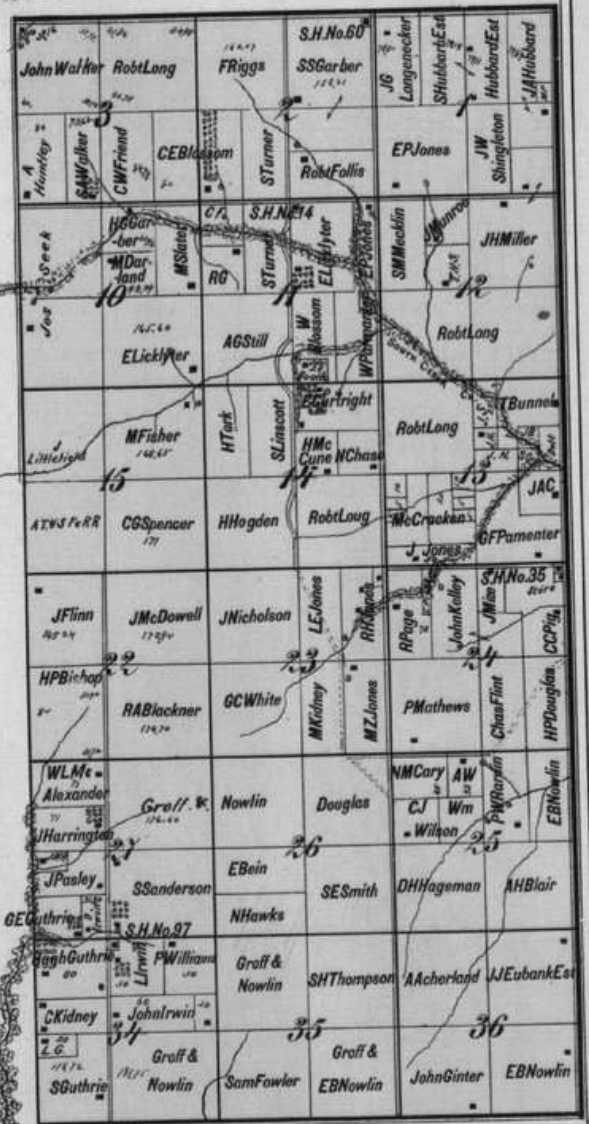

REFERENCES

- Farm House ■ ■
- Post Office PO
- Blacksmith Shop Bk.Sh.
- Wagon Road ———
- Private Road - - - - -
- Hedge ———
- School House S.H.
- Church Ch.
- Rail Road ———
- Rail Road Proposed - - - - -

- Bridge ———
- Orchard ■ ■ ■ ■ ■
- Bluffs ———
- Stone Quarry ■ ■ ■ ■ ■
- Wind Mill ———
- Spring ———
- Timber ■ ■ ■ ■ ■
- Sand Bank ■ ■ ■ ■ ■
- Cemetery ———
- Same Owner ———





PLAT
TOWN 9 SOUTH
RANGE 15 EAST
BY
BIRD & NICHOLS
CHICAGO.

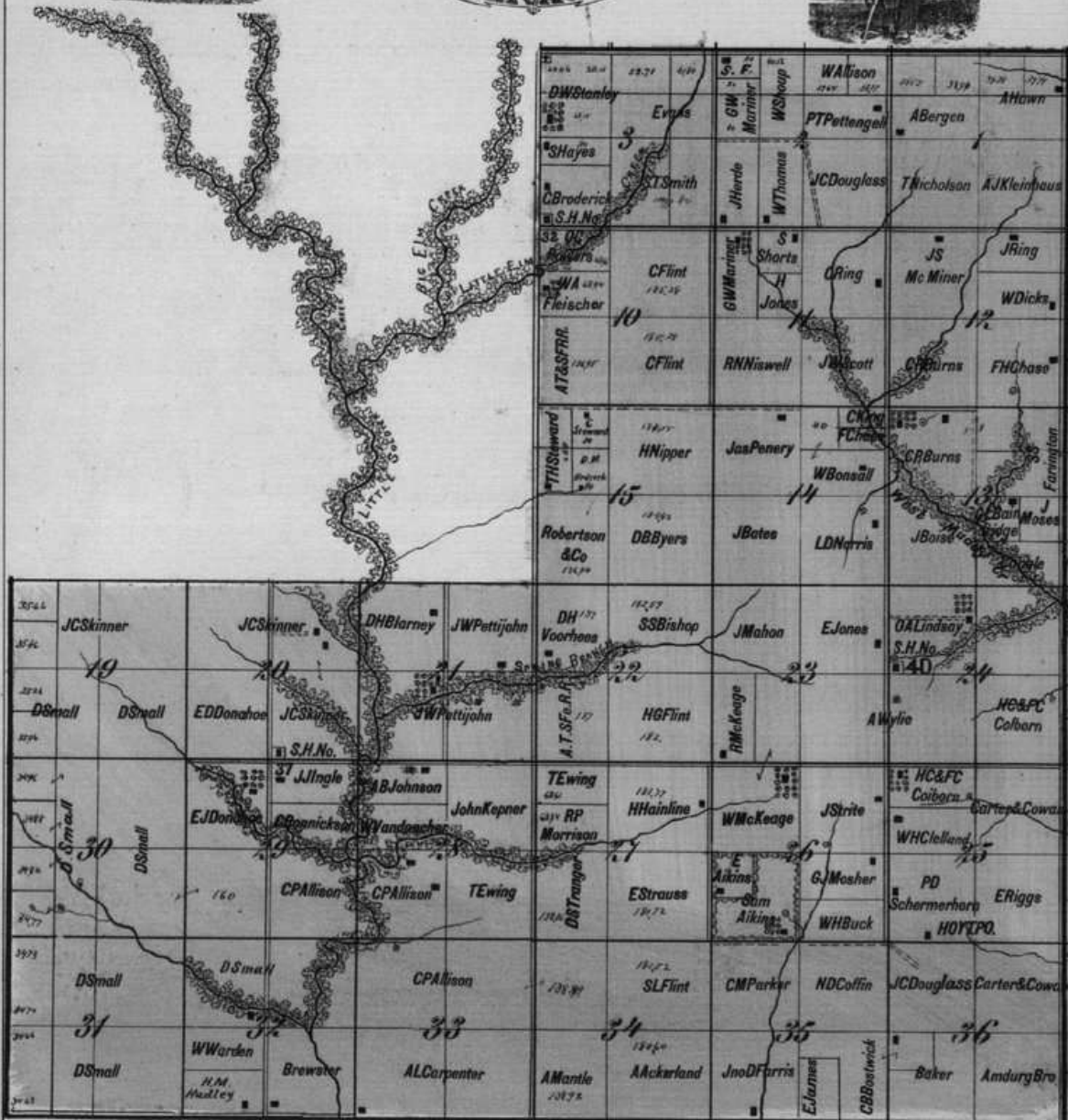

REFERENCES

- Farm House
- Post Office
- Blacksmith Shop Bk. Sh.
- Wagon Road
- Private Road
- Hedge
- School House
- Church
- Rail Road
- Rail Road Proposed

R. 15 E.



- Orchard
- Bluffs
- Stone Quarry
- Wind Mill
- Timber
- Sand Bank
- Cemetery
- Same Owner

PLAT
TOWN 5 SOUTH
RANGE 16 EAST
BY BIRD & MICKLE
CHICAGO

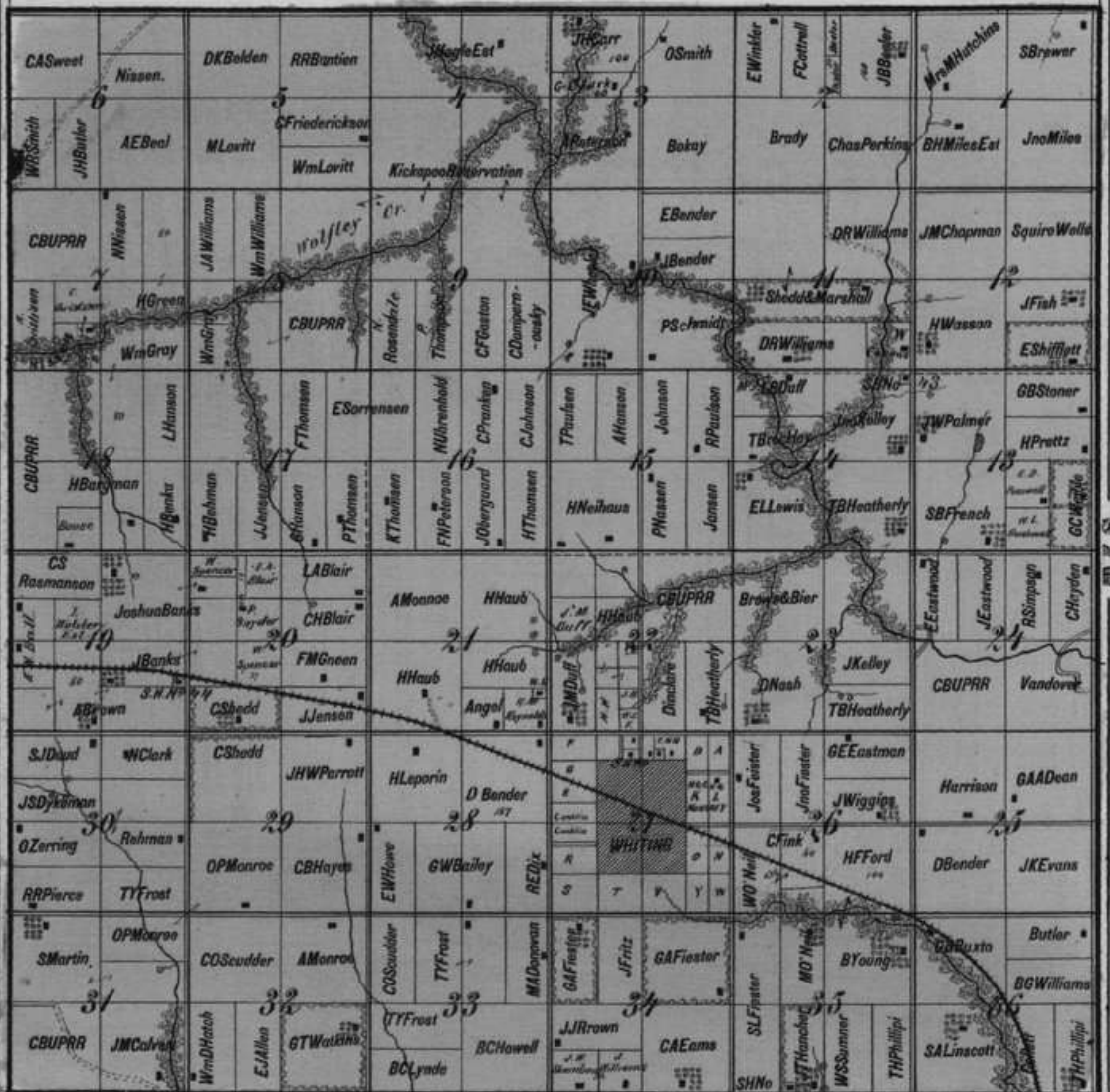
REFERENCES

- | | | | |
|-----------------|--------------------|--------------|------------|
| Farm House | Hedge | Bridge | Spring |
| Post Office | School House | Orchard | Timber |
| Blacksmith Shop | Church | Bluffs | Sand Bank |
| Wagon Road | Rail Road | Stone Quarry | Cemetery |
| Private Road | Rail Road Proposed | Wind Mill | Same Owner |

T.S.S.

Town 6 S. R. 16 E.



T. 6 S.

R. 16 E.



RES. OF F.M. BEIGHTLE ON SEC. 12 T. 7 R. 13

PLATE
TOWN 1 SOUTH
RANGE 16 EAST
BY
BIRD & MIDDLE
CHICAGO



T. 7 S.

REFERENCES

- Farm House
- Post Office
- Blacksmith Shop
- Wagon Road
- Private Road
- Hedge
- School House
- Church
- Rail Road
- Rail Road Proposed

- Bridge
- Orchard
- Bluffs
- Stone Quarry
- Wind Mill
- Spring
- Timber
- Sand Bar
- Comer
- Same Owner





PLAT

TOWN 8 SOUTH

RANGE 16 EAST

BY

GRID & MICKLE

CHICAGO

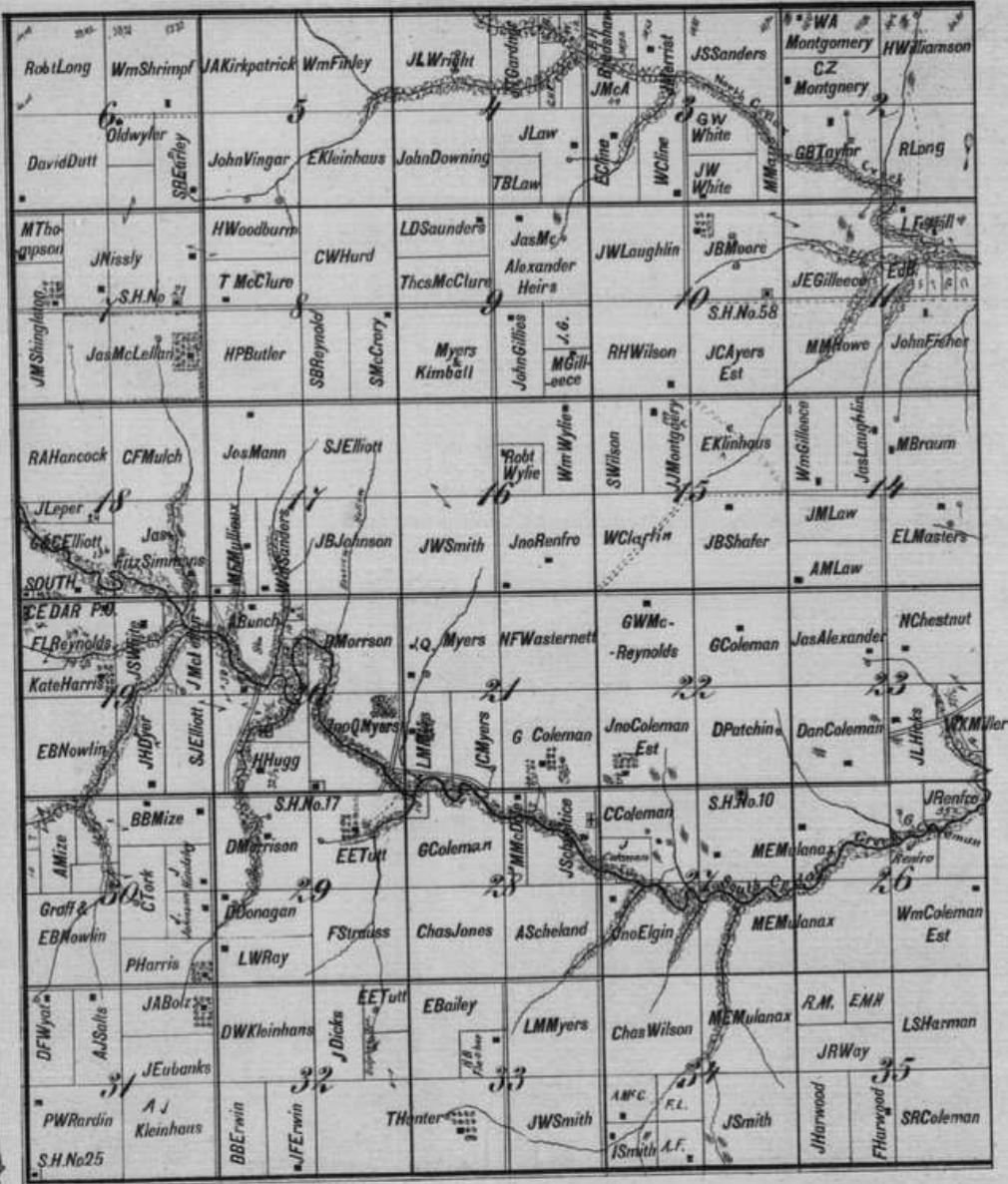

REFERENCES

- | | | | |
|-----------------|--------------------|--------------|------------|
| Farm House | Hedge | Bridge | Spring |
| Post Office | School House | Orchard | Timber |
| Blacksmith Shop | Church | Bluffs | Sand Bank |
| Wagon Road | Rail Road | Stone Quarry | Cemetery |
| Private Road | Rail Road Proposed | Wind Mill | Same Owner |





PLAT
TOWN 9 SOUTH
RANGE 16 EAST
BY
BIRD & NICOLE
CHICAGO.

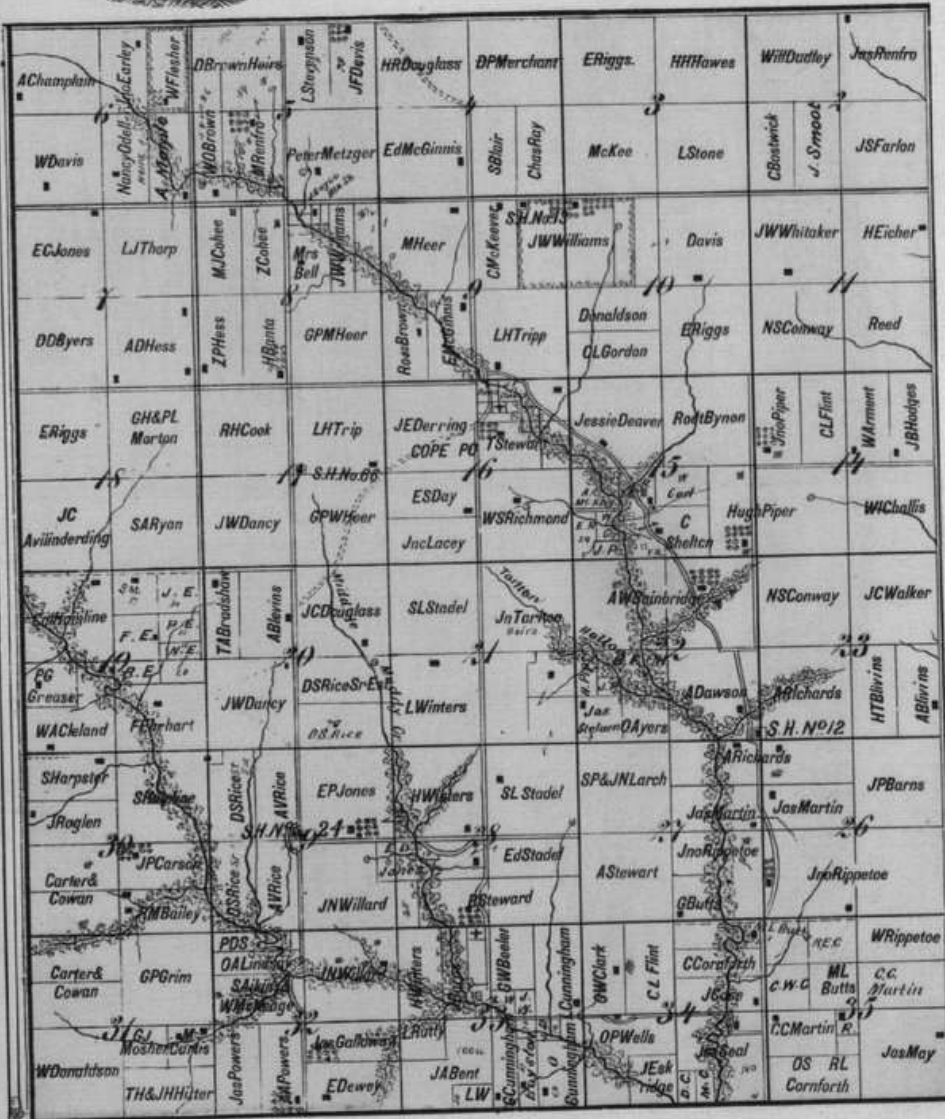

REFERENCES

- Farm House
- Post Office
- Blacksmith Shop
- Wagon Road
- Private Road
- Hedge
- School House
- Church
- Rail Road
- Rail Road Proposed



- Bridge
- Orchard
- Bluffs
- Stone Quarry
- Wind Mill
- Spring
- Timber
- Sand Bank
- Cemetery
- Same Owner

HOLTON

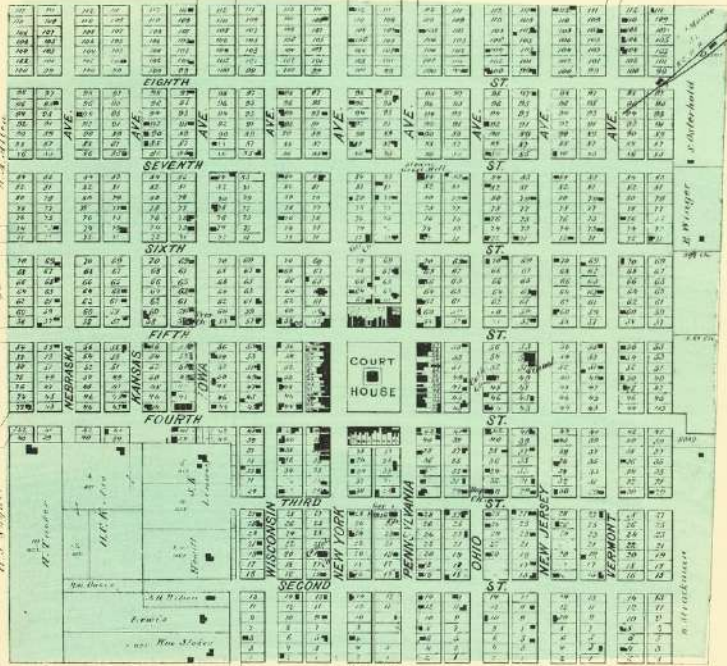

TIPPINVILLE.

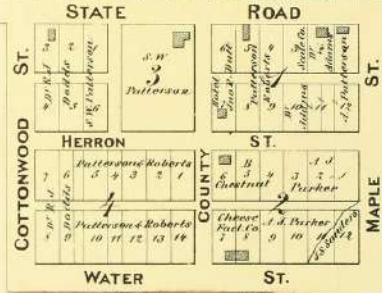
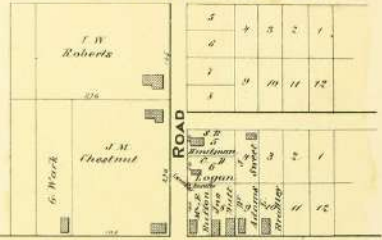

CIRCLEVILLE

LARKIN

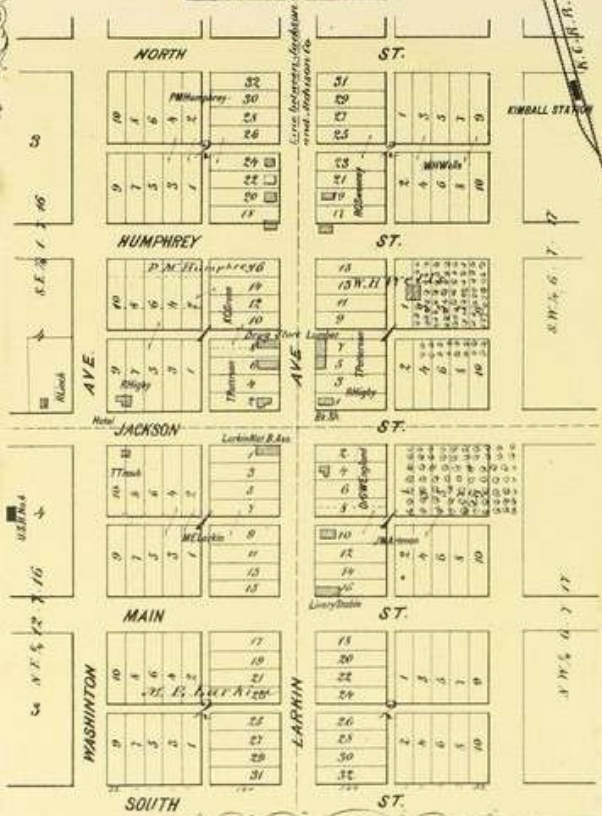

SOLDIER

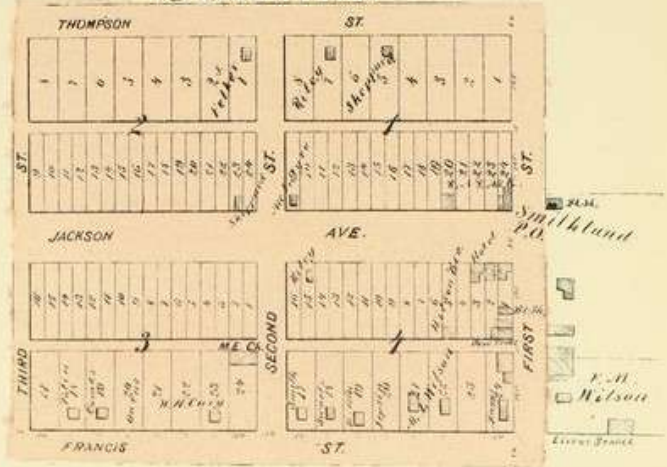

WHITING

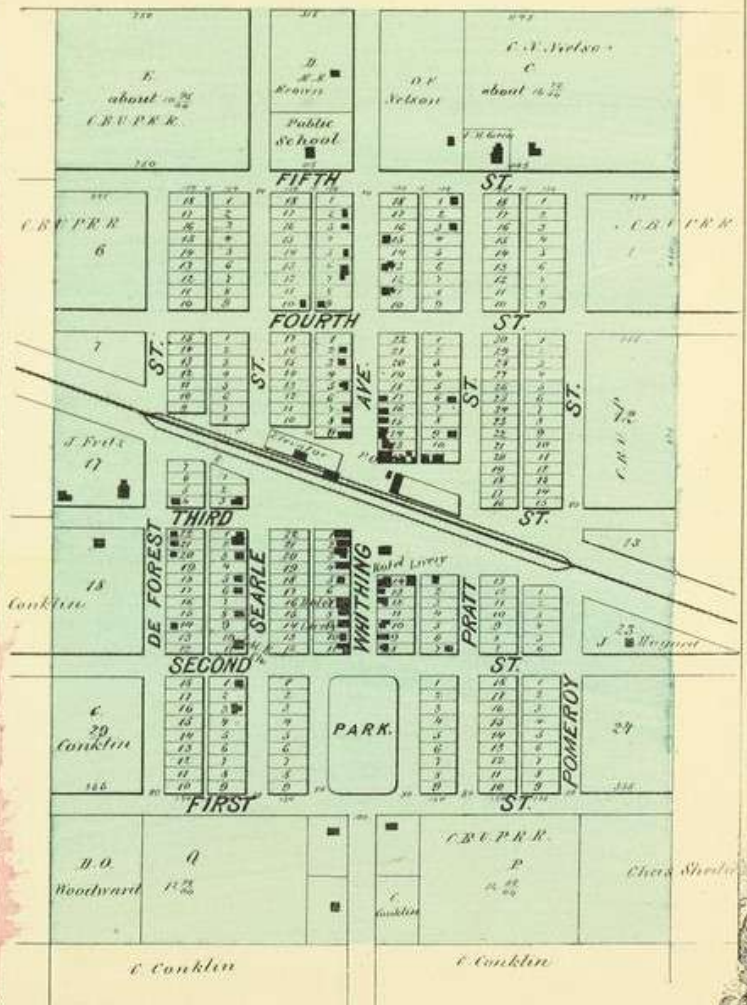

NETAWAKA

