

MAP OF MIAMI CO., KANSAS.

Scale 1/2 inch to the mile.

marais des Cigues.

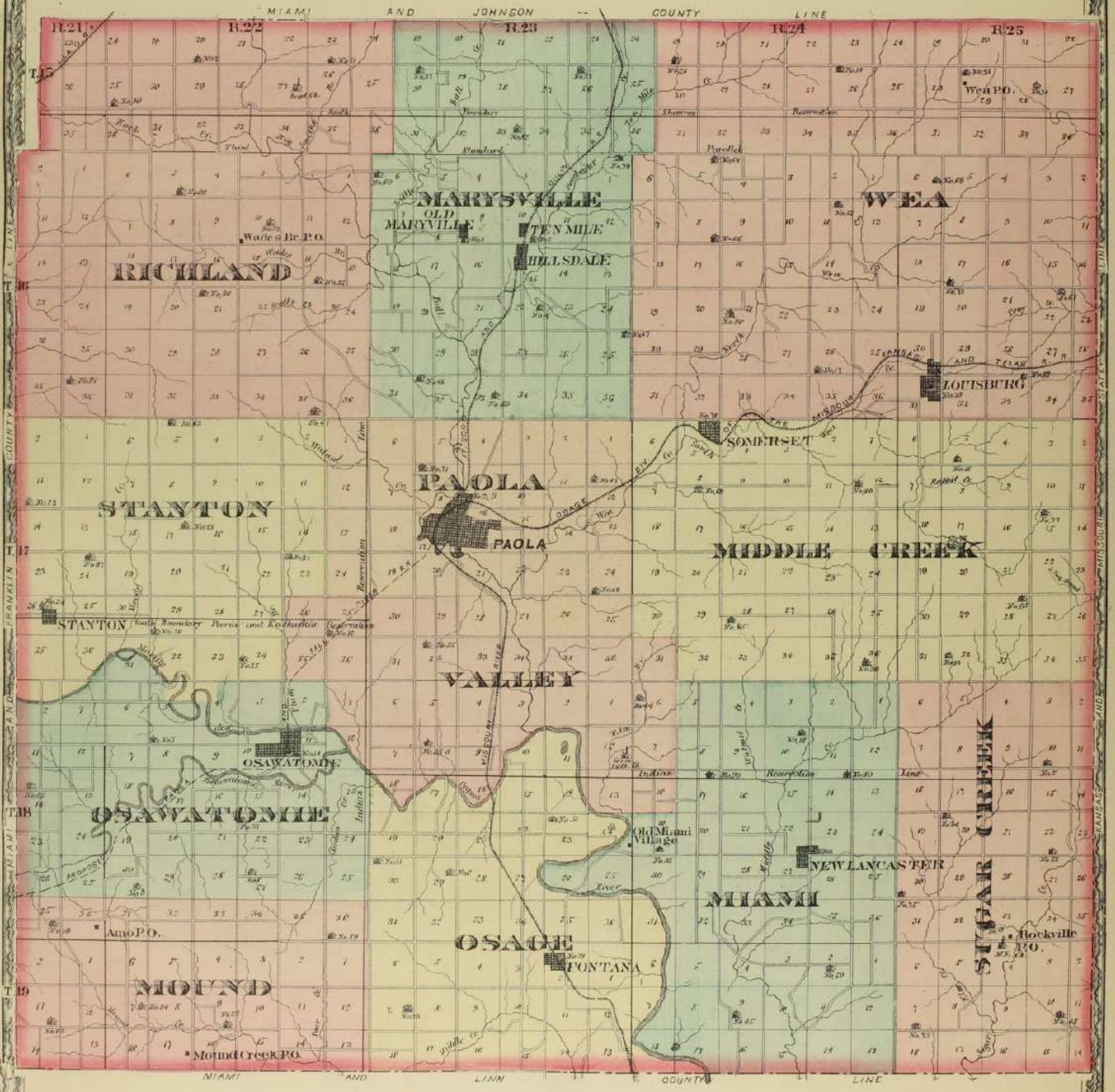

TOWNSHIP 19 SOUTH RANGE 25 EAST

OF THE 6TH PRINCIPAL MERIDIAN.

Scale: 2 inches to the mile

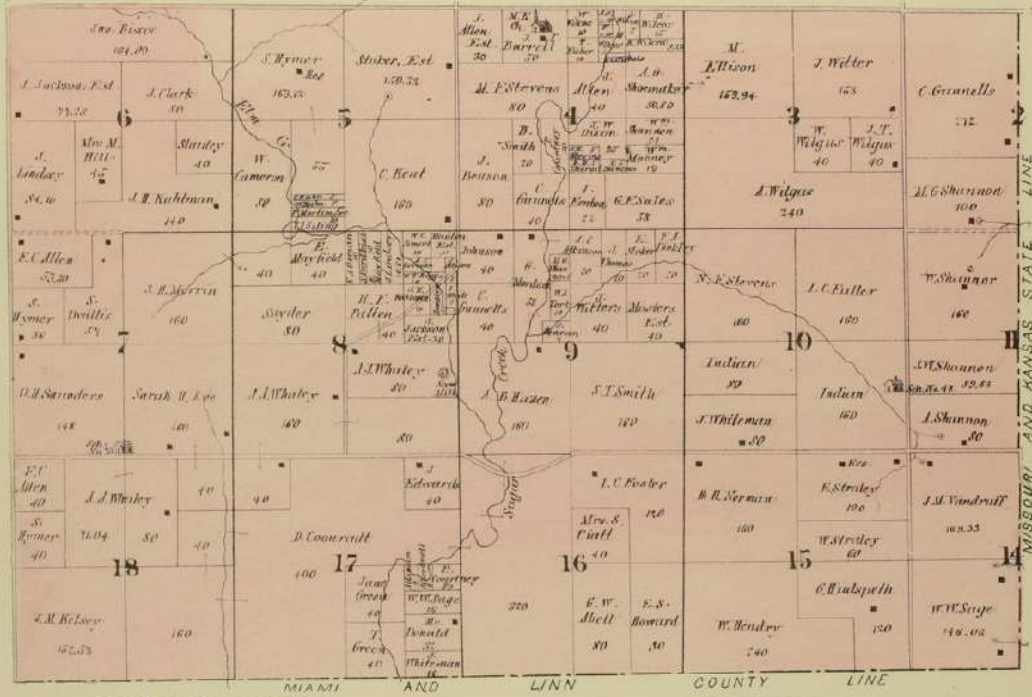

HILLSDALE

NEW LANCASTER

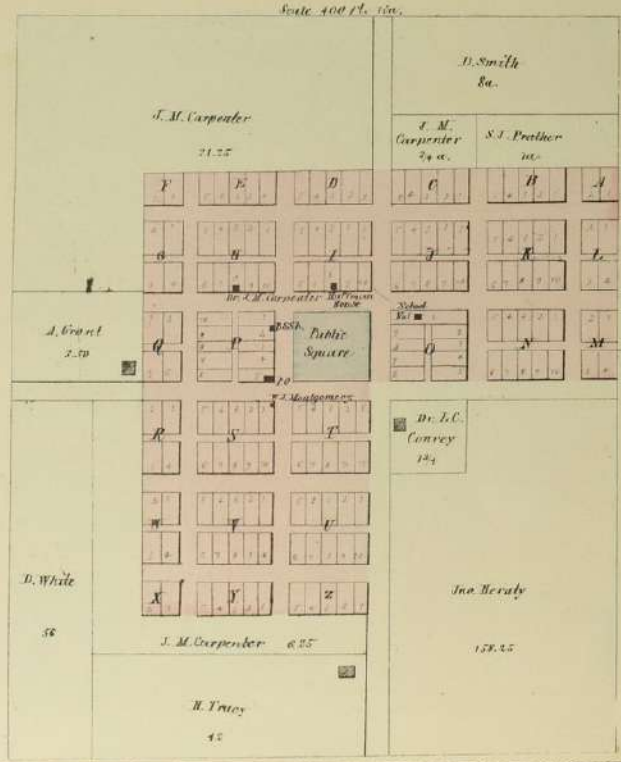
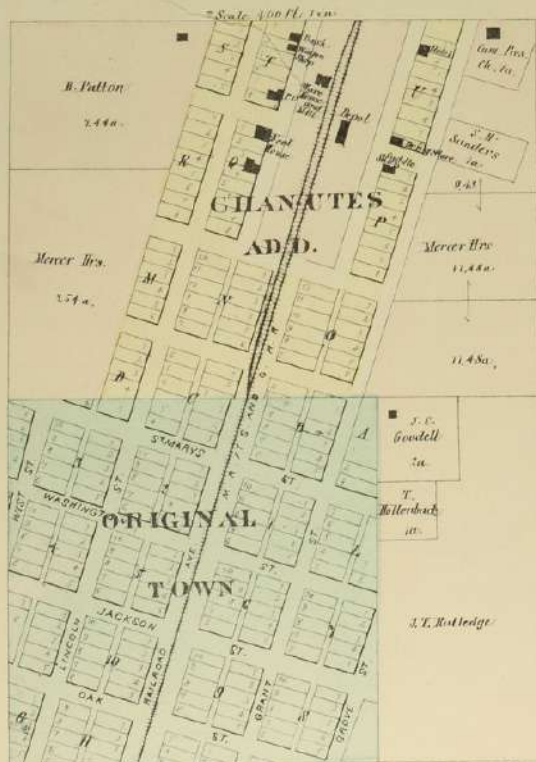

TOWNSHIP 18 SOUTH RANGE 25 EAST

OF THE 6TH PRINCIPAL MERIDIAN.

Scale: 2 inches to the mile.

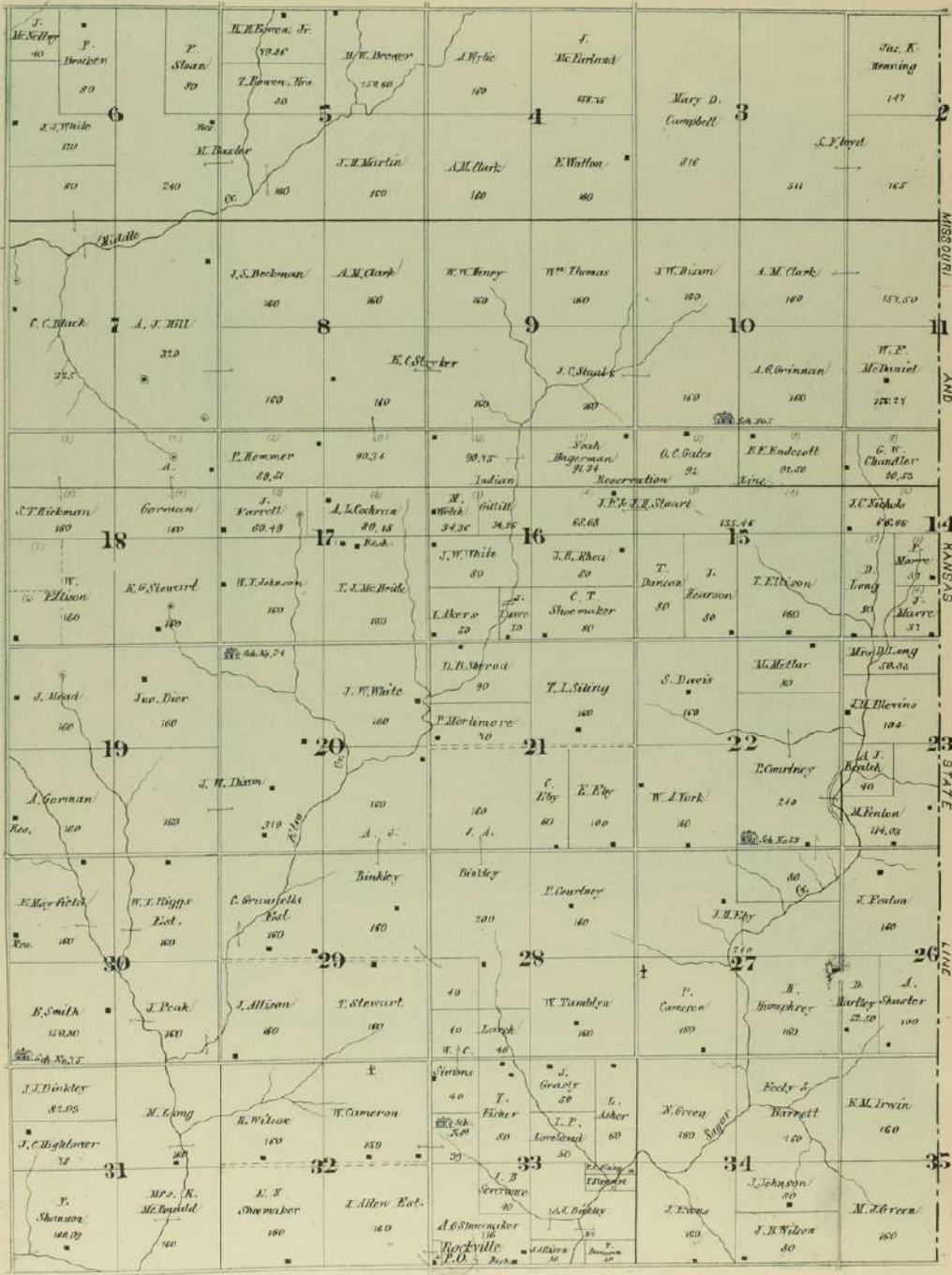

TOWNSHIP 17 SOUTH RANGE 25 EAST

OF THE 6TH PRINCIPAL MERIDIAN.

Scale: 2 inches to the mile.

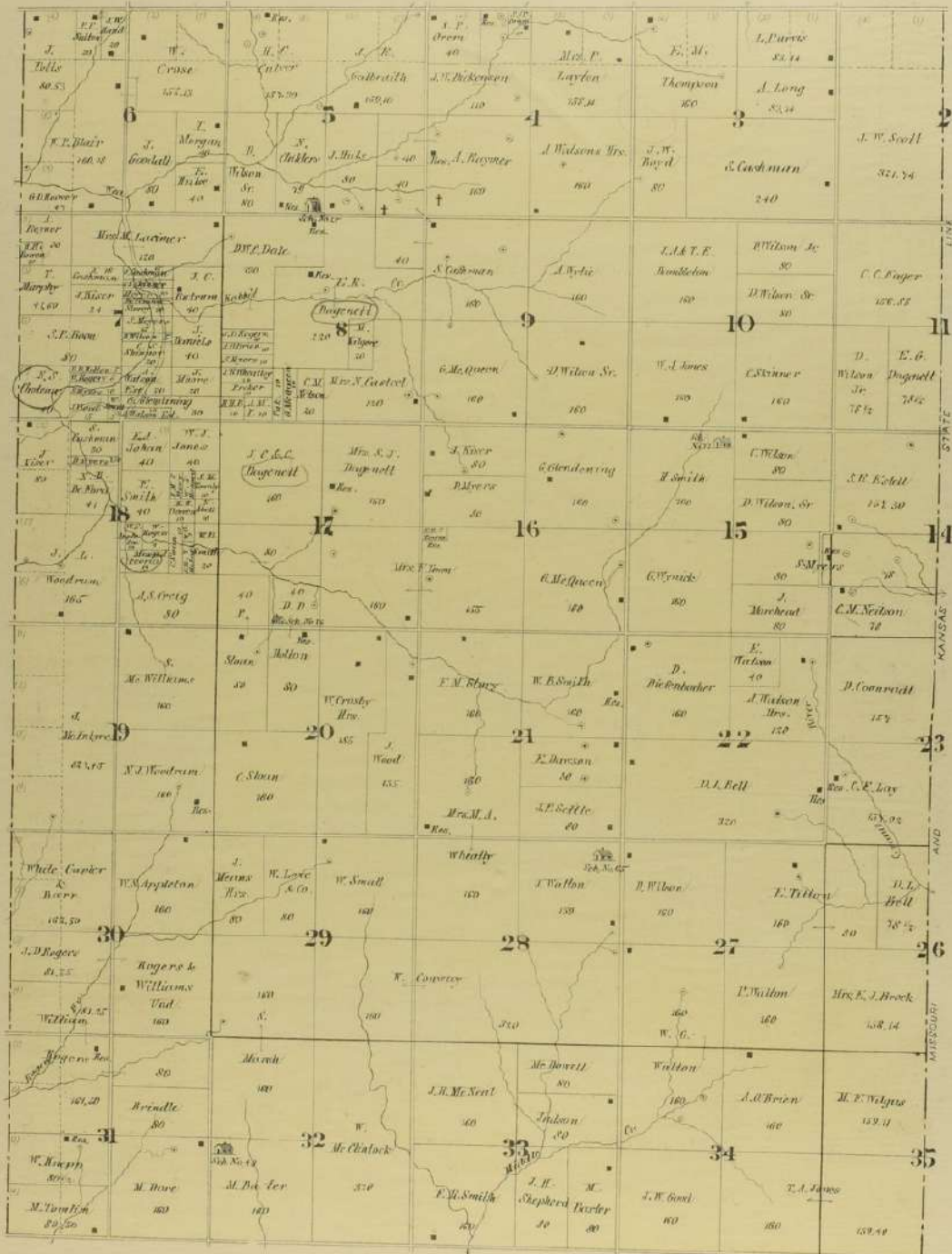

LOUISBURG

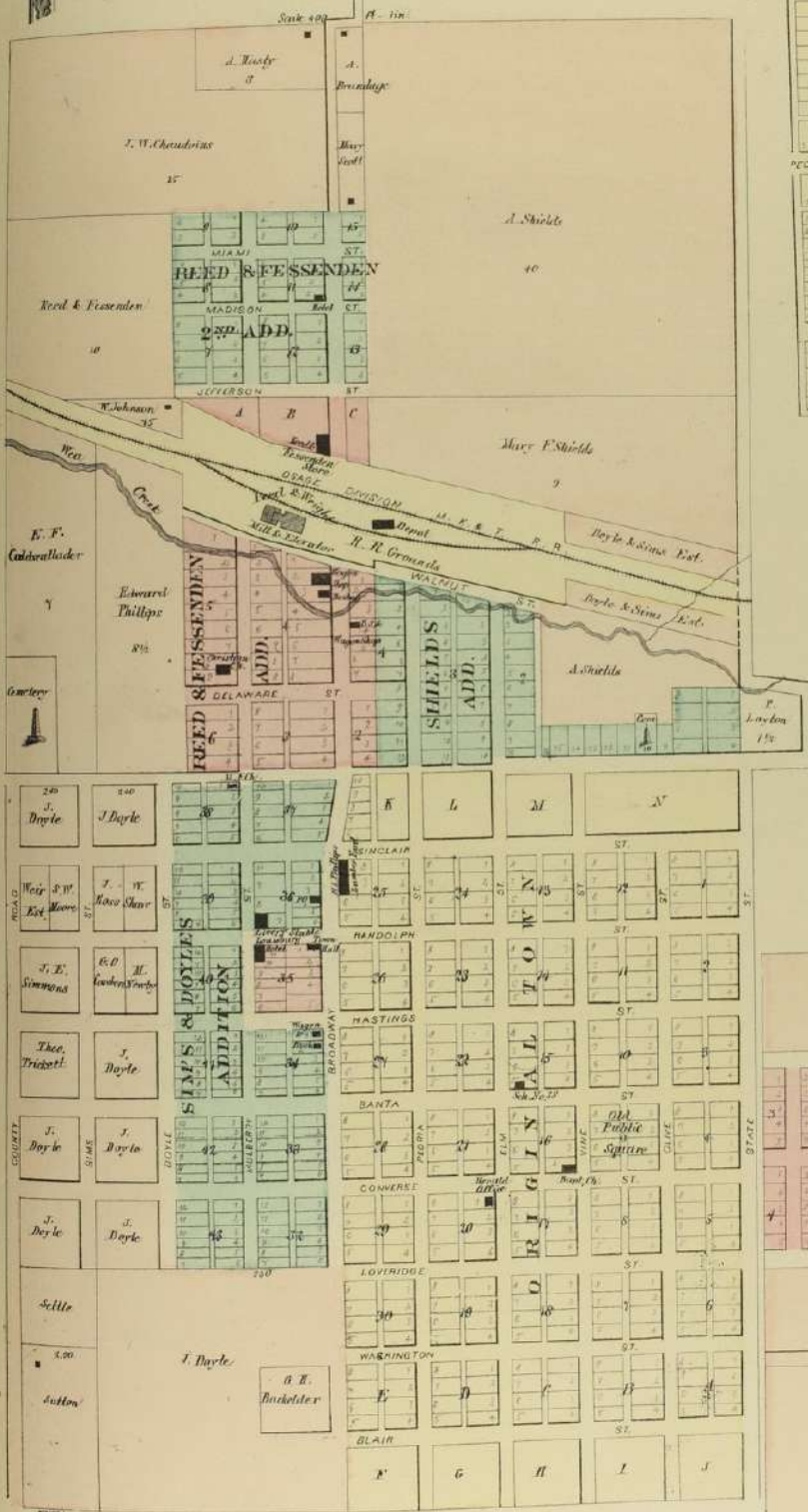

Stanton

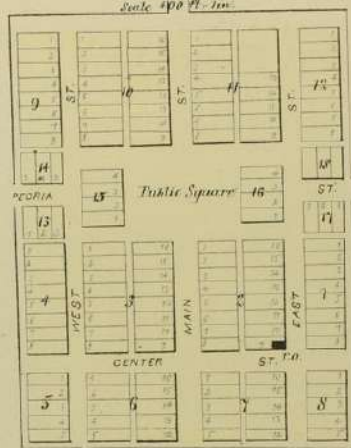

WEA P.O.

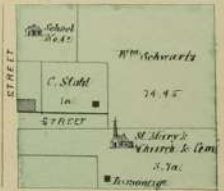

Old Maryville

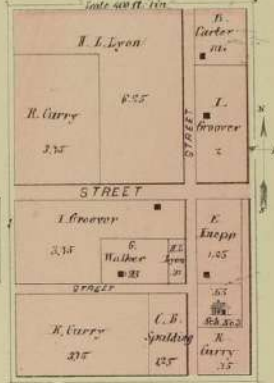

Ten Mile

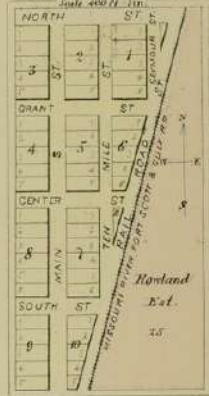

FONTANA



TOWNSHIP 16 SOUTH RANGE 25 EAST

OF THE 6TH PRINCIPAL MERIDIAN.

Scale .2 inches to the mile.

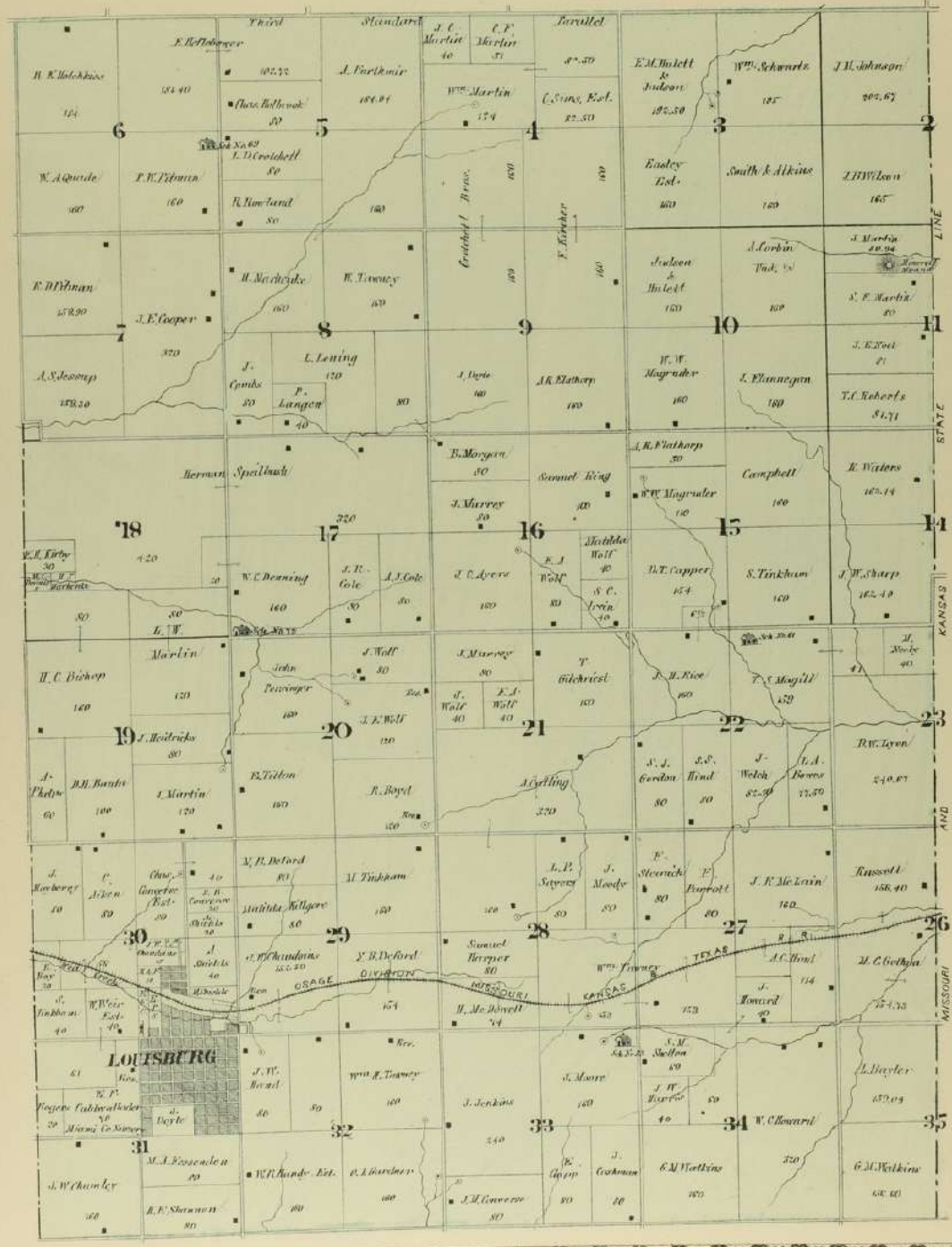

TOWNSHIP 16 SOUTH RANGE 24 EAST

OF THE 6TH PRINCIPAL MERIDIAN.

Scale: 2 inches to the mile.

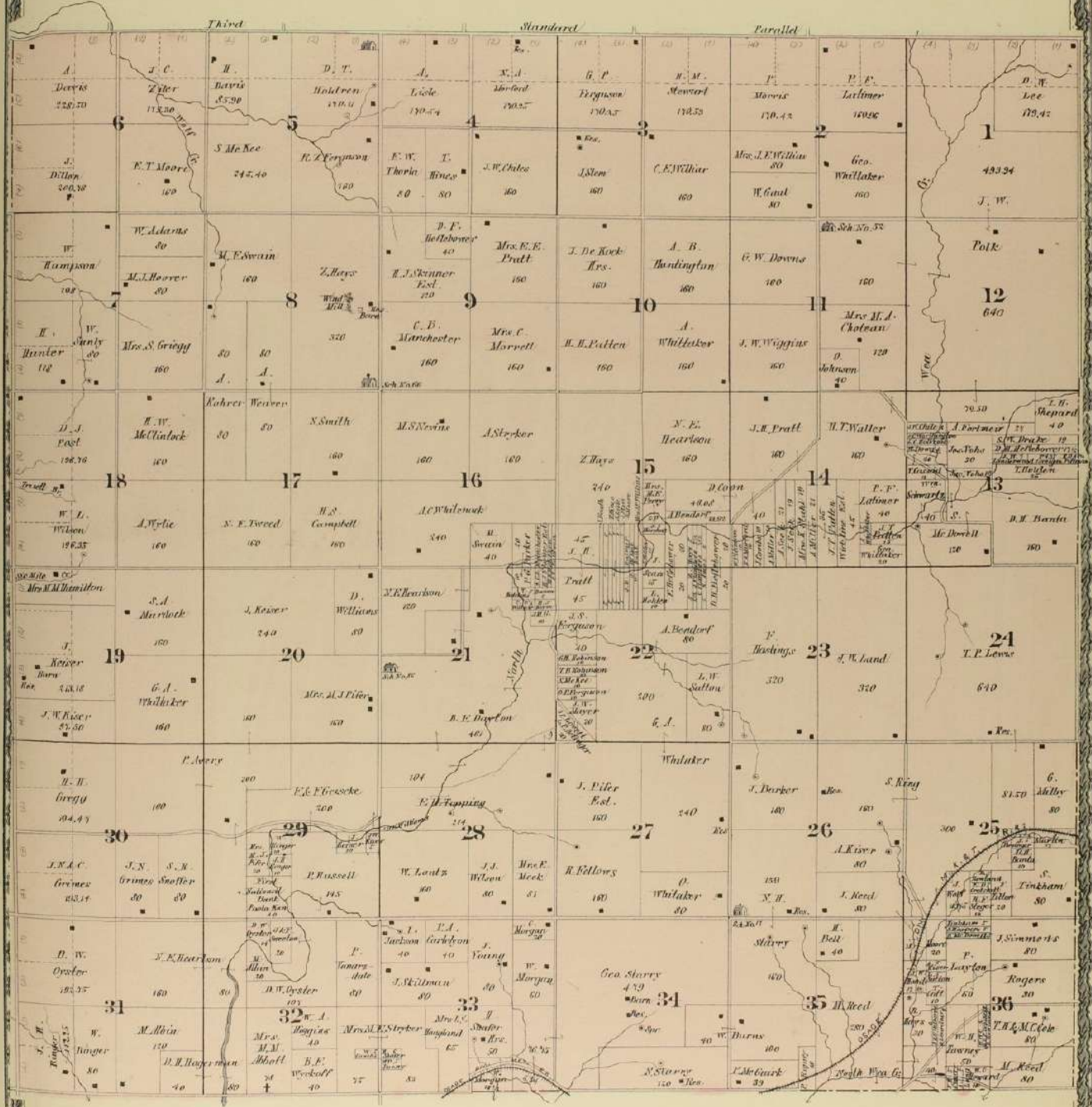

TOWNSHIP 17 SOUTH RANGE 24 EAST

OF THE 6TH PRINCIPAL MERIDIAN.

Scale: 2 inches to the mile.

SOMERSET

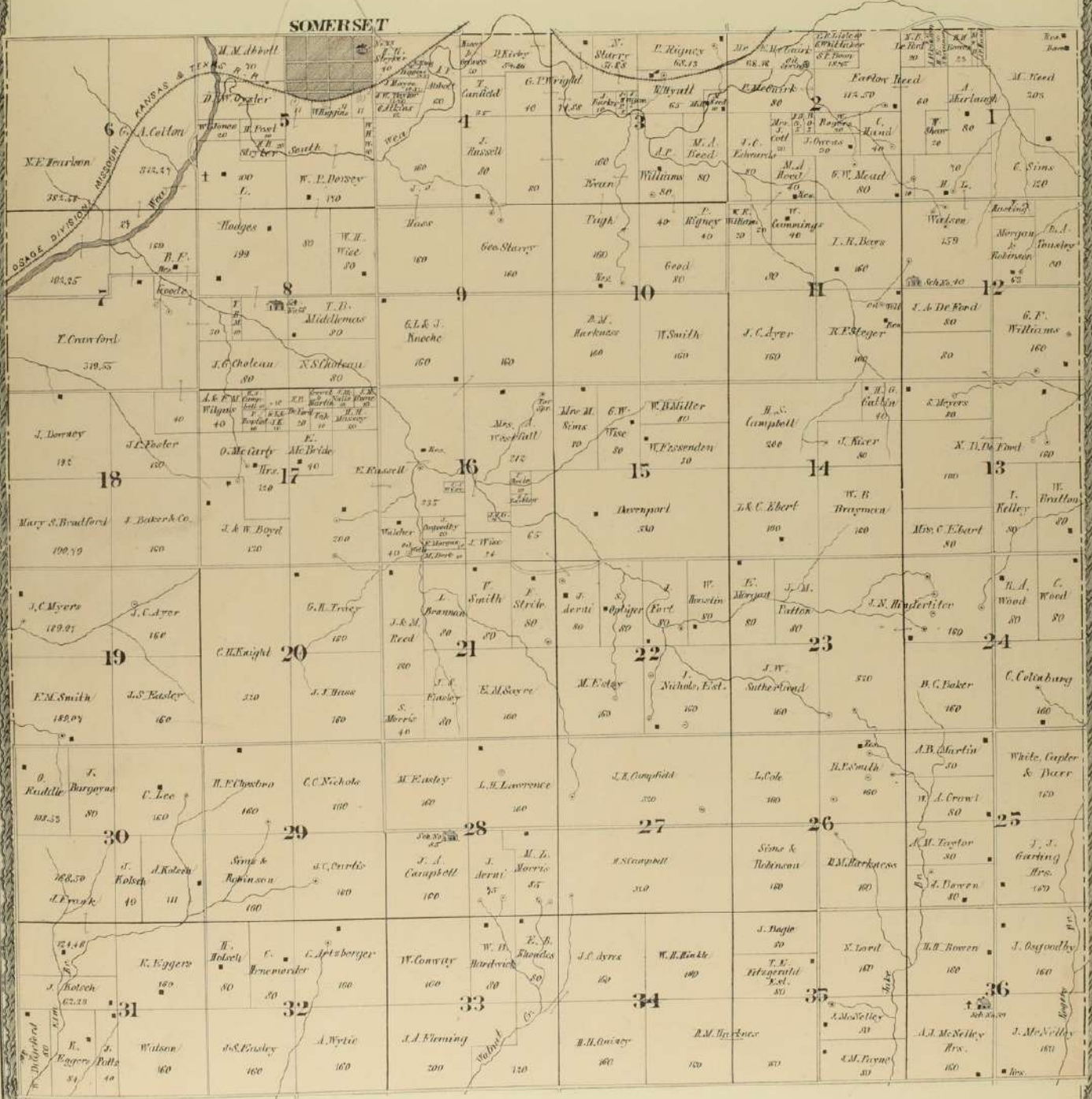

TOWNSHIP 18 SOUTH RANGE 24 EAST

OF THE 6TH PRINCIPAL MERIDIAN.

Scale 2 inches to the mile.

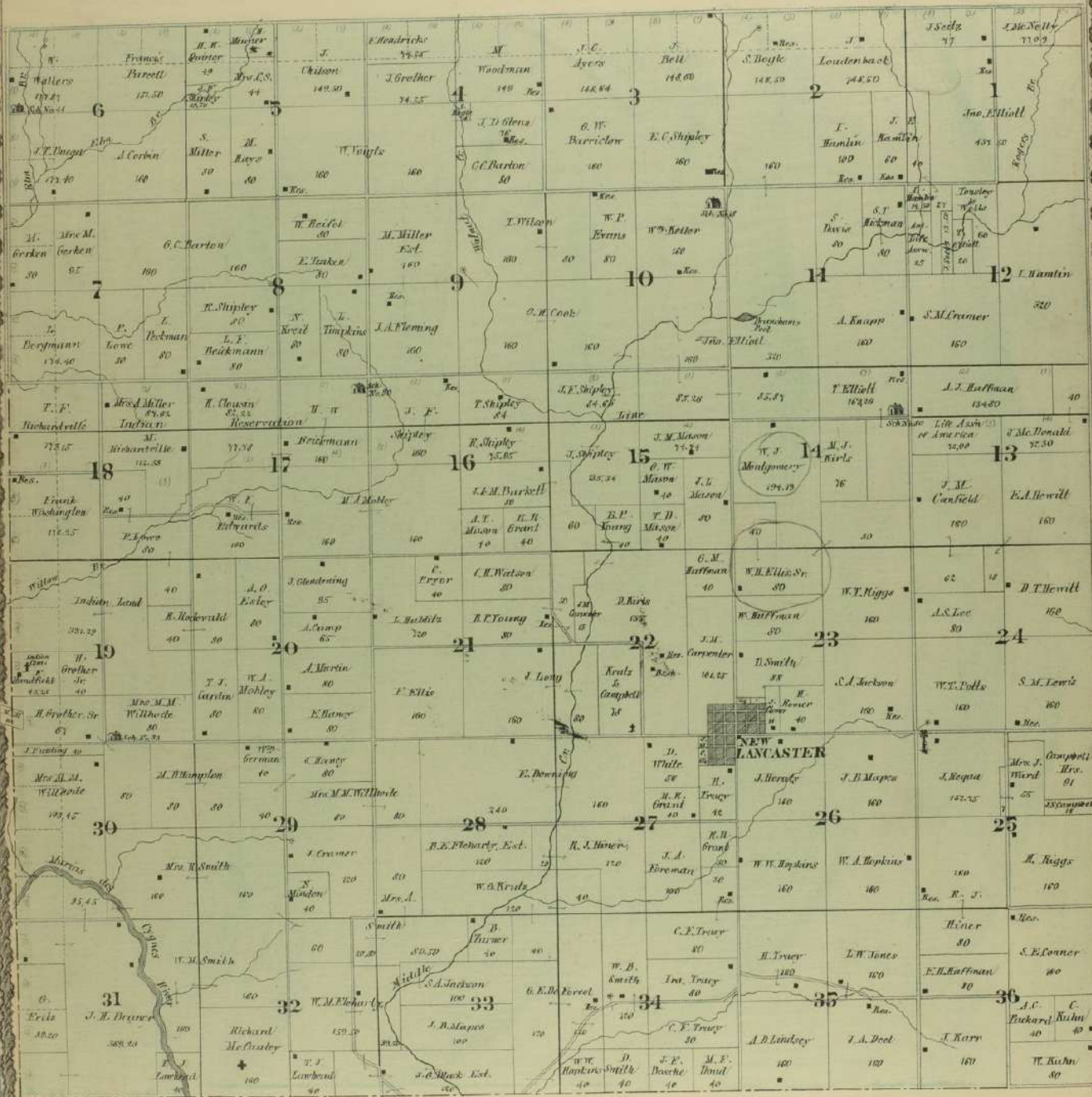

TOWNSHIP 19 SOUTH RANGE 24 EAST

OF THE 6TH PRINCIPAL MERIDIAN.

Scale: 2 inches to the mile.

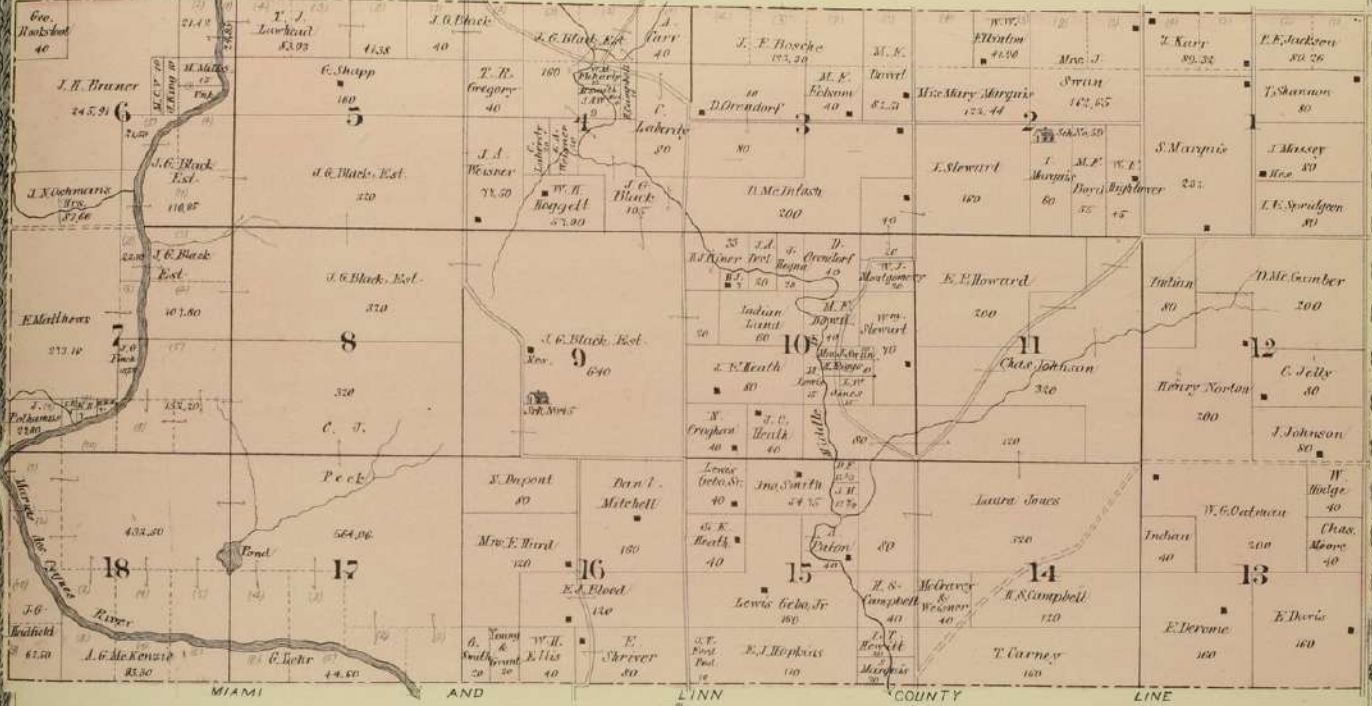

TOWNSHIP 19 SOUTH RANGE 23 EAST

OF THE 6TH PRINCIPAL MERIDIAN.

Scale: 2 inches to the mile.

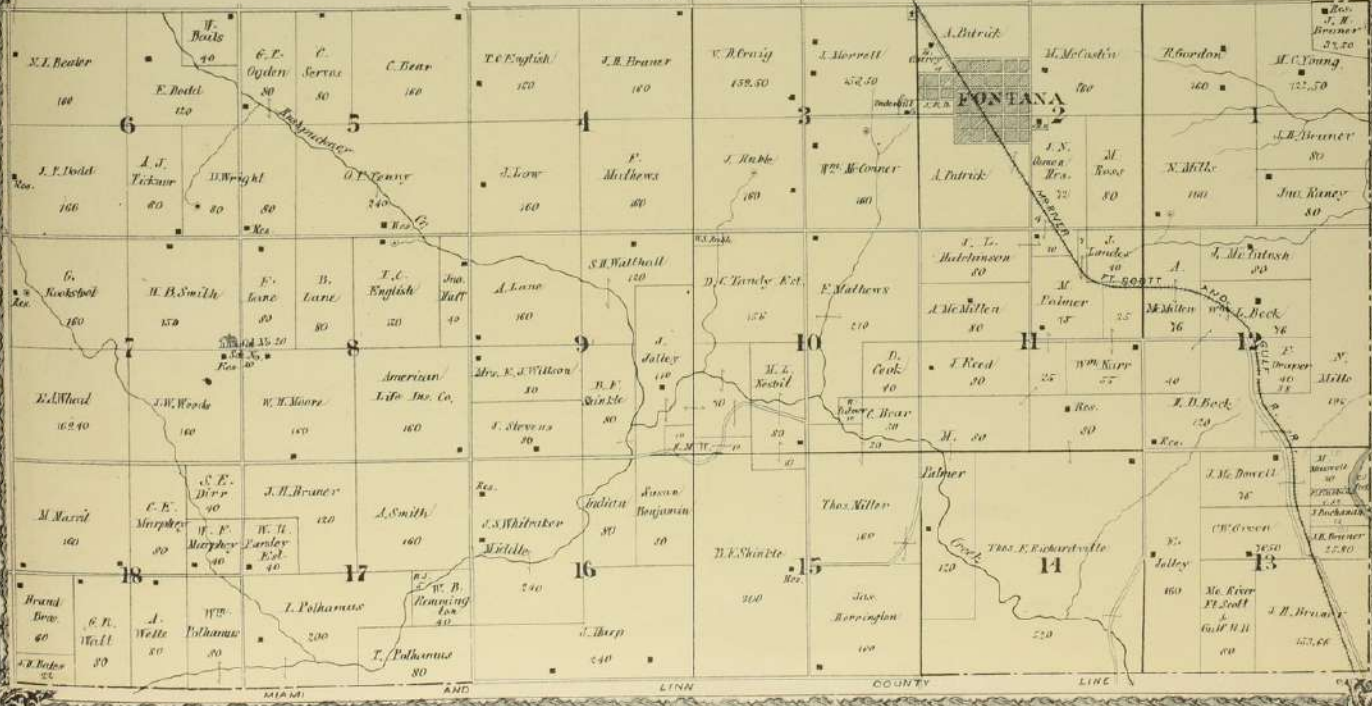

CITY OF PACE

Scale 400 ft.

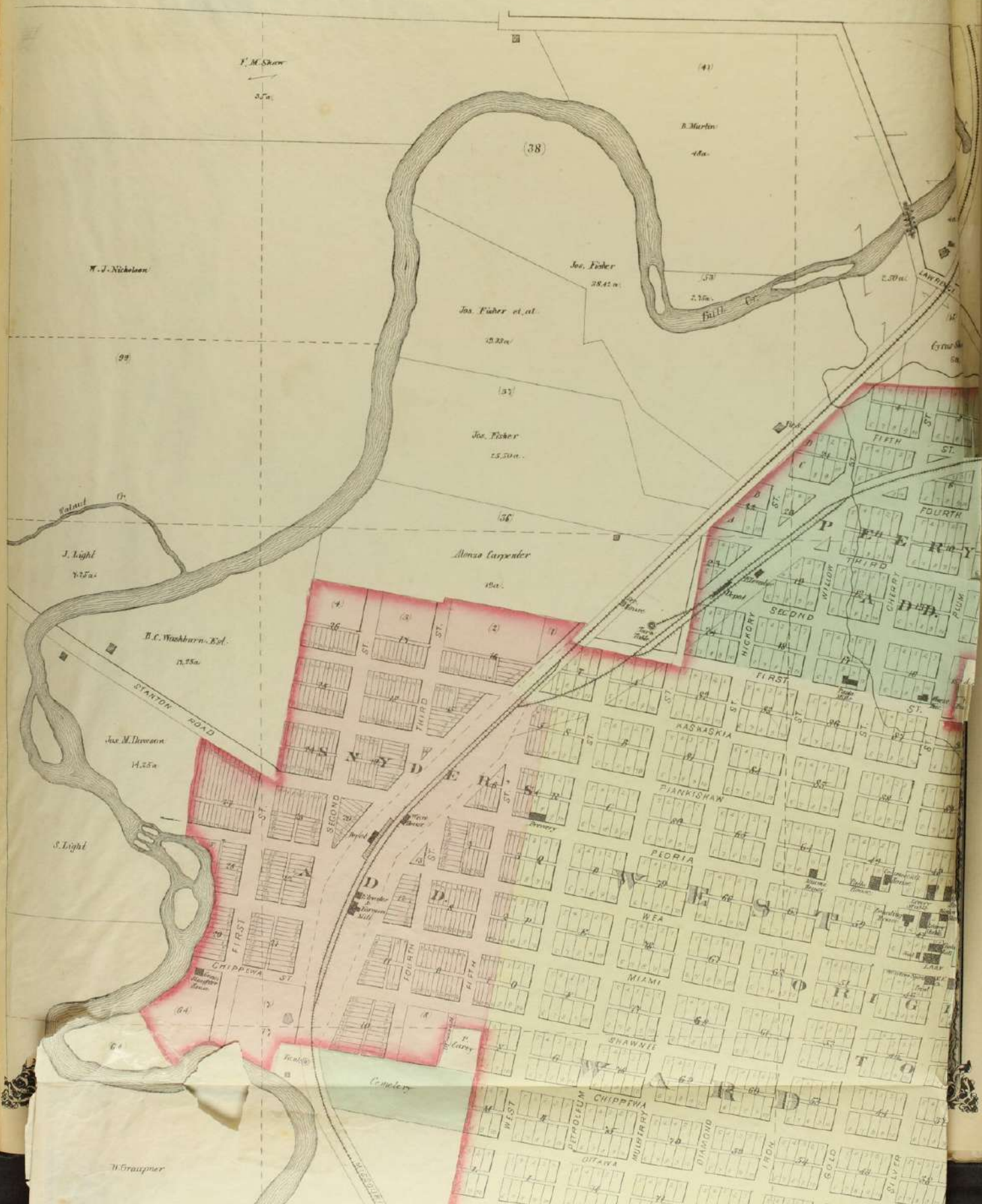

CITY OF PAOLA

Scale 400 Ft. = 1 in.

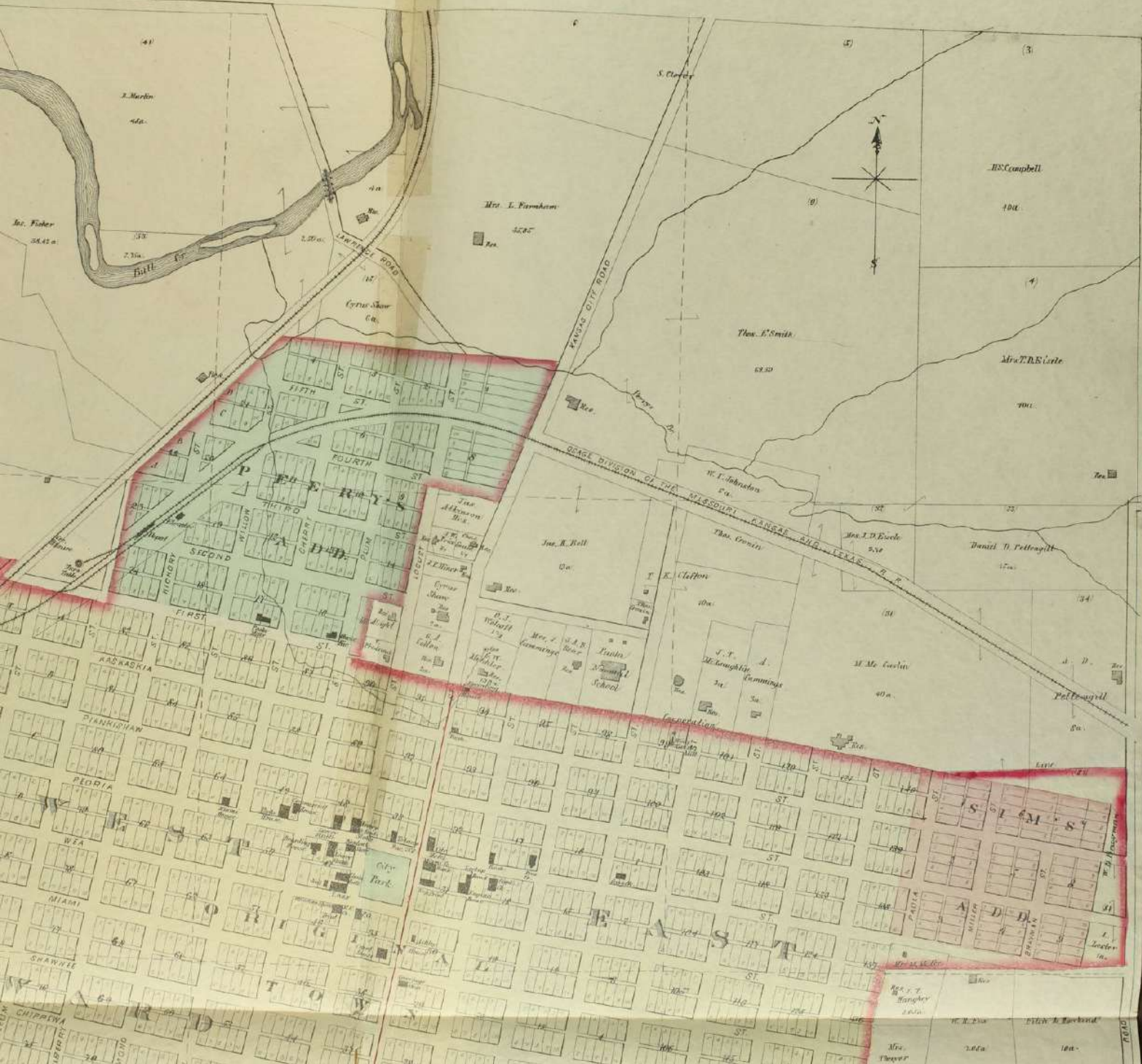

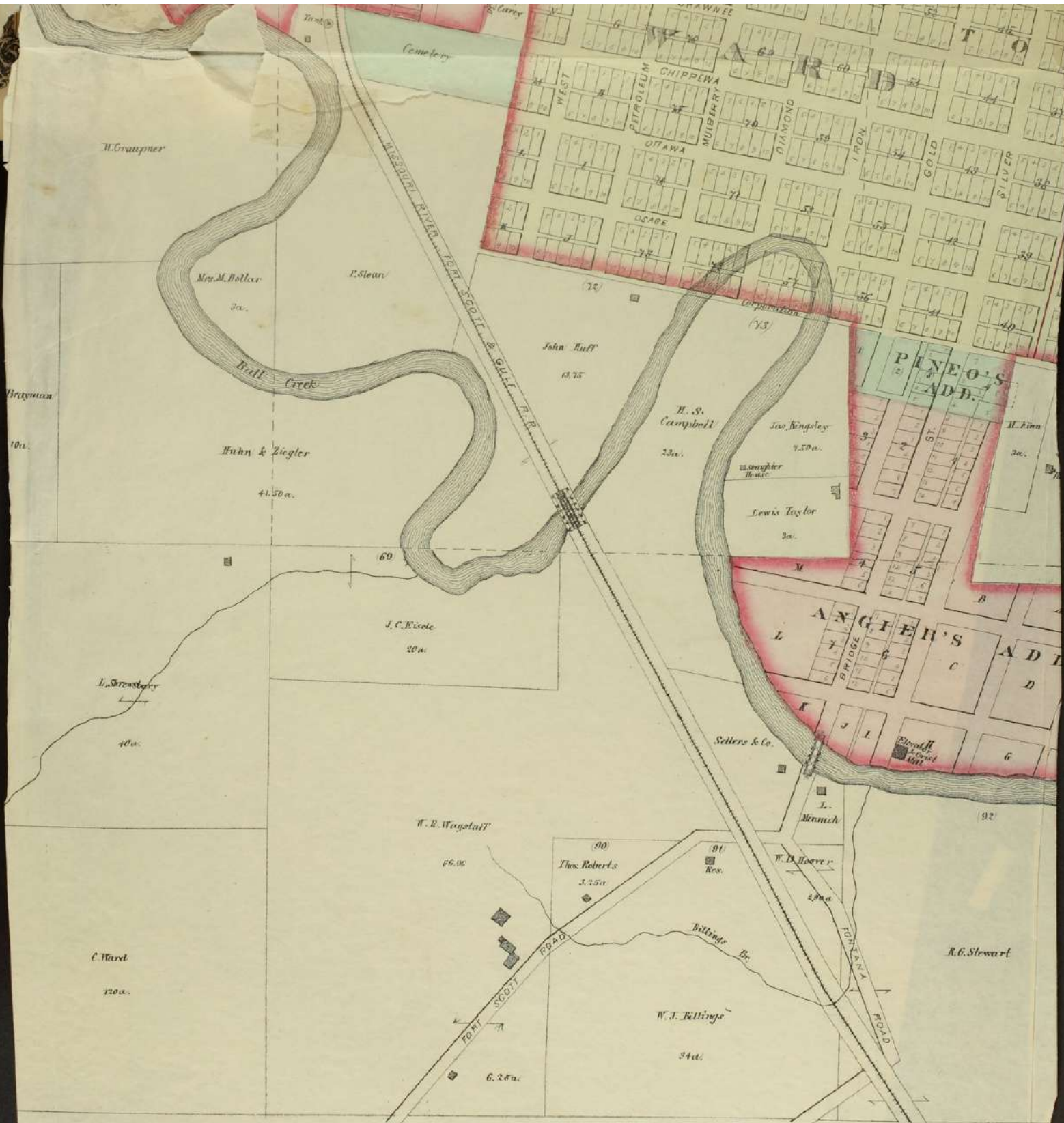

H. Graupner

Mrs. M. Dollar

E. Sloan

Brayman

10a.

Fohn & Zugler

41.50a.

69

J. C. Eskole

20a.

L. Strowder

40a.

W. R. Wagstaff

66.06

Thos. Roberts

3.75a.

81

Rec.

W. D. Hoover

49a.

C. Ward

120a.

G. S. G.

W. J. Billings

34a.

R. G. Stewart

92



PINEO'S
ADD.

ANGIE'S
ADD.

Sellers & Co.

L. Minnich

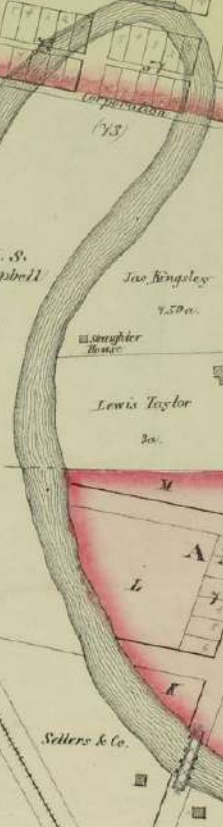
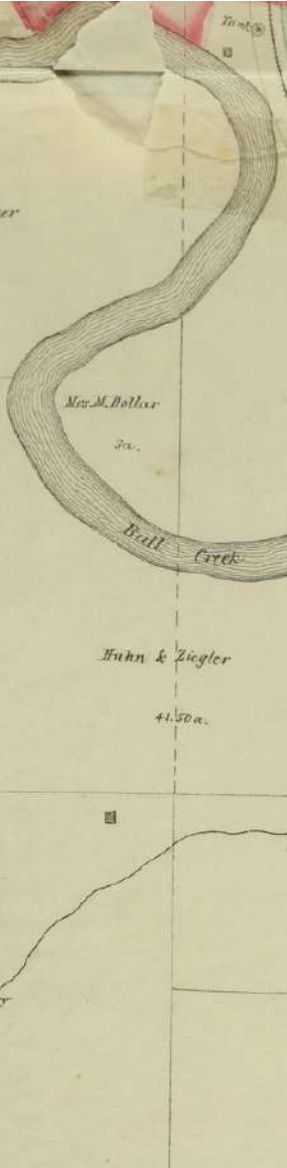

Billings Br.

DOUGLASS AVENUE

ROAD

ROAD

ROAD



TOWNSHIP 17 SOUTH RANGE 23 EAST

OF THE 6TH PRINCIPAL MERIDIAN.

Scale, 2 inches to the mile.

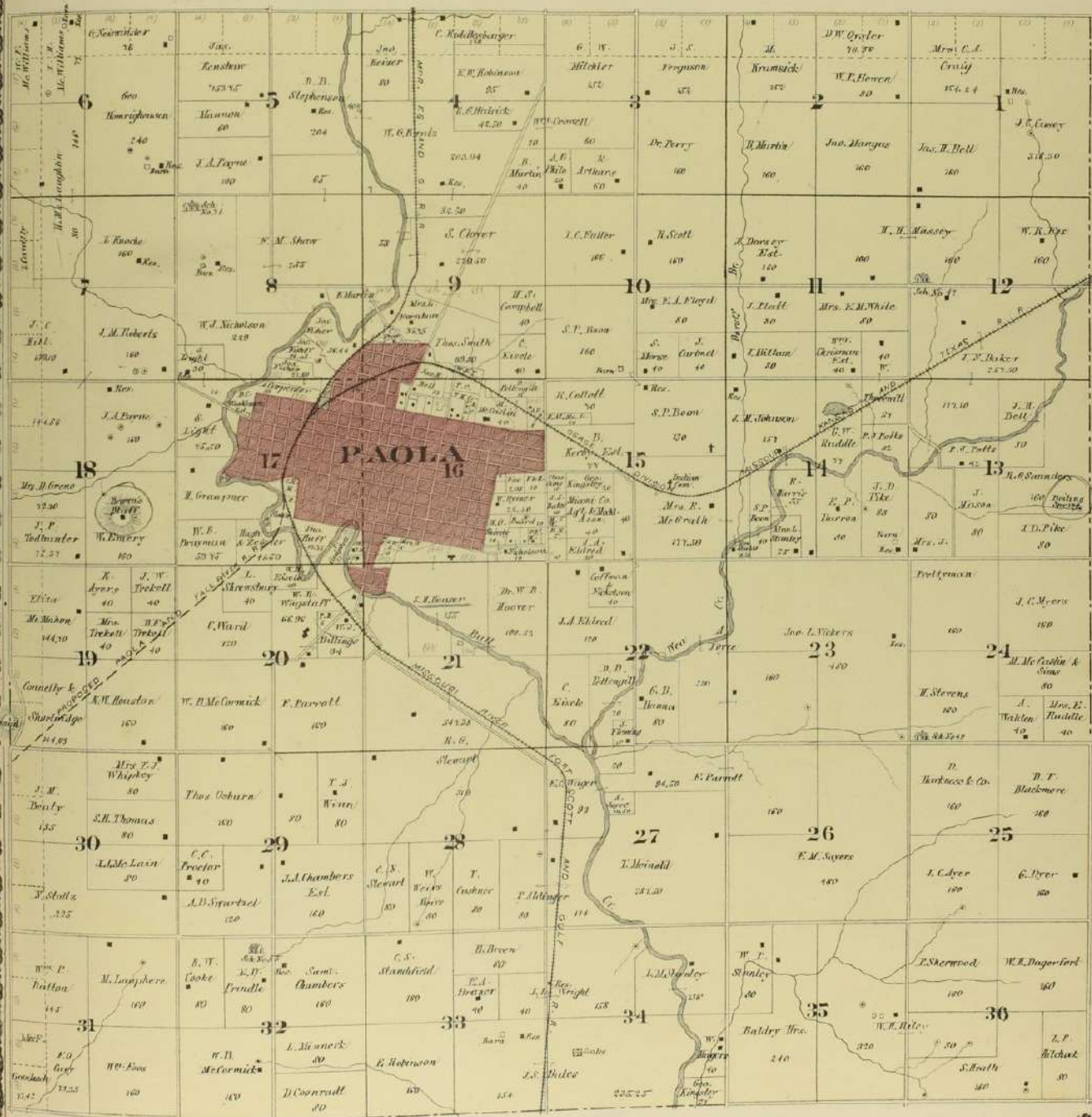

TOWNSHIP 16 SOUTH RANGE 23 EAST

OF THE 6th PRINCIPAL MERIDIAN.

Scale, 2 inches to the mile.

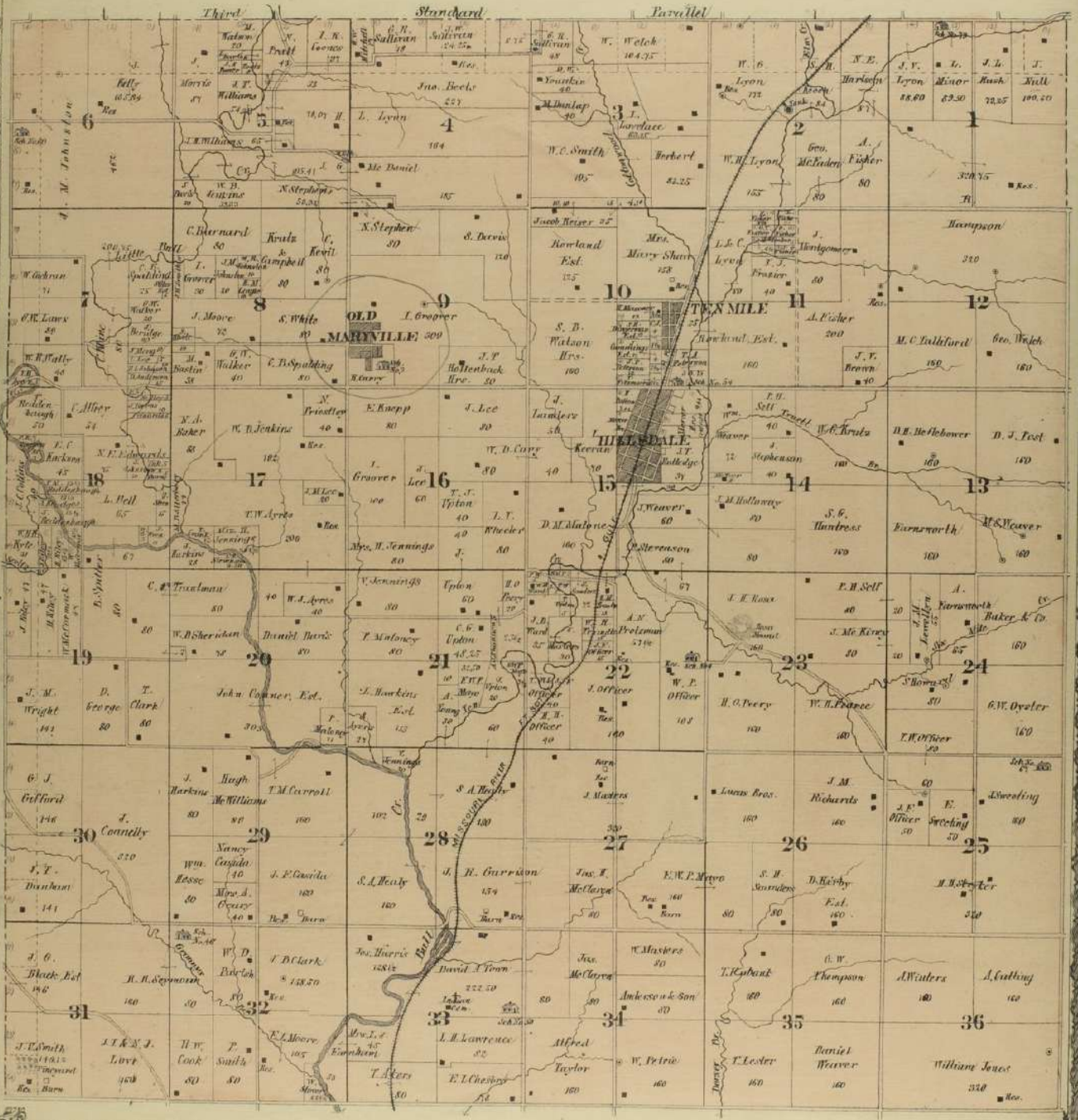

TOWNSHIP 15 SOUTH RANGE 23 EAST

OF THE 6TH PRINCIPAL MERIDIAN.

Scale 2 inches to the mile.

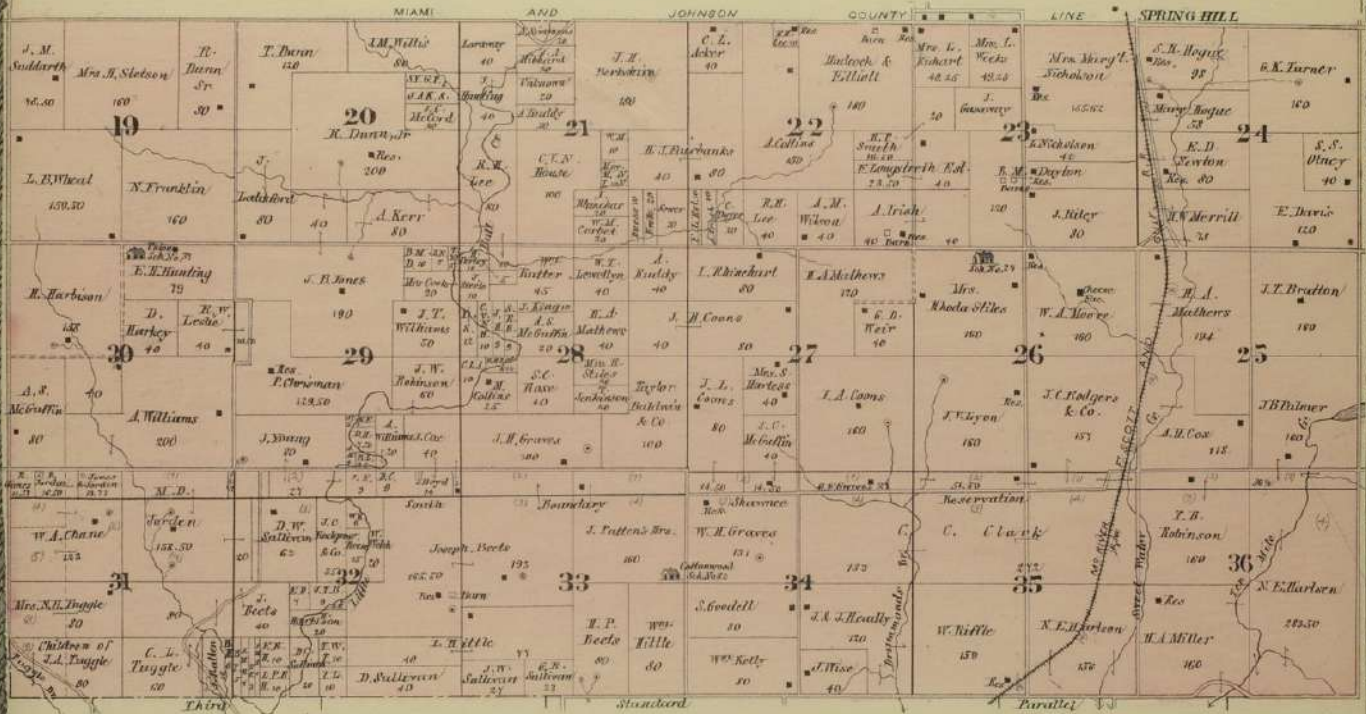

SOMERSET

Scale 400 ft. 1 in.

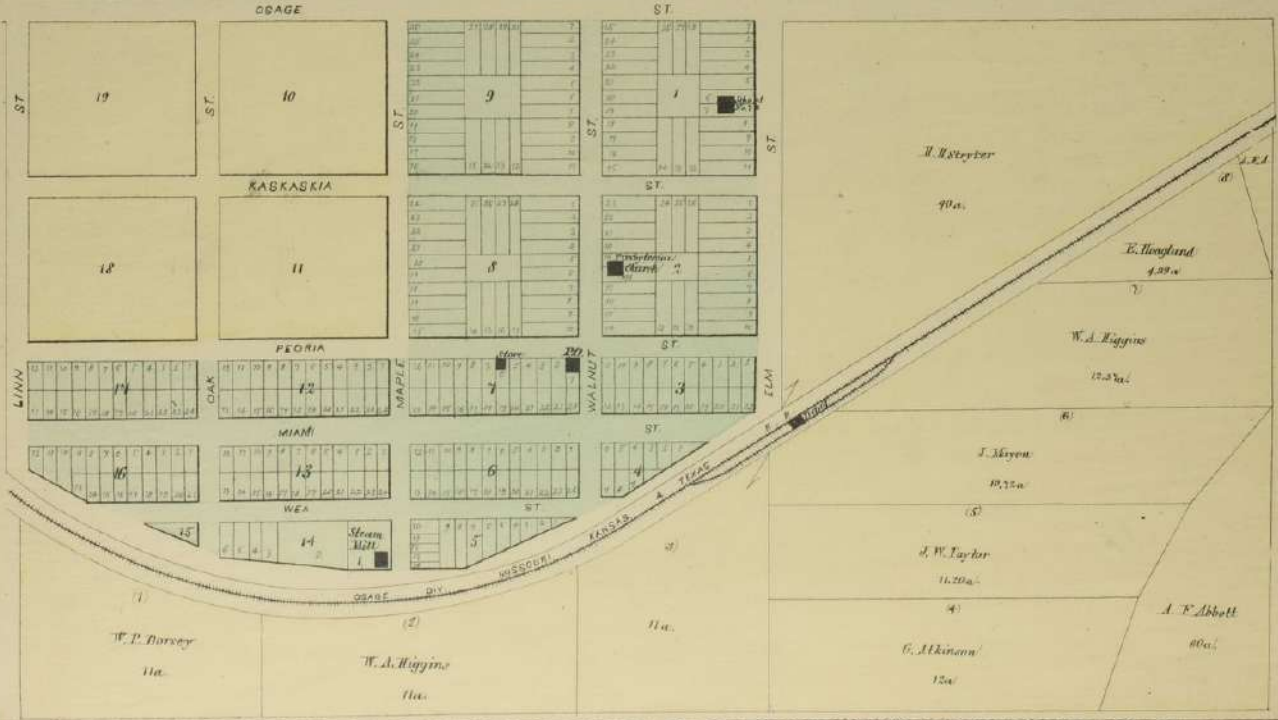

TOWNSHIP 16 SOUTH RANGES 21 & 22 EAST

OF THE 6TH PRINCIPAL MERIDIAN

Scale: 2 inches to the mile.

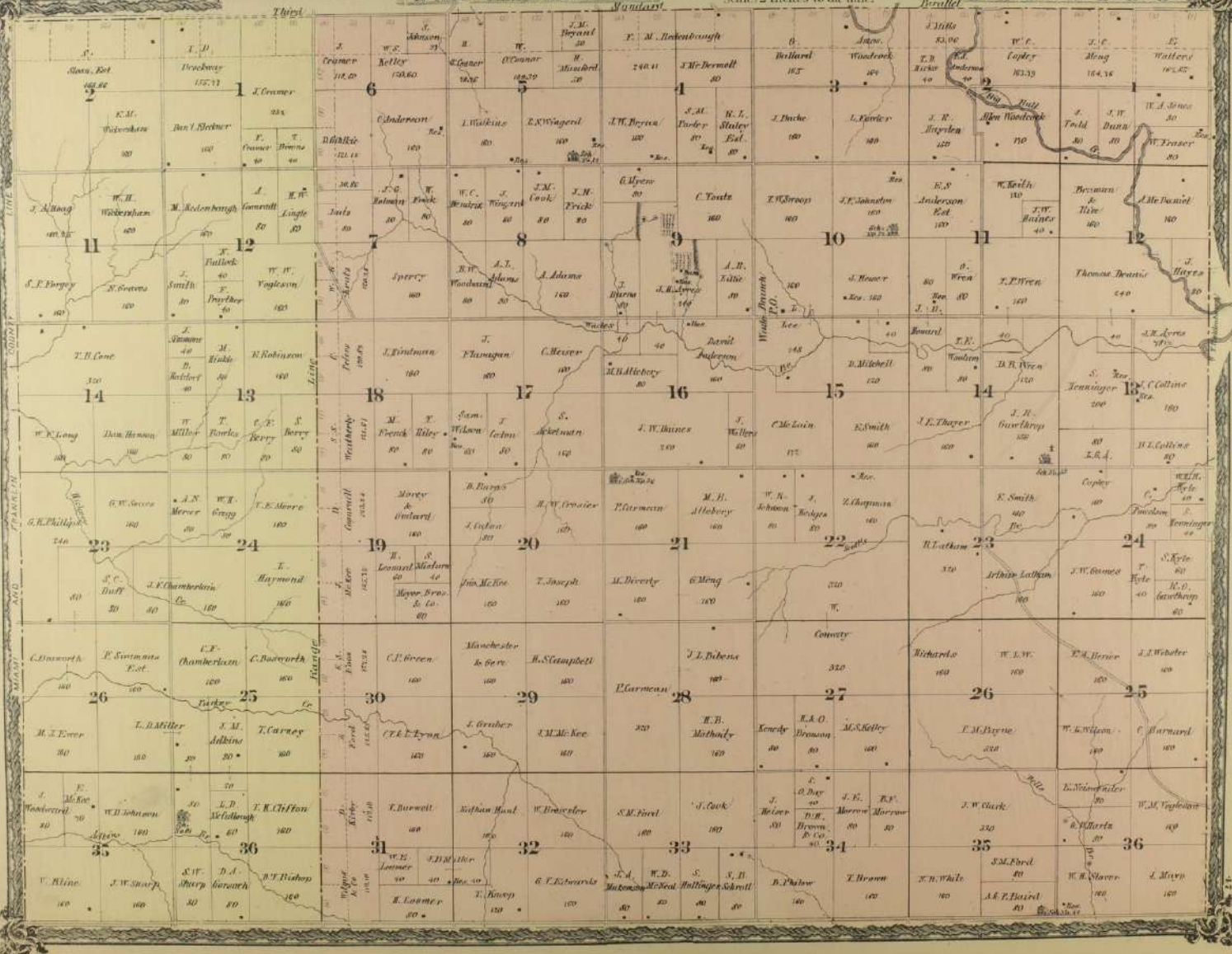

TOWNSHIP 17 SOUTH RANGES 21 & 22 EAST

OF THE 6TH PRINCIPAL MERIDIAN.

Scale, 2 inches to the mile.



OSAWATOMIE

Scale 400 ft. = 1 in.

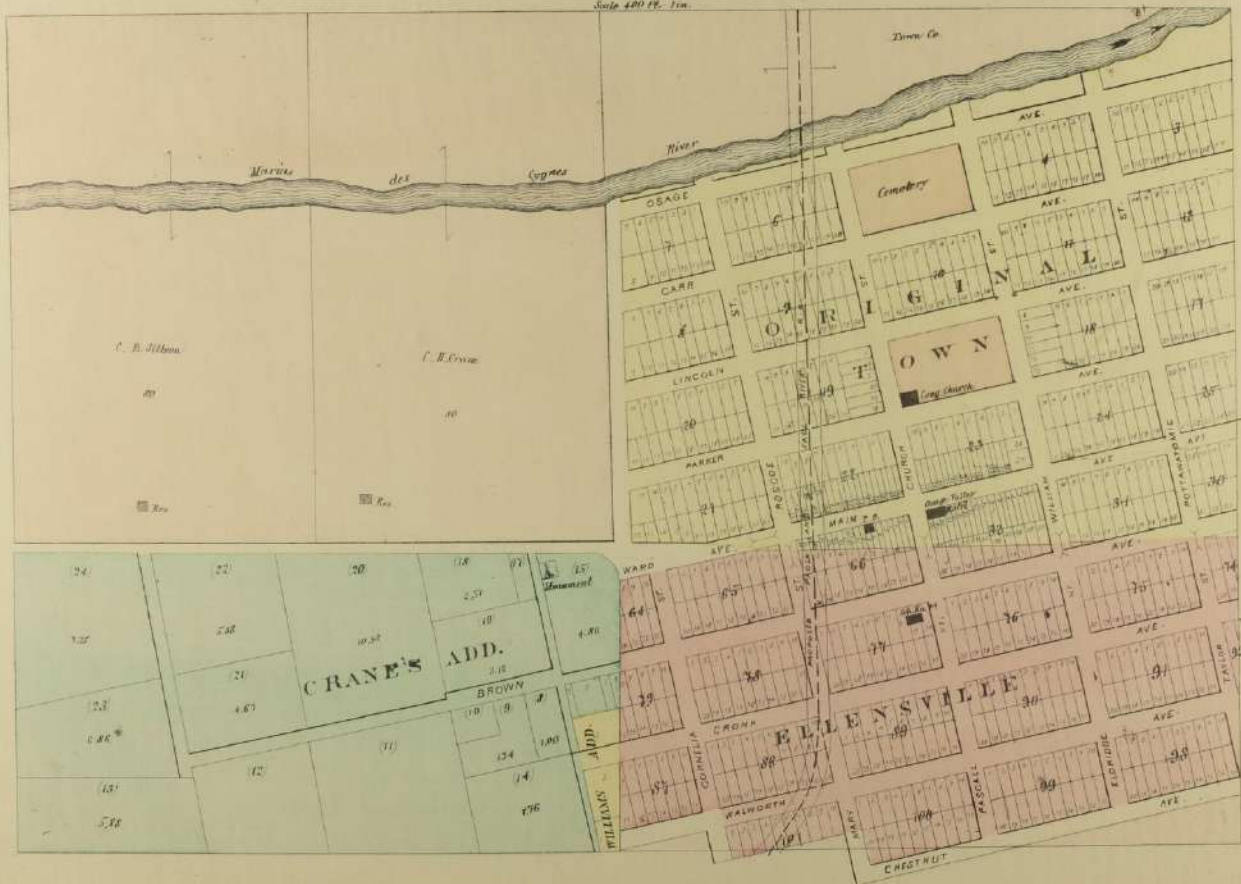

TOWNSHIP 18 SOUTH RANGES 21 & 22 EAST

OF THE 6th PRINCIPAL MERIDIAN.

Scale: 2 inches to the mile.

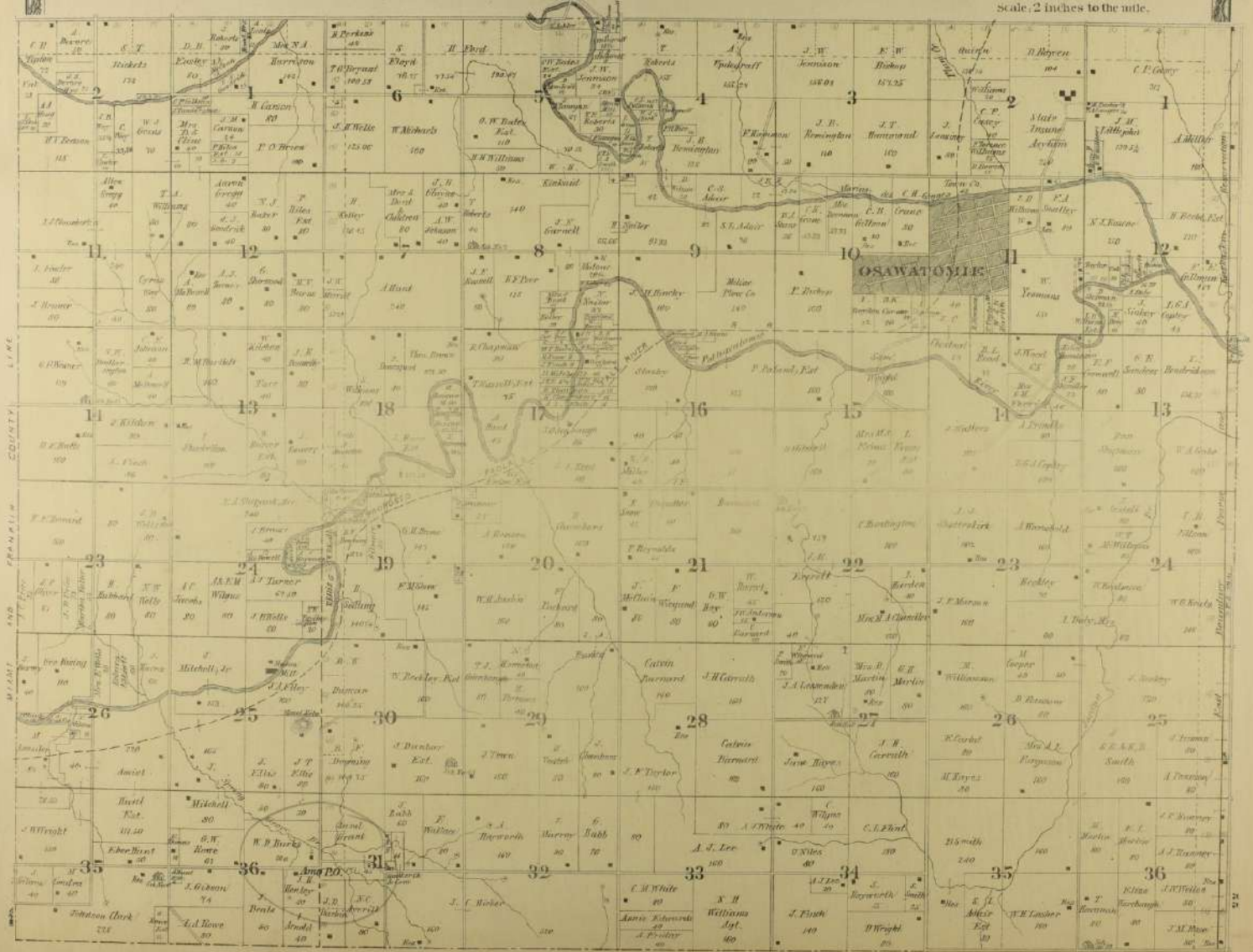

TOWNSHIP 19 SOUTH RANGES 21 & 22 EAST

OF THE 6TH PRINCIPAL MERIDIAN

Scale 2 inches to the mile.

