

20.98-102281

MAY 1987

Number 2

VOLUME XX

THE DESCENDER

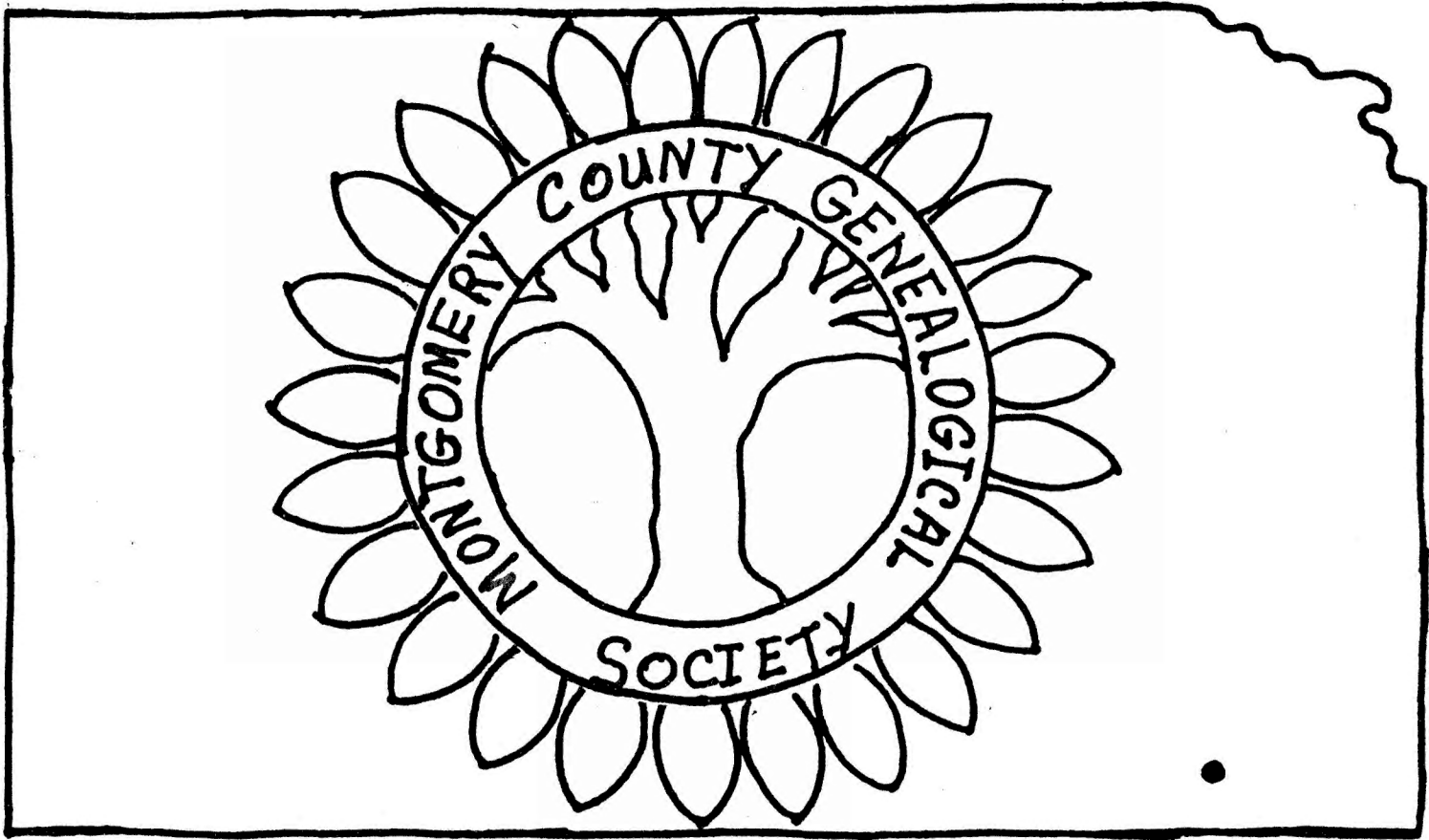

KANSAS

MONTGOMERY COUNTY GENEALOGICAL SOCIETY

Box 444, Coffeyville, Kansas 67337

President - - - - - Pastor Herman GUY
 Vice President- - - - - Mrs. Maxine DICK
 Secretary - - - - - Mrs. Carol DUVALL
 Treasurer - - - - - Mrs. Ann KETTERMAN
 Records Chairman- - - - - Mrs. Evelyn HENISEY
 Editor- - - - -

The Montgomery County Genealogical Society meetings are held on the second Thursday of each month at 7:30 p.m. These meetings are held in the Community Room of the Coffeyville Public Library at Tenth and Willow Streets. Single memberships in the Society are \$5.00 or \$7.00 for husband and wife. Out-of-town memberships are \$7.00 (due to postage) per year. Our year runs from January 1st to December 31st.

"The Descender" is published quarterly: February, May, August, and November. The price of a single magazine is \$1.50. Free magazines to members with one per family, please. A fee of \$1.50 is asked for queries and free queries to all members.

Neither the Editor nor the Society accepts responsibility for the accuracy of the material which has been submitted for publication

TABLE OF CONTENTS

	<u>PAGE</u>
Officers, Society Data, " <u>The Descender</u> " - - - - -	31
Books for Sale - - - - -	32
Researching Old Newspapers - - - - -	33
Clymore District #15- - - - -	38
Post Offices in Montgomery County, Kansas - - - - -	43
The Prairie Pipe Line Company - - - - -	46
Nowata County Oklahoma- - - - -	50
Where Do You Stand in Searching The County Records? - - - - -	54
Ozro Falls Cemetery - - - - -	56
Queires - - - - -	59
Marriages from Rauch Index File - - - - -	60
What's New at Library - - - - -	60

BOOKS FOR SALE

The following is a list of books which are typed and xeroxed pages. The covers are clear plastic with a sturdy white seam binder. The art work on the under cover is drawn by artist Don SPRAGUE.

The books will be sent with postage included in the above prices. Send your orders to:

MONTGOMERY COUNTY GENEALOGICAL SOCIETY

Box 444

Coffeyville, Kansas 67337

Index of Marriage Records in Montgomery County, Kansas

1870 - 1884. Brides also indexed. Price \$9.75.

Rural Cemetery Book I

South half of Montgomery County, Kansas, including smaller towns and ghost towns. Does not include larger towns of Coffeyville and Caney. 186 pages. Price \$10.00.

Rural Cemetery Book II

North half of Montgomery County, Kansas, including smaller towns and ghost towns. Does not include Independence, Cherryvale, or Elk City. 67 pages. Price \$7.00.

Elmwood (Slosson) Cemetery Index

The oldest Coffeyville cemetery in south part of town. DALTONS are buried here. 88 pages. Price \$7.00.

Drum Creek Township Book

1870 - 1900. This book was researched by one of our out-of-town members, Mr. Robert VANDYNE, of Salina, Kansas. This book is the latest one we have published and includes federal and state census, cemeteries, maps, and histories of people in the Drum Creek Township. Price \$11.00.

Researching Old Newspapers

By Carl Rauch

The ninth article of this series explores some of the early industries found from our present newspaper subject, The Coffeyville (KS) Journal. While we are examining The Journal and thus the area of it's circulation, let us remember to seek out the history of the various work places that were the back bone of the community.

In this example, the manufacture of ice, which was one of the large steps forward in public health, and led to many of the modern uses of refrigeration that we enjoy today.

The site of the following described plant was located east of Coffeyville, just south of the Eighth Street Bridge on the Verdigris River. This column was copied from 17 April 1896 issue of The Coffeyville Journal:

One of Coffeyville's Most Notable Institutions

"Among the many growing and attractive industries of Coffeyville, there is none that bears a more intimate relation to the community, than the Coffeyville Ice Works. It is highly probable that the fewest number of our people will thoroughly appreciate this declaration. It is also a fact that this institution has received less prominence in the newspapers than any other in Coffeyville. There is an excuse for this. The establishment of the plant at a distance of nearly two miles from the city, was an

experiment on the part of the projectors of the enterprise. This threw it out of the daily range of visitors and the work of its erection and the manufacture of its product were not brought to the attention of the public as they would have been, had the factory been in the city. The wisdom displayed in the selection of the site has been fully demonstrated. No better, or more appropriate place could have been secured. Close to the line of the Mo. Pac. railway and on a high bluff of the Verdigris, above the point point of sewerage and where a constant supply of good water can always be obtained, it must be conceded that the ice works are favorably located, both for the successful prosecution of the business and the rapid manufacture of ice. The editor of The Journal paid his first visit to the ice plant on Wednesday. We were cordially received by Mr. Hoffman, the business manager of the concern, and introduced to Mr. Daniel Dodge, the practical man of the factory. Mr. Dodge came to Coffeyville from Joplin, Mo. He has had seven years experience in running ice plants and is thoroughly acquainted with the machinery and methods employed in first class factories. Through his courtesy the writer was enabled to get an insight into the seemingly intricate methods by which beautiful, pure and solid ice is formed from well water. A full description of the plant may not prove uninteresting at this time. The buildings are frame with corrugated iron roof. They cover a space of about 40x116 feet. The central, or main building, in two stories high. The machinery is driven by a twenty-five horse power engine with seventy-five horse power boiler capacity. Natural gas is used exclusively for fuel, and is

supplied by the consolidated companies. The pump has a capacity of 550 gallons per minute, and is connected with a well fifty feet deep and eight feet in diameter. It is also connected with the river. The waste water used in and about the plant is drawn from the river, but the water used in making the ice is taken exclusively from the well. The supply is exceedingly pure in its original state, and seemingly inexhaustible. The impression on the public mind seems to be general, that manufactured ice is formed from a combination of water and chemicals. This is incorrect. It is formed from eminently pure water by the use of chemicals. We have heard persons say: "The manufactured ice tastes of ammonia." This is all imagination, as will be presently shown. We are not aware of the plans that others pursue, but ice is made at the Coffeyville plant on the following plan: The water that is used is raised from the well by the pump, converted into steam and deposited in two large retorts. It is then passed to what is called the deaerator, for settling purposes, and subsequently reboiled in order to free it from all foreign substances. It is then cooled in the pipes and passed through a large charcoal filter and deposited in what is known as the "sponge box." From this point the now thoroughly pure water passes into a receiving tank, from which it is subsequently taken to the cans for freezing. A glass of this water presents an appearance scarcely distinguishable from the glass itself. It is as pure as it is possible to make water by artificial means. The freezing process is conducted by what is known as the absorption system. The final results are obtained by means of anhydrous gas, which is

liberated in coils placed in the large freezing tank. Cans filled with the prepared water in its purest state, are immersed in the tank, which contains the chemically prepared bath, the water of which is under the influence of the expansion coils. The gas being liberated from high pressure, seeks its boiling point, which is 40 degrees below zero. The prepared water in the cans from which the ice is made, seeks its boiling point at 212 degrees Fahrenheit. The former being so much lower than the latter, the water in the cans is frozen solid before it reaches its boiling point. Nothing in the shape of a chemical enters the cans or touches the ice. The freezing comes from the outside, and is the result of the brine bath, which is made available by the expansion coils that pass through it. Each can produces a beautiful block of pure ice that weights 200 pounds. When the freezing is complete, the cans are raised by machinery constructed for that purpose, immersed in a warm bath to loosen the ice from the cans, and the cake of ice deposited on a chute by which it is conveyed by gravity to the storage room. Our young friend G. W. Fox has charge of this department of the work, and we were pleased to note the splendid condition in which the freezing room is kept. Everything connected therewith is as "neat as a pin," and as clean as a parlor. The storage capacity of the plant is five hundred tons. The ice houses are connected with the Mo. Pac. by about 300 feet of side track. The manufacture of ice for this season, was commenced on the first of February. The product has been about eighteen tons every 24 hours. The

company had been favored with many large orders, and their small sales have been numerous. Notwithstanding the fact that very little natural ice was secured in the west last winter, a condition which will make the demand for the artificial article very great, the Coffeyville Ice company has not taken advantage of the necessities of the public and advanced the price of their product. They expect to sell their output at reasonable figures and thus win the confidence and esteem of consumers for all time to come. One of the most enthusiastic promoters of the ice plant, and one to whom the community is largely indebted for its location in Coffeyville, is Mrs. Hoffman. She assists in the management, attends to the shipping and makes a full hand in whatever department she lends her labors. She has made some of the largest and best contracts of the season, and her influence is felt and appreciated in the business and the success that has crowned the undertaking. The management of the Coffeyville Ice works is in honest and competent hands. It is a real pleasure to transact business with either Mr. or Mrs. Hoffman. Our visit to their popular and rising industry was made very gratifying by their kind attentions. They have a high place among our best citizens, and the fact that they were among the first settlers of Coffeyville gives them a standing in commercial and social circles that is second to no others in the community."

CLYMORE DISTRICT #15

1870 - 198

Township 34, Range 17 East

Researched by Carol Duvall

(Copied in part from the Montgomery County Records)

The Patrons met in the home of Bailey Webb on the 24th of October 1870, to carry out the order of Superintendent Bass, issued on October 12th, designating it as District # 15. The origin of the name came from its geographic location near Claymore Creek. The site for the location was in the SW corner of the SW $\frac{1}{4}$ of Section 4, Township 34, Range 17E.

This school was built because of a need and not because it was the town of Clymore. The two places have been confused many times as being the same, but the only connection is, both were named after a well known and well liked Indian who camped and traded in those areas. Clymore trading post was on Mr. Lushbaugh's property near Pumpkin Creek in Sect-5, Township 35S, Range 17E.

In the school year 1944-45 while attending Round Prairie Dist. #39 (that was located down the road West about 2 $\frac{1}{2}$ mi.) we had only 11 students that year and not enough for a good Christmas program, so our teacher Mrs. Reba Whetstine (Schenck) and Virginia Parker Clymore's teacher decided we would have our program together at Clymore. We were all very excited as we all had friends in the other school.

The children attended this Clymore school for 77 years. In the year 1947, March 1, the County reorganization Committee formed a new Clymore #15 by annexing all of Kalloch #2, Clymore #15, Butler #83, parts of Colony #101 and Roberts #85 and that part of Blue Ribbon Jt 112 lying in Montgomery Co.

With the enlarged District, transportation became a problem, with distance for some being much greater than others, so a program was set up to purchase property that would be more centrally located for all children.

Land was purchased in Section 19 in NW $\frac{1}{2}$ of the NE $\frac{1}{2}$ of Township 34S., Range 17E. The purchase was made from Bert J. and Ella DeTar for the price of \$1.00 with the condition "that a 36" hog tight woven wire fence, plus two strands of barbed wire above the same" be build on three sides of the three acre plot.

The year of 1947 - 48 and for 4 years after, school was held at Butler and Kallock buildings until the new building could be completed. On March 1, 1950 the part of Blue Ribbon lying in Labette County was added by petition of the patrons living in Jt 112 of Labette County.

In 1951 patrons approved a \$35,000.00 bond issue with which a new school house was constructed and equipment was purchased the next year for \$5,000.00. The new Clymore School house was built in 1952, about 3 $\frac{1}{2}$ miles southwest of the original building, but was still near Claymore Creek and this as we understand was the reason to continue using the name of Clymore. In the year 1954 - 55, seventy two children were in attendance and three teachers at the new Clymore School #15.

On July 1, 1965, by virtue of a petition for unification filed by the Coffeyville School Board and on authority of the Unification laws of the 1963 -65 Kansas Legislature, Clymore was disorganized and made a part of Unified School District #445 and remained a part of that District, with school being conducted there until May 30, 1984, this being the last term in the Clymore building. Starting school that fall the children were bussed to Coffeyville and divided between Lowell, Longfellow and Whittier Schools.

By vote of the voters of #445 School District, the building of Clymore School was sold to Cherokee Township in Nov. 1984, for the price of \$2.00 to be used by patrons of the Township, but if no longer to be used by township it is to revert back to the School District #445.

<u>YEARS</u>	<u>TEACHER</u>	<u>SALARY</u>	<u>MONTHS</u>
1881-82	J.B. Reese	\$ 40.00	
1882-83	J.H. Hodges	40.00	6
1883-84	C.E. Engles	35.00	5
1884-85	J.H. Fritts	40.00	6
1885-86	J.H. Fritts	35.00	6
1886-87			
1887-88			
1888-89	George Engels	37.50	6
1889-90	George Engels	37.50	6
1890-91	Mattie Flack	35.00	7
1891-92	L. Burkhart	35.00	6
1892-93	Sarah Collins		
1893-94	J.M. Heritage		
1894-95	G.M. Moore	28.00	6
1895-96	B.E. Pennington	28.00	6
1896-97	Emma Woodruff		
1897-98	C.E. Engel		
1898-99	J.M. Heritage	33.33	
1899-00	Eva Fling	33.30	7
1900-01	Mary Beatty	33.33	6
1901-02	C.E. Engel	33.33	6
1903-04	Clara Taylor	35.00	6
1904-05	Bertha Biggs		
1905-06	C.E. Engels	40.00	6
1901-02	Eva Fling	35.00	6
1906-07	Elsie Vandermark	37.50	6
1907-08	Bernice Housel	50.00	6
1908-09	Bernice Housel	60.00	6
1909-10	Myrtle Randolph	45.00	6
1910-11	Josephine VanCleave	45.00	7
1911-12	Josephine VanCleave		
1912-13	Gracie Hobbs	50.00	7
1913-14	Anna Allen		
1914-15	Anna Allen	60.00	7
1915-16	Clara Emming	50.00	7
1916-17	Ethel Cooper	60.00	7

BOARD MEMBERS

1895-96

Director --- James Glidewell
Clerk ----- Frank Carl
Treasurer -- James Gilkey

1896-97

Director --- James Glidewell
Clerk ----- Frank Carl
Treasurer -- NO RECORD

1897-98

Director --- James Glidewell
Clerk ----- Frank Carl
Treasurer -- John W. DeGeer

1898-99

Director --- Henry Schneider
Clerk ----- Frank Carl
Treasurer -- John DeGeer

1899-00

Director --- Henry Schneider
Clerk ----- Frank Carl
Treasurer -- John W. DeGeer

1900-01

Director --- Henry Schneider
Clerk ----- Lulu Schneider
Treasurer -- John W. DeGeer

1901-02

Director --- Frank Carl
Clerk ----- Lulu Schneider
Treasurer -- John Hughes

1902-03

Director --- Frank Carl
Clerk ----- Lulu Schneider
Treasurer -- Elmer Duckworth

1903-04

Director --- John Hughes
Clerk ----- Lulu Schneider
Treasurer -- Elmer E. Duckworth

1904-05

Director --- James Glidewell
Clerk ----- E.E. Bartle
Treasurer -- Elmer E. Duckworth

1905-06

Director --- James Glidewell
Clerk ----- E.E. Bartle
Treasurer -- Elmer E. Duckworth

1906-07

Director --- James Glidewell
Clerk ----- Clanton Jackman
Treasurer -- Elmer E. Duckworth

1907-08

Director --- William Stemmer
Clerk ----- J.Clanton Jackman
Treasurer -- John Wishall

1908-09

Director --- William Stemmer
Clerk ----- J.Clanton Jackman
Treasurer -- John B. Wishall

1909-10

Director --- William Stemmer
Clerk ----- J.Clanton Jackman
Treasurer -- John B. Wishall

1910-11

Director --- William Stemmer
Clerk ----- J.Clanton Jackman
Treasurer -- John B. Wishall

1911-12

Director --- William Stemmer
Clerk ----- NO RECORD
Treasurer -- John B. Wishall

1912-13

Director --- William Stemmer
Clerk ----- H.C. Becker
Treasurer -- John B. Wishall

If you wish information on any of the other schools in Cherokee Township write to Carol in c/o Montgomery County Genealogical Society, Box 444, Coffeyville, Kansas 67337.

CHEROKEE TOWNSHIP Schools

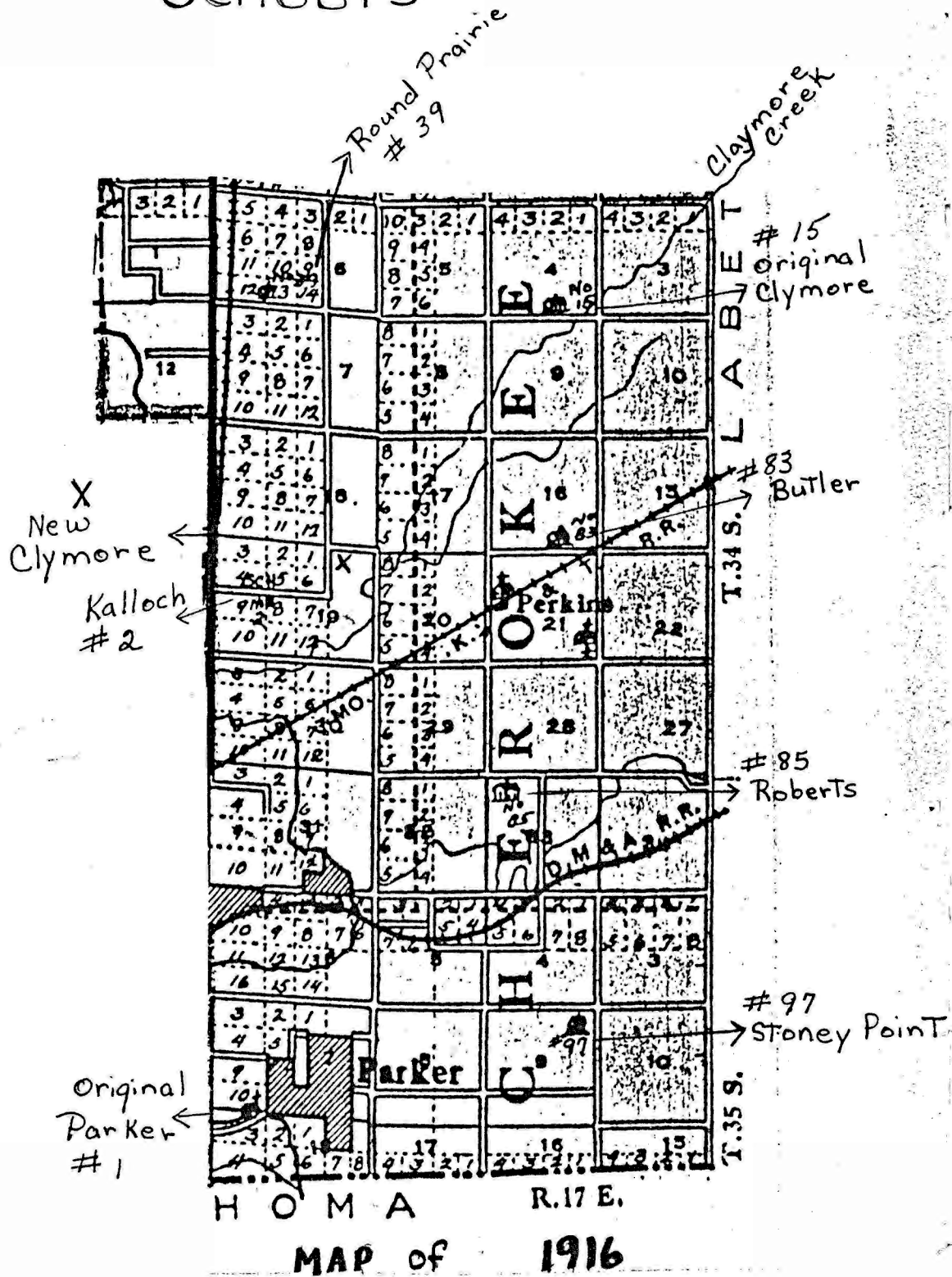

POST OFFICES IN MONTGOMERY COUNTY, KANSAS

Submitted by Ivan PFALSER

PARKER CITY (24 November 1869 - 27 December 1876)
(Cherokee Twp.) (Location Sec. 7, Twp. 35S, R 17E.)

Parker originally called Parkersburg and was on the east side of the Verdigris River, and south east of present town of Coffeyville. Its neighbor to the north-east was Westralia and it also had a Post Office for a short while. Competition was strong between the two communities with Parker the winner. When the railroad was located on the west side of the river the Parker town migrated to Coffeyville.

PARKER TOWNSHIP (9 July 1879 - 24 March 1882)
(2 April 1883 - 20 January 1888)
(Location Sec. 4, Twp. 34S. R 16E.)

The 1881 Atlas of Montgomery County gives the location in NW Parker Twp. This post office was placed here to serve the North Parker Twp. area. It was in a house. The house later was added onto and a small grocery and stop over rest place was provided as well as the post office. In July 1889 it became the BAGLEY POST OFFICE until its closing in February 1901. One of the Postmasters was Mr. Peter Huling.

PERKINS 25 June 1890 - 15 Dec. 1893 (Sec. 21, Twp. 34, R17E.)
(Cherokee Twp.)

James FLACK was the first postmaster. This community was started because it was on the Missouri, Kansas and Texas railroad. It later was called Hunterville & Hunter.

RADICAL 18 Jan. 1888 - 30 Dec. 1893

Benjamin MURPHY was the first postmaster. One could conjector that the Post Office might have been a spin-off from the community of Radical City. There was a name change for Radical City on 24 May 1887 and eight months later, Radical was established.

RADICAL CITY

15 Jan. 1870 - 24 May 1887

The first postmaster was Thomas A. TRENT and it was located four miles north and two miles west of Independence (S3-R15E-T32S). When Joseph H. Ritchie became postmaster, he initiated a request for a name change to RITCHIE.

RITCHIE

24 May 1887 - 6 Feb. 1890

The original post office name was Radical City but under the postmaster Joseph H. RITCHIE, a new name came into being. It is assumed that its location remained the same. Under postmaster Joseph E. HARDEN, the name was again changed. It then became known as Larimer.

LARIMER

6 Feb. 1890 - 31 Oct. 1905

This post office had originally been known as Radical City, and then Ritchie before becoming Larimer. The first postmaster was Joseph E. HARDEN and was located four miles north and two miles west of Independence (S3-R15E-T32S).

SAINT PAUL

21 Feb 1870 - 27 Nov. 1874

This community had the distinction of straddling the Chautauqua/Montgomery County line, one and one-half miles west and one mile north of Caney (S2-R14E-T35S). The first postmaster was James PARKINSON. The post office is also listed as being in Chautauqua County, undoubtedly its exact location during its period of operation floated from one side of the county line to the other.

STERNERTON

18 July 1871 - 31 Jan. 1891

Named for its first postmaster, Samuel A. STERNER, it was located five miles north and four miles east of Elk City. (S13-R14E-T31S)

SUNNYSIDE

10 June 1872 - 3 March 1874

Located at the foot of a hill (sunnyside), the post office was located approximately one and one-half miles west and three miles north of Wayside (S17-R14E-T33S). Its first postmaster was Samuel TERRY.

TALLY SPRINGS 2 June 1871 - 28 Dec. 1874

Named for a local natural spring, the community lost its identity to Kallock which developed along the Kansas City, Lawrence and Southern Railroad. Tally Springs was located two miles north of Coffeyville (S24-R16E-T34S) and George E. DENISON was the first postmaster.

TRUMAN 12 Jan. 1876 - 17 June 1884

Undoubtedly a family surname, it was located five miles south of Elk City (S31-R14E-T32S). Its first postmaster was Peter HULING.

WAYSIDE 16 May - (Recently closed)

Located along the Atchison, Topeka and Santa Fe Railroad, it started out as a "wayside" for rail cars (S3-R14E-T34S). Its first postmaster was Joesph Hall.

WESTRALIA 15 Jan. 1869 - 12 Oct. 1870

Credited by the U.S. Post Office records as being the first post office in Montgomery County, its position as the first community is contested by Claymore which was established earlier as a trading post. Historians locate Westraillia as being located south of Claymore which, in turn, was located on Pumkin Creek, east of the present town of Coffeyville. The name Westraillia was derived by conjunction of the "West Trail". Early historical records of Caney refer to regular trips by residents to Westraillia to pick up supplies and mail. The first postmaster was William R. BRUNER.

WHITE POST 29 Aug. 1872 - 4 Nov. 1874

The first postmaster was James C. PARKHURST.

This completes the listing of towns and communities located in Montgomery County which had official post offices. A future article will list those named communities or town variation named that had no post office.

By Ivan Pfalser

THE PRAIRIE PIPE LINE COMPANY

(This information is continued from our February 1987 issue)

COOLEY, William G. Born January 24th, 1879, at Americus, Kansas. Entered service of The Prairie Oil & Gas Company August 5th, 1913, as Clerk in General Office, Independence, Kansas. February 1st, 1915, transferred to The Prairie Pipe Line Company, in the same capacity, and has been in service up to present time. Continuous service date August 5th, 1913.

COOPER, James A. Born January 26th, 1891, at Jonesboro, Arkansas. Entered service of the Company June 15th, 1916. Since August 31st, 1917, has been employed as Engineer-Operator, Gauger and at present is Engineer-Operator in F.D. No 11. Continuous service date June 15th, 1916.

COOPER, Robert F. Born October 13th, 1892, at Baxter Springs, Kansas. Entered service of the Company March 15th, 1917, as Stenographer in General Office, at Independence, Kansas. August 1st, 1917, to May 22nd, 1919, had service in United States Army. Reentered service of the Company May 22nd, 1919, as Freight Chaser in F.D. No 18. October 1st, 1919, promoted to Warehouseman at Ranger, Texas. January 20th, 1923, transferred to Caney Warehouse, in the same capacity. Continuous service date March 15th, 1917.

COPE, Leroy Born July 30th, 1887, at Bellflower, Missouri. Had broken service with The Prairie Pipe Line Company from June 1st, 1916, to August 1st, 1917. Entered service of The Prairie Oil and Gas Company as Laborer September 1st, 1917. February 1st, 1918, reentered service of The Prairie Pipe Line Company and has since been employed as Laborer, Assistant Fireman, Fireman, Assistant Engineer and at present is Fireman in F.D. No 9. Continuous service date September 1st, 1917.

COPPAGE, Arthur M. Born February 3rd, 1870, at Herman, Illinois. Entered service of the Company May 13th, 1909, as Operator on Northern Division and has been in the service up to present time. Continuous service date May 13th, 1909.

The Prairie Pipe Line Company Contd.

COPPAGE, Frank L. Born August 1st, 1887, at Herman, Illinois. Entered service of The Prairie Oil & Gas Company May 13th, 1909, as Operator of Northern Division. February 1st, 1915, transferred to The Prairie Pipe Line Company, in the same capacity, and has been in service up to present time. Continuous service date May 13th, 1909.

CORLE, Ross Born June 30th, 1871, at Streeter, Illinois. Entered service of the Company December 1st, 1917, and has since been employed as Laborer and Truck Driver in F.D.No.2. Continuous service date December 1st, 1917.

CORLEY, Charles B. Born October 27th, 1887, at Jackson, Mississippi. Entered service of The Prairie Oil & Gas Company February 27th, 1909, as Laborer. February 17th, 1910, promoted to Fireman. March 1st, 1911, promoted to Engineer. February 1st, 1915, transferred to The Prairie Pipe Line Company, as Gauger in F.D. No. 11, and has been in service up to present time. Continuous service date February 27th, 1909.

CORNELL, John W. Born December 24th, 1878, at Salina, Kansas. Entered service of the Company June 16th, 1916, as Chief Run Clerk in General Office, Independence, Kansas, and has been in service up to present time. Continuous service date June 16th, 1916.

COWEN, Rex D. Born December 22nd, 1901, at Sullivan, Indiana. Entered service of the Company July 23rd, 1917, as Clerk in Tulsa Office. February 1st, 1922, promoted to District Foreman's Clerk of F.D. No. 11, Tulsa, Oklahoma, and has been in service up to present time. Continuous service date July 23rd, 1917.

COX, Demetrious M. Born January 22nd, 1886, at Elk City, Kansas. Entered service of The Prairie Oil & Gas Company January 1st, 1906, as Laborer in F.D. No. 3. May 1st, 1914, promoted to Construction Foreman and February 1st, 1915, transferred to The Prairie Pipe Line Company, in the same capacity, working in various districts until July 30th, 1925, when he was promoted to General Line Foreman on Southern Division. October 1st, 1927, appointed Assistant District Foreman of F.D. No. 1. Continuous service date January 1st, 1906.

COYLE, George Born April 13th, 1864, at Olean, New York. Entered service of National Transit Company at Olean, New York, July 1st, 1884, and was employed in construction work and as Engineer until November 1st, 1888, when he was transferred to the service of The Buckeye Pipe Line Company in Northwestern Ohio, with which Company he was employed as Engineer and Gauger until December 1st, 1903, when he was transferred to the service of The Prairie Oil & Gas Company as District Foreman, at Independence, Kansas. July 1st, 1905, promoted to Division Superintendent with headquarters at Independence, Kansas. December 1st, 1909, promoted to Assistant General Superintendent with headquarters at Tulsa, Oklahoma. February 1st, 1915, upon the organization of The Prairie Pipe Line Company, he was elected Director and appointed General Superintendent with headquarters at Tulsa, Oklahoma, and at present time is acting in that capacity. Continuous service date July 1st, 1884.

COYLE, John A. Born September 13th, 1872, at Petersburg, Pennsylvania. Entered service of The Prairie Oil & Gas Company July 1st, 1911, as Scout and continued until January 1st, 1916, when he entered service of The Prairie Pipe Line Company as Gauger. October 1st, 1918, promoted to Chief Gauger at Tulsa, Oklahoma. June 30th, 1921, appointed District Foreman at Nowata, Oklahoma. Continuous service date July 1st, 1911.

CRANE, Fred A. Born February 22nd, 1896, at Sapulpa, Oklahoma. Entered service of The Prairie Oil & Gas Company May 13th, 1914, as Clerk in General Office at Independence, Kansas. February 1st, 1915, transferred to The Prairie Pipe Line Company, in the same capacity. August 1st, 1917, to April 1st, 1919, had service with United States Army. Reentered service of the Company April 1st, 1919, as Gauger in F.D. No. 19. November 15th, 1920, transferred to General Office at Independence, Kansas, as Clerk, and has been in service up to present time. Continuous service date May 3rd, 1914.

The Prairie Pipe Line Company Contd.

CRAWFORD, William F. Born July 18th, 1855, at Tilden, Illinois. Entered service of the Company June 25th, 1916, as Assistant Engineer in F.D. No. 1. September 25th, 1916, promoted to Operator and has been in service up to present time. Continuous service date June 25th, 1916.

CRIMMEL, Henry W. Born June 14th, 1898, at Lima, Ohio. Entered service of the Company July 1st, 1916, as Clerk in General Office, at Independence, Kansas. July 1st, 1917, to March 1st, 1918, had service with United States Army. Reentered service of the Company March 1st, 1918, as Telegrapher in General Office. May 27th, 1920, at his own request, transferred to F.D. No. 1, as Telegrapher, and has been in service up to present time. Continuous service date July 1st, 1916.

GRITCHFIELD, Charles E. Born August 28th, 1869, at Philsons, Pennsylvania. Entered service of Southern Pipe Line Company July 2nd, 1890, continuing with that Company as Laborer, Fireman and Engineer until March 2nd, 1905, when he entered the service of The Prairie Oil & Gas Company, as Chief Engineer on Northern Division. February 1st, 1915, transferred to The Prairie Pipe Line Company, in the same capacity, and has been in service up to present time. Continuous service date July 2nd, 1890.

CRITZ, Fred M. Born January 29th, 1879, at Memphis, Missouri. Entered service of The Prairie Oil & Gas Company January 1st, 1905, as Laborer on Northern Division. November 20th, 1906, promoted to Fireman. February 1st, 1914, promoted to Tour Engineer and February 1st, 1915, transferred to The Prairie Pipe Line Company, in the same capacity, having been in continuous service up to present time. Continuous service date January 1st, 1905.

CROLL, Emmett V. Born August 7th, 1897, at Clinton, Arkansas. Entered service of the Company August 1st, 1918, as Laborer in F.D. No. 1, and is acting in that capacity at present time. Continuous service date August 1st, 1918.

NOWATA COUNTY T 28 N R 17 E

Adair Amy	Chummuee William
Adair Arizona	Clagget Alexander
Adair Emma	Clagget Elizabeth
Adair Inola	Clagget Hane
Adair Wm	Clagget Isabelle
Adair Winona	Clagget Morial
Alberty Eli	Clagget Nancy
Allen Alice	Claggert Wm
Arnwand Cornelius	Claidian Edna
Barney Feliz	Clark Ocie
Barney Jessie	Cline Ben
Barley Rose	Cline Dora
Beck Lillie	Cline Rosa
Brown Anderson	Cline Johnie
Bworns James	Cline Raymond
Brown Jess Jr	Cline Ross
Brown Jessie	Cline Roy
Brown Polly	Clymes Bettie
Bruner Sophia	Cockrum Sallie
Buckner Horace	Connor Albert
Buffalo Lincoln	Connor Annie
Butter Frank	Connor Clara
Butter Myrtle	Connor Edwin
Carlile Homer	Connor Ella
Cokes Crati	Connor Jonie
Cakes Floyd	Coocy Joseph
Cakes Louelate	Coon Joe
Cakes Mettie	Coore Joe
Cannon Edwin	Crittendon Cherokee
Cash John	Crittenden Mary
Cash Samuel	Crittenden Nannie
Chambers Adkinson	Crittenden Ora
Chambers Ed	Crittenden Sanders
Chambers Francis	Crittenden Thomas
Chambers Hurt	Deel Mack
Chambers Jasper	Deel Robert L

Dege Mary
Dickson Effie
Downing Alice
Downing Benjamin
Downing Leroy
Downing Lydia
Downing Maggie
Downing Simpson
Drew Anginora
Dukes Lou
Duncan Annie
Duncan Emma
Duncan Hubert
Duncan Nathaniel
Duncan Sallie
Duncan Sally
Dykes Low E
Eagle Ollie
Felds Armie
Fields Betsy
Fields William
Finley Viola
Fogg Bird
Fogg Mary
Foreman Juanita
Foreman Lila
Foster Clara
Foster Jerry
Francis Beatrice
Gibson Ada
Gibson Harvey
Gibson Pearlle
Gibson Sarah
Glass Robert
Gunter Louisa
Hall Georgiana
Hall Jennie

Nowata County Contd.

Hall Josephine
Hammet Mary
Harris William
Harrison William Jr
Hathcoat Nanie
Hawkins Dibrell
Hawkins Jessie
Hensley A V
Hensley Houston
Hensley John
Hensley Joseph
Henson Charlotte
Hester Alfred
Hester Hettie
Henson Johnie
Hicks Austin
Howard Lucille
Hudpitch Nellie
Hudson Susan
Ivey Augustus
Ivey Julia
Johnson Alfred
Johnson Ben
Johnson Ernest
Johnson Jesse
Johnson Luman
Johnson Mary
Johnson Mary Blanche
Johnson Minnie
Johnson Nellie
Jones Henry
Keefer Frederick Charles
Keefer Nora
Keller Annie
Keller George
Kelley Nellie
Keys Cora Elaine

Nowata County Contd.

Kirk Silas	Miller Ute	Rowan Delilah
Kneeland Fannie	Miller Wm	Rurrels Minerva
Kneeland Herbert	Mink Mary	Runyon William
Kneeland Louie G	Woore Frank	Sanders Alecks
Kuhn Clara	Moore Helen	Sanders Clyde
Kuhn Ella	Moore Herbert	Sanders Corene
Kuhn Ruby	McAnally Sallie	Sanders Cunelius
Kuhn William	McClure Leroy	Sanders David
Lane Lillie	McClure Lewis	Sanders Edward
Lane Maggie	McClure Rhoda	Sanders Florence
Lane Mary	McClure William	Sanders Johnie
Lane Mary J	Nancie George	Sanders Maude
Lane Susan	Nane Ella	Sanders Nancy
Lasley John	Ned Nellie	Sanders Nannie
Lee Amelia	Neil Ola Mae	Sanders Willard
Lee Audrey Dortel	Nofire Joshua	Sanders William
Lilly Earnest	Oral Nancy	Scott Ethel M
Locust Mike	Paden Nora	Scott Geo
Locust William	Ragsdale Alice	Scott Huckleberry
Longhorn James P	Rainey Walter Lee	Scott James A
Markham Clarence	Reed George Jr	Scott Lula
Markham Legas	Reed Mabel	Scott Maria
Markham Mattie	Reaves Charles	Scott Myrtle
Mayfield Johnie	Reaves Dimer	Shannon Roosevelt
Miller Ace	Reaves Effee	Shell Margaret
Miller Admiral	Rider Charles M	Silk Anderson
Miller Charles	Rider Jefferson Davis	Silk Annie
Miller Elizabeth	Rider Stand W	Silk Josephine
Miller Franklin	Riley Blanche	Silk Lillie
Miller George	Robinson Annie	Smith Charley
Miller Johnie	Rogers Charles	Smith Dennis
Miller Joseph	Rogers John	Spears Stephen
Miller Lovenia	Rogers Philip	Stroud Sarah
Miller Mary	Rogers Walter	Thompson Charles
Miller Mattie	Roller Lizzie	Thompson Clarence
Miller Nellie	Roach Charles	Thompson Clifford
Miller Noah	Roach James	Thompson Clyde
Miller Raymond	Roach Julia	Thompson Eddie
Miller Richard	Ross Rachel	Thompson Edward
Miller Stand W	Ross Thelma	Thompson Florence

Nowata County Contd.

Thompson Henry
Thompson Houston
Thompson Jesse
Thompson Lucinda
Thompson Pouppey
Thompson Richard
Thompson Sarah
Thompson Susan
Thrasher Ella
Towie Samuel
Tyner Canzedia
Tyner Della
Vann Arthur
Vann Edmond
Vann Isabell
Vann Jesse
Ward Maneva
Ward Tennie
Welch Lane
Wheeler Alden
Wheeler Jennie
Wheeler Mary
Wheeler Tolbert
White Charles H
White Nannie
Whitmore Ema
Whitmire Geo
Whitmire Lydia
Williams Emma
Wilkins Mary
Wilkins Sallie
Wilson Mattie
Wolfe Ola
Wood Leroy
Wood Minnie
Yahalak Jack
Young Jennie

Young Thos
Young Willie

Taken from a Nowata County,
Oklahoma Map

by Evelyn Henisey

WHERE DO YOU STAND IN SEARCHING THE COUNTY RECORDS?

Have you written to county offices for information of your ancestor whom you think lived in that county? Have you inquired about a marriage of which you did not know the date within a ten year certainty? And with only the name of one of the participants? Did you ask about a will and give no approximate date? Was your letter typed, or was it written in a hard to read handwriting? Was your letter unanswered? Did you ask for the name and address of some local person who did genealogy research in that area?

Had you received prior documents from that office? Did you inquire of a particular document relating to the previous document? Did you inquire of a will or administration, knowing the name of the deceased? And knowing the name of the executors or administrators. Did you relate to a certain book and pages in your request? If you wrote to a recorder of deeds, did you provide the names of the grantor and grantee? Did you give the land description by the section number, the township, and the range number? Did you give the approximate date?

Did the county official offer the name of a local researcher? Or tell you that they were too busy, and had no genealogy department? Are you about ready to stop searching for your ancestors? Probably some of the trouble many of the inquirers have is because they do not know what should be the answers to some of their inquiries from the standpoint of the county official. The county official has other work in the regular performance of their position. The researcher is interested in obtaining the information of his ancestor from the same records the county official uses. To this end the county official is the genealogy department. The beginning researcher is at an disadvantage in knowing too little of the workings of the several county offices. Sometimes it may be better that a beginner have the service of a researcher until he is better acquainted with researching. There is a dividing point however, because an experienced researcher can be 'put off' in obtaining information which he has requested and has not received. It is well to know more about the dividing point between what service the researcher should ask to be done, and that which the records office should be required to furnish. One can never know too much about ones own business, and this may require learning about anothers' business.

Probably all states have a state code which governs the requirements which govern the actions of the county offices. This code will give information on what is required of the county officials, as well as what is not required. Probably most state codes regarding information (copies, etc.) requested or researched in the county office, are very similar. If you are having trouble or wish to learn more of 'where you stand' in regards to requesting information from county officials, maybe you should write the Secretary of State of that state requesting a copy of the code relating to searching in the county offices, and the making of copies of such documents as you request. A copy of a part of the Indiana code is shown on the following page.

Submitted by R. L. Edwards

A PAGE FROM THE INDIANA CODE

f. The definition of a "trade secret" is defined by reference to IC 24-2-3-2 (The Uniform Trade Secrets Act). It means "information, including a formula, pattern, compilation, program, device, method, technique, or process that: (1) derives independent economic value, actual or potential, from not being generally known to, and not being readily ascertainable by proper means by other persons who can obtain economic value from its disclosure and use; and (2) is the subject of efforts that are reasonable under the circumstances to maintain its secrecy." It ties into Sec. 4(a) (4) relating to confidentiality of records containing "trade secrets."

g. The definitions of "inspect" and "copy" tie into the general inspection and copying rights accorded by the statute.

The definition of "inspect" was broadened in 1985 to include the right to listen to tape recordings or other aural records and to manually transcribe or make notes, abstracts or other memoranda from them (P.L. 54-1985; S.E.A. 43). This clarification is intended to resolve any problems which might be associated with listening to tape recordings of judicial proceedings and of police department dispatcher's activities. (NOTE: This amendment does not become effective until January 1, 1986; see SECTION 9, P.L. 54-1985; S.E.A. 43).

h. A definition of "work product of an attorney" was added by a 1985 amendment. It is intended to correlate with existing Indiana precedent defining the term. The definition ties in with Sec. 4(b) (2) relating to discretionary non-release of the work product of defined attorneys. It was prompted by litigation in Fort Wayne, in which the city unsuccessfully contended that a settlement document constituted work product. (NOTE: This amendment does not become effective until January 1, 1986; see SECTION 9, P.L. 54-1985; S.E.A. 43).

TEXT:

5-14-3-3 — (a) Any person may inspect and copy the public records of any public agency during the regular business hours of the agency, except as provided in section 4 (5-14-3-4) of this chapter. A request for inspection or copying must:

(1) Identify with reasonable particularity the record being requested; and

(2) Be, at the discretion of the agency, in writing on or in a form provided by the agency.

No request may be denied because the person making the request refuses to state the purpose of the request, unless such condition is required by other applicable statute.

(b) A public agency may not deny or interfere with the exercise of the right stated in subsection (a). The public agency shall either:

(1) Provide the requested copies to the person making the request; or

(2) Allow the person to make copies:

(A) On the agency's equipment; or

(B) On his own equipment.

(c) Notwithstanding subsections (a) and (b), a public agency may, in accordance with a nondiscriminatory uniform policy of the agency, permit a person to duplicate or obtain a duplicate copy of a computer tape, computer disc, microfilm, or other similar or analogous record system that contains information owned by or entrusted to the agency. (IC 5-14-3-3, as added by P.L. 19-1983, 6; P.L. 54-1985, 2.)

EXPLANATION:

Sec. 3 Inspection and Copying Rights. The main thrust of the statute is encompassed within this section, that is, that any person has the right to inspect and copy the public record of any public agency and that a public agency can not deny or interfere with the exercise of that right.

Two conditions are imposed: (1) the right must be exercised "during the regular business hours" of the public agency, and (2) the record being requested must be identified with "reasonable particularity."

(By 1985 amendment, a person seeking information from personnel files of public employees must particularize "by employee name" and not generally on all employees or for groups of employees, Sec. 4(b)(8); P.L. 54-1985; S.E.A. 43)

Additionally an agency has the discretion to require a person to make a request "in writing on or in a form provided by the agency." (P.L. 54-1985; S.E.A. 43) However, no request, whether oral or written, may be denied because the person making the request refuses to state the purpose of the request unless statement of a purpose is required by other applicable

OZRO FALLS CEMETERY

HOLROYD, Alice Armina (Cardin)	1866	---	1949
HOLROYD, Arie Lewellen	1872	---	1949
HOLROYD, Cassius	---	14 Jul	1893
HOLROYD, Edgar	1902	---	1902
HOLROYD, Flora E.	04 Feb 1890	---	14 Mar 1981
HOLROYD, George Washington	1864	---	1935
HOLROYD, Hazel (Williams), wife of W.F.	21 Oct 1890	---	18 May 1962
HOLROYD, Inf. son of Fred & Hazel	---	---	13 Dec 1920
HOLROYD, Inf. son of W.F. & R.	1891	---	1891
HOLROYD, James Marion	16 Aug 1892	---	09 Nov 1977
HOLROYD, Joye Marjorie (Lemert)	28 Jan 1893	---	16 Apr 1973
HOLROYD, Laura Ellen (Green)	07 Feb 1869	---	12 Dec 1928
HOLROYD, Libbens Stannard "D.A.R."	26 Jun 1861	---	18 Dec 1919
HOLROYD, Luceba Marila	26 Jun 1861	---	14 May 1940
HOLROYD, Mable	14 Feb 1902	---	05 Aug 1903
HOLROYD, Madison Lewellen	1894	---	1972
HOLROYD, Marila	20 Jan 1898	---	23 Nov 1899
HOLROYD, Mark Ashworth	09 Jun 1857	---	31 Jan 1941
HOLROYD, Mary M., wife of Rev. Stephen	13 Mar 1826	---	09 Aug 1890
HOLROYD, Oscar John, father of Susan, Robert, Michael, Oscar Jr., William	03 Jan 1923	---	16 Aug 1977
HOLROYD, Oscar John	1855	---	1927
HOLROYD, Rebecca (Park)	1857	---	1892
HOLROYD, Rebeca C. Infant	1892	---	1892
HOLROYD, Stephen (Rev.)	05 Mar 1818	---	21 Nov 1891
HOLROYD, Viola (Ness), wife of Libbens	15 Dec 1871	---	18 May 1960
HOLROYD, William Fay	1859	---	1927
HOLROYD, William Frederick	28 Oct 1889	---	21 Jul 1946
HOLROYD, William Glenn, son of C.J. & A.	1894	---	1894
HOLROYD, Winifred, dau of Fred & Hazel	17 Dec 1925	---	17 Dec 1941
HOOPER, Emma A. (Peet)	1892	---	1921
HOWARD, H.C., son of F. & M. (11 y, 3 m, 15 d)		18 Aug	1884
HOWELL, Blanche	1891	---	1907
HOWELL, Iva M.	06 Dec 1881	---	03 May 1961
HOWELL, Laura	10 Jan 1860	---	27 Feb 1893
HOWELL, Orval L. Vet.	1893	---	1980
HOWELL, William H.	06 Oct 1856	---	08 Sep 1951

Ozro Falls Cemetery Contd

HUTCHINSON, Anna E. (Gordon) Malone "Mother" (buried beside Jon Pressley Malone)	31 Dec 1880 --- 12 Mar 1943
HUTCHISON, Francis	---
HUTCHISON, Fred	17 Oct 1878 --- 21 Apr 1955
HUTCHINSON, Ruben	---
HUTCHINSON, Vint	---
JENT, Henry C.	1868 --- 1950
JENT, Minnie (Durland), wife of H.C. (born at Hadland, Norway)	29 Jan 1873 --- 03 Mar 1909
JOHNSON, A. (born at Christiana, Norway) (died at Ozro, Ks., 74 y, 11d)	01 Jul 1816 --- 14 Jul 1890
JOHNSON, C. Our Mother Parents of Marila, Glorine, Anna Laura, Mark	27 Dec 1820 --- 08 Nov 1903
JOHNSON, Henry Iver, born in Sweden	04 Jul 1892 --- ---
JOHNSON, Pauline (Holroyd), born near Hewins	26 Feb 1901 --- 29 Jun 1979
JOYCE, Delsie	1882 --- 1918
JOYCE, Samuel	1865 --- 1940
KINCAID, Clark H.	08 Jul 1928 --- 14 Feb 1933
KYGAR, Charley	1883 --- 1943
KYGAR, Edna Earle, dau. of W.H. & M.S.	10 Sep 1890 --- 12 Feb 1910
KYGAR, Herbert, father of Vaughn, Floy, Mary Jo	18 Feb 1894 --- 10 Feb 1984
KYGAR, Mary Jo, dau of Herb & Rosalyn	--- 16 May 1932
KYGAR, Mary Susan (Harris), wife of W.H. "Mother"	09 May 1859 --- 19 Jun 1938
KYGAR, Roslyn (Lemert), wife of Herbert	01 Jun 1890 --- 12 Dec 1982
LAND, Cecil H.	06 Feb 1900 --- 08 Jul 1964
LAND, Infant of W.E. & M.	--- 15 Feb 1897
LAND, Maggie (West), wife of Squire	01 Apr 1876 --- 06 Feb 1958
LAND, Squire	10 Feb 1873 --- 02 Jun 1957
LAWRENCE, Clifford C. "Beloved husband & father"	26 Sep 1909 --- 19 Jul 1979
LAWRENCE, Edgar "Father"	1890 --- 1955
LAWRENCE, Minnie (Beck) "Mother" wife of Edgar	1890 --- 1980
LAWRENCE, Pauline (Pappan), wife of Clifford C.	31 Jan 1927 --- ---
LAYTON, America, wife of G.W. (53 y, 7 m, 11 d)	15 Dec 1893
LAYTON, Devora A. (Leonard), wife of G.W.	28 Jun 1877 --- 11 May 1914
LAYTON, George W. (59 y, 11 m., 17 d)	10 Oct 1893
LAYTON, Herman H.	20 Oct 1875 --- 18 Jun 1953
LAYTON, Howard H. "Shorty"	22 Jan 1909 --- 14 Jun 1968

Ozro Falls Cemetery Contd.

LAYTON, Infant son of H.H. & M.L.	---	09 Feb 1907
LAYTON, Infant son of G.W. & America	19 May 1881 ---	19 May 1881
LAYTON, Lois Maxine, Baby, dau. of Howard & Deveen (Lawrence)		
	23 Jun 1930 ---	14 Mar 1931
LAYTON, Mary, dau. of G.W. & America	16 Sep 1882 ---	06 Feb 1883
LAYTON, Mary L. (Pitts)	12 Jun 1879 ---	-4 Apr 1947
LAYTON, Maude (Bohannon), wife of Howard H.	03 Jan 1912 ---	14 Dec 1964
LAYTON, Muriel	20 Sep 1905 ---	03 Nov 1965
LAYTON, Pearl (Marshall)	03 Aug 1908 ---	25 Apr 1950
LAYTON, Ralphie Carl, son of G.W. & V.A.	29 Mar 1895 ---	11 Nov 1901
LAYTON, Will "Father"	13 Feb 1871 ---	27 Feb 1956
LEDBETTER, Chad Earl, son of Larry & Sue	27 Sep 1974 ---	13 Feb 1975
LEDBETTER, Larry Wayne Pvt, US Army	09 Feb 1944 ---	28 Mar 1982
LEDBETTER, Mary Sue (Carter), wife of Larry	1944 ---	---
LEMERT, Abner	1813 ---	1896
LEMERT, Bernard	---	---
LEMERT, Josephine (Dale), wife of Leroy	1859 ---	1946
LEMERT, Abner "Dale"	22 May 1899 ---	17 Dec 1983
LEMERT, Larry Carroll, KS Cpl., Co. A, 822 Eng. Avn. Bn., Korea		
	05 Jan 1932 ---	04 Jul 1955
LEMERT, Merl L.	1900 ---	19--
LEMERT, Bula	1910 ---	19--
LEMERT, Leroy	1852 ---	1927
LEMERT, Ora Leroy "Lee"	24 May 1925 ---	26 Aug 1983
LEMERT, Orin Earl	30 Oct 1882 ---	21 Apr 1964
LEMERT, Phebe, wife of Abner	1813 ---	1891
LEMERT, Anna (Fisher)	08 Nov 1875 ---	09 Jul 1938
LEONARD, Ernest Harold	31 Aug 1899 ---	---
LEONARD, Essie (Rutledge)	27 Aug 1900 ---	---
Above parents of Adajean Ernestine		
LEWELEN, Madison (50 y, 5 m, 17 d)		01 Apr 1894
LEWELEN, Mary	1852 ---	1930
LEWELEN, Reece	1875 ---	1914
LITTRELL, Artie E., wife of J. Hugh	30 Oct 1881 ---	13 Oct 1939
LITTRELL, George L.	22 Dec 1886 ---	03 Feb 1938
LITTRELL, J. Hugh	07 Nov 1873 ---	17 Apr 1955
LITTRELL, Lucile M., wife of Lloyd K.	16 Apr 1924 ---	---
LITTRELL, Loyd K.	07 Feb 1913 ---	26 Mar 1962
LITTRELL, Mimmie R.	09 Jul 1885 ---	30 Jun 1974

QUERIES

THOMPSON: Would like to correspond and exchange information with anyone knowing of the following. Reverend William F. THOMPSON b. 12 Feb. 1839 Camden, Benton County, Tennessee d. 3 Nov. 1914 Coffeyville, Kansas. Married: #1 Antimassa M. Poe, #2 name unknown, #3 Melissa E. (?). His children: James Virgil, Francis Marion, Ada Jane, Rudolphus John, Mary Wilma, Mattie and Allen. ARTHUR F. FREEMAN, 7542 St. Philomena Way, Citrus Heights, Ca. 95610-2522.

David R. GREEN b about 1849 Illinois, wife Delia Levina b 1875 Arkansas, child Olive Rose b June 1895 Coffeyville. Believe they were there in 1895. Any other GREEN or CREECH families. NORMAN L. MOYES, 455 S. Main, Orem, Utah 84050.

Flora Twiss POTTER lived in Coffeyville in 1932 found her in City Directory. I would like to correspond with one of her children. James Twiss came to Independence settled in Peebler School District #42. Mrs. Charles SHUKER, Mrs. Martha ROBINSON, Ida Bell MILLER were all related. CONDRAN H. MILLER, 8314 Hadley, Overland Park, Kansas 66212

David Newcomer ROPP d July 5th or 15th 1872 Walnut Grove Montgomery Co. wife Mary Ann. Had large family of girls. I have not found them before 1870. Mrs. SHEILA CHAMBERS, 6703 Red Jacket Rd., Springfield, Va. 22152

Where John Riley JONES and wife Rachel died. When Oliver left Cherryvale. City Director of Cherryvale 1900-1920. Names JONES, Andrew George. NANCY LONG, 547 Centry Drive, Anaheim, Ca. 92805

Jessie Alice CUNNINGHAM b Mar 26, 1910 Cherryvale father Jessie CUNNINGHAM b 1880 Mother Sadie GIBSON b 1885 any records of this family. Mrs. DORIS TINNEY, 447 Old Main Street, Rocky Hill, Connecticut 06067

Looking for Ancestors of John Walker DABNEY an early settler of Liberty. MIRIAM KENDAL, 141 Emerald Bay, Laguna Beach, Ca. 92651

William Morgan WHITE and wife Nancy BAILEY lived in Coffeyville around 1900 til their deaths. Believe Nancy died 1938, can't locate in 1900 or 1910 census. KATIE HOSS, 2514 Arthur, Boise, Idaho 83703

MARRIAGES FROM RAUCH INDEX FILE

JAMES George	12 Nov 1881	WHITESIDE Mary
JAMES Wm. A	12 Nov 1894	ELLINGTON Emma
JARVIS Sarah	25 Nov 1896	PADON William
JESSON Lizzie	17 June 1876	CLINE David
JESSON Wm	3 Sept 1881	MORGAN Amanda
JESSON Mary	2 Sept 1876	MORGAN Jesse
JOHNSON J H	26 Dec 1894	ORB Luella
JOHNSON J S	11 Mar 1896	CUSTER Alice
JONES Prof E S	8 Nov 1895	BLAIR Lou
JONES Gilbert	9 Dec 1882	LEONARD Lizzie
JONES Joseph	8 May 1880	DAVIS Emma
JOURNEYCAKE Cora	10 Sept 1881	CARY William
JUDD Milton	25 Apr 1895	SCOTT Edna
KAMM J H	1 Oct 1896	EGGLESTON Hattie
KEEBLE James	6 Nov 1895	BOLEN Fannie
KEELER Jessie	2 Nov 1893	HOLTON J Francis
KEELER Miss	20 Mar 1880	STONE Robert
KEETON Thomas	23 Jan 1895	BOLAY Mrs. Anna
KELLER Margaret	20 Nov 1880	MORGAN W H
KELLOGG DUANE	29 Dec 1893	RUSSELL Nellie

WHAT'S NEW AT LIBRARY

920	Goodwin, Doris Kearns: The Fitzgeralds and the Kennedys
929.1	Cerny, Johni: Ancestry's Guide to Research
929.3	1830 Census--East Tennessee
929.3	1830 Census--Middle Tennessee
929.3	1830 Census--West Tennessee
929.3	Jackson, Ronald Vern: 1890 Oklahoma Census Index--Veterans
929.3	Jackson, Ronald Vern: Virginia 1810 Census Index
929.4	Smith, Elsdon C.: American Surnames
930.1	The World Atlas of Archaeology
941	Britain
943.053	Asprey, Robert B.: Frederick the Great: The Magnificent Enigma
947	Tolstoy, Nikolai: The Tolstoys
949.5	Gage, Nicholas: Hellas, A Portrait of Greece
951	Fairbank, John King: The Great Chinese Revolution: 1800-1985