

OUTLINE MAP OF  
**MORRIS COUNTY**  
KANSAS

Scale 1/2 inch to 1 mile

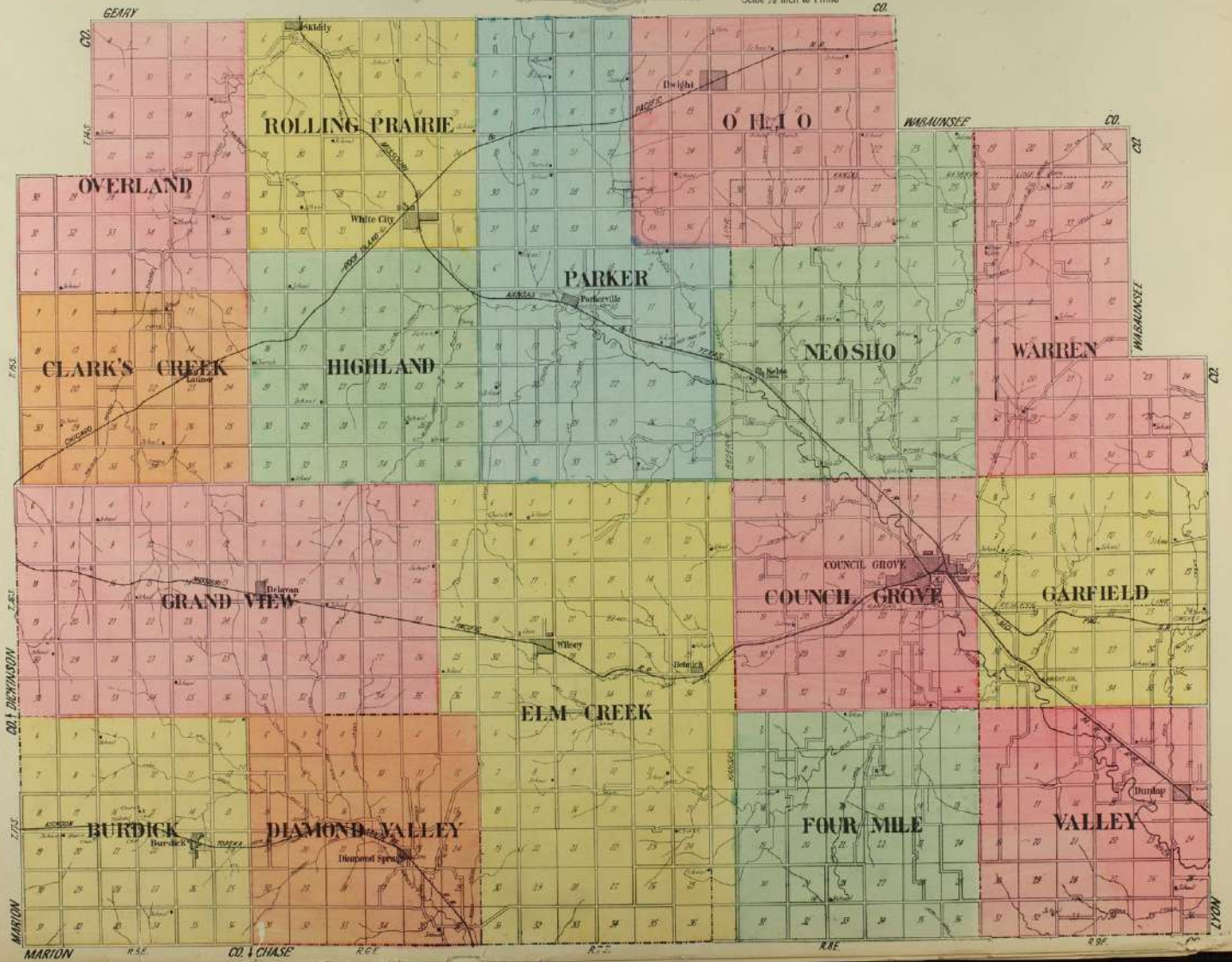



8

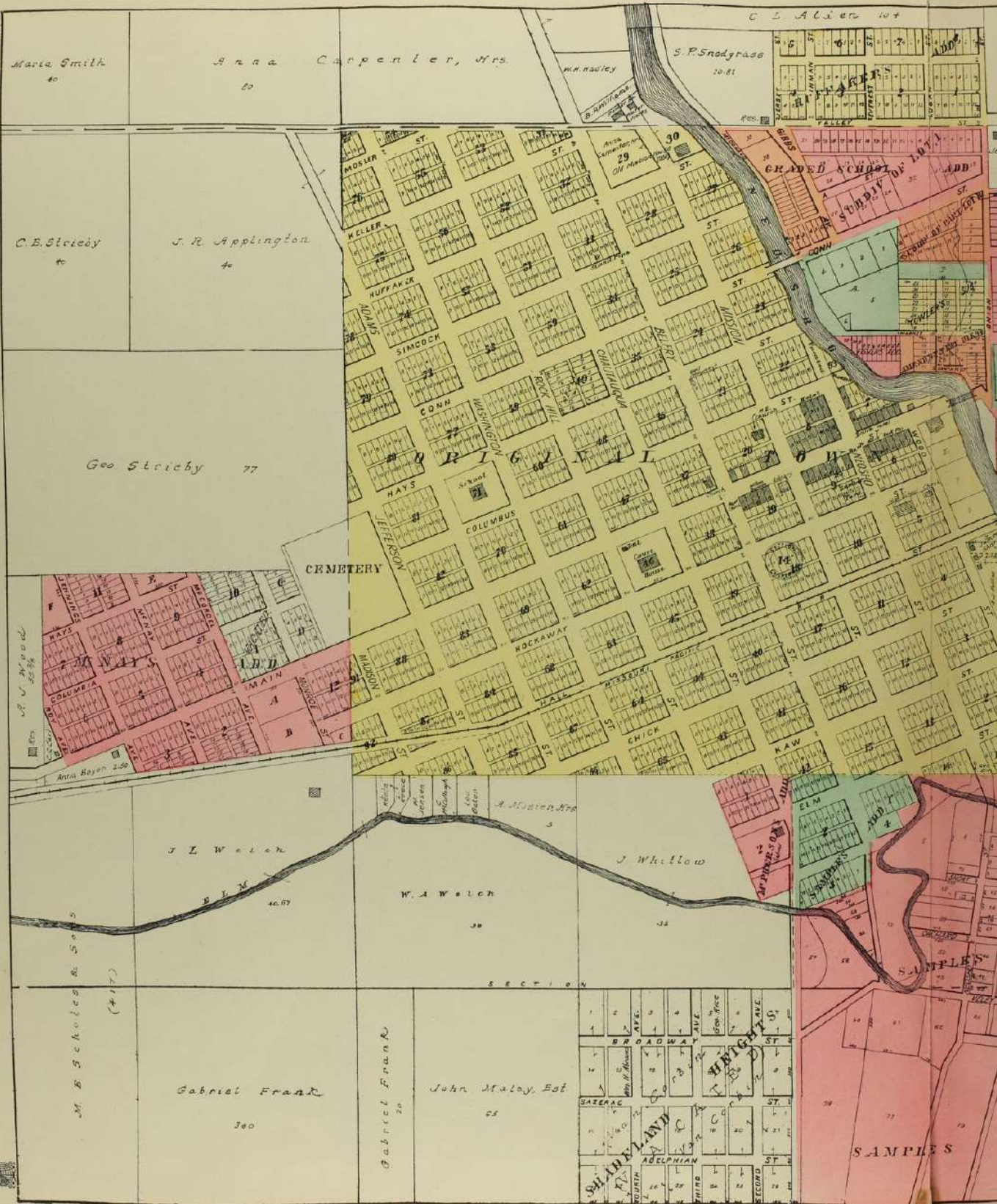



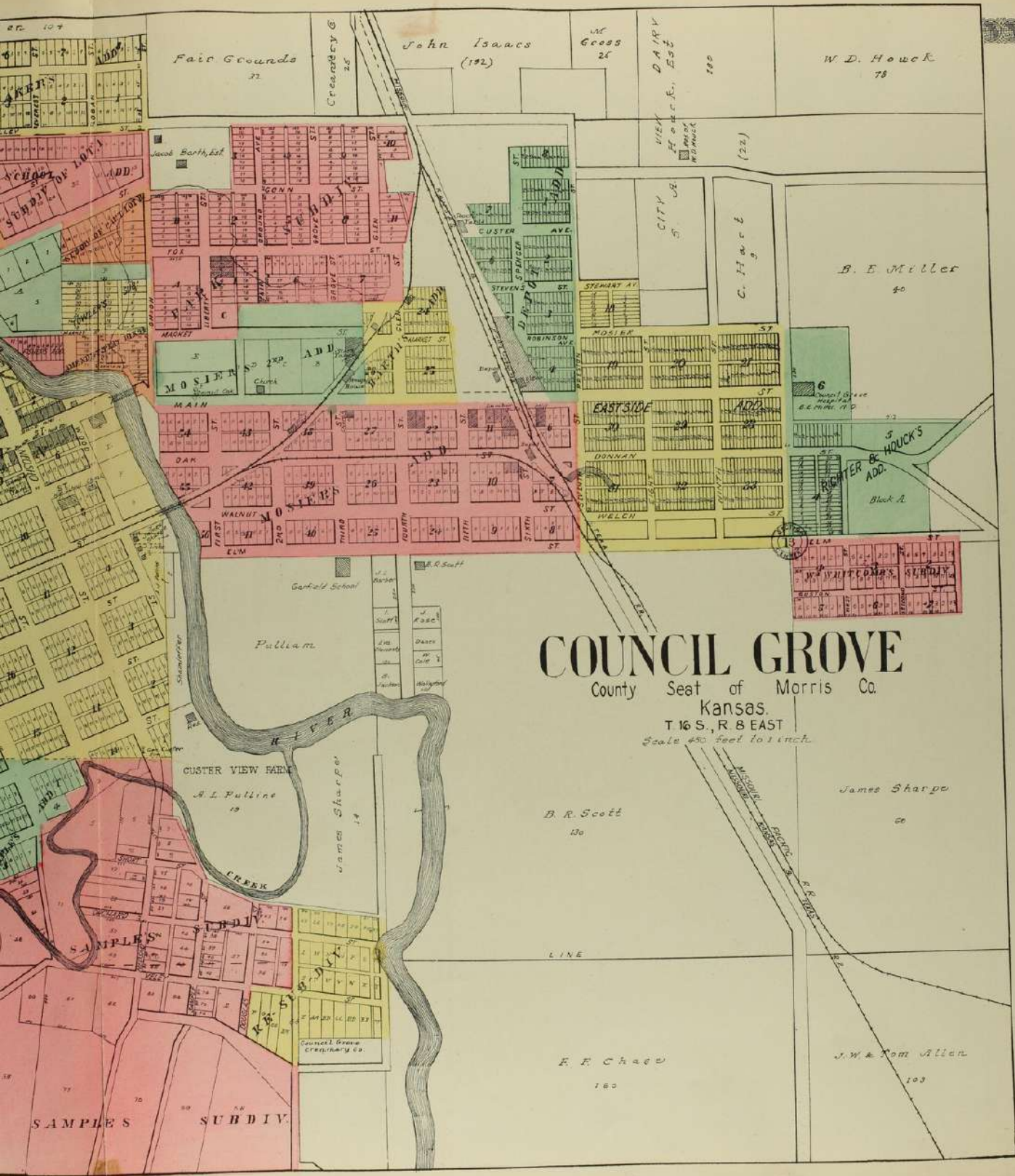

# COUNCIL GROVE

County Seat of Morris Co.  
Kansas.

T 16 S., R 8 EAST  
Scale 480 feet to 1 inch.



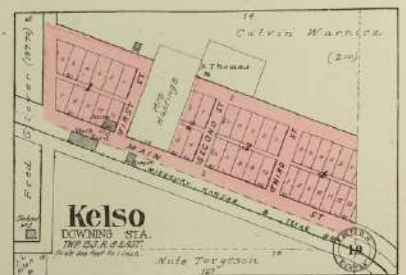
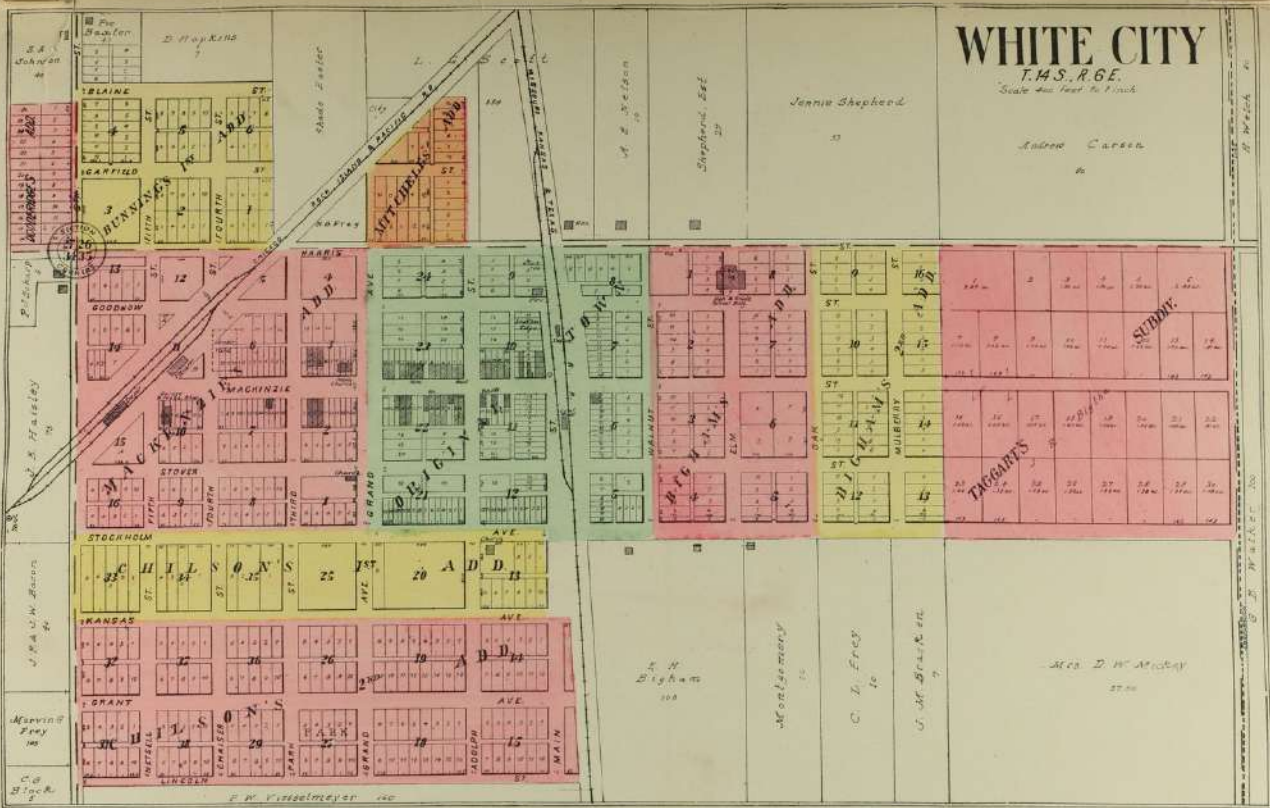



**MAP OF**  
 Part of Township 14 S., Range 5 E.  
 OF THE 6th P. M.  
 Scale 1/4 inches to 1 mile





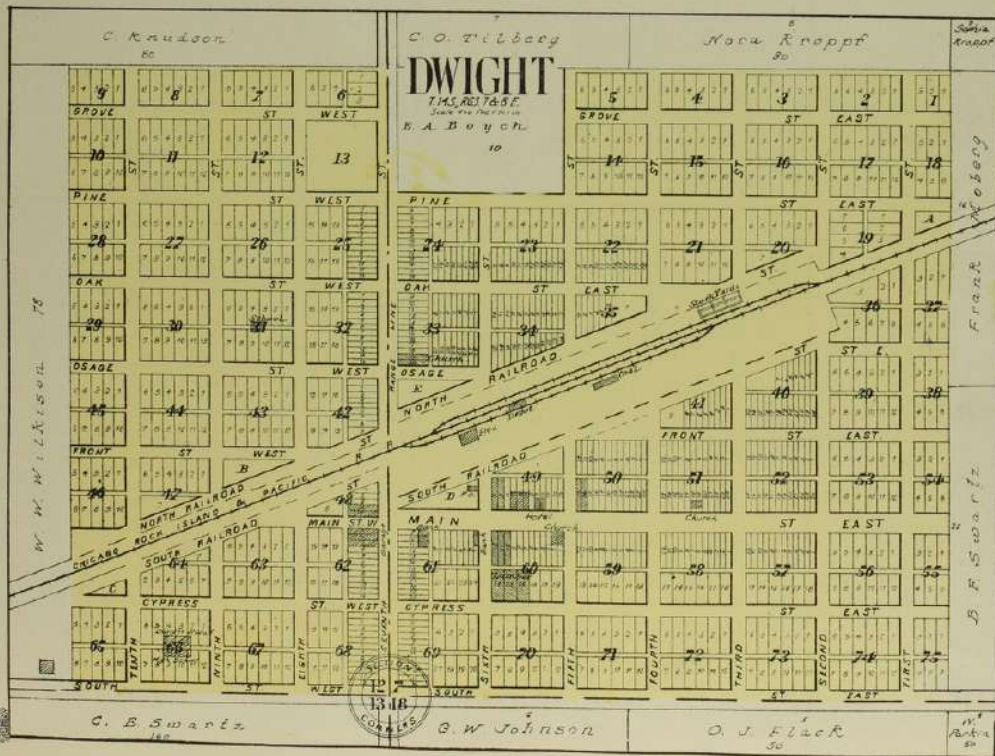
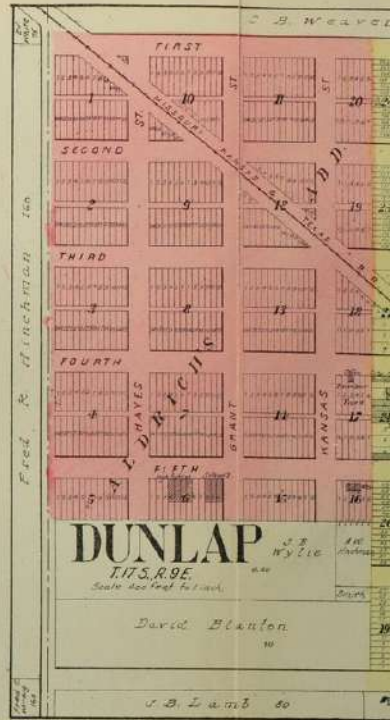
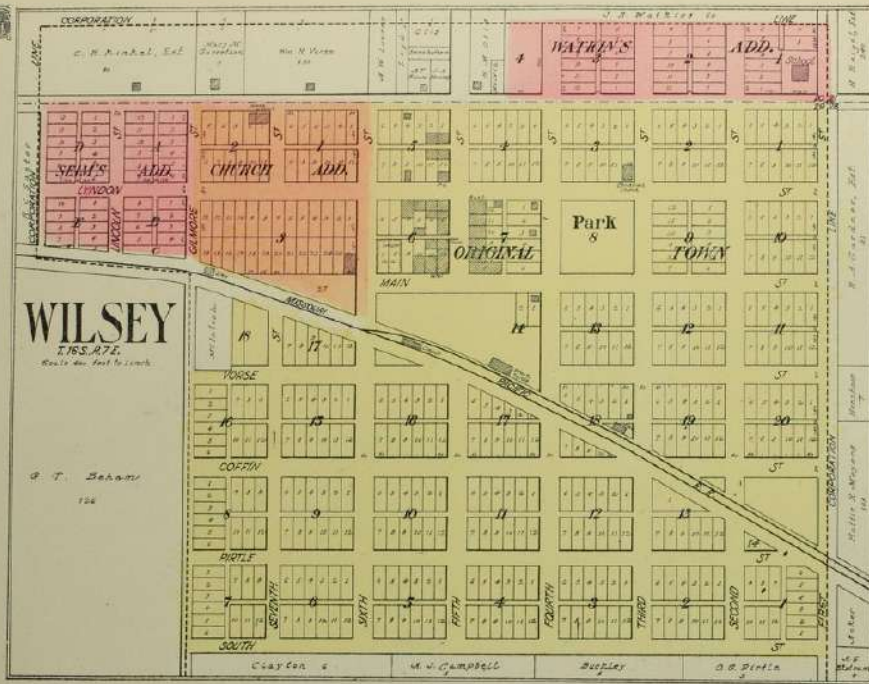



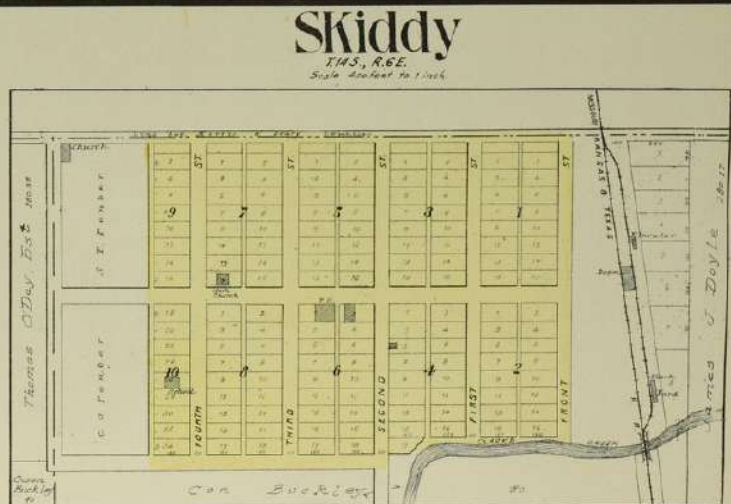
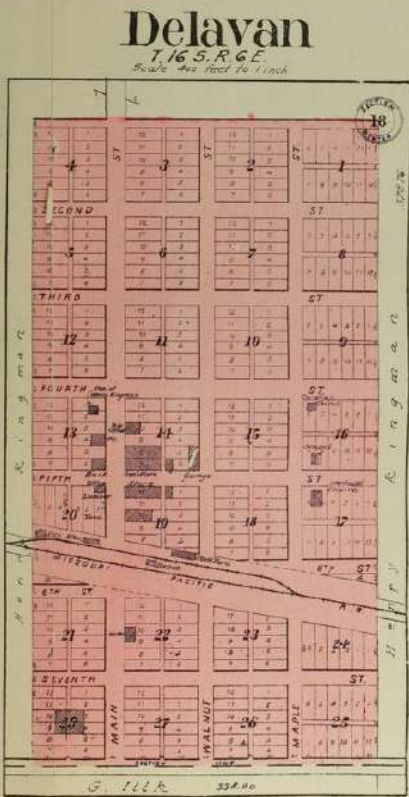
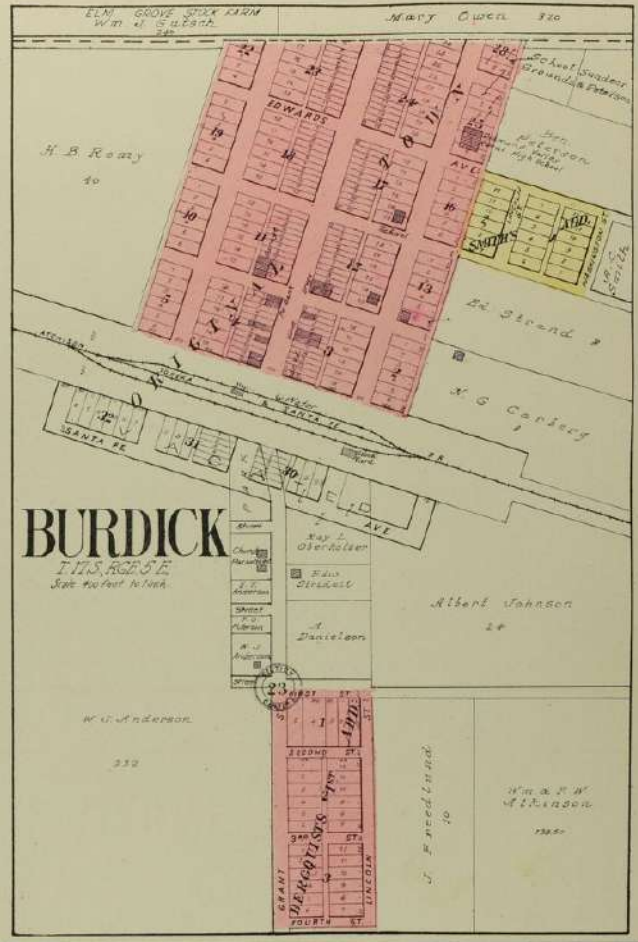
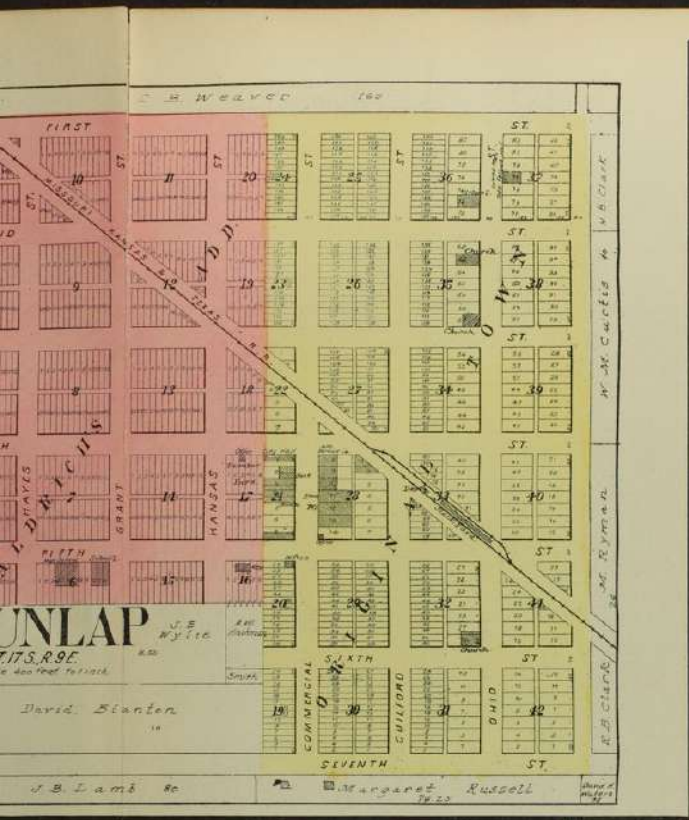



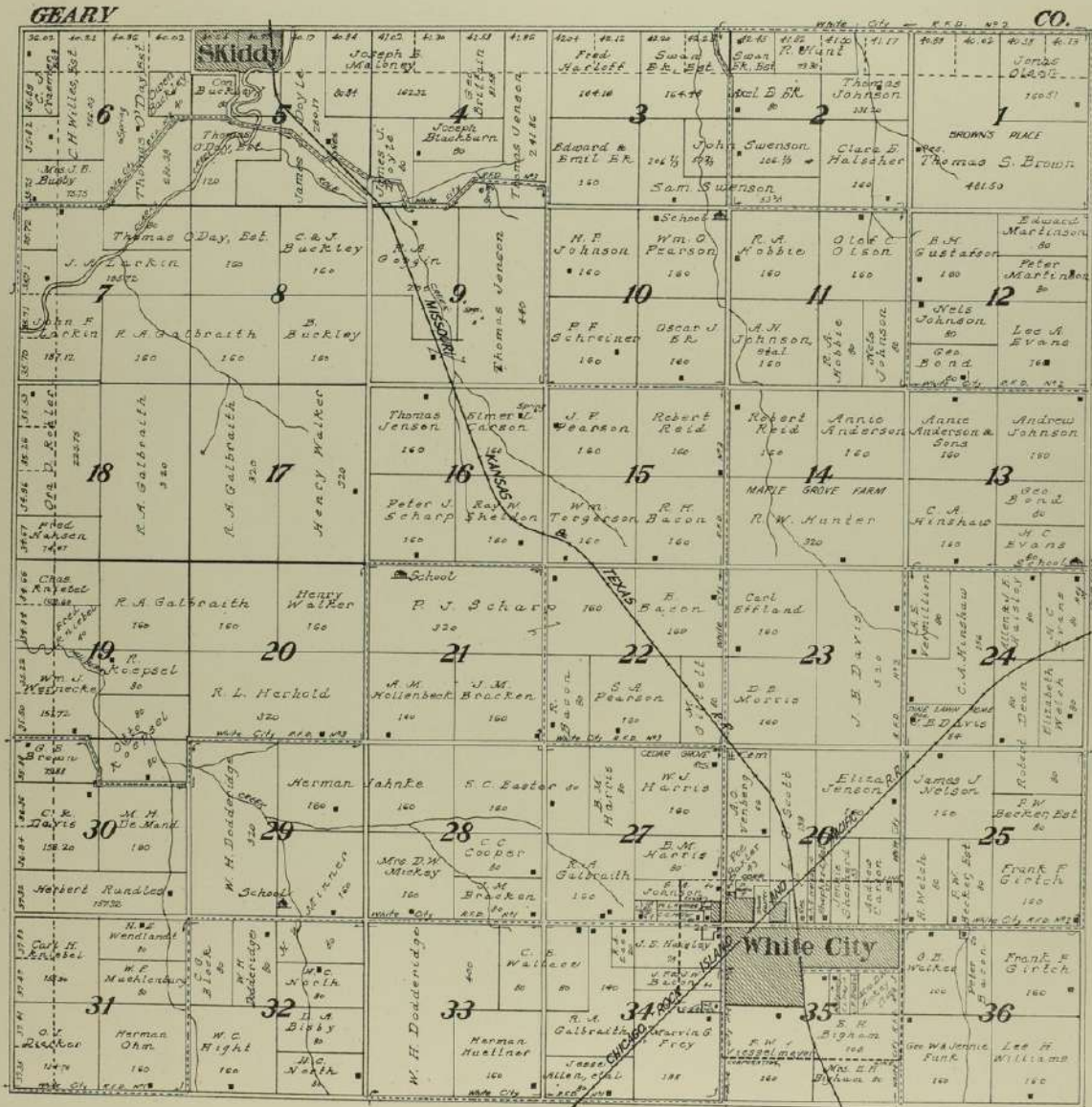



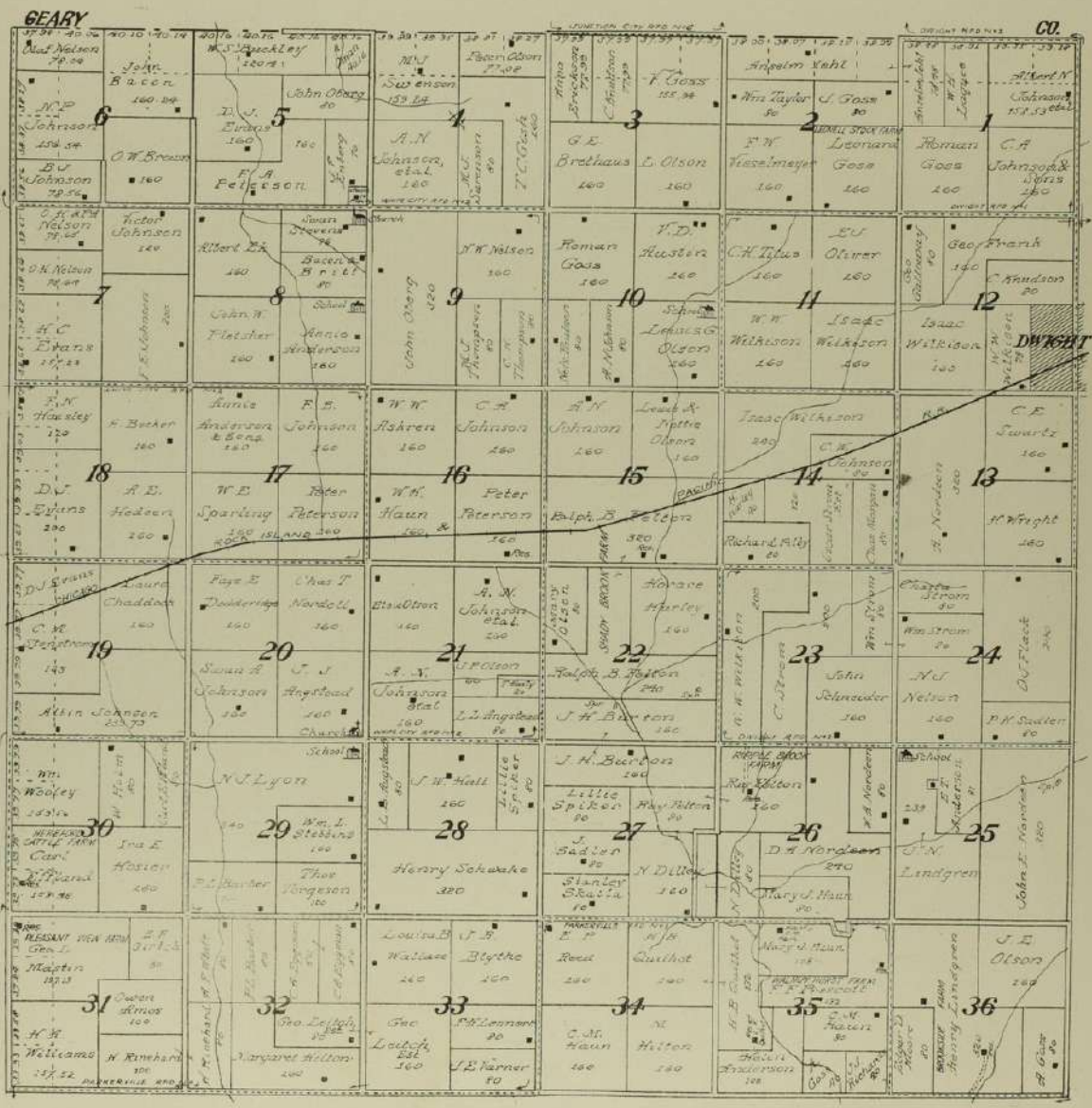

  
**MAP OF**  
**TOWNSHIP 14 S., RANGE 7 E.**  
**OF THE 6th P. M.**  
 Scale 1 1/4 inches to 1 mile







  
**MAP OF**  
**Part of Township 14 S., Range 8 E.**  
**OF THE 6th P. M.**  
 Scale 1 3/4 inches to 1 mile



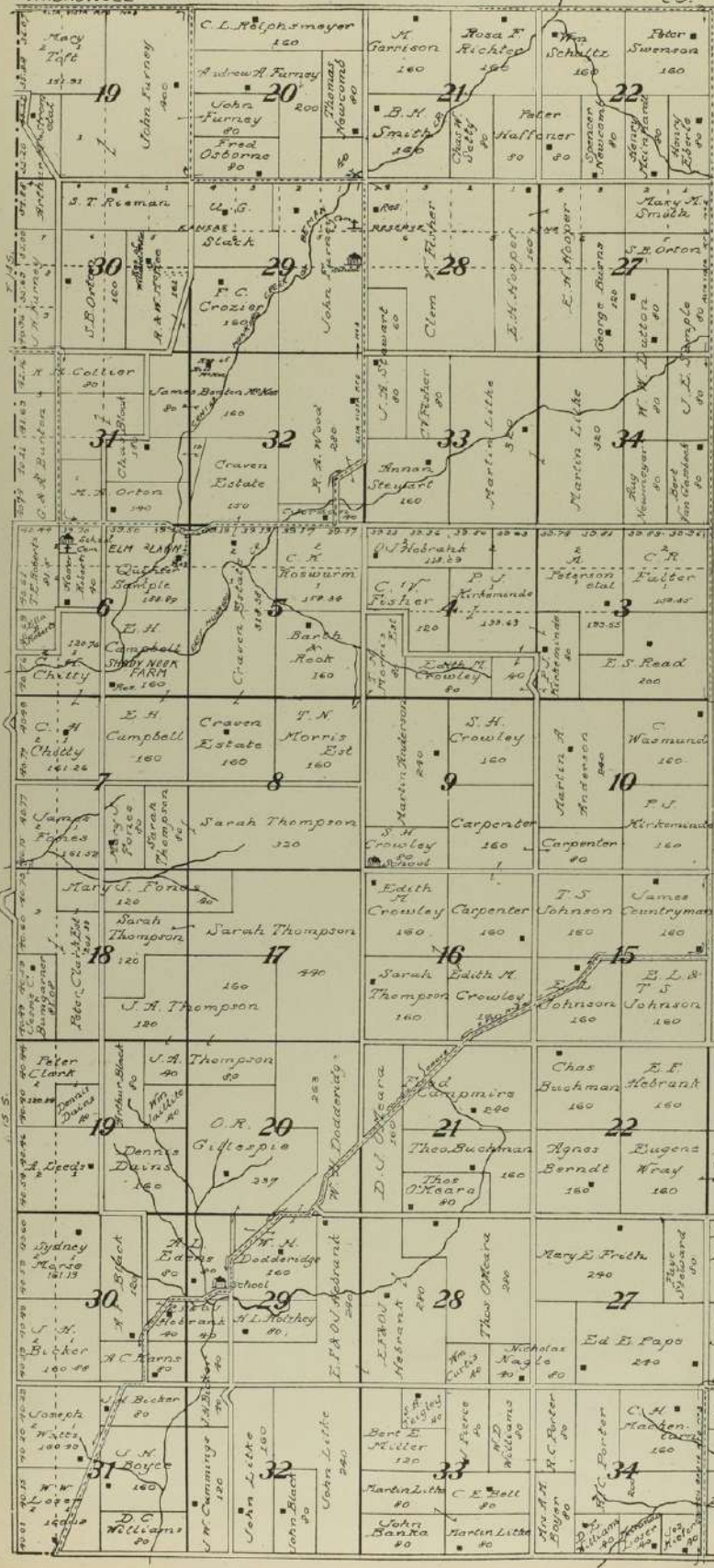



**MAP OF**
  
**PART of TOWNSHIP 14 S., and**
  
**PART of TOWNSHIP 15 S., RANGE 9 E.**
  
**OF THE 6th P. M.**

Scale 1 1/4 inches to 1 mile





  
**MAP OF**
  
**TOWNSHIP 15 S., RANGE 5 E.**
  
 OF THE 6th P. M.

Scale 1 1/4 inches to 1 mile



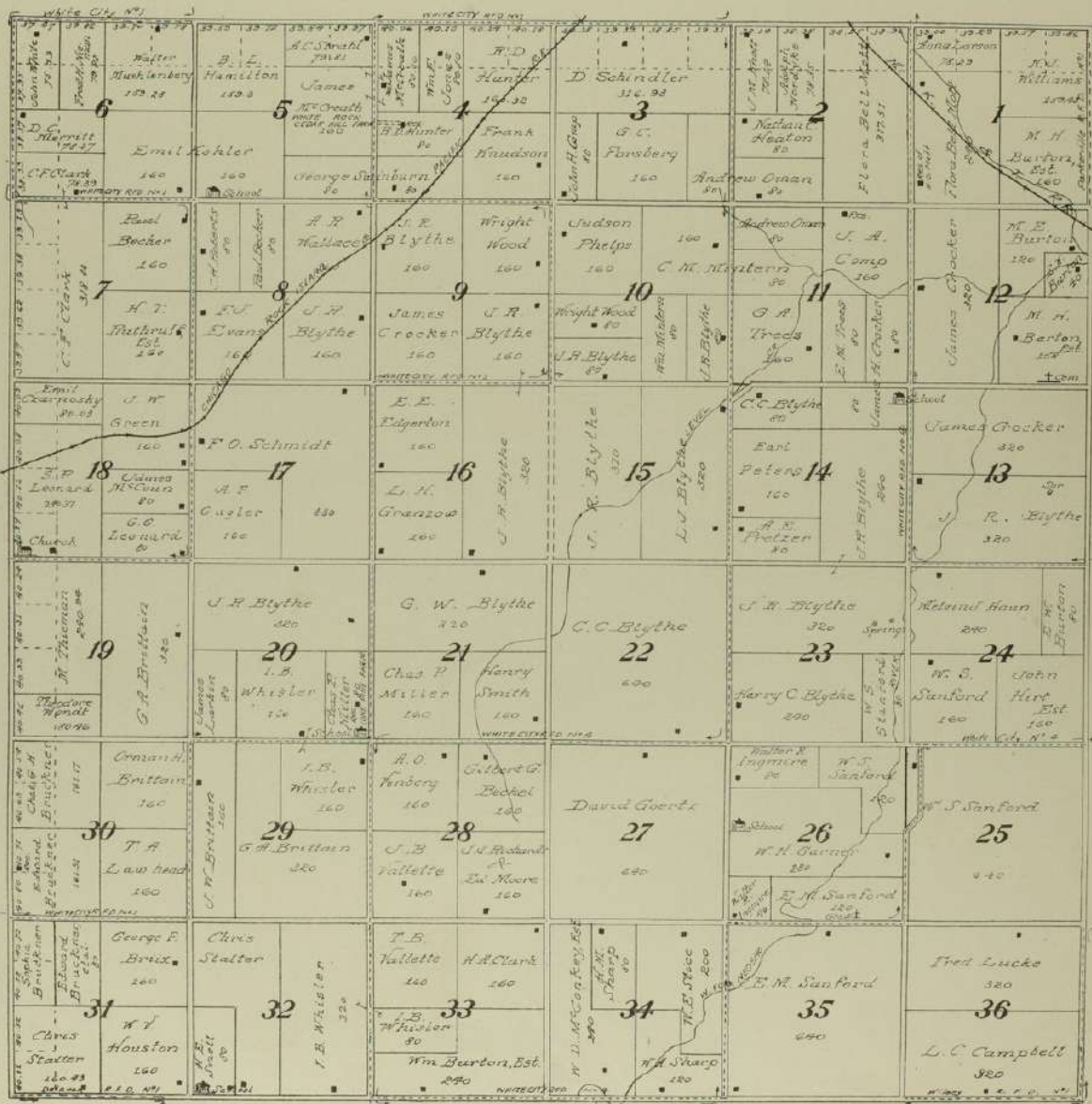









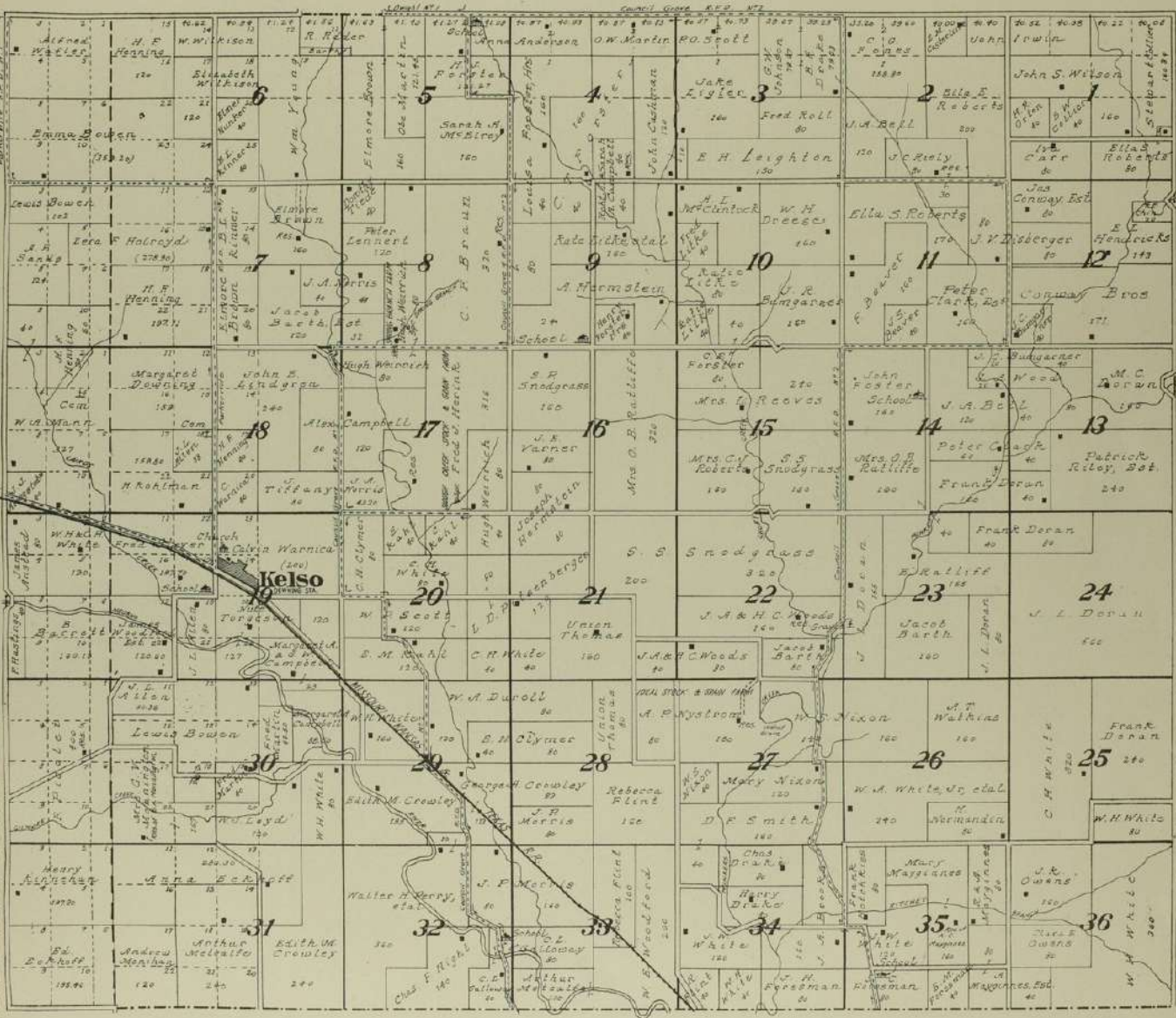







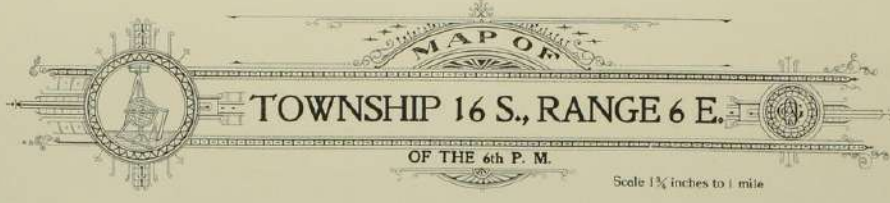

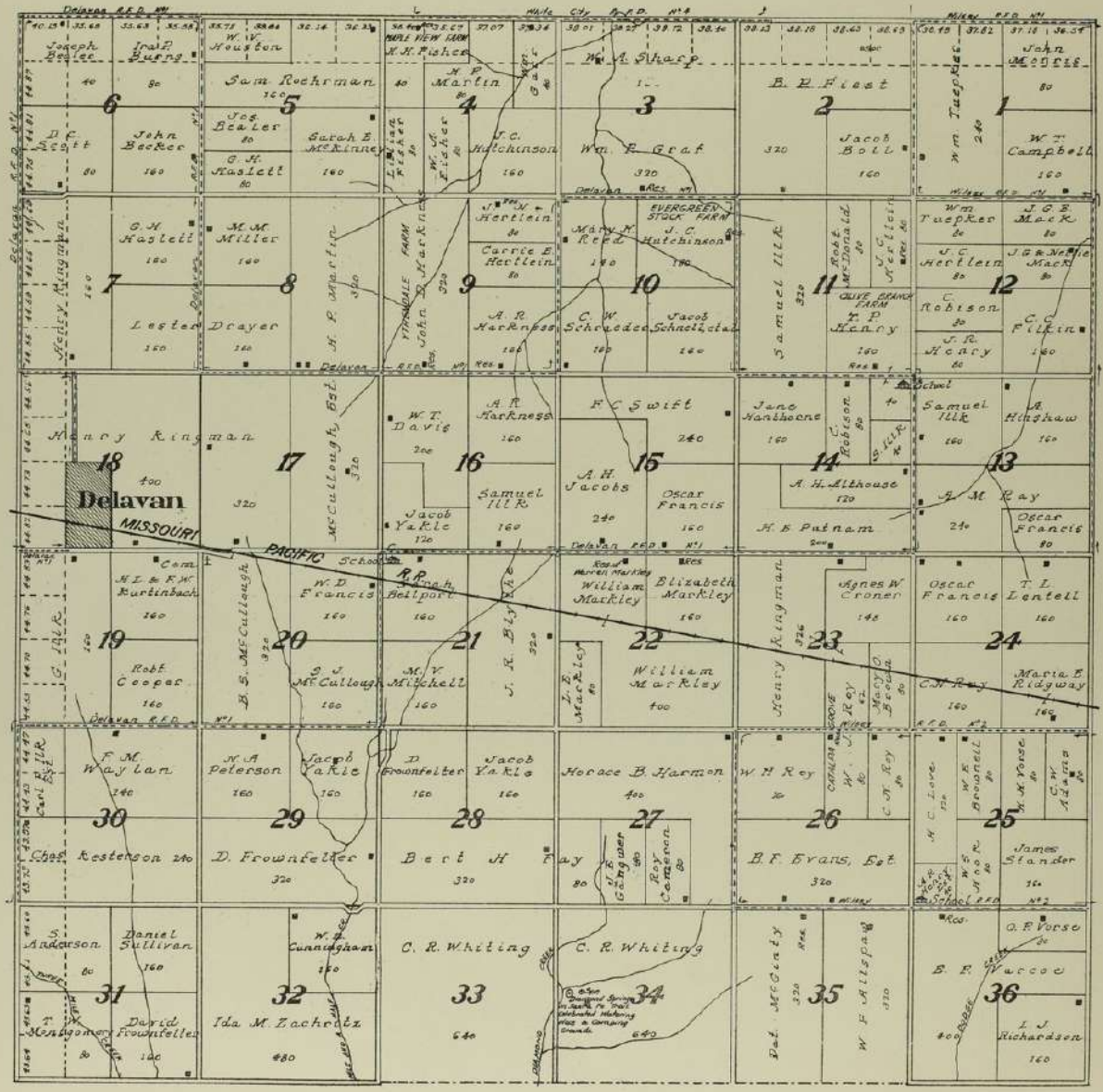
  
**MAP OF**  
**TOWNSHIP 16 S., RANGE 6 E.**  
**OF THE 6th P. M.**  
 Scale 1 1/4 inches to 1 mile



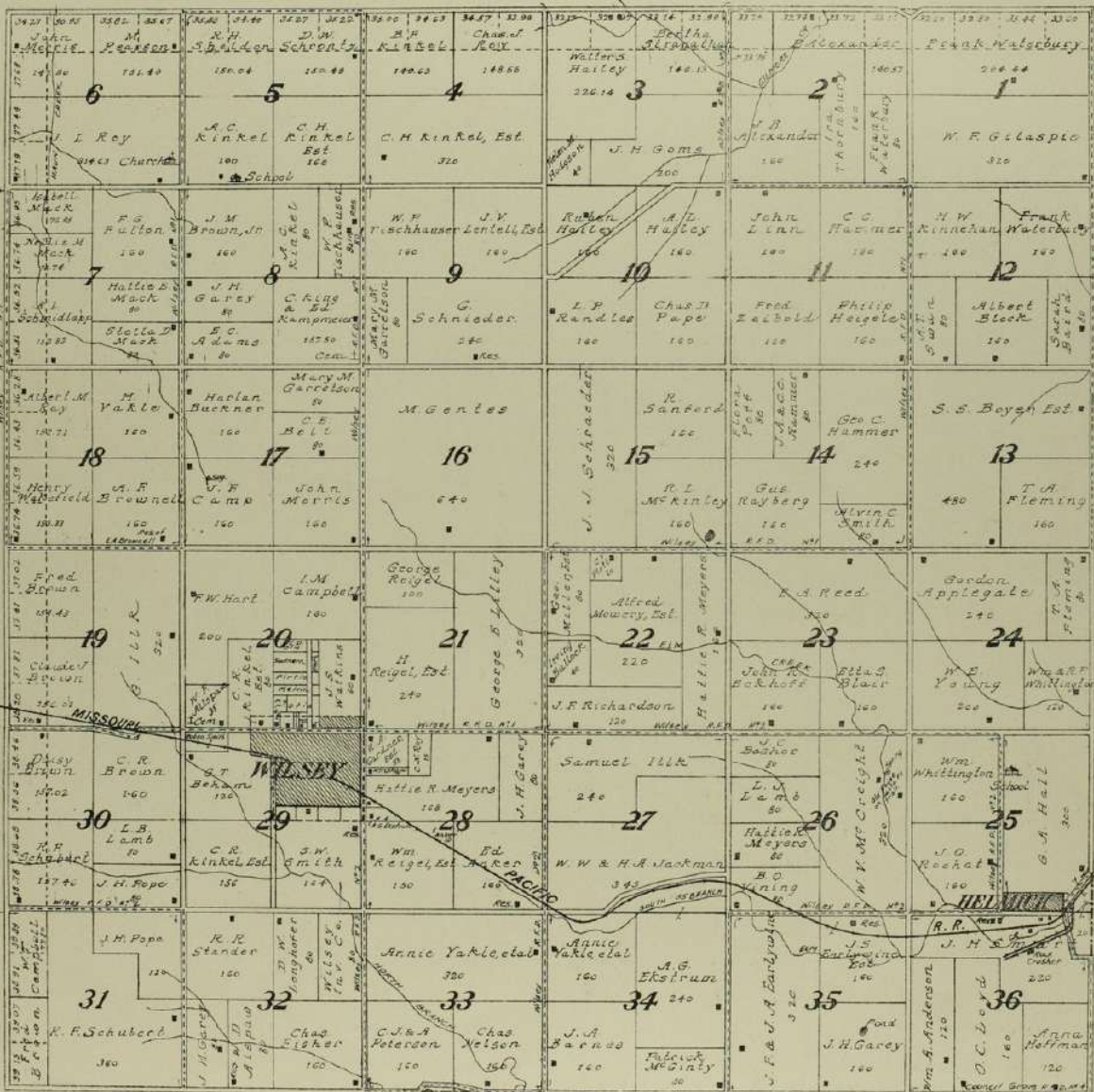

**MAP OF**
  
**TOWNSHIP 16 S., RANGE 7 E.**
  
**OF THE 6th P. M.**
  
 Scale 1 3/4 inches to 1 mile





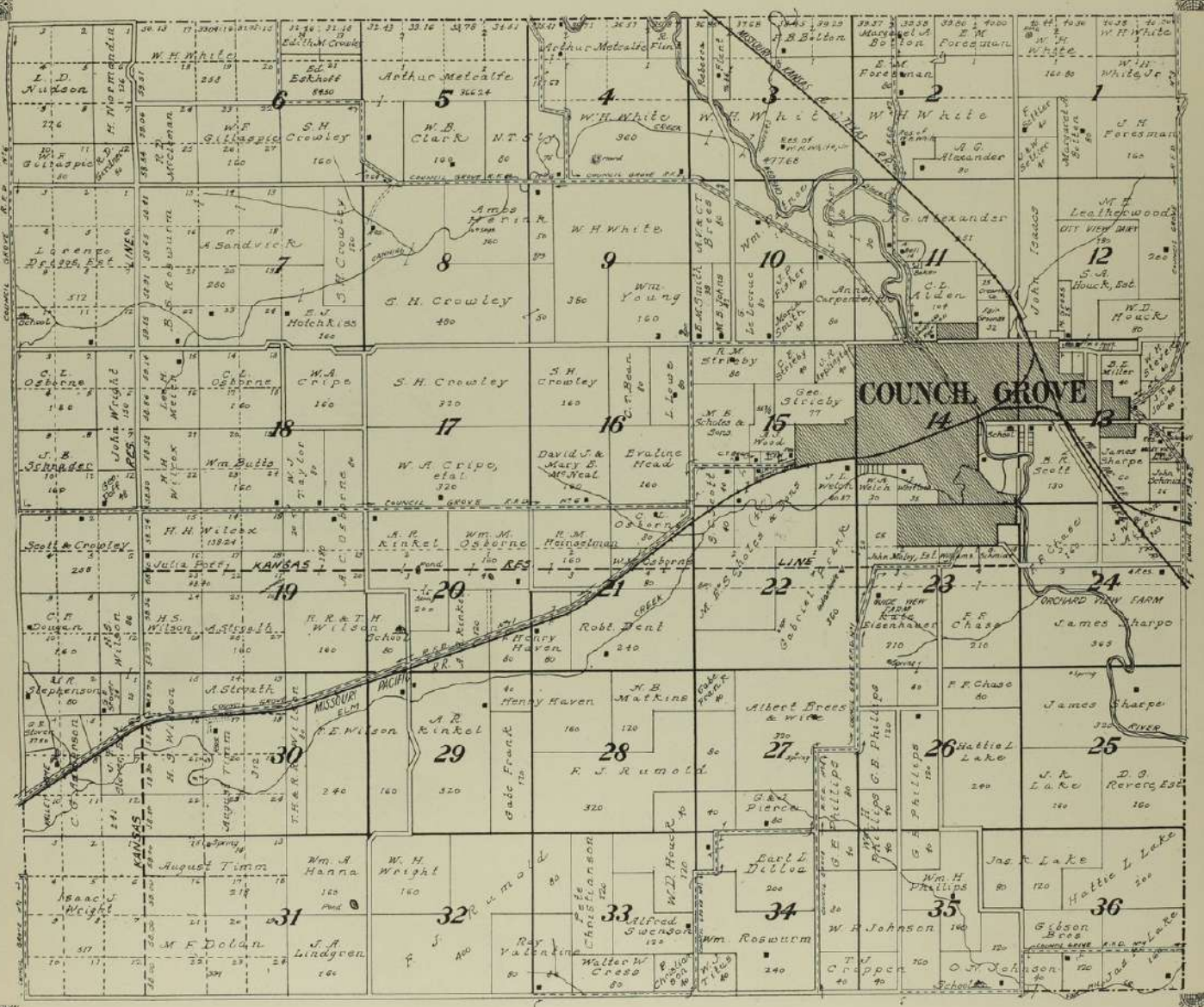

  
**MAP OF**  
**TOWNSHIP 16 S., RANGE 8 E.**  
 OF THE 6th P. M.  
 Scale 1 1/4 inches to 1 mile



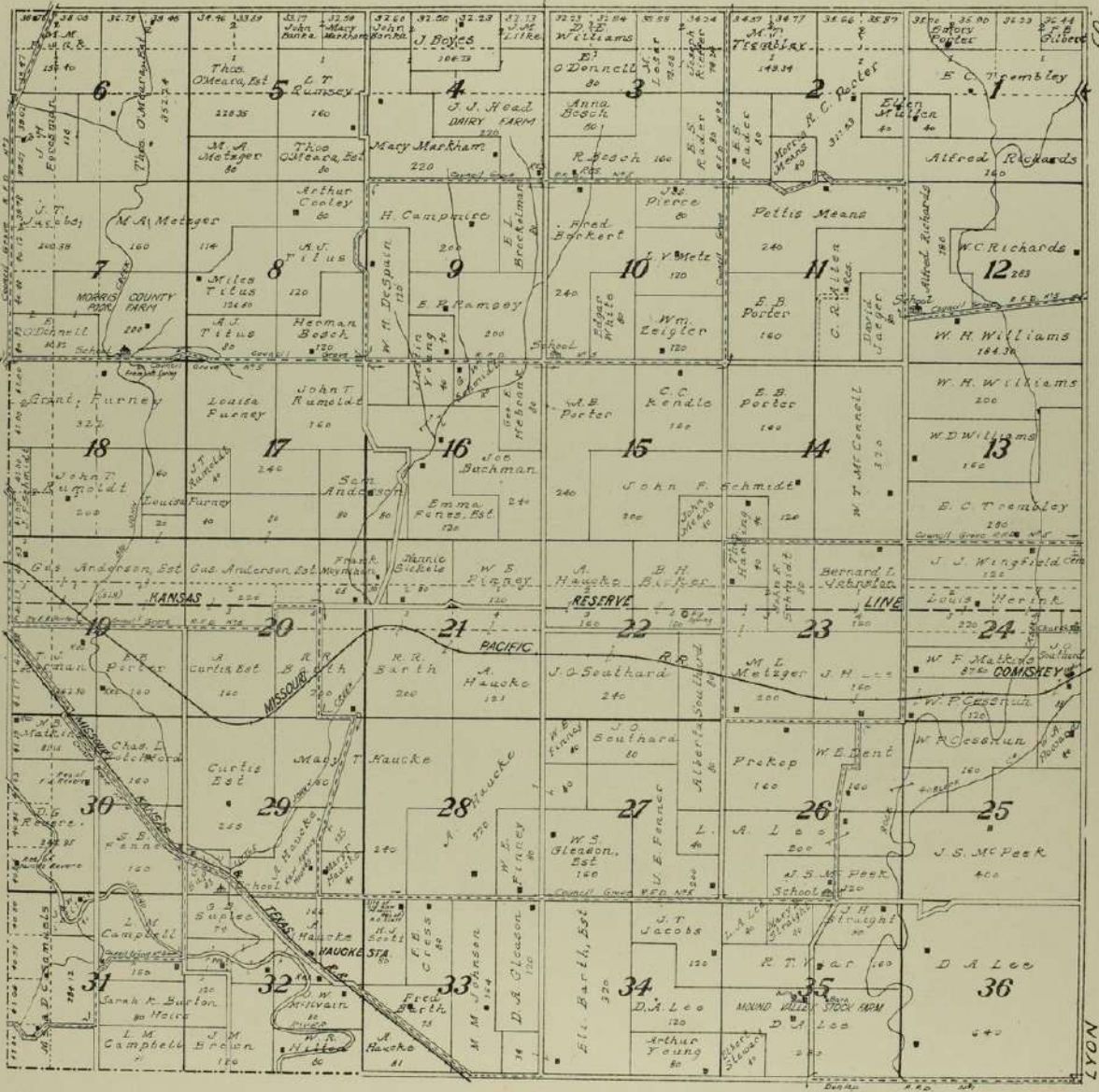

Scale 1 1/2 inches to 1 mile





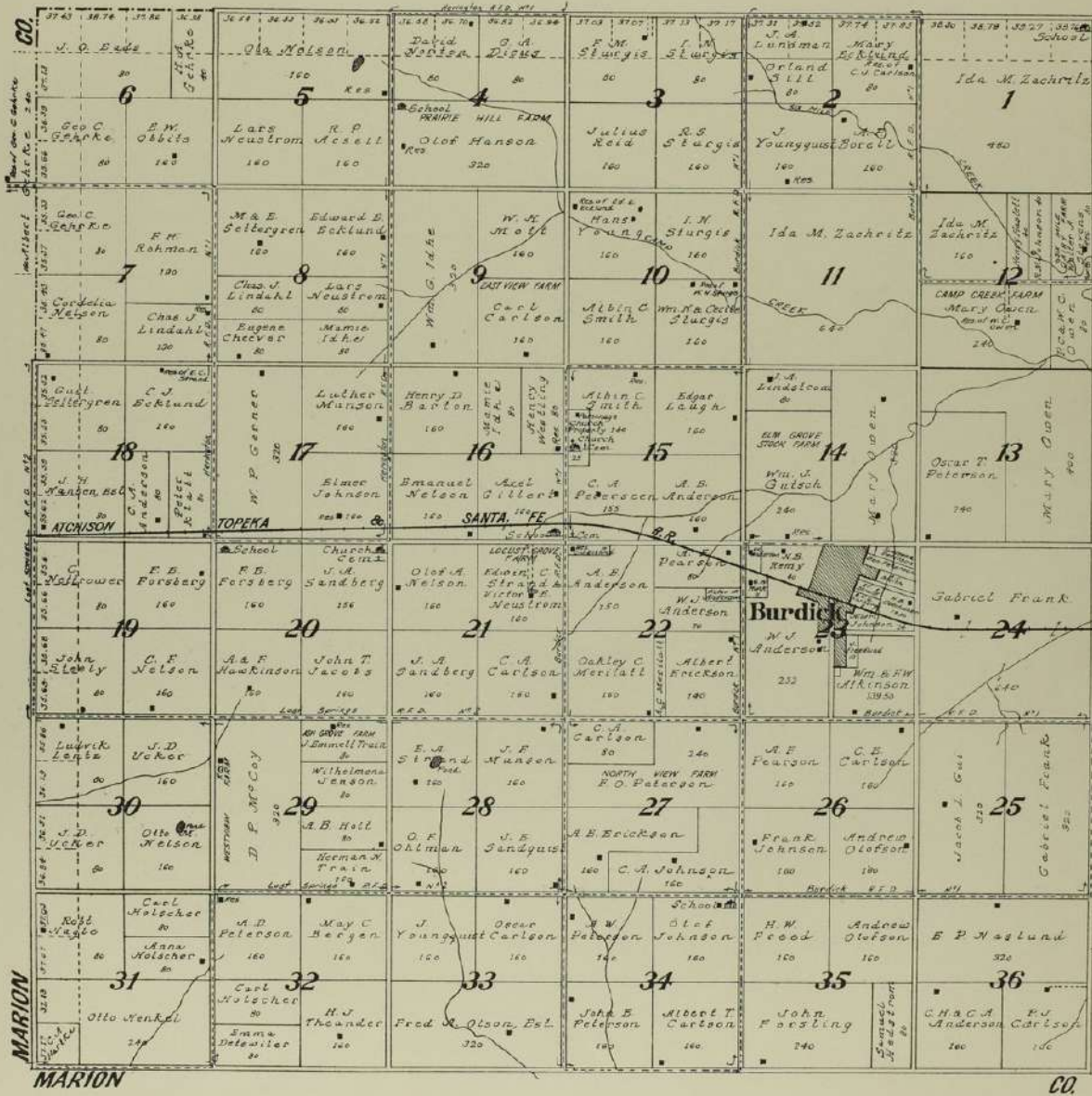

  
**MAP OF**  
**TOWNSHIP 17 S., RANGE 5 E.**  
**OF THE 6th P. M.**  
 Scale 1 1/4 inches to 1 mile





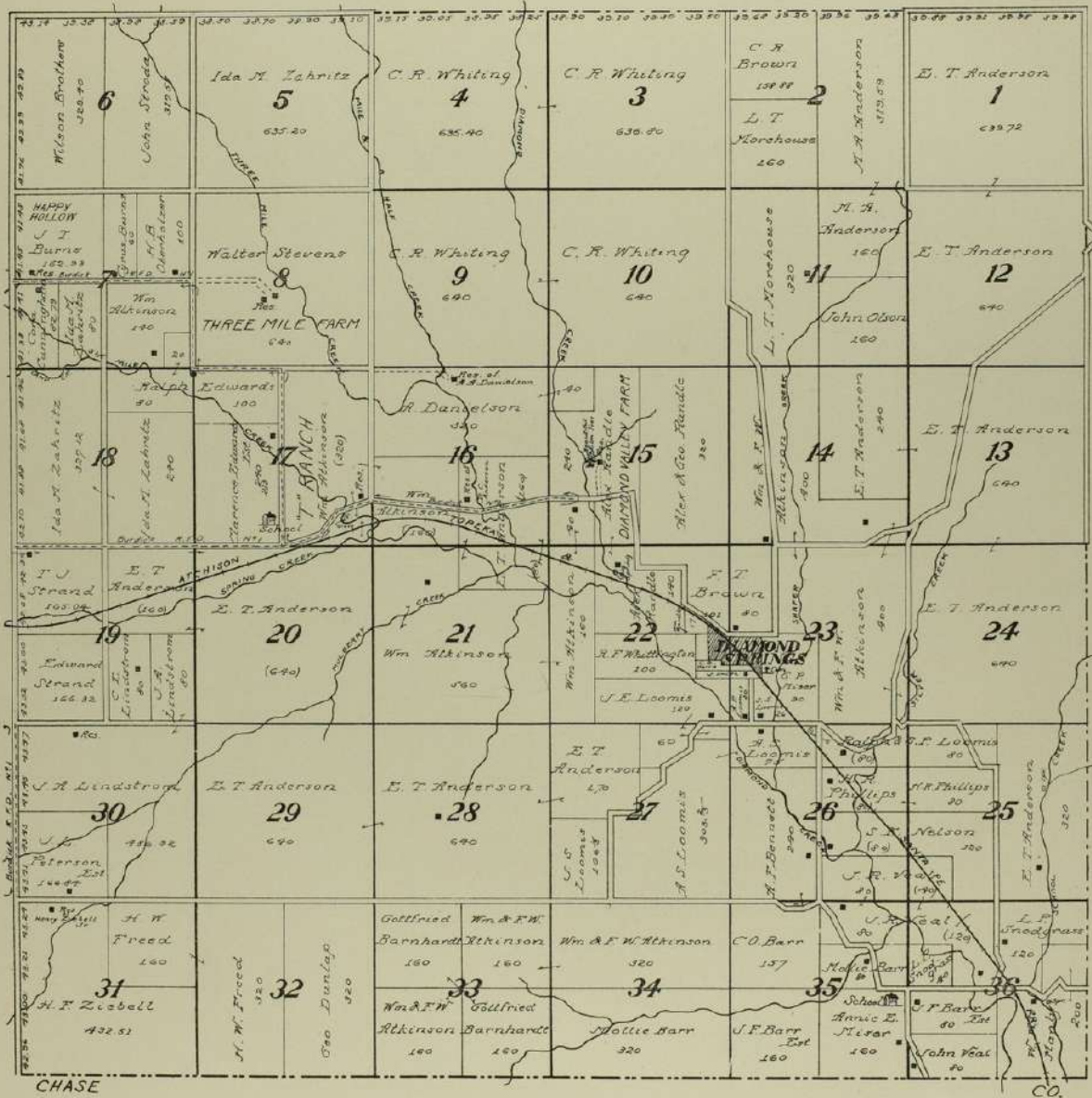

  
**MAP OF**  
**TOWNSHIP 17 S., RANGE 6 E.**  
**OF THE 6th P. M.**  
 Scale 1 1/4 inches to 1 mile



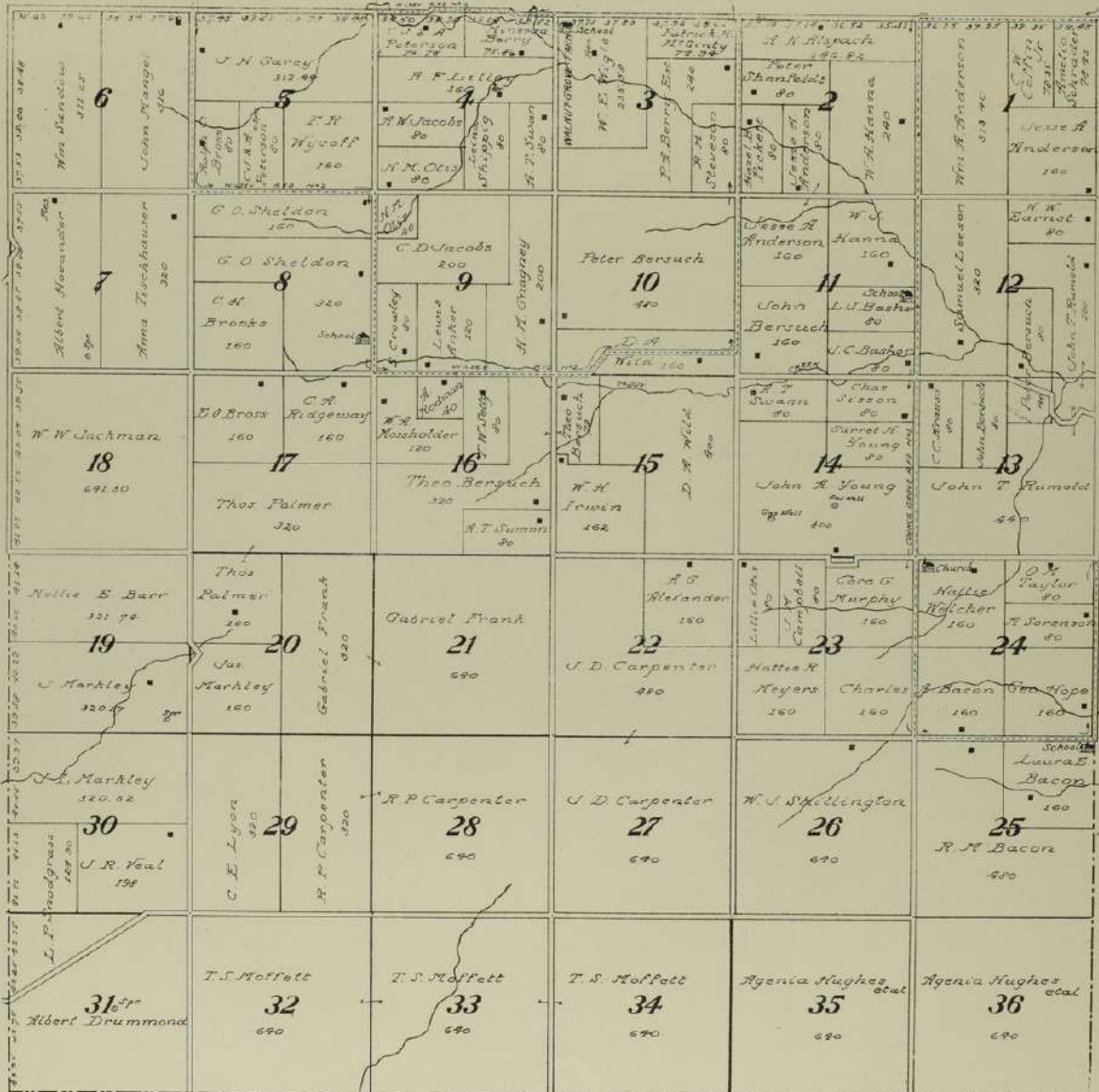

  
**MAP OF**
  
**TOWNSHIP 17 S., RANGE 7 E.**
  
**OF THE 6th P. M.**
  
 Scale 1 1/2 inches to 1 mile



CHASE

CA.



**MAP OF**  
**TOWNSHIP 17 S., RANGE 8 E.**  
**OF THE 6th P. M.**  
 Scale 1 1/4 inches to 1 mile

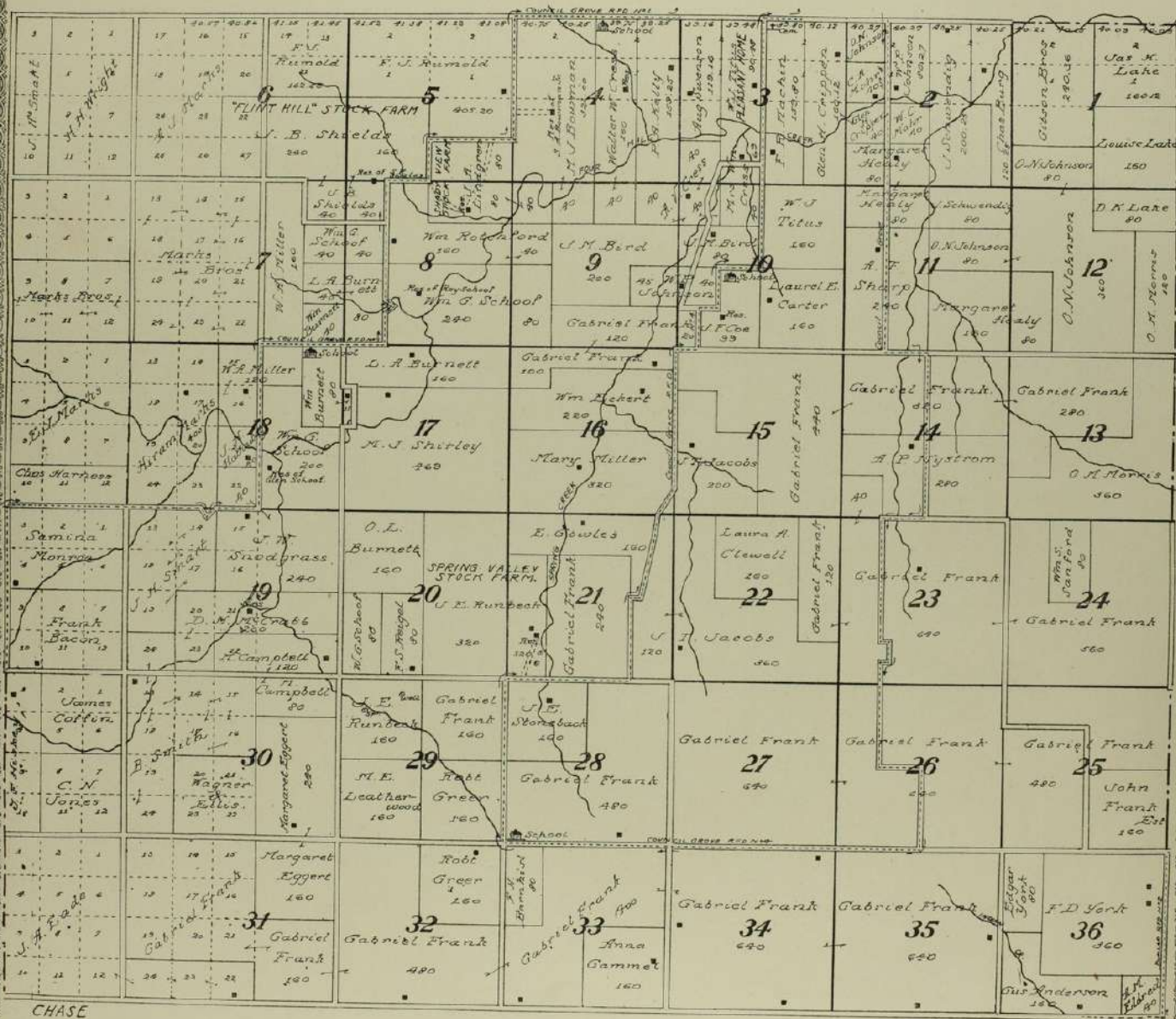

CHASE

CO.



  
**MAP OF**  
**TOWNSHIP 17 S., RANGE 9 E.**  
**OF THE 6th P. M.**  
 Scale 1 3/4 inches to 1 mile

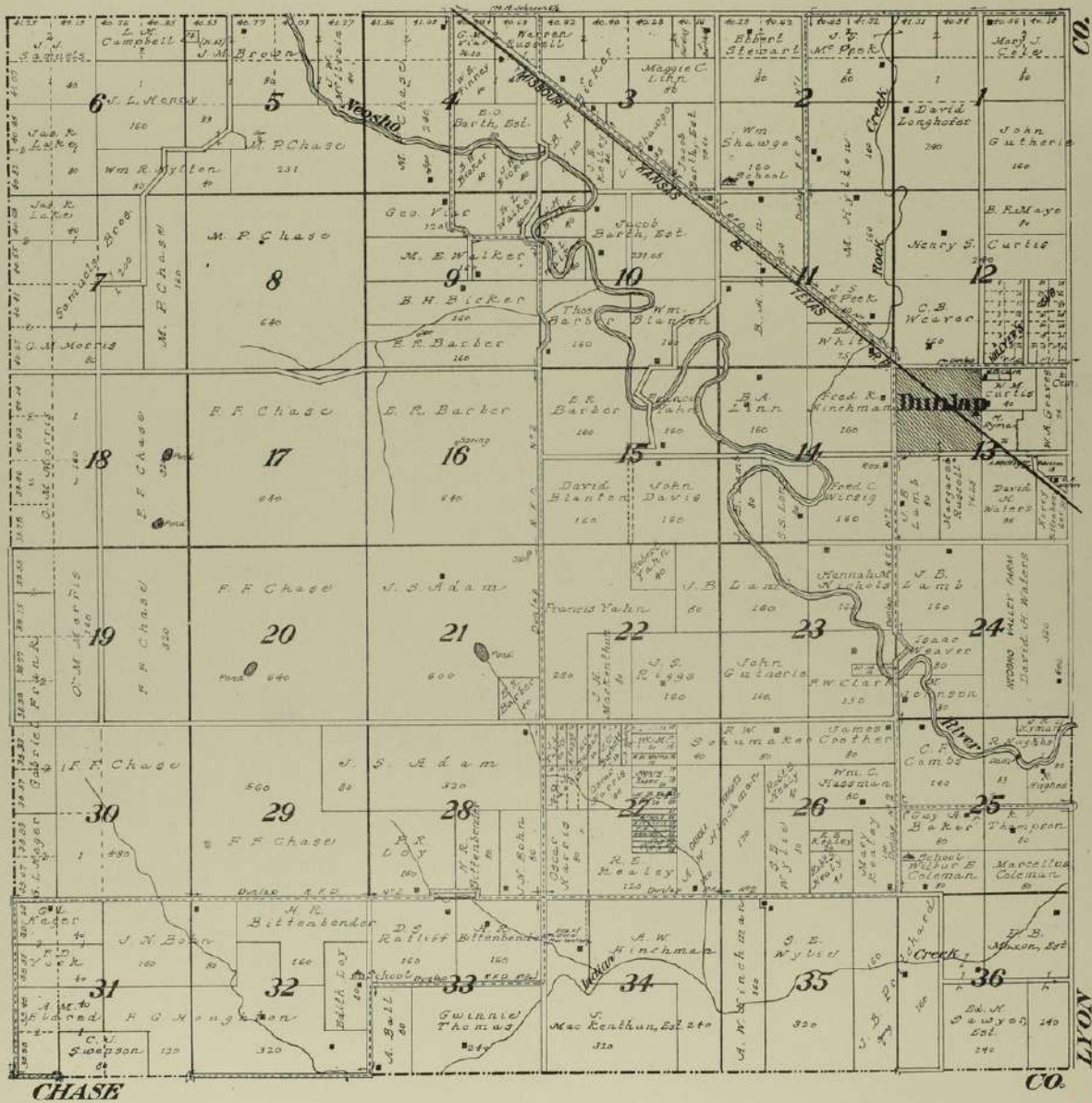

MISSOURI STATE HISTORICAL SOCIETY