

EXPLANATION

- Section Line
- Farm or lot line
- Wagon Road
- Railroad
- Creek or Springs
- House
- Church
- School House
- Adjacent lands owned by same party, connected by a line, thus
- Post Office
- Coal, Lead or Zinc Mine
- County Bridge

# OUTLINE MAP OF NEMAHIA COUNTY, KANSAS.

Scale 1/2 Inch to 1 Mile

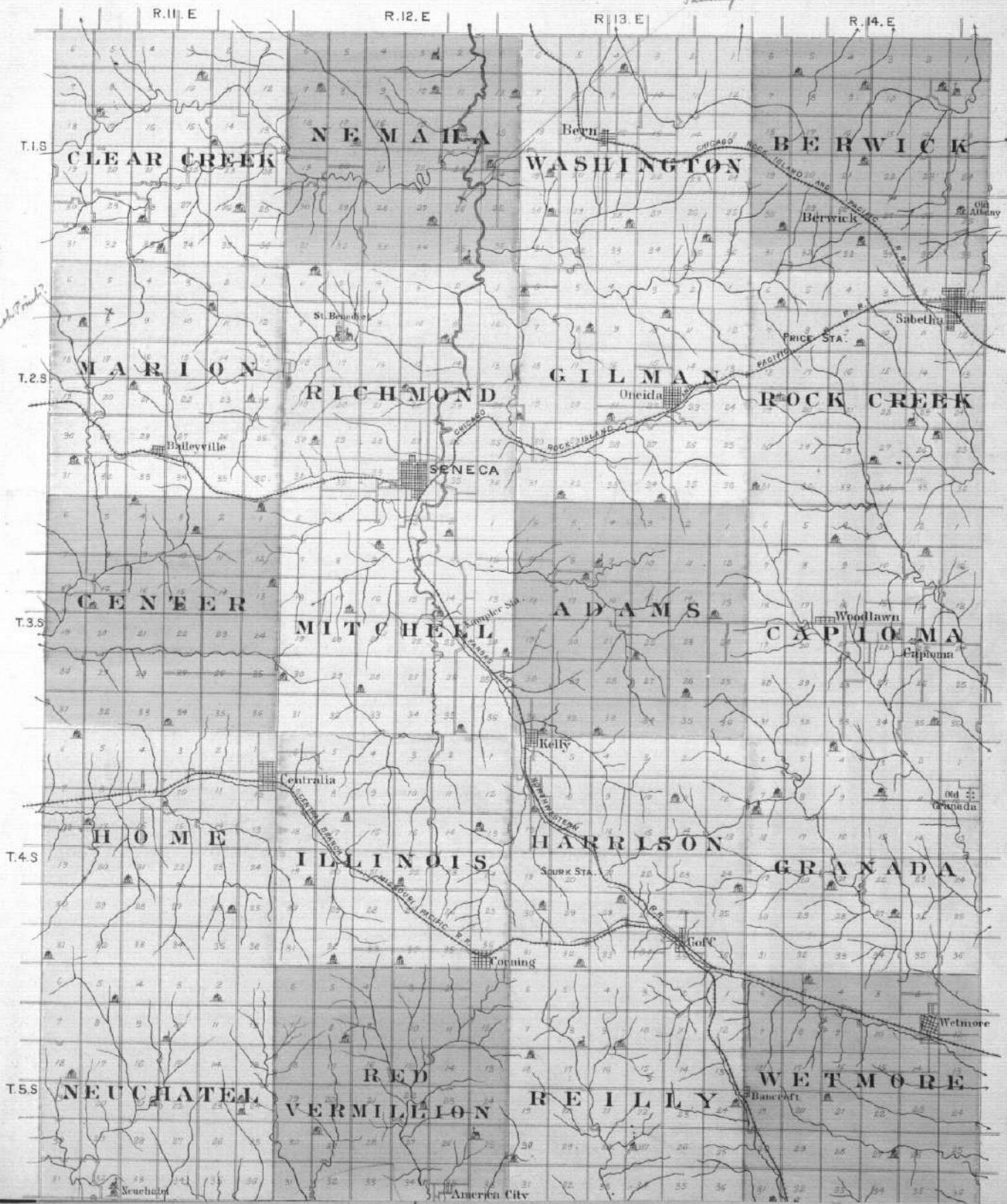

SOUTH PART CITY OF  
**SENECA**  
 County Seat of  
 NEMAH COUNTY, KANSAS.  
 LOCATED ON SECS. 33 & 34 OF T.2.S.R.12.E. OF THE 6PM.  
 Scale 300 Feet to 1 Inch.

John E. Smith

301

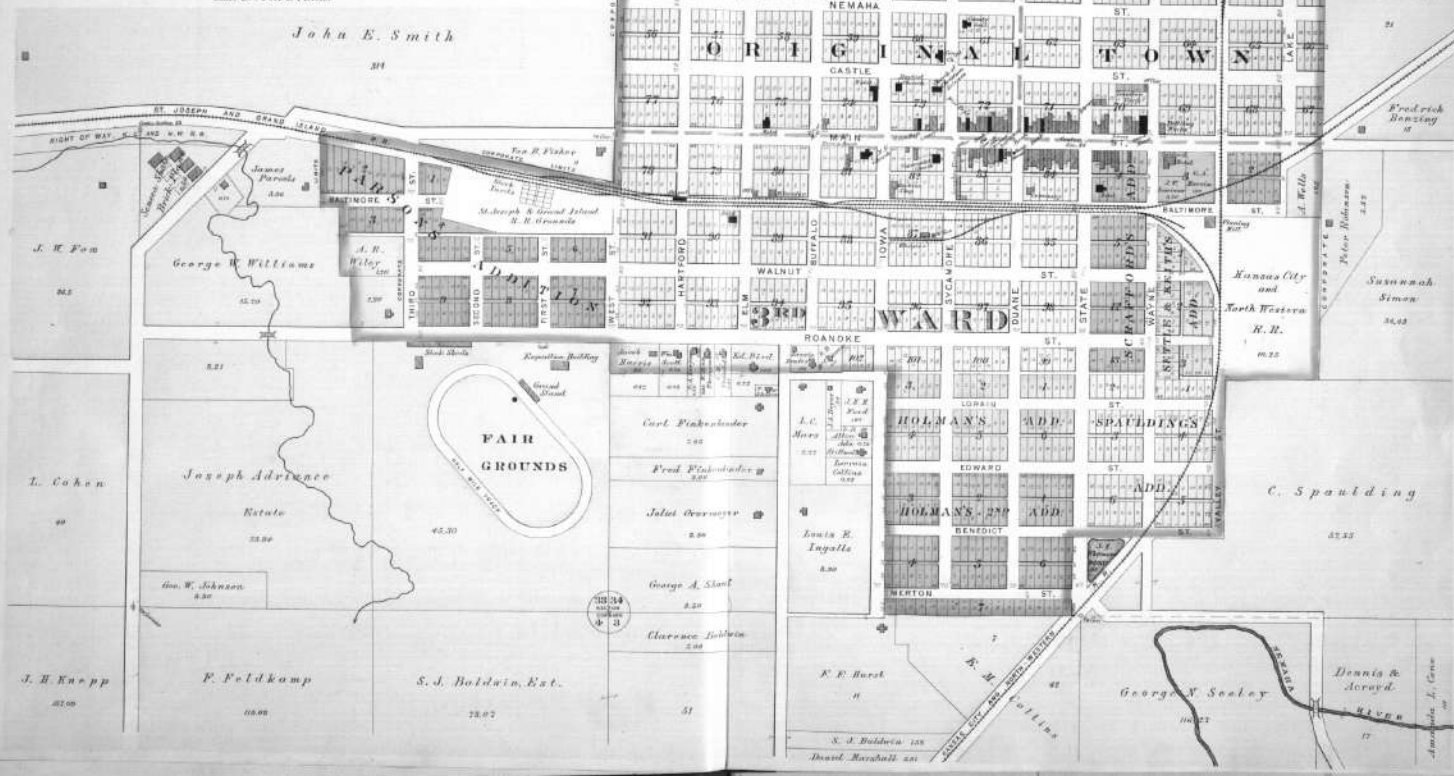

**EXPLANATION**  
**WIDTH OF COUNTY ROADS**

	This arrow means 40 Foot Road
	50 "
	60 "
	66 "
	55 "
	Not of Record

PLAT OF

**RICHMOND**

Scale 2 Inches to the Mile. Township 2 South. Range 12 East. of the 6<sup>th</sup> Principal Meridian.

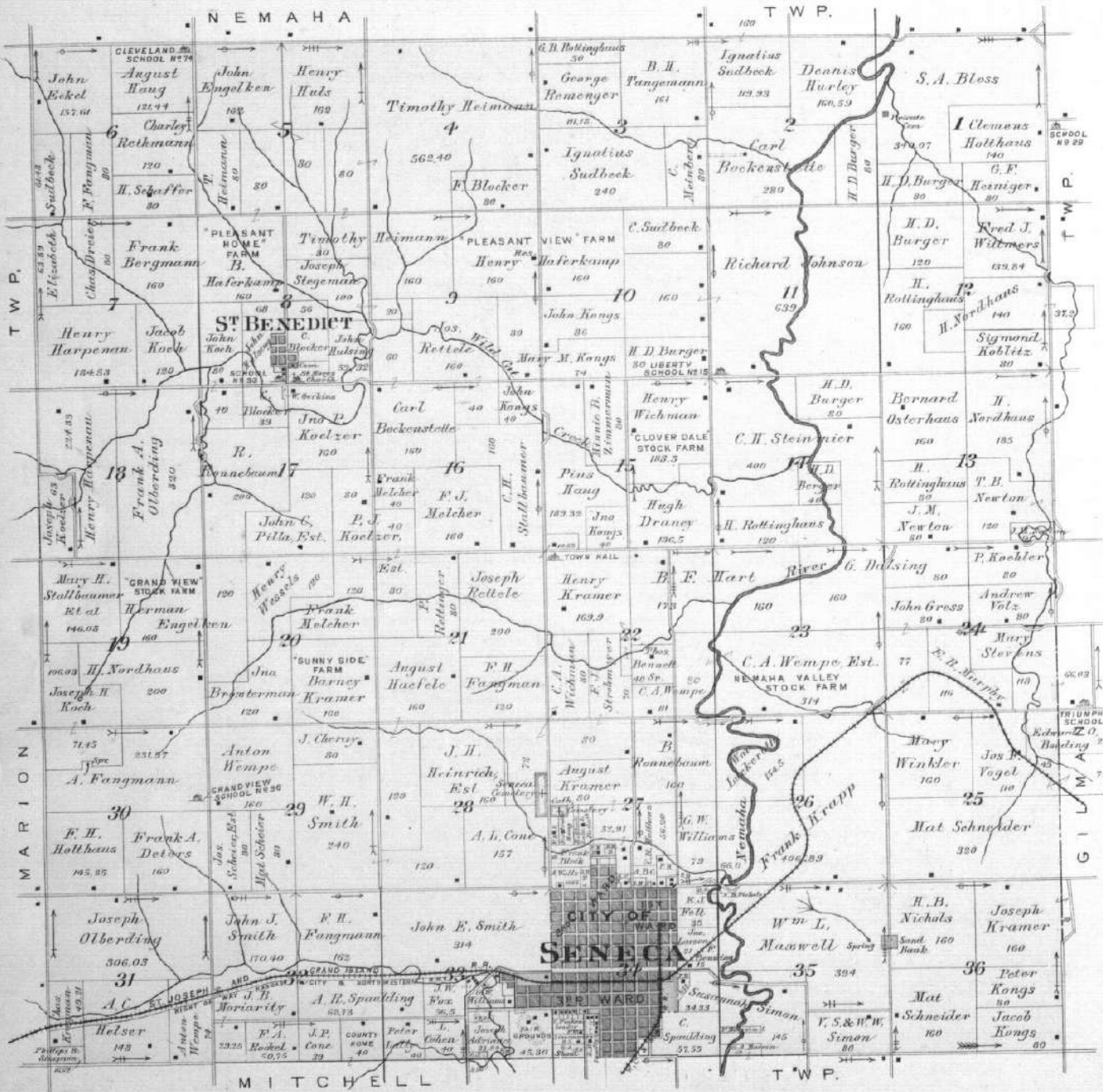



NORTH PART CITY OF  
**SENECA**  
 County Seat of  
 NEMAHA COUNTY, KANSAS.  
 LOCATED ON SECS. 33 & 34 OF T.2 S. R.12 E. OF THE 6TH  
 Scale 300 Feet to 1 Inch.

SENECA CEMETERY

CATHOLIC CEMETERY

E. E. Smith 100

A. L. Conc 101

A. Wells 102

Frank Mack 103

August Kramer 104

C. E. Matthews 105

G. W. W. 106

John E. Smith 107

A. Wells 108

Frank Mack 109

Anton Peruch 110

L. H. Pistenbroyer 111

Peter Schmitt 112

Simon Hanz 113



A. J. F. 114

John Larson 115

Fredrick Henning 116





**EXPLANATION**  
**WIDTH OF COUNTY ROADS**

← This arrow means 40 foot Road

← " " " " " " 50 " " " "

← " " " " " " 60 " " " "

← " " " " " " 49 1/2 " " " "

← " " " " " " 48 " " " "

← " " " " " " 32 " " " "

← " " " " " " 30 " " " "

← " " " " " " Not of Record

← " " " " " " Road Int'cut Not open

**PLAT OF**  
**CLEAR CREEK**

Scale 2 Inches to the Mile. Township 1 South, Range 11 East. of the 6<sup>th</sup> Principal Meridian.

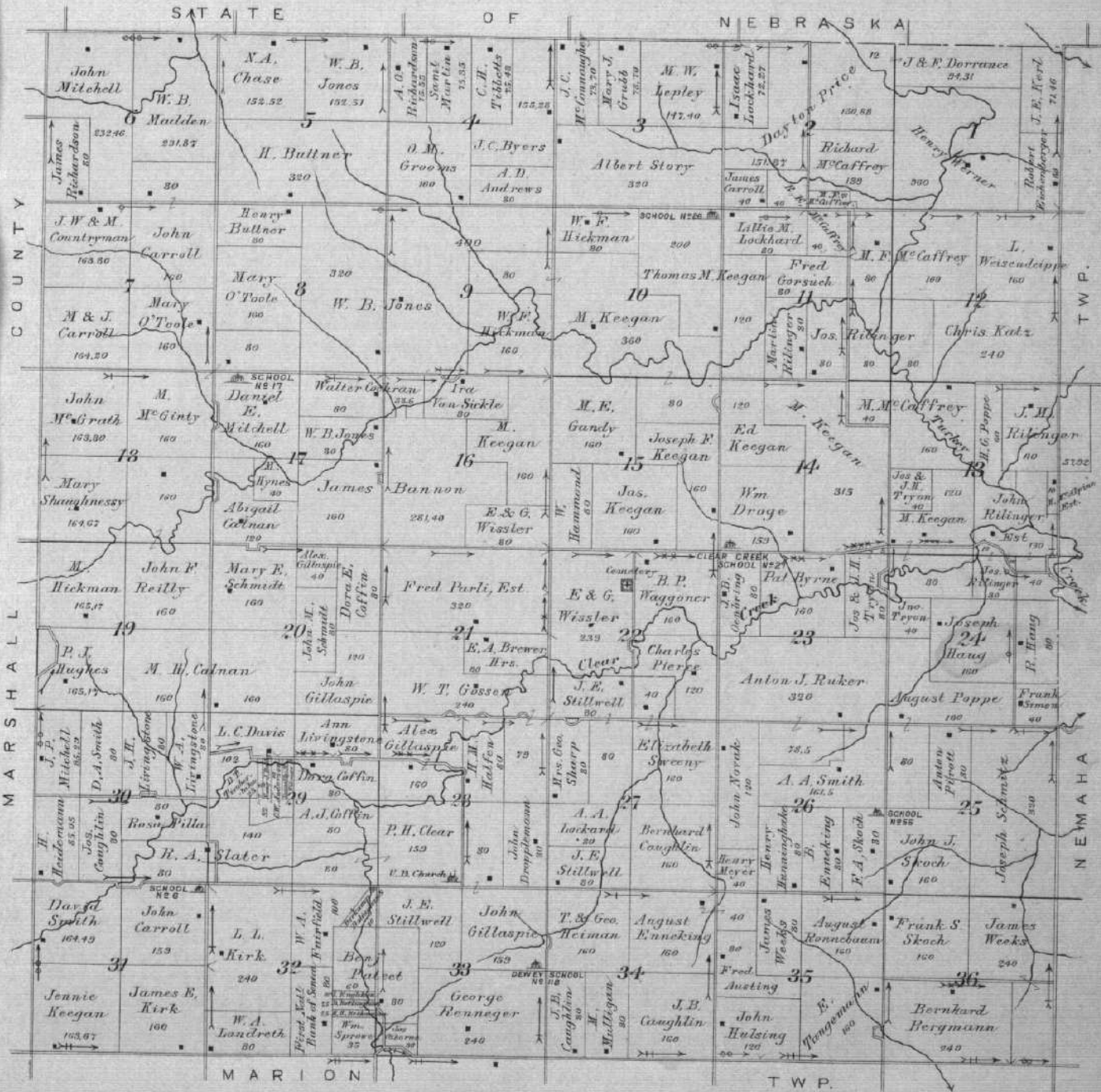

# TAYLOR RAPIDS

SHOWING VACATION  
LOCATED IN SEC. 24, T. 1 S. R. 12 E. OF THE 6. P.M.  
Scale 300 Feet to one Inch.

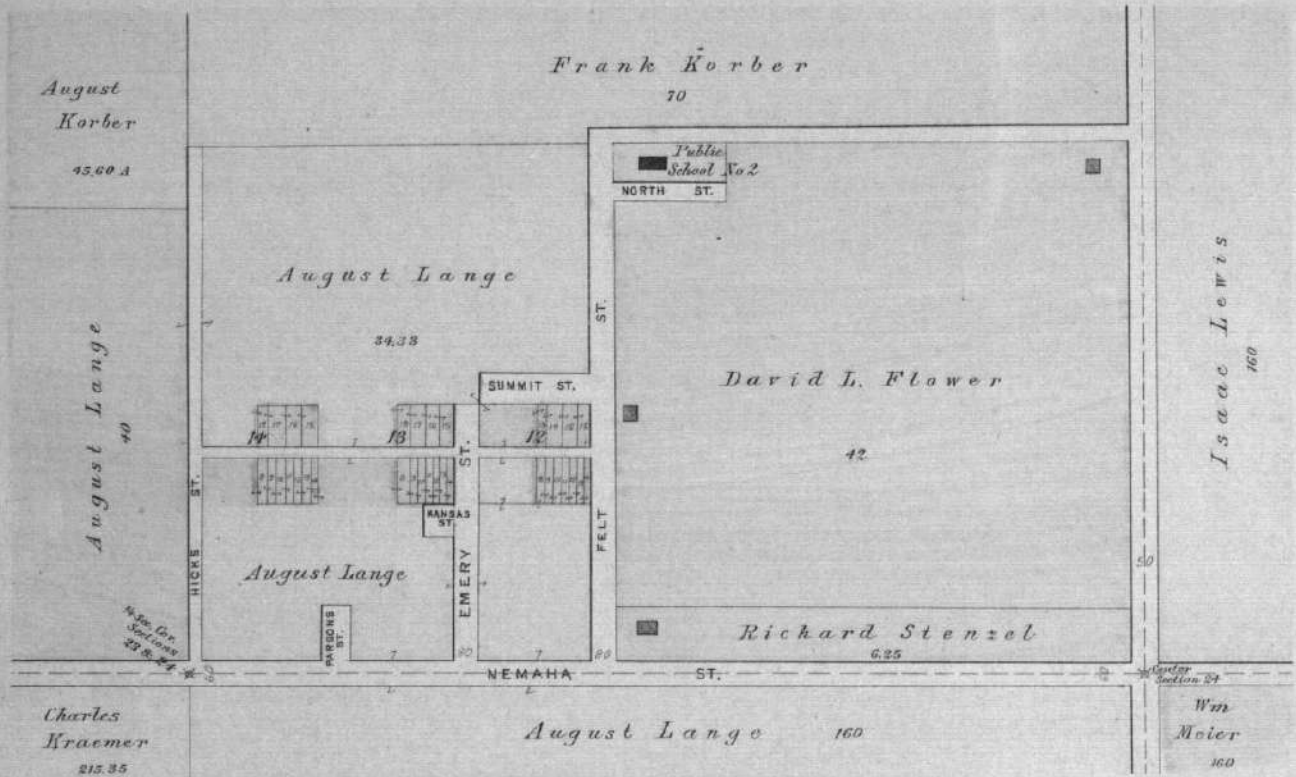

# BAILEYVILLE

LOCATED IN SECTION 28 OF  
MARION TOWNSHIP  
Scale 300 feet to one inch.

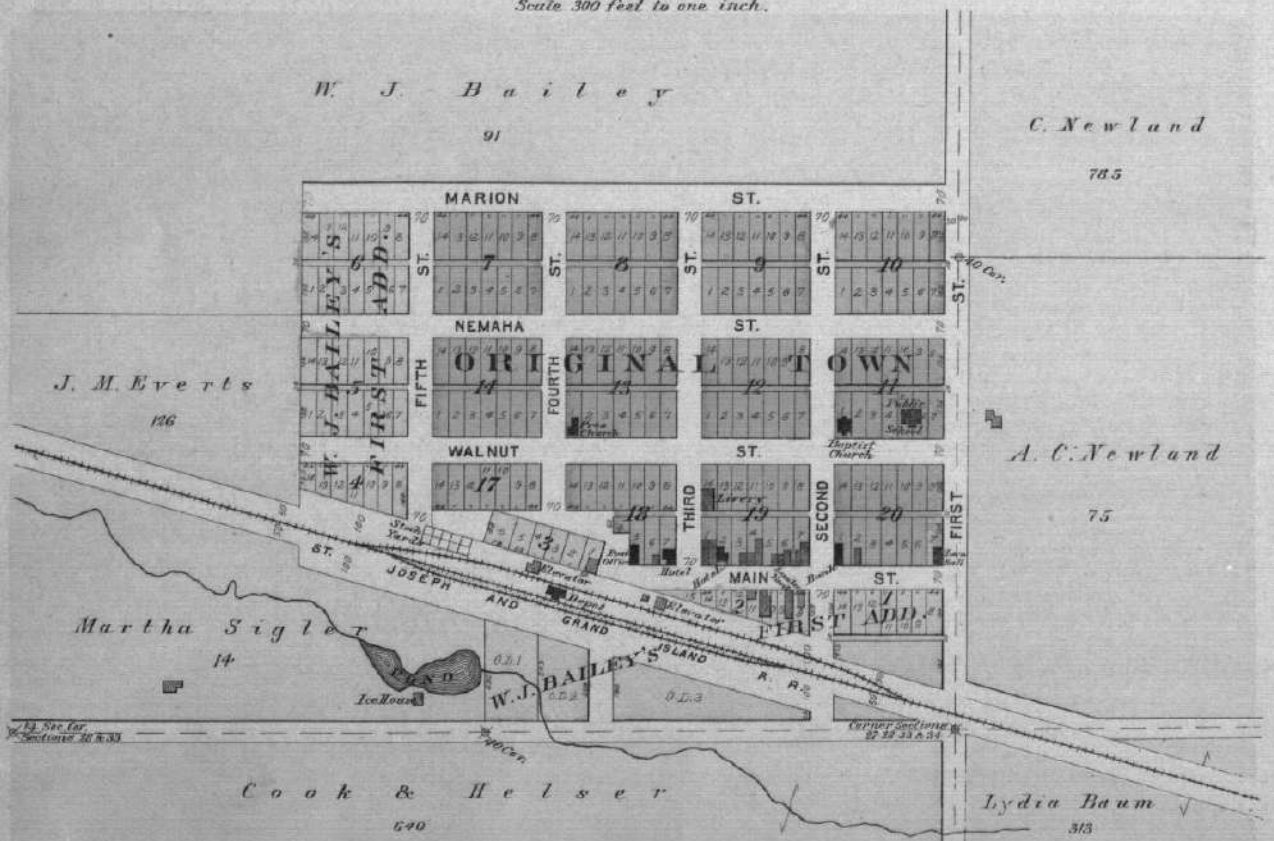





EXPLANATION  
WIDTH OF COUNTY ROADS

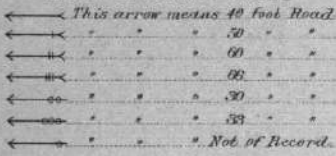

PLAT OF  
**CENTER**

Scale 2 Inches to the Mile. Township 3 South, Range 11 East, of the 6<sup>th</sup> Principal Meridian.

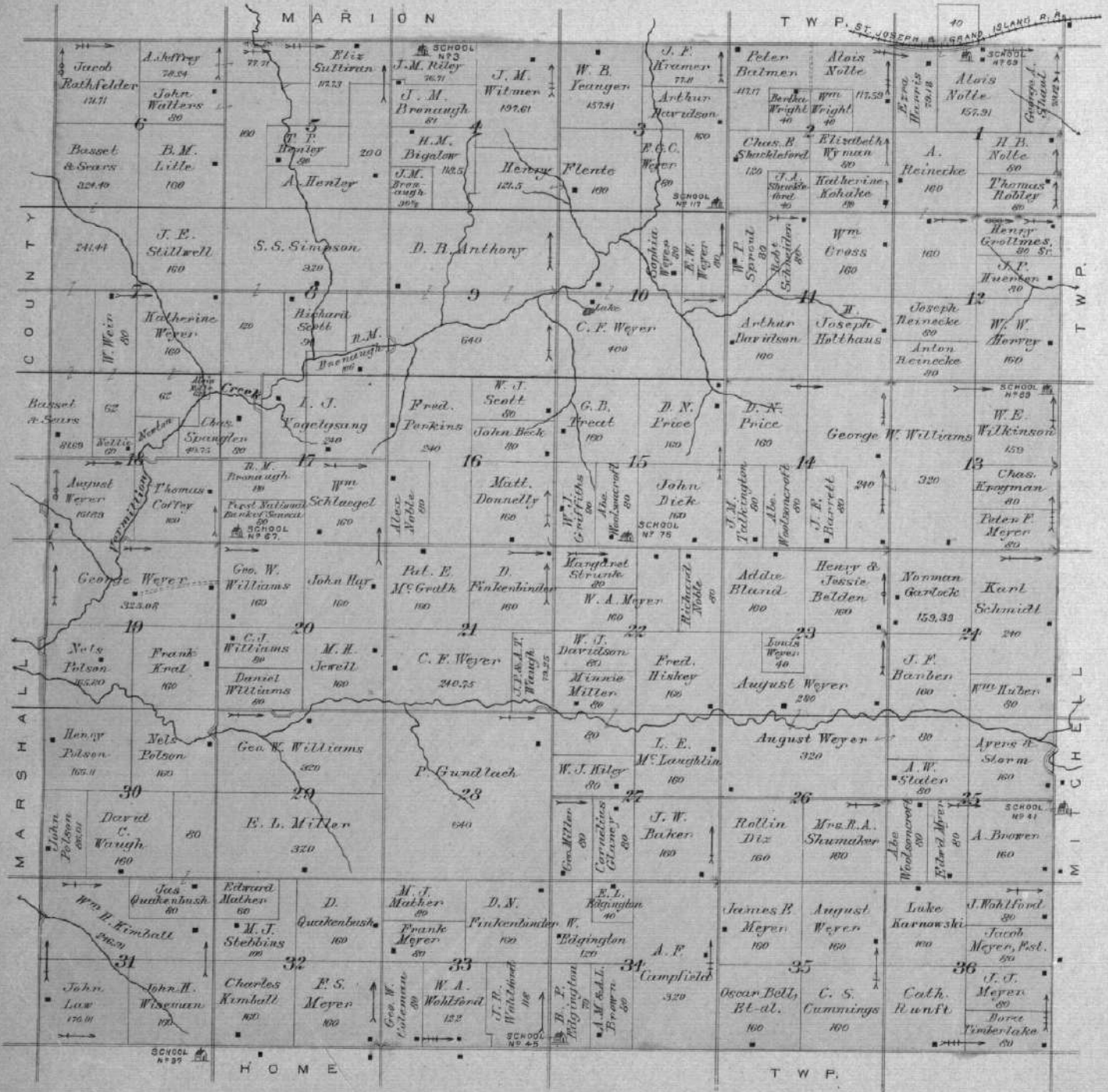

**EXPLANATION**  
**WIDTH OF COUNTY ROADS**

←—————→	This arrow means 40 foot Road
←———→	50 "
←——→	60 "
←——→	66 "
←——→	75 "
←——→	80 "
←——→	90 "
←——→	100 "
←——→	Not of Record

**PLAT OF**  
**HOME**

Scale 2 Inches to the Mile. Township 4 South. Range 11 East. of the 6<sup>th</sup> Principal Meridian.

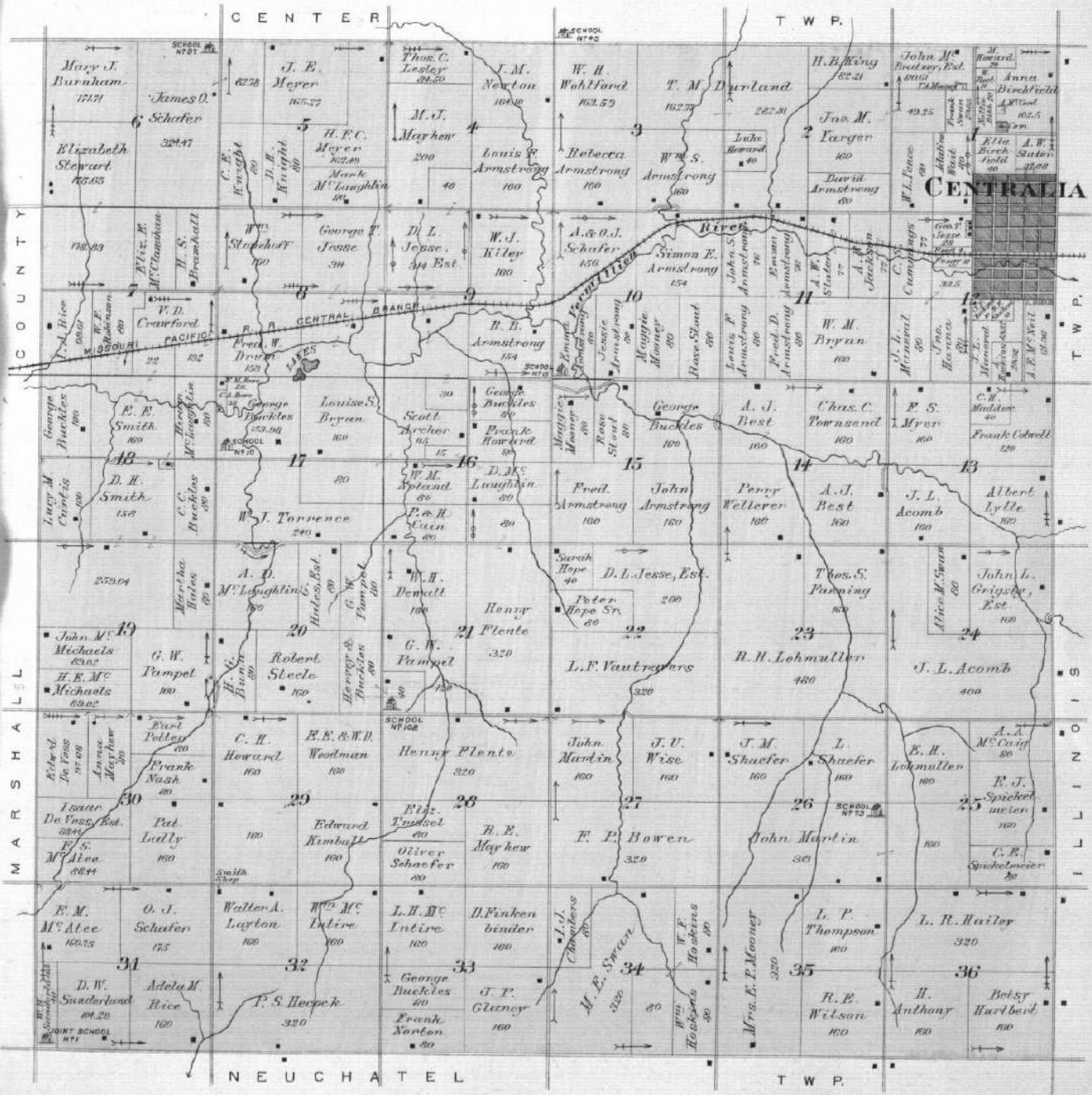

# CENTRALIA

LOCATED IN SECTIONS 1 & 12,

HOME TOWNSHIP

Scale 300 feet to one inch.

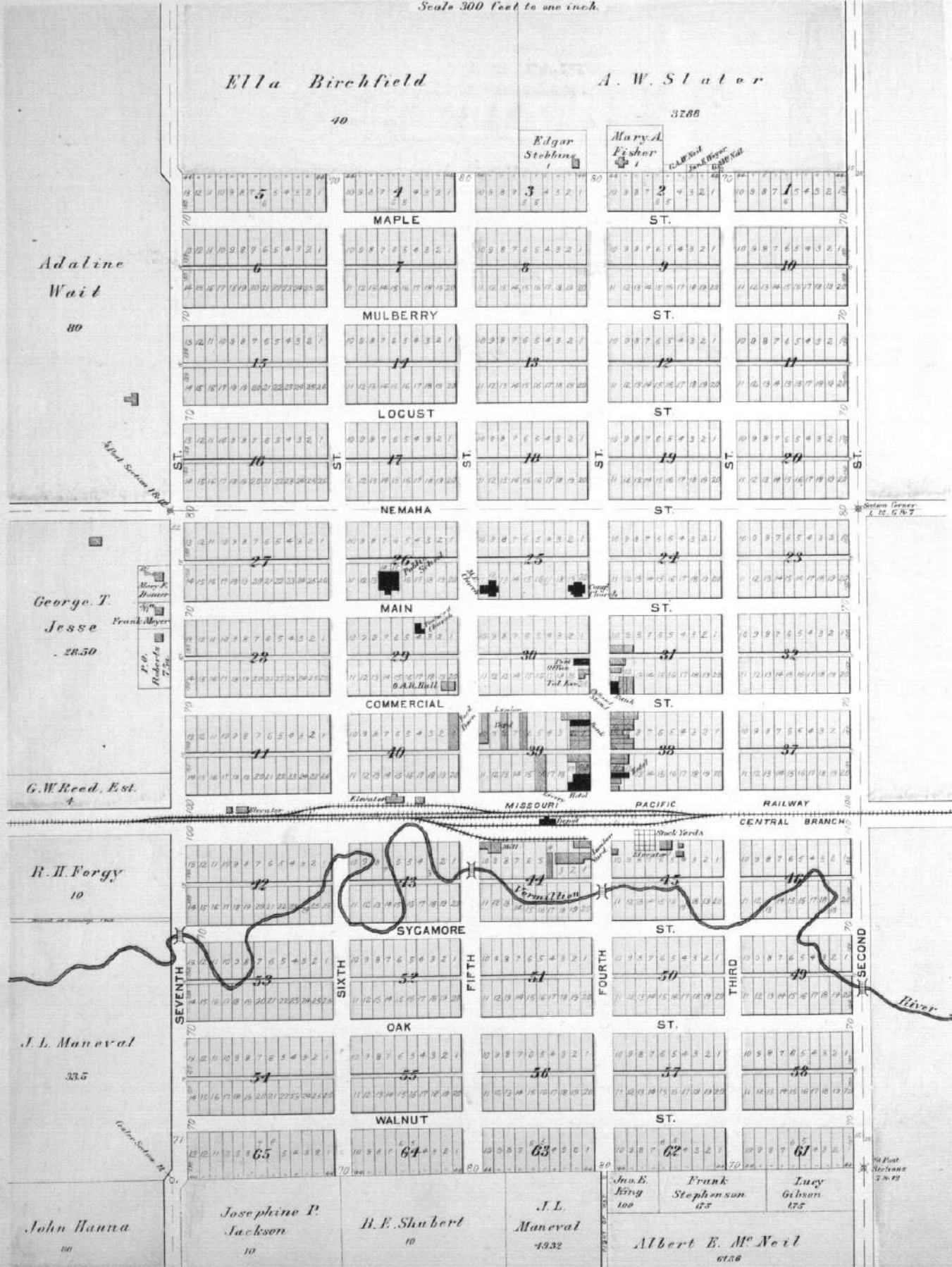

# PLAT OF NEUCHATEL

**EXPLANATION**  
**WIDTH OF COUNTY ROADS**  
 This arrow means 40 foot Road.  
 ← " " " " 50 " " "  
 ← " " " " 60 " " "  
 ← " " " " 35 " " "  
 ← " " " " Not of Record

Scale 2 Inches to the Mile. Township 5 South, Range 11 East, of the 6th Principal Meridian.

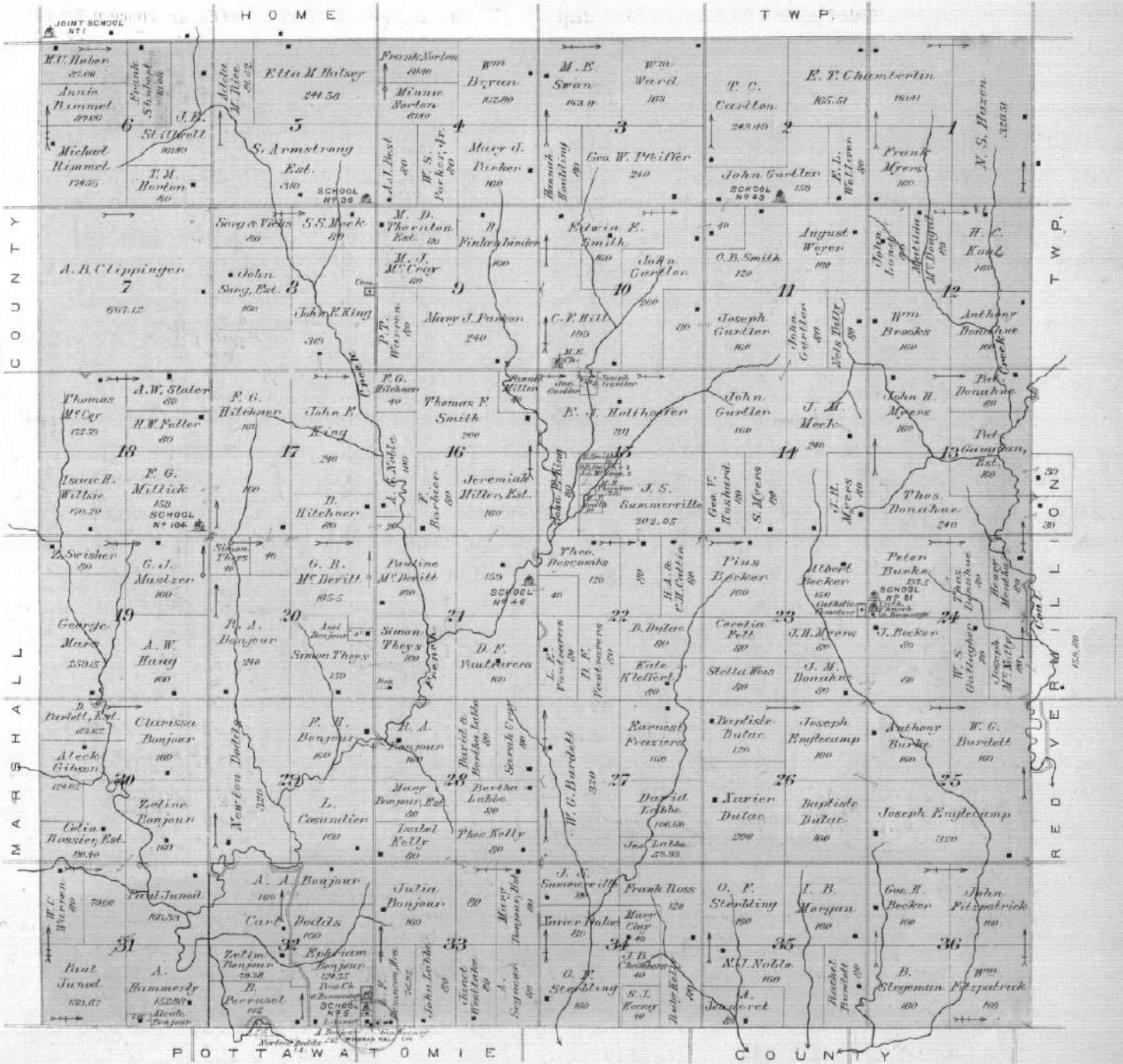

EXPLANATION

WIDTH OF COUNTY ROADS

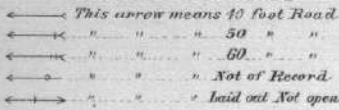

PLAT OF

RED VERMILLION

Scale 2 Inches to the Mile. Township 5 South. Range 12 East. of the 6th Principal Meridian.

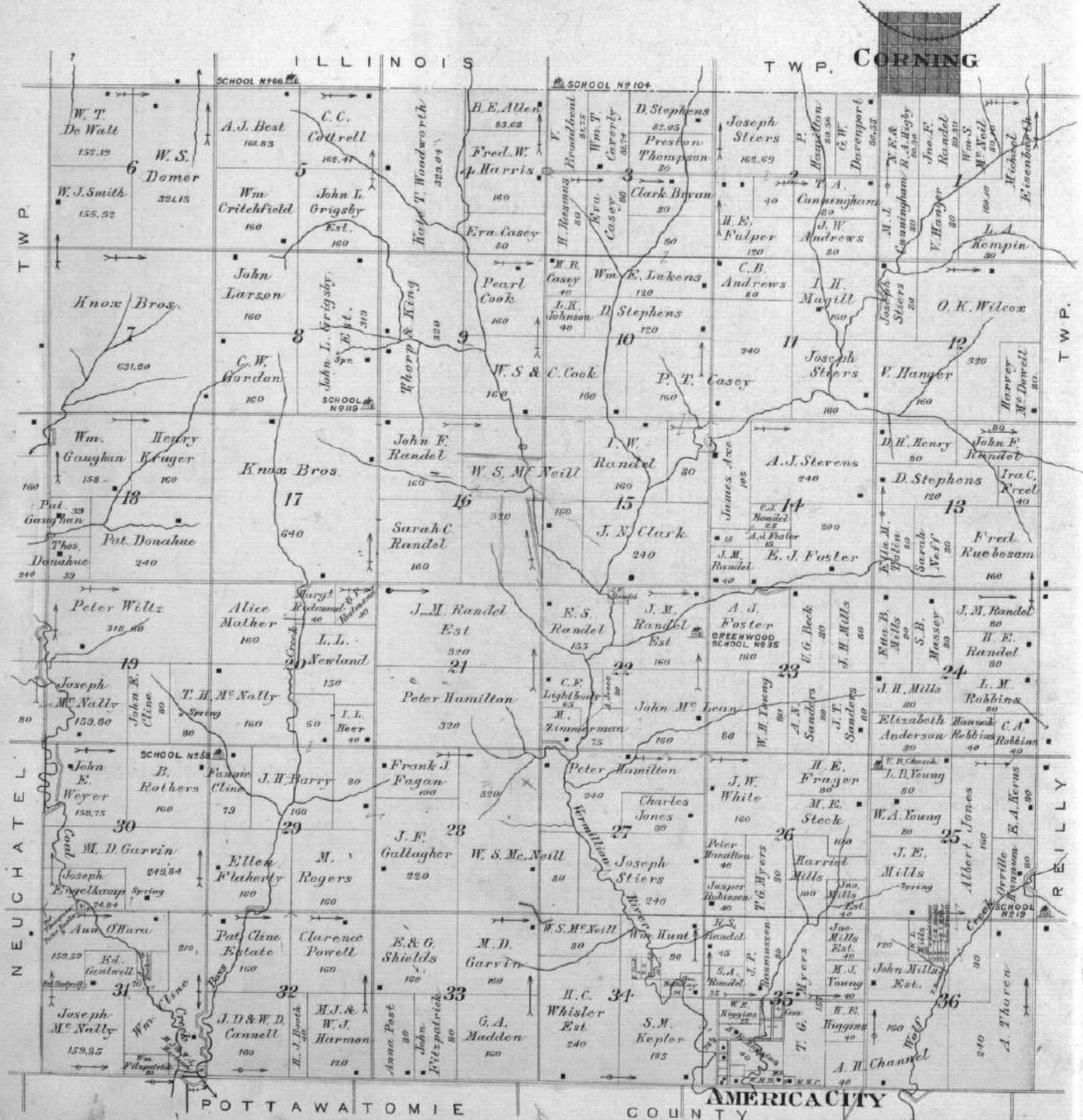

**EXPLANATION**  
**WIDTH OF COUNTY ROADS**

←————→	This arrow means 40 foot Road.
←——— ———→	50
←——— ——— ———→	60
←——— ——— ——— ———→	80
←——— ——— ——— ——— ———→	15
←——— ——— ——— ——— ——— ———→	Not of Record

**PLAT OF**  
**ILLINOIS**

Scale 2 Inches to the Mile. Township 4 South, Range 12 East, of the 6<sup>th</sup> Principal Meridian.

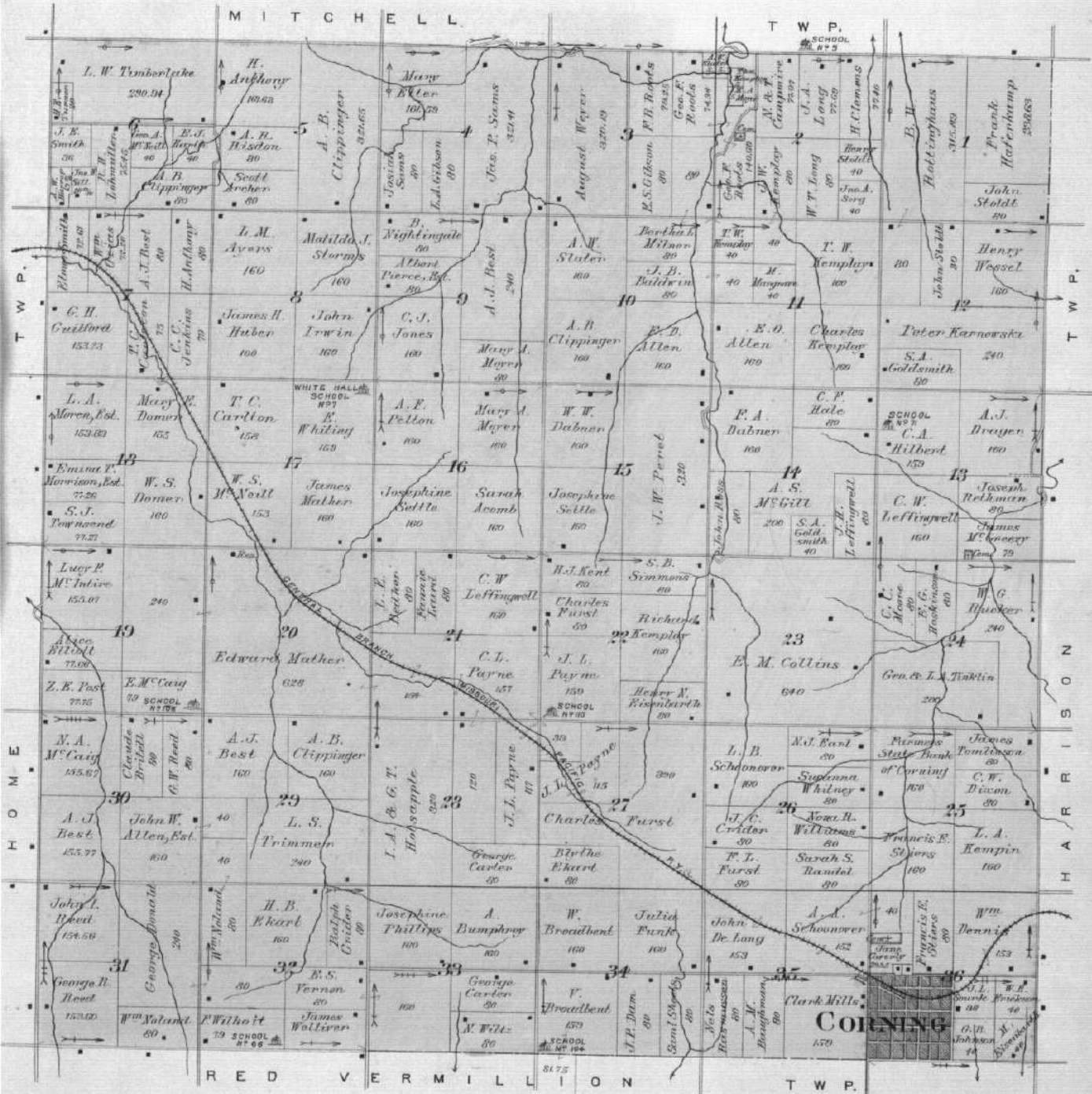

# CORNING

LOCATED IN SEC. 36, T. 4, S. R. 12, E. OF THE 6<sup>TH</sup> P.M.

Scale 300 feet to one inch.

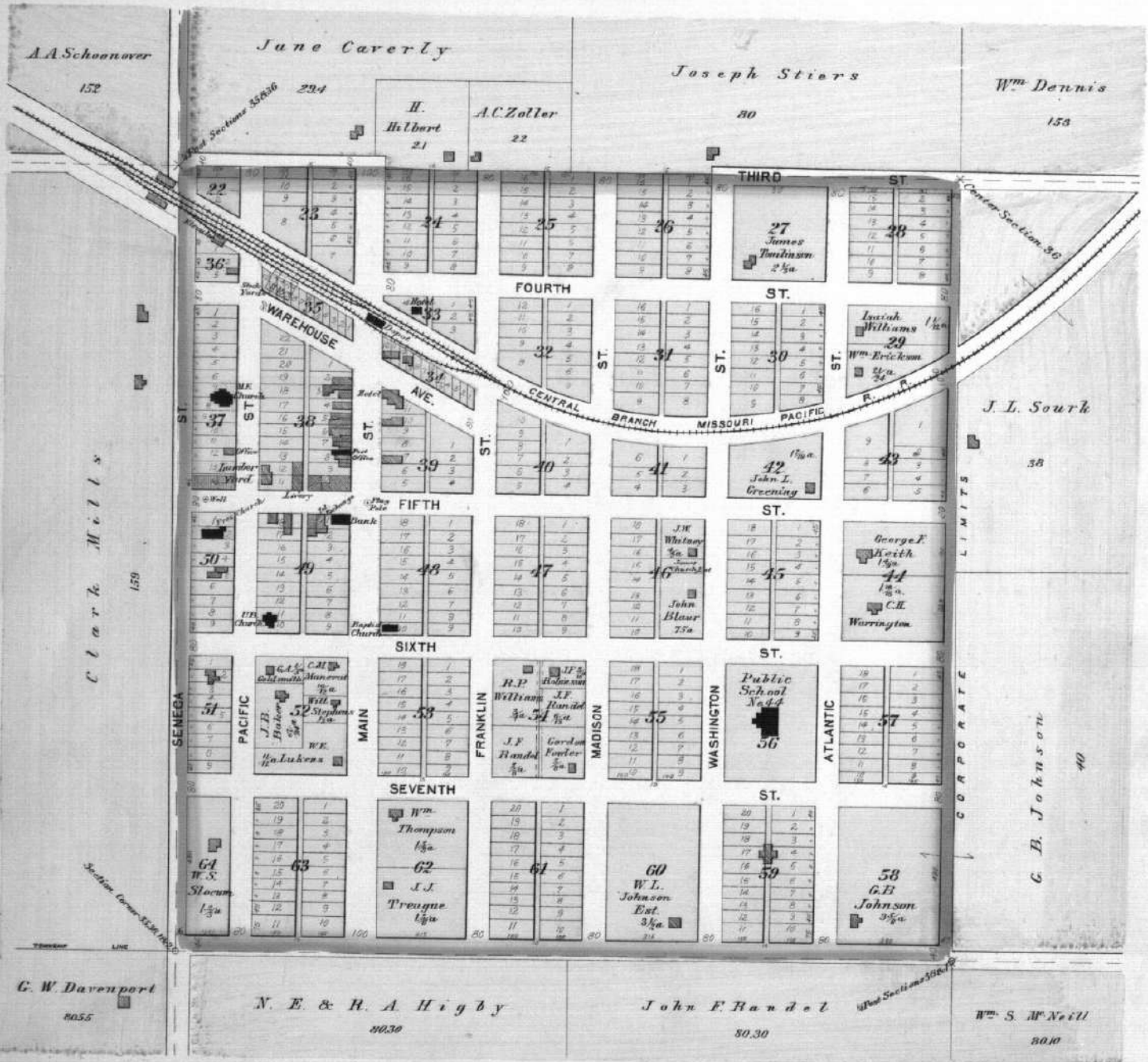



EXPLANATION  
WIDTH OF COUNTY ROADS

- ← This arrow means 40 foot Road
- ← " " " " " " 50 " " "
- ← " " " " " " 60 " " "
- ← " " " " " " 66 " " "
- ← " " " " " " 35 " " "
- ← " " " " " " 30 " " "
- ← " " " " " " Not of Record
- ← " " " " " " Laid out not open

# PLAT OF REILLY

Scale 2 Inches to the Mile. Township 5 South. Range 13 East. of the 6th Principal Meridian.



# GOFF

LOCATED IN SECTIONS 26 & 35

HARRISON TOWNSHIP

Scale 300 feet to one inch.

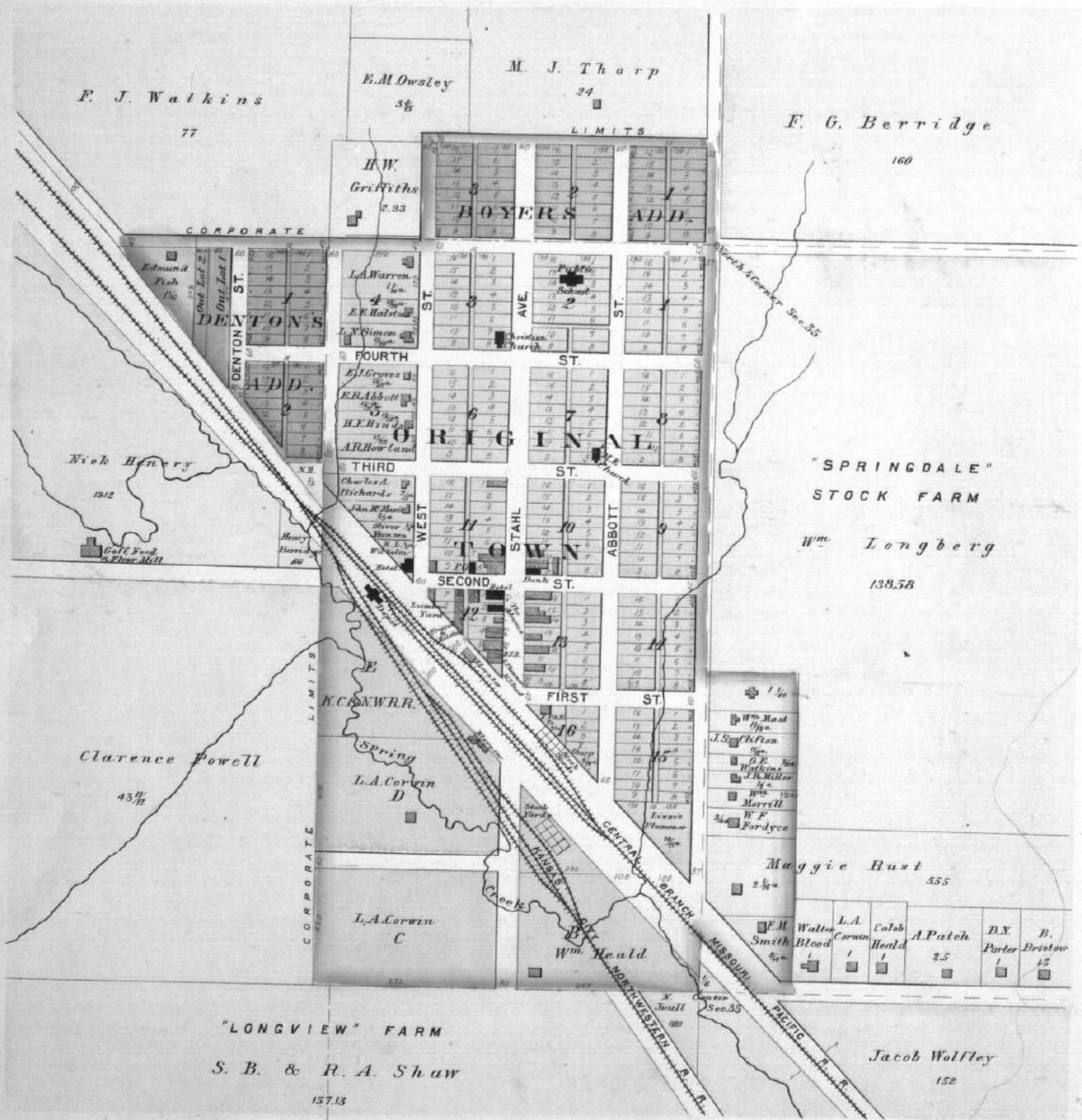

**EXPLANATION**  
**WIDTH OF COUNTY ROADS**  
 ← This arrow means 40 Foot Road  
 ← " " " 50 " "  
 ← " " " 66 " "  
 ← " " " " Laid out Not Opened  
 ← " " " " Not of Record

**PLAT OF**  
**HARRISON**

Scale 2 Inches to the Mile. Township 4 South. Range 13 East. of the 6<sup>th</sup> Principal Meridian.

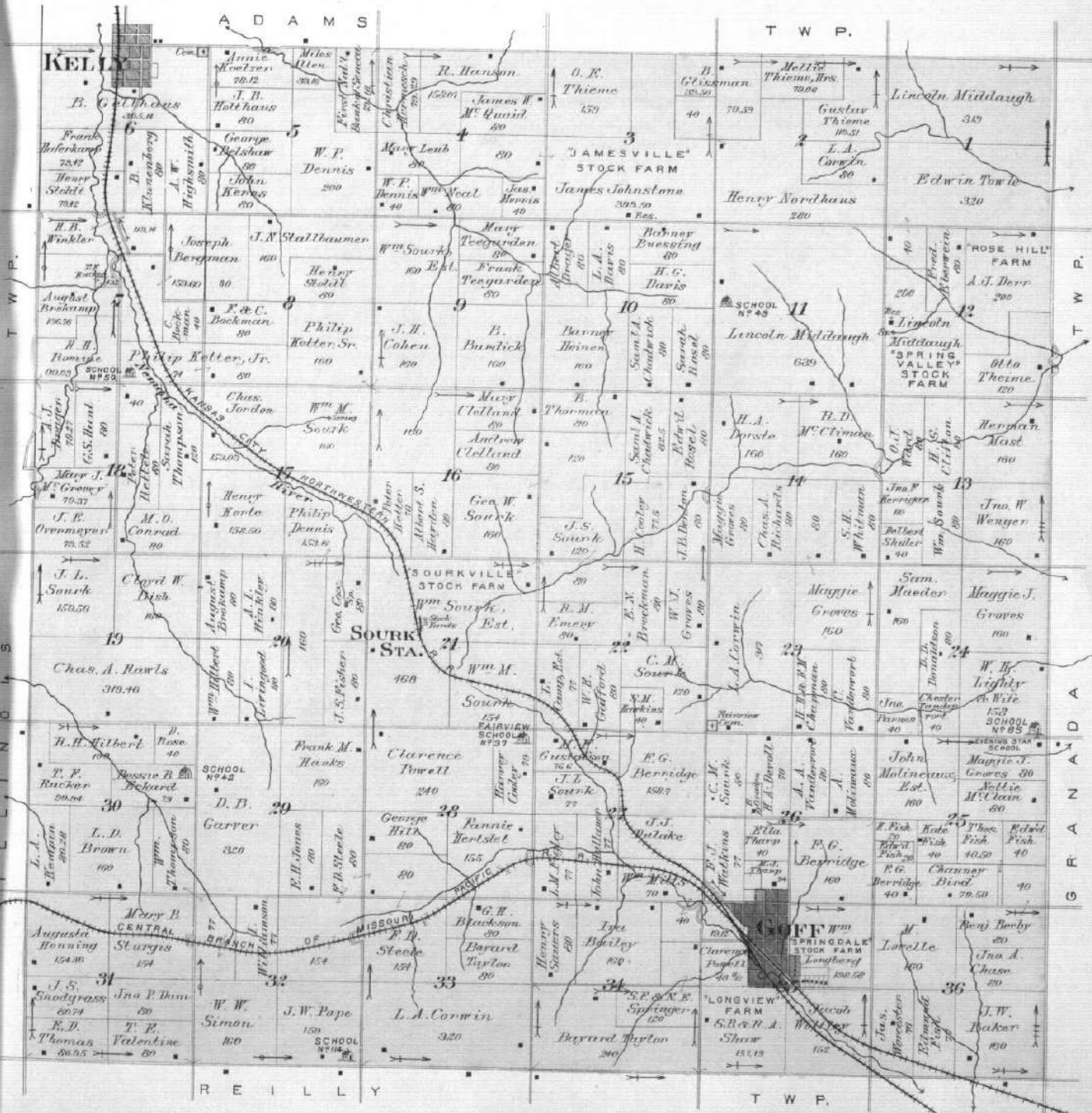

# KELLY

LOCATED IN SEC. 31 OF ADAMS TWP. & OF SEC. 6 HARRISON TWP.

Scale 200 feet to one inch.

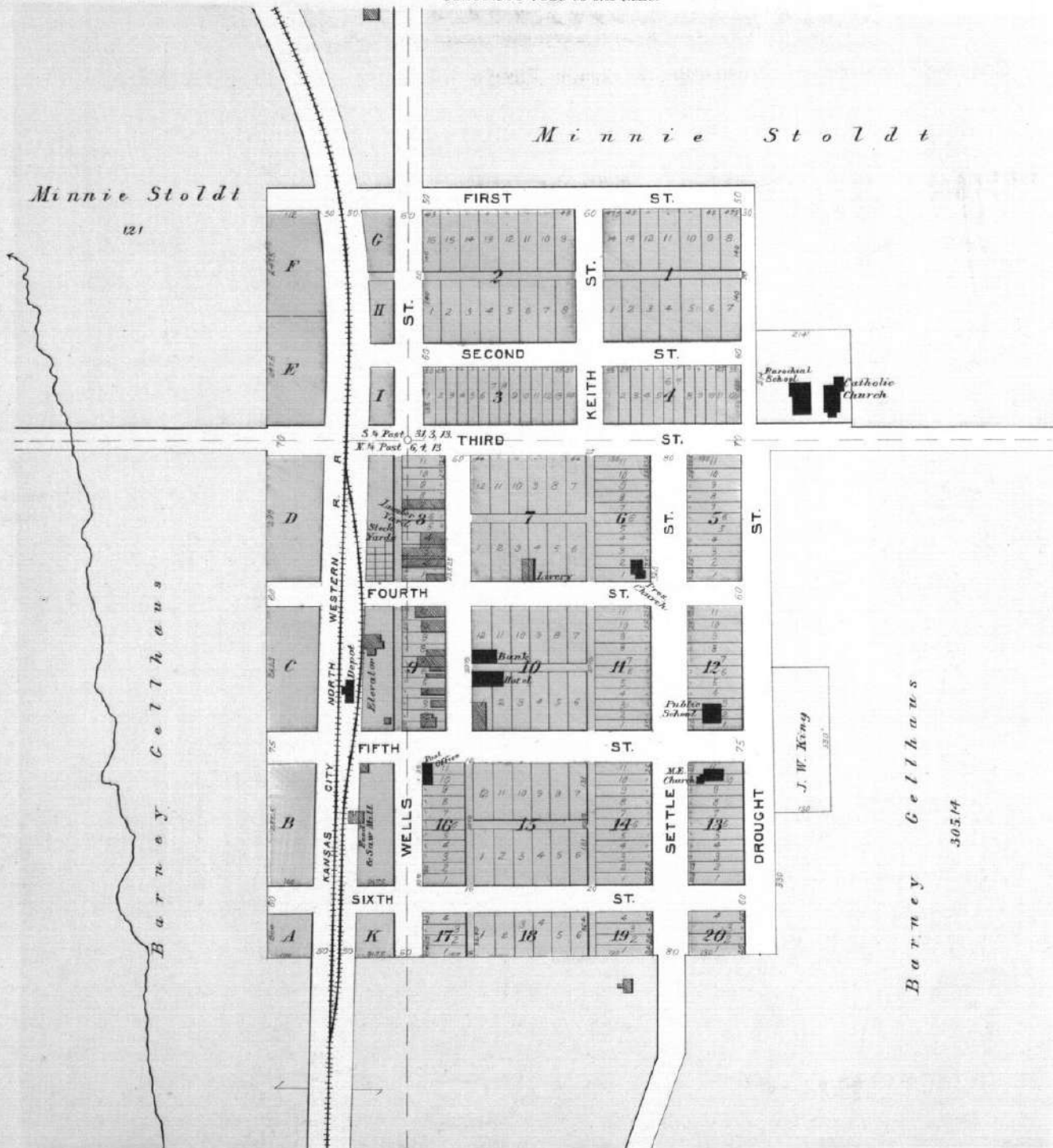

# PLAT OF **ADAMS**

EXPLANATION	
WIDTH OF COUNTY ROADS	
↔	This arrow means 40 foot Road
↔	" " " " means 50 " "
↔	" " " " means 60 " "
↔	" " " " means 45 " "
↔	" " " " means 55 " "
↔	" " " " means 30 " "
↔	" " " " Not of Record

Scale 2 Inches to the Mile. Township 3 South, Range 13 East, of the 6th Principal Meridian.



# ONEIDA

LOCATED IN GILMAN TOWNSHIP

Scale 300 Feet to one inch.

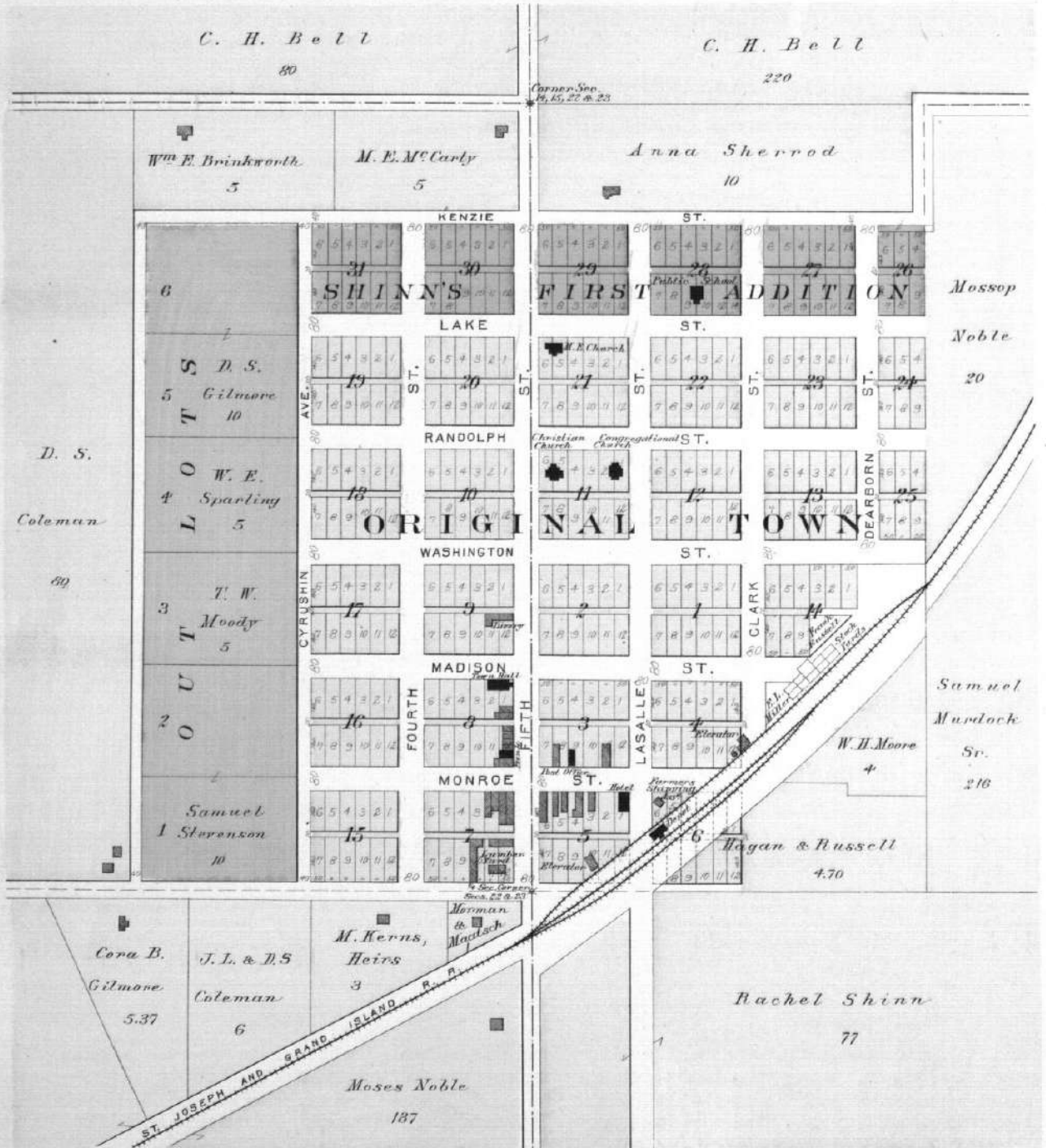

PLAT OF  
**GILMAN**

**EXPLANATION**  
 WIDTH OF COUNTY ROADS  
 ← This arrow means 40 feet Road  
 ← " " " " " " 50 " " "  
 ← " " " " " " 60 " " "  
 ← " " " " " " 55 " " "  
 ← " " " " " " Not of Record

Scale 2 Inches to the Mile. Township 2 South, Range 13 East. of the 6th Principal Meridian.

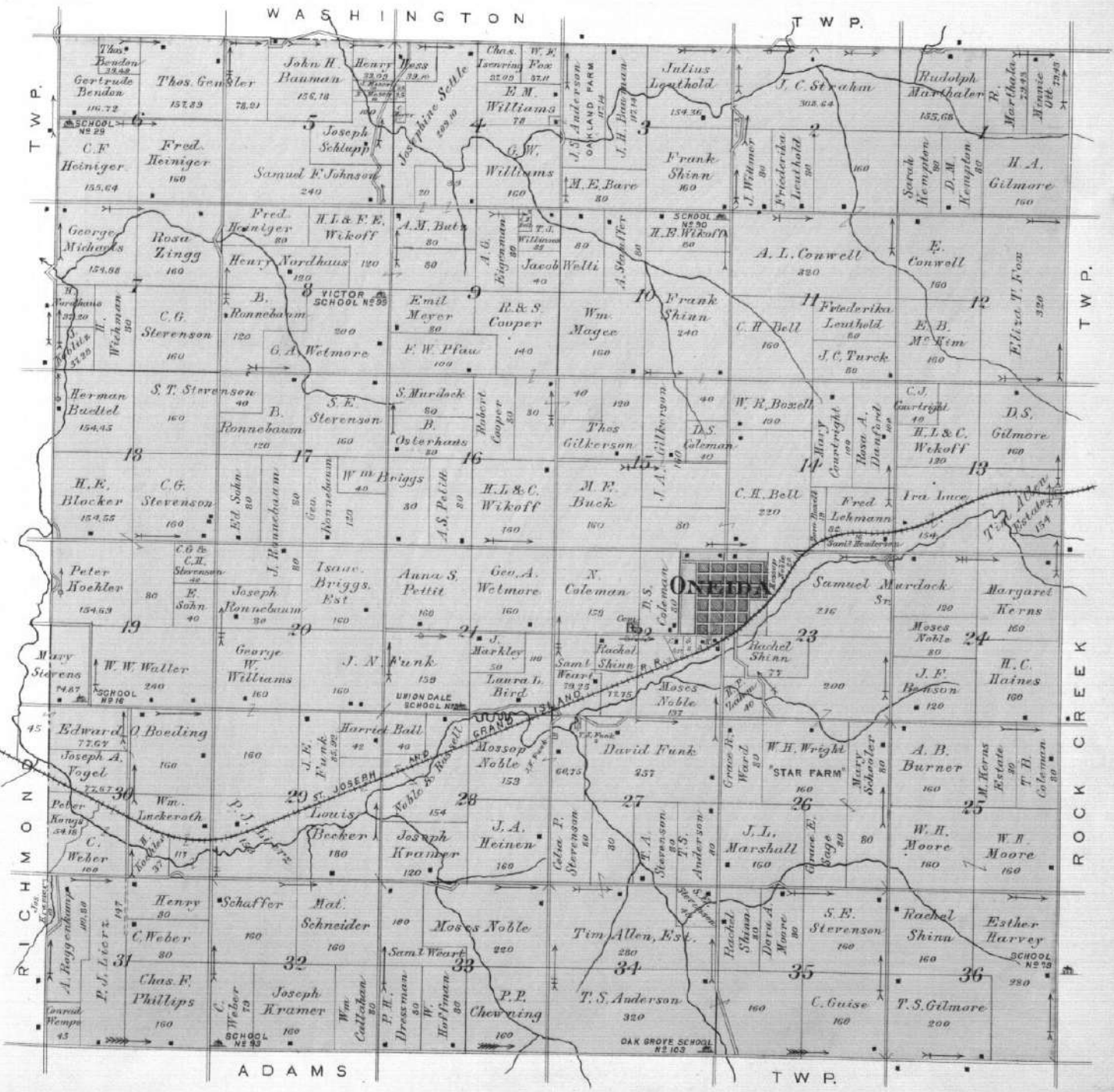

# BERN

LOCATED IN WASHINGTON TOWNSHIP

Scale 300 feet to one inch.

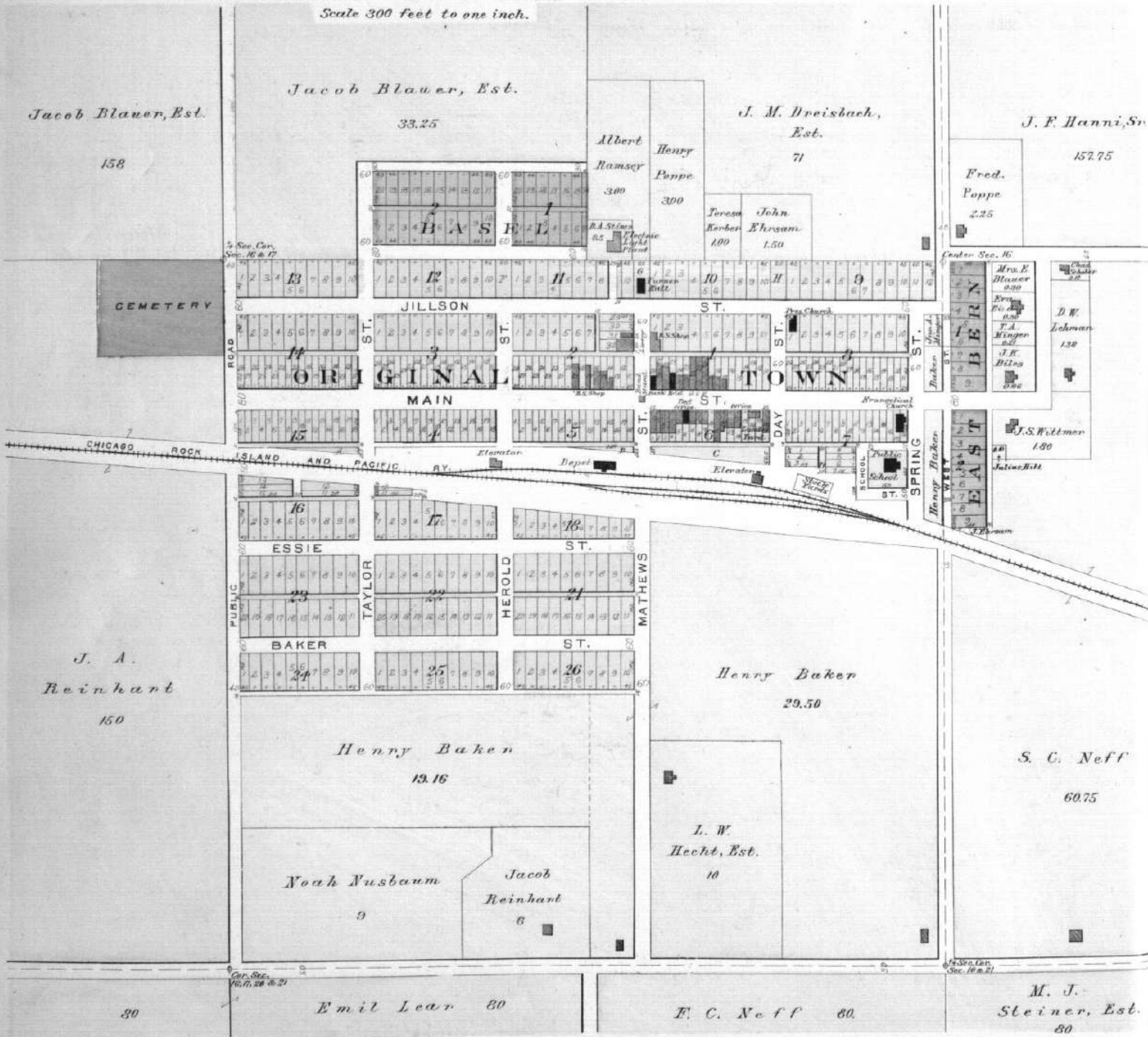



**EXPLANATION**  
WIDTH OF COUNTY ROADS

←	This arrow means 40 foot Road
←	" " " " 50 " "
←	" " " " 60 " "
←	" " " " 25 " "
←	" " " " 46 1/2 " "
←	" " " " 30 " "
←	" " " " 33 " "
←	" " " " 66 " "
←	" " " " Not of Record

**PLAT OF**  
**WASHINGTON**

Scale 2 Inches to the Mile. Township 1 South. Range 13 East. of the 6th Principal Meridian.

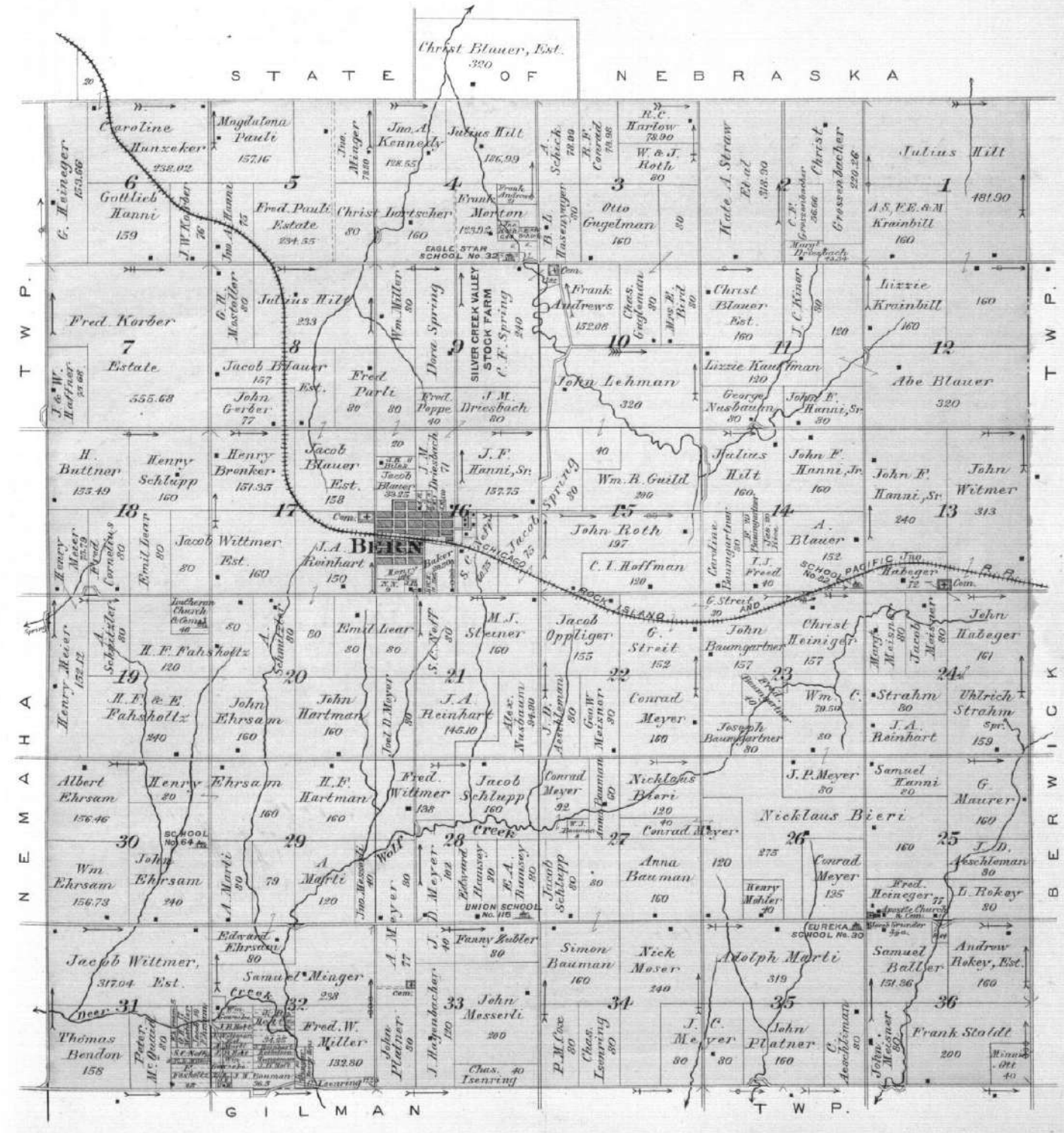

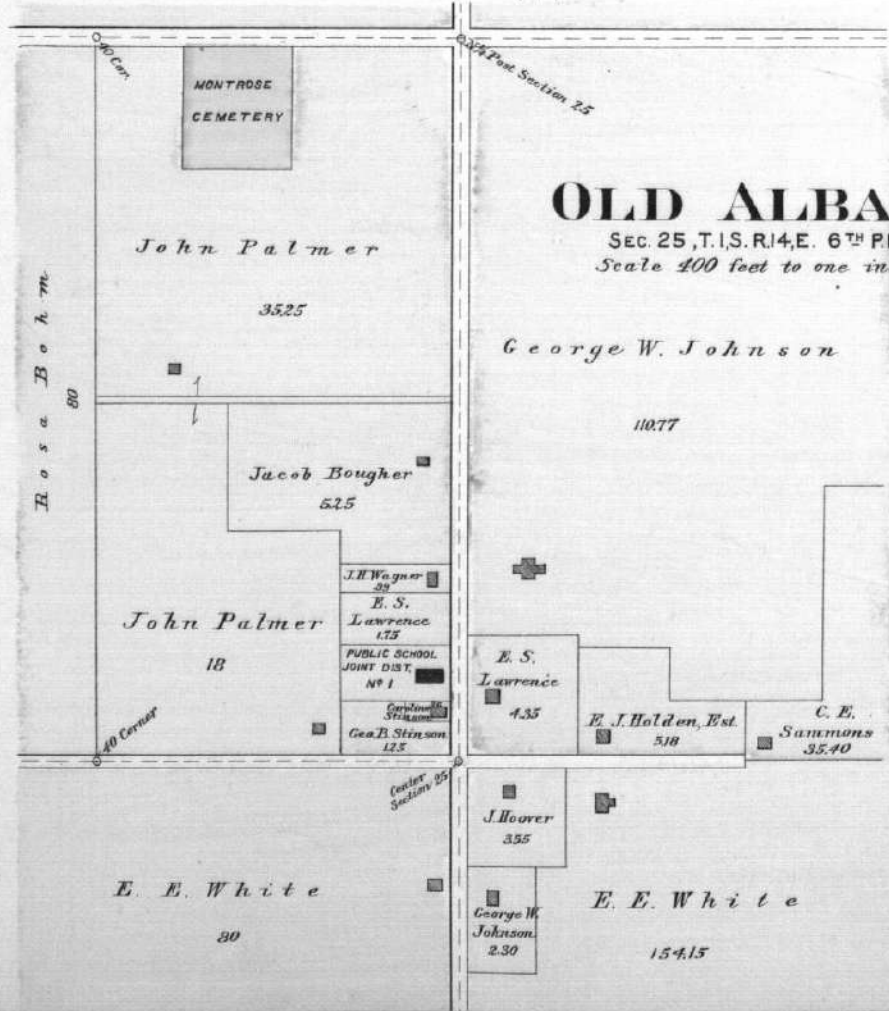
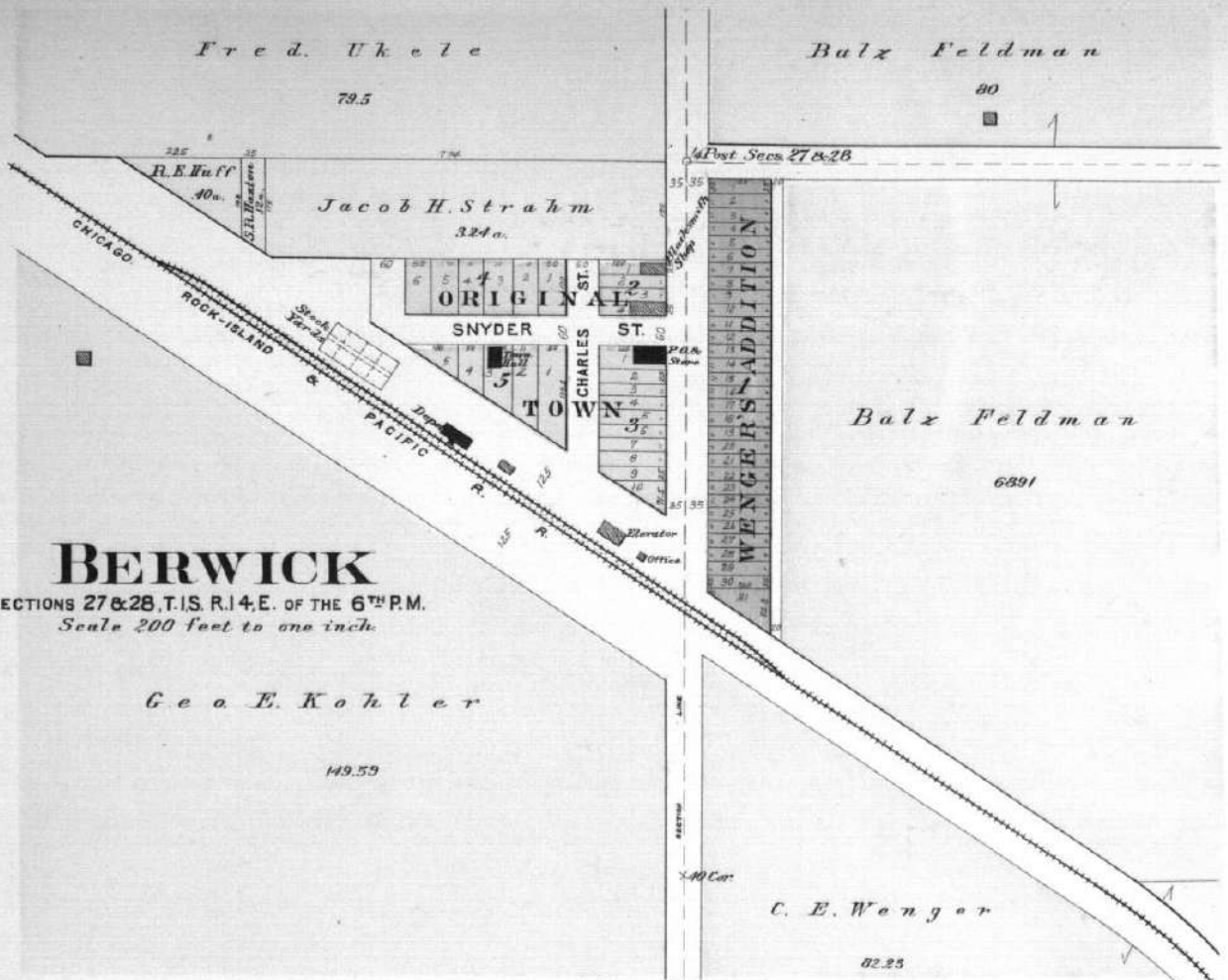

EXPLANATION  
WIDTH OF COUNTY ROADS

This arrow means 40 foot Road

←	50 "
←←	60 "
←←←	66 "
←←←←	25 "
←←←←←	33 "
←←←←←←	45 "
←←←←←←←	30 "
○	Not of Record

PLAT OF  
**BERWICK**

Scale 2 Inches to the Mile. Township 1 South. Range 14 East. of the 6th Principal Meridian.



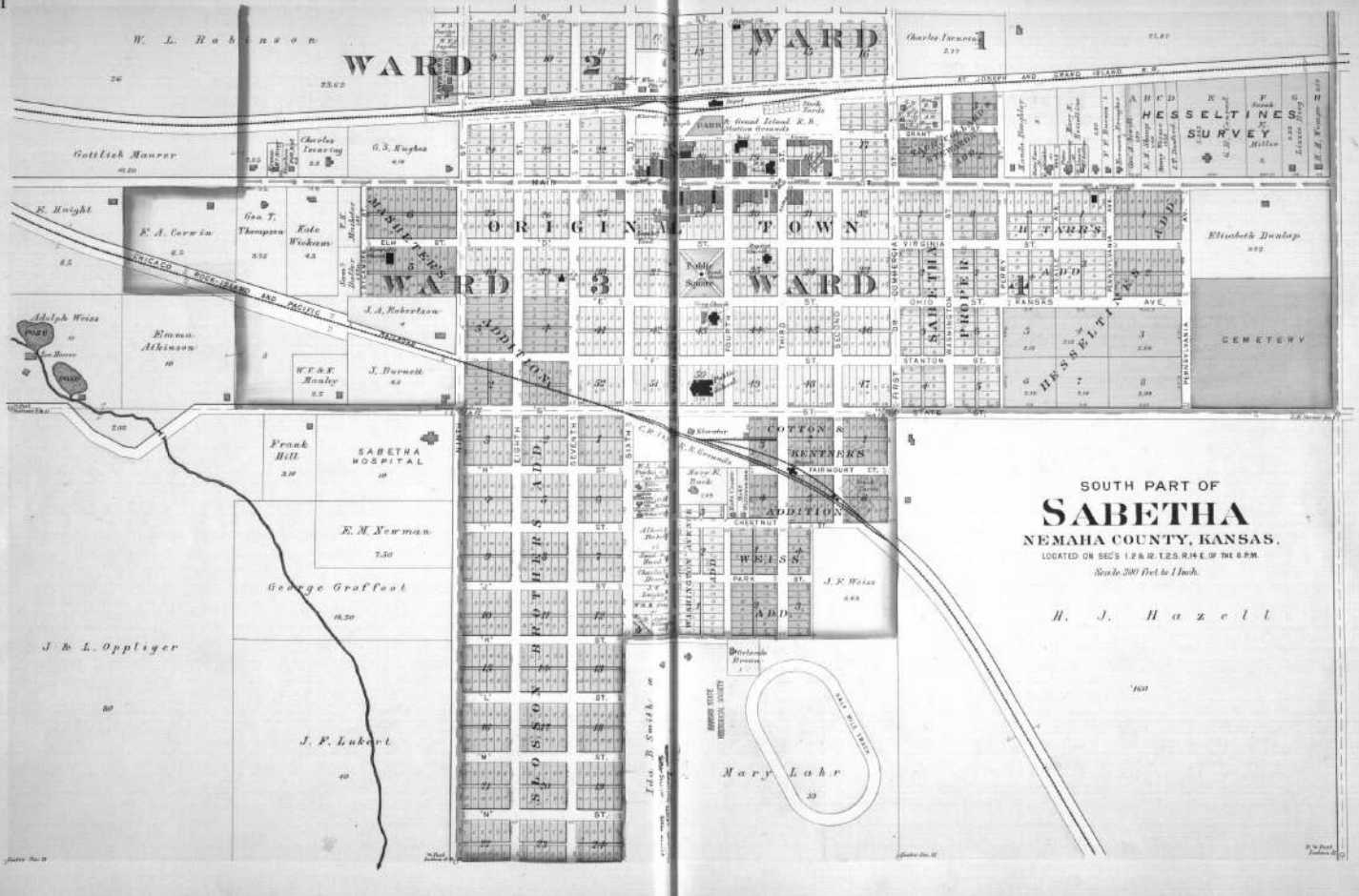

SOUTH PART OF  
**SABETHA**  
NEMAHA COUNTY, KANSAS.  
LOCATED ON SECS 12 & 13 T.25 S. R.4 E. OF THE 6TH.  
Scale 200 Feet to 1 Inch.

H. J. Hazell

Mary Lahr

WARD 2

WARD 1

ORIGINAL TOWN

WARD 3

Charles Lawrence

W. L. Robinson

Gottlieb Maurer

E. A. Corwin

Geo. T. Thompson

Kate Wickens

J. A. Robertson

J. Burnett

W. F. & F. Rowley

Frank Hill

E. M. Newman

George Groffest

J. & L. Oppliger

J. F. Lukart

1900

EXPLANATION

WIDTH OF COUNTY ROADS

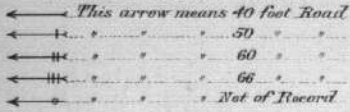

PLAT OF



Scale 2 Inches to the Mile. Township 2 South. Range 14 East. of the 6th Principal Meridian.

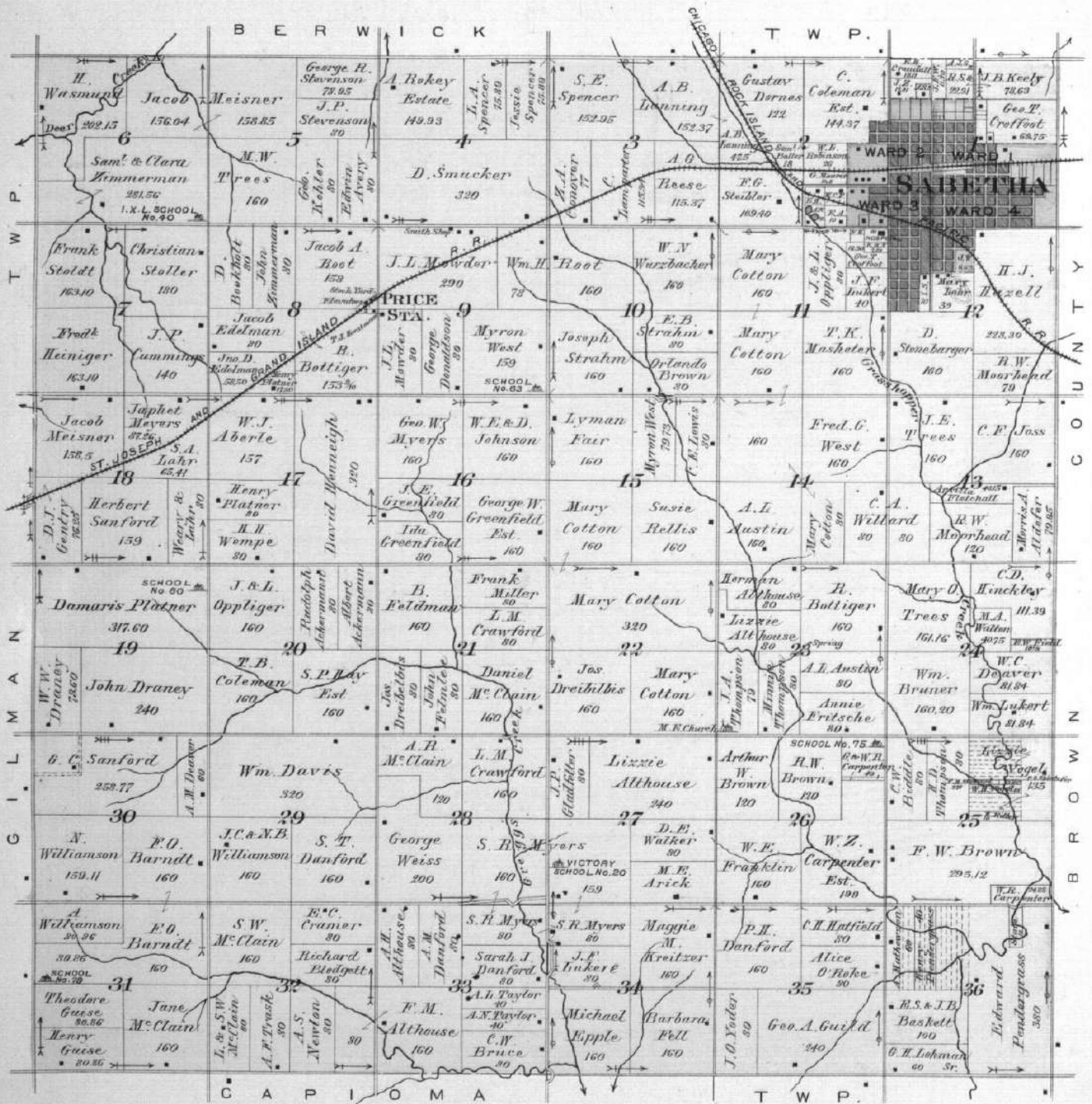

EXPLANATION  
WIDTH OF COUNTY ROADS

- ← This arrow means 40 feet Road
- ← " " " " 50 " " "
- ← " " " " 60 " " "
- ← " " " " 66 " " "
- ← " " " " 30 " " "
- ← " " " " Not of Record

# PLAT OF CAPIOMA

Scale 2 Inches to the Mile. Township 3 South. Range 14 East. of the 6th Principal Meridian.

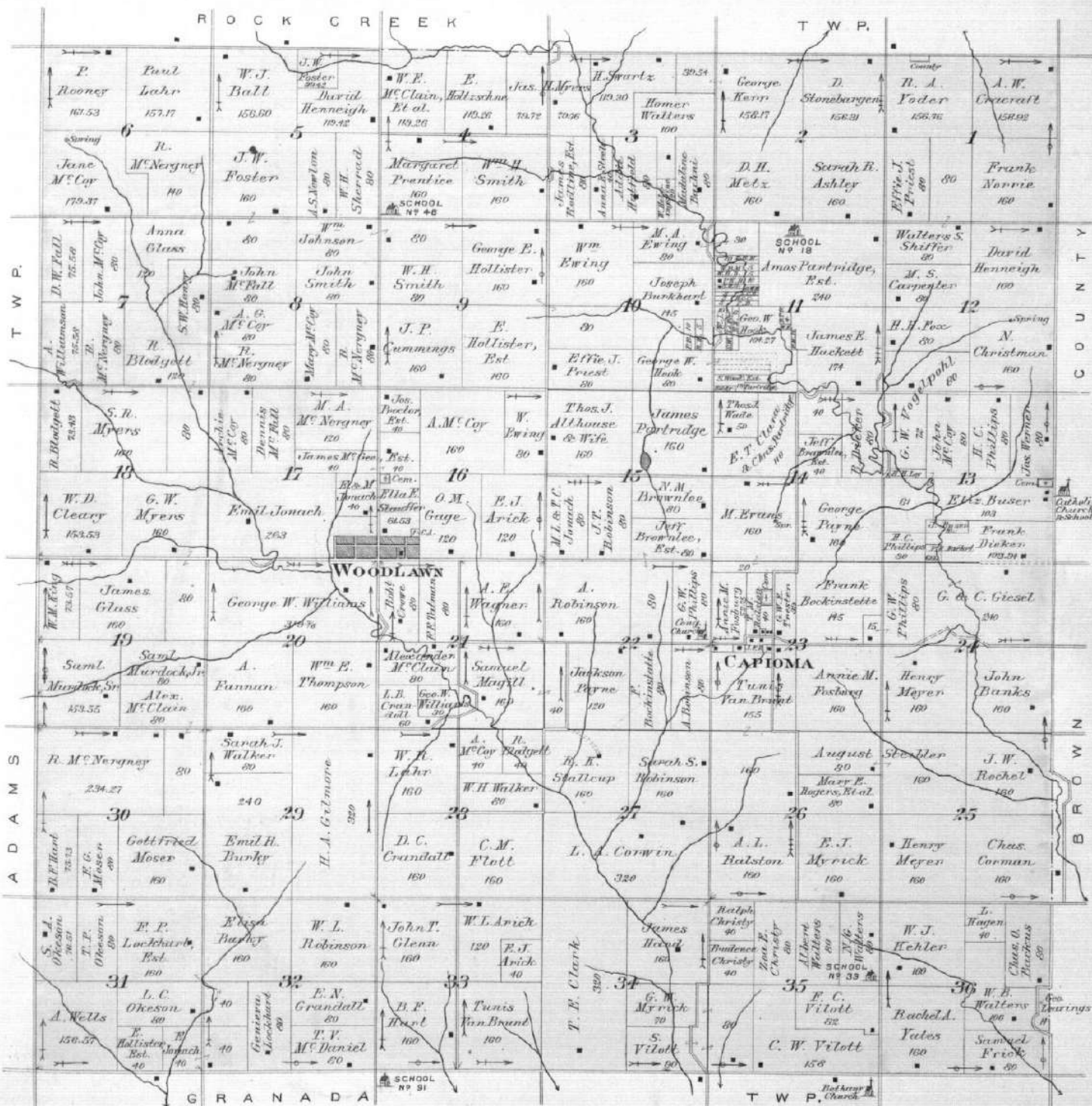

**NORTH PART OF  
SABETHA  
NEMAHA COUNTY, KANSAS.**  
 LOCATED ON SECS 12 & 13, T.25. R.1E. OF THE 6.2M.  
 Scale 300 Feet to 1 Inch.

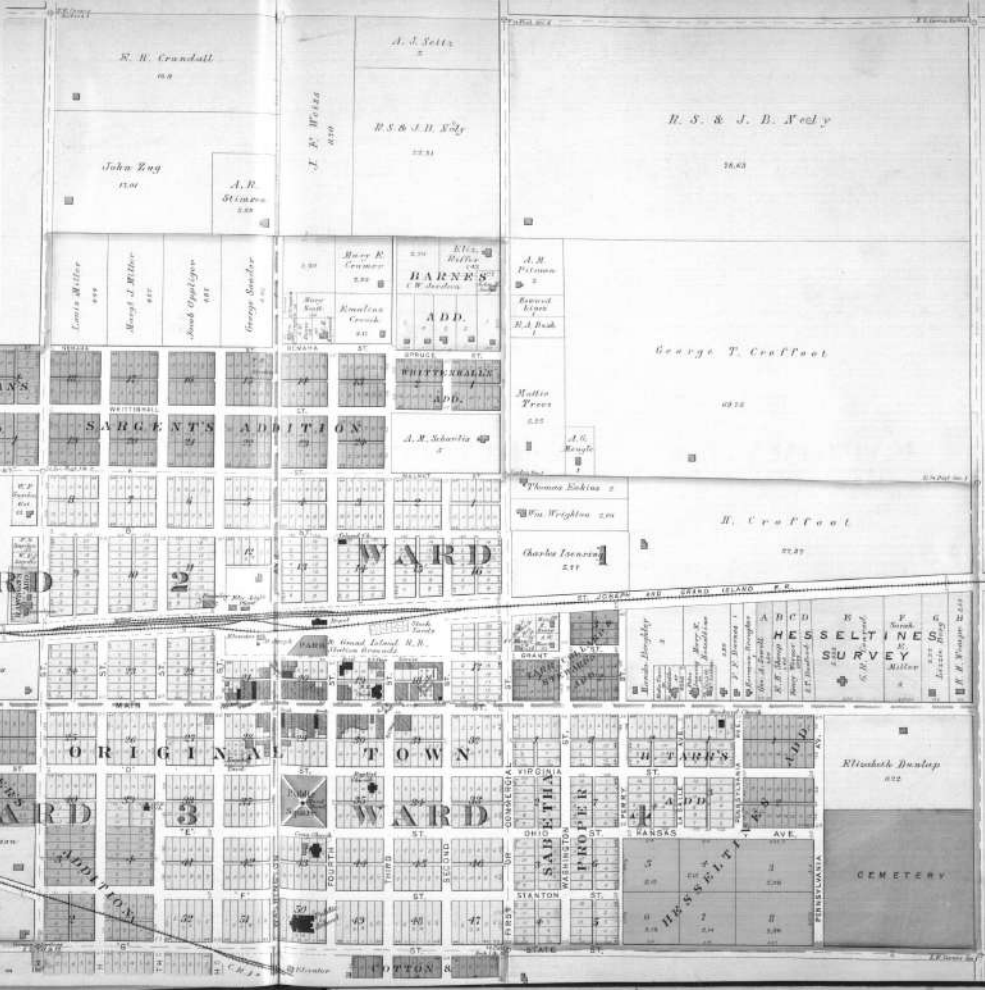

C. Coleman, 1883

W. L. Robinson

Gottlieb Munser

K. A. Corwin

R. M. Atkinson

G. S. Engler

W. H. Thompson

J. A. Robertson

J. Burnett

BARNES

George T. Croffoot

H. Croffoot

ORIGINAL TOWN

SABETHA

HESSLETINE SURVEY

CEMETERY

# WOODLAWN

LOCATED IN SECTIONS 16&17  
CAPIOMA TOWNSHIP  
Scale 300 feet to one inch.

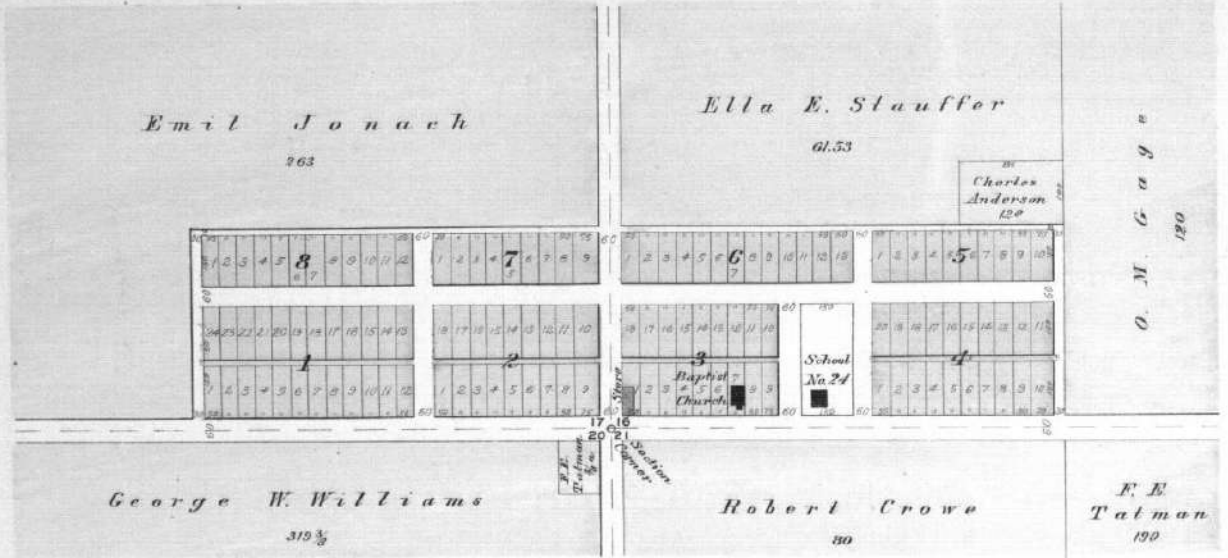

# CAPIOMA

LOCATED IN SECTION 23  
CAPIOMA TOWNSHIP  
Scale 400 feet to one inch.

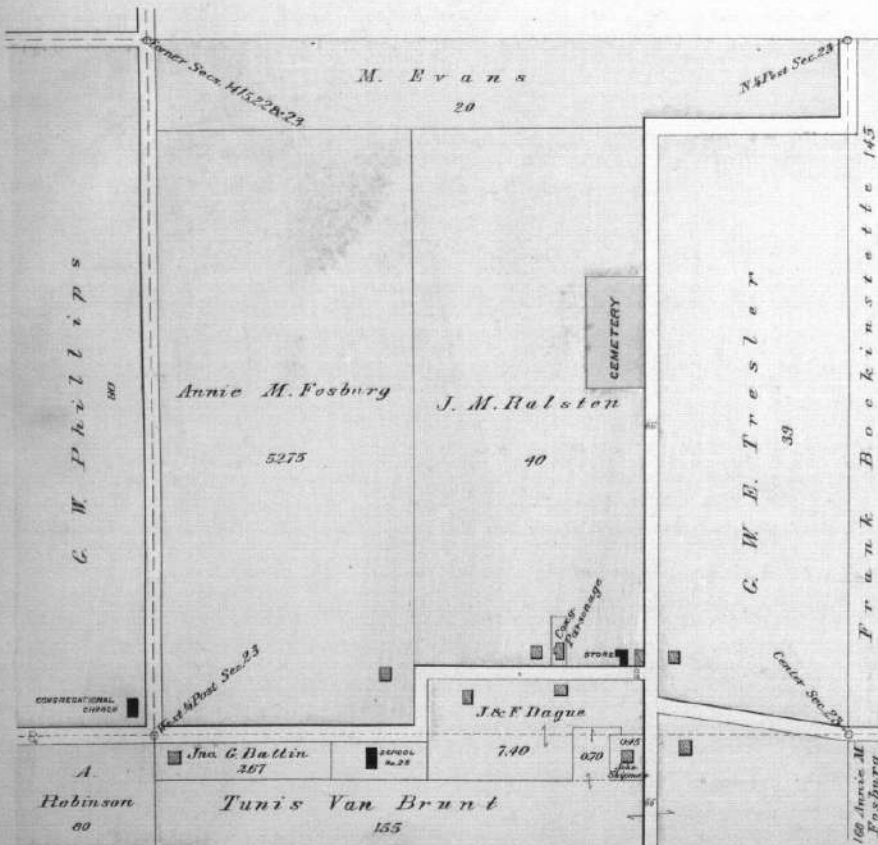

# WEST 1/2 SECTION 2

GRANADA TOWNSHIP  
Scale 660 feet to one inch.

		1	
		2	
		3	
<i>P. C. Vitolt</i>		4	
93.54		5	
		6	
		7	
		8	
		9	
<i>D. W. Drown</i>		10	
43.39		11	
		12	
		13	
<i>S. B. Miles, Est.</i>	25	14	
<i>P. H. Lockhart</i>	5	15	
<i>Punis Van Brunt</i>	10	16	
<i>M. A. Chellis</i>	10	17	
<i>L. D. Lancaster</i> 5	<i>Jna Brindel</i> 5	18	
<i>D. W. Drown</i>	10	19	
<i>Punis Van Brunt</i>	10	20	
<i>D. W. Drown</i> 5	<i>J. P. Searles</i> 5	21	
	<i>O. Theime</i> 5	22	
	<i>S. B. Miles, Est.</i>	15	23
<i>L. D. Lancaster</i> 10	<i>W. J. Groves</i> 5	24	
	<i>L. A. Clark</i> 5	25	
	<i>J. Berry</i>	10	26
<i>Lydia Curran</i> 5	<i>D. C. Halston</i> 5	27	
<i>S. B. Miles, Est.</i> 5	<i>G. W. Hook</i> 5	28	
		29	
		30	
		31	
		32	
		33	
		34	
		35	
		36	
		37	
		38	
		39	
		40	
		41	
		42	
		43	
		44	
		45	
		46	
		47	
		48	
		49	
		50	
		51	
		52	
		53	
		54	
		55	
		56	
		57	
		58	
		59	
		60	
		61	
		62	
		63	
		64	
		65	
		66	
		67	
		68	
		69	
		70	
		71	
		72	
		73	
		74	
		75	
		76	
		77	
		78	
		79	
		80	
		81	
		82	
		83	
		84	
		85	
		86	
		87	
		88	
		89	
		90	
		91	
		92	
		93	
		94	
		95	
		96	
		97	
		98	
		99	
		100	



# PLAT OF GRANADA

## EXPLANATION

WIDTH OF COUNTY ROADS

- ← This arrow means 40 foot Road
- ← " " " " 50 " " "
- ← " " " " 66 " " "
- ← " " " " 36 " " "
- ← " " " " Not of Record
- ← " " " " 60 foot Road

2 Inches to the Mile Township 4 South, Range 14 East, of the 6<sup>th</sup> Principal Meridian.

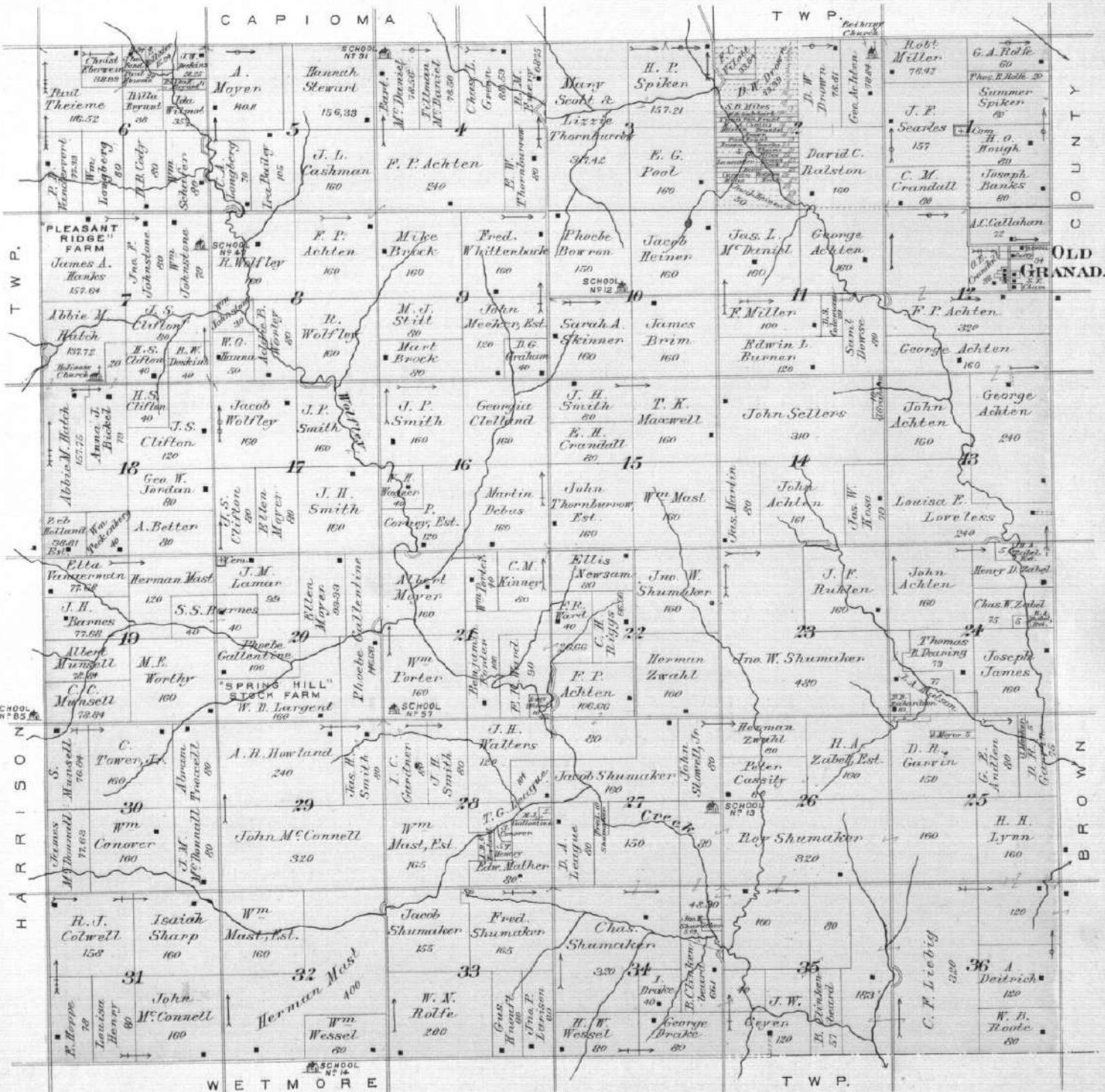

OLD GRANADA

39

**WETMORE**

LOCATED IN SECTION 2&11  
WETMORE TOWNSHIP

Scale 300 feet to one inch.

Ervin  
Adamsou

160

Center Sec. 2&11

Samuel Sisson  
Estate.

40

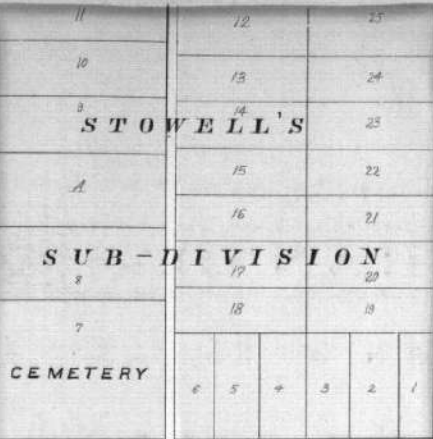

Robert  
Thornburrow  
281.5

Center Sec. 12 11&12

A.  
Hazeltine

117



Robert Thornburrow  
229.5

R.H.  
Gibbons  
10

Samuel Thornburrow  
487.5  
R. A. DeForest  
20

Center Section 11

J. F. Noyes

M. Holmes  
Est.  
28

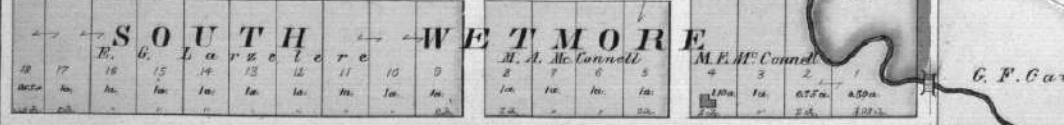
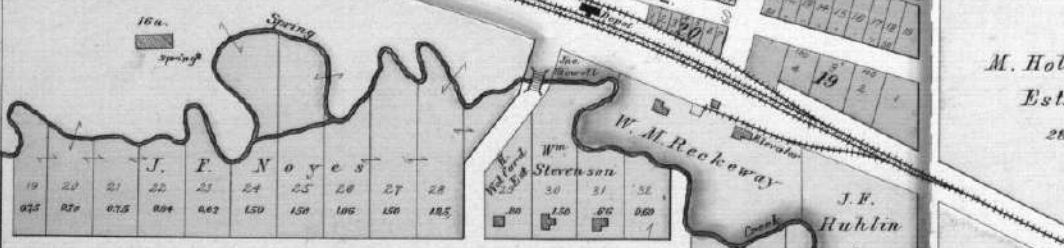

Arthur M. Hough  
20

Eliza Means  
40

A. M. Connell  
39

Cawood, Bros  
1

G. F. Cawood

49

EXPLANATION  
WIDTH OF COUNTY ROADS

←	This arrow means 40 foot Road
←	" " " 50 " "
←	" " " 60 " "
←	" " " 65 " "
←	" " " 75 " "
←	" " " 85 " "
←	" " " 95 " "
←	" " " 100 " "
←	" " " Laid out Not open
←	" " " Not of Record.

# PLAT OF WETMORE

Scale 2 Inches to the Mile. Township 5 South. Range 14 East. of the 6<sup>th</sup> Principal Meridian.

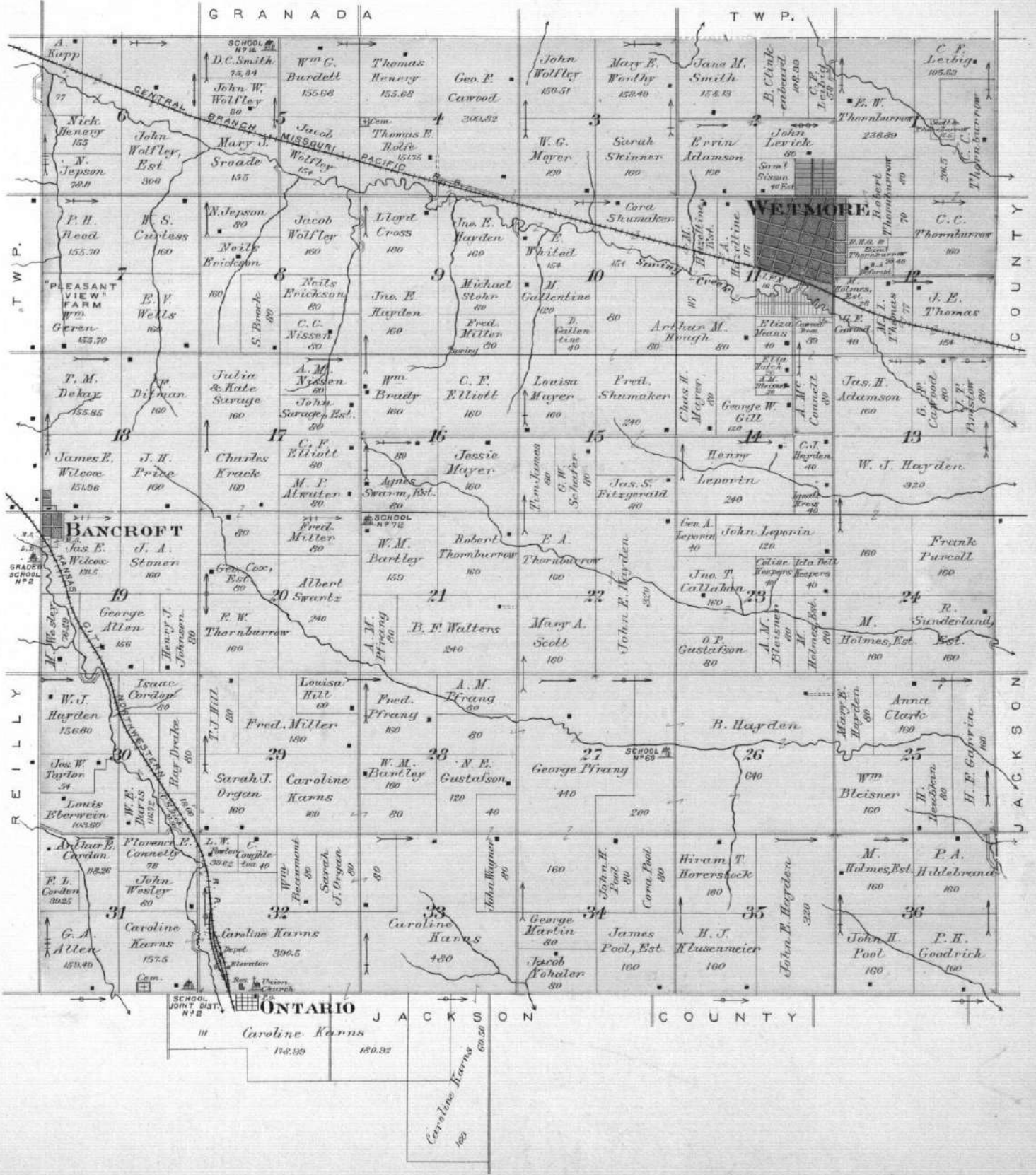

# SECTIONS 31 AND 32

WASHINGTON TWP.  
Scale 660 Feet to 1 Inch

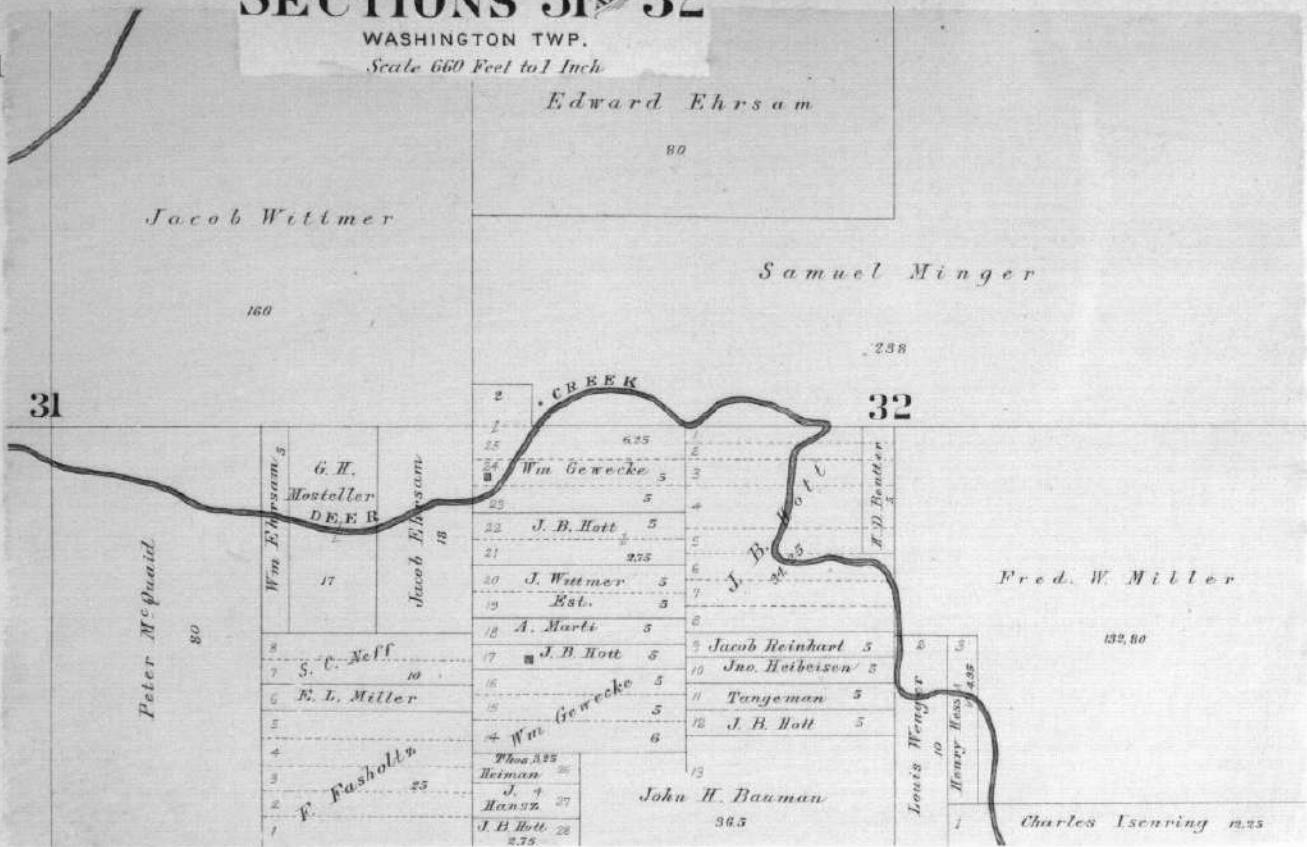

# AMERICA CITY

SHOWING VACATION  
LOCATED IN SEC. 35 T. 53. R. 11 E. OF THE 6<sup>TH</sup> P.M.  
Scale 400 Feet to one Inch

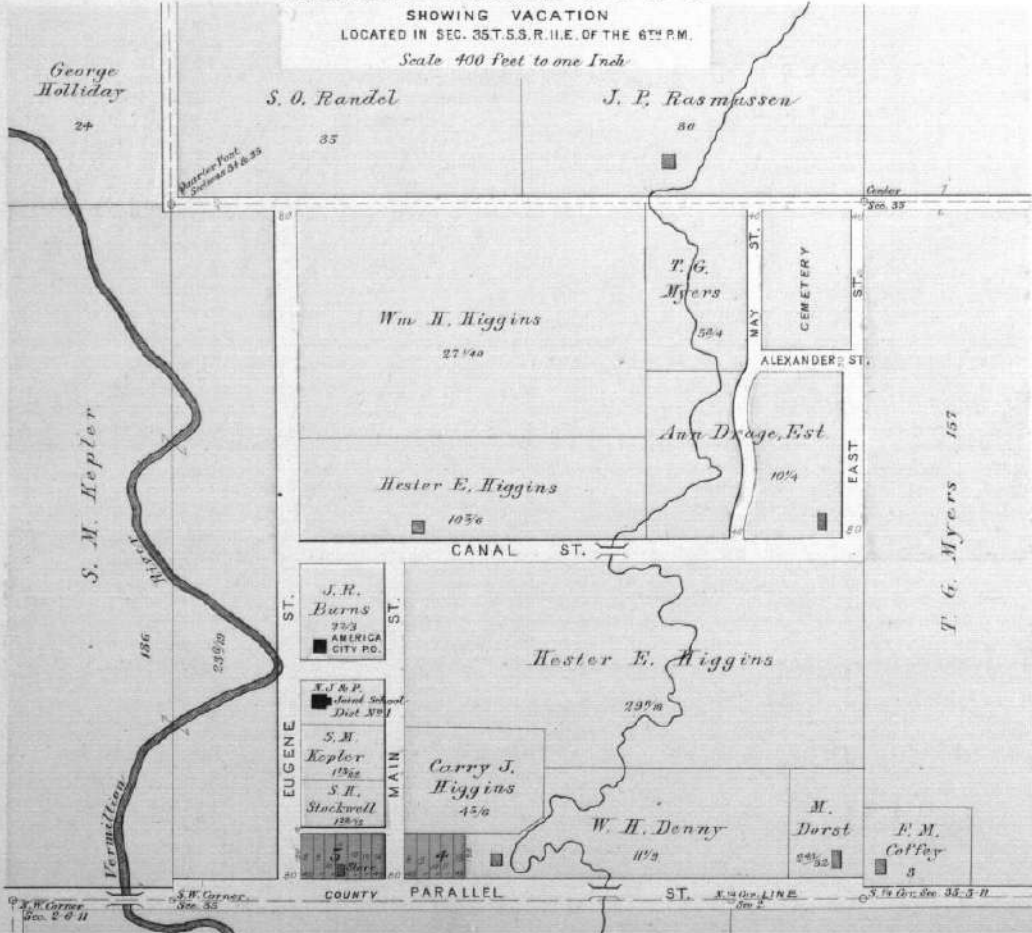

# SECTIONS 10 & 11

CAPOMA TOWNSHIP  
Scale 850 feet to one inch.

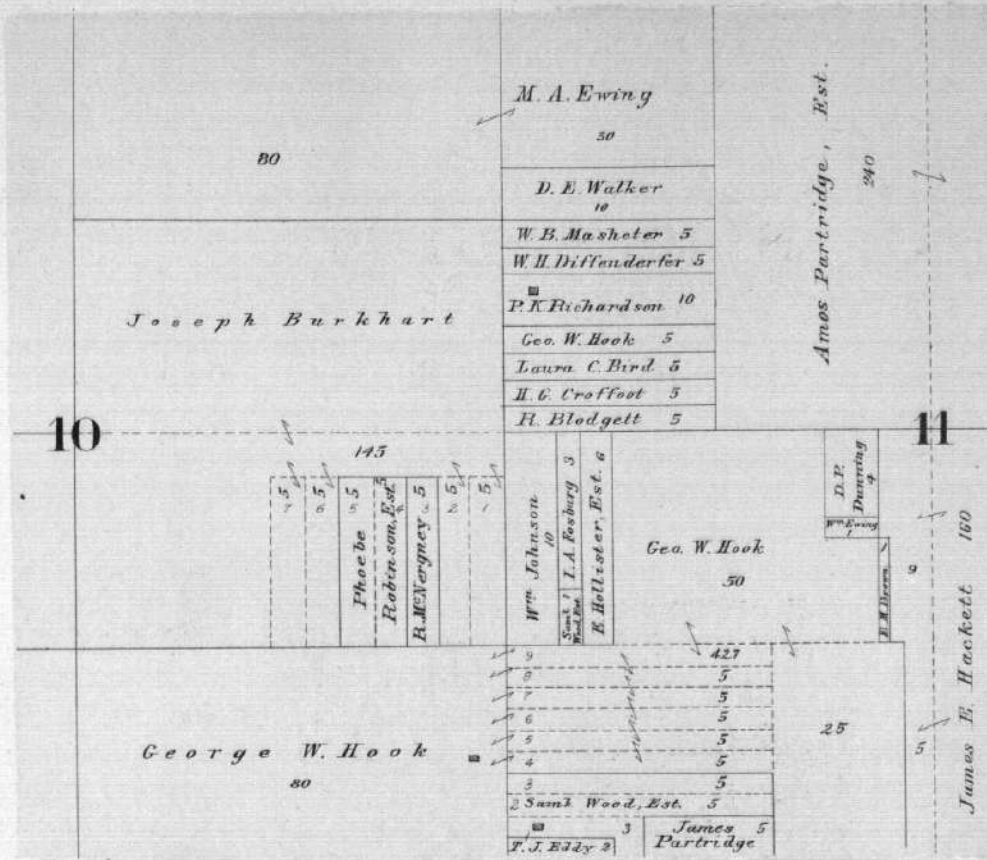

# N.E. 1/4 SECTION 12

GRANADA TOWNSHIP  
SHOWING  
OLD GRANADA  
Scale 400 feet to one inch.

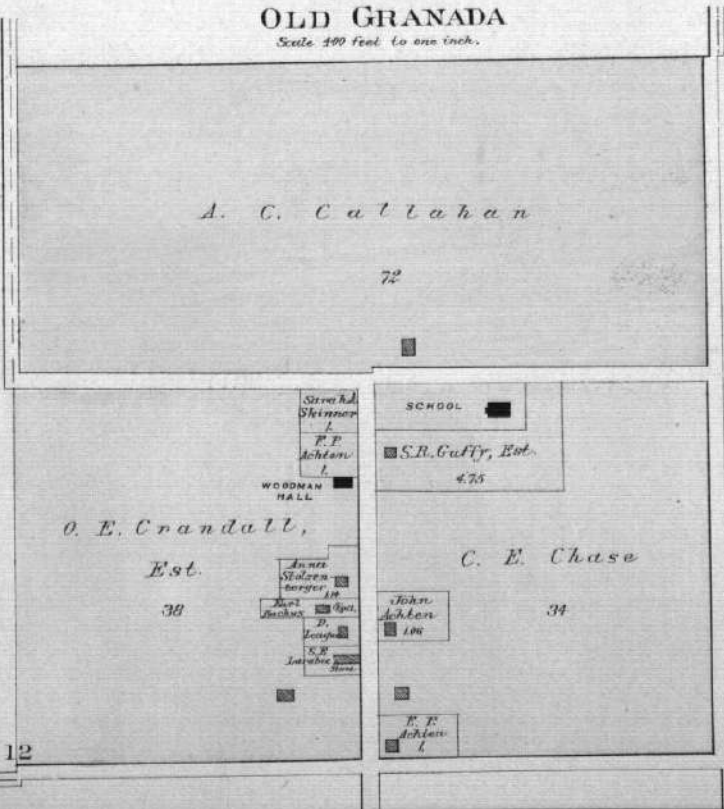

# BANCROFT

LOCATED IN SECTIONS 18 AND 19  
WETMORE TWP.  
Scale 300 feet to one inch.

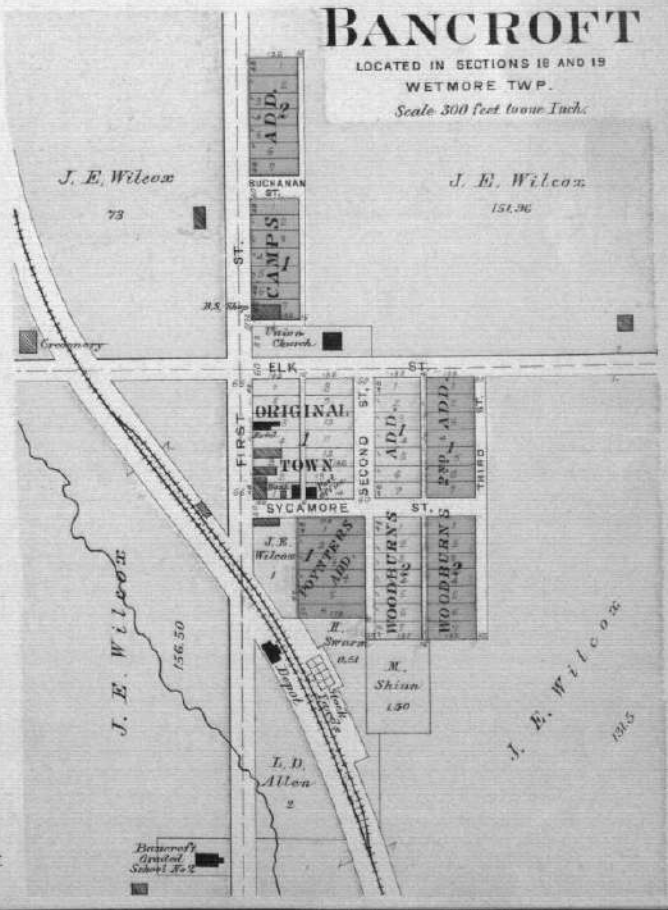

# ST. BENEDICT

LOCATED ON SECTION 8, T.2S. R.12.E. 6TH P.M.  
Scale 200 feet to one inch.

