

SEP 30 1930  
Sw 794

The Anderson Publishing Co.  
Map and Atlas Publ.  
Des Moines, Iowa  
Copyrighted.

TOPOGRAPHICAL MAP  
OF  
**NEMAHACOUNTY**  
KANSAS

REFERENCES:  
Rail Road — School —  
Wagon Road — Church —  
Corp. Line — Houses —  
Creek — Cem. —  
Primary Roads —  
County Roads —

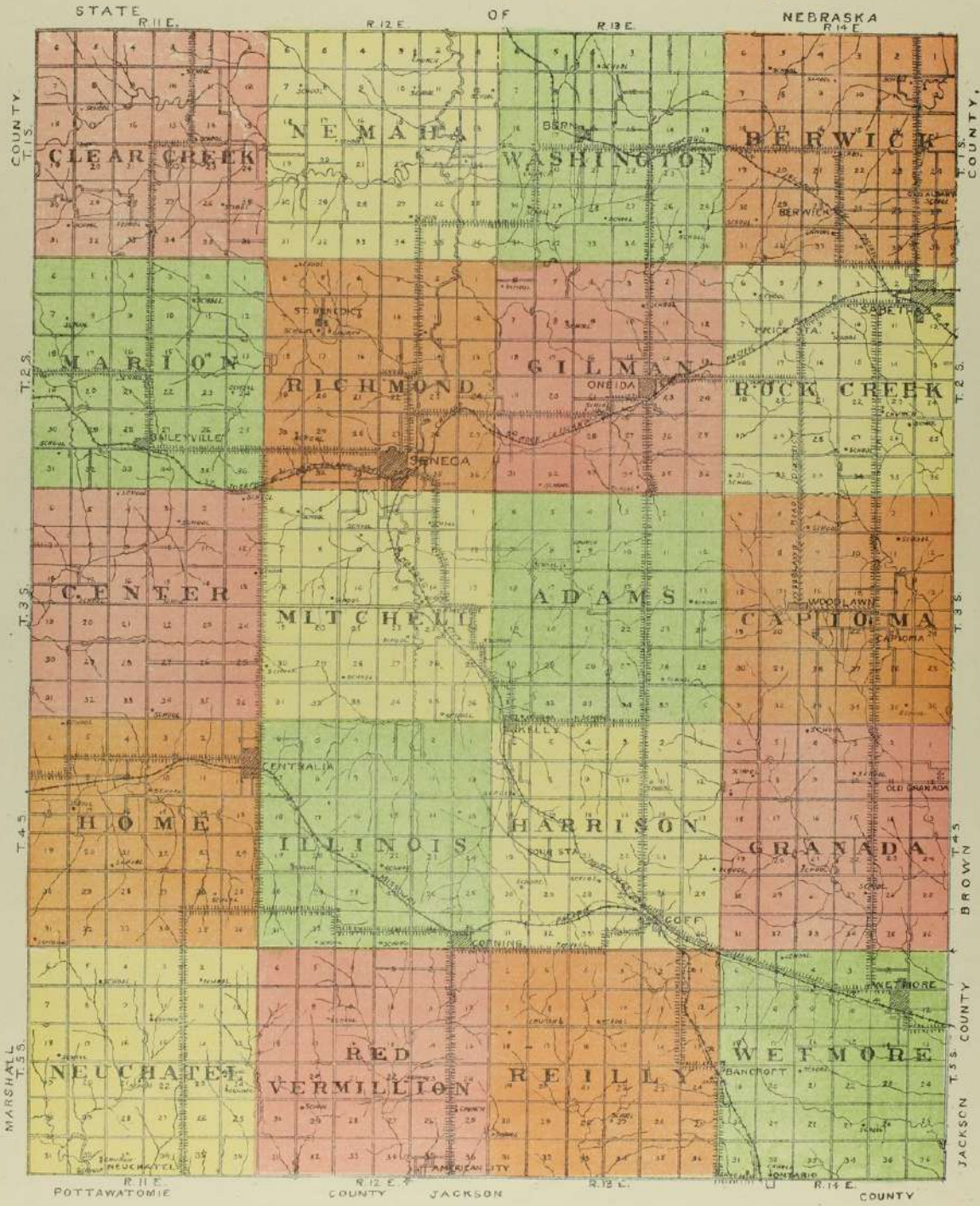



The Anderson Publishing Co.  
Map and Atlas Publ.  
Des Moines, Iowa  
Copyrighted

# MAP OF BERWICK TOWNSHIP

- REFERENCES:
- Rail Road ———
  - Wagon Road ———
  - Ch. Line ———
  - Creek ———
  - Rural Routes ———
  - School ———
  - Church ———
  - House ———
  - Com. ———

Scale: Fourches to one Mile.  
Township 15 South Range 4 East of the 6th P.M.

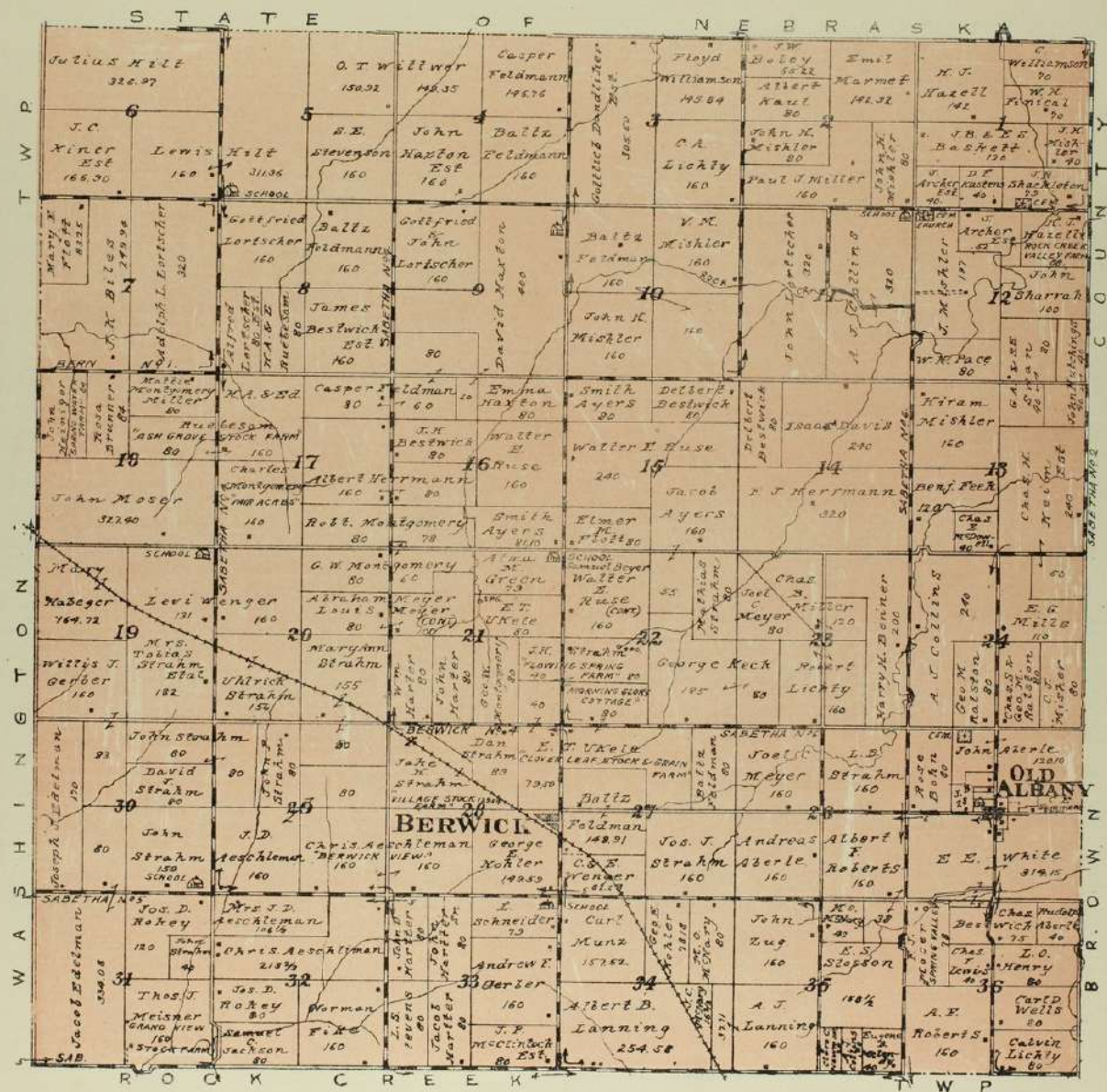

STATE OF NEBRASKA  
T W P  
T  
N  
O  
G  
Z  
I  
H  
N  
W  
A  
W  
S I B

1  
2  
3  
4  
5  
6  
7  
8  
9  
10  
11  
12  
13  
14  
15  
16  
17  
18  
19  
20  
21  
22  
23  
24  
25  
26  
27  
28  
29  
30  
31  
32  
33  
34  
35  
36

ROCK CREEK T W P



The Anderson Publishing Co.  
Map and Atlas Publ.  
Des Moines, Iowa  
Copyrighted

# MAP OF WASHINGTON TOWNSHIP

Scale: 400 Feet to one Mile.  
Township 1 South      Range 13 East of the 6th P.M.

- REFERENCES:
- Rail Road ————
  - Wagon Road ————
  - Co. Lines ————
  - Creek ————
  - Rural Routes ————
  - School ————
  - Church ————
  - Houses ————
  - Cem. ————

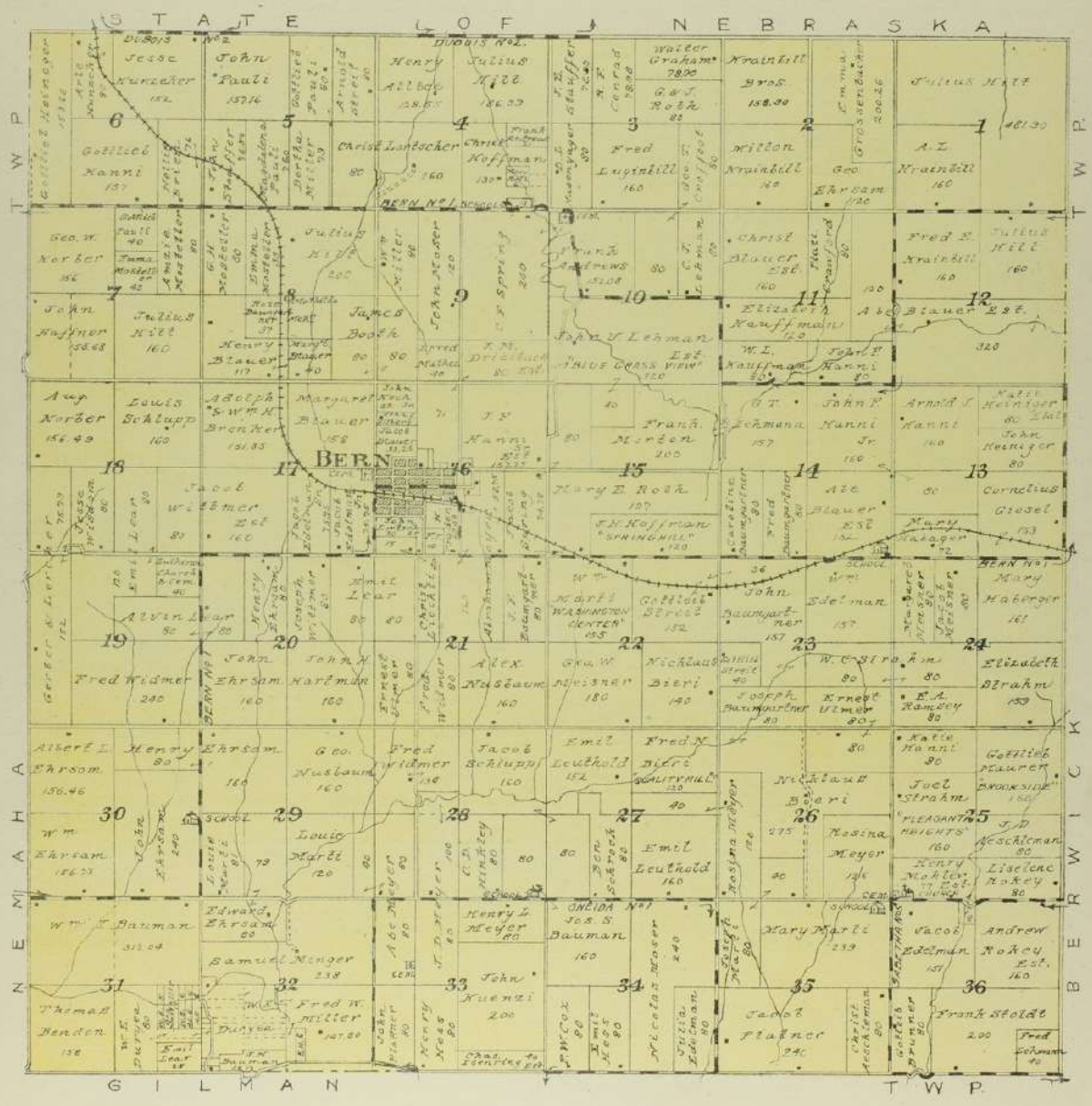



The Anderson Publishing Co  
Map and Atlas Publ.  
Des Moines, Iowa  
Copyrighted

# MAP OF NEMAHA TOWNSHIP

Scale 4 inches to one Mile.  
Township 18 South Range 12 East of the 6th PM.

REFERENCES:  
Rail Road — School  
Wagon Road — Church  
Cott. Line — Houses  
Creek — Corn  
Rural Routes —

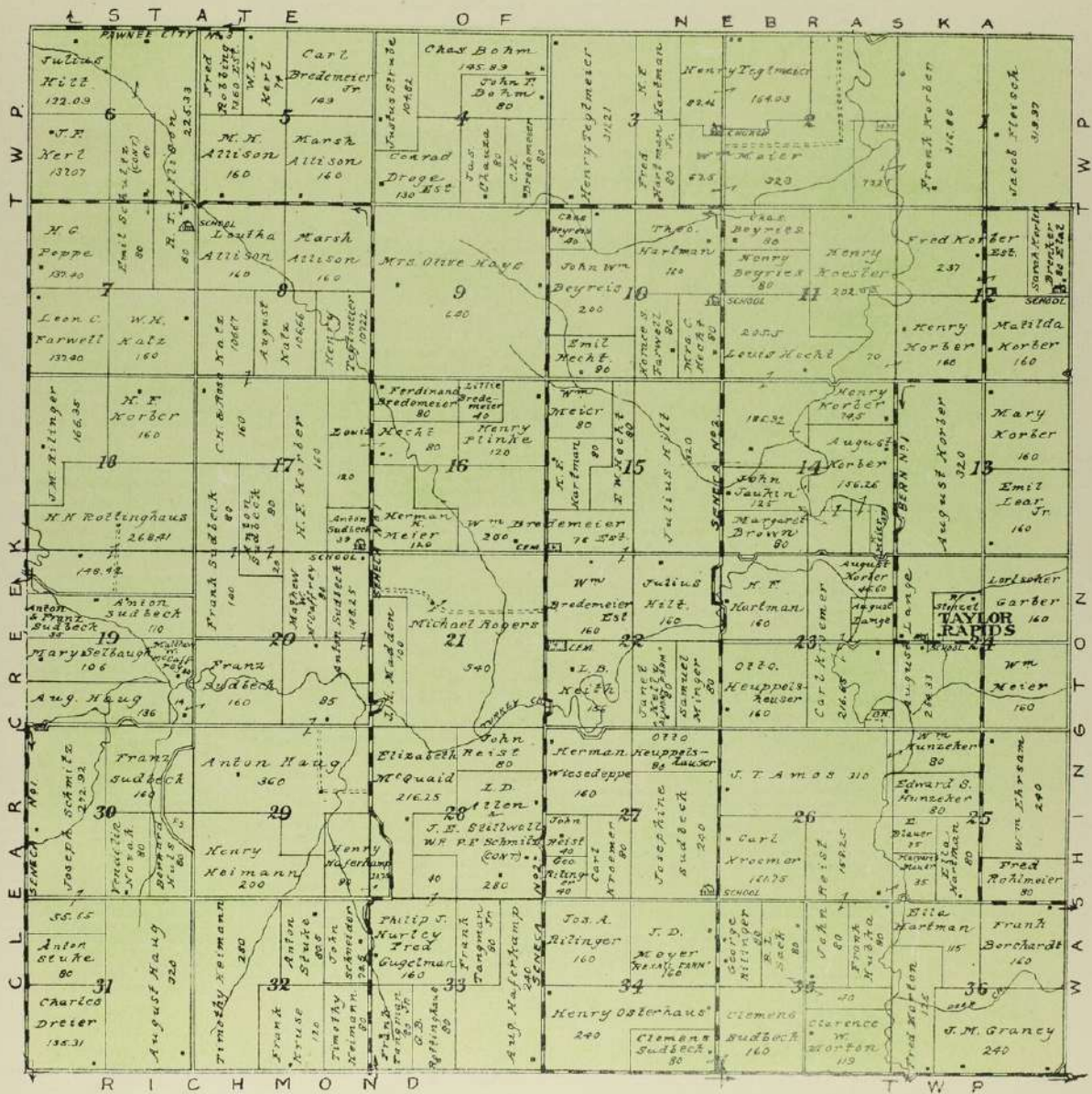

RICHMOND TWP



The Anderson Publishing Co  
Map and Atlas Publ.  
Des Moines, Iowa  
Copyrighted.

# MAP OF CLEAR CREEK TOWNSHIP

Scale Fourches to one Mile  
Township 15 South Range 11 East of the 6th P.M.

- REFERENCES
- Rail Road ———
  - Wagon Road ———
  - Corp. Line ———
  - Creek ———
  - Rural Routes ———
  - School ———
  - Church ———
  - Houses ———
  - Gen. ———

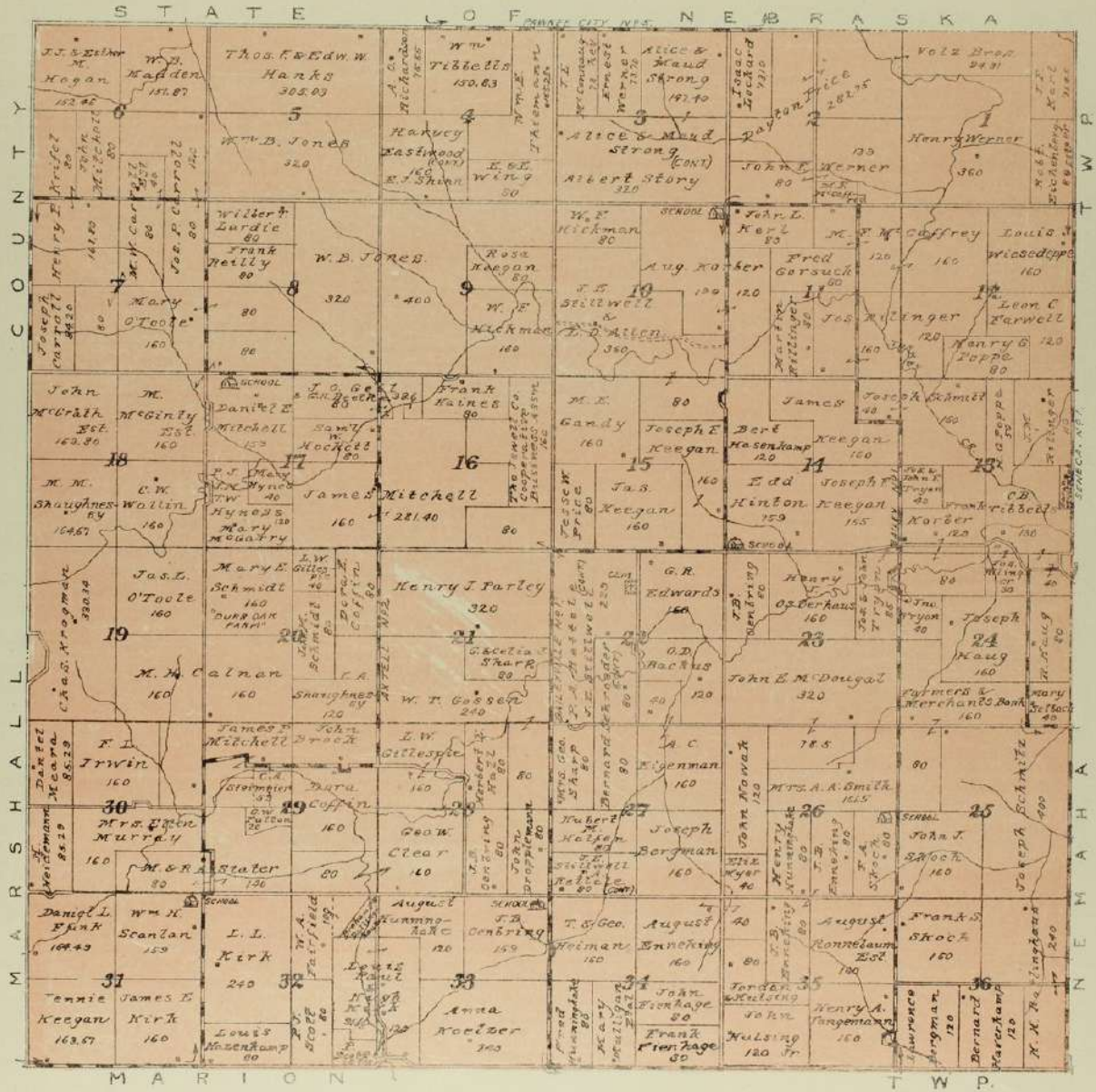

M A R I O N T W P.



The Anderson Publishing Co  
Map and Atlas Dept.  
Des Moines, Iowa  
Copyrighted

# MAP OF MARION TOWNSHIP

Scale 1/4 inch to one mile.  
Township 2 South Range 11 East of the 6th P.M.

- REFERENCES:
- Rail Road — School
  - Wagon Road — Church
  - Co. Line — Houses
  - Creek — Corn
  - Rural Routes —

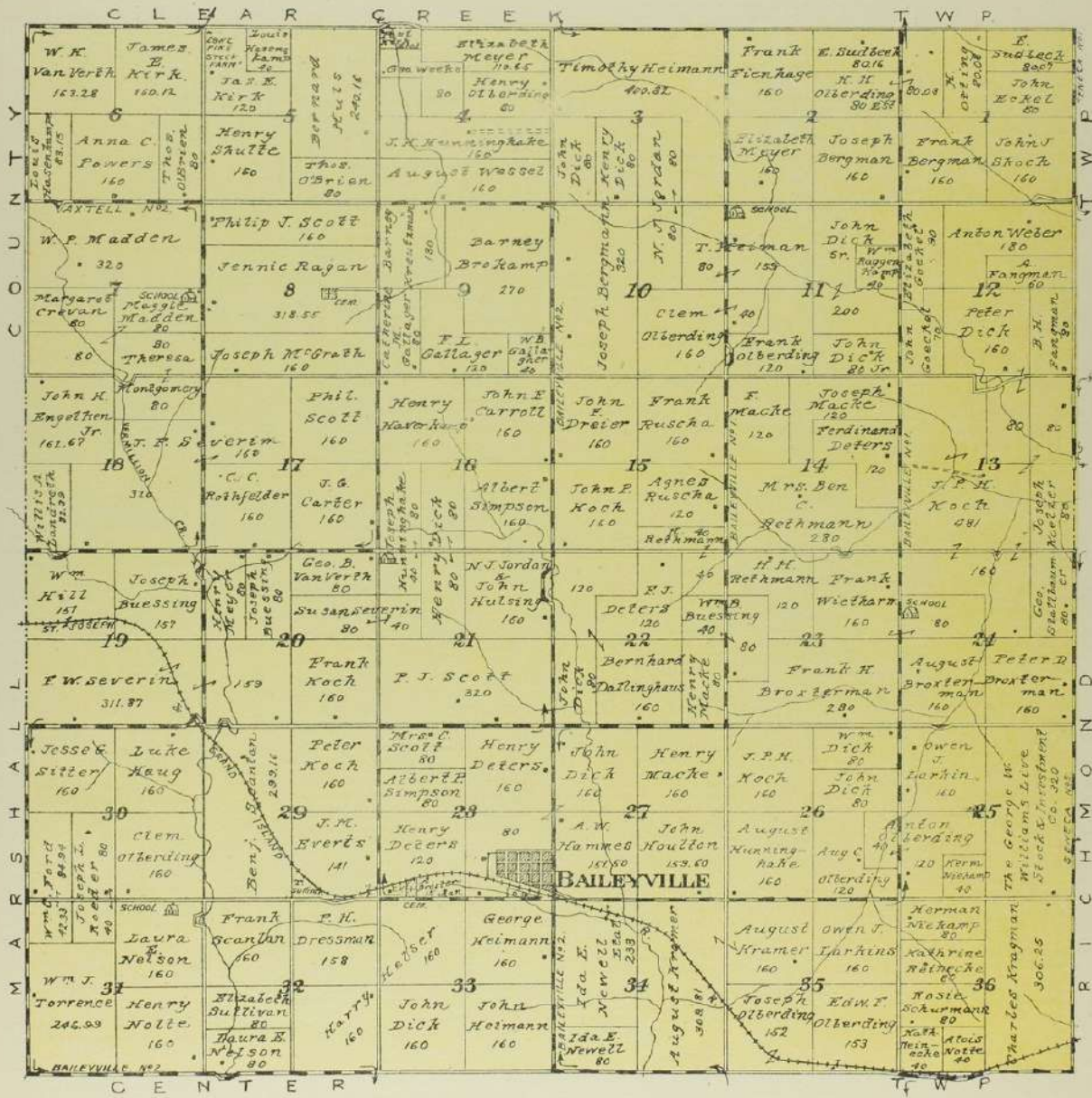



The Anderson Publishing Co.  
Map and Atlas Publ.  
Des Moines, Iowa  
Copyrighted

# MAP OF RICHMOND TOWNSHIP

Scale 4 inches to one Mile.  
Township 25 South Range 12 East of the 6th P.M.

- REFERENCES:
- Rail Road — School
  - Wagon Road — Church
  - Co. Line — Houses
  - Creek — Cem.
  - Rural Routes

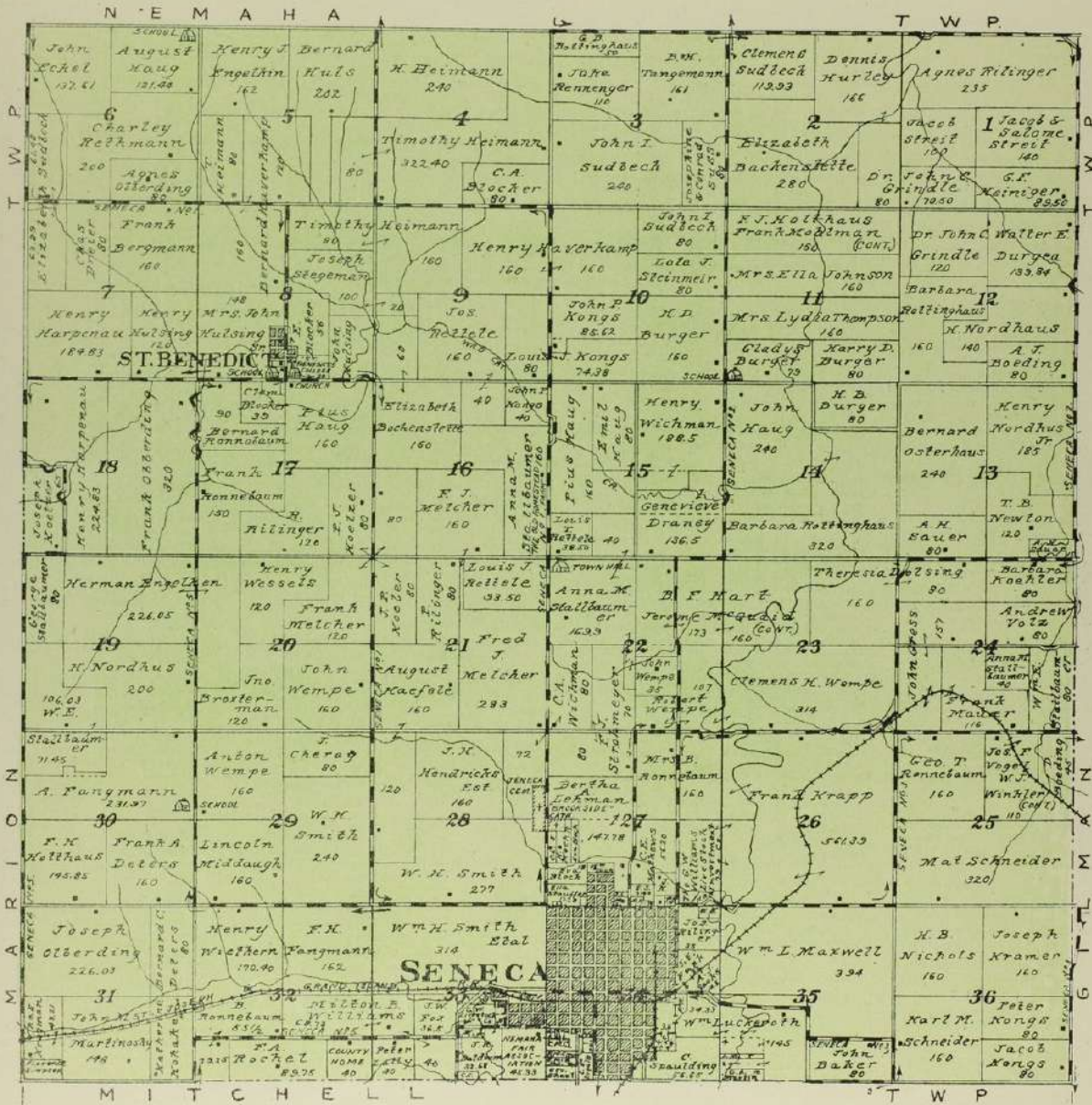



The Anderson Publishing Co  
Map and Atlas Publ.  
Des Moines, Iowa  
Copyrighted

# MAP OF GILMAN TOWNSHIP

Scale 1 inch to one Mile.  
Township 2 South Range 13 East of the 6th R.M.

REFERENCES:  
Rail Road — School  
Wagon Road — Church  
Corp. Line — Houses  
Creek — Cem.  
Rural Routes —

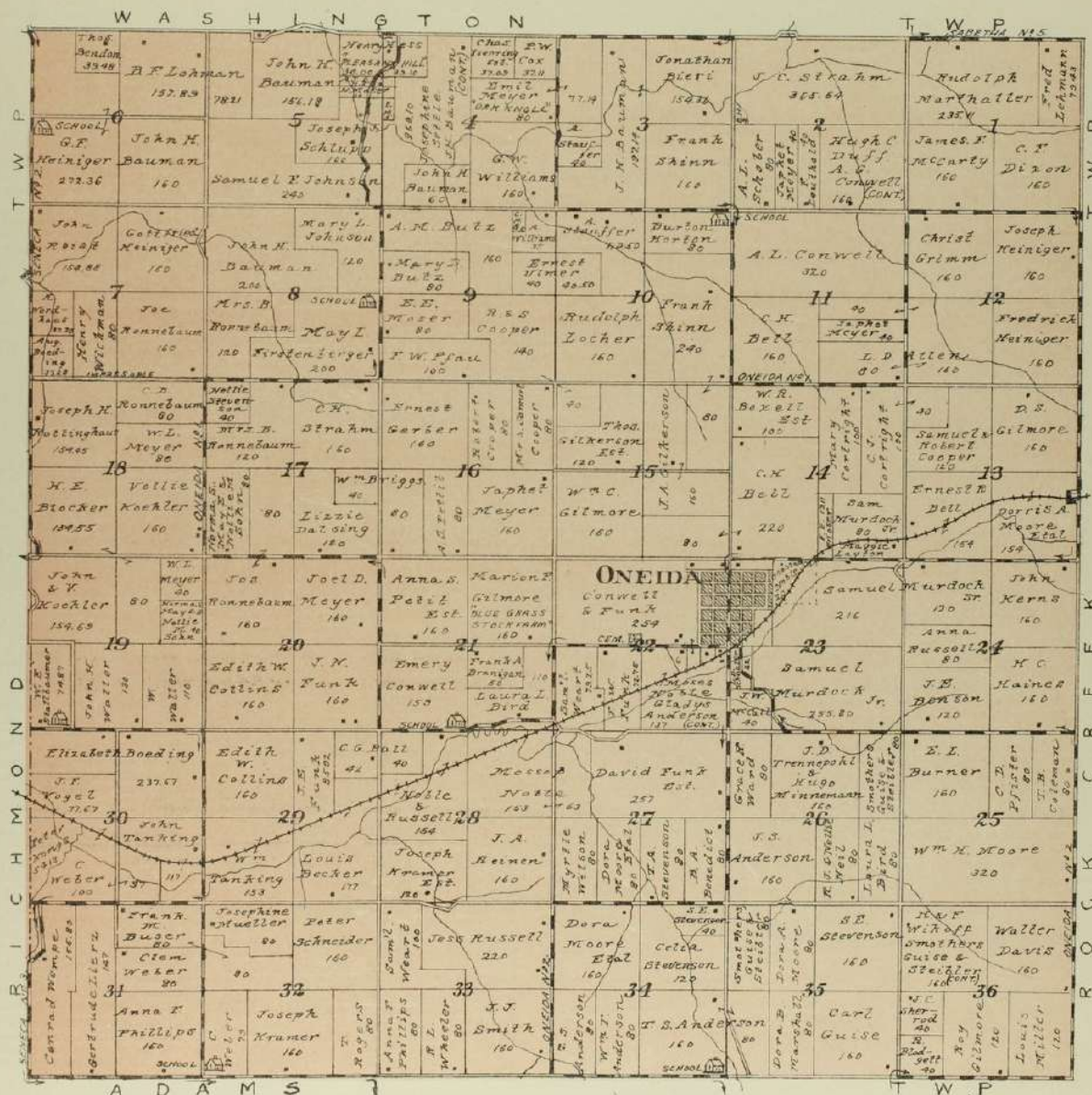



The Anderson Publishing Co  
Map and Atlas Dept.  
Des Moines, Iowa  
Copyrighted.

# MAP OF ROCK CREEK TOWNSHIP

Scale: 1 inch = 1 mile  
Township 28 South Range 14 East of the 100th Meridian

- REFERENCES:
- Rail Road — School
  - Wagon Road — Church
  - Com. Line — Houses
  - Creek — Cem.
  - Rural Routes —

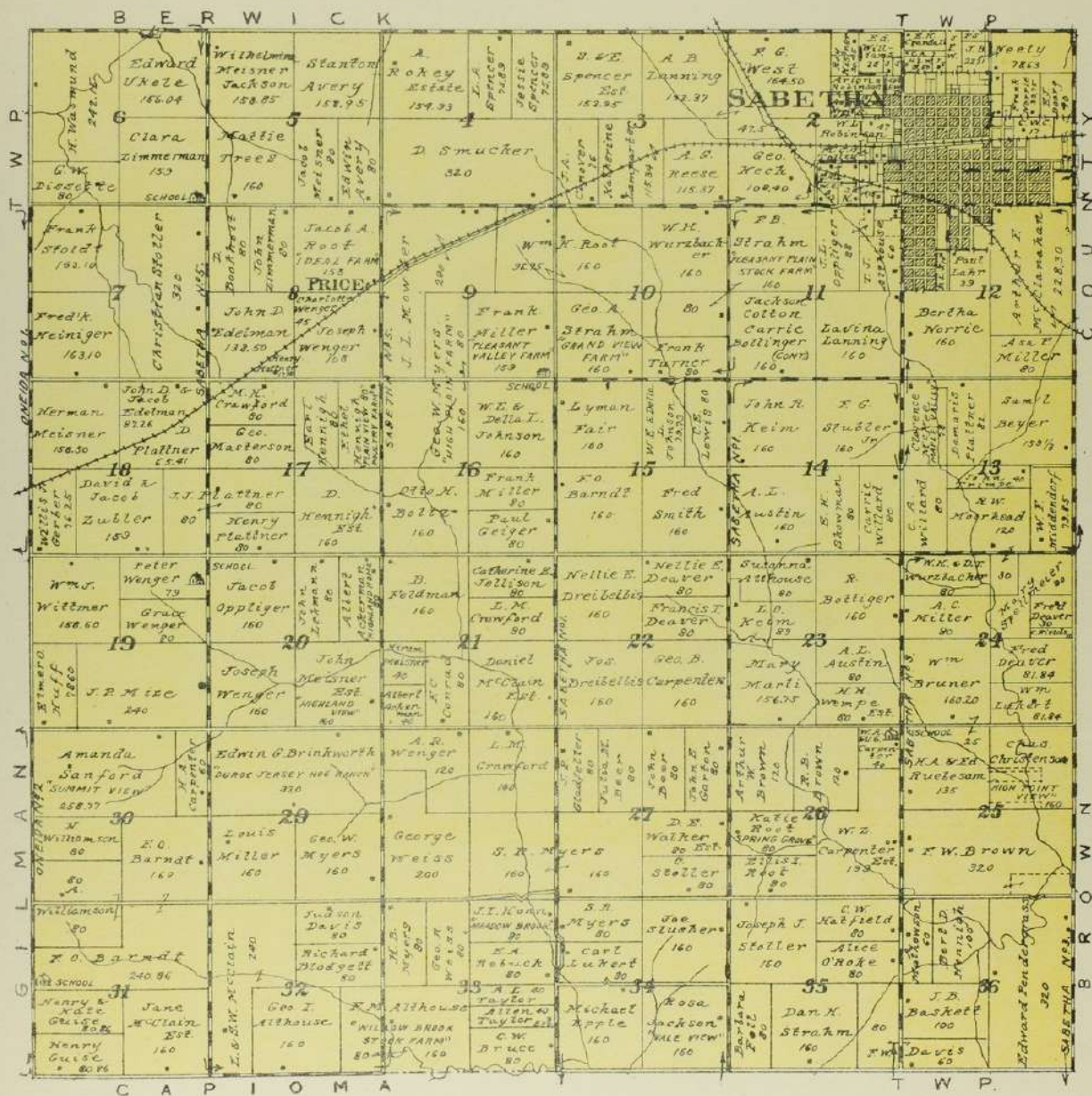



The Anderson Publishing Co  
Map and Atlas Publ.  
Des Moines, Iowa  
Copyrighted.

# MAP OF CAPIOMA TOWNSHIP

Scale Brackets to one Mile  
Township 38 South Range 14 East of the 6th P.M.

- REFERENCES**
- Rail Road ————
  - Wagon Road ————
  - Corraline ————
  - Creek ————
  - School Districts ————
  - Rural Routes ————
  - School ————
  - Church ————
  - House ————
  - Gen. ————

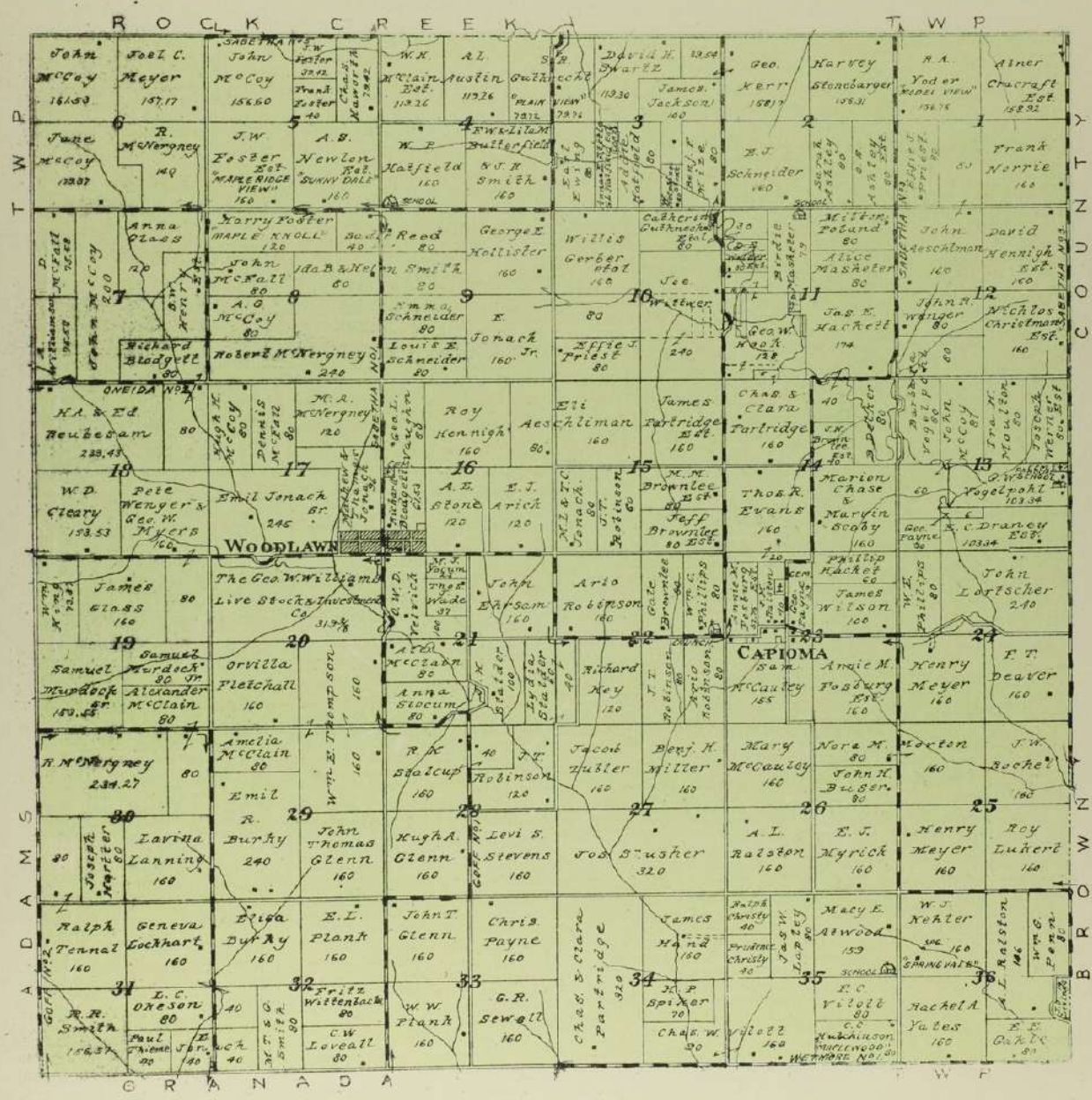



The Anderson Publishing Co.  
Map and Atlas Dept.  
Des Moines, Iowa  
Copyrighted.

# MAP OF ADAMS TOWNSHIP

Scale 1/4 inches to one mile.  
Township 3 South Range 13 East of the 6th R.M.

REFERENCES:  
Rail Road — School  
Wagon Road — Church  
Cox Line — Houses  
Creek — Cem.  
Rural Routes —

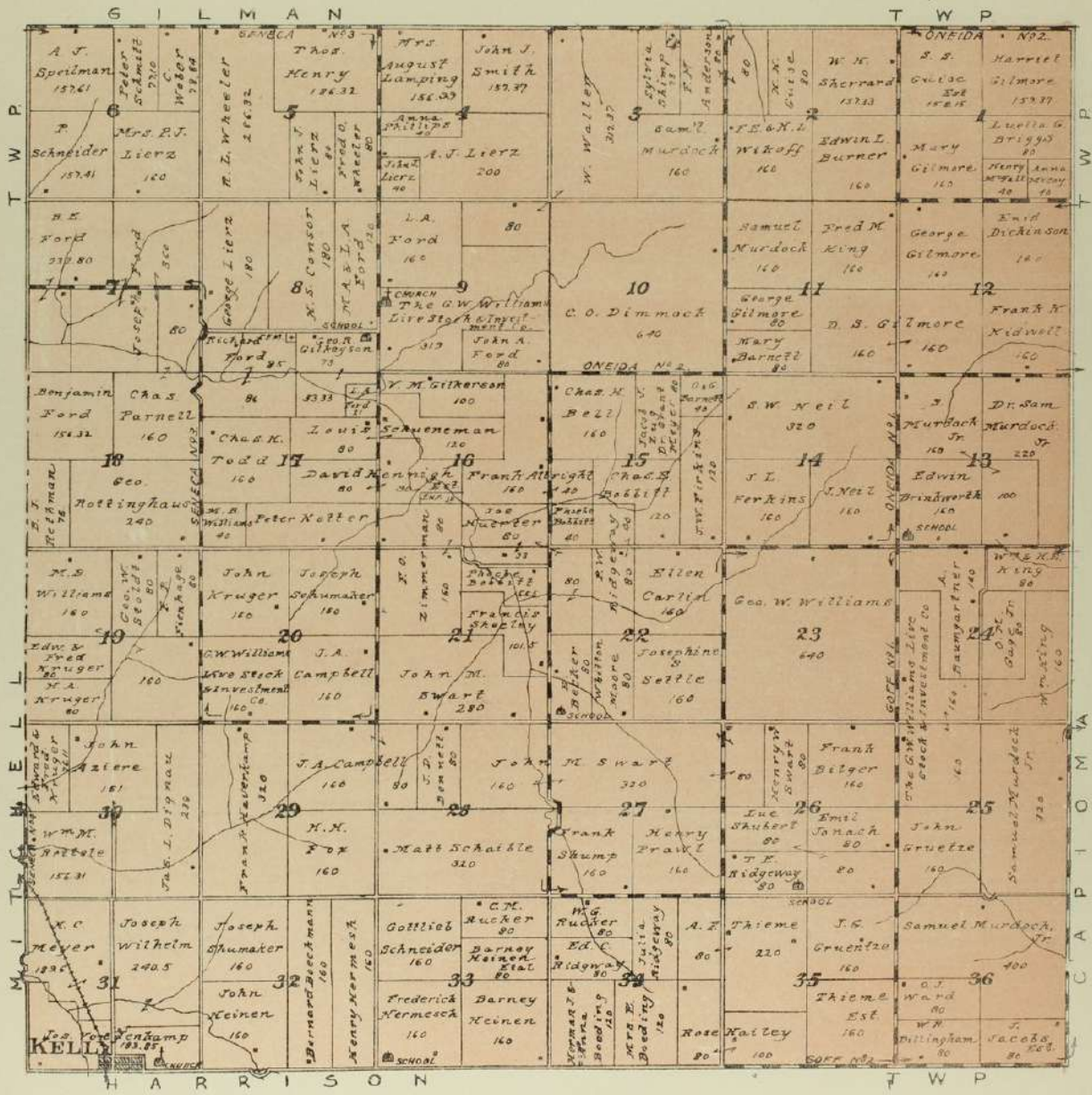



The Anderson Publishing Co  
Map and Atlas Publ.  
Des Moines, Iowa  
Copyrighted

# MAP OF MITCHELL TOWNSHIP

Scale 60ches to one Mile  
Township 3 South Range 12 East of the 6th R.M.

REFERENCES:  
Rail Road — School —  
Wagon Road — Church —  
Corp Line — Houses —  
Creek — Cem. —  
Rural Routes —

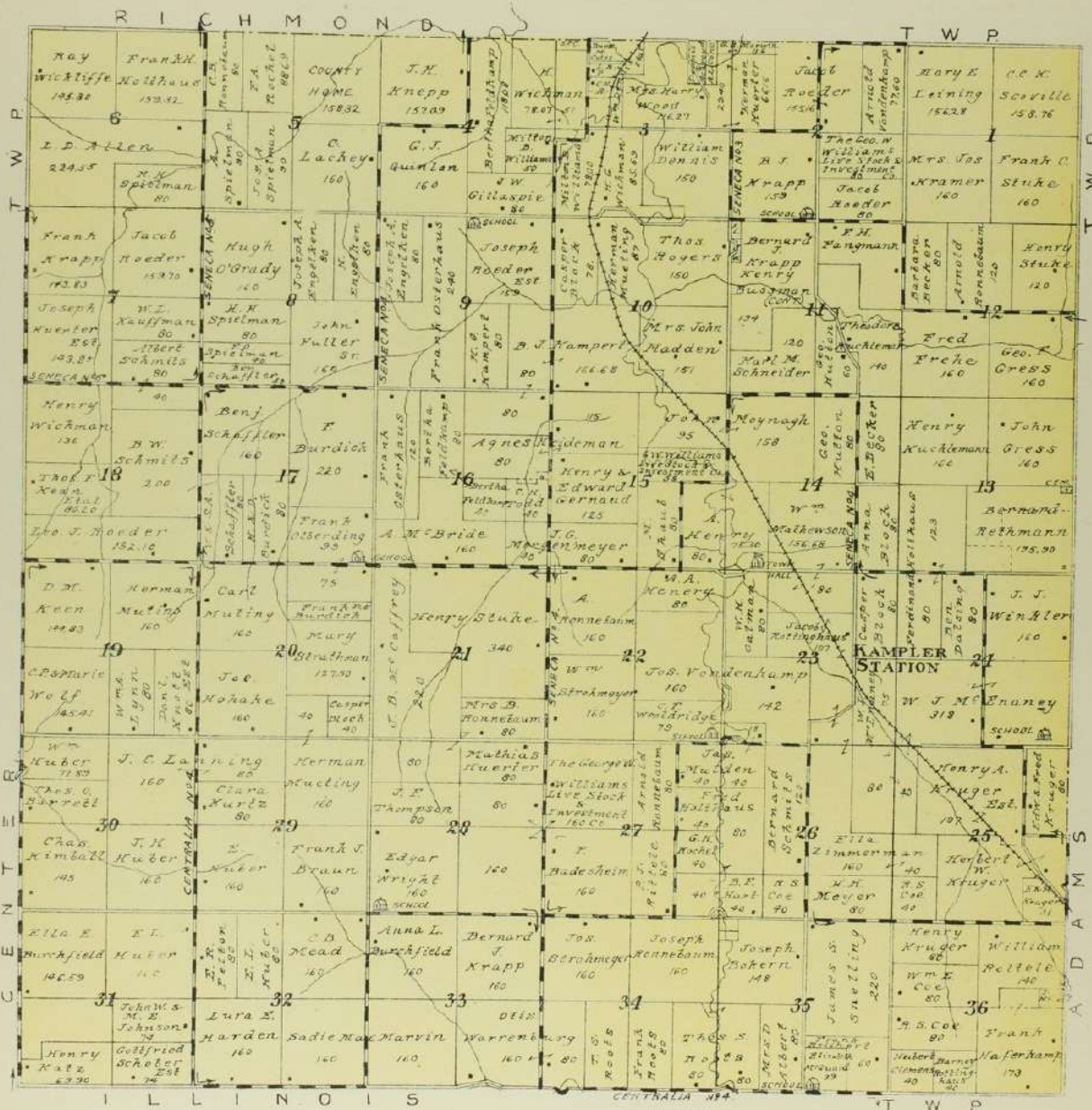



The Anderson Publishing Co.  
Map and Atlas Publ.  
Des Moines, Iowa  
Copyrighted

# MAP OF CENTER TOWNSHIP

Scale 1/4 inches to one Mile.  
Township 35 South Range 11 East of the 9th P.M.

REFERENCES:  
Rail Road — School  
Wagon Road — Church  
Corp. Line — Houses  
Creek — Cem.  
School District —  
Rural Routes —

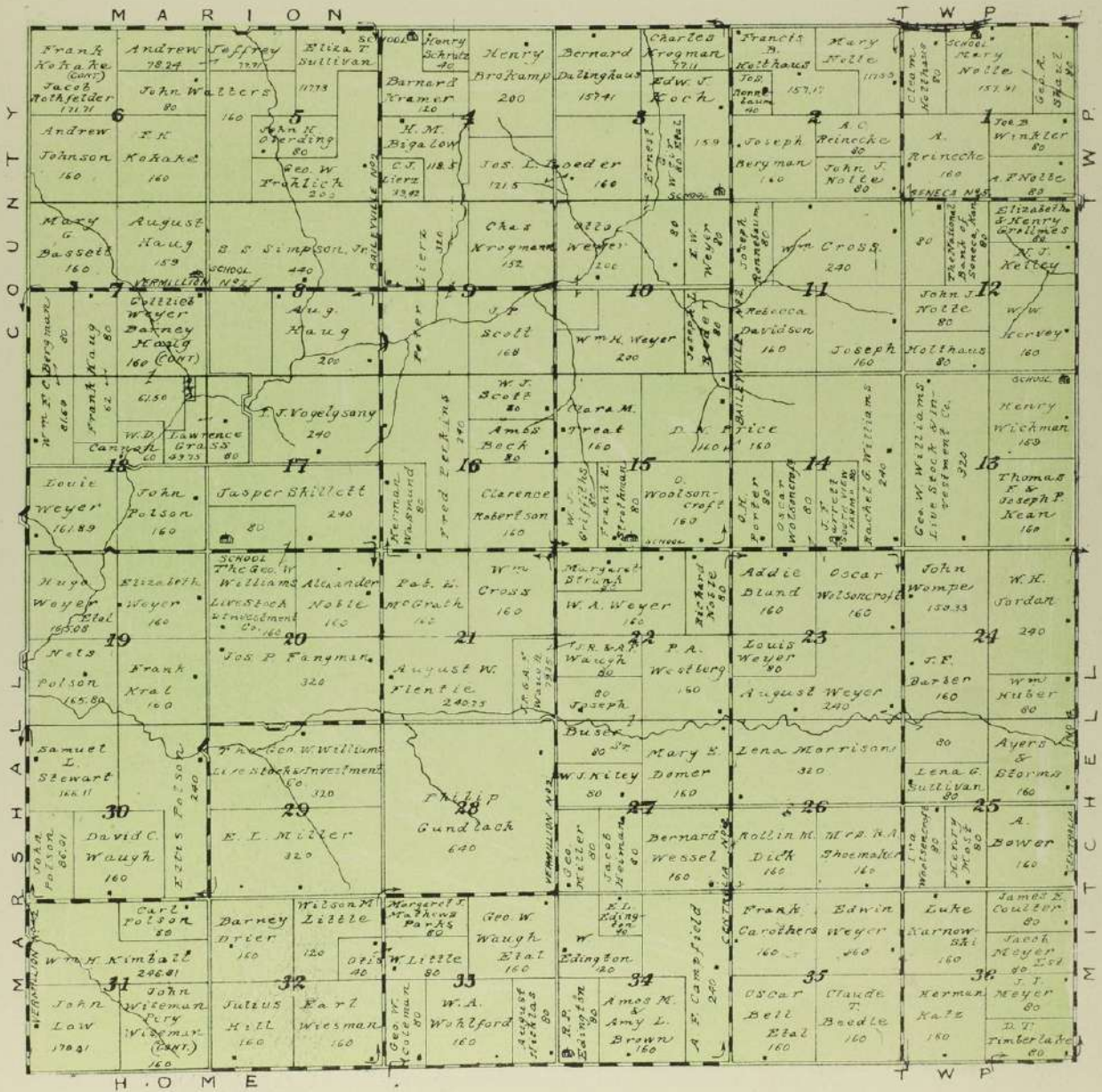



The Anderson Publishing Co.  
Map and Atlas Publ.  
Des Moines, Iowa  
Copyrighted

# MAP OF HOME TOWNSHIP

Scale 1/4 inches to one Mile  
Township 4 South Range 11 East of the 6th P.M.

- REFERENCES.
- Rail Road ————
  - Wagon Road ————
  - Corp Line ————
  - Creek ————
  - Rural Routes ————
  - School ————
  - Church ————
  - Houses ————
  - Cem. ————

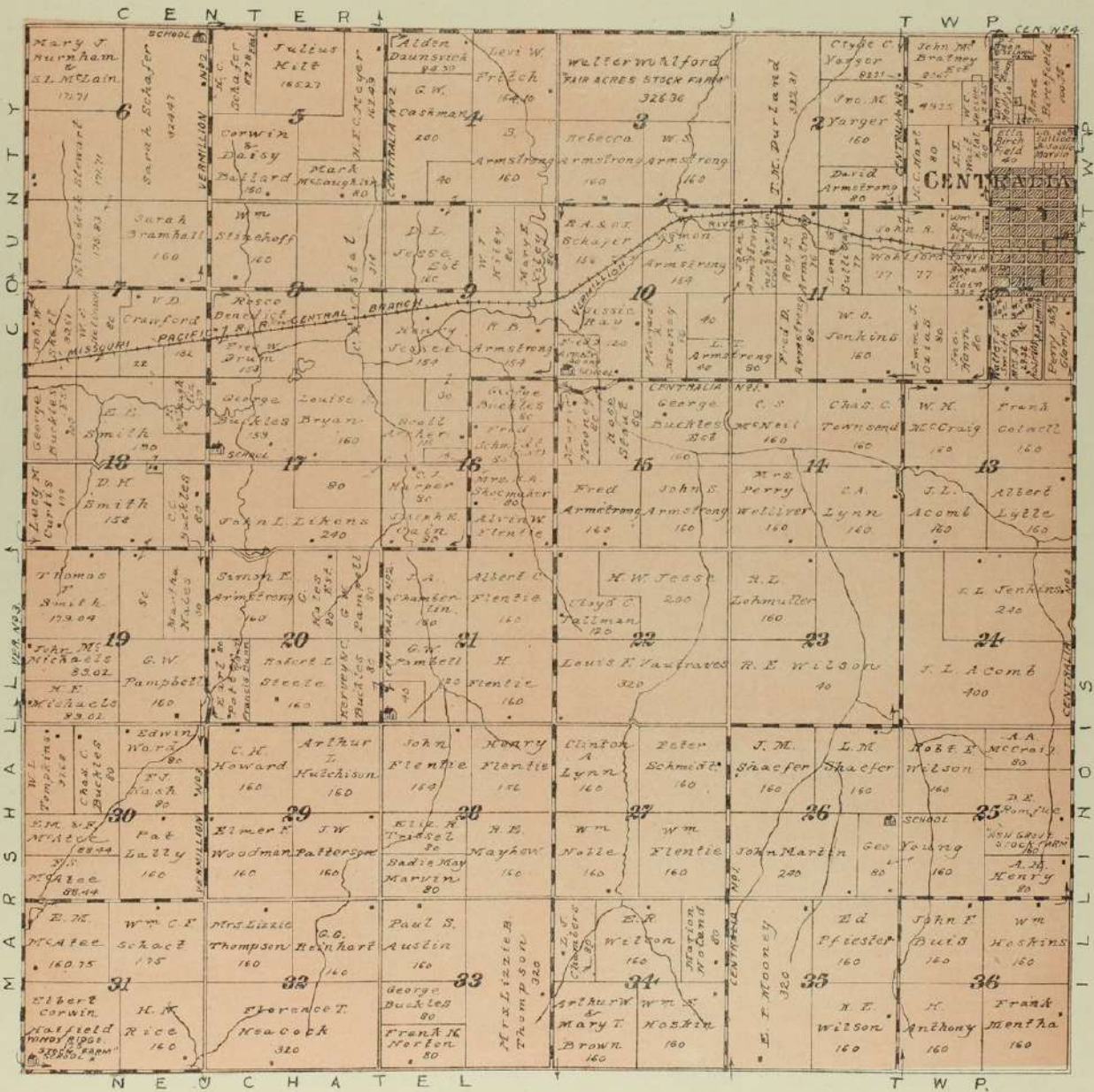



The Anderson Publishing Co  
Map and Atlas Publ.  
Des Moines, Iowa  
Copyrighted

# MAP OF ILLINOIS TOWNSHIP

Scale Fifteenches to one Mile  
Township 4 South Range 12 East of the 6th R.M.

- REFERENCES:
- Rail Road ———
  - Wagon Road ———
  - Corp Line ———
  - Creek ———
  - Rural Routes ———
  - School ———
  - Church ———
  - Houses ———
  - Com. ———

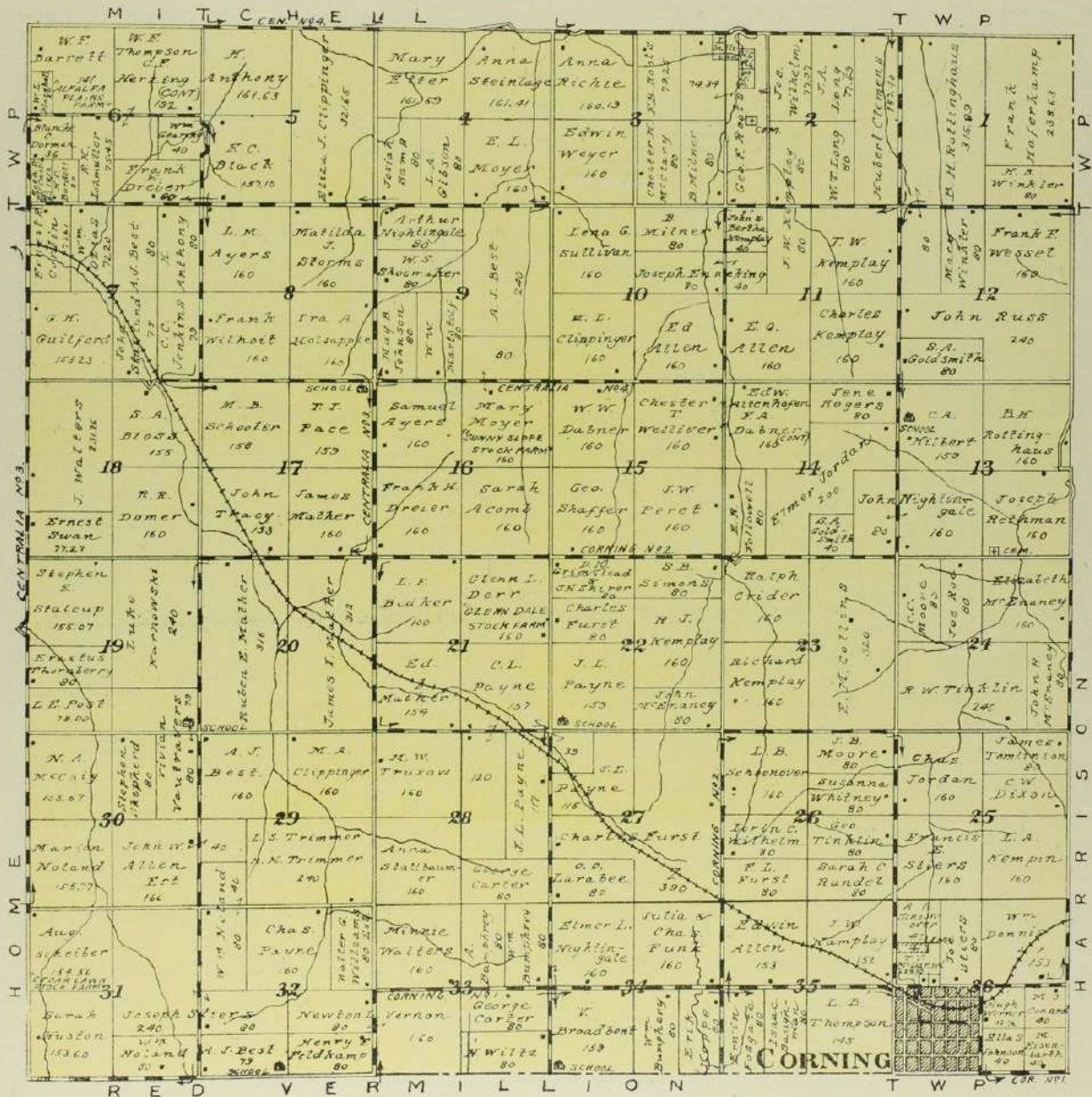

KANE'S STATE



The Anderson Publishing Co  
Map and Atlas Dept.  
Des Moines, Iowa  
Copyrighted

# MAP OF HARRISON TOWNSHIP

Scale 4 inches to one Mile  
Township 48 South Range 13 East of the 6th R.M.

- REFERENCES:
- Rail Road ——— School
  - Wagon Road ——— Church
  - Comp. Line ——— Houses
  - Creek ——— Cem.
  - Rural Routes ———

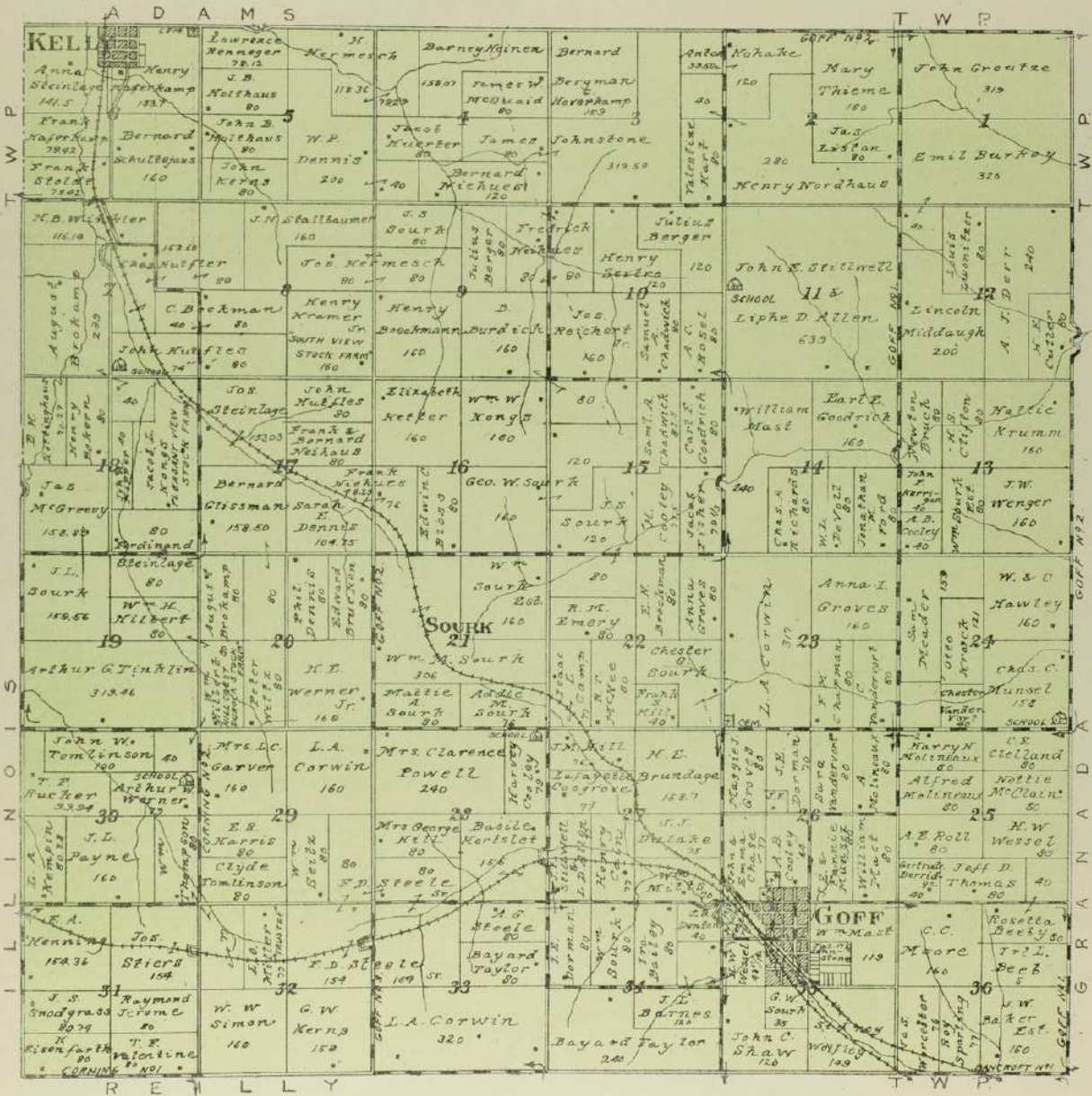



The Anderson Publishing Co.  
Map and Atlas Publ.  
Des Moines, Iowa  
Copyrighted

# MAP OF GRANADA TOWNSHIP

Scale 5 inches to one Mile.  
Township 45 South Range 1 East of 106 W.M.

REFERENCES:  
Rail Road — School —  
Wagon Road — Church —  
Comp. Line — Houses —  
Creek — Cem. —  
Rural Routes —

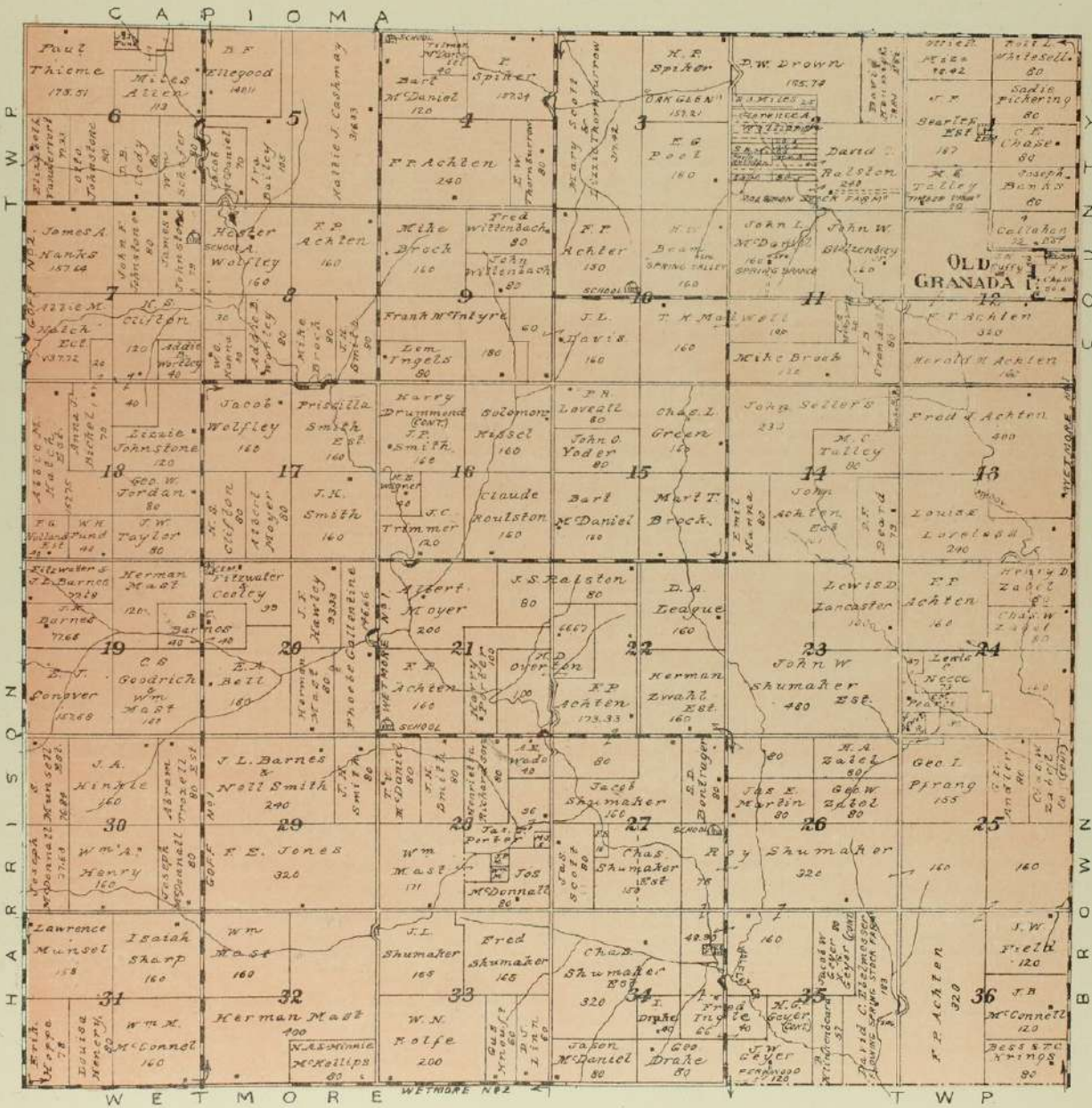

W E T M O R E

T W P







The Anderson Publishing Co.  
Map and Atlas Publ.  
Des Moines, Iowa  
Copyrighted

# MAP OF REILLY TOWNSHIP

Scale 1/4 inches to one Mile  
Township 5 S. of T. Range 13 E. of the 6th R.M.

REFERENCES:  
Rail Road — School —  
Wagon Road — Church —  
Coop Line — Houses —  
Creek — Cem. —  
Rural Routes —

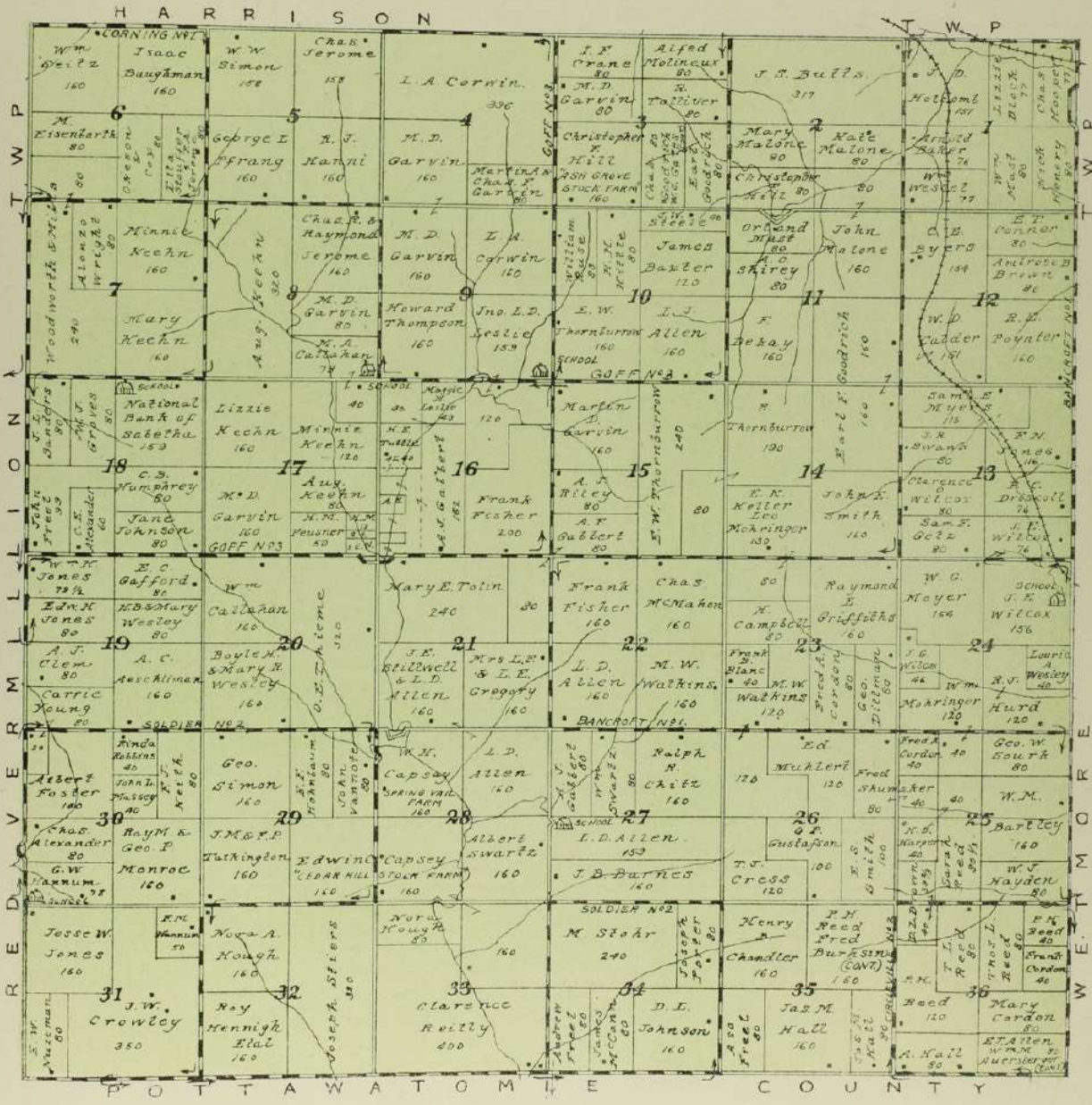



The Anderson Publishing Co.  
Map and Atlas Publ.  
Des Moines, Iowa  
Copyrighted.

# MAP OF RED VERMILION TOWNSHIP

**REFERENCES:**  
 Rail Road — School  
 Wagon Road — Church  
 Corp Line — Houses  
 Creek — Cem.  
 Rural Routes —

Scale Inches to one Mile.  
 Township 5S South Range 12E East of the 6th R.M.

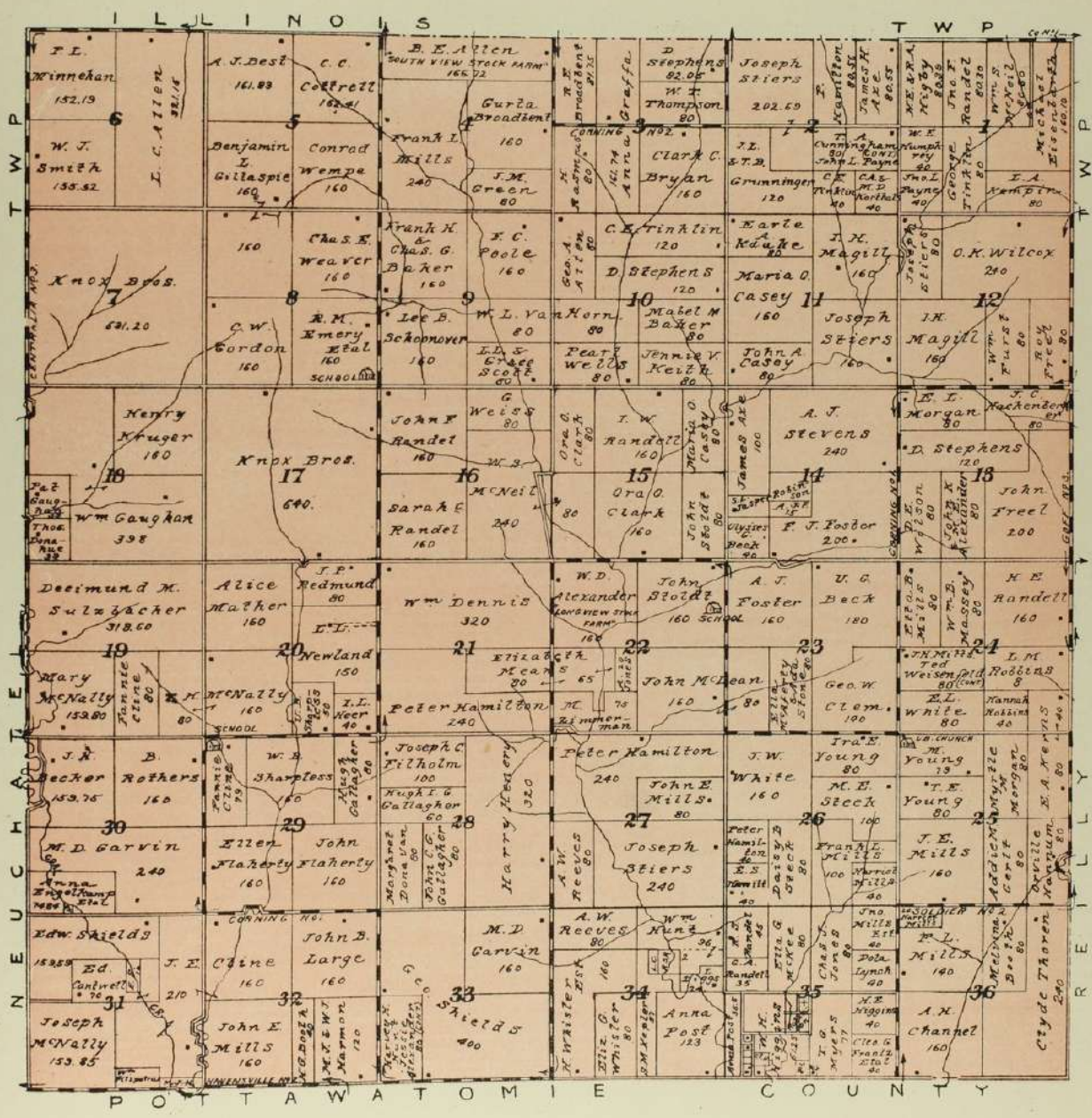



The Anderson Publishing Co.  
Map and Atlas Publ.  
Des Moines, Iowa  
copyrighted

# MAP OF NEUCHATEL TOWNSHIP

Scale Distances to one Mile.  
Township 5 South Range 1 East of the 6th R.M.

- REFERENCES
- Rail Road — School
  - Wagon Road — Church
  - Co. Line — Houses
  - Creek — Cem.
  - Rural Routes —

