

OUTLINE MAP OF NEOSHO COUNTY

KANSAS.

Scale 1/2 Inch to the Mile.

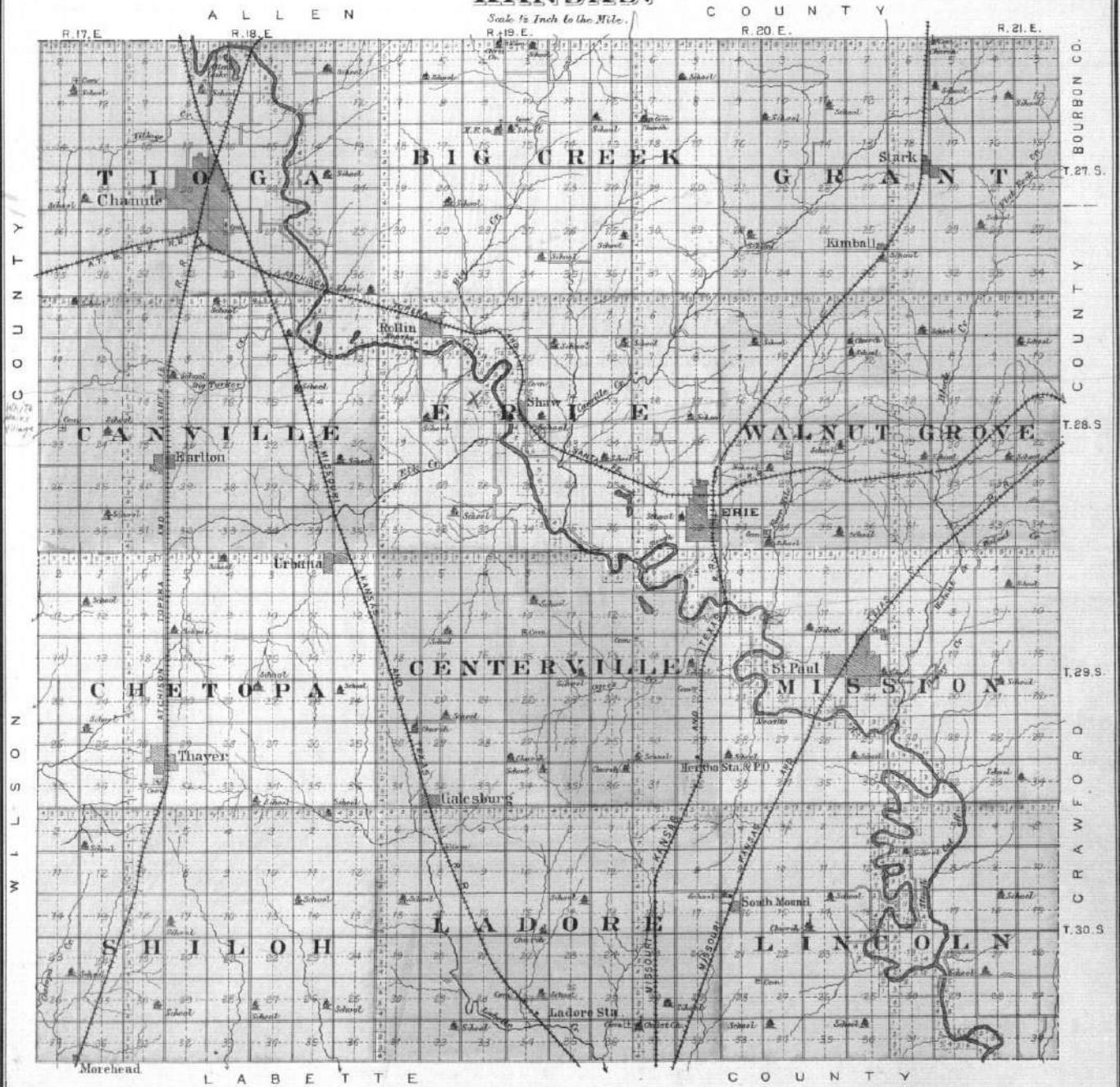

Conville Trading Post

Woodford Robinson

PLAT OF
GRANT
 TOWNSHIP

Scale 2 Inches to the Mile.
 A L L E N

Part of Township 27 North, Ranges XX and XXI East

of the 6th Principal Meridian.
 C O

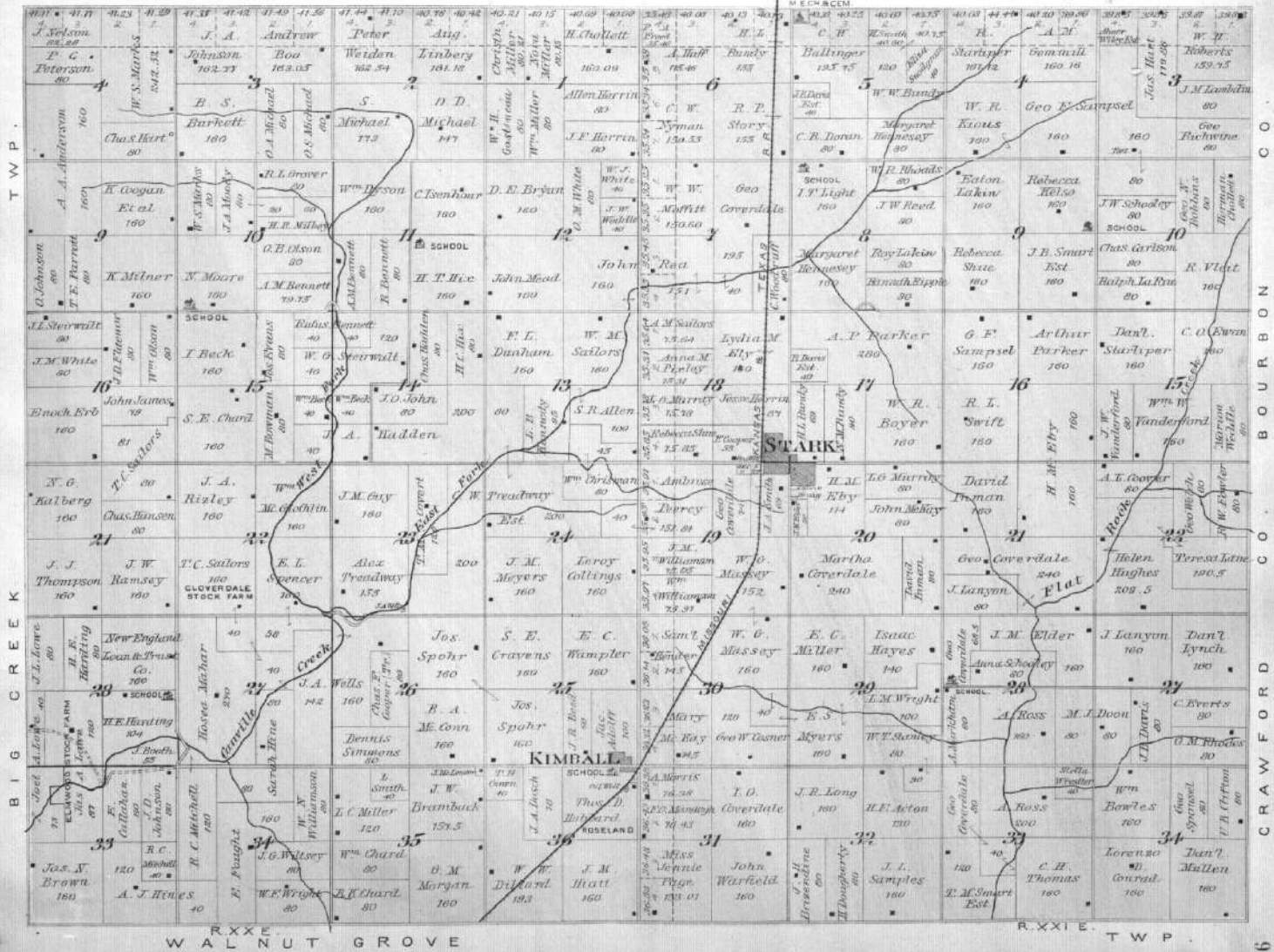

W A L N U T G R O V E

R. XXI E. T W P.

PLAT OF BIG CREEK TOWNSHIP

Scale 2 Inches to the Mile Township 27 South Range XIX East and Part of Township 27 South Range XX East of the 6th Principal Meridian.

ALLEN

LEANNA PO & STORE

COUNTY

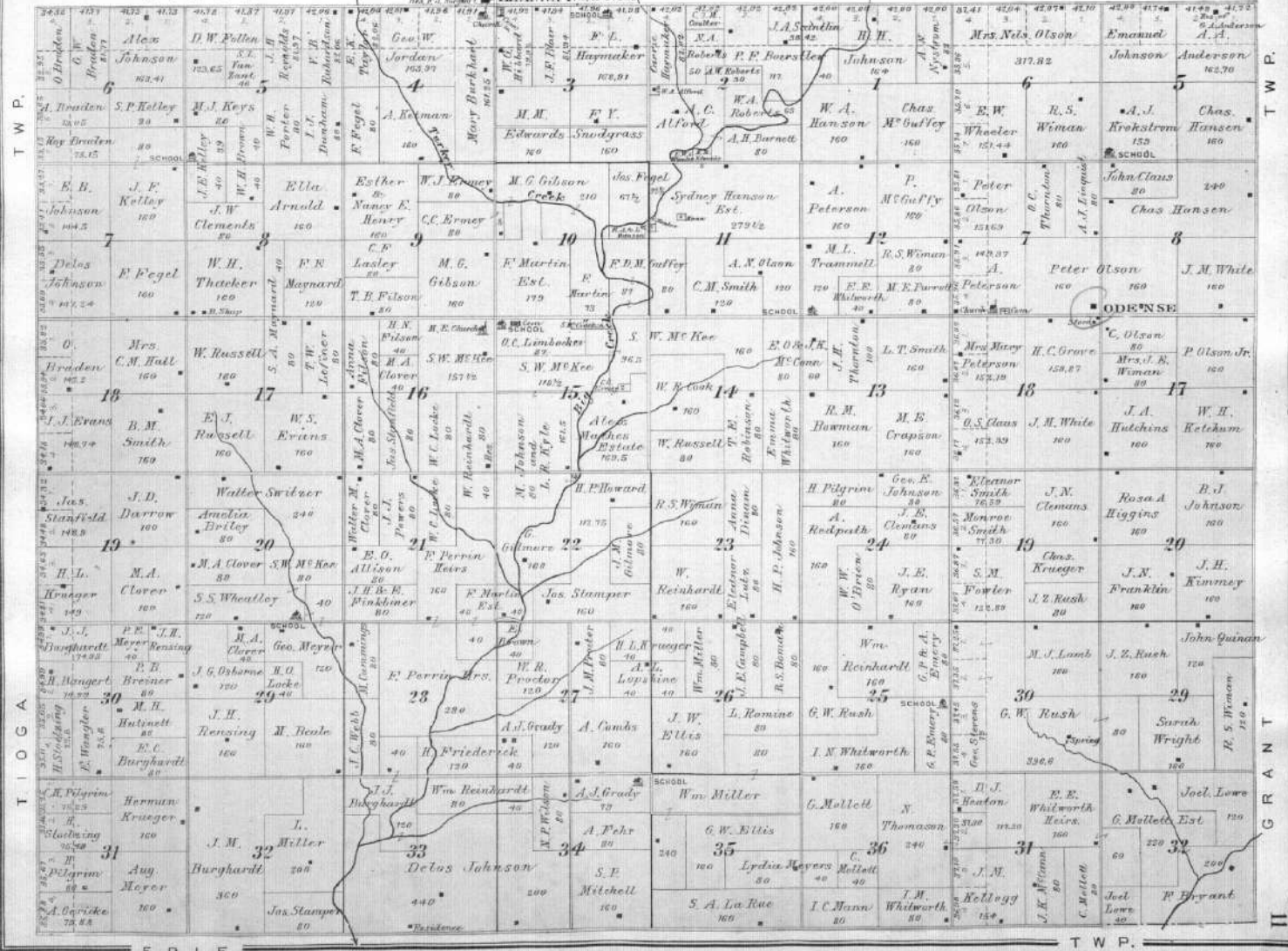

ERIE

T W P.

TIOGA

TOWNSHIP

Scale 2 Inches to the Mile. Township 27 South Range XVIII East and Part of Township 27 South Range XVII East of the 6th Principal Meridian.



CANVILLE

TWP.

PLAT OF
CANVILLE
 TOWNSHIP

Scale 2 Inches to the Mile. Township 28 South Range XVIII East and Part of Township 28 South Range XVII East of the 6th Principal Meridian.

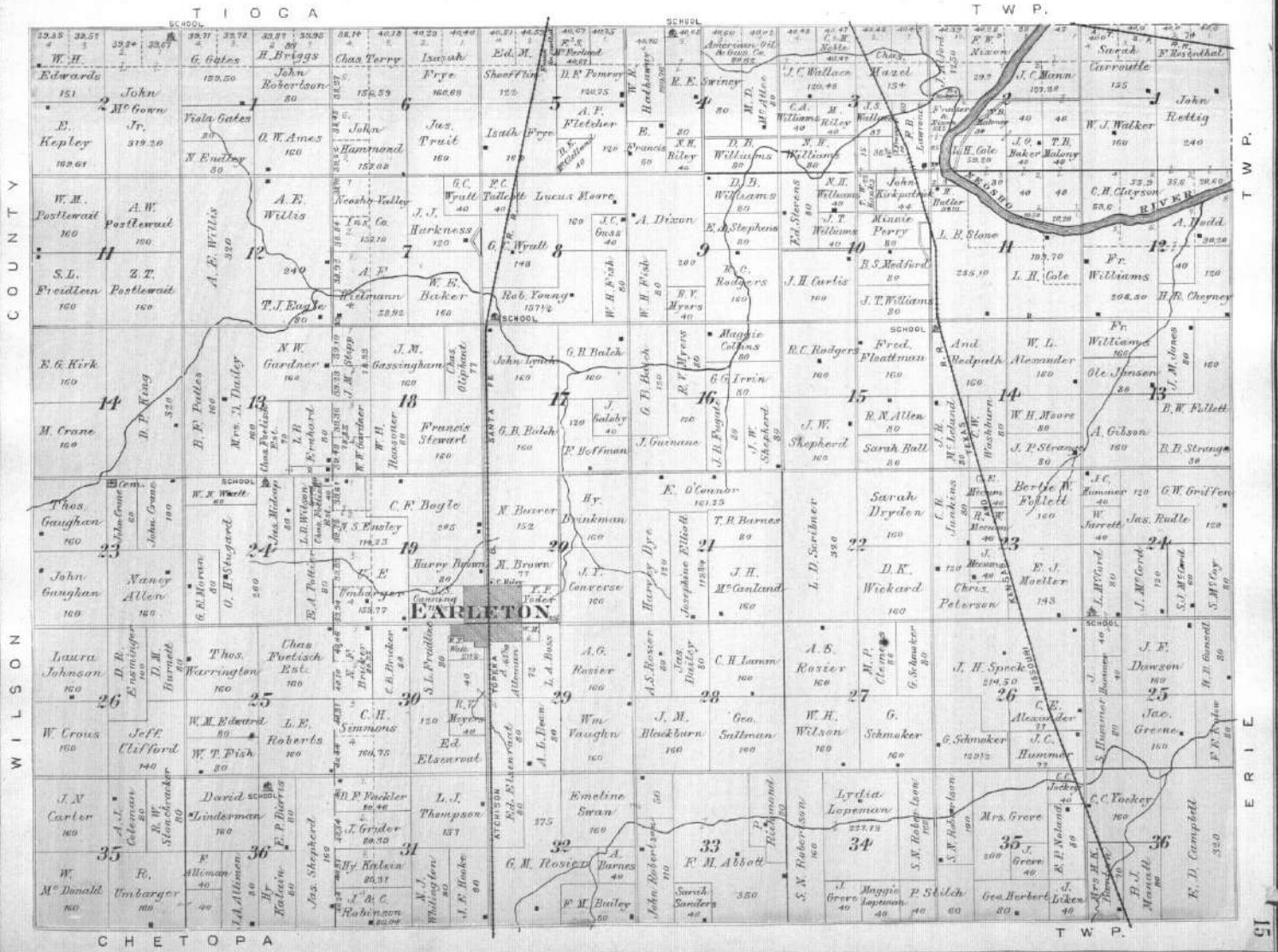

WILSON

ERIE

C H E T O P A

T W P.

WALNUT GROVE

TOWNSHIP

Scale 2 Inches to the Mile

Part of Township 28 South Ranges XX & XXI East

of the 6th Principal Meridian

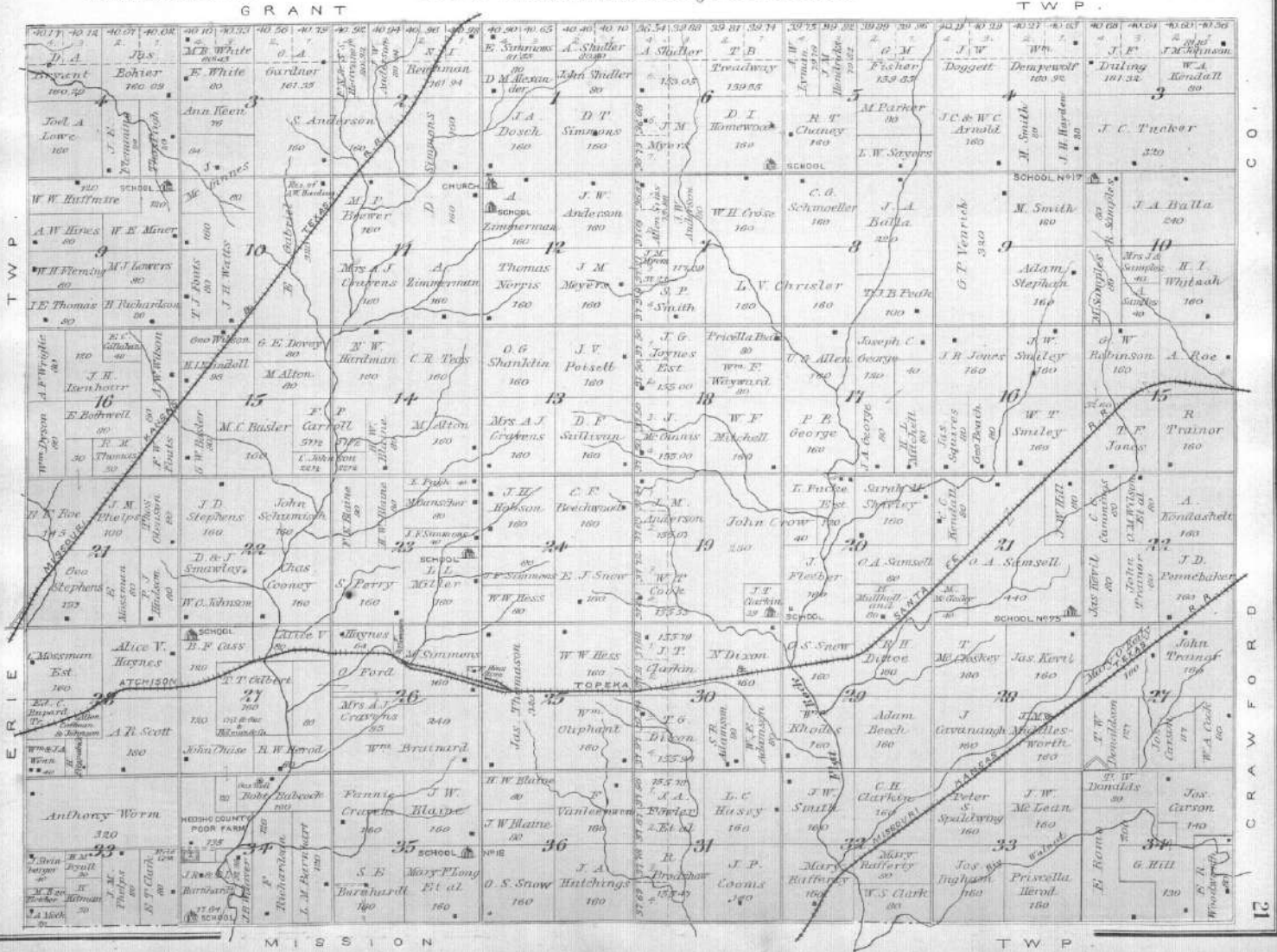

C O C R A W F O R D

MISSION

T W P

21

PLAT OF

MISSION

TOWNSHIP

Scale 2 Inches to the Mile.

Part of Township 29 South Ranges XX and XXI East

of the 6th Principal Meridian.

WALNUT GROVE

TWP

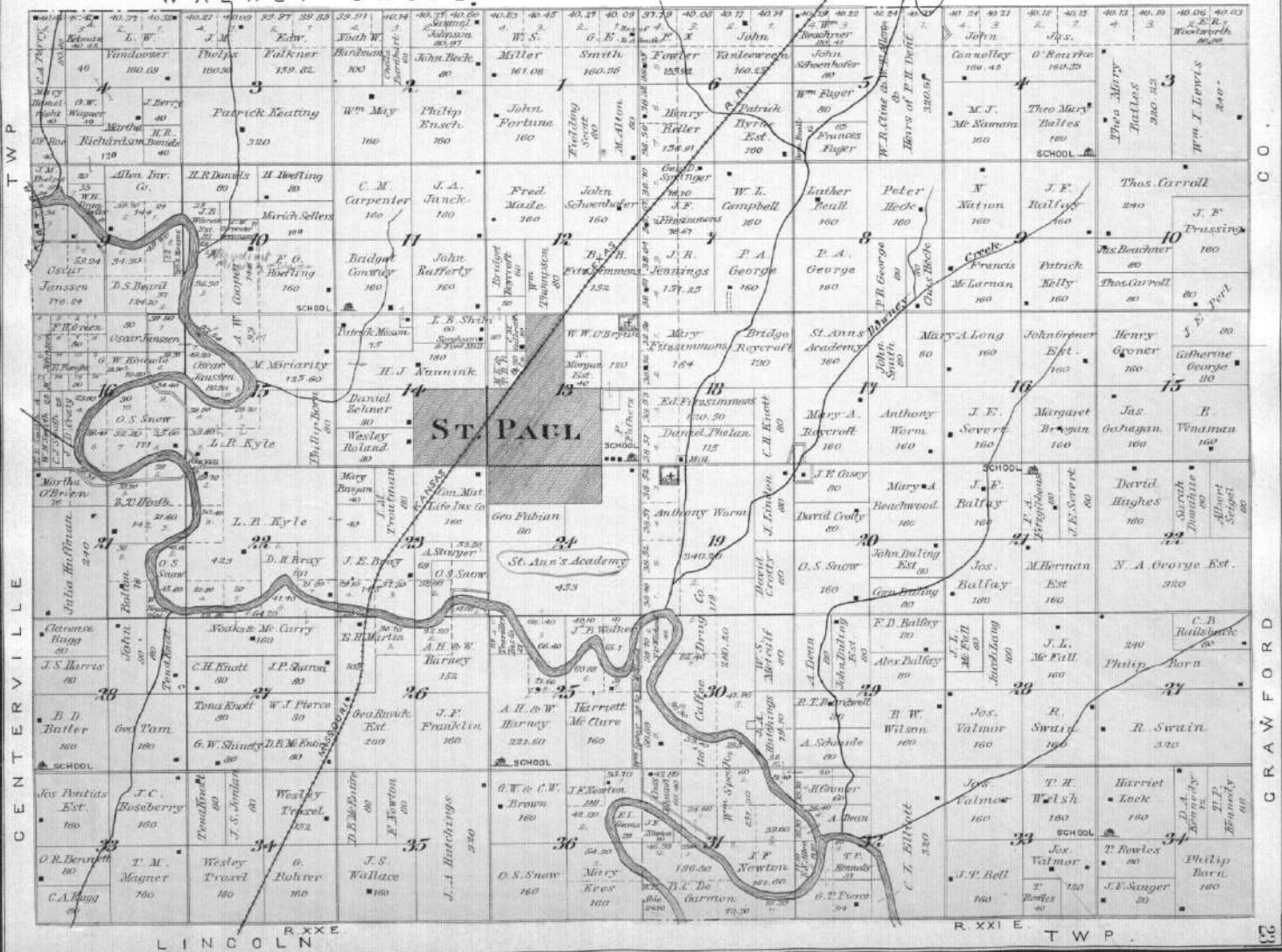

TWP

CENTERVILLE

CRAWFORD

CRAWFORD

R. XX E.

R. XXI E.

LINCOLN

TWP

33

PLAT OF CENTERVILLE

TOWNSHIP

Scale 2 Inches to the Mile.

Part of Township 29 South Ranges XIX and XX East

of the 6th Principal Meridian.

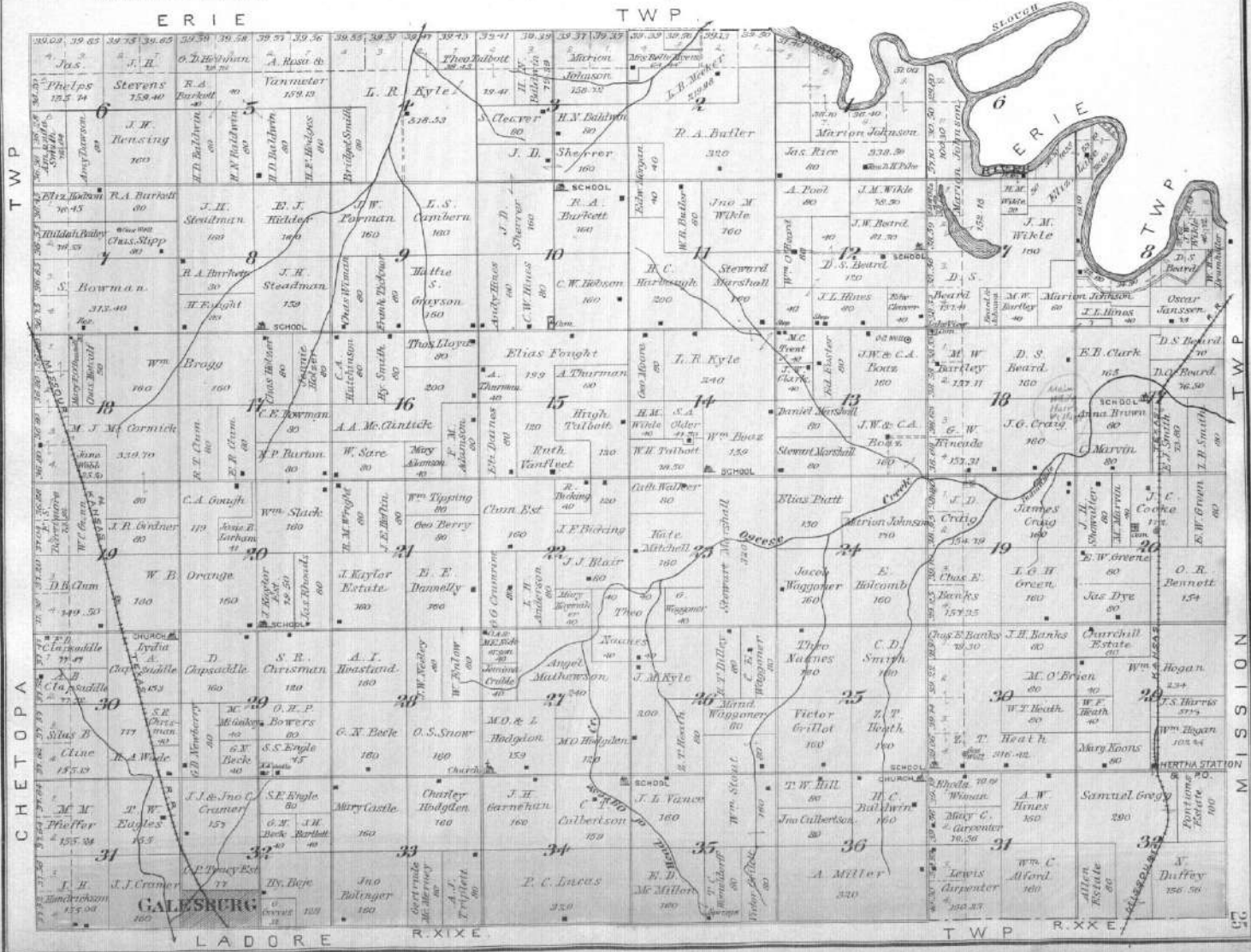

PLAT OF
CHETOPA
 TOWNSHIP

Scale 2 Inches to the Mile Township 29 South Range XVIII East and Part of Township 29 South Range XVII East of the 6th Principal Meridian.

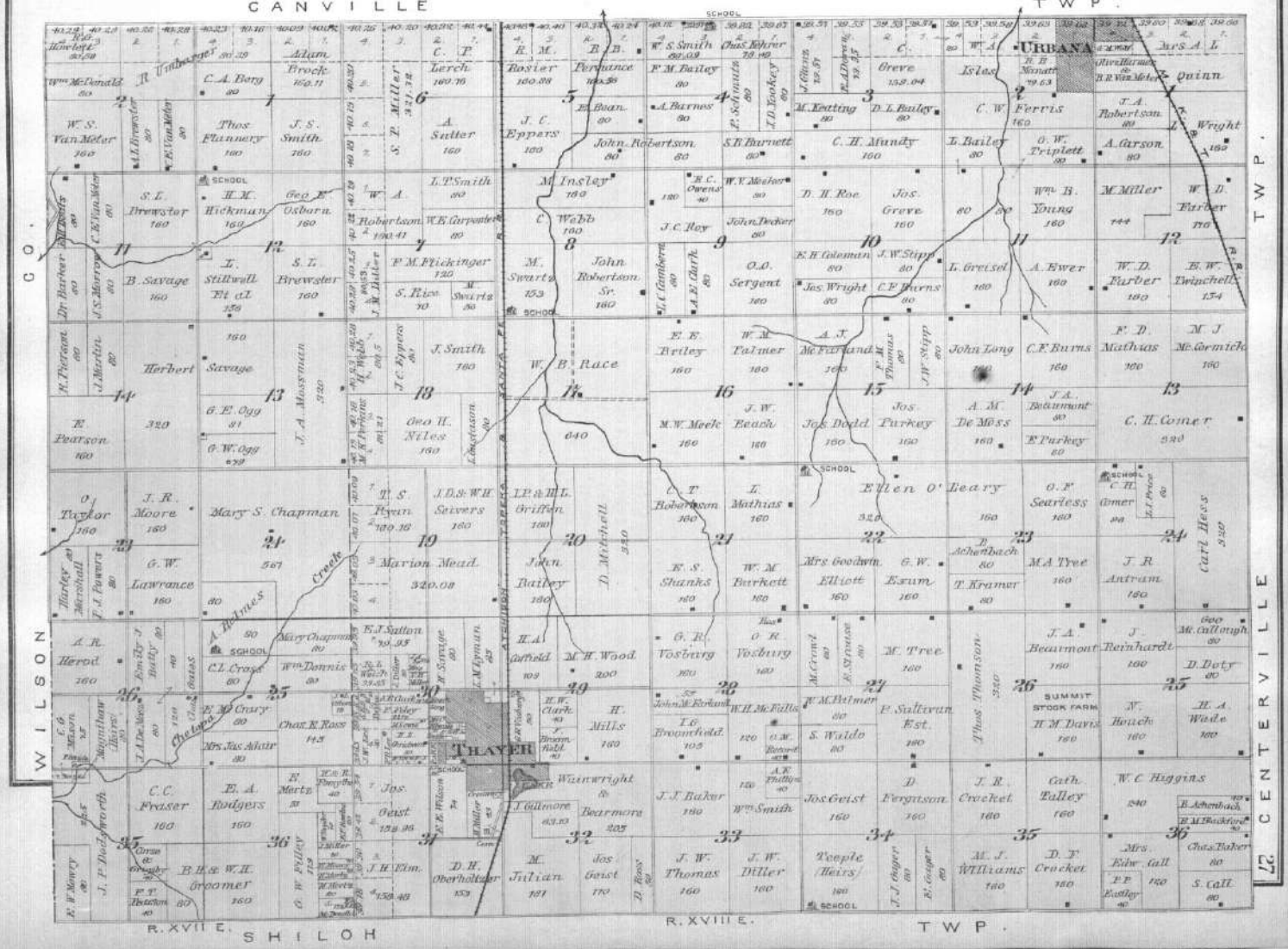

T W P . U R B A N A T W P . S H I L O H T W P .

SHILOH

TOWNSHIP

Scale 2 Inches to the Mile Township 30 South Range XVIII East and Part of Township 30 South Range XVII East of the 6th Principal Meridian.

CHETOPA

TWP



RXVII E

LABETTE

RXVIII E

CO

LADORE

TOWNSHIP

Scale 2 Inches to the Mile. Township 30 South Range XIX East and Part of Township 30 South Range XX East of the 6th Principal Meridian.

CENTERVILLE TWP

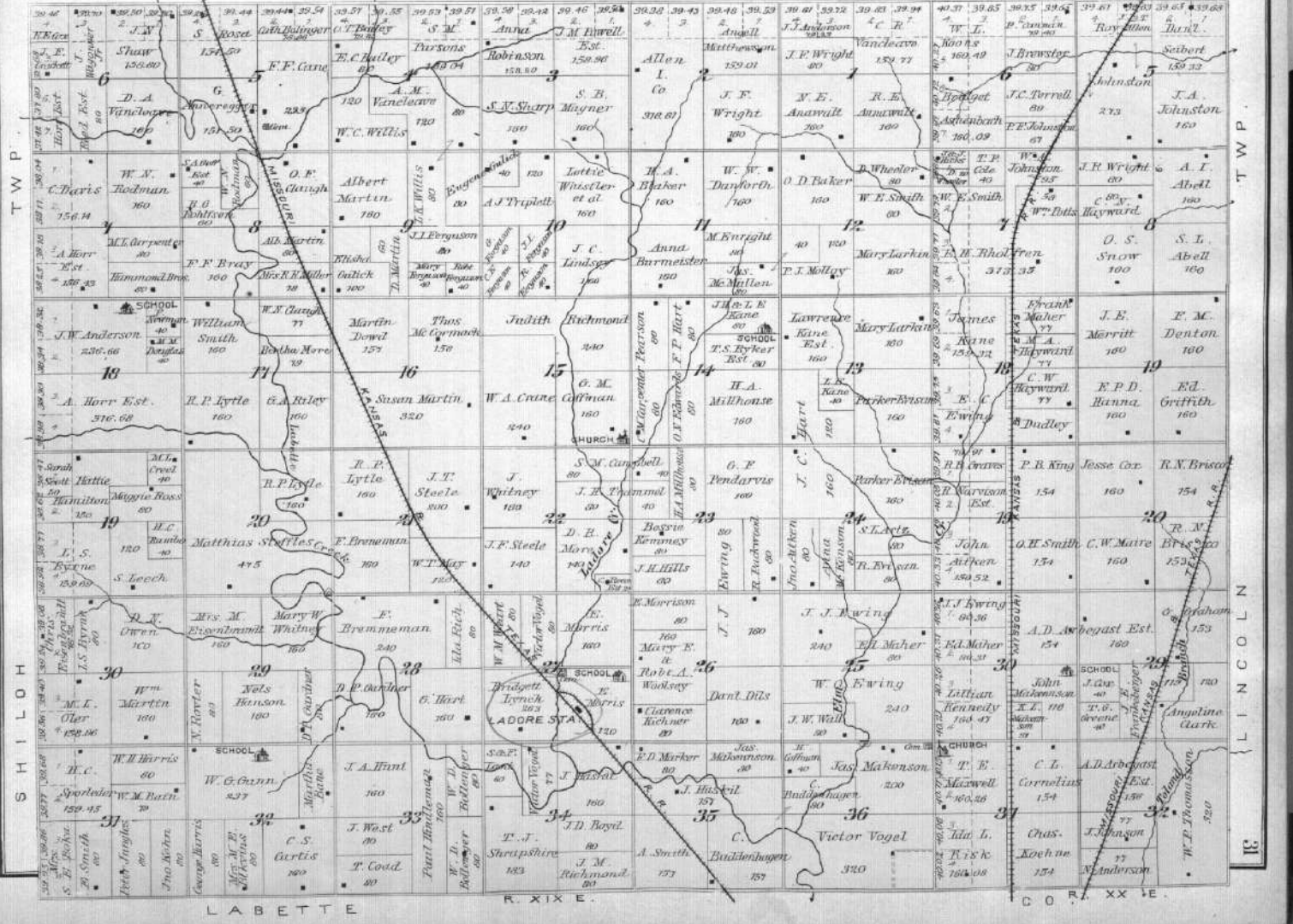

LABETTE

R. XIX E.

COR. XX E.

KIMBALL
GRANT TWP.
Scale 300 feet to 1 inch.

Jas. Adolph 100

Thos. D. Hubbard 100

SILAW
ERIE TOWNSHIP
Scale 300 Ft. 1 Inch.

Elmer A. Fisk

STATION GROUNDS

MOREHEAD
SHILOH TWP.
Scale 300 Feet to 1 Inch.

J. P. Nichols 40

Neola

LABETTE COUNTY

CITY OF ERIE
ERIE TOWNSHIP
County Seat of Neosho County, Kas.
Scale 400 feet to one inch.

J. M. Crupson 10

J. M. & T. J. Crupson 23.53

Kate C. Wright 16.22

J. H. Newhall 5

Coffman, Allen & Johnson 103.90

I. N. George 10.00

Mrs. A. Hooley 10.33

W. A. Kyle 5.00

White 3.12

D. A. Bryant 39.31

A. H. Osburn 50.00

T. B. Lienbecker 12.50

W. T. Allen

HANNAN'S ADD.

DUTTON'S ADD.

H. C. Prange

B. C. De Garmo 22.70

A. H. Miller 17.70

High School

Count House

STATION

URBANA
CHETOPA TP.
Scale 300 ft. to 1 inch.

FRONT ST.

SECOND ST.

COMMERCIAL ST.

THIRD ST.

FOURTH ST.

FIFTH ST.

SIXTH ST.

Geo M. Wolf

Olive Harmer

R. B. Van Meter

J. A. Robertson

C. W. Ferris 100

Mrs. A. Quinn

North Part of CHANUTE

TIOGA TWP.
Scale one (1/2) inch.



Section 101 & 102 of 1856

See 11



South Part of
CHANUTE
 TIOGA TWP.
 Scale - 400 Ft. to 1 Inch.

P. S. Warner
 100

J. C. Carpenter
 100

Callahan & Co.
 Brick & Co.

D. H. Kennerly
 103

Jan. O'Neil
 12

M. B. Bostick
 12

H. Savage 60

H. N. Lyman 55

A. H. Coffield 100

Minich

Long

Mrs. Edwards

E. Smith

City Park

C. Joseph 2.50

E. E. Wilson

74

KELLOGG ST.

ST.

ST.

WORK ST.

GREENWOOD ST.

ST.

WILSON ST.

LABETTE ST.

ST.

NEOSHO ST.

CHETOPA ST.

OSAGE ST.

MONTGOMERY ST.

JEFFERSON ST.

NEW ST.

M. Miller 49

Greenery

THAYER

CHETOPA TWP.
Scale 500 Feet to one inch

G. R. Vosburg

50



LAKE

Wainwright & Bearmore

205

H. W. Clark 40

J. Bromfield 40

30

Mrs. A. E. Clark

M. Lewis P. H. Foley

H. I. Christman

R. Jenks

J. O. S. G. C. S. T.

J. Harnady

SANTA FE R. R.

DEPOT

TOROKA

ATCHISON

30

A. H. D. ...

ORIGINAL

WORK ST.

M. LACHRY'S ADD.

J. W. Sparks

ADVENT SCHOOL

Qualls

ST.

ST.

ST.

ST.

ST.

ST.

ST.

ST.

ST.

ST.

ST.

Harry Brown

80

M. Brown

77

EARLETON

CANVILLE TWP.

Scale 200 Feet to one inch.

J. S. Cunningham

S. L. Friedline

W. N. Wall

21.5

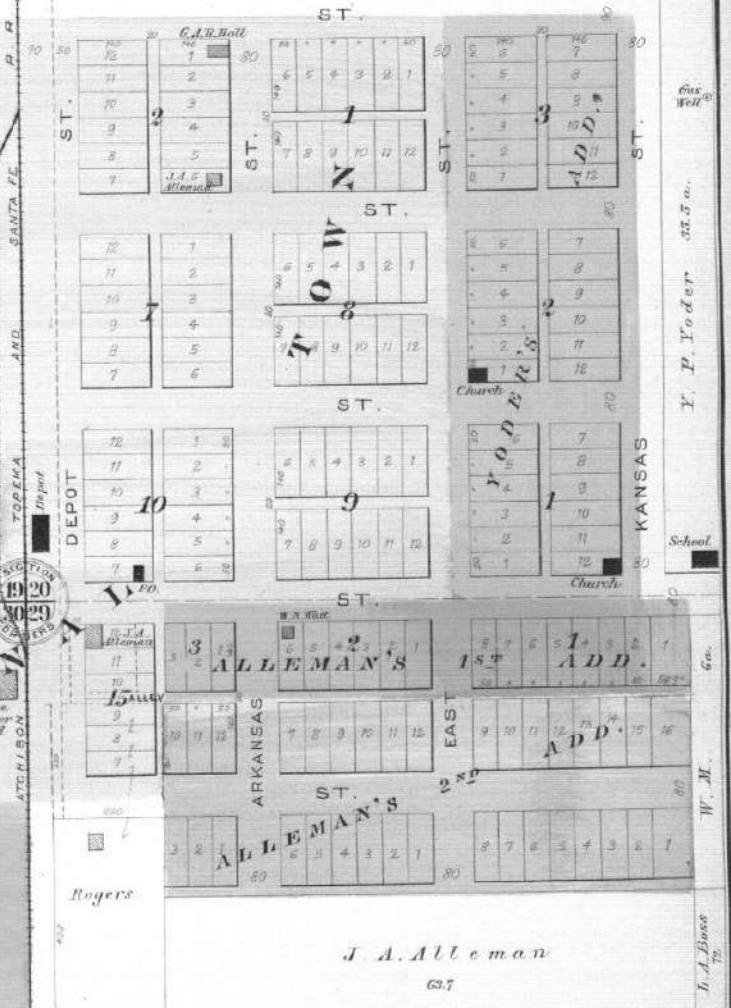

Rogers

J. A. Alleman

63.7

J. A. Bloss

PLAT OF
LINCOLN
 TOWNSHIP

Scale 2 Inches to the Mile.

Part of Township 30 South Ranges XX and XXI East

of the 6th Principal Meridian



LA BETTE

CRAWFORD COUNTY

ERIE

TOWNSHIP

Scale 2 Inches to the Mile.

of the 6th Principal Meridian

Township 28 South Range XIX East and Parts of Townships 28 & 29 South Ranges XIX and XX East

