

OUTLINE MAP OF  
**OSBORNE COUNTY**  
KANSAS

Copyright 1917 by Geo. A. Gile & Co.

Scale 3/16 of 1 inch to 1 mile

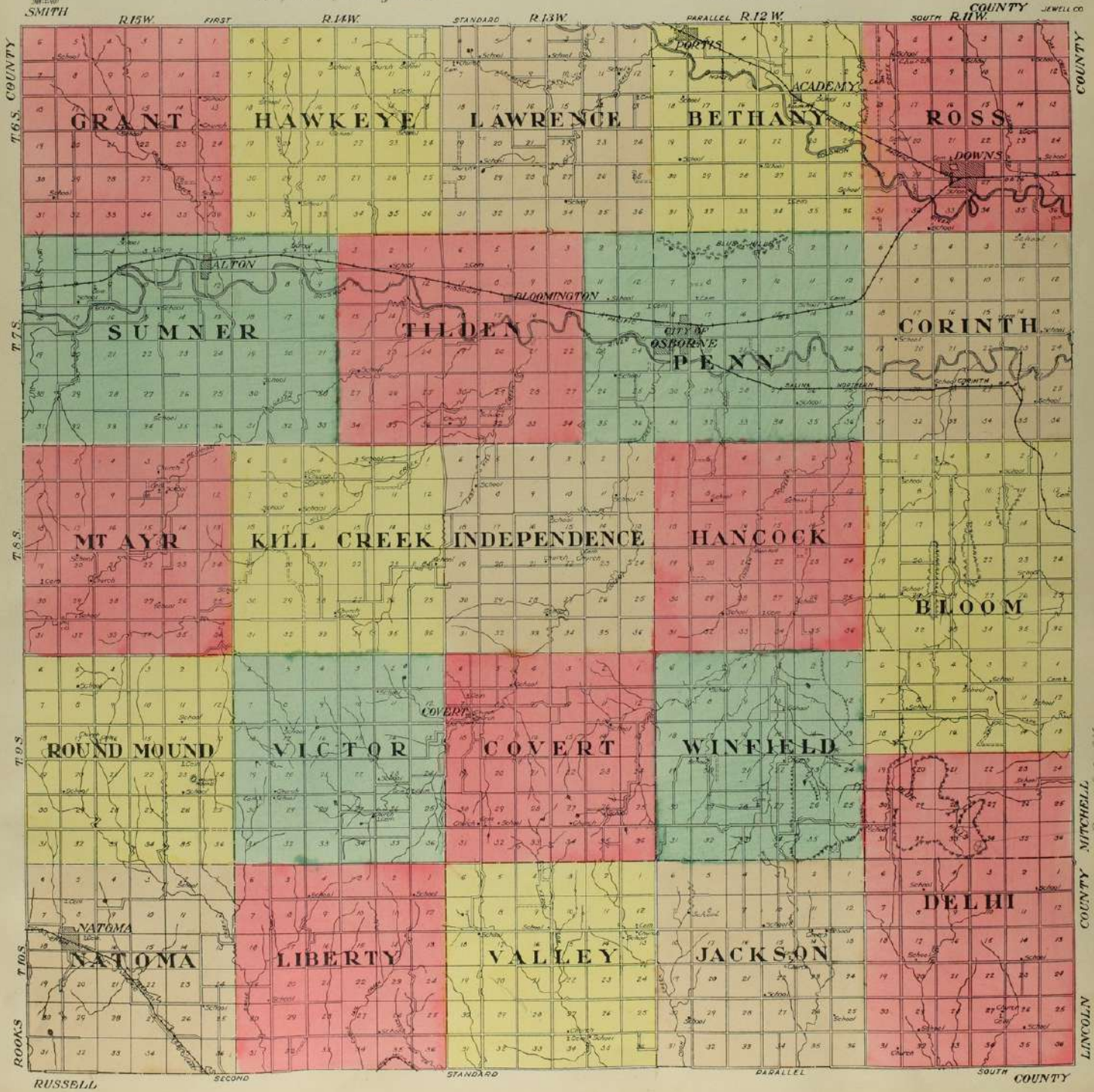

**MAP OF**  
**GRANT**  
 TOWNSHIP  
 Scale 2 inches to 1 mile

Township 6 South, Range 15 West of the 6th P. M.

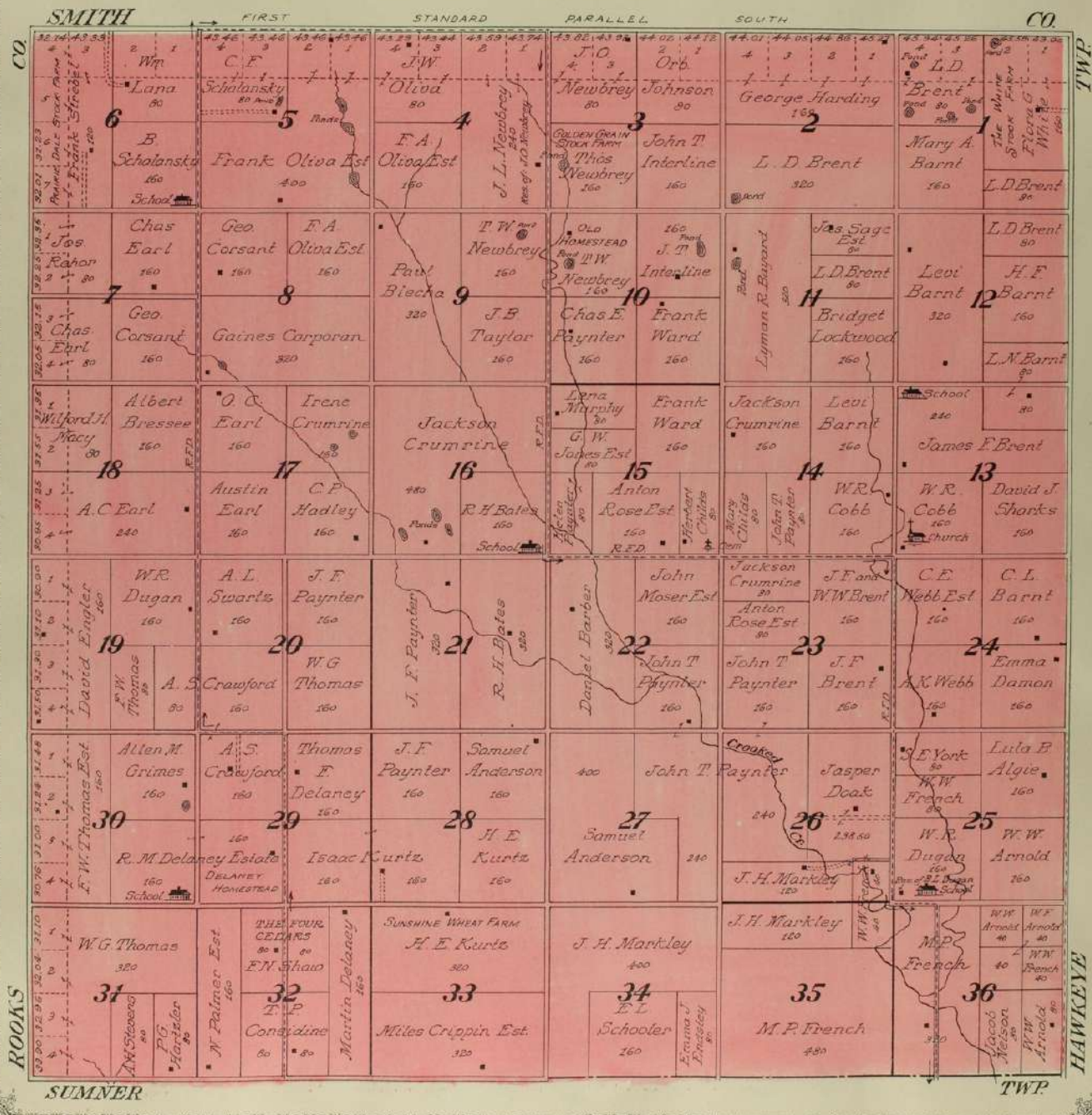

ROCKS

SUMNER

HAWKEYE

TWP.

CITY OF OSBORNE  
COUNTY SEAT OF OSBORNE CO., KANS.  
Scale 360 feet to 1 inch  
Copyright 1917 by Geo. H. Gies & Co.

R. M. Taylor  
157.50

Fred Voxall  
28

John Kaser  
1

Wm. H. Hill  
9.15

Fred Voxall  
15

MISSOURI PACIFIC R.R.

JOHN W. BROWN

A. K. SMITH

C. D. CHRISTIAN

W. DEAN

CORPORATION LIMITS

CORPORATION LIMITS

CORPORATION LIMITS

PENN

SOUTH

FIFTH

WEST

CHESTNUT

WALNUT

CORPORATION LIMITS

LIMITS

S. B. Farwell  
5

Jas. M. Bloomer  
10

John Kaser  
73

J. M. Clark  
8.24

E. A. Clark  
5

Mary A. Suttan

Walter R. Phillips  
5

FAV SCOTCH & EMINGER'S  
PITTS

YOXALL'S

YOXALL'S

HOPFMAN'S

SECON

ADD

ADD

ADD

ADD

NIQUETTE & TRUMANS

NIQUETTE & TRUMANS

ORIGINAL

ADD

ADD

ADD

E. E. Ellis  
8

Chas Kirchoff  
7

J. W. Harvey  
30

E. E. Ellis  
9

John Pitzer  
10

FA. Rothenberger  
5

C. S. Sutton  
10

Mrs. E. Pratt  
5

C. J. Hook  
5

A. A. Waugh  
20

Josie B. Pulver  
50

F. A. Rothenberger  
20

C. J. Hook  
20

NORTH  
YOXALL

SIXTH  
MARKET

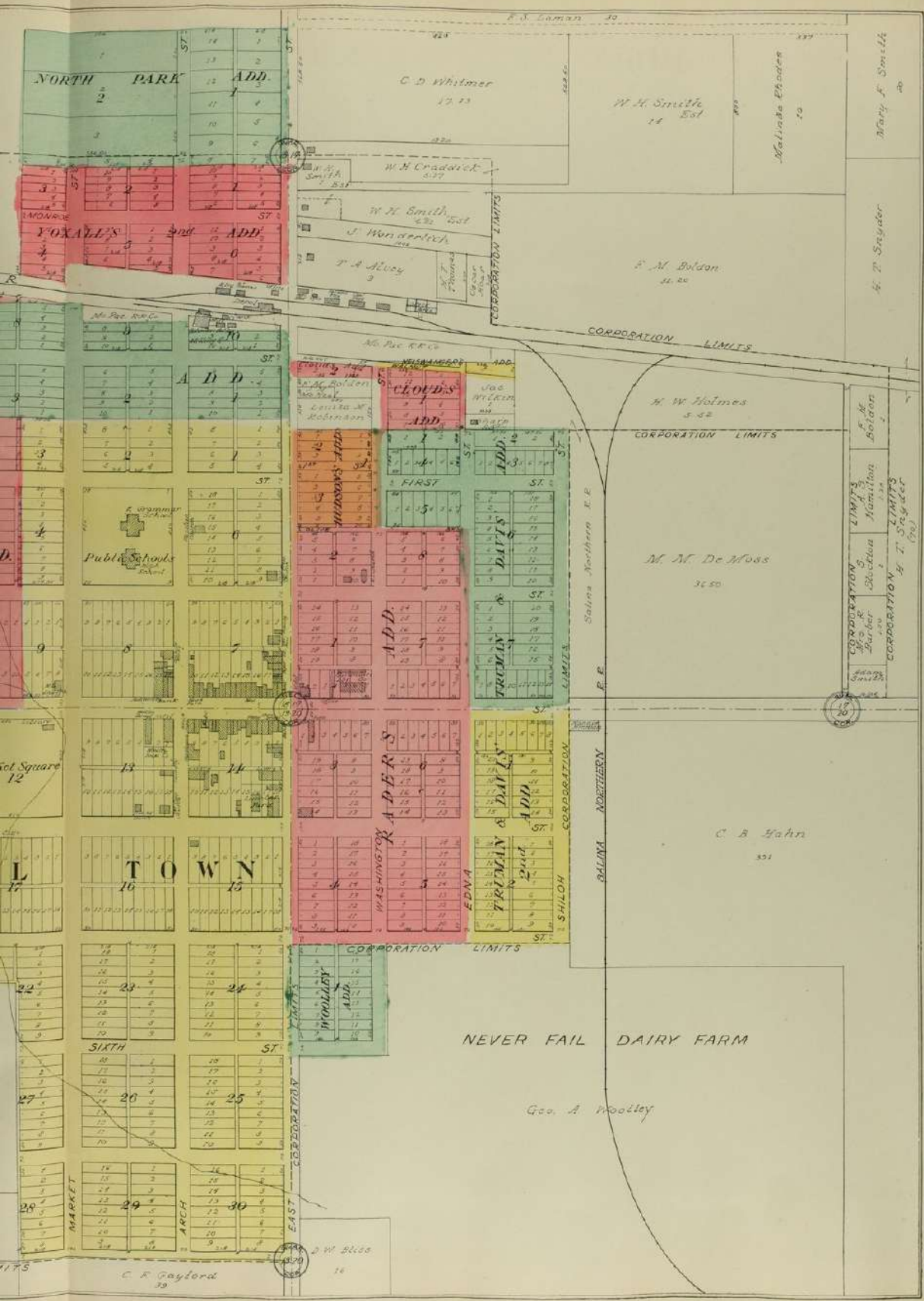

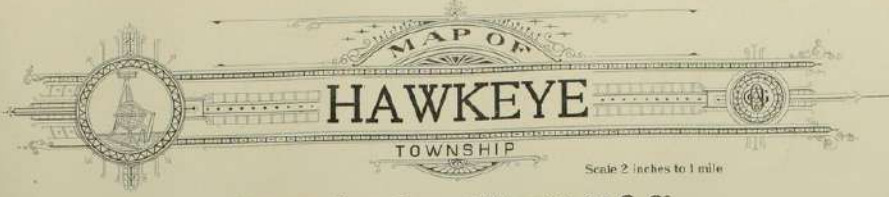

  
**MAP OF**  
**HAWKEYE**  
 TOWNSHIP  
 Scale 2 inches to 1 mile

Township 6 South, Range 14 West of the 6th P. M.

	SMITH	FIRST	STANDARD	PARALLEL	SOUTH	CO.
TWP	36.40 40.80 4 Levi S.A. 40	38.13 38.41 L.R. 40	34.49 33.96 E.L. 40	33.93 33.54 W.D. Reinhold 40	37.93 37.48 W.D. C.W. ELLER 40	30.20 30.41 Locust Vale 40
	30.20 30.41 Barni 40	38.13 38.41 Bayard 40	34.49 33.96 Conrad 40	33.93 33.54 Frank Ward 40	37.93 37.48 Reinhold 40	30.20 30.41 L.E. Reach 40
	30.20 30.41 Chris & Mary Knapp 40	38.13 38.41 John Painter 40	34.49 33.96 H.W. Freese 40	33.93 33.54 W.E. Wakeman 40	37.93 37.48 Henry Freese 40	30.20 30.41 Arthur Howell 40
	30.20 30.41 Valley View Farm 40	38.13 38.41 J.T. Vale Estate 40	34.49 33.96 Frank Ward 40	33.93 33.54 Frank Ward 40	37.93 37.48 Highland Ranch 40	30.20 30.41 Foy Duer 40
	30.20 30.41 Mary Knapp 40	38.13 38.41 T.T. Vale Est 40	34.49 33.96 J.G. Dickman 40	33.93 33.54 E.F. Vance 40	37.93 37.48 F.W. Recker 40	30.20 30.41 J.O. Conrad 40
	30.20 30.41 Horace Francisco 40	38.13 38.41 Geo. Appers 40	34.49 33.96 E.F. Vance 40	33.93 33.54 W.F. Bullings 40	37.93 37.48 John L. Stroup 40	30.20 30.41 J.W. Dimond 40
	30.20 30.41 Geo. W. Perfect 40	38.13 38.41 Zella L. Woolan 40	34.49 33.96 J.W. Green 40	33.93 33.54 Hattie E. Benson 40	37.93 37.48 J.W. Fuller 40	30.20 30.41 J.T. Payler 40
	30.20 30.41 Milo E. Fuller 40	38.13 38.41 J.W. Fuller 40	34.49 33.96 J.W. Green 40	33.93 33.54 J.W. Green 40	37.93 37.48 J.W. Martin 40	30.20 30.41 Mary L. Foote 40
	30.20 30.41 Loyal J. Fuller 40	38.13 38.41 J.W. Fuller 40	34.49 33.96 W.C. Elliott 40	33.93 33.54 W.C. Elliott 40	37.93 37.48 Wilson Brittain 40	30.20 30.41 Geo. Conn 40
	30.20 30.41 W.S. McClain 40	38.13 38.41 J.R. Mallory 40	34.49 33.96 J.F. Drey 40	33.93 33.54 J.T. Paynter 40	37.93 37.48 J.C. Stanford 40	30.20 30.41 Nevada Ward 40
	30.20 30.41 B.F. Boeson 40	38.13 38.41 J.T. Paynter 40	34.49 33.96 O. Johnson 40	33.93 33.54 W.G. Stockbridge 40	37.93 37.48 Jos. Pick 40	30.20 30.41 H.L. Beck 40
	30.20 30.41 Elinor Taylor 40	38.13 38.41 W.G. Stockbridge 40	34.49 33.96 W.G. Stockbridge 40	33.93 33.54 Jos. Pick 40	37.93 37.48 W.A. Pick 40	30.20 30.41 J.C. Stanford 40
	30.20 30.41 W. Arnold 40	38.13 38.41 W.G. Stockbridge 40	34.49 33.96 W.G. Stockbridge 40	33.93 33.54 L.B. Foster 40	37.93 37.48 G.A. Conn 40	30.20 30.41 Nevada Ward 40
	30.20 30.41 Lope Barat 40	38.13 38.41 W.G. Stockbridge 40	34.49 33.96 W.G. Stockbridge 40	33.93 33.54 L.B. Foster 40	37.93 37.48 G.A. Conn 40	30.20 30.41 Nevada Ward 40
	30.20 30.41 Frank Bishop 40	38.13 38.41 M.F. Willoughby 40	34.49 33.96 W.G. Stockbridge 40	33.93 33.54 L.B. Foster 40	37.93 37.48 G.A. Conn 40	30.20 30.41 Nevada Ward 40
TWP	SUMNER			TWP	TILDEN	LAWRENCE

  
**MAP OF**  
**LAWRENCE**  
**TOWNSHIP**  
 Scale 2 inches to 1 mile

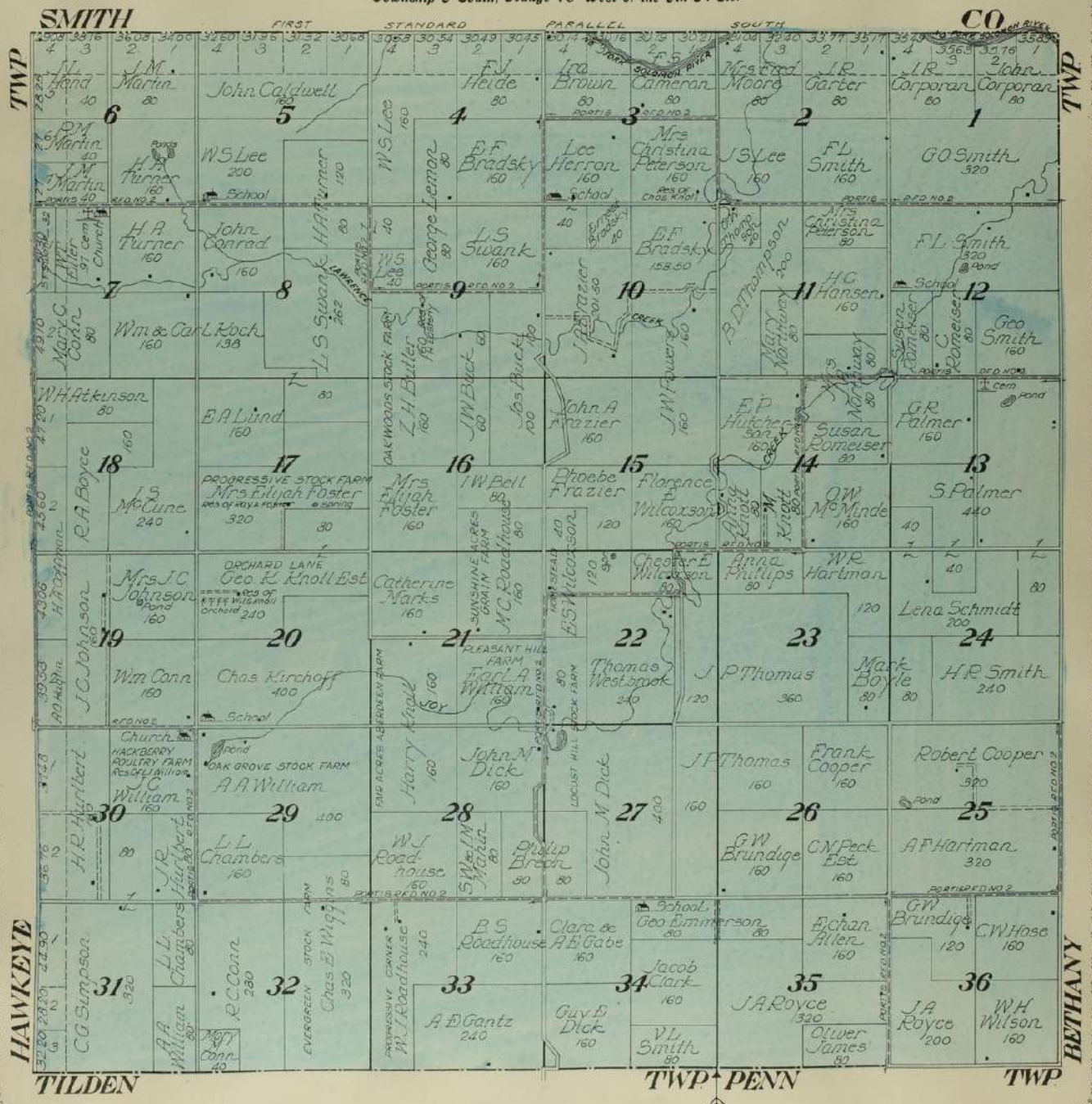
Township 6 South, Range 13 West of the 6th P. M.





C. D. Jones  
340

# DOWNS

ROSS TWP Scale 360ft - 1inch  
Copyright 1917 by Geo. A. Ogle & Co.

V. L. Siskell  
140

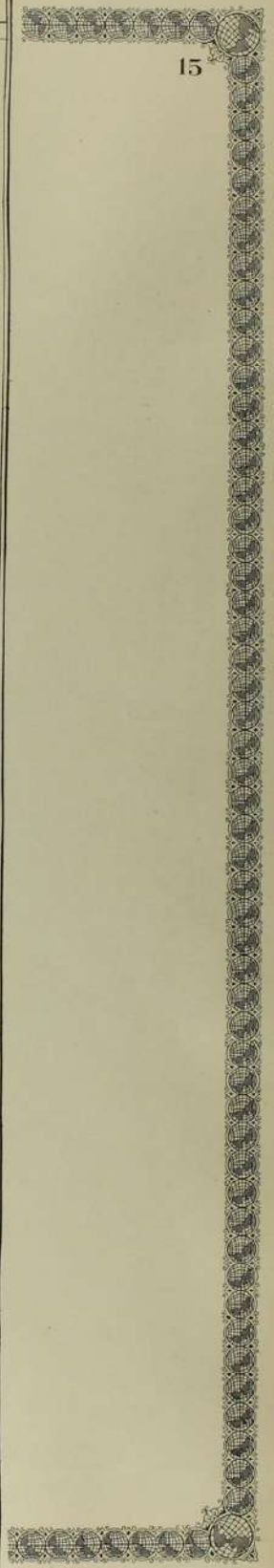
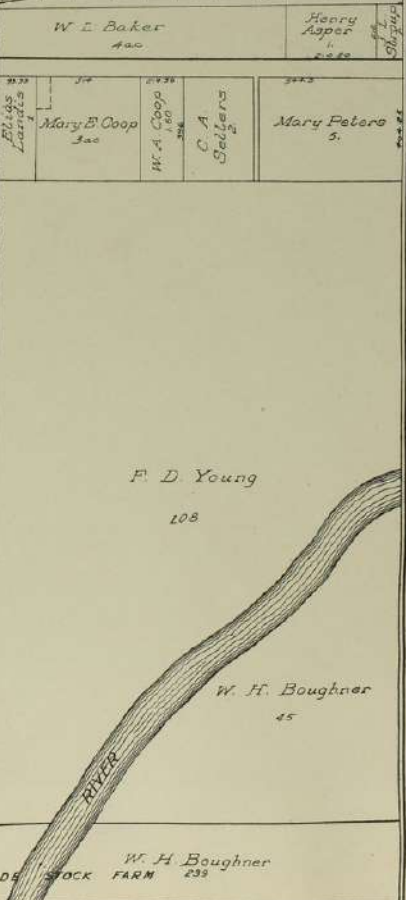
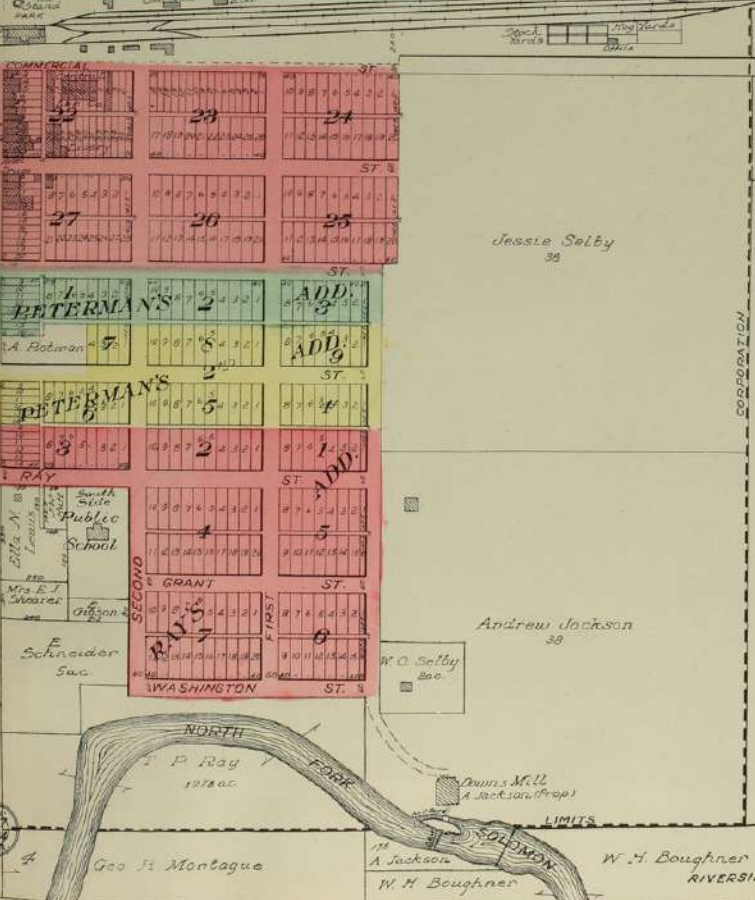
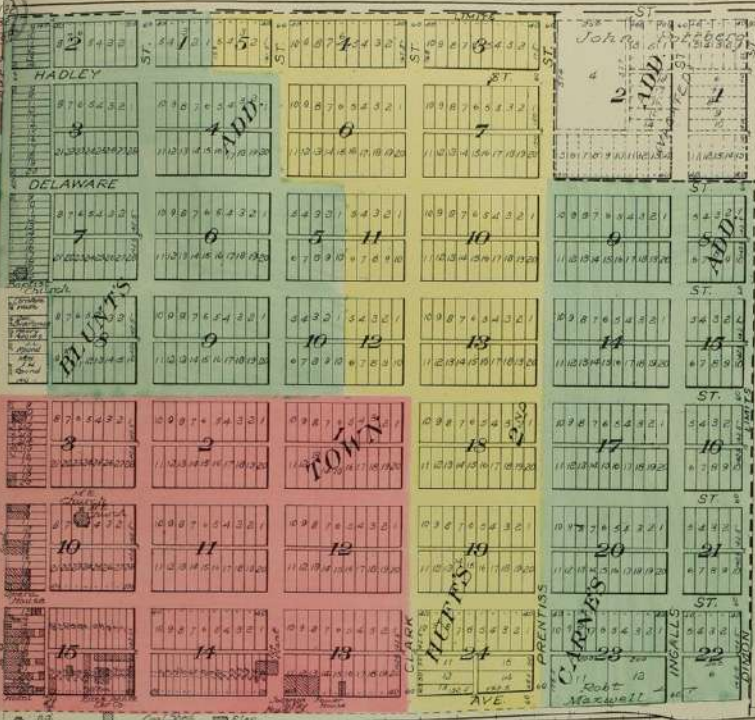



  
**MAP OF**  
**BETHANY**  
 TOWNSHIP  
 Scale 2 inches to 1 mile

Township 6 South, Range 12 West of the 6th P. M.

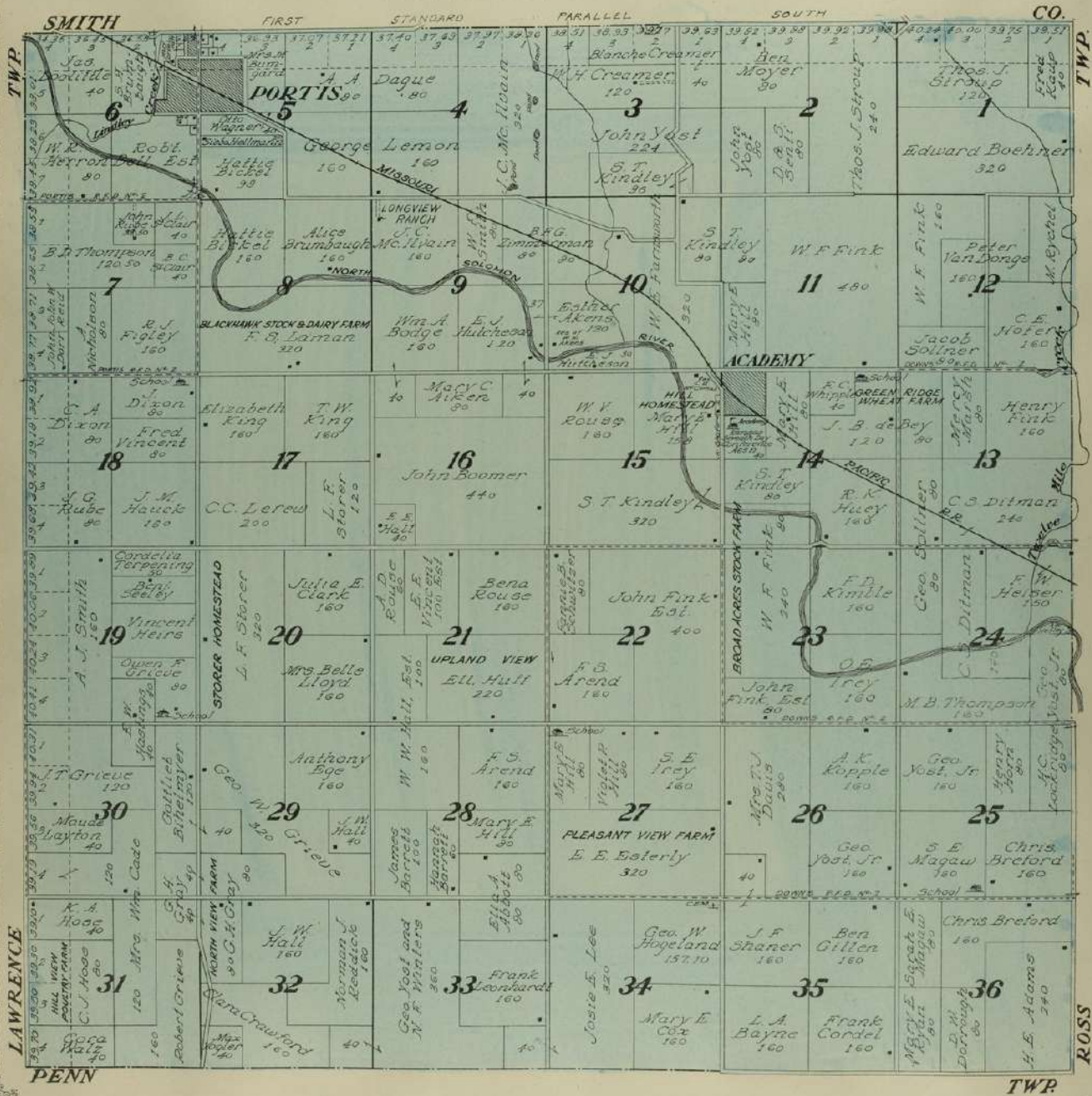

MAP OF  
**ROSS**  
TOWNSHIP

Scale 2 inches to 1 mile

Township 6 South, Range 11 West of the 6th P. M.

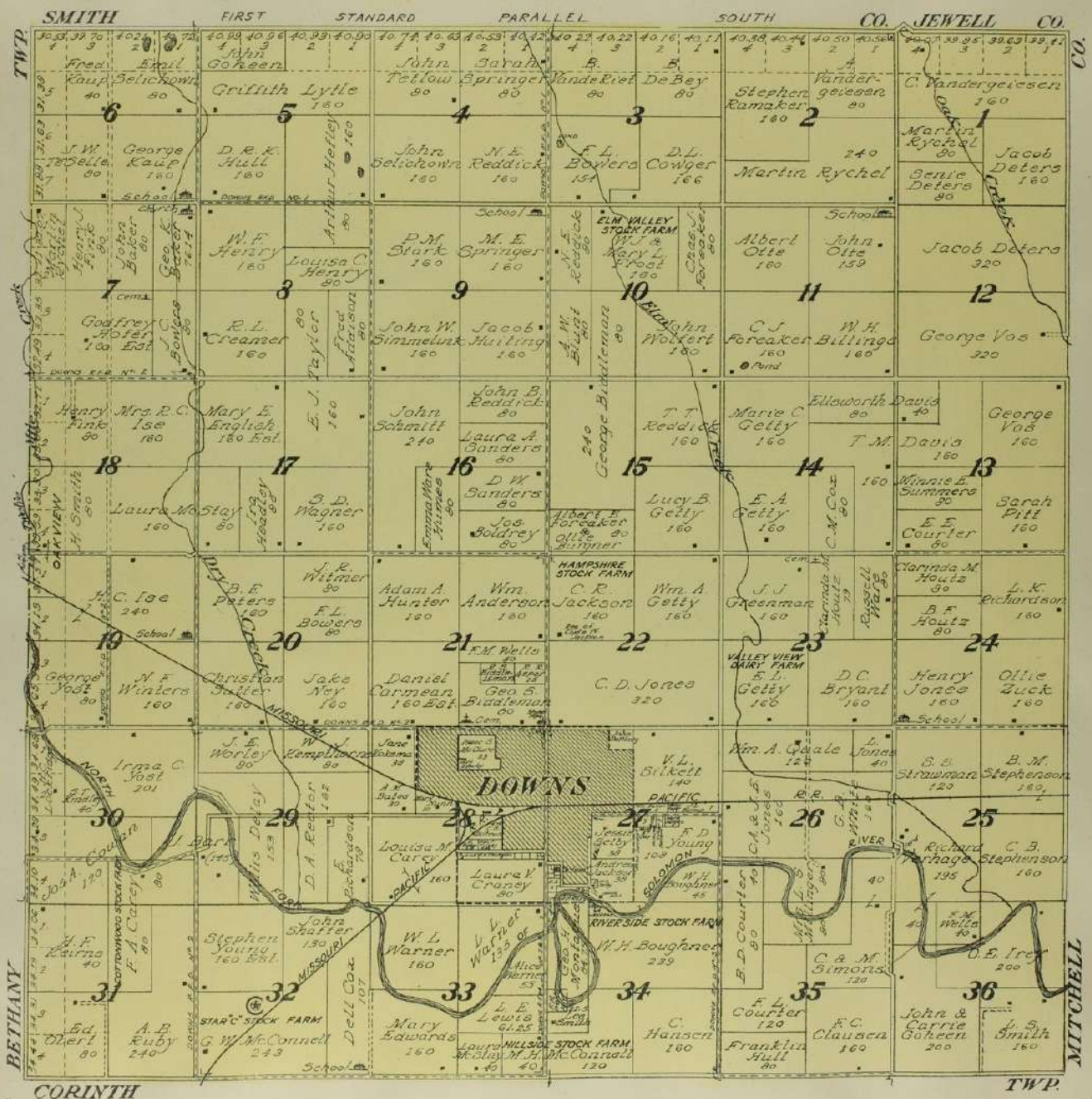

BETHANY

MITCHELL

CORINTH

TWP.

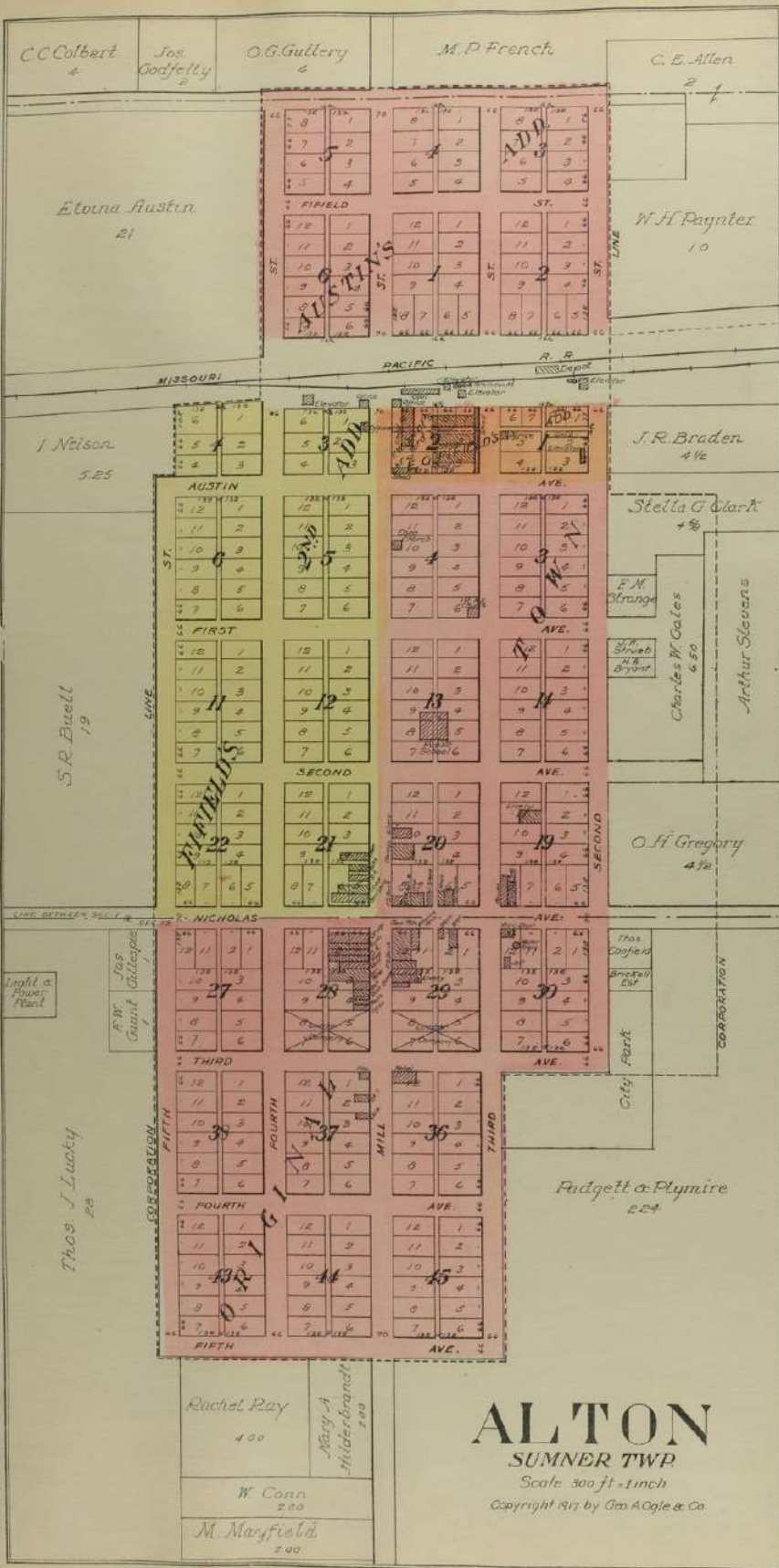

  
**MAP OF**  
**SUMMER**  
 TOWNSHIP  
 Scale 2 inches to 1 mile

Township 7 South, Range 15 West and Part of Township 7 South, Range 14 West of the 6th P. M.

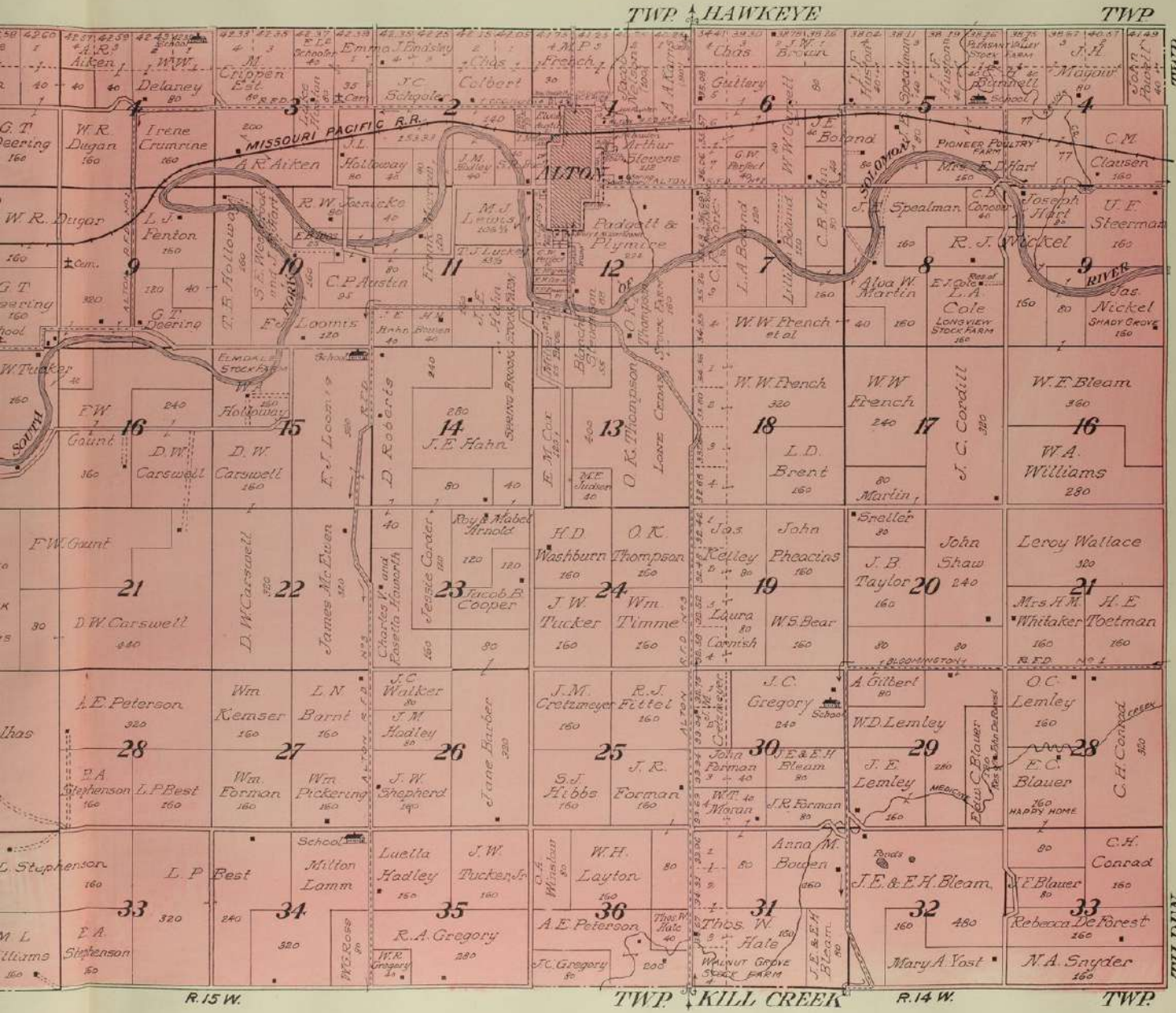

TWP

TILDEN

  
**MAP OF**  
**TILDEN**  
 TOWNSHIP  
 Scale 2 inches to 1 mile  
 Part of Township 7 South, Ranges 13 and 14 West of the 6th P. M.

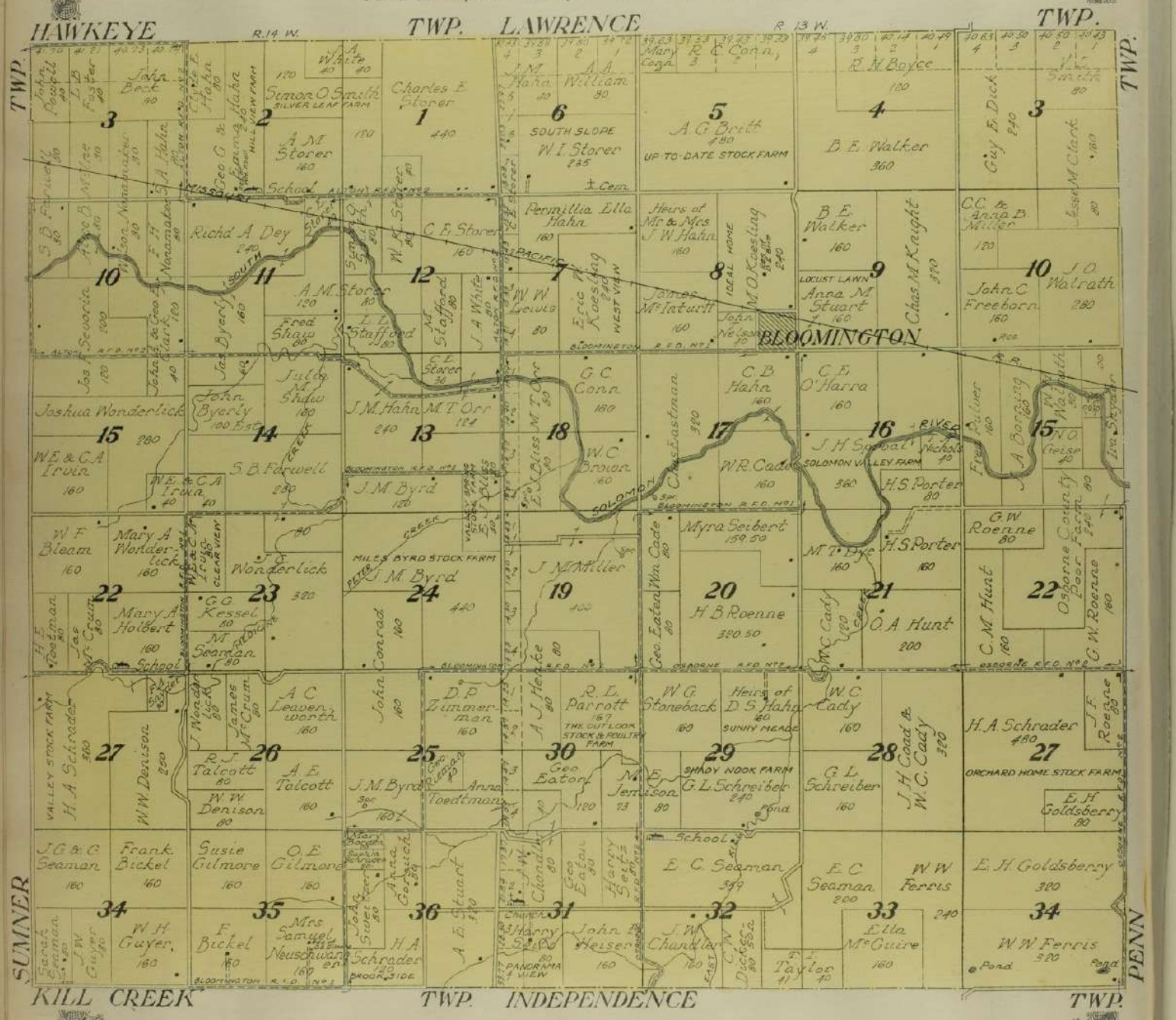

MAP OF  
**PENN**  
TOWNSHIP

Scale 2 inches to 1 mile

Township 7 South, Range 12 West and Part of Township 7 South, Range 13 West of the 6th P. M.



TILDEN

HANCOCK TWP

MAP OF  
**CORINTH**  
TOWNSHIP  
Scale 2 inches to 1 mile

Township 7 South, Range 11 West of the 6th P.M.

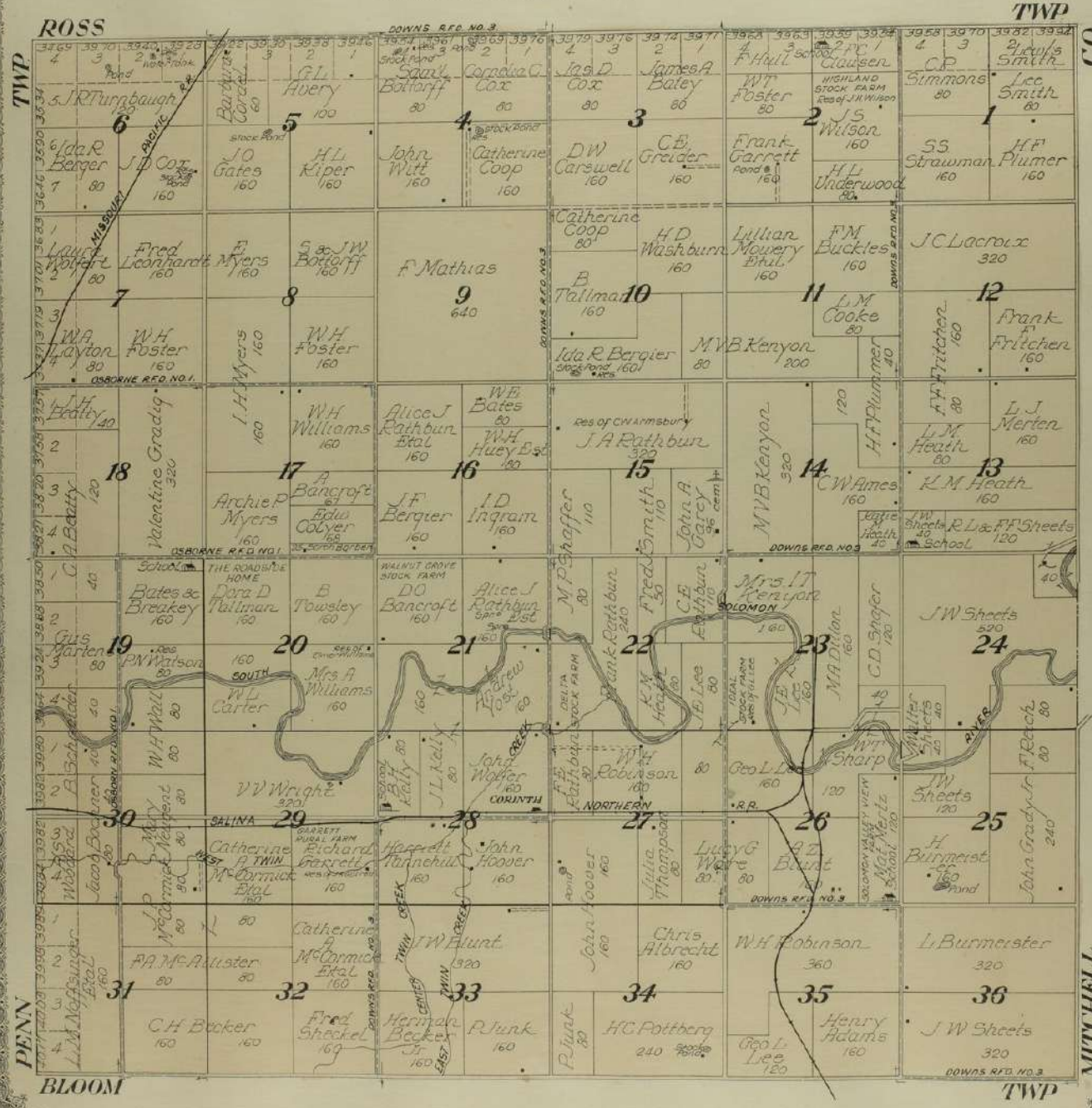

MITCHELL TWP



  
**MAP OF**  
**MT. AYR**  
 TOWNSHIP

Scale 2 inches to 1 mile

Township 8 South, Range 15 West of the 6th P. M.

SUMNER

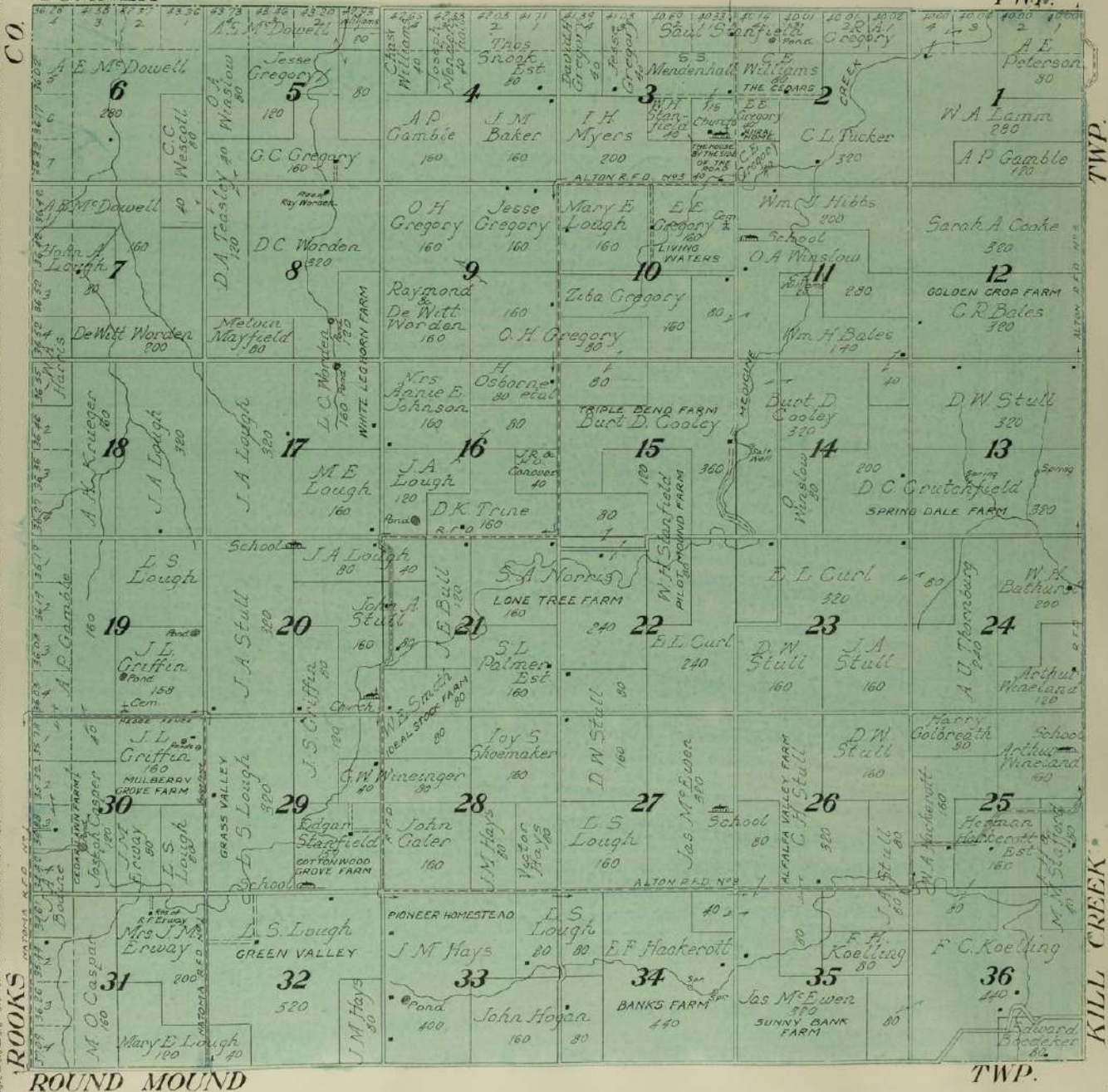
TWP.





MAP OF  
**KILL CREEK**  
TOWNSHIP

Scale 2 inches to 1 mile

Township 8 South, Range 14 West of the 6th P. M.

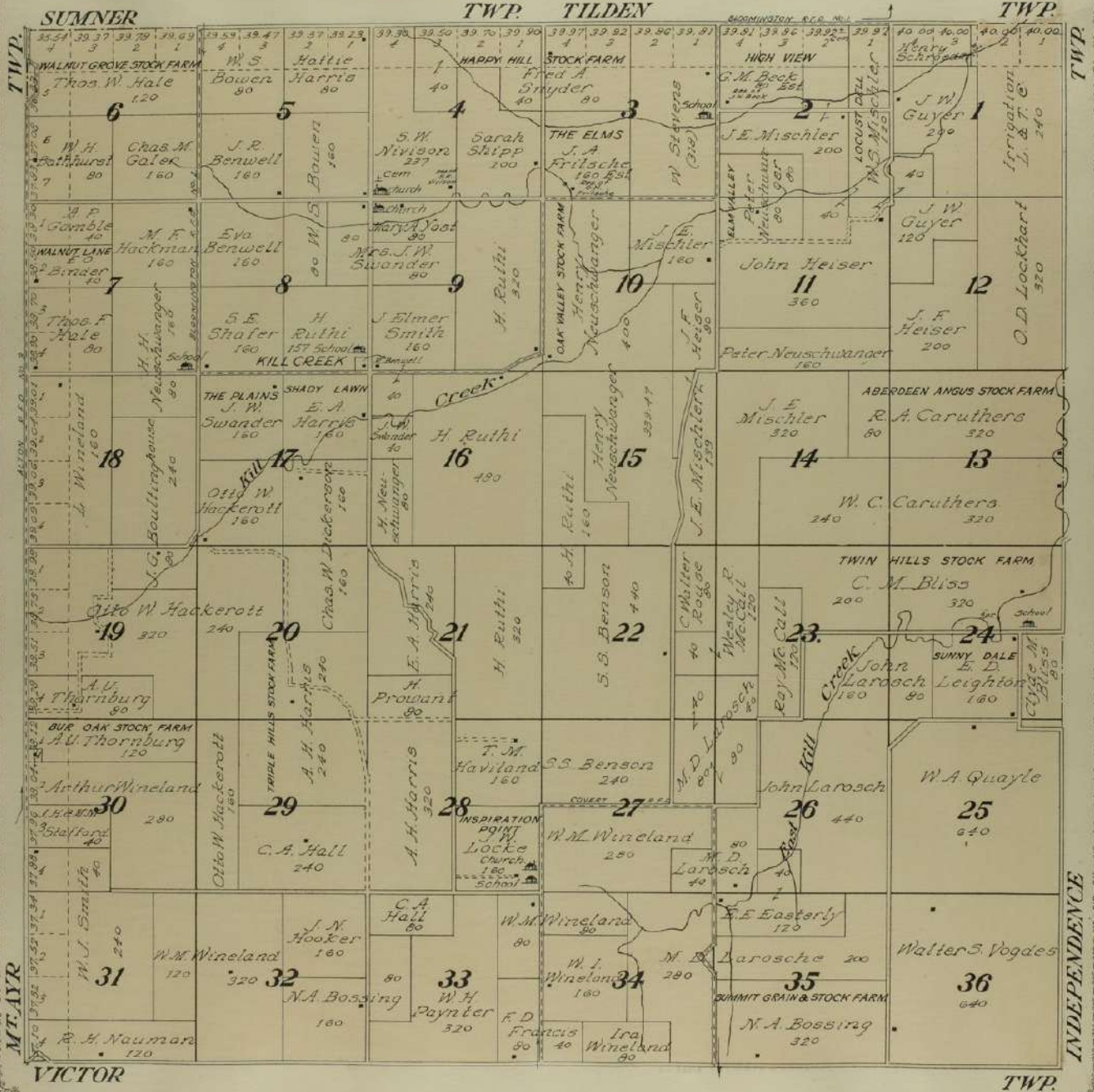

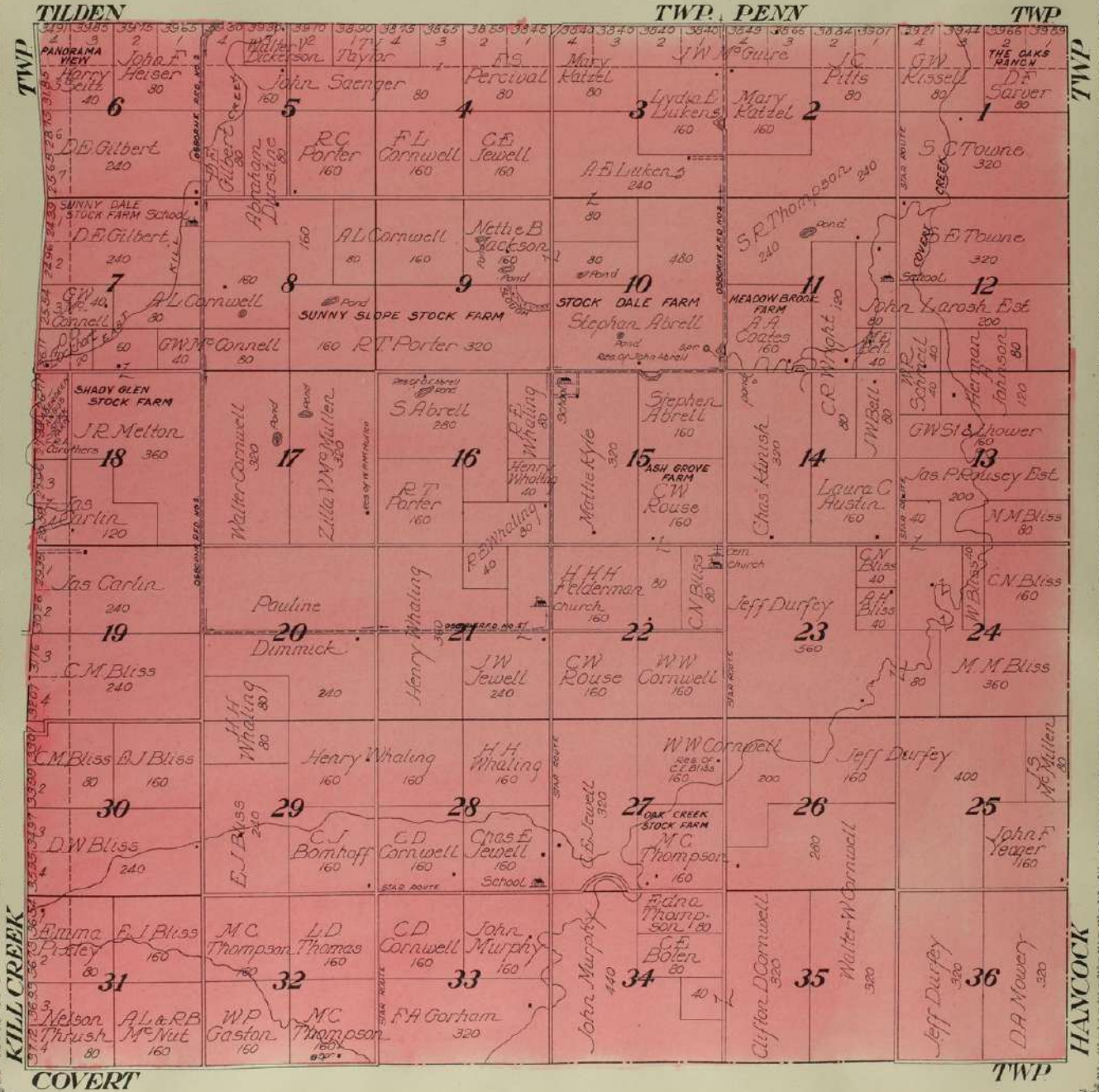

  
**MAP OF**  
**INDEPENDENCE**  
 TOWNSHIP  
 Scale 2 inches to 1 mile

Township 8 South, Range 15 West of the 6th P. M.

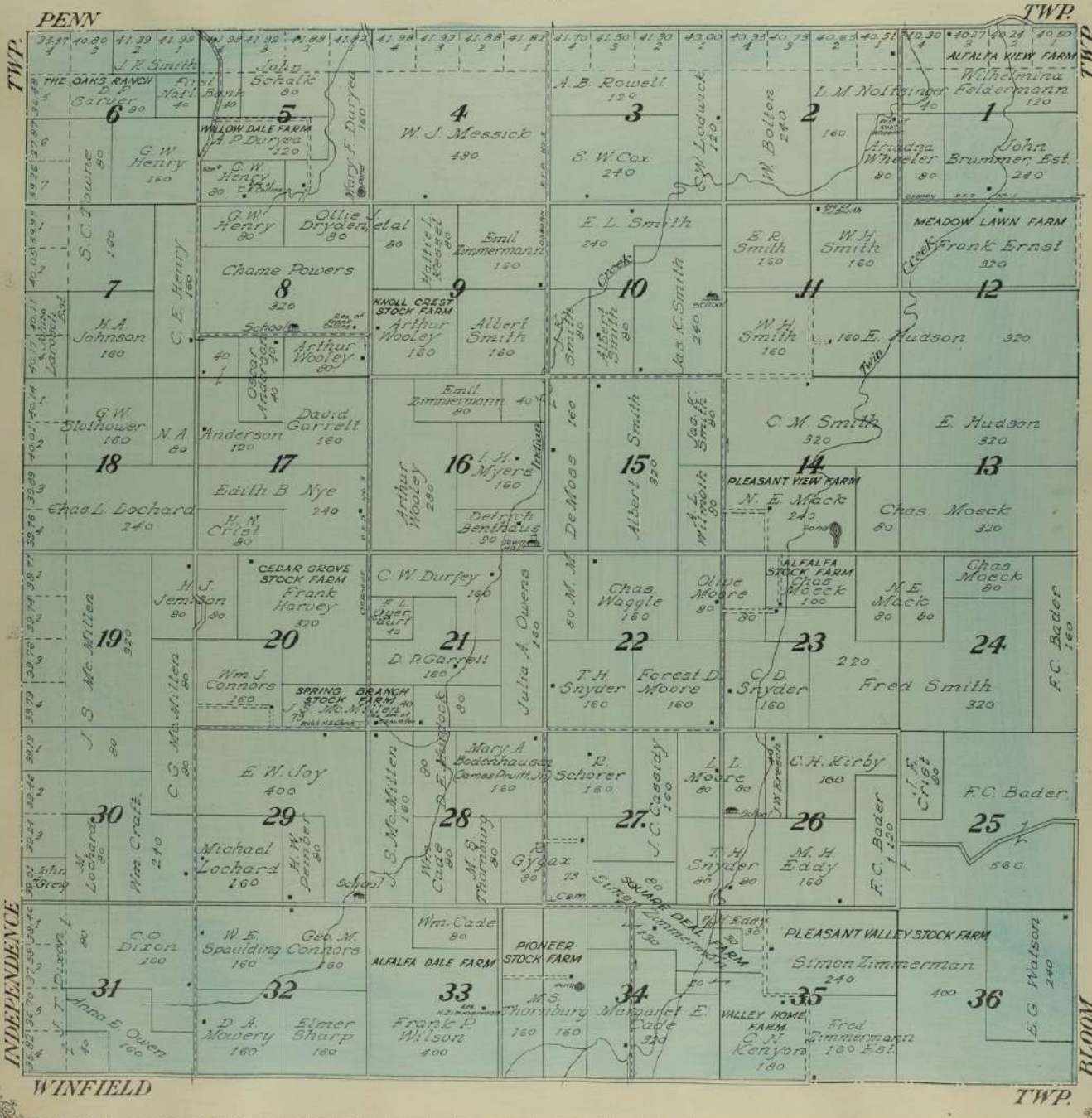

**MAP OF**  
**HANCOCK**  
 TOWNSHIP  
 Scale 2 inches to 1 mile

Township 8 South, Range 12 West of the 6th P.



# PORTIS

BETHANY TWP.

Scale 300 ft. = 1 inch

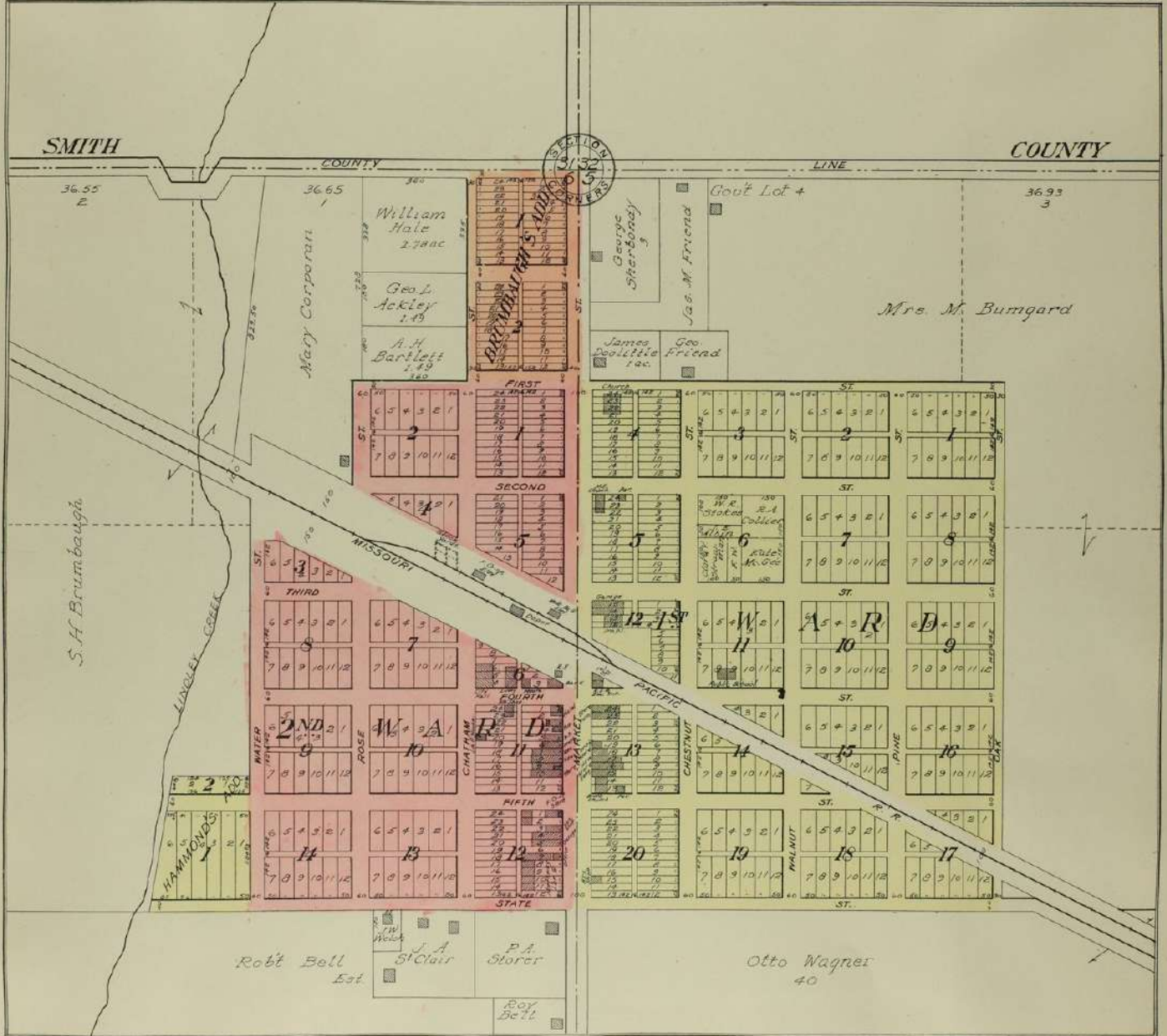

  
**MAP OF**  
**BLOOM**  
 TOWNSHIP  
 Scale 2 inches to 1 mile

Township 8 South, Range 17 West and Part of Township 9 South, Range 17 West of the 6th P.M.

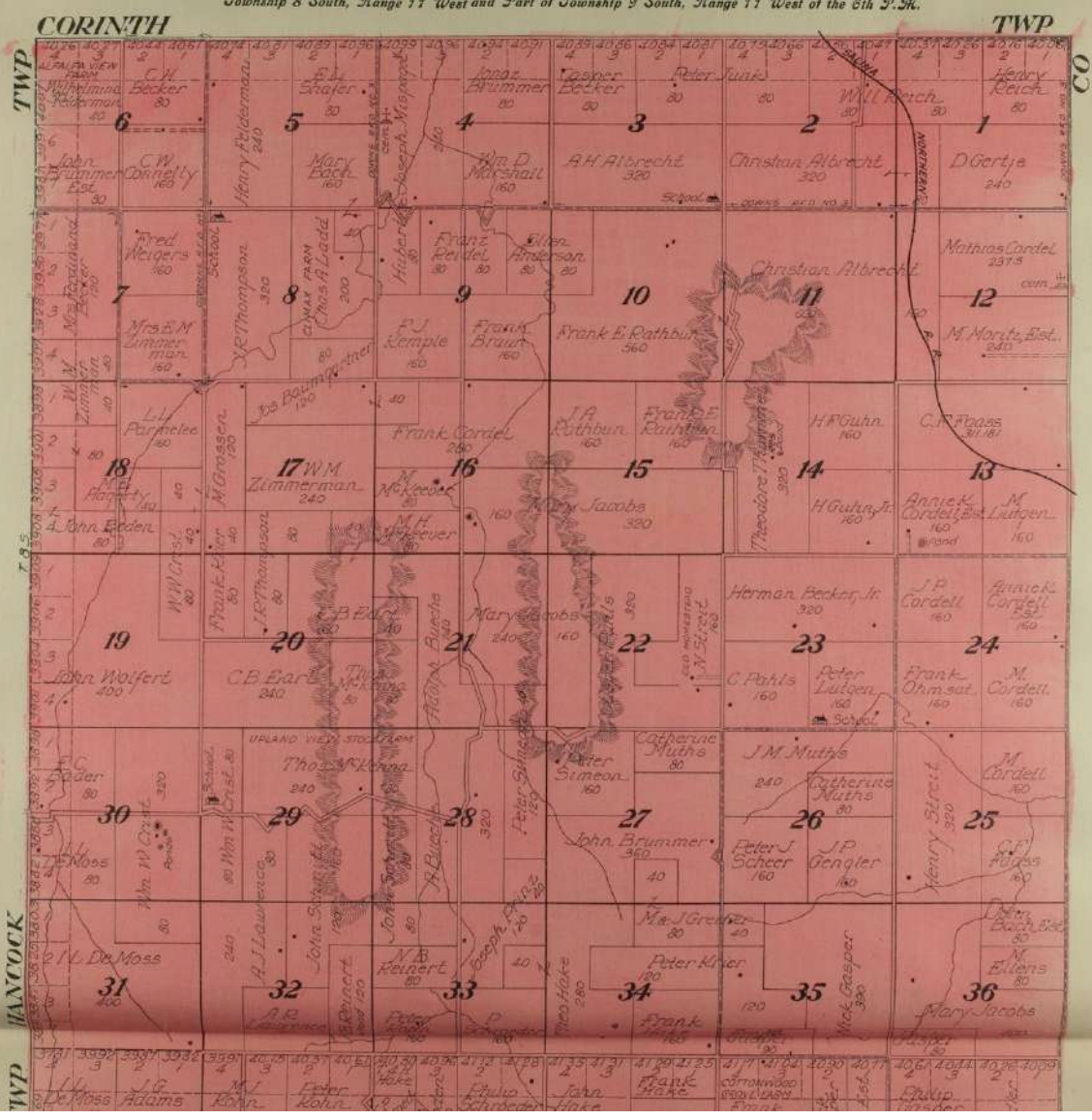

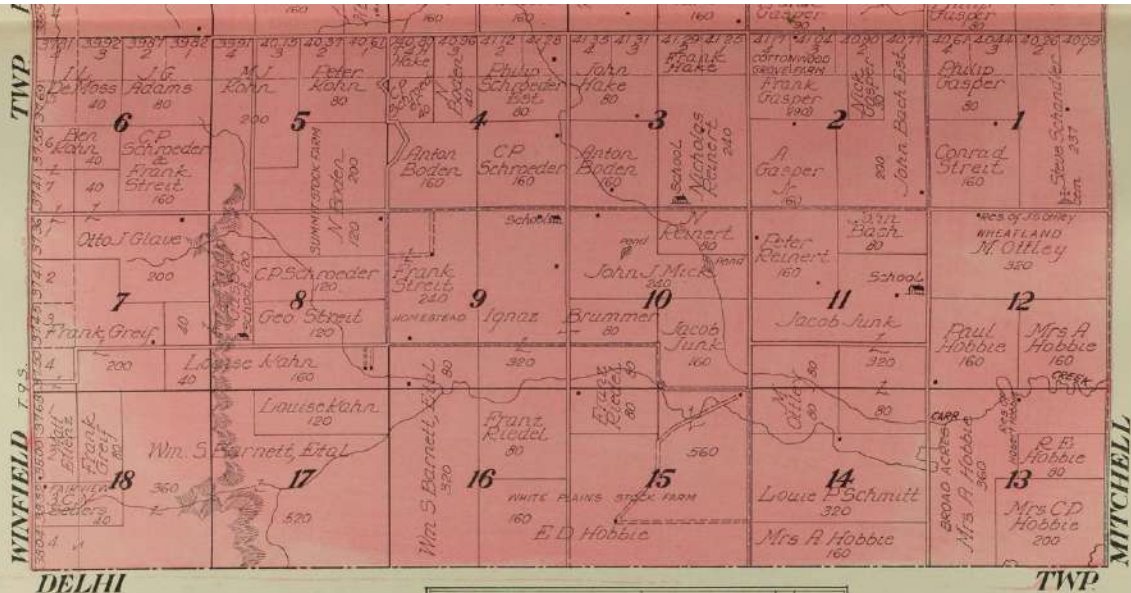

DELHI

TWP

### ACADEMY

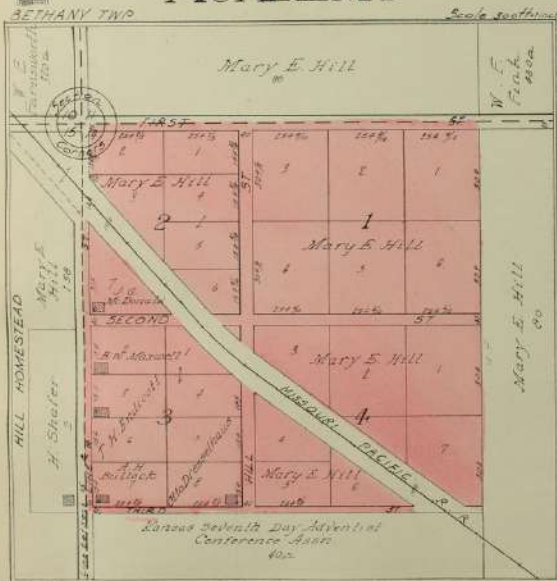

### COVERT

Located in the SE 1/4 of Sec. 7  
COVERT TWP.

Scale 300ft = 1 inch

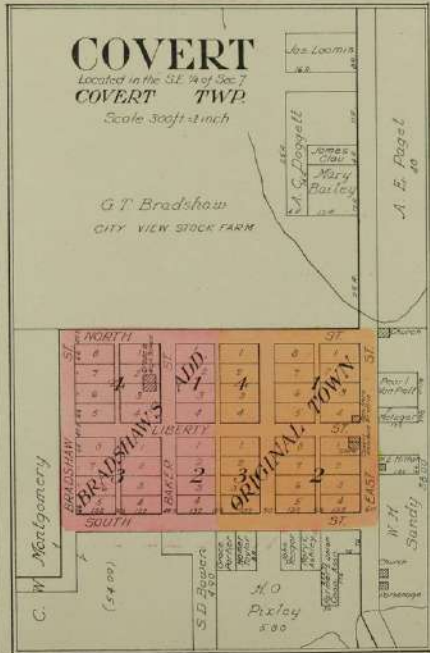

### BLOOMINGTON

PLATTED AS TILDEN

TILDEN TWP. Scale south 1/4 inch

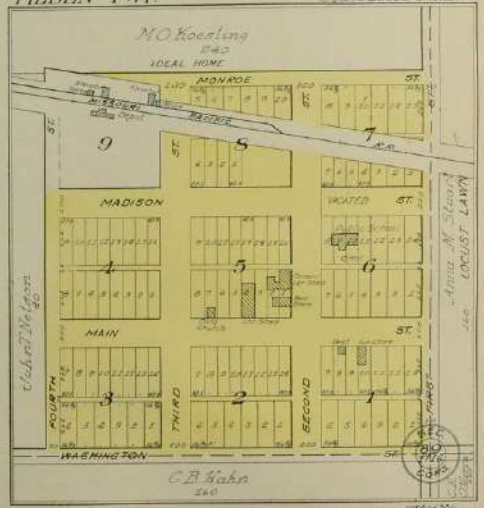

MAP OF  
**ROUND MOUND**  
TOWNSHIP

Scale 2 inches to 1 mile

Township 9 South, Range 15 West of the 6th P. M.

MT. AYR

TWP.



ROOKS

VICTOR

NATOMA

TWP.

  
**MAP OF**  
**VICTOR**  
 TOWNSHIP  
 Scale 2 inches to 1 mile

Township 9 South, Range 14 West of the 6th P. M.

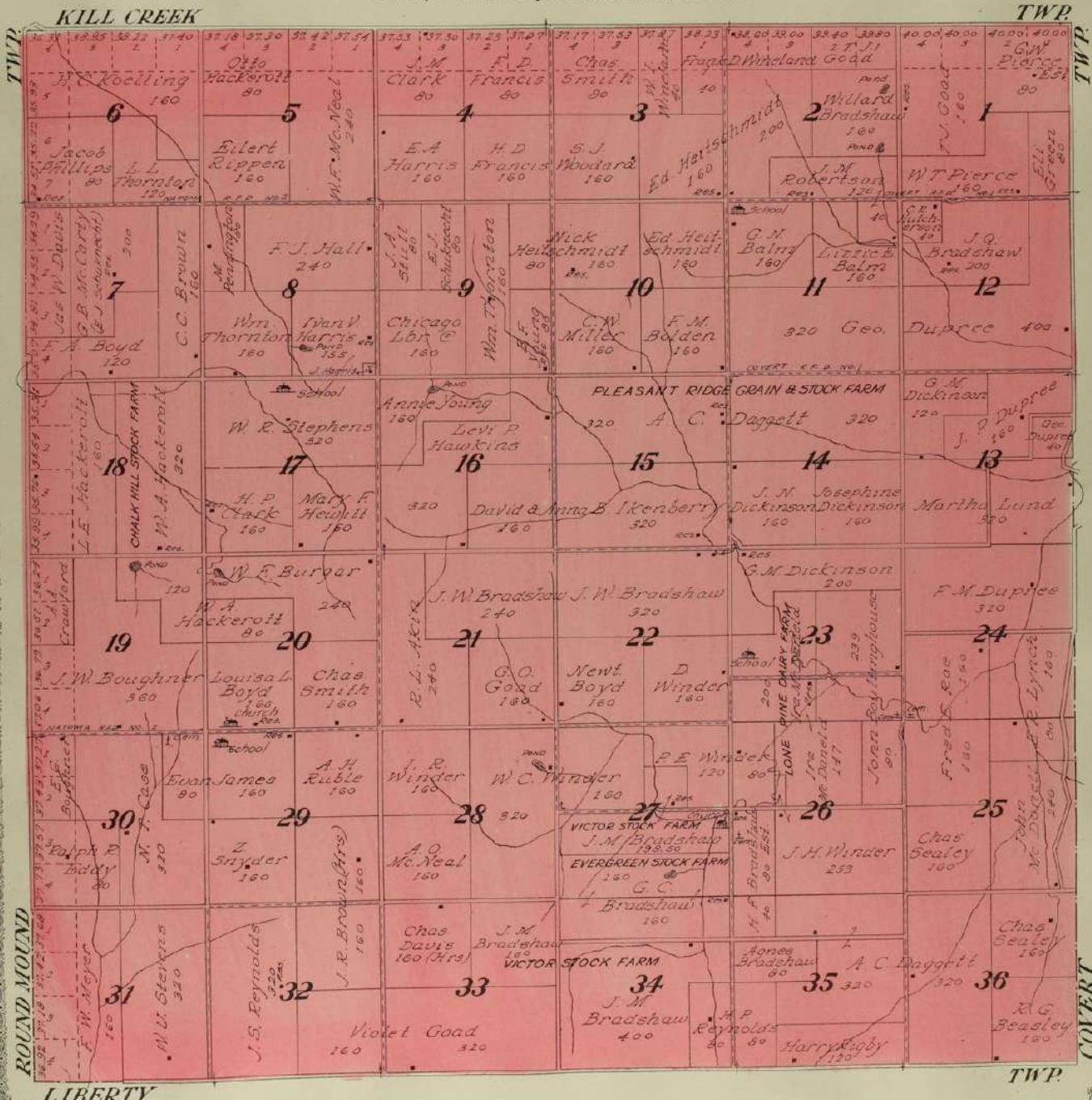

KANSAS STATE HISTORICAL SOCIETY



  
**MAP OF**  
**COVERT**  
 TOWNSHIP  
 Scale 2 inches to 1 mile

Township 9 South, Range 13 West of the 6th P. M.

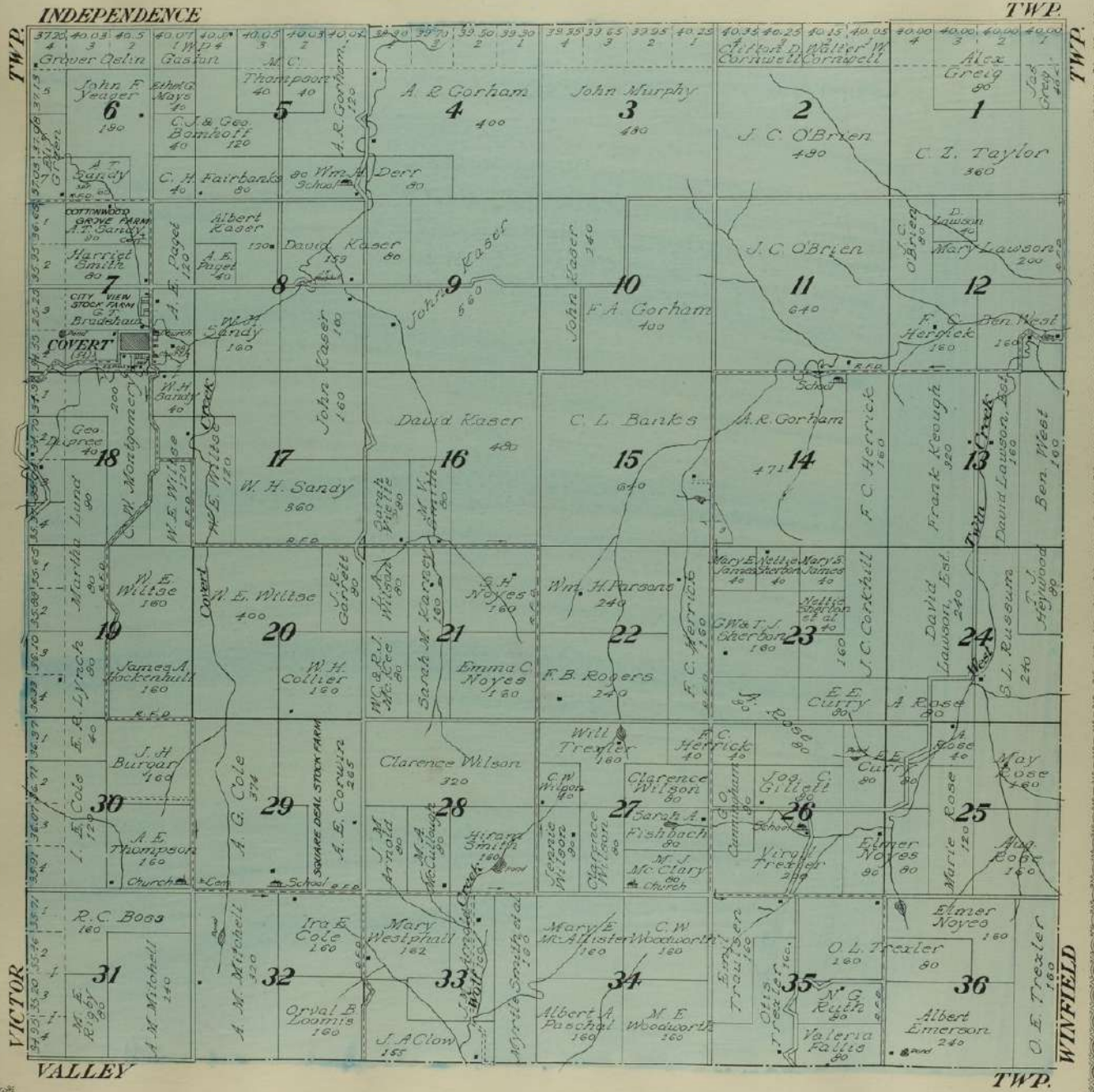

MAP OF  
**WINFIELD**  
TOWNSHIP

Scale 2 inches to 1 mile

Township 9 South, Range 12 West of the 6th P. M.

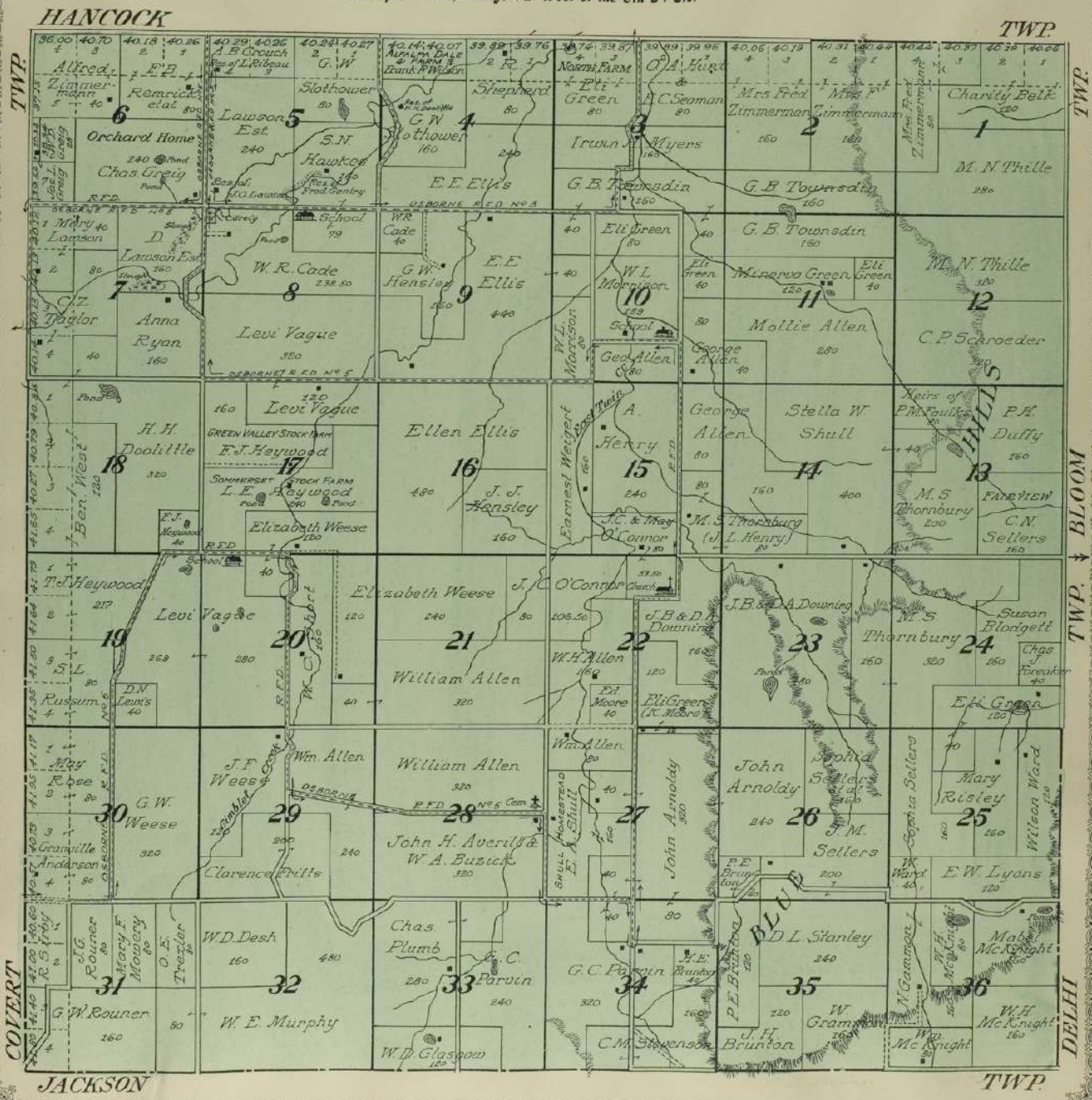

COVERT

JACKSON

DELI

TWP.

TWP.

BLOOM

TWP.

MAP OF  
**NATOMA**  
TOWNSHIP

Scale 2 inches to 1 mile

Township 10 South, Range 15 West of the 6th P.M.

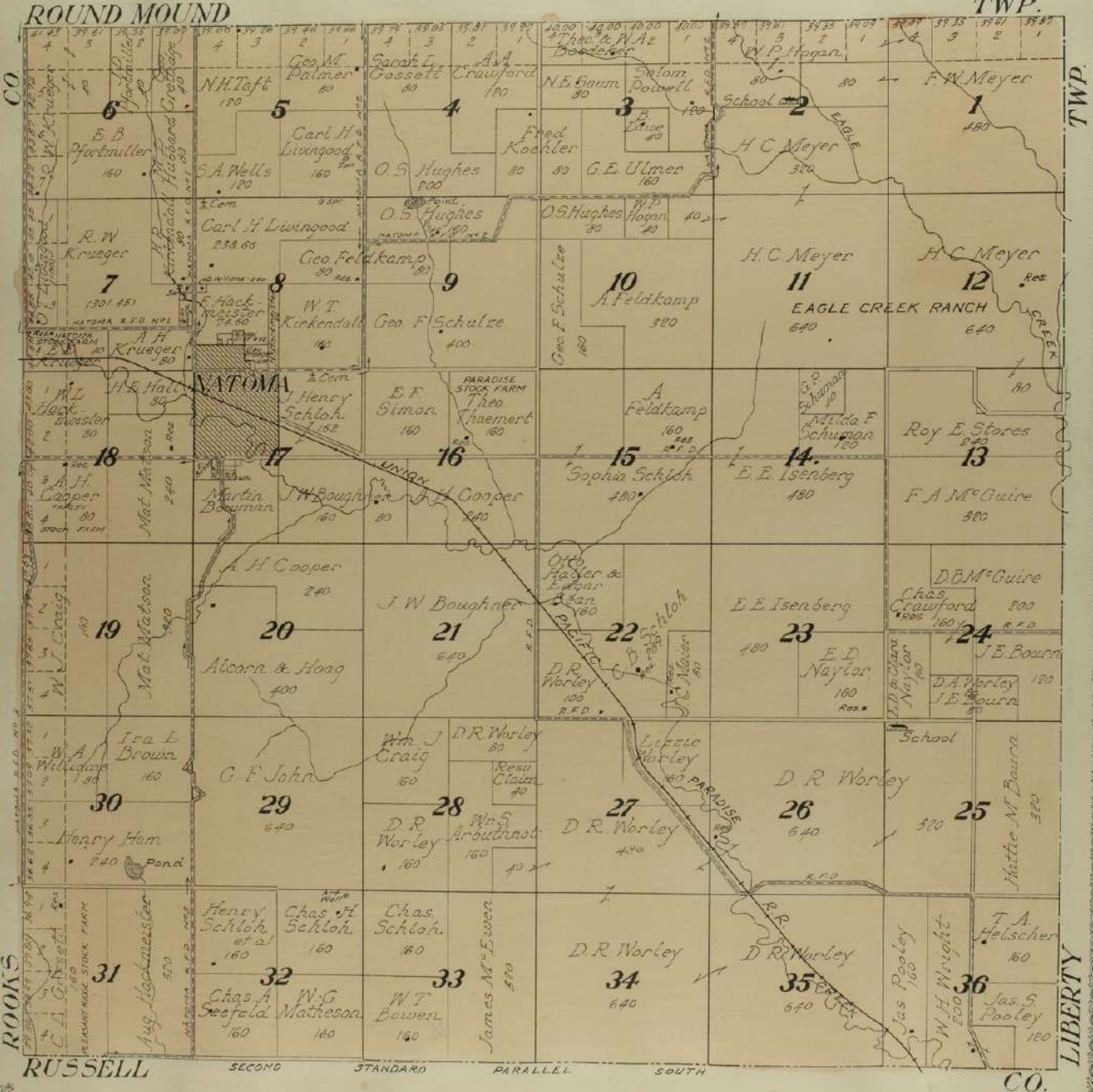

RUSSELL SECOND STANDARD PARALLEL SOUTH CO. LIBERTY

  
**MAP OF**  
**LIBERTY**  
**TOWNSHIP**  
 Scale 2 inches to 1 mile

Township 10 South, Range 14 West of the 6th P.M.

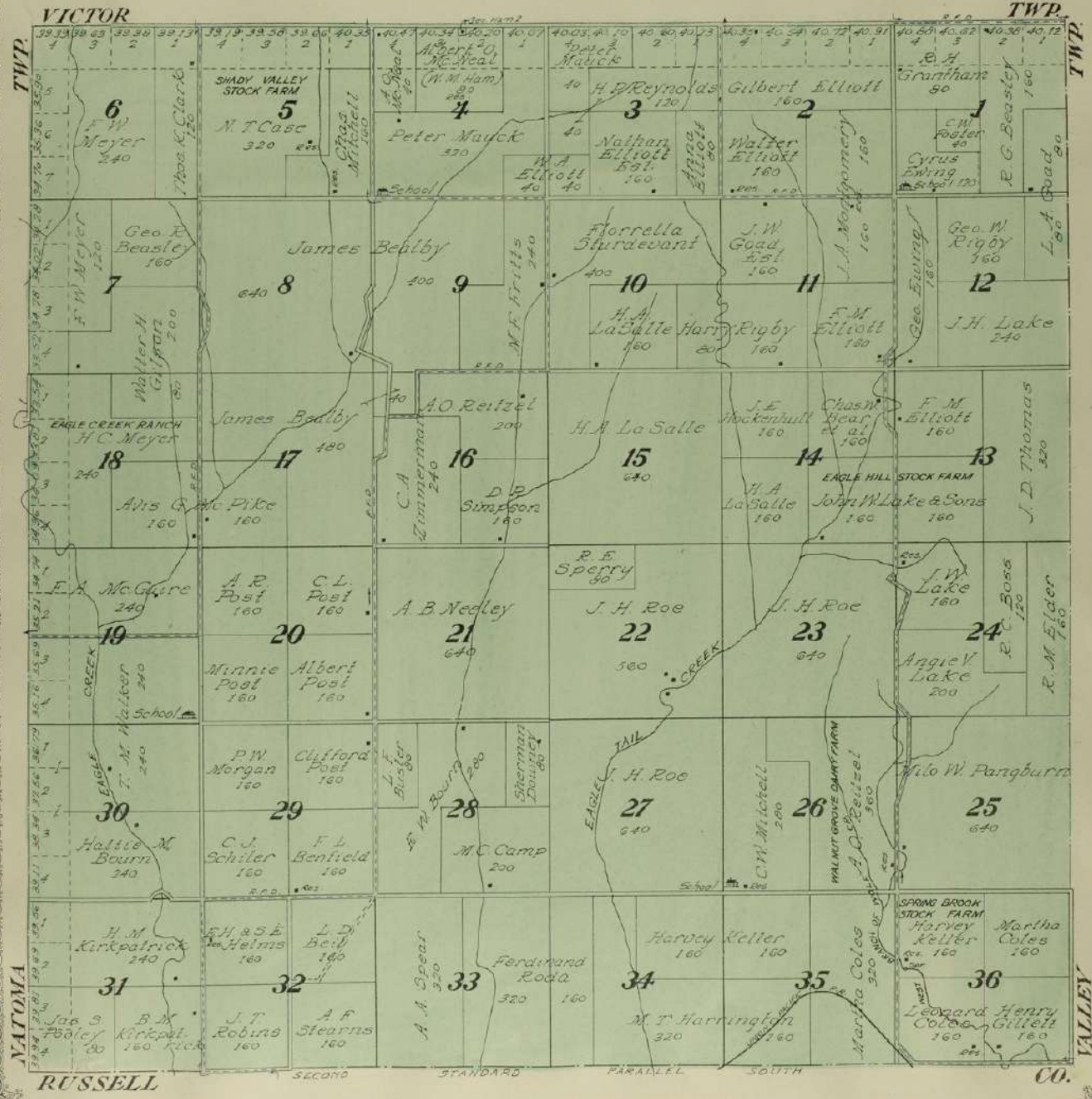



  
**MAP OF**  
**JACKSON**  
**TOWNSHIP**

Scale 2 inches to 1 mile

Township 10 South, Range 12 West of the 6th P.M.

WINFIELD

TWP.

47.66 4 M.W. 40	39.78 2 Alta 80	39.56 1 Alta 80	39.34 4 Alta 80	39.41 3 Alta 80	39.49 2 Alta 80	39.56 1 W.D. 80	39.64 4 W.D. 80	39.71 3 A.R. 80	39.78 2 John A. Averill 160	39.86 1 John A. Averill 160	39.87 4 John N. Rogers 160	39.73 3 John N. Rogers 160	39.65 2 John N. Rogers 160	39.58 1 John N. Rogers 160	39.50 4 John N. Rogers 160	39.42 3 John N. Rogers 160	39.34 2 John N. Rogers 160	39.19 1 Wm. Knight 80	39.56 4 Sarah A. McKnight 80	39.74 3 S. Mc. Nerny 80	39.19 2 I. N. Armistead 80		
6 Frank Lockhart 240	5 Murphy 80	Alta Murphy 160	J.G. Rouner 320	M.O. Mowery 160	4 A.R. Prather 240	3 E. Langley 160	J. N. Rogers 160	John N. Rogers 160	John N. Rogers 160	John N. Rogers 160	John N. Rogers 160	John N. Rogers 160	John N. Rogers 160	John N. Rogers 160	John N. Rogers 160	John N. Rogers 160	John N. Rogers 160	John N. Rogers 160	John N. Rogers 160	John N. Rogers 160	John N. Rogers 160		
1 Jas O. Glasgow 160	G.A.S. O'Brien 160	Louis Rouner 160	B.W. Kune 160	John F. Day 160	E. Langley 80	A.M. Applegate 160	Hosea Langley 160	W.N. Pondland 160	B.L. Standley 160	Peter Voight 240	G.A.S. Nancy Nerbitt 160	J.M. Fallis 160	J.A. Davidson 160	EP Grantham Est. 400	Hosea Langley 160	Jos. Hirs 160	A.A. Applegate 160	H.S. Applegate 160	Mrs. Jasper Rogers 160	E.L. Stanley 80			
18 W.P.O. Brian 160	J.M. Fallis 160	Geo. W. Elliott 280	Art. D. Jellison 160	W.S. Wallace 80	Albert Langley 160	J.C. Cooper 160	E.H. Cobb 160	W.P. O'Brien 160	J.M. Hutchinson 160	E.L. Parker 160	Henry Barber 80	W.P.O. Brian 160	J.T. Robinson 160	Pleasant View 160	G.W. Elliott 340	J.C. Cooper 160	E.H. Cobb 160	W.P. O'Brien 160	J.M. Hutchinson 160	E.L. Parker 160	Henry Barber 80		
19 J.R. Marlar 400	Jessie Beverly 160	FS Robinson 120	L.M. Gates 160	Darl L. Lewis 80	L.C. Cobb 160	A.L. Kooper 160	W.P. O'Brien 160	J.A. Spoon 160	Frank Applegate 320	Fred L. Duell 160	J.A. Spoon 160	J.R. Marlar 400	D.N. Lewis 160	J.F. Branda 160	W.H. Ward 240	S. Whitaker 160	R.A. Prather 160	W.P. O'Brien 160	J.A. Spoon 160	Frank Applegate 320	Fred L. Duell 160	J.A. Spoon 160	
30 J.R. Mowery 160	M.O. Mowery 160	Joseph Branda 160	William Q. Robinson 160	Mrs. C. Earnest 160	A.R. Prather 160	S.G. Breath 160	W.J. Earnest 160	AW Maupin 120	E.L. Parker 160	Wm. Foster 160	Joseph Zamecni 160	J.R. Mowery 160	J.R. Mowery 160	Jos. Hirst 160	Robert Janne 320	Marvin Mowery 160	W.J. Earnest 160	AW Maupin 120	E.L. Parker 160	Wm. Foster 160	Joseph Zamecni 160		
31 J.H. Averill 240	O.S. Spoon 320	Margaret Keouch 640	J.M. Walz 320	A.A. Applegate 160	A.A. Applegate 320	Joseph Kutich 80	240	Joseph Kutich 240	Jas. Palmer 160	H.A. Hurlbut 160	J.H. Averill 240	W.B. Daniels 240	David Herbel 160	L. Euholt 160	Margaret Keouch 640	J.M. Walz 320	A.A. Applegate 160	A.A. Applegate 320	Joseph Kutich 80	240	Joseph Kutich 240	Jas. Palmer 160	H.A. Hurlbut 160

RUSSELL

SECOND

STANDARD

PARALLEL

SOUTH

CO.

  
**MAP OF**  
**DELHI**  
 TOWNSHIP  
 Scale 2 inches to 1 mile

Township 10 South, Range 11 West and Part of Township 9 South, Range 11 West of the 6th P. M.

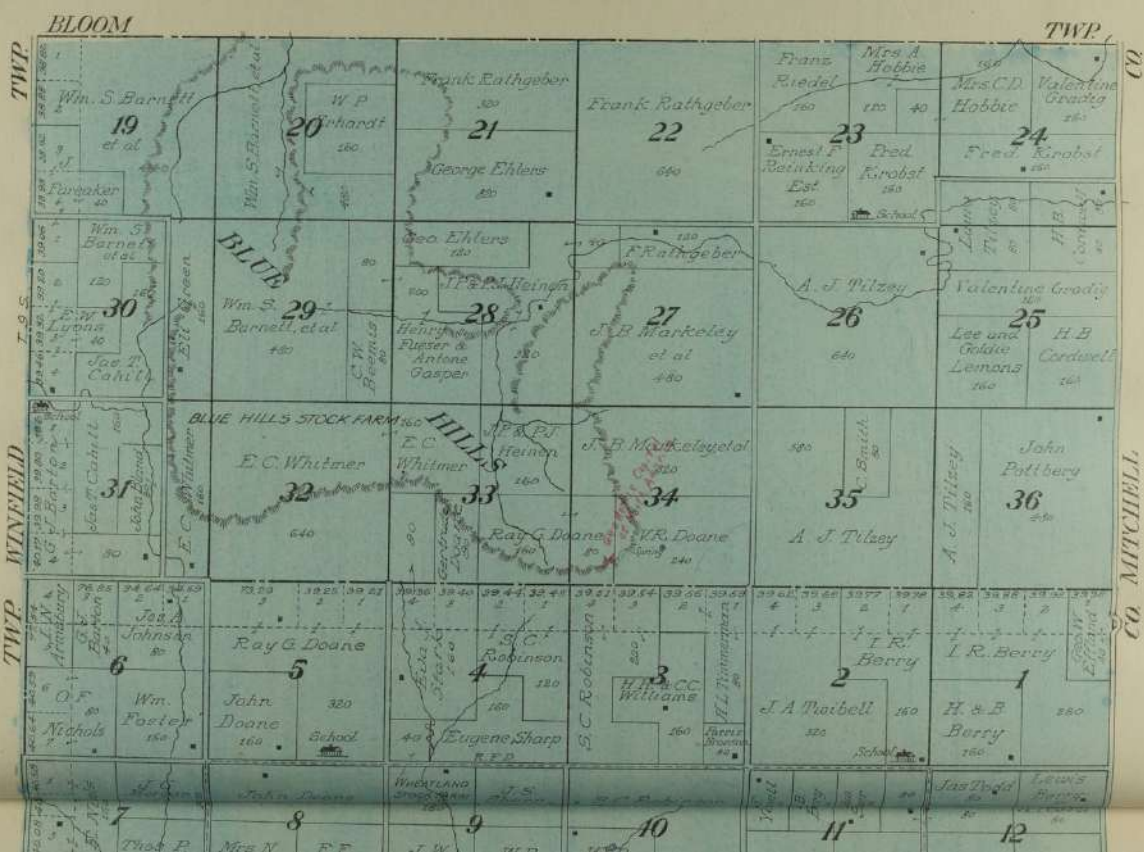

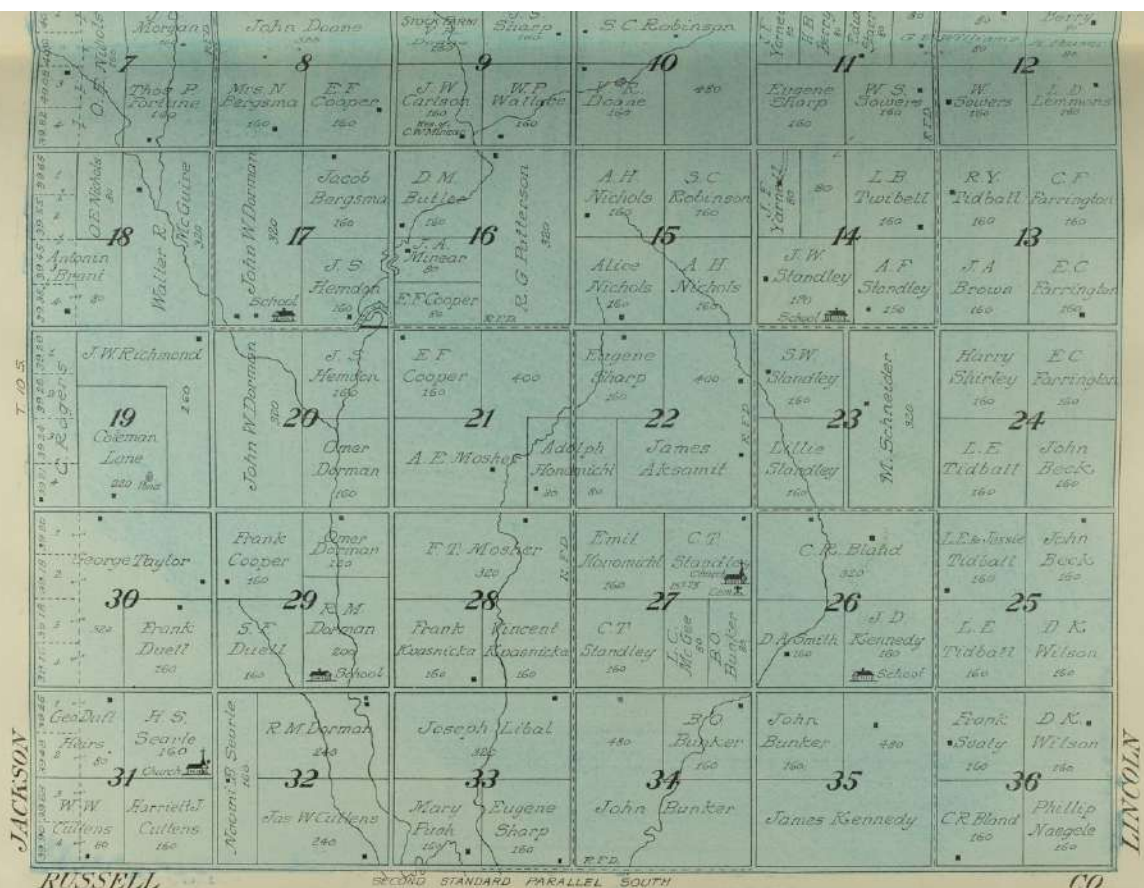

RUSSELL SECOND STANDARD PARALLEL SOUTH LINCOLN CO.



# NATOMA

NATOMA TWP. Scale 300ft=1 inch  
Copyright 1917 by Geo. A. Ogle & Co.

