

R U S H C O U N T Y

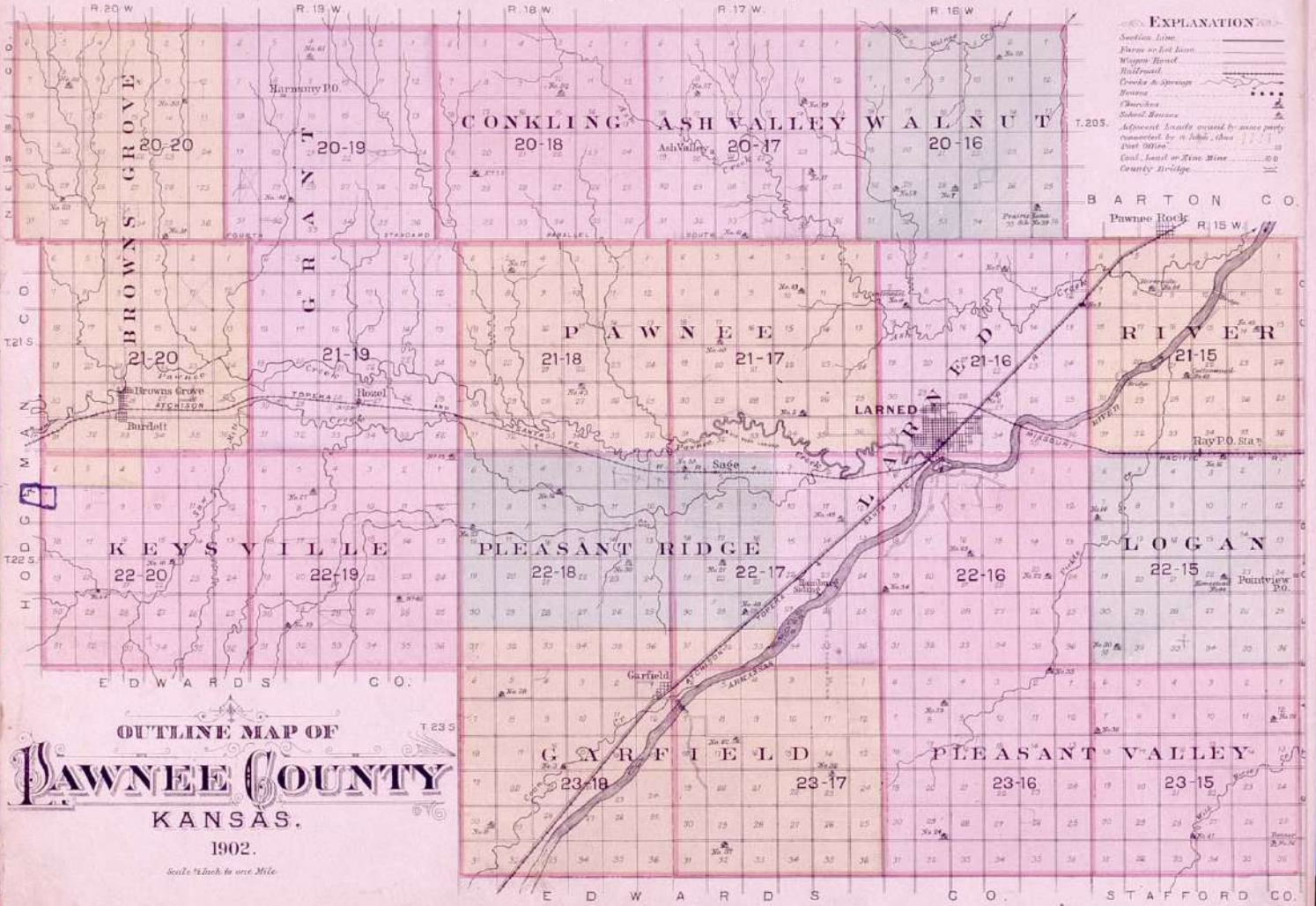

EXPLANATION

- Section line
- Range or Lot Line
- Water Course
- Railroad
- Creek & Springs
- Business
- Schools
- School House
- Approved Bonds owned by same party
- Connected by a link, then
- Lost Office
- Coal, Iron or Zinc Mine
- County Bridge

OUTLINE MAP OF
PAWNEE COUNTY
 KANSAS.
 1902.
 Scale 1/2 inch to one Mile

TOWNSHIP 20 SOUTH RANGE 17 WEST.

Scale 2 Inches to the Mile.

of the 6th Principal Meridian.

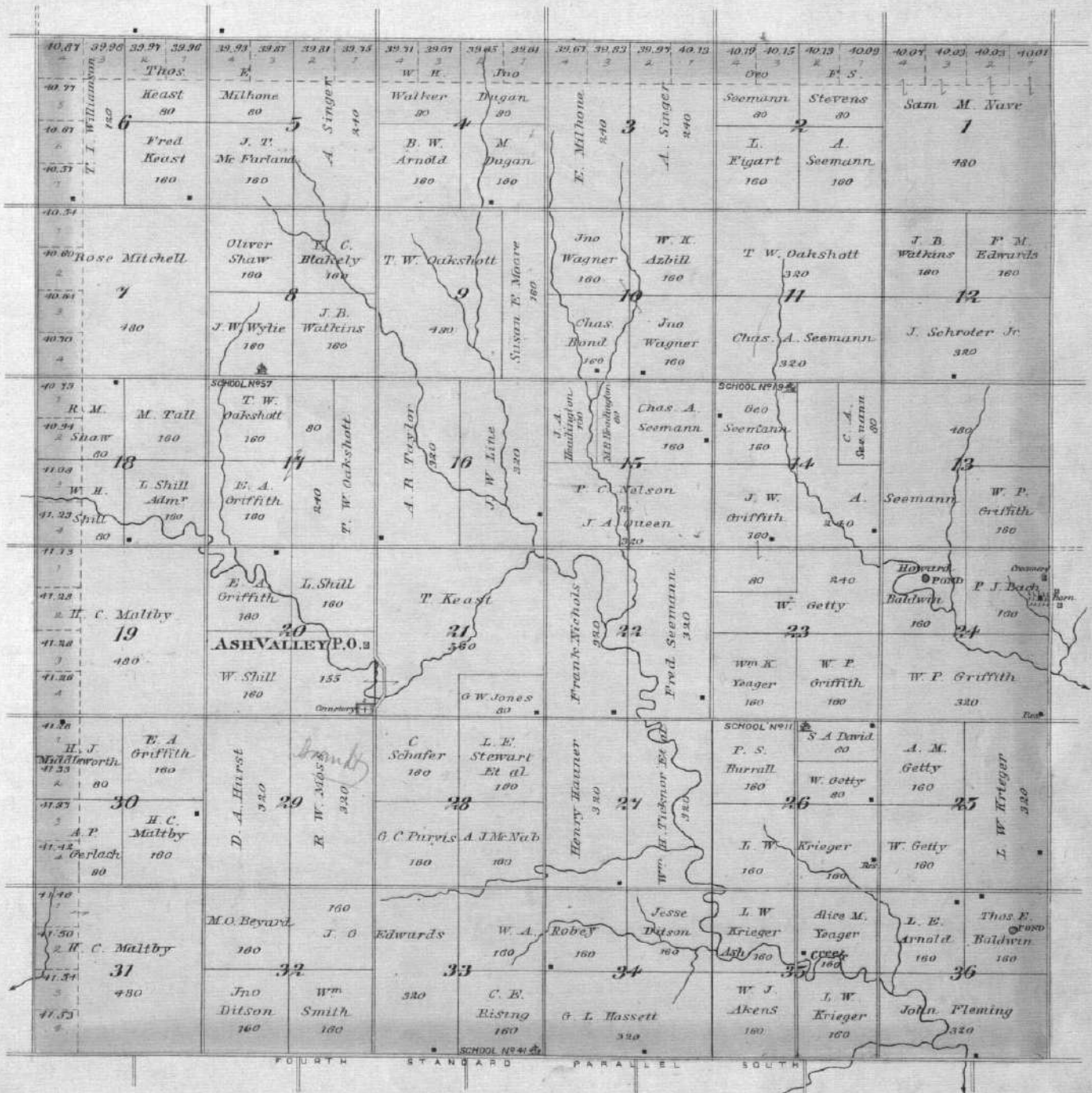

TOWNSHIP 20 SOUTH RANGE 16 WEST.

Scale 2 inches to the Mile.

of the 6th Principal Meridian.

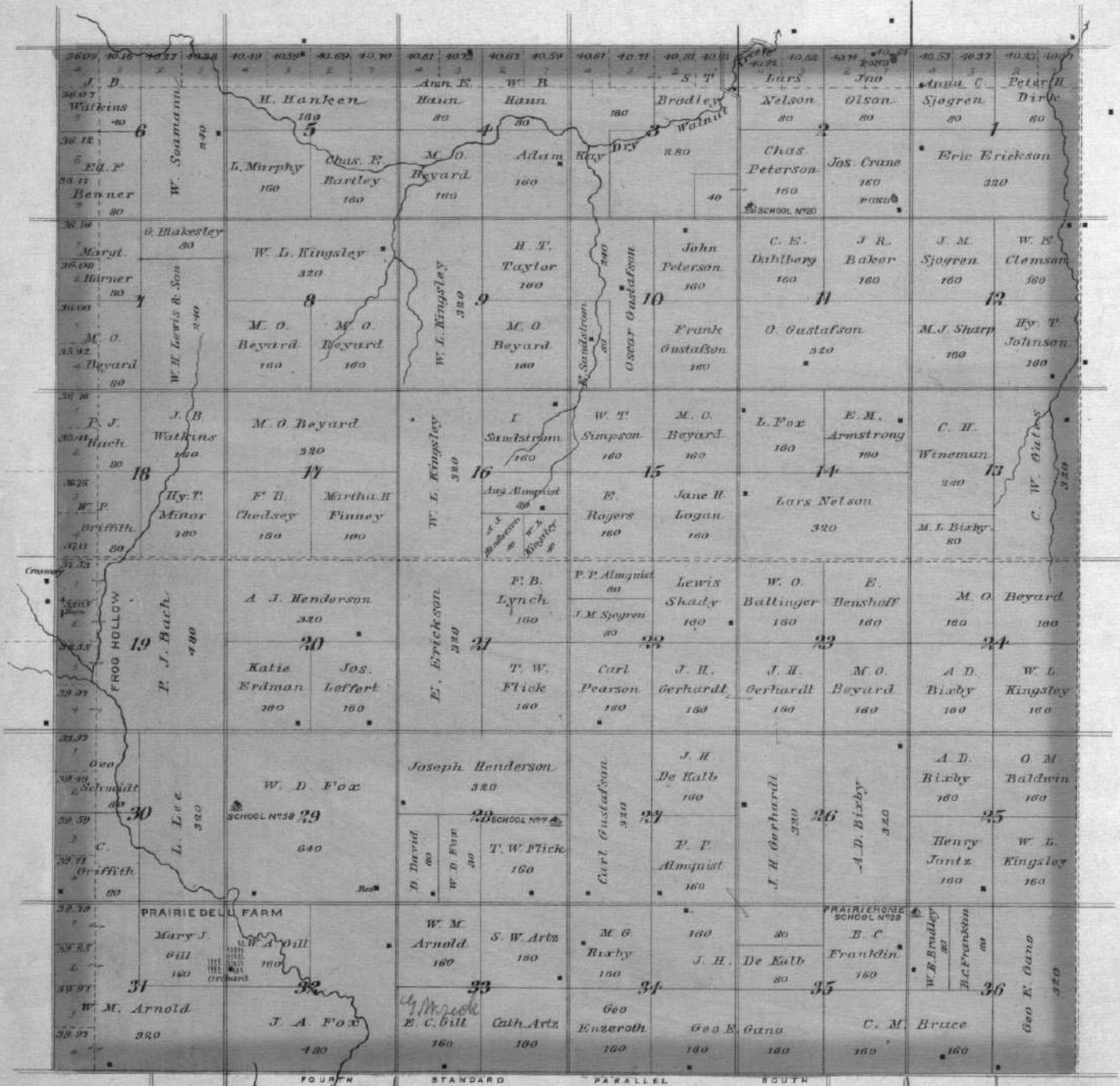

TOWNSHIP 22 SOUTH RANGE 18 WEST

Scale 2 Inches to the Mile.

of the 6th Principal Meridian.



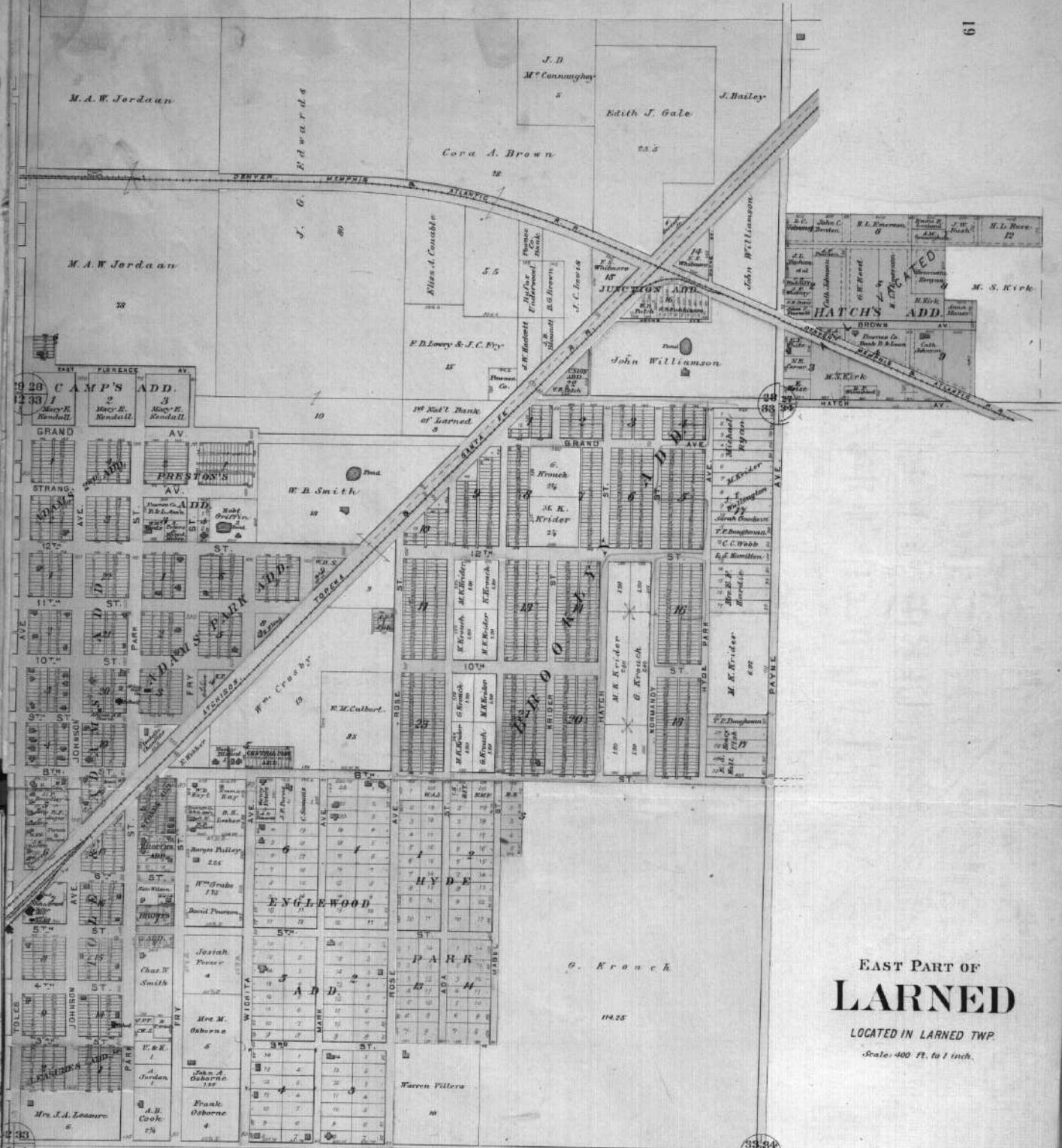

EAST PART OF
LARNED

LOCATED IN LARNED TWP.

Scale: 400 Ft. to 1 inch.

E. P. Bright J. Faell

47 457 586 359

LOT 4 LOT 3 LOT 2 LOT 1

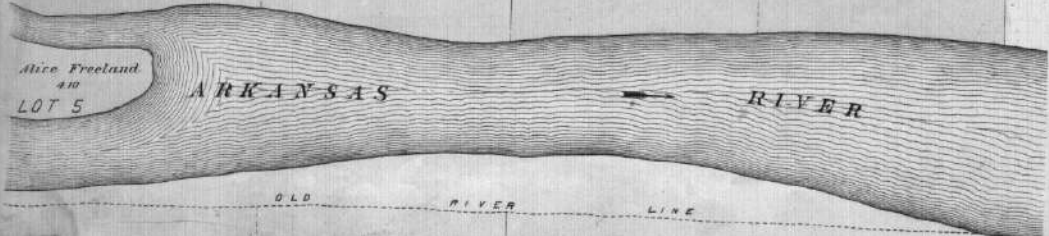

WEST PART OF LARNED

LOCATED IN LARNED TWP.

Scale: 400 Ft. to 1 inch.

Note: This plan is shown by state 1 4

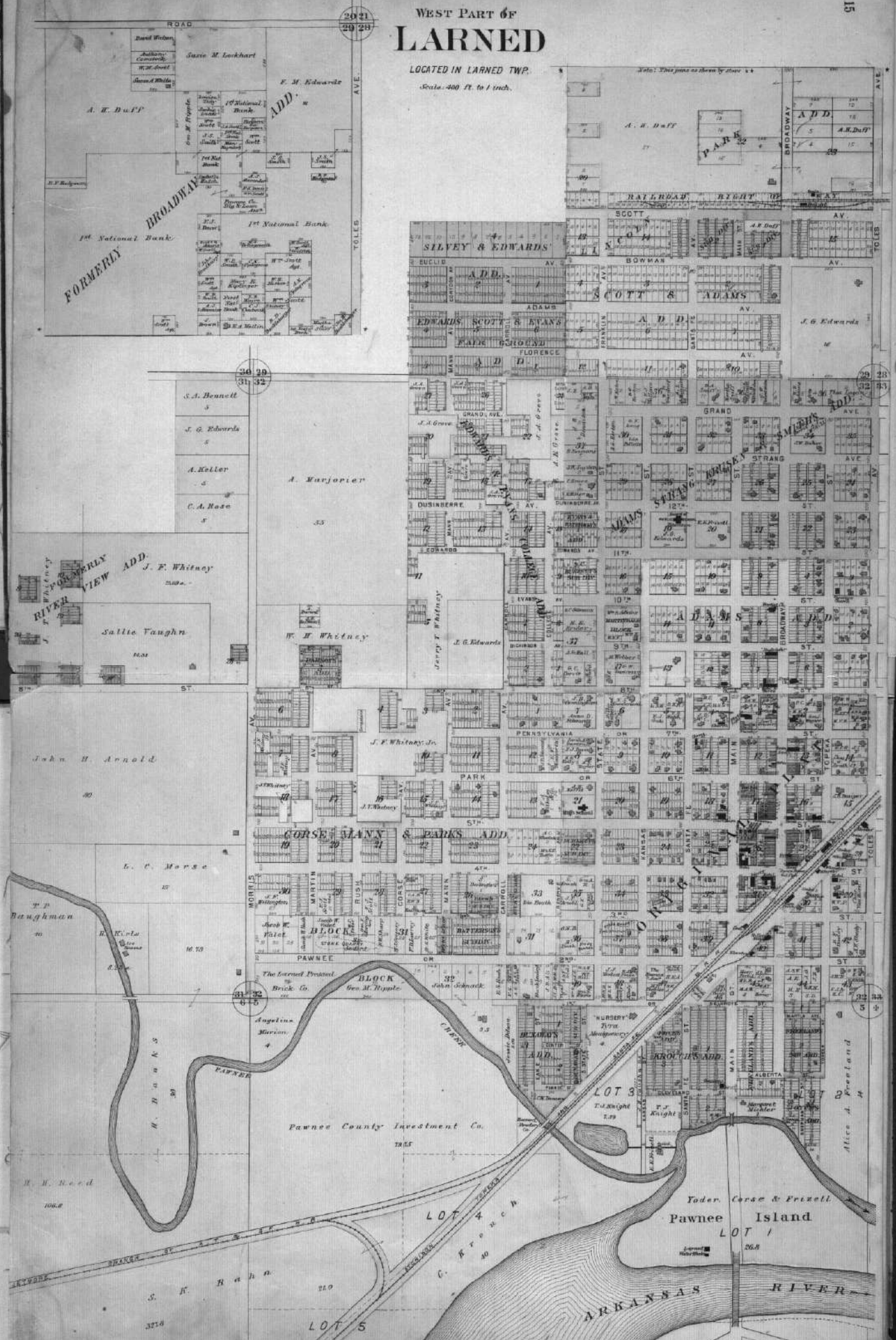

FORMERLY BROADWAY

1st National Bank

A. E. Duff

Suzie M. Lockhart

F. M. Edwards

1st National Bank

SILVEY & EDWARDS

PARK

RAILROAD

A. E. Duff

A. E. Duff

S. A. Bennett

J. G. Edwards

A. Keller

C. A. Hase

A. Marjorie

Sallie Taughn

W. H. Whitney

John H. Arnold

L. C. Morse

Baughman

M. H. Reed

S. F. Raha

Pawnee County Investment Co.

BLOCK

Geo. M. Rynke

LOT 3

LOT 4

LOT 5

Toder, Corse & Erixell
Pawnee Island

ARKANSAS RIVER

TOWNSHIP 21 SOUTH RANGE 19 WEST.

Scale 2 Inches to the Mile.

of the 6th Principal Meridian.



ROZEL
GRANT TWP.
IN SW. 1/4 OF SEC. 27-21-19
Scale 200 ft = 1 inch

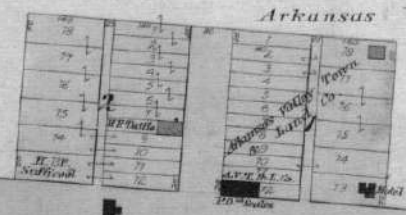

Arkansas Valley Town & Land Co.

20 21
29 20

21 22
20 21

BROWN'S GROVE AND BURDETT

BROWN'S GROVE TWP
Scale 300 ft. = 1 inch.

Anna
Mauer
4.0

J. C. Searcy

Esther Williams

11.21

Maria Barker
8.0

S. L.
Palmer
7.25

Maria Barker

INDIANA ST.

IOWA ST.

BLOSSOMS ST.

MAIN ST.

ADD. ST.

R. M. Norris

63

64.33

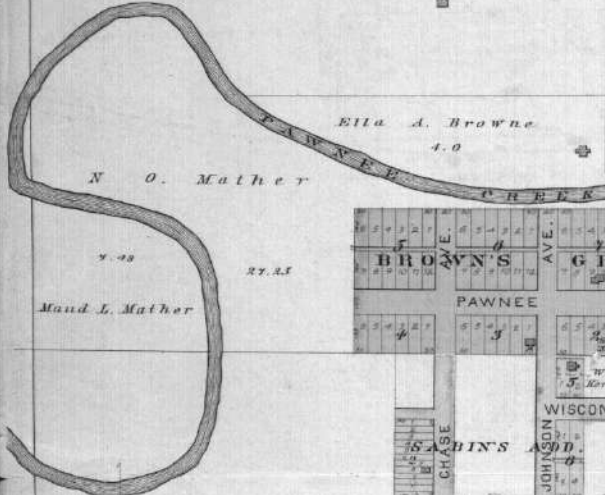

N. O. Mather

Ella A. Browne
4.0

7.43

27.25

Maud L. Mather

BROWN'S GROVE
PAWNEE AVE.

WATER

1ST ST.
2ND ST.

G. A. Dunn et al

30

T. C. Wilson

42.81

WISCONSIN AVE.
CHASE ST.
JOHN ST.
ADAMS ST.
VERMONT ST.
MICHIGAN ST.
ELM ST.
LOCUST ST.

PAWNEE VALLEY & DENVER A. A. DE JEWORE BRANCH OF A. T. & S. F. R. R.

The Burdett T. Co.

80.0

Arkansas Valley Land & T. Co.

29.09

R. M. Norris

20 22
32 33

22 23
32 33

MAPLE ST.
SPRUCE ST.
ELM ST.
LOCUST ST.
PINE ST.
BROADWAY
ARIZONA AVE.
CANDLER AVE.

The Burdett T. Co.

477.90

TOWNSHIP 20 SOUTH RANGE 19 WEST

Scale 2 Inches to the Mile.

of the 6th Principal Meridian.

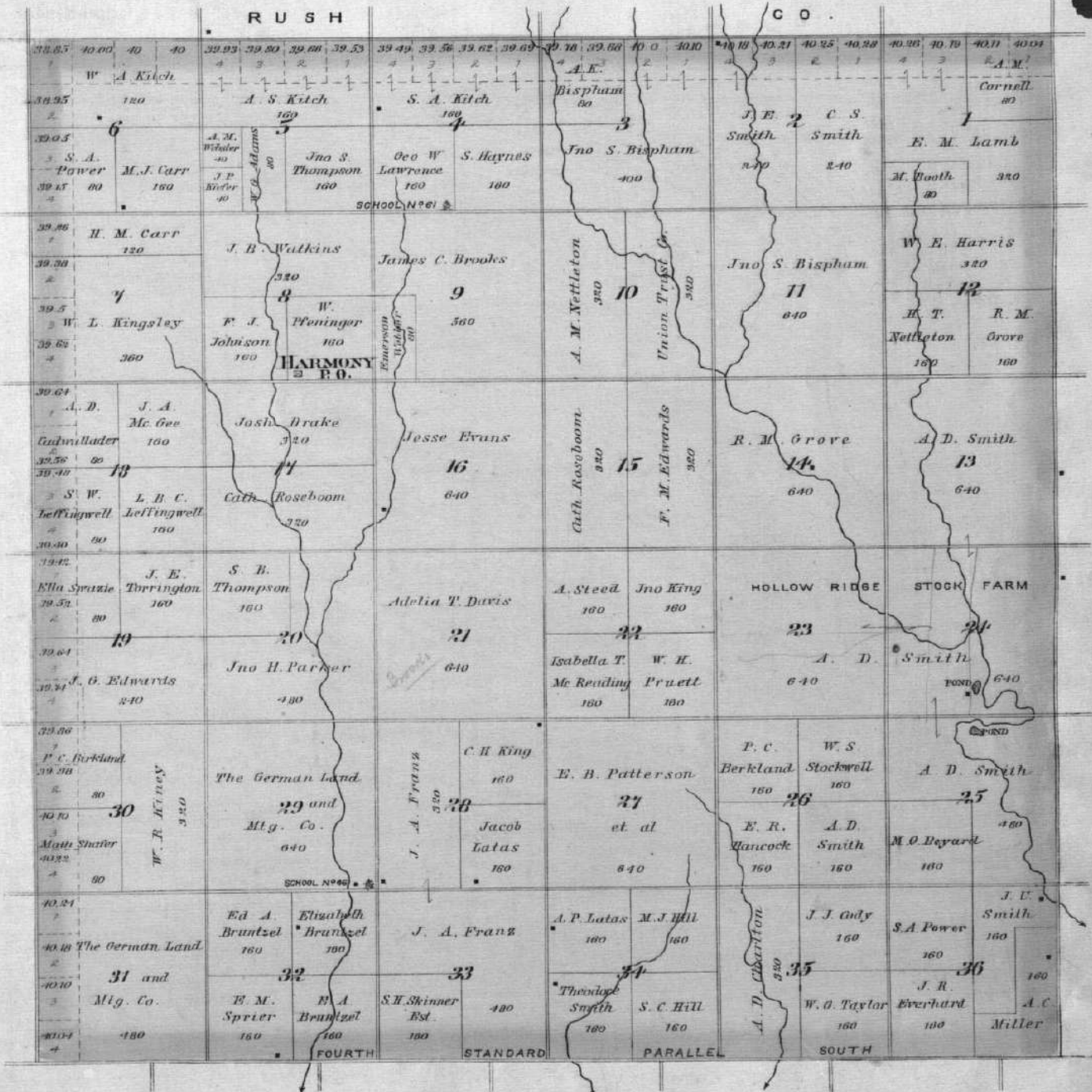

TOWNSHIP 20 SOUTH RANGE 18 WEST

Scale 2 Inches to the Mile.

of the 6th Principal Meridian.

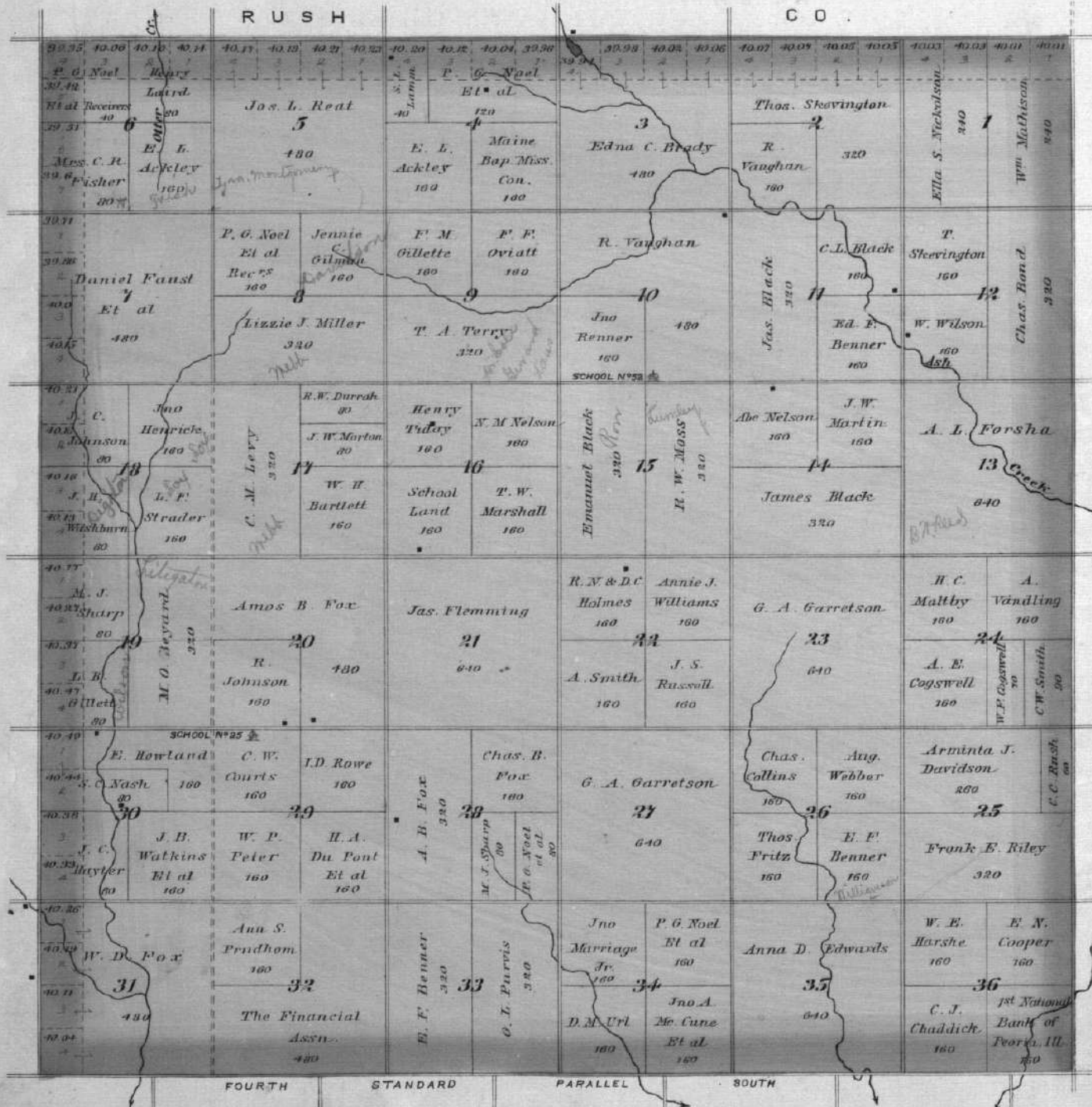

TOWNSHIP 20 SOUTH RANGE 20 WEST.

Scale 2 Inches to the Mile.

of the 6th Principal Meridian.

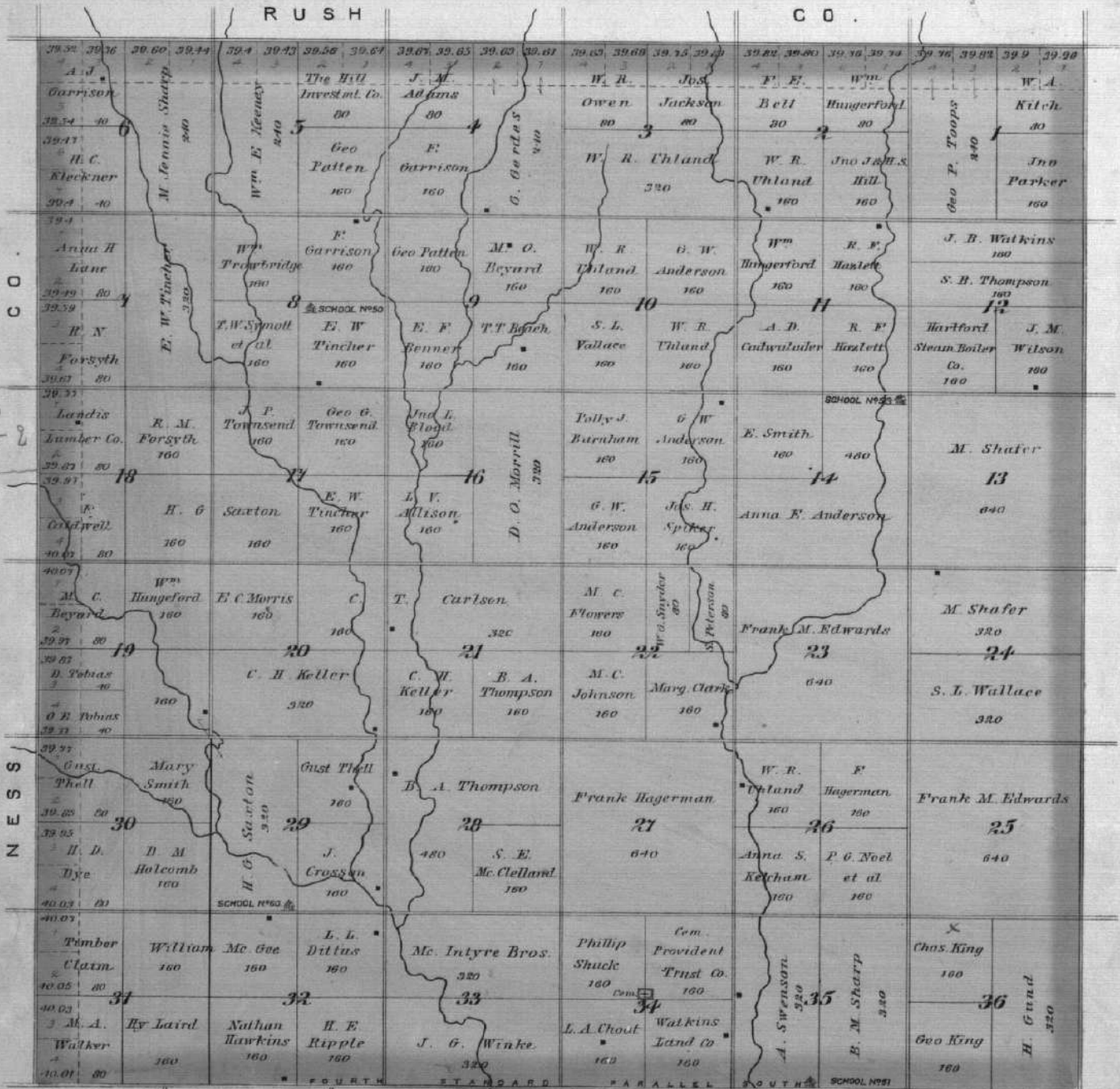

TOWNSHIP 21 SOUTH RANGE 20 WEST

Scale 2 Inches to the Mile.

of the 6th Principal Meridian.

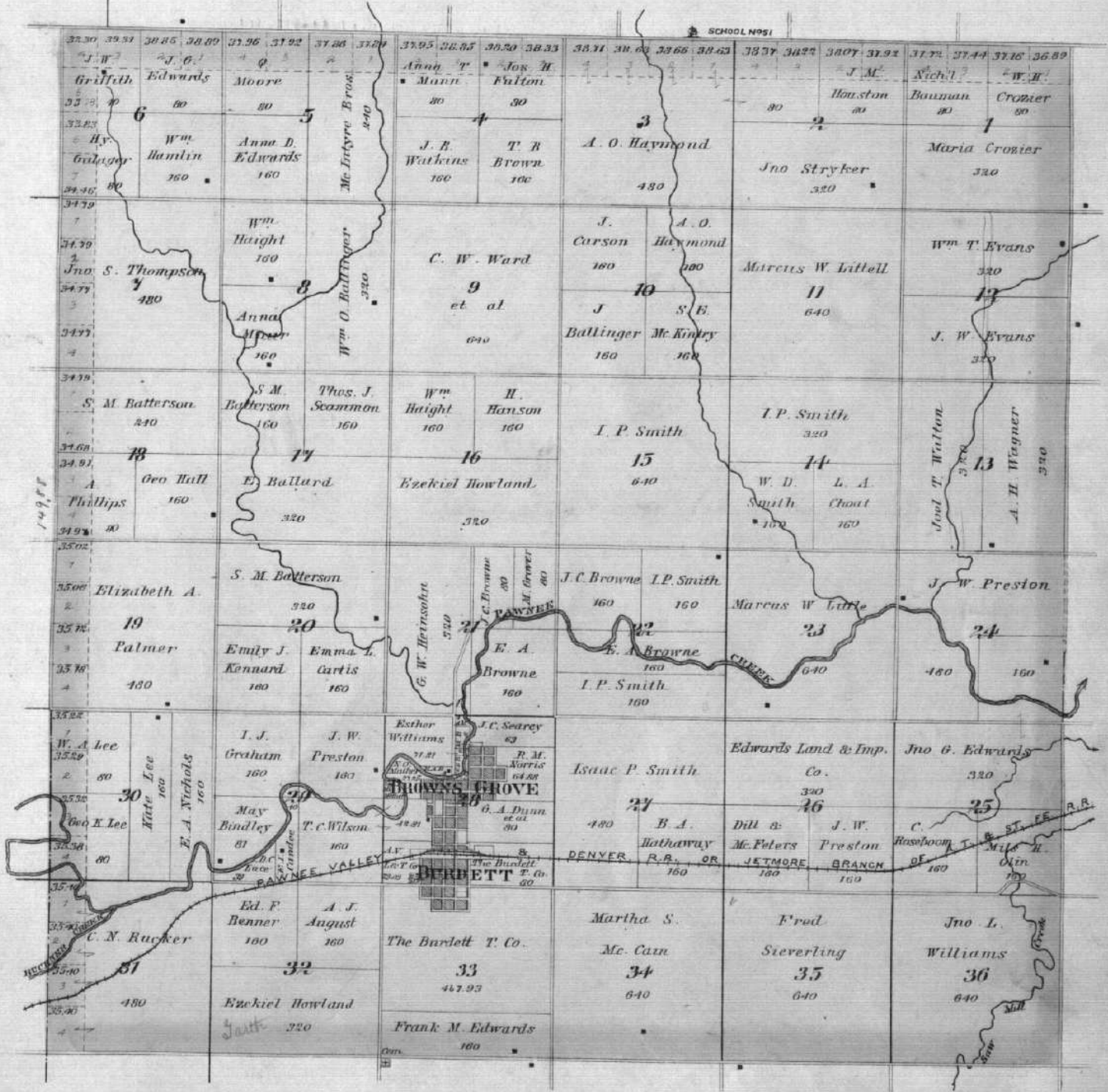

TOWNSHIP 21 SOUTH RANGE 16 WEST

Scale 2 Inches to the Mile.

of the 6th Principal Meridian.

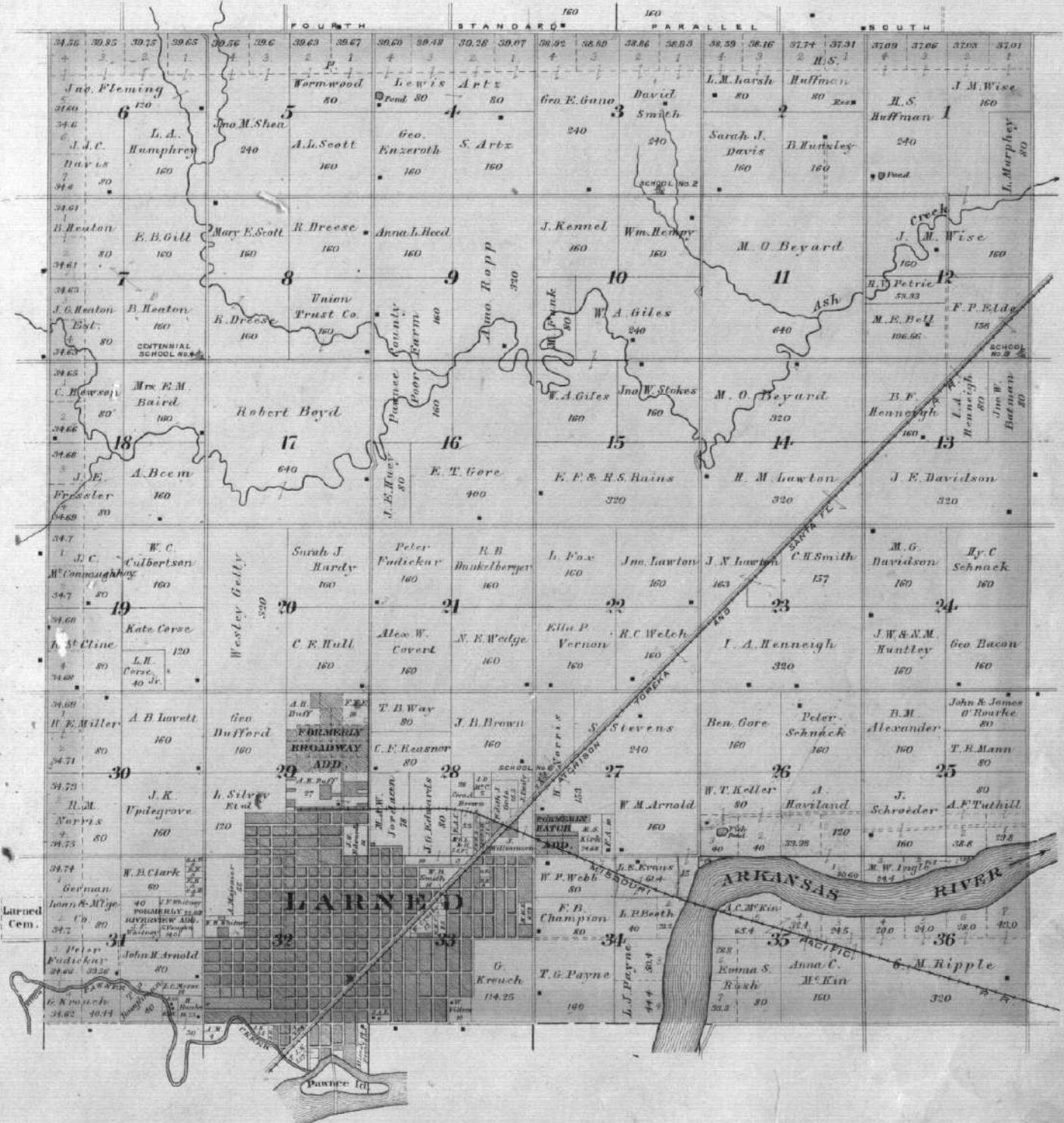

TOWNSHIP 21 SOUTH RANGE 17 WEST

Scale 2 Inches to the Mile.

of the 6th Principal Meridian.

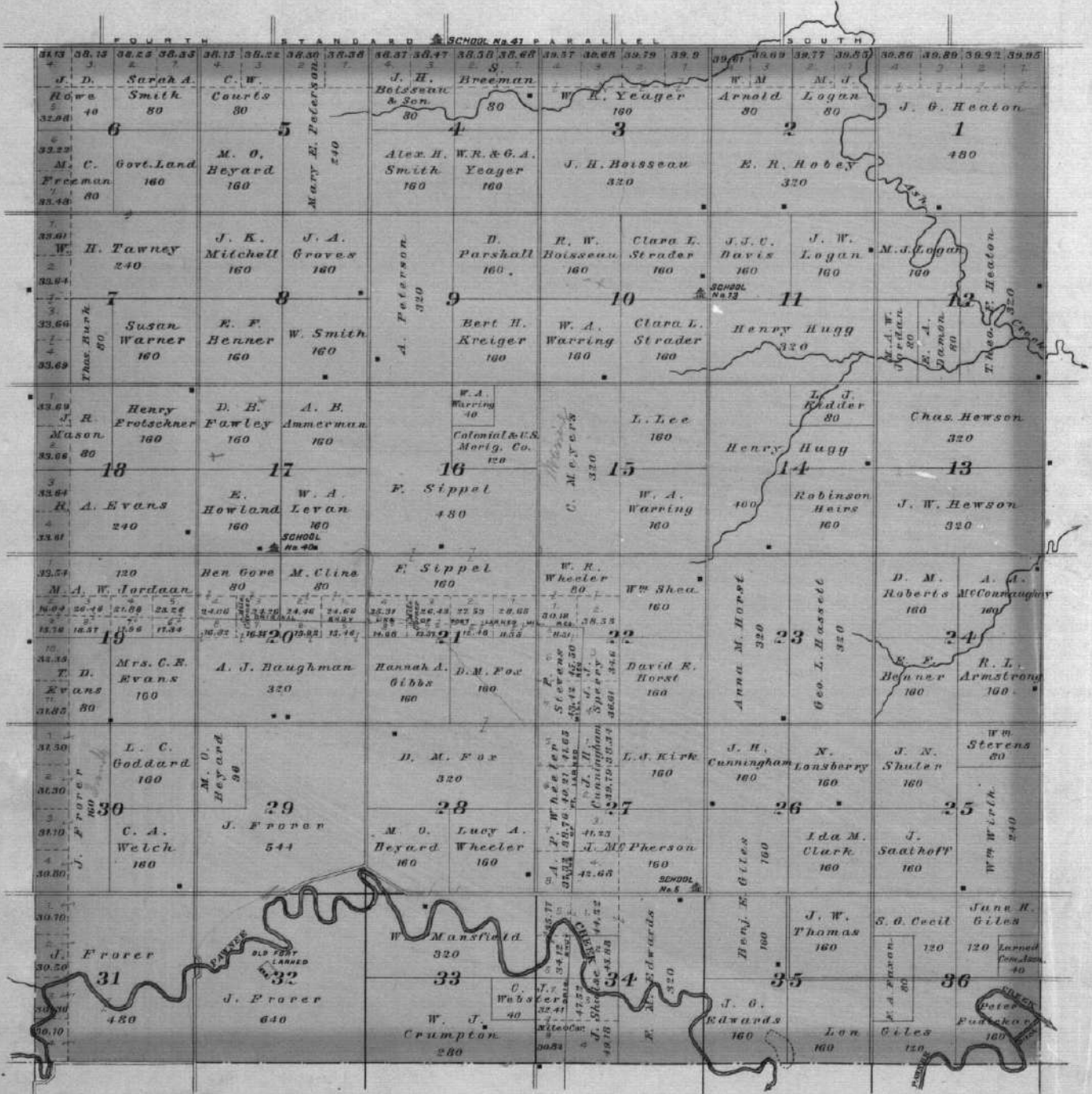

TOWNSHIP 21 SOUTH RANGE 15 WEST

Scale 2 Inches to the Mile.

of the 6th Principal Meridian.

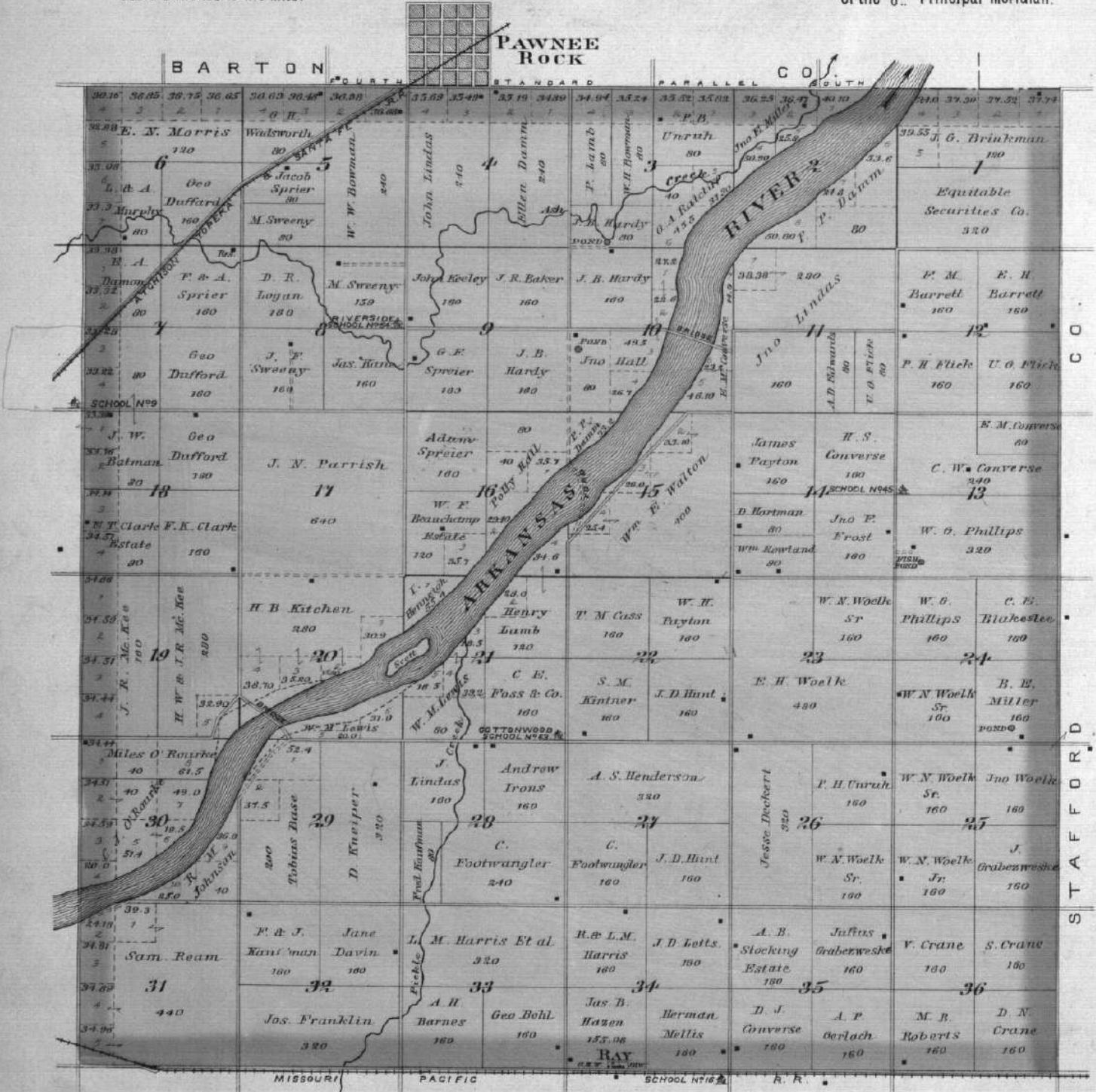

RAY
 RIVER TWP.
 Scale 264' = 1 inch.

Jas. B. Hazen

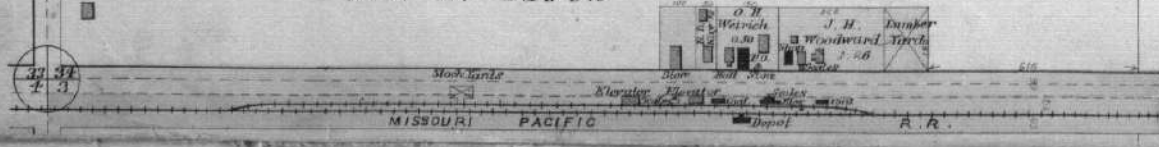

TOWNSHIP 22 SOUTH RANGE 15 WEST

Scale 2 Inches to the Mile.

of the 6th Principal Meridian.

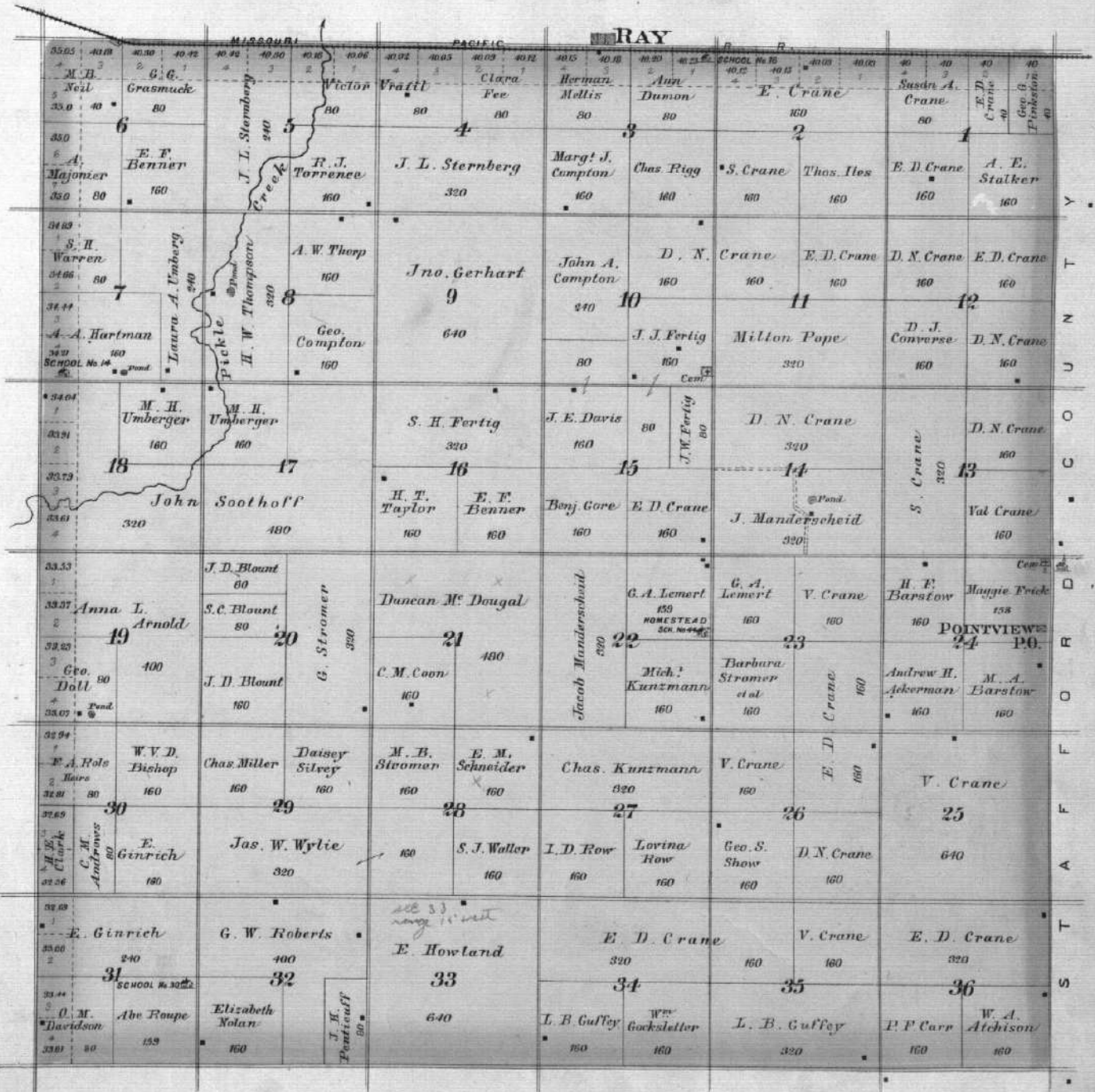

TOWNSHIP 22 SOUTH RANGE 16 WEST

Scale 2 Inches to the Mile.

of the 6th Principal Meridian.

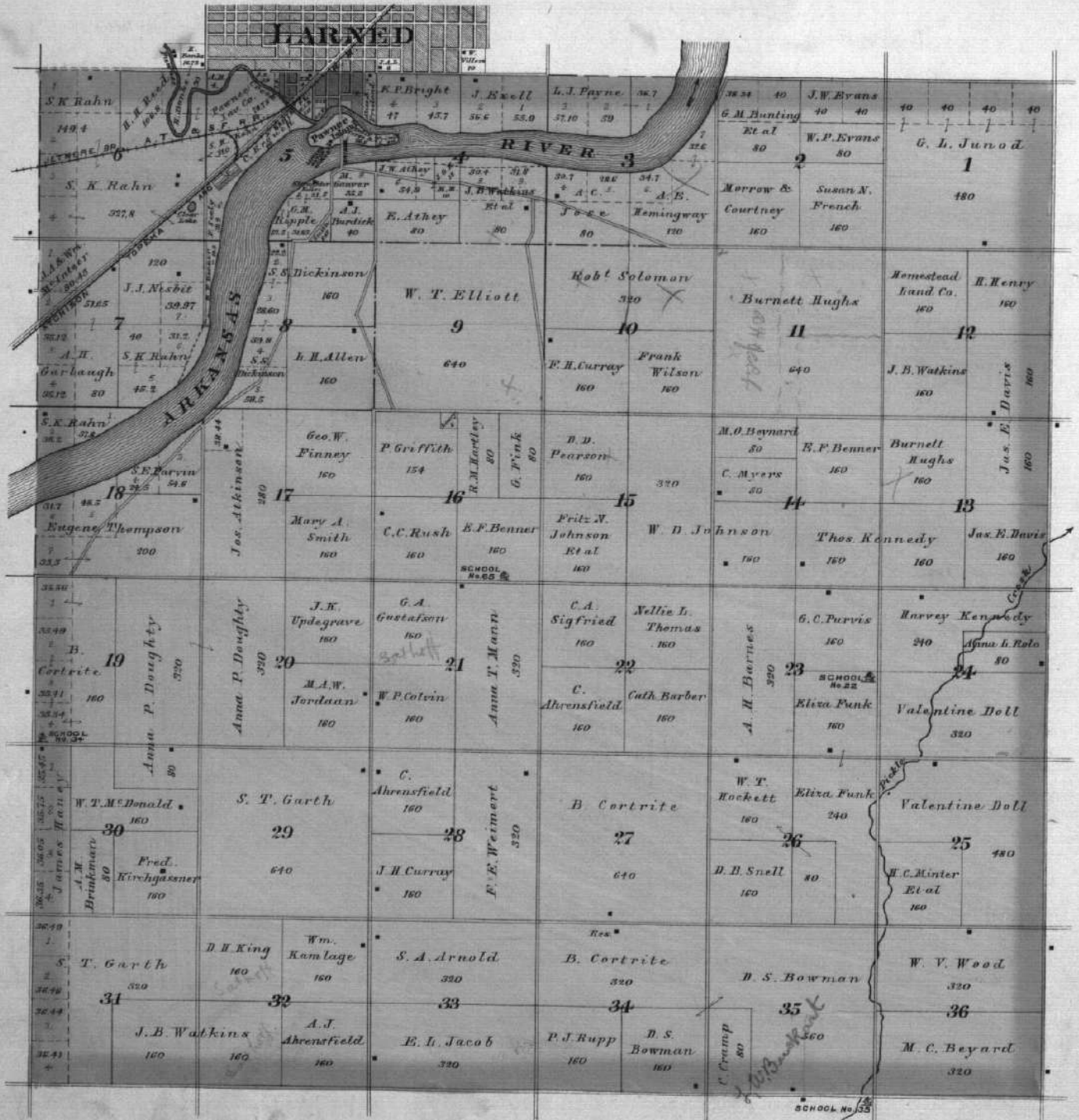

TOWNSHIP 22 SOUTH RANGE 17 WEST.

Scale 2 Inches to the Mile.

of the 6th Principal Meridian.

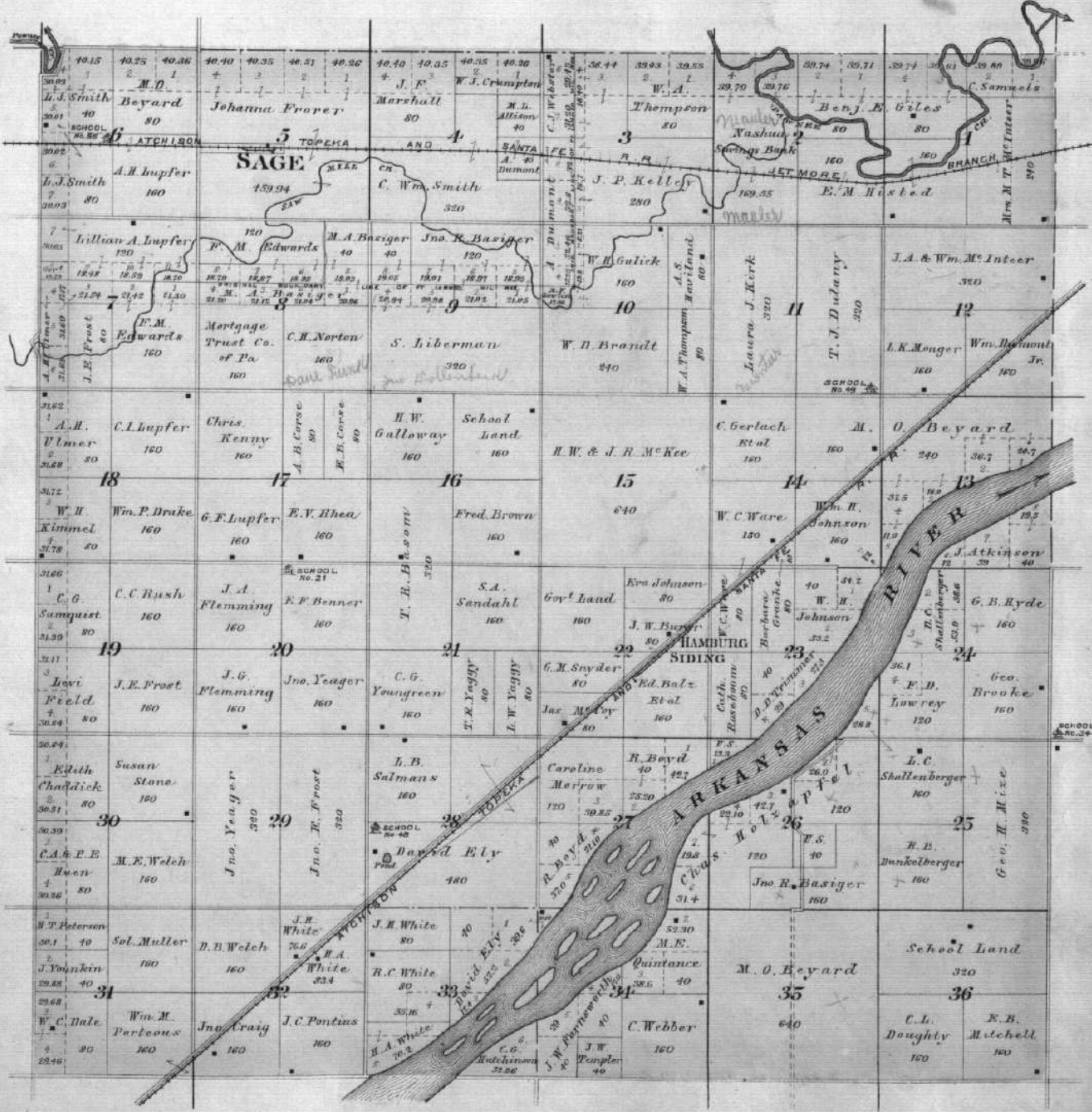

TOWNSHIP 22 SOUTH RANGE 19 WEST

Scale 2 Inches to the Mile.

of the 6th Principal Meridian.

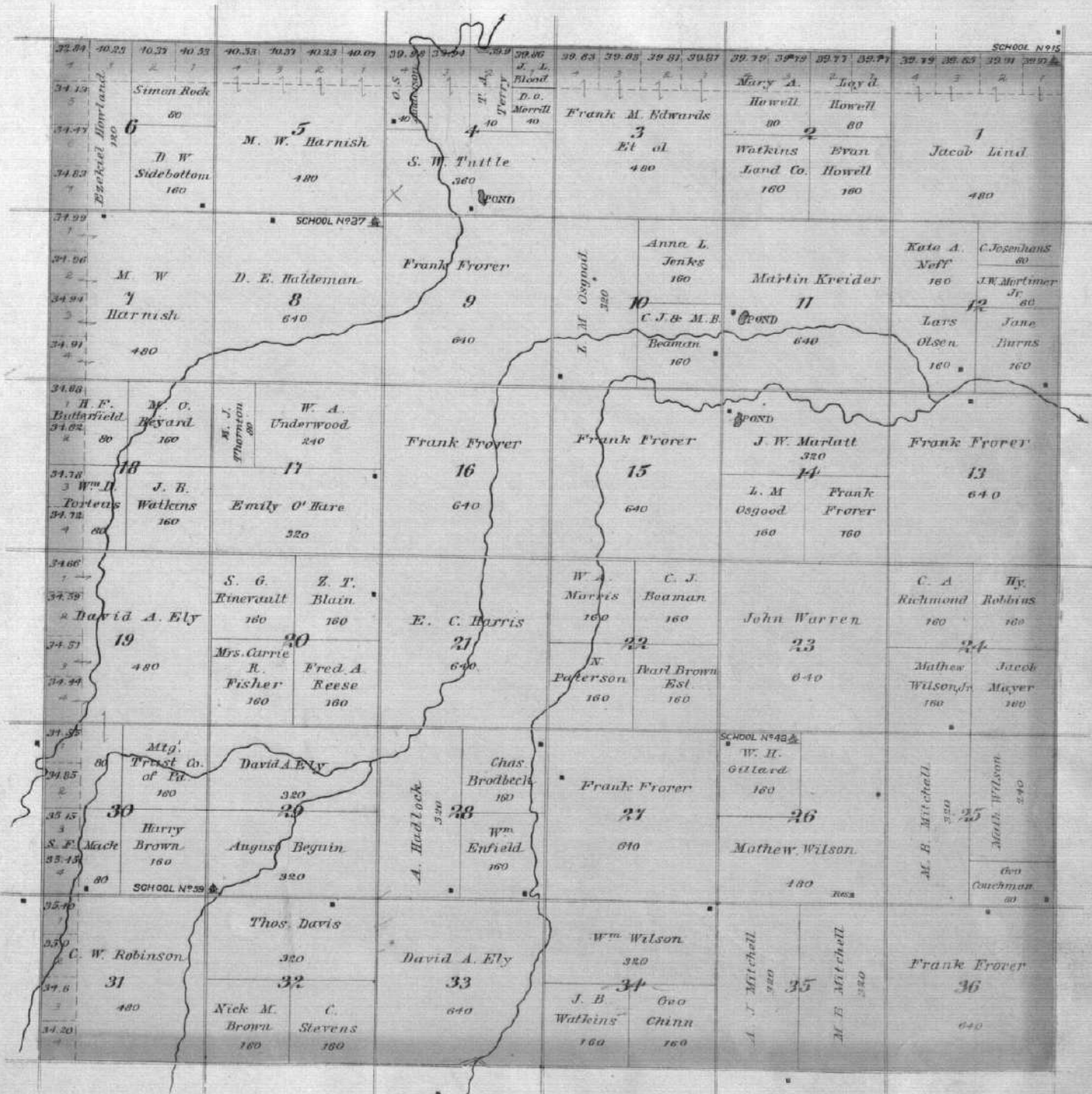

TOWNSHIP 22 SOUTH RANGE 20 WEST

Scale 2 Inches to the Mile.

of the 6th Principal Meridian.



TOWNSHIP 23 SOUTH, RANGE 17 WEST

Scale 2 Inches to the Mile.

of the 6th Principal Meridian.

30.95 H. K. Peterson 40.0	30.95 W. D. Postous 40.0	30.95 J. C. Pontius 40.0	30.95 M. O. 40.0	30.95 Chas. G. Hutchinson 40.0	30.95 Roseboord 40.0	30.95 H. Gore 40.0	30.95 Fred L. Kimball 40.0
30.90 W. D. Postous 40.0	30.90 W. S. Wilson 40.0	30.90 C. E. Anderson 40.0	30.90 Chas. G. Hutchinson 40.0	30.90 Jno Watson 160	30.90 Frank Hagerman 160	30.90 Fred L. Kimball 320	30.90 Martg. Trust G. G. Co. of Pa. Grassmucke 160 160
30.85 R. W. Lee 40.0	30.85 Geo W Lewis 160	30.85 Chas. G. Hutchinson 640	30.85 Jno Anderson 160	30.85 C. P. Anderson 160	30.85 E. F. Benner 160	30.85 C. O. G. & D. C. Wheeler 160	30.85 J. B. Watkins 160
30.80 United States Land 40.0	30.80 Chas. G. Hutchinson 640	30.80 School Land 160	30.80 Emily Blume 160	30.80 C. Anderson 160	30.80 S. R. Mc Kibbin 80	30.80 M. B. Paramore 320	
30.75 R. Howard 160	30.75 Chas. G. Hutchinson 640	30.75 H. H. Godfrey 160	30.75 E. H. Arden 160	30.75 A. E. Pitton 160	30.75 A. P. Gerlich 160	30.75 J. B. Watkins 160	30.75 Isaac B. Arnold 400
30.70 C. V. Tyffe 160	30.70 Wm Kilgore 160	30.70 H. S. Houdysholl 160	30.70 Barbara E. Bailey 320	30.70 Jas. Wilson 160	30.70 O. E. Webb 160	30.70 S. L. Arnold 160	30.70 D. Posey 320
30.65 Nancy A. Hawes 160	30.65 Wm Kilgore 160	30.65 J. C. Fuhnestock 160	30.65 F. M. Foss 160	30.65 Geo L. Hassett 160	30.65 Anna D. Edwards 160	30.65 Peter Lundgren 320	30.65 J. H. Barnes 320
30.60 Mrs. S. A. Bowler 160	30.60 Ang Korte 160	30.60 O. W. Bawlus 160	30.60 F. H. Holmes 160	30.60 Geo P. Miller 160	30.60 E. Kilgore 160	30.60 Ed. F. Benner 160	30.60 T. G. Fosier 160
30.55 J. H. Henderson 320	30.55 J. H. Misner 160	30.55 E. Beeth 160	30.55 Geo P. Miller 480	30.55 J. Richard 160	30.55 F. C. Brightman 160	30.55 C. S. Schertz et al 320	30.55 J. C. Massey 80
30.50 Mrs. S. A. Bowler 160	30.50 Jno P. Corner 160	30.50 D. M. Aldrich 160	30.50 R. C. Welch 160	30.50 Wm Slingerland 160	30.50 D. M. Aldrich 160	30.50 C. C. Peterson 240	30.50 Lorenzo Pope 640

TOWNSHIP 23 SOUTH RANGE 18 WEST.

Scale 2 Inches to the Mile.

of the 6th Principal Meridian.

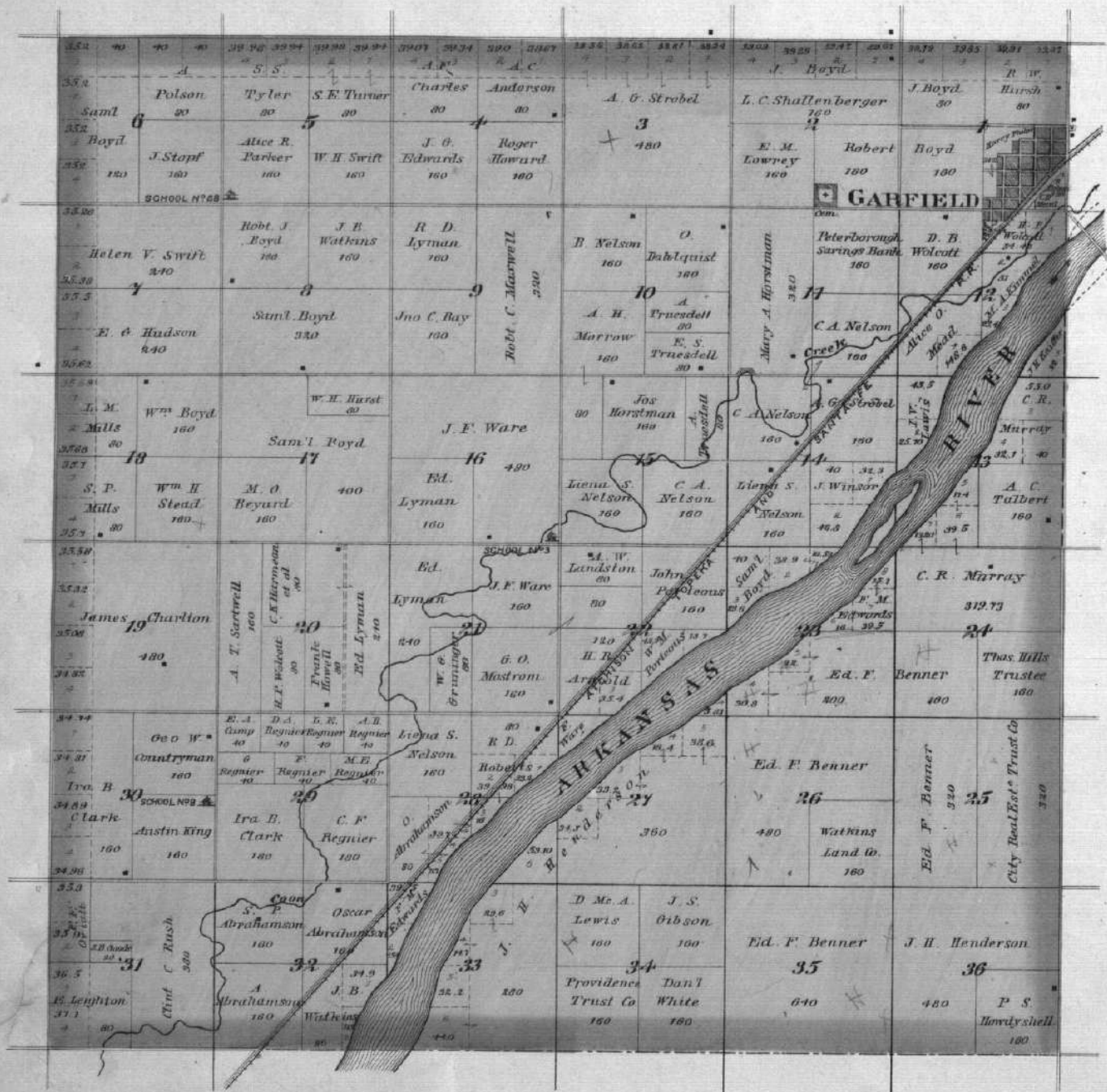

GARFIELD

GARFIELD TWP.
Scale 250 ft = 1 inch

Order
Sec. 7

By Ord.
Sec. 7

PUBLIC ROAD

ROAD

Harry Phelps

25.03

H. P. Wolcott
0.82

H. P. Wolcott
30.28
LOT 6

H. P. Wolcott
18.4
LOT 7

LOT 3
8.54

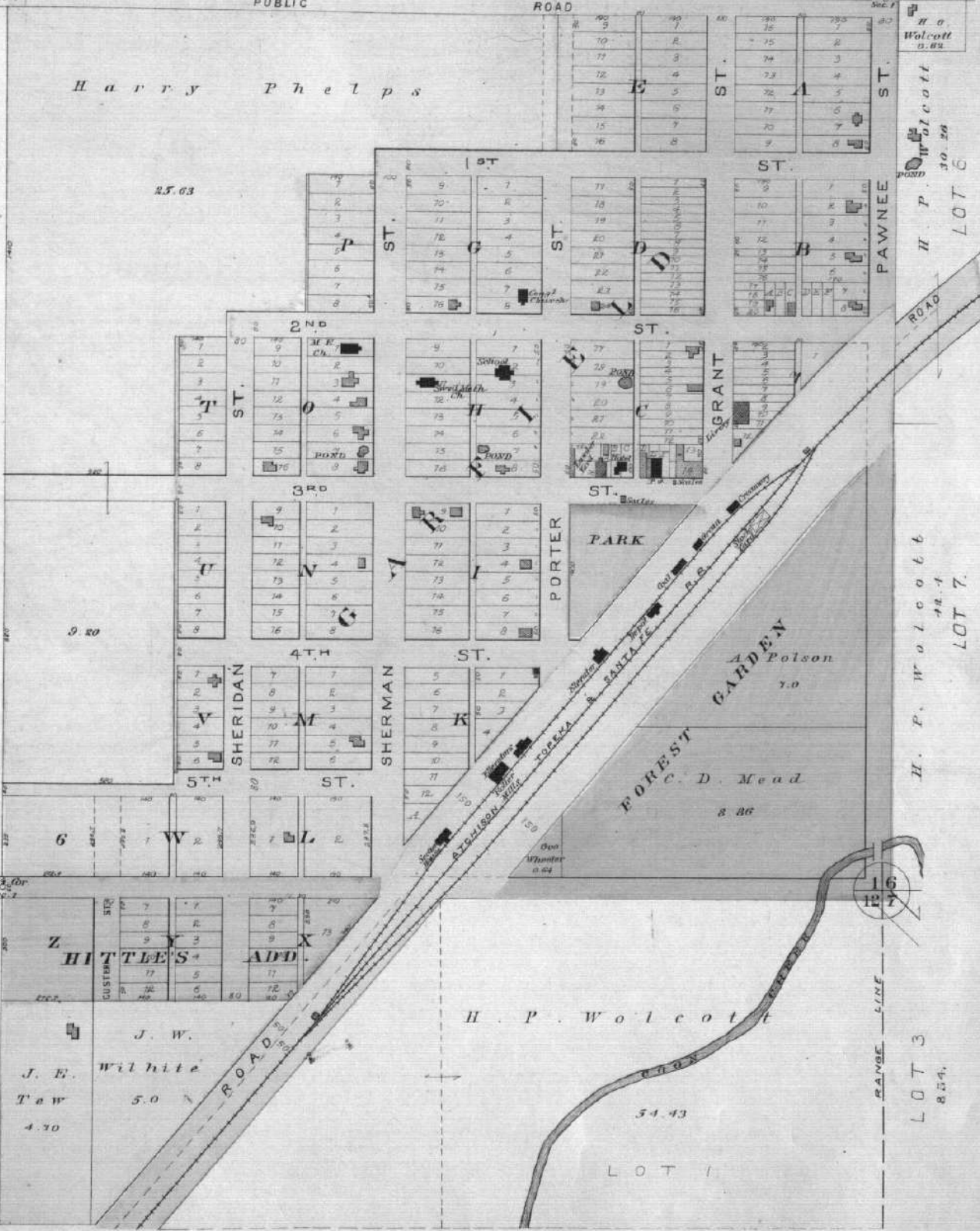

RANGE LINE

Struck for
Sec. 7

TOWNSHIP 23 SOUTH RANGE 15 WEST

Scale 2 Inches to the Mile.

of the 6th Principal Meridian.

34.19 H. T. Taylor 40 6	40.30 Geo L. Hassett 80	40.74 D. S. Bowman 160	40.62 J. M. Stevens 80	40.23 A. E. Burns 80	37.94 A. J. Smith 480	38.98 Burns 80	32.3 A. J. Smith 160	39.98 J. T. Johnson 480	40.33 E. Howland 320	40.31 J. Mc. Comas 160	40.19 J. P. Beardsley 160	40.08
34.53 Anna E. Van Vorhes 80	Mich'l. Tynan 160	E. B. Kelsey 160	L. A. Chaat 160	S. Crane 160	A. J. Smith 160	A. J. Smith 160	J. T. Johnson 480	J. P. Beardsley 160				
34.88 H. Wolf 80	Albert A. Doerr 160	Mich'l. Tynan 160	J. M. Chamberlin 160	Sebastian Crane 640	A. J. Smith 320	A. J. Smith 160	S. C. Cash 320	J. H. & E. B. Singer 160	J. H. Singer 160			
34.99 A. W. & C. W. Hook 160	J. P. Henahan 160	Anton Vasecky 160	S. Crane 160		C. W. Smith 160	D. M. Nease 160	S. C. Cash 320	J. C. Bird 160	E. Beardsley 160			
35.26 J. W. & C. W. Hook 80	Pat Henahan 160	R. B. Driemelberger 920	L. A. Hammel 80	A. S. Ackerman 80	D. M. Nease 160	Samuel Becler 160	Thos. W. Ely 320	J. P. Beardsley 640				
35.36 J. Doerr 240	The City Real Est. and Trust Co. 160		L. A. Hammel 80	S. Crane 160	A. J. Smith 480	A. J. Smith 160						
37.12 Wm Chalfant 160	A. & F. J. Inderlied 160	P. G. Foot et al 160	Jas. C. Garrard 320	Thos. W. Ely 160	R. C. Steele 160	John Smith 640	J. H. Starke 320	F. H. Lund Admr. 160				
37.41 A. A. Doerr 400	Peter Almeier 160	E. E. Frickell 160	Jas. C. Garrard 320	A. J. Smith 160	A. M. Geer 160	G. H. Mike Co. 160	J. H. Starke 320	Chas Lund 160				
37.43 F. Pitts 80	A. J. Smith 160	J. B. Young & Son 640	A. J. Smith 160	J. S. Mott 160	J. S. Mott 160	E. F. Benner 160	Geo J. Davis 100	A. J. Smith 160				
37.47 J. De Loss Brown 80	C. M. Frick 160		E. Frick 160	L. H. St. John 320	L. H. St. John 320	O. & J. Stritt 160	J. B. Waitans 160	W. A. Hearn 320	A. Hohner 160			
36.0 Wm Chalfant 480	Caroline Kulow 160	E. Frick 160	Jas. C. Garrard 640	H. E. Thompson 160	J. De Loss Brown 160	M. A. Hearn 640	F. B. Billmore 160	A. St. John 160				
	Mary E. Frick 160	Wm Fricks 160		A. E. Phillips 80	Nat. H. Drifill 160		Geo W. Grandy 160	Hearn 160				

TOWNSHIP 23 SOUTH RANGE 16 WEST

Scale 2 Inches to the Mile.

of the 6th Principal Meridian.

