

**POTTAWATOMIE
COUNTY.
INDEX.**

TOWNSHIPS.

Belvue	11
Bluc	21
Blue Valley	22
Center	5
Clear Creek	17
Emmet	18
Grant	1
Green	19
Lincoln	3
Lone Tree	12
Louisville	14
Mill Creek	2
Pottawatomie	9
Rock Creek	7
Sherman	6
Shannon	15
St. George	10
St. Marys	23
St. Clare	18
Spring Creek	8
Union	16
Vienna	4
Wamego	13

TOWNS.

Belvue	11
Blaine	17
Fostoria	14
Garrison	19
Havensville	1
Louisville	14
Olsburg	20
Onaga	3
St. Clare	18
St. George	11
St. Mary's	22
Wamego	13
Westmoreland	12
Wheaton	12

Compiled from Reel Westmoreland Map

GRANT TOWNSHIP.

T. 6. R. 12.

Havensville.

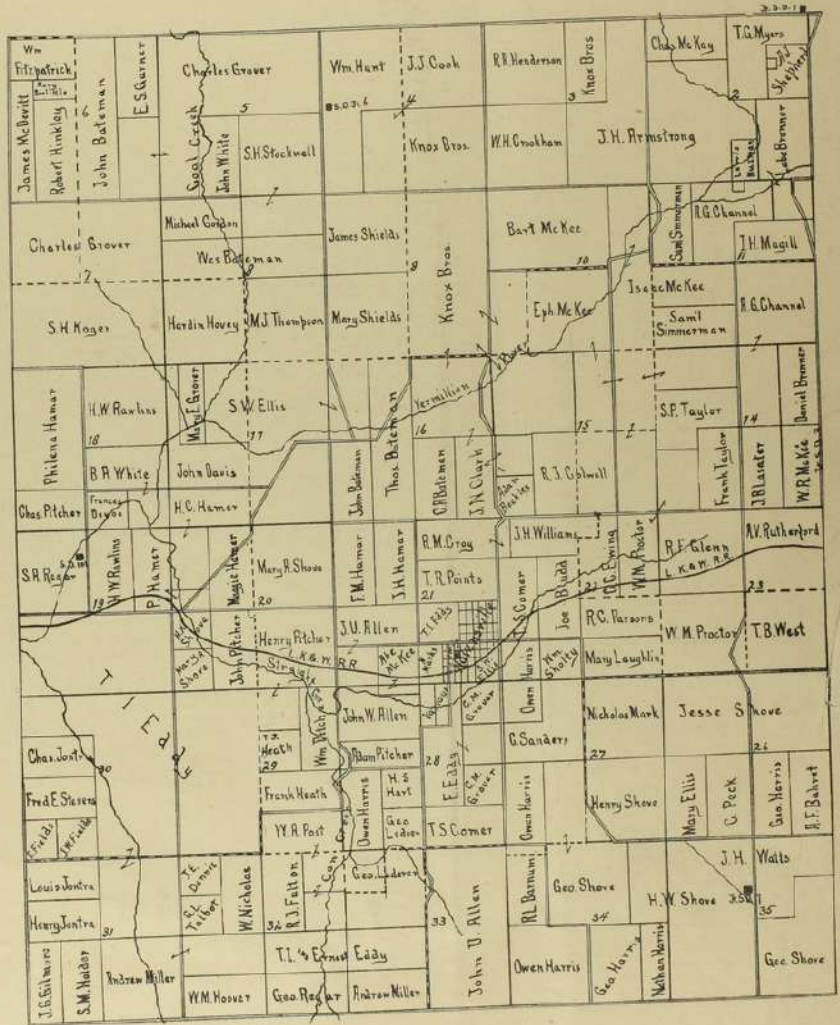
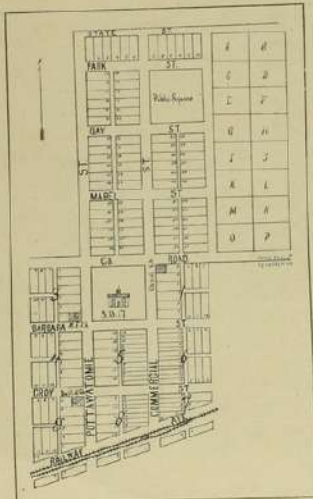

MILL CREEK TOWNSHIP.

T. 6. R. 11.

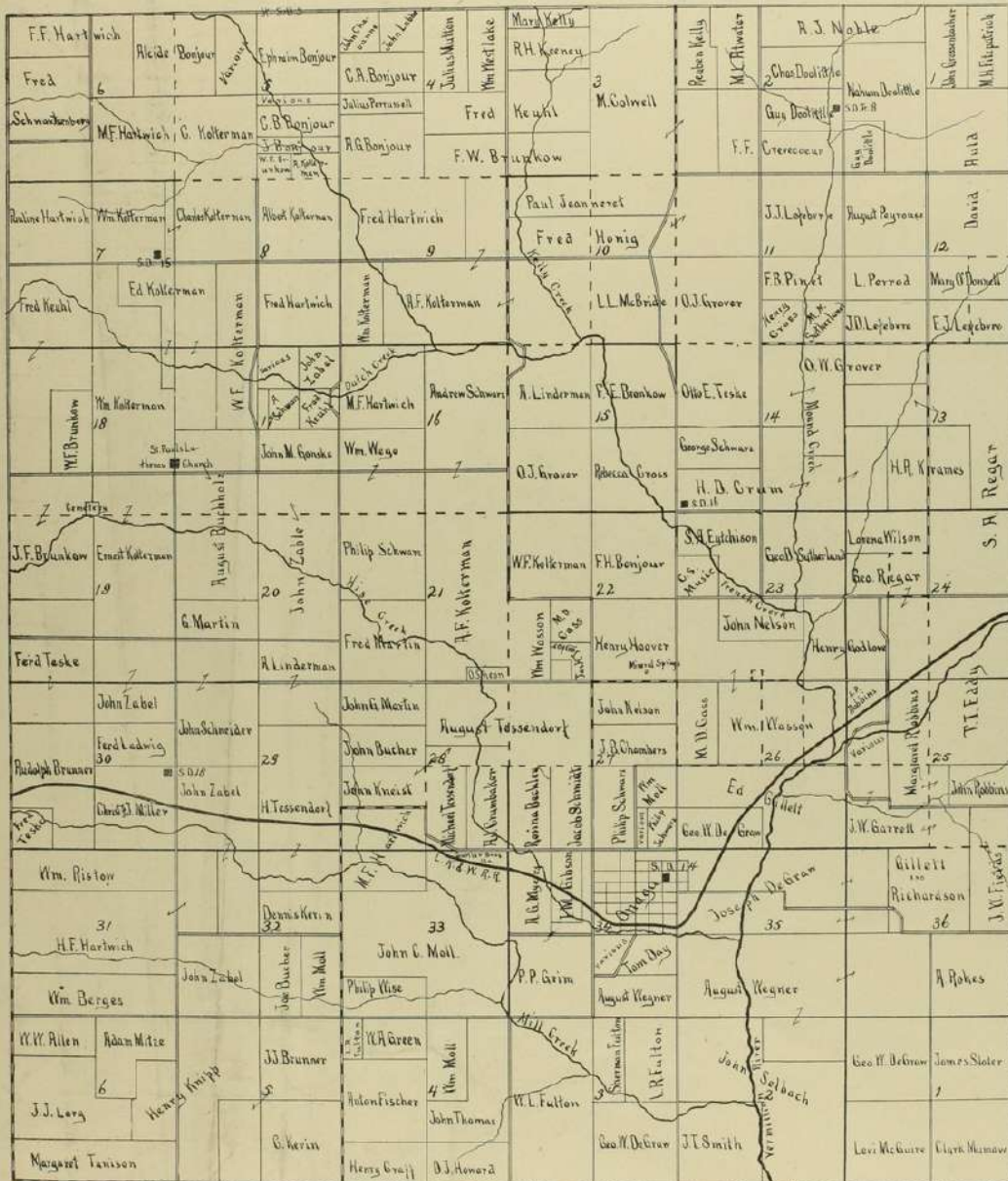

LINCOLN TOWNSHIP.

T. 7. R. 12.

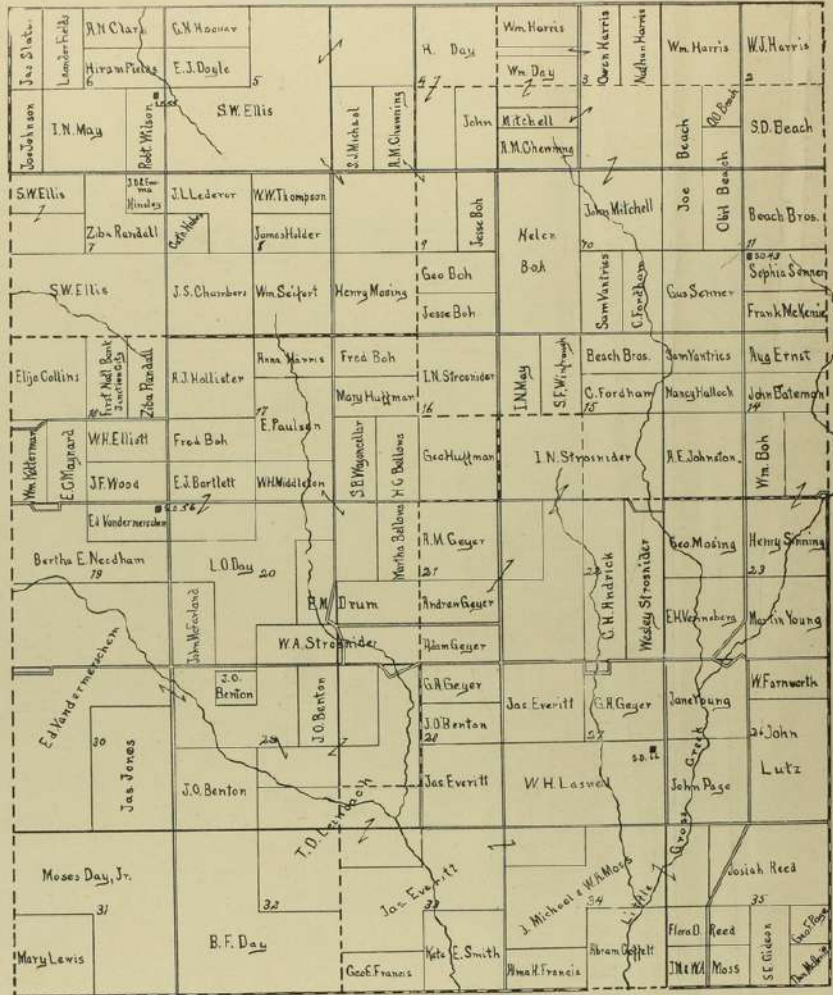

Onaga.

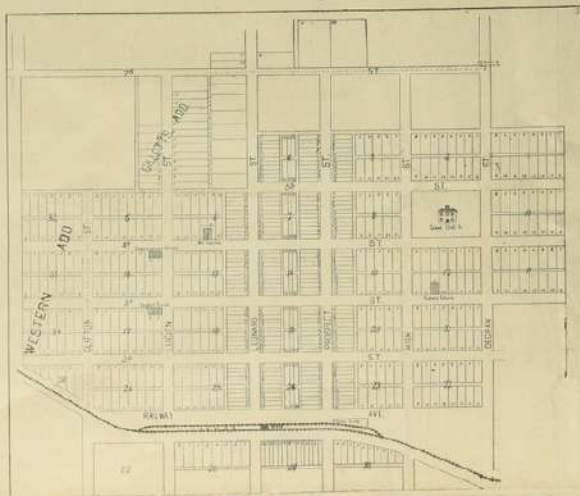

VIENNA TOWNSHIP.

T. 7. R. 11.

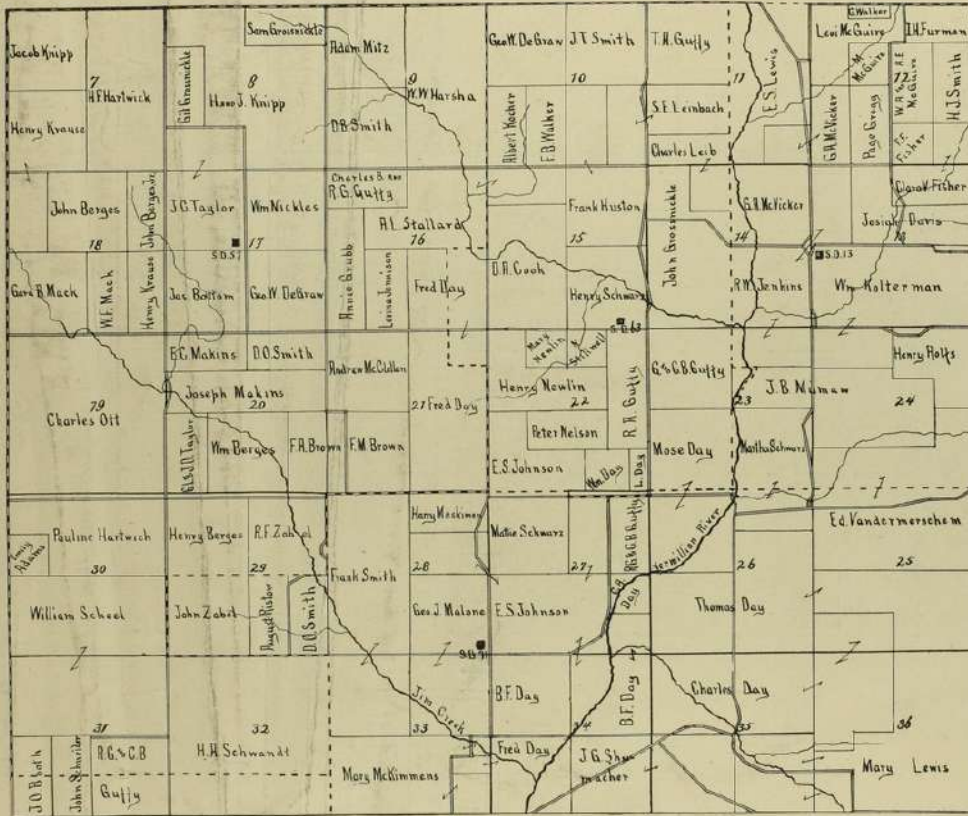

CENTER TOWNSHIP.

T. 8. R. 10 and 11.

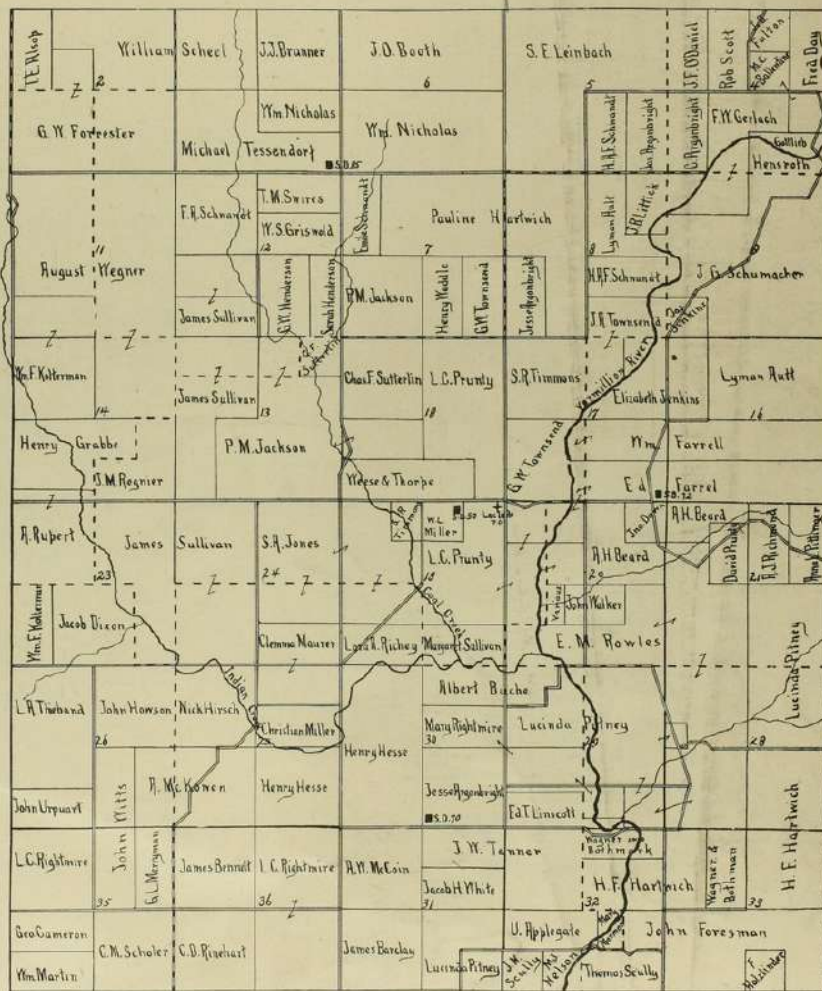

SHERMAN TOWNSHIP.

T. 7. R. 10.

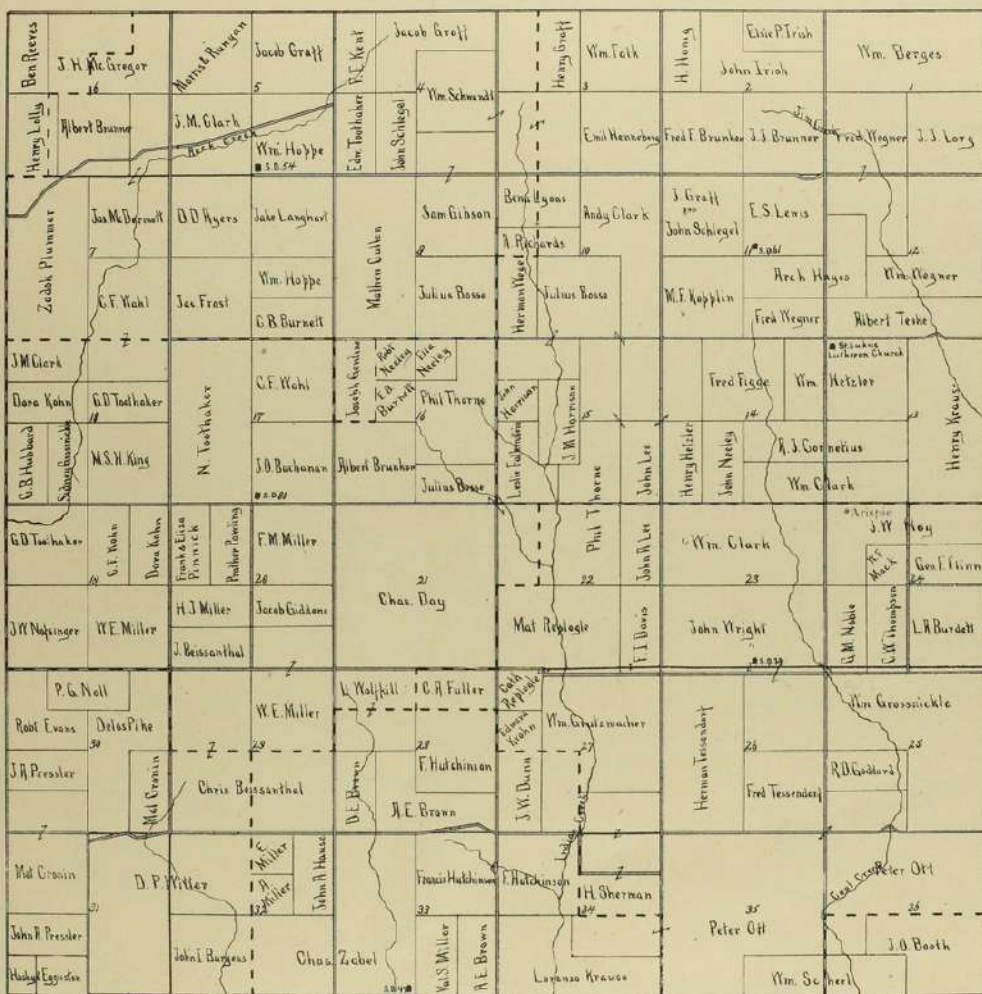

ROCK CREEK TOWNSHIP.

T. 7. R. 9.

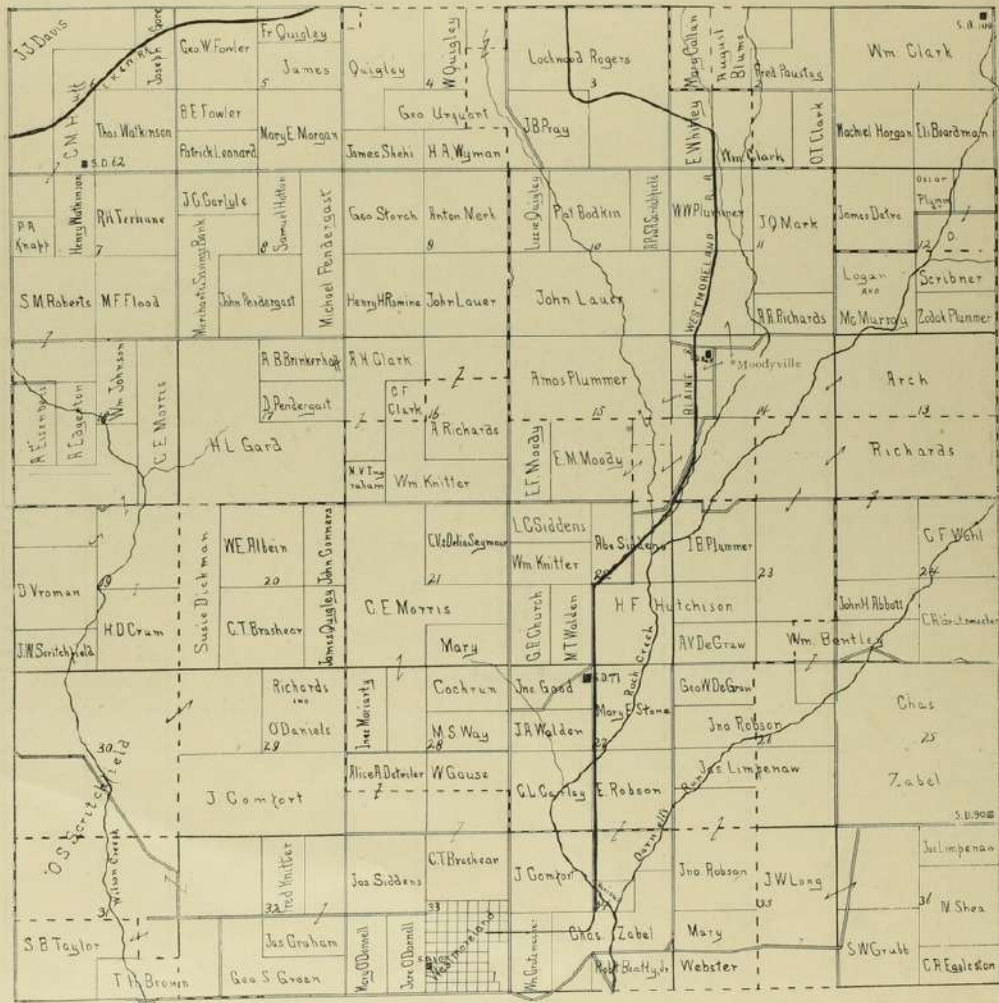

SPRING CREEK TOWNSHIP.

T. 6. R. 8.

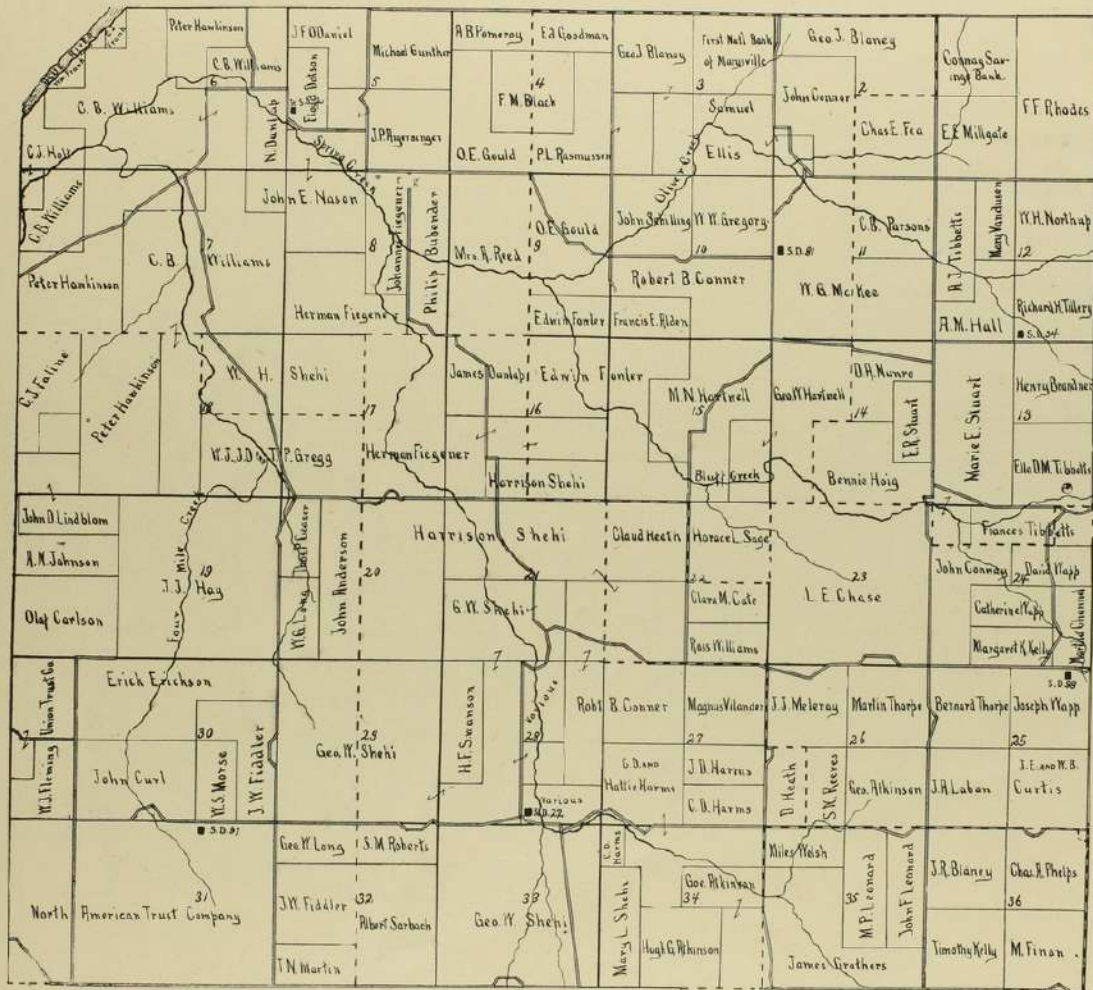

POTTAWATOMIE TOWNSHIP.

T. 7. R. 8 and 9.

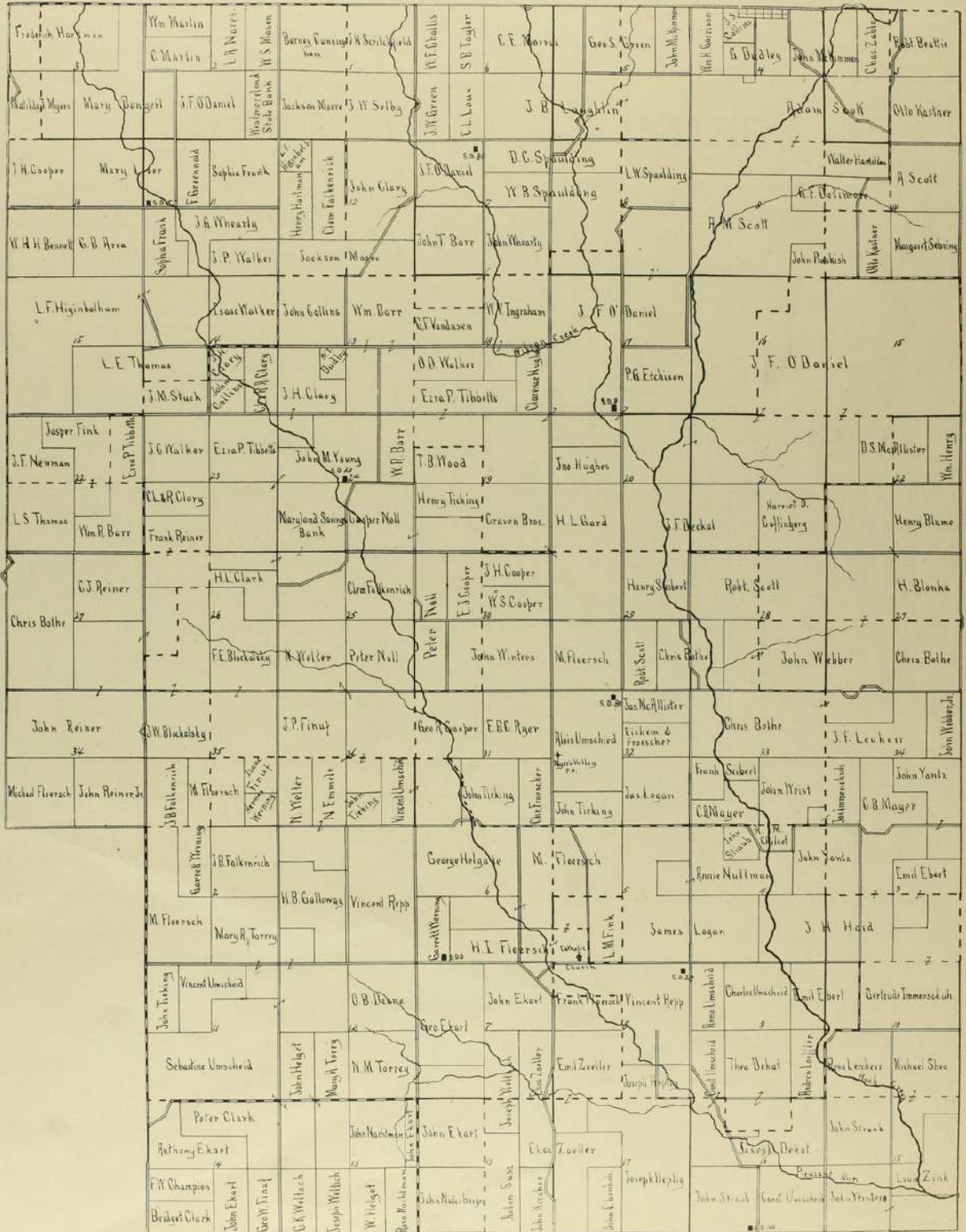

BELVUE TOWNSHIP.

T. 9. R. 11.

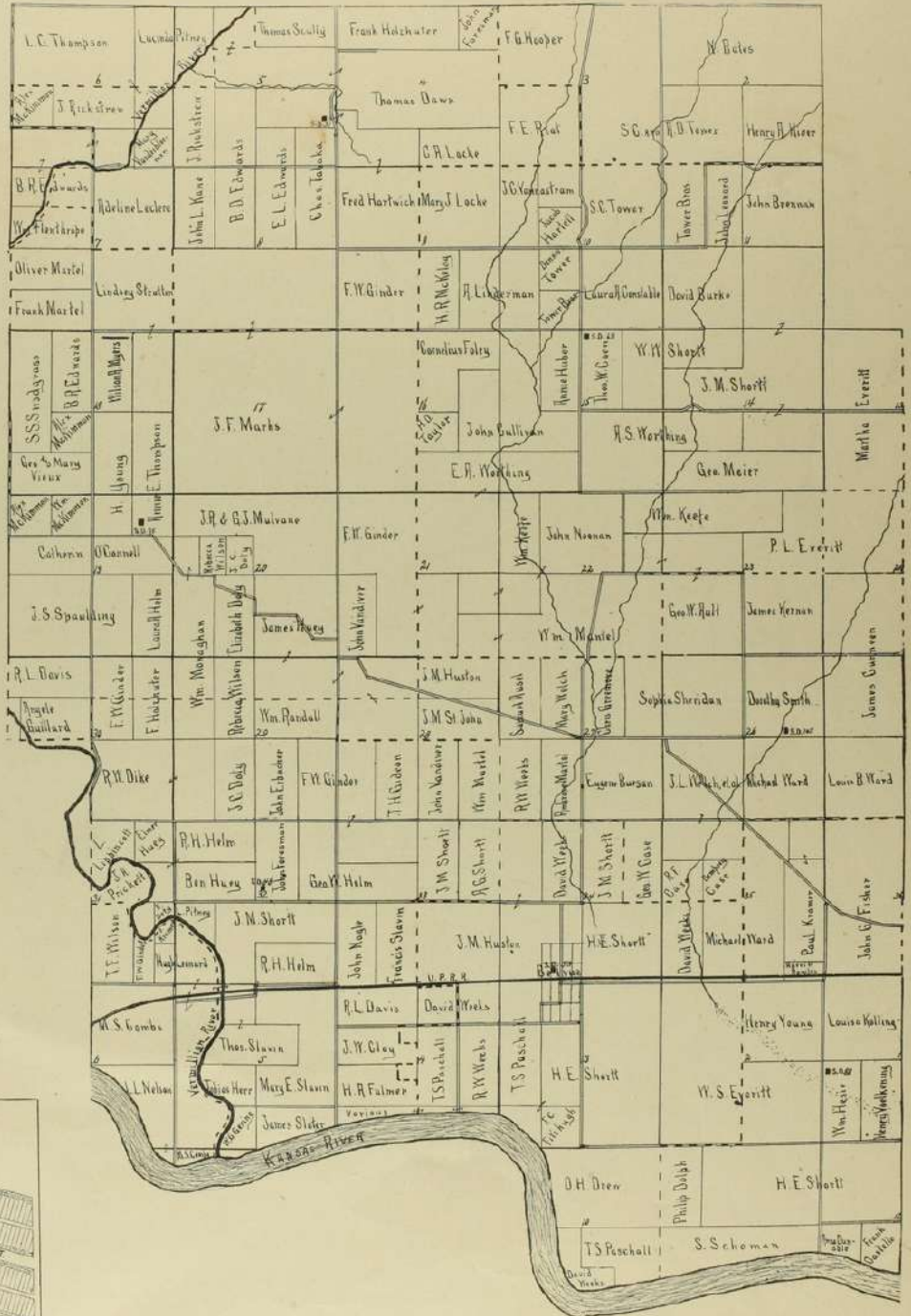

Belvue.

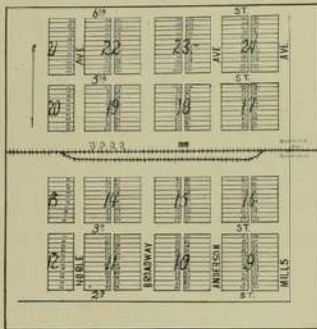

St. George.

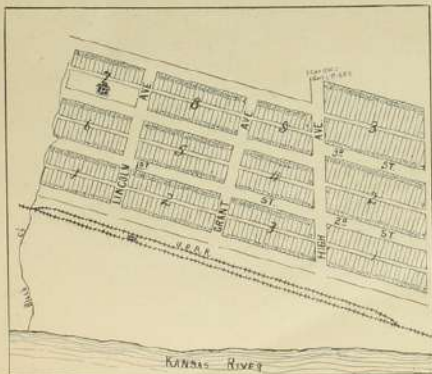

LONE TREE TOWNSHIP.

T. 7. R. 9 and 10.



Westmoreland.

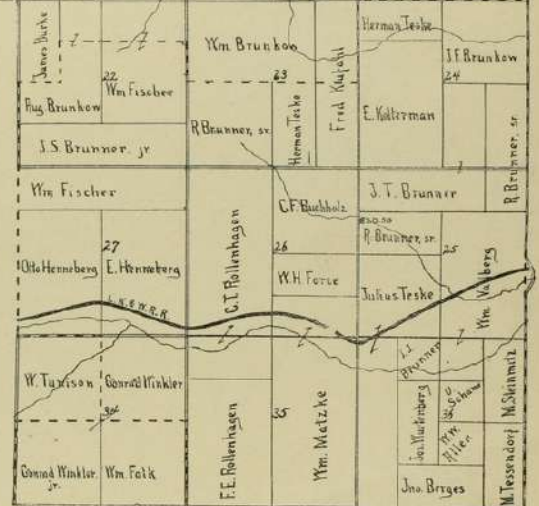
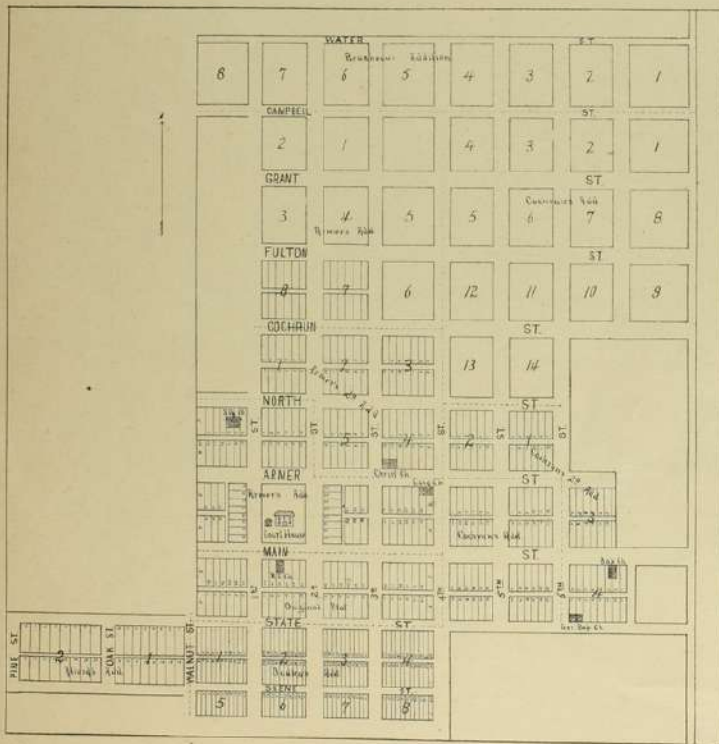

Wheaton.

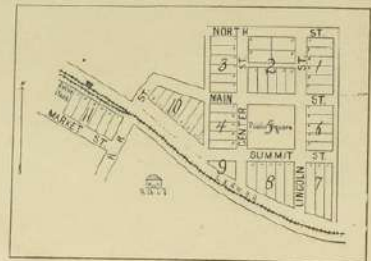

WAMEGO TOWNSHIP.

T. 10. R. 10.

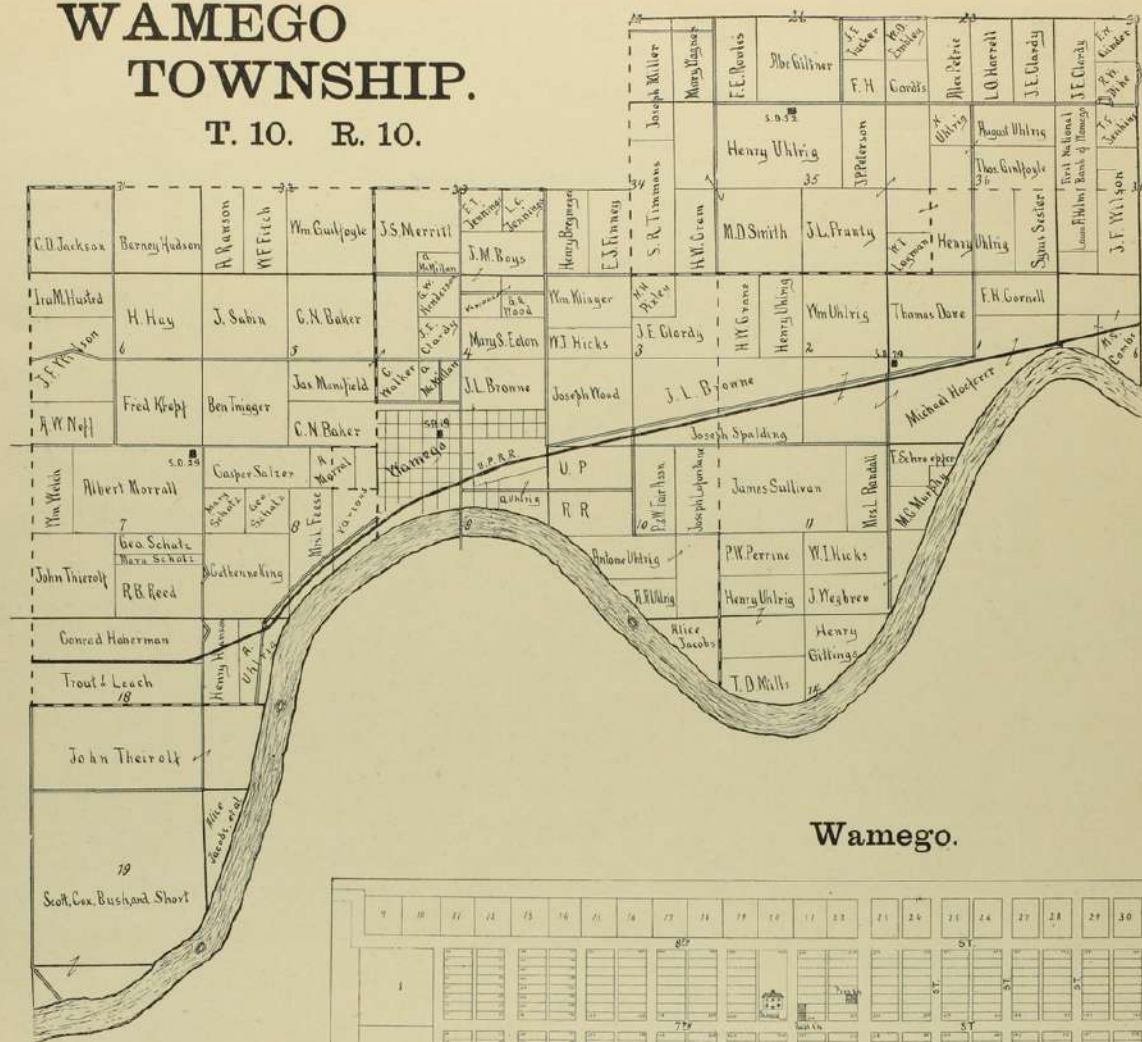

Wamego.

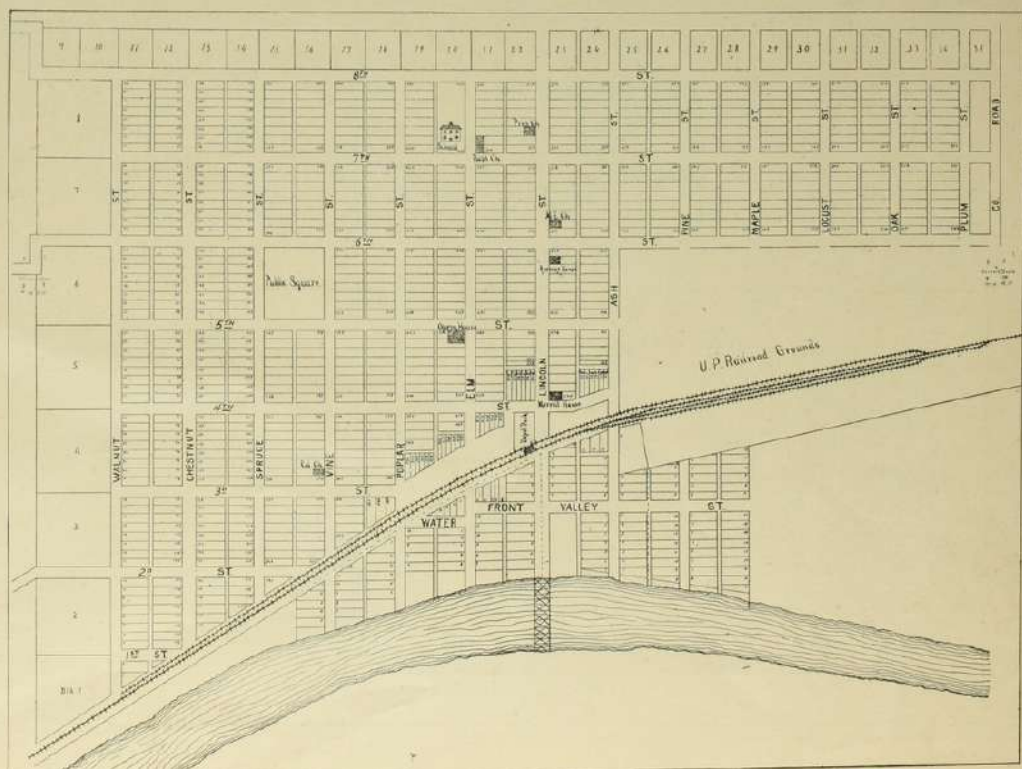

LOUISVILLE TOWNSHIP.

T. 9. R. 10.

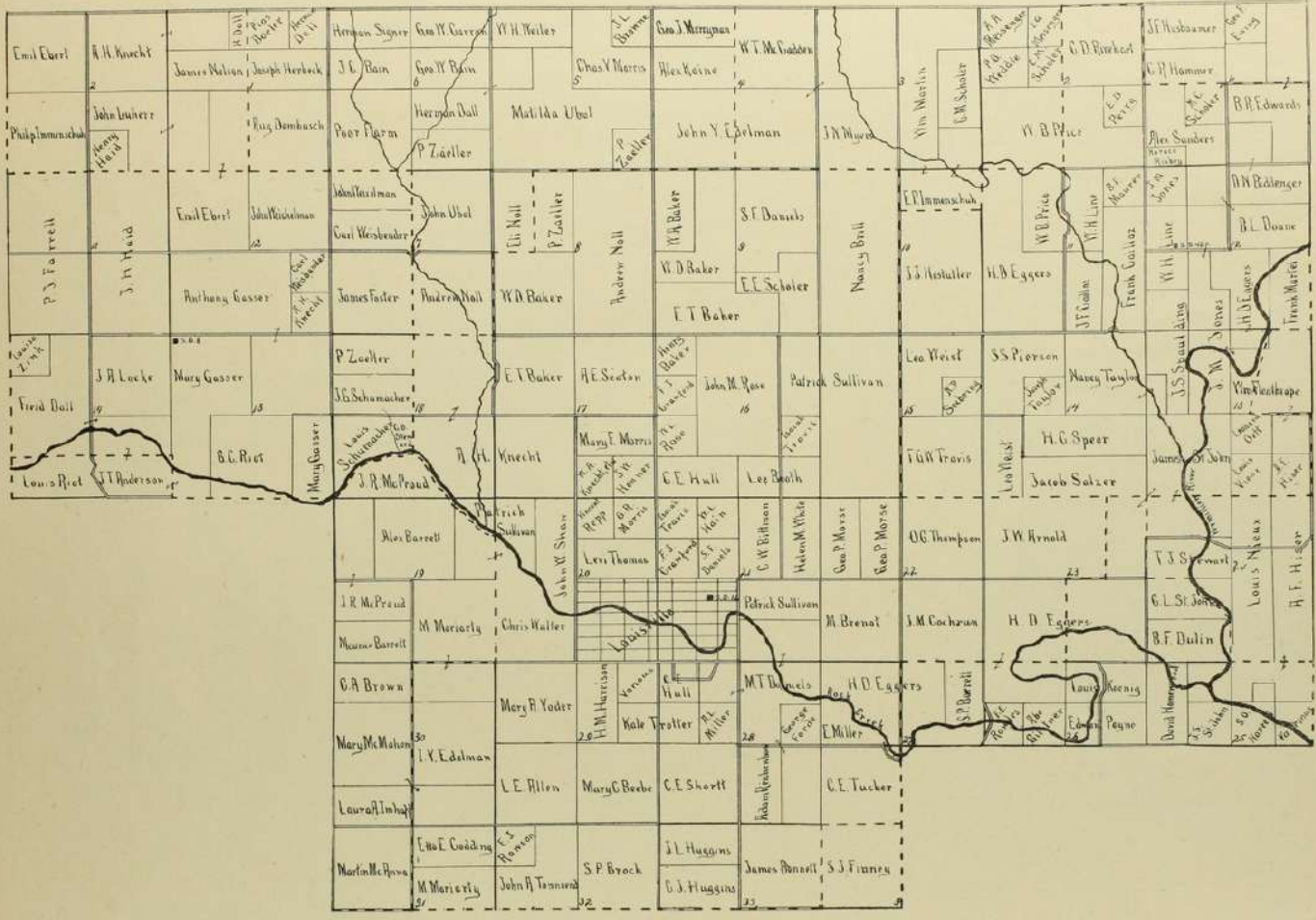

Louisville.

Fostoria.

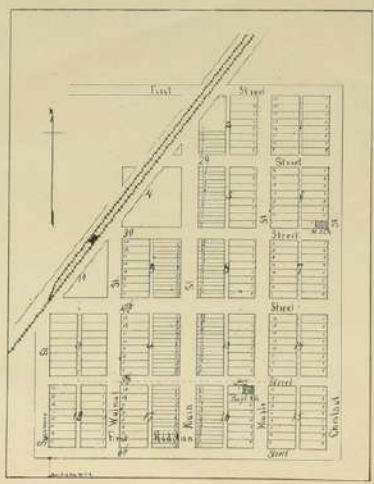
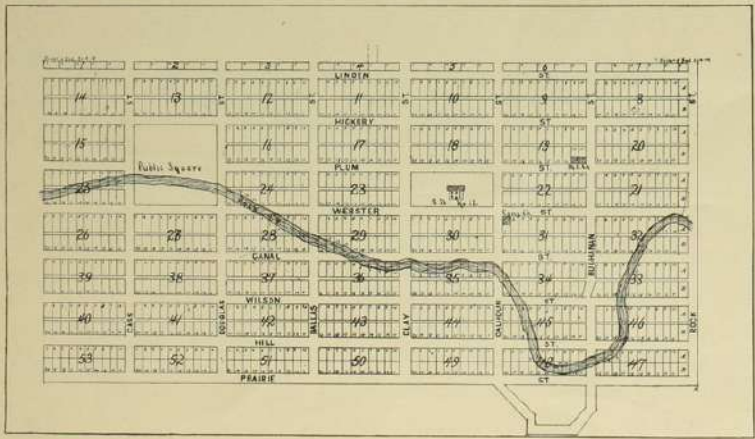

SHANNON TOWNSHIP.

T. 7. R. 8.

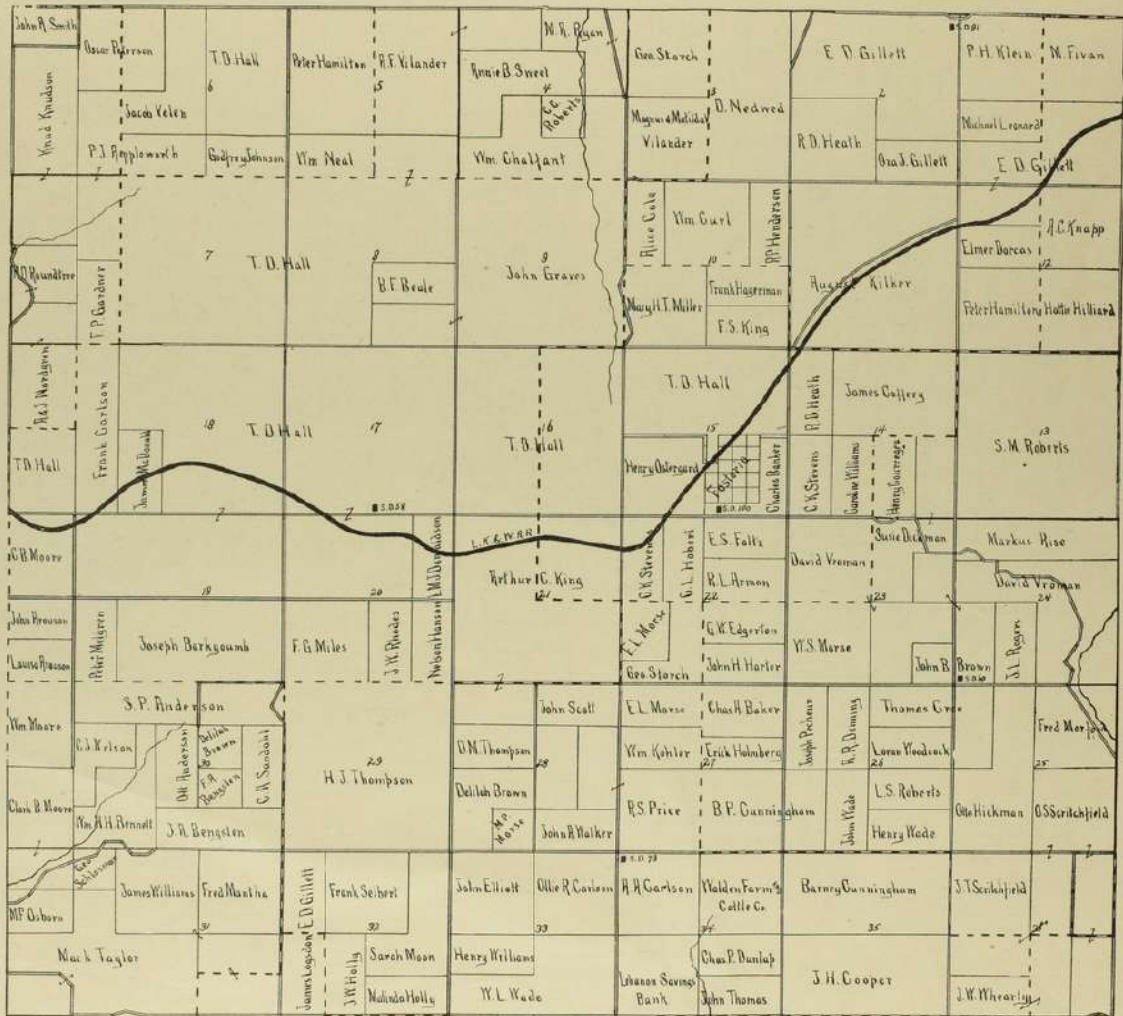

UNION TOWNSHIP.

T. 8. R. 9 and 10.

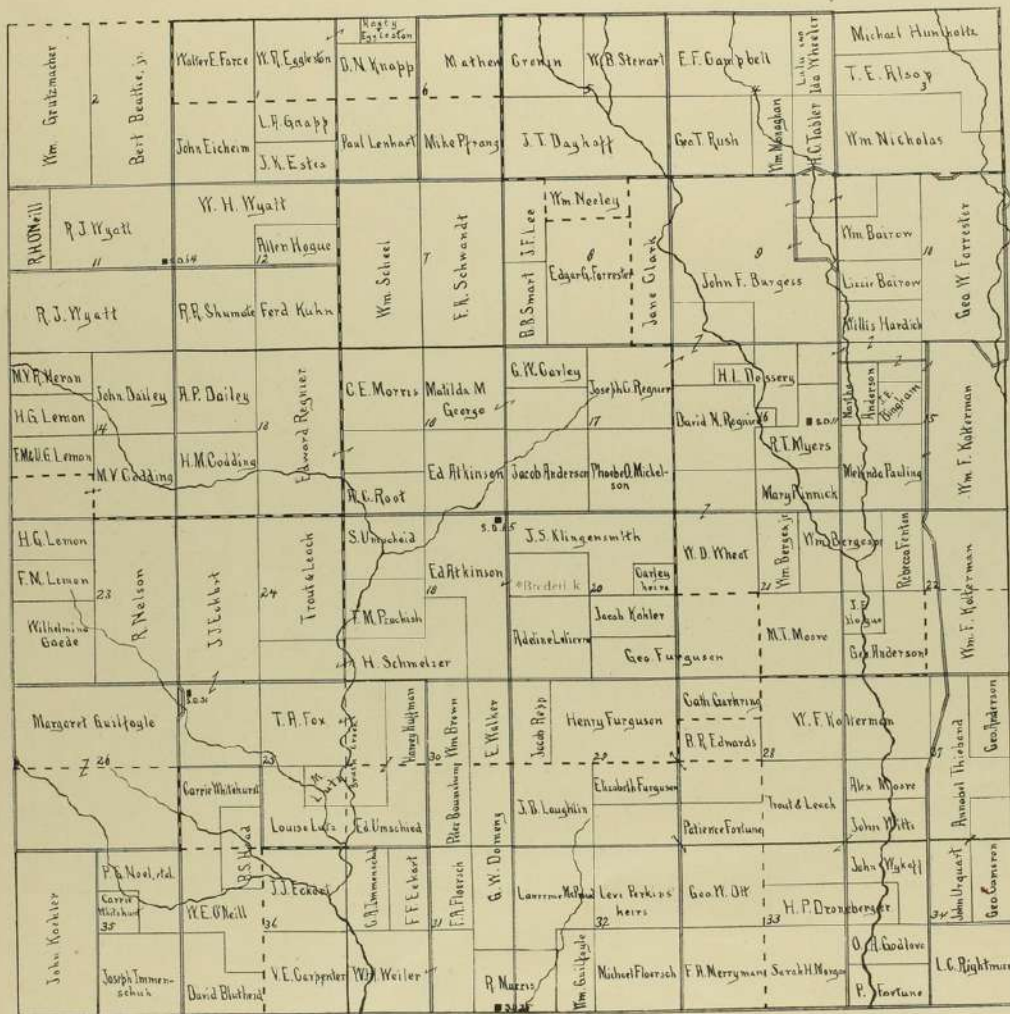

CLEAR CREEK TOWNSHIP.

T. 6. R. 9 and 10.

Blaine.

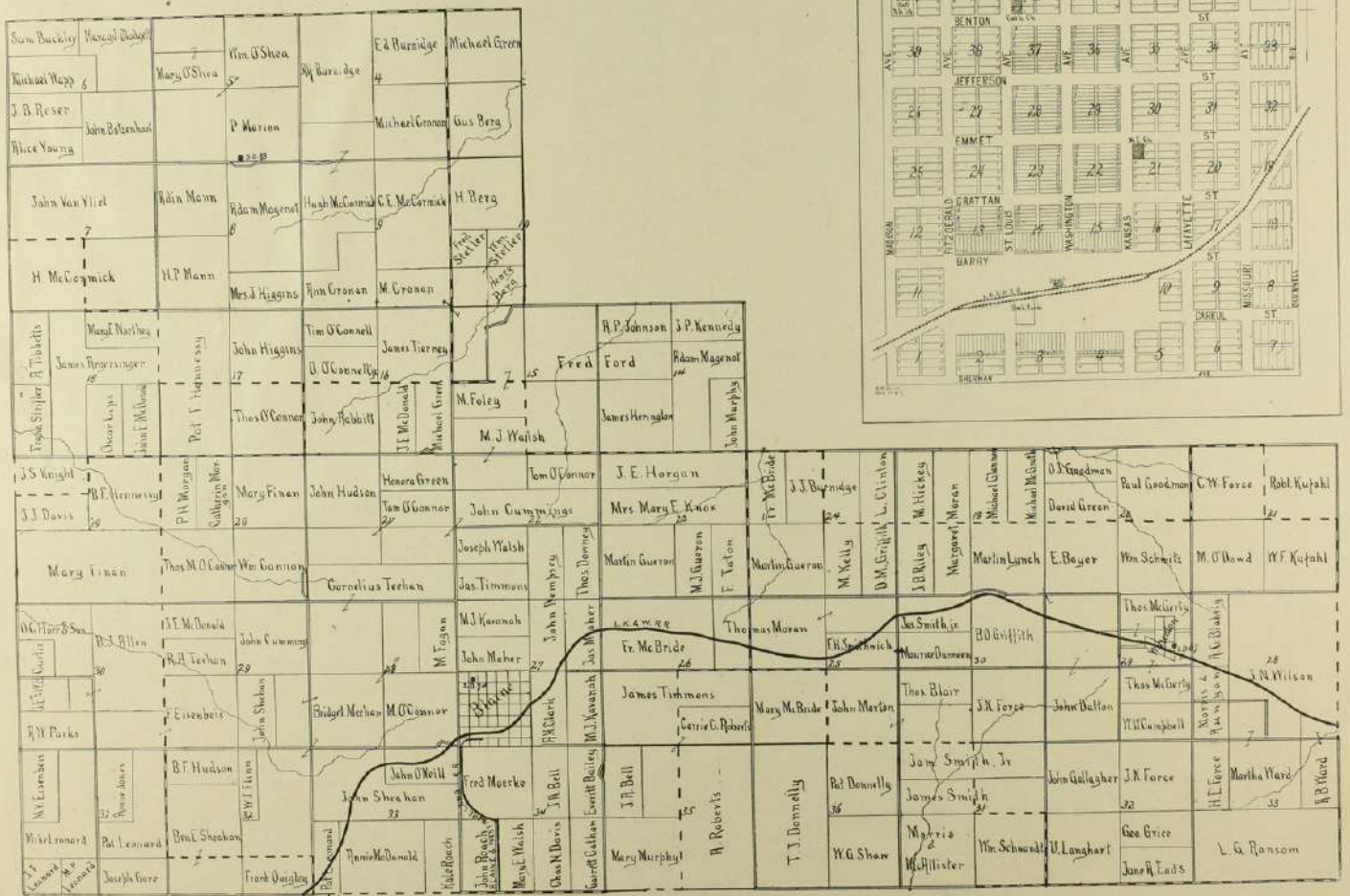

ST. CLERE TOWNSHIP.

T. 7. R. 12.

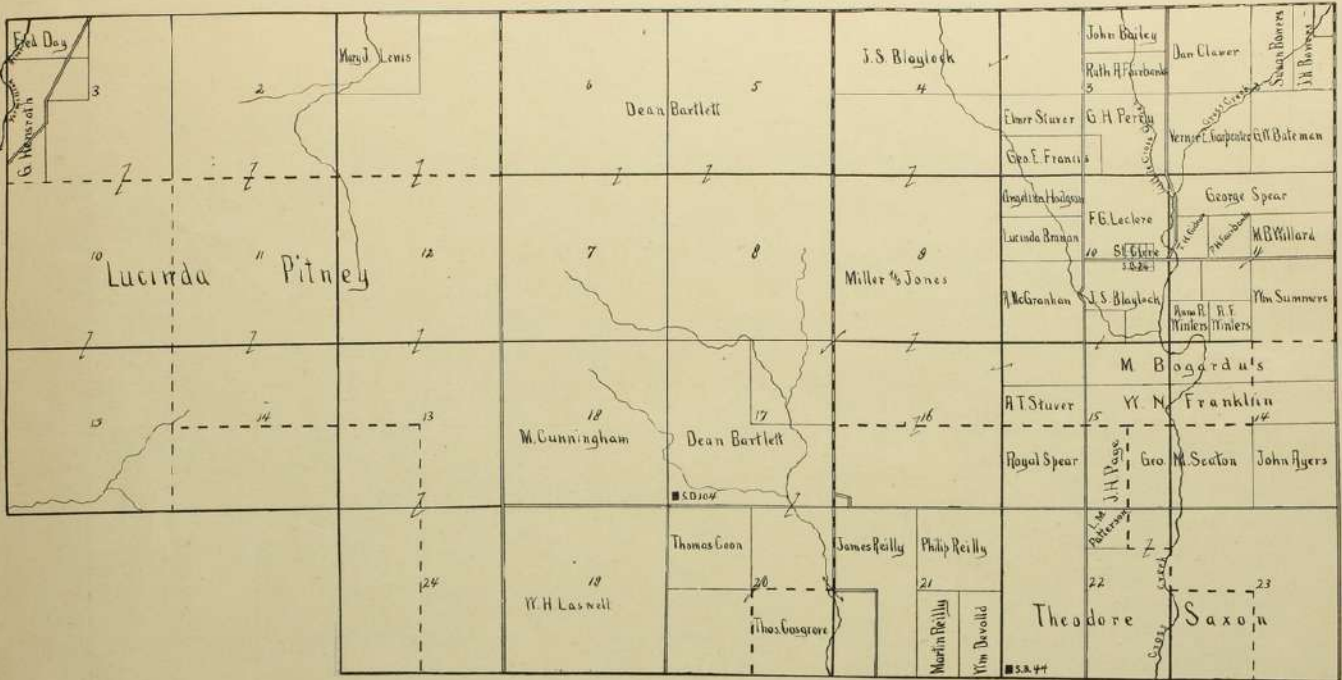

EMMET TOWNSHIP.

T. 7. R. 12.

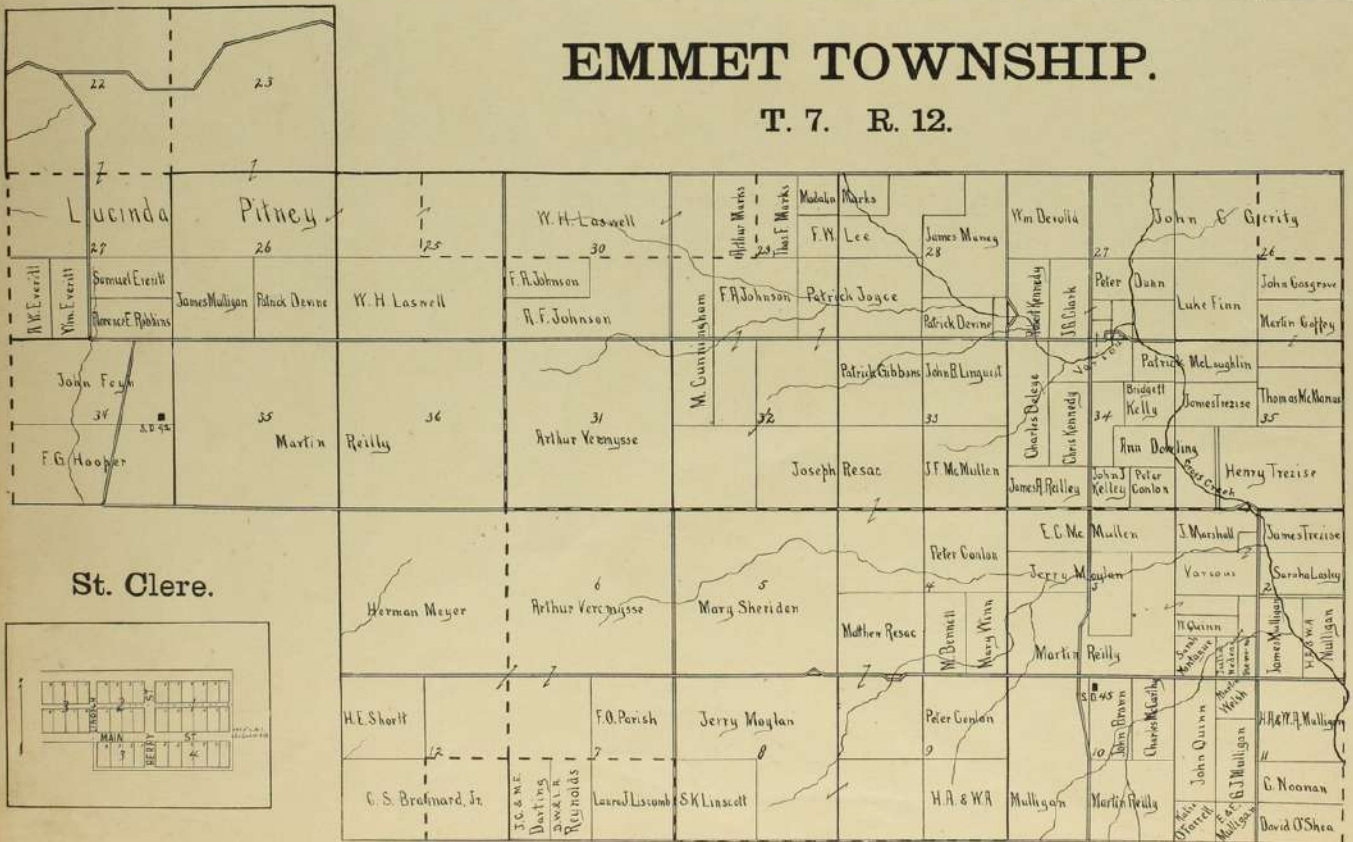

St. Clere.

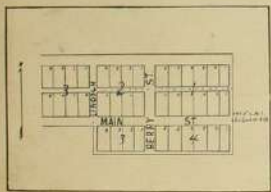

Garrison.

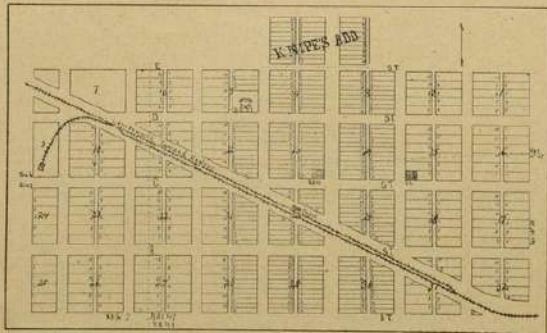

GREEN TOW

T. 9. R. 7



GREEN TOWNSHIP.

T. 9. R. 7

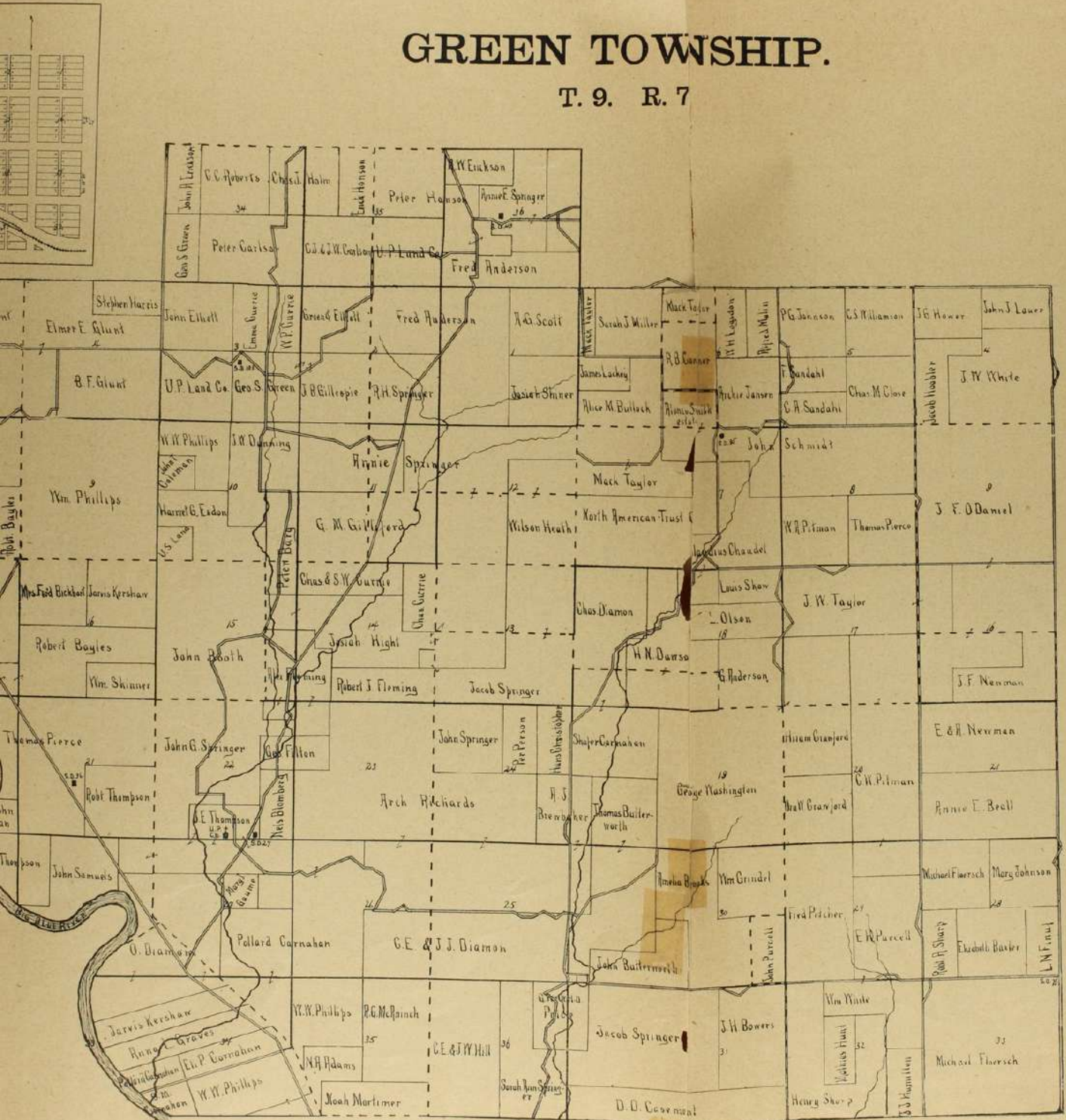

BLUE TOWNSHIP.

T. 9 and 10. R. 8.

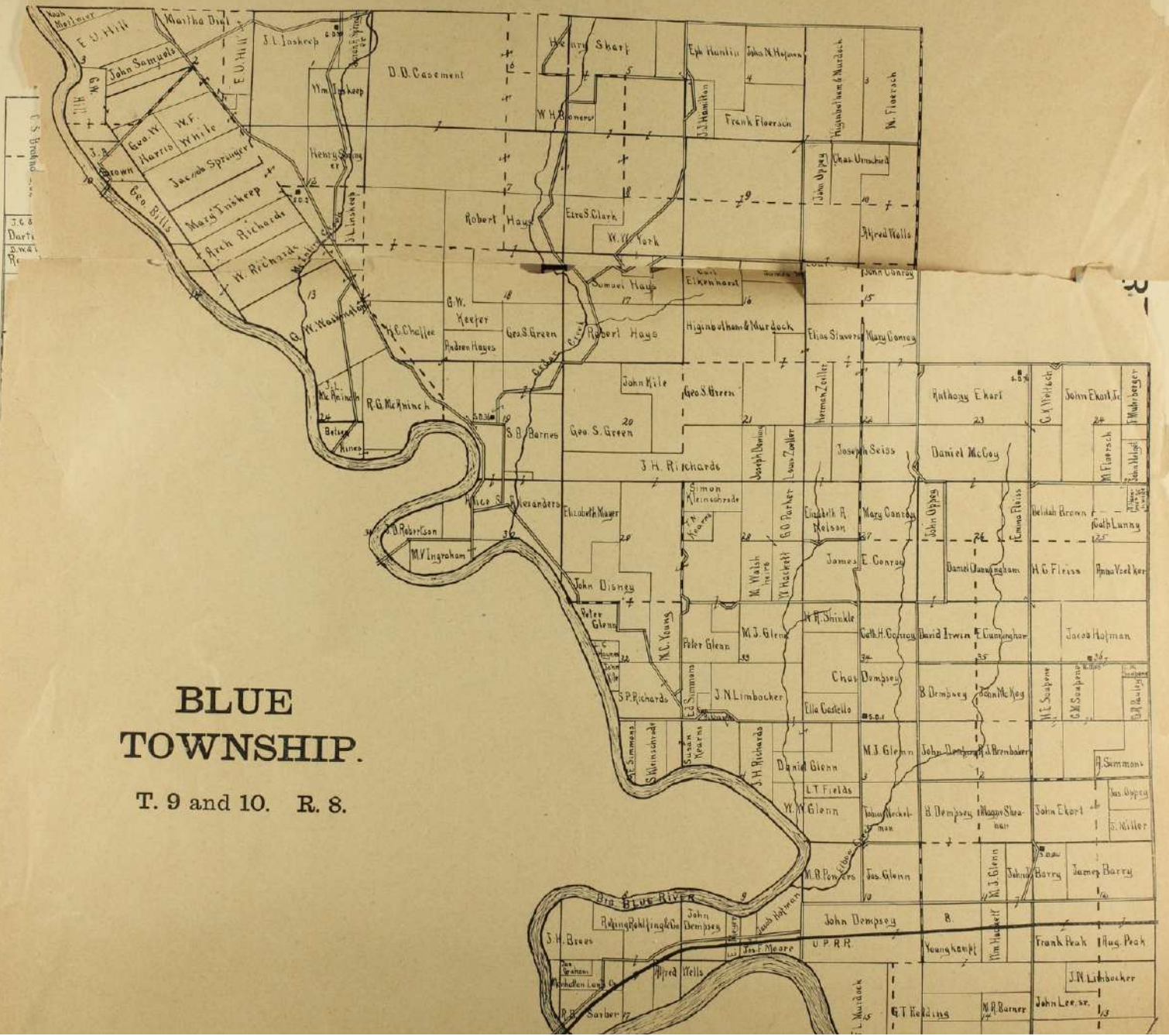

BLUE TOWNSHIP.

T. 9 and 10. R. 8.

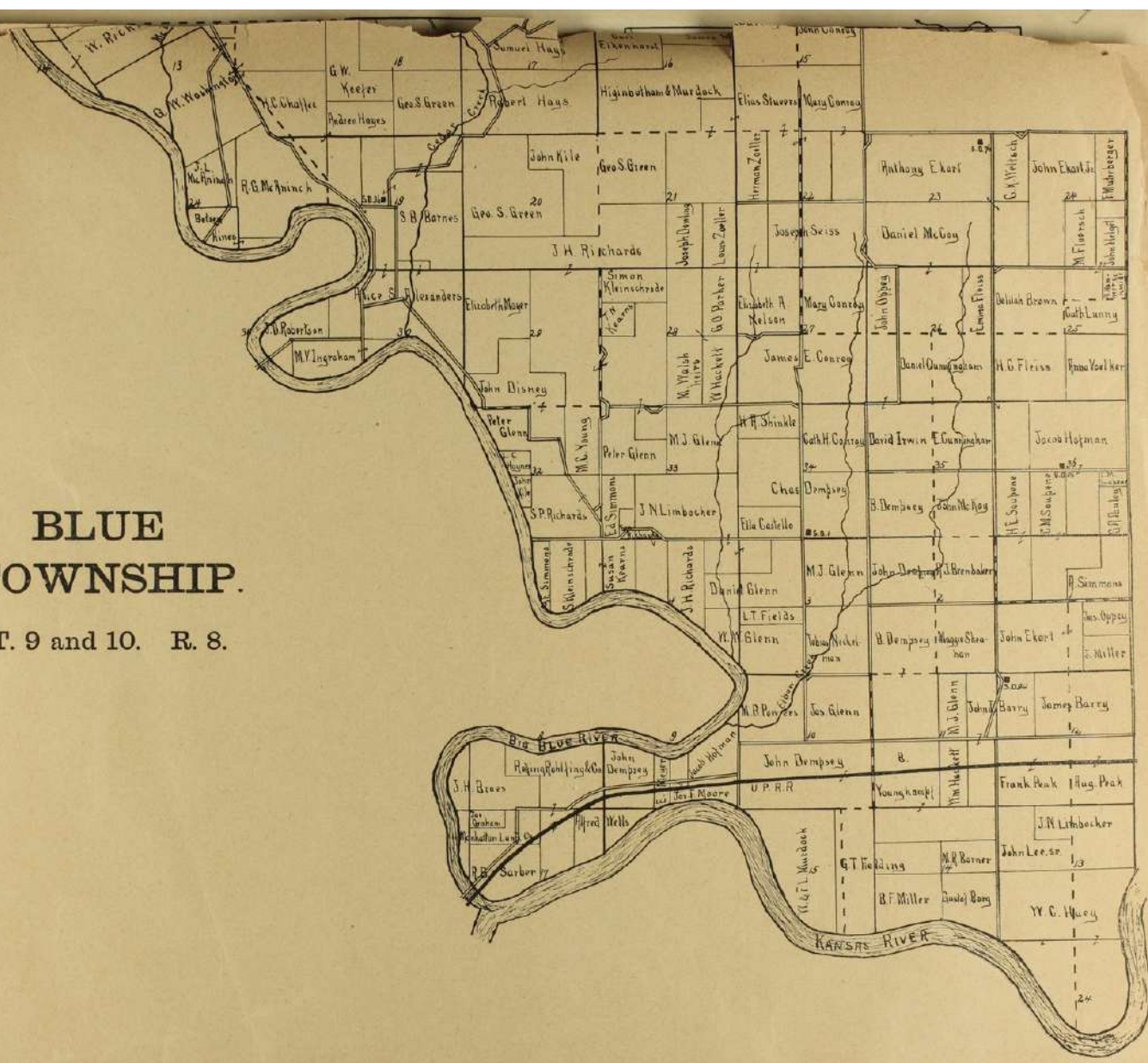

Scale

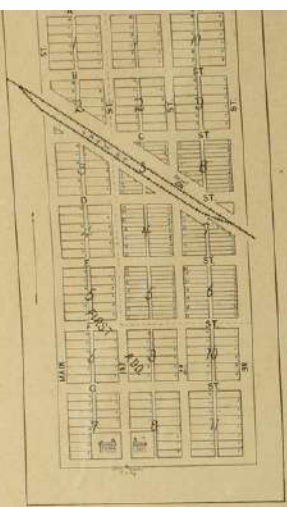

ST. MARYS TOWNSHIP.

T. 9 and 10. R. 12.

St. Marys.



St. Marys.

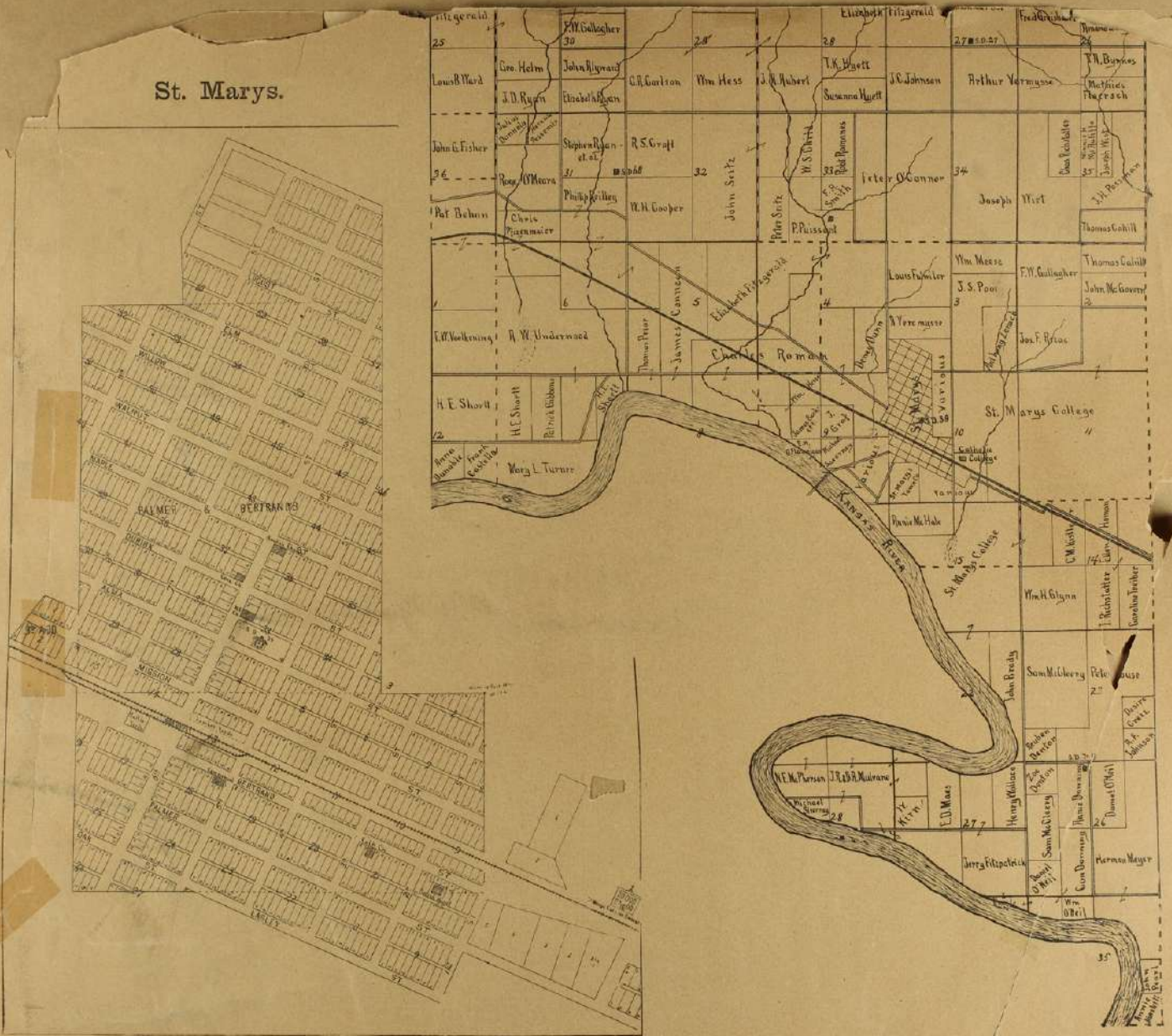

Garrison.

GREEN TOWN

T. 9. R. 7.

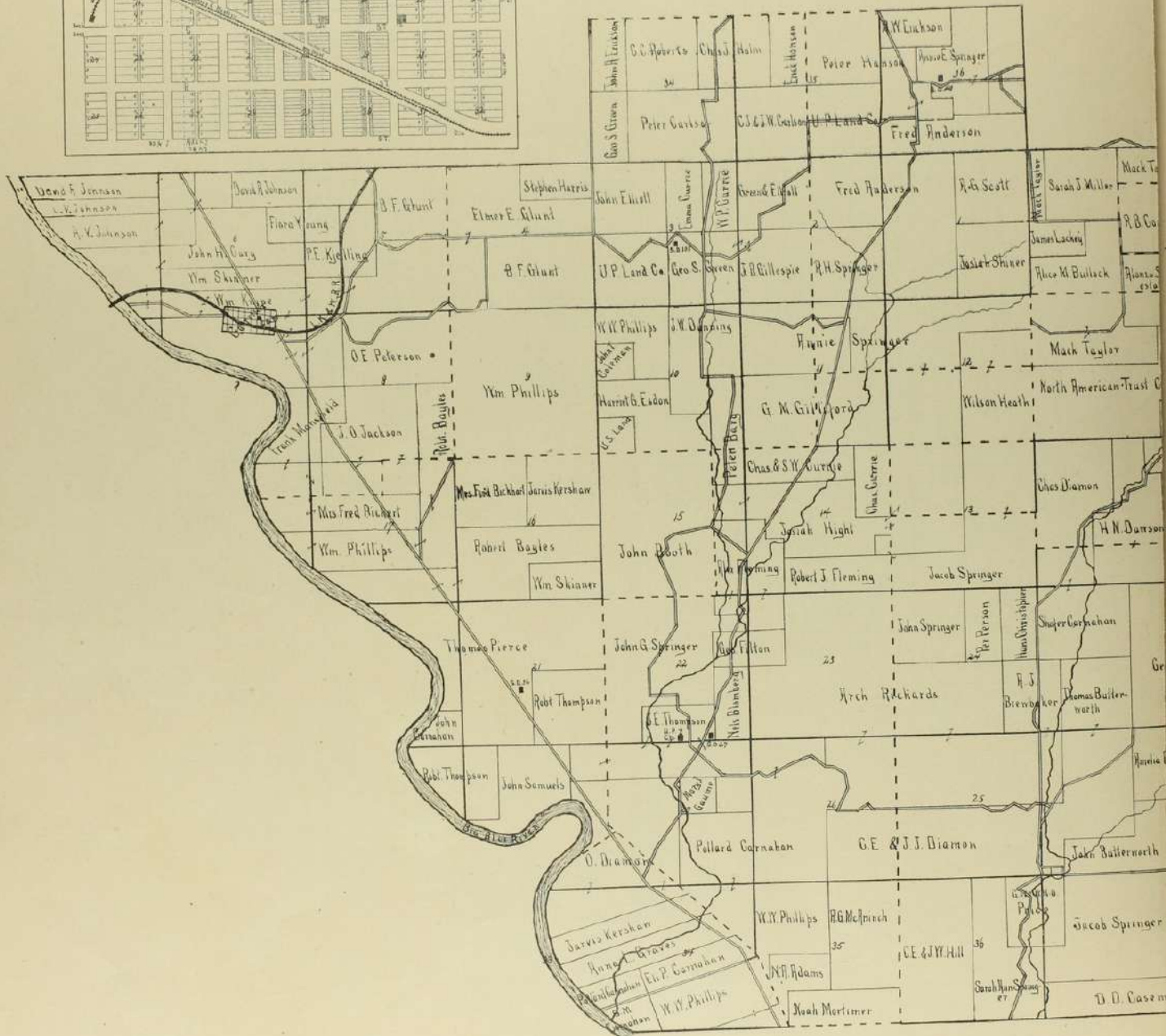

rison.



GREEN TOWNSHIP.

T. 9. R. 7.

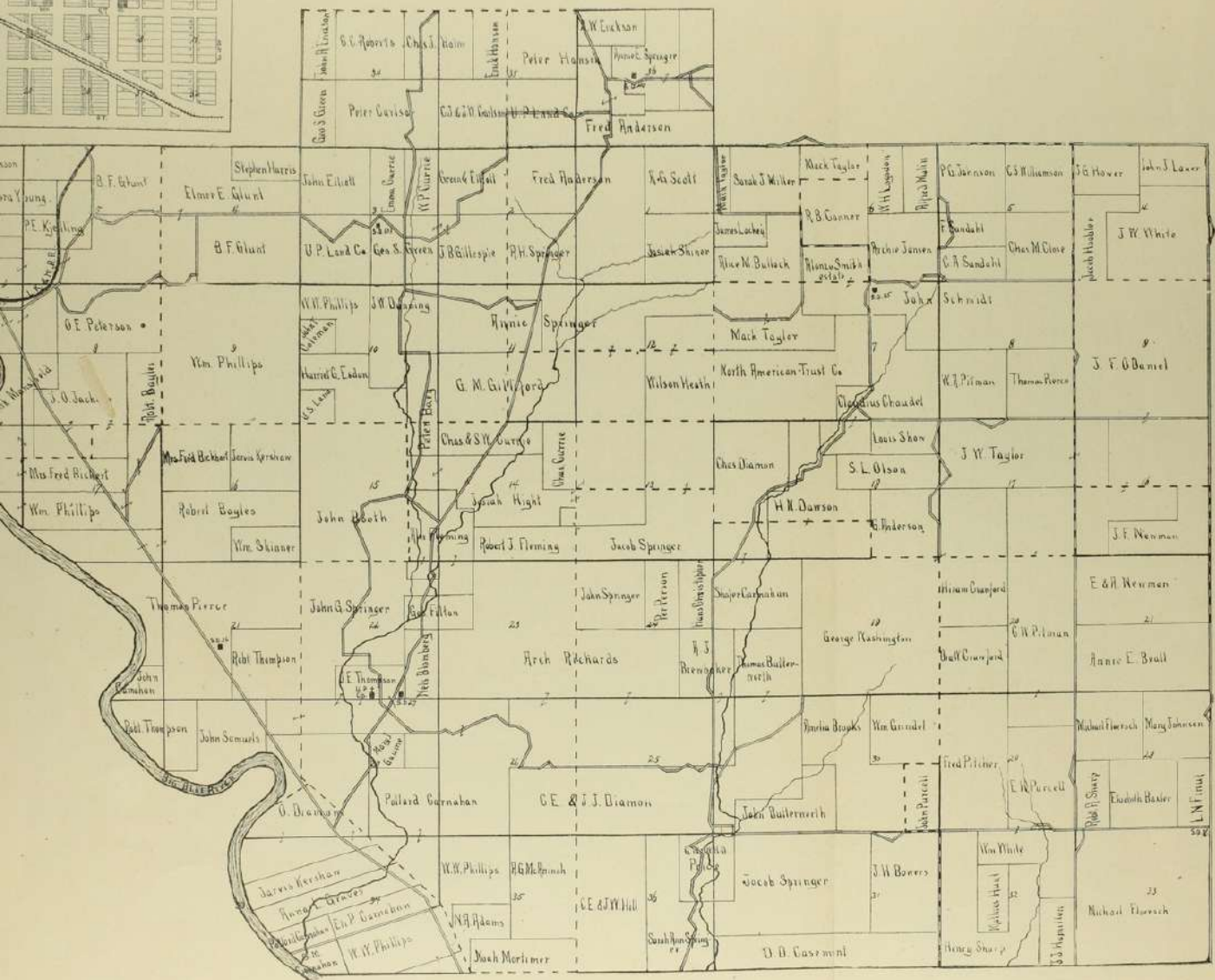

BLUE TOWNSHIP.

T. 9 and 10. R. 8.

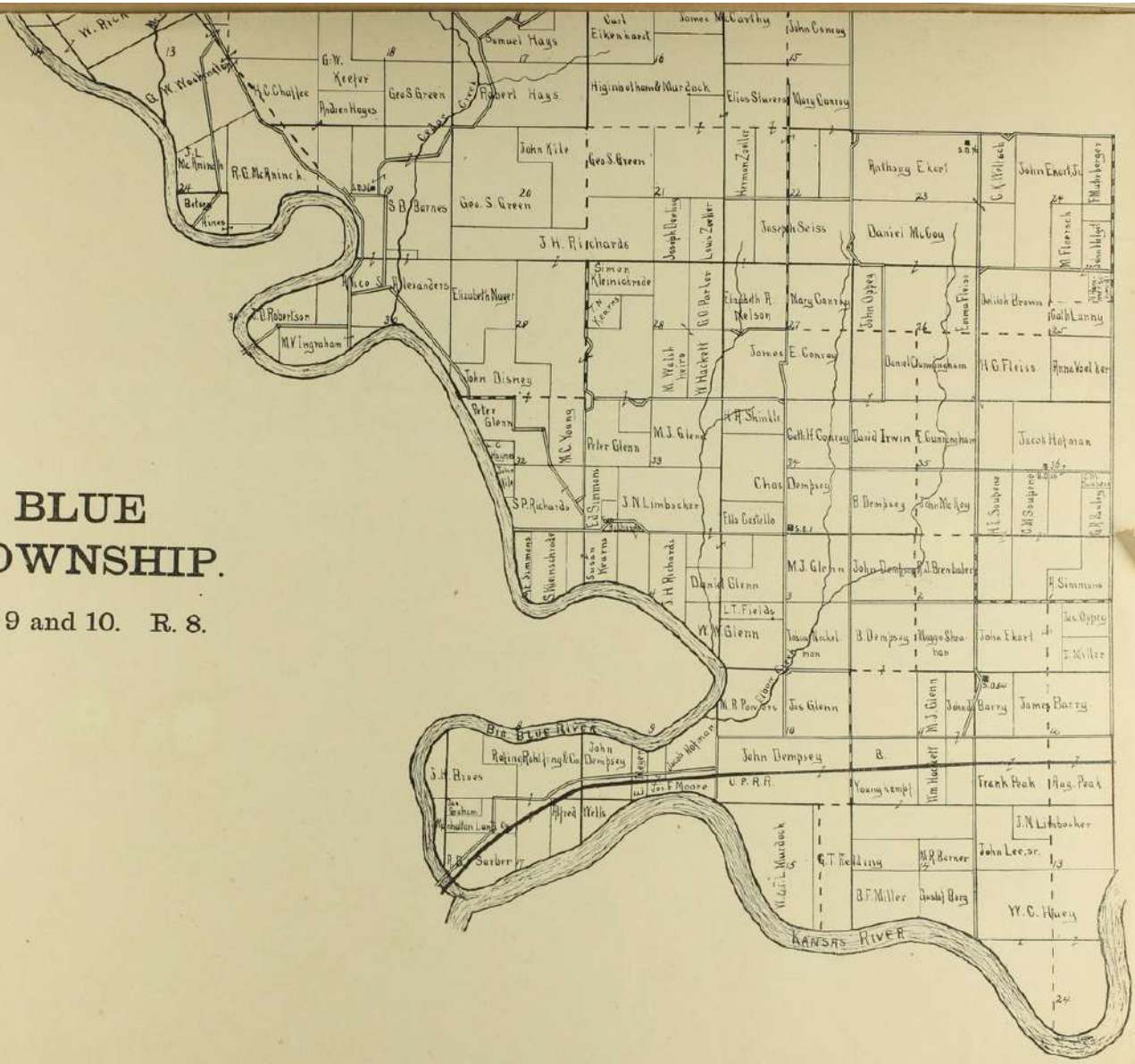

BLUE VALLEY TOWNSHIP.

Olsburg.

T. 6 and 7. R. 7.

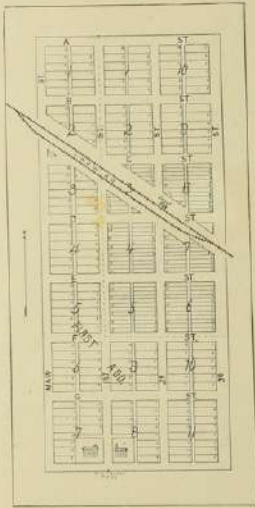

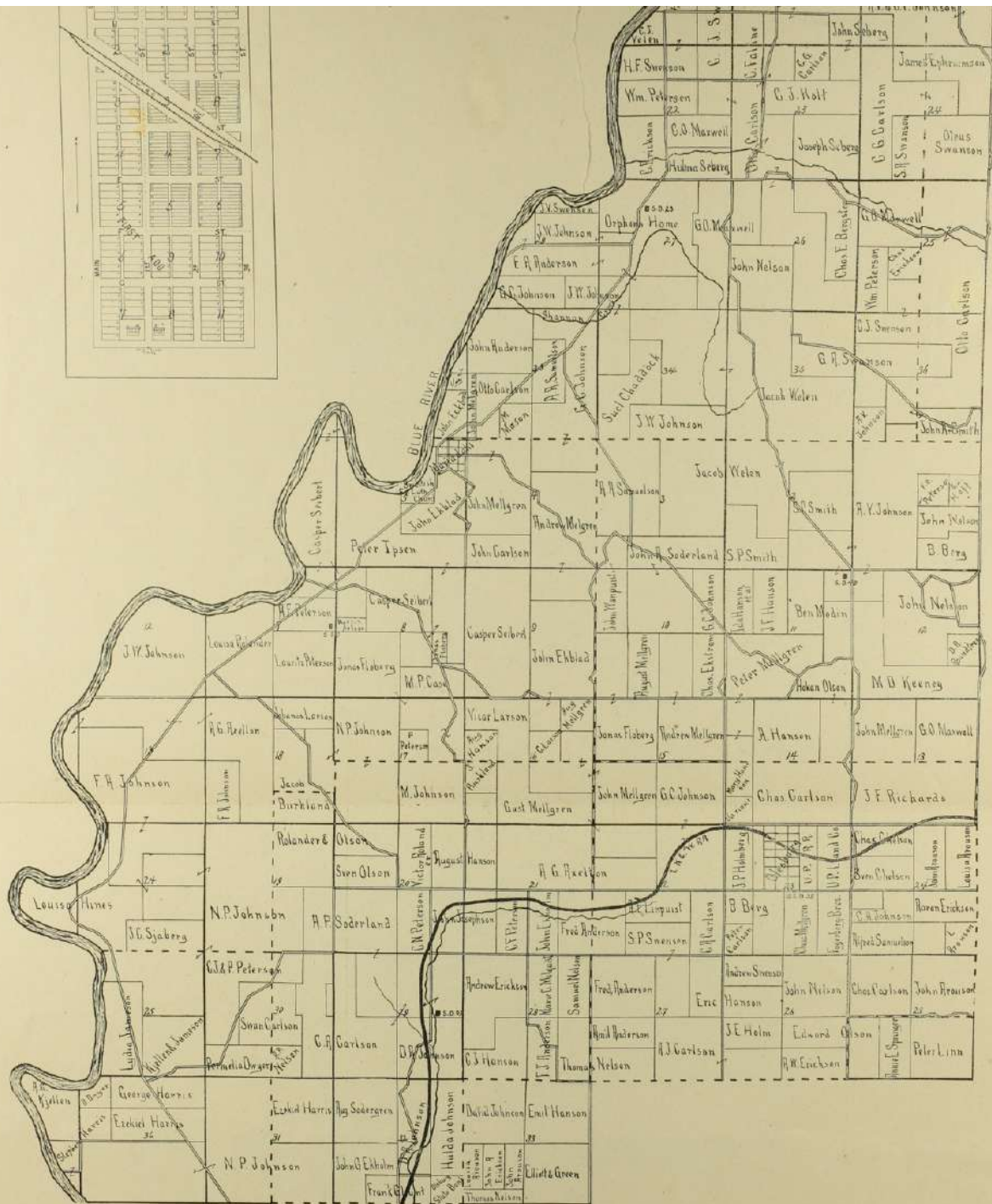
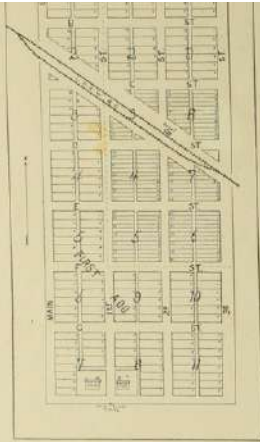

ST. MARYS TOWNSHIP.

T. 9 and 10. R. 12.

St. Marys.

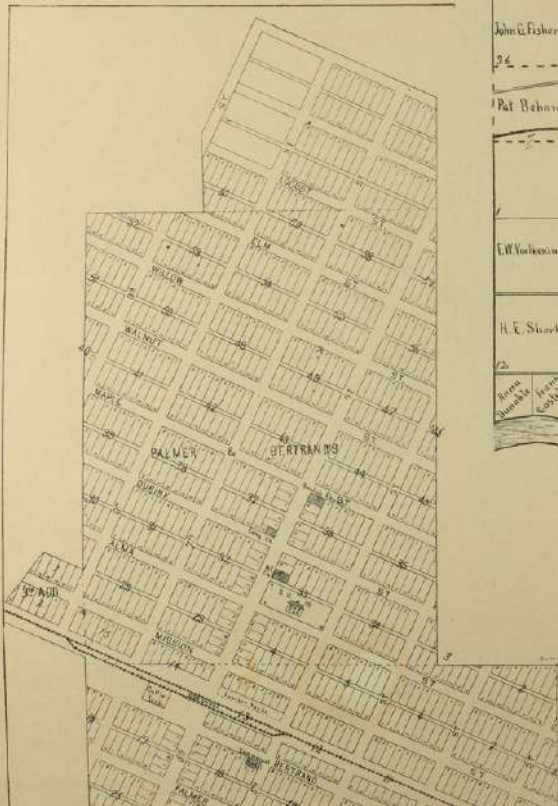

St. Marys.

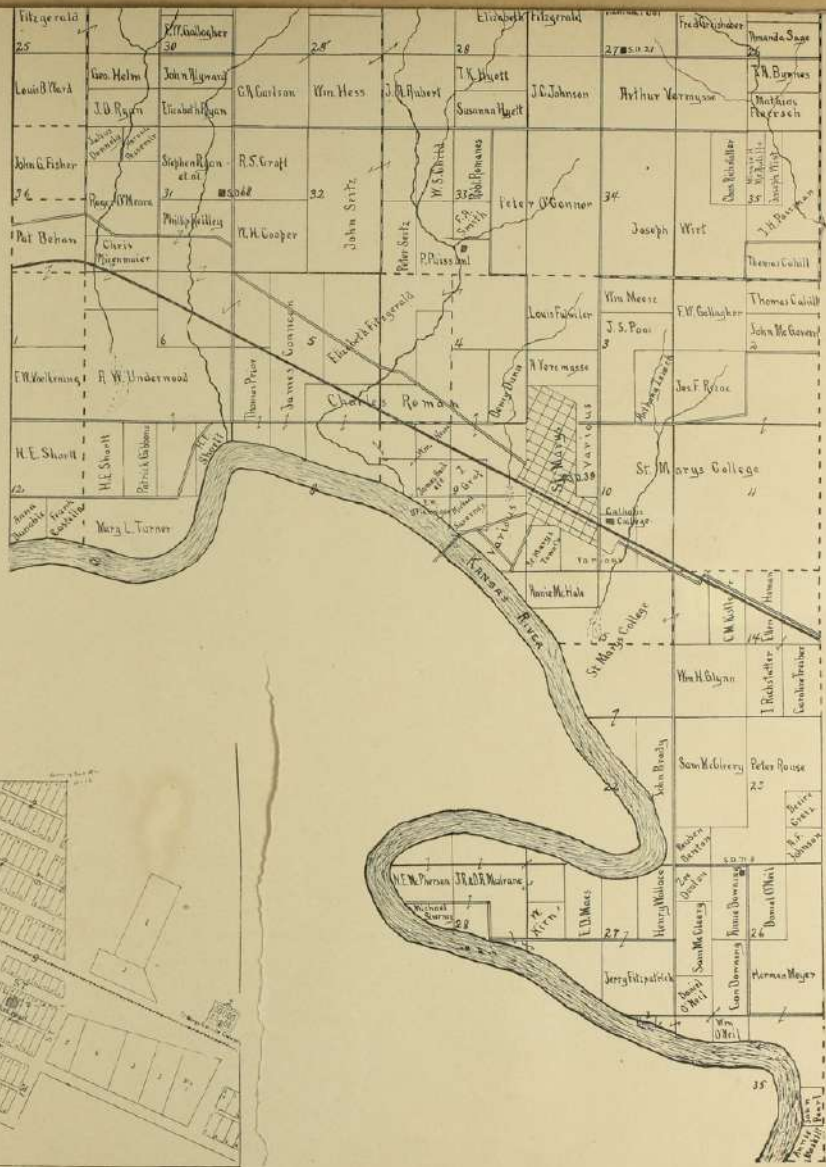

MILL CREEK TOWNSHIP.

T. 6. R. 11.

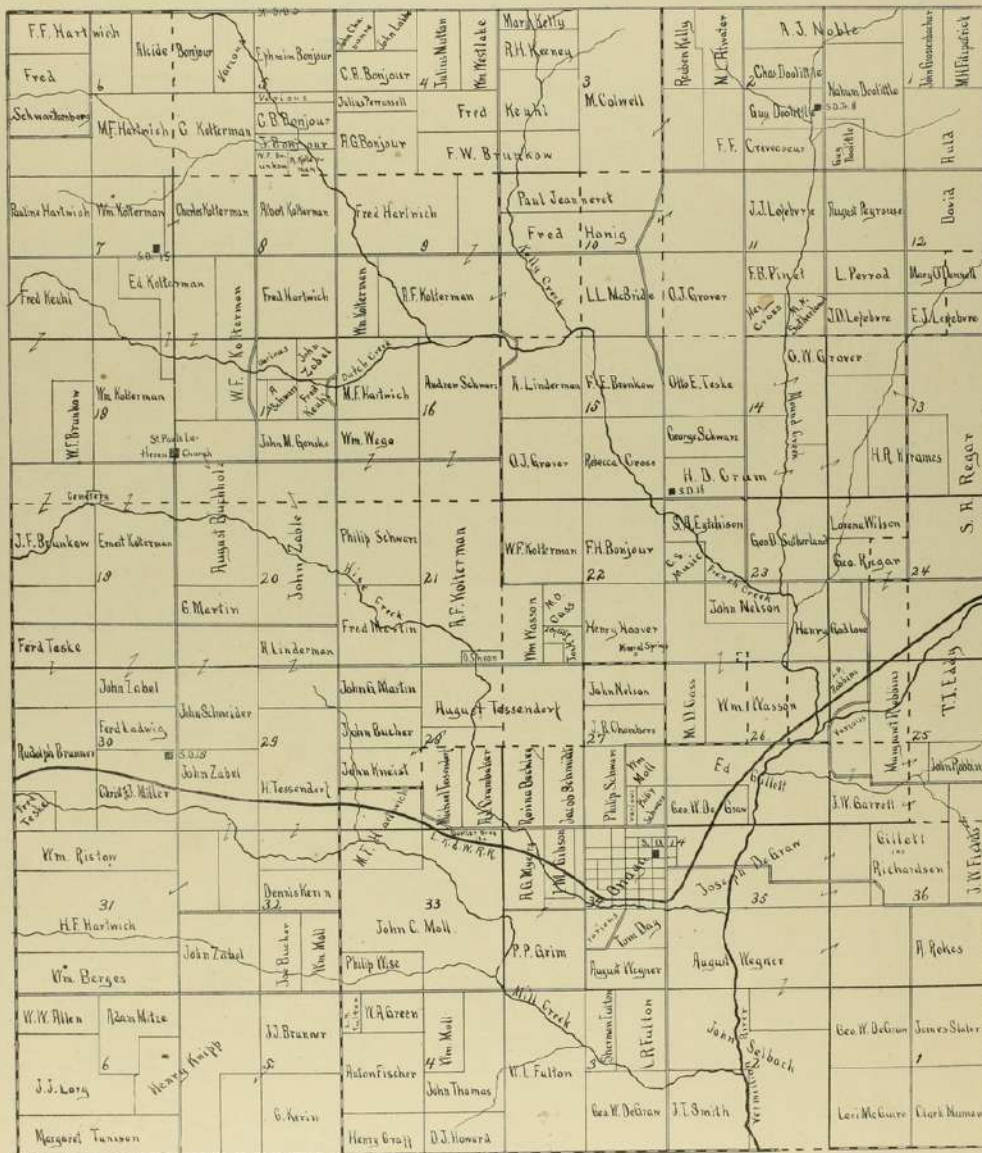

GRANT TOWNSHIP.

T. 6. R. 12.

Havensville.

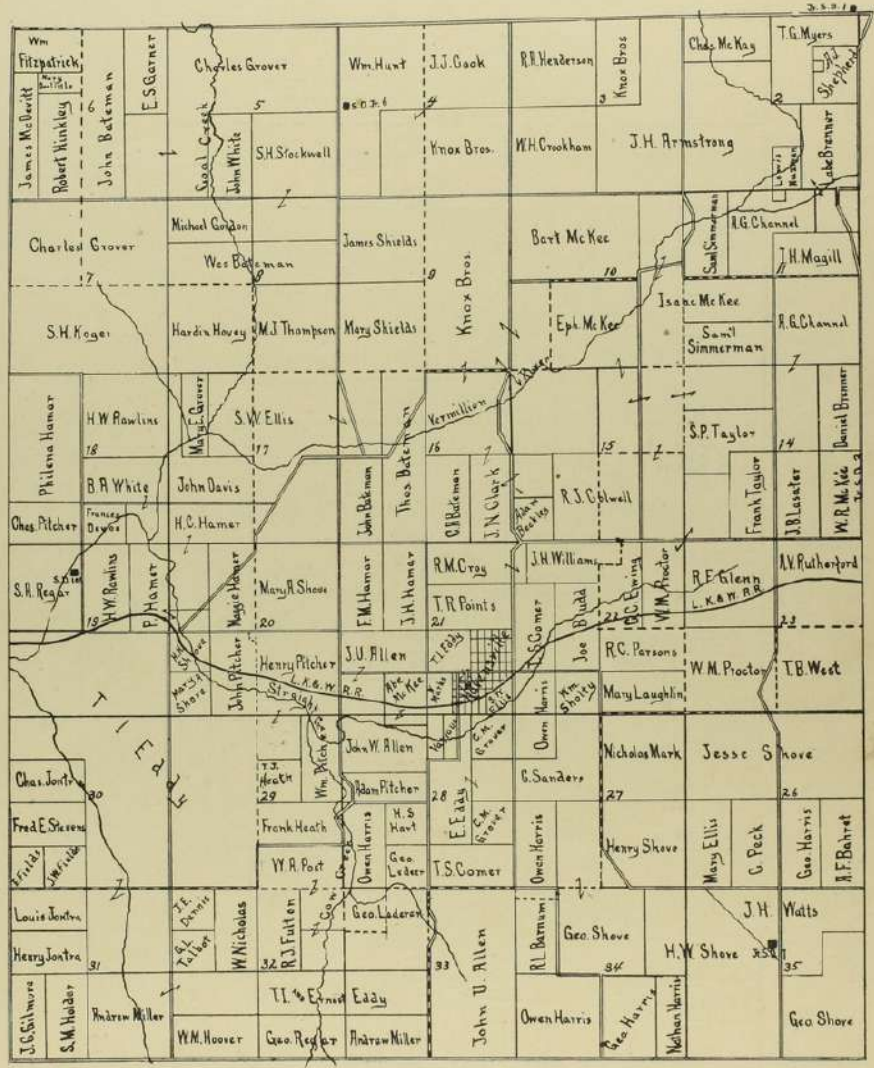
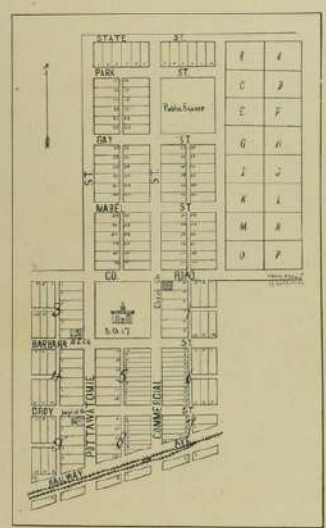

LINCOLN TOWNSHIP.

T. 7. R. 12.

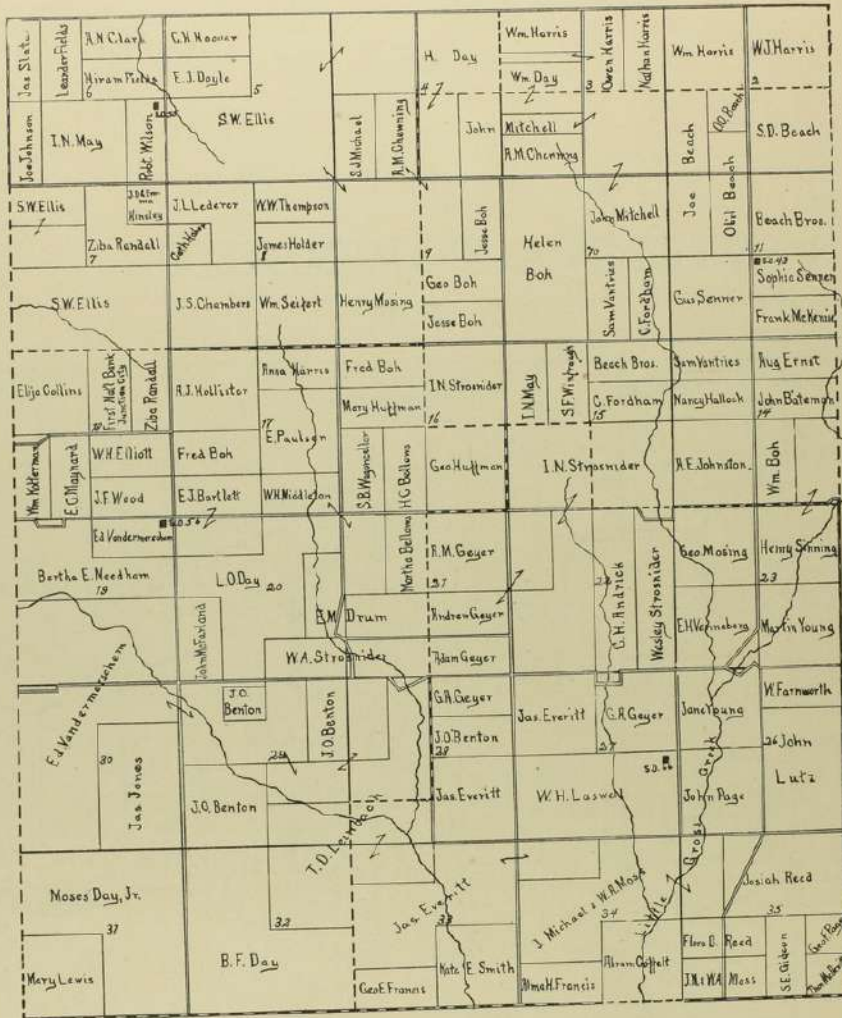

Onaga.



VIENNA TOWNSHIP.

T. 7. R. 11.

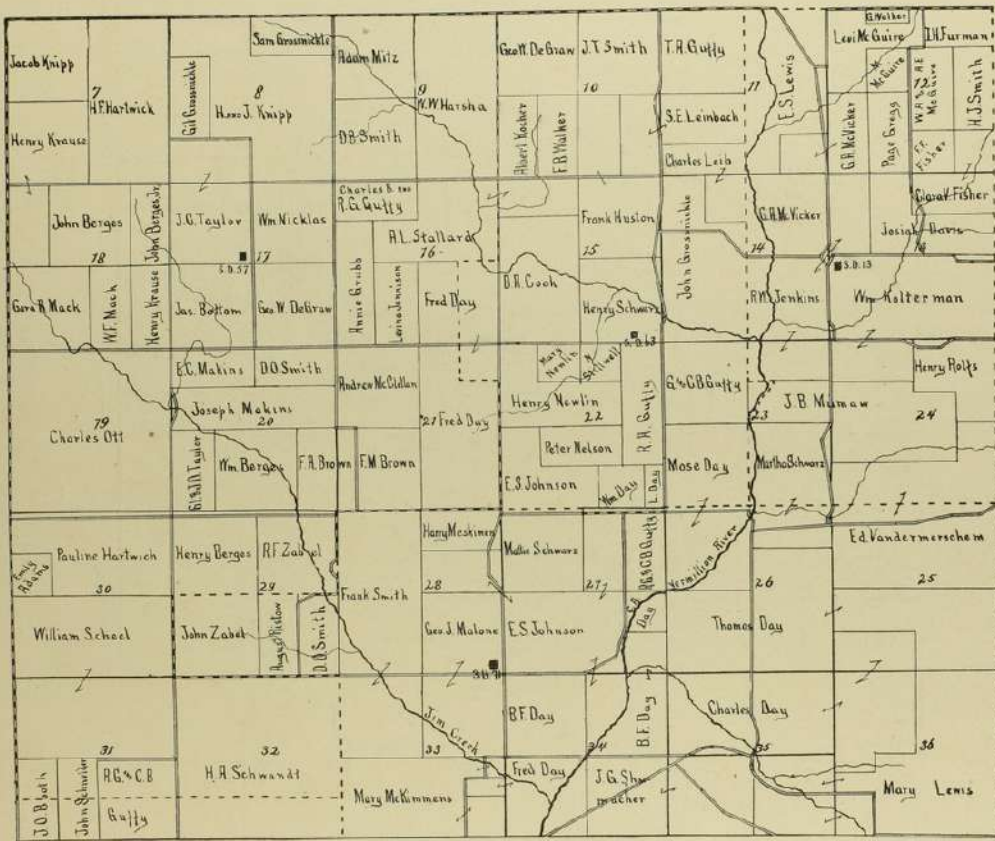

CENTER TOWNSHIP.

T. 8. R. 10 and 11.

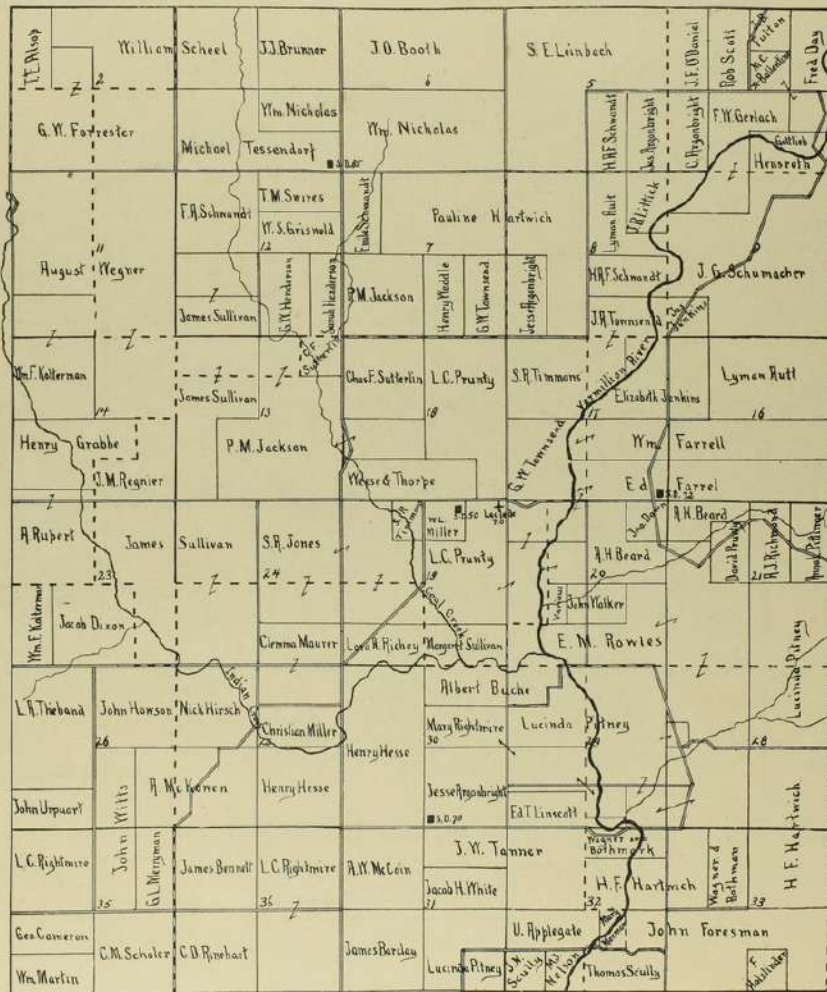

SHERMAN TOWNSHIP.

T. 7. R. 10.

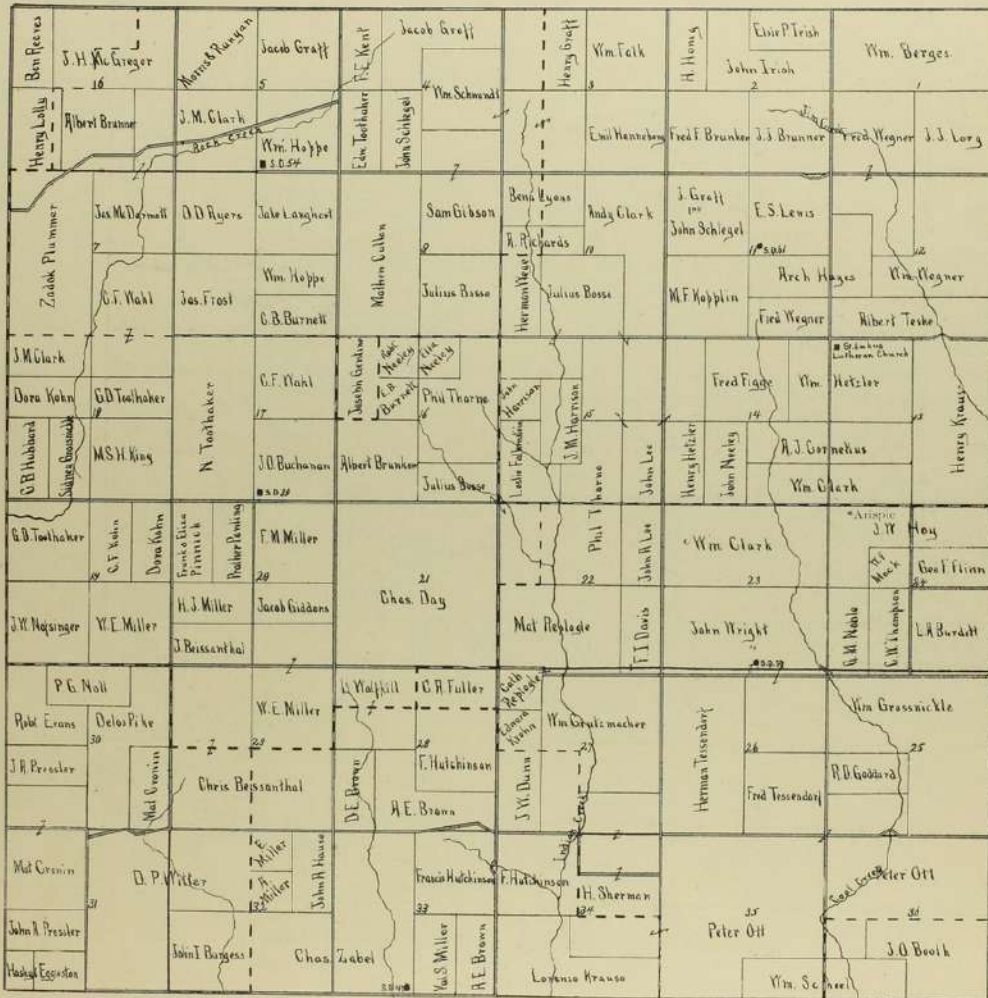

ROCK CREEK TOWNSHIP.

T. 7. R. 9.

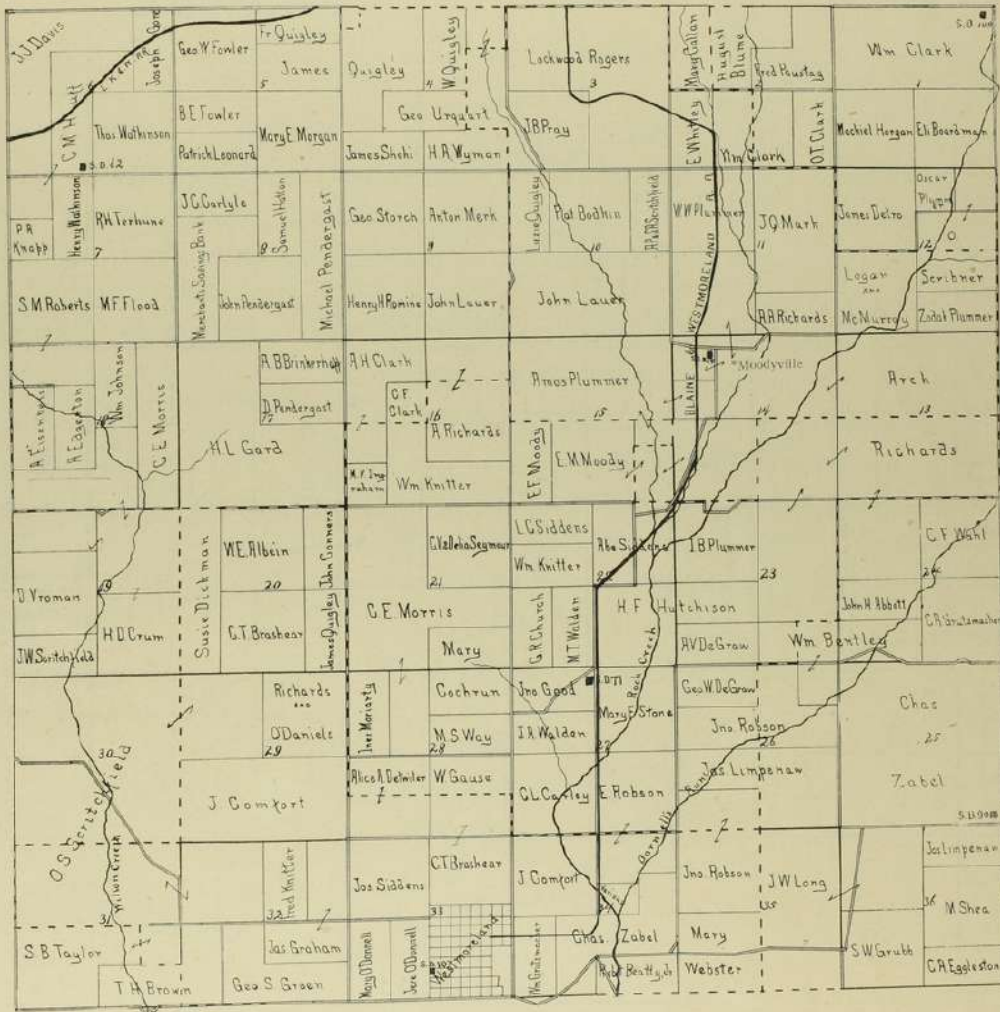

SPRING CREEK TOWNSHIP.

T. 6. R. 8.

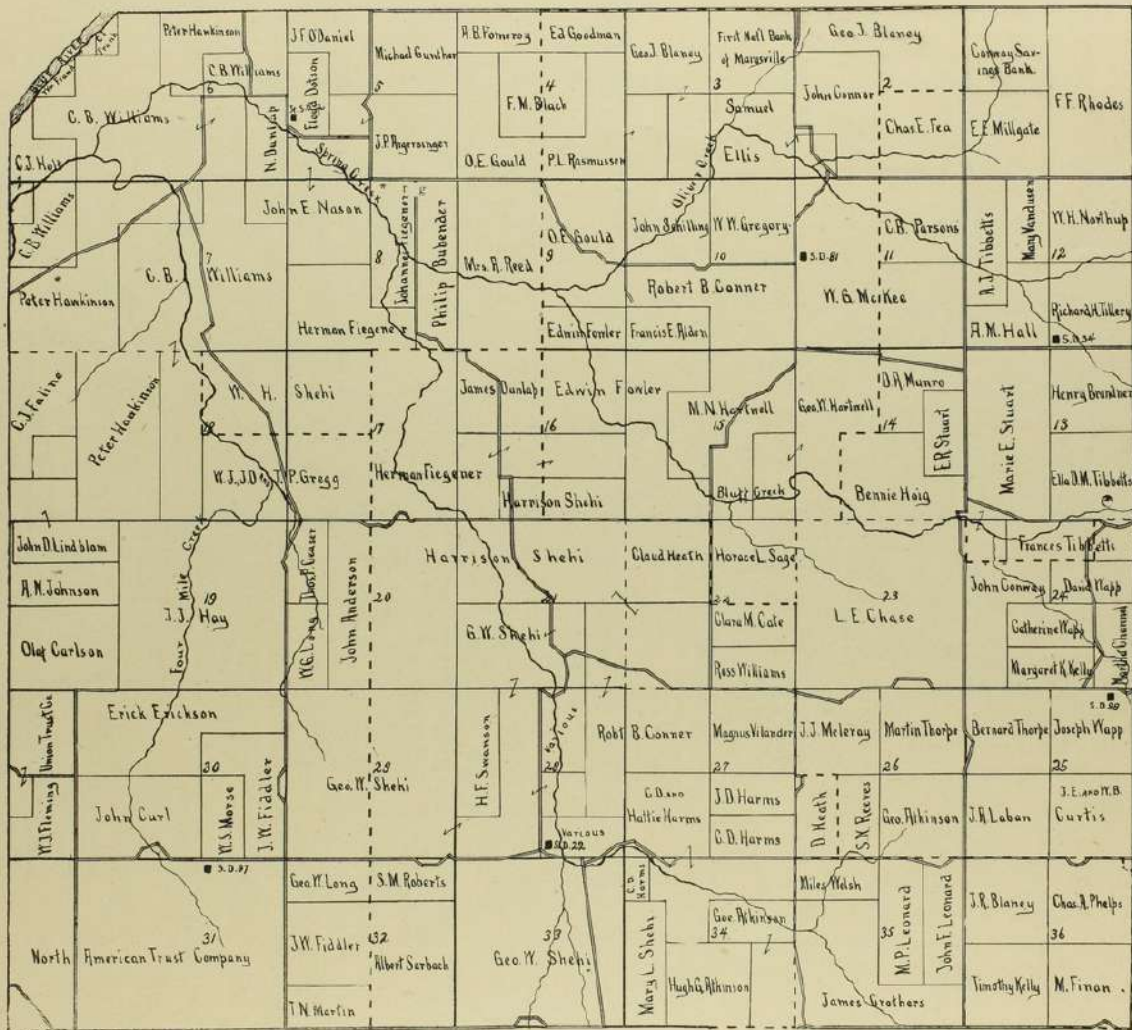

POTTAWATOMIE TOWNSHIP.

T. 7. R. 8 and 9.

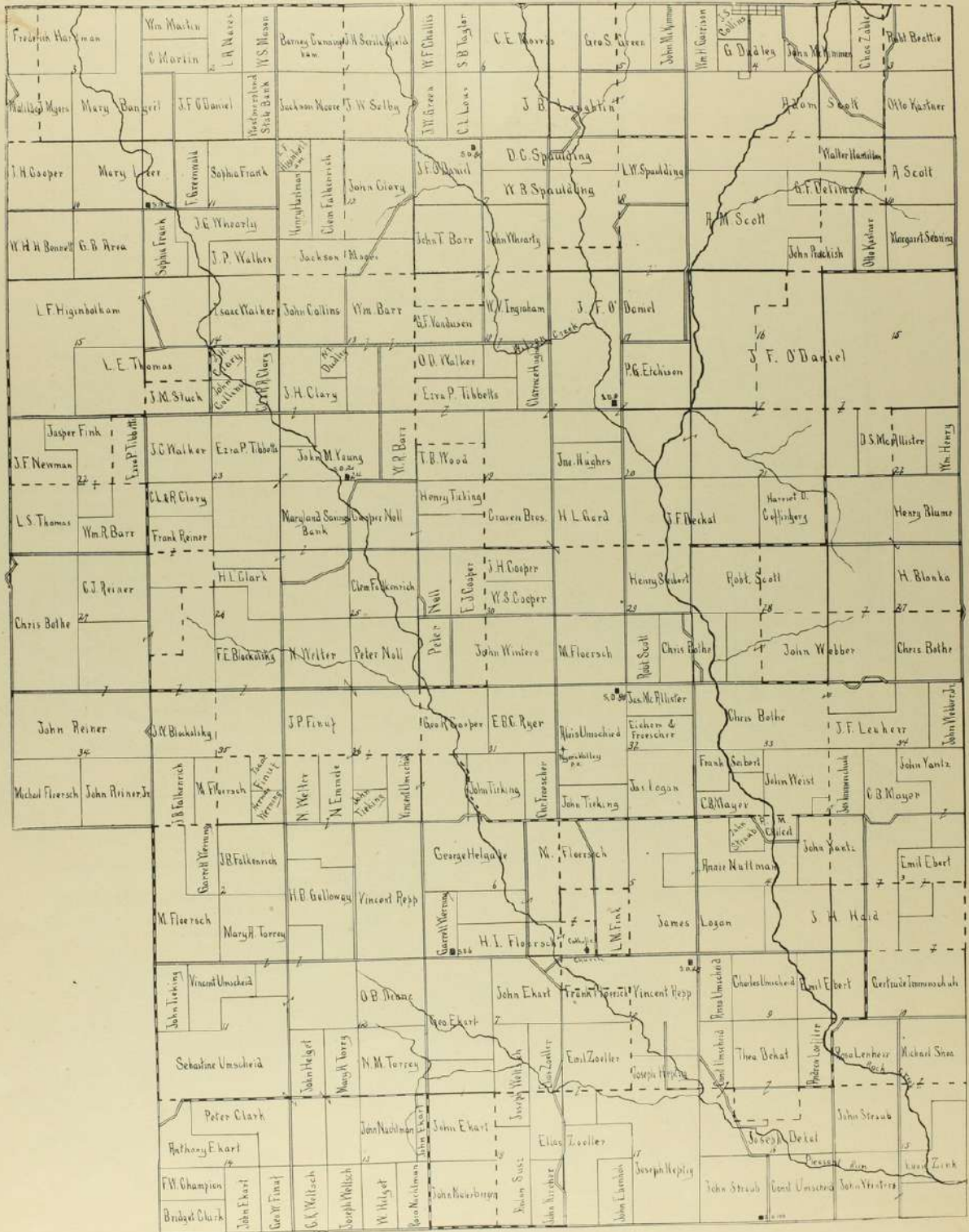

ST. GEORGE TOWNSHIP.

T. 9. R. 9.

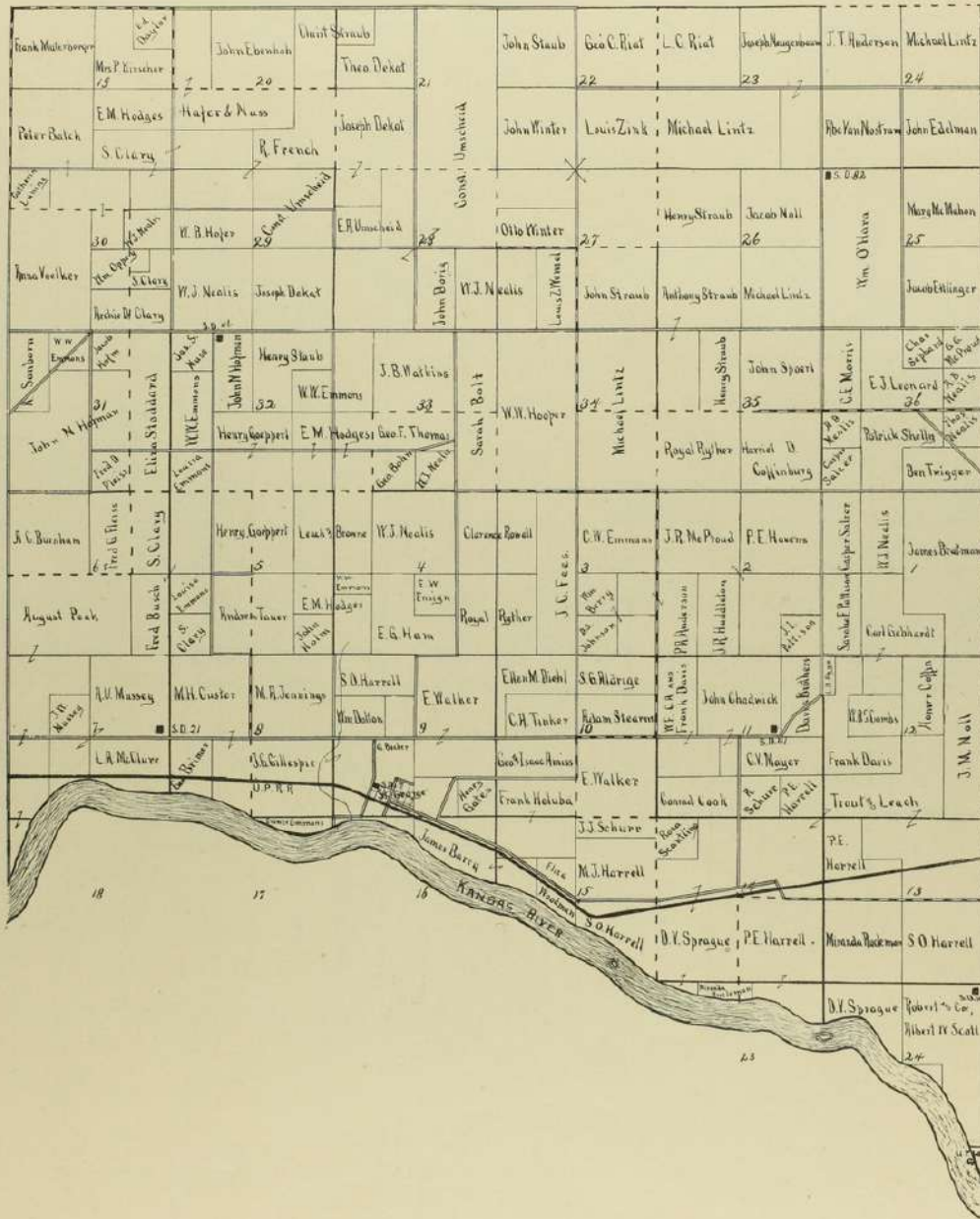

BELVUE TOWNSHIP.

T. 9. R. 11.

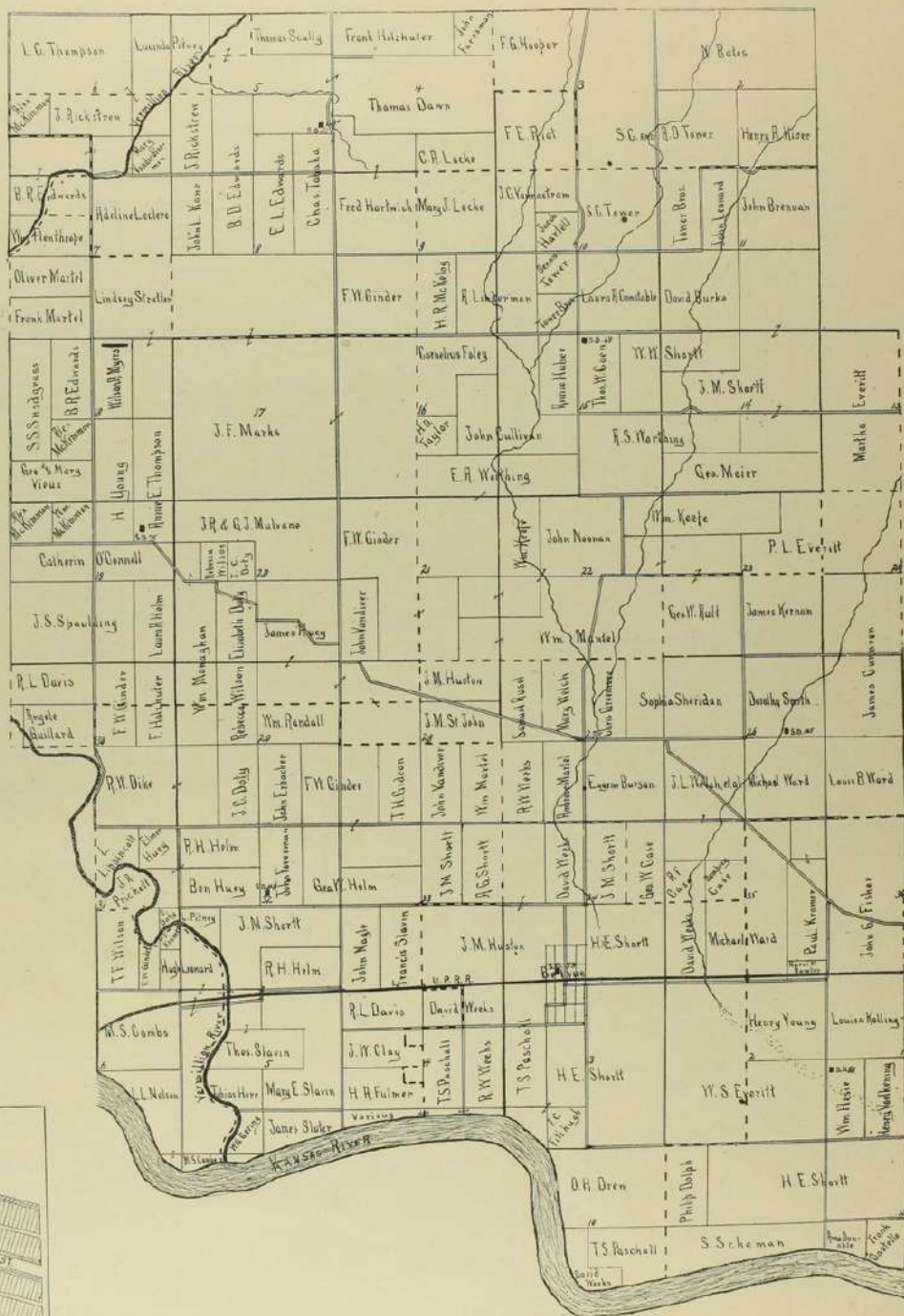

Belvue.

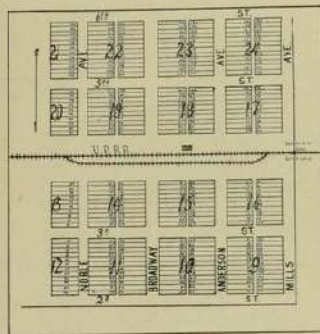

St. George.

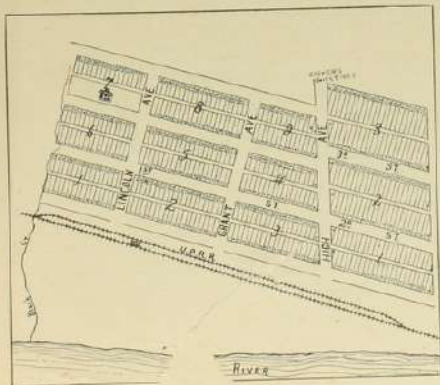

LONE TREE TOWNSHIP.

T. 7. R. 9 and 10.

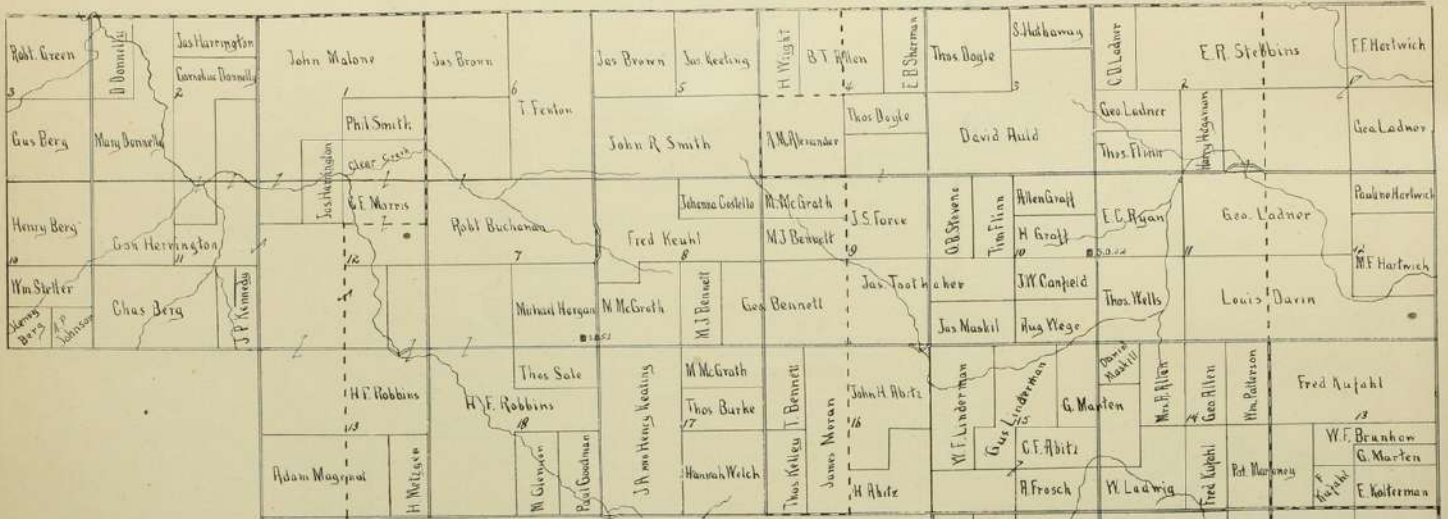

Westmoreland.

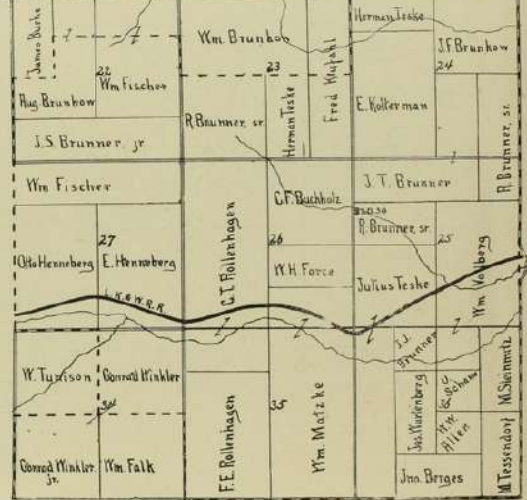
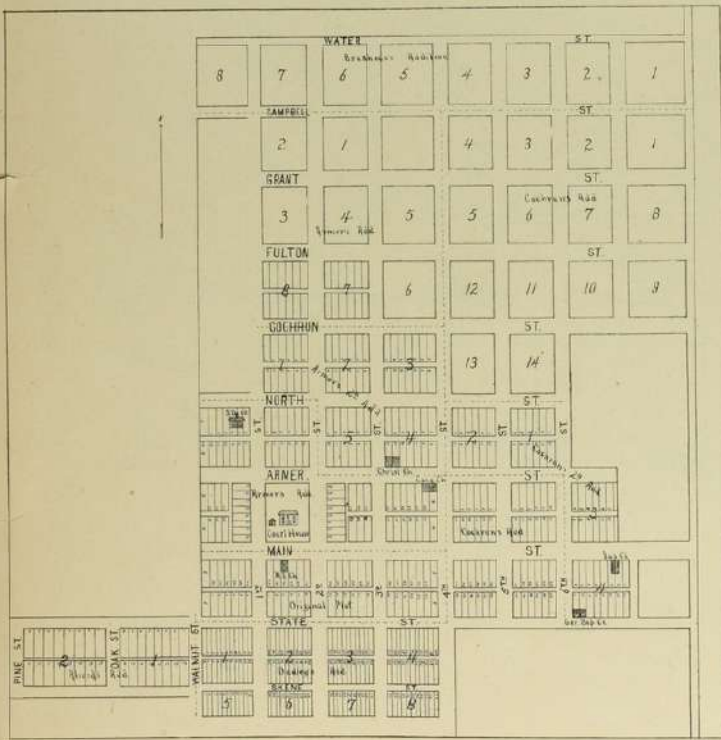

Wheaton.

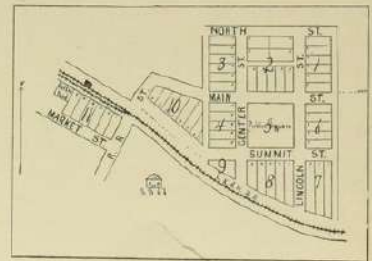

WAMEGO TOWNSHIP.

T. 10. R. 10.

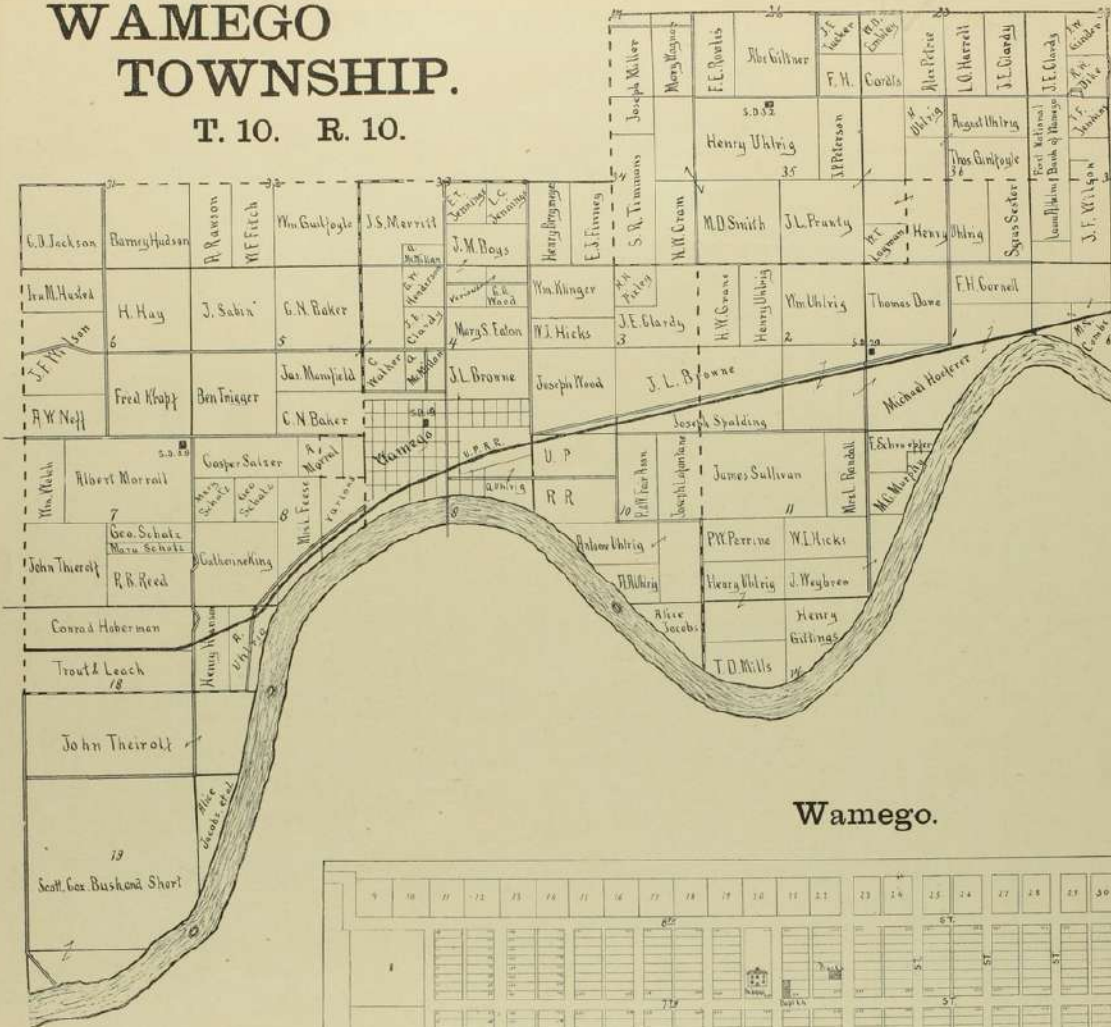

Wamego.

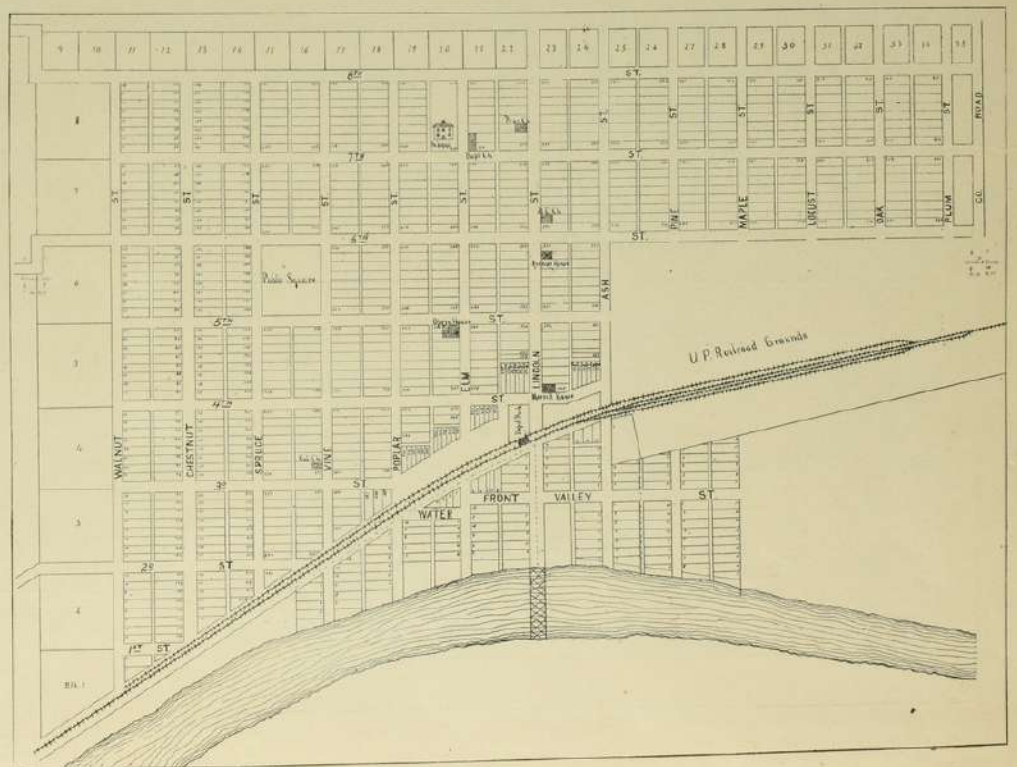

SHANNON TOWNSHIP.

T. 7. R. 8.

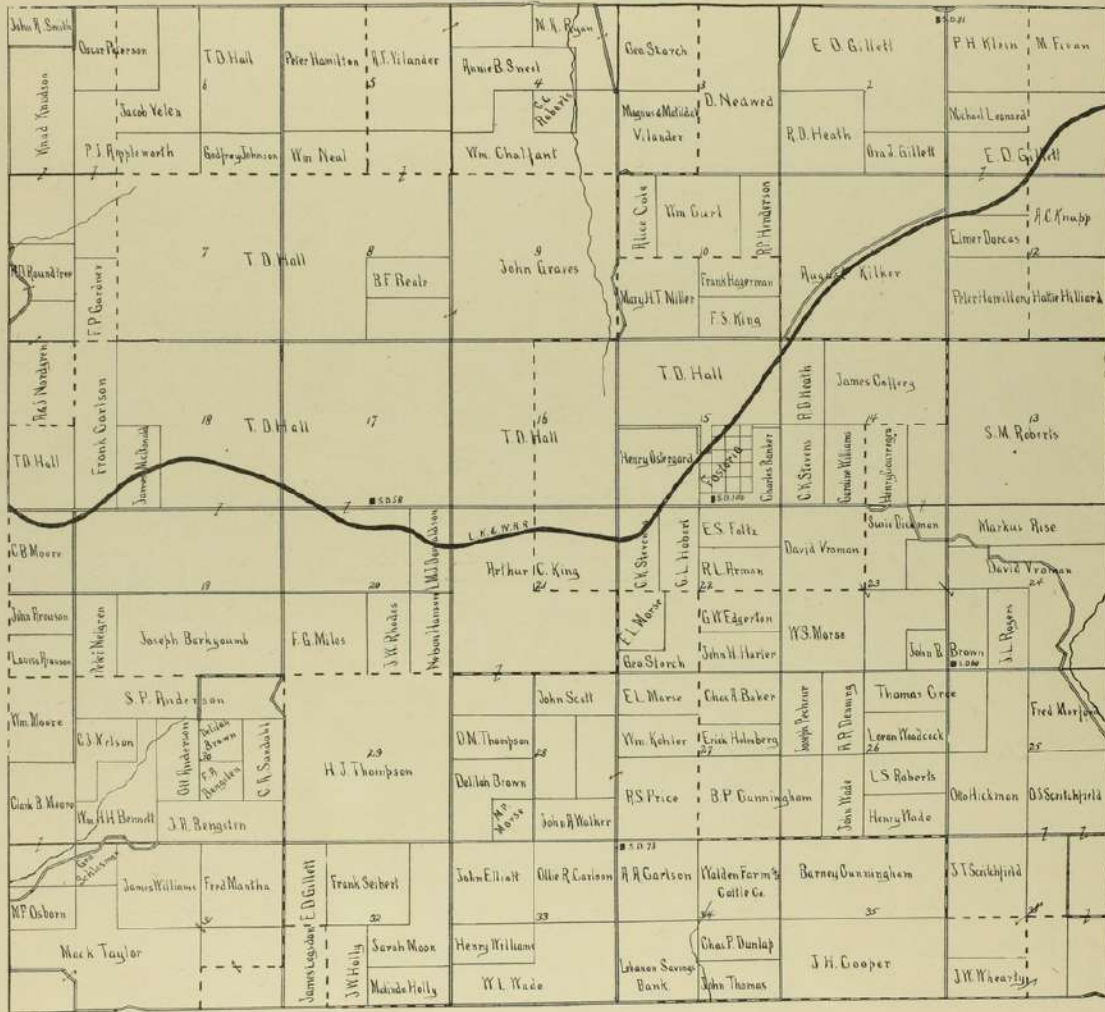

UNION TOWNSHIP.

T. 8. R. 9 and 10.

Wm. Spitzmacher	2	Walter E. Force	W. R. Eggen	D. N. Knapp	Mathew Cronin	M. B. Stewart	E. F. Campbell	Michael Hunholtz
	Best Beattie, Jr							T. E. Alsop
		John Eichorn	L. A. Gnapp	Paul Lenhart	Mike Pfriang	J. T. Dayhoff	Geo. T. Rush	Wm. Nicholas
			J. K. Estes					
R. H. O'Neill	R. J. Wyatt	W. H. Wyatt	Allen Haguo	Wm. Schuel	F. H. Schwanndt	Wm. Neeley		Wm. Bairrow
						J. E. Lee		Geo. W. Forester
	R. J. Wyatt	R. R. Shumate	Ferd. Kuhn			B. B. Smart	John F. Burgess	Lizzie Bairrow
						E. G. Forrest		Willis Hardick
M. V. Keron	John Dailey	A. P. Dailey	Edward Regner	G. E. Morris	Melida M. George	G. W. Corley	Joseph C. Regner	H. L. Deppery
H. G. Lemon								David N. Regner
F. M. W. Lemon	M. V. Colding	H. N. Colding		E. A. Atkinson	Jacob Anderson	Phoebe Melson		P. T. Myers
				A. E. Root				Mary Pennick
H. G. Lemon				S. D. Mascheid	J. S. Klingensmith			W. D. Wheat
F. M. Lemon	R. Nelson	J. J. Eckert	Trout Leach	Ed Atkinson		Barley Heise		Wm. Burgess
Wilhelmine Goede				F. M. Beckich		Jacob Kohler		M. T. Moore
				H. Schmeltzer		Geo. Ferguson		Geo. Anderson
Margaret Guilfoyle		T. H. Fox		Henry Hoffmann	E. Walker	Henry Ferguson	Cath. Goshing	W. F. Kierman
				George Hoffmann			B. R. Edwards	
		Carrie Mueckert		Blair Baumgartner	Wm. Brown	J. B. Laughlin	Elizabeth Ferguson	Alex. Moore
		Louisa Lutz		Ed Mascheid				Thos. Leach
								John Witts
John Kohler	P. R. Noel, et al.	W. E. O'Neill	J. J. Eckert	G. L. Wimmerich	F. E. Hart	G. W. Downey	Levi Perkins' heirs	John Witts
	Joseph Immenschuh	David Blathard		V. E. Caspiter	Wm. Weiler			John Witts
						R. Muzzis	Michal Floersch	F. A. Merryman
								Sarah M. Morgan
								J. A. Goodlove
								P. Fortuna
								L. C. Rightmire

CLEAR CREEK TOWNSHIP.

T. 6. R. 9 and 10.

Blaine.

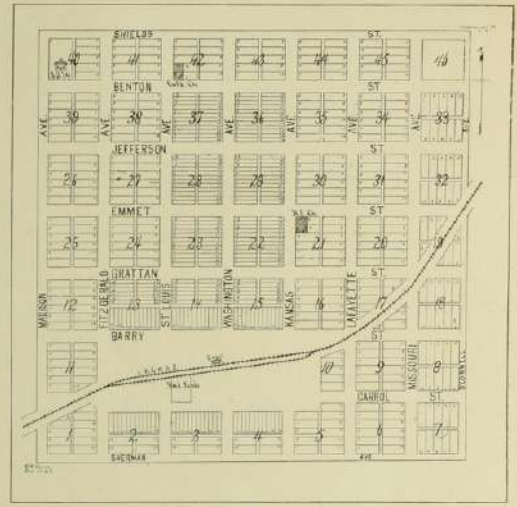
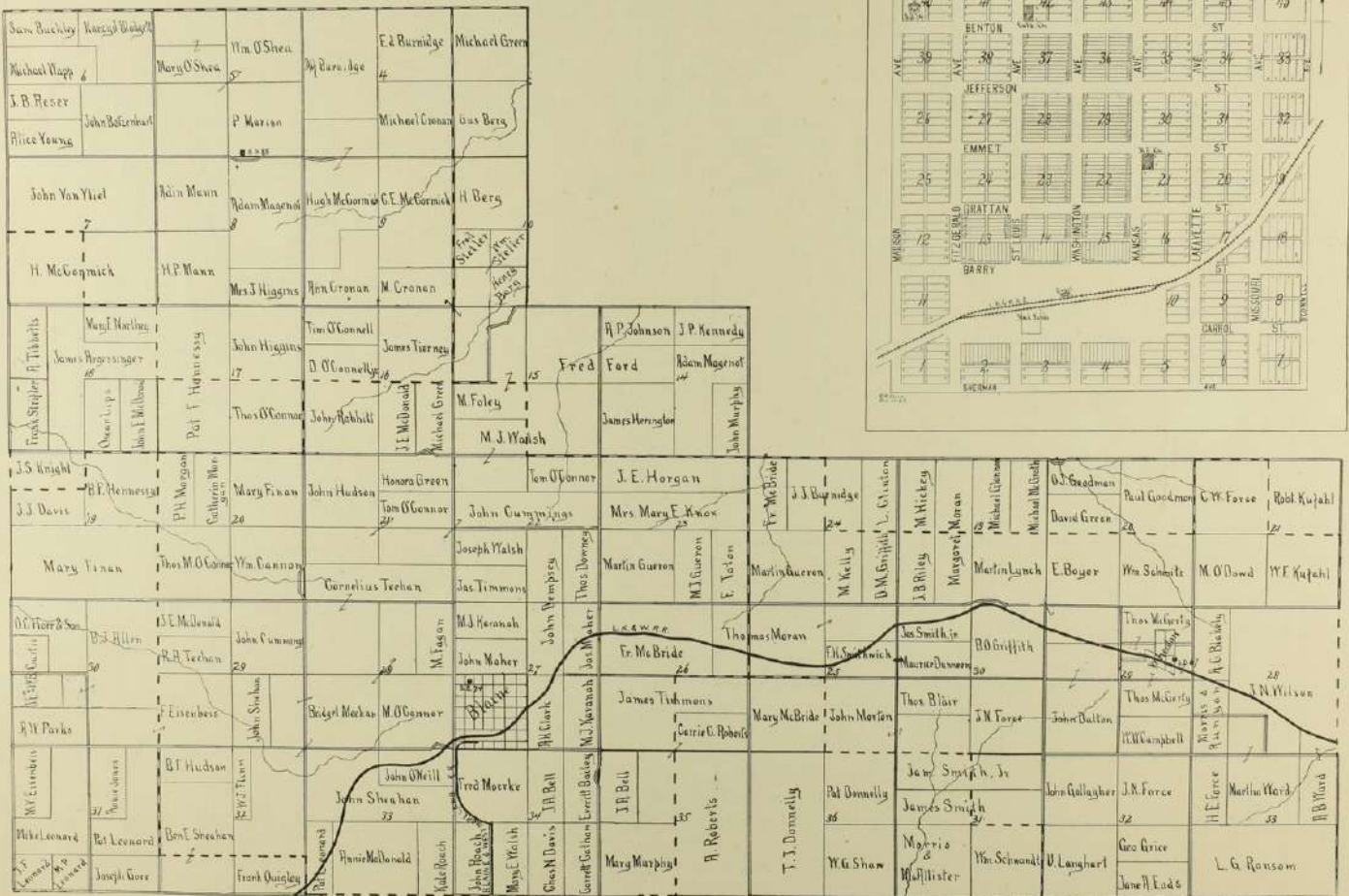

ST. CLERE TOWNSHIP.

T. 7. R. 12.

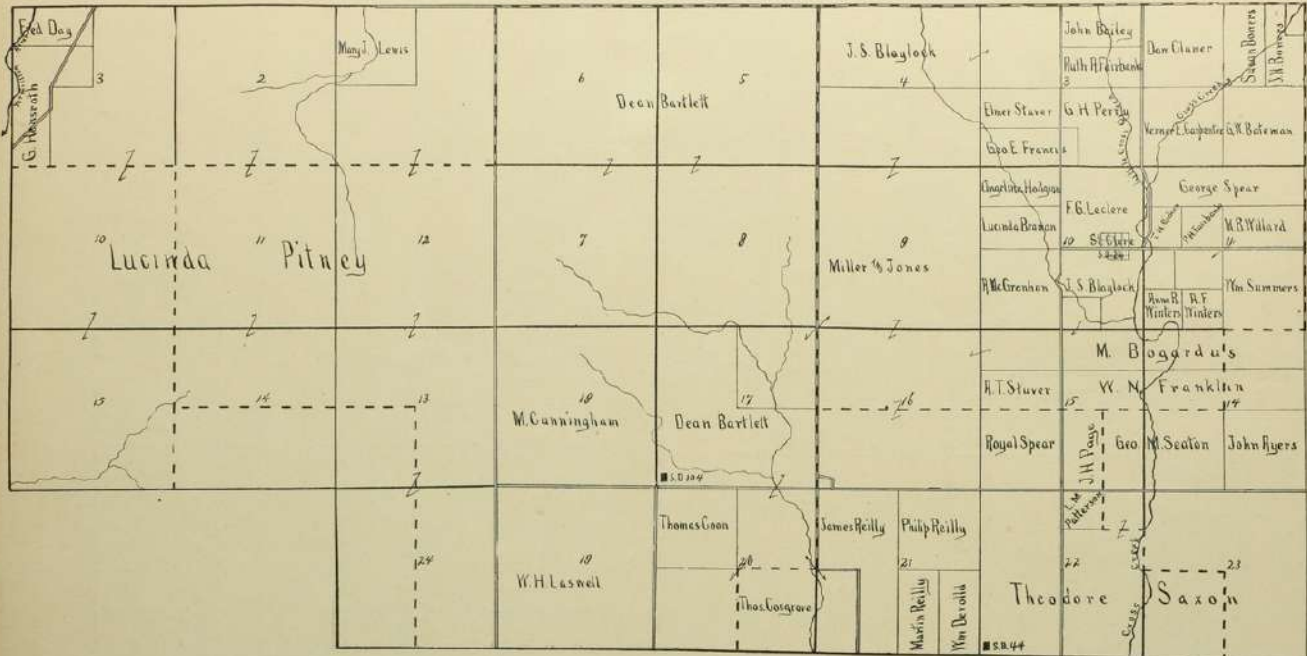

EMMET TOWNSHIP.

T. 7. R. 12.

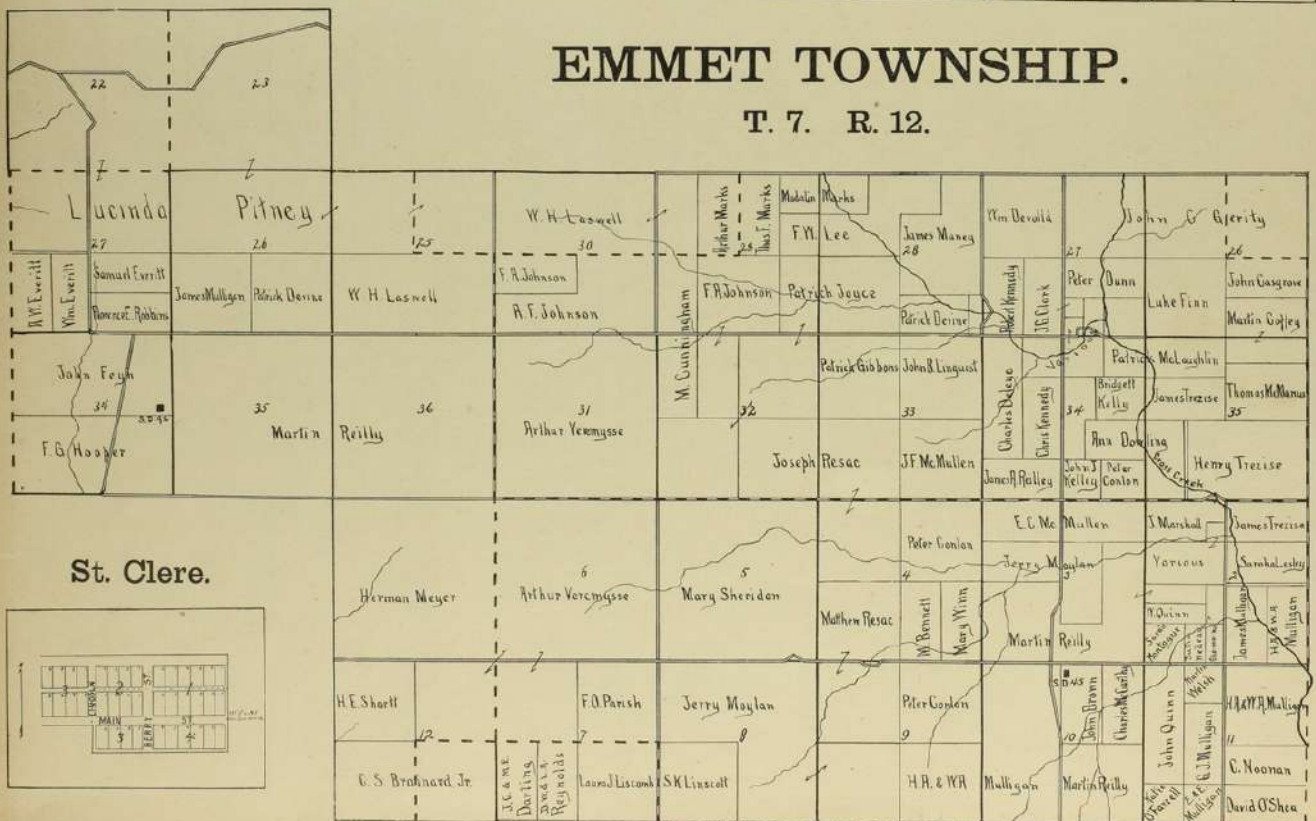

St. Clere.

