

OUTLINE

7

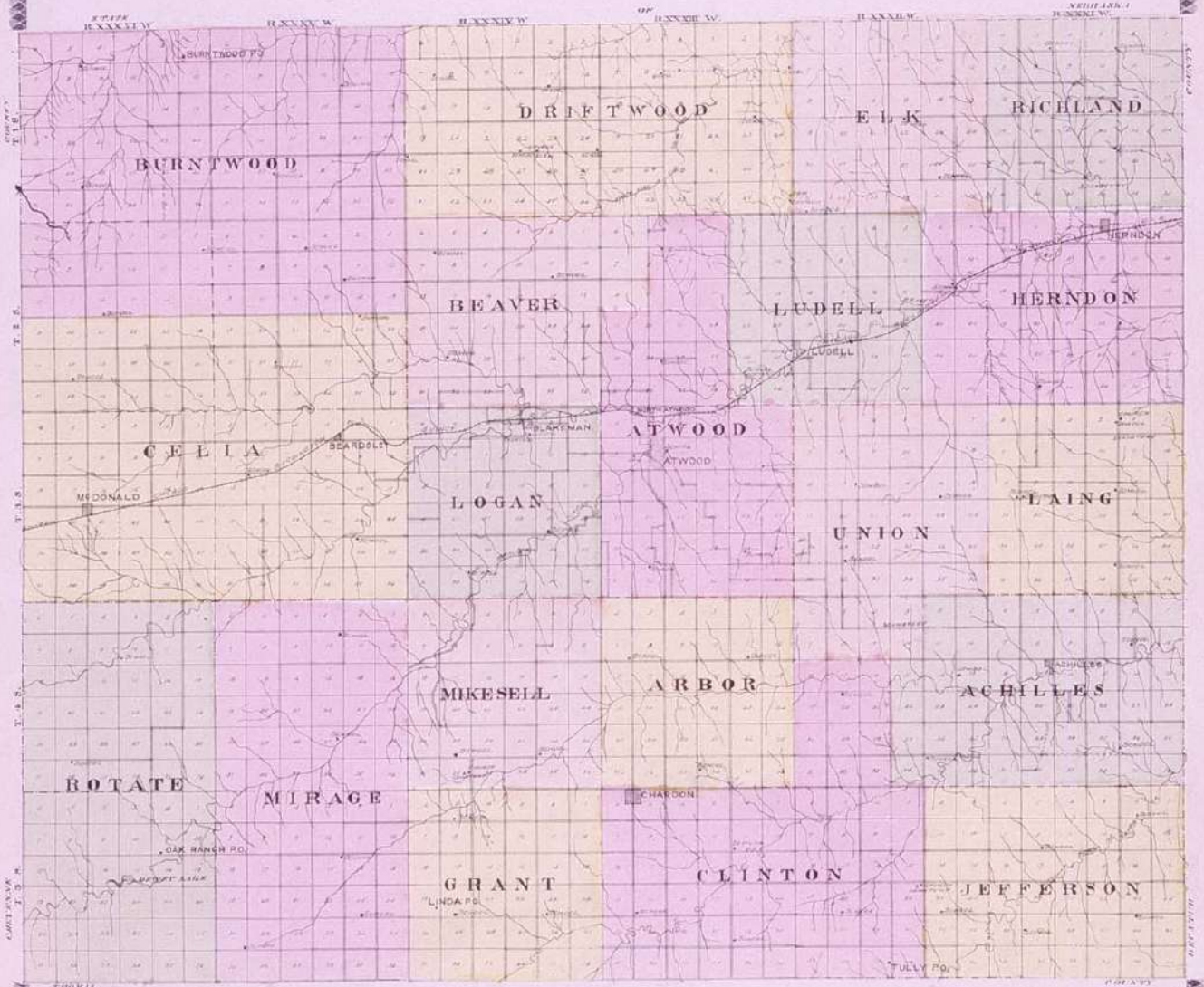



TOWNSHIP 1 S. RANGE XXXII

Scale 1/64,000

OF THE 6TH Principal Meridian

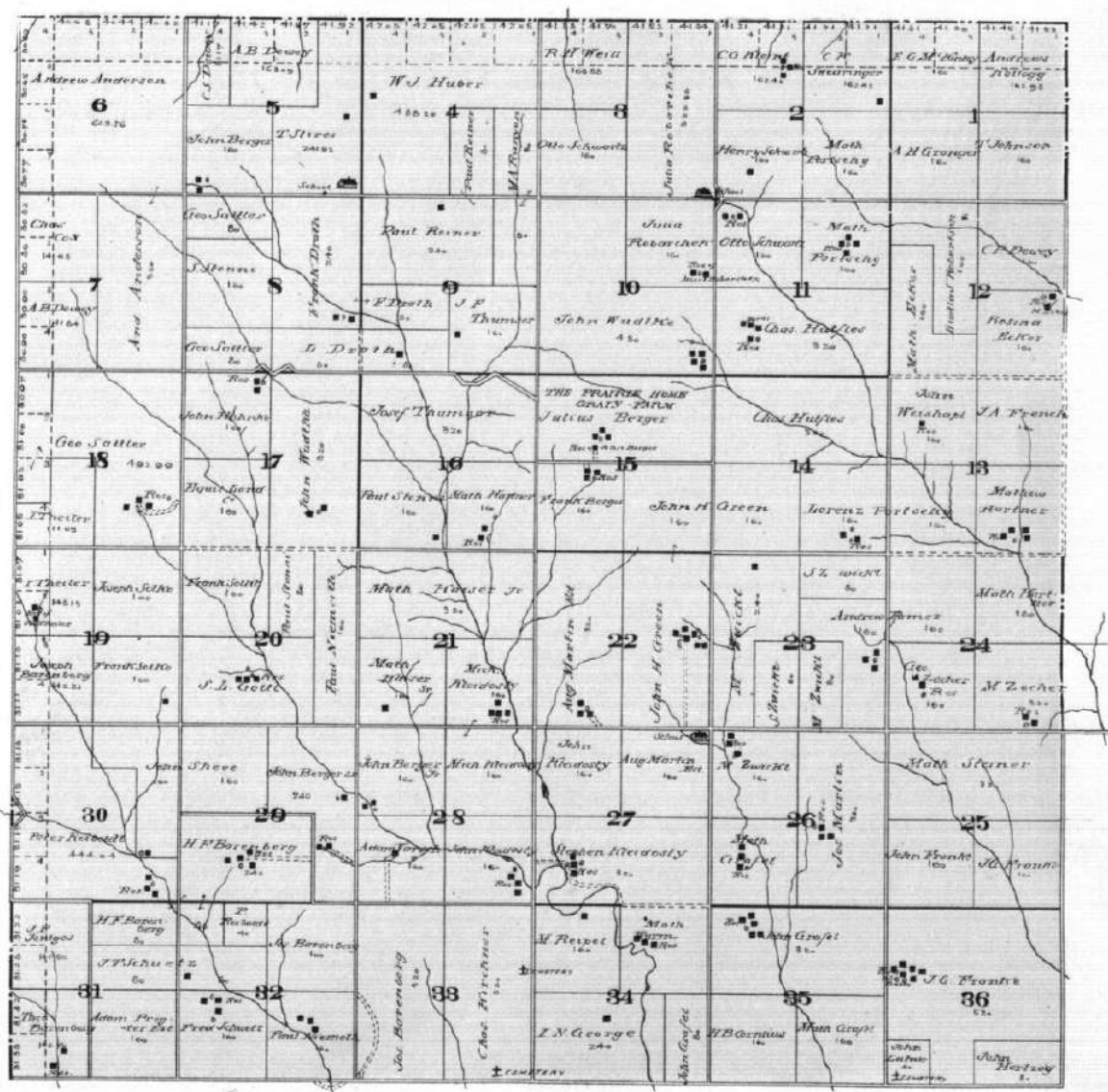

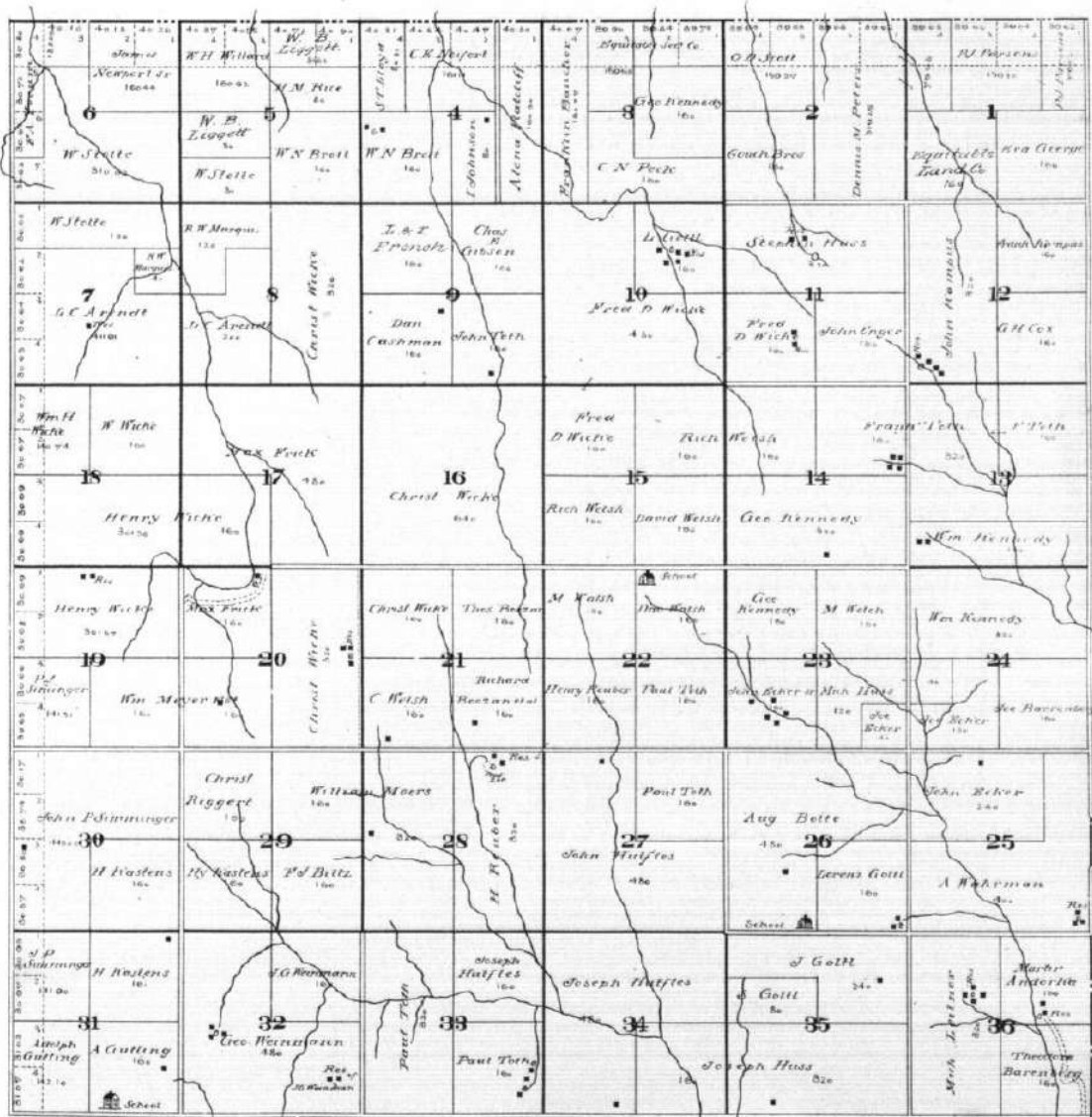

MAP OF
TOWNSHIP I S. RANGE XXXIII W.
OF THE 6TH Principal Meridian





TOWNSHIP 1 S. RANGE XXIV W.

Scale 1 inch = 36.3 feet

OF THE 6TH Principal Meridian



MAP OF
TOWNSHIP 1 S. RANGE XXXV.
 OF THE 6TH Principal Meridian

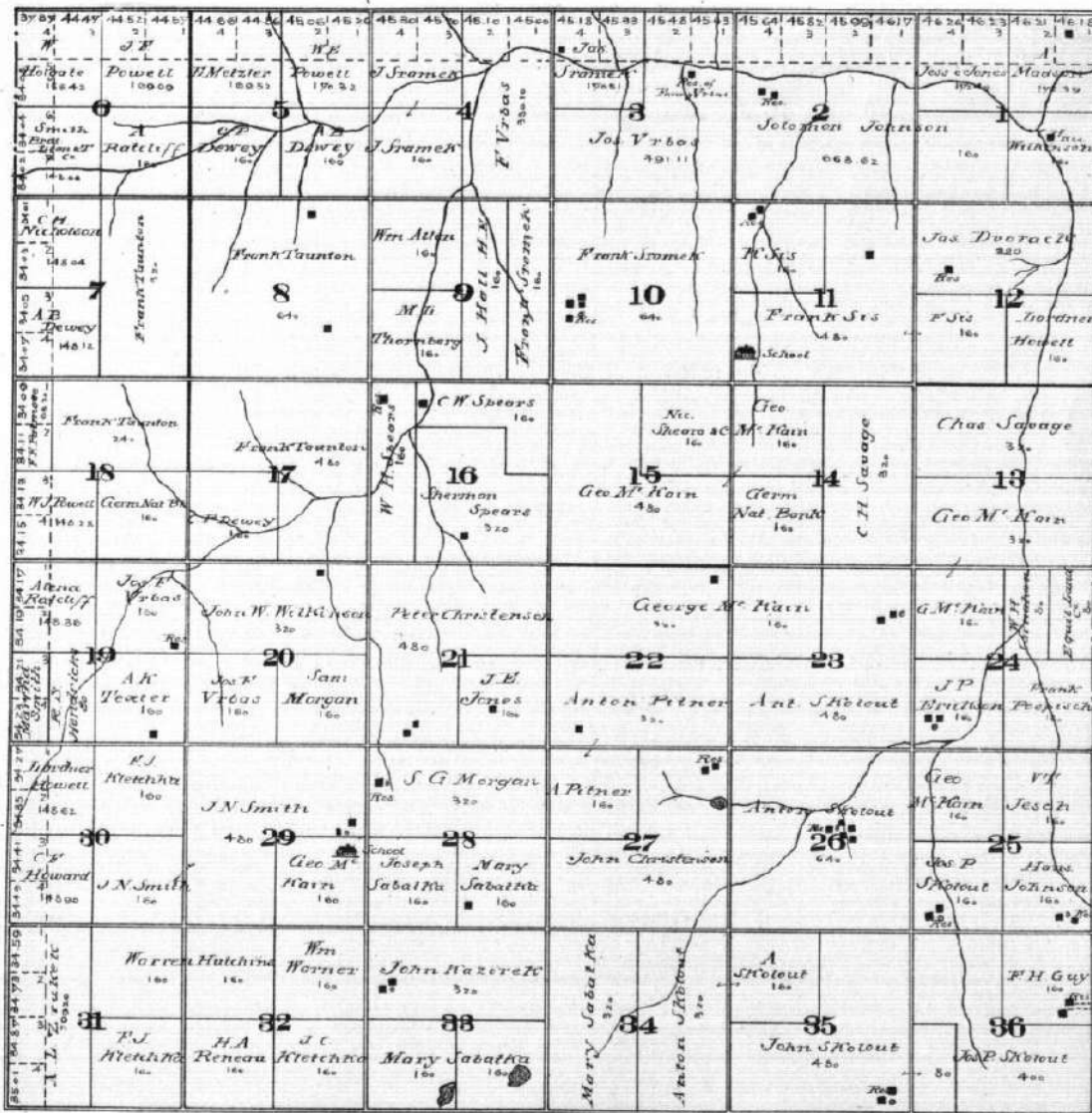



TOWNSHIP 1 S. RANGE XXXVI W.

 OF THE 6TH Principal Meridian

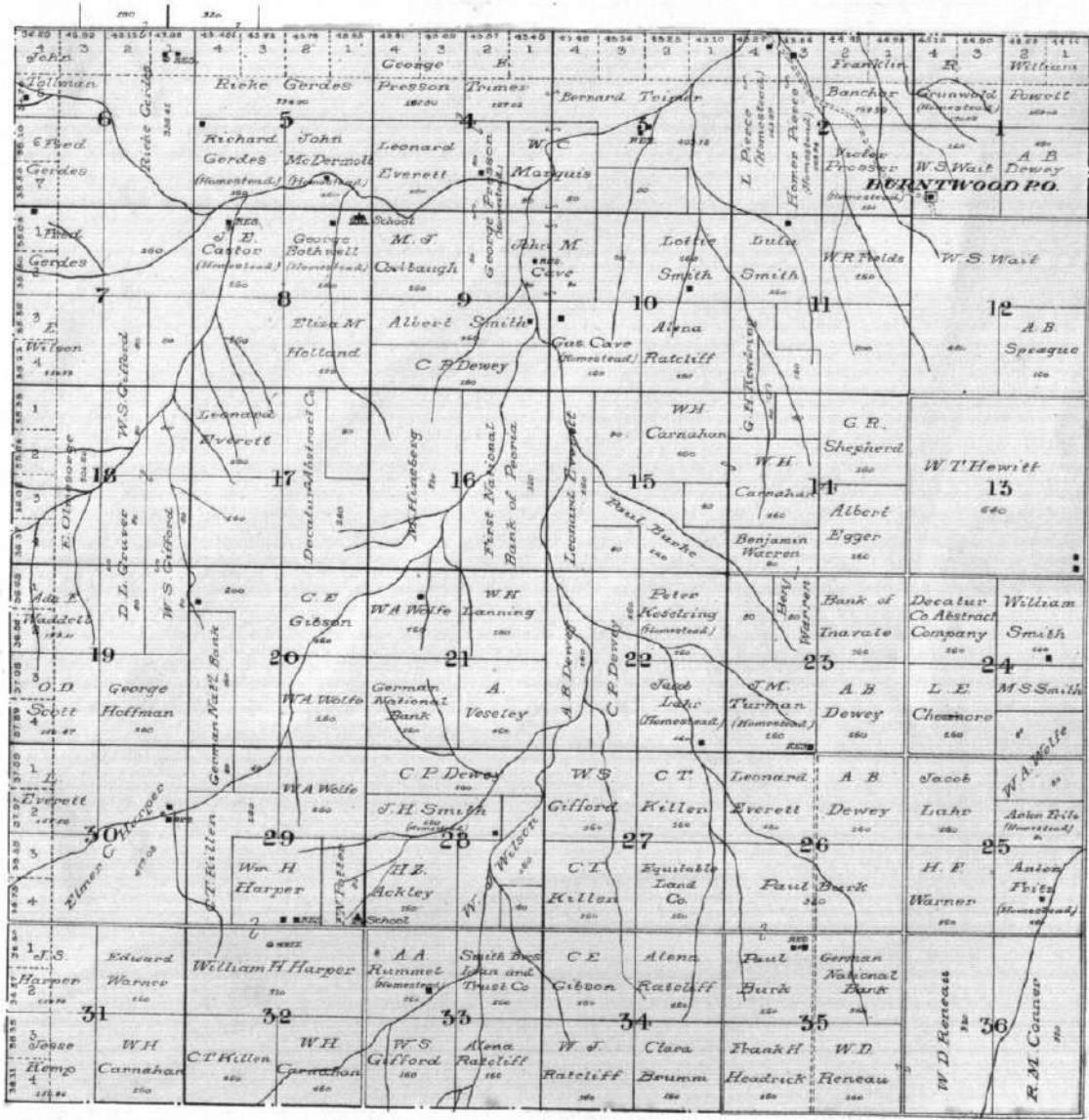

MAP OF
TOWNSHIP 2 S. RANGEXXXI W.
 OF THE 6TH Principal Meridian

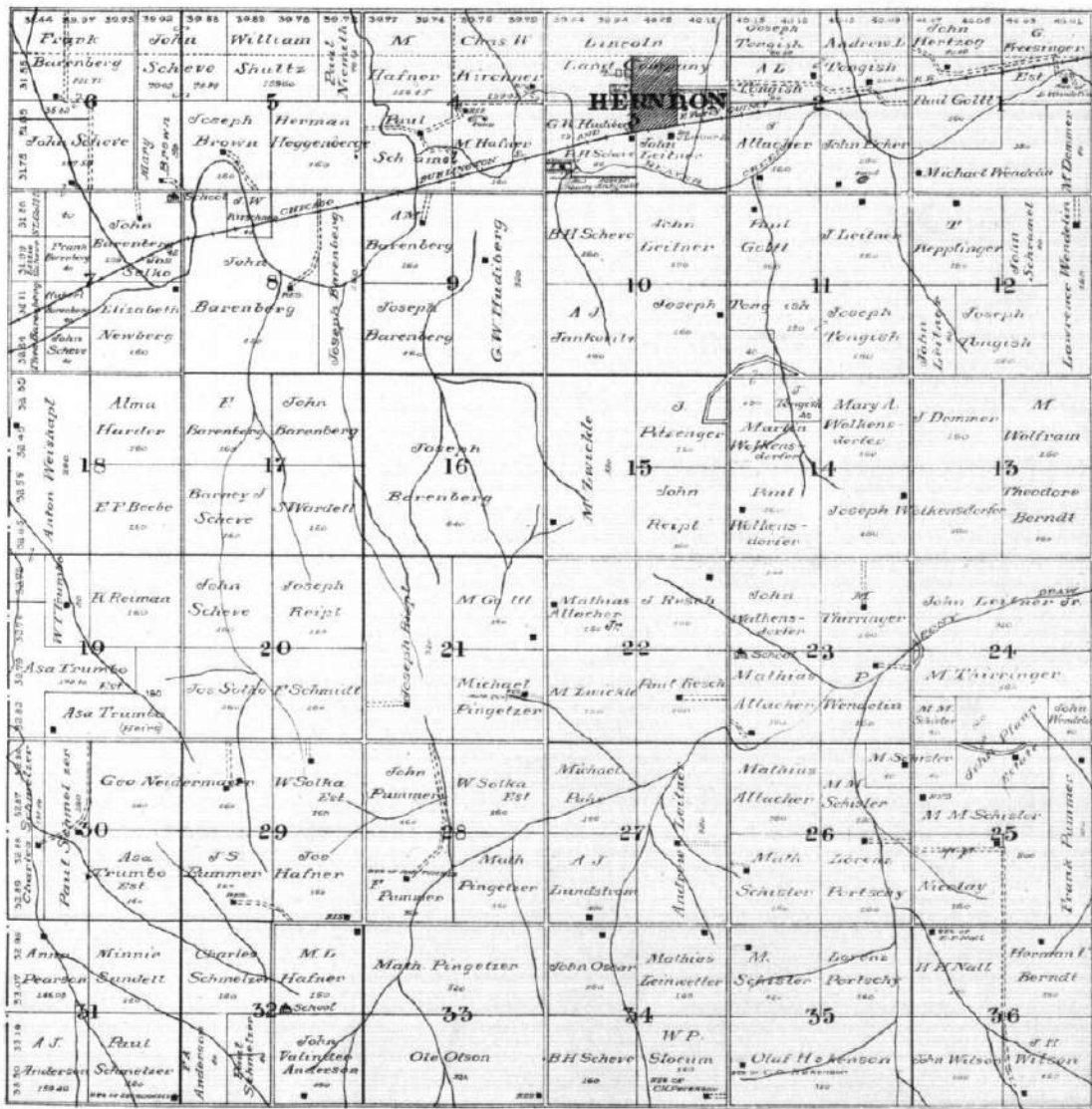

TOWNSHIP 25. RANGE XXXI W.

 OF THE 6th Principal Meridian

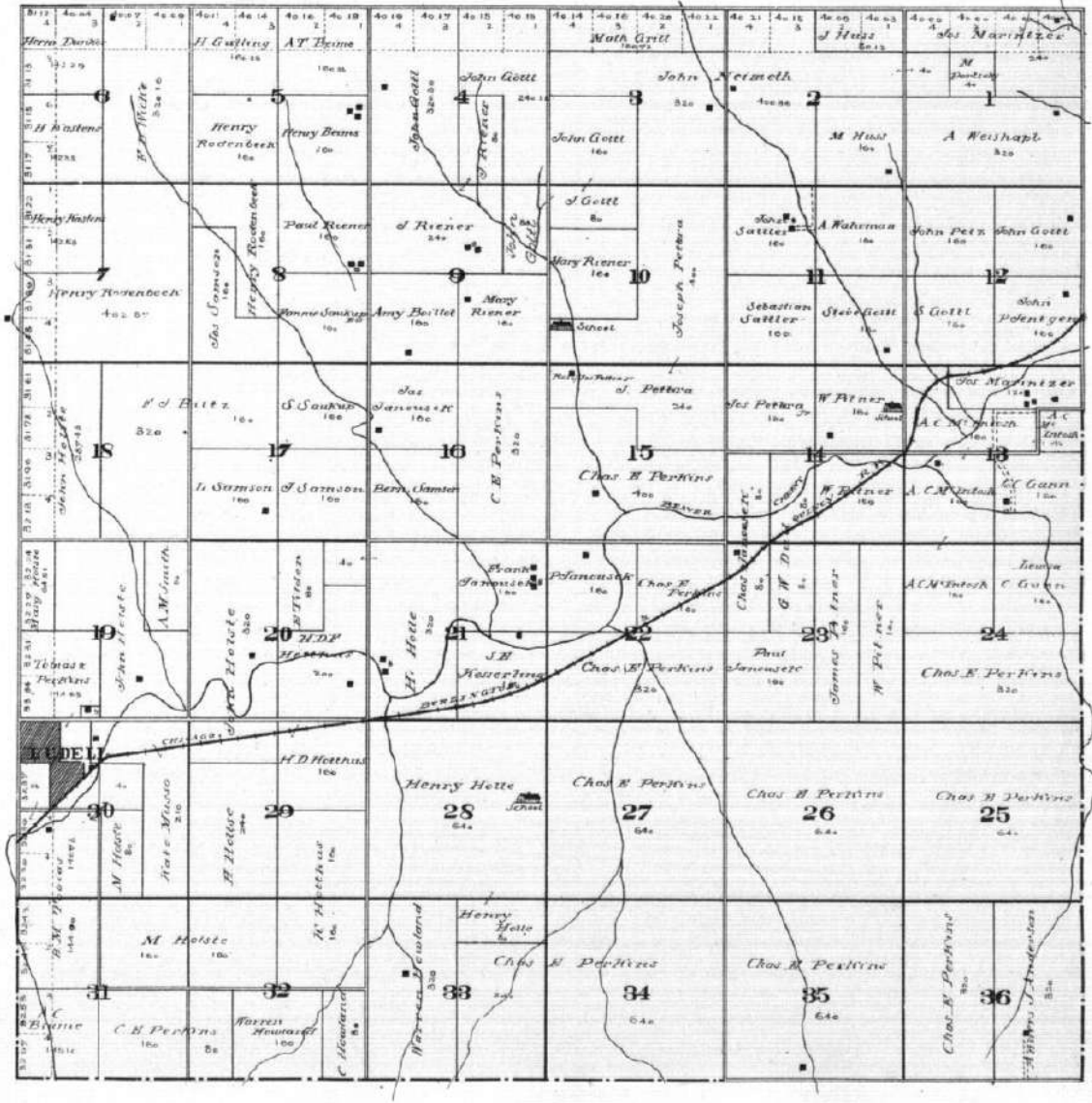



MAP OF
TOWNSHIP 25. RANGE XXXIII W.
Scale 1/62,500

OF THE 6TH Principal Meridian

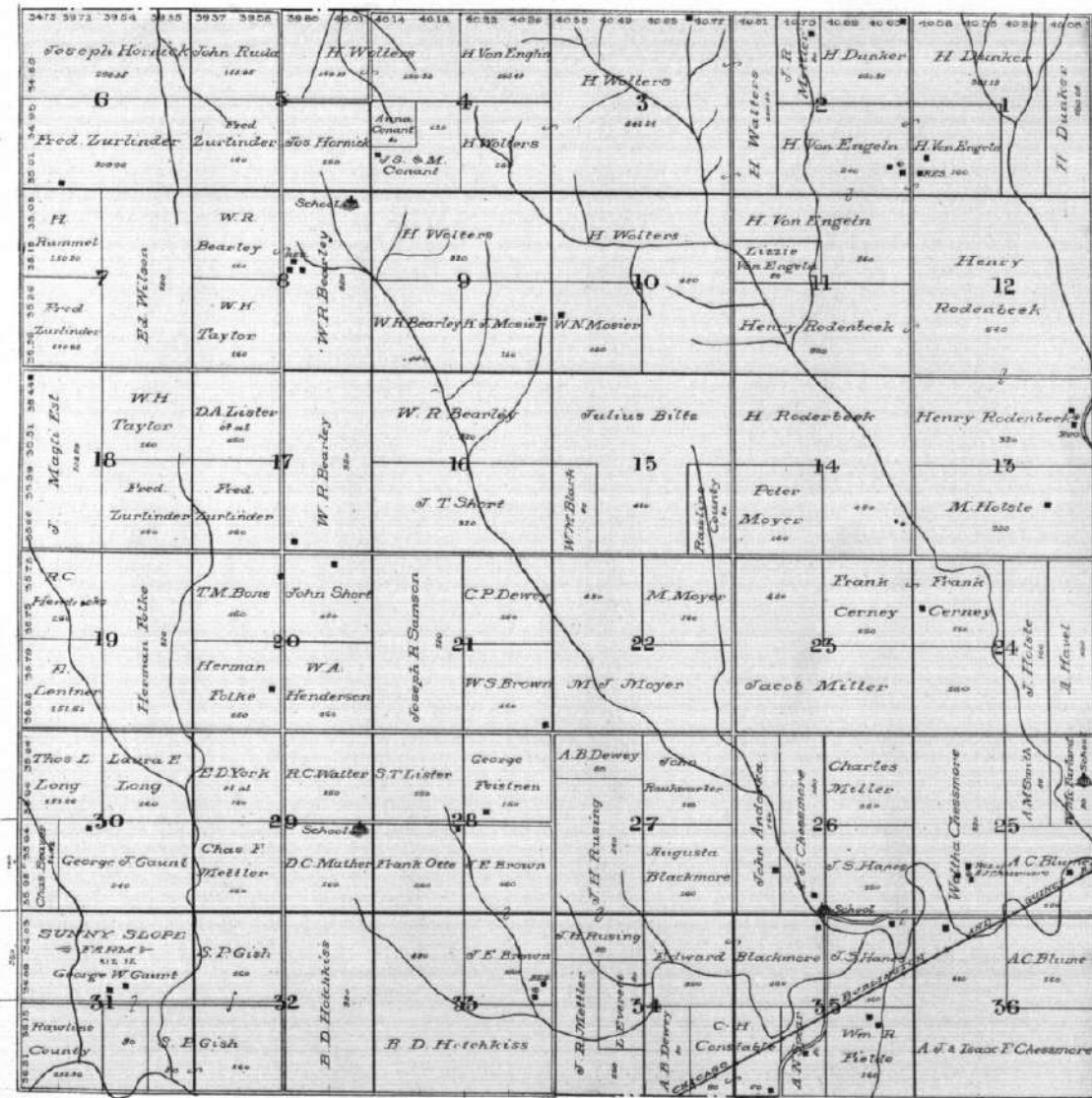



 MAP OF
TOWNSHIP 2 S. RANGE XXXI W.
 OF THE 6TH Principal Meridian

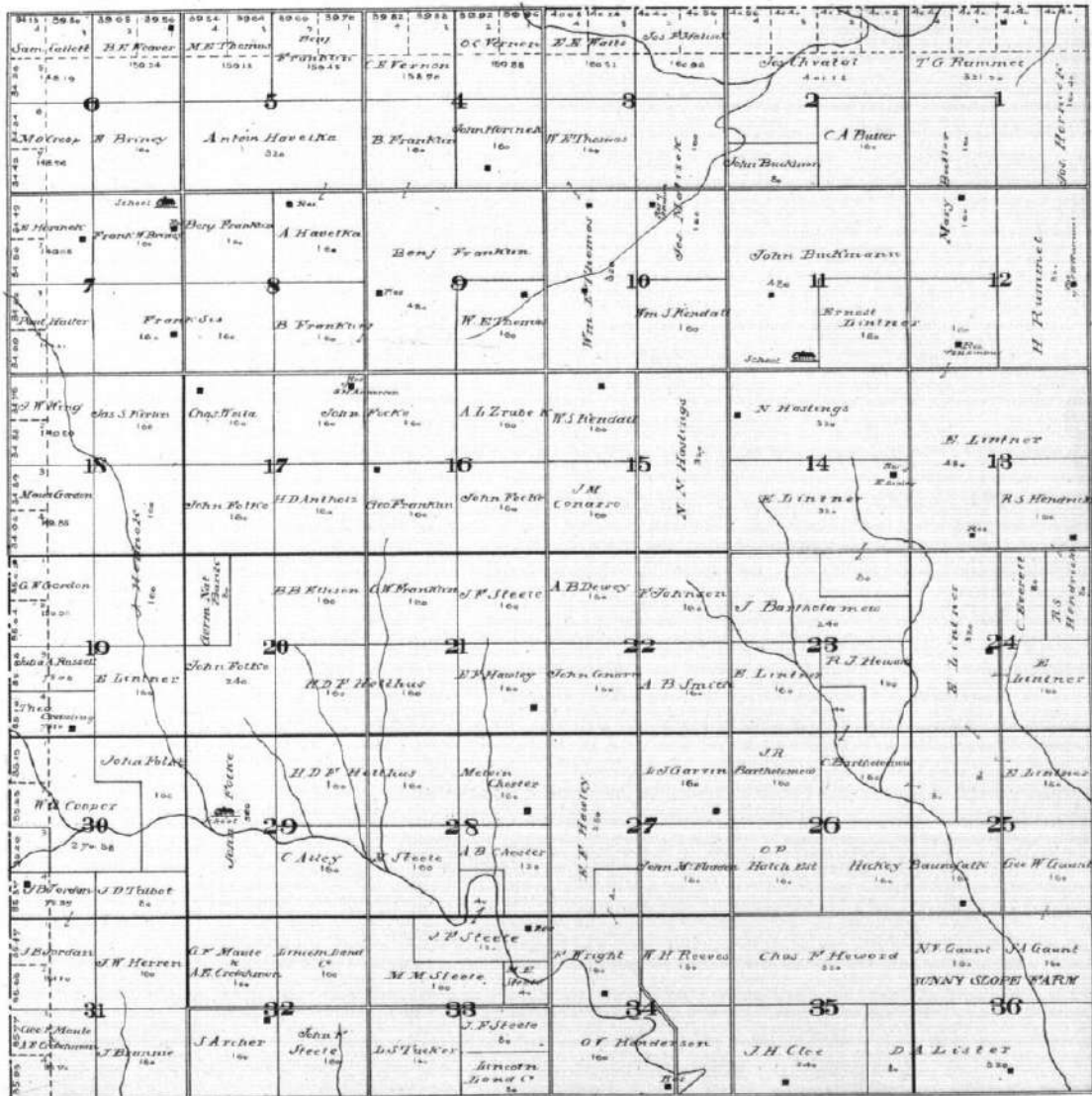



TOWNSHIP 2S. RANGE XXXV W.

 OF THE 8TH Principal Meridian



MAP OF
TOWNSHIP 2S. RANGE XXXVI W.
East Meridian of 101°
OF THE 6th Principal Meridian

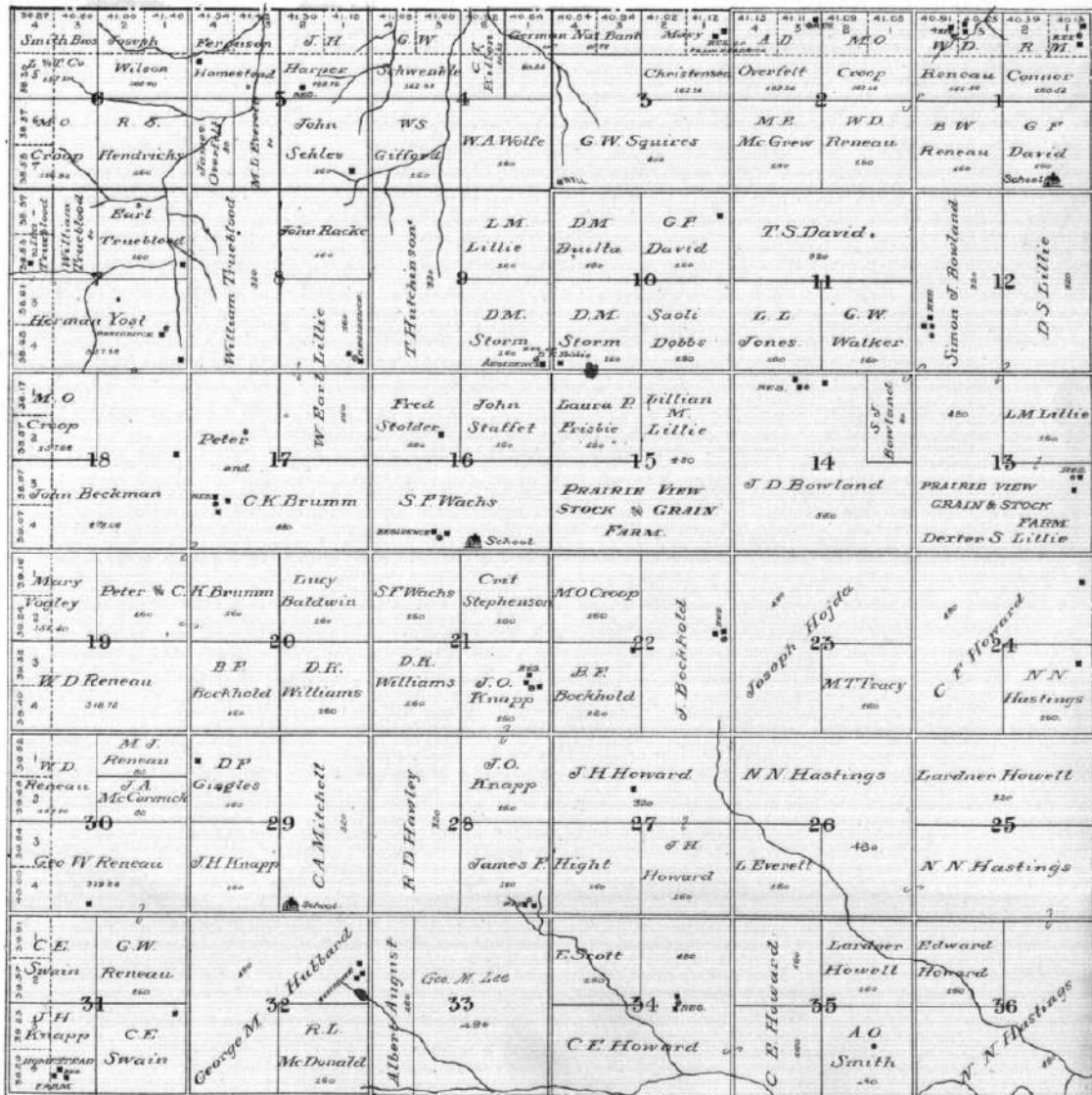

KANSAS STATE HISTORICAL SOCIETY

42416



MAP OF
TOWNSHIP 35. RANGE XXXI W.
Scale 1/62500 or 1" = 1/4 mile

OF THE 6th Principal Meridian

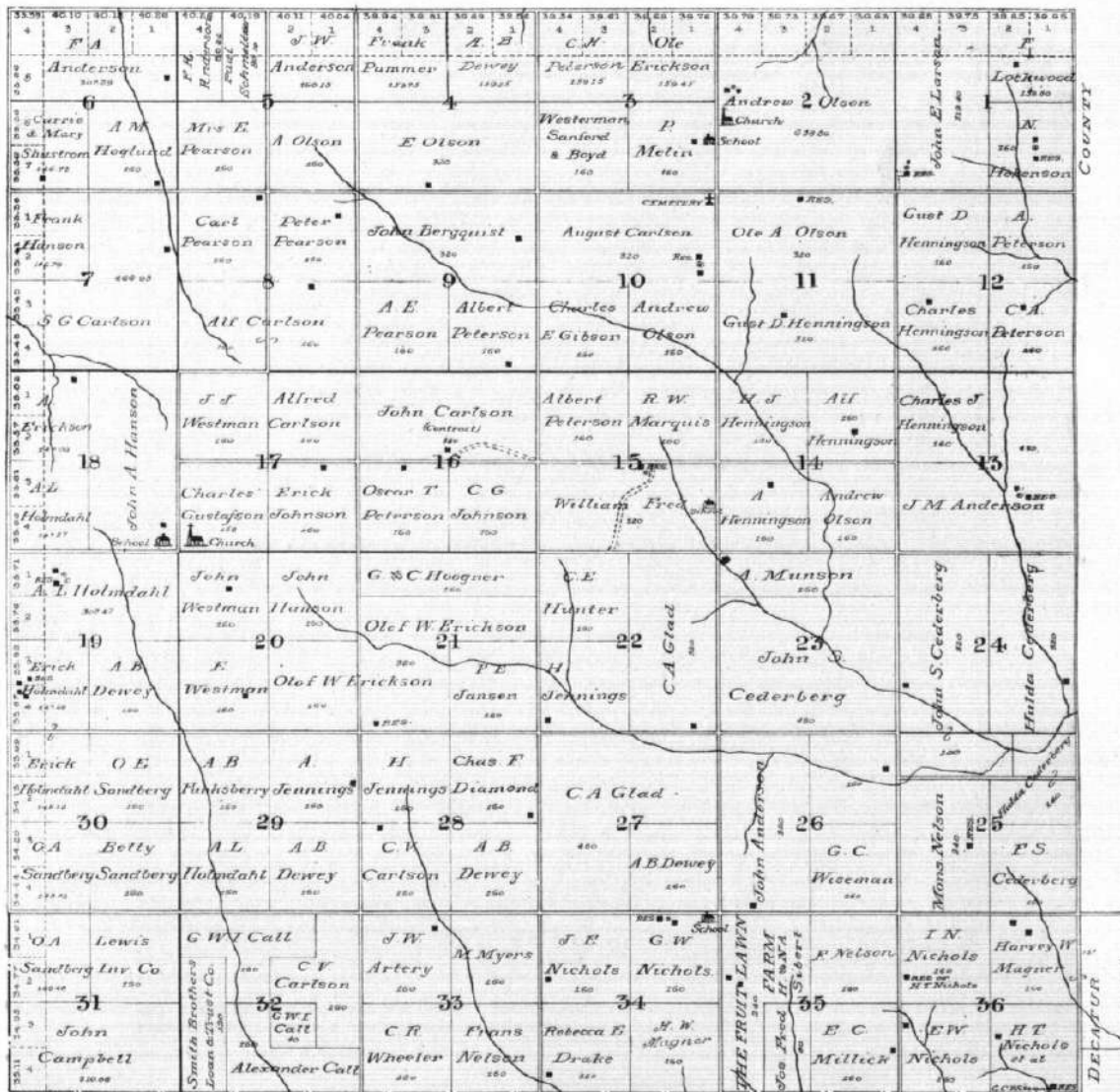



MAP OF

TOWNSHIP 3S. RANGE XXXIII W.

Under the 6th Principal Meridian

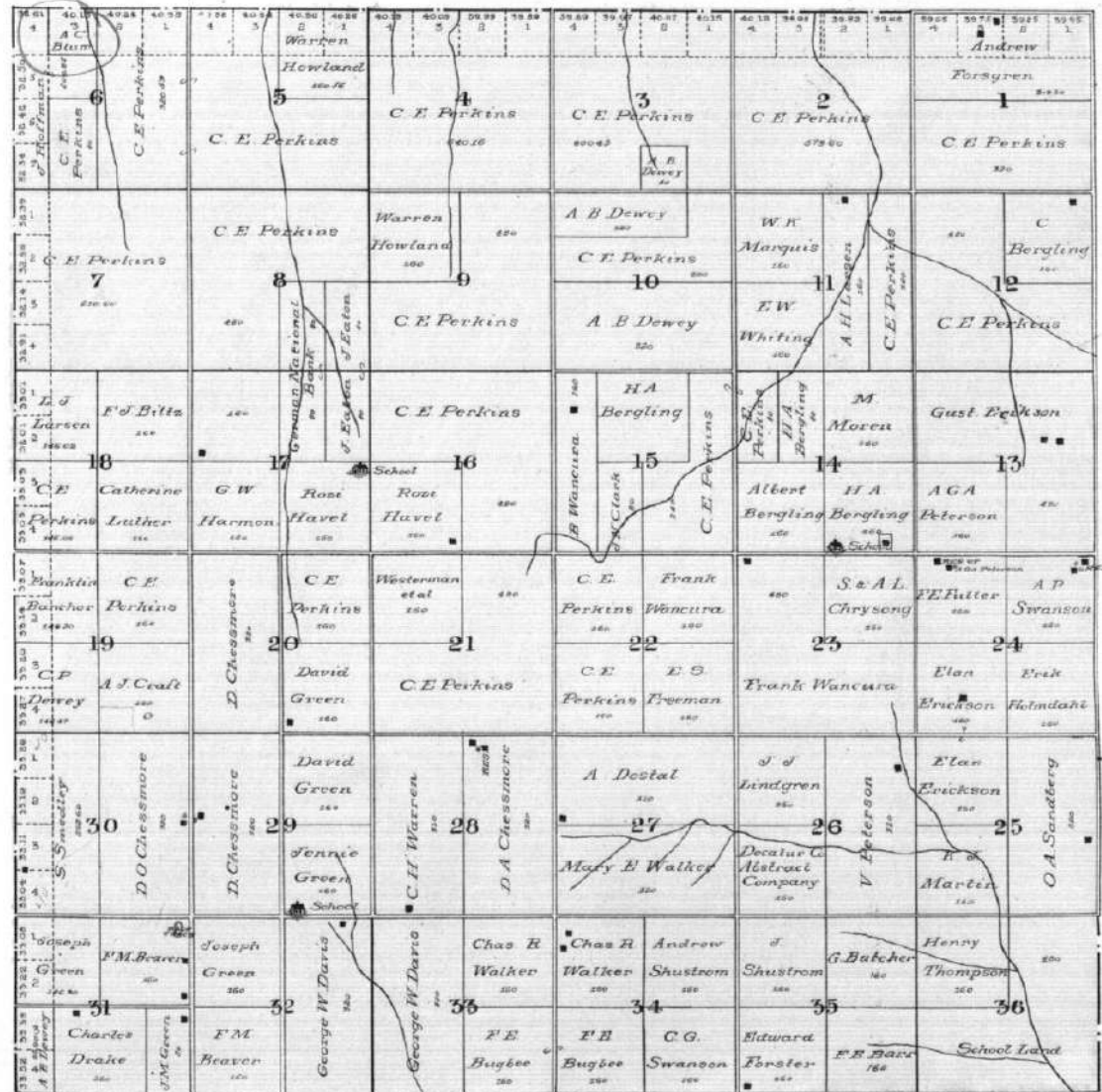



MAP OF
TOWNSHIP 35. RANGE XXXIII W.
Clark, 1881 and 1882, N. 112

OF THE 6TH Principal Meridian

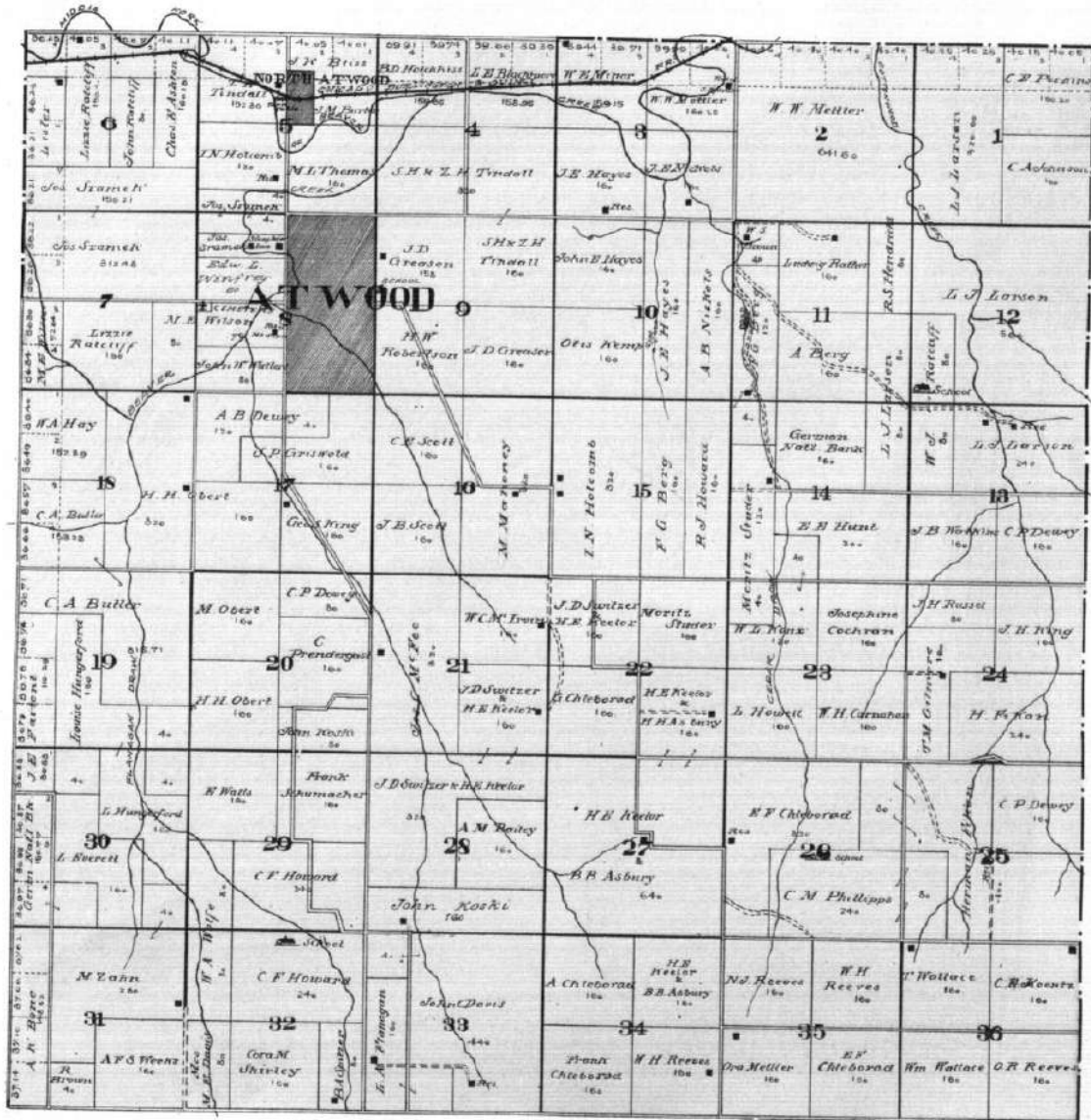



MAP OF

TOWNSHIP 3S. RANGE XXXI W.

Secs. 36 to 43

OF THE 6TH Principal Meridian

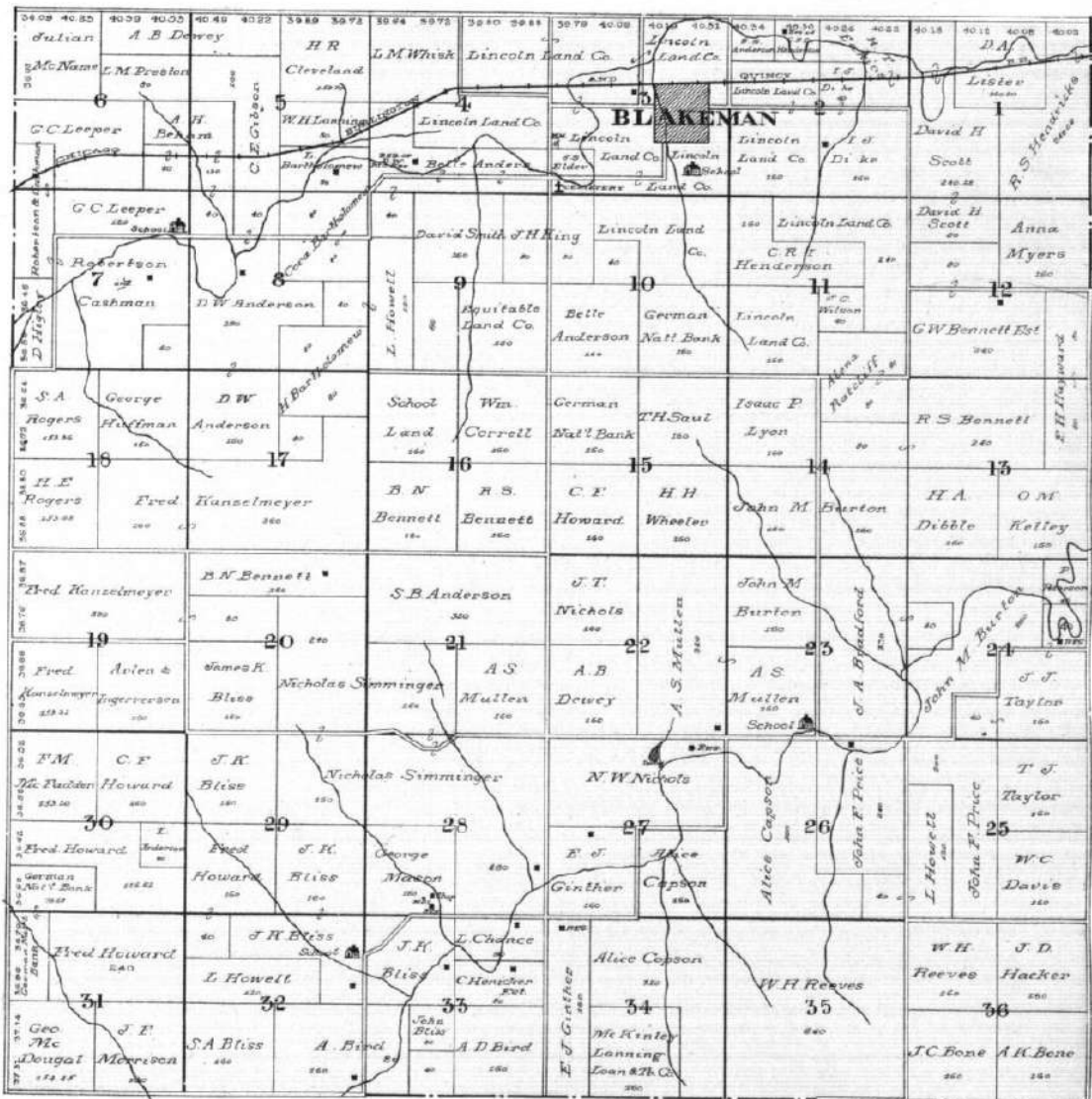



TOWNSHIP 35. RANGE XXXV

 OF THE 6TH Principal Meridian

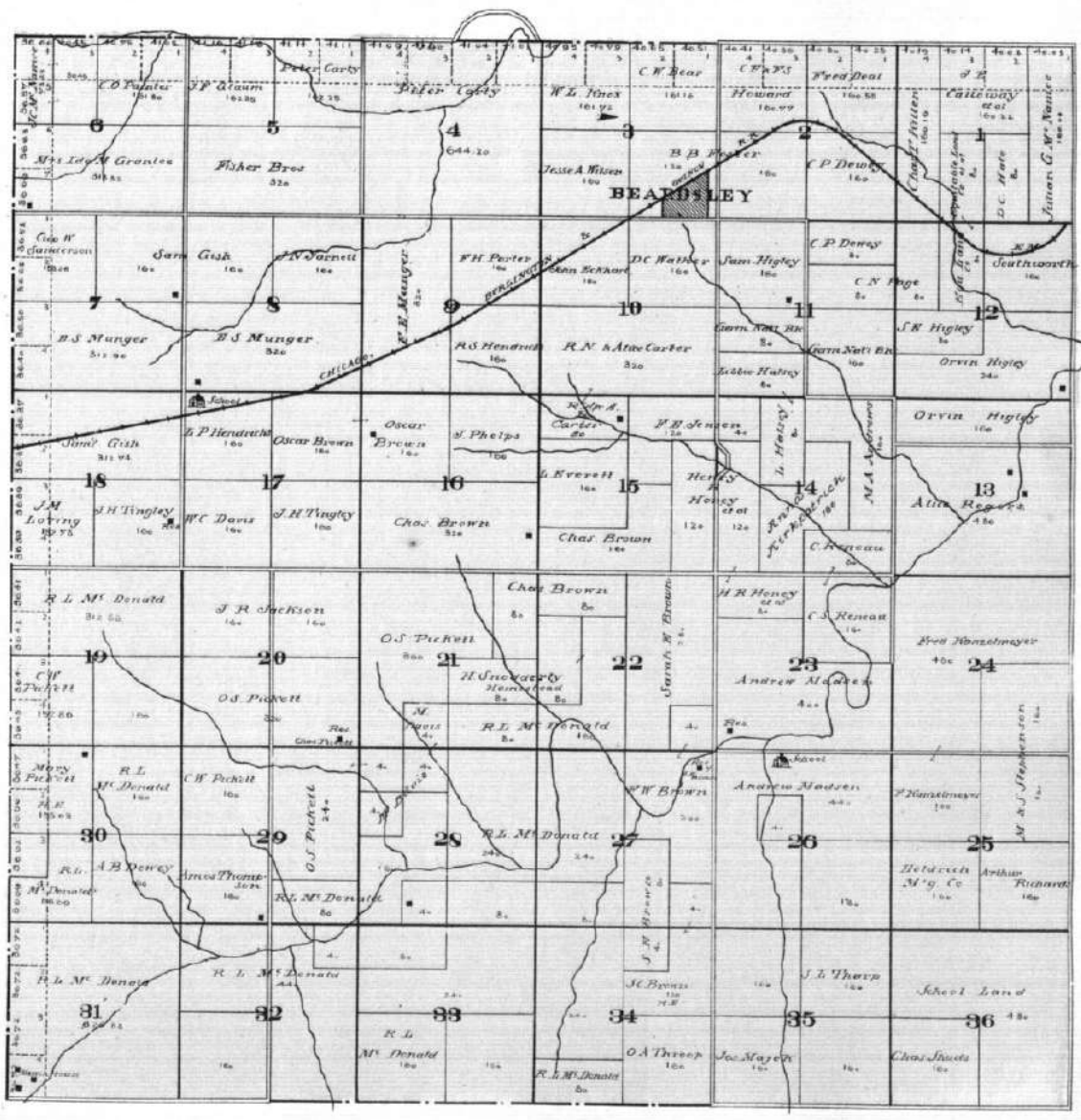

MAP OF
TOWNSHIP 35. RANGE XXXVI W.
Scale 1/8 inch = 1 mile
OF THE 6TH Principal Meridian

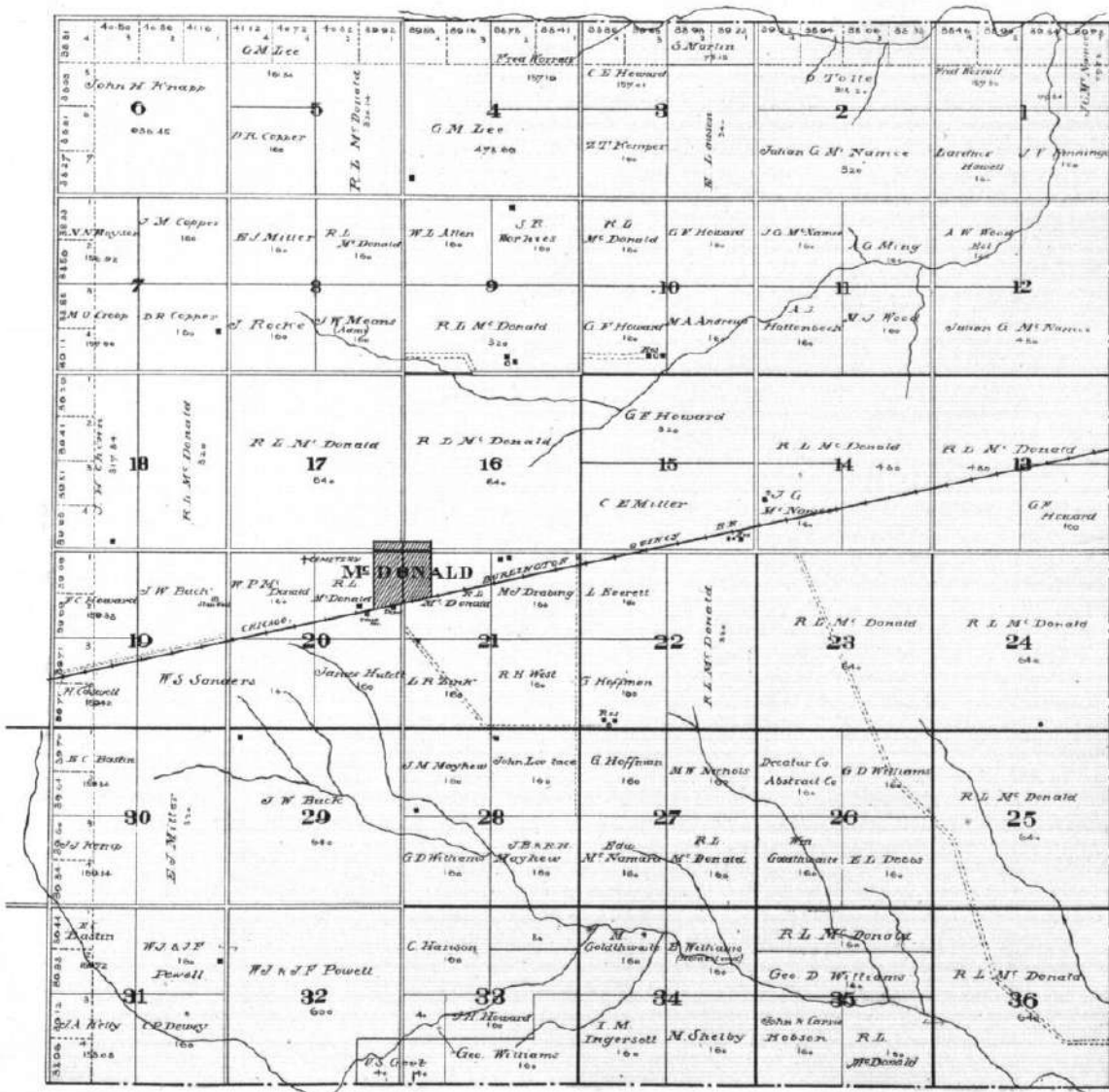



TOWNSHIP 4 S. RANGE XXXI W

OF THE 6TH Principal Meridian





MAP OF
TOWNSHIP 4 S. RANGE XXXIII W.
 OF THE 6TH Principal Meridian

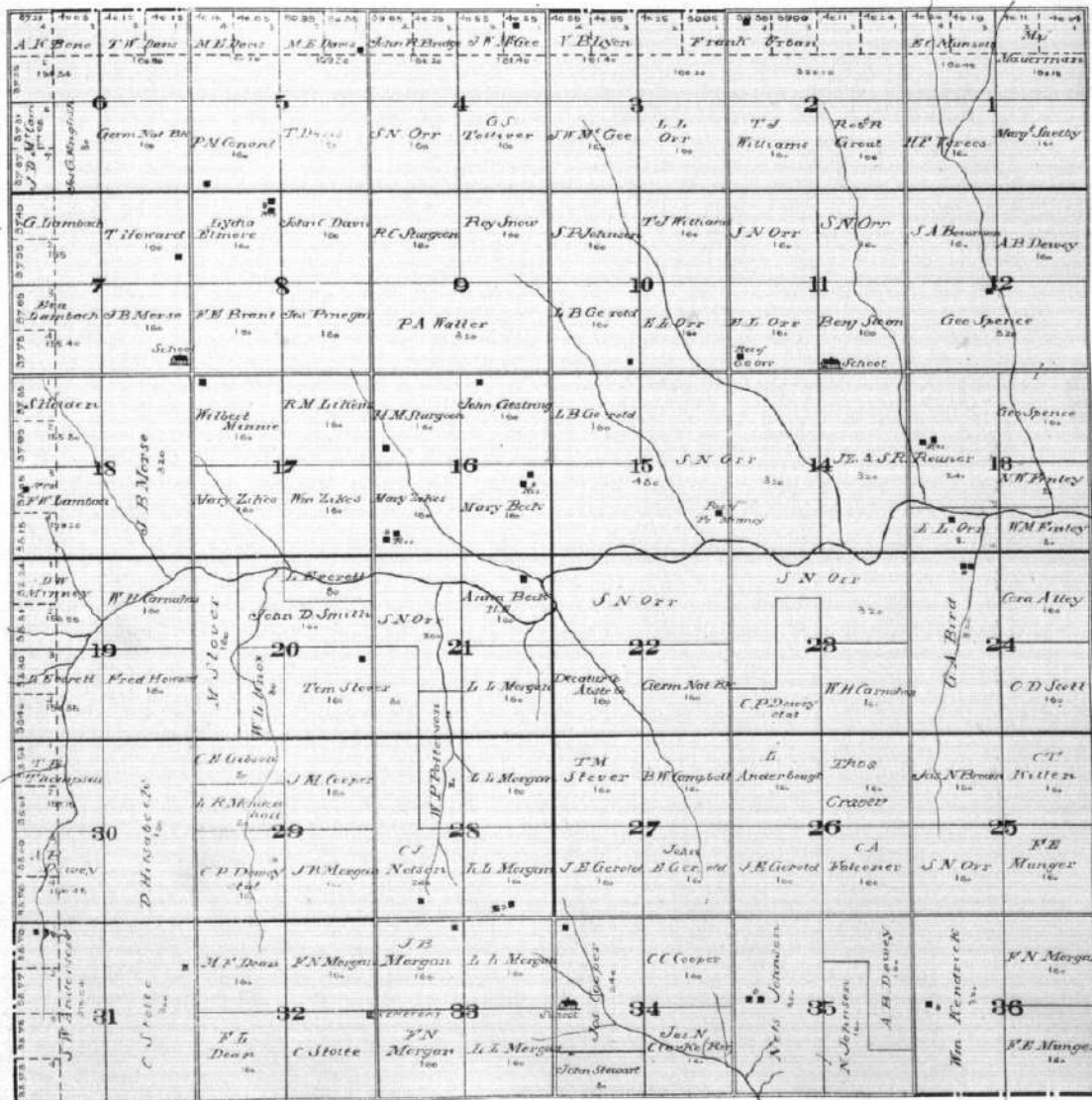

MAP OF
TOWNSHIP 4 S. RANGE XXXIV W.
 OF THE 6th Principal Meridian

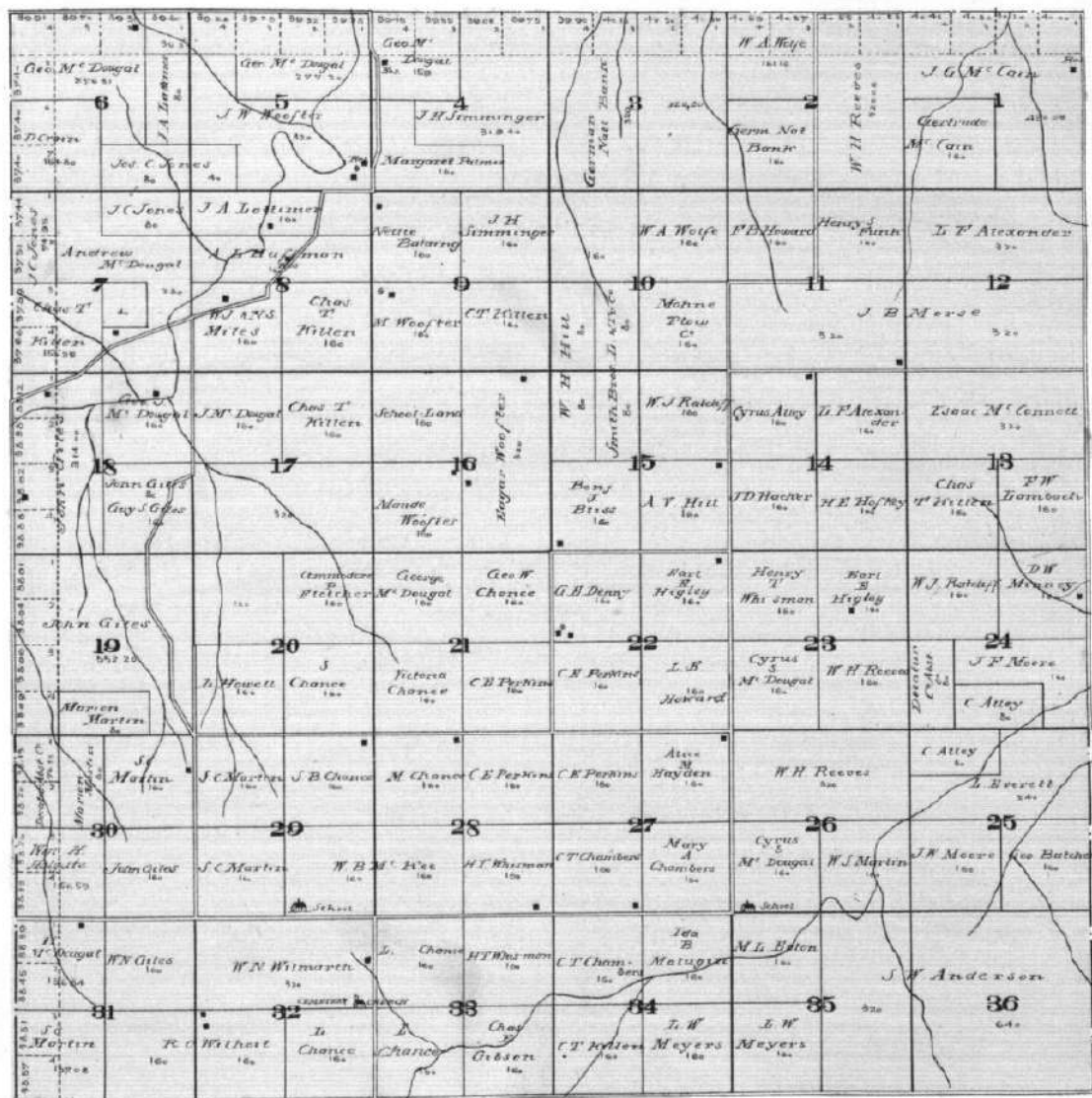



MAP OF
TOWNSHIP 4S. RANGE XXXV.
 OF THE 6TH PRINCIPAL MERIDIAN

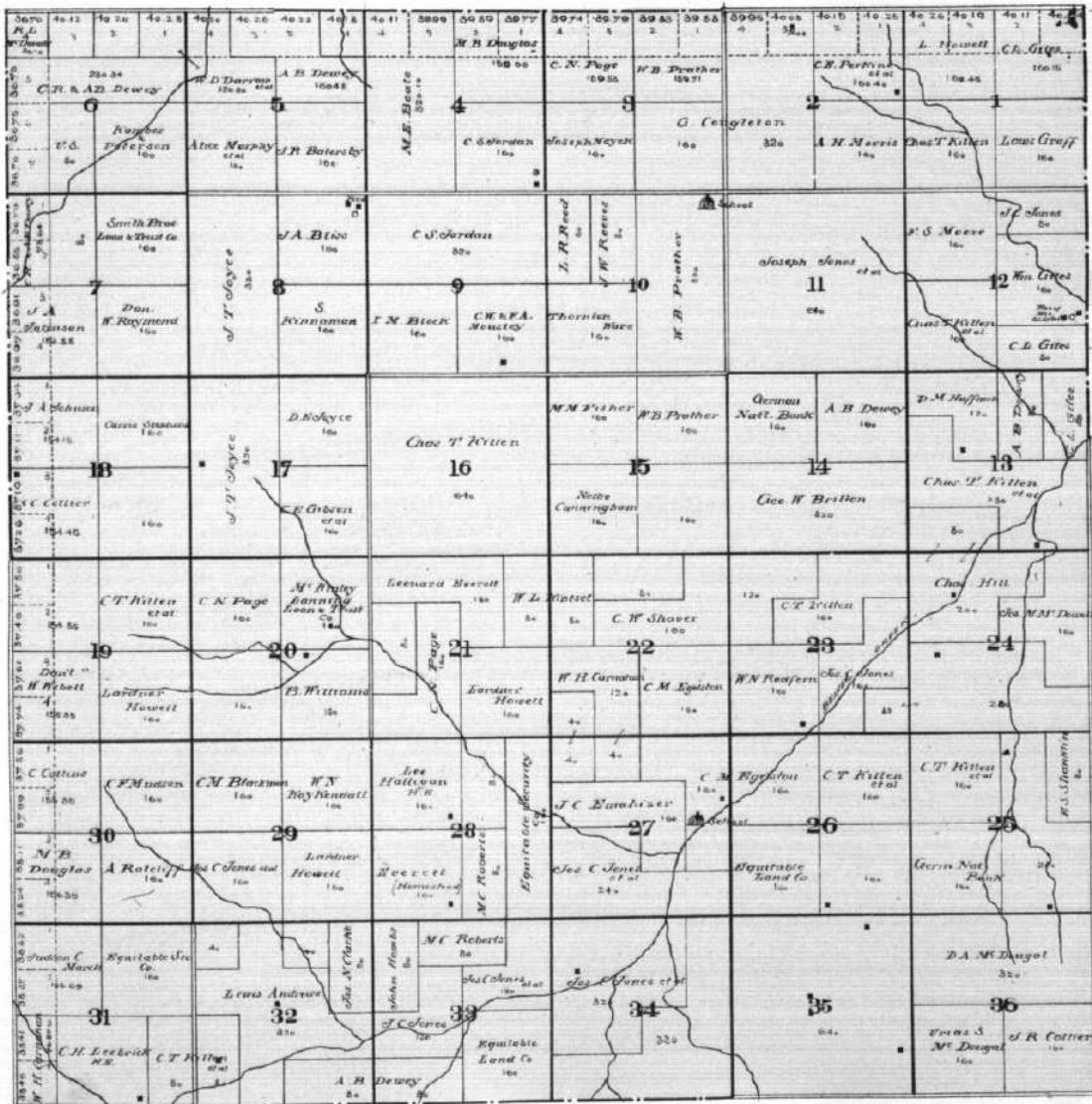

MAP OF
TOWNSHIP 5 S. RANGE XXXI W.
OF THE 6TH PRINCIPAL MERIDIAN

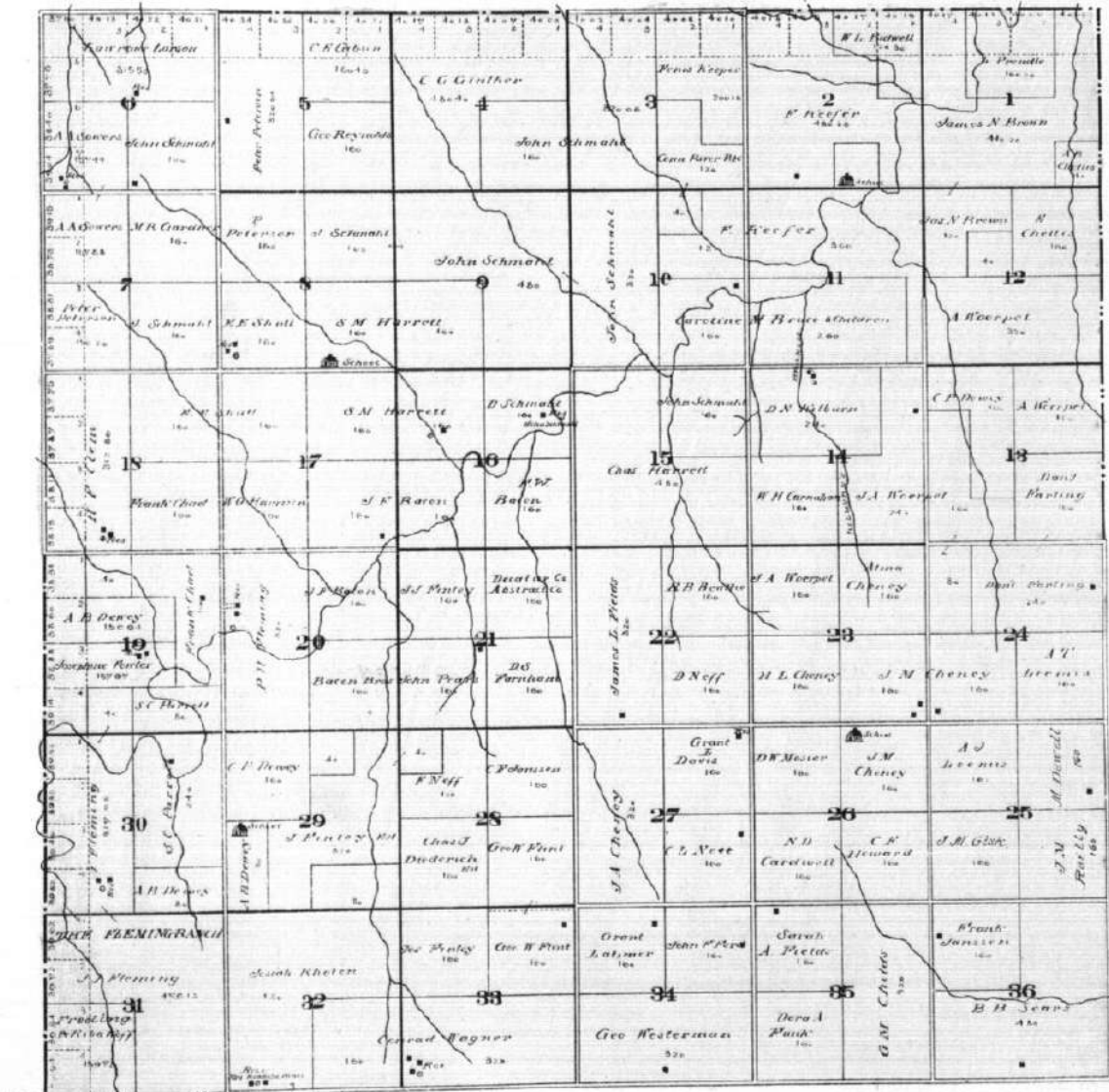

MAP OF
TOWNSHIP 5 S. RANGE XXXIII W.
Stat. 1816-1817

OF THE 6TH Principal Meridian

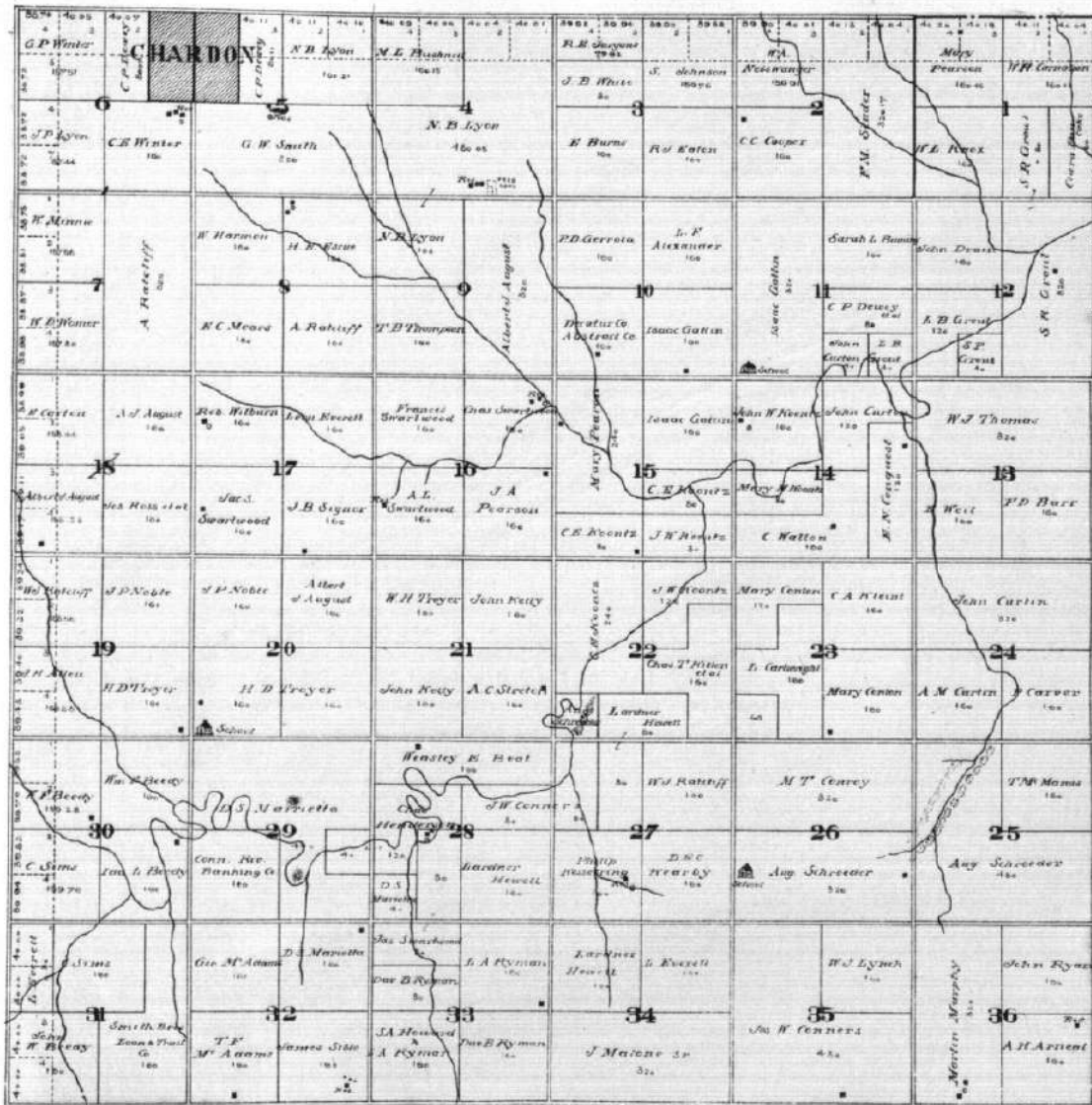



MAP OF
TOWNSHIP 5 S. RANGE XXXIV W.
Secs. 36 to 42, T. 5 S., R. 34 W.

OF THE 6TH Principal Meridian

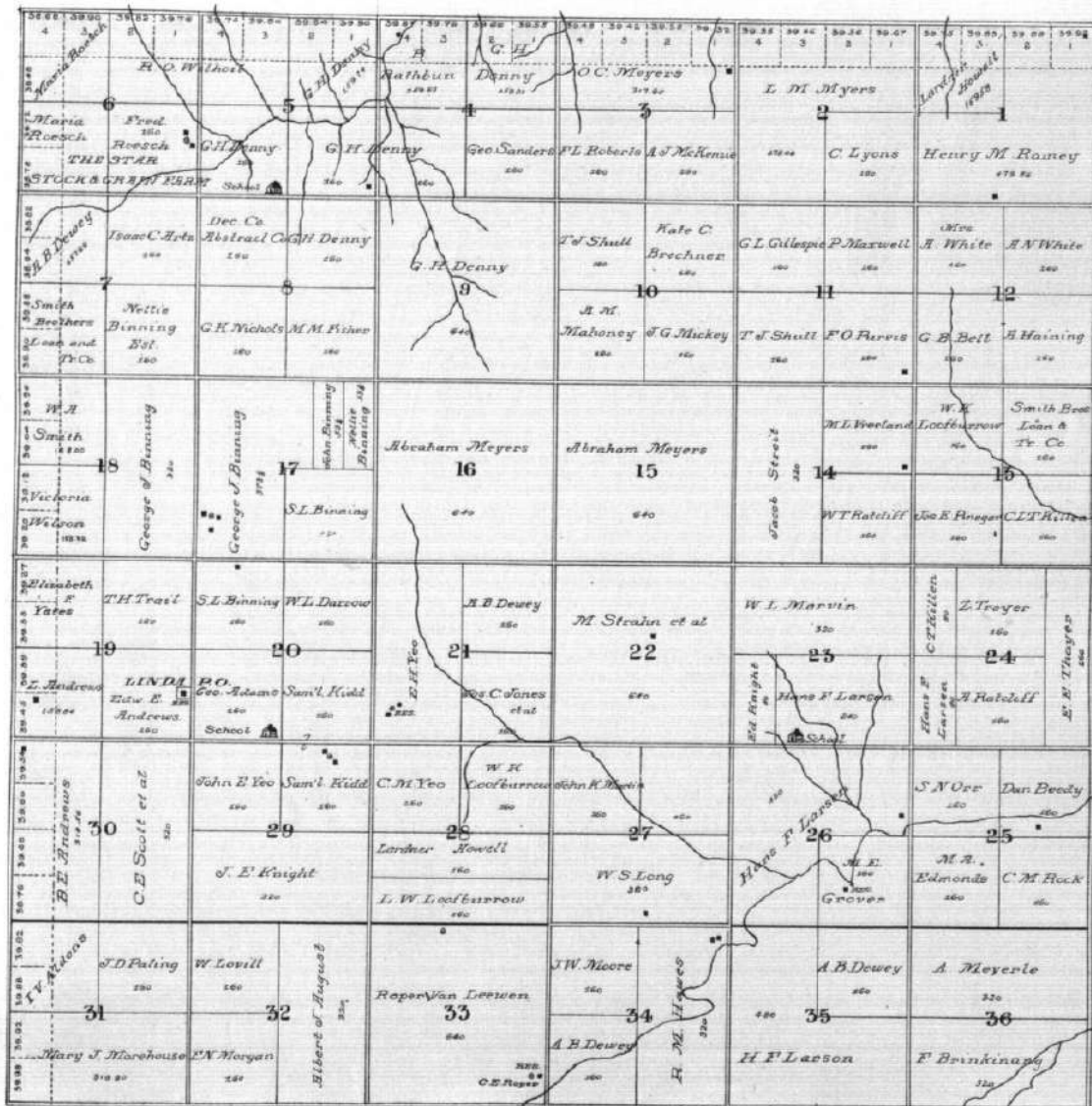



MAP OF
TOWNSHIP 5 S. RANGE XXXV W.
Scale 30' = 1" U.S. & C.

OF THE 6TH Principal Meridian

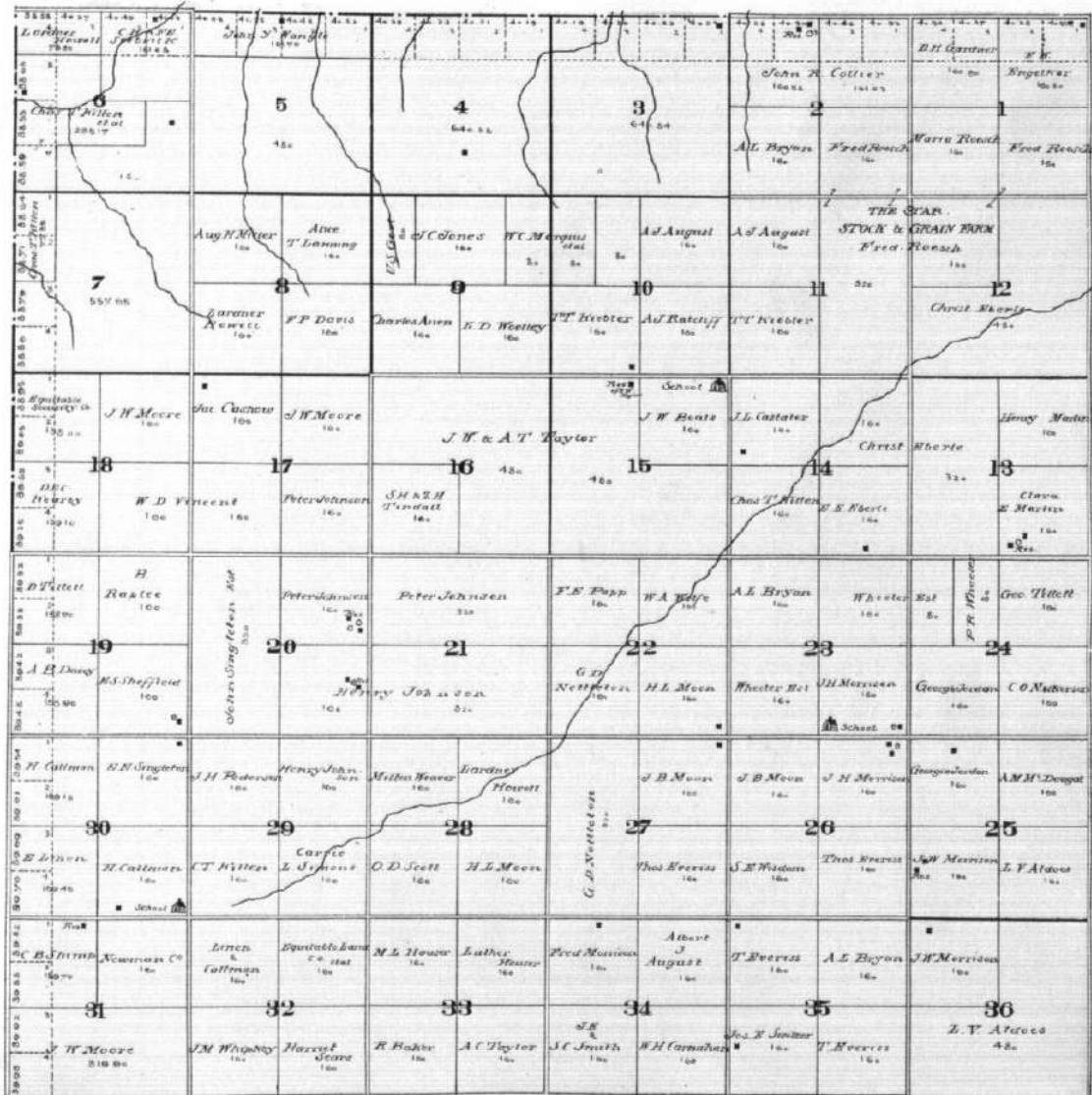



TOWNSHIP 5 S. RANGE XXXVI W.

OF THE 6TH Principal Meridian



