

# OUTLINE MAP OF RICE COUNTY

Copyright 1919 by Geo. Atgle & Co.

KANSAS

Scale 1/4 inch to 1 mile

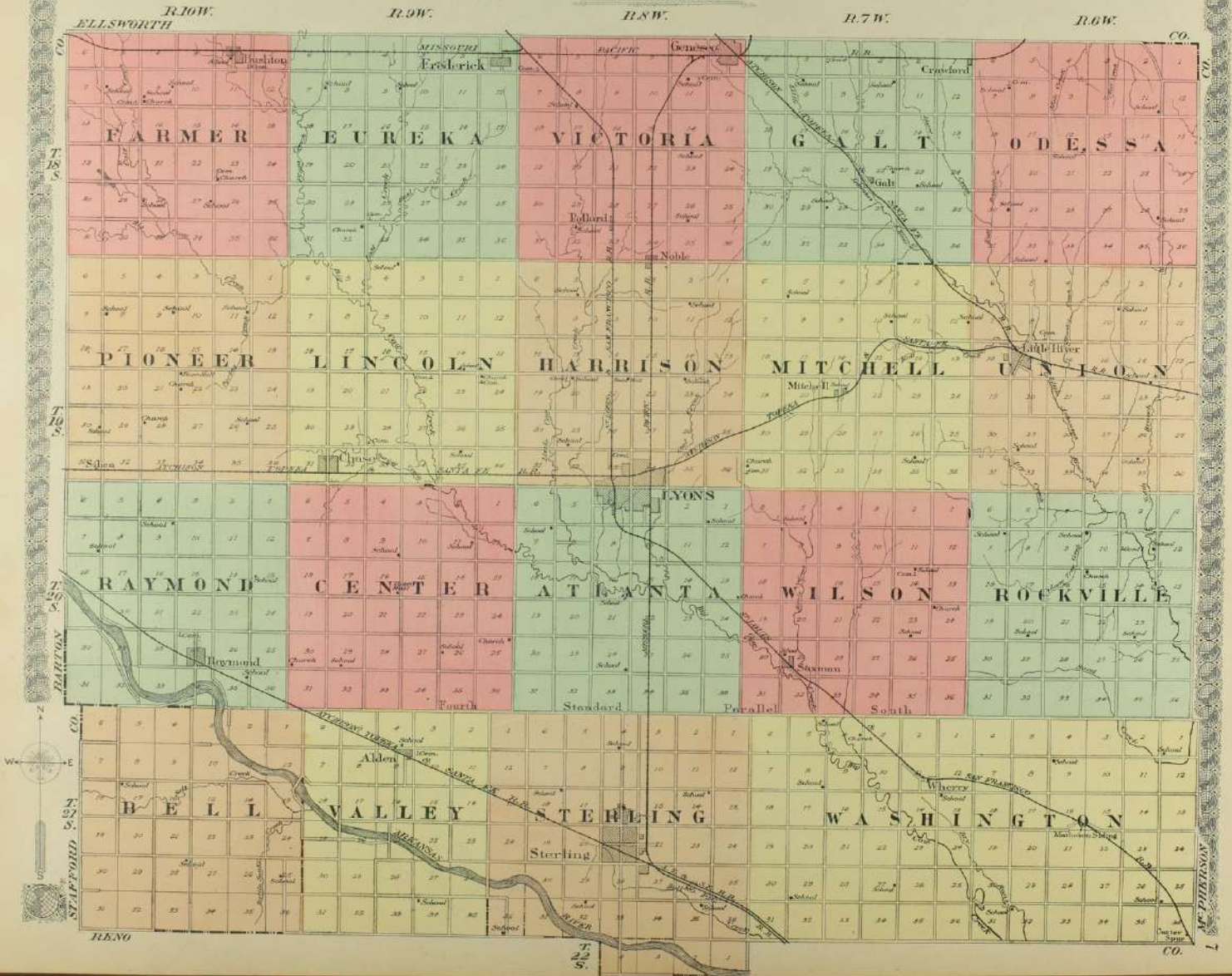

NORTH PART  
THE CITY OF  
**LYON**  
COUNTY SEAT OF RICHMOND  
ATLANTA AND HARRIS  
Scale 400 feet to 1 in.  
Copyright 1919 by Geo. A. Ogle  
Note: Large shaded figures denote water

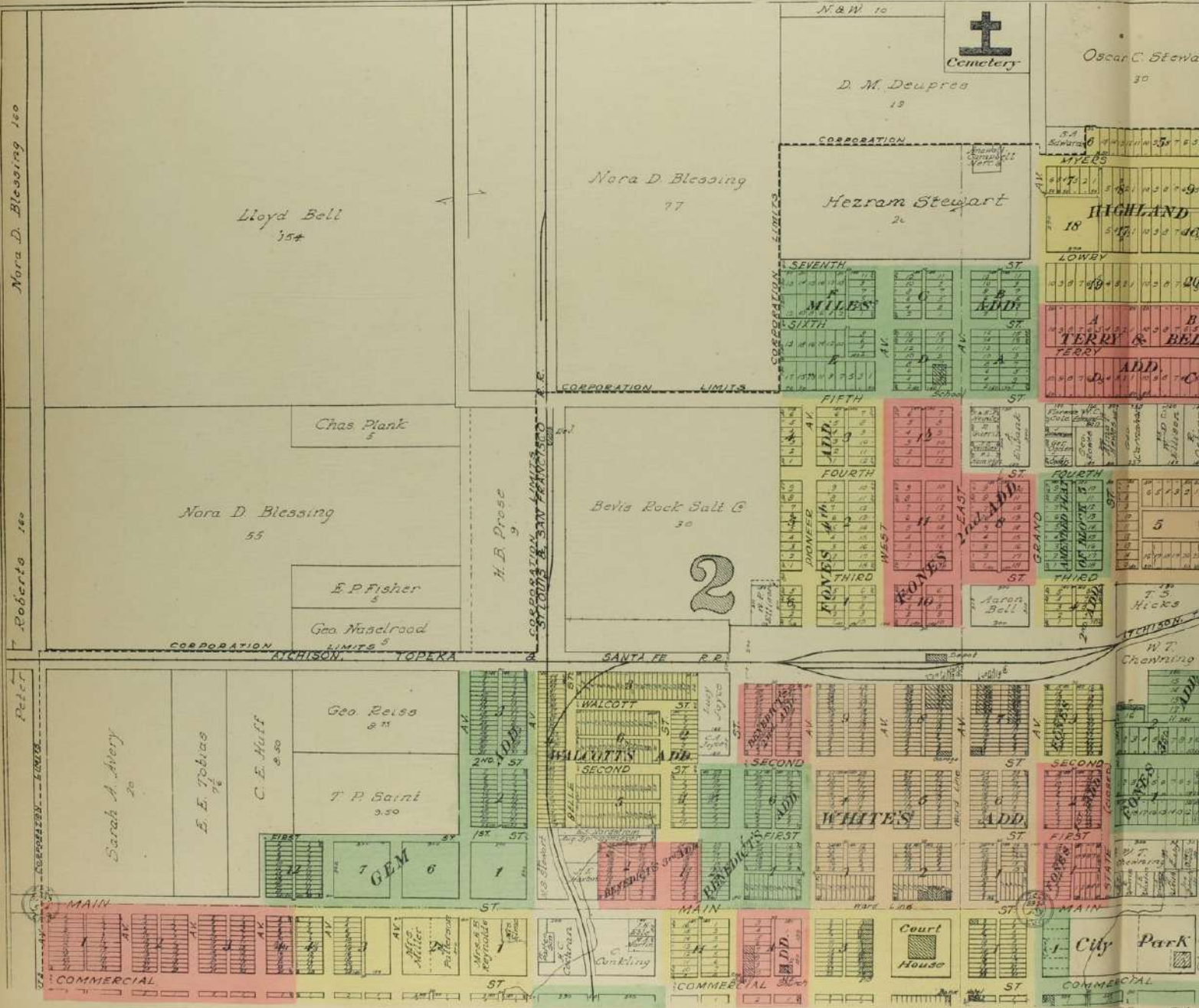

Nora D. Blessing 100

Roberto 100

Peter

FOR SOUTH PART SEE PAGE

NORTH PART OF  
THE CITY OF  
**LYONS**  
SEAT OF RICE CO., KANS.

TA AND HARRISON TWPS.

Scale 400 feet to 1 inch  
Copyright 1919 by Geo. A. Ogle & Co.  
Lot numbers denote Word Numbers

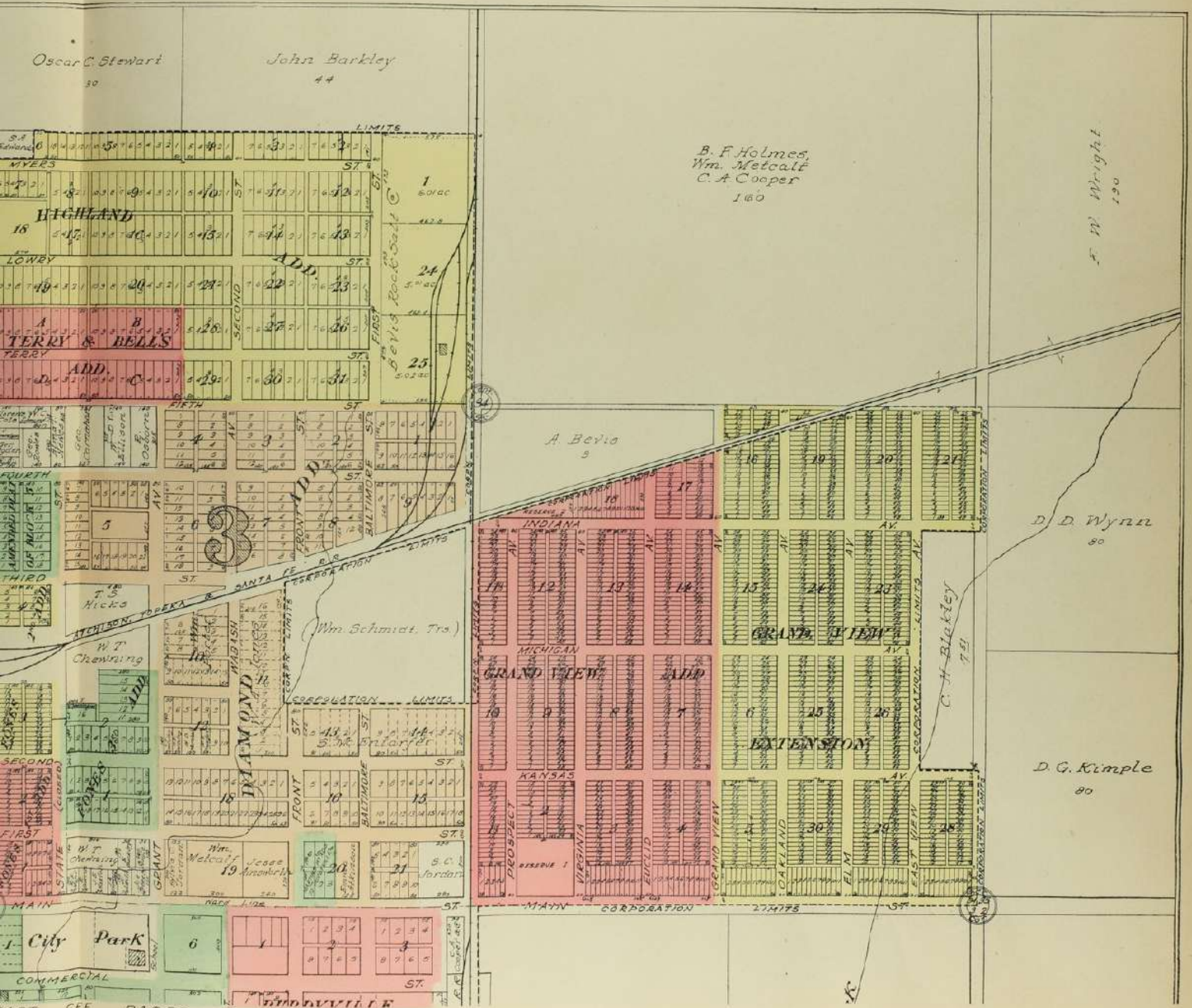

# RAYMOND

Scale 300 feet = 1 inch

RAYMOND TWP

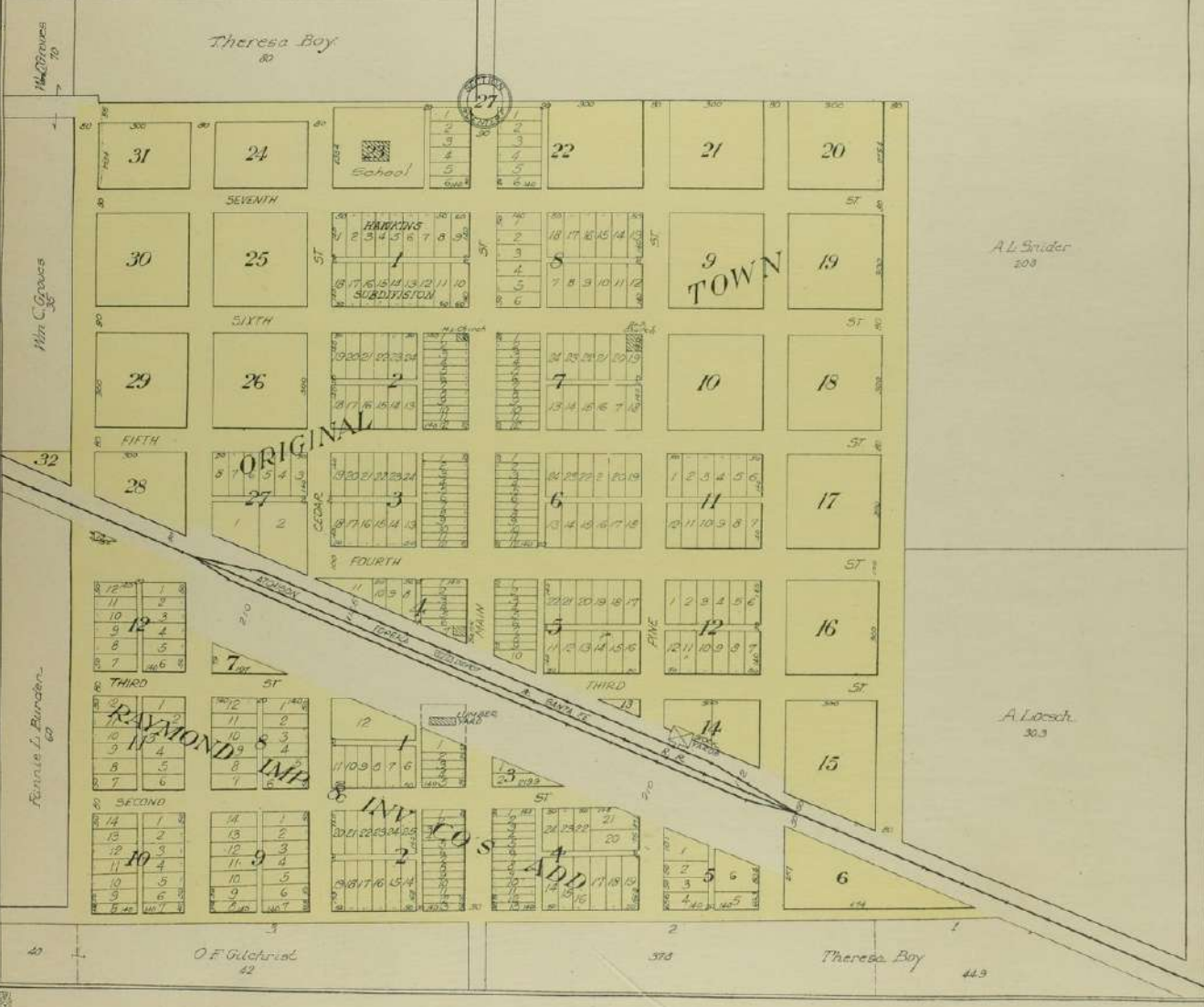

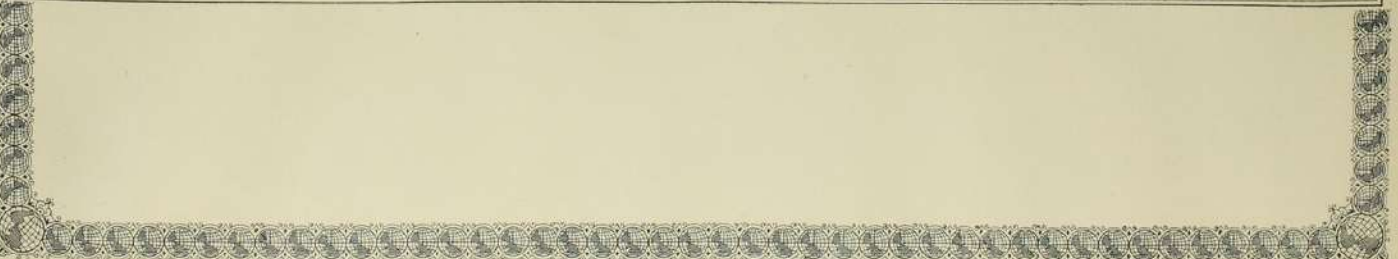
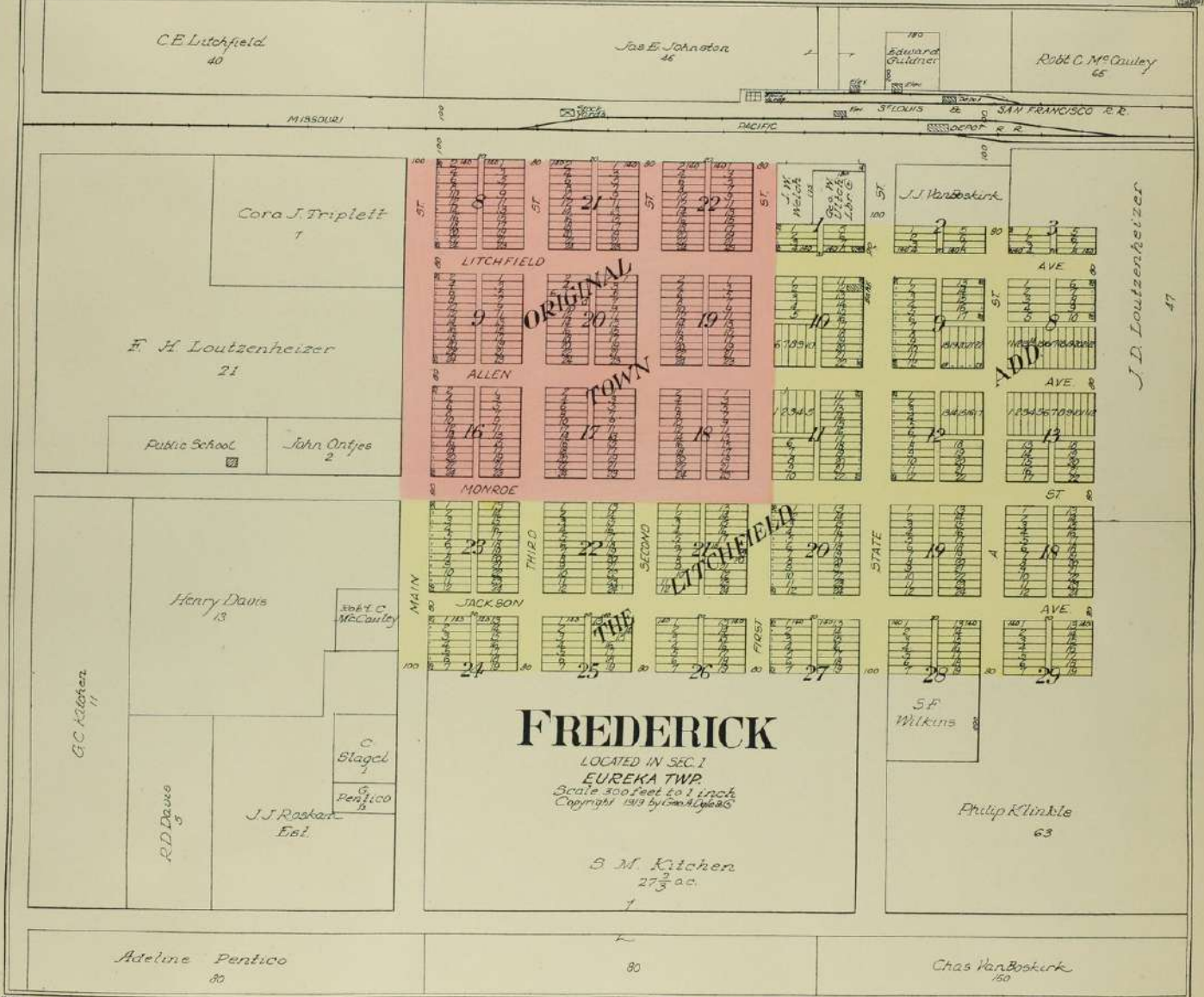
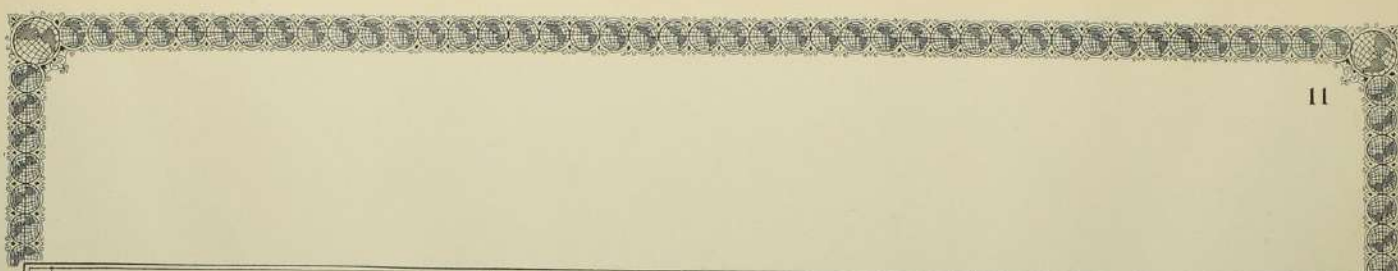

SOUTH PART OF  
THE CITY OF  
**LYONS**  
COUNTY SEAT OF RICE COUNTY  
ATLANTA AND HARRISON  
Scale 400 feet to 1 inch  
Copyright 1919 By Geo. A. Ogle & Co.  
Note: Large shaded figures denote Ward Numbers

FOR NORTH PART SEE PAGES 8 & 9

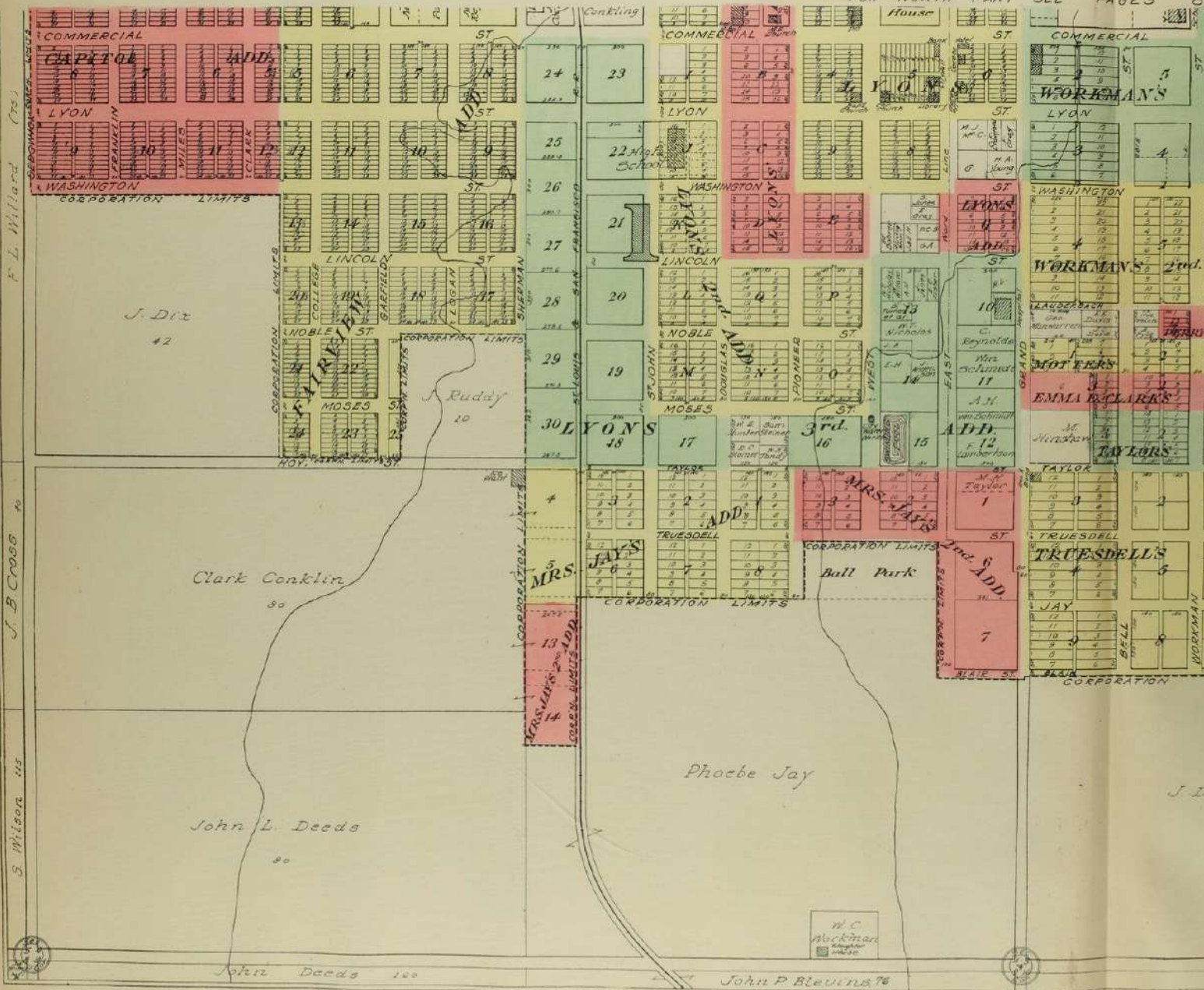

SOUTH PART OF  
THE CITY OF  
**YONS**  
SEAT OF RICE CO., KANS.

AND HARRISON TWP.  
Scale 400 feet to 1 inch  
Copyright 1919 by Geo. A. Ogle & Co.  
Figures denote Word Numbers

SEE PAGES 8 AND 9

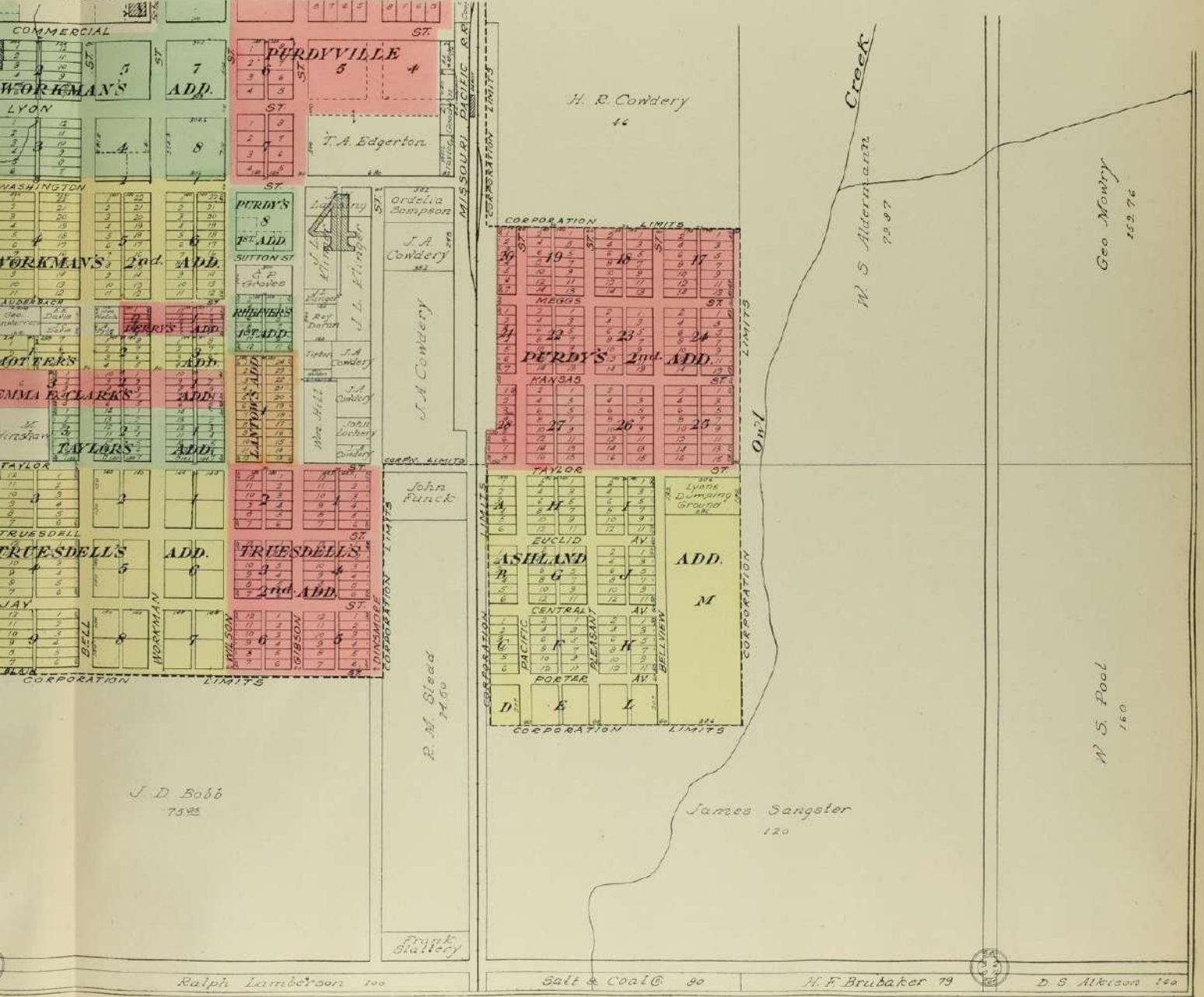

Ralph Lamberoon 100

Salt & Coal Co 90

H. F. Brubaker 79

D. S. Atkinson 140

# CHASE

LOCATED IN SECTIONS 31 AND 32

LINCOLN TWP

Scale 300ft=1inch

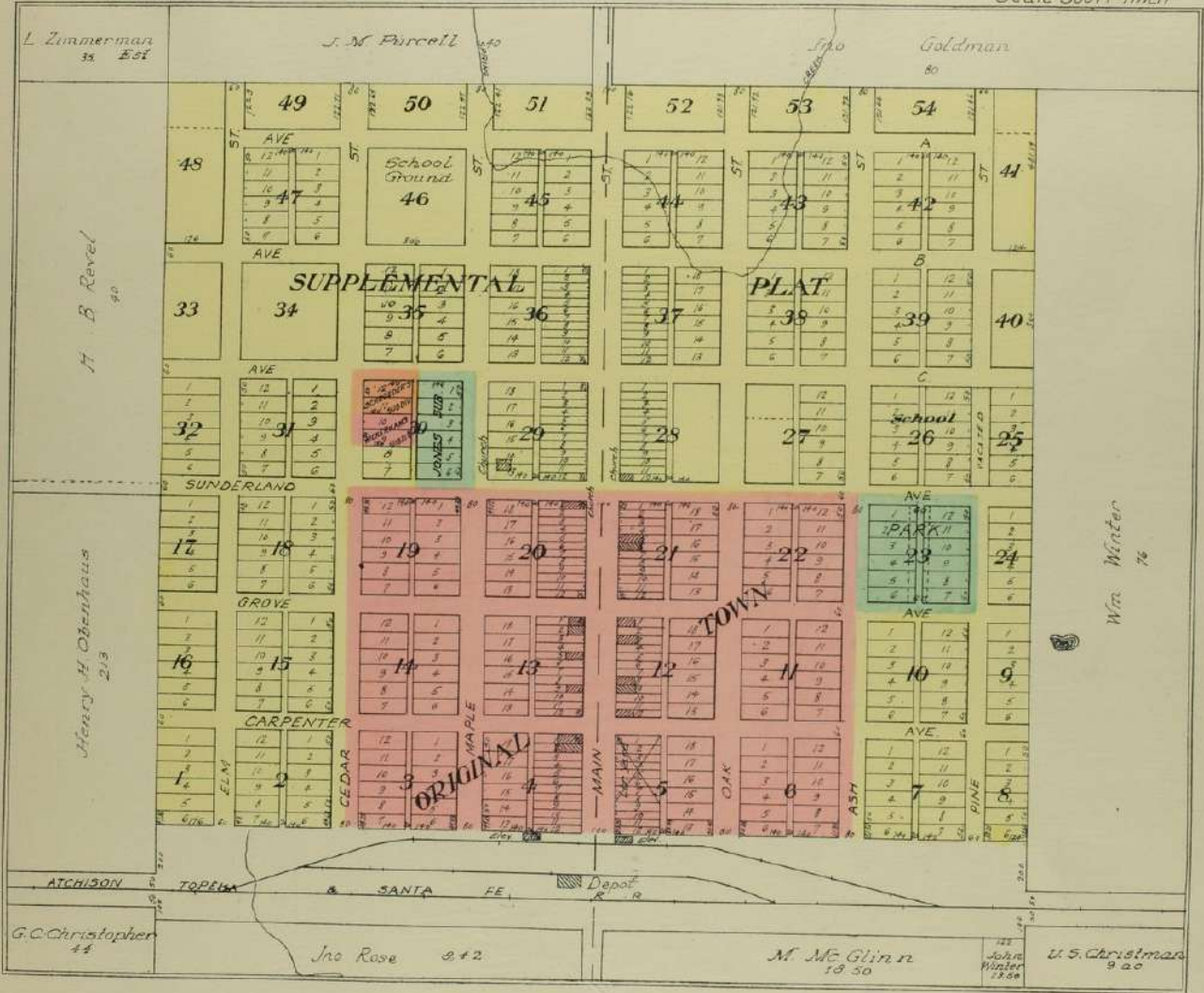



# ALDEN

VALLEY TWP

Scale 300 feet = 1 inch

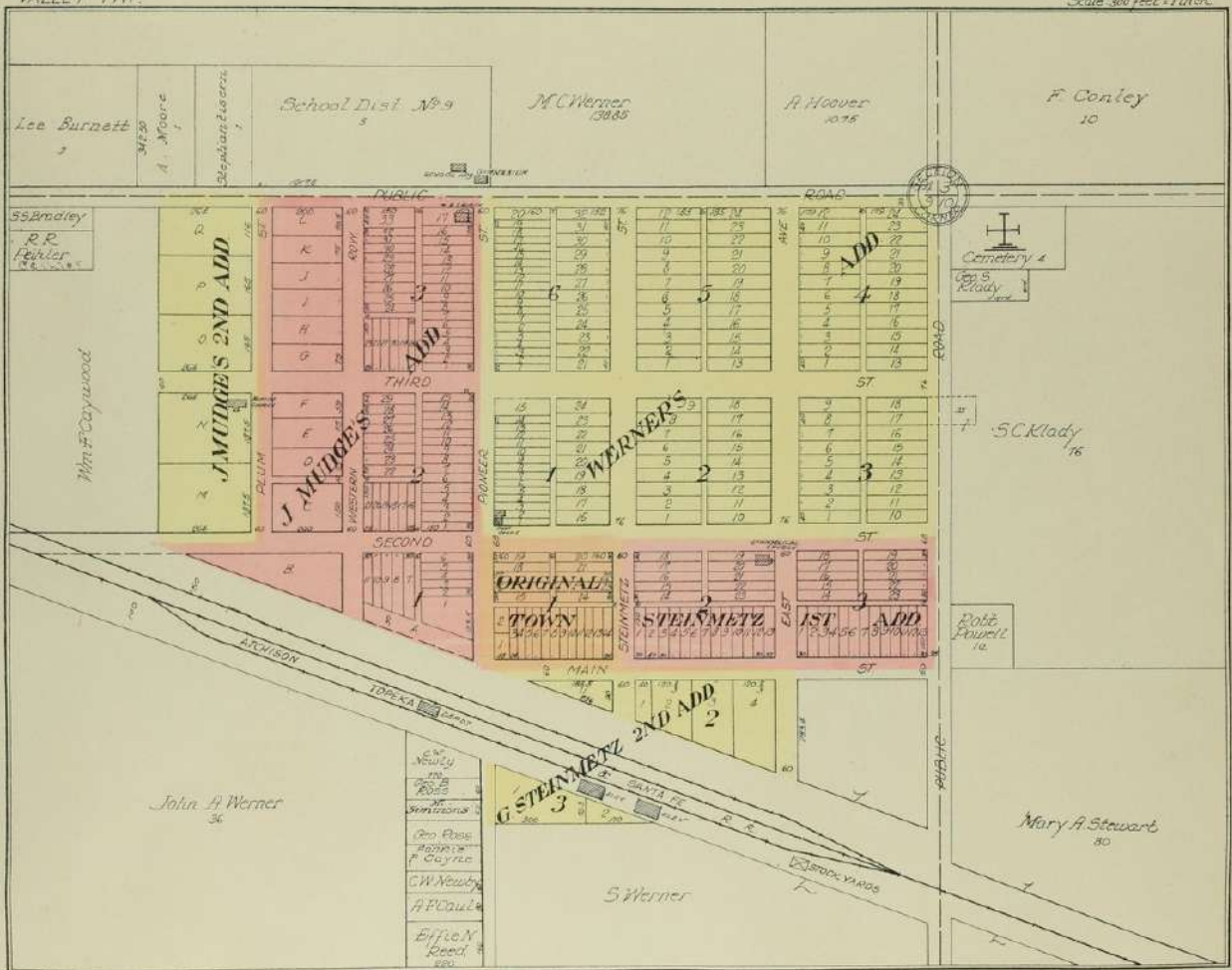



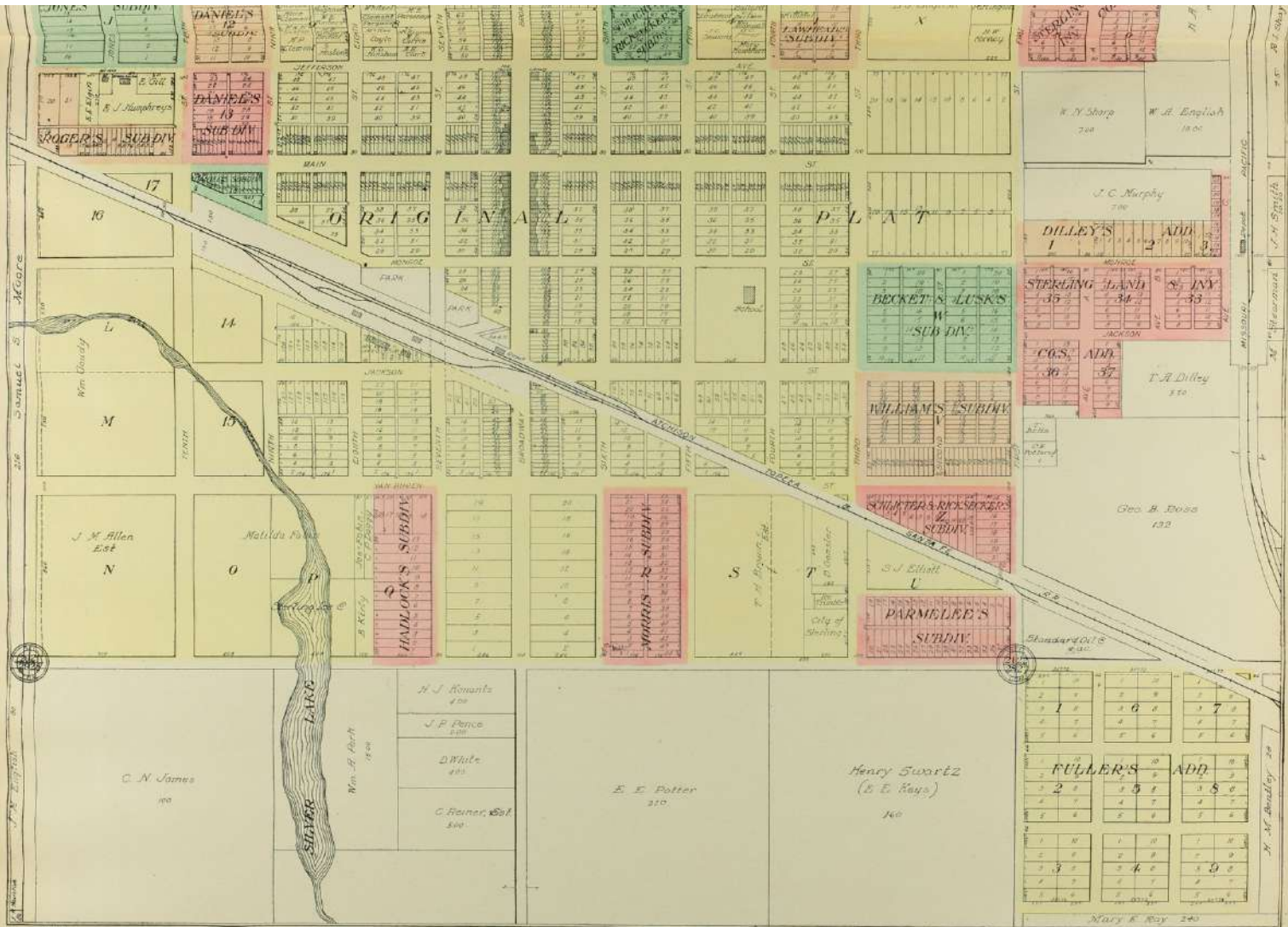

**MAP OF**  
**BELL**  
 TOWNSHIP  
 Scale 2 inches to 1 mile

Township 21 South, Range 10 West of the 6th P.M.



MAP OF  
**RAYMOND**  
TOWNSHIP

Scale 2 inches to 1 mile

Township 20 South, Range 10 West of the 6th P.M.

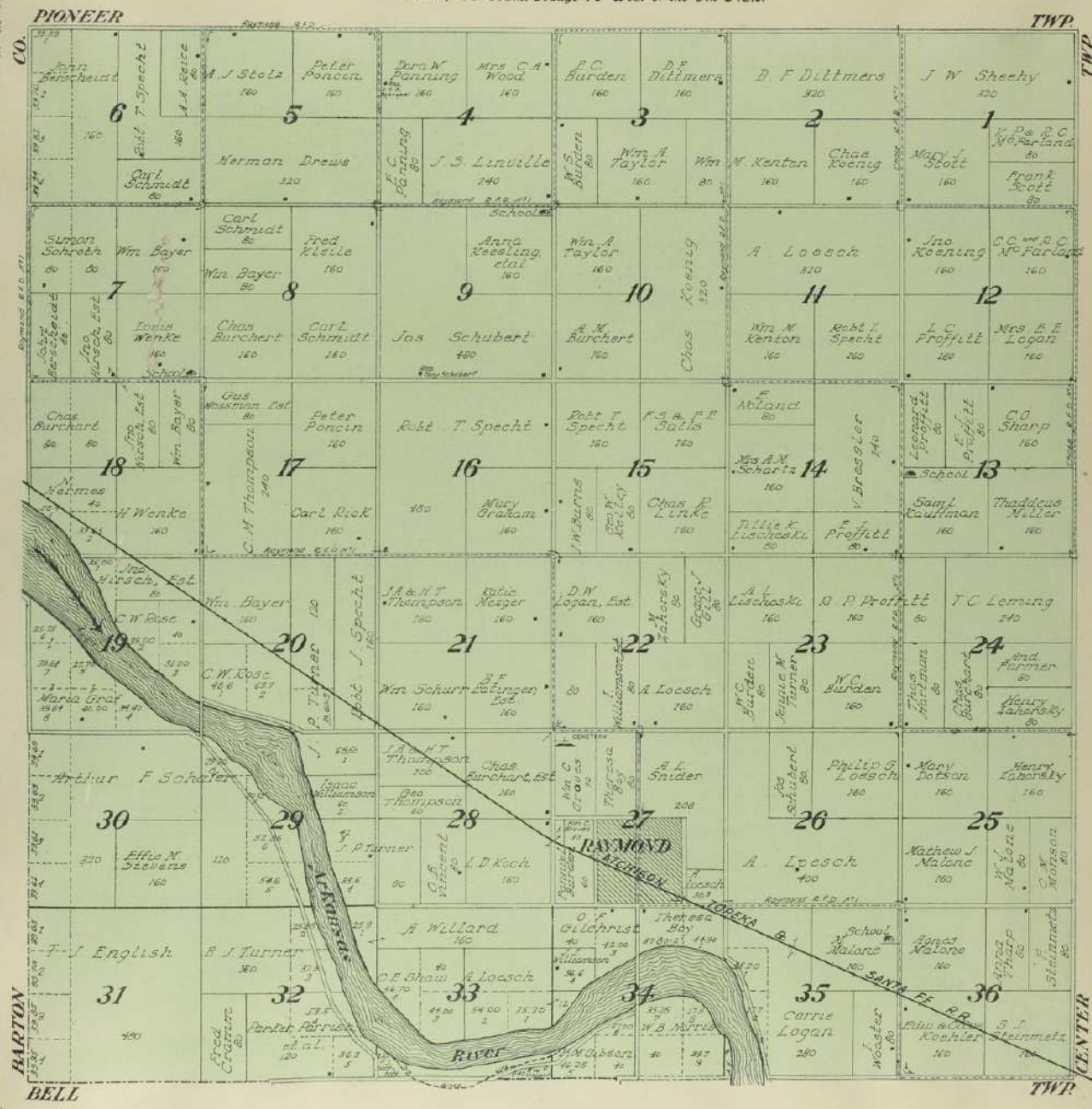

# GENESEO

VICTORIA TWP.

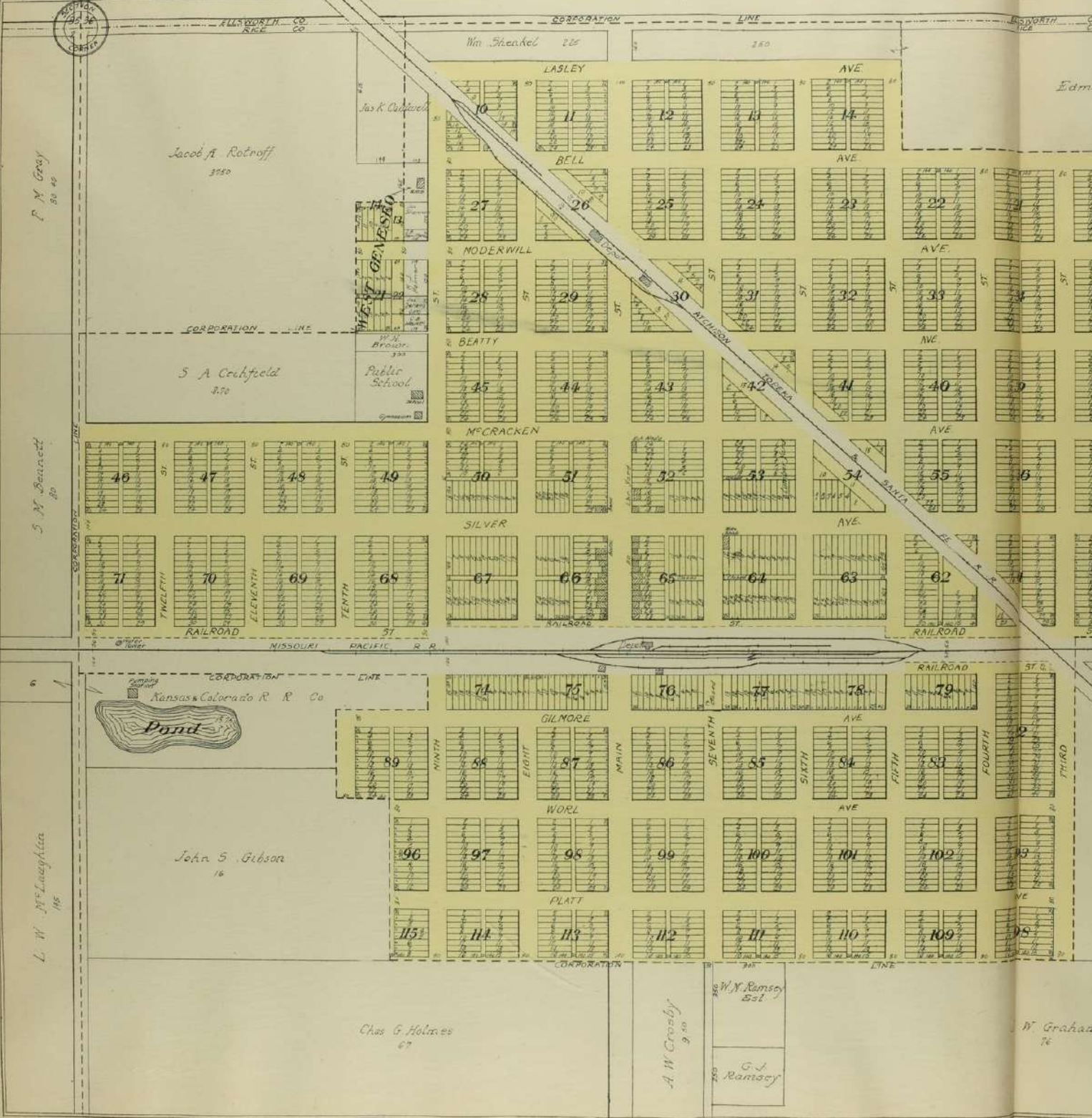

Scale 300 ft = 1 inch

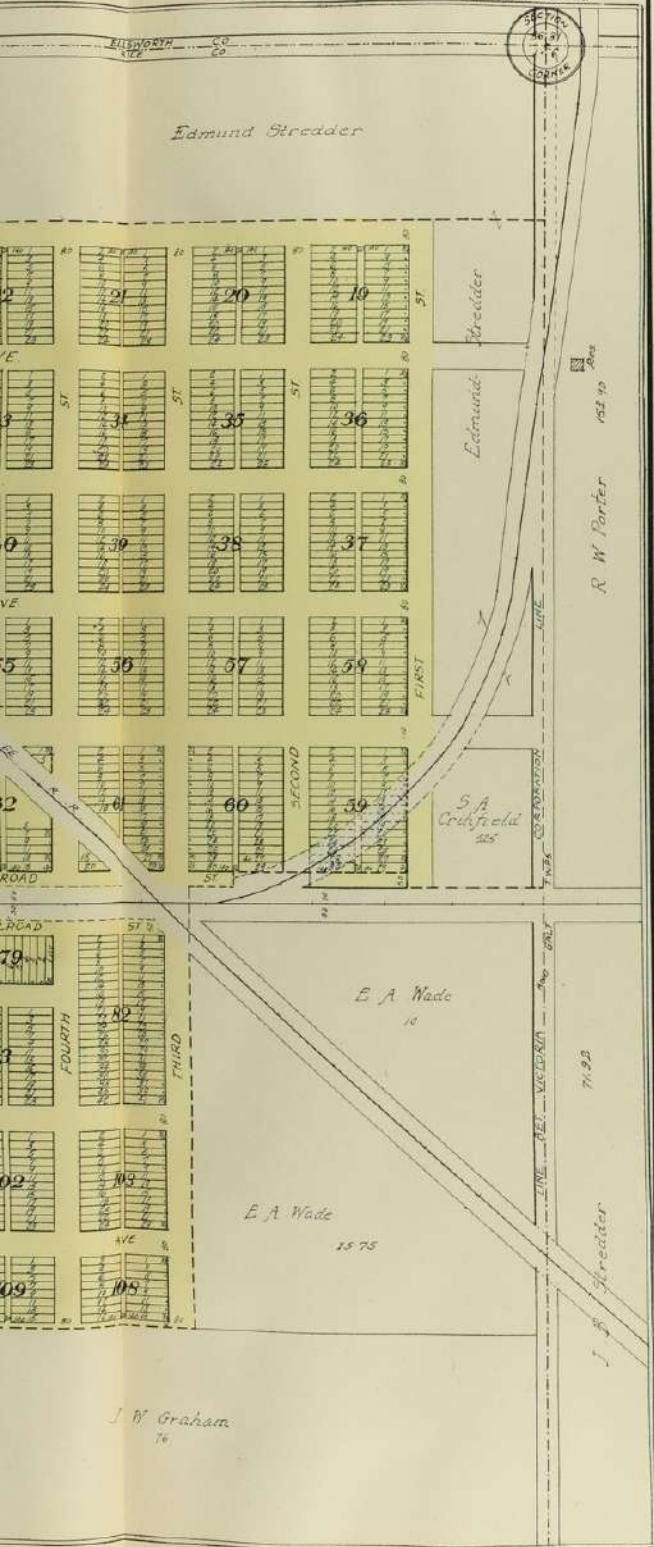

# BUSHTON

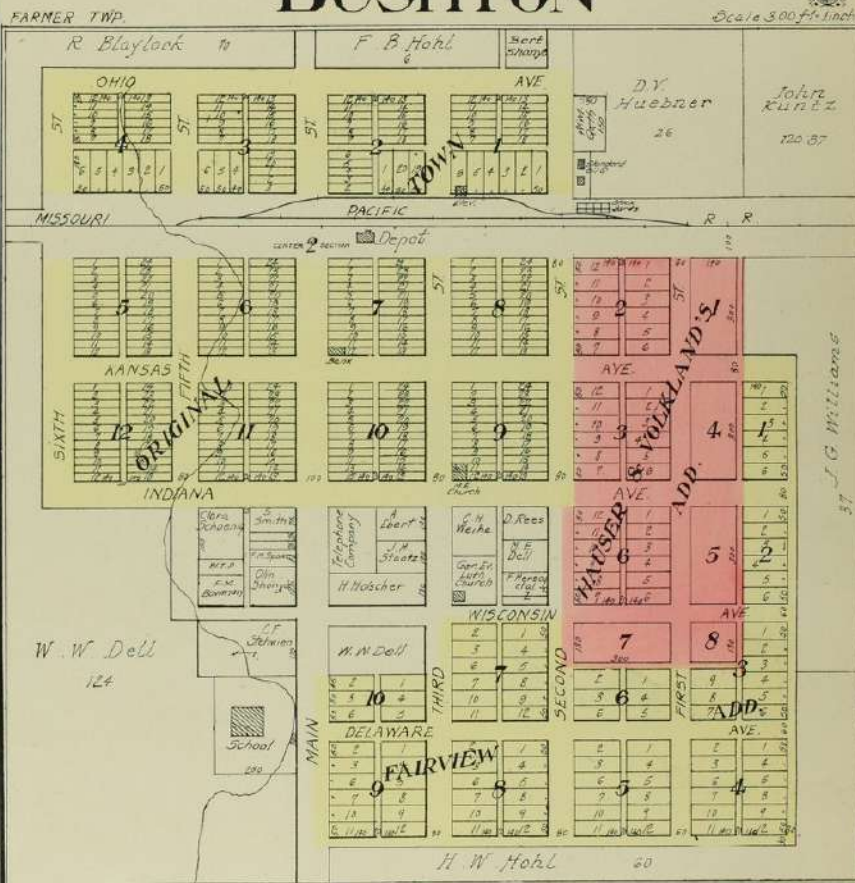

Scale 300 ft = 1 inch





MAP OF  
**FARMER**  
TOWNSHIP

Scale 2 inches to 1 mile

Township 18 South, Range 10 West of the 6th P.M.

ELLSWORTH

CO

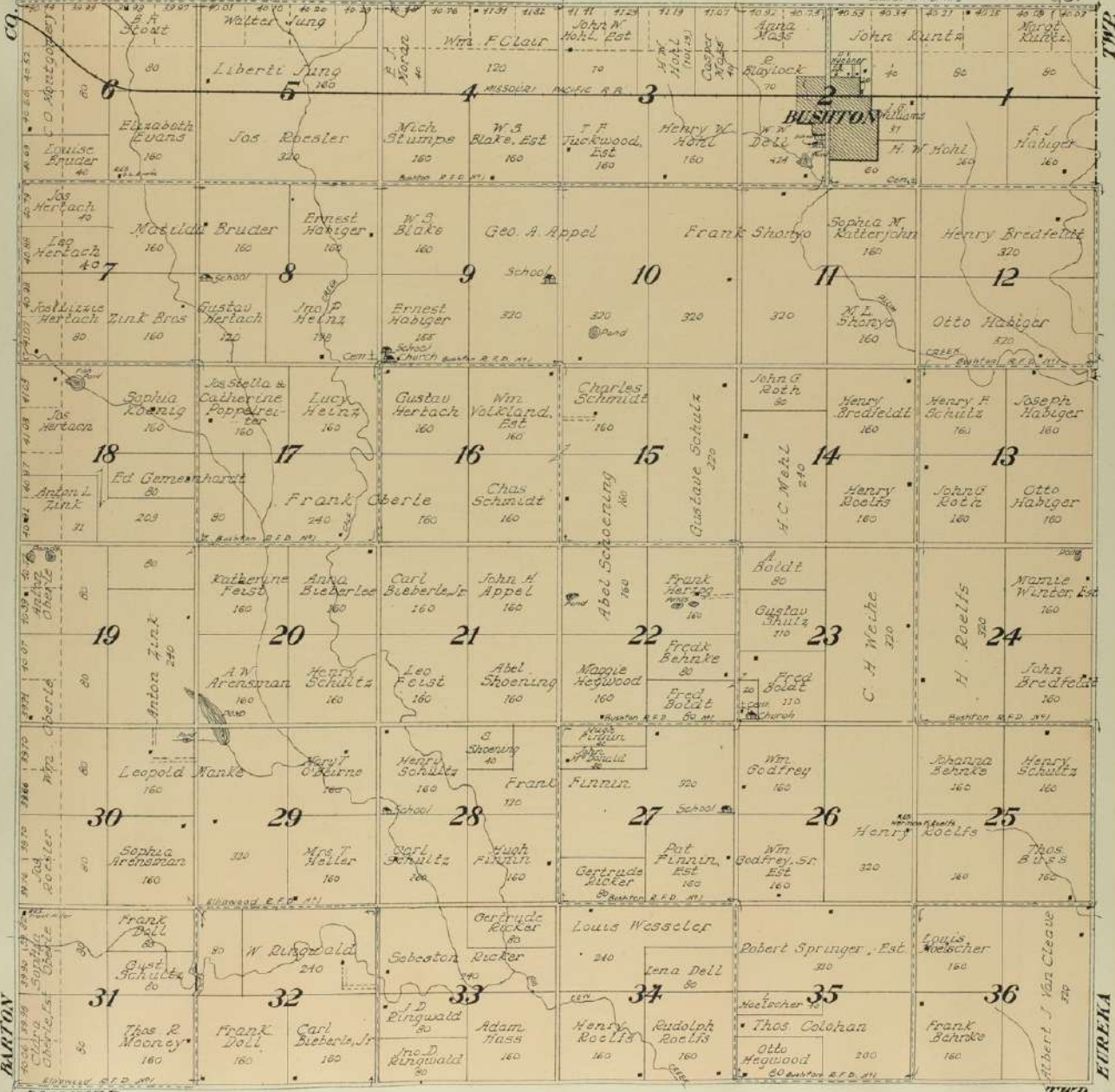

BARTON

EUREKA

PIONEER

TWP.

# LITTLE RIVER

UNION TWP.

Scale 300 ft. = 1 inch



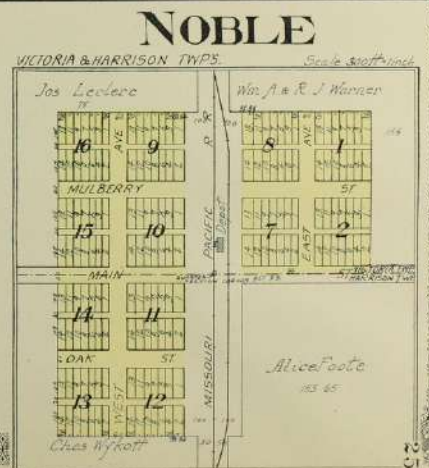
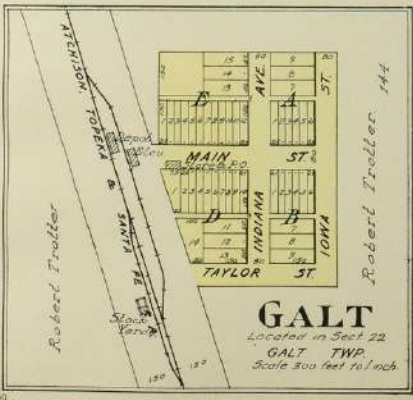
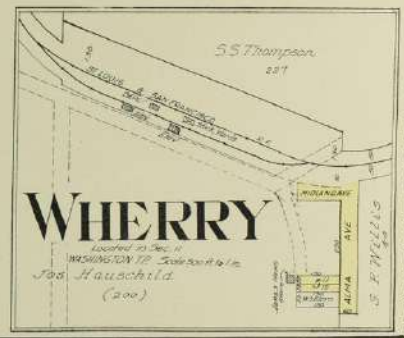
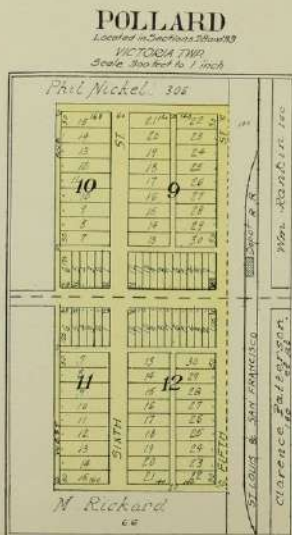
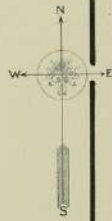
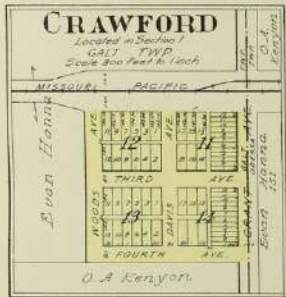
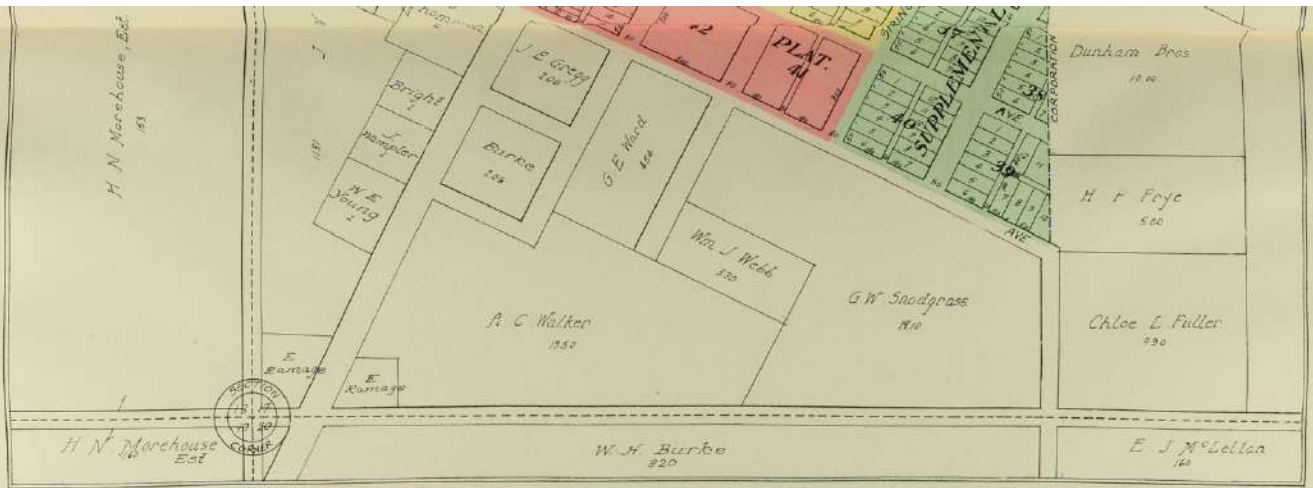



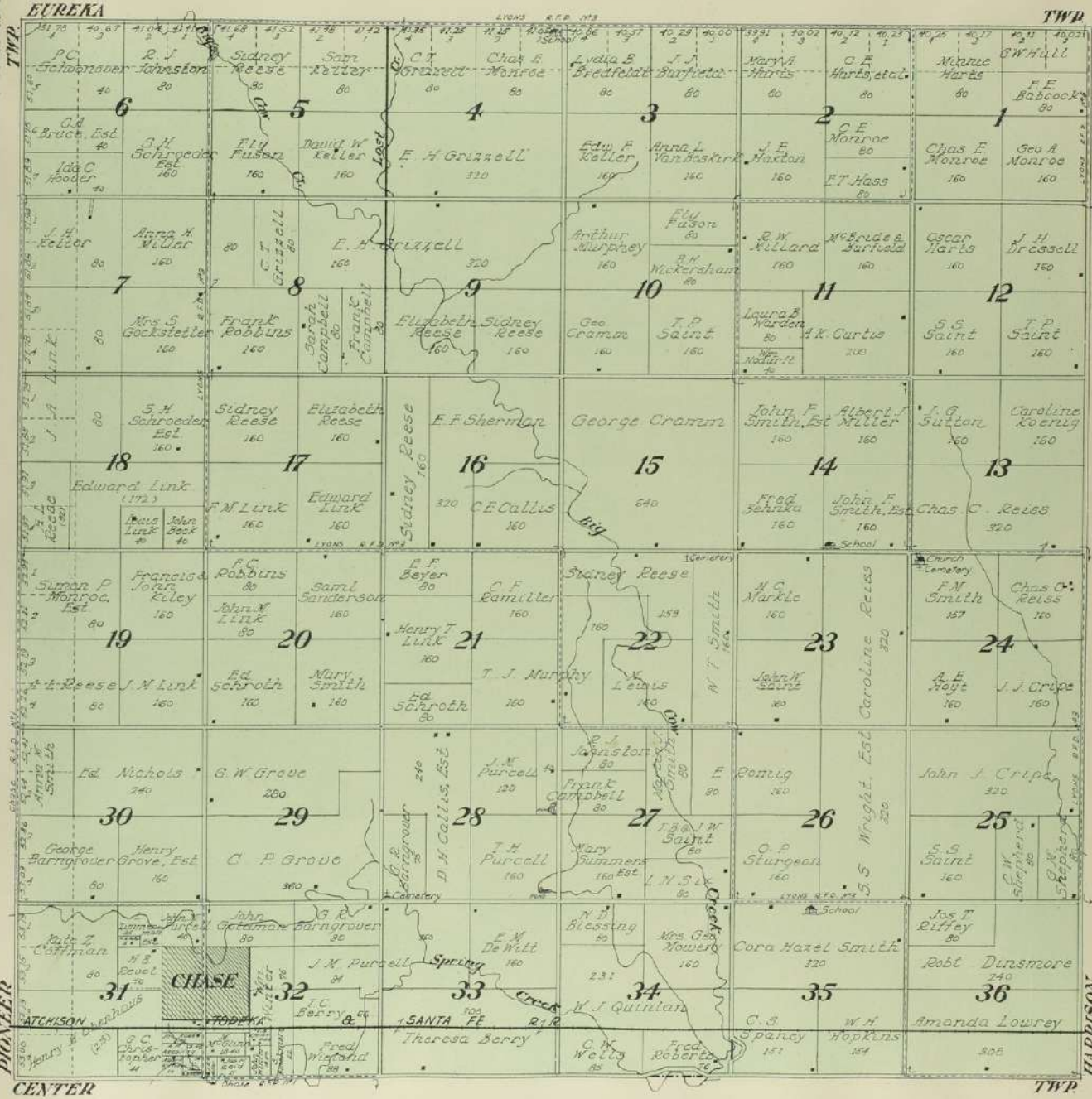

  
**MAP OF**  
**LINCOLN**  
 TOWNSHIP  
 Scale 2 inches to 1 mile

Township 19 South, Range 9 West of the 6th P.M.





  
**MAP OF**  
**CENTER**  
**TOWNSHIP**  
 Scale 2 inches to 1 mile

Township 20 South, Range 9 West of the 6th P. M.

<b>LINCOLN</b>													<b>TWP</b>
<b>TWP</b>													<b>TWP</b>
<b>RAYMOND</b>													<b>ATLANTA</b>
													<b>TWP STERLING TWP</b>

**MAP OF**  
**VALLEY**  
 TOWNSHIP  
 Scale 2 inches to 1 mile

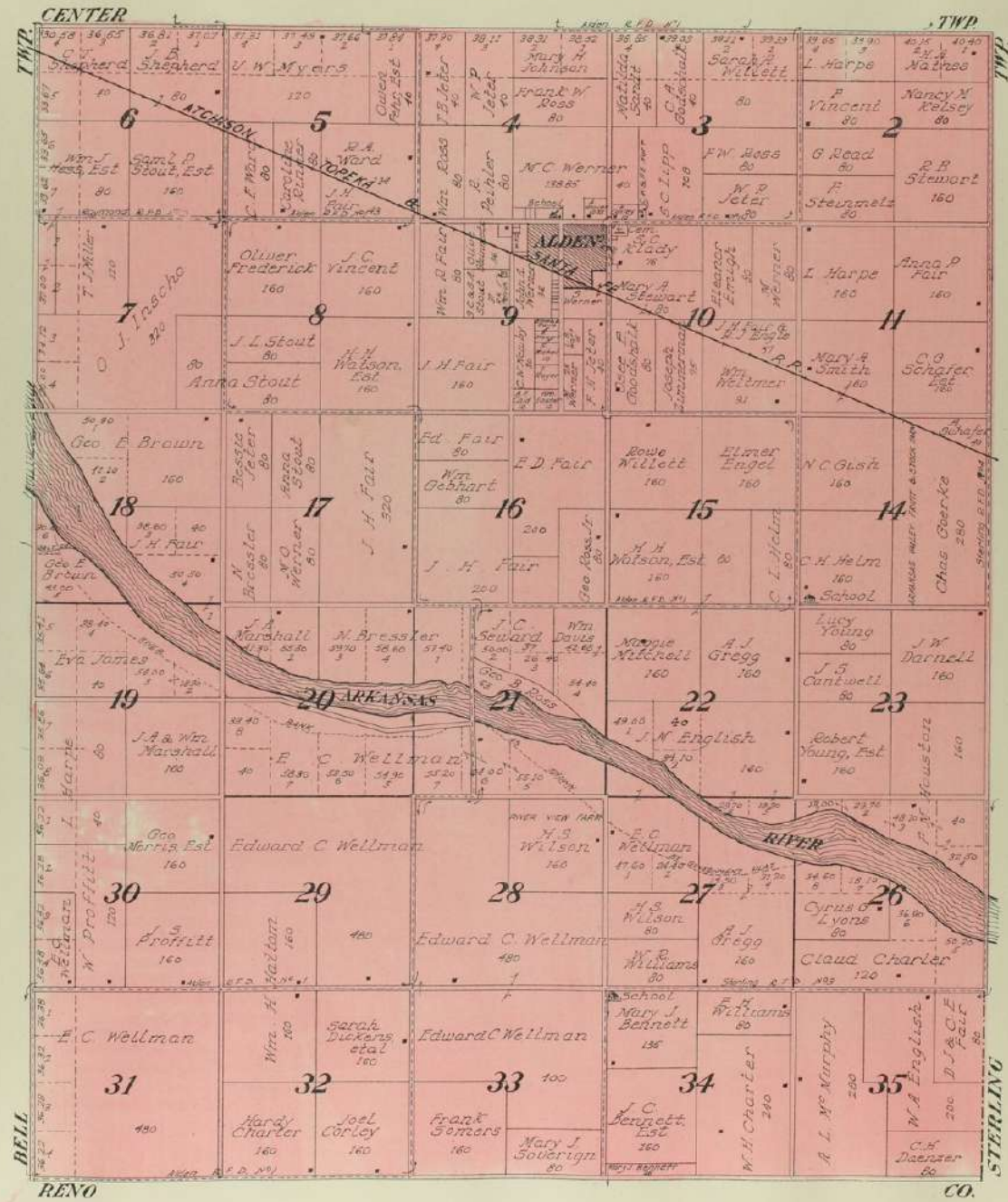
Part of Township 21 South, Range 9 West of the 6th P. M.



# STERLING

TOWNSHIP

Scale 2 inches to 1 mile

Township 21 South, Range 8 West, Part of Township 21 South, Range 9 West

and Part of Township 22 South, Range 8 West of the 6th P.M.

30

R. 9 W.

CENTER TWP

ATLANTA

R. 8 W.

TWP

WILSON TWP

TWP

TWP

VALLEY

T 22 S



RENO

RIVER

CO.



  
**MAP OF**  
**ATLANTA**  
**TOWNSHIP**

Scale 2 inches to 1 mile

Township 20 South, Range 8 West of the 6th P. M.

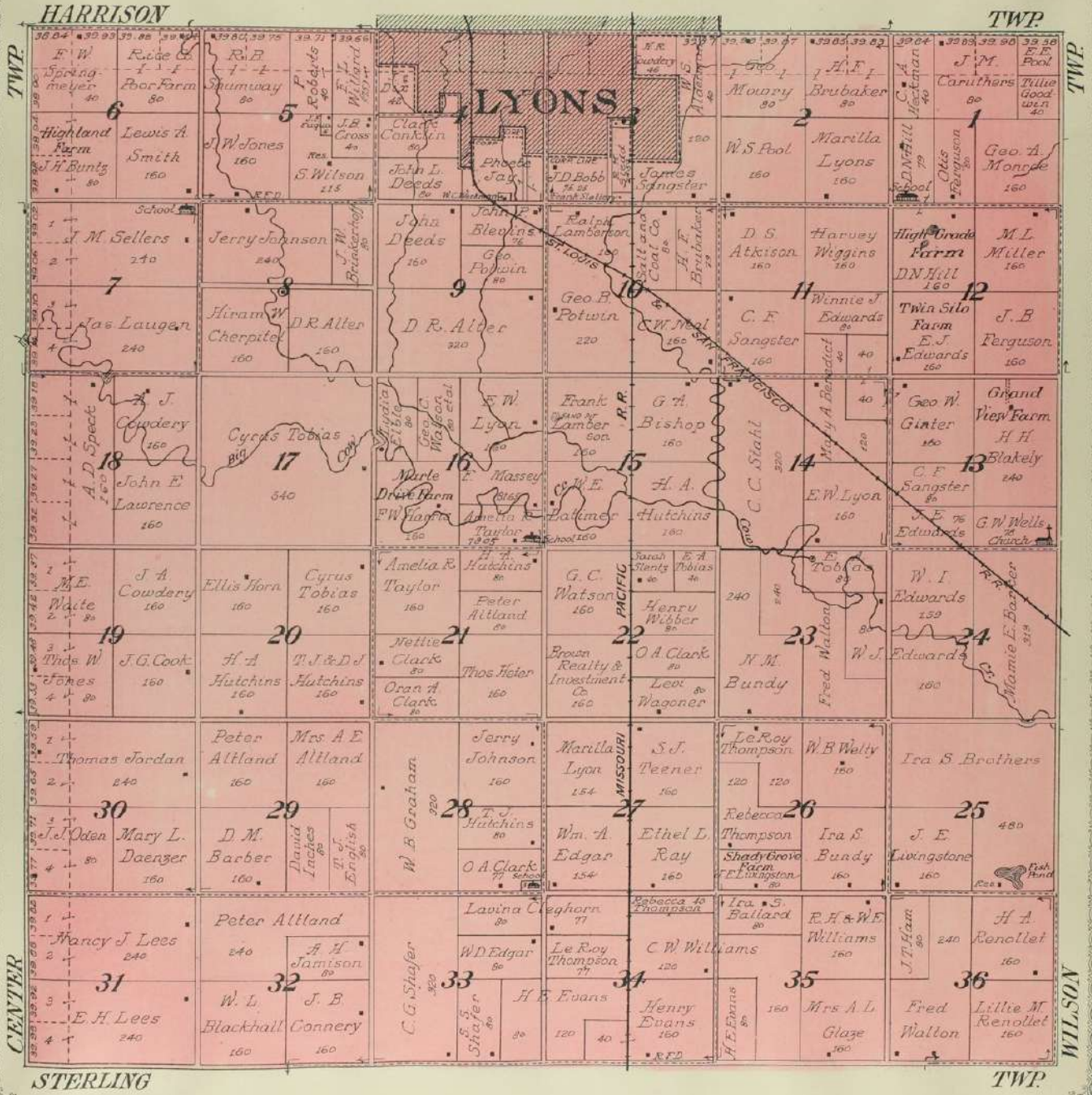

STERLING

WILSON

**HARRISON**
  
 TOWNSHIP

Scale 2 inches to 1 mile

Township 19 South, Range 8 West of the 6th P. M.

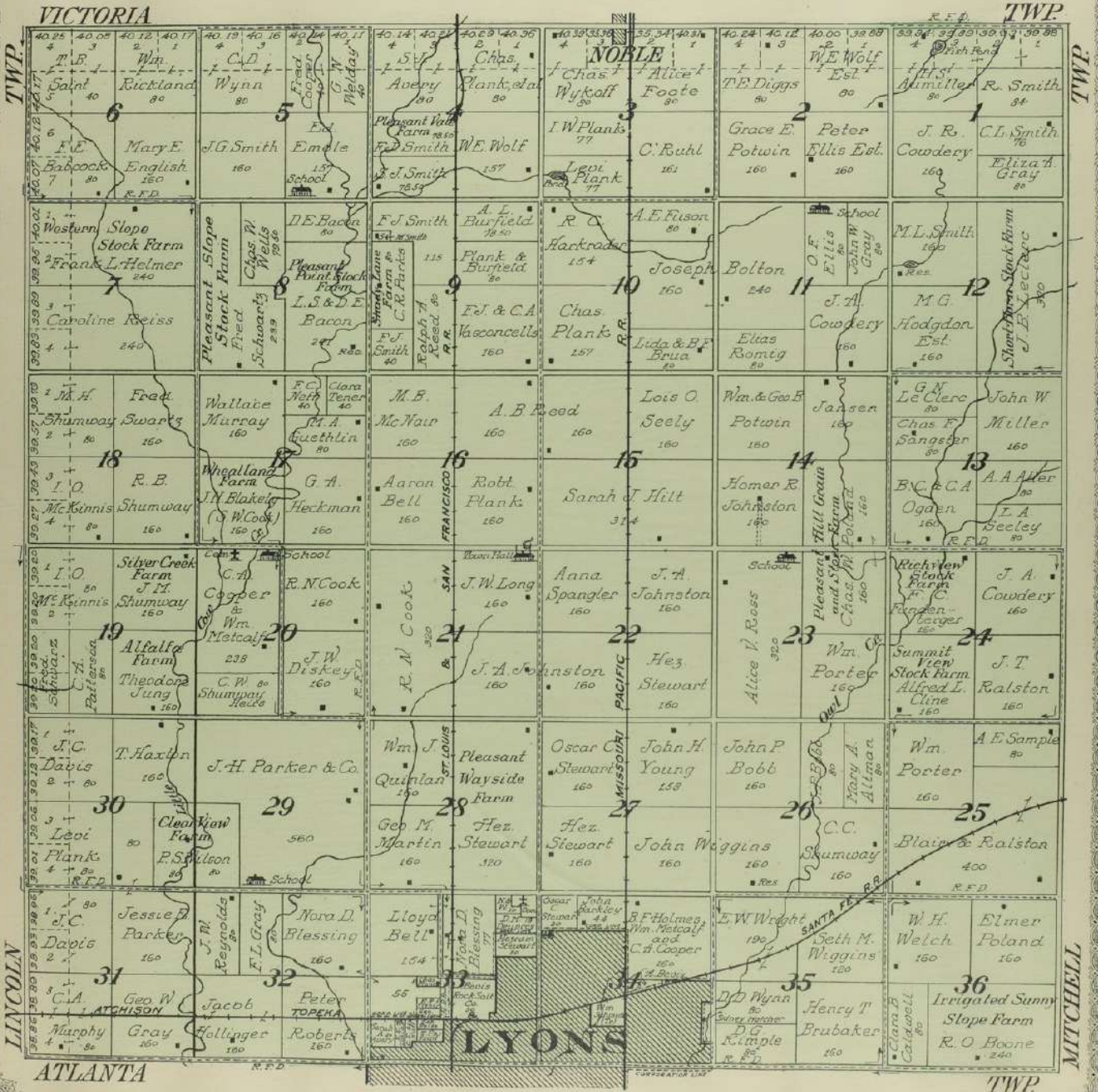

TWP. VICTORIA

LYONS

TWP. MITCHELL

TWP. LINCOLN

ATLANTA

TWP.

MAP OF  
**VICTORIA**  
TOWNSHIP

Scale 2 inches to 1 mile

Township 18 South, Range 8 West of the 6th P. M.

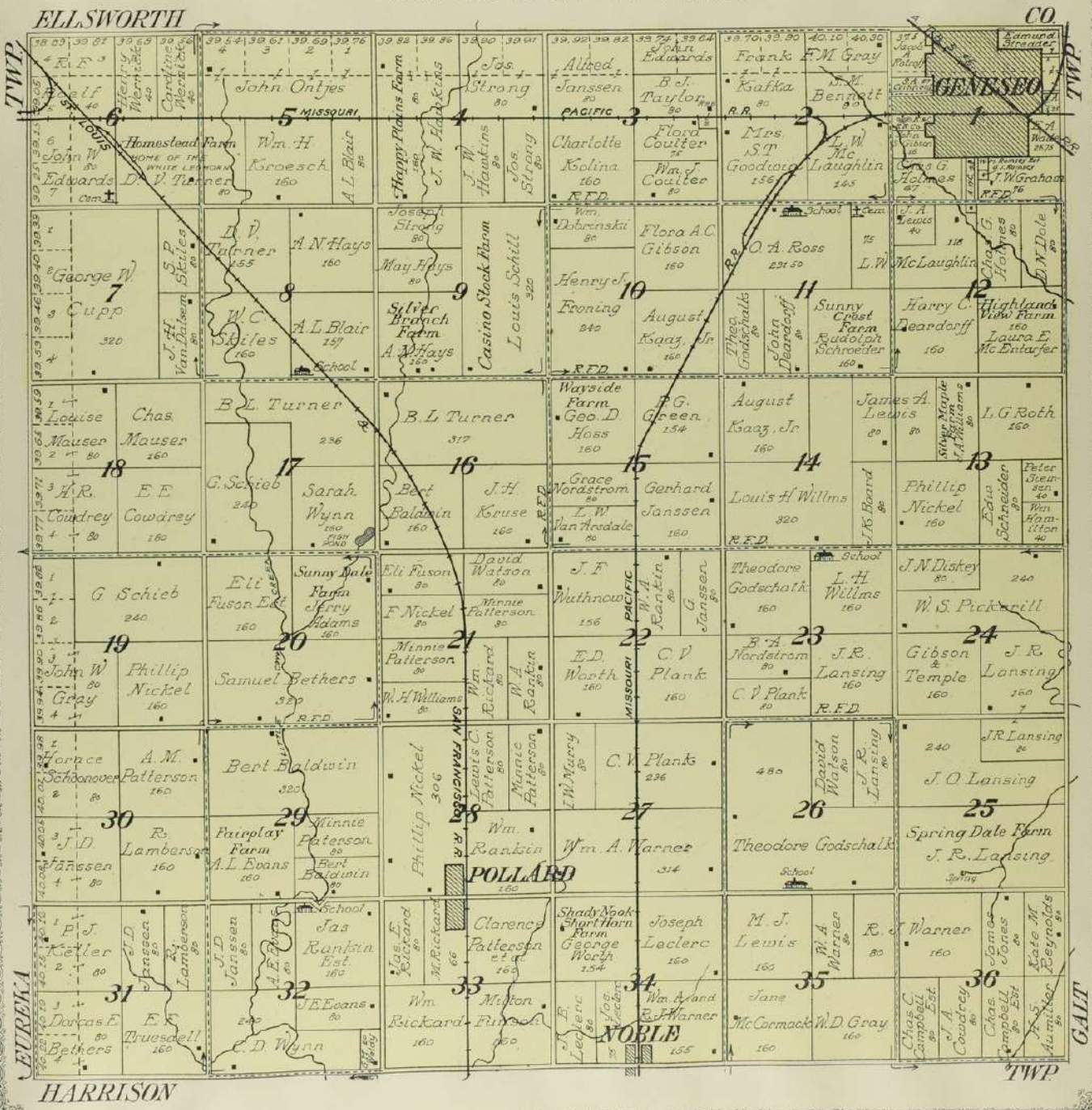

  
**MAP OF**  
**GALT**  
**TOWNSHIP**

Scale 2 inches to 1 mile

Township 18 South, Range 7 West of the 6th P. M.

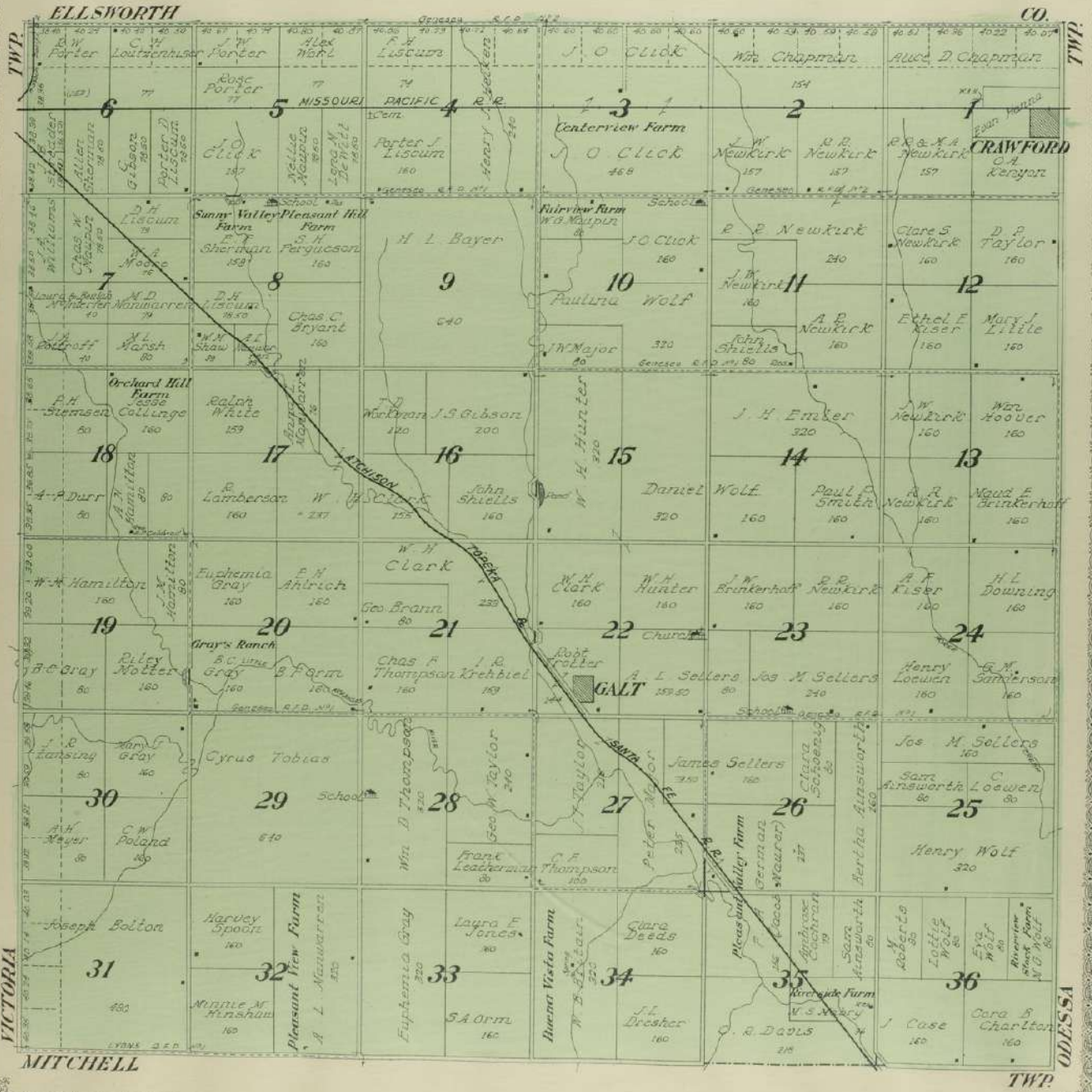

ELLSWORTH

CO

TWP

TWP

VICTORIA

ODESSA

MITCHELL

TWP

MAP OF  
**MITCHELL**  
TOWNSHIP

Scale 2 inches to 1 mile

Township 19 South, Range 7 West of the 6th P. M.

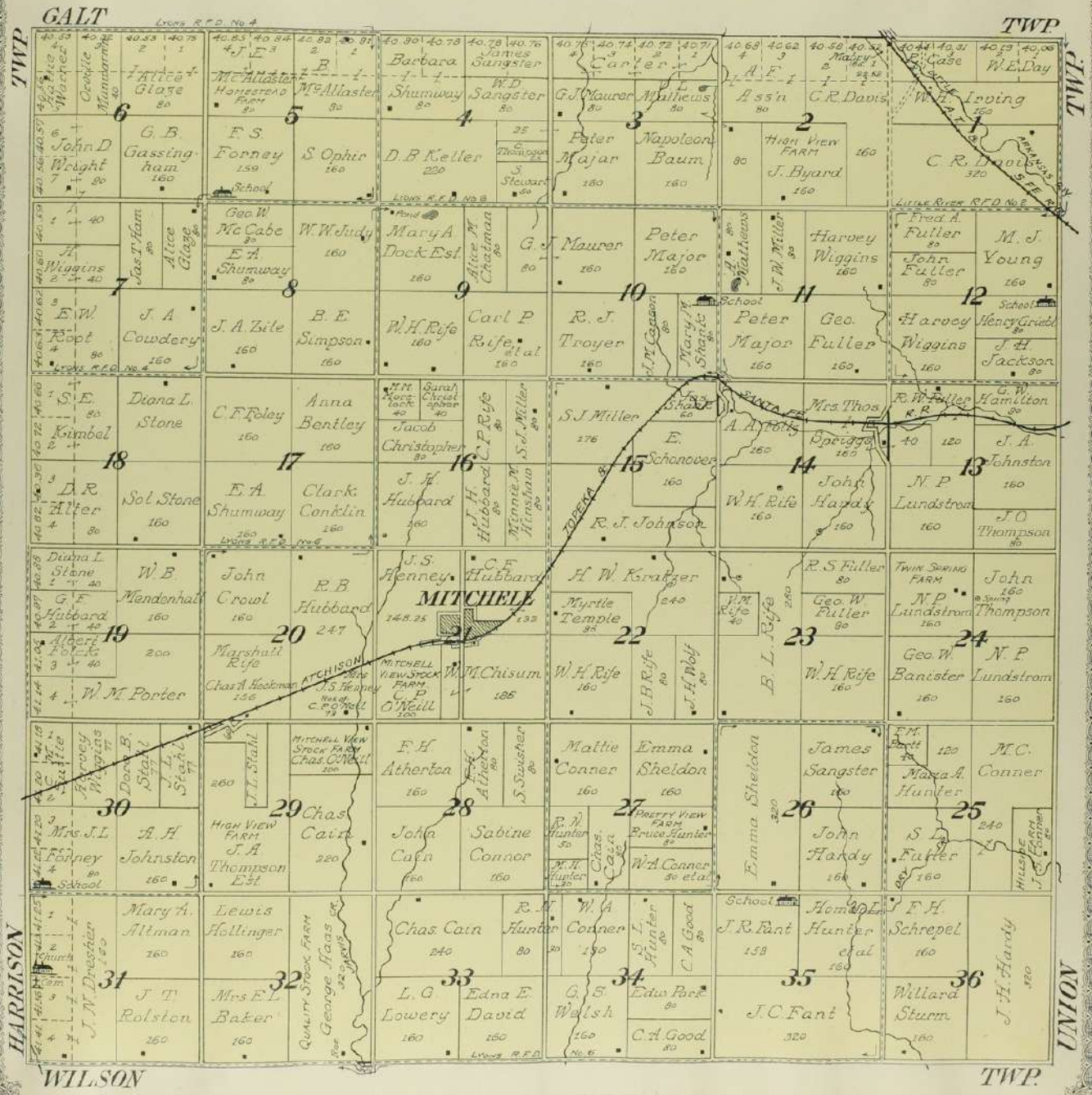

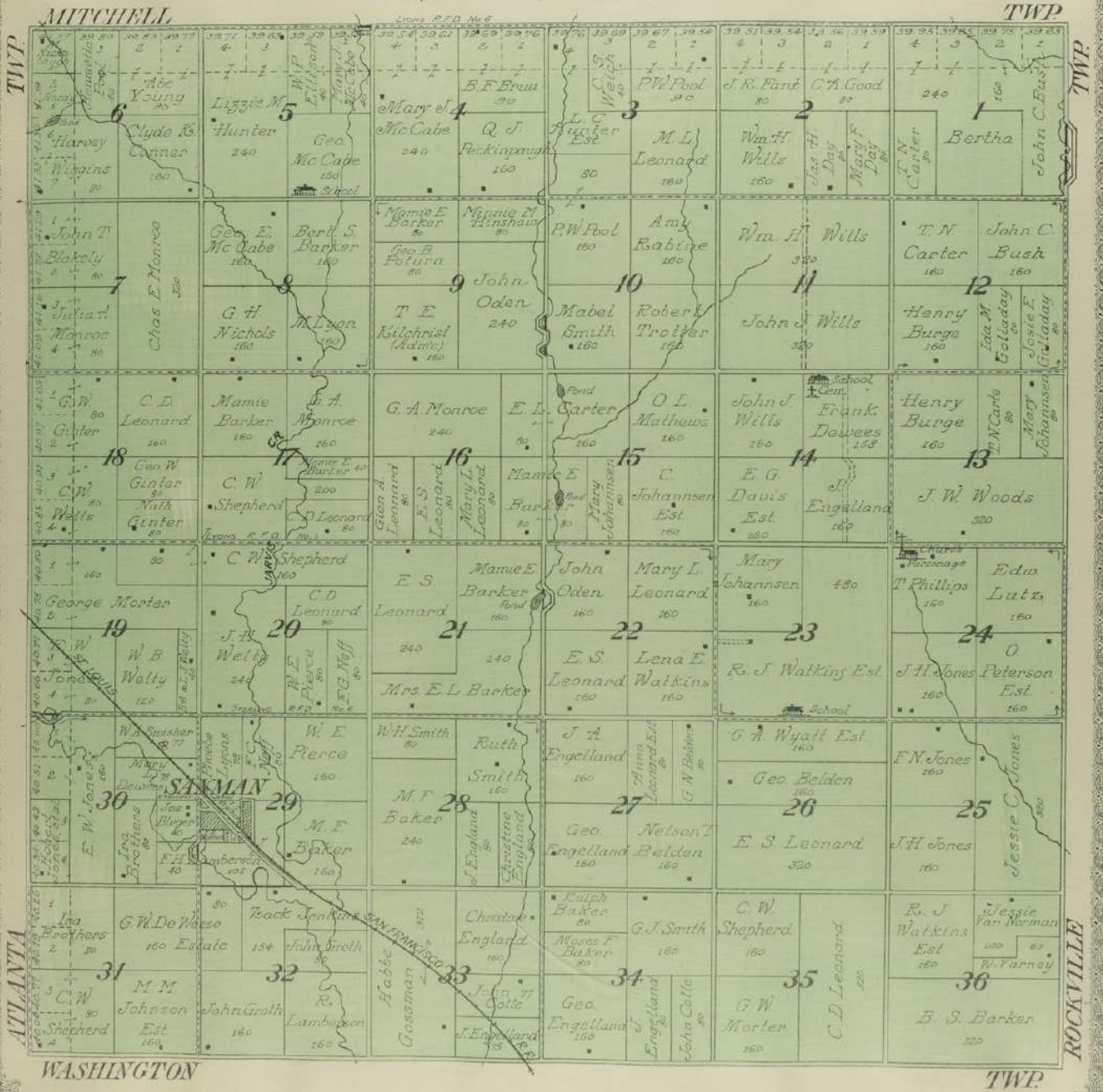

  
**MAP OF**  
**WILSON**  
 TOWNSHIP  
 Scale 2 inches to 1 mile.

Township 20 South, Range 7 West of the 6th P. M.



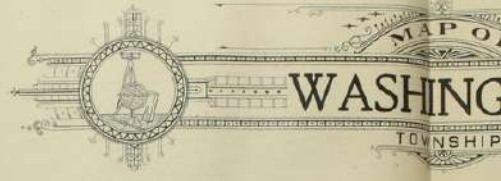



Township 21 South, Range 6 and

TWP ROCK

WILSON										TWP ROCK																								
TWP										TWP																								
6	5	4	3	2	1	7	8	9	10	11	12	18	17	16	15	14	13	19	20	21	22	23	24	30	29	28	27	26	25	32	33	34	35	36
Sterling & Co. 1880										Sterling & Co. 1880																								
Reno										Reno																								

STERLING

R.T.W.



MAP OF  
**WASHINGTON**  
 TOWNSHIP  
 Scale 2 inches to 1 mile

South, Range 6 and 7 West of the 6th P. M.

TWP. ROCKVILLE

TWP.

3164 2 3167 3 3171 4 3175 5 3179 6 3183 7 3187 8 3191 9 3195 10 3199 11 3203 12 3207 13 3211 14 3215 15 3219 16 3223 17 3227 18 3231 19 3235 20 3239 21 3243 22 3247 23 3251 24 3255 25 3259 26 3263 27 3267 28 3271 29 3275 30 3279 31 3283 32 3287 33 3291 34 3295 35 3299 36	3261 1 3265 2 3269 3 3273 4 3277 5 3281 6 3285 7 3289 8 3293 9 3297 10 3301 11 3305 12 3309 13 3313 14 3317 15 3321 16 3325 17 3329 18 3333 19 3337 20 3341 21 3345 22 3349 23 3353 24 3357 25 3361 26 3365 27 3369 28 3373 29 3377 30 3381 31 3385 32 3389 33 3393 34 3397 35 3401 36	3405 1 3409 2 3413 3 3417 4 3421 5 3425 6 3429 7 3433 8 3437 9 3441 10 3445 11 3449 12 3453 13 3457 14 3461 15 3465 16 3469 17 3473 18 3477 19 3481 20 3485 21 3489 22 3493 23 3497 24 3501 25 3505 26 3509 27 3513 28 3517 29 3521 30 3525 31 3529 32 3533 33 3537 34 3541 35 3545 36	3549 1 3553 2 3557 3 3561 4 3565 5 3569 6 3573 7 3577 8 3581 9 3585 10 3589 11 3593 12 3597 13 3601 14 3605 15 3609 16 3613 17 3617 18 3621 19 3625 20 3629 21 3633 22 3637 23 3641 24 3645 25 3649 26 3653 27 3657 28 3661 29 3665 30 3669 31 3673 32 3677 33 3681 34 3685 35 3689 36	3693 1 3697 2 3701 3 3705 4 3709 5 3713 6 3717 7 3721 8 3725 9 3729 10 3733 11 3737 12 3741 13 3745 14 3749 15 3753 16 3757 17 3761 18 3765 19 3769 20 3773 21 3777 22 3781 23 3785 24 3789 25 3793 26 3797 27 3801 28 3805 29 3809 30 3813 31 3817 32 3821 33 3825 34 3829 35 3833 36	3837 1 3841 2 3845 3 3849 4 3853 5 3857 6 3861 7 3865 8 3869 9 3873 10 3877 11 3881 12 3885 13 3889 14 3893 15 3897 16 3901 17 3905 18 3909 19 3913 20 3917 21 3921 22 3925 23 3929 24 3933 25 3937 26 3941 27 3945 28 3949 29 3953 30 3957 31 3961 32 3965 33 3969 34 3973 35 3977 36
Others H. K. Hughes G. K. Fuller Nicholas D. Dresback F. E. McCracken F. W. Wolfs Chas. Shular Claus Rhode Harry W. Frode E. N. Stroud J. W. Morris	Julia A. Renolett J. T. Moll Ira S. Brothers M. H. Angus A. J. Morris Jacob Steiner F. Propes Wm. T. McKee J. W. Morris	D. Tees J. P. Freeman Jos. Ratney W. & P. Walsler John C. Brown John C. Brown F. E. Haynes Lyons Country Club C. M. Burdick MATHESON SIDING G. A. Gosch C. W. Morris C. W. Morris D. T. Tharp D. J. Tharp W. Elnore F. R. Allen Will Kimball	H. M. Miller Jos. Ratney John C. Brown John C. Brown Lyons Country Club C. M. Burdick MATHESON SIDING C. B. Gosch C. W. Morris Oliver F. McGonigle S. E. McGonigle A. E. Warden Estella Vickers N. A. Fenwick	Carl Walsler John F. Jacobson H. H. Taylor C. B. Showalter Carl Walsler F. W. Van Duesel F. Majors Jas. Majors Wm. Garrison Xavier Warnett J. M. Gillick Lurena Campbell A. F. Kearns G. D. Enos, et al Eric Gabrielson	C. E. Lackey G. F. Lackey Sand Creek G. F. Lackey G. F. Lackey F. Majors Ora Moor Henry F. Moon R. W. Underluter Abe Pantratz, et al Silvester Kering Abe Peters James Smith G. D. Enos, et al School J. E. Conklin C. W. Humphreys Albert Berry CARTER School Remond

P. 6 W.

CO.

  
**MAP OF**  
**UNION**  
 TOWNSHIP  
 Scale 2 inches to 1 mile

Township 19 South, Range 6 West of the 6th P. M.

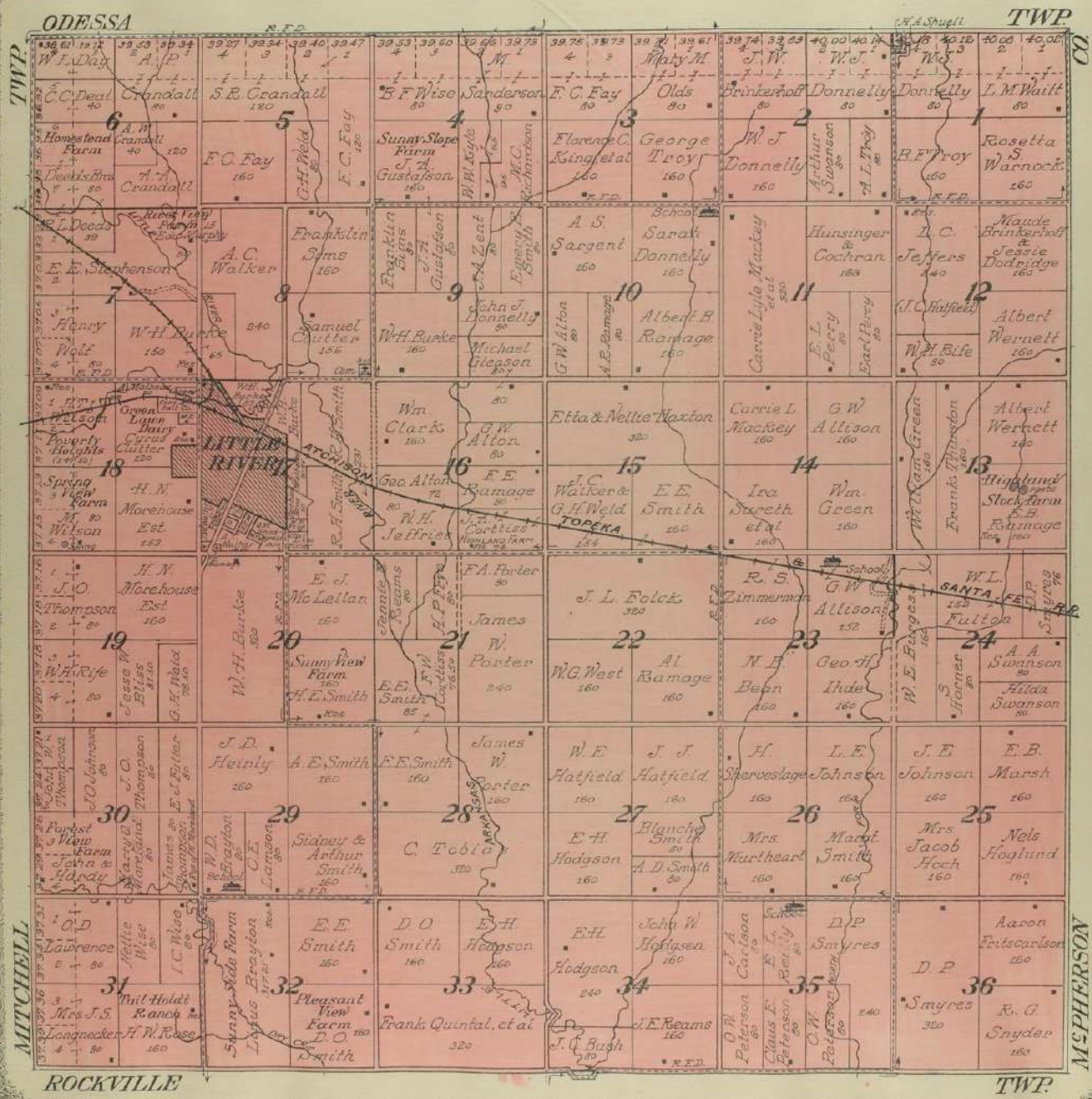

  
**MAP OF**  
**ODESSA**  
 TOWNSHIP  
 Scale 2 inches to 1 mile

Township 18 South, Range 6 West of the 6th P. M.

ELL SWORTH

CO.

36.19 M. Stail	40.26 S. H.	40.44 O. A.	40.53 E. M.	40.46 F. C.	40.30 F. C.	40.21 A. V.	40.24 A. V.	40.29 Lawrence	40.47 W. H.	40.53 W. H.	40.83 W. H.	40.88 W. H.	40.73 Steele	40.64 Steele	40.88 Steele	40.80 Steele	40.23 Steele	40.07 Steele	
50. A Kenyon	Blakey	Kenyon	De Witt	Fowler	A. V.	A. V.	A. V.	Burke	Burke	Burke	Burke	Burke	A. Cochran	H. E.	A. W.	Martin	A. Holt		
6 Evan Stock Farm	Pacific	Anna L. Leigh	240	Buchanan	240	Burke	240	Burke	240	Burke	240	A. Cochran	H. E.	A. W.	Martin	A. Holt			
Hanna	Regina Buehler	W. A. Miller	240	A. R. Buchanan	240	Burke	240	Burke	240	Burke	240	A. Cochran	H. E.	A. W.	Martin	A. Holt			
7 Wm. Chapman	Sophia M. Taylor	Evergreen	240	Aaron Schaefer	240	Byron Walker	240	E. J. Akers	240	E. J. Akers	240	E. J. Akers	240	E. J. Akers	240	E. J. Akers	240	E. J. Akers	
8 Don H. Euler	M. F. Kenyon	O. A. Kenyon	240	R. B. Krebs	240	Cedar Lawn Farm	240	Aaron Schaefer	240	E. O. Yowell	240	E. J. Akers	240	E. J. Akers	240	E. J. Akers	240	E. J. Akers	
9 Wm. Baker	O. A. Kenyon	Bert Parkley	160	Cedar Lawn Farm	160	R. F. Rolfs	160	Percheron Stock Farm	160	Barton Welch	160	Kerry Titus	160	Chester Titus	160	Philp Star	C. Klein		
10 Wm. Baker	O. A. Kenyon	Bert Parkley	160	Cedar Lawn Farm	160	R. F. Rolfs	160	Percheron Stock Farm	160	Barton Welch	160	Kerry Titus	160	Chester Titus	160	Philp Star	C. Klein		
11 Wm. Baker	O. A. Kenyon	Bert Parkley	160	Cedar Lawn Farm	160	R. F. Rolfs	160	Percheron Stock Farm	160	Barton Welch	160	Kerry Titus	160	Chester Titus	160	Philp Star	C. Klein		
12 Wm. Baker	O. A. Kenyon	Bert Parkley	160	Cedar Lawn Farm	160	R. F. Rolfs	160	Percheron Stock Farm	160	Barton Welch	160	Kerry Titus	160	Chester Titus	160	Philp Star	C. Klein		
13 Wm. Baker	O. A. Kenyon	Bert Parkley	160	Cedar Lawn Farm	160	R. F. Rolfs	160	Percheron Stock Farm	160	Barton Welch	160	Kerry Titus	160	Chester Titus	160	Philp Star	C. Klein		
14 Wm. Baker	O. A. Kenyon	Bert Parkley	160	Cedar Lawn Farm	160	R. F. Rolfs	160	Percheron Stock Farm	160	Barton Welch	160	Kerry Titus	160	Chester Titus	160	Philp Star	C. Klein		
15 Wm. Baker	O. A. Kenyon	Bert Parkley	160	Cedar Lawn Farm	160	R. F. Rolfs	160	Percheron Stock Farm	160	Barton Welch	160	Kerry Titus	160	Chester Titus	160	Philp Star	C. Klein		
16 Wm. Baker	O. A. Kenyon	Bert Parkley	160	Cedar Lawn Farm	160	R. F. Rolfs	160	Percheron Stock Farm	160	Barton Welch	160	Kerry Titus	160	Chester Titus	160	Philp Star	C. Klein		
17 Wm. Baker	O. A. Kenyon	Bert Parkley	160	Cedar Lawn Farm	160	R. F. Rolfs	160	Percheron Stock Farm	160	Barton Welch	160	Kerry Titus	160	Chester Titus	160	Philp Star	C. Klein		
18 Wm. Baker	O. A. Kenyon	Bert Parkley	160	Cedar Lawn Farm	160	R. F. Rolfs	160	Percheron Stock Farm	160	Barton Welch	160	Kerry Titus	160	Chester Titus	160	Philp Star	C. Klein		
19 Wm. Baker	O. A. Kenyon	Bert Parkley	160	Cedar Lawn Farm	160	R. F. Rolfs	160	Percheron Stock Farm	160	Barton Welch	160	Kerry Titus	160	Chester Titus	160	Philp Star	C. Klein		
20 Wm. Baker	O. A. Kenyon	Bert Parkley	160	Cedar Lawn Farm	160	R. F. Rolfs	160	Percheron Stock Farm	160	Barton Welch	160	Kerry Titus	160	Chester Titus	160	Philp Star	C. Klein		
21 Wm. Baker	O. A. Kenyon	Bert Parkley	160	Cedar Lawn Farm	160	R. F. Rolfs	160	Percheron Stock Farm	160	Barton Welch	160	Kerry Titus	160	Chester Titus	160	Philp Star	C. Klein		
22 Wm. Baker	O. A. Kenyon	Bert Parkley	160	Cedar Lawn Farm	160	R. F. Rolfs	160	Percheron Stock Farm	160	Barton Welch	160	Kerry Titus	160	Chester Titus	160	Philp Star	C. Klein		
23 Wm. Baker	O. A. Kenyon	Bert Parkley	160	Cedar Lawn Farm	160	R. F. Rolfs	160	Percheron Stock Farm	160	Barton Welch	160	Kerry Titus	160	Chester Titus	160	Philp Star	C. Klein		
24 Wm. Baker	O. A. Kenyon	Bert Parkley	160	Cedar Lawn Farm	160	R. F. Rolfs	160	Percheron Stock Farm	160	Barton Welch	160	Kerry Titus	160	Chester Titus	160	Philp Star	C. Klein		
25 Wm. Baker	O. A. Kenyon	Bert Parkley	160	Cedar Lawn Farm	160	R. F. Rolfs	160	Percheron Stock Farm	160	Barton Welch	160	Kerry Titus	160	Chester Titus	160	Philp Star	C. Klein		
26 Wm. Baker	O. A. Kenyon	Bert Parkley	160	Cedar Lawn Farm	160	R. F. Rolfs	160	Percheron Stock Farm	160	Barton Welch	160	Kerry Titus	160	Chester Titus	160	Philp Star	C. Klein		
27 Wm. Baker	O. A. Kenyon	Bert Parkley	160	Cedar Lawn Farm	160	R. F. Rolfs	160	Percheron Stock Farm	160	Barton Welch	160	Kerry Titus	160	Chester Titus	160	Philp Star	C. Klein		
28 Wm. Baker	O. A. Kenyon	Bert Parkley	160	Cedar Lawn Farm	160	R. F. Rolfs	160	Percheron Stock Farm	160	Barton Welch	160	Kerry Titus	160	Chester Titus	160	Philp Star	C. Klein		
29 Wm. Baker	O. A. Kenyon	Bert Parkley	160	Cedar Lawn Farm	160	R. F. Rolfs	160	Percheron Stock Farm	160	Barton Welch	160	Kerry Titus	160	Chester Titus	160	Philp Star	C. Klein		
30 Wm. Baker	O. A. Kenyon	Bert Parkley	160	Cedar Lawn Farm	160	R. F. Rolfs	160	Percheron Stock Farm	160	Barton Welch	160	Kerry Titus	160	Chester Titus	160	Philp Star	C. Klein		
31 Wm. Baker	O. A. Kenyon	Bert Parkley	160	Cedar Lawn Farm	160	R. F. Rolfs	160	Percheron Stock Farm	160	Barton Welch	160	Kerry Titus	160	Chester Titus	160	Philp Star	C. Klein		
32 Wm. Baker	O. A. Kenyon	Bert Parkley	160	Cedar Lawn Farm	160	R. F. Rolfs	160	Percheron Stock Farm	160	Barton Welch	160	Kerry Titus	160	Chester Titus	160	Philp Star	C. Klein		
33 Wm. Baker	O. A. Kenyon	Bert Parkley	160	Cedar Lawn Farm	160	R. F. Rolfs	160	Percheron Stock Farm	160	Barton Welch	160	Kerry Titus	160	Chester Titus	160	Philp Star	C. Klein		
34 Wm. Baker	O. A. Kenyon	Bert Parkley	160	Cedar Lawn Farm	160	R. F. Rolfs	160	Percheron Stock Farm	160	Barton Welch	160	Kerry Titus	160	Chester Titus	160	Philp Star	C. Klein		
35 Wm. Baker	O. A. Kenyon	Bert Parkley	160	Cedar Lawn Farm	160	R. F. Rolfs	160	Percheron Stock Farm	160	Barton Welch	160	Kerry Titus	160	Chester Titus	160	Philp Star	C. Klein		
36 Wm. Baker	O. A. Kenyon	Bert Parkley	160	Cedar Lawn Farm	160	R. F. Rolfs	160	Percheron Stock Farm	160	Barton Welch	160	Kerry Titus	160	Chester Titus	160	Philp Star	C. Klein		

GALT

MCPHERSON

UNION

TWP.

# SAXMAN

LOCATED IN SECTION 29

Scale - 300 ft per 1 inch

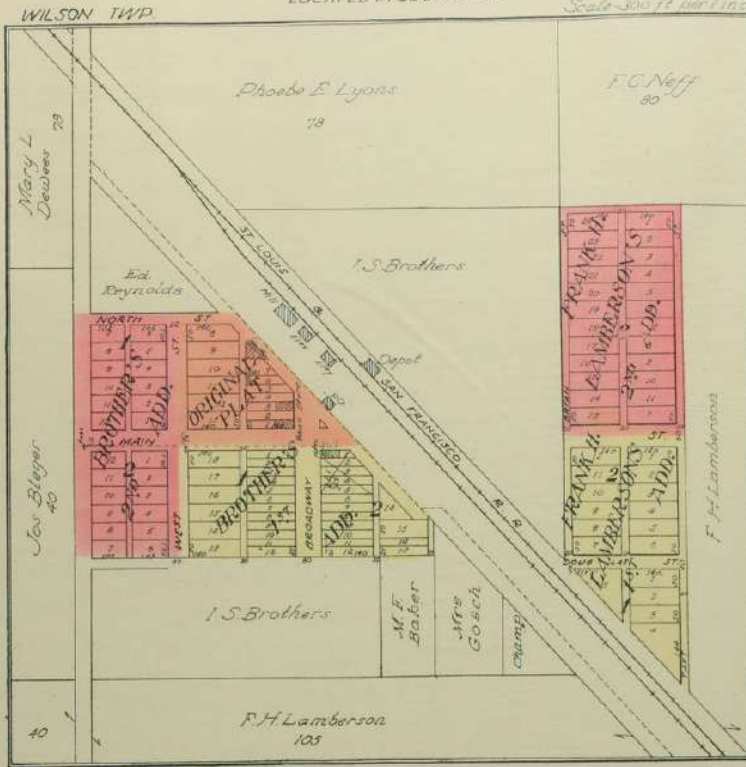

# MITCHELL

MITCHELL TWP

Scale - 300 feet = 1 inch

