

OUTLINE MAP OF

ROOKS COUNTY

KANSAS

7

Scale 1 inch = 10 miles

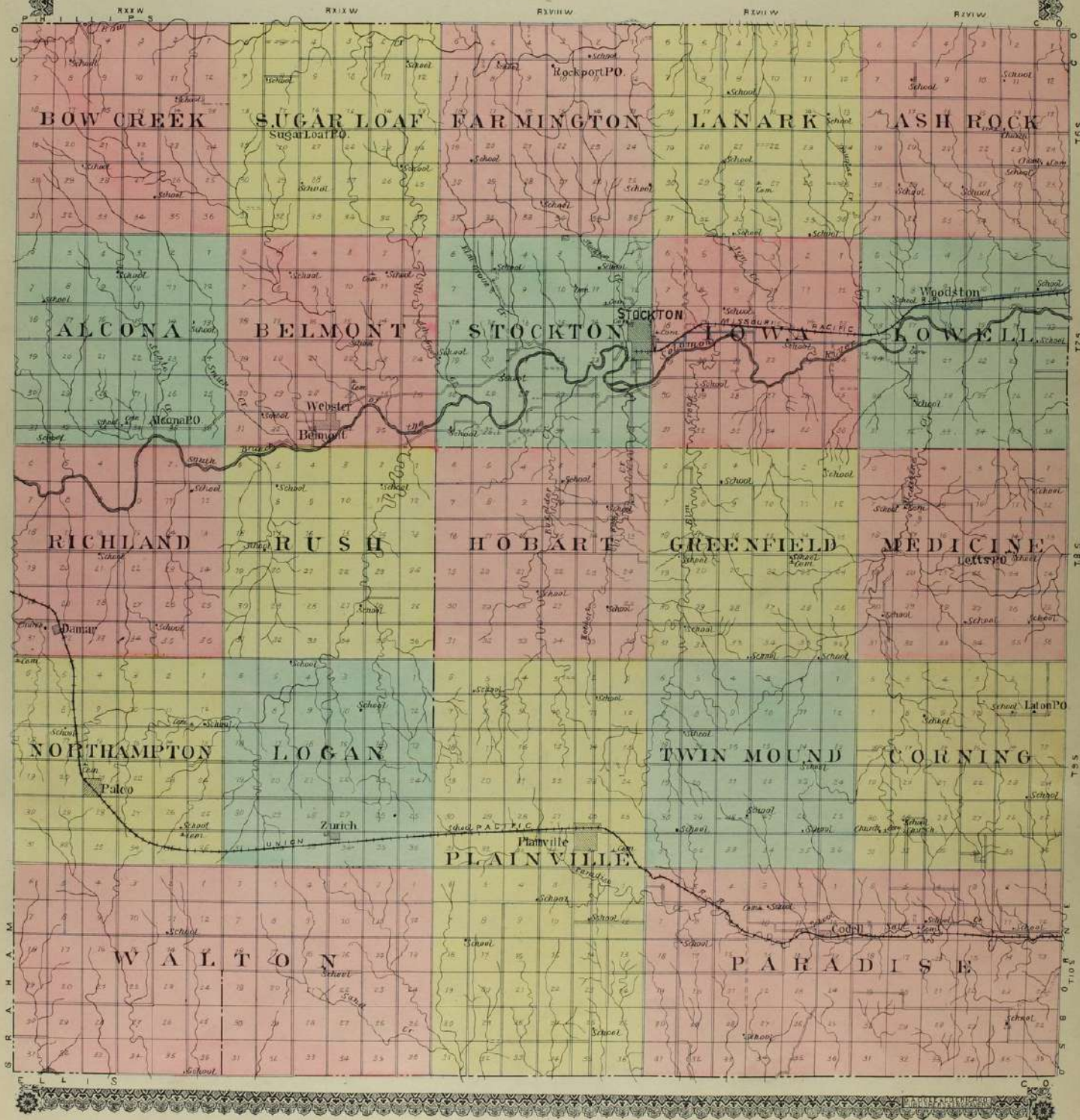

MAP OF
ASH ROCK
TOWNSHIP
Township 6 South Range XVI West of the 6th P.M.

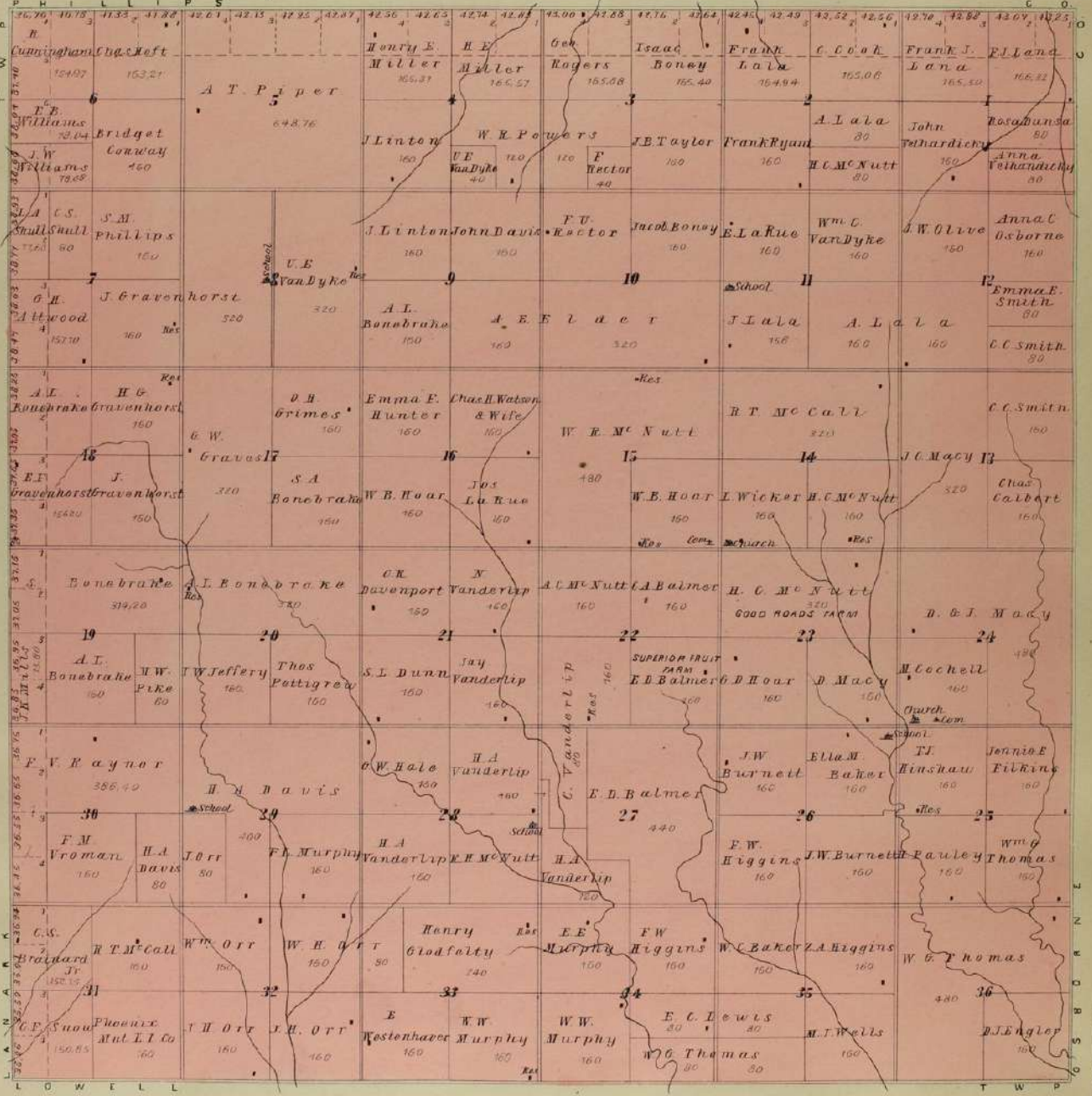

L O W E L L T W P



LANARK

 TOWNSHIP

Township 6 South Range XVII West of the 6th P.M.

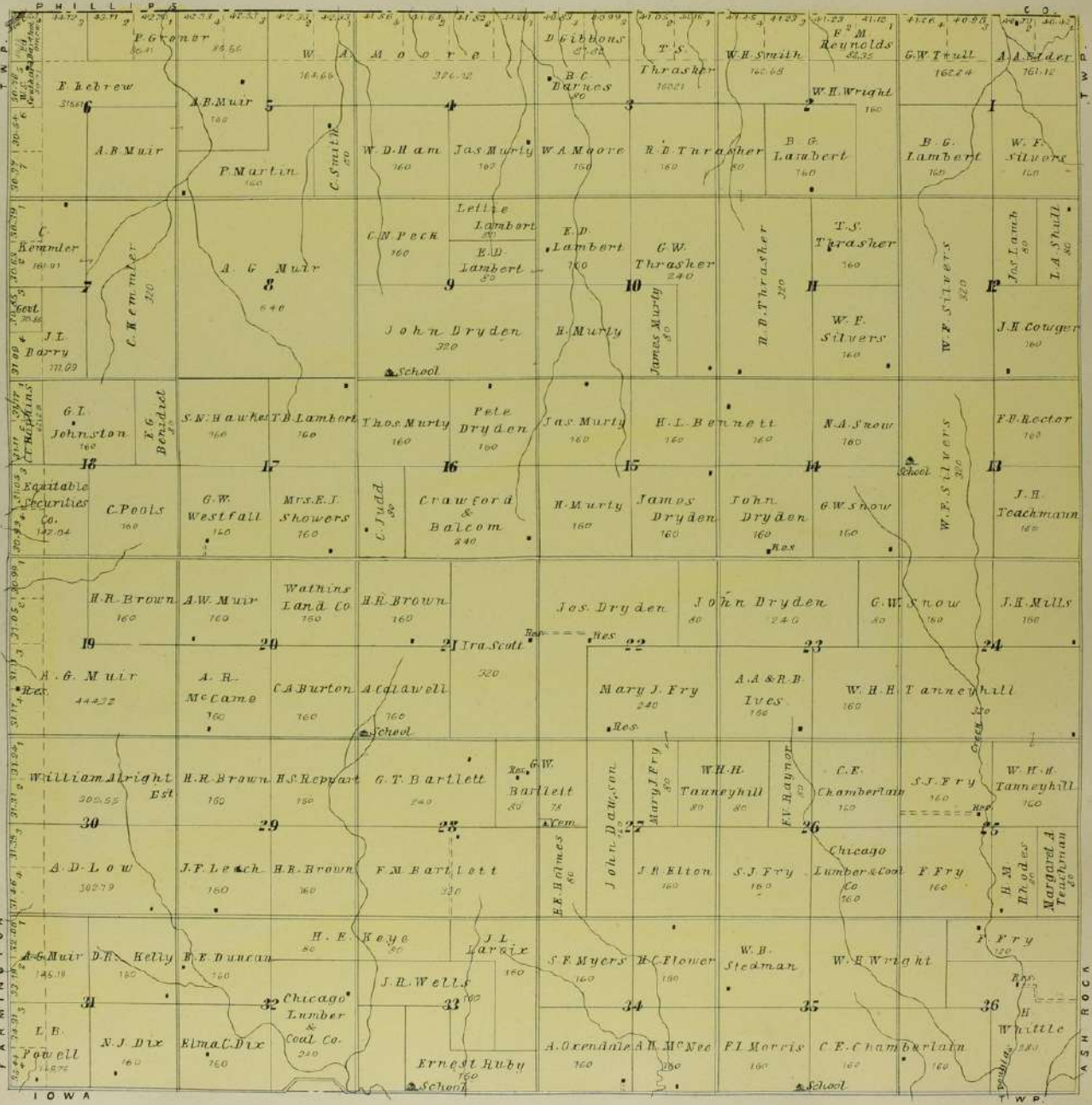



MAP OF
FARMINGTON
 TOWNSHIP
 Township 6 South Range XVIII West of the 6th P.M.

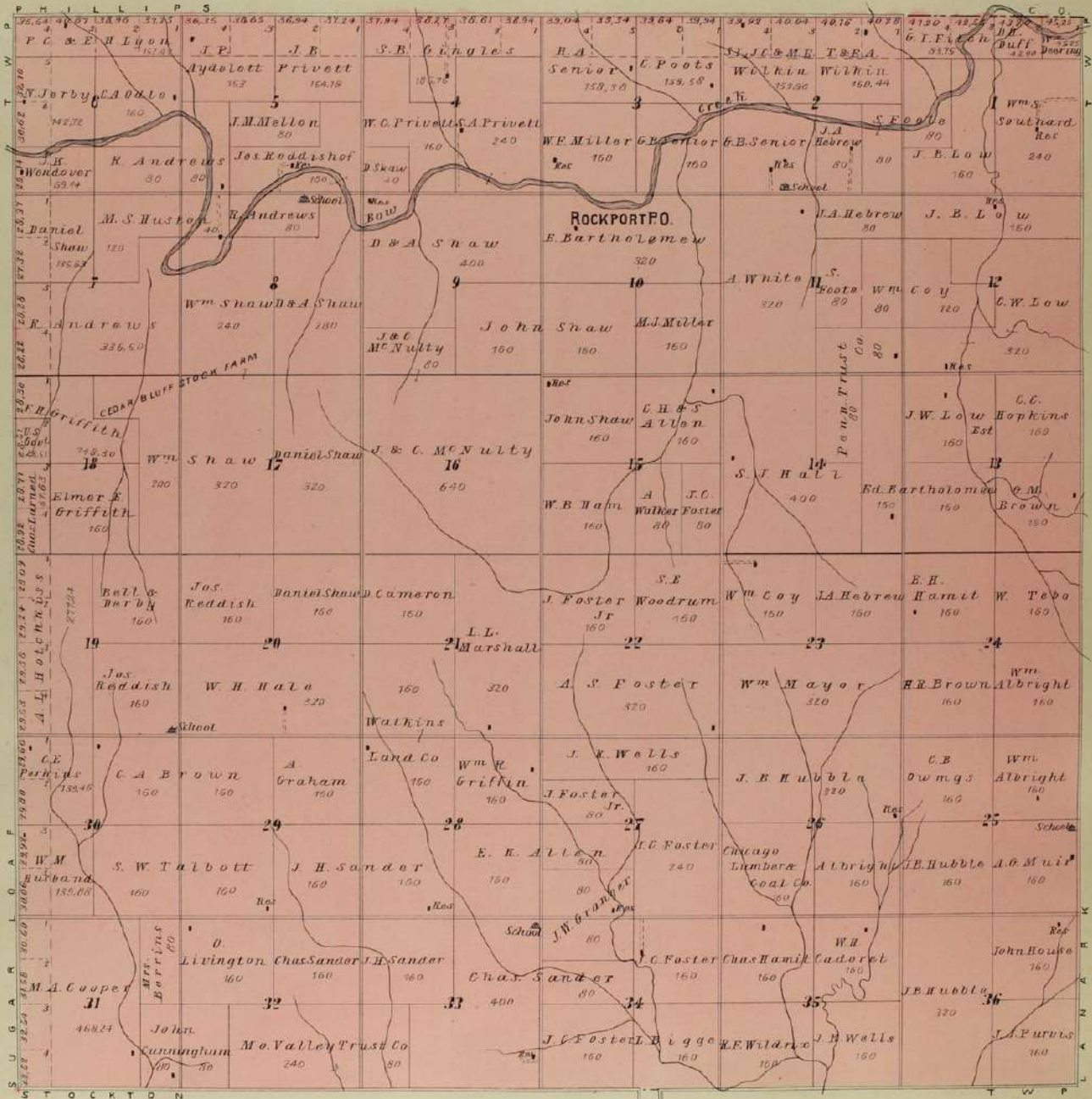

Wm. A. Cooper



MAP OF
SUGAR LOAF
TOWNSHIP
 Township 6 South Range XIX West of the 6th P.M.

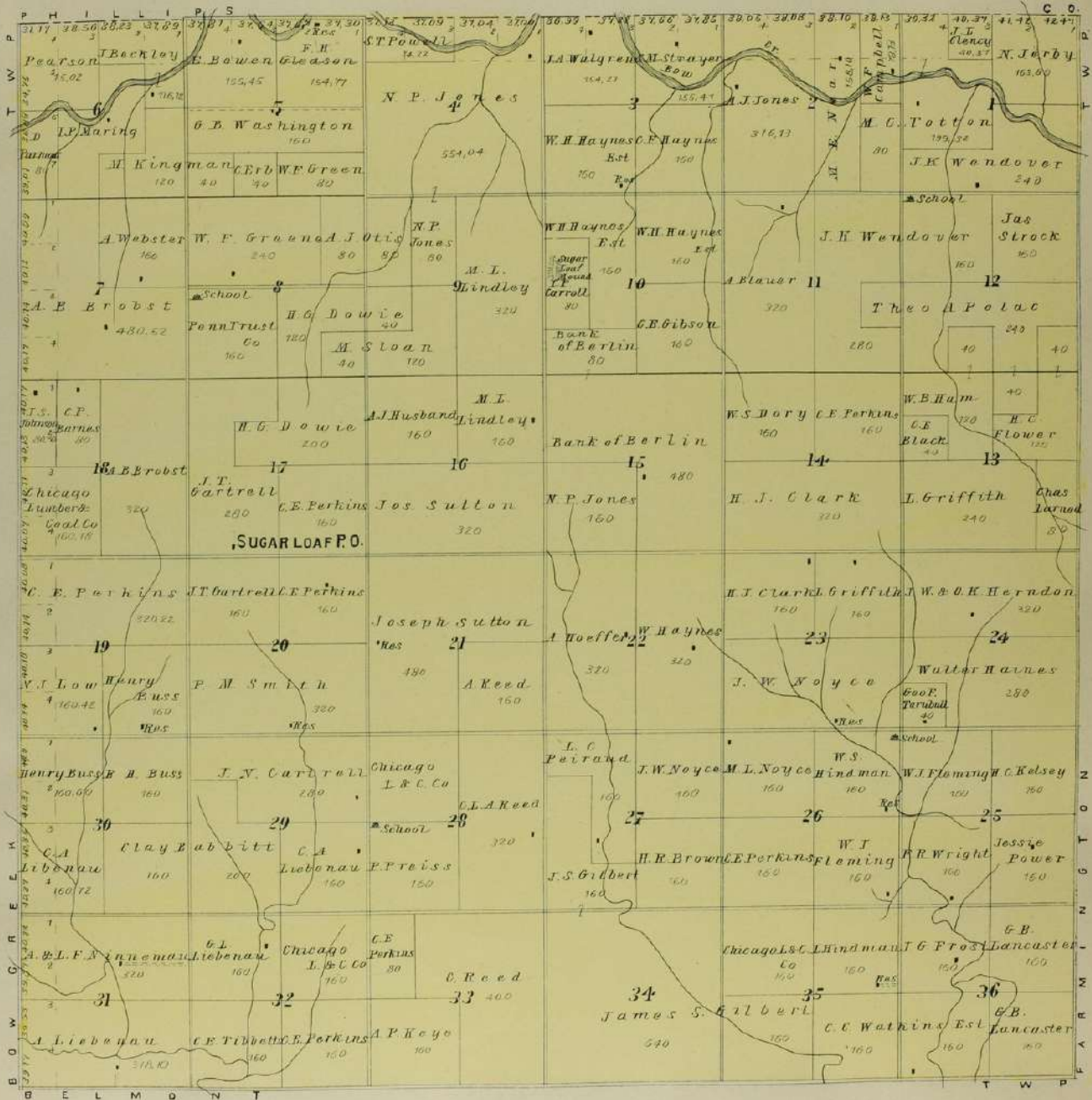

MAP OF
BOW CREEK
 TOWNSHIP
 Township 6 South Range XX West of the 6th P.M.

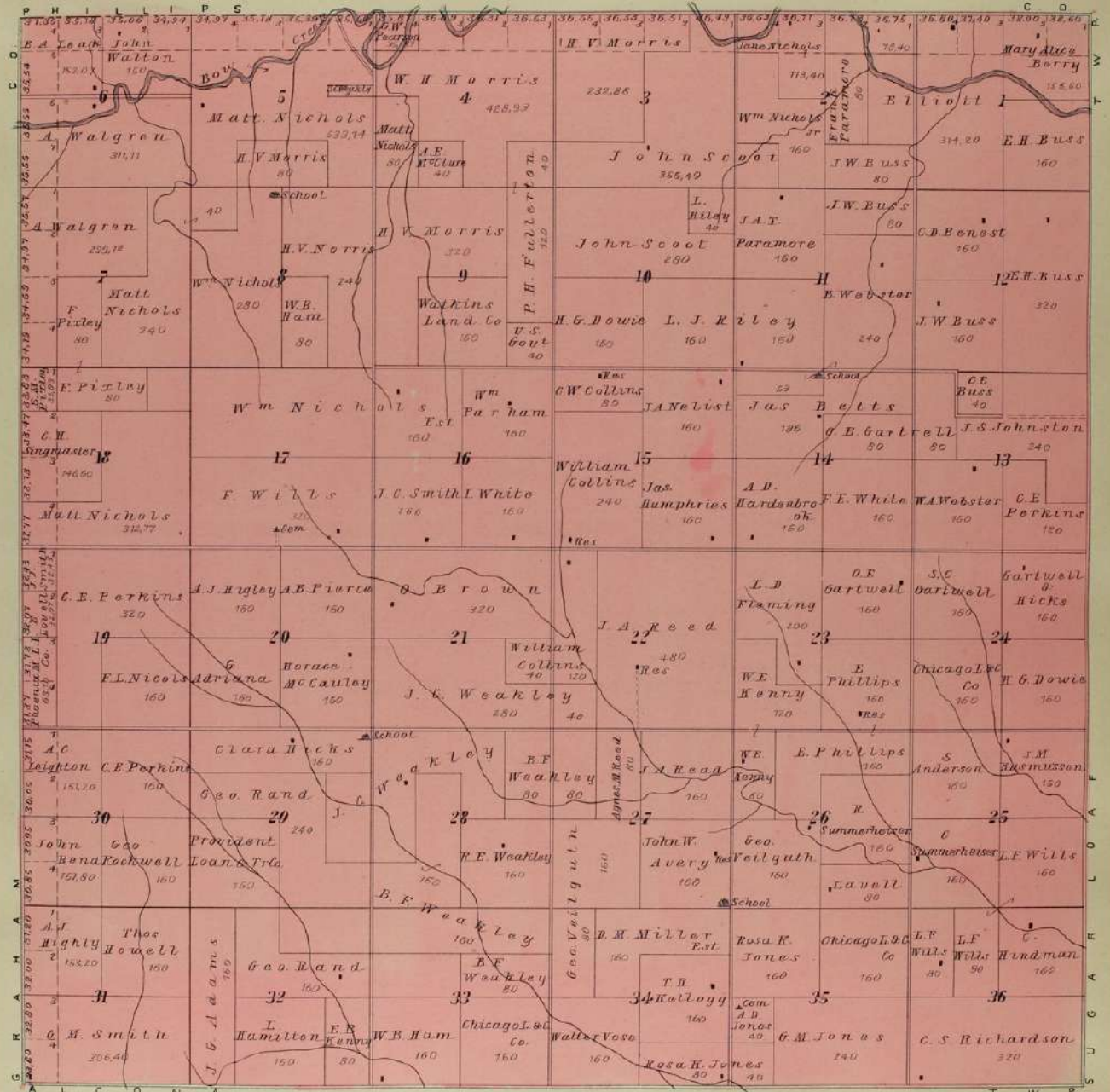



MAP OF
ALCONA
 TOWNSHIP
 Township 7 South Range XX West of the 6th P.M.
Scale 2 1/2 inches to 1 Mile

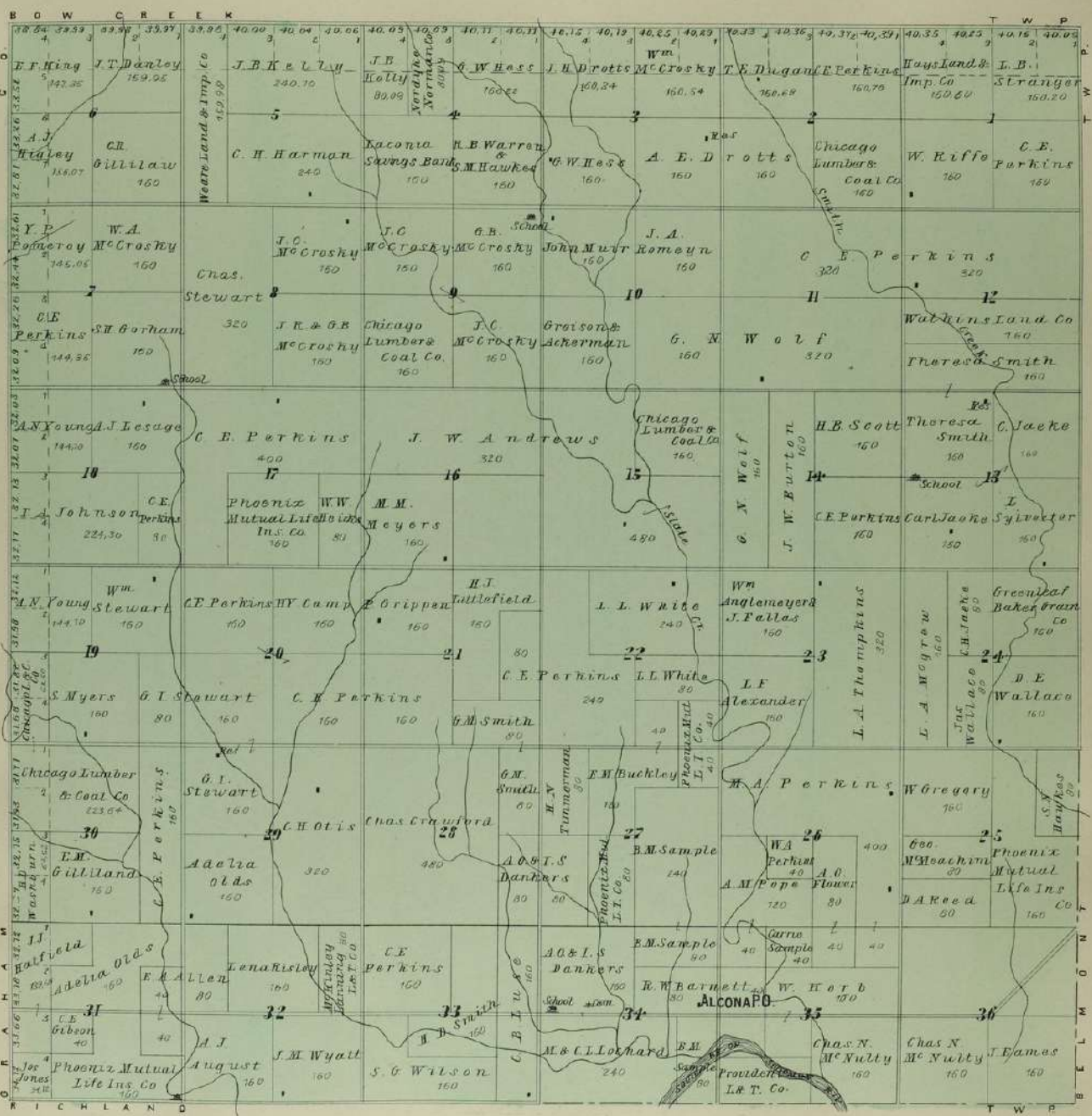



MAP OF
BELMONT
 TOWNSHIP
 Township 7 South Range XIX West of the 6th P.M.

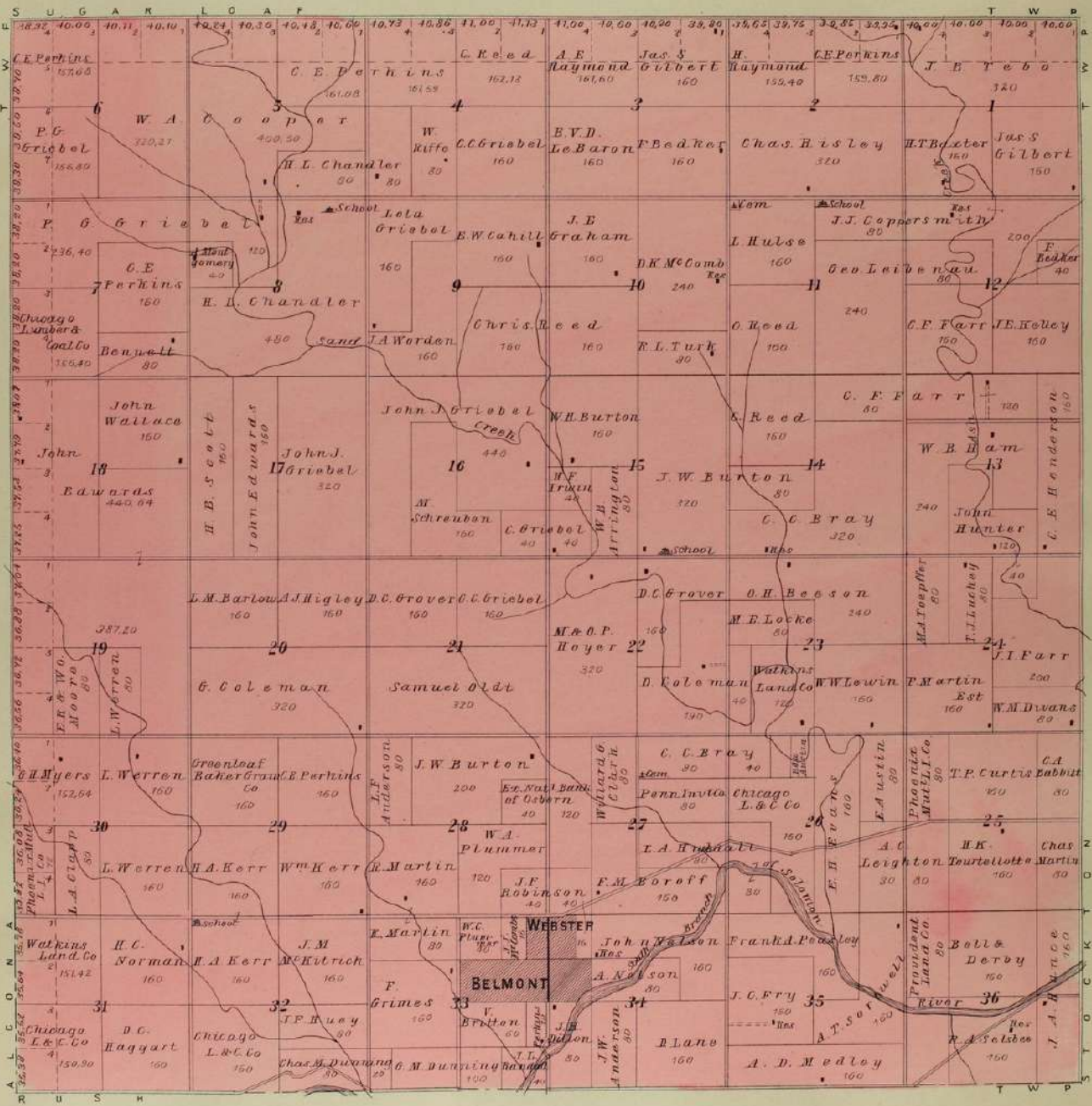

W.C. Stage

MAP OF
STOCKTON
 TOWNSHIP
 Township 7 South Range XVIII West of the 6th P.M.

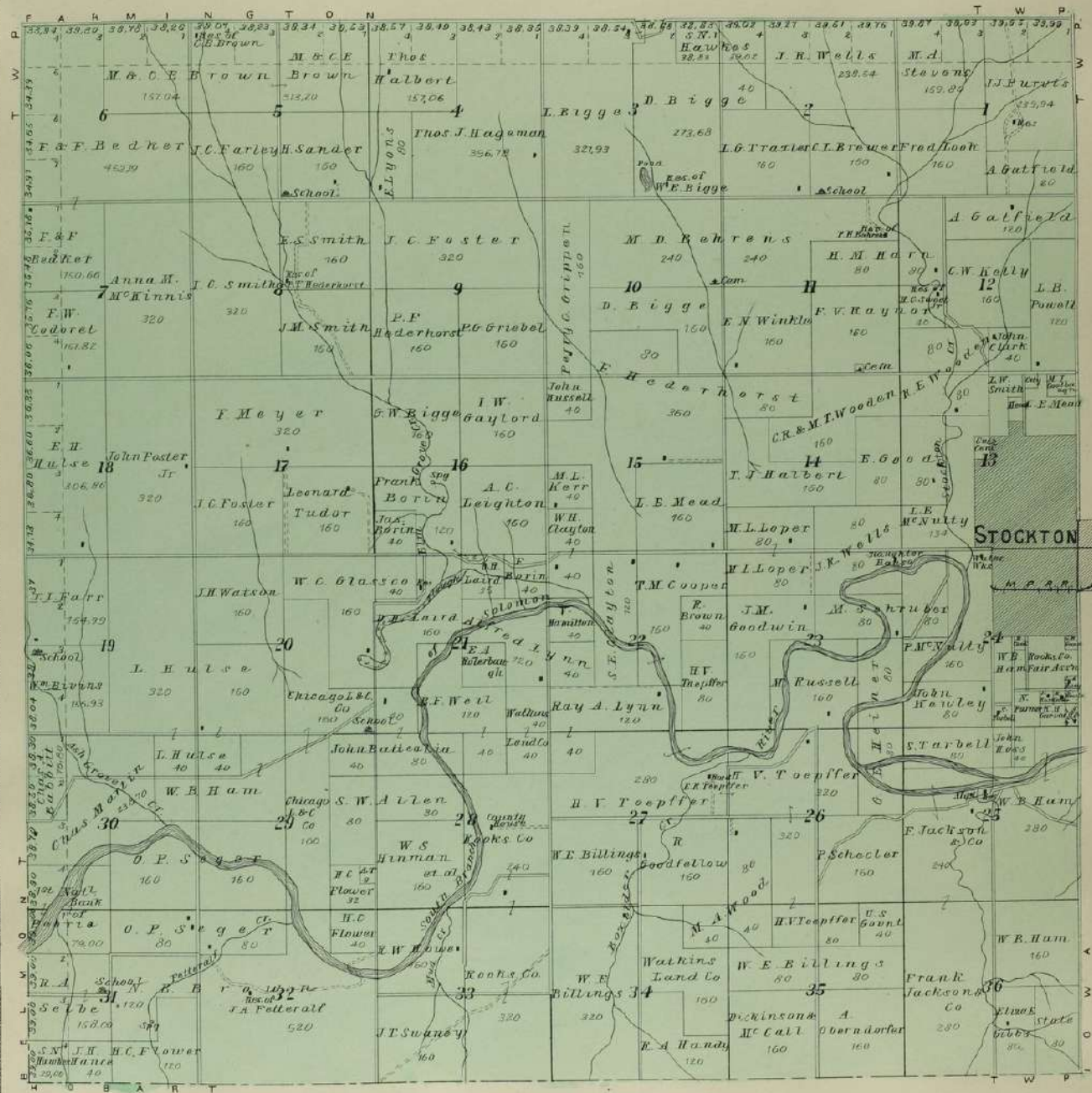



 MAP OF
IOWA
 TOWNSHIP
 Township 7 South Range XVII West of the 6th P.M.

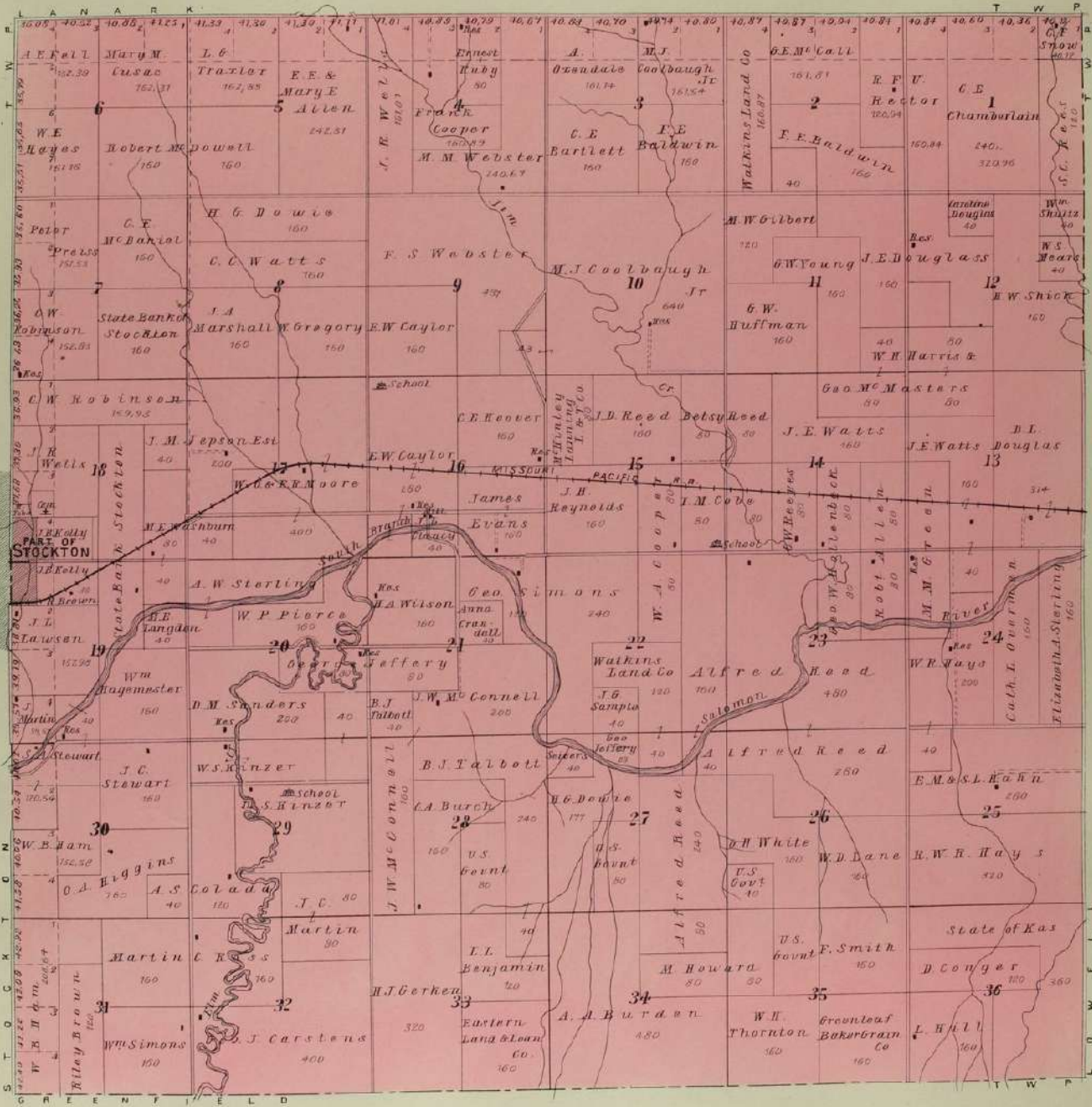

MAP OF
LOWELL
TOWNSHIP
 Township 7 South Range XVI West of the 6th P.M.

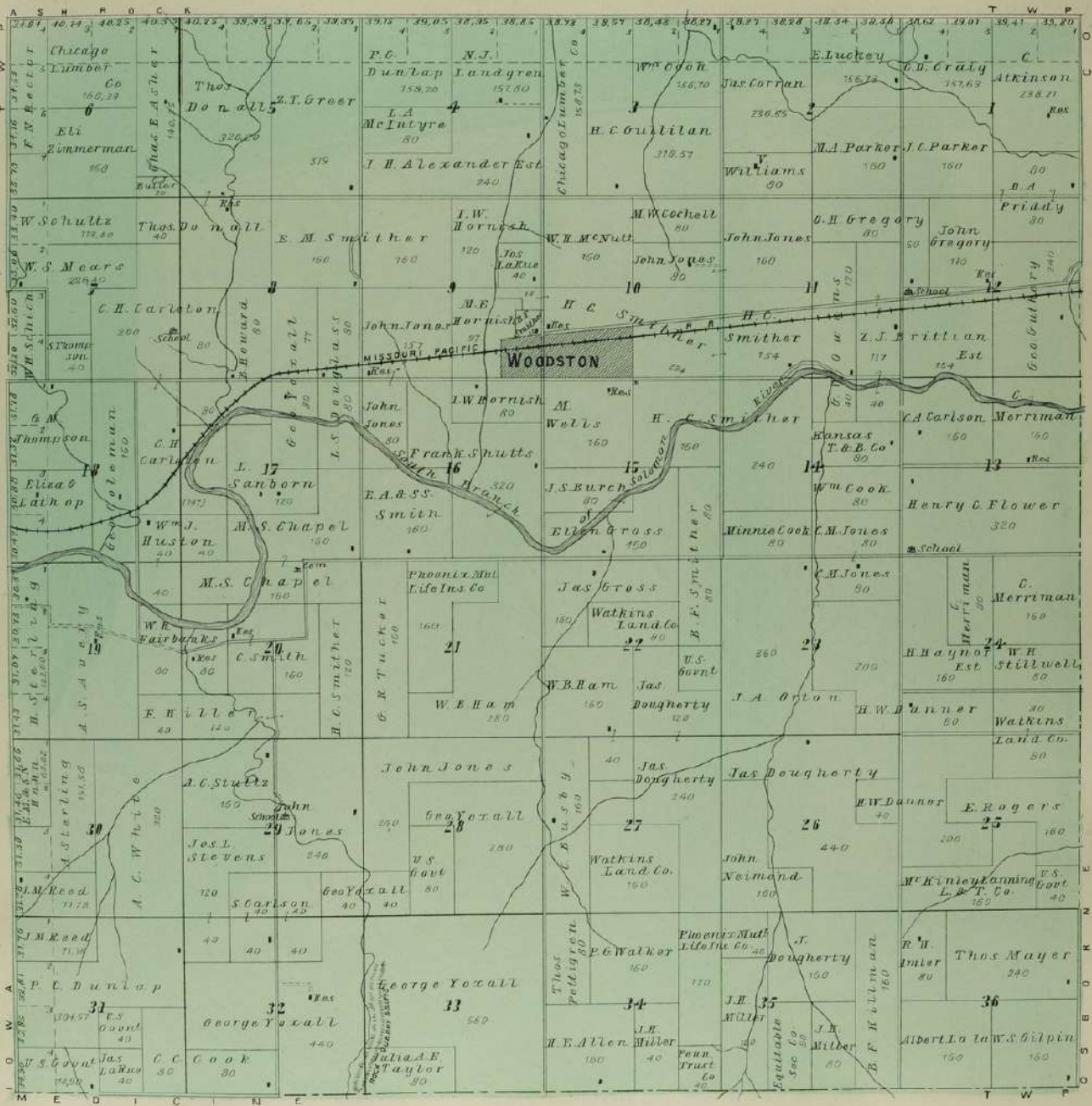

MAP OF
MEDICINE
TOWNSHIP
Township 8 South Range XVI West of the 6th P.M.

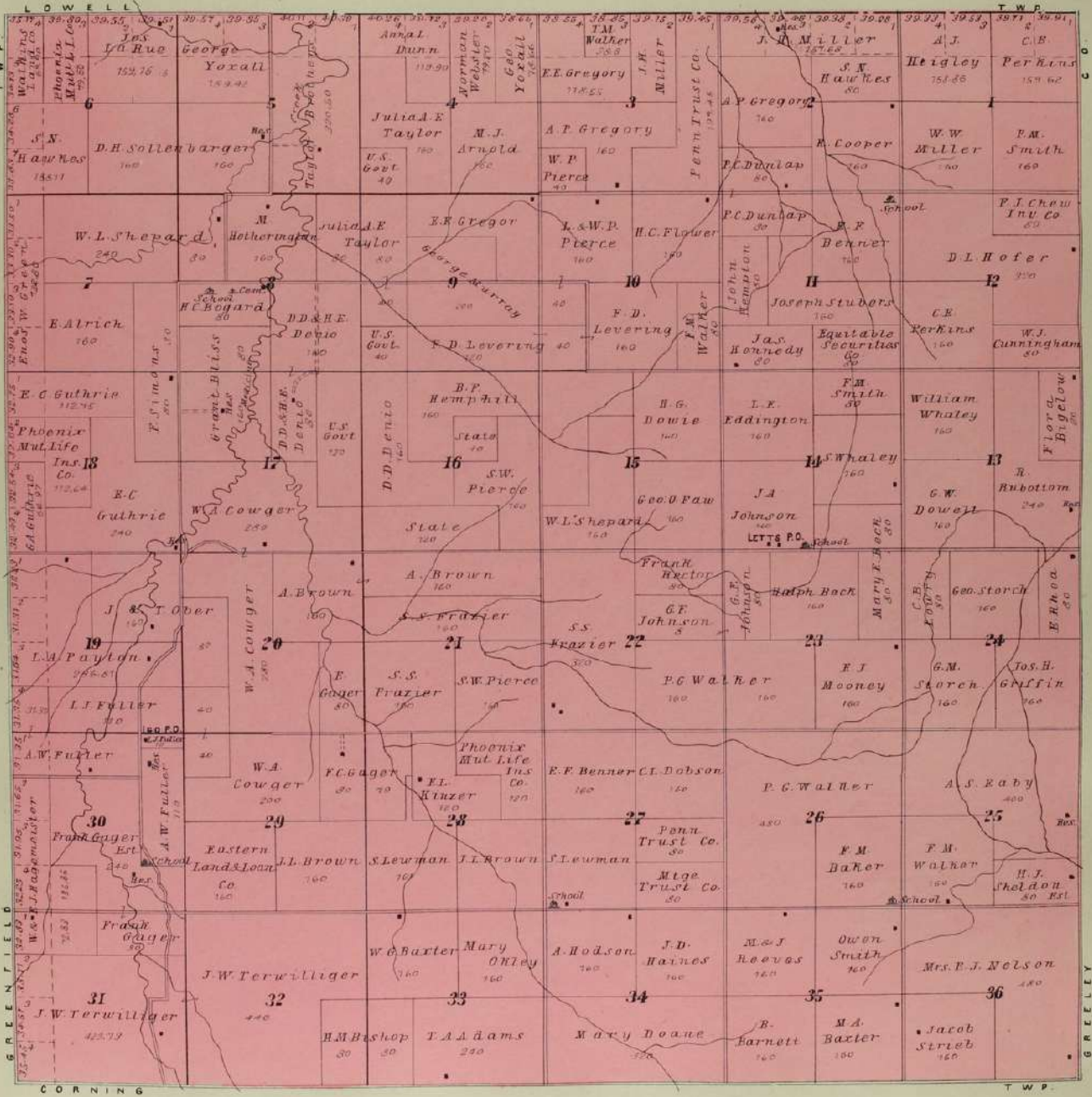



MAP OF
GREENFIELD
TOWNSHIP
 Township 8 South Range XVII West of the 6th P.M.





MAP OF
HOBART
 TOWNSHIP
 Township 8 South Range XVIII West of the 6th P.M.
 Sub. 2nd March 1905

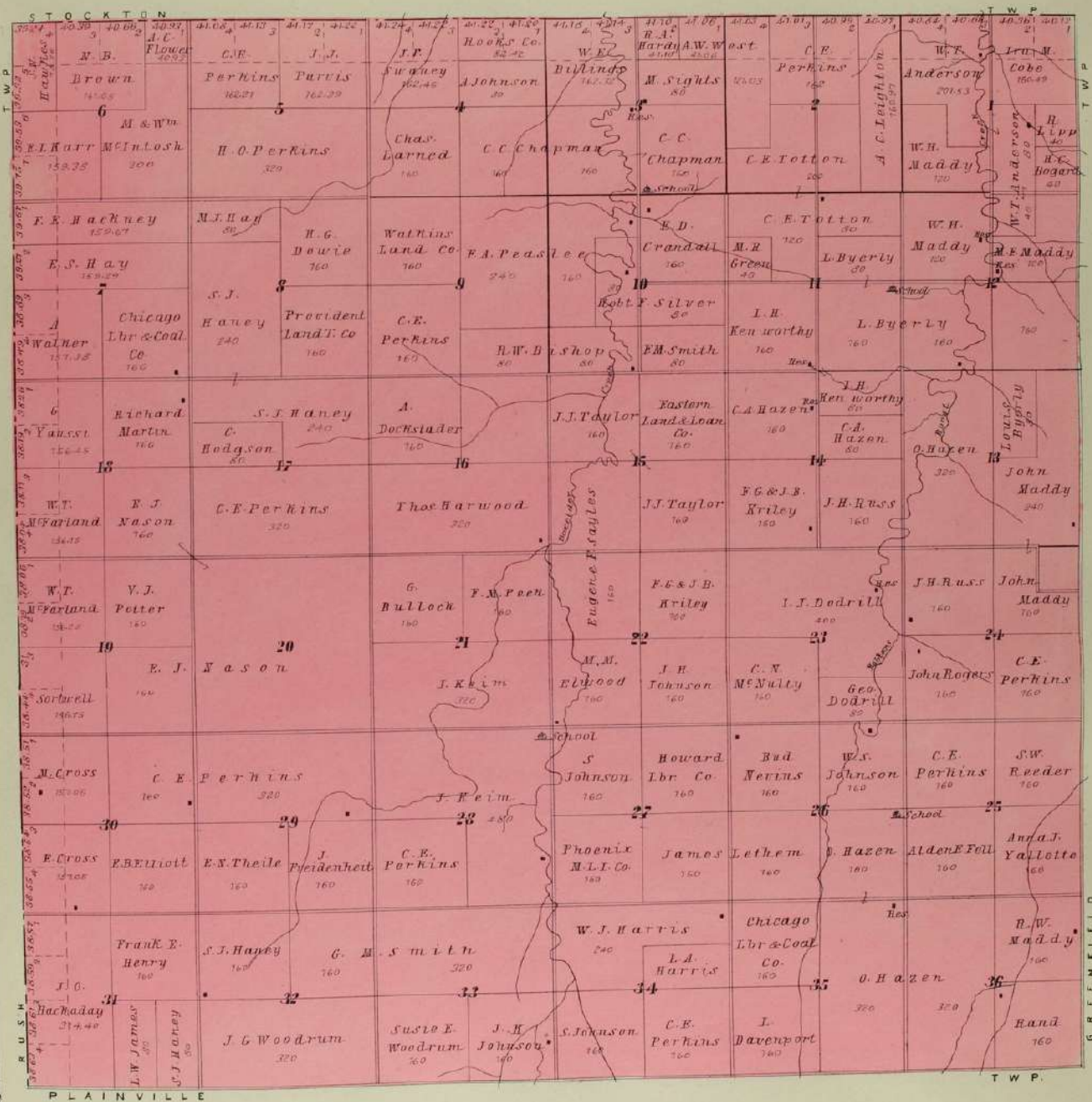

PLAINVILLE

T W P.

GREENFIELD



MAP OF
RUSH
TOWNSHIP
 Township 8 South Range XIX West of the 6th P.M.

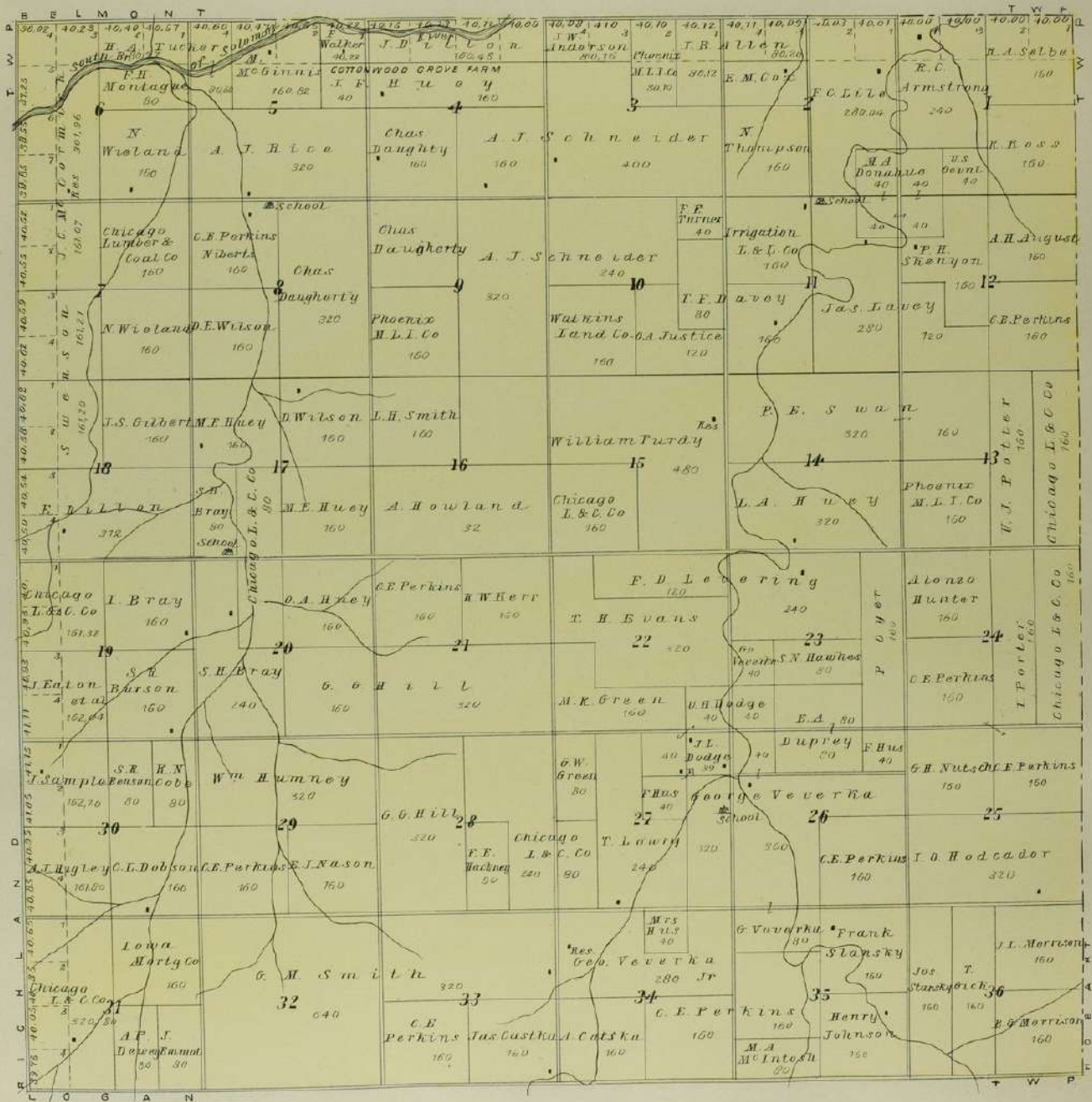



MAP OF
RICHLAND
 TOWNSHIP
 Township 8 South Range XX West of the 6th P.M.

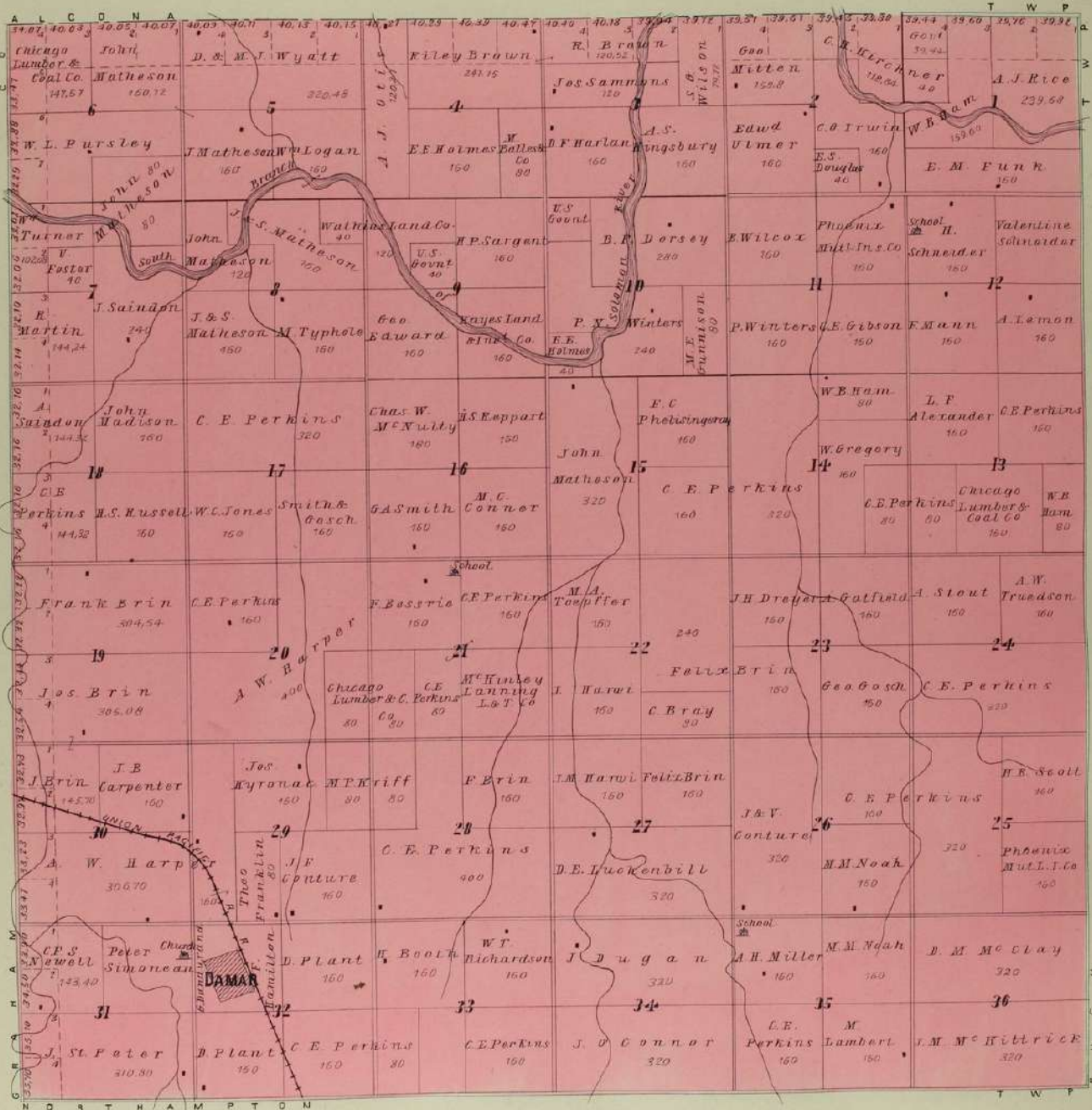



MAP OF
NORTHAMPTON
 TOWNSHIP
 Township 9 South Range XX West of the 6th P.M.

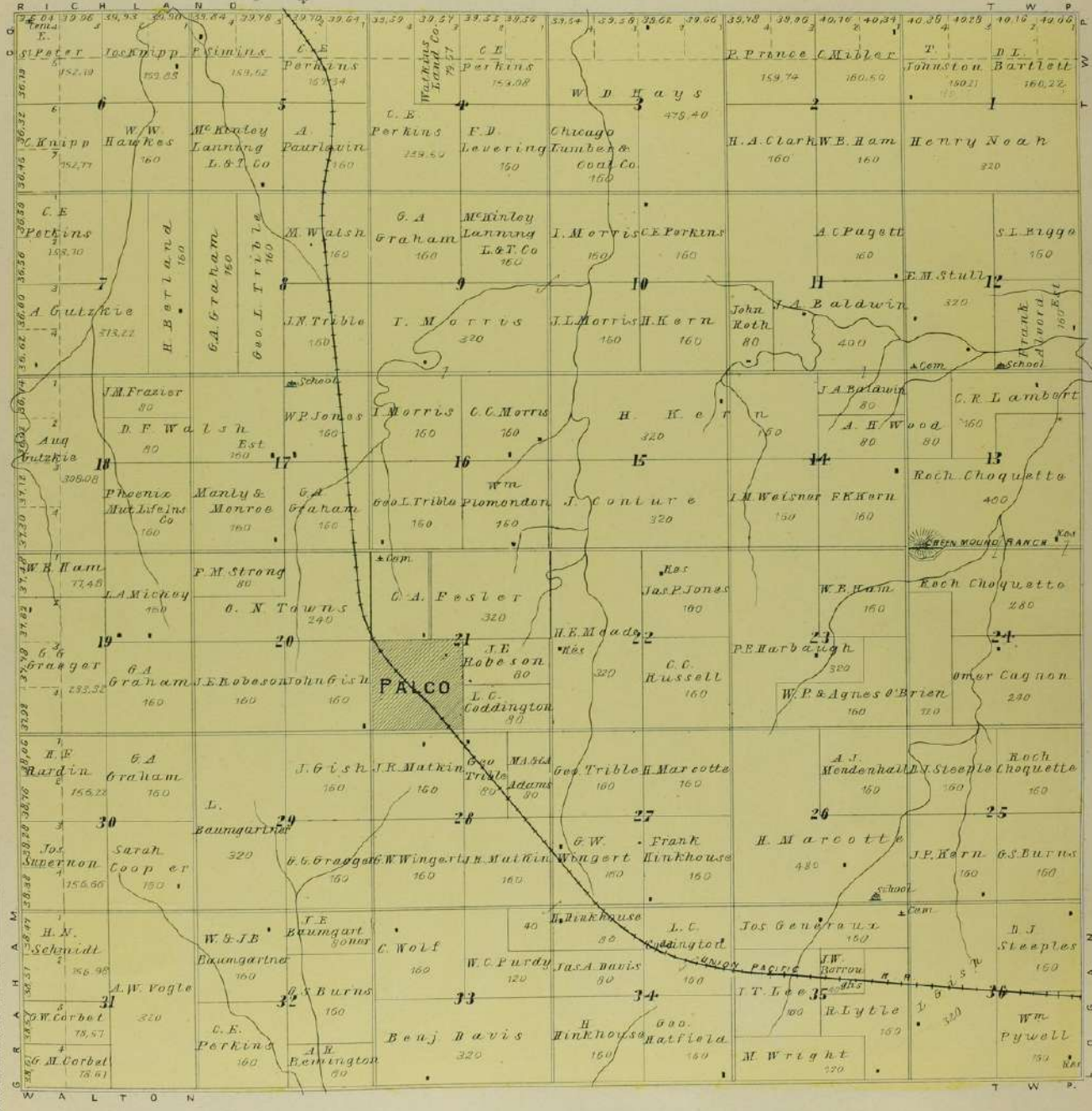



LOGAN

 TOWNSHIP

Township 9 South Range XIX West of the 6th P.M.

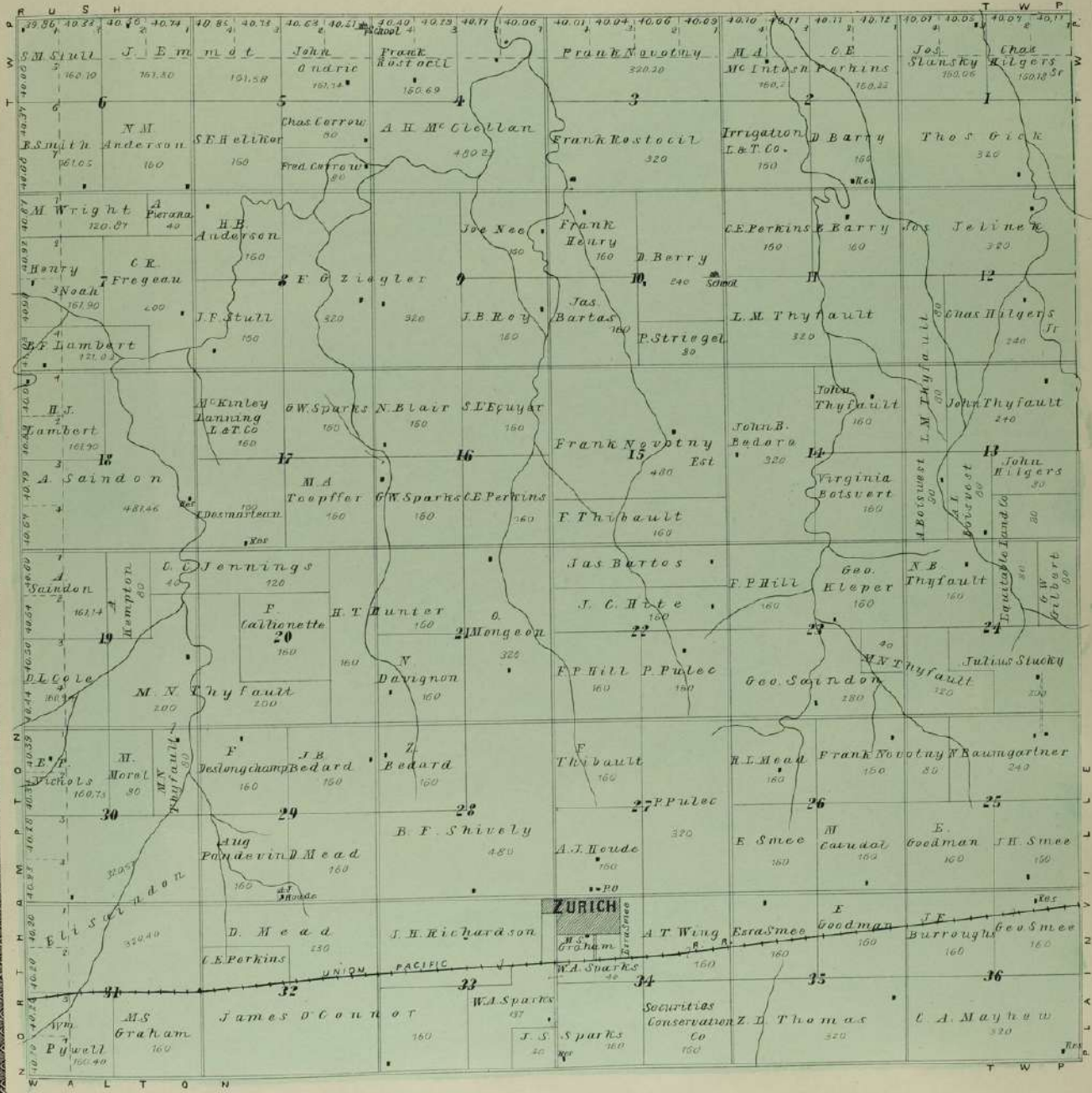



PLAINVILLE

 TOWNSHIP

Townships 9 and 10 South, Range XVIII West of the 6th P.M.

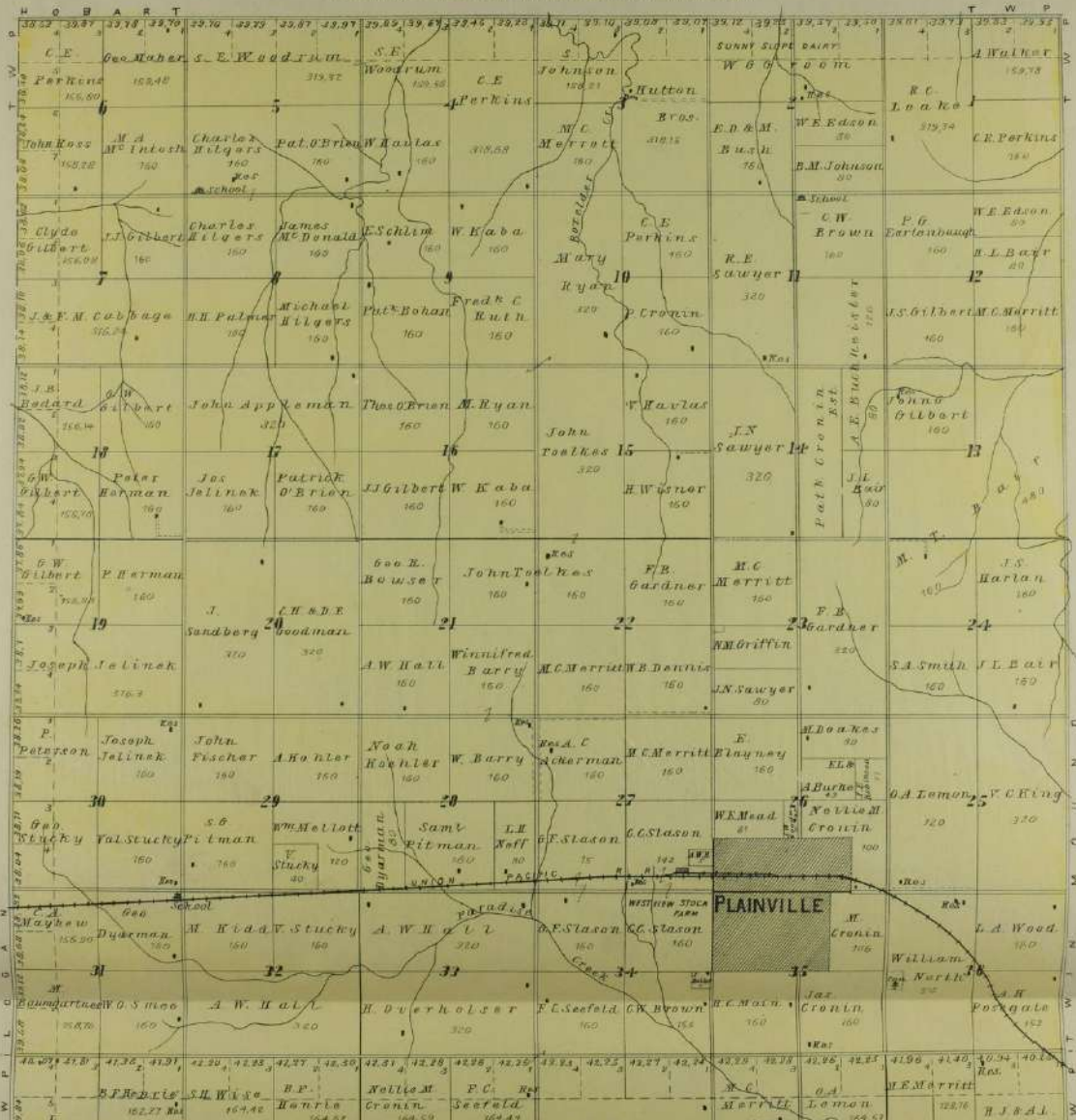





MAP OF
TWIN MOUND
TOWNSHIP
 Township 9 South Range XVII West of the 6th P.M.

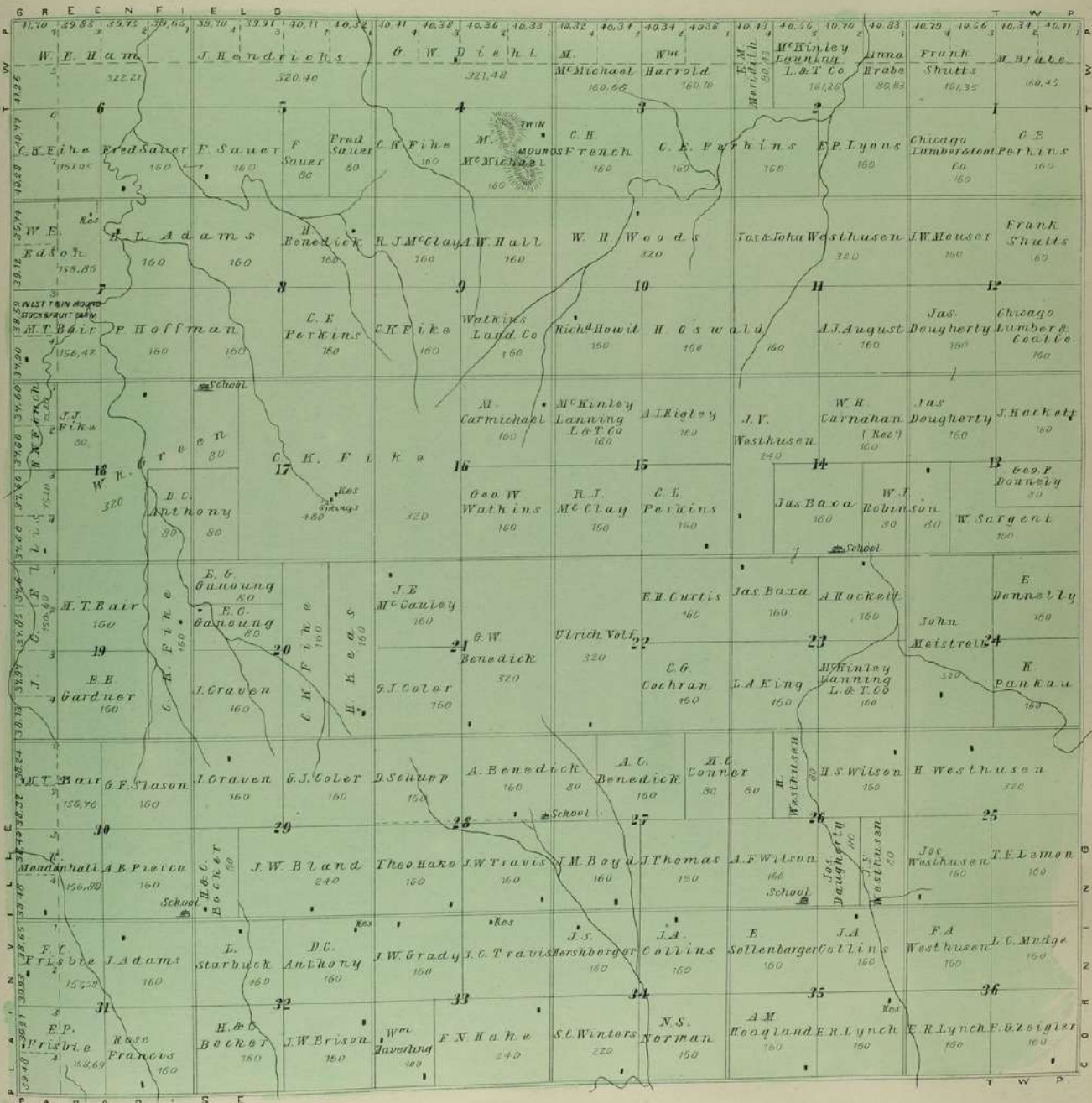



CORNING

 TOWNSHIP

Township 9 South Range X VI West of the 6th E.M.

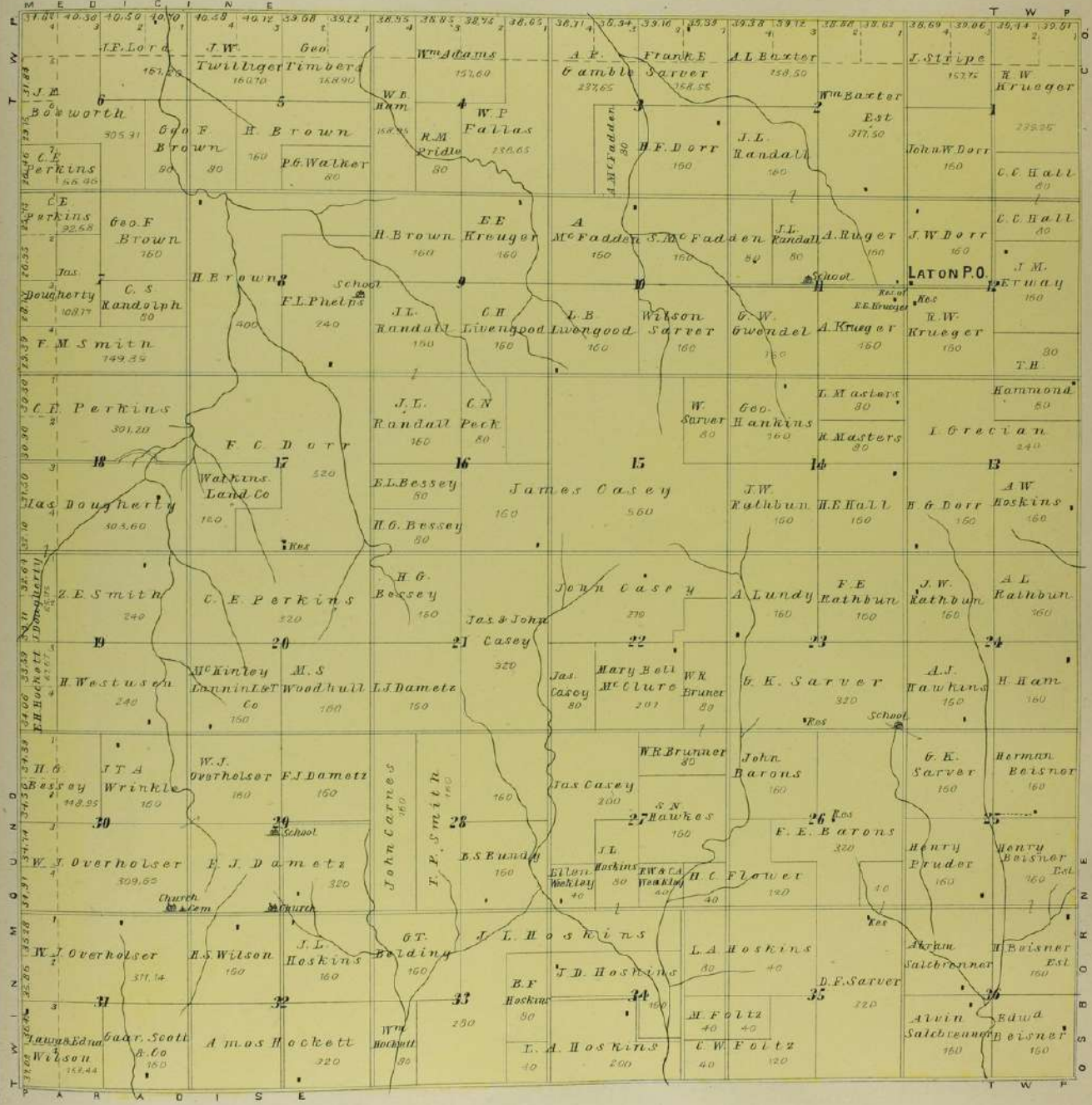
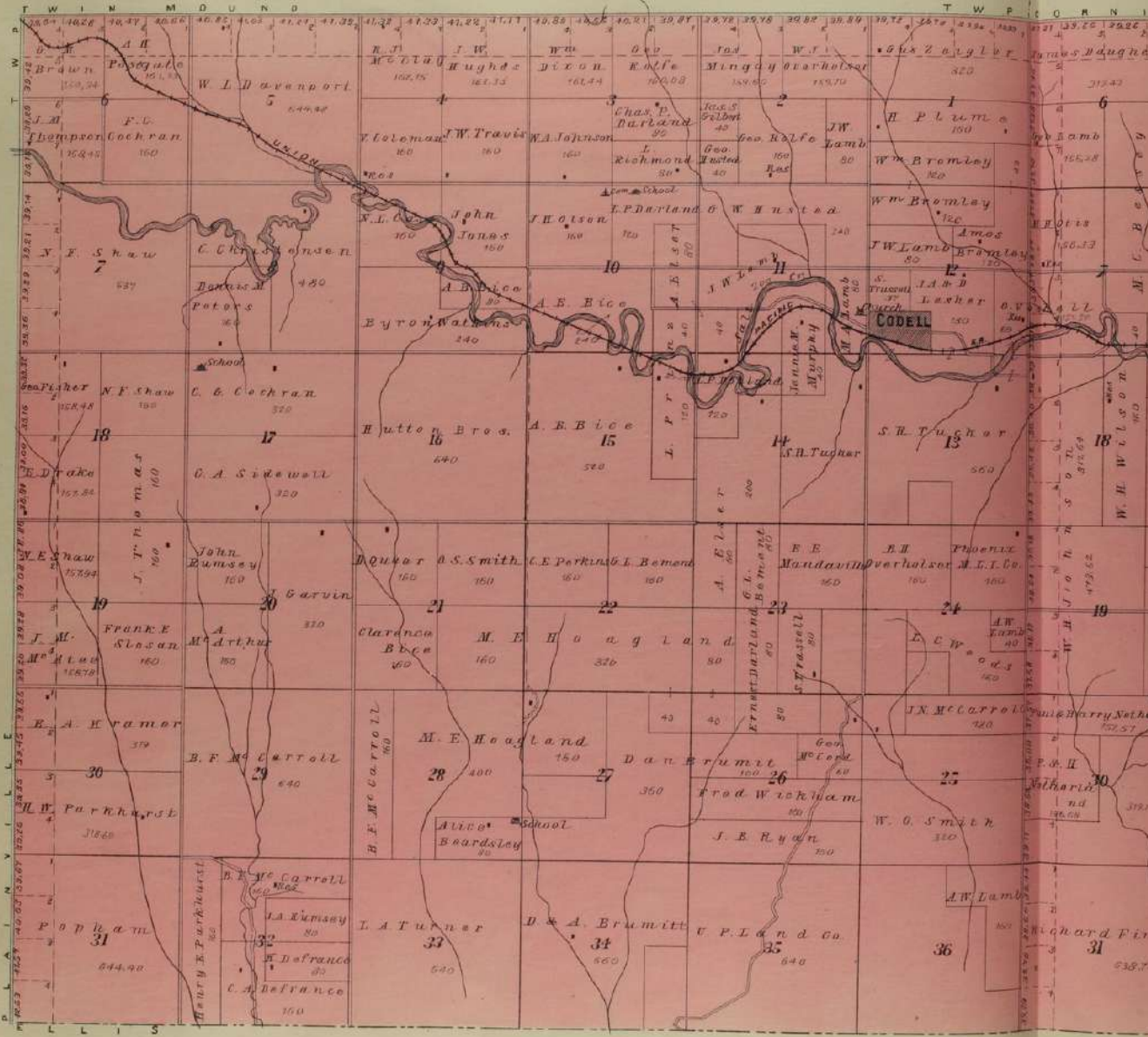

PLATE 10

MAP OF
PARADISE
 TOWNSHIP
 Township 10 South Range XVI and XVII West



MAP OF PARADISE TOWNSHIP

h Ranges XVI and XVII West of the 6th P.M.

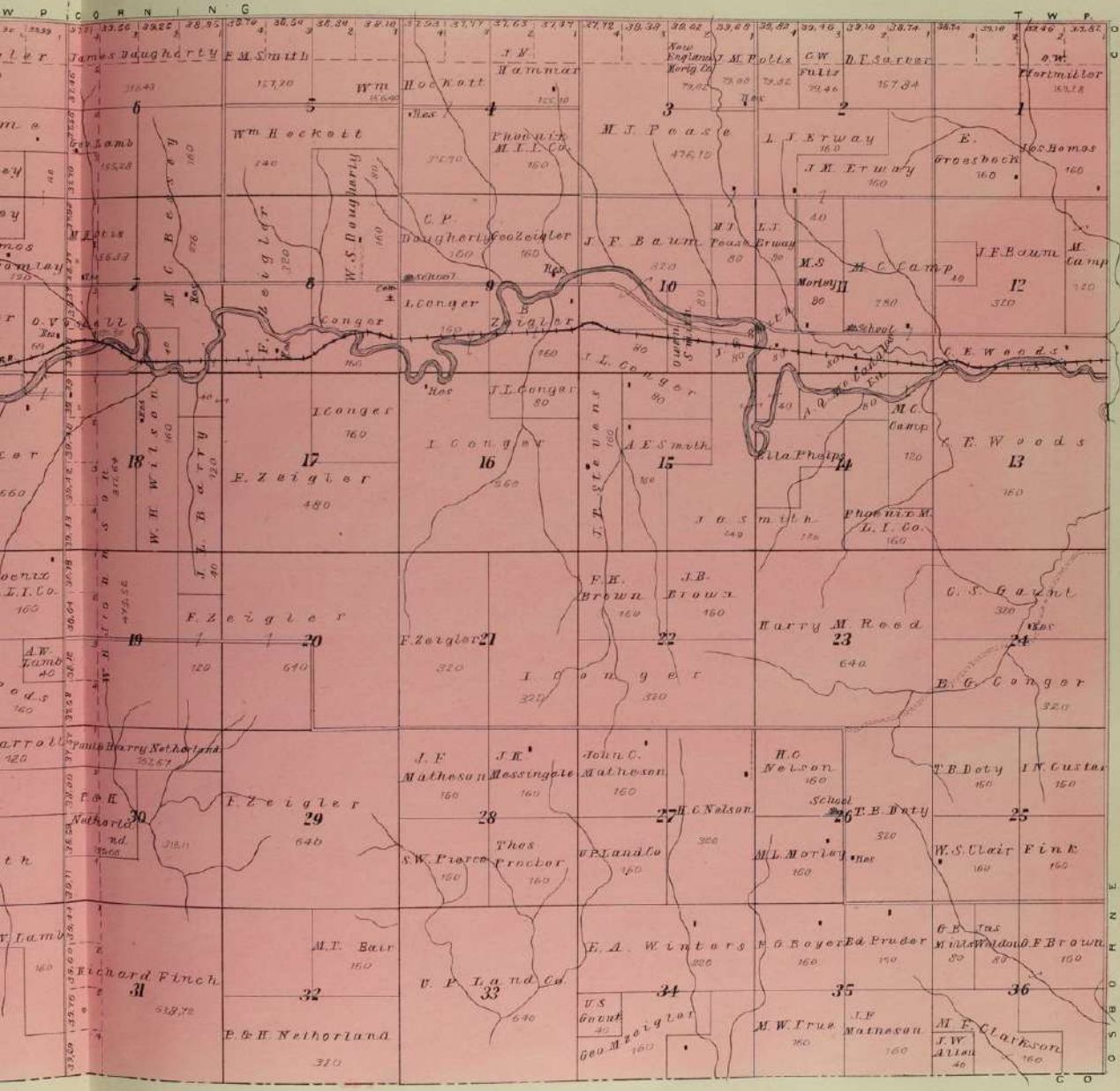

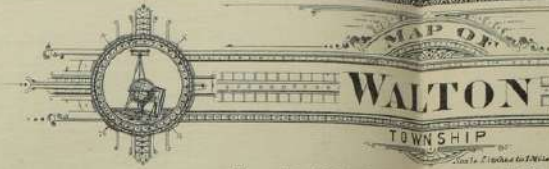

Township 10 South, Range XIX and XX West

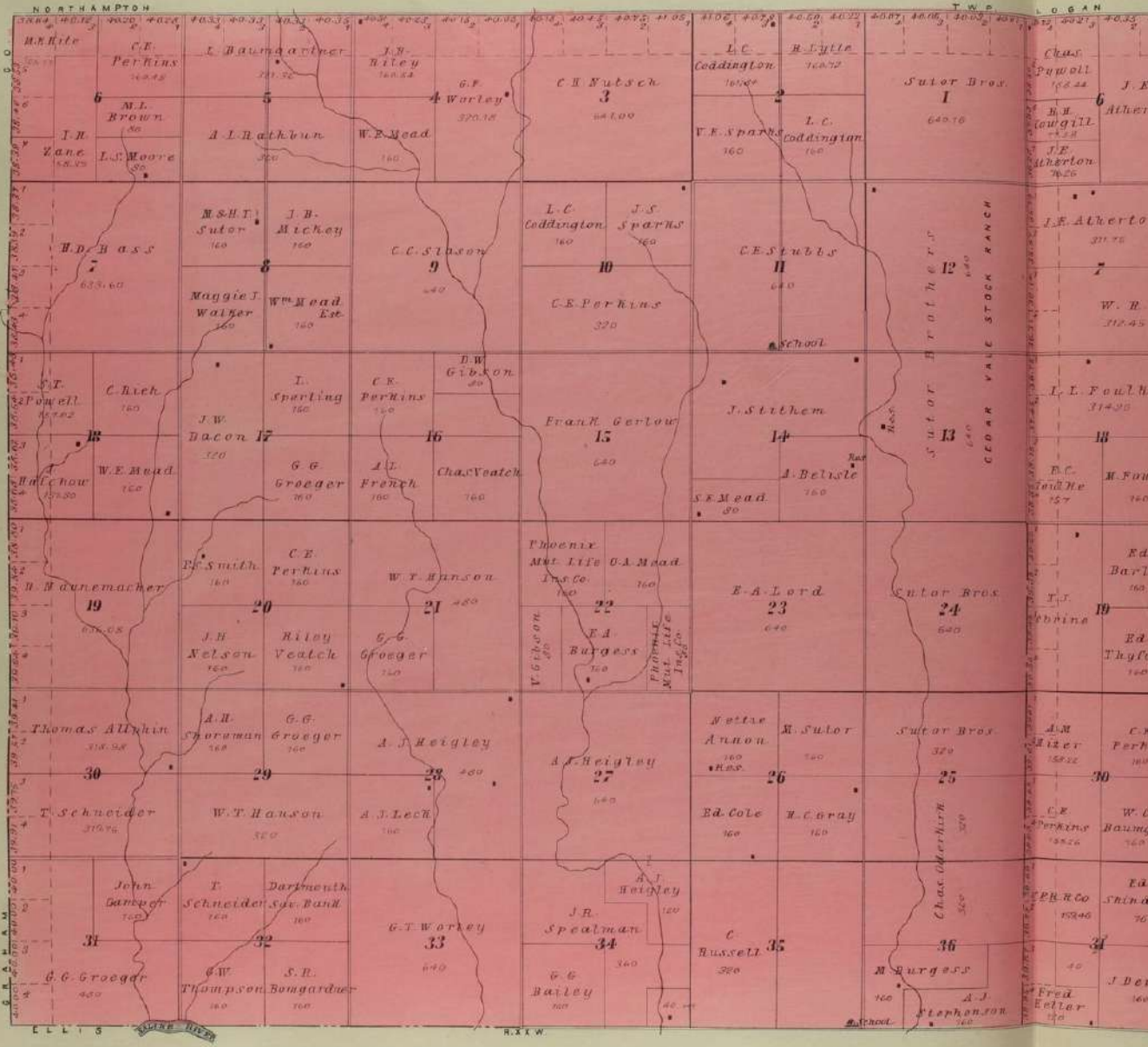

MAP OF WALTON TOWNSHIP

South, Ranges XIX and XX West of the 6th P.M.

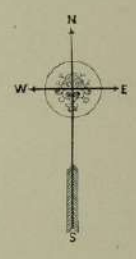
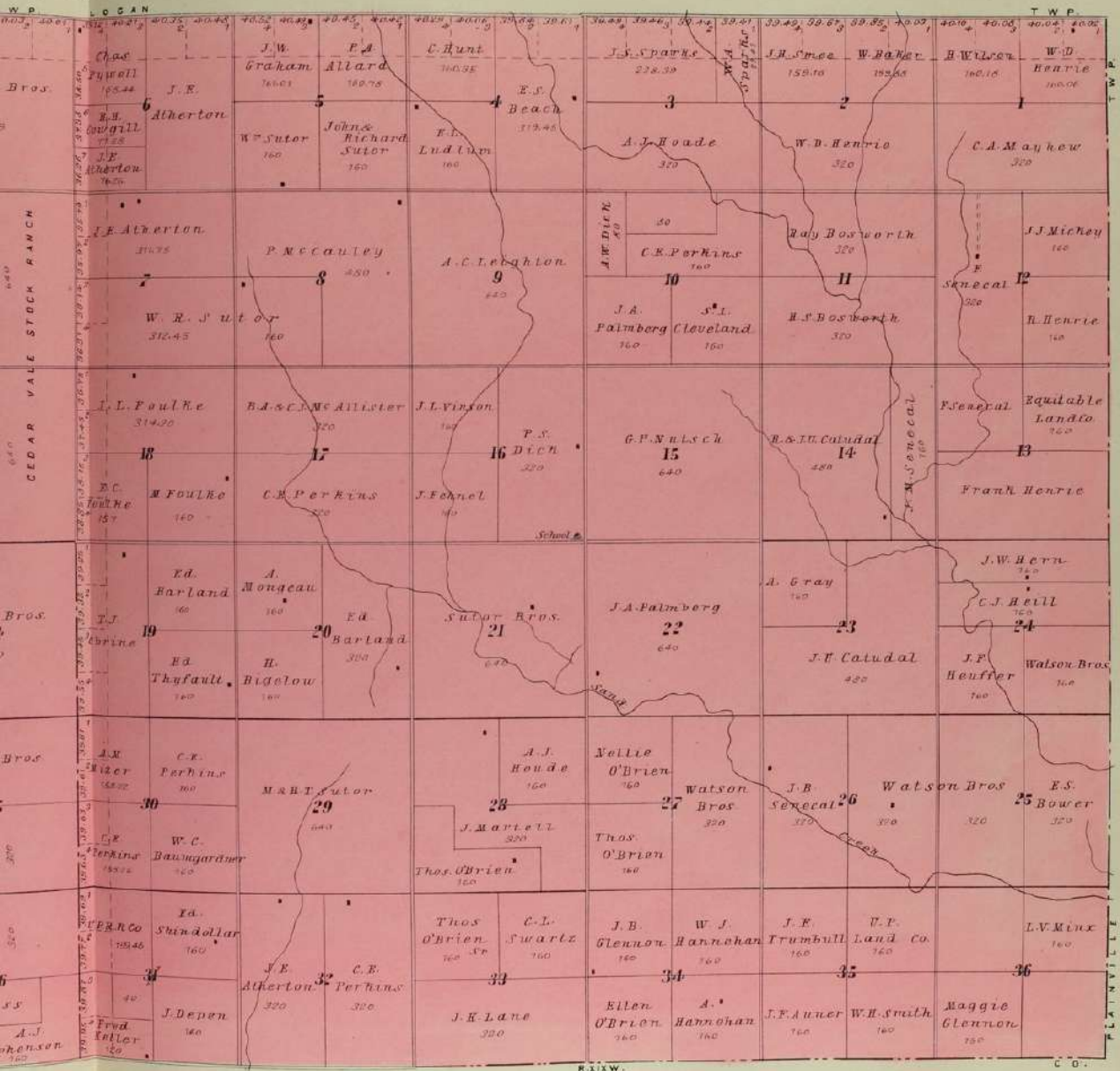

R. XIX.

C. O.

STOCKTON
County Seat of Rooks Co. Kas.
Scale 300 ft. to 1 inch.

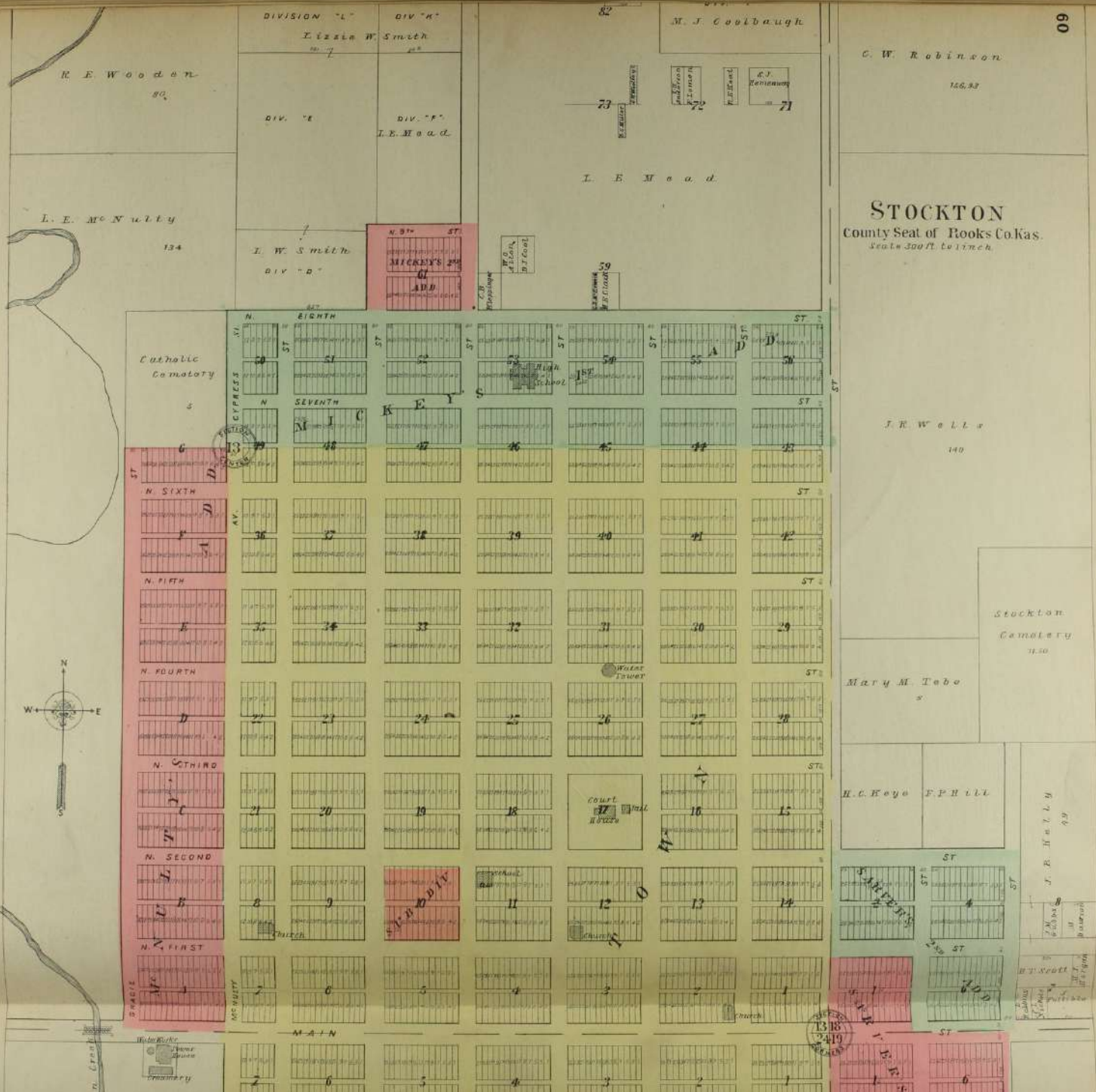

R. E. Woodson
89.

DIVISION "L" DIV "K"
I. E. W. Smith
DIV. "E" DIV. "F"
I. E. Mead

M. J. Cooldough

C. W. Robinson
126.23

L. E. McNulty
134

I. W. Smith
DIV. "D"

MICKEY'S
ADD

I. E. Mead

Catholic
Cemetery

J. R. Wells
140

Stockton
Cemetery
1150

Mary M. Tebo

H. C. Keya F. P. Hill

J. B. H. C. L. Y
9.9

H. T. Scott
11.7

1388
1349

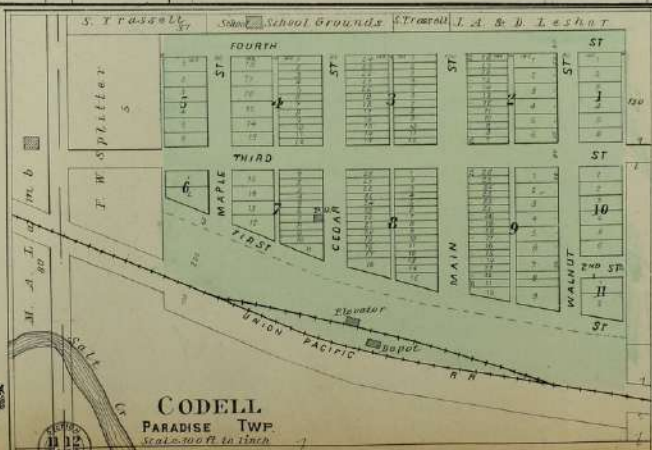
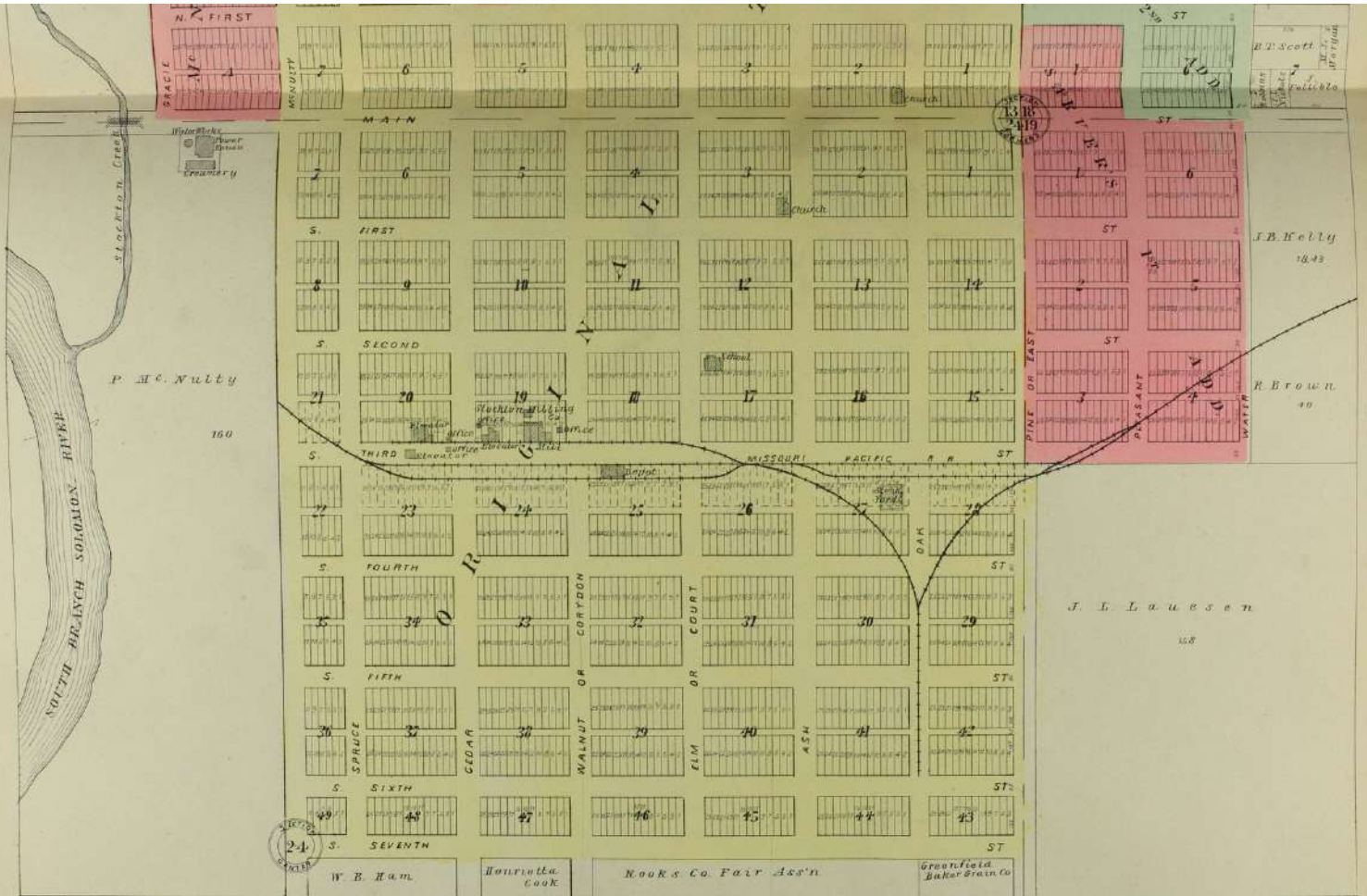

DAMAR
 RICHLAND TWP.
 Scale 300 ft to 1 in.

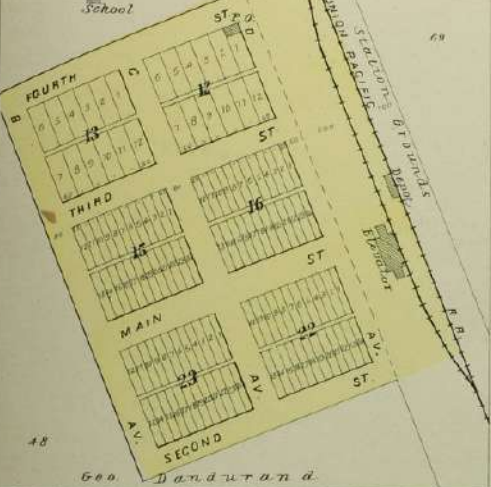

H. F. Shively

300
 School
 Church
 J. H. Richardson
 119

A. J. Howde

100
 Post Office

ZURICH
 LOGAN TWP.
 Scale 300 ft to 1 in.

65

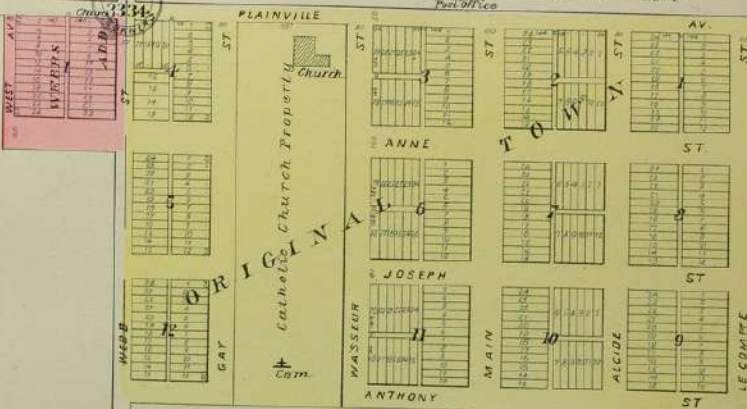

PALCO
 NORTHAMPTON TWP.
 Scale 300 ft to 1 in.

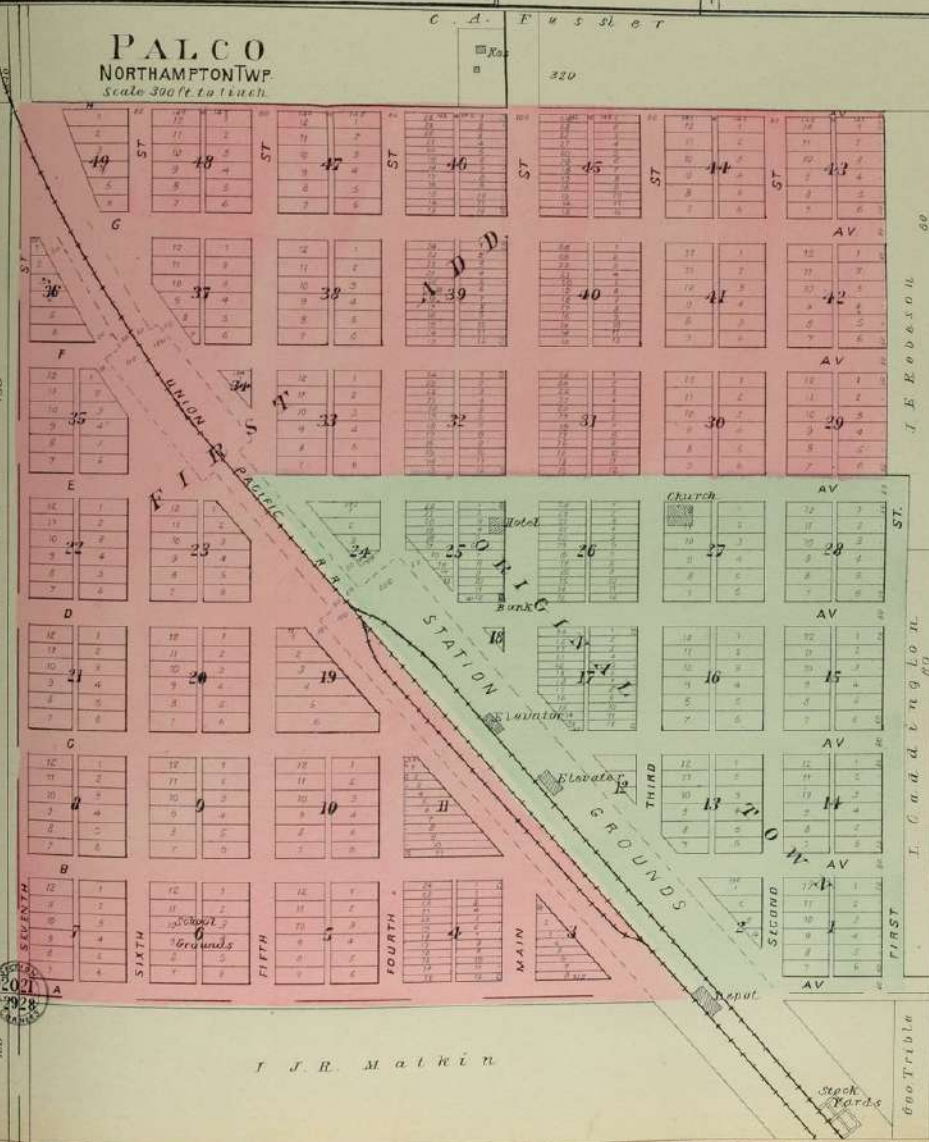

C. A. Fisher

320

M. S. Graham

25
 Elevator
 Elevator
 Stock
 Tails

UNION PACIFIC
 W. A. Sparks



I. J. R. Malin

PLAINVILLE
 TWP.
 Scale 300 ft to 1 in.



E. J. R. S. M. a.

