

*Annual
Farm & Ranch
Directory
of
Rush County,
Kansas
1967*



OFFICIAL
1967

Rush County Kansas Farm & Ranch Directory

Single Copy Price \$7.50

BISON, KANSAS

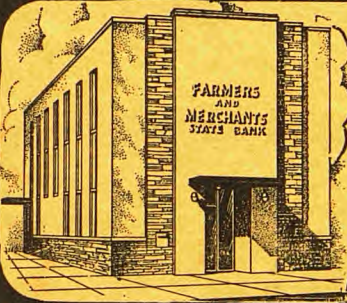

Farmers & Merchants State Bank



LA CROSSE



Oldest Bank In Rush County

Established in 1888

CAPITAL & SURPLUS — \$150,000.00

Member Federal Deposit Insurance Corporation

FDIC
FEDERAL DEPOSIT INSURANCE CORPORATION

Each depositor insured to \$10,000

"WE CARE FOR OUR CUSTOMERS"

Mid Continent L. P. Service, Inc.

FACTORY METHOD TRACTOR CONVERSIONS

METERED GAS SYSTEMS



Larned

AT 5-6166

Great Bend

N. Main

SW 3-3312



Complete Farm - Home - Oil Field Service

THE RUSH COUNTY ELEVATOR CO., Inc.

SEED CLEANING WITH HART-CARTER DISC MACHINE

BUY AND SELL GRAIN OF ALL KINDS

GOOCH'S FEEDS • BULK DELIVERY

Allied Chemical Fertilizer Blended For Your Specification

Ph. 394-2244

W. E. (BILL) HARPER, Mgr.

McCracken, Kan.

OCHS INCORPORATED



Parts — Sales — Service



ALLIS-CHALMERS FARM EQUIPMENT

PHONE 387-2361 P.O. BOX 361 OTIS, KANSAS

PIVONKA IMPLEMENT CO

Pearce - Simpson & Regency

CB Radios

Sales & Service

Timken, Kansas

John Deere

Phone EL 5-

THE NEKOMA STATE BANK
SAFE SILENT SERVICE

NEKOMA, KANSAS

PHONE EL 6-2195



SAMS K T SERVICE

WHERE QUALITY IS YOUR FRIEND
EVERYTHING FOR THE FARM



Gasoline • Oils • Greases • Gear Lubes

ACCESSORIES OF ALL KINDS

Ph. 394-7342

McCracken, Kansas

COMMODITY WEIGHTS and MEASURES

THE FOLLOWING WEIGHTS ARE ACCURATE ENOUGH FOR
GENERAL USE

APPLES: 1 barrel — 150 lb. — 3 bu.	CEMENT: 1 barrel (4 bags) — 376 lbs.
CORN (ear): 2¼ to 2½ cu. ft. — 1 bu.	COAL: 1 bushel — 80 lbs. or 1 bag — 100 lbs.
CRANBERRIES: 1 barrel — 100 lbs.	GASOLINE: 1 barrel — 55 gal. — 363 lbs.
CREAM: 1 gallon — 8.4 lbs.	GRAVEL: 1 cu. ft. — 95 lbs.
EGGS: 30 doz. crate — 55-60 lbs.	KEROSENE: 1 barrel — 385 lbs. or 1 gal. — 7 lbs.
FLOUR: 1 barrel — 196 lbs.	LATH: 49" standard bundle of 50 — 23 lbs.
ICE: 1 cu. ft. — 56 lbs.	LIME: 1 barrel — 320 lbs. or 1 bu. — 75 lbs.
ICE CREAM: 1 gallon — 7 lbs.	NAILS: 1 keg — 100 lbs.
LINSEED OIL: 1 barrel — 400 lbs.	FUEL OIL: 1 barrel — 42 gal. (Approx. 8 lbs. per gal.)
MILK: 1 gallon — 8.6 lbs. or 46½ qts. — 100 lbs.	DRY SAND: 1 cu. ft. — 110 lbs.
SUGAR: 1 barrel — 350 lbs.	SHINGLES: 1 bundle (about 250) — 50 lbs.
VINEGAR: 1 barrel — 400 to 500 lbs. — 48 gal.	TURPENTINE: 1 barrel — 432 lbs. or 1 gal. — 7.2 lbs.
WATER: 1 cu. ft. — 62½ lbs. — 7½ gal. 1 gal. — 8 1/3 lbs.	WOOD: 1 cord — 128 cu. ft.

For Your Aerial Spraying Contact GILBERT A. LEGLEITER

- Experienced
- Bonded
- Registered



- Insect Control
- Weed
- Defoliating

AERIAL SPRAYING SERVICE

3 N. 2 E. ½ N. on W.

R.R.1

LA CROSSE, KANSAS



AUTO - TRUCK - LIFE - LIABILITY - HAIL - FIRE

**Your Insurance Needs
Are Our Concern. . .**

**WE ARE
READY TO HELP!**

Regardless of how large or small, call
us and let Farm Bureau Insurance provide
the right coverage for you.

- **FARM MASTER — HOMEOWNERS**
...for farm or town - over 25 coverages.
- **LIFE —** insure your future Retirement income.

**FARM BUREAU
INSURANCE**

JIM HASKELL

PHONE CA 2-3415 LA CROSSE

Rush County Farm Bureau



affiliated
with



"The Voice of Agriculture"

The Largest General Farm Organization
In The Country

Save Money On Your
Blue Cross - Blue Shield
Through Our Farm Bureau Group

LA CROSSE

KANSAS

HOW TO READ YOUR DIRECTORY

Farmers' names are listed alphabetically by last name, followed by first name or initial, post office address, route number and name of township -- then comes the section number and "O" or "R" for owner or renter.

Following is an example of the method used:

Petrek Wayne L.C. L.C. 36 O
(Last Name) (First Name) (P.O. Address) (Route No.) (Township) (Section No.) (O or R)

ABBREVIATIONS TOWNS

	Zip Code			Zip Code	
Albert	67511	Alb.	Nekoma	67559	Nek.
Alexander	67513	Ale.	Otis	67565	Otis
Bison	67520	Bis.	Pawnee Rock	67567	P.R.
La Crosse	67548	L.C.	Pfeifer	67660	Pfe.
Liebenthal	67553	Lie.	Rush Center	67575	R.C.
Mc Cracken	67556	M.C.	Schoenchen	67667	Sch.
			Timken	67582	Tim.

TOWNSHIPS

Alexander	Ale.	Garfield	Gar.
Banner	Ban.	Hampton	Ham.
Belle Prairie	B.P.	Illinois	Ill.
Big Timber	B.T.	La Crosse	L.C.
Brookdale	Bro.	Lone Star	L.S.
Center	Cen.	Pioneer	Pio.
Fairview	Fair.	Pleasantdale	Ple.
		Union	Un.

A

ALLEN, BILLY T., BIS., PLE. 32, O
 ALLEN, CLIFFORD L., BIS., ILL. 11, S, O
 ALTER, DALE, ALB., GAR. 22,
 AMICK, MRS. V. D., M.C., BRO. 4, O
 APPEL, DELMER, R.C., CEN. 30, R
 APPEL, SAM, NEK., UN. 1, O
 APPL, THEODORE, BIS., L.S. 29, O
 ATER, ELMER, ALB., GAR. 22, O
 ATER, MRS. MINNIE, ALB., GAR. 22, O
 AVEY, D. J., ALB., PIO. 15, S, O

B

BAILEY, DAVE, R.C., CEN. 30, O
 BAILEY, M. L., R.C., CEN. 30, O
 BAKER, DONALD E., TIM., BAN. 14, R
 BALDWIN, BEVERLY, L.C., FAIR. 23, R
 BALDWIN, ROSS, M.C., HAM. 36, O
 BALDWIN, THOMAS, NEK., UN. 19, O
 BALES, LARRY, BIS., L.S. 12, S, O
 BANNISTER, CHARLES, ALE., B.P. 28, O
 BARREN, T. D., R.C., CEN. 26, O
 BASGALL, JEROME J., BIS., ILL. 4, O
 BASGALL, TONY J., BIS., ILL. 16, R
 BAUS, WILLIAM E., ALE., ALE. 3, O
 BECKER, WALTER, NEK., UN. 33, S, O
 BERENS, BEN, BIS., ILL. 8, O
 BERGMAN, HANS, OTIS, PLE. 12, R
 BERTHERUS, MELVIN, BIS., PIO. 21, R
 BESPARET, CHARLES J., TIM., L.S. 18, S, O
 BESPARET, BILLY, TIM., BAN. 33, O
 BIEBER, DOROTHY, BIS., L.S. 15, O
 BIEBER, GRACE, BIS., L.S. 15, O
 BIEKER, MRS. CHARLES N., SCH., B.T. 6, O
 BIEKER, MARGARET, L.C., L.C. 3, R
 BISTERFELT, HENRY, L.C., L.C. 3, R
 BIZEK, CHARLES, TIM., BAN. 2, O
 BORTONEK, KENNETH, OTIS, PLE. 12, S, R
 BORTZ, CHARLES, R.C., CEN. 13, O
 BORTZ, DEAN, R.C., CEN. 13, R
 BORTZ, ELMER, TIM., BAN. 24, S, O
 BORTZ, ELMER F., TIM., BAN. 20, S, O
 BOTT, DONALD J., M.C., ALE. 2, R
 BOTT, J. A., ALE., B.P. 2, O
 BOTT, MAGDALENE, ALE., B.P. 34, O
 BOTT, MARY, ALE., B.P. 34, O
 BOTT, PAUL, M.C., ALE. 36, R
 BOTT, ROBERT, ALE., B.P. 3, O
 BOWMAN, PAUL, NEK., UN. 19, O
 BRACK, ADOLPH, BIS., PIO. 31, O
 BRACK, BILLY, ALB., PIO. 10, R
 BRACK, BRYON, OTIS, PIO. 26,
 BRACK, FRED J., R.C., CEN. 20, S, O
 BRACK, HERMAN K., BIS., PIO. 29, O
 BRACK, KEITH, ALB., GAR. 24, R
 BRACK, KENNETH, OTIS, PIO. 34, O
 BRACK, LELAND, OTIS, PIO. 12, O
 BRACK, MARVIN, OTIS, PIO. 16, O
 BRACK, MORRIS, ALB., PIO. 16, S, O
 BRACK, MRS. P. J., ALB., PIO. 13, S, O

THE CITIZENS STATE BANK



ESTABLISHED 1909

CAPITAL AND SURPLUS \$150,000.00

Phone 394-2284

McCracken, Kansas

BRACK, WILBER R., M.C., ALE. 34, R
 BRADY, CALVIN, ALB., GAR. 34, O
 BRADY, T.G., ALB., GAR. 4, O
 BRAUER, HENRY, NEK., UN. 9, O
 BRAZDA, ALFRIEDA, TIM., GAR. 30, S, O
 BRAZDA, HARRY, TIM., GAR. 30, S, O
 BRENNING, DON, L.C., L.C. 28, R
 BRYANT, A.C., ALE., B.P. 21, O
 BUCL, ERNEST, TIM., BAN. 27, R
 BUDDE, OLIVE, ALB., GAR. 35, O
 BULLOCK, FRED, M.C., HAM. 6, N, O
 BURGARDT, LEONARD, ALB., PIO. 14, S, R
 BURK, CECIL, NEK., B.P. 1, R
 BUTTON, KENNETH, R.C., CEN. 31, O

C
 CAMPBELL, CLAUDE, R.C., CEN. 32, S, O
 CARSON, VIRGIL W., M.C., BRO. 19, O
 CHENEY, FRANK, R.C., CEN. 23, R
 CHLUMSKY, ALFRED, R.C., CEN. 27, O
 CHRISTIANSON, L.A., ALB., GAR. 28, S, O
 COLLINS, CHARLES, NEK., UN. 22, O
 CONARD, WAYNE, TIM., BAN. 32, S, O
 COOK, GEORGE, R.C., L.C. 7, R
 COX, LYLE, OTIS, PIO. 26, R
 CROTINGER, ARTHUR, BIS., PIO. 4, O
 CROTINGER, GERALD, M.C., HAM. 3, N, O
 CUNNINGHAM, L.S., BIS., PLE. 4, S, O
 CUTHRELL, LAWRENCE, OTIS, PLE. 10, O

OTIS LUMBER & GRAIN CO.

RETAIL LUMBER & BUILDERS HARDWARE
Clean All Seeds With Carter Disc Cleaner

RILCO SHEDS

HIGHEST MARKET FOR GRAINS

Phone 387-2454 or 387-2458

Otis, Kansas



OIL SERVICE

COMPLETE SERVICE

Gas • Oil • Grease • Gear Lube



TANK WAGON

Phone 387-2565

Otis, Kansas

DIRECTORY SERVICE COMPANY

ANNUAL

FARM & RANCH DIRECTORY OF

RUSH COUNTY
KANSAS

1967

In making this Farm Directory of your County — the aim of The Directory Service Company is to equal or excel any works of a similar nature anywhere in the United States. Every possible effort has been made to bring this directory entirely up to date. However, we do not accept responsibility for omissions or errors. If you notice any omission or error in this Directory, please let us know.

Call or Write for Information on similar County Directories in: Colorado, Illinois, Indiana, Iowa, Kansas, Michigan, Minnesota, Missouri, Nebraska, North Dakota, Ohio, Oklahoma, South Dakota and Wisconsin.

FREE DISTRIBUTION TO FARMERS IN THIS COUNTY

New Edition Published Each Year.

\$7.50 EACH.

Write for quantity discount.

Phone 515 — 295-2473

Algona, Iowa 50511

D

DAUBERT, BEN P., OTIS, P10, 32, 0
 DAUBERT, JOEL, OTIS, P10, 16, 0
 DECKER, JACOB, BIS., ILL, 2, 5, 0
 DEGERHARDT, R.F., BIS., ILL, 21, R
 DERR, BOB, M.C., ALE, 16, 0
 DERR, PETE, M.C., ALE, 15, 0
 DERR, WESLEY, M.C., HAM, 10, 0
 DE WALD, HARLAN, L.C., BRO, 13, 0
 DE WALD, LE ROY, OTIS, PLE, 35, R
 DIETZ, EUGENE, R.C., L.C., 14, S, R
 DIRKS, FRED H., L.C., L.C., 15, S, 0
 DIRKS, LESTER, TIM., L.S., 14, S, 0
 DIRKS, VERNON, ALB., GAR, 23, S, 0
 DIRKS, WILLIAM H., ALB., GAR, 22, S, 0
 DOME, RALPH, M.C., ALE, 13, S, 0
 DREHER, PHILIP, L.C., B.T., 20, 0
 DREHER, RUDOLPH, L.C., FAIR, 23, 0
 DURAND, ORVILLE, M.C., HAM, 4, R

E

EBELING, NORMAN, NEK., B.P., 12, R
 EDWARDS, E.O., JR., BIS., L.S., 32, R
 EDWARDS, ZANE, BIS., ILL, 28, R
 EILTS, HARRY, R.C., UN, 24, S, R
 EITEL, JOHN, TIM., GAR, 6, 0
 ELIAS, CLAUDE, M.C., HAM, 26, R
 ENGEL, PAUL A., BIS., ILL, 9, R
 ENGLE, BURL, L.C., B.T., 4, S, R
 ERB, MELVIN, BIS., L.S., 25, R
 ERBES, CLARENCE, BIS., L.S., 13, R
 ERBES, LORIS, L.C., L.C., 3, 0

F

FELDER, VERNON, NEK., UN, 30, 0
 FIALA, EDWARD J., BIS., ILL, 33, R
 FICKEN, A.G., BIS., L.S., 33, 0
 FICKEN, WARREN, BIS., L.S., 6, R
 FICKEN, WAYNE, L.C., L.C., 24, 0
 FLAMIK, MRS. J.J., R.C., CEN, 27, 0
 FLETCHER, VERN, SR., M.C., HAM, 29, 0
 FOLKERTS, ARNOLD, R.C., UN, 23, S, 0
 FOLKERTS, AUGUST, TIM., GAR, 31, S, 0
 FOLKERTS, HARVEY, L.C., B.T., 8, S, R
 FOLKERTS, OTTO J., TIM., BAN, 22, S, 0
 FOOS, JOHN, JR., L.C., L.C., 35, R
 FOOS, REINHOLD, R.C., CEN, 31, R
 FOOS, THEODORE, R.C., UN, 27, S, 0
 FORD, EVERETT, R.C., UN, 22, 0
 FOX, LYNN, BIS., P10, 5, R
 FRANK, RAYMOND, ALE., B.P., 4, 0
 FREIDENBERGER, ALEX J., BIS., L.S., 13, R
 FRICK, ARTHUR, NEK., UN, 32, 0
 FRICK, DON, ALE., B.P., 9, R
 FRITZLER, LE ROY, ALE., B.P., 26, 0
 FUNK, RUBIN, BIS., PLE, 20, R

G

GEORG, FRED A., ALE., ALE, 4, 0
 GEORG, JOHN, M.C., ALE, 14, S, 0
 GEORG, RAYMOND, R.C., UN, 36, 0
 GEORGE, LAVERN, P.R., GAR, 36, S, R
 GERSTENKORN, HUBERT, TIM., L.C., 13, S, 0
 GIESICH, LESTER, ALB., GAR, 25, 0
 GISICK, CLARENCE, TIM., BAN, 19, 0
 GISICK, GEORGE, L.C., L.C., 1, 0
 GISICK, RALPH, BIS., L.S., 5, 0
 GLANTZ, H.E., BIS., P10, 9, 0
 GLANTZ, MAYNARD, BIS., P10, 9, 0
 GORDON, GLEN, M.C., HAM, 10, 0
 GOTTSCHALK, ADOLPH, L.C., B.T., 2, 0
 GOUGH, DONALD, R.C., CEN, 30, S, 0
 GOUGH, EARL, R.C., CEN, 30, S, 0
 GRAVER, JOHN, R.C., CEN, 24, S, 0
 GRUMBEIN, AUBREY, L.C., L.C., 35, 0
 GRUNWALD, LESTER, ALB., GAR, 14, 0

H

HABBERMAN, JOE, R.C., CEN, 24, 0
 HABERMAN, MELVIN, R.C., CEN, 10, R
 HAGELGLANTZ, HENRY, ALB., P10, 11, 0
 HAGERMAN, ARTHUR, ALB., GAR, 16, 0
 HAGERMAN, ERNEST, P.R., GAR, 34, S, 0
 HAGERMAN, FRANK, TIM., BAN, 29, S, 0
 HAGERMAN, FRED A., SR., R.C., CEN, 19, S, 0
 HAGERMAN, LESTER A., TIM., GAR, 20, S, 0
 HAGERMAN, LOUIS, NEK., UN, 35, S, 0
 HALL, A.C., NEK., B.P., 11, R
 HAMRDLA, HARRY, TIM., BAN, 27, 0
 HANDY, GEORGE, ALB., GAR, 34, R
 HANHARDT, KENNETH, BIS., L.S., 24, R
 HANHARDT, ROBERT, BIS., L.S., 24, R
 HARDWICK, F.M., M.C., FAIR, 32, 0
 HARDY, CARL H., BIS., L.S., 11, S, 0
 HARMS, LESTER, TIM., GAR, 31, S, 0
 HARPER, ELDON, ALB., GAR, 34, 0
 HARTMAN, ABE, OTIS, P10, 2, 0
 HARTMAN, KATIE, BIS., ILL, 17, 0
 HEATON, LESLIE, R.C., UN, 23, 0
 HECHT, DAVID, P.R., GAR, 36, S, R
 HEISER, LOREN, R.C., UN, 35, R
 HEMKEN, EDWIN, ALB., GAR, 34, S, R
 HEMKEN, GUS E., R.C., CEN, 11, 0
 HEMKEN, HENRY, ALB., GAR, 23, S, 0
 HEMKEN, HERMAN, ALB., GAR, 23, S, 0
 HEMKEN, MELVIN, ALB., GAR, 23, S, R
 HERBEL, EDWARD, BIS., P10, 19, 0
 HERBEL, HARRY F., ALB., P10, 15, S, 0
 HERGENRETER, HARRY, ALB., GAR, 14, R
 RHERGERT, JAKE, ALB., GAR, 26, 0
 HERMAN, LEONARD, L.C., B.T., 10, S, 0
 HERMAN, PASCHAL, LIE., ILL, 7, R
 HERMANN, EUGENE, L.C., B.T., 21, 0
 HERMANN, HERBERT, LIE., B.T., 22, 0

T-17-18-S HAMPTON TWP. ALEXANDER HAMPTON TWP. R-20-W

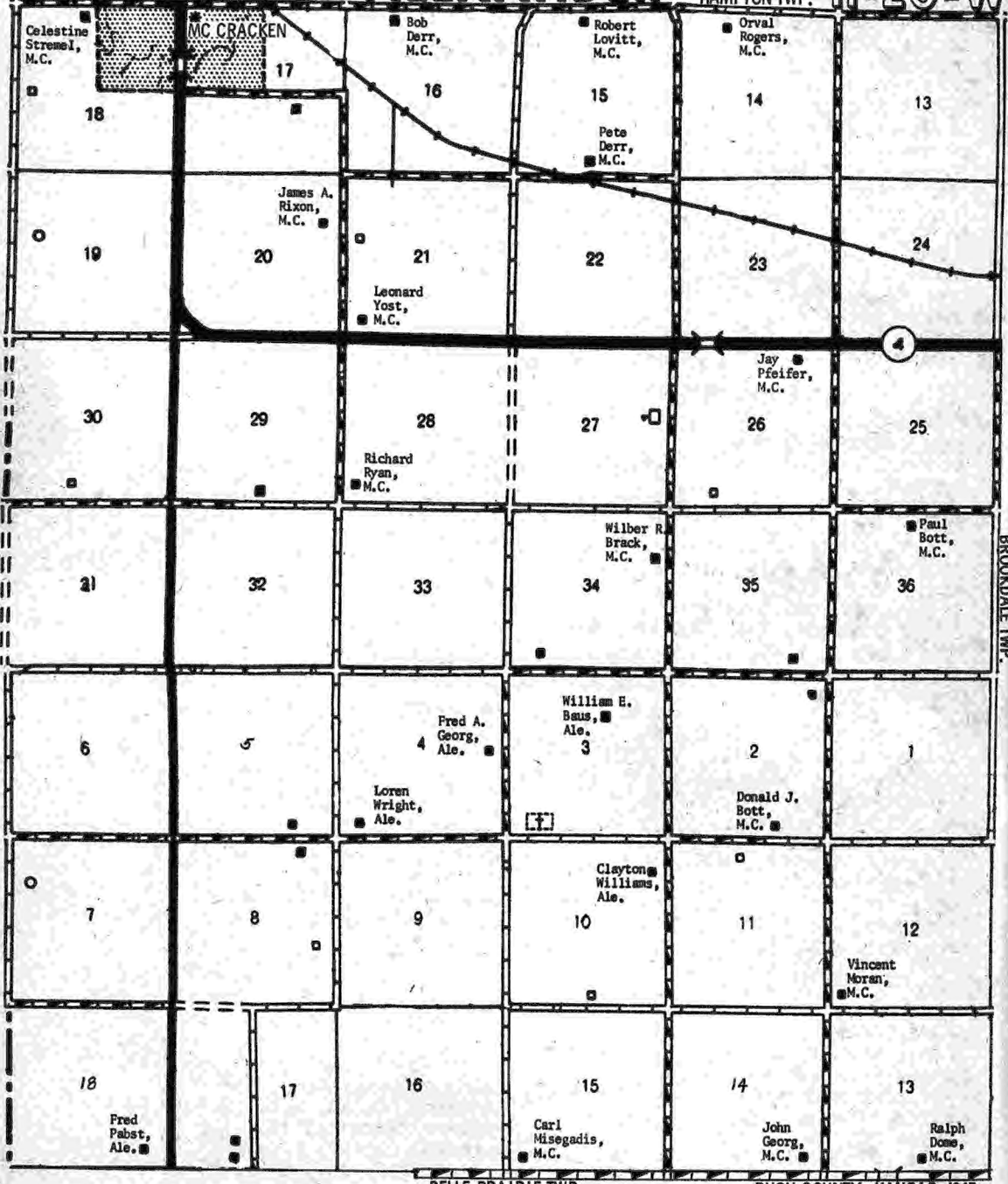

BELLE PRAIRIE TWP. RUSH COUNTY, KANSAS 1967



TIMKEN CO-OPERATIVE ASS'N. Phone EL 5-2110 Timken, Kansas

Grain - Feed - Petroleum - Seed - Fertilizers - Anhydrous Ammonia - Butane - Propane Sales & Service - Bonded Storage - 622,000 Bu.

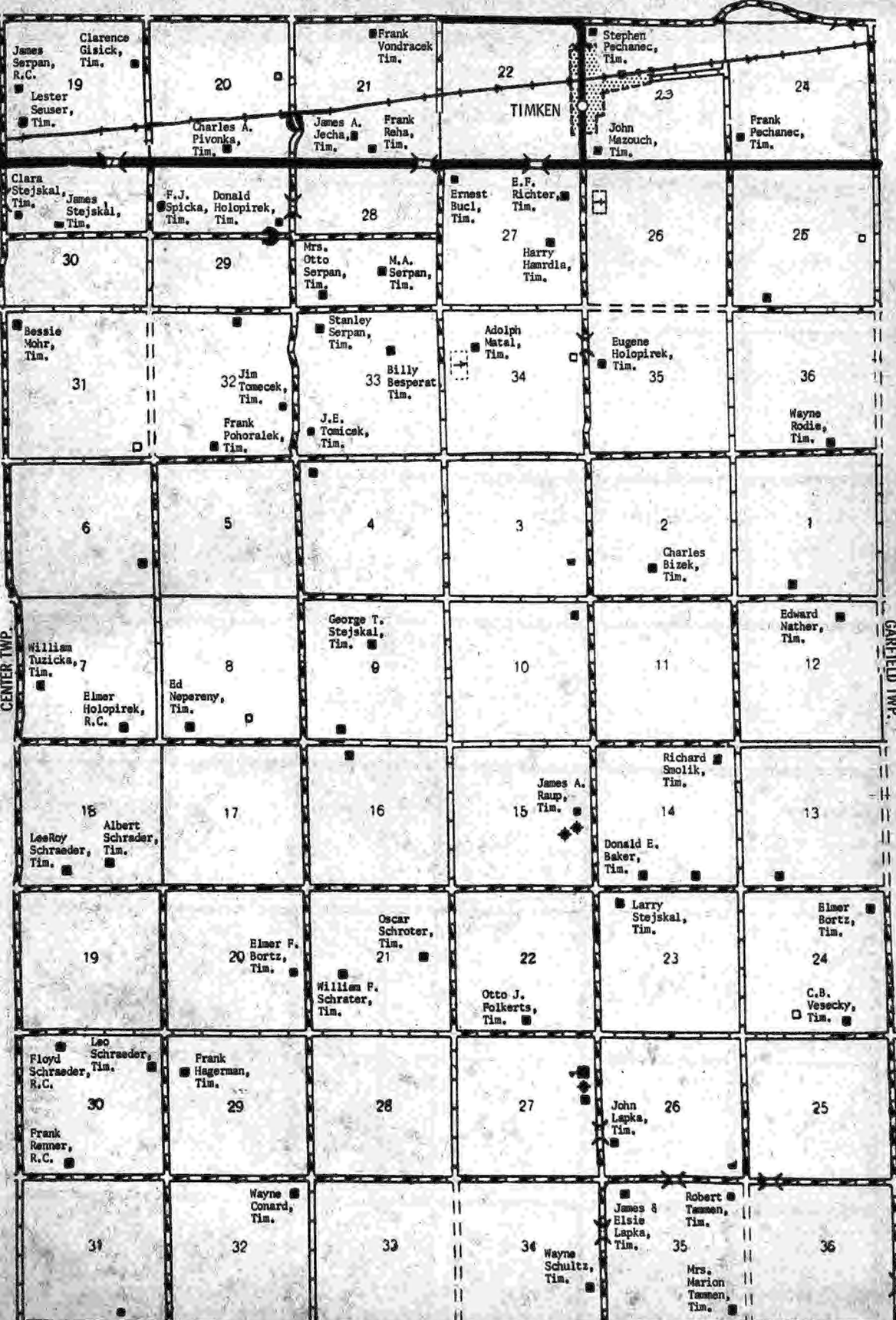

T-18-19-S ALEXANDER TWP. BELLE PRAIRIE ALEXANDER TWP. R-20-W

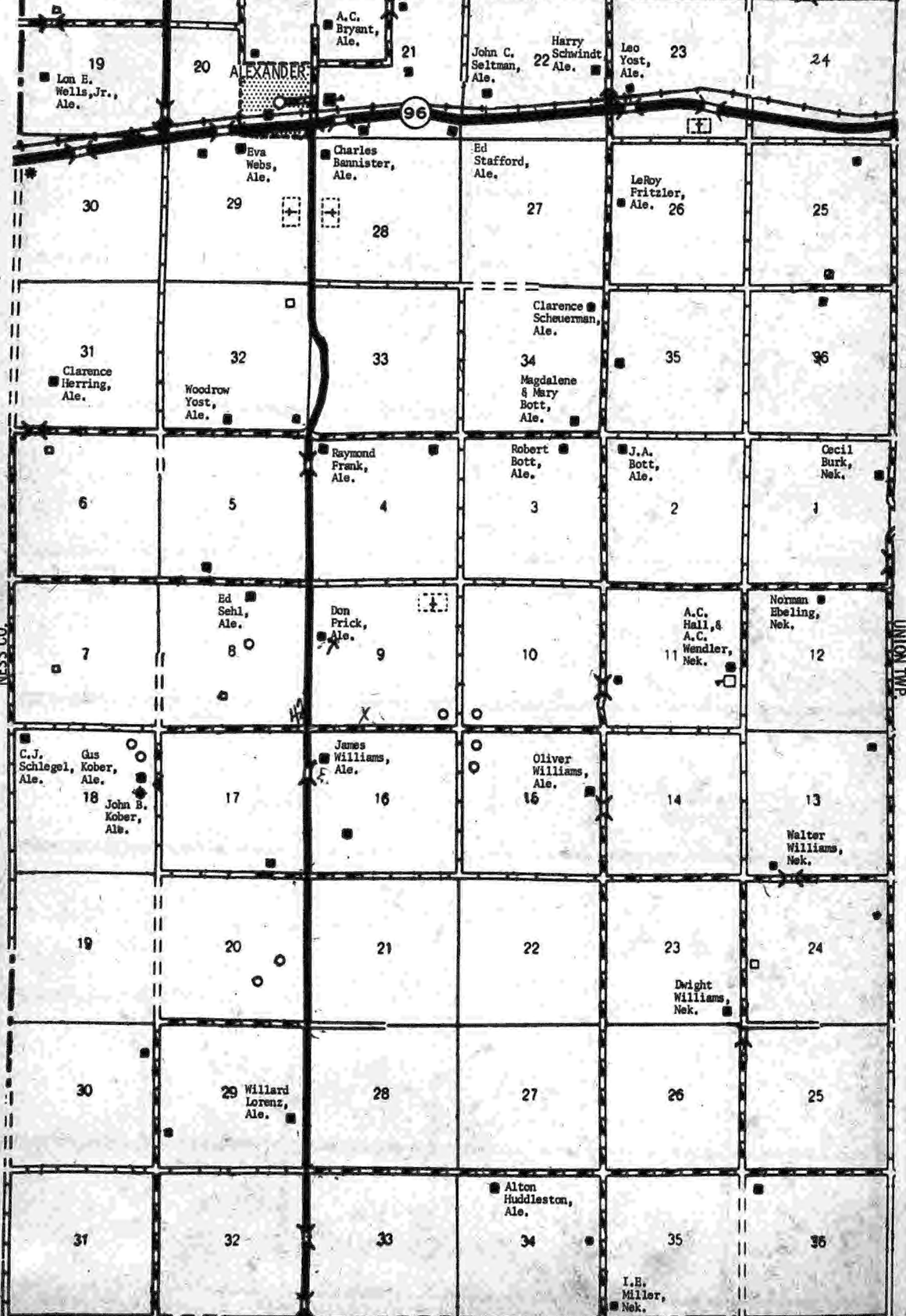

NESS CO.

UNION TWP.

SD

T-16-17-S

ELLIS CO.

BIG TIMBER

ELLIS CO.

R-18-W

FAIRVIEW TWP.

ILLINOIS TWP.

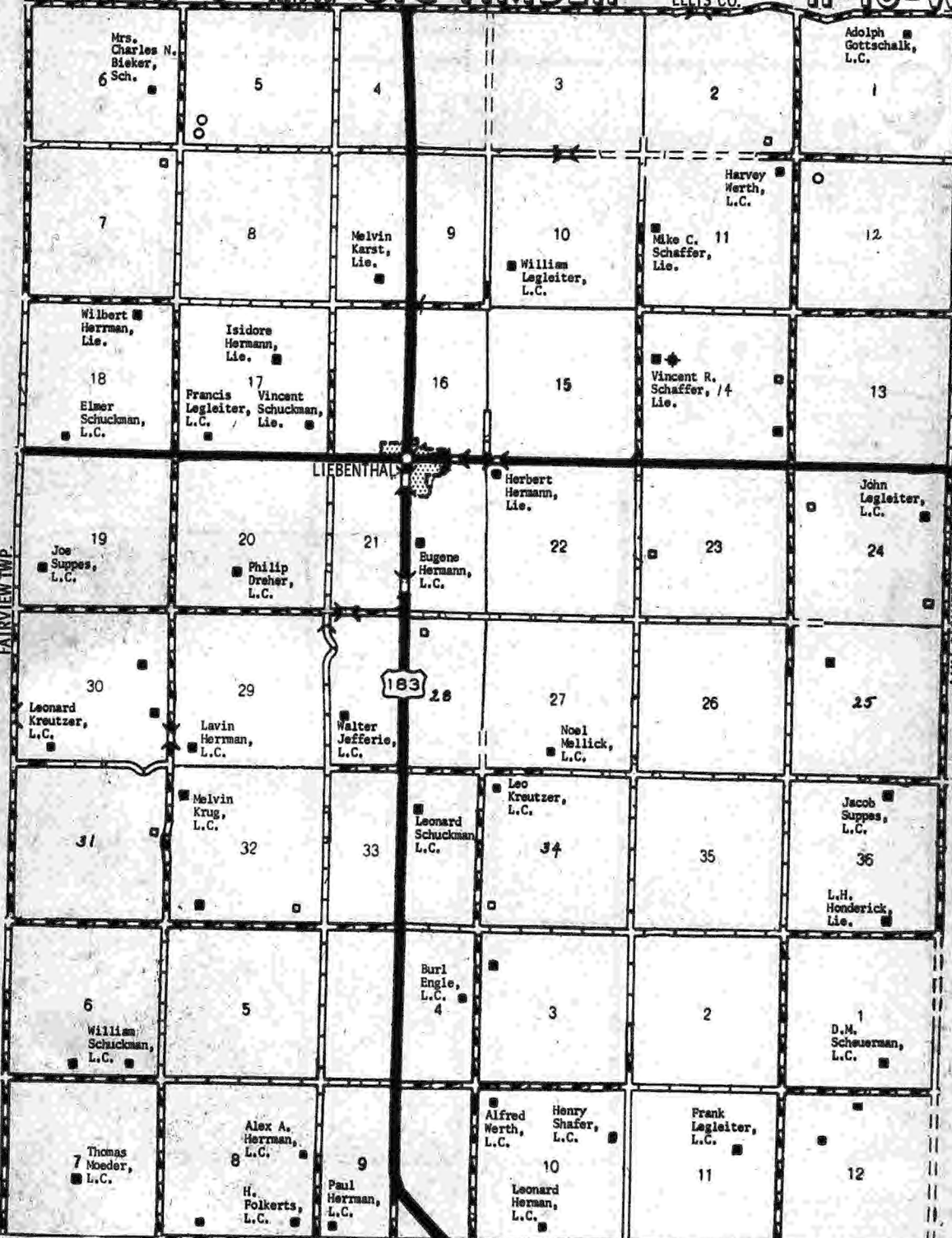

LA CROSSE TWP.

RUSH COUNTY, KANSAS 1967



BISON FARMERS COOP ASSN.

GRAIN - FEED - PETROLEUM - FERTILIZER

Locker & Groceries
BISON, KANSAS

BUTANE - PROPANE - SALES & SERVICE - BONDED STORAGE 622,000 BU.



T-17-18-S FAIRVIEW TWP. **BROOKDALE** FAIRVIEW TWP. **R-19-W**

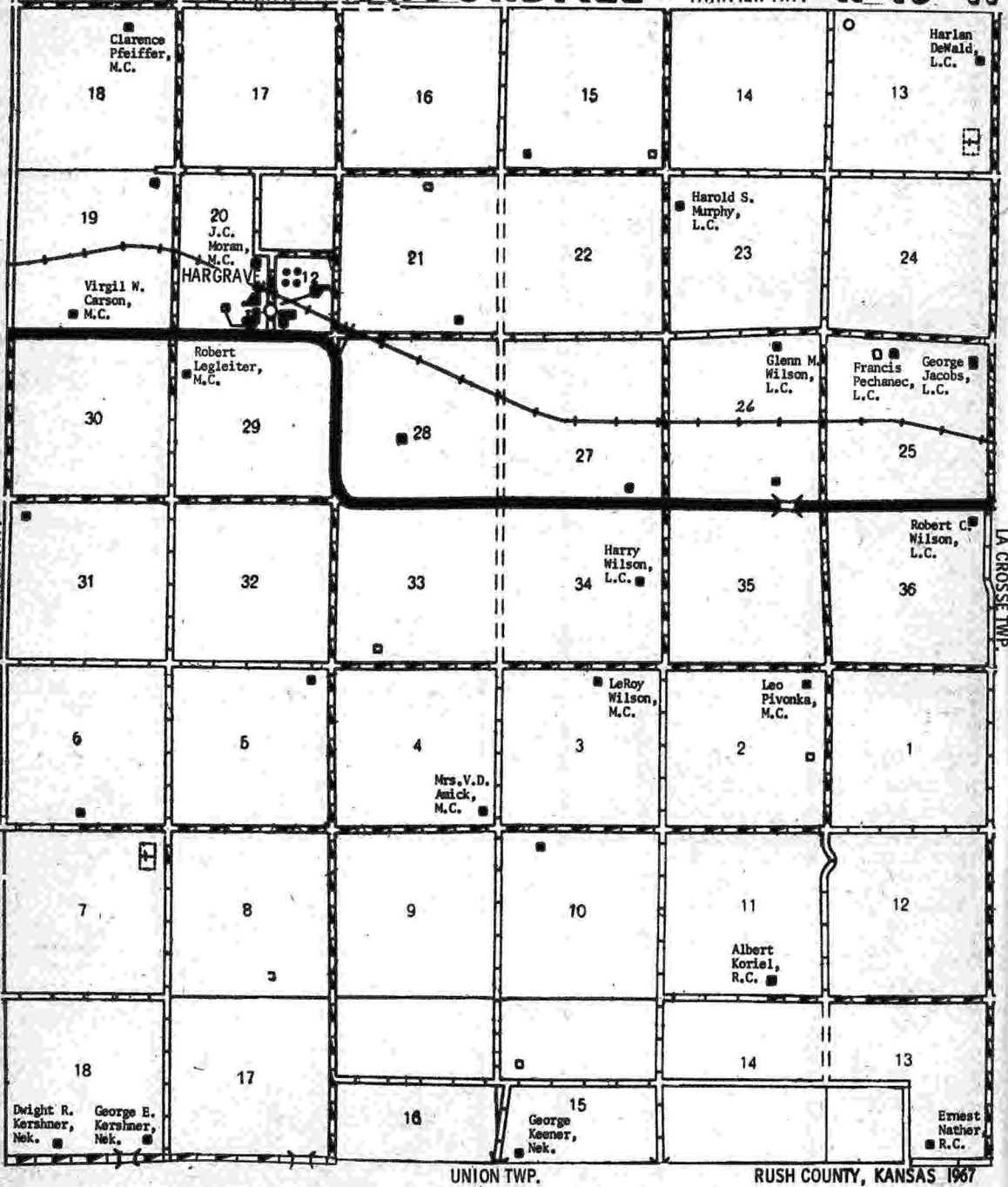

UNION TWP.

RUSH COUNTY, KANSAS 1967



TIMKEN CO-OPERATIVE ASS'N. Phone EL 5-2110
 Timken, Kansas

Grain — Feed — Petroleum — Seed — Fertilizers — Anhydrous Ammonia
 — Butane — Propane Sales & Service — Bonded Storage — 622,000 Bu.

T-18-19-S

LA CROSSE TWP.

CENTER

LA CROSSE TWP.

R-18-W

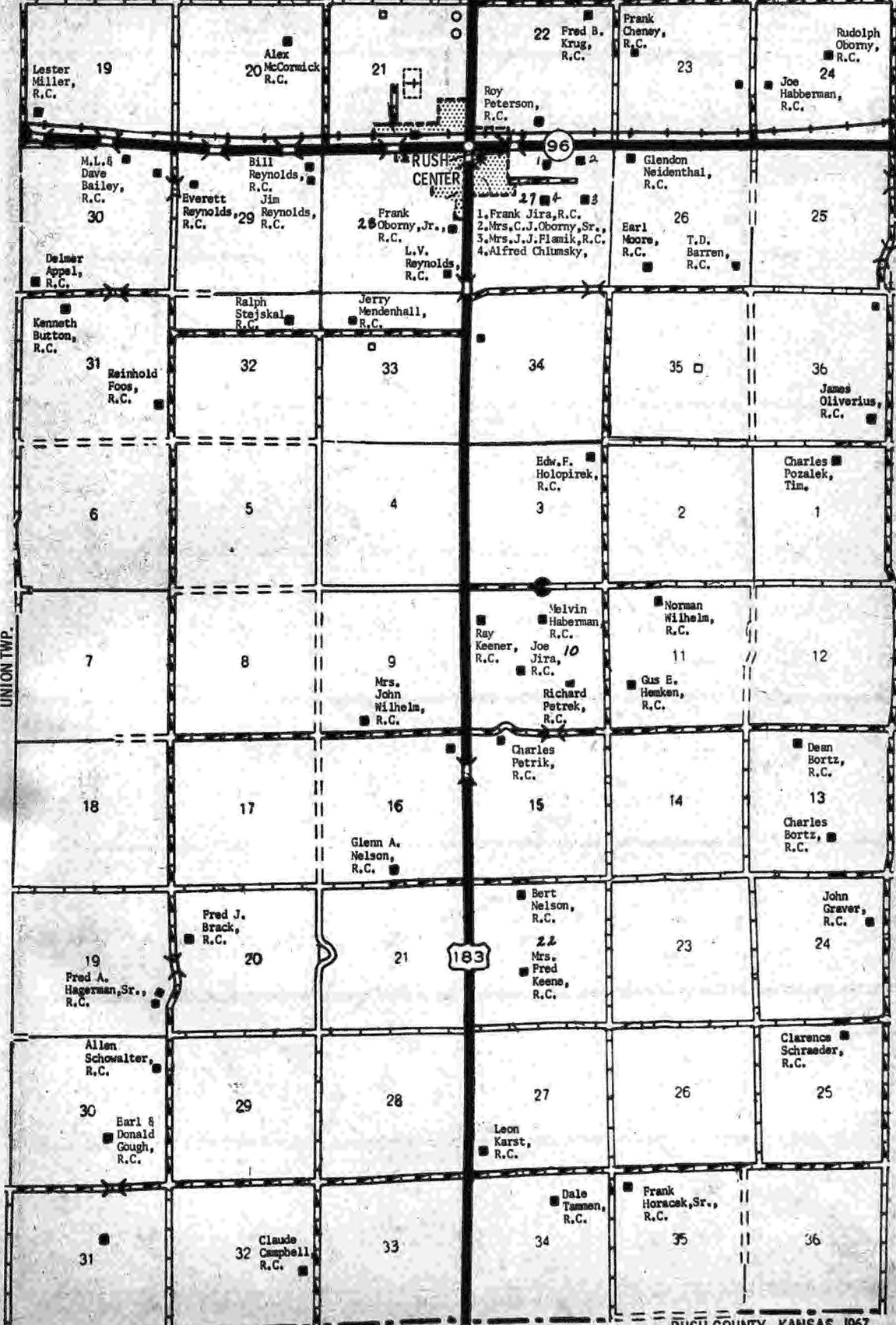



T-16-17-S

ELLIS CO.

FAIRVIEW

ELLIS CO.

R-19-W

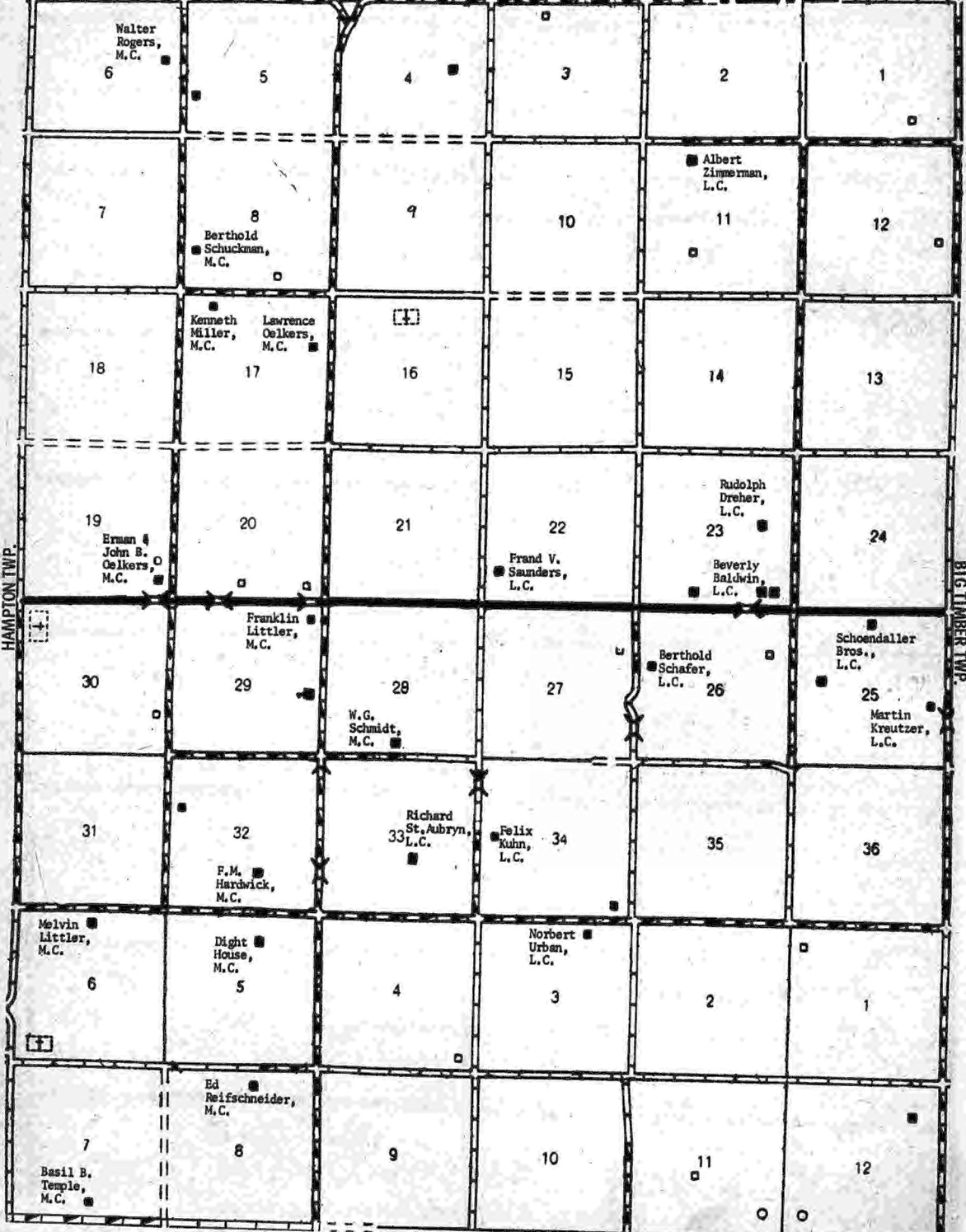

BROOKDALE TWP.

RUSH COUNTY, KANSAS 1967

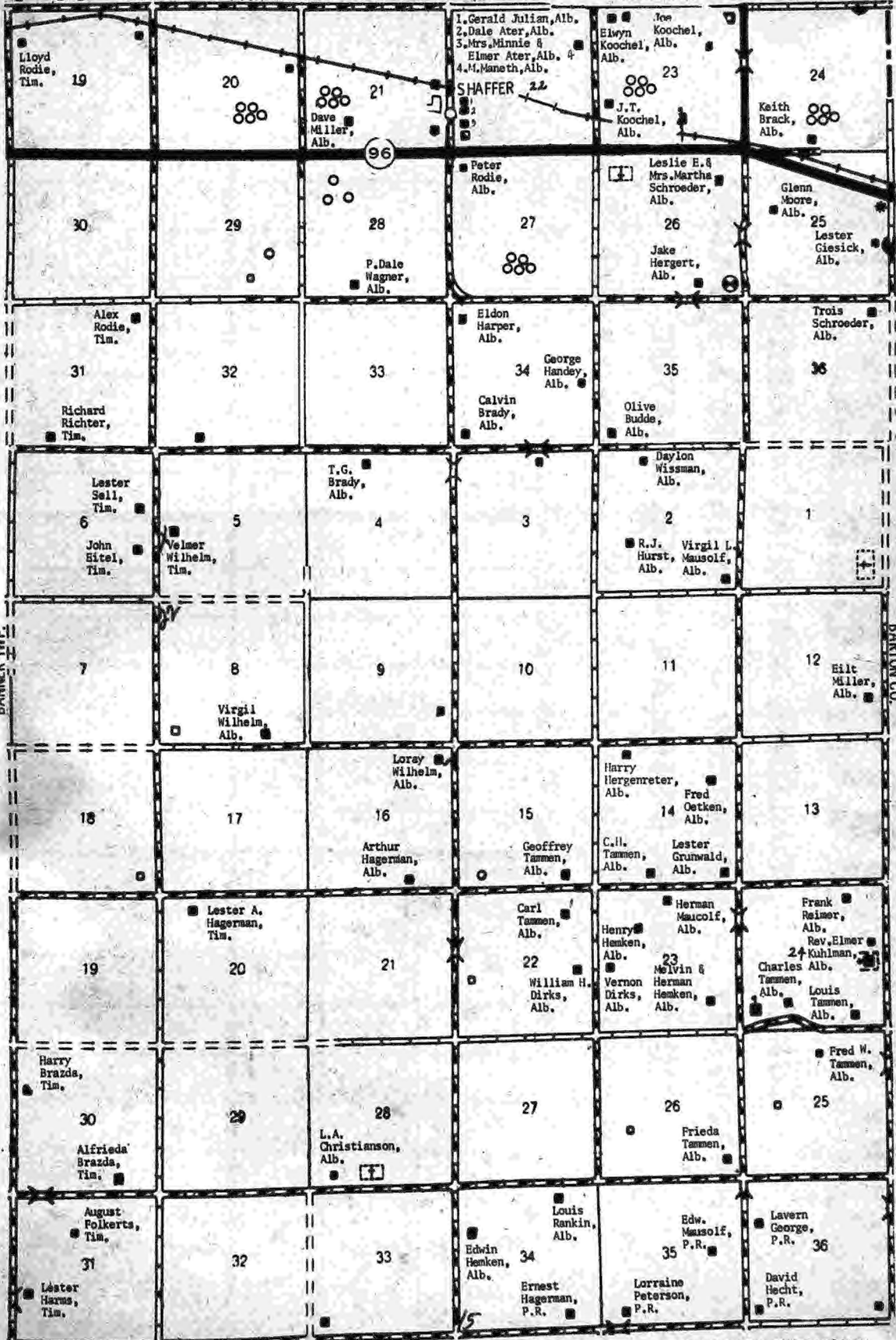

BANNER TWP.

BARTON CO.

HUMBURG LUMBER CO., INC.

LUMBER — BUILDING MATERIAL — GRAIN

HARDWARE — PLUMBING — APPLIANCES & REPAIRS

HOOVER — COLEMAN — KELVINATOR

EL 6-2521

BISON, KANSAS

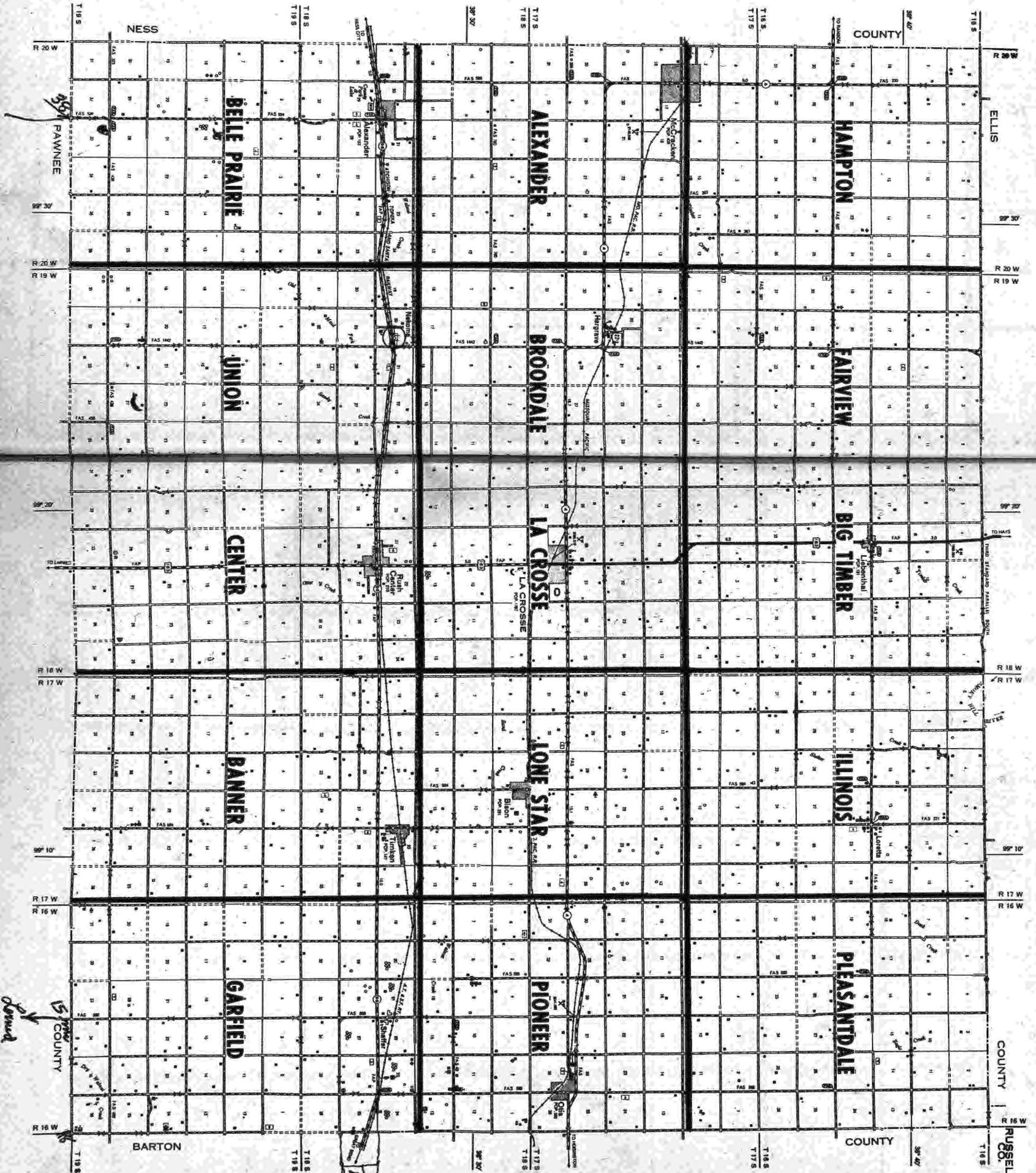

SCHWAB'S HATCHERY & FARM SUPPLY

Feed Mill - Baby Chicks - Cream - Eggs - Poultry

114 WEST 11th

LA CROSSE, KANSAS

T-16-17-S

ELLIS CO.

HAMPTON

ELLIS CO.

R-20-W

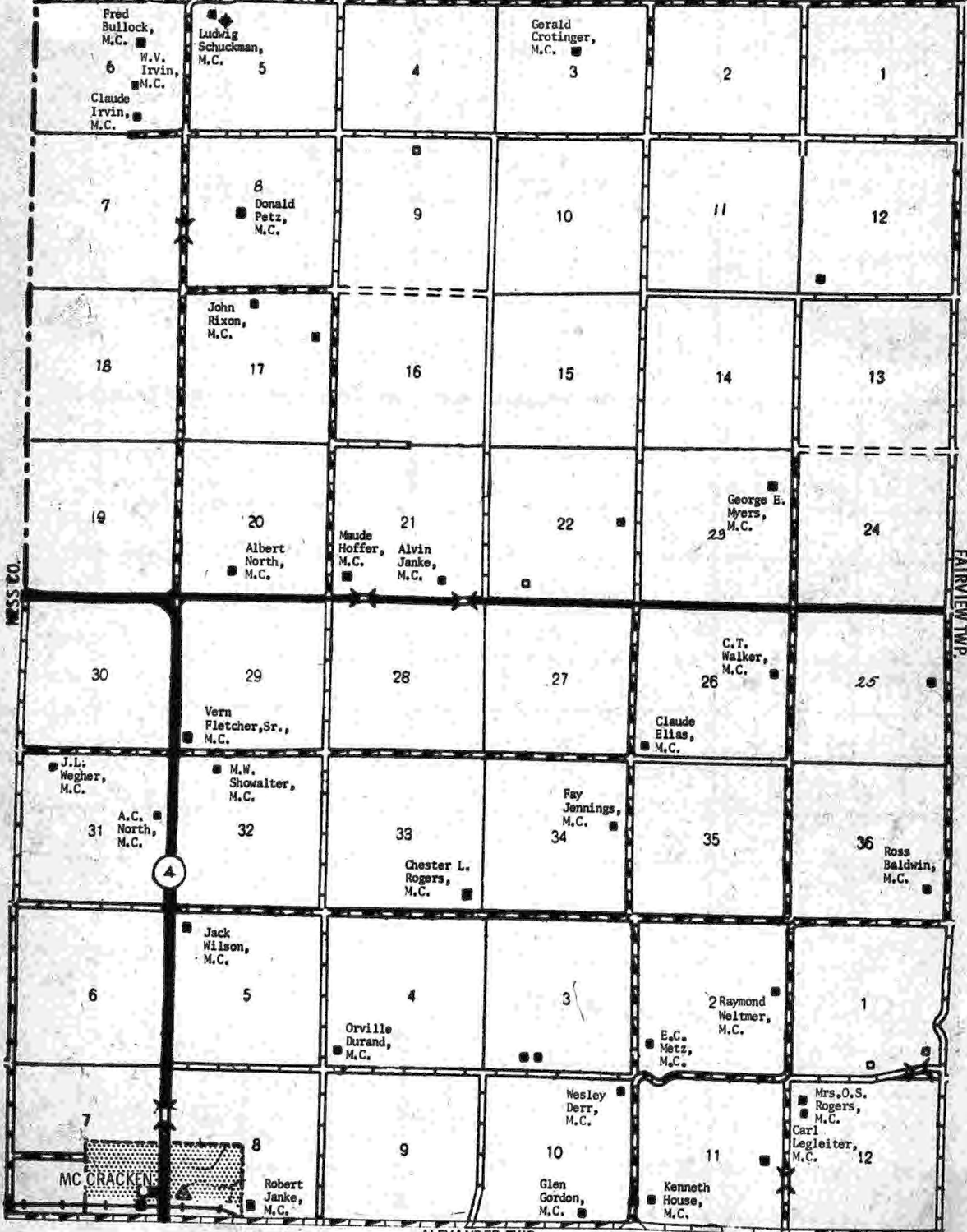

ALEXANDER TWP.

RUSH COUNTY, KANSAS 1967



TIMKEN CO-OPERATIVE ASS'N. Phone EL 5-2110 17
Timken, Kansas

Grain - Feed - Petroleum - Seed - Fertilizers - Anhydrous Ammonia
-Butane - Propane Sales & Service - Bonded Storage - 622,000 Bu.

T-16-17-S

ELLIS CO.

ILLINOIS

ELLIS CO.

R-17-W

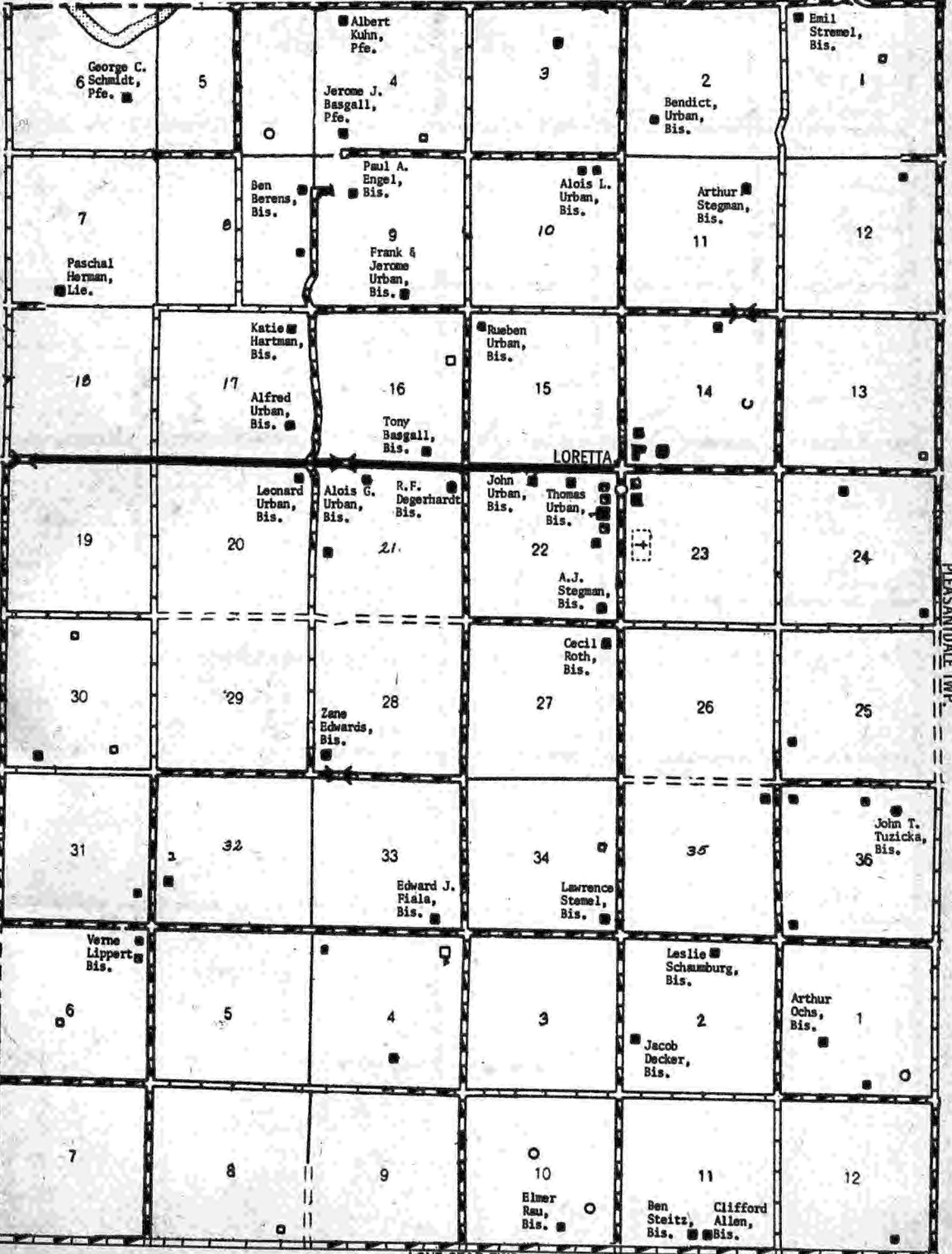

BIG TIMBER TWP.

PLEASANTDALE TWP.

LONE STAR TWP.

RUSH COUNTY, KANSAS 1967

SCHWAB'S HATCHERY & FARM SUPPLY

Feed Mill - Baby Chicks - Cream - Eggs - Poultry

114 WEST 11th

LA CROSSE, KANSAS

T-17-18-S

BIG TIMBER TWP.

LA CROSSE

BIG TIMBER TWP.

R-18-W

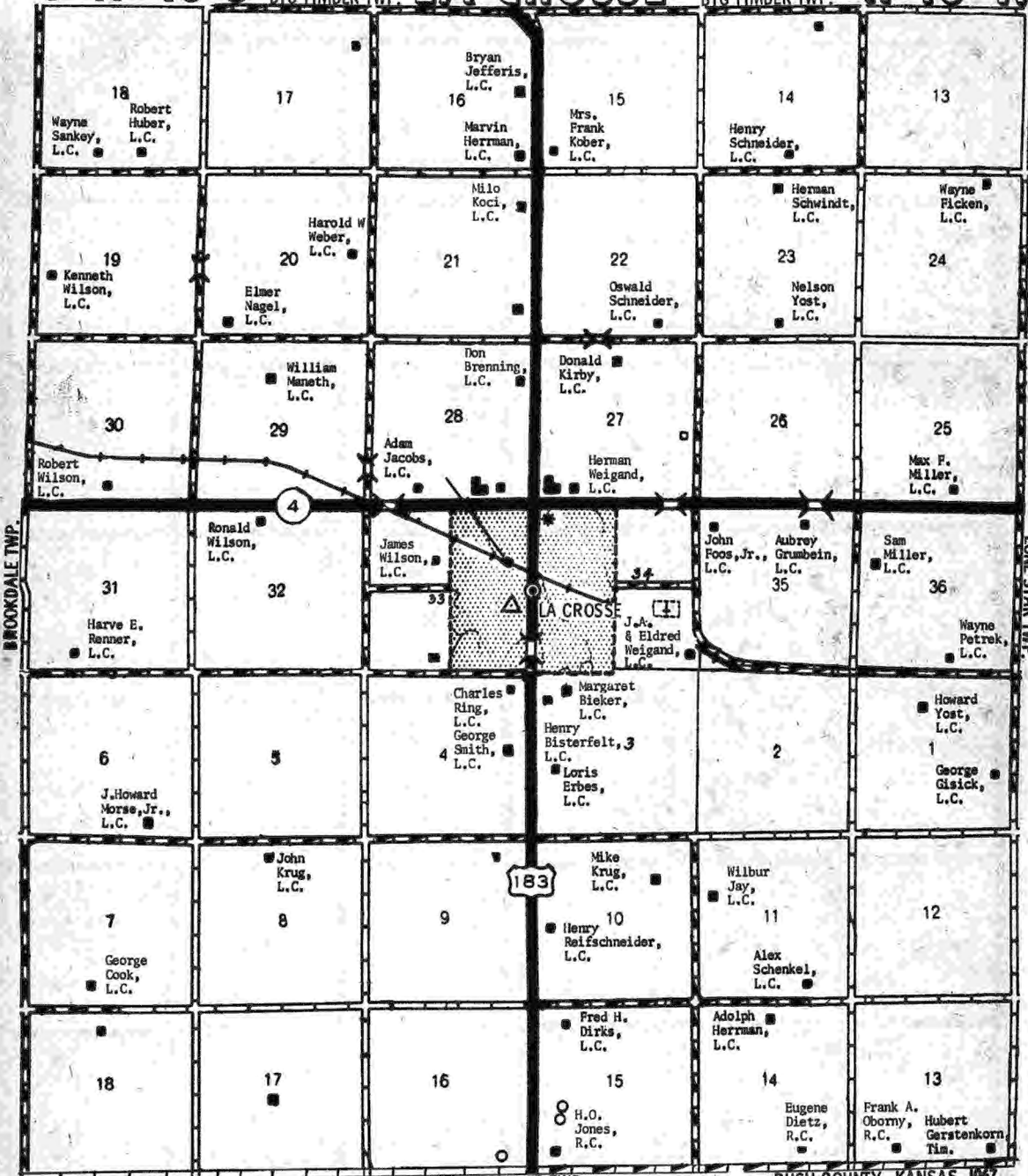

CENTER TWP.

RUSH COUNTY, KANSAS 1967

OTIS TRACTOR CO.



Complete Sales & Service



PHONE 387-2534

OTIS, KANSAS

T-17-18-S ILLINOIS TWP. LONE STAR ILLINOIS TWP. R-17-W

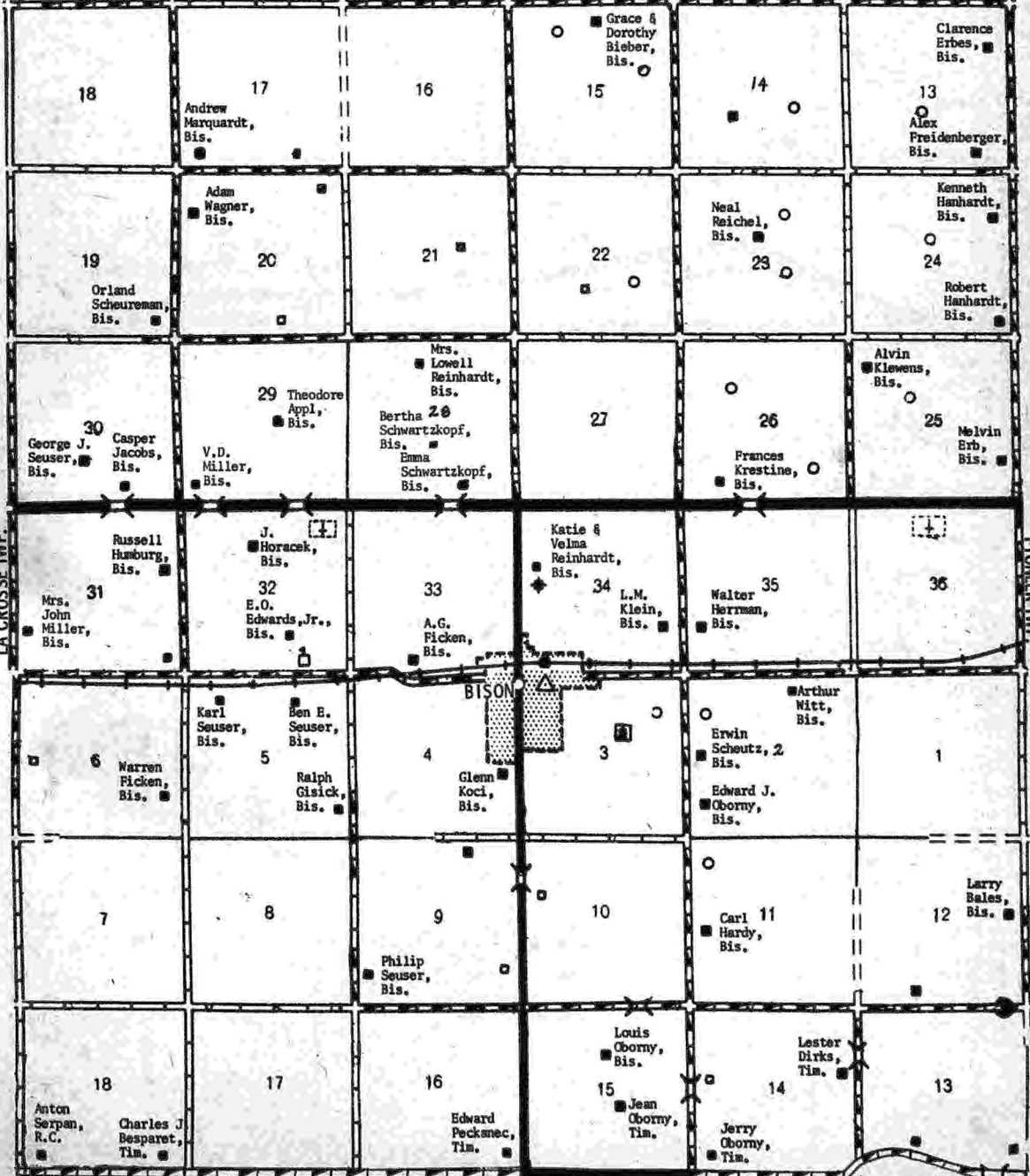

BANNER TWP.

RUSH COUNTY, KANSAS 1967



BISON FARMERS COOP ASSN.

GRAIN - FEED - PETROLEUM - FERTILIZER

Locker & Groceries
BISON, KANSAS

BUTANE - PROPANE - SALES & SERVICE - BONDED STORAGE 622,000 BU.

T-17-18-S

PLEASANTDALE TWP.

PIONEER

PLEASANTDALE TWP.

R-16-W

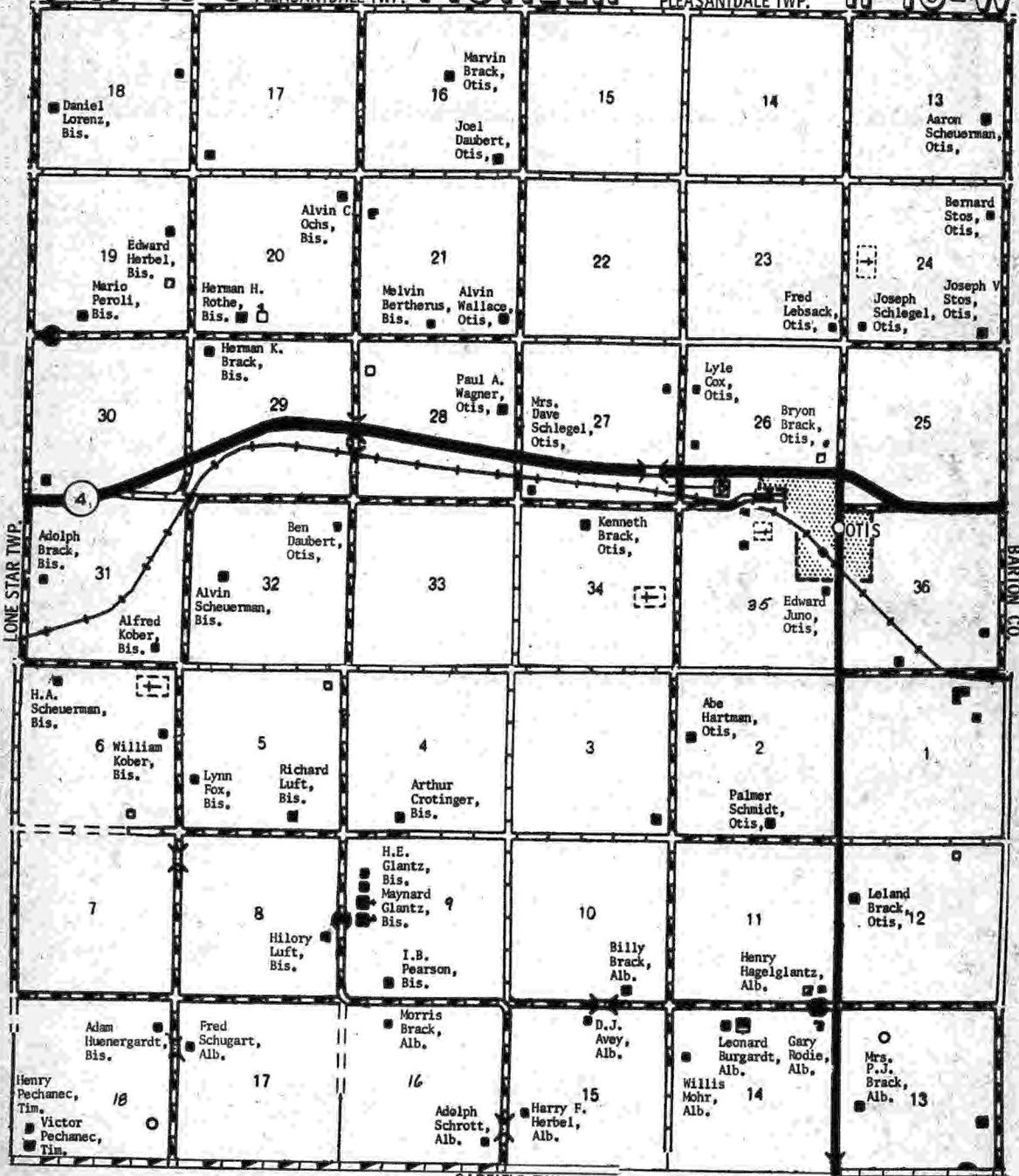

GARFIELD TWP.

RUSH COUNTY, KANSAS 1967



T-16-17-S ELLIS CO. PLEASANTDALE ELLIS CO. R-16-W

6	5	4	3	Fred T. Jones, Otis, 2	Raymond Wagner, Otis, 1
7	Joe J. Kisner, Bis. Harold Riedl, Bis. 8	9	10 Lawrence Guthrell, Otis, 1	11	12 Hans Bergman, Otis, 1
I.A. Stremel, Bis. Eddin Stremel, Bis. 18	17	16	Fred Schlezal, Otis, 15	Julius Suppes, Otis, 14	13
LeRoy Stremel, Bis. 19	Rubin Funk, Bis. 20	21	G.A. Wegele, Otis, 22	Clarence Suppes, Otis, 23	San Wagner, Otis, 24
30 Reuben Ochs, Bis. 1	29 Dan Moore, Bis. 1	William Kaiser, Bis. 1 Jacob Wegele, Otis, 1 28 Wilmer Ochs, Otis, 1 Dan Ochs, Jr., Bis. 1	Louis Maier, Otis, 1 Henry Maier, Otis, 1 27	26	25
31	32 Billy T. Allen, Bis. 1	33	34 Clarence Tuzicka, Otis, 1	Eberhardt Math, Otis, 1 35 LeRoy DeWald, Otis, 1	36
6	5	L.S. Cunningham, Bis. 4	3 Anton J. Schenk, Otis, 1	2	1 John E. Kaiser, Otis, 1
7 Jerald Hopkins, Bis. 1	8 Darrell Ochs, Bis. 1	9 Quinten Packard, Bis. 1	10 Adolph Tuzicka, Otis, 1 Albert Tuzicka, Otis, 1 Frank Tuzicka, Bis. 1	11 Fred J. Kerbs, Otis, 1	12 Samuel J. Moore, Otis, 1 Kenneth Bortonek, Otis, 1

BARTON CO.

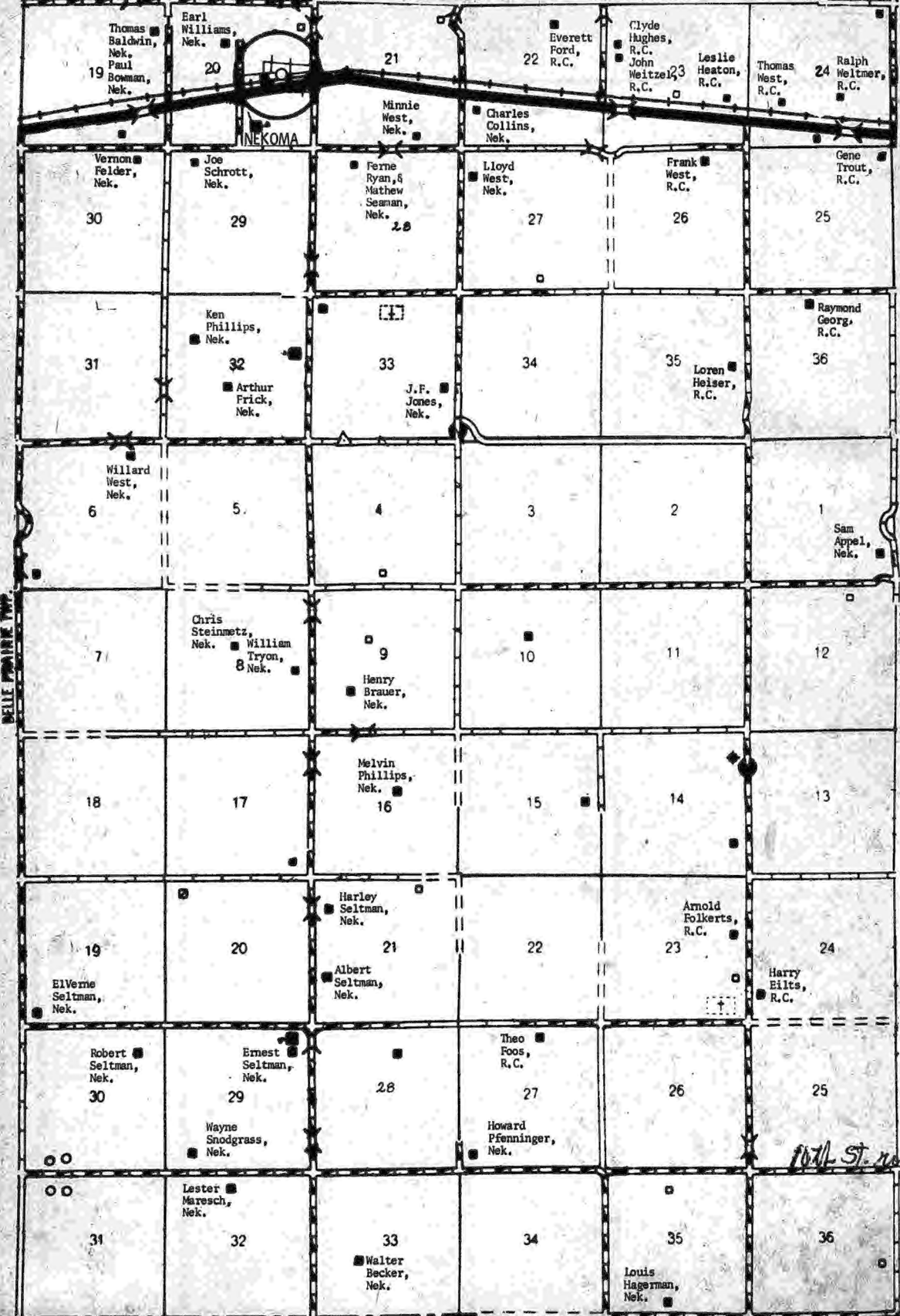



"ZIP CODE DIRECTORIES"

Here at last—answer to everybody's mailing headaches! U.S. Post Office wants ALL MAIL ZIP CODED. Everybody knows zip coded mail is delivered faster and soon zip codes will be necessary requirement on all mail! How do you know what the zip code for any area is?—Just look in this red hot new ZIP CODE DIRECTORY! Over 35,000 listings—covers all 50 states plus U.S. possessions! Sells for only \$1.00—worth its weight in gold to anyone who uses the mails.

SEND \$1.00 to ZIP CODE

BOX 10 ALGONA, IOWA 50511

HERMANN, ISIDORE, L.I.E., B.T.17, O
 HERRING, CLARENCE, ALE., B.P.31, O
 HERRMAN, ADOLPH A., L.C., L.C.14, S, R
 HERRMAN, ALEX A., L.C., B.T.8, S, O
 HERRMAN, LAVIN, L.C., B.T.29, R
 HERRMAN, MARVIN, L.C., L.C.16, O
 HERRMAN, PAUL, L.C., B.T.9, S, O
 HERRMAN, WALTER, BIS., L.S.35, R
 HERRMAN, WILBERT, L.I.E., B.T.18, O
 HOFFER, MAUDE, M.C., HAM.21, O
 HOLOPIREK, DONALD, TIM., BAN.29, R
 HOLOPIREK, EDW.F., R.C., CEN.3, O
 HOLOPIREK, ELMER, R.C., BAN.7, O

HOLOPIREK, EUGENE, TIM., BAN.35, O
 HONDERICK, L.H., L.I.E., B.T.36, O
 HOPKINS, JERALD, BIS., PLE.7, S, R
 HORACEK, FRANK, SR., R.C., CEN.35, S, O
 HORACEK, J., BIS., L.S.32, O
 HOUSE, DIGHT, M.C., FAIR.5, S, O
 HOUSE, KENNETH, M.C., HAM.11, O
 HOUSECHILD, L.H., L.C., FAIR.33, O
 HUBER, ROBERT, L.C., L.C.18, O
 HUDDLESTON, ALTON, ALE., B.P.34, S, R
 HUENERGARDT, ADAM, ALB., P10.18, S, O
 HUGHES, CLYDE, R.C., UN.23, R
 HUMBURG, RUSSELL, BIS., L.S.31, R

Mr. Agribusinessman:

WHY — and HOW — do you receive your copy of this County Farm Directory FREE? The answer is —

Good Will

And Friendly Co-operation

- The many business and professional firms who through their advertisements have made this book possible for you, know that a directory so completely compiled is valuable to its thousands of readers.

- They know that the persons listed in this directory are important, thoughtful citizens who are the most valuable friends any business can have.

- They know that their investment will pay dividends by continuing the spirit of good will, confidence, and co-operation between the business man and the farmer.

- The SPONSORS of this book — the ADVERTISERS — can supply your requirements with the best in quality, price and service. The fact that they stand behind their product with their signature is proof of their integrity. . . . When buying mention your "FARM DIRECTORY" to them.

**PATRONIZE THE ADVERTISERS
 IN THIS DIRECTORY**

HURST, R. J., ALB., GAR. 2, 0

I

IRVIN, CLAUDE, M. C., HAM. 6, N, 0
IRVIN, W. V., M. C., HAM. 6, N, 0

J

JACOBS, ADAM, L. C., L. C. 28, 0
JACOBS, CASPER, BIS., L. S. 30, R
JACOBS, GEORGE, L. C., BRO. 25, 0
JANKE, ALVIN, M. C., HAM. 21, 0
JANKE, ROBERT, M. C., HAM. 8, 0
JAY, WILBUR, L. C., L. C. 11, R
JECHA, JAMES, TIM., BAN. 22, 0
JEFFERIS, BRYAN, L. C., L. C. 16, 0
JEFFERIS, WALTER, L. C., B. T. 28, 0
JENNINGS, FAY, M. C., HAM. 34, 0
JIRA, FRANK, R. C., CEN. 27, 0
JIRA, JOE, R. C., CEN. 10, 0
JONES, FRED T., OTIS, PLE. 2, 0
JONES, H. O., R. C., L. C. 15, S, 0
JONES, J. F., NEK., UN. 33, R
JULIAN, GERALD, ALB., GAR. 22, 0
JUNO, EDWARD, OTIS, PIO. 35, 0

K

KAISER, JOHN E., OTIS, PLE. 1, S, 0
KAISER, WILLIAM, BIS., PLE. 28, 0
KARST, LEON, R. C., CEN. 27, S, R
KARST, MELVIN, LIE., B. T. 9, R
KEENE, MRS. FRED, R. C., CEN. 22, S, 0
KEENER, GEORGE, NEK., BRO. 16, S, R
KEENER, RAY, R. C., CEN. 10, 0
KERBS, FRED J., OTIS, PLE. 11, S, 0
KERSHNER, DWIGHT R., NEK., BRO. 18, S, R
KERSHNER, GEORGE E., NEK., BRO. 17, S, 0
KIRBY, DONALD, L. C., L. C. 27, R
KISNER, JOE J., BIS., PLE. 8, R
KLEIN, L. M., BIS., L. S. 34, 0
KLEWENO, ALVIN, BIS., L. S. 25, 0
KOBER, ALFRED, BIS., PIO. 31, R
KOBER, MRS. FRANK, L. C., L. C. 15, R
KOBER, GUS, ALE., B. P. 18, 0
KOBER, JOHN B., ALE., B. P. 18, 0
KOBER, WILLIAM, BIS., PIO. 6, R
KOCI, GLENN, BIS., L. S. 4, R
KOCI, MILO, L. C., L. C. 21, 0
KOOCHAL, J. T., ALB., GAR. 23, 0
KOOCHAL, ELWYN, ALB., GAR. 23, R
KOOCHAL, JOE, ALB., GAR. 23, 0
KORIEL, ALBERT, R. C., BRO. 11, 0
KRESTINE, FRANCES, BIS., L. S. 26, 0
KREUTZER, LEO, L. C., B. T. 34, 0
KREUTZER, LEONARD, L. C., B. T. 30, 0
KREUTZER, MARTIN, L. C., FAIR. 25, 0
KRUG, FRED B., R. C., CEN. 22, 0
KRUG, JOHN, L. C., L. C. 8, 0
KRUG, MELVIN, L. C., B. T. 32, R

KRUG, MIKE, L. C., L. C. 10, 0
KUHLMAN, REV. ELMER, ALB., GAR. 24, S,
KUHN, ALBERT, PFE., ILL. 4, R
KUHN, FELIX, L. C., FAIR. 34, 0

L

LAPKA, ELSIE, TIM., BAN. 35, S,
LAPKA, JAMES, TIM., BAN. 35, S,
LEBSACK, FRED, OTIS, PIO. 23, 0
LEGLEITER, CARL, M. C., HAM. 12, R
LEGLEITER, FRANCIS, L. C., B. T. 17, 0
LEGLEITER, FRANK, L. C., B. T. 11, S, 0
LEGLEITER, JOHN, L. C., B. T. 24, 0
LEGLEITER, ROBERT, M. C., BRO. 29, R
LEGLEITER, WILLIAM, L. C., B. T. 10, 0
LIPPERT, VERNE, BIS., ILL. 6, S,
LITTLER, FRANKLIN, M. C., FAIR. 29,
LITTLER, MELVIN F., M. C., FAIR. 6, S, R
LORENZ, DANIEL, BIS., PIO. 18, R
LORENZ, WILLARD, ALE., B. P. 29, S,
LOVITT, ROBERT, M. C., ALE. 15, 0
LUFT, HILORY, BIS., PIO. 8, R
LUFT, RICHARD, BIS., PIO. 5, 0

M

MAIER, HENRY, OTIS, PLE. 27, 0
MAIER, LOUIS, OTIS, PLE. 27, 0
MANETH, MELVIN, ALB., GAR. 22, 0
MANETH, WILLIAM, L. C., L. C. 29, 0
MARESCH, LESTER, NEK., UN. 32, S, 0
MARQUARDT, ANDREW, BIS., L. S. 17, 0
MATAL, ADOLPH, TIM., BAN. 34, R
MAUCOLF, HERMAN, ALB., GAR. 23, S, 0
MAUSOLF, EDW., P. R., GAR. 35, S, 0
MAUSOLF, VIRGIL L., ALB., GAR. 2, 0
MAZOUCH, JOHN C., TIM., BAN. 23, 0
MC CORMICK, ALEX, R. C., CEN. 20, 0
MELLICK, NOEL, L. C., B. T. 27, 0
MENDENHALL, JERRY, R. C., CEN. 33, 0
METZ, E. C., M. C., HAM. 2, 0
MILLER, DAVE, ALB., GAR. 21, 0
MILLER, EILT, ALB., GAR. 12, 0
MILLER, I. E., NEK., B. P. 35, S, 0
MILLER, MRS. JOHN, BIS., L. S. 31, 0
MILLER, KENNETH, M. C., FAIR. 17, R
MILLER, LESTER, R. C., CEN. 19, 0
MILLER, MAX F., L. C., L. C. 25, 0
MILLER, SAM, L. C., L. C. 36, 0
MILLER, V. D., BIS., L. S. 29, R
MISEGADIS, CARL, M. C., ALE. 15, S, R
MOEDER, THOMAS, L. C., B. T. 7, S, 0
MOHR, BESSIE, TIM., BAN. 31, 0
MOHR, WILLIS, ALB., PIO. 14, S, 0
MOORE, DAN, BIS., PLE. 29, 0
MOORE, EARL, R. C., CEN. 26, 0
MOORE, GLENN, ALB., GAR. 25, 0
MOORE, SAMUEL J., OTIS, PLE. 12, S, R
MORAN, J. C., M. C., BRO. 20, 0
MORAN, VINCENT, M. C., ALE. 12, 0

MORSE, J. HOWARD, JR., L.C., L.C. 6, O
 MURPHY, HAROLD S., L.C., BRO. 23, O
 MUTH, EBERHARDT, OTIS, PLE. 35, R
 MYERS, GEORGE E., M.C., HAM. 23, O

N

NAGEL, ELMER, L.C., L.C. 20, O
 NATHER, EDWARD, TIM., BAN. 12, R
 NATHER, ERNEST, R.C., PRO. 13, S
 NEIDENTHAL, GLENDON, R.C., CEN. 26, R
 NELSON, BERT, R.C., CEN. 22, S, R
 NELSON, GLENN A., R.C., CEN. 16, R
 NEPERENY, ED, TIM., BAN. 8, O
 NORTH, A.C., M.C., HAM. 31, O
 NORTH, ALBERT, M.C., HAM. 20, O

O

OBORNY, MRS. C. J., SR., R.C., CEN. 26, O
 OBORNY, EDWARD J., BIS., L.S. 2, O
 OBORNY, FRANK A., R.C., L.C. 12, S, O
 OBORNY, FRANK, JR., R.C., CEN. 28, O
 OBORNY, JEAN, TIM., L.S. 15, S, O
 OBORNY, JERRY, TIM., L.S. 14, S, O
 OBORNY, LOUIS, BIS., L.S. 15, S, O
 OBORNY, RUDOLPH, R.C., CEN. 24, O
 OCHS, ALVIN C., BIS., PIO. 20, O
 OCHS, ARTHUR, BIS., ILL. 1, S, R
 OCHS, DAN, JR., BIS., PLE. 28, R
 OCHS, DARRELL, BIS., PLE. 8, S, R
 OCHS, REUBEN, BIS., PLE. 30, O
 OCHS, WILMER, OTIS, PLE. 28, O
 OELKERS, ERMAN, M.C., FAIR. 19, R
 OELKERS, JOHN B., M.C., FAIR. 19, O
 OELKERS, LAWRENCE, M.C., FAIR. 17, R
 OETKEN, FRED, ALB., GAR. 14, O
 OLIVERIUS, JAMES, R.C., CEN. 36,

P

PABST, FRED, ALE., ALE. 18, S, O
 PACKARD, QUINTEN, BIS., PLE. 9, S
 PEARSON, I. B., BIS., PIO. 9, O
 PECKANEC, EDWARD, TIM., L.S. 16, S, O
 PECHANEC, FRANCIS, L.C., BRO. 25, R
 PECHANEC, FRANK, TIM., BAN. 24, O
 PECHANEC, HENRY, TIM., PIO. 18, S, O
 PECHANEC, STEPHEN, TIM., BAN. 23, R
 PECHANEC, VICTOR, ALB., PIO. 18, S, O
 PEROLI, MARIO, BIS., PIO. 19, R
 PETERSON, LORRAINE, P.R., GAR. 35, S, O
 PETERSON, ROY, R.C., CEN. 22, O
 PETREK, RICHARD, R.C., CEN. 10, O
 PETREK, WAYNE, L.C., L.C. 36, O
 PETRIK, CHARLES, R.C., CEN. 15, O
 PETZ, DONALD, M.C., HAM. 8, N, R
 PFEIFFER, JAY, M.C., ALE. 26, R
 PFEIFFER, CLARENCE, L.C., BRO. 18, O
 PFENNINGER, HOWARD, R.C., UN. 27, S, O
 PHILLIPS, KEN, NEK., UN. 32, R
 PHILLIPS, MELVIN, NEK., UN. 16, R

PIVONKA, CHARLES A., TIM., BAN. 20, R
 PIVONKA, LEO, M.C., BRO. 2, O
 POHORALEK, FRANK, TIM., BAN. 32, O
 POZALEK, CHARLES, TIM., CEN. 1, O

R

RANKIN, LOUIS, ALB., GAR. 34, S, O
 RAU, ELMER, BIS., ILL. 10, S, O
 RAUP, JAMES A., TIM., BAN. 15, O
 REHA, FRANK, TIM., BAN. 21, O
 REICHEL, NEAL, BIS., L.S. 23, R
 REIFSCHEIDER, ED, M.C., FAIR. 8, S, R
 REIFSCHEIDER, HENRY, L.C., L.C. 10,
 REIMER, FRANK, ALB., GAR. 24, S, O
 REINHARDT, KATIE, BIS., L.S. 34, O
 REINHARDT, MRS. LOWELL, BIS., L.S. 28, O
 REINHARDT, VELMA, BIS., L.S. 34, O
 RENNER, FRANK, R.C., BAN. 30, S, R
 RENNER, HARVE E., L.C., L.C. 31, O
 REYNOLDS, BILL, R.C., CEN. 29, O
 REYNOLDS, EVERETT, R.C., CEN. 29,
 REYNOLDS, JIM, R.C., CEN. 29, O
 REYNOLDS, L. V., R.C., CEN. 28, O
 RICHTER, E. F., TIM., BAN. 27, O
 RICHTER, RICHARD, TIM., GAR. 31, R
 RIEDL, HAROLD, BIS., PLE. 9, R
 RING, CHARLES, L.C., L.C. 4, R
 RIXON, JAMES A., M.C., ALE. 20, O
 RIXON, JOHN, M.C., HAM. 17,
 RODIE, ALEX, TIM., GAR. 31, O
 RODIE, GARY, ALB., PIO. 14, S, R
 RODIE, LLOYD, TIM., GAR. 19, R
 RODIE, PETER, ALB., GAR. 27, O
 RODIE, WAYNE, TIM., BAN. 36, O
 ROGERS, CHESTER L., M.C., HAM. 33, O
 ROGERS, ORVAL, M.C., ALE. 14, O
 ROGERS, MRS. O. S., M.C., HAM. 12, O
 ROGERS, WALTER, M.C., FAIR. 6, O
 ROTH, CECIL, BIS., ILL. 27, R
 ROTHE, HERMAN H., BIS., PIO. 20, O
 RYAN, FERNE, NEK., UN. 28, O
 RYAN, RICHARD, M.C., ALE. 28, O

S

SANKEY, WAYNE, L.C., L.C. 18, O
 SAUNDERS, FRAND V., L.C., FAIR. 22, O
 SCHAFER, BERTHOLD, L.C., FAIR. 26, R
 SCHAFER, MIKE C., LIE., B.T. 11, O
 SCHAFER, VINCENT R., LIE., B.T. 14, O
 SCHAUMBURG, LESLIE, BIS., ILL. 2, S, R
 SCHENK, ANTON J., OTIS, PLE. 3, S, R
 SCHENKEL, ALEX, R.C., L.C. 11, O
 SCHEUERMAN, AARON, OTIS, PIO. 13, R
 SCHEUERMAN, ALVIN, BIS., PIO. 32, R
 SCHEUERMAN, CLARENCE, ALE., B.P. 34, O
 SCHEUERMAN, D. M., L.C., B.T. 1, S, O
 SCHEUERMAN, H. A., BIS., PIO. 6, O
 SCHEUREMAN, ORLAND, BIS., L.S. 19, R
 SCHEUTZ, ERWIN, BIS., L.S. 2,
 SCHLEGEL, C. J., ALE., B.P. 7, O

DIRECTORY DAN ASKS THAT YOU
PATRONIZE THE PROGRESSIVE BUSINESSES.
DISPLAYING THIS SHIELD



FREE DISTRIBUTION TO FARMERS

MERCHANT PHIL SAYS THAT

The SPONSORS of this book — the ADVERTISERS — can supply your requirements with the best in quality, price and service. The fact that they stand behind their product with their signature is proof of their integrity. . . . When buying mention your "FARM DIRECTORY" to them.

In making this Farm Directory of your County — the aim of The Directory Service Company is to equal or excel any works of a similar nature anywhere in the United States. Every possible effort has been made to bring this directory entirely up to date. However, we do not accept responsibility for omissions or errors. If you notice any omission or error in this Directory, please let us know.

Call or Write for Information on similar County Directories in: Colorado, Illinois, Indiana, Iowa, Kansas, Michigan, Minnesota, Missouri, Nebraska, North Dakota, Ohio, Oklahoma, South Dakota and Wisconsin.

New Edition Published Each Year.

\$7.50 EACH.

Phone 515 — 295-2473

Write for quantity discount.

Algona, Iowa 50511

DIRECTORY SERVICE
Company

SCHWAB'S HATCHERY & FARM SUPPLY

27

Feed Mill - Baby Chicks - Cream - Eggs - Poultry

114 WEST 11th

LA CROSSE, KANSAS

SCHLEGEL, MRS. DAVE, OTIS, P10.27, 0
 SCHLEGEL, JOSEPH, OTIS, P10.24, 0
 SCHLEZEL, FRED, OTIS, PLE.15, 0
 SCHMIDT, GEORGE C., PFE., ILL.6, R
 SCHMIDT, PALMER, OTIS, P10.2, 0
 SCHMIDT, W.G., M.C., FAIR.28, 0
 SCHNEIDER, HENRY, L.C., L.C.14, R
 SCHNEIDER, OSWALD, L.C., L.C.22, 0
 SCHOENDALLER BROS., L.C., FAIR.25, 0
 SCHOWALTER, ALLEN, R.C., CEN.30, S, R
 SCHRADER, ALBERT, TIM., BAN.18, 0
 SCHRAEDER, CLARENCE, R.C., CEN.25, S, 0
 SCHRAEDER, FLOYD, R.C., BAN.30, S, 0
 SCHRAEDER, LEE ROY, TIM., BAN.18, 0
 SCHRAEDER, LEO, TIM., BAN.30, S, 0
 SCHRATER, WILLIAM F., TIM., BAN.21, S, 0
 SCHROEDER, LESLIE F., ALB., GAR.26, 0
 SCHROEDER, MRS. MARTHA, ALB., GAR.26, 0
 SCHROEDER, TROIS, ALB., GAR.36, 0
 SCHROTER, OSCAR, TIM., BAN.21, S, 0
 SCHROTT, ADOLPH, ALB., P10.16, S, R
 SCHROTT, JOE, NEK., UN.29, 0
 SCHUCKMAN, BERTHOLD, M.C., FAIR.8, R
 SCHUCKMAN, ELMER, L.C., B.T.18, R
 SCHUCKMAN, LEONARD, L.C., B.T.33, 0
 SCHUCKMAN, LUDWIG, M.C., HAM.5, N, R
 SCHUCKMAN, VINCENT, LIE., B.T.17, 0
 SCHUCKMAN, WILLIAM, L.C., B.T.6, S, 0
 SCHUGART, FRED, ALB., P10.17, S, R
 SCHULTZ, WAYNE, TIM., BAN.34, S, R
 SCHWARTZKOPF, BERTHA, BIS., L.S.28, 0
 SCHWARTZKOPF, EMMA, BIS., L.S.28, 0
 SCHWINDT, HARRY, ALE., B.P.22, R
 SCHWINDT, HERMAN, L.C., L.C.23, 0
 SEAMAN, MATHEW, NEK., UN.28, 0
 SEHL, ED., ALE., B.P.8, 0
 SELL, LESTER, TIM., GAR.6, 0
 SELTMAN, ALBERT, NEK., UN.21, S, 0
 SELTMAN, EL VERNE, NEK., UN.19, S, 0
 SELTMAN, ERNEST, NEK., UN.29, S, 0
 SELTMAN, HARLEY, NEK., UN.21, S, 0
 SELTMAN, JOHN C., ALE., B.P.22, 0
 SELTMAN, ROBERT, NEK., UN.30, S, 0
 SERPAN, JAMES, R.C., BAN.19, 0
 SERPAN, M.A., TIM., BAN.28, 0
 SERPAN, MRS. OTTO, TIM., BAN.28, 0
 SERPAN, STANLEY, TIM., BAN.33, R
 SEUSER, BEN E., BIS., L.S.5, 0
 SEUSER, GEORGE J., BIS., L.S.30, R
 SEUSER, KARL, BIS., L.S.5, 0
 SEUSER, LESTER, TIM., BAN.19, 0
 SEUSER, PHILIP, BIS., L.S.9, 0
 SHAFER, HENRY, L.C., B.T.10, S, 0
 SHOWALTER, M.W., M.C., HAM.32, R
 SMITH, GEORGE, L.C., L.C.4, R
 SMOLIK, RICHARD, TIM., BAN.14, R
 SNODGRASS, WAYNE, NEK., UN.29, S, R
 SPICKA, F.J., TIM., BAN.29, 0
 STAFFORD, ED., ALE., B.P.21, 0
 ST. AUBRYN, RICHARD, L.C., FAIR.33,
 STEGMAN, A.J., BIS., ILL.22, 0
 STEGMAN, ARTHUR, BIS., ILL.11, 0

STEINMETZ, CHRIS, NEK., UN.8, 0
 STEITZ, BEN, BIS., ILL.11, S, 0
 STEJSKAL, CLARA, TIM., BAN.30, R
 STEJSKAL, GEORGE T., TIM., BAN.9, R
 STEJSKAL, JAMES, TIM., BAN.30, 0
 STEJSKAL, LARRY, TIM., BAN.23, S, 0
 STEJSKAL, RALPH, R.C., CEN.32, R
 STOS, BERNARD, OTIS, P10.24, R
 STOS, JOSEPH V., OTIS, P10.24, 0
 STREMEL, CELESTINE, M.C., ALE.18, 0
 STREMEL, EDWIN, BIS., PLE.18, 0
 STREMEL, EMIL, BIS., ILL.1, 0
 STREMEL, I.A., BIS., PLE.18, 0
 STREMEL, LAWRENCE, BIS., ILL.34, 0
 STREMEL, LE ROY, BIS., PLE.19, R
 SUPPES, CLARENCE, OTIS, PLE.23, R
 SUPPES, JACOB, L.C., B.T.36, 0
 SUPPES, JOE, L.C., B.T.19, 0
 SUPPES, JULIUS, OTIS, PLE.14, R

T

TAMMEN, C.H., ALB., GAR.14, 0
 TAMMEN, CARL, ALB., GAR.22, S, 0
 TAMMEN, CHARLES, ALB., GAR.24, S, 0
 TAMMEN, DALE, R.C., CEN.34, S, R
 TAMMEN, FRED W., ALB., GAR.25, S, 0
 TAMMEN, FRIEDA, ALB., GAR.26, S, 0
 TAMMEN, GEOFFREY, ALB., GAR.15, 0
 TAMMEN, LOUIS, ALB., GAR.24, S, 0
 TAMMEN, MRS. MARION, TIM., BAN.35, S, 0
 TAMMEN, ROBERT, TIM., BAN.35, S, R
 TEMPLE, BASIL B., M.C., FAIR.7, S, 0
 TOMICEK, JIM, TIM., BAN.32, 0
 TOMICEK, I.E., TIM., BAN.33, 0
 TROUT, GENE, R.C., UN.25, R
 TRYON, WILLIAM, NEK., UN.8, 0
 TUZICK, WILLIAM, TIM., BAN.7, 0
 TUZICKA, ADOLPH, OTIS, PLE.10, S, 0
 TUZICKA, ALBERT, BIS., PLE.10, S, R
 TUZICKA, CLARENCE, OTIS, PLE.34, R
 TUZICKA, FRANK, BIS., PLE.10, S, 0
 TUZICKA, JOHN T., BIS., ILL.36,

U

URBAN, ALFRED, BIS., ILL.17, R
 URBAN, ALOIS G., BIS., ILL.21, 0
 URBAN, ALOIS L., BIS., ILL.10, 0
 URBAN, BENDICT, BIS., ILL.2, 0
 URBAN, FRANK, BIS., ILL.9, 0
 URBAN, JEROME, BIS., ILL.9, 0
 URBAN, JOHN, BIS., ILL.22, 0
 URBAN, LEONARD, BIS., ILL.20, 0
 URBAN, NORBERT, L.C., FAIR.3, S, 0
 URBAN, RUEBEN, BIS., ILL.15, R
 URBAN, THOMAS, BIS., ILL.22, 0

V

VESECKY, C.B., TIM., BAN.24, S, 0
 VONDRACEK, FRANK, TIM., BAN.21, 0

BISON FARMERS COOP ASSN.

GRAIN - FEED - PETROLEUM - FERTILIZER

 Locker & Groceries
 BISON, KANSAS

BUTANE - PROPANE - SALES & SERVICE - BONDED STORAGE 622,000 BU.

PIONEER HYBRID SEED CORN

PIONEER.
 BRAND
 SEED CORN

**HIGH YIELDS
 TOP PERFORMANCE
 GREATER PROFITS**

PIONEER.
 BRAND
 SEED CORN

Your Representatives in RUSH COUNTY are:

THOMAS B. WEST, Nekoma 67559

Phone 4232

ROBERT LEE KRAISINGER, Timken 67582

Phone EL 5-2335

WILLIS MOHR, Albert 67511

Phone Bison E 46-2212

GARST & THOMAS HYBRID CORN CO.
COON RAPIDS, IOWA

WAGNER, ADAM, BIS., L.S. 20, 0
 WAGNER, P. DALE, ALB., GAR. 28, 0
 WAGNER, PAUL A., OTIS, P. 10. 28, R
 WAGNER, RAYMOND, OTIS, PLE. 1, 0
 WAGNER, SAM, OTIS, PLE. 24, 0
 WALKER, C. T., M.C., HAM. 26, 0
 WALLACE, ALVIN, OTIS, P. 10. 21, R
 WEBER, HAROLD W., L.C., L.C. 20, 0
 WEBS, EVA, ALE., B.P. 29, 0
 WEGELE, G. A., OTIS, PLE. 22, R
 WEGELE, JACOB, OTIS, PLE. 28, R
 WEGHER, J. L., M.C., HAM. 31, R
 WEIGAND, ELDRED, L.C., L.C. 34, R
 WEIGAND, HERMAN, L.C., L.C. 27, 0
 WEIGAND, J. A., L.C., L.C. 34, R
 WEITZEL, JOHN, R.C., UN. 23, 0
 WELLS, LON E., JR., ALF., B.P. 19, R
 WELTMER, RALPH, R.C., UN. 24, 0
 WELTMER, RAYMOND, M.C., HAM. 2, R
 WENDLER, A. C., NEK., B.P. 11, R
 WERTH, ALFRED, L.C., B.T. 10, S, 0
 WERTH, HARVEY, L.C., B.T. 11, 0
 WEST, FRANK, R.C., UN. 26, 0
 WEST, LLOYD, NEK., UN. 27, P
 WEST, MINNIE, NEK., UN. 21, 0
 WEST, THOMAS B., R.C., UN. 25, R
 WEST, WILLARD, NEK., UN. 6, R
 WILHELM, MRS. JOHN, R.C., GEN. 9, 0
 WILHELM, LORAY, ALB., GAR. 16, R
 WILHELM, NORMAN, R.C., GEN. 11, R
 WILHELM, VELMER, TIM., GAR. 5, 0
 WILHELM, VIRGIL, ALB., GAR. 8, R
 WILLIAMS, CLAYTON, ALE., ALE. 10, R
 WILLIAMS, DWIGHT, NEK., B.P. 23, S, 0
 WILLIAMS, EARL, NEK., UN. 20, R
 WILLIAMS, JAMES, ALE., B.P. 16, 0
 WILLIAMS, OLIVER, ALE., B.P. 15, 0
 WILLIAMS, WALTER, NEK., B.P. 13, 0
 WILSON, GLENN M., L.C., BRO. 26, 0
 WILSON, HARRY, L.C., BRO. 34, 0
 WILSON, JACK, M.C., HAM. 5, 0
 WILSON, JAMES, L.C., L.C. 33, 0
 WILSON, KENNETH, L.C., L.C. 19, 0
 WILSON, LE ROY, M.C., BRO. 3, 0
 WILSON, ROBERT, L.C., L.C. 30, 0
 WILSON, ROBERT C., L.C., BRO. 36, 0
 WILSON, RONALD, L.C., L.C. 32, 0
 WISSMAN, DAYLON, ALB., GAR. 2, R
 WITT, ARTHUR, BIS., L.S. 2, 0
 WRIGHT, LOREN, ALE., ALE. 4, R

Y

YOST, HOWARD, L.C., L.C. 1, 0
 YOST, LEO, ALE., B.P. 23,
 YOST, LEONARD, M.C., ALE. 21, R
 YOST, NELSON, L.C., L.C. 23, 0
 YOST, WOODROW, ALE., B.P. 32, R

Z

ZIMMERMAN, ALBERT, L.C., FAIR. 11, 0

Midwest's Largest Farm Directory Publisher

To my many Friends
a hearty "Thank You" for
your help in making this
Farm Directory



Keith Chambers

Box 302, Culbertson, Nebraska 69024

Phone 308-278-2443

Your Local **DIRECTORY SERVICE** Representative
Company

Serving *Kansas* Business - Industry - Agriculture

May we hear from you?

We're happy to send you this free county Farm Directory through the compliments of the Businesses advertised herein. We would appreciate knowing how you like it. Will you please write to me — today? We acknowledge every letter. Thank you. We enjoy serving you.

Call or Write for Information on similar County Directories in: Iowa, Illinois, Indiana, Kansas, Minnesota, Missouri, Nebraska, North Dakota, Oklahoma, South Dakota and Wisconsin.

DIRECTORY SERVICE
Company

Algona, Ia. 50511

"Service is our Middle Name"

DO YOU APPRECIATE

GETTING THESE BOOKS?

**DROP US A LINE, SO WE CAN TELL THE
ADVERTISERS**

**BETTER YET! YOU TELL THEM &
THANK THEM WITH YOUR PATRONAGE**

DIRECTORY SERVICE
Company

ALGONA, IOWA 50511
RETURN REQUESTED

BULK RATE
U. S. POSTAGE
PAID
Permit No. 35
ALGONA, IOWA

HOME STATE BANK
LA CROSSE, KANSAS

Bill Robbins, Cashier
CA 2-2571
Clarence Wilson, Pres.

Umbrella of Complete Coverage

Disability
Motorcycle
Hospitalization
Estate Programing



Life Auto
Farm Owners
Personal Liability
Risk Insurance of All Types

Great Bend, Kans.

SWift 3-9638

Karst Water Well Drilling & Service

AERMOTOR & FAIRBANKS-MORSE PUMPS
WINDMILLS and SUBMERSIBLE PUMPS
Phone CA 2-3175 LaCrosse, Kans.

OLIVER FARM EQUIPMENT



TREND TRUCKS - RICHARDSON A FLEX
WHITE OLIVER INDUSTRIAL
ZERO - CONDE - MUELLER DAIRY EQUIP.



ELLIS COUNTY IMPLEMENT

SERVICE ON ALL MAKES
PH. 625-6587 HAYS, KANS.

HUMBURG GAS

Farm & Home
Supplies & Service

HARDWARE APPLIANCES PLUMBING LP GAS
WATER WELLS HEATING AIR CONDITIONING

NEW OR REMODELING ALL BUILDINGS

Ph. CA 2-2600

LaCrosse, Kans.