

OUTLINE MAP OF SUMNER COUNTY KANSAS

Copyright 1918 by Geo. A. Apple & Co.

Scale 7/32 of 1 inch to 1 mile

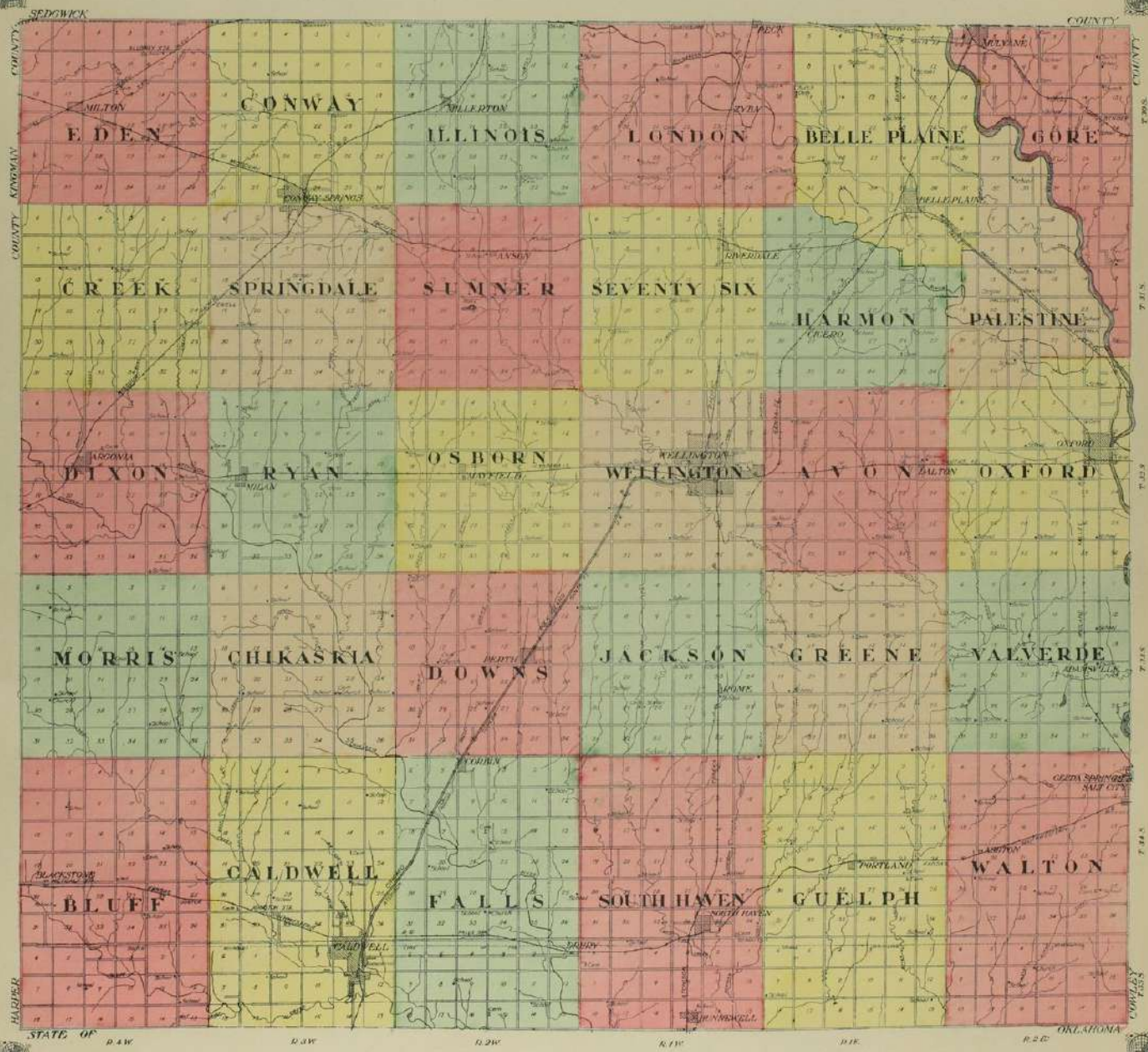

STATE OF HARPER SEDWICK COWLEY OKLAHOMA
D.4W. D.5W. D.6W. R.1W. R.1E. R.2E.

WEST PART OF
WELLINGTON
 COUNTY SEAT OF SUMNER CO., KANSAS
 WELLINGTON TWP
 Scale 500 ft. = 1 inch
 Copyright 1918 by Geo. A. Boyle & Co.

L. H. Finney
 160

Geo. D. Vaughn
 40

H. B. Sykes
 9

Geo. A. Boyle
 20

WELLINGTON NURSERIES Class Worden 320

Map section showing a grid of land parcels. The parcels are color-coded in shades of pink and red. The grid is labeled with 'TWO-TENTH', 'THIRTIETH', 'THIRTY-FIFTH', 'THIRTY-EIGHTH', 'THIRTY-NINTH', and 'FORTIETH' along the vertical axis. The horizontal axis is labeled 'SEVENTH', 'EIGHTH', 'NINTH', 'TENTH', 'ELEVENTH', 'TWELFTH', 'THIRTEENTH', 'FOURTEENTH', 'FIFTEENTH', 'SIXTEENTH', 'SEVENTEENTH', 'EIGHTEENTH', 'NINETEENTH', 'TWENTIETH', 'TWENTY-FIRST', 'TWENTY-SECOND', 'TWENTY-THIRD', 'TWENTY-FOURTH', 'TWENTY-FIFTH', 'TWENTY-SIXTH', 'TWENTY-SEVENTH', 'TWENTY-EIGHTH', 'TWENTY-NINTH', and 'THIRTIETH'.

WELLINGTON NURSERIES A Worden Est

Map section showing a grid of land parcels. The parcels are color-coded in shades of pink, red, and yellow. The grid is labeled with 'TWO-TENTH', 'THIRTIETH', 'THIRTY-FIFTH', 'THIRTY-EIGHTH', 'THIRTY-NINTH', and 'FORTIETH' along the vertical axis. The horizontal axis is labeled 'SEVENTH', 'EIGHTH', 'NINTH', 'TENTH', 'ELEVENTH', 'TWELFTH', 'THIRTEENTH', 'FOURTEENTH', 'FIFTEENTH', 'SIXTEENTH', 'SEVENTEENTH', 'EIGHTEENTH', 'NINETEENTH', 'TWENTIETH', 'TWENTY-FIRST', 'TWENTY-SECOND', 'TWENTY-THIRD', 'TWENTY-FOURTH', 'TWENTY-FIFTH', 'TWENTY-SIXTH', 'TWENTY-SEVENTH', 'TWENTY-EIGHTH', 'TWENTY-NINTH', and 'THIRTIETH'.

Map section showing a grid of land parcels. The parcels are color-coded in shades of pink and red. The grid is labeled with 'TWO-TENTH', 'THIRTIETH', 'THIRTY-FIFTH', 'THIRTY-EIGHTH', 'THIRTY-NINTH', and 'FORTIETH' along the vertical axis. The horizontal axis is labeled 'SEVENTH', 'EIGHTH', 'NINTH', 'TENTH', 'ELEVENTH', 'TWELFTH', 'THIRTEENTH', 'FOURTEENTH', 'FIFTEENTH', 'SIXTEENTH', 'SEVENTEENTH', 'EIGHTEENTH', 'NINETEENTH', 'TWENTIETH', 'TWENTY-FIRST', 'TWENTY-SECOND', 'TWENTY-THIRD', 'TWENTY-FOURTH', 'TWENTY-FIFTH', 'TWENTY-SIXTH', 'TWENTY-SEVENTH', 'TWENTY-EIGHTH', 'TWENTY-NINTH', and 'THIRTIETH'.

Map section showing a grid of land parcels. The parcels are color-coded in shades of pink, red, and yellow. The grid is labeled with 'TWO-TENTH', 'THIRTIETH', 'THIRTY-FIFTH', 'THIRTY-EIGHTH', 'THIRTY-NINTH', and 'FORTIETH' along the vertical axis. The horizontal axis is labeled 'SEVENTH', 'EIGHTH', 'NINTH', 'TENTH', 'ELEVENTH', 'TWELFTH', 'THIRTEENTH', 'FOURTEENTH', 'FIFTEENTH', 'SIXTEENTH', 'SEVENTEENTH', 'EIGHTEENTH', 'NINETEENTH', 'TWENTIETH', 'TWENTY-FIRST', 'TWENTY-SECOND', 'TWENTY-THIRD', 'TWENTY-FOURTH', 'TWENTY-FIFTH', 'TWENTY-SIXTH', 'TWENTY-SEVENTH', 'TWENTY-EIGHTH', 'TWENTY-NINTH', and 'THIRTIETH'.

Northwest corner of the map section showing a grid of land parcels. The parcels are color-coded in shades of pink, red, and yellow. The grid is labeled with 'TWO-TENTH', 'THIRTIETH', 'THIRTY-FIFTH', 'THIRTY-EIGHTH', 'THIRTY-NINTH', and 'FORTIETH' along the vertical axis. The horizontal axis is labeled 'SEVENTH', 'EIGHTH', 'NINTH', 'TENTH', 'ELEVENTH', 'TWELFTH', 'THIRTEENTH', 'FOURTEENTH', 'FIFTEENTH', 'SIXTEENTH', 'SEVENTEENTH', 'EIGHTEENTH', 'NINETEENTH', 'TWENTIETH', 'TWENTY-FIRST', 'TWENTY-SECOND', 'TWENTY-THIRD', 'TWENTY-FOURTH', 'TWENTY-FIFTH', 'TWENTY-SIXTH', 'TWENTY-SEVENTH', 'TWENTY-EIGHTH', 'TWENTY-NINTH', and 'THIRTIETH'.

Map section showing a grid of land parcels. The parcels are color-coded in shades of pink, red, and yellow. The grid is labeled with 'TWO-TENTH', 'THIRTIETH', 'THIRTY-FIFTH', 'THIRTY-EIGHTH', 'THIRTY-NINTH', and 'FORTIETH' along the vertical axis. The horizontal axis is labeled 'SEVENTH', 'EIGHTH', 'NINTH', 'TENTH', 'ELEVENTH', 'TWELFTH', 'THIRTEENTH', 'FOURTEENTH', 'FIFTEENTH', 'SIXTEENTH', 'SEVENTEENTH', 'EIGHTEENTH', 'NINETEENTH', 'TWENTIETH', 'TWENTY-FIRST', 'TWENTY-SECOND', 'TWENTY-THIRD', 'TWENTY-FOURTH', 'TWENTY-FIFTH', 'TWENTY-SIXTH', 'TWENTY-SEVENTH', 'TWENTY-EIGHTH', 'TWENTY-NINTH', and 'THIRTIETH'.

J. M. & V. Ready
 1800

Sumner County Infirmary

12 AND 13

ARGONIA

Scale 300 feet to 1 inch

DIXON TWP

F. M. Sumpter 6524

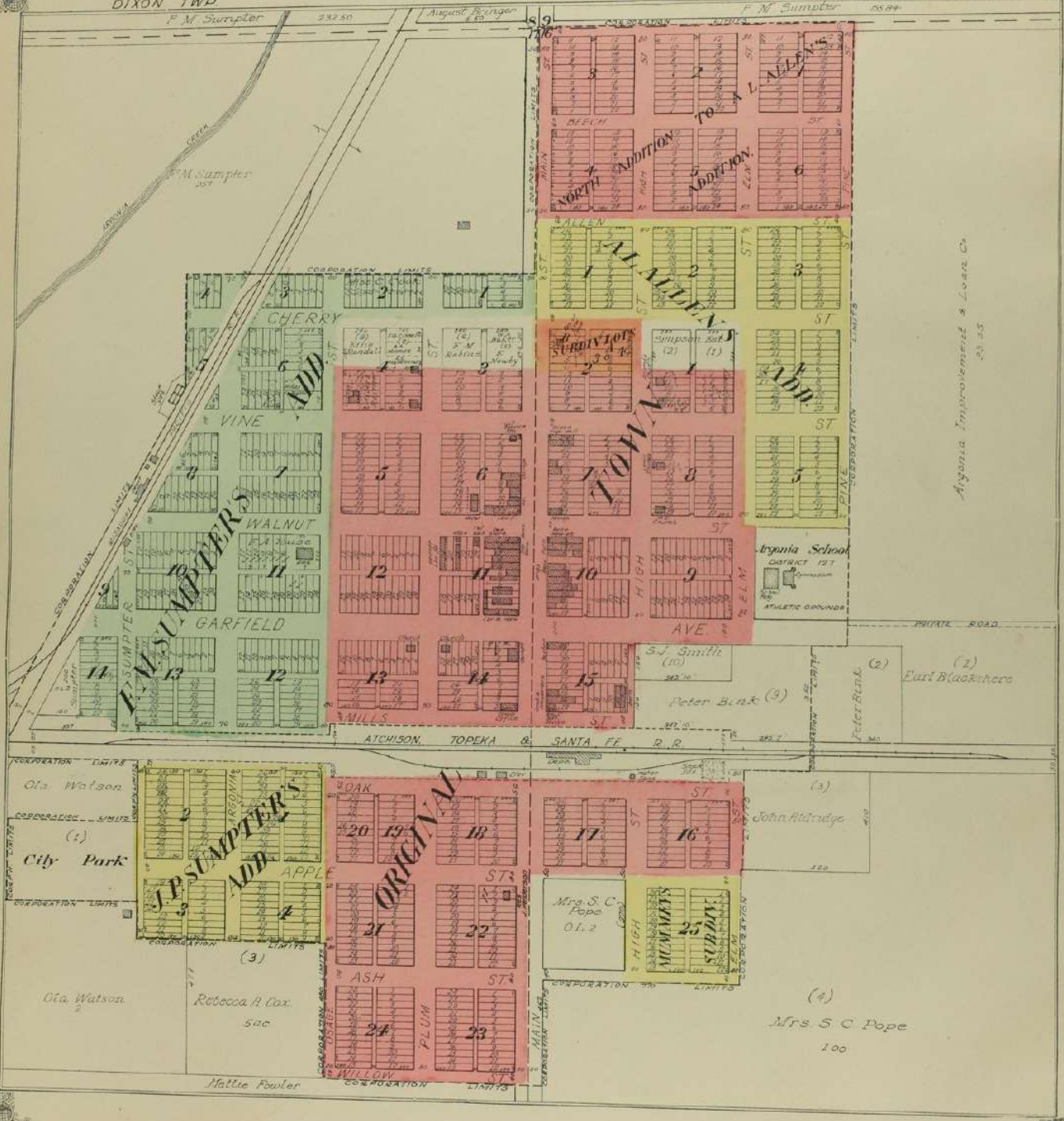

Argonia Improvement & Loan Co.
53 25

SOUTH HAVEN

Located in Sections 34 and 35
SOUTH HAVEN TWP.
Scale 300 feet to 1 inch.

Ira Foy, Est.

120

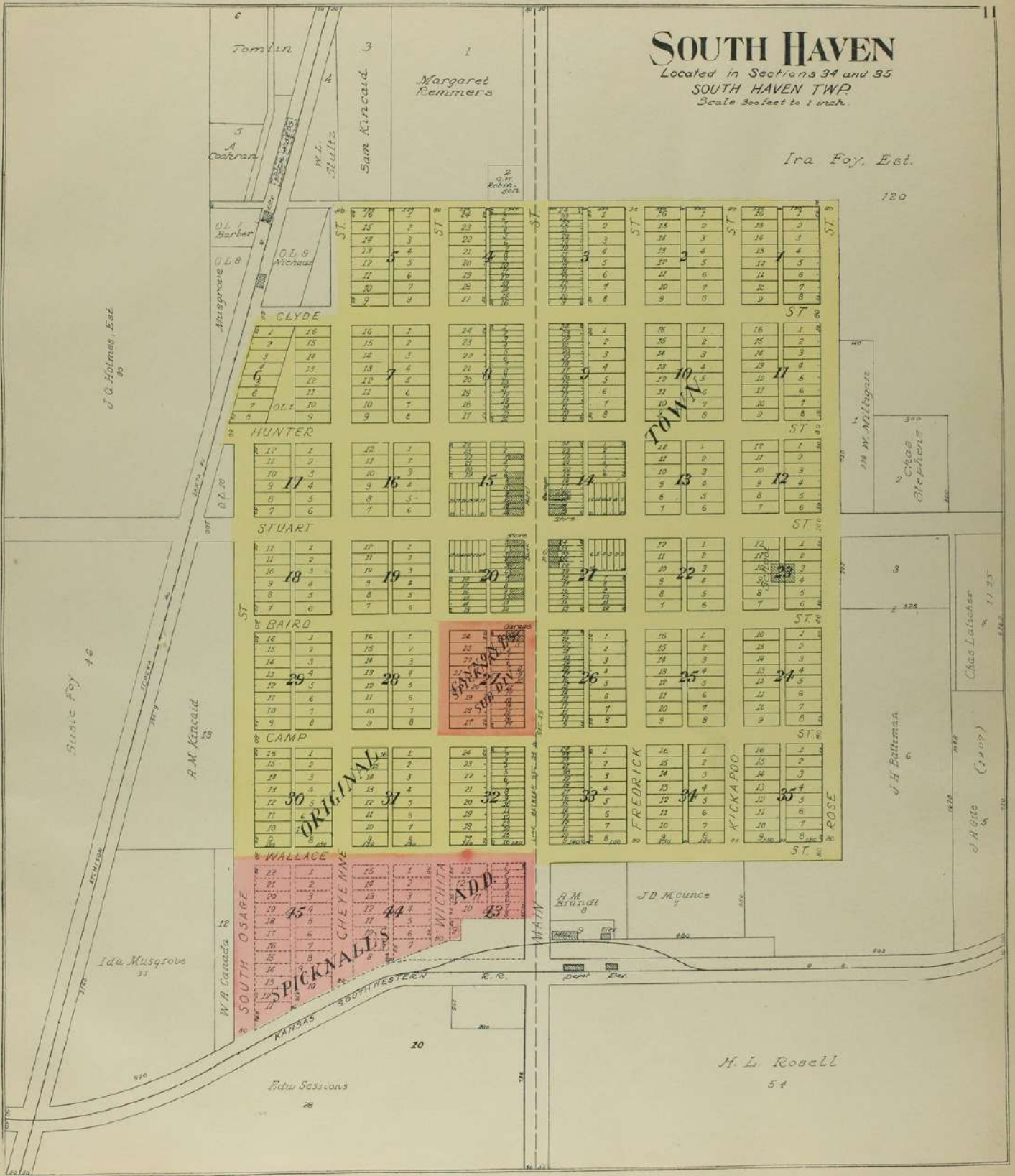

EAST PART OF WELLINGTON

COUNTY SEAT OF SUMNER CO., KANS.

WELLINGTON TWP

Scale 500 ft. = 1 inch

Copyright 1888 by Geo. A. Hyle & Co.



SEE PAGES 6 AND 9.

Mrs. Lizzie Smith

1112
1443

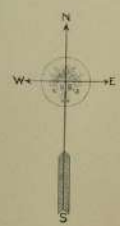

J. H. Allen
160

Mrs. Ferrell
11

D. C. & A. L. Renn
116

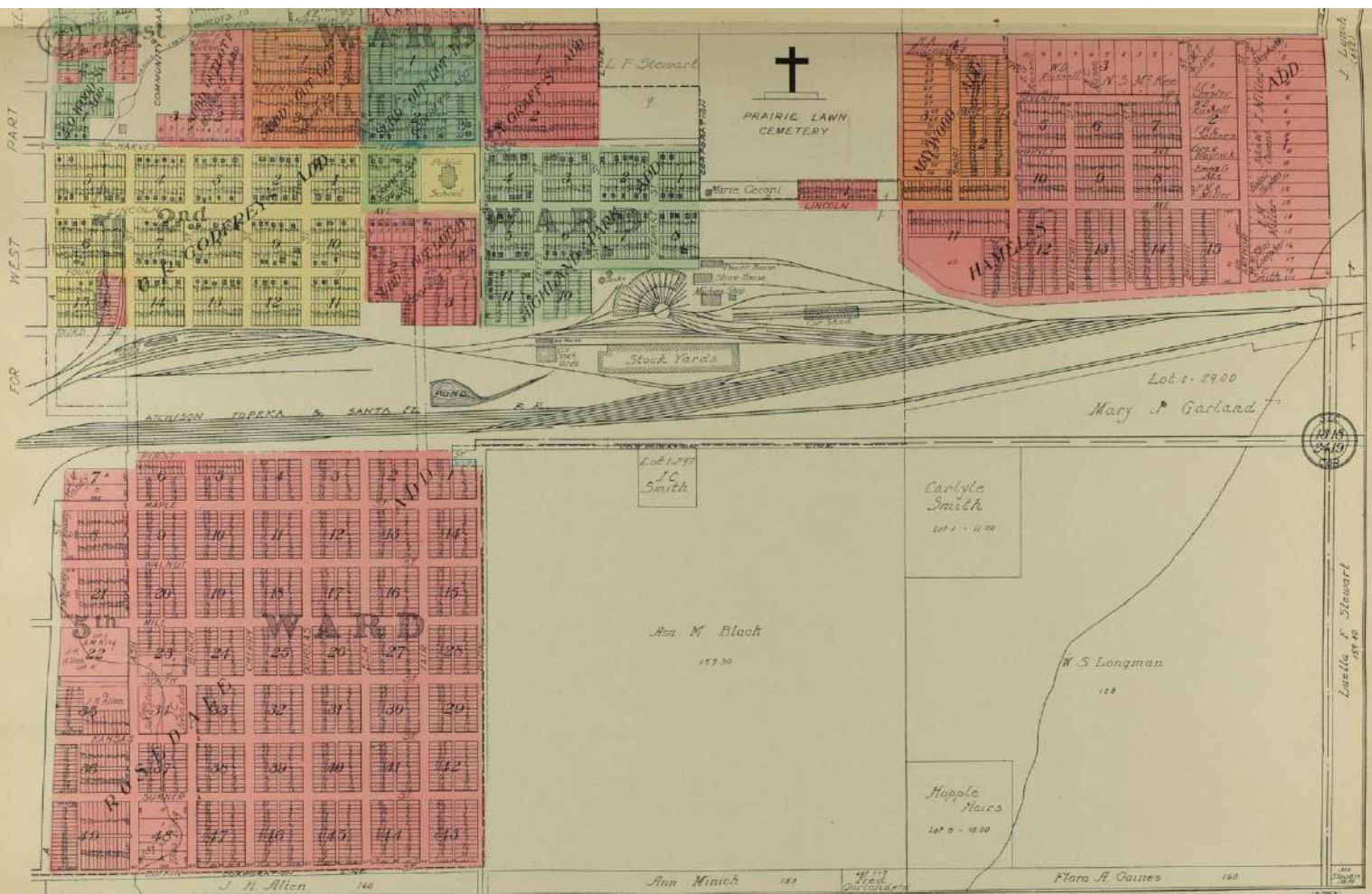

MAP OF
CREEK
TOWNSHIP

Scale 2 inches to 1 mile

Township 31 South, Range 4 West of the 6th P. M.

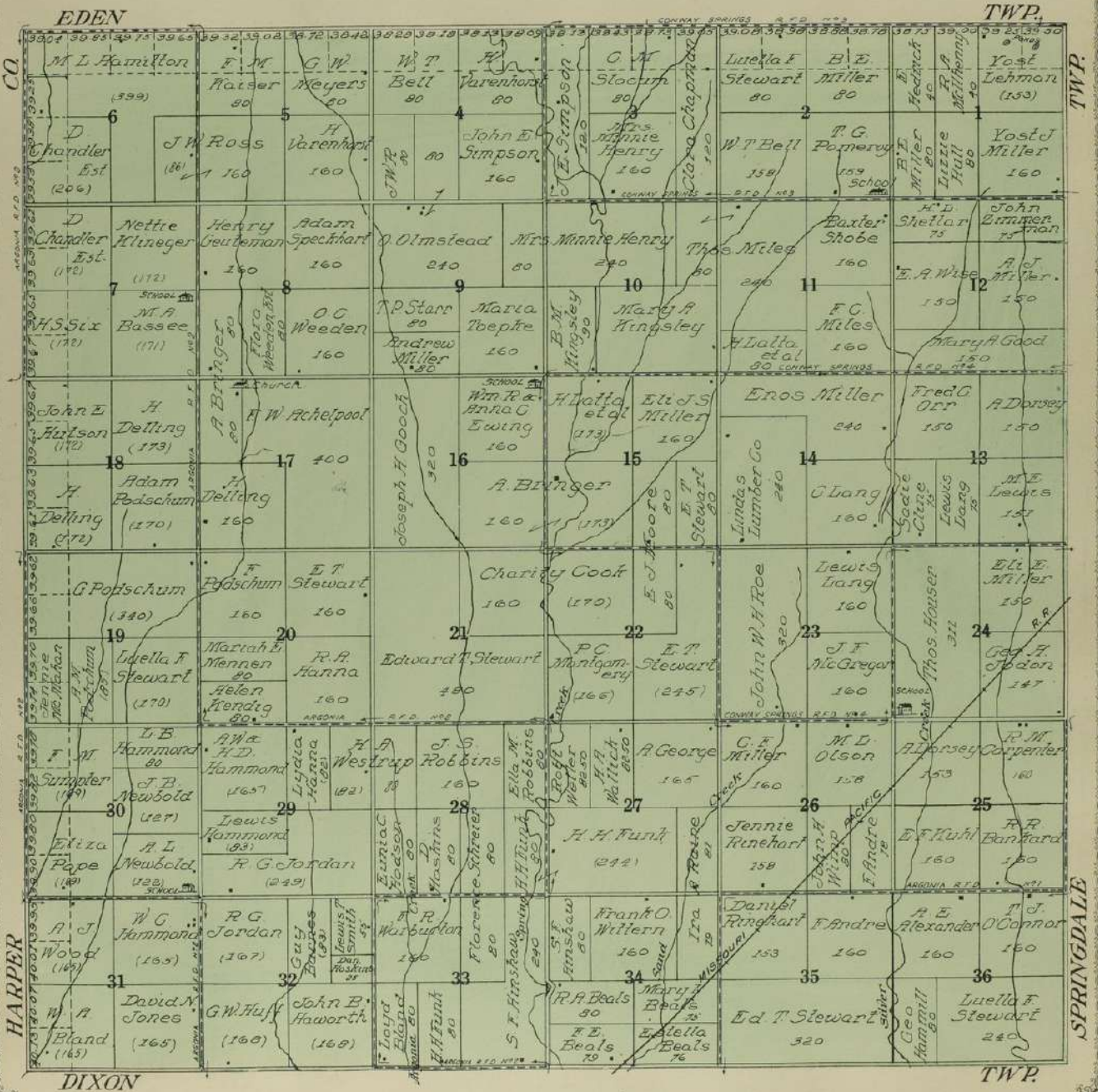

CO

HARPER

TWP.

SPRINGDALE

EDEN

TWP.

DIXON

TWP.

S.H. Horner & D.J. Dacy
CORPORATION
KANSAS SOUTHWESTERN

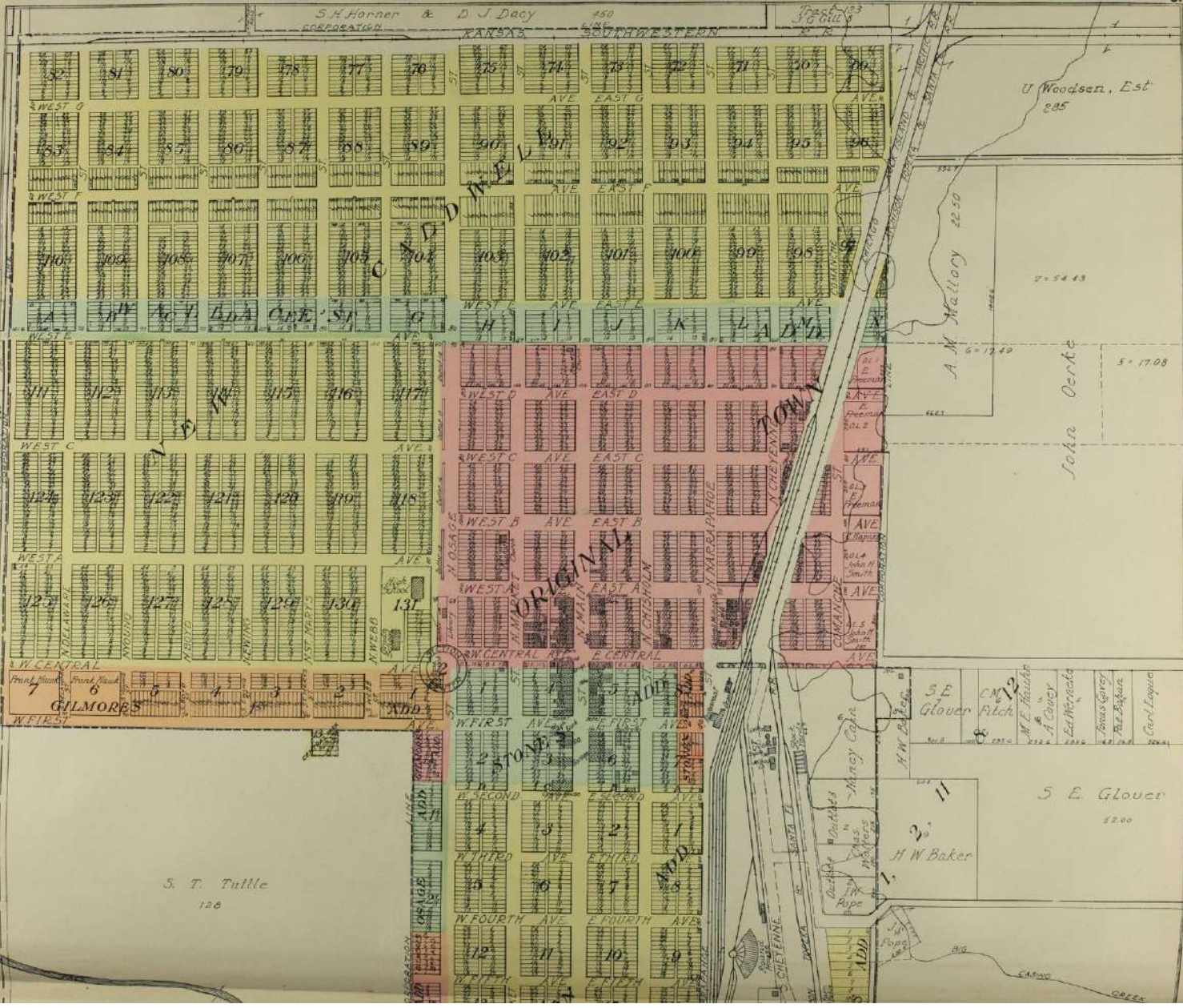

U. Woodson, Est 285

A.M. Mallory 22.50

John Oerte
6-12.40
5-17.08

GILMORE'S
W. FIRST

S. T. Tuttle
128

S.E. Glover
M.E. Washin
A. Cooney
Ed. Marzetta
Thomas Gray
Paul Duffan
Carl Logue

S. E. Glover
12.00

H.W. Baker

CREEK

CALDWELL

CALDWELL TWP.
Scale: 425 ft. = 1 inch
Copyright 1918 by Geo. A. Oyle & Co.

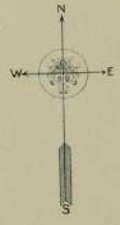

SECTION 15
S. OSAGE
S. MARSH
S. CHESHAM
S. MAIN
S. TOTTENHAM
S. CHESHAM
S. MARSH
S. OSAGE

SUBDIVISION

SECTIONS

S. T. Tuttle
140 40

L. J. Campbell

Wm. Bouttes
172 34 37

Adeline Reggs
15

Chas. E. Weybright
64 30

J. B. Kinchloe
2

Rhoda Wight
147 58

Robt. Massengill
79

S. T. Tuttle
145

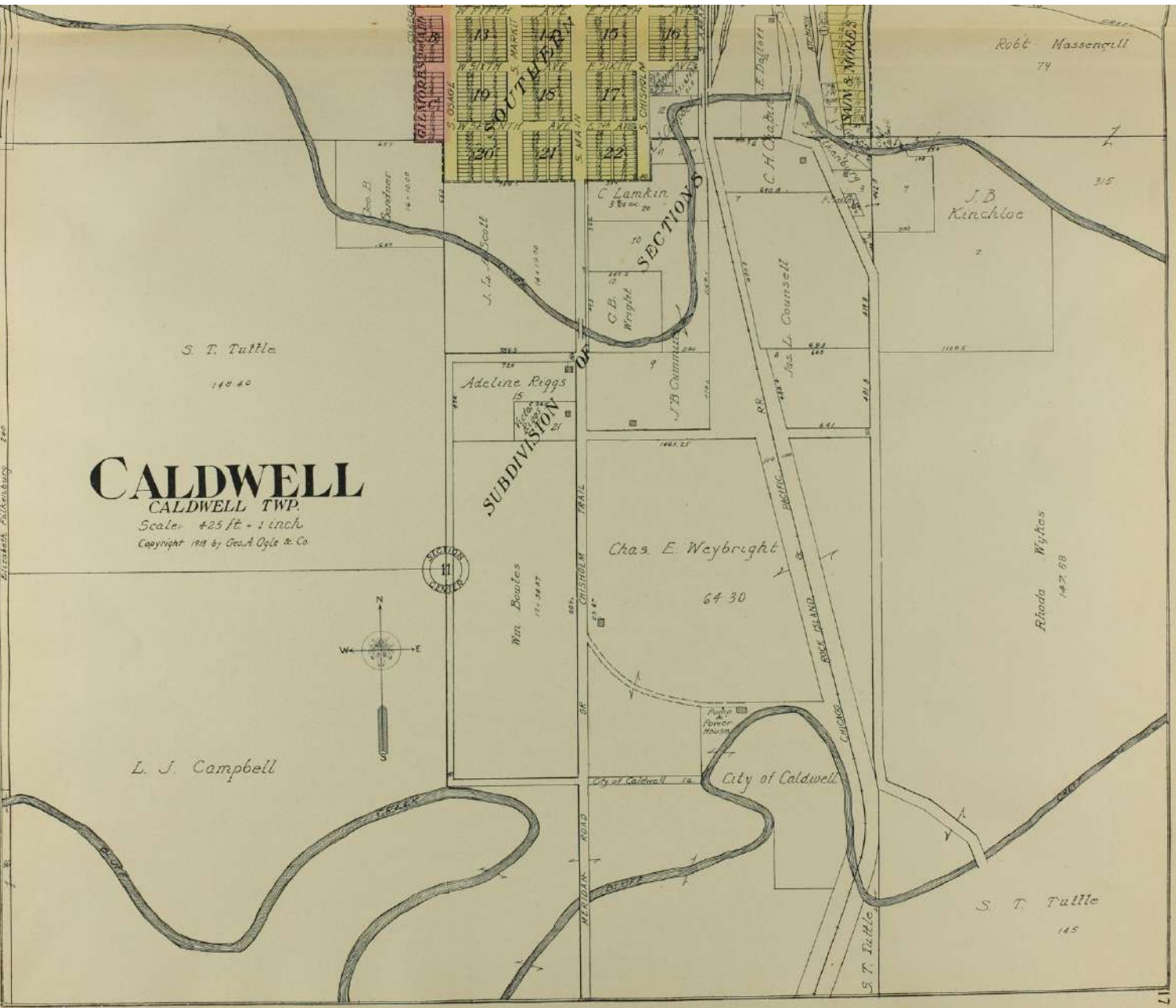



MAP OF
DIXON
 TOWNSHIP
 Scale 2 inches to 1 mile

Township 32 South, Range 4 West of the 6th P. M.

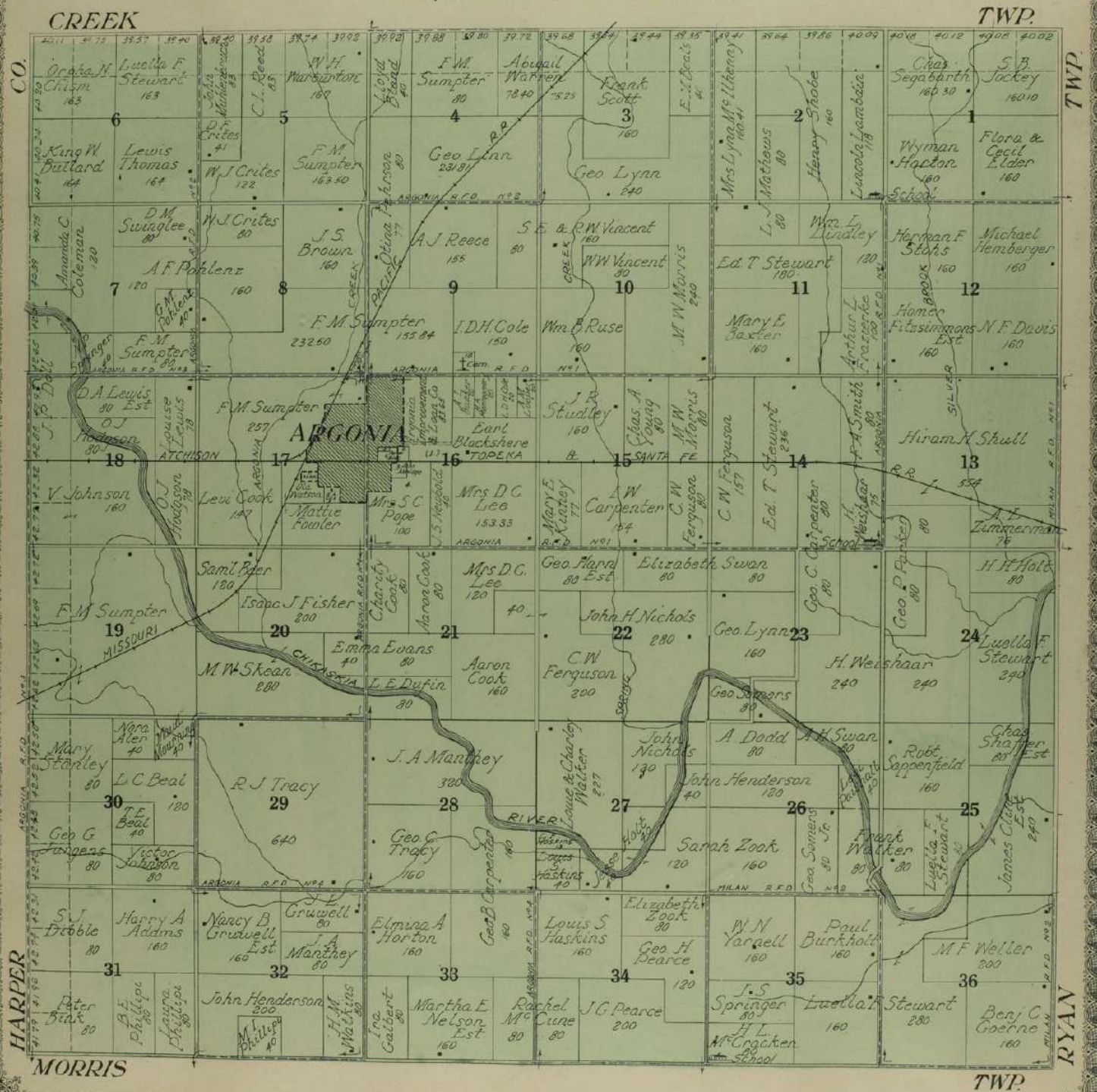

MAP OF
MORRIS
TOWNSHIP
Scale 2 inches to 1 mile

Township 33 South, Range 4 West of the 6th P. M.

DIXON										TWP.									
6										1									
7										12									
8										11									
9										10									
18										13									
17										14									
16										15									
19										24									
20										23									
21										22									
30										25									
29										26									
28										27									
31										36									
32										35									
33										34									
36										33									
35										32									
34										31									
33										30									
32										29									
31										28									
30										27									
29										26									
28										25									
27										24									
26										23									
25										22									
24										21									
23										20									
22										19									
21										18									
20										17									
19										16									
18										15									
17										14									
16										13									
15										12									
14										11									
13										10									
12										9									
11										8									
10										7									
9										6									
8										5									
7										4									
6										3									
5										2									
4										1									
3										0									
2										1									
1										0									
0										1									
1										2									
2										3									
3										4									
4										5									
5										6									
6										7									
7										8									
8										9									
9										10									
10										11									
11										12									
12										13									
13										14									
14										15									
15										16									
16										17									
17										18									
18										19									
19										20									
20										21									
21										22									
22										23									
23										24									
24										25									
25										26									
26										27									
27										28									
28										29									
29										30									
30										31									
31										32									
32										33									
33										34									
34										35									
35										36									
36										37									
37										38									
38										39									
39										40									
40										41									
41										42									
42										43									
43										44									
44										45									
45										46									
46										47									
47										48									
48										49									
49										50									
50										51									
51										52									
52										53									
53										54									
54										55									
55										56									
56										57									
57										58									
58										59									
59										60									
60										61									
61										62									
62										63									
63										64									
64										65									
65										66									
66										67									
67										68									
68										69									
69										70									
70										71									
71										72									
72										73									
73										74									
74										75									
75										76									
76										77									
77										78									
78										79									
79										80									
80										81									
81										82									
82										83									
83										84									
84										85									
85										86									
86										87									
87										88									
88										89									
89										90									
90										91									
91										92									
92										93									
93										94									
94										95									
95										96									
96										97									
97										98									
98										99									
99										100									
100										101									
101										102									
102										103									
103										104									
104										105									
105										106									
106										107									
107										108									
108										109									
109										110									
110										111									
111										112									
112										113									
113										114									
114										115									
115										116									
116										117									
117										118									
118										119									
119										120									
120										121									
121										122									
122										123									
123										124									
124										125									
125										126									
126										127									
127										128									
128										129									
129										130									
130										131									
131										132									
132										133									
133										134									
134										135									
135										136									
136										137									
137										138									
138										139									
139										140									
140										141									
141										142									
142										143									
143										144									
144										145									
145										146									
146										147									
147										148									
148										149									
149										150									
150										151									
151										152									
152										153									
153										154									
154										155									
155										156									
156										157									
157										158									
158										159									
159										160									
160										161									
161										162									
162										163									
163										164									
164										165									
165										166									
166										167									
167										168									
168										169									
169										170									
170										171									
171										172									
172										173									
173										174									
174										175									
175										176									
176										177									
177										178									
178										179									
179										180									
180										181									
181										182									
182										183									
183										184									
184										185									
185										186									
186										187									
187										188									
188										189									
189										190									
190										191									
191										192									
192										193									
193										194									
194										195									
195										196									
196										197									
197										198									
198										199									
199										200									
200										201									
201										202									
202										203									
203										204									
204										205									
205										206									
206										207									
207										208									
208										209									
209										210									
210										211									
211										212									
212										213									
213										214									
214										215									
215										216									
216										217									
217										218									
218										219									
219										220									
220										221									
221										222									
222										223									
223										224									
224										225									
225										226									
226										227									
227										228									
228										229									
229										230									
230										231									
231										232									
232										233									
233										234									
234										235									
235										236									
236										237									
237										238									
238										239									
239										240									
240										241									
241										242									
242										243									
243										244									
244										245									
245										246									
246										247									
247										248									
248										249									
249										250									
250										251									
251										252									
252										253									
253										254									
254										255									
255										256									
256										257									
257										258									
258										259									
259										260									
260										261									
261										262									
262										263									
263										264									
264										265									
265										266									
266										267									
267										268									
268										269									
269										270									
270										271									
271										272									
272										273									
273										274									
274										275									
275										276									
276										277									
277										278									
278										279									
279										280									
280										281									
281										282									
282										283									
283										284									
284										285									
285										286									
286										287									
287										288									
288										289									
289										290									
290										291									
291										292									
292										293									
293										294									
294										295									
295										296									
296										297									
297										298									
298										299									
299										300									
300										301									
301										302									
302										303									
303										304									
304										305									
305										306									
306										307									
307										308									
308										309									
309										310									
310										311									
311										312									
312										313									
313										314									
314										315									
315										316									
316										317									
317										318									
318										319									
319										320									
320										321									
321										322									
322										323									
323										324									
324										325									
325										326									



MAP OF
BLUFF
 TOWNSHIP
 Scale 2 inches to 1 mile

Township 34 South, Range 4 West
 and Fractional Township 35 South, Range 4 West of the 6th P. M.

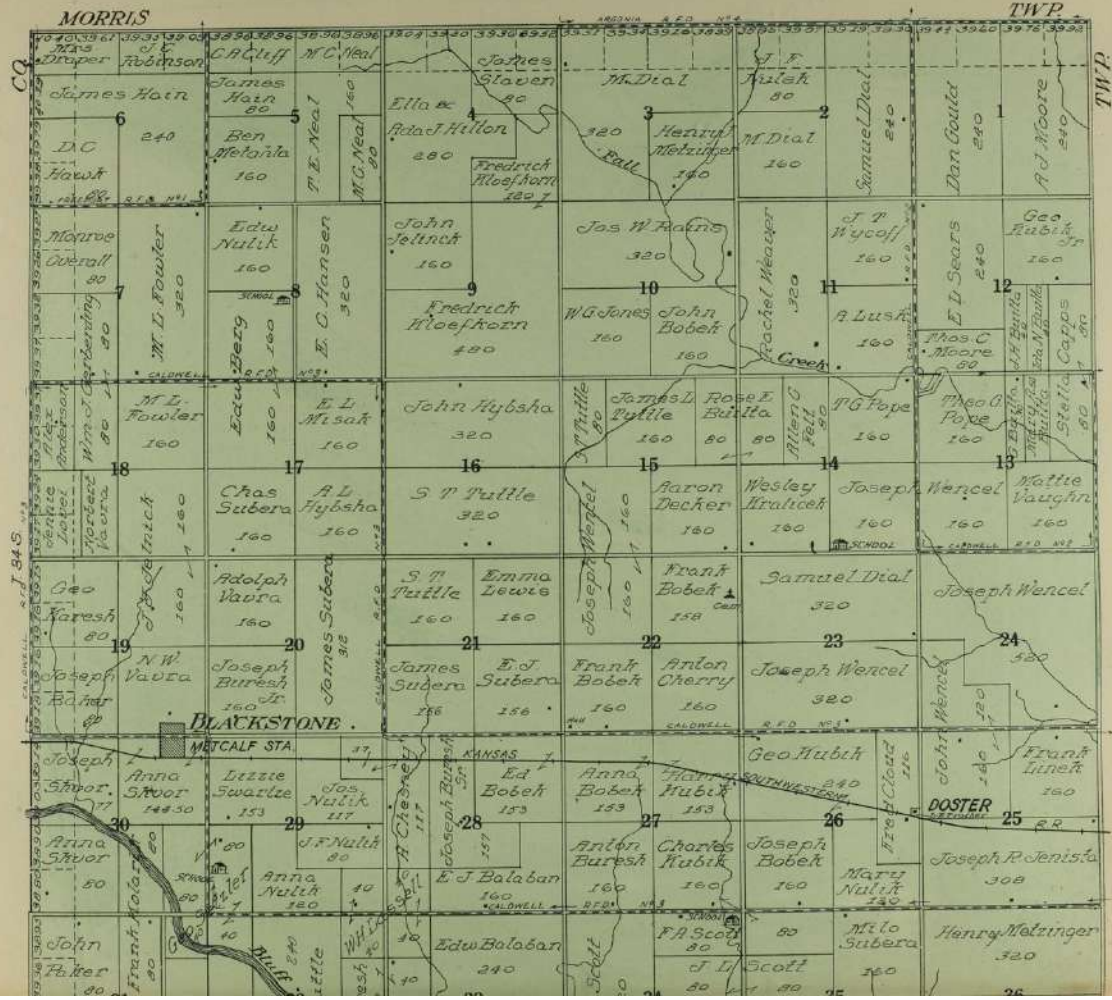

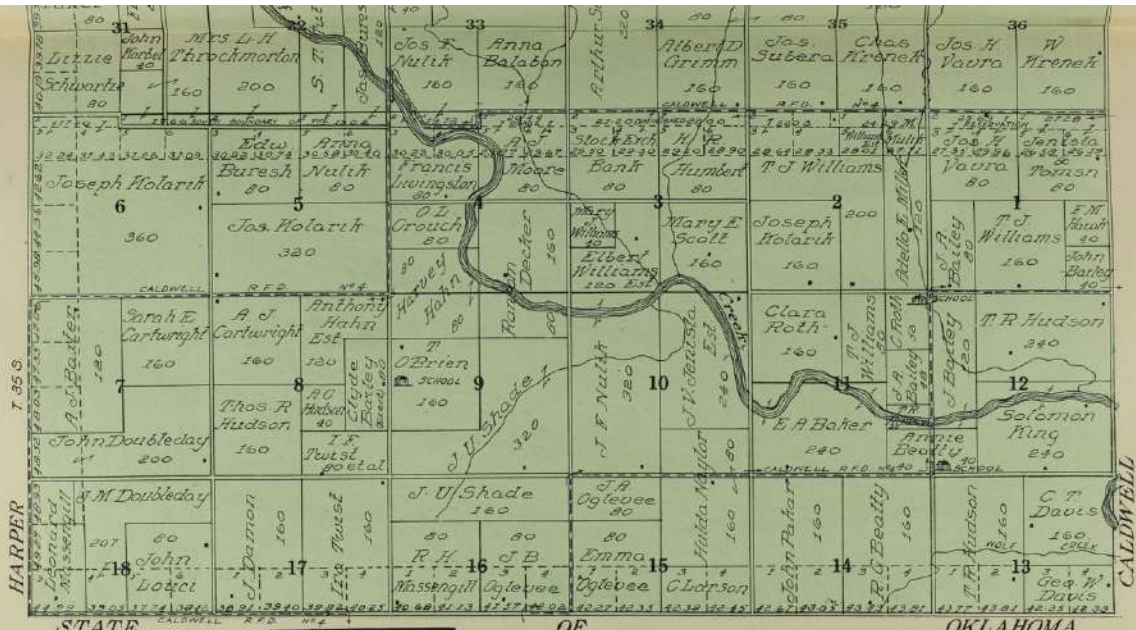

MILTON
OF
OKLAHOMA



BLACKSTONE
METCALF STA.

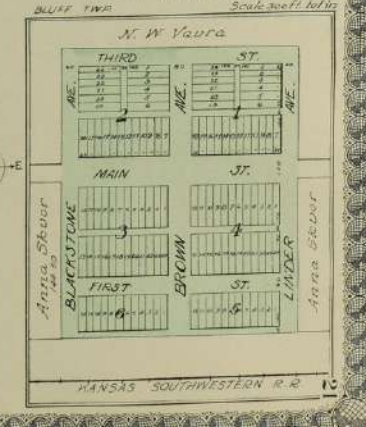

MAP OF
CONWAY
TOWNSHIP

Scale 2 inches to 1 mile

Township 30 South, Range 3 West of the 6th P. M.

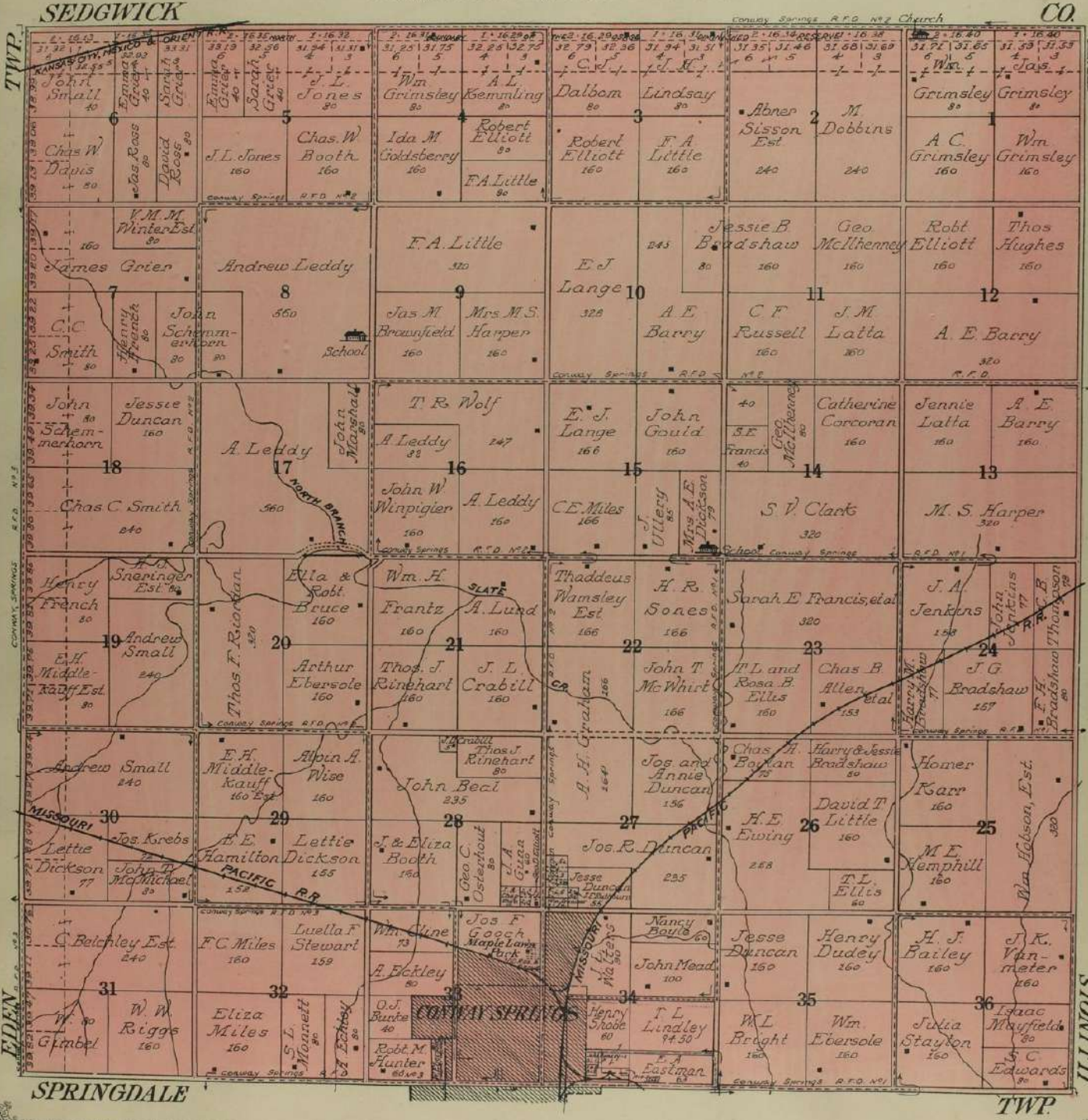

SPRINGDALE

TWP

ILLINOIS

TWP

TWP

EDEN

EDEN

CO

CO



MAP OF
SPRINGDALE
 TOWNSHIP

Scale 2 inches to 1 mile

Township 31 South, Range 3 West of the 6th P. M.

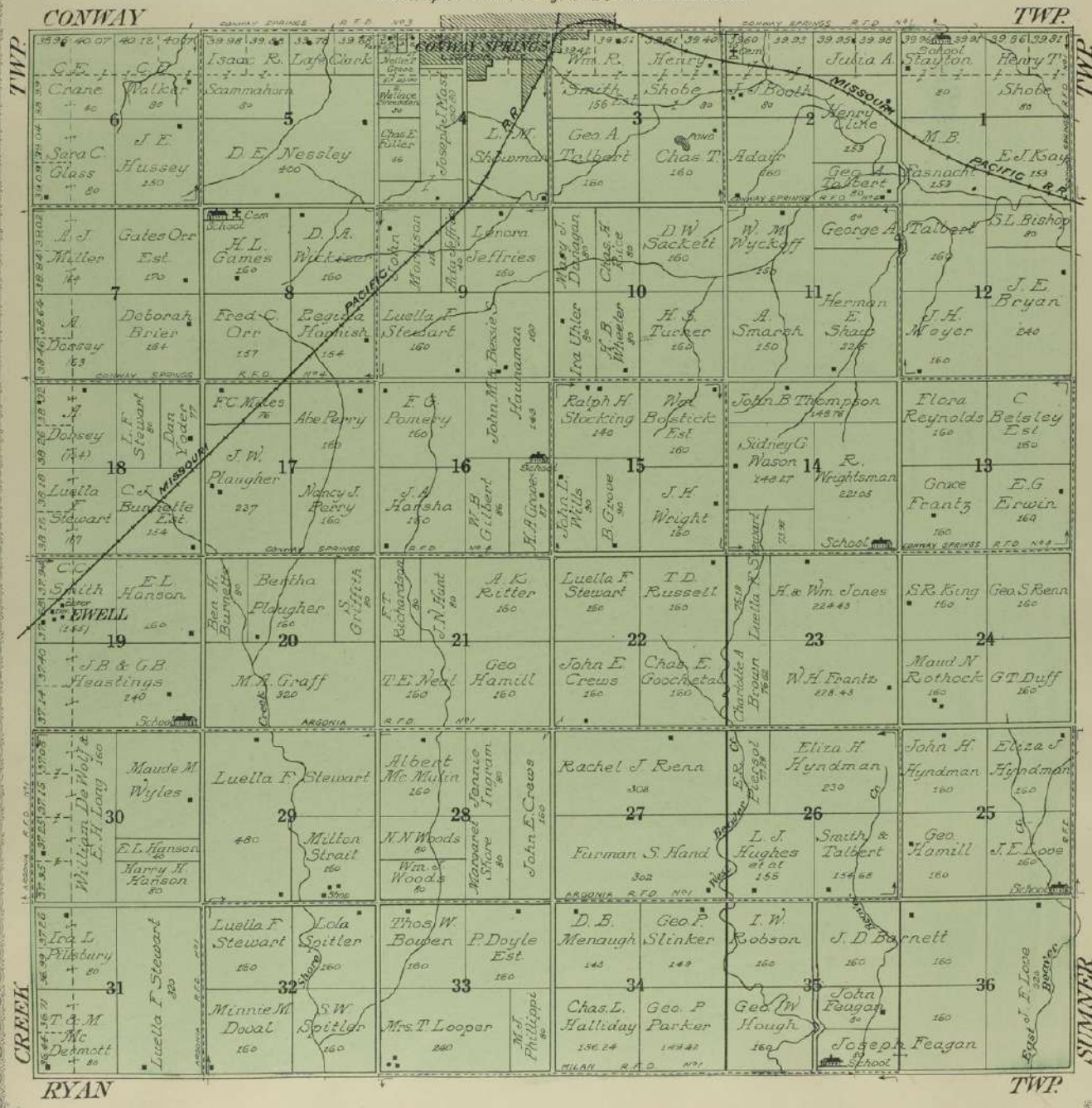

RYAN

TWP.

TWP.

CREEK

TWP.

SUMNER

CONWAY SPRINGS

CONWAY AND SPRINGDALE TOWNSHIPS
Scale 400 Feet to 1 Inch
Copyright 1908 by Geo. S. Elliott

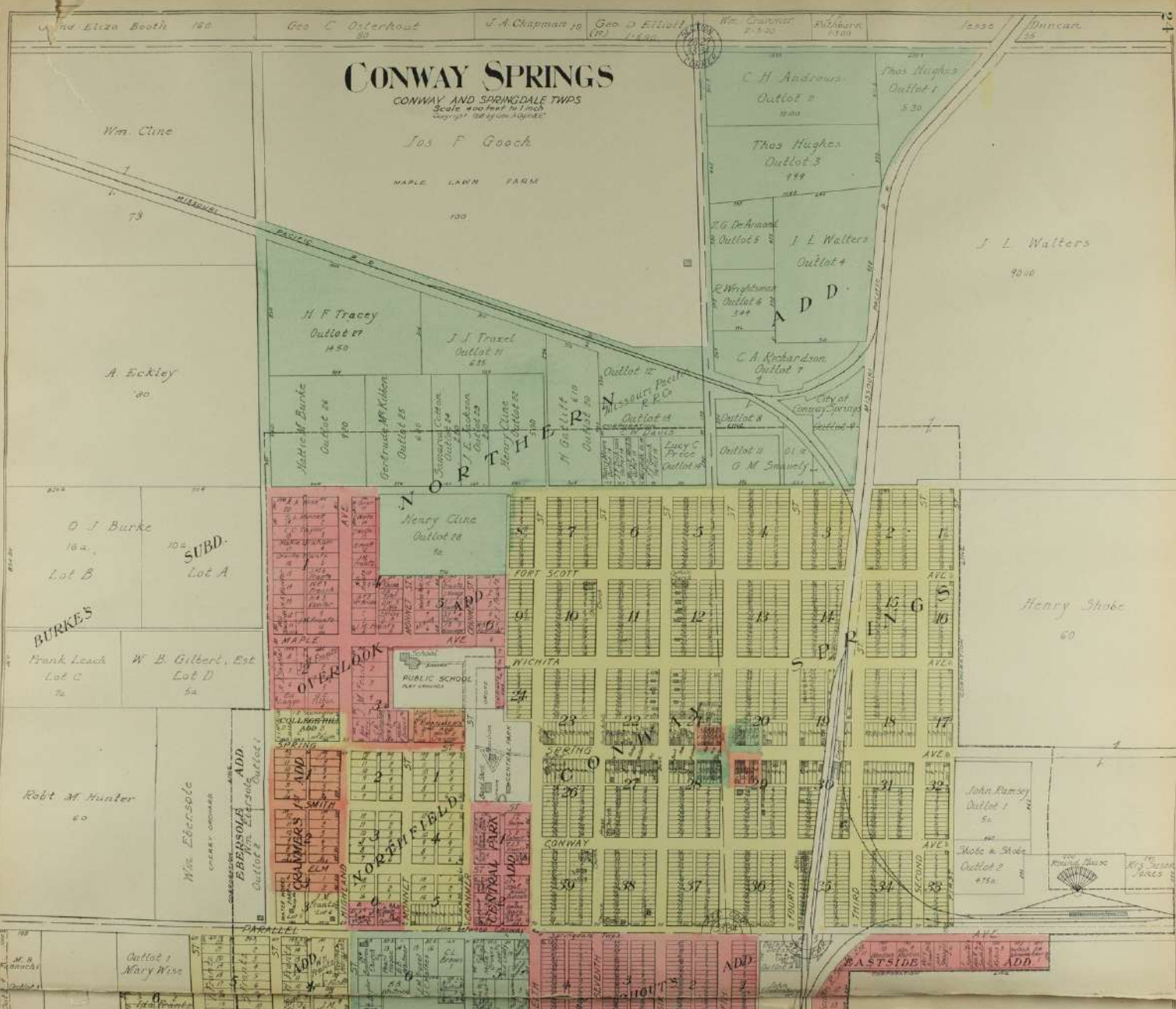

Wm. Eliza Booth 180 Geo. C. Osterhout 50 J. A. Chapman 10 Geo. S. Elliott (P) 1,400 Wm. Cranner 2,500 W. H. Barn 1,000 1,250 Duncan 55

Wm. Cline

Jos. F. Gook
MAPLE LAWN FARM

C. H. Andrews
Outlot 2
19.00

Thos. Hughes
Outlot 1
5.30

Thos. Hughes
Outlot 3
1.19

J. G. DeArmond
Outlots 2

J. L. Walters
Outlot 4

E. Wrightman
Outlot 6
3.42

C. A. Richardson
Outlot 7

A. Eckley

H. F. Tracey
Outlot 17
14.50

J. J. Traxel
Outlot 11
2.15

Matric W. Burke
Outlot 24
1.90

Gertrude W. Kibben
Outlot 25
4.40

Henry Cline
Outlot 22
1.00

Outlot 10
1.10

Outlot 8
1.00

Outlot 9
1.00

Outlot 11
1.00

Outlot 12
1.00

Outlot 13
1.00

Outlot 14
1.00

Outlot 15
1.00

Outlot 16
1.00

Outlot 17
1.00

Outlot 18
1.00

Outlot 19
1.00

Outlot 20
1.00

Outlot 21
1.00

Outlot 22
1.00

Outlot 23
1.00

Outlot 24
1.00

Outlot 25
1.00

Outlot 26
1.00

Outlot 27
1.00

Outlot 28
1.00

Outlot 29
1.00

Outlot 30
1.00

Outlot 31
1.00

Outlot 32
1.00

Outlot 33
1.00

Outlot 34
1.00

Outlot 35
1.00

Outlot 36
1.00

Outlot 37
1.00

Outlot 38
1.00

Outlot 39
1.00

Outlot 40
1.00

Outlot 41
1.00

Outlot 42
1.00

Outlot 43
1.00

Outlot 44
1.00

Outlot 45
1.00

Outlot 46
1.00

Outlot 47
1.00

Outlot 48
1.00

Outlot 49
1.00

Outlot 50
1.00

Outlot 51
1.00

Outlot 52
1.00

Outlot 53
1.00

Outlot 54
1.00

Outlot 55
1.00

Outlot 56
1.00

Outlot 57
1.00

Outlot 58
1.00

Outlot 59
1.00

Outlot 60
1.00

Outlot 61
1.00

Outlot 62
1.00

Outlot 63
1.00

Outlot 64
1.00

Outlot 65
1.00

Outlot 66
1.00

Outlot 67
1.00

Outlot 68
1.00

Outlot 69
1.00

Outlot 70
1.00

Outlot 71
1.00

Outlot 72
1.00

Outlot 73
1.00

Outlot 74
1.00

Outlot 75
1.00

Outlot 76
1.00

Outlot 77
1.00

Outlot 78
1.00

Outlot 79
1.00

Outlot 80
1.00

Outlot 81
1.00

Outlot 82
1.00

Outlot 83
1.00

Outlot 84
1.00

Outlot 85
1.00

Outlot 86
1.00

Outlot 87
1.00

Outlot 88
1.00

Outlot 89
1.00

Outlot 90
1.00

Outlot 91
1.00

Outlot 92
1.00

Outlot 93
1.00

Outlot 94
1.00

Outlot 95
1.00

Outlot 96
1.00

Outlot 97
1.00

Outlot 98
1.00

Outlot 99
1.00

Outlot 100
1.00

Outlot 101
1.00

Outlot 102
1.00

Outlot 103
1.00

Outlot 104
1.00

Outlot 105
1.00

Outlot 106
1.00

Outlot 107
1.00

Outlot 108
1.00

Outlot 109
1.00

Outlot 110
1.00

Outlot 111
1.00

Outlot 112
1.00

Outlot 113
1.00

Outlot 114
1.00

Outlot 115
1.00

Outlot 116
1.00

Outlot 117
1.00

Outlot 118
1.00

Outlot 119
1.00

Outlot 120
1.00

Outlot 121
1.00

Outlot 122
1.00

Outlot 123
1.00

Outlot 124
1.00

Outlot 125
1.00

Outlot 126
1.00

Outlot 127
1.00

Outlot 128
1.00

Outlot 129
1.00

Outlot 130
1.00

Outlot 131
1.00

Outlot 132
1.00

Outlot 133
1.00

Outlot 134
1.00

Outlot 135
1.00

Outlot 136
1.00

Outlot 137
1.00

Outlot 138
1.00

Outlot 139
1.00

Outlot 140
1.00

Outlot 141
1.00

Outlot 142
1.00

Outlot 143
1.00

Outlot 144
1.00

Outlot 145
1.00

Outlot 146
1.00

Outlot 147
1.00

Outlot 148
1.00

Outlot 149
1.00

Outlot 150
1.00

Outlot 151
1.00

Outlot 152
1.00

Outlot 153
1.00

Outlot 154
1.00

Outlot 155
1.00

Outlot 156
1.00

Outlot 157
1.00

Outlot 158
1.00

Outlot 159
1.00

Outlot 160
1.00

Outlot 161
1.00

Outlot 162
1.00

Outlot 163
1.00

Outlot 164
1.00

Outlot 165
1.00

Outlot 166
1.00

Outlot 167
1.00

Outlot 168
1.00

Outlot 169
1.00

Outlot 170
1.00

Outlot 171
1.00

Outlot 172
1.00

Outlot 173
1.00

Outlot 174
1.00

Outlot 175
1.00

Outlot 176
1.00

Outlot 177
1.00

Outlot 178
1.00

Outlot 179
1.00

Outlot 180
1.00

Outlot 181
1.00

Outlot 182
1.00

Outlot 183
1.00

Outlot 184
1.00

Outlot 185
1.00

Outlot 186
1.00

Outlot 187
1.00

Outlot 188
1.00

Outlot 189
1.00

Outlot 190
1.00

Outlot 191
1.00

Outlot 192
1.00

Outlot 193
1.00

Outlot 194
1.00

Outlot 195
1.00

Outlot 196
1.00

Outlot 197
1.00

Outlot 198
1.00

Outlot 199
1.00

Outlot 200
1.00

Outlot 201
1.00

Outlot 202
1.00

Outlot 203
1.00

Outlot 204
1.00

Outlot 205
1.00

Outlot 206
1.00

Outlot 207
1.00

Outlot 208
1.00

Outlot 209
1.00

Outlot 210
1.00

Outlot 211
1.00

Outlot 212
1.00

Outlot 213
1.00

Outlot 214
1.00

Outlot 215
1.00

Outlot 216
1.00

Outlot 217
1.00

Outlot 218
1.00

Outlot 219
1.00

Outlot 220
1.00

Outlot 221
1.00

Outlot 222
1.00

Outlot 223
1.00

Outlot 224
1.00

Outlot 225
1.00

Outlot 226
1.00

Outlot 227
1.00

Outlot 228
1.00

Outlot 229
1.00

Outlot 230
1.00

Outlot 231
1.00

Outlot 232
1.00

Outlot 233
1.00

Outlot 234
1.00

Outlot 235
1.00

Outlot 236
1.00

Outlot 237
1.00

Outlot 238
1.00

Outlot 239
1.00

Outlot 240
1.00

Outlot 241
1.00

Outlot 242
1.00

Outlot 243
1.00

Outlot 244
1.00

Outlot 245
1.00

Outlot 246
1.00

Outlot 247
1.00

Outlot 248
1.00

Outlot 249
1.00

Outlot 250
1.00

MAP OF
RYAN
TOWNSHIP
 Scale 2 inches to 1 mile

Township 32 South, Range 3 West of the 6th P. M.

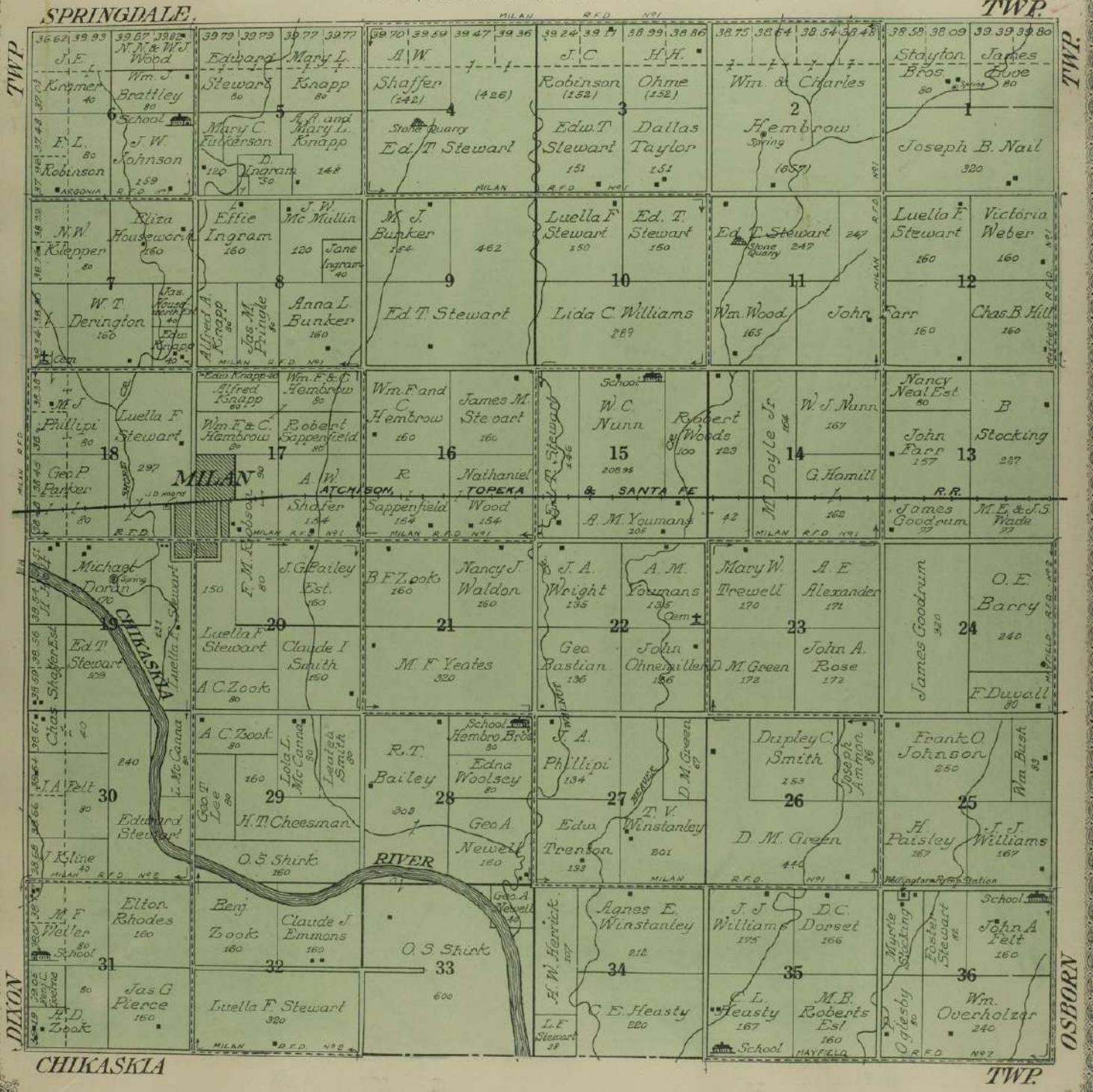

TWP.

TWP.

DIXON

OSBORN

CHIKASKIA

TWP.

MAP OF
CHIKASKIA
 TOWNSHIP

Scale 2 inches to 1 mile

Township 33 South, Range 3 West of the 6th P. M.

RYAN

TWP.

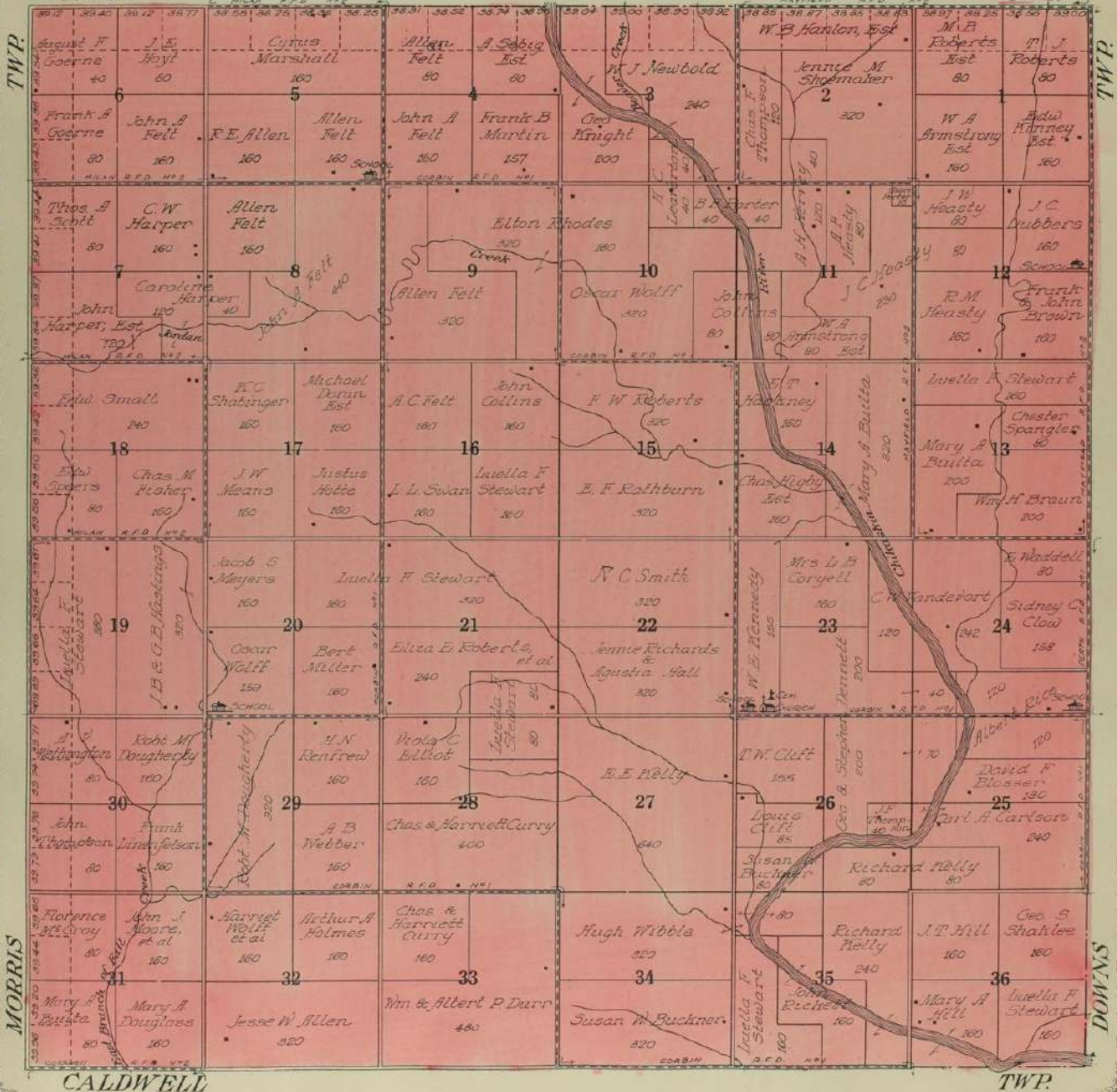

CALDWELL

TWP.

MORRIS

DOWNS



MAP OF
CALDWELL
 TOWNSHIP
 Scale 2 inches to 1 mile

Township 34 South, Range 3 West and
 Fractional Township 35 South, Range 3 West of the 6th P. M.



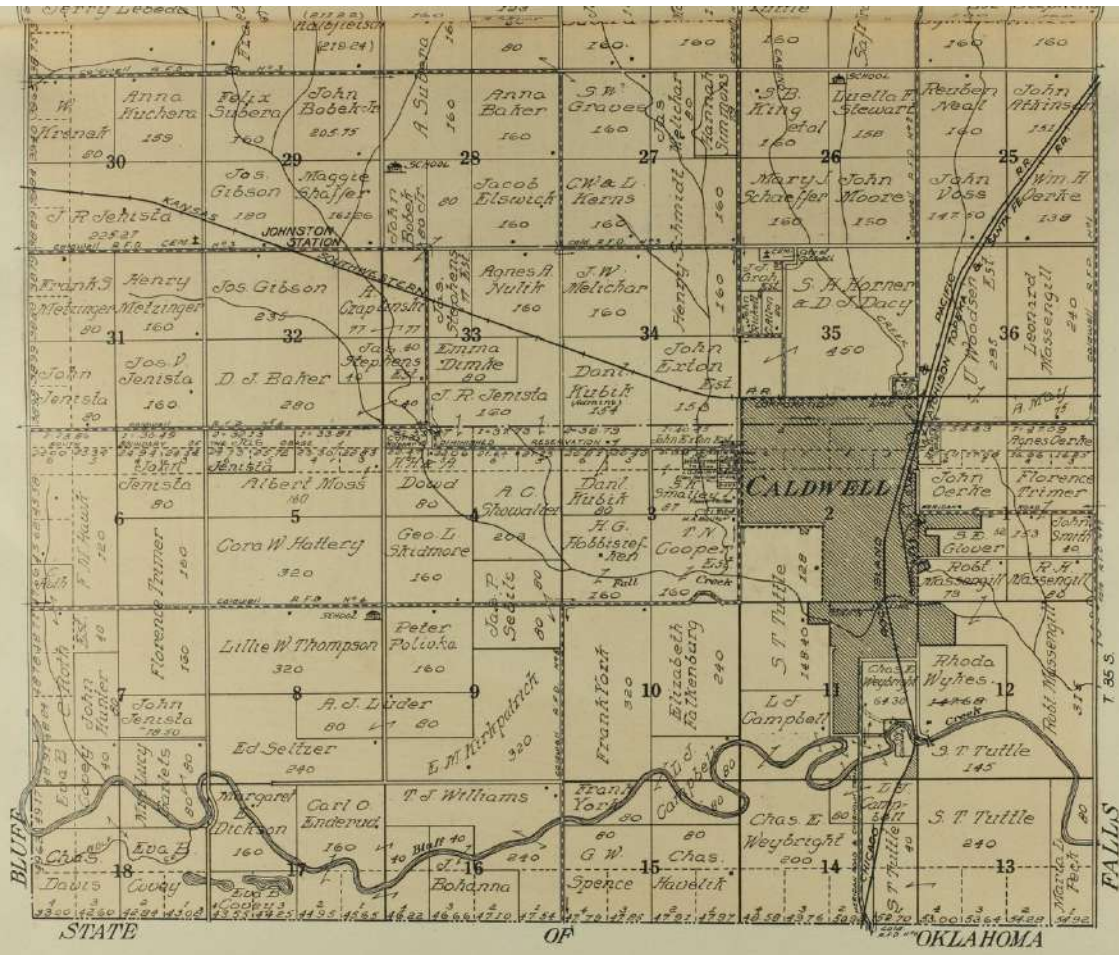

BLUPE STATE OF OKLAHOMA FALLS



MAP OF
ILLINOIS
 TOWNSHIP

Scale 2 inches to 1 mile

Township 30 South, Range 2 West of the 6th P. M.

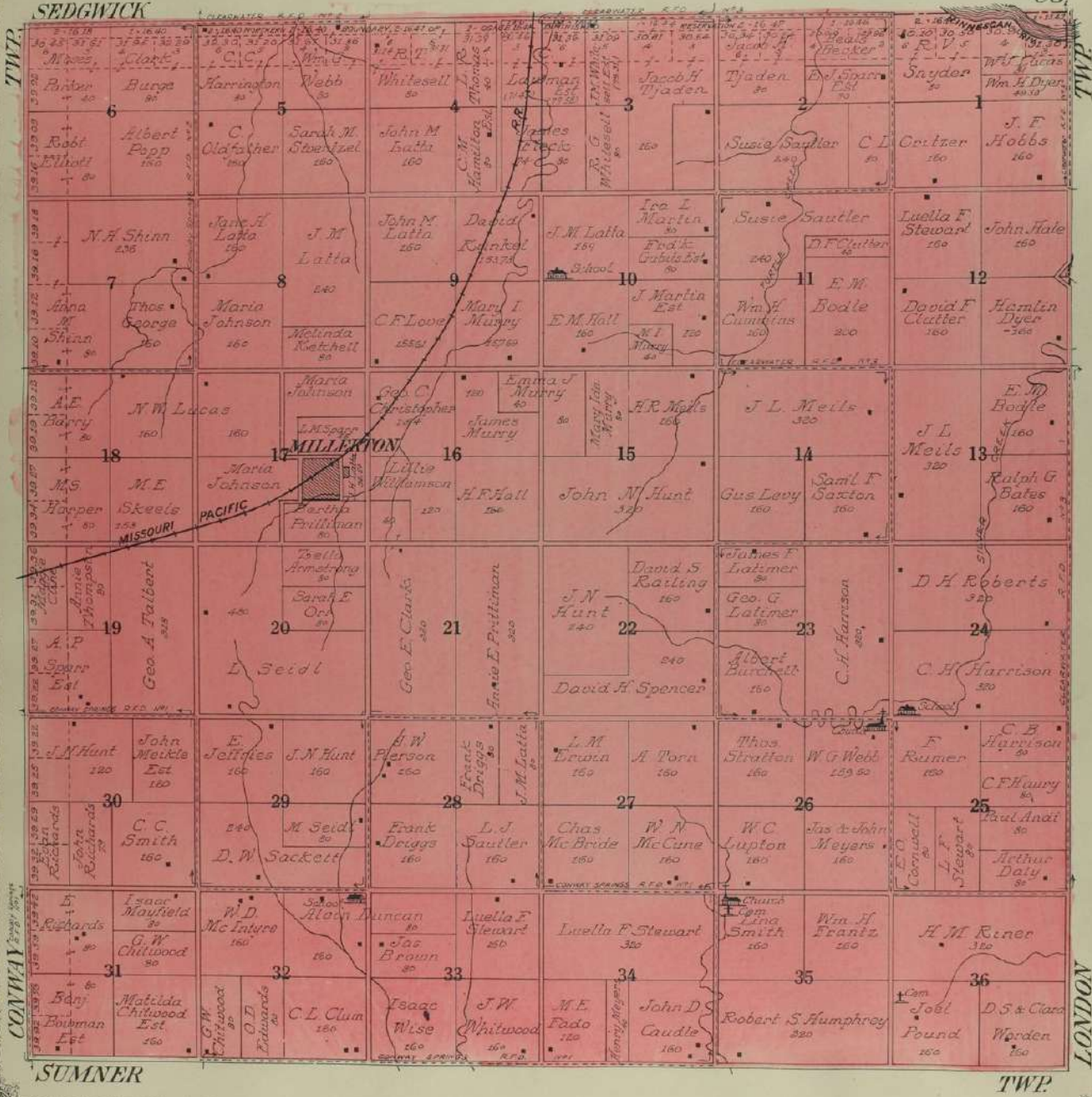

MAP OF
SUMNER
 TOWNSHIP
 Scale 2 inches to 1 mile

Township 31 South, Range 2 West of the 6th P. M.

ILLINOIS

TWP.

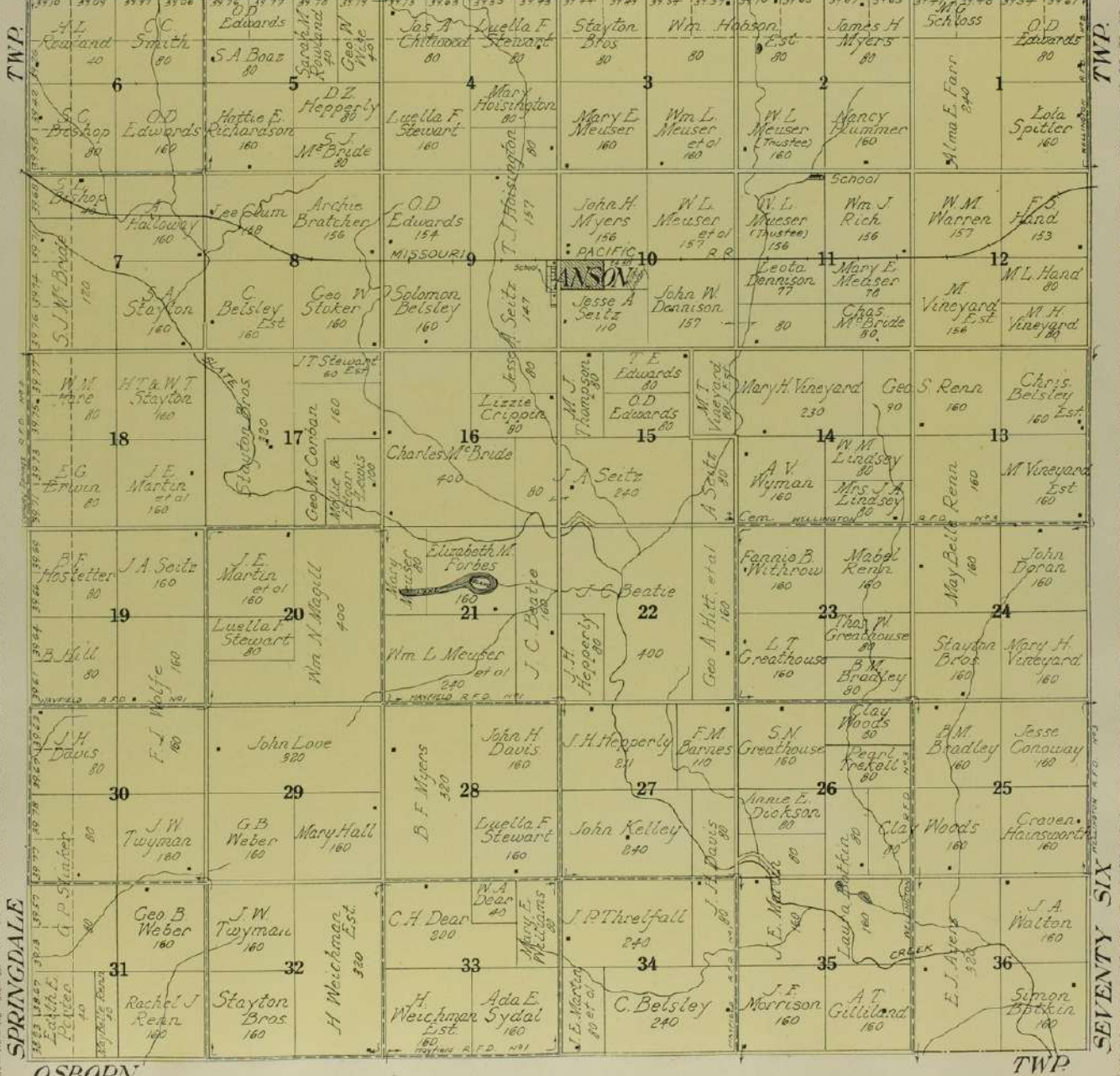

KANSAS STATE HISTORICAL SOCIETY

SPRINGDALE

OSBORN

SEVENTY SIX

TWP.

Geo. Muller

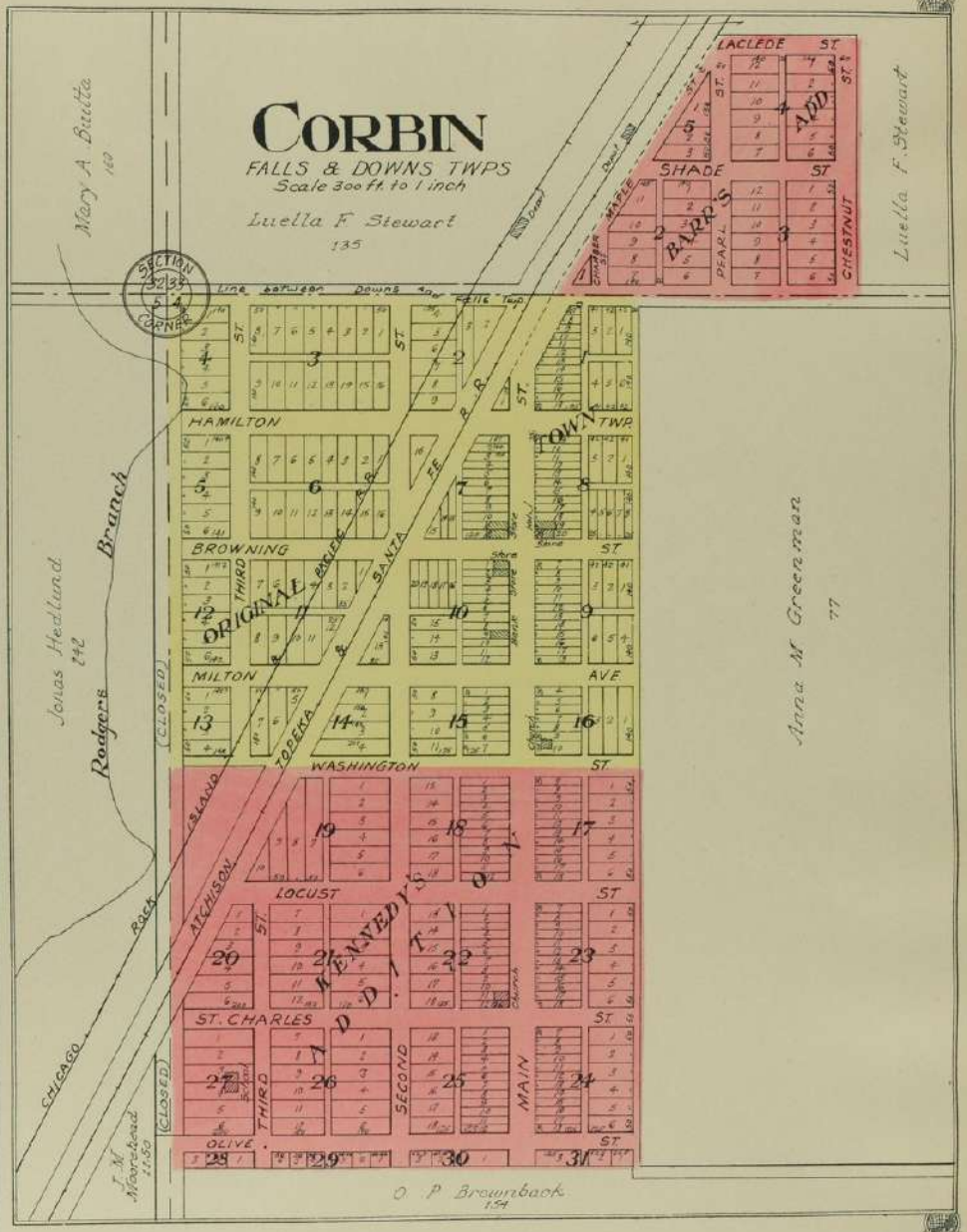

CORBIN
 FALLS & DOWNS TWPS
 Scale 300 ft. to 1 inch

Luella F. Stewart
 135

SECTION
 32
 CORBIN

Mary A. Buitta
 160

Luella F. Stewart

Anna M. Greenman
 77

O. P. Brownback
 154

F. E. Watson
 OUT LOT 18
 830

Outlot 14. 400
 Ina Shade
 Outlot 13. 100
 E. D. Fisher
 Outlot 12. 100
 Mrs. E. Drummond
 Outlot 11. 100
 P. B. McWilliams
 Outlot 10. 100
 Outlot 9. 100
 Outlot 8. 100
 Outlot 7. 100

Outlot 6. 13.00
 P. B. McWilliams
 Geo. T. Drake
 Outlot 5. 10.00

Martha Denton

S. Loper

MULVANE

GORE TWP.
 Scale 300 feet to 1 inch
 Copyright 1902 by Geo. A. Gyle & Co.

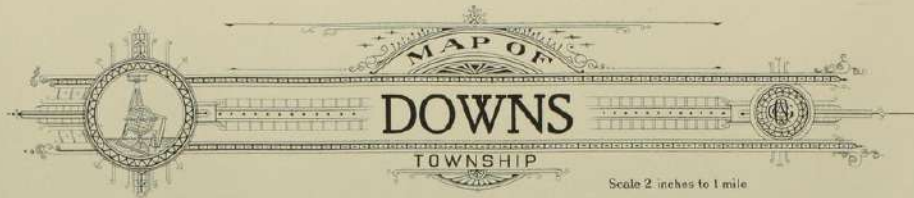

MAP OF
DOWN'S
 TOWNSHIP
 Scale 2 inches to 1 mile

Township 33 South, Range 2 West of the 6th P. M.

OSBORN

TWP

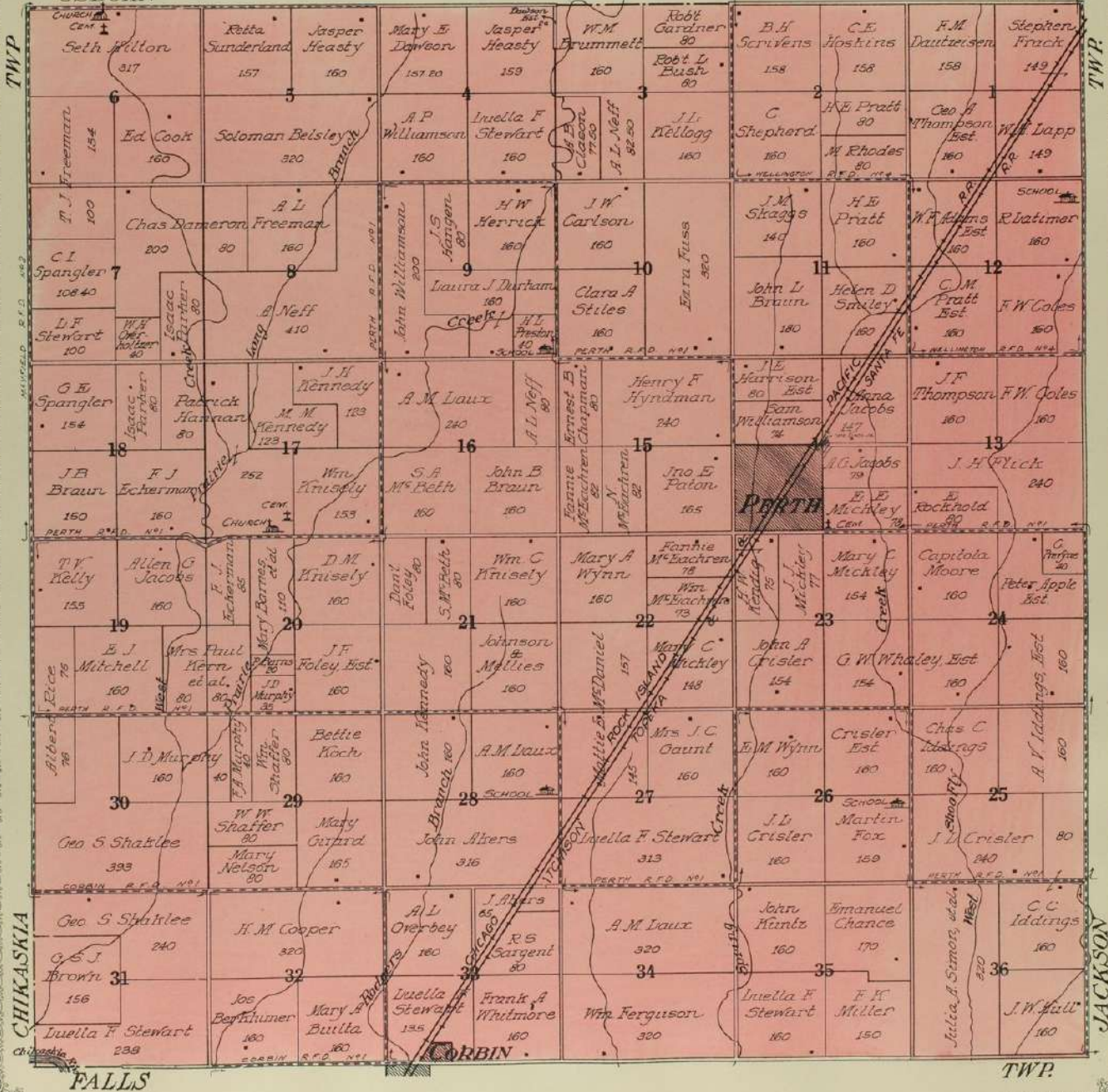

CHIKASKIA

JACKSON

FALLS

TWP

MAP OF
FALLS
 TOWNSHIP
 Scale 2 inches to 1 mile

Township 34 South, Range 2 West and
 Fractional Township 35 South, Range 2 West of the 6th P. M.

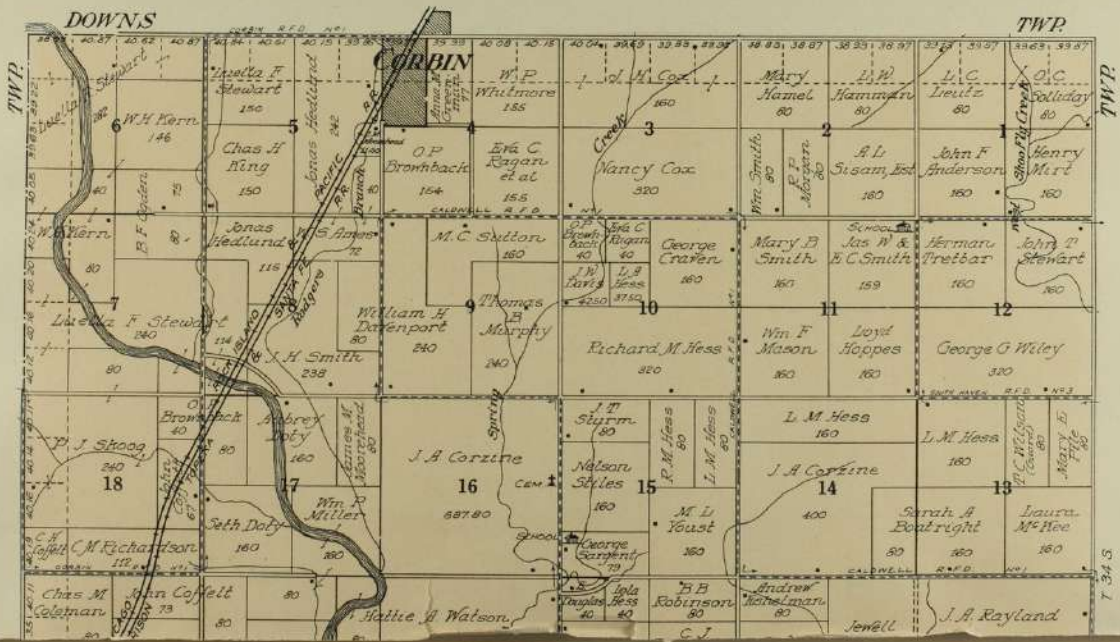

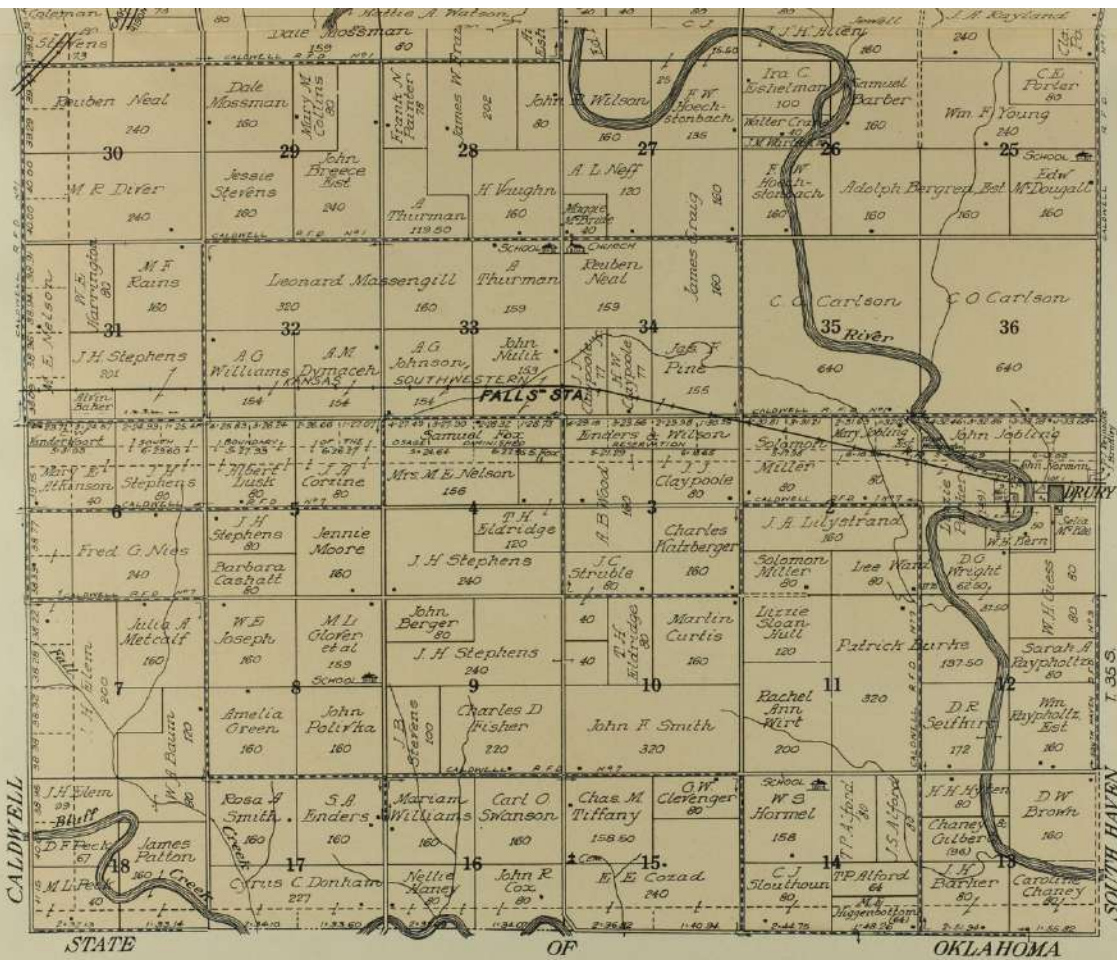

MAP OF LONDON TOWNSHIP

Scale 2 inches to 1 mile

Township 30 South, Range 1 West and Part of Township 30 South, Range 1 East of the 6th P. M.

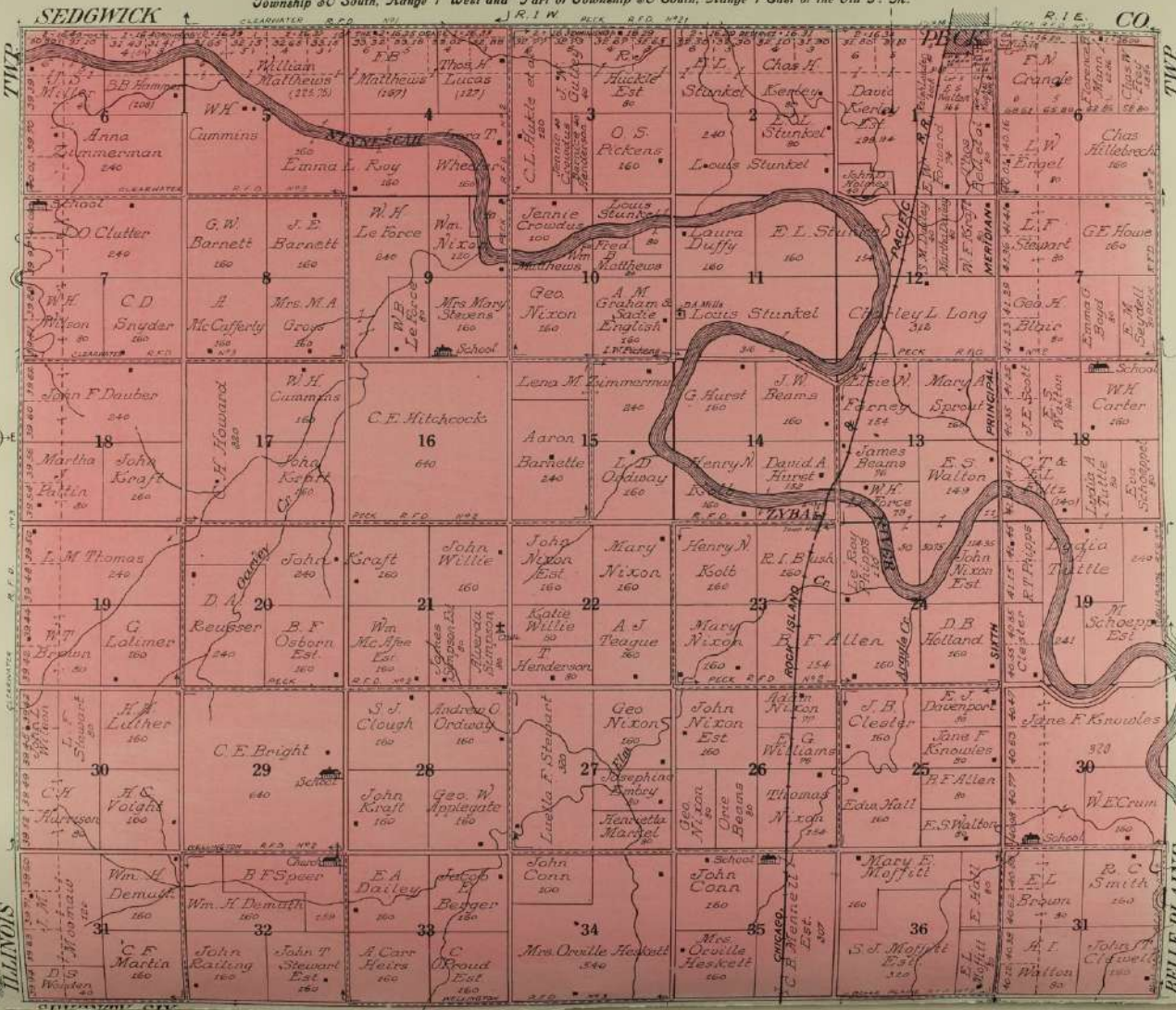

MAP OF SEVENTY SIX TOWNSHIP

Scale 2 inches to 1 mile

Township 31 South, Range 1 West of the 6th P. M.

LONDON

TWP

TWP

TWP

David Worden 152	M T Vineyard 157	Ida Bell 78	M's Cook 77	Warren Barber Heirs 205	Florence Heskett 111	H.A. Forsythe 160
Lola Spitzer 166	Simon Peterson 160	J.B. Sylvester 160	Clarie O'Proud Heirs 320	Ollie Heskett 640	Win Morris 153	Ira Wheeler 160
W.A. Shaffer 160	Fred L. Thomas 154	Dan'l D Saylor 154	Teague & Brouner 154	Clarie O'Proud Heirs 184	W.H. Math 160	Luella F Stewart 158
S.M. Stewart 165	Berj Nystron 163	James Green 160	Luella F Stewart 320	J.F. Johnston 164	Susan Clough 164	Susan Clough 154
Emily A Faucett 164	S.E. Blake 160	L.D. Ordway 160	J.M. Swan 160	Chas M Cowan Heirs 166	John C Sylvester 152.52	J.W. Heskett, Est 320
Thos E Worden 183	Dorcy E Thomas 163	E.J. Franz 160	Mary A Stoker 160	Joel Pound 280	J.C. White 180	John Ryan Heirs 165
H.E. Trehett 185	Geo. E Chilcote 140	Allen L Laux 160	Mary A Stoker 160	Retta M Sunderland 160	Sam'l Dunbar 180	Carrie E Heskett 160
Ella M Myers 165	W.H. Hughes 105	J.M. Marahan 160	John A Markley 160	Hazel M Murphy 160	Martin C Ellis 100	J.N. Lush 174
Elmer L Shaffer 80	Delta D Frankum 160	Geo Morris & Ma Pfister 160	John Ludwig 160	L.E. Curtis 160	J.F. Giff 240	CF Horner, Est 140
T.W. Butcher 80	G.Y. Colfax 239	Henry B Armstrong 160	Essie Morrison 160	G.W. Appleman 160	J.W. Ott 80	M.R. Metcalf Heirs 180
Simon Eobbin 476	John C Frankum 320	Chas & Edw Peasel 160	Chas & Edw Peasel 160	Jos & Andrew Eobbs 160	D.O. Frambers 160	Francis E & S.E. Pierpont 160
Lola Spitzer 160	A.J. & J.A. Martley 175	R.M. Sunderland 160	Chas & Edw Peasel 240	Samuel Barlow 240	John Hier, Heirs 320	M.R. Metcalf Heirs 180
						Christian & Rebecca Bowers 153
						J.B. Hummell 154
						L.F. Stewart 80
						O.C. Frambers 480
						Nellie Colander 158
						C.E. Hitchcock 240
						W.M. Reedy 160
						J.W. Ott 80
						Jennie McConkey 154
						Chas D Mathews 160
						W.M. Reedy 160

WELLINGTON

TWP

SUMNER

HARMON

OXFORD

OXFORD TWP

Scale 400 feet to 1 inch

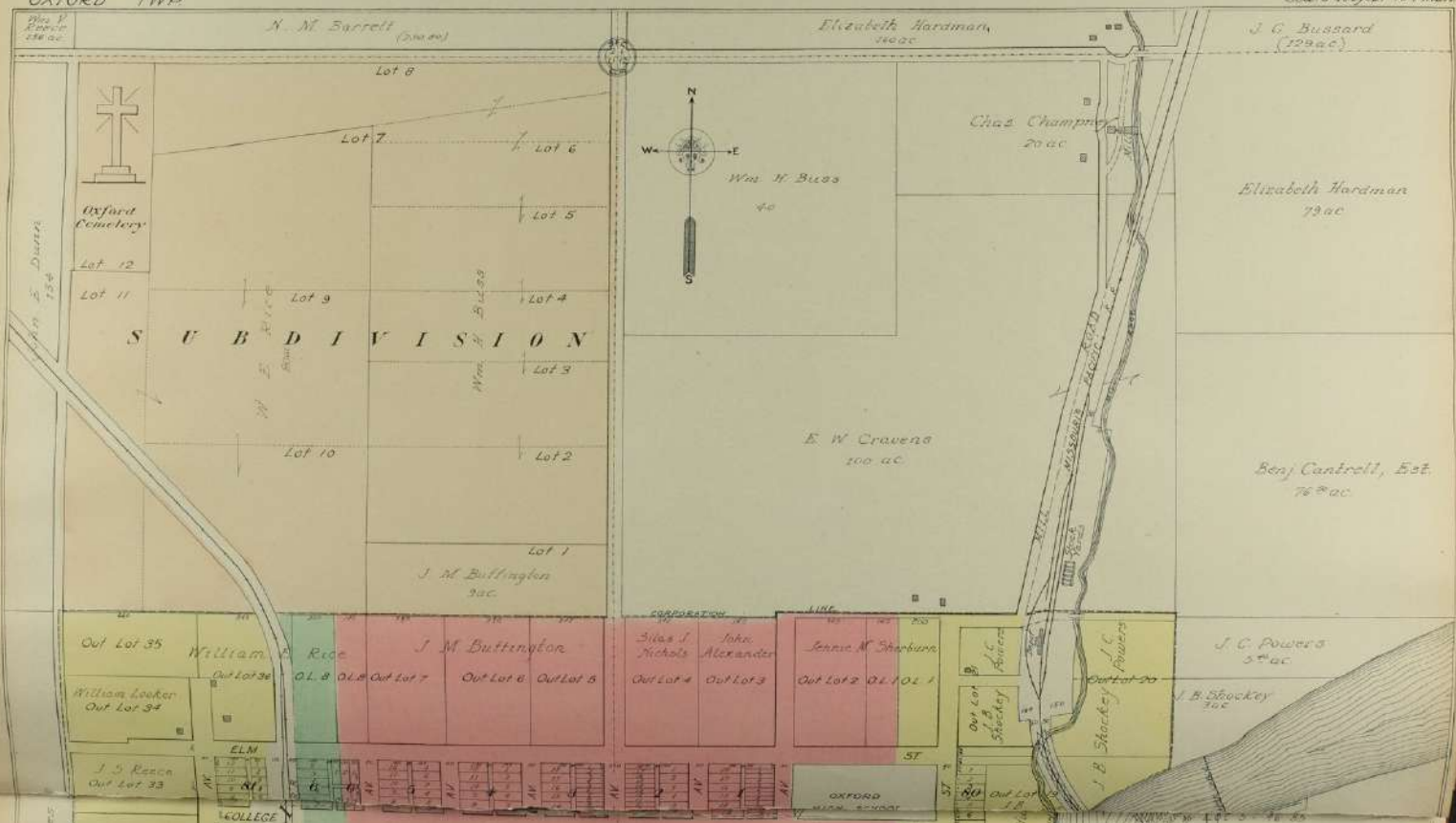



MAP OF
JACKSON
 TOWNSHIP
 Scale 2 inches to 1 mile

Township 33 South, Range 1 West of the 6th P. M.

WELLINGTON

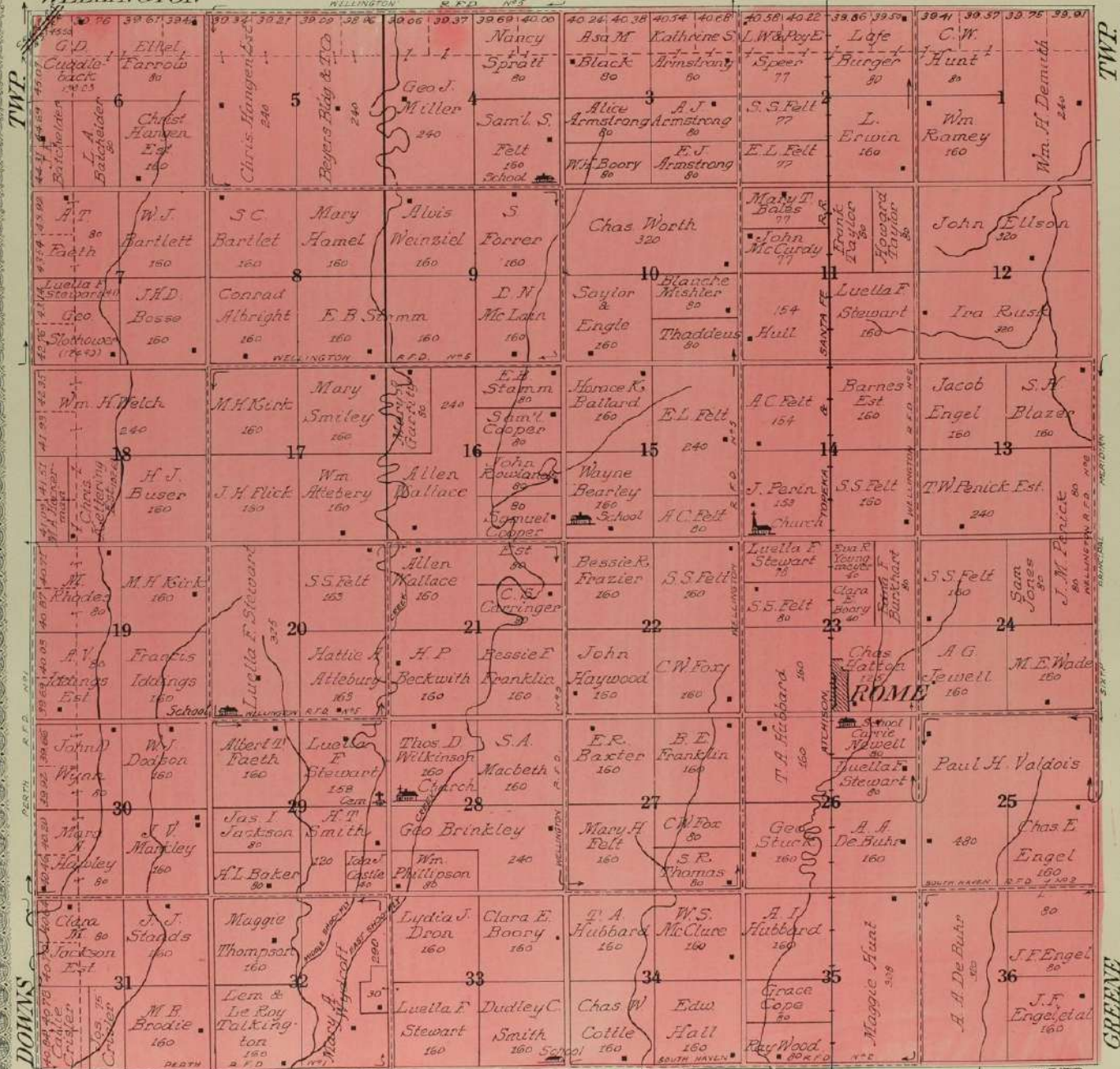
TWP.



SOUTH HAVEN

TWP.

GREENE

TWP.

TWP.

MAP OF
SOUTH HAVEN
 TOWNSHIP
 Scale 2 inches to 1 mile

Township 34 South, Range 1 West and
 Fractional Township 35 South, Range 1 West of the 6th P. M.

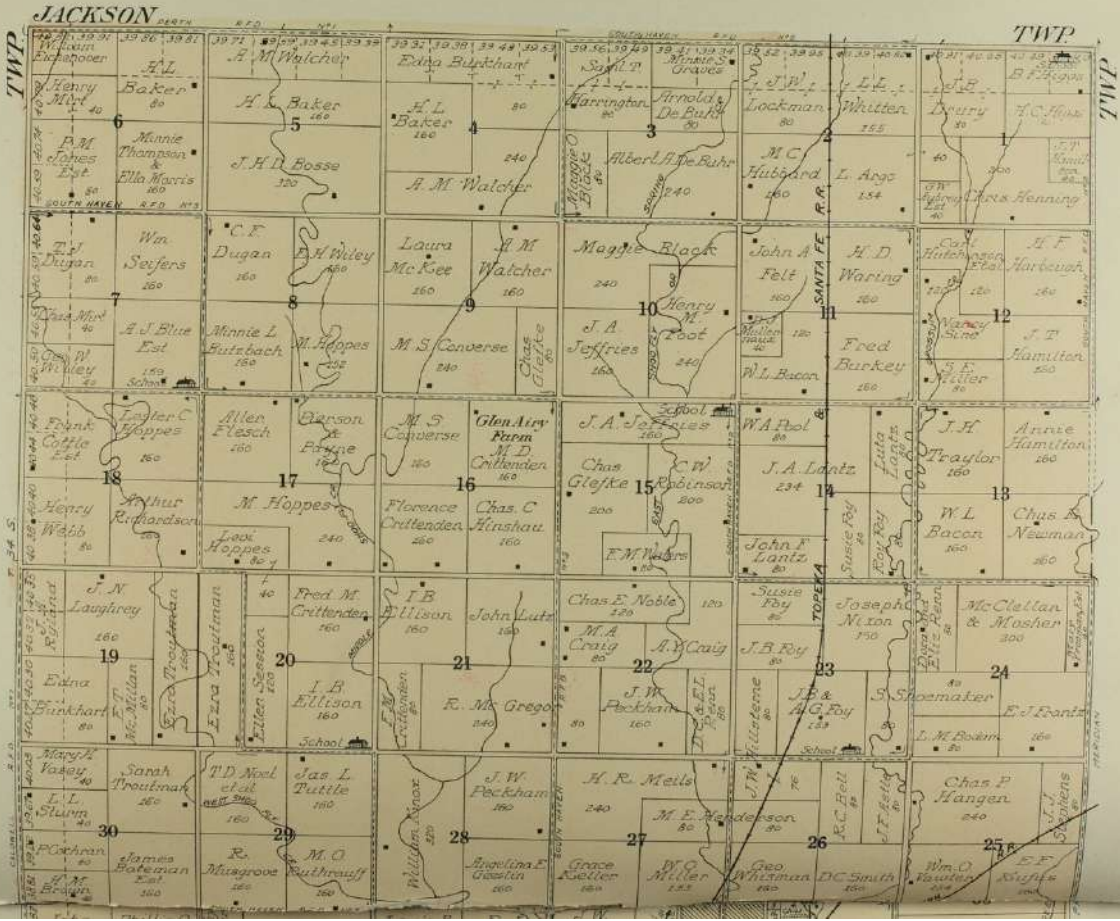

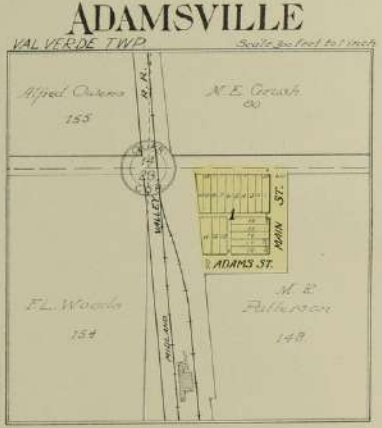
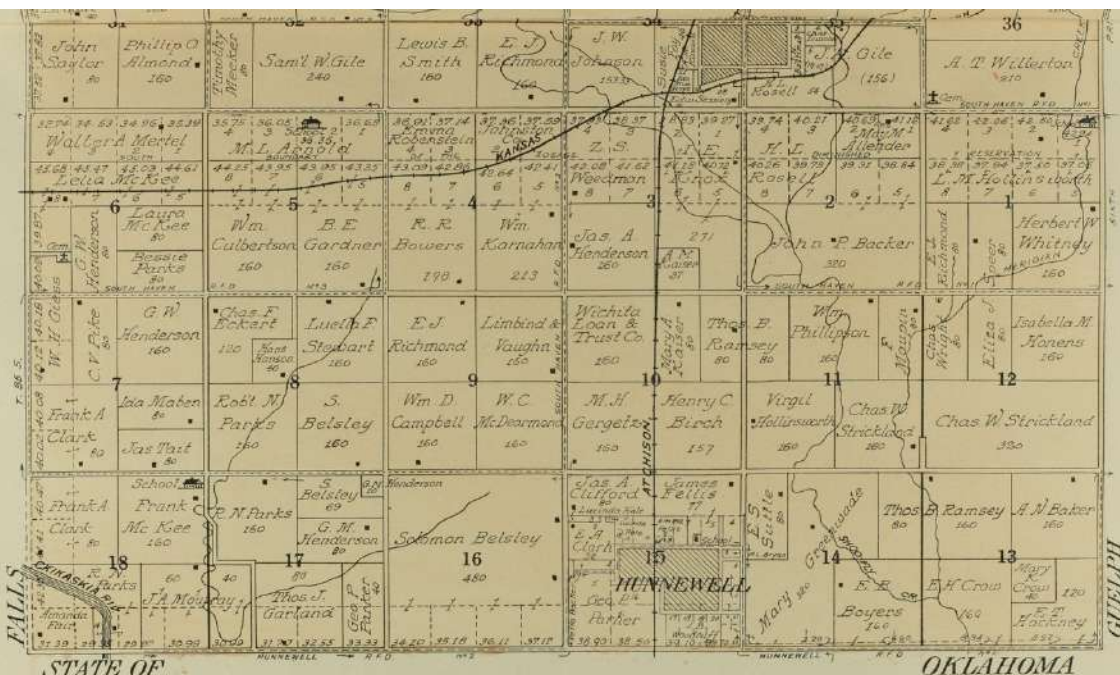

BELLE PLAINE

BELLE PLAINE TWP.

Scale 300 ft = 1 inch

Copyright 1918 by Geo. A. Cogle & Co.

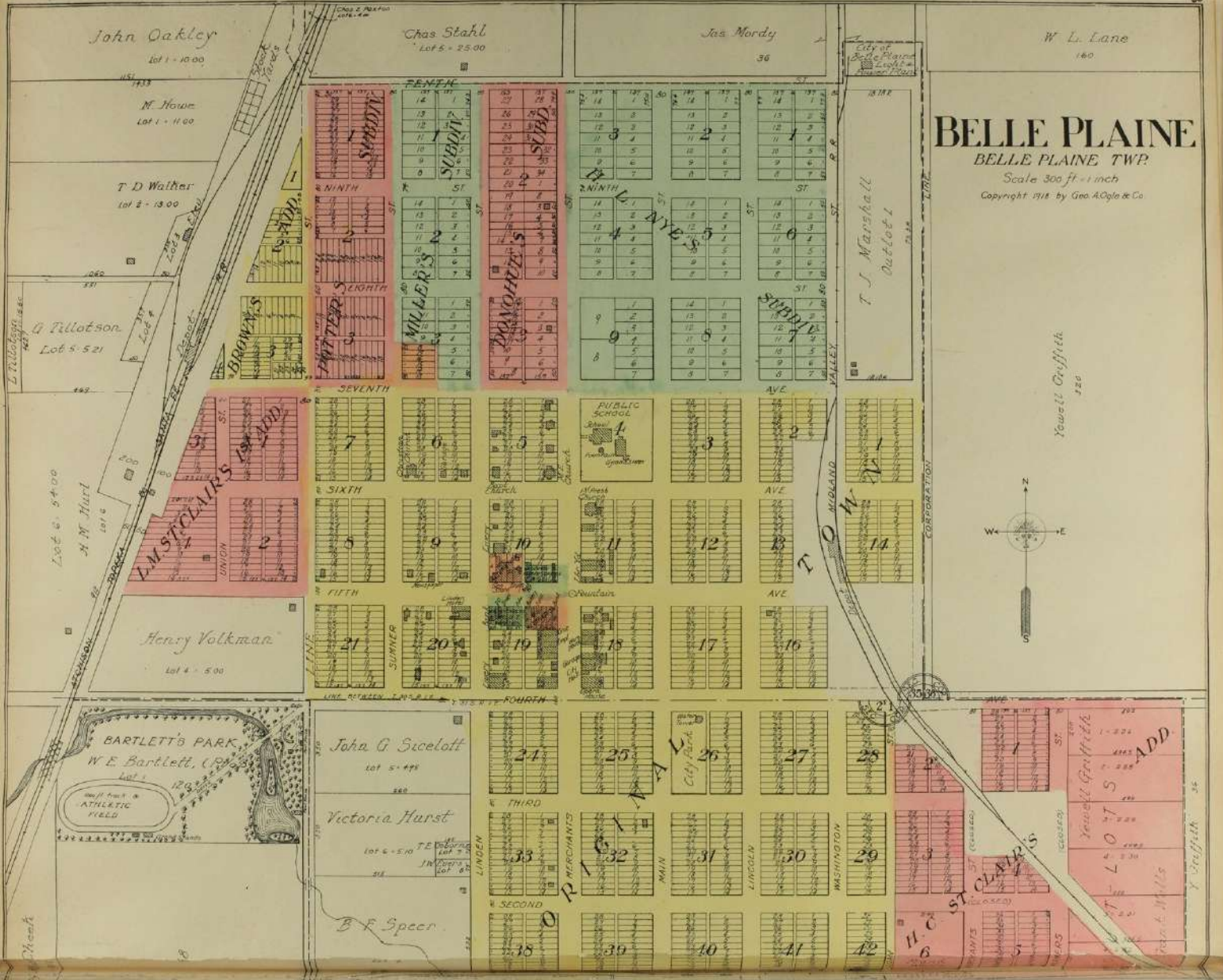

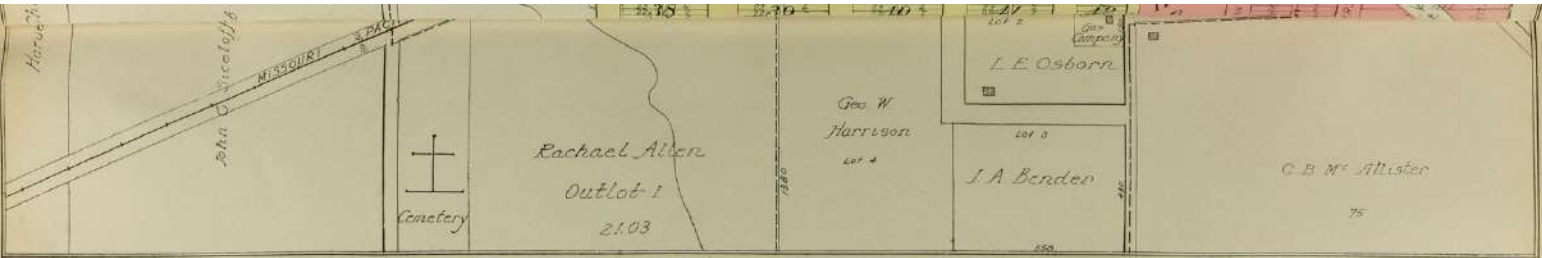

PERTH

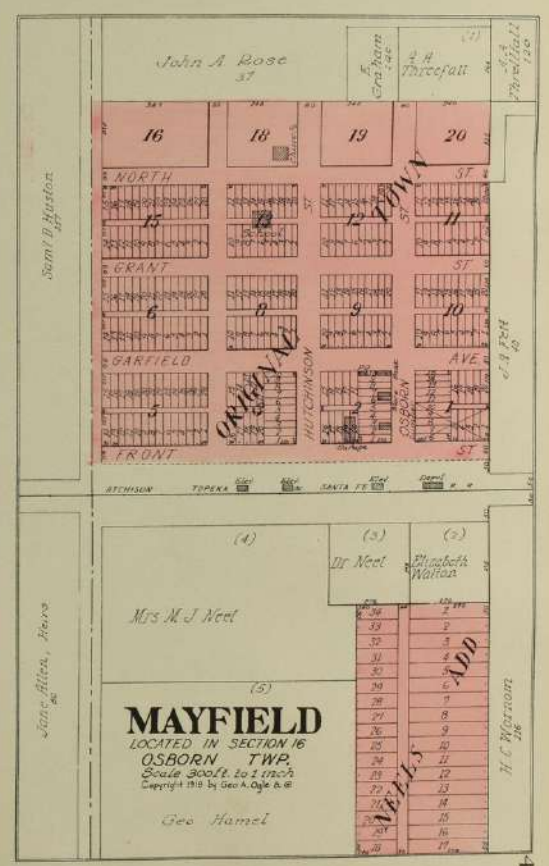
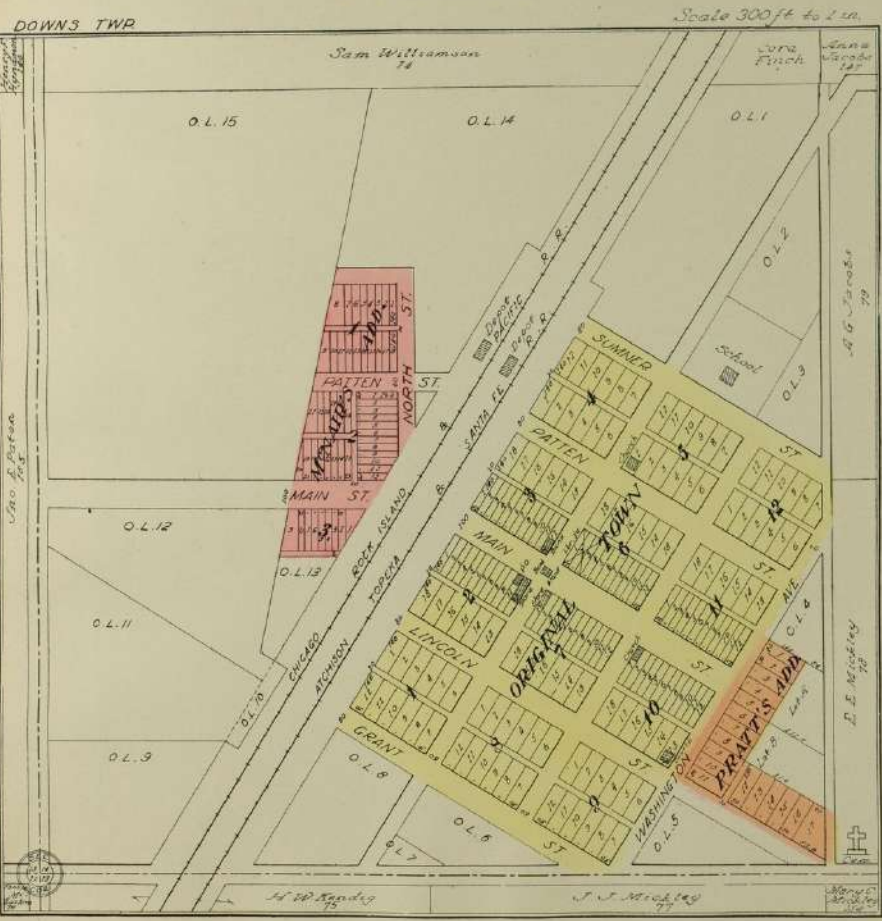



MAP OF
GREENE
 TOWNSHIP

Scale 2 inches to 1 mile

Township 33 South, Range 1 East of the 6th P. M.

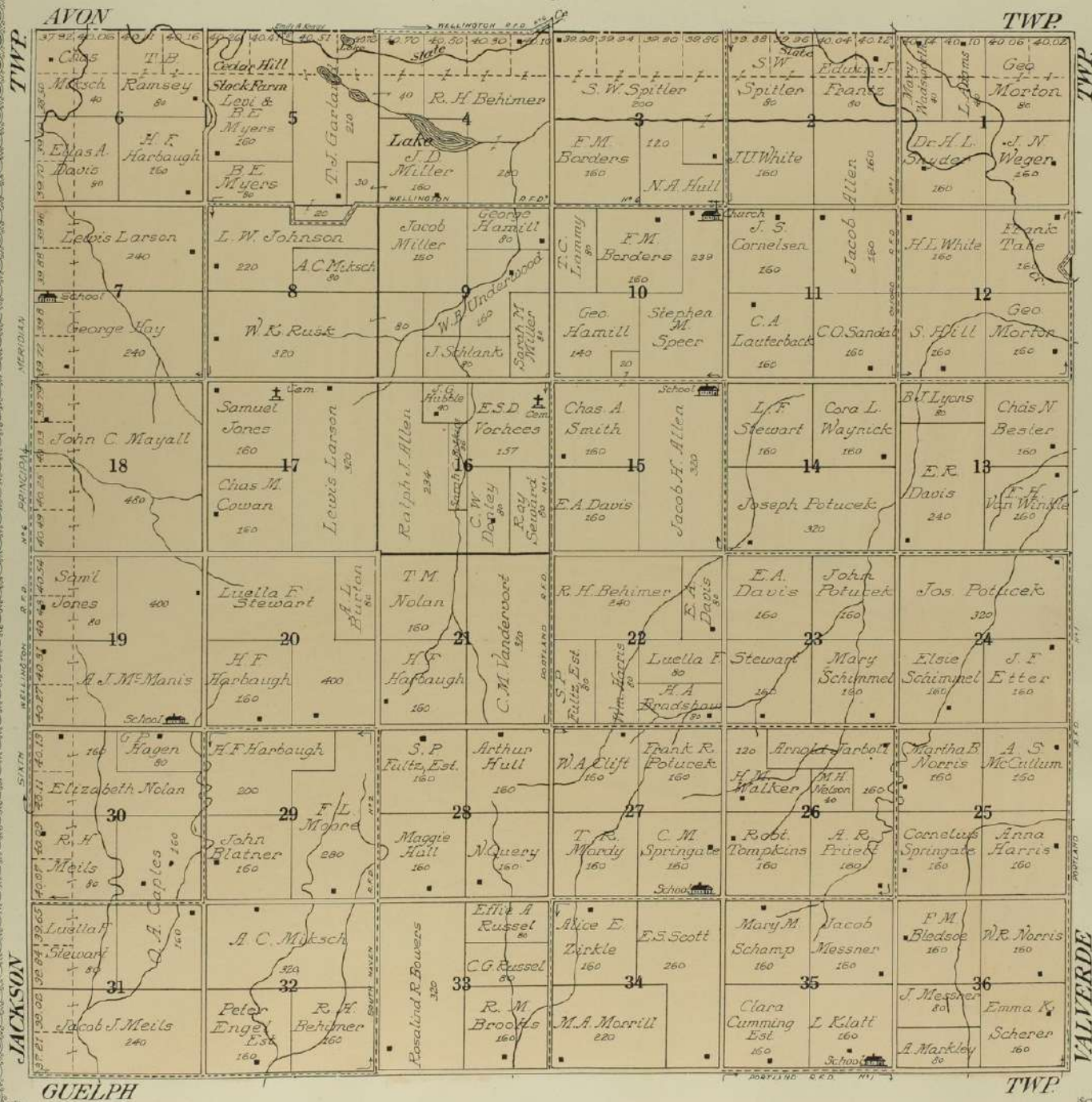



MAP OF
GUELPH
 TOWNSHIP
 Scale 2 inches to 1 mile

Township 34 South, Range 1 East and
 Fractional Township 33 South, Range 1 East of the 6th P. M.

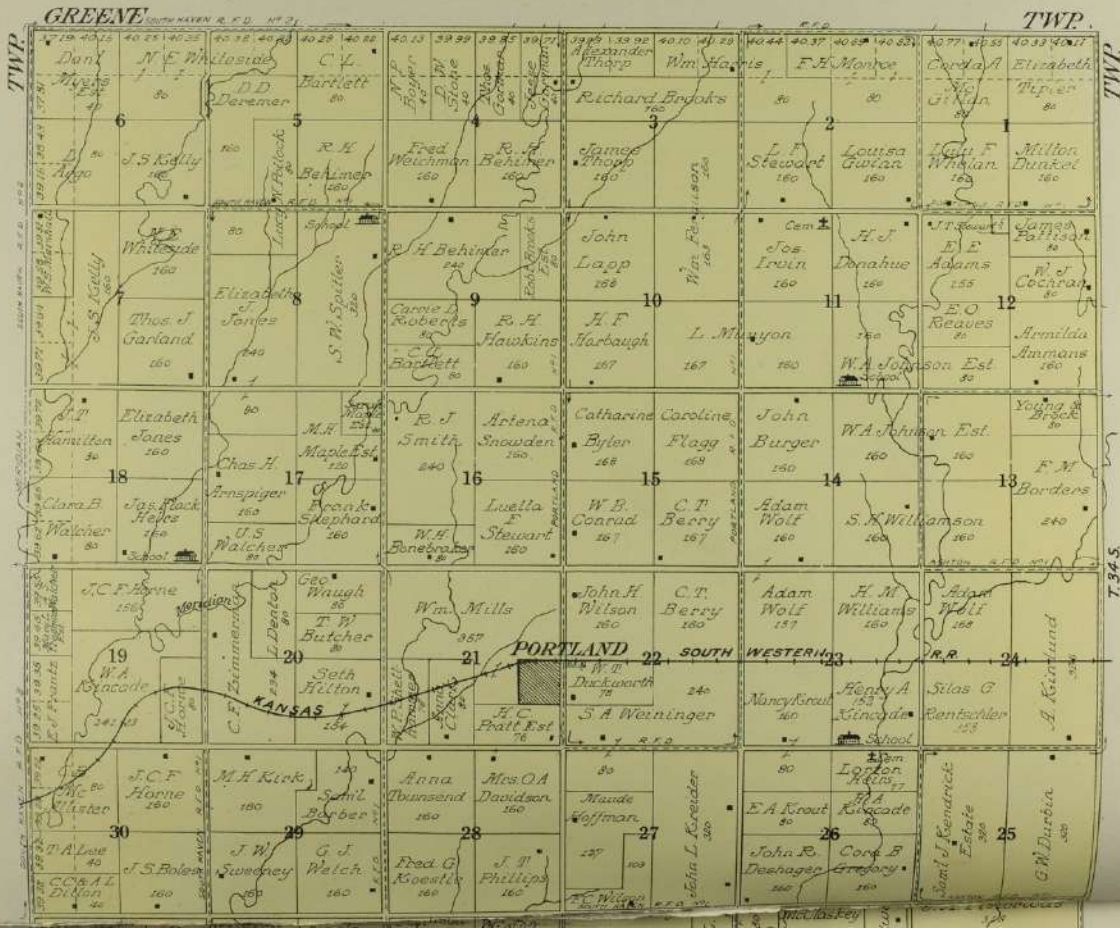

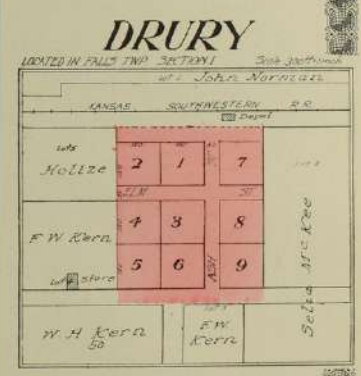
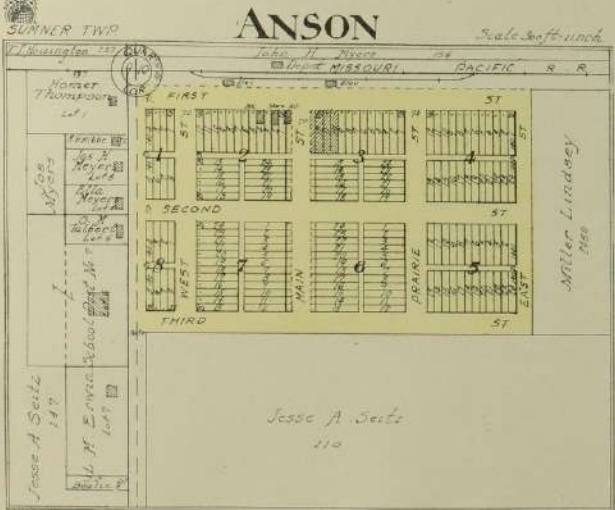
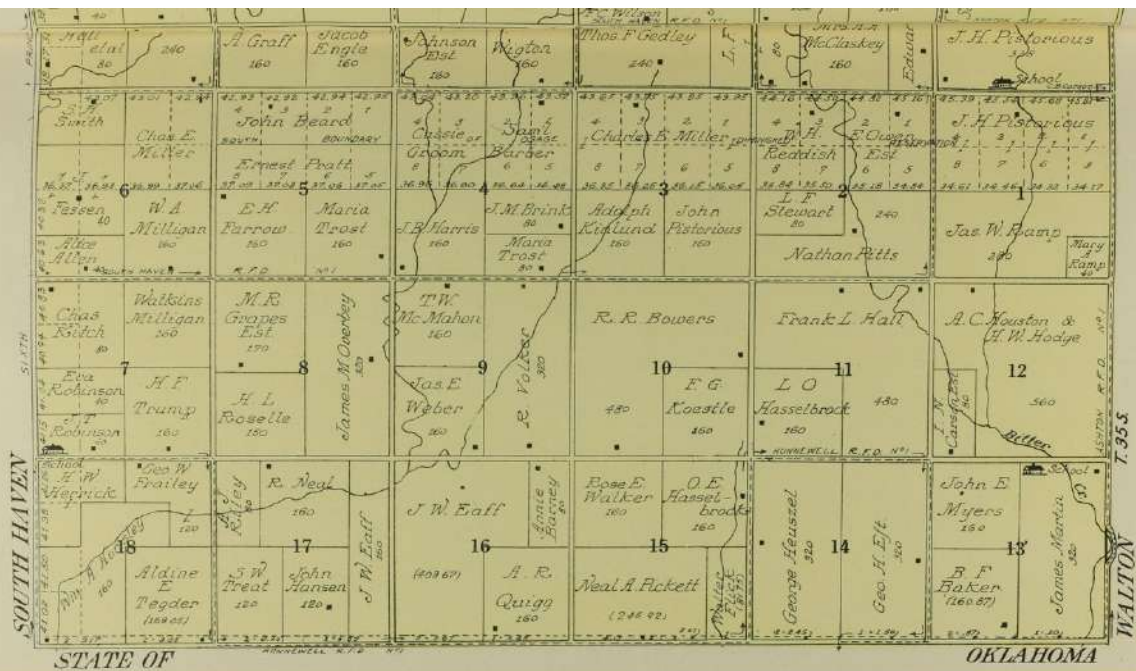

MAP OF
OXFORD
TOWNSHIP
Scale 2 inches to 1 mile

Township 32 South, Range 2 East and
Part of Township 31 South, Range 2 East of the 6th P. M.

PALESTINE

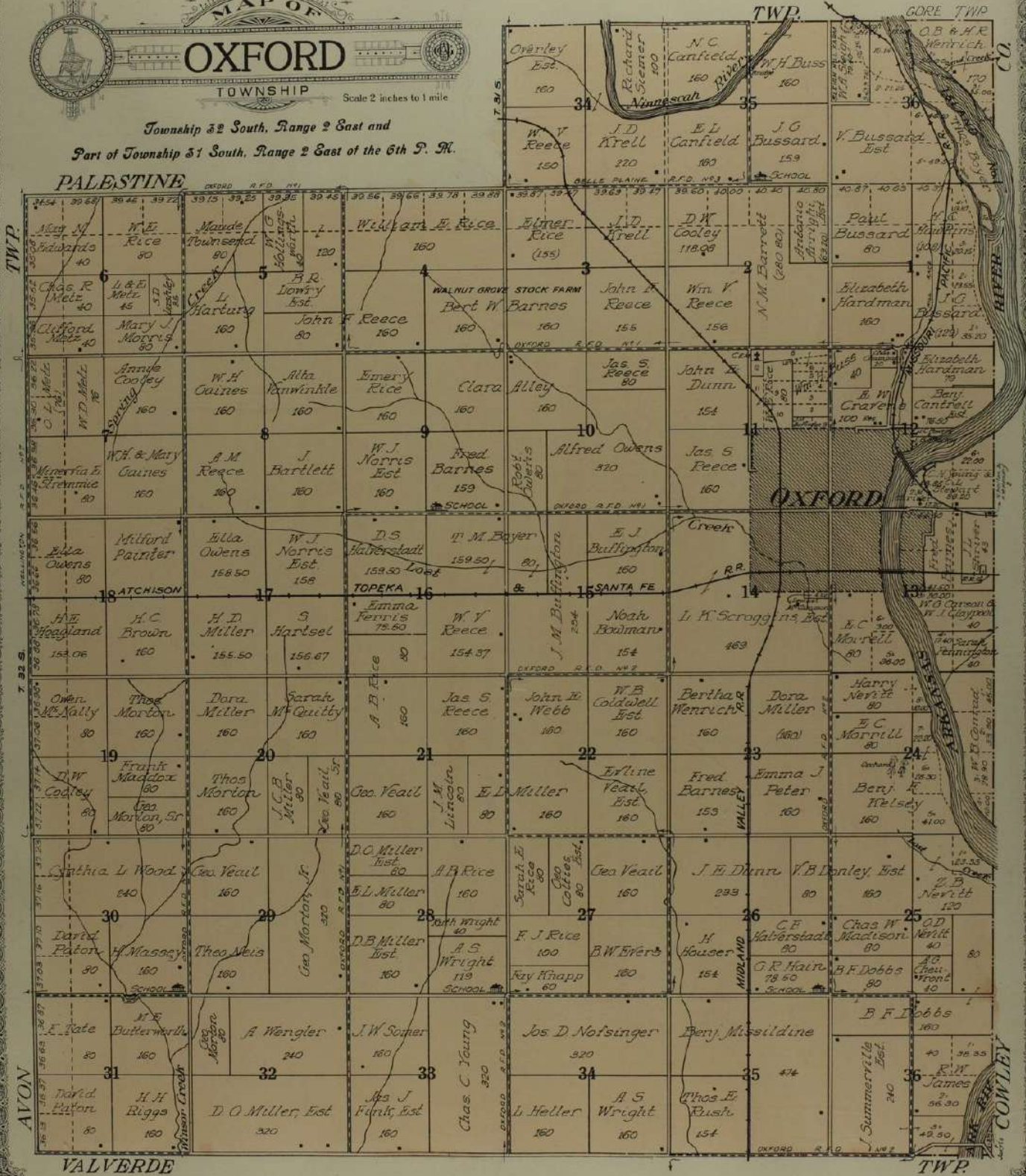

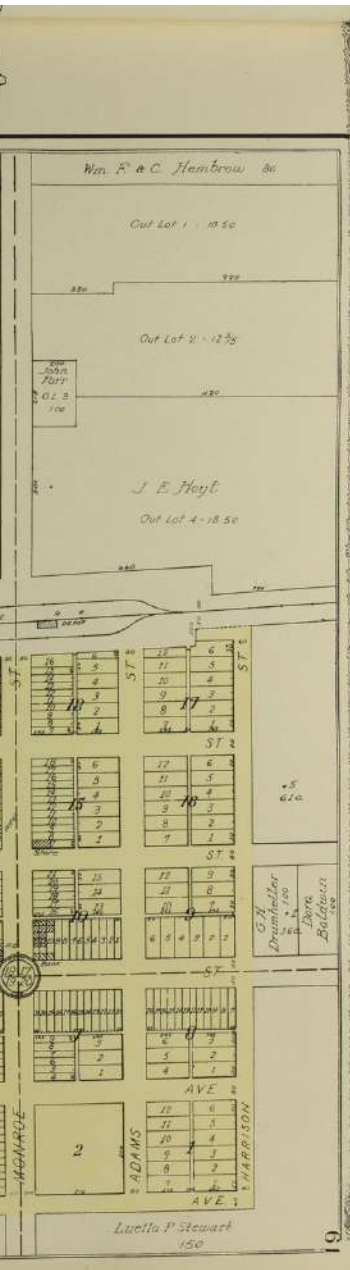
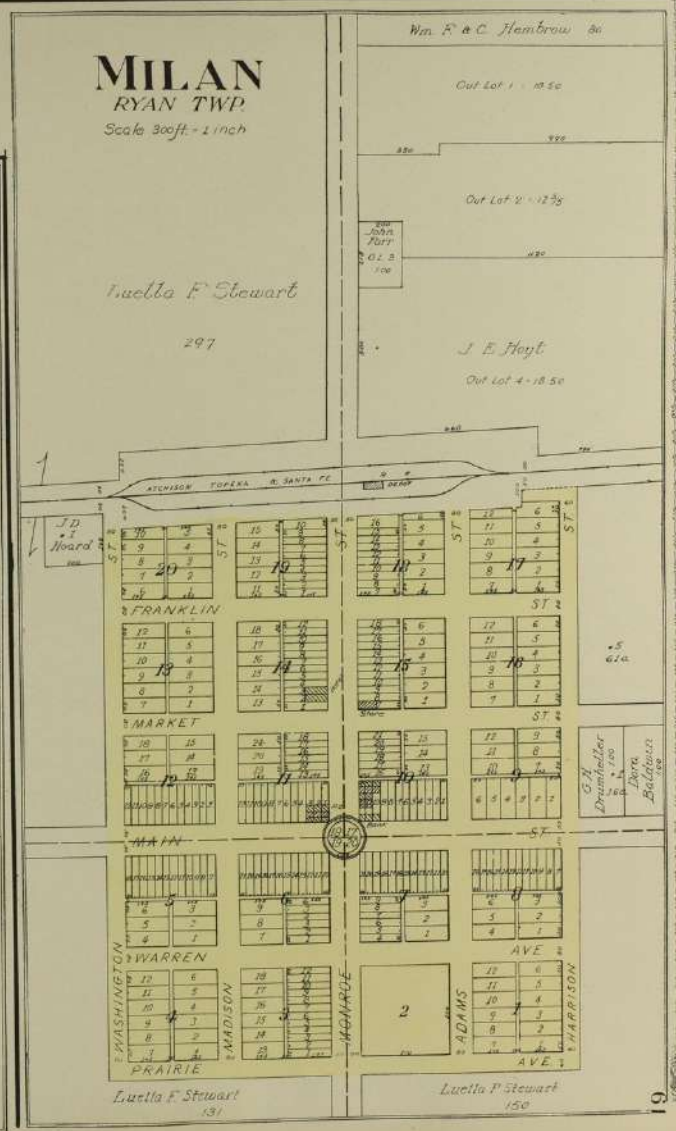
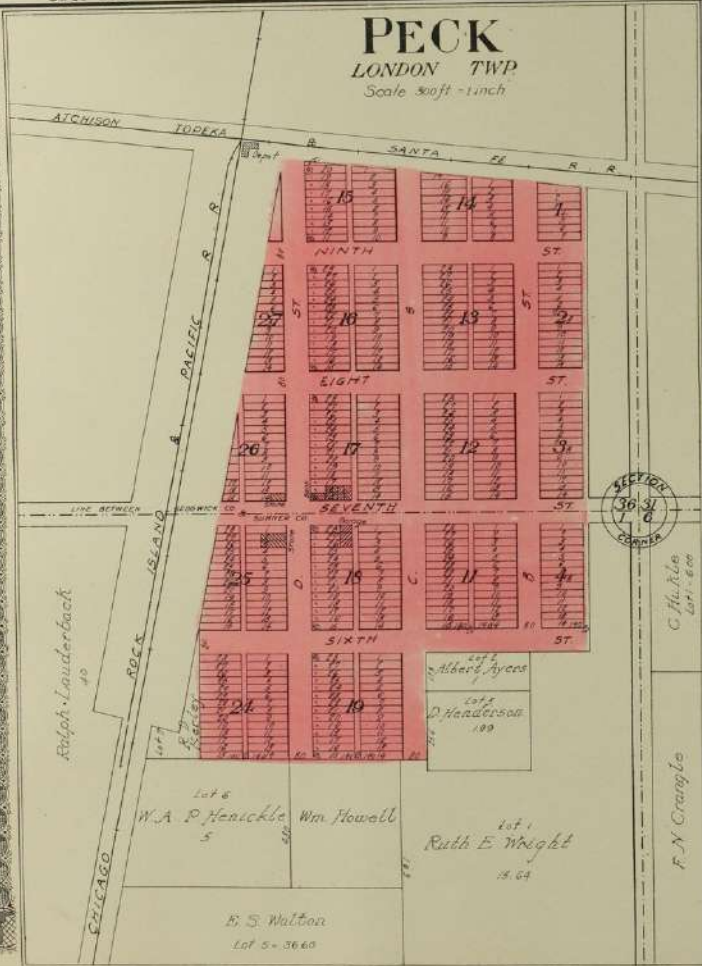
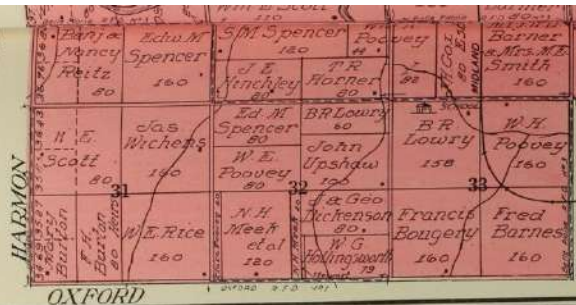



MAP OF
WALTON
 TOWNSHIP

Scale 2 inches to 1 mile

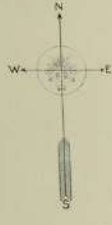
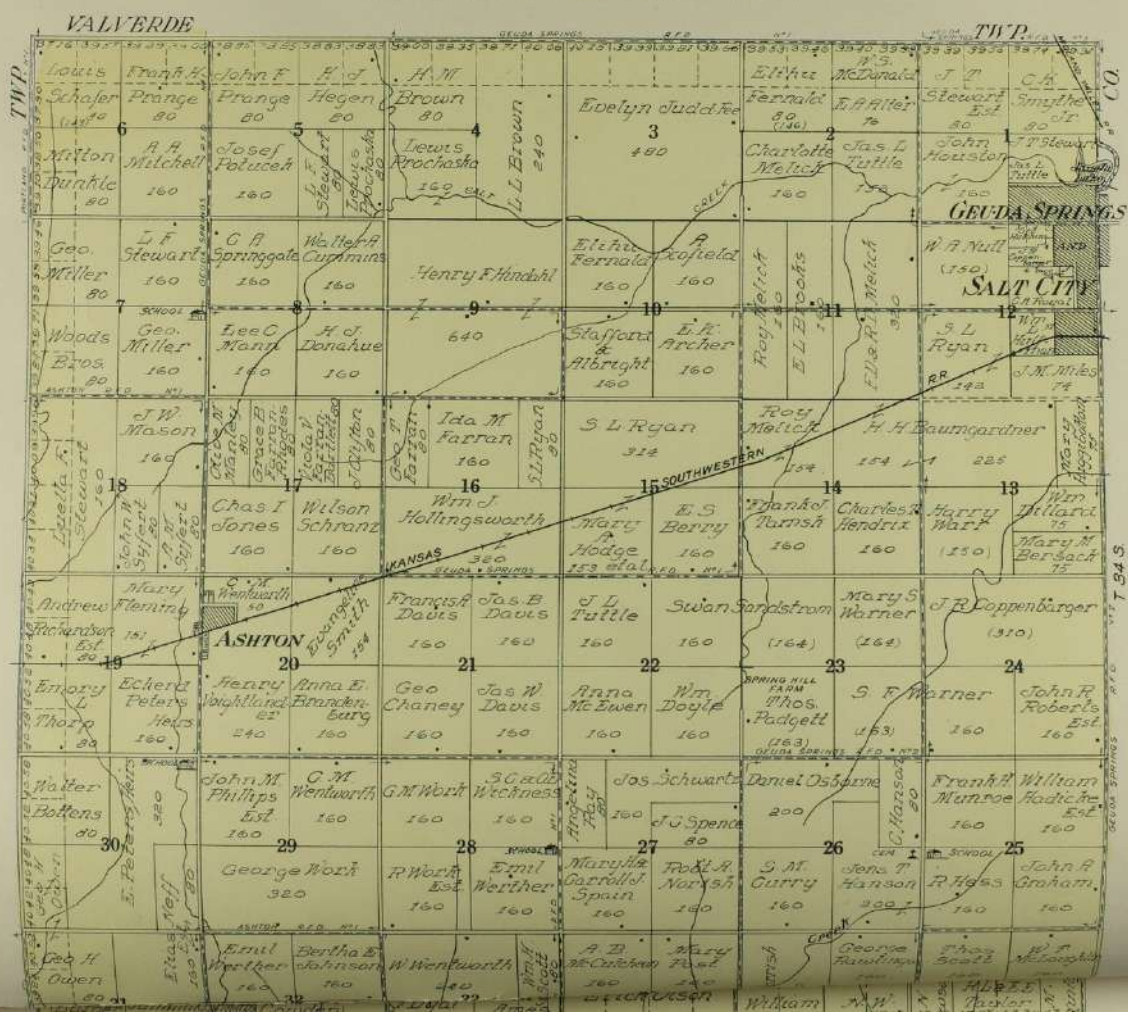
Township 34 South, Range 2 East and
 Fractional Township 35 South, Range 2 East of the 6th P. M.



GEUDA SPRINGS AND SALT CITY

T. 34 S. R. 23 E. 2 & 3 E

Scale - 350 ft = 1 inch

