

OUTLINE MAP OF
TREGO COUNTY
KANSAS

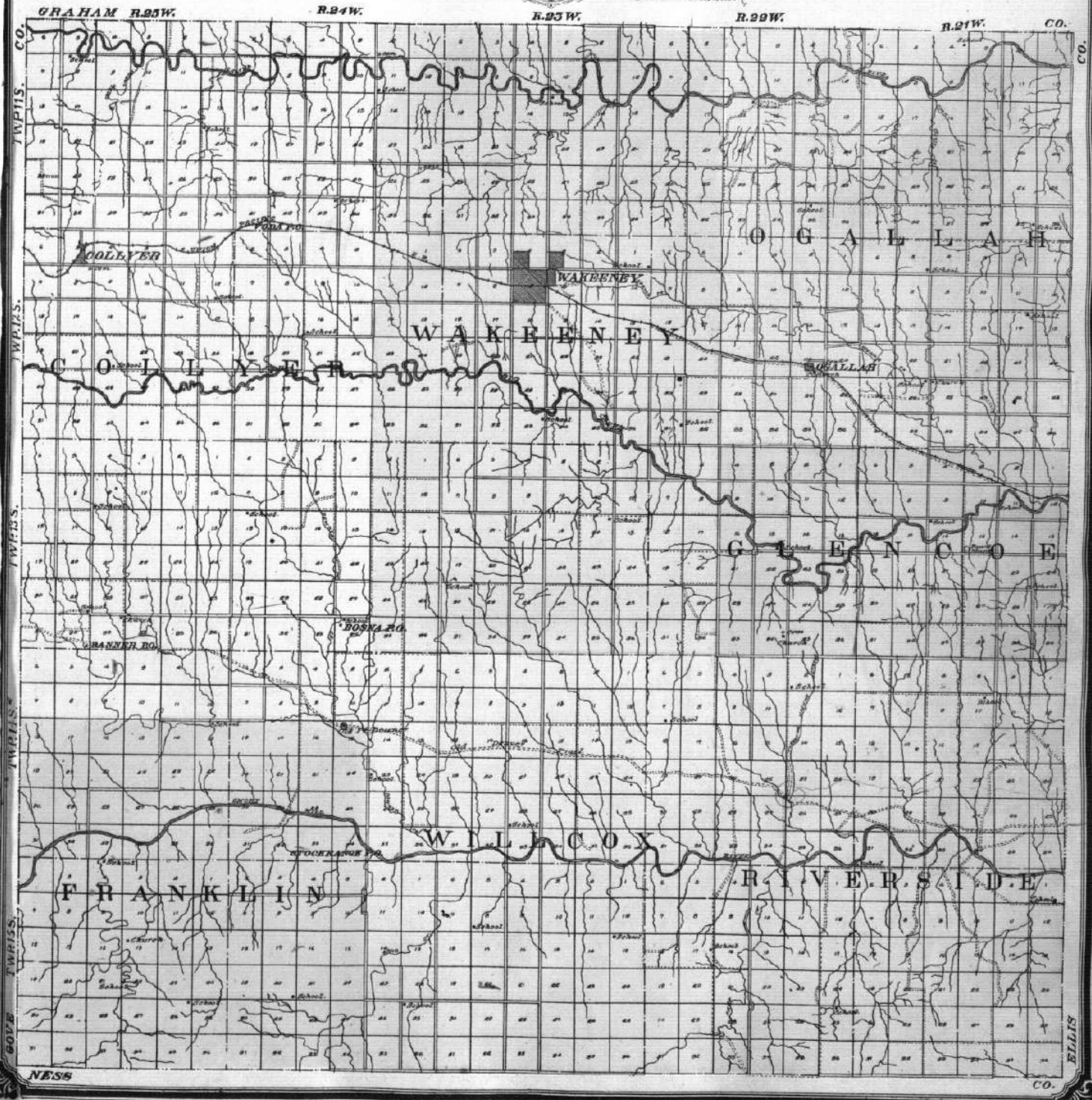

© Harbinger Printing

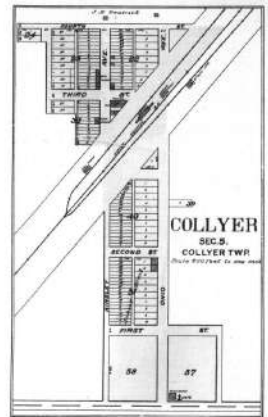

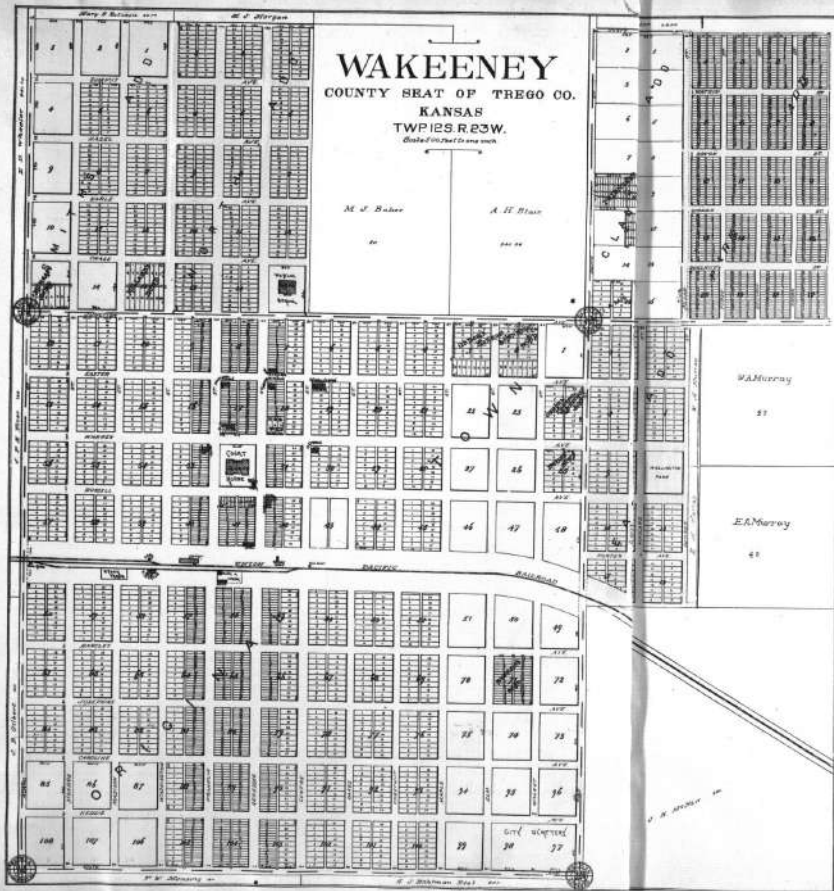

MAP OF
TOWNSHIP 11 S RANGE 21 W
 Scale 1/2" = 1000' (approx.)

of the 6th Principal Meridian.

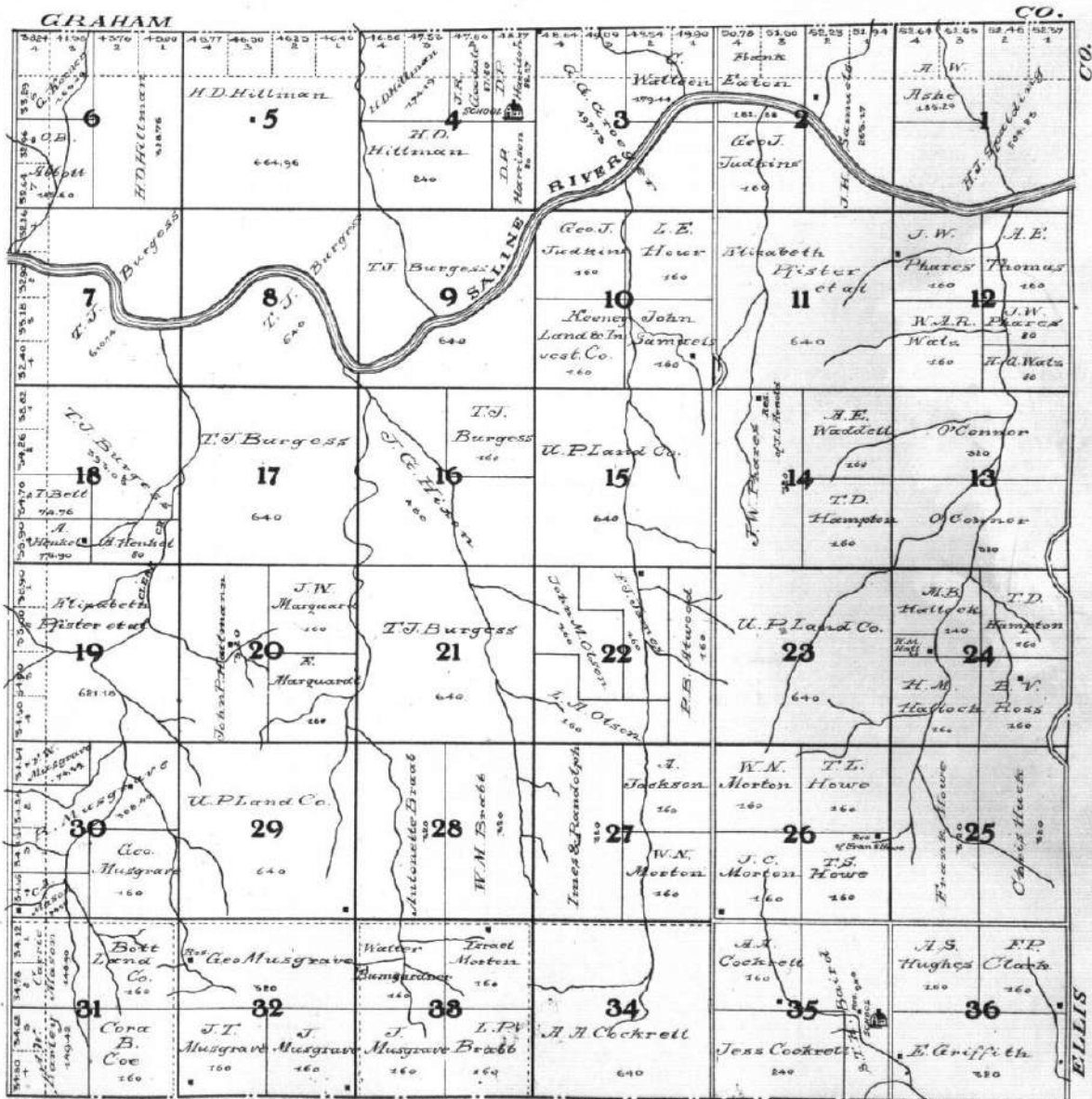



MAP OF
TOWNSHIP 11 S RANGE 22 W
Scale 1/4 inch = 1 mile.

of the 6th Principal Meridian.

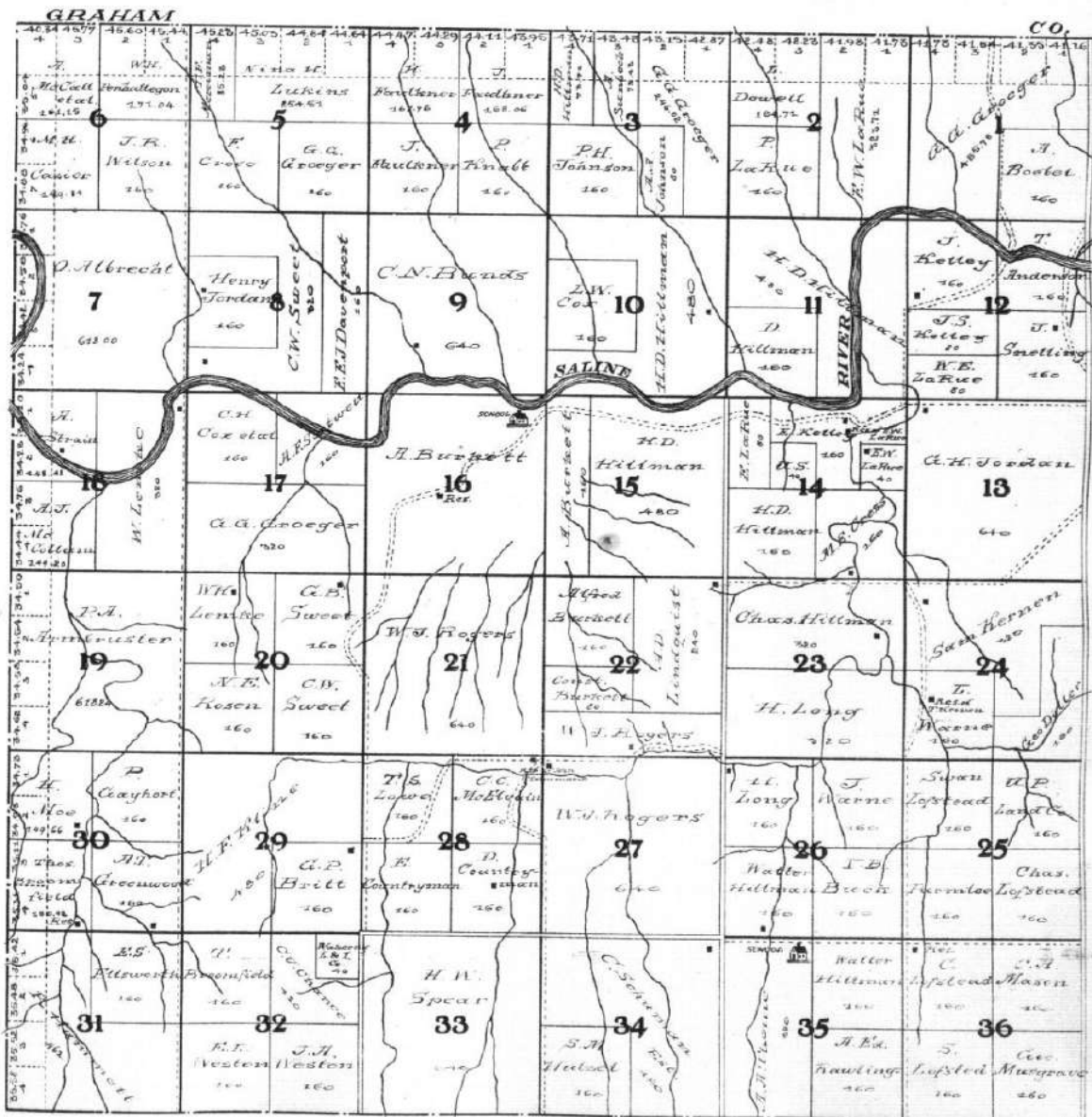



MAP OF
TOWNSHIP II S RANGE 23 W
Scale 1/2 inch to 1 mile.

of the 6th Principal Meridian.

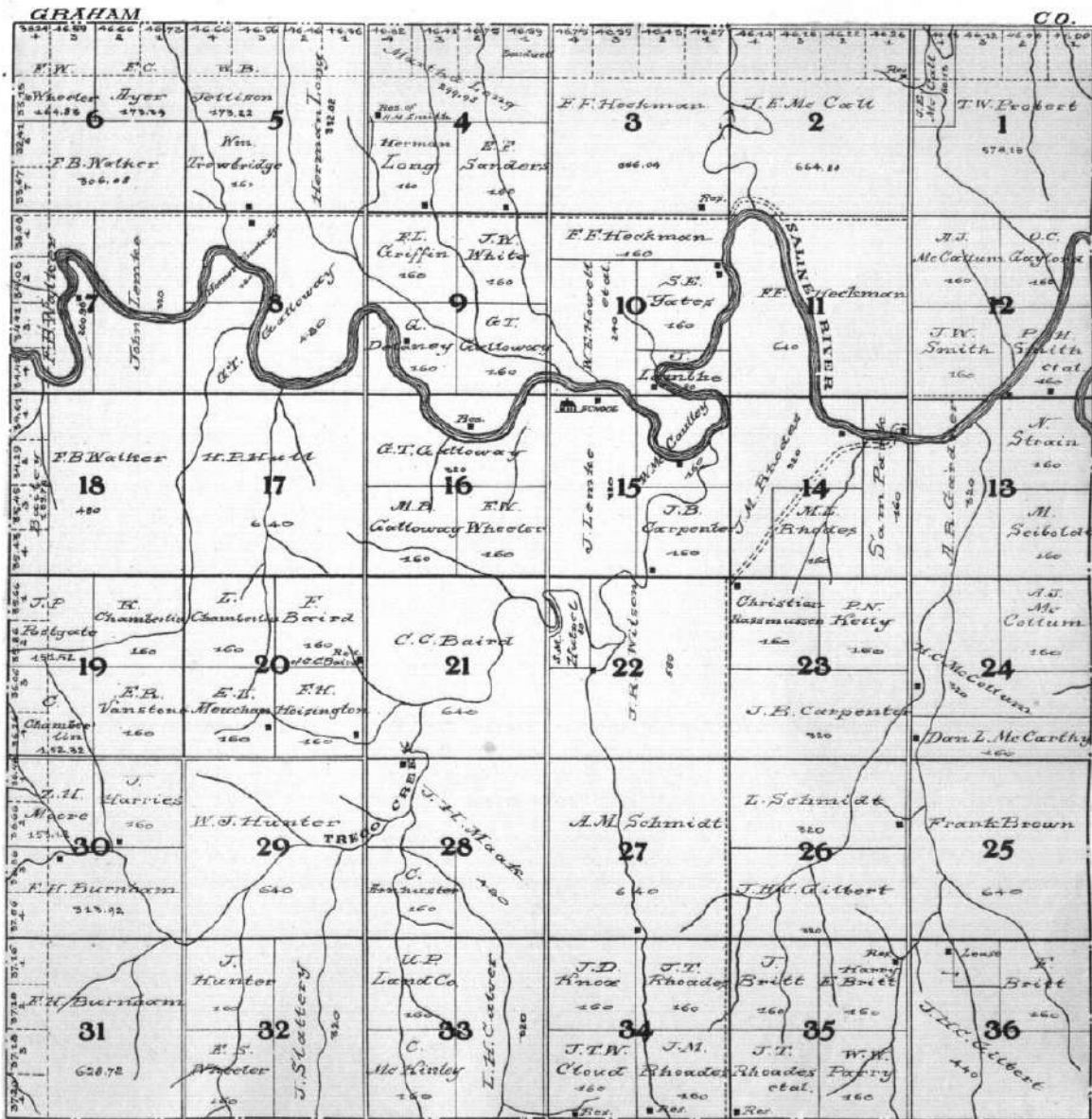



MAP OF
TOWNSHIP 11 S RANGE 24 W
Scale 1/64 inch to a Mile.

of the 6th Principal Meridian.

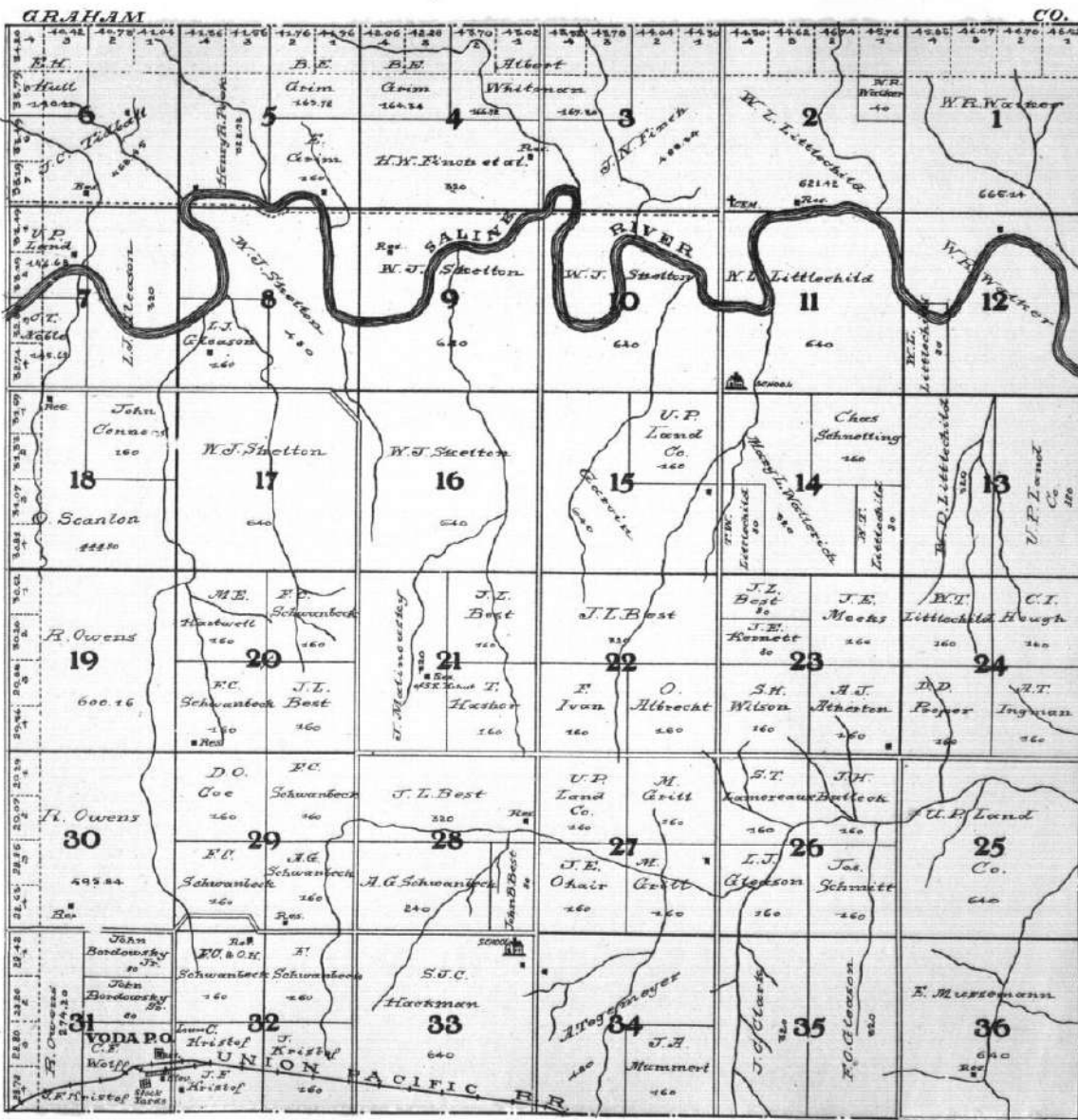



MAP OF
TOWNSHIP 11 S RANGE 25 W
Scale 1/4 inch to 1 mile.

of the 6th Principal Meridian.

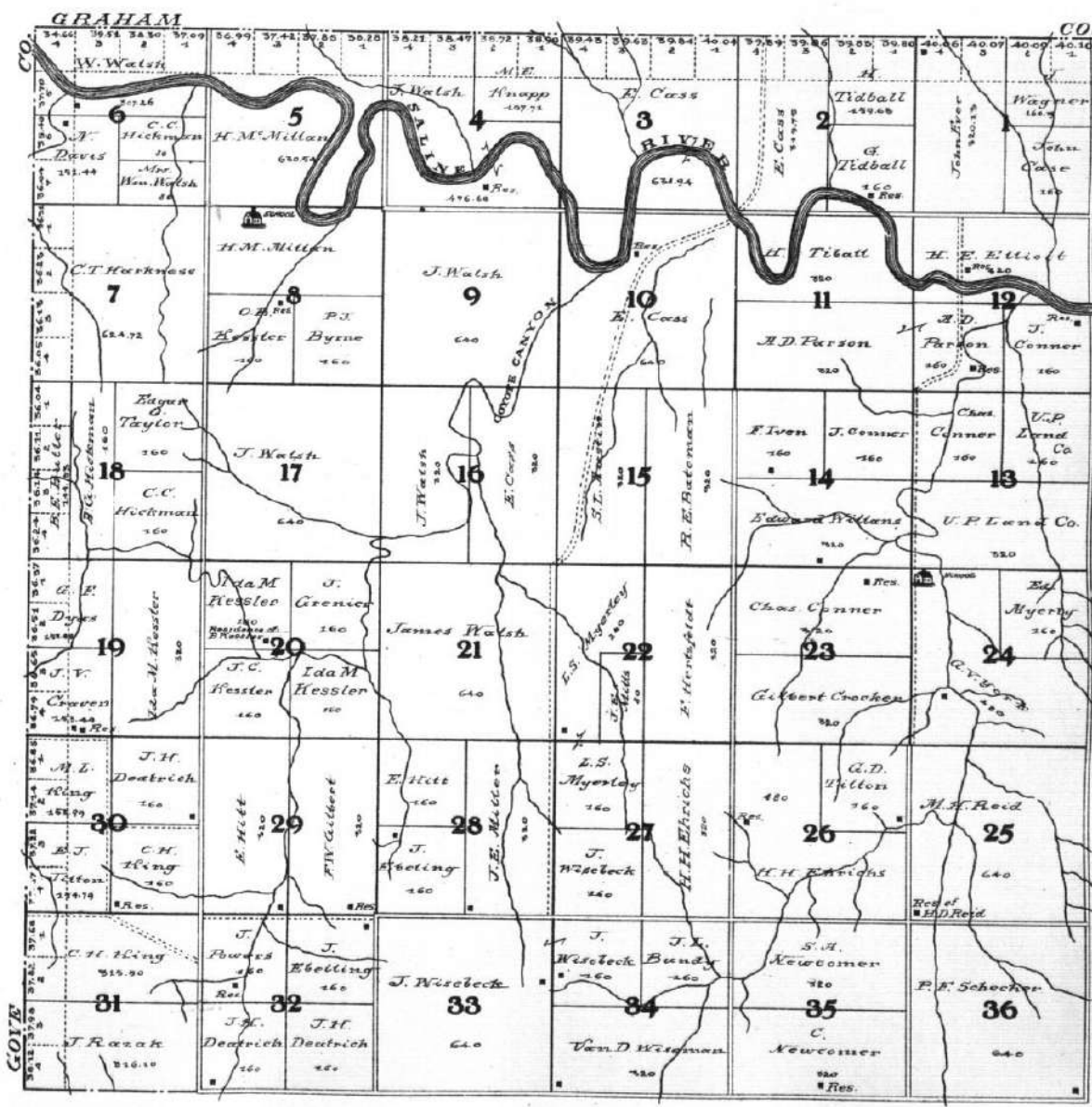

MAP OF
TOWNSHIP 12 S RANGE 21 W
 Scale 1/4 inch to 1 Mile.

of the 6th Principal Meridian.

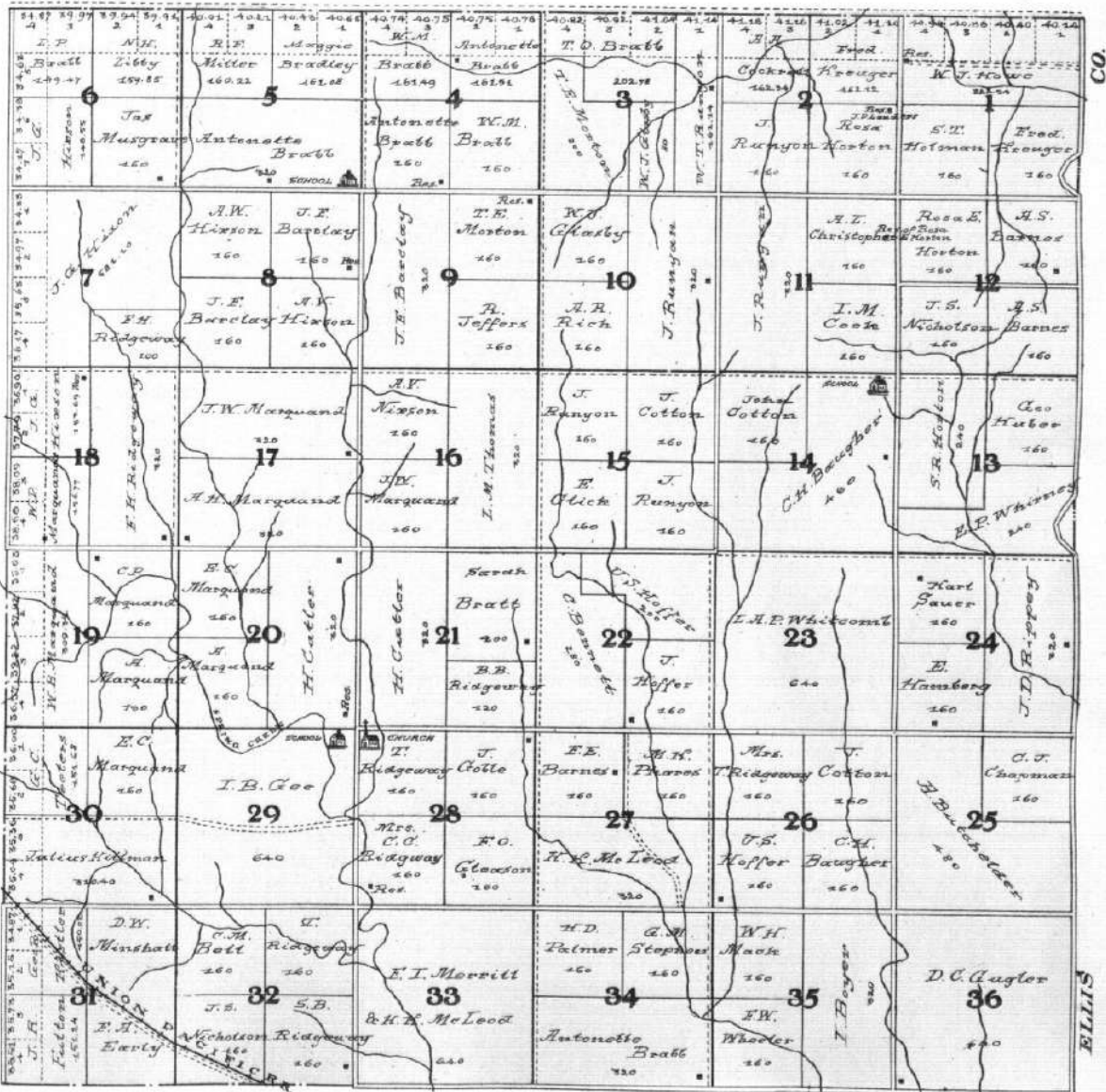

Scale 1/64 inch to 1 Mile.

of the 6th Principal Meridian.

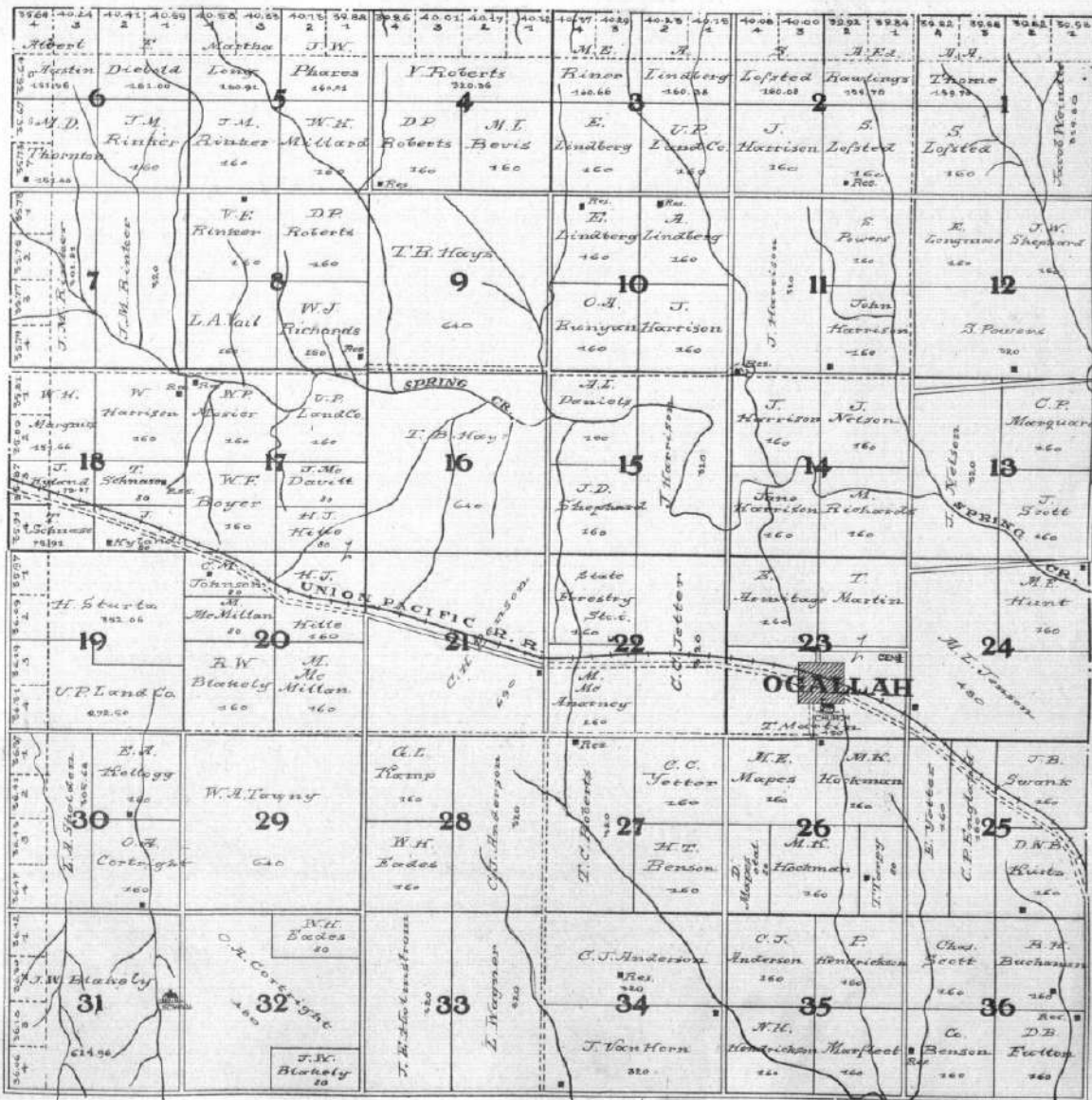

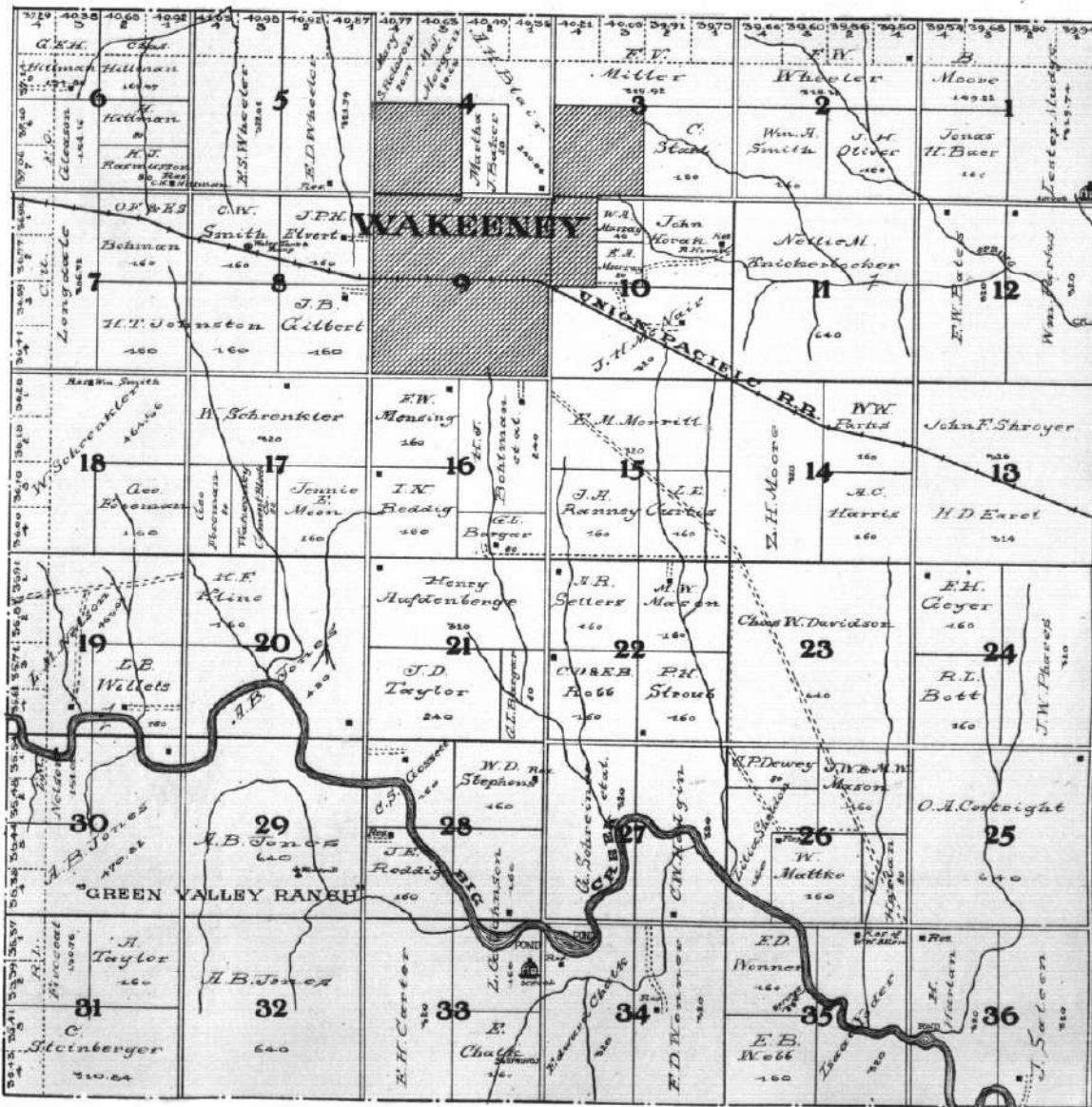



 MAP OF
TOWNSHIP 12 S RANGE 24 W
 Scale By indicated Mile.
 of the 6th Principal Meridian.





MAP OF

TOWNSHIP 12 S RANGE 25 W

 Scale 1/4 inch = 1 Mile.

of the 6th Principal Meridian.

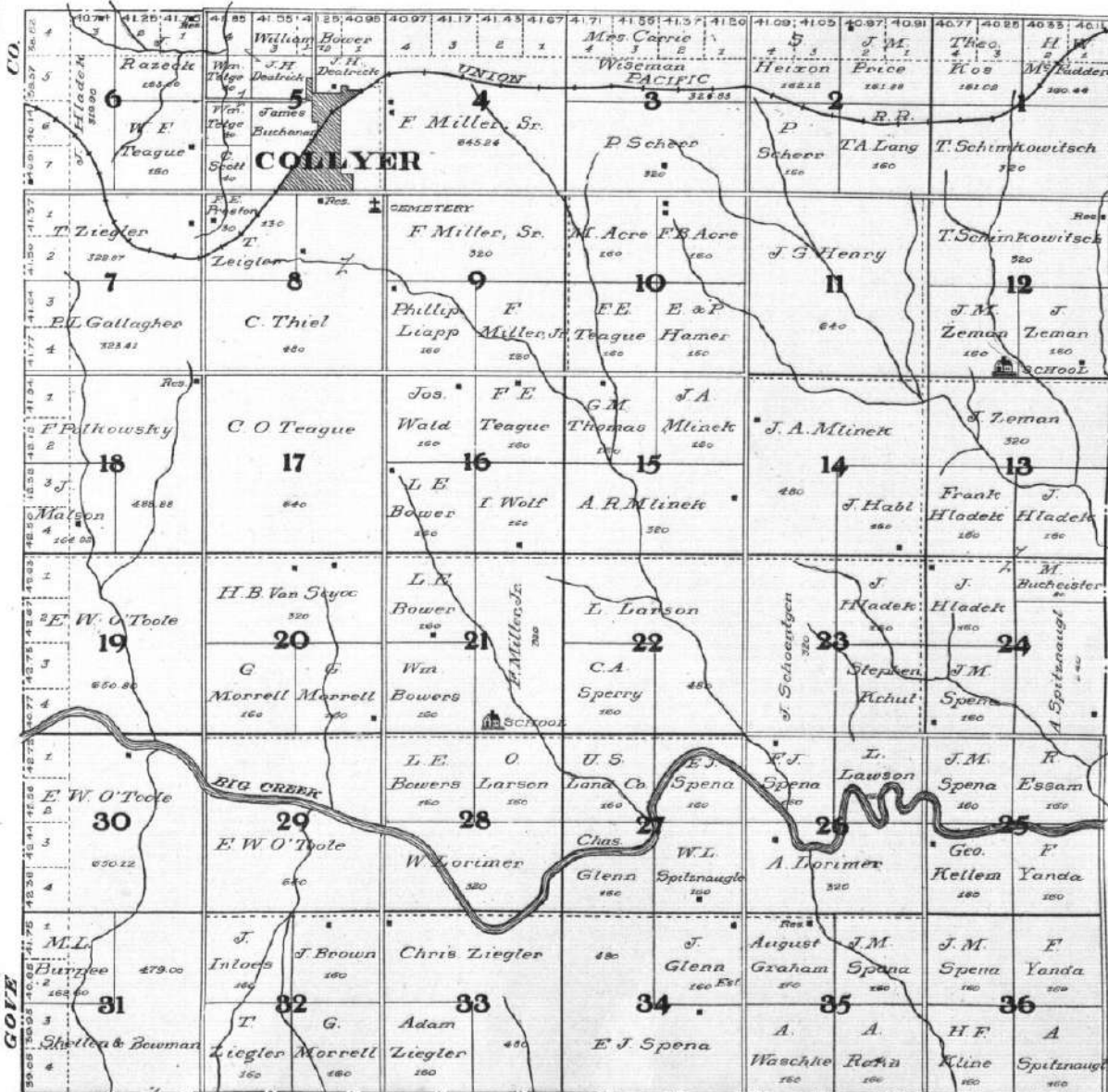



MAP OF
TOWNSHIP 13 S RANGE 21 W
Scale 16 inches to a mile.

of the 6th Principal Meridian.

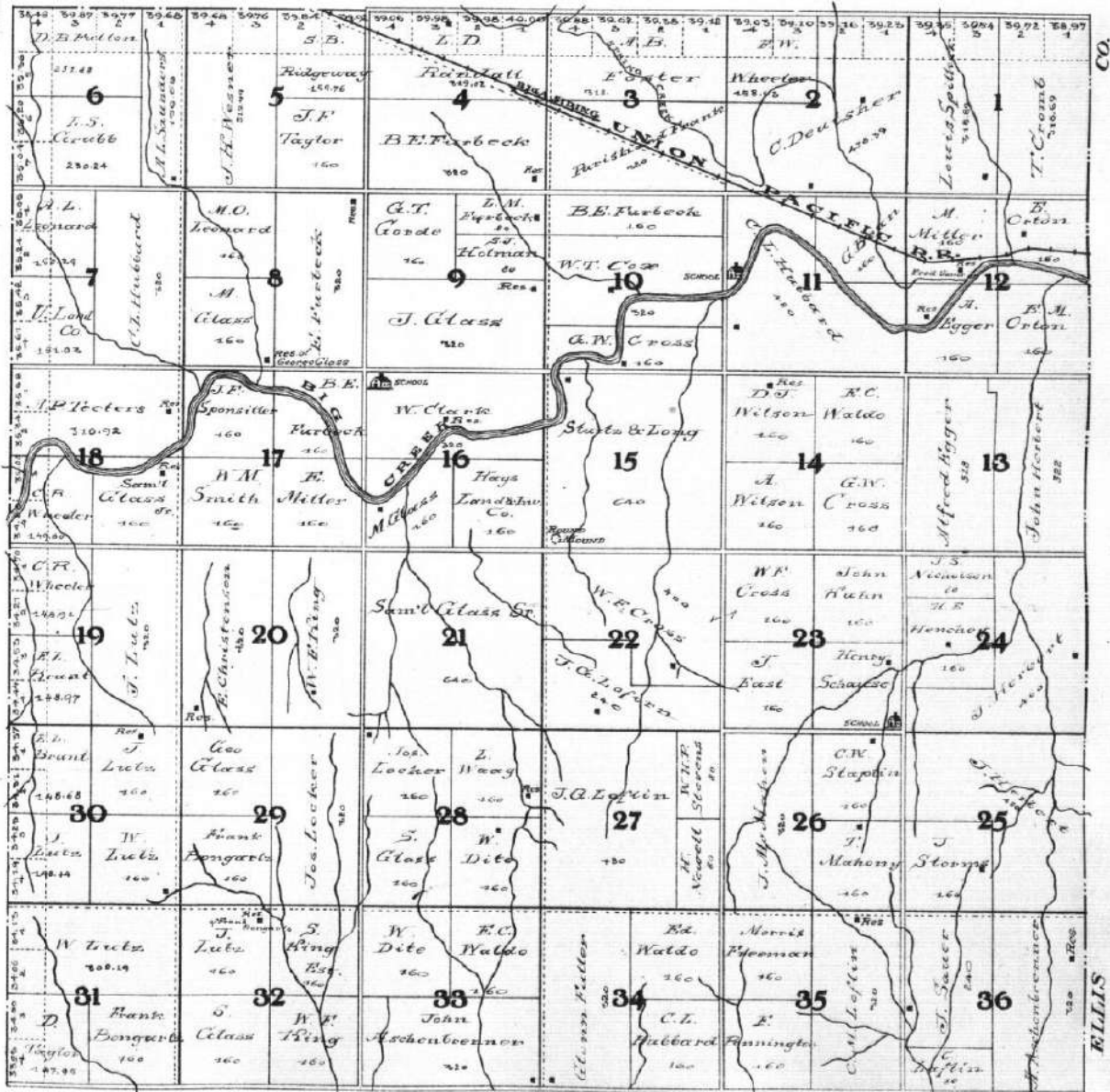



MAP OF
TOWNSHIP 13 S RANGE 22 W
 Scale 1/4 inch to 1 Mile.

of the 6th Principal Meridian.

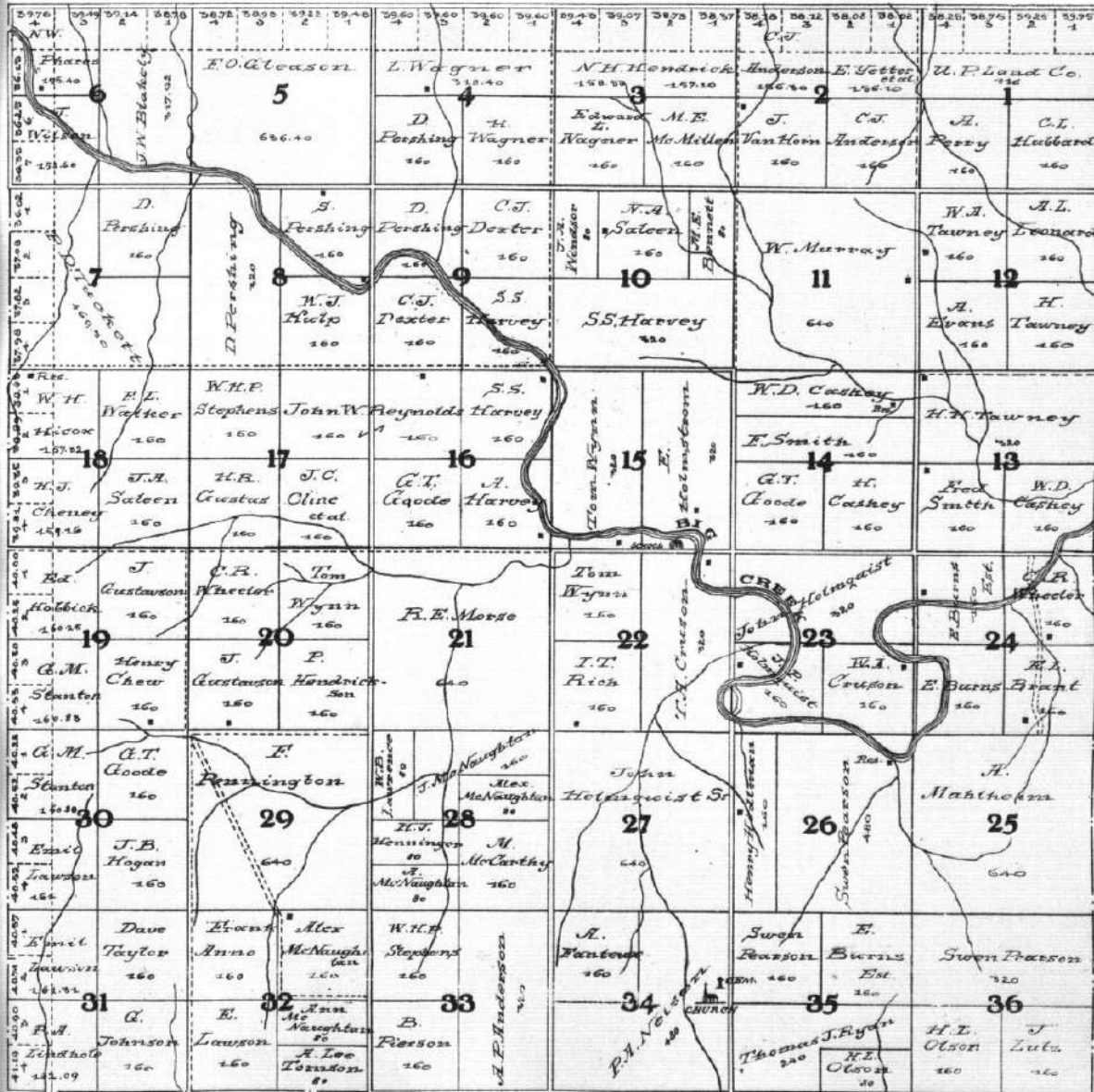



MAP OF

TOWNSHIP 13 S RANGE 23 W

Scale 1/4 inch = 1 Mile.

of the 6th Principal Meridian.

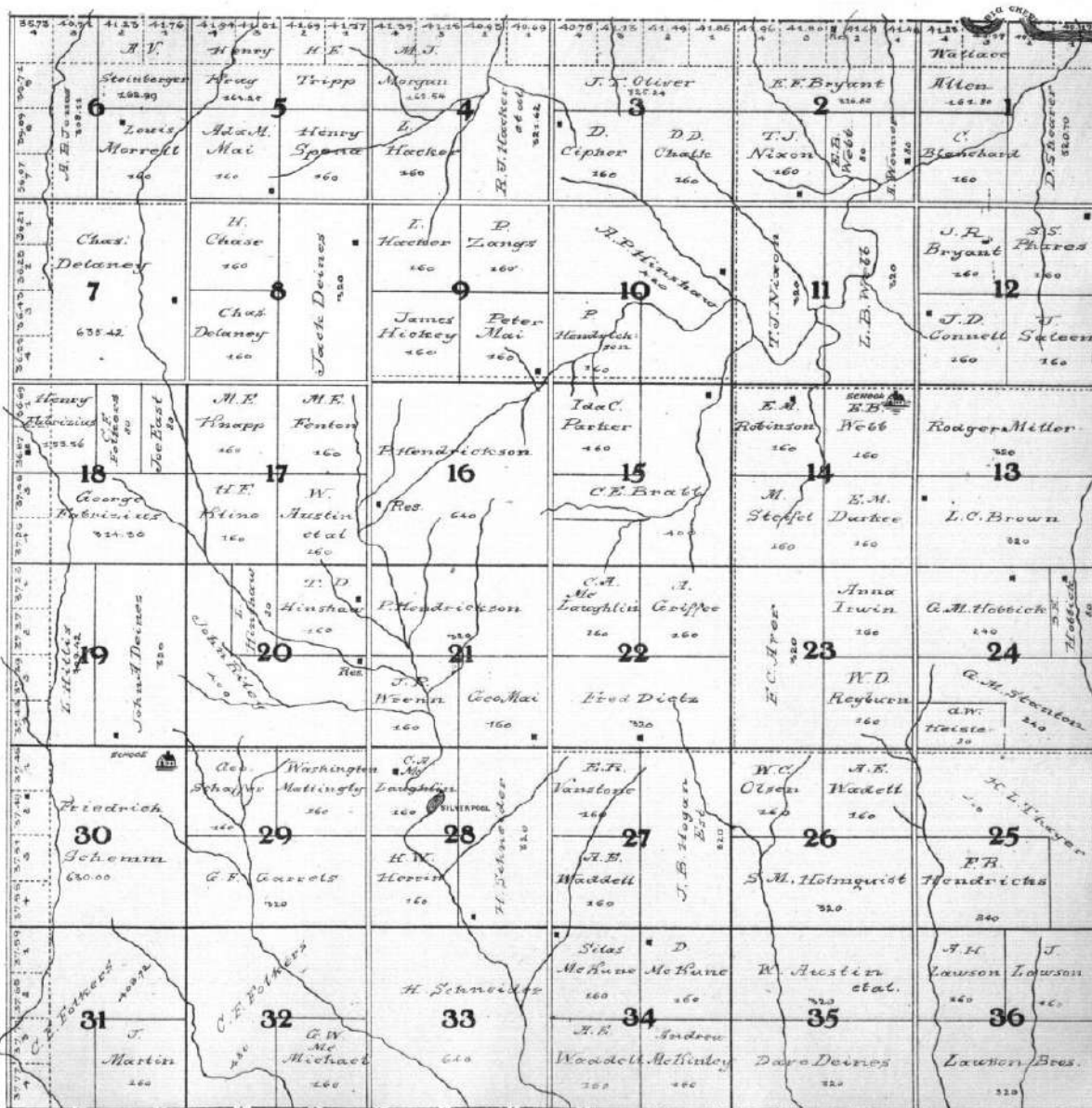



MAP OF
TOWNSHIP 13S RANGE 24 W
Scale 1/4 inch to a Mile.

of the 6th Principal Meridian.

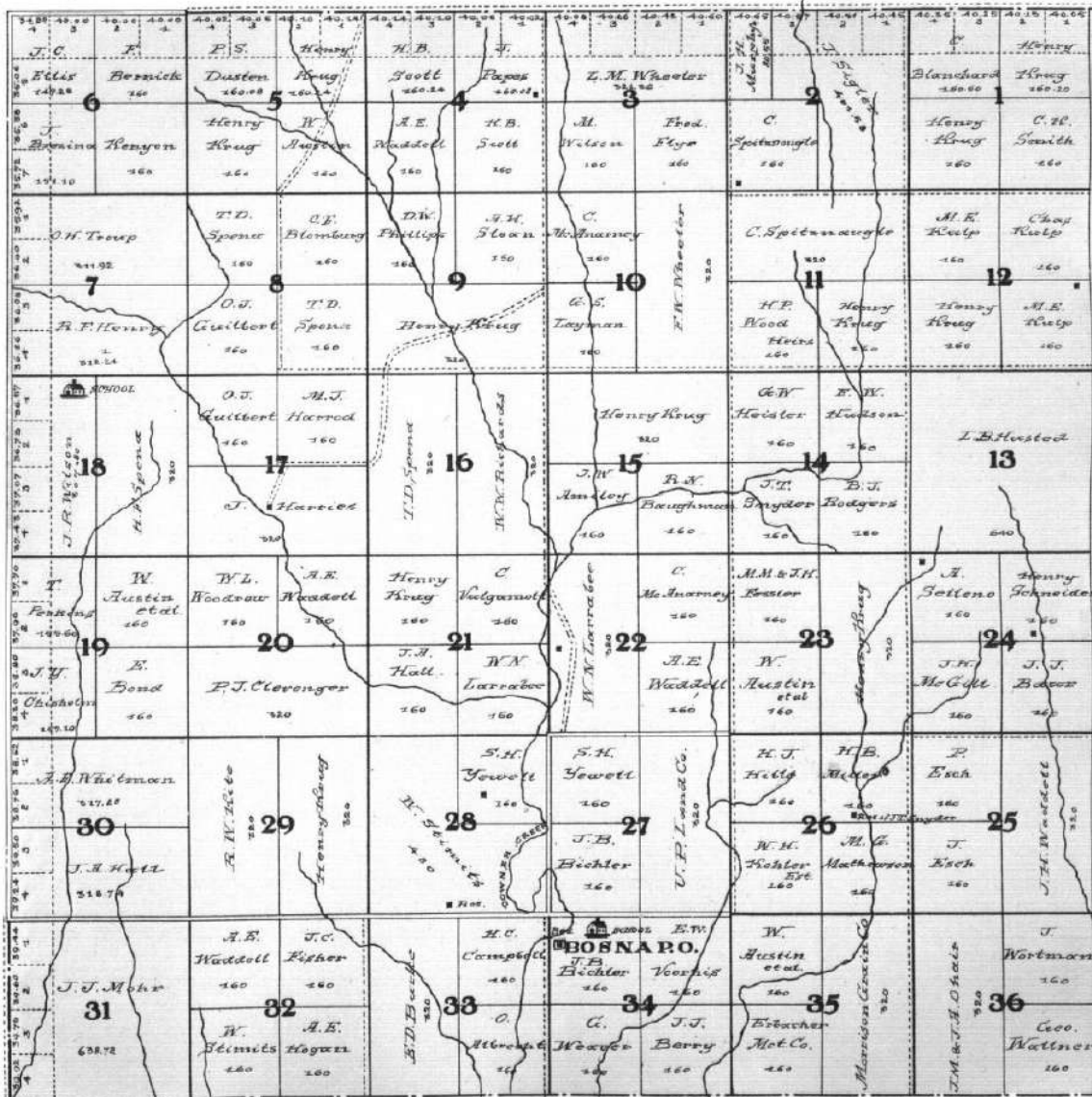



MAP OF

TOWNSHIP 13S RANGE 25 W

Scale 1/4 inch to 1 Mile.

of the 6th Principal Meridian.

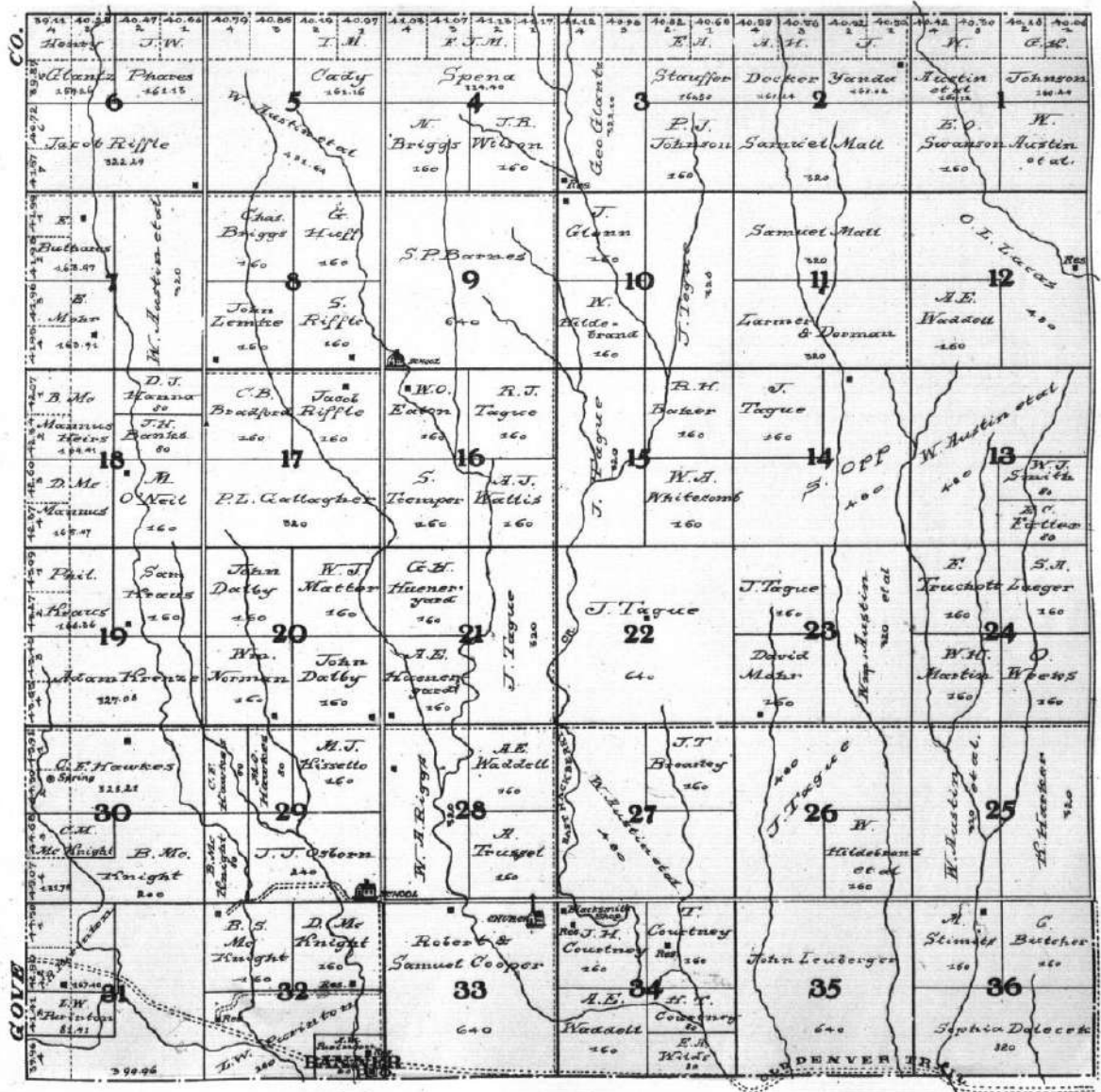



MAP OF
TOWNSHIP 14S RANGE 21 W
 Scale 1/4" = 1 Mile
 of the 6th Principal Meridian.

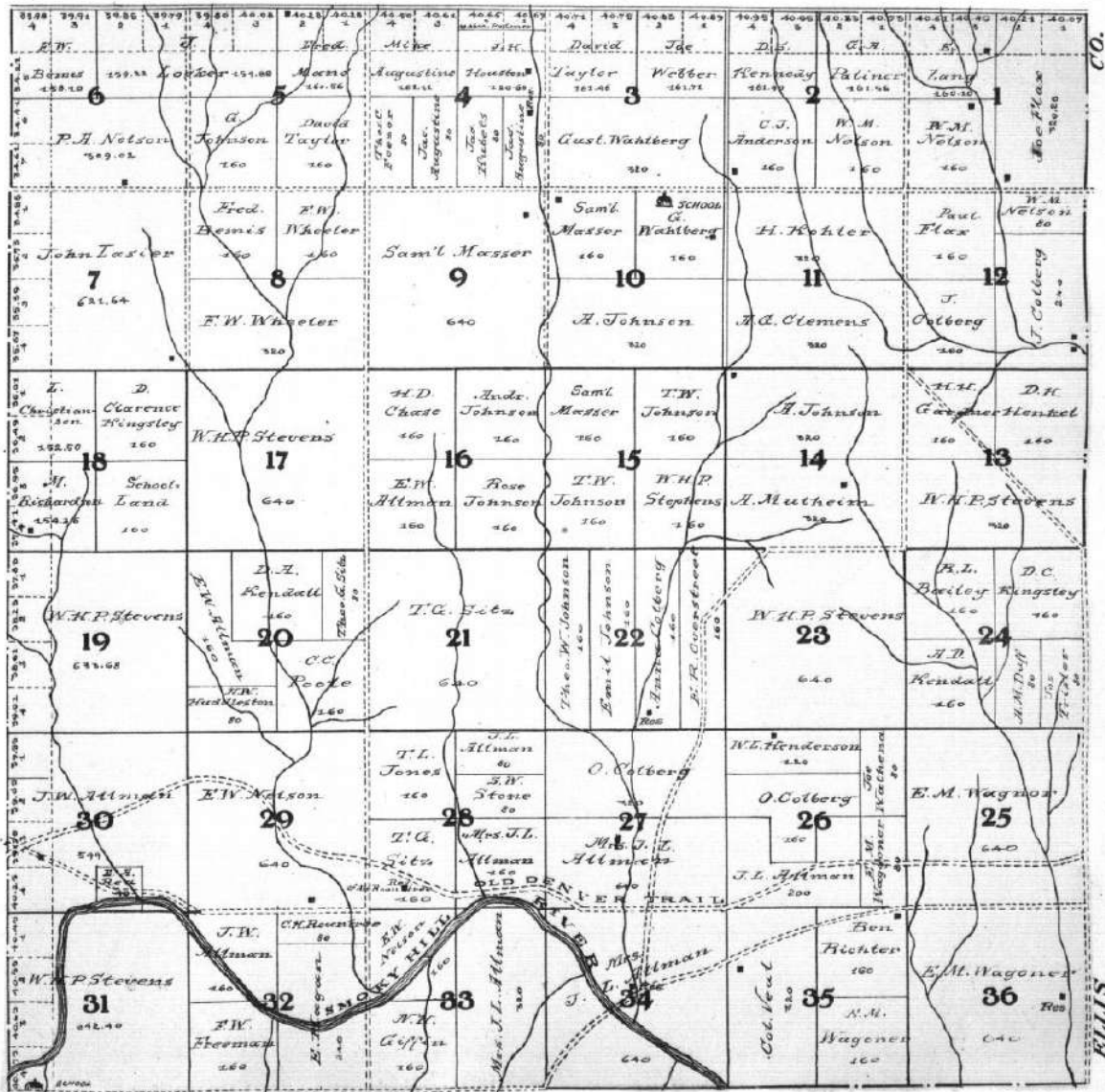



MAP OF
TOWNSHIP 14 S RANGE 22 W
 Scale 1/4 inch to 1 mile.
 of the 6th Principal Meridian.

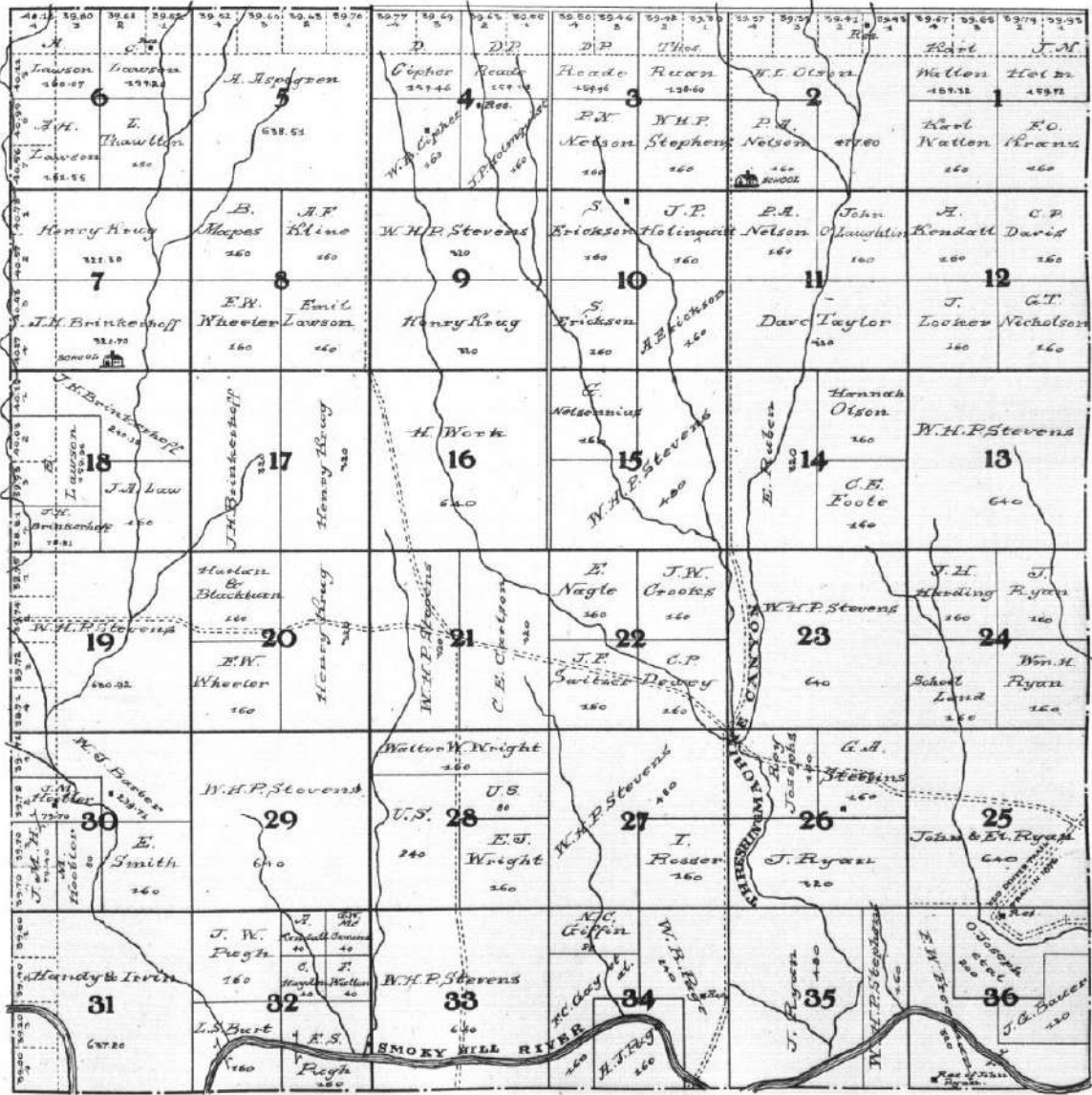



MAP OF
TOWNSHIP 14 S RANGE 23 W
Scale 1/2 inch = 1 mile.

of the 6th Principal Meridian.

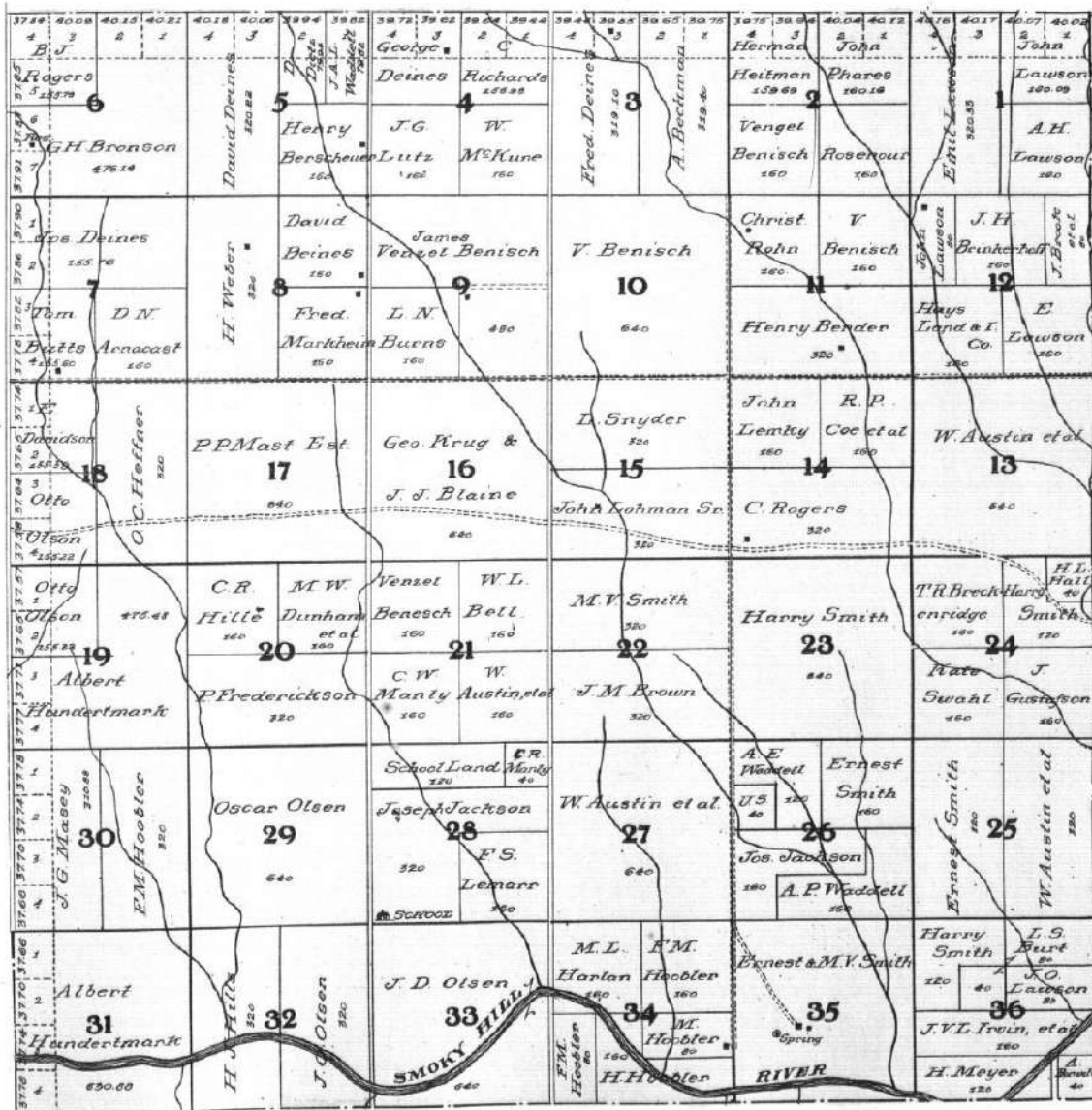



MAP OF

TOWNSHIP 14S RANGE 24W

Scale 24 inches to a Mile.

 of the 6th Principal Meridian.

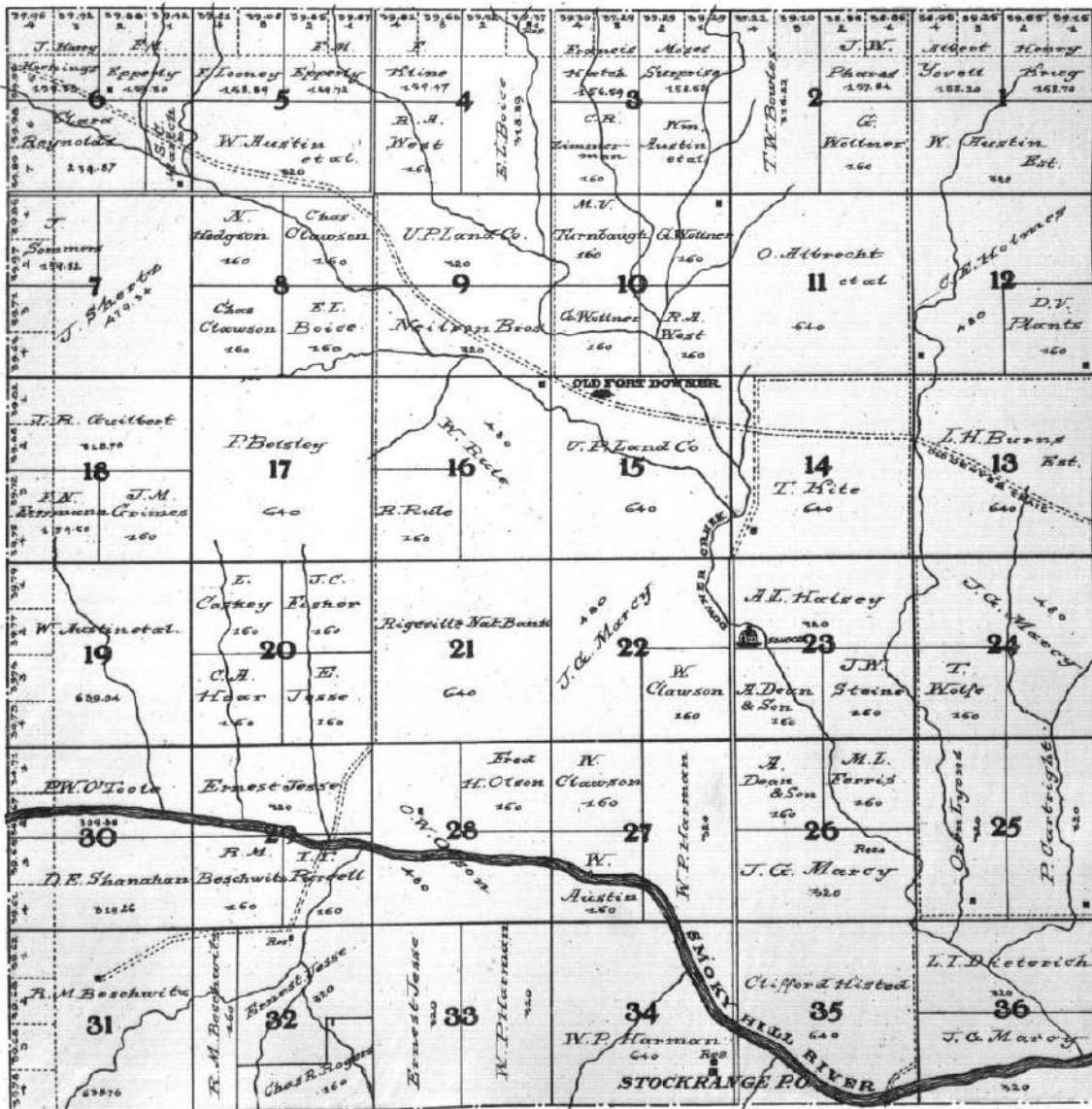

Denver Road



MAP OF

TOWNSHIP 14 S RANGE 25 W

of the 6th Principal Meridian.

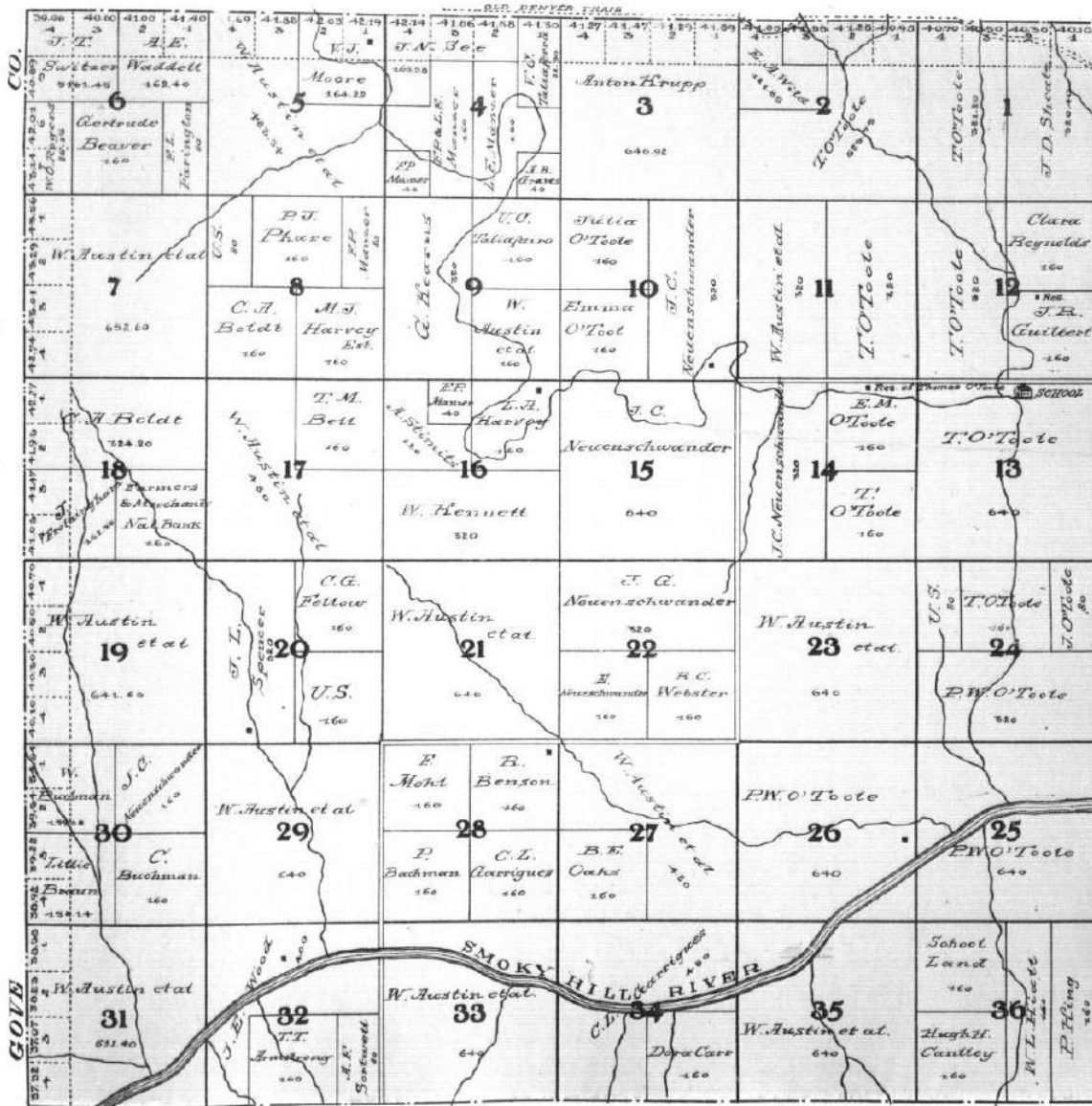



MAP OF
TOWNSHIP 15 S RANGE 21 W
 Scale 1/4 inch to 1 Mile.

of the 6th Principal Meridian.

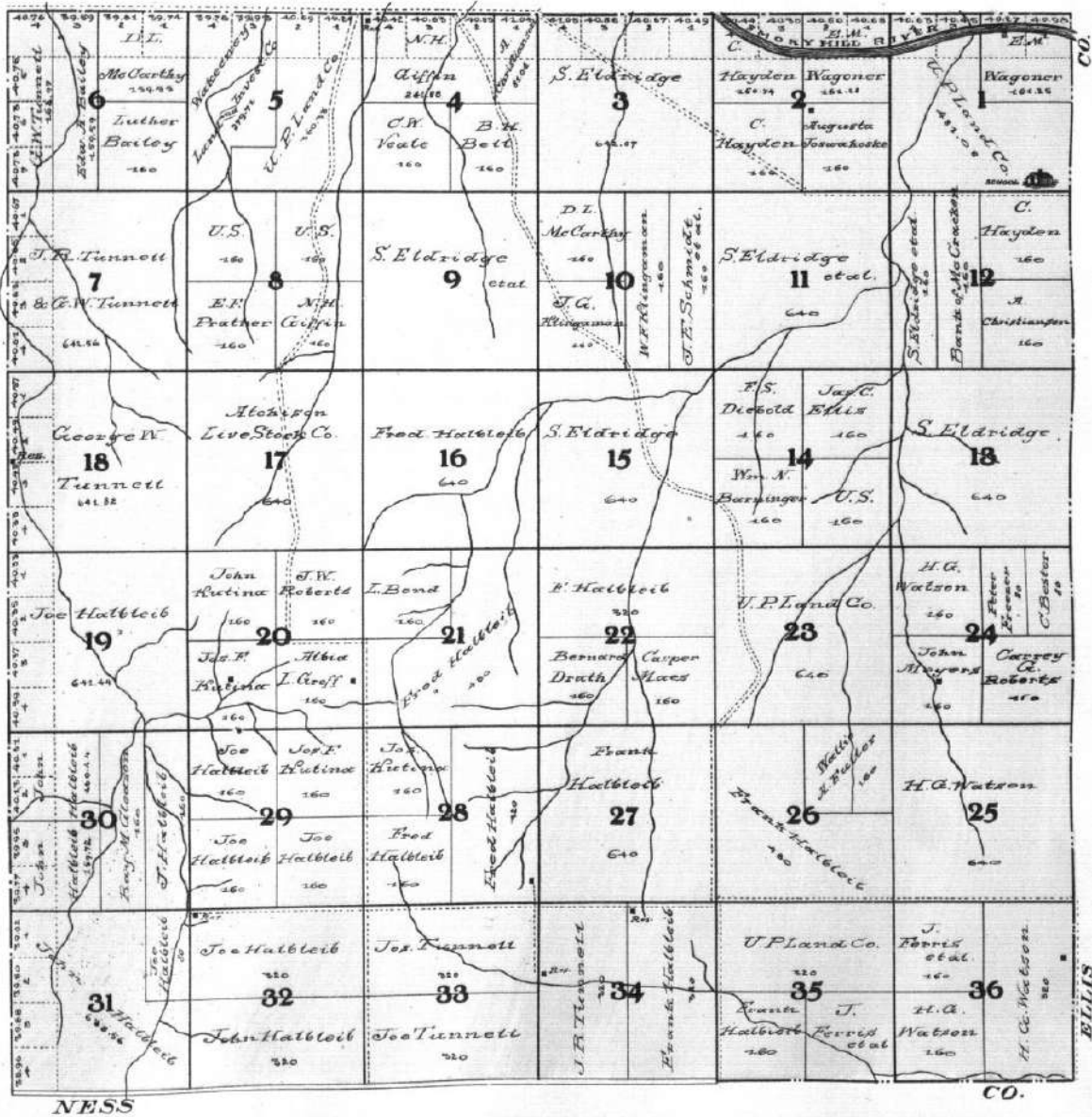



MAP OF
TOWNSHIP 15 S RANGE 22 W
Scale 1/62,500

of the 6th Principal Meridian.

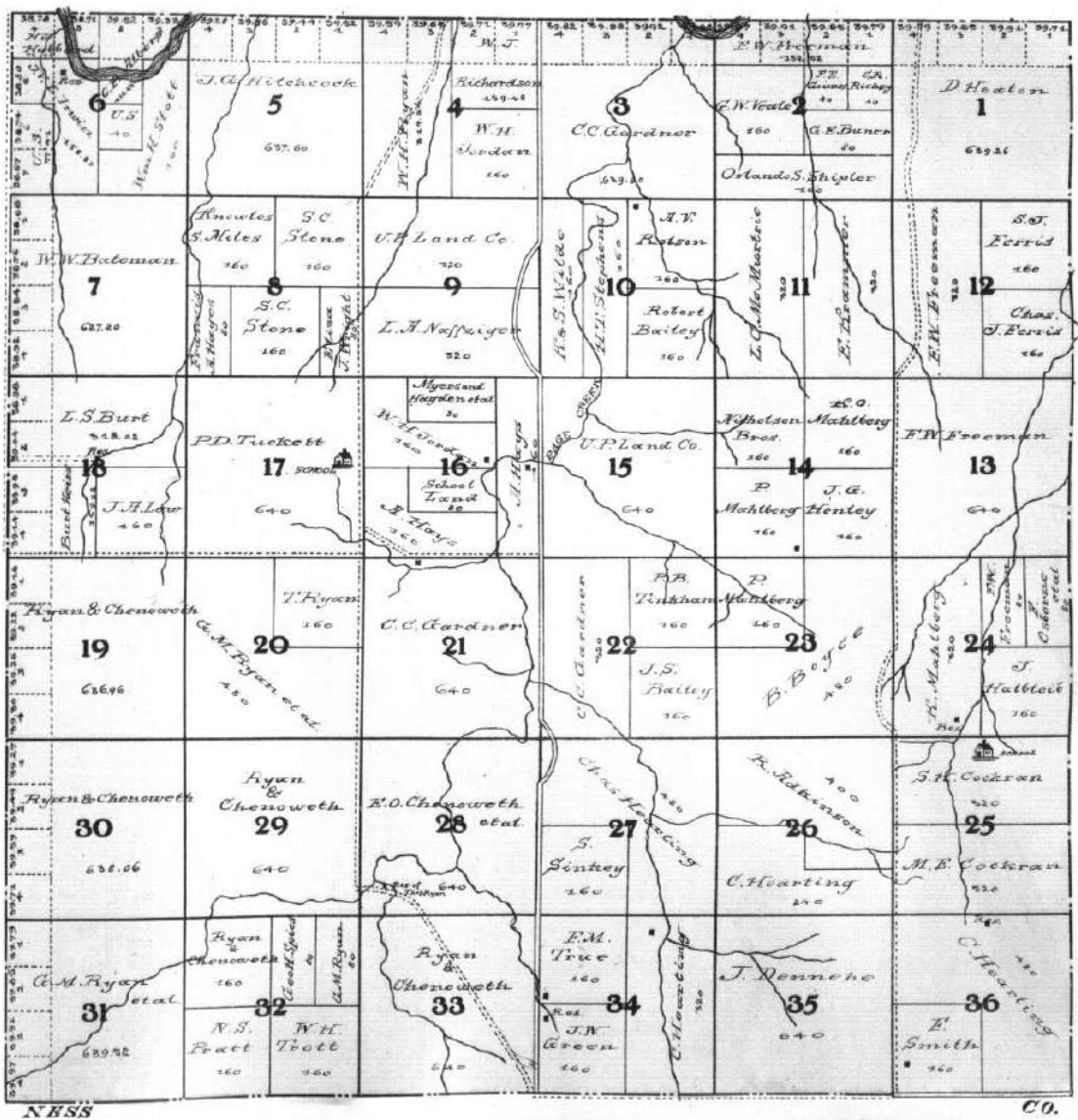

N.B.S.S.

C.O.

MAP OF
TOWNSHIP 15S RANGE 23W
 Scale 1/4 inch to 1 Mile.

of the 6th Principal Meridian.

3670, 3974, 3955, 3809 4 3 2 1 H. J. Helle 6 476.59	3028, 3038, 3044, 3032 4 3 2 1 H. J. Helle 5 476.59	3920, 3925, 3972, 3977 4 3 2 1 J. O. Olson 4 476.59	3922, 3928, 3932, 3926 4 3 2 1 Charles Rogers 3 510.20	3607, 3604, 3905, 3979 4 3 2 1 K. W. Rogers 2 510.20	3907, 3904, 3905, 3979 4 3 2 1 Spangler 1 510.20
3947, 3947, 3947, 3947 4 3 2 1 J. G. Blackstone 7 655.20	3947, 3947, 3947, 3947 4 3 2 1 W. Austin, et al 8 476.59	3947, 3947, 3947, 3947 4 3 2 1 D. E. Spangler, H. E. Welch 9 640	3947, 3947, 3947, 3947 4 3 2 1 W. Austin, et al 10 320	3947, 3947, 3947, 3947 4 3 2 1 K. W. Rogers 11 400	3947, 3947, 3947, 3947 4 3 2 1 Hardy & Irvin 12 650.02
3947, 3947, 3947, 3947 4 3 2 1 Union Pacific Land Co 18 655.20	3947, 3947, 3947, 3947 4 3 2 1 H. Hardy E. Welch 17 640	3947, 3947, 3947, 3947 4 3 2 1 P. P. Mast Estate 16 640	3947, 3947, 3947, 3947 4 3 2 1 K. W. Rogers 15 640	3947, 3947, 3947, 3947 4 3 2 1 R. M. Barnes, J. Gatewood 14 320	3947, 3947, 3947, 3947 4 3 2 1 SCHOOL A. W. Bronson 13 640
3947, 3947, 3947, 3947 4 3 2 1 C. C. Combest 19 437.66	3947, 3947, 3947, 3947 4 3 2 1 W. E. Stowe, W. Scofield 20 160	3947, 3947, 3947, 3947 4 3 2 1 P. P. Mast 21 640	3947, 3947, 3947, 3947 4 3 2 1 A. E. Waddell 22 160	3947, 3947, 3947, 3947 4 3 2 1 Hawley Smith 23 640	3947, 3947, 3947, 3947 4 3 2 1 Trego, C. Hopper 24 160
3947, 3947, 3947, 3947 4 3 2 1 O. E. Lane 30 160	3947, 3947, 3947, 3947 4 3 2 1 O. E. Lane, G. F. Wightman 29 160	3947, 3947, 3947, 3947 4 3 2 1 C. McCreary 28 160	3947, 3947, 3947, 3947 4 3 2 1 W. Lynn 27 400	3947, 3947, 3947, 3947 4 3 2 1 J. Gatewood 26 160	3947, 3947, 3947, 3947 4 3 2 1 G. W. Poland, G. W. Poland 25 160
3947, 3947, 3947, 3947 4 3 2 1 J. Small 31 319.58	3947, 3947, 3947, 3947 4 3 2 1 J. S. Smith 32 160	3947, 3947, 3947, 3947 4 3 2 1 C. C. Combest 33 160	3947, 3947, 3947, 3947 4 3 2 1 G. W. Lynn 34 160	3947, 3947, 3947, 3947 4 3 2 1 D. B. Curtis, A. E. Griffith 35 160	3947, 3947, 3947, 3947 4 3 2 1 Roy Smith 36 640
3947, 3947, 3947, 3947 4 3 2 1 Schreiber Smith 81 160	3947, 3947, 3947, 3947 4 3 2 1 J. S. Smith, A. Shell 32 160	3947, 3947, 3947, 3947 4 3 2 1 C. C. Combest 33 160	3947, 3947, 3947, 3947 4 3 2 1 C. C. Combest 34 160	3947, 3947, 3947, 3947 4 3 2 1 H. C. Beamer, H. H. Poland 35 320	3947, 3947, 3947, 3947 4 3 2 1 DIAMOND GRAIN & STOCK FARM. J. L. Beamer 36 640

NESS

CO.



MAP OF

TOWNSHIP 15 S RANGE 24 W

State Pl. in natural size.

of the 6th Principal Meridian.



N.B.S.S.

CO.



MAP OF
TOWNSHIP 15 S RANGE 25 W
Scale 1/64 inch = 1 mile.

of the 6th Principal Meridian.

