

# MAP OF BUCHANAN COUNTY, MO.

Showing an Outline of the County and its Subdivisions its Congressional and Civil T. P.'s with the Locations of its Towns and Villages, Post Offices, Churches, School Houses, Streams, Wagon Roads, Rail Roads, Proposed Rail Roads &c. &c.

PUBLISHED BY BRINK, McDONOUGH & CO. 1877

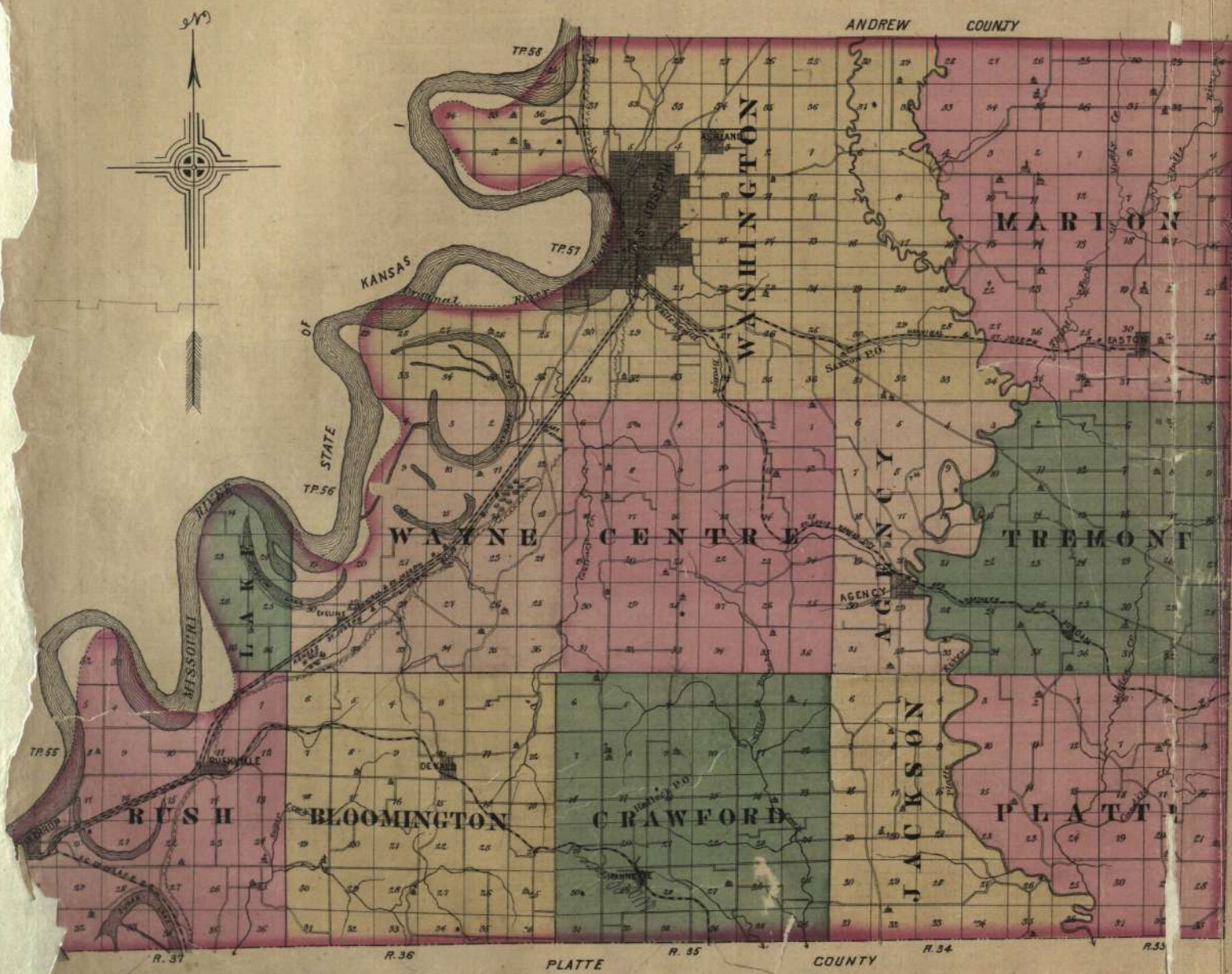

Townships 55 & 56 North  
Range 33 West  
of 5th Principal Meridian and

Tp. 55 N. R. 33 W. of 5th P.M.

Tp. 56 N. R. 33 W. 5th P.M.

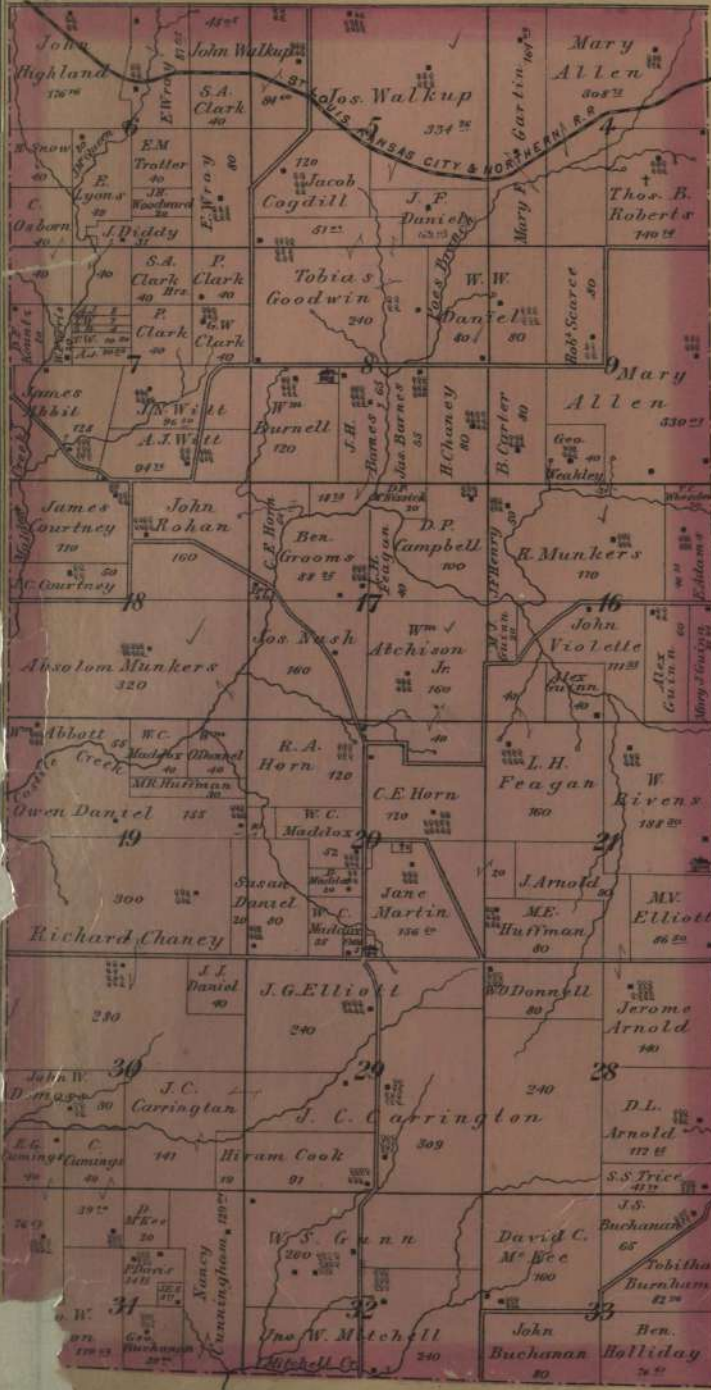

PLATTE COUNTY

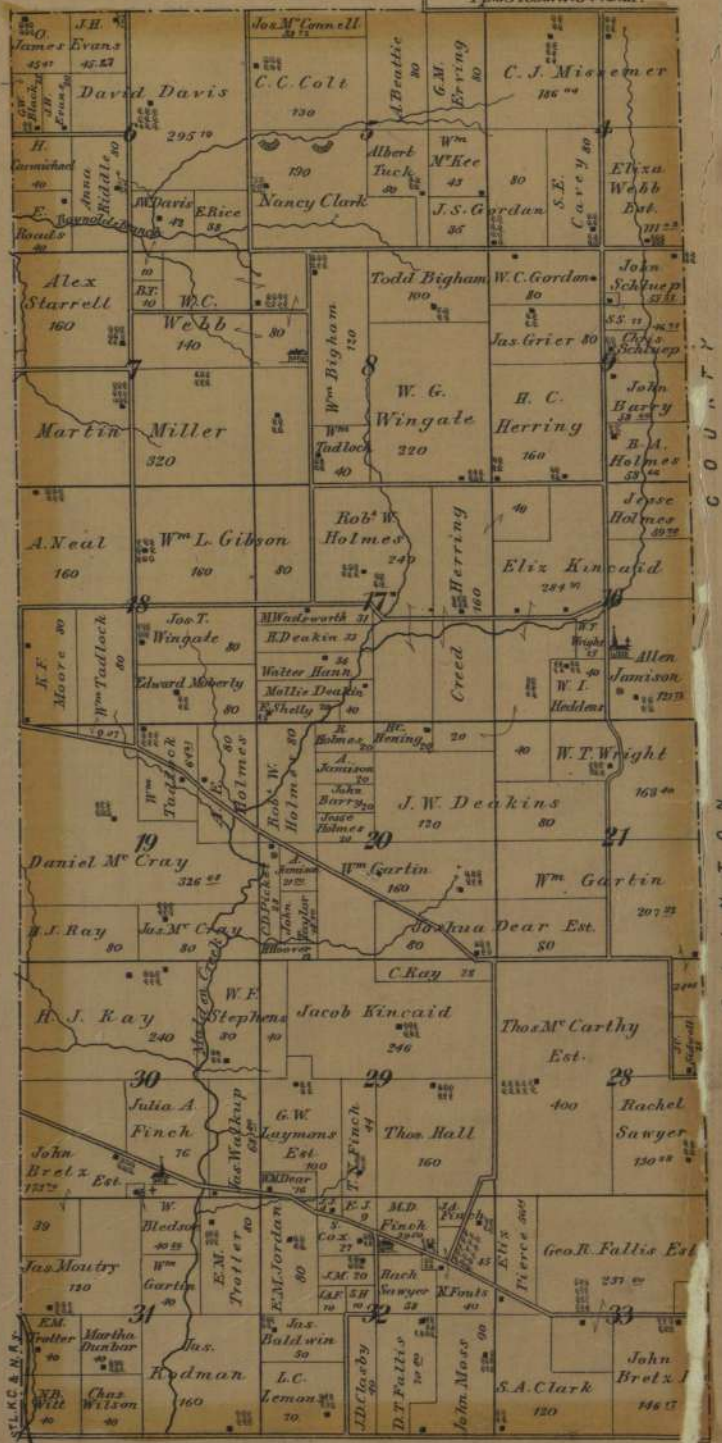

CLINTON COUNTY

Townships 57 & 58 North  
Range 33 West  
of 5th Principal Meridian

Tp 57 Range 33

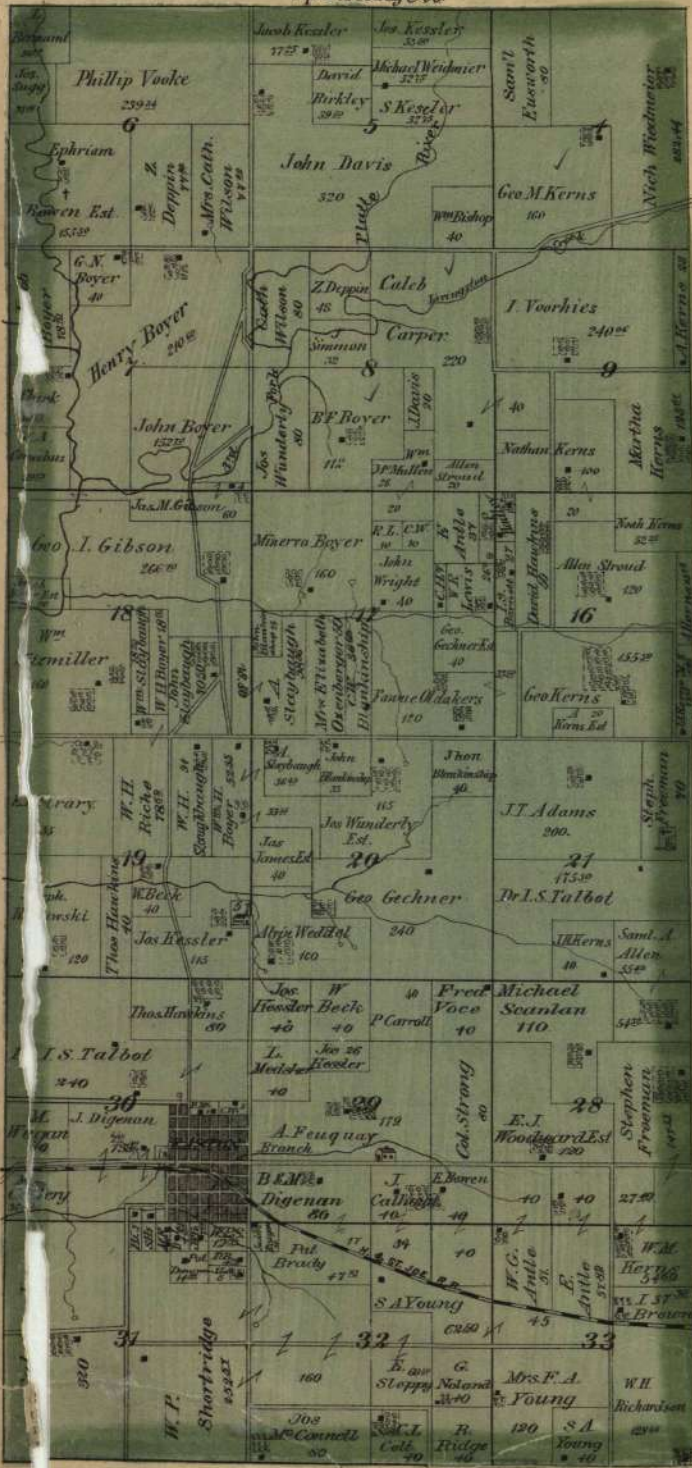

Tp 58 Range 33

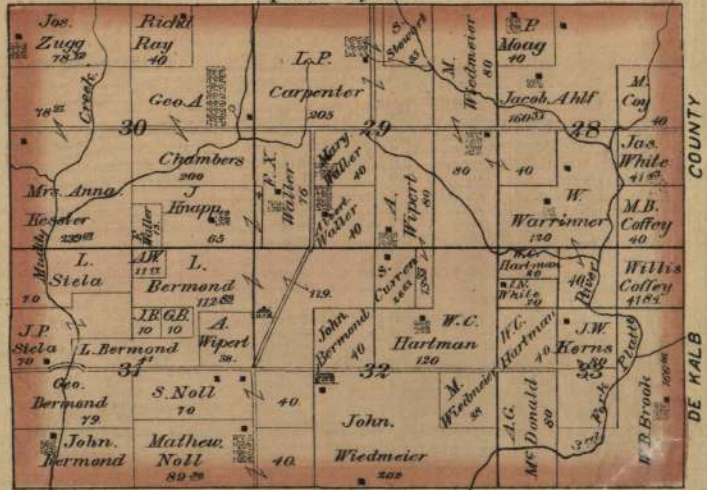

Township 55 North  
Range 34 West  
of 5th Principal Meridian

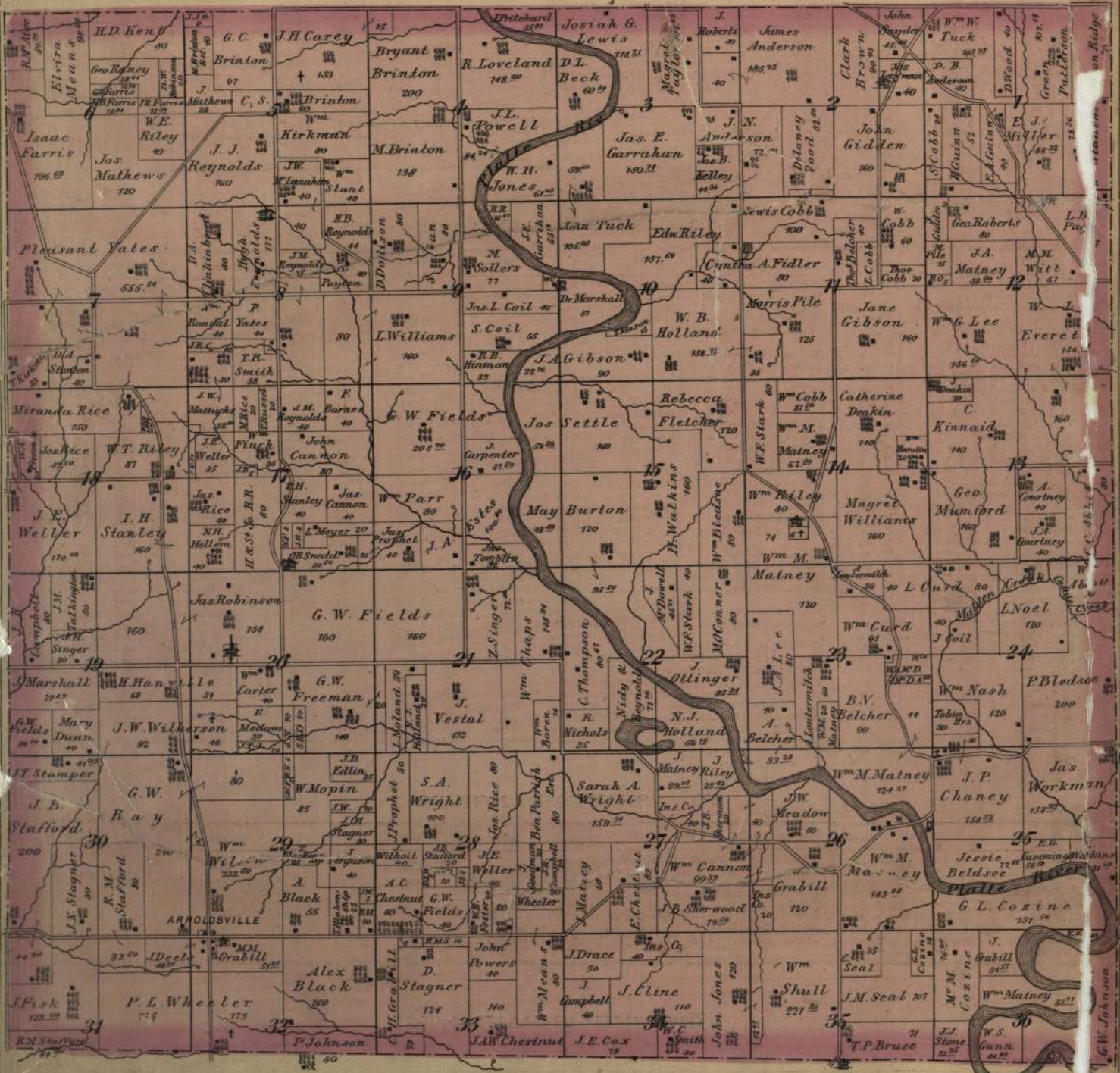

PLATTE COUNTY

Township 56 North  
Range 34 West  
of 5th Principal Meridian

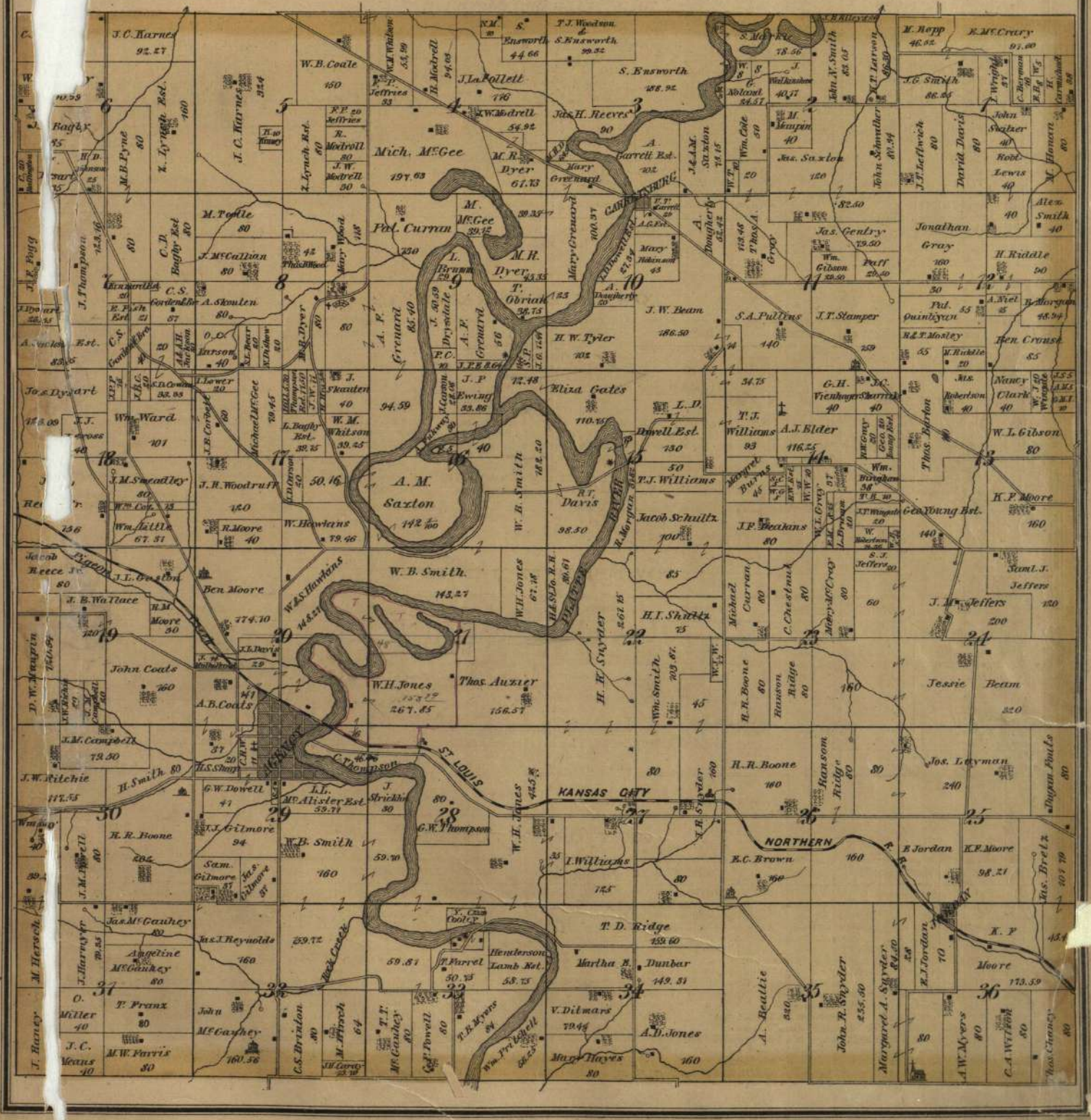



Township 58 North  
Range 34 West  
of 5th Principal Meridian

ANDREW COUNTY

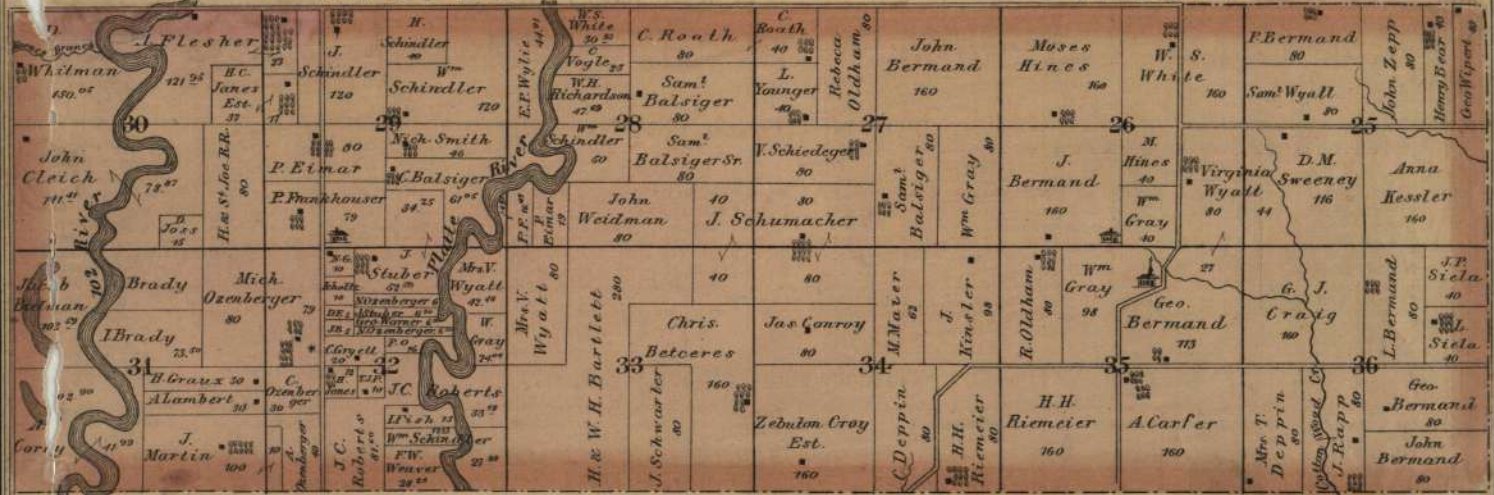

Township 58 North  
Range 35 West  
of 5th Principal Meridian

ANDREW COUNTY

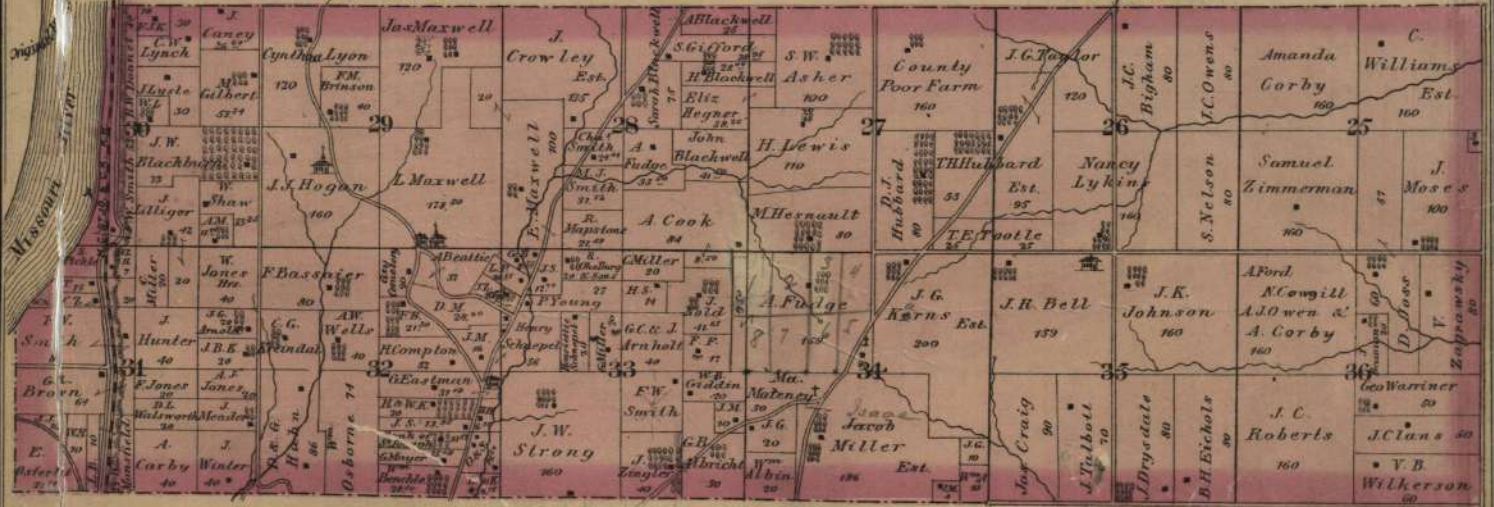

Township 55 North  
Range 35 West  
of 5th Principal Meridian

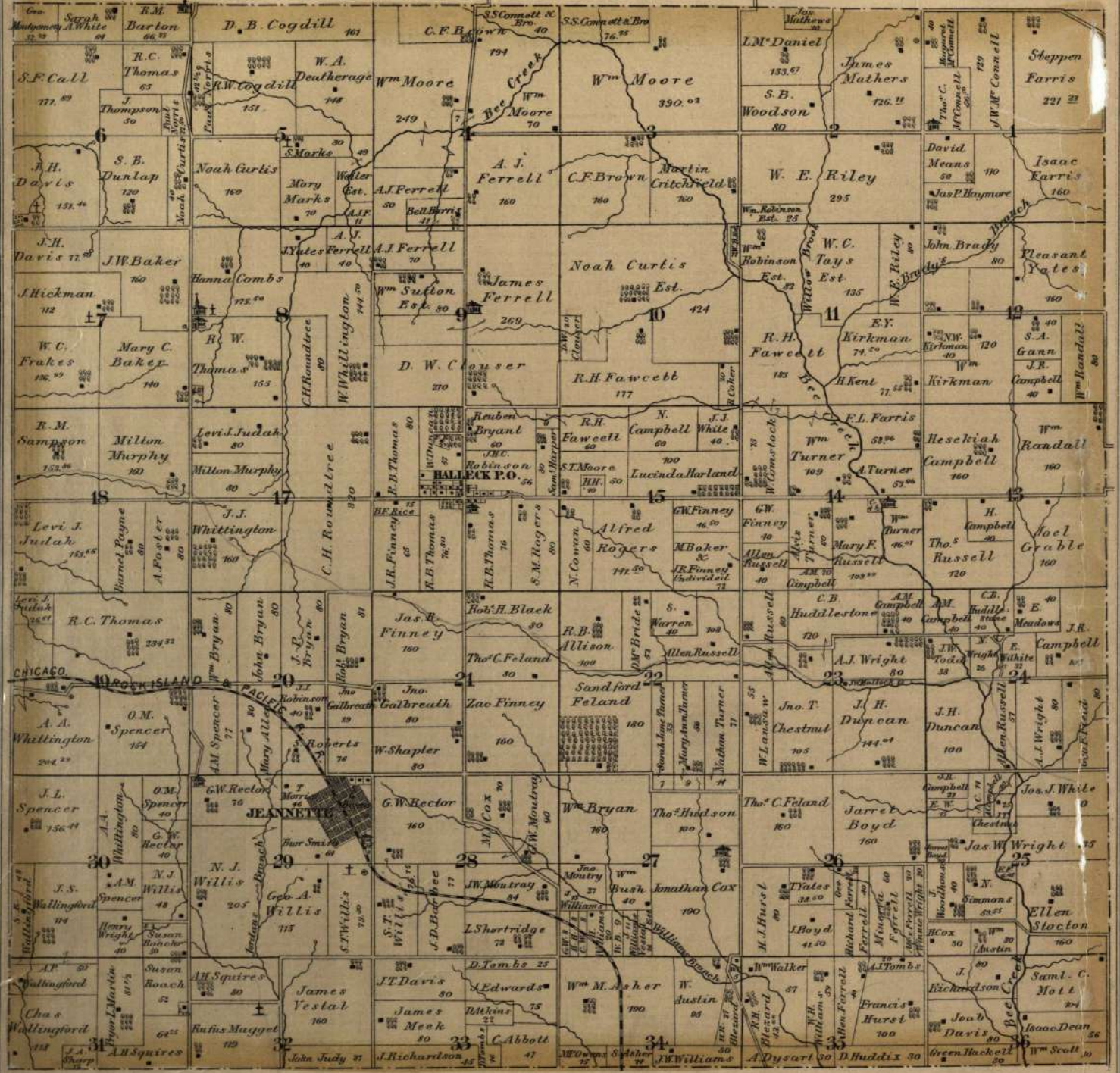

PLATTE

COUNTY



Township 56 North  
Range 35 West  
of 5th Principal Meridian

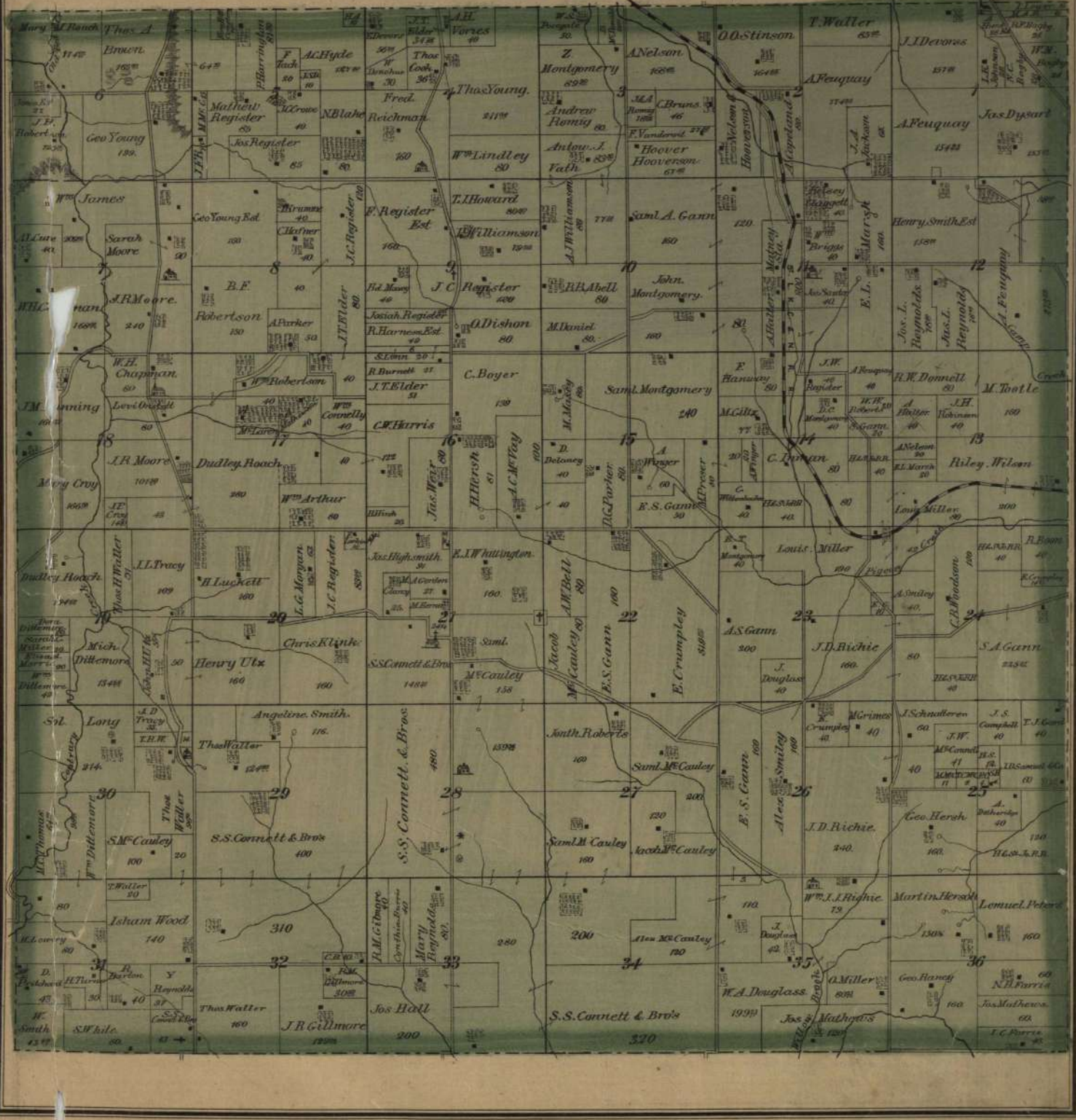



Township 55 North  
Range 36 West  
of 5th Principal Meridian



STATE OF KANSAS

Township 56 North Range 36 West of 5th Principal Meridian

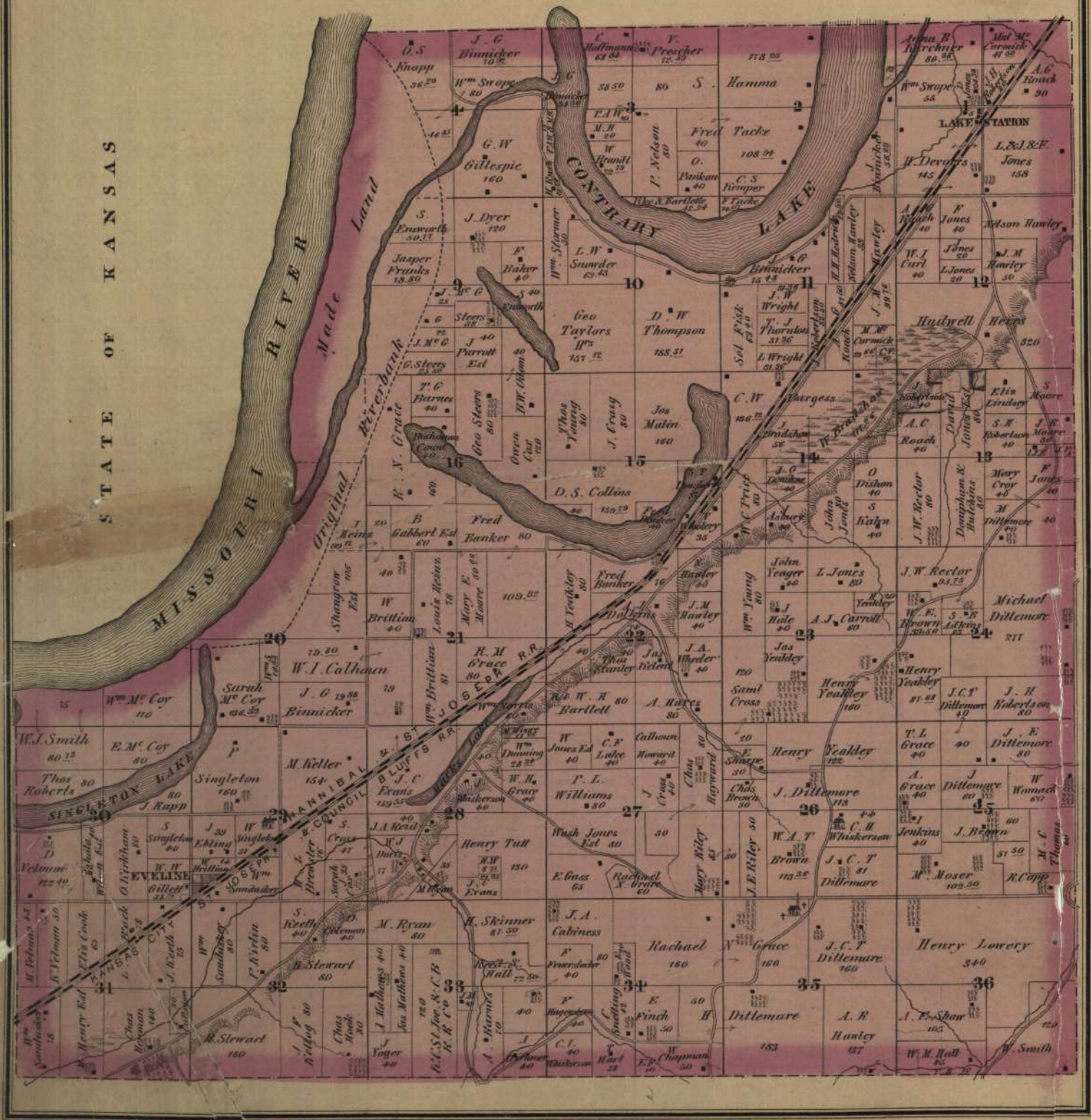

MISSOURI RIVER  
Original  
Plyer bank  
Made Land

CONRARY LAKE

LAKE STATION  
L.&J.&F. Jones

SINGLETON LAKE  
W.I. Calhoun  
J.G. Binnicker

ANNIBAL  
J.C. Francis  
M. Ryan

Wash Jones Est  
J.A. Cabiness  
Rachael Grace

Henry Yeakley  
J.C.T. Dillemore  
Henry Lowery

J.E. Dillemore  
J.H. Robertson  
J.E. Dillemore

W.I. Smith  
Thos Roberts  
Wm. H. H. Bartlett

Henry Tall  
Wash Jones Est  
J.A. Cabiness

Henry Yeakley  
J.C.T. Dillemore  
Henry Lowery

J.E. Dillemore  
J.H. Robertson  
J.E. Dillemore

J.E. Dillemore  
J.H. Robertson  
J.E. Dillemore

Townships 37 & 38 North  
Range 36 West  
of 5th Principal Meridian

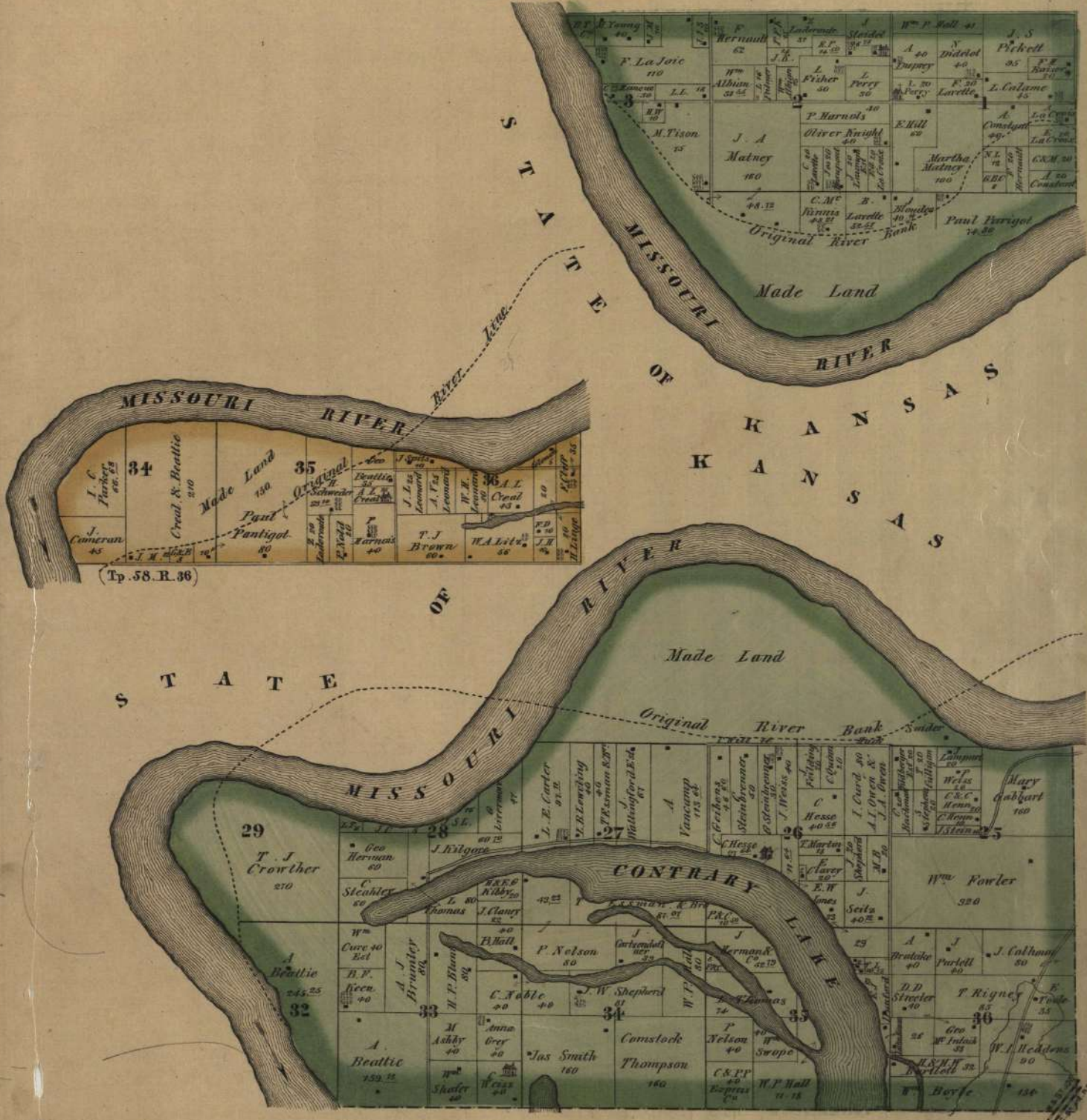

Township 55 North  
Range 37 West  
of 5th Principal Meridian

STATE OF KANSAS

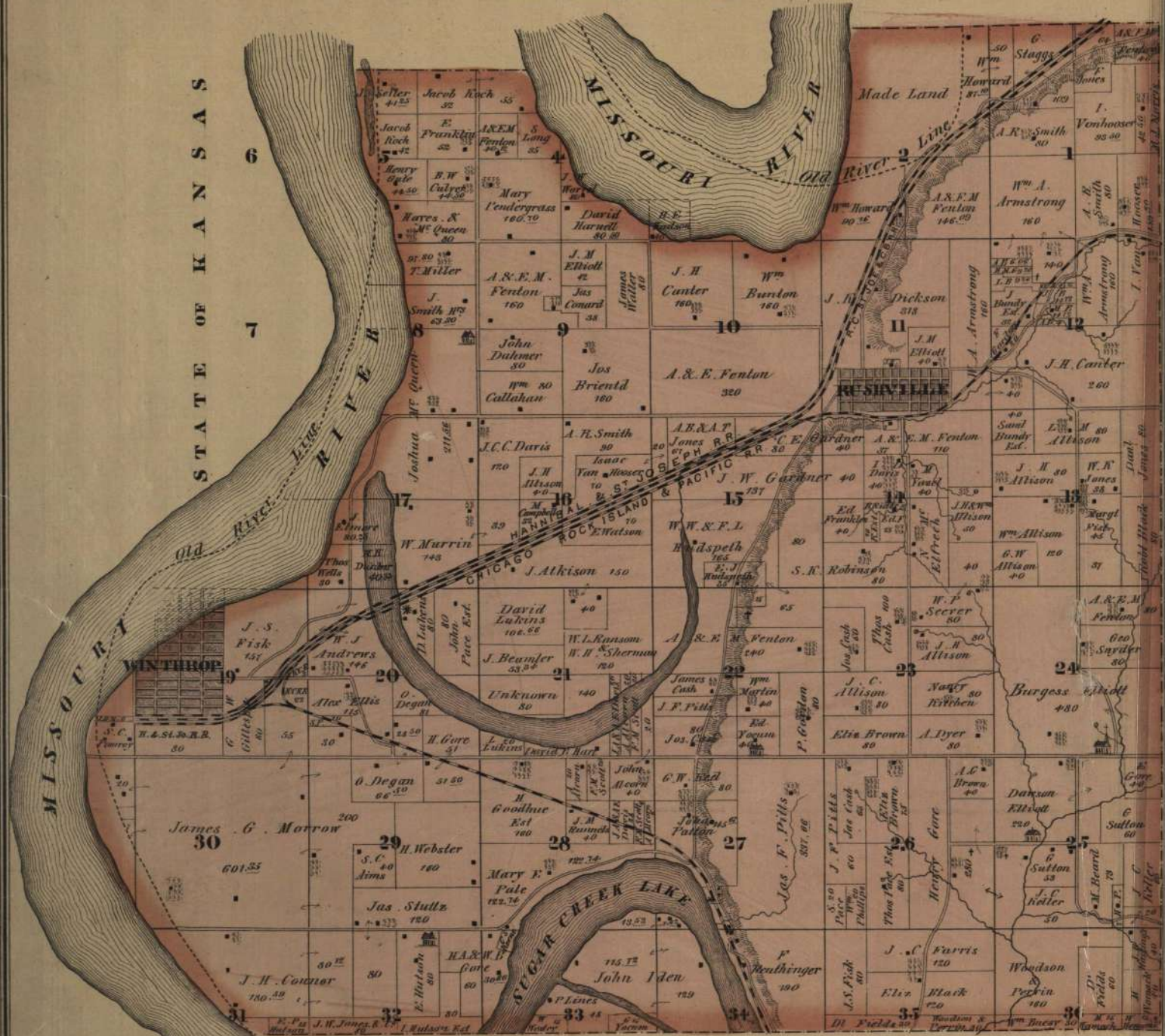

PLATTE COUNTY

Fractional  
Township 56 North  
Range 37 West  
of 5<sup>th</sup> Principal Meridian

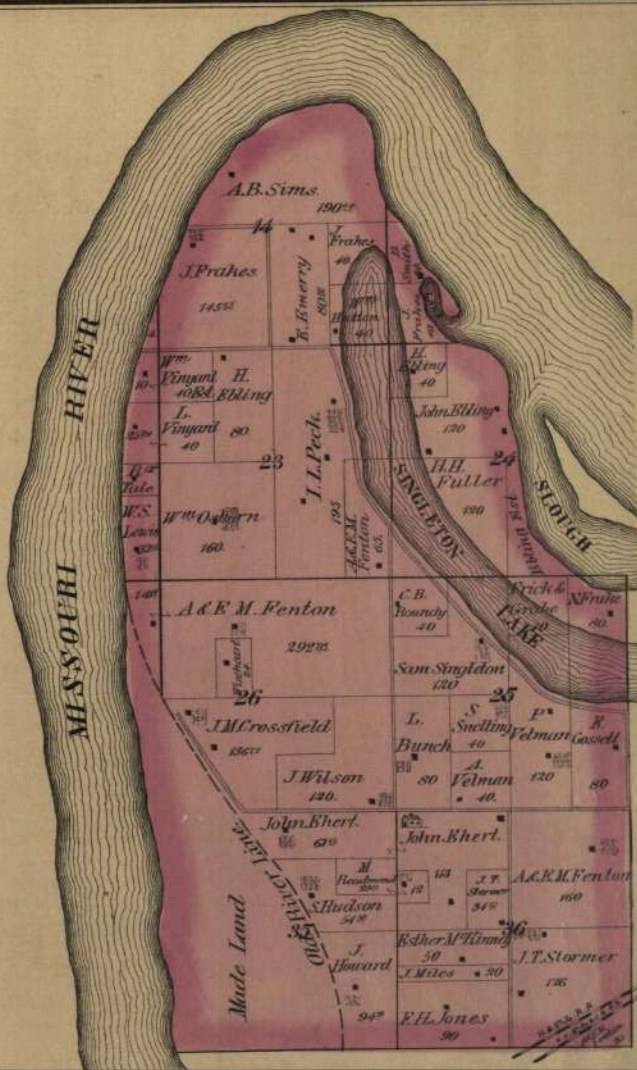

**JEANNETTE**

Located on N.E. 1/4 of Sec. 29 Town. 55 N  
Range 35 West of 5<sup>th</sup> P.M.  
Layed out in 1872  
Scale 600 Feet to 1 Inch

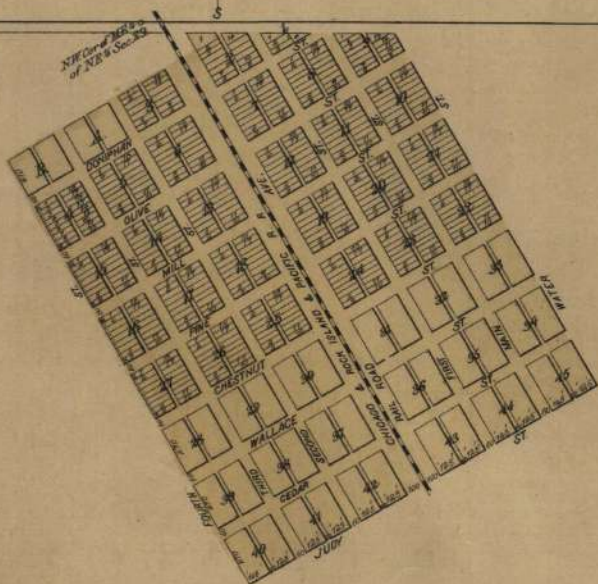

**DE KALB**

Located in South East 1/4 of Section 10  
Township 55 Range 36 West of 5<sup>th</sup> P.M.  
Scale 600 Feet to 1 Inch

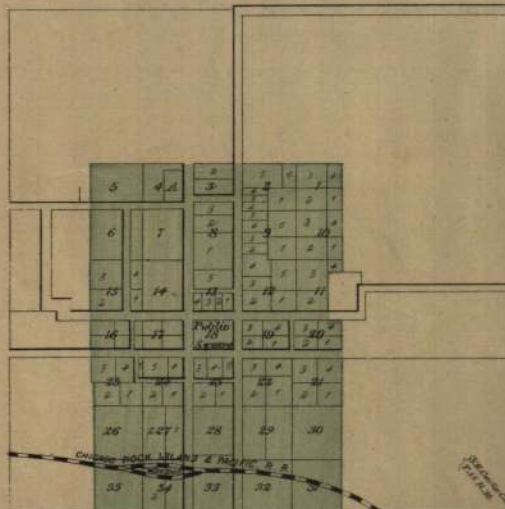

# WINTHROP

Located in Sec. 19 Town 55 Range 57 W of 5<sup>th</sup> P.M.  
Scale 600 Ft to 1 inch

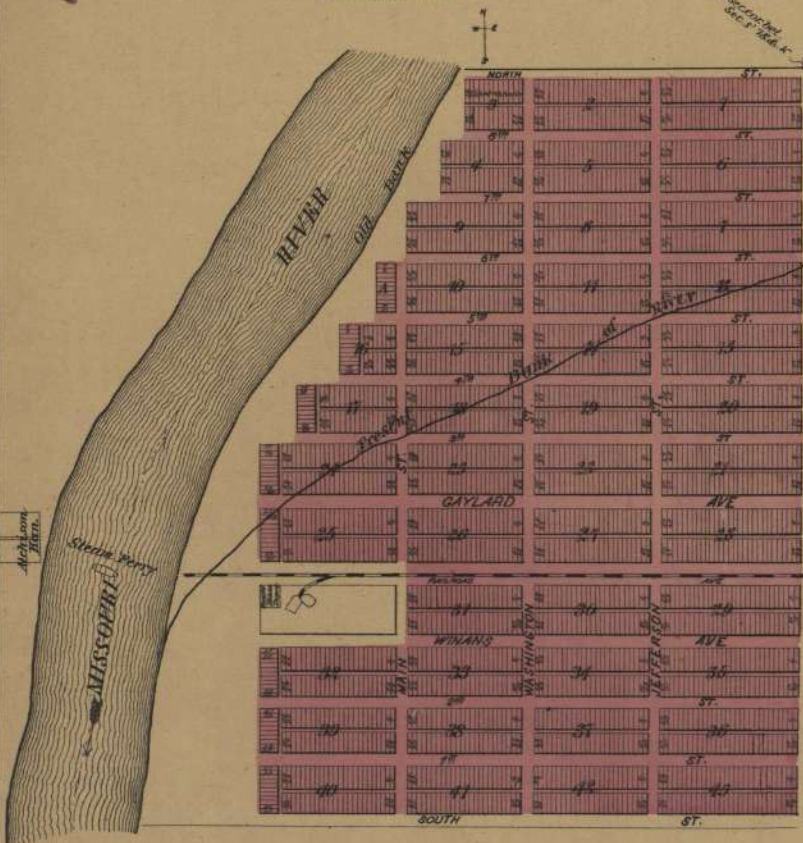

# ASHLAND

Being NW 1/4 of Sec. 3 Town 57 Range 35 W of 5<sup>th</sup> P.M.  
Scale 600 Ft to 1 inch

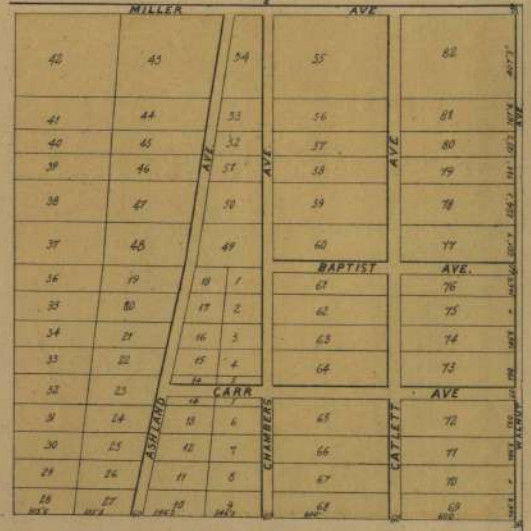

# JORDAN

Scale 600 Ft to 1 inch



# EVELINE

Located in Sec. 29 Town 56 Range 36 N.W. of 56  
Scale 600 Ft to 1 inch



# RUSHVILLE

FORMERLY CALLED COLUMBUS  
Located in Section 11 Town 53 N Range 51 West of 5<sup>th</sup> P.M.  
Scale 600 Ft to 1 inch

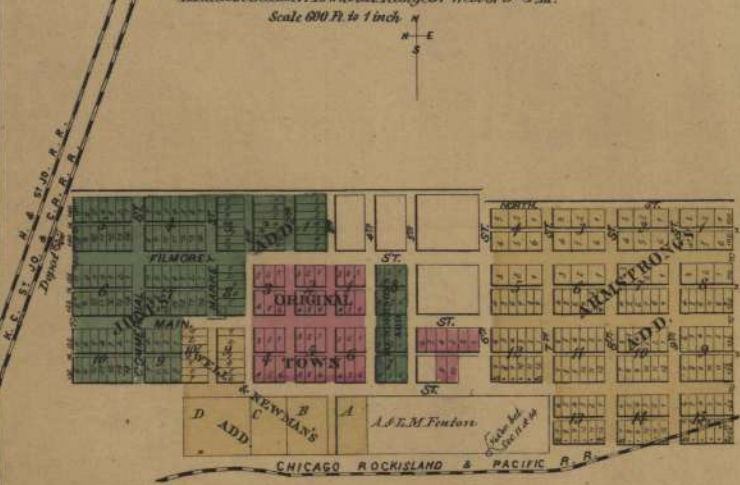

# AGENCY

Located in Sections 20 & 30 in Township 56 N Range 34 West of 5<sup>th</sup> P.M.  
Scale 600 Ft to 1 inch



# EASTON

Located in Sec. 30 Town 57 N Range 33 W of 3<sup>th</sup> P.M.  
Scale 600 Ft to 1 inch

