

OB-MO  
10126-180

HC-TN-2630967  
1224008  
HC-1598

COLLINS CEMETERY

977,8745  
Y3

Located in Ernest Twp.  
R. 27, T 31, Sect 6

Four miles north of Lockwood  
and 3/4 mile east.

Copied by Lyde Daniel

Additional information by:  
Lyle Daniel &  
Mrs. Z. Hazel Yates

Hemet, California  
Family History Center  
25 North Kirby  
Hemet, CA 92343  
658-8104

PUBLISHED BY  
DADE COUNTY MISSOURI HISTORICAL SOCIETY

P.O. BOX 344

GREENFIELD, MO. 65661

Aug. 1975

Wetzel Cemetery - Approx 2.3 miles North-west of Greenfield on BB Hiway - WATCH for Wetzel sign on west side of BB. Then east a short distance down A Lane.  
 Greenfield Cemetery - North off Square 2 blocks to Barrett  
 Approx 3-4 Blocks on Barrett St.  
 Collins Cemetery -

TOWNSHIP 31 RANGE 27

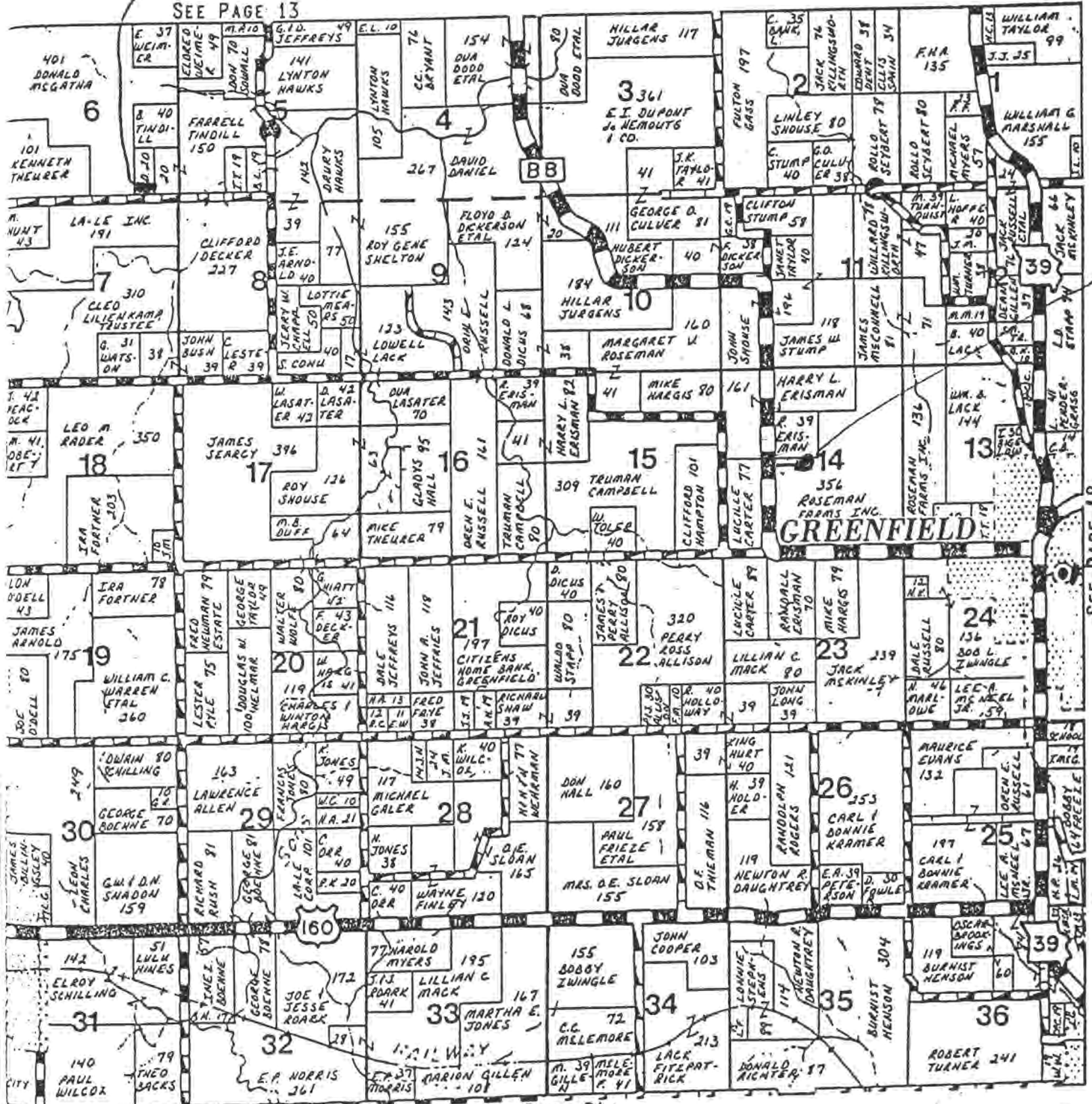

DADE COUNTY MISSOURI CEMETERY RECORDS - Collins

The Collins Cemetery Association was Incorporated with the following people acting as trustees: Farrell Tindill, Oba Lasater and Ralph C. Kelley. Since the death of Ralph C. Kelley, James Polston has become a member of the Board of Trustees.

Officers are: President, Lyle A. Daniel; Vice President Wilber "Bill" Lasater; Secretary Mrs. Ova (Nola Daniel) Lasater; Treasurer Mrs. Raymond (Pluma Daniel) Marlow.

Quick claim deed:

Made on 08 Nov 1913 between Charles M. Collins and Cordelia J. Collins of the County of Dade and State of Mo - Parties of the First Part and O.Z. Palmer, F.L. Kelley and J.P. Tindill, Trustees for the general public.

All of a certain tract of land commencing sixteen rods west of of the south-west corner of the south-east quarter of the south-east quarter of section six (6) township thirty-one (31) of range twenty-seven (27) thence 13 rods north, thence 12 rods west, thence 13 rods south, thence 12 rods east of point of beginning, for the purpose of a general burying place.

Quit-Claim Deed

Made 01 June 1940 between Charles M. Collins, single person of the county of Dade, State of Mo. - party of the first part and Allen B. Daniel, Oscar C. Tindill and Ode W. Lasater, Trustees for the New Additon to the cemetery known as the "Collins Cemetery".

One dollar and other valuable considerations.

A certain tract of land beginning at the North east corner of the old cemetery thence running east 15 rods 6 ½ feet, thence north 13 rods to place of beginning. All being in the South-east quarter of the south east quarter of section six (6), Township thirty one (31) of range twenty seven (27).

## OLD PART

Starting from West side of Cemetery, reads South to North  
 Spaces have been numbered consecutively, but numbers are only listed here for those with a marker of some kind. Wording from the tombstone or marker is underlined.

ROW 1

2. KELLEY, Alta Hester 1883 - 25 July 1931  
 Wife of Frank Kelley. Dau of Chester L. & Eliza F. (Modlin) Daniel
3. KELLEY, Frank Leslie 19 Nov 1875 - 10 Nov 1962, MO Pvt Co H 5 Regt. Ho.  
 Son of Wm. H. & Elizabeth J. (Melton) Kelley Sp. W. Inf.
8. KELLER, Lee C. 5 Dec 1864 - 23 Feb 1954, b. Cyon Co. Ind. son of  
 Abraham Keller. His mother is buried in Indiana. M. at Gosport  
 Indiana to Lizzie Montgomery on 8 Aug. 1886.
9. KELLER, Lizzie 1867 - 1935. Wife of Lee C. Keller. Dau of \_\_\_\_\_ Montgomery.
10. KELLER, Abraham. d 6 Nov 1900 83 years 26 days. Wife is buried in Indiana.
13. Native stone, no dates
14. VANLANDINGHAM, Octavia E. 5 Aug 1853 - 6 Aug 1902 wife of James W.  
 Vanlandingham. Dau. of Peter and Mary G. (Bethel) Daniel
16. DANIEL, Peter 22 May 1811 - 24 Oct 1890 b. TN m. Mary G. Bethel
- 17 DANIEL, Mary G. (Bethel) 4 Jan 1816 - 15 Oct 1895 b. in Tenn.  
 wife of Peter Daniel
18. DANIEL, Chester L d. 11 July 1890 Age 44 y 7-m 12 d. b - 29 Nov 1845  
 Son of Peter & Mary G. Daniel. M. Eliza F. Modlin Civ Fed.
- 19 DANIEL, Eliza Frances 6 July 1853 - 1 Mar 1920 Dau of Allen E. Modlin  
 Wife of Chester L. Daniel
- 20 DANIEL, Nova T 6 May 1902- 8 Dec 1924 Dau of Tom and Pearl (Renfro) Daniel
- 21 DANIEL, Edna Blanche d. 4 Aug 1900, 6 Mo 15 Da  
 Dau of Allen B. & Mary Keller Daniel. Two other children, Dufferon  
 and Thelma Daniel are buried near Enid, Oklahoma.
- 22 DANIEL, Clara 28 Apr 1904 - 6 Aug 1904 Dau of Thomas & Pearl Daniel
23. HARRIS, Mary A 31 Mar 1809 - 17 Mar 1901
- 25 TAYLOR, Susan 23 Nov 1836 - 6 Jan 1874 (1893?)
- 26 TAYLOR, Lydia Alice 26 Oct 1873 - 18 Jan 1896
- 27 McQUELLEY, Mary J 18 June 1867 - 26 Apr 1903
- 28 TAYLOR, Andrew
- 29 TAYLOR, J.M. 1877 -1920. Son of James B. Taylor. Sister: Martha Palmer
- (30 TAYLOR, James E 15 Jan 1833 - 31 Mar 1917 Civ Fed
- (31 TAYLOR, Sarah 3 Oct 1827 - 23 Oct 1914 His second wife.
- 32 B.P.
- 35 Native stone - no dates

## ROW 1 - Old Part (Continued)

- 36 PALMER, O. Z. 1858 - 1935 Baptist Preacher  
 37 PALMER, Martha 1858 - 1944 d. Baptist Home, Ironton, Mo. Wife of  
 Rev. O. Z. Palmer

## ROW 2

2. KELLEY, Chas. Beldon 21 March 1905 - 21 July 1907. Son of C.H. &  
 Jessie (Keller) Kolley. C.H. is buried in Lockwood Cometary  
 4. KELLEY, Greocley 31 Aug 1881 - 1 Nov 1917 Son of Wm. H. & Elizabeth  
 (Melton) Kelley  
 5. KELLEY, William H 2 June 1847 - 16 May 1924. Son of Thomas and  
 \_\_\_\_\_ (Wolf) Kelley. Husband of Elizabeth (Melton)  
 6. KELLEY, Elizabeth Jane (Melton) 28 Dec 1855 - 10 Sept 1924.  
 Wife of William H. Kelley  
 11. Native stone - no dates  
 17. COLLINS, C.M. "Charley" 1855 - 29 Dec 1941. Son of Rev. S.L. &  
 Mary M. Collins  
 23. DANIEL, Ova Carl 30 Oct 1910 - 12 Sept 1928. Son of Tom & Pearl Daniel  
 29. COOK, Noah McFarland 11 Nov 1859 - 8 Nov 1914. m. Lillian Anna Harris  
 30. COOK, Emmet 23 Oct 1883 - 6 Nov 1910 Son of Noah and Lillian Anna  
 (Harris) Cook  
 36. Native stone - no dates

## ROW 3

1. WITTEN, Lavise 1849 - 1913 wife of August Witten  
 2. WITTEN August 1845 - 1919  
 5. Native stone - no dates  
 8. TEMPLETON, John Rushton 19 Mar 1899 - 5 Dec 1899  
 13. FAMLIGNER, Georgia 1857 - 1929 Dau of Owen W. & Hannah (Penn) Bates  
 m(1) 16 May 1875 Benjamin F. Harris. m(2) \_\_\_\_\_ Faullmer  
 14. Native stone - no dates  
 15. HARRIS, Benjamin F 30 May 1851 - 10 May 1891. Son of Israel and  
 Emaline (\_\_\_\_\_) Harris  
 16. HARRIS, John H 13 Oct 1883 - 20 Feb 1906  
 17. COLLINS, Lillian Anna 1865 - 11 Dec 1928. Dau of Israel & Emaline  
 Harris m(1) Noah Cook. m(2) Charles Collins (his second wife)  
 18. COLLINS, Cordelia Jane 1854 - 1922 Dau of Israel & Emaline Farris.  
 m(1) James A King 5 March 1871. m(2) Charles Collins 21 Jan 1877  
 (his 1st wife)



## ROW 3 (continued)

- 19 COLLINS, Dora E 22 Aug 1882 - 15 July 1903 Dau of C. M. "Charley" and Cordelia (Harris) Collins
- 20 COLLINS, Joseph d 18 Dec 1888 2 yr 2 mo
- 21 SWEENEY, Infant d. 1 Mar 1884 5 days child of W.E. & J.E. Sweeney
- 24 HARRIS, Joseph M 29 Aug 1845 - 16 May 1890 son of Israel & Emaline Harris. m. Lourillar N. Buchanan 2 Jan 1870
- 25 HARRIS, Lourillar N.J. 23 Sept 1884. Dau J.H. Buchanan. m. Joseph M. H Harris.
- 26-29 Harris family - no stones
- 30 Native stone, no dates
- 35 Native stone - no dates
- 36 Native stone - no dates

## ROW 4

2. SINGER, Lillie I 17 Oct 1910 - 12 Feb 1913 dau Frank & Effie Singer
- 3 SINGER, Ovie 15 Mar 1915 - 17 Feb 1916 son of Frank & Effie Singer
- 4 SINGER, Frank 1884 - 1972 m. 3 Mar 1907 Effie Rankin
- 5 SINGER, Effie 1882 - 1969 wife of Frank Singer Dau of \_\_\_\_\_ Rankin
- 8 Native stone - no dates
- 16 Native stone - no dates
- 18 Native stone - no dates
- 20 Native stone - no dates
- 23 BUCHANAN, James H 12 Nov 1811 - 16 Dec 1893. m(1) Rosia Clopton  
m(2) Roanna (Dicus) Sloan m(3) Mrs. Sarah J.A.E. Etter
- 24 BUCHANAN, Wm. Andrew 1851 - 4 Aug 1938 son of J.H. Buchanan  
husband of Clara L. Carman m. 14 Sept 1873
- 25 BUCHANAN, Clara 1855 - 1934 wife of Wm. Andrew Buchanan  
dau of \_\_\_\_\_ and Milly (McBride) Carman
- 26 FARMER, Retta Emiline 1887 - 1916
- 27 FARMER, Ronald E 31 Aug 1905 - 24 Aug 1910 Son of Robert & Retta Farmer
- 28 HARRIS, Emeline 30 Apr 1825 - Nov 1910 wife of Israel Harris
- 29 HARRIS, Israel d 12 March 1882 age 62 yr 10 mo 26 da
- 35 KELLER, Julia 1854 - 1946 dau of \_\_\_\_\_ Young. Wife of John Keller  
who is buried in Oklahoma
- 36 KELLER, Curtis 23 May 1900 - 15 Mar 1935 Son of John & Julie (Young)  
Keller Single Okla Pvt 1 C 1 38th Inf. WW I
- 37 Native stone - no dates

## ROW 5

- 2 Native stone - no dates
- 3 STRAND, Beulah J 13 Mar 1925 - 25 June 1953 dau Edward A & Robbie W.  
(Finley) Strand
- 4 STRAND, Edward A 1877 - 23 May 1937 m. Robbie W. Finley
- 5 STRAND, Robbie W 10 Dec 1883 - 19 Apr 1958 dau Robert & Eliza J. Finley  
step dau of John Evans. Wife of Edward A. Strand
- 8 BATES, Charles d 23 June 1899 Age 87 yr 3 mo 6 da
- 9 BATES, Louisa d 22 Nov 1891 Age 69 yr
- 11 BARNES, Clahab d 9 Dec 1878 3 mo 18 da
- 12 BARNES, Infant 2 Oct 1883
- 13 Native stone - no dates
- 14 SORDEN, Oliver 9 Dec 1881 - 15 March 1940
- 15 SORDEN, Edith (Grant) 19 Nov 1885 - 28 Aug 1957
- 17 LASATER, Ida B 14 Mar 1867 - 9 Apr 1963 Dau of George Palmer
- 18 LASATER, Eddward Lewis 1 Dec 1867 10 Dec 1943 son of Hardy & Casandra  
(Walker) Lasater. m. Ida B. Palmer
- 19 LASATER, Blanche 10 June 1901 - 10 June 1901 dau Ode & Sarah (Burnett)  
Lasater
- 20 LASATER, Infant dau of Edd L & Ida B. Lasater
- 22 ROGERS, Elizabeth 2 Nov 1828 - 24 July 1914. Wife of Jacob Rogers
- 23 ROGERS, Jacob d. 14 July 1891 Age 63 yr 30 da
- 24 ROGERS, Minnie B 23 Apr 1868 - 19 Oct 1873
- 26 PURDY, Celia (Rogers) 1858 - 24 July 1934 Dau of Jacob & Elizabeth Rogers  
wife of William A Purdy
- 27 FURDY, William A 1850 - 1940 m. Celia Rogers
- 29 FURDY, Bertha A 1883 - 1966 dau of W.A. & Celia (Rogers) Purdy

## ROW 6

- 2 BROCKEN, Otis 1916 - 11 Feb 1928 son of Orville & Bell Bronson
- 11 COLEMAN, Ralph S 1 Sept 1890 - 2 July 1891
- 18 LASATER, Casander (Walker) 3 Jan 1831 - 9 Oct 1912 wife of Hardy Lasater
- 19 LASATER, Hardy 1824 - 6 Aug 1897 Son of Cannon L. Lasater
- 21 LASATER, Newton 1864 - 1894 Son of Hardy & Casander Lasater
- 23
- 24 \_\_\_\_\_ Floyd I
- 25 Native stone - no dates

## ROW 6 (Continued)

- 26 LASATER, Matilda 1859 - 24 Apr 1936 Dau of Jacob Rogers. Wife of  
William Jasper Lasater
- 27 LASATER, William Jasper 3 Aug 1856 - 10 Jan 1951. Son of Hardy and  
Casander (Walker) Lasater. m. Matilda Rogers
- 28 VanBUSKIRK, Lydia 2 Jan 1842 - 28 July 1922
- 29 SHIPLEY, Claud 1 Mar 1872 - 15 Sept 1953 Son of George & Mary (Rowan)  
Shipley. m. Osie VanBuskirk
- 30 MILLIGAN, Martha V d. 22 March 1959 Age 82 y 10 m 19 da

## ROW 7

- 3 COWEN, \_\_\_\_\_ Native stone, no date. Brother of Nettie (Cowen) Mitchell
- 6 COTTEW, Stephen S 1847 - 1930 CO H 59th Regt. Ill Vol Inf Civ Fed
- 7 COTTEW, Christina E 1854 - 1899 Wife of Stephen S. Cottew
- 8 GEHON, Alice Edith 22 Sept 1884 - 20 July 1913 dau of Stephen S. &  
Christina E. Cottew
- 9 GEHON, Thomas Mason 1881 - 17 Oct 1950 Son of Martin V.B. &  
Emma (VanOsdell) Gehon
- 14 WOOLDRIDGE, Margaret 1840 - 1930 Wife of John Wooldridge
- 15 WOOLDRIDGE, Matilda 2 Apr 1878 - 11 Aug 1949 Dau of John W. & Margaret  
Wooldridge
- 16 WOOLDRIDGE, John W 1834 - 1909 Civ Fed
- 17 WOOLDRIDGE, Thomas 1873 - 1902 Son of John W. & Margaret Wooldridge
- 18 PURDY, Thomas S 15 Feb 1818 - 1 Feb 1899
- 20 VAN BUSKIRK, Elzanna 1805 - 1884
- 23 Native stone - no dates
- 24 PURDY, Infant d. 9 Oct 1881 Age 6 mo 17 days
- 25 VanBUSKIRK, Henrietta 26 Jan 1881 - 14 Oct 1881
- 26 VanBUSKIRK, Mary E 24 June 1854 - 22 July 1883 Wife of Daniel
- 27 VanBUSKIRK, Nathan 18 Jan 1883 - 5 Aug 1883
- 28 VanBUSKIRK, Daniel 5 June 1849 - 10 Nov 1910
- 29 SHIPLEY, Osie 29 Oct 1878 - 22 May 1919 Dau of Daniel & Mary E. VanBuskirk.  
wife of Claud Shipley
- 30 SHIPLEY, Mary E 21 Apr 1902 - 7 Dec 1922 Dau of Claud & Osie (VanBuskirk)  
Shipley
- 31 CLAYTON, James E
- 37 MARSHALL, Ralph 1909 - 1935 Son of James & Alice Marshall.  
Helen Bush (Helen m<sup>2</sup> Finis Allison)



## ROW 8

- 5 PRICE, Daniel 24 Nov 1837 - 22 Feb 1907
- 6 PRICE, Didama 25 Jan 1841 - 4 Apr 1901
- 7 PRICE, Charley D
- 8 PRICE, Fred I
- 12 BURNETT, W.L. 25 Nov 1822 - 13 July 1905
- 13 BURNETT, Anna 4 Dec 1833 - 13 Jan 1911
- 14 Native stone
- 15 Native stone
- 17 Native stone
- 18 TINDILL, Sarah (Vanhooser) 1858 1 June 1894 Wife of Cannon Tindill  
(he is buried in Oklahoma)
- 19 Native stone
- 20 Native stone
- 21 Native stone
- 22 TINDILL, Maud Elizabeth 1891 - 1892 Dau of James & Alice (Bush) Tindill
- 23 TINDILL, Frank Leo 24 Sept 1890 - 8 Nov 1916 son of James & Alice (Bush) Tindill
- 24 TINDILL, William d 16 Feb 1903 Age 83 yr 1 mo 21 da
- 25 TINDILL, Mary J 11 Oct 1830 - 14 Feb 1923 Wife of William Tindill
- 26 TINDILL, Charles Monroe "Charley" 19 Apr 1862 - Mar 1944 son of William & Mary J ( ) Tindill
- 27 TINDILL, Emily 5 April 1862 - 16 Dec 1940. dau Christopher & Malinda Clark
- 31 STRAHAN, Frank Jr Dec 1920 (Stillborn) son of Frank & Linnie (Collins) Strahan
- 35 CALMER, Theodore "Tobe" 5 Dec 1874 - 7 July 1932 m. 31 Oct 1901 Ella Polston
- 36 CALMER, Ella 1 May 1883 - 23 Dec 1957 dau \_\_\_ Polston m. Theodore Calmer
- 37 CALMER, Clifford 8 Dec 1917 - 23 Jan 1918 son of Theodore & Ella Calmer

## ROW 9

- 5 KIMBLER, Mary Lucille 1923 - 24 Mar 1938 dau Roy & Letta (Davis) Kimbler
- 6 KIMBLER, William Henry 7 Jan 1872 - 24 May 1951 Son Rev. W.Z.T. Kimbler  
m. Laura M. Gentry (sister of Sidney Ann Jeffreys)
- 7 KIMBLER, Laura Melissa 11 Sept 1868 - 15 Sept 1925. dau of Minor Gentry  
m. Henry Kimbler
- 9 BURNETT, Charles William 7 Sept 1872 - 30 June 1959 Son of Lavander &  
Elvira Burnett. m. Hattie S. Martin
- 10 BURNETT, Hattie S 29 Jan 1873 - 26 Dec 1930. Dau of John & Mollie (Rogers)  
Martin. John son of Isaac & Margaret (Mitchell) Martin. Mollie dau of  
Jacob Rogers. Hattie m. Charles Burnett.
11. BURNETT, James S 18 March 1878 - 23 Jan 1895
- 12 BURNETT, W.L. Sgt Co F - 48 MO Inf

Row (continued)

- 14 BLACKBURN, Retta d. 5 Jan 1910 Age 18 yr 6 mo 3 da. wife of R.G. Blackburn
- 15 COLLINS, Mary M 16 Feb 1822 (OH) - 21 1902. Wife Rev. Stephen L. Collins
- 16 COLLINS, Rev. Stephen L 4 May 1816 (NY) - 31 March 1902 (Center Twp #126  
1880 Census Dade Co MO)
- 18 COLLINS, Alpha L
- 20 BURNETT, Claude 1874 - 1918 Brent, France. Returned for burial 28 May  
1920. Son of James Burnett.
- 21 BURNETT, James 1868 - 9 Mar 1907
- 22 BURNETT, William C 1892 - 1893
- 23 Native stone

No stones found for the following sisters Buried somewhere in Collins:

- • OSENBAUGH, Mattie (Tindill) d. Fall of 1881. 1st wife of Cary Osenbaugh
- OSENBAUGH, Mary (Tindill) d. 28 Oct 1913 3rd wife of Cary Osenbaugh
- 35 Native stone
- 36 Native stone

ROW 10

- 3 SHOEMAKER, John Aaron 12 Nov 1919 - 16 Dec 1939
- 13 Native Stone - no dates
- 14 COLLINS, Ira J 1885 - 26 Sept 1931 grandson of Stephen Collins
- 19 HAMPTON, Farrell & Harold twin sons of Ralph & Irma (Tindill) Hampton
- 20 LITTLE, Lola L 1919 - 1925 twin to Leo Dau Laurence - Lula (Tindill)  
Little
- 21 LITTLE, Lula M 10 Aug 1900 - 30 June 1935 dau Charles & Emma (Clark) Tindill
- 24 TINDILL, James Otis apr 1896 - 15 Feb 1928 Son of Charley & Emily  
(Clark) Tindill
- 26 TINDILL, James 1925 - 15 Mar 1930 Son of James Otis & Bessie (Culver)  
Tindill
- 27 TINDILL, Oletha Mae b - d 21 Jan 1929 dau Carl & Oletha (Greer) Tindill
- 32 MITCHELL, Arthur son of Thomas E & Barby (Watkins) Mitchell Native stone  
no dates
- 33 SHANNON, Ida b - d 29 Sept 1869 dau John W & Martha Jane (Mitchell)  
Shannon
- 34 SHANNON, Joseph A 16 June - 13 Oct 1870 Son of John W & Martha (Mitchell)  
Shannon
- 35 SHANNON, Lucy b - d 11 Oct 1867 dau of John W & Martha J (Mitchell)  
Shannon
- 36 Native stone - no dates

36 Native stone - no dates

37 SHANNON, John W d 1 Aug 1880 age 38 yr 7 mo 17 da. Son of Joseph & Martha Shannon, Joseph born Londonderry Ireland, Martha born Pa. Wife Martha Jane Mitchell was dau of Wm B. & Malinda (Burlison) Mitchell Civ Fed

39 Native stone - no dates

## ROW 11

3 SHOEMAKER, Laura 25 Apr 1892 (Arkansas) - 7 March 1933. Dau of Charles M & Amanda (Watkins) Clark. Wife of John Shoemaker (buried at Joplin Mo.)

5 BUCHANAN, Sarah A.J.E. d. \_\_\_\_\_ Age 80 Yr 7 Mo 8 da. M(1) Stokely Etter. M(2) James H. Buchanan

6 Native stone - no dates

12 OSENBAUGH, Cary E 1861 - 19 Oct 1934. m(1) Mattie Tindill m(2) Elisa "Lizzie" Burnett 4 Mar 1883 m(3) Mary Tindill m(4) Hattie Sterman

13 OSENBAUGH, Hattie (Sterman) 1872 - 1953

15 HAWKINS, Andrew d. 18 March 1884 Age 24 yr 6 mo 4 da

16 LASATER, Elizabeth (Hawkins) 5 Dec 1860 - 27 Mar 1909

17 LASATER, John 21 Oct 1858 - 22 Apr 1911

21 ROGERS, Estes 1873 - 1947

22 ROGERS, Etta M. (Springer) 6 Oct 1876 - 13 Feb 1953 Wife of Estes Rogers

26 PETERSON, Nancy M d. Age 44 yrs

33 Native stone - no dates

36 BUSH, Richard 1912 - 1916 Son of James O. & Minnie (Polston) Bush

37 Native stone - no dates

## ROW 12

1 CLARK, Eva 16 Jan 1899 - 27 March 1900

2 CLARK, Amanda 8 July 1871 - 21 Apr 1901 Dau of Watkins, M. Charles W. Clark

4 McBRIDE, Thomas 18 Mar 1801 - 15 Jan 1886

5 McBRIDE, Matilda d. 9 Aug 1885

7 DANIEL, "Millie" (McBride) d. 3 Nov 1891 Age 55 yrs. m(1) \_\_\_\_\_ Carman. (6)  
m(2) Green W. Daniel

8 DANIEL, Green W 2 Mar 1844 - 25 Mar 1913. Son of Peter & Mary Daniel, Civ Fed

22 KING, Infant daughter

29 PALMER, George 8 Nov 1818 - 7 Apr 1885

30 PALMER, Elizabeth Oct 1838 - 6 June 1873 Wife of George

32 PALMER, Harley 1 April 1871 - July 1872

34 PALMER, John 9 March 1845 - 6 Feb 1881. M. Mollie L. Watson 3 Feb 1876

Civ Fed

- 36 BUSH, James A 15 Dec 1843 - 16 July 1912 Civ Fed  
 37 BUSH, Mary M. (Palmer) d. 5 Aug 1927 Wife of James A. No stone

## ROW 13

- 2 WATKINS, John W d 2 Dec 1913 14 Mo CO 1 Cav  
 22 GALLAHER, Rosa M d 16 Aug 1872 4 years  
 23 GALLAHER, Martha J  
 26 CLARK, Charles d 7 Aug 1885 Age 11 mo  
 34 SHOWALTER, Mary (Palmer) 1 Jan 1811 - 15 Jan 1901  
 35 SHOWALTER, Jeremiah 16 Feb 1888 - 12 Mar 1896  
 36 BUSH, Kyle 7 June 1926 - 10 Mar 1933 son of George F. & Myrtle (Dye) Bush  
 37 BUSH, George F 31 July 1873 - 12 Dec 1943 Son of James A. & Mettie Bush.  
 m. Myrtle Dye

## ROW 14

- 7 STEPHENS, Lulah 20 July 1883 - 27 Jan 1884  
 10 KELLEY, Adda 1893 - 1916 Dau. of Calvin Kelley  
 11 KELLEY, Infant daughter of Calvin Kelley  
 12 KELLEY, Martha 1856 - 1895  
 14 LACK, John d. 1 Dec 1944 Son of John & Celina E. (Peterson) Lack  
 15 LACK, John 2 Feb 1839 - 23 Jan 1926 m. Celina Peterson Civ Fed  
 16 LACK, Celina E 25 Oct 1855 - 29 Mar 1915 Dau Merry & Nancy Peterson.  
 Wife of John Lack  
 17 HOAG, Tressie M 1883 - 11 Dec 1932. Dau of John & Celina E. (Peterson)  
 Lack. Wife of Walter E. Hoag  
 18 HOAG, Walter E 1882 - 1942 Came from Iowa

## ROW 15

- 1 FRENCH, Ray E d. 5 Jan 1897 10 mo 26 da. Son of James M. & Emma  
 (Carson) French  
 2 FRENCH, Clarence d. 5 June 1900 - 19 years 24 da. Son of James M. & Emma  
 (Carson) French  
 3 FRENCH, James M 16 Aug 1856 - 4 Sept 1913  
 4 FRENCH, Emma (Carson) 15 Dec 1857 - 5 July 1930  
 5 DANIEL, Eula 31 July 1900 - 2 June 1916 Dau of Henry & Lillie (French)  
 Daniel

## ROW 15 (Continued)

- 12 LACK, Webb W 6 Feb 1891 - 15 Dec 1961 Son of John & Celina Lack  
m. Audra Montgomery
- 13 Lack, Audra dau of "Bud" Montgomery. Wife of Webb W. Lack
- 14 LACK, Warren W d. 28 March 1923 Son of Webb & Audra (Montgomery) Lack
- 17 TINDILL, Callie 16 July 1881 - 18 Sept 1933. Dau of John & Celina E.  
(Peterson) Lack. Wife of Linzy T. Tindill
- 18 TINDILL, Linzy T 22 July 1877 - 17 Apr 1956. Son of Cannon & Sarah  
(Vanhooser) Tindill. m. Mrs. Martha Jane Belcher, widow of J.W. Belcher
- 23 Native stone - no date
- 24 Native stone - no date
- 29 BUSH, Bill. son of James A. and Mary M. (Palmer) Bush. m. Neil Miller  
Had both legs amputated. No Stone.
- 30 BUSH, Neil (Miller) d. 22 July 1944. No stone

## ROW 16

- 1 ELSON, Jerome 25 Oct 1845 - 30 Mar 1915.
- 2 ELSON, Mary E 16 Nov 1856 - 7 Aug 1943. Wife of Jerome Elson
- 3 ELSON, Gereme Elmer 24 Feb 1882 - 13 Feb 1931. Son of Jerome & Mary E.  
Elson. His wife, Frances, buried in Weiser, Idaho 1973.
- 7 Native stone - no dates
- 8 Native stone - no dates
- 9 DANIEL, Adrion 17 Jan 1907 - 17 Dec 1939. Son of Allen B. & Mary B. (Keller)  
Daniel. m. Clara Polston dau of Arthur & Flossie (Lasater) Polston
- 12 FRAIZER, Mary Ellen 2 Aug 1905 - 28 Sept 1917
- 15 BORCHART, J.L. 1850 - 1931
- 16 RANKIN, John 1870 - 19 Feb 1937 m. Ruth Borchart
- 17 RANKIN, Ruth 1889 - 1956 dau of J.L. Borchart
- 18 DEITZ, Mary C 1860 - 1934
- 19 PERRY, Duran 1924 - 1935 Son of Vester Perry
- 20 PERRY, Vester d. 15 Feb 1936 WW I
- 25 POLSTON, Arthur "Bud" 29 July 1884 - 6 Mar 1936. Son of Osear & Melinda  
Polston (Hampton) Polston. Bro. of Ida Bell (Polston) Mitchell
- 26 POLSTON, Flossie 23 Aug 1891 - 29 Sept 1956. Dau of Edward & Ida Lasater.  
Wife of Arthur Polston

## ROW 17

- 4 DANIEL, Henry 1869 - 1943 m. Lillian French
- 5 DANIEL, Lillian 6 Mar 1878 - 8 Jan 1959. Dau of James & Emma French  
Emma m(1) Jim Purdy. Wife of Henry Daniel



## Row 17 (continued)

- 7 DANIEL, Allen B 1 Sept 1880 - 1 March 1964 Son of Chester L and Eliza F  
(Medlin) Daniel. m. Mary B. Keller
- 8 DANIEL, Mary Bertha 26 Dec 1878 - 8 May 1962 Dau of John & Julia (Young)  
Keller. Wife of Allen B. Daniel
- 10 DANIEL, Byrel V 16 June 1918 - 5 Sept 1945 Son of Allen B & Mary B  
(Keller) Daniel. Husband of Naomi Montgomery who m(2) Tom McArthur,  
PFC 149 Inf 38th Inf Div WW II
- 24 DENTON, Lydia (Tindill) 1870 - 23 May 1942. Dau of Wm. & Jane Tindill.  
m(1) Jim Burnett m(2) \_\_\_\_\_ Denton
- 25 LASATER, Allen Sanford 7 Sept 1870 - 12 Jan 1954 Son of Hardy & Casander L.  
Lasater
- 26 LASATER, Melvina 25 Dec 1871 - 1 Dec 1949. Dau of Sarah Rogers. Wife of  
Allen Lasater
- 28 BURNETT, Roy 13 Dec 1899 - 19 Jan 1964 Son of Charles & Hettie (Marvin)  
Burnett m. Leola Blevins
- 31 KELLER, Frank B 26 June 1889 - 19 Nov 1973. Son of John & Julia (Young)  
Keller WW I
- 32 KELLER, Lillie B 29 Nov 1888 - 16 Apr 1971 dau of Ralph C. & Rachel M  
Pyle. Wife of Frank Keller Sister of Clem Pyle

## ROW 18

- 2 SLAGLE, Brenton b & D 18 June 1969. Son of Charles & Phylis (Tindill)  
Slagle
- 4 TINDILL, Carl 25 Nov 1910 - 1965. Son of Oscar & Jesse (French) Tindill
- 5 TINDILL, Oscar 27 May 1883 - 1 Mar 1953. Son of Charles & Emma Tindill  
m. Jesse French
- 6 TINDILL, Jessie (French) 1886 - 1954. Dau of James & Emma French. Wife  
of Oscar Tindill
- 12 LASATER, Ervin Louis 4 June 1942 - 25 July 1942. Son of Emmerson &  
Lola (Bell) Lasater
- 18 SOBREN, Merna Rae b & D 22 Jan 1953. Dau of Raymond & Anna (Tindill)  
Sorden
- 19 TINDILL, James P 21 Aug 1867 - 24 June 1948 Son of William & Mary J  
Tindill. m. Alice Bush
- 20 TINDILL, Alice 28 Jan 1870 - 22 Aug 1959. Dau of James & Mary Bush.  
Wife of James P. Tindill
- 23 TINDILL, Russell 26 Mar 1879 - Mar 1958. Nephew of James P. Tindill  
Husband of Rhoda Patterson
- 24 TINDILL, Rhoda 1 Oct 1885 - 15 Apr 1946. Dau of \_\_\_\_\_ Patterson. Wife of  
Russell Tindill.
- 29 LASATER, Ruth 13 Feb 1904 - 16 Aug 1969. Dau of Frank & Alta E. (Daniel)  
Kelley. Wife of James Lasater

## Pow 19 (Continued)

- 34 COLLINS, Harold 8 June 1916 - 27 Aug 1970. Son of Ira Collins WW II
- 35 FINLEY, Byron 4 Aug 1913 - 3 Oct 1973. Son of Charley Wilmer & Stella  
(Jeffries) Finley. m. Mary Ann Taylor

## ROW 19

1. WILKINSON, Sherman 17 June 1865 - 4 Apr 1952. Son of Samuel H. H. &  
Mathilda C. (Thompson) Wilkinson. m. Louatta Daniel
- 2 WILKINSON, Louetta 26 Aug 1871 - 23 Jan 1948. Dau of Chester L. & Eliza  
F. (Medlin) Daniel. Wife of Samuel J. Sherman Wilkinson
- 13 BELL, Ruth Louise 29 July 1947 - 30 July 1947. dau of Orville Bell
- 14 DANIEL, James W 22 March 1886 - 3 Sept 1956. Son of Chester L. &  
Eliza F (Medlin) Daniel. m. Iva Keller
- 20 KELLEY, Benjamin 30 Sept 1888 - 8 Nov 1958 Son of Wm. H. & Elizabeth  
J. Kelley. Single. MO S2 US Navy WW I
- 21 KELLEY, John 6 Nov 1885 - 13 Oct 1967. Son of William H. & Elizabeth J.  
(Melton) Kelley. Single
- 26 PURDY, Arch 27 Apr 1895 - 3 Nov 1969. Son of W. A. "Alec" & Celia  
(Rogers) Purdy.

## ROW 20

- 2 EVANS, John 22 Dec 1862 - 17 Mar 1949. Second husband of Eliza J  
(Stockton)
- 3 EVANS, Eliza J "Ida" 1 Jan 1861 - 12 Jan 1949. Dau of Jasper W. &  
Parthena (Lewis) Stockton. m(1) Robert Wilmer Finley (d. Sept 1899)  
m(2) John Evans
- 8 HAMPTON, Ralph 8 Apr 1903 - 2 May 1972. Son of Charley Hampton  
m. Erma Tindill
- 9 HAMPTON, Erma 24 Apr 1905 - 14 Jan 1949. Dau of \_\_\_\_\_ Tindill. m. Ralph  
Hampton
- 10 MITCHELL, Elzie (Weaver) 2 Mar 1880 - Dec 1958. Son of John Aaron &  
\_\_\_\_\_(Folston) Mitchell. m. Myrtle Cowan
- 11 MITCHELL, Myrtle Dau of \_\_\_\_\_ Cowan. m. Elzie Weaver Mitchell
- 16 DANIEL, Thurman Otto 3 Feb 1905 - 1 Dec 1950. Son of Allen B. &  
Mary B. (Keller) Daniel m. Mary Armstrong.

## ROW 21

- 6 DANIEL, Darrell 21 Dec 1948 - 12 July 1973. Son of Lyle A. & Elizabeth  
(Tindill) Daniel. m. Connie Ennis dau of Elvin & Lorine Ennis Vietnam
- 10 LASATER, George 14 May 1873 - 12 Aug 1971. Son of Hardy & Casander  
Lasater. m. Alice Purdy
- 11 LASATER, Alice 6 May 1877 - 11 Apr 1953 Dau of \_\_\_\_\_ Purdy m. George  
Lasater
16. BUSH, John 7 Dec 1881 - 8 May 1953. Son of James Bush. m. Mary M.  
Palmer

No stones were found for the following, although other information indicates they were buried in this cemetery.

DUFFY children of D.P. & \_\_\_\_\_(Weir) Duffy

These vererans are listed in the Greenfield Vedette listing of Soldier Dead, and not listed the same here:

Elevins, John Civ Con

Burnett, Lavandar Civ Fed

Clayton, Sam Civ Fed

We have endeavored to make the indexes as usable as possible. At first we tried to list every name that appeared in the text of the cemetery records, but this made the index too clumsy with repetitions. Now we are listing just the names of persons buried in this cemetery. We do not try to index parent's names, although they may appear in the text. Since the majority of tracing done with these records will be from the present to the past this should be no handicap. You may get the pleasant surprise of finding not only grandma but her parent's names also, including the maiden name of her mother. This might appear for only one child in the family. So if you are interested in the Tindill family, for instance, read all entries under that name. As part of this, women are indexed under their maiden name and each married name. Thus, Cordelia Jane (Harris) King Collins will be found in the index as:

(Harris), Cordelia Collins  
King, Cordelia \*  
Collins, Cordelia J

\* indicates a married name that will require a careful reading since this was not the name on her tombstone.

_____, Floyd I 271	Bush, John 279
Barnes, Clahab 271	Bush, Kyle 276
Barnes, Infant 271	Bush, Mary M 276
Bates, Charles 271	Bush, Neil 277
(Bates) Georgia Faulkner 269	Bush, Richard 275
Bates, Louisa 271	
Bell, Ruth Louise 279	Calmer, Clifford 273
(Bethel) Mary G. Daniel 268	Calmer, Ella 273
Blackburn, Retta 274	Calmer, Theodore 273
Elevins, John 280	(Carman) Clara Buchanan 270
Borchart, J.L. 277	Carman, Millie * -275
(Borchart), Ruth Rankin 277	(Carson), Emma French 276
Bronson, Otis 271	Clark, Amanda 275
Buchanan, Clara 270	Clark, Charles 276
Buchanan, James H 270	(Clark), Emily Tindill 273
(Buchanan), Lourillar Harris 270	Clark, Eva 275
Buchanan, Sarah A.J.E. 275	(Clark), Laura Shoemaker 275
Buchanan, William Andrew 270	Clayton, James H 272
Burnett, Anna 273	Clayton, Sam 280
Burnett, Charles William 273	Coleman, Ralph S 271
Burnett, Claude 274	Collins, Alpha L 274
Burnett, Hattie S 273	Collins, Charley 269
Burnett, James 274	Collins, Cordelia J 269
Burnett, James S 273	Collins, Dora E 270
Burnett, Lavander 280	Collins, Harold 279
Burnett, Lydia (Tindill) * 278	Collins, Ira J 274
Burnett, Roy 278	Collins, Joseph 270
Burnett, W.L. 273	Collins, Lillian Anna 269
Burnett, William C 274	Collins, Mary M 274
Burnett, William L 273	Collins, Rev. Stephen L 274
(Bush) Alice Tindill 278	Cook, Emmett 269
Bush, Bill 277	Cook, Lillian (Harris) 269
Bush, George F 276	Cook, Neah McFarland 269
Bush, James A 276	(Cottew) Alice E. Gehon 272
	Cottew, Christina E 272
	Cottew, Stephen S 272

Cowen \_\_\_\_\_ 272  
 (Cowen), Myrtle Mitchell 279  
 Daniel, Adrion 277  
 Daniel, Allen B 270  
 (Daniel), Alta Felley 268  
 Daniel, Byrel V 278  
 Daniel, Chester E 268  
 Daniel, Clara 268  
 Daniel, Darrell 279  
 Daniel, Edna Blanche 268  
 Daniel, Eliza Frances 268  
 Daniel, Eula 276  
 Daniel, Green 275  
 Daniel, Henry 277  
 Daniel, James 279  
 Daniel, Lillian 277  
 (Daniel), Louetta Wilkinson 279  
 Daniel, Mary Bertha 278  
 Daniel, Mary G 268  
 Daniel, Millie 275  
 Daniel, Neva T 268  
 (Daniel), Octavia E Vanlandingham 268  
  
 Daniel, Ova Carl 269  
 Daniel, Peter 268  
 Daniel, Thurman Otto 279  
 Daitz, Mary C 277  
 Denton, Lydia 278  
 Duffy children 280  
  
 Elson, Gerome Elmer 277  
 Elson, Jerome 277  
 Elson, Mary E 277  
 Etter, Sarah \* 275  
 Evans, Eliza J "Ida" 279  
 Evans, John 279  
  
 Farmer, Rotta Thiline 270  
 Farmer, Ronald E 270  
 Faulkner, Georgia 269  
 Finley, Byron 279  
 Finley, Eliza J 279  
 (Finley), Robbie W. Strand 271  
 Fraizer, Mary Ellen 277  
 French, Clarence 276  
 French, Emma 276  
 French, James H 276  
 (French), Jessie Tindill 278  
 (French) Lillian Daniel 277  
 French, Ray E 276  
  
 Gallaher, Martha J 276  
 Gallaher, Rosa M 276  
 Gehon, Alice E 272  
 Gehon, Thomas Mason 272  
  
 (Gentry), Laura M. Kimbler 273  
 (Grant) Edith Sorden 271  
  
 Hampton, Emma 279  
 Hampton, Farrell 274  
 Hampton, Harold 274  
 Hampton, Ralph 279  
 Harris, Benjamin F 269  
 (Harris), Cordelia Collins 269  
 Harris, Emeline 270  
 Harris family 270  
 Harris, Georgia (Bates) 269  
 Harris, Israel 270  
 Harris, John H 269  
 Harris, Joseph M 270  
 (Harris), Lillian A. Collins 269  
 Harris, Lourillar W.J. 270  
 Harris, Mary A 268  
 Hardins, Andrew 275  
 (Hardins), Elizabeth Lasater 275  
 Hoag, Tressie H 276  
 Hoag, Walter E 276  
  
 Keller, Abraham 268  
 Keller, Curtis 270  
 Keller, Frank B 278  
 Keller, Julia 270  
 Keller, Lee C 268  
 Keller, Lillie B 278  
 Keller, Lizzie 268  
 (Keller), Mary Bertha Daniel 278  
 Kelley, Adda 276  
 Kelley, Alta Wester 268  
 Kelley, Benjamin 279  
 Kelley, Charles B 269  
 Kelley, Elizabeth J 269  
 Kelley, Frank L 268  
 Kelley, Greeley 269  
 Kelley, Infant 276  
 Kelley, John 279  
 Kelley, Martha 276  
 (Kelley), Ruth Lasater 278  
 Kelley, William H 269  
 Kimbler, Henry 273  
 Kimbler, Laura M 273  
 Kimbler, Mary Lucille 273  
 King, Cordelia (Harris) 269  
 King, Infant dau 275  
  
 Lack, Audra 277  
 (Lack) Callie Tindill 277  
 Lack, Celina E 276  
 Lack, John 276  
 Lack, John 276  
 (Lack) Tressie H. Hoag 276  
 Lack, Warren W 277  
 Lack, Webb W 277



Lasater, Alice 279  
 Lasater, Allen Sanford 278  
 Lasater, Blanche 271  
 Lasater, Casander 271  
 Lasater, Edd L 271  
 Lasater, Elizabeth J 275  
 Lasater, Ervin Louis 278  
 (Lasater), Flossie Polston 277  
 Lasater, George 279  
 Lasater, Hardy 271  
 Lasater, Ida B 271  
 Lasater, Infant dau 271  
 Lasater, John 271  
 Lasater, John 275  
 Lasater, Matilda 272  
 Lasater, Melvina 278  
 Lasater, Newton 271  
 Lasater, Ruth 278  
 Lasater, William Jasper 272  
 Little Lola L 274  
 Little, Lulu M 274  
  
 McBride, Matilda 275  
 (McBride), Millie Daniel 275  
 McBride, Thomas 275  
 McCulley, Mary J 268  
  
 Marshall, Ralph 272  
 (Martin), Hattie S. Burnett 273  
 (Medlin), Eliza Daniel 268  
 (Melton), Elizabeth J. Kelley 269  
 (Miller), Neil Bush 277  
 Milligan, Martha V 272  
 Mitchell, Arthur 274  
 Mitchell, Elzie 279  
 Mitchell, Myrtle 279  
 (Montgomery), Auca Lack 277  
 (Montgomery), Lizzie Keller 268  
  
 Osenbaugh, Cary E 275  
 Osenbaugh, Hattie 275  
 Osenbaugh, Mary (Tindill) 274  
 Osenbaugh, Mattie (Tindill) 274  
  
 P., B 268  
 Palmer, Elizabeth 275  
 Palmer, George 275  
 Palmer, Harley 275  
 (Palmer), Ida B. Lasater 271  
 Palmer, John 275  
 Palmer, Martha 269  
 (Palmer), Mary M. Bush 276  
 (Palmer), Mary Showalter 276  
 Palmer, O.Z. 269  
 (Patterson) Rhoda Tindill 278  
 Perry, Duran 277  
 Perry, Vester 277  
  
 (Peterson), Celina E. Lack 276  
 Peterson, Nancy M 275  
 Polston, Arthur 277  
 (Polston), Ella Calmer 273  
 Polston, Flossie 277  
 Price, Charley D 273  
 Price, Daniel 273  
 Price, Didama 273  
 Price, Fred I 273  
 (Purdy), Alice Lasater 279  
 Purdy, Arch 279  
 Purdy, Bertha A 271  
 Purdy, Celia 271  
 Purdy, Infant 272  
 Purdy, Thomas S 272  
 Purdy, William A 271  
 (Pyle), Lillie E. Keller 278  
  
 (Rankin), Effie Singer 270  
 Rankin, John 277  
 Rankin, Ruth 277  
 (Rogers), Celia Purdy 271  
 Rogers, Elizabeth 271  
 Rogers, Estes 275  
 Rogers, Etta M 275  
 Rogers, Jacob 271  
 (Rogers), Matilda Lasater 272  
 (Rogers), Melvina Lasater 278  
 Rogers, Minnie B 271  
  
 Shannon, Ida 274  
 Shannon, John W 275  
 Shannon, Joseph A 274  
 Shannon, Lucy 274  
 Shipley, Claud 272  
 Shipley, Mary E 272  
 Shipley, Osie 272  
 Shoemaker, John Aaron 274  
 Shoemaker, Laura 275  
 Showalter, Jeremiah 276  
 Showalter, Mary 276  
 Singer, Effie 270  
 Singer, Frank 270  
  
 Singer, Lillie 270  
 Singer, Orvie 270  
 Slagle, Brenton 278  
 Sorden, Edith 271  
 Sorden, Ferna Rae 278  
 Sorden, Oliver 271  
 (Springer), Etta M. Rogers 275  
 Stephens, Lulah 276  
 (Storman), Hattie Osenbaugh 275  
 (Stockton), Eliza J. Evans 279  
 Strahan, Frank Jr. 273  
 Strand, Beulah J 271  
 Strand, Edward A 271  
 Strand, Robbie W 271  
 Sweeney, Infant 270

Taylor, Andrew 268  
Taylor, J.T. 268  
Taylor, James E 268  
Taylor, Lydia Alice 268  
(Taylor), Martha Palmer 269  
Taylor, Sarah 268  
Taylor, Susan 268  
Templeton, John Rushton 269  
Tindill, Alice 278  
Tindill, Callie 277  
Tindill, Carl 278  
Tindill, Charley 273  
Tindill, Emily 273  
(Tindill), Erma Hampton 279  
Tindill, Frank Lee 273  
Tindill, James 274  
Tindill, James Otis 274  
Tindill, James P 278  
Tindill, Jessie 278  
Tindill, Linzy T 277  
(Tindill), Lula M. Little 274  
(Tindill), Mary J 273  
(Tindill), Mary Osenbaugh 274  
(Tindill), Mattie Osenbaugh 274  
Tindill, Maud E 273  
Tindill, Oletha Mae 274  
Tindill, Oscar 278  
Tindill, Rhoda 278  
Tindill, Russell 278  
Tindill, Sarah (Vanhooser) 273  
Tindill, William 273

VanBuskirk, Daniel 272  
VanBuskirk, Elkana 272  
VanBuskirk, Henrietta 272  
VanBuskirk, Lydia 272  
VanBuskirk, Mary E 272  
VanBuskirk, Nathan 272  
(VanBuskirk), Osie Shipley 272  
(VanHooser), Sarah Tindill 273  
Vanlandingham, Octavia E 268  
(Walker) Casander Lasater 271  
(Watkins) Amanda Clark 275  
Watkins, John W 276  
Wilkinson, Louetta 279  
Wilkinson, Sherman 279  
Witten, August 269  
Witten, Lavise 269  
Wooldridge, John W 272  
Wooldridge, Margaret 272  
Wooldridge, Matilda 272  
Wooldridge, Thomas 272  
  
(Young), Julia Keller 270

Add:

(Tindill), Lydia Denton 278