

AN ILLUSTRATED

HISTORICAL ATLAS
OF
MAP



*Prepared by
John S. Phelps*

GREENE COUNTY, MO.

Carefully Compiled from Personal Examinations and Surveys.

Published by BRINK, McDONOUGH & CO.
1876.

GREENE COUNTY

Showing an Outline of the County and its Subdivisions its Congressional and Civil T.P.s
with the Locations of its Towns and Villages, Post Offices, Churches, School Houses, Streams, Rivers,
Roads, Rail Roads, Proposed Rail Roads &c. &c.
PUBLISHED BY BRINK, McDOONOUGH & CO.
LINE 1876.

24

POLK COUNTY

23

COUNTY

21

DALLAS COUNTY

20

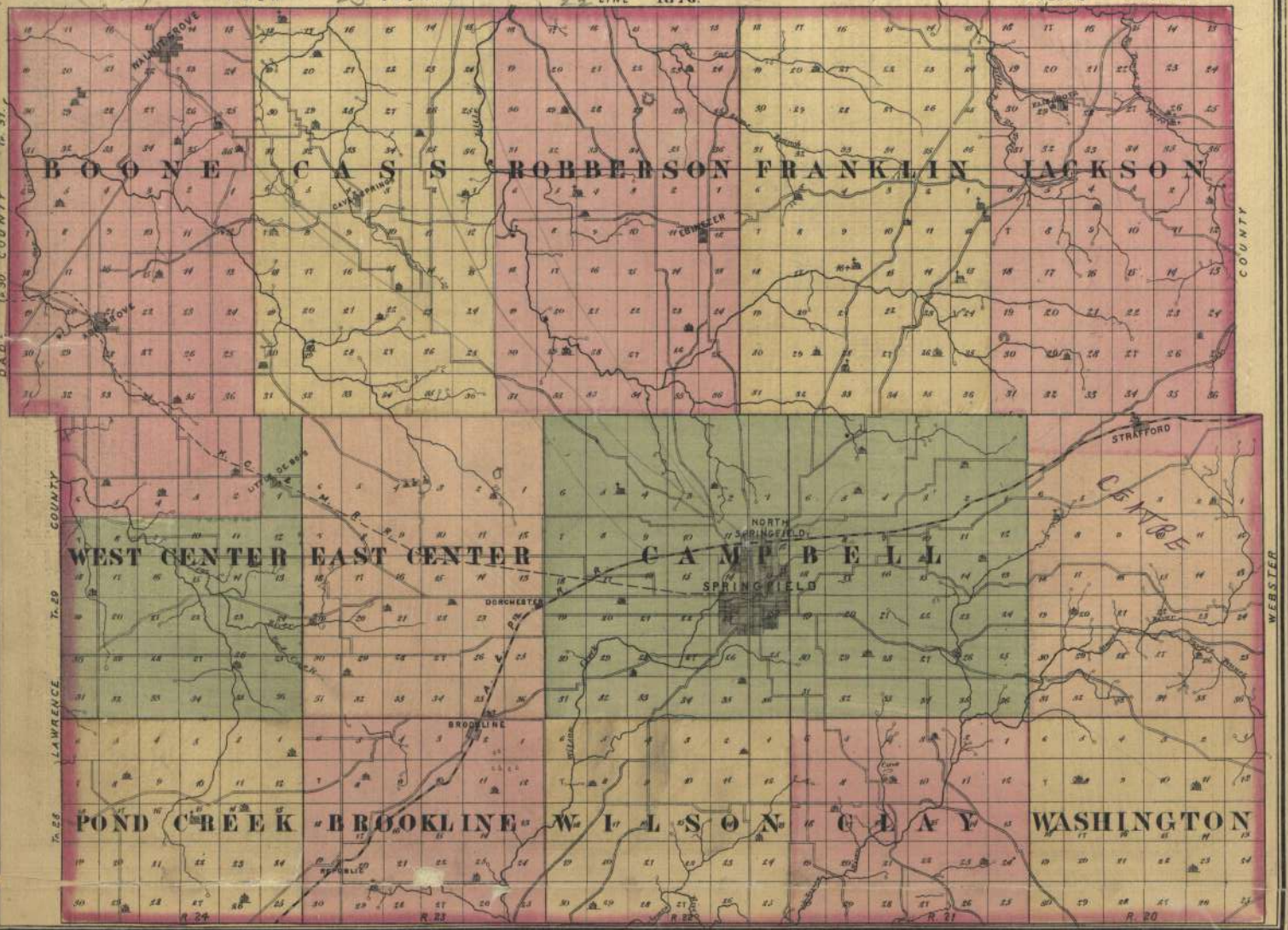

Township 28 North
Range 20 West
of 5th Principal Meridian

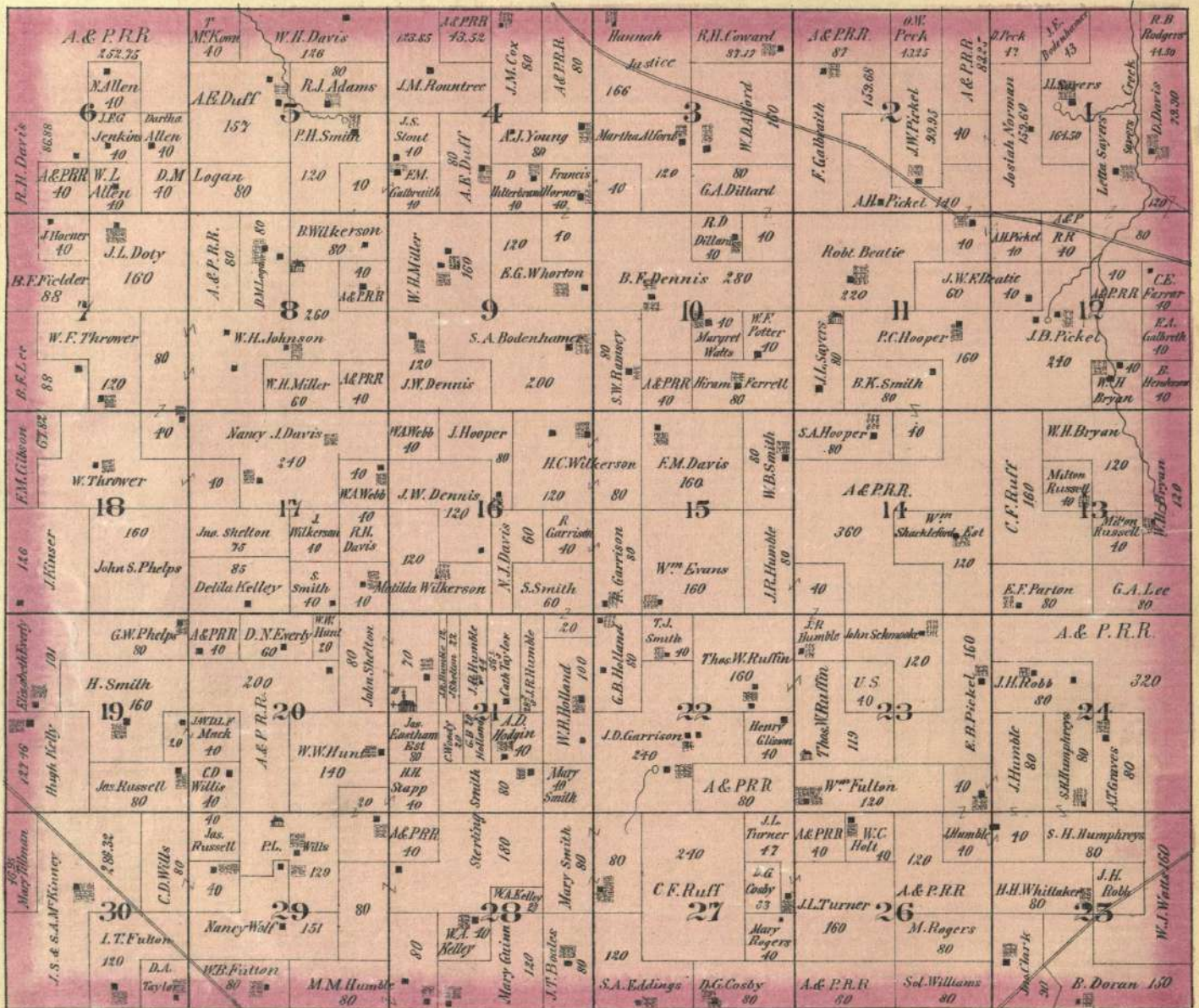

Township 29 North
Range 20 West
of 5th Principal Meridian

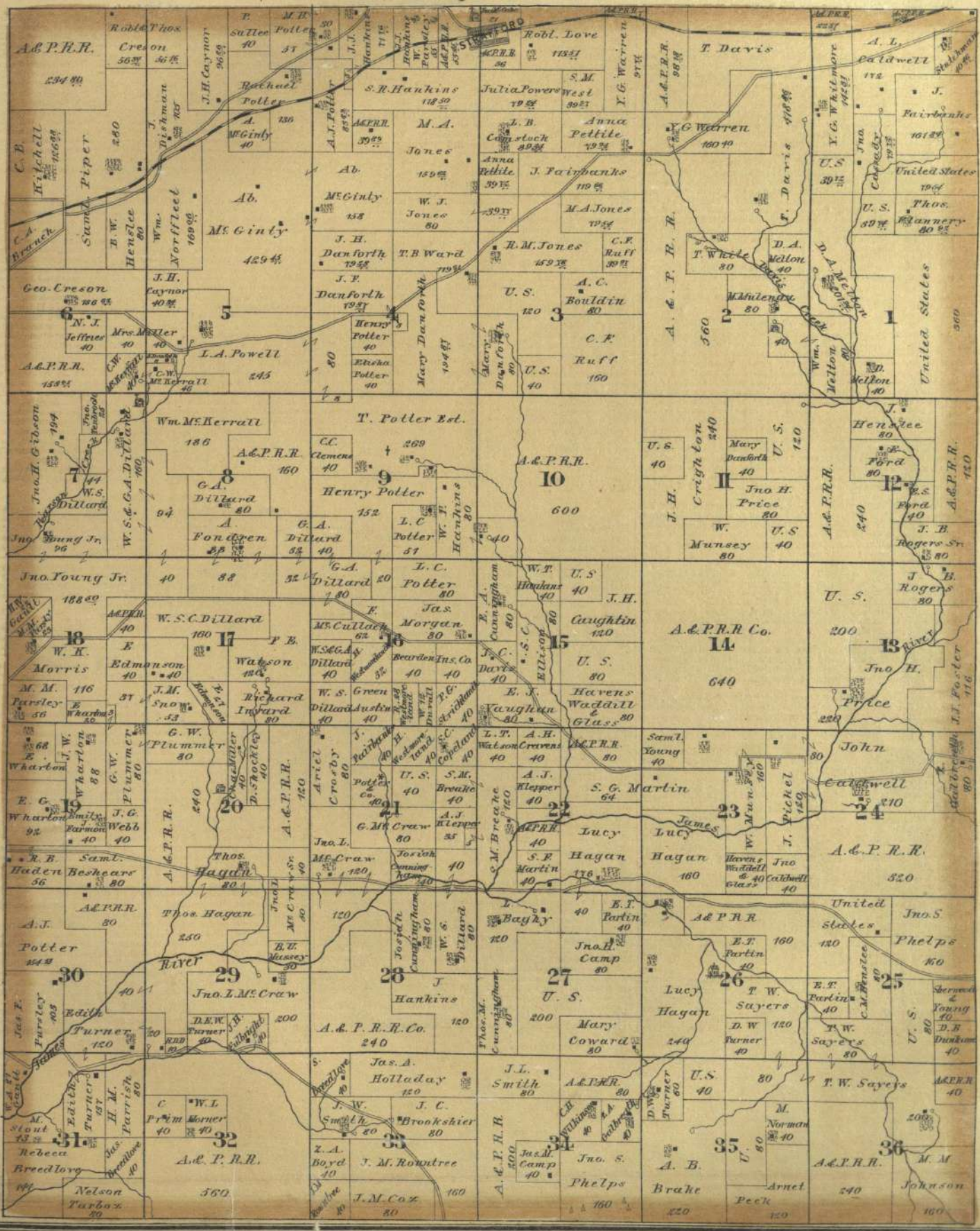

Township 30 North
Range 20 West
of 5th Principal Meridian

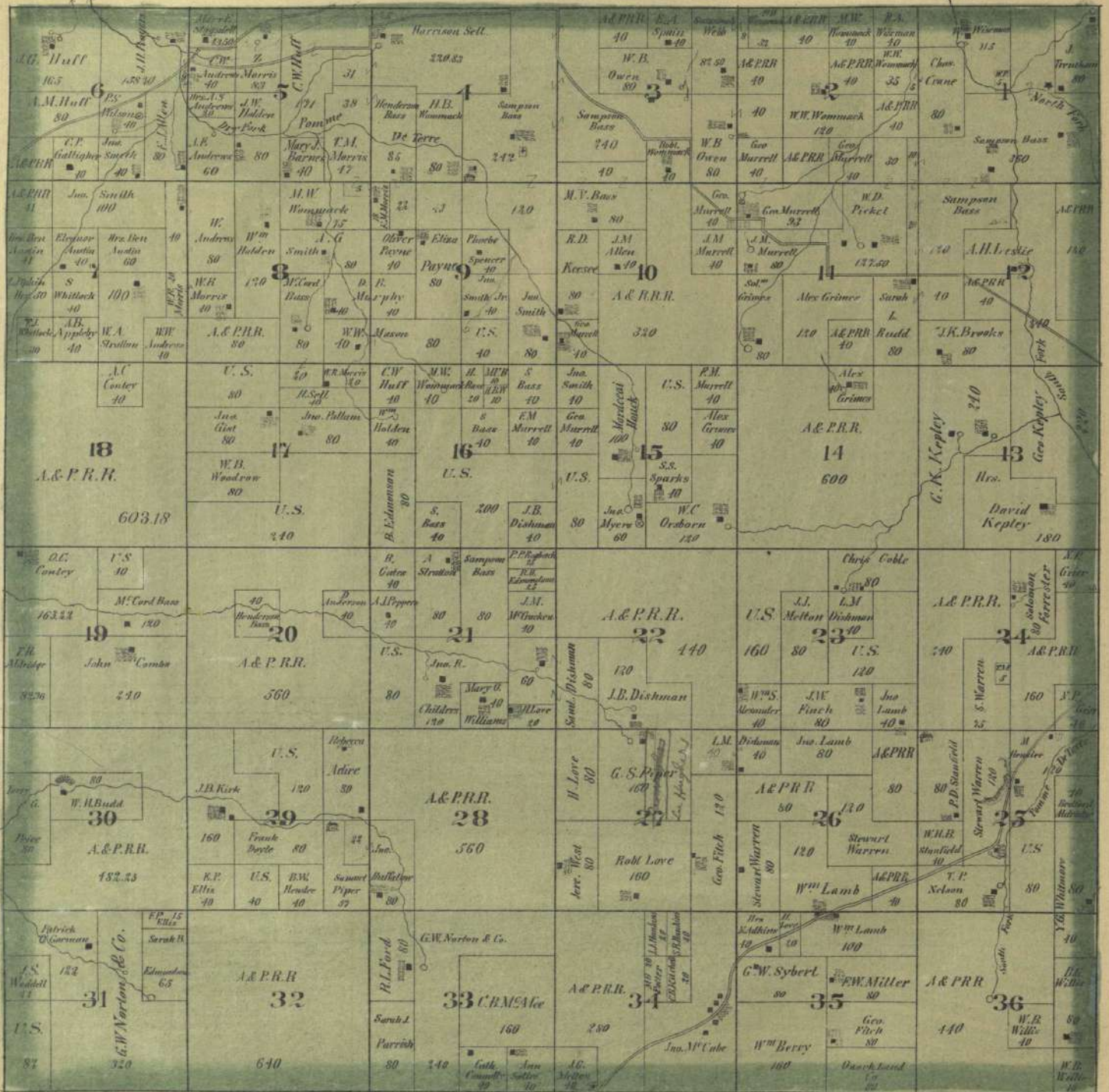

Township 31 North
Range 20 West
of 5th Principal Meridian

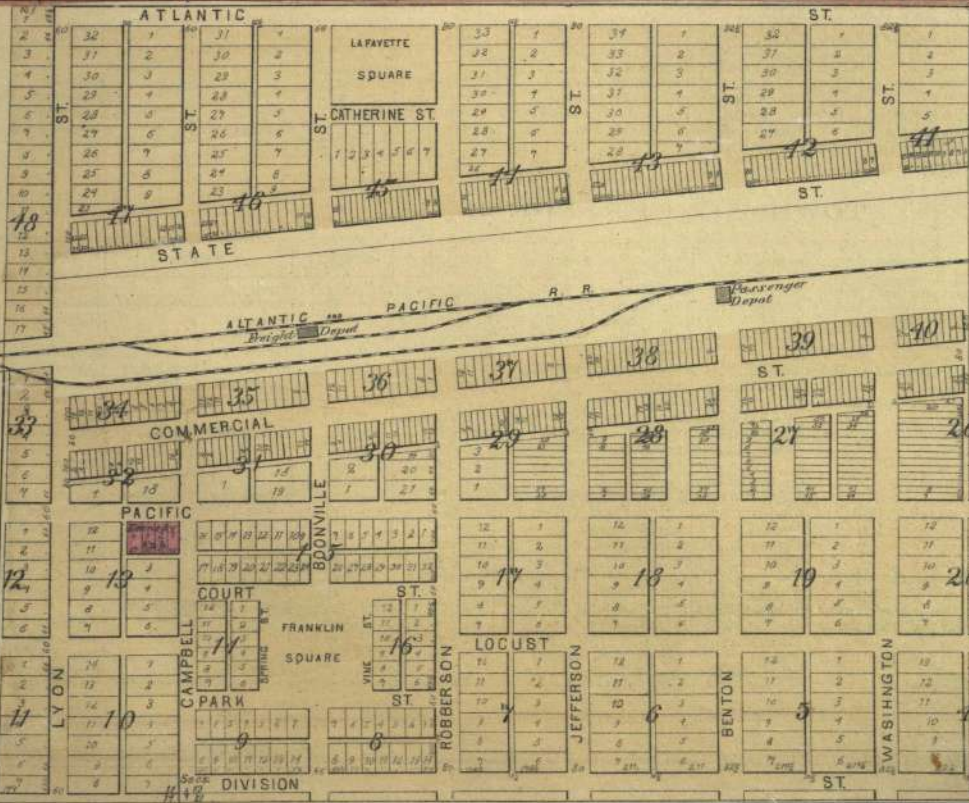
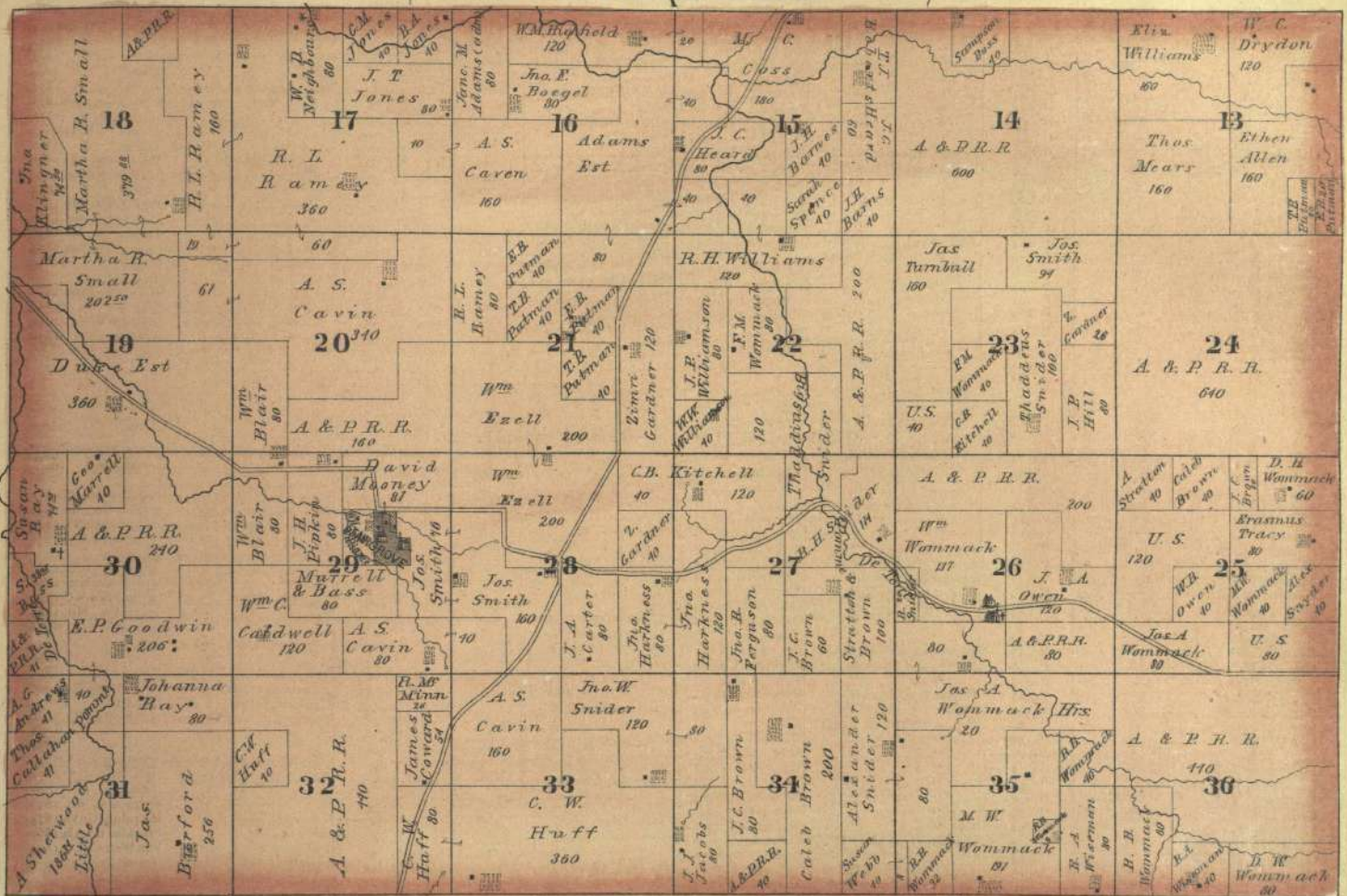

NORTH SPRINGFIELD

Located in Secs 11, 12, Town 22 N
Range 22 W of 5th P.M.

Scale 100 ft to One inch

10⁰⁰ Acs
Atlantic and Pacific
Railroad Cos.
Land

Township 29 North
Range 21 West
of 5th Principal Meridian

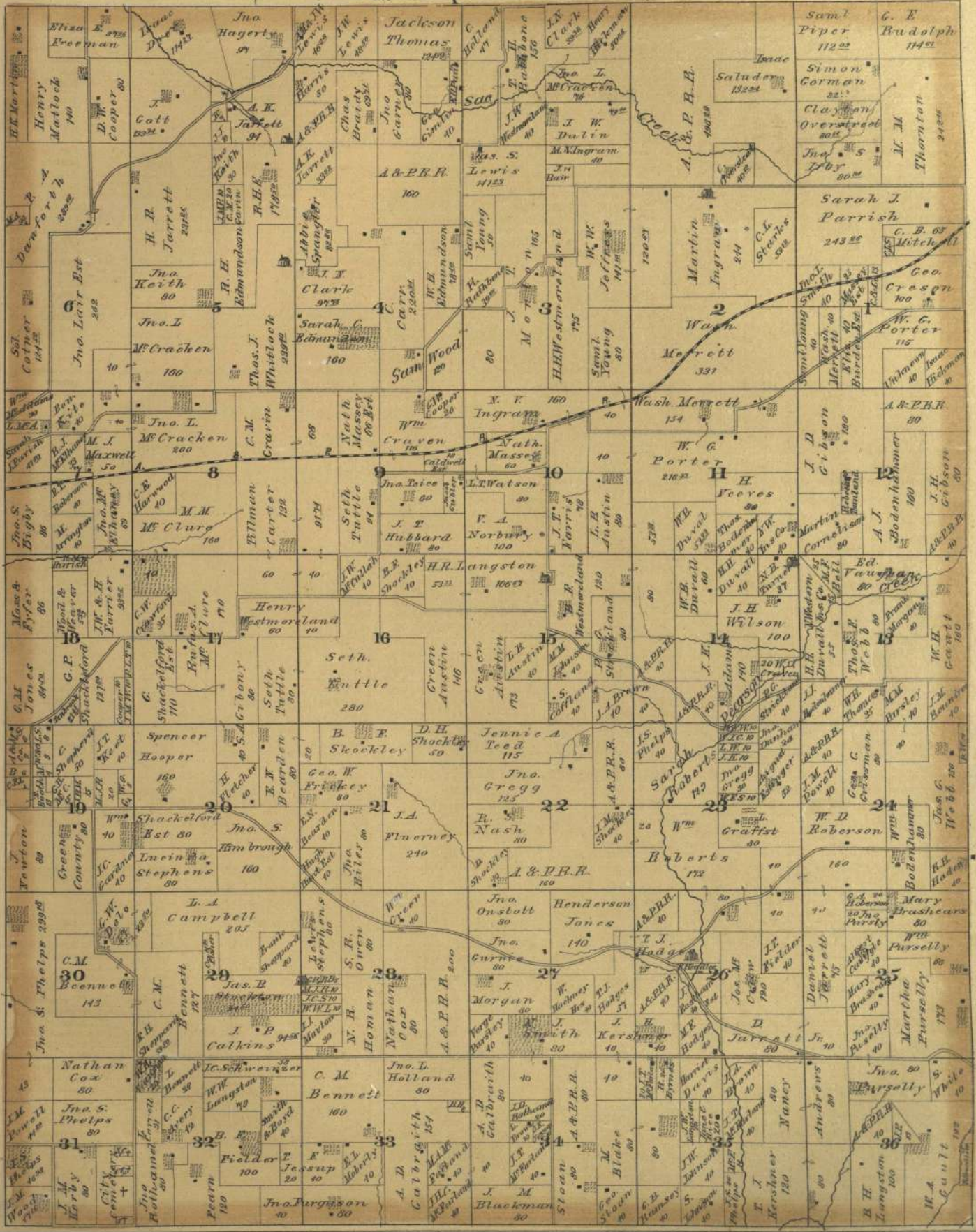

Township 30 North
Range 21 West
of 3rd Principal Meridian

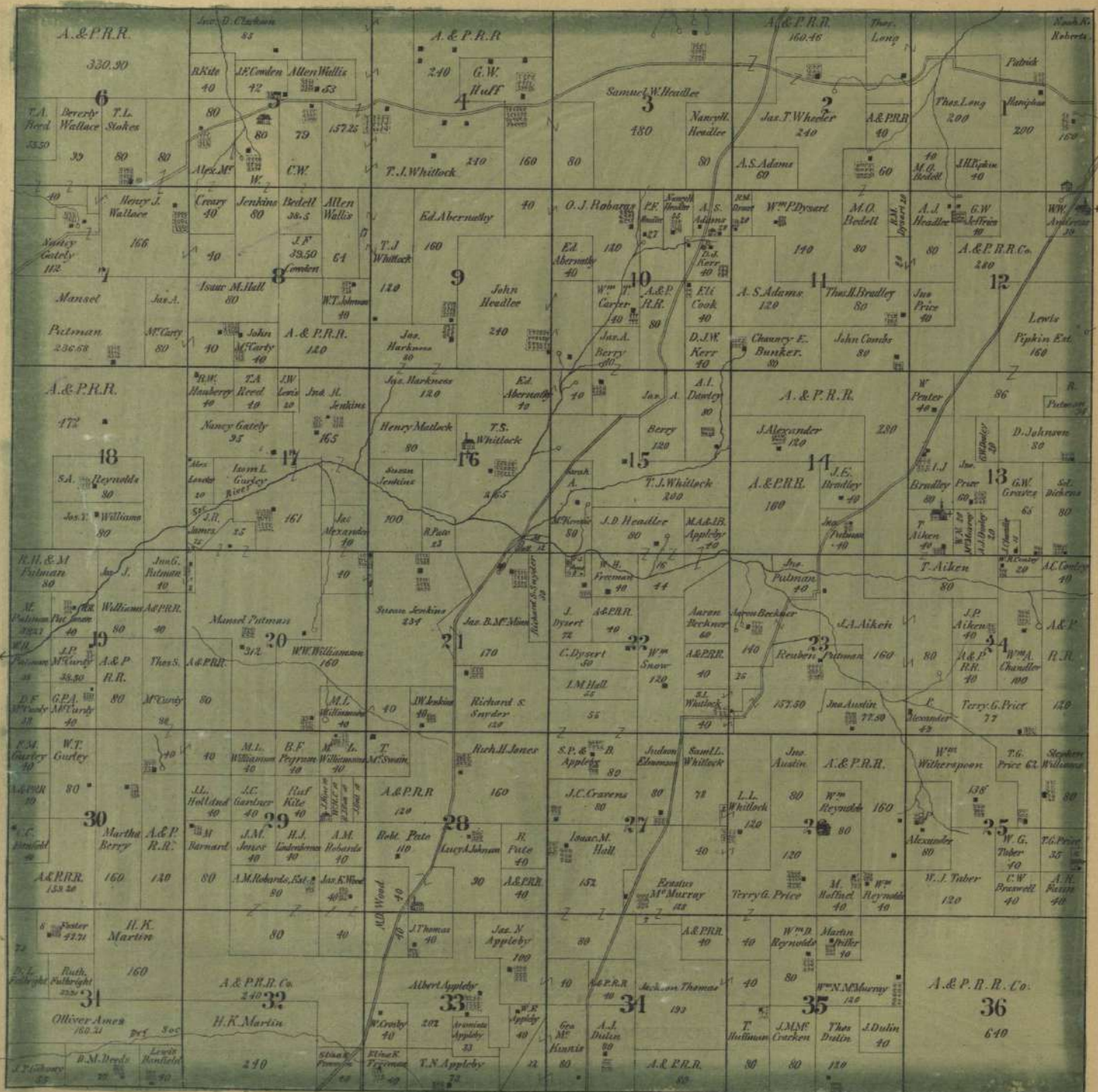

Township 31 North
Range 21 West
of 5th Principal Meridian

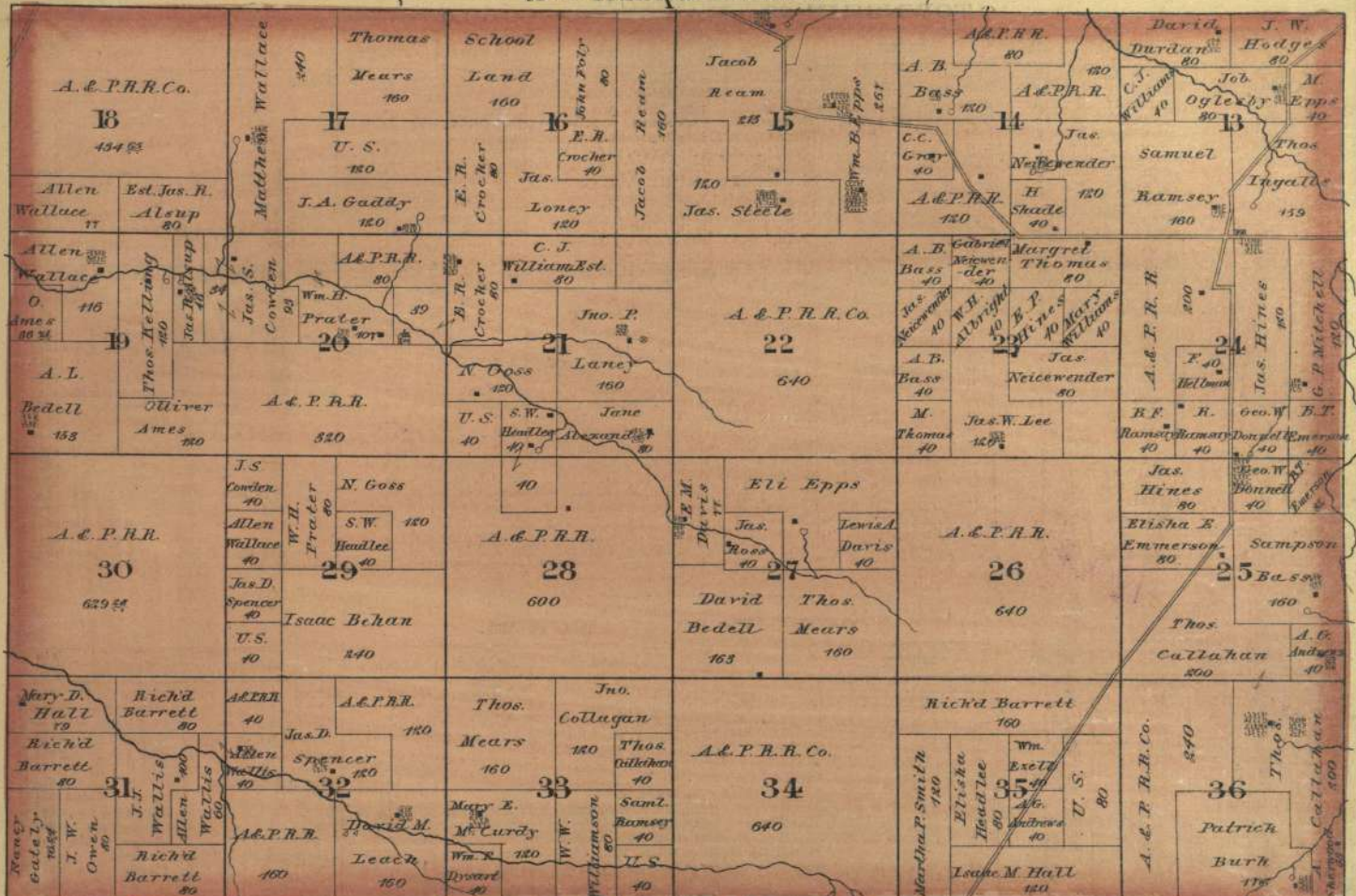

WALNUT GROVE

Sited in Sects 14, 15, 22 & 23 Tp 31, R 24 Green Co. Mo.

Scale 400ft. to inch.

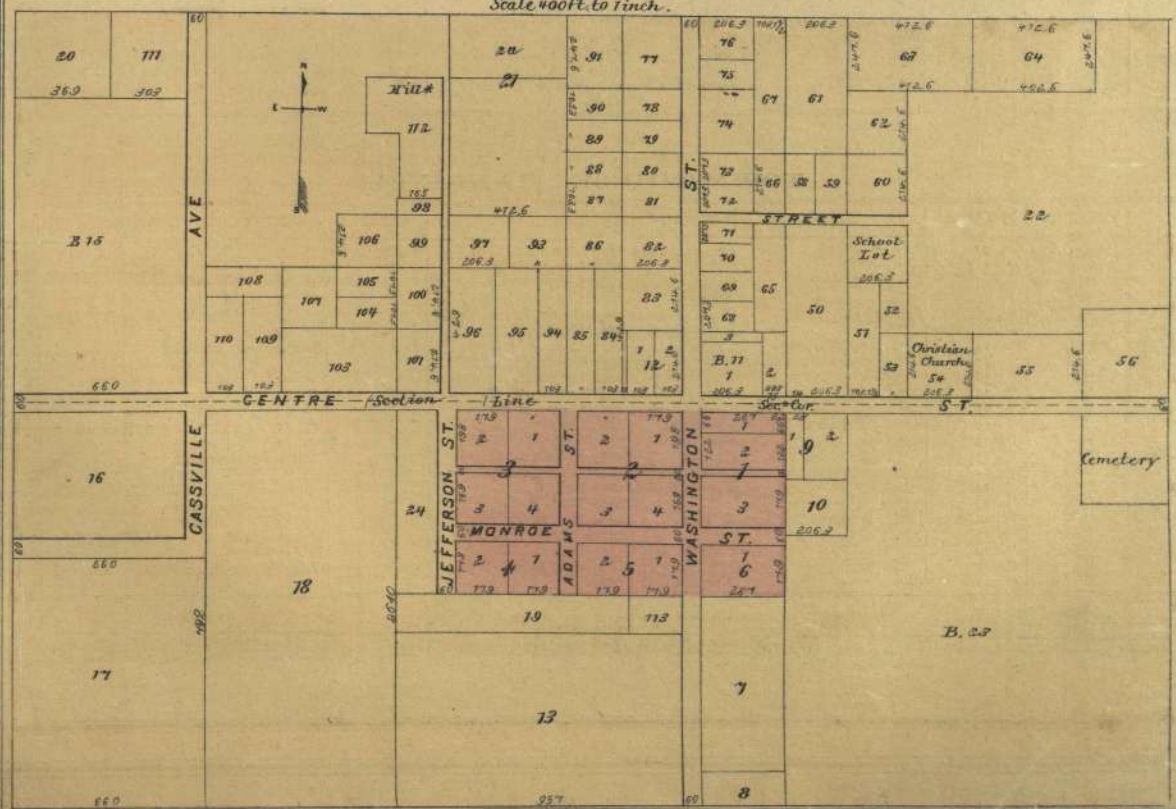

Township 28 North Range 22 West of 5th Principal Meridian

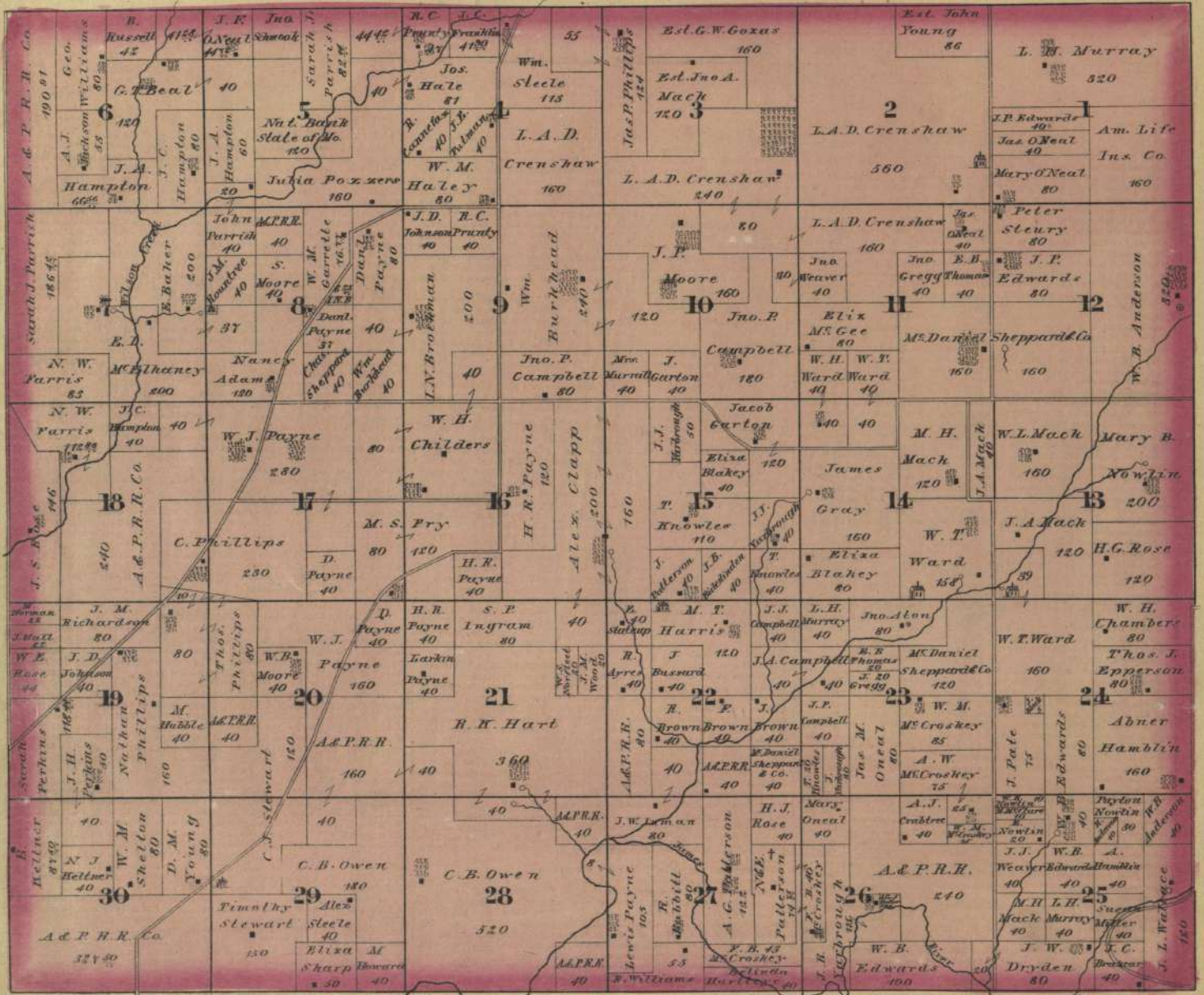

Township 30 North
Range 22 West
of 5th Principal Meridian

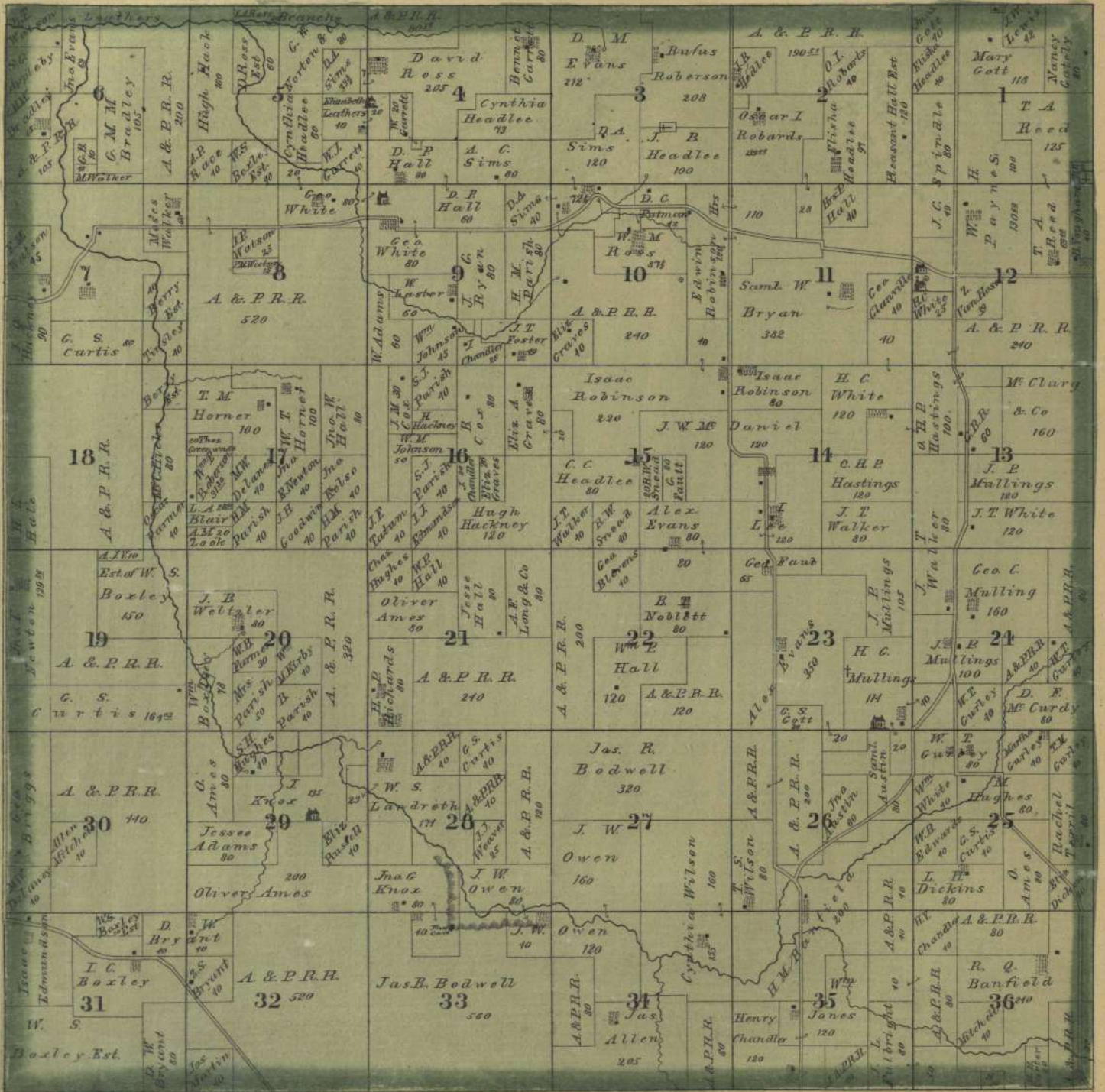

Township 31 North Range 22 West of 5th Principal Meridian

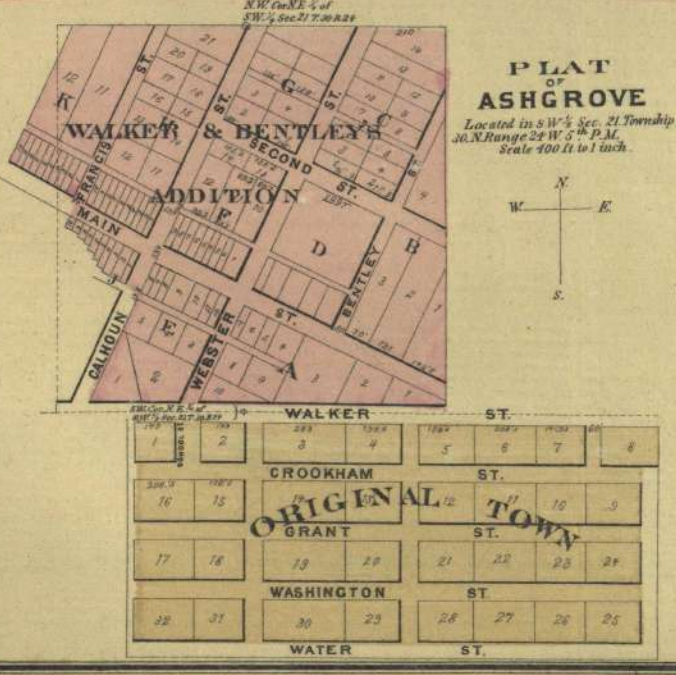
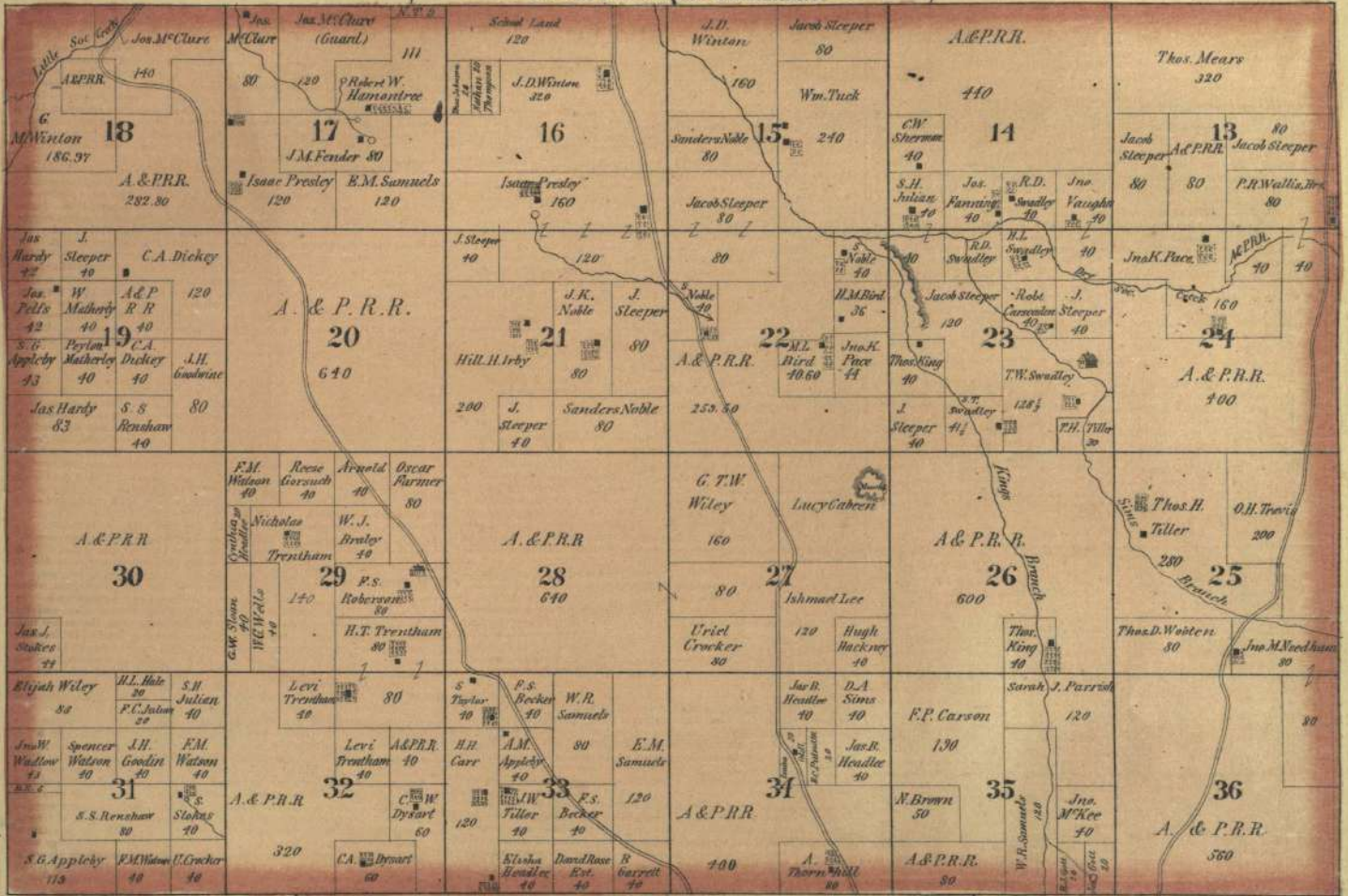

Township 28 North
Range 23 West
of 5th Principal Meridian

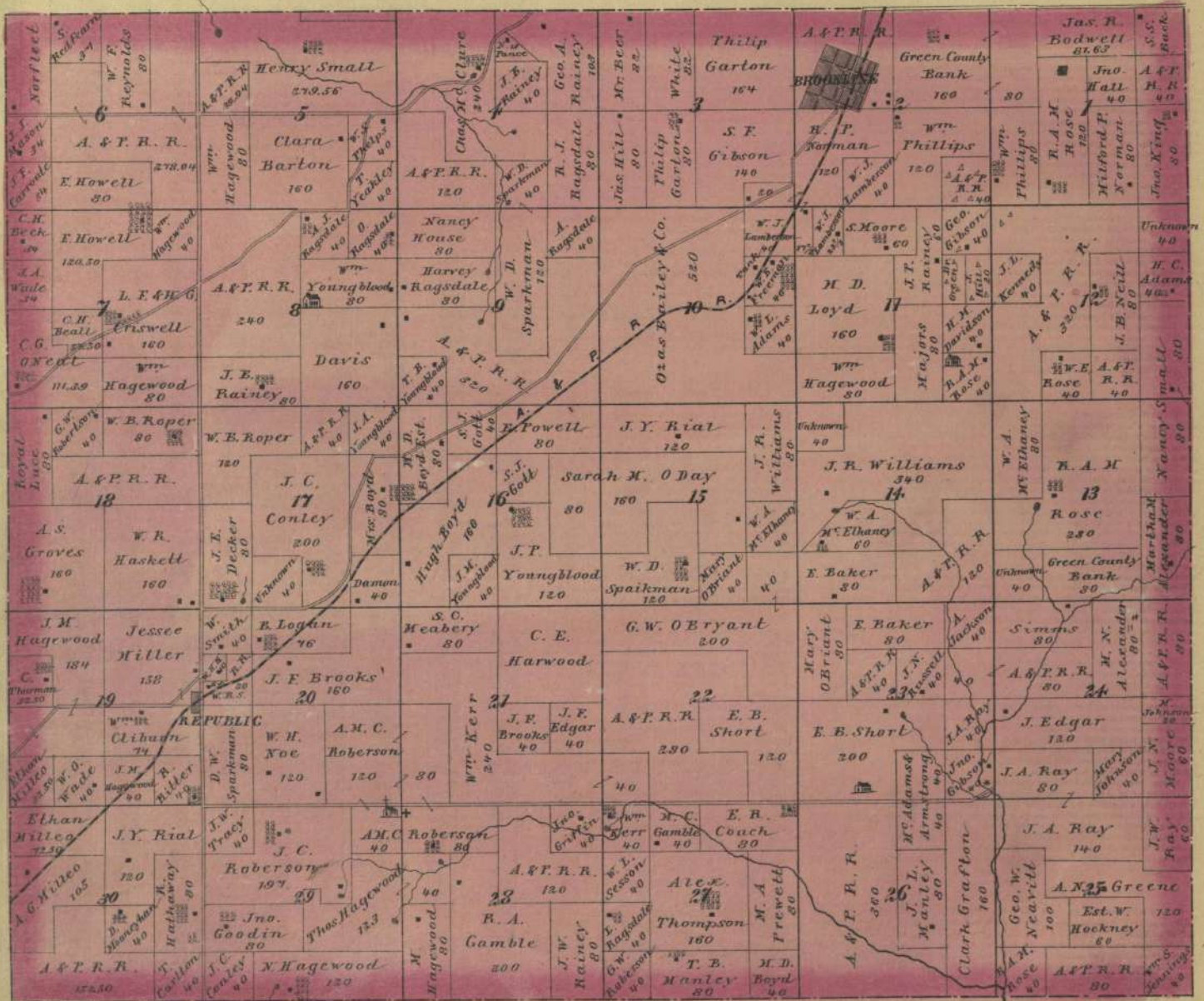

Township 29 North
Range 23 West
of 5th Principal Meridian

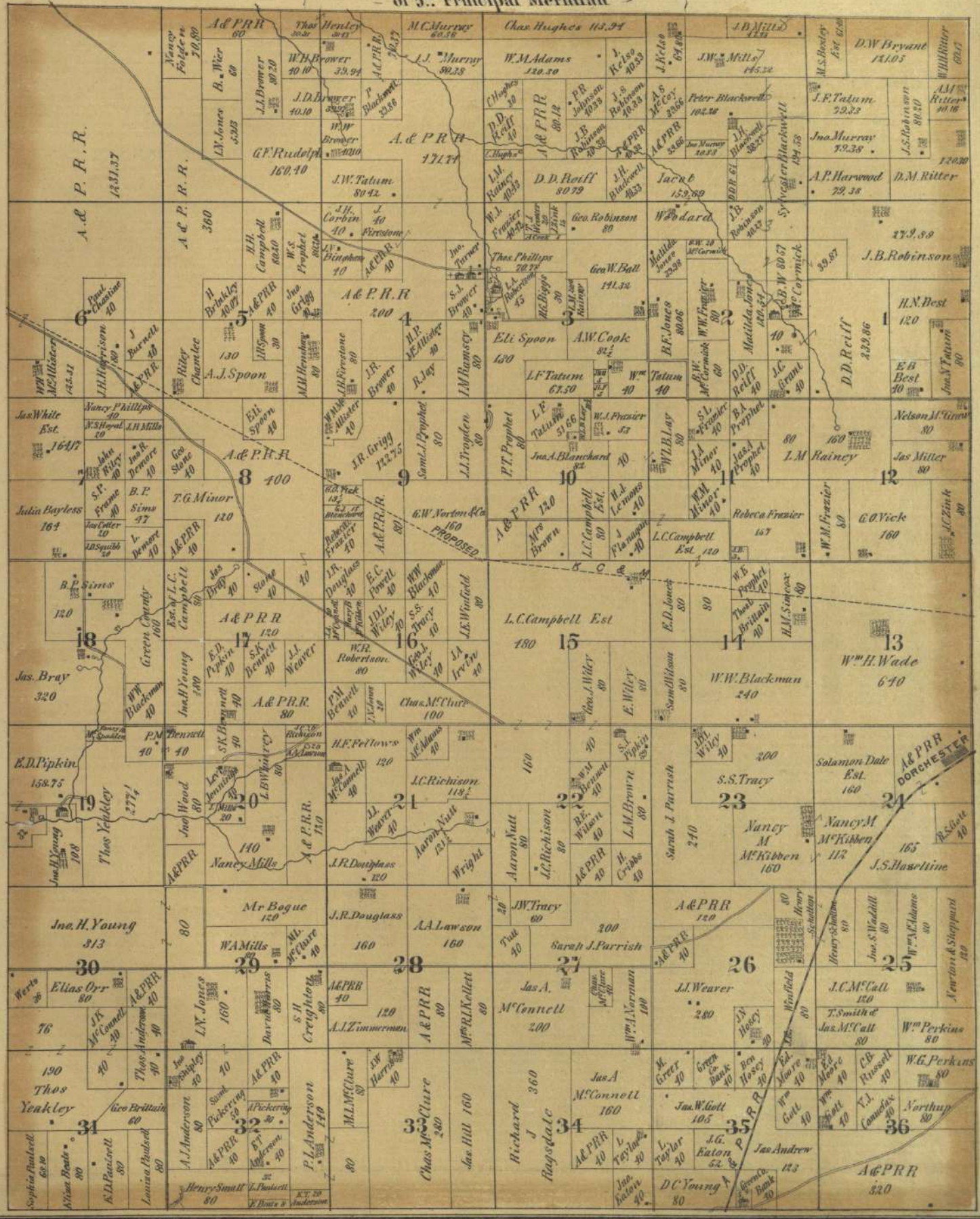

Township 30 North
Range 23 West
of 5th Principal Meridian

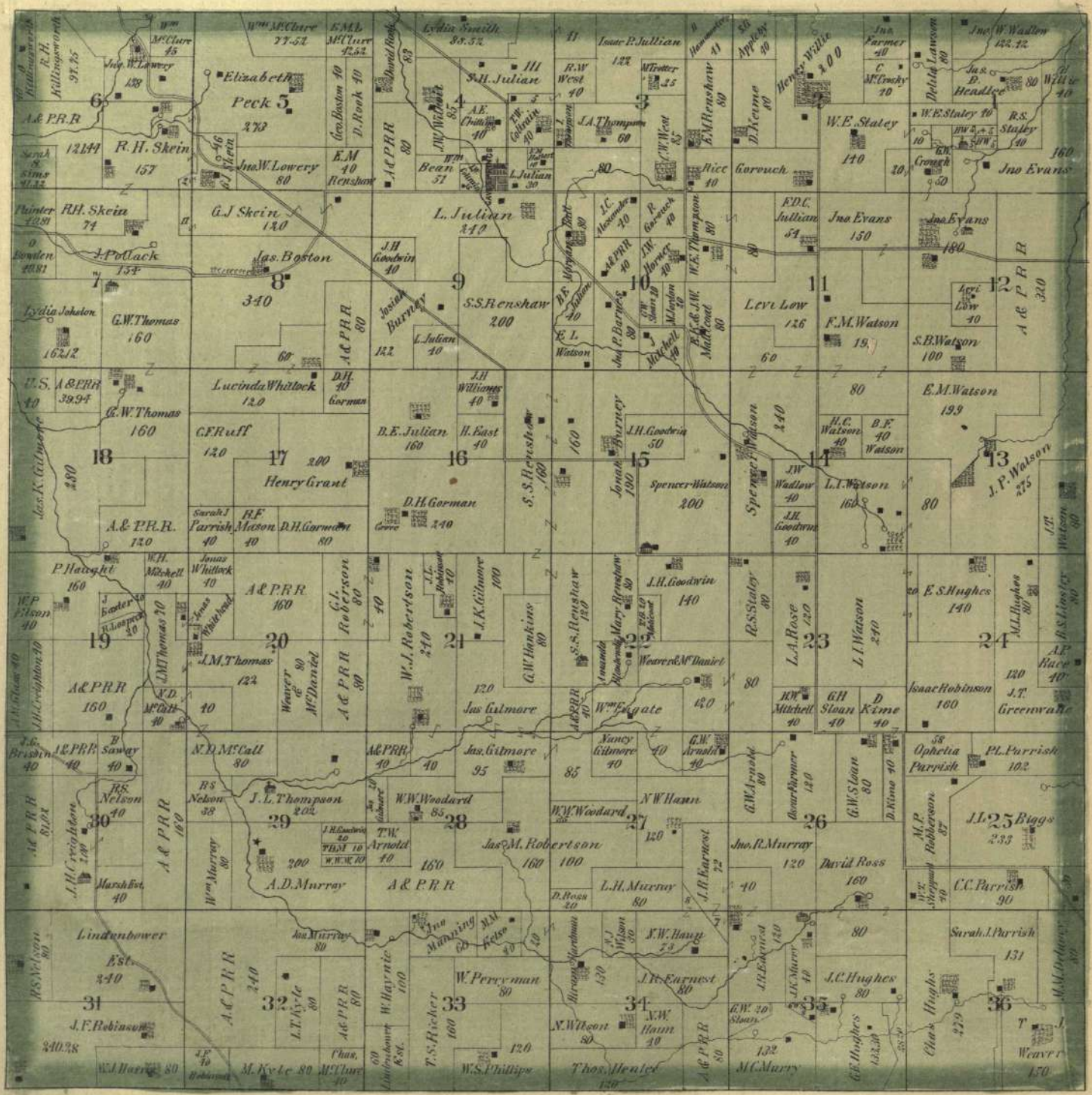

Township 31 North
Range 23 West
of 5th Principal Meridian

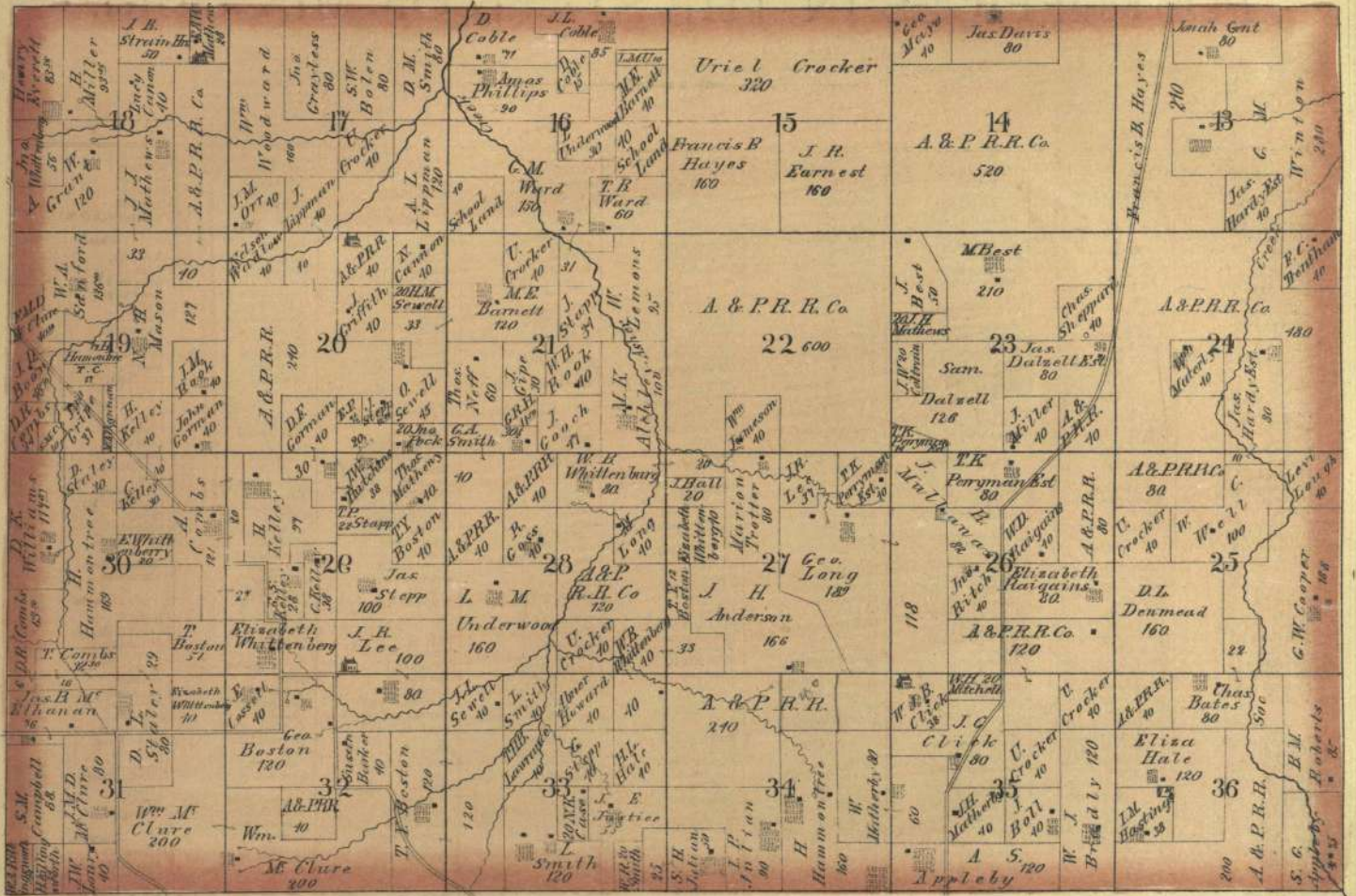

STRAFFORD

Located in NW 1/4 Sec 3 & NE 1/4 Sec 17 T28R20
Laid out in 1871
Scale 100ft to one inch

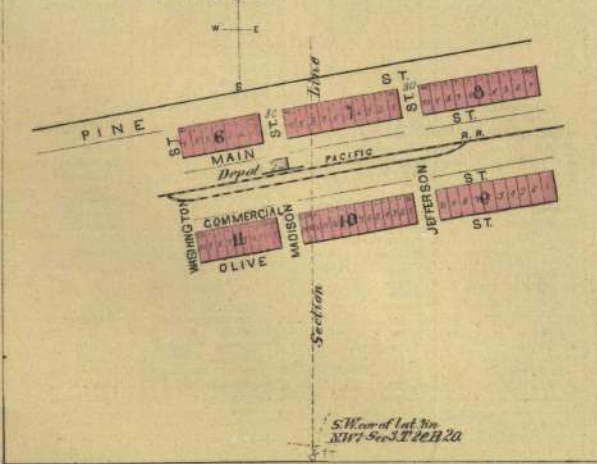

DORCHESTER

Located in NE 1/4 Sec 21 T28N
Range 23 West 5th P.M.
Scale 100ft to 1 inch

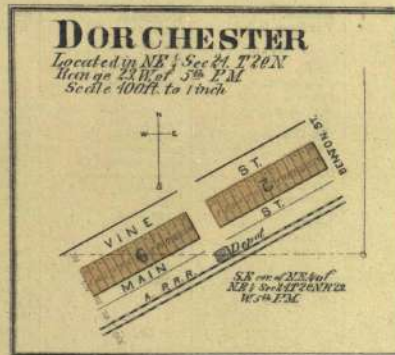

CAVE SPRING

Located in SW 1/4 Sec 27 T30N
Range 23 West 5th P.M.
Scale 100ft to 1 in

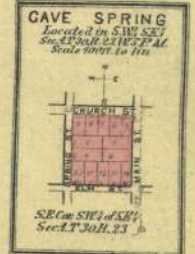

Township 29 North
Range 24 West
of 5th Principal Meridian

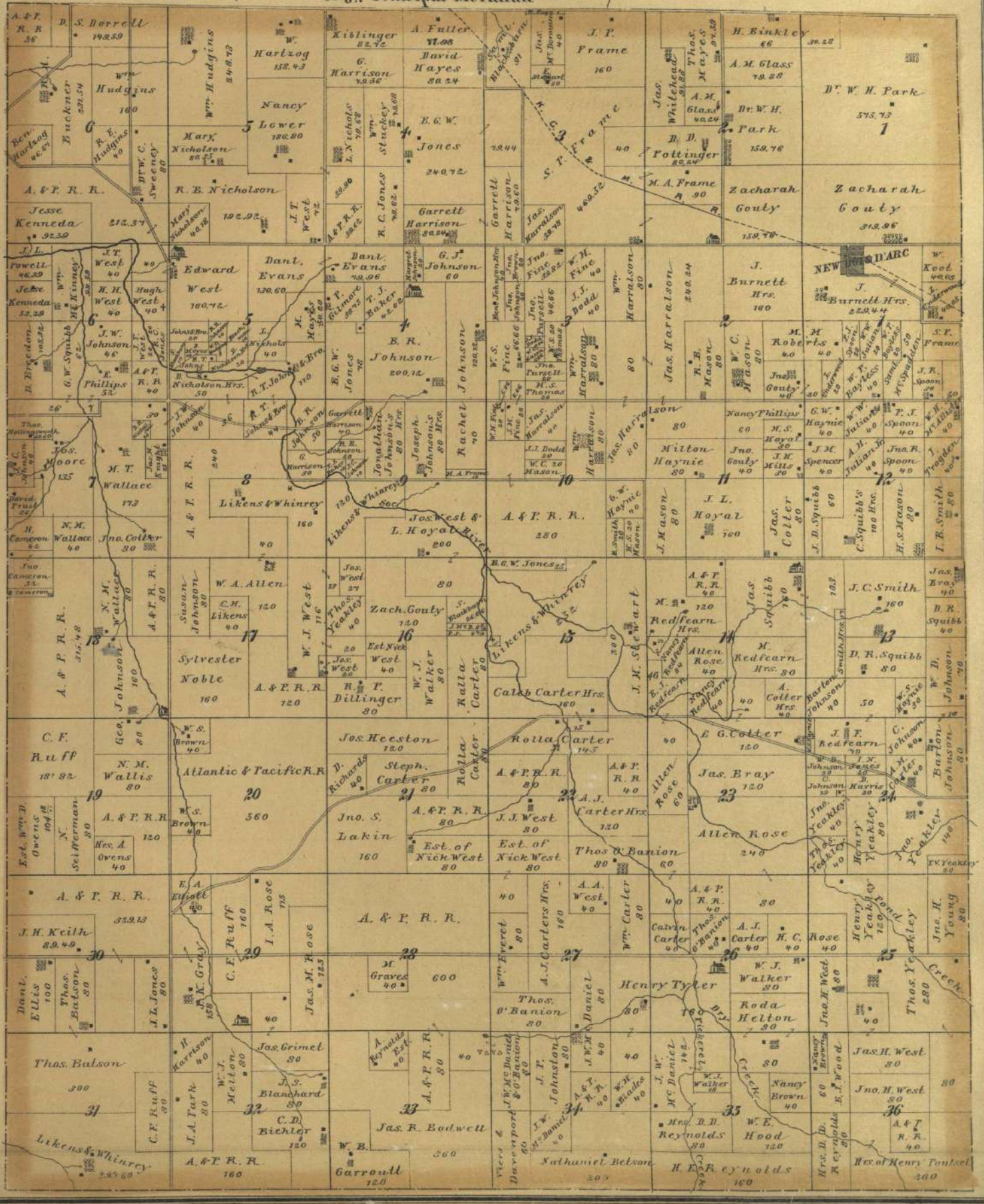

Township 30 North
Range 24 West
of 5th Principal Meridian

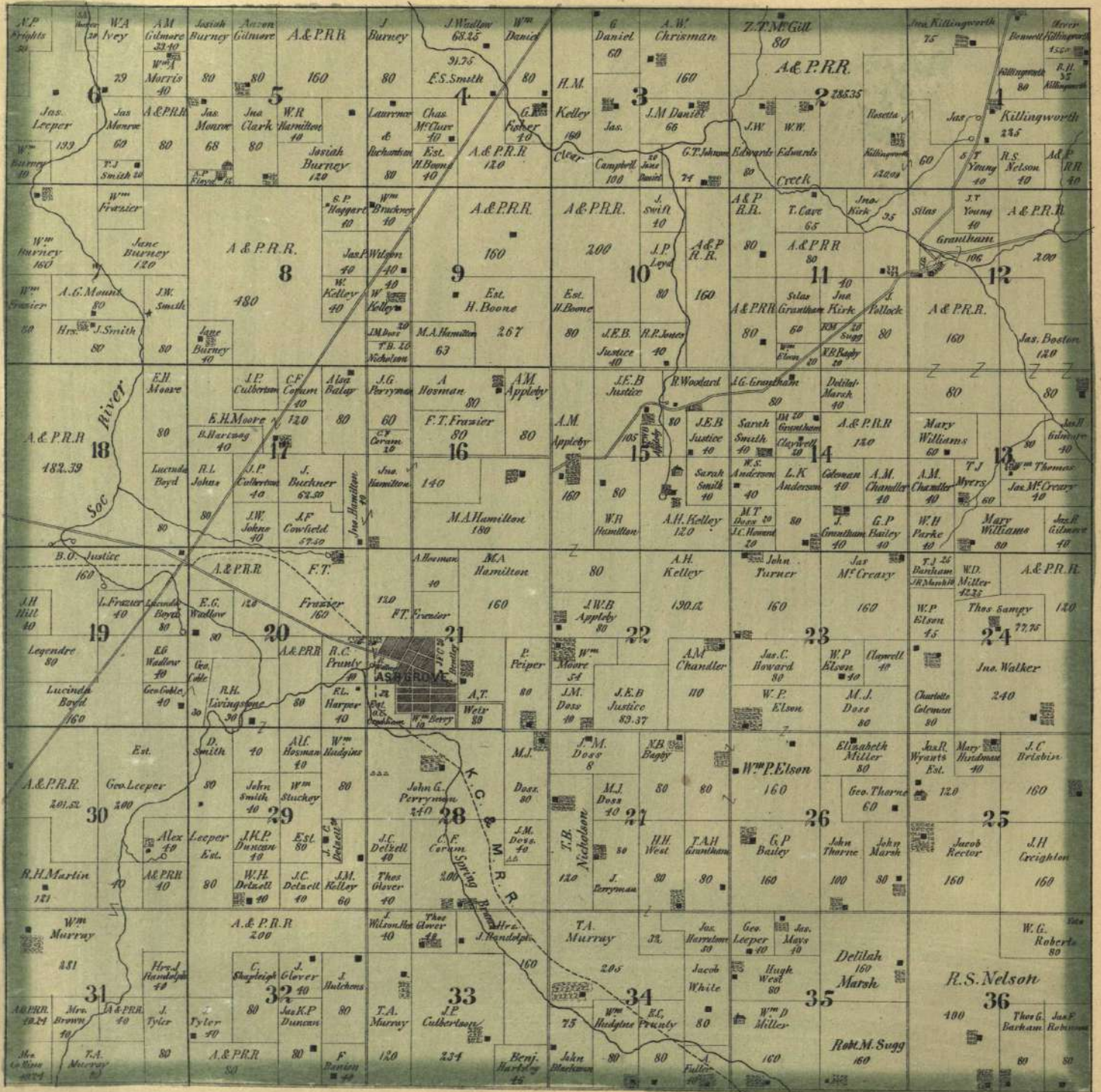

Township 31 North
Range 24 West
of 5th Principal Meridian

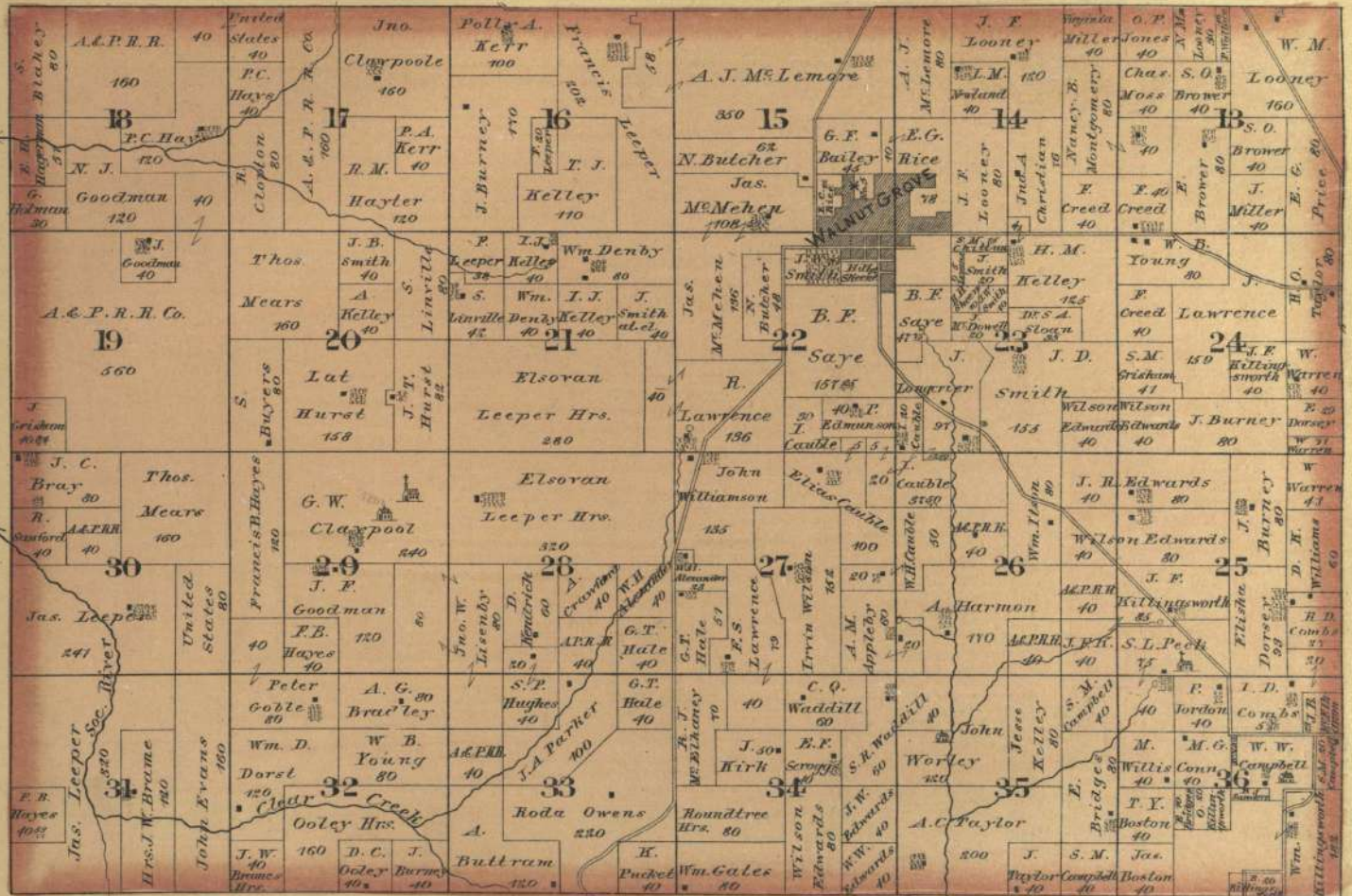

BROOKLINE
Located in NW 1/4 Sec. 2
T. 31 N. R. 24 W. 5th P.M.
Scale 400 ft. to 1 inch



WALNUT GROVE

Located in NE 1/4 Sec. 22
T. 31 N. R. 24 W. 5th P.M.
Scale 400 ft. to 1 inch

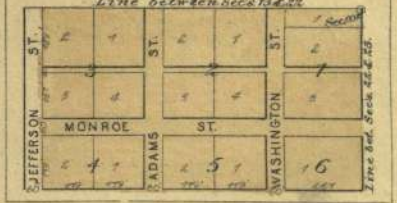

MAP OF NORTH HALF OF SPRINGFIELD MISSOURI.

Landed to Sections 17 & 18, Twp. 23 N. Range 21 W. of 92nd M.
Scale 1/2" = 100' (1/4" = 50')

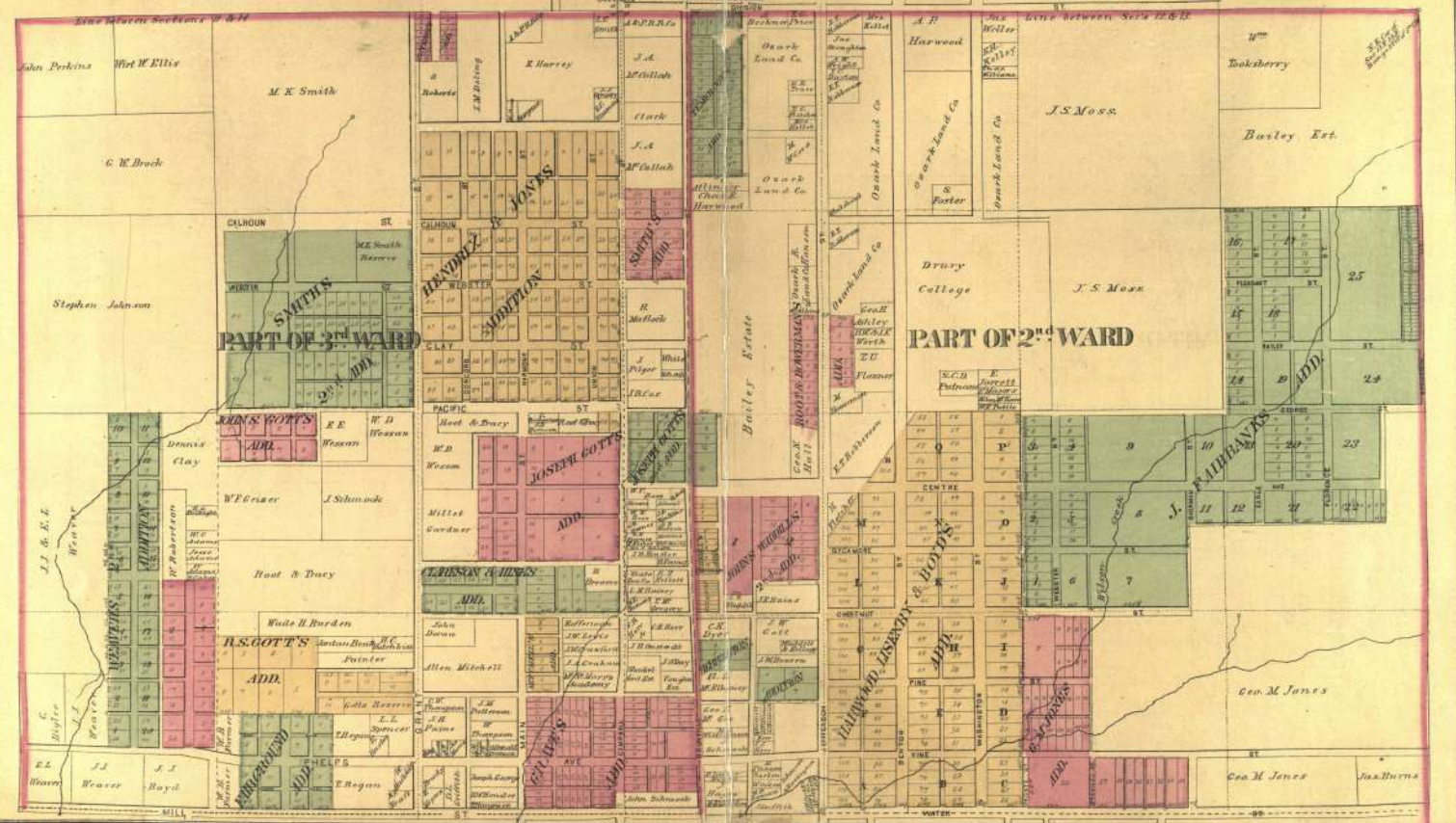

MAP OF SOUTH HALF OF SPRINGFIELD MISSOURI.

Laid to Sections 22 & 23 of T. 38 N. R. 22 W. of R. 11 E.
Scale 10000 feet to an inch.

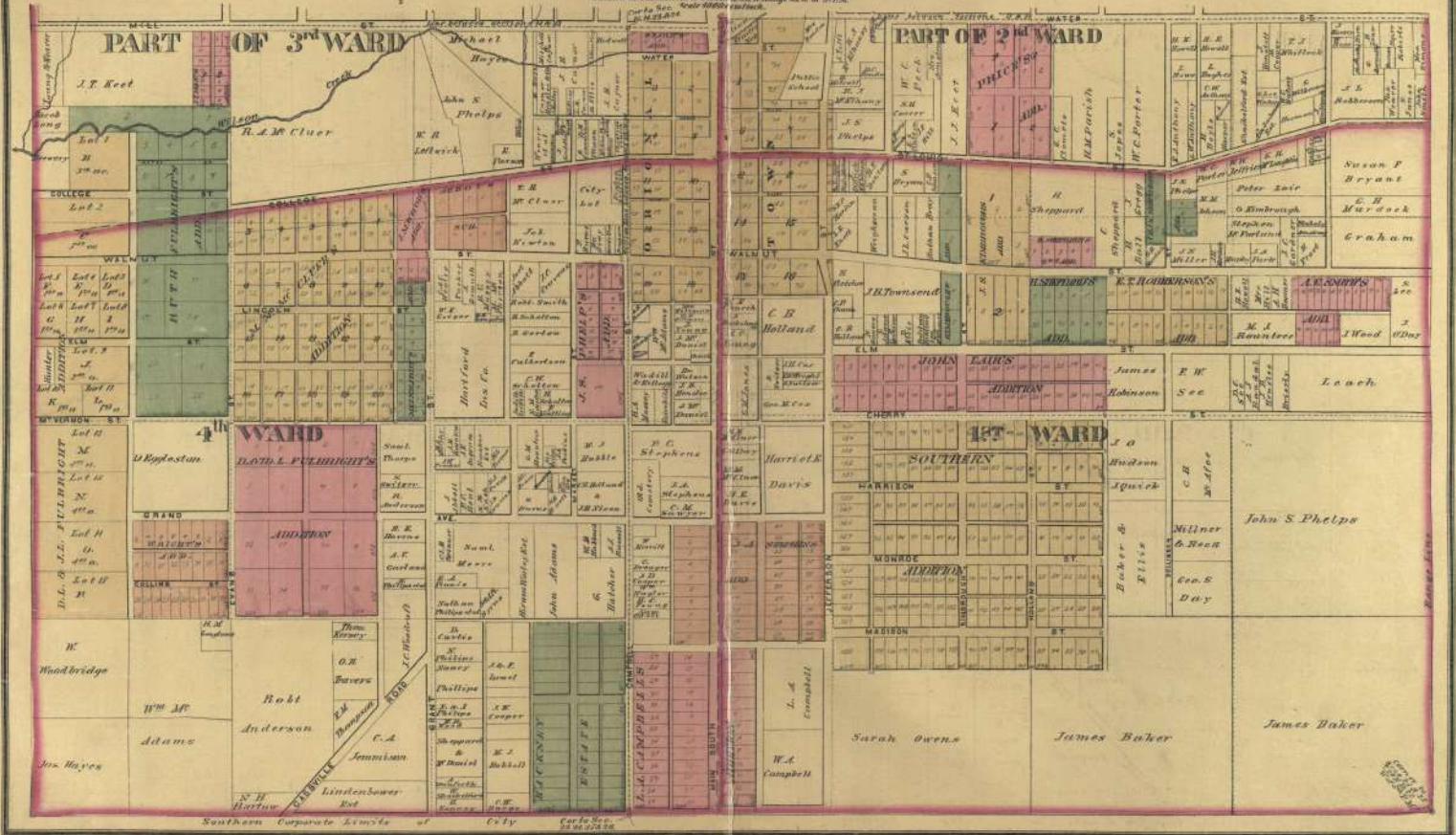

Southern Corporate Limits of City