

HOWELL COUNTY MISSOURI

PUBLISHED BY
W.W. HIXSON MAP & ATLAS CO.
ROCKFORD ILLINOIS

TEXAS R. 10W. R. 9W. R. 8W. R. 7W. CO.

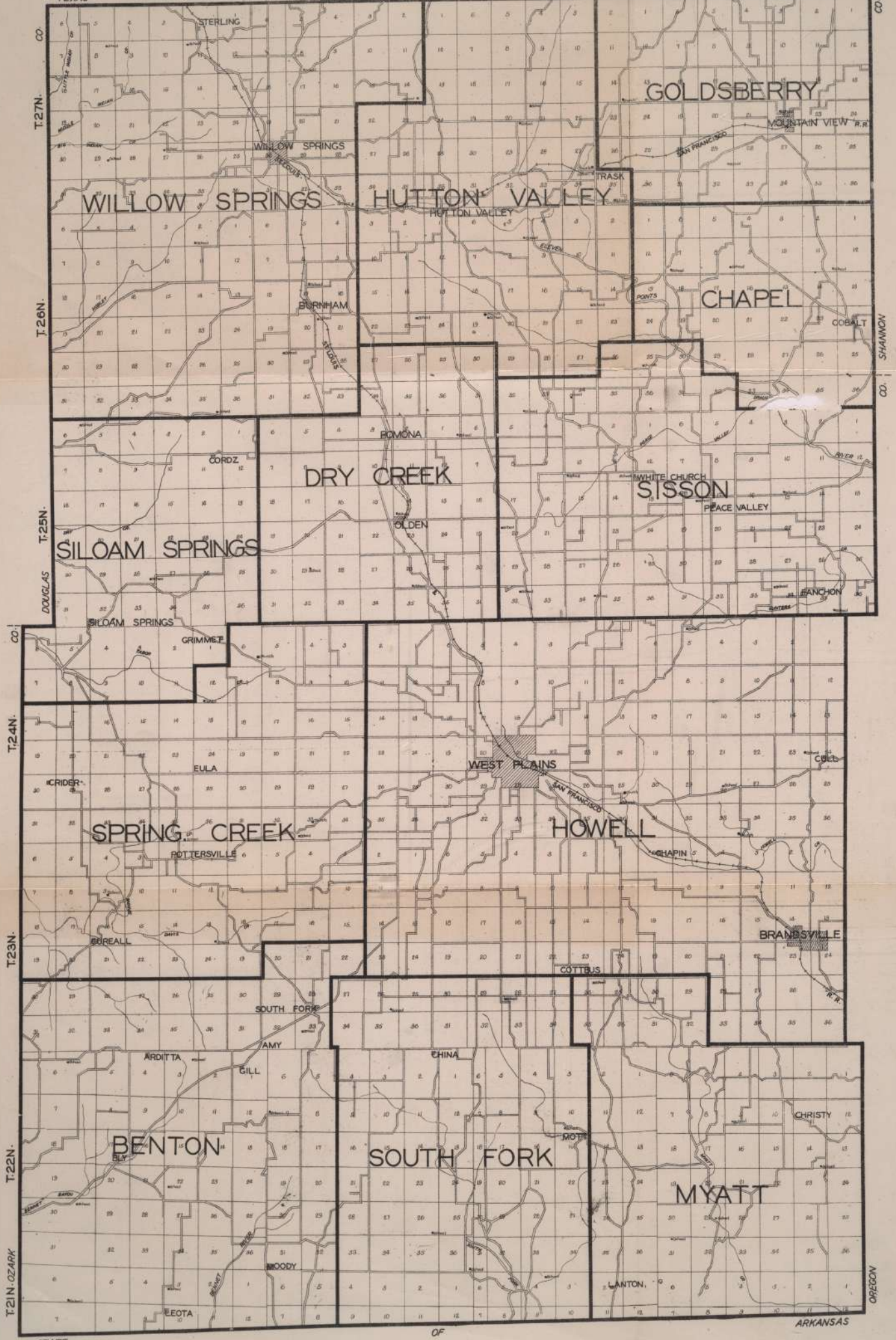

STATE

OF

ARKANSAS

T.21&22N.

PART OF MYATT

R.7W.

Room
no. 46
H64
333,097178

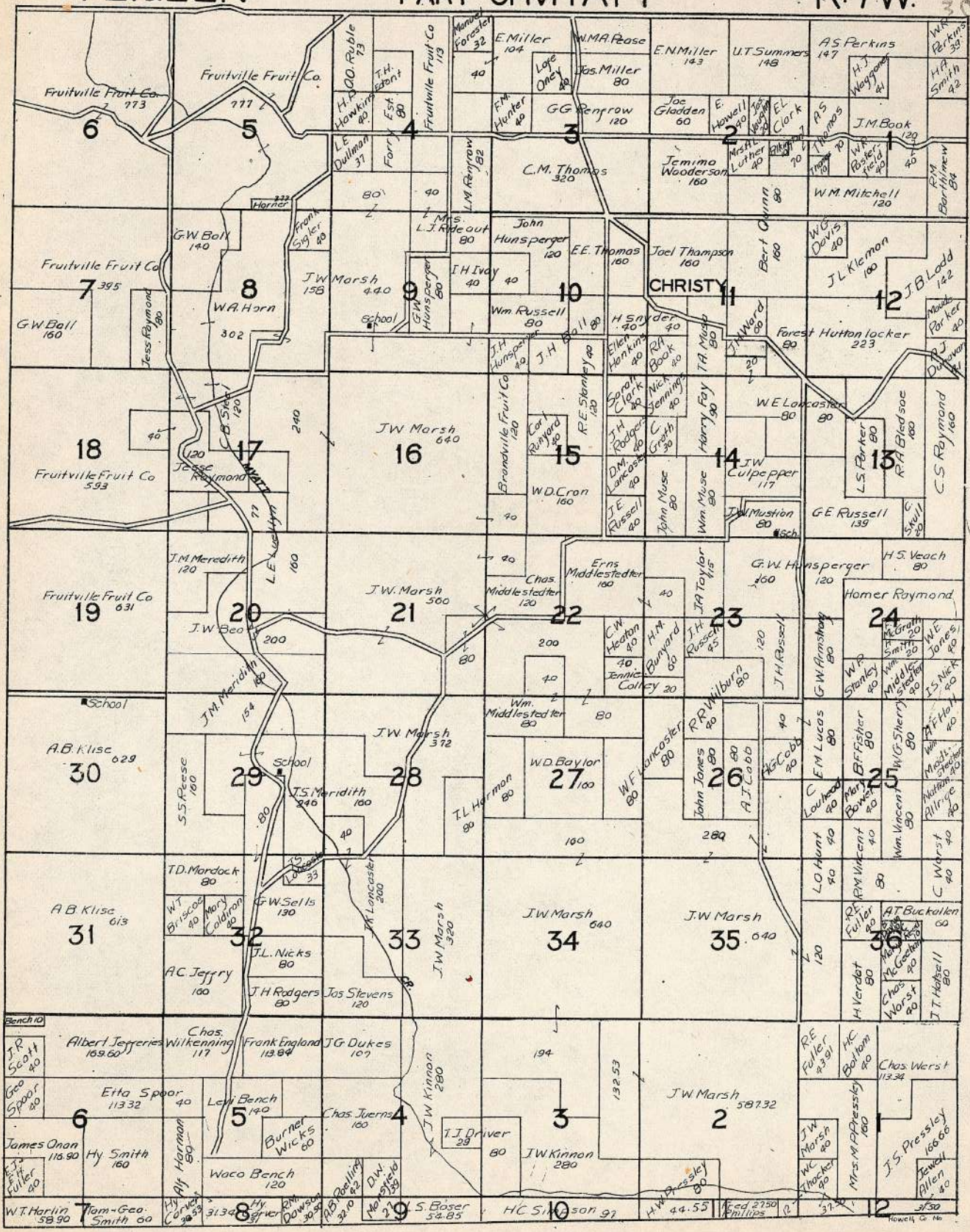

284824 58

T.23N.

R.7W.

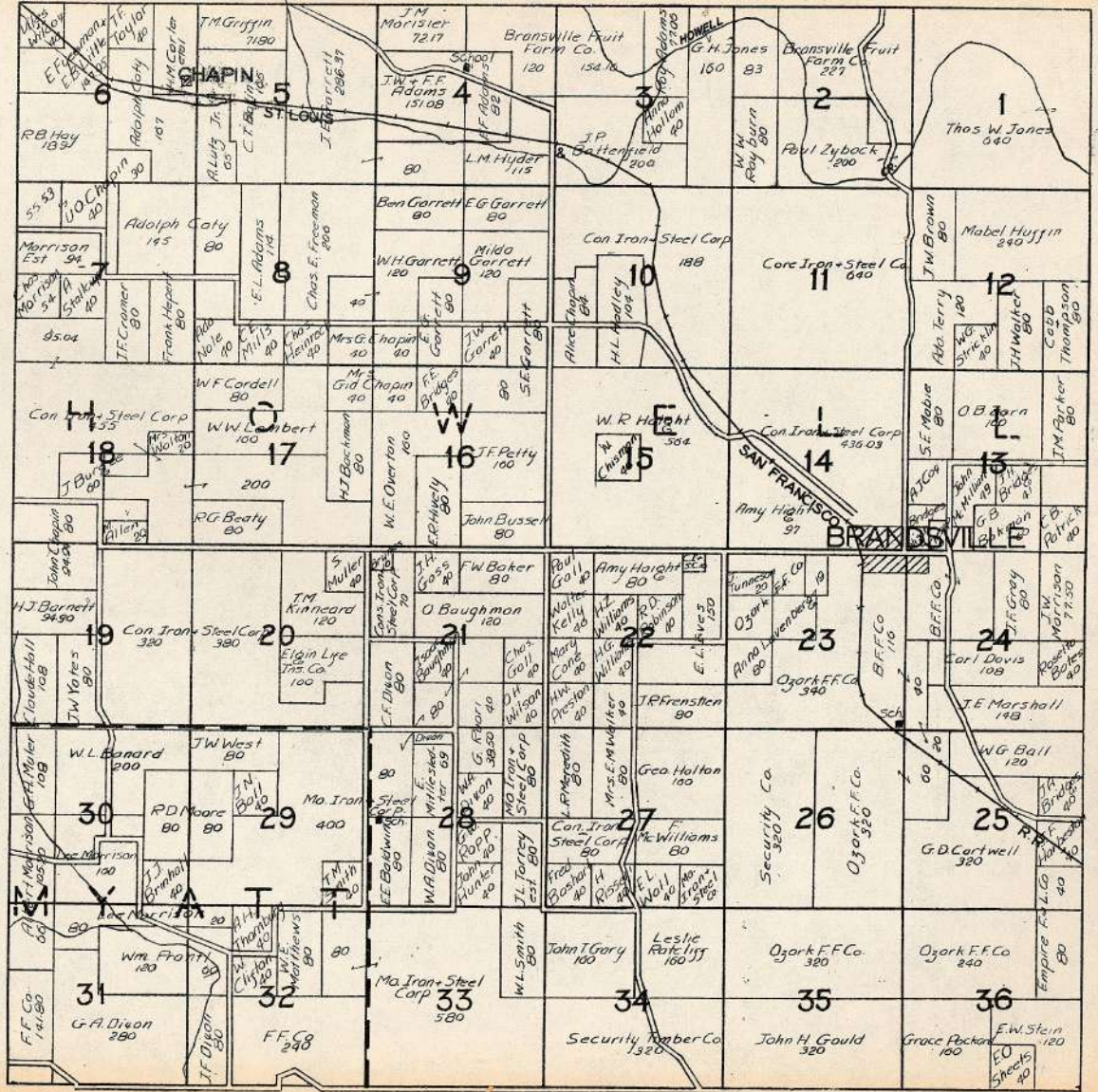

T.24N.

PART OF HOWELL

R.7W.

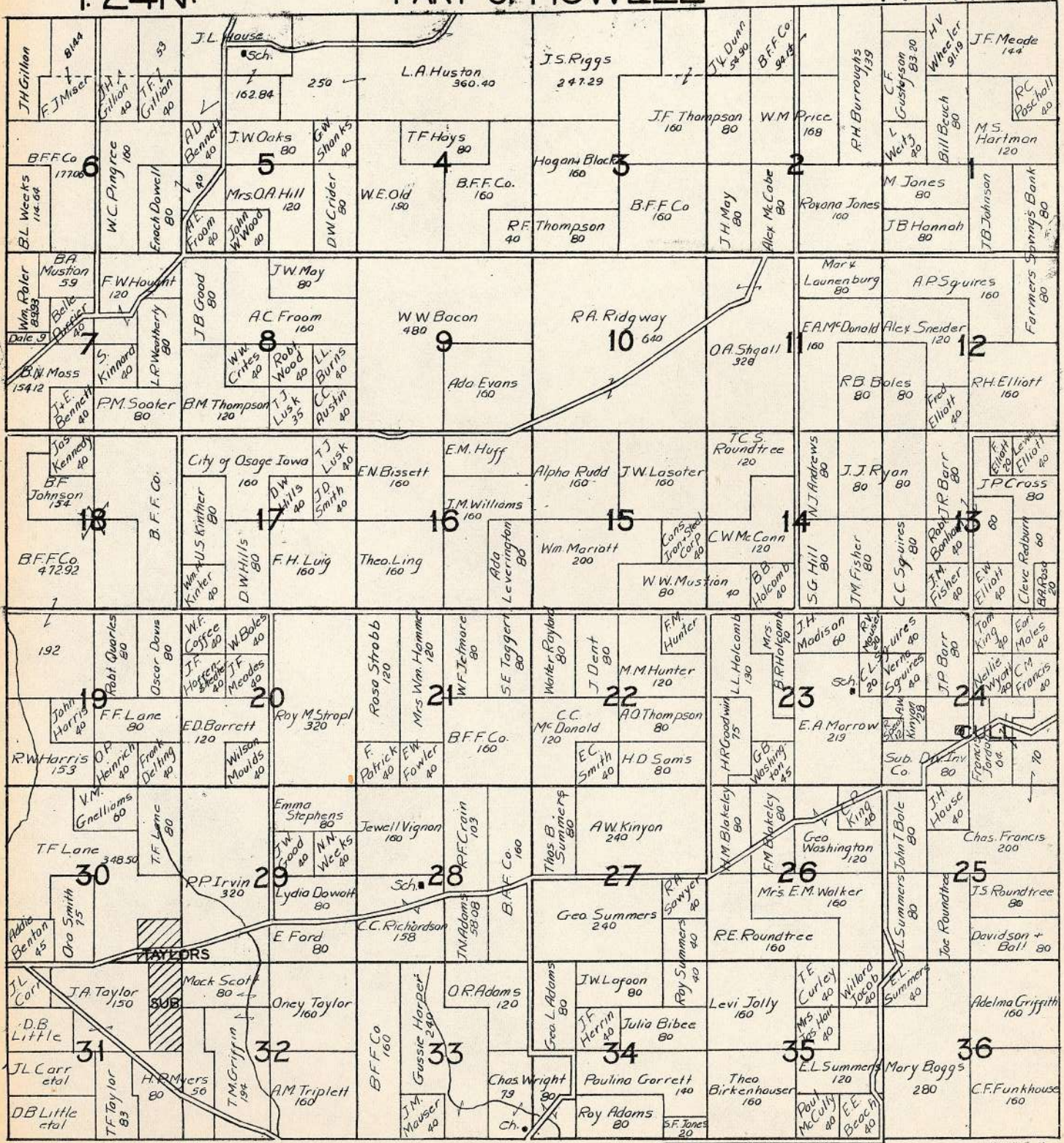

T.25N.

PART OF SISSON

R.7W.

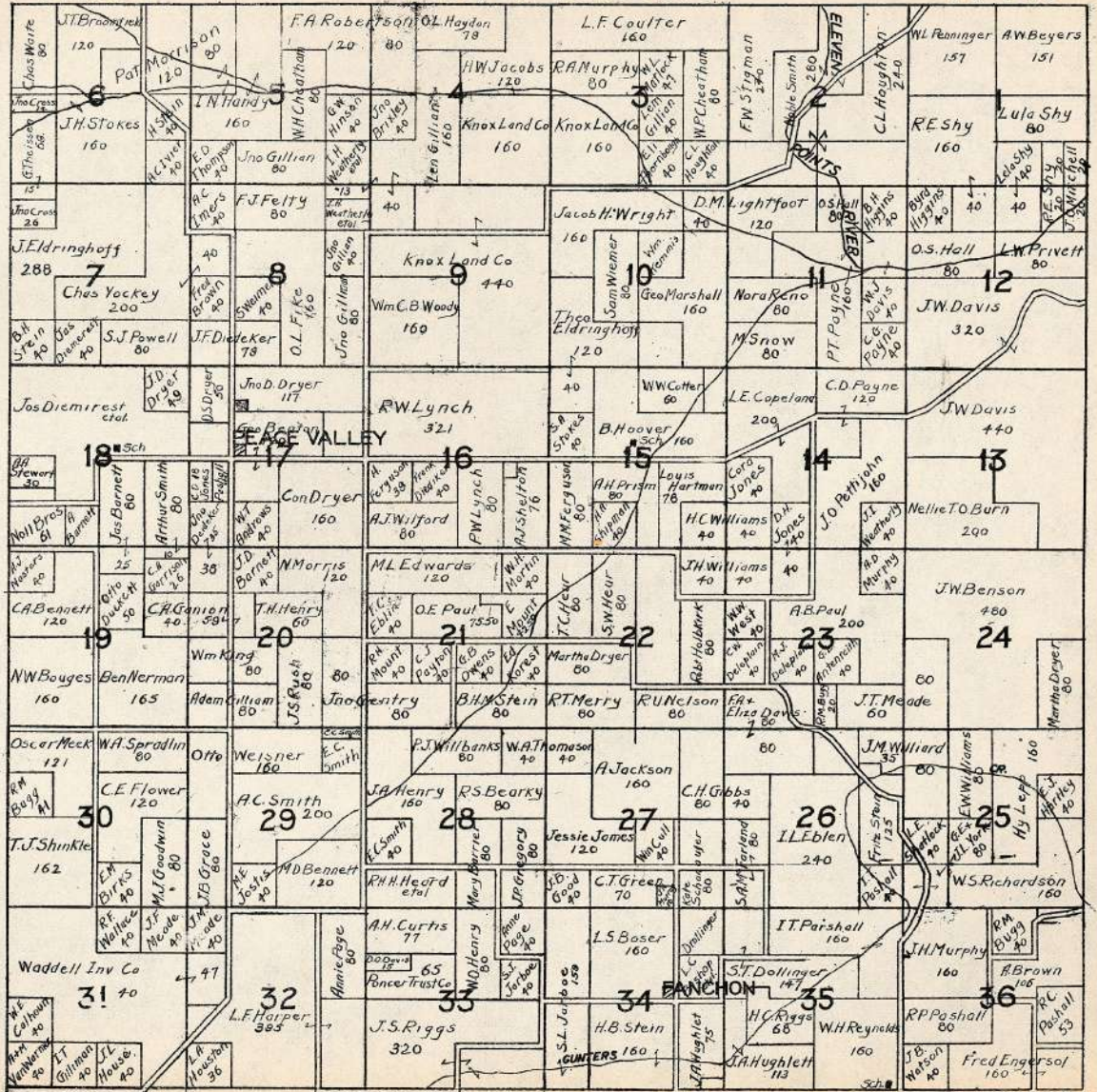

T.26N.

R.7W.

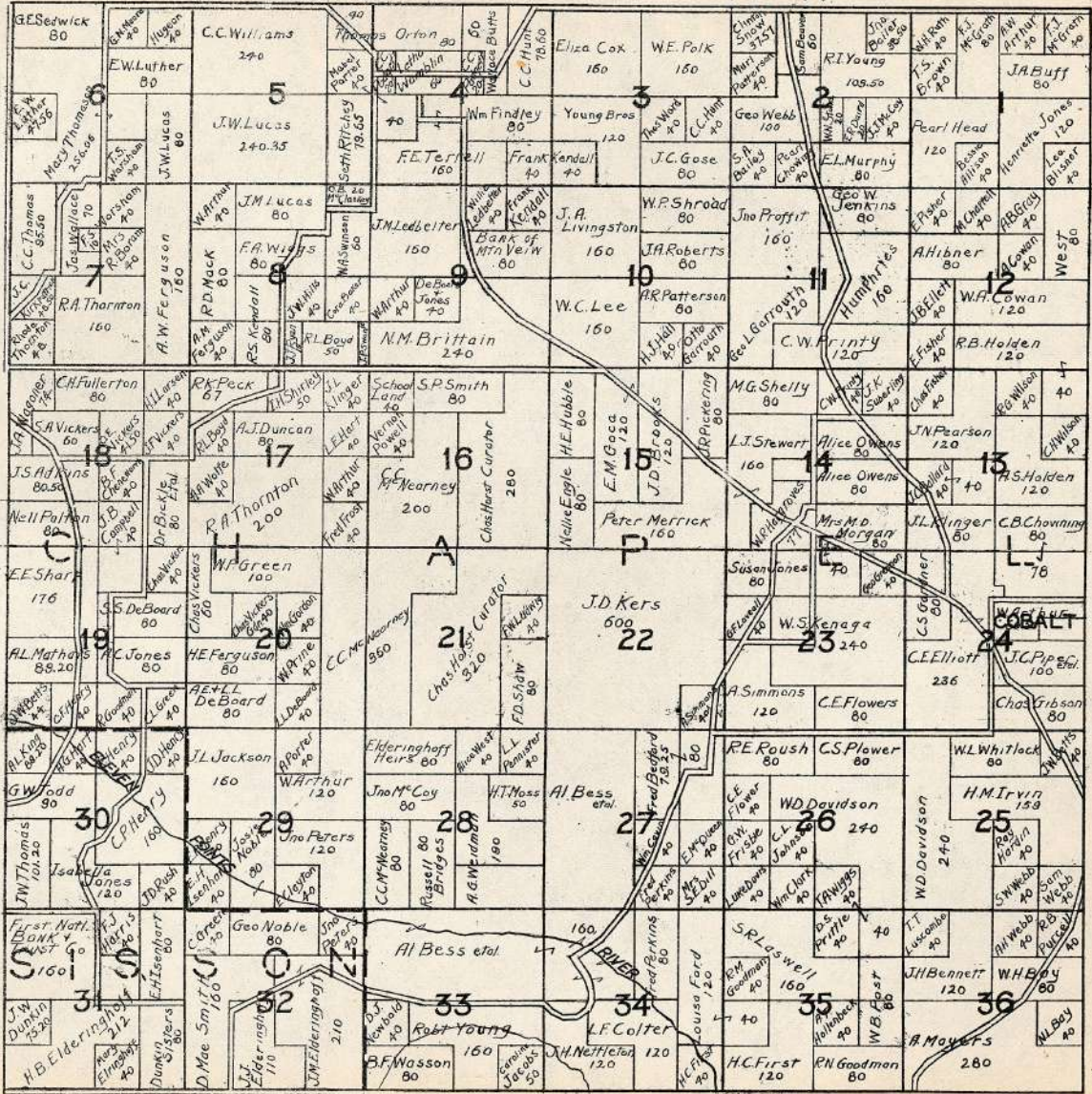

T.27N.

PART OF GOLDSBERRY

R.7W.

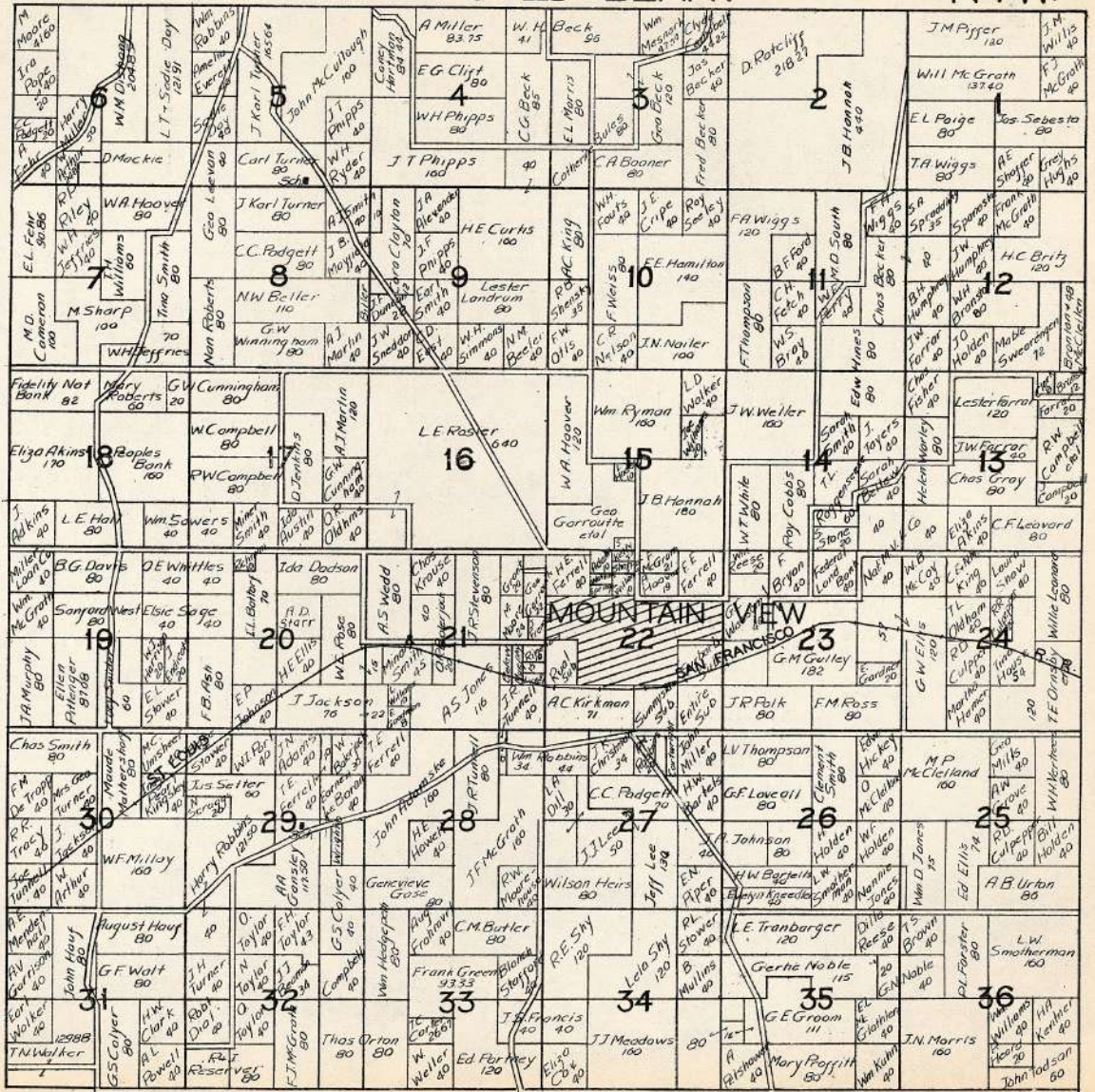

T.21&22N.

R.8W.

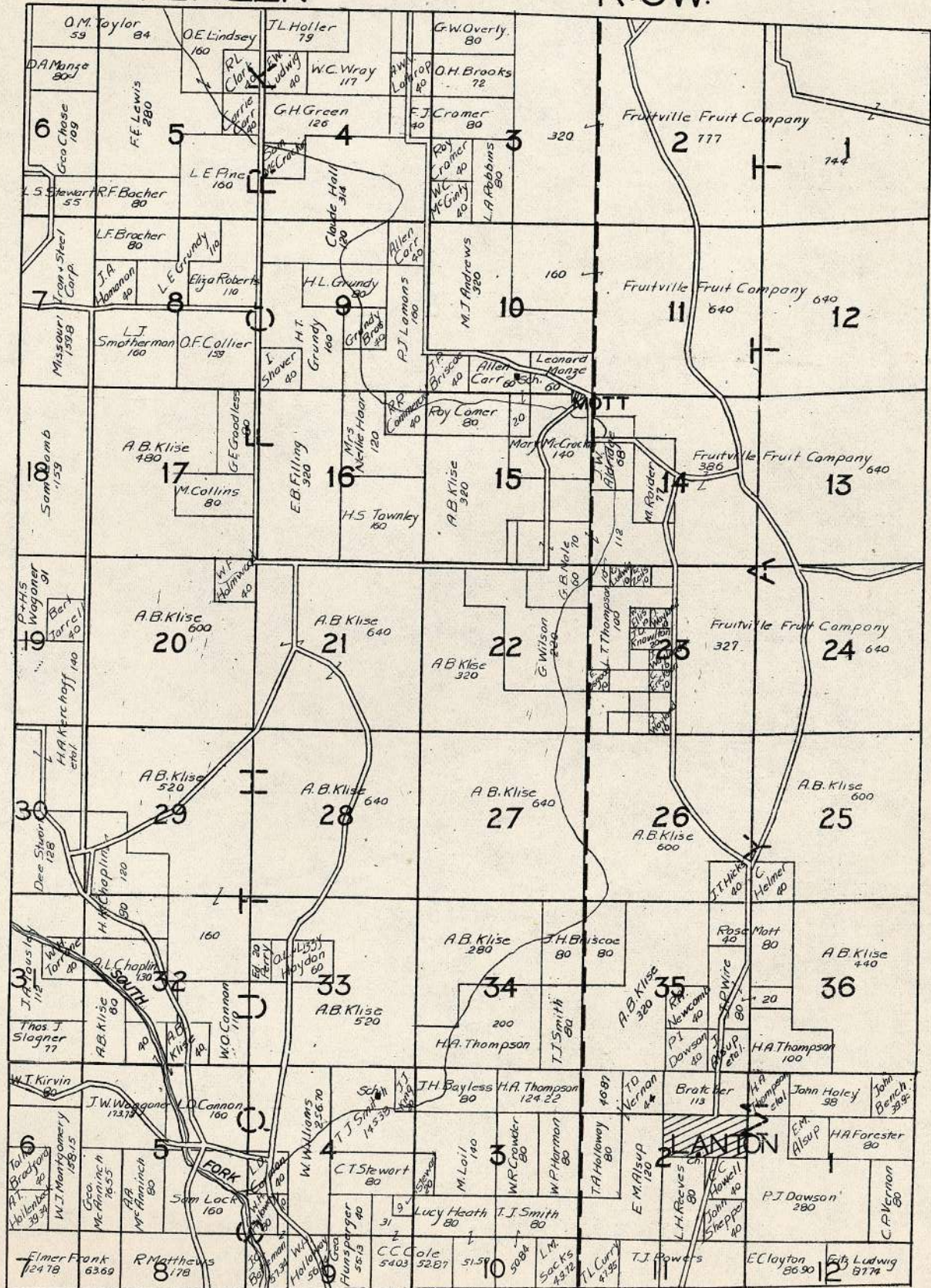

T.23N.

R.8W.

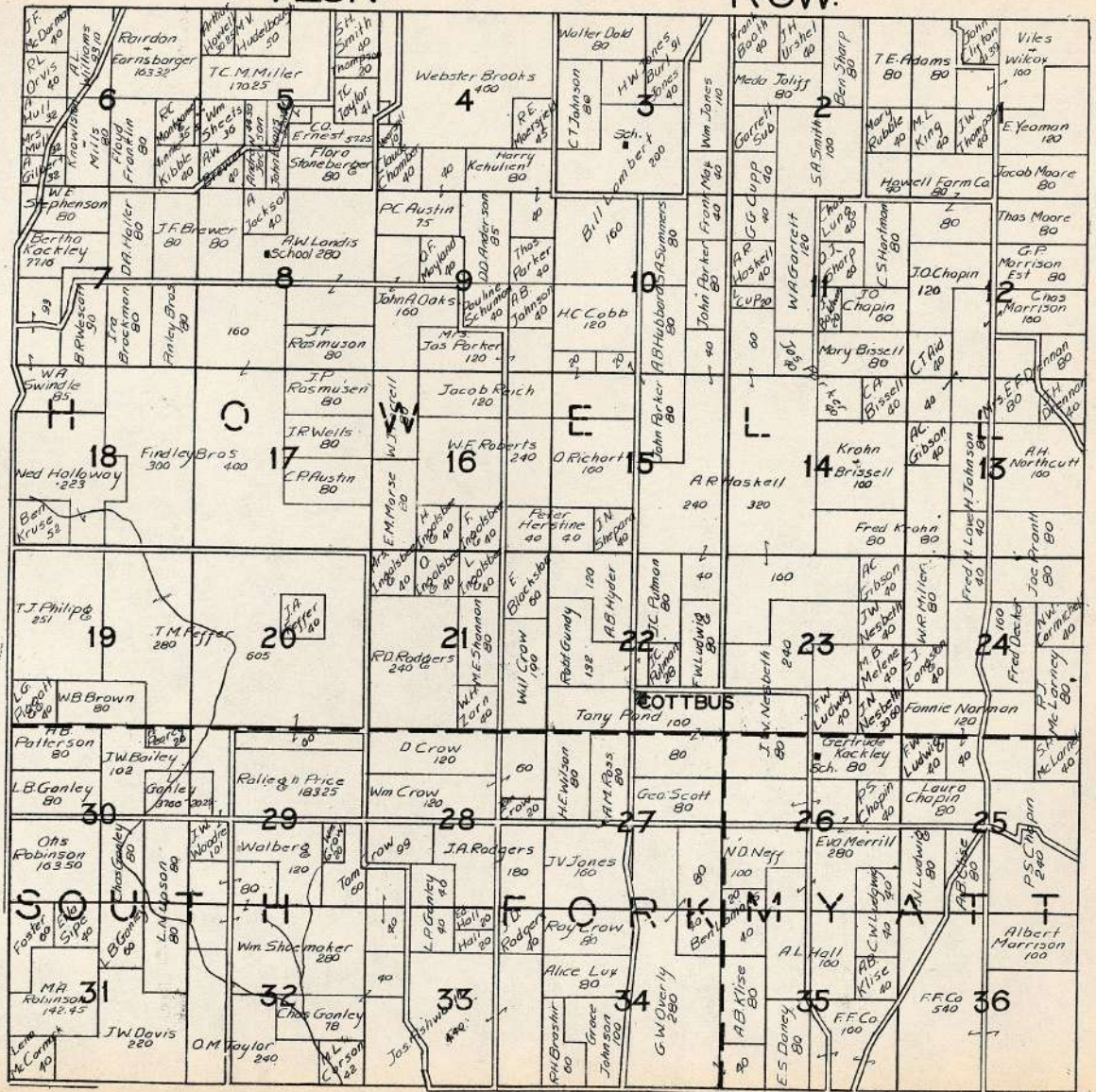

T.25N.

R.8W.

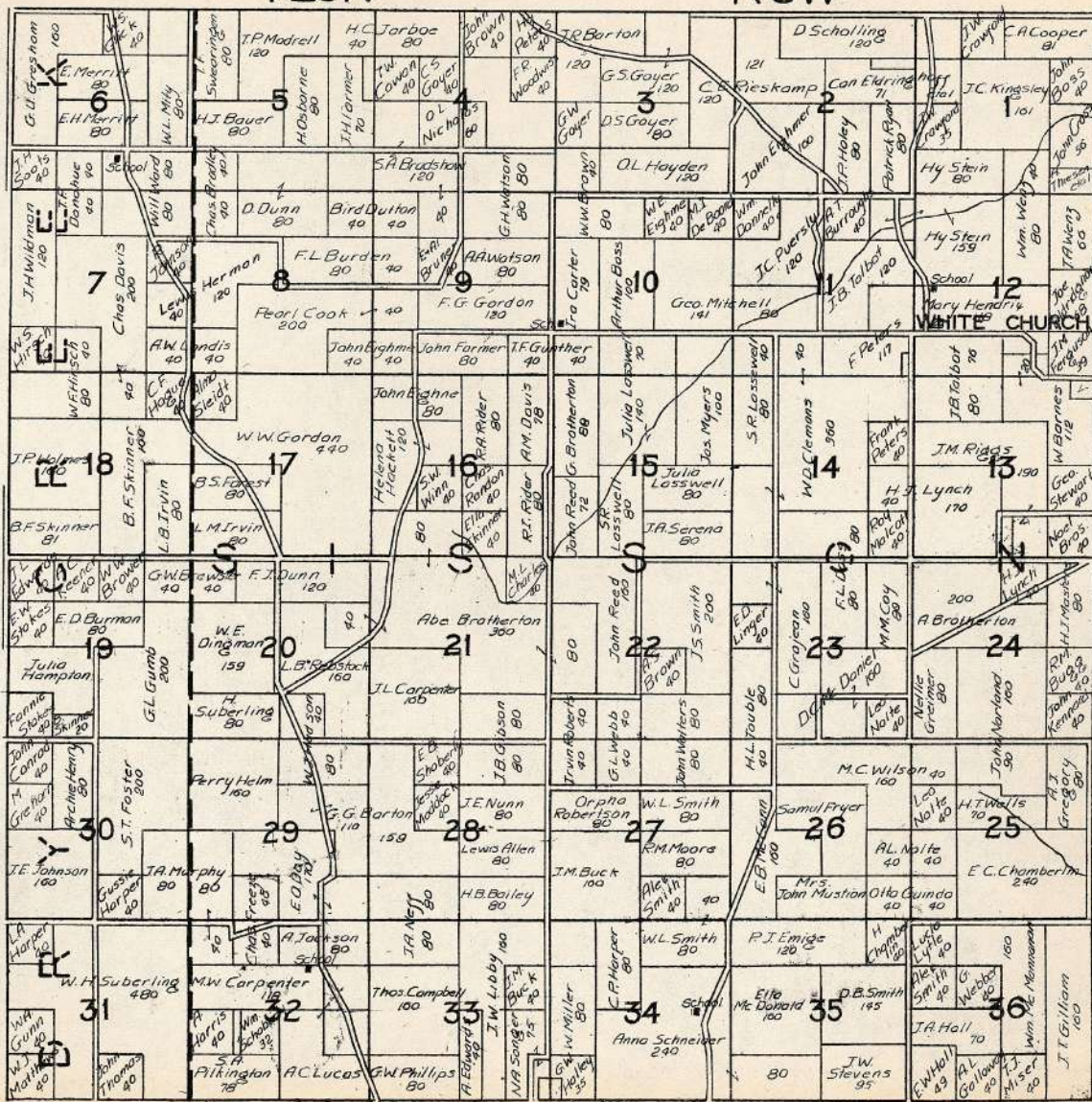

T.26N.

R.8W.

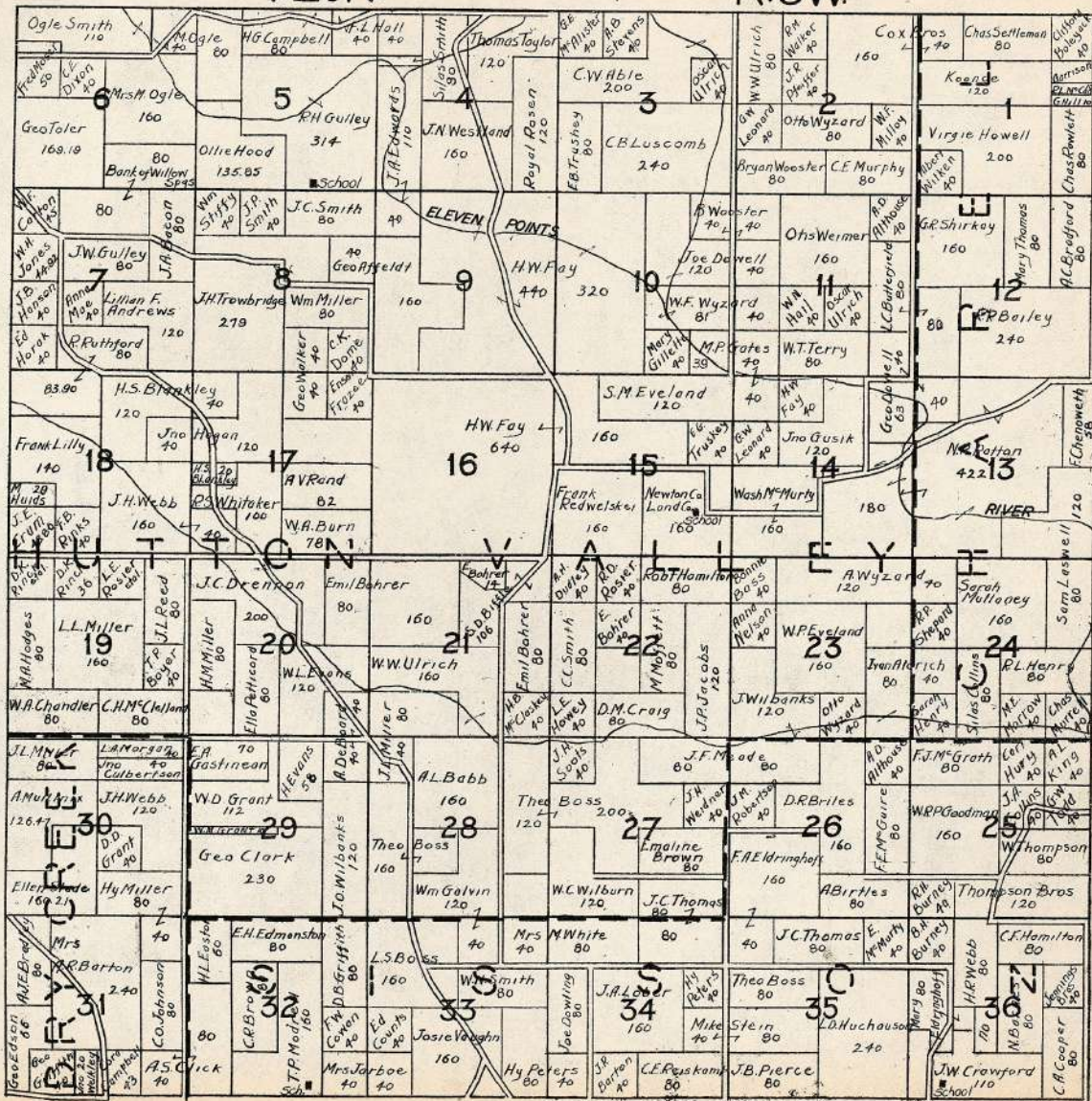

T.27N.

R.8W.

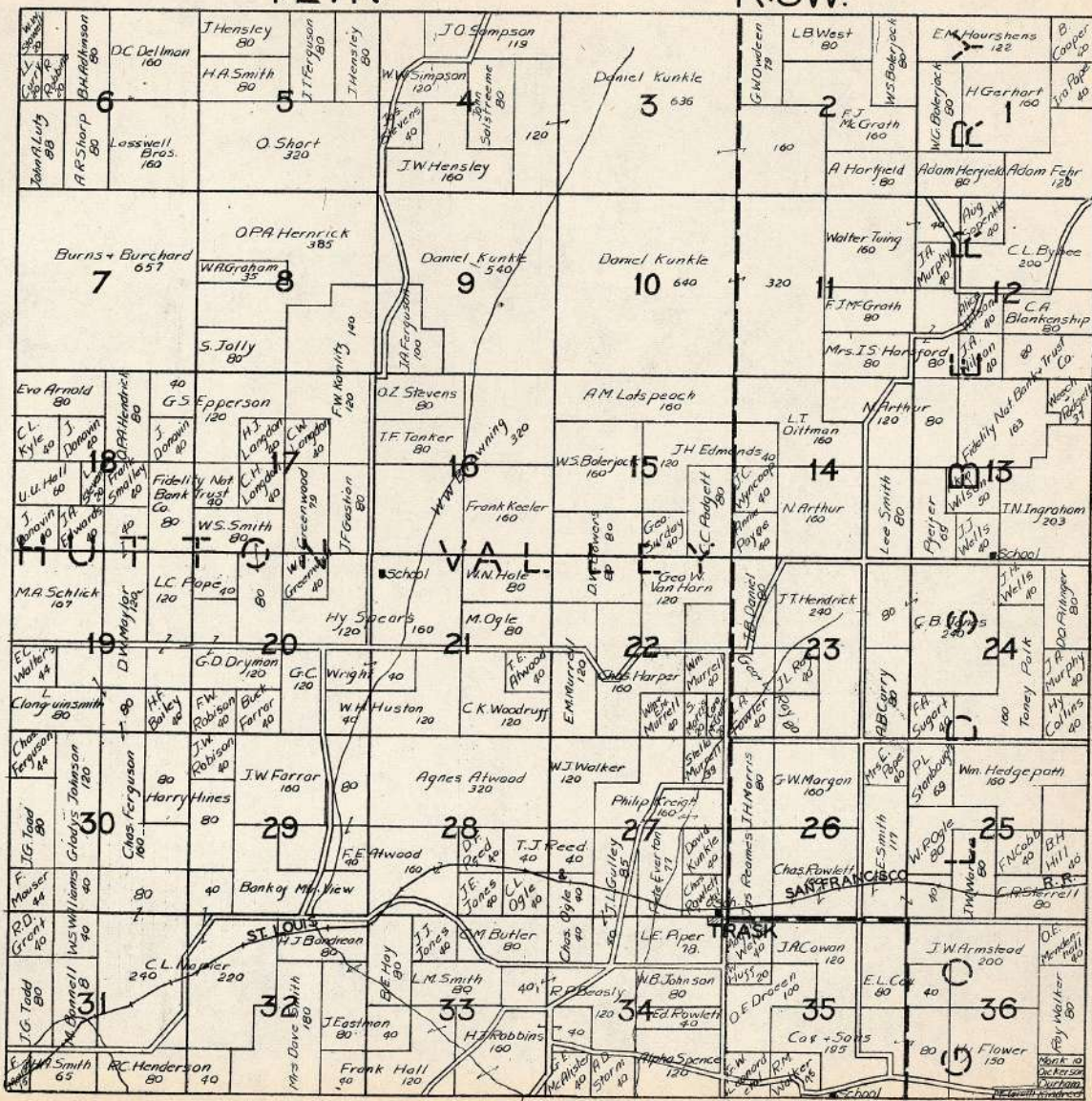

T.21 & 22N.

R.9W.

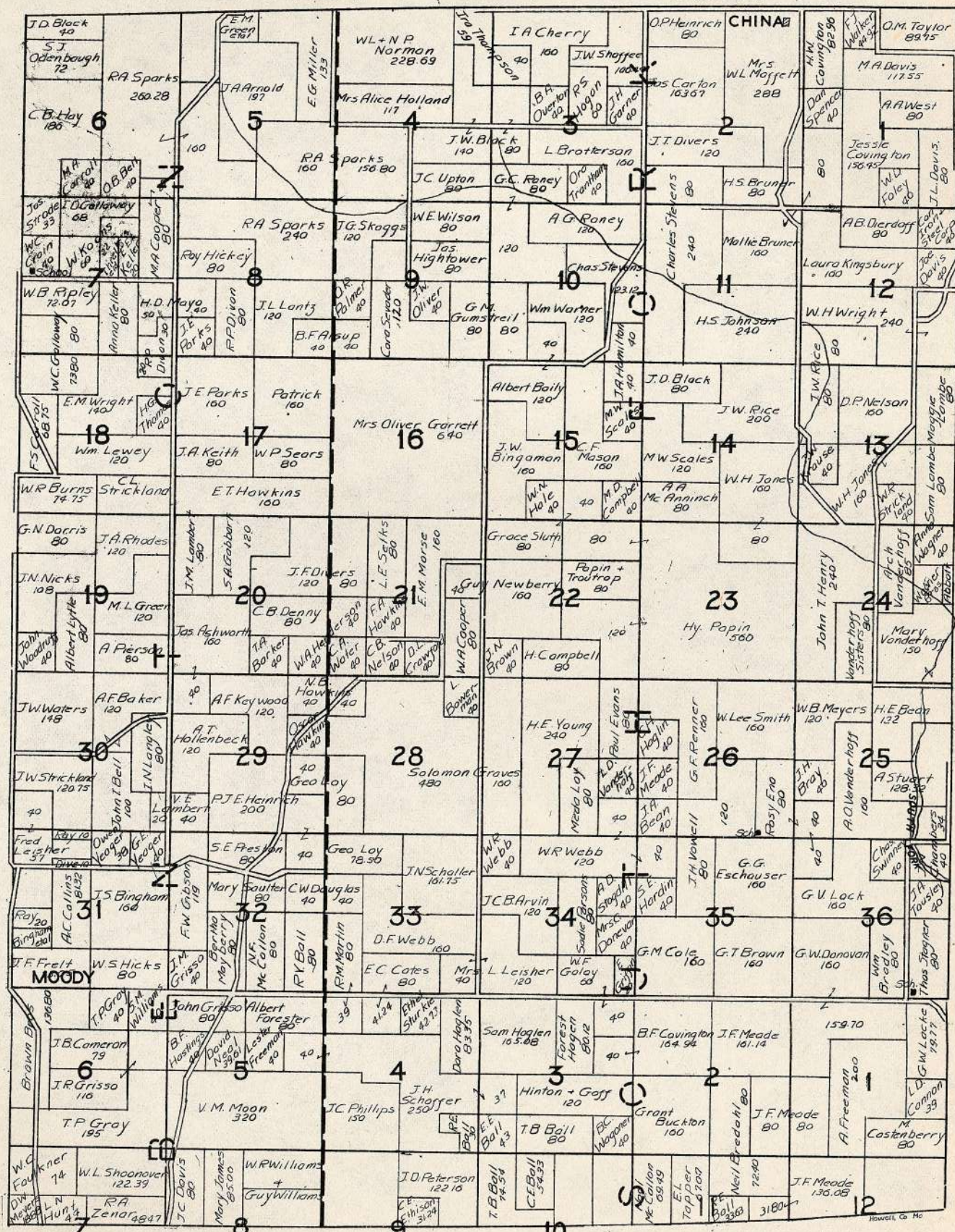

T.23N.

R.9W.

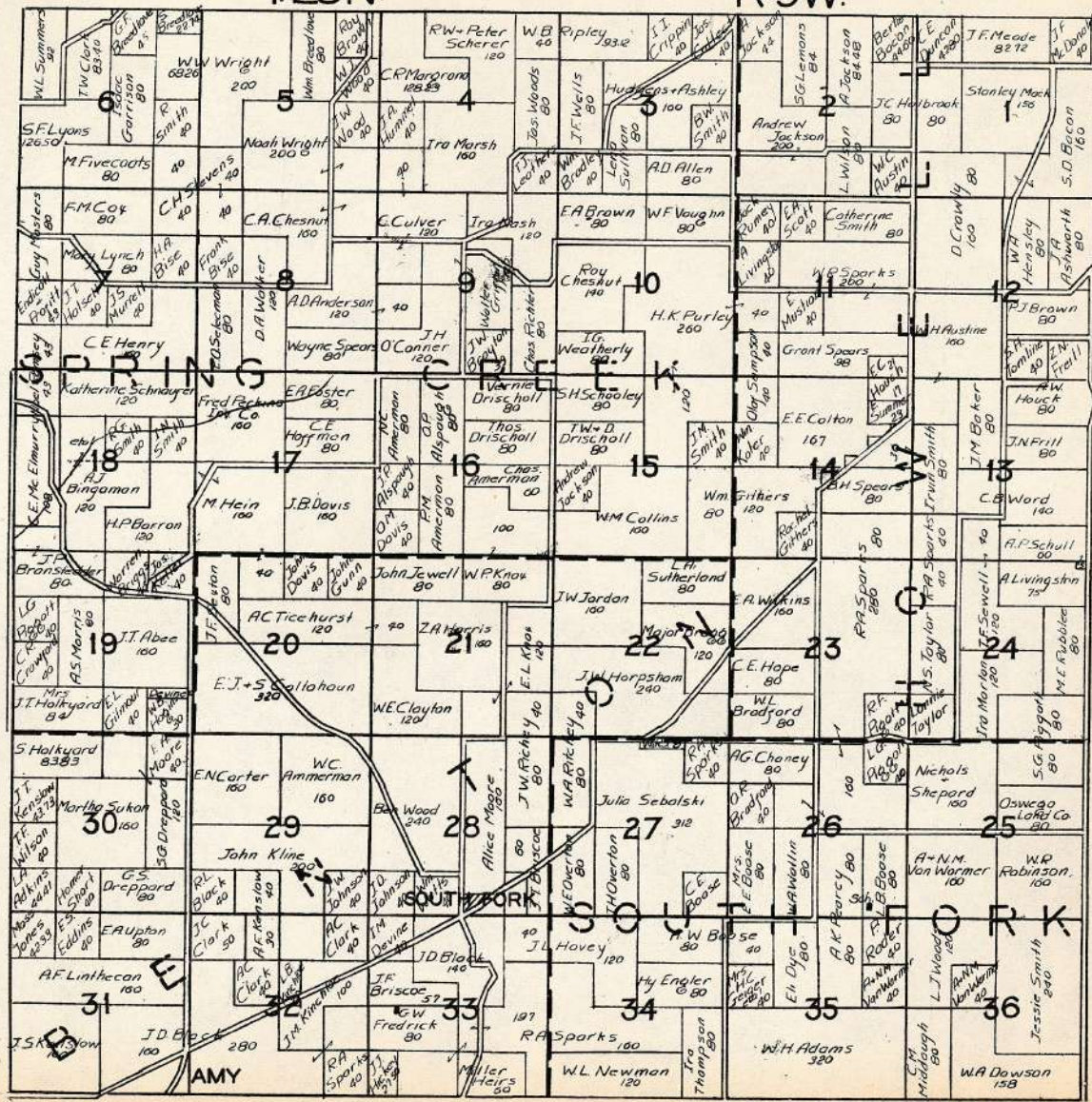

T.24N.

R.9W.

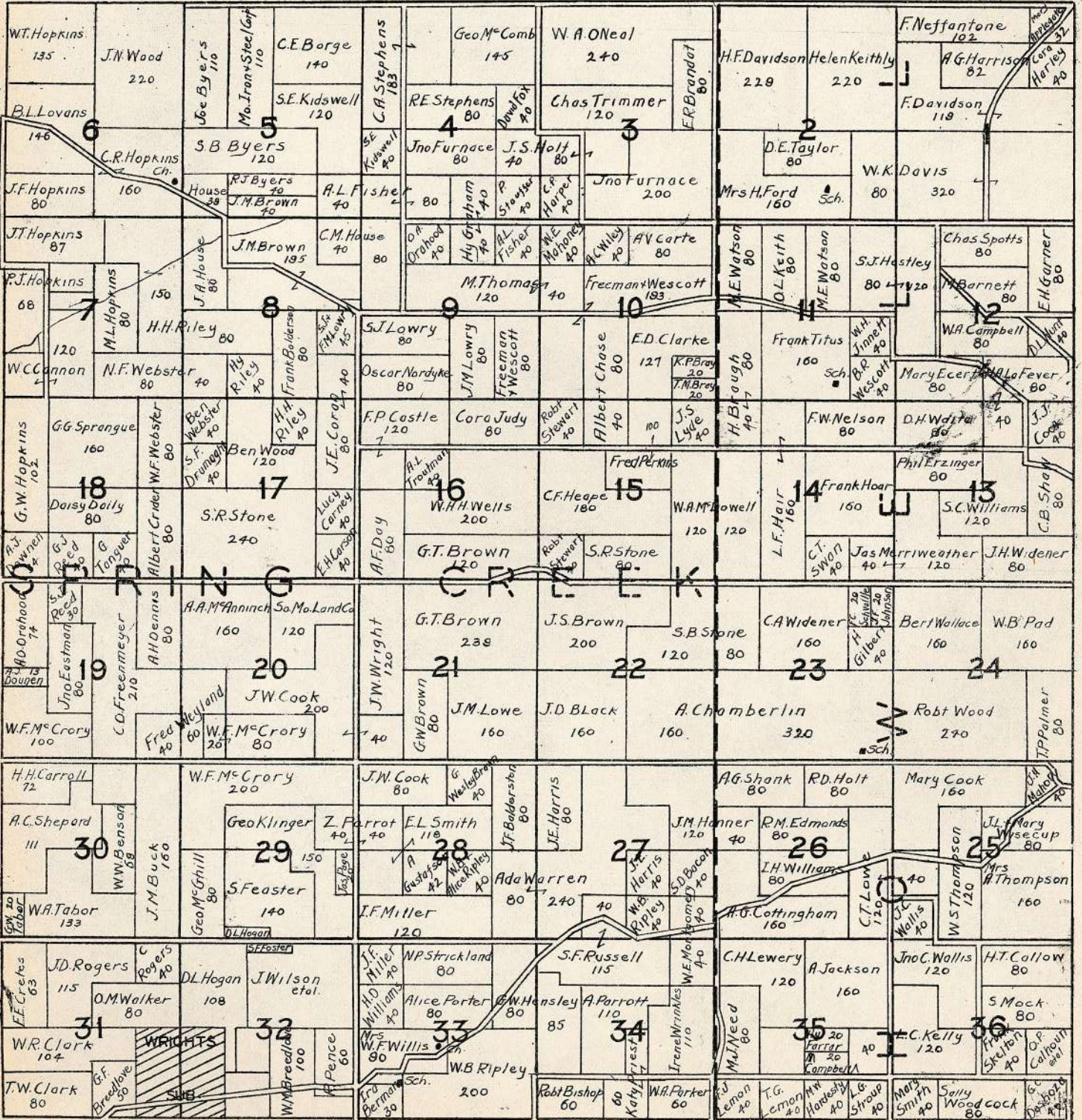

T25N.

PART OF DRY CREEK

R. 9W.

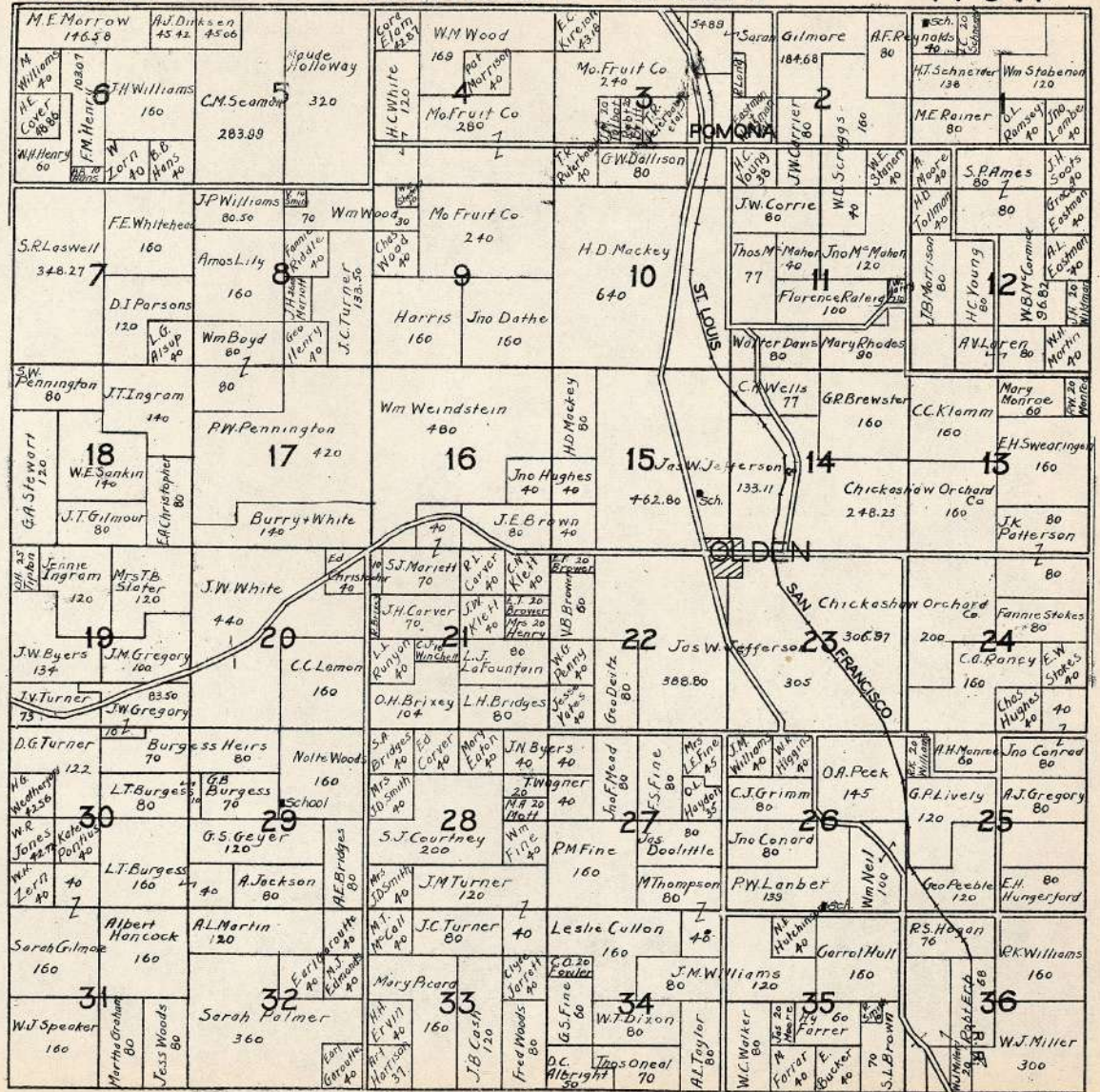

T.26N.

R.9W.

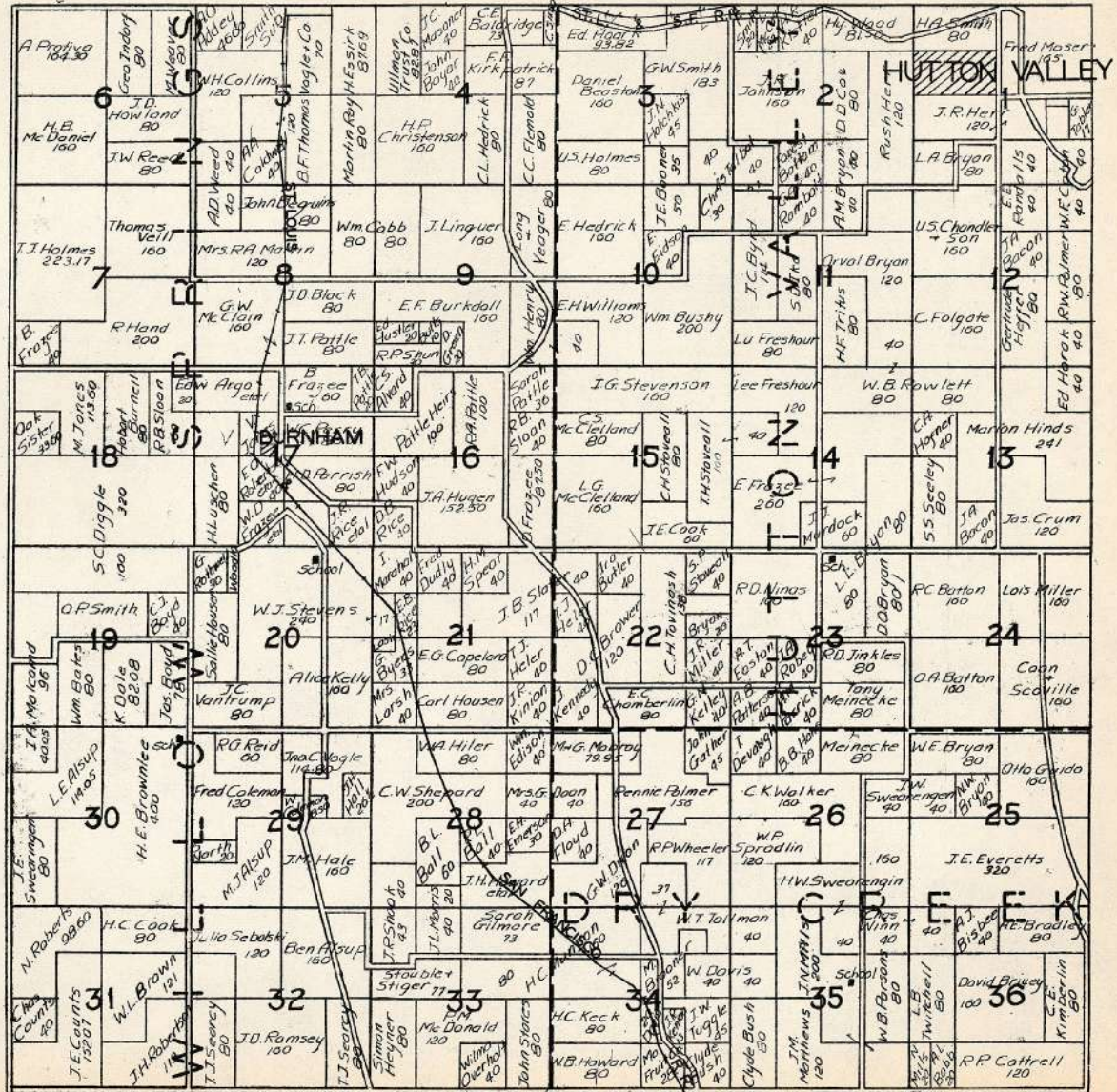

T.27N.

R.9W.

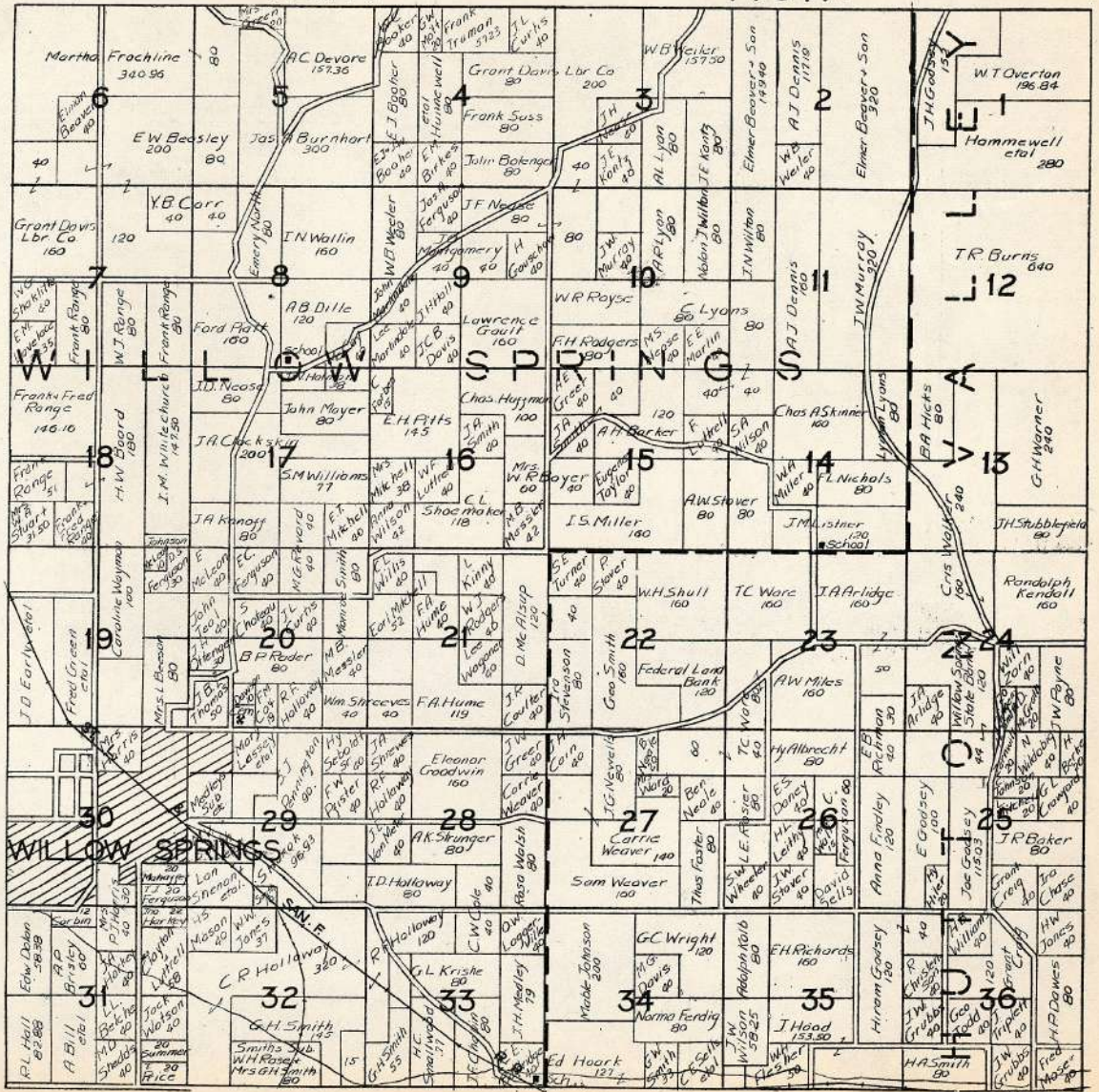

T. 21N.

PART OF BENTON

R. 10W.

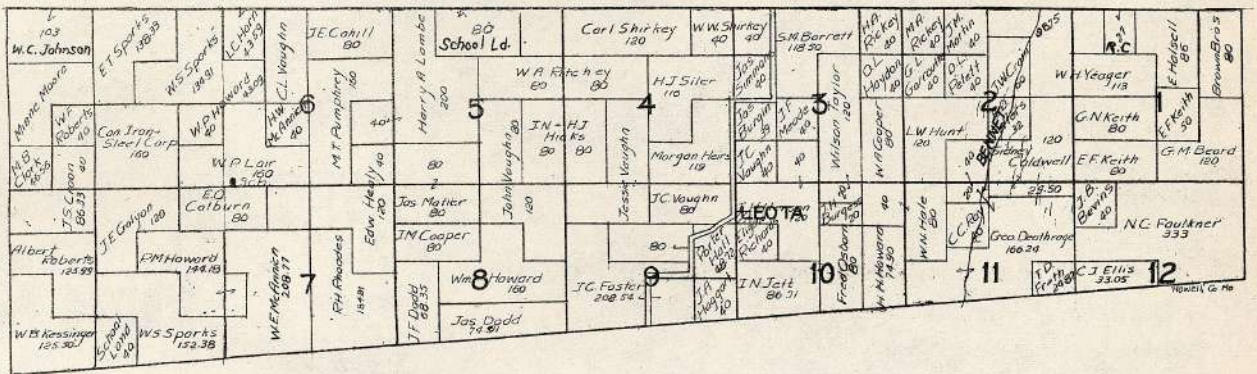

T. 22N.

PART OF BENTON

R. 10W.

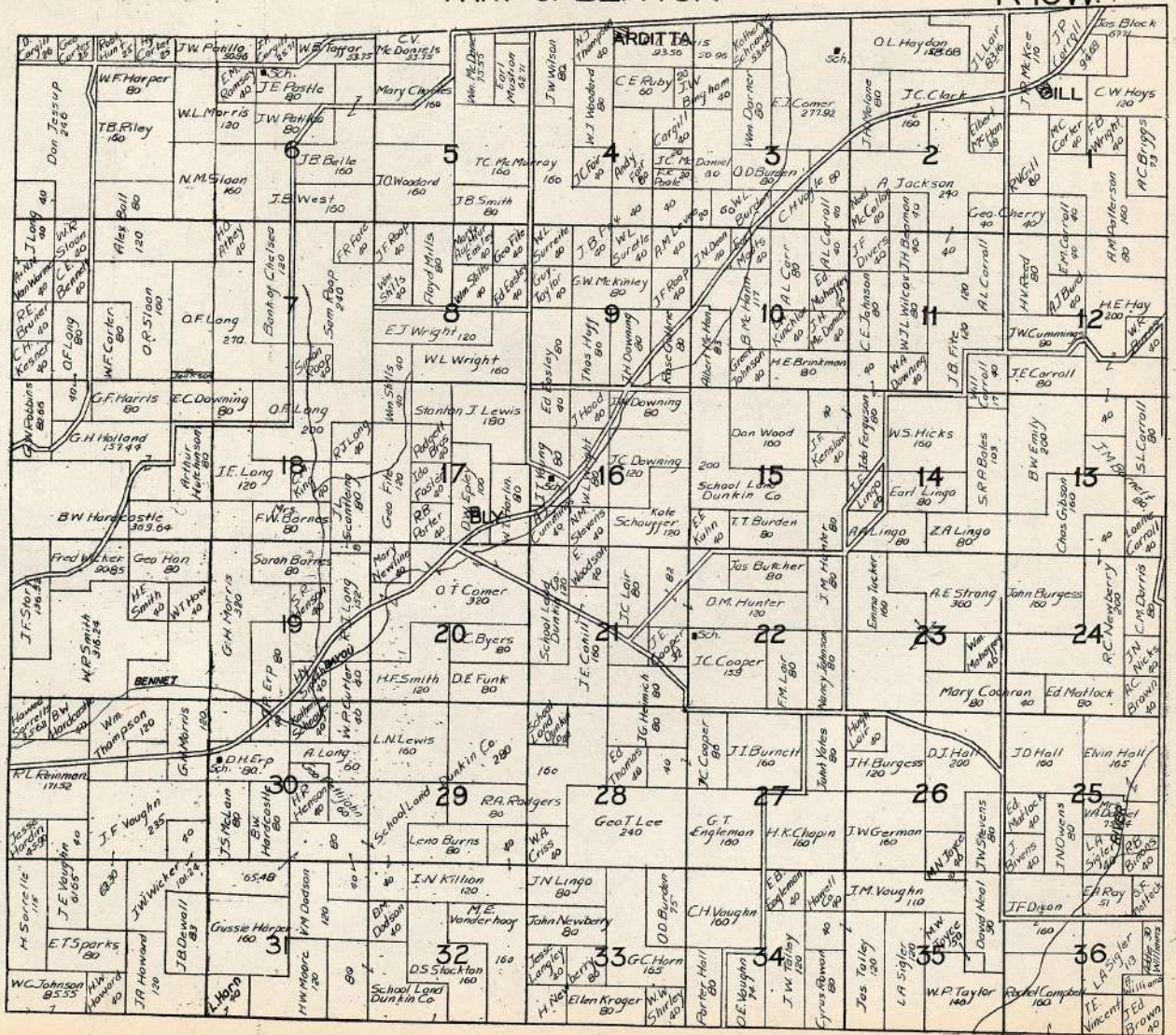

T.23N.

R.10W.

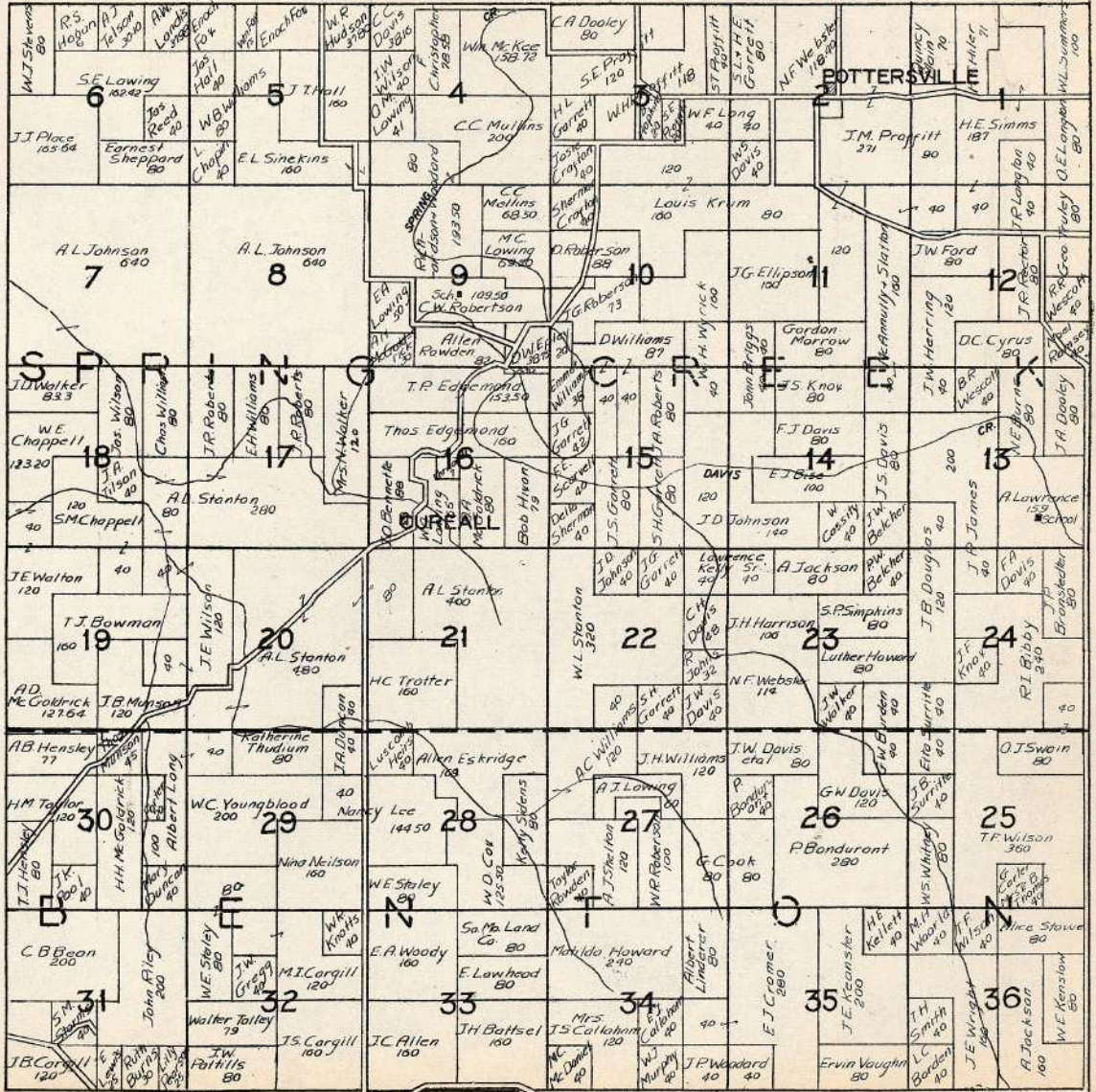

T.25N. PART OF SILOAM SPRINGS R.10W.

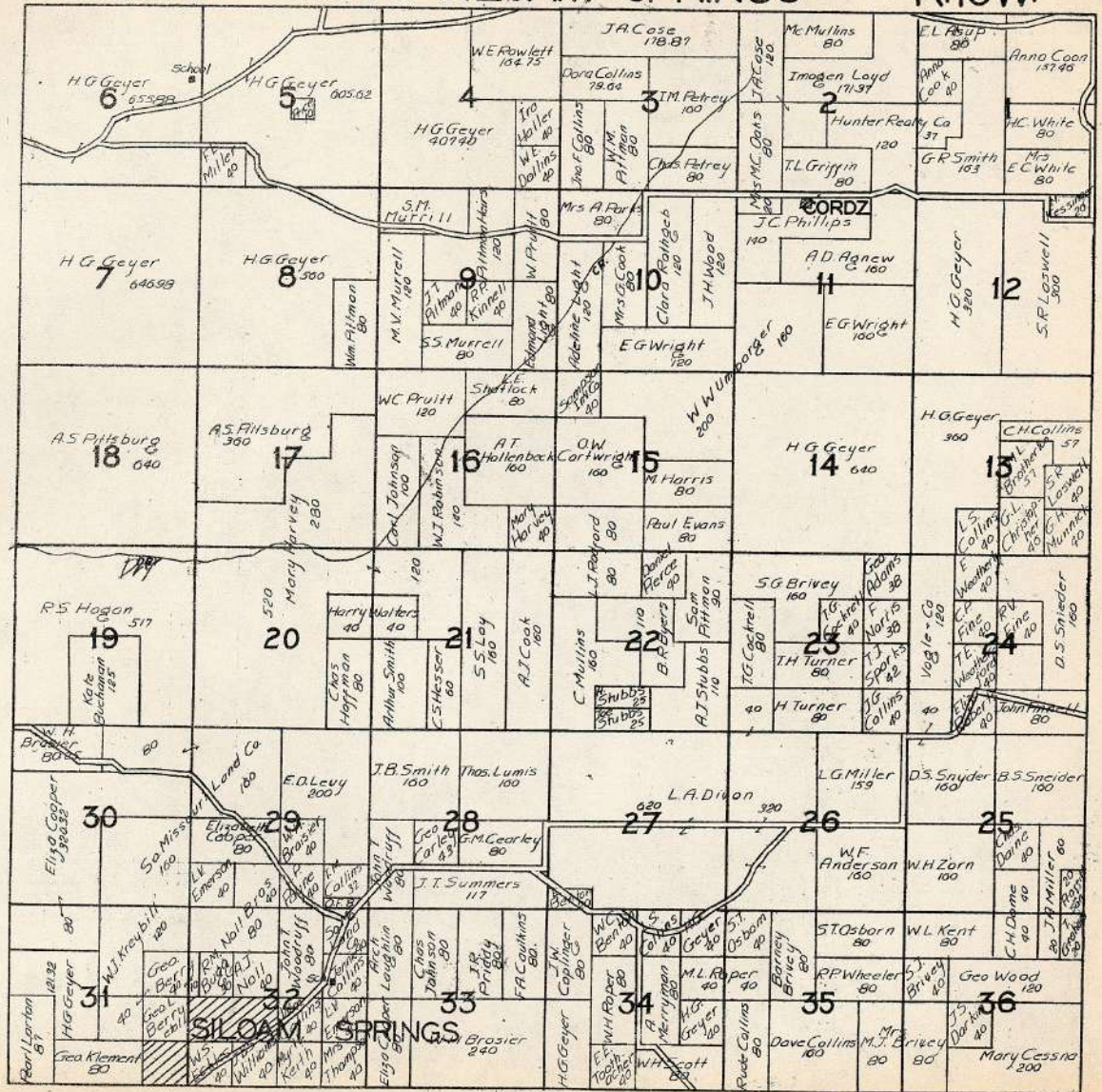

T.26N.

PART OF WILLOW SPRINGS

R.10W.

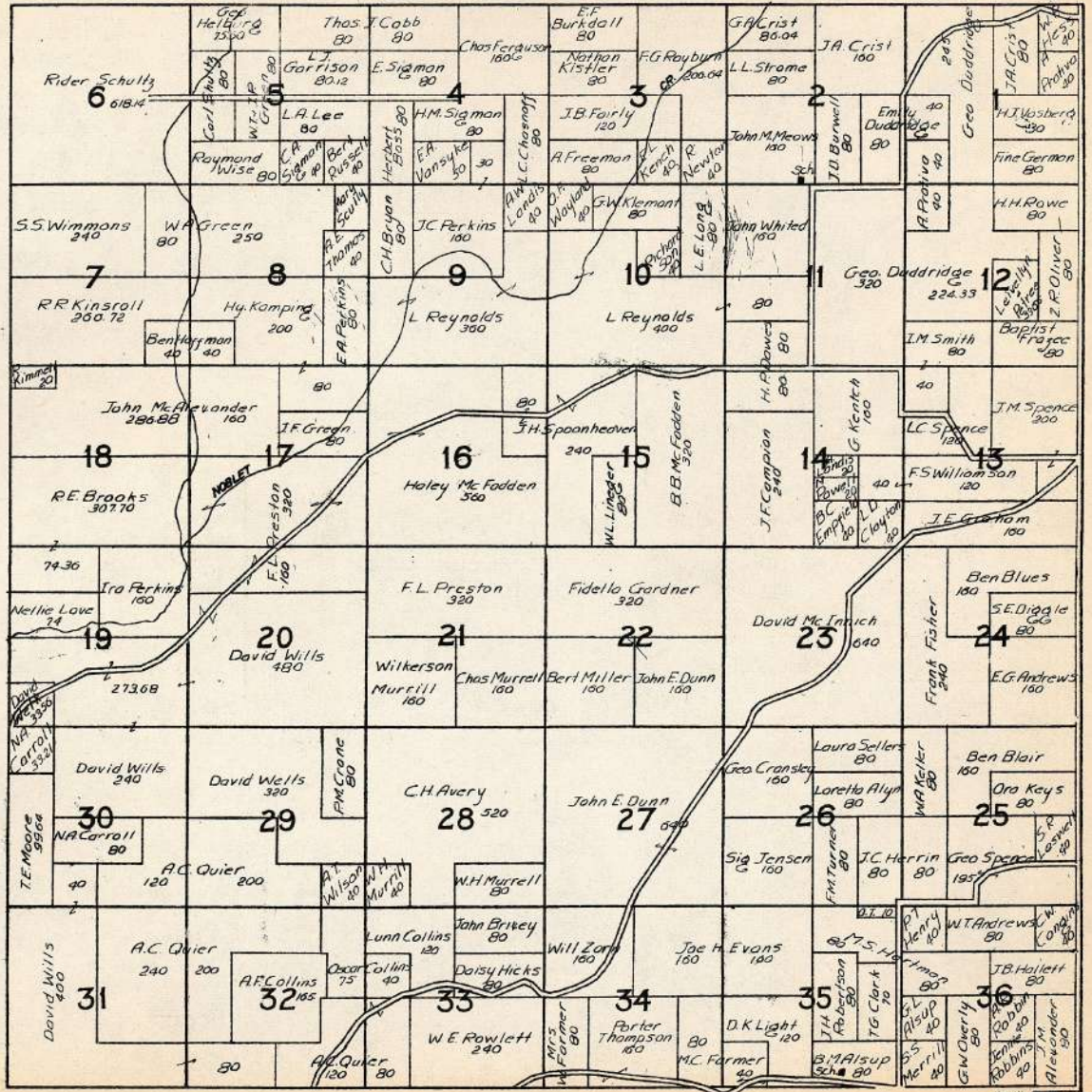

T.27N. PART OF WILLOW SPRINGS R.10W.

