

For an 1876 map, see page 16.

[This map is of 1883, not a part of this Atlas  
as published. It was taken from the 1883 County History.]

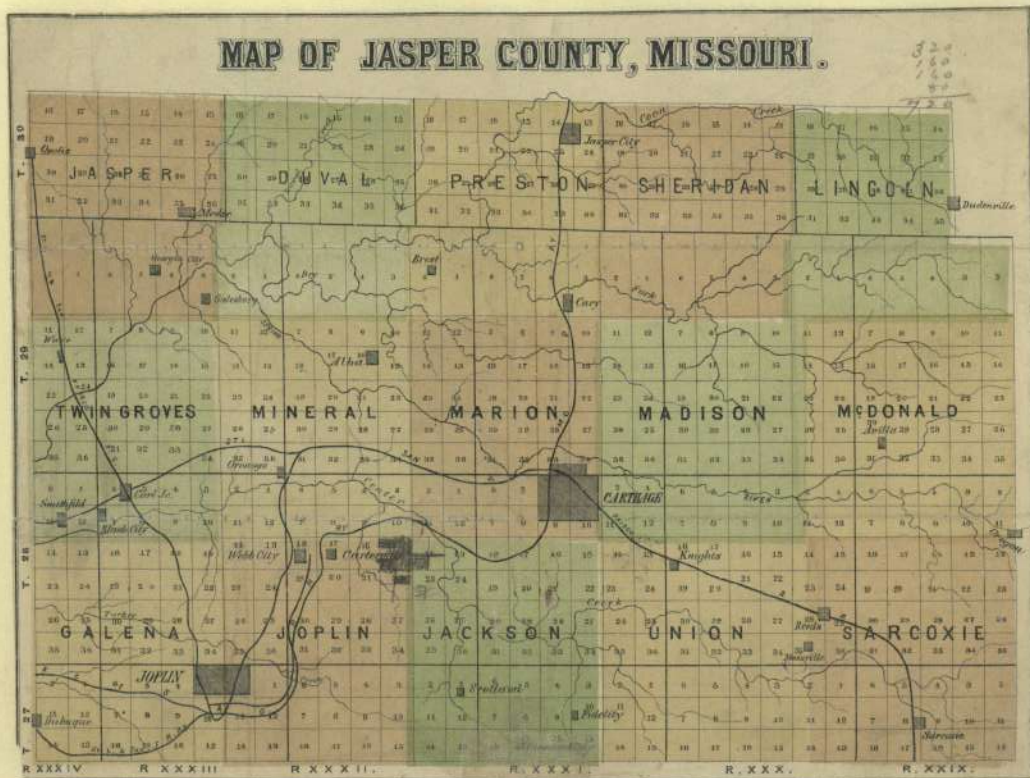

*Township 27 North  
Range 29 West  
of 5th Principal Meridian*

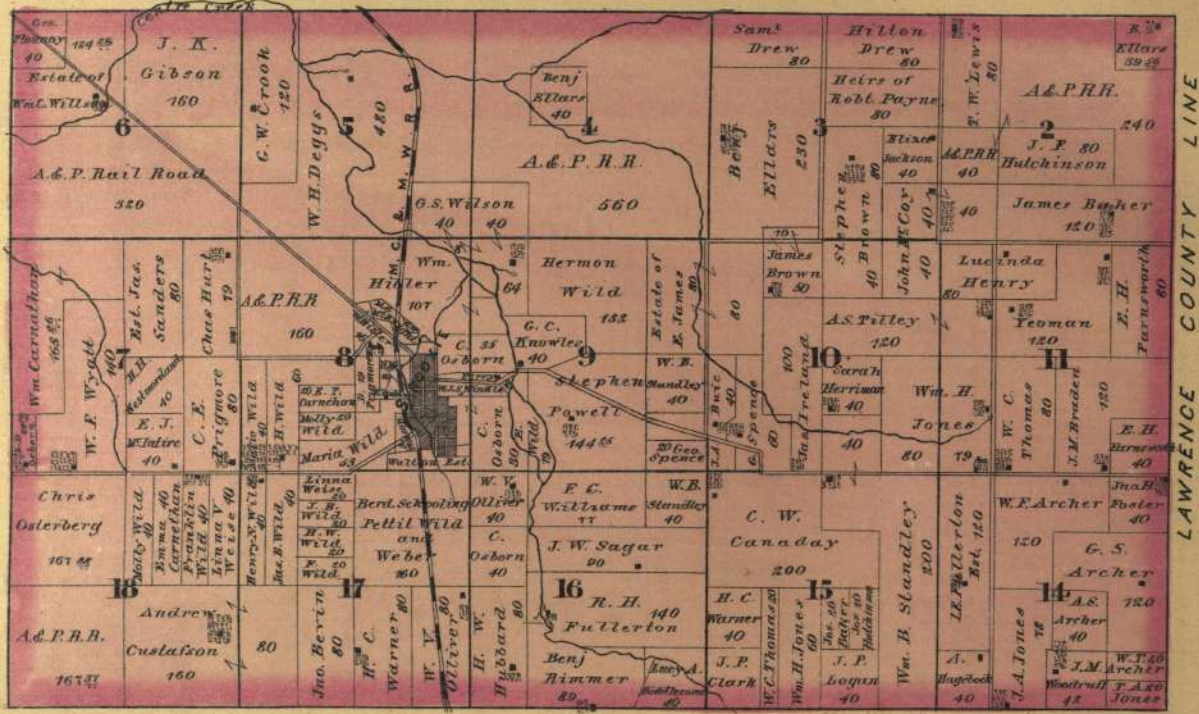

**SARCOXIE**

Located in S.E. 4 Sec. 30 E.  
N. Range 29 W. of 5th P.M.  
Scale 400 ft. to 1 Inch

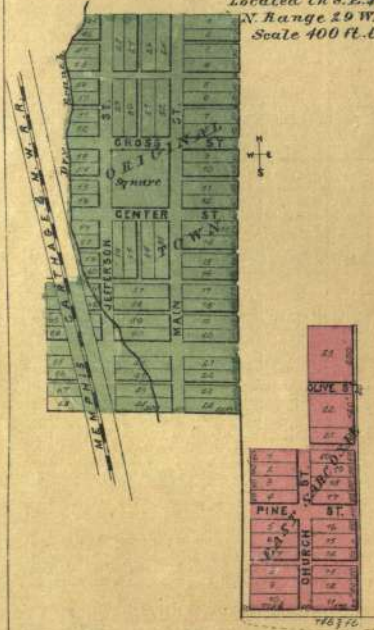

**MAP OF AVILLA**

Located in S.E. 4 Sec. 30 E.  
N. Range 29 W. of 5th P.M.  
Scale 400 ft. to 1 Inch

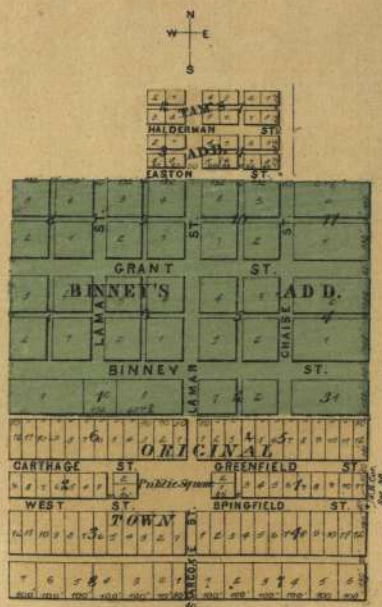

**GALESBURG**

Located on N. E. 4 Sec. 3 Town  
29 Range 33 W. of 5th P.M.  
Scale 400 ft. to 1 In.



Township 28 North  
Range 29 West  
of 5<sup>th</sup> Principal Meridian

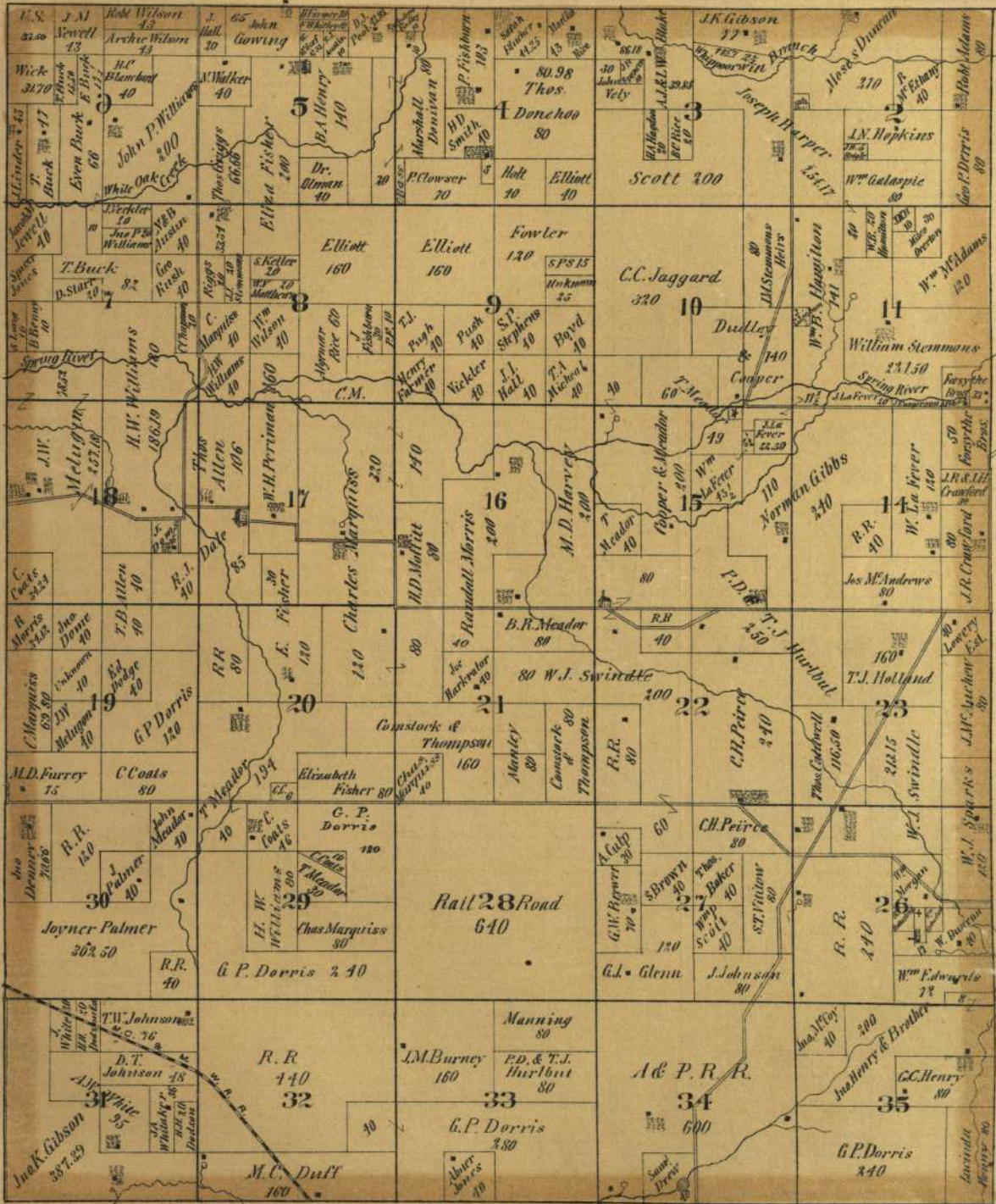

Township 29 North, Range 29 West  
of 5th Principal Meridian.

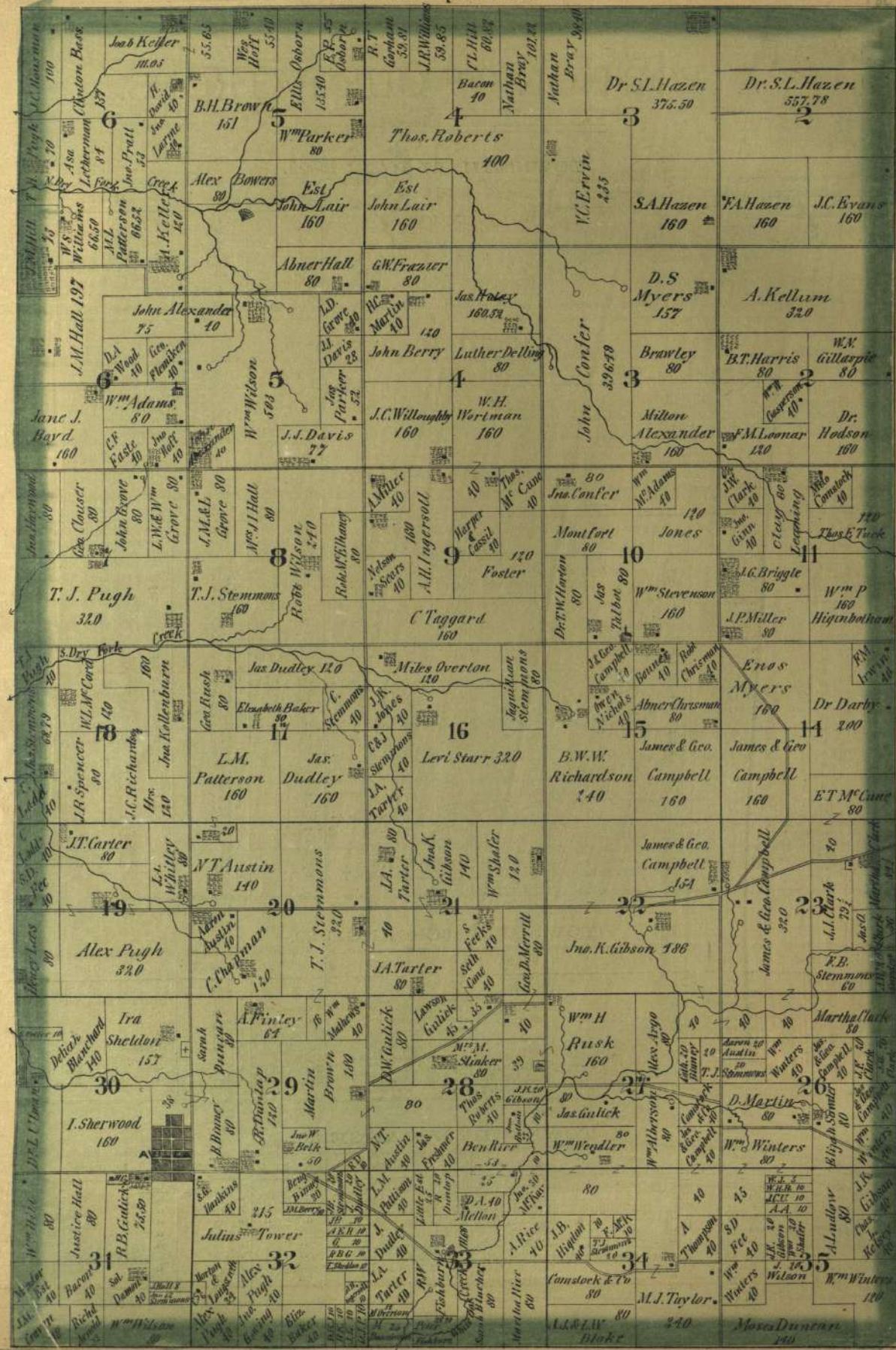

*Township 30 North*  
*Range 29 West*  
 of 5<sup>th</sup> Principal Meridian

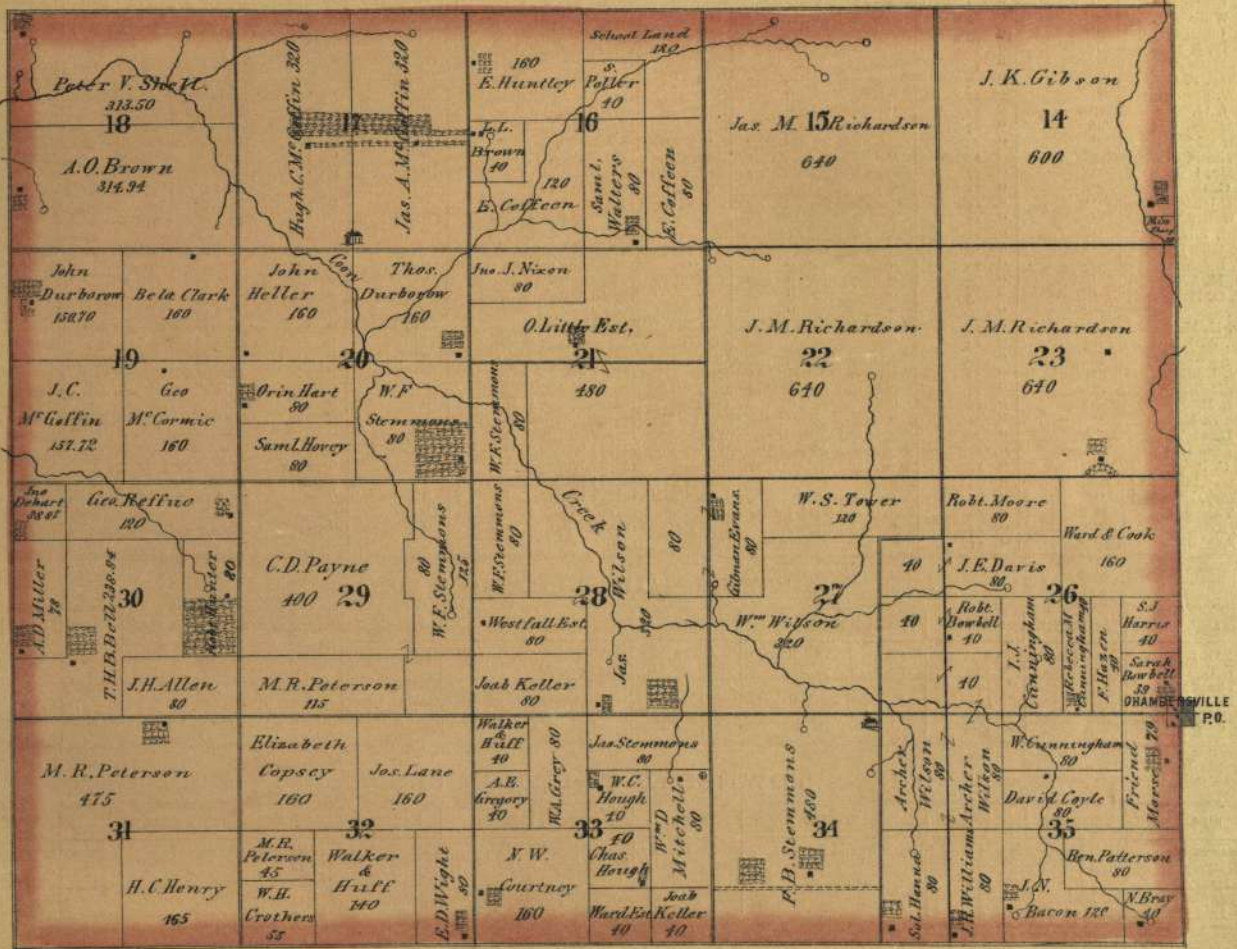

**Township 27 North**  
**Range 30 West**  
of 3<sup>rd</sup> Principal Meridian

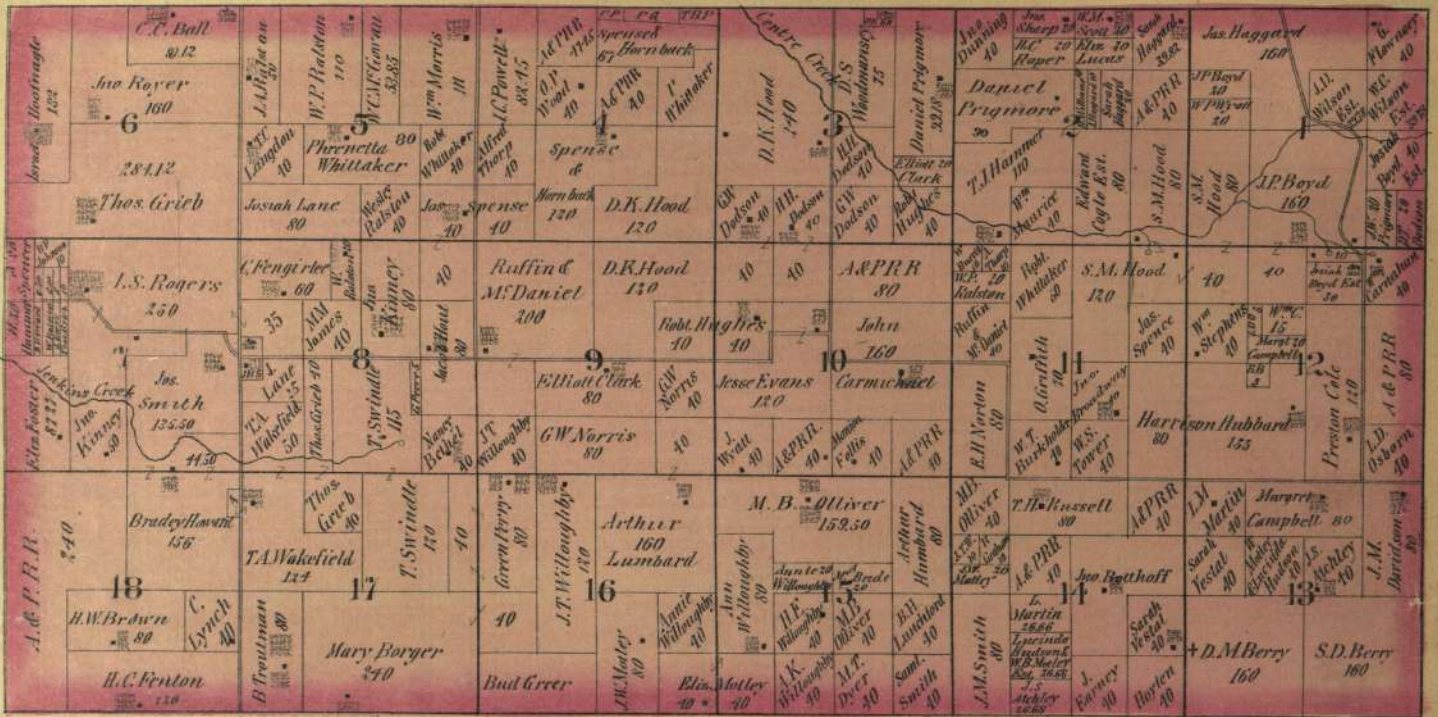

**REEDS**

Located in Sections 25 & 26 Township  
18 N. Range 30 W. of 3<sup>rd</sup> P.M.  
Scale 400 feet to 1 inch.

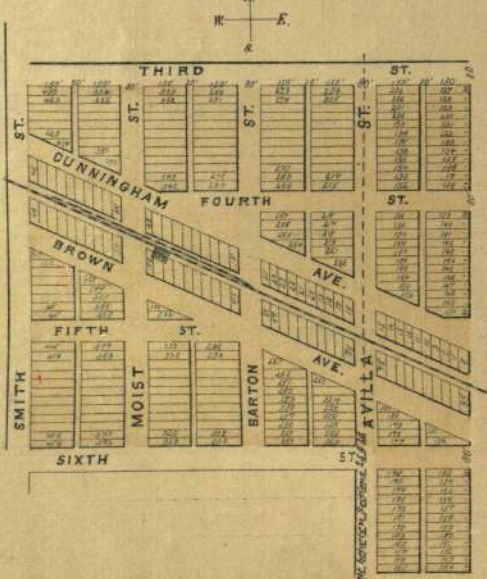

**ORONOGO MINERSVILLE.**

Formerly called  
Scale 400 feet to 1 inch

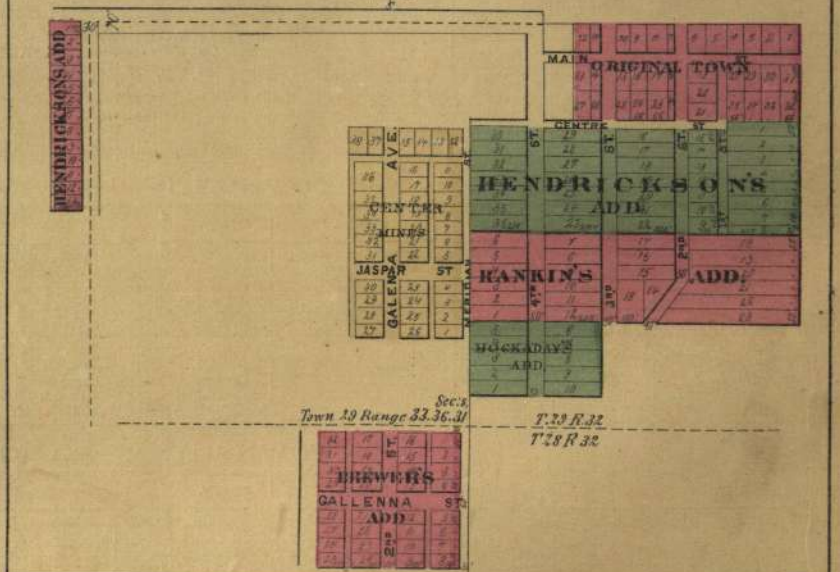

Township 28 North  
Range 30 West  
of 3<sup>d</sup> Principal Meridian

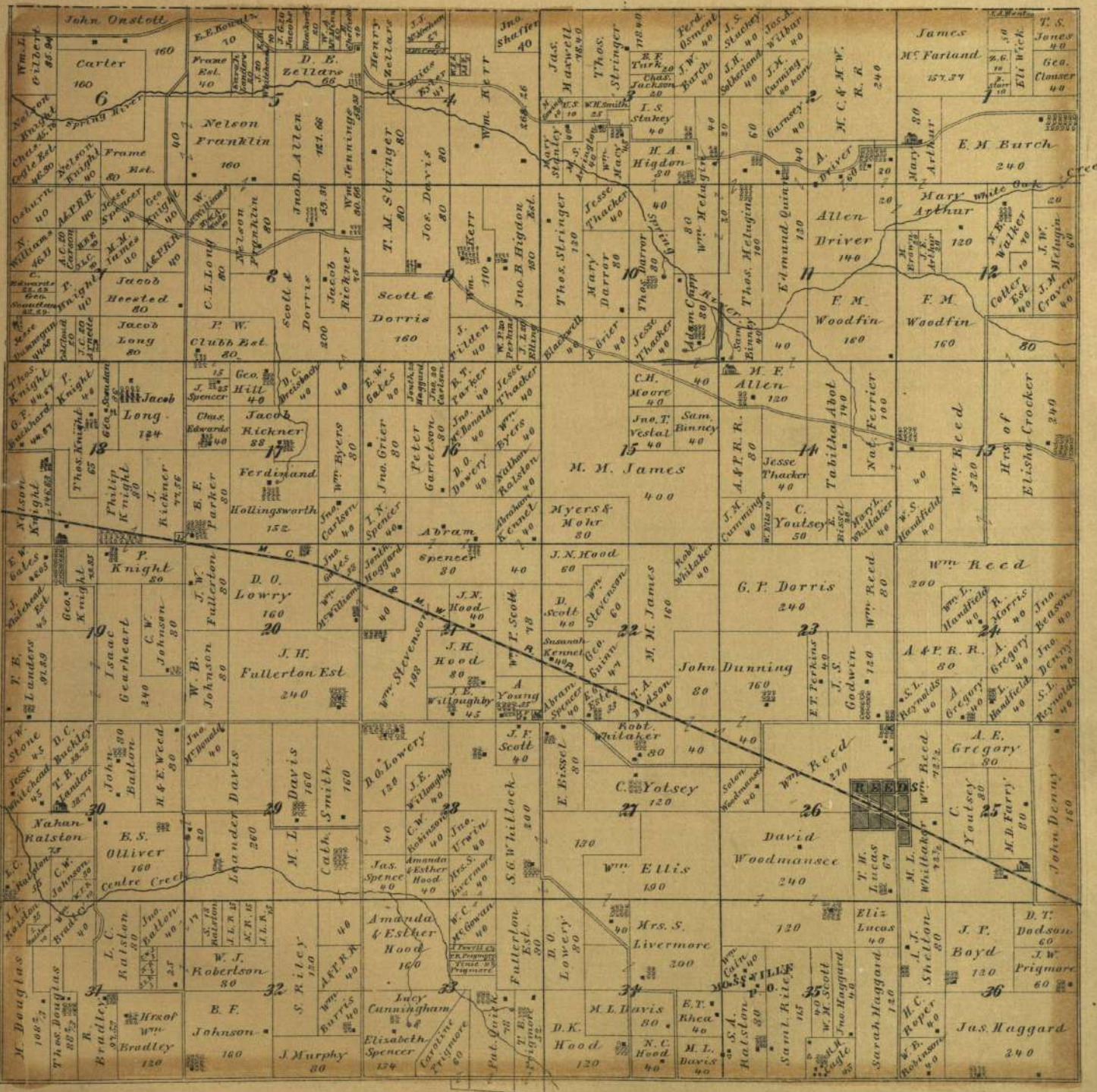





Townships 27 & 30 North Ranges 30 & 31 West of 5th Principal Meridian

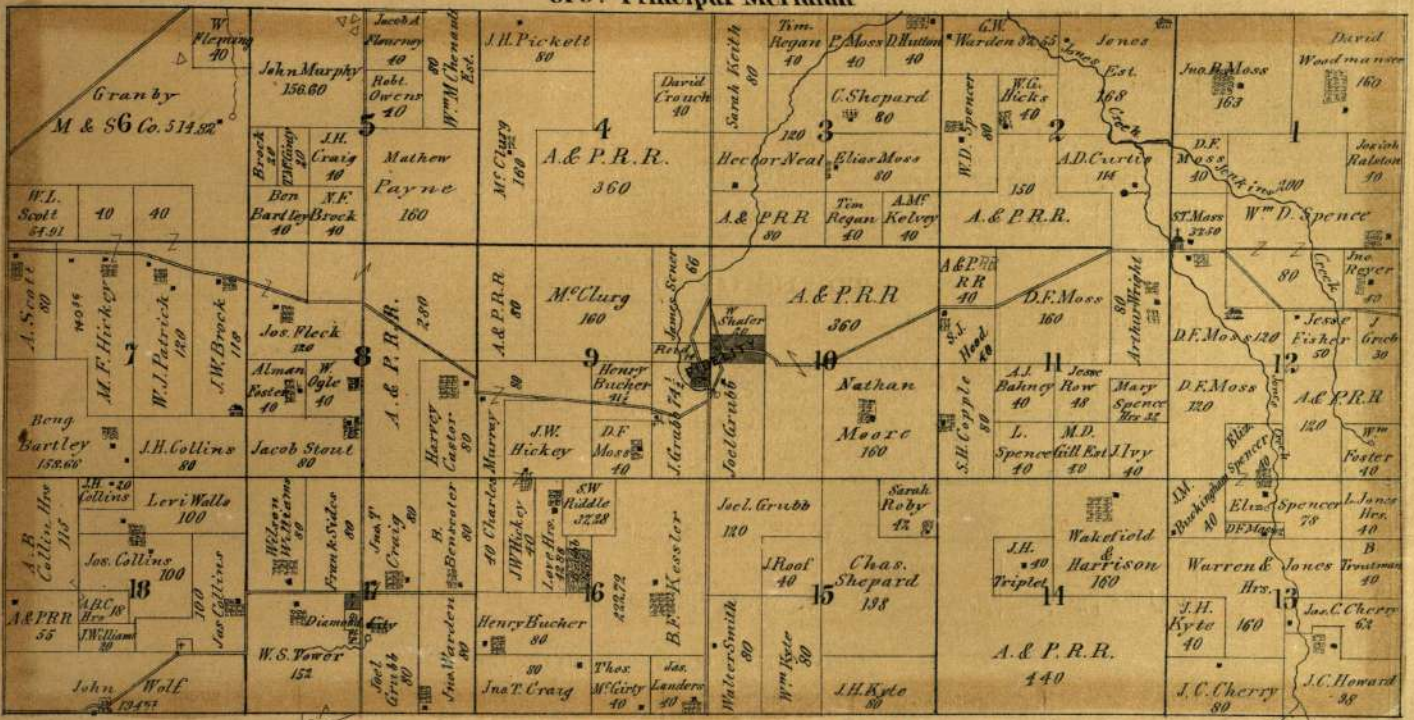

Township 30 North Range 30 West of 5th P.M.

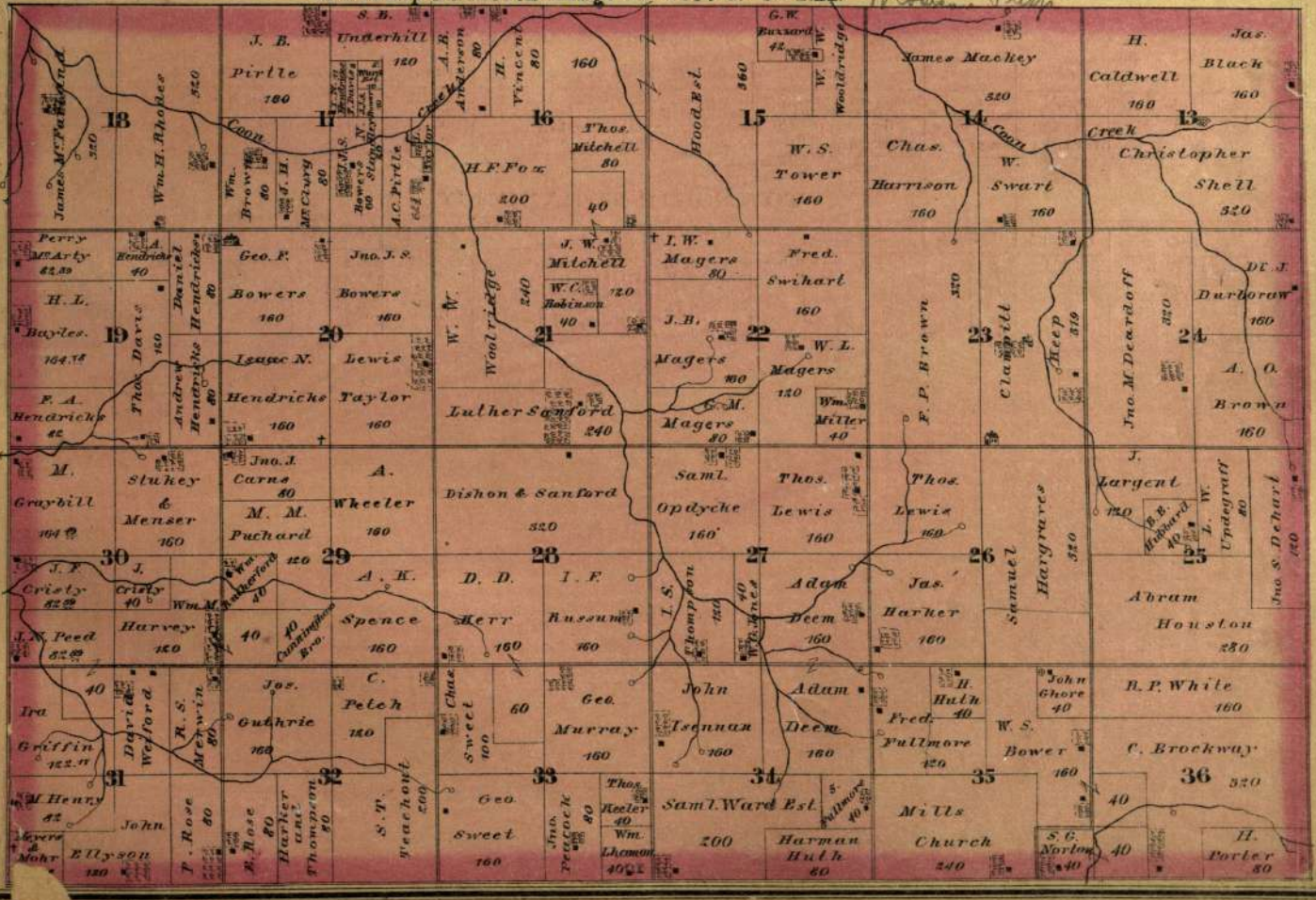

Township 28 North  
Range 31 West  
of 5th Principal Meridian

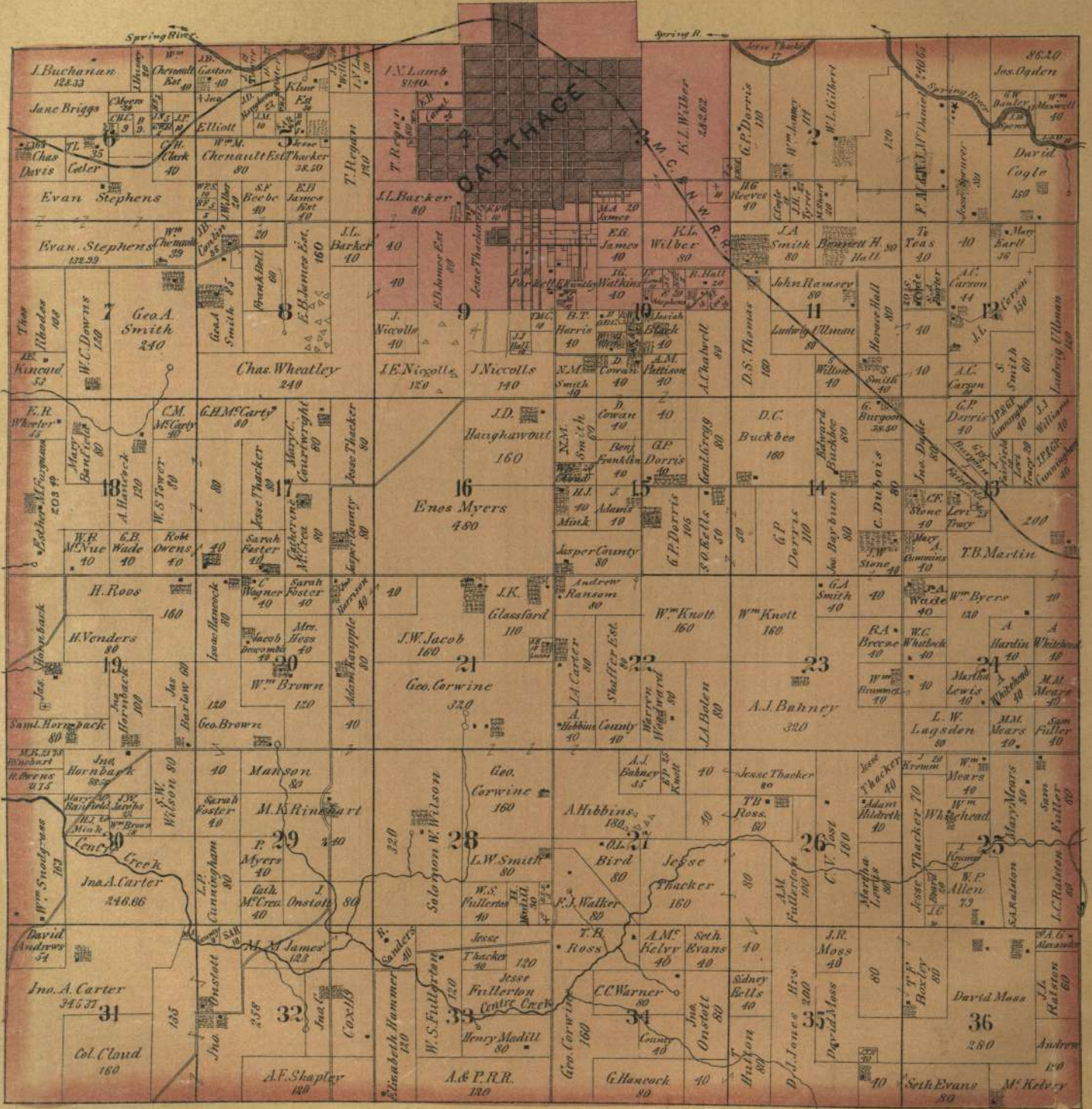

Township 29 North, Range 31 West  
of 5th Principal Meridian.

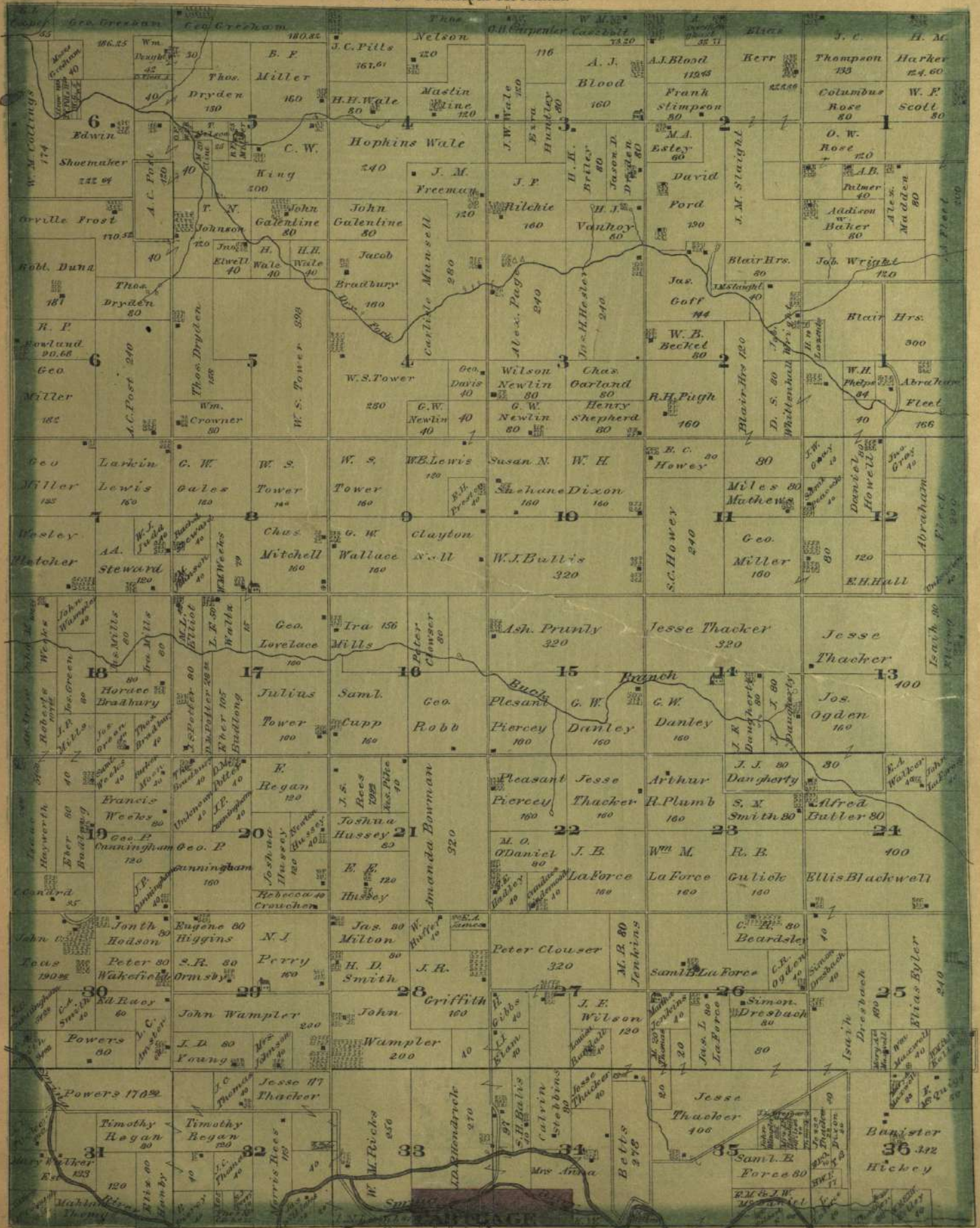

**Township 30 North**  
**Range 31 West**  
of 5th Principal Meridian

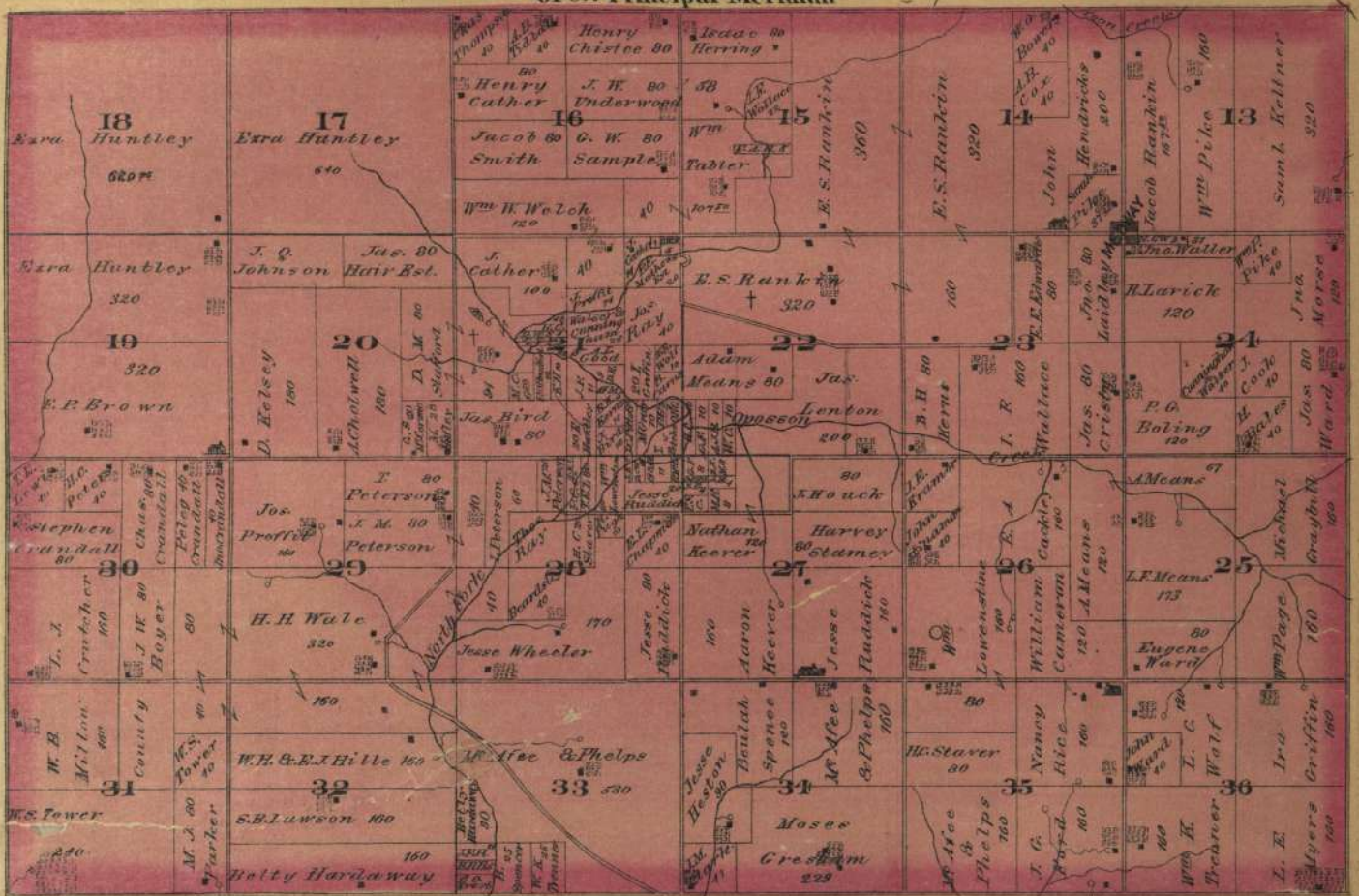

**SHERWOOD**  
FORMERLY CALLED, RURAL  
Located in S.W. Sec. 22, 28  
T. 33 & S.W. Sec. 13, 28  
Scale 400 ft. to in.

**SCOTTLAND**  
Located in SW 1/4 of Sec. 1  
Town 27 N. Range 32 W. 5th PM  
Scale 400 ft. to 1 inch

**DAMIANO**  
Located on S.W. 1/4 of NW 1/4 Sec. 35  
Town 28 N. Range 30 W. 5th P.M.  
Scale 400 ft. to 1 inch.

# Township 27 North Range 32 West of 5th Principal Meridian

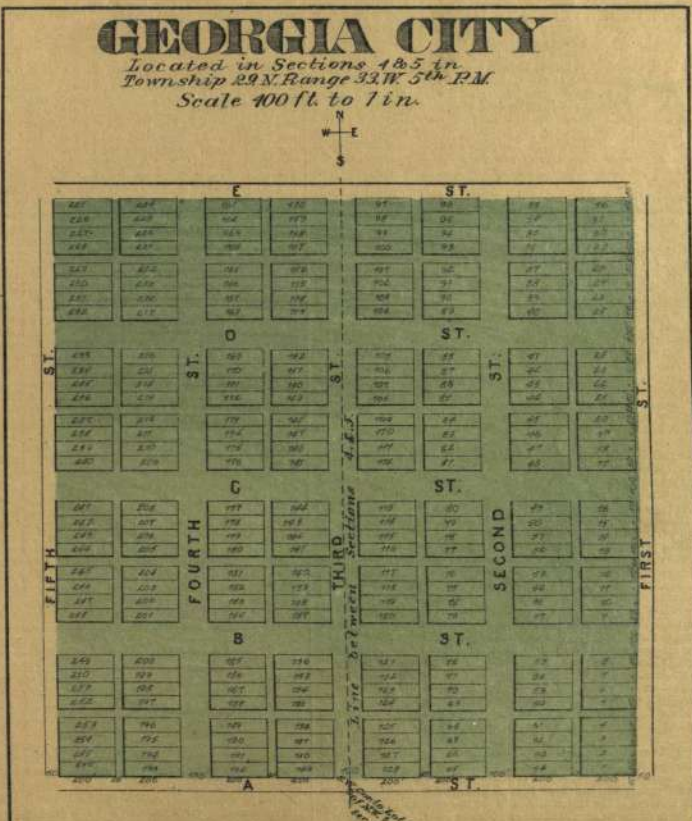
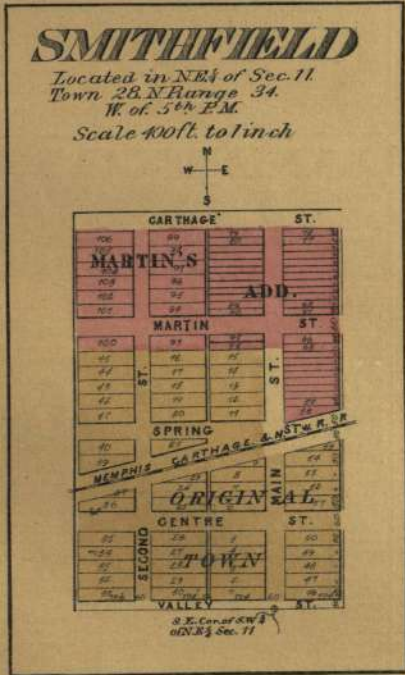
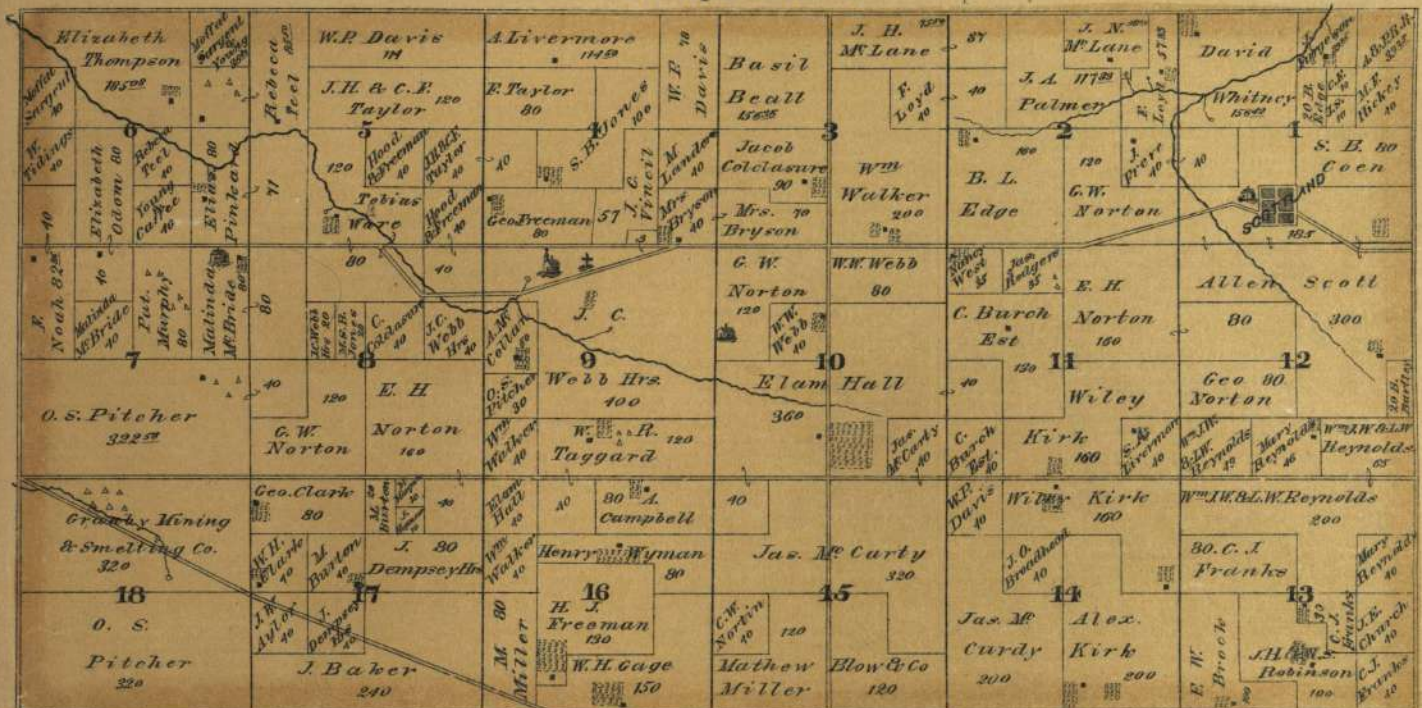

Township 28 North  
Range 32 West  
of 5th Principal Meridian

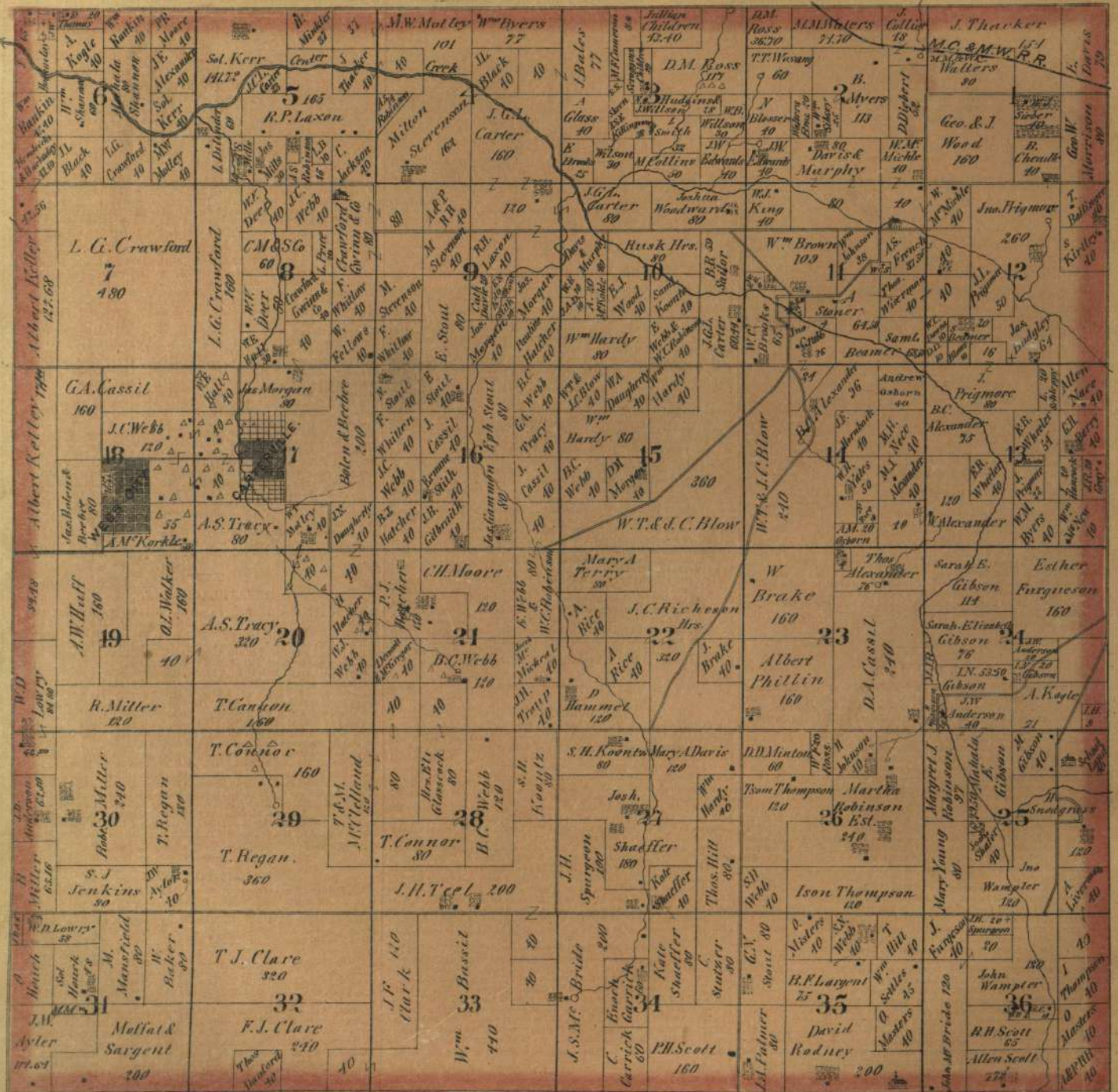

Township 29 North, Range 32 West  
of 5th Principal Meridian.

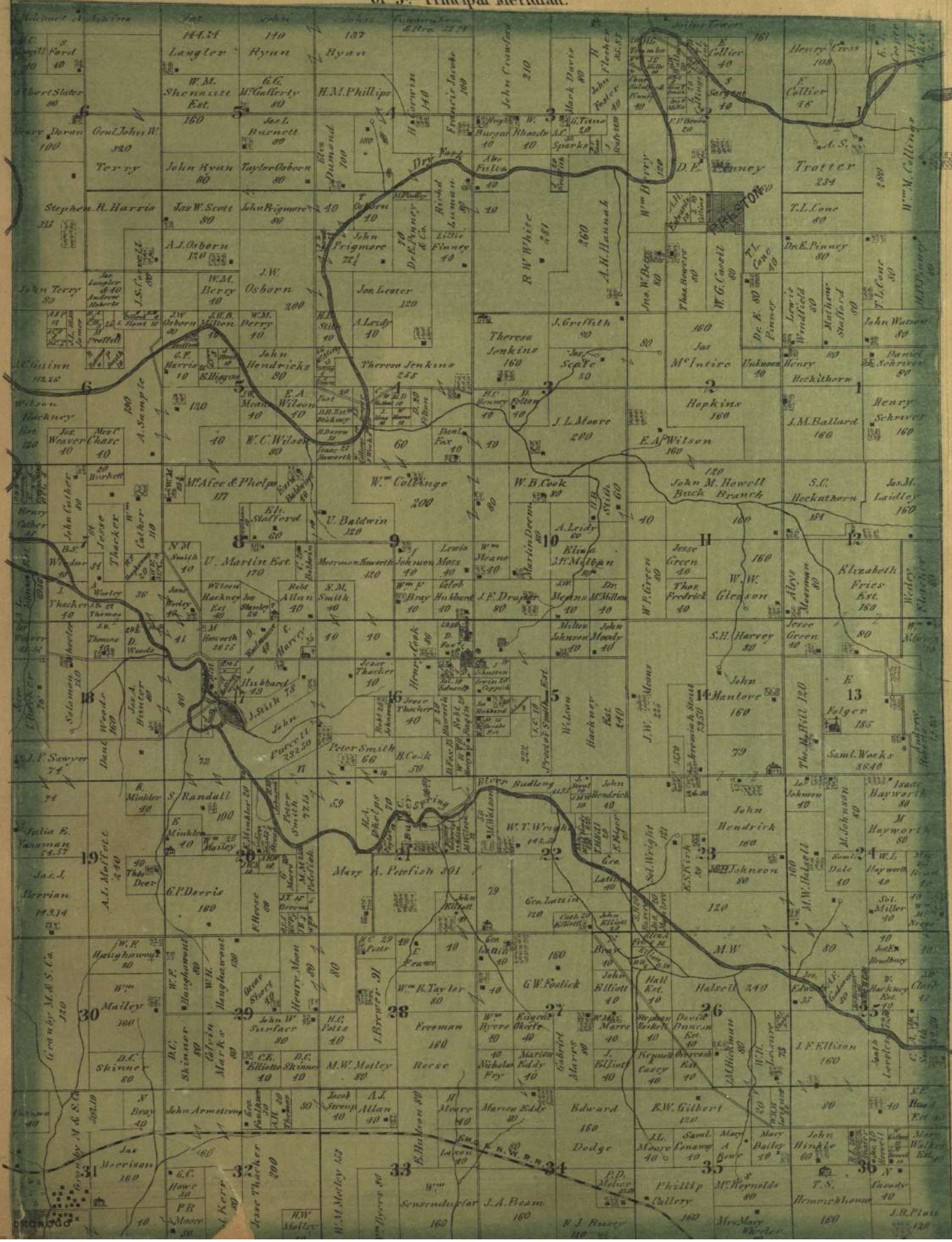

*Township 30 North  
Range 32 West  
of 5th Principal Meridian*

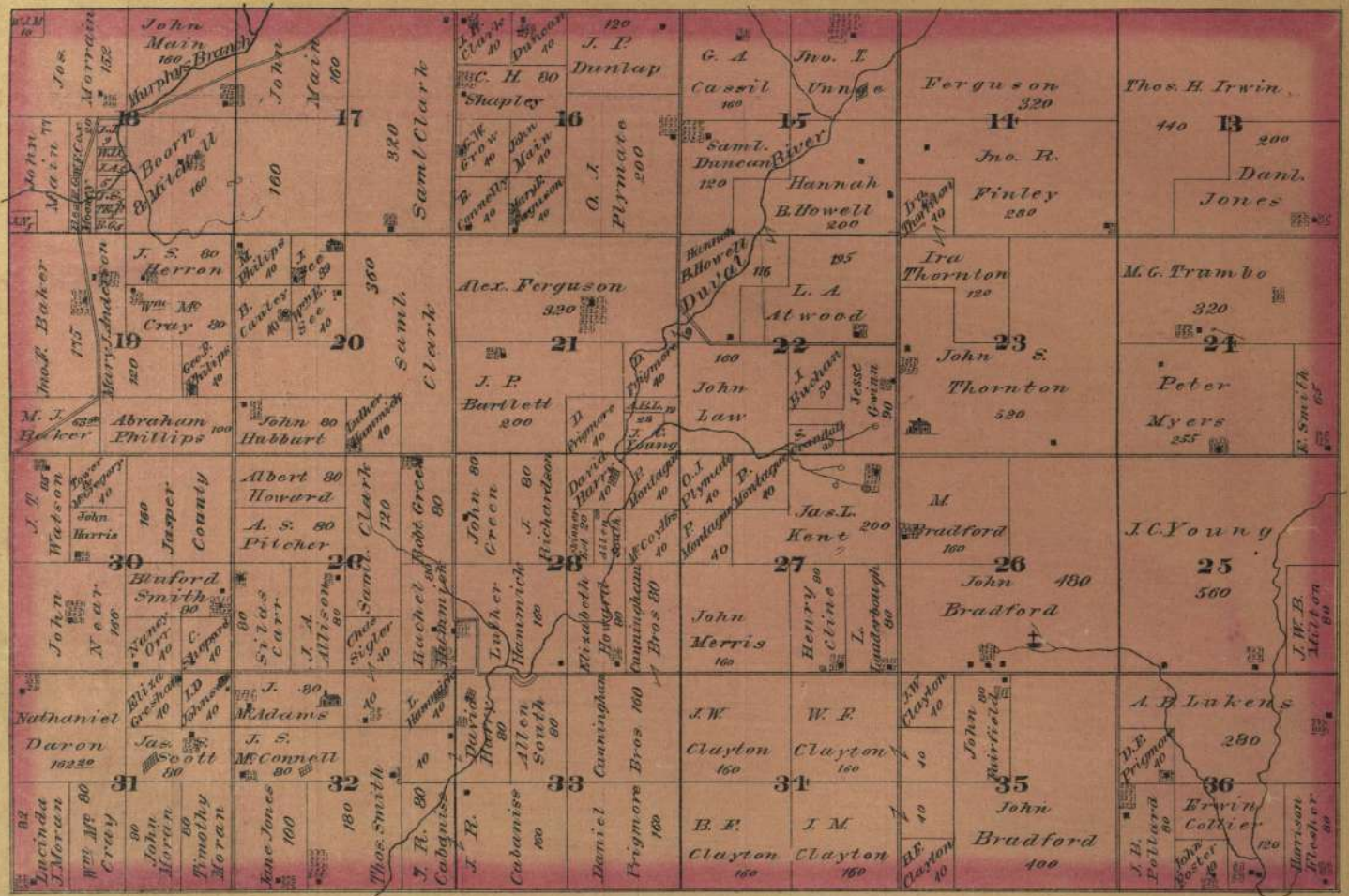

**CARTERVILLE**

Located on W<sup>3</sup> of Sec. 17,  
Town 28 N, Range 32 W, 5th P.M.  
Scale 400 ft. to 1 in.

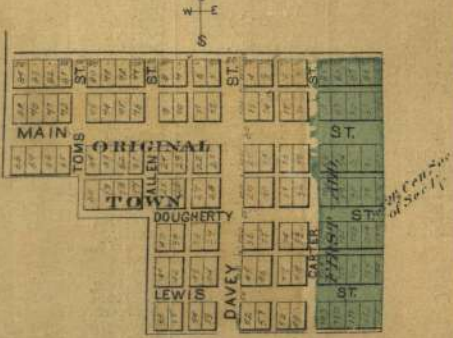

**MEDOC**

Located in S<sup>24</sup> Sec. 35, T. 30 N, R. 32 W of 5th P.M.  
Scale 400 ft. to 1 inch.

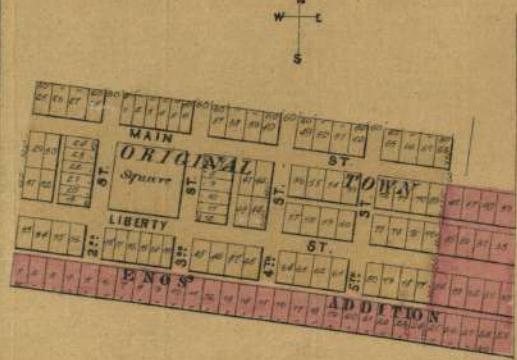

**FIDELITY**

Located in SW<sup>1</sup> of NW<sup>4</sup>  
Sec. 10, T. 27 N, R. 31 W, 5th P.M.  
Scale 400 ft. to 1 in.

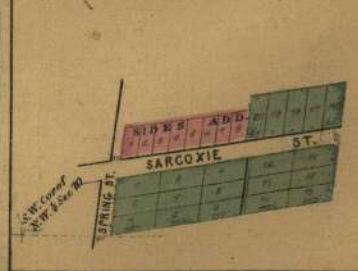



# Township 27 North Range 33 West of 5th Principal Meridian

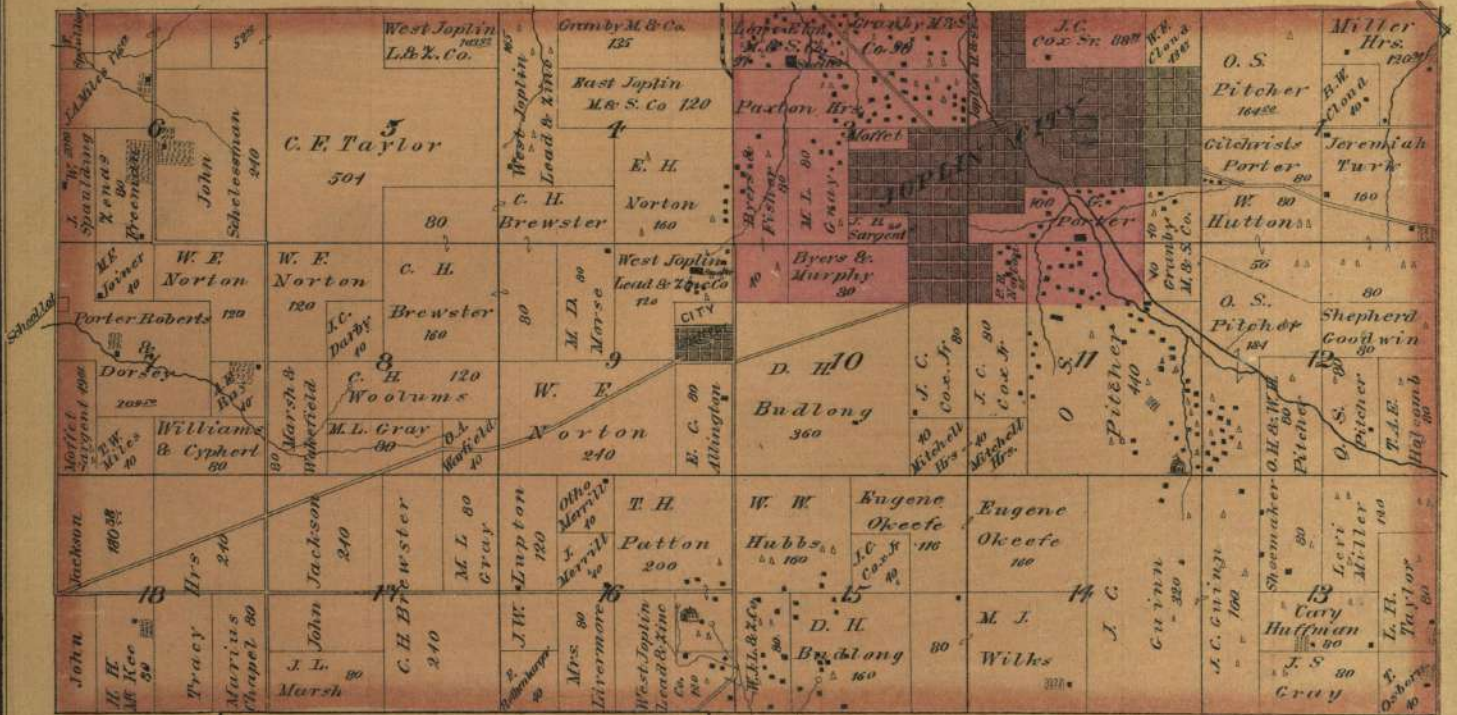

## WEBB CITY

Located in S.E. 4 Sec. 18 Town  
28 N. Range 32 W. 5th P.M.  
Scale 400 ft. by 1 inch

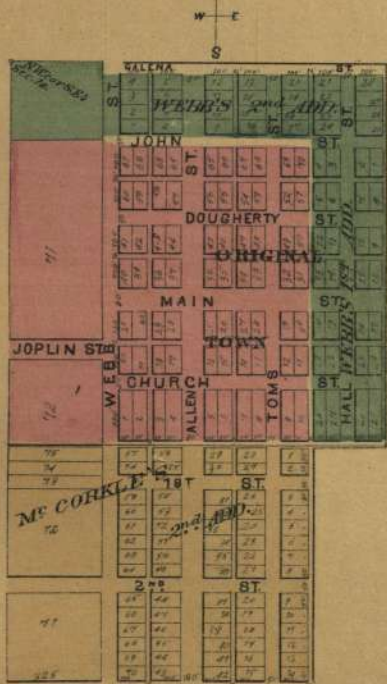

## SPAULDING

Located in Lot No. 2 of S.W.  
Sec. 31, T.28 N., R. 33 W. 5th P.M.  
Scale 400 ft. to 1 in.

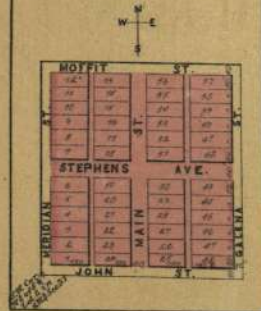





T. 27 R. 34 WEST OF 5th P. M.



*Townships 27 & 30 North*  
*Ranges 33 & 34 West*  
 of 5th Principal Meridian

Township 30 ↓

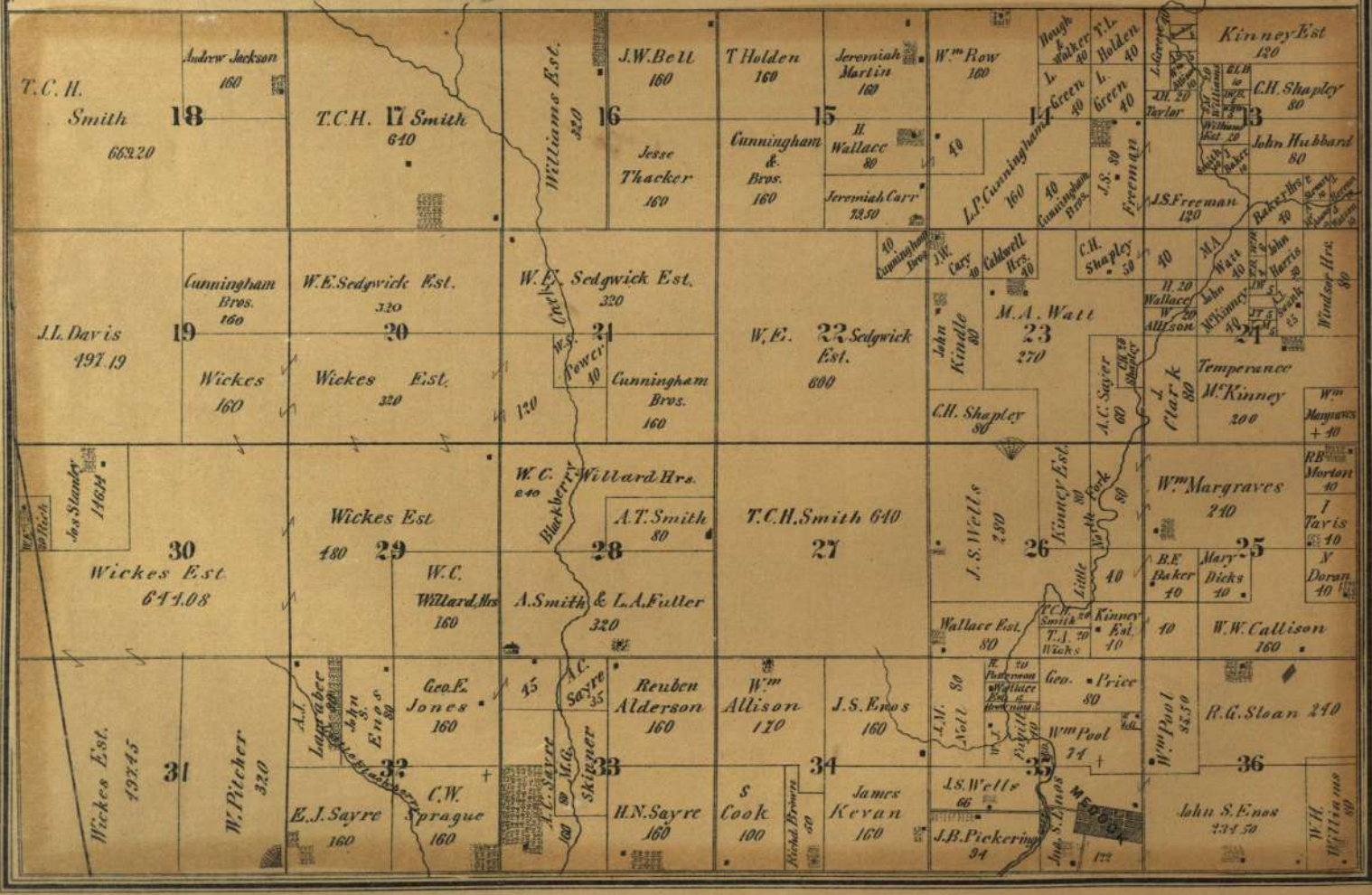





# JOPLIN

FORMERLY CALLED  
MURPHYSBURG

Laid out in July 1871. Scale 600ft. to in.  
Located in Sections 2, 3, 10 & 11 Town 27N Range 32W 5th PM  
Compiled from official records by  
E.J. Chamberlain C.E.

