

OUTLINE MAP OF
MILLER COUNTY
 MISSOURI

Scale 1 inch to 1 mile

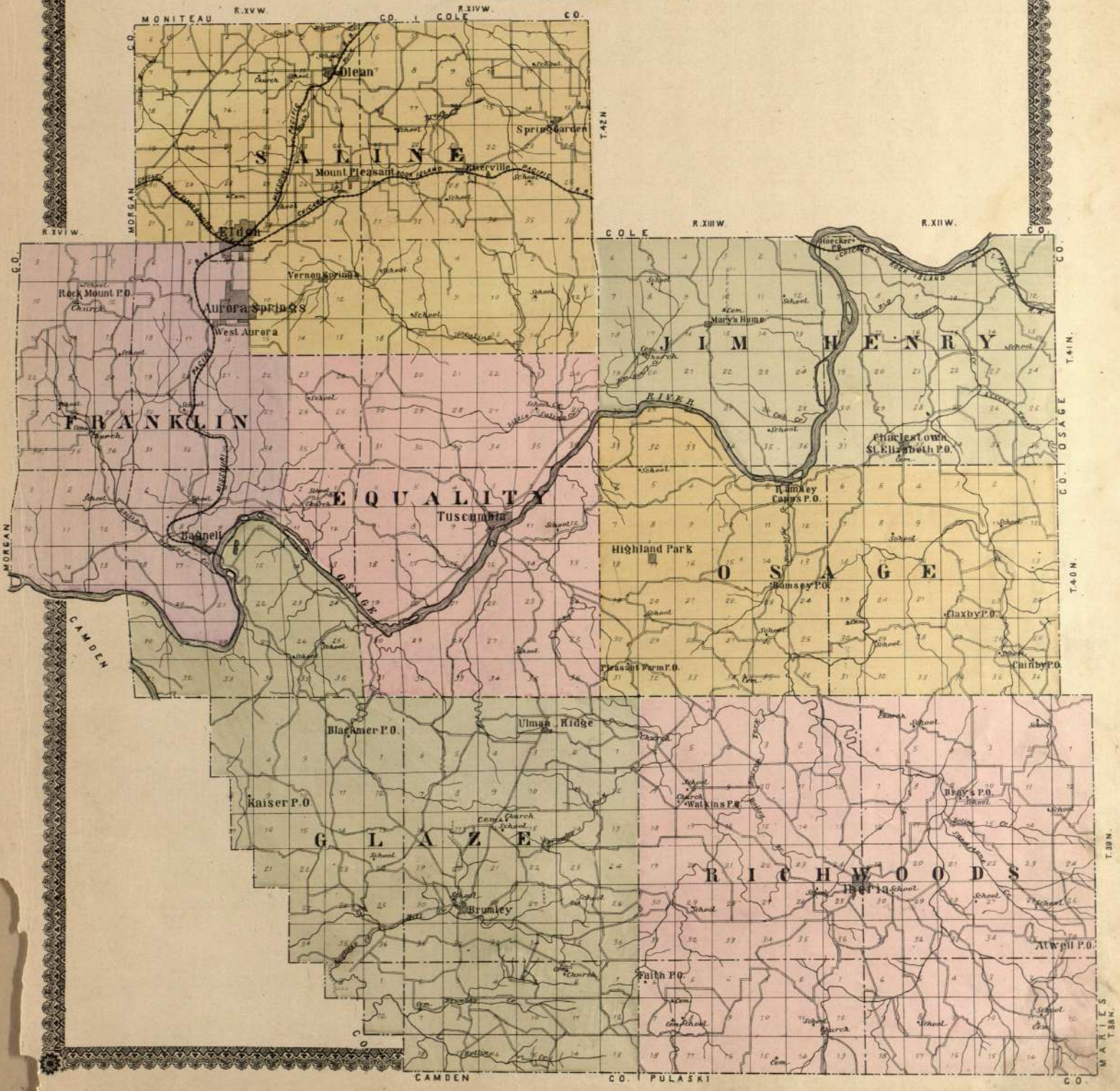



MAP OF
TOWNSHIP 38 & 39 N. RANGE XII W.
Scale 1 inch = 3600 feet
OF THE 5TH P. M.

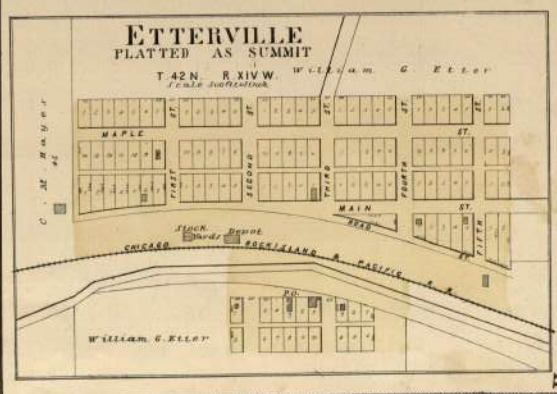
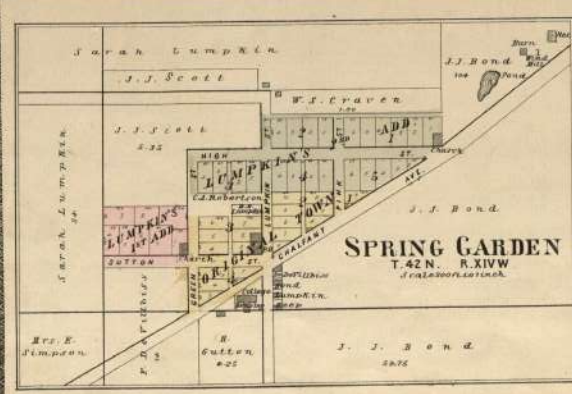
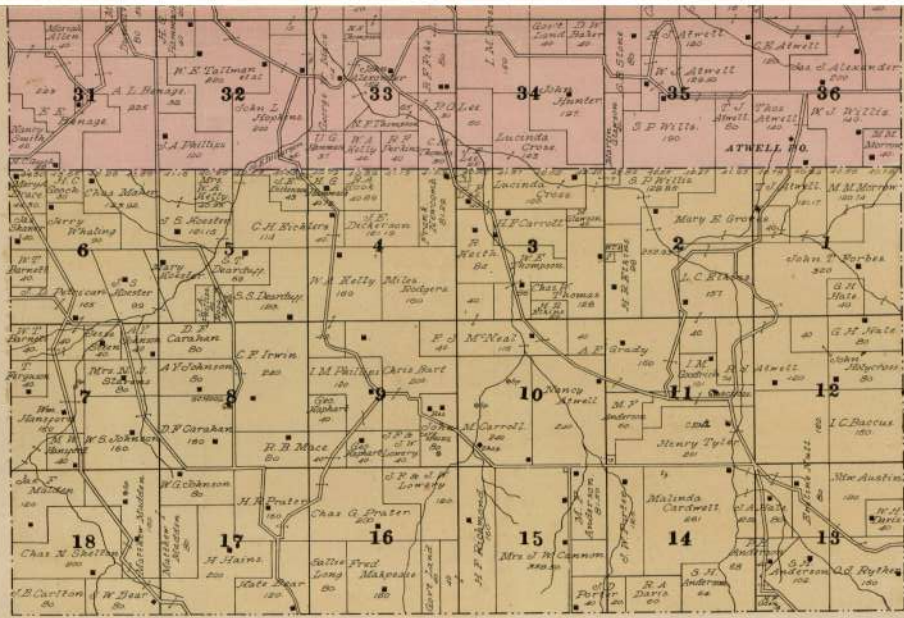
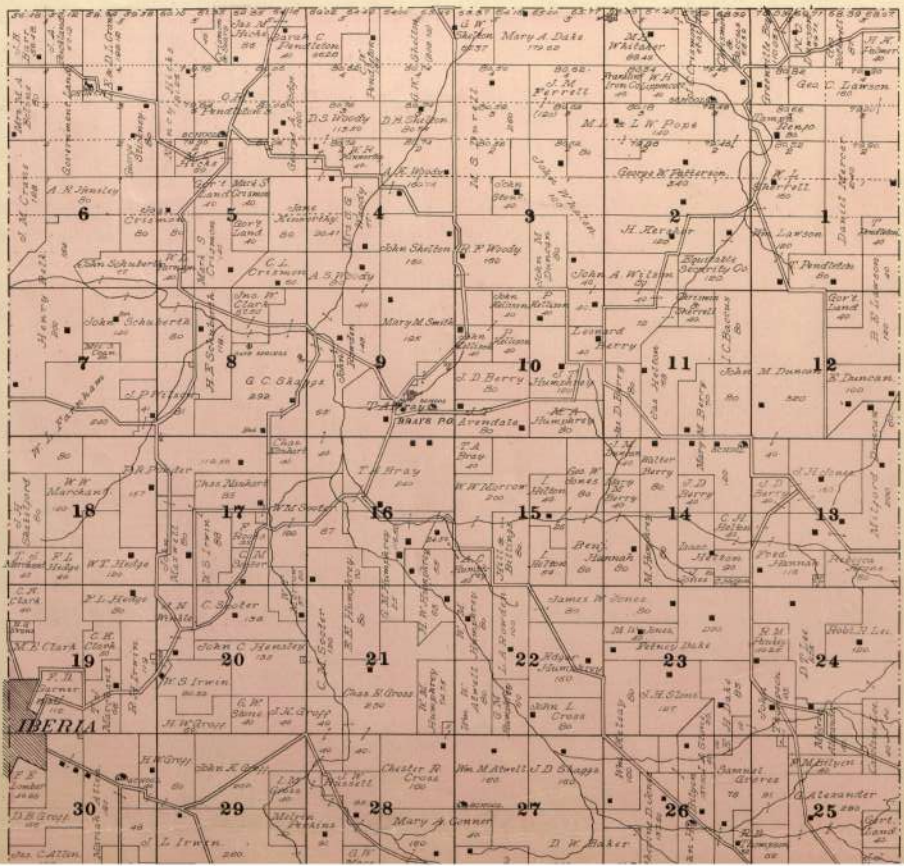

MAP OF
TOWNSHIP 40 N. RANGE XII W.
Scale 1 inch to 1 mile
OF THE 5TH P. M.

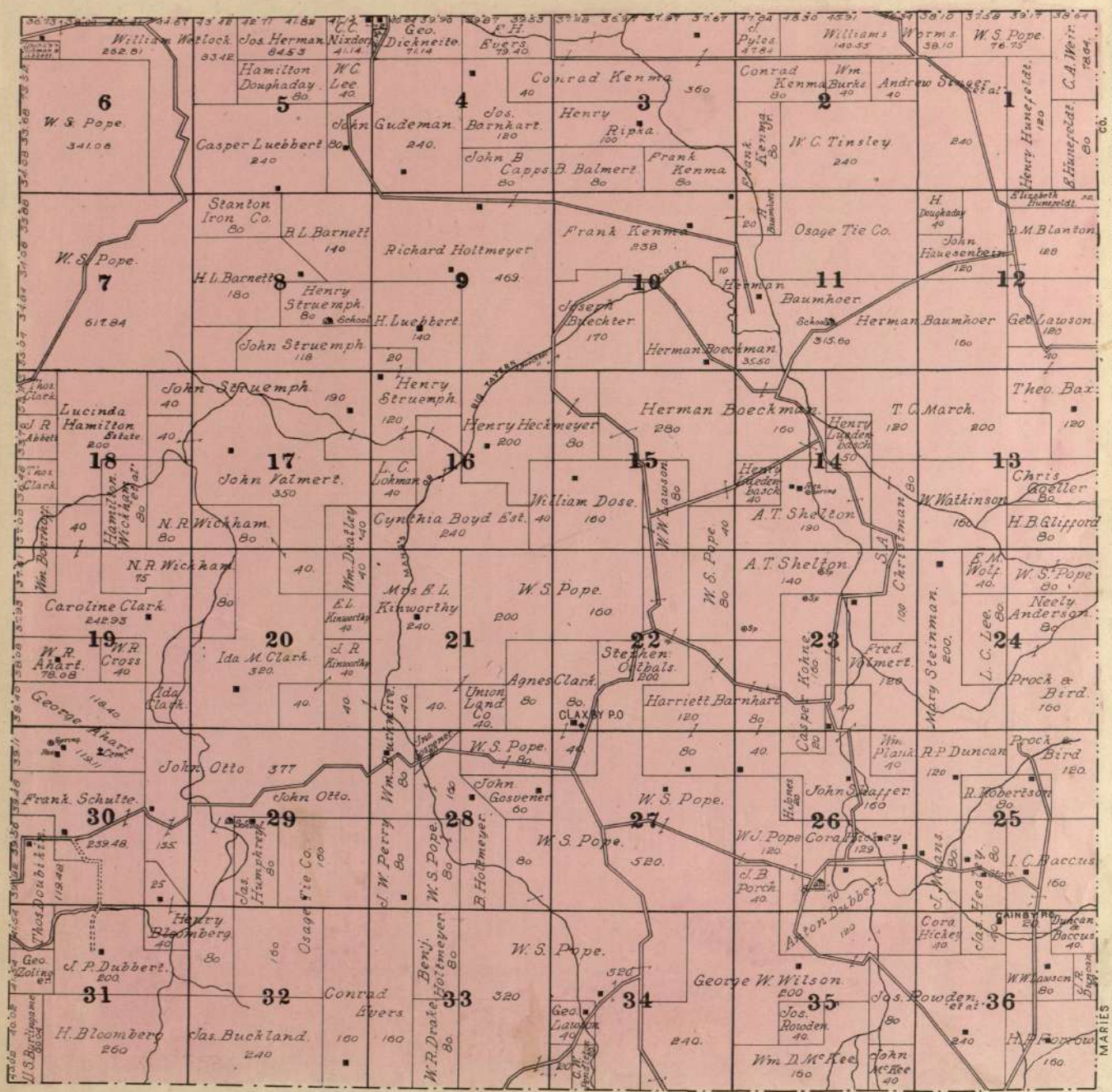

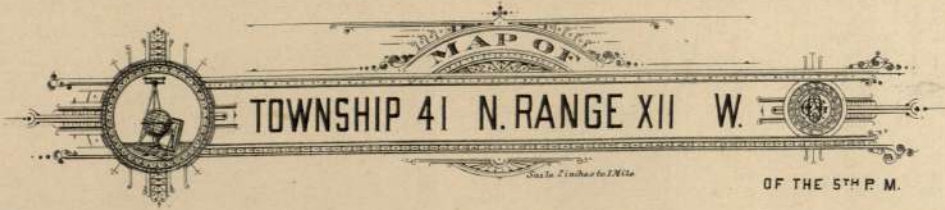

MAP OF
TOWNSHIP 41 N. RANGE XII W.
Scale 1 inch to 1 Mile
OF THE 5TH P. M.

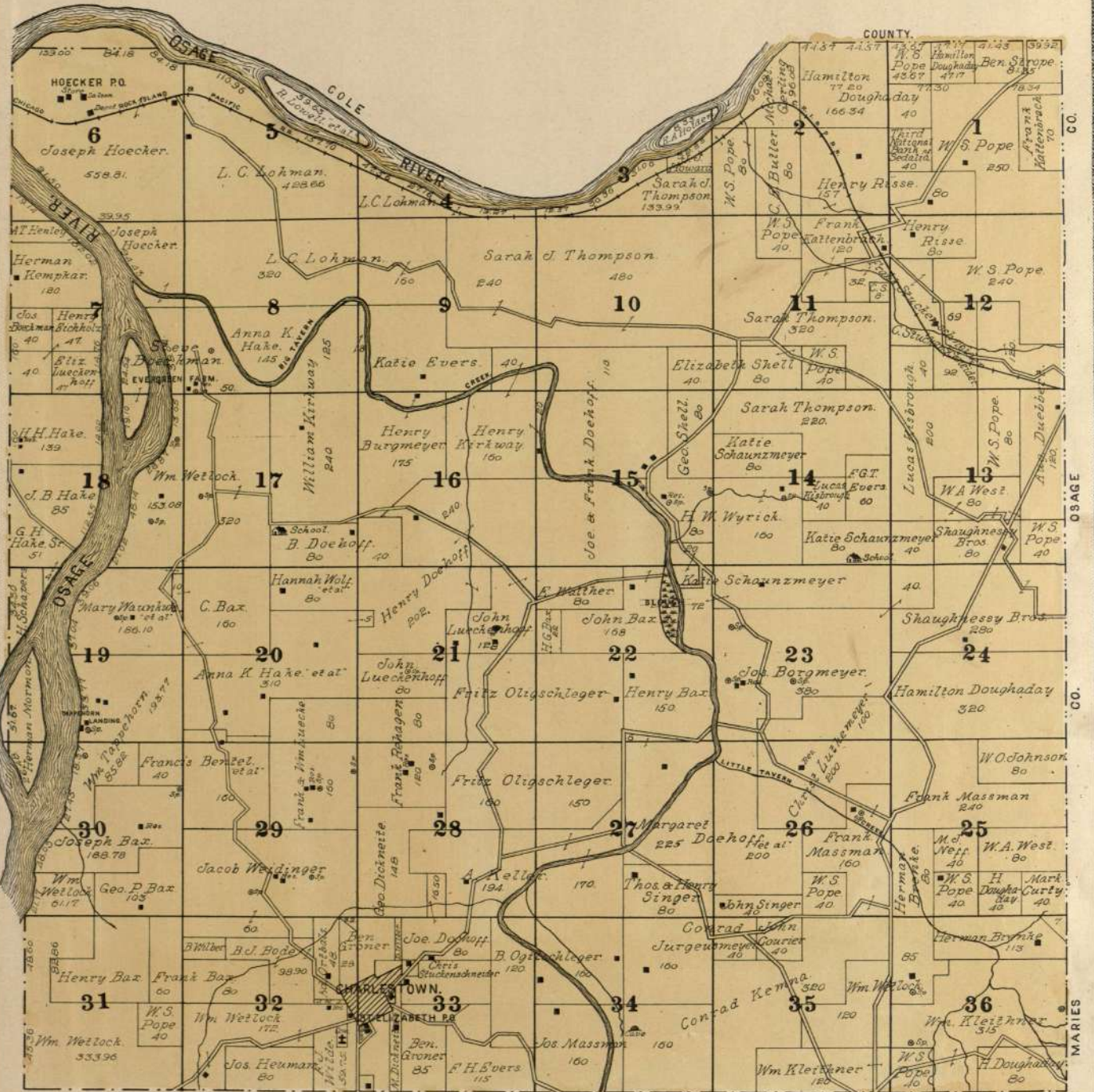

MAP OF
TOWNSHIP 38 & 39 N. RANGE XII W.
 OF THE 5TH P. M.

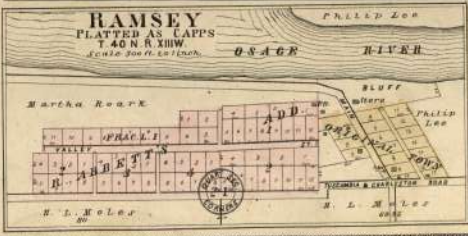
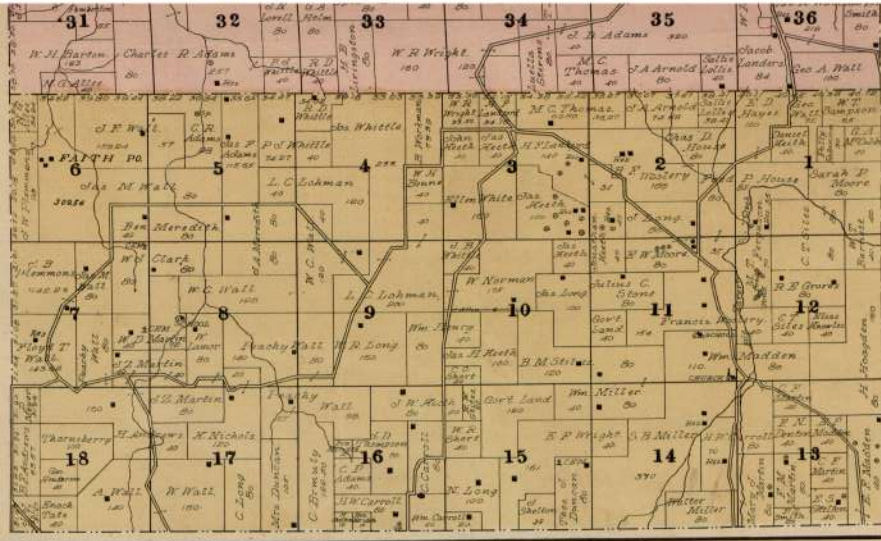
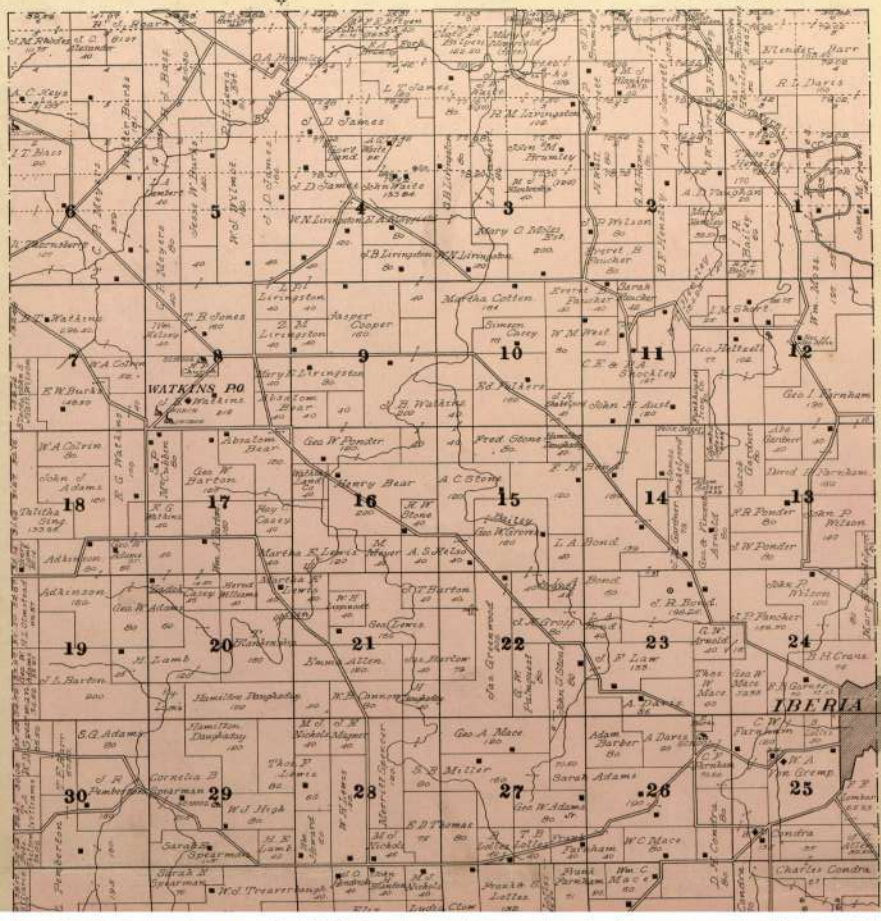

MAP OF
TOWNSHIP 38 & 39 N. RANGE XIV W.
OF THE 5TH P. M.

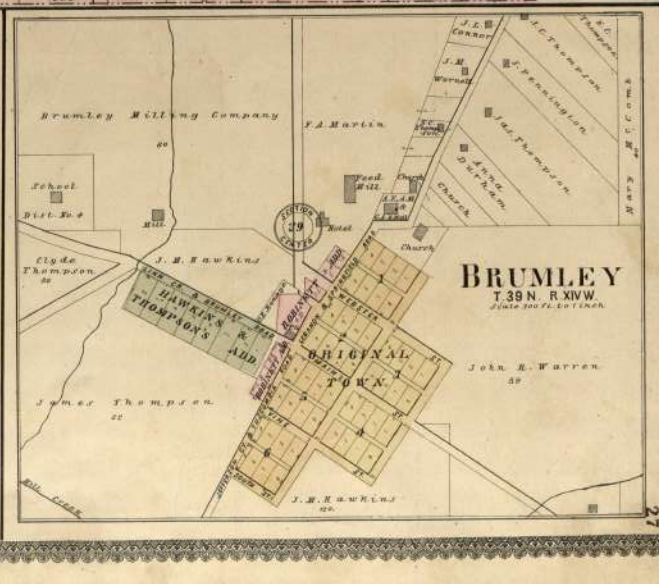
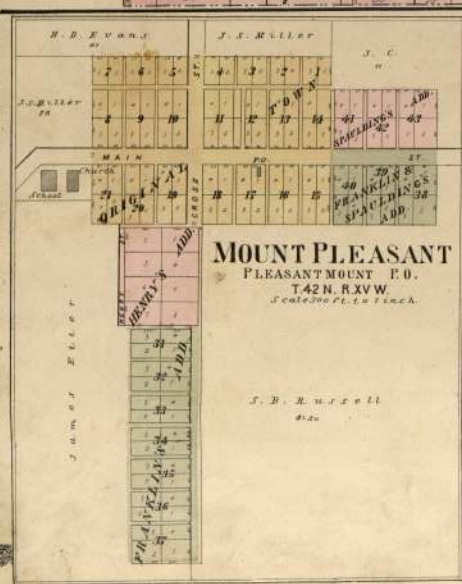
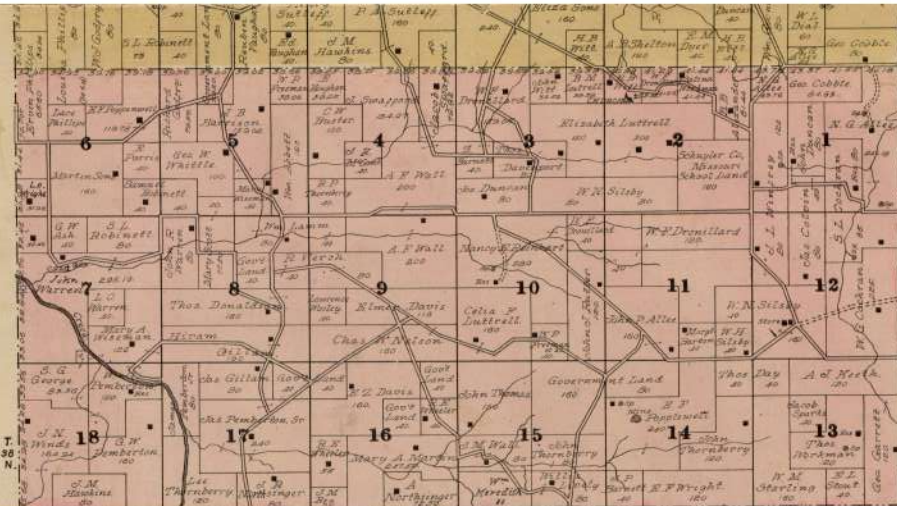
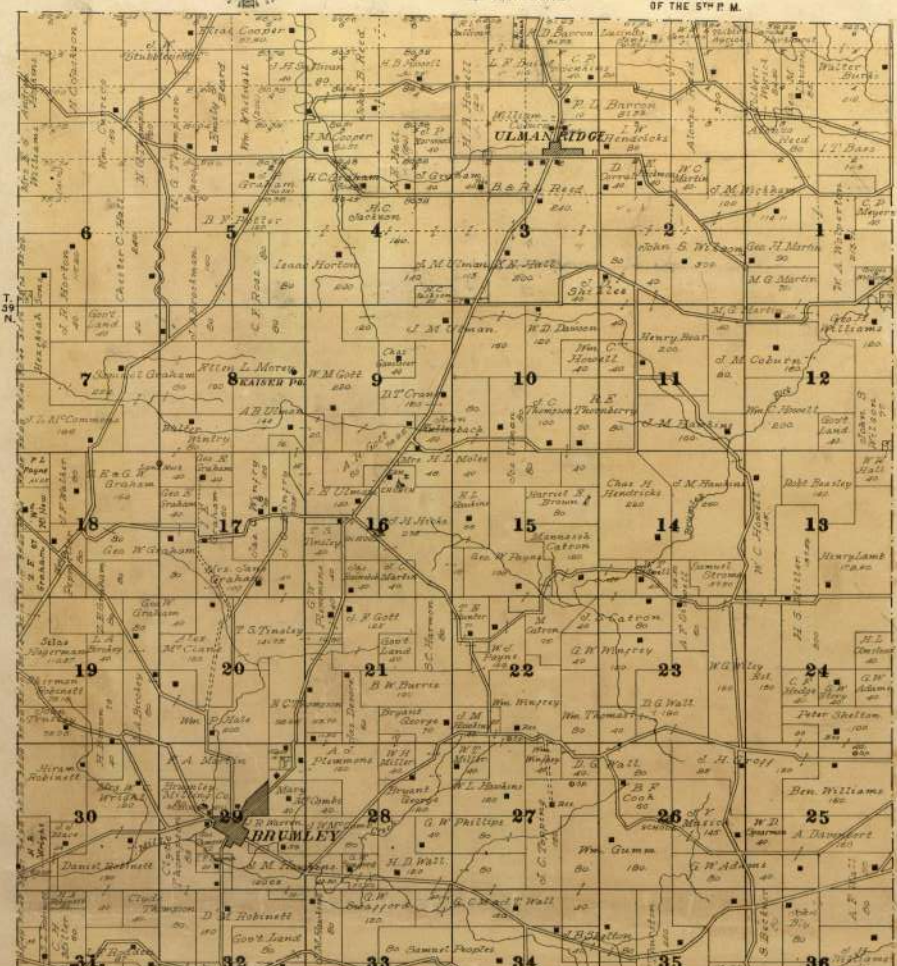

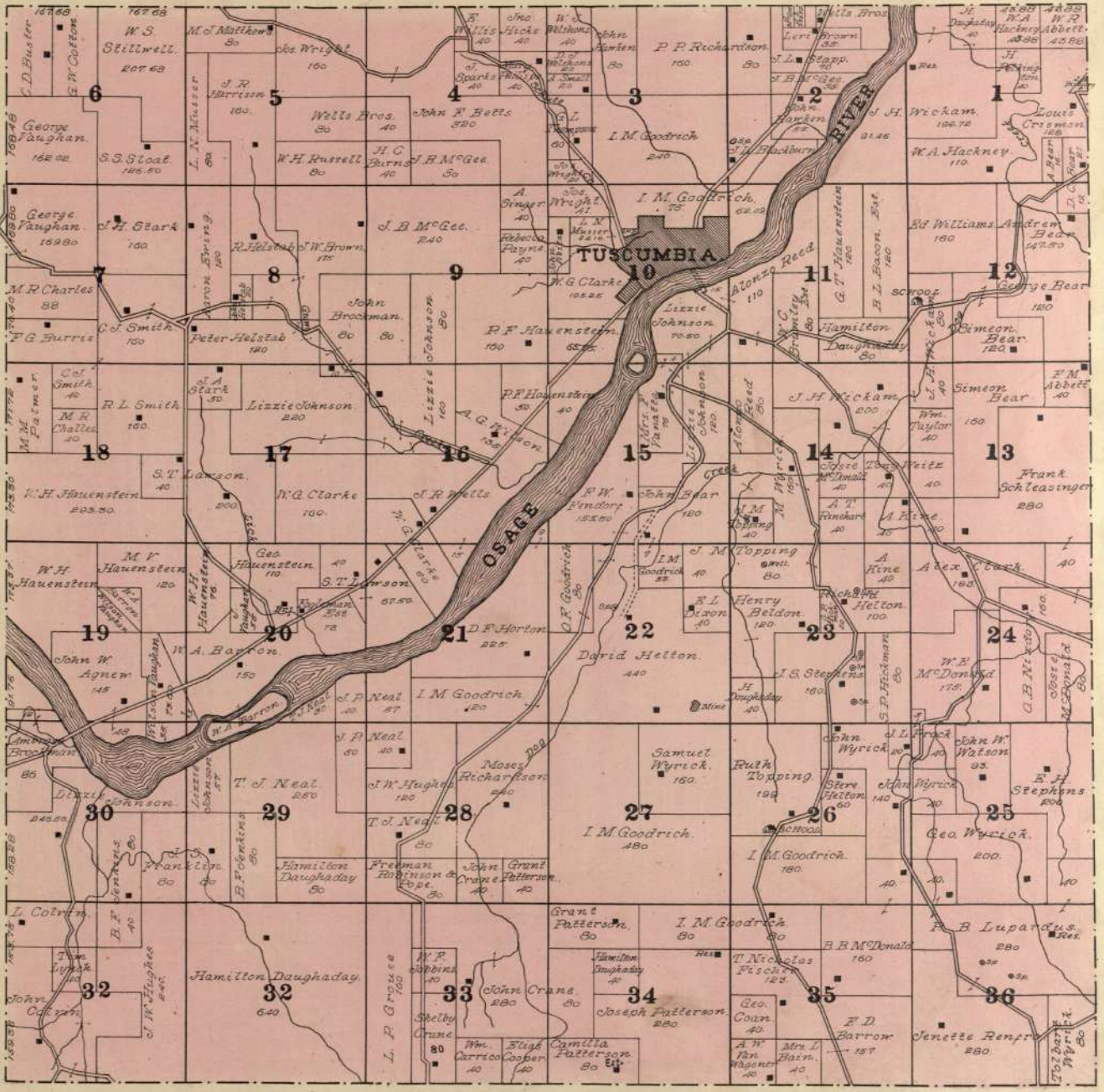

MAP OF
TOWNSHIP 40 N. RANGE XIV W.
Scale 2 inches to 1 Mile
OF THE 5TH P. M.



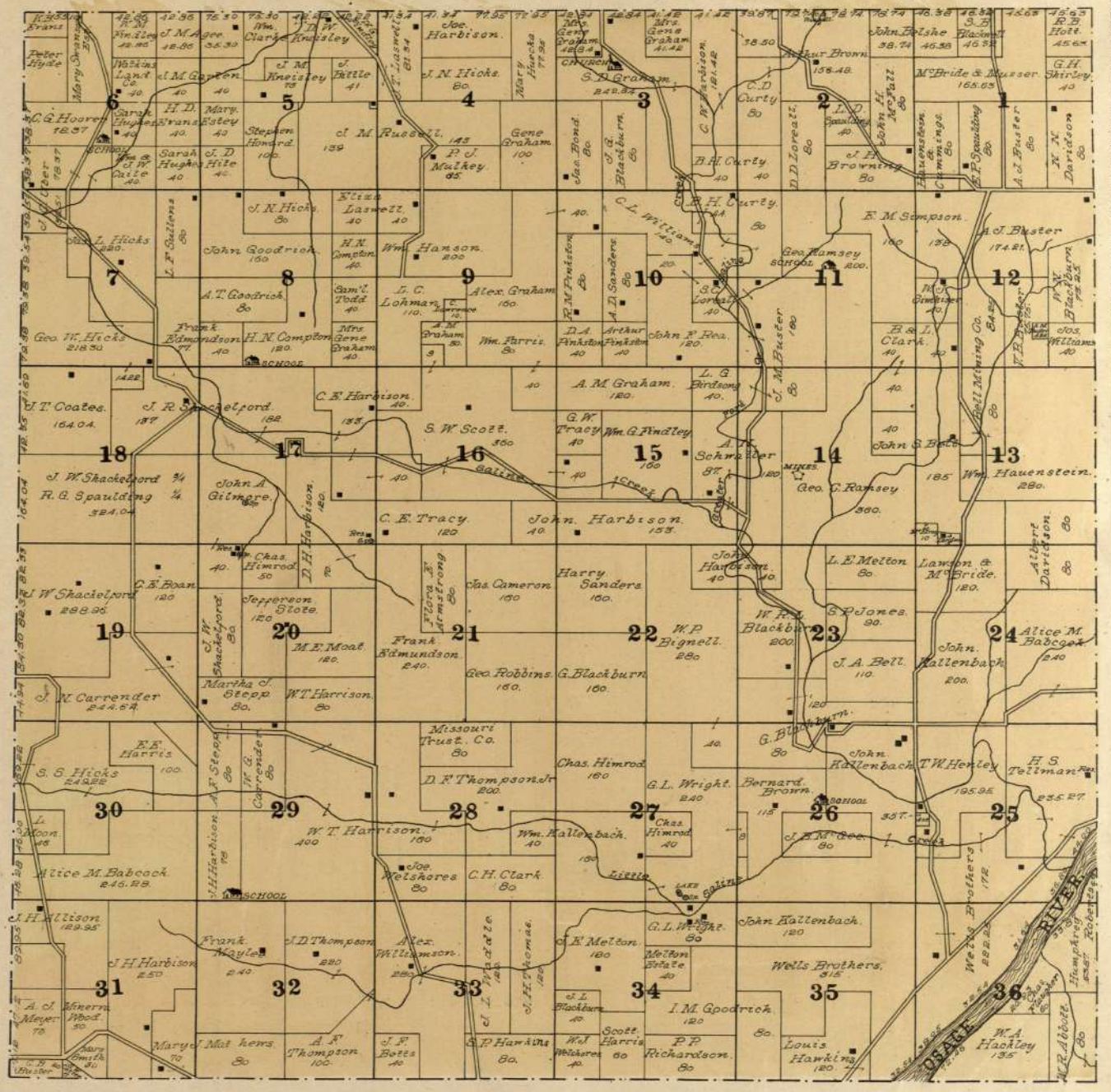

MAP OF
TOWNSHIP 41 N. RANGE XIV W.
Scale 1 inch to 36 Miles
OF THE 5TH P. M.



33

MAP OF
TOWNSHIP 42 N. RANGE XIV W.
OF THE 5TH P. M.

Scale 2 inches to 1 Mile

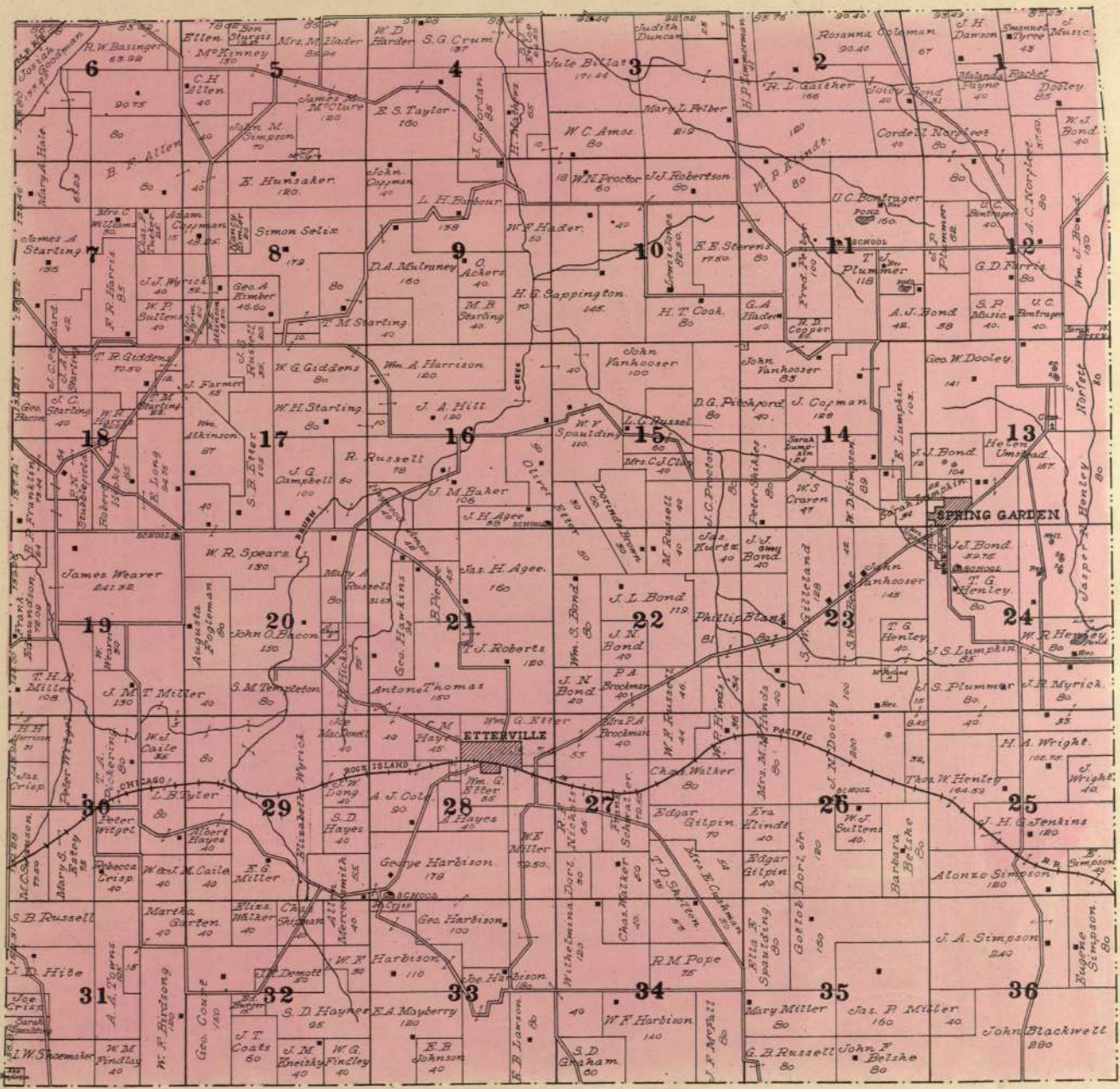

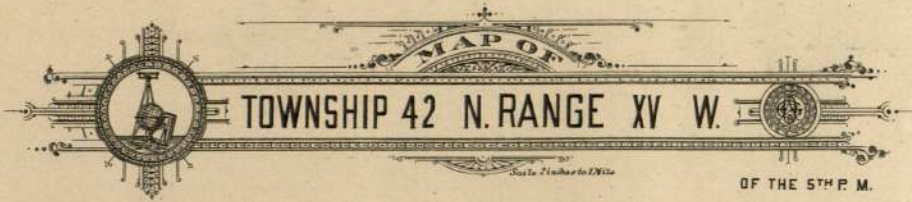

MAP OF
TOWNSHIP 42 N. RANGE XV W.
 OF THE 5TH P. M.

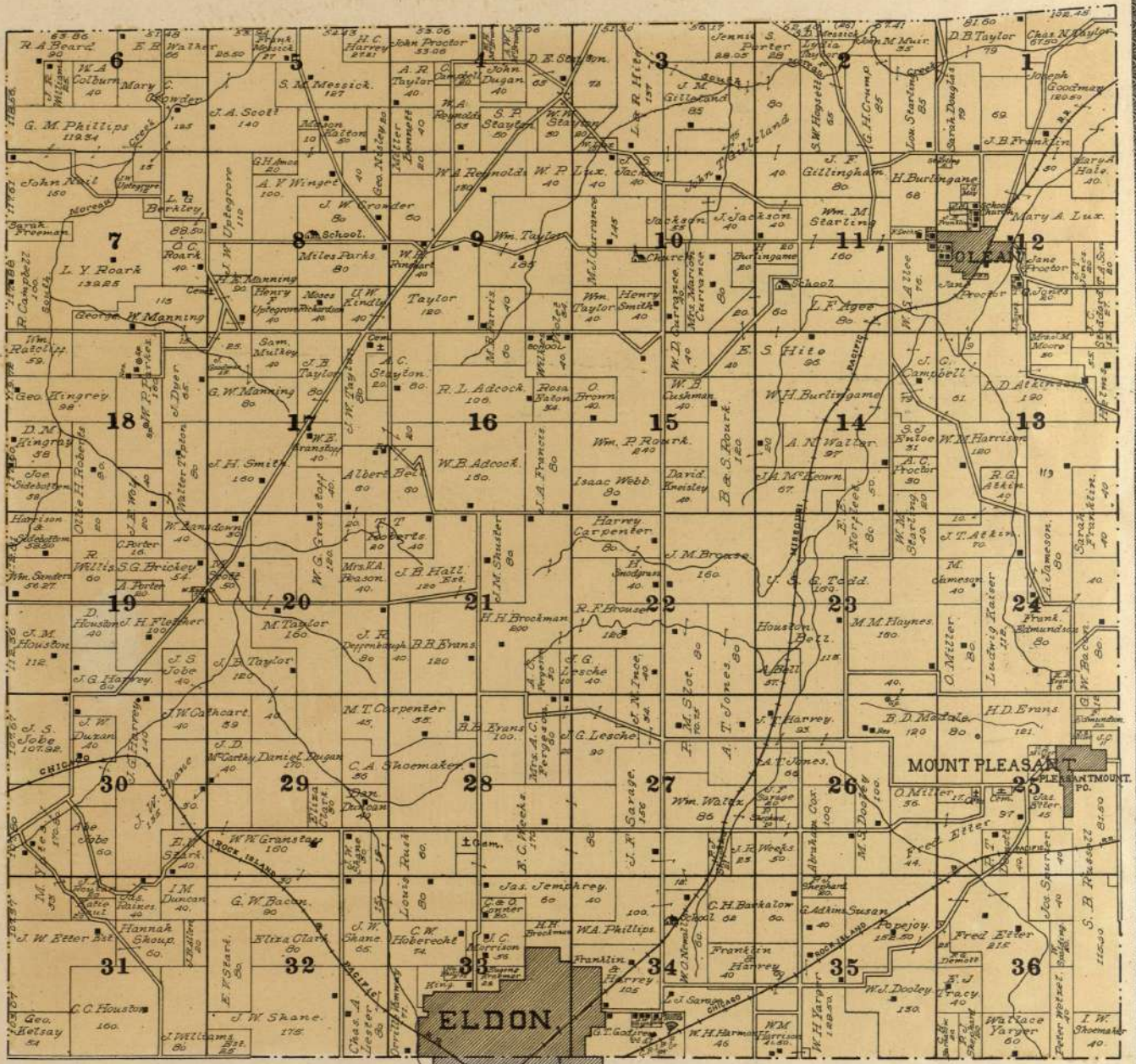

MAP OF
TOWNSHIP 41 N. RANGES XV & XVI W.
 OF THE STATE OF MO.

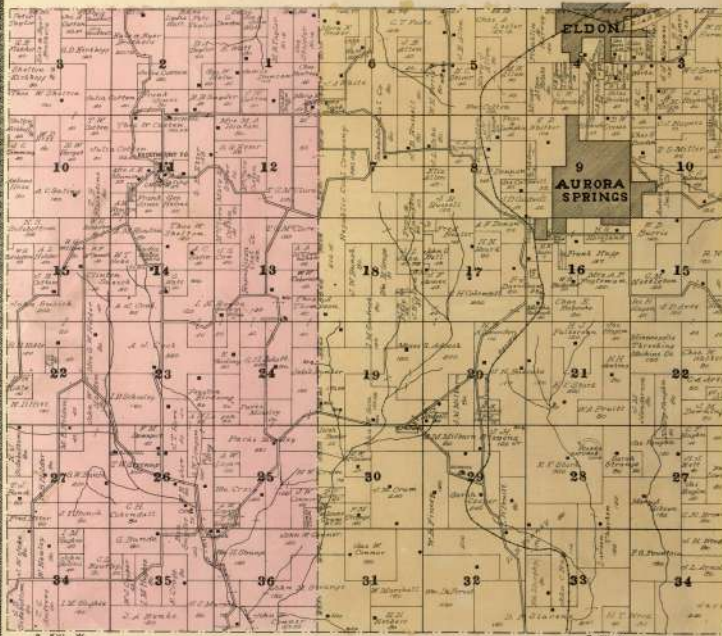

IBERIA
 T. 35N. R. 10E. 10W.
 MO.

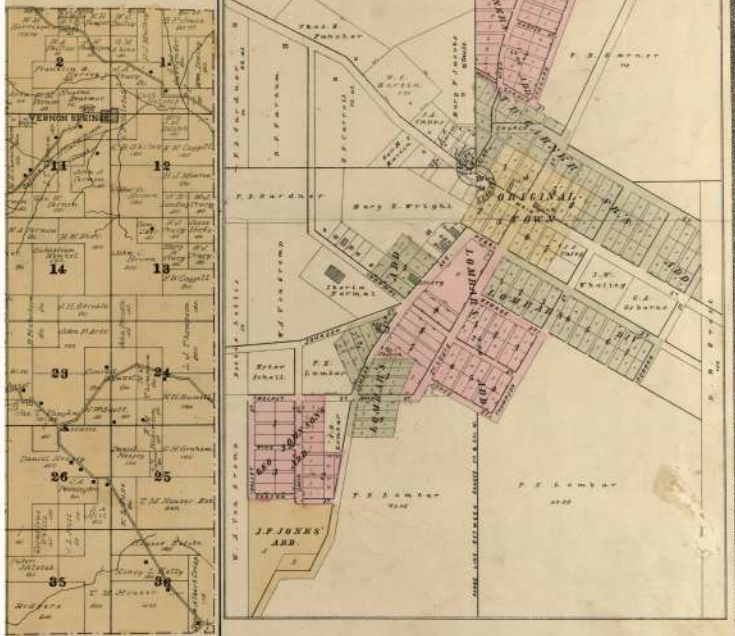

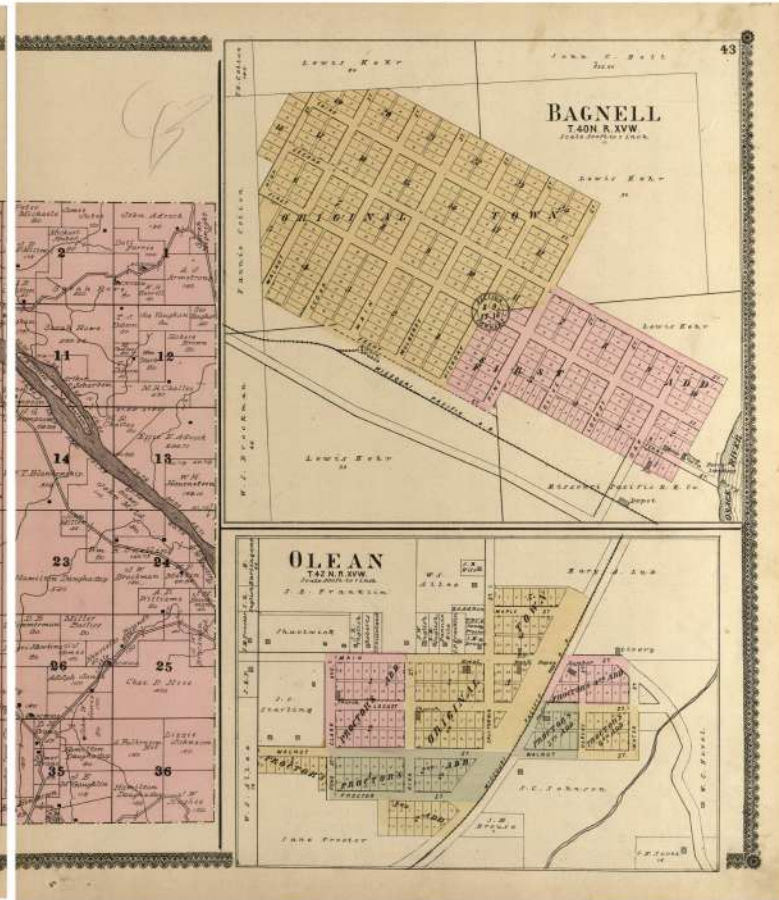

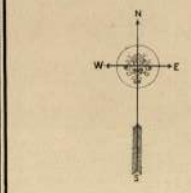
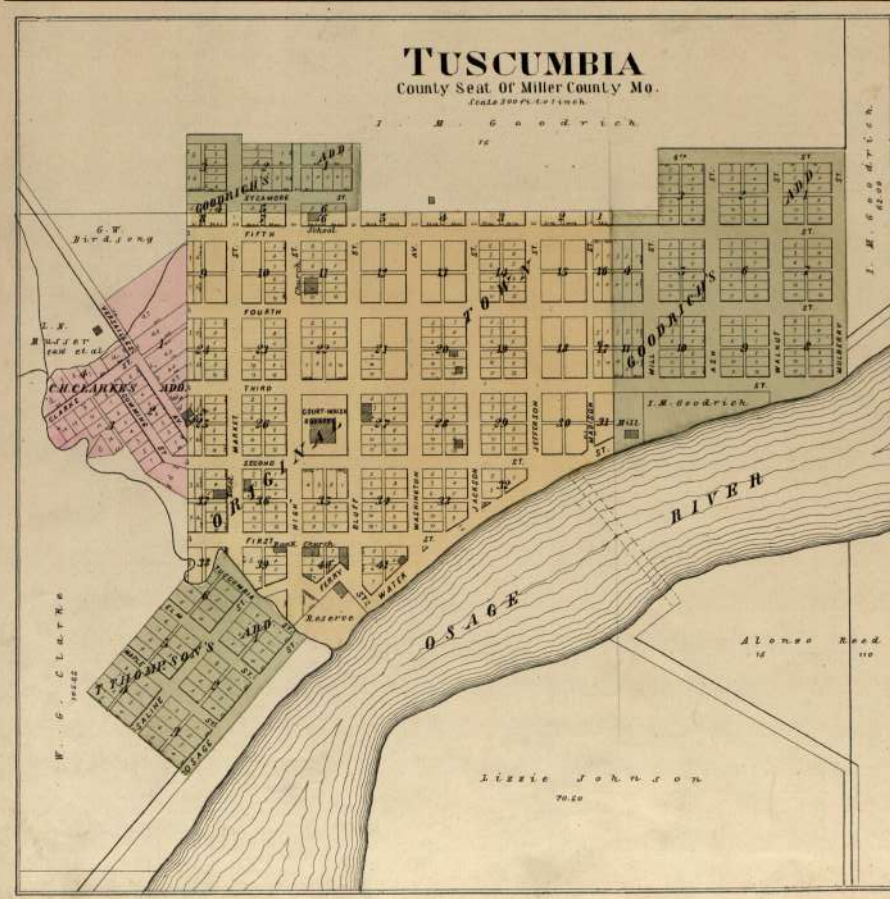
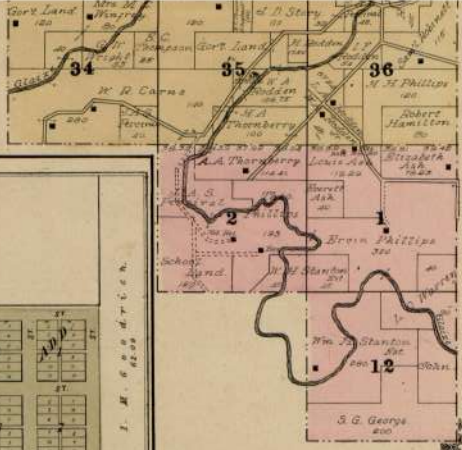
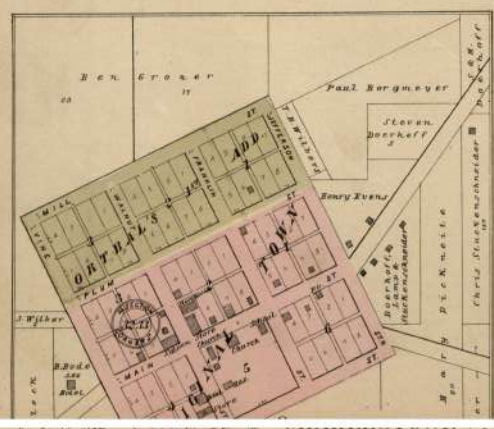
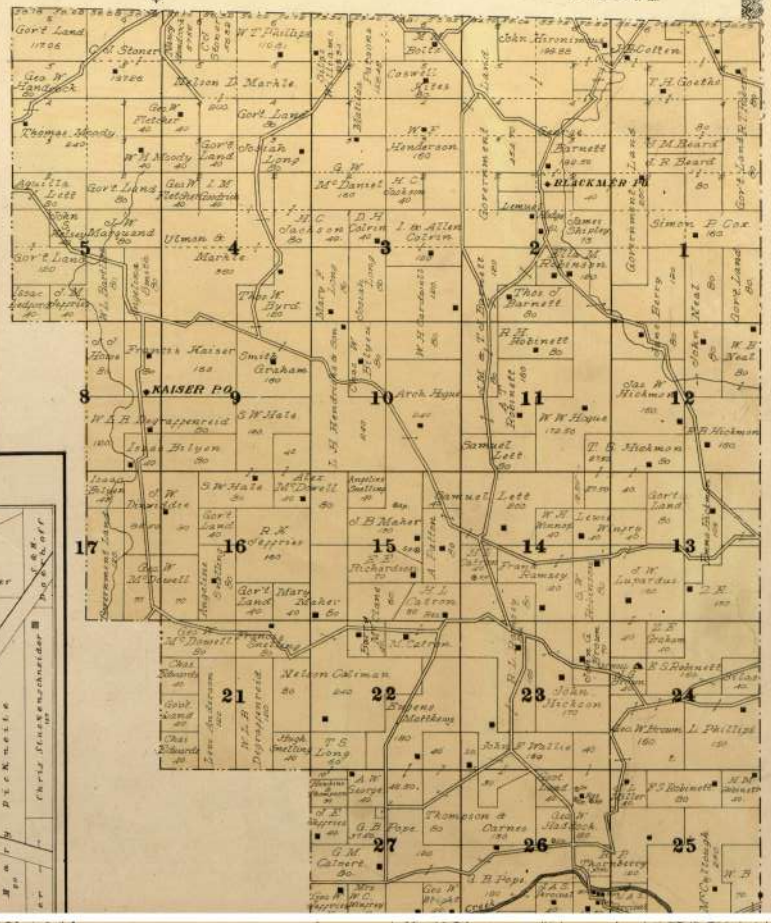
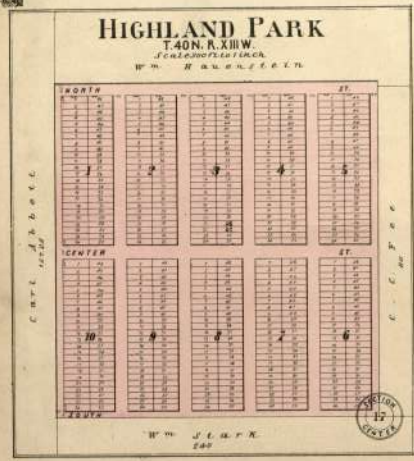

Last night

AURORASPRINGS

T.41N R.37W

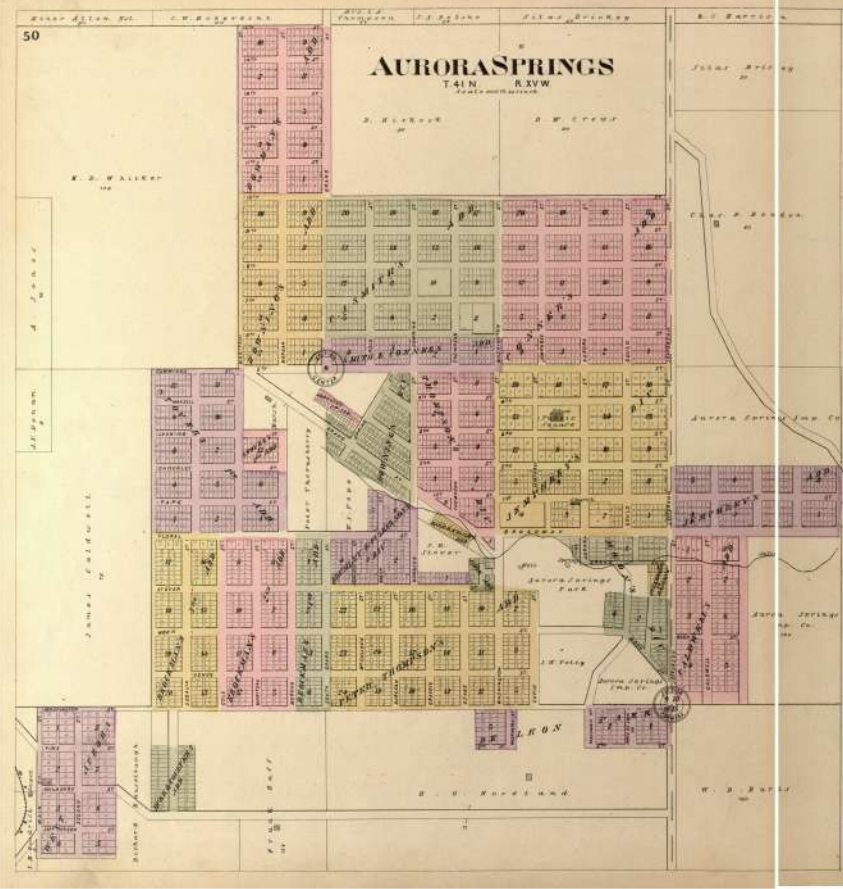

ELDON

T.41&42N. R.37W

