

SIGNALS

NODAWAY COUNTY GENEALOGICAL SOCIETY

September, 1984

Officers of Nodaway County Genealogical Society 1984-1985

First Brave (Prèsident) Lula Degase
 Second Brave (Vice-President) Barbara Owens
 Scribe (Secretary) Lela Dew
 Wampum Keeper (Treasurer) Joan Eitel
 Keepers of the Bundle (Society Librarians) Catherine Busby,
 Ruth McClurg
 Trader (Supply & form clerk) Howard Comer
 Smoke Signals Committee, Donna Fryar, Jewell Jones, Barbara
 Gayler, Lee Poynter, Vivian Pruitt

 Our 1984-85 year begins with September. Now is the time for renewals (dues). Members of the Nodaway County Genealogical Society receive four quarterly newsletters a year. The yearly fee is \$5.00 per person or \$7.50 per family. MEMBERS PLEASE SEND FREE QUERIES.

THE NODAWAY COUNTY GENEALOGICAL SOCIETY PRESENTS ITS FIFTH ANNUAL WORKSHOP

TRACING CULTURAL MOVEMENTS IN MISSOURI

J.W. Jones Building on the NWMSU campus
 20 October 1984 Maryville, Mo.

Registration 7:15-8:45

- 7:30- 8:30 Study Groups A. Beginning Genealogy B. Resources
- 9:00-10:30 Dr. Milton D. Rafferty, Southwest Missouri State University
 "Geographical Factors in Influencing Early Settlements of Mo."
- 10:45-11:45 Tom Brown, Trenton Junior College, Trenton, Mo.
 "Migration Along the Missouri River"
- 11:45-12:45 Lunch Break
- 12:45- 2:00 Michael Everman, Missouri Cultural Resource Center
 "Cultural Conservation in Missouri"
- 2:15- 3:15 Study Groups C. Research Success: KY, VA, NC, GA
 D. Research Success: MD, PA, OH, IN, IL, NE



This Project is Supported by a Grant From
 THE MISSOURI COMMITTEE FOR THE HUMANITIES, INC.
 The State-Based Arm of
 THE NATIONAL ENDOWMENT FOR THE HUMANITIES

There is no charge for this workshop, but you should pre-register for your choices of the Study Groups, and submit \$4.25 for the noon luncheon which will be provided in the Ballroom of the J.W.

Jones Building. Please return registration by October 10, 1984. The Public is invited.

!!! NOTICE !!!

We have for sale the following Nodaway County Cemetery Records:

Atchison Township - 56 pages, plus every name index. \$6.75 postpaid.

Lincoln Township - 70 pages, plus every name index. \$7.25 postpaid.

Nodaway Township - 92 pages, plus every name index. \$8.25 postpaid.

Washington Twp. - 55 pages, plus every name index. \$5.75 postpaid.

Also 1882 Nodaway County History Index. Every name index to Nodaway County's first published history book. \$5.75 postpaid.

NEWNodaway County, MO 1890 Special Census. Surviving Soldiers, Sailors, and Marines and Widows, Etc. 225 pages, indexed. \$15.00 postpaid.

Send check or money order to: Nodaway County Genealogical Society
Box 214, Maryville, MO 64468

* * Our Thanks for the following donations to our library: * *

Microfiche 1890 Louisiana Census Index of Civil War Veterans and their Widows.
Published and donated by Index Pub. Co., Salt Lake City, UT

"Gentry County, MO Births 1868-1900." Published by Northwest MO Genealogy Society, St. Joseph, MO. (Trade for our published cemetery records)

"Gentry County, MO Probate Index 1885-1902." Published by Northwest MO Genealogy Society, St. Joseph, MO. (Trade for our published cem. records)

"Select Catalogs of National Archives Microfilm Publications"

1. Genealogical and Biographical Research
2. Immigrant and Passenger Arrivals
3. Black Studies

Published by National Archives Trust Fund Board, U. S. General Services Administration, Washington, D.C., 1983 & 1984. (Obtained by our society.)

"Self Family Quarterly Vol. I Index." Donated by Daniel C. McCarthy,
1534 Foxridge Run, S.W., Winter Haven, FL 33880. Membership, \$10 per year.

"Trogon Genealogy News", Vol., No. I January, 1984. Donated by The Trogon Historical Society, 712 S. Peachtree, Springfield, MO 63670.

"Genealogists' Exchange," Vol. 4, No. 1. Published by Genealogical Text, Research & Equipment, 1021 Market Street, Ste. Genevieve, MO 63670

"Platte County, MO Historical & Genealogical Society Bulletin," Vol. 37, No. 2, Spring 1984. Published by Platte County Historical Society, PO Box 103, Platte City, MO 64709

"Worth Co., MO Marriages 1873-1910, Books A-E." Published by Northwest MO Genealogy Society, PO Box 68, Station E, St. Joseph, MO 64505. Donated by Jewell Jones.

"Holt Co., MO Marriages, Book B, Pages 130-333, 1860-1870." Published by Northwest MO Genealogy Society. Donated by Jewell Jones.

"Holt Co., MO Marriages, Book C, Pages 1-266, 1870-1881." Published by Northwest MO Genealogy Society. Donated by Jewell Jones.

Col. 3 "Old Settlers--A number of Them in Jackson Township. We are indebted to Cooper Gooden for the following sketch of old settlers of Jackson Township: Allen Rhodes was born in Ohio, December, 1828. He has lived here thirty-seven years. He owns 287 acres of land, but is a retired farmer--a Democrat in politics.

Benton Smith was born in Indiana, February 27, 1841. He came to Missouri in 1845, and to this county 51 years ago. He owns 415 acres of land. Democrat in politics.

Lyman Hunt was born in New York in 1827. He came to this county 37 years ago. He recently sold most of his land, but owns forty acres yet. He is a retired farmer--Republican in politics.

Capt. A. B. Bentley was born in Brookfield, Ohio, December 26, 1822 and moved to Iowa in 1853, and from there to Missouri in 1857. He has resided in Jackson Township thirty-one years. Owns 80 acres of land. He was a law partner of Judge Lafe Dawson at one time. He is a Democrat in politics.

Peter Hawk was born in Virginia in 1827, lived in Indiana nineteen years, and in Illinois one year, and here forty-three years. He owns 552 acres of land and considerable Ravenwood property. He is a retired farmer. Republican in politics.

Adelma Stingley was born in Ohio, April 29, 1823. Came to this state fifty-three years ago, and has lived in Nodaway County 42 years. He owns 280 acres. Is a retired farmer--Democrat in politics. It is said that he never voted for anyone not a Democrat but once, and that was a justice of the peace.

Moses Spier was born in Ohio, May 4, 1834, and is 63 years old. He came to Jackson Township in 1855, and settled on the farm he now lives on. Part of Ravenwood was built on his farm. He owns now 162 acres. He is a Republican.

Said Mr. Gooden to a Democrat reporter: 'I came from Delaware to this county in 1864, and settled in Jackson Township. At that time I never expected to live to see our prairies settled up. When we look around for those early pioneers who wrought many of these changes and blazed the way for those that came after them, we find them few and far between, and those few will soon have rounded out their allotted time, with ripe and honorable old age, and then the old landmarks will all have been moved away. Time is hastening on and we are hastening with it. Sometimes we rise with the billows; sometimes in the trough of the sea of time; but too soon the tide recedes and we are stranded on the shores of perhaps forgetfulness.'"

Col. 3 "An Honored Old Settler. John Stundon was in town Saturday and spent a few moments in our sanctum. We found out in conversation with him, that he is in his 78th year. He came to this country in 1845, and came to Nodaway County in 1867, settling in the same vicinity, in Grant township, where he now lives, where he owns a good farm. Mr. Stundon, in 1849, crossed the plains with the Fremont party to California. He was gone about two years, but it took about three-fourths of that time to go and come. They used mule teams. Now the trip can be made in three or four days by railroad. A great change in mode of traveling. Mr. Stundon is very vigorous for a man of his years, and the Democrat hopes he may live long yet and ever be prosperous and happy."

ANCESTOR CHART 93

GREAT-GRANDPARENTS



PLACE YOUR NAME HERE

1 Massie, Lela Emily
 BORN 28 March 1908
 WHERE Doyless County, Mo.
 WHEN MARRIED 4 July 1932
 DIED
 WHERE

NAME OF HUSBAND OR WIFE
 Dew, Paul Bertcoll

Address:

FATHER

Massie, Estill
 BORN 2 October 1884
 WHERE McFall, Mo. Gentry Co.
 WHEN MARRIED November 19—
 DIED 12 January 1929
 WHERE Home, Albany, Mo.

MOTHER

3 Christie, Blanche Lee
 BORN 25 December 1886
 WHERE McFall, Mo. Gentry County.
 DIED 22 July 1980
 WHERE Hospital - Maryville, Mo.
 Modaway

GRANDFATHER

1 Massie, John
 BORN 6 January 1850
 WHERE Bourbon County, Ky.
 WHEN MARRIED 5 October 1875
 DIED 14 October 1910
 WHERE Home, McFall, Mo.

GRANDMOTHER

5 Lewis, Lucy Ann?
 BORN 24 December 1849
 WHERE Shelby County, Ky.
 DIED 27 December 1940
 WHERE Home, McFall, Mo.

GRANDFATHER

6 Christie, Samuel
 BORN 3 March 1860
 WHERE Gentry County, Mo.
 WHEN MARRIED 4 July 1882 or 1883
 DIED 3 May 1930
 WHERE Home of daughter -
 Albany, Mo.

GRANDMOTHER

7 Pulsifer, Clarissa E. (Clara)
 BORN 2 February 1864
 WHERE Gentry County, Mo.
 DIED 26 April 1934
 WHERE Home of daughter
 Albany, Mo.

- 8 Massie, John (first husband)
 BORN
 WHERE
 WHEN MARRIED
 DIED
 WHERE
- 9 Breckenridge, Mary
 BORN 25 June 1821
 WHERE Bourbon County, Ky.
 DIED 30 September 1902
 WHERE Gentry County, Mo.
- 10 Lewis, Abram
 BORN 14 March 1825
 WHERE
 WHEN MARRIED December 1848
 DIED 21 June 1897
 WHERE McFall, Mo.
- 11 Neal (Neil) Harriett
 BORN 13 April 1828
 WHERE Kentucky
 DIED 18 February 1918
 WHERE McFall, Mo.
- 12 Christie, Abram
 BORN 13 April 1818
 WHERE ~~Kentucky~~
 WHEN MARRIED 12 November 1840
 DIED 10 June 1880
 WHERE Gentry County, Mo.
- 13 Johnson, Sarah (Sally)
 BORN 6 August 1818
 WHERE Kentucky
 DIED 3 May 1909
 WHERE Gentry County, Mo.
- 14 Pulsifer, Nero
 BORN 12 March 1842
 WHERE Illinois
 WHEN MARRIED 12 April 1863
 DIED 14 March 1909
 WHERE Gentry County, Mo.
- 15 Potter, Sarah A. E.
 BORN 30 July 1845
 WHERE Tennessee
 DIED 5 March 1845
 WHERE Gentry County, Mo.

() Check here if you know additional information on other generations not shown

NODAWAY COUNTY RECORDED MARRIAGES

- Bowman, George, m. Nancy Foresythe, Nov. 9, 1845.
 Bowman, Henry, m. Maria Heady (Hagey), Sept. 18, 1855.
 Bowman, Jacob, m. Mary Jane Huff, Nov. 30, 1848.
 Bowman, Jacob, m. Mariah Walters, June 21, 1849.
 Bowman, Jacob, Sen., m. Miss Mary Ann Sego Given, Jan. 1, 1861.
 Bowman, John, m. Miss Mary Collins, Mar. 21, 1872.
 Bowman, Joseph, m. Lyda Ann Huff, Mar. 13, 1856.
 Bowman, Joseph, m. Permelia Lee, Oct. 24, 1850.
 Bowman, Joseph, m. Miss Sarah Ellen Millen (Miller),
 Aug. 15, 1860.
 Bowman, Richard, m. Susan Young, Nov. 21, 1850.
 Bowman, Samuel, m. Ann B. Parks, Sept. 7, 1857.
 Bowman, Wilbern, m. Miss Almedia Cullison, Mar. 27, 1871.
 Boyl, John T., m. Ruth Bolt, Oct. 28, 1857.
 Boyd, S. H., m. Jane Haugh, Aug. 2, 1857.
 Bracher, Alfred, m. Iduma Chapman, Apr. 26, 1871.
 Bracker, James, m. Harriet E. Morehouse, Mar. 9, 1869.
 Bradford, S. P., m. Miss A.M. Alenbaugh, Dec. 8, 1874.
 Bradley, Carlos P., m. Margaretta Crandall, Sept. 4, 1869.
 Bradley, John C., m. Miss Elvina Graves, Oct. 30, 1859.
 Bradley, Lewis C., m. Miss Margaret C. Ingram, Jan. 10, 1875.
 Bradley, Stephen, m. Margaret A. Rhodes, Feb. 29, 1872.
 Bradley, James S., m. Sarah E. Sevrns, Jan. 24, 1875.
 Bradly, Uriah, m. Mary J. Buttler, Mar. 15, 1868.
 Bramble, Henry, m. Charlotte McCrey (McCray), Jan. 12, 1873.
 Brand, Adam, m. Miss Mary Koenig, Feb. 21, 1870.
 Brand, John M., Dr., m. Nancy J. Helmich, Holt Co., Mo.
 Dec. 13, 1866.
 Bratcher, James W., m. Miss Maryetta Green, Mar. 8, 1874.
 Bratcher, William Franklin, m. Cinthia Ingels, Aug. 30, 1860.
 Bridges, Jesse, Adams Co., Ia., m. Elmira Baker, Page Co., Ia.
 June 20, 1858 (Recorded twice)
 Bridgewater, William, m. Milly Roach, Dec. 31, 1849.
 Briggs, Julian A., m. Miss Mollie Perdew, Feb. 21, 1872.
 Briggs, Oscar S., m. Selly Ann Denning, Feb. 22, 1868.
 Bright, William, m. Martha Donica, Nov. 21, 1869.
 Brittenham, Salomon, m. Miss Mary Flaherty, Sept. 6, 1873.
 Brittain, L. C., m. Miss Mary C. Weathermon, July 25, 1872.
 Brittain, John W., m. Martha J. Weathermon, Apr. 6, 1871.
 Britton, Thomas D., m. Effa M. Reece, July 31, 1866.
 Britton, Thomas H., m. Elmira Turnepseed, Aug. 30, 1863.
 Broadric, Isaac, m. Miss Cordelia Moore, Oct. 14, 1869.
 Broadrick, James, m. Nancy Morris, Sept. 6, 1866.
 Broadrick, S., m. L. A. Lucus, Apr. 28, 1859.
 Brockman, John, m. Easter(n) Ca-li- (Carlis or Cavlis),
 Oct. 10, 1847.
 Brokard, George, m. Emily J. Mathes, July 1, 1866.
 Brooks, James, m. Barbary Hakankratt, both of Taylor Co., Ia.,
 Aug. 13, 1866.
 Brooks, William F., m. Miss Lovia I. Hubbard, Jan. 23, 1870.
 Brown, Bengamin M., m. Marcy Jane Spoonemore, Jan. 21, 1858.

NODAWAY COUNTY RECORDED MARRIAGES

Brown, Carr, m. Farabe F. Needels, Feb. 22, 1868.
 Brown, Elisha, m. Thirso Ann Moore, Oct. 15, 1847.
 Brown, Ely, m. Frances Baysinger, Apr. 7, 1872.
 Brown, Franklin, m. Miss Jane Bond, Nov. 20, 1870.
 Brown, Hudson, Worth Co., Mo., m. Miss Almir'a Grove,
 Page Co., Ia., July 1, 1871.
 Brown, John, m. Prissilla Bohanan, Feb. 8, 1846.
 Brown, John D., m. Miss Louisa Hyman, Sept. 12 (17?), 1860.
 Brown, Samuel S., m. Allula L. Bender, Feb. 25, 1872.
 Brown, Swain R., m. Miss Mary Etta Booth, Dec. 16, 1873.
 Brown, William, m. Mrs. Jane Dillon, Apr. 12, 1872.
 Brown, William A. T., m. Mary Jane More, Oct. 3, 1852.
 Brown, Wilson, m. Elleanor Linville, Dec. 25, 1853.
 Brown, Wilson, m. Miss Martha A. M. Trapp, Nov. 20, 1870.
 Brown, Wilson H., m. Miss Phebe A. Brown, Aug. 30, 1866.
 Broyles, Asa, m. Elizabeth Butts, July 3, 1853.
 Broyles, James, m. Miss Nancy A. Patton, June 3, 1873.
 Broyles, John C., m. Jane Cook, Sept. 25, 1859.
 Broyles, Samuel, m. Sarah Jane Coleman, Jan. 6, 1861.
 Broyles, Solomon, m. Sarah E. Wright, Sept. 1, 1858.
 Broyles, William P., m. Miss Ruth Clemens, Dec. 28, 1862.
 Bruce, Charles E., m. Miss June Cox, Jan. 5, 1875.
 Brumett, William, m. Cordelia C. Self, May 24, 1868.
 Bryan, James N., m. Miss Florence Morgan, Mar. 5, 1872.
 Buckingham, Joshua, m. Rebecca Stonebreaker, Jan. 18, 1849.
 Buckland, Nels, m. Margaret Ross, Mar. 28, 1850.
 Bugbee, Frank B., m. Elizabeth C. Birdwell, Apr. 31,
 1871. Filed May 1, 1871.
 Bum(Burn), Thomas Franklin, m. Susan Davis, Dec. 14, 1862.
 Bun, Silvester, (See Been, Silvester)
 Buns, H. B., m. Phebe J. Peters, Oct. 9, 1862.
 Burch, Absolum B., m. Miss Francis Hiles, Dec. 24, 1870.
 Burch, Achillus L. m. Martha M. Burch, Dec. 1, _____ Filed
 Dec. 14, 1868.
 Burch, Constant J. m. Miss Sarah J. Linebaugh, Jan. 29, 1871.
 Burch, Denis Newton, m. Mrs. Susan Miller, Sept. 30, 1873.
 Burch, James A., m. Miss Sarah Creps, Page Co., Ia.,
 Mar. 2, 1869.
 Burd, G. W., (See Bird, G. W.)
 Burdick, Willard A., m. Miss Sidney C. Richerdson,
 Sept. 13, 1871. At Xenia.
 Burk, William, m. Sarah Conway, Oct. 28, 1866.
 Burke, G. B., Page Co., Ia., m. Miss Amanda Shepard, Leav-
 enworth Co., Kan., Dec. 13, 1862.
 Burn, Thomas Franklin, (See Bum, Thomas Franklin)
 Burnett, Elias, m. Mary P. Kelly, Nov. 5, 1868.
 Burnett, James, (See Bennett, James)
 Burnett, James, m. Mrs. Mary J. Brown, Dec. 8, 1864.
 Burnett, Richard S., m. Miss Rebeca E. Allen, Dec. 26, 1861.
 Burnett, W. H., m. Miss Elizabeth Mann, Dec. 24, 1874.
 Burns, Caleb S. m. Jerusha Byers, Sept. 17, 1846.

Nodaway County Estate Index (con't) 1846-1956

<u>Surname</u>	<u>Box</u>	<u>File</u>	<u>Surname</u>	<u>Box</u>	<u>File</u>
Bowlin, Lucinda	173	16	Borger, Katherine J.	305	8
Bomar, Alice	173	17	Bookman, Nellie M.	307	2
Booher, Artie E.	184	14	Bolich, Daniel	308	25
Booze, Alcuins L.	184	15	Bowman, Nina A.	309	9
Bowman, Henry dec'd.	184	16	Boque, Mary C.	313	20
Bowman, George D.	184	17	Booze, Harvey	319	27
Booze, Henry C.	184	18	Bradbury, William	8	9
Booze, Herman C., Louis E., Inez R. Virginia H.	198	1	Bright, Wm. H.	1	1
Booher, Abraham	198	2	Brown, Jacob M.	1	2
Bowen, Mary E.	198	3	Broyles, William	2	4
Bowman, Maria	198	4	Breit, Edward U.	5	12
Borush, John W. dec'd.	198	5	Briggs, Bessie	5	13
Bond, Anna N., dec'd.	198	6	Bradley, Clarissa	5	14
Bond, James H.	212	23	Brogan, Joel D.	5	22
Bond, Irma F. & Forest M.	212	7	Brittain, L. C.	6	4
Bond, Mary M., dec'd.	212	8	Bridges, James R.	6	7
Bosley, Alzeda	212	9	Brown, Wilson D.	6	10
Booher, Benjamin	225	27	Brand, John	6	15
Bonar, Elizabeth A.	227	28	Bradley, George W.	7	1
Boatwright, Wm. N.	227	29	Brown, Andrew	7	18
Bowman, David L.	250	7	Bradley, Mark B.	7	19
Boatwright, Wm. T.	250	3	Briggs, Lorenzo D.	8	6
Bowers, George H.	108	7	Brand, Frederick	8	7
Boyle, Effie M. et-al	141	12	Brush, William	8	8
Bostick, Eliza E.	161	5	Bracken, Cornelius L.	8	15
Bowman, Andrew J.	198	7	Brady, Dudley	8	16
Booze, Charley	236	3	Brown, Isiah	8	17
Boedeker, Henry A.	237	11	Briggs, Lucinda	10	8
Boedeker, Henry August	240	3	Bradley, Clara	10	9
Bowman, Barbara Jane	240	7	Brown, J. D.	10	10
Bogart, Oliver P.	244	6	Broyles, S. T.	10	11
Bodle, Hugh L.	245	14	Bridger, Thomas W.	10	12
Borglum, Gloria Anne	256	3	Brett, John	10	13
Boedeker, Anna "unsound Mind"	256	8	Brown, "heirs of" Wilson G.	12	1
Boatwright, Mary P.	256	18	Brownfield, Samuel C.	12	2
Bosch, Mary Ellen	260	1	Brown, Mary P. et al	12	3
Bodle, Cordelia	260	20	Brown, Effie May	12	4
Bosch, Benjamin	266	10	Browrink, heirs of John W.	12	5
Boedeker, Anna dec'd	279	10	Broyles, Amanda and Sarah E.	12	6
Bowman, Georgia A.	284	9	Brewer, "heirs of" John	12	7
Bosch, Binta Arlette and Marjean Larue	285	7	Briggs, Eugene and Silas W.	13	1
Bonar, Franklin E.	286	6	Brummitt, Katherine	13	2
Booth, Emma	287	19	Brand, William	13	3
Bonar, Susie	289	26	Bridges, James D.	13	4
Booze, Anna	294	26	Brooks, Wm.	13	5
Boedeker, Marcella Rose and Leo Anthony	294	29	Browfield, Clayton et-al	13	6
Boring, Frank Richard	298	10	Brush, Abner C.	13	7
Bostwick, Elmer Ellsworth	298	22	Brittian, Arthur L. and John S. E.	13	8
Bosley, Rosa Lee	299	22	Bremer, Ignatius	21	26
Boatwright, Richard Henry	299	26	Broderick, Isaac	28	16
Bottcher, Adele E.	299	29	Bradbury, Kate D.	28	17
Boedeker, Wm. F.	301	16	Broderick, Nancy E.	28	18
Bosch, Cora Effie	285	4	Brown, Warren E.	29	1
			Bruce, Charles E.	29	5
			Briggs, Pearl and Scott	29	7

Nodaway County Estate Index (con't) 1846-1956

<u>Surname</u>	<u>Box</u>	<u>File</u>	<u>Surname</u>	<u>Box</u>	<u>File</u>
Brennan, Timothy E.	29	14	Brown, Julia E.	198	17
Brummitt, Banner	29	15	Brown, Gladys A., Blanche B. and Ernest H.	212	10
Bradley, Leonard E.	29	16	Brainard, Andrea J.	212	11
Briggs, Lawrence H.	29	17	Brunk, Jacob dec'd	212	24
Bracken, Alonzo E.	29	18	Brogan, Calab dec'd	212	12
Brand, John C.	29	20	Brown, Maretta C.	212	13
Brown, "heirs of" John H.	29	21	Bright, Charles B. dec'd	212	14
Brett, Charles H.	29	22	Bram, Alvina	212	15
Brown, Kate	29	23	Brand, Mary	212	16
Brittingham, Riley	30	32	Brunk, Joseph S.	212	17
Broyles, James C.	75	5	Brown, Edward R.	212	18
Bradley, John C.	87	1	Bredenbeck, Elise	250	1
Brewnick, John W.	87	2	Brewer, Thos. A.	250	2
Brown, Samuel S.	87	3	Bremer, Ignatius	242	14
Briggs, Silas W.	87	4	Brady, Ellen	242	15
Bradley, Lucias	108	8	Bruce, Edith E. "minor"	242	16
Brady, Wm.	108	9	Brashear, Thos. A.	234	20
Brittain, Wiley J.	127	24	Brown, Nellie E.	242	13
Bredenbeck, Wm.	128	11	Bremer, Rosa	237	10
Brush, Abner C.	128	12	Brady, Kathryn	226	1
Brewer, Sarah A.	128	13	Brady, Margaret	226	2
Brown, Wm. A.	141	3	Bremer, Clemens	236	5
Brown, Lewis et-al	141	4	Brinkman, Henry	7	2
Broyles, Carl Elywn	141	5	Bradbury, William	8	9
Brown, Frank	142	5	Brooks, Mary S.	241	8
Bridges, James R.	142	6	Brooks, Hazel J.	241	9
Brown, Earl et-al	142	7	Bram, Wm. A.	253	6
Breen, John J.	251	8	Brink, John R.	244	23
Brady, Catherine and Mary	142	9	Breit, Frederick	244	26
Bramblet, Thos et-al	142	10	Brascheid, James and Stella	254	21
Broyles, Wilson	145	22	Breen, John J. dec'd	276	19
Braumiller, Joel	164	6	Bryant, Wm. G.	260	3
Bryant, James Harvey	164	7	Brunk, Catherine M.	260	17
Brown, Daniel	167	16	Brennan, John T.	260	19
Brady, Cornelius	167	17	Briggs, Eugene	263	17
Bradford, John E.	167	18	Brennan, Mary	267	3
Bridges, Mabel E.	167	19	Broscheid, Peter Wm.	267	19
Brittian, Mary C.	173	18	Brennan, Larry J.	275A	14
Brown, Mary E.	173	19	Breit, Kenneth J.	280A	1
Brand, Rachel	173	20	Brown, Wm. H.	272	9
Brown, Wilson W.	173	21	Brown, Junas F.	272	23
Brohan, James	173	22	Bremer, Alphonso	276	8
Brown, Mildred and Paul	180	27	Brogan, Clara	278	23
Breit, Mary E. et-al	184	19	Bredenlick, Amelia	284	10
Broyles, Asa	184	20	Browning, Wm. Robt.	285	28
Briggs, Wilburt F.	184	21	Bright, Vivian Nathman	283	6
Brennan, Maurice D.	184	22	Briggs, Silas Wright	287	28
Briggs, Mary, Rebecca, Beth, Ilene, Frances Lorne	198	8	Brown, Alice	290	18
Broyles, America J.	198	9	Brady, Rose A.	292	16
Brandt, Charles	198	10	Brown, Charles W.	293	27
Brandt, Martha Ellen	198	11	Brown, George M.	294	3
Brady, John C.	198	12	Bradley, Reuben Henry	295	8
Brown, Wm. T.	198	13	Brash, Marie Estella	296	14
Brand, Frank	198	14	Brown, Floyd	297	16
Brunk, George	198	15	Bracken (Braden?) Grace	300	1
Brady, Leonard J. and Loren M.	198	16	Broyles, Grace G.	300	15
			Braniger, Earl C.	302	9

This is a recent map of Atchison Township, Nodaway Co. Mo., showing location of cemeteries, taken from our publication, "Atchison Township Cemeteries".

T-66-67-N PAGE CO. 1A RICHISON W
 PAGE CO. 1A R-36-37-W-66-67-N
 RICHISON JOHNSON CEM. PAGE CO. 1A R-36-W

- SECTION 30
- 1 Paul Smith
 - 2 Donald Spoden
 - 3 Martin Follmer
 - 4 Arthur Johnson
 - 5 Lewis Johnson
 - 6 Robert Hackett, II
 - 7 Mrs. Dennis Montague, Cite 1

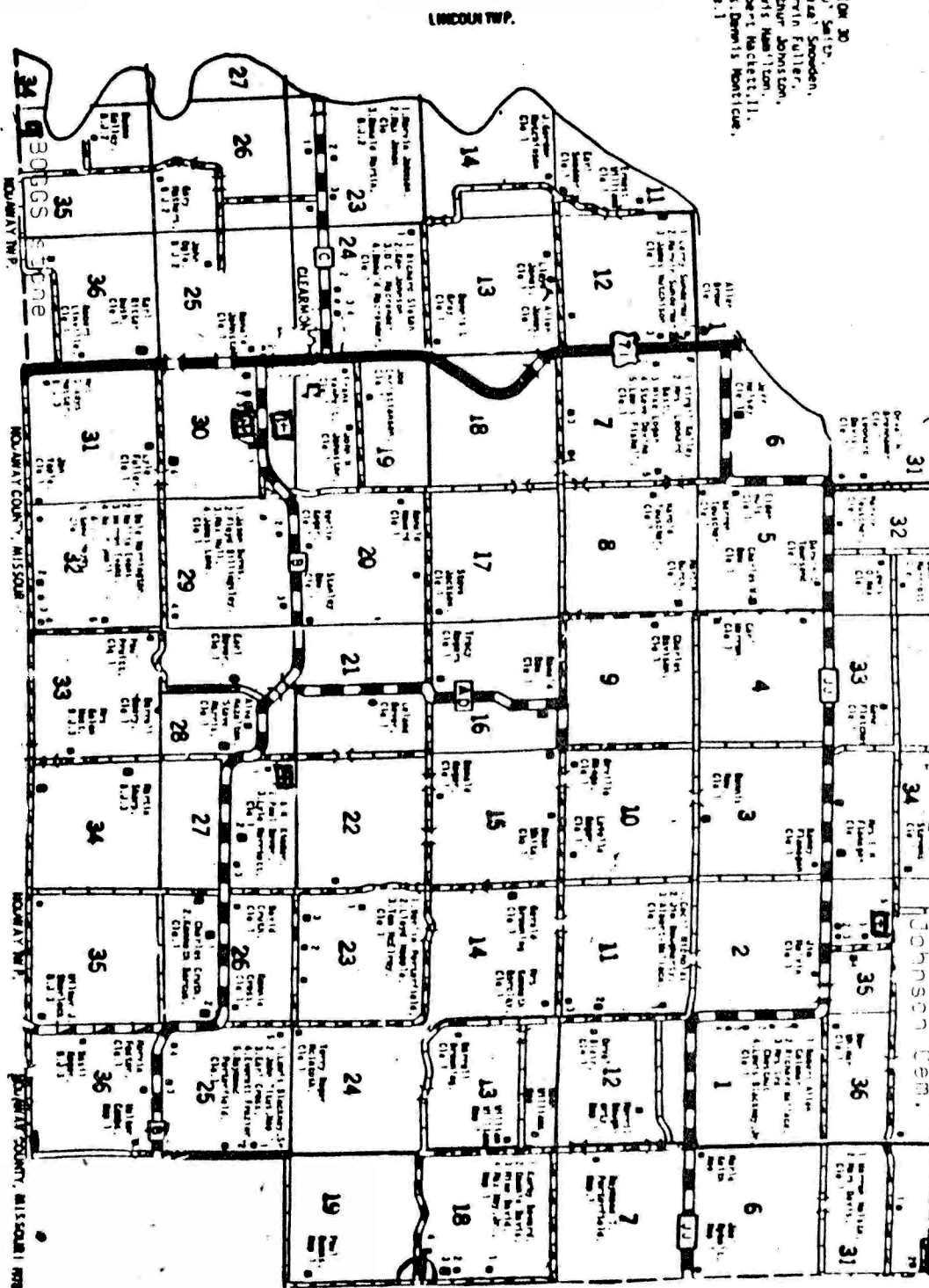

Sect. 30 Clearmont Cem.
 Sect. 27 Hazel Dell Cem.
 Sect. 35 Boggs family stone
 Sect. 35 Johnson Cem.

INDEX

Able 161	Bramblet 158	Buckland 156	Harris 161	Pulsifer 154
Alenbaugh 155	Brand 155-157-158	Bugbee 156	Haugh 155	Rafferty 151
Allen 156	Brandt 158	Bum (Burn)156	Hawk 153	Reece 155
Baker 155	Braniger 158	Bun 156	Heady (Hagey) 155	Renfro 161
Baustert 162	Brascheid 158	Burch 156	Helmich 155	Rhodes 153-155
Baysinger 156	Brash 158	Burd 156	Hiles 156	Richardson 156
Belieu 161	Brashear 158	Burdick 156	Hubbard 155	Roach 155
Bender 156	Bratcher 155	Burk 156	Huff 155	Ross 156
Bentley 153	Braumiller 158	Burke 156	Hunt 153	Schmalshay 161
Bently 162	Breckenridge 154	Burn 156	Hyman 156	Self 156
Bennett 156	Bredenbeck 158	Burnett 156	Ingels 155	Sevrs 155
Birdwell 156	Breen 158	Burns 156	Ingraham 161	Shepard 156
Black 161	Breit 157-158	Busby 151	Ingram 155	Simmons 161
Boatwright 157	Bremer 157-158	Buttler 155	Johnson 154	Smith 153-162
Bodle 157	Brennan 158	Butts 156	Jones 151-152	Spier 153
Boedeker 157	Brett 157-158	Byers 156	Kelly 156	Spoonmore 155
Bogart 157	Brewer 157-158	Ca- li (Carlis or	Kilgore 162	Stingley 153
Bohanan 156	Brewnick 158	Cavlis) 155	Koenig 155	Stonebreaker 156
Bolich 157	Bridger 157	Chadwick 162	Lax/Lacks 161	Stundon 153
Bolt 155	Bridges 155-157-158	Chapman 155	Lee 155	Tibbetts 162
Bomar 157	Bridgewater 155	Charter 162	Lewis 154	Trapp 156
Bonar 157	Briggs 155-157-158	Christie 154	Linebaugh 156	Trullinger 162
Bond 156-157	Bright 155-157-158	Clemens 156	Linville 156	Turnspeed 155
Booher 157	Brink 158	Coleman 156	Lucus 155	Walker 161
Bookman 157	Brinkman 158	Collins 155	Mann 156	Walters 155
Booth 156-157	Brittain 155-157-158	Comer 151	Markwell 162	Weatherman 155
Booze 157	Brittenhan 155	Cook 156	Massie 154	Whipp 161
Boque 157	Brittian 157-158-162	Conway 156	Mathes 155	Wolfer 161
Borger 157	Brittingham 158	Cox 156	McCarthy 152	Wright 156
Borglum 157	Britton 155	Crandall 155	McClurg 151	Young 155
Boring 157	Broadric 155	Creps 156	McCrey (McCray)	
Borush 157	Broadrick 155	Cullison 155	155	
Bosch 157	Brockman 155	Davis 156	Millen (Miller)	
Bosley 157	Broderick 157	Dawson 153	155	
Bostick 157	Brogan 157-158	Degase 151	Miller 156	
Bostwick 157	Brohan 158	Denning 155	Moore 155-156	
Bottcher 157	Brokard 155	Dew 151-154	More 156	
Bowen 157	Brooks 155-157-158-	Dillon 156	Morehouse 155	
Bowers 157	161	Donica 155	Morgan 156	
Bowlin 157	Browfield 157	Eitel 151	Morris 155	
Bowman 155-157	Brown 151-155-156-	Everman 151	Neal (Neil)154	
Boyd 155	157-158	Flaherty 155	Needels 156	
Boyl 155	Brownfield 157	Foresythe 155	Nelson 162	
Boyle 157	Browning 158	Fox 161	Owens 151	
Bracken 157-158	Browrink 157	Fryar 151	Parker 162	
Bracher 155	Broyles 156-157-	Gayler 151	Parks 155	
Bracker 155	158	Given 155	Patton 156	
Bradbury 157-158	Bruce 157-158	Gooden 153	Perdew 155	
Bradford 155-158	Brummett 156	Graves 155	Peters 156	
Bradley 155-157-158	Brummitt 157-158	Green 155	Peterson 161	
Bradly 155	Brunk 158	Grove 156	Pfeiffer 162	
Brady 157-158	Brush 157-158	Hakankratt 155	Poe 161	
Brainard 158	Bryan 156	Hardesty 162	Potter 154	
Bram 158	Bryant 158	Hardisty 162	Poynter 151	
Bramble 155	Buckingham 156	Harris 161	Pruitt 151	

QUERY RULES: Members are allowed to submit free queries, not to exceed 35 words, excluding your name and address. We are now accepting queries relating to adjoining counties, rather than exclusively Nodaway County as we have done in the past. Non members must pay \$1.00 per query. TYPE OR PRINT CLEARLY IN INK with no abbreviations. Capitalize or underline surnames. Each query must be submitted on a 3x5 card.

Queries will be printed as space permits. The information will be read at Society meetings, so if anyone present has knowledge of the information desired, they may answer. Submit queries to Smoke Signals, Nodaway County Genealogical Society, Box 214, Maryville, Missouri 64468.

- SIMMONS Interested in hearing from relative of William Jackson SIMMONS, buried at King City or Stanberry, Mo., or Rowland SIMMONS, buried at Hopkins, Mo., sons of James SIMMONS of Warren Co., Ill. Wanting to revive our SIMMONS family history.
Lois SCHMALSHOY; RR2 Box 93; Avon, Illinois 61415
- BELIEU Need info on Micajah B. BELIEU b. 1785, NC; marr. 1. Rebecca RENFRO, 2. Polly BROOKS; lived in NW Missouri from early 1830's; was in Nodaway Co. in 1850. Where/ when died?
Will exchange any BELIEU information.
Carole M. PETERSON; 1062 W. Nebo St.; Roseburg, OR 97470
- FOX Trying to obtain information of Joseph FOX. He was born in Hamilton, PA in 1836 and died in Conception, MO 15 March 1908. I am trying to find out his parents names and names of sisters and brothers.
Louis WOLFER; 1300 E. 18th St.; McMinnville, OR 97128
- WHIPP Desire info about Benjamin Franklin WHIPP; lived in Barnard 1865-1890; member of Christian Church. Had a General Store in Graham.
Mrs. James A. WALKER; 4531 Ashton Dr.; Sacramento, CA 95825
- HARRIS Desire info of Wooten HARRIS b. 1801/03 S.D.; d. 1860/62
LAX/LACKS Nodaway Co. Sarah LAX/LACKS b. 1815/20 TN; d. 1895 Holt Co.
POE Sarah Jane POE b. 23 Dec. 1841 KY/MO; d. 9 Dec. 1911 Kansas City MO; husband James S. HARRIS
Mrs. Mary Harris BLACK; R#3; Atchison, KS 66002
- HARRIS Need parents of Andrew J. HARRIS and Rebecca Jane ABLE,
ABLE parents of Gertrude B. b. Nov. 1878. Lived Maryville, MO.
Mrs Joyce INGRAHAM; 640 Cornelia Court; Mtn. View, CA 94040

Membership is currently \$5.00 per year, Sept-Sept, includes quarterly newsletter. Free queries with membership. Please return this form with check or money order to:

Smoke Signals
Nodaway County Genealogical Society
Box 214
Maryville, Missouri 64468

Renewal ()
New ()

Name _____

Address _____

City _____ State _____ Zip _____

PFEIFFER Interested in contacting and exchanging info with any descendant of Hubert PFEIFFER who died Feb. 22, 1892, buried at Workman Chapel Cemetery. My husband is a descendant of Johann PFEIFFER, brother of Hubert. Mary E. PFEIFFER; 7225 N.E. 116th; Kirkland, WA 98034

NELSON Need death and burial info on Joseph Riter NELSON and wf.
 CHADWICK Lydia A. CHADWICK, in Nodaway Co. 1867 to after 1882. Same
 SMITH on Julia A. SMITH wf. of E.C. TIBBETTS. Who were parents?
 TIBBETTS Nancy L. PARKER; 1607 Wilshire Ave.; Norman, OK 73069

HARDESTY Would like to correspond with anyone having info on family
 HARDISTY of Christopher Ray HARDESTY or HARDISTY, resided in Nodaway Co. 1870 thru 1900.
 Jeannine BAUSTERT; P.O. Box 608; Sperry, OK 74073

CHARTER My Great Grandfather Nathan Jackson CHARTER and wife Sarah
 HARDESTY R. HARDESTY, I believe, are buried in Nodaway Co. Would like info on location of cemetery. Sarah d. 1875 and Nathan d. 1894.
 Jeannine BAUSTERT; P.O.Box 608; Sperry, OK 74073

BRITTIAN Need info for William P. and Susan J. BRITTIAN BENTLY,
 BENTLY marr. Nodaway Co. 1861. Daughter Malory Ellen marr. T.M.
 TRULLINGER TRULLINGER. Birth place James MARKWELL b. 1800's ?
 MARKWELL Ozelle DRAPER KILGORE; Star Route; Benjamin, TX 79105

Smoke Signals
 Nodaway County Genealogical Society
 Box 214
 Maryville, Missouri 64468

