

OUTLINE MAP OF
RANDOLPH COUNTY
MISSOURI

Scale $\frac{1}{2}$ of 1 inch to 1 mile

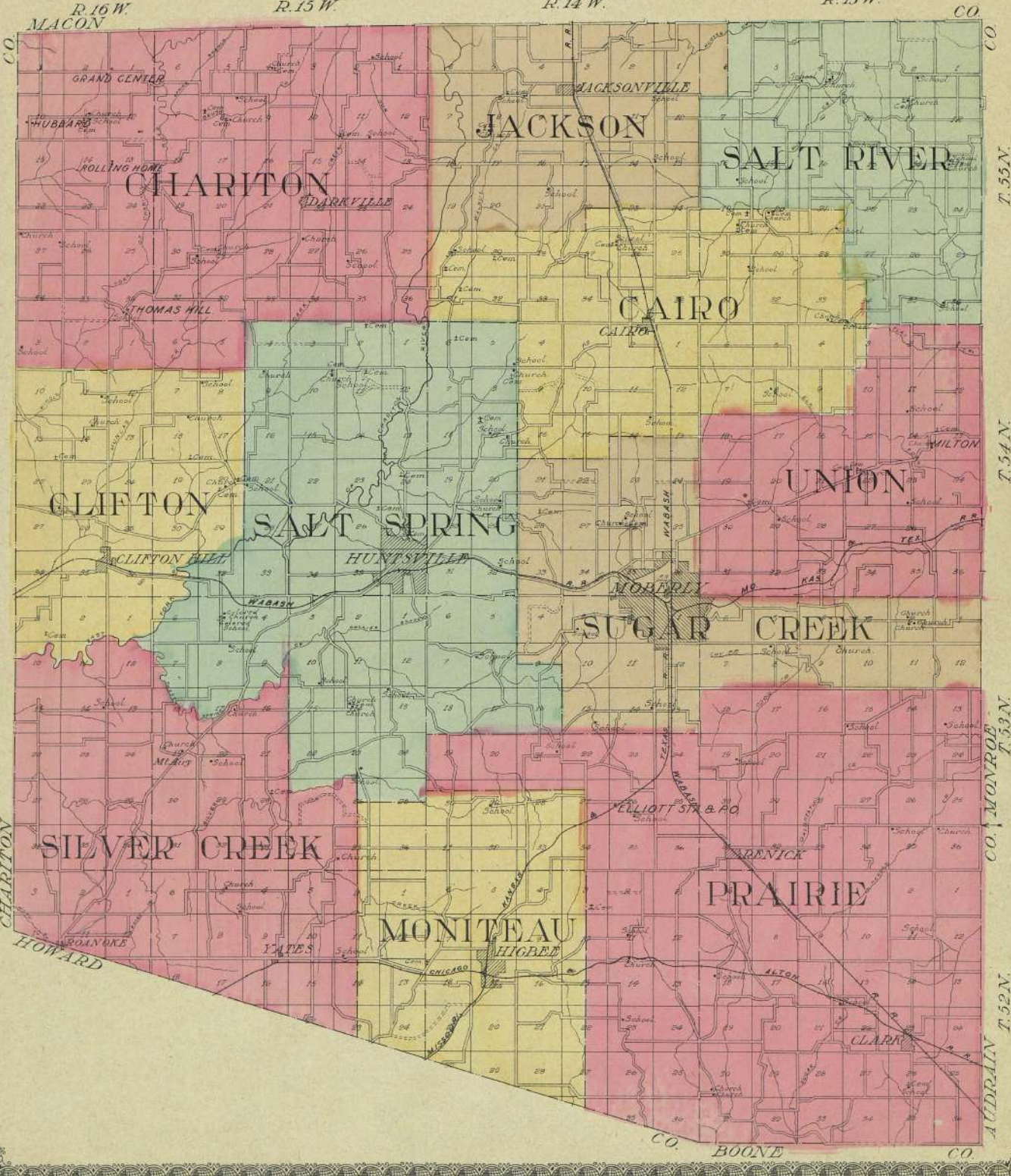

HUNTSVILLE

COUNTY SEAT OF RANDOLPH COUNTY, MO.
(PLATTED AS HUNTSVILLE & S. HUNTSVILLE)
TWP. 54 N., R. 15 W.

Scale: 400 ft. = 1 inch.

Note: Ward boundaries and corporation line shown with heavy dotted lines.

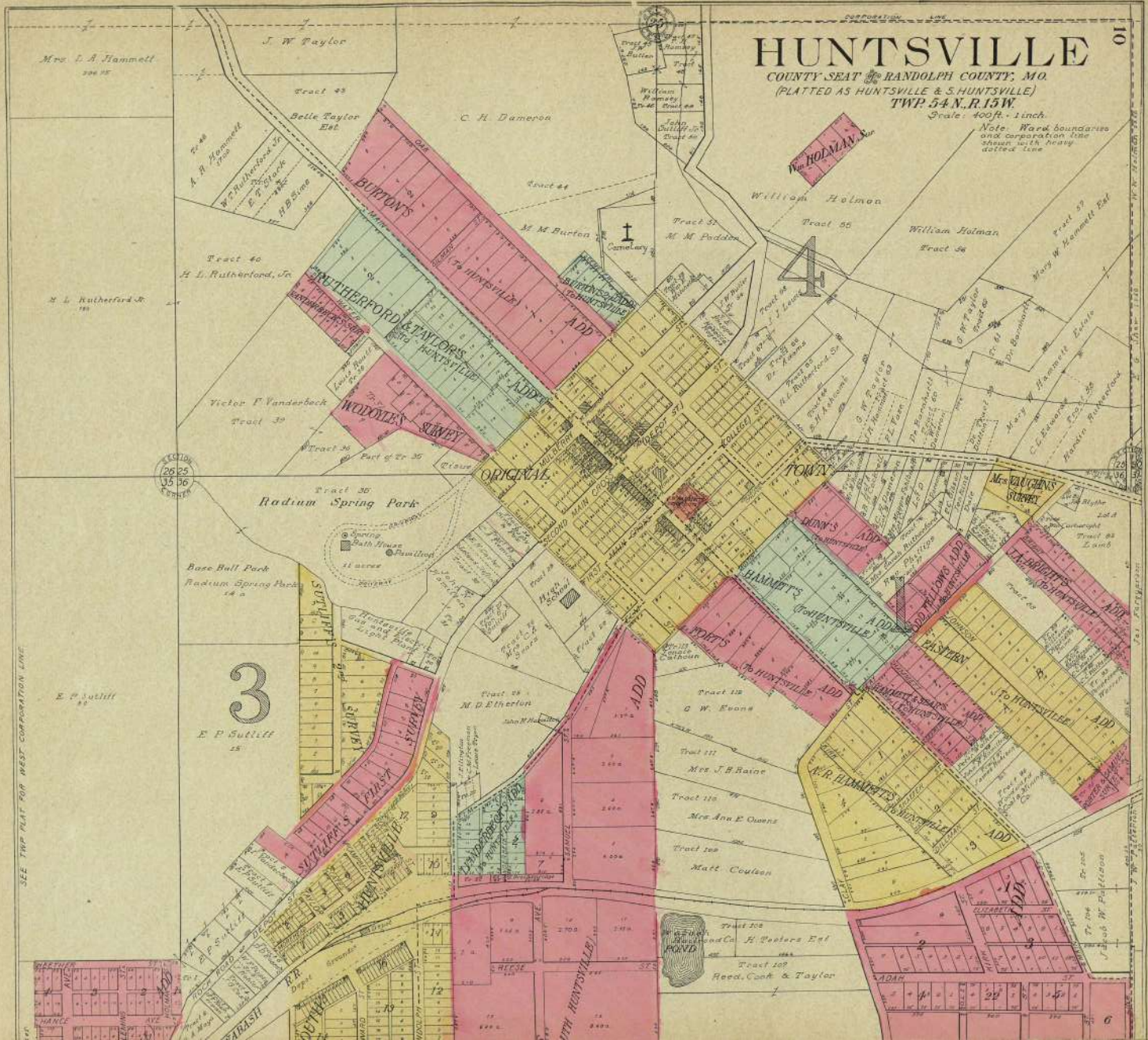

SEE TWP PLAT FOR WEST CORPORATION LINE.

3
E. P. Sulliff
15

W. HODMAN

4

51

6

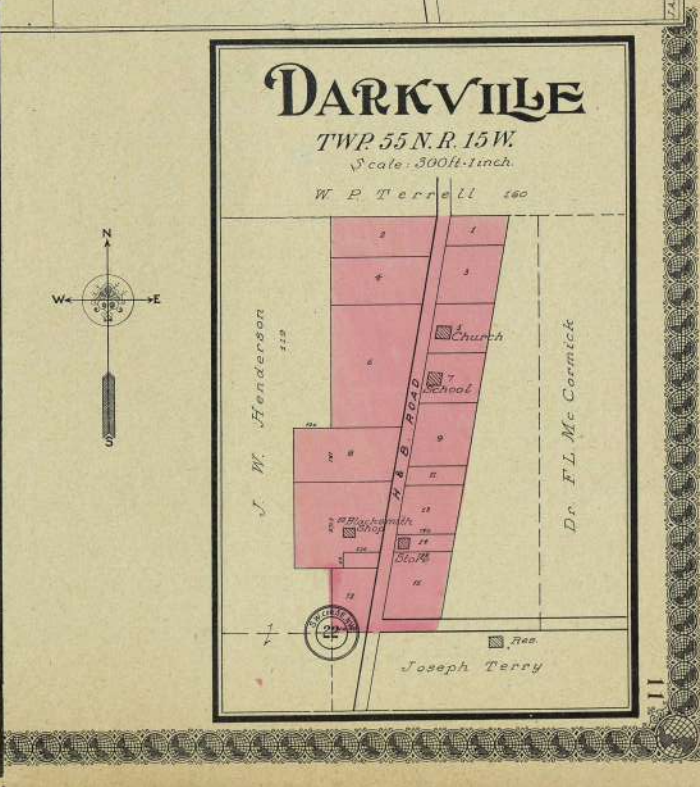
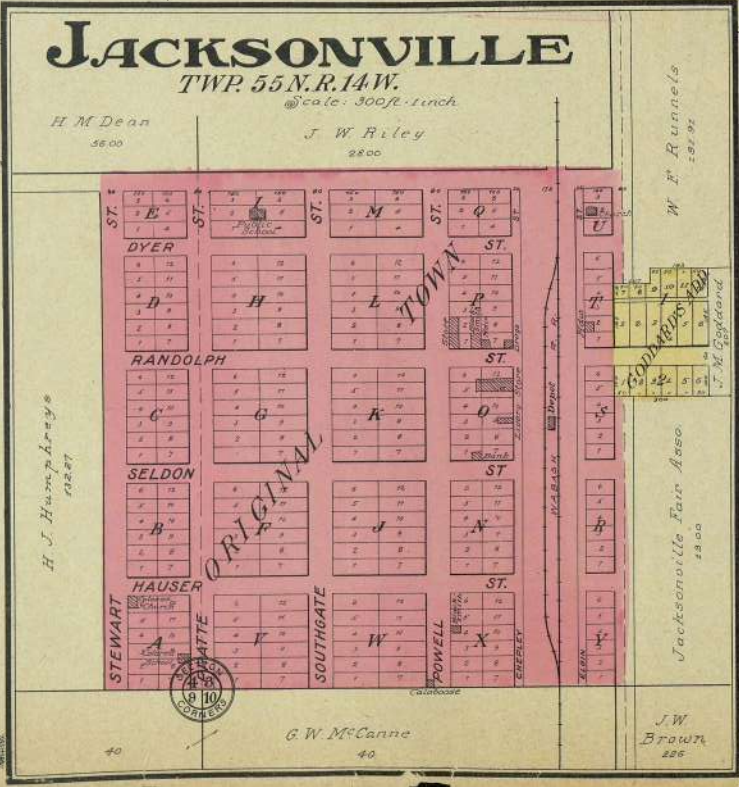
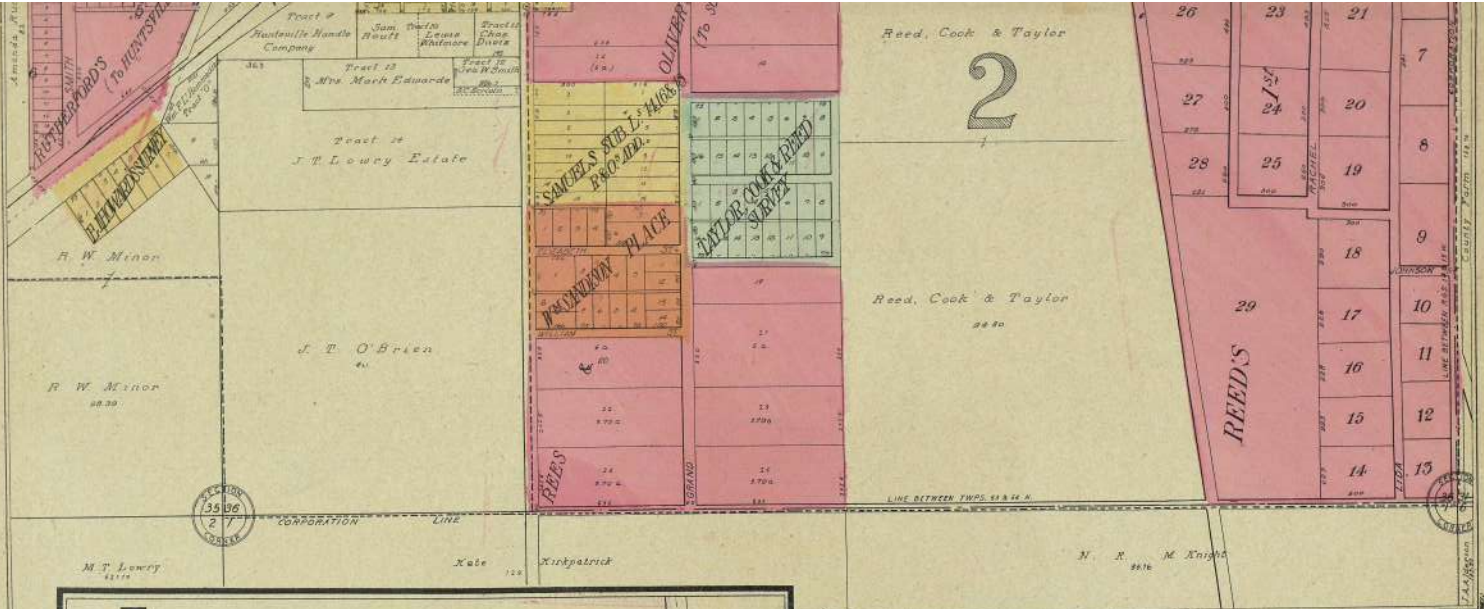

14

J. W. Fox 160

Appel Est. 20

20 25
35 36
100 100

Warren Esry

R. J. Tydings

S. M. Buchanan

5800

4800

108

Tract
Geo St
1500

Sugar Creek

Warren Esry

A. M. Buchanan

S. M. Buchanan

R. J. T.

300

Tract 4
Tract 10
Spartan & Baskett & Baskett
4.24
4.24

J. & A. Dossey

27

J. Williams

5

Jesse Polston

R. W. Hinton

1881

075

Tract

3 a

2.75 a

Tract

5 a



Part of Bk 4

BUCHANAN

2nd ADD

BUCHANAN

J. C. Foster

Wm Blackford

G. J. Ginther

36

Laura Williams

472

Wabash Railroad

Machine and

Winslow Buck

40

CLEVELAND ST

WABASH ST

WABASH ST

WABASH ST

WABASH ST

WABASH ST

WABASH ST

WABASH ST

WABASH ST

WABASH ST

WABASH ST

WABASH ST

WABASH ST

WABASH ST

WABASH ST

WABASH ST

WABASH ST

WABASH ST

WABASH ST

WABASH ST

WABASH ST

WABASH ST

WABASH ST

WABASH ST

WABASH ST

WABASH ST

WABASH ST

WABASH ST

WABASH ST

Est of J. F. Smith

J. Meats

City of Moberly

SECTION
3435
32

City of Moberly

Forest Park

Reservoir

FOR SOUTH PART OF MO

A. Pyle 40 H. Frank Holman

NORTH PART OF MOBERLY MISSOURI

TWP. 53N., RGS. 13&14W. TWP. 54N. R. 14W.
Scale: 400 ft. = 1 inch.

Note: Ward and Corporation Boundaries are shown by a heavy dotted line.
City limits were determined by ordinance excluding therefrom all grounds of Wabash R.R.Co., between west branch main track of its food and north branch main line track being North of Coates St.

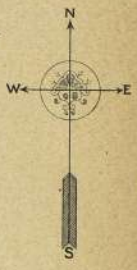

Block I. L. W. Winter

1	2	3	4	5	6	7	8	9	10	11	12	13	14	15	16	17	18	19	20	21	22	23	24	25	26	27	28	29	30	31	32	33	34	35	36	37	38	39	40
1	2	3	4	5	6	7	8	9	10	11	12	13	14	15	16	17	18	19	20	21	22	23	24	25	26	27	28	29	30	31	32	33	34	35	36	37	38	39	40

J. and J. Furnish 1873

J. S. Phipps 1900

G. J. Gunther 1800

A. N. Meals 48.00

Lambert 3.95
Tract 6 A. Douglas # 5.15
Tract 7 J. O. Wheeler 4.14
Tract 8 John Schreinemann # 8.00
Tract 9
Tract 12 A. Douglas # 3.57

Omar O'Neil 3

C. C. Halburton

BAUSTIN

1	2	3	4	5	6	7	8	9	10	11	12	13	14	15	16	17	18	19	20	21	22	23	24	25	26	27	28	29	30	31	32	33	34	35	36	37	38	39	40
1	2	3	4	5	6	7	8	9	10	11	12	13	14	15	16	17	18	19	20	21	22	23	24	25	26	27	28	29	30	31	32	33	34	35	36	37	38	39	40

CHANDLER'S ADD

Jas P Sinnock Tract 118 16.66 a.

A. N. Meals 40

J. Q. Orr Tract 110 5 a.

Tract 117 W. B. Cottingham 12.00

Geo. E. Sheard 6 a.

A. L. Scott Ed Miles 22.00

WASHINGTON AVE

1	2	3	4	5	6	7	8	9	10	11	12	13	14	15	16	17	18	19	20	21	22	23	24	25	26	27	28	29	30	31	32	33	34	35	36	37	38	39	40
1	2	3	4	5	6	7	8	9	10	11	12	13	14	15	16	17	18	19	20	21	22	23	24	25	26	27	28	29	30	31	32	33	34	35	36	37	38	39	40

MOREHEAD

1	2	3	4	5	6	7	8	9	10	11	12	13	14	15	16	17	18	19	20	21	22	23	24	25	26	27	28	29	30	31	32	33	34	35	36	37	38	39	40
1	2	3	4	5	6	7	8	9	10	11	12	13	14	15	16	17	18	19	20	21	22	23	24	25	26	27	28	29	30	31	32	33	34	35	36	37	38	39	40

J. E. & J. M. Harrison 600

NEWTON'S SUB

7 7.051 a. 8 3.75 a. 9 ADD

Line between Fungus 13 & 14 West

Arthur Barrett 8 A. W. Figgott 13.50

Car Shops Grounds 218.00

WABASH R.R.

FRANKLIN

1	2	3	4	5	6	7	8	9	10	11	12	13	14	15	16	17	18	19	20	21	22	23	24	25	26	27	28	29	30	31	32	33	34	35	36	37	38	39	40
1	2	3	4	5	6	7	8	9	10	11	12	13	14	15	16	17	18	19	20	21	22	23	24	25	26	27	28	29	30	31	32	33	34	35	36	37	38	39	40

10 17 20 21

OWBYS

11 12 13 14 15 16 17 18 19 20 21 22 23 24 25 26 27 28 29 30 31 32 33 34 35 36 37 38 39 40

C. H. Mullen 5a

T. H. Kroner 43.00

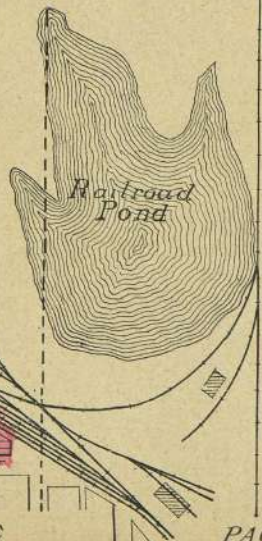

MADISON

1	2	3	4	5	6	7	8	9	10	11	12	13	14	15	16	17	18	19	20	21	22	23	24	25	26	27	28	29	30	31	32	33	34	35	36	37	38	39	40
1	2	3	4	5	6	7	8	9	10	11	12	13	14	15	16	17	18	19	20	21	22	23	24	25	26	27	28	29	30	31	32	33	34	35	36	37	38	39	40

11 12 13 14 15 16 17 18 19 20 21 22 23 24 25 26 27 28 29 30 31 32 33 34 35 36 37 38 39 40

OWBYS

12 13 14 15 16 17 18 19 20 21 22 23 24 25 26 27 28 29 30 31 32 33 34 35 36 37 38 39 40

J. L. Grimes 6

J. L. Grimes 6



FOR NORTH PART OF MOBERLY SEE PAGES 14 & 15

RESERVOIR

City of Moberly
FOREST PARK
200-00
400-00

City of Moberly
CORPORATION LINE

Joseph Lang
15

A. B. Hochberger
10

W. W. Babcock
40

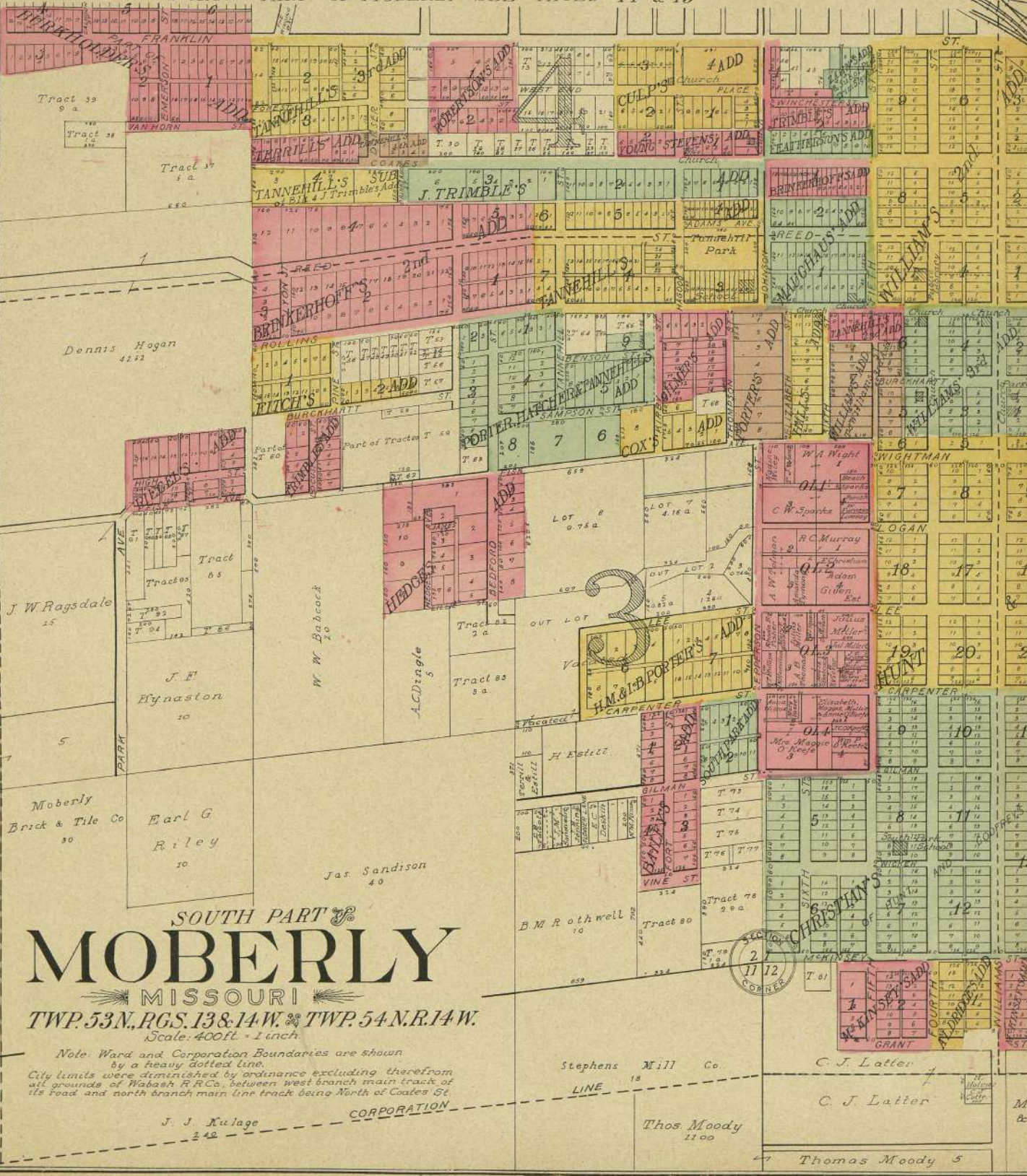

SOUTH PART OF
MOBERLY
MISSOURI

TWP. 53N., RGS. 13 & 14W. & TWP. 54N. R. 14W.
Scale: 400 Ft. = 1 inch.

Note: Ward and Corporation Boundaries are shown by a heavy dotted line. City limits were diminished by ordinance excluding therefrom all grounds of Wabash R.R. Co. between west branch main track of its road and north branch main line track being North of Coates St.

Stephens Mill Co.
C. J. Latter
C. J. Latter
Thos. Moody
1100
Thomas Moody 5



BASH R.R. POND

FOR NORTH PART OF MOBERLY SEE PAGES 14 & 15

14 & 15

19

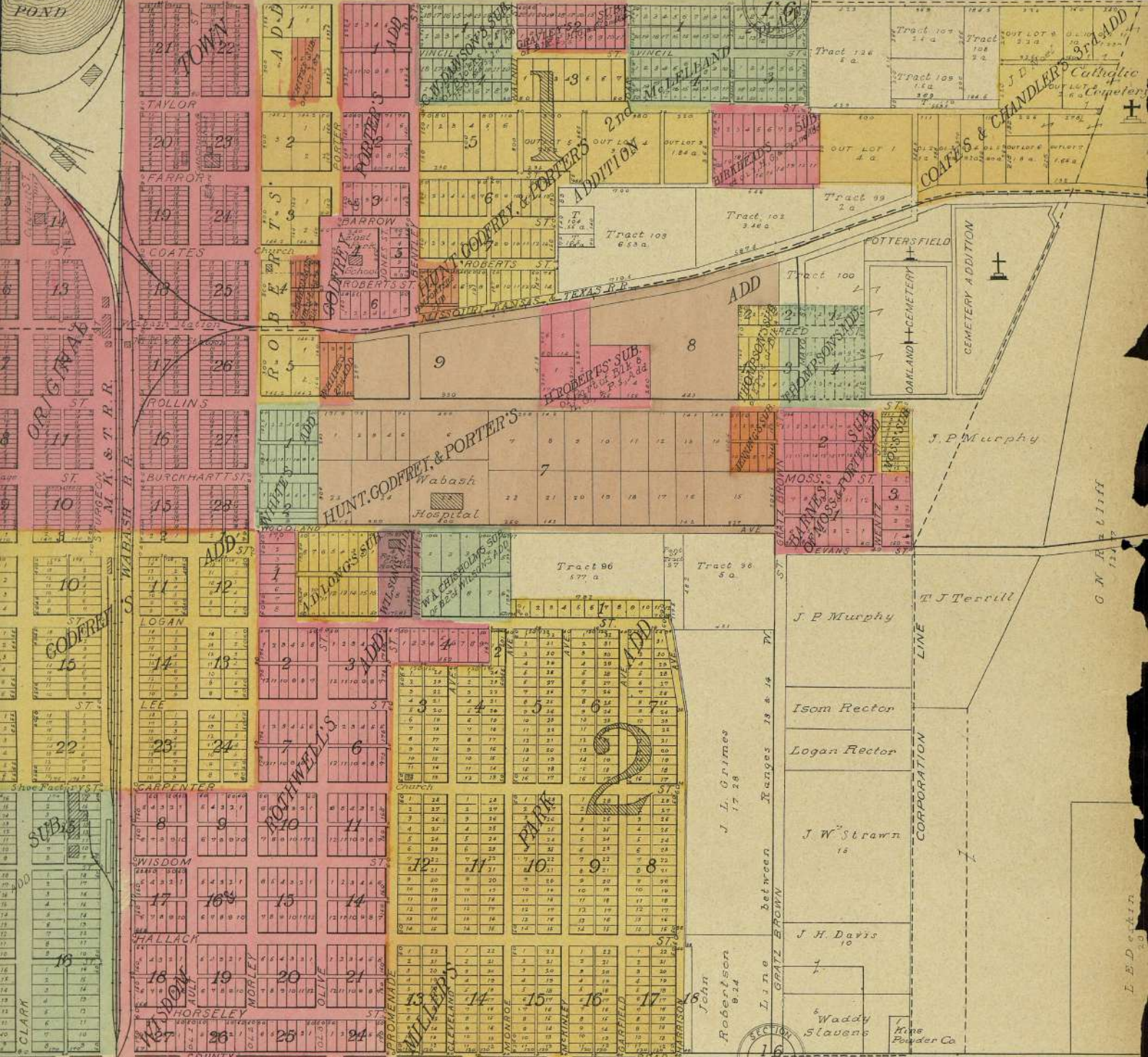

Moberly Brick Tile Co 1700
 John Lynch et al
 J H Jackson 1128
 J. H. Kroner
 A. H. Thieman
 H. Welheim 685
 W. Haag 685
 John Haag 5
 Q. C. Roberts Est 6085
 Q C Roberts Estate
 108
 J. T. ...
 I. E. D. ...



MAP OF

PART of TOWNSHIP 52 N., RANGE 14 W.

 of the 5th P. M.

Scale 2 inches to 1 mile

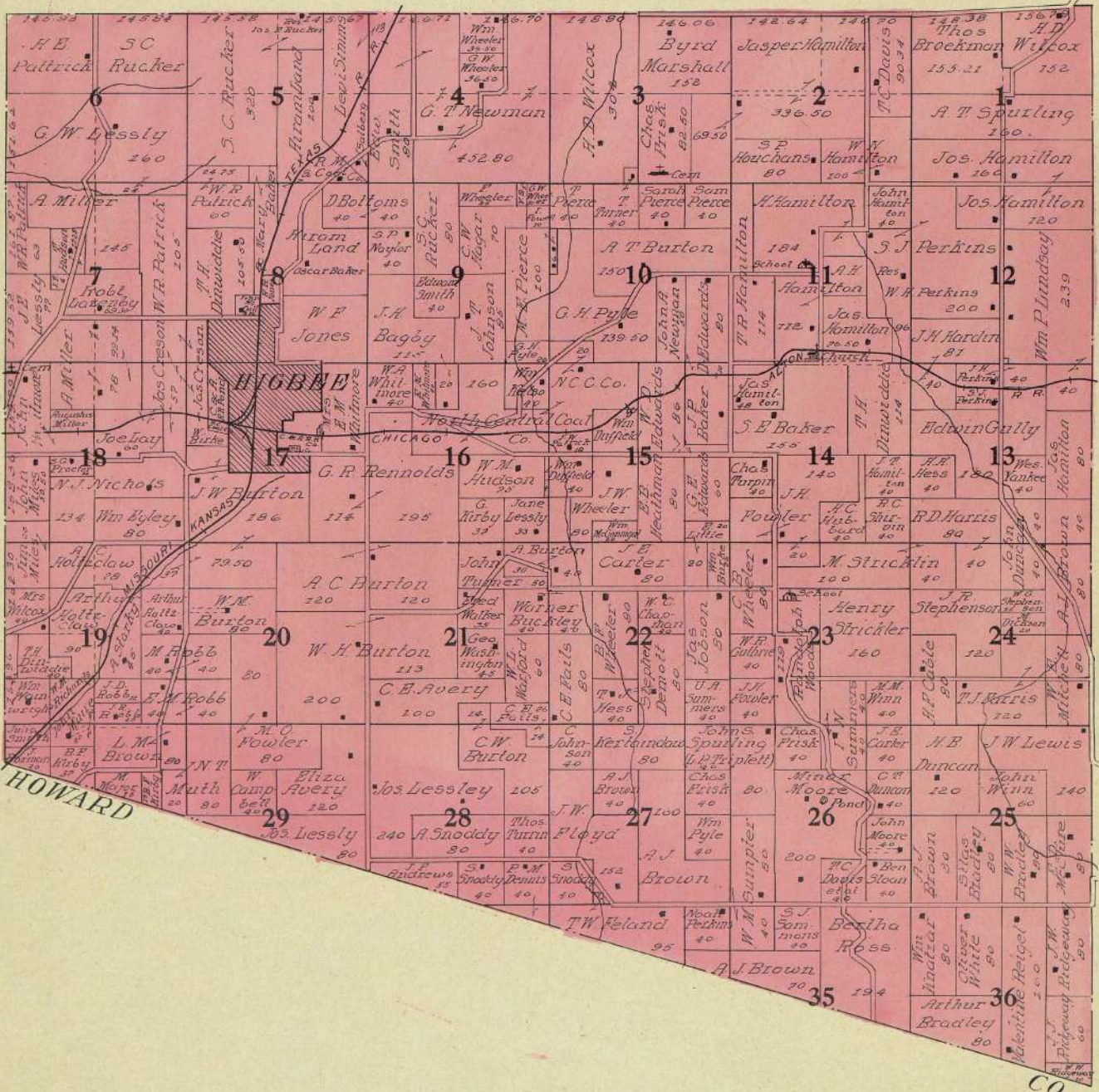

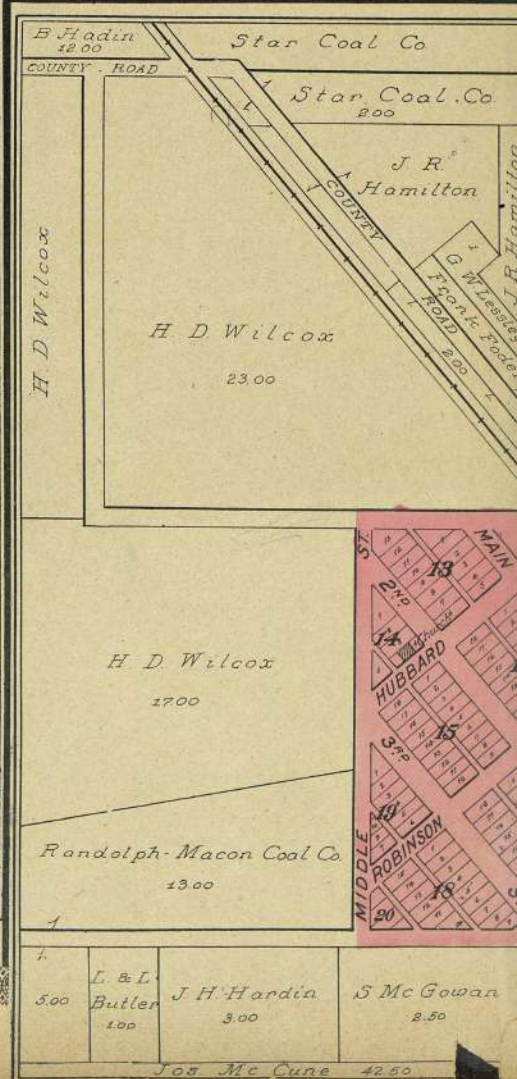
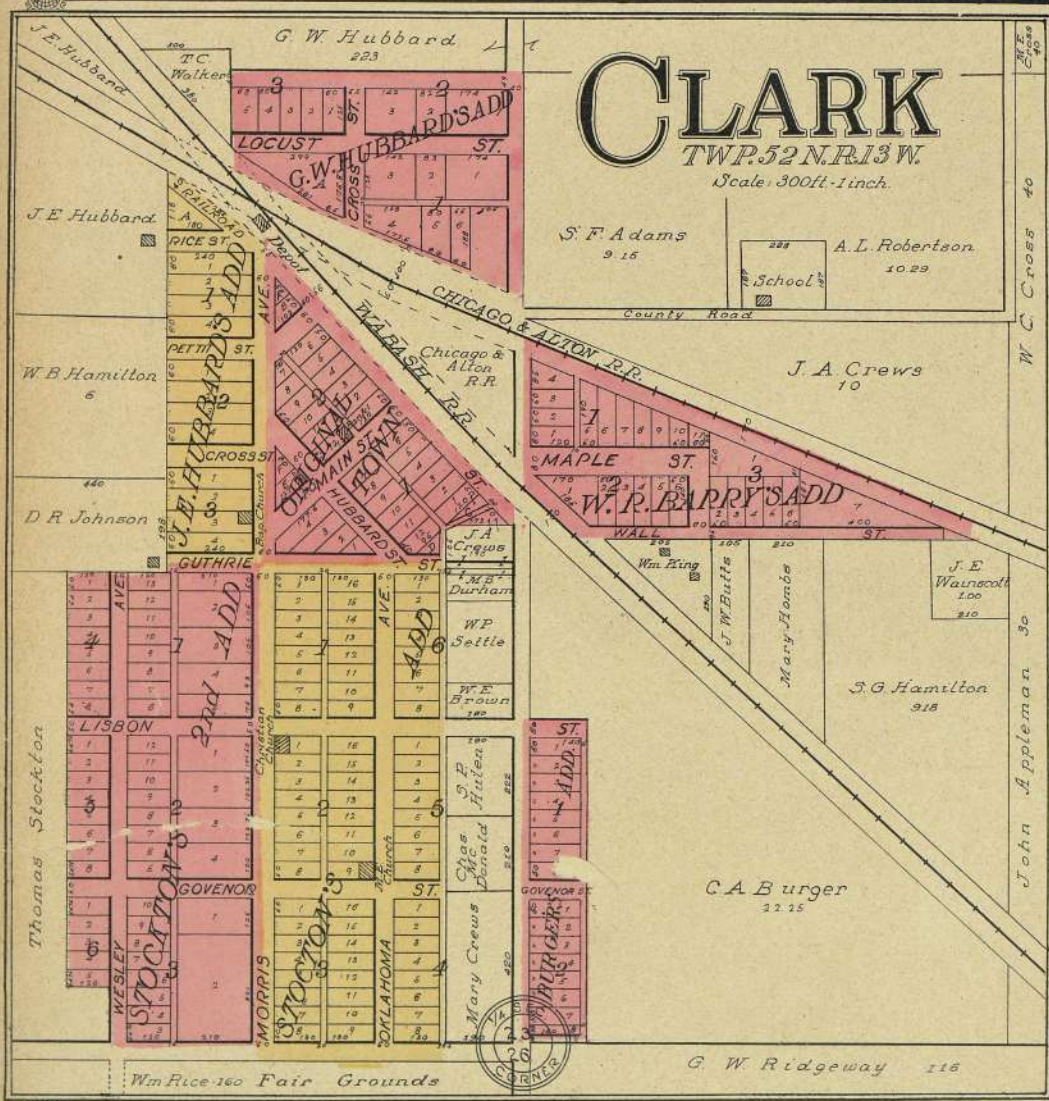
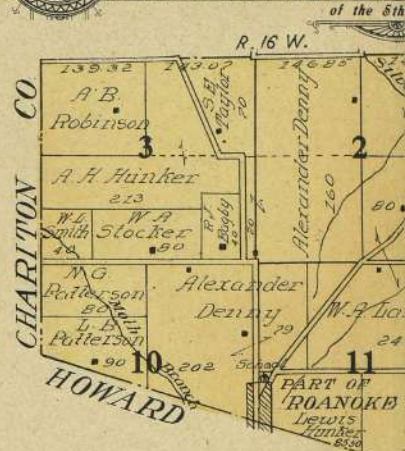
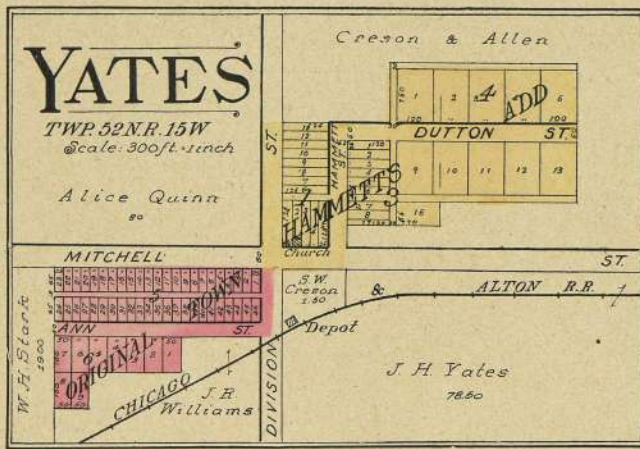

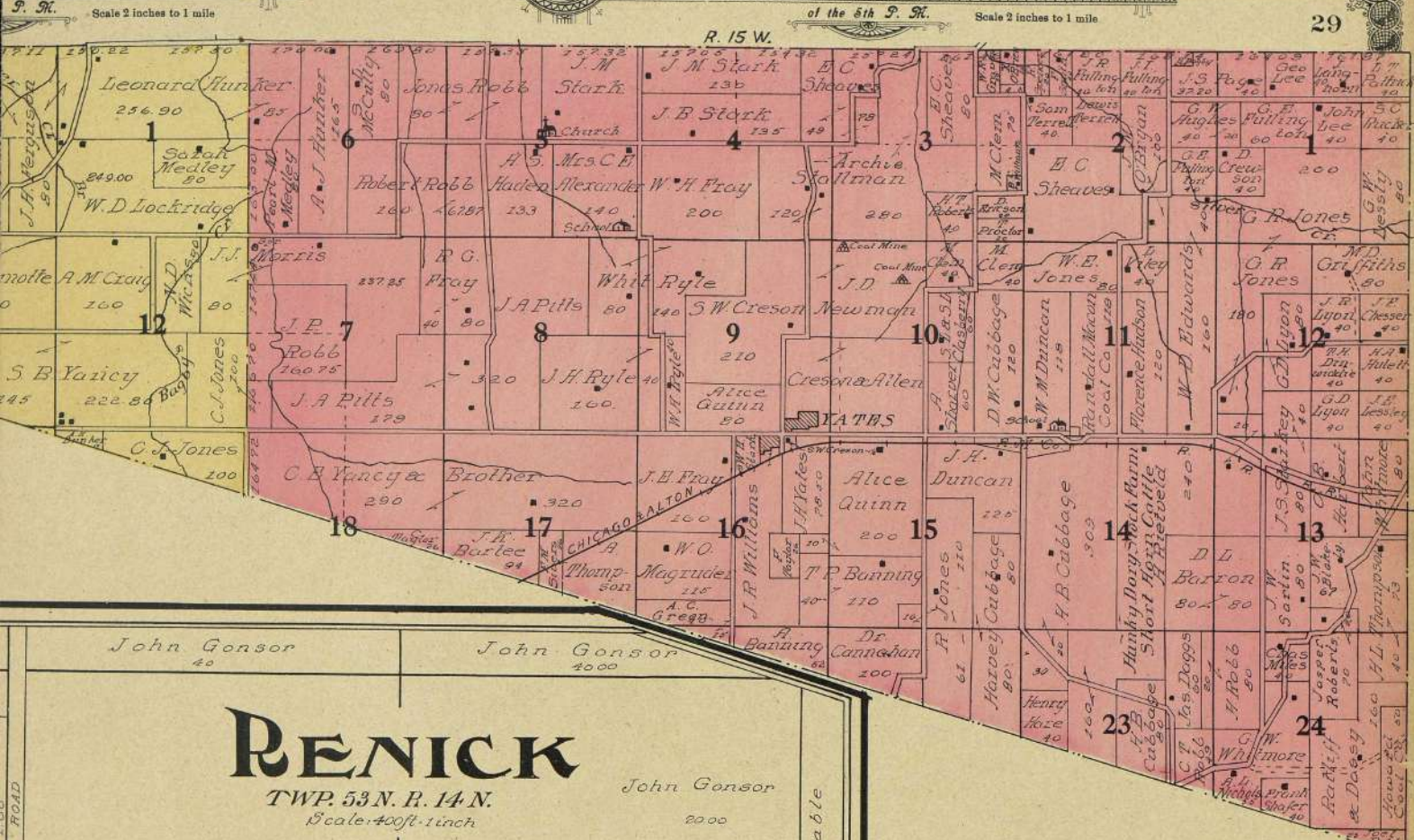

RENICK

TWP. 53 N. R. 14 N.
Scale: 400ft = 1 inch

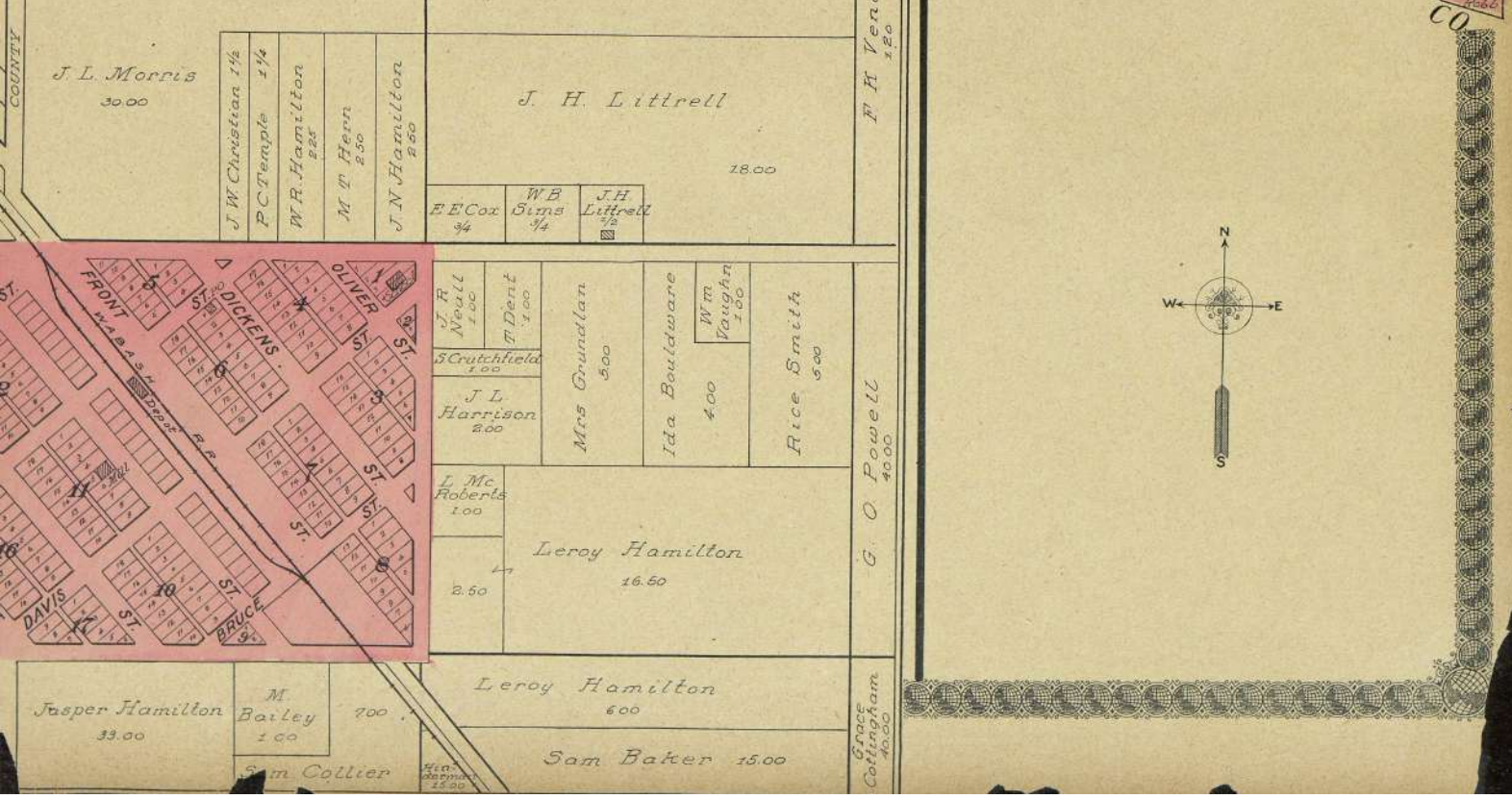

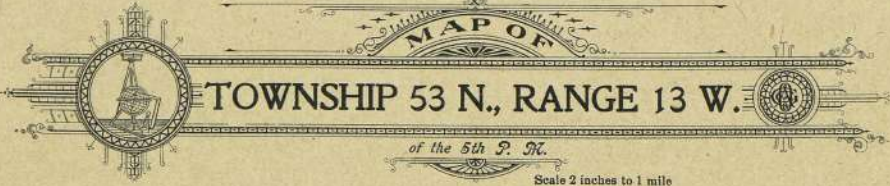

MAP OF

TOWNSHIP 53 N., RANGE 13 W.

 of the 5th P. M.

Scale 2 inches to 1 mile

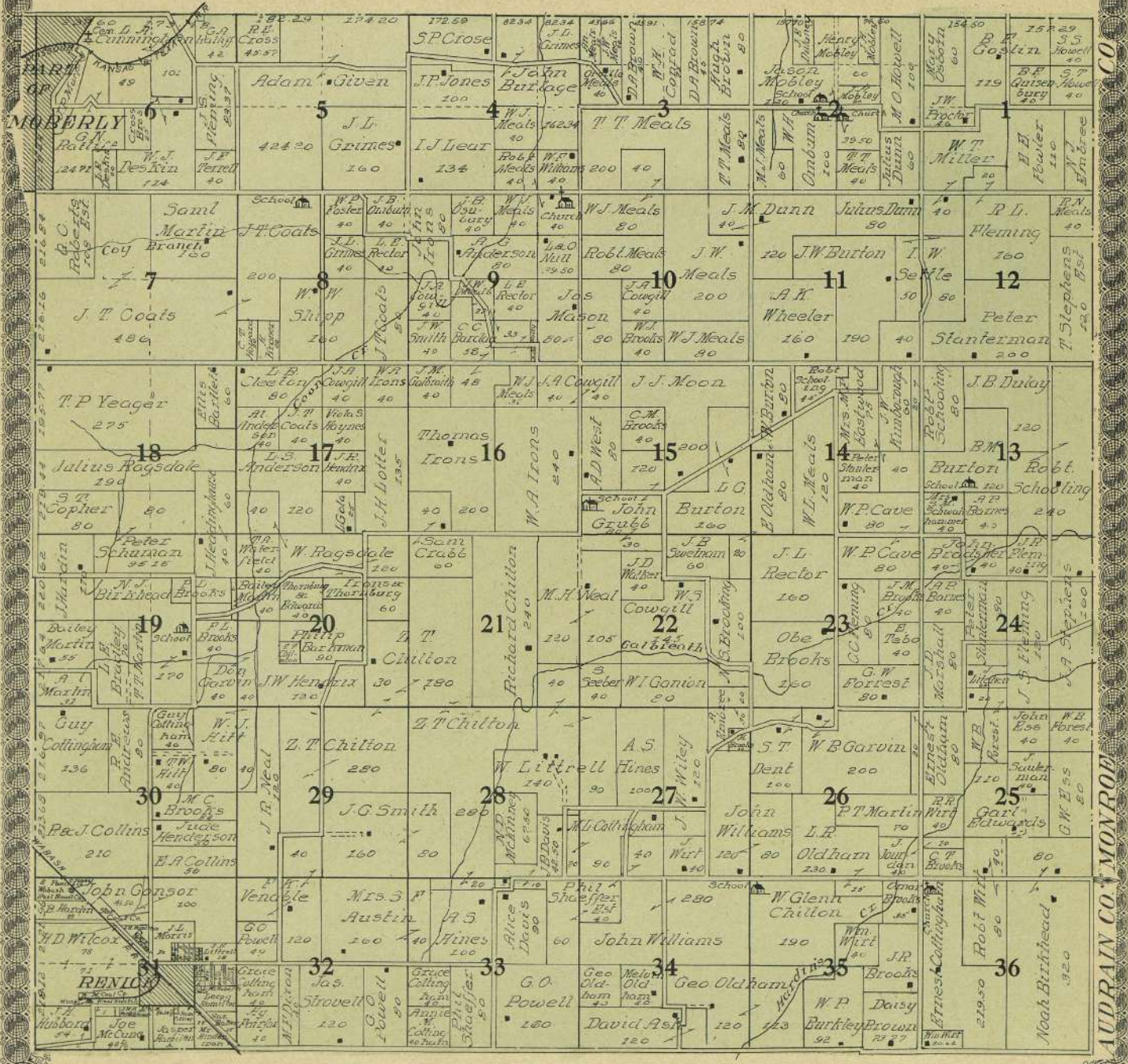

AUDRAIN CO. MONROE

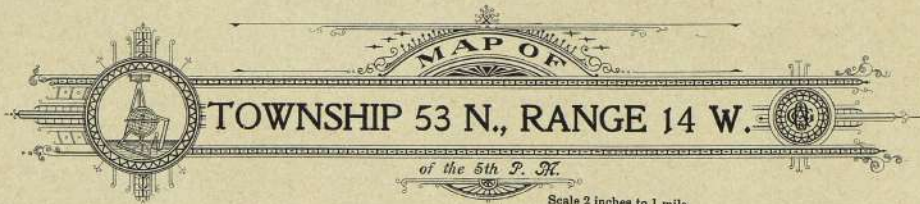

MAP OF

TOWNSHIP 53 N., RANGE 14 W.

 of the 5th P. M.

Scale 2 inches to 1 mile

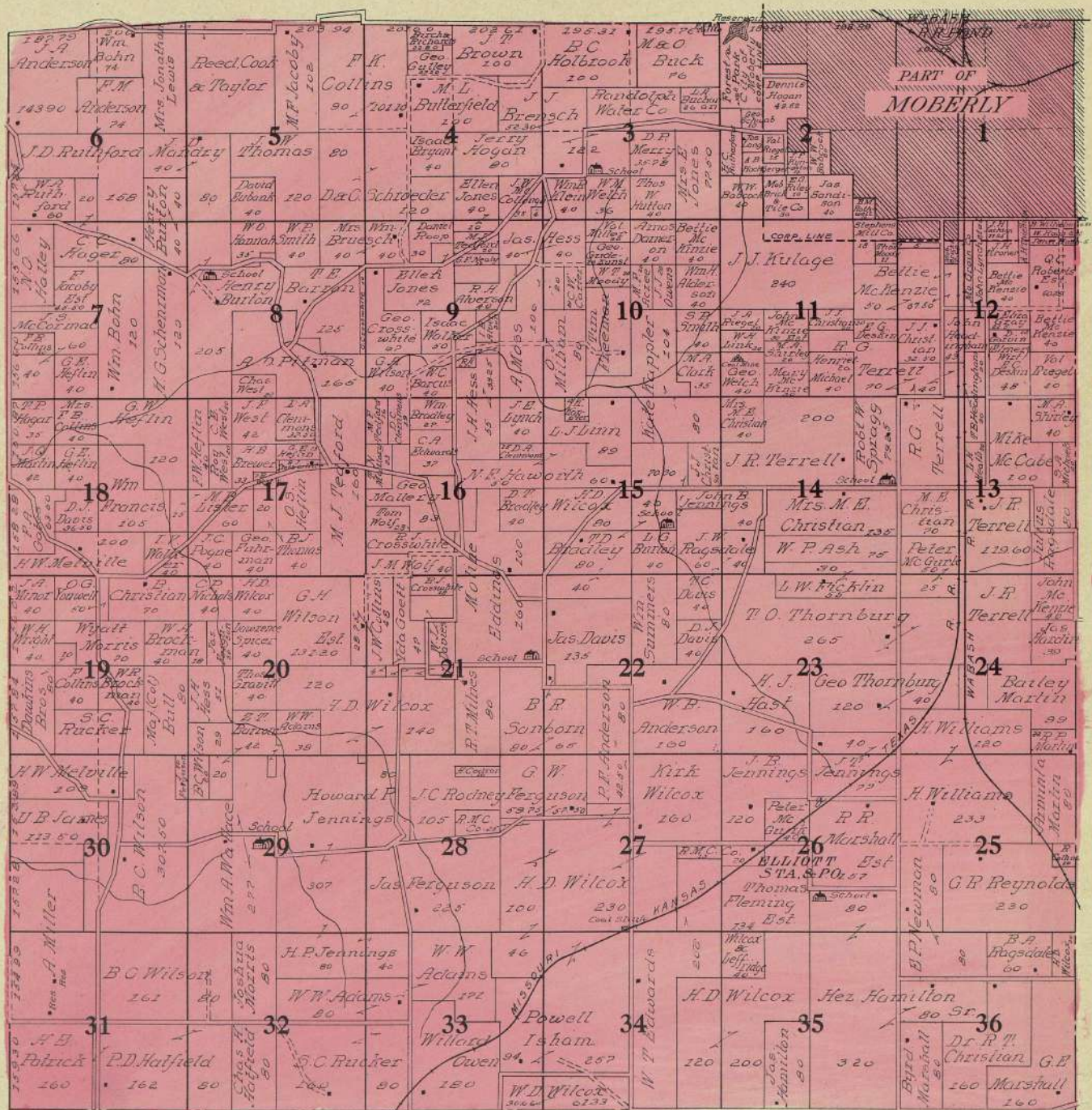



MAP OF
TOWNSHIP 53 N., RANGE 15 W.
of the 5th P. M.
 Scale 2 inches to 1 mile

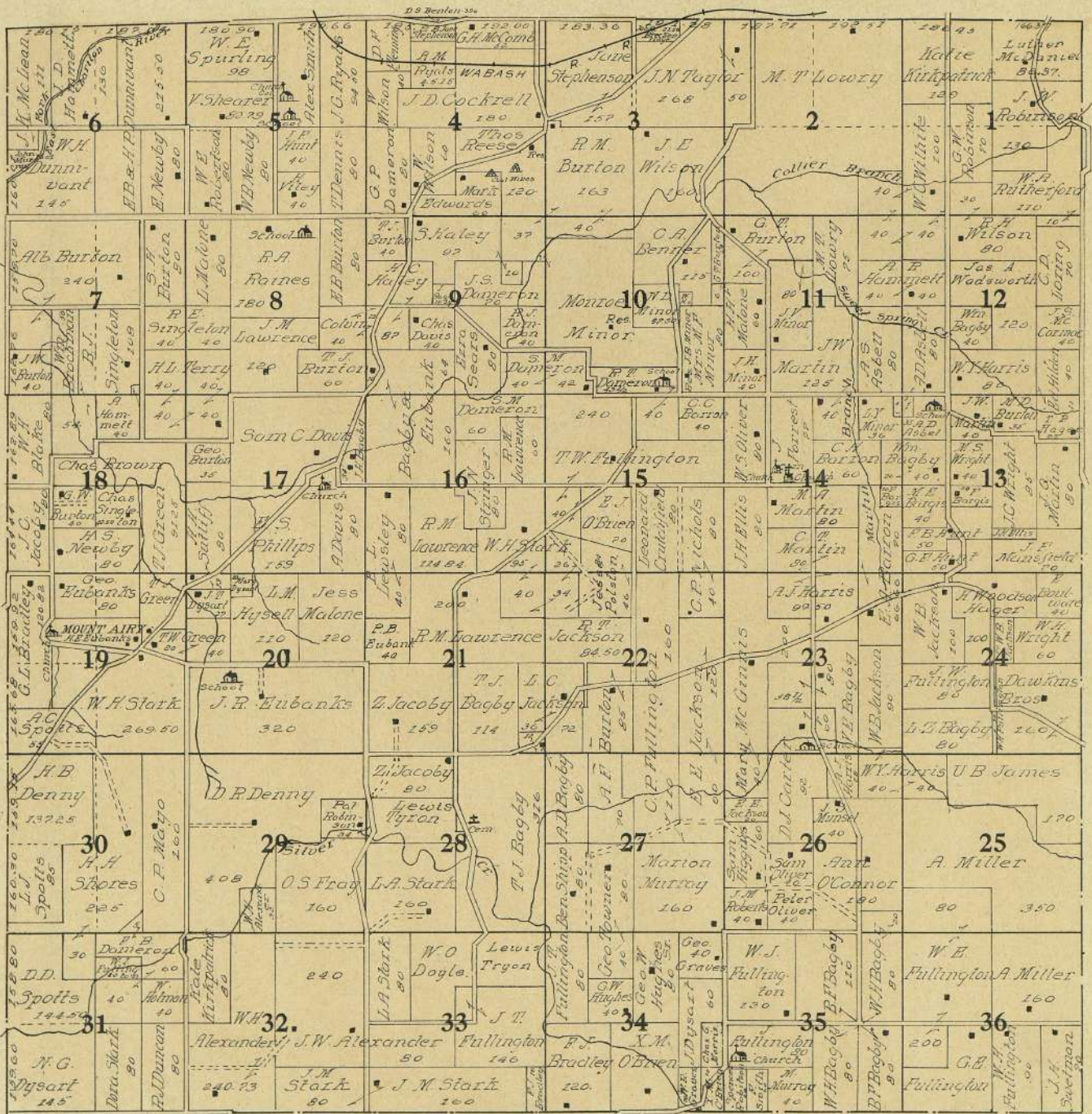

MAP OF
PART of TOWNSHIP 53 N., RANGE 16 W.
of the 5th P. M.

Scale 2 inches to 1 mile

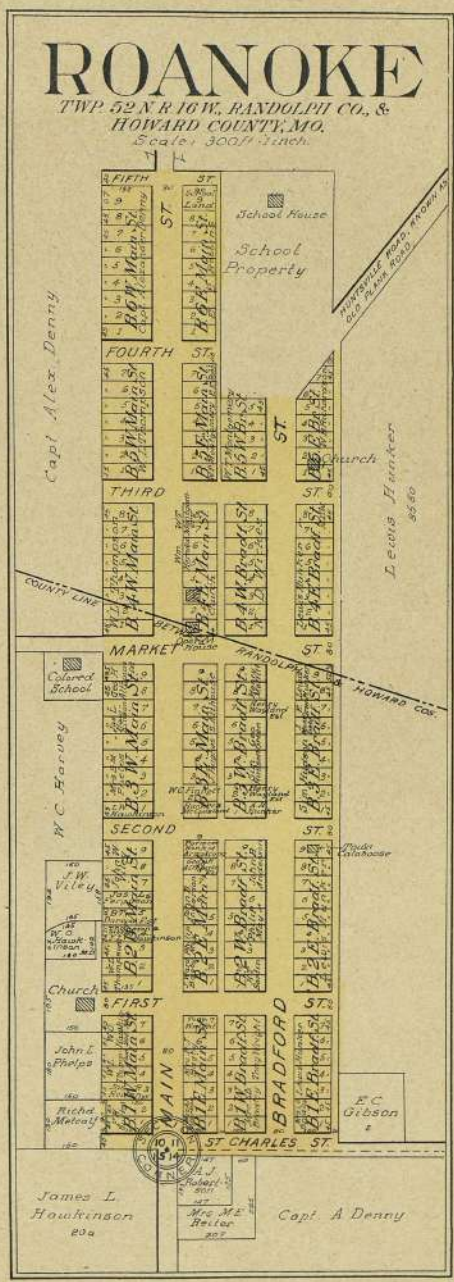
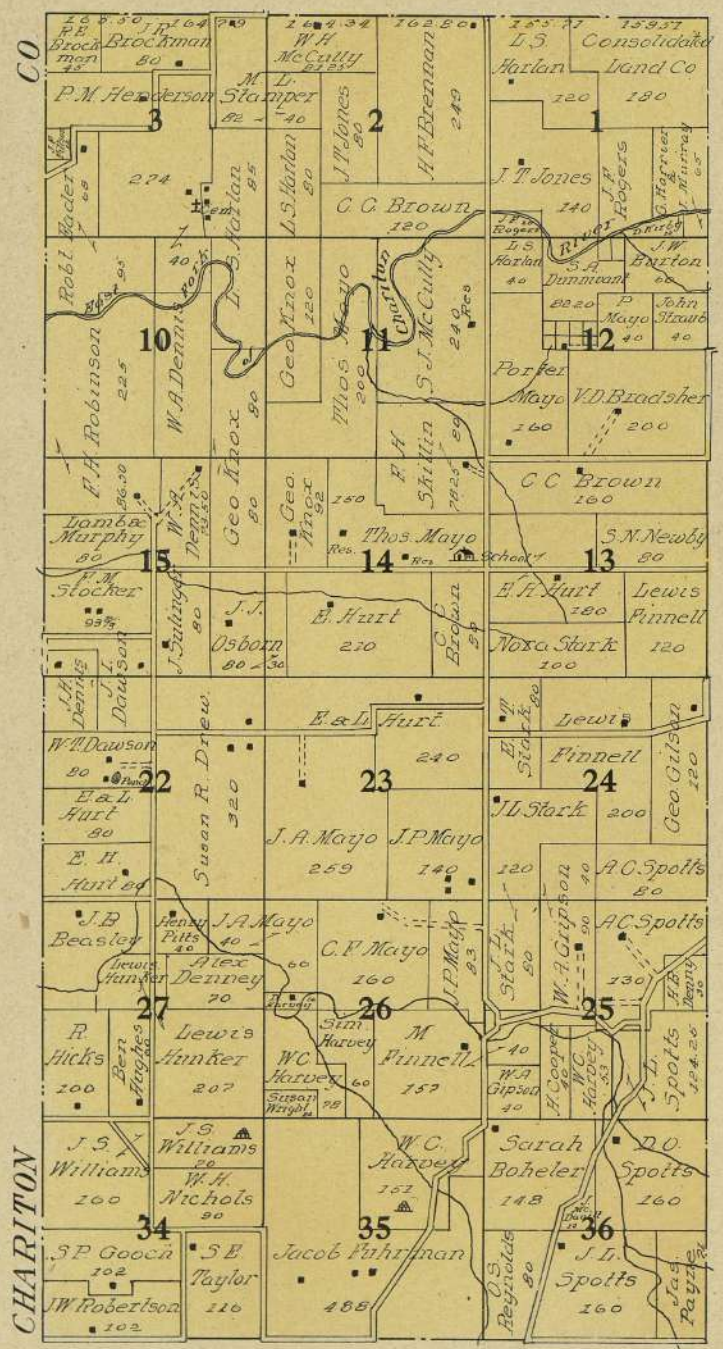

CHARITON



MAP OF

TOWNSHIP 54 N., RANGE 13 W.

 of the 5th P. M.

Scale 2 inches to 1 mile

276.63 W J Boney & Son 6	159.38 W C Johnson Geo Gulekund 80 Jt 5	126.02 W P Campbell 80/80 4	157.39 A L Bennett 80/80 3	158.03 H T Newton 209.03 2	158.05 J B Padgett 200 1	154.20 Claud T Stephens 200 1	154.20 J D Johnson Wm R Johnson 40 1
Isaac Brown 242.89 7	W G Cox 146.66 6	F D Haynes 120 5	Jas L L Purnish 65/40 4	E J Newton 160 3	M S Burton 50 2	J B Padgett 200 1	J B Hedgesley 120 1
J G Roberts 190 7	M B Cox 125 6	C E Triner 65/40 5	J H Newlin 40 4	P J Vince 80 3	G W Burton 40 2	J W Pool 40 1	J B Hedgesley 120 1
J H Roberts 155 7	Mrs G A Rowland 180 6	Omar O'Neil 160 5	A B Vince 40 4	A B Vince 120 3	J W Pool 40 2	E B Guiltine 40 1	J B Hedgesley 120 1
J H Roberts 170 7	Hollis Lewis 110 6	Jos Rowland 240 5	W E Hall 160 4	W G Boney 120 3	L E Falton 80 2	Mike Streiff 120 1	J B Hedgesley 120 1
Chas G Gilbert 231 18	J A McAdam 60 17	W H Daley 40 16	W R Burton 40 15	W G Boney 120 14	L E Falton 80 13	A E Carter 160 12	J B Hedgesley 120 1
E G Elser 116.75 19	J M Smith 120 18	H W French 40 17	Luther French 40 16	Luther French 40 15	A E Carter 160 14	J W Wight 40 13	J B Hedgesley 120 1
Wm Siler 700 Est 19	J D & W W Hutsell 334 18	C H Richardson 244 17	A C Westfall 144.84 16	M McCampbell 106.25 15	D A Spaxer 40 14	Vroman 40 13	Mrs J B Jennings 184 12
J D & W W Hutsell Bros 100 30	Mark 100 29	J C Hutsell 100 28	J B Elliott 160 27	J B Elliott 160 26	Godfrey 80 25	Geo Scott 80 24	J W Darby 100 23
M P Selby 320 31	E L Crowe 200 30	W M Stark 84 29	J W Given 200 28	J W Given 200 27	Chas Kitcher 40 26	Chas Kitcher 40 25	R J Nicholls 140 24
M P Selby 130 Est 31	J D Chrisman 120 30	J M Perley 40 29	E C Parrish 120 28	E C Parrish 120 27	J W Gee 40 26	J W Gee 40 25	J E Dunn 80 24
L A Cunningham 1474 31	Clarence Ragsdale 103.74 30	A J Steep 40 29	W A Scott 100 28	W A Scott 100 27	J E Dunn 80 26	J E Dunn 80 25	J E Dunn 80 24

CO
 MONROE

Scale 2 inches to 1 mile

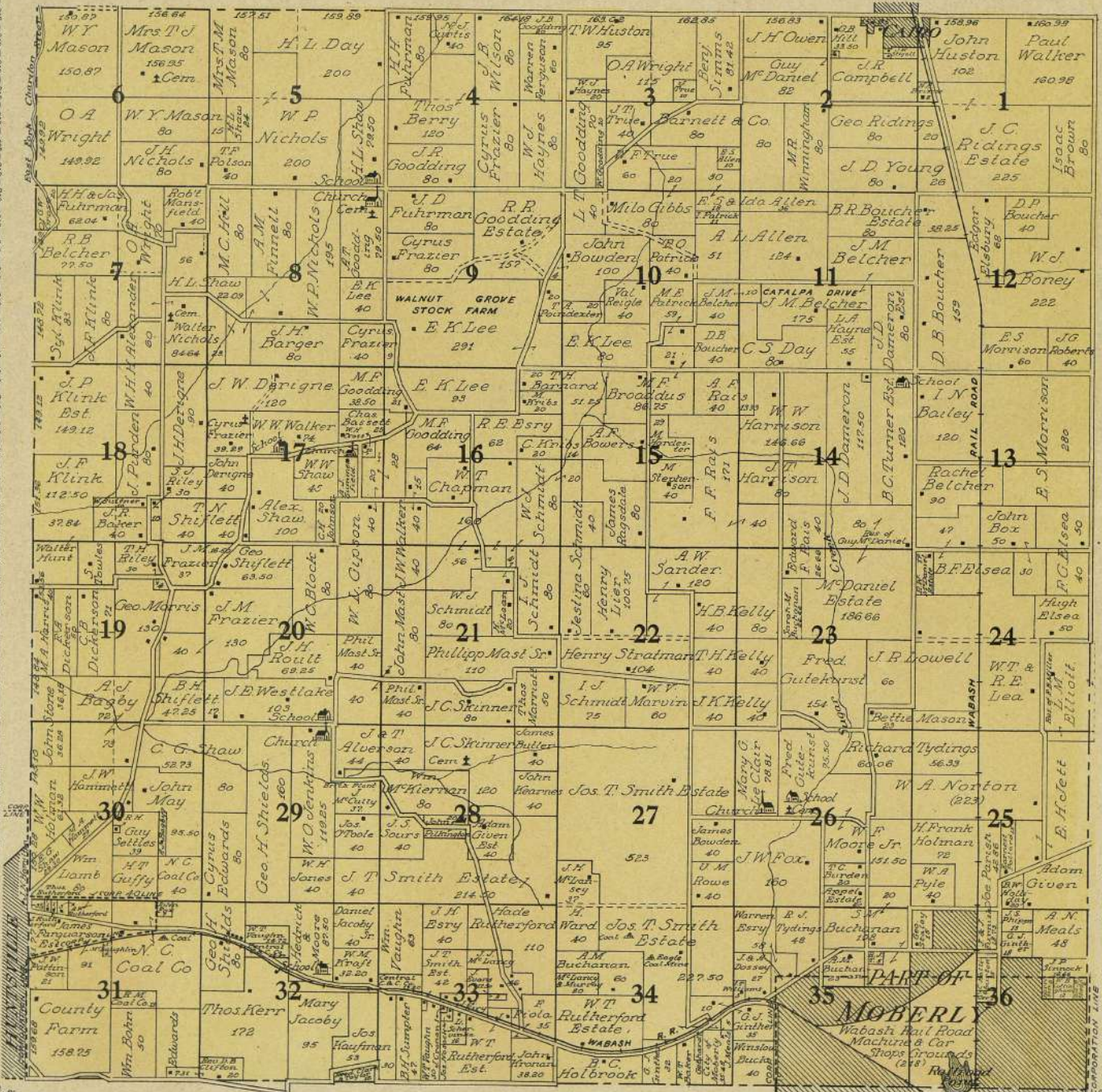

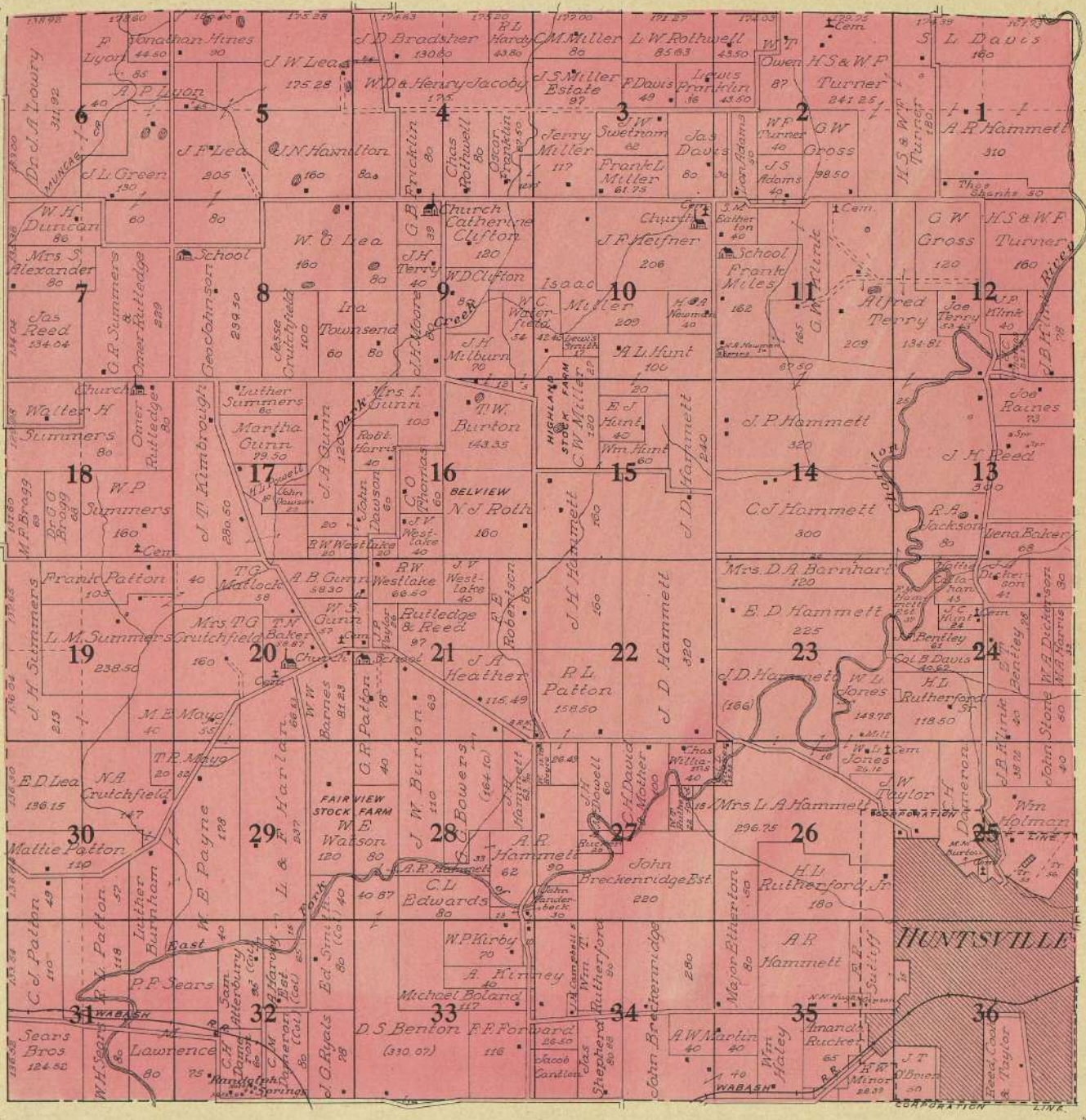

MAP OF
TOWNSHIP 55 N., RANGE 13 W.
 of the 5th P. M. Scale 2 inches to 1 mile

MACON

CO.

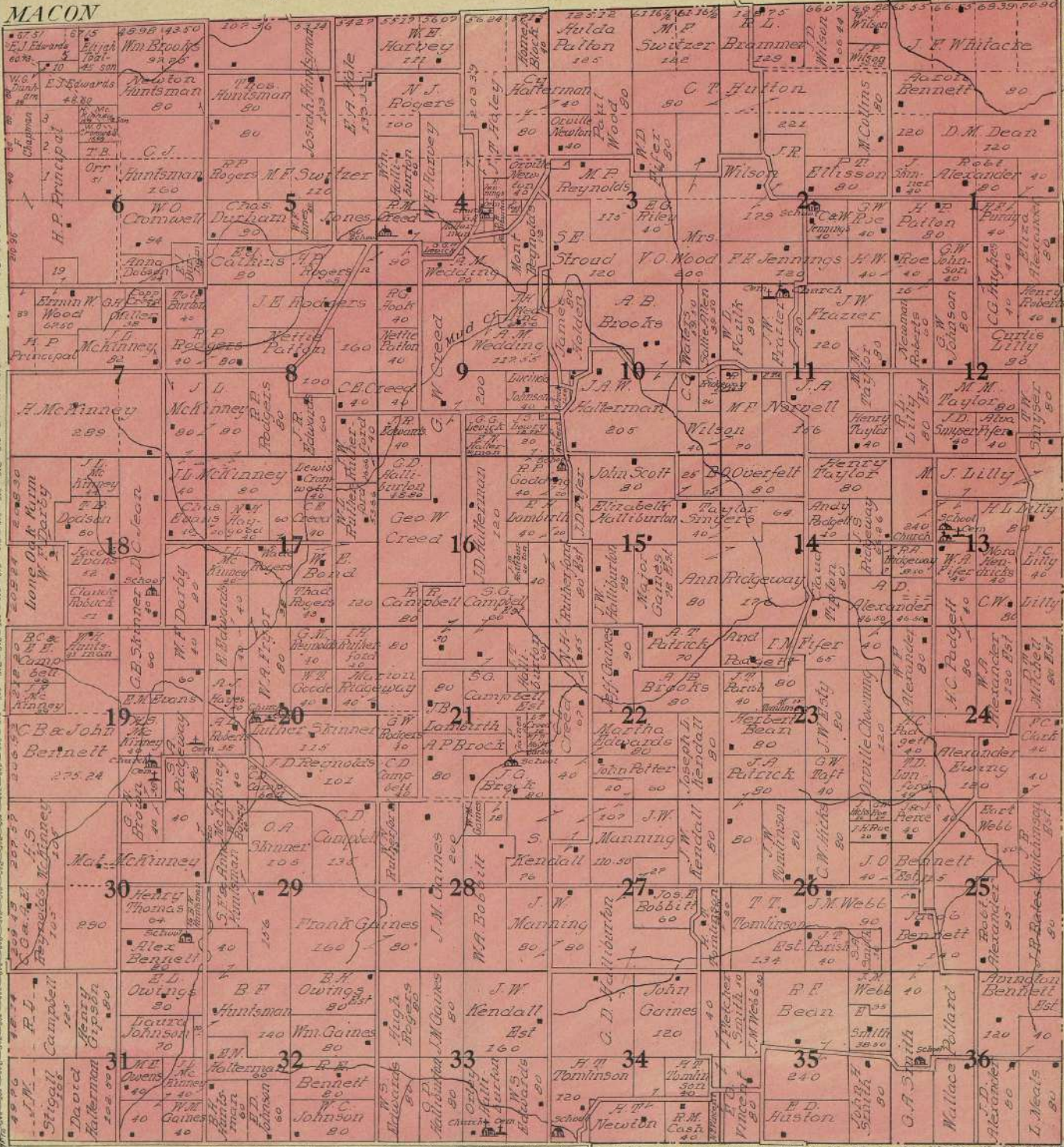

CO.

MONROE

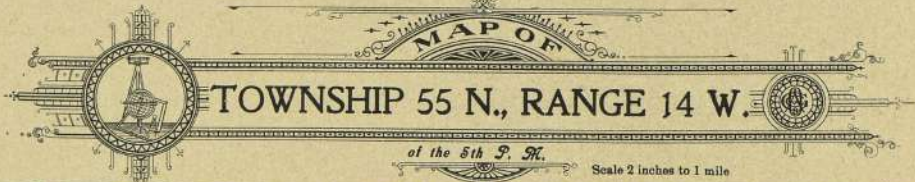

MAP OF
TOWNSHIP 55 N., RANGE 14 W.
 of the 5th P. R.

Scale 2 inches to 1 mile

MACON

CO

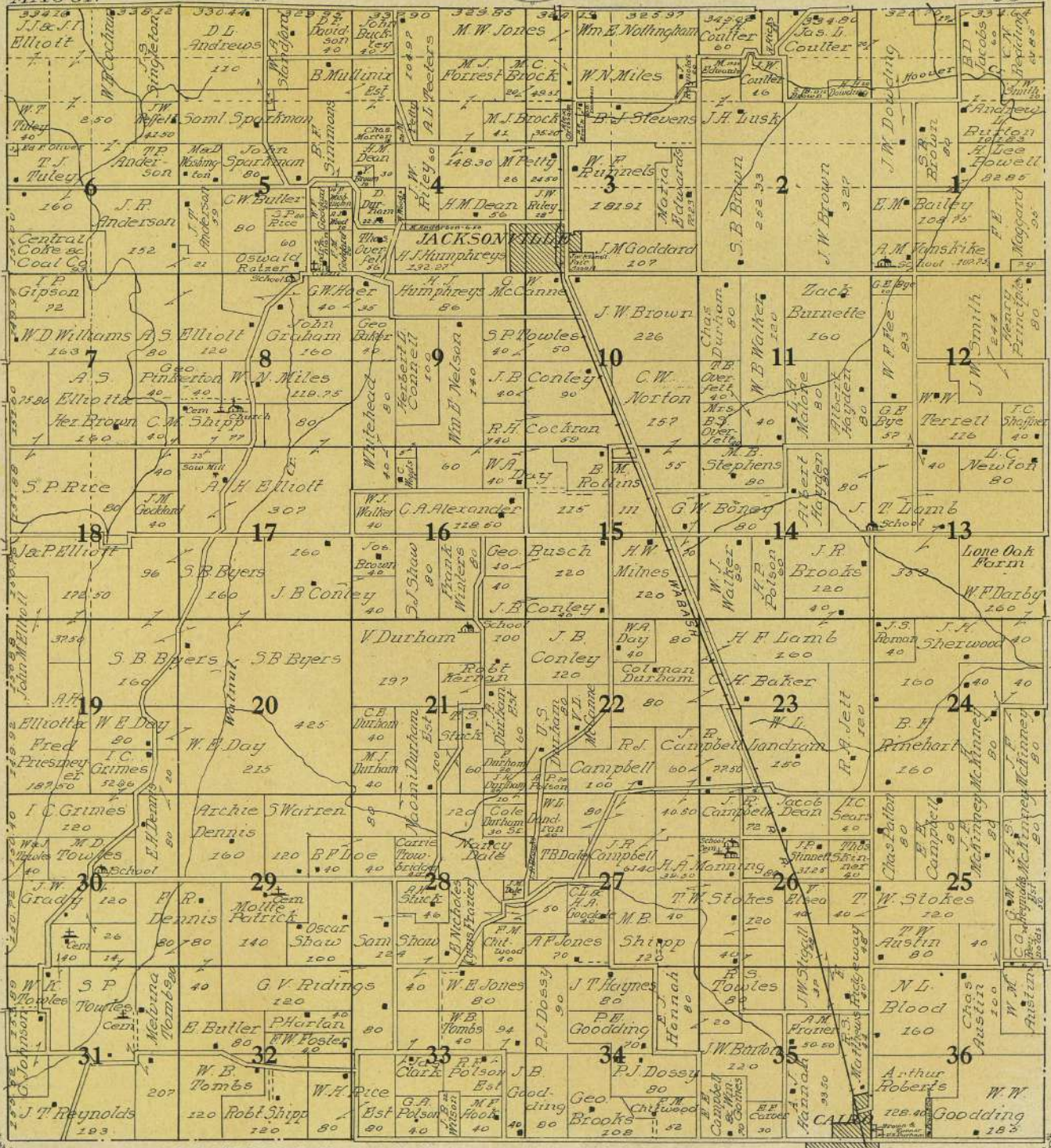

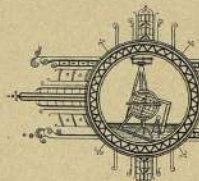

MAP OF PART of TOWNSHIP 55 N., RANGE 16 W. of the 5th P. M.

of the 5th P. M.

Scale 2 inches to 1 mile

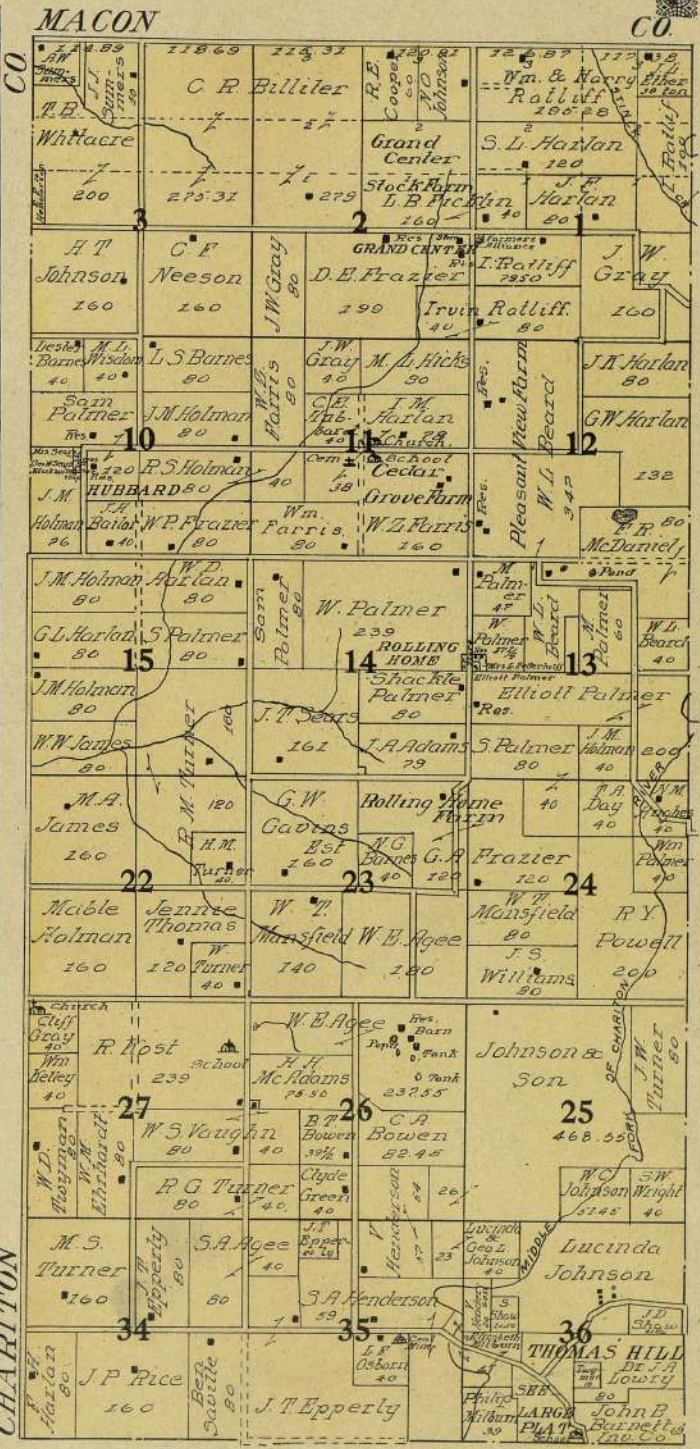
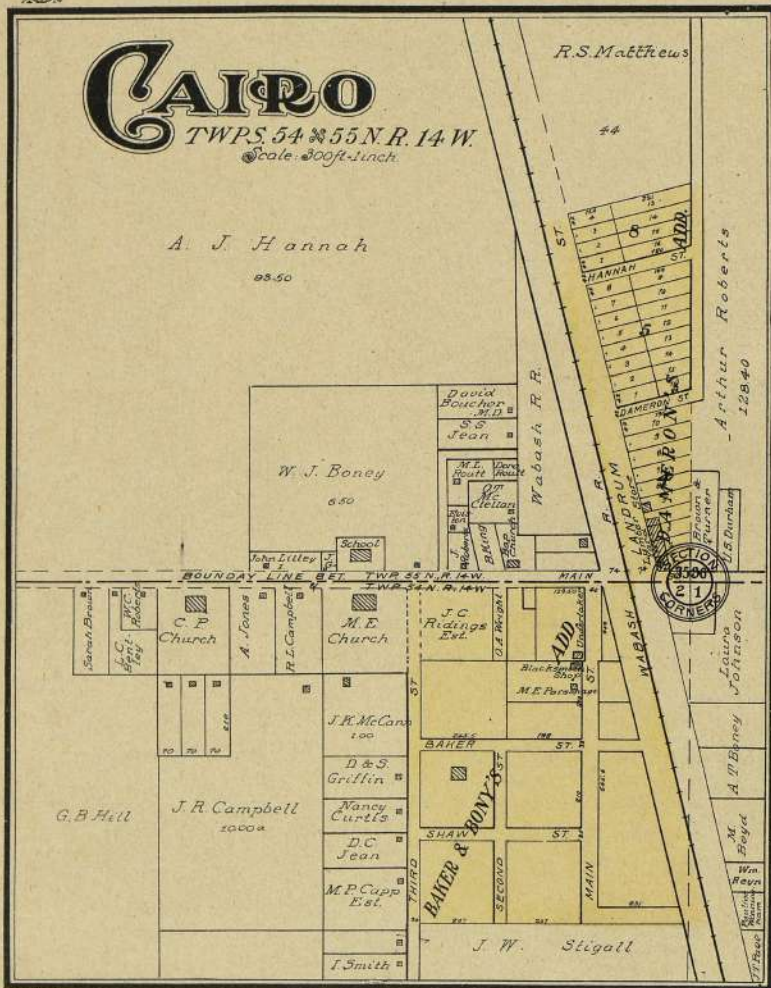

ENLARGED PLAT OF SW 1/4 OF SEC. 36. TWP 55 N. R. 16 W. Scale: 6 inches to 1 mile.

