

EXPLANATION

- Section Line
- Farm or Lot Line
- Wagon Road
- Railroad
- Creeks & Springs
- Houses
- Churches
- School Houses
- Adjacent Lands owned by same party connected by a hook, thus
- Post Office
- Coal, Lead or Zinc Mine
- County Bridge

OUTLINE MAP OF  
*Scotland County*  
 Scale 1/2 inch to one mile.  
 MISSOURI.  
 1898.

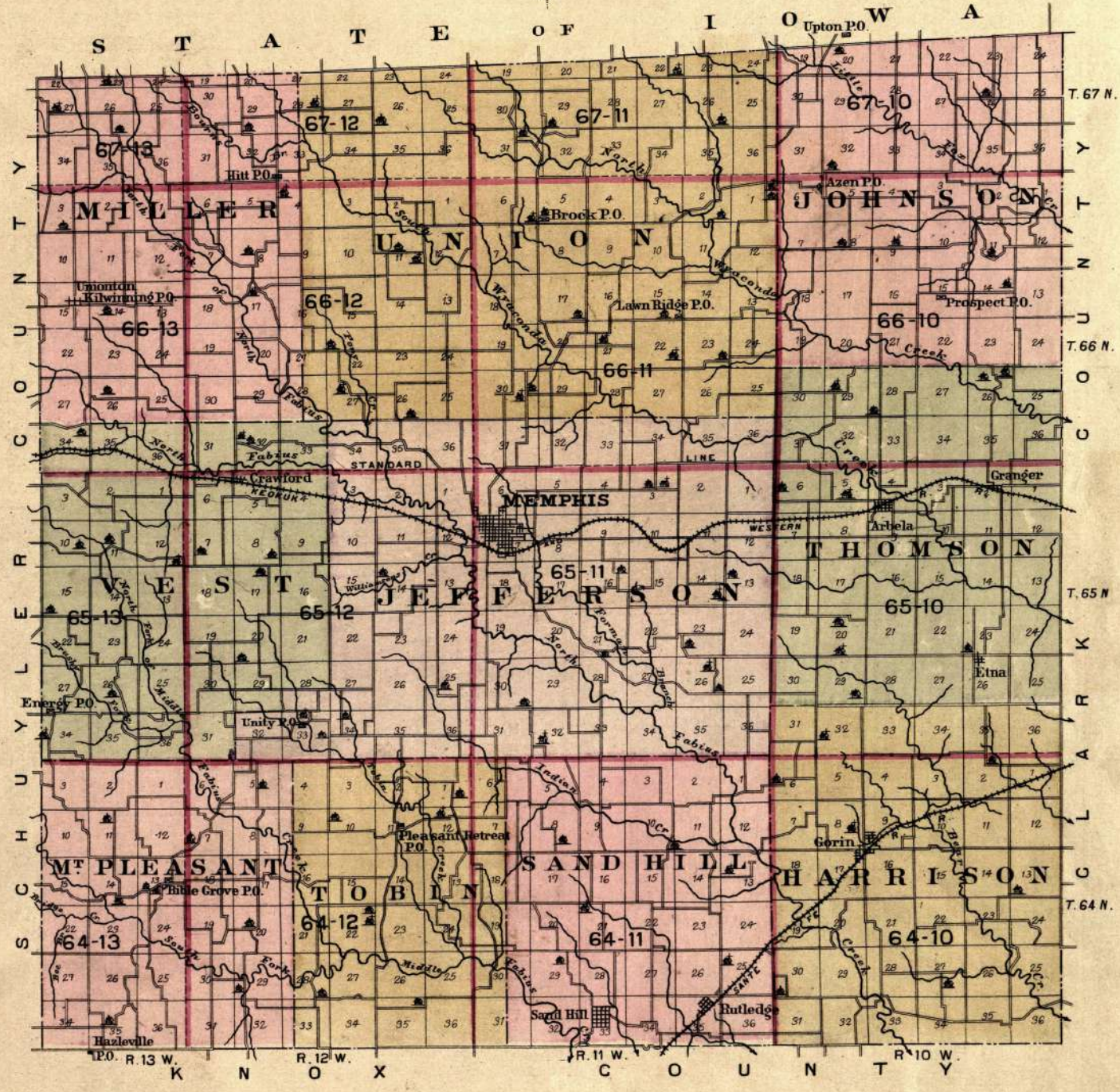

# PLAT OF HARRISON

Scale 2 Inches to the Mile.

Townships 64 & 65 North. Range 10 West.

of the 5th Principal Meridian.

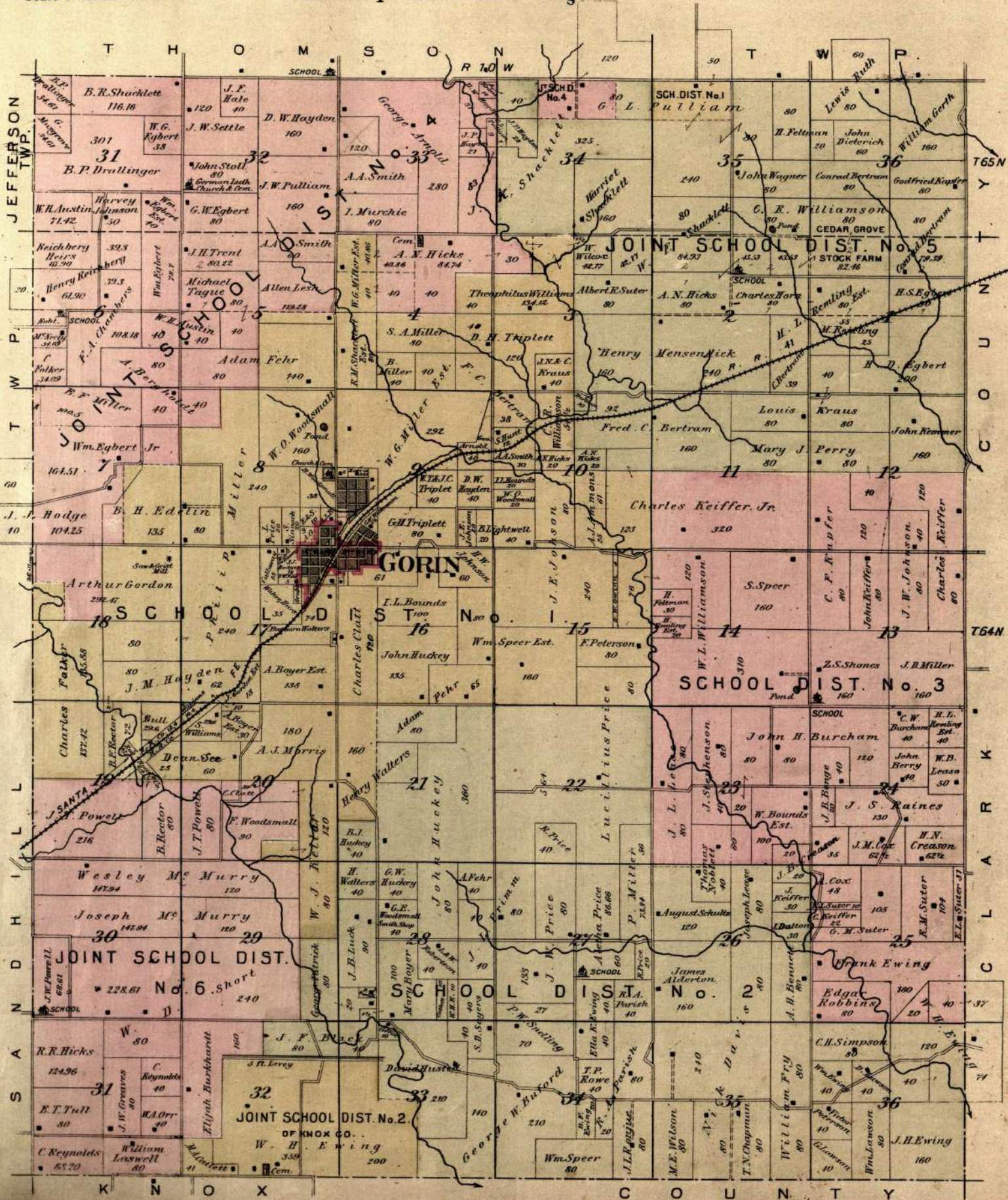

# PLAT OF SAND HILL

Scale 2 Inches to the Mile.

Township 64 North. Range 11 West.

of the 5th Principal Meridian.

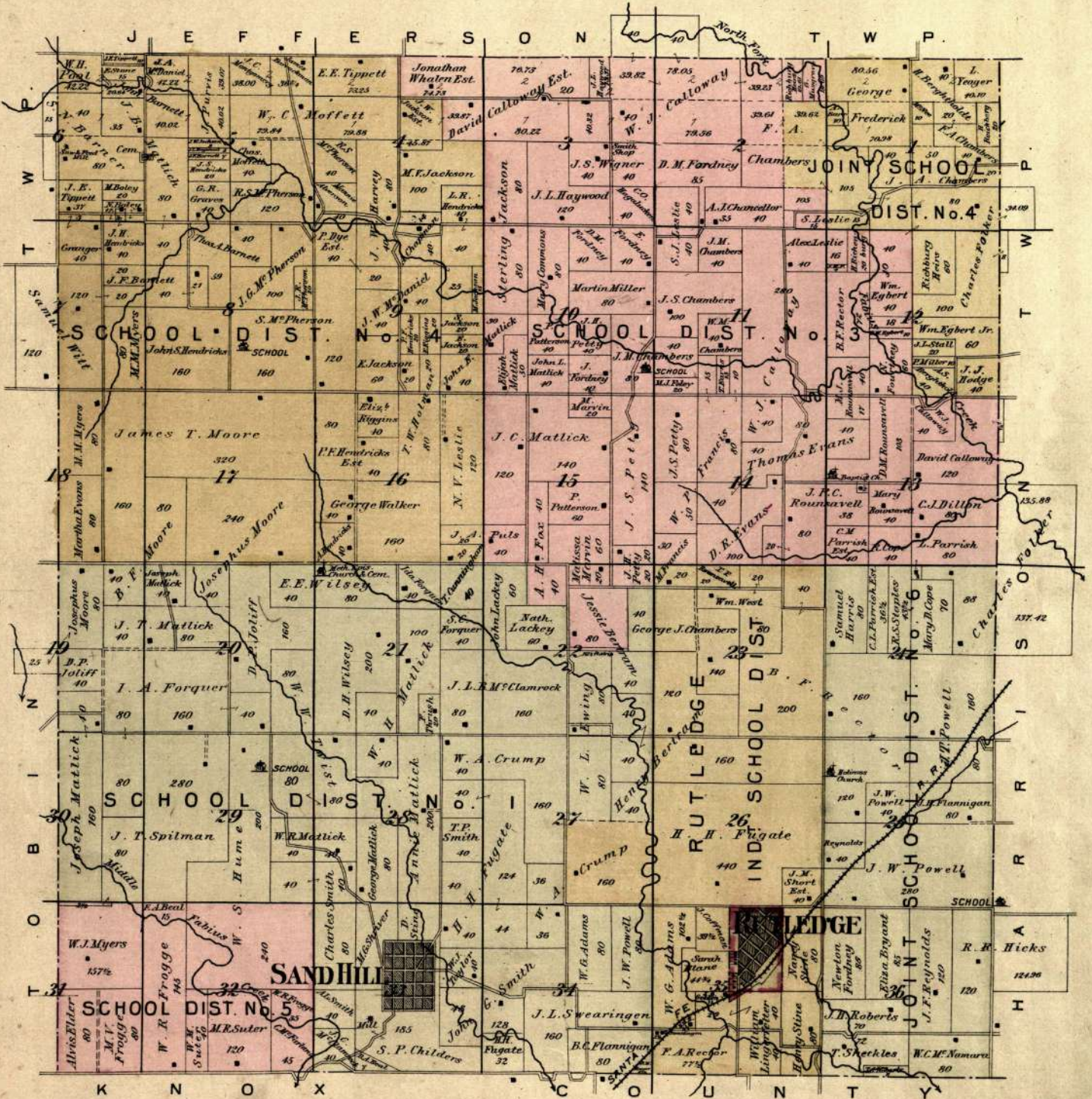

# GORIN

LOCATED IN HARRISON TWP.

Scale: 200 ft. to one inch.

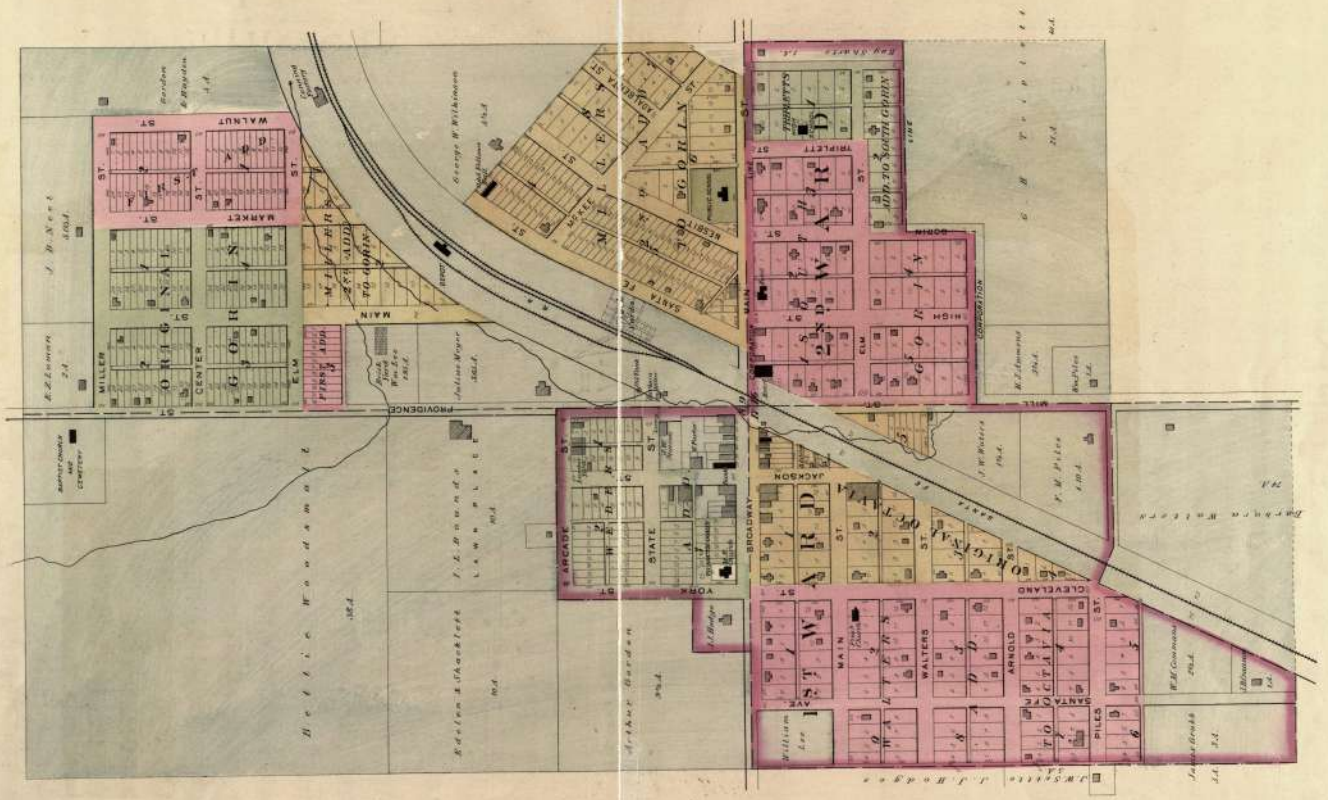

# RUTLEDGE

LOCATED IN SAND HILL TWP.

Scale 200 ft. to one inch

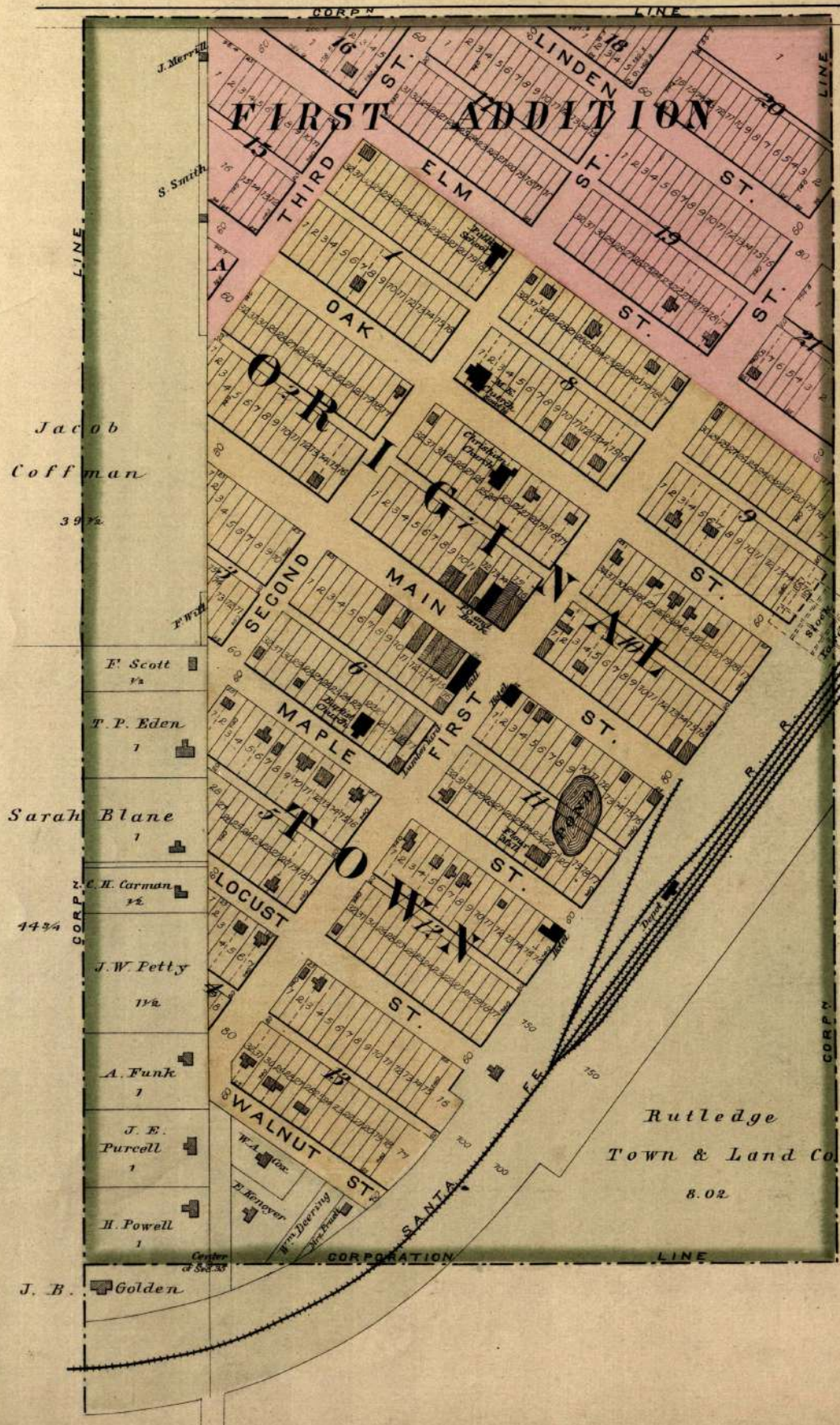

# BIBLE GROVE P.O.

LOCATED IN MT PLEASANT TWP.

Scale 8 inches to 1 mile

# SAND HILL

LOCATED IN SAND HILL TWP.

Scale 300 ft. to one inch

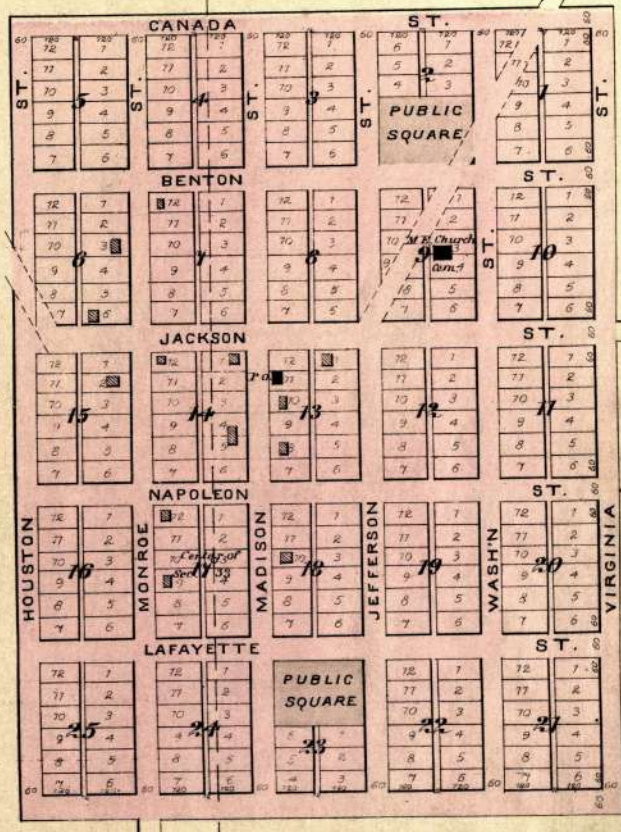
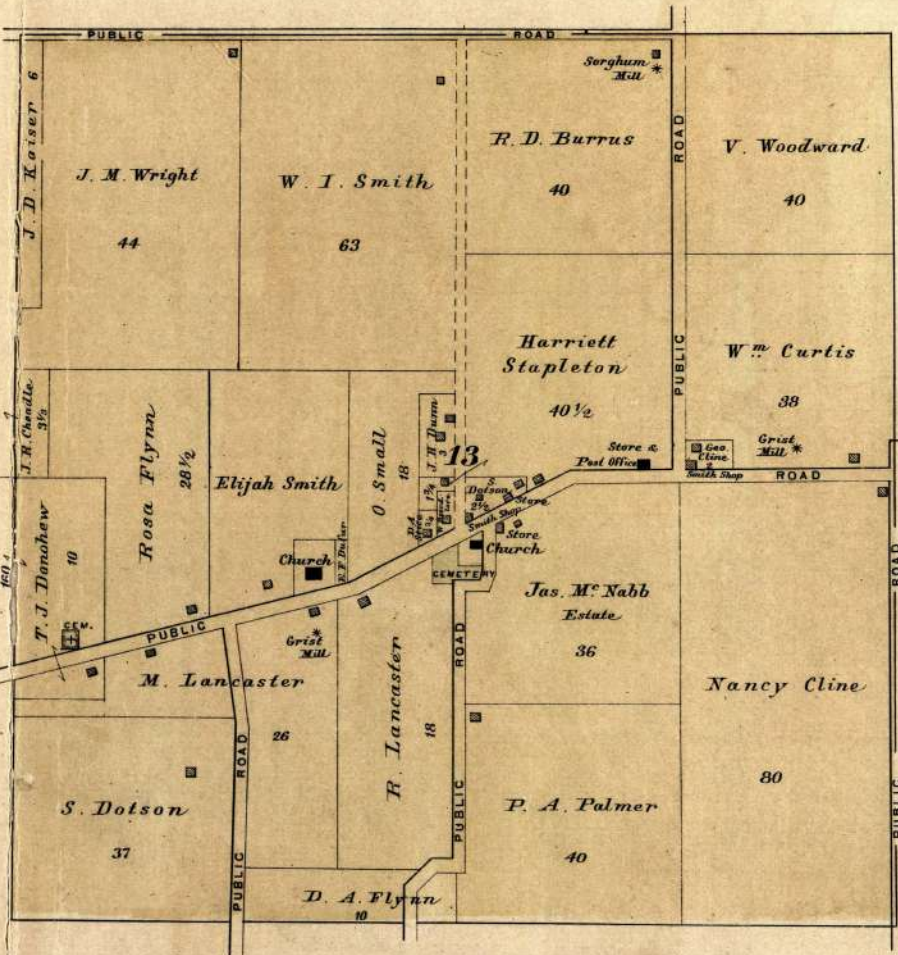

# PLAT OF MT PLEASANT

Scale 2 Inches to the Mile.

Township 64 North. Ranges 12 & 13 West.

of the 5<sup>th</sup> Principal Meridian.

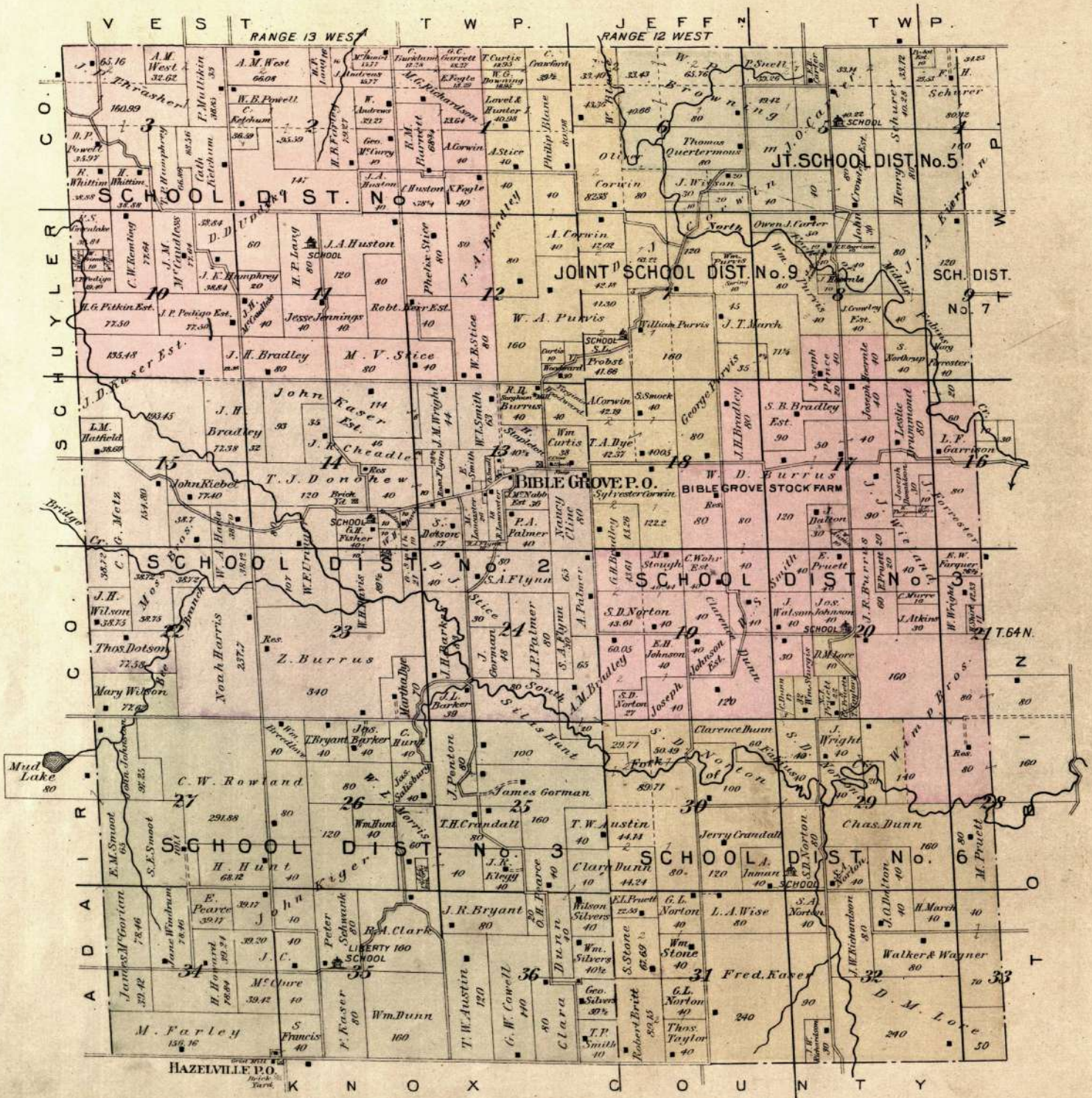

# PLAT OF TOBIN

Scale 2 Inches to the Mile.

Township 64 North. Ranges 11 & 12 West.

of the 5th Principal Meridian.

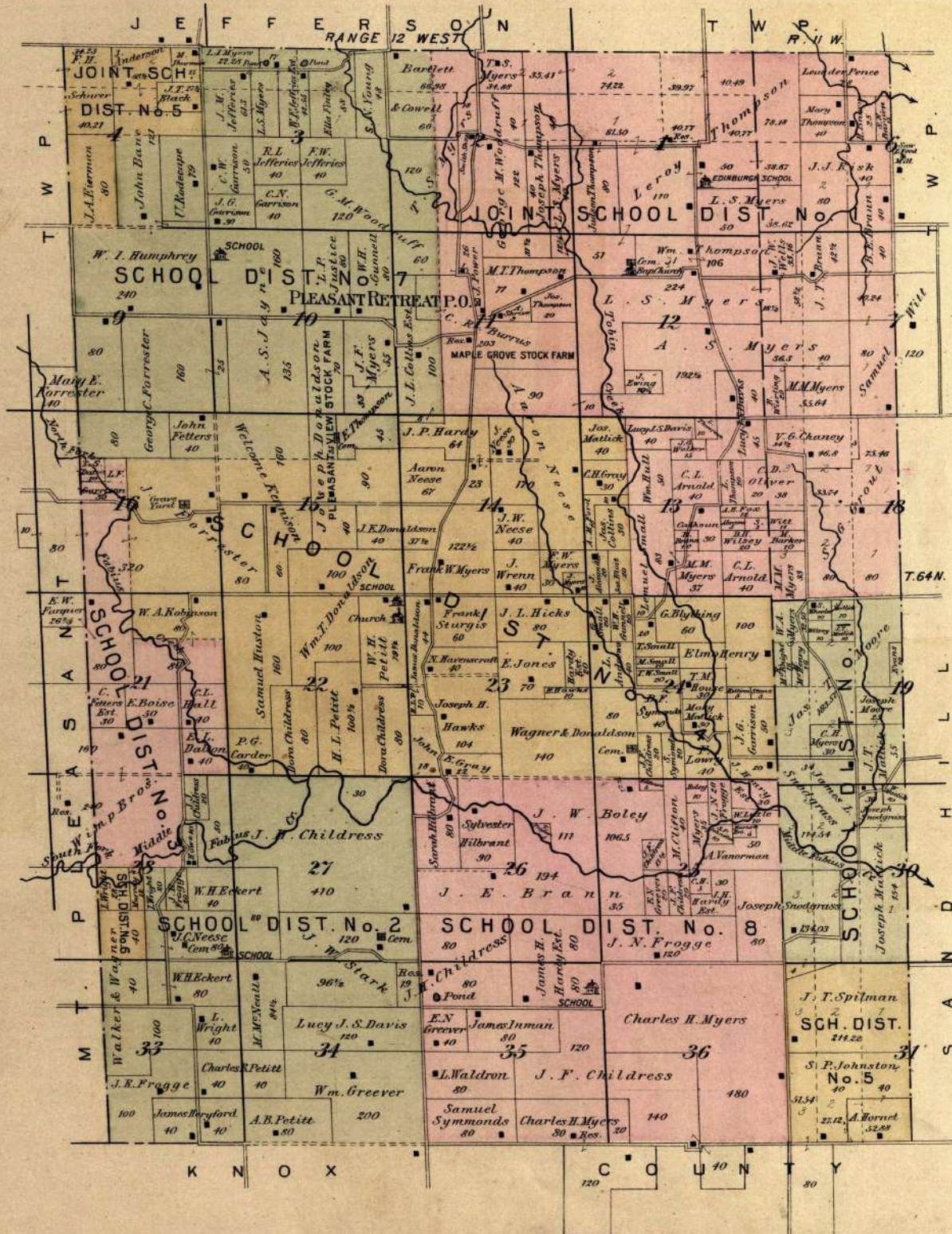



# PLAT OF VEST

Scale 2 Inches to the Mile.

Townships 65 & 66 North. Ranges 12 & 13 West.

of the 5<sup>th</sup> Principal Meridian.

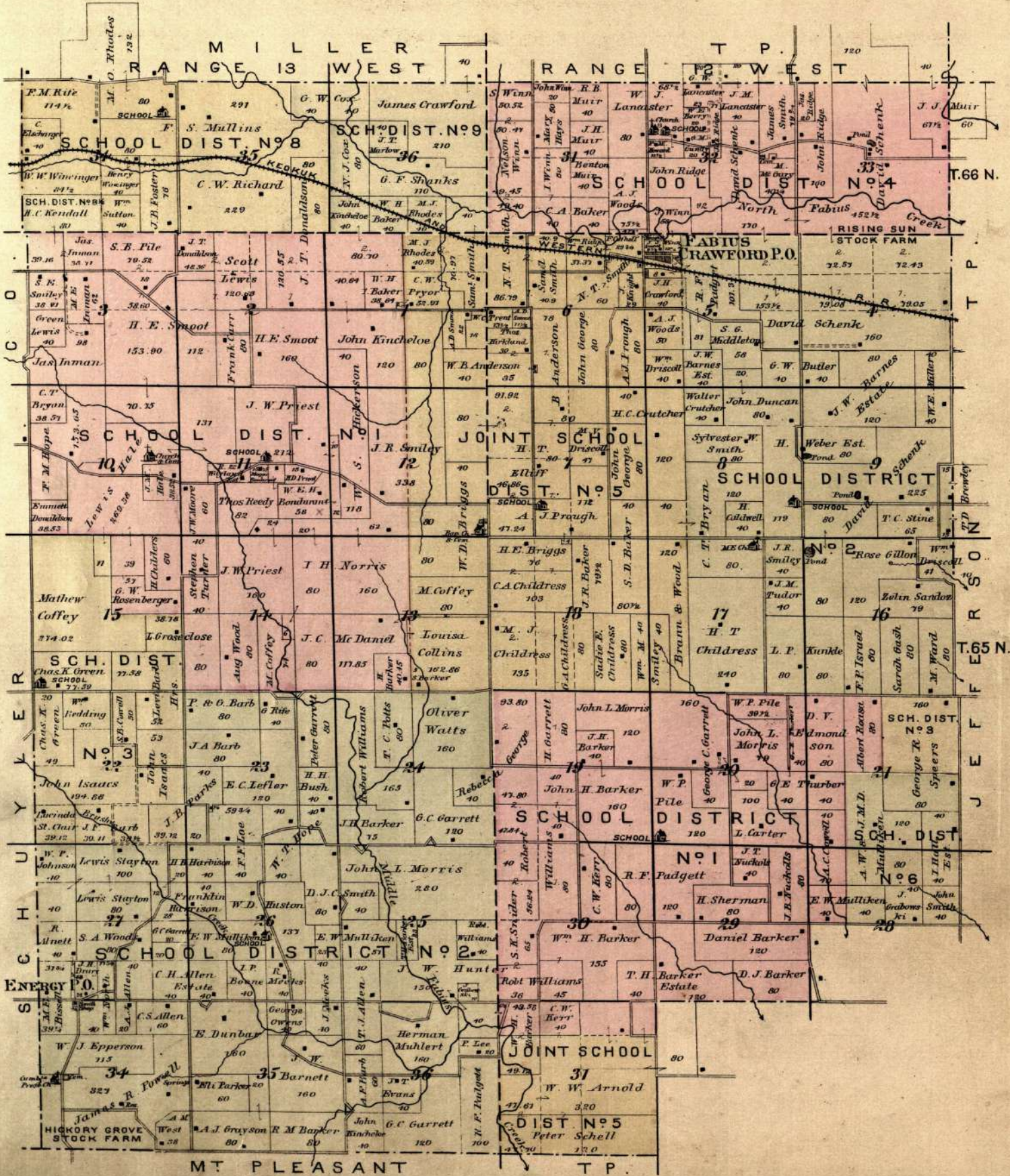

MT PLEASANT T.P.

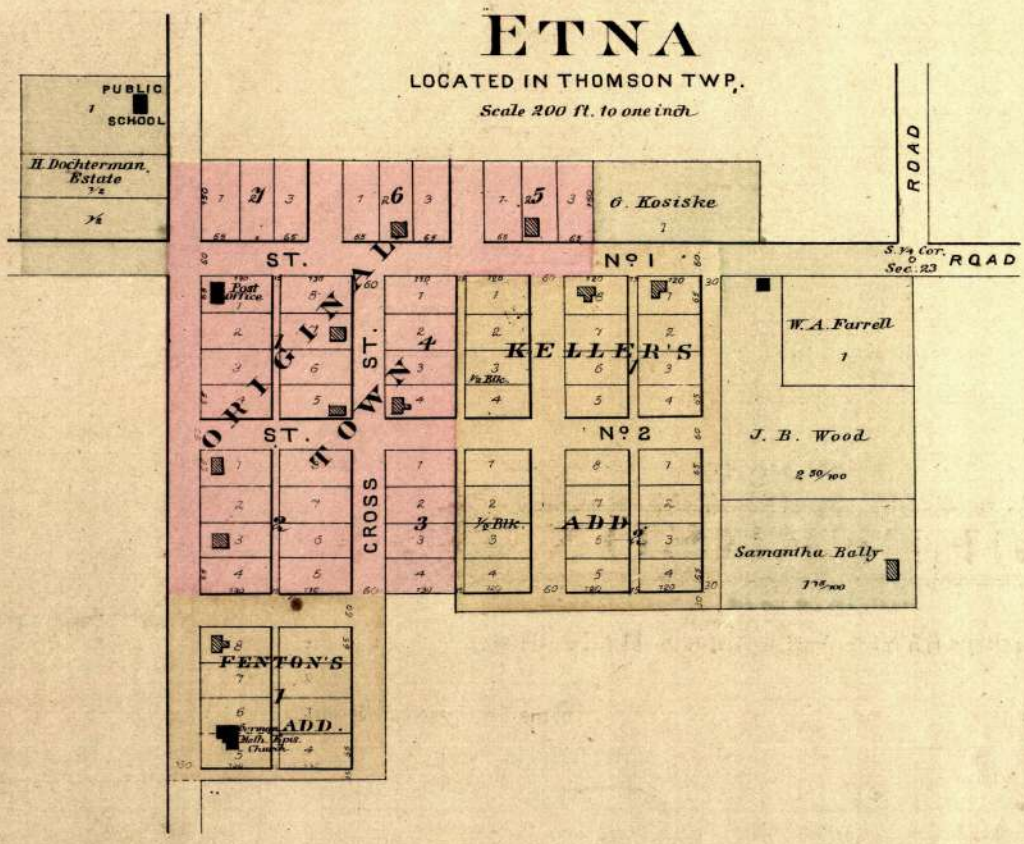

### KILWINNING P.O.

PLATTED AS UNIONTON  
LOCATED IN MILLER TWP. IN SEC. 15-66-13.  
Scale 200 ft. to one inch.

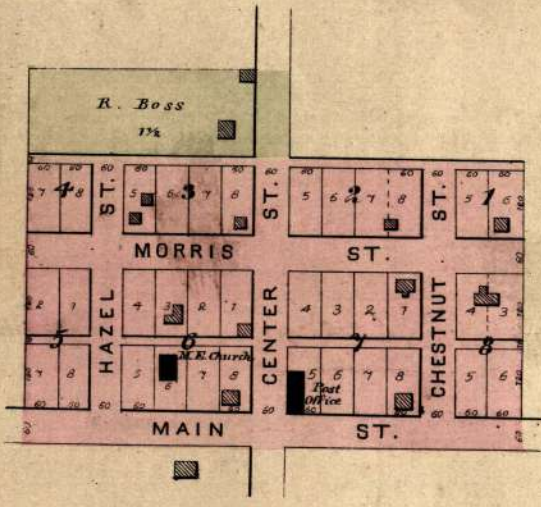

### CRAWFORD

PLATTED AS FABIUS  
LOCATED IN VEST TWP. IN SEC. 5-65-12.  
Scale 200 ft. to one inch.

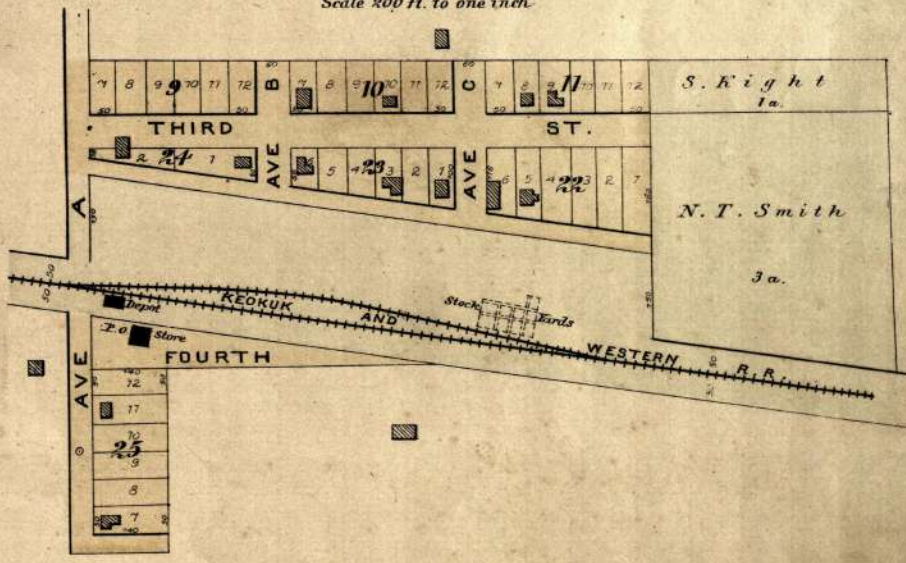

PLAT OF  
**JEFFERSON**

Townships 65 & 66 North, Ranges 11 & 12 West.

Scale 2 Inches to the Mile.

of the 5th Principal Meridian.

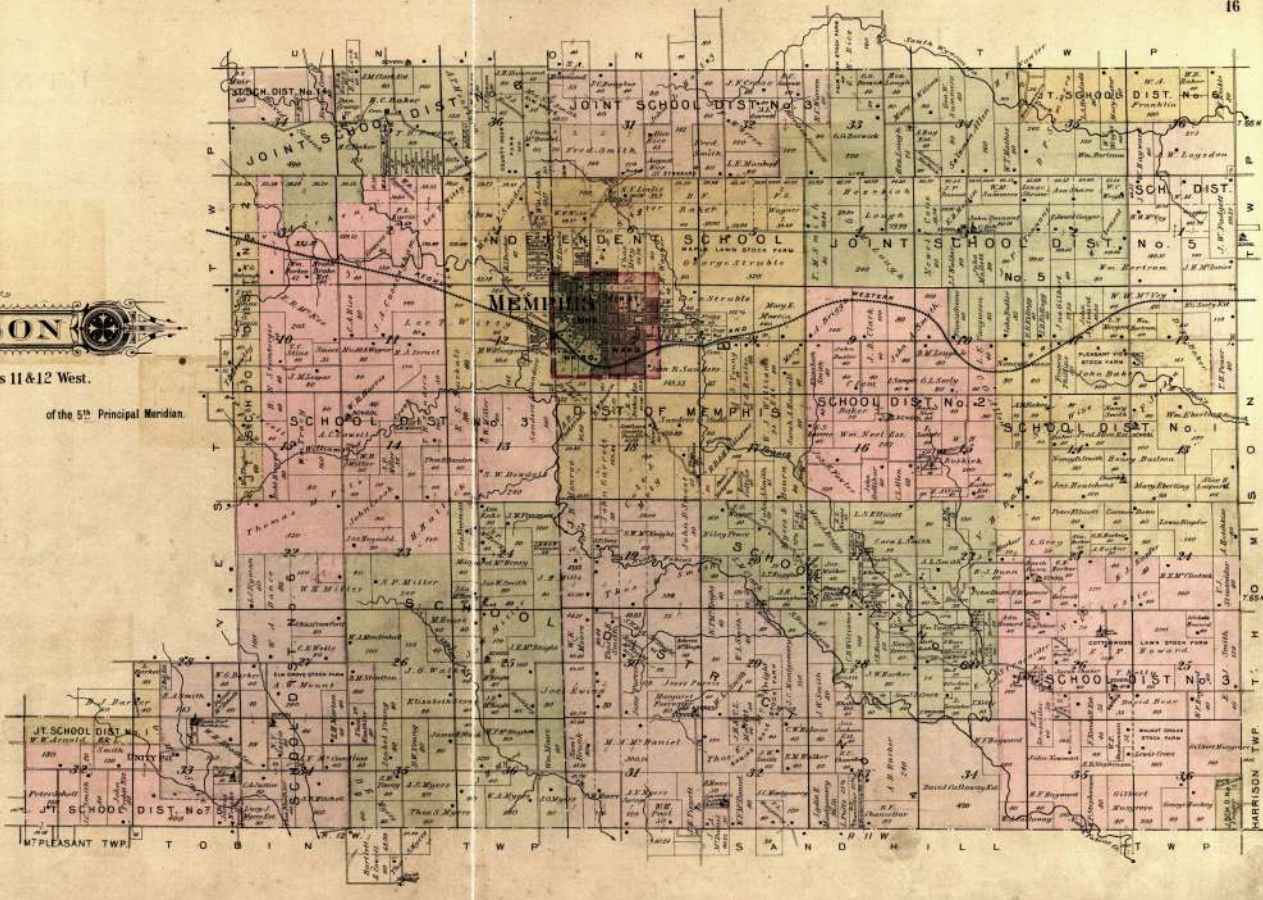

# PLAT OF THOMSON

Scale 2 Inches to the Mile.

Townships 65 & 66 North. Range 10 West.

of the 5th Principal Meridian.

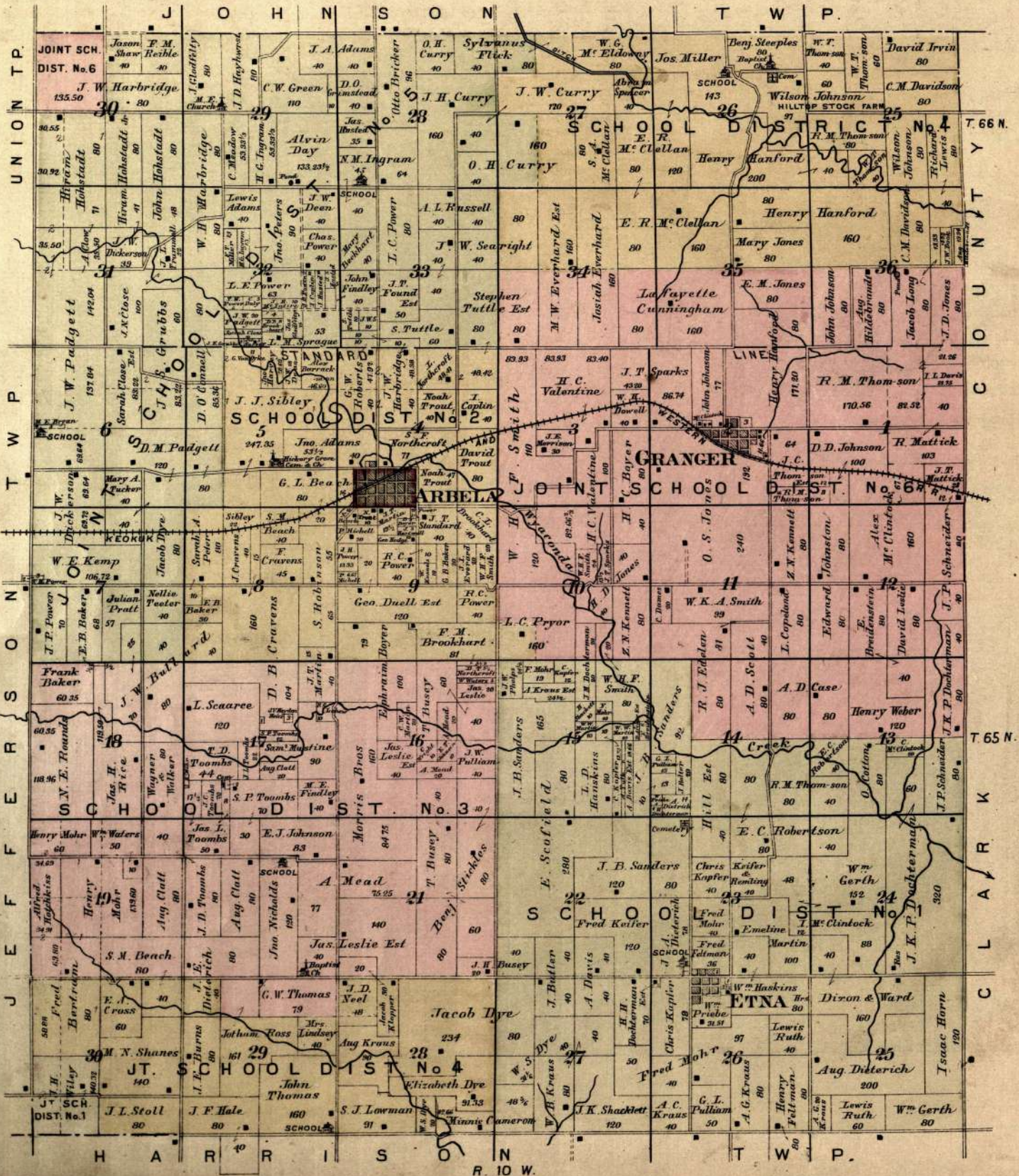

# ARBELA

LOCATED IN THOMSON TWP.

18

Scale 200 ft. to one inch

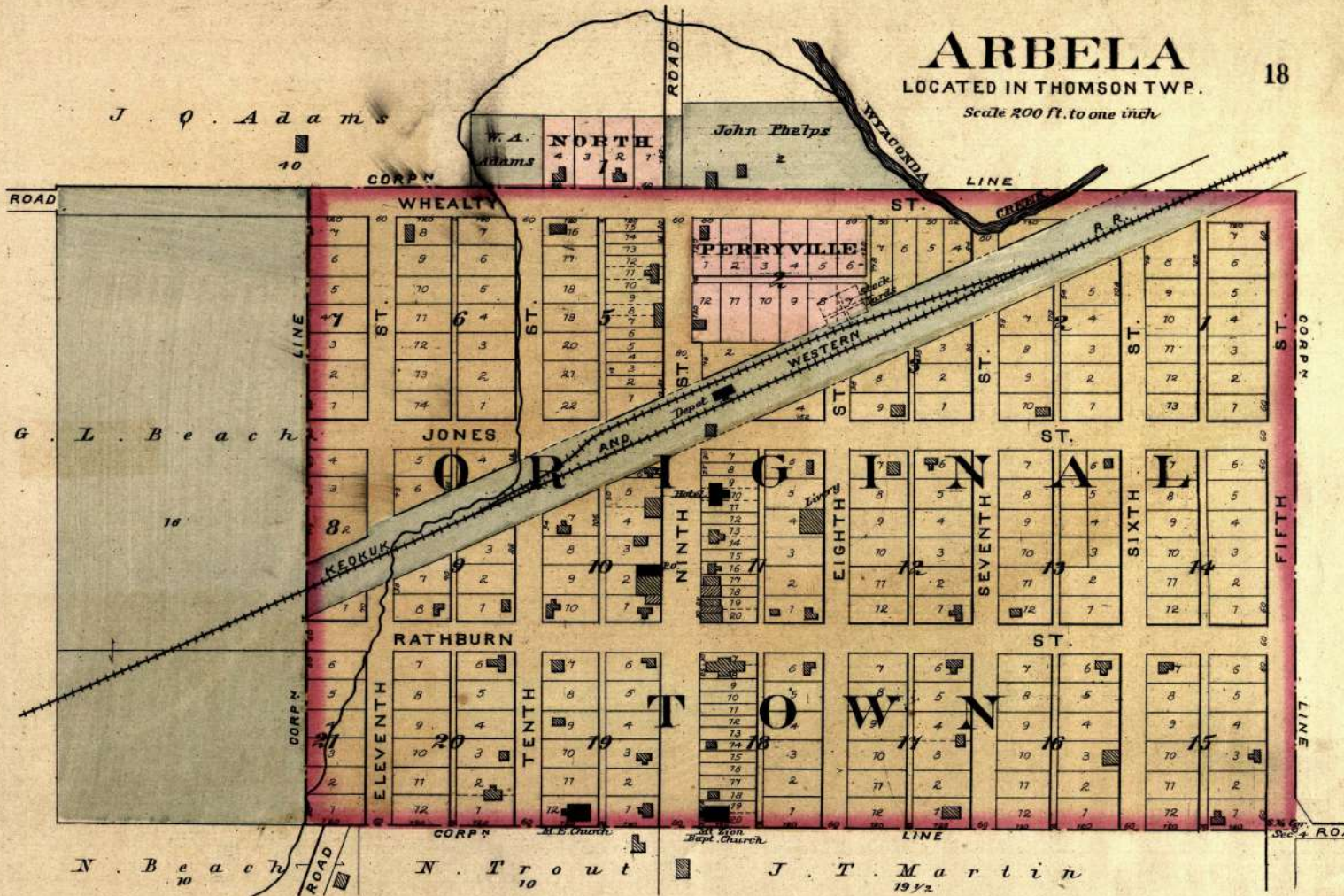

# GRANGER

LOCATED IN THOMSON TWP.

Scale 200 ft. to one inch

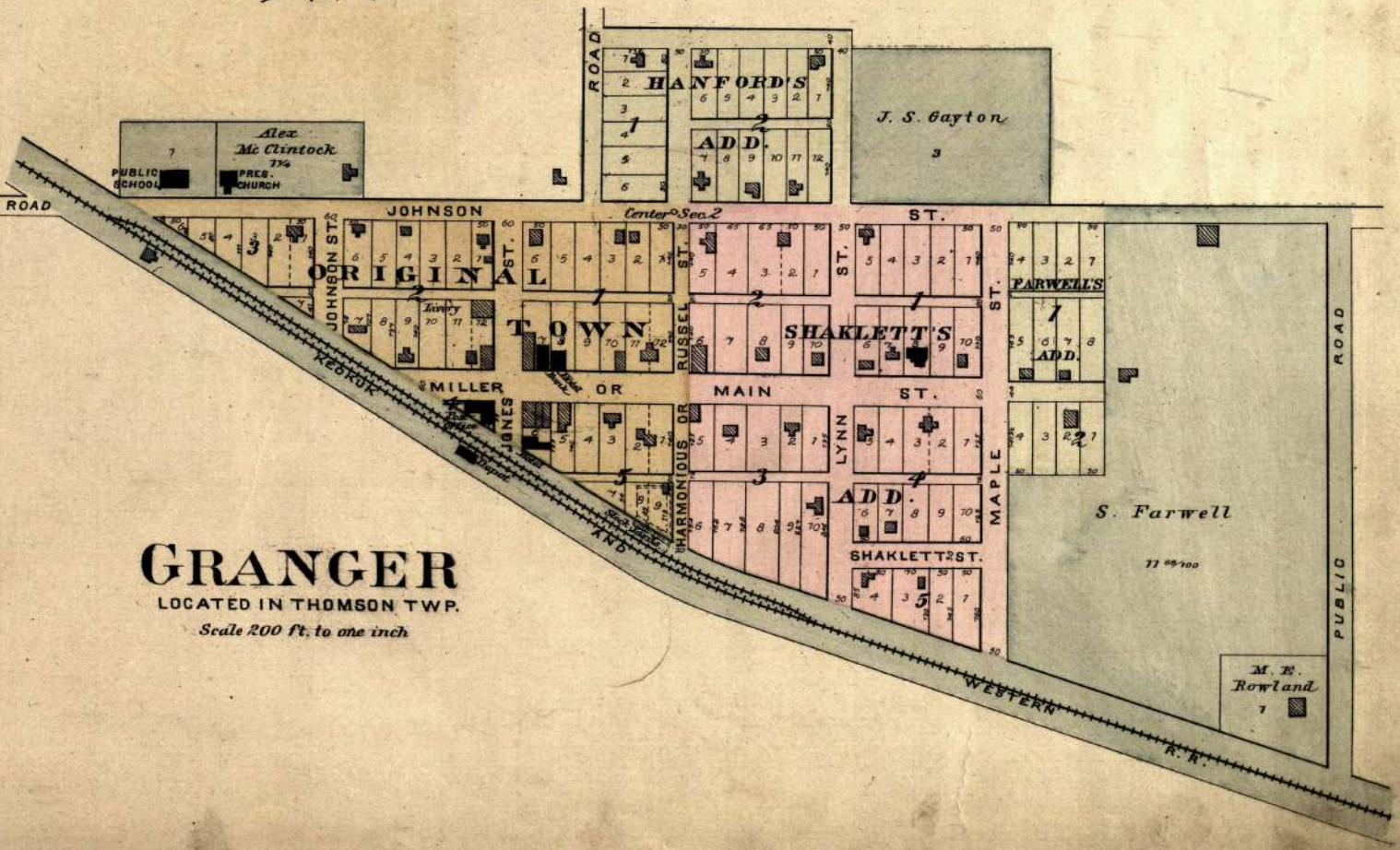

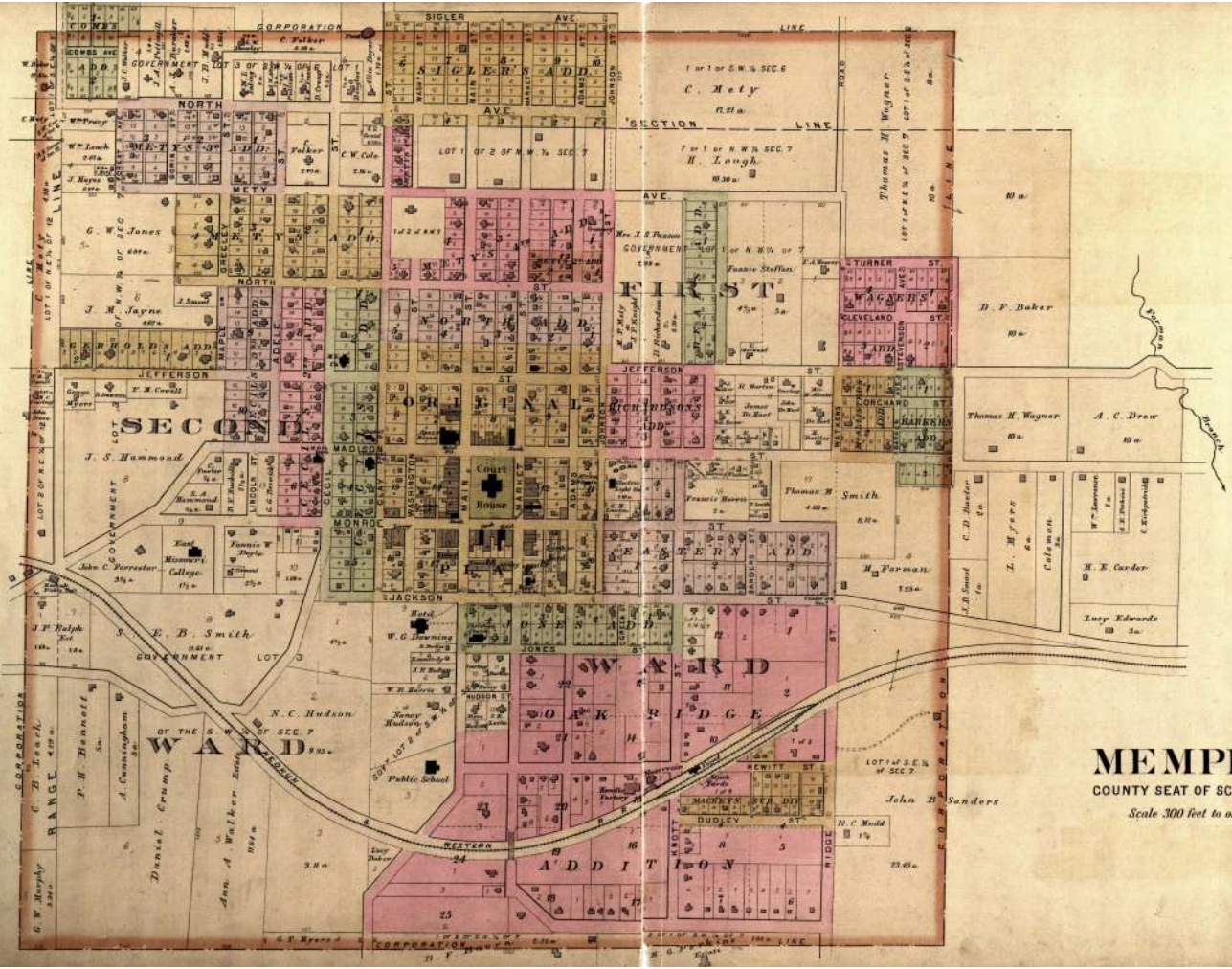

**MEMPHIS**  
 COUNTY SEAT OF SCOTLAND CO.  
 Scale 300 feet to one inch.

PLAT OF  
**JOHNSON**

Scale 2 Inches to the Mile.

Townships 66 & 67 North. Range 10 West.

of the 5th Principal Meridian.

S T A T E O F I O W A

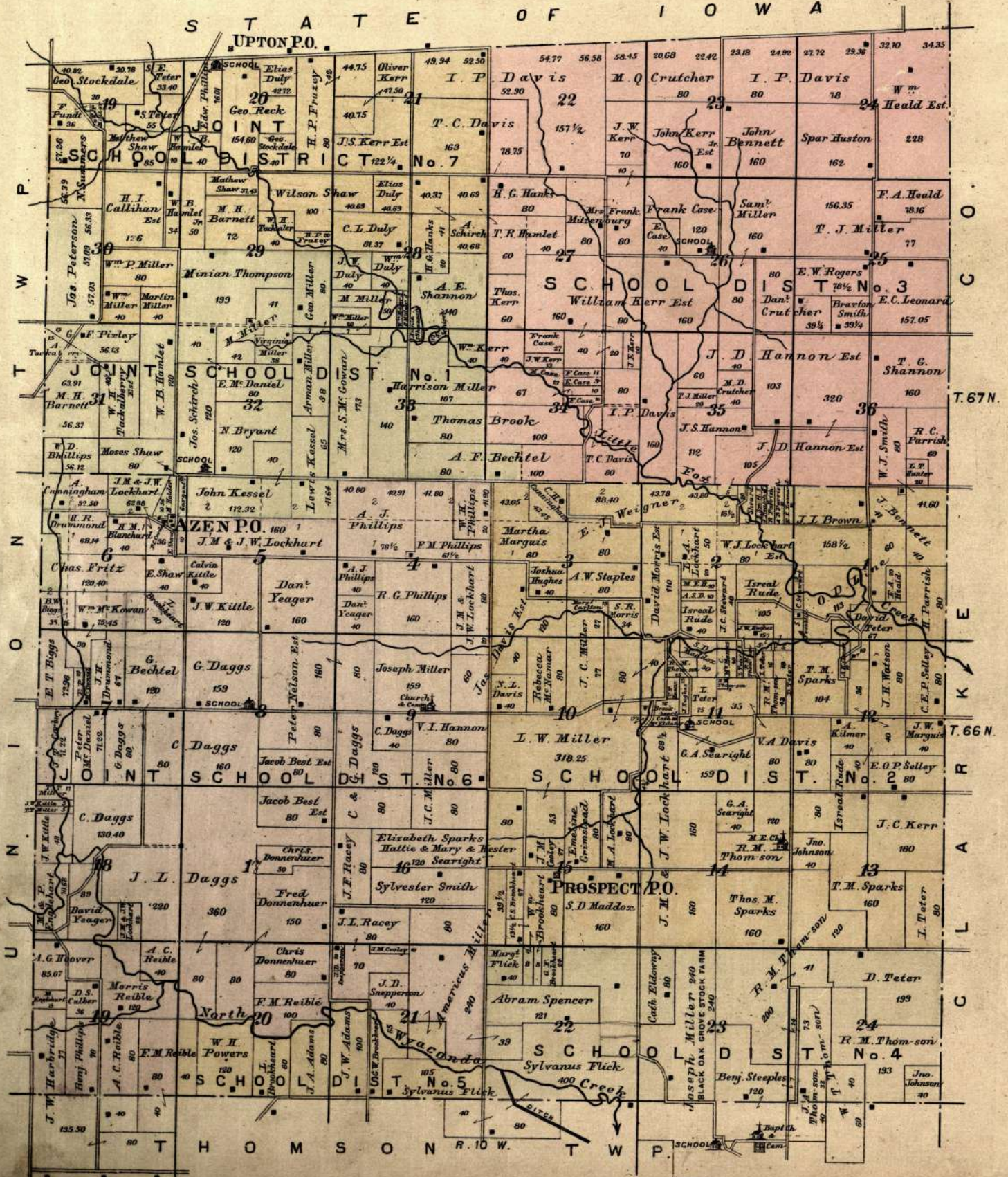

PLAT OF  
  
**MILLER**

Scale 2 Inches to the Mile. Townships 66 & 67 North. Ranges 12 & 13 West. of the 5<sup>th</sup> Principal Meridian.

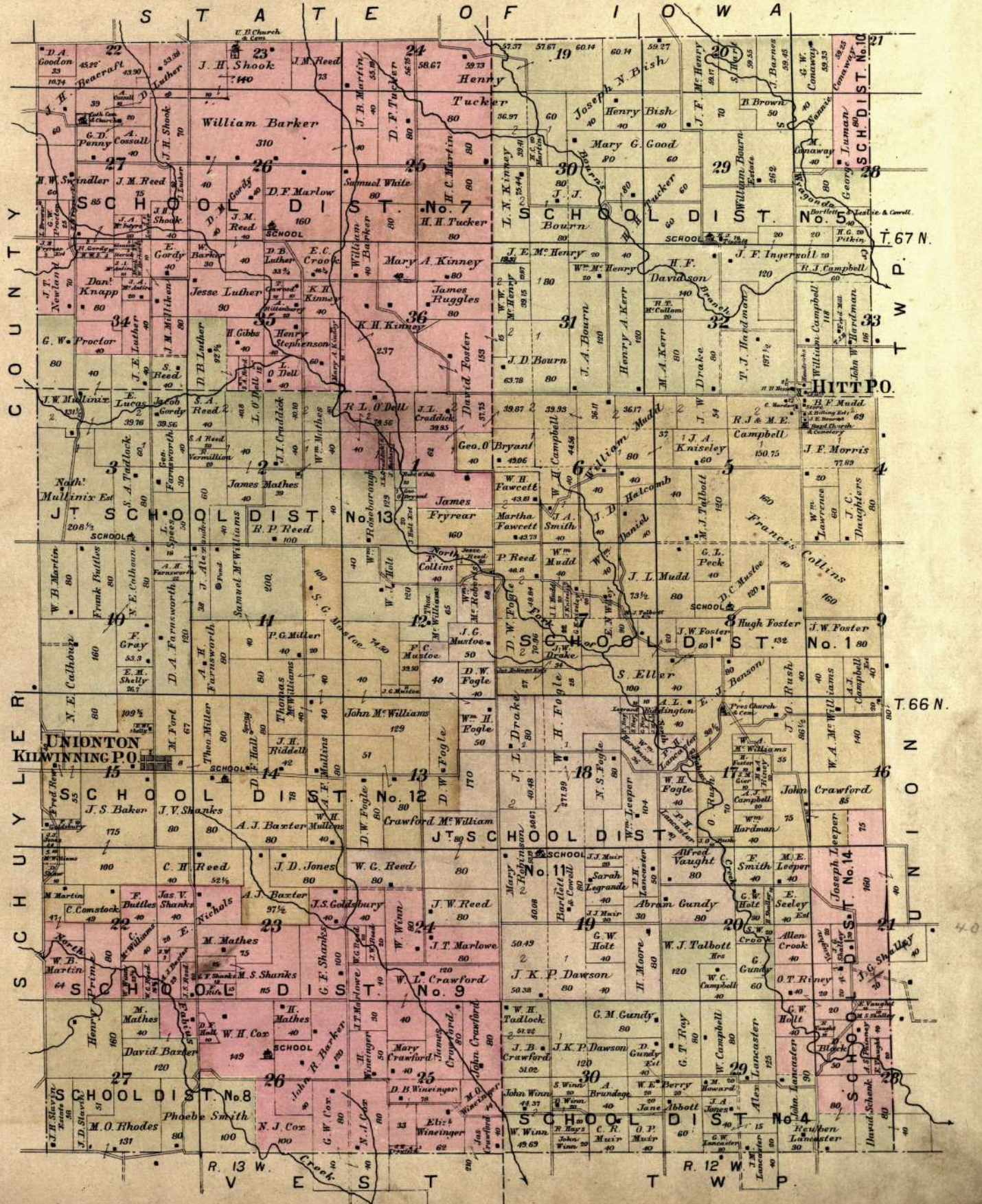

36  
 48  
 74  
 80

4080



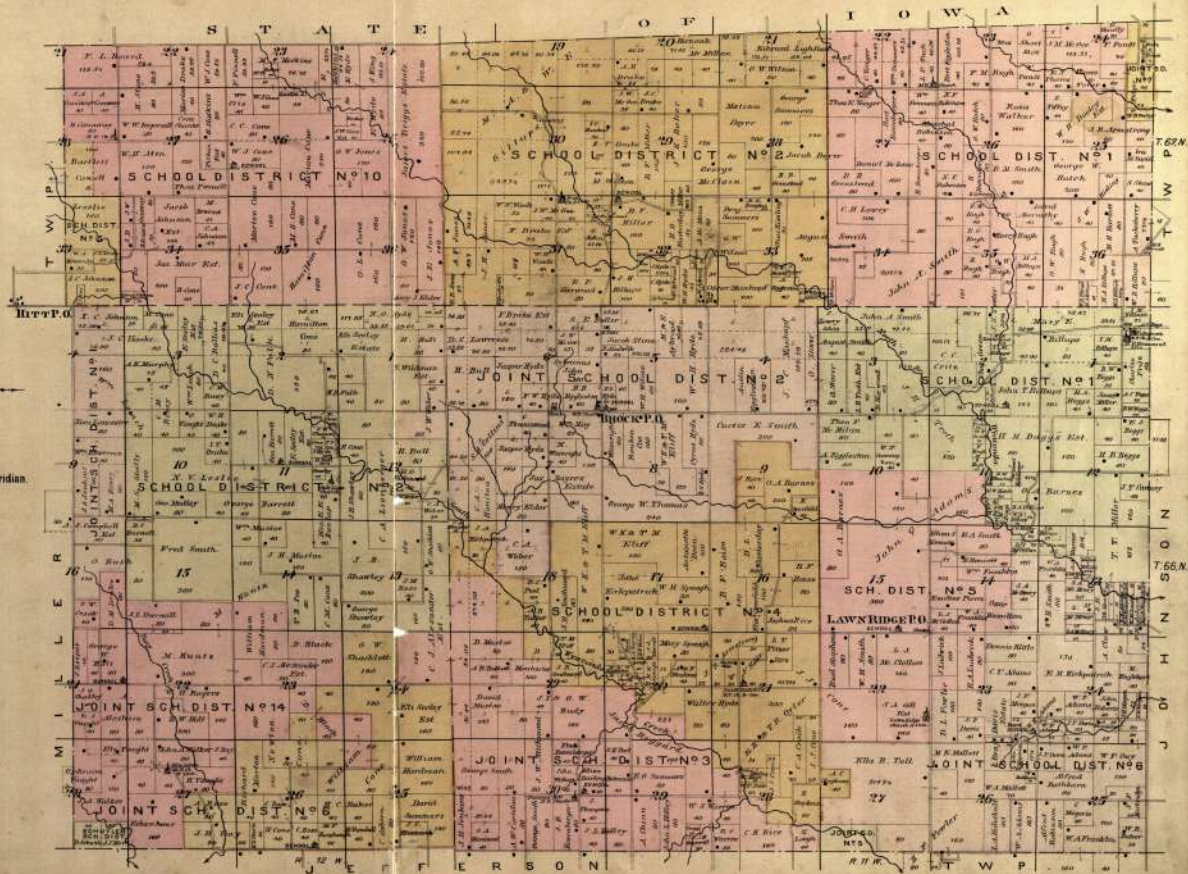

Townships 66 & 67 North. Ranges 11 & 12 West.

Scale 2 Inches to the Mile. of the 5<sup>th</sup> Principal Meridian.