

MAP OF
CLARKE COUNTY
WASHINGTON TERRITORY

COMPILED FROM THE COUNTY RECORDS, RAIL ROAD SURVEYS
AND OTHER AUTHENTIC DATA

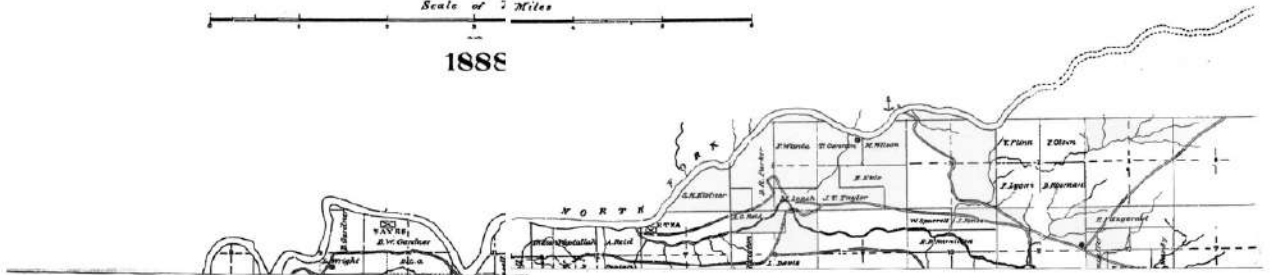

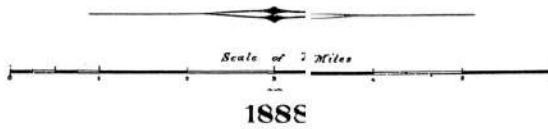
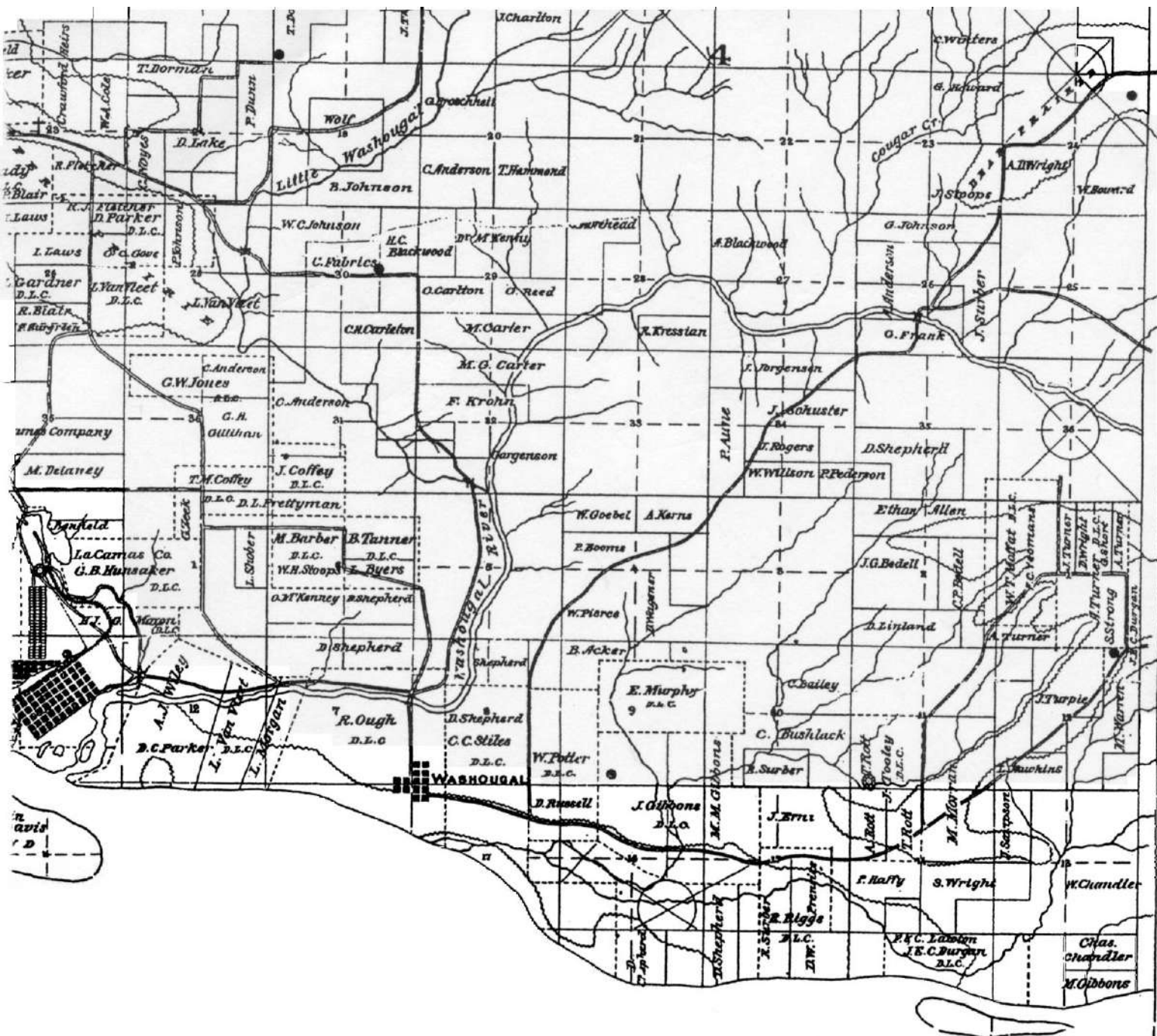

ry, and a copy filed with the Librarian of Congress.

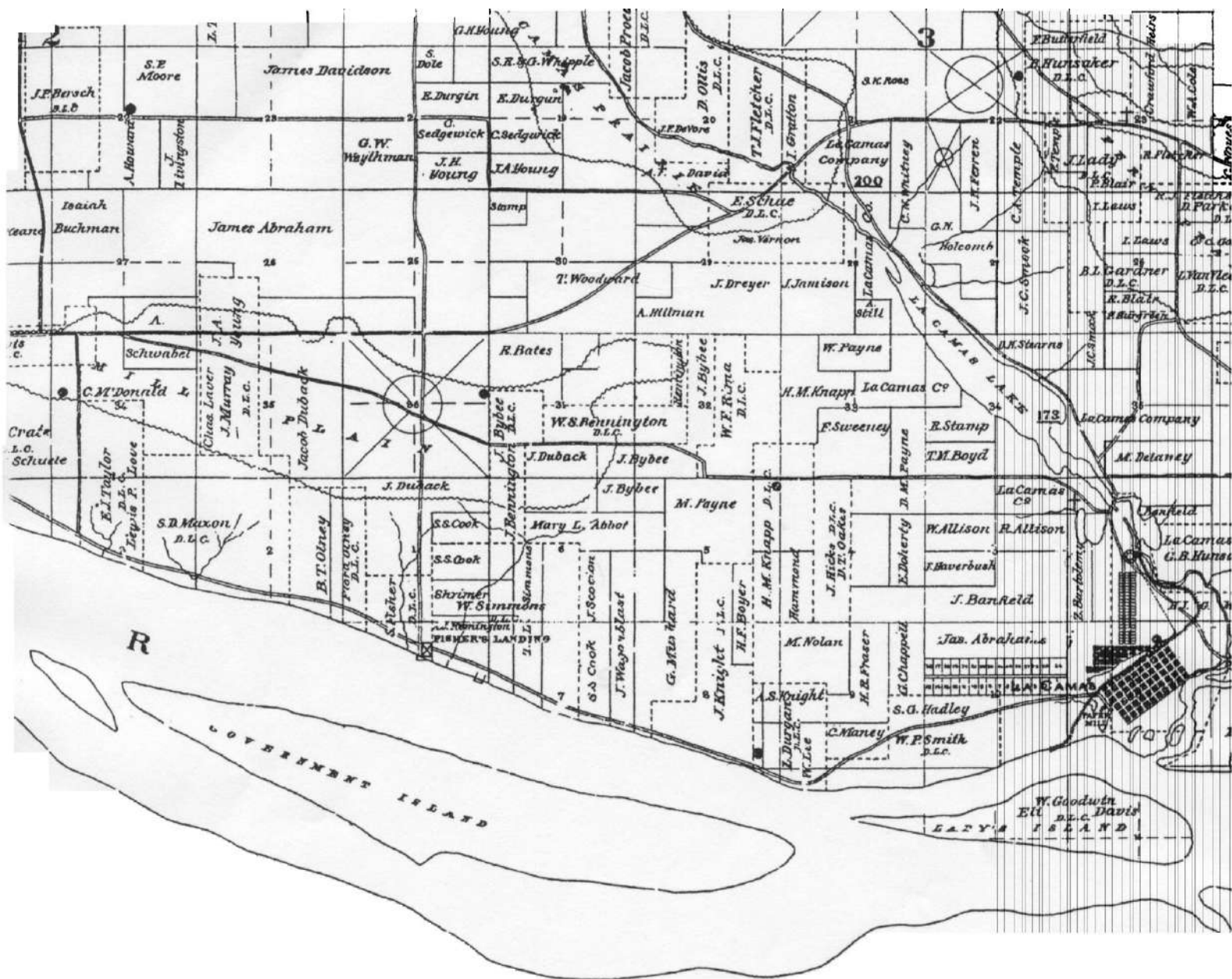

Auditor of Clarke County W. T. in the Office of the Clerk of the U.S. District Court for the District of Washington Territory, and a co

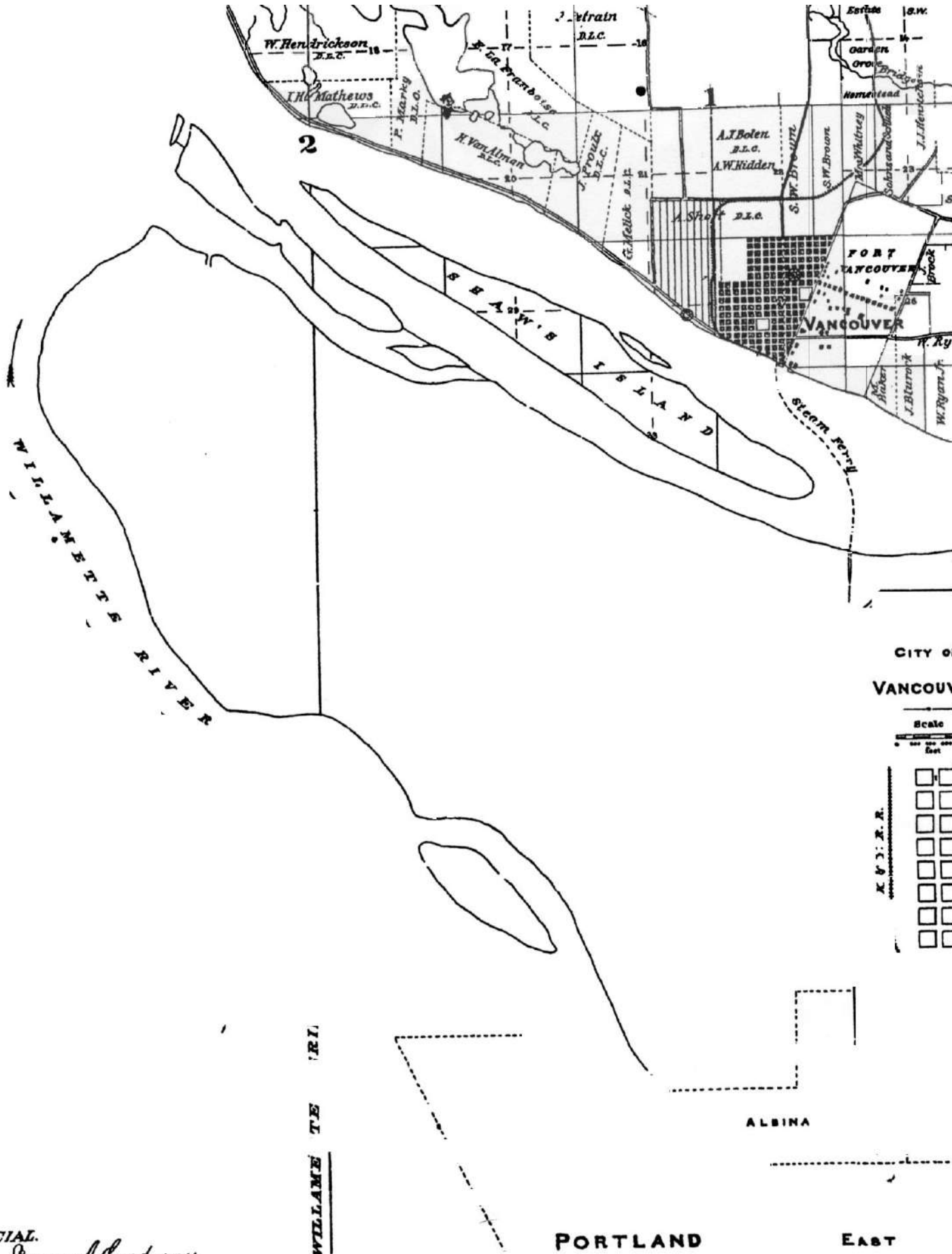

OFFICIAL.
James A. Snodgrass
 Auditor of Clarke County

Compiled by
R.A. Habersham

CITY OF
VANCOUVER

Scale
 0 100 200 300 400 500
 Feet

K.V.C.R.R.

BASE LINE

PORTLAND

EAST

ALBINA

WILLAMETTE RIVER

WILLAMETTE RIVER

SEASIDE ISLAND

FORT VANCOUVER
 VANCOUVER

STEAM FERRY

W. Hendrickson D.L.C.

J.H. Mathews D.L.C.

2

X. Van Almen D.L.C.

J. Vratn D.L.C.

S. La. Wendolise D.L.C.

P. Mackay D.L.C.

J. Proulx D.L.C.

G. Mellok D.L.C.

A.J. Bolen D.L.C.
 A.W. Hidden

A. Sturt D.L.C.

Estab. G.W.
 Garden Over Bridge

Hornstead

S.W. Brown

S.W. Brown

Mrs. Whitney

Sokals and Saffell

J. J. Henshaw

N. Ry

J. Blurock

W. Ryan, Jr.

Brook

Dorr & Olsen

REFERENCES.

- | | | | |
|------------------------------|-------|------------------------------|-------|
| County Roads shown thus | ----- | Post Offices | ⊠ |
| Railroads built and building | ----- | Sawmills | ⊙ |
| " located | ----- | School Lands | ⊠ |
| Bridges | ⊕ | Prairies | ----- |
| Churches | ⊕ | Elevations above Sea Level | 500 |
| Schools | ⊙ | Head of Steamboat Navigation | ⚓ |

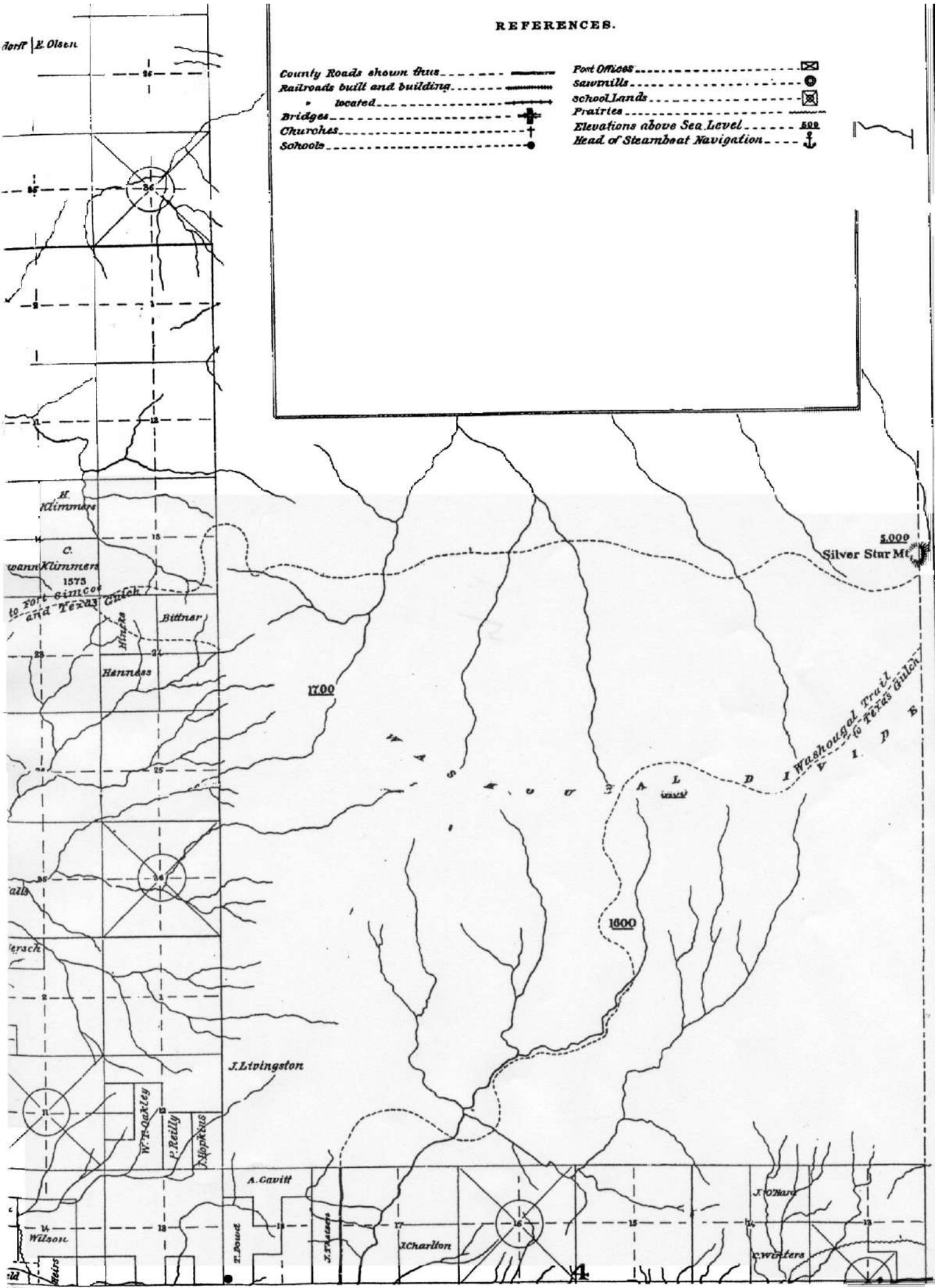

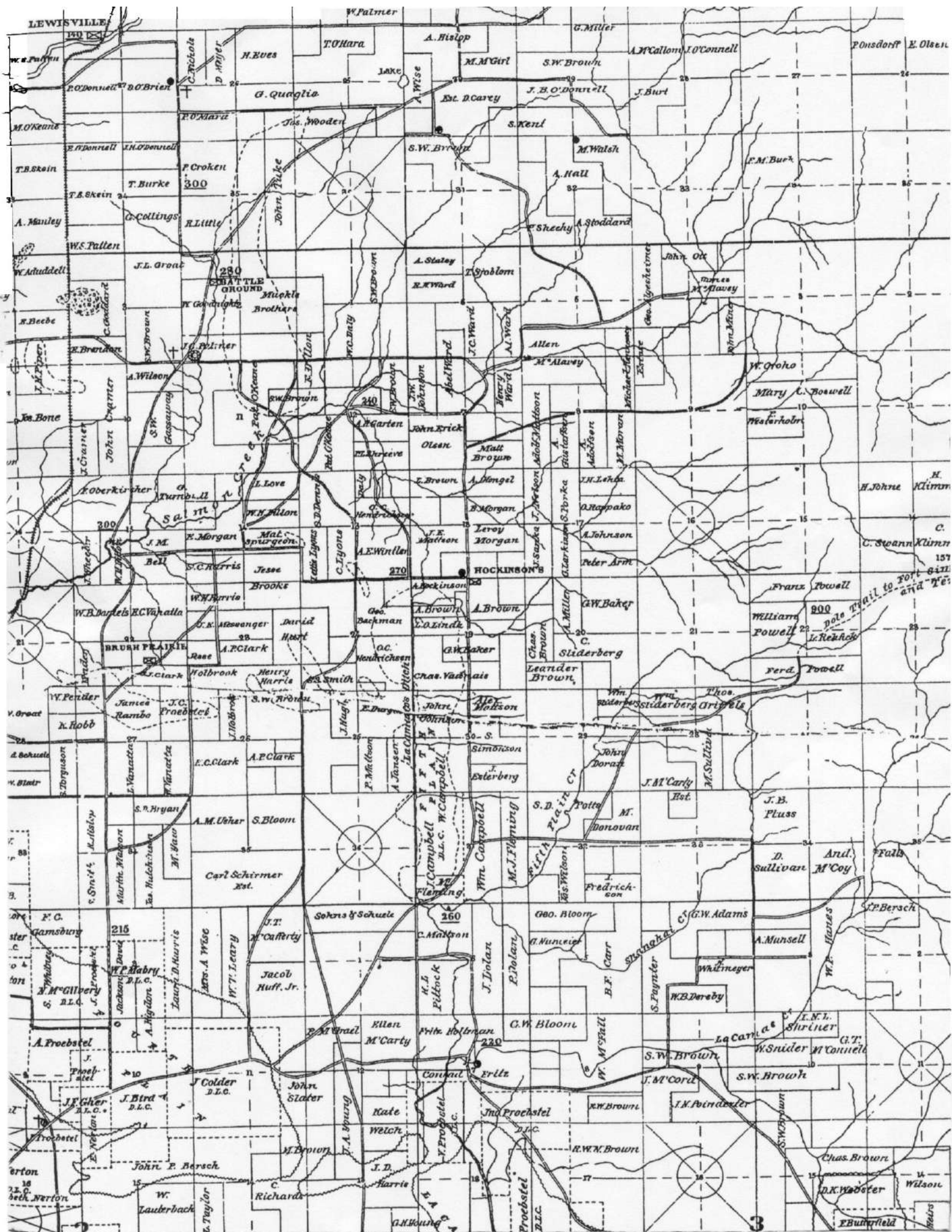





DAVIS

VANCOUVER LAKE

SHILSHOO LAKE

G. Beatty
D.L.C.

J. Stanley
D.L.C.

S.R. Whipple
D.L.C.

J.S. Hathaway
D.L.C.

M. Hathaway
D.L.C.

P. Laws
D.L.C.

J. Petrain
D.L.C.

W. Dillon
D.L.C.

D. Shurgis
D.L.C.

C. Powley
D.L.C.

W. Green
J.B. Knapp
D.L.C.

A.J. Watrous
D.L.C.

W. Churchill
Est.

J.A. Bennett
D.L.C.

Louis Doane
D.L.C.

A. Robie
D.L.C.

J. Fueria
D.L.C.

W. Laker
D.L.C.

I. Patterson
D.L.C.

S.W. Brown
D.L.C.

B. Packard
D.L.C.

Ed. Meulon
D.L.C.

Ed. Meulon
D.L.C.

W. Wendel
D.L.C.

Mary Goss
D.L.C.

W. Kelly
D.L.C.

G.S. Fry
D.L.C.

J.H. Goddard
D.L.C.

Whipple & Thomas
D.L.C.

Jas. Abraham
D.L.C.

D.K. Lambert
D.L.C.

J. Barron
D.L.C.

Nicholas
D.L.C.

T.J. Wilson
D.L.C.

W.R. Anderson
D.L.C.

B.L. Morrison
D.L.C.

Mrs. J.R. Hathaway
D.L.C.

J.J. Cross
D.L.C.

Jas. Abraham
D.L.C.

D.K. Lambert
D.L.C.

Mrs. McC. Rourke
D.L.C.

C. Dimick
D.L.C.

J.B. Blanchet
D.L.C.

W. Kelly
D.L.C.

C.N. Froud
D.L.C.

Mrs. F.M. Bell
D.L.C.

M. Mitcakh
D.L.C.

J.J. Cross
D.L.C.

W. Blank
D.L.C.

Mrs. McC. Rourke
D.L.C.

C. Dimick
D.L.C.

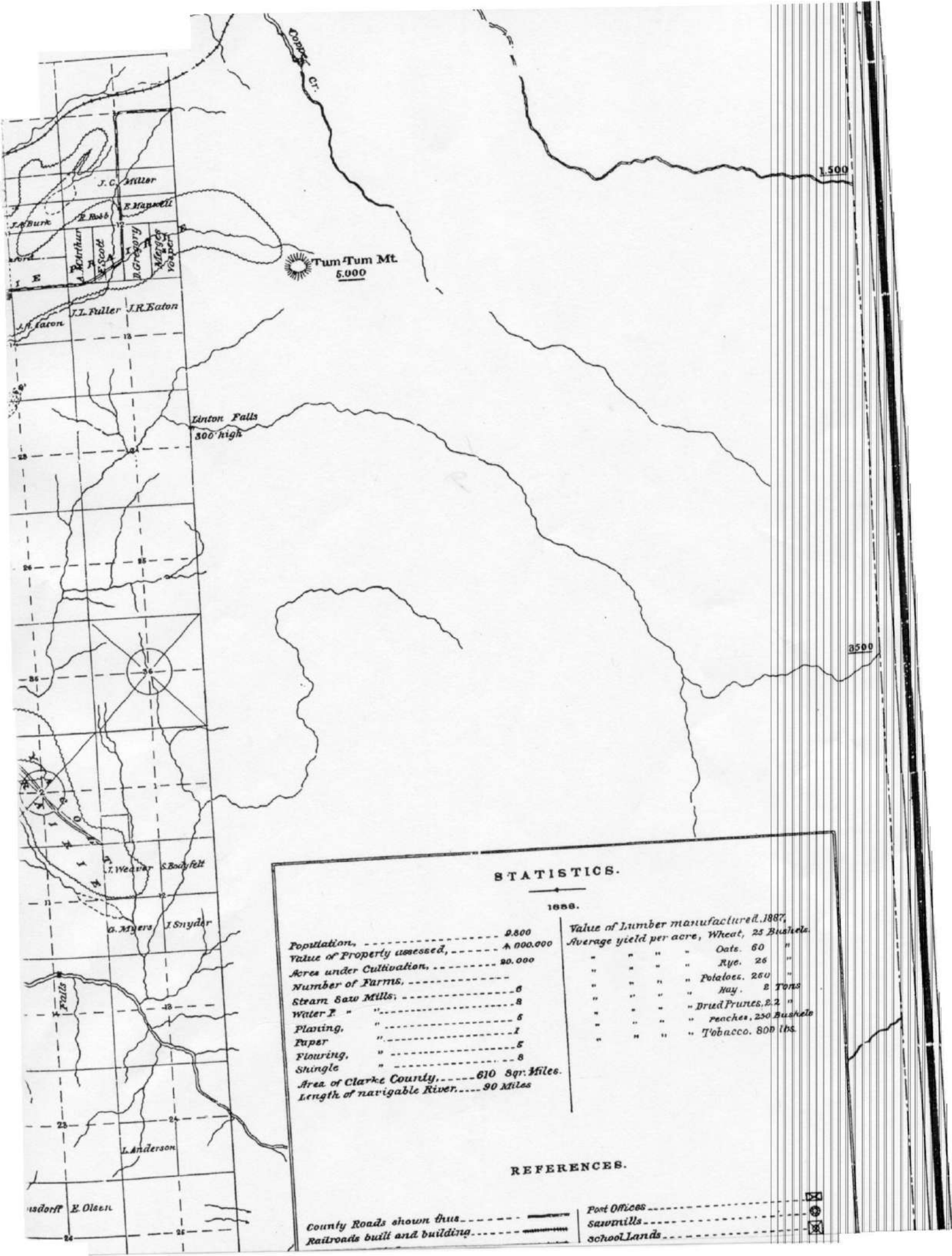

STATISTICS.

1888.

Population,	9,800
Value of Property assessed,	\$ 1,000,000
Acres under Cultivation,	20,000
Number of Farms,	
Steam Saw Mills,	8
Water " "	8
Planing, "	5
Paper "	1
Flouring, "	5
Shingle "	8
Area of Clarke County,	610 Sqr. Miles.
Length of navigable River,	90 Miles

Value of Lumber manufactured, 1887,	
Average yield per acre, Wheat, 25 Bushels.	
" " " " Oats, 60 "	
" " " " Rye, 26 "	
" " " " Potatoes, 260 "	
" " " " Hay, 2 Tons	
" " " " Dried Fruits, 2.2 "	
" " " " Peaches, 250 Bushels	
" " " " Tobacco, 800 lbs.	

REFERENCES.

County Roads shown thus	Post Offices	
Railroads built and building	Sawmills	
	School Lands	

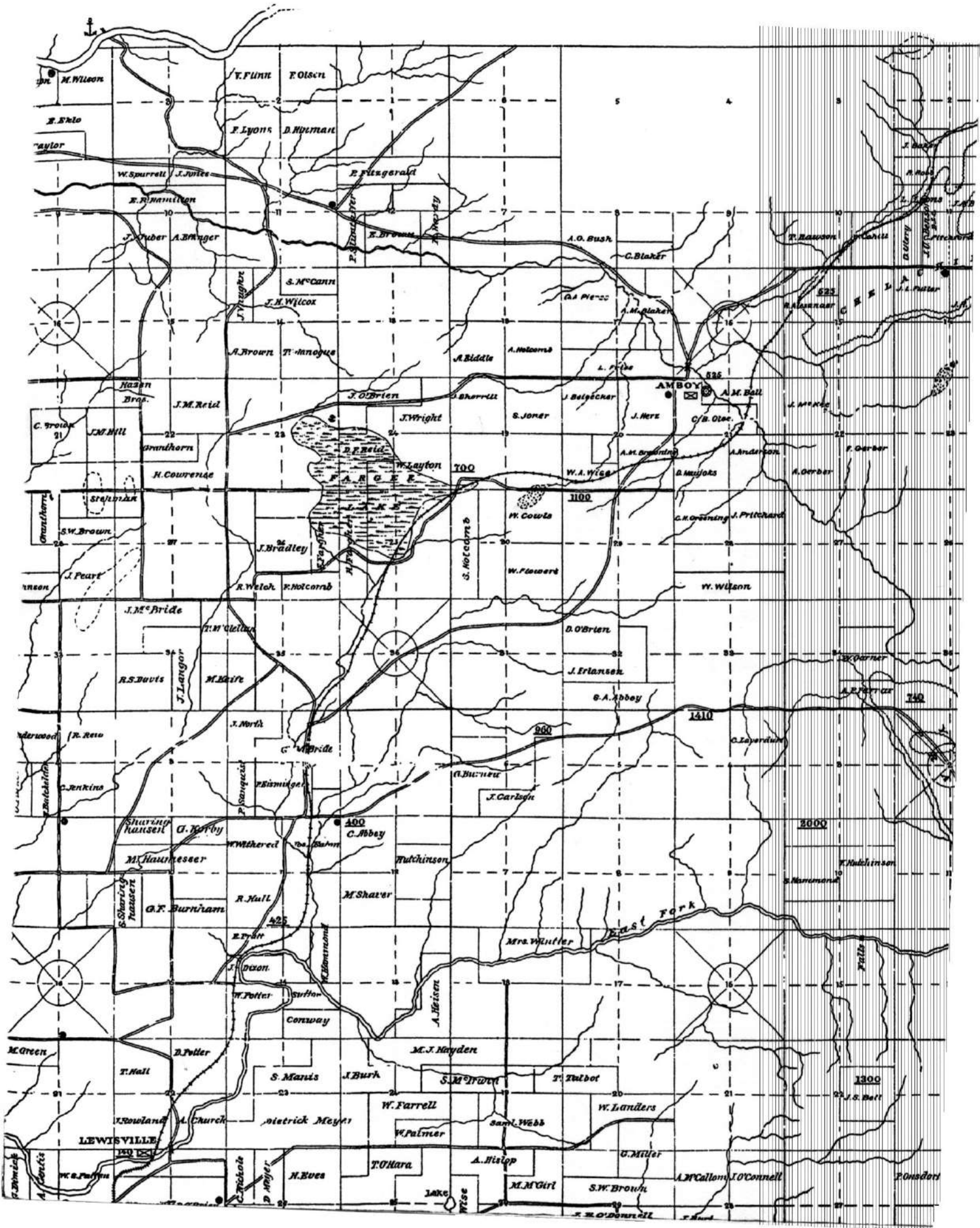



NORTH

F. Wanta T. Carver M. Will
S.H. Kistner D.R. Barker
Lunch J.T. Taylor
A.C. Reid L. Davis

HAYRE
D.W. Gardner
L. Wright D.L.C.

Jacob John
Mary Bagley
C. Bachman
C. Bachman
J. Springer D.L.C.
S. Lishan D.L.C.

M. Du-Aid D. Gardner
K. Koughan
W. Perberg
W. Perberg

India Kaptalla
A. Reid
Madam Louis
L. Nor
K.H. Lund
O. Dober
J.N. Calvin

L. Nor
K.H. Lund
O. Dober
J.N. Calvin

J.H. Calvin K.W. Snapp
J.H. Harsley
J.H. Harsley
R.H. Reid
Grazdhorst

E. Olsen
J. Anderson
L. Arrild
L. Lund
C. Aur
J.C. Miller
J.H. Bolen
E. Sutton
W. Brothers

H. Bart
J. Ehrke
L. Lindholm
L. Anderson
B. Bagley
Christianson

J.H. Calvin K.W. Snapp
J.H. Harsley
J.H. Harsley
R.H. Reid
Grazdhorst

W. Bratton D.L.C.
S. Lishan D.L.C.
C.H. Fairfield D.L.C.
O. Kinder
P.E. K.

G. Warnace
F. Saunders
L.M. Love
L. M. Love
L. M. Love
L. M. Love

H. Bart
J. Ehrke
L. Lindholm
L. Anderson
B. Bagley
Christianson

J.H. Calvin K.W. Snapp
J.H. Harsley
J.H. Harsley
R.H. Reid
Grazdhorst

O. Kinder
P.E. K.
W.C.
Thornton
D. Jones
D. Cowley
D. Cowley
D. Cowley
D. Cowley

G. Warnace
F. Saunders
L.M. Love
L. M. Love
L. M. Love
L. M. Love

H. Bart
J. Ehrke
L. Lindholm
L. Anderson
B. Bagley
Christianson

J.H. Calvin K.W. Snapp
J.H. Harsley
J.H. Harsley
R.H. Reid
Grazdhorst

O. Kinder
P.E. K.
W.C.
Thornton
D. Jones
D. Cowley
D. Cowley
D. Cowley
D. Cowley

G. Warnace
F. Saunders
L.M. Love
L. M. Love
L. M. Love
L. M. Love

H. Bart
J. Ehrke
L. Lindholm
L. Anderson
B. Bagley
Christianson

J.H. Calvin K.W. Snapp
J.H. Harsley
J.H. Harsley
R.H. Reid
Grazdhorst

O. Kinder
P.E. K.
W.C.
Thornton
D. Jones
D. Cowley
D. Cowley
D. Cowley
D. Cowley

G. Warnace
F. Saunders
L.M. Love
L. M. Love
L. M. Love
L. M. Love

H. Bart
J. Ehrke
L. Lindholm
L. Anderson
B. Bagley
Christianson

J.H. Calvin K.W. Snapp
J.H. Harsley
J.H. Harsley
R.H. Reid
Grazdhorst

O. Kinder
P.E. K.
W.C.
Thornton
D. Jones
D. Cowley
D. Cowley
D. Cowley
D. Cowley

G. Warnace
F. Saunders
L.M. Love
L. M. Love
L. M. Love
L. M. Love

H. Bart
J. Ehrke
L. Lindholm
L. Anderson
B. Bagley
Christianson

J.H. Calvin K.W. Snapp
J.H. Harsley
J.H. Harsley
R.H. Reid
Grazdhorst

O. Kinder
P.E. K.
W.C.
Thornton
D. Jones
D. Cowley
D. Cowley
D. Cowley
D. Cowley

G. Warnace
F. Saunders
L.M. Love
L. M. Love
L. M. Love
L. M. Love

H. Bart
J. Ehrke
L. Lindholm
L. Anderson
B. Bagley
Christianson

J.H. Calvin K.W. Snapp
J.H. Harsley
J.H. Harsley
R.H. Reid
Grazdhorst

O. Kinder
P.E. K.
W.C.
Thornton
D. Jones
D. Cowley
D. Cowley
D. Cowley
D. Cowley

G. Warnace
F. Saunders
L.M. Love
L. M. Love
L. M. Love
L. M. Love

H. Bart
J. Ehrke
L. Lindholm
L. Anderson
B. Bagley
Christianson

J.H. Calvin K.W. Snapp
J.H. Harsley
J.H. Harsley
R.H. Reid
Grazdhorst

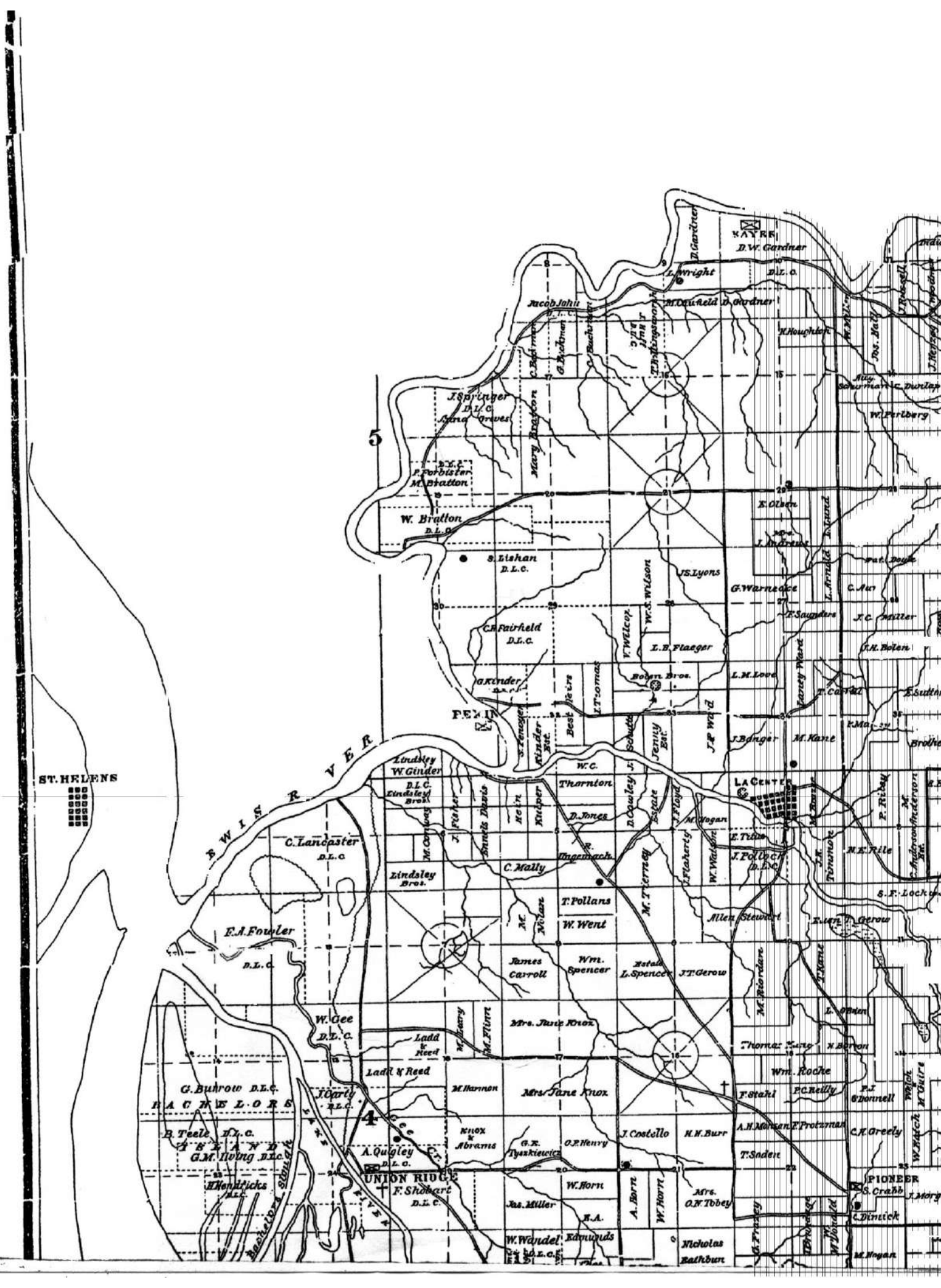

ST. HELENS

RIVER
WIRRAL

5

PEX

G. Burrow D.L.C.
HACKFLOORS

B. Teale D.L.C.
F. E. A. N. B.
G.M. Irving D.L.C.

Thompsons
D.L.C.

J. O'Carry
D.L.C.

A. Quigley
D.L.C.

F. Shohart
D.L.C.

UNION RIDGE
D.L.C.

M. Harmon

Ladd & Reed

W. Gee
D.L.C.

E.A. Fowler
D.L.C.

Lindsley Bros.

C. Lancaster
D.L.C.

Lindsay W. Ginder
D.L.C.

W. Bratton
D.L.C.

J. Springer
D.L.C.

S. Eishan
D.L.C.

P. Forbister
M. Stratton

J. Springer
D.L.C.

Jacob John

W. Wright

D.V. Gardner
D.L.C.

M. O'Connell
D.L.C.

M. O'Connell
D.L.C.

W.C.

Thornton

D. Jones

C. Mally

T. Pollans

W. Went

James Carroll

Mrs. Jane Knox

Mrs. Jane Knox

Mrs. Jane Knox

Mrs. Jane Knox

M. T. Terry

Wm. Spencer

L. Spence

J.T. Gerow

M. Riordan

Wm. Roche

F. Staki

P.C. Reilly

P.J. Donnell

C.K. Greely

PIONEER
S. Crahb

J. Pollock
D.L.C.

Allen Stewart

J. Gerow

M. Riordan

Wm. Roche

F. Staki

P.C. Reilly

P.J. Donnell

C.K. Greely

PIONEER
S. Crahb

J. Pollock
D.L.C.

Allen Stewart

J. Gerow

M. Riordan

Wm. Roche

F. Staki

P.C. Reilly

P.J. Donnell

C.K. Greely

PIONEER
S. Crahb

J. Pollock
D.L.C.

Allen Stewart

J. Gerow

M. Riordan

Wm. Roche

F. Staki

P.C. Reilly

P.J. Donnell

C.K. Greely

PIONEER
S. Crahb

