

# MAP OF COFFEY CO., KANSAS.

Scale 1/2 in. to 1 mile.

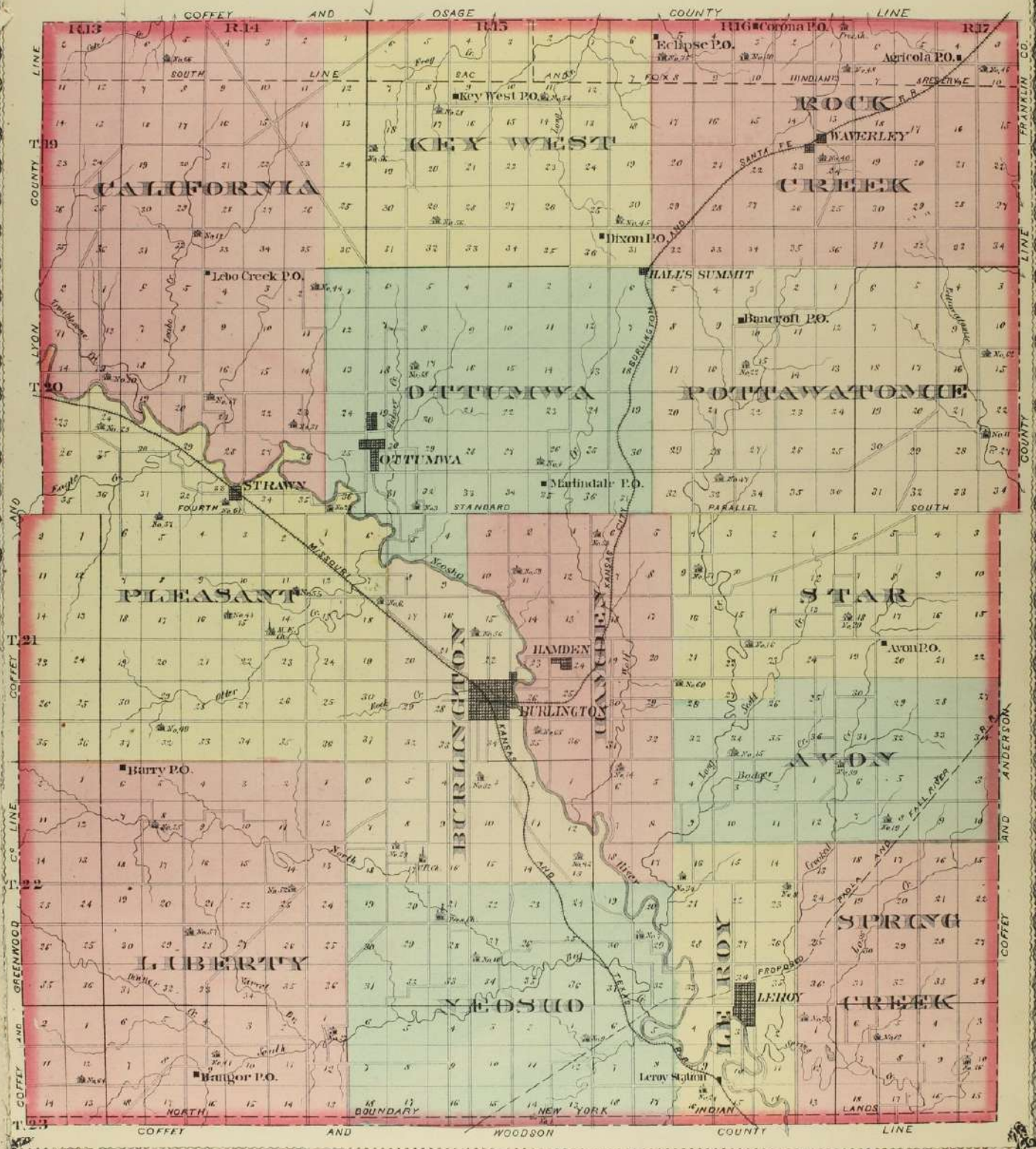

# LE ROY

Scale 300 ft to 1 inch

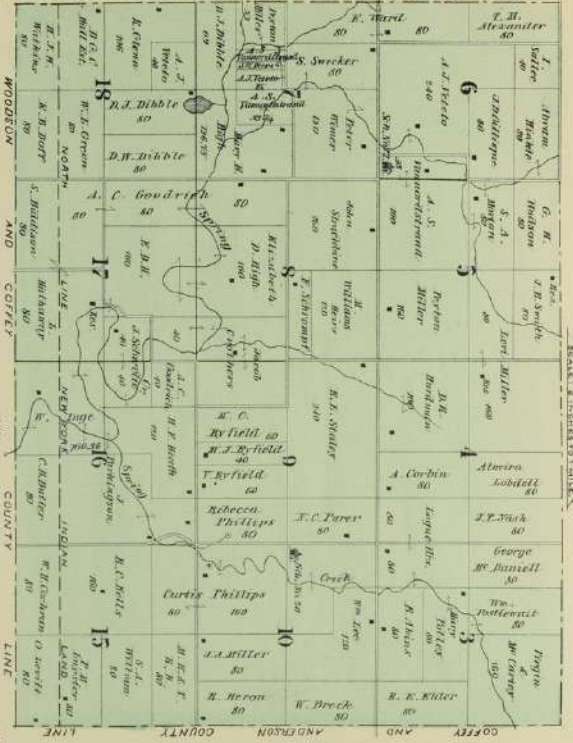
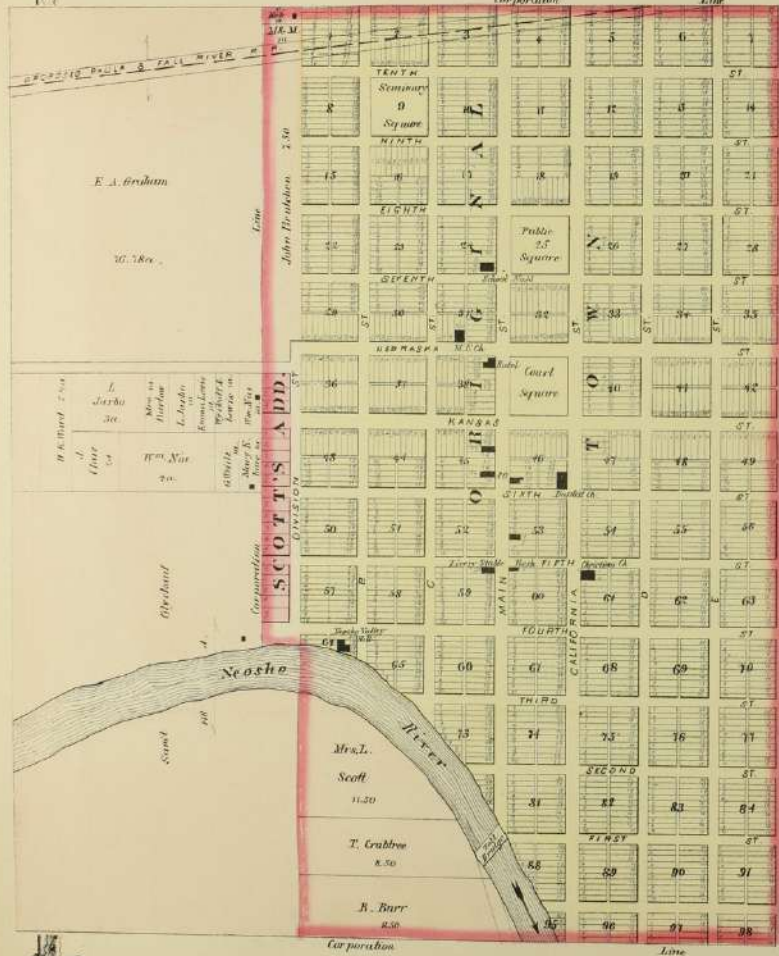

**TOWNSHIP 23 SOUTH RANGE 17 EAST**

OF THE DISTRICT OF MISSOURI

PLAT

MAP OF  
**TOWNSHIP 22 SOUTH RANGE 17 EAST.**  
 OF THE 6<sup>TH</sup> PRINCIPAL MERIDIAN.  
 SCALE: 2 INCHES TO A MILE.

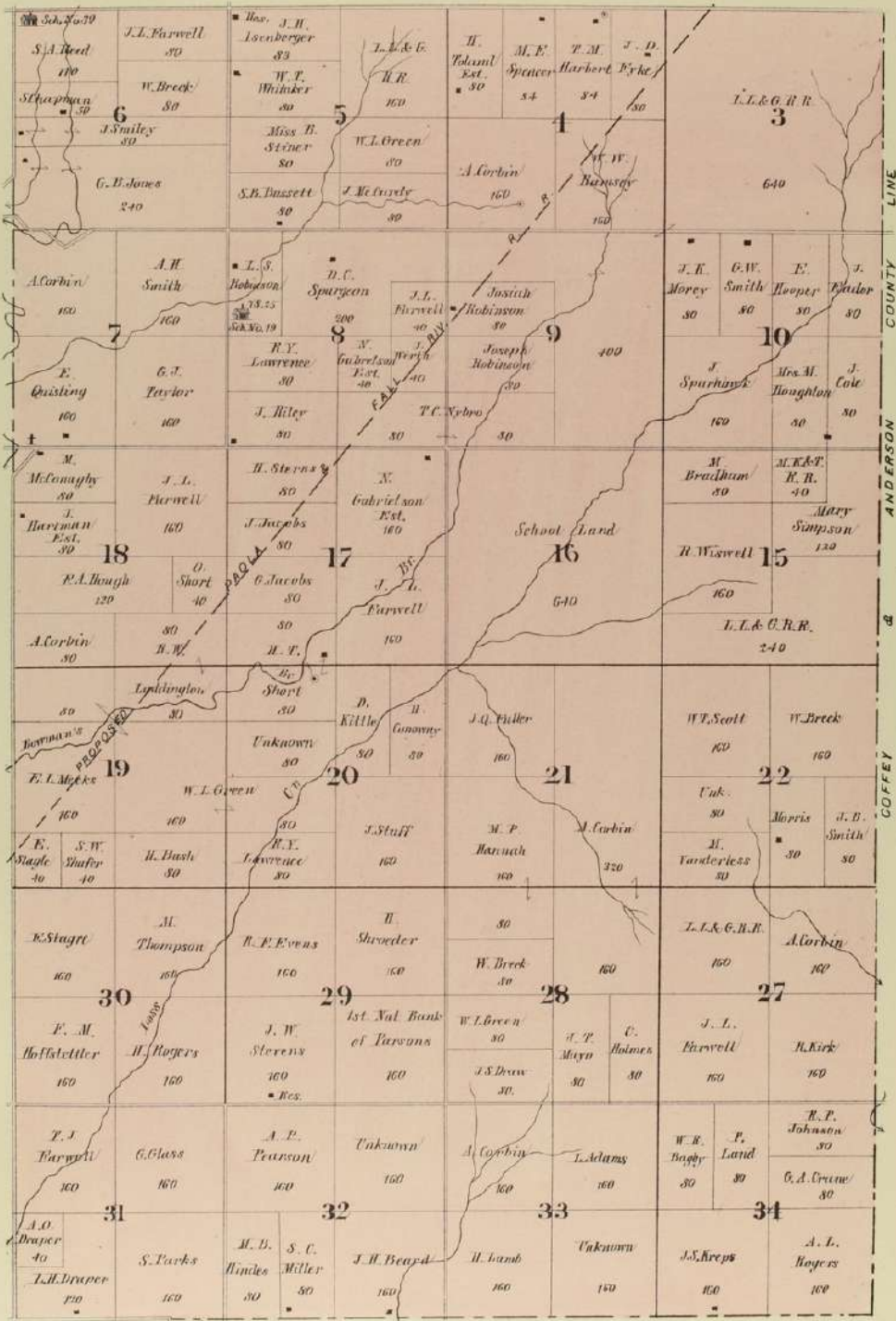

ANDERSON COUNTY LINE  
 ANDERSON COUNTY  
 COFFEY COUNTY

MAP OF  
**TOWNSHIP 21 SOUTH RANGE 17 EAST.**  
 OF THE 6TH PRINCIPAL MERIDIAN  
 SECTION 36, 37, 38  
 SCALE 2 INCHES TO 1 MILE

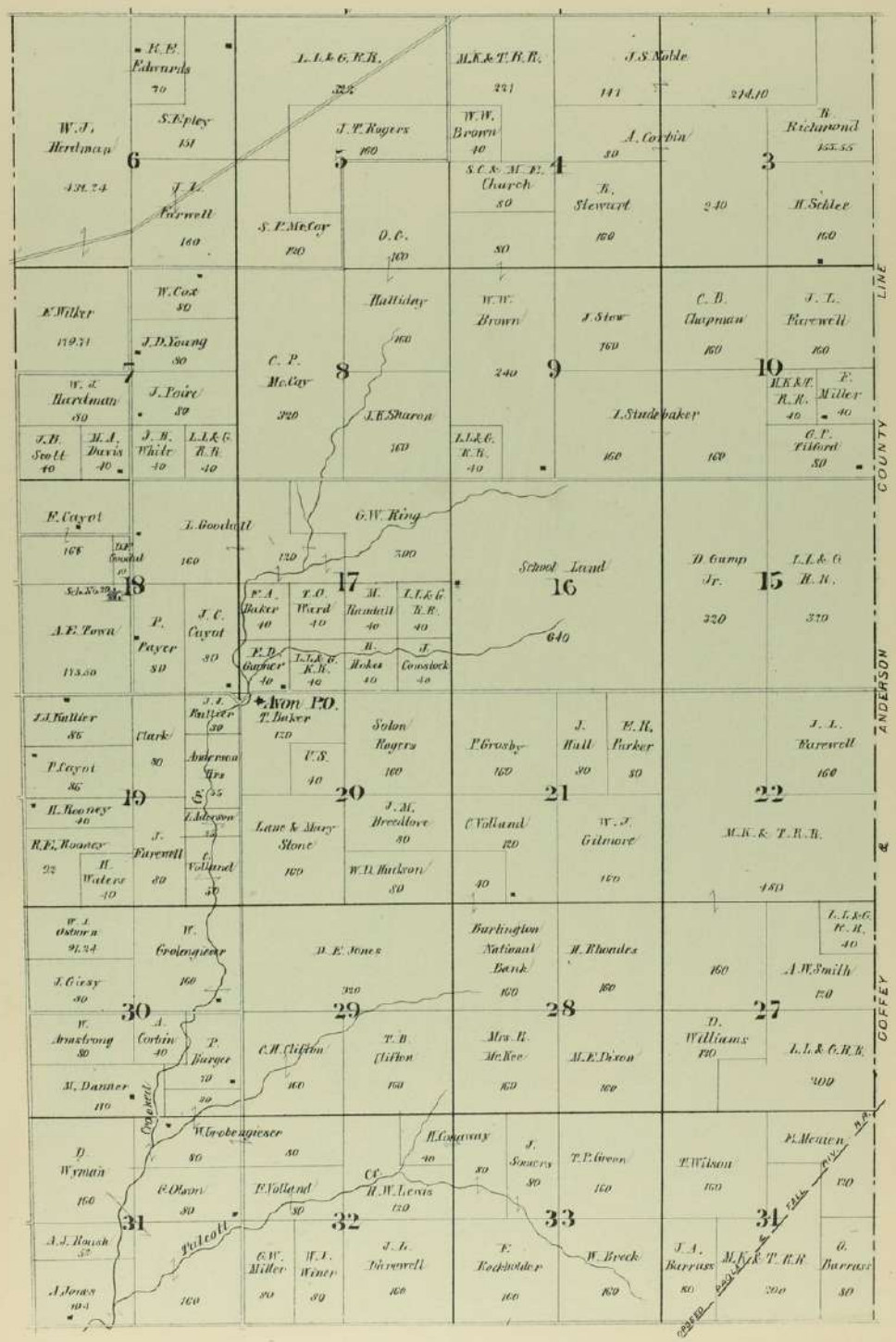

ANDERSON COUNTY  
 COFFEY COUNTY

MAP OF  
**TOWNSHIP 20 SOUTH RANGE 17 EAST.**  
 OF THE 6<sup>th</sup> PRINCIPAL MERIDIAN.  
 SCALE 1 INCH TO 1 MILE

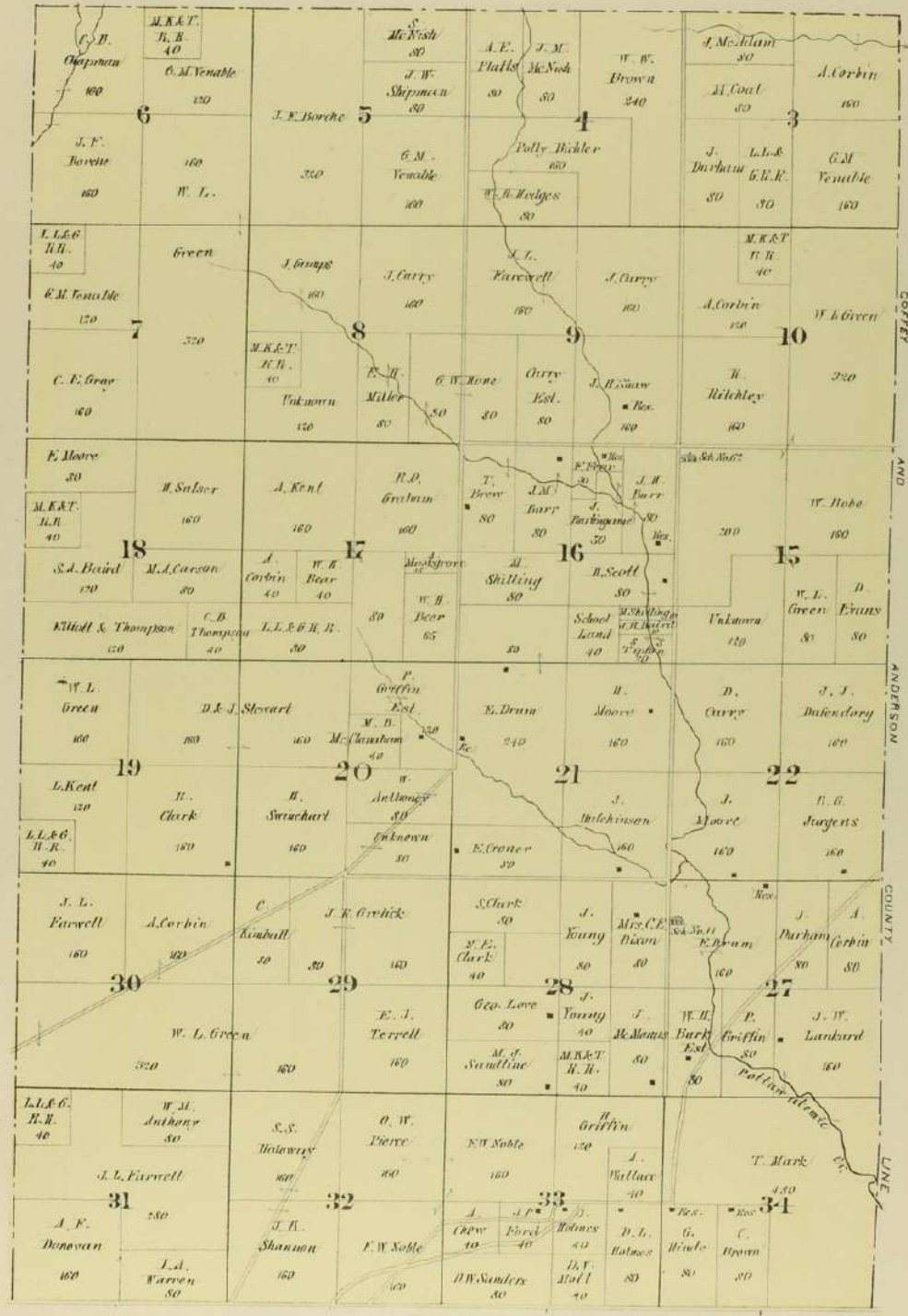

COFFEY AND ANDERSON COUNTY LINE

MAP OF  
**TOWNSHIP 19 SOUTH RANGE 17 EAST.**  
 OF THE 6<sup>TH</sup> PRINCIPAL MERIDIAN  
 SCALE 8 INCHES TO A MILE

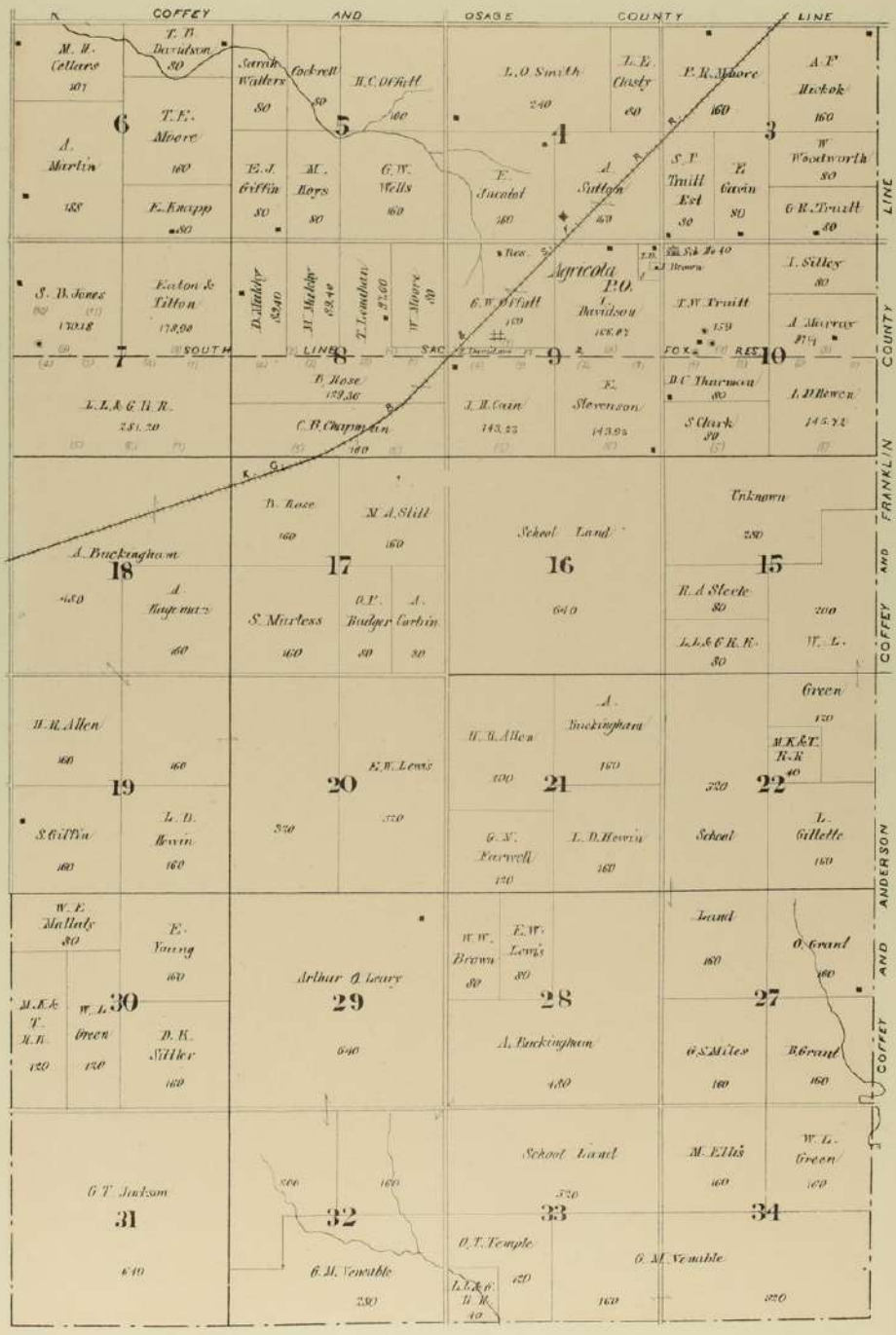

**MAP OF**  
**TOWNSHIP 19 SOUTH RANGE 16 EAST.**  
 OF THE 6<sup>TH</sup> PRINCIPAL MERIDIAN.  
 SCALE: AS SHOWN TO 1 MILE.

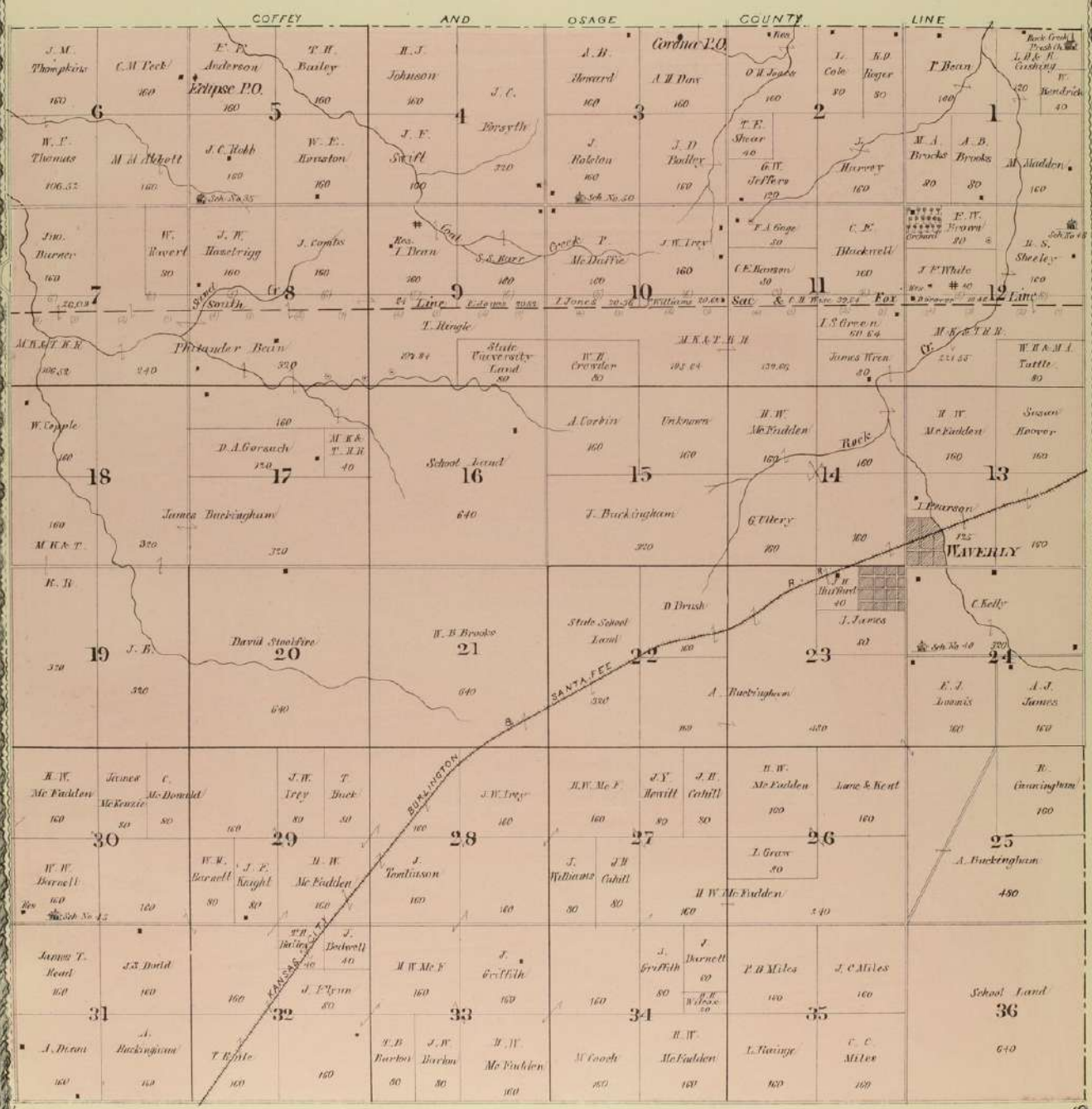

**MAP OF**  
**TOWNSHIP 20 SOUTH RANGE 16 EAST.**  
**OF THE 6TH PRINCIPAL MERIDIAN**

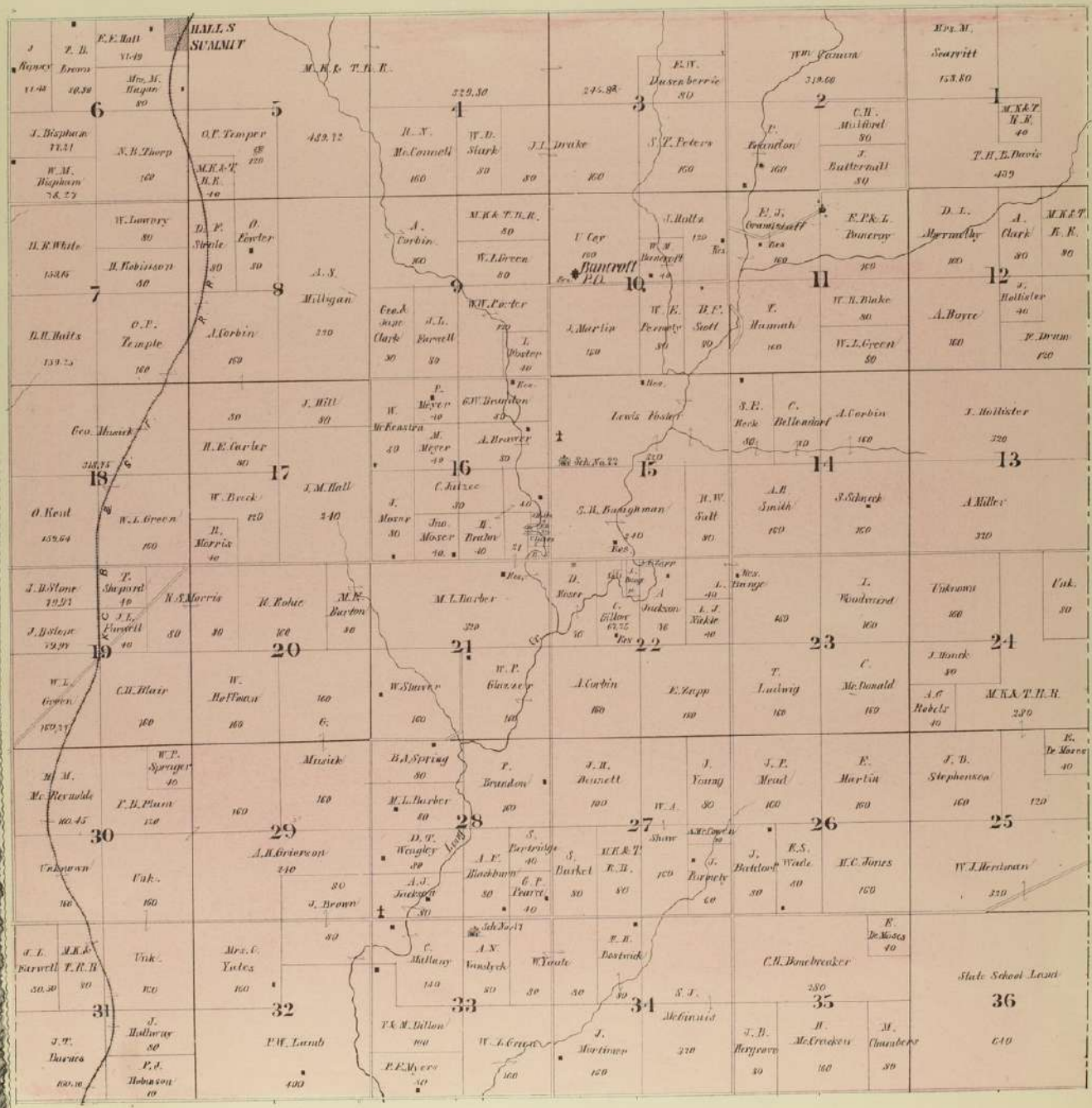



MAP OF  
**TOWNSHIP 21 SOUTH RANGE 16 EAST.**  
 OF THE 6<sup>TH</sup> PRINCIPAL MERIDIAN  
 SCALE 2 INCHES TO A MILE

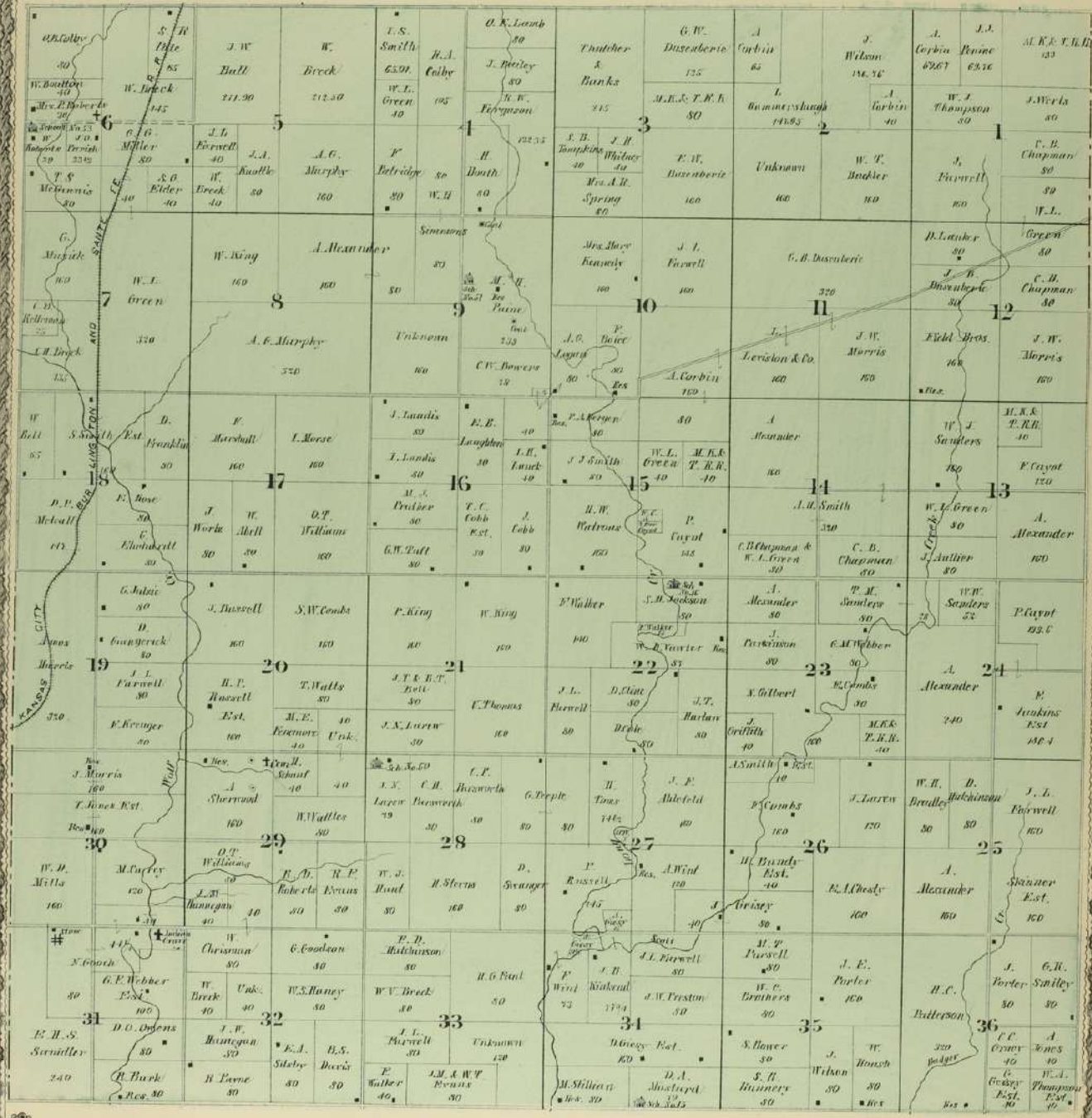

**MAP OF**  
**TOWNSHIP 22 SOUTH RANGE 16 EAST.**  
 OF THE 6<sup>TH</sup> PRINCIPAL MERIDIAN  
 SHOWING  
 SECTION LINES  
 SCALE 1 INCH = 36 FEET

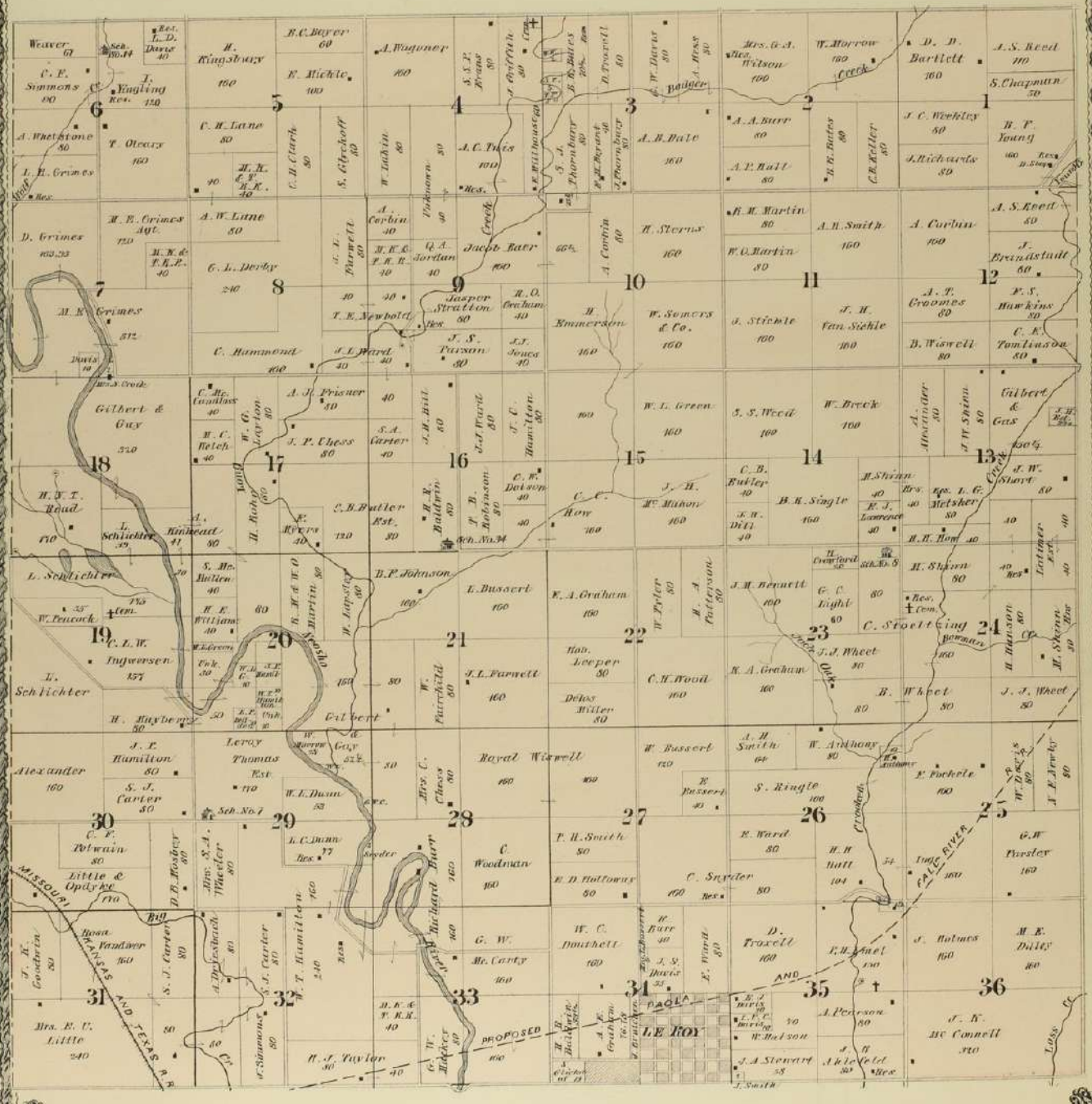

MAP OF  
**TOWNSHIP 23 SOUTH RANGE 16 EAST.**  
 OF THE 6<sup>TH</sup> PRINCIPAL MERIDIAN  
 BEARING S. 81° 30' E. DIST. 3.75 MI.

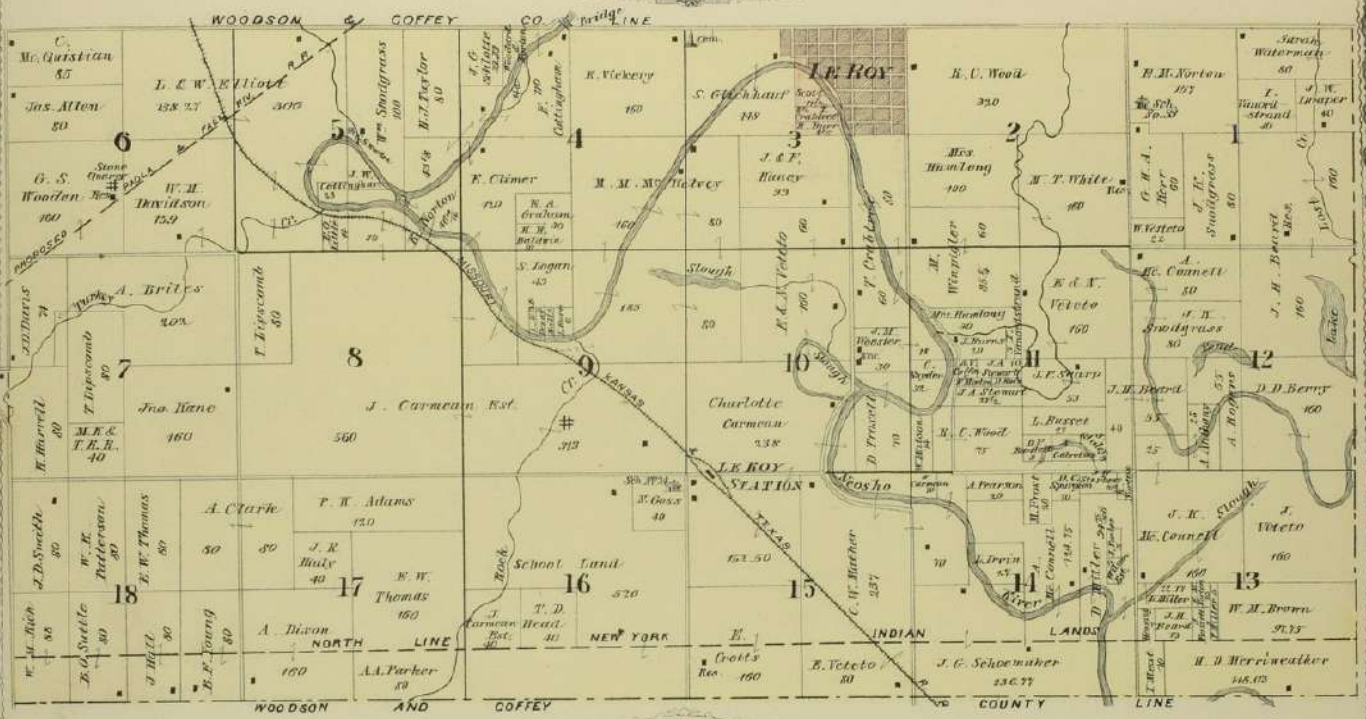

MAP OF  
**TOWNSHIP 23 SOUTH RANGE 15 EAST.**  
 OF THE 6<sup>TH</sup> PRINCIPAL MERIDIAN  
 BEARING S. 81° 30' E. DIST. 3.75 MI.

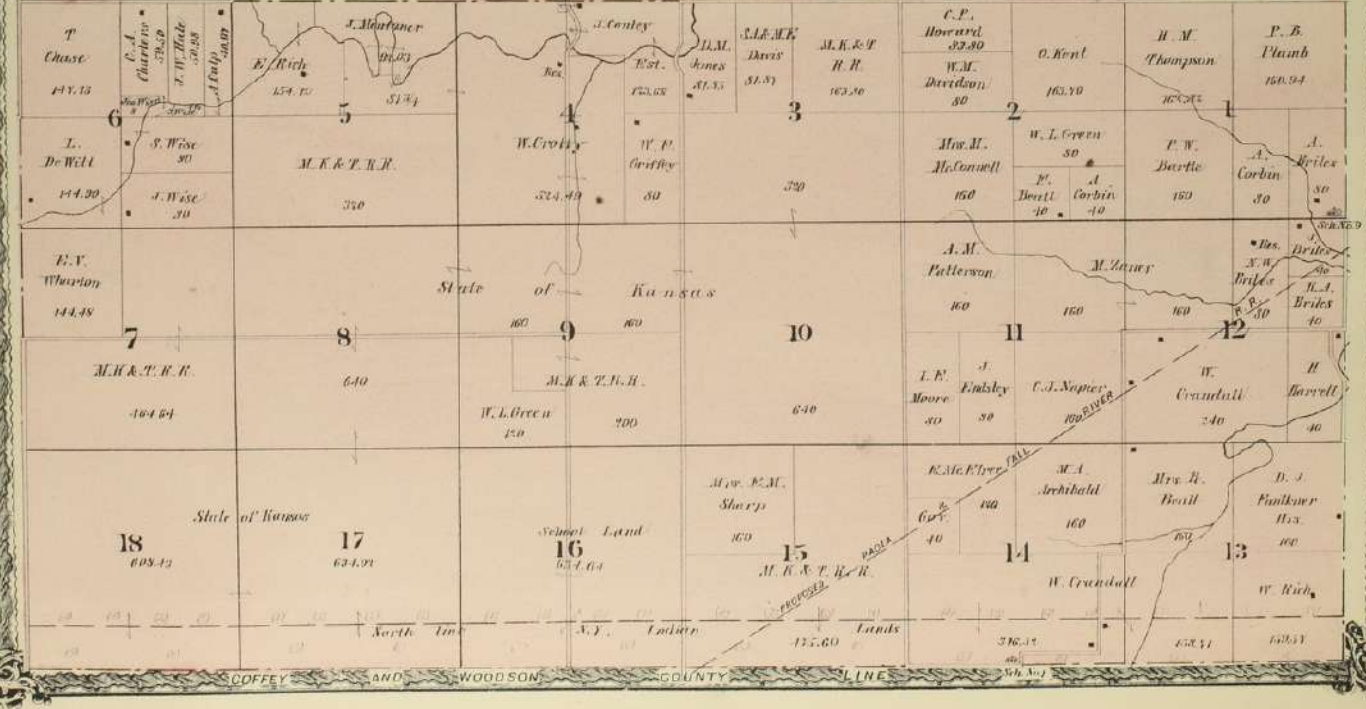



# BURLINGTON

SCALE, 500 FEET TO THE INCH

James W. Drake 1870.

W.S. Fisher  
I. Horey  
17,300

F. M. Coe 1868.  
160

Corporation Land

WHISTLER ST  
WHISTLER'S  
KINZIE ST  
ADD  
ST

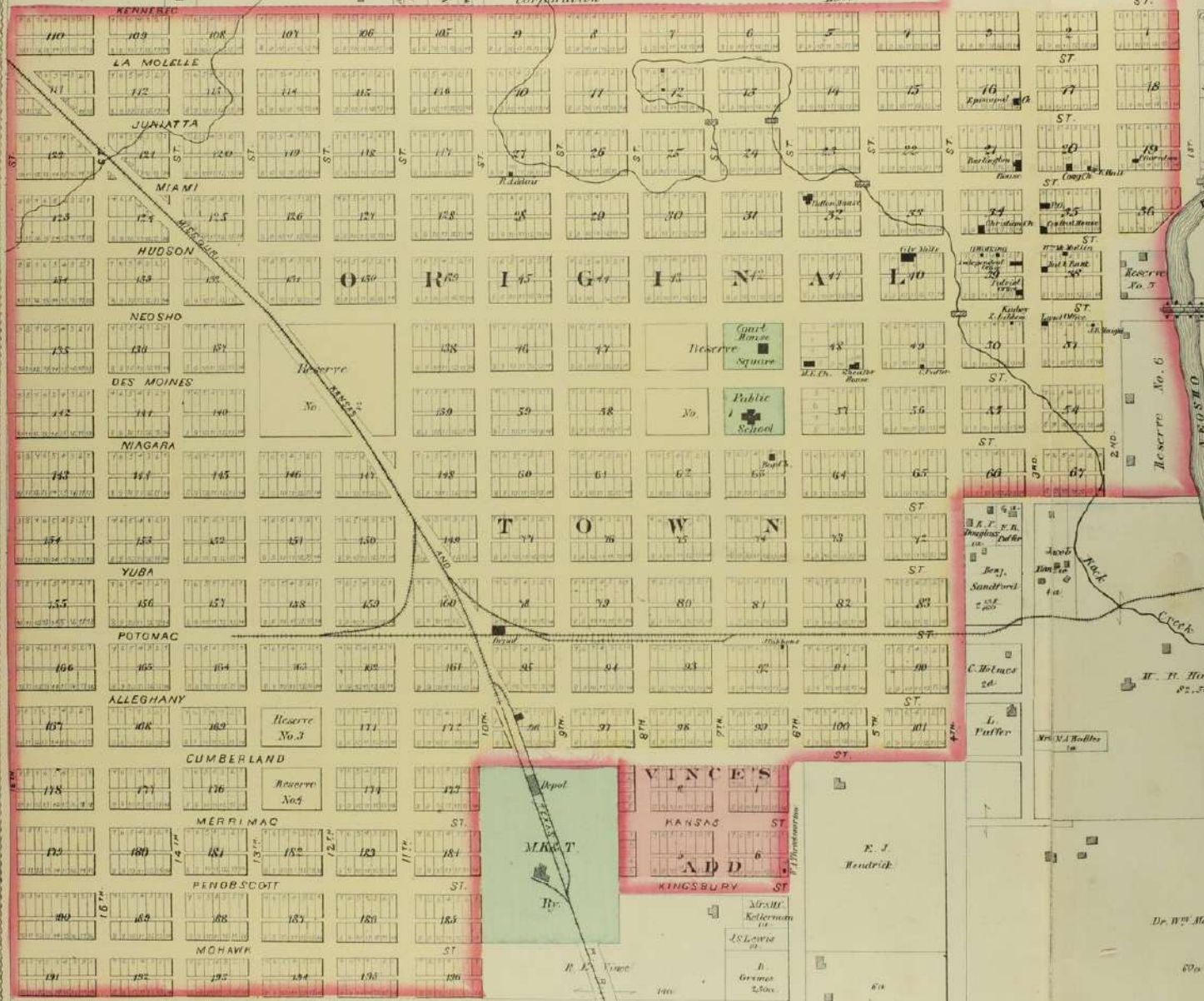

W. C. Barker C. H. 320	W. C. Barker C. H. 320	H. F. G. W. Gardner 1870	H. F. G. W. Gardner 1870
H. L. Jorboe 40 a	H. L. Jorboe 25 3/4 a	H. L. Jorboe 25 3/4 a	H. L. Jorboe 25 3/4 a
H. L. Jorboe 40 a	H. L. Jorboe 25 3/4 a	H. L. Jorboe 25 3/4 a	H. L. Jorboe 25 3/4 a

H. L. Jorboe

H. L. Jorboe

E. J. Hendrick

J. M. Lee

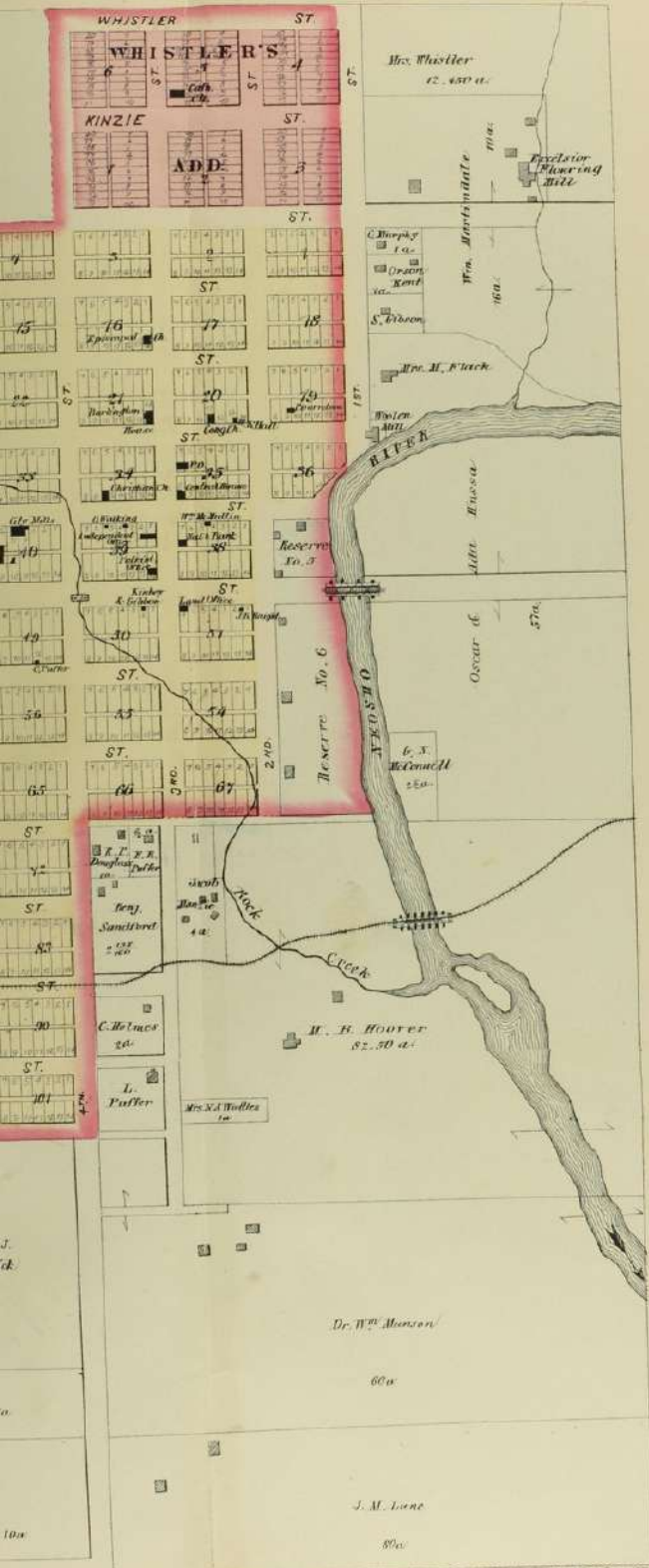

# OTTUMWA

Scale: 500 feet to 1 inch

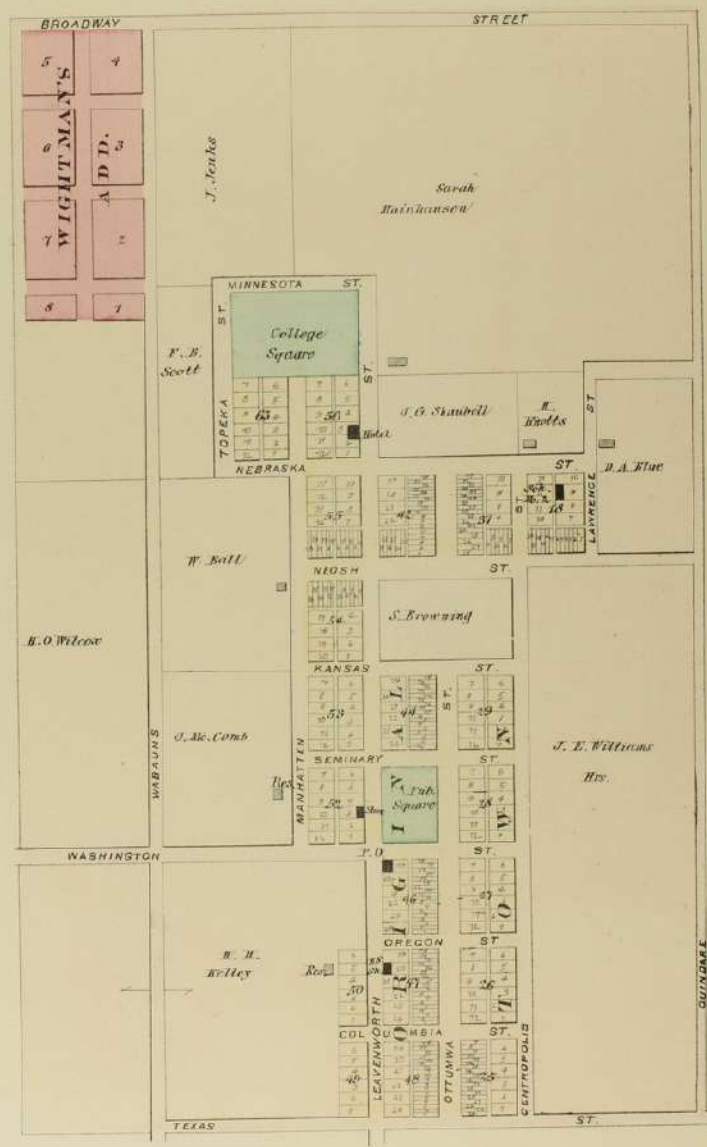

QUINORAK

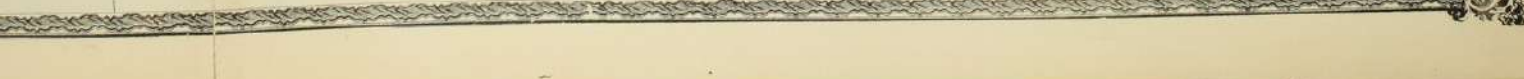

MAP OF  
**TOWNSHIP 21 SOUTH RANGE 15 EAST.**  
 OF THE 6th PRINCIPAL MERIDIAN

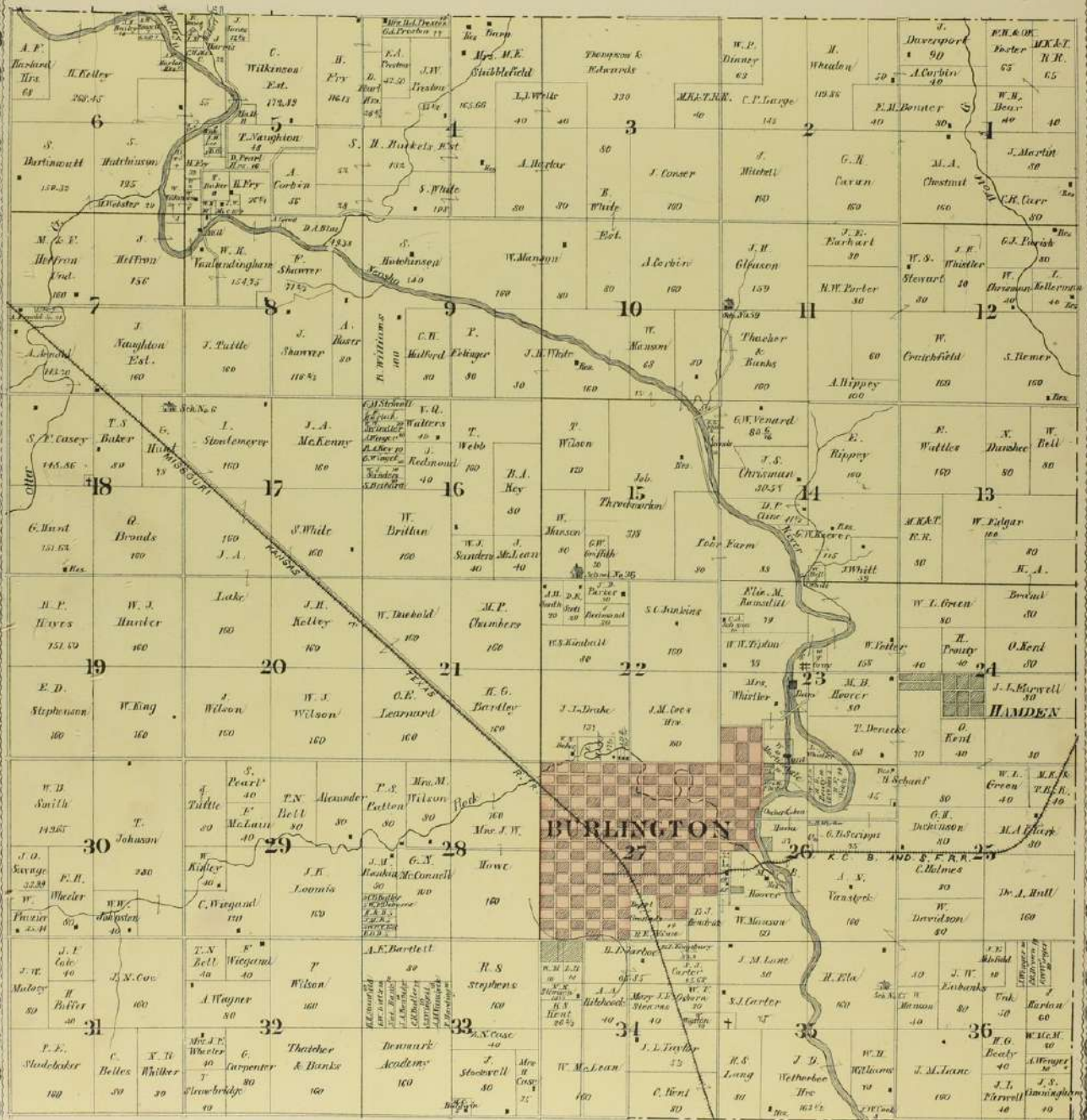

MAP OF  
**TOWNSHIP 20 SOUTH RANGE 15 EAST.**  
 OF THE 6TH PRINCIPAL MERIDIAN  
 SCALE 1 INCH TO 1 MILE

J. W. Hinton 148.32	Dougherty 161.30	M. W. Lowles 162.50	C. G. Comstock 163.65	Hewitt & Heldon 164.33	C. H. Smith 81.30	A. Corbin 165.32	E. Jackson 165.34	P. R. Salmons 161.75	G. W. Balkin 161.75	H. McLaughlin 163.87	G. Erichsner 161.85	W. B. Martini 180.63
Hogges & Sterry 183.31	J. Connelly 80	C. Johnson 40	E. A. Smith 40	W. M. Pearson 160	A. Leonard 160	E. F. Ricker 160	A. Hagerman 160	T. Collett 160	G. Spencer 160	W. J. Green 50	W. Brock 160	J. Williams & Lawrence 50
W. Grisnold 136.47	W. M. Pearson 40	W. C. Berry 30	E. W. Harris 160	M. Turner 160	J. M. Shelly 160	Unknown 160	W. L. Green 160	W. P. Bennett 160	W. Brock 160	A. Stephenson 160	C. H. Stephenson 160	
Unknown 196.7	W. H. Schofield 196.7	C. S. Bailey 160	W. H. McLarnish 160	Banks & Thatcher 160	J. I. Barwell 200	J. W. Walker 160	J. L. Barwell 160	H. Hopkins 160	J. L. Barwell 160	A. C. Page 160	W. J. Green 160	Unknown 160
J. D. Kelley 190.95	A. F. Dawson 40	W. M. Johnson 160	J. Kutter 160	Hadgate 160	S. Despain 30	School Land 220	M. J. Callaway 220	Unknown 220	W. R. Kimball 160	G. S. Bennett 50	G. W. King 220	
J. M. Doyle 189.2	W. M. Johnson 160	J. Kutter 160	S. S. Herry 40	Jos. Lacey 160	C. Barval 30	S. Despain 40	J. Throckmorton 160	Unknown 220	J. Kimball 160	M. Miller 240	G. S. Herry 160	G. W. Barton 160
S. Axel 160.38	A. I. Lyle 160	Lance 40	Melary Depaize 40	D. Scott 40	J. Jenks 160	W. Brock 50	Unknown 160	O. E. Leonard 30	Geo. Masick 160	A. L. McConnell 160	A. Handr 40	Geo. Shuca 50
W. B. Haver 100	T. Chubb 100	M. Hoar 160	M. T. Minger 40	M. A. Little 50	G. W. Carter 30	H. M. Swain 80	Denmark Academy 160	J. C. Watkins 80	E. Creed 80	Geo. Brown 160	A. Trout 30	J. L. Farrell 240
J. Smith 100	R. L. Jones 100	S. Wainwright 100	W. Grove 160	A. E. Taylor 160	A. J. King 160	S. Smith 160	S. C. Watkins 50	E. Creed 50	Unknown 160	D. D. Brothers 80	W. B. Reynolds 50	M. R. T. H. R. 50
W. Bell 100	S. Shaffer 50	J. Harris 150	J. Turner 160	A. Hagerman 160	J. W. Hiscr 160	G. W. Reynolds 160	Unknown 160	Geo. W. Garrett 50	W. B. Reynolds 50	J. C. Corbin 160	A. Corbin 160	H. O. Graham 50
J. H. Allen 40	M. Dix 130	H. Richards 130	A. J. Hamilton 50	W. J. Green 30	A. J. Holtz 40	J. Hampton 160	A. C. Draper 160	G. Masick 160	Martindale P.O. 160	W. J. Martin 40	J. L. Clark 160	E. A. Harrell 50
H. H. Keller 160	W. J. Green 30	J. E. Denson 50	W. J. Green 30	A. J. Holtz 40	H. G. Gopin 40	W. Williams 160	P. B. Plumb 160	M. J. Culinary 160	J. L. Donald 160	J. L. Williams 40	J. L. Clark 160	E. A. Harrell 50





MAP OF  
**TOWNSHIP 19 SOUTH RANGE 13 & 14 EAST**

OF THE 6TH PRINCIPAL MERIDIAN  
SCALE 1 INCH TO 1 MILE

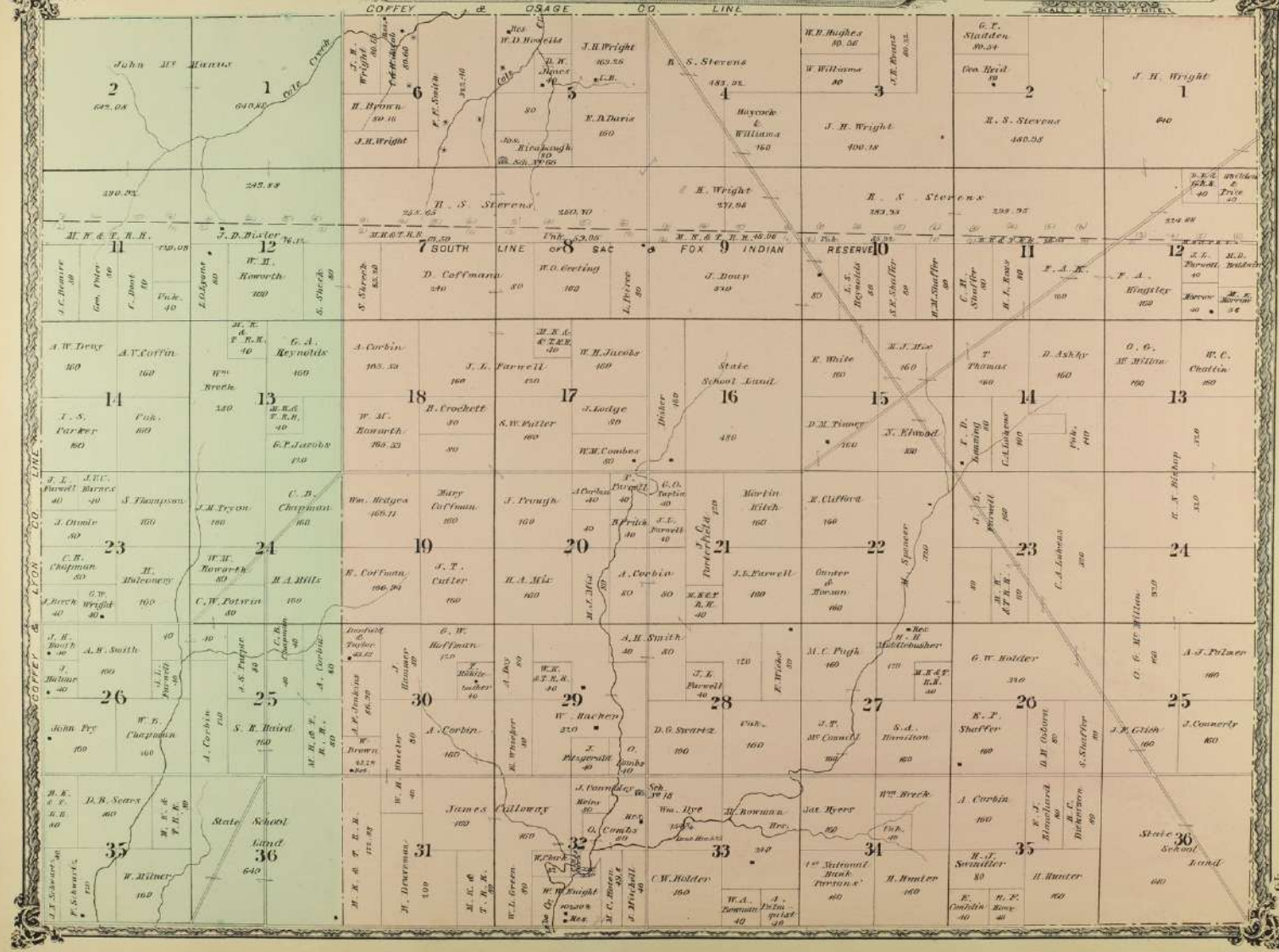

MAP OF TOWNSHIP 20 SOUTH RANGE 13 & 14 EAST.

OF THE 6th PRINCIPAL MERIDIAN

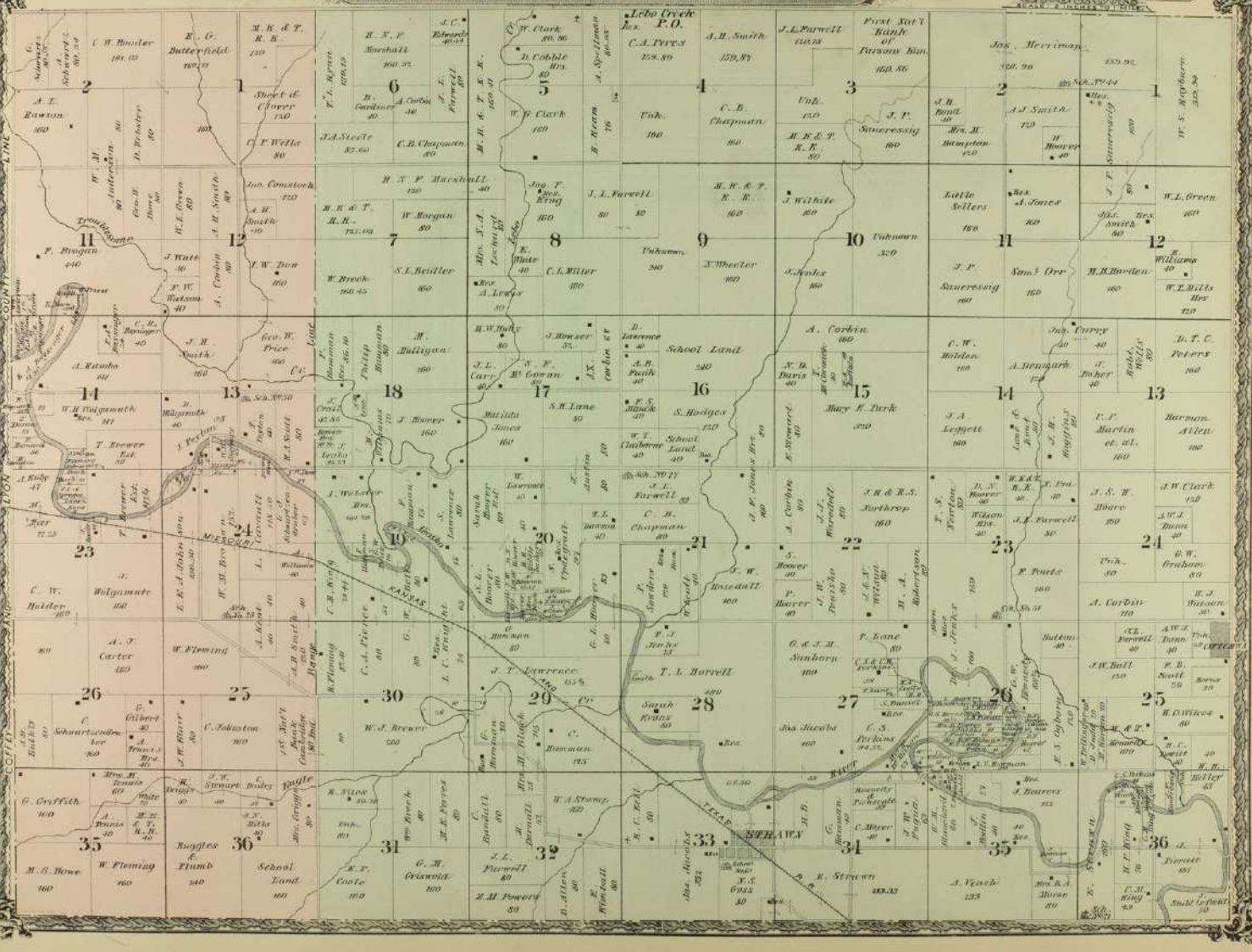

# MAP OF TOWNSHIP 21 SOUTH RANGE 13 & 14 EAST.

OF THE 6TH PRINCIPAL MERIDIAN  
SCALE 1 INCH TO 36.3 FEET

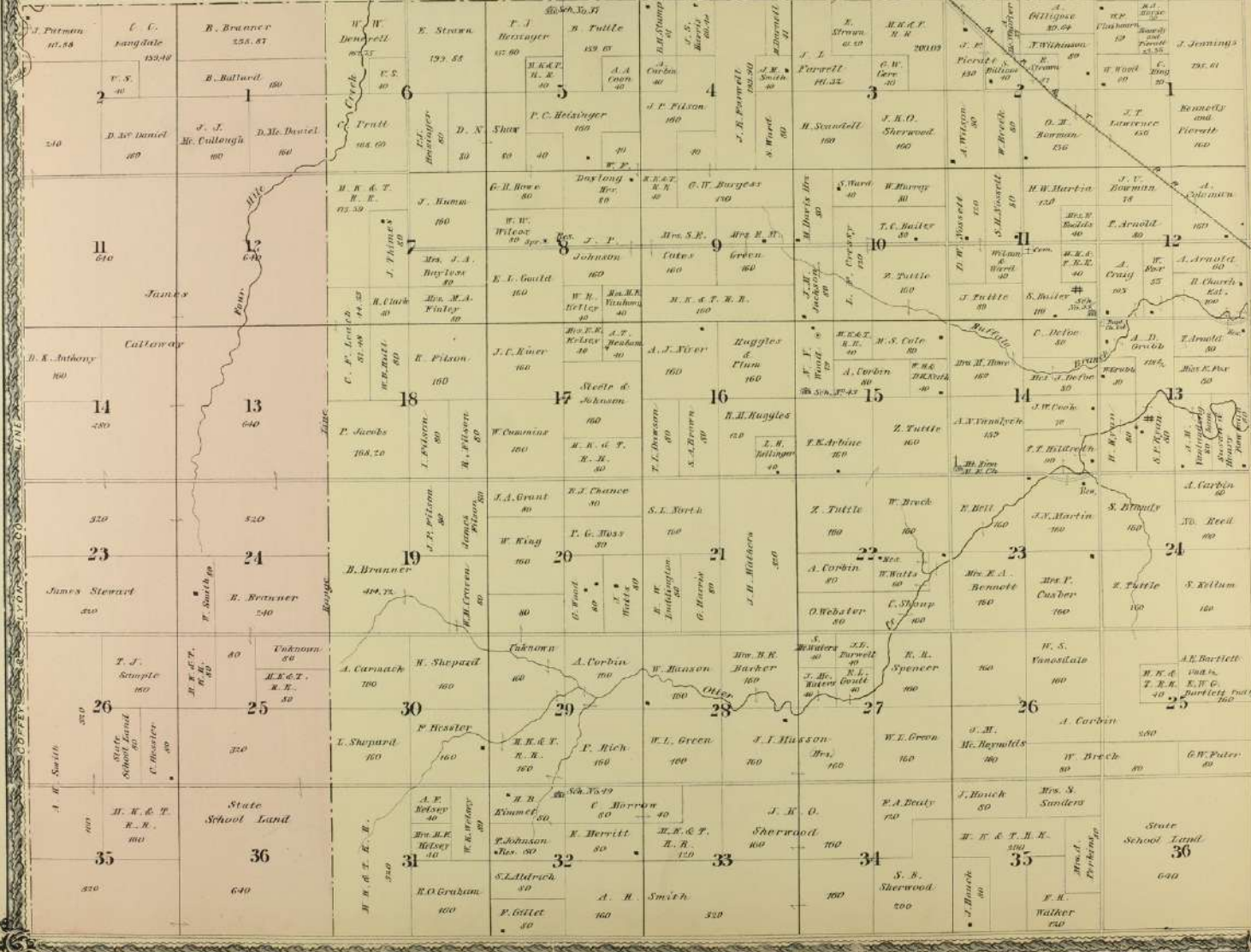

MAP OF TOWNSHIP 22 SOUTH RANGE 138-1 EAST.

OF THE 6TH PRINCIPAL MERIDIAN

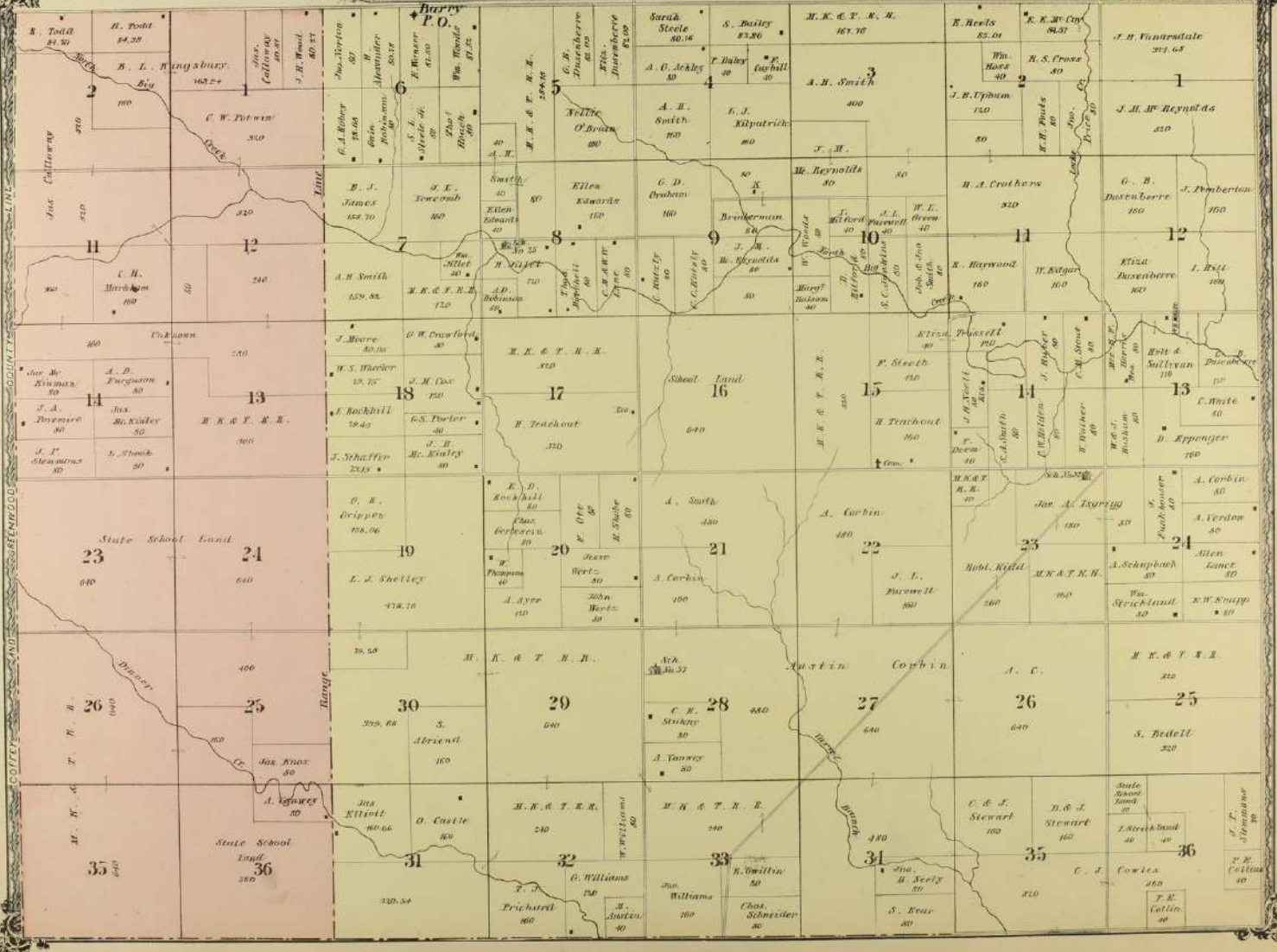

COUNTY LINE

Barry P.O.  
Cedar Creek  
Dixie Creek  
Range Line  
COUNTY AND RENEWED

**MAP OF**  
**TOWNSHIP 23 SOUTH RANGE 138-14 EAST.**  
 OF THE 6TH PRINCIPAL MERIDIAN

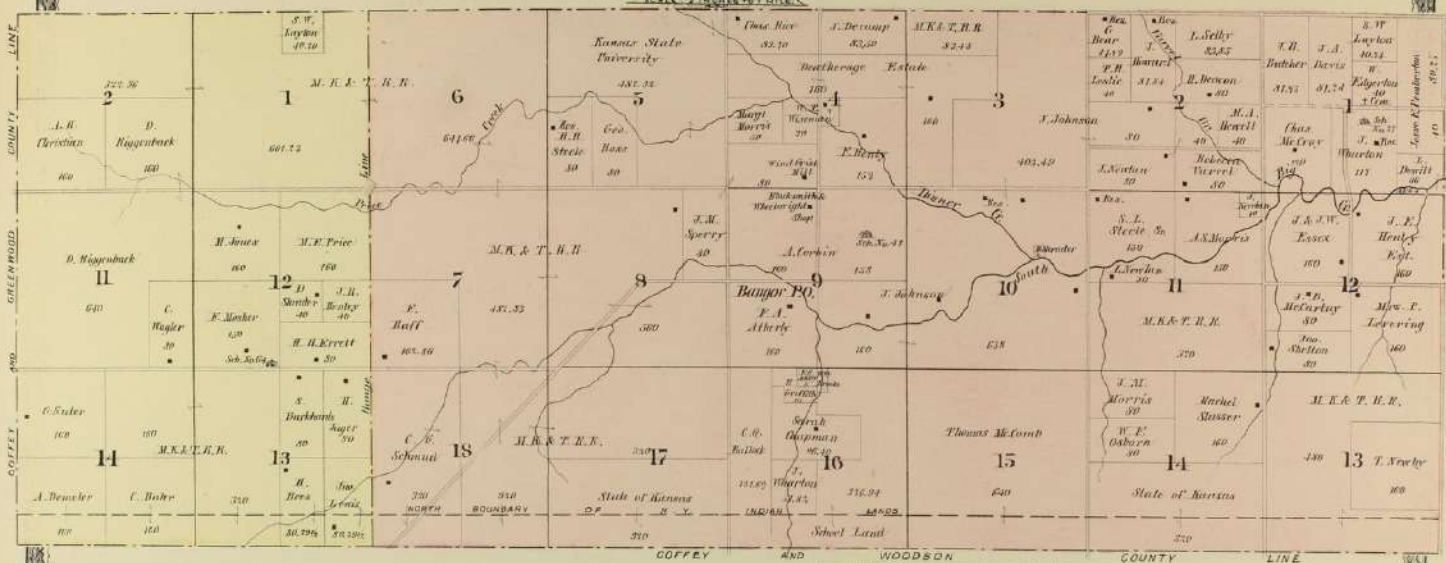

**HAMDEN**  
 Route 20077 to Ouch

