

OUTLINE MAP OF
COFFEY COUNTY
KANSAS

Copyright 1909 by Geo. A. Doyle & Co.

Scale 1/4 inch to 1 mile

7

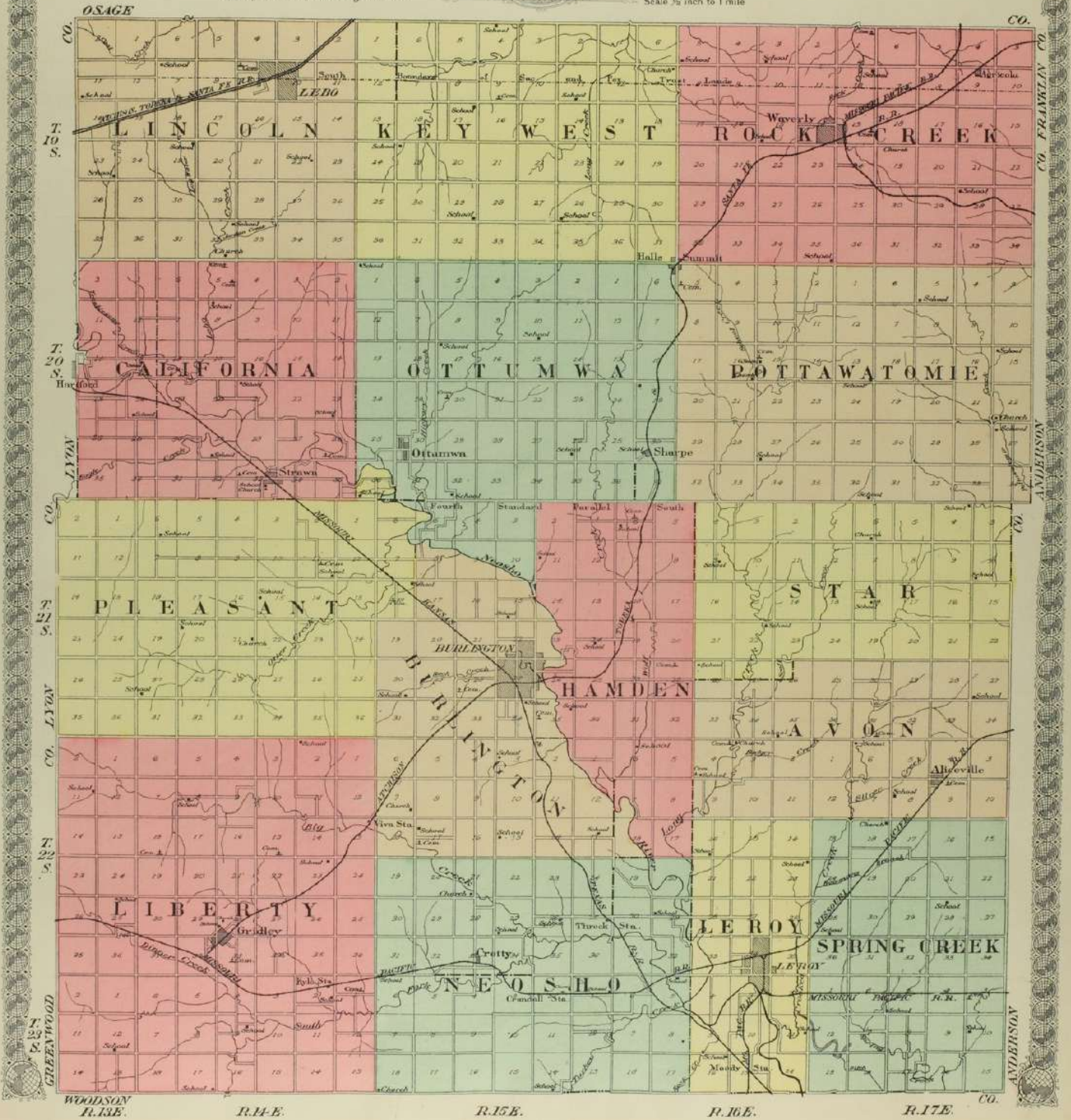

Norman Strieby
165

H. L. Kennedy
100

A. Tomkins
30

F. W. Litton
40 1/2

L. M. Kennedy
100

NORTH PART OF
BURLINGTON
County Seat of Coffey Co.,
KANSAS

T. 21 S., R. 15 E. Scale 300 feet to 1 inch
Copyright 1909 by Geo. A. Coye & Co.

W. T. Heesler
50 1/2

E. A. Evans
5

Cora Couvult
19

John Lytle
50

Ulysses Grant
6 1/4

L. T. Grant
5

L. Stone
2

W. T. Liberty
2

P. Perouche
2 1/2

5 T. ...

A. B. ...

L. ...

D. ...

P. ...

...

CROSS	120
MARTINDALE	9
KENNEDY	9
SANDERS	10
GARRETTSON	13
FRANKLIN	11
KENNEBEC	9

110	109	108	107	106	105
111	112	113	114	115	110
122	121	120	119	118	117
123	124	125	126	127	128
134	133	132	131	130	129

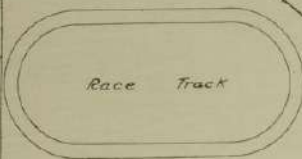

Coffey County Fair Assn.
FAIR GROUNDS
50 AC



FOR SOUTH PART SEE PAGES

Mama M. Wilson
160

Iva Morris
135.80

W. Morris
20

Rena M. Harrington
70.50

Chas. Hornicker

Fred & Carl
Mathers

Rena M. Harrington
5.25

Emma
Carpenter
25

M. Weisdorfer
5.59

M. Decker
5

A. Wadman
7.50

O. W. Huon

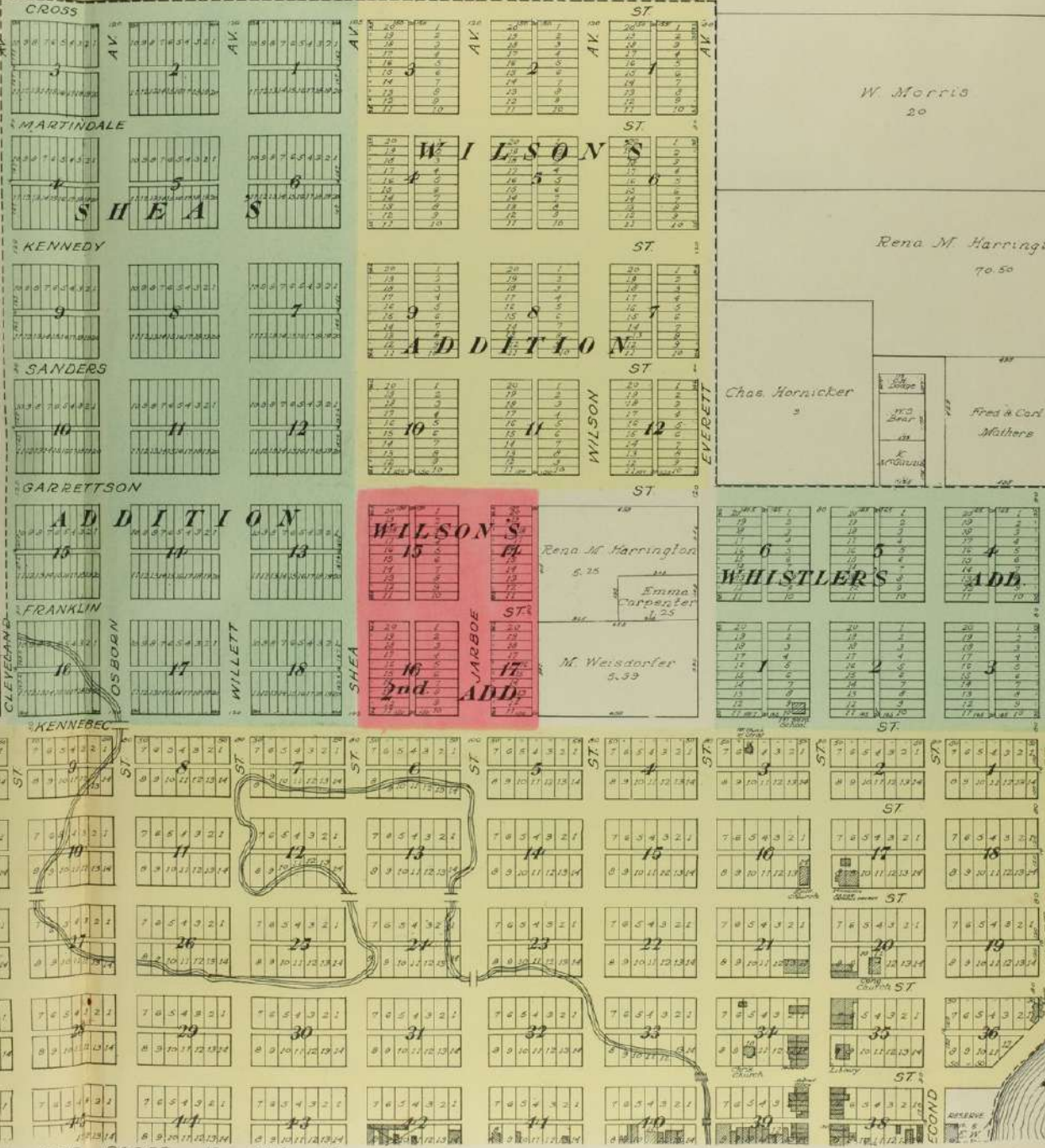

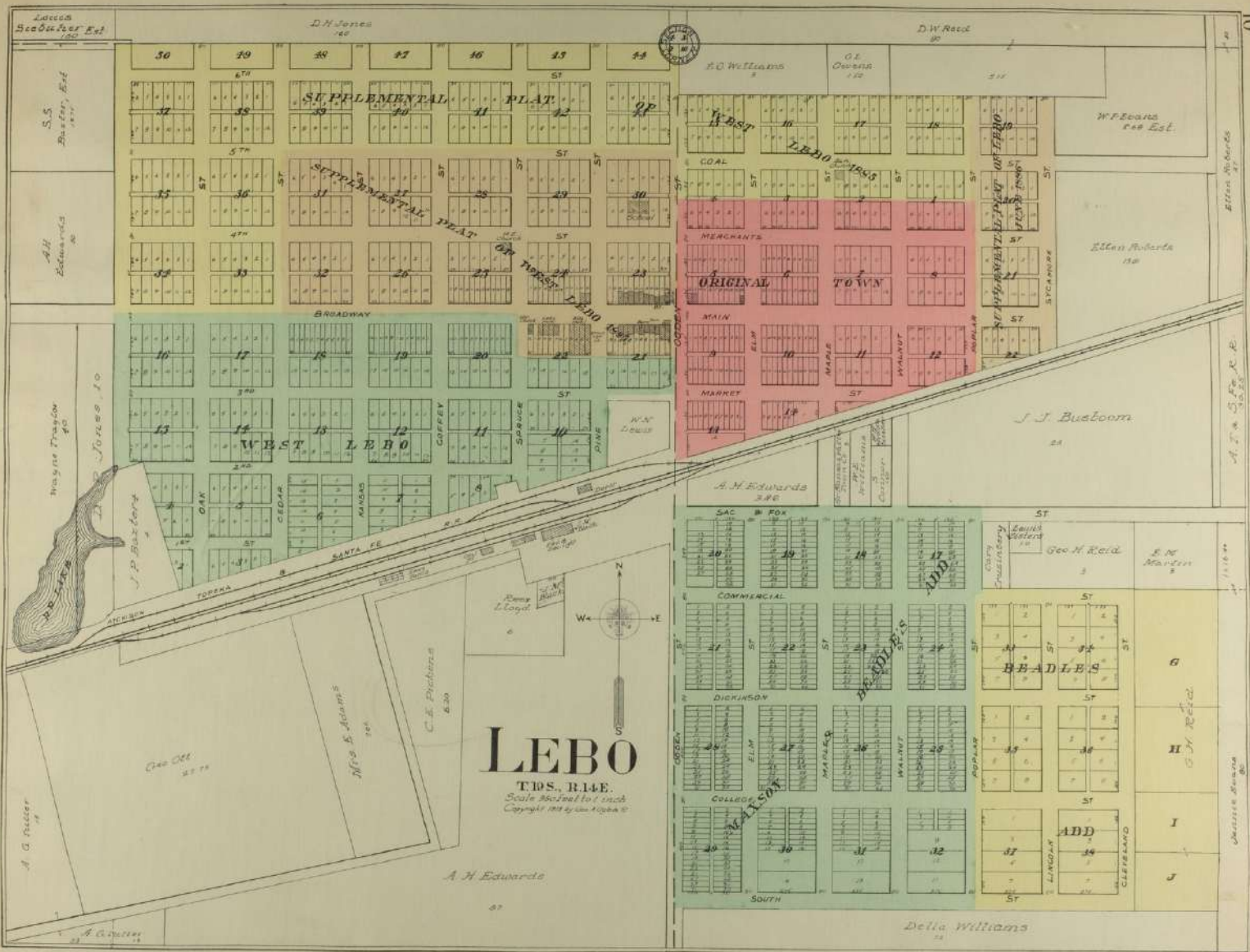

MAP OF
TOWNSHIP 19 S., RANGE 14 E. and
PART OF TOWNSHIP 19 S., RANGE 13 E.

OF THE 6th P. M.

Scale 2 inches to 1 mile

OSAGE

R. 13 E.

R. 14 E.

CO.

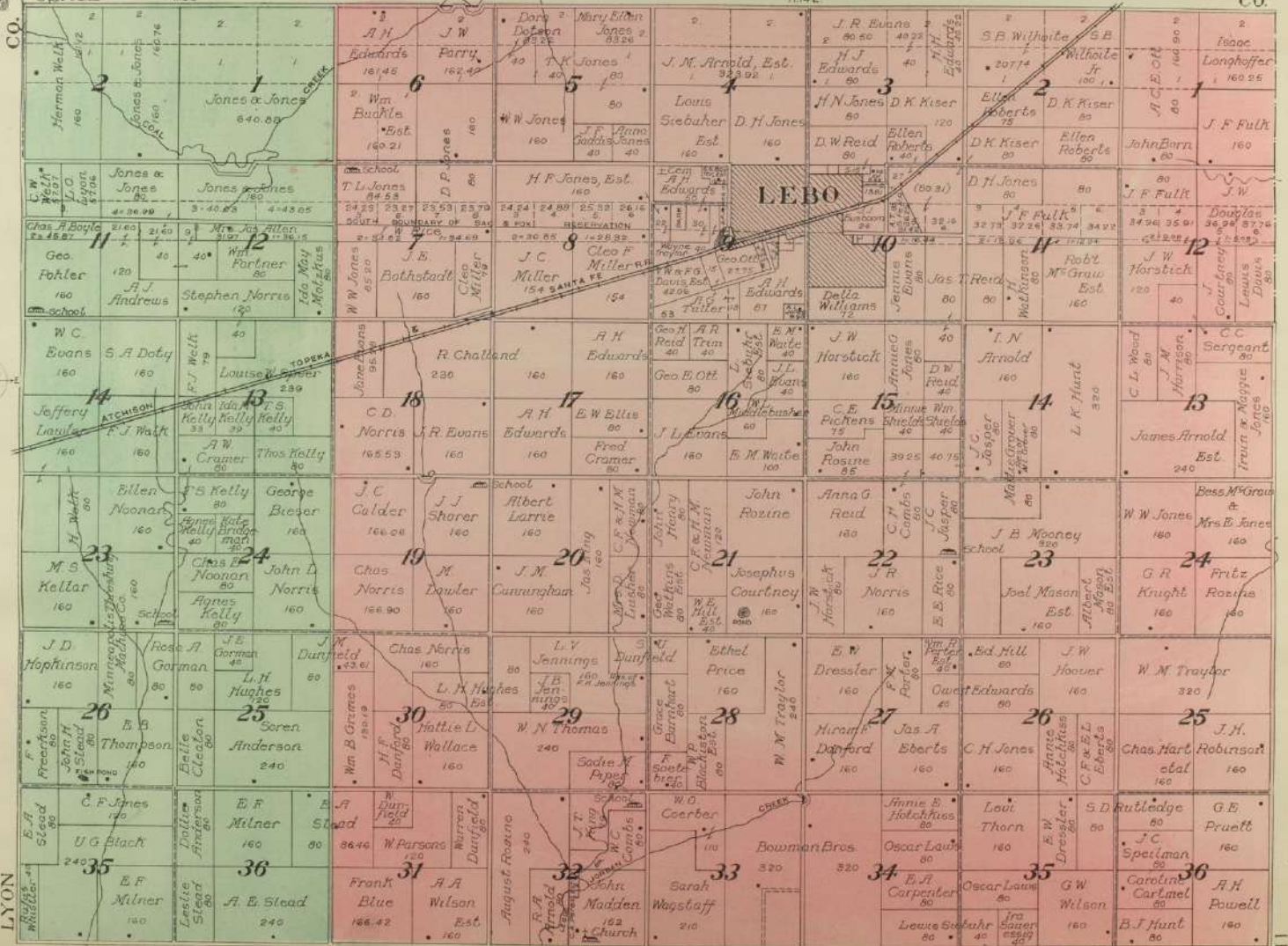

LYON

5040.



121	122	123	124	125	126	127	128	129	130	131	132	133	134	135	136	137	138	139	140	141	142	143	144	145	146	147	148	149	150	151	152	153	154	155	156	157	158	159	160	161	162	163	164	165	166	167	168	169	170	171	172	173	174	175	176	177	178	179	180	181	182	183	184	185	186	187	188	189	190	191	192	193	194	195	196
-----	-----	-----	-----	-----	-----	-----	-----	-----	-----	-----	-----	-----	-----	-----	-----	-----	-----	-----	-----	-----	-----	-----	-----	-----	-----	-----	-----	-----	-----	-----	-----	-----	-----	-----	-----	-----	-----	-----	-----	-----	-----	-----	-----	-----	-----	-----	-----	-----	-----	-----	-----	-----	-----	-----	-----	-----	-----	-----	-----	-----	-----	-----	-----	-----	-----	-----	-----	-----	-----	-----	-----	-----	-----	-----	-----



Henry Jackson
15

B. F. Johnson
15

J. H. Bryan
5

T. F. Mitchens
5

A. L. Woodford
10

D. Gates
11

W. P. Phillips
44.75

A. J. Winn
100

H. T. Lamborn
6.14

G. W. Davis
11

A. J. Winn
305.85



Isaac Zeigler
3

... PART SEE PAGES 8 AND 9.



SOUTH PART OF
BURLINGTON
 County Seat of Coffey Co.,
 KANSAS

T. 21 S., R. 15 E. Scale 300 feet to 1 inch
 Copyright 1913 by Geo. A. Coye & Co.
 J. M. Lane
 80



MAP OF
TOWNSHIP 19 S., RANGE 15 E.
 OF THE 6th P. M.

Scale 2 inches to 1 mile

OSAGE

CO.

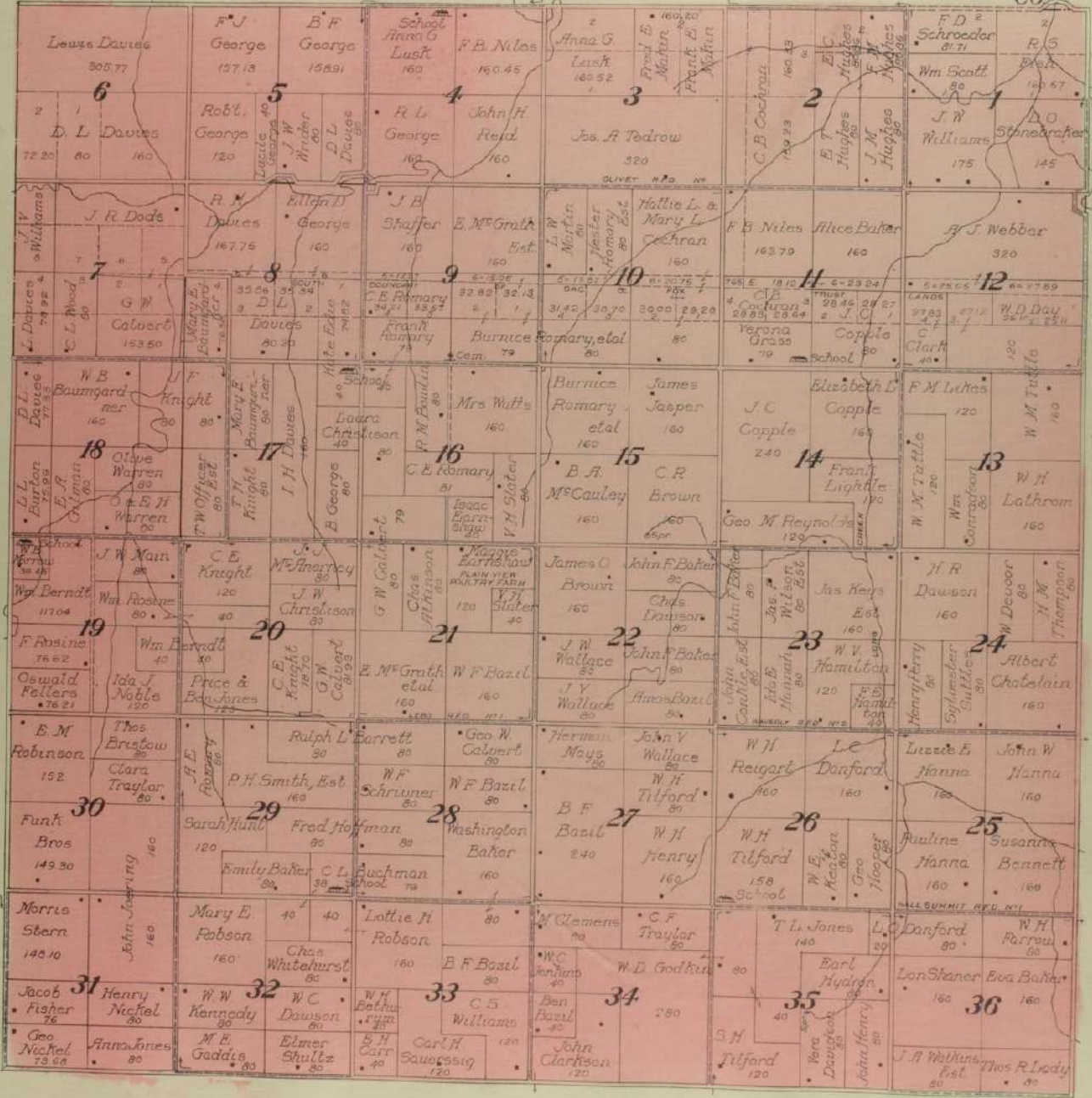

MAP OF
TOWNSHIP 19 S., RANGE 16 E.
 OF THE 6th P. M.
 Scale 2 inches to 1 mile

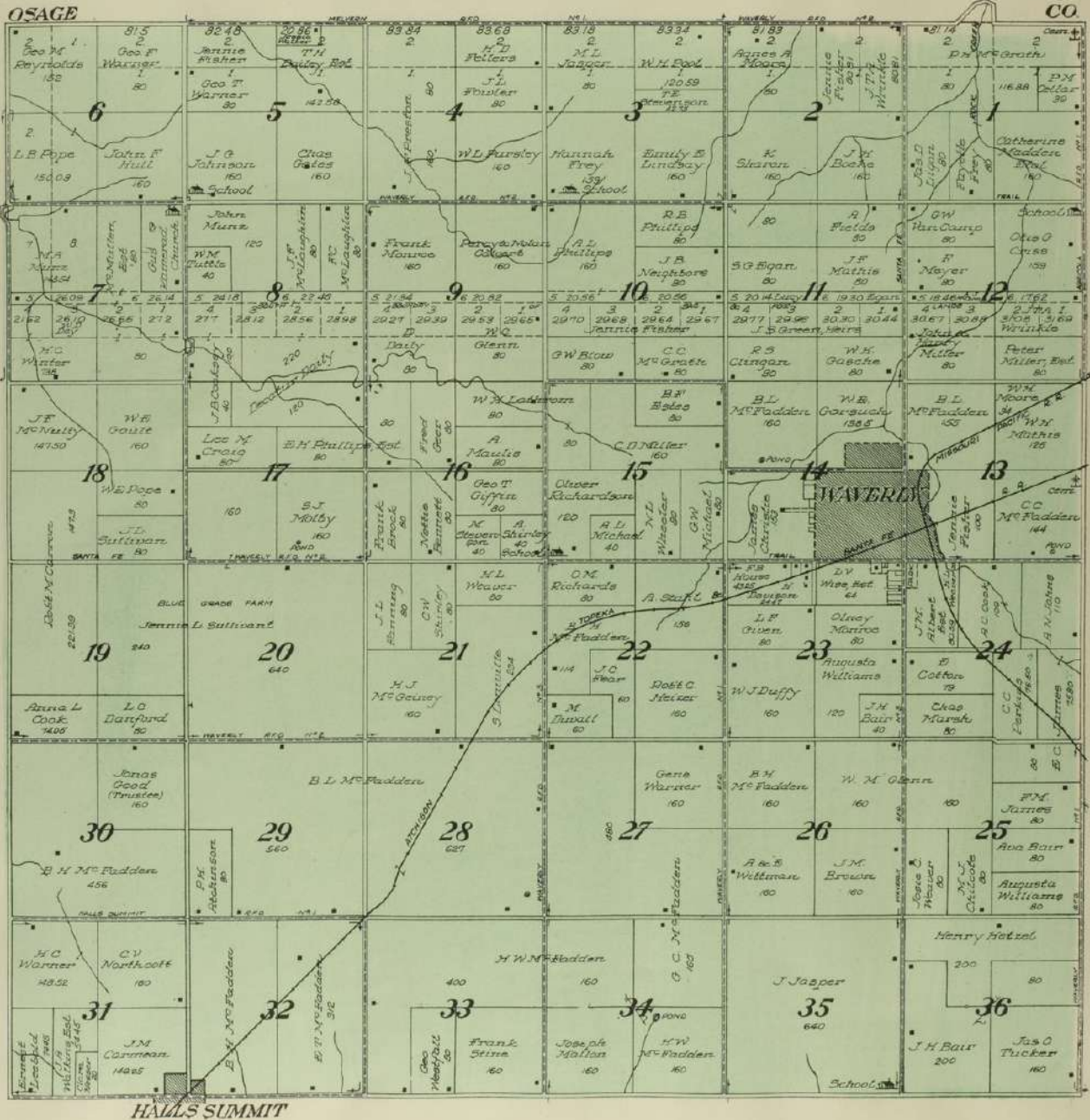

LEROY

T'S. 22 and 23 S., R. 10 E.

Scale 350 ft. to 1 inch

Henry Wright
40

C. E. Keys
40

J. W. Henry
40

J. W. Henry
40



Wm. O'Higgins
39

H. C. Waage
38

Frank Fockele
22.50

H. W. C. Jones
30

Fairview Stock Farm
C. W. Jones
38

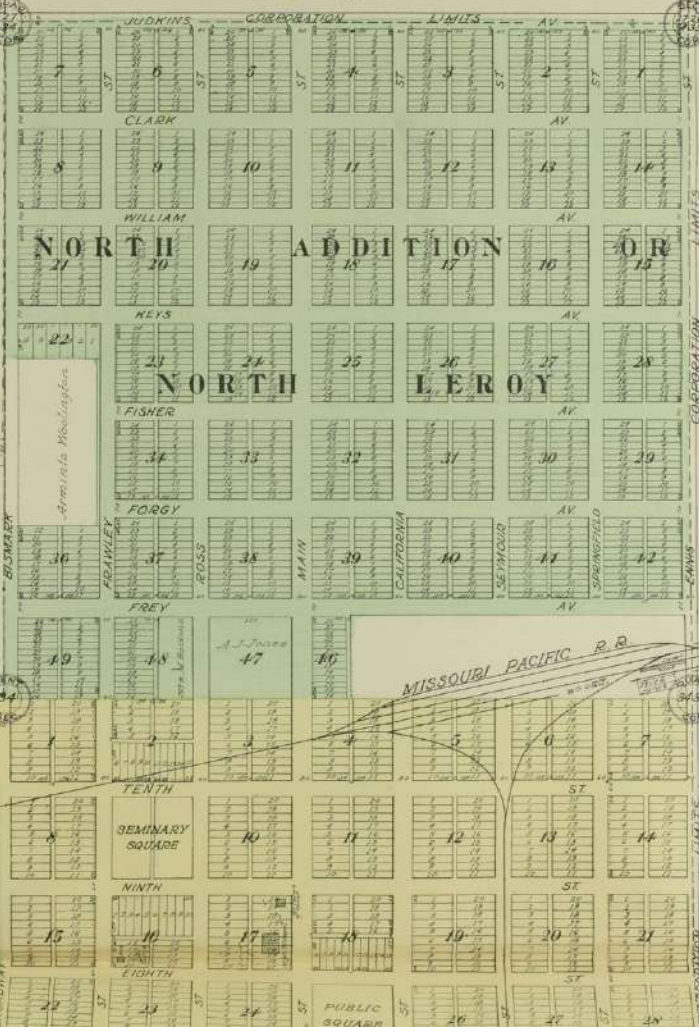

JUDKINS CORPORATION LIMITS

CLARK AV.

NORTH ADDITION

KEYS AV.

FISHER AV.

FORGY AV.

FREY AV.

FIFTH AV.

NINTH ST.

EIGHTH ST.

PUBLIC SQUARE ST.

MISSOURI PACIFIC R.R.

W. B. Hays
48

Josephine Hale
10

I. T. Osborn
10

Mrs. S. A. Dever
10

Helen Cox

E. B. Foster

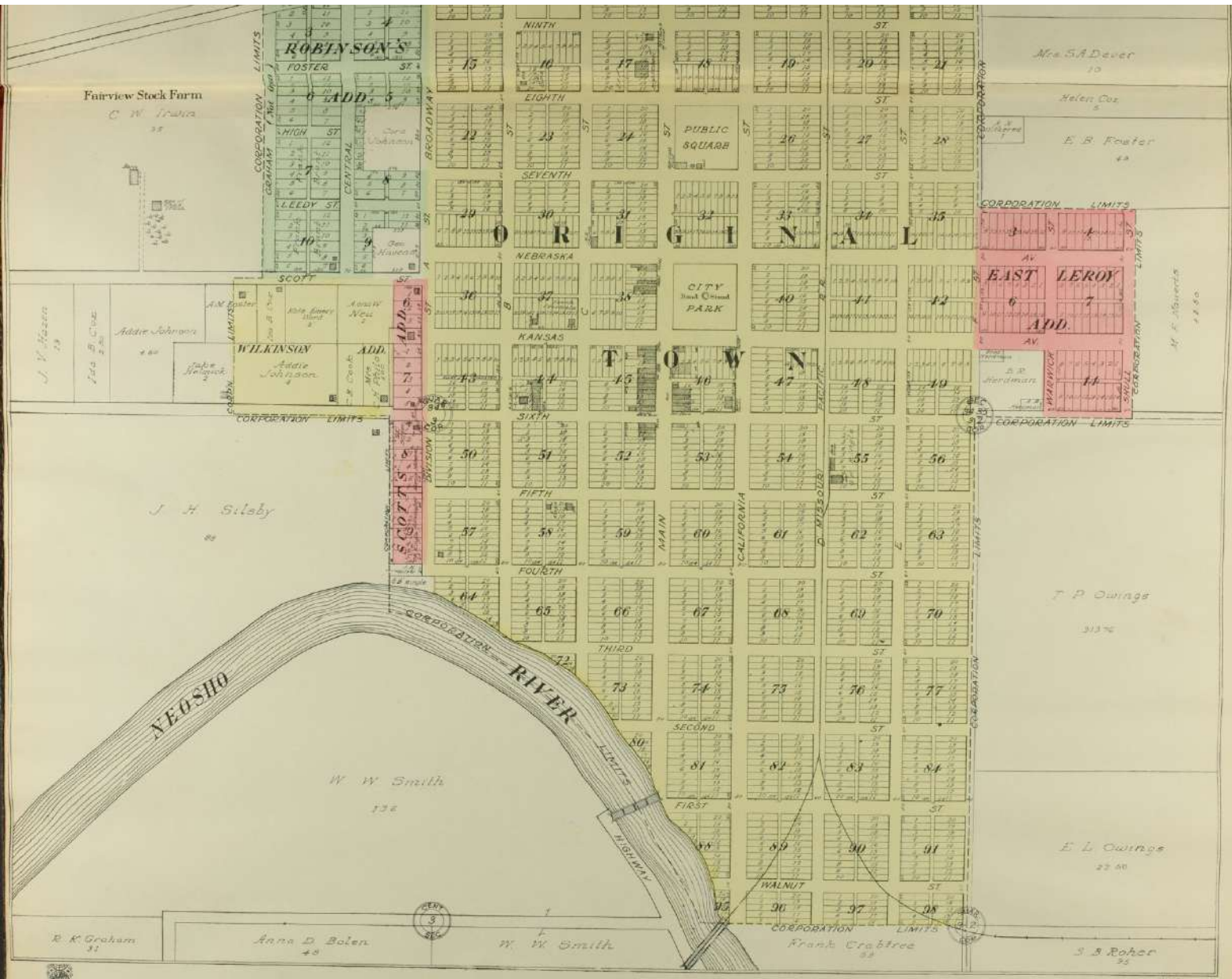



MAP OF
Part of Township 19 S., Range 17 E.
OF THE 6th P. M.
 Scale 2 inches to 1 mile

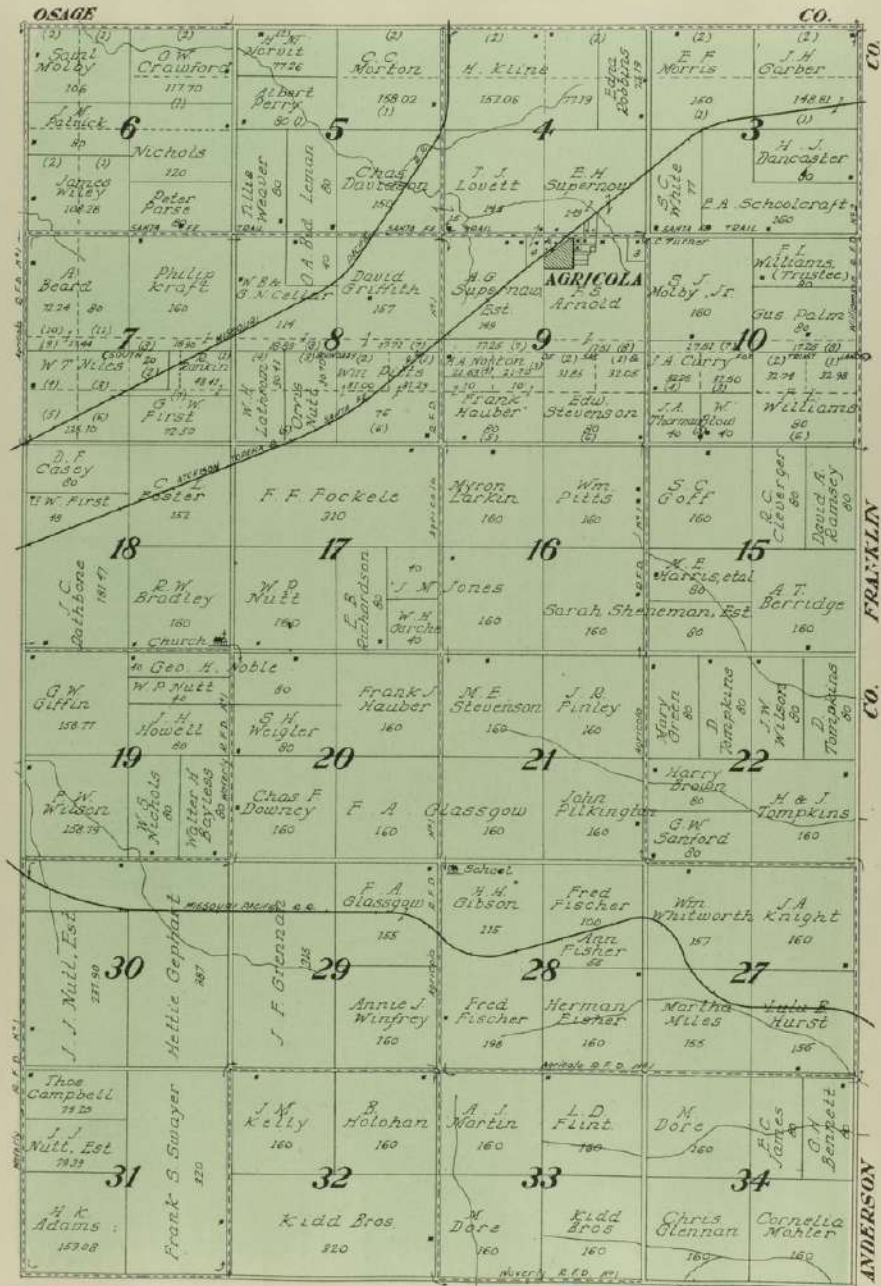

MAP OF
TOWNSHIP 20 S., RANGE 14 E. and
PART of TOWNSHIP 20 S., RANGE 13 E.

OF THE 4th P. M.

Scale 2 inches to 1 mile

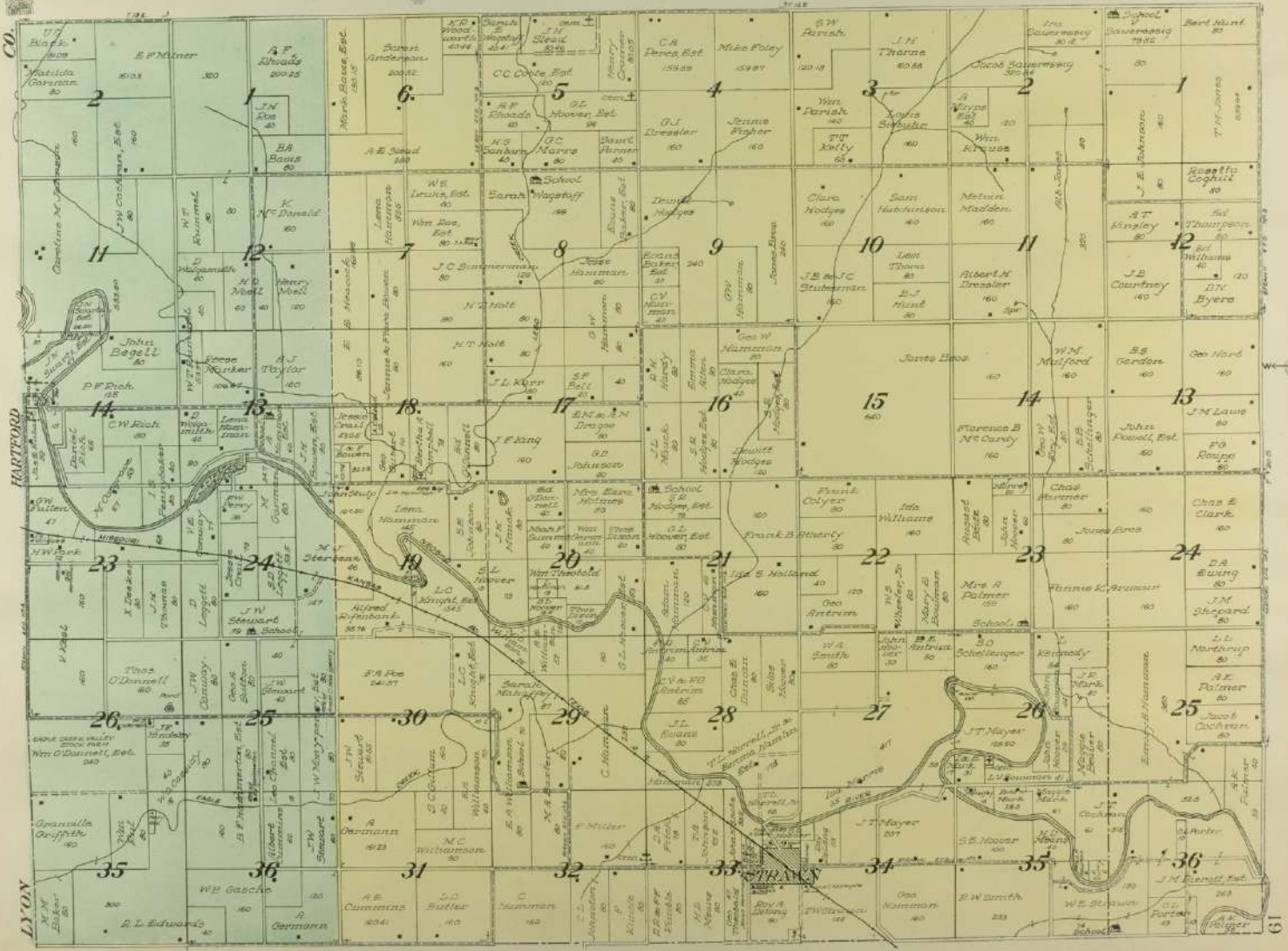

W. E. Gorsuch
138.50

B. L. McFadden
160

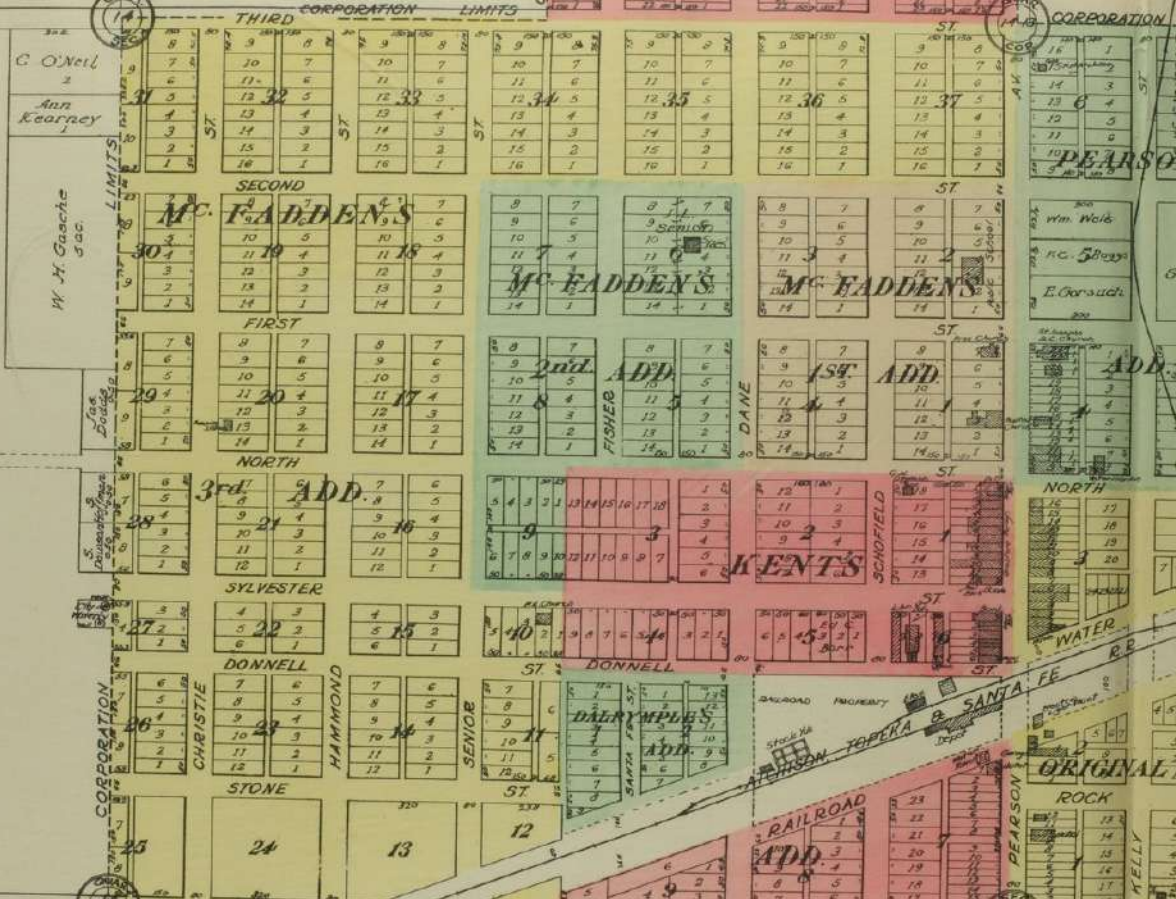

James Christie
153

F. B. House
43.25

E. H. Glass
3

Lena Farley
3

A. F. Heath
1

H. A. Shower
2

L. V. Wise, Est.
61

WAVERLY

T. 10S., R. 16E.

Scale 3/16" = 1' = 1" = 16'

Copyright 1913 by Geo. K. Ogle & Co.

H. Davison
24.47

L. F. Given
80

Olney Monroe
80

L. Burge
2

John Brewer

E. Drum
1.20

Winnis Page
6.25

J. M. Kelly
2.00

Drum
8.25

A. H. Patterson
2.50

E. C. James
1.35

CITY PARK

BALL PARK

OTTUMWA

T 20 S R 15 E

Scale 300ft to inch

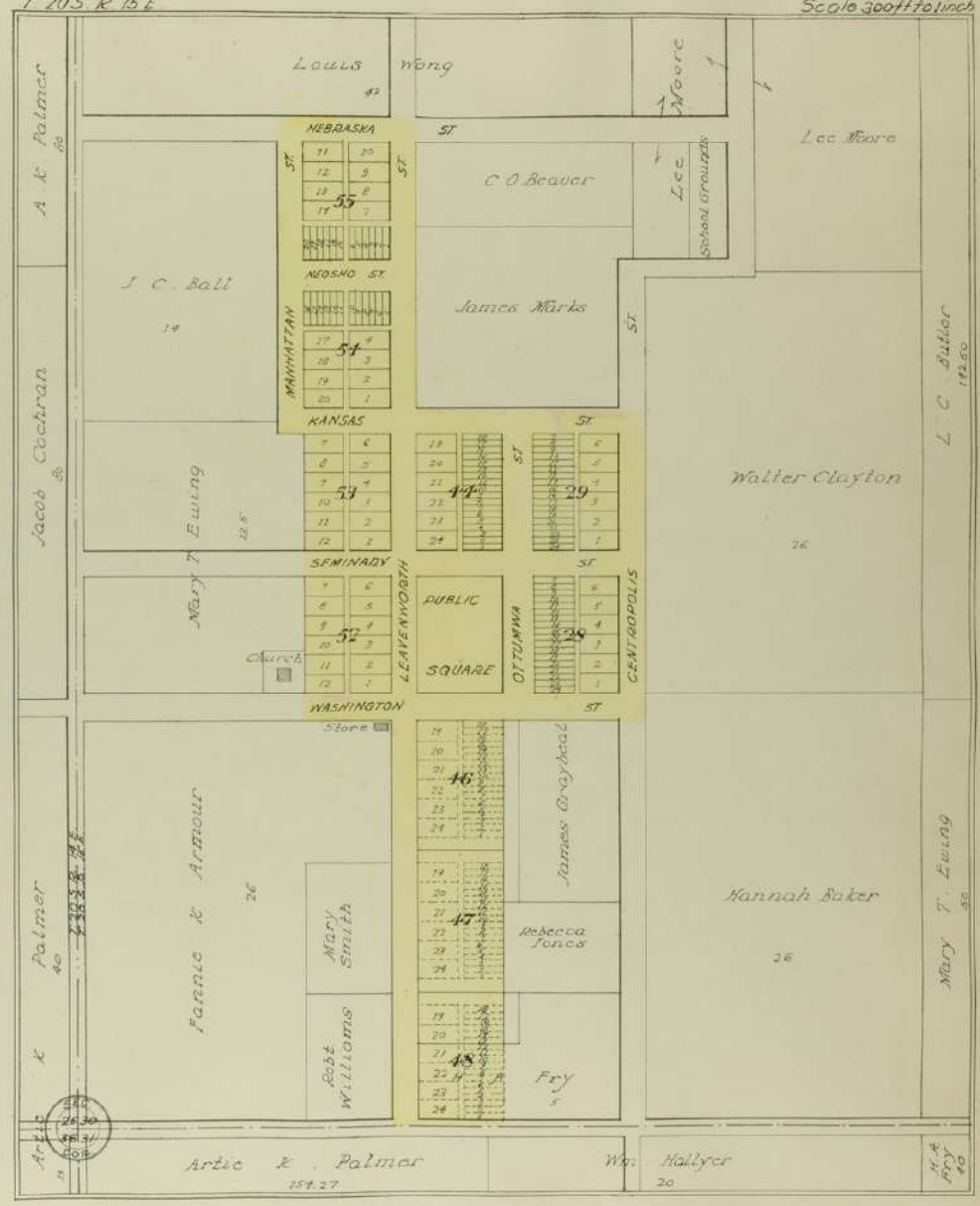
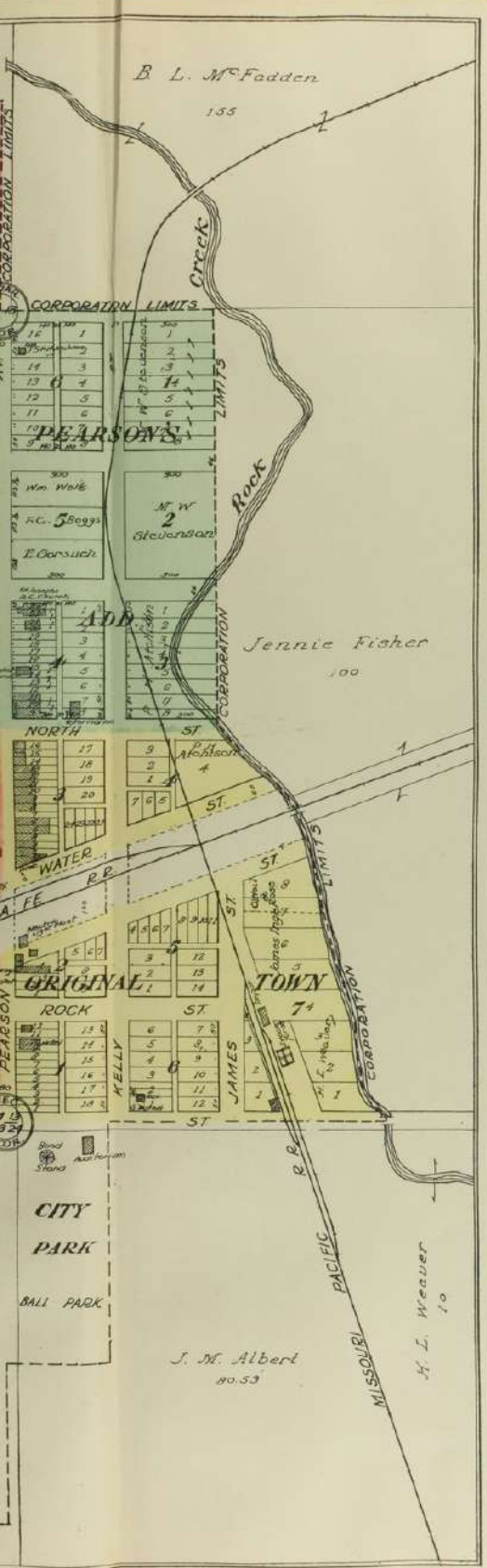



MAP OF
TOWNSHIP 20 S., RANGE 15 E.
 OF THE 6th P. M.

Scale 2 inches to 1 mile

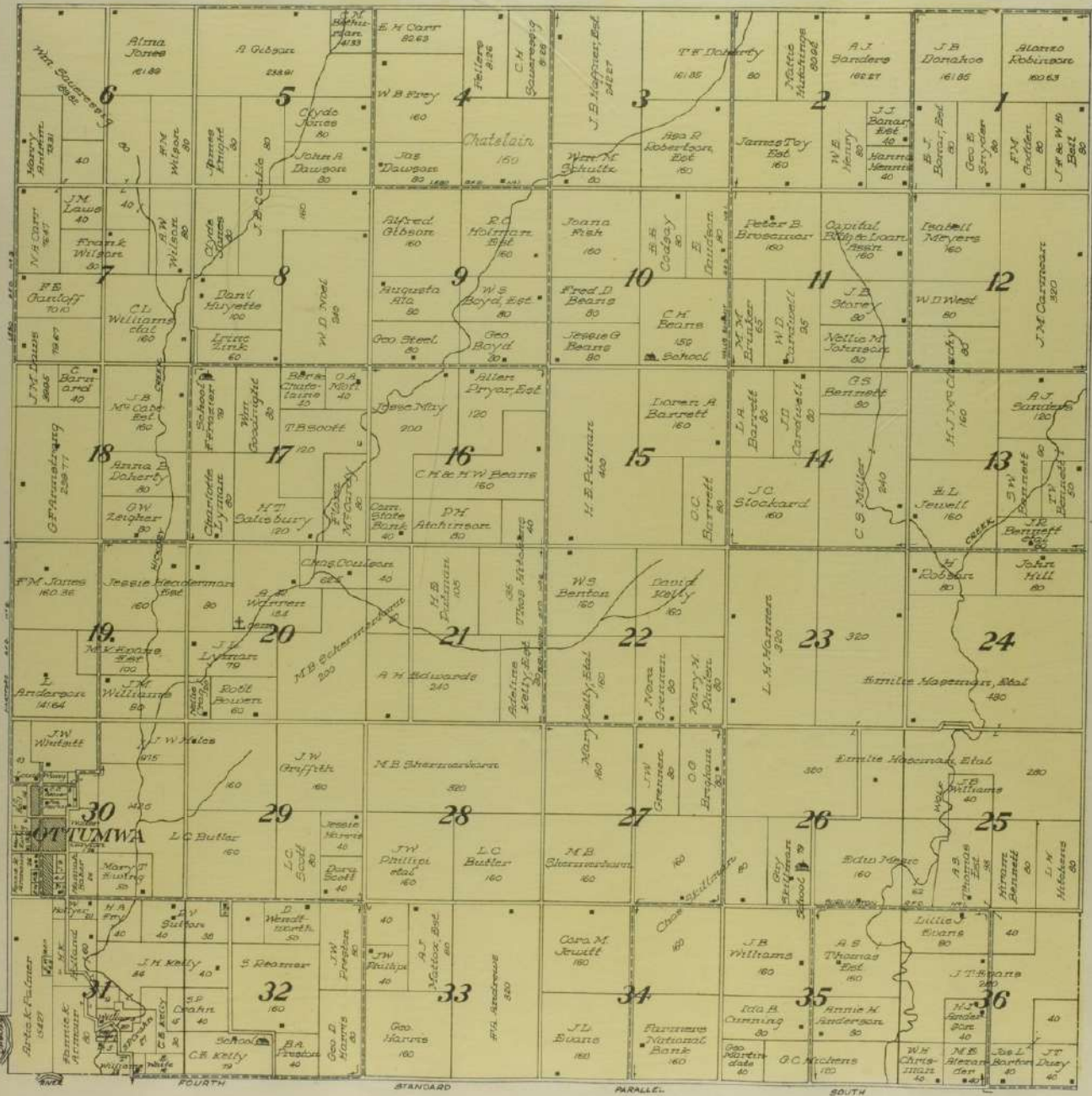



MAP OF
TOWNSHIP 20 S., RANGE 16 E.
 OF THE 6th P. M.
 Scale 2 inches to 1 mile

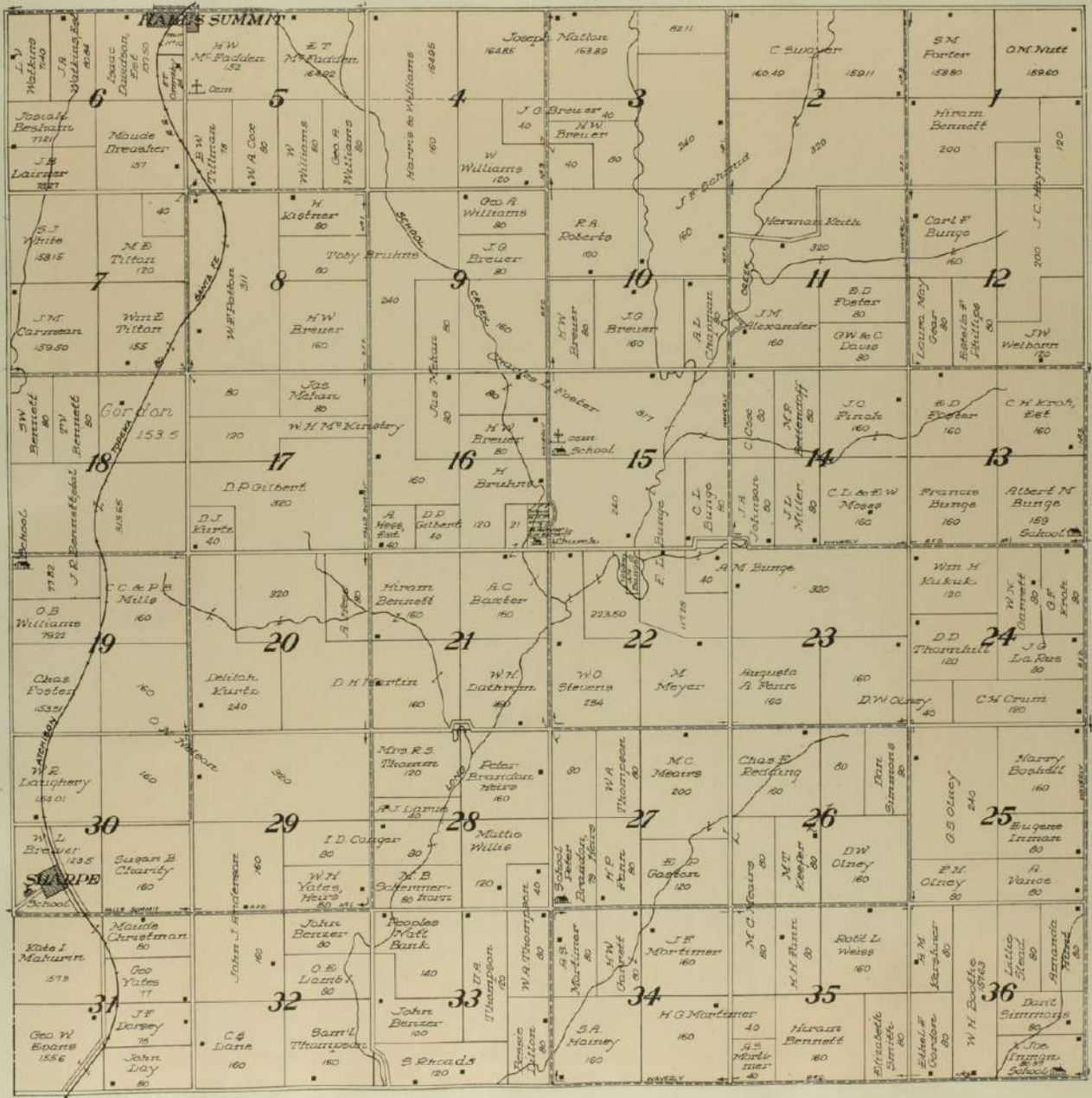

MAP OF
 Part of Township 20 S., Range 17 E.
 OF THE 6th P. M.
 Scale 2 inches to 1 mile

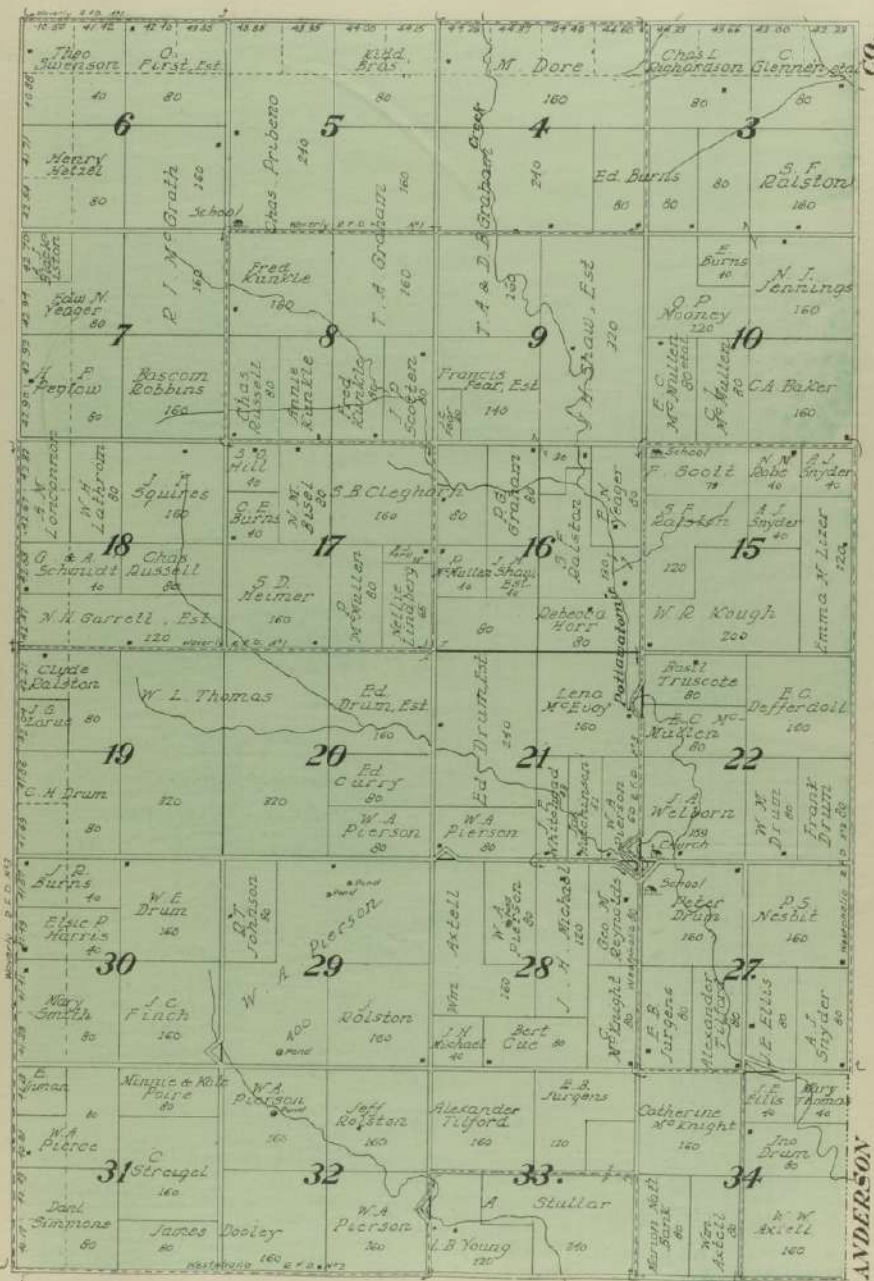

MAP OF
TOWNSHIP 21 S., RANGE 14 E. and
PART of TOWNSHIP 21 S., RANGE 13 E.
OF THE 4th P. M.

Scale 2 inches to 1 mile

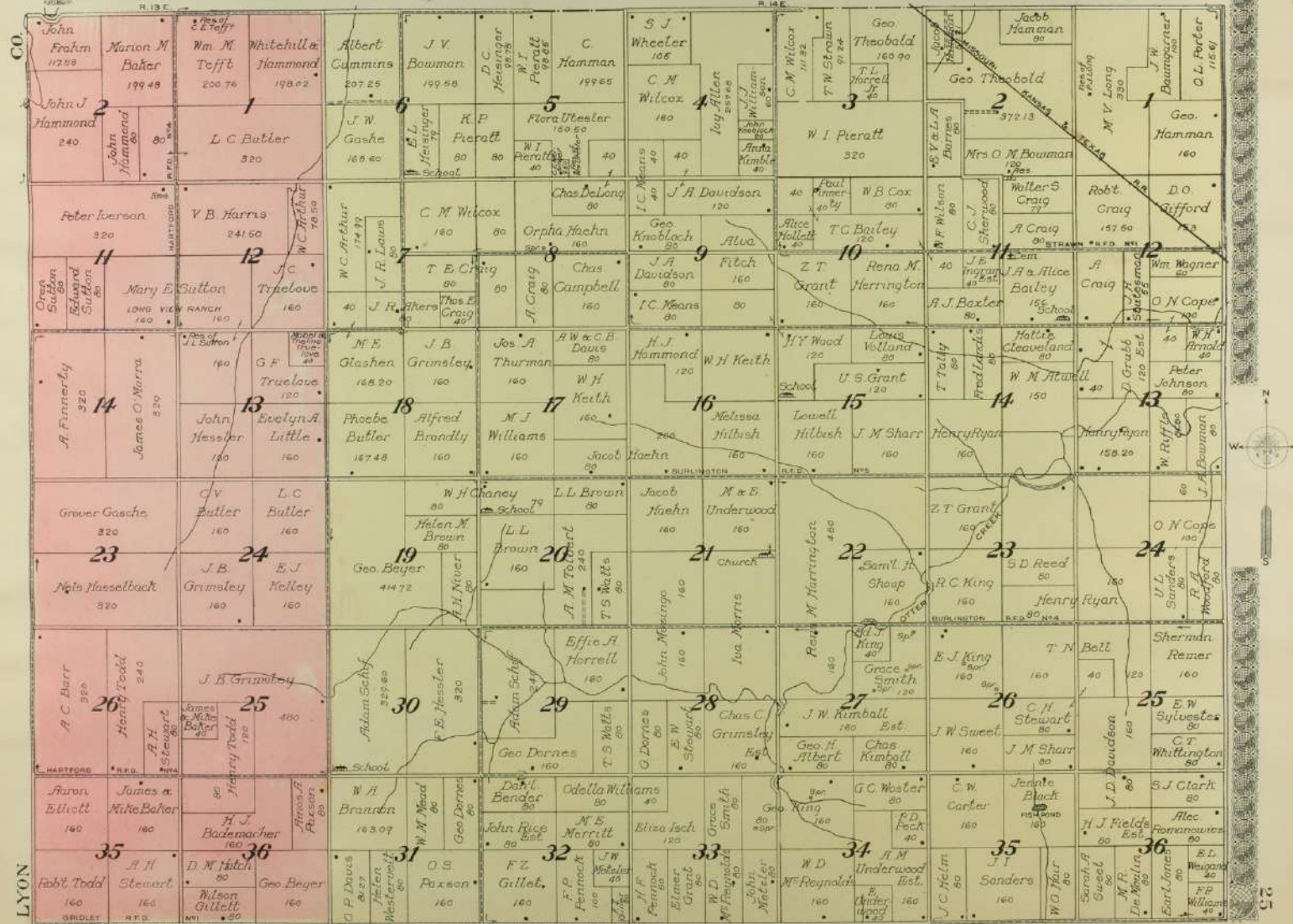



MAP OF

TOWNSHIP 21 S., RANGE 15 E.

 OF THE 6th P. M.

Scale 2 inches to 1 mile

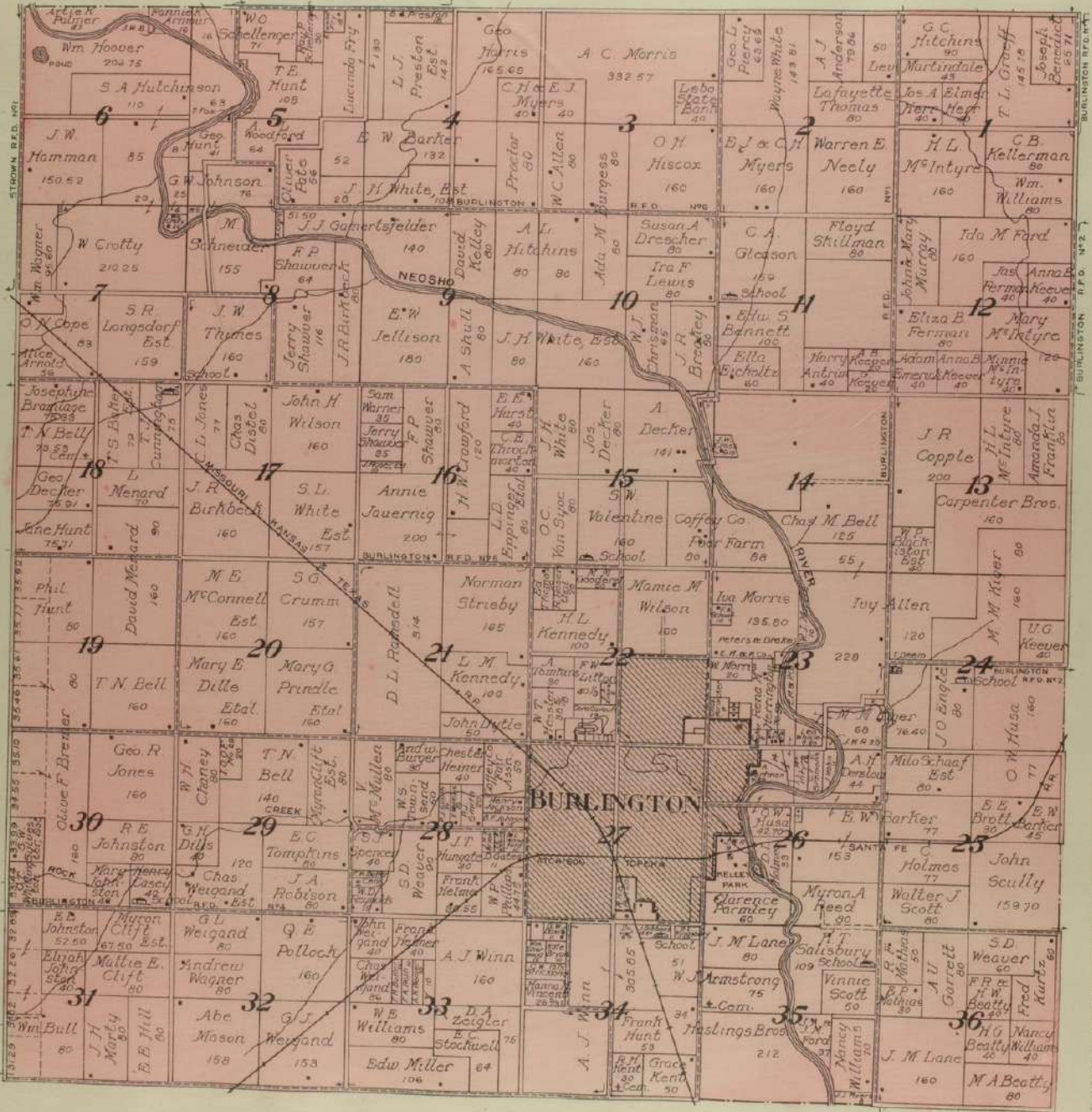



MAP OF
TOWNSHIP 21 S., RANGE 16 E.
OF THE 6th P. M.
 Scale 2 inches to 1 mile

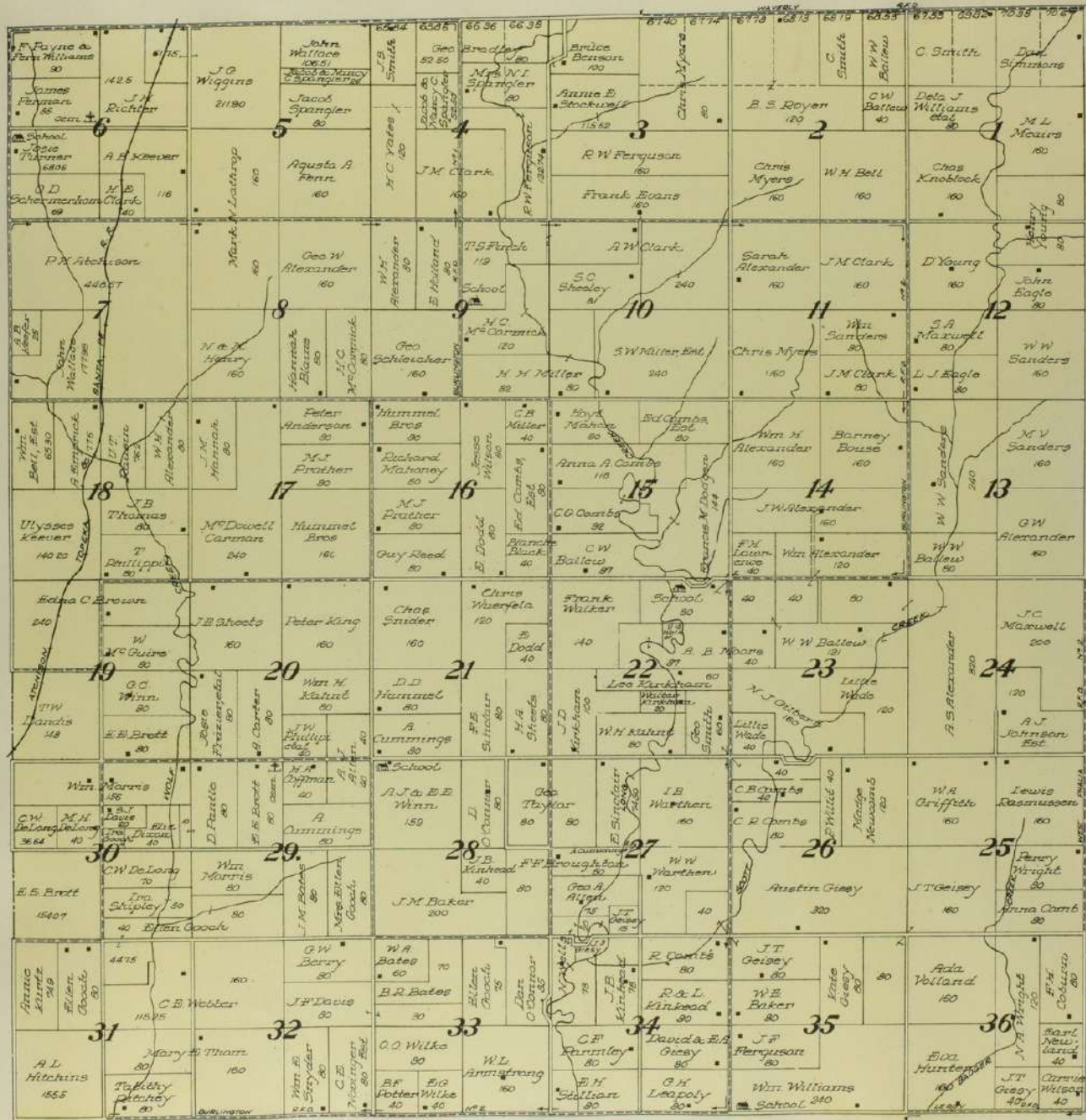



MAP OF
Part of Township 21 S., Range 17 E.
 OF THE 6th P. M.
 Scale 2 inches to 1 mile

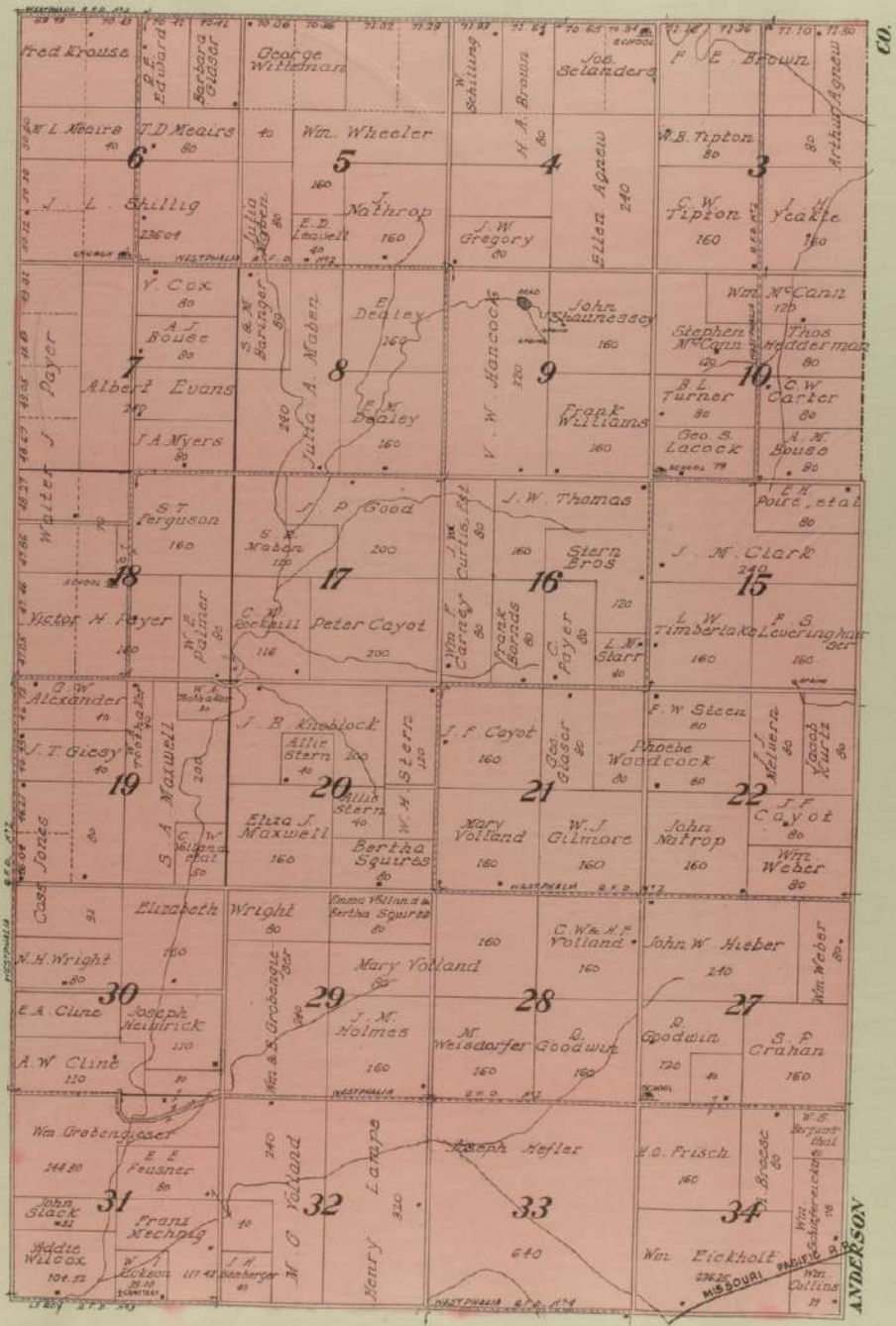

MAP OF
TOWNSHIP 22 S., RANGE 14 E. and
PART of TOWNSHIP 22 S., RANGE 13 E.

OF THE 9th P. M.

Scale 2 inches to 1 mile

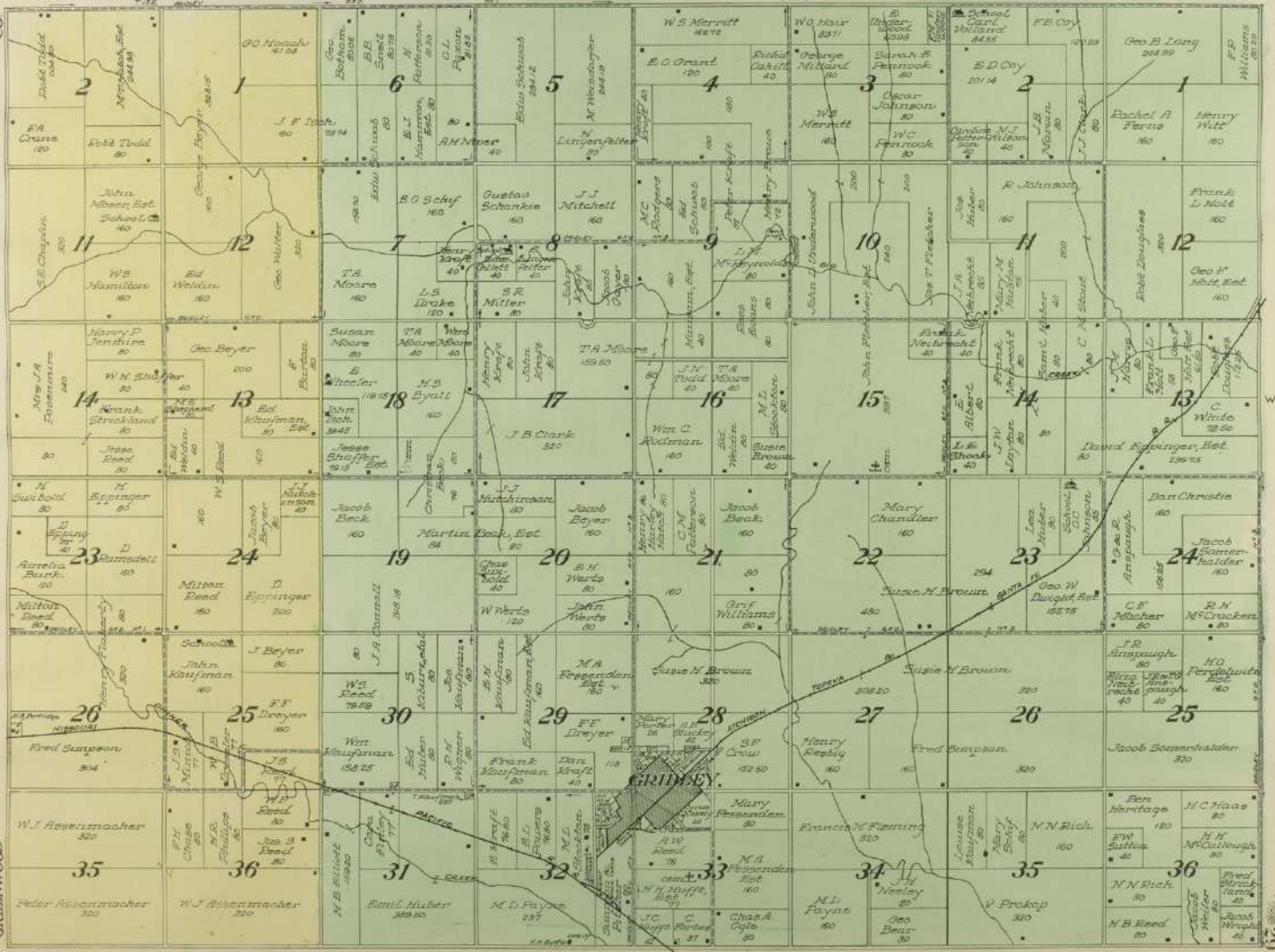

GREENWOOD



MAP OF

TOWNSHIP 22 S., RANGE 15 E.

 OF THE 6th P. M.

Scale 2 inches to 1 mile

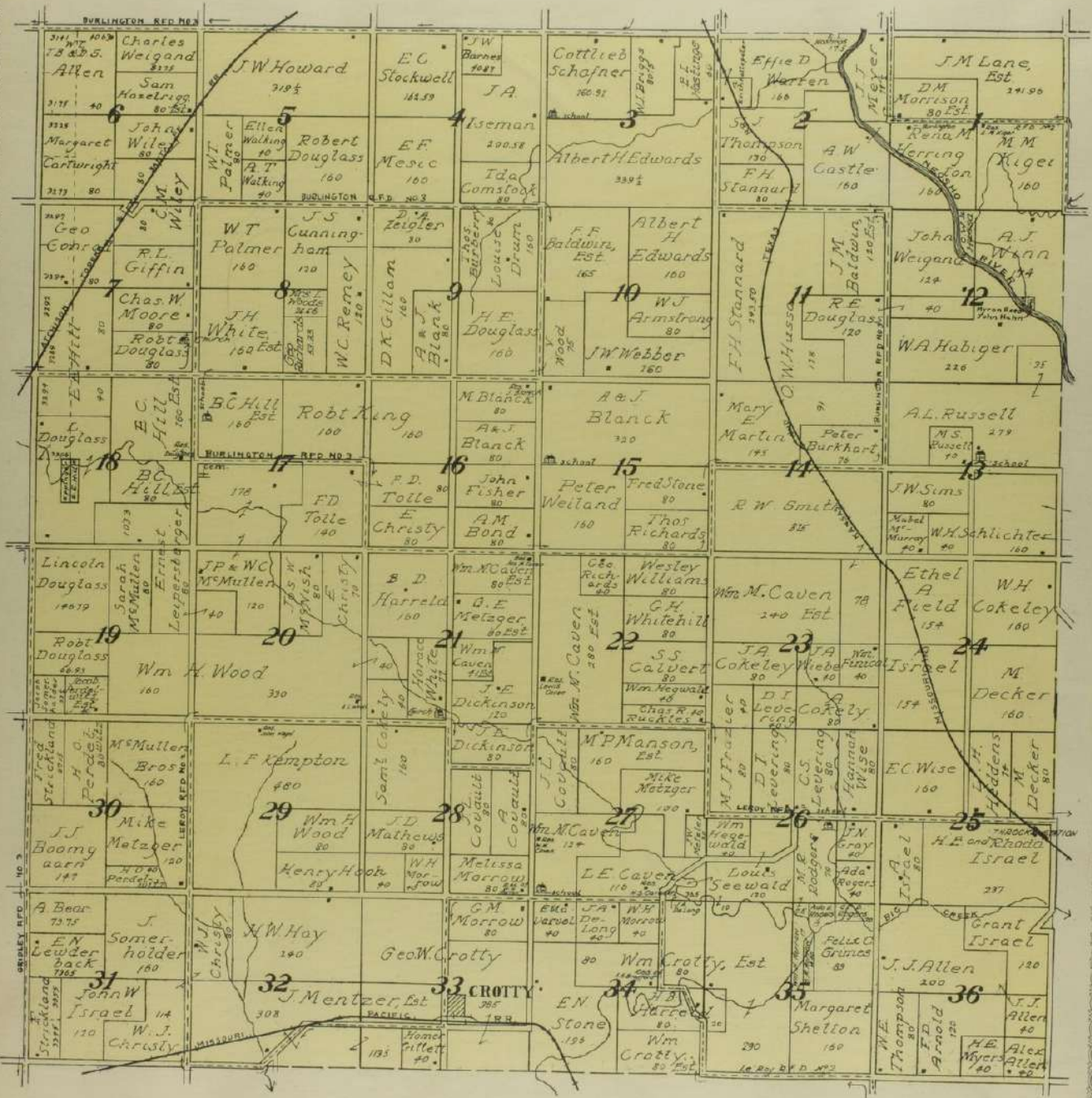



MAP OF
TOWNSHIP 22 S., RANGE 16 E.
 OF THE 6th P. M.

Scale 2 inches to 1 mile

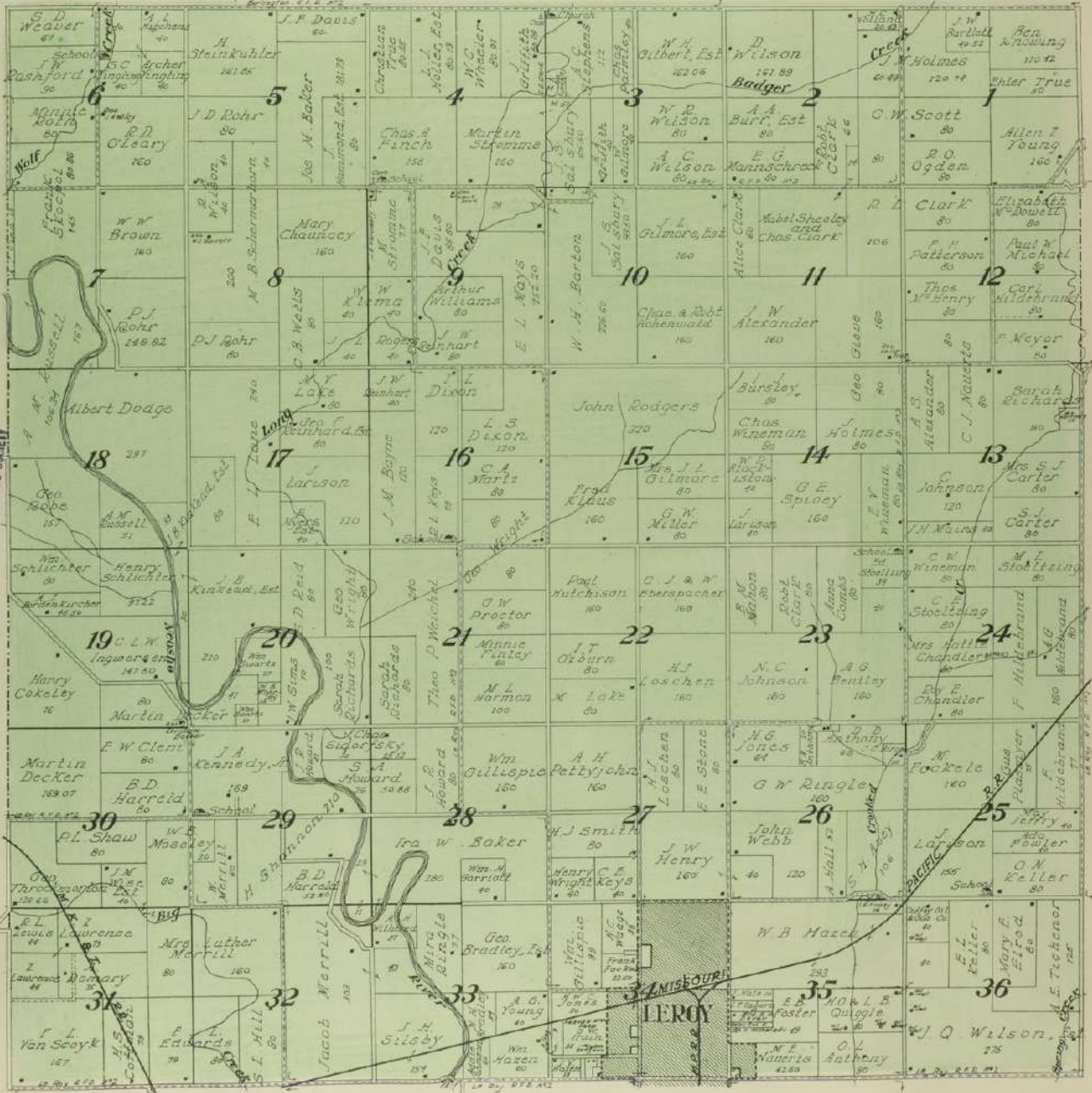

MAP OF
Part of Township 23 S., Ranges 13 and 14 E.
OF THE 6th P. M.

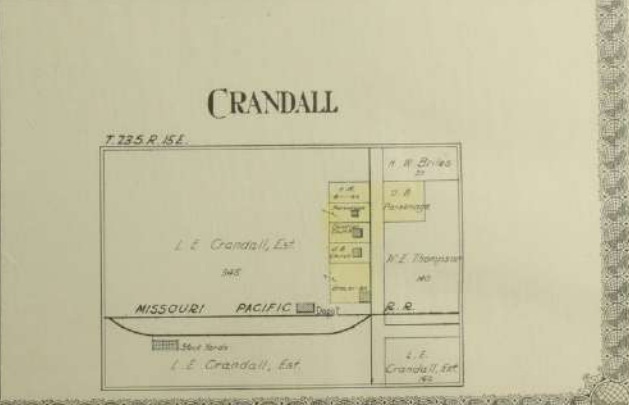
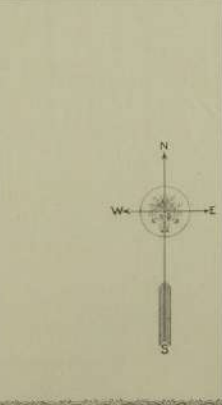
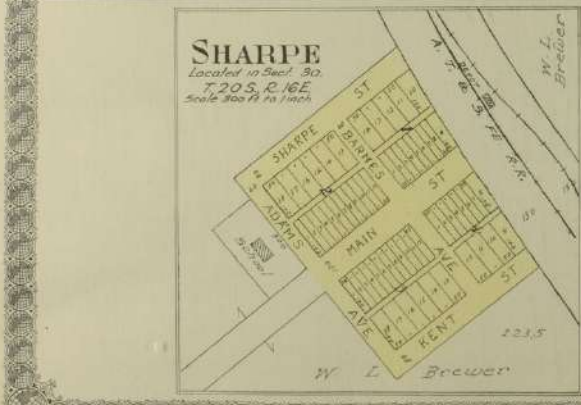
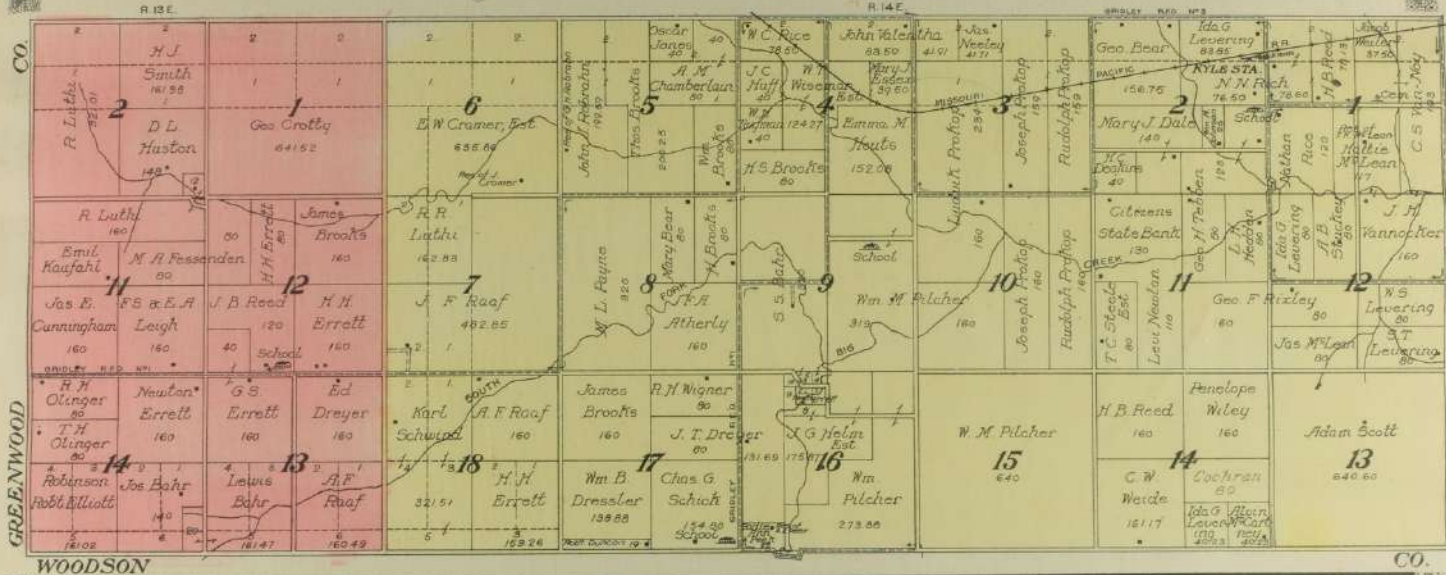

MAP OF
Part of Township 23 S., Range 15 E.

33

OF THE 6th P. M.

Scale 2 inches to 1 mile

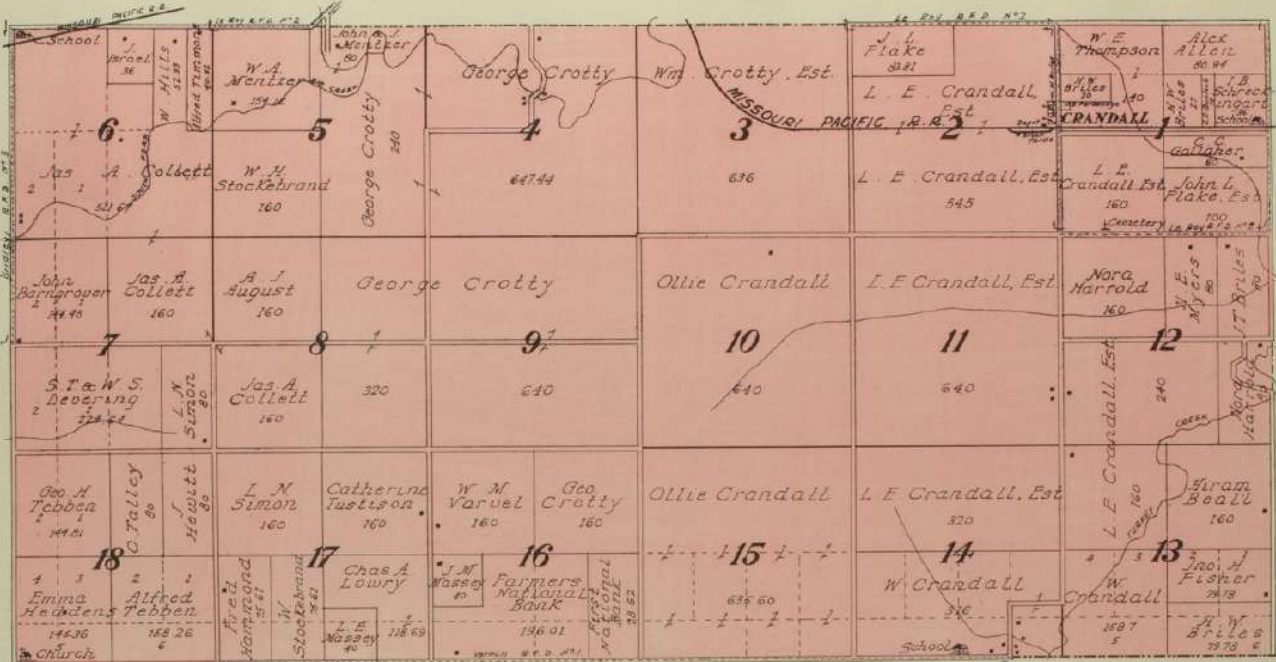

MAP OF
Part of Township 23 S., Range 16 E.

OF THE 6th P. M.

Scale 2 inches to 1 mile

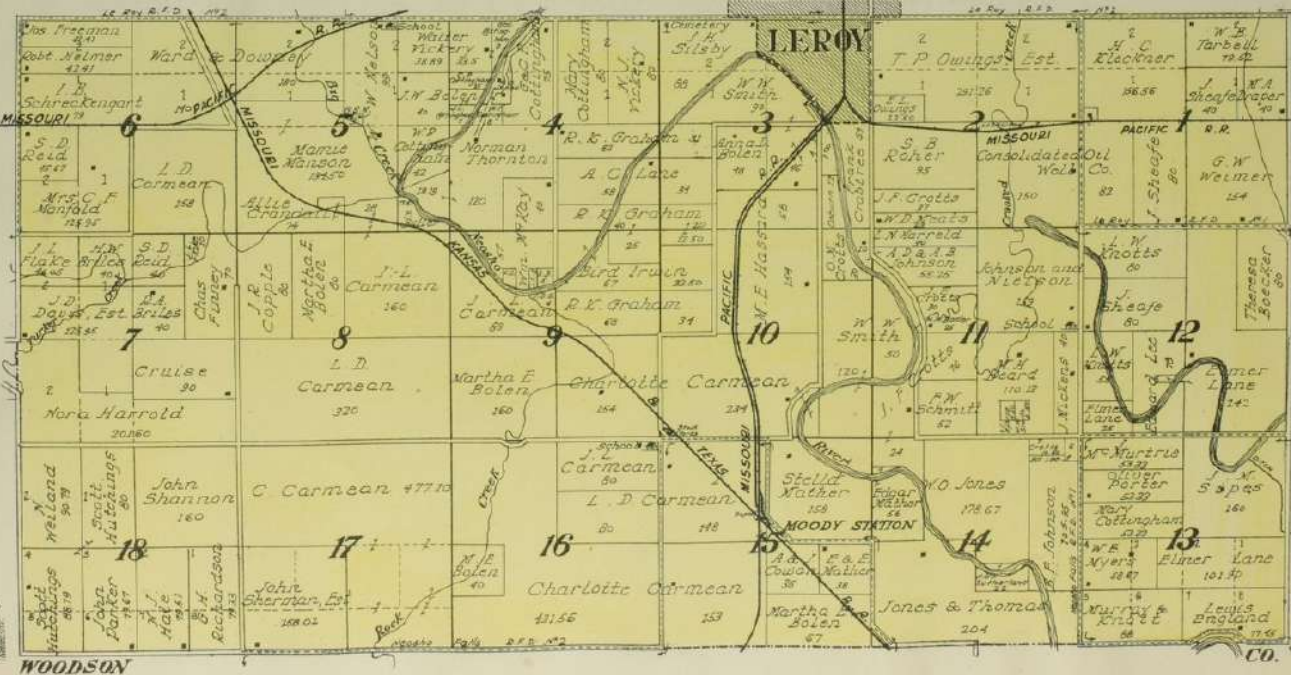

ALICEVILLE

T. 22 S., R. 17 E.

Scale 300ft = 1 inch

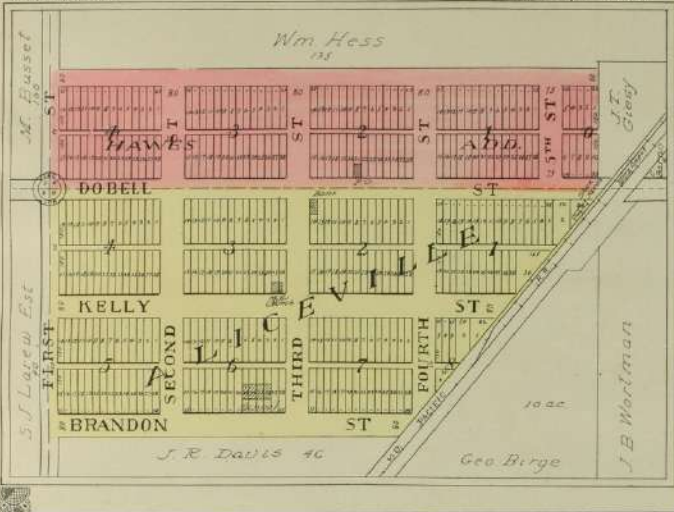

CROTTY

T. 22 S., R. 17 E.

Scale 300ft = 1 inch

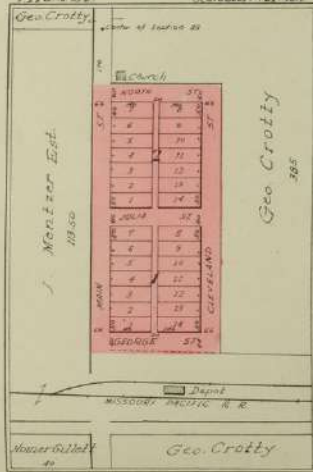

AGRICOLA

T. 22 S., R. 17 E.

Scale 300ft = 1 in.



MAP OF Part of Townships 22 and 23 S., Range 17 E.

OF THE 6th P. M.

Scale 2 inches to 1 mile

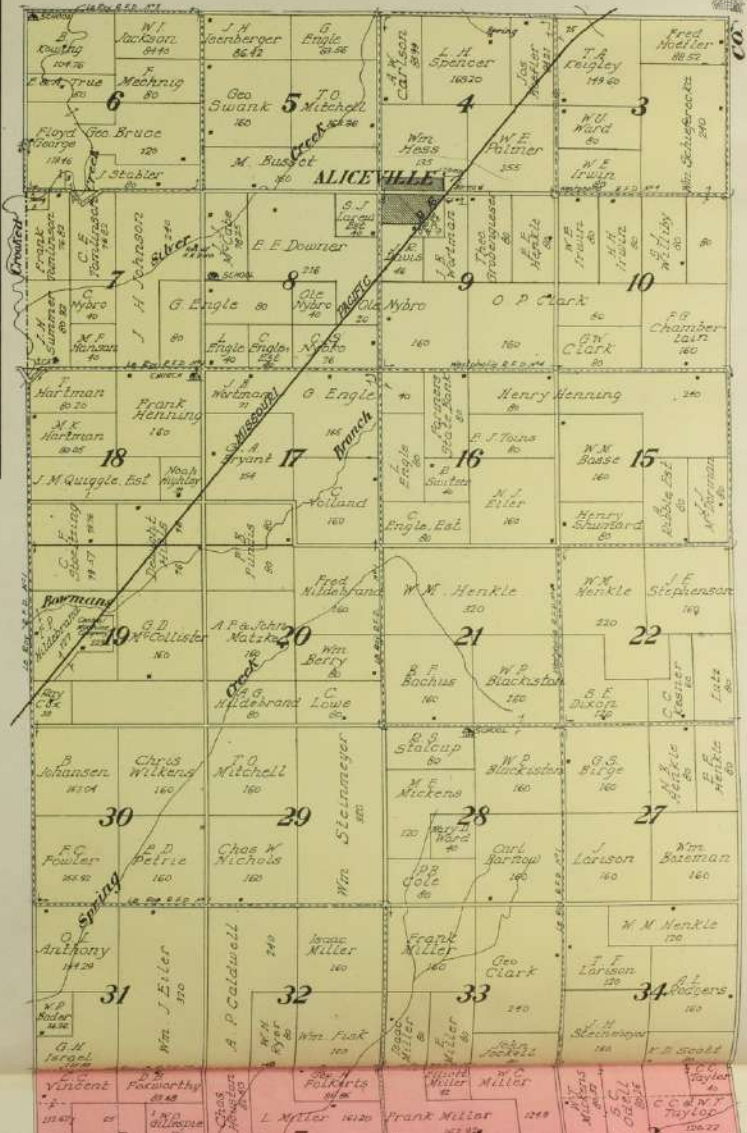

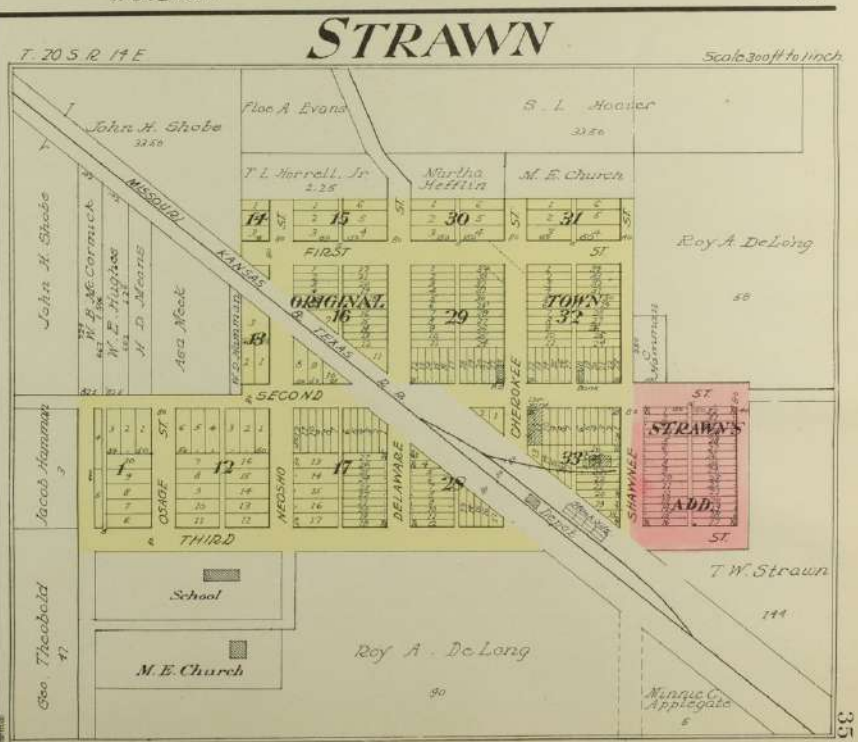
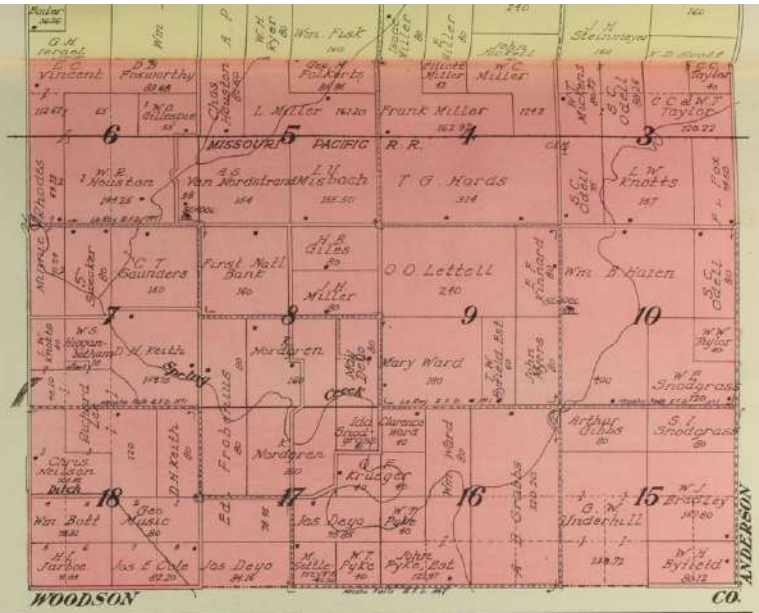

GRIDLEY
T. 22 S., R. 14 E.
Scale 200 feet to 1 inch.
Copyright 1913 by A. C. & C.
I. F. Dreyer

