

OUTLINE MAP OF  
**HARPER COUNTY**  
 KAS.  
*Scale 200 of an Inch to the Mile.*

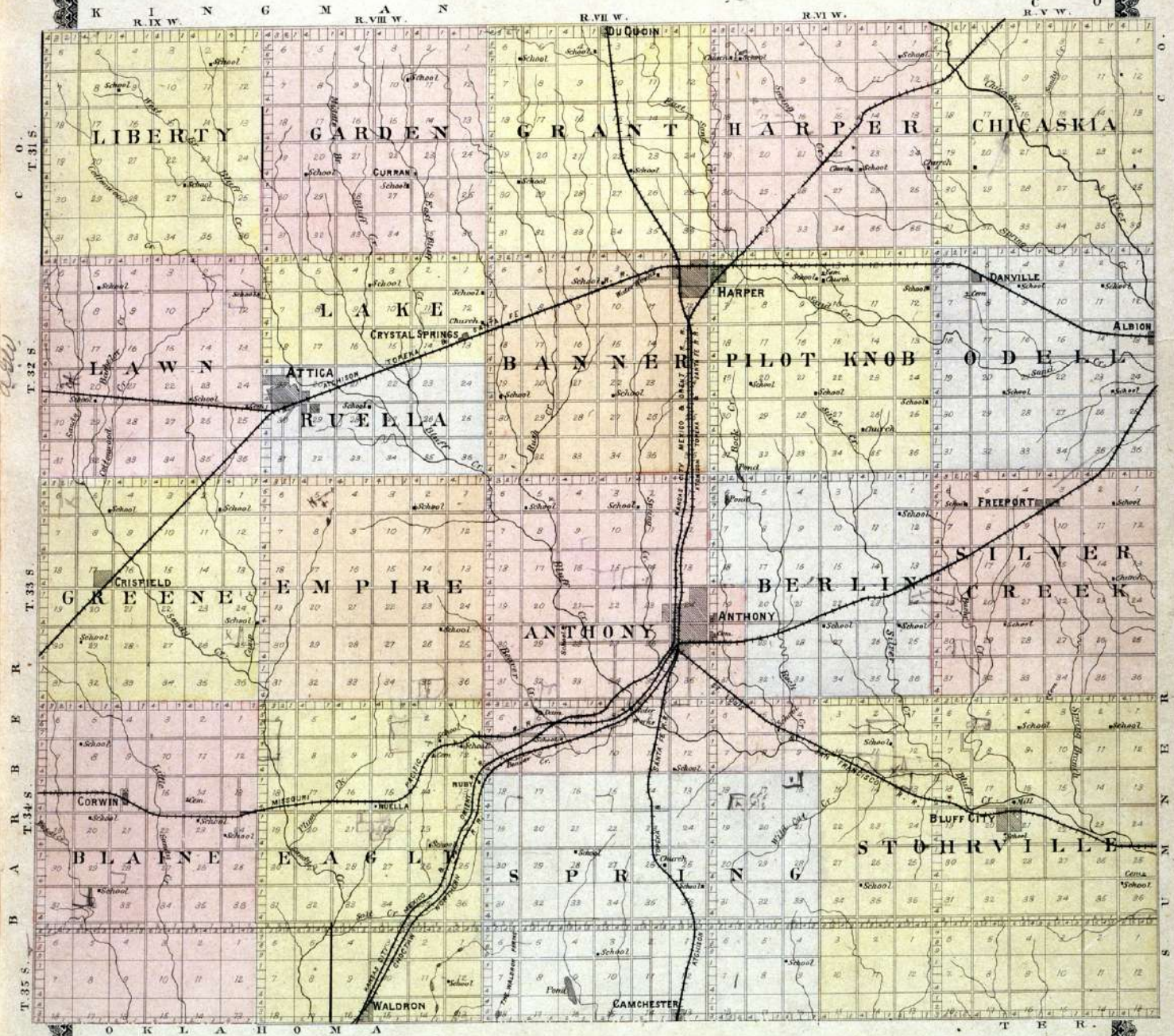

# WALDRON EAGLE TWP.

Scale 3960 ft. to an inch

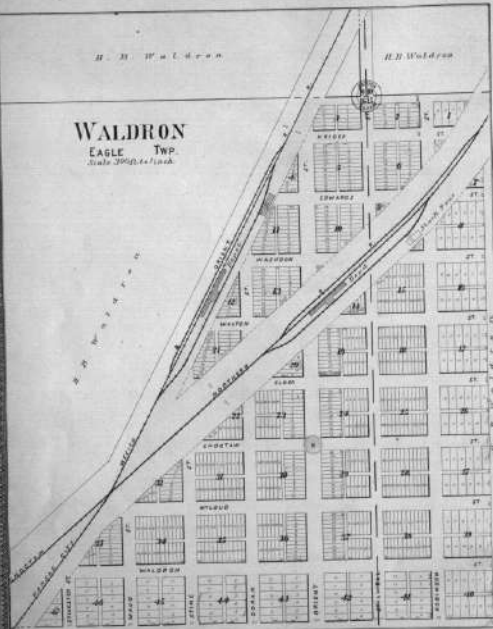

# ANTHONY TOWNSHIP

Township 23 North, Range 7 West, Part of Range 6 West, and Part of Township 18 North, Range 6 East of 47 West



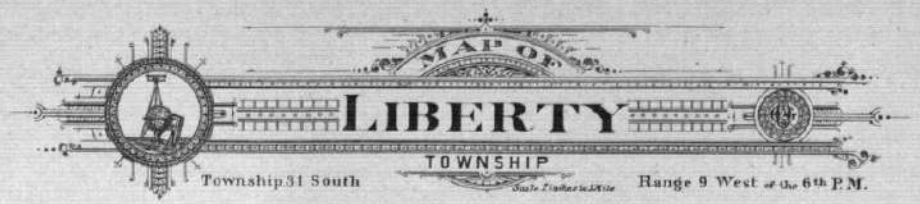

  
 MAP OF  
**LIBERTY**  
 TOWNSHIP  
 Township 31 South Range 9 West of the 6th P.M.

K I N G M A N										C O.		
3426 Jacob's 148.64	4007 George P. Yorkum 160.26	4033 E. B. Cox 99.70	4013 Minnie Coe 240.20	4038 Wm. Leslie 125.90	4030 A. S. McFarlan 159.84	4030 H. H. Hunter 23.25	3997 W. M. Williams 119.97	3992 Fred. McAllister 40	3994 George Gould 160	4004 Frank Zoeller 325.16	4004 Geo. M. Brown 160	4003 John F. Deansmore 160
3443 Sophia White 148.83	3443 W. H. Palmer 160	3443 Beemer 160	3443 J. G. Eckels 80	3443 Samson Buss 150	3443 Wm. Leslie 125.90	3443 James Nichols 160	3443 Adam Shriver 160	3443 George Gould 160	3443 School	3443 J. B. Watkins 125.83	3443 J. B. Watkins 160	3443 Geo. M. Brown 160
3455 William Brett 160	3455 McDarrell 160	3455 J. B. Watkins 160	3455 Ed. Miller 160	3455 Ed. Miller 160	3455 James Nichols 160	3455 Adam Shriver 160	3455 J. C. N. S. 280	3455 J. C. N. S. 280	3455 J. C. N. S. 280	3455 J. B. Watkins 160	3455 John F. Deansmore 160	3455 John F. Deansmore 160
3467 Samuel L. Kimmel 458.55	3467 S. L. Kimmel 510	3467 S. L. Kimmel 510	3467 Ed. Miller 160	3467 Ed. Miller 160	3467 W. N. Williams 160	3467 Ed. Miller 160	3467 L. Welch 80	3467 George Gould 240	3467 George Gould 240	3467 F. Washburn 160	3467 Walton Loan Co. 160	3467 Walton Loan Co. 160
3480 J. B. Watkins 160.22	3480 S. L. Kimmel 510	3480 S. L. Kimmel 510	3480 School Land 80	3480 School Land 80	3480 E. A. Singer 80	3480 T. P. Spillman 80	3480 K. M. Spillman 80	3480 George Gould 480	3480 George Gould 480	3480 Savings Bank 160	3480 George R. Darns 640	3480 George R. Darns 640
3492 H. Mudge 150.56	3492 S. L. Kimmel 510	3492 S. L. Kimmel 510	3492 School Land 80	3492 School Land 80	3492 E. S. Ellsworth 80	3492 T. P. Spillman 80	3492 K. M. Spillman 80	3492 George Gould 480	3492 George Gould 480	3492 Savings Bank 160	3492 George R. Darns 640	3492 George R. Darns 640
3504 J. B. Watkins 161.12	3504 L. Bradford 40	3504 Anthony 20	3504 McDowell 80	3504 McDowell 80	3504 H. C. Spaulding 220	3504 W. B. Horner 160	3504 R. B. Broadhead 160	3504 George Gould 590	3504 George Gould 590	3504 Savings Bank 160	3504 George R. Darns 640	3504 George R. Darns 640
3516 J. B. Watkins 161.60	3516 L. Bradford 40	3516 Anthony 20	3516 McDowell 80	3516 McDowell 80	3516 H. C. Spaulding 220	3516 W. B. Horner 160	3516 R. B. Broadhead 160	3516 George Gould 590	3516 George Gould 590	3516 Savings Bank 160	3516 George R. Darns 640	3516 George R. Darns 640
3528 C. D. Farris 160	3528 John D. Vickers 160	3528 S. M. Smitheiser 80	3528 S. M. Smitheiser 80	3528 S. M. Smitheiser 80	3528 H. C. Spaulding 220	3528 R. B. Broadhead 160	3528 R. B. Broadhead 160	3528 George Gould 590	3528 George Gould 590	3528 Savings Bank 160	3528 George R. Darns 640	3528 George R. Darns 640
3540 Sophia White 148.83	3540 L. D. Work 40	3540 R. E. Frazer 40	3540 John D. Vickers 160	3540 S. M. Smitheiser 80	3540 G. Brose 160	3540 J. H. Foss 40	3540 George W. Clark 280	3540 George W. Clark 280	3540 George W. Clark 280	3540 Savings Bank 160	3540 George R. Darns 640	3540 George R. Darns 640
3552 J. M. Warner 40	3552 D. Oppenheimer 80	3552 M. P. Praker 80	3552 John D. Vickers 160	3552 S. M. Smitheiser 80	3552 G. Brose 160	3552 J. H. Foss 40	3552 George W. Clark 280	3552 George W. Clark 280	3552 George W. Clark 280	3552 Savings Bank 160	3552 George R. Darns 640	3552 George R. Darns 640
3564 J. M. Warner 40	3564 D. Oppenheimer 80	3564 M. P. Praker 80	3564 John D. Vickers 160	3564 S. M. Smitheiser 80	3564 G. Brose 160	3564 J. H. Foss 40	3564 George W. Clark 280	3564 George W. Clark 280	3564 George W. Clark 280	3564 Savings Bank 160	3564 George R. Darns 640	3564 George R. Darns 640
3576 J. M. Warner 40	3576 D. Oppenheimer 80	3576 M. P. Praker 80	3576 John D. Vickers 160	3576 S. M. Smitheiser 80	3576 G. Brose 160	3576 J. H. Foss 40	3576 George W. Clark 280	3576 George W. Clark 280	3576 George W. Clark 280	3576 Savings Bank 160	3576 George R. Darns 640	3576 George R. Darns 640
3588 J. M. Warner 40	3588 D. Oppenheimer 80	3588 M. P. Praker 80	3588 John D. Vickers 160	3588 S. M. Smitheiser 80	3588 G. Brose 160	3588 J. H. Foss 40	3588 George W. Clark 280	3588 George W. Clark 280	3588 George W. Clark 280	3588 Savings Bank 160	3588 George R. Darns 640	3588 George R. Darns 640
3600 J. M. Warner 40	3600 D. Oppenheimer 80	3600 M. P. Praker 80	3600 John D. Vickers 160	3600 S. M. Smitheiser 80	3600 G. Brose 160	3600 J. H. Foss 40	3600 George W. Clark 280	3600 George W. Clark 280	3600 George W. Clark 280	3600 Savings Bank 160	3600 George R. Darns 640	3600 George R. Darns 640

L A W N T W P

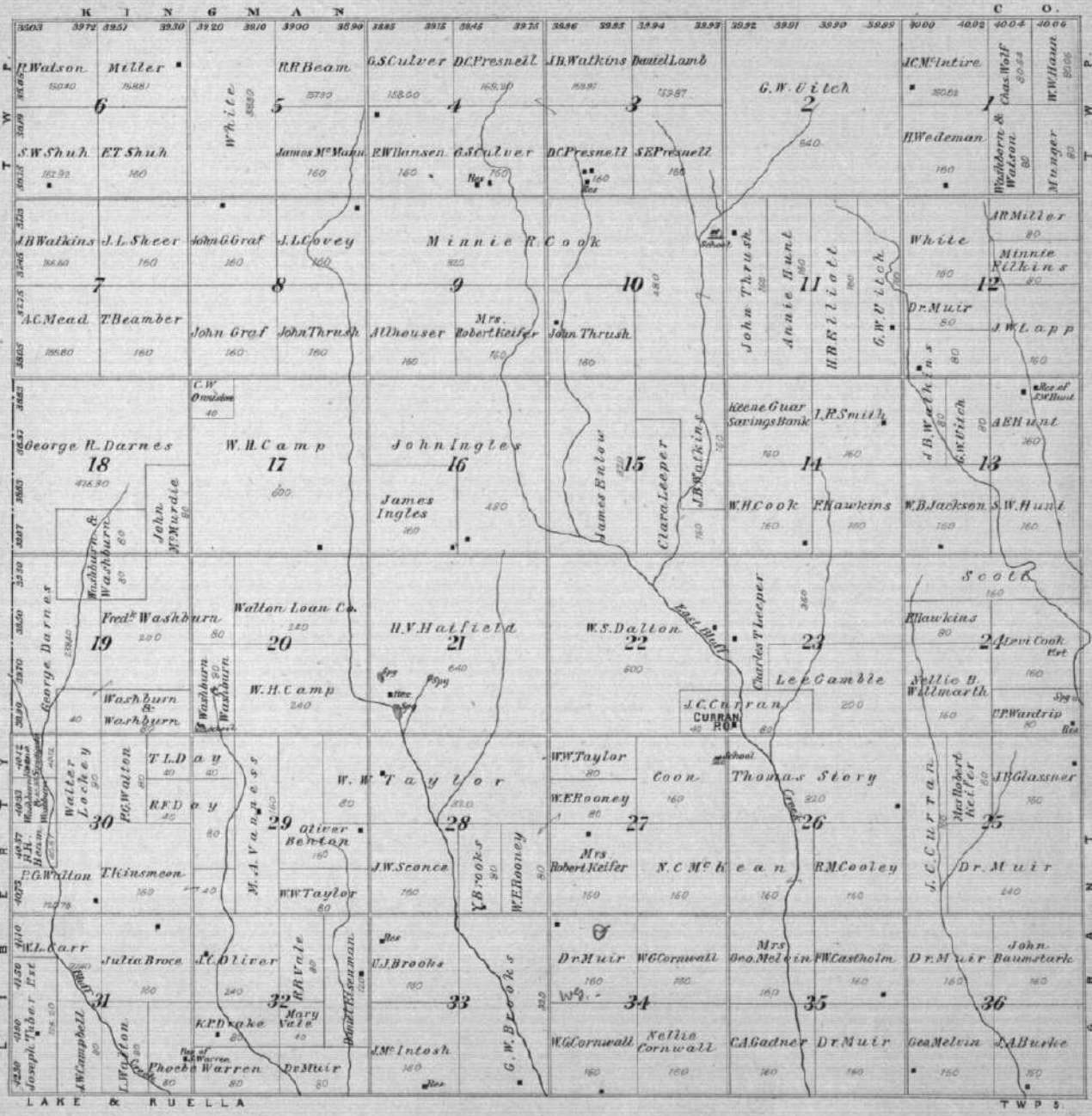

  
**MAP OF**  
**GARDEN**  
**TOWNSHIP**  
 Township 31 South. Range 8 West of the 6th P.M.

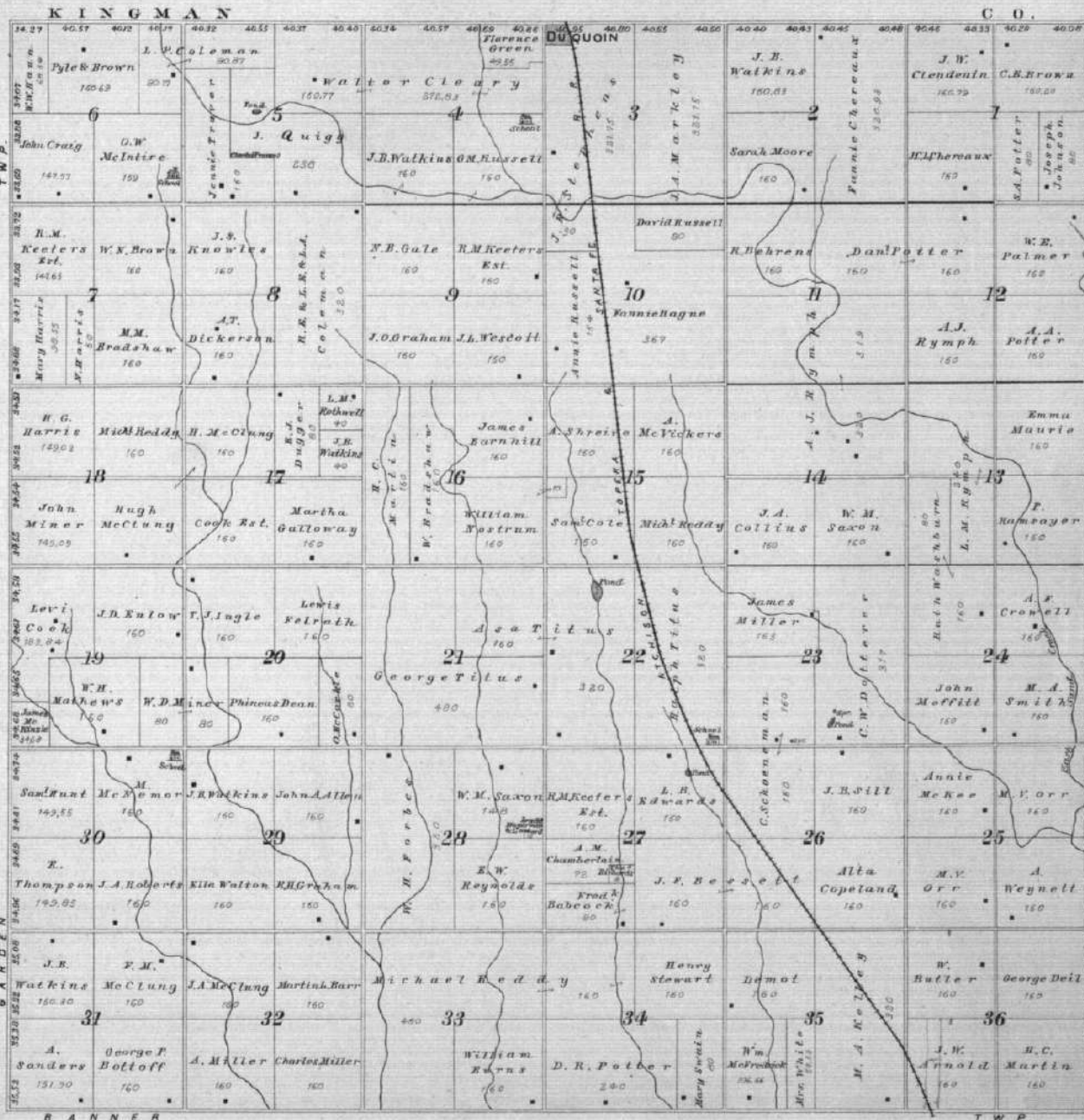

  
**MAP OF**  
**GRANT**  
**TOWNSHIP**  
 Township 31 South Range 7 West of the 6th P.M.



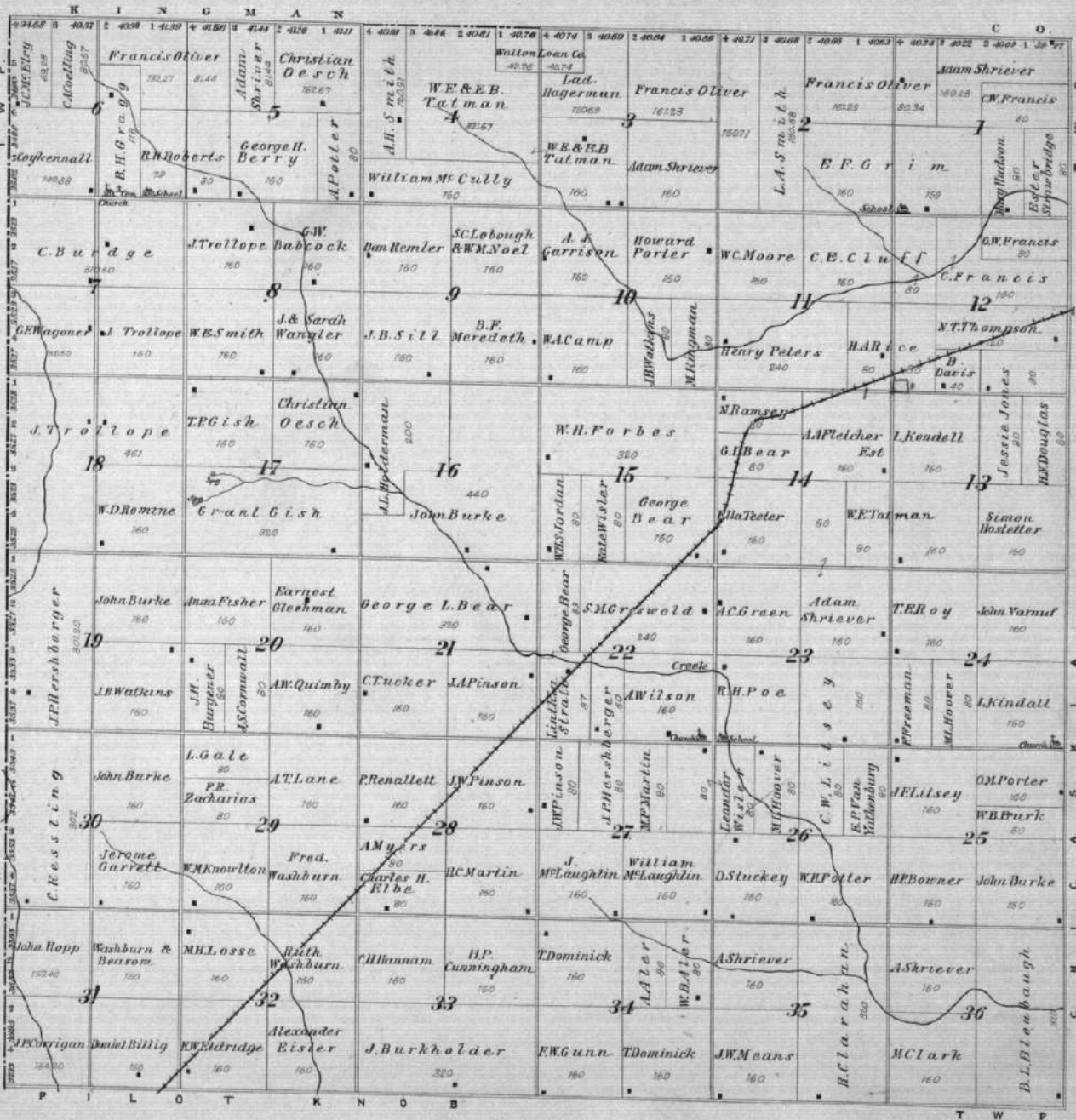

  
**MAP OF**  
**HARPER**  
 TOWNSHIP  
 Township 31 South Range 6 West of the 6th P.M.

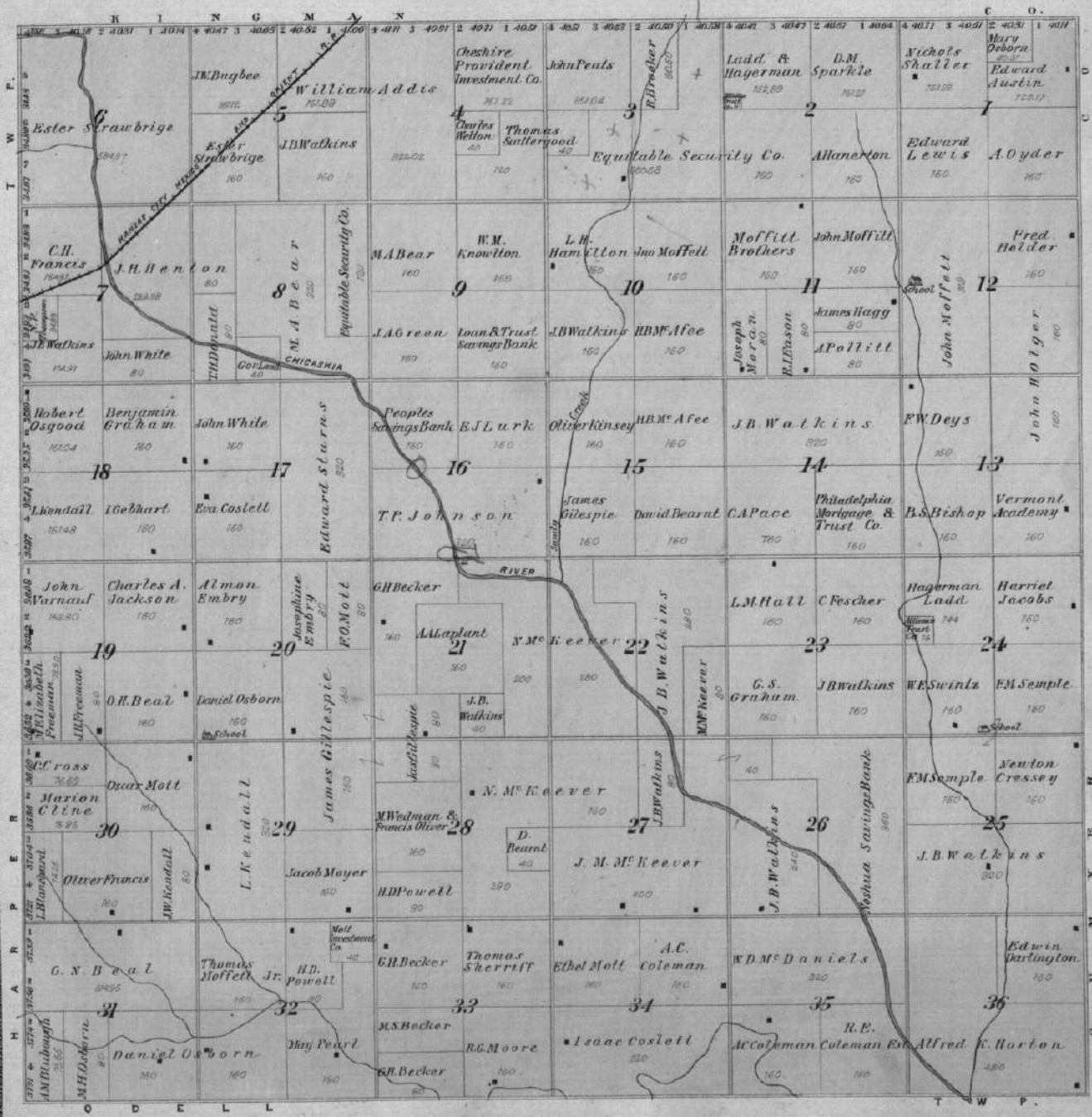

S. H. ...  
 12-31-6, N. ...  
 H. E. ...  
 K. W. ...

  
**MAP OF**  
**CHICASKIA**  
**TOWNSHIP**  
 Township 31 South, Range 5 West of the 6th P.M.



  
**MAP OF**  
**ODELL**  
**TOWNSHIP**  
 Township 32 South, Range 5 West of the 6th P.M.

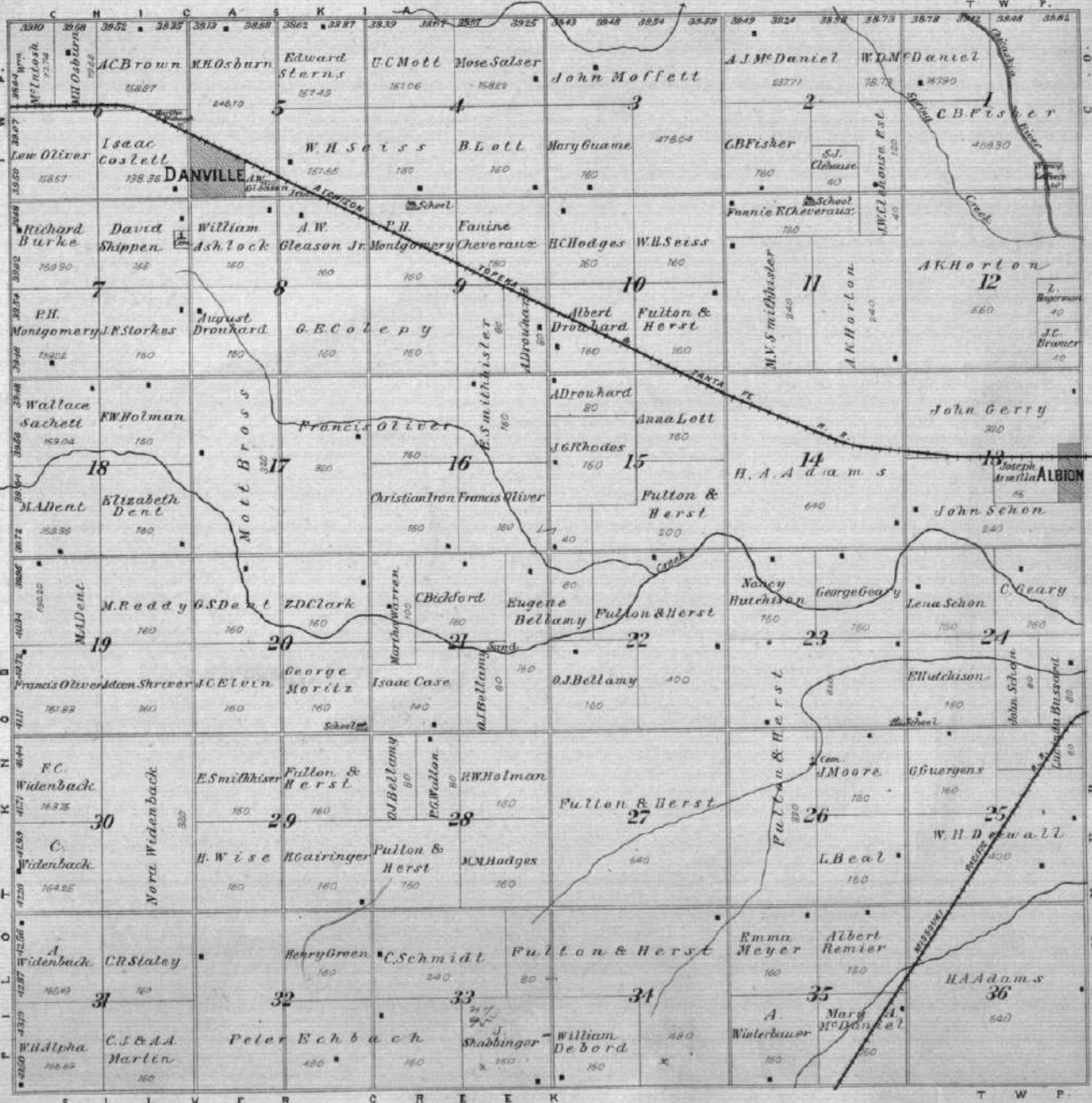





  
**MAP OF**  
**PILOT Knob**  
**TOWNSHIP**  
 Township 32 South, Range 6 West of the 6th P.M.



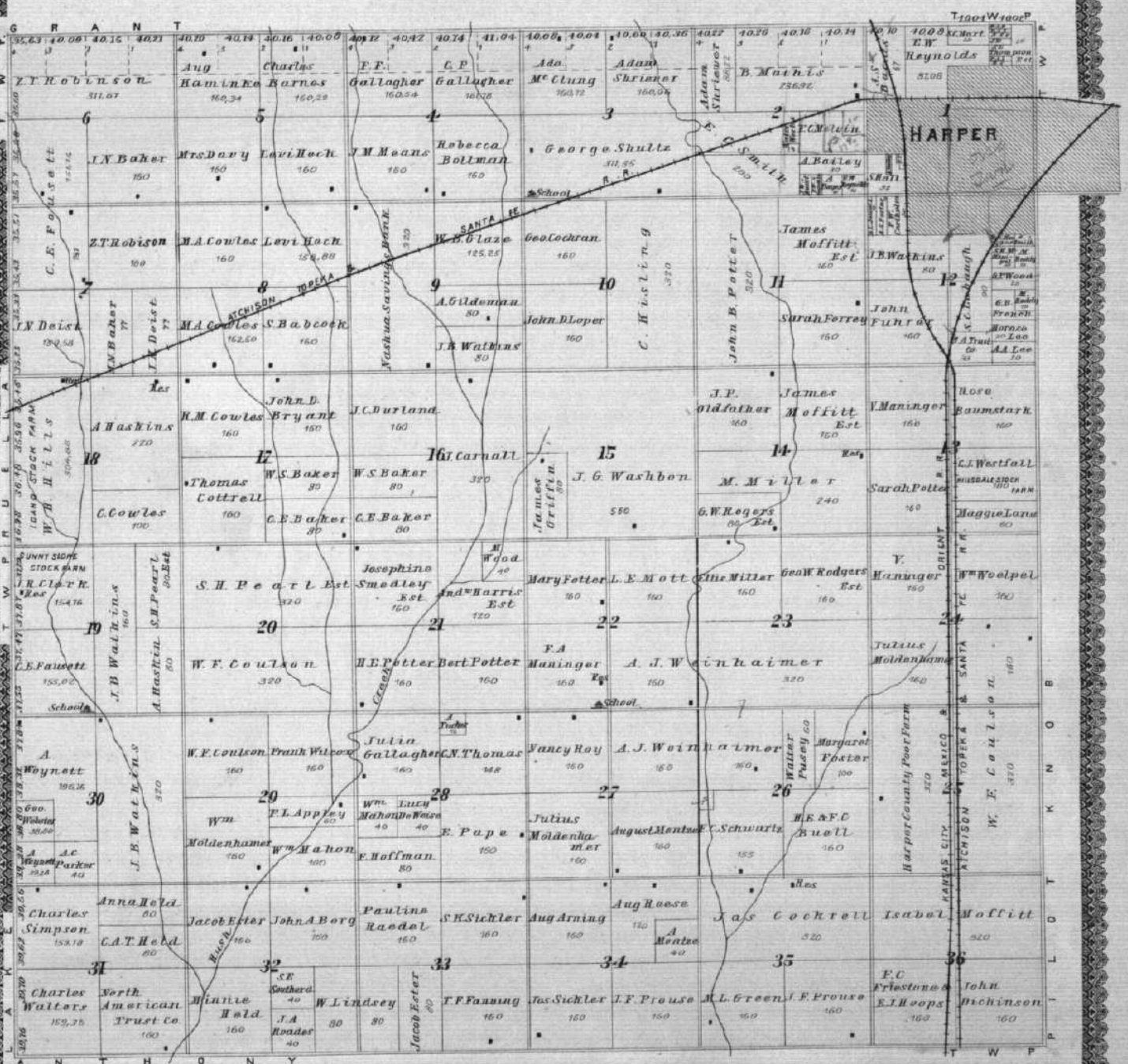

  
**MAP OF**  
**BANNER**  
 TOWNSHIP  
 Township 32 South, Range 7 West of the 6th P.M.



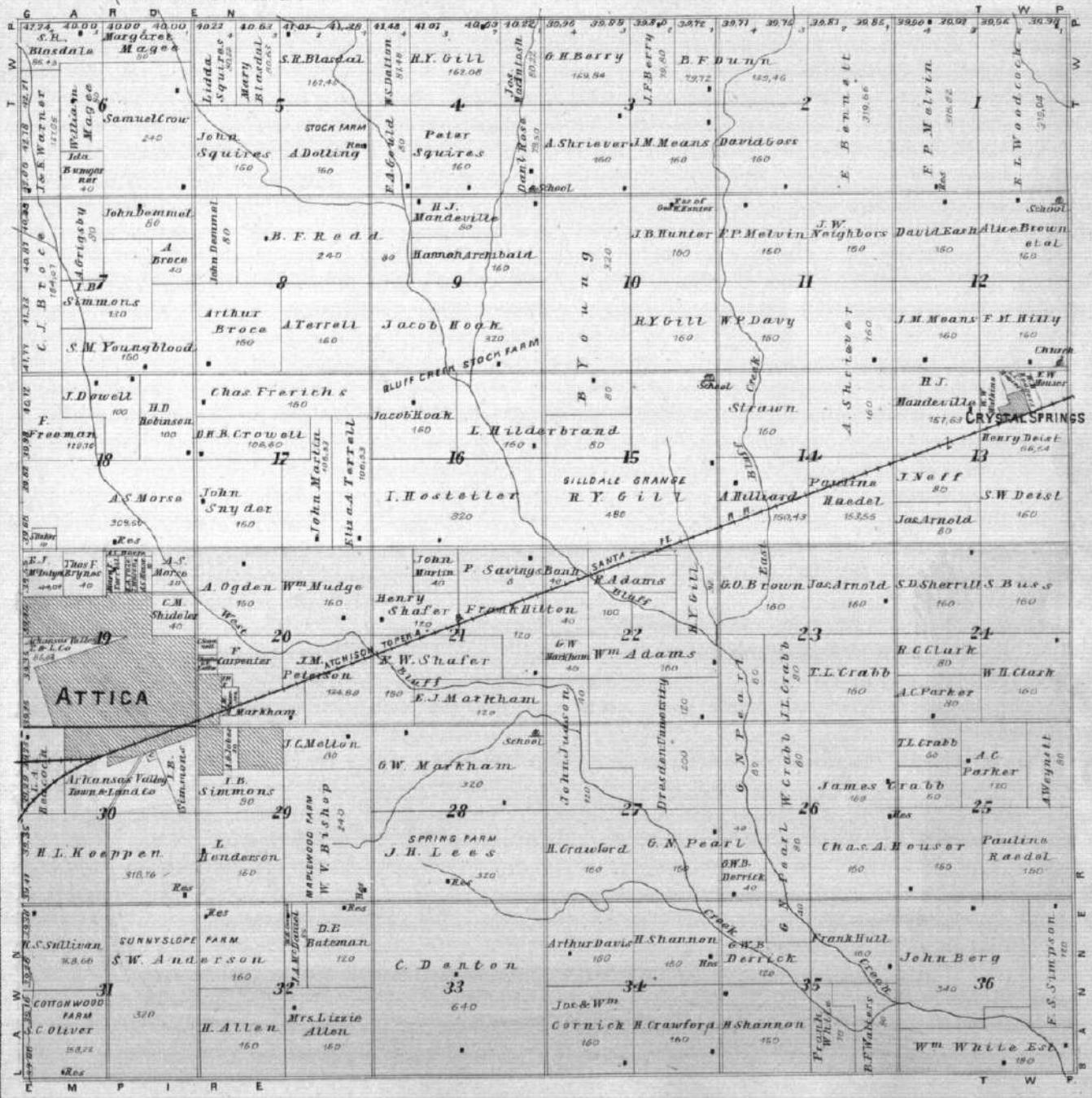

  
**MAP OF**  
**LAKE AND RUELLA**  
**TOWNSHIP**  
 Township 32 South. Range 8 West of the 6th P.M.

NOTE } LAKE TWP COLORED YELLOW.  
 } RUELLA TWP COLORED GREEN.

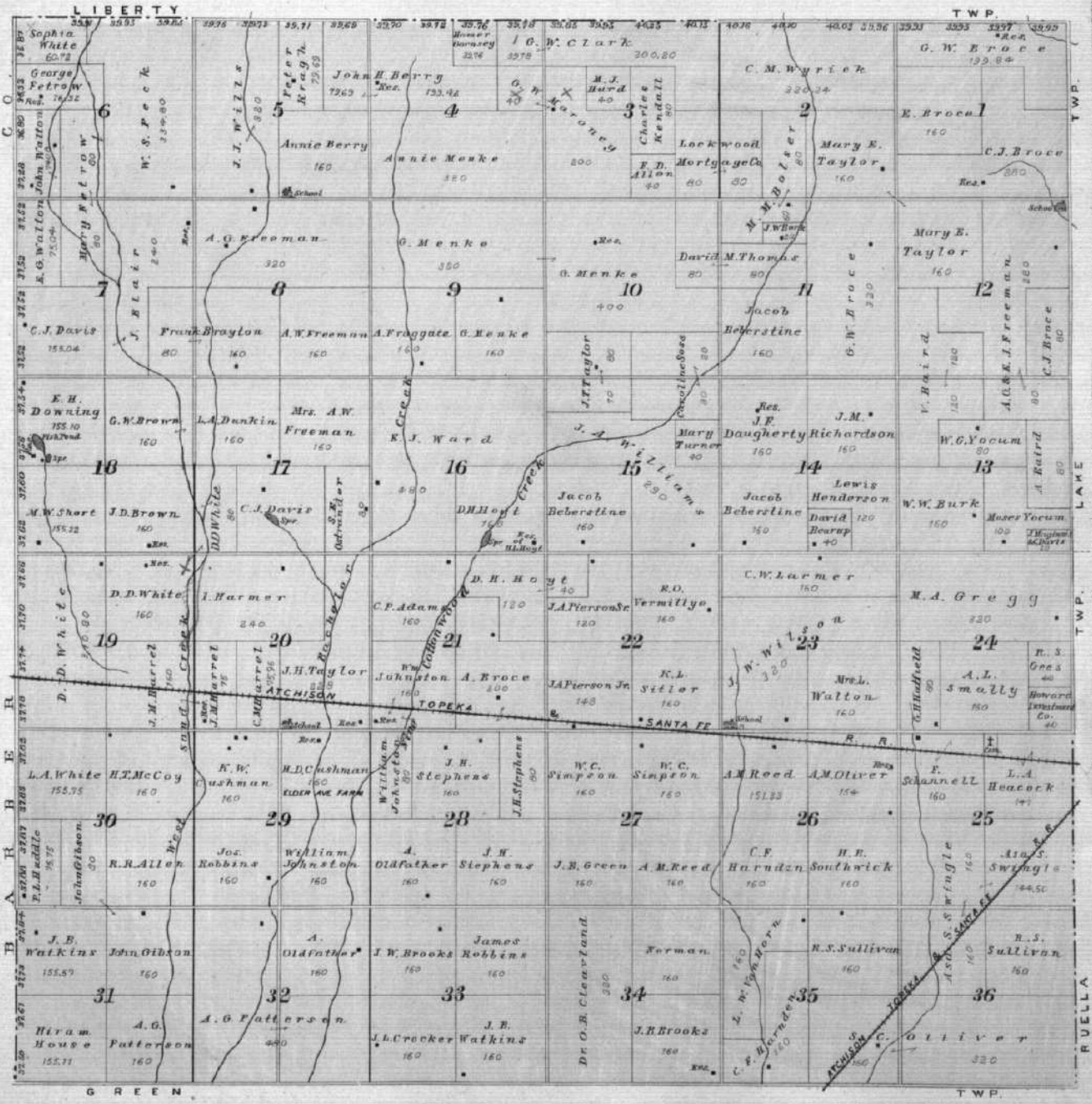

**MAP OF**  
**LAWN**  
**TOWNSHIP**  
 Township 32 South Range 9 West of the 6th P.M.



  
 MAP OF  
**EMPIRE**  
 TOWNSHIP  
 Township 33 South, Range 8 West of the 6th P.M.

R U E L L A										T W P																																																																																																																																	
39.92	39.90	39.88	39.86	39.84	39.82	39.80	39.78	39.76	39.74	39.72	39.70	39.68	39.66	39.64	39.62	39.60	39.58	39.56	39.54	39.52	39.50	39.48	39.46	39.44	39.42	39.40	39.38	39.36	39.34	39.32	39.30	39.28	39.26	39.24	39.22	39.20	39.18	39.16	39.14	39.12	39.10	39.08	39.06	39.04	39.02	39.00																																																																																													
EK Robinson 159.89 6										Ladd Harlow 72.90 72.97 5										A Latham 192.57 A. R. G a r v e r 280 4										Anna Meyer 150.99 3										W <sup>c</sup> & J. D. Cornick 153.95 2										H. Shannon 72.54 B. F. Walters 155.96 1										William White Est. 160																																																																															
W. S. & M. E. Lammon 160 7										S. M. Futerbaugh 80 80 8										W. H. Rosenbough 160 9										H. Allen 160 10										Alexander McKinney 240 11										John R. Kropp Jr. 150 12										J. B. Campbell 300 13										J. H. Richardson 160 14										J. Miller 160 15										Alfred Miller 160 16										S. Buckman 80 17										J. Miller 80 18																													
A. B. Watkins 160 19										J. B. Grisbey 80 80 20										A. R. Garver 560 21										John Fishbaugh 380 22										Hiram Allen 300 23										J. Fishbaugh 800 24										M. L. Allen 80 80 25										M. L. Corbett 160 26										J. A. Miller 490 27										J. H. Richardson 300 28										Alfred Miller 160 29										H. G. Kropp 160 30										D. A. Sechler 160 31										W. Marts 160 32									
John H. Hale 158.00 33										J. W. Grigsby 160 34										A. H. Garver 330 35										C. W. Wilson 640 36										J. D. Cornick 240 37										M. A. Lockwood 640 38										Alfred Miller 160 39										H. G. Kropp 160 40										D. A. Sechler 160 41										W. Marts 160 42																																																	
J. B. Watkins 153.15 43										Chester Parker 160 44										J. B. Watkins 160 45										R. B. Byrnes 160 46										C. W. Wilson 330 47										J. W. Cornick 240 48										M. A. Lockwood 640 49										D. A. Sechler 160 50										W. Marts 160 51																																																											
Charles A. Morse 163.78 52										George Means 160 53										C. W. Wilson 160 54										C. W. Wilson 330 55										H. H. Walcott 80 80 56										William A. Cornick 160 57										C. A. Hallman 160 58										H. Grove 80 59										Chas. Grove Est. 160 60																																																											
George Means 159.95 61										O. W. Neff 160 62										Lina Wood Law 80 63										Henry Montague 160 64										M. Jones 160 65										W. M. Law 300 66										S. L. Houser 80 80 67										M. Jones 160 68										Mary Hoath 160 69										J. G. Reynolds 480 70										D. Law 320 71										W. M. Law 80 72																													
F. M. Ellery 156.80 73										Norwich Bank 160 74										Geo Evans 640 75										Clara Hallowell 160 76										Mary Hoath 160 77										H. W. Kastens 400 78										Mary Hoath 160 79										W. M. Parland 160 80										W. M. Law 160 81										W. M. Law 160 82																																																	
S. L. Smith 375.20 83										S. L. Smith 375.20 84										L. L. Law 240 85										A. M. Ohlke 80 86										C. C. Coryell 160 87										Bliss Dewpree 80 88										H. E. Allen 80 89										J. W. Cornick 800 90										F. & J. Sibert 160 91										William Tobias 160 92																																																	
S. L. Smith 63.840 93										S. L. Smith 63.840 94										A. W. Lincoln 380 95										W. M. Law 160 96										B. E. Burnap 160 97										F. & J. Sibert 160 98										Horace Evans 147 99										John Sibert 160 100										Carrie M. Lain 640 101																																																											
S. L. Smith 160 102										Julia Champion 160 103										S. L. Smith 160 104										E. W. Houser 160 105										A. Parker 160 106										P. C. Bell 160 107										P. W. Seamahorn 160 108										F. & J. Sibert 340 109										H. S. Sibert 340 110																																																											
E A G L E										T W P																																																																																																																																	

MISSOURI STATE HISTORICAL SOCIETY

  
**MAP OF**  
**BERLIN**  
**TOWNSHIP**  
 Township 35 South, Range 6 West of the 6th P.M.



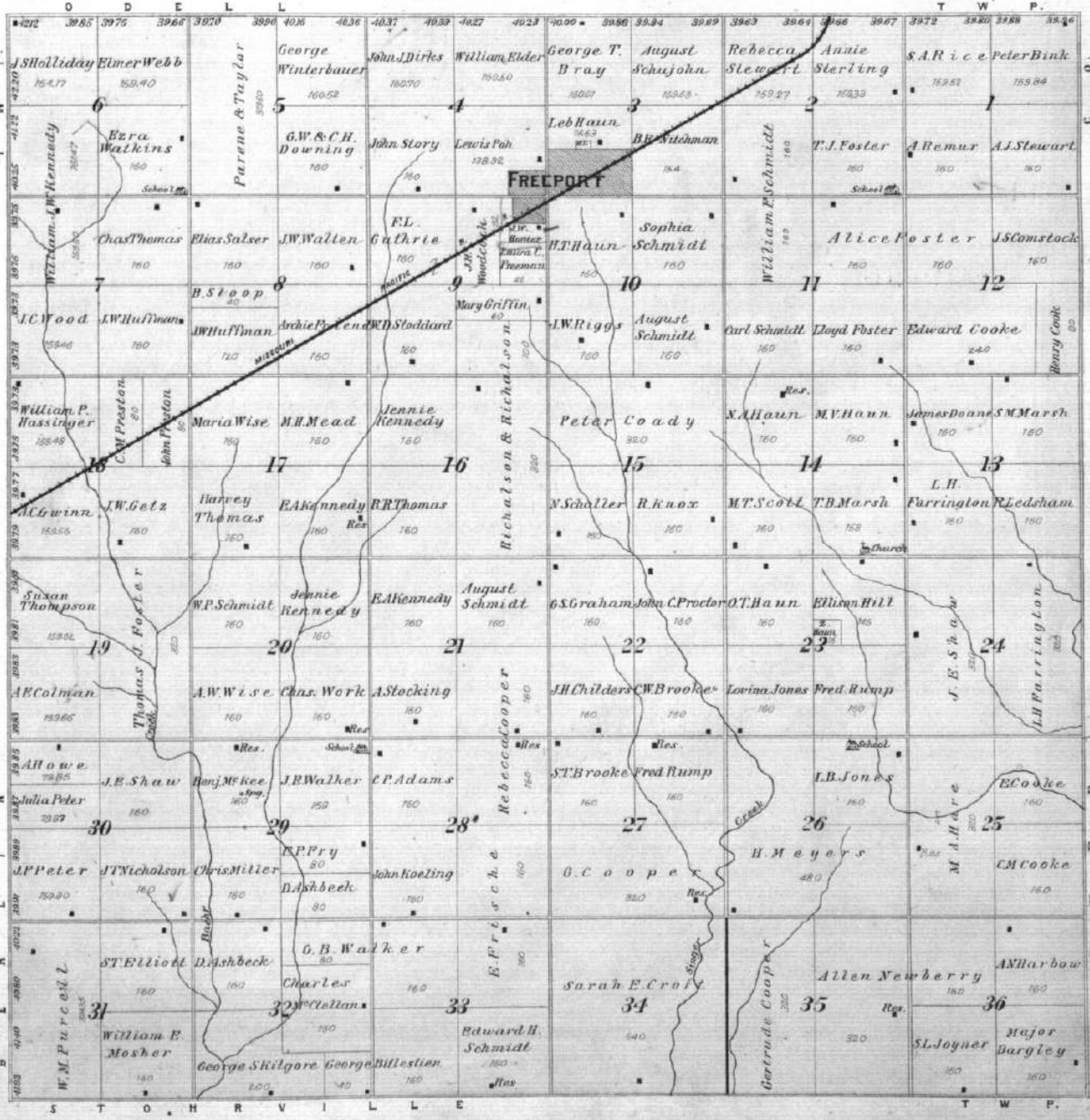

  
**SILVER CREEK**
  
 TOWNSHIP

Township 33 South      Range 5 West of the 6th P.M.

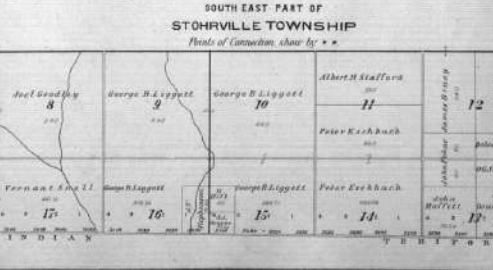
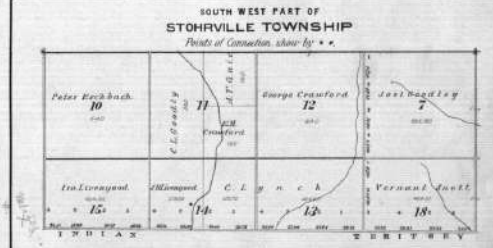
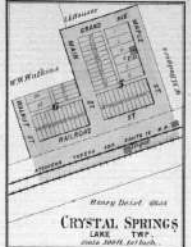
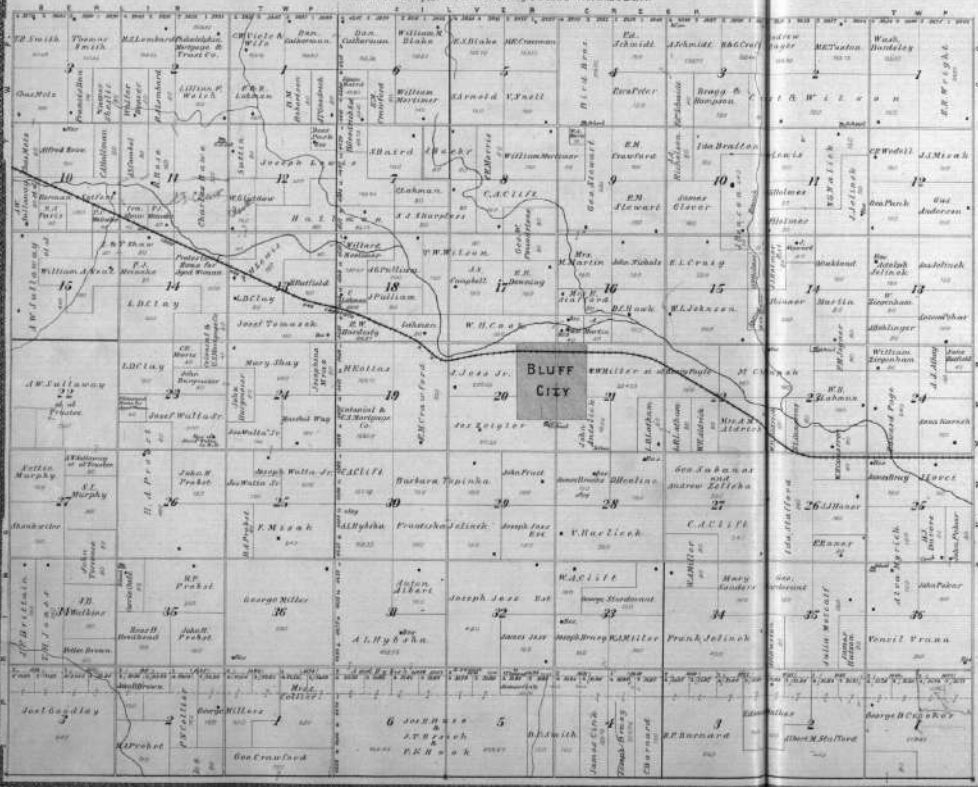

**MAP OF**  
**STOHRVILLE**  
 TOWNSHIP  
 Parts of Townships and 33 north, Ranges 3 and 4 West - 4 & 2 M.





# SPRING TOWNSHIP

Parts of Townships 18 & 19 South, Ranges 6 and 7 West of the 6th P.M.

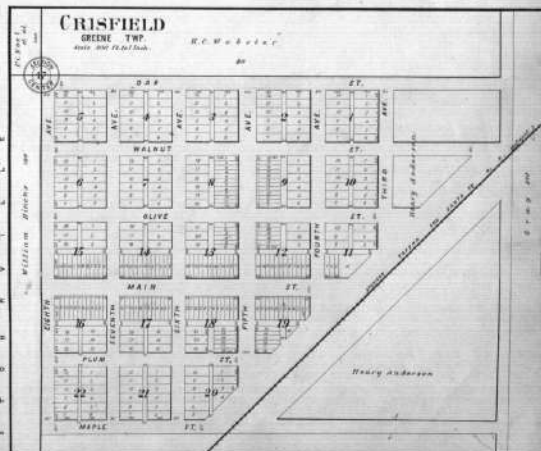
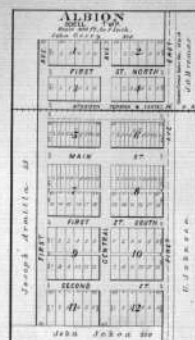
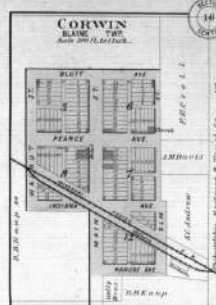
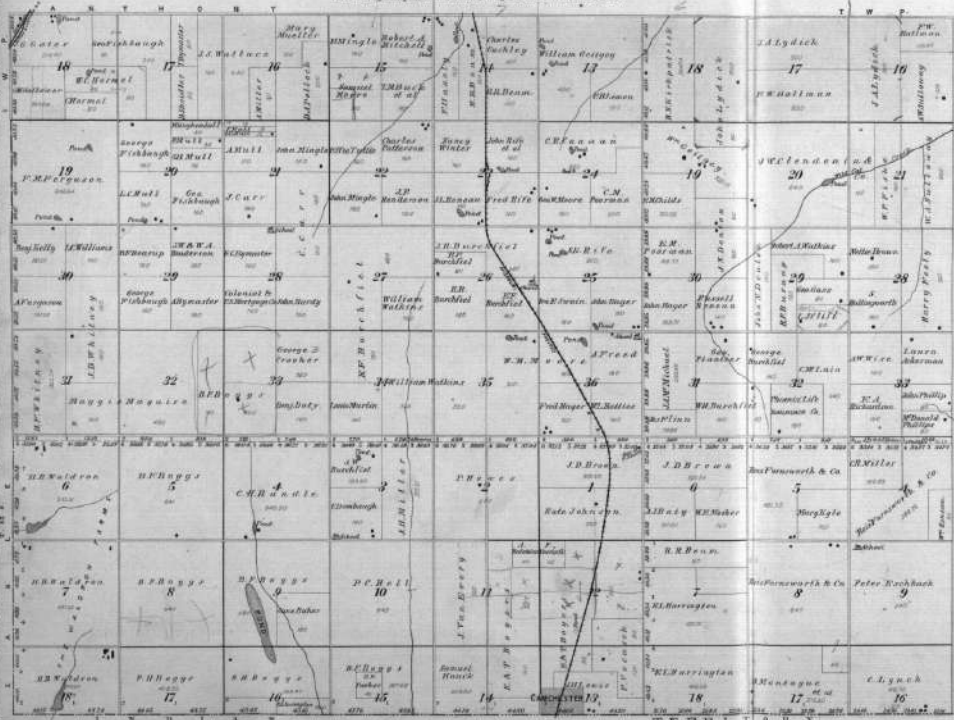

MAP OF  
**EAGLE**  
TOWNSHIP

Townships 34 and Fractional Townships 35 South, Ranges West 4 to 6 P.M.

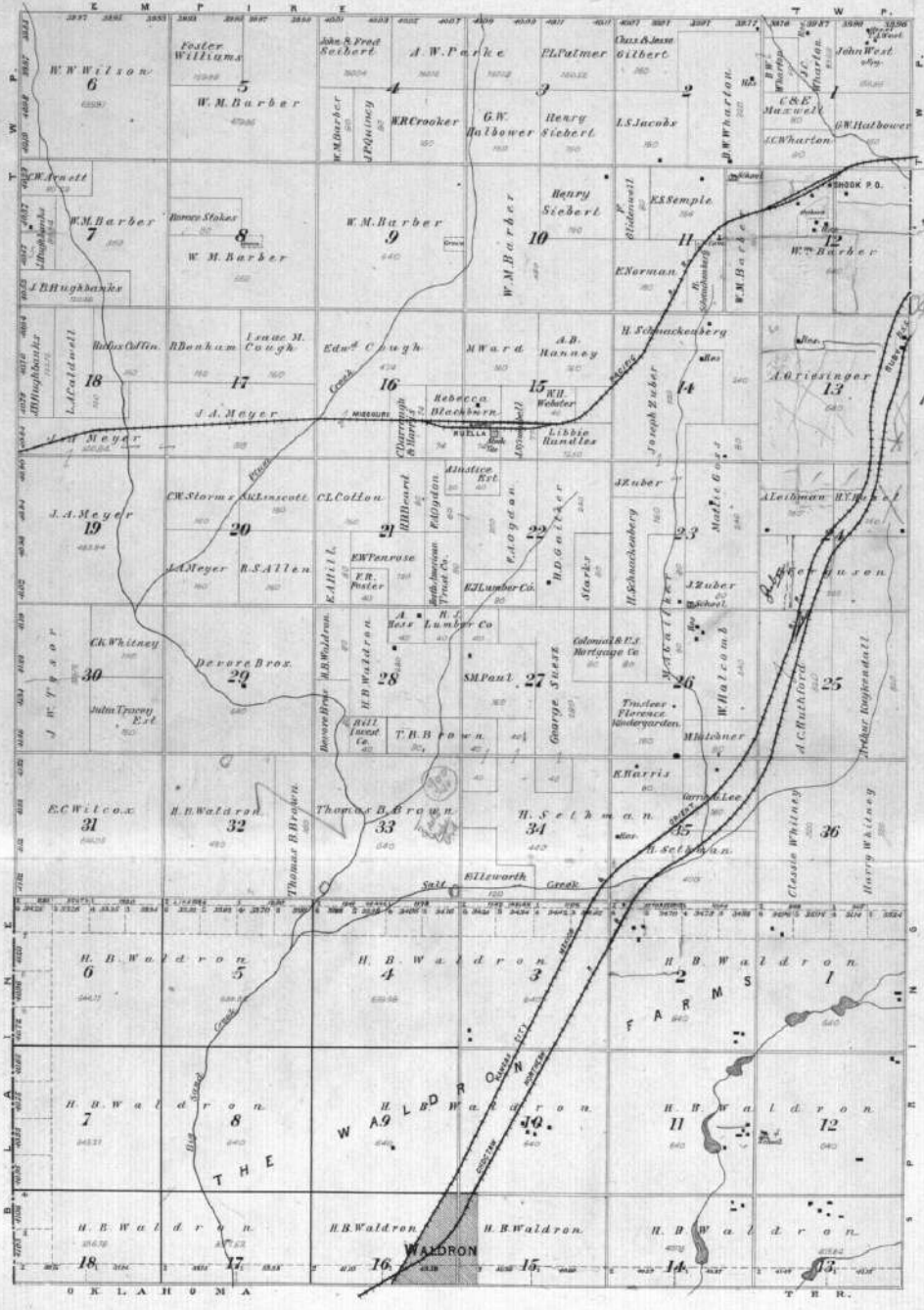

SOUTH PART OF  
**BLAINE TOWNSHIP**

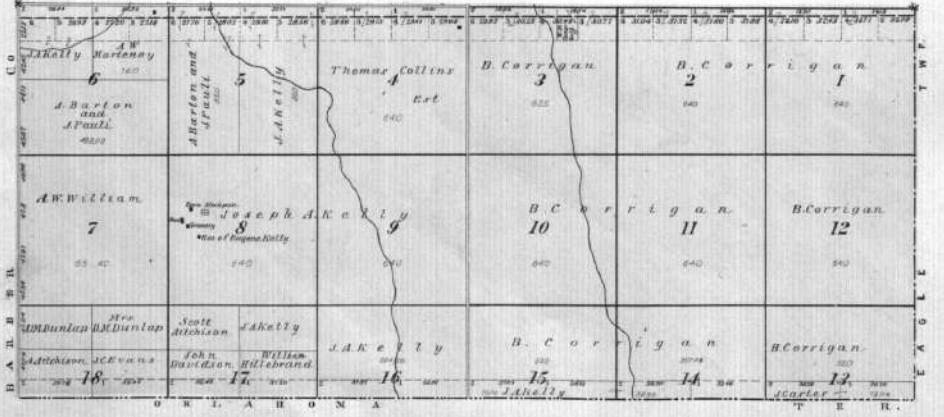

  
 MAP OF  
 NORTH PART OF  
**BLAINE**  
 TOWNSHIP

Township 34 and Fractional Township 35 South, Range 9 West at the 6<sup>th</sup> P.M.

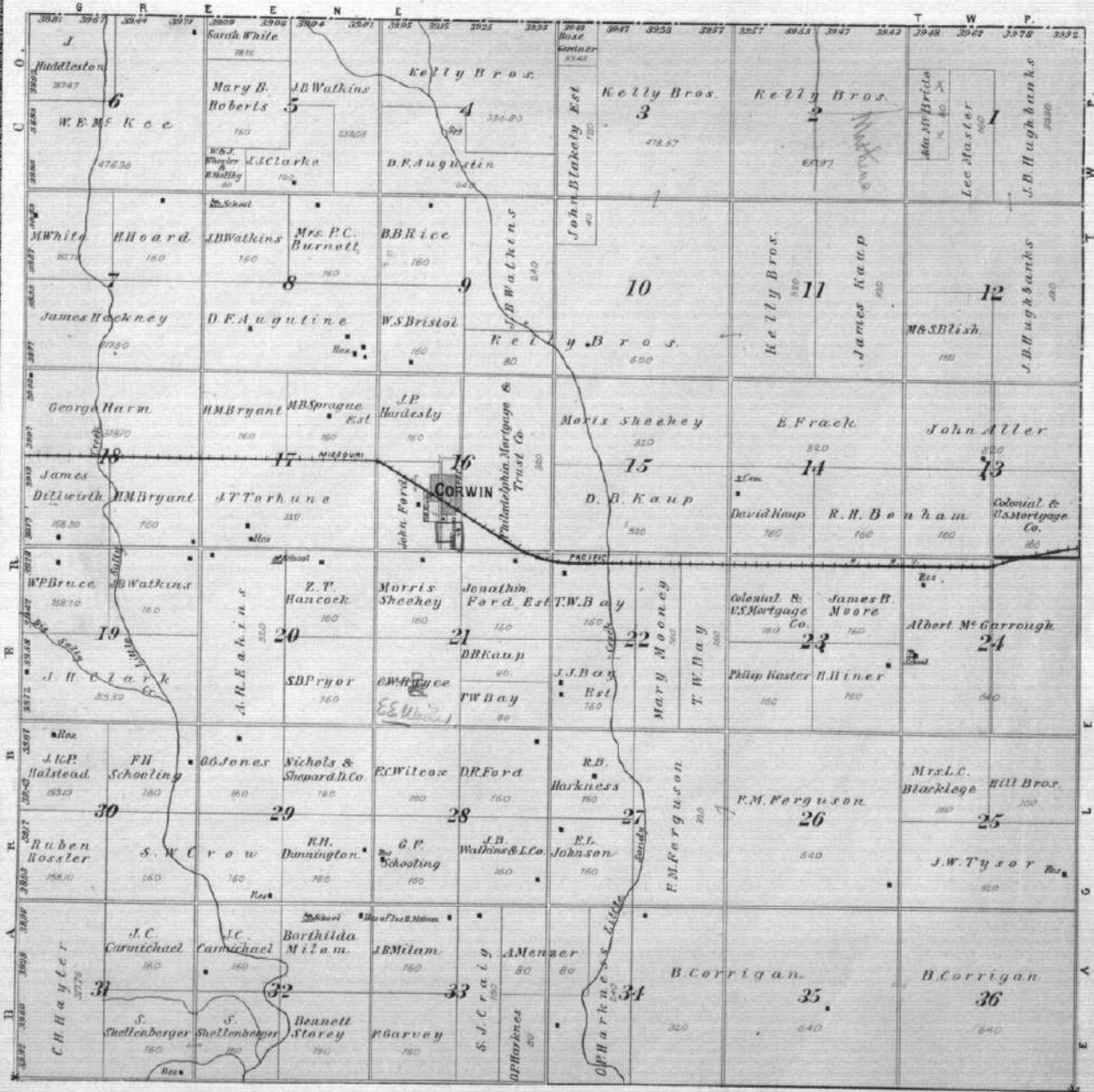

ANTHONY  
County Seat of Harper Co. Kas.  
ANTHONY TWP  
Scale 400 ft. to 1 inch

NOTE  
This adjoins the map plat on the west Point of connections indicated by \*\*\*

JENNINGS  
ADD.  
SPRING ST.  
R. O. Small 20 I. M. Couch 40

A. W. R. R. B. a. M. L. I. V. H. ughbanks  
E. I. c. e 100 100 164.00

J. F. M u l l e r  
S. W. Priddy  
E. D. C. I. o. u. e

300 3/4

STREETS: SHERMAN ST, S. W. PRIDDY ST, E. D. C. I. O. U. E ST, J. I. J. O. M. O. S. ST, I. L. J. O. M. O. S. ST, E. B. O. S. E. ST

STREETS: BARFIELD, HIGHLAND, VINE, SPRING, STEEDMAN, WASHINGTON, GRANT, EVANS, IRVINGTON, PENNSYLVANIA, MASSACHUSETTS, IMAPEL, MICHIGAN, WISCONSIN, ILLINOIS, INDIANA, OHIO, MISSOURI, KANSAS, ARIZONA, CALIFORNIA, TEXAS, LOUISIANA, MISSISSIPPI, ALABAMA, GEORGIA, FLORIDA, SOUTH CAROLINA, NORTH CAROLINA, VIRGINIA, MARYLAND, DELAWARE, PENNSYLVANIA, OHIO, INDIANA, ILLINOIS, MISSOURI, KANSAS, ARIZONA, CALIFORNIA, TEXAS, LOUISIANA, MISSISSIPPI, ALABAMA, GEORGIA, FLORIDA, SOUTH CAROLINA, NORTH CAROLINA, VIRGINIA, MARYLAND, DELAWARE

ADD.  
D. C. A. T. H. A. R. M. A. N.  
W. R. M. A. F. F. E. K. E. T.  
C. E. M. E. T. E. R. Y.

100 100 100

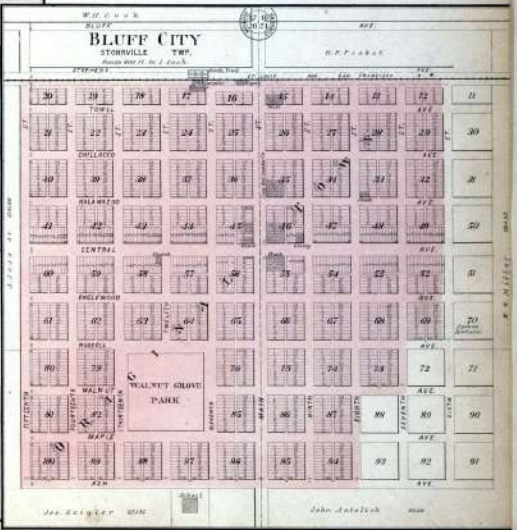
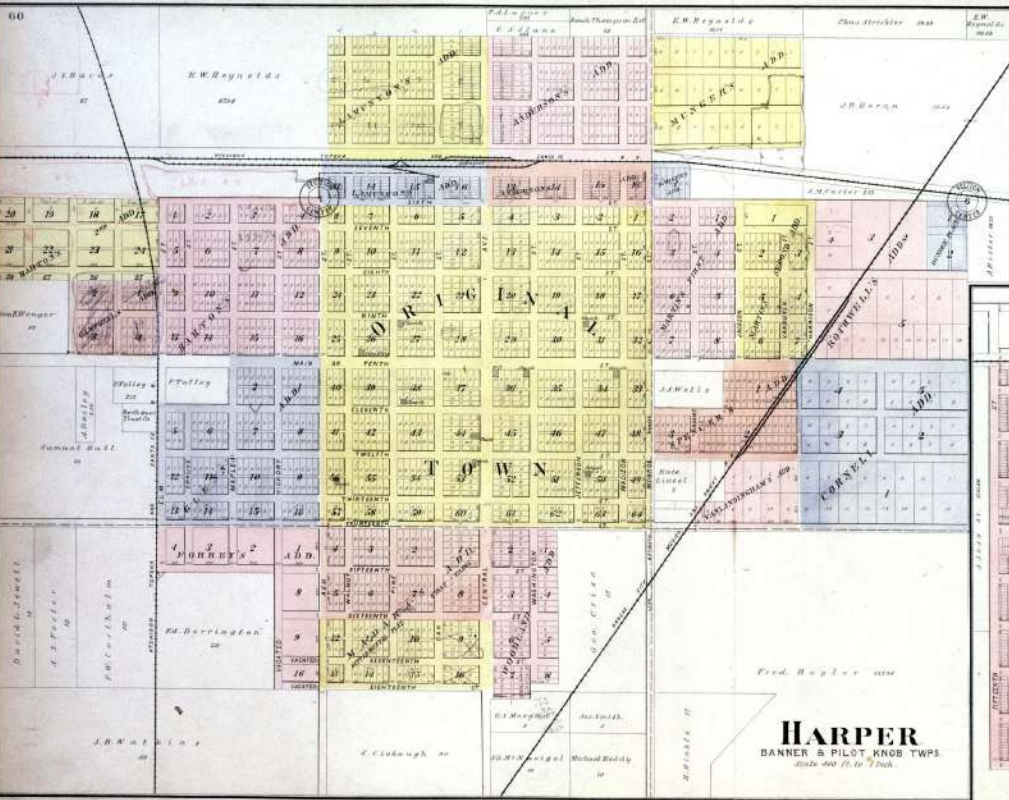

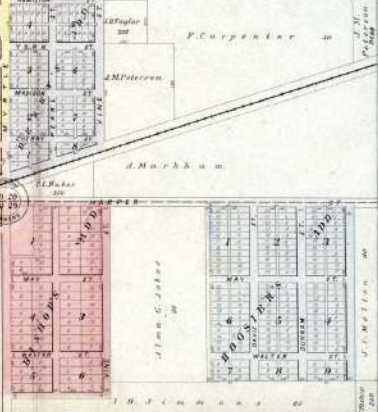
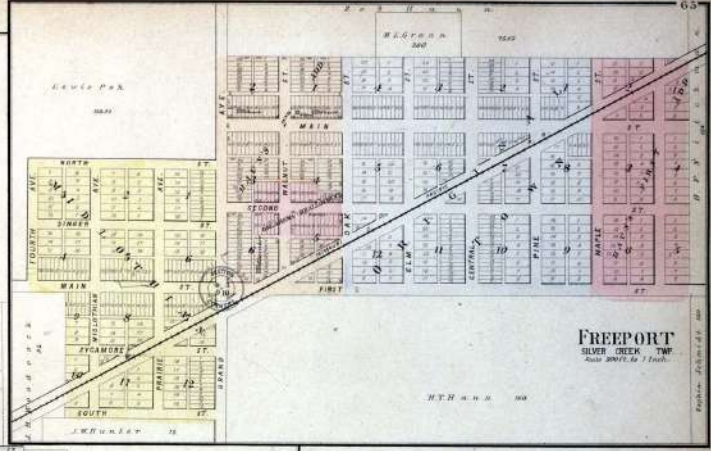
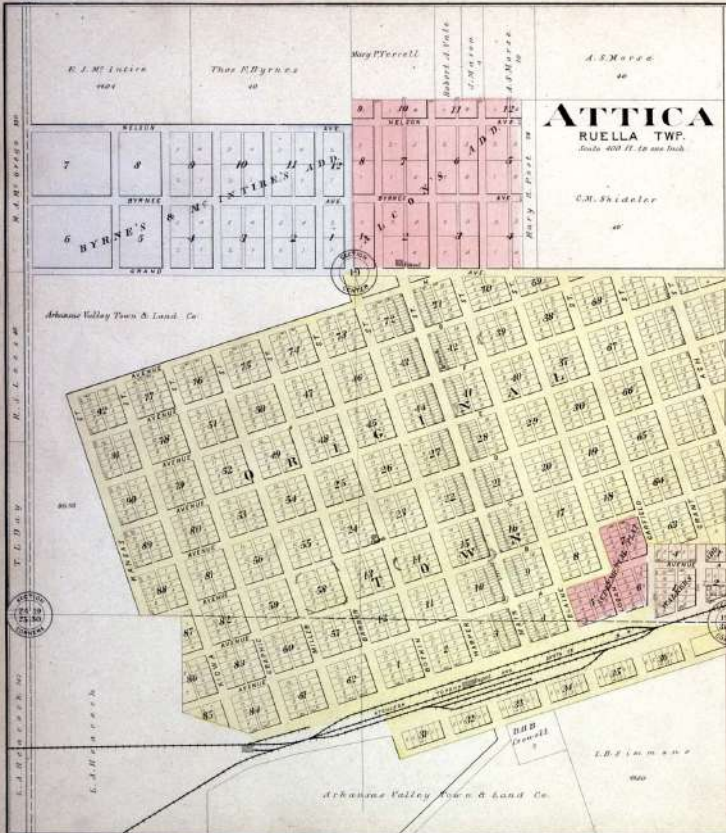

  
**MAP OF**  
**GREENE**  
 TOWNSHIP  
 Township 33 South Range 9 West of the 6th P.M.

