

OUTLINE MAP OF  
**LEAVENWORTH COUNTY**  
 KANSAS.  
 Scale 1/8 inch to 1 M. U.

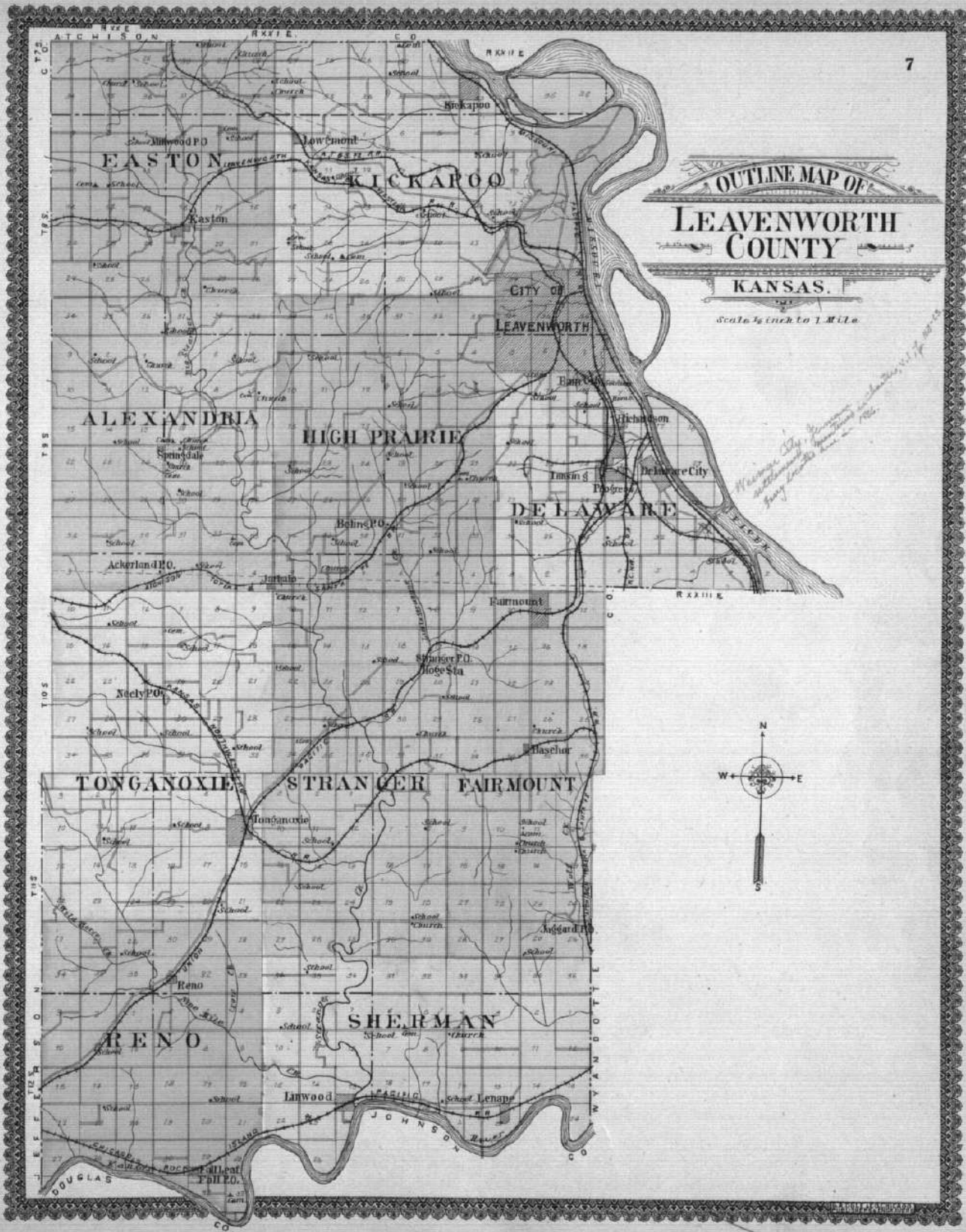

*Warning City boundaries  
 not shown in this map  
 they are shown in the  
 full map.*

# MAP OF EASTON TOWNSHIP

Parts of Townships 7 and 8 South, Ranges XX and XXI East of the 5th P.M.



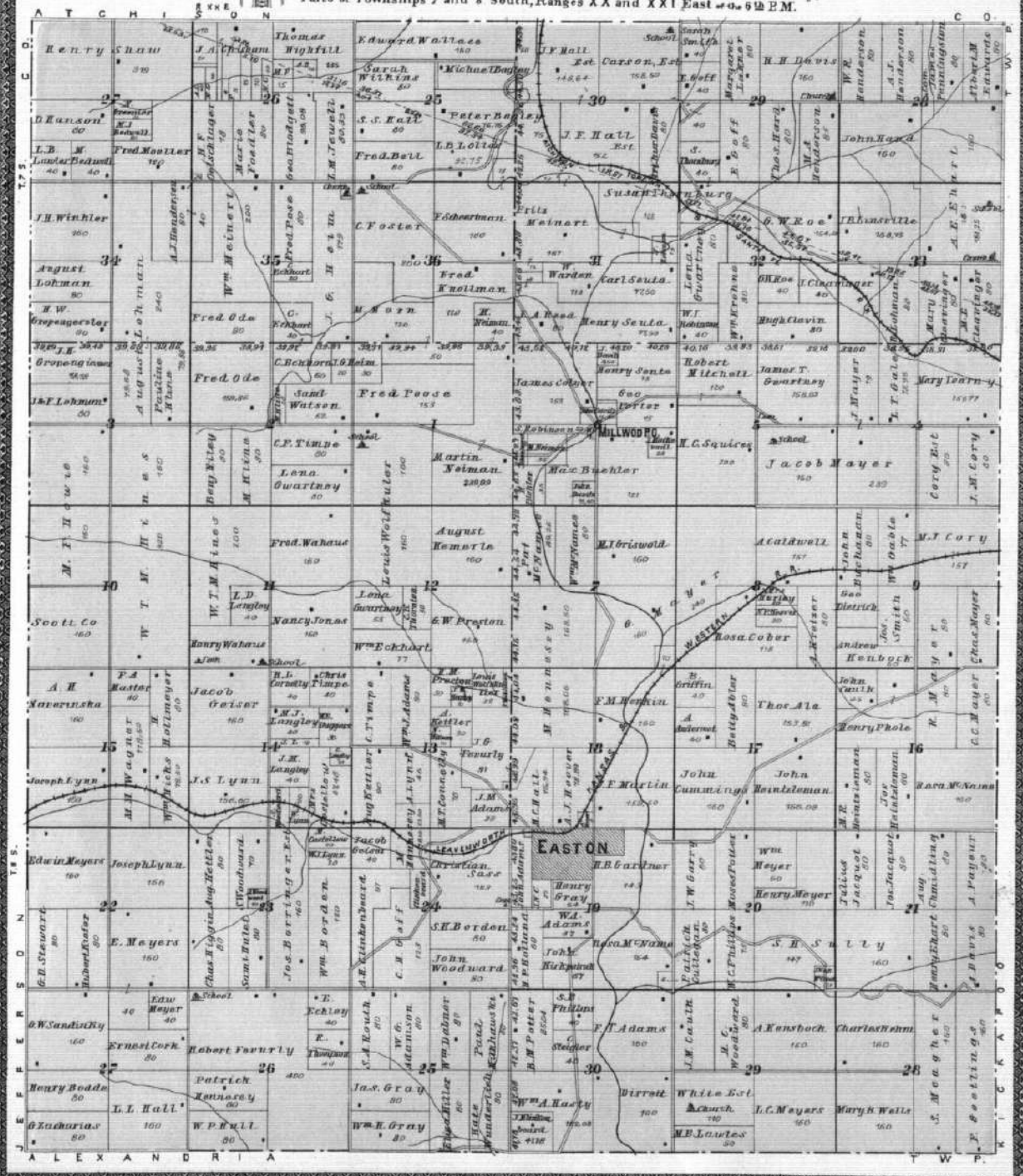

ALEXANDRIA W.F.

# KICKAPOO

Parts of Townships 9 and 8 South, Range K1 East and Parts of Townships 7 and 6 South, Range XXII and XXIII East of the 9th P.M.

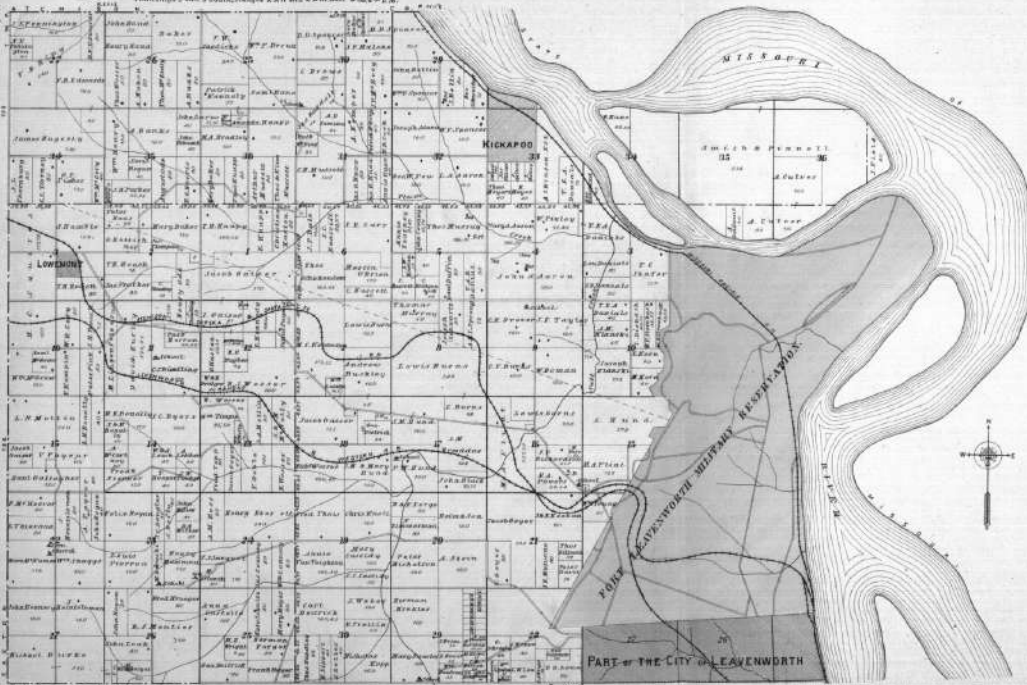

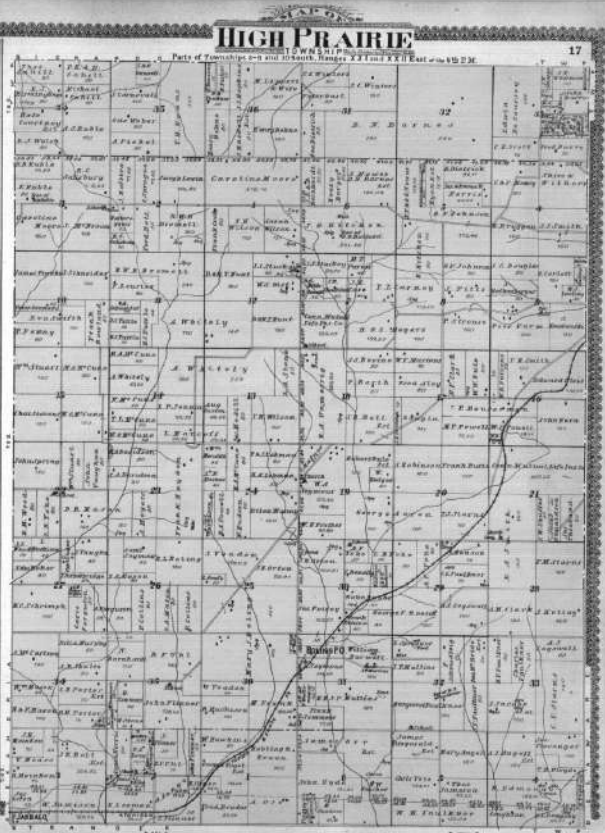

MAP OF ALEXANDRIA

TOWNSHIP

Parts of Townships 8-9 and 10 South, Ranges XX and XXI East of the 6th P.M.

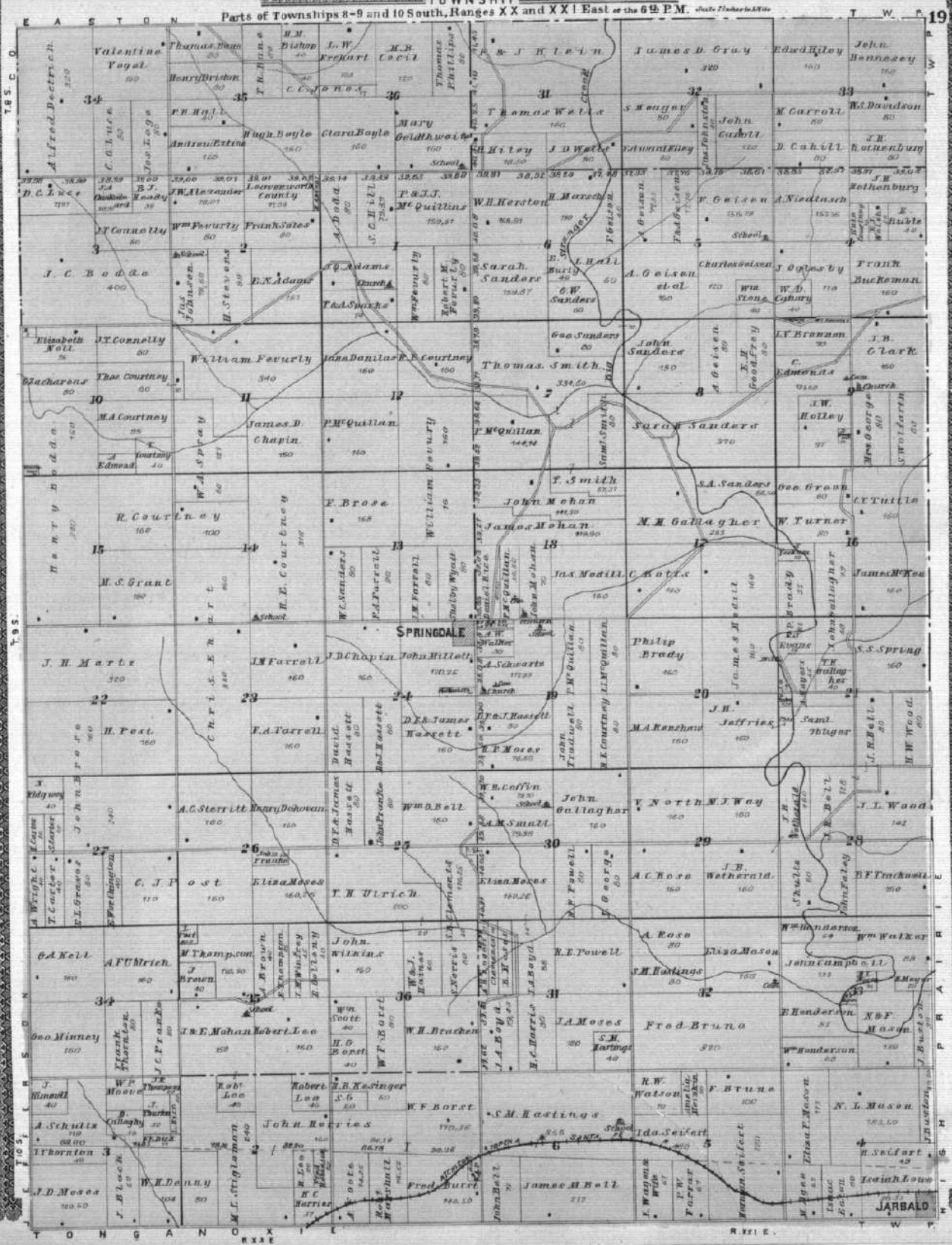

1850

TONGAN

1850

EASTON

T W P 19

1850

# MAP OF TONGANOXIE

TOWNSHIP  
Parts of Townships 10 and 11 South,  
Ranges XX and XXI East 40° 56' 48" E.M.

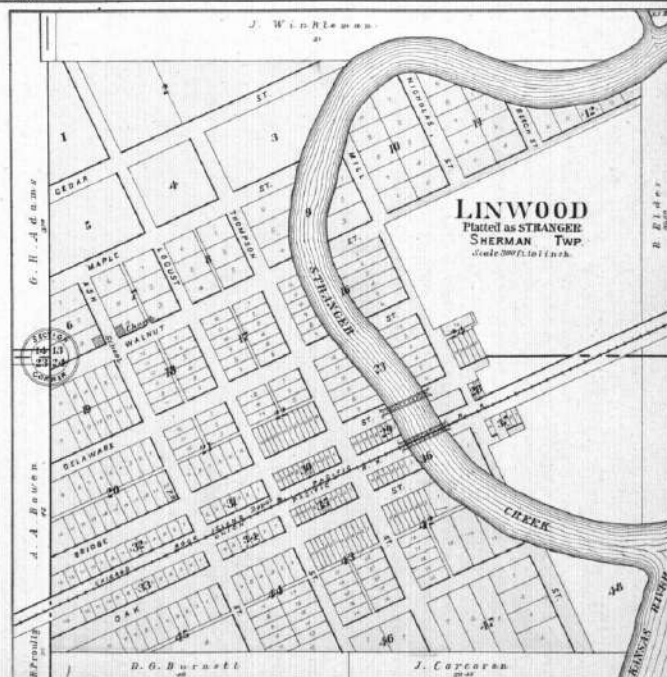
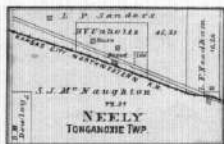
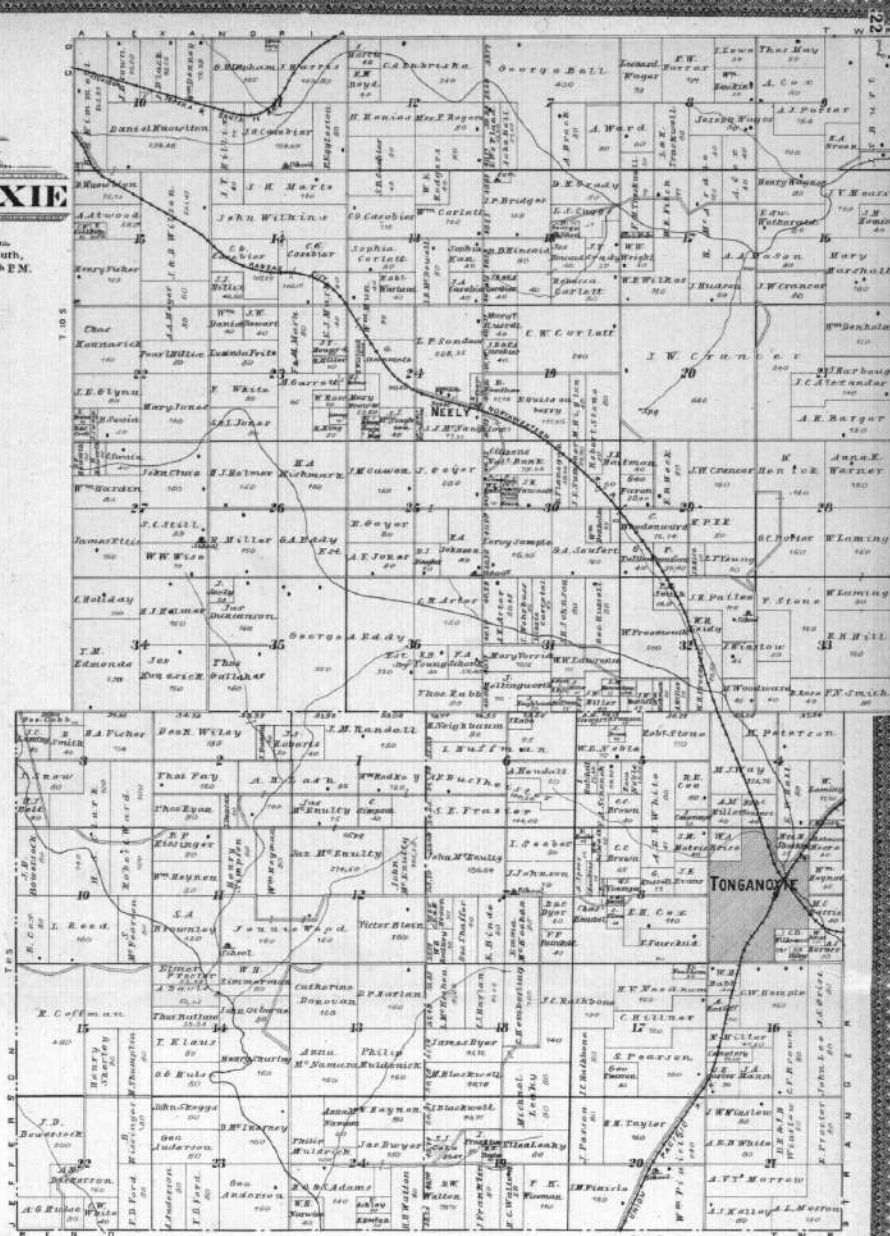

**MAP OF  
STRANGER  
TOWNSHIP**  
Parts of Townships 10 and 11 South,  
Ranges XX I and XXII East of 69° E.M.

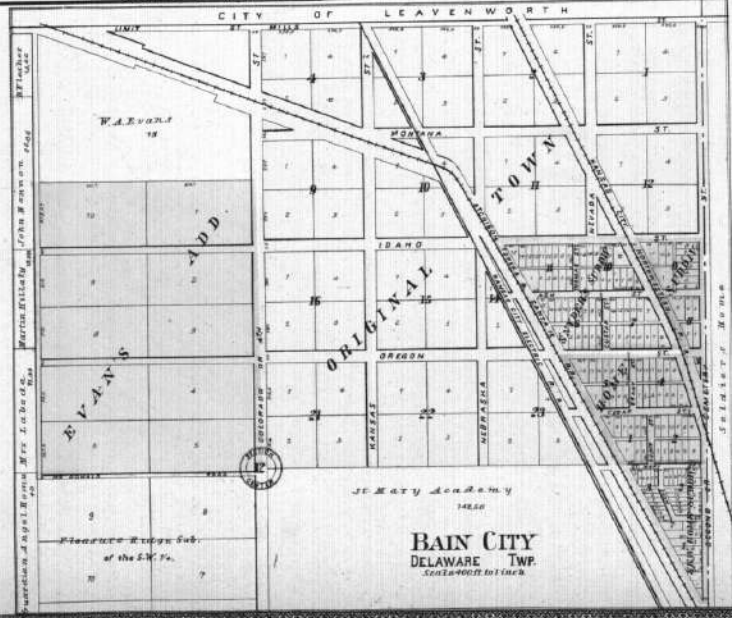
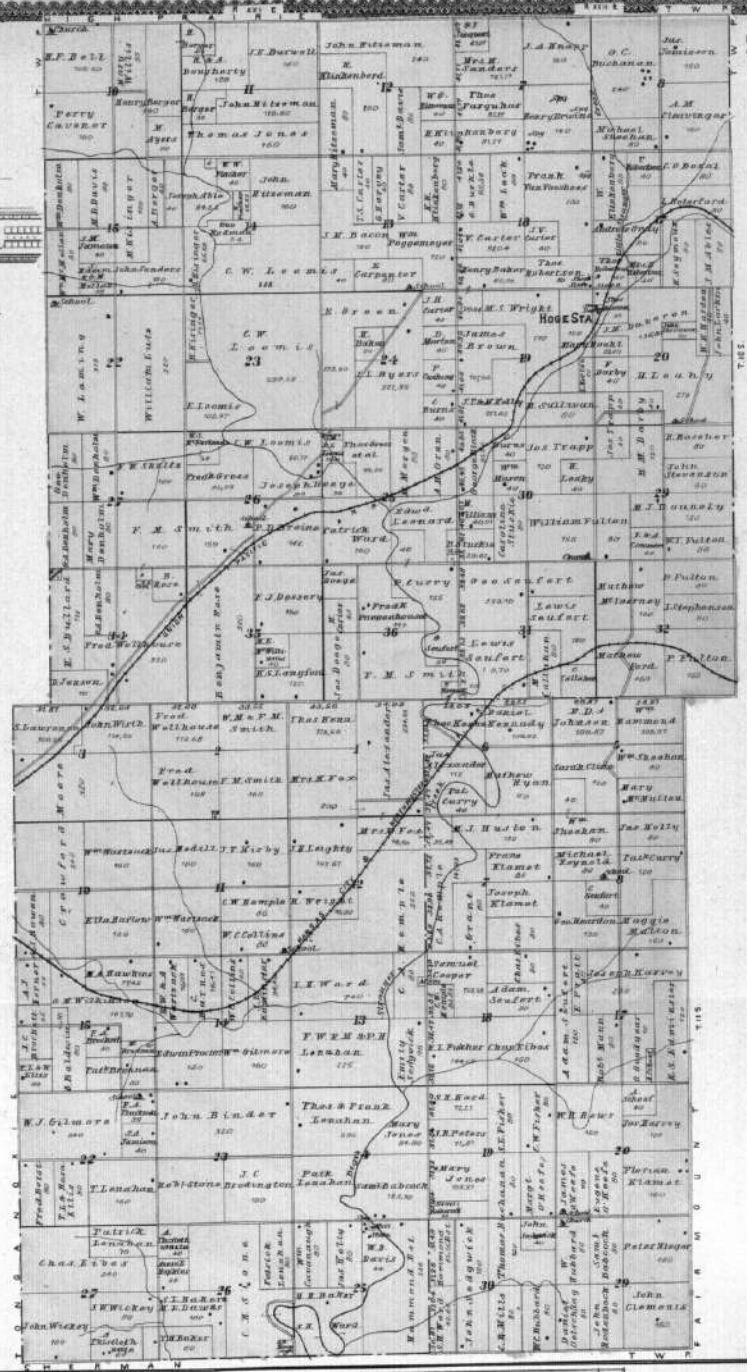

**MAP OF FAIRMOUNT TOWNSHIP**  
 Parts of Townships 10 and 11 South, Range XX II East - 6th E.M.

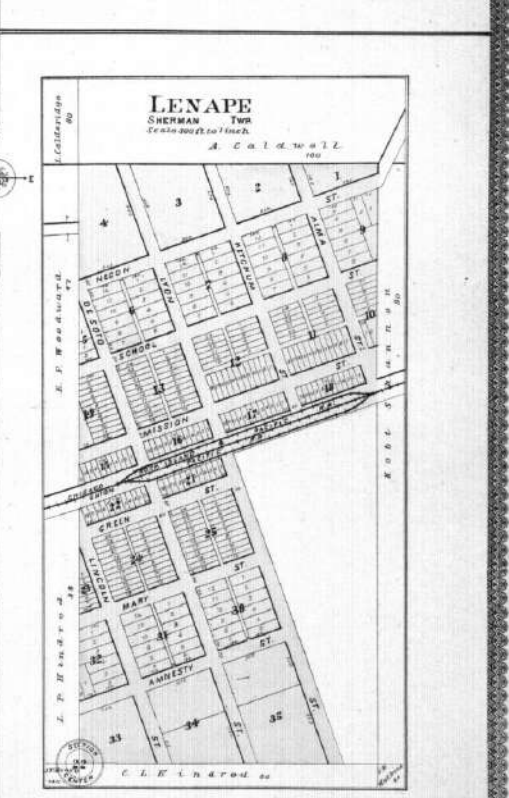
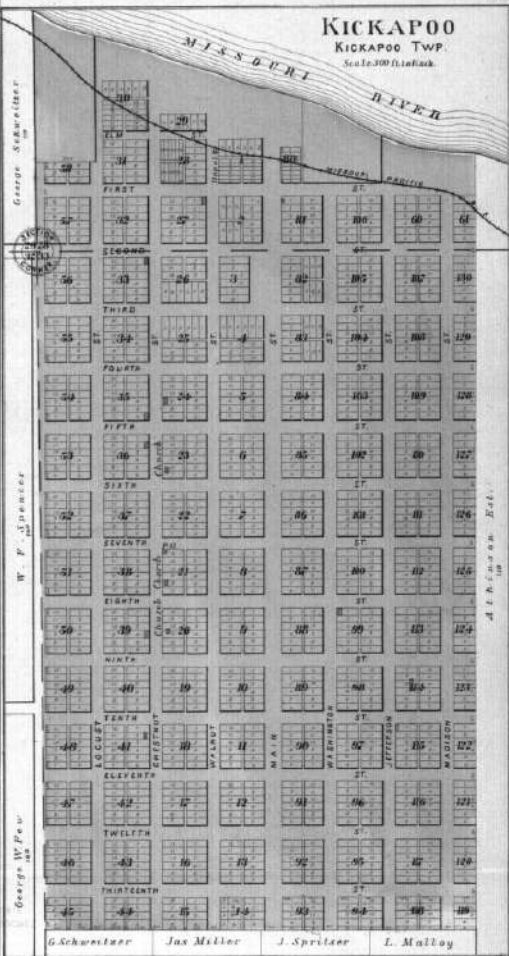
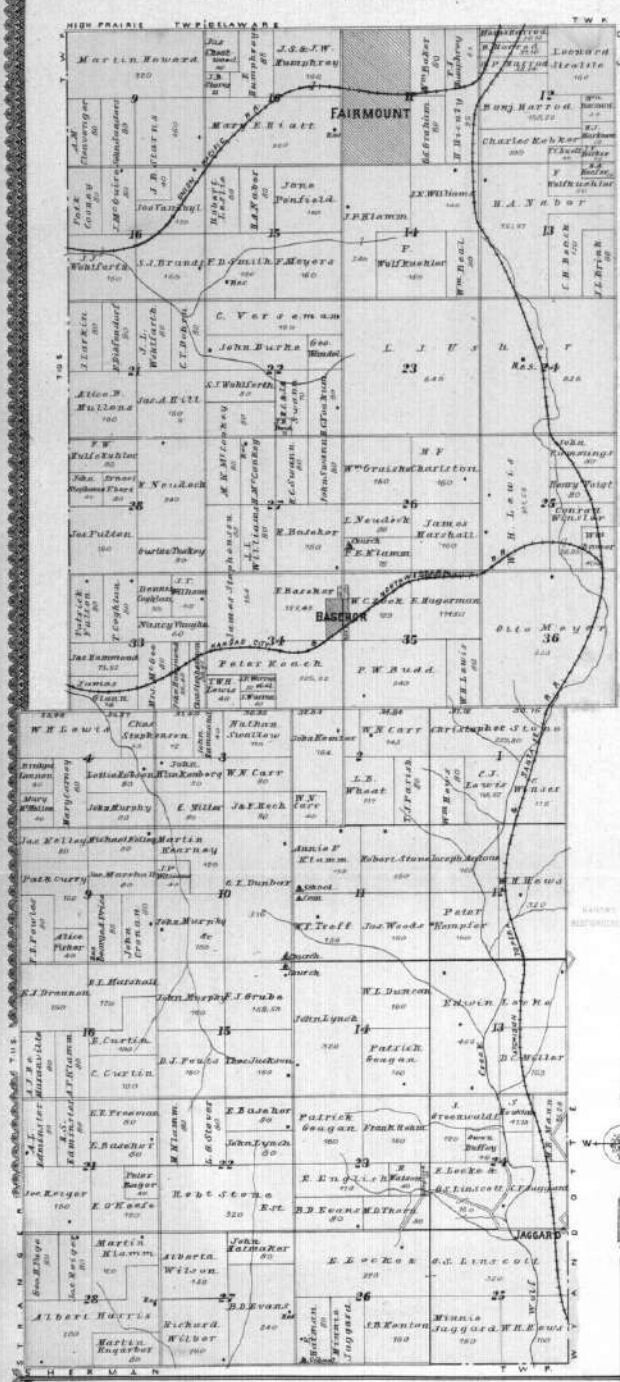



# SHERMAN TOWNSHIP

Parts of Townships 11 and 12 South, Ranges XXI and XXII East - 60 P.M.



## DELAWARE CITY

DELAWARE TWP  
STATE OF DELAWARE

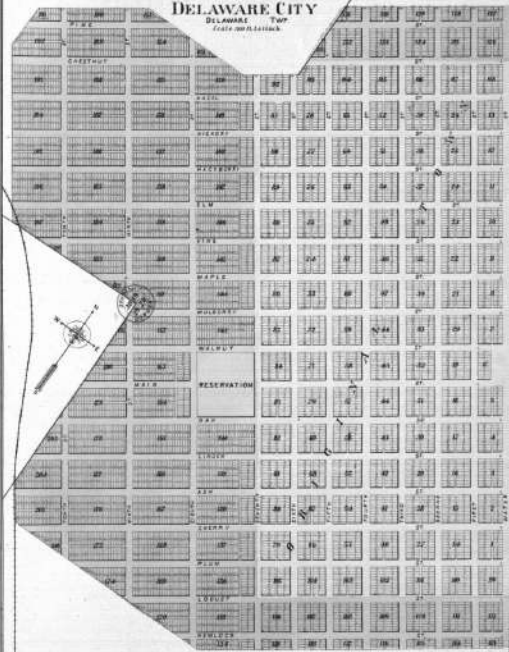

M. J. B. H. I.



MAP OF  
**RENO**  
 TOWNSHIP

Parts of Townships 11-12 and 13 South, Ranges XX and XXI East of the 6th P.M.

NORTH PART OF THE CITY OF  
**LEAVENWORTH**  
KANSAS







**FAIRMOUNT**  
FAIRMOUNT TWP.  
Scale 320 ft. to 1 inch.

