

ASHLAND

XI, R. 5

Scale & Mile (40 Chains) to an Inch

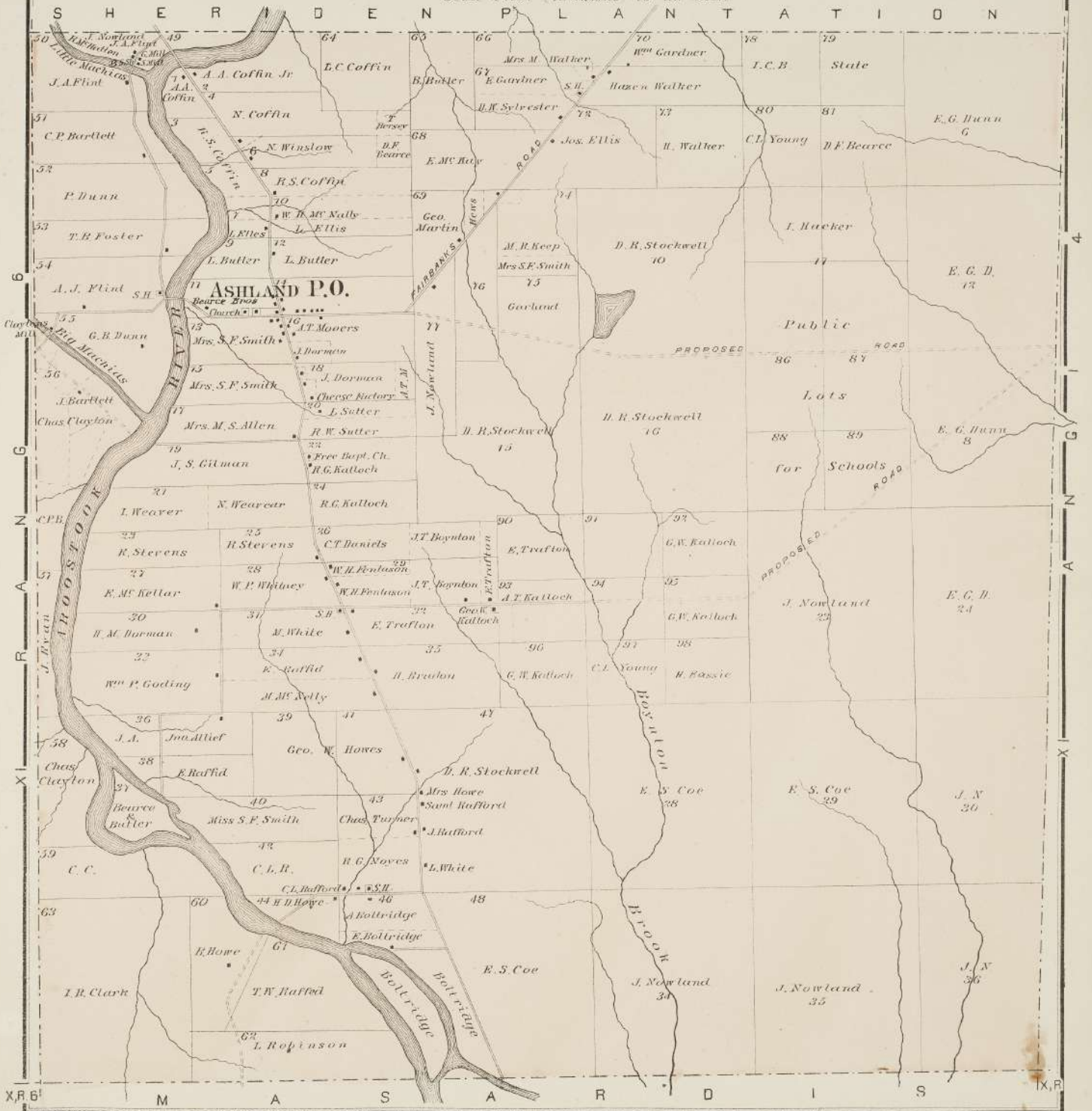

Van Buren Subscribers' Directory.

- B. F. Brown & Co., General Variety Store.
- Bacon Cyr, Farmer.
- Michel Cyr, "
- Damasc Dalgle, Farmer, Post Master and Hotel Keeper.
- Charles Farrell, Dealer in Dry Goods, Groceries, Boots, Shoes, Crockery and Hardware.
- Michael Farrell, Ferryman and Farmer.
- C. F. Hammond, Post Master and Dealer in General Mds.
- A. E. Hammond, Clerk.
- M. V. Hall, Proprietor of Van Buren House.
- Thomas H. Pelletier, Physician.
- Augustin Violette, Farmer, Hunter and Trapper.
- Severe Violette, Trial Justice and Town Clerk.

VAN BUREN

Scale 33 rods (8chs) to an inch

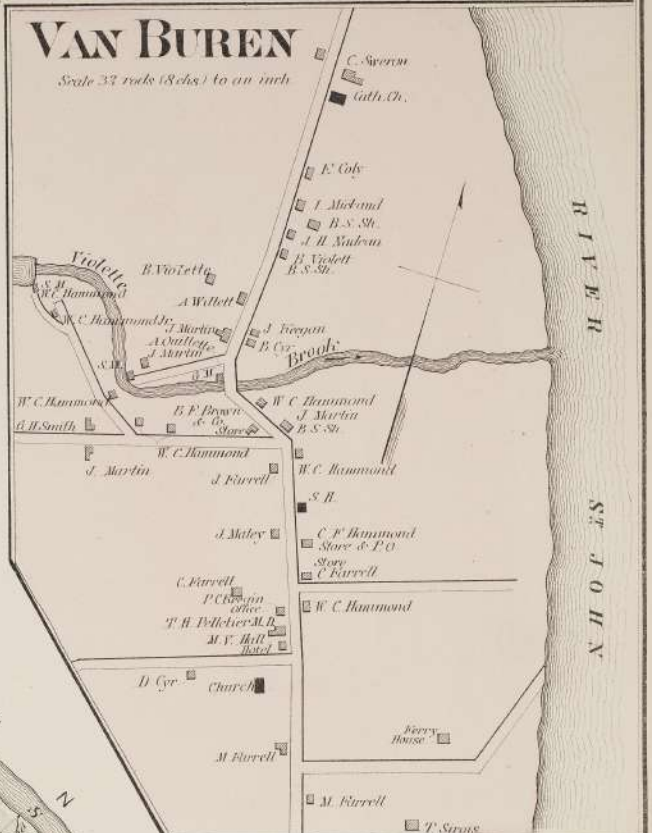

BLAINE

Scale 500 Feet to an Inch.



Scale 1 Mile 80 Chains to an Inch

BRIDGEWATER R. 1

Scale 1/4 Mile (40 Chains) to an Inch

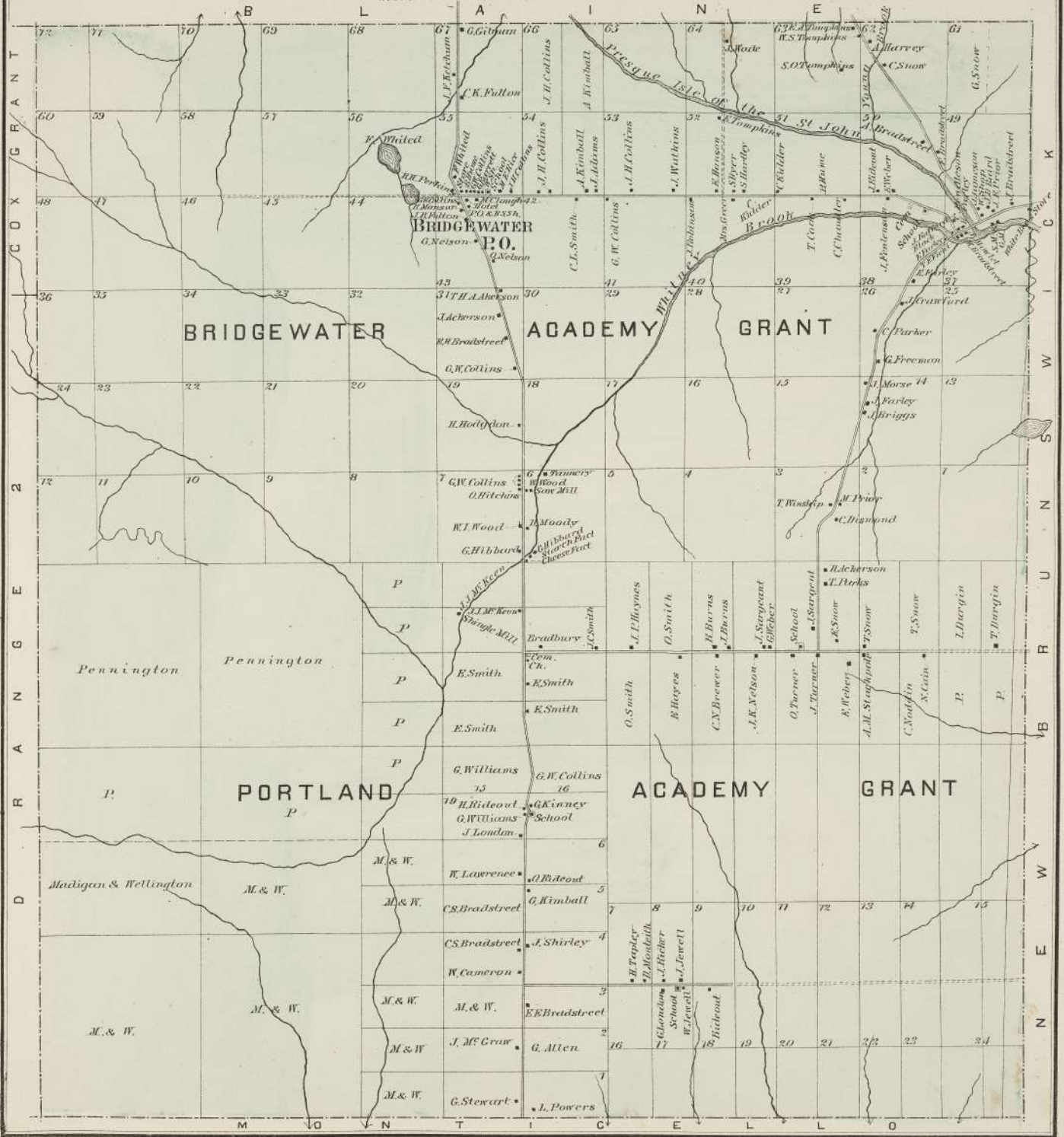

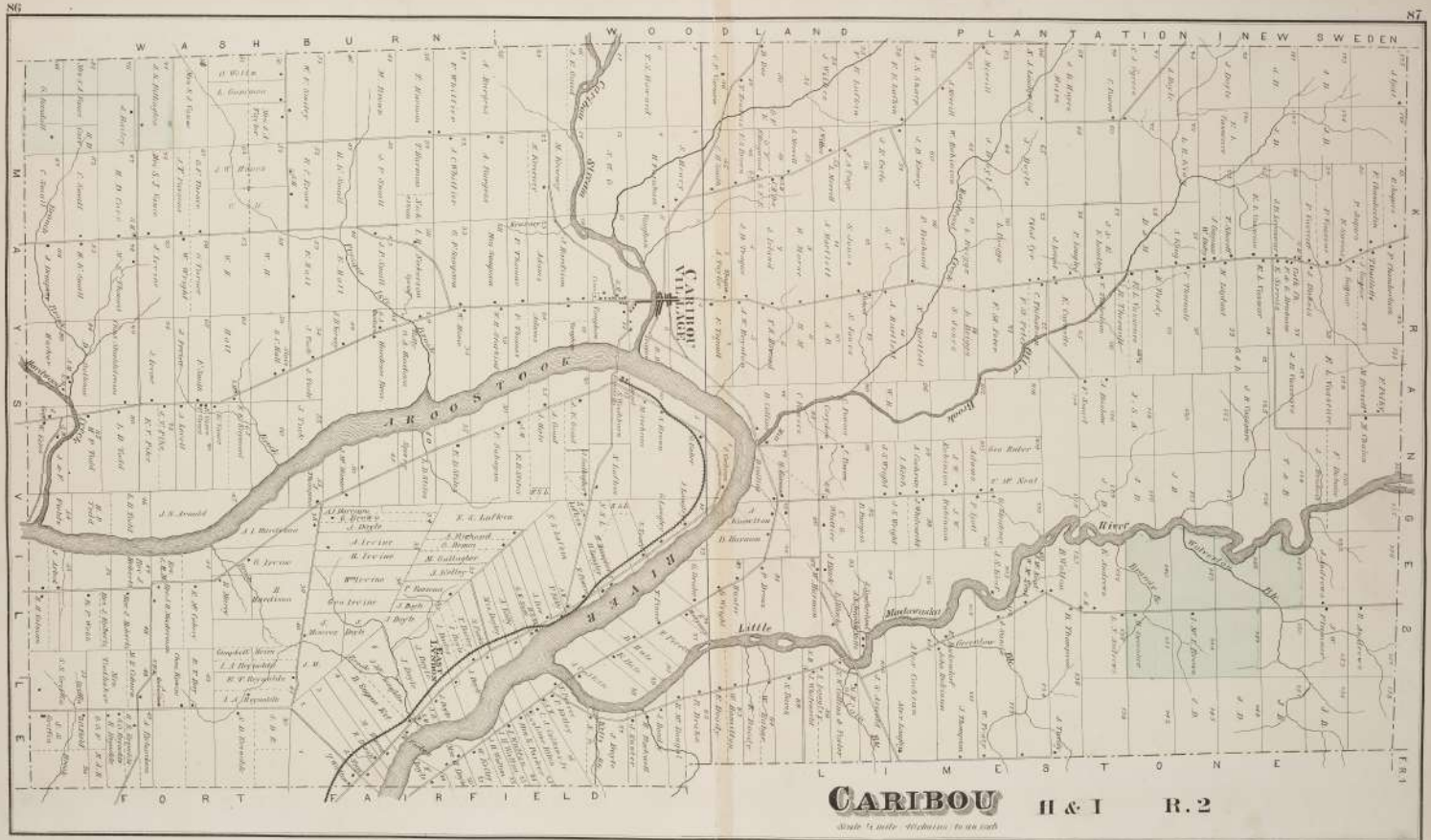

CARIBOU H & I R. 2

Scale 1 mile distance to an inch



EASTON

TC, R. 1

Scale 1/2 Mile (40 Chains) to an Inch



WEST FIELD M A R S H I L L

FORT FAIRFIELD

Scale 1/4 inch = 40 chains to an inch



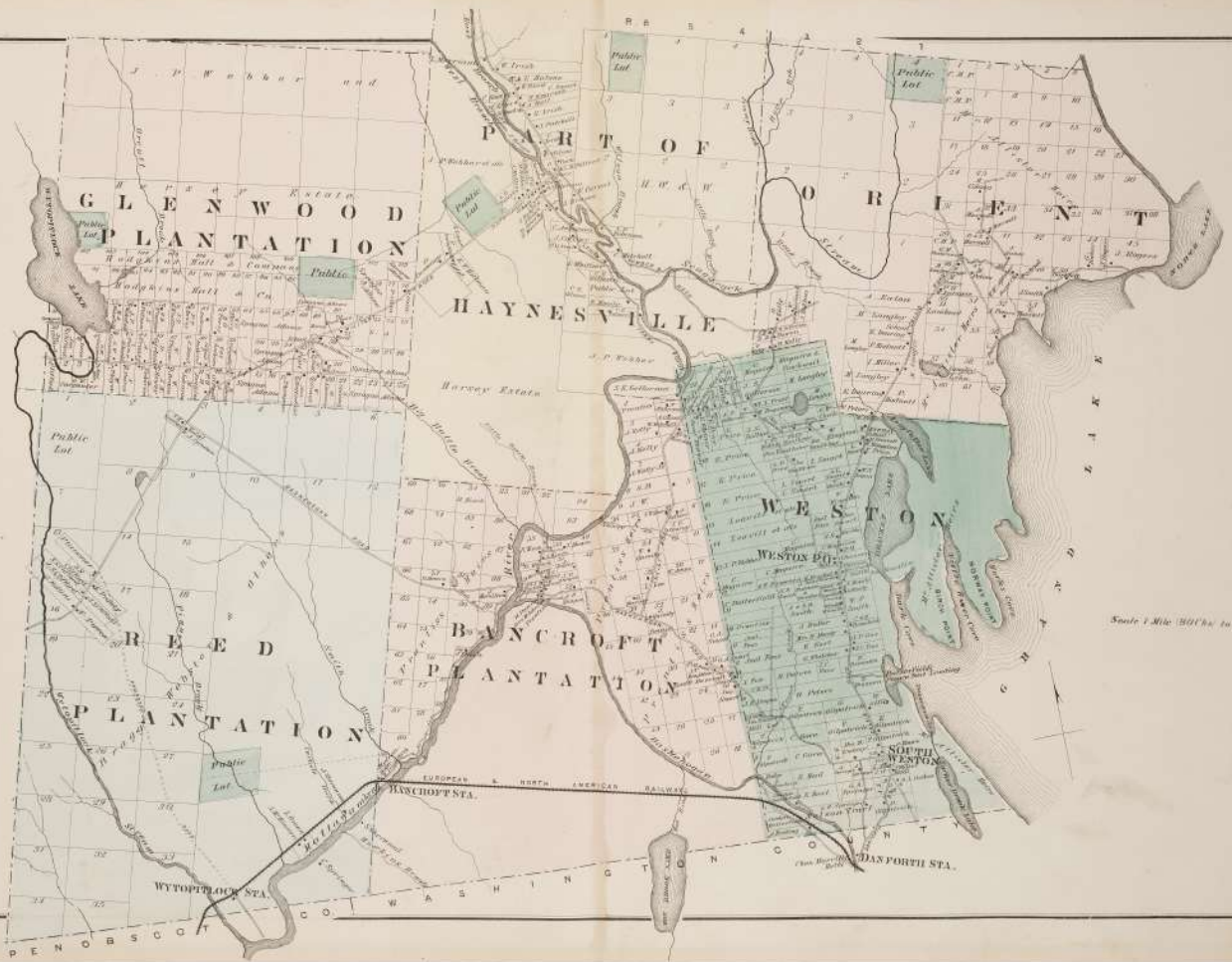

PENOBSCOT

WASHINGTON CO.

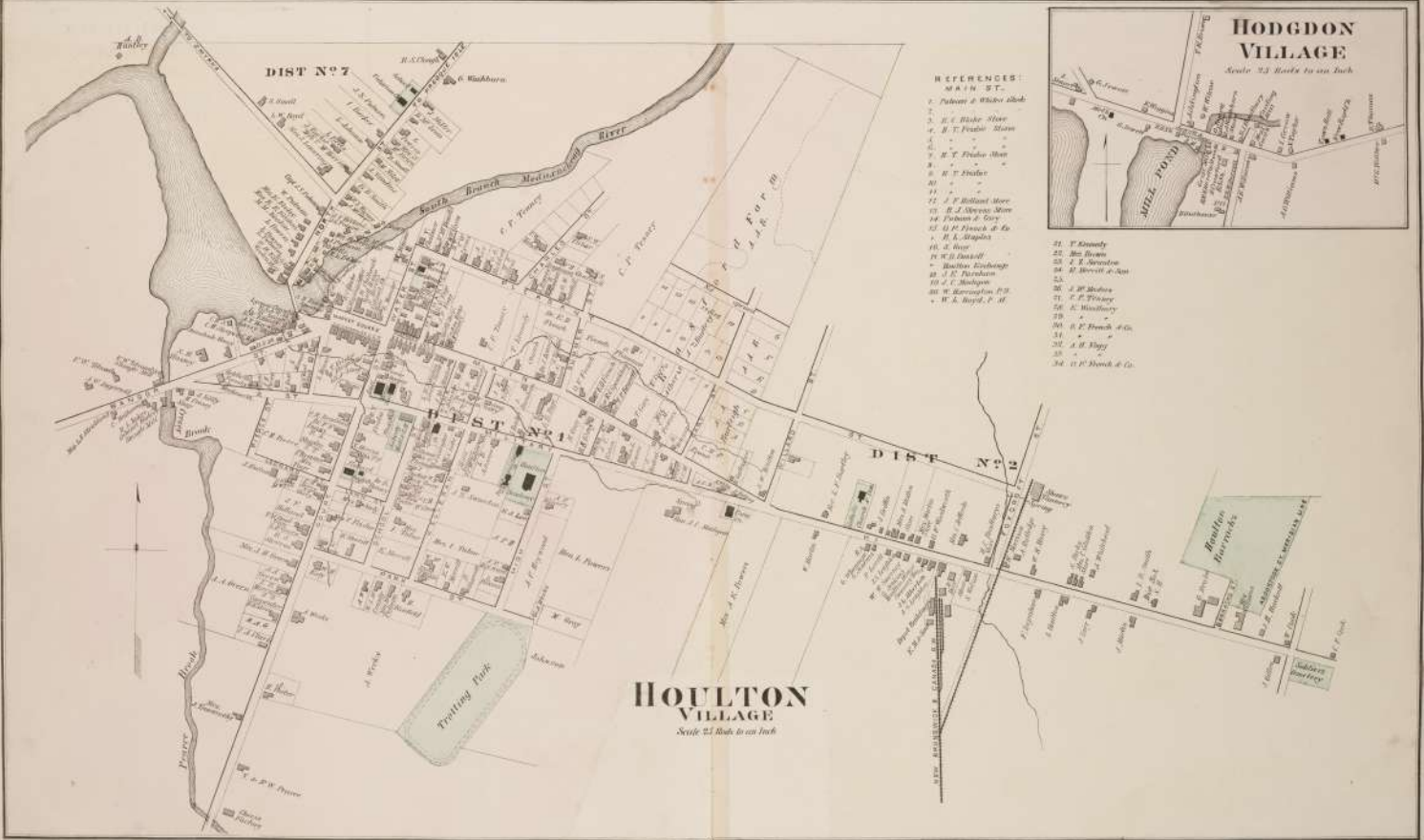

Scale 1 Mile (80 Chains) to an Inch

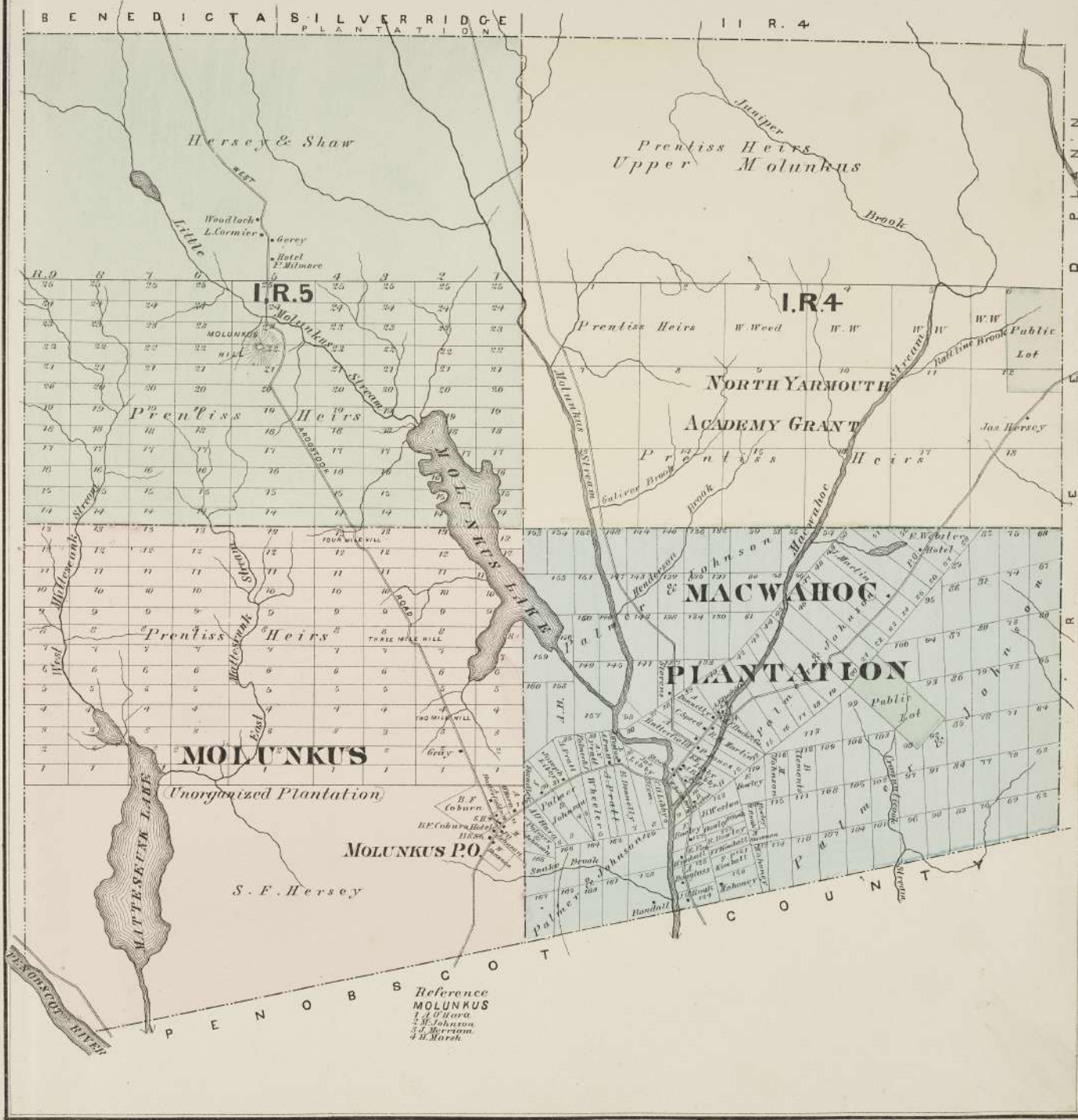

LITTLETON

R. 1

Scale 1/2 Mile (40 Chains) to an Inch

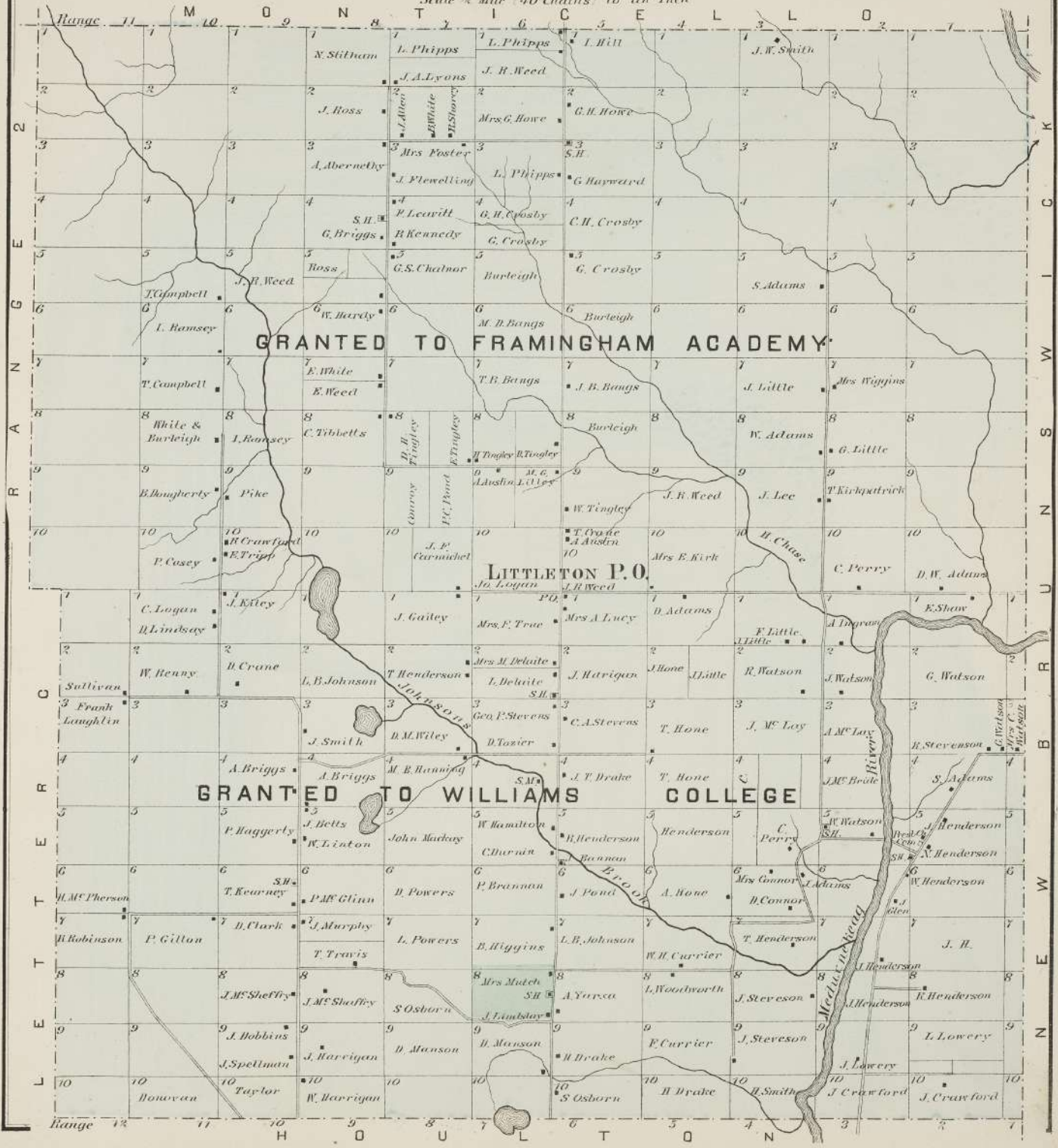

MONTICELLO

R. 1

Scale 1/2 Mile (40 Chains) to an Inch

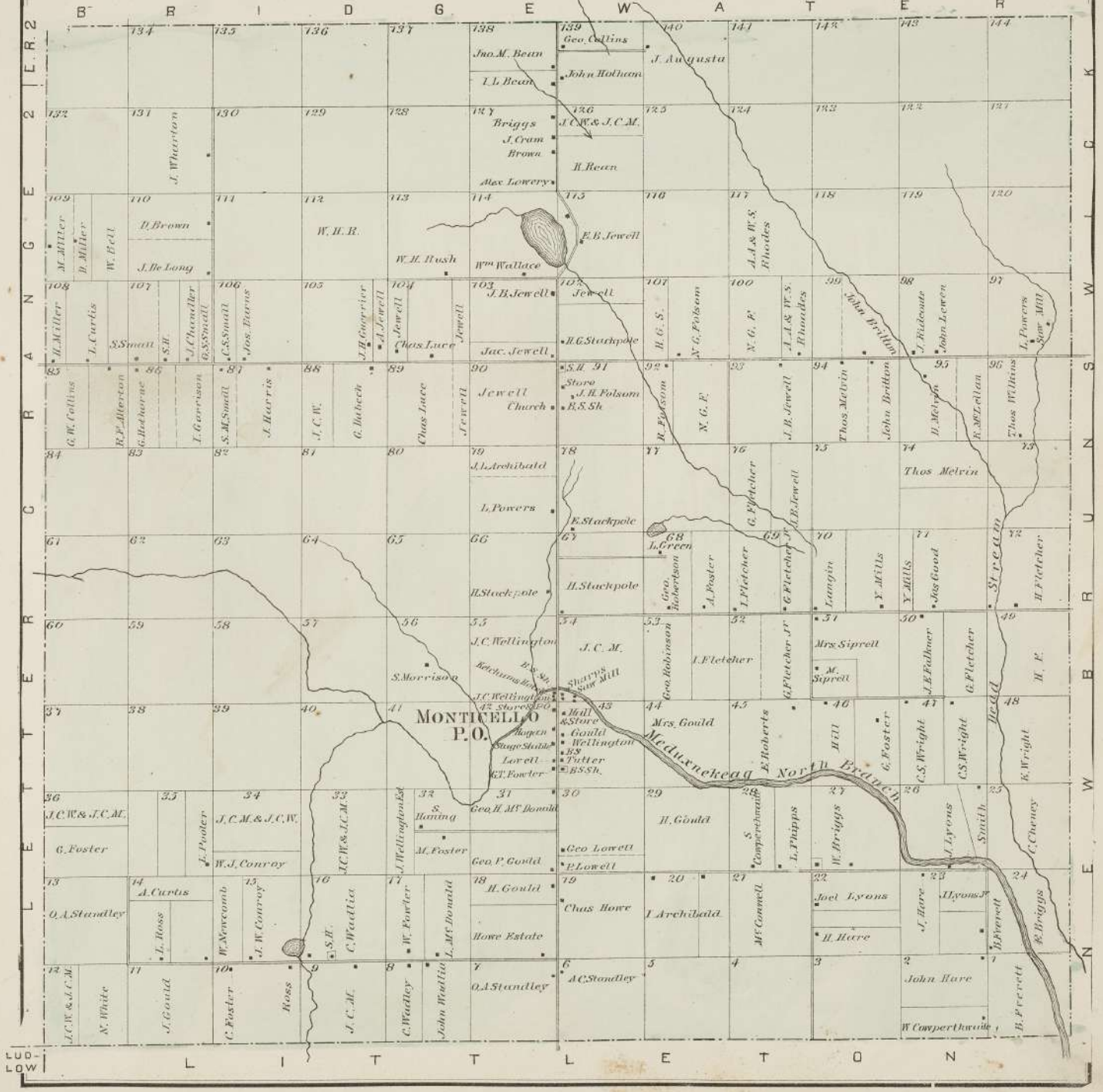

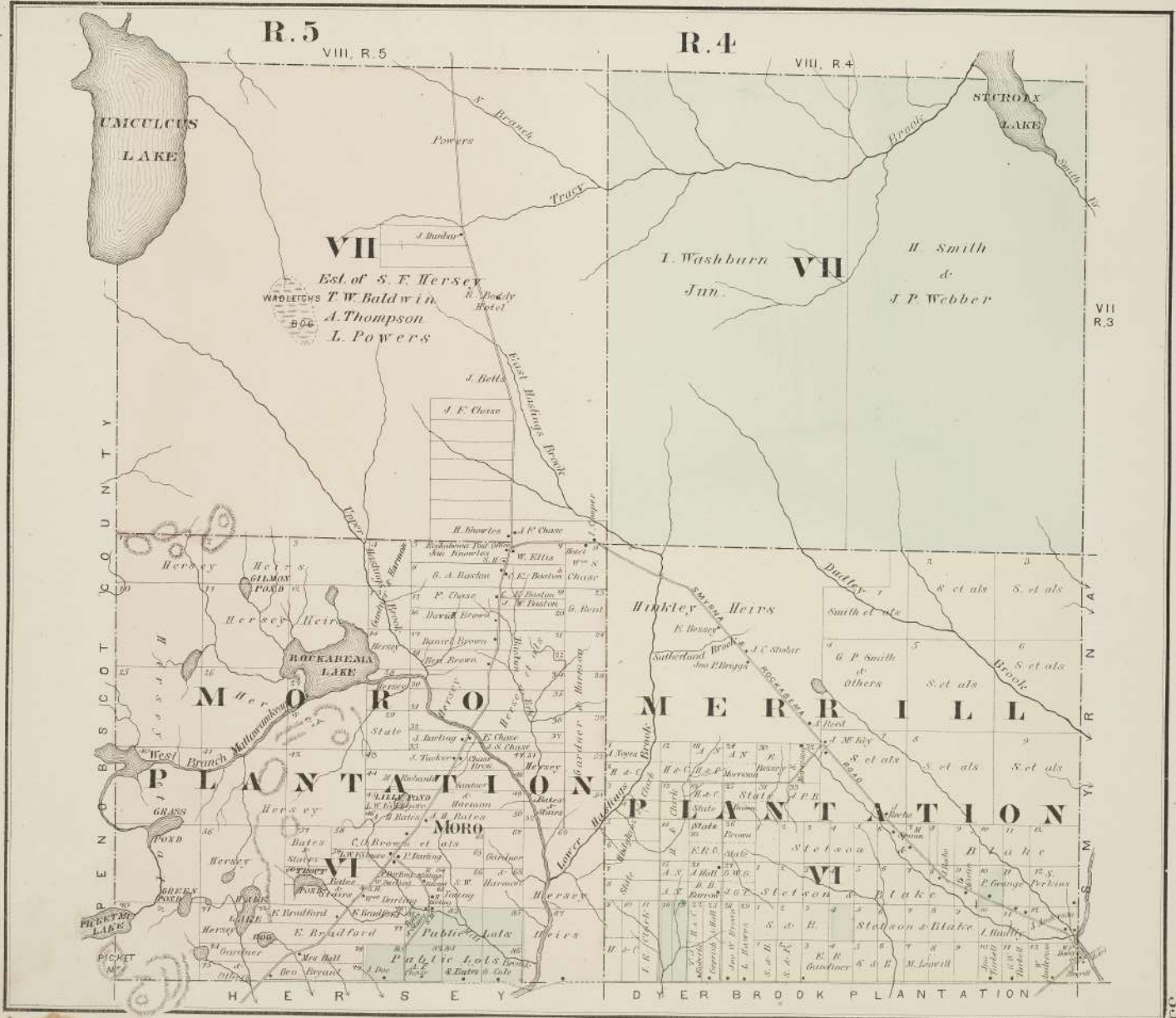

V
E
R
M
O
N
T

VII
R.3

XV, R. 3

Scale $\frac{1}{2}$ Mile 40 Chains to an Inch

MAP OF THE SWEDISH COLONY.

Scale $\frac{1}{2}$ mile to an inch

Landkarte von Neu Schweden by Roe & Colby. 1877.

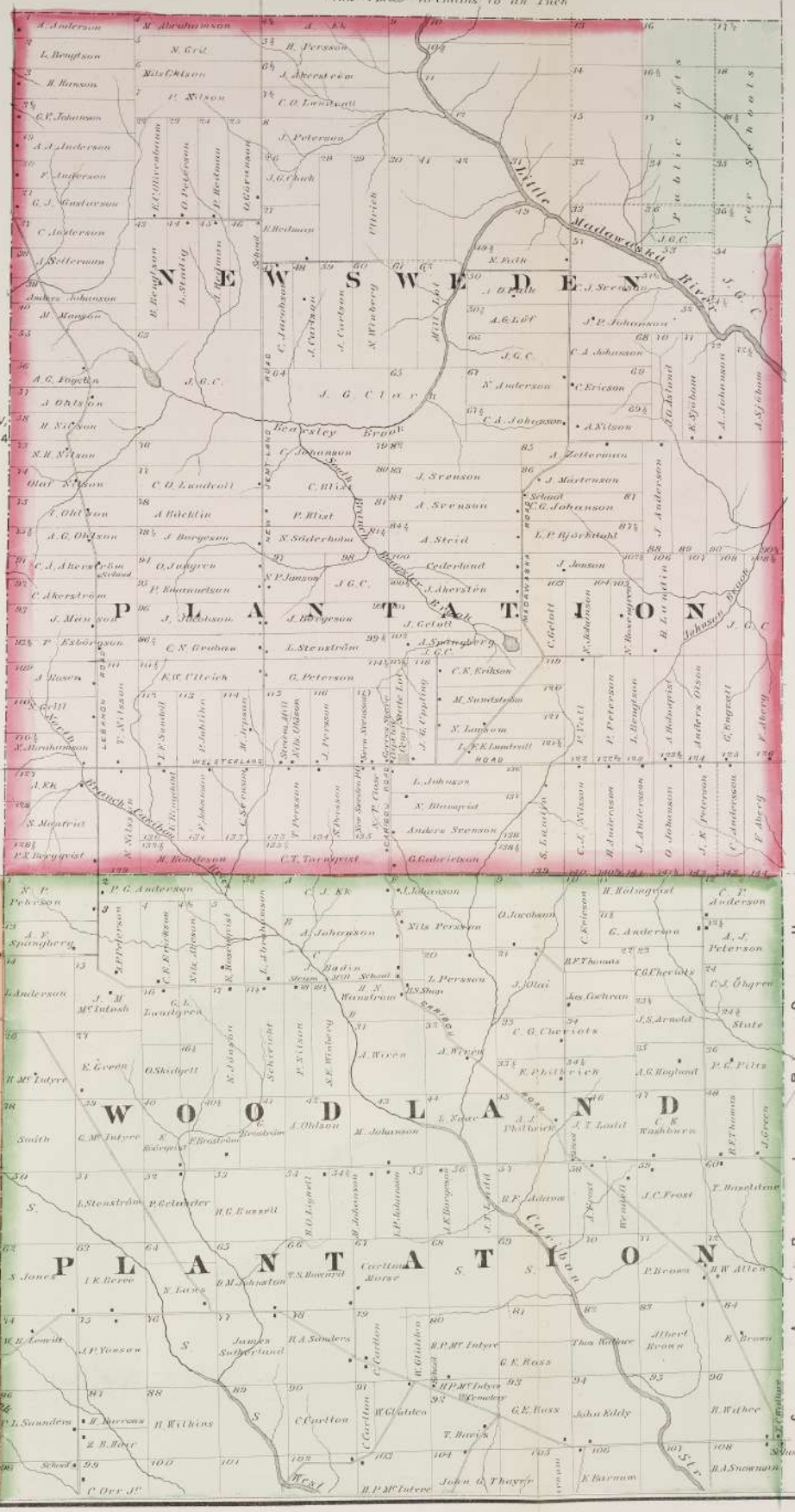

K. R. 2

XV, R. 4

R 4

D
O
B
E
A
C

PL'T' N11. R 1 & AMITY R.1

Scale 24 Mile (60 chains) to an inch

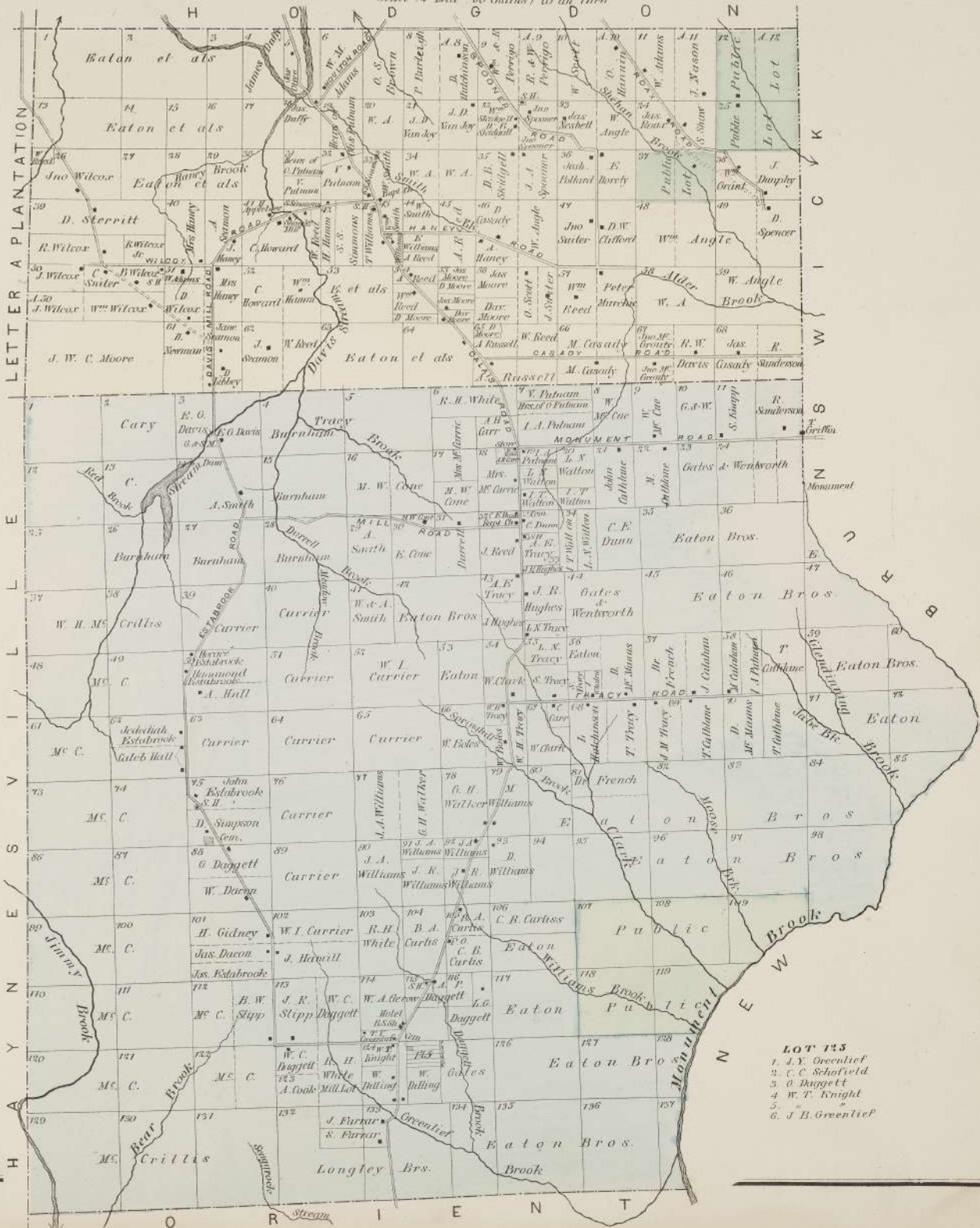

- LOT 125**
1. J. Y. Greenleaf
 2. C. C. Schofield
 3. O. Daggett
 4. W. T. Knight
 - 5.
 6. J. B. Greenleaf

PRESQUE ISLE

F, R. 2

Scale 1/2 Mile (40 Chains) to an Inch



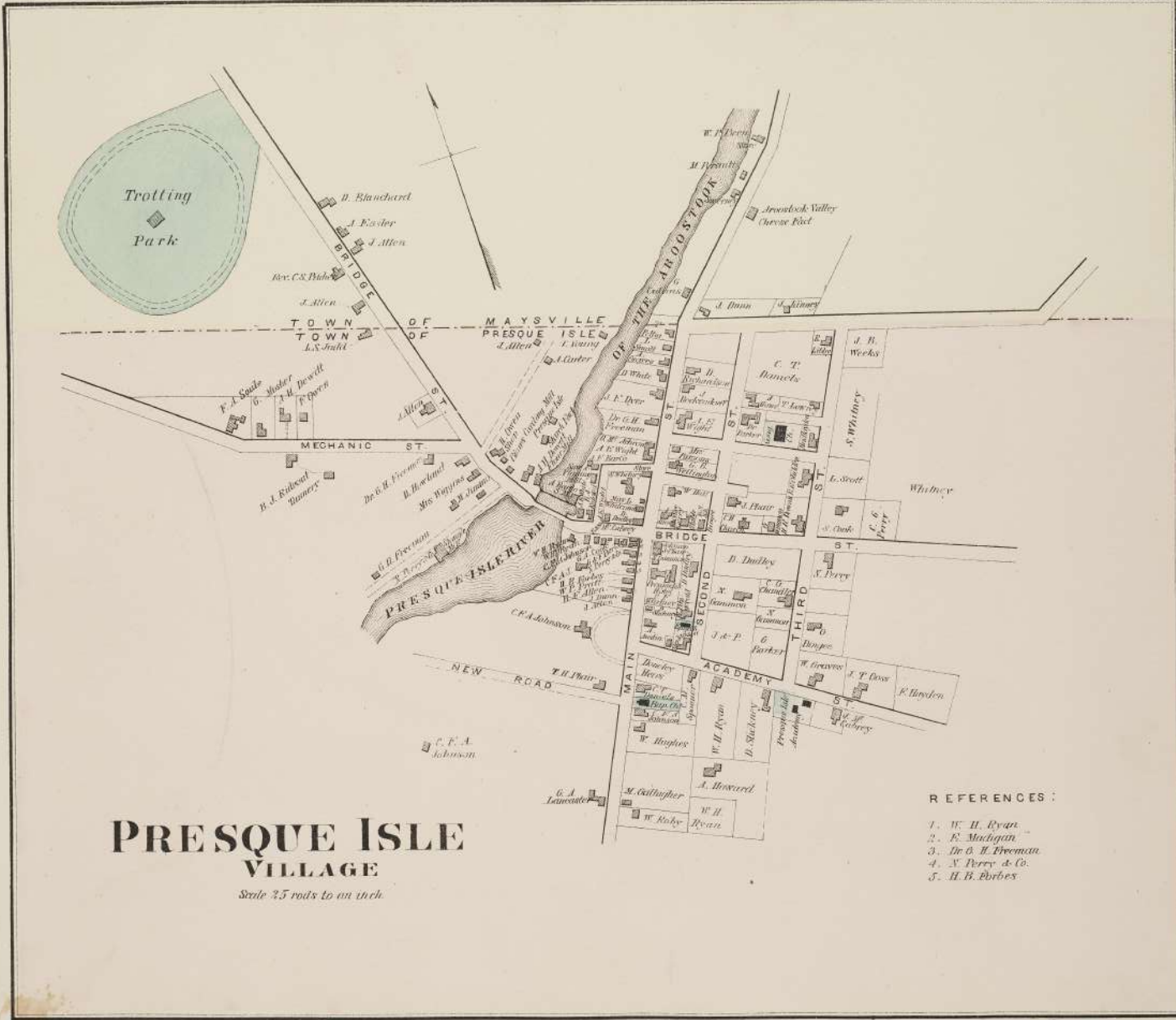

PRESQUE ISLE VILLAGE

Scale 3.5 rods to an inch

REFERENCES :

1. W. H. Ryan
2. F. Michigan
3. Dr. G. H. Freeman
4. N. Perry & Co.
5. H. B. Ebbes



SHERMAN
 III, R. 5
 Scale 1/4 Mile (40 Chains) to an Inch

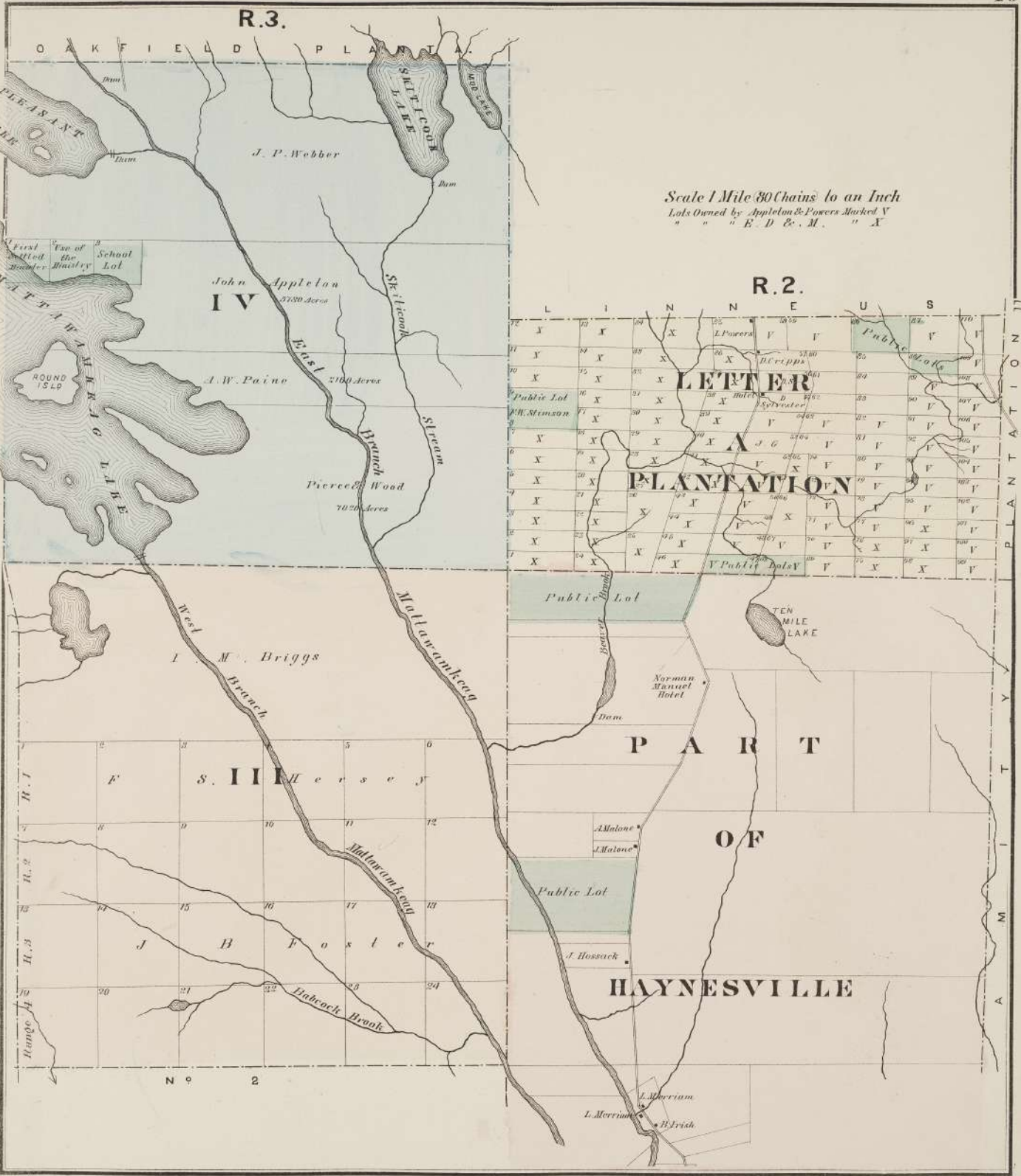

R.3.

R.2.

Scale 1 Mile 80 Chains to an Inch
 Lots Owned by Appleton & Powers Marked X
 " " " E. D. & M. " X

PART

OF

HAYNESVILLE

IV

S. III HERSHEY

LETTER

PLANTATION

PLEASANT LAKE

ROUND ISLAND LAKE

MALLETT LAKE

TEN MILE LAKE

R. 1
R. 2
R. 3
Range 4

N 2

L
I
N
E
S
P
L
A
N
T
A
T
I
O
N
P
A
R
T
O
F
H
A
Y
N
E
S
V
I
L
L
E

R. 3

VIII R. 3

Scale 1 Mile (80 Chains) to an Inch
Lots owned by C.G. Stearns marked x
Vacant Lands

R. 2

C R. 2

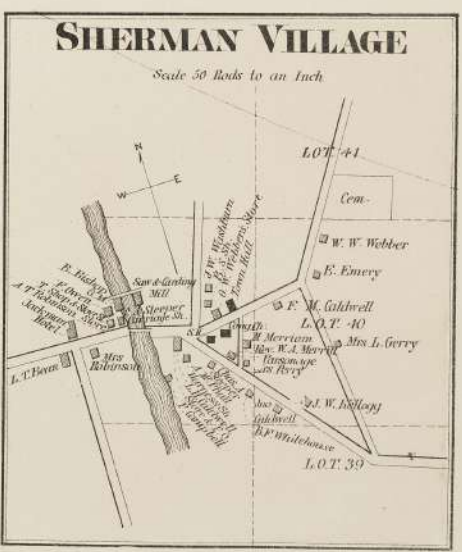
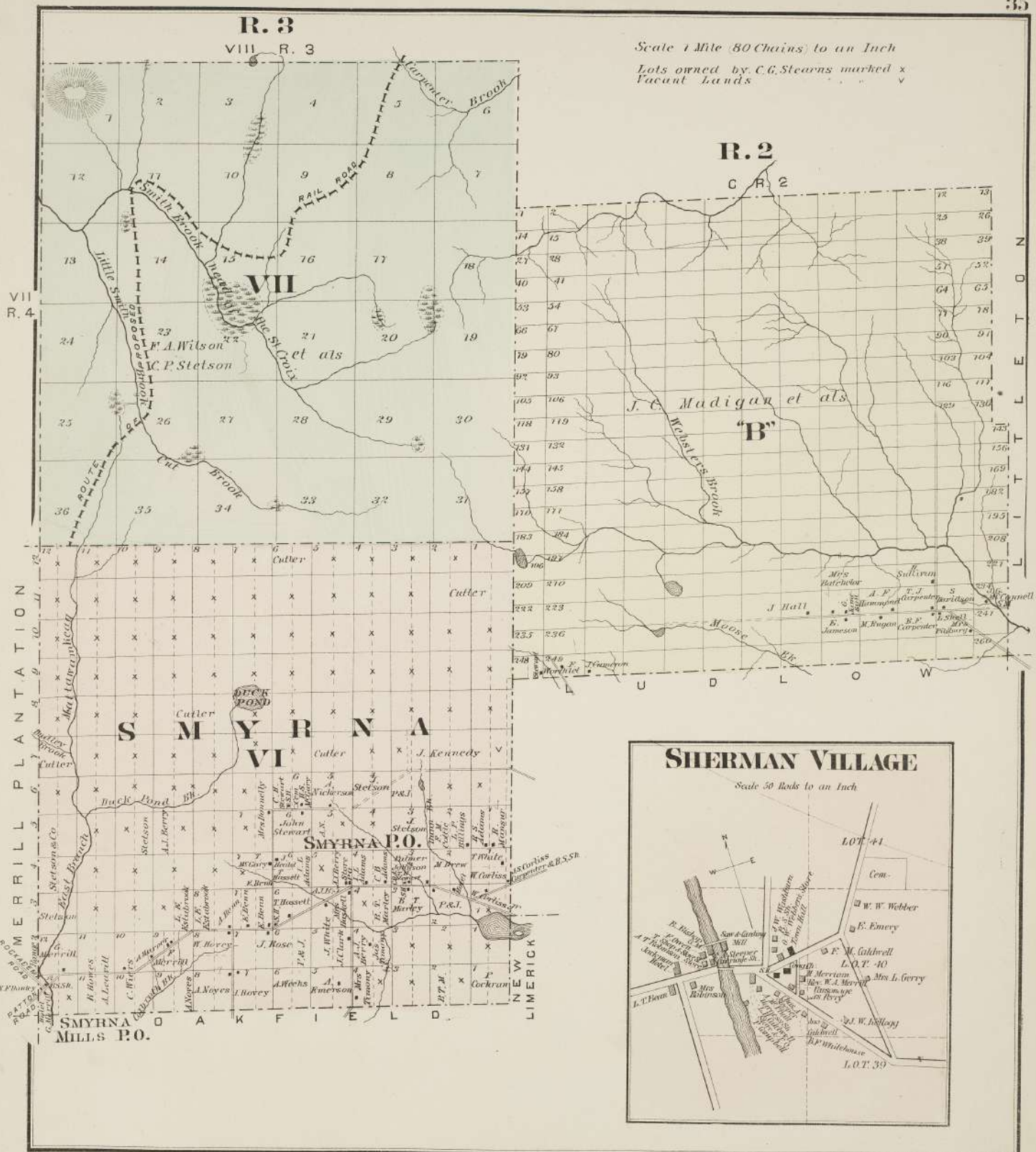

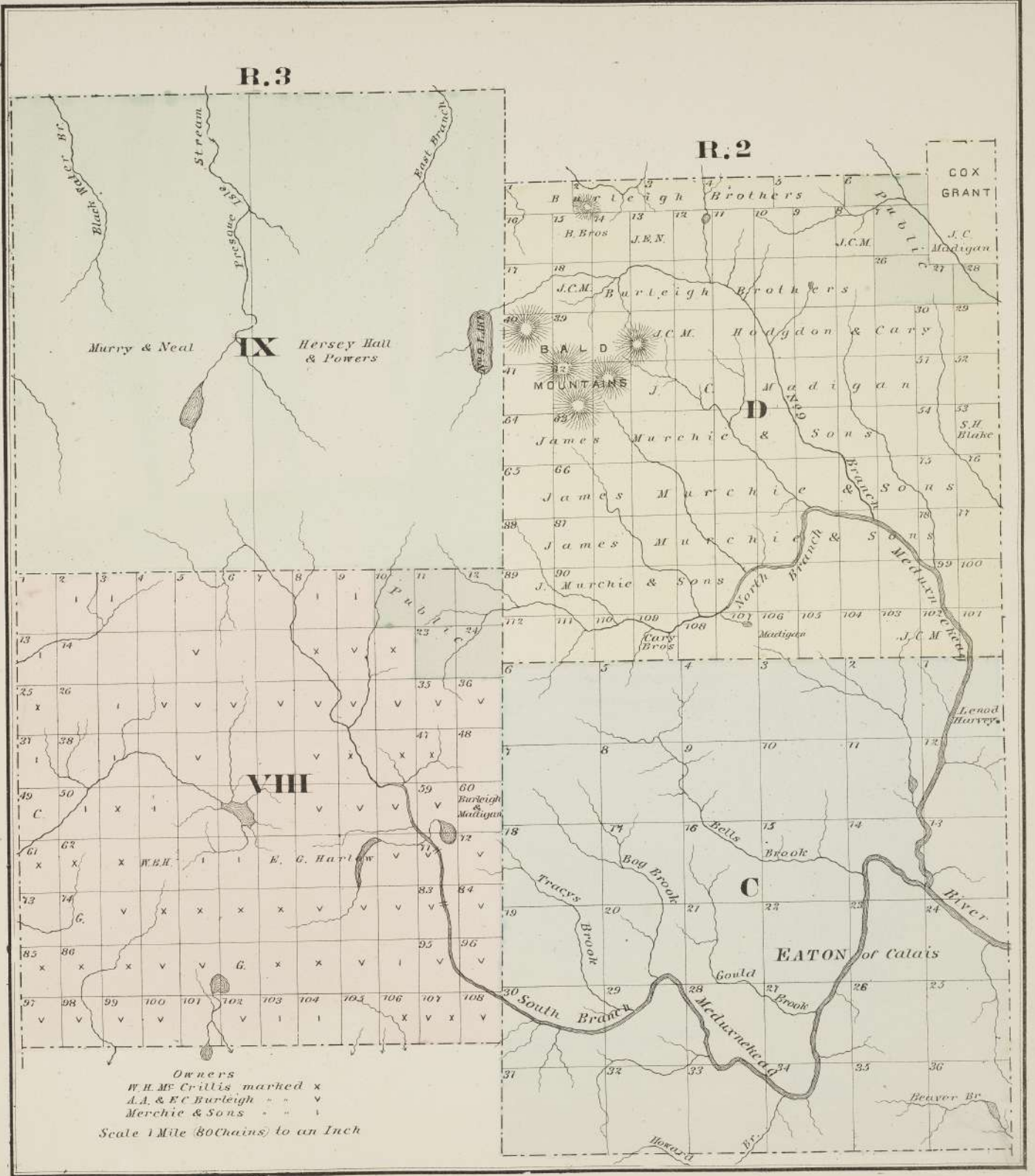

R.3

R.2

Murry & Neal

IX Hersey Hall & Powers

COX GRANT

Burlleigh Brothers

H. Bros

J.E.N.

J.C.M.

J.C. Madigan

J.C.M. Burlleigh Brothers

BALD

J.C.M. Hodgdon & Cary

MOUNTAINS

J.C. Madigan

James Murchie & Sons

S.H. Blake

James Murchie & Sons

James Murchie & Sons

J. Murchie & Sons

Cary Bros

Madigan

J.C.M.

Lenox Horvey

VIII

Burlleigh & Madigan

E. G. Harlow

Bells Brook

Bog Brook

Travers Brook

Gould

EATON of Calais

South Branch

Gould Brook

Medwicket

Beaver Br

Owners
 W.H.M. Crittis marked x
 A.A. & F.C. Burlleigh " v
 Murchie & Sons " i
 Scale 1 Mile (80 Chains) to an Inch

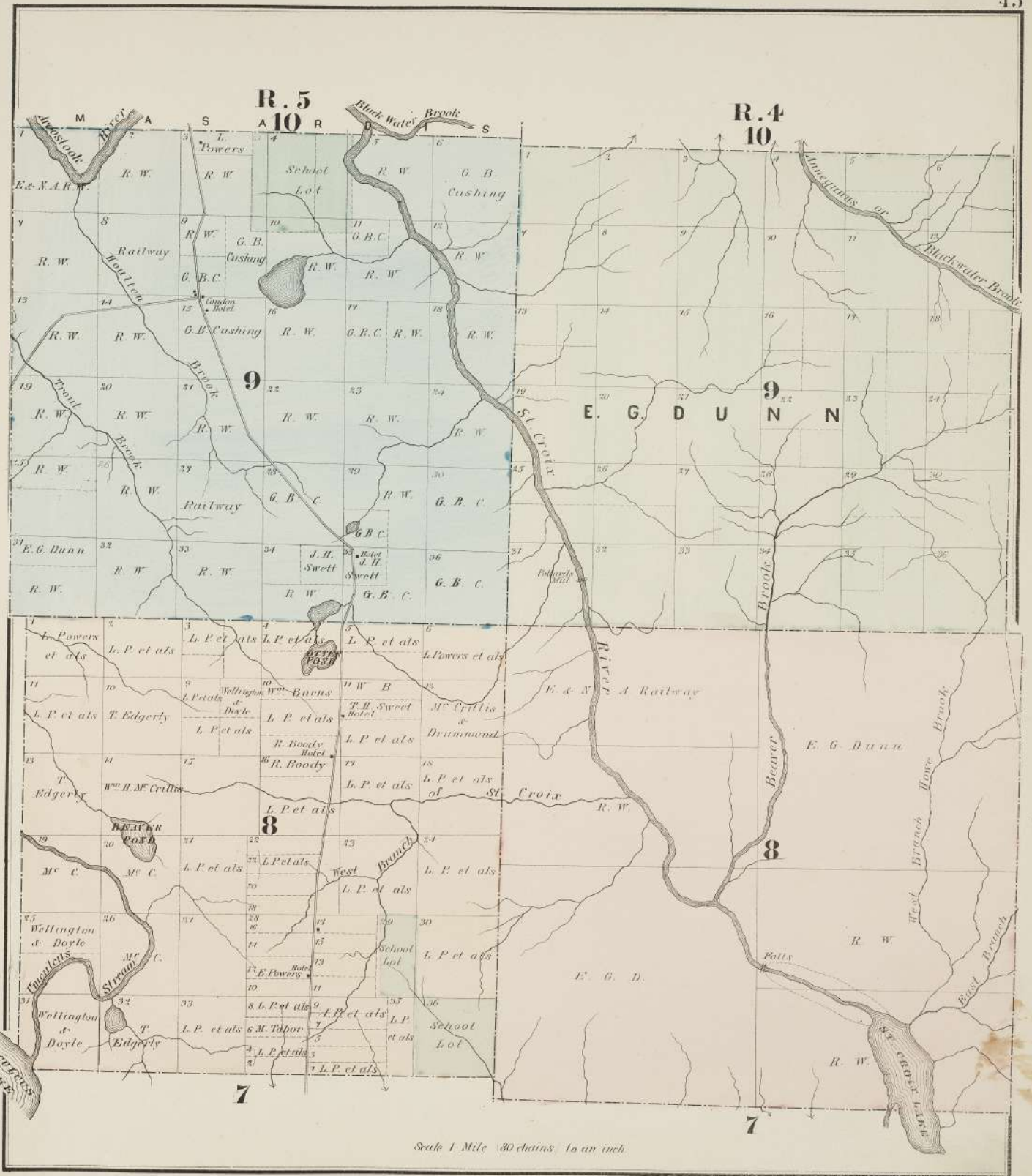

W. H. B. & Co.
L. A. H.

Scale 1 Mile 80 Chains to an Inch

P E R H A M

W O O D L A N D

W A D E

XIII, R. 4

PLANTATION

WASHBURN

XIII, R. 3

CASTLE HILL

XII, R. 4

PLANTATION

MAPLETON

XII, R. 3

PLANTATION

X I R 4

C H A P M A N P L A N ' N

XIII, R. 3

XII, R. 4

XII, R. 3

X I R 4

P U B L I C L O T S

P U B L I C L O T S

S C H O O L L O T

S C H O O L L O T

P R E S Q U E I S L E

