

33

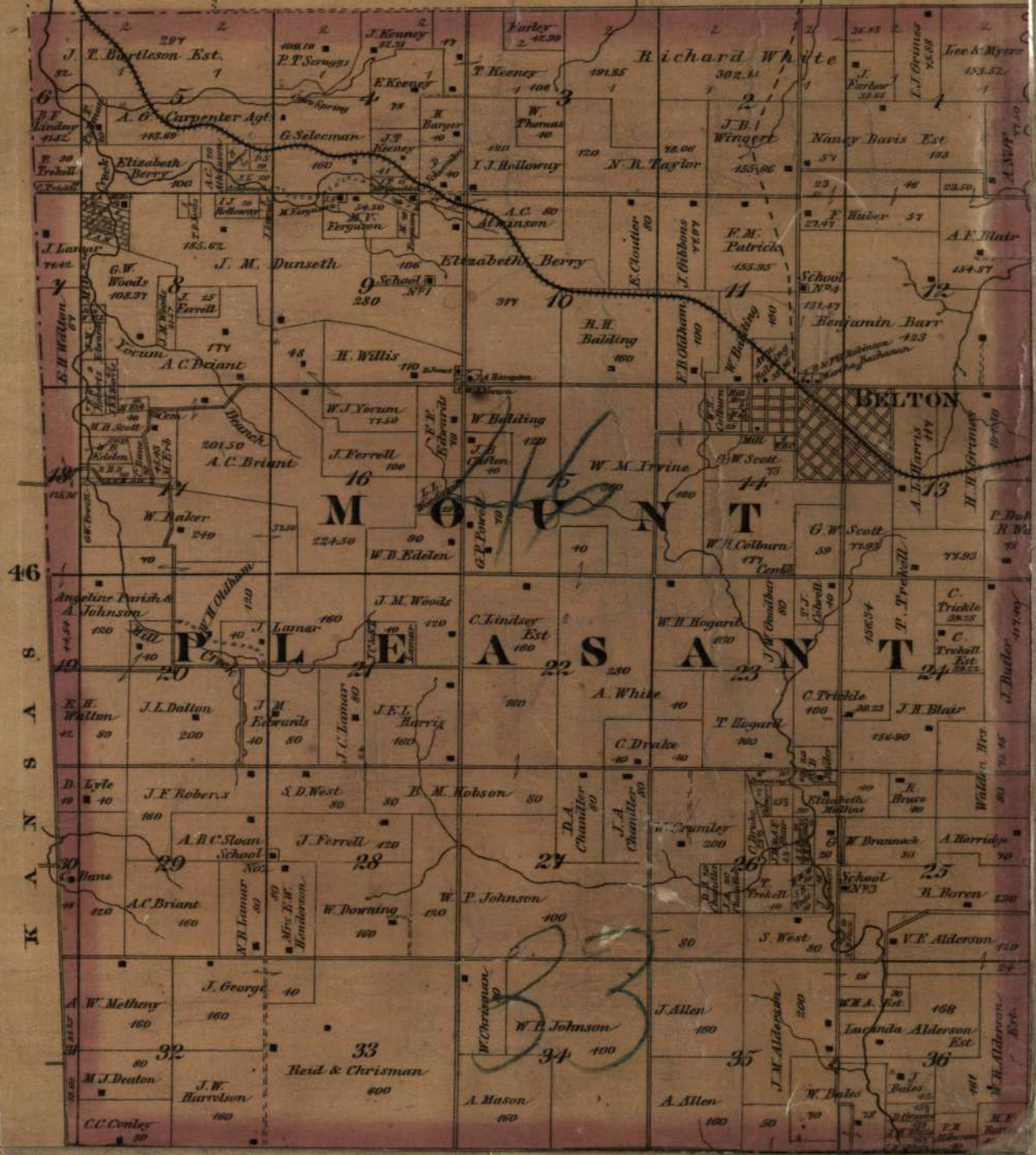

46
S
A
S
A
N
A
K

BELTON

MOUNTAIN

PLAINS

33

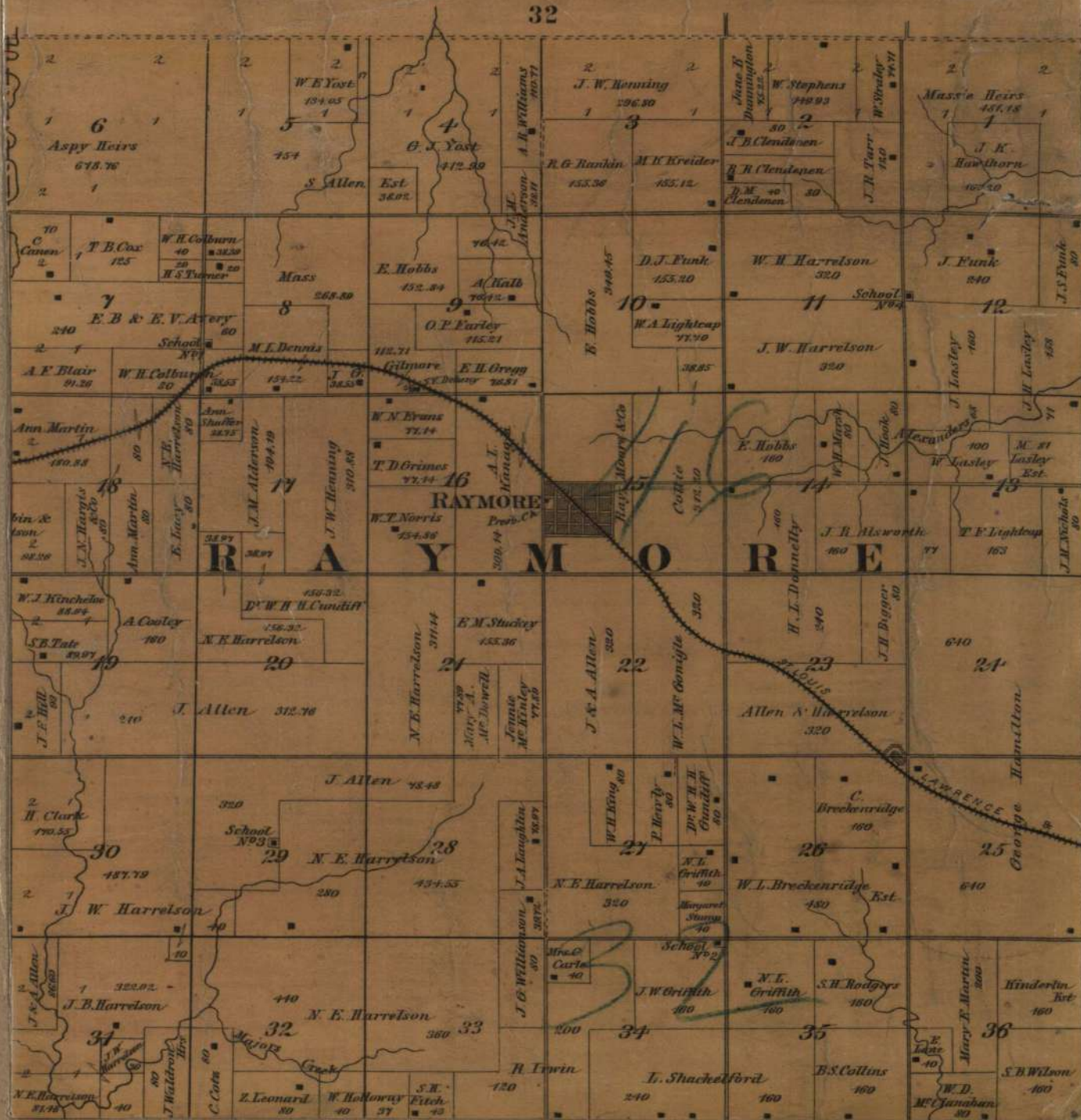

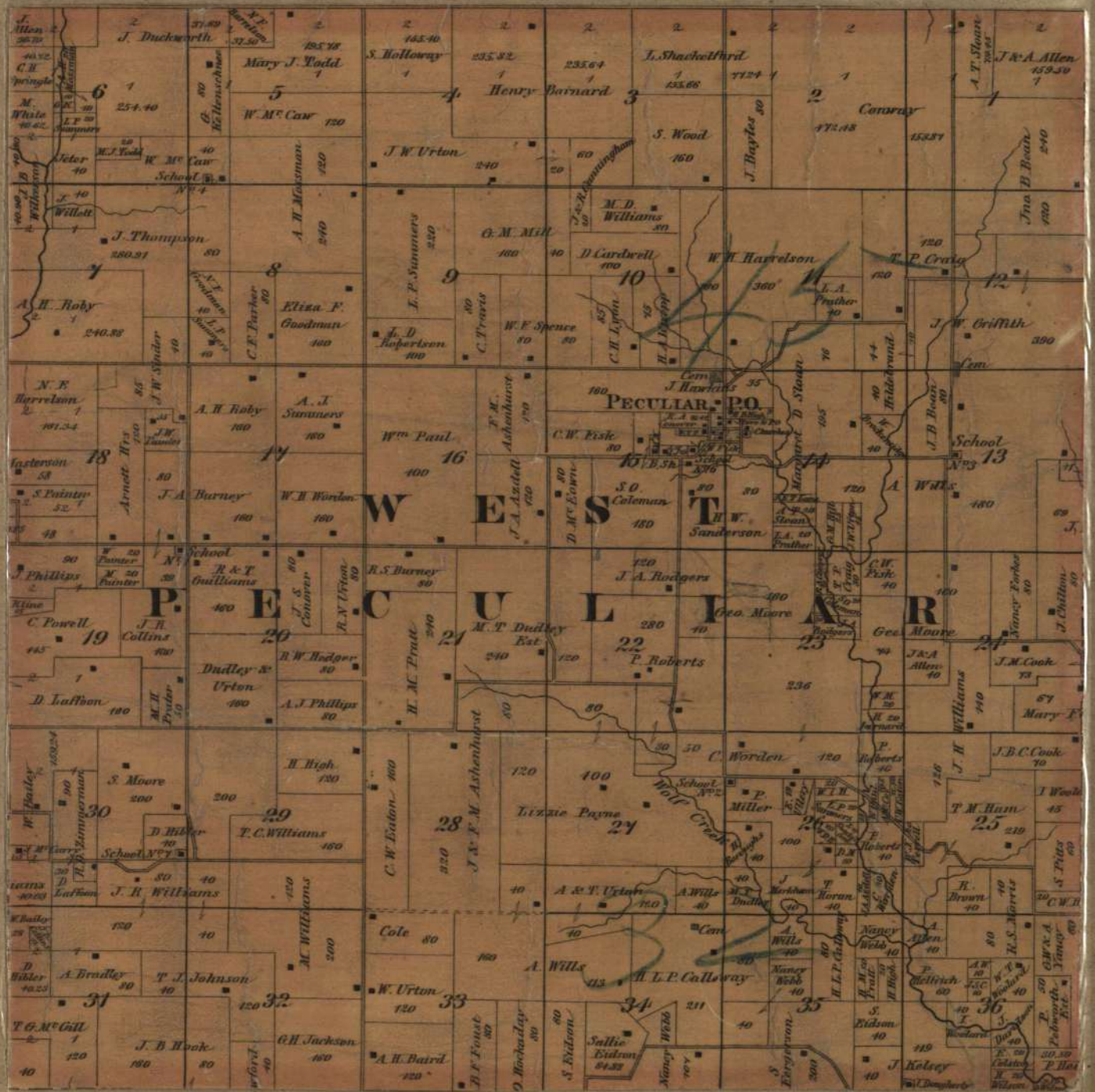

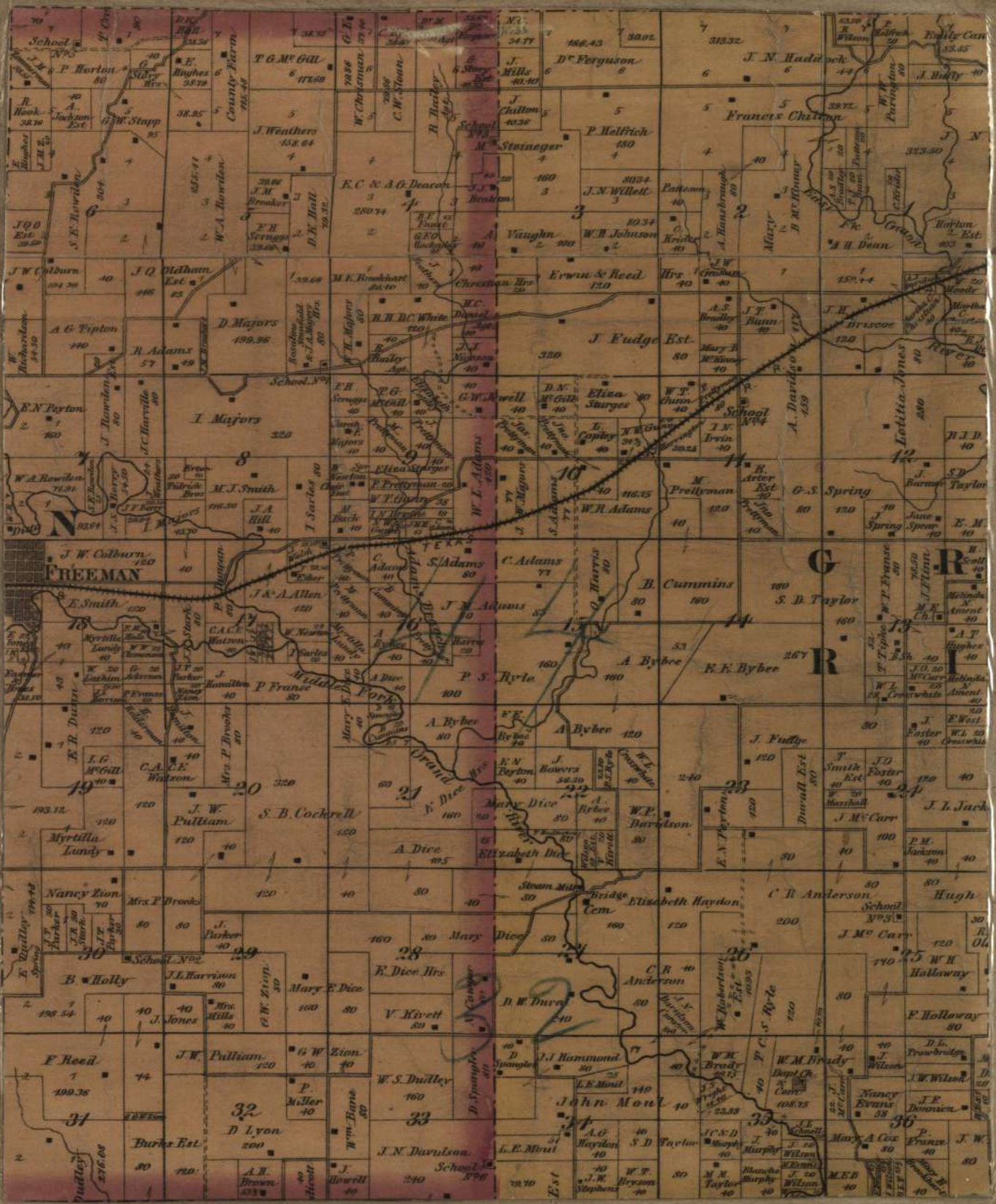

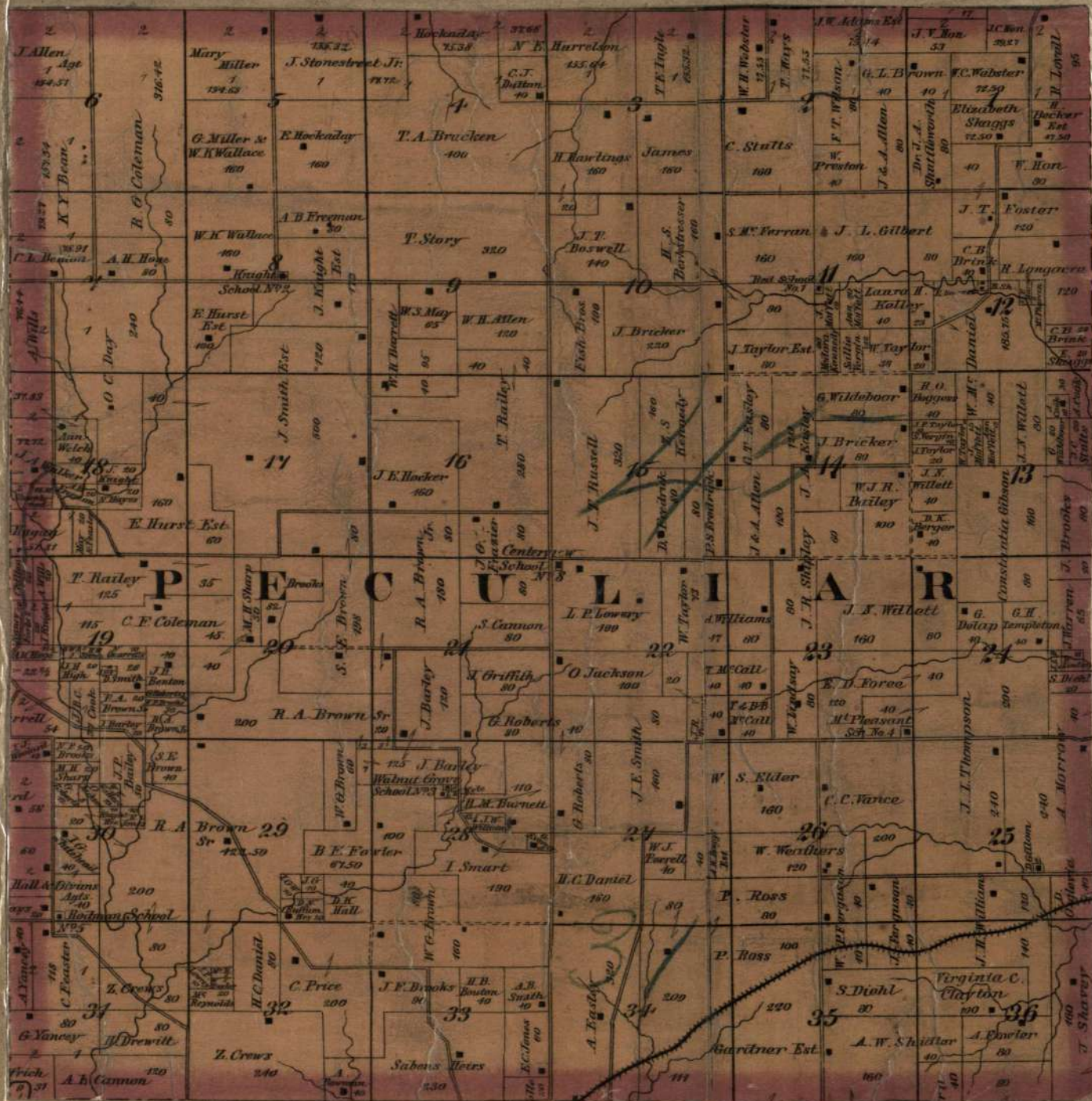

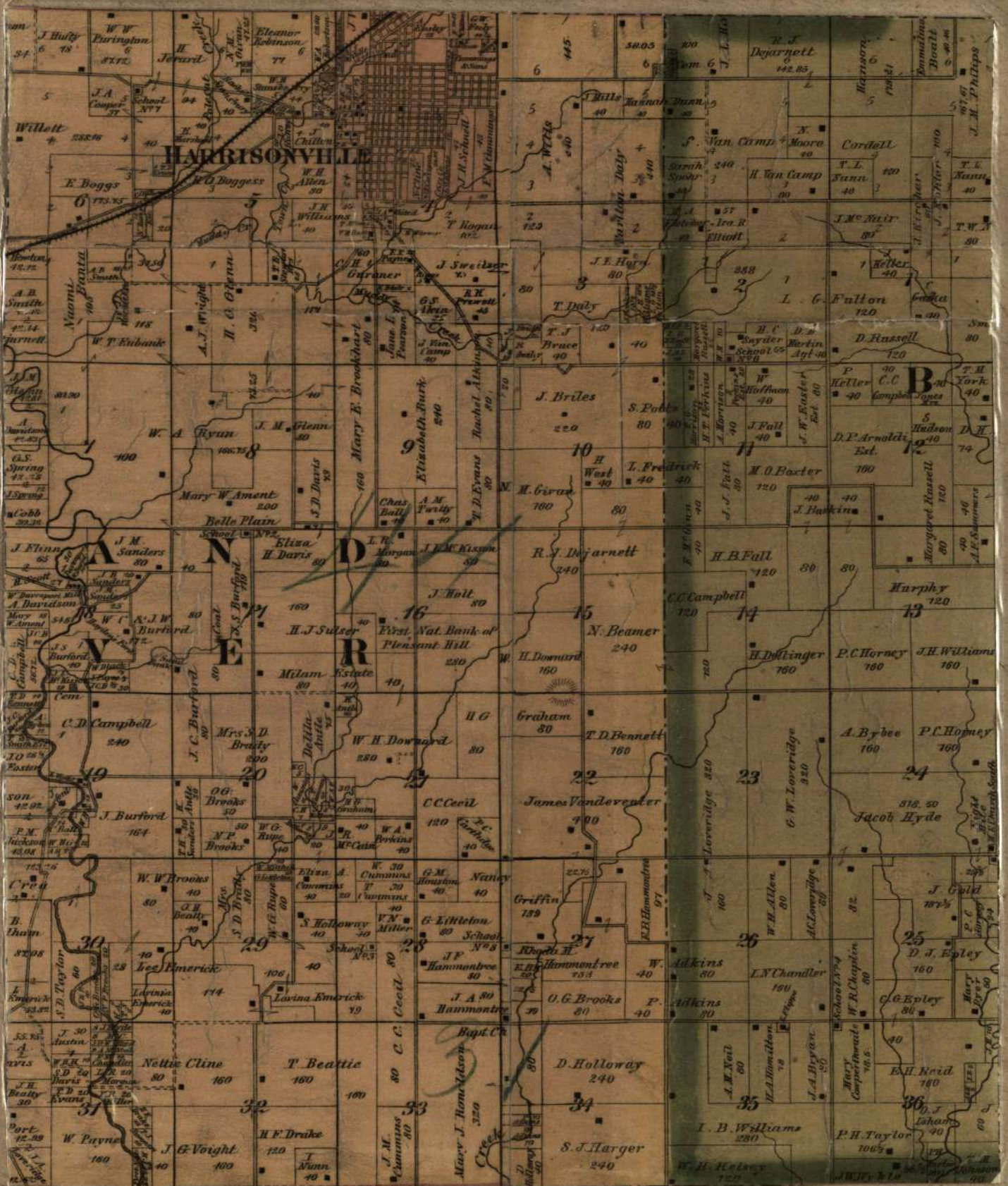

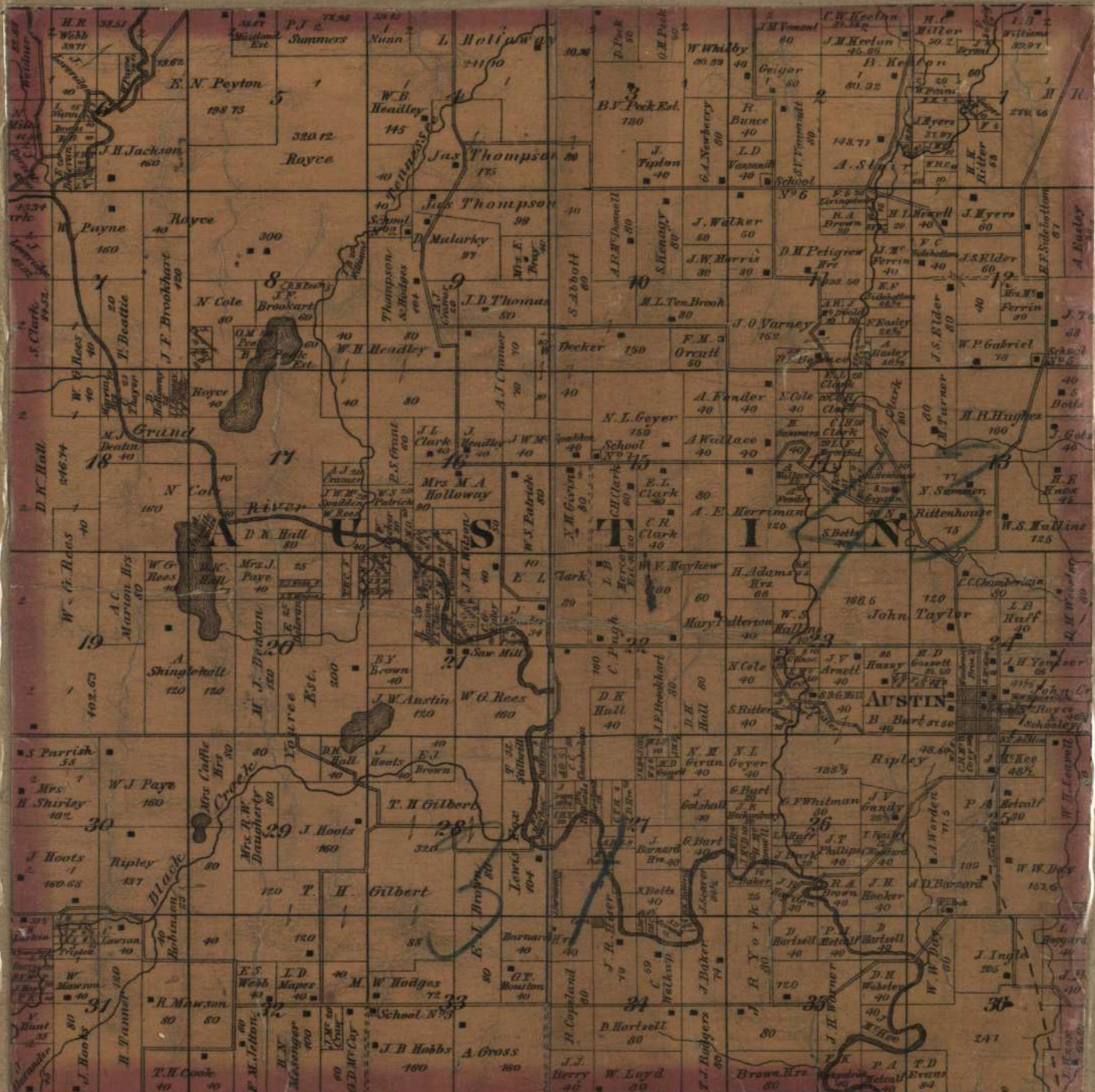

BATES COUNTY INDEX

and Stock Dealer.	East Lynne. 11	Kenagy D. P., Farmer and Stock Dealer.	Gunn City. 36
mer and Stock	Garden City. 36	King William, Farmer.	Index. 19
mer and Stock	East Lynne. 2	Layton David, "	Garden City. 36
farmers and Stock	East Lynne. 2	Loaders' Milk W. A., Farmer.	Index. 29
Farmers and	Garden City. 25	Lucas W. W., Farmer and Assessor.	Gunn City. 4
	"	Miller Joe, Farmer and Stock Dealer.	East Lynne. 13
	"	Newton J. E., Farmer and Stock Dealer.	

DATTON.

Bell James, Farmer.	Austin. 32
Campbell Col. C. D., Farmer and Stock Dealer.	Datton. 10

T 43
R 31

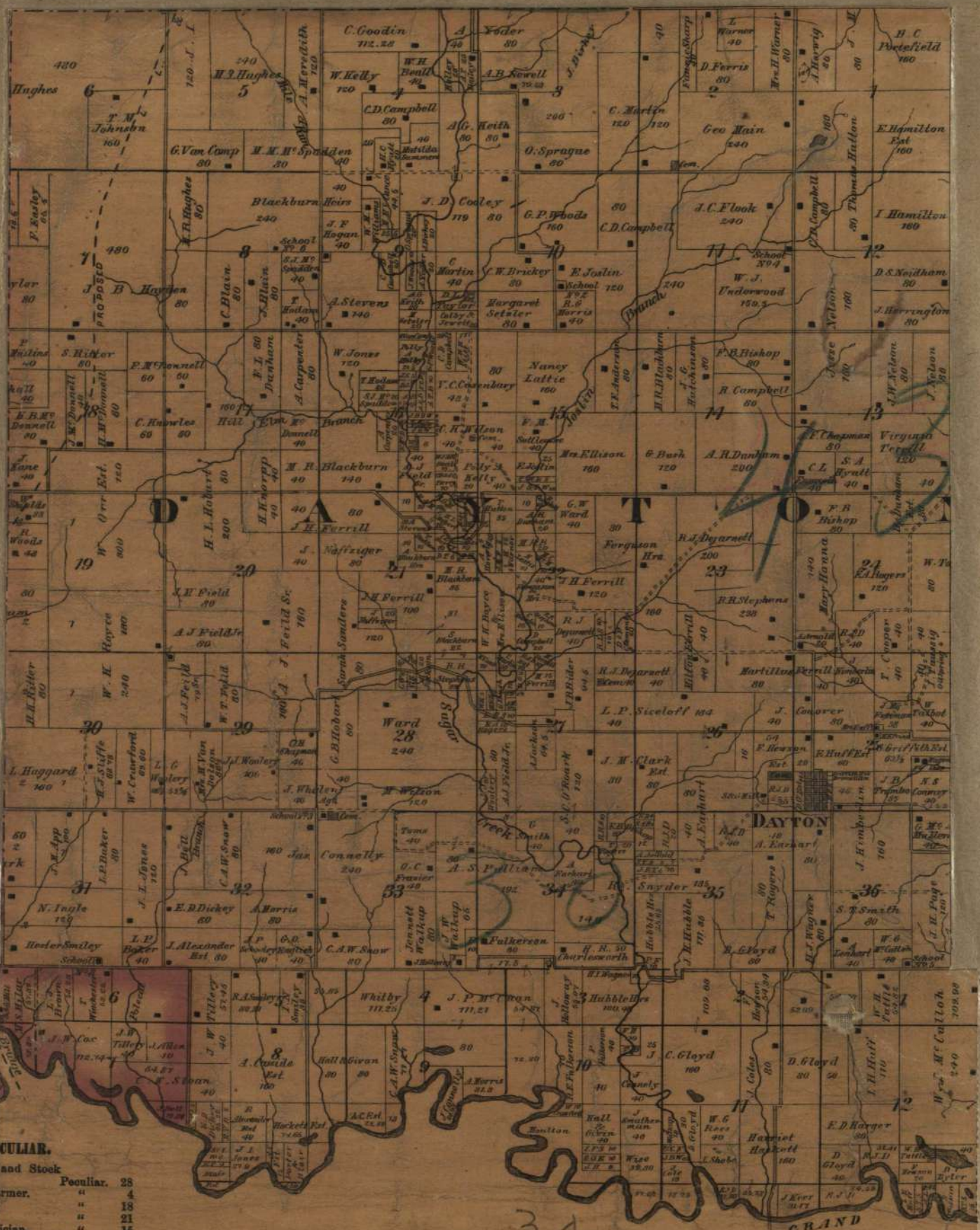

PECULIAR.

and Stock	Peculiar.	28
Armer.	"	4
	"	18
	"	21
ician.	"	15
	"	21
Postmaster.	"	14
Harrisonville.	"	25
nt.	Peculiar.	14

RAYMORE.

GRAND

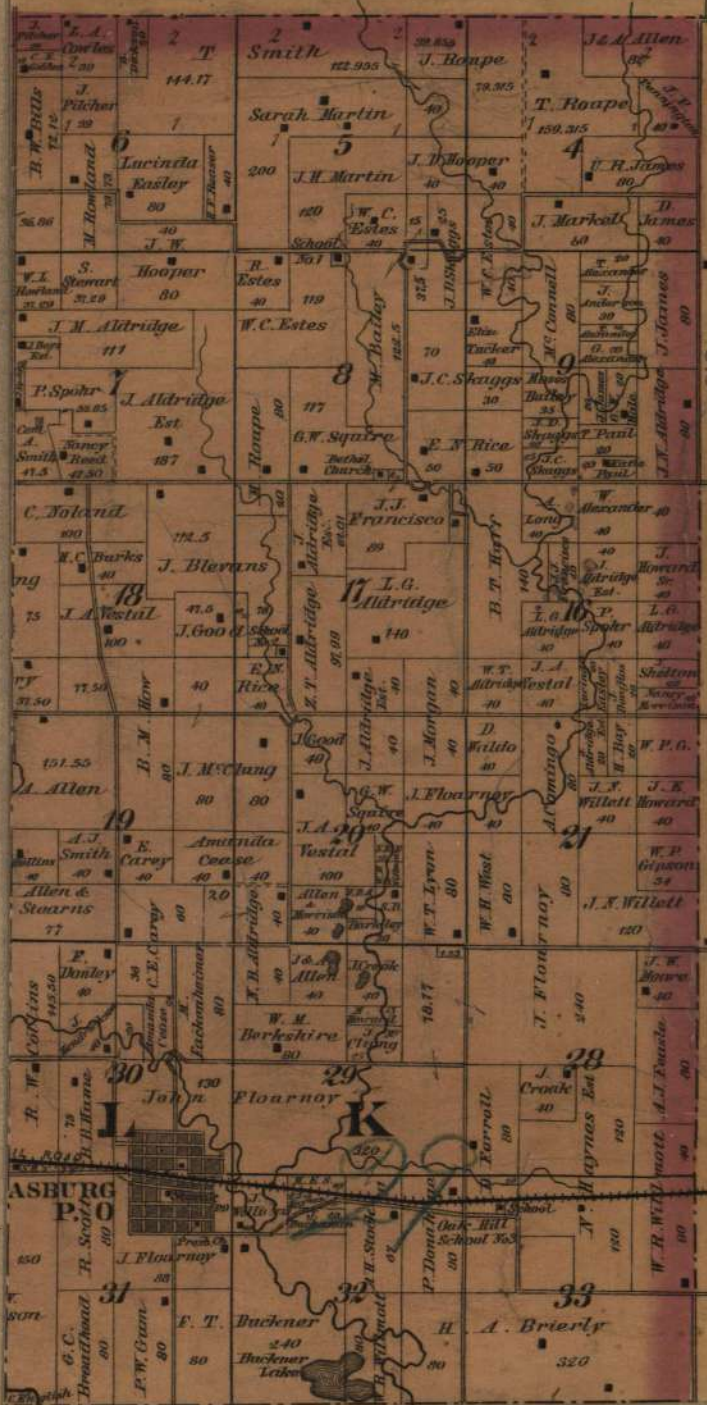

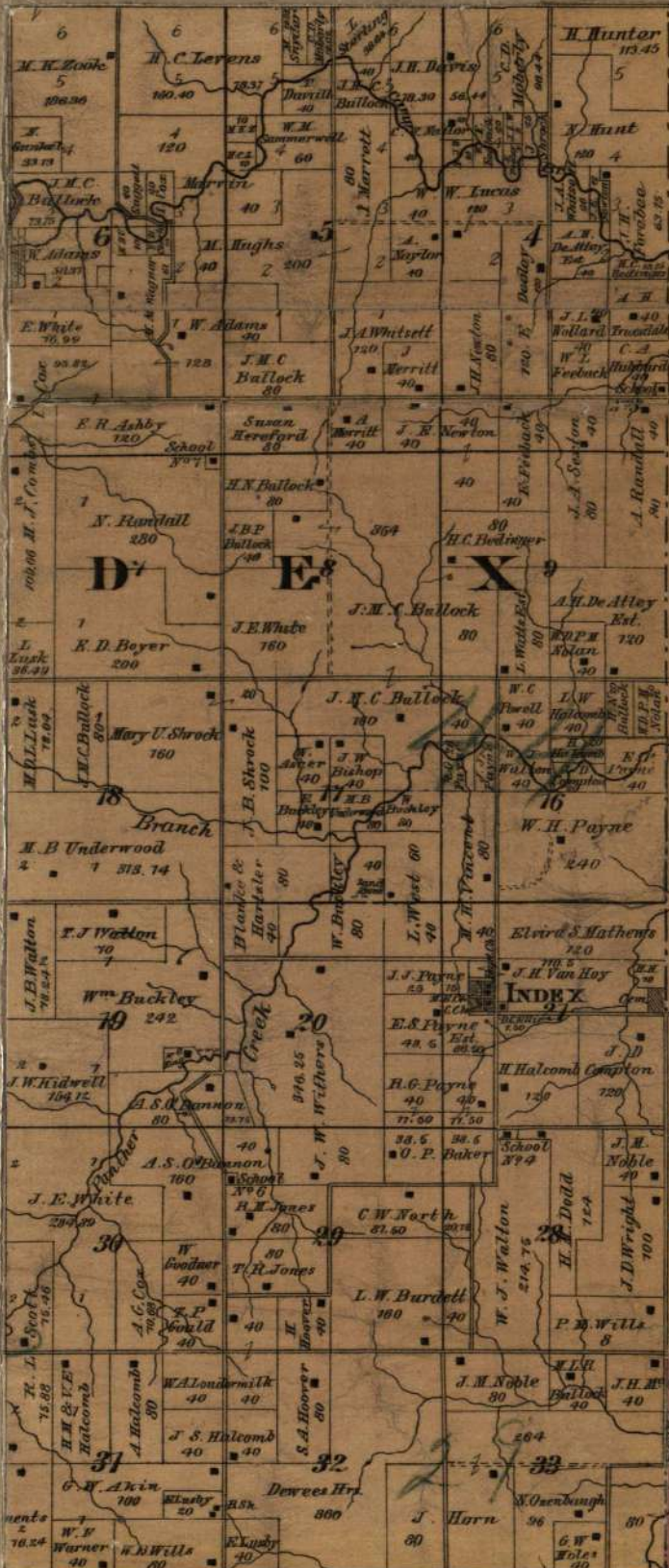

- 13 Kauffman E. V., " "
- 14 Lutes E. P., " "
- 15 McCandless Geo., " "
- 16 McCoy A. W., " "
- 17 McIntosh A. J., Physician and Surgeon. " "
- 18 Morrow James & John, Farmers. " "
- 19 Pearson W. M., Blacksmith. " "
- 20 School District No. 1. " "
- 21 School District No. 2. " "
- 22 School District No. 3. " "
- 23 Scott R. M., Farmer. " "
- 24 Shorb T. I., " "
- 25 Staley M., " "
- 26 Strite F. J., " "
- 27 Tumbleson F. M., Farmer. " "
- 28 Horn Cattle. " "
- 29 House Richard, Prop'r Belton Hotel. " "
- 30 Keeney Thomas, Farmer and Stock. " "
- 31 Lamar John, " "
- 32 Love Dr. Geo. L., Physician and Sur. " "
- 33 Mount Pleasant Twp. Board. " "
- 34 Neff Amos, Farmer. " "
- 35 Oldham F. B., " and Twp. Assessor. " "
- 36 Oldham W. H., " Stock Raiser. " "
- 37 Patrick F. M., " Dealer. " "
- 38 Scott Geo. W., " Grain Dealer. " "
- 39 Trezell Thomas, Farmer and Stock. " "
- 40 Trumbull L. M., Justice and Attorney at Law. " "
- 41 Wingert J. B., Farmer and Stock Dealer. " "
- 42 Woods James M., " "

CAMP BRANCH

- 1 Bailey G. T., Dry Goods, Groceries, Clothing and General Merchandise. East Lynne.
- 2 Barnard F. L., Farmer and Machinist. Harrisonville.
- 3 Bricey C. W., Prop'r M. K. & T. R. R. Hotel. East Lynne.
- 4 Cass A. B., Township Clerk. " "
- 5 Coffman Jas. H., Grain, Lumber and Stock Dealer. " "
- 6 Colby G. W., Teacher. " "
- 7 Coover J., Farmer. " "
- 8 Dodge Benjamin, Farmer. Harrisonville.
- 9 Epley C. G., Farmer, Carpenter and Joiner. " "
- 10 Farrow G. W., M. D., Physician and Surgeon. East Lynne.
- 11 Fielding John B., Farmer and Stock Raiser. " "
- 12 Fulton L. G., Farmer and Stock Raiser. Harrisonville.
- 13 Gill Wright, J. P., Farmer. East Lynne.
- 14 Greaser Isaac, Farmer and Stock Raiser. " "
- 15 Hassler A., Farmer. " "
- 16 Henthorn M. B., Farmer. Harrisonville.
- 17 Hoye Henry, " " "
- 18 Hord S. S., " " "
- 19 Hunter W. R., " East Lynne.
- 20 Hyde Jacob, Farmer and Stock Raiser. Harrisonville.
- 21 Kauffman Stephen, Farmer. East Lynne.
- 22 Kees J. O., Farmer. Gunn City.
- 23 King Isaac, " " "
- 24 King I. B., " " "
- 25 Kircher Jacob, " Harrisonville.
- 26 Middlesworth Wm., " East Lynne.
- 27 Newell S. S., Farmer and Stock Raiser. " "
- 28 Potts L. B., " " "
- 29 Reid Jas. L., " Harrisonville.
- 30 Russell Margaret, Farmer. " "
- 31 Sharp David, " East Lynne.
- 32 Shuey J. W. & Sons, " " "
- 33 Smith Wm. A., Farmer and Proprietor East Lynne Mills. East Lynne.
- 34 Stine N. H., Farmer. " "
- 35 Summers A. F., " Harrisonville.
- 36 Taylor P. H., " and Stock Raiser, and Twp. Assessor. " "
- 37 Thorpe Wm., Farmer and Stock Raiser. East Lynne.
- 38 Wellman H. B., Farmer. " "
- 39 Wiseman T. L., " and Stock Raiser. Harrisonville.
- 40 Yoder A., Farmer. East Lynne.
- 41 Yoder C. P., " and Stock Raiser. " "
- 42 Yoder S. H., " " "
- 43 Young J. A., " " "
- 44 Zook Eli, " " "

BIG CREEK

- 1 Barron W. H., Farmer.
- 2 Brannock W. A., " "
- 3 Bright J. T., M. D., Physician.
- 4 Bruce Jas. T., Farmer.
- 5 Cline Wm., " "
- 6 Hooper Sarah R., " "
- 7 Judy R. S., " "
- 8 Lynn James, " "
- 9 Mills B. F., " "
- 10 Mobley Levi, " "
- 11 Morrow Wm. J., " Greenwood.
- 12 Nichols J. J., " "
- 13 Robinson J. W., " "
- 14 School District No. 4. " "
- 15 School District No. 6. " "
- 16 Sharp James T., Farmer.
- 17 Todd E. P., " "
- 18 Wherritt B., " "
- 19 Wherritt T. J., " "
- 20 Wolfe Charles, " "

EVERETT.

- 1 Cable G. H., Farmer.
- 2 Clark Silas, " "
- 3 Clary John W., Mechanic and Farmer.
- 4 Dorsett James, Farmer.
- 5 Licklider S. E., " "
- 6 Longwell James, " "
- 7 McCoy Brice, Farmer and Stock Raiser.
- 8 Scarce Wm., Farmer.
- 9 Steen W. H., " and Stock Raiser.
- 10 Sweeney Thos. J., " "
- 11 Wilcox James H., " "

PECULIAR.

- 1 Benton C. L., Farmer. H.
- 2 Berkstresser H. S., Farmer. P.
- 3 Brown R. A., Sr., " H.
- 4 Brown R. A., Jr., " "
- 5 Brown S. E., " "
- 6 Brown W. G., " "
- 7 Brickr J., " "
- 8 Burnett M. H., Clergyman.
- 9 Crews Zach., Farmer.
- 10 Diehl Simon, " "
- 11 Elder Wm. S., " "
- 12 Lowrey L. P., " "
- 13 School District No. 1. " "
- 14 School District No. 2. " "
- 15 School District No. 3. " "
- 16 School District No. 4. " "
- 17 School District No. 8. " "
- 18 Shidler A. W., Farmer. Ha.
- 19 Smart Isaac, " "
- 20 Stultz J. C., " Ple.
- 21 Vance C. C., " Ha.
- 22 Wallace W. K., " Ple.
- 23 Webb J. M., " "

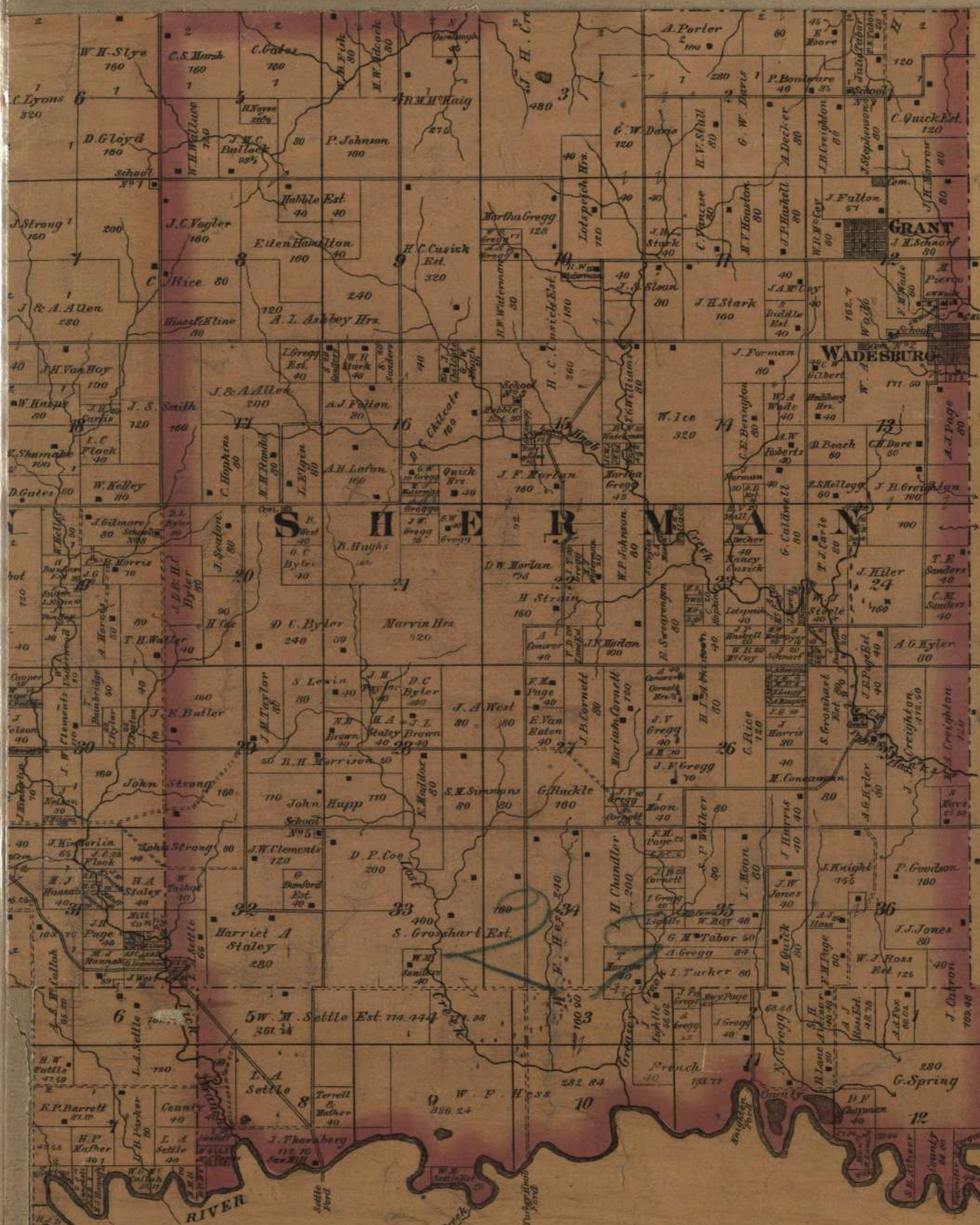

HENRY COUNTY

Explanation.

- Section Line —————
- Farm Line —————
- Rail Road —————
- Wagon Road —————
- Number of Section 25
- Number of Acres 80-150
- Streams —————
- Location of Houses.

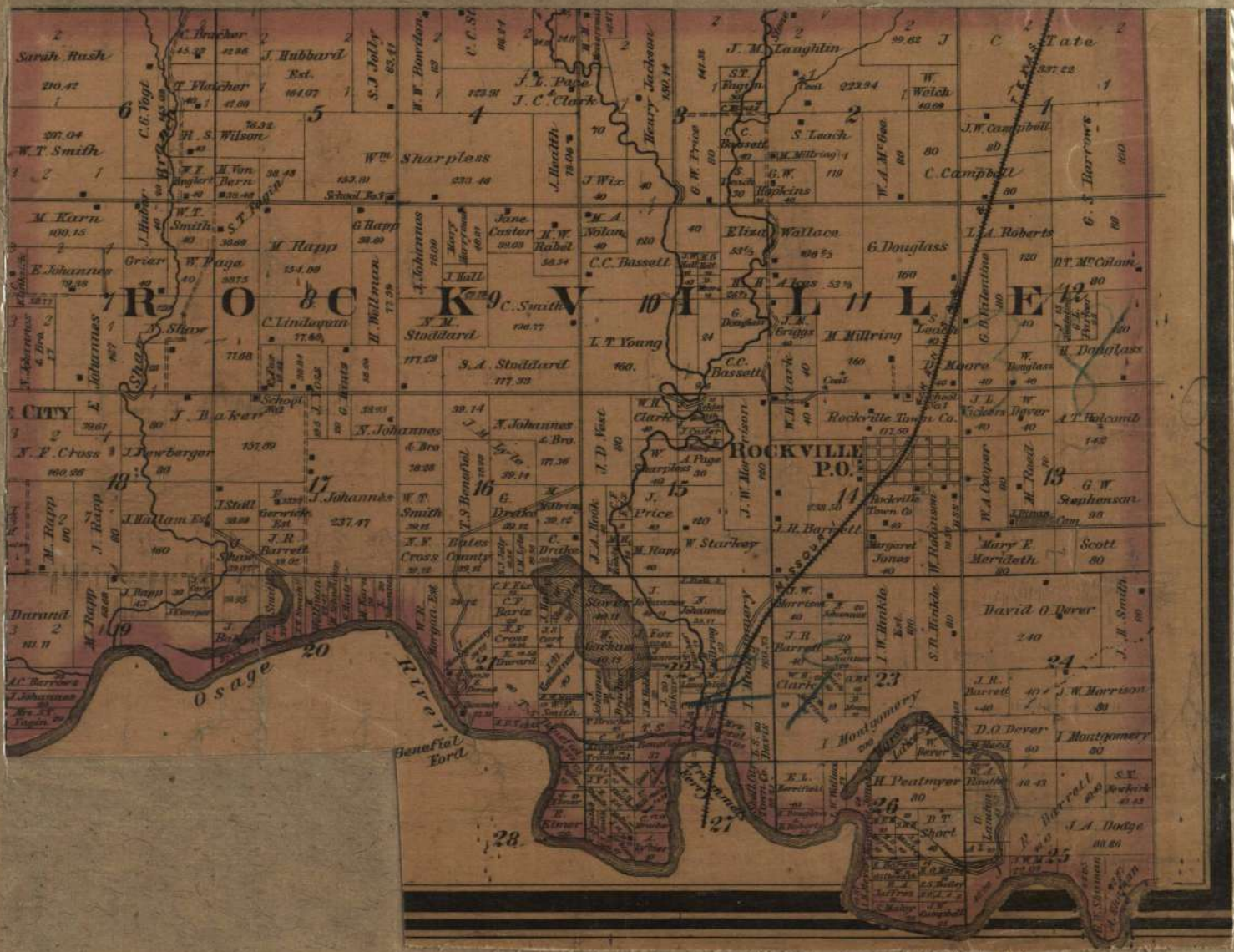

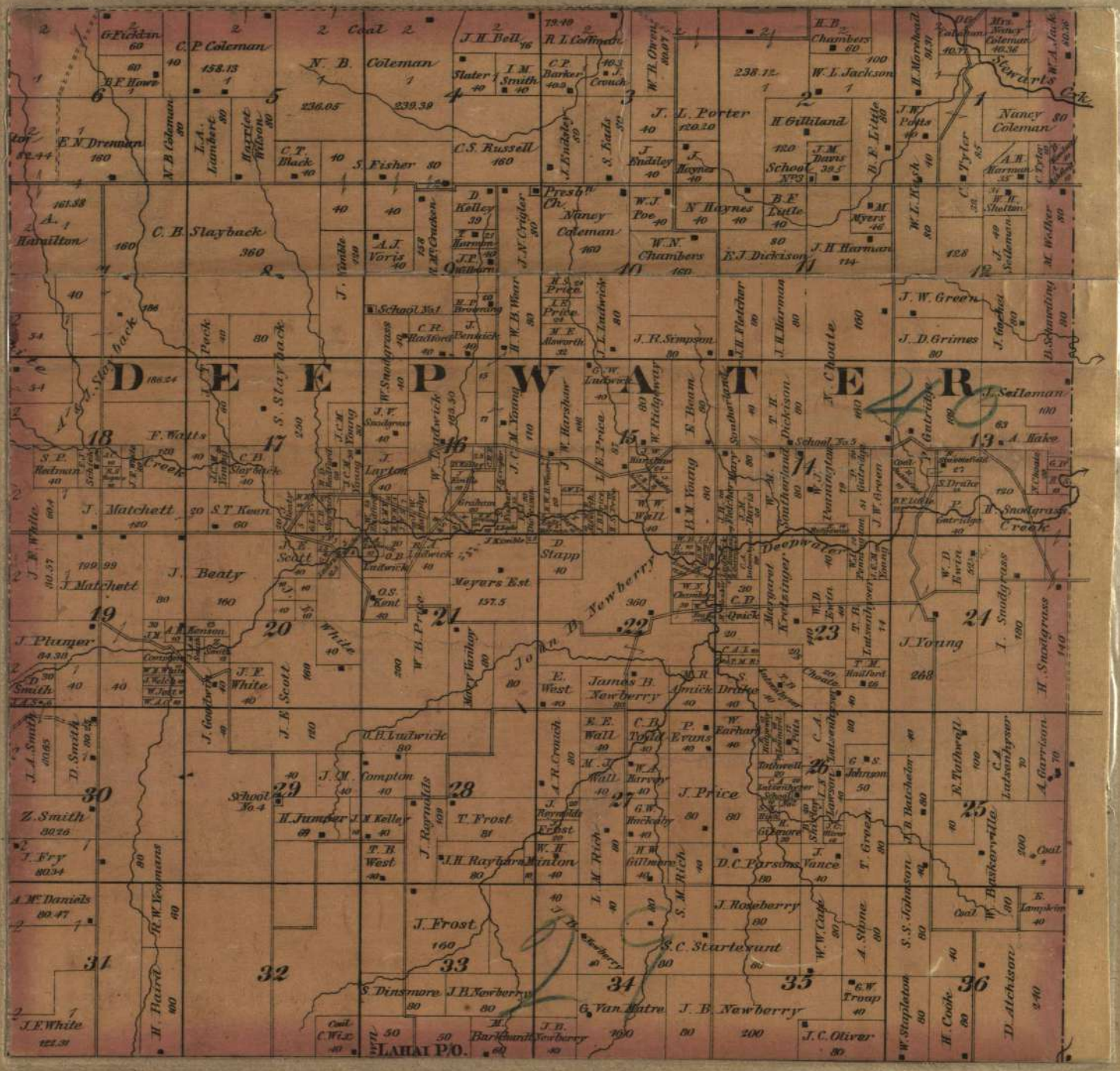

LAHAI P.O.

mler. Lone Oak. 22
 J. A. Farmer. Lone Oak. 23
 B. Farmer and Stock Dealer. Butler. 1
 m. C., Physician and Farmer. " 18
 oc. N., for School Dist. No. 2. " 14
 I. H., Farmer and Stock Raiser. " 11
 W. R., Farmer and Stock Dealer. " 11
 W., Farmer and Stock Dealer. " 11

Shockey John, Farmer and Stock Dealer. " 4
 Smith U. T., Farmer. Prairie City. 13
 Tutt H. O., Probate Judge. Papinville.
 Wilson D. H., Dealer in General Mer-
 chandise. "
 Zeal Phillip, Dealer in General Mdse. 29

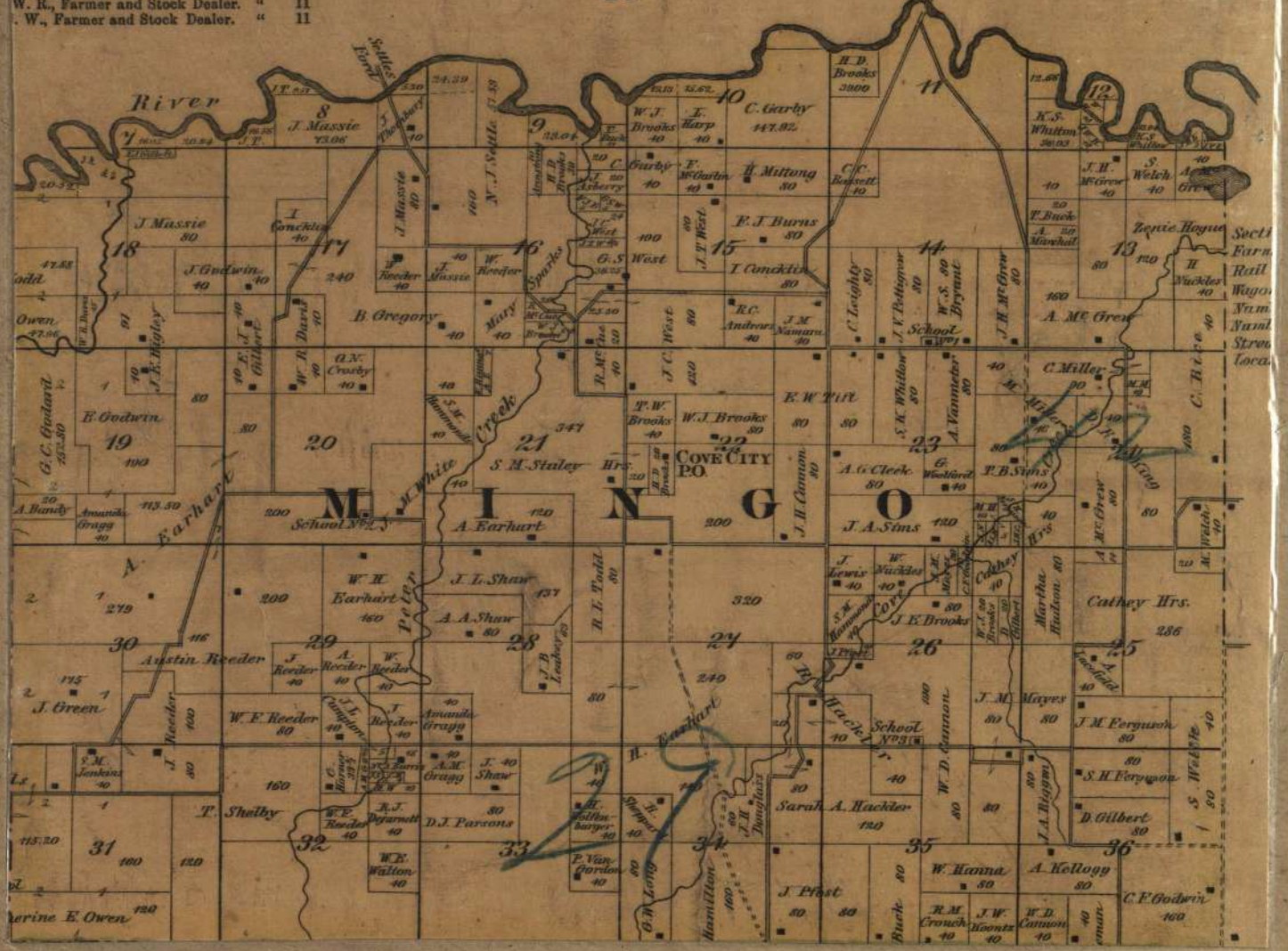

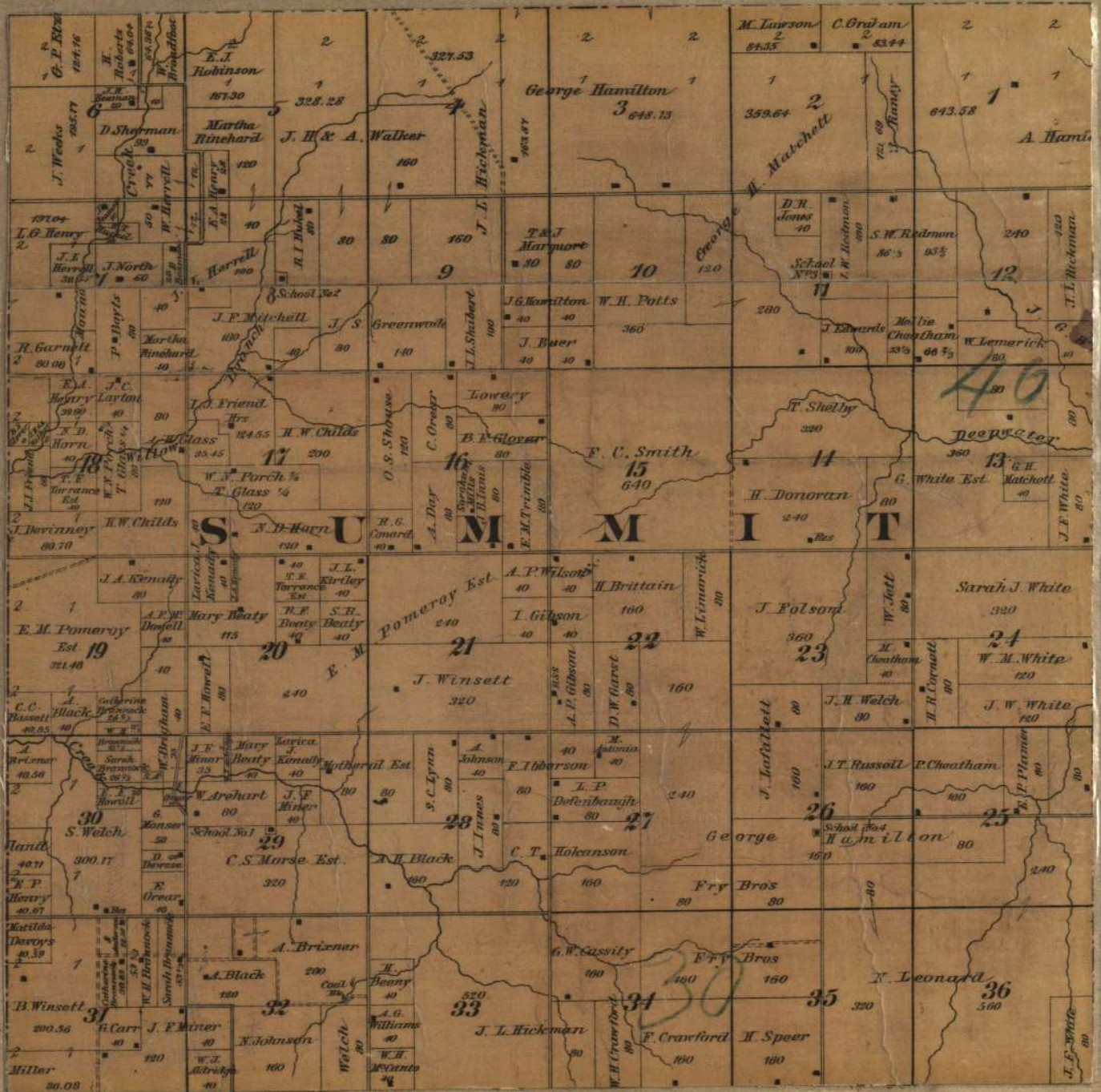

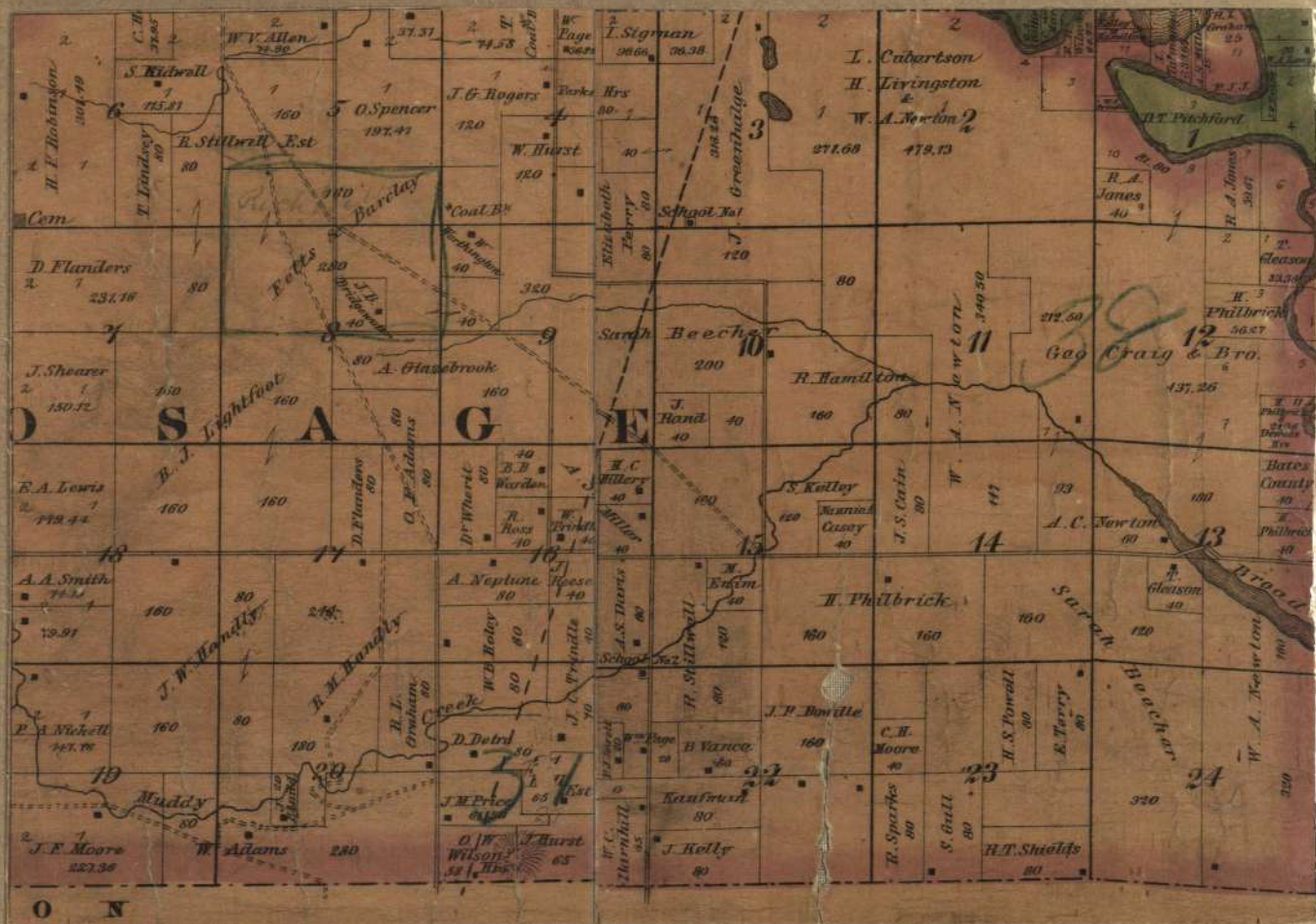

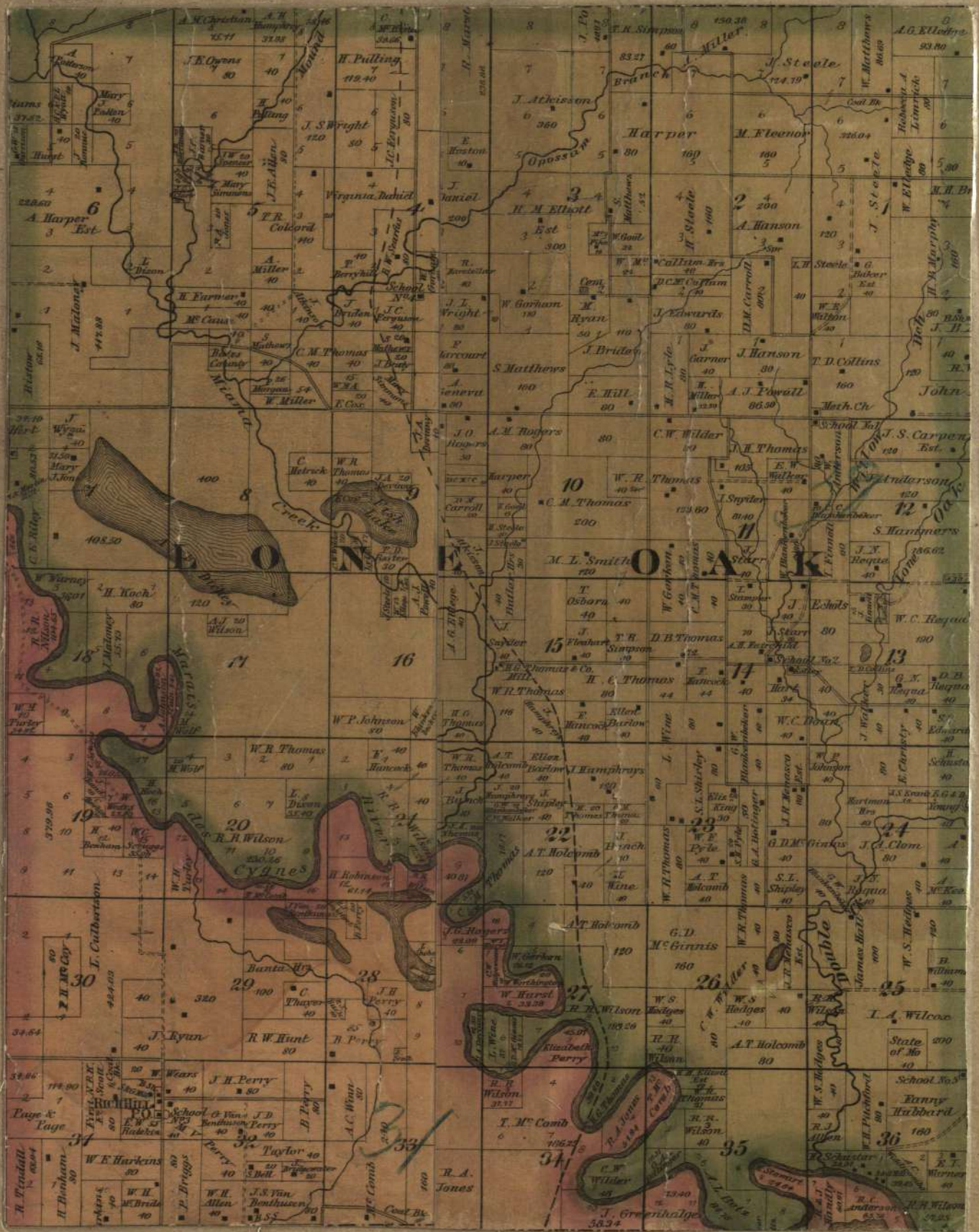

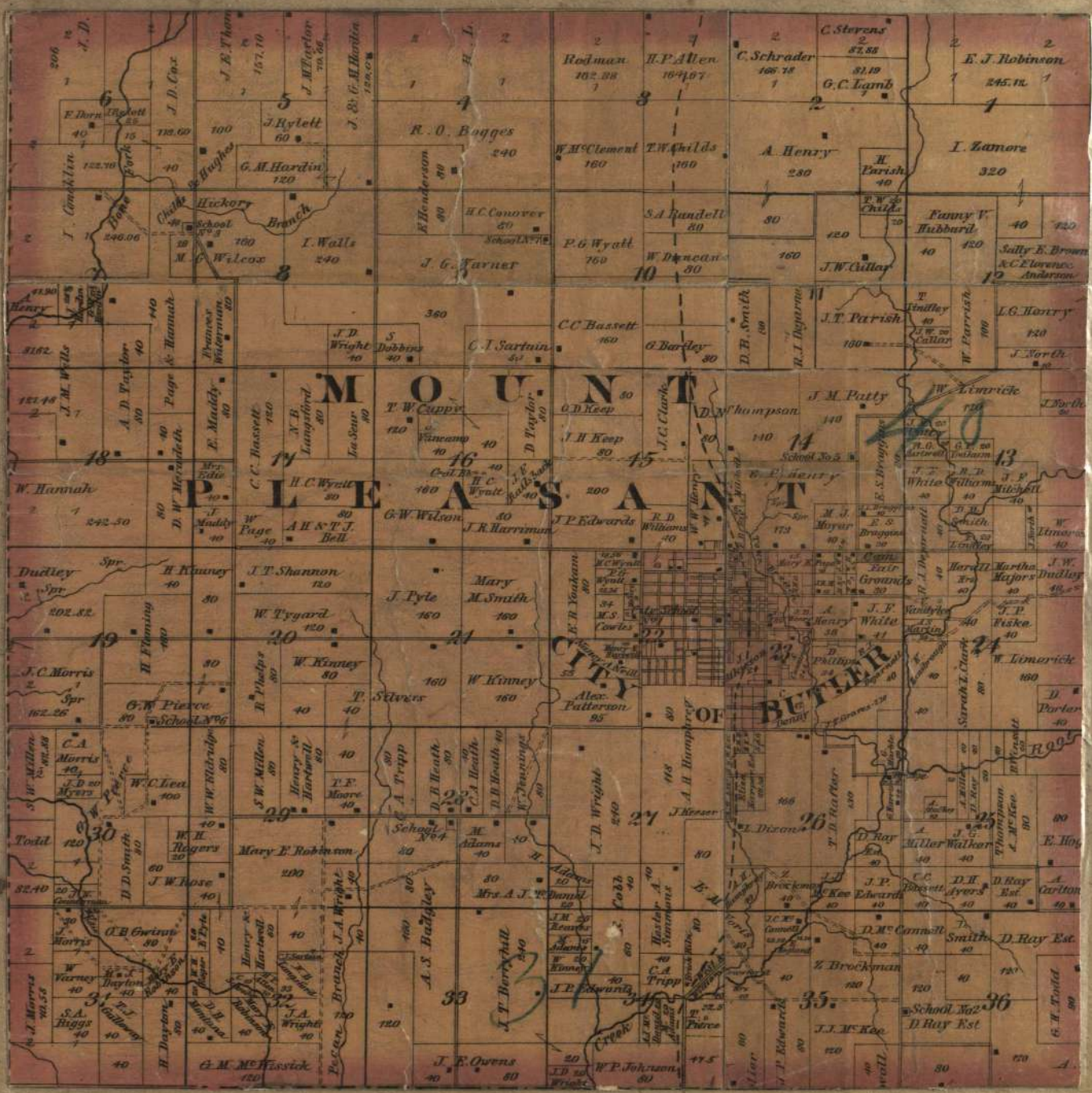

33-38

38

