

MAP OF HOLT COUNTY, MO.

Showing an Outline of the County and its Subdivisions its Congressional and Civil T.P.s with the Locations of its Towns and Villages, Post Offices, Churches, School Houses, Streams, Waggon Roads, Rail Roads, Proposed Rail Roads &c. &c.

PUBLISHED BY BRINK, MCDONOUGH & CO. 1877

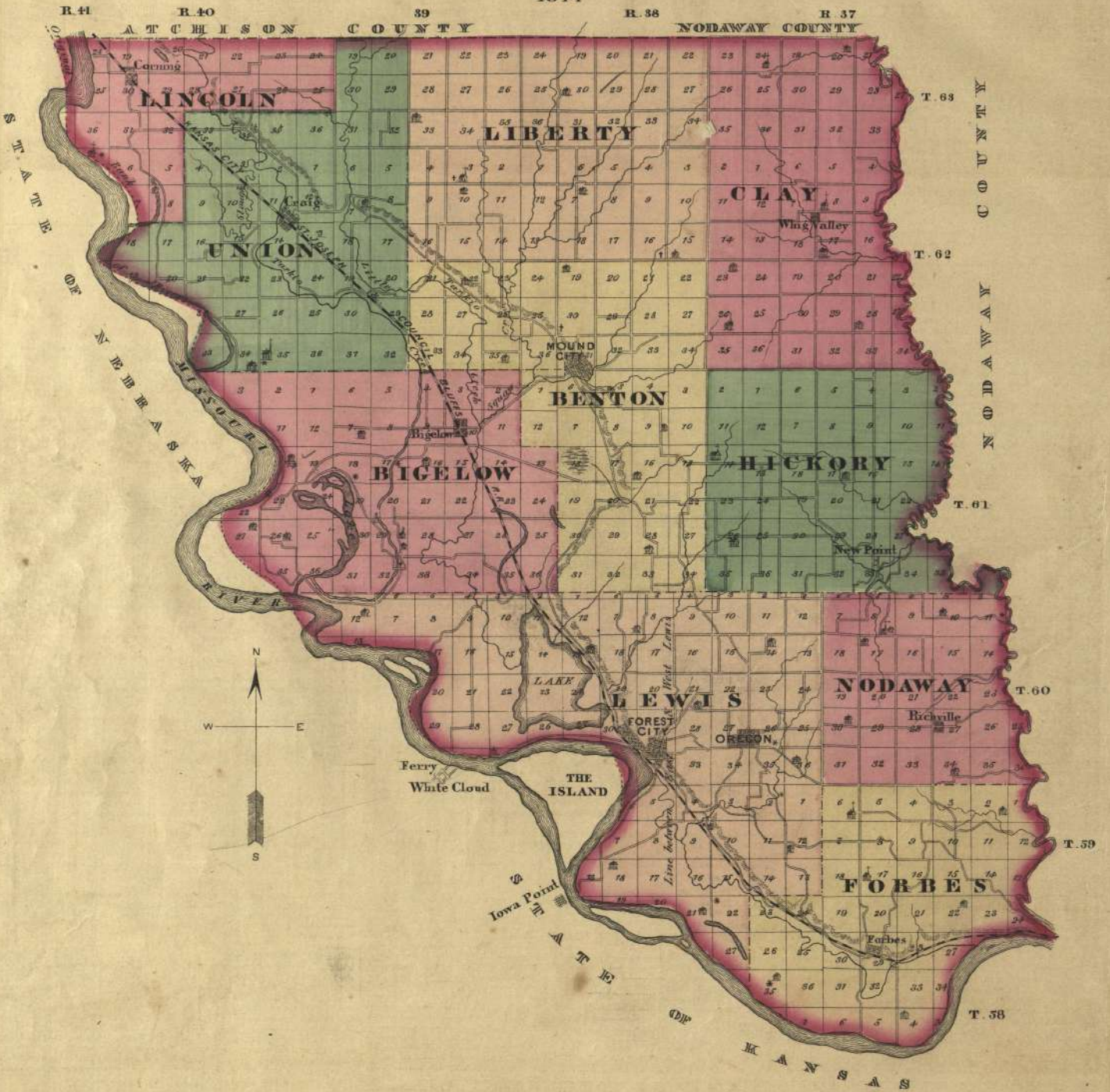

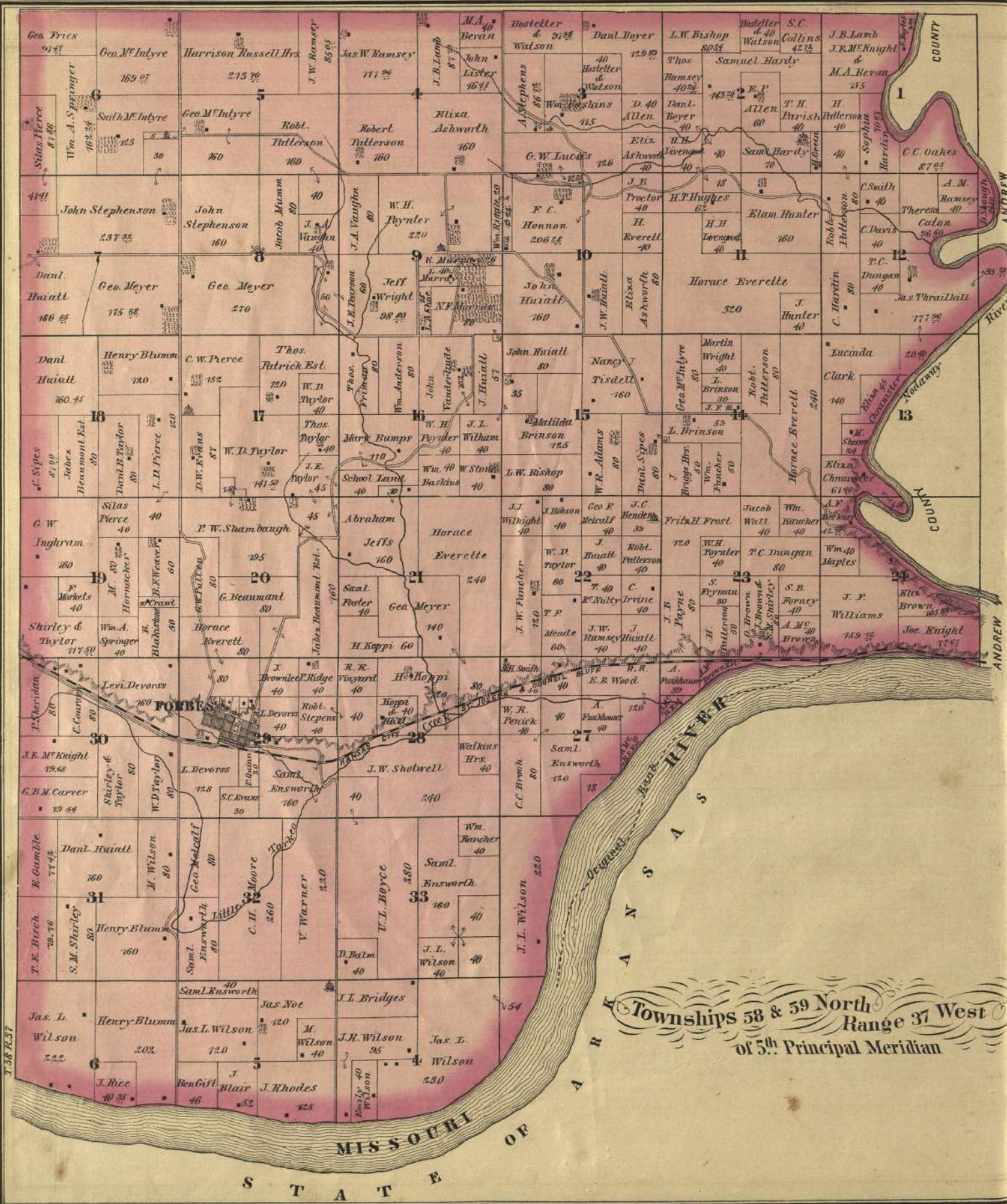

TOWNSHIPS 58 & 59 North
 Range 37 West
 of 5th Principal Meridian

T. 38 R. 37

MISSOURI STATE

Township 61 North Range 37 West of 5th Principal Meridian

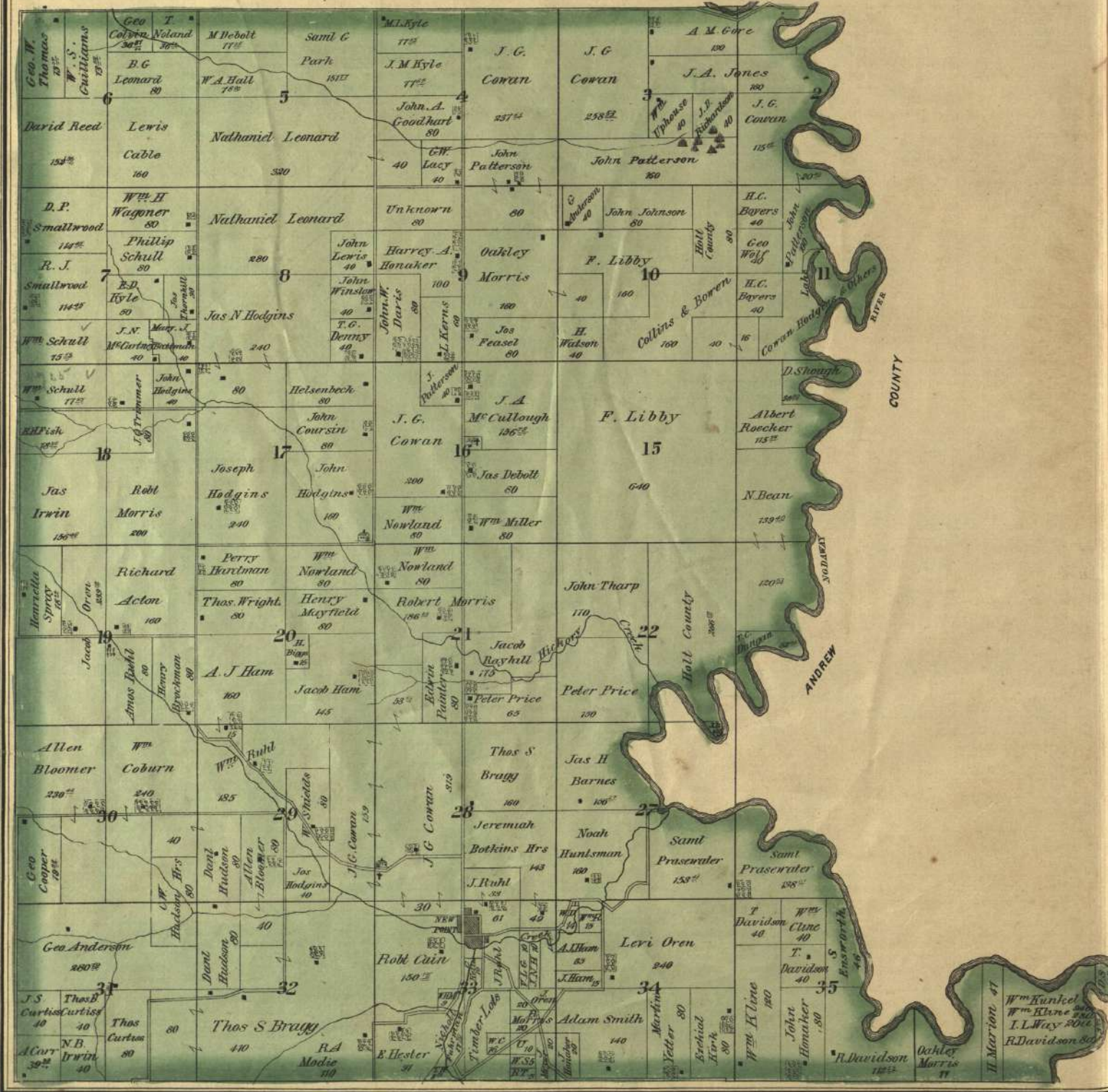

Township 63 North, Range 37 West
of 5th Principal Meridian.

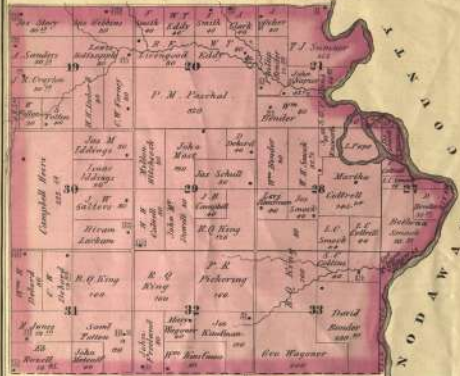

Township 63 North, Ranges 37 & 38 West
of 5th Principal Meridian.

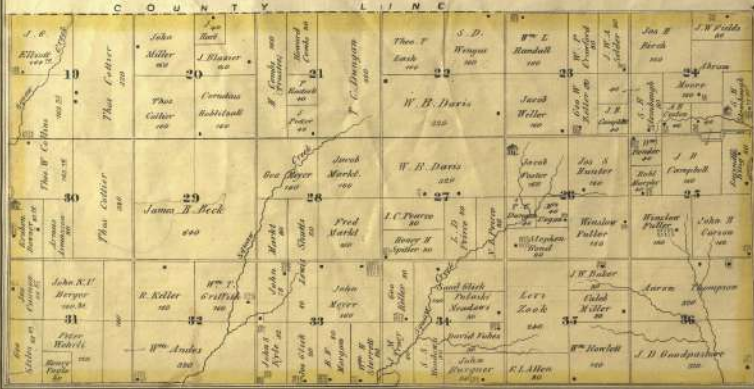

Townships 58 & 59 North, Ranges 36 & 39 West
of 5th Principal Meridian.

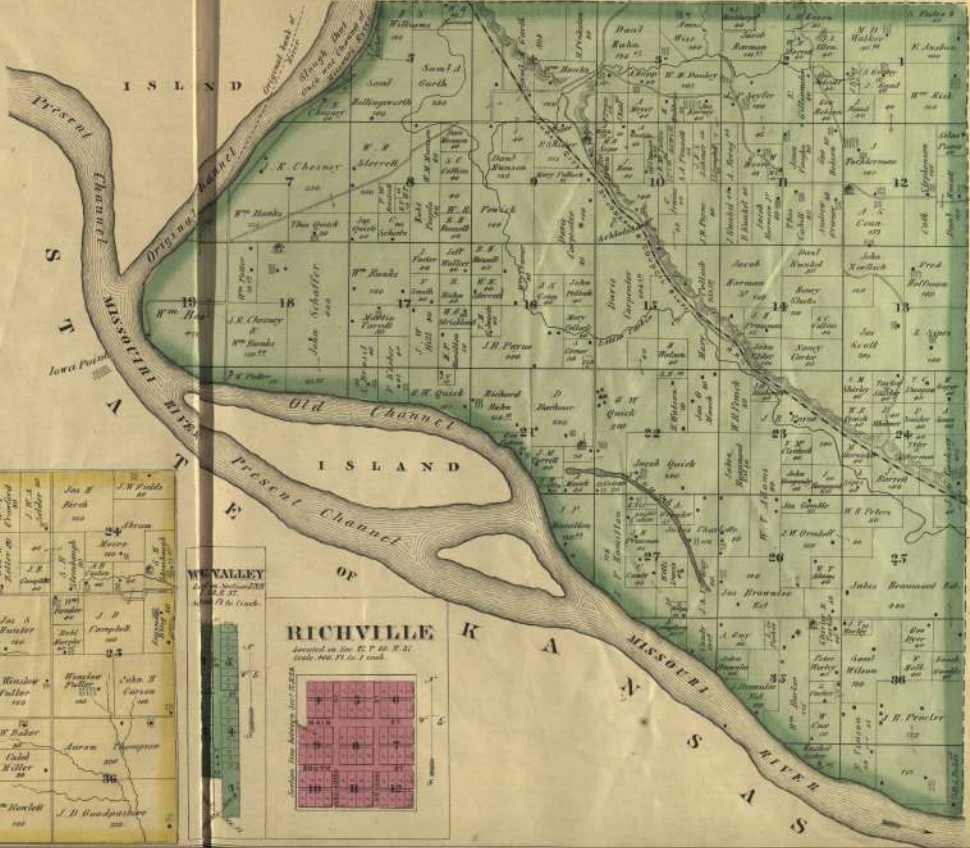

RICHVILLE
Surveyed on Dec. 27, 1852.
Scale 400 Feet to 1 inch.



Township 60 North
Range 38 West
of 5th Principal Meridian

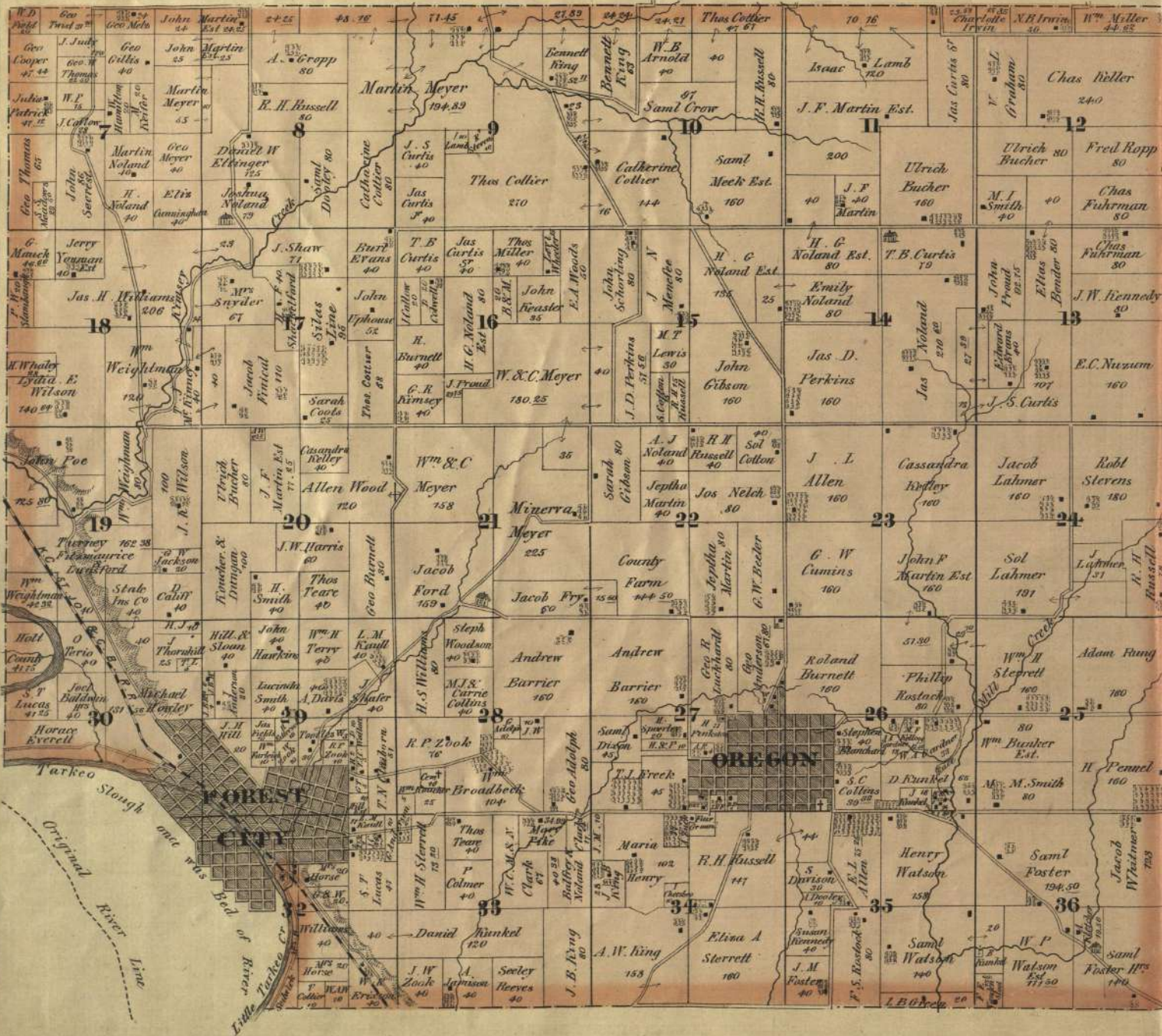

Township 61 North Range 38 West of 5th Principal Meridian

MOUND CITY

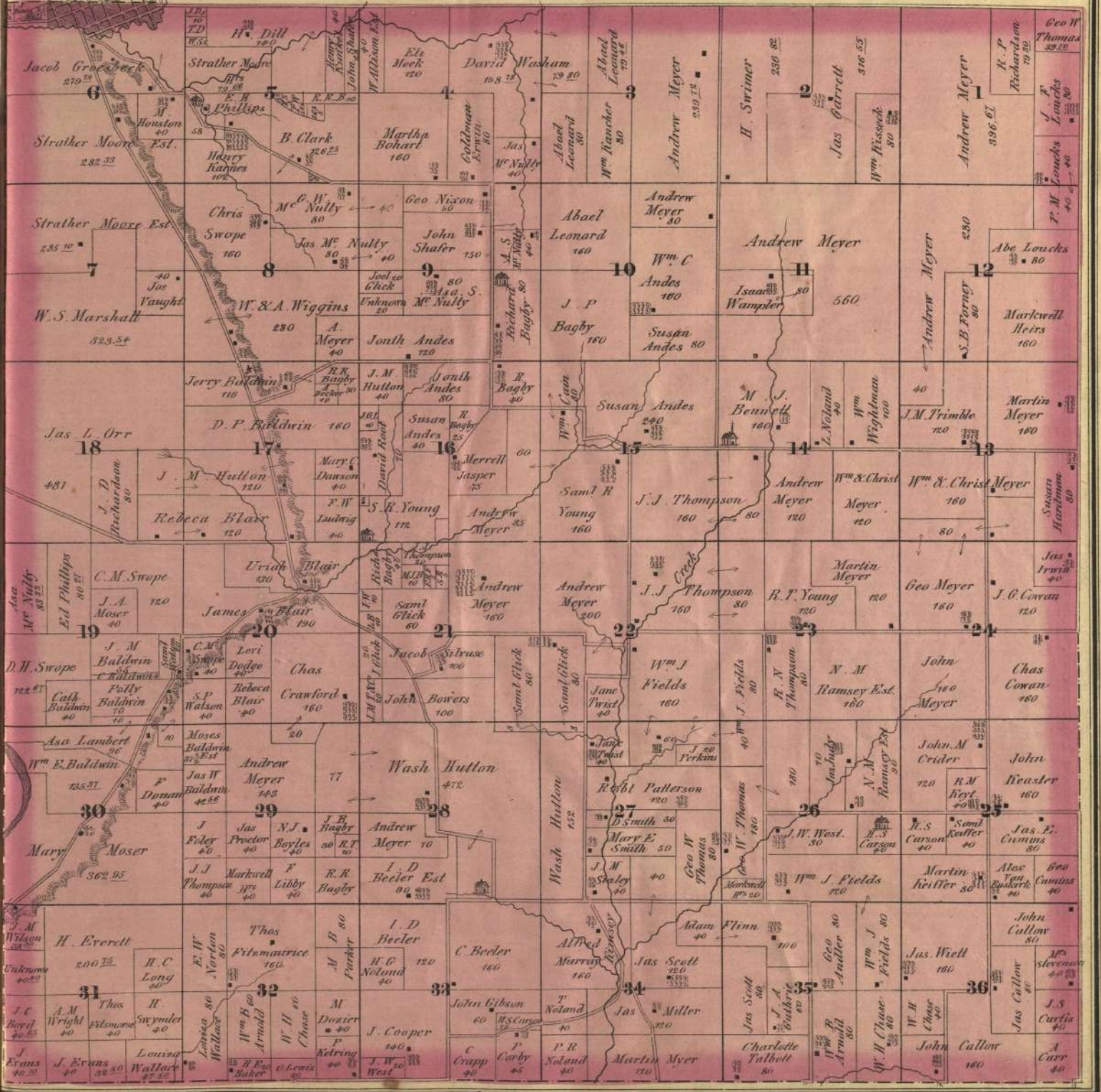

Township 62 North
Range 38 West
of 5th Principal Meridian

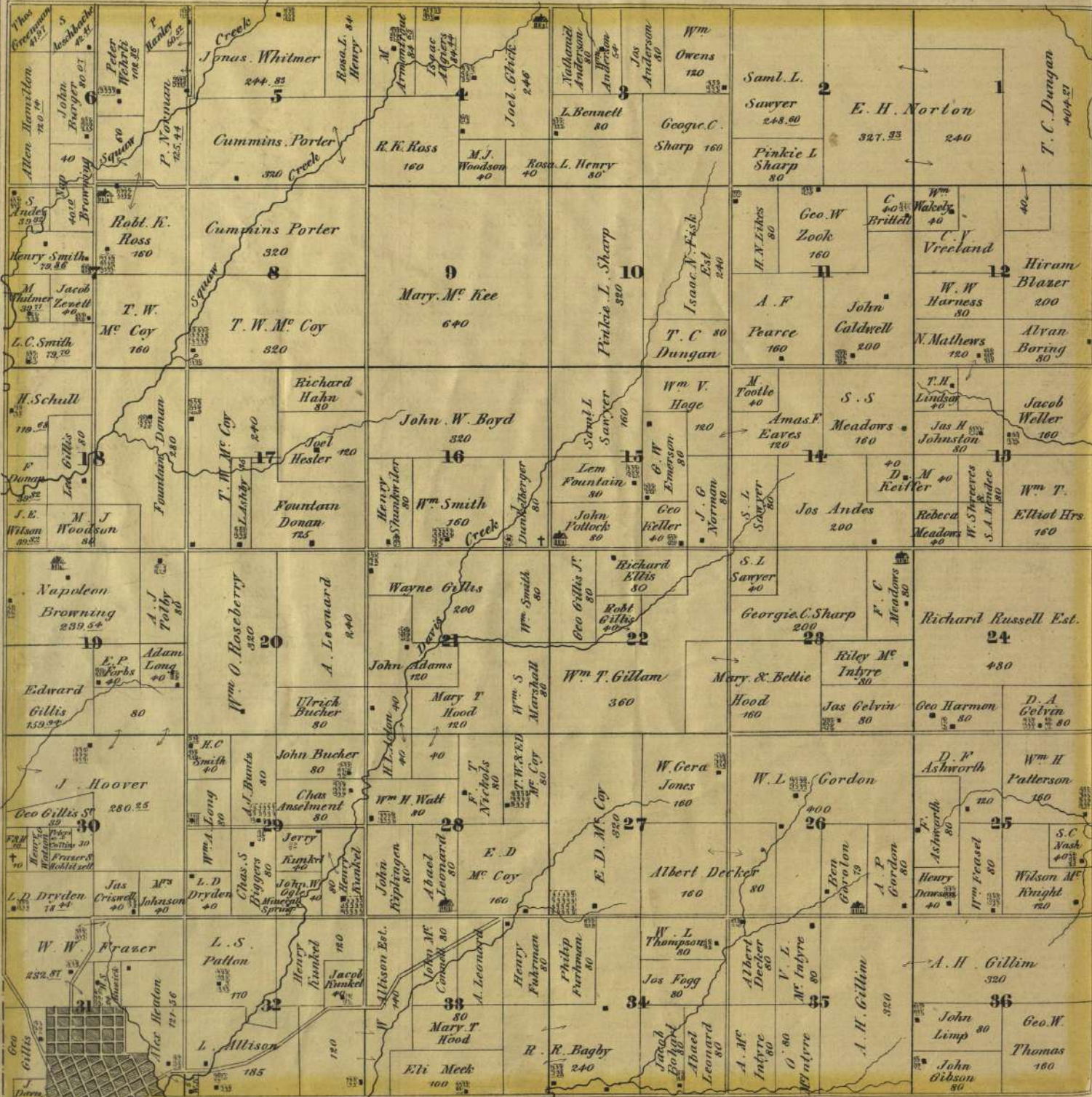

MOUND CITY

Township 60 North
Ranges 39 & 40 West
of 5th Principal Meridian

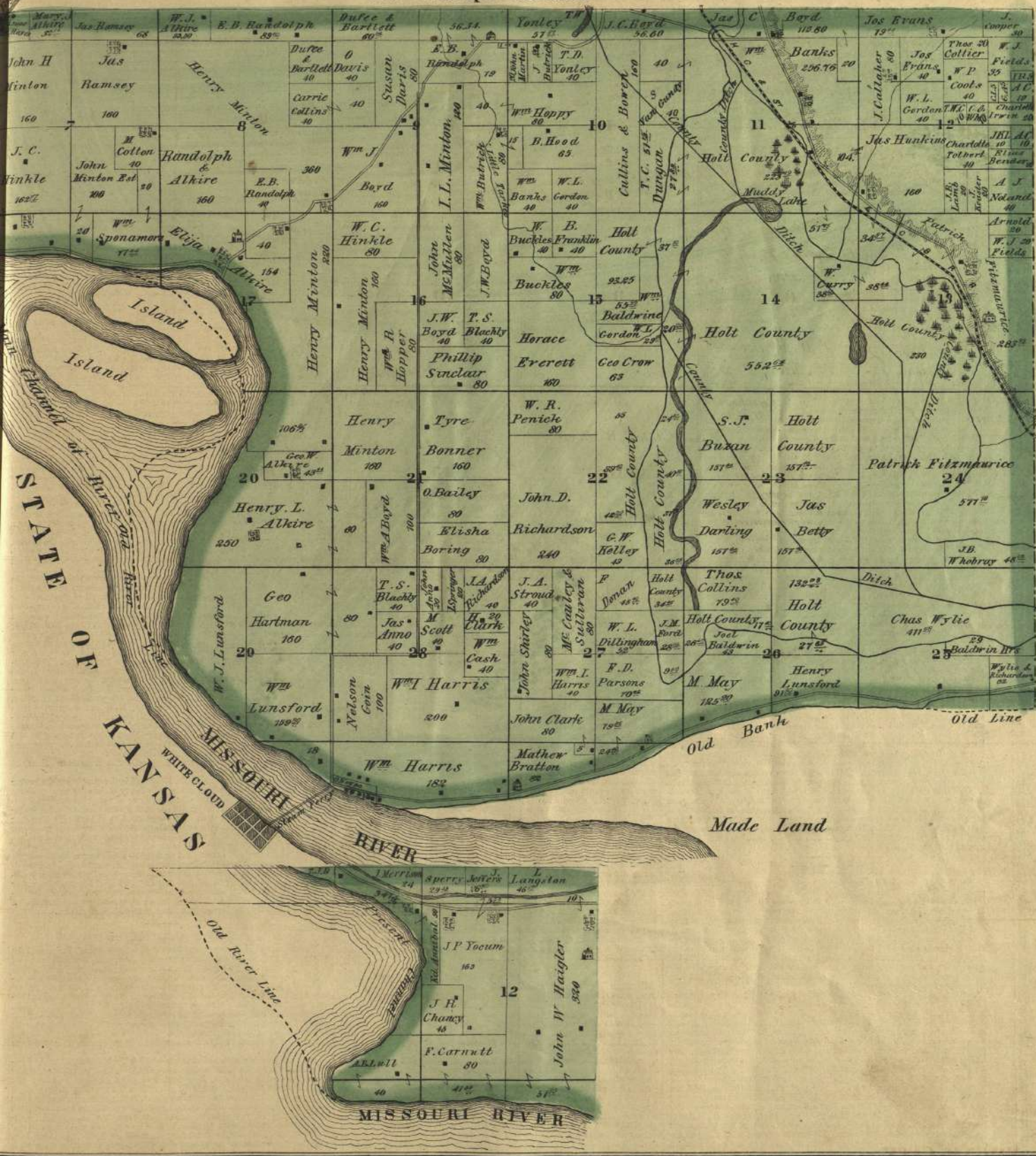

Township 61 North
Range 39 West
of 5th Principal Meridian

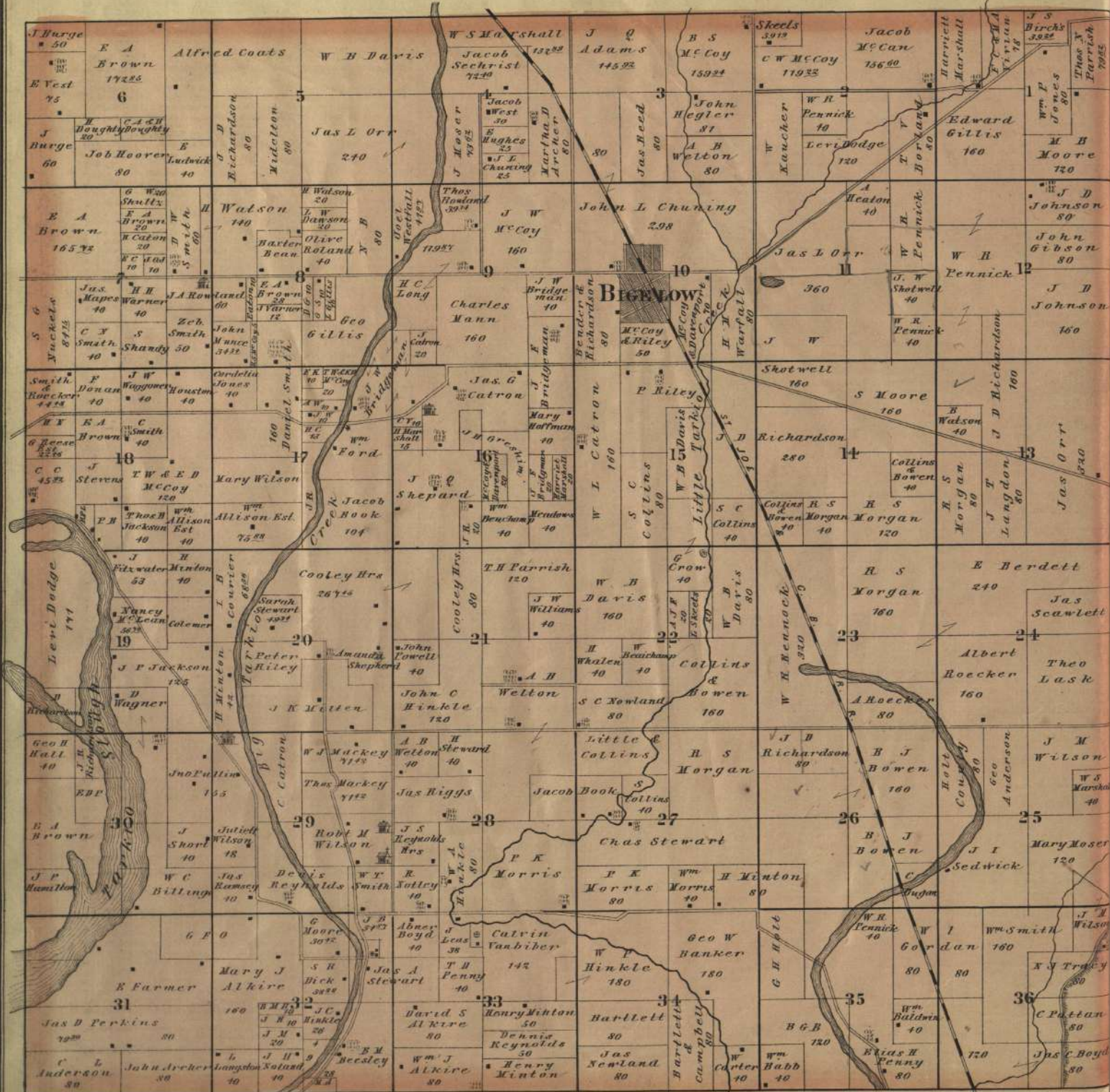

Township 62 North
Range 39 West
of 5th Principal Meridian

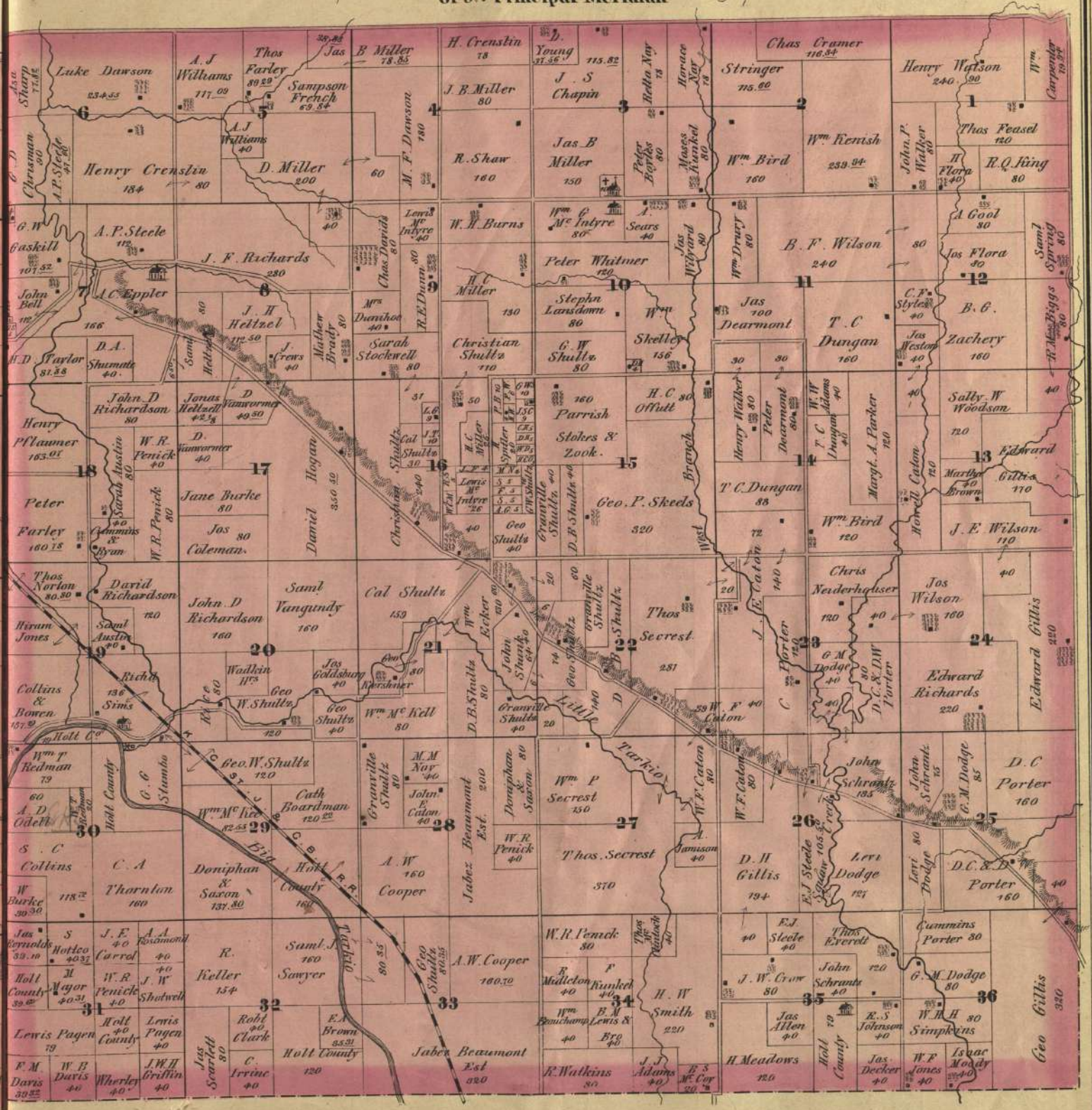

MAP OF OREGON

Layed out in 1841
 Located in Sections 36, 37, 38, 39
 Scale 400 Feet to 1 Inch

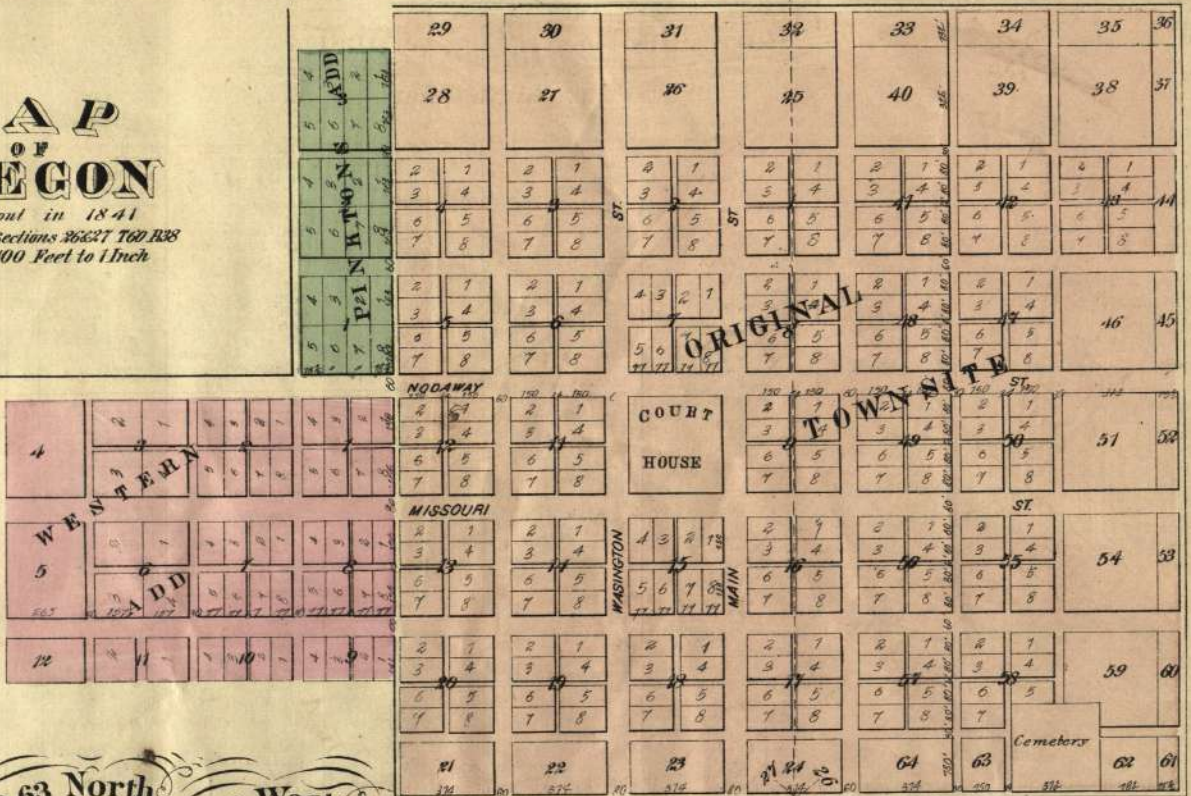

Township 63 North
Range 39 West
 of 5th Principal Meridian

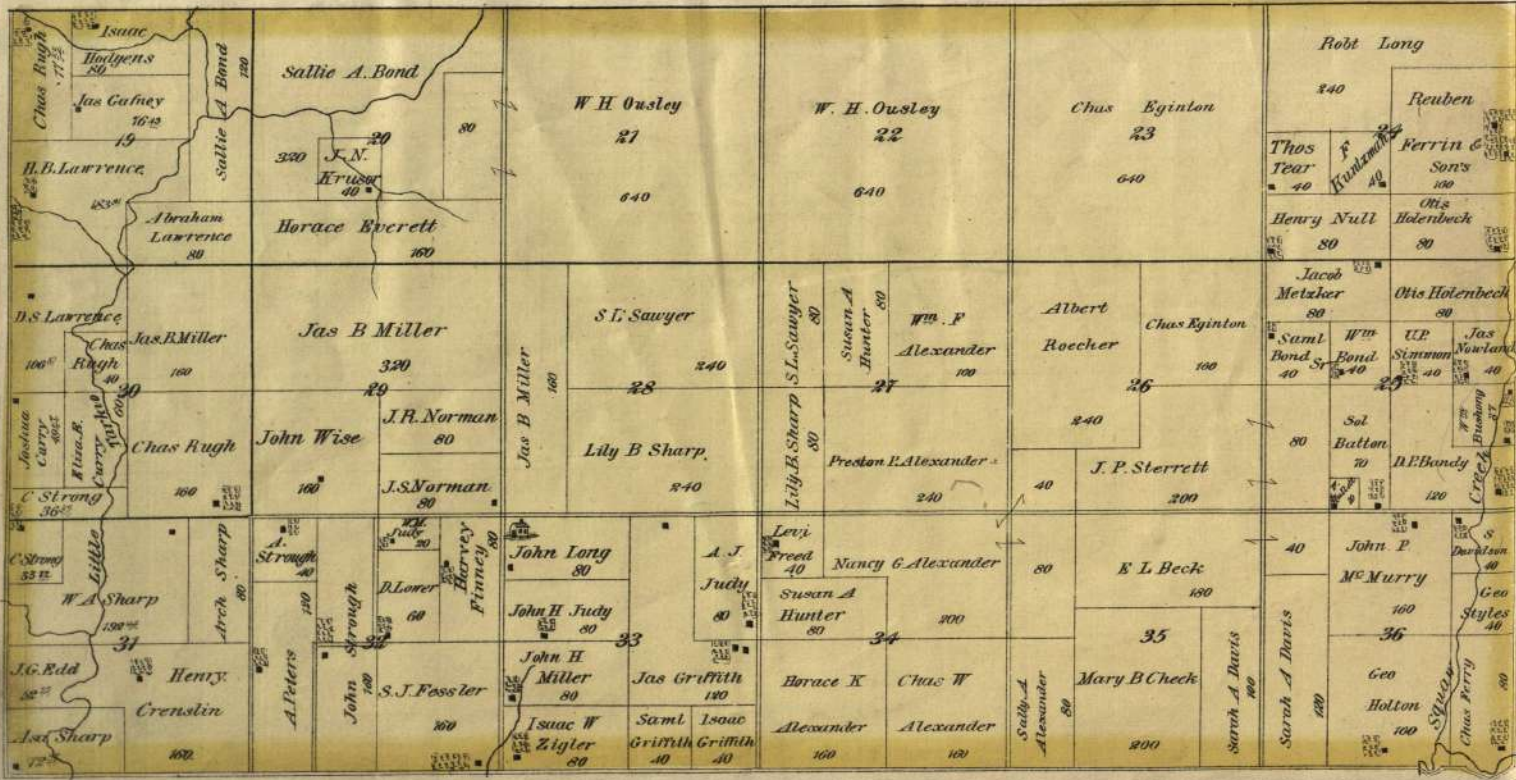

Township 61 North
Range 40 West
of 5th Principal Meridian

CRAIG

Located in Sections 11, 12 & 14
T. 52 N. R. 40 W. of 5th P.M.
Scale 400 Ft. to 1 inch.

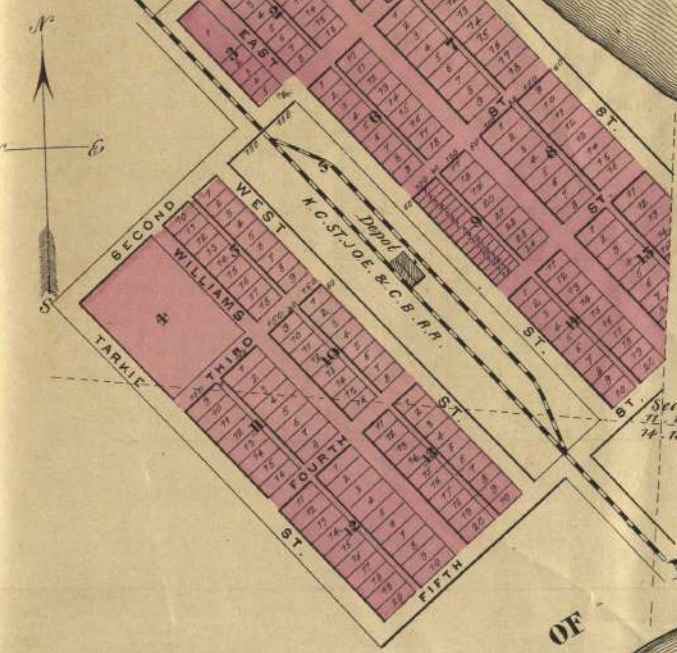

FORBES

Located in Section 29
T. 59 N. R. 37 W. 5th P.M.
Scale 400 Feet to 1 inch.

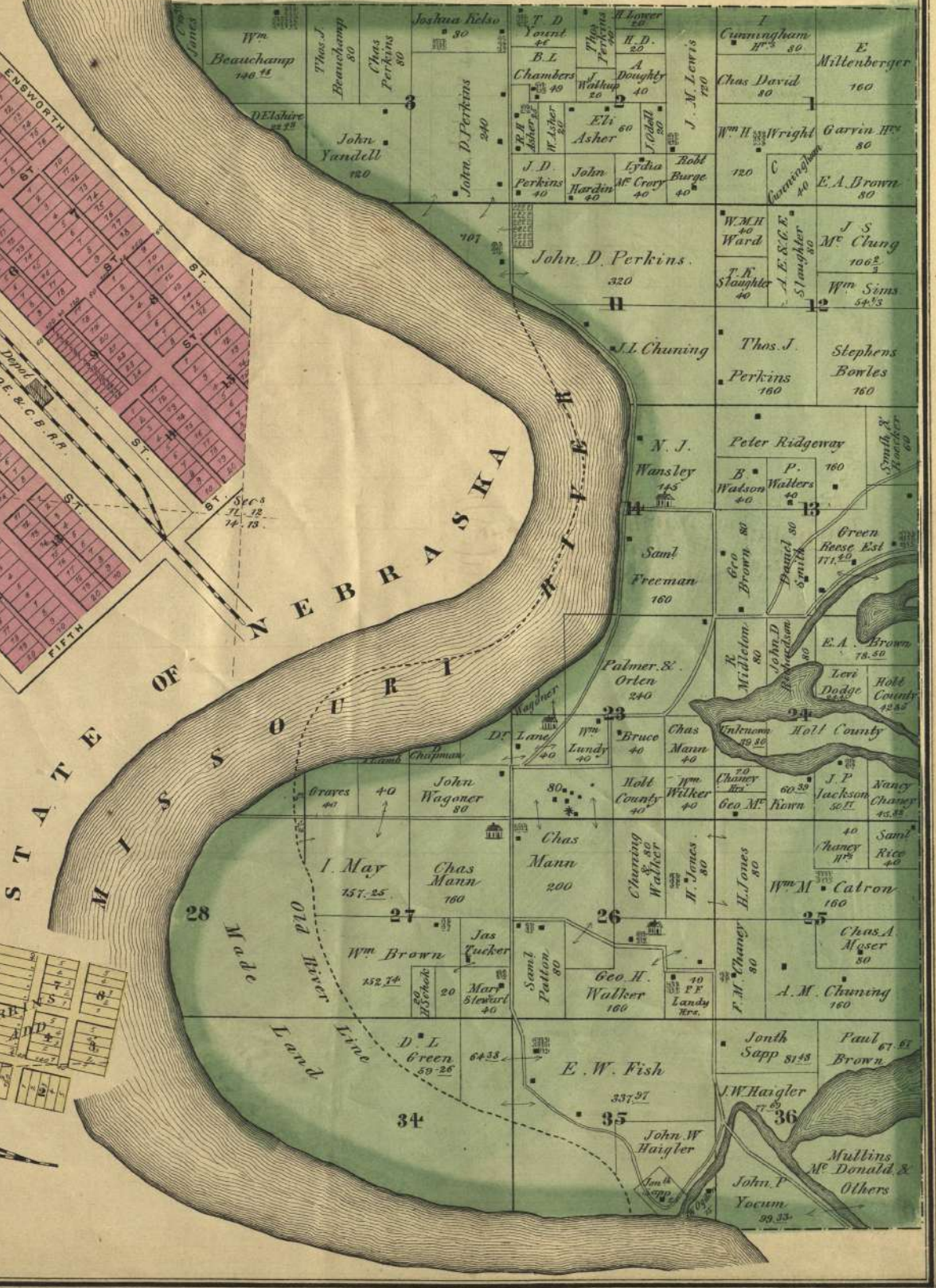
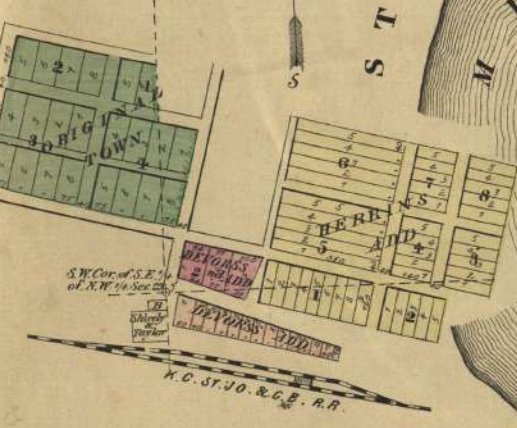

Township 62 North Range 40 West of 5th Principal Meridian

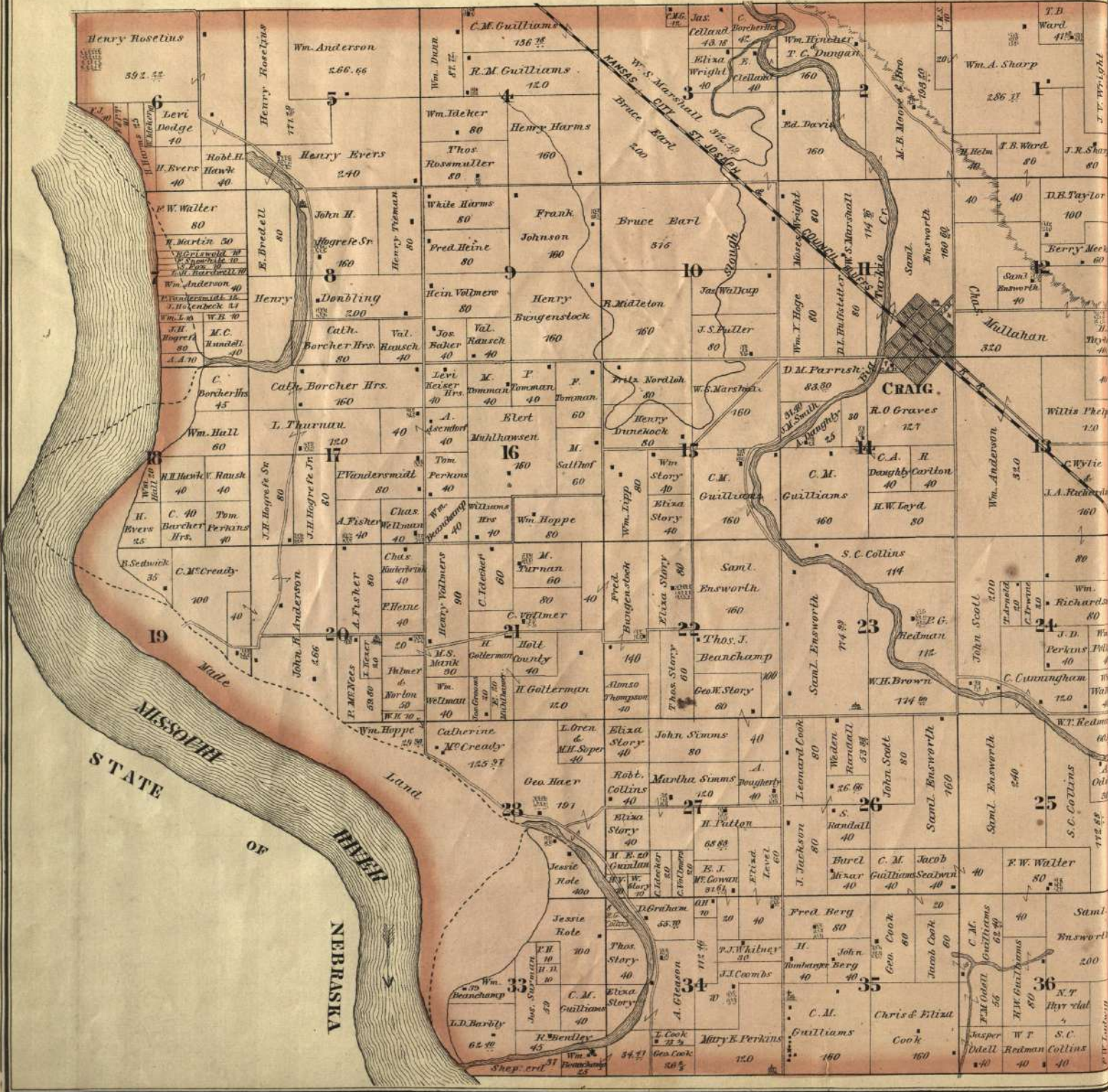

Townships 62 & 63 North
Ranges 40 & 41 West
of 5th Principal Meridian

