

MAP OF PLATTE COUNTY, MISSOURI.

Scale 1/2 inch to the mile.



TOWNSHIP 51 & 52 NORTH RANGE 33 WEST.

OF THE 5TH PRINCIPAL MERIDIAN.

Scale 2 Inches to the Mile.

Town 51 North Range 33 West

Town 52 North Range 33 West

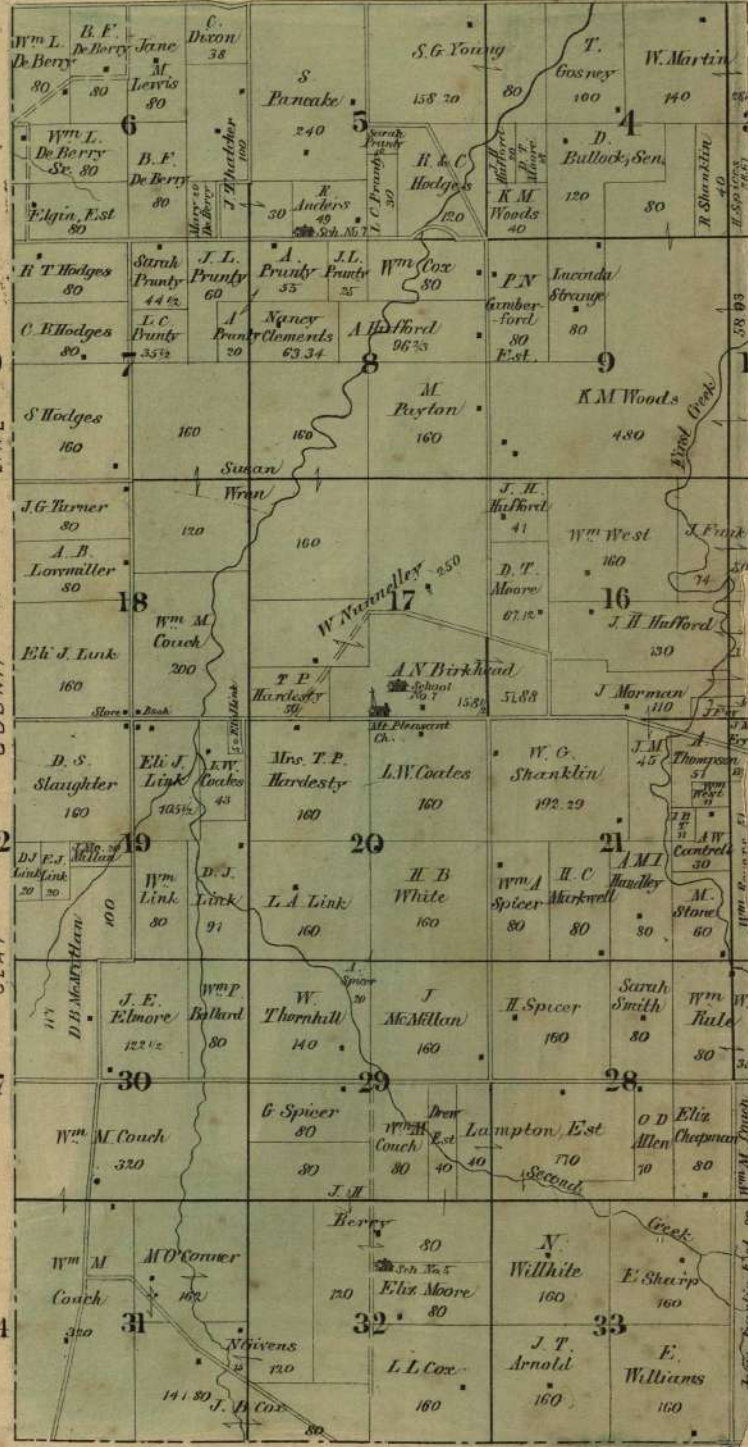
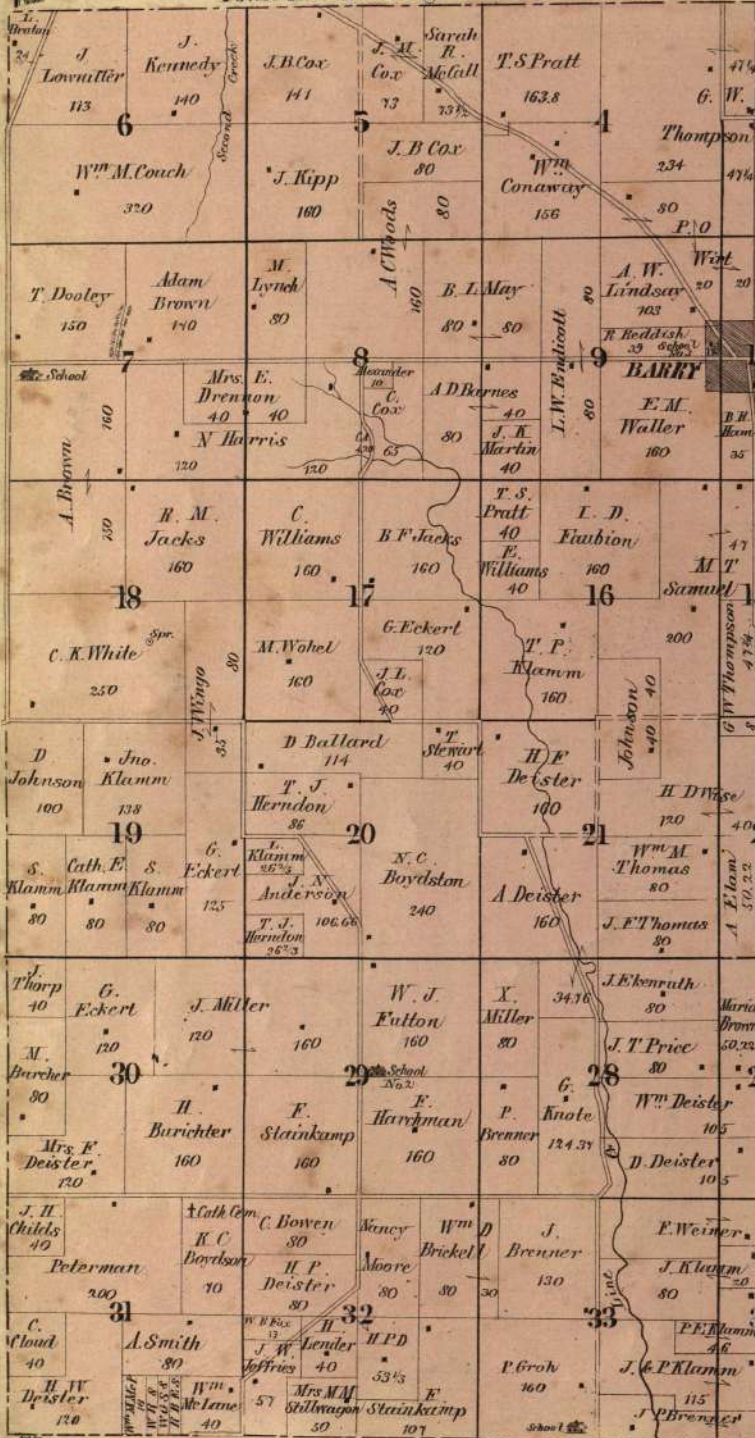

TOWNSHIP 54 & 55 NORTH RANGE 34 WEST.

OF THE 5TH PRINCIPAL MERIDIAN.

Scale 2 Inches to the Mile.

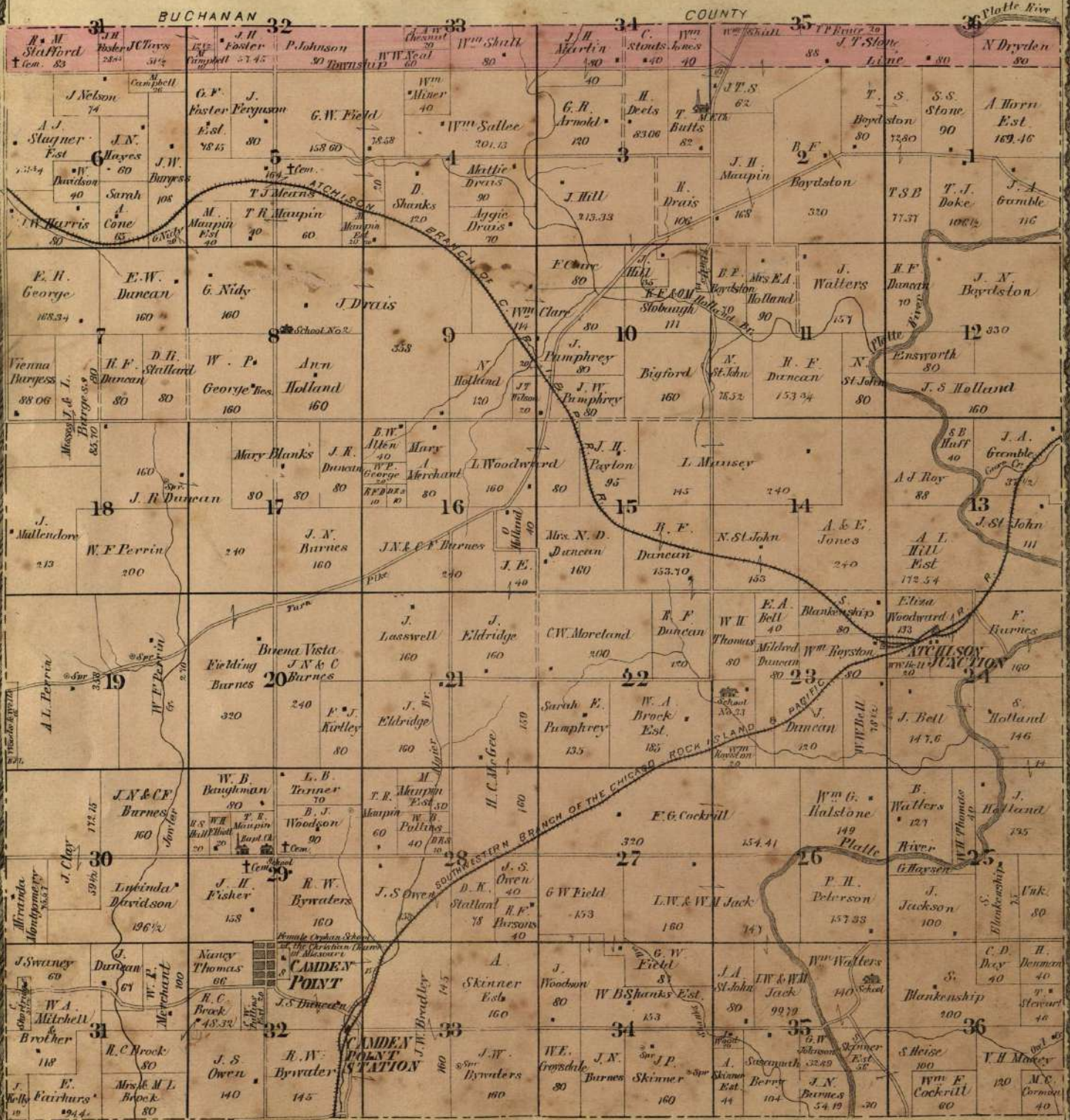

TOWNSHIP 53 NORTH RANGE 34 WEST.

OF THE 5TH PRINCIPAL MERIDIAN.

Scale 2 Inches to the Mile.

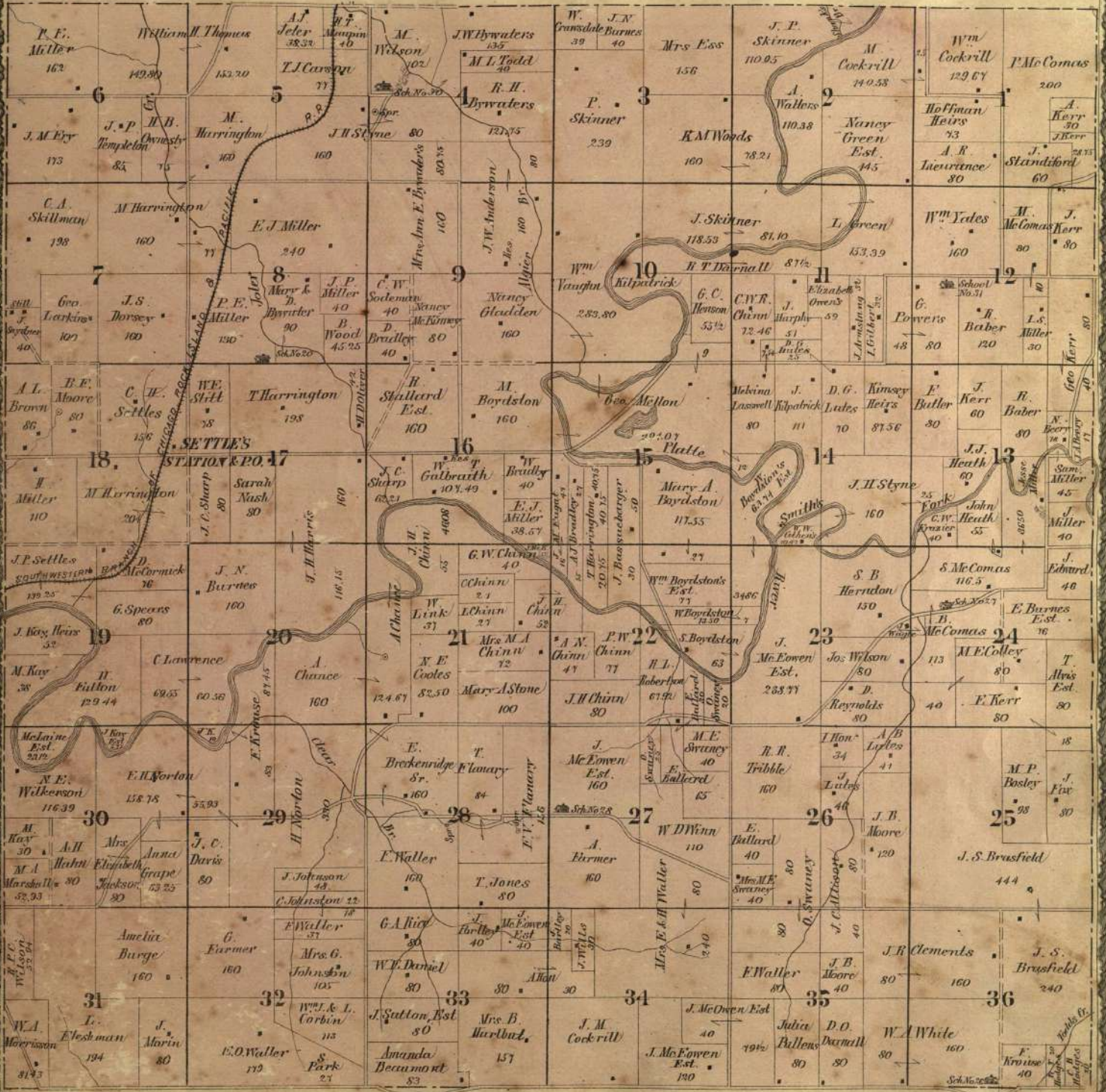

Platte City.

Scale 300ft = 1 inch

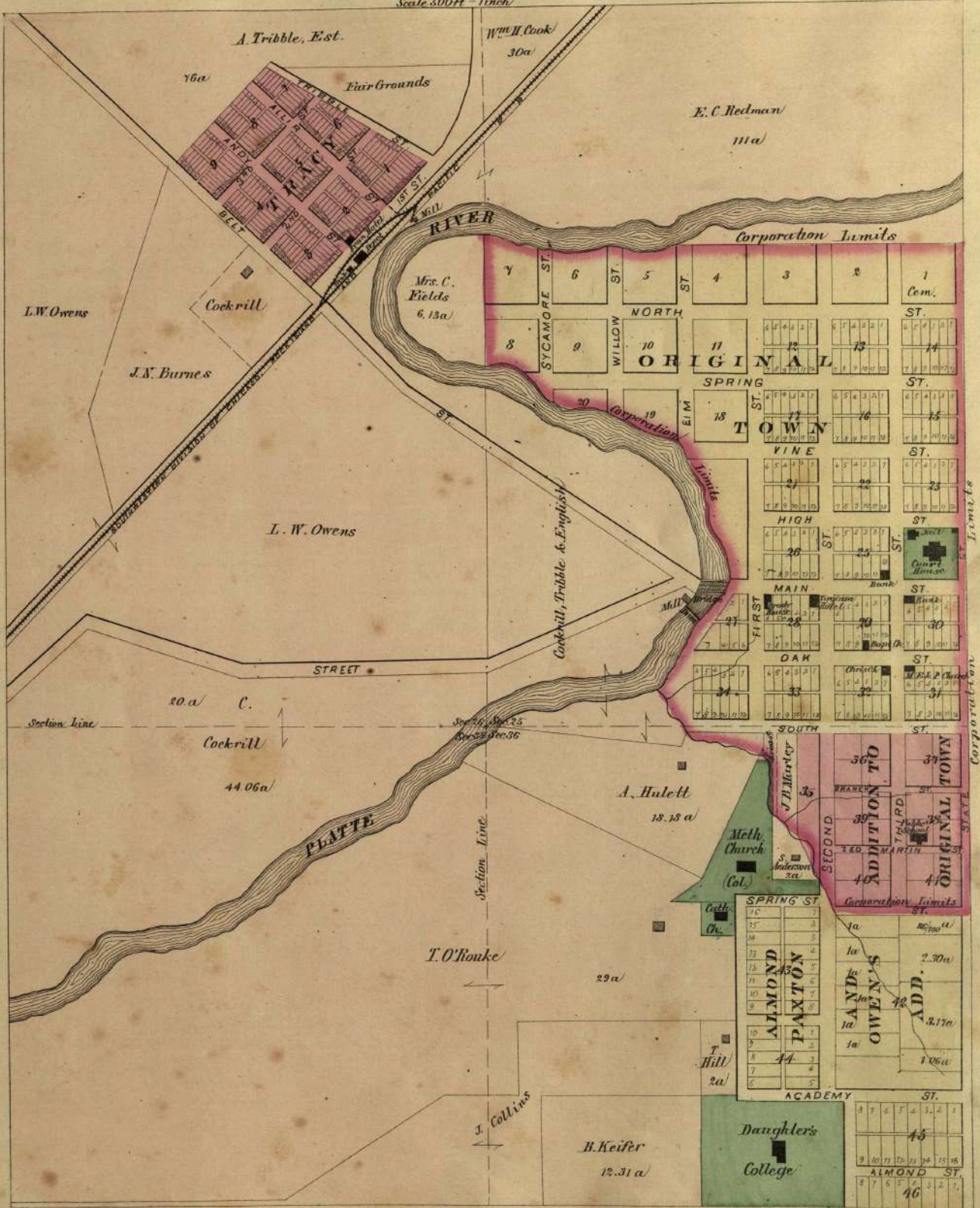

TOWNSHIP 50 NORTH RANGE 33 & 34 WEST.

OF THE 5TH PRINCIPAL MERIDIAN.

Scale 2 Inches to the Mile.



IATAN

Scale 500 Ft. - 1 in.



EDGERTON

Scale 500 Ft. - 1 in.

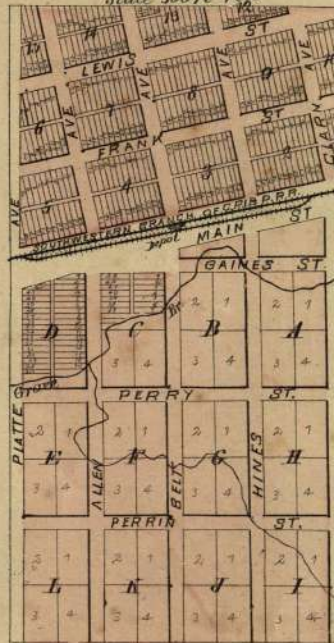

PARKVILLE

Scale 500 Ft. - 1 in.

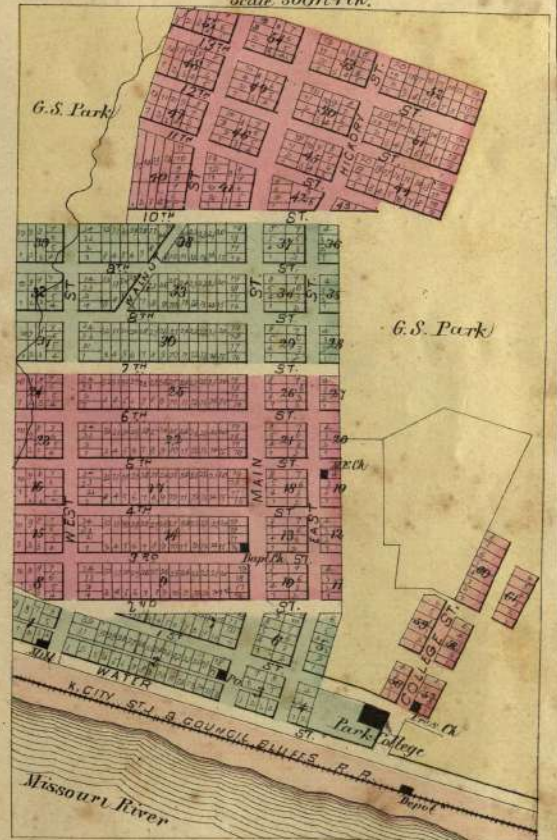

EAST LEVENWORTH City Point P.O.

Scale 500 Ft. - 1 in.

TOWNSHIP 51 NORTH RANGE 35 WEST.

OF THE 5TH PRINCIPAL MERIDIAN.

Scale 2 Inches to the Mile.

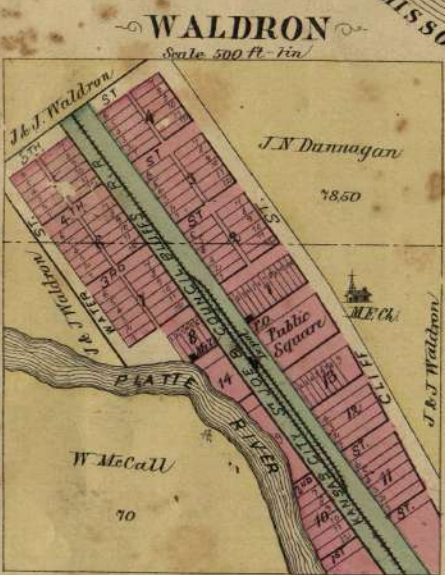
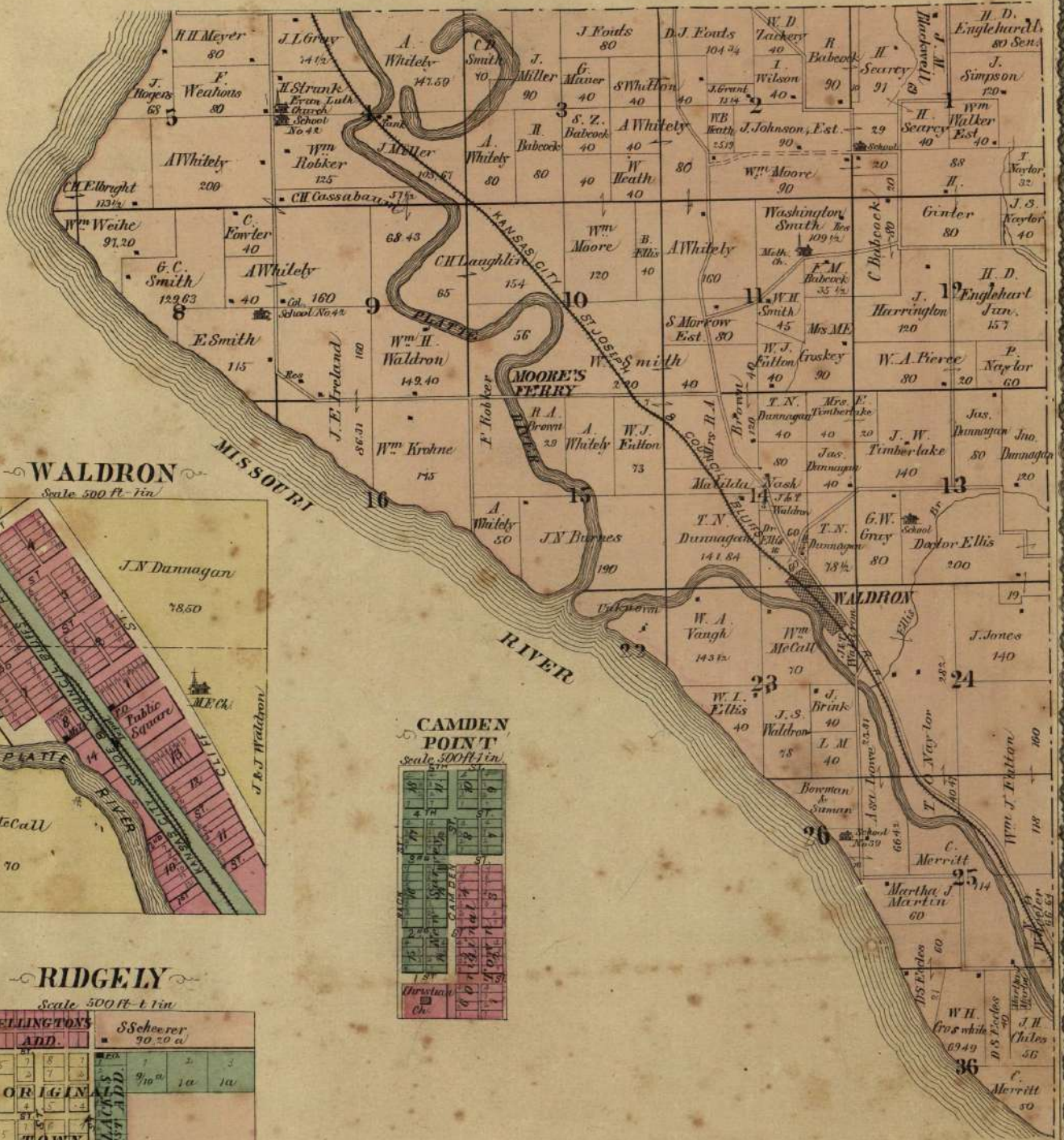

RIDGELY

Scale 500 ft. = 1 in.



TOWNSHIP 52 NORTH RANGE 35 WEST.

OF THE 5TH PRINCIPAL MERIDIAN.

Scale 2 Inches to the Mile.

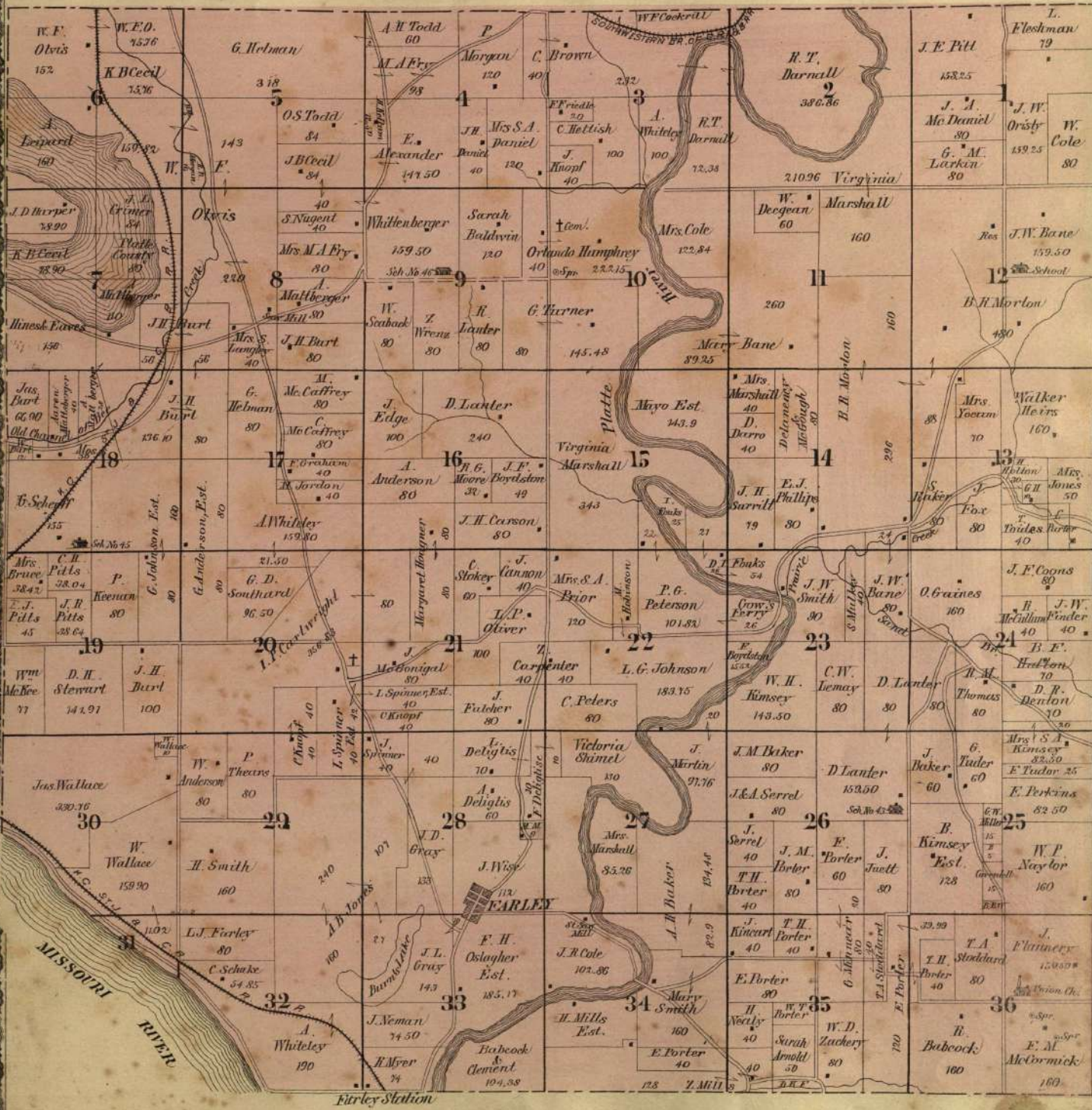

TOWNSHIP 53 NORTH RANGE 35 WEST.

OF THE 5TH PRINCIPAL MERIDIAN.

Scale 2 Inches to the Mile.

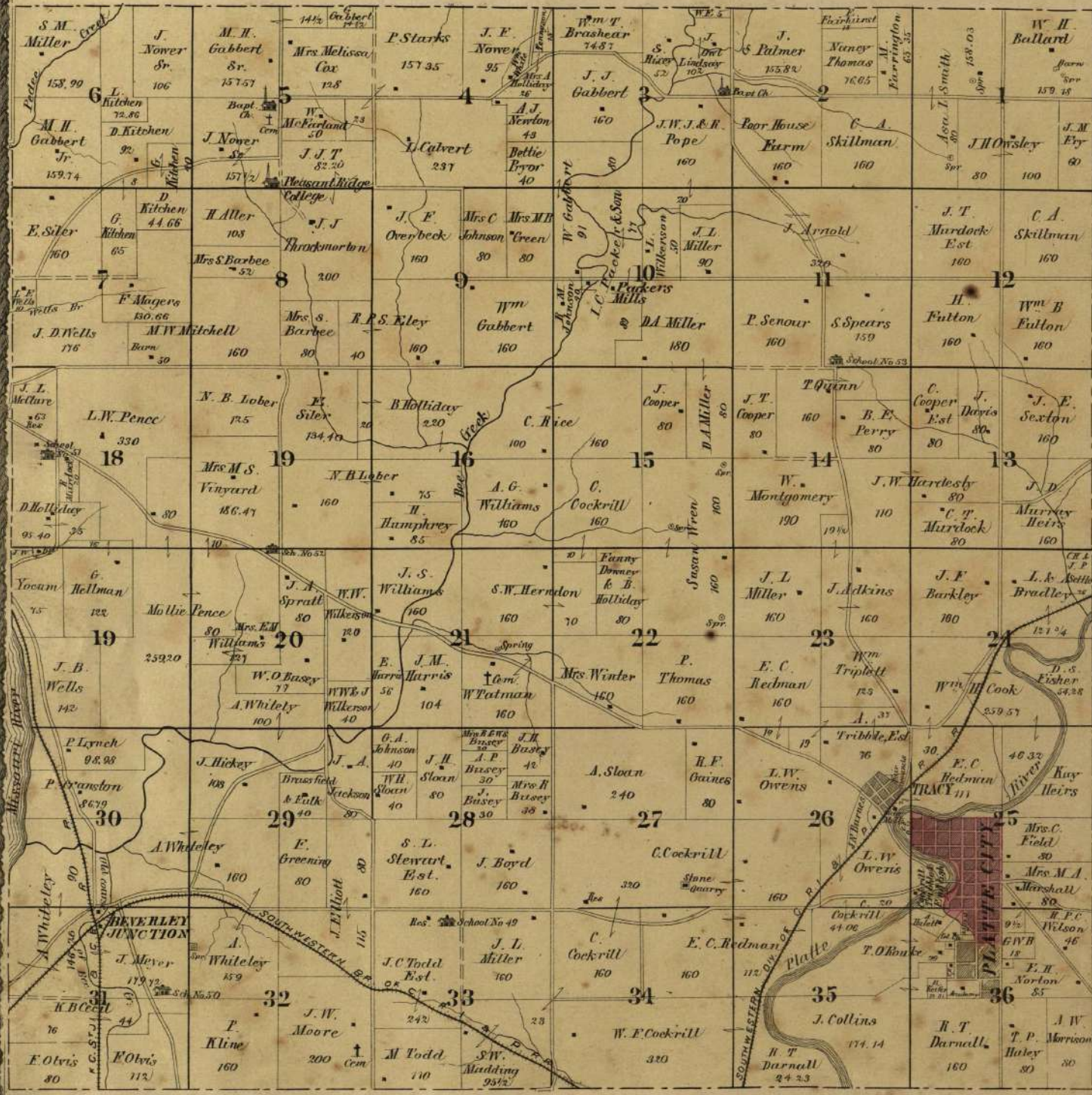

TOWNSHIP 54 & 55 NORTH RANGE 35 WEST.

OF THE 5TH PRINCIPAL MERIDIAN.

Scale 2 Inches to the Mile.

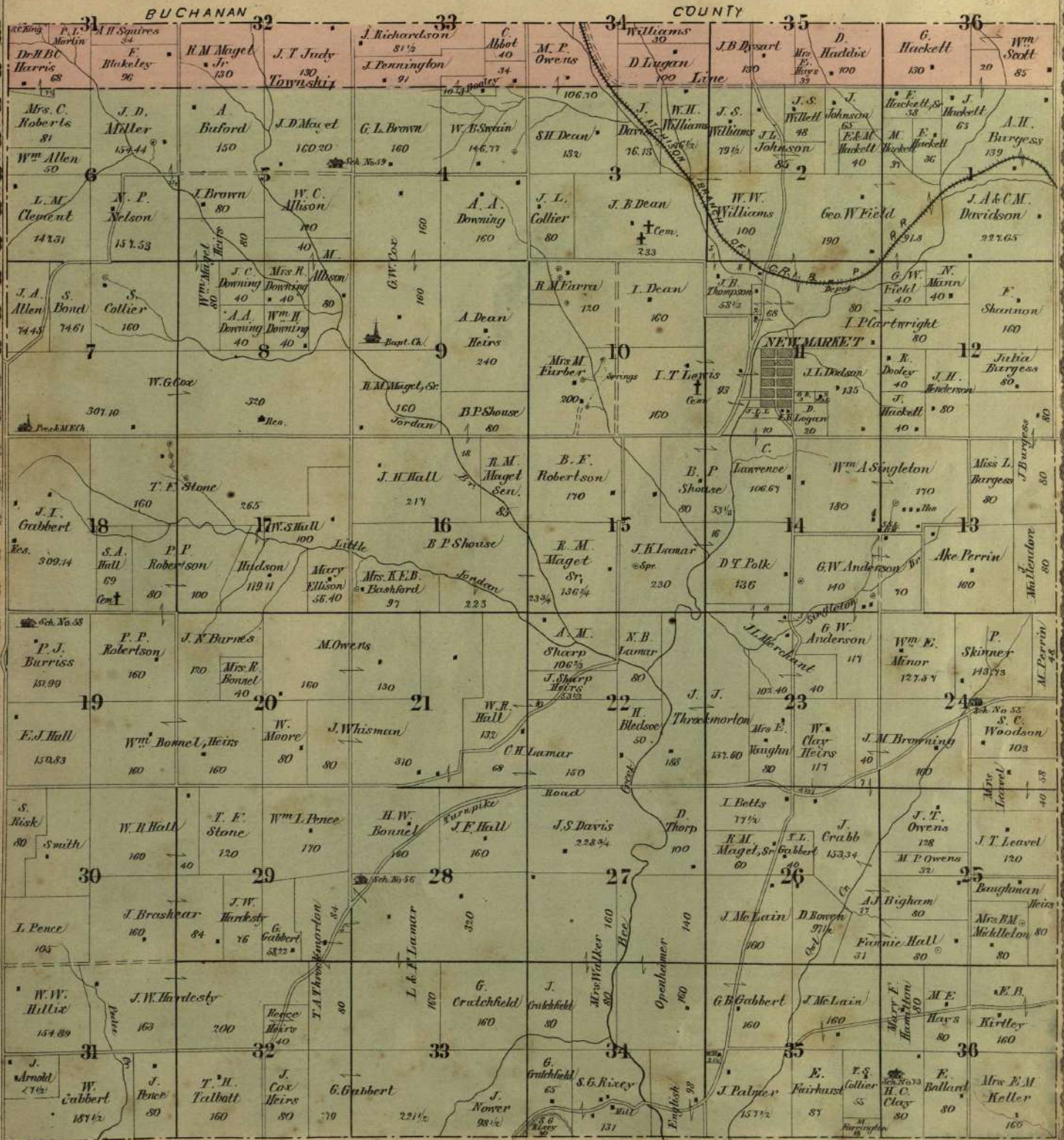



WESTON

Scale 500 ft - 1 in

TOWNSHIP 54 & 55 NORTH RANGE 36 WEST.

OF THE 5TH PRINCIPAL MERIDIAN.

Scale 2 Inches to the Mile.

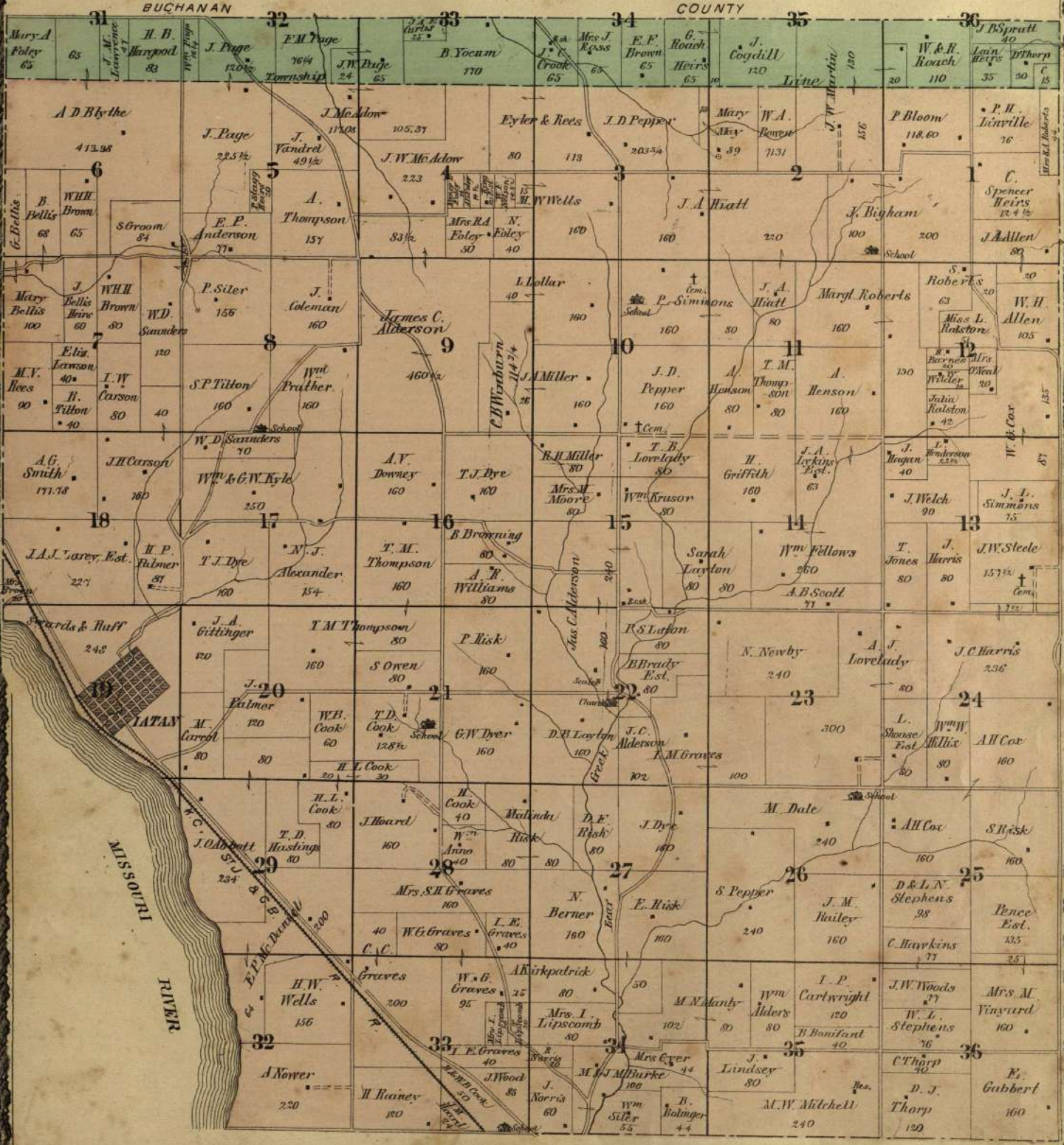

TOWNSHIPS 52 & 53 NORTH RANGE 36 WEST.

OF THE 5TH PRINCIPAL MERIDIAN.

Scale 2 Inches to the Mile.

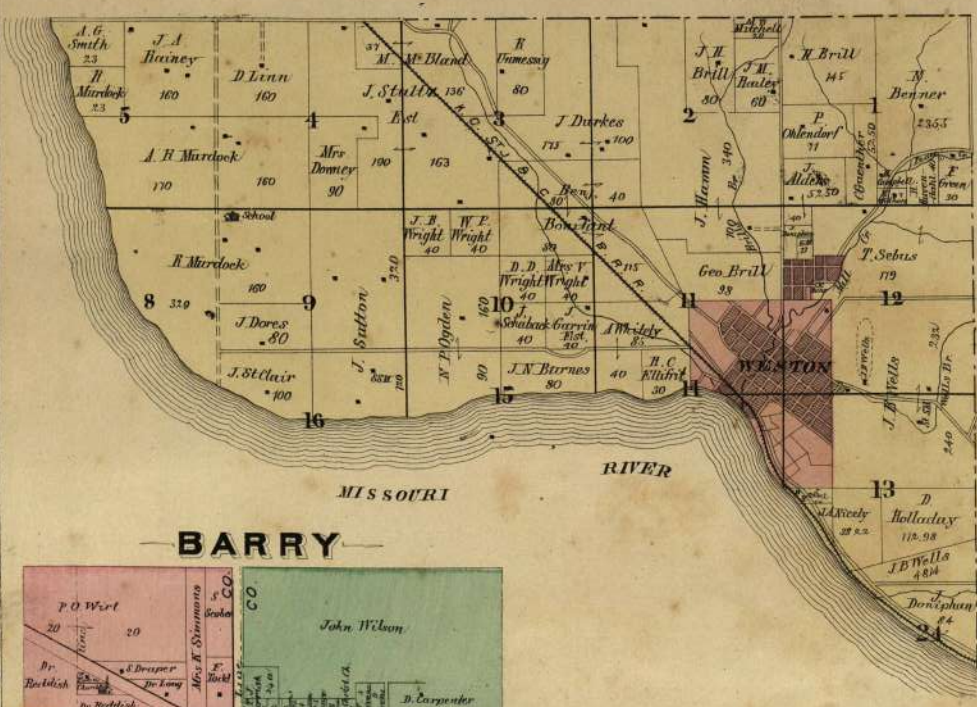

BARRY

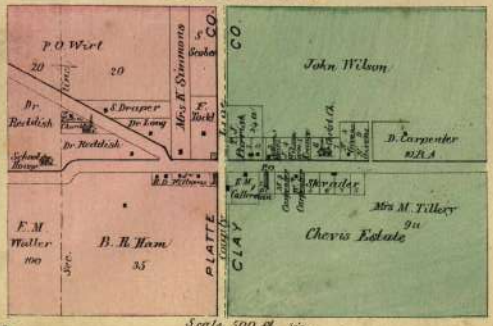

Scale 500 ft - 1 in.

